

Subdivisions
Book "A"
FIELD NOTES

PART OF
OF THE SURVEY OF THE

• SUBDIVISION LINES OF •

T. 22 N. ~ R. 20 W.

and

RESURVEY OF

EAST BOUNDARY of T. 22 N. - R. 20 W.

of the Gila & Salt River Base & Meridian,

In the State of

Arizona

EXECUTED BY

William B. Kimmel, U.S. Surveyor

and

H. N. Bradstreet, U.S. Transitman

In the capacity of U. S. Surveyor, under instructions dated April 24, 1913,

issued by the United States Surveyor General to govern surveys included in

Group No. 27, which were approved by the Commissioner of the General Land

Office, May 7, 1913, pursuant to authority contained in the Act of

Congress dated August 24, 1912

and Resurvey Survey, commenced May 28, 1913

and Resurvey Survey, completed June 10, 1913

BOOK 2499

INDEX DIAGRAM.

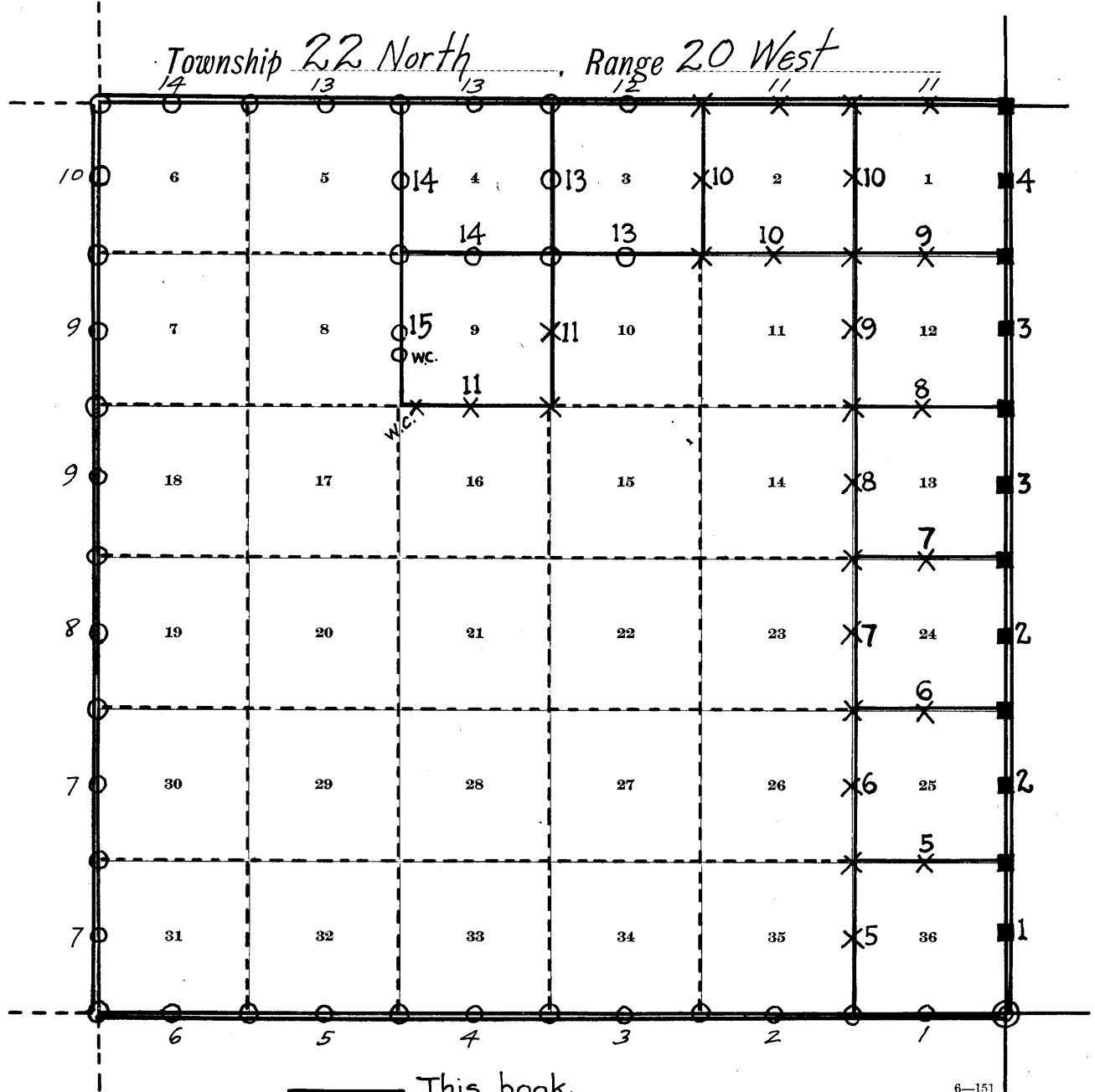

(18)

Survey commenced May 28, 1913, and executed with a Young and Sons Transit, No. 8541, with Solar attachment. The instrument was examined, tested on the true meridian at Phoenix, found correct and was approved by the surveyor general for Arizona, November 27, 1912. At our camp in sec. 13, T. 22 N., R. 20 W., in latitude $35^{\circ}18'$ N., longitude $114^{\circ}21'W.$ at 8h. 30m. p.m. by my watch, which was correct local mean time, I observe Polaris $15^{\circ}55'$ in accordance with instructions in the Manual, and mark the line thus determined, by a pin set in the ground about five chains north of my station.

May 29, 1913, at 6h. 30m. a.m. I lay off the azimuth of Polaris, $0^{\circ}13'$ to the east, and mark the true meridian thus determined, by a pencil mark on a stake firmly set in the ground east of the point established last night, the magnetic bearing of said true meridian is $N. 15^{\circ}55'W.$, which gives the magnetic declination, $15^{\circ}55'$ East.

At 4h. 0m. p.m., l.m.t., I set off $35^{\circ}18'$ on the lat. arc; $21^{\circ}39\frac{1}{2}'N.$ on the decl. arc; the resulting observation agrees with the Polaris observation.

May 30, 1913, At 7h. 0m. a.m., l.m.t., I set off $35^{\circ}18'$ on the lat. arc; $21^{\circ}45\frac{1}{2}'N.$ on the decl. arc; this resulting observation also agrees with the Polaris observation; therefore, I conclude that the adjustments of the instrument are correct.

May 30, 1913

May 29, 1913

Preliminary to commencing the subdivision of this township, I run north on a random line, on the East boundary of sec. 36; at 40.00 chs. I find no trace of $\frac{1}{4}$ sec. cor. and at 80.00 chs. I find no trace of the ^{original} cor. of secs. 25, 30, 31 and 36. therefore I resurvey the range line, as follows:

May 29, 1913

May 31, 1913, at the ^{old} cor. of Twps. 21 and 22 N., R.'s. 19 and 20 W., which is a sandstone $10 \times 8 \times 10$ ins. ^{above ground} firmly set, and marked and witnessed as described by the surveyor general. at 8h. a.m., l.m.t. I set off $35^{\circ}15'$ on the lat. arc; $21^{\circ}54'N.$ on the decl. arc; and determine a true meridian with the solar.

Thence I run, on a true line, North, bet. secs. 31 and 36.

Overrolling, rocky land, through dense undergrowth.

25.75 Wash 15 lks. wide, course SE., ascend SW. slope 75 ft.

27.30 A granite rock 4 ft. x 4 ft. x 12 ft. high, 2 ft. east of line.

34.00 Ridge, bears E. and W., descend N. slope 70 ft.

39.40 Set an iron post, 3 ft. long, 1 in. in dia., 26 in. in the ground, for W.C. to $\frac{1}{4}$ sec. cor., marked on brass cap

W.C. $\frac{1}{4}$ in. N. half,

S 31 in SE. and

S 36 in SW. quadrant, from which

A cedar 6 ins. in dia., bears N. $64^{\circ}E.$, 20 lks. dist., marked W.C. $\frac{1}{4}$ S 31 B T.

A cedar 5 ins. in diam., bears S. $37^{\circ}W.$, 6 lks. dist., marked W.C. $\frac{1}{4}$ S 36 B T (after diligent search no traces of

Enter wash, course E. (the old ^{1/4} cor. are found.

40.00 > 39.55 Point for $\frac{1}{4}$ sec. cor. in wash

40.80 Leave wash, course E. ascend S. slope, 50 ft.

46.50 Top of ascent, cont. along W. slope of rocky knoll.

48.00 Descend N. slope 40 ft.

65.05 Wash, 15 lks. wide, course E. ascend SE. slope 55 ft.

72.00 Top of ascent, bears E. and W. cont. over rolling, rocky land slopes E.

74.60 Wash, 50 lks. wide, course E.

80.00 Set an iron post, 3 ft. long, 3 ins. in dia., 24 ins. in the ground, for ^{re-established} cor. of secs. 25, 30, 31 and 36,

marked on brass cap

T 22 N in N. half,

R 20 W S 25 in NW.,

R 19 W S 30 in NE.,

S 31 in SE. and

S 36 in SW. quadrant, from which

228
BOOK 2499

	<p>A cedar 6 ins. in dia., bears S. 70° E., 128 lks. dist., marked T 22 N R 19 W S 31 B T, no other trees within limits, raise a mound of stone 2 ft. base, 1½ ft. high, W. of cor. pits impracticable, after diligent search no traces of the old cor. are found. Land, rolling and hilly, Soil, rocky, 4 th. rate, Undergrowth, cat claw, scrub cedar, cacti, greesewood, &c.</p>
	<p>on true line North, bet. secs. 25 and 30. Over rolling, rocky land, through dense undergrowth.</p>
2.00	Enter wash, course SE.
4.00	Leave wash, course SE. ascend SW. slope, 160 ft.
25.00	Basalt ridge, bears NW. and SE. descend NE. slope, 60 ft.
36.00	Head of gulch, course SE. ascend SE. slope, 290 ft.
40.00	Set an iron post, 3 ft. long, 1 in. in dia., 26 ins. in the ground, for ^{re-established} ¼ sec. cor., marked on brass cap ¼ S 25 in W. and S 30 in E. half; and raise a mound of stone 2 ft. base, 1½ ft. high W. of cor. pits impracticable. after diligent search no traces of the old ^{¼ sec.} cor. are found.
	At this ¼ sec. cor. set off 21° 55½' N., on the decl. arc; and 12h. 2m. 1. m. t., observe the sun on the meridian; the resulting lat. is 35° 16' N. which is correct.
54.40	Rocky point, top of ascent, Thorn spring and corral bears S. 63° 30' E. about 60 chs. dist. descend NE. slope, 350 ft.
77.00	Foot of descent, enter wash, course E.
79.80	Leave wash, course E.
89.99	Set an iron post, 3 ft. long, 3 ins. in dia., 24 ins. in the ground, for ^{re-established} cor. of secs. 19, 24, 25 and 30, marked on brass cap T 22 N in N. half, R 20 W S 24 in NW., R 19 W S 19 in NE., S 30 in SE. and S 25 in SW. quadrant. from which A cedar 7 ins. in dia., bears N. 29° 30' W., 65 lks. dist., marked T 22 N R 20 W S 24 B T, no other trees within limits, raise a mound of stone 2 ft. base, 1½ ft. high W. of cor. pits impracticable. after diligent search no traces of old cor. are found. Land, rolling and mountainous, Soil, rocky, 4 th. rate. Undergrowth, cat claw, scrub cedar, cacti, greesewood, &c.
	<p>on true line North, bet. secs. 19 and 24. over rolling land, through dense undergrowth.</p>
17.50	Wash, 15 lks. wide, 4 ft. deep, course NE.
25.00	Wash 12 lks. wide, 4 ft. deep, course SE.
40.00	Set an iron post, 3 ft. long, 1 in. in dia., 26 ins. in the ground, for ^{re-established} ¼ sec. cor., marked on brass cap ¼ S 24 in W. and S 19 in E. half, from which A cedar 5 ins. in dia., bears S. 69° 30' W., 86 lks. dist. marked ¼ S 24 B T. no other trees within limits. raise a mound of stone 2 ft. base, 1½ ft. high W. of cor. pits impracticable. after diligent search no traces of old ^{¼ sec.} cor. are found.
43.90	Wash 45 lks. wide, course SE., ascend SW. slope, 130 ft.
57.00	Rocky point, top of ascent, descend NW. slope, 100 ft.
64.75	Draw course NE., foot of descent, cont. over rolling land.
80.00	Set an iron post, 3 ft. long, 3 ins. in dia., 24 ins. in the ground, for ^{re-established} cor. of secs. 13, 18, 19 and 24, marked on brass cap T 22 N in N. half, R 20 W S 13 in NW., R 19 W S 18 in NE.,

	<p>S 19 in SE. and S 24 in SW. quadrants, from which A cedar 4 ins. in diam., bears S. 4° 30' E., 62 lks. dist., marked T 22 N R 19 W S 19 B T . no other trees within limits, raise a mound of stone 2 ft. base, 1½ ft. high, W. of cor. pits impracticable. after diligent search no traces of old cor. are found. Land, rolling, Soil, rocky, 4 th. rate. Undergrowth, cat claw, scrub cedar, cacti, greesewood, &c. May 31, 1913.</p>
	<p>June 5 th., 1913, at 6h. 30m. a.m. l.m.t., I set off 35° 17½' N. on the lat. arc; 22° 33' N. on the decl. arc; and determine a true meridian with the solar, at the ^{re-established} cor. of secs., 13, 18, 19 and 24, above described Thence I run, on a true line, North, bet. secs. 13 and 18. over rolling rocky land, through dense undergrowth.</p>
6.25	Wash 60 lks. wide, course S 70° E.
13.65	Road bears E. and W. To Kingman.
22.00	West cottonwood spring, bears S. 80° W. about 22 chs. dist., East cottonwood spring, bears N. 84° E. about 15 chs. dist.
40.00	Set an iron post, 3 ft. long, 1 in. in dia., 26 ins. in the ground, ^{re-established} for ¹ / ₄ sec. cor. marked on brass cap ½ S 13 in W. and S 18 in E. half, from which A cedar limb 5 ins. in dia., bears N. 88° E., 92 lks. dist., marked ½ S 18 B T A cedar 10 ins. in dia., bears S. 26° 15' W., 161 lks. dist., marked ½ S 13 B T . after diligent search no traces of old ¹ / ₄ sec. cor. were found.
54.65	Wash 10 lks. wide, course SE.
77.75	Wash 10 lks. wide, course SE.
80.00	Set an iron post, 3 ft. long, 3 ins. in dia., 24 ins. in the ground, ^{re-established} for cor. of secs. 7, 12, 13 and 18. marked on brass cap T 22 N in N. half, R. 20 W S 12 in NW., R 19 W S 7 in NE., S 18 in SE. and S 13 in SW. quadrant, from which A cedar 6 ins. in dia., bears N. 75° 30' E., 174 lks. dist., marked T 22 N R 19 W S 7 B T . no other trees within limits, raise a mound of stone 2 ft. base, 1½ ft. high W. of cor. pits impracticable. after diligent search no traces of old cor. are found. Land, rolling and hilly, Soil, rocky, 4 th. rate. Undergrowth, cat claw, scrub cedar, cacti, greesewood, &c. June 2, 1913.
	<p>on a true line North, bet. secs. 7 and 12. ascend rolling, rocky SE. slope 130 ft., through dense undergrowth</p>
30.00	Spur ridge, bears NW. and SE., cottonwood trees at Mud spring, bears N. 64° E., about 60. chs. dist., descend rocky N. slope, 50 ft.
38.00	Foot of descent. bears E. and W., cont. over rolling land slopes to the east.
40.00	Set an iron post, 3 ft. long, 1 in. in dia., 26 ins. in the ground, ^{re-established} for ¹ / ₄ sec. cor., marked on brass cap ½ S 12 in W. and S 7 in E. half, and raise a mound of stone 2 ft. base, 1½ ft. high, W. of cor. pits impracticable. after diligent search no traces of old ¹ / ₄ sec. cor. are found.
45.00	Wash 15 lks. wide, 5 ft. deep, course E.
51.00	Wash 40 lks. wide, 3 ft. deep, course E.
56.00	Wash 6 lks. wide, course E., ascend 75 ft. rolling slopes S.
64.00	Change to E. slope.
72.00	Top of ascent, cottonwood trees at Mud spring, bears

230
BOOK 2499

80.00

S. 66° E. about 50 chs. dist.,
descend 20 ft. rolling slopes E.
Set an iron post, 3 ft. long, 3 ins. in dia., 24 ins. in the
ground, ^{re-established} for [^] cor. of secs. 1, 6, 7 and 12,
marked on brass cap
T 22 N. in N. half,
R 20 W S 1 in NW.,
R 19 W S 6 in NE.,
S 7 in SE. and
S 12 in SW. quadrant, from which
A cedar 10 ins. in dia., bears S. 61° W., 214 lks. dist.,
marked T 22 N R 20 W S 12 B T
no other trees within limits, raise a mound of stone
2 ft. base, 1½ ft. high, W. of cor., pits impracticable.
after diligent search no traces of old cor. are found.
Land, rolling, and hilly,
Soil, rocky, 4 th. rate,
Undergrowth, cat claw, scrub cedar, cacti, greesewood, &c.

on a true line

North [^] bet. secs. 1 and 6,descending rolling, rocky E. slope 20 ft. through dense
undergrowth.

6.00

Wash 45 lks. wide, course SE. ascend rocky SW. slope 160 ft.

24.00

Rocky spur, bears E. and W. cont. rolling, broken, rocky W. slope.

30.00

Ascend rolling W. slope, 110 ft.

40.00

Set an iron post, 3 ft. long, 1 in. in dia., 26 ins. in the
ground, ^{re-established} for [^] sec. cor.

marked on brass cap

¼ S 1 in W. and

S 6 in E. half, raise a mound of stone 2 ft. base, 1½ ft.
high W. of cor. pits impracticable. ¼ sec. cor.

after diligent search no traces of old cor. are found.

At this ¼ sec. cor., I lay off 22° 33½' N., on the

decl. arc; and at 12h. 2m. 1. m. t., observe the sun on the

meridian; the resulting lat. is 35° 19½' N. which is correct.

41.00

Top of ascent, bears E. and W., cont. rolling, broken W. slope.

74.60

Ravine 25 ft. deep, course W.

80.00

Set an iron post, 3 ft. long, 3 ins. in dia., 24 ins. in the
ground, ^{re-established} for [^] cor. of Tps. 22 and 23 N., Rs. 19 and 20 W.,

marked on brass cap

T 23 N in N.,

R 19 W in E.,

T 22 N in S.,

R 20 W in W. half,

S 36 in NW.,

S 31 in NE.,

S 6 in SE. and

S 1 in SW. quadrants. from which

A cedar 5 ins. in dia., bears S. 34° W., 70 lks. dist.,

marked T 22 N R 20 W S 1 B T. no other trees within limits.

raise a mound of stone 2 ft. base, 1½ ft. high S. of cor. pits

after diligent search no traces of old cor. are found. (impracticable

Land, rolling and hilly.

Soil, rocky, 4 th. rate.

Undergrowth, cat claw, scrub cedar, cacti, greesewood, &c.

June 5, 1913.

	<p>June 2, 1913, at 8h. 0m. AM, 1. m. t., I set off $35^{\circ}15'N$ on the lat. arc; $22^{\circ}11'N$ on the decl. arc; and determine a meridian with the solar at the cor. of secs. 1, 2, 35 and 36, on the S. bdy. of the Tp., set by H. N. Bradstreet May 30, 1913 & described in Book "B"</p> <p>Thence I run, $N. 0^{\circ}01'W.$, bet. secs. 35 and 36. Ascend 35 ft. along rocky W. slope, through dense undergrowth. Enter draw course $S. 10^{\circ}W.$, cont. up draw. 8.00 Head of draw, ascend S. slope 11.00 Low saddle in ridge, bears E. and W. descend rolling NE. slope 60 ft. 21.00 Wash 30 lks. wide, course NE. cont. over rolling land slopes E. 27.00 Wash 30 lks. wide course E. 40.00 Set an iron post, 3 ft. long, 1 in. in dia., 26 ins. in the ground, for $\frac{1}{4}$ sec. cor. marked on brass cap $\frac{1}{4}$ S 35 in W. and S 36 in E. half, from which A cedar 5 ins. in dia., bears $S. 65^{\circ}30'E.$, 17 lks. dist., marked $\frac{1}{4}$ S 36 B T A cedar 8 ins. in dia., bears $S. 35^{\circ}30'W.$, 107 lks. dist., marked $\frac{1}{4}$ S 35 B T 40.20 Wash 60 lks. wide, course SE. 40.80 Ascend S. slope, 165 ft. 46.00 Change slope ascend SE. slope, 54.00 Top of ascent, rocky point, descend NE. slope 35 ft. 57.70 Foot of descent, ascend SE. slope 80 ft. 65.50 Spur of ridge, bears E. and W. descend NE. slope 55 ft. 69.00 Gulch, course E. ascend S. slope 45 ft. 71.00 Rocky spur ridge, bears NW. and SE. descend NE. slope 70 ft. 75.00 Gulch, course E. ascend SE. slope 40 ft. 77.00 Top of ascent, cont. steep E. slope. 80.00 Set an iron post, 3 ft. long, 2 ins. in dia., 24 ins. in the ground, for cor. of secs. 25, 26, 35 and 36. marked on brass cap T 22 N R 20 W in N. half, S 26 in NW., S 25 in NE., S 36 in SE. and S 35 in SW. quadrants, from which A cedar 10 ins. in dia., bears $S. 86^{\circ}E.$, 217 lks. dist., marked T 22 N R 20 W S 36 B T no other trees within limits, raise a mound of stone 2 ft. base, $1\frac{1}{2}$ ft. high, W. of cor. pits impracticable. Land, mountainous, Soil, rocky, 4 th. rate, Undergrowth, scrub cedar, cat claw, cacti, greesewood, &c. June 3, 1913, At this cor. I set off $22^{\circ}12'N$ on the decl. arc; and at 12h. 2m. PM, 1. m. t., observe the sun on the meridian; the resulting lat. is $35^{\circ}15'N$ which is correct.</p>	231
40.00	East, on a random line, bet. secs. 25 and 36. Set temp. $\frac{1}{4}$ sec. cor.	
80.06	Intersect E. bdy. of Tp., 8 lks. S. of the cor. of secs. 25, 30, 31 and 36, recently re-established by me & hereinbefore described, Thence I run, $S. 89^{\circ}57'W.$, on a true line, bet. secs. 25 and 36, Over rolling rocky land, ascending, through dense undergrowth.	
7.25	Wash 10 lks. wide, course SE	
23.75	Enter wash 15 lks. wide course SE.	
27.40	Leave wash, from SW.	
31.75	Same wash, at mouth of gulch, course SE. ascend NE. slope 75 ft.	
33.00	Spring in gulch, about 1 ch. N.	
33.50	Foot of cliff 30 ft. high bears N. and S.	
34.25	Top of cliff bears N. and S.	
34.50	Rocky spur ridge, bears NE. and SW. descend NW. slope 30 ft.	
36.00	Foot of descent, cont. along N. slope.	
39.40	Gulch course NE. cont. along S. slope,	
40.03	Set an iron post, 3 ft. long, 1 in. in dia., 26 ins. in the ground, for $\frac{1}{4}$ sec. cor.	

232

BOOK 2499

	marked on brass cap ¼ S 25 in N. and S 36 in S. half, from which A cedar 7 ins. in dia., bears N. 57° 30' E., 104 lks. dist., marked ¼ S 25 B T. A cedar 9 ins. in dia., bears S. 59° 30' E., 61 lks. dist., marked ¼ S 36 B T.
44.00	Enter gulch, course SE. cont. up gulch.
45.00	Leave gulch, from NW., ascend NE. slope 230 ft.
59.50	Spur ridge, bears NW. and SE., descend SW. slope 50 ft.
65.90	Gulch course S. ascend E. slope 190 ft.
73.00	Rocky spur ridge, bears N. and S. descend SW. slope 85 ft.
78.00	Gulch course SE. ascend E. slope 35 ft.
80.06	The cor. of secs. 25, 26, 35 and 36, hereinbefore described. Land, rolling and mountainous, Soil, rocky 4 th. rate, Undergrowth, scrub cedar, cat claw, cacti, greasewood, &c. June 2, 1913.
	June 3, 1913, at 7h. 30m. a.m., l.m.t., I set off 35° 15' N on the lat. arc; 22° 18½' N on the decl. arc; and determine a true meridian with the solar, at the cor. of secs. 25, 26, 35 and 36, hereinbefore described, Thence I run N. 0° 01' W., bet. secs. 25 and 26. Along rocky E. slope, through dense undergrowth, Gulch course SE., ascend SW. slope 430 ft.
1.65	
37.75	Ridge bears E. and W., descend NE. slope 225 ft.
40.00	Set an iron post, 3 ft. long, 1 in. in dia., 26 ins. in the ground, for ¼ sec. cor. marked on brass cap ¼ S 26 in W. and S 25 in E. half, from which A cedar 8 ins. in dia., bears S. 83° 30' E., 105 lks. dist., marked ¼ S 25 B T A cedar 7 ins. in dia., bears S. 23° 30' W., 55 lks. dist., marked ¼ S 26 B T.
46.00	Upper Burrow spring, bears N. 43° W., about 30 chs. dist.
54.25	Bottom of Burrow gulch, course E. Lower Burrow spring about 8 chs. W., ascend SE. slope 175 ft.
66.30	Rocky spur ridge, bears NW. and SE., descend NE. slope 30 ft.
68.25	Foot of descent, ascend SE. slope 210 ft.
80.00	Set an iron post, 3 ft. long, 2 ins. in dia., 24 ins. on the ground, (at foot of cliff 30 ft. high, bears S. 20° W. and N. 30° W.) for cor. of secs. 23, 24, 25 and 26. marked on brass cap T 22 N R 20 W in N. half, S 23 in NW., S 24 in NE., S 25 in SE. and S 26 in SW. quadrant, from which A cedar 7 ins. in dia., bears N. 88° E., 194 lks. dist., marked T 22 N R 20 W S 24 B T no other trees within limits, raised a mound of stone 2 ft. base, 1½ ft. high, 15 lks. S. of cor. (the nearest point where it could be built permanent) pits impracticable Land, mountainous, Soil, rocky 4 th. rate, Undergrowth, scrub cedar, cat claw, cacti, greasewood, &c. June 3, 1913, At this cor. I set off 22° 19' N. on the decl. arc; and at 12h. 2m. l.m.t., observe the sun on the meridian; the resulting lat. is 35° 16' which is correct.
	N. 89° 57' E., on a random line bet. secs. 24 and 25.
40.00	Set temp. ¼ sec. cor.
80.08	Intersect E. bdy. of Tp. 7 lks. N. of cor. of secs. 19, 24, 25 and 30, recently re-established by me & hereinbefore described, Thence I run, West, on a true line bet. secs. 24 and 25. Over rolling rocky land, ascending 200 ft. slopes E. Through dense undergrowth.
17.40	Enter wash, course S. 70° E.
19.50	Leave wash, from SW.

39.50 Top of ascent, bears NW. and SE., descend SW. slope 30 ft.
 40.04 Set an iron post, 3 ft. long, 1 in. in dia., 26 ins. in the ground, for $\frac{1}{4}$ sec. cor. marked on brass cap
 $\frac{1}{4}$ S 24 $\frac{1}{2}$ in N. and S 25 in S. half, and raised a mound of stone 2 ft. base, A $1\frac{1}{2}$ ft. high N. of cor. pits impracticable.
 40.50 Gulch course SE., ascend NE. slope 100 ft.
 47.00 Rocky spur ridge, bears NW. and SE., descend W. slope 40 ft.
 50.00 Foot of descent, bears N. and S. ascend SE. slope 195 ft.
 60.00 Rocky spur ridge, bears N. and S. descend SW. slope 35 ft.
 63.00 Foot of descent, ascend SE. slope 370 ft.
 80.08 The cor. of secs. 23, 24, 25 and 26, hereinbefore described. Land, rolling and mountainous, Soil, rocky 4 th. rate. Undergrowth, scrub cedar, cat claw, cacti, greasewood, &c.
 June 3, 1913.

233

June 4, 1913, at 7h. 0m. A.M., 1. m. t., I set off $35^{\circ}16\frac{1}{2}'$ N. on the lat. arc; $22^{\circ}26'$ N. on the decl. arc; and determine a true meridian with the solar, at the cor. of secs. 23, 24, 25 and 26, hereinbefore described,
 Thence I run
 N. $0^{\circ}01'$ W., bet. secs. 23 and 24.
 Ascending along steep, rocky, cliffy E. slope 200 ft. Through scattering undergrowth.
 25.20 Lava spur ridge, bears NE. and SW. cont. along rocky W. slope, enter dense undergrowth NE. and SW.
 36.00 Top of cliffs, bears NE. and SW., descend 530 ft. rocky, cliffy NW. slope
 39.00 Top of cliffs, bears SE. and SW., descend broken, rocky, cliffy N. slope,
 40.00 Foot of cliffs, bears E. and W.
 Set an iron post, 3 ft. long, 1 in. in dia., 26 ins. in the ground, for $\frac{1}{4}$ sec. cor. marked on brass cap
 $\frac{1}{4}$ S 23 in W. and S 24 in E. half, from which
 A cedar 6 ins. in dia., bears S. $81^{\circ}30'$ E., 27 lks. dist., marked $\frac{1}{4}$ S 24 B T
 A cedar 6 ins. in dia., bears N. $56^{\circ}30'$ W., 60 lks. dist., marked $\frac{1}{4}$ S 23 B T.
 53.50 Gulch course NE., cont. along rolling, broken, rocky E. slope.
 80.00 Set an iron post, 3 ft. long, 2 ins. in dia., 24 ins. in the ground, for cor. of secs. 13, 14, 23 and 24. marked on brass cap
 T 22 N R 20 W in N. half,
 S 14 in NW.,
 S 13 in NE.,
 S 24 in SE. and S 23 in SW. quadrant, from which
 A cedar 6 ins. in dia., bears S. 43° E., 63 lks. dist., marked T 22 N R 20 W S 24 B T
 A cedar 6 ins. in dia., bears S. $16^{\circ}15'$ W., 44 lks. dist., marked T 22 N R 20 W S 23 B T
 no other trees within limits, raised a mound of stone 2 ft. base, $1\frac{1}{2}$ ft. high W. of cor. pits impracticable.
 Land, mountainous,
 Soil, rocky 4 th. rate,
 Undergrowth, scrub cedar, cat claw, cacti, greasewood, &c.
 At this cor. I set off $22^{\circ}27'$ N. on the decl. arc; and at 12h. 2m. P.M., 1. m. t., observe the sun on the meridian, the resulting lat. is $35^{\circ}18'$ N. which is within $\frac{1}{2}'$ of correct.

40.00 East, on a random line, bet. secs. 13 and 24.
 Set temp. $\frac{1}{4}$ sec. cor.
 80.03 Intersect E. bdy. of Tp. 28 lks. S. of cor. of secs. 13, 18, 19 and 24, recently re-established by me & hereinbefore described, Thence I run
 S. $89^{\circ}48'$ W., on a true line bet. secs. 13 and 24.
 Over rolling, rocky land, through dense undergrowth.
 40.01 $\frac{1}{2}$ Set an iron post, 3 ft. long, 1 in. in dia., 26 ins. in the

234
BOOK 2499

ground, for $\frac{1}{4}$ sec. cor.
marked on brass cap
 $\frac{1}{4}$ S 13 in N. and
S 24 in S. half, from which
A cedar 5 ins. in dia., bears S. 40° W., 143 lks. dist.,
marked $\frac{1}{4}$ S 24 B T
A cedar 7 ins. in dia., bears N. 70° E., 133 lks. dist.,
marked $\frac{1}{4}$ S 13 B T
43.80 Enter wash 30 lks. wide, course S. 70° E.
47.30 Leave wash, from S. 70° W., ascend E. slope 300 ft.
80.03 The cor., of secs. 13, 14, 23 and 24, hereinbefore described.
Land, rolling and mountainous,
Soil, rocky, 4 th. rate,
Undergrowth, scrub cedar, cat claw, cacti, greasewood, &c.
June 4, 1913.

June 7, 1913, at 6h. 30m. a.m., l.m.t., I set off 35° 17 $\frac{1}{2}$ ' N on the
lat. arc; 22° 46' N. on the decl. arc; and determine a
meridian with the solar at the cor. of secs. 13, 14, 23 and
24, hereinbefore described,
Thence I run
N. 0° 01' W. bet. secs. 13 and 14.
40.00 Along rolling, rocky E. slope, through dense undergrowth.
Set an iron post, 3 ft. long, 1 in. in dia., 26 ins. in the
ground, for $\frac{1}{4}$ sec. cor.
marked on brass cap
 $\frac{1}{4}$ S 14 in W. and
S 13 in E. half, from which
A cedar 5 ins. in dia., bears N. 45° 45' E., 92 lks. dist.,
marked $\frac{1}{4}$ S 13 B T
no other trees within limits, raised a mound of stone
2 ft. base, 1 $\frac{1}{2}$ ft. high W. of cor. pits impracticable.
54.80 Willow spring about 1 ch. E.
55.20 2 in. water pipe, water flows S. 70° E.
55.30 Water tunnel, about 160 lks. W.
56.35 Walkers house, bears S. 70° E. about 2 chs. dist.
Barn bears N. 75° E. about 3 chs. dist.
about 10 acres of cultivated land and orchard, bears
N. 65° E. about 12 chs. dist.
59.00 Well about 1 ch. E.
64.40 Spring about 3 chs. E.
80.00 Set an iron post, 3 ft. long, 2 ins. in dia., 26 ins. in the
ground, for cor. of secs. 11, 12, 13 and 14.
marked on brass cap
T 22 N R 20 W in N. half,
S 11 in NW.,
S 12 in NE.,
S 13 in SE. and
S 14 in SW. quadrant, from which
A cedar 5 ins. in dia., bears S. 66° 30' W., 113 lks. dist.,
marked T 22 N R 20 W S 14 B T
A cedar 5 ins. in dia., bears N. 26° W., 123 lks. dist.,
marked T 22 N R 20 W S 11 B T
no other trees within limits, raised a mound of stone
2 ft. base, 1 $\frac{1}{2}$ ft. high W. of cor. pits impracticable.
Land, rolling, and mountainous,
Soil, rocky, 4 th. rate,
Undergrowth, scrub cedar, cat claw, cacti, greasewood, &c.
June 7, 1913.

N. 89° 48' E., on a random line, bet. secs. 12 and 13.
40.00 Set temp. $\frac{1}{4}$ sec. cor.
79.99 Intersect. E. bdy. of Tp. 7 lks. N. of cor. of secs. 7, 12, 13 and
18, recently re-established by me & hereinbefore described,
Thence I run,
S. 89° 51' W., on a true line bet. secs. 12 and 13.
Over rolling rocky land, through dense undergrowth.
4.70 Wash 10 lks. wide, 3 ft. deep, course SE.
14.50 Draw course NE. ascend E. slope 350 ft.
39.55 Rocky ridge bears N. and S. descend SW. slope 180 ft.
39.99 $\frac{1}{2}$ Set an iron post, 3 ft. long, 1 in. in dia., 26 ins. in the
ground, for $\frac{1}{4}$ sec. cor.
marked on brass cap
 $\frac{1}{4}$ S 12 in N. and
S 13 in S. half,

235
BOOK 2499

64.60 raised a mound of stone 2 ft. base, 1½ ft. high N. of cor.
 71.00 Wash 8 lks. wide, course S. cont. over rolling land.
 73.90 Wash 40 lks. wide, course SE. ascend E. slope 70 ft.
 79.99 Road, bears N 35° W and SE.
 The cor. of secs. 11, 12, 13 and 14, hereinbefore described.
 Land rolling and mountainous
 Soil rocky 4 th. rate.
 Undergrowth, scrub cedar, cat claw, cacti, greasewood, &c.

20.25 N. 0° 01' W., bet, secs. 11 and 12.
 Along rolling rocky E. slope, through dense undergrowth.
 34.00 Road bears S. 15° E. and N. 15° W.
 35.00 Wash 6 lks. wide, course SE.
 40.00 Wash 6 lks. wide, course SE.
 Set an iron post, 3 ft. long, 1 in. in dia., 26 ins. in the
 ground, for ¼ sec. cor.
 marked on brass cap
 ¼ S 11 in W. and
 S 12 in E. half, from which
 A cedar 4 ins. in dia., bears S. 64° 15' W., 206 lks. dist.,
 marked ¼ S 11 B T
 no other trees within limits, raised a mound of stone
 2 ft. base, 1½ ft. high W. of cor. pits impracticable.
 40.40 Wash 30 lks. wide course S. 30° E., ascend SW. slope 240 ft.
 78.25 Gulch course SW. ascend SE. slope 70 ft.
 80.00 Set an iron post, 3 ft. long, 2 in. in dia., 24 ins. in the
 ground, for cor. of secs. 1, 2, 11 and 12.
 marked on brass cap
 T 22 N R 20 W in N. half,
 S 2 in NW.,
 S 1 in NE.,
 S 12 in SE. and
 S 11 in SW. quadrant, from which
 A cedar 4 ins. in dia., bears S. 83° 45' E., 116 lks. dist.,
 marked T 22 N R 20 W S 12 B T
 no other trees within limits, raised a mound of stone
 2 ft. base, 1½ ft. high W. of cor. pits impracticable.
 Land, rolling and mountainous,
 Soil, rocky, 4 th. rate.
 Undergrowth, scrub cedar, cat claw, cacti, greasewood, &c.
 June 7, 1913, At this cor. I set off 22° 46' N. on the decl.
 arc; and at 12h. 1½ m. P.M., observe the sun on the
 meridian, the resulting lat. is 35° 19' N. which is correct.

40.00 N. 89° 51' E., on a random line bet. secs. 1 and 12.
 79;94 Set temp. ¼ sec. cor.
 Intersect E. bdy. of Tp. 11 lks. S. of cor. of secs. 1, 6, 7 and
 12, recently re-established by me & hereinbefore described,
 Thence I run,
 S. 89° 46' W., on a true line bet. secs. 1 and 12.
 15.50 Ascend rocky NE. slope 200 ft. through dense undergrowth.
 23.20 Spur ridge bears NW. and SE., descend SW. slope 65 ft.
 34.50 Gulch course S. 20° E., ascend SE. slope 790 ft.
 39.97 Draw course SE., ascend E. slope
 Set an iron post, 3 ft. long, 1 in. in dia., 26 ins. in the
 ground, for ¼ sec. cor.
 marked on brass cap
 ¼ S 1 in N. and
 S 12 in S. half, from which
 A cedar 6 ins. in dia., bears S. 70° E., 46 lks. dist.,
 marked ¼ S 12 B T
 A cedar 6 ins. in dia., bears N. 30° W., 153 lks. dist.,
 marked ¼ S 1 B T
 48.50 Change slope, ascend SE. slope,
 53.20 Foot of perpendicular cliff 30 ft. high, bears NE. and SW.
 61.50 Rocky ridge bears S. and NW., descend W. slope 475 ft.
 78.00 Gulch course SW. ascend SE. slope 30 ft.
 79.94 The cor. of secs. 1, 2, 11 and 12, hereinbefore described.
 Land, mountainous,
 Soil, rocky, 4 th. rate,
 Undergrowth, scrub cedar, cat claw, cacti, greasewood, &c.

236

40.00 N.0°01'W., on a random line bet.secs.1 and 2.
 Set temp. 1/4 sec.cor.
 80.19 Intersect N.bdy.of Tp, 25 lks.E.of cor.of secs.1, 2, 35
 and 36, recently established by me & described in Book "B";
 Thence I run
 S.0°12'E.on a true line bet.secs.1 and 2.
 Descend rocky SW.slope 110 ft.through scattering
 undergrowth.
 10.20 Wash 10 lks.wide course NW.
 12.20 Wash 10 lks.wide course NW., ascend N.slope 150 ft.
 21.00 Top of rocky knoll, descend SE.slope 80 ft.
 26.00 Draw course E.ascend NE.slope 465 ft.
 40.19 Set an iron post, 3 ft.long 1 in.in dia., 26 ins.in the
 ground, for 1/4 sec.cor, *marked on brass cap. 1/4 S 2 in N. and 51 in E. half.*
 raised a mound of stone 2 ft. base, 1 1/2 ft.high W.of cor. *pits*
 58.50 Rocky ridge, bears NW.and SE., descend NW.slope 265 ft. *(impracticable,*
 68.00 Change slope, descend W.slope
 70.75 Spur rocky ridge, bears NE.and SW., descend SE.slope 185 ft.,
 80.19 The cor.of secs. 1, 2, 11 and 12, hereinbefore described.
 Land, Mountainous,
 Soil, rocky, 4 th.rate,
 Undergrowth, scrub cedar, cat claw, cacti, greasewood, &c.
 June 2, 1913.

1.25 West, on true line, bet.secs.2 and 11.
 14.00 Through dense undergrowth, ascend SE.slope 15 ft. rocky,
 Top of ascent, descend rocky SW.slope 170 ft.
 17.50 Gulch course S.ascend E, slope 60 ft.
 21.00 Spur ridge, bears N.and S., descend SW.slope 40 ft.
 25.00 Foot of descent, ascend SE.slope 40 ft.
 35.80 Top of ascent, descend rolling S.slope 60 ft.
 37.50 Gulch, course SE.ascend NE.slope 400 ft.
 40.00 Road bears NW.and SE
 Set an iron post, 3 ft.long, 1 in.in dia., 26 ins.in the
 ground, for 1/4 sec.cor.
 Marked on brass cap
 1/4 S 2 in N. and
 S 11 in S.half, from which
 A cedar 4 ins.in dia., bears N.10°30'E., 170 lks.dist.,
 marked 1/4 S 2 B T
 A cedar 4 ins.in dia., bears S.76°15'E., 76 lks.dist.,
 marked 1/4 S 11 B T
 65.75 Ridge bears NW.and S. descend W.slope 185 ft.
 73.00 Foot of descent, bears NW.and S. cont.along S.slope.
 80.00 Set an iron post, 3 ft.long, 2 ins.in dia., 24 ins.in the
 ground, for cor.of secs.2, 3, 10 and 11.
 marked on brass cap
 T 22 N R 20 W in N.half,
 S 3 in NW.,
 S 2 in NE.,
 S 11 in SE.and
 S 10 in SW.quadrant, from which
 A cedar 5 ins.in dia., bears N.46°E., 38 lks.dist.marked
 T 22 N R 20 W S 2 B T
 no other trees within limits, raised a mound of stone
 2 ft.base, 1 1/2 ft.high W.of cor. pits impracticable.
 Land, Mountainous,
 Soil, rocky, 4 th.rate
 Undergrowth, scrub cedar, cat claw, cacti, greasewood, &c.
 June 7, 1913.

June 9, 1913, at 8h^{00m} a.m. 11.m.t., I set off 35°19'N on the
 lat.arc; 22°56'N on the decl.arc; and determine a
 meridian with the solar at the cor.of secs.2, 3, 10
 and 11, above described.
 Thence I run,
 N.0°01'W., on a random line, bet.secs.2 and 3.
 40.00 Set temp. 1/4 sec.cor.
 80.19 Intersect N.bdy.of Tp, 18 lks.E.of cor.of secs.2, 3, 34
 and 35, recently estab. by me & described in Book "B"
 Thence I run
 S.0°09'E.on a true line bet.secs.2 and 3.
 Ascend rolling, rocky, NE.slope 175 ft. through dense
 undergrowth.

JOK 2499

26.00 Spur ridge, bears NW. and SE., ascend NW. slope 85 ft.
 38.00 Ridge, bears NE. and SW., descend SE. slope 250 ft.
 40.19 Set an iron post, 3 ft. long, 1 in. in dia., 26 ins. in the ground, for $\frac{1}{4}$ sec. cor. marked on brass cap
 $\frac{1}{4}$ S 3 in W. and
 S 2 in E. half,
 raised a mound of stone 2 ft. base, $1\frac{1}{2}$ ft. high W. of cor. pits (impracticable.)
 52.80 Road, bears S. 70° W. and N. 70° E.
 53.10 Gulch, course S. 70° W., ascend rolling NW. slope 175 ft.
 78.00 Low saddle in ridge, bears E. and W., descend S. slope 15 ft.
 80.19 The cor. of secs. 2, 3, 10 and 11, hereinbefore described.
 Land Mountainous
 Soil rocky 4 th. rate, basalt formation,
 Undergrowth, scrub cedar, cat claw, cacti, greasewood, &c.
 June 9, 1913,

BOOK 2499

June 10, 1913, at 8h.30 a.m., l.m.t., I set off $35^{\circ}19'$ on the lat. arc; $23^{\circ}01'$ N. on the decl. arc; and determine a meridian with the subar at the cor. of secs. 3, 4, 9 and 10. Thence I run, recently estab. by H.N. Bradstreet & hereinafter described
 S. $0^{\circ}02'$ E. bet. secs. 9 and 10.
 Over rolling rocky land along E. slope, through dense undergrowth.
 3.00 Ridge, bears N. 20° W. and S. 20° E., cont. along rolling rocky W. slope
 7.50 Road bears N. 20° E. and S. 20° W.
 9.75 Road bears S. 20° E. and N. 20° W.
 14.40 Road bears N. 30° E. and S. 30° W.
 40.00 Set an iron post, 3 ft. long, 1 in. in dia., 26 ins. in the ground, for $\frac{1}{4}$ sec. cor., marked on brass cap,
 $\frac{1}{4}$ S 9 in W. and
 S 10 in E. half, from which
 A cedar 4 ins. in dia., bears N. $57^{\circ}30'$ W., 158 lks. dist., marked $\frac{1}{4}$ S 9 B T
 no other tree within limits, raised a mound of stone 2 ft. base, $1\frac{1}{2}$ ft. high W. of cor. pits impracticable.
 49.20 Enter draw course N. 20° W. ascend up rocky draw,
 52.50 Fork of draw, from SE. and SW. ascend rolling rocky N. slope 425 ft.
 65.00 Slope changes to NE slope,
 77.50 Ridge bears NW. and SE. descend S. slope 20 ft.
 80.00 Set an iron post, 3 ft. long, 2 ins. in dia., 24 ins. in the ground. for cor. of secs. 9, 10, 15 and 16, marked on brass cap
 T 22 N R 20 W in N. half,
 S 9 in NW.,
 S 10 in NE.,
 S 15 in SE. and
 S 16 in SW. quadrant,
 raised a mound of stone 2 ft. base, $1\frac{1}{2}$ ft. high W. of cor. pits (impracticable.)
 Land, Mountainous
 Soil, rocky, 4 rate, basalt formation.
 Undergrowth, scrub cedar, cat claw, cacti, greasewood, &c.

West, on true line, bet. secs. 9 and 16.
 Ascending along steep rocky S. slope 20 ft. through dense undergrowth.
 7.00 Top of ascent, descend along steep W. slope 405 ft.
 10.00 Slope changes, to SW. slope,
 26.15 Head of gulch course S. ascend E. slope 25 ft.
 28.10 Spur ridge bears NE. and SW. descend NW. slope 90 ft.
 31.20 Line touches N. end of cliff that is 40 ft. high, extends S. about 130 lks.
 33.00 Head of gulch course N. ascend NE. slope 25 ft.
 35.80 Rocky ridge bears NW. and SE. descend SW. slope 60 ft.
 37.75 Head of gulch course S. ascend SE. slope 75 ft.
 40.00 Set an iron post, 3 ft. long, 1 in. in dia., 26 ins. in the ground, for $\frac{1}{4}$ sec. cor. marked on brass cap
 $\frac{1}{4}$ S 9 in N. and
 S 16 in S. half, from which

238 BOOK	2499	<p>A cedar 7 ins. in dia., bears N. 38° W., 34 lks. dist., marked $\frac{1}{4}$ S 9 BT no other trees within limits, raised a mound of stone 2 ft. base, 1½ ft. high N. of cor. pits impracticable.</p> <p>41.55 Top of rocky point, impassable on line, thence Thence offset N. 100 lks. then run on offset line West descend SW. slope 40 ft.</p> <p>43.75 Foot of descent, ascend SE. slope 25 ft.</p> <p>45.70 rocky ridge, bears N. and S. a perpendicular rock 100 ft. high on the true line. descend rocky, broken, cliffy, SW. slope 340 ft.</p> <p>47.50 Offset S. 100 lks. to true line.</p> <p>51.00 Prospect hole about 50 lks. N.</p> <p>54.00 Bottom of a Granite conyon, course NW. ascend cliffy NE. slope 125 ft.</p> <p>61.00 Rocky spur ridge bears N. and S. descend W. slope 150 ft.</p> <p>63.10 Gulch course N. ascend cliffy E. slope 210 ft.</p> <p>70.00 Foot of perpendicular cliff 100 ft. high bears N. and S. impassable. Set a Granite stone 14 X 8 X 8 ins. in a mound of stone, for W C to the cor. of secs. 8, 9, 16 and 17, marked with 4 notches on S. and 4 notches on E. faces and W C on W. face, and raise a mound of stone 2 ft. base, 1½ ft. high N. of cor. pits Land mountainous, (impracticable.) Soil rocky 4 th. rate, granite formation. Undergrowth, scrub cedar, cat claw, easti, greasewood, &c.</p> <p style="text-align: right;">June 10, 1913.</p>	
-------------	------	---	--

BOOK 239
249

Chains June 9, 1913: At 8h^{0m} a.m., l.m.t., I set off 35° 19' N. on the lat. arc, 22° 56' N. on the decl. arc, and determine a meridian with the solar at the cor. of secs. 2, 3, 10 & 11, which is an iron post^{recently estab. by W.B. Kimmel} hereinbefore described, thence I run, West on a true line, bet secs 3 & 10.
 Along south slope, through dense scrub cedar undergrowth.
 2.00 Asc. SE slope.
 3.00 Ridge, brs. N. & S.; 20 ft. above cor. Desc. SW slope, 200 ft.
 20.00 Foot of desc.; thence across level land.
 24.00 Wash, 15 lks. wide, course NW. Asc. slight SE slope.
 32.00 Wash, 20. lks. wide, course SW.
 33.50 Road, Burns Spring to Kingman, bears NE & SW.
 38.00 Low ridge, N. & S., Thence along S. slope.
 40.00 Set an iron post, 3 ft. long, 1 in. diam., 26 ins. in the ground, for $\frac{1}{4}$ sec. cor., marked on brass cap.
 $\frac{1}{4}$ S3 on N. and
 S10 on E. half,
 and raise a mound of stone, 2 ft. base, 1 $\frac{1}{2}$ ft. high, N. of cor.
 Asc slightly from cor.
 54.00 Low ridge, Brs. NE. & SW., 40 ft. above cor., Thence along N. slope.
 73.70 Wash, 6 lks. wide, course N.
 74.00 Road, brs. N. to Chloride; S. to Burns Spring.
 78.00 Wash, 12 lks. wide, 1 ft. deep, course N. Asc. E. slope.
 80.00 Set an iron post, 3 ft. long, 2 ins. diam, 24 ins. in ground, for cor. of secs. 3, 4, 9 & 10, marked on brass cap
 T22N R20W in N. half,
 S4 in NW,
 S3 in NE,
 S10 in SE, and
 S9 in SW quadrant;
 and raise a mound of stone, 2 ft. base, 1 $\frac{1}{2}$ ft high, W. of cor. Fits impracticable. Secs, 3rd and 4th rate.
 Land rolling.
 Soil sandy loam. rocky; 3rd and 4th rate.
 Timber, scattering scrub cedar.
 Undergrowth, catclaw and greasewood.

From the cor. of secs. 3, 4, 9 & 10, previously described,
 I run N. 0° 02' W. on a random line, bet. secs. 3 & 4.
 40.00 Set temp. $\frac{1}{4}$ sec. cor.
 80.27 Intersect N. bdy. of Tp, 11 lks E. of the cor. of secs. 3, 4, 33 & 34, which is an iron post, previously set by me and described in Book "B", Page 12.
 Thence I run,
 S. 0° 07' E., on a true line, bet. secs 3 & 4.
 Over level land.
 28.00 Asc. NE slope, 180 ft.
 40.27 Set an iron post, 3 ft. long, 1 in diam., 26 ins. in the ground, for $\frac{1}{4}$ sec. cor, marked on brass cap,
 $\frac{1}{4}$ S4 in W. and
 S3 in E. half,
 and raise a mound of stone, 2 ft. base, 1 $\frac{1}{2}$ ft. high, W. of cor.
 Continue asc. from cor.
 45.00 End of asc, 80 ft. above cor. Rocky point 1 ch. W. Desc. SE slope, 90 ft.
 53.30 Gulch, course E. Asc NE slope, 75 ft.
 62.00 East end of hill. Desc SW slope, 150 ft.
 72.00 Along, ridge, brs. N & S.
 80.27 The cor of secs. 3, 4, 9 & 10, hereinbefore described.
 Land, rolling and mountainous.
 Soil, loose rocks on hills, sandy loam, 3rd rate on level.
 Timber, scrub cedar.
 Undergrowth, greasewood and catclaw.
 Mountainous land, 40 chs.
 The sky was overcast at noon, making an observation for lat at this cor. impossible.

From the corner of secs. 3, 4, 9 & 10, as set by me, and

240. Chains. ~~hereinbefore~~ described, I run
 West on true line bet. secs. 4 & 9, Asc. slightly from
 cor.

0.50 Low ridge, 20 ft. above cor, brs. N & S. Desc. very
 steep W slope, 290 ft.

10.00 South east end of old fruit house, Enter cultivated
 orchard of Burns Spring Ranch. Across level land.

10.30 Road, SE & NW.

10.50 Irrigation ditch, flows NW, 1 ft. wide 6" deep.

12.00 Burns Spring brsd, S21¹/₂E about 10 chs. dist. slope.

12.60 Burns Spring Ranch House brs. N 1 ch. dist.

13.20 Rock wall of road, brs. SE & NW. Asc. NE slope.

13.60 Four strand wire fence, brs. SE & NW. Gate to road, 40
 lks. SE; garden, 40 lks. NW.

15.00 Trail, SE & NW.

32.00 End of ascent, 200 ft. above ditch. I ch. S, a rock
 cliff, 60 ft. high. Burns Spring canyon, 14 chs. N.
 Along N slope.

36.00 Desc. NW slope, 40 ft. to

40.00 Set an iron post, 3 ft. long, 1 in diam., 26 ins. in
 the ground, for $\frac{1}{4}$ sec. cor., marked on brass cap
 $\frac{1}{4}$ S4 on N and
 S9 on S half,
 and raise a mound of stone, 2 ft. base, 1 $\frac{1}{2}$ ft. high,
 N. of cor. Pits impracticable.

52.00 Desc steep W slope from cor, 250 ft.

59.00 Gulch, course N. Desc. 30 ft.

62.75 Gulch, NW. Asc NE slope, 60 ft.

65.00 Granite boulder, 15 X 15 X 20 ft., on line. Desc. NW
 slope, 20 ft.

66.00 Gulch, NW.

73.00 Gulch, N. Asc NE slope, 130 ft.

74.50 Spur ridge, extends 2 chs NE. Desc NW slope. 25 ft.

80.00 Gulch, N. Asc NE slope, 180 ft.

Set an iron post, 3 ft. long, 2 ins. diam., 24 ins. in
 the ground, for cor. to secs. 4, 5, 8 & 9, marked on
 brass cap
 T22N R20W in N half;
 S5 in NW,
 S4 in NE,
 S9 in SE, and
 S8 in SW quadrant;
 and raise a mound of stone, 2 ft. base; 1 $\frac{1}{2}$ ft high, W.
 of cor. Pits impracticable.
 Land, mountainous.
 Soil, granite rocks and decomposed granite in canyons.
 No timber, very little undergrowth.
 Mountainous land, 80 chs.

June 9, 1913.

June 10, 1913: At 9h. 30m. a.m., 1.m.t., I set off 35°

19' N. on the lat., arc, 23° 01' N. on the decl. arc,
 and determine a meridian with the solar, at the cor.
 of secs. 4, 5, 8 & 9, set by ~~me~~ described above,
 Thence I run,
 N. 0° 03' W., on a random line, bet. secs 4 & 5.

39.80 The 40 ch. point being on face of cliff, and inaccess-
 ible, I leave a temporary point here.

80.12 Intersect the N. Bdy. of the Tp, 14 lks E. of the cor.
 of secs. 32, 33, 4 & 5, which is an iron post, set
 by me and described in Book "B" page 13.

Thence I run,
 S 0° 09' E on a true line bet. secs. 4 & 5.

44.20 Desc. SW slope through scat. scrub cedar, 50 ft.

65.50 Gulch, SW; asc NW slope, 20 ft.

69.50 SW end of spur ridge, desc. SE slope, 125 ft.

16.00 Enter Canyon, with wash in bottom, 1 ch. wide, course W.

17.00 Leave Canyon; asc NW slope, asc 310 ft.

22.20 Rocky cliff, 30 ft. high.

28.75 Rocky ridge, brs. E & W. Desc. SW slope., 50 ft.

241

BOOK 2499

- Chains.
- 32.50 Small Gulch, course W, asc. NW. slope, over jagged boulders, 35 ft.
 - 35.50 Rocky ridge, 2 chs. long, brs. SE & NW., desc SW slope.
 - 38.00 Along SW slope of massive pile of rocks and boulders.
 - 40.12 Point for $\frac{1}{4}$ sec. cor falls on precipice.
 - 40.32 100 ft. below ridge, set an iron post, 3 ft long 1 in. diam., 26 ins. in the ground for witness cor. to $\frac{1}{4}$ sec. cor. secs 4 & 5, marked on brass cap WC $\frac{1}{4}$ in N. half, S4 in SE. and S5 in SW. quadrant, and raise a mound of stone, 2 ft. base, 1 $\frac{1}{2}$ ft. high, W. of cor. Pits impracticable.
 - 42.00 Gulch, course SW; 50 ft. below cor. Asc. 40 ft.
 - 45.00 Rocky point; desc SW slope, 115 ft.
 - 53.70 Burns spring Canyon, course NW. A stream of water, 1 in. deep, and 1 ft wide here. Asc. very steep NE slope, over bare, white ledges, 600 ft.
 - 74.00 Perpendicular cliff, 60 ft high.
 - 76.00 Rocky knife blade ridge, brs. SE & NW. Desc SW slope 70 ft.
 - 80.12 The cor. of secs. 4, 5, 8 & 9, hereinbefore described. Land mountainous. Soil decomposed granite in washes and canyons, bare granite ledges. Timber and undergrowth, scattering cedar. Mountainous land, 80 chs.

At the cor. of secs, 4, 5, 8 & 9 above described, I set off 23° 01 $\frac{1}{2}$ ' N on the decl. arc, and at 11h. 59m. a.m., 1.m.t., I observe the sun on the meridian; the resulting lat. is 35° 19' N. which is correct. 0.1' of the correct lat.

- Thence I run, S0° 03' E, on a true line, bet secs. 8 & 9. Desc. very rocky SW. slope, 360 ft.
- 12.50 Gulch, course SW. Along W. slope.
- 18.00 Desc. S. slope, 60 ft.
- 22.00 Gulch, course W; Asc NW. slope.
- 24.00 Spur ridge, extends 4 chs. W. Desc. SW. slope, 100 ft.
- 29.00 Point of rock, 35 ft high; projects SW. Desc. SW. slope, 260 ft.
- 33.00 ^{GRANITE} Canyon with wash, 50 lks. wide in bottom, course NW. Asc. NE slope, 90 ft.
- 40.00 Set an iron post, 3 ft. long, 1 in diam., 26 ins. in the ground, for $\frac{1}{4}$ sec. cor, marked on brass cap $\frac{1}{4}$ S8 in W. and S9 in E. half, and raise a mound of stone, 2 ft. base, 1 $\frac{1}{2}$ ft, high, W. of corner. Pits impracticable.
- 44.00 Base of cliff, 200 ft. high, and succession of cliffs, over which I cannot run line. Set an iron post, 3 ft. long, 2 ins. diam., 24 ins. in the ground, for witness corner to secs. 8, 9 16 & 17, marked on brass cap ^{cor. of} WC N. of centre, T22N R20W in N half; S8 in NW, S9 in NE, S16 in SE, and S17 in SW quadrant, and raise a mound of stone, 2 ft. base, 1 $\frac{1}{2}$ ft; high, W. of corner. Pits impracticable. Land mountainous. Soil very rocky 4th rate. No timber. Good grass. Cactus Mountainous land, 44 chs.

June 10, 1913.

General Description.

This township is nearly all rough and rocky mountains, the soil is rocky and very poor, little or no grass. A few cedar trees, but most of it is covered with a dense undergrowth of scrub cedar, cat claws, cacti, greasewood, scrub oak, &c.

The western part of this Tp. drains to the West, the Central and Northern part to the North and the Eastern part to the East.

W.A. Walker lives in sec. 13, and a lessee of the Frisco Mining Co. lives in sec. 4

William B. Kimmel.
U. S. Surveyor.

J. A. Bradstreet
U. S. Transitman.

242
BOOK 2499
BOOK 2499

CERTIFICATE OF ASSISTANTS.
same applies to Subdivisions Book "D"

We, the undersigned, hereby certify upon honor that we assisted, to the best of our skill and ability, *and H.N. Bradstreet, U.S. TRANSITMAN*
 William B. Kimmel, U. S. Surveyor, during the periods and in the capacities *under Group 27*
 stated opposite our several signatures, in surveying all those parts or portions of
the Subdivision lines of Township 22 North - Range 20 West,
and
the Subdivision lines of Township 24 North, Range 3 West,
and
Retracing the 6th Standard Parallel North through part of Range 3 West,
and Resurveying the East boundary of Township 22 North, Range 20 West,
 of the *Gila and Salt River Base and* Meridian, in the State of *Arizona.*
 which are represented in the foregoing field notes, as having been executed by *them* and under *their* direc-
retracement & resurvey
 tion; and that said survey has been, in all respects, to the best of our knowledge and belief, well and
 faithfully executed.

NAME.	PERIOD OF SERVICE.		CAPACITY.
	BEGUN.	ENDED.	
<i>J. M. Rank</i>	May 27, 1913.	June 11, 1913.	Moundman
<i>Hal Grinskan</i>	May 27, 1913.	June 19, 1913.	Chainman
<i>Wesley Mullenax</i>	May 27, 1913.	June 28, 1913.	Chainman Flagman
<i>Monty Miller</i>	May 27, 1913.	June 28, 1913.	Chainman
<i>E. L. Mosher</i>	May 27, 1913.	June 28, 1913.	Chainman
<i>J. M. Robertson</i>	June 21, 1913.	June 28, 1913.	Moundman
<i>H. M. Tompkins</i>	May 27, 1913.	June 28, 1913.	Moundman
<i>Samuel H. O'Leary</i>	May 27, 1913.	June 28, 1913.	Chainman

Subscribed and certified to before me on the dates of the final service as shown above.

William B. Kimmel
U. S. Surveyor.

244 8
BOOK 2499

FINAL OATH OF UNITED STATES SURVEYOR.

same applies to Subdivisions Book "D"

We ^{and Transitman, respectively,}
Wm B Kimmel and *H N Bradstreet*, U. S. Surveyor, do solemnly swear that, in pursuance
of special instructions ^{for Group 27} received from the U. S. Surveyor General for *Arizona*
bearing date of the *24th* day of *April*, 1913, ^{we} have well, faithfully, and truly,
in ^{our} own proper persons, and in strict conformity with said instructions, the Manual of Surveying
Instructions, and the laws of the United States, surveyed ^{all} those parts or portions of *the*
Subdivisional lines of T 22 N R 20 W and T 22 N R 3 W,
and retraced the 6th Standard Parallel North, through part of Range 3 West,
and Resurveyed the East boundary of T. 22 N. - R. 20 W,

Base of the *G & S R*
Meridian, in the State of *Arizona*, which are represented in
the foregoing field notes ^{and notes in Book "D"}, as having been executed by ^{us} *W B Kimmel* and ^{our} *H N Bradstreet* under ^{our} direction; and ^{we} do further
solemnly swear that all the corners of said survey, ^{retracement & resurvey} have been established, and perpetuated in strict accord-
ance with the Manual of Surveying Instructions, and the special written instructions of the U. S. Surveyor
General for *Arizona* and in the specific manner described in the field notes, and that
the foregoing ^{and notes in Book "D"} are the original field notes of such survey, *retracement and resurvey.*

William B. Kimmel
U. S. Surveyor.

Subscribed by said *W B Kimmel* and *H N Bradstreet* ^{se & Bradstreet} and sworn to before me } *U. S. Transitman*
this *14th* day of *July*, 1913

Frank S. Ingalls
SURVEYOR-GENERAL OF ARIZONA



APPROVAL.

OFFICE OF THE UNITED STATES SURVEYOR GENERAL,
Phoenix, Arizona March 2, 1914

The foregoing field notes of the survey of *part of*
the Subdivisional lines of
Township 22 North, Range 20 West
and Resurvey of East bdy. of Township 22 North, Range 20 West
of the
Gila and Salt River Base and Meridian, Arizona.
executed by *William B. Kimmel, U.S. Surveyor* and *H. N. Bradstreet, U.S. TRANSITMAN*
under ^{their} special instructions, dated ^{for Group 27} *April 24,* 1913, having been
critically examined, and the necessary corrections and explanations made, the said field notes, and the
^{and resurveys} surveys, they describe, are hereby approved.

Frank S. Ingalls
U. S. Surveyor General.

~~I certify that the foregoing transcript of the field notes of the above described surveys in~~
~~has been correctly copied from the original notes on file in this office.~~