

Standard
BOOK "D"

2510

BOOK 2510

FIELD NOTES

OF THE SURVEY OF THE

Third Guide Meridian East: through Twp. 25th N.
between Ranges No. 12 and 13 East.

of the Gila and Salt River Basins Meridian,

in the Territory of Arizona

EXECUTED
AS SURVEYED BY

Sidney E. Blouh

United States ^{Examiner of Surveys} ~~Deputy Surveyor~~

^{Examiner of Surveys}

Special Instructions from the Commissioner of the General Land Office
Under his ~~Contract No.~~ dated Oct 2nd 1907 and May 15th 1908

Survey commenced February 8th 1910 ~~190~~

Survey completed February 8th 1910 ~~190~~

NAMES AND DUTIES OF ASSISTANTS.

<u>Armed L. Warner and Earl Albright</u>	<u>Chairmen</u>
<u>P. J. White and Chas L. Shumway</u>	<u>Chairmen</u>
<u>Ralph C. Sampson</u>	<u>Wardman</u>
<u>William Pearson</u>	<u>Wagoner</u>

BOOK 2510

INDEX DIAGRAM.

Township

Range

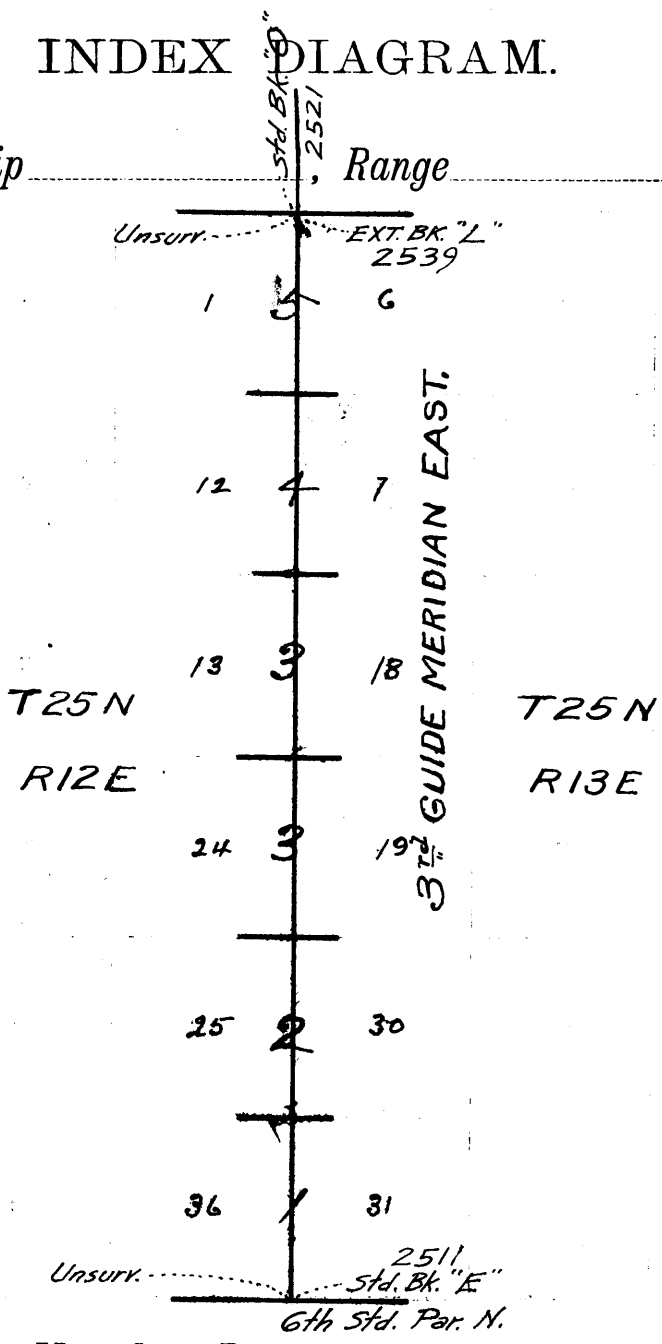

Meanders Page

PRELIMINARY OATHS OF ASSISTANTS.

WE, Fred L. Warner, Carl Albright and N. J. White and Chas. L. Shumway
do solemnly swear that we will well and faithfully execute the duties of chainmen; that we will level the
chain upon even and uneven ground, and plumb the tally pins, either by sticking or dropping the same; that
we will report the true distances to all notable objects, and the true lengths of all lines that we assist in
measuring, to the best of our skill and ability, and in accordance with instructions given us, in the survey of
The Third Guide Meridian East through Twp 25 N. R. Ranges 12 and 13 E.

Chas. L. Shumway and Carl Albright, Chainmen
N. J. White and Fred L. Warner, Chainmen

Subscribed and sworn to before me this 7th
day of February, 1910



Sidney E. Blout
U.S. Examiner of Surveys

I, Ralph C. Sampson, do solemnly swear that we will well and truly perform the duties of moundman in the establishment
of corners, according to the instructions given me to the best of my skill and ability, in the survey of

The Third Guide Meridian East through Twp 25 N. R. Ranges 12 and 13 East.
G. & S. R. Base & Mer., Arizona.

Ralph C. Sampson, Moundman.
Moundman.

Subscribed and sworn to before me this 7th
day of February, 1910



Sidney E. Blout
U.S. Examiner of Surveys

~~WE, _____ and _____
do solemnly swear that we will well and truly perform the duties of axmen in the establishment of corners
and other duties, according to instructions given us, to the best of our skill and ability, in the survey of~~

~~Subscribed and sworn to before me this _____
day of _____, 19__~~



I, William R. Carson, do solemnly swear that I will well and truly
perform the duties of flagman according to instructions given me, to the best of my skill and ability, in the
survey of The third guide Meridian East through Twp 25 N. R. Ranges 12 and
13 East, G. & S. R. Base & Mer., Arizona. William R. Carson, Flagman.

Subscribed and sworn to before me this 7th
day of February, 1910



Sidney E. Blout
U.S. Examiner of Surveys

Survey commenced Feb. 8th 1910 and executed with a
 Waltham E. Gurley engineers transit No. 76 with a Burch
 solar attachment. The horizontal limb is provided with
 one double vernier reading to single minutes of arc.
 The verniers of the latitudes and declination arcs read
 to 0' 30" of arc. I examined the adjustments of the transit
 and find them to be as nearly perfect as I am able to
 make them, and know from recent tests of the
 solar apparatus by comparing its indications resulting
 from solar observations made during a.m. and p.m.
 hours with a meridian established by observations on
 Polaris that the instrument is in fact's factory
 adjustment, therefore I begin at the Standard
 Cor. of T₂₅N, R₁₂ and R₁₃E, which I established
 on the 6th Standard Parallel North
 Feb. 7th 1910, and described in Standard Book "F"
 Latitude 35° 30' 35" N. Longitude
 111° 00' 32" W.

On 7th 4:45^m a.m. ^{l.m.t.} I set off 35° 30' 35" N on the lat. arc and determined a meridian
 with the solar alt. the above. Cor. three
 runs.

North Feb. Recs. 31 and 36

Run on N.E. slope over rolling sandy land through
 sage and greasewood bush undergrowth and bunch
 grass.

Difference between measurements of 4000 Chs. by
 two sets of chainmen is 2 Chs., position of middle
 point

By 1st set 4001 Chs.

By 2nd set 3999 Chs. the mean of which is

4000

Set an iron post 3 ft. long, 1 in. in diam. 26 ins.
 in the ground for 4 in. cor. marked on brass
 cap 4536 on W. half and 531 on E. half.

Dig pits 18x18x12 ins. N and S. of post 3 ft. deep and
 raise a mound of earth 3 1/2 ft. base, 1 1/2 ft. high.
 W. of cor.

Difference between measurements of 8000 Chs. by two
 sets of chainmen is 2 Chs. position of middle point.

By 1st set 8001 Chs.

By 2nd set 7999 Chs. the mean of which is

8000

Set an iron post 3 ft. long 3 in. in diam. 24 ins.
 in the ground for Cor. of recs 25, 30, 31 and 36
 marked on brass cap T₂₅N. in N. half, R₁₂E

BOOK 2510

S 25 in N.W., R 13 E S 30 in N.E., S 31 in S.E. and S 36 in S.W. quadrants.

Dig pits 18 x 18 x 12 ins. in each sec. 5 1/2 ft. dia. and raise a mound of earth 4 ft. base 2 ft. high. W. of cor.
Land rolling.

Soil sandy 3rd rate,
No timber

North T₆ sec. 25 and 30

Descend N.E. slope over rolling sandy land through sage and greasewood brush undergrowth and bunch grass

19,00 Foot of descent, leave rolling land bear E and W. Enter level land bear E and W.

Difference between measurements of 4000 Chs. by two sets of chainmen is 3 lks., position of middle points

By 1st set Chs. 40,01 1/2 Chs.

40,00 By 2nd set Chs. 39,98 1/2 Chs., the mean of which is
Set an iron post 3 ft. long 1 in. in diam. 26 ins. in the ground for 1/4 sec. cor. marked on brass cap T 25 on W. half and S 30 on E half.

Dig pits 18 x 18 x 12 ins. N and S. of post. 3 ft. dia. and raise a mound of earth 3 1/2 ft. base, 1 1/2 ft. high. W. of cor.

Difference between measurements of 8000 Chs. by two sets of chainmen is 2 lks., position of middle points

By 1st set Chs. 80,01 Chs.

80,00 By 2nd set Chs. 79,99 Chs., the mean of which is.

Set an iron post 3 ft. long 3 ins. in diam., 24 ins. in the ground for cor. of sec. 19, 24, 25 and 30 marked on brass cap. T 25 N. in N half R 12 E, S 24 in N.W., R 13 E S 19 in N.E., S 30 in S.E. and S 25 in S.W. quadrants

Dig pits 18 x 18 x 12 ins. in each. sec. 5 1/2 ft. dia. and raise a mound of earth, 4 ft. base, 2 ft. high. W. of cor.

Land level and rolling.
Soil sandy 3rd rate,
No timber

North beh. secs 19 and 24.

Over level sandy land through sage and greasewood bush undergrowth and bunch grass.

2,50 Road to Loupp Agency bears N.E. and S.W.

Difference between measurements of 4000 Chs. by two sets of chainmen is 4 lks., position of middle point.

By 1st Set. 4002 Chs.

By 2nd Set 3998 Chs. the mean of which is

40,00 Set an iron post 3 ft. long, 1 in. in diam. 26 ins. in the ground for $\frac{1}{4}$ sec. cor. marked on brass cap $\frac{1}{4}$ S 24 on W. half and S 19 on E. half.

Dig pits 18x18x12 ins N. and S. of post 3 ft. dia. and raise a mound of earth 3 $\frac{1}{2}$ ft. base, 1 $\frac{1}{2}$ ft. high. W. of cor.

55,35 Dry sand wash. 15 lks. wide 1 ft. deep course S.W. Difference between measurements of 80,00 Chs. by two sets of chainmen is 4 lks. position of middle point.

By 1st Set 80,02 Chs.

By 2nd Set 79,98 Chs. the mean of which is

80,00 Set an iron post 3 ft. long 3 ins. in diam 24 ins. in the ground for cor. of secs. 13, 18, 19, and 24, marked on brass cap T 25 N. in N. half. R 12 E S 13 in N.W. R 13 E. S 18 in N.E. S 19 in S.E. and S 24 in S.W. quadrants.

Dig pits 18x18x12 ins in each. sec 5 $\frac{1}{2}$ ft. dia. and raise a mound of earth 4 ft. base 2 ft. high. W. of cor.

Land rolling and level.

Soil sandy 3rd rate.

No timber.

North beh. secs 13 and 18.

Over level sandy land through sage and greasewood bush undergrowth and bunch grass.

31,00 Level land bears N.W. and S.E. Center rolling land bears N.W. and S.E. acc. S.W. slope.

Difference between measurements of 4000 Chs. by two sets of chainmen is 1 lk., position of middle point.

By 1st Set. 40,00 $\frac{1}{2}$ Chs.

BOOK 2510

40.00 By 2nd Set. 39,99½ Chs. the mean of which is
Set an iron post 3 ft. long 1 in. in diam 26
ins. in the ground for $\frac{1}{4}$ sec. cor. marked on
brass cap T 25 N₂ on W. half and S 18 on E half.
Dig pits 18 x 18 x 12 ins. N and S. of post 3 ft. dia.
and raise a mound of earth 3½ ft. base, 1½ ft.
high W. of cor.

Difference between measurements of 80.00 Chs. by
two sets of chainmen is 2 lbs. position of
middle point.

By 1st Set 80.01 Chs.

80.00 By 2nd Set 79.99 Chs. the mean of which is
Set an iron post 3 ft. long 3 in. in diam. 24 ins.
in the ground for cor. of sec. 7, 12, 13 and
18, marked on brass cap T 25 N₂ in N half.
R 12 E S 12 in N.W. R 13 E S 7 in N.E. S 18 in S.E. and
S 13 in S.W. quadrants.

Dig pits 18 x 18 x 12 ins. in each. sec. 5½ ft. dia.
and raise a mound of earth 4 ft. base, 2 ft.
high W. of cor.

Land level and rolling
Soil sandy 3rd rate.
No timber.

NOTE At this cor. Deb. off. 15° 03½' S. on the decl. arc
and at noon observe the sun on the meridian
the resulting latitude being 35° 34' N.

North bet. sec 7 and 12.

Ascend gradually S.W. slope over rolling sandy land
through sage brush undergrowth and brush grass
6.00 Top of sand ridge bears N.W. and S.E., desc.
gradually N.E. slope.

Difference between measurements of 40.00 Chs.
by two sets of chainmen is, 6 lbs. position of
middle point.

By 1st Set. 39.97 Chs.

40.00 By 2nd Set 40.03 Chs the mean of which is.
Set an iron post 3 ft. long 1 in. in diam. 26 ins.
in the ground for $\frac{1}{4}$ sec. cor. marked on brass
cap. T 25 N₂ on W. half and S 7. on E half.
Dig pits 18 x 18 x 12 ins. N and S. of post. 3 ft. dia. and.

raise a mound of earth $3\frac{1}{2}$ ft. base, $1\frac{1}{2}$ ft. high. W. of cor.
 4155 Intersect left bank of the De Nebito Wash. 8 ft. high. water muddy. 4 in deep. bears NE and SW.
 4800 Right bank of the De Nebito Wash. bears NE and SW begin ascent over S.E. slope
 Difference between measurements of 80,00 Chs. by two sets of Chainmen is 8 lbs. position of middle point.
 By 1st set 80,04 Chs.
 By 2nd set 79,96 Chs. the mean of which is
 80,00 Set an iron post 3 ft. long 3 in. in diam. 24 ins. in the ground for cor. of secs. 1, 6, 7 and 12 marked on brass cap T₂₅ N. in N half. R₁₂ E S₁ in N.W. T₁₃ E S₆ in N.E. S₇ in S.E. and S₁₂ in S.W. quadrant.
 Dig pits 18x18x12 ins. in each. sec. $5\frac{1}{2}$ ft. dia. and raise a mound of earth 4 ft. base 2 ft. high. W. of cor.
 Land rolling
 Soil sandy 3rd rate.
 No timber.

North Sec. 1 and 6.
 Ascend S.E. slope over hilly sandy land through sage and greasewood brush undergrowth and bunch grass.
 3,00 Top of sand ridge bears NE and SW. desc.
 24,00 Path of descent in depression bears NE and SW. asc. gently.
 Difference between measurements of 40,00 Chs. by two sets of Chainmen is 3 lbs. position of middle point.
 By 1st set 39,98½ Chs.
 By 2nd set 40,01½ Chs. the mean of which is
 40,00 Set an iron post 3 ft. long, 1 in. in diam. 26 ins. in the ground for 4 sec. cor. marked on brass cap T₇ S₁ on W. half and S₆ on E. half.
 Dig pits 18x18x12 ins. N and S. of post 3 ft. dia. and raise a mound of earth $3\frac{1}{2}$ ft. base, $1\frac{1}{2}$ ft. high W. of cor.

BOOK 2510

Difference between measurements of 80.00 Chs. by two sets of chainmen is 5 lbs portion of middle point

By 1st set. 80 02 1/2 Chs.

By 2nd set 79 97 1/2 Chs. the mean of which is 80.00

Set an iron post 3 ft. long 3 ins. in diam. 24 ins. in the ground for cor. of T₂₅ N. R₁₂ and R₁₃ E. marked on brass cap T₂₆ N in N half; T₂₅ N. in S. half, T₁₂ E S₃₆ in NW, T₁₃ E S₃₁ in NE, T₁₃ E S₆ in SE, and T₁₂ E S₁ in SW, quadrants.

Dig pits 24 x 24 x 12 ins N.E and W. of post 4 ft. and S of post 8 ft. dish and raise a mound of earth 5 ft. base, 2 1/2 ft. high S. of cor. Land rolling.

Soil sandy 3rd rate.
No timber.

February 8th 1910

General Description

Townships 25 N. R₁₂ and R₁₃ E. are generally rolling sand hills which are covered with bunch grass and sage brush, there is some land in T₂₅ N. R₁₃ E which is suitable for agricultural purposes if water can be obtained for irrigation purposes.

Feb 8th 1910

Sidney E. Blouh
U.S. Examiner of Surveys

U.S. EXAMINER OF SURVEYS
FINAL OATHS OF ~~DEPUTY SURVEYOR~~ AND HIS ASSISTANTS.

BOOK 2510

LIST OF NAMES.

A list of the names of the individuals employed by Sidney E. Bloush
Examiner of Surveys
~~Deputy Surveyor~~, United States, to assist in running, measuring, and
marking the lines and corners described in the foregoing field notes of the survey of the Third Guide

Meridian East through Twp 25 N. bet. Ranges 12 and 13 East.
G. & S. R. Base & Mer., Arizona.

showing the respective capacities in which they acted: Van L. White Courserman

Fred L. Warner, Earl Albright, J. V. White and Chairman

Chas. L. Shumway Chairman

Ralph C. Sampson Moundman.

Moundman

Asman.

Asman.

William R. Carson Flagman.

FINAL OATH OF ASSISTANTS.

We hereby certify that we assisted Sidney E. Bloush
Examiner of Surveys
~~Deputy Surveyor~~, United States, in surveying all

those parts or portions of the Third guide meridian East, through Twp 25 N.

bet. ranges 12 and 13 E.

of the Gila and Salt

River Base and meridian, Territory of Arizona, which are represented

in the foregoing field notes as having been surveyed by him and under his direction; and that said survey
has been in all respects, to the best of our knowledge and belief, well and faithfully surveyed, and the
corner monuments established, according to the instructions furnished by the United States Commissioner

~~General~~ of the General Land Office Van L. White Courserman

Earl Albright, Fred L. Warner Chairman.

J. V. White, Chas. L. Shumway Chairman.

Ralph C. Sampson Moundman.

Moundman.

Asman.

Asman.

William R. Carson Flagman.

Subscribed and sworn to before me this 8th
day of February, 1900

Sidney E. Bloush
U.S. Examiner of Surveys



12 8
BOOK 2510

EXAMINER OF SURVEYS
DEPUTY SURVEYOR.

I, Sidney E. Blout, United States ~~Deputy Surveyor~~ ^{Examiner of Surveys}, do solemnly swear that, in pursuance of ~~Special Instructions~~ ^{Special Instructions} received from ~~the Commissioner of the United States Surveyor General for the General Land Office~~ ^{the Commissioner of the General Land Office}, bearing date of the ~~2nd day of Oct. 1907~~ ^{and the 15th day of May 1908}, I have well, faithfully, and truly, in my own proper person, and in strict conformity with the instructions furnished by the ~~United States Surveyor General for the General Land Office~~ ^{United States Commissioner of the General Land Office}, the Manual of Surveying Instructions, and the laws of the United States, surveyed all those parts or portions of The 3rd Guide Meridian East, through Tps 25 North, Twp Ranges 12 and 13 East.

of the Gila and Salt River Base and meridian, in the Territory of Arizona, which are represented in the foregoing field notes as having been surveyed by me, and under my direction; and I do further solemnly swear that all the corners of said survey have been established and perpetuated in strict accordance with the Manual of Surveying Instructions, and the special written instructions of the ~~United States Surveyor General for the General Land Office~~ ^{Commissioner of the General Land Office} and in the specific manner described in the field notes, and that the foregoing are the original field notes of such survey.

Sidney E. Blout
United States ~~Deputy Surveyor~~ ^{Examiner of Surveys}

Subscribed by said Sidney E. Blout, and sworn to before me }
this 14th day of March, 1908

Frank S. Ingalls
SURVEYOR-GENERAL OF ARIZONA



APPROVAL.

OFFICE OF THE UNITED STATES SURVEYOR GENERAL,

Phoenix Arizona APR 25, 1908

The foregoing field notes of the survey of the
3rd Guide Meridian East thru Tps. 25 N.
between Rs. 12 and 13 East, of the

Gila and Salt River Base and Meridian, Arizona.

executed by Sidney E. Blout, U.S. Examiner of Surveys, under ~~his contract No. 2~~ ^{Special Instructions from the Commissioner of the General Land Office}, dated October 2, 1907 and May 15, 1908, having been critically examined, and the necessary corrections and explanations made, the said field notes, and the surveys they describe, are hereby approved.

Frank S. Ingalls
United States Surveyor General.

I certify that the foregoing transcript of the field notes of the above-described surveys in _____, has been correctly copied from the original notes on file in this office.

United States Surveyor General.