

Exteriors  
**BOOK A**

2528

FIELD NOTES

BOOK 2528

OF THE ~~SURVEY OF THE~~

*Survey of the South and East Boundaries  
and Resurvey of the North Boundary of  
Twp. 26 N. - R. 18 E.*

Of the *Gila and Salt River Basins and* Meridian,  
*in the Territory of Arizona*

EXECUTED  
AS SURVEYED BY

*Sidney E. Blount*, United States ~~Deputy Surveyor~~ *Examiner of Surveys*

*Special Instructions* From the Commissioner of the General Land Office  
Under ~~this~~ Contract No. \_\_\_\_\_, dated *October 2<sup>nd</sup> 1907 and May 15<sup>th</sup>*, 1908

& Resurvey  
Survey commenced *June 17*, 1908

& Resurvey  
Survey completed *June 19*, 1908

108  
17

BOOK 2528

NAMES AND DUTIES OF ASSISTANTS.

<i>Fred L. Warner</i>	<i>Chairman</i>
<i>Naw L. White</i>	<i>Chairman</i>
<i>Harry J. Hassler</i>	<i>Moundman</i>
<i>Pelix Manning</i>	<i>Flagman</i>

BOOK 2528

# INDEX DIAGRAM.

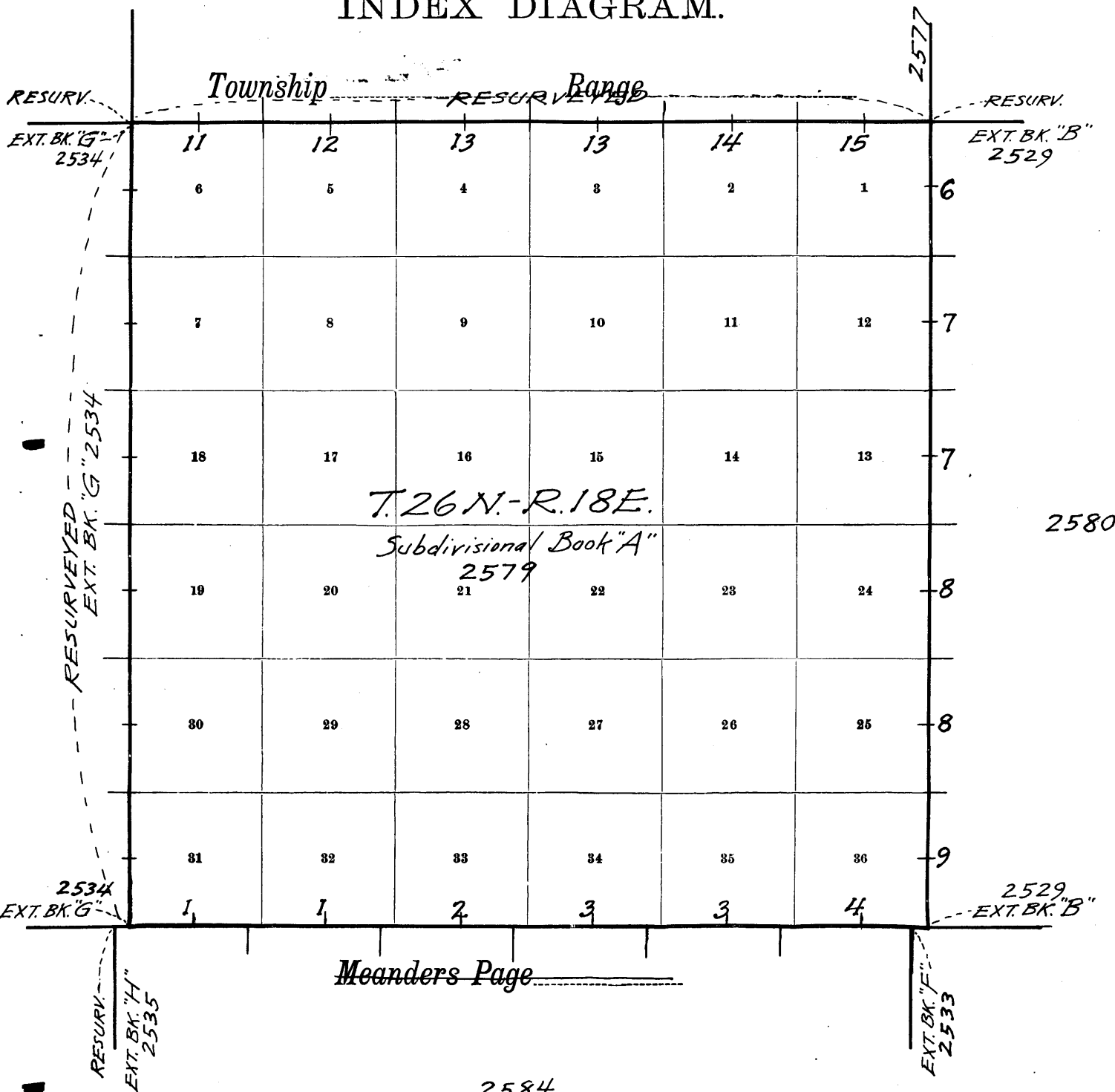

110  
12

BOOK 2528

PRELIMINARY OATHS OF ASSISTANTS.  
Same applies to Exterior Books "B", "G" and "AX"

WE, Fred L. Warner, Van L. White and Ralph J. West and Walter C. Swaffer  
do solemnly swear that we will well and faithfully execute the duties of chainmen; that we will level the chain upon even and uneven ground, and plumb the tally pins, either by sticking or dropping the same; that we will report the true distances to all notable objects, and the true lengths of all lines that we assist in measuring, to the best of our skill and ability, and in accordance with instructions given us, in the survey of the South bdrs. of Tps. 26 N., Rs. 17, 18 and 19 E., the E. bdy. of T. 26 N., R. 18 E. and the S $\frac{1}{2}$  of the East bdy. of T. 26 N., R. 19 E. and portions of North and East bdrs. of T. 27 N., R. 19 E. and resurvey of the North bdrs. of Tps. 26 N., Rs. 17, 18 and 19 E., the E. bdy. of T. 26 N., R. 17 E. & N $\frac{1}{2}$  of E. bdy. of T. 26 N., R. 19 E. and West bdy. and portions of North and East bdrs. of T. 27 N., R. 19 E. of the G. & S. R. Base & Mer., Arizona

Ralph J. West and W. A. Swaffer, Chainmen.  
Van L. White and Fred L. Warner, Chainmen.

Subscribed and sworn to before me this 10<sup>th</sup>  
day of June, 1908



Sidney E. Blount  
U.S. Examiner of Surveys

WE, Henry Jennings and Harry J. Hassler  
do solemnly swear that we will well and truly perform the duties of moundmen in the establishment or re-establishment of corners, according to the instructions given us, to the best of our skill and ability, in the survey of the South bdrs. of Tps. 26 N., Rs. 17, 18 & 19 E., the East bdy. of T. 26 N., R. 18 E. & the S $\frac{1}{2}$  of the East bdy. of T. 26 N., R. 19 E. and portions of North and East bdrs. of T. 27 N., R. 19 E. and resurvey of the North bdrs. of Tps. 26 N., Rs. 17, 18 and 19 E., the E. bdy. of T. 26 N., R. 17 E. & N $\frac{1}{2}$  of E. bdy. of T. 26 N., R. 19 E. and West bdy. and portions of North and East bdrs. of T. 27 N., R. 19 E. of the G. & S. R. Base & Mer., Arizona.

Henry Jennings, Moundman.  
Harry J. Hassler, Moundman.

Subscribed and sworn to before me this 10<sup>th</sup>  
day of June, 1908



Sidney E. Blount  
U.S. Examiner of Surveys

~~WE~~, Charles A. Dutton and ~~me~~  
do solemnly swear that ~~we~~ will well and truly perform the duties of axman in the establishment or re-establishment of corners and other duties, according to instructions given ~~me~~ to the best of ~~my~~ skill and ability, in the survey of the South bdrs. of Tps. 26 N., Rs. 17, 18 & 19 E., the East bdy. of T. 26 N., R. 18 E. & the S $\frac{1}{2}$  of East bdy. of T. 26 N., R. 19 E., and resurvey and portions of North and East bdrs. of T. 27 N., R. 19 E. and resurvey of the North bdrs. of Tps. 26 N., Rs. 17, 18 & 19 E., the East bdy. of T. 26 N., R. 17 E. & the N $\frac{1}{2}$  of East bdy. of T. 26 N., R. 19 E. and West bdy. and portions of North and East bdrs. of T. 27 N., R. 19 E. of the G. & S. R. Base & Meridian, Arizona.

Charles A. Dutton, Axman.

Subscribed and sworn to before me this 2<sup>nd</sup>  
day of July, 1908



Sidney E. Blount  
U.S. Examiner of Surveys

WE, Pelix Manning and Robt. E. Colborne do solemnly swear that ~~we~~ will well and truly perform the duties of flagman according to instructions given ~~us~~ to the best of ~~our~~ skill and ability, in the survey of the South bdrs. of Tps. 26 N., Rs. 17, 18 & 19 E., the East bdy. of T. 26 N., R. 18 E. & the S $\frac{1}{2}$  of East bdy. of T. 26 N., R. 19 E. and resurvey and portions of North and East bdrs. of T. 27 N., R. 19 E. and resurvey of the North bdrs. of Tps. 26 N., Rs. 17, 18 & 19 E., the East bdy. of T. 26 N., R. 17 E. & the N $\frac{1}{2}$  of East bdy. of T. 26 N., R. 19 E. and West bdy. and portions of North and East bdrs. of T. 27 N., R. 19 E. of the G. & S. R. Base & Mer., Arizona.

Felix Manning, Flagman.

Subscribed and sworn to before me this 10<sup>th</sup>  
day of June, 1908



Robt. E. Colborne - Flagman  
C. L. Shumway - Flagman  
Sidney E. Blount  
U.S. Examiner of Surveys

Survey Commenced June 17<sup>th</sup> 1908 and executed with a Young & Sons Light Mountain Transit No 10 with a Smith Solar attachment, the horizontal limb being provided with two double verniers placed opposite to each other reading to single minutes of arc, which is also the least count of the verniers of the latitude and declination arcs.

I begin at the Cor. of Nps. 25 and 26 N. R's 17 and 18 E which I re-established June 16 1908. and described in Exterior Book "G"  
Latitude  $35^{\circ} 35' 48''$  N. Longitude  $110^{\circ} 28' 1/2''$  W.

At this cor. I set off  $35^{\circ} 36'$  N. on the lat. arc,  $23^{\circ} 34' 1/2''$  N. on the decl. arc and at 7<sup>h</sup> 00<sup>m</sup> a.m. I determined a meridian with the solar

Thence I run

East. Sec. 6 and 21.

Over low rolling sand hills through sage brush greasewood and bunch grass

39.49 Set a malapai stone  $18 \times 12 \times 6$  ins 12 ins in the ground for  $1/4$  sec. cor. marked '4' on N face

Dig pits  $18 \times 18 \times 12$  ins. E and W. of stone 3 ft. dist. and raise a mound of earth  $3 1/2$  ft. base,  $1 1/2$  ft. high. N. of cor.

79.49 Set a malapai stone  $20 \times 12 \times 6$  ins 16 ins in the ground for Cor. of Secs. 5, 6, 31 and 32., marked with 5 notches on E and 1 notch on W. edges.

Dig pits  $18 \times 18 \times 12$  ins. in each sec.  $5 1/2$  ft. dist. and raise a mound of earth 4 ft. base 2 ft. high W. of cor.

Sand lilly

Soil sandy 3<sup>rd</sup> rate.

No timber

East. Sec. 5 and 32.

Across gradually over SW. slope over low rolling sand hills through sage brush greasewood and bunch grass

34.00 Dry ravine 25 lbs. wide 6 ft. deep course S.W. and

40.00 Set a malapai stone  $15 \times 14 \times 6$  ins, 10 ins in the

South Boundary of M<sup>o</sup> 26 N, R18E

ground for  $\frac{1}{4}$  sec. cor marked  $\frac{1}{4}$  row N face  
 Raise a mound of stone 2 ft base  $1\frac{1}{2}$  ft high  
 N. of cor. Pits impracticable

45.00 Top of ridge trans N.E. and S.W. desc  
 50.55 Dry ravine Course S.W. asc  
 52.00 Top of ridge trans N.E. and S.W.  
 54.00 Dry ravine Course S.W. asc  
 55.00 Top of ridge trans N.E. and S.W. desc  
 59.00 Dry ravine course S.W. asc.  
 65.00 Top of ridge trans N. and S. desc.  
 69.00 Dry ravine Course S.W. asc.  
 75.00 Top of ridge trans N.E. and S.W. desc  
 77.50 Dry ravine course S asc  
 80.00 Set a malapai stone 18x12x6 ins, 12 ins. in the  
 ground for cor. of sec. 4, 5, 32 and 33 marked  
 with 4 notches on E and 2 notches on W edge  
 Raise a mound of stone 2 ft base  $1\frac{1}{2}$  ft high W. of  
 cor. Pits impracticable  
 Land hilly.  
 Soil sandy and stony 3<sup>rd</sup> and 4<sup>th</sup> rate.  
 No timber

Each sec. 4 and 33  
 Cor hilly sandy and stony land through scattering  
 sage brush greasewood and bunch grass

3.00 Top of ridge trans N. and S. desc on S.E. slope  
 26.90 Dry ravine Course S.E. asc.  
 27.30 Top of ridge trans N.W. and S.E. desc.  
 29.70 Dry ravine Course S.W. asc.  
 31.00 Top of ridge trans N.W. and S.E. desc.  
 40.00 Set a malapai stone 14x8x5 ins, 10 ins. in  
 the ground for  $\frac{1}{4}$  sec. cor. marked  $\frac{1}{4}$  row N  
 face  
 Dig pits 18x18x12 ins East W. of stone 3 ft dist  
 and raised mound of earth  $3\frac{1}{2}$  ft base  $1\frac{1}{2}$   
 ft high N. of cor.

41.00 Top. desc. hilly land trans N.E.  
 and S.W. Enter level bottom land trans N.E.  
 and S.W.

80.00 Set a malapai stone 18x18x12 ins, 12 ins. in

South Boundary of Twp. 26 N. R18 E.

Chains

BOOK 2528

the ground for Cor. of secs. 3, 4, 33 and 34 marked with 3 notches on E and W edges.  
 Dig pits 18x18x12 ins in each sec. 5 1/2 ft. dia and raise a mound of earth 4 ft. base 2 ft. high W. of cor.  
 Land level and hilly  
 Soil sandy and stony 2<sup>nd</sup> and 4<sup>th</sup> rate  
 No timber

East. Cor. sec. 3 and 34  
 Over level bottom land through sage brush greasewood and bunch grass.

40.00 Set a malapais stone 14x12x11 ins, 10 ins in the ground for 1/4 sec. cor marked 1/4 on N. face.

Dig pits 18x18x12 ins, East W. of stone 3 ft. dia and raise a mound of earth 3 1/2 ft. base 1 1/2 ft. high N. of cor.  
 At this Cor. D. set off 23° 24' N. on the decl. arc. and at noon observe the sun on the meridian, and obtain on the lat. arc a reading of 35° 35'.

80.00 Set an malapais stone 12x10x7 ins in the ground for Cor. of secs 2, 3, 34 and 35 marked with 2 notches on E and 4 notches on W. edges

Dig pits 18x18x12 ins, in each sec 5 1/2 ft. dia and raise a mound of earth 4 ft. base 2 ft. high W. of cor  
 Land level  
 Soil sandy and adobe 2<sup>nd</sup> rate  
 No timber

East. Cor. sec 2 and 35  
 Over level land through sage brush, greasewood and bunch grass.

31.70 Road from Placea Ariz to Winslow Ariz bears N15°W and S15°E

South Boundary of Twp. 26 N. R. 18 E.  
 S. 1/4

BOOK 2528

- 40.00 Set a malapa stone 14x13x4 ins, 9 ins. in the ground for 1/4 sec. cor, mkd. 1/4 on N. face Dig pits 18x18x12 ins. E and W. of stone 3 ft. dist. and raise a mound of earth 3 1/2 ft. base 1 1/2 ft. high N. of cor.
- 54.50 Road bears N.W. and S.E. leads to Hellbrook Dig
- 73.60 Leave tent land bears N.E. and W., ascend N.W. slope of Butte over stony mountainous land.
- 77.00 Pipe of ascent on N. face of Butte 50 ft above bottom level desc over stony N.E. slope.
- 80.00 Set a malapa stone 14x12x8 ins, 10 ins in the ground for cor of sec. 1, 2, 35 and 36. mkd. with 1 notch on E. and 5 notches on W. Wedges Raise a mound of stone 2 ft. base, 1 1/2 ft. high W. of cor. Pits impracticable Land level and mountainous. Soil sandy a dobe and stony 2<sup>nd</sup> 3<sup>rd</sup> and 4<sup>th</sup> feet No timber Mountainous land. 6,400 elev.

East. bet. sec. 1 and 36.

Descend N.E. slope of Butte, over stony mountainous land. through scattering sage and greasewood brush.

- 57.00 Slope descent, leave stony mountainous land. bears N.E. and S.W. Enter level bottom land bears N.E. and S.W.

- 40.00 Set a malapa stone 14x12x6 ins, 10 ins in the ground for 1/4 sec. cor. mkd. 1/4 on N. face Dig pits 18x18x12 ins E and W. of stone 3 ft. dist. and raise a mound of earth 3 1/2 ft. base 1 1/2 ft. high N. of cor.

- 80.00 Set a malapa stone 14x10x5 ins, 10 ins in the ground for cor. of Tps. 25 and 26 N. R. 18 E. 18 and 19 E. marked. T 26 N on N.E. R 19 E on S.E. T 25 N. on S.W. R 18 E. on N.W. faces, with 6 notches on N.E. sand Wedges Dig pits 24x24x12 ins. on line N.E. and W 4 ft. and S. of post 8 ft. dist. and raise a



Chain

mound of earth 5 ft. base 2 1/2 ft. high S. of cor.  
Land level and mountainous  
Soil sandy and stony 2<sup>nd</sup> and 3<sup>rd</sup> rate  
No timber

June 17<sup>th</sup> 1908

## East boundary of Twp 26 N, R 18 E.

BOOK 2328

Chains

June 17<sup>th</sup> 1908 At 4<sup>h</sup> 00<sup>m</sup> pm. l.m.l. Deb off  $35^{\circ} 36' N$  on the lat. arc  $23^{\circ} 24\frac{1}{2}' N$  on the decl. arc and determine a meridian with the solar at the cor of Twp 25 and 26 N, R 18 and <sup>hereinbefore described</sup> 19 E, which I established this day.

Thence I run

North on a random line on the East boundary of Twp 26 N, R 18 E. setting temp 4 Sec. and rec. cor. at intervals of 40.00 Chs.

I discontinue the field work on this day at the temp. cor. of recs. 25, 30, 31 and 36.

June 17<sup>th</sup> 1908

June 18<sup>th</sup> 1908 At 7<sup>h</sup> 00<sup>m</sup> am. l.m.l. Deb off  $35^{\circ} 37' N$  on the lat. arc  $23^{\circ} 26' N$  on the decl. arc and determine a meridian at the temp. pt. for cor. of recs. 25, 30, 31 and 36. Thence I continue my <sup>random</sup> line North on the E. bdy. of the Twp. and at 480.12 Chs. intersect E and W. line 6 hrs W. of the <sup>old</sup> cor. of Twp 26 and 27 N, R 18 and 19 E., which is a soft sand stone  $14 \times 10 \times 3$  ins lying on a mound of earth.

This cor being in a state of dilapidation. I destroy all trace of the old cor. and reestablish it in its original position as follows. Set an iron post 3 ft. long 3 ins in diam 24 ins in the ground for cor. of Twp. 26 and 27 N, R 18 and 19 E. mkd on brass cap. T 27 N. on N. half. T 26 N. on S. half, R 18 E. S 36 in NW, R 19 E. S 31 in NE. R 19 E. S 36 in SE. and R 18 E. S 1 in SW. quadrant. Dig pits  $24 \times 24 \times 12$  ins. NE, and W 4 ft. and S. of post 8 ft. dia. and raise a mound of earth 5 ft. base  $2\frac{1}{2}$  ft. high. S. of cor.

Thence I run

South on a true line on E bdy. of Twp. bet. recs. 1 and 6. Over low rolling sand hills through sage and greasewood undergrowth and scattering bunch grass.

40.12 Set a malapai stone  $14 \times 7 \times 5$  ins, 8 ins in the ground for 4 sec. cor. mkd. to on W face

Dig pits  $18 \times 18 \times 12$  ins N and S. of stone 3 ft. dia. and raise a mound of earth  $3\frac{1}{2}$  ft. base  $1\frac{1}{2}$  ft. high W of cor.

80.12 Set a malapai stone  $12 \times 6 \times 6$  ins 8 ins in the ground for cor. of recs. 1, 6, 7 and 12 mkd. with 1 notch on N. and 5

notches on S edges.  
 Dig pits 18x18x12 ins. in each sec, 5 1/2 ft. dist and  
 raise a mound of earth 4 ft. base, 2 ft. high W  
 of cor.  
 Land rolling sand hills.  
 Soil sandy 3<sup>rd</sup> rate.  
 No timber

South Feb. sec 7 and 12

Over low rolling sand hills through sage and  
 greasewood brush undergrowth and scattering bunch  
 grass  
 40.00 Set a malapai stone 13x9x6 ins, 9 ins. in the ground  
 for 1/4 sec. cor. mkd. 4. in W face.

Dig pits 18x18x12 ins N and S of stone 3 ft. dist and  
 raise a mound of earth 3 1/2 ft. base, 1 1/2 ft. high W  
 of cor.  
 72.00 Leave hilly land leave N.E and SW enter rolling sandy  
 land leave N.E and SW.

80.00 Set a malapai stone 12x8x6 ins, 8 ins. in the  
 ground for cor. of sec. 7, 12, 13 and 18, mkd. with  
 2 notches on N. and 4 notches on S. edges  
 Dig pits 18x18x12 ins in each sec. 5 1/2 ft. dist and  
 raise a mound of earth 4 ft. base 2 ft. high W of cor.  
 Land rolling and hilly.  
 Soil sandy 3<sup>rd</sup> rate.  
 No timber

South Feb. sec. 13 and 18

Over rolling sandy land through sage and greasewood  
 brush undergrowth and bunch grass  
 17.65 Road leading from Winslow Ariz to Kaans Canyon Ariz  
 leave N.E and SW.

40.00 Set a malapai stone 14x9x7 ins 10 ins. in the ground.  
 for 1/4 sec. cor marked 4. in W face  
 Dig pits 18x18x12 ins N and S. of stone 3 ft. dist and.  
 raise a mound of earth 3 1/2 ft. base, 1 1/2 ft. high.  
 W of cor.

Chain

BOOK 2528

80.00 Set a malapai stone 12x10x6 ins, 8 ins. in the ground  
for cor. of sec 13, 18, 19 and 24, mhd with 3 notches on  
N. and S. edges  
Dig pits 18x18x12 ins in each sec. 5 1/2 ft. dia and raise  
a mound of earth 4 ft. base, 2 ft. high W of cor.  
Land rolling  
Soil sandy 3<sup>rd</sup> rate.  
No timber

South. Lch. sec 19 and 24

Over rolling sandy land through sage and greasewood  
bush undergrowth, and bunch grass

- 36.75 Begin descent into dry arroyo, Jetteto Wash.  
40.00 The point for the 1/4 sec. cor falls in the bottom of  
the arroyo where natural causes would insure its  
destruction therefore at.  
39.00 Set a malapai stone 14x10x4 ins. 9 ins in the ground  
for witness cor to the 1/4 sec. cor. mhd. W.C. 1/4 on W face  
Dig pits 18x18x12 ins N and S. of stone 3 ft. dia and raise  
a mound of earth 3 1/2 ft. base 1 1/2 ft. high. W of cor.  
41.00 Center of Arroyo course S.W.  
44.75 Left bank of Arroyo 30 ft high bank N.E and S.W  
60.00 Leave rolling land bank N.E and S.W. ascend N.W. slope  
over hilly stony land bank N.E and S.W.  
80.00 Set a malapai stone 18x14x8 ins 12 ins. in the  
ground for cor. of sec 19, 24, 25 and 30 mhd with  
4 notches on N. and 2 notches on S. edges  
Dig pits 18x18x12 ins in each sec 5 1/2 ft dia and  
raise a mound of earth 4 ft. base 2 ft. high W of cor.  
Land rolling and hilly.  
Soil sandy and stony 3<sup>rd</sup> rate.  
No timber

South Lch. sec. 25 and 30.

Ascend N.W. slope over stony hilly land

- 18.00 Top of ridge bank N.E and S.W. desc  
20.75 Dry ravine course S.W. asc  
40.00 Set a malapai stone 12x8x5 ins 8 ins in the ground

East boundary of Pps 26 N, R18E

BOOK 2528

Chains

for 1/4 sec. cor marked 4 on W face  
 Dig pits 18x18x12 ins N and S of stone 3 ft dist and raise a mound of earth 3 1/2 ft base, 1 1/2 ft high W of cor  
 42.00 Top of ridge from N.E. and S.W. desc  
 52.00 Dry canal course S.W.  
 80.00 Set a malapai stone 14x8x8 ins 10 ins in the ground.  
 for cor of sec 25 30 31 and 36. marked with 5 notches on N. and 1 notch on S edge  
 Dig pits 18x18x12 ins in each sec 5 1/2 ft dist and raise a mound of earth 4 ft base 2 ft high W of cor  
 Land hilly  
 Soil stony 3rd rate  
 No timber

South 1/4 sec. 31 and 36

Over rolling sandy land sloped to S.W., through sage and greasewood brush undergrowth and scattering bunch grass  
 40.00 Set a malapai stone 12x8x8 ins. 8 ins in the ground.  
 for 1/4 sec. cor. marked 4 on W face.  
 Dig pits 18x18x12 ins N and S of stone 3 ft dist and raise a mound of earth 3 1/2 ft base 1 1/2 ft high W of cor.  
 80.00 Intersect the cor. of Pps. 25 and 26 N, R18 and 19 E, hereinbefore described.  
 Land rolling  
 Soil sandy 2nd and 3rd rate.  
 No timber

June 18<sup>th</sup> 1908

## Resurvey of North Boundary of Twp. 26 N. R. 18 E.

Chains

11-11

Survey commenced June 18<sup>th</sup> 1908 and executed with a Young and Sons light mountain Transit 7010 with a Smith solar attachment, the horizontal limb being provided with two double verniers placed opposite to each other reading to angle minutes of arc. which is also the least count of the vernier of the latitude and declination arcs. From recent tests of the solar upon a meridian established by observation on Polaris I know that the instrument is in satisfactory adjustment, therefore I begin at the Cor. of Twp. 26 and 27 N. R. 18 and 19 <sup>herein before described</sup> E. <sub>N</sub> established by me this day. Latitude  $35^{\circ}41'01''$  N. Longitude  $110^{\circ}22'12''$  W.

At this cor. I set off  $35^{\circ}41'$  N. on the lat. arc.  $23^{\circ}26'$  N. on the decl. arc. and at 4<sup>th</sup> 00<sup>m</sup> p.m. June 18<sup>th</sup> 1908 determine a meridian with the solar.

Thence I run

West on a random line on the North boundary of sec. 1, making diligent search at each 40.00 and 80.00 chs for the old 1/4 sec and sec. cor., at 2 miles the old cor. of sec. 2, 3, 34 and 35 bear N. 44 lbs dist

June 18 1908

June 19<sup>th</sup> 1908: I set off  $35^{\circ}41'$  N. on the lat. arc.  $23^{\circ}27'$  N. on the decl. arc. and at 7<sup>th</sup> 00<sup>m</sup> am. <sup>1.17 p.m.</sup> determine a meridian with the solar at the temp. pt. for cor. of sec. 2, 3, 34 and 35, 44 lbs S. of the old sec. cor. which I found yesterday

Thence I continue my <sup>random</sup> line West. and find that nearly all of the <sup>old</sup> corners are obliterated. At 5 miles 78 chs and 64 lbs. intersect N and S line 126 lbs S of the cor. of Twp. 26, and 27 N. R. 17 and 18 E. <sup>described in Exterior Book "G"</sup> <sub>by me June 15<sup>th</sup> 1908.</sub> <sub>N</sub> established. Around retracements made in Twp. 27 N. R. 18 E. I find that there are but very few corners to be found. in the Twp. and since there are no lands allotted within the Twp. and a resurvey having been suggested by the Allotting Agent I resurvey the line as follows. The fallacy corresponds to a correction of  $0^{\circ}9'$  or 22 lbs. per mile N. counting from the N.E. cor. therefore I run, on true line

$S 89^{\circ}51' E.$  to sec. 6 and 31

Ascend. W. slope over hilly sandy land through sage

## Resurvey of the North boundary of Twp. 26 N. R18 E

1212

Johnson

BOOK 2528

- and greasewood brush and bunch grass
- 10.00 Dry sand wash course N.W.
- 14.00 Point of ridge trail N.W. and S.E.
- 17.00 Dry sand wash course N.W.
- 38.64 Set an iron post 3 ft. long 1 in in diam 26 in in the ground for <sup>re-established</sup> sec. cor. marked on town cop  $\frac{1}{4}$  S 31 on N half and S. 6 on S half.
- Dig pits 18x18x12 in in each sec. 5 ft. dist and raise a mound of earth 3  $\frac{1}{2}$  ft. base 1  $\frac{1}{2}$  ft. high N. of cor.
- 59.00 Dry wash course S.W. one adobe ridge
- 72.00 Top of ridge trail N.E. and S.W. desc.
- 78.00 Dry ravine course S.W. asc.
- 78.64 Set an iron post 3 ft. long 3 in. in diam 24 in in the ground for <sup>re-established</sup> cor. of sec. 5, 6, 31 and 32 marked on town cop R18 E on E half. T 27 N S 32 in N.E. T 26 N S 31 in S.E. S 6 in S.W. and S 31 in N.W. quadrant
- Dig pits 18x18x12 in in each sec. 5 ft. dist and raise a mound of earth 4 ft base 2 ft high. W of cor
- Land hilly
- Soil sandy and adobe 2<sup>nd</sup> and 3<sup>rd</sup> rate
- Wotanka
- 
- S 89° 51' E. bet. sec 5 and 32.
- Ascend N.W. slope over hilly adobe and sandy land through scattering sage and greasewood brush and bunch grass
- 9.35 Top of ridge trail N.W. and S.E. desc
- 13.00 Dry ravine course N.W. asc
- 24.75 Top of ridge trail N.W. and S.E. desc
- 26.35 Dry ravine course N.W. asc.
- 27.20 Top of ridge trail N.W. and S.E. desc
- 29.45 Dry ravine course N.W. asc
- 31.60 Top of ridge trail N.W. and S.E. desc
- 32.25 Dry ravine course N.W. asc
- 40.00 Set an iron post 3 ft. long 1 in in diam. 26 in in the ground for <sup>re-established</sup> sec. cor. marked on town cop  $\frac{1}{4}$  S 32 on N. half and S 5 on S half.
- Raise a mound of stone 2 ft base 1  $\frac{1}{2}$  ft high N. of cor. Pits impracticable.
- 80.00 Set an iron post 3 ft. long 3 in in diam 24 in in

BOOK 2528

the ground for <sup>re-established</sup> cor. of sec. 4, 5, 32 and 33 marked on  
base of R18 E. on E half T27 N S 33 in N.E. T26 N S4  
in S.E. S5 in S.W. and 332 in NW  
quadrant

Dig pits 18x18x12 ins in each sec 5 1/2 ft. dia  
and raise a mound of earth 4 ft. base 2 ft. high.

W. of cor.

Land hilly

Soil sandy and adobe 2<sup>nd</sup> and 3<sup>rd</sup> rate

No timber

S89°51'E br. sec 4 and 33.

Over rolling sandy land through sage and  
greasewood brush and scattering bunch grass

40.00 Set an iron post 3 ft. long 1 1/2 in dia and 26 ins in  
the ground for <sup>re-established</sup> cor. marked at base of  
1/4 S 33 on N half and S 4 on S half.

Dig pits 18x18x12 ins E and W. of post 3 ft. dia  
and raise a mound of earth 3 1/2 ft. base 1 1/2 ft.  
high N. of cor.

80.00 Set an iron post 2 ft. long 3/4 in dia and 24  
ins in the ground for <sup>re-established</sup> cor. of sec 8, 4, 33 and 34  
marked on base of R18 E on E half T27 N S 34  
in N.E. T26 N S 3 in S.E. S 4 in S.W. and 333 in  
NW quadrant.

Dig pits 18x18x12 ins in each sec 5 1/2 ft. dia and  
raise a mound of earth 4 ft. base 2 ft. high W  
of cor.

Land rolling

Soil sandy 2<sup>nd</sup> and 3<sup>rd</sup> rate.

No timber

S89°51'E br. sec 3 and 34

Over rolling sandy land through sage and  
greasewood brush undergrowth and scattering  
bunch grass.

40.00 Set an iron post 3 ft. long 1 1/2 in dia and 26 ins in  
the ground for <sup>re-established</sup> cor. marked at base of



Recovery of the North Boundary of Tp. 26 N R18 E  
144

BOOK 2528

$\frac{1}{4}$  S 34 on N. half. and S 30 on S half.

Dig pits 18 x 18 x 12 ins E and W of post 3 ft dist and raise a mound of earth  $3\frac{1}{2}$  ft base  $1\frac{1}{2}$  ft high N. of cor.

80.00 Intersect the old Cor. of Secs 2, 3, 34 and 35 which is a sand stone lying on the ground. mhd with 4 notches on one edge and 2 notches on opposite edge Trace of pits and mound. Destroy all evidence of the old cor and re establish it in its original position as follows

Set an iron post 3 ft long 3 ins in diam 24 ins in the ground for cor of Secs. 2, 3, 34 and 35 mhd. on base Cop. N18E on E half T 27 N S 35 in N.E. T 26 N S 2 in S.E. S 3 in S.W. and S 34 in N.W. quadrants.

Dig pits 18 x 18 x 12 ins in each sec 5  $\frac{1}{2}$  ft dist and raise a mound of earth 4 ft base 2 ft high W of cor.

Land rolling

Soil sandy 2<sup>nd</sup> and 3<sup>rd</sup> rate

No timber

S 89° 51' E bet sec 2 and 35.

Over rolling sandy land through sage and greasewood brush and retting ranch grass  
2. 35 Road from Winslow Ariz to Placea Ariz head N.W. and S.E.

40.00 Set an iron post 3 ft long 1 in in diam. 26 ins in the ground for <sup>re-established</sup> 4 sec. cor. mhd. on base Cop  $\frac{1}{4}$  S 35 on N half. and S 2 on S half.

Dig pits 18 x 18 x 12 ins E and W of post 3 ft dist and raise a mound of earth  $3\frac{1}{2}$  ft base,  $1\frac{1}{2}$  ft high N. of cor

68.00 Top of low sand ridge head N.E. and S.W. and gently over S.E. slope

72.50 Road from Winslow Ariz and to Placea Ariz head N.E. and S.W.

80.00 Set an iron post 3 ft long 3 ins in diam. 24 ins in the ground for <sup>re-established</sup> cor. sec. 1, 2, 35 and 36. marked on base Cop N18E on E half. T 27 N. S 36 in N.E. T 26 N. S 1 in S.E. S 2 in S.W. and S 36-

BOOK 2528

in NW quadrant.  
Dig pits 18x18x12 ins in each sec 5 1/2 ft. dist and  
raise a mound of earth 4 ft base 2 ft high W of cor  
Land rolling  
Soil sandy 2<sup>nd</sup> and 3<sup>rd</sup> rate  
No timber

S 89° 51' E bet. sec 1 and 36.  
Over rolling sandy land through sage and  
greasewood brush undergrowth and bunch  
grass

11.57 Road bears NW and SE. Leads to Placea Ariz  
40.00 Set an iron post. 3 ft. long 1 in in diam 26 in  
in the ground for <sup>re-established</sup> 4 sec. cor. mhd on brass cap  
1/4 S 36 on N. half and S 1 on S half.

Dig pits 18x18x12 ins E and W of post 3 ft. dist  
and raise a mound of earth 3 1/2 ft. base 1 1/2  
ft. high N. of cor.

80.00 <sup>(re-established)</sup> NW cor of Twp. 26 and 27 N. R 18 and 19 E., <sup>hereinbefore</sup> described.  
Land rolling  
Soil sandy 2<sup>nd</sup> and 3<sup>rd</sup> rate  
No timber

June 19<sup>th</sup> 1908

The final affidavits of assistants will be found  
in Book "O" of Exteriors.

Boundaries of Township N° 26 North, Range N° 18 East,  
Latitudes, Departures, and Closing Errors.

Line Designated	True Bearing	Distance	Latitudes		Departure	
			N.	S.	E.	W.
South Boundary	West	479.49				479.49
West Boundary	North	480.82	480.82			
North Boundary	S 89° 51' E.	478.64		1.25	478.64	
East Boundary	South	480.12		480.12		
Convergency					.51	
Totals.			480.82	481.37	479.15	479.49
				480.82		479.15
	Error in Latitude			0.55		
	Error in Departure					0.34

--- Sidney E. Blast ---  
U.S. Examiner of Surveys.

U.S. EXAMINER OF SURVEYS  
FINAL OATHS OF DEPUTY SURVEYOR AND HIS ASSISTANTS.

LIST OF NAMES.

A list of the names of the individuals employed by Sidney E. Blain  
Examiner of Surveys  
United States Deputy Surveyor, to assist in running, measuring, and

marking the lines and corners described in the foregoing field notes of the survey of the South and East Boundaries and Resurvey of the North Boundary of T26N, R18E.  
showing the respective capacities in which they acted:

- Wm. L. Warner ..... Chainman.
- Wm. L. White ..... Chainman.
- Harry J. Hasler ..... Moundman.
- Wm. L. Mairing ..... ~~Moundman~~ Flagman.
- ..... Axman.
- ..... Axman.
- ..... Flagman.

FINAL OATH OF ASSISTANTS.

We hereby certify that we assisted \_\_\_\_\_  
 \_\_\_\_\_ United States Deputy Surveyor, in surveying all  
 those parts or portions of the \_\_\_\_\_  
 \_\_\_\_\_ of the \_\_\_\_\_  
 \_\_\_\_\_ meridian, \_\_\_\_\_ of \_\_\_\_\_, which are represented  
 in the foregoing field notes as having been surveyed by him and under his direction; and that said survey  
 has been in all respects, to the best of our knowledge and belief, well and faithfully surveyed, and the  
 corner monuments established, according to the instructions furnished by the United States Surveyor  
 General for \_\_\_\_\_

*See Superior Book 10*

- ..... Chainman.
- ..... Chainman.
- ..... Moundman.
- ..... Moundman.
- ..... Axman.
- ..... Axman.
- ..... Flagman.

Subscribed and sworn to before me this \_\_\_\_\_ }  
day of \_\_\_\_\_, 190 \_\_\_\_\_ }



EXAMINER OF SURVEYS  
FINAL OATH OF UNITED STATES DEPUTY SURVEYOR.

I, Sidney F. Blout, <sup>Examiner of Surveys</sup> ~~United States Deputy Surveyor~~, do solemnly swear that, in pursuance of <sup>Special Instructions</sup> ~~a contract~~ received from the Commissioner of the United States Surveyor General Land Office, bearing date of the 2nd day of Oct. 1907 and the 15th day of May, 1908, I have well, faithfully, and truly, in my own proper person, and in strict conformity with the instructions furnished by the <sup>Commissioner of the</sup> ~~United States Surveyor General~~ Land Office, the Manual of Surveying Instructions, and the laws of the United States, surveyed all those parts or portions of the South and East boundaries and resurveyed the North boundary of Township N<sup>o</sup> 26 North, Range N<sup>o</sup> 18 East of the Gila and Salt River Base and Meridian, in the Territory of Arizona, which are represented in the foregoing field notes as having been surveyed <sup>or resurveyed</sup> by me, and under my direction; and I do further solemnly swear that all the corners of said survey have been established <sup>or re-established</sup> and perpetuated in strict accordance with the Manual of Surveying Instructions, and the special written instructions of the <sup>Commissioner of the</sup> ~~United States Surveyor General~~ Land Office, and in the specific manner described in the field notes, and that the foregoing are the original field notes of such survey and resurvey.

Subscribed by said Sidney F. Blout, and sworn to before me }  
 this 25th day of April, 1908 }  
 United States Deputy Surveyor.  
 Examiner of Surveys.



APPROVAL.

OFFICE OF THE UNITED STATES SURVEYOR GENERAL,

Phoenix, Arizona. APR 25, 1908

The foregoing field notes of the survey of the South and East boundaries and resurvey of North boundary of Township N<sup>o</sup> 26 North - Range N<sup>o</sup> 18 East of the Gila and Salt River Base and Meridian, Arizona.

executed by Sidney F. Blout, U.S. Examiner of Surveys under <sup>Special Instructions from the Commissioner of the General Land Office</sup> ~~his contract No.~~, dated October 2, 1907 and May 15, 1908, ~~190~~, having been critically examined, and the necessary corrections and explanations made, the said field notes, and the surveys, they describe, are hereby approved.

Frank S. Ingalls  
 United States Surveyor General.  
 SURVEYOR GENERAL OF ARIZONA

I certify that the foregoing transcript of the field notes of the above-described surveys in \_\_\_\_\_, has been correctly copied from the original notes on file in this office.

\_\_\_\_\_  
 United States Surveyor General.