

Exterior
BOOK "B"

BOOK 2529

FIELD NOTES

OF THE SURVEY OF THE

South bdy. and S 1/2 of East bdy. of, and

RESURVEY OF THE

North bdy. and N 1/2 of East bdy. of

T. 26 N. - R. 19 E

Of the *Gila and Salt River Base and* Meridian,

in the Territory of Arizona

EXECUTED
AS SURVEYED BY

Sidney E. Blair, United States ~~Deputy Surveyor~~ *Examiner of Surveys*

Special Instructions from *The Commissioner of the General Land Office*

Under ~~his Contract No.~~ _____, dated *October 2, 1907 and May 15*, 1908

and resurvey
Survey, commenced *July 1st*, 1908

and resurvey
Survey, completed *July 3rd*, 1908

NAMES AND DUTIES OF ASSISTANTS.

Fred L. Warner

Chairman

Chas. L. White

Chairman

Ralph N. Westlund

Chairman

Walter A. Swaffer

Chairman

Harry J. Hassler

wardman

Robt E. Claborn

Playman

Pelix Manning

Playman

Charles A. Dutton

Asman

BOOK 2529

INDEX DIAGRAM.

Township No. 26 North, Range No. 19 East

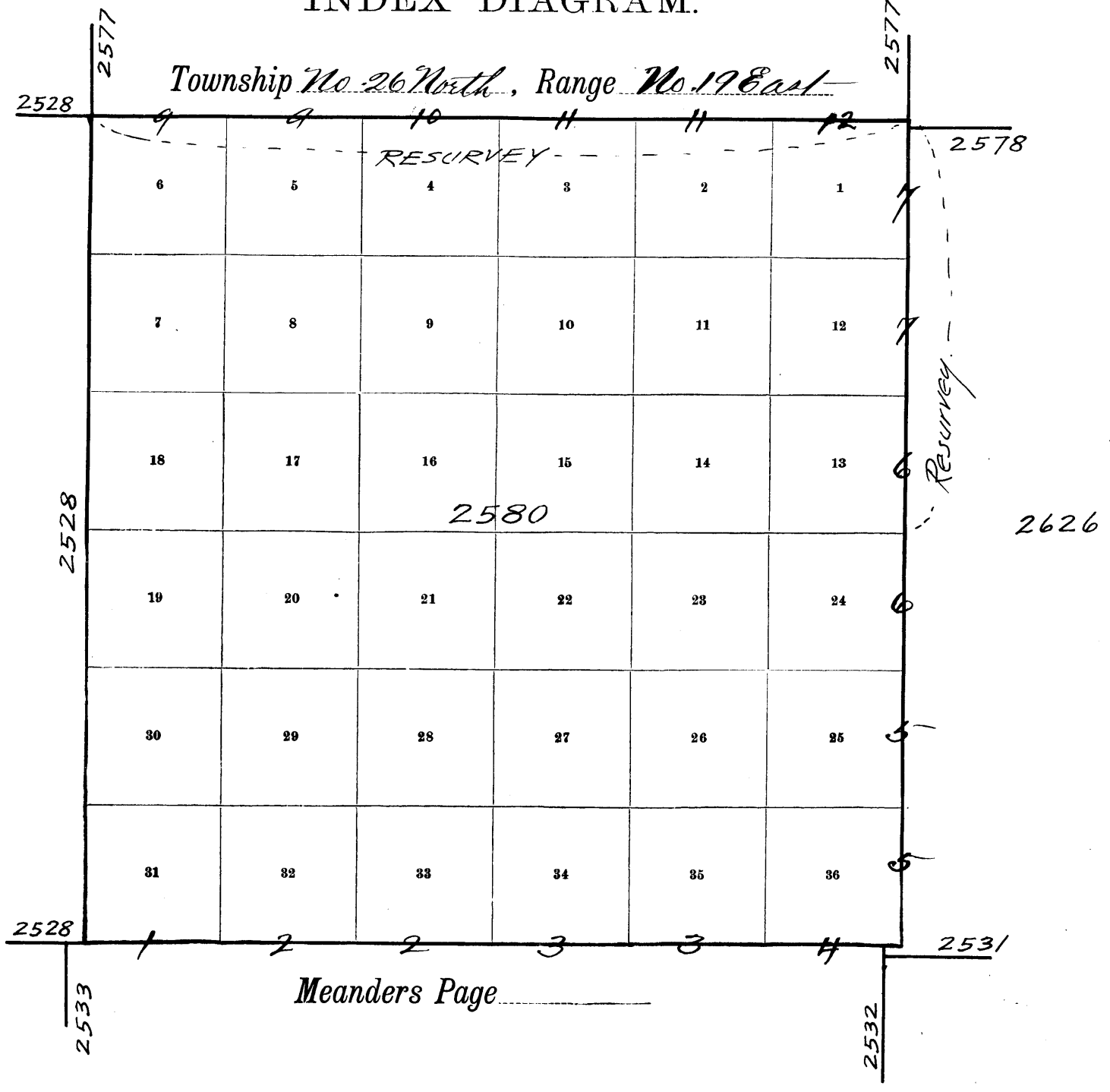

Meanders Page

2583

For PRELIMINARY OATHS OF ASSISTANTS.
See Exterior Book "A"

WE, _____ and _____
do solemnly swear that we will well and faithfully execute the duties of chainmen; that we will level the chain upon even and uneven ground, and plumb the tally pins, either by sticking or dropping the same; that we will report the true distances to all notable objects, and the true lengths of all lines that we assist in measuring, to the best of our skill and ability, and in accordance with instructions given us, in the survey of _____

_____, Chainman.
_____, Chainman.

Subscribed and sworn to before me this _____
day of _____, 190 }



WE, _____ and _____
do solemnly swear that we will well and truly perform the duties of moundmen in the establishment of corners, according to the instructions given us, to the best of our skill and ability, in the survey of _____

_____, Moundman.
_____, Moundman.

Subscribed and sworn to before me this _____
day of _____, 190 }



WE, _____ and _____
do solemnly swear that we will well and truly perform the duties of axmen in the establishment of corners and other duties, according to instructions given us, to the best of our skill and ability, in the survey of _____

_____, Axman.
_____, Axman.

Subscribed and sworn to before me this _____
day of _____, 190 }



I, _____, do solemnly swear that I will well and truly perform the duties of flagman according to instructions given me, to the best of my skill and ability, in the survey of _____

_____, Flagman.

Subscribed and sworn to before me this _____
day of _____, 190 }



Survey Commenced July 1st 1908 and executed with a Young and Sons light mountain transit No. 10 with the Smith solar attachment, the horizontal limb being provided with two double verniers placed opposite to each other reading to single minutes of arc which is also the least count of the verniers of the latitude and declination arcs.

Began at the Cor. of Twp 25 and 26 N, R 18 and 19 E ^{described in Exterior Book "A"} which was established June 17th 1907, Latitude $35^{\circ} 35' 48''$ N, Longitude $110^{\circ} 22' 12''$ W

At this Cor. At 12^h 50.3^m a.m. l.m.t. by my watch which is correct local mean time I observed Polaris at Eastern elongation in accordance with the instructions in the manual and mark a point in the direct outward determined by a tach driver in a stake set in the ground 5 Chs. N. of the cor.

At 6^h 30^m a.m. ^{l.m.t.} Lay off the azimuth of Polaris $1^{\circ} 27'$ to the west and mark the meridian thus determined by a tach driver in a stake set in the ground 5 Chs. N. of the cor. then I run East. Sec. 26 and 31

Over level land through sage brush and greasewood undergrowth

39.49

Set a malapas stone 12x9x7 ins. 8 ins. in the ground for 1/4 sec. cor. marked 1/4 on N. face.

Dig pits 18x18x12 ins. E and W of stone 3 ft. dist and raise a mound of earth 3 1/2 ft. tall 1/2 ft. high N. of cor.

79.49

Set a malapas stone 12x9x5 ins. 8 ins. in the ground for cor. of sec. 5, 6, 31 and 32. marked with 5 notches on E and 1 notch on Wedges.

Dig pits 18x18x12 ins. in each sec 5 1/2 ft. dist and raise a mound of earth 4 ft. tall 2 ft. high. W of cor.

Land level.

Soil sandy and a dol. 2nd and 3rd rate

Chain

BOOK 2529

No timber

East bet. secs. 5 and 32.

Over low rolling hills, through sage brush greasewood and bunch grass

40.00 Sep a malapai stone 12x10x5 ins, 8 ins. in the ground for $\frac{1}{4}$ sec. cor. marked $\frac{1}{4}$ out N. face
Dig pits 18x18x12 ins E and W. of stone 3 ft. dist and raise a mound of earth 3 $\frac{1}{2}$ ft. base, 1 $\frac{1}{2}$ ft. high N. of cor.

80.00 Sep a malapai stone 13x8x4 ins 7 ins. in the ground for cor. of secs. 4, 5, 32 and 33 marked with 4 notches on E and 2 notches on W edges,
Dig pits 18x18x12 ins. in each sec. 5 $\frac{1}{2}$ ft. dist and raise a mound of earth 4 ft. base 2 ft. high W of cor.

Land hilly.

Soil sandy 3rd rate

No timber

East bet. secs 4. and 33.

Over low rolling sand hills through sage brush greasewood and bunch grass undergrowth.

16.50 Dry sand 140 lbs. wide, 15 ft. deep course N.W.

40.00 Sep a malapai stone 12x7x6 ins, 8 ins. in the ground for $\frac{1}{4}$ sec. cor. marked $\frac{1}{4}$ out N. face
Dig pits 18x18x12 ins E and W. of stone 3 ft. dist. and raise a mound of earth 3 $\frac{1}{2}$ ft. base, 1 $\frac{1}{2}$ ft. high N. of cor.

80.00 Sep a malapai stone 18x18x12 ins, 12 ins in the ground for cor. of secs 3, 4, 33 and 34 marked with 3 notches on E and W edges

Dig pits 18x18x12 ins. in each sec. 5 $\frac{1}{2}$ ft. dist. and raise a mound of earth 4 ft. base, 2 ft. high. W. of cor.
Land rolling sand hills

Soil sandy 3rd rate

No timber

South Boundary of Twp. 26 N. R. 19 E

Chains

BOOK 2529

East 1/4 sec. 3 and 34
ascend gradually over S.W. slope over low sand hills through sage brush, greasewood and bunch grass

40.00 Set a malapai stone 14x9x5 ins, 10 ins in the ground for 1/4 sec. cor. marked 1/4 on N. face.

Dig pits 18x18x12 ins E and W. of stone 3 ft. dist. and raise a mound of earth 3 1/2 ft. base 1 1/2 ft. high N. of cor.

74.09 Road from Polacca to Winslow Ariz. bears N.W. and S.E.

80.00 Set a malapai stone 18x16x10 ins, 12 ins. in the ground for cor. of secs. 2, 3, 34 and 35 marked with 2 notches on E, and 4 notches on W. edges.

Dig pits 18x18x12 ins in each sec. 5 1/2 ft. dist. and raise a mound of earth 4 ft. base, 2 ft. high W. of cor.

Land hilly.
Soil sandy 3rd rate
No timber

East 1/4 sec. 2 and 35
Over rolling sand hills through sage brush, greasewood and bunch grass

40.00 Set a malapai stone 12x9x6 ins, 8 ins. in the ground for 1/4 sec. cor. marked 1/4 on N. face

Dig pits 18x18x12 ins E and W. of stone 3 ft. dist. and raise a mound of earth 3 1/2 ft. base 1 1/2 ft. high N. of cor.

80.00 Set a malapai stone 14x9x6 ins, 10 ins. in the ground for cor. of secs 1, 2, 35 and 36 marked with 1 notch on E and 5 notches on W. edges

Dig pits 18x18x12 ins. in each sec. 5 1/2 ft. dist. and raise a mound of earth 4 ft. base 2 ft. high W. of cor.

Land rolling sand hills
Soil sandy 3rd rate.
No timber

South Boundary of T₁. 26 N. R 19 E
Chains

BOOK 2529

East bet. sec. 1 and 36

Over rolling and hilly sandy land through
sage brush greasewood and bunch grass

84.75 Road from Holbrook Arizona to Keanis Canyon
Ariz bet. N. and S.

40.00 Set a malapai stone 15 x 10 x 4 ins. 10 ins. in
the ground for cor. cov. marked $\frac{1}{4}$ on N. face
Dig pits 18 x 18 x 12 ins. East W of stone. 3 ft. dist
and raise a mound of earth $3\frac{1}{2}$ ft. base $1\frac{1}{2}$ ft.
high N. of cor.

80.00 Set a malapai stone 14 x 12 x 7 ins. 10 ins.
in the ground for cor. of T₁. 25 and 26 N.
R 19 and 20 E. marked T 26 N. on N.E. R 20 E.
on S.E. T 25 N. on S.W. and R 19 E on N.W. faces with
6 notches on N.E. S and W edges
Dig pits 24 x 24 x 12 ins. on line N.E. and W. 4 ft.
and S. of post 8 ft. dist. and raise a mound of
earth 5 ft. base $2\frac{1}{2}$ ft. high. S. of cor.

Land rolling and hilly.

Soil sandy 2nd and 3rd rate.

No timber

July 1st 1908.

July 2nd 1908 Ah. 7^h 04^m am. S. int. S. set off $35^{\circ}36'$ N. $23^{\circ}04'$ N. on the decl. arc, and determine a meridian with the solar at the cor. of Tps 25 and 26 N. R's 19 and 20 E established by me July 1st 1902, and hereinbefore described.

Thence run
North by sec 31 and 32.

Across SW. slope over low rolling sand hills through sage brush greasewood and bunch grass.

40.00

Set a malapai stone 12x10x7 ins. 8 ins. in the ground for $\frac{1}{4}$ sec. cor. marked $\frac{1}{4}$ on W face:

Dig pits 18x18x12 ins. N. and S. of stone 3 ft. dist. and raise a mound of earth 3 ft. base $\frac{1}{2}$ ft. high W of cor.

80.00

Set a malapai stone 12x1x7 ins. 8 ins. in the ground for cor. sec 25 20 31 and 32. marked with 5 notches on N. and 1 notch on S edge

Dig pits 18x18x12 ins. in each sec $5\frac{1}{2}$ ft. dist. and raise a mound of earth 4 ft. base 2 ft. high W of cor.

Sand hilly
Soil sandy 3rd rate
No timber

North by sec 25 and 30.

Over low rolling sand hills through sage brush greasewood and bunch grass.

40.00

Set a malapai stone 13x10x5 ins. 9 ins. in the ground for $\frac{1}{4}$ sec. cor. marked $\frac{1}{4}$ on W face

Dig pits 18x18x12 ins. N. and S. of stone 3 ft. dist. and raise a mound of earth 3 ft. base $\frac{1}{2}$ ft. high W of cor.

80.00

Set a malapai stone 12x9x5 ins. 8 ins. in the ground for cor. of sec. 19 24 25 and 30. marked with 4 notches on N. and 2 notches on S edge

Dig pits 18x18x12 ins. in each sec $5\frac{1}{2}$ ft. dist. and raise a mound of earth 4 ft. base 2 ft. high W of cor.

Sand hilly
Soil sandy 3rd rate
No timber

BOOK 2529

North $\frac{1}{4}$ sec. 19 and 24Over low rolling sand hills, sloped toll. through
sage brush greasewood and bunch grass.

140.00 Set a malopai stone $14 \times 9 \times 6$ ins. 16 ins. in the
ground for $\frac{1}{4}$ sec. cor. marked $\frac{1}{4}$ on W face
Dig pits $18 \times 18 \times 12$ ins N and S. of stone 3 ft. dist,
and raise a mound of earth 3 ft. base $1\frac{1}{2}$ ft.
high W of cor.

46.00 Dig ravine 100 lbs wide 5 ft. deep curved
S.W.

57.10 Road from N.E. and S.W. leads to Keams Canyon Ariz.

80.00 Set a malopai stone $12 \times 10 \times 6$ ins, 8 ins. in the
ground for ^{re-established} cor. of sec. 13, 18, 19 and 24, marked
with 3 notches on N and S edges.

Dig pits $18 \times 18 \times 12$ ins in each sec $5\frac{1}{2}$ ft. dist and
raise a mound of earth 4 ft. base, 2 ft. high W of cor.
No trace of old section cor. can be found.

Land hilly.

Soil sandy 3rd rate.

No timber

Resurvey of $N\frac{1}{2}$ of East boundary of Tp. 26 N. R. 19 E.

North $\frac{1}{4}$ sec. 13 and 18, resurveying

Ascend gradually, S. slopes over low rolling
sand hills.

40.00 Set a malopai stone $15 \times 10 \times 6$ ins 10 ins. in the
ground for ^{re-established} $\frac{1}{4}$ sec. cor. marked $\frac{1}{4}$ on W face
Dig pits $18 \times 18 \times 12$ ins N and S. of stone 3 ft. dist.
and raise a mound of earth 3 ft. base $1\frac{1}{2}$ ft. high
W. of cor. No trace of old $\frac{1}{4}$ sec. cor. can be found.

80.00 Set a malopai stone $15 \times 11 \times 4$ ins. 10 ins. in
the ground for ^{re-established} cor. of sec. 7, 12, 13 and 18.
marked with 2 notches on N. and 4 notches on
S. edges.

Dig pits $18 \times 18 \times 12$ ins in each sec. $5\frac{1}{2}$ ft. dist.
and raise a mound of earth 4 ft. base, 2 ft. high
W of cor. No trace of old sec. cor. can be found.

Land hilly.

Soil sandy 3rd rate.

No timber

BOOK 2523

North between 7 and 12, resurveying,
 Ascend gradually S.W. slope over rolling sand.
 hills through sage brush, bunchgrass and
 greasewood bush.

21.00 Cross dry ravine 40 lbs. wide 10 ft. deep course
 S.W.

40.00 Set a malapai stone 16 x 12 x 6 ins. 17 ins. in
 the ground for ^{re-established} 1/4 sec. cor., marked 1/4 on W
 face.
 Dig pits 18 x 18 x 12 ins. N. and S. of stone 3 ft.
 dist. and raise a mound of earth 3 1/2 ft. base
 1 1/2 ft. high W. of cor. No trace of old 1/4 sec. cor. can be found.

67.00 Top of ridge bears N.E. and S.W. desc.

68.00 Dry ravine course S.W. asc.

77.00 Top of ridge bears N.E. and S.W. desc.

80.00 Set a malapai stone 14 x 9 x 7 ins. 10 ins. in
 the ground for ^{re-established} cor. of sec. 1, 6, 7 and 12, marked with 1 notch
 on N and 5 notches on S edges
 Dig pits 18 x 18 x 12 ins. in each sec. 5 1/2 ft. dist.
 and raise a mound of earth 4 ft. base, 2 ft. high.
 W. of cor. No trace of old sec. cor. can be found.
 Land hilly
 Soil sandy 3rd rate.
 No timber

North Feb. sec. 1 and 6, resurveying.
 Descend N.W. slope of ridge over sandy hilly land.

1.75 Dry ravine course S.W. asc.

5.00 Top of ridge bears N.E. and S.W. desc.

8.50 Dry ravine course S.W. asc.

12.00 Top of ridge bears N.E. and S.W. desc.

16.00 Center of dry ravine course S.W. asc.

18.00 Top of ridge bears N.E. and S.W. desc.

30.00 Dry ravine 20 ft. deep course S.W. asc.

32.50 Top of ridge bears N.E. and S.W.

40.00 Set a malapai stone 13 x 7 x 6 ins. 9 ins. in the
 ground for ^{re-established} 1/4 sec. cor., marked 1/4 on W face
 Dig pits 18 x 18 x 12 ins. N. and S. of stone 3 ft. dist.
 and raise a mound of earth 3 1/2 ft. base 1 1/2 ft.
 high W. of cor. No trace of old 1/4 sec. cor. can be found.

43.00 Dry ravine 25 ft. deep course S.W. asc.

Resurvey of N $\frac{1}{2}$ of the East Boundary of Twp. 26 N. R. 19 E.

Chains

BOOK 2529

46.00 Top of ridge beam N.E. and S.W. desc.
 10.00 Dig ravines 20 ft. deep course N.W. asc.
 78.00 Top of ridge beam N.W. and S.E. desc.
 80.00 Set an iron post 3 ft. long, 3 ins. in diam 2 x ins. in the ground for ^{re-established} Cor. of Twp. 26 and 27 N. R. 19 and 20 E. marked on beam Cop. T 27 N. on N. half. T 26 N. on S half., R 19 E S 36 in N.W. R 20 E S 31 in N.E. R 20 E S 6 in S.E. and R 19 E S 7 in S.W. quadrants.
 Dig pit 24 x 24 x 12 in on line N.E. and W. 4 ft. and S. of post 8 ft. dist. and raise a mound of earth 5 ft. base, 2 1/2 ft. high S. of cor. No trace of old Tp. cor. can be found.
 Land hilly and broken
 Soil sandy and adobe 3rd rate.
 No timber

July 2nd 1908

This 2nd day of July 1908. I employ Charles A. Dutton to perform the duties of Axman, Walter C. Snuffer to perform the duties of Chainman, and Robt. E. Claborn to perform the duties of Flagman, No officer authorized to administer oaths other than myself, being available without inconvenience. Delay and expense I administered the required preliminary oaths.

Sidney E. Blous
 U.S. Examiner of Surveys
 July 2nd 1908

July 3rd 1908 At 7^h 04^m am l.m.l. Dip off 35° 41' N.
on the lat arc 22° 59 1/2' N. on the decl. arc and
determine a meridian with the solar on the
Cov. of Twp. 26 and 27 N. R 19 and 20 E. re established
by me July 2nd 1908, and hereinbefore described.

Thence Run

West on a random line along the North boundary
of Twp. 26 N. R19E. Setting trip 1/4 sec. and sec. cor.
at intervals of 40.00 chs. and at 479.35 Chs. Dubuett
N. and S. line 15 lks. S. of the Cov. of Twp. 26 and 27 N.
A's 18 and 19 E. described in Exterior Book "A", re-estab. by me June 18, 1908.
I find no traces of the old corners along this line.

This falling answers to a correction of 0° 01' on 2 1/2 lks.
N. per mile counting from the N.E. cor of the Twp. therefore

Descend

S 89° 59' E. bet. sec. 6 and 31

Over rolling sandy land through sage and greasewood.
brush undergrowth and scattering bunch grass

39.35 Set an iron post 3 ft long 1 in in diam 26 in in
the ground for ^{re-established} 4 sec. cor. mkd out base Cop. 1/4
S 81 on N. half and 36 on S. half.

Dig pits 18 x 18 x 12 in in E and W. of post. 3 ft. dist and
raise a mound of earth 3 1/2 ft base, 1 1/2 ft high.

W. of cor.

79.35 Set an iron post 3 ft long 3 in in diam, 24 in
in the ground for ^{re-established} Cov. of sec. 5, 6, 31 and 32.
mkd out base Cop. R19E. on E half, T 27 N S. 32 in
N.E. T 26 N S. 5 in S.E. 36 in S.W. and 331 in N.W.
quadrant.

Dig pits 18 x 18 x 12 in in each. sec. 5 1/2 ft dist.
and raise a mound of earth 4 ft base 2 ft high.

W. of cor.

Land rolling
Soil sandy 2nd and 3rd rate.
No timber

S 89° 59' E bet. sec. 5 and 32.

Descend S.E. slope over rolling sandy land.
through sage and greasewood brush and
bunch grass undergrowth

2, 50 Dry ravine 30 lks and 4 ft. deep course S.

Resurvey of North boundary of Tp 26 N. R 19 E.
Chambers

BOOK 2529
10

40.00 Set an iron post 3 ft. long 1 in in diam
26 ins in the ground for ^{re-established} sec. cor. mhd. on
base cap 4 S 32 on N. half and S 5 on S half.
Dig pits 18 x 18 x 12 ins E and W of post 3 ft. dist.
and raise a mound of earth 3 1/2 ft. base 1 1/2 ft.
high N. of cor.

80.00 Set an iron post 3 ft. long 3 ins in diam. 24 ins
in the ground for ^{re-established} cor. of sec. 4, 5, 32 and 33.
mhd on base cap. T 19 E on E half. T 27 N. S 33 in
N.E. T 26 N S. 4 in S.E. S 5 in S.W and S 32 in NW.
quadrant.
Dig pits 18 x 18 x 12 ins. in each. sec. 5 1/2 ft. dist.
and raise a mound of earth 4 ft. base, 2 ft. high.
W. of cor.
Land rolling.
Soil sandy 2nd and 3rd rate.
No timber

S 89° 59' E. Feb. sec 4 and 33.

Land rolling sandy land slopes to S.E. through
sage and greasewood brush and scattering bunch
grass.

4.50 Dry ravine 50 lbs wide 6 ft. deep course S.E.

31.50 Dry ravine 100 lbs. wide banks 5 ft. high course S.E.

40.00 Set an iron post 3 ft. long 1 in in diam 26 ins.
in the ground for ^{re-established} sec. cor. mhd on base
cap. 4 S. 33 on N. half and S 4 on S. half
Dig pits 18 x 18 x 12 ins E and W. of post 3 ft. dist.
and raise a mound of earth 3 1/2 ft. base 1 1/2 ft.
high N. of cor.

80.00 Set an iron post 3 ft. long 3 ins. in diam
24 ins. in the ground for ^{re-established} cor. of sec. 3, 4, 33
and 34, mhd on base cap. T 19 E on E half.
T 27 N. S 34 in N.E. T 26 N S 3 in S.E. S 4 in S.W. and
S 33 in NW. quadrant.

Dig pit 18 x 18 x 12 ins in each. sec. 5 1/2 ft. dist.
and raise a mound of earth 4 ft. base, 2 ft. high
W. of cor.
Land rolling
Soil sandy 3rd rate.

No timber

At this cor & set off $22^{\circ} 58' N$ on the decl. arc
and at $12^h 04^m$ p.m. I. mt. observe the sun on the
meridian the resulting lat. being $35^{\circ} 41' N$.

$S 89^{\circ} 59' E$ Feb. sec 3 and 34.

Over rolling sandy land through sage and greasewood
brush and bunch grass

8.55 Road bears NW and SE leads to Placea
Ariz

33.75 Road bears NW and SE leads to Placea Ariz

40.00 Set an iron post 3 ft. long, 1 in in diam
26 in in the ground ^{re-established} for $\frac{1}{4}$ sec. cor. marked on
brass cap $\frac{1}{4}$ S. 34 on N. half and S. 3 on S.
half.

Dig pits $18 \times 18 \times 12$ in each and W of post 3 ft. dist
and raise a mound of earth $3\frac{1}{2}$ ft. base 11 ft.
high N. of cor.

80.00 Set an iron post 3 ft. long, 3 in in diam 24
in in the ground ^{re-established} for $\frac{1}{4}$ cor. of sec. 2, 3, 34 and
35 mhd on brass cap. T 19 E. on E half. T 27 N.
S 35 in N.E. T 26 N S. 2 in S.E. S 3 in S.W. and S 34
in NW quadrant.

Dig pits $18 \times 18 \times 12$ in in each. sec 5 $\frac{1}{2}$ ft. dist
and raise a mound of earth 4 ft. base 2 ft. high.

W of cor

Land rolling

Soil sandy 2nd and 8th rate.

No timber

$S 89^{\circ} 59' E$ Feb. sec 2 and 35

Over rolling sandy land through sage and
greasewood brush and bunch grass

9.50 Right bank of sand wash 10 ft. high bears
NE and SW

14.00 Left bank of same wash 10 ft. high bears NE
and SW.

40.00 Set an iron post 3 ft. long 1 in in diam 26

Resurvey of North Boundary of Twp 26 N R 19 E
Chains

BOOK 2529

is in the ground for ^{re-established} 4 sec. cor. mhd on brass cap 4835 on N. half. and 82 on S. half.
 Dig pits 18 x 18 x 12 ins E and W of post. 3 ft. dia. and raise a mound of earth 3 1/2 ft. base 1 1/2 ft. high N. of cor.
 57.00 Right bank of sand Wash (dry) bears NE and SW. called Jetteto Wash.
 74.50 Left bank of same wash. bears NE and SW. ascend gradually on N.W. slope
 74.92 Wire fence bears NE and SW.
 80.00 Set an iron post. 3 ft. long 3 ins. in diam 24 ins. in the ground for ^{re-established} cor. of sec. 1 & 2. 35 and 36. mhd on brass cap R 19 E on E half. T 27 N S 36 in NE T 26 N S 1 in SE. S 2 in S.W. and S 35 in N.W. quadrant.
 Dig pits 18 x 18 x 12 ins in each. sec 5 1/2 ft. dia. and raise a mound of earth 4 ft. base 2 ft. high W of cor.
 Sand rolling
 Soil sandy 3rd rate
 No timber

S 89° 59' E bet. sec. 1 and 36.
 Ascend N.W. slope over rolling sandy and adobe land. through Sage and greasewood brush.
 20.00 Leave rolling land bears NE and SW. Enter hilly land bears NE and SW.
 40.00 Set an iron post. 3 ft. long 1 in in diam 26 ins in the ground for ^{re-established} 4 sec. cor. mhd on brass cap 4836 on N. half. and 81 on S. half.
 Dig pits 18 x 18 x 12 ins E and W of post. 3 ft. dia. and raise a mound of earth 3 1/2 ft. base 1 1/2 ft. high. N. of cor.
 52.00 Dry sand wash. course N.W.
 80.00 ^{re-established} Sec. cor. of Twp 26 and 27 N. R S 19 and 20 E.; hereinbefore described.
 Sand rolling and hilly
 Soil sandy 2nd and 3rd rate.
 No timber

July 3rd 1908

Boundaries of Township N°26 North, Range N°19 East
 Latitudes, Departures and Closing Errors.

146

13

Line Designated	True Bearing	Distance	Latitudes		Departures	
			N.	S.	E.	W.
South boundary	West	479.49				479.49
West boundary	North	480.12	480.12			
North boundary	S.89°59'E.	479.35		1.39	479.35	
East boundary	South	480.00		480.00		
Convergency					.51	
Totals			480.12	481.39	479.86	479.49
			480.12	479.49		
	Error in Latitude		1.27			
	Error in Departure				0.37	

BOOK 2580

Sidney E. Blout
 U.S. Examiner of Surveys.

Ext. Book "B."

U.S. EXAMINER OF SURVEYS
FINAL OATHS OF DEPUTY SURVEYOR AND HIS ASSISTANTS.

LIST OF NAMES.

A list of the names of the individuals employed by Sidney E. Blunt

U.S. Examiner of Surveys, United States Deputy Surveyor, to assist in running, measuring, and

marking the lines and corners described in the foregoing field notes of the survey of the South bdy. and S 1/2 of East bdy and resurvey of North bdy and N 1/2 of East bdy of Tp. 26 N. - R. 19 E. of the Gila and Salt River Base and Meridian in the Territory of Arizona.

Fred L. Warner and Van L. White Chainmen.

Ralph J. Westrand and Walter A. Swoffer Chainmen.

..... Moundman.

Harry J. Haesler Moundman.

Chas. A. Dutton Axman.

Robt. E. Claborn ~~Axman~~ Flagman

Felix Manning Flagman.

FINAL OATH OF ASSISTANTS.

We hereby certify that we assisted _____

_____, United States Deputy Surveyor, in surveying all those parts or portions of the _____

_____ of the _____ meridian, _____ of _____, which are represented

in the foregoing field notes as having been surveyed by him and under his direction; and that said survey has been in all respects, to the best of our knowledge and belief, well and faithfully surveyed, and the corner monuments established, according to the instructions furnished by the United States Surveyor General for _____

..... Chainman.

..... Chainman.

..... Moundman.

..... Moundman.

..... Axman.

..... Axman.

..... Flagman.

Subscribed and sworn to before me this _____ }
day of _____, 190 _____ }



149
16
BOOK 2529

U. S. EXAMINER OF SURVEYS
FINAL OATH OF UNITED STATES DEPUTY SURVEYOR.

I, Sidney E. Blout, ^{Examiner of Surveys} United States Deputy Surveyor, do solemnly swear that in pursuance of ^{Special Instructions} a contract received from the Commissioner of the United States Surveyor General Land Office, bearing date of the 2nd day of Oct. 1897 and 15th day of May, 1908, I have well, faithfully, and truly, in my own proper person, and in strict conformity with the instructions furnished by the ^{Commissioner of the United States Surveyor General Land Office}, the Manual of Surveying Instructions, and the laws of the United States, surveyed, ^{or resurveyed} all those parts or portions of the North, South and East boundaries of Township N° 26 North, Range N° 19 East, of the Gila and Salt River Base and Meridian, in the Territory of Arizona, which are represented in the foregoing field notes as having been surveyed, by me, and under my direction; and I do further solemnly swear that all the corners of said ^{or resurveyed} survey, ^{and resurvey} have been established, and ^{or reestablished} perpetuated in strict accordance with the Manual of Surveying Instructions, and the special written instructions of the ^{Commissioner of the United States Surveyor General Land Office}, and in the specific manner described in the field notes, and that the foregoing are the original field notes of such survey and resurvey.

Subscribed by said Sidney E. Blout, and sworn to before me }
this _____ day of _____, 1908 }
Sidney E. Blout United States Deputy Surveyor.
Examiner of Surveys.



APPROVAL.

OFFICE OF THE UNITED STATES SURVEYOR GENERAL,

Phoenix, Arizona APR 25, 1914

The foregoing field notes of the survey of the South bdy and S¹/₂ of East bdy of and resurvey of North bdy and N¹/₂ of East bdy of Township N° 26 North, Range N° 19 East of the Gila and Salt River Base and Meridian, Arizona executed by Sidney E. Blout, U.S. Examiner of Surveys, under Special Instructions executed by from the Commissioner of the General Land Office under his contract No. _____, dated October 2, 1907 and May 15, 1908, having been critically examined, and the necessary corrections and explanations made, the said field notes, and the ^{surveys and} resurveys they describe, are hereby approved.

Frank Langford
United States Surveyor General.
SURVEYOR GENERAL OF ARIZONA

I certify that the foregoing transcript of the field notes of the above described surveys in _____, has been correctly copied from the original notes on file in this office.

United States Surveyor General.