

Exterior  
BOOK "C"

2530

BOOK 2530

FIELD NOTES

OF THE SURVEY OF THE

*East and North boundaries of Twp. No. 25-76.  
Range No. 21 East.*

*Of the Gila and Salt River Basins and Meridian,*

*in the Territory of Arizona*

EXECUTED  
AS SURVEYED BY

*Sidney E. Blouh*

*Examiner of Surveys*

United States ~~Deputy Surveyor~~

*Special Instructions from the Commissioner of the General Land Office*

Under his Contract No. \_\_\_\_\_, dated *Dec. 2<sup>nd</sup> 1907, and May 15<sup>th</sup>*, 1908

Survey commenced *June 29<sup>th</sup>*, 1910

Survey completed *June 30<sup>th</sup>*, 1910

NAMES AND DUTIES OF ASSISTANTS.

David L. White      Compassman

Fred L. Warner      Chairman

Charles A. Dutton      Chairman

R. Y. White      Moundman

Jack Ney      Axman

William P. Carr      Flagman

BOOK 2530

Book No. 2530

# INDEX DIAGRAM.

Township *No. 25. N.*, Range *No. 21. E.*

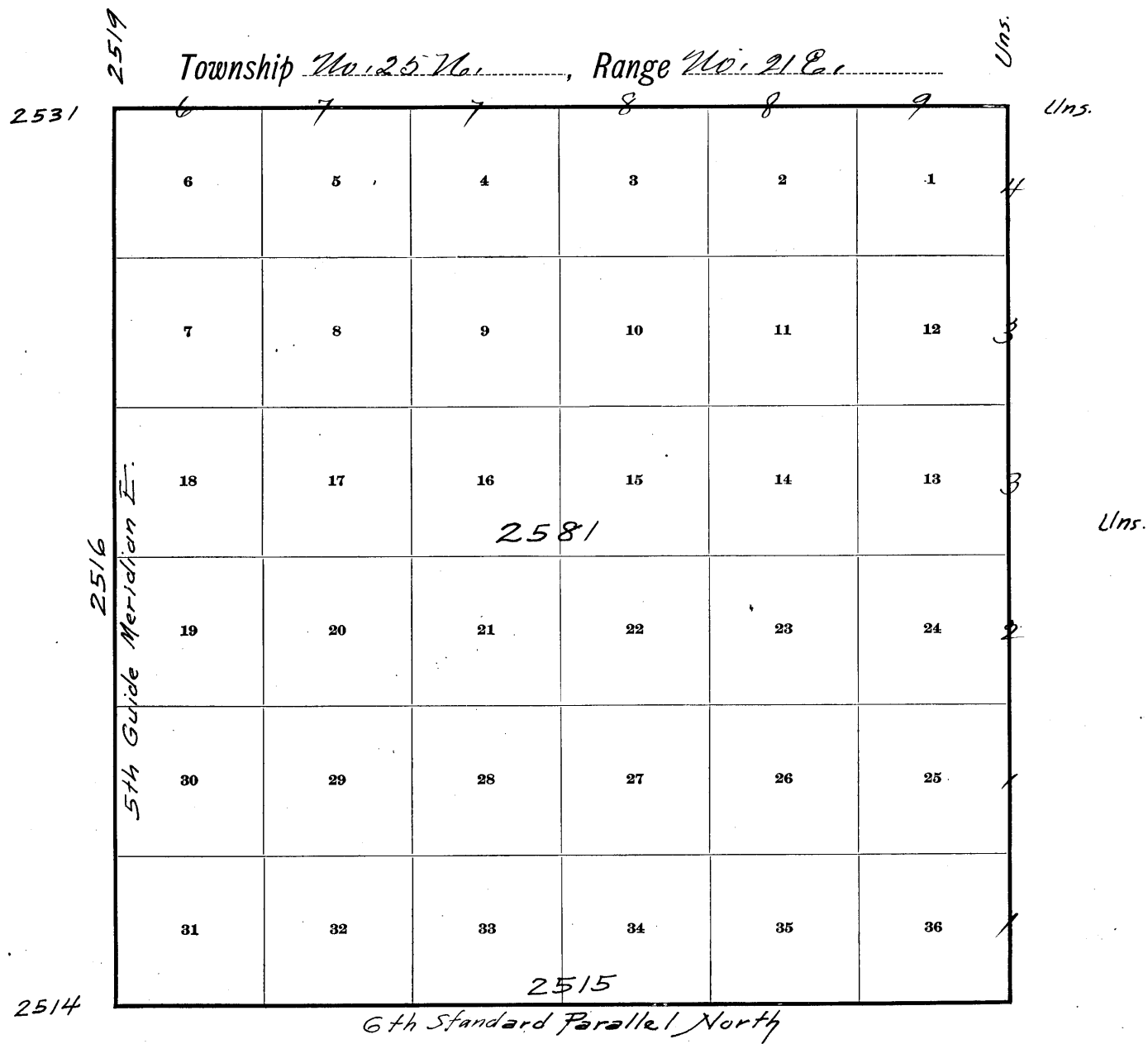

Meanders Page .....

PRELIMINARY OATHS OF ASSISTANTS.

WE, Fred L. Warner and Charles A. Dutton do solemnly swear that we will well and faithfully execute the duties of chainmen; that we will level the chain upon even and uneven ground, and plumb the tally pins, either by sticking or dropping the same; that we will report the true distances to all notable objects, and the true lengths of all lines that we assist in measuring, to the best of our skill and ability, and in accordance with instructions given us, in the survey of The East and North boundaries of M. No. 2576, P. No. 21 E., of the G. & S. R. Base and Meridian, Arizona.

Fred L. Warner, Chainman.  
Charles A. Dutton, Chainman.

Subscribed and sworn to before me this 29<sup>th</sup> day of June, 1910



Sidney E. Blouh  
U.S. Examiner of Surveys

WE, J. J. White do solemnly swear that ~~we~~ will well and truly perform the duties of moundman in the establishment of corners, according to the instructions given ~~us~~, to the best of ~~my~~ skill and ability, in the survey of The East and North boundaries of M. No. 2576, P. No. 21 E., of the G. & S. R. Base and Meridian, Arizona.

J. J. White, Moundman.

Subscribed and sworn to before me this 29<sup>th</sup> day of June, 1910



Sidney E. Blouh  
U.S. Examiner of Surveys

WE, Jack Mey do solemnly swear that ~~we~~ will well and truly perform the duties of axman in the establishment of corners and other duties, according to instructions given ~~us~~, to the best of ~~my~~ skill and ability, in the survey of The East and North boundaries of M. No. 2576, P. No. 21 E. of the G. & S. R. Base and Meridian, Arizona.

Jack Mey, Axman.

Subscribed and sworn to before me this 29<sup>th</sup> day of June, 1910



Sidney E. Blouh  
U.S. Examiner of Surveys

I, William R. Carson, do solemnly swear that I will well and truly perform the duties of flagman according to instructions given me, to the best of my skill and ability, in the survey of The East and North boundaries of M. No. 2576, P. No. 21 E. of the G. & S. R. Base and Meridian, Arizona.

William R. Carson, Flagman.

Subscribed and sworn to before me this 29<sup>th</sup> day of June, 1910



Sidney E. Blouh  
U.S. Examiner of Surveys

East boundary of Twp 25 N., R 21 E.

chains

Survey commenced June 29<sup>th</sup> 1910 and executed with a Young & Sons light mountain transit No. 10 with a Smith Solar attachment. The horizontal limb is provided with two double verniers, placed opposite to each other reading to single minutes of arc, which is also the least count of the verniers of the latitude and declination arcs.

Examine the adjustments of the transit and find them to be perfect, and know from recent tests of the solar apparatus, by comparing its indications resulting from observations made on the sun during a.m. and p.m. hours, with a meridian established by observations on Polaris, that the instrument is in satisfactory adjustment.

Begin at the Standard Cor. of Twp. 25 N., R 21 and 22. E. described in Standard Book "I" which I re established June 28<sup>th</sup> 1910., Latitude 35° 30' 33" N. Longitude 110° 03' W.

June 29<sup>th</sup> 1910. At 8<sup>h</sup> 30<sup>m</sup> a.m. <sup>1. mt.</sup> set off 35° 30' N. on the lat. arc. 23° 16 1/2' N. on the decl. arc. and determine a meridian with the solar at the above mentioned cor. Thence I run.

North by. Recs. 31 and 36.

Over level sandy and adobe valley land through sage and greasewood brush undergrowth and bunch grass.

40.00 Set an iron post 3 ft. long 1 in. in diam 26 ins. in the ground for 1/4 sec. cor. marked on brass cap. 1/4 S 36 on W. half and S 31 on E half.

Dig pits 18x18x12 ins. N and S. of post. 3 ft. dia. and raise a mound of earth 3 1/2 ft. base 1 1/2 ft. high. W. of cor.

41.00 Leave level land bears E and W., enter rolling sandy land bears E and W., ascend gradually over S.E. slope

80.00 Set an iron post 3 ft. long 2 1/2 in. in diam. 24 ins. in the ground for. Cor. of sec. 26, 30, 31 and 36. marked on brass cap. T 25 N. in N.E. half, R 21 E S 25 in N.W., R 22 E S 30 in N.E. S 31 in S.E. and S 36 in S.W. quadrant.

Dig pits 18x18x12 ins. in each. Sec. 5 1/2 ft. dia. and raise a mound of earth 4 ft. base 2 ft. high. W. of cor

Land level and rolling  
Soil sandy and adobe 2<sup>nd</sup> and 3<sup>rd</sup> rate.  
No timber

North by. Recs. 25 and 30.

Chain

East boundary of Tp No 25 N., R. No. 21 E.

- Ascend gradually over S.E. slope through scattering sage and greasewood brush undergrowth and bunch grass
- 40.00 Set an iron post 3 ft. long, 1 in. in diam. 26 ins. in the ground for 4 sec. cor. marked on brass Cap. 1/4 S 25 on W. half and S 30 on E half  
Dig pits 18x18x12 ins. N and S of post 3 ft. dist and raise a mound of earth 3 1/2 ft. base, 1 1/2 ft. high. W. of cor
- 47.50 Top of ascent. on sand stone bluff. 25 ft. high. bears N. 60° E and S 60° W. desc over broken stony land.
- 48.50 Top of bluff bears N 60° E and S 60° W. desc steeply.
- 54.00 Top of steep descent. leave broken land bears N 70° E and S 70° W. Enter level sandy land.
- 80.00 Set an iron post 3 ft. long 3 in. in diam 24 ins. in the ground for cor. of secs. 19, 24, 25 and 30, marked on brass Cap T 25 N. in N. half. R 21 E S 24 in N.W. R 22 E S 19 in N.E. S 30 in S.E. and S 25 in S.W. quadrant.  
Dig pits 18x18x12 ins. in each. sec. 5 1/2 ft. dist. and raise a mound of earth 4 ft. base. 2 ft. high. W. of cor. Land level, rolling and broken. Soil sandy adobe and stony 2<sup>nd</sup> 3<sup>rd</sup> and 4<sup>th</sup> rate. No timber

North br. secs. 19 and 24

Over level sandy and adobe land through scattering sage and greasewood brush undergrowth and bunch grass.

- 40.00 Set an iron post 3 ft. long 1 in. in diam 26 ins. in the ground for 4 sec. Cor. marked on brass Cap. 1/4 S 24 on W. half and S 19 on E half  
Dig pits 18x18x12 ins. N and S of post 3 ft. dist and raise a mound of earth 3 1/2 ft. base, 1 1/2 ft. high. W. of cor.
- 77.00 Dry sand wash. 30 lbs. wide 8 ft. deep course S.E. bears level land bears N 80° W and S 80° E., Enter rolling land bears N 80° W. and S 80° E., ascend gently over S.W. slope
- 80.00 Set an iron post 3 ft. long 3 ins. in diam. 24 ins. in the ground for. Cor. of secs. 13, 18, 19 and 24, marked on brass Cap. T 25 N. in N. half. R 21 E S 13 in NW

East boundary of Np No 25 76, R. No. 21 E.

Chain

R22E S18 in N.E. S19 in S.E. and S24 in S.W. quadrants.  
Dig pits 18x18x12 ins. in each sec. 5 1/2 ft. dist. and  
raise a mound of earth 4 ft. base, 2 ft. high. W. of  
Cor.

Land level and rolling  
Soil sandy and adobe 2<sup>nd</sup> and 3<sup>rd</sup> rate.  
No timber

North br. recs. 13 and 18.

Ascend S.W. slope over rolling sandy land through  
scattering sage and greasewood brush undergrowth  
and bunch grass

40.00 Set an iron post 3 ft. long 1 in. in diam. 26 ins. in  
the ground for cor. marked on brass Cap 4 S  
13 on W. half and S18 on E. half.

Dig pits 18x18x12 ins. N and S. of post 3 ft. dist. and  
raise a mound of earth 3 1/2 ft. base, 1 1/2 ft. high. W.  
of Cor.

NOTE At this cor. I set off 23° 16' N. on the decl. arc and at  
noon observed the sun on the meridian and obtained  
on the lat. arc a reading of 35° 33 1/2' N.

73.00 Dry sand wash 10 lbs. wide 2 ft. deep course S.W.

80.00 Set an iron post 3 ft. long 3 in. in diam. 24 ins. in  
the ground for cor. of recs. 7, 12, 13 and 18, marked  
on brass Cap T25 76 in W. half, R21E S12 in N.W.

R22E S7 in N.E. S18 in S.E. and S13 in S.W. quadrants.  
Dig pits 18x18x12 ins. in each sec. 5 1/2 ft. dist. and  
raise a mound of earth 4 ft. base, 2 ft. high. W. of  
Cor.

Land rolling.  
Soil sandy 3<sup>rd</sup> rate.  
No timber

North br. recs. 7 and 12.

Ascend S.W. slope over rolling sandy land through scattering  
sage and greasewood brush undergrowth and bunch  
grass.

91.40 Leave rolling land bear E. and W. Enter clayey hilly  
land bear E. and W. are. steep S. slope

East boundary of Tp No. 25 N., R. No 20 E.

Chains

- 36.75 Top of clay ridge bear E and W. desc. steeply.
- 40.00 Set an iron post 3 ft. long 1 in. in diam. 26 ins. in the ground for  $\frac{1}{4}$  sec. cor. marked on brass cap.  $\frac{1}{4}$  S 12 on W. half and S 7 on E half.  
Raise a mound of stone 2 ft. base, 1 1/2 ft. high W. of cor.
- 41.00 Dry ravine 10 ft. below  $\frac{1}{4}$  sec. cor. course E. asc. S slope of mesa.
- 47.96 Top of steep ascent on S. edge of mesa bear N 50° E and S 50° W. Leave hilly land bear N.E. and S.W., enter rolling land bear N.E. and S.W. asc. gradually over S.E. slope
- 53.50 Enter scattering cedar timber bear N.E. and S.W.
- 80.00 Set an iron post 3 ft. long 3 ins in diam. 24 ins in the ground for cor. of sec. 1, 6, 7 and 12. marked on brass cap T 25 N. in N. half, N 21 E 31 in NW, N 22 E 36 in N.E. 37 in S.E. and S 12 in S.W. quadrant from which.  
A cedar 4 ins. in diam. bear N 25 1/2° W 100 lbs. dia. marked T 25 N. R 21 E. S 1 B T. No other trees suitable for bearing trees available.  
Dig pits 24 x 18 x 12 ins. in each. sec N.E. S.E. and S.W. of post 5 1/2 ft. dist. and raise a mound of earth 4 ft. base 2 ft. high W. of cor.  
Land rolling and hilly.  
Soil sandy and clayey. 3<sup>rd</sup> and 4<sup>th</sup> strata.  
Timber Cedar

North 1/2 sec. 1 and 6.

- Ascend S.E. slope over rolling sandy land through scattering scrub cedar timber and bunch grass
- 13.00 Top of gradual ascent on sand ridge bear N.W. and S.E. Leave rolling land and timber bear N.W. and S.E. Enter hilly land bear N.W. and S.E. desc steep N.E. slope
- 27.50 Foot of steep descent. leave hilly land bear N.W. and S.E. enter rolling land bear N.W. and S.E. desc gradually.
- 31.35 Road bear N 40° E and S 40° W. leads to a spring in sec. 1. T 25 N. R 21 E
- 37.00 A point, from which a deserted Indian Hogan bear west 8.00 chs. dist.



Chain East boundary of N. No. 25 T6, R. No. 21 E.

40.00 Set an iron post 3 ft. long 1 in in diam 26 ins. in the ground for  $\frac{1}{4}$  sec. cor. marked on brass Cap. T26 S1 on W half and S36 on E half.

Dig pits 18x18x12 ins N and S. of post 3 ft. dist. and raise a mound of earth 3 1/2 ft. base 1 1/2 ft. high W. of cor.

From this cor. a spring bears S40 1/2 W.

76.40 Hook of descent in depression bears N.W. and S.E. drains to the N.W. asc. S.E. slope.

80.00 Set an iron post 3 ft. long 3/4 in in diam. 24 ins in the ground for cor. of N. No. 25 and 26 T6, R. No. 21 and 22 E. marked on brass Cap. T26 N in N. half, T25 T6 in S. half, T21 E. S36 in N.W., T22 E S31 in N.E., T22 E. S36 in S.E. and T21 E S31 in S.W. quadrants.

Dig pits 24x24x12 ins. on each line N.E. and W. 4 ft. S. of post 8 ft. dist. and raise a mound of earth 5 ft. base 2 1/2 ft. high S. of cor.

From this cor a spring bears S11 20 W.

Land rolling and hilly.

Soil sandy 3rd rate.

Timber scattering scrub Cedars

June 29<sup>th</sup> 1910

Chains

North boundary of Tps. 25 N., R 21 E.

June 30<sup>th</sup> <sup>1910</sup> At 7<sup>h</sup> 00<sup>m</sup> <sup>1. m. t</sup> set off 35° 36' N. on the  
 lat. arc 23° 14' N. on the decl. arc and determined a  
 meridian with the solar at the cor. of Tps. 25 and 26  
 N. R 21 and 22 E. <sup>hereinbefore described</sup> Thence I run  
 N 89° 56' W. on a random line along the N. side of  
 T 25 N. R 21 E. setting temp 4 sec. and sec. cords at  
 intervals of 40.00 chs; and at 478.92 chs. Intersect  
 the Fifth Guide Meridian East. 30 lbs. S. of the cor.  
 of Tps. 25 and 26 N. R 20 and 21 E. <sup>described in Standard Book "J"</sup> which I established  
 May 6<sup>th</sup> 1910

The following answers to a correction of 0° 02', or 5 lbs.  
 N. per mile coming from the N.E. cor. of the Tps.  
 therefore I run

S 89° 54' E., bet. sec. 6 and 31, marking and blazing  
 the true line

Ascend S.W. slope over rolling and hilly land through  
 scattering cedar timber and sage bush undergrowth  
 and bunch grass.

15.00 Top of sand ridge 20 ft. above cor. bears N and S. desc.

22.00 Level timber bears N and S.

38.92 Set an iron post 3 ft. long 1 in. in diam. 26 ins. in the  
 ground for 4 sec. cor. marked on brass cap 4 331 on  
 N. half and 36 on S. half.

Dig pits 18 x 18 x 12 ins. E and W. of post. 3 ft.  
 dist and raise a mound of earth 3½ ft. base  
 1½ ft. high N. of cor.

47.80 Dry ravine 10 lbs. wide. course S. asc. gradually  
 over W. slope.

77.00 Old. road. bears N 20° E and S 20° W. leads to Keanis  
 Canyon Ariz

78.92 Set an iron post 3 ft. long 3 ins. in diam. 24 ins.  
 in the ground for cor. of sec. 5, 6, 31 and 32.  
 marked on brass cap. T 21 E. in E half. T 26 N S 32  
 in N.E. T 25 N. S 5 in S.E. 36 in S.W. and 331 in N.W.  
 quadrant.

Dig pits 18 x 18 x 12 ins. in each. sec. 5½ ft. dist. and  
 raise a mound of earth 4 ft. base. 2 ft. high. W.  
 of cor.

Land rolling.  
 Soil sandy 3<sup>rd</sup> rate.  
 Number Cedar

NOTE On the 4 sec. cor. bet. sec. 6 and 31 I set off 23° 12½' N.

North boundary of Twp 25 N. R 21 E.

chains

on the decl arc and at noon observe the sun on the meridian and obtain on the Cal. arc. a reading of. 35° 36' 16.

S 89° 54' E bet. secs. 5 and 32.

Around W. slopes over rolling sandy land through scattering sage brush undergrowth and bunch grass

21.15 Top of sand ridge bears N and S. desc.

40.00 Set an iron post 3 ft. long 1 in. in diam. 26 ins. in the ground for 4 sec. cor. marked on brass cap. 1/4 S 32 on N. half and S 5 on S half.

Dig pits 18x18x12 ins E and W. of post. 3 ft. dist and raise a mound of earth 3 1/2 ft. base, 1 1/2 ft. high. N. of cor.

46.08 Old road bears N and S leads to Keams Canyon Ariz.

80.00 Set an iron post. 3 ft. long, 3 ins. in diam. 24 ins. in the ground for cor. of secs. 4, 5, 32 and 33, marked on brass cap T 21 E in E half, T 26 N S 33 in N.E. T 25 N. S 4 in S.E. S 5 in S.W. and S 32. in N.W. quadrant.

Dig pits 18x18x12 ins. in each. sec. 5 1/2 ft. dist. and raise a mound of earth 4 ft. base, 2 ft. high W. of cor.

Land rolling.  
Soil sandy 3rd rate.  
No timber

S 89° 54' E bet. secs. 4 and 33.

Over rolling sandy land through scattering sage brush undergrowth and bunch grass.

4 51 Old road bears N and S. leads to Keams Canyon Ariz

32, 38 Top of stony ridge bears N and S. desc.

40.00 Set an iron post 3 ft long 1 in in diam. 26 ins in the ground for 4 sec. cor marked on brass cap 1/4 S 33 on N. half and S 4 on S. half

Dig pits 18x18x12 ins. E and W. of post. 3 ft. dist. and raise a mound of earth 3 1/2 ft. base, 1 1/2 ft. high. N. of cor.

80.00 Set an iron post. 3 ft. long 3 ins. in diam. 24 ins

## North boundary of Twp 25 N. R 21 E.

in the ground for Cor. of sec. 3, 4, 33 and 34 marked on brass Cap. R 21 E in E half, T 26 N. 334 in N.E. T 25 N. S 3 in S.E. S 4 in S.W. and 333 in N.W. quadrant.

Dig pits 18x18x12 ins. in each. sec. 5 1/2 ft. dist and raise a mound of earth 4 ft. base. 2 ft. high W. of cor.

Land rolling.

Soil sandy 3<sup>rd</sup> rate.

No timber

S 89° 54' E Sec. sec. 3 and 34

Over rolling sandy land through scattering sage and greasewood bush. undergrowth and bunch grass

40.00 See an iron post 3 ft. long 1 in. in diam. 26 ins. in the ground for 4 sec. cor. marked on brass Cap. 4 334 on N. half and 33 on S. half.

Dig pits 18x18x12 ins. E and W. of post. 3 ft. dist and raise a mound of earth 3 1/2 ft. base. 1 1/2 ft. high. W. of cor.

Begin gradual <sup>ascent</sup> over N.W. slope

80.00 See an iron post 3 ft. long. 3 ins. in diam. 24 ins. in the ground for Cor. of sec. 2, 3, 34 and 35, marked on brass Cap R 21 E in E half, T 26 N. S 35 in N.E. T 25 N. S 2 in S.E. S 3 in S.W. and S 34 in N.W. quadrant.

Dig pits 18x18x12 ins. in each. sec. 5 1/2 ft. dist and raise a mound of earth 4 ft. base. 2 ft. high. W. of cor.

Land rolling.

Soil sandy 3<sup>rd</sup> rate.

No timber

S 89° 54' E. Sec. sec. 2 and 35.

Ascend gradually over N.W. slope, over sandy land through scattering sage and greasewood bush. undergrowth and bunch grass

39.15 Top of sand ridge runs north S. desc. gradually,

40.00 See an iron post 3 ft. long. 1 in. in diam. 26 ins. in the ground for 4 sec. cor. marked on brass Cap.

North boundary of T<sub>25</sub>N. R<sub>21</sub>E.

Chain

1/4 S 35 on N. half and S 2 on S half.  
Dig pits 18x18x12 ins. E and W. of post 3 ft. dia. and  
raise a mound of earth 3 1/2 ft. base, 1 1/2 ft. high. W.  
of cor.

5390 Old road bears N. E and S. W. leads to Kearns Canyon  
Ariz.

60,80 Depression bears N. W. and S. E. drains to the  
N. W. ascend gradually over S. W. slope.

80,00 Set an iron post 3 ft. long 3 ins. in diam. 24 ins.  
in the ground for cor. of secs. 1, 2, 35 and 36.  
marked on bears Cap N 21 E in E half, T 26 N,  
S 36 in N. E. T 25 N, S 1 in S. E. S 2 in S. W. and S 35 in  
N. W. quadrant.

Dig pits 18x18x12 ins. in each sec. 5 1/2 ft. dia. and  
raise a mound of earth 4 ft. base, 2 ft. high. W.  
of cor.

Land rolling  
Soil sandy 3<sup>rd</sup> rate  
No timber

S 89° 54' E. bet. secs. 1 and 36.  
Ascend S. W. slope over rolling sandy land, through  
scattering sage and greasewood brush undergrowth  
and bunch grass.

40,00 Set an iron post 3 ft. long 1 1/2 in. diam. 26 ins. in the  
ground for 4 sec. cor. marked on bears Cap 7 S 36  
on N. half and S 1 on S half.

Dig pits 18x18x12 ins. E and W. of post 3 ft. dia. and  
raise a mound of earth 3 1/2 ft. base, 1 1/2 ft. high. W.  
of cor.

64,29 Old wood road bears N and S.

70,90 Top of sand ridge 10 ft. high bears N 40° E and S 40° W.

77,03 Old road to spring in Sec. 1 T 25 N R 21 E bears N  
and S.

80,00 The cor. of T<sub>25</sub> and 26 N., R<sub>21</sub> and 22 E. <sup>heretofore</sup> described.

Land rolling  
Soil sandy 3<sup>rd</sup> rate.  
No timber

June 30<sup>th</sup> 1910

Boundaries of Twp 25 N, R 21 E.

Latitudes departures and closing errors.

Line Designated	True Bearing	Distance CHS	Latitudes		Departures	
			N CHS	S CHS	E CHS	W CHS
South Boundary (6 <sup>th</sup> Stan Parallel North)	N. 89° 53' W	159.80	.32			159.80
	S. 89° 46' W	80.20		.33		80.20
	N. 89° 48' W	159.50	.55			159.50
West Boundary (5 <sup>th</sup> Guide Meridian E.)	N. 89° 57' W	80.18	.07			80.18
	North	480.00	480.00			
North Boundary	S 89° 54'	478.92		00.84	478.92	
East Boundary	South	480.00		480.00		
Convergency					.51	
Totals			480.94	481.17	479.43	479.68
				480.94		479.43
		Error in Latitude		0.23		
				Error in Departure	0.25	

General Description.

This township consists of a high stony mesa land in the southern part; it is rolling in the central and northern parts. Nearly the entire township is prairie land, producing an abundance of grass. The township is poorly watered and has very little timber on the mesa portions.

Much water from the summer rain fall could be stored in natural basins at a small expense thus affording water for a great many head of sheep. The township should be subdivided.

Sidney E. Blouh  
U.S. Examiner of Surveys

June 30<sup>th</sup> 1910.

U.S. EXAMINER OF SURVEYS  
FINAL OATHS OF DEPUTY SURVEYOR AND HIS ASSISTANTS.

LIST OF NAMES.

A list of the names of the individuals employed by Sidney E. Blous  
Examiner of Surveys  
~~Deputy Surveyor~~, United States ~~Deputy Surveyor~~, to assist in running, measuring, and marking the lines and corners described in the foregoing field notes of the survey of the East and North boundaries of Twp. No. 25 N., Range No. 21 East, of the Gila and Salt River Base and Meridian, Arizona. showing the respective capacities in which they acted:

- Fred L. Warner Van L. White - Compassman. Chainman.
- Charles A. Dutton Chainman.
- P. J. White. Moundman.
- Jack Mey. Moundman.
- Jack Mey. Axman.
- William R. Carson Axman.
- William R. Carson Flagman.

FINAL OATH OF ASSISTANTS.

We hereby certify that we assisted Sidney E. Blous  
Examiner of Surveys  
~~Deputy Surveyor~~, United States ~~Deputy Surveyor~~, in surveying all those parts or portions of the East and North boundaries of Twp. No. 25 N. of Range No. 21 East.

of the Gila and Salt River Base and Meridian, Territory of Arizona, which are represented in the foregoing field notes as having been surveyed by him and under his direction; and that said survey has been in all respects, to the best of our knowledge and belief, well and faithfully <sup>executed</sup> surveyed, and the corner monuments established, according to the instructions furnished by the ~~United States Surveyor General for~~ of the General Land Office Van L. White. Compassman  
Fred L. Warner Chainman.  
Charles A. Dutton Chainman.  
P. J. White. Moundman.  
Jack Mey. Moundman.  
Jack Mey. Axman.  
William R. Carson. Axman.  
William R. Carson. Flagman.

Subscribed and sworn to before me this 28th day of July, 1910

Sidney E. Blous  
U.S. Examiner of Surveys



FINAL OATH OF UNITED STATES EXAMINER OF SURVEYS DEPUTY SURVEYOR.

I, Sidney E. Blout, <sup>Examiner of Surveys</sup> United States ~~Deputy Surveyor~~, do solemnly swear that, in pursuance of ~~a contract~~ <sup>Special Instructions</sup> received from ~~the Commissioner of the United States Surveyor General for~~ <sup>the Commissioner of the General Land Office</sup>, bearing date of the ~~2<sup>nd</sup> day of Oct. 1907~~ <sup>and the 15<sup>th</sup> day of May 1908</sup>, I have well, faithfully, and truly, in my own proper person, and in strict conformity with the instructions furnished by the ~~United States Surveyor General for~~ <sup>Commissioner</sup> of the ~~General Land Office~~, the Manual of Surveying Instructions, and the laws of the United States, surveyed all those parts or portions of The East and North boundaries of Twp. 25 N., R. 21 East

of the Gila and Salt River Base and Meridian, in the ~~Territory~~ <sup>State</sup> of Arizona, which are represented in the foregoing field notes as having been surveyed by me and under my direction; and I do further solemnly swear that all the corners of said survey have been established and perpetuated in strict accordance with the Manual of Surveying Instructions, and the special written instructions of the ~~United States Surveyor General for~~ <sup>Commissioner</sup> of the ~~General Land Office~~ and in the specific manner described in the field notes, and that the foregoing are the original field notes of such survey.

Subscribed by said Sidney E. Blout, and sworn to before me }  
 this \_\_\_\_\_ day of \_\_\_\_\_, 19\_\_\_\_ }  
 United States ~~Deputy Surveyor~~ <sup>Examiner of Surveys</sup>.



APPROVAL.

OFFICE OF THE UNITED STATES SURVEYOR GENERAL,

Phoenix, Arizona APR 25 1914

The foregoing field notes of the survey of the  
East and North boundaries of  
Township N° 25 North, Range 21 East of the  
Gila and Salt River Base and Meridian, Arizona.

executed by Sidney E. Blout, U.S. Examiner of Surveys  
 under ~~his contract No.~~ <sup>Special Instructions from the Commissioner of the General Land Office</sup>, dated October 2, 1907 and May 15, 1908, having been critically examined, and the necessary corrections and explanations made, the said field notes, and the surveys they describe, are hereby approved.

Frank S. Ingalls  
 United States Surveyor General.  
 SURVEYOR-GENERAL OF ARIZONA

I certify that the foregoing transcript of the field notes of the above described surveys in \_\_\_\_\_, has been correctly copied from the original notes on file in this office.

United States Surveyor General.