

Exterior  
BOOK "D"

BOOK 2531

2531

FIELD NOTES

OF THE SURVEY OF THE

*North boundary of Twp. No. 25 N., R. No. 20 E. etc.*

Of the *Gila and Salt River Basins* and Meridian,

*in the Territory of Arizona*

EXECUTED  
AS SURVEYED BY

*Sidney C. Blouk*

United States ~~Deputy Surveyor~~ *Examiner of Surveys*

*Special Instructions from the Commissioner of the General Land Office.*

Under ~~his Contract No.~~ dated *Oct. 2<sup>nd</sup> 1907. and May 15<sup>th</sup> 1908*

Survey commenced *May 6<sup>th</sup>* 1910, ~~19~~

Survey completed *May 7<sup>th</sup>* 1910, ~~19~~



19  
1B

# INDEX DIAGRAM.

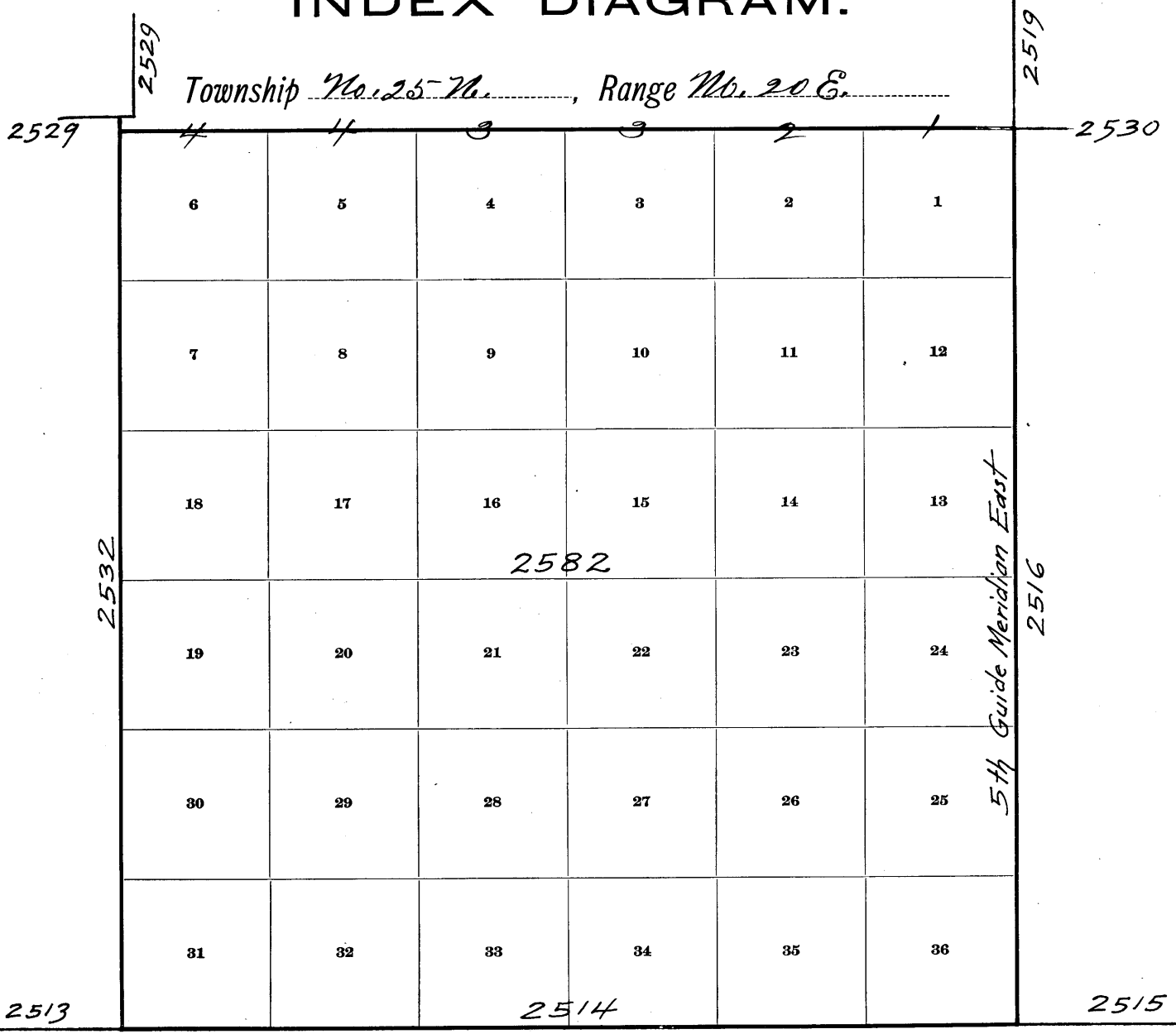

Meanders Page .....

20  
10

PRELIMINARY OATHS OF ASSISTANTS.

WE, Fred L Warner and T. J. White

do solemnly swear that we will well and faithfully execute the duties of chainmen; that we will level the chain upon even and uneven ground, and plumb the tally pins, either by sticking or dropping the same; that we will report the true distances to all notable objects, and the true lengths of all lines that we assist in measuring, to the best of our skill and ability, and in accordance with instructions given us, in the survey of

The North boundary of Twp. No. 25 N., Range No. 20 E. of the G. & S. R. Base & Meridian, Arizona.

Fred L Warner, Chainman.

T. J. White, Chainman.

Subscribed and sworn to before me this 5<sup>th</sup> day of May, 1910



Sidney E. Blout  
U.S. Examiner of Surveys

WE, Chas L Shumway and Ralph C Sampson

do solemnly swear that we will well and truly perform the duties of moundmen in the establishment of corners, according to the instructions given us, to the best of our skill and ability, in the survey of

The North boundary of Twp. No. 25 N., Range No. 20 East of the G. & S. R. Base & Meridian, Arizona.

Chas L Shumway, Moundman.

Ralph C Sampson, Moundman.

Subscribed and sworn to before me this 5<sup>th</sup> day of May, 1910



Sidney E. Blout  
U.S. Examiner of Surveys

~~WE, \_\_\_\_\_ and \_\_\_\_\_~~

~~do solemnly swear that we will well and truly perform the duties of axmen in the establishment of corners and other duties, according to instructions given us, to the best of our skill and ability, in the survey of~~

~~\_\_\_\_\_, Axman.~~  
~~\_\_\_\_\_, Axman.~~

~~Subscribed and sworn to before me this \_\_\_\_\_ day of \_\_\_\_\_, 19\_\_\_\_~~



I, William B Carson, do solemnly swear that I will well and truly perform the duties of flagman according to instructions given me, to the best of my skill and ability, in the survey of

The North boundary of Twp. No. 25 N., Range No. 20 East of the G. & S. R. Base & Meridian, Arizona.

William B Carson, Flagman.

Subscribed and sworn to before me this 5<sup>th</sup> day of May, 1910



Sidney E. Blout  
U.S. Examiner of Surveys

North boundary of Tps 25 N., R 20 E

Chain

Survey commenced May 6<sup>th</sup> 1910 and executed with a W and L E. Gurley engineers transit No. 76 with a Burt solar attachment, The horizontal limb is provided with one double vernier reading to single minutes of arc, The verniers of the latitude and declination arcs read to 0' 30" of arc.

Examined the adjustments of the transit and find them perfect and know from recent tests of the solar apparatus by comparing its indications resulting from solar observations made during a.m. and p.m. hours with a meridian determined by observations on Polaris, that the instrument is in satisfactory adjustment. therefore I begin at the cor. of Tps. 25 and 26 N. R's 20 and 21 E. <sup>on the 5<sup>th</sup> Guide Meridian, East</sup> which I established May 6<sup>th</sup> 1910 <sup>and described in Standard Book "J"</sup> latitude 35° 35' 48" N. Longitude 110° 09' 26" W.

From the survey of the E boundary of Tps 25 N. R's 19 and 20 E. <sup>see Exterior Book "E"</sup> and from my retracements <sup>and resumed</sup> of the 6<sup>th</sup> Standard Parallel North through R. 20 E. <sup>see Standard Book "H"</sup> I know that the cor. of Tps. 25 and 26 N. R's 20 and 21 E. and the cor. of Tps. 26 N. R's 19 and 20 E. can not be connected by a line which does not deviate more than 0' 21" of arc from an E and W. line, therefore at 10<sup>h</sup> 30<sup>m</sup> a.m. <sup>l.m.t.</sup> May 6<sup>th</sup> 1910, I set off 35° 36' N. on the lat. arc 16° 26 1/2' N. on the decl. arc and determined a meridian with the solar at the cor. of Tps 25 and 26 N. R's 20 and 21 E. <sup>described in Standard Book "J"</sup>

Thence I run

- West; on a true line on N. edge of Tps. Feb. sec. 1 and 36.
- Descend S.W. slope over rolling sandy land through scattering cedar timber and bunch grass.
- 4.00 Leave timber bears N.W. and S.E.
- 27.00 Runnel (dry) course S 70° W. asc. gently
- 36.96 Road from Holbrook Arizona to Kaibab Canyon Arizona bears N 20° W. and S 20° E.
- 40.00 Set an iron post 3 ft. long 1 in. in diam. 26 in. in the ground for 1/4 sec. cor. marked on brass cap 1/4 S 36° on N. half and S 1 on S half
- Dug pits 18 x 18 x 12 in. E and W. of post 3 ft. dia. and raise a mound of earth 3 1/2 ft. base, 1 1/2 ft. high N. of cor.
- 45.00 Top of sand ridge 10 ft. above cor. bears N.E. and S.W. desc.
- 53.00 Dry sand wash. 10 lbs. wide course S 35° W. asc
- 80.00 Set an iron post 3 ft. long 3 in. in diam. 24 in

Chain North boundary of <sup>10</sup> T25 N. R20 E.

in the ground for cor. of sec. 1, 2, 35 and 36. marked on brass Cop T26 N. S 36 in N.E., T25 N. S 1 in S.E. S2 in S.W. and S35 in N.W. quadrants and R20 E in E. half.

Dig pits 18x18x12 ins. in each. sec. 5 1/2 ft. dia. and raise a mound of earth 4 ft. base, 2 ft. high W. of cor.

Land rolling  
Soil sandy 3<sup>rd</sup> rate.  
Timber Cedar

NOTE May 6<sup>th</sup> 1910 at the cor. of sec. 1, 2, 35 and 36<sup>above described</sup> set off 16 27 1/2' N. on the decl. arc. and at noon observe the sun on the meridian and obtain on the lat. arc a reading of 35° 36' N.

West, Sec. 2 and 35-

3,80 Ascend over rolling sandy S.E. slope through scattering sage and greasewood brush undergrowth and bunch grass. Top of sand ridge 20 ft. above sec. cor. bears N 35° E. and S 35° W. desc. gently over N.W. slope.

40,00 See an iron post 3 ft. long 1 in. in diam. 26 ins. in the ground for 1/4 sec. cor. marked on brass Cop 1/4 S 35- on N. half and S 2 on S. half.

Dig pits 18x18x12 ins. East W. of post. 3 ft. dia. and raise a mound of earth 3 1/2 ft. base, 1 1/2 ft. high. W. of cor.

48,55 Road bears N 40° E and S 40° W. leads to Keavin Canyon Arizona

80,00 See an iron post 3 ft. long 3 ins. in diam. 24 ins. in the ground for cor. of sec. 2, 3, 34 and 35 marked on brass Cop R20 E in E half T26 N. S 35 in N.E. T25 N. S 2 in S.E. S 3 in S.W. and S 34 in N.W. quadrants.

Dig pits 18x18x12 ins. in each. sec 5 1/2 ft. dia. and raise a mound of earth 4 ft. base, 2 ft. high W. of cor.

Land rolling  
Soil sandy 3<sup>rd</sup> rate.  
No timber

North boundary of Np 25 N. R20 E.

West, Sec. 3 and 34.  
 Descend gradually over N.W. slope through scattering sage  
 and greasewood bush undergrowth and bunch grass  
 7.75' North of descent in depression bears N.E. and S.W., drains to  
 the S.W. ascend gradually over S.E. slope  
 40.00 Set an iron post 3 ft. long 1 in. in diam. 26 ins. in the  
 ground for  $\frac{1}{4}$  sec. cor. marked on brass cap  $\frac{1}{4}$  S 34 on N.  
 half and S 30 on S. half.  
 Dig pits 18x18x12 ins. E and W. of post. 3 ft. dia. and  
 raise a mound of earth 3  $\frac{1}{2}$  ft. base, 1  $\frac{1}{2}$  ft. high. No.  
 of cor.  
 42.80 Top of sand ridge 10 ft. above cor. bears N and S. desc  
 W. slope.  
 67.00 Dry sand wash 20 lbs. wide 3 ft. deep course S.  
 80.00 Set an iron post 3 ft. long 3 ins. in diam 24 ins. in  
 the ground for cor. of sec. 3, 4, 33, and 34, marked  
 on brass cap N 20 E in E half. T 26 N, S 34 in N.E. T 25  
 N, S 3 in S.E. S 4 in S.W. and S 33 in N.W. quadrants.  
 Dig pits 18x18x12 ins. in each sec. 5  $\frac{1}{2}$  ft. dia. and  
 raise a mound of earth 4 ft. base, 2 ft. high W. of  
 cor.  
 Land rolling.  
 Soil sandy 2<sup>nd</sup> and 3<sup>rd</sup> rate.  
 No timber

May 6<sup>th</sup> 1910

May 7<sup>th</sup> 1910. Ah. 7<sup>h</sup> 45<sup>m</sup> and <sup>1.1 m.t.</sup> S. sec off. 35° 36' N. and  
 the lab. arc 16° 42' N. on the decl. arc. and determined  
 a meridian with the solar at the cor. of sec. 3, 4,  
 33 and 34 <sup>above described</sup> Thence Drive  
 West, Sec. 4 and 33.  
 Descend gradually over W. slope, through scattering sage  
 and greasewood bush undergrowth and bunch grass  
 40.00 Set an iron post 3 ft. long 1 in. in diam. 26 ins. in the  
 ground for  $\frac{1}{4}$  sec. cor. marked on brass cap  $\frac{1}{4}$  S 33 on  
 N. half and S 4 on S. half.  
 Dig pits 18x18x12 ins. E and W. of post. 3 ft. dia. and  
 raise a mound of earth 3  $\frac{1}{2}$  ft. base, 1  $\frac{1}{2}$  ft. high. No.  
 of cor.  
 40.52 Road bears N.W. and S.E. leads to Holbrook Arizona.  
 80.00 Set an iron post 3 ft. long 3 ins. in diam 24 ins  
 in the ground for cor. of sec. 4, 5, 32 and 33.

marked on brass Cop R20E in E. half T26N. S33 in  
N.E. T25N. S4 in S.E. S5 in S.W. and S32 in N.W.  
quadrants.

Dig pits 18x18x12 ins. in each sec. 5½ ft. dia. and  
raise a mound of earth 4 ft. base, 2 ft. high. W.  
of cor.

Land rolling.

Soil sandy 2<sup>nd</sup> and 3<sup>rd</sup> rate.

No timber

West, Secs. 5 and 32.

Descend S.W. slope over gently rolling sandy land  
through scattering sage and greasewood bush  
undergrowth and bunch grass

40.00 Set an iron post 3 ft. long 1 in. in diam. 26 ins.  
in the ground for ¼ sec. cor. marked on brass Cop  
¼ S32 on N. half. and S5 on S. half.

Dig pits 18x18x12 ins. E and W. of post. 3 ft. dia.  
and raise a mound of earth 3½ ft. base. 1½ ft.  
high N. of cor.

46.67 Road from Winslow Arizona to Kaibab Canyon  
Arizona bears N.E. and S.W.

80.00 Set an iron post 3 ft. long 3 ins. in diam. 24  
ins. in the ground for cor. of secs. 5, 6, 31 and 32  
marked on brass Cop R20E in E. half, T26N S32  
in N.E. T25N. S5 in S.E. S6 in S.W. and S31 in  
N.W. quadrant.

Dig pits 18x18x12 ins. in each sec. 5½ ft. dia.  
and raise a mound of earth 4 ft. base, 2 ft. high.  
W. of cor.

Land rolling.

Soil sandy 2<sup>nd</sup> and 3<sup>rd</sup> rate.

No timber

West, Secs. 6 and 31.

Over rolling sandy land. Slopes to the S.W. through  
scattering sage and greasewood bush undergrowth  
and bunch grass

40.00 Set an iron post 3 ft. long 1 in. in diam. 26 ins. in  
the ground for ¼ sec. cor. marked on brass  
Cop ¼ S31 on N. half and S6 on S. half



North boundary of Tps 25 N. R 20 E.

Chains

Dig pits 18 x 18 x 12 ins East W. of post. 3 ft. dia. and raise a mound of earth 3 1/2 ft. base, 1 1/2 ft. high N. of cov.

78.82 Intersect W. ldy. of Tps. 4.62 Ch. S. of the Closing Cor. of Tps. 25 N. R's 19 and 20 E. on S ldy. of Tps 26 N. R 19 E. <sup>recently estab. by me as described in Exterior Book "F"</sup> Den all iron post. 3 ft. long. 3 ins. in diam. 24 ins. in the ground for closing cor. of Tps. 25 and 26 N. R's 20 E. marked on brass cap, T 19 E - T 25 N S 1 T 26 N S 36 in W. half., C.C. R 20 E in E. half., T 26 N. S 31 in NE. and T 25 N. S 6 in SE. quadrants.

Dig pits 30 x 24 x 12 ins. Crosswise on each line N and S. 4 ft. and E. of post 8 ft. dia. and raise a mound of earth 5 ft. base, 2 1/2 ft. high. E. of cov.

I change the cor. of Tps. 26 N. R's. 19 and 20 E. from a cor. of two Tps. to a cor. of Tps. 26 N. R 19 E. <sup>as described in Exterior Book "E"</sup> and change the markings on the closing cor. of Tps. 25 N. R's 19 and 20 E. <sup>as described in Exterior Book "E"</sup> to refer to Tps. 25 N. R 19 E. and Tps. 26 N. R 20 E.

Land rolling  
Soil sandy 2<sup>nd</sup> and 3<sup>rd</sup> rate  
No timber

May 7<sup>th</sup> 1910.

Latitudes Departures and Closing Errors.  
Bdrs. Township 25 North, Range 20 East.

Line Designated.	True Bearing	Distance	Latitudes		Departures	
			N	S	E	W
South Boundary (6 <sup>th</sup> Stand Parallel North)	N 89° 51' W	479.55 <sup>+</sup>	1.26			479.55 <sup>+</sup>
West Boundary	North	479.35 <sup>+</sup>	479.35 <sup>+</sup>			
North Boundary	East	478.82 <sup>+</sup>			478.82 <sup>+</sup>	
East Boundary (5 <sup>th</sup> Guide Meridian E)	South	480.00 <sup>+</sup>		480.00		
Convergency Tdfats			480.61	480.00	479.33	479.55
			480.00			479.33
	Error in Lat.		0.61			
				Error in Dep.		0.22

Sidney E. Blout  
U. S. Examiner of Surveys.



I, Sidney E. Blout, United States ~~Deputy Surveyor~~ <sup>Examiner of Surveys</sup>, do solemnly swear that in pursuance of ~~a contract~~ <sup>Special Instructions</sup> received from ~~the Commissioner of the United States Surveyor General for the General Land Office~~ <sup>the Commissioner of the General Land Office</sup>, bearing date of the ~~2<sup>nd</sup> day of Oct., 1907~~ <sup>and the 15<sup>th</sup> day of May, 1908</sup>, I have well, faithfully, and truly, in my own proper person, and in strict conformity with the instructions furnished by the ~~United States Surveyor General for the General Land Office~~ <sup>United States Commissioner</sup>, the Manual of Surveying Instructions, and the laws of the United States, surveyed all those parts or portions of The North boundary of Twp. No. 25 N., Range No 20 East of the

River Base and Meridian, in the Territory of Arizona, which are represented in the foregoing field notes as having been surveyed by me, and under my direction; and I do further solemnly swear that all the corners of said survey have been established and perpetuated in strict accordance with the Manual of Surveying Instructions, and the special written instructions of the ~~United States Surveyor General for the General Land Office~~ <sup>United States Commissioner</sup> and in the specific manner described in the field notes, and that the foregoing are the original field notes of such survey.

Subscribed by said Sidney E. Blout, and sworn to before me See this \_\_\_\_\_ day of \_\_\_\_\_, 19\_\_\_\_, 19\_\_\_\_.

United States ~~Deputy Surveyor~~ <sup>Examiner of Surveys</sup>.

APPROVAL.

OFFICE OF THE UNITED STATES SURVEYOR GENERAL,

Phoenix, Arizona APR 25 1, 1914

The foregoing field notes of the survey of the  
North boundary of  
Township No 25 North, Range No 20 East of the  
Gila and Salt River Base and Meridian, Arizona  
executed by Sidney E. Blout, U.S. Examiner of Surveys under Special Instructions  
executed by from the Commissioner of the General Land Office  
under his contract No. \_\_\_\_\_, dated October 2, 1907 and May 15, 1908, having been critically examined, and the necessary corrections and explanations made, the said field notes, and the surveys they describe, are hereby approved.

Frank S. Ingalls  
United States ~~Surveyor General~~ <sup>Surveyor-General</sup> OF ARIZONA

I certify that the foregoing transcript of the field notes of the above-described surveys in \_\_\_\_\_, has been correctly copied from the original notes on file in this office.

United States Surveyor General.