

29
①

4-679.

BOOK 2532

2532

Exterior
BOOK "E"

FIELD NOTES

OF THE SURVEY OF THE

East Boundary of Tp No. 25 N. of Range No. 19 East.

Of the *Gila and Salt River Base* and _____ Meridian,

in the Territory of Arizona

EXECUTED
AS SURVEYED BY

Sidney E. Blough

_____, United States ~~Deputy Surveyor~~ ^{Examiner of Surveys}

Special Instructions from the Commissioner of the General Land Office
Under his Contract No. _____, dated *Oct 2nd 1907 and May 15th*, 1908

Survey commenced *May 2nd* _____ 1910., ~~1908~~

Survey completed *May 2nd* _____ 1910., ~~1908~~

NAMES AND DUTIES OF ASSISTANTS.

Wm L. White Comptroller

Fred L. Warner Chairman

D. V. White Chairman

Ralph C. Sampson Warrantman

Chas L. Shumway Assessor

William R. Carson Flagman

Blank lines for additional entries.

BOOK 2532

INDEX DIAGRAM.

Township No. 25 North, Range No. 19 East

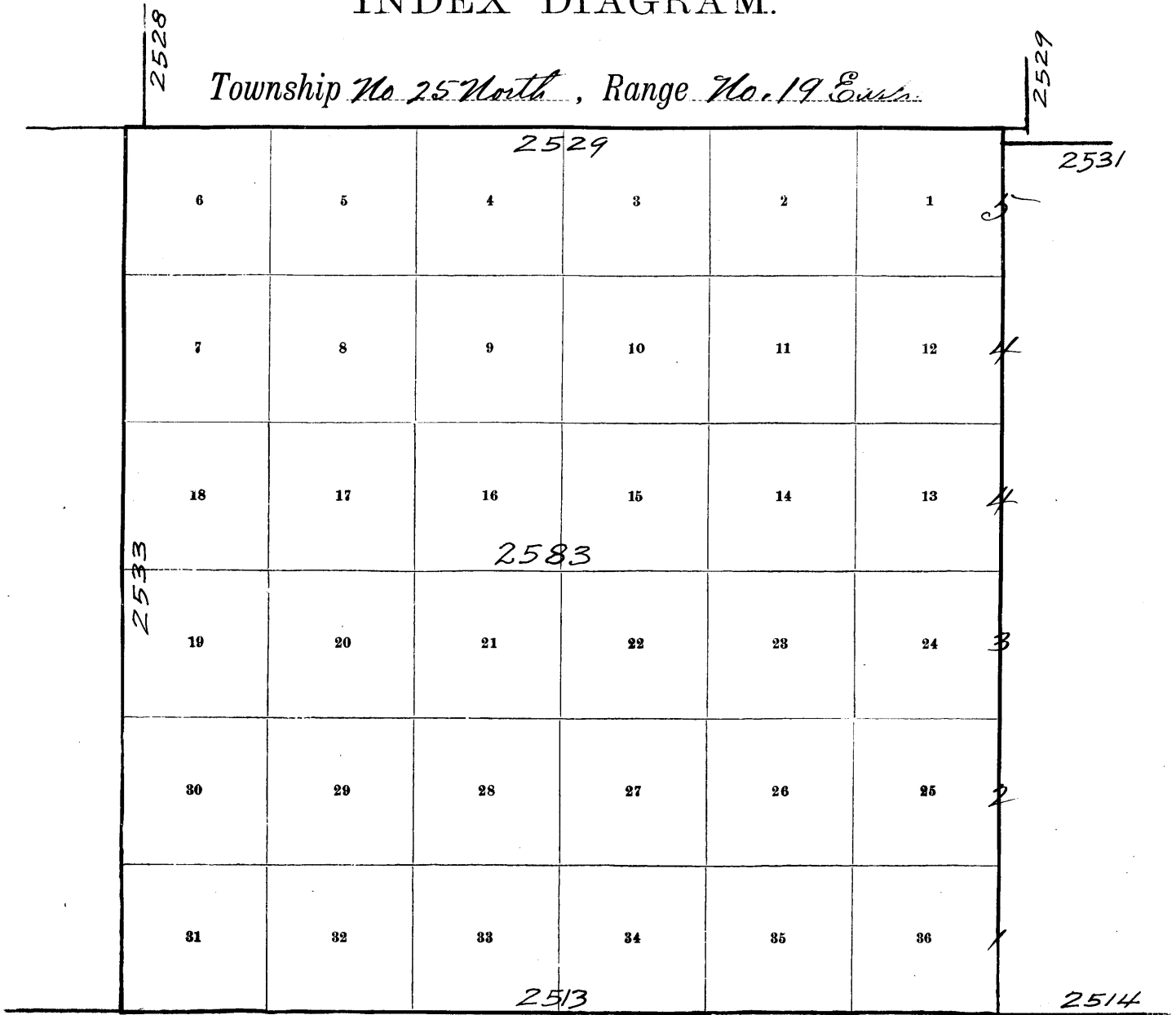

6th Standard Parallel North
Meanders Page

32
10

PRELIMINARY OATHS OF ASSISTANTS.

WE, Fred L. Warner and J. J. White

do solemnly swear that we will well and faithfully execute the duties of chainmen; that we will level the chain upon even and uneven ground, and plumb the tally pins, either by sticking or dropping the same; that we will report the true distances to all notable objects, and the true lengths of all lines that we assist in measuring, to the best of our skill and ability, and in accordance with instructions given us, in the survey of

The East boundary of Tm No. 25 No., Range No. 19 East, of the G. & S. R. Base and Meridian, Arizona.

Fred L. Warner, Chainman.

J. J. White, Chainman.

Subscribed and sworn to before me this 1st day of May 1910, ~~190~~



Sidney E. Blous
U.S. Examiner of Surveys

I, Ralph C. Sampson

do solemnly swear that ~~we~~ will well and truly perform the duties of moundman in the establishment of corners, according to the instructions given ~~me~~ to the best of ~~my~~ skill and ability, in the survey of

The East boundary of Tm No. 25 No., Range No. 19 East of the G. & S. R. Base and Meridian, Arizona.

Ralph C. Sampson, Moundman.

Ralph C. Sampson, Moundman.

Subscribed and sworn to before me this 1st day of May 1910, ~~190~~



Sidney E. Blous
U.S. Examiner of Surveys

I, Chas. L. Shumway

do solemnly swear that ~~we~~ will well and truly perform the duties of axman in the establishment of corners and other duties, according to instructions given ~~me~~ to the best of ~~my~~ skill and ability, in the survey of

The East boundary of Tm No. 25 No., Range No. 19 E. of the G. & S. R. Base and Meridian, Arizona.

Chas. L. Shumway, Axman.

Chas. L. Shumway, Axman.

Subscribed and sworn to before me this 1st day of May 1910, ~~190~~



Sidney E. Blous
U.S. Examiner of Surveys

I, William R. Carson

do solemnly swear that I will well and truly perform the duties of flagman according to instructions given me, to the best of my skill and ability, in the survey of

The East boundary of Tm No. 25 No., Range No. 19 East of the G. & S. R. Base and Meridian, Arizona.

William R. Carson, Flagman.

Subscribed and sworn to before me this 1st day of May 1910, 190



Sidney E. Blous
U.S. Examiner of Surveys

Each boundary of Twp 25 N. R. 19 E.

Chain

Survey commenced May 2nd 1910 and executed with a W and L. E. Gurley engineers transit No. 76 with a Park. Solar attachment. The horizontal limb is provided with one double vernier reading to single minutes of arc. The verniers of the latitude and declination arcs, reading to 0' 30" of arc. I examine the adjustments of the transit and find them to be perfect. and know from recent tests of the solar apparatus by comparing the results of observations made on the sun during am. and p.m. hours with a meridian established by observations on Polaris, that the instrument is in satisfactory adjustment.

I begin at the ^{old} Standard Cor. of Twp. 25 N. R. 19 and 20 E. which is a malapa stone 16x10x6. ins. loosely set. marked and witnessed as described by the Surveyor General. Latitude 35° 30' 35" N. Longitude 110° 15' 49" W.

May 2nd 1910 at the above described cor. I set off 35° 30 1/2' N. in the lat. arc. 15° 15' N. in the decl. arc. and at 8^h 00^m a.m. ^{l.m.t.} determine a meridian with the solar.

Thence I run,

North, set. sec 31 and 36; Descend steep N.W. slope over stony mountainous land through scattering pine and cedar timber and bunch grass undergrowth.

31.00 Foot of ditch in dry sand wash. 30 lbs. wide 2 ft. deep. Course N.W. leave mountainous land leave N.W. and S.E. Enter rolling land leave N.W. and S.E.

40.00 Set an iron post 3 ft. long 1 in. in diam. 26 ins. in the ground for 1/4 sec. cor. marked on bears cap 4 S 36 on W half and 3 31 on E. half. from which
A pine 14 ins. in diam. bears S 84° E 77 lbs. dist marked 1/4 S 31 B.T.
A cedar 10 ins. in diam. bears N 52 3/4° W. 30 lbs. dist marked 1/4 S 36 B.T.

41.00 Dry sand wash 40 lbs. wide Course N.W. leave rolling sandy land leave N.W. and S.E., Enter stony mountainous land leave N.W. and S.E. ascend steep rocky S.W. slope.

63.00 Top of rocky spur 40 ft. above sand wash. leave East W. descend N. slope

69.70 Dry sand wash. 20 lbs wide Course West. ascend

71.00 Top of spur leave East W. desc. steep N. slope

East boundary of N/4 25 T6. R 19 E.

2 Chain

- 80.00 Set an iron post 3 ft. long, 3 ins. in diam. 24 ins. in the ground for cor. of sec. 25, 30, 31 and 36 marked on brass cap. T 25 N. in N. half, R 19 E S 25 in N.W. T 20 E S 30 in N.E. S 31 in S.E. and S 36 in S.W. quadrant from which. A Cedar 6 ins. in diam. bears S 55 1/2° E 78 lbs. dist. marked T 25 N. R 20 E S. 31 B.T.
A Cedar 8 ins. in diam. bears S 63° W 325 lbs. dist. marked T 25 N. R 19 E, S 36 B.T. No other trees available.
Dig pits 24 x 24 x 12 ins in each sec. N.E. and N.W. of post. 5 1/2 ft. dia. and raise a mound of earth 4 ft. base 2 ft. high W. of cor.
Land mountainous and rolling.
Soil sandy and stony 3rd and 4th rate.
Timber prairie pine and Cedar
Mountainous land 70.00 ch.
-
- North, bet. sec. 25 and 30
Descend N. slope over mountainous land through scattering prairie pine and Cedar timber and bunch grass.
- 0.25 Leave timber bears East W.
- 16.00 Enter Cedar timber bears NW and S.E.
- 17.65 Dry sand wash 30 lbs. wide ab. foot of descent. Course N 60° W. ascend S.W. slope
- 40.00 Set an iron post 3 ft. long, 1 in in diam 26 ins in the ground for 1/4 sec. cor. marked on brass cap 1/4 S 25 on W. half and S 30 on E. half. From which.
A Cedar 8 ins. in diam. bears S 80 1/2° E 58 lbs. dist marked 1/4 S 30 B.T.
A Cedar 12 ins. in diam. bears S 75 1/2° W 222 lbs. dist marked, 1/4 S 25 B.T.
- 46.00 Top of Spur 20 ft. above 1/4 sec. cor. bears N.E. and S.W. desc.
- 48.00 Dry, rocky ravine 100 lbs. wide course S.W. asc slope S.W. slope of mesa.
- 61.00 Top of steep ascent on S. slope of mesa. bears N.W. and S.E. Leave mountainous land bears N.W. and S.E.
Enter rolling sandy land bears N.W. and S.E.
- 75.00 North edge of mesa bears N 80° E and S 80° W. Leave rolling sandy land bears N 80° E and S 80° W. Enter stony mountainous land bears N 80° E and S 80° W desc. abrupt N. slope
- 80.00 Set an iron post 3 ft. long 3 ins. in diam. 24 ins

in the ground for cor. of secs. 19, 24, 25 and 30. marked
on brass cap T25 N. in N. half, R19 E S24 in NW,
T20 E S19 in NE, S30 in SE and S25 in SW quadrant
from which.

Cedar 8 ins. in diam. bears N 40 1/4 E 8 lks. dist. marked
T25 N, R20 E S, 19 B.T.

A cedar 8 ins. in diam. bears S 11 3/4 E 98 lks. dist.
marked T25 N, R20 E S 30 B.T.

A cedar 10 ins. in diam. bears S 53 W. 114 lks. dist.
marked T25 N, R19 E, S25 B.T. and

A cedar 4 ins. in diam. bears N 36 1/2 W 103. lks. dist.
marked T25 N, R19 E S24, B.T.

Land rolling and mountainous.
Soil sandy and stony 3rd and 4th rate.
Timber pine and cedar.
Mountainous land. 6600 Chs.

North, Sec. 19 and 24.

Descend stony NW slope over mountainous land through
scattering cedar timber

15.60 Dry rocky ravine 15 lks. wide course NW are.

18.80 Top of rocky spur 20 ft. above the ravine bears E and W.
desc. steeply.

29.70 Dry sand wash 20 lks. wide 3 ft. deep course NW. Pass
mountainous land and timber bears E and W. Enter
rolling land bears E and W. descend gently NW slope.

40.00 Set an iron post. 3 ft. long 1 in. in diam 26 ins. in
the ground for 1/4 sec. cor. marked on brass cap. 1/4
S24 on W. half and S19 on E. half.

Dig pits 18x18x12 ins. N and S. of post. 3 ft. dist. and
raise a mound of earth 3 1/2 ft. base, 1 1/2 ft. high W. of
cor.

55.40 Road to Meany's Canyon Arizona bears NE and SW.

58.30 Dry sand wash 10 lks wide 2 ft. deep course NW.

65.00 Old road to Meany's Canyon ariz bears NE and SW.

80.00 Set an iron post. 3 ft. long, 3 ins. in diam. 24 ins
in the ground for cor. of secs. 13, 18, 19 and 24
marked on brass cap T25 N. in N. half, R19 E. S
13 in NW, T20 E S18 in NE, S19 in SE. and S24
in SW quadrant.

Dig pits 18x18x12 ins. in each sec. 5 1/2 ft. dist. and

4

Chain

East boundary of T₂₅ N. R19E.

raise a mound of earth 4 ft. base, 2 ft. high. W. of cor
 Land rolling and mountainous.

Soil sandy and stony 3rd rate.

Timber Cedar

mountainous land 29.70 Ch.

NOTE

At this cor Det off. $15^{\circ} 17\frac{1}{2}'$ N on the decl arc. and
 at noon observe the sun on the merid. arc. and
 obtain on the lat. arc. a reading of $35^{\circ} 33'$ N.

North, T_{ch}. secs. 13 and 18.

Descend gentle N.W. slope over rolling sandy land
 through scattering sage and greasewood bush
 undergrowth and bunch grass

27.92 Road from Winslow Arizona to Kean's Canyon Ariz
 bears $N 38^{\circ} E$ and $S 38^{\circ} W$.

35.35 Old road to Kean's Canyon bears N.E. and S.W.

40.00 Set an iron post 3 ft. long 1 in. in diam. 26 ins. in
 the ground for $\frac{1}{4}$ sec. cor. marked $\frac{1}{4}$ S 13 on W. half.
 and S 18 on E half.

Dig pits 18x18x12 ins. N. and S. of post 3 ft. dist. and
 raise a mound of earth $3\frac{1}{2}$ ft. base, $1\frac{1}{2}$ ft. high. W.
 of cor.

80.00 Set an iron post 3 ft. long 3 in. in diam 24 ins. in
 the ground for cor. of secs. 7, 12, 13 and 18. marked
 on brass Cap T₂₅ N. in N. half. R19E S12 in N.W.
 T₂₀ E. S7 in N.E. S18 in S.E. and S13 in S.W. quadrants
 Dig pits 18x18x12 ins. in each sec. $5\frac{1}{2}$ ft. dist and
 raise a mound of earth 4 ft. base, 2 ft. high. W.
 of cor.

Land rolling

Soil sandy 3rd rate

No timber

North, T_{ch}. secs. 7 and 12.

Descend gentle N.W. slope over rolling sandy land
 through scattering sage and greasewood bush
 undergrowth and bunch grass

40.00 Set an iron post 3 ft. long 1 in. in diam 26 ins. in
 the ground for $\frac{1}{4}$ sec. cor. marked on brass Cap $\frac{1}{4}$
 S 12 on W. half. and S 7 on E half.

East boundary of Tps 25 N. R 19 E

chains

Dig pits 18x18x12 ins. N and S. of post 3 ft. dia and raise a mound of earth 3 1/2 ft. base, 1 1/2 ft. high. W. of Cor.

80.00 Set an iron post. 3 ft. long. 3 ins. in diam. 24 ins in the ground for Cor of Secs. 1, 6, 7 and 12. marked on base Cap T 25 N. in N. half, R 19 E S 1 in N.W. R 20 E S 6 in N.E. S 7 in S.E. and S 12 in S.W. quadrant.

Dig pits 18x18x12 ins. in each sec. 5 1/2 ft. dia, and raise a mound of earth 4 ft. base, 2 ft. high. W. of Cor.

Land rolling.
Soil sandy 3rd rate.
No timber

North, Secs. 1 and 6.

Descend gentle N.W. slope over rolling sandy land through scattering sage and greasewood brush undergrowth and bunch grass.

12.30 Road from Holbrook Arizona to Placea Arizona bears N.W. and S.E.

36.80 Dry sand wash. 15 lbs. wide 2 ft. deep Course N.E.

40.00 Set an iron post. 3 ft. long 1 in. in diam. 26 ins in the ground for 1/4 sec. Cor. marked on base Cap 1/4 S 1 on W. half and S 6 on E half

Dig pits 18x18x12 ins. N and S of post. 3 ft. dia and raise a mound of earth 3 1/2 ft. base, 1 1/2 ft. high. W. of cor.

83.97 Intersect N. Ldy. of Tps. 11, 70 Ch. W. of the Cor. of Tps. 25 and 26 N. R's 19 and 20 E. ^{as described in Exterior Book "B"} Set an iron post. 3 ft. long 3 ins. in diam. 24 ins. in the ground for closing Cor. of Tps. 25 N. R's 19 and 20 E. marked on base Cap T 26 N., R 19 E S 36, T 20 E S 31 in N. half., C.C. T 25 N. in S half., T 20 E S 6 in S.E. and T 19 E S 1 in S.W. quadrant.

Dig pits 30x24x12 ins. crosswise on each line E and W. of post 4 ft. and S. of post 8 ft. dia and raise a mound of earth 5 ft. base. 2 1/2 ft. high. S. of Cor.

Land rolling.
Soil sandy 3rd rate.
No timber

Change the ^{markings of the} Cor. of Tps. 25 and 26 N.; R's 19 and 20 E. to a Cor. of Tps. 26 N. R's 19 and 20 E. only. ^{as described in Exterior Book "B"} May 2nd 1910.

Boundaries of Tp. 25 N. - R. 19 E.

Latitudes Departures and Closing Errors.

Line Designated	True Bearing	Distance	Latitudes		Departures	
			N	S	E	W
South Boundary (6 th Standard Parallel North)	N89°47'W	477.22	1.80			477.22
West boundary	North	481.80	481.80			
North boundary	East	475.65			475.65	
East boundary	South	483.97		483.97		
Convergence					51	
Totals			483.60	483.97	476.16	477.22
				483.60		476.16
		Error in Latitude		0.37		
				Error in Departure		1.06

-- Sidney E. Blout --
U. S. Examiner of Surveys.

U.S. EXAMINER OF SURVEYS
FINAL OATHS OF ~~DEPUTY SURVEYOR~~ AND HIS ASSISTANTS.

LIST OF NAMES.

A list of the names of the individuals employed by Sidney E. Blount
~~United States Deputy Surveyor~~, Examiner of Surveys, to assist in running, measuring, and
 marking the lines and corners described in the foregoing field notes of the survey of the East
boundary of Twp. No. 25 N. R. No. 19 E of the G. & S. R. Base and Meridian,
 showing the respective capacities in which they acted: Arizona.

Fred L. Warner Van L. White Compassman
 _____, Chainman.
J. Y. White _____, Chainman.
Ralph C. Sampson _____, Moundman.
 _____, ~~Moundman~~
Chas. L. Shumway _____, Axman.
 _____, ~~Axman~~
William R. Carson _____, Flagman.

FINAL OATH OF ASSISTANTS.

We hereby certify that we assisted Sidney E. Blount
~~United States Deputy Surveyor~~, Examiner of Surveys, in surveying all
 those parts or portions of the East boundary of Twp. No. 25 N. R. 19 East

_____ of the St. Louis and
Salh River Base and meridian, Territory of Arizona, which are represented
 in the foregoing field notes as having been surveyed by him and under his direction; and that said survey
 has been in all respects, to the best of our knowledge and belief, well and faithfully ~~surveyed~~ ^{executed}, and the
 corner monuments established, according to the instructions furnished by the ~~United States Surveyor~~ ^{Commissioner}
~~General for~~ of the General Land Office Van L. White Compassman
Fred L. Warner _____, Chainman.
J. Y. White _____, Chainman.
Ralph C. Sampson _____, Moundman.
 _____, ~~Moundman~~
Chas. L. Shumway _____, Axman.
 _____, ~~Axman~~
William R. Carson _____, Flagman.

Subscribed and sworn to before me this 28th
 day of July 1910, ~~190~~



Sidney E. Blount
U.S. Examiner of Surveys

49
2002 2006

FINAL OATH OF UNITED STATES ~~DEPUTY~~ ^{EXAMINER OF SURVEYS} DEPUTY SURVEYOR.

Sidney E. Blout, ^{Examiner of Surveys} United States Deputy Surveyor, do solemnly swear that, in pursuance of ~~a contract~~ ^{Special Instructions} received from ~~the Commissioner of the United States Surveyor General for~~ ^{the Commissioner of the General Land Office} bearing date of the ~~2nd day of Oct., 1907~~ ^{and the 15th day of May, 1908}, I have well, faithfully, and truly, in my own proper person, and in strict conformity with the instructions furnished by the ~~United States Surveyor General for~~ ^{Commissioner} of the ~~General Land Office~~, the Manual of Surveying Instructions, and the laws of the United States, surveyed all those parts or portions of ~~The East boundary of Twp. No. 25 N., Range No. 19 E.~~ ^{The East boundary of Twp. No. 25 N., Range No. 19 E.}

of the ~~Gila and Salt River~~ ^{Gila and Salt} Meridian, in the ~~Territory~~ ^{State} of ~~Arizona~~, which are represented in the foregoing field notes as having been surveyed by me, and under my direction; and I do further solemnly swear that all the corners of said survey have been established and perpetuated in strict accordance with the Manual of Surveying Instructions, and the special written instructions of the ~~United States Surveyor General for~~ ^{Commissioner} of the ~~General Land Office~~ and in the specific manner described in the field notes, and that the foregoing are the original field notes of such survey.

Joe United States Deputy Surveyor.
Examiner of Surveys.
Subscribed by said *Sidney E. Blout*, and sworn to before me }
this _____ day of _____, 190



APPROVAL.

OFFICE OF THE UNITED STATES SURVEYOR GENERAL,

Phoenix Arizona APR 25, 1914

The foregoing field notes of the survey of ~~the~~ ^{the} _____
East boundary of Twp. No. 25 N., Range No. 19 E.
of the Gila and Salt River Base and Meridian, Arizona.

executed by *Sidney E. Blout, U.S. Examiner of Surveys*
under ~~his contract No.~~ ^{Special Instructions from the Commissioner of the General Land Office}, dated *October 2, 1907 and May 15, 1908*, 190, having been critically examined, and the necessary corrections and explanations made, the said field notes, and the surveys they describe, are hereby approved.

Frank Ingalls
United States Surveyor General.

I certify that the foregoing transcript of the field notes of the above-described surveys in _____, has been correctly copied from the original notes on file in this office.

United States Surveyor General.