

Subdivisional
BOOK-A

2579

BOOK 2579

FIELD NOTES

OF THE SURVEY OF THE

Subdivision Lines of Township
No 26 North, Range No 18 East

Of the Gila and Salt River Base and Meridian,

in the Territory of Arizona

EXECUTED
AS ~~BY~~ BY

Widney E. Blout

United States

Examiner of Surveys

Special Instructions from Commissioner of the General Land Office
Under ~~his~~ Contract No. , dated Feb 2nd 1907, and May 15th 1908

Survey commenced June 19th, 1908

Survey completed June 30th, 1908

174
1A

NAMES AND DUTIES OF ASSISTANTS.

Harry Lake May	Compassman
Fred L. Warner	Chairman
Van L. White	Chairman
Ralph M. Westlund	Chairman
Harry J. Hassler	Woodman
Felix Manning	Flagman
Sam P. Lonayestewa	Arman
Jay E. Jellick	Arman

Book No. 2579

INDEX DIAGRAM.

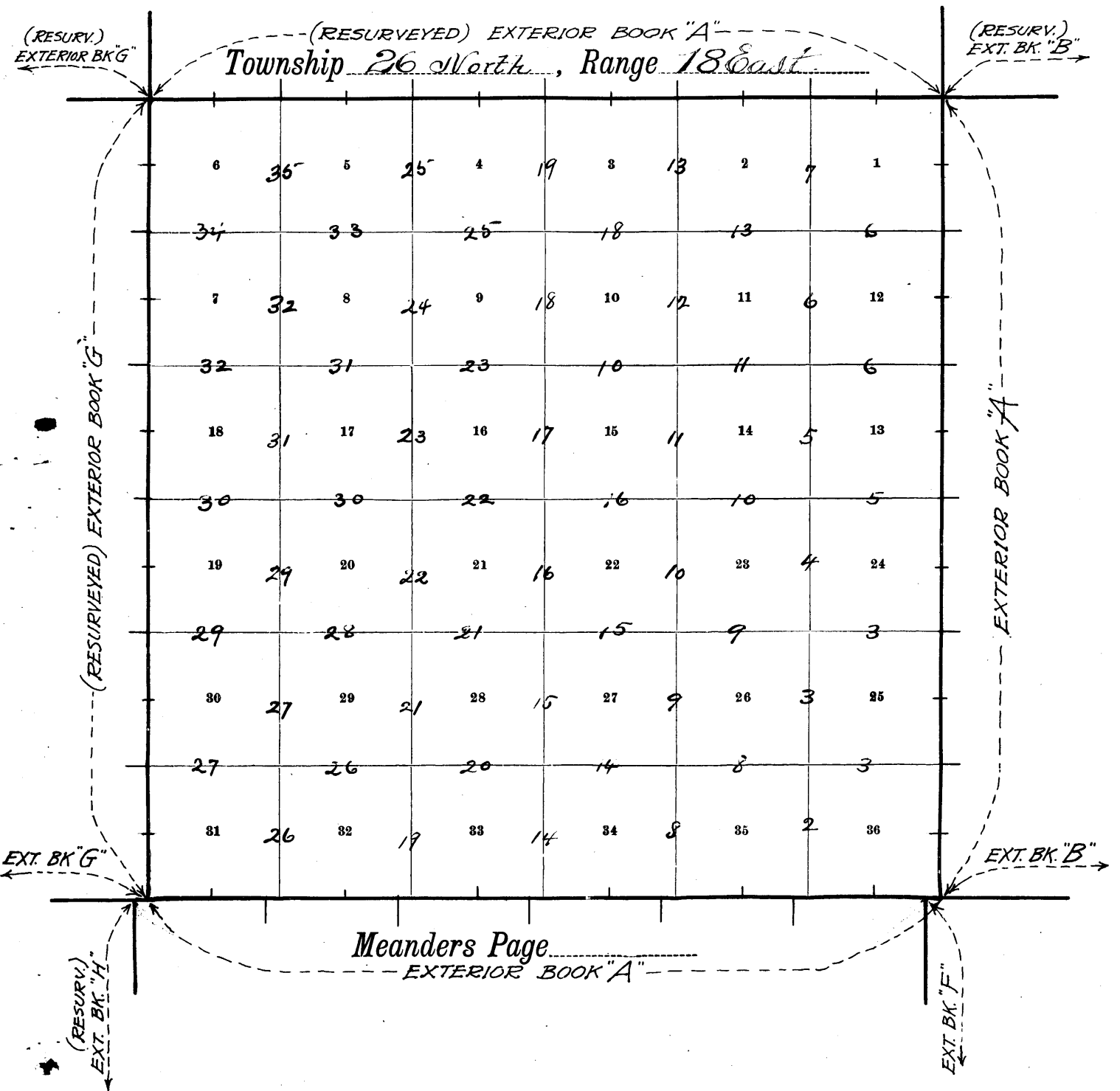

176
10

BOOK 2579

PRELIMINARY OATHS OF ASSISTANTS.
(SAME APPLIES TO SUBDIVISIONAL BOOKS "B" & "G")

WE, Fred R. Warner, Van L. White, Ralph J. Westraud and Walter A. Snodgrass
do solemnly swear that we will well and faithfully execute the duties of chainmen; that we will level the chain upon even and uneven ground, and plumb the tally pins, either by sticking or dropping the same; that we will report the true distances to all notable objects, and the true lengths of all lines that we assist in measuring, to the best of our skill and ability, and in accordance with instructions given us, in the survey of
All or part of the Subdivisional lines of Township No. 26 North Range No. 17, 18 and 19 East, and resurvey of part of the Subdivision lines in Tp. 26 N.-R. 19 E. of the G. & S. R. Base & Meridian, Arizona.

Ralph J. Westraud and W. A. Snodgrass Chainmen.
Van L. White and Fred Warner, Chainmen.

Subscribed and sworn to before me this 9th
day of June, 1908



Sidney E. Blount
U.S. Examiner of Surveys

WE, Henry Jennings and Harry J. Haasler
do solemnly swear that we will well and truly perform the duties of moundmen in the establishment or re-establishment of corners, according to the instructions given us, to the best of our skill and ability, in the survey of
All or part of the Subdivisional lines of Township No. 26 North Ranges No. 17, 18 and 19 East and resurvey of part of the Subdivision lines in Tp. 26 N.-R. 19 E. of the G. & S. R. Base & Meridian, Arizona.

Henry Jennings, Moundman.
Harry J. Haasler, Moundman.

Subscribed and sworn to before me this 9th
day of June, 1908



Sidney E. Blount
U.S. Examiner of Surveys

WE, Charles A. Dutton, Jay E. Jellick and Sam P. Louagestewa
do solemnly swear that we will well and truly perform the duties of axmen in the establishment or re-establishment of corners and other duties, according to instructions given us, to the best of our skill and ability, in the survey of
All or part of the Subdivisional lines of Township No. 26 North Ranges No. 17, 18 and 19 East and resurvey of part of the Subdivision lines in Tp. 26 N.-R. 19 E. of the G. & S. R. Base & Meridian, Arizona.

Charles A. Dutton, Axman.
Sam P. Louagestewa, Axman.
Jay E. Jellick, Axman.

Subscribed and sworn to before me this 9th
day of June, 1908



Sidney E. Blount
U.S. Examiner of Surveys

WE, Chas. L. Shumway, R. E. Claborn and Felix Manning we do solemnly swear that we will well and truly perform the duties of flagmen according to instructions given ^{us} ~~me~~, to the best of ^{our} ~~my~~ skill and ability, in the survey of
All or part of the Subdivisional lines of Township No. 26 and 27 and North of Range No. 17, 18 and 19 E., and resurvey of part of the Subdivision lines in Tp. 26 N.-R. 19 E. of the G. & S. R. Base & Meridian, Arizona.

R. E. Claborn, Flagman.
Chas. L. Shumway Flagman
Felix Manning Flagman

Subscribed and sworn to before me this 9th
day of June, 1908



Sidney E. Blount
U.S. Examiner of Surveys

Chains

Survey Commenced June 19th 1908, and executed with a Young & Sons light mountain transit No. 10, with solar attachment. The horizontal limb is provided with two double verniers placed opposite to each other, reading to single minutes of arc, which is also the least count of the verniers of the latitude and declination arcs.

I examine the adjustments of the transit and correct the level and collimation errors; then to test the solar apparatus, by comparing its indications, resulting from solar observations, made during 10 a.m. and 4 p.m. hours with a meridian determined by observations on Polaris, I proceed as follows.

At the Cor. of Tps. 25 and 26, N. R's 18 and 19 E.; Latitude $35^{\circ} 35' 48''$ N., Longitude $110^{\circ} 22' 12''$ W. I set off $35^{\circ} 36'$ N. on the lat. arc, $23^{\circ} 27\frac{1}{2}'$ N. on the decl. arc, and at 5^h 01^m p.m. l.m.l. determine a meridian with the solar, and mark a point thereof, by a tack driven in a stake set firmly in the ground 5 Chs N. of the Cor.
June 19 1908

June 20th 1908, At 1^h 33.4^m a.m. l.m.l. I observe Polaris at Eastern elongation in accordance with manual of instructions, and mark a point in the line thus determined, by a nail driven in a peg driven in the ground 5 Chs N. of my station.

At 6 a.m. l.m.l. June 20th I lay off the azimuth of Polaris $1^{\circ} 27.3'$ to the west and mark the meridian thus determined, by a tack driven in the stake set last evening, on which the meridian falls 0.5 ins east of the point determined by the solar.

At 7^h 01^m a.m. l.m.l. I set off $35^{\circ} 36'$ N. on the lat. arc, $23^{\circ} 28'$ N. on the decl. arc, and mark a point in the meridian determined with the solar, by a tack driven in the stake already set 5 Chs N. of my station; this point falls 0.3 ins east of the meridian established by the

Claims

BOOK 2579

Polaris observation

The solar apparatus by p.m. and a.m. observations defined positions for meridians, respectively about 0' 26" west and 0' 15" east of the meridian established by the Polaris observation; therefore I conclude that the adjustments of the instruments are satisfactory

I commenced at the cor. of secs. 1, 2, 35 and 36. on the south bdy of the T₁. ^{and described in Exterior Book "A" set by me June 17, 1908,} at this cor. set off 35° 36' or. on the lat. arc. 23° 27' or. on the decl. arc. and at 8^h 01^m a.m. l.m.l. determine a meridian with the solar Transit

N 0° 01' W Bet. secs. 35 and 36.

Descend N.E. slope of Butte over stony mountainous land.

2.00 Foot of descent 75 ft. below cor. leave stony mountainous land head E and S.W. Enter level bottom land covered with sage and greasewood brush 3 ft. high.

33.00 Leave level bottom land head N.E. and S.W., ascend S.E. slope of sand ridge over hilly land head N.E. and S.W.

36.70 Top of sand ridge head N.E. and S.W. descend over N.W. slope

40.00 See a malapai stone 12x10x7 ins. 8 ins. in the ground for $\frac{1}{4}$ sec. cor. mark $\frac{1}{4}$ on W. face. Dig pits 18x18x12 ins. N and S. stone 3 ft. dish and raise a mound of earth 3 $\frac{1}{2}$ ft. base, 1 $\frac{1}{2}$ ft. high. W. of cor.

80.00 See a malapai stone 14x10x6 ins, 10 ins. in the ground, for cor. of secs 25, 26, 35 and 36. mark with 1 notch on E. and S. edges, Dig pits 18x18x12 ins. in each sec, 5 $\frac{1}{2}$ ft. dish, and raise a mound of earth 4 ft. base 3 ft. high W. of cor.

Land Mountainous, hilly and level bottom. Soil stony sandy and adobe. 2nd 3rd and 4th rate. No timber.

Mountainous land 2.00 class.

Obains

- Cash on a random line bet. sec 25 and 36.
- 40.00 Set temp. $\frac{1}{4}$ sec. cor.
- 79.84 Intersect E. bdy of T₁ at the cor. of sec. 25, 30, 31 and 36, recently established by me & described in Exterior Book "A,"
Thence I run
West on a true line bet. sec 25 and 36.
Over low rolling sand hills, through scattering sage and greasewood brush, and bunch grass
- 39.92 Set a malapai stone 14x10x4 ins. 10 ins. in the ground for $\frac{1}{4}$ sec. cor. mk'd $\frac{1}{4}$ on N. face
Dig pits 18x18x12 ins. E. and W. of stone 3 ft. dia., and raise a mound of earth 3 $\frac{1}{2}$ ft. base 1 $\frac{1}{2}$ ft. high N. of cor.
- 79.84 The cor. of sec 25, 26, 35 and 36, hereinbefore described.
Land hilly.
Soil sandy 3rd rate.
No timber.

- N 0° 01' W. bet. sec 25 and 26.
- Over low rolling sand hills through sage and greasewood brush and bunch grass.
- 23.50 Dry Arroyo. 4 Ch. wide Course S.W., Jetteto Wash.
- 40.00 Set a malapai stone 12x10x6 ins. 8 ins. in the ground for $\frac{1}{4}$ sec. cor. mk'd. $\frac{1}{4}$ on W. face.
Dig pits 18x18x12 ins. N. and S. of stone 3 ft. dia. and raise a mound of earth 3 $\frac{1}{2}$ ft. base 1 $\frac{1}{2}$ ft. high W. of cor.
- 80.00 Set a malapai stone 20x9x8 ins. 15 ins. in the ground. For cor. of sec. 23, 24, 25 and 26. mk'd. with 1 notch on E. and 2 notches on S. edges.
Dig pits 18x18x12 ins. in each sec. 5 $\frac{1}{2}$ ft. dia. raise a mound of earth 4 ft. base. 2 ft high. W. of cor.
Land hilly.
Soil sandy 2nd and 3rd rate.
No timber.

- Cash on a random line bet. sec 24 and 25
- 40.00 Set temp. $\frac{1}{4}$ sec. cor.
- 79.86 Intersect E. bdy. of T₁ 2 lbs. S. of the cor. of

rec'd 19, 24, 25 and 30, ^{recently established by me &} described in Exterior Book "A"

Thence Drive

S 89° 59' W on a true line bet. rec'd 24 and 25 -
Descend NW slope over stony hilly land, through
sage and greasewood brush and scattering bunch
grass

35.00 Begin abrupt descent into dry arroyo, Jetteto Wash.

37.00 Foot of descent in bottom of arroyo 25 ft deep
Course SW. ascend right bank.

39.00 Top of right bank. Enter low rolling sand
hills bet. NW E. and 24.

39.73 Set a malapai stone 12 x 8 x 6 ins. 8 ins. in the
ground for $\frac{1}{4}$ sec. Cor. mark'd $\frac{1}{4}$ on NW face.
Dig pits 18 x 18 x 12 ins. E. and W. of stone 3 ft. dia.,
and raise a mound of earth $3\frac{1}{2}$ ft. base, $1\frac{1}{2}$ ft.
high N. of cor.

79.86 Tie cor. of rec'd 23, 24, 25 and 26; hereinbefore
described.
Land hilly
Soil sandy and stony 3rd rate.
No timber.

N 0° 01' W. Bet. rec'd 23 and 24.

Over low rolling sand hills through scattering
sage and greasewood brush and bunch grass

40.00 Set a malapai stone 12 x 10 x 7 ins. 8 ins. in
the ground for $\frac{1}{4}$ sec. cor. mark'd $\frac{1}{4}$ on W face
Dig pits 18 x 18 x 12 ins. N and S. of stone 3 ft. dia.
and raise a mound of earth $3\frac{1}{2}$ ft. base
 $1\frac{1}{2}$ ft. high, N. of cor.

80.00 Set a malapai stone 18 x 14 x 8 ins. 14 ins. in
the ground for. Cor. of rec'd 13, 14, 23 and 24
mark'd with 1 notch NW E. and 3 notches on
S. edges.

Dig pits 18 x 18 x 12 ins. in each. sec. $5\frac{1}{2}$ ft.
dia. and raise a mound of earth 4 ft. base
2 ft. high. W of cor.

Land hilly
Soil sandy 2nd and 3rd rate.
No timber.

NOTE On the above Cor. I set off. 23° 27' N. on the

decl. arc. and at 12^h 01^m p.m. C.M.L. observed
the sun on the meridian. and obtain on
the lat. arc a reading of $35^{\circ} 38\frac{1}{2}' N.$ for
the latitude of this place

40.00 $N 89^{\circ} 59' E$ on a random line bet. sec. 13 and 24
Beh temp. $\frac{1}{4}$ sec. cor.
79.86 Intersect E. bdy. of Twp. 26 N. S. of the cor. of sec.
13, 18, 19 and 24, recently estab. by me & described in Exterior Book "A"
Thence & run

39.93 $S 89^{\circ} 58' W$ on a true line bet. sec. 13 and 24
Over rolling sandy land through scattering
sage brush and bunch grass.
Beh a malapai stone $14 \times 11 \times 6$ ins. 10 ins. in
the ground for $\frac{1}{4}$ sec. cor. mark $\frac{1}{4}$ on N. face
Dig pits $18 \times 18 \times 12$ ins. E and W. of stone 3 ft.,
diam. and raise a mound of earth $3\frac{1}{2}$ ft. base
 $1\frac{1}{2}$ ft. high N. of cor.

79.86 The cor. of sec. 13, 14, 23 and 24, ^{hereinbefore} described.
Land rolling.
Soil sandy 3rd rate.
No timber.

40.00 $N 0^{\circ} 01' W$ Bet. sec. 13 and 14
Over rolling sandy land through scattering
sage brush and bunch grass!
Beh a malapai stone $13 \times 8 \times 5$ ins. 9 ins. in
the ground for $\frac{1}{4}$ sec. cor. mark $\frac{1}{4}$ on W. face
Dig pits $18 \times 18 \times 12$ ins. N and S. of stone 3 ft. diam.
and raise a mound of earth $3\frac{1}{2}$ ft. base $1\frac{1}{2}$
ft. high W. of cor.

80.00 Beh a malapai stone $14 \times 9 \times 8$ ins. 10 ins. in
the ground for cor. of sec. 11, 12, 13 and 14
mark with 1 notch on E. and 4 notches on S.
edges.
Dig pits $18 \times 18 \times 12$ ins. in each sec. $5\frac{1}{2}$ ft.
diam. and raise a mound of earth 4 ft.
base, 2 ft. high W. of cor.
Land rolling.
Soil sandy 2nd and 3rd rate.
No timber.

BOOK 2579

- N 89° 58' E. on a random line bet. sec. 12 and 13
 40.00 Sec. temp. $\frac{1}{4}$ sec. cor.
- 79.96 Intersect E. bely. of T4. 5 lbs. N. of the Cor. of
 sec. 7, 12, 13 and 18; ^{recently established by me} & described in Exterior Book "A";
 Three Drums
 West on a true line bet. sec. 12 and 13
 Over low rolling sand hills, through scattering
 sage brush and bunch grass.
- 39.98 Set a malapai stone 12 x 10 x 6 ins. 8 ins. in
 the ground for $\frac{1}{4}$ sec. cor. mk'd. $\frac{1}{4}$ on N. face.
 Dig pits 18 x 18 x 12 ins. East W. of stone 3 ft. dist.
 and raise a mound of earth 3 $\frac{1}{2}$ ft. base, 1 $\frac{1}{2}$ ft.
 high N. of cor.
- 79.96 The Cor. of. sec. 11, 12, 13 and 14, ^{hereinbefore} described.
 Sand hilly.
 Soil sandy 3rd rate.
 No timber.

- N 0° 01' W. bet. sec. 11 and 12
 Over low rolling sand hills through scattering
 sage brush and bunch grass
- 40.00 Set a malapai stone 12 x 10 x 7 ins. 8 ins. in the
 ground, for $\frac{1}{4}$ sec. cor. mk'd. $\frac{1}{4}$ on W. face
 Dig pits 18 x 18 x 12 ins. N. and S of stone 3 ft.
 dist. and raise a mound of earth 3 $\frac{1}{2}$ ft. base
 1 $\frac{1}{2}$ ft. high W. of cor.
- 80.00 Set a malapai stone 14 x 9 x 6 ins. 10 ins. in
 the ground for Cor. of sec. 1, 2, 11 and 12
 mk'd. with 1 notch on E. and 5 notched on
 S edges.
 Dig pits 18 x 18 x 12 ins. in each sec. 5 $\frac{1}{2}$ ft.
 dist. and raise a mound of earth 4 ft.
 base, 2 ft. high W. of cor.
 Sand hilly.
 Soil sandy 3rd rate.
 No timber.

June 20th 1908.

June 26th 1908. I set off 35° 40' N. on the lat. and
 23° 22' $\frac{1}{2}$ W. on the decl. arc. and at 10^h 02^m $\frac{1}{2}$
 a.m. l. mt. determined a meridian with the
 solar at the cor. of. sec. 1, 2, 11 and 12, ^{described} above.

- Thence I run
East on a random line bet. secs. 1 and 12
40.00 Set temp. $\frac{1}{4}$ sec. cor.
79.90 Intersect E. bdry. of Twp. 14 lks. S. of the cor.
of secs. 1-6-7 and 12, recently estab. by me & described in
Exterior Book "A"
Thence I run
S. $89^{\circ} 54' W.$ on a true line bet. secs. 1 and 12
Over low rolling sand hills, through
scattering sage brush and bunch-grass
39.95 Set a malapai stone 12x10x7 ins 8 ins in
the ground for $\frac{1}{4}$ sec. cor. mk'd. $\frac{1}{4}$ on N. face.
Dig pits 18x18x12 ins. E and W. of stone 3 ft.
dial. and raise a mound of earth $3\frac{1}{2}$ ft
base, $1\frac{1}{2}$ ft high N. of cor.
79.90 The cor. of secs. 1-2-11 and 12, ^{hereinbefore} described
Land hilly.
Soil sandy 3rd rate
No timber
- at the $\frac{1}{4}$ sec. cor. bet. secs. 1
and 12 I set off $23^{\circ} 22' N.$ on the decl. arc and
at 12^h 02^m p. m. l. m. t. observe the sun on
the meridian, the resulting latitude
being $35^{\circ} 40' N.$ nearly.
- N. $0^{\circ} 01' W.$ on a random line bet. secs. 1 and 2
40.00 Set temp. $\frac{1}{4}$ sec. cor.
80.38 Intersect N. bdry. of the Twp. 20 lks. ^{S. $89^{\circ} 51' E.$} of the
cor. of secs. 1-2-35 and 36, ^{recently re-established by me} & described in EXTERIOR BOOK "A"
Thence I run
S. $0^{\circ} 10' E.$ on a true line bet. secs. 1 and 2
Over low rolling sand hills, through
scattering sage brush and bunch grass.
4.30 Top of sand ridge bears N.E. and S.W. desc.
gradually over S.E. slope.
13.38 Road from Kearns Canyon Ariz. to
Winslow Ariz. bears N.E. and S.W.
40.38 Set a Malapai stone 14x10x5 ins. 10 ins.
in the ground for $\frac{1}{4}$ sec. cor. mk'd. $\frac{1}{4}$ on N.
face.
Dig pits 18x18x12 ins. N. and S. of stone 3 ft. dial.
and raise a mound of earth $3\frac{1}{2}$ ft. base

BOOK 2579

80.38 1½ ft. high N. of cov.
The cov. of secs. 1-2-11 and 12, ^{hereinbefore} described.
Land hilly.
Soil sandy 3rd rate.
No timber.

June 26-1908

June 22nd 1908 at 7^h 01^m a.m. l.m.t. I set off. 35° 36' N. on the lat. arc. 23° 28' N. on the decl. arc. and determine a meridian with the solar at the cov. of secs. 2-3-34 and 35 on the south bdy. of the Twp., ^{recently established by me &} described in Exterior Book "A"
Thence I run
N. 0° 01' N. bet. secs. 34 and 35
Over level sandy land through sage and greasewood brush 2½ ft. high.
70.00 Set a malapai stone 12 x 10 x 4 ins. 8 ins. in the ground for ¼ sec. cov. m'kd. 4 on N. face.
Dig pits 18 x 18 x 12 ins N. and S. of stone 3 ft. dist. and raise a mound of earth 3½ ft. base 1½ ft. high N. of cov.
67.00 Learn level land bears N.E. and S.W. ascend gently over low sand hills bears N.E. and S.W.
80.00 Set a malapai stone 13 x 8 x 7 ins. 9 ins. in the ground for cov. of secs. 26-27-34 and 35, m'kd. with 2 notches on E. and 1 notch on S. edge.
Dig pits 18 x 18 x 12 ins. in each sec. 5½ ft. dist. and raise a mound of earth 4 ft base 2 ft high N. of cov.
Land hilly and level.
Soil sandy 2nd and 3rd rate.
No timber.

70.00 Cast on a random line bet. secs. 26 and 35
Set temp ¼ sec. cov.
79.86 Intersect N and S. line 10 lks. S. of the cov. of secs. 25-26-35 and 36, hereinbefore described.
Thence I run
S. 89° 56' N. on a true line bet. secs. 26 and 35.
Over low rolling sand hills through scattering sage brush and bunch grass.
39.93 Set a malapai stone 14 x 7 x 6 ins. 10 ins. in

the ground. for $\frac{1}{4}$ sec. cov. mk'd $\frac{1}{4}$ on N. face.
Dig pits 18x18x12 ins E and W of stone 3 ft. dist.
and raise a mound of earth $3\frac{1}{2}$ ft. base. $1\frac{1}{2}$ ft
high N. of cov.

52.85

Road from Winslow Ariz. to Polacca Ariz.
bears N. and S.

79.86

The cov. of secs. 26-27-34 and 35, ^{hereinbefore} described.
Land hilly.
Soil sandy 2nd and 3rd rate.
No timber.

N. $0^{\circ}01'$ W. bet. secs. 26 and 27

Ascend gently over S.E. slope through
scattering sage brush and bunch grass.
Set a malapai stone 12x7x6 ins. 8 ins. in
the ground for $\frac{1}{4}$ sec. cov. mk'd $\frac{1}{4}$ on N. face
dig pits 18x15x12 ins. N and S. of stone 3 ft.
dist. and raise a mound of earth $3\frac{1}{2}$ ft base
 $1\frac{1}{2}$ ft high N. of cov.

70.00

56.00

Top of sand ridge bears N.E. and S.W. desc.
gradually over N.W. slope.

80.00

Set a malapai stone 12x8x6 ins. 8 ins in the
ground for cov of secs 22-23-26 and 27 mk'd,
with 2 notches on E and S edges.

dig pits 18x18x12 ins. in each sec. $5\frac{1}{2}$ ft.
dist and raise a mound of earth 4 ft. base
2 ft. high N. of cov.

Land hilly.

Soil sandy 3rd rate.

No timber.

N. $89^{\circ}56'$ E. on a random line bet. secs. 23 and 26

40.00

Set temp $\frac{1}{4}$ sec. cov.

79.86

Intersect N. and S. line 14 lbs. N. of the cov of
secs. 23-24-25 and 26, hereinbefore described

Thence Run

N. $89^{\circ}58'$ W. on a true line bet. secs. 23 and 26
over rolling hilly sandy land, through
scattering sage and greasewood brush and bunch grass.

39.93

Set a malapai stone 14x8x5 ins. 10 ins. in the
ground for $\frac{1}{4}$ sec. cov. mk'd $\frac{1}{4}$ on N. face.

BOOK 2579

- 42.37 Dig pits 18x18x12 ins. E and W. of stony 3 ft dist and raise a mound of earth 3½ ft. base 1½ ft high N. of cov.
- 79.86 Road from Winslow Ariz. to Polacca Ariz bears N and S.
- 79.86 The cov. of secs. 22-23-26 and 27, hereinbefore described.
Land hilly,
Soil sandy 3rd rate,
No timber.

- 40.00 N. 0° 01' W. Bet. secs. 22 and 23.
Ascend gradually S.E. slope over low rolling sand hills through scattering bunch grass.
Set a malapai stone 15x6x6 ins. 10 ins. in the ground for ¼ sec. cov. m'kd. 4 on W. face.
Dig pits 18x18x12 ins. N and S. of stony 3 ft. dist. and raise a mound of earth 3½ ft base 1½ ft. high N. of cov.

NOTE. Cut this cov. 1 set off. 23° 27' N. on the decl. arc. and at 12^h 01^m p.m. l.m.t. observe the sun on the meridian and obtain on the lat. arc. a reading of 35° 38' N. for the latitude of this place.

- 80.00 Set a malapai stone 14x8x4 ins. 10 ins. in the ground for cov. of secs 14-15-22 and 23 m'kd. with 2 notches on E. and 3 notches on S. edge.
Dig pits 18x18x12 ins. in each sec. 5½ ft. dist. and raise a mound of earth 4 ft. base 2 ft. high W. of cov.
Land hilly.
Soil sandy 3rd rate.
No timber.

- 40.00 S. 89° 58' E. on a random line bet. secs. 14 and 23
Set temp ¼ sec. cov.
- 79.94 Intersect N and S line 3 lks. N. of the cov of secs. 13-14-23 and 24, hereinbefore described,
Thence Drum
N. 89° 57' W. on a true line bet secs 14 and 23

Chains

- Over rolling sandy land slopes to S.E. through scattering sage brush and bunch grass.
- 39.97 Set a malapai stone 12x8x8 ins, 8 ins. in the ground for $\frac{1}{4}$ sec. cor. mk'd, $\frac{1}{4}$ on N. face. Dig pits 18x18x12 ins: E and W of stone 3 ft. dist, and raised mound of earth 3 $\frac{1}{2}$ ft. base 1 $\frac{1}{2}$ ft. high N. of cor.
- 42.14 Road from Winslow Ariz to Pinedale Ariz from N. and S.
- 79.94 The Cor. of sec. 14, 15, 22 and 23, ^{hereinbefore} described. Land rolling. Soil sandy 3rd rate. No timber.

- N 0° 01' W. Bet. sec. 14 and 15. Around S.E. slope over low rolling sand hills, through scattering sage brush and bunch grass.
- 40.00 Set a malapai stone 14x7x6 ins. 10 ins. in the ground for $\frac{1}{4}$ sec. cor., mk'd, $\frac{1}{4}$ on W. face. Dig pits 18x18x12 ins. N and S. of stone 3 ft. dist, and raised mound of earth 3 $\frac{1}{2}$ ft. base, 1 $\frac{1}{2}$ ft. high N. of cor.
- 80.00 Set a malapai stone 13x7x6 ins. 9 ins. in the ground for Cor. of sec. 10, 11, 14 and 15 - mk'd. with 2 notches on E. and 4 notches on S. edges. Dig pits 18x18x12 ins. in each. sec. 5 $\frac{1}{2}$ ft. dist and raise a mound of earth 4 ft. base, 2 ft. high W of cor. Land hilly. Soil sandy 3rd rate. No timber.

- S 89° 57' E. on a random line bet. sec. 11 and 14
- 40.00 Set temp. $\frac{1}{4}$ sec. cor.
- 79.94 Intersect N and S. line at the cor. of sec. 11, 12, 13 and 14, hereinbefore described. Thence S run.
- N 89° 57' W. on a true line bet. sec. 11 and 14.

BOOK 2579

- Ascend E. slope over low rolling sand hills, through scattering sage brush and bunch grass.
- 27.20 Road from Winslow-Arizona to Placea Ariz
Leas N and S.
- 39.97 Set a malapai stone 13 x 10 x 7 ins., 9 ins. in
the ground for $\frac{1}{4}$ sec. cor. mid. $\frac{1}{4}$ on N. face
Dig pits 18 x 18 x 12 ins. E. and W. of stone 3 ft.
dist. and raise a mound of earth $3\frac{1}{2}$ ft. low
 $1\frac{1}{2}$ ft. high N. of cor.
- 68.00 Top of sand ridge from N.E. and S.W. thence
over rolling sandy land along top of ridge.
- 79.94 The cor. of sees 10, 11, 14 and 15, ^{hereinbefore} described.
Land hilly and rolling.
Soil sandy 3rd rate.
No timber.

June 22nd 1908

- June 26th 1908 At 7th 31^m a.m. level - Set a
39' N. on the lat. arc. 23° 23' N. on the
decl. arc. and determined a meridian with the
solar at the cor. of sees 10, 11, 14 and 15, ^{hereinbefore} described
Thence I run
N 0° 01' W. Bet. sees 15 and 17
Over low rolling sand hills, through sage and
greasewood brush and bunch grass.
- 40.00 Set a malapai stone 14 x 7 x 5 ins., 9 ins. in
the ground for $\frac{1}{4}$ sec. cor. mid. $\frac{1}{4}$ on W. face.
Dig pits 18 x 18 x 12 ins. N and S. of stone 3 ft. dist.
and raise a mound of earth $3\frac{1}{2}$ ft. low, $1\frac{1}{2}$
ft. high W. of cor.
- 80.00 Set a malapai stone 12 x 10 x 7 ins., 8 ins. in
the ground for cor. of sees 2, 3, 10 and 11,
mid. with 2 notches on E. and 5 notches
on S. edges.
Dig pits 18 x 18 x 12 ins. in each see, $5\frac{1}{2}$ ft.
dist. and raise a mound of earth 4 ft. low
2 ft. high W. of cor.
Land hilly.
Soil sandy 3rd rate.
No timber.

Claims

40.00 S 89° 57' E on a random line bet. sec. 2 and 11
 Sec. temp. 1/4 sec. cor.
 79.84 Intersect N. and S. line 24 lbs. S. of the cor. of sec.
 1, 2, 11 and 12, hereinbefore described,
 Thence Drum
 S 89° 53' W on a true line bet. sec. 2 and 11
 ascend gradually E. slope over low sand hills
 through scattered sage brush and bunch grass.
 21.50 Road from Winslow Arizona to Polacca Ariz
 bet. N and S.
 39.92 Set a malapai stone 13 x 7 x 5 ins, 9 ins. in the
 ground for 1/4 sec. cor., mk'd. 1/4 on N. face.
 Dig pits 18 x 18 x 12 ins. East W. of stone 3 ft. dist,
 and raise a mound of earth 3 1/2 ft. base, 1 1/2 ft
 high N. of cor.
 79.84 The Cor. of sec. 2, 3, 10 and 11, hereinbefore
 described.
 Land hilly.
 Soil sandy 3rd rate.
 No timber.

40.00 N 0° 01' W on a random line bet. sec. 2 and 3.
 Sec. temp. 1/4 sec. cor.
 80.51 Intersect N. lky. of Twp. 35 lbs. S 89° 51' E of the Cor. of
 sec. 2, 3, 34 and 35, recently re-established by me ⁶² described in Exterior Book "A",
 Thence Drum
 S 0° 16' E. on a true line bet. sec. 2 and 3.
 Over low sand hills through sage and greasewood
 brush and bunch grass, general slope NW.
 36.00 Top of sand ridge bet. N.E. and S.W. desc.
 S.E. slope.
 40.51 Set a malapai stone 14 x 6 x 5 ins, 10 ins. in
 the ground for 1/4 sec. cor. mk'd. 1/4 on W. face,
 Dig pits 18 x 18 x 12 ins. N and S. of stone 3 ft. dist.
 and raise a mound of earth 3 1/2 ft. base, 1 1/2
 ft. high W. of cor.
 80.51 The Cor. of sec. 2, 3, 10 and 11, hereinbefore described.
 Land hilly.
 Soil sandy 3rd rate.
 No timber.

June 26th 1908

BOOK 2579

- June 23rd 1908. At 7^h 02^m a.m. L. M. & I set off.
 35° 36' N. on the lat. arc 23° 27½' N. on the decl.
 arc. and determined a meridian with the solar
 at the Cor. of sec. 3, 4, 33 and 34 on the S. side
 of the Twp; recently established by me & described in Exterior Book "A"
 Thence I run
 N 0° 02' W. bet. sec. 33 and 34
 Over level sandy land through sage and greasewood
 brush 3 ft. high.
- 40.00 Set a malapai stone 14 x 8 x 6 ins. 10 ins. in the
 ground for ¼ sec. cor. mid. ¼ on W. face.
 Dig pits 18 x 18 x 12 ins. N. and S. of stone 3 ft. dist. and
 raise a mound of earth 3½ ft. base 1½ ft. high
 W. of Cor.
- 43.35 Over level land head N.E. and S.W. ascend
 gently S.E. slope over low rolling sand hills,
 head N.E. and S.W.
- 80.00 Set a malapai stone 12 x 8 x 8 ins. 8 ins. in the
 ground for Cor. of sec. 27, 28, 33 and 34, mid.
 with 3 notches on E. and 1 notch on S. edge.
 Dig pits 18 x 18 x 12 ins. in each sec. 5½ ft. dist.
 and raise a mound of earth 4 ft. base 2 ft.
 high W. of Cor.
 Sand hilly and level.
 Soil sandy 3rd rate.
 No timber.
- 40.00 Cross on a random line bet. sec. 27 and 34
 Set temp. ¼ sec. Cor.
- 80.12 Intersect N. and S. line on the Cor. of sec. 26
 27, 34 and 35, hereinbefore described,
 Thence I run
 West, on a true line bet. sec. 27 and 34
 Ascend S.E. slope over low rolling sand hills,
 through scattering sage brush and bunch grass.
- 40.06 Set a malapai stone 12 x 8 x 4 ins. 8 ins. in
 the ground for ¼ sec. cor. mid. ¼ on N. face
 Dig pits 18 x 18 x 12 ins. E. and W. of stone 3 ft. dist.
 and raise a mound of earth 3½ ft. base,
 1½ ft. high N. of cor.
- 80.12 The Cor. of sec. 27, 28, 33 and 34, ^{hereinbefore} described.

Bellevue

Land hilly.
Soil sandy 2nd and 3rd rate.
No timber.

No^o 02 W. Sec. 27 and 28.
Crewd gently over SE. Slope low sand hills,
through sage and greasewood brush and bunch grass.

40.00 Set a malapai stone 14x8x6 ins. 10 ins. in
the ground for 1/4 sec. cor. mid. 1/4 on W. face
Dig pits 18x18x12 ins N. and S. of stone 3 ft. dia.
and raise a mound of earth 3 1/2 ft. base, 1 1/2
ft. high W. of cor.

80.00 Set a malapai stone 12x8x8 ins. 8 ins. in
the ground for cor. of sec. 21, 22, 27 and 28.
mid. with 3 notches on E. and 2 notches
on S. edges.
Dig pits 18x18x12 ins. in each sec. 5 1/2 ft. dia.
and raise a mound of earth 4 ft. base, 2 ft.
high W. of cor.

Land hilly.
Soil sandy 3rd rate.
No timber.

Each on a standard line bet. sec. 22 and 27.
40.00 Set a 1/4 sec. cor.
80.10 Intersect N. and S. line 14 lvs. S. of the cor.
of sec. 22, 23, 26 and 27, hereinbefore described,
Thence Drum

S 89° 54' W. on a true line bet. sec. 22 and 27.
Over low rolling sand hills, through sage and
greasewood brush and bunch grass.

40.05 Set a malapai stone 13x9x5 ins. 9 ins. in
the ground for 1/4 sec. cor. mid. 1/4 on N. face
Dig pits 18x18x12 ins. E. and W. of stone 3 ft.
dia. and raise a mound of earth 3 1/2 ft.
base, 1 1/2 ft. high N. of cor.

80.10 The cor. of sec. 21, 22, 27 and 28; hereinbefore
described.
Land hilly.
Soil sandy 3rd rate.
No timber.

Claims

BOOK 2579

N⁰ 02' W. bet. recs. 21 and 22.
 Around S.E. slope over low rolling sand hills
 through scattering sage and greasewood brush
 and bunch grass.

40.00 Set a malapai stone 14 x 9 x 6 ins. 10 ins. in
 the ground for $\frac{1}{4}$ sec. cor. mid. $\frac{1}{4}$ on W. face
 Dig pits 18 x 18 x 12 ins. N. and S. of stone 3 ft. dia.
 and raise a mound of earth 3 $\frac{1}{2}$ ft. base 1 $\frac{1}{2}$
 ft. high W. of cor.

NOTE At this Cor. Det. of. 25° 26 $\frac{1}{2}$ ' N. on the decl. arc
 and at 12^h 02^m p.m. l.m.t. observed the sun
 on the meridian the resulting latitude
 being 35° 38' + N. which is about the proper
 latitude of this place.

80.00 Set a malapai stone 14 x 7 x 5 ins. 10 ins. in
 the ground for Cor. of recs. 15, 16, 21, and 22,
 marked T 26 N. on N.E. face, R 18 E on S.E. face
 with 3 notches on E. and S. edges.
 Dig pits 18 x 18 x 12 ins. in each. rec 5 $\frac{1}{2}$ ft. dia.
 and raise a mound of earth 4 ft. base
 2 ft. high W. of cor.
 Land hilly.
 Soil sandy 3rd rate.
 No timber.

N 89° 54' E. on a random line bet. recs. 15 and 22
 40.00 Set temp. $\frac{1}{4}$ sec. cor.

80.16 Intersect N. and S. line 21 lks. N. of the Cor.
 of recs. 14, 15, 22 and 23, hereinbefore described,
 Thence S run

N 89° 57' W. on a true line bet. recs. 15 and 22
 Over low rolling sand hills through scattering
 sage and greasewood brush and bunch grass

40.08 Set a malapai stone 12 x 9 x 5 ins. 8 ins. in
 the ground. for $\frac{1}{4}$ sec. Cor. mid. $\frac{1}{4}$ on N. face
 Dig pits 18 x 18 x 12 ins. E. and W. of stone
 3 ft. dia. and raise a mound of earth 3 $\frac{1}{2}$
 ft. base, 1 $\frac{1}{2}$ ft. high N. of Cor.

80.16 The Cor. of recs. 15, 16, 21 and 22, ^{hereinbefore} described.
 Land hilly.
 Soil sandy 3rd rate.

Chains

17

No timber.

N^o 02 W beh. recd 15 and 16.

Over low sand hills through scattering bunch grass

32.00 Top of sand ridge bear N.E. and S.W. desc.

40.00 Set a malapai stone 13x8x6 ins, 9 ins. in the ground for 1/4 sec. cor. mk'd. 1/4 on W. face

Dig pits 18x18x12 ins. N. and S. of stone 3 ft. dia., and raise a mound of earth 3 1/2 ft. base, 1 1/2 ft. high W of cor.

80.00 Set a malapai stone 14x7x4 ins, 10 ins. in the ground for Cor. of recd. 9, 10, 15 and 16. mk'd.

with 3 notches on E, and 4 notches on S. edges

Dig pits 18x18x12 ins. in each sec. 5 1/2 ft.

dia., and raise a mound of earth 4 ft. base, 2 ft. high W of cor.

Land hilly.

Soil sandy 3rd rate.

No timber.

S 89° 57' E. over a random line beh. recd. 10 and 15.

40.00 Set temp. 1/4 sec. cor.

80.14 Intersect N. and S. line 5 lbs. S. of the Cor. of recd. 10, 11, 14 and 15, hereinbefore described,

Thence run

N 89° 59' W on a true line beh. recd. 10 and 15

Over low rolling sand hills through sage brush and bunch grass.

40.07 Set a malapai stone 12x9x5 ins. 8 ins. in the ground for 1/4 sec. cor. mk'd. 1/4 on N. face

Dig pits 18x18x12 ins. E. and W. of stone 3 ft. dia., and raise a mound of earth 3 1/2 ft. base, 1 1/2 ft. high N. of cor.

80.14 The Cor. of recd. 9, 10, 15 and 16, hereinbefore described.

Land hilly

Soil sandy, 3rd rate.

No timber.

June 23rd 1908

BOOK 2579

June 27th 1908 At 8^h 03^m a.m. l.m.l. I set off 35° 39' N. on the base line 23° 21' N. on the decl. arc. and determine a meridian with the solar at the cor of sec 9, 10, 15 and 16, hereinbefore described,

Thence I run

N 0° 02' W. bet. sec 9 and 10

Around S. slope over low rolling sand hills through sage and greasewood brush and bunch grass

40.00 Set an iron post 3 ft. long 1 in. in diam. 26 ins. in the ground for $\frac{1}{4}$ sec. cor marked on brass cap. $\frac{1}{4}$ S 9 on W half and S 10 on E. half.

Dig pits 18 x 18 x 12 ins N and S. of post 3 ft. dist. and raise a mound of earth 3 $\frac{1}{2}$ ft. base, 1 $\frac{1}{2}$ ft. high W. of cor

80.00 Set an iron post 3 ft. long 2 ins. in diam 24 ins. in the ground for cor of sec. 3, 4, 9 and 10 marked on brass cap T 26 N. S 4 in N.W. T 19 E. S 3 in N.E. S 10 in S.E. and S 9 in S.W. quadrant.

Dig pits 18 x 18 x 12 ins in each sec. 5 $\frac{1}{2}$ ft. dist. and raise a mound of earth 4 ft. base, 2 ft. high W. of cor.

Land hilly.

Soil sandy 3rd rate.

No timber.

40.00 S 89° 59' E on a random line bet. sec 3 and 10 Set trip. $\frac{1}{4}$ sec. cor.

80.16 Intersect N and S. line 5 lks. N. of the cor. of sec. 2, 3, 10 and 11, hereinbefore described,

Thence I run

N 89° 57' W on a true line bet. sec 3 and 10

Around S.E. slope over hilly sandy land covered with sage and greasewood brush and bunch grass

18.00 Top of sand ridge bears N.E. and S.W. decl.

40.00 Set a malopai stone 12 x 10 x 7 ins., 8 ins. in the ground for $\frac{1}{4}$ sec. cor. mkd. $\frac{1}{4}$ on N. face.

Dig pits 18 x 18 x 12 ins E and W of stone 3 ft. dist. and raise a mound of earth 3 $\frac{1}{2}$ ft. base, 1 $\frac{1}{2}$ ft. high N. of cor.

Chains

19

80.16 The cor. of secs. 3, 4, 9 and 10, hereinbefore described.
Land hilly.
Soil sandy 3rd rate
No timber

40.00 No^o 02' W on a random line bet. sec 3 and 4
Set temp. $\frac{1}{4}$ sec. cor.
80.46 Intersect N. bdy. of T₄-21 l^{ts}. $58^{\circ}51'E$ of the cor. of secs.
3, 4, 33 and 34, recently re-established by me & described in Exterior Book "A"
Thence I run
S $0^{\circ}11'E$ over true line bet. sec 3 and 4
Ascend S. slope over low rolling land hills through
sage brush and bunch grass.

40.46 Set an iron post 3 ft long 1 in. in diam 26 ins.
in the ground for $\frac{1}{4}$ sec. cor. marked out brass
cap. $\frac{1}{4}$ on W. half and 3 on E half.

Dig pits 18x18x12 ins. N and S. of post. 2 ft. dist.
and raise a mound of earth 3 $\frac{1}{2}$ ft. base. 1 $\frac{1}{2}$ ft.
high W. of cor.

80.46 The cor. of secs 3, 4, 9 and 10, hereinbefore described.
Land hilly.
Soil sandy. 3rd rate.
No timber

NOTE At this cor. I set off $23^{\circ}20'N$ on the latitude arc
and at 12^h 03^m p.m. l. met. observed the sun on
the meridian the resulting latitude being
 $35^{\circ}41'N$. nearly
June 27th 1908

June 24th 1908: At 7^h 32^m a.m. l. met. I set
off $35^{\circ}36'N$ on the lat. arc, $23^{\circ}26'N$ on the
decl. arc and determine a meridian with the
solar at the cor. of secs 4, 5, 32 and 33 on the
S. bdy. of the T₄; recently established by me &
described in Exterior Book "A"
Thence I run
No^o 03' W bet. sec 32 and 33.
Ascend steep S. slopes of Malapai Butte over
steep mountainous land through scattering
sage brush and bunch grass.
2.00 I have run 50 l^{ts} with 10 ft. deep course 3 in.

BOOK 2579

- 13.25 Top of Spur 100 ft. above Cor. bear N.W. and S.E. desc.
- 18.65 Dry ravine Course E. asc.
- 19.70 Top of Spur bear N.W. and S.E. desc. steeply.
- 21.00 Bottom of Dry ravine Course S.E. ascend abruptly over malapai cliffs and ledges.
- 30.80 Top of Butte 400 ft. above Cor. descend N.E. slope over stony land.
- 40.00 Set a malapai stone 14x10x8 ins. 10 ins. in the ground for $\frac{1}{4}$ sec. cor. mark $\frac{1}{4}$ on W. face. Raise a mound of stone 2 ft. base, $1\frac{1}{2}$ ft. high W. of cor. Pits impracticable.
- 42.25 Dry ravine Course, N.E. ascend steeply.
- 60.00 Top of Spur bear N.E. and S.W. desc.
- 66.00 Dry ravine 40 lks. Wide at foot of steep descent Course N.E. Leave mountainous land bear N.E. and S.W. Enter hilly land bear N.W. and S.E. Slopes to the N.E.
- 80.00 Set a malapai stone 13x9x4 ins. 9 ins. in the ground for Cor. of secs. 28, 29, 32 and 33. marked with 4 notches on East and 1 notch on 3 edges. Raise a mound of stone 2 ft. base $1\frac{1}{2}$ ft. high W. of cor. Pits impracticable. Land hilly and mountainous. Soil sandy and stony 3rd and 4th rate. No timber. Mountainous land 66.00 Chs.

- East on a random line bet. secs. 28 and 33
- 40.00 Set temp. $\frac{1}{4}$ sec. cor.
- 79.98 Intersect N and S. line 16 lks. S. of the Cor. of Secs. 27, 28, 33 and 34, hereinbefore described, Thence Drive S89°53' W. on a true line bet. secs. 28 and 33. Over low rolling sand hills on S.E. slope through sage brush and greasewood brush and bunch grass.
- 39.99 Set a malapai stone 12x11x4 ins. 8 ins. in the ground for $\frac{1}{4}$ sec. cor. mark $\frac{1}{4}$ on N. face Dig pits 18x18x12 ins. East W. of stone 3 ft. dia. and raise a mound of earth $3\frac{1}{2}$ ft. base,

Chains

79.98 $1\frac{1}{2}$ ft. high W. of Cor.
The Cor. of sec. 28, 29, 32 and 33, ^{hereinbefore} described.
Layd hills.
Soil sandy 3rd rate.
No timber.

No^o 03' W. bet. sec 28 and 29.
Over low rolling sand hills sloping to N.E.
through sage and greasewood brush and
bunch grass.
40.00 Set a malapai stone 14x10x6 ins. 10 ins. in
the ground for $\frac{1}{4}$ sec. cor. mark'd. $\frac{1}{4}$ on W. face!
Dig pits 18x18x12 ins. N. and S. of stone 3 ft.
dit. and raise a mound of earth $3\frac{1}{2}$ ft. base
 $1\frac{1}{2}$ ft. high W. of Cor.

This Cor is situated at foot of descent in a
depression which bears N.E. and S.W.
45.00 North side of depression bears N.E. and S.W.
Ascend over low hills.

71.00 Tops of sand ridges bears N.E. and S.W. dir.

80.00 Set a malapai stone 14x10x7 ins. 10 ins. in the ground
for Cor of sec. 20, 21, 28 and 29. mark'd with
4 notches on E. and 2 notches on S. edges.
Dig pits 18x18x12 ins. in each sec. $5\frac{1}{2}$ ft. dit.
and raise a mound of earth 4 ft. base, 2 ft.
high W. of Cor.

Layd hilly and rolling.
Soil sandy 3rd rate.
No timber.

NOTE At this Cor set off $23^{\circ}25\frac{1}{2}'$ N. on the decl. and
and at 12^h 02^m pm. limit observed the sun on
the meridian the resulting latitude being
 $35^{\circ}38'$ N. nearly.

40.00 $N 89^{\circ}53' E$ on a random line bet. sec. 21 and 28
Set temp. $\frac{1}{4}$ sec. cor:

80.02 Intersect N and S. line 14 lks. N. of the Cor.
of sec. 21, 22, 27 and 28; hereinbefore described,
Thence I run.

$S 89^{\circ}59' W$ on a true line bet. sec 21 and 28

BOOK 2579

- Over low rolling sand hills through sage and greasewood brush and bunch grass.
- 40.01 Set a malopai stone 14x7x7 ins, 10 ins. in the ground for $\frac{1}{4}$ sec. cor. mid. $\frac{1}{4}$ on N face. Dig pits 18x18x12 ins. E. and W. of stone 3 ft. dist. and raise a mound of earth 3 $\frac{1}{2}$ ft. base 1 $\frac{1}{2}$ ft. high N. of cor.
- 55.00 Top of sand ridge bears N.E. and S.W. desc. over N.W. slope.
- 80.02 The cor. of secs. 20, 21, 28 and 29, ^{hereinbefore} described. Land hilly. Soil sandy 3rd rate. No timber.

- N $0^{\circ}03'W$ bet. secs. 20 and 21.
- Over low rolling sand hills sloping to NW. through sage and greasewood brush and bunch grass.
- 40.00 Set a malopai stone 14x9x6 ins, 10 ins. in the ground for $\frac{1}{4}$ sec. cor. mid. $\frac{1}{4}$ on W. face. Dig pits 18x18x12 ins N. and S. of stone 3 ft. dist. and raise a mound of earth 3 $\frac{1}{2}$ ft. base 1 $\frac{1}{2}$ ft. high W. of cor.
- 80.00 Set a malopai stone 14x9x7 ins 12 ins. in the ground for cor. of secs 16, 17, 20 and 21 mid. with 4 notches on E and 3 notches on S edges. Dig pits 18x18x12 ins in each sec 5 $\frac{1}{2}$ ft. dist. and raise a mound of earth 4 ft. base 2 ft. high. W. of cor. Land hilly. Soil sandy 3rd rate. No timber.

- N $89^{\circ}59'E$ on a random line bet. secs 16 and 21
- 40.00 Set temp. $\frac{1}{4}$ sec. cor.
- 79.82 Intersect N and S. line 12 lbs. S. of the cor. of secs 15, 16, 21 and 22, hereinbefore described. Thence S run S $89^{\circ}54'W$ on a true line bet. secs 16 and 21

Cohasset

23

- Over low-rolling sand hills through scattering sage and greasewood brush and bunch grass
- 20.00 Top of sand ridge bears N.E. and S.W. decl.
- 39.91 Set an iron post 3 ft long 1 in. in diam. 26 ins. in the ground for $\frac{1}{4}$ sec. cor. marked on brass cap $\frac{1}{4}$ S 16 on N half and S 21 on S. half.
Dig pits 18 x 18 x 12 ins. E and W. of post 3 ft. dist. and raise a mound of earth 3 $\frac{1}{2}$ ft. base, 1 $\frac{1}{2}$ ft. high N. of cor.
- 79.82 The cor. of sec. 16, 17, 20 and 21, hereinbefore described.
Land hilly.
Soil sandy 3rd rate.
No timber.
- June 24, 1908

- June 27th 1908. At 7^h 07^m a.m. level - Dred off. 35° 38 $\frac{1}{2}$ ' N. on the lat. arc. 23° 21' N. on the decl. arc. and determine a meridian with the solar at the cor. of sec. 16, 17, 20 and 21, ^{hereinbefore} described.
Thence I run
N 0° 03' W. bet. sec. 16 and 17
Over rolling sandy land covered with sage and greasewood brush and bunch grass.
- 40.00 Set an iron post 3 ft long 1 in. in diam. 26 ins. in the ground for $\frac{1}{4}$ sec. cor. marked on brass cap $\frac{1}{4}$ S 17 on W half and S 16 on E half
Dig pits 18 x 18 x 12 ins. N and S. of post 3 ft. dist. and raise a mound of earth 3 $\frac{1}{2}$ ft. base 1 $\frac{1}{2}$ ft. high. W of cor.
- 80.00 Set an iron post 3 ft long 2 ins. in diam. 24 ins. in the ground for cor. of sec. 8, 9, 16 and 17, marked on brass cap T 26 N. S 8 in N.W. T 18 E, S 9 in N.E. S 16 in S.E. and S 17 in S.W. quadrant
Dig pits 18 x 18 x 12 ins. in each sec. 5 $\frac{1}{2}$ ft. dist. and raise a mound of earth 4 ft. base 2 ft high. W of cor.
Land rolling.
Soil sandy 2nd and 3rd rate.
No timber.

① V 89° 54' E on a random line bet. sec. 9 and 16.

BOOK 2579

- 40.00 Set temp. $\frac{1}{4}$ sec. cov.
- 79.84 Intersect N. and S. line 14 lks. N. of the Cor. of sec 9, 10, 15 and 16, hereinbefore described,
Thence I run
West on a true line bet. sec 9 and 16.
Over low rolling sand hills through sage
and greasewood bush and bunch grass.
- 39.92 Set an iron post 3 ft long 1 in. in diam. 26 ins. in
the ground for $\frac{1}{4}$ sec. cov. marked on brass cap
 $\frac{1}{4}$ 59 on N. half and 816 on S half
Dig pits 18 x 18 x 12 ins. East W. of post 3 ft. dist.
and raise a mound of earth 3 $\frac{1}{2}$ ft. base 1 $\frac{1}{2}$
ft. high N. of Cor.
- 79.84 The Cor. of sec. 8, 9, 16 and 17, ^{hereinbefore} described.
Land hilly.
Soil sandy 2nd and 3rd rate.
No timber.

N 0° 03' W. bet. Secs. 8 and 9.

Creed gradually over low rolling sand hills.
through sage and greasewood bush and
bunch grass

- 40.00 Set an iron post 3 ft long 1 in. in diam. 26
ins. in the ground for $\frac{1}{4}$ sec. cov. marked on
brass cap. $\frac{1}{4}$ 38 on W half, and 89. on E half.

Dig pits 18 x 18 x 12 ins. N. and S. of post 3 ft. dist. and
raise a mound of earth 3 $\frac{1}{2}$ ft. base 1 $\frac{1}{2}$ ft. high
W of cov.

- 80.00 Set an iron post 3 ft long 2 in. in diam. 24 ins
in the ground for Cor of sec 4, 5, 8 and 9, marked
on brass cap T. 26 N. S. 5 in N.W. R 18 E S 4 in N.E.
S 9 in S.E. and S 8 in S.W. quadrant

Dig pits 18 x 18 x 12 ins. in each sec. 5 $\frac{1}{2}$ ft. dist. and
raise a mound of earth 4 ft. base 2 ft. high W.
of cov

Land hilly.

Soil sandy 3rd rate.

No timber.

Chains

40.00 East on a random line bet. sec. 4 and 9.
 79.88 Set temp. $\frac{1}{4}$ sec. cor.
 Intersect N. and S. line 8 lks S. of the cor. of sec.
 3, 4, 9 and 10, hereinbefore described.

Thence I run

39.94 S 89° 57' W on a true line bet. sec. 4 and 9,
 Descend W. slope over low rolling sand hills
 through sage and greasewood bush.
 Set an iron post 3 ft long 1 in in diam 26
 ins in the ground for $\frac{1}{4}$ sec. cor. marked
 on brass cap 484 on W. half and 89 on S.
 half.

79.88 Dig pits 18x18x12 ins. E and W. of post 3 ft. dia.
 and raise a mound of earth 3 $\frac{1}{2}$ ft. base, 1 $\frac{1}{2}$ ft.
 high N. of the cor.

The cor. of sec. 4, 5, 8 and 9, hereinbefore described.
 Land hilly.
 Soil sandy 3rd rate.
 No timber.

June 27th, 1908

June 29-1908
 40.00 N 0° 03' W on a random line bet. sec. 4 and 5 -
 Set temp. $\frac{1}{4}$ sec. cor.
 80.66 Intersect N. ltry. of T₄ - 35 lks S 89° 51' E
 of the cor. of
 sec. 4, 5, 32 and 33; described in Exterior Book "A"
 Recently re-established by me &

Thence I run

40.66 S 0° 18' E. on a true line bet. sec. 4 and 5 -
 Over low rolling sand hills through sage
 and greasewood bush and bunch grass
 Set an iron post 3 ft long 1 in in diam 26
 ins in the ground for $\frac{1}{4}$ sec cor. marked on brass cap.
 485 on W. half and 84 on E half

80.66 Dig pits 18x18x12 ins. N and S. of post. 3 ft.
 dia. and raise a mound of earth 3 $\frac{1}{2}$ ft. base
 1 $\frac{1}{2}$ ft. high W. of cor.

The cor. of sec. 4, 5, 8 and 9, hereinbefore described.
 Land hilly.
 Soil sandy 2nd and 3rd rate.
 No timber

June 29th, 1908

Subdivision of T₄ 26 N. R 18 E.

BOOK 2579

- June 25th 1908: At 8^h 02^m a.m. l.m.t.-D.
 Set off. 35° 36' N. on the lat. arc. 23° 24½' N. on
 the decl. arc. and determined a meridian
 with the solar at the Cor. of Secs. 5-6. 31 and 32
 on the Story of T₄; ^{recently established by me & described} in Exterior Book "A"
 Thence I run
 N 0° 03' W bet. sec. 31 and 32.
 Over low rolling sand ridged slopes to S.W.
 34.00 Top of ridge bet. N.E. and S.W. desc.
 40.00 Set a malapai stone 12x8x7 ins. 8 ins. in the
 ground. for ¼ sec. cor. mark. ¼ on W. face
 Dig pits 18x18x12 ins. N. and S. of stone 3 ft. dist. and
 raise a mound of earth 3½ ft. base 1½ ft. high W.
 of cor.
 60.00 Depression bet. N.E. and S.W. ascend.
 80.00 Set a malapai stone 14x12x6 ins., 8 ins. in the
 ground for cor. of sec. 29, 30, 31 and 32 mark.
 with 5 notches on E. and 1 notch on S. edges.
 Dig pits 18x18x12 ins. in each sec. 5½ ft. dist.
 and raise a mound of earth 4 ft. base 2 ft. high
 W. of cor.
 Land rolling and hilly.
 Soil sandy 3rd rate.
 No timber.
-
- East on a random line bet. sec. 29 and 32
 40.00 Set buy. ¼ sec. cor.
 80.02 Intersect N. and S. line 10 ch. N. of the cor. of
 sec. 28, 29, 32 and 35, hereinbefore described,
 Thence I run
 N 89° 56' W. on a true line bet. sec. 29 and 32
 Ascend E. slope of ridge over hilly sandy land
 through sage and greasewood brush and bunch
 grass.
 2.50 Top of ridge bet. N.E. and S.W. Enter rolling
 land bet. N.E. and S.W.
 12.00 Begin descent over N.W. slope
 40.01 Set a malapai stone 14x10x5 ins. 9 ins. in the
 ground for ¼ sec. cor. mark. ¼ on N. face
 Dig pits 18x18x12 ins. E. and W. of stone 3 ft.
 dist. and raise a mound of earth 3 ft.

Chain

80.02 Low 1 1/2 ft high N. of Cor.
The Cor of sees. 29, 30, 31 and 32, hereinbefore described.
Land hilly and rolling.
Soil sandy 3rd rate.
No timber.

40.00 Walk on a random line bet. sees 30 and 31
Set temp. 1/4 sec. Cor.

79.40 Intersect W. ldy. of N. at the Cor of sees. 25
30, 31 and 36, recently reestab. by me & described in Exterior
Book "G"
Thence I run

10.00 East on a true line bet. sees. 30 and 31
Descend gradually over E. slope sand ridge
through sage brush and bunch grass.

29.00 Top of ridge bears N.E. and S.W. desc.
33.00 Foot of descent in depression bear N.E. and S.W.
asc. gently.

39.40 Set a Malapai Stone 12x8x6 ins, 8 ins. in the
ground for 1/4 sec. Cor. mark, 400 N. face.
Dig pits 18x18x12 ins E. and W. of stone 3 ft.
dlt. and raise a mound of earth 3 1/2 ft. high
1 1/2 ft. high N. of Cor.

79.40 The Cor of sees. 29, 30, 31 and 32, ^{hereinbefore} described.
Land hilly and rolling
Soil sandy 2nd and 3rd rate
No timber

3.00 No 03' W. bet. sees. 29 and 30.
Over low rolling sand hills along foot of high
malapai peak -

20.00 Top of ridge bears N.E. and S.W. desc.
Foot of descent in depression bear N.E. and S.W.
ascend gradually.

30.00 Top of sand ridge bears N.E. and S.W. desc.
35.00 Foot of descent in depression bear N.E. and S.W.
asc. S. slope of ridge.

40.00 Set a malapai stone 18x18x12 ins, 12 ins.
in the ground for 1/4 sec. Cor mark, 400 N. face

BOOK 2579

- Dig pits 18x18x12 ins N and S. of stone 3 ft. dist.
and raise a mound of earth 3 1/2 ft. base 1 1/2 ft high.
W. of Cor.
- 80.00 Set a malapai stone 12x12x11 ins. 8 ins. in the
ground for Cor. of sec. 19, 20, 29 and 30. mkd.
with 5 notches on E and 2 notches on S. edges.
Dig pits 18x18x12 ins. in each sec. 5 1/2 ft. dist.
and raise a mound of earth 4 ft. base 2 ft. high
W. of Cor.
Land hilly.
Soil sandy, 3rd rate.
No timber
- NOTE - At this Cor. Det. off. 23° 24' N. on the decl. arc and
at 12^h 02^m L.M. L.M.T. observe the sun on the
meridian and obtain on the bar a reading
of 35° 38' N. which is a little higher than the
true latitude of this place
- 89° 56' E on a random line bet. sec. 20 and 29.
- 40.00 Set temp. 1/4 sec. cor.
- 80.06 Intersect N and S line 8 ins N. of the cor. of sec.
20, 21, 28, and 29, hereinbefore described,
Thence Run
N 89° 53' W. on a true line bet. sec. 20 and 29.
Descend W. slope of sand ridge over hilly land.
through scattering sage brush and bunch grass
- 36.00 Dry ravine course S.W. Ascend gradually
- 40.03 Set a malapai stone 12x10x5 ins. 8 ins. in the
ground for 1/4 sec. cor. mkd. 4 on N. face.
Dig pits 18x18x12 ins E and W. of stone 3 ft. dist.
and raise a mound of earth 3 1/2 ft. base, 1 1/2
ft. high N. of cor.
- 57.00 Top of ridge bears NE and SW. descend over
N.W. slope
- 80.06 The cor. of sec. 19, 20, 29 and 20, ^{hereinbefore} described.
Land hilly.
Soil sandy 3rd rate.
No timber.

Chains

29

- 40.00 Walk on a random line bet. sees 19 and 30
- 74.20 Beh. temp. 4 sec. Cor.
- 79.20 Intersect W. side of Np. 5 line N. of the Cor. of sees. 19, 24, 25 and 30, ^{recently re-established by me &} described in Exterior Book "G"
Thence Drive
78°59'58"E. on a true line bet. sees. 19 and 20.
Descend E. slope over rolling sandy land. through sage and greasewood brush and bunch grass
- 36.00 Foot of descent in a depression, bears N.E. and S.W. ascend W. slope.
- 39.20 Set a malapari stone 12x10x7 ins. 8 ins. in the ground for 4 sec. Cor., mark 4 on W. face
Dig pits 18x18x12 ins. East W. of stone 3 ft. deep, and raise a mound of earth 3 1/2 ft. high 1/2 ft. high N. of Cor.
- 79.20 The Cor. of sees. 19, 20, 29 and 30, ^{hereinbefore} described.
Land rolling.
Soil sandy 2nd and 3rd rate.
No timber.

- 15.00 No 03 W. bet. sees. 19 and 20
- Ascend S.W. slope over hilly sandy land. Covered with sage brush and bunch grass.
- 21.80 Top of ridge bears N.E. and S.W. line.
- 26.00 Dry ravine bears W. asc.
- 29.00 Top of ridge bears East W. descends from butte about 20 ch. E. of line
- 30.25 Dry ravine bears S.W. asc.
- 40.00 Top of ridge bears E. and W. desc.
- 40.00 Set a malapari stone 14x10x6 ins. 10 ins. in the ground for 4 sec. Cor., mark 4 on W. face
Dig pits 18x18x12 ins. N. and S. of stone 3 ft. deep, and raise a mound of earth 3 1/2 ft. high, 1/2 ft. high W. of cor.
- 54.00 Foot of descent in depression bears N.E. and S.W. bears hilly land bears N.E. and S.W. thence over rolling sandy land bears N.E. and S.W.
- 80.00 Set a malapari stone 14x10x6 ins. 10 ins. in the ground, for Cor. of sees. 17, 18, 19 and 20
mark with 5 notches on E. and 3 notches on S. edges.

Subdivision of Twp. 26 N., W. 18 E.

BOOK 2579

Dig pits 15x18x12 ins in each sec. 5 1/2 ft. dia,
and raise a mound of earth 4 ft. base, 2 ft. high
W. of cor.

Land hilly and rolling.

Soil sandy and stony 2nd and 3rd rate.
No timber.

June 25, 1908

June 29th 1908 Ab. 8th 02nd a.m. C. m. l. Dreb off.
35° 38 1/2' N. on the hor. arc . 23° 15' N. on the decl. arc
and determine a meridian with the solar at the
cor. of secs. 17, 18, 19 and 20, hereinbefore described.

Thence Drive

S 89° 53' E. on a random line bet. secs. 17 and 20

40.00 Set temp. 4 sec. cor.

80.16 Intersect N. and S. lines 5th W. of the Cor. of secs.
16, 17, 20 and 21, hereinbefore described,

Thence Drive

N 89° 51' W. on a true line bet. secs. 17 and 20.

Over rolling sandy land. Covered with sage and greasewood
bush and bunch grass.

40.08 Set a malapa stone 14x10x7 ins. 10 ins. in the
ground. for 1/4 sec. cor. mid. 1/4 on N. face.

Dig pits 18x18x12 ins E. and W. of stone 3 ft. dia.
and raise a mound of earth 3 1/2 ft. base 1 1/2 ft.
high W. of cor.

80.16 The cor. of secs. 17, 18, 19 and 20, hereinbefore described.

Land rolling.

Soil sandy 2nd and 3rd rate.

No timber.

40.00 S 89° 58' W. on a random line bet. secs. 18 and 19.
Set temp. 4 sec. cor.

79.00 Intersect W. line of No. 8 (the N. of the Cor. of secs.
13, 18, 19 and 24), ^{recently re-established by me and}
_{described in Exterior Book "G,"}

Thence Drive

N 89° 55' E. on a true line bet. secs. 18 and 19.

Over rolling sandy land. through sage bush
and bunch grass.

39.00 Set a malapa stone 12x9x7 ins. 8 ins. in the
ground. for 1/4 sec. cor. mid. 1/4 on N. face.

Dig pits 18x18x12 ins E. and W. of stone 3 ft. dia.

79.00 and raise a mound of earth $3\frac{1}{2}$ ft base $1\frac{1}{2}$ ft high W of cor.
 The cor. of secs. 17-18-19 and 20, ^{hereinbefore} described.
 Land rolling.
 Soil sandy 2nd and 3rd rate.
 No timber.

40.00 N. $0^{\circ}03'W$. bet. secs. 17 and 18
 Ascend gently S.E. slope over rolling sandy land through sage and greasewood brush and bunch grass.
 Set an iron post 3 ft long 1 in. in diam 26 ins. in the ground for $\frac{1}{4}$ sec. cor. marked $\frac{1}{4}$ S 18 on W. half and S. 17 on E. half.
 Dig pits $18 \times 18 \times 12$ ins N and S. of post. 3 ft. dist. and raise a mound of earth $3\frac{1}{2}$ ft. base $1\frac{1}{2}$ ft. high W. of cor.

80.00 Set a malapai stone $12 \times 10 \times 6$ ins, 9 ins. in the ground for cor. of secs. 7-8-17 and 18, m'kd. with 5 notches on E. and 4 notches on S. edge.
 Dig pits $18 \times 18 \times 12$ ins. in each sec. $5\frac{1}{2}$ ft. dist. and raise a mound of earth 4 ft. base 2 ft high W. of cor.
 Land rolling.
 Soil sandy 2nd and 3rd rate.
 No timber.

40.00 S. $89^{\circ}51'E$. on a random line bet. secs. 8 and 17
 Set temp. $\frac{1}{4}$ sec. cor.

80.18 Intersect N and S. line 5 lks. S. of the cor. of secs. 8-9-16 and 17, hereinbefore described.
 Thence I run

40.09 N. $89^{\circ}53'W$. on a true line bet secs 8 and 17
 Over level sandy land through sage and greasewood under growths.
 Set a malapai stone $12 \times 10 \times 6$ ins, 8 ins in the ground for $\frac{1}{4}$ sec. cor m'kd. $\frac{1}{4}$ on N. face.

BOOK 2579

80.18 Dig pits 18x18x12 ins. E and W. of post 3 ft dist and raise a mound of earth 3 1/2 ft. base 1 1/2 ft. high N. of cor.
The cor. of secs. 7-8-17 and 18, hereinbefore described.
Land level and rolling.
Soil sandy 2nd and 3rd rate.
No timber.

40.00 S. 89°55' W. on a random line bet. secs. 7 and 18
Set temp 1/4 sec cor.
78.84 Intersect W. bdy. of Twp. 7 lks. S. of the cor. of secs. 7-12-13 and 18, recently re-established by me & described in Exterior Book "G"
Thence I run
N. 89°58' E. on a true line bet. secs 7 and 18,

12.30 Ascend W. slope of sand ridge over hilly land covered with sage brush and bunch grass.
38.84 Top of ridge bears N.E. and S.W. desc. E. slope.
Set an iron post 3 ft long 1 in. in diam 26 ins. in the ground for 1/4 sec. cor. marked on brass cap 1/4 S. 7 on N. half and S. 18 on S. half.
Dig pits 18x18x12 ins. E and W. of post 3 ft. dist. and raise a mound of earth 3 1/2 ft. base 1 1/2 ft. high N. of cor.

68.00 Leave hilly land bears N.E. and S.W. Enter rolling land bears N.E. and S.W.
78.84 The cor. of secs. 7-8-17 and 18, hereinbefore described.
Land hilly and rolling.
Soil sandy 2nd and 3rd rate.
No timber.

NOTE. At the cor of secs. 7-8-17 and 18, I set off 23°14' N. on the lat. arc. and at 12^h 03^m p.m. l.m.t. observe the sun on the meridian, the resulting latitude being 35°39' N.

10.00 N. 0°03' W. bet secs. 7 and 8.
Over level sandy land, through sage and greasewood brush and bunch grass.
Leave level land bears N.E. and S.W. Ascend S.E.

40.00 slope over hilly land bears N.E. and S.W.
 Set a Malapai stone 14 x 9 x 7 ins. 10 ins.
 in the ground for $\frac{1}{4}$ sec. cor. marked $\frac{1}{4}$ on
 W. face
 Dig pits 18 x 18 x 12 ins N and S of stone 3 ft
 dist and raise a mound of earth $3\frac{1}{2}$ ft. base
 1 $\frac{1}{2}$ ft. high W. of cor.
 48.00 Top of sand ridge bears N.E. and S.W. desc. over
 N.W. slope
 56.50 dry ravine course N.W. asc.
 60.00 Top of ridge bears N.E. and S.W. desc.
 64.20 dry ravine course S.W. asc.
 69.80 Top of ridge bears N.E. and S.W. desc.
 75.00 dry ravine course S.W. asc.
 79.50 Top ridge bears N.E. and S.W. thence across top.
 80.00 Set a malapai stone 14 x 10 x 6 ins 10 ins. in
 the ground for cor of secs. 5-6-7 and 8.
 marked with 5 notches on E. and S. edges.
 Dig pits 18 x 18 x 12 ins. in each sec. $5\frac{1}{2}$ ft.
 dist. and raise a mound of earth 4 ft. base
 2 ft. high W. of cor.
 Land level and hilly.
 Soil sandy 3rd rate.
 No timber.

S. $89^{\circ}53'E$. on a random line bet. secs 5
 and 8
 40.00 Set temp $\frac{1}{4}$ sec. cor.
 86.12 Intersect N and S. line 10 lbs. S. of cor. of
 secs. 4-5-8 and 9, hereinbefore described,
 Thence Run.
 N. $89^{\circ}57'W$. on a true line bet. secs 5 and 8.
 One level sandy land covered with
 sage and greasewood bush.
 40.06 Set an iron post 3 ft long 1 in. in diam
 26 ins. in the ground for $\frac{1}{4}$ sec. cor.
 marked on brass cap, $\frac{1}{4}$ S 5 on N. half
 and S. 8 on S. half.
 Dig pits 18 x 18 x 12 ins. E and W. of post 3 ft. dist.

Chains

BOOK 2579

and raise a mound of earth $3\frac{1}{2}$ ft base $1\frac{1}{2}$ ft high N. of cor.
 67.00 Top of sand ridge bears N.E. and S.W. desc.
 72.00 Dry sand wash 30 ft deep course S.W. asc.
 80.12 The cor. of secs. 5-6-7 and 8. hereinbefore described.
 Land level and broken
 Soil sandy 2nd and 3rd rate
 No timber
 June 29th 1908

June 30th 1908; at 8^h 32^m a.m. l.m.t. I set off
 $35^{\circ} 40'$ N. on the lat. arc, $23^{\circ} 11\frac{1}{2}'$ N. on the
 decl. arc, and determining a meridian with the
 solar at the cor. of secs. 5-6-7 and 8, ^{hereinbefore} described.
 Thence I run
 S. $89^{\circ} 58'$ W. on a random line bet. secs 6 and 7
 40.00 Set a temp $\frac{1}{4}$ sec. cor.
 78.72 Intersect W. bdry. of Tp. 5 ^{tho. S. of the cor. of secs}
 1-6-7 and 12) ^{Result re-established by me and} described in Exterior Book of.
 Thence I run
 East. on a true line bet. secs. 6 and 7
 Ascend N.W. slope over sandy hilly land
 covered with sage and greasewood brush
 37.30 Top of ridge bears N.E. and S.W. descend over
 S.E. slope
 38.72 Set an iron post 3 ft. long 1 in. in diam 26 ins.
 in the ground for $\frac{1}{4}$ sec. cor. marked on brass
 cap. $\frac{1}{4}$ S 6 on N. half and S 7 on S. half.
 Dig pits 18x15x12 ins East and W. of post 3 ft.
 dist. and raise a mound of earth $3\frac{1}{2}$ ft base
 $1\frac{1}{2}$ ft high N of cor.
 51.75 Dry ravine course S.W. asc.
 62.00 Top of ridge bears N.E. and S.W. desc.
 67.65 Dry ravine course S.W. asc.
 78.00 Top of ridge bears N.E. and S.W. desc.
 78.72 The cor. of secs 5-6-7 and 8, hereinbefore described.
 Land rolling and hilly
 Soil sandy 3rd rate
 No timber

Claims

N^o 03' W. on a random line bet. sec. 5 and 6.

40.00 Sec. temp. $\frac{1}{4}$ sec. cov.

80.91 Intersect N. bdy. of Np-12 th ^{589' 51" E.} of the Cov. of sec. 5, 6, 31 and 32; and described in Exterior Book "A" recently re-established by me.

Three Drums

S^o 08' E. on a true line bet sec 5 and 6.

Ascend. N. slope over broken and hilly land, ridged and ravine.

1.60 Dry wash 20 lbs. wide Course S.W.

7.20 Dry ravine 100 lbs. wide 10 ft. deep. Course W.

14.55 Dry ravine 150 lbs wide, tined 6 ft high. Course W.

20.28 Dry ravine 50 lbs wide, tined 10 ft high. Course W.

40.91 Set an iron post 3 ft long 1 in in diam., 26 ins. in the ground for $\frac{1}{4}$ sec. cov. marked on brass cap $\frac{1}{4}$ 36 on W half and 35 on E half

Dig pits 18x18x12 ins. N. and S. of post 3 ft. dia. and raise a mound of earth 3 $\frac{1}{2}$ ft. base 1 $\frac{1}{2}$ ft. high N. of cov.

55.90 Dry ravine 40 lbs. wide Course N.W.

57.90 Top of ridge bears N.W. and S.E. dir.

59.70 Dry ravine 20 ft deep 1 ch. wide Course N.W. asc. over very broken land.

80.91 The Cov. of sec 5, 6, 7 and 8, hereinbefore described.

Land broken and hilly.

Soil sandy 2nd at 3rd rate.

No timber.

June 20th 1885

General Description

The land in this township consists of rolling sand hills, and the soil ranges from a rich sandy loam, to fine sand. The soil of the bottom land, along the sand wash, in the southern part of the township is a rich sandy loam and will produce good crops without the aid of irrigation. A portion of this land is being farmed at the present time, to a limited extent by the Navajo and Hopi Indians. The soil of the remaining

BOOK 2579

portion of the township. Can nearly all be classed as 3rd rate, is covered with a good growth of bunch grass, but is unsuitable for agricultural purposes owing to its hilly character and the arid conditions of the country.

No timber of any variety was found in the township and no stone or minerals of a commercial value.

The township is poorly watered.

There are no settlers residing in the township at the present time.

The township is admirably adapted for stock grazing purposes.

Sidney E. Blout

U.S. Examiner of Surveys

JUNE 30, 1908

U.S. EXAMINER OF SURVEYS
FINAL OATHS OF DEPUTY SURVEYOR AND HIS ASSISTANTS.

LIST OF NAMES.

A list of the names of the individuals employed by Sidney E. Blount

Examiner of Surveys

, United States Deputy Surveyor, to assist in running, measuring, and

marking the lines and corners described in the foregoing field notes of the survey of the Subdivision lines

of Twp. 26 N. R. 18 E. of the Gila and Salt River Base and Meridian in the Territory of Arizona

showing the respective capacities in which they acted:

- | | | |
|--------------------------|-----------------------|-------------------------|
| <u>Pred. L. Warner</u> | <u>Harry Lake May</u> | <u>Compassman</u> |
| | | , Chainman. |
| <u>Van L. White</u> | | , Chainman. |
| <u>Ralph P. Westland</u> | | <u>Chainman</u> |
| | | , Chainman . |
| <u>Harry J. Hassler</u> | | , Moundman. |
| <u>Sam V. Longestewa</u> | | , Axman. |
| <u>Jay E. Jellick</u> | | , Axman. |
| <u>Delix Manning</u> | | , Flagman. |

FINAL OATH OF ASSISTANTS.

We hereby certify that we assisted Sidney E. Blount

Examiner of Surveys

, United States Deputy Surveyor, in surveying all

those parts or portions of the Subdivision lines of

Township 26 North Range 18 East

of the Gila and

Salt River Base and Meridian, Territory of Arizona, which are represented

in the foregoing field notes as having been surveyed by him and under his direction; and that said survey has been in all respects, to the best of our knowledge and belief, well and faithfully ^{executed} surveyed, and the corner monuments established, according to the instructions furnished by the Commissioner of the

General Land Office

, Chainman.

Walter A. Swartz, Chainman.

, Moundman.

, Moundman.

, Axman.

, Axman.

, Flagman.

Subscribed and sworn to before me this _____

day of _____, 190 _____



U.S. Examiner of Surveys

214
38
BOOK 2579

EXAMINER OF SURVEYS
FINAL OATH OF UNITED STATES DEPUTY SURVEYOR.

I, Sidney E. Blout, ~~United States Deputy Surveyor~~, ^{Examiner of Surveys} do solemnly swear that, in pursuance of ~~a contract~~ ^{special instructions} received from ~~the Commissioner of the~~ ^{the Commissioner of the} United States Surveyor General ~~Land Office~~, bearing date of the 2nd day of Oct. 1907 & the 15th day of May 1908 I have well, faithfully, and truly, in my own proper person, and in strict conformity with the instructions furnished by the ~~United States Surveyor General Land Office~~ ^{Commissioner of the}, the Manual of Surveying Instructions, and the laws of the United States, surveyed all those parts or portions of the Subdivision lines of Township 26 North, Range 18 East

of the Gila and Salt River Base and Meridian, in the territory of Arizona, which are represented in the foregoing field notes as having been surveyed by me, and under my direction; and I do further solemnly swear that all the corners of said survey have been established and perpetuated in strict accordance with the Manual of Surveying Instructions, and the special written instructions of the ~~United States Surveyor General Land Office~~ ^{Commissioner of the} and in the specific manner described in the field notes, and that the foregoing are the original field notes of such survey.

See Subdivisional Book "I"

Subscribed by said Sidney E. Blout, and sworn to before me }
this _____ day of _____, 190 _____ }
~~United States Deputy Surveyor~~
~~Examiner of Surveys~~



APPROVAL.

OFFICE OF THE UNITED STATES SURVEYOR GENERAL,

Phoenix, Arizona APR 25 1914

The foregoing field notes of the survey of the Subdivision lines of Township 26 North - Range 18 East of the Gila and Salt River Base and Meridian, Arizona

executed by Sidney F. Blout, U.S. Examiner of Surveys ~~under his contract No. _____~~ ^{Special Instructions from the Commissioner of the General Land Office}, dated Oct. 2, 1907 and May 15, 1908, 190 _____, having been critically examined, and the necessary corrections and explanations made, the said field notes, and the surveys they describe, are hereby approved.

Frank Ingalls
~~United States Surveyor General~~
SURVEYOR-GENERAL OF ARIZONA

I certify that the foregoing transcript of the field notes of the above-described surveys in _____ has been correctly copied from the original notes on file in this office.

~~United States Surveyor General~~