

Subdivisional  
**BOOK "K"**

2389

BOOK 2589

FIELD NOTES

OF THE SURVEY OF THE

*Subdivision lines of T<sub>1</sub>P. No 25 North*

*Range No. 16 East*

*Of the Gila and Salt River Basins and Meridian,*

*in the Territory of Arizona*

EXECUTED  
AS CORRECTED BY

*Sidney E. Blouch*, United States *Examiner of Surveys*  
~~Deputy Surveyor~~

*Special Instructions from the Commissioner of the General Land Office*  
Under ~~Contract No.~~, dated *October 2<sup>nd</sup> 1907* and *May 15<sup>th</sup> 1908*.

Survey commenced *March 5<sup>th</sup>*, 1910

Survey completed *March 18<sup>th</sup>*, 1910

NAMES AND DUTIES OF ASSISTANTS.

<u>Vanda White</u>	<u>Compassman</u>
<u>Fred L. Warner</u>	<u>Chairman</u>
<u>D. W. White</u>	<u>Chairman</u>
<u>Earl Albright</u>	<u>Chairman</u>
<u>Ralph C. Sampson</u>	<u>Moundman</u>
<u>Chas L. Shumway</u>	<u>Moundman</u>
<u>William R. Carson</u>	<u>Wagonman</u>
<u>George Harris</u>	<u>Wagonman</u>

BOOK 2589

Book No. 2589

# INDEX DIAGRAM.

Township No. 25 N., Range No. 16 E.

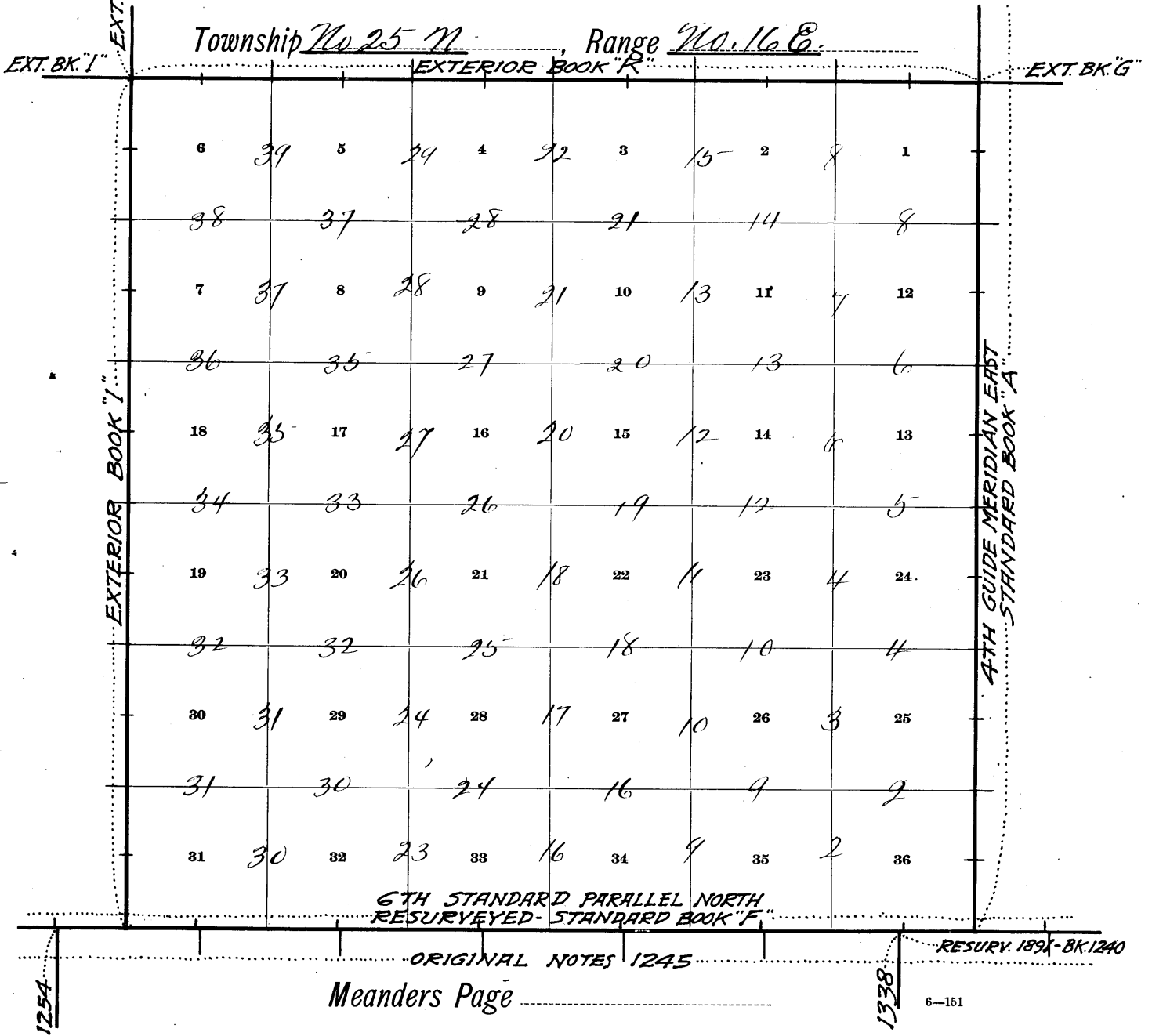

50  
BOOK 2589

PRELIMINARY OATHS OF ASSISTANTS.

WE, Fred L Warner and R. Y. White

do solemnly swear that we will well and faithfully execute the duties of chainmen; that we will level the chain upon even and uneven ground, and plumb the tally pins, either by sticking or dropping the same; that we will report the true distances to all notable objects, and the true lengths of all lines that we assist in measuring, to the best of our skill and ability, and in accordance with instructions given us, in the survey of

The Subdivisional lines of Twp 25 N. Range No 16 East; of the G. & S. R. Base & Meridian, Arizona.

Fred L Warner, Chainman.

R. Y. White, Chainman.

Subscribed and sworn to before me this 4<sup>th</sup> day of March, 1910



Sidney E. Blous  
U.S. Examiner of Surveys

WE, Chas L Shumway and Ralph C. Sampson

do solemnly swear that we will well and truly perform the duties of moundmen in the establishment of corners, according to the instructions given us, to the best of our skill and ability, in the survey of

The Subdivisional lines of Twp 25 N. Range 16 East of the G. & S. R. Base & Meridian, Arizona.

Chas L Shumway, Moundman.

Ralph C. Sampson, Moundman.

Subscribed and sworn to before me this 4<sup>th</sup> day of March, 1910



Sidney E. Blous  
U.S. Examiner of Surveys

~~WE, \_\_\_\_\_ and \_\_\_\_\_~~

~~do solemnly swear that we will well and truly perform the duties of axmen in the establishment of corners and other duties, according to instructions given us, to the best of our skill and ability, in the survey of~~

~~\_\_\_\_\_ Axman.  
\_\_\_\_\_ Axman.~~

~~Subscribed and sworn to before me this \_\_\_\_\_ day of \_\_\_\_\_, 19\_\_\_\_~~



I, William R Carson, do solemnly swear that I will well and truly perform the duties of flagman according to instructions given me, to the best of my skill and ability, in the survey of

The Subdivisional lines of Twp 25 N. R. 16 E. of the G. & S. R. Base & Meridian, Arizona.

William R Carson, George Harris, Flagman.

Subscribed and sworn to before me this 4<sup>th</sup> day of March, 1910



Sidney E. Blous  
U.S. Examiner of Surveys

Survey Commenced March 5<sup>th</sup> 1910 and executed with a Waud L. Co. Surley engineers transit No. 76. with a Burh. solar attachment. The horizontal limb is provided with one double vernier reading to single minutes of arc. The vernier of the latitude and declination arcs, reading to 0' 30" of arc.

Examine the adjustments of the transit and correct the level and collimation errors. then to test the solar apparatus by comparing its indications resulting from solar observations made on the sun during a.m. and p.m. hours with a meridian established by observations on polaris. Proceed as follows.

At my camp which is located near the cor. of Sec. 15, 16, 21 and 22. Twp 25 N. R 16 E. Latitude 35° 33' N. Longitude 110° 38' W., At 8<sup>h</sup> 31<sup>m</sup> p.m. l.m.t. by my watch which is correct local mean time observe Polaris at western elongation in accordance with instructions in the Manual. and mark a point in the direction thus determined by a tack driven in a stake set firmly in the ground 5 chs. N. of my instrument.

March 5<sup>th</sup> 1910

March 6<sup>th</sup> 1910 At 8<sup>h</sup> 00<sup>m</sup> a.m. l.m.t. lay off the azimuth of Polaris 1° 26½' to the east and mark the meridian thus determined, by a tack driven in a stake set in the ground 5.00 chs. N. of my instrument.

At 9<sup>h</sup> 00<sup>m</sup> a.m. l.m.t. set off 35° 33' N. on the lab. arc, 5° 49' S. on the decl. arc. and determine a meridian with the solar. and mark a point thereof by a tack driven in the stake already set 5.00 chs N. of my instrument. This point falls 0.4 ins E. of the point established by the Polaris observations.

At 3<sup>h</sup> 00<sup>m</sup> p.m. l.m.t. set off 35° 33' N. on the lab. arc, 5° 42' S. on the decl. arc. and determine a meridian with the solar and mark a point thereof by a tack driven in the stake already set 5.00 chs N. of my instrument. This point

BOOK 2589

falls 0.3 in west of the point determined by the Polaris observation.

The solar apparatus by a.m. and p.m. observations defines positions for meridians respectively about 0'21" East and 0'15" west of the meridian established by the Polaris observation, therefore I conclude that the adjustments of the instrument are satisfactory

March 6<sup>th</sup> 1910

March 8, 1910: At 7<sup>h</sup> 30<sup>m</sup> a.m. <sup>l.m.t.</sup> set off 35° 30' 1/2" N. on the lat. arc. 5' 02" S. on the decl. arc. and determine a meridian with the solar alt. the stand. cor. of secs. 35 and 36. T 25 N, R 16 E which I re-established March 7, 1908 and described in Standard Book "F" latitude 35° 30' 35" N. Longitude 110° 36' W.

Then I run:

N 0° 01' W. bet. sec. 35 and 36.

Across S.E. slope over rolling sandy land through scattering sage and greasewood brush undergrowth and bunch grass

40.00 Shaw iron post. 3 ft. long 1 in. in diam. 26 ins. in the ground for 1/4 sec. cor. marked on brass cap 1/4 S 35 on W. half and S 36 on E. half.

Dig pits 18x18x12 ins N and S. of post. 3 ft. dia and raise a mound of earth 3 1/2 ft. base. 1 1/2 ft. high W. of cor.

80.00 Shaw iron post. 3 ft. long. 2 in. in diam. 24 ins. in the ground for cor. of secs. 25, 26, 35 and 36 marked on brass cap. T 25 N. S 26 in NW. R 16 E. S 25 in NE. S 36 in SE. and S 35 in SW.

quadrant.

Dig pits 18x18x12 ins. in each. sec. 5 1/2 ft. dia. and raise a mound of earth 4 ft. base. 2 ft. high. W. of cor.

Land rolling

Soil sandy 3<sup>rd</sup> rate.

No timber

East on a haulow line bet. sec. 25 and 36.

40.00 Set temp. 1/4 sec. cor.

Chain

80.06 Intersect the 4<sup>th</sup> <sup>2nd</sup> <sup>estab. by me & described in Standard Book "A"</sup> <sup>sec. 25, 30, 31 and 36</sup> <sup>thence down</sup> <sup>W 89° 55' W.</sup> <sup>on a true line bet. sec. 25 and 36.</sup> <sup>ascend.</sup> <sup>E. slope over hilly sandy land through scattering sage and greasewood brush undergrowth and bunch grass.</sup>

17.00 Top of sand ridge bears N and S. desc W. slope  
25.15 Old road bears N 30° E and S 30° W. leads to Burro Spring.

40.08 Set an iron post 3 ft. long 1 in. in diam 26 ins in the ground for 1/4 sec. cor. marked on brass cap 4 S 25 on N. half and S 36 on S. half Dig pits 18x18x12 ins. E and W. of post. 3 ft. dia. and raise a mound of earth 3 1/2 ft. base. 1 1/2 ft. high. W. of cor.

61.00 Dry ravine course South ascend E. slope over rolling land.

80.06 The cor. of sec. 25, 26, 35 and 36, heretofore described. Land rolling and hilly. Soil sandy 3<sup>rd</sup> rate. No timber

W 0° 01' W. bet. sec. 25 and 26.

Ascend gradually S.E. slope over hilly sandy land through scattering sage and greasewood brush undergrowth and bunch grass.

40.00 Set an iron post 3 ft. long 1 in. in diam. 26 ins. in the ground for 1/4 sec. cor. marked on brass cap 4 S 26 on W. half and S 25 on E half. Dig pits 18x18x12 ins. N and S. of post. 3 ft. dia. and raise a mound of earth 3 1/2 ft. base 1 1/2 ft. high. W. of cor.

52.00 Foot of sand stone bluff. 20 ft. high. bears N 60° E and S 60° W. ascend obliquely.

56.00 Top of a bluff ascend on bluff. bears N.E. and S.W. leave hilly land bears N.E. and S.W. Enter level mesa land.

80.00 Set an iron post 3 ft. long 2 ins. in diam 24 ins in the ground for cor. of sec. 23, 24, 25 and 26 marked on brass cap. T 25 N. S 23 in N.W. R 16 E S 24 in N.E. S 25 in S.E. and S 26 in S.W. quad.

## Subdivision of Twp 25 N. R 16 E

BOOK 2589

Dig pits 18x18x12 ins. in each sec. 5 1/2 ft. dia.  
and raise a mound of earth 4 ft. base 2 ft. high.  
W. of cor.

Level level and hilly.

Soil sandy and stony 3<sup>rd</sup> and 4<sup>th</sup> rate.

No timber

NOTE At this cor. D. reb. at 4° 59' S. on the decl. arc and  
at noon observe the sun on the meridian and  
obtain on the lat. arc a reading of 35° 32 1/2' N.

89° 55' E on a random line bet. sec. 24 and 25  
40.00 Sep. temp 1/4 sec. cor.

80.16 Intersect the 4<sup>th</sup> <sup>estab. by me & described in Standard Book "A"</sup> Guide Meridian East. 16 lbs.  
S. of the cor. of sec. 19, 24, 25 and 30, <sup>Thence</sup> Drum  
89° 58' W. on a true line bet. sec. 24 and 25

Over level sandy land through scattering sage  
brush, undergrowth and bunch grass

0.80 Over level land bears N.W. and S.E. Enter broken  
stony land. descend abruptly over sand stone ledge  
10 ft. high.

1.26 Top of ledge bears N.W. and S.E. desc. steeply.

23.25 Dry sand wash. 25 lbs wide, 2 ft. deep course.  
South, arc.

40.08 Set an iron post 3 ft. long 1 in. in dia. and 26 ins. in  
the ground for 1/4 sec. cor. marked on brass cap  
145 on N. half and 325 on S. half

Dig pits 18x18x12 ins. East W. of post. 3 ft. dia.  
and raise a mound of earth 3 1/2 ft. base, 1 1/2 ft.  
high N. of cor.

45.00 Top of escarp on E. edge of mesa. 75 ft. above  
cor. bears N.E. and S.W. Run hilly land bears  
N.E. and S.W. Enter level mesa land bears  
N.E. and S.W.

80.16 The cor. of sec. 23, 24, 25 and 26, heretofore  
Land level and hilly. (described)

Soil sandy 3<sup>rd</sup> and 4<sup>th</sup> rate.

No timber

W 0° 01' W. bet. sec. 23 and 24

Over level sandy mesa land through scattering



Subdivision of N/4 25 N. R 16 E

Chain

- 40.00 Sage brush undergrowth and bunch grass. Set an iron post 3 ft. long, 1 in. in diam. 26 ins. in the ground for 1/4 sec. cor. marked on brass cap 1/4 S 230 W. half and S 24 on E. half. Dig pits 18x18x12 ins. N and S. of post. 3 ft. deep and raise a mound of earth 3 1/2 ft. base, 1 1/2 ft. high. W. of cor.
- 46.00 North edge of mesa leave level land toward N.E. and S.W. Enter hilly broken land. Leave N.E. and S.W. descend steep N.W. slope of mesa.
- 56.00 Dry canal course N.E. side.
- 76.12 Begin ascent over south slope of stony ridge
- 77.80 N/4 of spur leave N.E. and S.W. descend abruptly over N.W. slope
- 80.00 Set an iron post 3 ft. long 2 ins. in diam. 24 ins. in the ground for cor. of secs. 13, 14, 23 and 24 marked on brass cap. T 25 N. S 14 in N.W. R 16 E. S 13 in N.E. S 24 in S.E. and S 28. in S.W. quadrants. Dig pits 18x18x12 ins. in each. Sec. 5 1/2 ft. deep and raise a mound of earth 4 ft. base 2 ft. high W. of cor.  
Land level and hilly.  
Soil sandy and stony 3<sup>rd</sup> and 4<sup>th</sup> rate.  
No timber

- 40.00 N 89° 58' E on a random line bet. secs. 13 and 24 Set temp 1/4 sec. cor.
- 80.20 Intersect the 4<sup>th</sup> <sup>estab. by me & described in Standard Book "A"</sup> Guide Meridian East. 5 lbs. S. of the cor. of secs. 13, 18, 19 and 24. Hence run S 89° 56' W. on a true line bet. secs. 13 and 24 Over level sandy mesa land through scattering sage brush and bunch grass.
- 40.10 Set an iron post. 3 ft. long 1 in. in diam. 26 ins. in the ground for 1/4 sec. cor. marked on brass cap 1/4 S 13 on N. half. and S 24 on S. half. Dig pits 18x18x12 ins. East W. of post. 3 ft. deep and raise a mound of earth 3 1/2 ft. base 1 1/2 ft. high. N. of cor.
- 61.40 West edge of mesa, leave level land toward N 30° E and S 20° W. Enter hilly broken land. descend steep rocky W. slope.

## Subdivision of Tp 25 N. R 16 E.

6

Chain

BOOK 2589

- 62.50 Foot of steep descent desc. gradually.  
 74.00 Dry ravine course N. and S.  
 80.20 The cor. of secs. 13, 14, 23 and 24, heretofore described  
 Land level, hilly and broken,  
 Soil sandy and stony 3<sup>rd</sup> and 4<sup>th</sup> rate.  
 No timber.

March 8<sup>th</sup> 1910.

March 10<sup>th</sup> 1910  
 At 8<sup>h</sup> 00<sup>m</sup> a.m. <sup>l.m.t.</sup> Dsch off.  $35^{\circ}33'N$   
 on the lat. arc.  $4^{\circ}15'$  S. on the decl. arc. and  
 determine a meridian with the solar ab.  
 the cor. of secs. 13, 14, 23 and 24, <sup>heretofore described</sup> then I run  
 $N0^{\circ}01'W$  bet. secs. 13 and 14.

- Descent N.E. slope over hilly land through scattering  
 sage brush undergrowth and bunch grass
- 17.50 Foot of descent in depression bears E and W.  
 drains to the West. ascend gradually.
- 30.48 Begin abrupt ascent over perpendicular  
 sand stone bluff. 30 ft. high. bears E and W.
- 30.75 Top of ascent on bluff. bears E and W. Leave  
 hilly land bears E and W. Enter level mesa  
 land.
- 40.00 Set an iron post. 3 ft. long 1 in. in diam. 26 ins  
 in the ground for  $\frac{1}{4}$  sec. cor. marked on brass  
 cap  $\frac{1}{4}$  S 14 on W. half and S 13 on E half.  
 Dig pits 18x18x12 ins. N and S. of post. 3 ft. dia.  
 and raise a mound of earth  $3\frac{1}{2}$  ft. base.  $1\frac{1}{2}$  ft. high.  
 W. of cor.
- 80.00 Set an iron post. 3 ft. long 2 ins. in diam. 24 ins. in  
 the ground for cor. of secs. 11, 12, 13 and 14 marked  
 on brass cap T 25 N S 11 in N.W. 716 E S 12 in N.E.  
 S 13 in S.E. and S 14 in S.W. quadrants.  
 Dig pits 18x18x12 ins. in each. sec.  $5\frac{1}{2}$  ft. dia.  
 and raise a mound of earth 4 ft. base. 2 ft. high.  
 W. of cor.  
 Land level and hilly.  
 Soil sandy and stony 3<sup>rd</sup> and 4<sup>th</sup> rate.  
 No timber

$N89^{\circ}56'E$  on a random line bet. secs. 12 and 13.

- 40.00 Set temp  $\frac{1}{4}$  sec. cor.

Subdivision of T<sub>4</sub> 25 N. 116 E.

Notes

7

- 80.08 Intersect the 4<sup>th</sup> Guide Meridian East. 8 lvs. S. of the cor. of <sup>estab. by me & described in Standard Book "A"</sup> secs. 7, 12, 13 and 18. Thence I run S 89° 53' W. on a true line bet. secs. 12 and 13. Over level sandy land through scattering sage and greasewood brush undergrowth and bunch grass.
- 40.04 Set an iron post 3 ft. long 1 in. in diam. 26 ins. in the ground for  $\frac{1}{4}$  sec. cor. marked on brass cap  $\frac{1}{4}$  S 12 on N. half and S 13. on S. half. Dig pits 18 x 18 x 12 ins. E and W. of post. 3 ft. dia. and raised a mound of earth  $3\frac{1}{2}$  ft. base.  $1\frac{1}{2}$  ft. high W. of cor.
- 80.08 The cor. of secs. 11, 12, 13 and 14, hereinbefore described. Land level. Soil sandy 3<sup>rd</sup> rate. No timber
- No 01' W bet. secs. 11 and 12. Over level sandy mesa land through scattering sage and greasewood brush undergrowth and bunch grass.
- 40.00 Set an iron post. 3 ft. long 1 in. in diam 26 ins. in the ground for  $\frac{1}{4}$  sec. cor. marked on brass cap  $\frac{1}{4}$  S 11 on W. half and S 12. on E half. Dig pits 18 x 18 x 12 ins. N. and S. of post. 3 ft. dia. and raised a mound of earth  $3\frac{1}{2}$  ft. base  $1\frac{1}{2}$  ft. high. W. of cor.
- 49.80 North edge of mesa, level land bears N.E. and S.W. enter hilly and broken land. desc. N.W. slope.
- 56.20 Foot of descent in dry sand wash. 15 lvs. wide course N.W. acc. S. slope of mesa.
- 63.40 Top of ascent on S. edge of mesa bears E and W. Leave hilly broken land bears E and W. Enter level land bears E. and W.
- 80.00 Set an iron post 3 ft. long. 2 ins. in diam 24 ins. in the ground for cor. of secs. 1, 2, 11 and 12, marked on brass cap T 25 N. S 2 in N.W. T 16 E. S 1 in N.E. S 12 in S.E. and S 11 in S.W. quadrants. Dig pits 18 x 18 x 12 ins. in each sec.  $5\frac{1}{2}$  ft. dia. and raised a mound of earth 4 ft. base, 2 ft. high.

BOOK 2589

W of cor  
Land level, hilly and broken.  
Soil sandy 3<sup>rd</sup> and 4<sup>th</sup> rate.  
No timber

NOTE Ob this cor. I set off  $4^{\circ}12'S$  on the decl. arc. and  
at noon observe the sun on the meridian, and  
obtain on the lat. arc a reading of  $35^{\circ}35'N$ .

- 40.00 Set temp.  $\frac{1}{4}$  sec. cor.
- 80.06 Intersect the 4<sup>th</sup> Guide Meridian East, 5 lks N.  
of the cor. of secs. 1, 6, 7 and 12, <sup>estab. by me & described in Standard Book "A"</sup> Thence I run  
 $S89^{\circ}53'W$  on a true line bet. secs. 1 and 12.  
Over level sandy land, through scattering sage  
and greasewood brush undergrowth and bunch  
grass.
- 40.03 Set an iron post 3 ft. long, 1 in. in diam. 26 ins.  
in the ground for  $\frac{1}{4}$  sec. cor. marked on brass  
cap  $\frac{1}{4}$  S on N half and S 12 on S half.  
Dig pits 18 x 18 x 12 ins E and W. of post. 3 ft. dia  
and raise a mound of earth  $3\frac{1}{2}$  ft. base,  $1\frac{1}{2}$  ft.  
high. N of cor.
- 80.06 The cor. of secs. 1, 2, 11 and 12, herebefore described.  
Land level.  
Soil sandy 3<sup>rd</sup> rate.  
No timber

- 40.00 Set temp.  $\frac{1}{4}$  sec. cor.
- 80.48 Intersect N. l. l. of Twp. 8 lks. N. 81<sup>th</sup> W. of the cor. of secs.  
<sup>estab. by me & described in Exterior Book "K"</sup> 1, 2, 35 and 36, Thence I run  
 $S0^{\circ}02'W$  bet. secs. 1 and 2.  
Ascend N. slope over rolling sandy land through  
scattering sage and greasewood brush undergrowth  
and bunch grass.
- 40.48 Set an iron post 3 ft. long 1 in. in diam. 26 ins. in  
the ground for  $\frac{1}{4}$  sec. cor. marked on brass cap.  
 $\frac{1}{4}$  S 2 on W. half and S 1 on E. half.

chain

9

80.48 Dig pits 18x18x12 ins. N. and S. of post 3ft. dist. and raise a mound of earth 3 1/2 ft. base, 1 1/2 ft. high W. of cor. The cor. of secs. 1, 2, 11, and 12, heretofore described.  
Land rolling  
Soil sandy 3rd rate.  
No timber

March 10, 1910.

March 9<sup>th</sup> 1910 At 7<sup>h</sup> 30<sup>m</sup> a <sup>1. mt.</sup> set off. 35° 30 1/2' N. on the left and 4° 38 1/2' S. on the decl. arc and determined a meridian with the solar on the stand. Cor. of sec. 34 and 35 <sup>re-estab. by me & described in Standard Book "F"</sup> on S. line of Twp. 25 N. thence I run N 0° 0' W. bet. sec. 34 and 35.  
Ascend gradually S.E. slope over rolling sandy land through scattering sage brush and bunch grass.

40.06 Set an iron post 3ft. long, 1 in. in diam. 26 ins. in the ground for 1/4 sec. cor. marked on brass cap. 7/8 S 34 on W. half and S 35 on E. half. Dig pits 18x18x12 ins. N. and S. of post 3ft. dist. and raise a mound of earth 3 1/2 ft. base 1 1/2 ft. high W. of cor.

80.00 Set an iron post 3ft. long, 2 ins. in diam. 24 ins. in the ground for cor. of sec. 26, 27, 34 and 35 marked on brass cap. T 25 N. S 27 in N.W., R 16 E. S 26 in N.E. S 35 in S.E. and S 34 in S.W. quadrants. Dig pits 18x18x12 ins. in each sec. 5 1/2 ft. dist. and raise a mound of earth 4 ft. base, 2 ft. high W. of cor.  
Land rolling.  
Soil sandy 3rd rate.  
No timber

40.00 S 89° 47' E on a random line bet. sec. 26 and 35. Set temp. 1/4 sec. cor.

80.28 Intersect N and S. line 3 lks. N. of the cor. of sec. 25, 26, 35 and 36, <sup>heretofore described</sup> thence I run N 89° 46' W. on a true line bet. sec. 26 and 35.

Ascend S.E. slope over rolling sandy land through scattering sage brush undergrowth and bunch grass.

40.14 Set an iron post 3ft. long 1 in. in diam. 26 ins. in the ground for 1/4 sec. cor. marked on brass cap.

BOOK 2589

$\frac{1}{4}$  S 26 on N. half and S 35 on S. half.

Dig pits 18x18x12 ins. E. and W. of post 3 ft. dia. and raise a mound of earth  $3\frac{1}{2}$  ft. base,  $1\frac{1}{2}$  ft. high. N. of cor.

80.28 The cor. of sec. 26, 27, 34 and 35, heretofore described.  
Land rolling.

Soil sandy 3<sup>rd</sup> rate.  
No timber

N $0^{\circ}01'$  W. bet. sec. 26 and 27.

Ascend S.E. slope over rolling sandy land, through scattering sage and greasewood bush undergrowth and bunch grass.

40.00 See an iron post 3 ft. long, 1 in. in diam. 26 ins. in the ground for  $\frac{1}{4}$  sec. cor., marked on base cap.  $\frac{1}{4}$  S 27 on W. half and S 26 on E. half.

Dig pits 18x18x12 ins. N. and S. of post 3 ft. dia. and raise a mound of earth  $3\frac{1}{2}$  ft. base,  $1\frac{1}{2}$  ft. high. W. of cor.

70.50 Top of ridge hard N.E. and S.W. decl.

80.00 See an iron post 3 ft. long, 2 ins. in diam., 24 ins. in the ground for cor. of sec. 22, 23, 26, and 27 marked on base cap. T 25 N. S 22 in N.W., R 16 E S

23 in N.E., S 26 in S.E. and S 27 in S.W. quadrant  
Dig pits 18x18x12 ins. in each sec.  $5\frac{1}{2}$  ft. dia. and raise a mound of earth 4 ft. base 2 ft. high. W. of cor.

Land rolling  
Soil sandy 3<sup>rd</sup> rate.  
No timber

NOTE At this cor. Dreb off.  $4^{\circ}35\frac{1}{2}'$  S. on the decl. arc. and at noon observed the sun on the meridian the resulting latitude being  $35^{\circ}32\frac{1}{2}'$  N.

S  $89^{\circ}46'$  E on a random line bet. sec. 23 and 26.

40.00 See temp.  $\frac{1}{4}$  sec. cor.

80.28 Intersect N. and S. line 5 lbs. S. of the cor. of sec. 23, 24, 25 and 26, <sup>heretofore described</sup> thence run

N  $89^{\circ}48'$  W. on a true line bet. sec. 23 and 26.

Over level sandy mesa land through scattering sage bush undergrowth and bunch grass.

Chain

4014 Set an iron post 3 ft. long 1 in. in diam. 26 ins in the ground for  $\frac{1}{4}$  sec. cor. marked on brass cap  $\frac{1}{4}$  S 23 on N. half and S 26 on S. half.

Dig pits 18x18x12 ins E and W. of post. 3 ft. deep and raise a mound of earth  $3\frac{1}{2}$  ft. base,  $1\frac{1}{2}$  ft. high N. of cor.

8028 The cor. of secs. 22, 23, 26 and 27, herebefore land level, described.  
Soil sandy 3<sup>rd</sup> rate.  
No timber

N $0^{\circ}$ 01'W. bet. secs 22 and 23.

Over rolling sandy land through scattering sage brush undergrowth and bunch grass

2,20 Near rolling land bears N.E. and S.W. Enter broken hilly land. descend abruptly over N.W. slope.

5,50 Sandstone ledge 30 ft. high. bears N.E. and S.W. desc.

8,00 Top of abrupt. desc. desc. gradually.

17,15 No bar of 'Chimney rock. 40 ft. in diameter. 100 ft. high. too steep to climb. No pass rock. D. offset. as follows.

West. 50 lbs. thence N $0^{\circ}$ 01'W. 1.00 ch. thence East. 50 lbs. to true line at base of rock on north side.

4000 Set an iron post. 3 ft. long 1 in. in diam. 26 ins. in the ground for  $\frac{1}{4}$  sec. cor. marked on brass cap  $\frac{1}{4}$  S 22 on W. half and S 23 on E. half.

Dig pits 18x18x12 ins. N and S. of post. 3 ft. deep and raise a mound of earth  $3\frac{1}{2}$  ft. base  $1\frac{1}{2}$  ft. high W. of cor.

8000 Set an iron post. 3 ft. long 2 ins in diam 24 ins. in the ground for cor. of secs 14, 15, 22, and 23. marked on brass cap. T 25 N. S 15 in N.W. T 16 E S 14 in N.E. S 23 in S.E. and S 22 in S.W. quadrants.

Dig pits 18x18x12 ins. in each sec.  $5\frac{1}{2}$  ft. deep and raise a mound of earth 4 ft. base 2 ft. high W. of cor.

Land rolling and hilly.

Soil sandy and stony 3<sup>rd</sup> and 4<sup>th</sup> rate.

No timber

Subdivision of Twp 25 N. R 16 E

Chains

BOOK 2589

40.00 S 89° 48' E on a random line bet. sec. 14 and 23  
Sec temp 1/4 sec. cor.

80.22 Intersect N and S. line at the cor of sec 13,  
14, 23 and <sup>heretofore described</sup> 24. Thence I run

N 89° 48' W. on a true line bet. sec 14 and  
23.

Descend N.W. slope over rolling sandy land  
through scattering sage brush undergrowth  
and bunch grass.

40.11 Set an iron post 3 ft. long 1 in in diam. 26  
ins. in the ground for 1/4 sec. cor. marked on  
brass cap 1/4 S 14 on N half. and S 28 on S.  
half.

Dig pits 18x18x12 ins. E and W. of post.  
3 ft. dish and raise a mound of earth  
3 1/2 ft. base 1 1/2 ft. high. W. of cor.

80.22 The cor of sec. 14, 15, 22 and 23, <sup>heretofore</sup> described.  
Land rolling and hilly.  
Soil sandy 3rd rate.  
No timber

March 9<sup>th</sup> 1910

March 12<sup>th</sup> <sup>1910</sup> at 7<sup>h</sup> 30<sup>m</sup> a.m. <sup>l.m.t.</sup> set off. 35° 33' N  
on the lat. arc 3° 28' S on the decl arc and  
determine a meridian with the solar at the  
cor. of. sec. 14, 15, 22 and <sup>heretofore described</sup> 23. Thence I run  
N 6° 01' W. bet. sec 14 and 15.

Descend N.W. slope over rolling and hilly sandy  
land through scattering sage brush undergrowth  
and bunch grass.

25.00 Foot of descent in depression bears E and W  
drains W. h. ascend gradually over S. slope

40.00 Set an iron post 3 ft. long 1 in. in diam  
26 ins. in the ground for 1/4 sec. cor marked  
on brass cap 1/4 S 15 on W. half and S 14 on  
E. half.

Dig pits 18x18x12 ins. N and S. of post 3 ft.  
dish. and raise a mound of earth 3 1/2 ft  
base, 1 1/2 ft. high. W. of cor.

80.00 Set an iron post. 3 ft. long. 2 ins. in diam  
24 ins in the ground for cor of sec 10, 11  
14 and 15 marked on brass cap T 25 N S 15.



in NW, T16E S11 in NE, S14 in S.E. and S15 in S.W. quadrants.

Raise a mound of stone 2 ft. base, 1 1/2 ft. high. W. of cor. Pits impracticable.

Land rolling

Soil sandy 3rd rate.

No timber

40.00 S89°48'E on a random line bet. sec. 11 and 14  
Set temp. 1/4 sec. cor.

80.24 Intersect N and S. line 3 lks. N. of the cor. of  
sec. 11, 12, 13 and 14 <sup>hereinbefore described</sup> thence run.

N89°47'W, on a true line bet. sec. 11 and 14

Over level sandy mesa land, through scattering  
sage brush undergrowth and bunch grass

40.12 Set an iron post 3 ft. long 1 in. in diam. 26  
ins. in the ground for 1/4 sec. cor. marked  
on bears cop. 1/4 S11 on N. half and S14 on S.  
half

Dig pits 18x18x12 ins. East W. of post. 3 ft.  
deep and raise a mound of earth 3 1/2 ft.  
base, 1 1/2 ft. high. N. of cor.

80.00 Leave level land bears NW, and S.E. Enter broken  
hilly land, desc. steeply over S.W. slope.

80.24 The cor. of sec. 10, 11, 14 and 15, hereinbefore  
described.

Land level and hilly.

Soil sandy 3rd rate.

No timber

N0°01'W, bet. sec. 10 and 11

Ascend S.W. slope over broken hilly land through  
scattering sage brush undergrowth and bunch  
grass.

0.88 Begin abrupt ascent over sandstone ledge 5 ft. high.  
bears NW and S.E.

1.25 Top of ascent on S. edge of mesa bears NW  
and S.E. Leave broken hilly land bears NW and  
S.E. Enter level sandy mesa land.

19.30 Leave level land bears E and W. Enter hilly  
land bears E and W. desc. N. slope.

BOOK 2589

- 40.00 Set an iron post 3 ft. long 1 in. in diam. 26 ins. in the ground for  $\frac{1}{4}$  sec. cor. marked on brass cap  $\frac{1}{4}$  S 10 W. half and S 11 on E. half.  
Dig pits 18x18x12 ins. N and S. of post. 3 ft. dia and raise a mound of earth  $3\frac{1}{2}$  ft. base,  $1\frac{1}{2}$  ft. high W. of cor.
- 53.00 Foot of descent in depression bears E and W drain to the west. ascend gradually over S. slopes
- 77.80 Foot of perpendicular sandstone cliff 90 ft. high bears E and W. asc.
- 78.00 Top of escarp on cliff. Level broken stony land bears E and W. Enter level sandy mesa land bears E and W.
- 80.00 Set an iron post 3 ft. long, 2 ins. in diam 24 ins. in the ground for cor. of sec. 2, 3, 10 and 11 marked on brass cap T 25 N S 3 in N.W., R 16 E. S 2 in N.E. S 11 in S.E. and S 10 in S.W. quadrants.  
Dig pits 18x18x12 ins. in each. rec.  $5\frac{1}{2}$  ft. dia. and raise a mound of earth 4 ft. base, 2 ft. high. W. of cor.  
Land level hilly and broken  
Soil sandy and stony 3<sup>rd</sup> and 4<sup>th</sup> rate.  
No timber
- NOTE At this cor. I set off.  $3^{\circ}25'S$ . on the decl. arc and at noon observed the sun on the meridian the resulting latitude being  $35^{\circ}35'26''$ .
- 89°47' E on a random line bet. sec 2 and 11  
40.00 Set temp.  $\frac{1}{4}$  sec. cor.
- 80.14 Intersects N and S. line 3 lps N. of the cor. of sec. 1, 2, 11 and 12 <sup>heretofore described</sup> Thence I run  
N 89°46' W. on a true line bet. sec. 2 and 11  
Over level sandy mesa land through scattering sage brush undergrowth and bunch grass
- 35.96 Leave level land bears N.W. and S.E. Enter broken stony land. bears N.W. and S.E., descend abruptly over sand stone cliffs
- 37.40 Foot of descent in dry ravine course South asc.
- 40.07 Set an iron post. 3 ft. long 1 in. in diam. 26 ins. in

Subdivision of Twp 25 N. R 16 E.

Chain

- the ground for  $\frac{1}{4}$  sec. cor. marked on brass cap.  
 $\frac{1}{4}$  S 2 on W half and S 11 on S. half.  
 Raise a mound of stone 2 ft. base,  $1\frac{1}{2}$  ft. high.  
 No. of cor pits impracticable
- 41.30 Top of arcut. on Edge of mesa bears N.E. and  
 S.W. bears broken stony land bears N.E. and S.W.  
 Enter level sandy land bears N.E. and S.W.
- 80.14 The cor. of secs. 2, 3, 10 and 11, herebefore described.  
 Land level and broken.  
 Soil sandy and stony 3<sup>rd</sup> and 4<sup>th</sup> rate.  
 No timber
- 
- 40.00 No<sup>o</sup> 01' W. on a random line bet. sec. 2 and 3.  
 Set temp  $\frac{1}{4}$  sec. cor.
- 80.46 Intersect N. line of Twp. 14 lks. N. 89<sup>o</sup> 41' W. of the cor.  
 estab. by me & described in Exterior Book "JK"  
 of secs 2, 3, 34 and 35. Hence I run  
 S 0<sup>o</sup> 05' W. on a true line bet. sec. 2 and 3.  
 Ascend steep N.W. slope over broken hilly land  
 through scattering sage brush undergrowth  
 and bunch grass
- 4.50 Top of steep arcut. ascend gradually
- 36.50 Top of sand ridge bears East W. desc. steeply
- 40.46 Set an iron post 3 ft. long 1 in. in diam. 26  
 ins. in the ground for  $\frac{1}{4}$  sec. cor. marked  
 on brass cap  $\frac{1}{4}$  S 3 on W half and S 2 on E.  
 half.  
 Dig pits 18 x 18 x 12 ins. N and S. of post. 3 ft.  
 dia. and raise a mound of earth 3  $\frac{1}{2}$  ft.  
 base,  $1\frac{1}{2}$  ft. high. W. of cor.
- 50.70 North Edge of canyon bears East W. desc abruptly
- 56.00 Bottom of canyon. Cross dry ravine course W.  
 ascend abruptly;
- 60.25 Top of arcut. on S. Edge of canyon, bears  
 broken stony land bears E and W. Enter  
 level sandy mesa land bears E and W.
- 80.46 The cor. of secs. 2, 3, 10 and 11, herebefore described.  
 Land level hilly and broken  
 Soil sandy and stony 3<sup>rd</sup> and 4<sup>th</sup> rate.  
 No timber

March 12<sup>th</sup> 1910

BOOK 2589

- March 11<sup>th</sup> 1910, Ab. 7<sup>h</sup> 15<sup>m</sup> <sup>l.m.t.</sup> <sup>am</sup> <sup>dash off</sup> 35° 30½' N. on the lat. arc. 3° 51½' S. on the decl. arc. and determine a meridian with the solar ab. the Standard Cor. of Secs. 33 and 34. <sup>re-estab. by me & described in Standard Book "F"</sup> on S. 1/4 of Twp. Thence run N 0° 02' W. 1/4 sec. 33 and 34.
- Descend N.W. slope over hilly sandy land, through scattering sage and greasewood brush undergrowth and bunch grass.
- 16.50 Dry sand wash 20 lbs. wide 2 ft. deep course S.W. arc.
- 37.40 Top of sand ridge bears N.E. and S. W. decl steeply.
- 40.00 Set an iron post 3 ft. long 1 in in diam. 26 ins. in the ground for ¼ sec. cor. marked on brass cap. ¼ S 33 on W. half and S. 34 on E. half., dig pits 18 x 18 x 12 ins. N and S. of post. 3 ft. dist. and raise a mound of earth 3½ ft. base, 1½ ft. high W. of cor.
- 42.40 Dry ravine 50 ft. below ¼ sec cor. course S.W. arc.
- 46.00 Top of adobe ridge 30 ft. high bears N.E. and S.W. decl.
- 49.45 Dry ravine course S.W. arc
- 54.00 Top of adobe ridge bears N.E. and S.W. decl.
- 56.15 Dry ravine course S.W. arc.
- 58.10 Top of adobe ridge bears N.E. and S.W. decl.
- 61.00 Dry ravine course S.W. arc.
- 62.30 Top of ridge bears E and W. decl
- 63.50 Wet sand ravine course S.E. arc.
- 80.00 Set an iron post 3 ft. long 2 ins. in diam 24 ins. in the ground for cor. of secs. 27, 28, 33 and 34 marked on brass cap T 25' N. S 28' in N.W. T 16 E. S 27' in N.E. S 34' in S.E. and S 33' in S.W. quadrant. dig pits 18 x 18 x 12 ins. in each. sec. 5½ ft. dist. and raise a mound of earth 4 ft. base 2 ft. high. W. of cor.,  
Land hilly.  
Soil sandy and adobe 3<sup>rd</sup> and 4<sup>th</sup> rate.  
No timber
- 
- 89° 42' E on a random line bet. sec. 27 and 34
- 40.00 Set temp. ¼ sec. cor.
- 80.02 Intersect N and S. line 5 lbs S. of the cor. of sec. 26

Subdivision of Tp 25 N. R 16 E.

Chains

- heretofore described  
 27, 34 and 35, <sup>Thereed Draw,</sup>  
 N 89° 44' W. on a true line bet sees. 27 and 34  
 Ascend S.E. slope over rolling sandy land through  
 scattering sage brush and bunch grass.  
 40.01 Set an iron post 3/4 ft. long 1 in. in diam. 26 ins. in  
 the ground for 1/4 sec. cor. marked on brass cap.  
 1/4 S 27 on W. half and S 34 on S. half.  
 Dig pits 18x18x12 ins. E and W. of post. 3/4 ft. dia. and  
 raise a mound of earth 3 1/2 ft. base, 1 1/2 ft. high.  
 N. of cor.  
 43.70 Top of sand ridge 20 ft. above 1/4 sec. cor. bears N.E. and  
 S.W. bears rolling land bears N.E. and S.W. Enter  
 hilly land. Desc. N.W. slope.  
 49.00 Foot of descent in depression bears N.E. and S.W. drains  
 to the S.W. asc.  
 68.30 Top of spur bears N.E. and S.W. Extends 8.00 chs.  
 S.W. of line. desc over S.W. slope  
 80.02 The cor. of sees. 27, 28, 33 and 34, heretofore described.  
 Land rolling and hilly  
 Soil sandy and stony 3<sup>rd</sup> and 4<sup>th</sup> rate.  
 No timber
- 
- N 90° 02' W bet sees. 27 and 28.  
 Ascend S.W. slope over hilly sandy and stony land  
 14.00 Top of divide bears N.E. and S.W. Descend N.W. slope.  
 40.00 Set an iron post 3/4 ft. long 1 in. in diam. 26 ins.  
 in the ground for 1/4 sec. cor. marked on brass cap.  
 1/4 S 28 on W. half and S 27 on E half.  
 Dig pits 18x18x12 ins. N. and S. of post. 3/4 ft. dia. and  
 raise a mound of earth 3 1/2 ft. base, 1 1/2 ft. high. W.  
 of cor.  
 45.60 North Edge of mesa on sandstone cliff. 150 ft.  
 high bears N.E. and S.W. desc. abruptly.  
 59.00 Foot of descent in depression at foot of mesa  
 bears N.W. and S.E. drains to the N.W. asc.  
 70.50 Top of sand ridge 20 ft. high. bears E and W. desc.  
 80.00 Set an iron post. 3/4 ft. long, 2 ins. in diam. 24 ins.  
 in the ground for cor. of sees 21, 22, 27 and 28.  
 marked on brass cap T 25 N 3 21 in N.W. R 16 E S.  
 22 in N.E. S 27 in S.E. and S. 28 in S.W. quadrants  
 Dig pits 18x18x12 ins in each. sec. 5 1/2 ft. dia. and  
 raise a mound of earth 4 ft. base. 2 ft. high W.

BOOK 2589

of cor.

Land hilly and broken.

Soil sandy and stony 3<sup>rd</sup> and 4<sup>th</sup> rate.

No timber

NOTE

At this cor. Dreh. off.  $3^{\circ}48\frac{1}{2}' S$ , on the decl. arc,  
and at noon observe the sun on the meridian  
and obtain on the lat. arc. a reading of  $35^{\circ}32\frac{1}{2}' N$ .

$S 89^{\circ}44' E$  on a random line bet. sec. 22 and 27,  
40.00 Set temp  $\frac{1}{4}$  sec. cor.

79.96 Thence ch. N and S line 5 lks. S. of the cor. of sec.  
22, 23, 26 and 27, <sup>heretofore described</sup> Thence I run

$N 89^{\circ}46' W$  on a true line bet. sec. 22 and 27,

Over level sandy mesa land through scattering  
sage and greasewood brush undergrowth and  
bunch grass.

12.20 W. edge of mesa. Leave level land bears  
N.E. and S.W. Enter broken stony land. bears N.E.  
and S.W. desc. abruptly over W. slope

12.60 Foot of abrupt descent desc. gradually.

19.75 Foot of descent in depression bears N.W. and  
S.E. drains to the N.W. sec.

39.98 Set an iron fork 3 ft. long 1 in. in diam. 26 in.  
in the ground for  $\frac{1}{4}$  sec. cor. marked on brass  
cap # 522 on N. half and S 27 on S. half.,  
Dig pits 18 x 18 x 12 in. East W. of fork. 3 ft. dia.  
and raise a mound of earth  $3\frac{1}{2}$  ft. base,  $1\frac{1}{2}$  ft.  
high N. of cor.

57.40 Top of sand ridge 40 ft. high. bears N and S. desc.

71.00 Foot of descent in depression bears N.E. and S.W.  
drains to the N.E. sec.

79.96 The cor. of sec. 21, 22, 27 and 28, heretofore  
Land level hilly and broken, <sup>(described)</sup>  
Soil sandy and stony 3<sup>rd</sup> and 4<sup>th</sup> rate.  
No timber.

$N 0^{\circ}02' W$ . bet. sec. 21 and 22.

Over low rolling sand hills. slopes to N.W. through  
scattering sage brush undergrowth and bunch  
grass.

Shaw's Subdivision of P. 25 N. R. 16 E

40.00 Set an iron post 3 ft long 1 in. in diam. 20 ins. in the ground for  $\frac{1}{4}$  sec. cor. marked on brass cap  $\frac{1}{4}$  S 21 on W. half and S 22 on E half.

Dig pits 18x18x12 ins. N and S. of post 3 ft. deep. and raise a mound of earth 3  $\frac{1}{2}$  ft. base 1  $\frac{1}{2}$  ft. high. W. of cor.

80.00 Set an iron post 3 ft. long 2 ins. in diam. 24 ins. in the ground for. cor. of secs. 15, 16, 21 and 22. marked on brass cap T 25 N. S 16 in N.W. R 16 E S 15 in N.E. S 22 in S.E and S 21 in S.W. quadrants.

Dig pits 18x18x12 ins. in each. sec. 5  $\frac{1}{2}$  ft. deep and raise a mound of earth 4 ft. base 2 ft. high. W. of cor.

Land hilly.  
Soil sandy 3<sup>rd</sup> rate.  
No timber.

N 89° 46' E on a random line bet. secs. 15 and 22.

40.00 Set temp  $\frac{1}{4}$  sec. cor.

79.96 Intersect N and S. line 5 lbs. N. of the cor. of secs. 14, 15, 22 and 23 <sup>herebefore described</sup> Thence S run

N 89° 44' W. on a true line bet. secs. 15 and 22.

Over rolling sandy land, through scattering sage and greasewood bush undergrowth and bunch grass.

39.98 Set an iron post 3 ft. long, 1 in. in diam 26 ins. in the ground for  $\frac{1}{4}$  sec. cor. marked on brass cap  $\frac{1}{4}$  S 15 on N. half and S 22 on S. half.

Dig pits 18x18x12 ins E and W. of post. 3 ft. deep. and raise a mound of earth 3  $\frac{1}{2}$  ft. base, 1  $\frac{1}{2}$  ft. high. N. of cor.

79.96 The cor. of secs 15, 16, 21 and 22, herebefore described.

Land rolling.  
Soil sandy 3<sup>rd</sup> rate.  
No timber.

March 11<sup>th</sup> 1910

March 16<sup>th</sup> 1910 ab. 7<sup>h</sup> 30<sup>m</sup> a.m. <sup>l.m.t.</sup> set off. 35° 33' 7" on the lab. arc. 1° 53  $\frac{1}{2}$ ' on the decl. arc and determined a meridian with the solar on the cor. of secs. 15, 16, 21 and 22, <sup>herebefore described</sup> Thence S run.

BOOK 2589

N 90° 02' W, Ch. sec. 15 and 16

Over rolling sandy land through scattering sage brush undergrowth and bunch grass

38.00 Begin gentle ascent over S.E. slope over hilly land bears N 8° and S 11°

40.00 Set an iron post 3 ft. long, 1 in. in diam. 26 ins. in the ground for 1/4 sec. cor. marked on brass cap 1/4 16 on W. half and S. 15 on E. half.

Dig pits 18 x 18 x 12 ins. N and S. of post. 3 ft. dia. and raise a mound of earth 3 1/2 ft. base 1 1/2 ft. high. W. of cor.

80.00 Set an iron post 3 ft. long, 2 in. in diam. 24 ins. in the ground for cor. of sec. 9, 10, 15 and 16, marked on brass cap T 25 N, S 9 in N. W., T 16 E S 10 in N. E. S 15 in S. E. and S 16 in S. W. quadrants.

Dig pits 18 x 18 x 12 ins. in each. sec. 5 1/2 ft. dia. and raise a mound of earth 4 ft. base, 2 ft. high. W. of cor

Land rolling.  
Soil sandy 3rd rate.  
No timber

40.00 S 89° 44' E on a random line bet. sec. 10 and 15  
Set temp. 1/4 sec. cor.

80.00 Intersect N and S. line 3 lks. N. of the cor. of sec. 10, 11, 14 and 15 <sup>hereinbefore described</sup> Thence S run

N 89° 43' W, on a true line bet. sec. 10 and 15

Over hilly sandy land, through scattering sage and greasewood bush, undergrowth and bunch grass

40.00 Set an iron post 3 ft. long 1 in. in diam. 26 ins. in the ground for 1/4 sec. cor. marked on brass cap 1/4 S 10 on N. half, and S 15 on S. half.

Dig pits 18 x 18 x 12 ins. East W. of post 3 ft. dia. and raise a mound of earth 3 1/2 ft. base, 1 1/2 ft. high. N. of cor.

57.00 Descend on bears N and S. drains to the south. Ascend gradually over E. slope of sand ridge

71.00 Top of sand ridge bears N and S. desc. W. slope. over low sand ridges.

80.00 The cor. of sec. 9, 10, 15 and 16, hereinbefore described. Land rolling and hilly. Soil sandy 3rd rate. No timber



Chains

N 0° 02' W. Ch. sec. 9 and 10.

Around S.E. slope over hilly sandy land through scattering sage and greasewood brush undergrowth and bunch grass.

- 9.40 Top of ridge bears N.E. and S.W. desc N.W. slope.
- 16.00 Foot of descent in circular depression sec.
- 18.30 Begin abrupt rockaceous over S. slope of mesa
- 20.75 Top of abrupt ascent on S. edge of mesa bears N.E. and S.W., leave broken hilly land bears N.E. and S.W., enter rolling sandy mesa land, bears N.E. and S.W.
- 33.20 North edge of mesa, leave rolling land bears N.E. and S.W. enter broken stony land. descend abruptly over N.W. slope.
- 35.00 Foot of abrupt descent at foot of mesa 75 ft. below top. leave broken stony land bears N.E. and S.W. enter rolling sandy land. descend gradually
- 40.00 Set an iron post 3 ft. long 1 in. in diam. 26 ins in the ground for  $\frac{1}{4}$  sec. cor. marked on base cap.  $\frac{1}{4}$  S 90 W. half. and S 10 on E. half.  
Dig pits 18x18x12 ins. N and S. of post 3 ft. dist. and raise a mound of earth 3  $\frac{1}{2}$  ft. base. 1  $\frac{1}{2}$  ft. high. W. of cor.
- 80.00 Set an iron post 3 ft. long 2 ins. in diam. 24 ins in the ground for cor. of sec. 3, 4, 9 and 10, marked on base cap T 25 N S 4 in N.W. T 16 E S 3 in N.E. S 10 in S.E. and S 9 in S.W. quadrant.  
Dig pits 18x18x12 ins in each sec. 5  $\frac{1}{2}$  ft. dist. and raise a mound of earth 4 ft. base, 2 ft. high. W. of cor.  
Land rolling hilly and broken.  
Soil sandy and stony 3<sup>rd</sup> and 4<sup>th</sup> rate.  
No timber

NOTE

At this cor I set off 1° 5' 0  $\frac{1}{2}$ ' S on the decl. arc and at noon observed the sun on the meridian and obtain on the lat. arc a reading of 35° 35' N.

S 89° 43' E. on a random line Ch. sec. 3 and 10.

- 40.00 Set temp.  $\frac{1}{4}$  sec. cor.
- 79.98 Intersect N and S. line at the cor. of sec. 2, 3, 10 and  $\frac{1}{4}$  hence I run heretofore described

BOOK 2589

- N 89° 49' W, on a true line bet. sec. 3 and 10  
Over level sandy mesa land, through scattering sage  
bush undergrowth and bunch grass.
- 1.50 East edge of Canyon 70 ft. deep. Level land bears  
N.E. and S.W., descend abruptly over broken stony land
- 3.00 Foot of descent in bottom of Canyon. Cross dry ravine  
course S.W. ascend abruptly
- 4.75 West edge of Canyon bears N.E. and S.W. Remains broken  
stony land bears N.E. and S.W. Enter level sandy mesa  
land.
- 16.60 West edge of mesa bears N.W. and S.E. Level sandy  
mesa land bears N.W. and S.E., descend perpendicular  
sand stone cliff 100 ft high. bears N.W. and S.E.
- 19.00 Foot of cliff. bears N.W. and S.E. descend gradually  
over rolling sandy land. slopes to N.W.
- 39.99 Suban iron post 3 ft. long 1 in. in diam. 26 ins. in  
the ground for 4 sec. cor. marked on brass, cap  
145 3 on N. half, and 310 on S. half.  
Dig pits 18 x 18 x 12 ins East W. of post. 3 ft. dia. and  
raise a mound of earth 3 1/2 ft. dia., 1 1/2 ft. high N.  
of cor.
- 79.98 The cor. of sec. 3, 4, 9 and 10, heretofore described.  
Land level rolling and broken.  
Soil sandy and stony 3<sup>rd</sup> and 4<sup>th</sup> rate.  
No timber

- N 0° 02' W, on a random line bet. sec. 3 and 4,  
40.00 Sub trap 1/4 sec. cor.
- 80.45 Intersect N. line of Twp. 16 lbs. N. 89° 41' W. of the cor. of sec.  
estab. by me & described in Exterior Book "K"  
3, 4, 33 and 34, Thence True.
- S 0° 05' W, on a true line bet. sec. 3 and 4,  
Over level sandy and adobe valley land, through  
scattering sage and greasewood bush undergrowth  
and bunch grass
- 3.45 Intersect Right bank of the Polacca Wash 10 ft. high.  
bears N. 50 E and S 50° W.
- 3.85 Center of dry bed of wash.
- 4.25 Left bank of the Polacca Wash. 10 ft. high. bears N.E.  
and S.W.
- 10.65 Right bank of branch of Polacca Wash. 20 ft. high.  
bears N.E. and S.W.

Chains

- 11.60 Center of dry bed of Wash. course S.W.
- 12.55 Left bank of the Place a Wash. 20 ft. high. bears N50°E and S50°W. thence over level land.
- 35.45 Leave level land bears N60°E and S60°W. Enter rolling sandy land. Ascend gently over N.W. slope
- 40.45 Set an iron post 3 ft. long 1 in. in diam 26 in. in the ground for  $\frac{1}{4}$  sec. cor. marked on brass cap  $\frac{1}{4}$  S 4 on W half. and S 3 on E. half.  
Dig pits 18x18x12 in. N and S. of post. 3 ft. dia and raise a mound of earth 3  $\frac{1}{2}$  ft. base. 1  $\frac{1}{2}$  ft. high. W. of cor.
- 80.45 The cor. of secs. 3, 4, 9 and 10, heretofore described. Land level and rolling.  
Soil sandy 3<sup>rd</sup> rate.  
No timber

March 16<sup>th</sup> 1910

1910  
March 14<sup>th</sup> 1910, 7<sup>h</sup> 15<sup>m</sup> a.m. l.m.t. Obs of 35° 30'  $\frac{1}{2}$  N. on the lat. arc 2° 40'  $\frac{1}{2}$  S. on the decl. arc. and determine a meridian with the solar on the Standard Cor. of secs. 32 and 33. on S. edge of Twp. <sup>re-estab. by me & described in Standard Book "F"</sup> Thence Drum N 10° 03' W. bet. secs. 32 and 33.

Ascend gradually S.E. slope over rolling sandy land through scattering sage and greasewood bushes. undergrowth and tufted grass.

- 40.00 Set an iron post. 3 ft. long 1 in. in diam. 26 in. in the ground for  $\frac{1}{4}$  sec. cor. marked on brass cap  $\frac{1}{4}$  S 32 on W half and S 33 on E. half

Dig pits 18x18x12 in. N and S. of post. 3 ft. dia and raise a mound of earth 3  $\frac{1}{2}$  ft. base. 1  $\frac{1}{2}$  ft. high. W. of cor.

- 56.00 Begin abrupt ascent. over S slope of mesa over broken stony land.

- 63.80 Top of abrupt ascent. on S. edge of mesa 100 ft. high. bears N.E. and S.W. descend steep N slope

- 80.00 Set an iron post. 3 ft. long. 2 in. in diam 24 in. in the ground for cor. of secs. 28, 29, 32 and 33. marked on brass cap T 25 N. S. 29 in N.W. T 16 E.

S 28 in N.E. S 33 in S.E. and S 32 in S.W. quadrants  
Dig pits 18x18x12 in. in each. sec. 5  $\frac{1}{2}$  ft. dia and raise a mound of earth 4 ft. base. 2 ft. high. W. of cor.

Land rolling and broken.

Soil sandy and stony 3<sup>rd</sup> and 4<sup>th</sup> rate.  
No timber

BOOK 2589

- 40.00 S 89° 42' E on a random line bet. sec. 28 and 33  
See temp. ¼ sec. cor.
- 80.02 Intersect mesa S. line at the cor. of sec. 27, 28, 33  
herebefore described  
and 34. Hence run
- SV 89° 42' W. on a true line bet. sec. 28 and 33.  
Descend W. slope over hilly sandy land through  
scattering sage bush undergrowth and bunch grass.
- 6.50 Dry ravine course South side.
- 12.35 Top of stony ridge bears mesa S. desc. rapidly.
- 23.70 West edge of mesa bears N.W. and S.E. descend  
abruptly over stony S.W. slope.
- 27.40 Foot of descent in depression bears mesa S.  
ascend S.E. slope over sandy land.
- 40.01 See an iron post 3 ft. long 1 in. in diam. 26 ins. in  
the ground for ¼ sec. cor. marked on brass cap.  
4528 on N. half and 533 on S. half.  
Dig pits 18 x 18 x 12 ins. E and W. of post 3 ft. dia.  
and raise a mound of earth 3½ ft. long, 1½ ft.  
high. No. of cor.
- 50.00 Top of steep ascent on E. edge of mesa bears N.E.  
and S.W. Leave broken stony land bears N.E. and S.W.  
Enter level sandy mesa land bears N.E. and S.W.
- 60.80 West edge of mesa bears N.E. and S.W. Leave level  
land bears N.E. and S.W. Enter broken stony land  
bears N.E. and S.W., descend sand stone cliff 150  
ft. high.
- 64.00 Foot of abrupt descent in dry ravine at foot of  
mesa bears N.E. asc. steeply.
- 80.02 The cor. of sec. 28, 29, 32 and 33, herebefore described.  
Land level hilly and broken.  
Soil sandy and stony 3<sup>rd</sup> and 4<sup>th</sup> rate.  
No timber

N 0° 03' W, bet. sec. 28 and 29.

Over rolling sand hills. through scattering sage  
bush undergrowth and bunch grass.

40.00 See an iron post 3 ft. long 1 in. in diam. 26 ins. in

chains

25

the ground for  $\frac{1}{4}$  sec. cor. marked on brass cap  $\frac{1}{4}$  S 29  
on W. half and S 28. on E. half,  
Dig pits 18 X 18 X 12 ins. N. and S. of post 3 ft. dia.  
and raise a mound of earth  $3\frac{1}{2}$  ft. base  $1\frac{1}{2}$  ft.  
high. W. of cor.

NOTE At this cor. Det. off.  $2^{\circ} 37\frac{1}{2}'$  S on the decl. arc and  
at noon observe the sun on the meridian, and  
obtain on the lat. arc a reading of  $35^{\circ} 32' N$ .

80.00 Set an iron post 3 ft. long 2 ins. in diam. 24 ins. in the  
ground for cor. of secs. 20, 21, 28 and 29, marked on  
brass cap. T 25 N 3 20 in NW. T 16 E S 21 in NE. S 28 in  
SE and S 29 in SW, quadrants.

Dig pits 18 X 18 X 12 ins. in each. sec.  $5\frac{1}{2}$  ft. dia. and  
raise a mound of earth 4 ft. base, 2 ft. high. W. of  
cor.

Land rolling and hilly.  
Soil sandy 3rd rate  
No timber

40.00 S  $89^{\circ} 42'$  E on a random line bet. secs 21 and 28.  
Set temp.  $\frac{1}{4}$  sec. cor.

79.90 Intersect N. and S. line at the cor. of secs. 21, 22, 27  
and 28, <sup>heretofore described</sup> thence draw

N  $89^{\circ} 42'$  W. on a true line bet. secs. 21 and 28.

27.50 Ascend E. slope over hilly sandy land through  
scattering sage brush, undergrowth and bunch grass  
Top of sand ridge bears N and S. desc.

39.95 Set an iron post 3 ft. long 1 in. in diam. 26 ins. in  
the ground for  $\frac{1}{4}$  sec. cor. marked on brass cap  
 $\frac{1}{4}$  S 21 on N. half and S 28 on S. half

Dig pits 18 X 18 X 12 ins. East W. of post 3 ft. dia. and  
raise a mound of earth  $3\frac{1}{2}$  ft. base.  $1\frac{1}{2}$  ft. high. W.  
of cor.

42.10 Dry sand wash 30 lbs. wide; ft. deep course N. W.  
dec. gently over rolling land.

79.90 The cor. of secs. 20, 21, 28 and 29, heretofore described.  
Land rolling and hilly.  
Soil sandy 3rd rate.  
No timber

BOOK 2589

N<sup>0</sup>03' W beh. sec. 20 and 21.

Over rolling sandy land. through scattering sage and greasewood bush undergrowth and bunch grass.

40.00 Set an iron post 3 ft. long 1 in. in diam. 26 ins. in the ground for  $\frac{1}{4}$  sec. cor. marked on brass cap.  $\frac{1}{4}$  S 20 W W. half. and S 21 on E half.Dig pits 18 X 18 X 12 ins N and S. of post. 3 ft. dia. and raise a mound of earth 3  $\frac{1}{2}$  ft. base, 1  $\frac{1}{2}$  ft. high W. of cor.

80.00 Set an iron post 3 ft. long 2 ins. in diam. 24 ins. in the ground for cor. of sec. 16, 17, 20 and 21 marked on brass cap T 25 N. S 17 in N.W. R 16 E. S 16 in N.E. S 21 in S.E. and S 20 in S.W. quadrants.

Dig pits 18 X 18 X 12 ins. in each sec. 5  $\frac{1}{2}$  ft. dia. and raise a mound of earth 4 ft. base, 2 ft. high W. of cor.

Land rolling.

Soil sandy, 3<sup>rd</sup> rate.

No timber

S 89° 42' E on a random line beh. sec. 16 and 21

40.00 Set temp.  $\frac{1}{4}$  sec. cor.79.90 Intersect N and S. line 3 lks. N. of the cor. of sec. 15 <sup>heretofore described</sup> 16, 21 and 22. Thence Drive

N 89° 41' W. on a true line beh. sec. 16 and 21

Over rolling sandy land through scattering sage bush undergrowth and bunch grass.

39.95 Set an iron post. 3 ft. long 1 in. in diam. 26 ins. in the ground for  $\frac{1}{4}$  sec. cor. marked on brass cap.  $\frac{1}{4}$  S 16 on N. half and S 21 on S. half.Dig pits 18 X 18 X 12 ins. E and W. of post. 3 ft. dia. and raise a mound of earth 3  $\frac{1}{2}$  ft. base, 1  $\frac{1}{2}$  ft. high N. of cor.

79.90 The cor. of sec. 16, 17, 20 and 21, heretofore described.

Land rolling.

Soil sandy 3<sup>rd</sup> rate.

No timber

March 14<sup>th</sup> 1910

March 17<sup>th</sup> 1910 Ah. 1<sup>h</sup> 00<sup>m</sup> p.m. <sup>l.m.t.</sup>  $35^{\circ}33'N.$   
on the lat. arc,  $1^{\circ}25\frac{1}{2}'S.$  on the decl. arc, and determine  
a meridian with the solar ab. the cor. of sees. 16  
17, 20 and 21, Thence I run

$N0^{\circ}03'W.$  to the cor. 16 and 17,

Descend NW slope over rolling sandy land through  
scattering sage and greasewood brush undergrowth  
and bunch grass.

40.00 Set an iron post 3 ft. long 1 in. in diam. 26 ins. in  
the ground for  $\frac{1}{4}$  sec. cor. marked on brass cap  $\frac{1}{4}$  S  
17 on W. half, and S 16 on E half.

Dig pits 18x18x12 ins. N and S of post. 3 ft. dia. and  
raise a mound of earth  $3\frac{1}{2}$  ft. base,  $1\frac{1}{2}$  ft. high.  
W. of cor.

80.00 Set an iron post 3 ft. long 2 in. in diam., 24  
ins. in the ground for cor. of sees. 8, 9, 16 and  
17 marked on brass cap.  $T25N. S8$  in NW, R16E.

39 in NE, S 16 in SE, and S 17 in SW quadrants  
Dig pits 18x18x12 ins in each. sec.  $5\frac{1}{2}$  ft. dia.  
and raise a mound of earth 4 ft. base, 2 ft.  
high W. of cor.

Land rolling.  
Soil sandy 3<sup>rd</sup> rate.  
No timber

40.00  $S89^{\circ}41'E$  on a random line bet. sees. 9 and 16.  
Set temp  $\frac{1}{4}$  sec. cor.

79.92 Intersect N and S. line 5 lks. S. of the cor. of sees.  
<sup>heretofore described</sup>  
9, 10, 15 and 16. Thence I run

$N89^{\circ}43'W.$  on a true line bet. sees. 9 and 16.

Descend N. W. slope over rolling sandy land through  
scattering sage brush undergrowth and bunch  
grass.

39.96 Set an iron post 3 ft. long 1 in. in diam., 26 ins.  
in the ground for  $\frac{1}{4}$  sec. cor. marked on brass  
cap  $\frac{1}{4}$  S 9 on N. half and S 16 on S. half.

Dig pits 18x18x12 ins. E and W. of post. 3 ft. dia.  
and raise a mound of earth  $3\frac{1}{2}$  ft. base,  $1\frac{1}{2}$  ft.  
high. W. of cor.

79.92 The cor. of sees 8, 9, 16 and 17, heretofore described.  
Land rolling.

BOOK 2589

Soil sandy 3<sup>rd</sup> rate,  
No timberN<sup>o</sup> 03' W. Lch. sec. 8 and 9.Descend gently N.W. slope over rolling sandy land  
through scattering sage and greasewood bush  
and bunch grass40.00 Set an iron post 3 ft. long, 1 in. in diam. 26 ins  
in the ground for  $\frac{1}{4}$  sec. cor. marked on brass  
cap 438 on W. half. and 59 on E. half.Dig pits 18x18x12 ins. N and S. of post. 3 ft. dia.  
and raise a mound of earth 3 $\frac{1}{2}$  ft. base, 1 $\frac{1}{2}$  ft.  
high. W. of cor.42.00 Foot of descent, leave rolling sandy land leave  
N.E. and S.W. Enter level adobe Valley land leave  
N.E. and S.W.80.00 Set an iron post 3 ft. long 2 ins. in diam. 24 ins  
in the ground for cor. of sec. 4, 5, 8 and 9.  
marked on brass Cap 725 N. S 5 in N.W. R 16 E S 4  
in N.E. 59 in S.E. and 58 in S.W. quadrants.Dig pits 18x18x12 ins. in each. sec. 5 $\frac{1}{2}$  ft. dia.  
and raise a mound of earth 4 ft. base, 2 ft. high.  
W. of cor.

Land level and rolling.

Soil sandy and adobe 2<sup>nd</sup> and 3<sup>rd</sup> rate,  
No timber

S 89° 43' E on a random line Lch. sec. 4 and 9.

40.00 Set temp  $\frac{1}{4}$  sec. cor.79.90 Intercept N and S. line 3 lks N. of the cor. of sec.  
3, 4, 9 and 10 <sup>herein before described</sup> thence S run.

N 89° 42' W. on a true line Lch. sec. 4 and 9.

Descend gently N.W. slope over rolling sandy land  
through scattering sage bush undergrowth and  
bunch grass.39.95 Set an iron post 3 ft. long 1 in. in diam. 26 ins.  
in the ground for  $\frac{1}{4}$  sec. cor. marked on brass cap  
143 on N. half. and 59 on S. half.Dig pits 18x18x12 ins E and W. of post. 3 ft. dia.  
and raise a mound of earth 3 $\frac{1}{2}$  ft. base, 1 $\frac{1}{2}$



Salinas

72.00 ft. high. N. of cor.  
Footh of descent, level rolling land bears N.E. and S.W., Enter level adobe valley land bears N.E. and S.W.

79.90 The cor. of sees. 4, 5, 8 and 9, hereinbefore described.  
Land level and rolling.  
Soil sandy and adobe 2<sup>nd</sup> and 3<sup>rd</sup> rate.  
No timber.

40.00 No 03' W. on a random line bet. sees. 4 and 5  
Set temp 1/4 sec. cor.

80.28 Intersect N. line of Twp. 10 lks. N. 89° 41' W. of the cor. of sees. 4, 5, 32, and 33. These same  
estab. by me & described in Exterior Book "K"

So 01' W. on a true line bet. sees. 4 and 5  
Descend gently S.E. slope over rolling sandy land through scattering sage brush undergrowth and bunch grass.

26.70 Road from Winslow Arizona to Placea Arizona  
bears N.E. and S.W.

27.00 Footh of gentle descent. level rolling land bears N.E. and S.W., Enter level adobe valley land bears N.E. and S.W.

40.28 Set an iron post 3 ft. long, 1 in. in diam. 26 ins. in the ground for 1/4 sec. cor. marked on brass cap 1/4 S 50 W half and S 40 W E. half. Dig pits 18 x 18 x 12 ins. N and S. of post. 3 ft. dia. and raise a mound of earth 3 1/2 ft. base. 1 1/2 ft. high W. of cor.

54.30 Right bank of the Placea Wash 25 ft. high. bears N.E. and S.W.

56.35 Center of dry bed of Wash.

58.46 Left bank of the Placea Wash. 25 ft. high. bears N.E. and S.W., thence over level land.

80.28 The cor. of sees. 4, 5, 8 and 9, hereinbefore described.  
Land level and rolling  
Soil sandy and adobe, 2<sup>nd</sup> and 3<sup>rd</sup> rate.  
No timber

March 17<sup>th</sup> 1910

March 15<sup>th</sup> 1910  
At 7<sup>h</sup> 30<sup>m</sup> a.m. l.m.t. set off 35° 30' 1/2' N. on the lat. arc, 2° 17' S. on the decl. arc, and determine a

BOOK 2589

meridian with the solar at the Standard Cor  
<sup>re-estab. by me & described in Standard Book "F"</sup>  
of sec. 31 and 32 on S. side of Twp. Thence I run  
N 0° 03' W, 1/4 sec. 31 and 32,

Ascend S. slope over hilly sandy land through  
scattering sage and greasewood bush undergrowth  
and bunch grass

39.50 Top of sand ridge bears N.E. and S.W. desc N.W. slope

40.00 Set an iron post 3/4 ft. long 1 in in diam. 26 in in  
the ground for 1/4 sec. cor. marked on brass cap  
1/4 S 31 on W half, and S 32 on E half.

Dig pits 18x18x12 ins. N and S of post. 3/4 ft. dia. and  
raise a mound of earth 3 1/2 ft. base, 1 1/2 ft. high.  
W of cor.

80.00 Set an iron post 3/4 ft. long 2 in in diam. 24 in.

in the ground for cor. of sec. 29, 30, 31 and 32.  
marked on brass cap T 25 N. S 30 in N.W. T 16 E.

S 29 in N.E. S 32 in S.E. and S 31 in S.W. quadrants.

Dig pits 18x18x12 ins. in each sec. 5 1/2 ft. dia.  
and raise a mound of earth 4 ft. base, 1 1/2 ft.  
high. W. of cor.

Land hilly.  
Soil sandy 3<sup>rd</sup> rate.  
No timber

40.00 S 89° 42' E on a random line bet. sec 29 and 32.  
Set temp 1/4 sec. cor.

80.04 Intersect N and S. line 3/4 sec. N. of the cor. of sec.  
28, 29, 32 and <sup>heretofore described</sup> 33A Thence I run

N 89° 41' W. on a true line bet. sec 29 and 32.

Descend W. slope over hilly sandy land through  
scattering sage and greasewood bush undergrowth  
and bunch grass.

6.00 Foot of descent in depression bear N and S.  
drains to the North arc.

20.00 Top of sand ridge bears N and S. desc. W. slope

40.02 Set an iron post 3/4 ft. long 1 in in diam. 26 in.  
in the ground for 1/4 sec. cor. marked on brass  
cap 1/4 S 29 on N. half and S 32 on S. half.

Dig pits 18x18x12 ins. E and W. of post. 3/4 ft. dia.  
and raise a mound of earth 3 1/2 ft. base, 1 1/2 ft.  
high. N. of cor.

Chains

47,00 Foot of descent in circular depression sec.  
 52,00 Top of sand ridge bears N and S. desc  
 80,04 The cor. of secs. 29, 30, 31 and 32, heretofore  
 described.  
 Land hilly.  
 Soil sandy 3<sup>rd</sup> rate.  
 No timber

40,00 NW 89° 42' W. on a random line bet. sec. 30 and 31  
 Set temp.  $\frac{1}{4}$  sec. cor.

80,04 Intersect W. l. of  $\frac{1}{4}$  Sec. 31 S. of the cor. of  
 sec. 25, 30, 31 and 36, <sup>estab. by me & described in Exterior Book "I"</sup> thence S run

S 89° 41' E on a true line bet. sec. 30 and 31

Around W. slope over hilly sandy land through  
 scattering sage and greasewood bush undergrowth  
 and bunch grass

40,04 Set an iron post 3 ft. long 1 in. in diam. 26 ins. in  
 the ground for  $\frac{1}{4}$  sec. cor. marked on brass cap  
 $\frac{1}{4}$  S 30 on N. half and S 31 on S. half.

Dig pits 18 x 18 x 12 ins. East W. of post 3 ft. dia.  
 and raise a mound of earth 3  $\frac{1}{2}$  ft. base, 1  $\frac{1}{2}$  ft.  
 high N. of cor.

80,04 The cor. of secs. 29, 30, 31 and 32, heretofore  
 described.  
 Land hilly.

Soil sandy 3<sup>rd</sup> rate.

No timber

N 10° 03' W. bet. sec. 29 and 30.

Descend gradually over NW. slope through  
 scattering sage and greasewood bush under-  
 growth and bunch grass.

40,00 Set an iron post 3 ft. long 1 in. in diam. 26  
 ins. in the ground for  $\frac{1}{4}$  sec. cor. marked  
 on brass cap  $\frac{1}{4}$  S 30 on W. half and S 29 on E.  
 half.

Dig pits 18 x 18 x 12 ins. N and S. of post 3 ft.  
 dia. and raise a mound of earth 3  $\frac{1}{2}$  ft. base  
 1  $\frac{1}{2}$  ft. high W. of cor.

NOTE At this cor. set off 2° 14' S. on the decl arc and  
 at noon observe the sun on the meridian  
 the resulting lat. being 35° 32' N. nearly.

## Subdivision of Twp 25 N. R 16 E.

32

Chain

BOOK 2589

46,60 Foot of descent in depression from N.W. and S.E. drains to the N.W. cor.

77,00 Top of sand ridge 15 ft. high from E and W. desc

80,00 Set an iron post 3 ft. long 2 ins. in diam. 2 4 ins. in the ground for cor. of secs. 19, 20, 29 and 30. marked on brass cap. 725 N. 319 in N.W. R 16 E 320 in N.E. 329 in S.E. and 330 in S.W. quadrants. Dig pits 18x18x12 ins in each sec. 5 1/2 ft. dia. and raise a mound of earth 4 ft. base, 2 ft. high W of cor.

Land rolling.

Soil sandy 3<sup>rd</sup> rate.

No timber

S 89° 41' E on a random line bet. secs. 20 and 29,

40,00 Set temp. 1/4 sec. cor.

79,98 Intersect N and S. line 2 lks S of cor. of secs. 20, 21, 28 and 29, <sup>hereinbefore described</sup> Thence True

N 89° 42' W. on a true line bet. secs. 20 and 29, Descend N.W. slope over rolling sandy land through scattering sage and greasewood bush undergrowth and bunch grass.

39,99 Set an iron post 3 ft. long 1 in. in diam. 26 ins. in the ground for 1/4 sec. cor. marked on brass cap 1/4 S 2000 N. half and S 29 on S. half. Dig pits 18x18x12 ins. E and W. of post 3 ft. dia. and raise a mound of earth 3 1/2 ft. base, 1 1/2 ft. high. N. of cor.

79,98 The cor. of secs. 19, 20, 29 and 30, hereinbefore described.

Land rolling.

Soil sandy 3<sup>rd</sup> rate.

No timber.

N 89° 41' W. on a random line bet. secs. 19 and 30

40,00 Set temp. 1/4 sec. cor.

80,12 Intersect W. base of Twp. 5 lks. N. of the cor. <sup>estab. by me & described in Exterior Book "D"</sup> of secs. 19, 24, 25 and 30, Thence True

S 89° 43' E on a true line bet. secs. 19 and 30. Ascend N.W. slope over rolling sandy land, through scattering sage and greasewood bush.

Chains

40.12 undergrowth and bunch grass.  
Set an iron post 3 ft. long 1 in. in diam 26 ins  
in the ground for  $\frac{1}{4}$  sec. cor. marked on brass  
cap  $\frac{1}{4}$  S 19 on N. half and S 30 on S. half.  
Dig pits 18 x 18 x 12 ins. E and W. of post 3 ft. dish  
and raise a mound of earth  $3\frac{1}{2}$  ft. base,  $1\frac{1}{2}$  ft.  
high W. of cor.

80.12 The cor of secs. 19, 20, 29 and 30, heretofore  
described.  
Land rolling.  
Soil sandy 3<sup>rd</sup> rate.  
No timber

March 15<sup>th</sup> 1910

March 17<sup>th</sup> 1910  
At 8<sup>h</sup> 00<sup>m</sup> Am. l.m.t. Set off  $35^{\circ} 32\frac{1}{2}'$  N.  
on the lat arc  $1^{\circ} 30' S.$  on the decl. arc and determine  
a meridian with the solar at the cor. of secs.  
19, 20, 29 and 30, <sup>heretofore described</sup> thence S run.

N  $0^{\circ} 03'$  W. bet. secs. 19 and 20

Descend N.W. slope over rolling sandy land through  
scattering sage and greasewood brush and bunch  
grass.

40.00 Set an iron post 3 ft. long 1 in. in diam. 26 ins.  
in the ground for  $\frac{1}{4}$  sec. cor. marked on  
brass cap.  $\frac{1}{4}$  S 19 on W. half. and S. 20 on E half.  
Dig pits 18 x 18 x 12 ins N and S. of post 3 ft.  
dish. and raise a mound of earth  $3\frac{1}{2}$  ft. base  
 $1\frac{1}{2}$  ft. high W. of cor.

80.00 Set an iron post 3 ft. long 2 ins. in diam. 24  
ins. in the ground for cor. of secs. 17, 18, 19 and  
20 marked on brass cap T 25 N S 18 in N.W. R 16  
E S 17 in N.E. S 20 in S.E. and S 19 in S.W. quad.  
rout.

Dig pits 18 x 18 x 12 ins in each sec.  $5\frac{1}{2}$  ft.  
dish and raise a mound of earth 4 ft. base 3 ft.  
high W. of cor.

Land rolling.  
Soil sandy 3<sup>rd</sup> rate.  
No timber

S  $89^{\circ} 42' E$  on a random line bet. secs. 17 and 20.

40.00 Set temp  $\frac{1}{4}$  sec. cor.

BOOK 2589

79.96 Intersect Mayd S, line ab. the cor. of secs. 16, 17, <sup>heretofore described</sup> 20 and 21 <sup>thence</sup> Drum  
 N 89° 42' W. on a true line bet. secs. 17 and 20.  
 Ascend N.W. slope over rolling sandy land, through scattering sage and greasewood bush undergrowth and bunch grass.

39.98 Set an iron post 3 ft. long, 1 in. in diam. 26 in. in the ground for  $\frac{1}{4}$  sec. cor. marked out brass cap.  $\frac{1}{4}$  S 17 on N. half and S 20 on S. half.  
 Dig pits 18 x 18 x 12 in. E and W. of post. 3 ft. dia. and raise a mound of earth 3  $\frac{1}{2}$  ft. base 1  $\frac{1}{2}$  ft. high N. of cor.

79.96 The cor. of secs. 17, 18, 19 and 20, heretofore described.  
 Land rolling.  
 Soil sandy. 3rd rate  
 No timber

40.00 N 89° 43' W. on a random line bet. secs 18 and 19  
 Set temp  $\frac{1}{4}$  sec. cor.

80.12 Intersect W. ldy. of Twp. 5 lks. N. of the cor. of <sup>estab. by me & described in Exterior Book "I"</sup> secs. 13, 18, 19 and 24 <sup>thence</sup> Drum  
 S 89° 45' E. on a true line bet. secs. 18 and 19.  
 Over level sandy and adobe valley land, through scattering sage and greasewood bush undergrowth and bunch grass

22.16 Dry sand wash 100 lks wide 5 ft. deep course South

36.00 Leave level land bears N.E. and S.W. Enter rolling land bears N.E. and S.W. Ascend gradually over N.W. slope

40.12 Set an iron post 3 ft. long, 1 in. in diam. 26 in. in the ground for  $\frac{1}{4}$  sec cor. marked out brass Cap. N 81° 18 on N half and S 19 on S. half.  
 Dig pits 18 x 18 x 12 in. E and W. of post. 3 ft. dia. and raise a mound of earth 3  $\frac{1}{2}$  ft. base 1  $\frac{1}{2}$  ft. high. N. of cor.

80.12 The cor. of secs. 17, 18, 19 and 20, heretofore described  
 Land level and rolling  
 Soil sandy and adobe. 2nd and 3rd rate.  
 No timber

March 17<sup>th</sup> 1910

NOTE

At the cor. of secs. 17, 18, 19 and 20, <sup>heretofore described</sup>

Set off  $1^{\circ}26\frac{1}{2}'$  S. on the decl arc and at noon observed the sun on the meridian and obtain a reading of  $35^{\circ}33'$  N. on the lat. arc.

March 18<sup>th</sup> 1910 At 7<sup>h</sup>30<sup>m</sup> a.m. l.m.t. Set off  $35^{\circ}33'$  N. on the lat. arc,  $1^{\circ}06\frac{1}{2}'$  S. on the decl. arc and determined a meridian with the solar at the cor. of sec. 17, 18, 19, and 20. thence I run heretofore described

$N0^{\circ}03'W$ . bet. sec 17 and 18.

Descend N.W. slope over rolling sandy land through scattering sage and greasewood bush undergrowth and bunch grass

32.00 Hook of declub, leave rolling sandy land head N.E. and S.W. Enter level adobe land.

40.00 Set an iron post 3 ft. long, 1 in. in diam. 26 ins. in the ground, for  $\frac{1}{4}$  sec. cor., marked out head cap.  $\frac{1}{4}$  S 18 on W. half and S 17 on E. half.

Dig pits 18x18x12 ins N. and S. of post 3 ft. dish and raise a mound of earth  $3\frac{1}{2}$  ft. base,  $1\frac{1}{2}$  ft. high W. of cor.

57.85- Dry sand wash 30 lbs. wide, 8 ft. deep. Course S.W.

80.00 Set an iron post 3 ft. long, 2 ins. in diam., 24 ins. in the ground for cor. of sec. 7, 8, 17 and 18, marked out head cap T 25 N., S 7 in N.W., R 16 E S 8 in N.E., S 17 in S.E. and S 18 in S.W. quadrants.

Dig pits 18x18x12 ins. in each sec,  $5\frac{1}{2}$  ft. dish, and raise a mound of earth 4 ft. base 2 ft. high W. of cor.

Land level and rolling.

Soil sandy and adobe 2<sup>nd</sup> and 3<sup>rd</sup> rate.

No timber

$S89^{\circ}42'E$  on a random line bet. sec 8 and 17

40.00 Set temp  $\frac{1}{4}$  sec cor.

79.96 Intersect N and S. line at the cor. of sec. 8, 9, 16 and 17 heretofore described thence I run

$N89^{\circ}42'W$  on a true line bet. sec. 8 and 17.

Descend N.W. slope over rolling sandy land through scattering sage and greasewood bush undergrowth and bunch grass

BOOK 2589

- 30.35 Foot of descent, level rolling land toward N.E. and S.W.  
Enter level adobe land.
- 38.00 Dry sand wash 25 lbs. wide, 5 ft. deep toward S.W.
- 39.98 Set an iron post 3 ft. long, 1 in. in diam 26 ins. in the ground for  $\frac{1}{4}$  sec. cor. marked out brass cap.  $\frac{1}{4}$  S 80 W N. half and S 17 W S. half.  
Dig pits 18x18x12 ins. East W. of post. 3 ft. dia., and raise a mound of earth  $3\frac{1}{2}$  ft. base,  $\frac{1}{2}$  ft. high. N. of cor.
- 79.96 The cor. of sec 7, 8, 17, and 18, heretofore described  
Land level and rolling.  
Soil sandy and adobe 2<sup>nd</sup> and 3<sup>rd</sup> rate.  
No timber
- 
- W 89° 45' W. on a random line bet. sec. 7 and 18.
- 42.00 Set temp.  $\frac{1}{4}$  sec. cor.
- 80.32 Intersect W. line of Twp. at the cor. of sec. 7, 12, 13 and 18, <sup>estab. by me & approved in Exterior Book "I"</sup> thence run
- S 89° 45' E on a true line bet. sec. 7 and 18.  
Descend gradually S.E. slope over rolling sandy land through scattering sage and greewood brush undergrowth and bunch grass.
- 13.00 Foot of descent, level rolling sandy land toward N.E. and S.W., Enter level adobe land toward N.E. and S.W.
- 24.35 Road from Winslow Ariz. to Placea Ariz  
bearing 76° E and S 60° W.
- 40.32 Set an iron post 3 ft. long, 1 in. in diam. 26 ins. in the ground for  $\frac{1}{4}$  sec. cor. marked out brass cap.  $\frac{1}{4}$  S 70 W N. half and S 18 W S. half.  
Dig pits 18x18x12 ins. East W. of post. 3 ft. dia. and raise a mound of earth  $3\frac{1}{2}$  ft. base  $\frac{1}{2}$  ft. high. N. of cor.
- 48.25 Right bank of the Placea Wash 20 ft. high bearing 75° E and S 50° W.
- 48.80 Center of dry bed of Wash toward S 50° W.
- 49.35 Left bank of the Placea Wash 20 ft. high bearing 75° E and S 50° W, thence over level land.



Chain

53.00 Dry sand wash 20 lbs wide 4 ft. deep. course  
S.W.

80.32 The cor. of secs. 7, 8, 17 and 18, hereinafore  
described.  
Land level and rolling  
Soil sandy and adobe 2<sup>nd</sup> and 3<sup>rd</sup> rate.  
No timber

N 0° 03' W. bet. secs. 7 and 8.  
Over level adobe valley land, through scattering  
sage and greasewood bush undergrowth and  
 bunch grass.

40.00 Set an iron post 3 ft. long 1 in. in diam. 26 ins  
in the ground for  $\frac{1}{4}$  sec. cor. marked on base  
cap. T 37 on W. half and S 8 on E. half.  
Dig pits 18 x 18 x 12 ins N and S. of post. 3 ft.  
ditch and raise a mound of earth 3  $\frac{1}{2}$  ft. base  
1  $\frac{1}{2}$  ft. high. W. of cor.

49.07 Left bank of the Placca Wash. 25 ft. high.  
Bears N 50° E and S 50° W.

49.97 Center of dry bed of W. ash. course S.W.

50.70 Right bank of the Placca Wash. 25 ft. high.  
Bears N 50° E and S 50° W.

61.00 Road from Winslow to Placca a line bears N.E. and S.W.  
73.00 Level land bears N.E. and S.W., center  
rolling sandy land bears N.E. and S.W. are  
gradually over S.E. slopes.

80.00 Set an iron post 3 ft. long 2 ins in diam. 24  
ins. in the ground for cor. of secs. 5, 6, 7 and  
8, marked on base cap. T 25 N. S 6 in N.W. R 16 E  
S 5 in N.E. S 8 in S.E. and S 7 in S.W. quadrants.  
Dig pits 18 x 18 x 12 ins. in each sec. 5  $\frac{1}{2}$  ft. ditch  
and raise a mound of earth 4 ft. base, 2 ft.  
high W. of cor.

Land level and rolling.  
Soil sandy and adobe 2<sup>nd</sup> and 3<sup>rd</sup> rate.  
No timber

40.00 S 89° 42' E on a random line bet. secs. 5 and 8.  
Set temp  $\frac{1}{4}$  sec. cor.

79.94 Intersect N and S. line 3 lbs. N. of cor. of secs.  
4, 5, 8 and 7, <sup>hereinafore described</sup> hence S. run

BOOK 2589

- N 89° 41' W. on a true line bet. secs. 5 and 8.  
Over level adobe valley land, through scattering  
sage and greasewood brush undergrowth and  
bunch grass
- 36.80 Left bank of the Placea Wash. 20 ft. high. bears  
N 60° E and S 60° W.
- 37.40 Center of dry bed of Wash. Course S 60° W.
- 38.00 Right bank of the Placea Wash. 20 ft. high. bears  
N 60° E and S 60° W. thence over level land.
- 39.97 Set an iron post 3 ft. long, 1 in. in diam. 26 in.  
in the ground for  $\frac{1}{4}$  sec. cor. marked on brass cap  
N 45° on N. half and S 8° on S. half.  
Dig pits 18 x 18 x 12 in. E and W. of post. 3 ft. dia.  
and raise a mound of earth 3  $\frac{1}{2}$  ft. base, 1  $\frac{1}{2}$  ft. high.  
No. of cor.
- NOTE On this cor. I set off 1° 3' S on the decl. arc and at  
noon observe the sun on the meridian, and obtain  
on the lat. arc a reading of 35° 35' N.
- 50.40 Road from Winslow Arizona to Placea Arizona  
bears N. E. and S. W.
- 69.40 Leave level adobe valley land bears N 50° E and  
S 50° W. Enter rolling sandy land bears N. E. and  
S. W. ascend gradually over S. E. slope
- 79.94 The cor. of secs. 5, 6, 7 and 8, heretofore described.  
Land level and rolling  
Soil sandy and adobe 2<sup>nd</sup> and 3<sup>rd</sup> rate.  
No timber

- N 89° 45' W. on a random line bet. secs. 6 and 7.
- 40.00 Set temp.  $\frac{1}{4}$  sec. cor.
- 80.18 Intersect W. bdy. of Tp 5 bet. N. of the cor. of  
estab. by me and described in Exterior Book 1  
secs. 11, 6, 7 and 12. Thence I run  
S 89° 47' E on a true line bet. secs. 6 and 7,  
Descend S. E. slope over rolling sandy land  
through scattering sage and greasewood  
brush undergrowth and bunch grass.
- 40.18 Set an iron post 3 ft. long, 1 in. in diam. 26  
in. in the ground for  $\frac{1}{4}$  sec. cor. marked on  
brass cap N 45° on N. half and S 7° on S. half.  
Dig pits 18 x 18 x 12 in. E and W. of post. 3 ft. dia.  
and raise a mound of earth 3  $\frac{1}{2}$  ft. base 1  $\frac{1}{2}$  ft.

high. N. of cor.

This cor. is situated on foot of descent in depression bears N. and S., acc. W. slope of sand ridge

61.50 Top of sand ridge bears N.E. and S.W. desc. gently over E. slope.

80.18 The cor. of secs. 5, 6, 7, and 8, hereinbefore described. Land rolling and hilly. Soil sandy 3<sup>rd</sup> rate. No timber.

N<sup>o</sup> 03' W. on a random line bet. secs 5 and 6.

40.00 Set temp. 1/4 sec. cor.

80.02 Intersect N. side of N<sup>o</sup> 12 E. N<sup>o</sup> 89' 41" W. of the cor. of secs. 30, 31 and 32, <sup>estab. by me & described in Exterior Book "18"</sup> thence I run

S<sup>o</sup> 2' W. on a true line bet. secs. 5 and 6.

Over W. slope through scattering sage and greasewood bush undergrowth and bunch grass.

40.02 Set an iron post 3 ft. long 1 in. in diam. 26 ins. in the ground for 1/4 sec. cor. marked on brass cap 1/4 S 60 W. half and 3.5 on E half. Dig pits 18x18x12 ins. N and S. of post. 3 ft. deep and raise a mound of earth 3 1/2 ft. base 1 1/2 ft. high. W. of cor.

42.30 Dry ravine 15 ft. deep course SW. ascend

45.00 Top of sand ridge bears N.E. and S.W. desc.

80.02 The cor. of secs. 5, 6, 7 and 8, hereinbefore described. Land rolling sand hills. Soil sandy 3<sup>rd</sup> rate. No timber.

March 18<sup>th</sup> 1907

General Description.

This township contains three varieties of land, level rolling and hilly, and the soil ranges from loose shifting sand to a sandy loam.

The soil of the bottom land along the Polacca Wash, is a sandy loam. Capable of producing good crops of corn without irrigation and is being farmed at the present time to a limited extent by the Navajo Indians. The soil of the remaining portion

BOOK

2589

of the township which is generally low rolling sand hills can nearly all be classed as *g<sup>rd</sup> state* is covered with a good growth of grass, but on account of the great amount of silica it contains is not suitable for any other purpose than grazing.

No timber or minerals of any <sup>kind</sup> found in the township and the only water occurs in ponds formed in time of rain and in the Polacca Wash which flows water for a short time during the year.

There are no permanent settlers in the township

Sydney E. Blous

US. Examiner of Surveys

MAR 18, 1910.

LIST OF NAMES.

A list of the names of the individuals employed by Sidney E. Blouk  
~~Examiner of Surveys~~  
 United States ~~Deputy Surveyor~~, to assist in running, measuring, and  
 marking the lines and corners described in the foregoing field notes of the survey of the Subdivisional  
lines of Twp. No. 25 N. R. 16 E. of the Gila and Salt River Base and Meridian  
Arizona Territory.  
 showing the respective capacities in which they acted:

Fred L. Warner ..... Chainman.  
Van L. White ..... Compassman.  
Mr. White ..... Chainman.  
Carl Albright ..... Chairman  
Ralph C. Sampson and Chas. L. Shumway ..... Moundman.  
 ..... Assman.  
 ..... Assman.  
William R. Carson and George Harris ..... Flagmen.

FINAL OATH OF ASSISTANTS.

We hereby certify that we assisted Sidney E. Blouk  
~~Examiner of Surveys~~  
 United States ~~Deputy Surveyor~~, in surveying all  
 those parts or portions of the Subdivisional line of Twp. No. 25 N. R. 16 E.

..... of the Gila and  
Salt River Base and Meridian, Territory of Arizona, which are represented  
 in the foregoing field notes as having been surveyed by him and under his direction; and that said survey  
 has been in all respects, to the best of our knowledge and belief, well and faithfully ~~surveyed~~ <sup>executed</sup> and the  
 corner monuments established, according to the instructions furnished by the ~~United States Surveyor~~ <sup>Commissioner</sup>  
~~General~~ of the General Land Office Van L. White Compassman  
Carl Albright Fred L. Warner ..... Chainman.  
J. J. White ..... Chainman.  
Ralph C. Sampson ..... Moundman.  
Chas. L. Shumway ..... Moundman.  
 ..... Assman.  
 ..... Assman.  
William R. Carson ..... Flagman.  
George Harris ..... Flagman.

Subscribed and sworn to before me this 23rd  
 day of March, 1910

Sidney E. Blouk  
U.S. Examiner of Surveys



92  
42  
BOOK 2589

EXAMINER OF SURVEYS  
~~FINAL OATH OF UNITED STATES DEPUTY SURVEYOR.~~

U.S. Examiner of Surveys

I, Sidney E. Blout, ~~United States Deputy Surveyor~~, do solemnly swear that, in pursuance of Special Instructions received from ~~United States Commissioner of the General Land Office~~, bearing date of the 2<sup>nd</sup> day of Oct. 1907 ~~and the 15<sup>th</sup> day of May, 1908~~, I have well, faithfully, and truly, in my own proper person, and in strict conformity with the instructions furnished by the ~~United States Commissioner General for of the General Land Office~~, the Manual of Surveying Instructions, and the laws of the United States, surveyed all those parts or portions of The Subdivisional Lines of Twp. No 25 North Range No. 16 East

of the Gila and Salt River Base and Meridian, in the Territory of Arizona, which are represented in the foregoing field notes as having been surveyed by me, and under my direction; and I do further solemnly swear that all the corners of said survey have been established and perpetuated in strict accordance with the Manual of Surveying Instructions, and the special written instructions of the ~~United States Commissioner General for of the General Land Office~~ and in the specific manner described in the field notes, and that the foregoing are the original field notes of such survey.

See Subdivisional Book "I"

United States Deputy Surveyor  
Examiner of Surveys

Subscribed by said \_\_\_\_\_, and sworn to before me }  
this \_\_\_\_\_ day of \_\_\_\_\_, 19



APPROVAL.

OFFICE OF THE UNITED STATES SURVEYOR GENERAL,

Phoenix, Arizona APR 25 1914

The foregoing field notes of the survey of the Subdivision lines of Township 25 North, Range 16 East, of the Gila and Salt River Base and Meridian, Arizona.

executed by Sidney E. Blout, U.S. Examiner of Surveys under Special Instructions from the Commissioner of the General Land Office, dated Oct. 2, 1907 and May 15, 1908, having been critically examined, and the necessary corrections and explanations made, the said field notes, and the surveys they describe, are hereby approved.

Frank Ingalls  
United States Surveyor General.  
SURVEYOR-GENERAL OF ARIZONA

I certify that the foregoing transcript of the field notes of the above-described surveys in \_\_\_\_\_, has been correctly copied from the original notes on file in this office.

United States Surveyor General