

MAR. 28. 1911

Subdivisional  
BOOK-N-

2592

BOOK 2592

# FIELD NOTES

and RESURVEY  
OF THE SURVEY OF THE

Subdivision lines of T<sub>1</sub>. No. 29 North  
Range No. 18 East

Of the Gila and Salt River Base and Meridian,

in the Territory of Arizona

EXECUTED  
AS SURVEYED BY

Sidney E. Blout, United States <sup>Examiner of Surveys</sup> ~~Deputy~~ Surveyor,

Special Instructions from the Commissioner of the General Land Office.  
Under his Contract No. \_\_\_\_\_, dated October 2<sup>nd</sup> 1907 and May 15<sup>th</sup> 1908

and Resurvey  
Survey commenced January 16<sup>th</sup> \_\_\_\_\_, 1907

and Resurvey  
Survey completed January 30<sup>th</sup> \_\_\_\_\_, 1909

1A

NAMES AND DUTIES OF ASSISTANTS.

<u>Sam L. White</u>	<u>Comptroller</u>
<u>Jay E. Fellich</u>	<u>Chairman</u>
<u>Lafayette Jennings</u>	<u>Chairman</u>
<u>Ralph P. Westlund</u>	<u>Chairman</u>
<u>Arthur C. Beard</u>	<u>Chairman</u>
<u>Fred L. Warner</u>	<u>Wardman</u>
<u>Chas L. Hummway</u>	<u>Assess</u>
<u>Harvey Lake Kay</u>	<u>Plagman</u>

BOOK 2592

BR No. 2592

INDEX DIAGRAM.

Township 29 North, Range No. 18 East

EXTERIOR BOOK "Q"

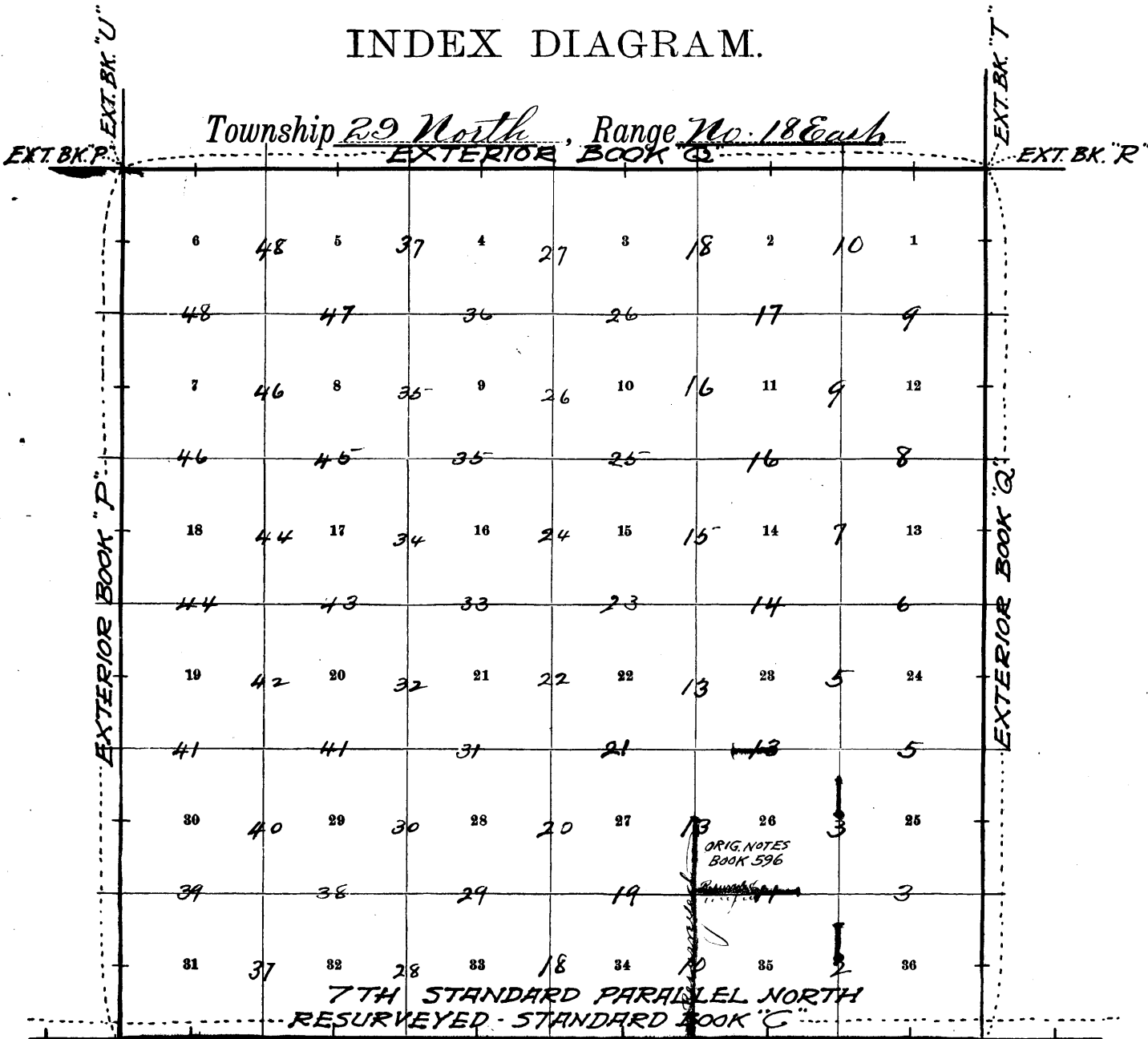

ORIGINAL NOTES - BOOK 1262

Meanders Page

PRELIMINARY OATHS OF ASSISTANTS.

See Subdivisional Book "M"

WE, \_\_\_\_\_ and \_\_\_\_\_  
do solemnly swear that we will well and faithfully execute the duties of chainmen; that we will level the chain upon even and uneven ground, and plumb the tally pins, either by sticking or dropping the same; that we will report the true distances to all notable objects, and the true lengths of all lines that we assist in measuring, to the best of our skill and ability, and in accordance with instructions given us, in the survey of \_\_\_\_\_

\_\_\_\_\_, Chainman.

\_\_\_\_\_, Chainman.

Subscribed and sworn to before me this \_\_\_\_\_ }  
day of \_\_\_\_\_, 190 \_\_\_\_\_ }



WE, \_\_\_\_\_ and \_\_\_\_\_  
do solemnly swear that we will well and truly perform the duties of moundmen in the establishment of corners, according to the instructions given us, to the best of our skill and ability, in the survey of \_\_\_\_\_

\_\_\_\_\_, Moundman.

\_\_\_\_\_, Moundman.

Subscribed and sworn to before me this \_\_\_\_\_ }  
day of \_\_\_\_\_, 190 \_\_\_\_\_ }



WE, \_\_\_\_\_ and \_\_\_\_\_  
do solemnly swear that we will well and truly perform the duties of axmen in the establishment of corners and other duties, according to instructions given us, to the best of our skill and ability, in the survey of \_\_\_\_\_

\_\_\_\_\_, Axman.

\_\_\_\_\_, Axman.

Subscribed and sworn to before me this \_\_\_\_\_ }  
day of \_\_\_\_\_, 190 \_\_\_\_\_ }



I, \_\_\_\_\_, do solemnly swear that I will well and truly perform the duties of flagman according to instructions given me, to the best of my skill and ability, in the survey of \_\_\_\_\_

\_\_\_\_\_, Flagman.

Subscribed and sworn to before me this \_\_\_\_\_ }  
day of \_\_\_\_\_, 190 \_\_\_\_\_ }



Survey commenced January 16<sup>th</sup> 1909, and executed with a W and L. E. Gurley engineers transit No 10 with a Burt solar attachment. The horizontal limb is provided with one double vernier reading to single minutes of arc. The verniers of the latitude and declination arcs read to 0' 30" of arc.

Examine the adjustments of the transit and correct the level and collimation errors, then to test the solar apparatus by comparing its indications resulting from solar observations made during am. and p.m. hours with a meridian established by observations on Polaris & proceed as follows.

At my camp which is located near the cor. of sec. 15, 16, 21 and 22 T 29 N R 18 E. Latitude  $35^{\circ} 54' N$ , Longitude  $110.25' W$ . At 8<sup>h</sup> 24<sup>m</sup> p.m. l.m.l. observed Polaris, in accordance with instructions in the Manual and mark the direction thus determined by a tack driven in a stake set firmly in the ground 5 chs. N. of my instrument.

Astronomical time of observation Jan 16<sup>th</sup> 1909 8<sup>h</sup> 24<sup>m</sup>

Astron. time U.C. Polaris Jan 15<sup>th</sup> 1909 h m  
5 47.9

Reduction to Jan 16<sup>th</sup> 1909 subtract 3.9

5<sup>h</sup> 44 subtract 5 44

Hour angle of Polaris at Obs. and Paris Argument for Table VII 2 40

Azimuth of Polaris at Observation 0° 56' W.

January 16<sup>th</sup> 1909

January 17<sup>th</sup> 1909 At 8<sup>h</sup> 30<sup>m</sup> a.m. l.m.t. lay off the azimuth of Polaris  $0^{\circ} 56'$  to the east and mark the meridian thus determined by a tack driven in a stake set in the ground 5 chs. N. of my instrument.

At 9<sup>h</sup> 10<sup>m</sup> a.m. l.m.l. set off  $35^{\circ} 54' N$  on the lat. arc.  $20^{\circ} 44' S$  on the decl. arc and determined a meridian with the solar and mark a point thereof by a nail driven in the stake already set 5 chs. N. of my instrument. This point falls

Chains

BOOK 2592

0.25-rod east of the meridian established by the  
Polaris observation -

At 12<sup>h</sup> 10<sup>m</sup> p.m. l. mt. & set. off 20° 44' S on the  
decl. arc and observe the sun on the meridian  
and obtain a reading of 35° 54' N. on the lab. arc

At 3<sup>h</sup> 10<sup>m</sup> p.m. l. mt. & set. off 35° 54' N. on the  
lab. arc. 20° 43' S. on the decl. arc and determine  
a meridian with the solar and mark a point  
thereof by a nail driven in the stake already set  
5 chs. N. of my instrument; this point falls 0.1 rod  
west of the meridian established by the Polaris  
observation.

The solar apparatus by a.m. and p.m. observations  
defined positions for meridians respectively about  
0' 13" East and 0.05" west of the meridian  
established by the Polaris observation therefore  
I conclude that the adjustments of the instrument  
are satisfactory

January 17<sup>th</sup> 1909.

I begin at the true point for Stand. Cor. of Secs. 1, 2, 35 and 36 on  
the S. edge of T 29 N, R 18 E. Latitude 35° 51' 28" N.  
Longitude 110° 22' 45" W. which is 2.25 chs. E. of the W.C. to  
Cor. of Secs. 1, 2, 35 and 36. which <sup>is</sup> established Oct. 23<sup>rd</sup> 1908.

Jan 18<sup>th</sup> 1909, at 8<sup>h</sup> 10<sup>m</sup> a.m. l. mt. & set. off 35° 51 1/2' N.  
on the lab. arc, 20° 32' S on the decl. arc, and  
determine a meridian with the solar at this  
cor.

Thence I run

N 0° 01' W for sec. 35 and 36.

Ascend S slope of mesa over mountainous land toward  
N.E. and S.W.

8.00 Top of ascent on S. edge of mesa toward N.E. and S.W.  
leave mountainous land toward N.E. and S.W. enter  
rolling land toward N.E. and S.W.

22.00 Through road toward N.E. and S.W.

40.00 Set a cedar post 2 ft long 3 in sq. with marked stone  
2 1/2 ins in the ground for <sup>re-established</sup> sec. cor marked 1/4 S 35 on W  
and S 36 on E. faces.

Raise a mound of stone 2 ft base 1 1/2 ft high W of cor.

Pis. impracticable No trace of orig. 1/4 sec. cor. found.

44.00 North edge of mesa toward N.E. and S.W. leave rolling land

Chains

trav N.E. and S.W. descend steep rocky NW slope over  
 mountainous land trav N.E. and S.W.  
 46.00 A point 200 lbs west of small spring.  
 60.00 No trace of old 1/4 sec. cor can be found.  
 75.00 Dry ravine Course W  
 80.00 Set a Cedar post 3 ft long 4 ins sq. with marked stone 24 ins in  
 the ground for cor. of sec 25 26 35 and 36 marked  
 T 29 N S 25 on N.E. R 18 E S 36 on S.E. S 35 on S.W. and  
 S 36 on N.W. face with 1 notch on E and S. edges  
 Dig pits 18x18x12 ins in each sec 5 1/2 ft. dist and  
 raise a mound of earth 4 ft. base 2 ft. high W of  
 cor.  
 Land rolling and mountainous.  
 Soil sandy and stony 3<sup>rd</sup> and 4<sup>th</sup> rate.  
 No timber.  
 Mountainous land. 44.00 chs.

Each on a random line bet. sec 25 and 36  
 40.00 Set temp 1/4 Sec. cor  
 80.00 Intersect E. bdy. of Twp. at the cor. of sec 25, 30, 31  
 and 36, recently estab. by me & described in Exterior Book "Q"  
 Thence D run  
 West on a true line bet. sec 25 and 36.  
 Over rolling sandy mead land.

40.00 Set a cedar post 3 ft long 3 ins sq. with marked  
 stone 24 ins in the ground for 1/4 sec. cor marked  
 1/4 S 25 on N. face and S 36 on S. face  
 Dig pits 18x18x12 ins E and W of post 3 ft. dist and  
 raise a mound of earth 3 1/2 ft. base, 1 1/2 ft. high N  
 of cor.

42.00 Wood road trav N.E. and S.W.  
 61.70 West edge of mead land, rolling land trav N and  
 S., descend abrupt rocky W. slope over mountainous  
 land trav N and S.

80.00 The cor of sec 25, 26, 35 and 36, heretofore described.  
 Land rolling and mountainous.  
 Soil sandy and stony 3<sup>rd</sup> and 4<sup>th</sup> rate.  
 No timber.  
 Mountainous land. 1830 chs.

N 6° 01' W bet. sec 25 and 26.

BOOK 2592

7.55 Ascend S.W. slope of mesa over stony mountainous land  
Top of mesa bear N.W. and S.E., leave mountainous  
land bear N.W. and S.E. enter rolling mesa land  
bear N.W. and S.E.

40.00 Set an iron post 3ft. long 1 in. in diam., 26 ins. in  
the ground for <sup>re-established</sup> 4 sec. cor. marked on base of 1/4 S  
26 on W half and 325 on E half.

Dig pits 18x18x12 in. and 3 of post. 3ft. dirt and  
raise a mound of earth 3 1/2 ft. base 1 1/2 ft. high W.  
of cor., No trace of old 1/4 sec. cor. can be found.

NOTE At this cor I set off 20° 31' 1/2 S on the decl. arc, and at  
12<sup>h</sup> 10<sup>m</sup> pm level observed the sun on the meridian  
the resulting latitude being 35° 53' N.

44.25 A point on the edge of mesa from which  
a spring bears N 16° 50' E 7.75 chs. dist.

The N.E. cor of Tom Polace's house bears N 49 1/2° W 23.35  
chs. dist.

The N.E. cor of another stone house bears N 51° W 18.35 chs.  
dist.

Leave rolling mesa land bear N.E. and S.W. and  
N.W. slope over stony mountainous land bear N.E.

60.00 and S.W. No trace of old 1/6 sec. cor. can be found.

66.00 Foot of descent on W. face of mesa, ascend S.W.  
slope.

69.00 Top of mesa bear N.W. and S.E. leave mountainous  
land bear N.W. and S.E. enter rolling sandy mesa  
land bear N.W. and S.E.

74.00 North edge of mesa bear N.E. and S.W. leave rolling  
mesa land bear N.E. and S.W., descend abrupt  
rocky N.W. slope over mountainous land bear  
N.E. and S.W.

80.00 Set an iron post 3ft. long 2 ins. in diam 24 ins.  
in the ground for cor of sec. 23, 24, 25 and 26  
marked on base of T 29 N, R 18 E S  
24 in N.E. 575 in S.E. and 326 in S.W. quadrants  
Raise a mound of stone 2ft. base, 1 1/2 ft. high W of cor.  
Pits impracticable

Land rolling and mountainous

Soil sandy and stony 3<sup>rd</sup> and 4<sup>th</sup> strata.

No timber

Mountainous land. 43.30 chs.



Chains

5

	East on a random line bet. sec. 24 and 25 -
40.00	Set temporary ¼ sec. cor.
79.90	Return to E. ldy of N. p. at the cor. of sec. 24, 19.24 25 and 30, recently estab. by me & described in Exterior Book "Q" Thence I run
	West, on a true line bet. sec. 24 and 25
	Over rolling sandy mead land. covered with scattering sage and greasewood brush undergrowth and bunch grass
7.75	Road to Polacca's ranch bears N.W. and S.E.
30.00	Enter scattering scrub cedar timber bears N and S
39.95	Set an iron post 3 ft. long 1 in in diam, 26 ins. in the ground for ¼ sec. cor. marked on bears cap ¼ S 24 on N half and S 25 on S half, from which A cedar 7 ins. in diam, bears N 50° W 88 lbs. dist. marked to S 24 B.T. A cedar 6 ins. in diam bears S 34 ½° E 353 lbs. dist. marked to S 25 B.T.
48.90	West edge of mesa on cliffs bears N.E and S.W. bears rolling land bears N.E and S.W., descend abrupt rocky N.W. slope over mountainous land bears N.E and S.W., bears timber bears N.E and S.W.
55.00	Dry ravine course N.W. arc.
60.00	Top of spur bears N. and S., desc.
64.00	Dry ravine course N. arc.
68.00	Top of rocky spur bears N. and S., desc.
71.00	Dry ravine course N. arc.
73.00	Top of spur bears N. and S. desc.
79.90	The cor. of sec. 23, 24, 25 and 26 here before described. Land rolling and mountainous, Soil sandy and stony 3 <sup>rd</sup> and 4 <sup>th</sup> rate. Timber Scattering cedar Mountainous land. 39.00 chs.
	N 70° 01' W bet. sec. 23 and 24
	Descend abrupt rocky N.W. slope over mountainous land covered with scattering sage and greasewood brush and bunch grass
3.00	Dry ravine course N.W. around S.W. slope
40.00	Set an iron post 3 ft. long 1 in. in diam 26 ins. in the ground for ¼ sec. cor. marked on bears cap.

Survey and Resurvey of the  
Subdivisions of <sup>lines of</sup> T 29 N. R 18 E

BOOK 2592

Chains

- 4323 on W half and 824 on E half.  
Dig pits 18x18x12 ins n and s. of post. 3ft. dist  
and raise a mound of earth 3 1/2 ft. base, 1 1/2  
ft high. W of cor.  
44.00 Top of spur beam E. and W, desc.  
50.00 Foot of descent leave mountainous land beam  
N.E. and S.W.; enter rolling sandy land beam N.E.  
and S.W.  
55.50 Wood road beam N.E. and S.W.  
57.50 Dry ravine 20 lbs. wide cross W.  
80.00 Set out iron post, 3ft. long 2 ins. in diam 24  
ins. in the ground for cor. of sec. 13, 14, 23 and  
24 marked on cross cap T 29 N. S 14 in N.W.  
T 18 E S 13 in N.E. 824 in S.E. and 823 in S.W.  
quadrant.  
Dig pits 18x18x12 ins. in each. sec. 5 1/2 ft. dist. and  
raise a mound of earth 4 ft. base 2 ft. high W. of  
cor.  
Land rolling and mountainous.  
Soil sandy and stony 3<sup>rd</sup> and 4<sup>th</sup> rates.  
No timber  
Mountainous land, 50.00 Chs

January 18<sup>th</sup> 1909

- 1909  
Jan. 20<sup>th</sup> at 8<sup>th</sup> 11<sup>m</sup> am. Com. D. set off 35° 54' n. on the  
lat arc. 20° 06' s. on the decl. arc and determine a meridian  
with the solar at the cor. of sec. 13, 14, 23 and 24, <sup>above</sup> described.  
Thence I run  
East on a random line bet. sec. 13 and 24  
40.00 Set temp 1/4 sec. cor.  
79.92 Intersect E. bdy. of T 29 N. at the cor. of sec. 13, 18, 19 and  
24, recently estab. by me & described in Exterior Book "C"  
Thence I run  
West on a true line bet. sec. 13 and 24.  
Descend W. slope over rolling sandy land through  
sage and greasewood. brush and bunch grass  
25.50 Leave rolling land beam N.E. and S.W. descend  
abrupt rocky N.W. slope over mountainous land  
beam N.E. and S.W.  
37.00 Foot of descent in dry ravine 100 lbs. wide 4 ft. deep

Chains

7

- Course N.W. leave mountainous land bear N.E. and S.W. ascend N.E. slope over hilly sandy land bear N.E. and S.W.
- 39.96 Set an iron post 3 ft. long 1 in. in diam. 26 ins. in the ground for  $\frac{1}{4}$  sec. cor. marked on base of Cap  $\frac{1}{4}$  S 13 on N half. and S 24 on S. half.  
 Dig pits 18x18x12 ins. East W of post. 3 ft. dist. and raise a mound of earth 3  $\frac{1}{2}$  ft. base 1  $\frac{1}{2}$  ft. high N of cor.
- 51.00 Top of sand hill bear N and S. desc. W. slope.
- 67.50 Road to Polacca Ariz bear N.E. and S.W., leave hilly land bear N.E. and S.W. enter rolling and level land bear N.E. and S.W.
- 79.92 The cor. of sec. 13, 14, 23 and 24, hereinbefore described. Land level rolling hilly and mountainous. Soil sandy and stony 2<sup>nd</sup> 3<sup>rd</sup> and 4<sup>th</sup> rate.  
 No timber  
 Mountainous land 11.50 chs.
- 
- N<sup>o</sup> 01 W. bet. sec. 13 and 14  
 Over level sandy land through sage and greasewood brush and scattering bunch grass
- 18.75 Dry sand wash 80 ft. wide banks 15 ft. high. Course S.W. leave level land bear N.E. and S.W. enter hilly land bear N.E. and S.W. ascend S.E. slope
- 38.00 Foot of mesa, leave hilly land bear N.E. and S.W. ascend abrupt rocky E. slope of mesa over mountainous land bear N.E. and S.W.
- 40.00 The point for the  $\frac{1}{4}$  sec. cor. falls on unsafe ground on steep S. slope. therefore I continue my line
- 41.00 Top of mesa bear N.E. and S.W. leave mountainous land bear N.E. and S.W. enter level sandy land bear N.E. and S.W.
- 43.00 Set an iron post 3 ft. long 1 in. in diam. 26 ins. in the ground for witness cor. to the  $\frac{1}{4}$  sec. cor. marked on base of T<sub>29</sub>N R<sub>18</sub>E S<sub>14</sub> on W. half. S<sub>13</sub> on E. half. W.C.  $\frac{1}{4}$  on S. half.  
 Raise a mound of stone 3 ft. base 1  $\frac{1}{2}$  ft. high. W of cor.  
 Pits impracticable
- 57.00 Leave rolling land bear N.W. and S.E. descend steep rocky

Chain

BOOK 2592

80.00 N.E. slope over broken hilly land.  
 Set an iron post. 3 ft. long. 2 in. in diam 24 ins. in  
 the ground for cor. of sec. 11, 12, 13 and 14 wh. on brass cap.  
 T 29 N. S 11 in N.W. R 18 E S 12 in N.E. S 13 in S.E. and S 14  
 in S.W. quadrant  
 Dig pits 18 x 18 x 12 ins in each sec. 5 1/2 ft. dist. and  
 raise a mound of earth 4 ft. base 2 ft. high W of cor.  
 Land level hilly and mountainous.  
 Soil sandy and stony 2<sup>nd</sup> 3<sup>rd</sup> and 4<sup>th</sup> rate.  
 No timber  
 Mountainous land 3.00 chs.

40.00 East on a random line bet. sec. 12 and 13.  
 Set temp 1/4 sec. cor.  
 79.90 Intersect the E. line of Twp. 3 lks. S. of the cor. of sec. 7  
 12, 13 and 18, recently estab. by me & described in Exterior Book "C"  
 Thence I run  
 S 89° 59' W on a true line bet. sec. 12 and 13  
 Over level sandy land through sage and greasewood  
 bush undergrowth and scattering bunch grass  
 7.00 Road to Colucca Ariz bears N.E. and S.W.  
 14.40 Dry ran. just 50 lks. wide 10 ft. deep. Course S.  
 39.95 Set an iron post. 3 ft. long 1 in in diam 26 ins. in  
 the ground for 1/4 sec cor. marked on brass cap 1/4  
 S 12 on N. half and S 13 on S half.  
 Dig pits 18 x 18 x 12 ins E. and W. of post 3 ft. dist and  
 raise a mound of earth 3 1/2 ft. base 1 1/2 ft. high N. of  
 cor.  
 At this cor. I set off 20° 0' 1/2' S. on the decl. arc, and  
 at 12<sup>h</sup> 11<sup>m</sup> p.m. I met & observed the sun on the  
 meridian, the resulting latitude being 35° 55' N.  
 50.00 Level land bears N.W. and S.E. ascend N.E.  
 slope over hilly stony land bears N.W. and S.E.  
 53.00 Top of steep ascent bears N.W. and S.E.  
 79.90 The cor. of sec. 11, 12, 13 and 14, heretofore described.  
 Land level and hilly.  
 Soil sandy and stony 2<sup>nd</sup> 3<sup>rd</sup> and 4<sup>th</sup> rate  
 No timber

Chains

40.00 No 01' W. line sec 11 and 12.  
 Ascend N.E. slope over hilly sandy land through scattering  
 sage and greasewood undergrowth and brush grass  
 Set an iron post 3ft long 1 in in diam. 26 ins in the  
 ground for  $\frac{1}{4}$  sec. cor. marked on brass cap  $\frac{1}{4}$  S 11 on  
 W. half and S 12 on E half.  
 Dig pits 18x18x12 ins in each. S. of post. 3ft dia and  
 raise a mound of earth  $3\frac{1}{2}$  ft. base.  $1\frac{1}{2}$  ft. high W. of cor.  
 44.00 Dry ravine course S.E. ascend S.W. slope.  
 80.00 Set an iron post 3ft long 2 ins. in diam. 24 ins. in  
 the ground for cor. of secs. 1, 2, 11 and 12. marked  
 on brass cap. T 29 N. S 2 in N.W. R 18 E S 1 in N.E. S 12  
 in S.E. and S 11 in S.W. quadrants.  
 Dig pits 18x18x12 ins in each. sec.  $5\frac{1}{2}$  ft. dia. and  
 raise a mound of earth 4 ft. base. 2 ft. high W. of cor.  
 Land rolling  
 Soil sandy 2<sup>nd</sup> and 3<sup>rd</sup> rate.  
 No timber

40.00 N 89° 59' E on a random line line sec 1 and 12  
 Set temp  $\frac{1}{4}$  sec. cor.  
 79.86 Intersect E. bdy. of N. 8 lkw. N. of the true point for  
 the cor. of sec 1, 6, 7, and 12.  
 Thened Drun,  
 N 89° 58' W. on a true line sec 1 and 12.  
 35.75 On level bottom land through sage and greasewood brush undergrowth  
 Wood road bears N and S. Bears level land bears N and S.  
 enter rolling land bears N and S. ascend gradually  
 over E. slope.  
 39.93 Set an iron post 3ft long 1 in in diam. 26 ins. in the  
 ground for  $\frac{1}{4}$  sec. cor. marked on brass cap  $\frac{1}{4}$  S 1 on N.  
 half and S 12 on S half.  
 Dig pits 18x18x12 ins in each E and W. of post. 3ft dia and raised  
 a mound of earth  $3\frac{1}{2}$  ft. base  $1\frac{1}{2}$  ft. high N. of cor.  
 45.00 Top of low sand ridge bears N. and S. desc. gently over W. slope  
 79.86 The cor. of secs. 1, 2, 11 and 12, heretofore described.  
 Land level rolling and hilly  
 Soil sandy 2<sup>nd</sup> and 3<sup>rd</sup> rate.  
 No timber

BOOK 2592

40.00 N 0° 01' W. on a random. true line sec. 1 and 2.  
Set temp 1/4 sec. cor  
79.95 Intersect N. ldy of Np. 10 lks. <sup>589.59 E</sup> of the cor. of sec. 1, 2, 35  
and 36, recently estab. by me & described in Exterior Book "Q"  
Thence Draw

30.00 S 0° 5' E on a true line sec. 1 and 2.  
Ascend N. slope over rolling sandy land through sage  
and greasewood brush and bunch grass  
Top of sand ridge head East W. Enter scattering cedar  
timber head East W descend S. slope of ridge over  
hilly land head East W.

39.95 Set an iron post. 3 ft. long 1 in in diam. 26 in in  
the ground for 1/4 sec. cor. marked on base of 1/4 S  
2 on W half and 31 on E half from which.

Cedar 6 in. in diam. head N 37° E 95 lks. dist. marked  
1/4 S 1 B.T.

Cedar 8 in. in diam. head N 38 1/2° W 171 lks. dist. marked  
1/4 S 2 B.T.

48.00 Part timber head East W

79.95 The cor. of sec 1, 2, 11 and 12, heretofore described.  
Land rolling and hilly.  
Soil sandy 3rd rate.  
Pinch Cedar

Jan. 20th, 1909.

1909  
January 19<sup>th</sup> 1909 8<sup>h</sup> 15<sup>m</sup> a.m. l.m.t. Det. off. 36° 51 1/2' N. on the ldy. and  
20° 19 1/2' S. on the decl. arc and determined a meridian  
with the solar on the Standard Cor. of sec. 34 and 35  
on the S. ldy of the Np, recently re-estab. by me & described  
in Standard Book "C"  
Thence Draw, resurveying

N 0° 01' W. sec 34 and 35

Descend N.W. slope over rolling sandy and hilly  
land through scattering sage and greasewood  
brush undergrowth and bunch grass.

10.00 Old road head N.W. and S.E.

20.00 No trace of old 1/4 sec. cor. can be found.

21.30 Road to Deep Spring head N.E. and S.W.

35.00 Dry ravine 20 lks. wide 4 ft. deep course S.W.

40.00 Set a cedar post. 3 ft. long. 3 in. sq. with  
marked stone 24 in. in the ground <sup>re-established</sup> for 1/4 sec. cor.  
marked 1/4 S 34 on W face and S 35 on E face.

Dig pits 18x18x12 in N. and S. of post. 3 ft. dia  
and raise a mound of earth 3 1/2 ft. base 1 1/2 ft.  
high W. of cor. No trace of the old 1/4 sec. cor can be found.

Chains

45.60 Left bank of dry sand wash, 4 ft high bank N.E. and S.W.  
 47.25 Right bank of sand wash 3 ft high bank N.E. and S.W., ascend gradually on S.E. slope  
 80.00 Set a cedar post 3 ft long 4 ins. sq. with marked stone 24 ins in the ground for <sup>re-established</sup> cor. of secs. 26, 27, 34 and 35 mtd. T<sub>29</sub>N, S<sub>26</sub> on N.E. R<sub>18</sub>E S<sub>35</sub> on S.E. S<sub>34</sub> on S.W. and S<sub>27</sub> on N.W. faces with 2 notches on E and 1 notch on S edges Dig pits 18x18x12 ins. in each sec. 5 1/2 ft. dist. and raise a mound of earth 4 ft base 2 ft high. W. of cor. ~~No trace of old sec. cor. can be found at this point~~  
 Land rolling  
 Soil sandy 2<sup>nd</sup> and 3<sup>rd</sup> rate  
 No timber.  
 Fail to find any trace of the old cor. of secs. 26, 27, 34 and 35-

40.00 East on a random line bet. sec 26 and 35 -  
 Set temp 1/4 sec. cor.  
 80.02 Intersect N. and S. line 3 lks N. of the cor. of secs 25, 26, 35 and 36, heretofore described.  
 Thence Run  
 N<sup>89</sup>°59' W on a true line bet. sec 26 and 35 -  
 Descend N.W. slope over mountainous land through sage and greasewood brush undergrowth and bunch grass  
 2.00 Dry ravine course N.W. asc.  
 5.00 Top of spur bank N.E. and S.W. desc.  
 13.00 Dry ravine course S.W. asc.  
 15.00 Top of spur bank N.E. and S.W. desc.  
 20.00 Leave mountainous land bank N and S. ~~No trace of old 1/16 sec. cor. can be found.~~  
 Enter rolling land bank N and S.  
 Thence resurveying

40.01 Set a cedar post 3 ft long. 3 ins. sq. with marked stone 24 ins in the ground for <sup>re-established</sup> 1/4 sec. cor. marked 1/4 S<sub>26</sub> on N. face and S<sub>35</sub> on S. face Dig pits 18x18x12 ins E and W. of post. 3 ft. dist. and raise a mound of earth 3 1/2 ft. base, 1 1/2 ft. high. N. of cor. ~~No trace of the old 1/4 sec. cor.~~  
 60.00 ~~No trace of old 1/16 sec. cor. can be found~~  
 71.50 Center of dry sand wash, 3 chs. wide, 4 ft. deep, course S.E. asc. gradually.  
 74.85 Road from Weepo Spring to Polacca, Arizona, bears North and South.  
 80.02 <sup>re-established</sup> The cor. of secs 26, 27, 34 and 35, heretofore described.

BOOK 2592

Land rolling and mountainous.  
Soil sandy 2<sup>nd</sup> and 3<sup>rd</sup> rate.  
No timber  
Mountainous land 20.00 chs.

W 0° 01' W Secs. 26 and 27, resurveying to 1/4 sec. cor.  
Ascend S.E. slope over hilly sandy land through  
sage and greasewood brush undergrowth and  
scattering bunch grass.

8.00 Top of stony ridge bears N.E. and S.W. desc.  
20.00 No trace of old 1/4 sec. cor. can be found.  
24.50 Dry ravine course E. asc.

40.00 Set a cedar post 3ft. long, 3 ins. sq. with  
marked stone, 24 ins in the ground for <sup>reestablished</sup> 1/4 sec  
cor. marked 1/4 S 27 on W. face and S 26 on E face  
Dig pits 18x18x12 ins., N and S. of post 3ft. dia,  
and raise a mound of earth 3 1/2 ft. base, 1 1/2  
ft high W. of cor. No trace of the old 1/4 sec cor. can be found.

NOTE At this cor I set off 20° 19' S on the decl. arc  
and at 12<sup>h</sup> 11<sup>m</sup> pm. I obs'd observe the sun on  
the meridian the resulting latitude being  
35° 52 1/2' N.

44.00 Top of sand ridge bears E. and W, desc.

50.50 Dry ravine course E. asc.

57.50 Sandstone ledge 10 ft high bears E. and W.

57.25 Wire fence bears E and W

62.50 Top of sand ridge bears E. and W desc.

66.25 Dry ravine course E. asc

72.75 Top of sand ridge bears E. and W, desc.

80.00 Set a cedar post 3ft. long 4 ins sq. with marked stone 24 ins in  
the ground for cor. of sec. 22, 23, 26 and 27,  
marked. T 29 N, S 23 on N.E. R 18 E S 26 on S.E., S  
27 on S.W. and S 22 on N.W. faces, with 2 notches  
on E. and S. edges.

Dig pits 18x18x12 ins in each sec. 5 1/2 ft. dia, and  
raise a mound of earth 4 ft. base, 2 ft. high W.  
of cor.

Land hilly.

Soil sandy and stony 3<sup>rd</sup> and 4<sup>th</sup> rate.

No timber.



Chains

40.00 S89°59' E on a random line bet. sec. 23 and 26  
 Sep temp  $\frac{1}{4}$  sec. cor.  
 80.00 Intersect N and S. line 2 lks N. of the cor. of sec.  
 23, 24, 25 and 26.  
 Thence S run.  
 N89°58' W. on a true line bet. sec. 23 and 26.  
 ascend E slope of spur over mountainous land  
 through sage and greasewood brush undergrowth  
 and bunch grass.  
 2.00 Top of spur bear N and S. desc.  
 11.00 Foot of steep descent, leave mountainous land  
 bear N and S., enter rolling land bear N and S  
 desc. gradually.  
 26.00 Dry sand wash 100 lks. wide banks 6 ft. high.  
 Course S., - ascend gently over E. slope.  
 40.00 Set an iron post  $\frac{3}{4}$  ft. long 1 in in diam 26 ins.  
<sup>re-established</sup>  
 in the ground for  $\frac{1}{4}$  sec. cor marked on bear  
 Cop  $\frac{1}{4}$  S 23 on N half and S 26 on S. half  
 Dig pits 18x18x12 ins. E and W. of post.  $\frac{3}{4}$  ft.  
 dia. and raise a mound of earth  $3\frac{1}{2}$  ft. base  $1\frac{1}{2}$   
 ft. high N. of cor. I find no trace of the old  $\frac{1}{4}$  sec. cor.  
 42.00 Road to Weepo Spring bear NW. and SE.  
 60.00 No trace of old  $\frac{1}{16}$  sec. cor. can be found.  
 68.50 Dry ravine 20 lks. wide  $\frac{3}{4}$  ft. deep course S.E.  
 70.50 Road to Placea Ariz bear NW. and SE.  
 74.00 Top of low sand ridge bear N.E. and S.W. desc.  
 80.00 The cor. of sec. 22, 23, 26 and 27, heretofore described.  
 Land rolling and mountainous.  
 Soil sandy 2<sup>nd</sup> and 3<sup>rd</sup> rate.  
 No timber  
 Mountainous land 11.00 chs.

N6°01' W bet. sec 22 and 23  
 Over low rolling sand hills. through sage  
 and greasewood brush undergrowth and scattering  
 bunch grass.  
 4.25 Dry course course N.E. asc  
 5.00 Top of sand ridge bear N.E. and S.W. desc  
 gradually  
 18.25 Road to Placea Ariz bear NW. and SE

14

Chain

BOOK 2592

- 26.00 Dry sand wash 300 lbs. wide 2 ft. deep Course  
S.E. ascend gradually.
- 31.00 Road to Weepo Spring. bears E and W.
- 37.00 Rare hilly land bears E and W. Ascend steep  
rocky E. slope of mesa over mountainous land  
bears E and W.
- 40.00 Set a Cedar post 3 ft long 3 ins sq. with marked  
stone 24 ins. in the ground for  $\frac{1}{4}$  sec. on marked  
 $\frac{1}{4}$  S 22 on W face. and S 23 on E face.  
Raise a mound of stone 2 ft. base  $1\frac{1}{2}$  ft. high W. of  
Cov. Pits impracticable
- 42.20 Top of mesa bears NW. and S.E. bears mountainous  
land bears NW. and S.E. enter rolling sandy  
mesa land bears NW. and S.E. ascend gradually.
- 80.00 Set an iron post 3 ft long 2 ins. in diam 24 ins.  
in the ground for Cov. of sec. 14, 15, 22 and 23  
marked on base Cop. T29N R18E  
S 14 in NE. S 23 in SE and S 22 in SW quadrant  
Dig pits 18x18x12 ins. in each sec.  $5\frac{1}{2}$  ft. dist. and  
raise a mound of earth 4 ft. base, 2 ft. high, W.  
of cov.  
Land rolling hills and mountainous.  
Soil sandy and stony 2<sup>nd</sup> 3<sup>rd</sup> and 4<sup>th</sup> rate.  
No timber  
Mountainous land. 5.20 Chs.

January 19<sup>th</sup> 1909

- January 21<sup>st</sup> 1909 At 8<sup>h</sup> 11<sup>m</sup> am. l.m. l. Deb off  $35^{\circ}54'N$ ,  
on the lat. arc  $19^{\circ}53\frac{1}{2}'S$  on the decl. arc, and  
determine a meridian with the solar alt. The  
Cov. of sec. 14, 15, 22 and 23, heretofore described,  
Thence I run  
S  $89^{\circ}58'E$  on a random line bet. sec. 14 and 23  
40.00 Deb temp.  $\frac{1}{4}$  sec. cov.
- 80.04 Intersect N and S. line 8 lbs. N. of the Cov. of sec. 13  
14, 23 and 24, heretofore described,  
Thence I run  
N  $89^{\circ}55'W$ , on a true line bet. sec. 14 and 23  
Over rolling sandy land: through sage and greasewood  
bush undergrowth and scattering buckgrass

Chains

- 22.75 Dry ravine 50 lbs. wide 10 ft. deep Course S. asc S.E. slope.
- 27.45 Level rolling land bears NE and SW ascend steep rocky S.E. slope of mesa over mountainous land bears NE and SW.
- 36.00 Top of mesa bears NE and SW. level mountainous land bears NE and SW. enter rolling land bears NE and SW.
- 40.02 Set an iron post. 3 ft. long 1 in. in diam. 26 ins. in the ground for 4 sec. cor. marked on base cap 4 S14 on N. half and S23 on S half.  
 Raise a mound of stone 2 ft. base, 1 1/2 ft. high N. of cor. Pits impracticable.
- 44.00 Level stony land bears NE and SW. enter sandy land bears NE and SW.
- 80.04 The cor. of sec. 14, 15, 22 and 23, hereinbefore described. Land rolling and mountainous. Soil sandy and stony 2<sup>nd</sup> and 3<sup>rd</sup> and 4<sup>th</sup> rate. No timber.  
 Mountainous land. 8.53 chs.

Wood 1/2 W. 1/2 sec. 14 and 15  
 Over rolling sandy mesa land through sage and greasewood bush undergrowth and scattering bunch grass.

- 1.00 Begin gradual descent over N.E. slope
- 40.00 Set an iron post. 3 ft. long, 1 in. in diam., 26 ins. in the ground for 4 sec. cor. marked on base cap 4 S15 on W. half and S14 on E half.  
 Dig pits 18 x 18 x 12 ins. N and S. of post. 3 ft. dist. and raise a mound of earth 3 1/2 ft. base 1 1/2 ft. high W. of cor.
- 73.00 Foot of descent in depression bears NE and SW. drains to NE. ascend over S.E. slope
- 80.00 Set an iron post. 3 ft. long, 2 ins. in diam., 24 ins. in the ground for cor. of sec. 10, 11, 14 and 15 marked on base cap. T<sub>29</sub>N, S<sub>10</sub> in N.W. R<sub>18</sub>E S11 in N.E. S14 in S.E. and S15 in S.W. quadrant.  
 Dig pits 18 x 18 x 12 ins. in each sec. 5 1/2 ft. dist and

BOOK 2592

raise a mound of earth 4 ft. base 2 ft. high W. of cor.  
Land rolling,  
Soil sandy 3<sup>rd</sup> rate.  
No timber.

S 89° 55' E on a random line bet. sec. 11 and 14  
40.00 Set temp. 1/4 sec. cor.  
80.02 Intersect N and S line at the cor. of sec. 11, 12, 13 and  
14, heretofore described,  
Thence S run

N 89° 55' W on a true line bet. sec. 11 and 14  
Over gently rolling sandy mesa land through  
sage and greasewood bush and bunch grass  
40.01 Set an iron post. 3 ft. long, 1 in. in diam., 26 in. in  
the ground for 1/4 sec. cor. marked <sup>on brass cap</sup> 4 S 11 on N. half  
and S 14 on S half.

Dig pits 18 x 18 x 12 ins. E and W. of post. 3 ft. dia.  
and raise a mound of earth 3 1/2 ft. base, 1 1/2 ft. high  
N. of cor.

40.50 Begin gentle ascent over S.E. slope  
80.02 The cor. of sec. 10, 11, 14 and 15, heretofore described.  
Land rolling.  
Soil sandy 2<sup>nd</sup> and 3<sup>rd</sup> rate.  
No timber.

NOTE At this cor. set off 19° 53 1/2' S. on the decl. arc and  
at 12<sup>th</sup> 11<sup>th</sup> p.m. limit observe the sun on the meridian  
the resulting latitude being 35° 55' N.

N 0° 01' W bet. sec. 10 and 11  
Around S.E. slope over rolling sandy land through sage  
and greasewood bush undergrowth and bunch  
grass  
20.00 Enter Cedar timber tract N.E. and S.W.  
39.00 Top of low sand ridges tract N.E. and S.W. desc  
gently over N.W. slope.  
40.00 Set an iron post. 3 ft. long 1 in. in diam., 26 in. in

Claims

the ground for  $\frac{1}{4}$  sec. cor. marked on brass cap  $\frac{1}{4}$  S 10  
 on W half and S 11 on E half, from which,  
 A cedar 8 ins. in diam bears S  $79\frac{3}{4}^{\circ}$  E 150 lks. dist.  
 marked  $\frac{1}{4}$  S 11 B.T.

A cedar 5 ins. in diam. bears N  $70\frac{1}{4}^{\circ}$  W 109 lks.  
 dist marked  $\frac{1}{4}$  S 10 B.T.

53.50 Dry ravine Course E. ascend gradually  
 80.00 Set an iron post. 3ft long 2 ins. in diam. 24 ins.  
 in the ground for cor. of sec. 2, 3, 10 and 11  
 marked on brass cap T 29 N, S 3 in NW, R 18 E S 2  
 in NE S 11 in SE and S 10 in SW quadrant.  
 from which.

A cedar 10 ins. in diam. bears N.  $54^{\circ}$  E 262 lks. dist.  
 marked T 29 N, R 18 E S 2 B.T.

A cedar 9 ins in diam. bears S  $52\frac{1}{4}^{\circ}$  E 262 lks  
 dist. marked T 29 N, R 18 E S 11 B.T.

A cedar 6 ins. in diam bears S  $72\frac{3}{4}^{\circ}$  W 186 lks  
 dist, marked T 29 N, R 18 E, S 10 B.T.

A cedar 14 ins. in diam. bears N  $84\frac{1}{4}^{\circ}$  W 192 lks  
 dist, marked T 29 N, R 18 E S 3 B.T.

Land rolling,  
 Soil sandy 2<sup>nd</sup> and 3<sup>rd</sup> rate.  
 Timber Cedar.

S  $89^{\circ}55'$  E over random line bet. sec. 2 and 11.

40.00 Set temp  $\frac{1}{4}$  sec. cor.

80.08 Intersect N and S. line 2 lks. S. of the cor. of sec.  
 1, 2, 11 and 12, heretofore described,  
 Thence run

N  $89^{\circ}56'$  W over a true line bet. sec. 2 and 11  
 ascend S.E. slope over hilly sandy land through  
 sage and greasewood. Bush undergrowth and  
 bunch grass.

9.00 Top of ridge bears N.E and S.W. desc. gradually

11.50 Dry ravine Course S.W. ascend gradually.

40.04 Set an iron post. 3ft. long 1 in. in diam. 26 ins.  
 in the ground for  $\frac{1}{4}$  sec. cor. marked on brass  
 cap  $\frac{1}{4}$  S 2 on N half and S 11 on S half.  
 Dig pits 18x18x12 ins E and W. of post. 3ft dist

BOOK 2592

and raise a mound of earth 3 1/2 ft. base 1 1/2 ft high  
N. of cor.

76.00 Enter scattering Cedar timber bear N and S

80.08 The Cor. of sec. 2, 3, 10 and 11, heretofore described.  
Land rolling.

Soil sandy 2<sup>nd</sup> and 3<sup>rd</sup> rate.  
Timber Cedar.

40.00 N 0° 01' W. on a standard line bet. sec. 2 and 3.  
Set temp 1/4 sec. cor.

79.88 Intersect N. Tdy. of 9<sup>th</sup> 8 lks. S 89° 59' E. of the Cor. of sec.  
2, 3, 34 and 35, recently estab. by me & described in *External*  
*Book "C"*  
Thence Drive

S 0° 04' E on a true line bet. sec. 2 and 3 -  
Ascend gradually N slope over rolling sandy land,  
through sage and greasewood brush and bunch grass

39.88 Set an iron post. 3 ft. long in. in diam 26 in. in  
the ground for 1/4 sec. cor. marked on base of 1/4  
S on W. half and S 2. on E half.

Dig pits 15x18x12 in N and S. of post. 3 ft. dist.  
and raise a mound of earth 3 1/2 ft. base, 1 1/2  
ft. high W. of cor.

66.00 Enter Cedar timber bear E and W,

69.00 Top of sand ridge bear N.E. and S.W. descend.  
gently over S.E. slope.

79.88 The Cor. of sec. 2, 3, 10, and 11, heretofore described.

Land rolling  
Soil sandy 2<sup>nd</sup> and 3<sup>rd</sup> rate.  
Timber Cedar.

January 21<sup>st</sup> 1909

1909  
January 22<sup>nd</sup> at h. 8<sup>h</sup> 10<sup>h</sup> am <sup>l.m.ty</sup> on the lat. arc. 19° 40' S on the decl. arc and,  
determine a meridian with the solar alt. The  
Stand. Cor. of sec. 33 and 34 on the S. Tdy. of the  
9<sup>th</sup> recently re-estab. by me & described in Standard Book "C"  
Thence Drive.

Chains

19

- No. 2 W. Ch. recs 33 and 34  
 Ascend S.E. slope over hilly sandy land through sage and  
 greasewood brush undergrowth and bunchgras.
- 2.50 Dry ravine 20 chs. wide 3ft deep course S.E.
- 25.35 Wire fence line N.E. and S.W.
- 40.00 Set a cedar post. 3ft long 3 ins sq. with marked stone  
 24 ins. in the ground for  $\frac{1}{4}$  sec. cor. marked 533 on  
 W. face and 534 on E. face.  
 Dig pits 18x18x12 ins N. and S. of post. 3ft. dia. and  
 raise a mound of earth 3 $\frac{1}{2}$  ft. base, 1 $\frac{1}{2}$  ft. high W.  
 of cor.
- 49.50 Foot of mesa, level hilly land toward N.W. and S.E. Ascend  
 steep rocky S.W. slope over mountainous land toward  
 N.W. and S.E.
- 64.00 Foot of sand stone cliffs 40 ft. high toward N.W. and S.E.  
 ascend abruptly.
- 68.00 Top of cliffs on S. edge of mesa toward N.W. and S.E.  
 level mountainous land toward N.W. and S.E. enter  
 rolling mesa land and scattering cedar timber  
 toward N.W. and S.E. ascend gradually.
- 75.00 Level timber toward N.W. and S.E.
- 80.00 Set a cedar post. 3ft. long. 4 ins. sq. with marked  
 stone 24 ins. in the ground for cor. of recs. 27, 28, 33  
 and 34 marked T 29 N S 27 on N.E., R18E. 334 on S.E.  
 333 on S.W. and 328 on N.W. faces. with 3 notches on  
 E and 1 notch on S edges.  
 Dig pits 18x18x12 ins in each rec. 5 $\frac{1}{2}$  ft. dia. and  
 raise a mound of earth 4ft base, 2ft high W. of cor.  
 Land rolling, hilly and mountainous.  
 Soil sandy and stony 3<sup>rd</sup> and 4<sup>th</sup> cuts.  
 Timber Cedar.  
 mountainous land 17.50 chs.
- 
- East on a random line Ch. recs 27 and 34
- 40.00 Set. long  $\frac{1}{4}$  sec. cor.
- 80.06 Intersect N and S. line at <sup>re-established</sup> the cor. of recs 26, 27, 34  
 and 35; heretofore described,  
 Thence Run  
 West on a true line Ch. recs. 27 and 34.

BOOK 2592

- Ascend E slope over hilly sandy land through sage  
and greasewood brush undergrowth and bunch  
grass.
- 16.50 Dry ravine 30 lbs. in d. 4 ft. deep course S.E. ascend  
sand ridge.
- 18.25 Top of ridge bear NW. and SE desc.
- 20.00 Bottom of depression bear NW. and S.E., drains to S.E. acc.
- 33.60 Top of rocky ridge bear NW. and S.E. desc. steeply.
- 35.00 Top of mesa bear NW. and S.E. leave hilly land bear  
NW. and S.E. ascend abrupt rocky S.E. slope of mesa over  
mountainous land bear NW. and S.E.
- 40.03 Set a cedar post 3 ft long 3 in sq. with marked stone  
24 ins in the ground for  $\frac{1}{4}$  sec. cor. marked  $\frac{1}{4}$  S 27  
on N. face and 334 on S. face.  
Build a mound of stone 2 ft base  $1\frac{1}{2}$  ft high N. of cor.  
Pits impracticable.
- 47.00 Top of ascent on E. edge of mesa bear N.E. and S.W.  
Leave mountainous land bear N.E. and S.W. enter  
rolling sandy mesa land bear N.E. and S.W. ascend gradually
- 69.50 Top of sand ridge bear N.E. and S.W. descend gradually
- 80.06 The cor. of rees. 27, 28, 33 and 34, heretofore described.  
Land rolling hilly and mountainous.  
Soil sandy and stony 2<sup>nd</sup> 3<sup>rd</sup> and 4<sup>th</sup> cat.  
No timber
- A rain and snow storm prevents further field work on  
this day.

January 22<sup>nd</sup> 1909

This 22<sup>nd</sup> day of January 1909. I discharge  
Ralph N. Westland Chainman, no officer authorized  
to administer oaths, other than myself, being  
available, without great inconvenience, delay and  
expense, I administer the required final oath.

Sidney E. Blouk.

U.S. Examiner of Surveys

January 23<sup>rd</sup> 1909  
At 10<sup>h</sup> 57<sup>m</sup> am. Com. I set off 35<sup>h</sup> 52<sup>m</sup> on the  
tab. arc. 19° 26 $\frac{1}{2}$ ' S. on the decl. arc and determine  
a meridian with the solar alt. the cor. of rees. 27, 28,  
33 and 34.

The end



Chain

N 76° 02' W bet. sec. 27 and 28.

Ascend S.W. slope over rolling sandy mesa land through sage and greasewood brush undergrowth.

28.50 Top of mesa trans N.W. and S.E. descended gently over N.E. slope.

30.00 Enter scattering cedar timber trans E. and W.

40.00 Set a cedar post 3 ft. long, 3 ins. in diam. 24 ins. in the ground for 4 sec. cor. marked  $\frac{1}{4}$  S 28 on W face and S 27 on E face from which.

A cedar 18 ins. in diam. trans S 75 $\frac{1}{2}$ ° E 145 lbs dist. marked  $\frac{1}{4}$  S 27 B.T.

A cedar 5 ins. in diam trans N 76 $\frac{1}{4}$ ° W 60 lbs. dist marked  $\frac{1}{4}$  S. 28 B.T.

50.00 Leave timber trans E. and W.

60.00 Enter cedar timber trans E. and W.

80.00 Set a cedar post 3 ft. long, 4 ins. sq. 24 ins. in the ground for cor. of sec. 21, 22, 27 and 28. marked T 29 N S 22 on N.E. R 18 E S 27 on S.E. S 28 on S.W. and S 21 on N.W. faces, with 3 notches on E and 2 notches on S. edges. from which.

A cedar 8 ins. in diam. trans N 53 $\frac{3}{4}$ ° E 31 lbs. dist. marked T 29 N. R 18 E S 22 B.T.

A cedar 8 ins. in diam trans S 79 $\frac{3}{4}$ ° E 200 lbs dist. marked T 29 N R 18 E S 27 B.T.

A cedar 10 ins. in diam. trans S 22 $\frac{1}{2}$ ° W 80 lbs dist, marked T 29 N R 18 E. S 28 B.T.

A cedar 5 ins. in diam. trans N 46 $\frac{1}{4}$ ° W 70 lbs. dist. marked T 29 N. R 18 E S. 21 B.T.

Land rolling  
 Soil sandy 3<sup>rd</sup> rate.  
 Timber Cedar.

Part on a random line bet. sec. 22 and 27.

40.00 Set temp  $\frac{1}{4}$  sec. cor.

80.06 Intersect N and S line 3 lbs. S. of the cor. of sec. 22 23, 26 and 27, heretofore described.

Thence run

S 89° 59' W. on a true line bet. sec. 22 and 27.

Over rolling sandy mesa land through sage and



Chains

- A cedar 14 ins. in diam. bears S 86° W 59 lks. dist. marked  
 1/4 S 21 B.T.
- 44.00 Descend abruptly over sand stone ledge 30 ft. high
- 45.50 Foot of ledge bears E and W. descend gradually.
- 60.00 Dry sand wash 200 lks. wide 3 ft. deep course N.E.  
 Ascend gradually over S.E. slope
- 74.50 Leave rolling land bears N.E. and S.W., enter broken  
 stony hilly land bears N.E. and S.W. ascend abruptly  
 over sand stone ledge 25 ft. high.
- 75.00 Top of sand stone ledge bears N.E. and S.W. leave hilly  
 land bears N.E. and S.W. enter level land bears N.E.  
 and S.W.
- 79.00 Leave level land bears N.W. and S.E., enter hilly stony  
 land bears N.W. and S.E. descend steep N.E. slope
- 80.00 Set a cedar post 3 ft. long 4 ins. sq. 24 ins. in the ground.  
 for cor. of sec. 15, 16, 21 and 22. marked T 29 N. R 18 E  
 on N.E. R 18 E. S 22 on S.E. S 21 on S.W. and S 16 on N.W.  
 faces, with 3 notches on each S. edge  
 from which.
- A cedar 10 ins. in diam. bears N 56 1/2° E 183 lks. dist. marked  
 T 29 N. R 18 E S 15 B.T.
- A cedar 8 ins. in diam. bears S 71° E 126 lks. dist. marked  
 T 29 N. R 18 E. S 22 B.T.
- A juniper pine 12 ins. in diam. bears S 37 1/2° W 75 lks. dist.  
 marked T 29 N. R 18 E S. 21 B.T.
- A cedar 7 ins. in diam. bears N 66° W 181 lks. dist.  
 marked T 29 N. R 18 E S. 16 B.T.
- Land level rolling broken and hilly  
 Soil sandy and stony 2<sup>nd</sup> 3<sup>rd</sup> and 4<sup>th</sup> rate.  
 Timber juniper pine and cedar.
- 
- N 89° 59' E on a random line bet. sec. 15 and 22
- 40.00 Set temp 4 sec. cor.
- 80.08 Intersect. N and S. line at the cor. of sec. 14, 15, 22,  
 and 23, heretofore described,  
 Thence down
- S 89° 59' W on a true line bet. sec. 15 and 22.
- Descend S.W. slope over rolling mesa land.
- 10.00 Foot of descent in depression bears N.W. and S.E. ascend.

Chains

BOOK 2592

- 30.00 S.E. slope  
Top of ridge bears N and S. later scattering cedar  
timber bears NW and SE descend gradually over W.  
slope.
- 40.04 Set an iron post 3ft. long, 1 in in diam., 26 ins in the  
ground for 4 rec. cor marked on bears cop. 1/4 S 15 on N half  
and S 22 on S half. from which.  
A cedar 8 ins. in diam bears N 48 1/2 W 34 lbs. dist. marked  
1/4 S 15 B.T.  
A cedar 8 ins. in diam. bears S 51 1/2 W 48 lbs. dist. marked  
1/4 S. 22 B.T.
- 45.50 Descend sand stone bluff 40 ft. high.
- 46.00 Foot of bluff bears NW and SE desc. gradually
- 53.00 Road bears NW and SE.
- 65.50 Dry ravine course SE. ascend.
- 80.08 The cor of recs. 15, 16, 21 and 22, heretofore described.  
Land rolling and hilly  
Soil sandy and stony 3<sup>rd</sup> and 4<sup>th</sup> rates.  
Timber Cedar.

January 23<sup>rd</sup> 1909

1909  
January 25<sup>th</sup> 1909 At 3:00 p.m. I set off 35° 54' N. on the  
lath arc 18° 55' S. on the decl. arc and determined  
a meridian with the solar at the cor of recs 15, 16,  
21 and 22, heretofore described.

Thence I run

N 0° 02' W bet. recs 15 and 16.

Descend NW. slope over rolling sandy mesa land  
through scattering cedar timber and sage and  
greasewood brush undergrowth 2 ft high.

- 5.00 Leave timber bears NW and SE.
- 6.00 Dry ravine course NE.
- 16.00 Top of ridge bears NE and SW desc.
- 29.50 Dry ravine 100 lbs. wide course NE. asc.
- 40.00 Set a cedar post 3ft long 3 ins sq. with marked  
stone 24 ins. in the ground for 4 rec. cor marked  
1/4 S 16 on W face and S 15 on E face.  
Dig pits 18 x 18 x 12 ins N and S. of post. 3ft. dia.  
and raise a mound of earth 3 1/2 ft base, 1 1/2 ft.  
high W. of cor.

Calvin

53.00 Dry ravine 25 lks. wide 4 ft deep Course E.  
 80.00 Set a cedar post 3 ft long, 4 in dia, with marked  
 stone 24 in. in the ground for cor. of sec. 9, 10  
 15 and 16. marked T 29 N, R 18 E S 15  
 on S.E., S 16 on S.W. and S 9 on N.W. faces, with  
 3 notches on E and 4 notches on S. edges.  
 Dig pits 18x18x12 in in each sec. 5 1/2 ft. dia and  
 raise a mound of earth 4 ft base, 2 ft high W.  
 of cor.  
 Land rolling and hilly.  
 Soil sandy 3<sup>rd</sup> rate.  
 Timber Cedar.

40.00 N 89° 59' E over sandown line bet sec 10 and 15  
 Set temp 1/4 sec. cor.  
 80.02 Intersect N and S line 2 lks S. of the cor. of sec  
 10, 11, 14 and 15, heretofore described,  
 Thence Drum  
 S 89° 58' W. on a true line bet sec. 10 and 15  
 Ascend S.E. slope over hilly land through sage  
 and greasewood bush undergrowth and bunch  
 grass,  
 18.00 Top of ridge bet N and S. due.  
 40.01 Set an iron post 3 ft long 1 in in diam 26 in  
 in the ground for 1/4 sec. cor marked on brass  
 cap 1/4 S 10 on N half and S 15 on S half.  
 Dig pits 18x18x12 in East W. of post. 3 ft. dia.  
 and raise a mound of earth 3 1/2 ft. base 1 1/2  
 ft high N. of cor.  
 80.02 The cor. of sec. 9, 10, 15 and 16 heretofore described.  
 Land hilly.  
 Soil sandy 3<sup>rd</sup> rate.  
 No timber.

January 25<sup>th</sup> 1907

1909  
 January 28<sup>th</sup> Ah 10<sup>h</sup> 50<sup>m</sup> am, <sup>l.m.t.</sup> D. W. off 35 55' N. on  
 the lat. arc 18° 12' S on the decl. arc and determine

BOOK 2592

a meridian with the solar at the cor. of sec 9, 10, 15 and 16.

Thence I run

N 0° 02' W. 1/4 sec 9 and 10.

Ascend S.W. slope over rolling sandy mesa land through sage and greasewood brush undergrowth and bunch grass.

40.00 Set a cedar post 3 ft. long 3 ins sq., with marked stave 24 ins. in the ground for  $\frac{1}{4}$  sec. cor. marked  $\frac{1}{4}$  S 9 on W face and S 10 on E face.

Dig pits 18x18x12 ins. N and S of post 3 ft. dist. and raise a mound of earth 3 1/2 ft. base 1 1/2 ft. high W. of cor.

68.00 Enter scattering cedar timber from NW and S.E.

76.00 Top of mesa from NW and S.E., descend gently over N.E. slope

80.00 Set a cedar post 3 ft. long 4 ins sq. 24 ins. in the ground for cor. of sec. 3, 4 9 and 10 marked T 29 N, R 18 E S 10 on S.E. S 9 on S.W. and S 4 on N.W. faces, with 3 notches on E and 5 notches on S edges from which.

A cedar 8 ins. in diam. from N 65° E 234 lks. dist. marked T 29 N, R 18 E S 3 B.T.

A cedar 6 ins. in diam. from S 31 1/4° E 366 lks. dist. marked T 29 N, R 18 E S 10 B.T.

A quiron pine 12 ins in diam. from S 65 1/4° W 414 lks. dist., marked T 29 N, R 18 E S 9 B.T.

A cedar 12 ins. in diam from N 7 1/4° W 329 lks. dist., marked T 29 N, R 18 E S 4 B.T.

Land rolling

Soil sandy 3<sup>rd</sup> rate.

Quiron pine and cedar.

N 79° 58' E. on a random line bet. sec 3 and 10

40.00 Set temp  $\frac{1}{2}$  sec. cor.

80.02 Intersects N. and S. line 5 lks S. of the cor. of sec. 2, 3, 10 and 11, hereinafter described, Thence I run

Chains

S89°56' W on a true line bet. sec 3 and 10  
 Ascend gradually S.E. slope, through scattering  
 juniper pine and Cedar timber, and sage brush  
 undergrowth.

30.00 Top of ridge bears N.E. and S.W. descend gradually  
 over N.W. slope

40.01 Set an iron post 3ft. long 1 in. in diam., 26  
 ins in the ground for  $\frac{1}{4}$  sec. cor., marked on  
 brass cap  $\frac{1}{4}$  S. 3 on N half and S 10 on S half  
 from which.

A Cedar 4 ins. in diam bears N 43° E 223 lbs  
 dist. marked  $\frac{1}{4}$  S 3 B.T.

A cedar 7 ins. in diam. bears S 63 $\frac{1}{2}$ ° W 213  
 lbs. dist. marked  $\frac{1}{4}$  S 10 B.T.

NOTE Ah this cor. set off 18" 11' S on the decl. arc and  
 at 12<sup>h</sup> 13<sup>m</sup> from. Limit observe the sun on the  
 meridian and obtain on the lab. arc, a reading  
 of 35° 56' N.

48.00 Dry ravine course S.W. asc. gently.

60.00 Top of ridge bears N.E. and S.W. thence over  
 nearly level mesa land bears N.E. and S.W.

80.02 The cor. of sec. 3, 4, 9 and 10, heretofore described.  
 Land rolling  
 Soil sandy 2<sup>nd</sup> and 3<sup>rd</sup> rate.  
 Timber juniper pine and Cedar.

N 0° 02' W. on a random line bet. sec 3 and 4

40.00 Set temp  $\frac{1}{4}$  sec. cor.

79.98 Intersect N. ldy. of Np. point <sup>at the true</sup> for Cor. of sec. 3, 4  
 which is 100 lbs. N 89° 59' W. of the Witness Corner to this corner.  
 33 and 34, recently estab. by me & described in Exterior Book Q.  
 Thence I run S 0° 02' E, on a true line, bet. sec 3  
 and 4, from true cor. point.

Over rolling stony mesa land through scattering  
 juniper pine and Cedar timber, and sage brush  
 and bunch grass undergrowth.

6.00 Top of sand stone ledge 15 ft. high. bears  
 E and W. desc. gently.

18.00 bears timber bears E and W.

39.98 Set an iron post 3ft long 1 in. in diam., 26 ins.

BOOK 2592

in the ground for  $\frac{1}{4}$  sec. cor., marked on base  
Cp. 4 34 on W half and 33 on E half.  
Dig pits 18x18x12 ins N and S of post. 3ft. dist. and  
raise a mound of earth  $3\frac{1}{2}$  ft. base,  $1\frac{1}{2}$  ft. high  
W. of cor.

This cor. is in bottom of depression base NW. and S.E.  
ascend NW. slope.

70.00 Enter scattering prairie pine and cedar timber  
base NE and SW

79.98 The cor. of secs 3, 4, 9 and 10, heretofore described.  
Land rolling

Soil sandy and stony 2<sup>nd</sup> 3<sup>rd</sup> and 4<sup>th</sup> rate  
Prairie prairie pine and cedar.

January 28<sup>th</sup> 1909

January 23<sup>rd</sup> 1909 At 8<sup>h</sup> 00<sup>m</sup> am, <sup>l.m.t.</sup> Ditch off  $35^{\circ} 51\frac{1}{2}' N$ .  
on the lat. arc,  $19^{\circ} 26' S$  on the decl arc and determine  
a meridian with the solar on the Standard Cor. of  
secs 32 and 33 on the 3<sup>d</sup> day of N<sup>o</sup>, recently re-estab. by  
Thence D run <sup>me and described in Standard Book "C"</sup>

N<sup>o</sup> 0 3 W. bet. secs. 32 and 33

Ascend N.E. slope over hilly stony land through sage  
and greasewood brush undergrowth and bunch grass.

12.00 Foot of descent in dry sand wash 400 lbs. wide off  
dep course S.E. asc. S.E. slope, over mountainous land base NW and SE.

35.00 Top of ridge base NW and S.E.

36.00 Dry ravine course S.E. asc.

36.65 Top of steep ascent base E and W. ascend gradually.

40.00 Set a cedar post. 3ft. long 3 ins. sq. with marked  
stone 24 ins. in the ground for  $\frac{1}{4}$  sec. cor. marked  
 $\frac{1}{4}$  S 32 on W face and 33 on E face.

Dig pits 18x18x12 ins N and S of post. 3ft. dist. and  
raise a mound of earth  $3\frac{1}{2}$  ft. base  $1\frac{1}{2}$  ft. high W.  
of cor.

51.00 Top of rocky spur base E and W. desc.

55.00 Dry ravine course E asc.

60.30 Top of spur base E. and W. desc.

66.50 Dry ravine course East. asc.

70.00 Top of spur base E and W. desc.

72.50 Dry ravine course East. asc.



Chains

76.00 Top of spur trail E and W. due. steeply.  
 80.00 Set a cedar post 3ft. long 4 in sq. with marked  
 stone 24 ins. in the ground for cor. of sec 28, 29,  
 32 and 33 marked T 29 N. S 28 on N.E. A188  
 S 33 on S.E. S 32 on S.W. and S 29 on N.W. faces.  
 with 4 notches on E and 1 notch on S edges.  
 Dig pits 18x18x12 ins. in each sec. 5 1/2 ft. dia.  
 and raise a mound of earth 4 ft. base 2 ft.  
 high W. of cor.  
 Land hilly and mountainous.  
 Soil sandy and stony 3<sup>rd</sup> and 4<sup>th</sup> rate.  
 No timber  
 mountainous land 68.00 chs.

40.00 East on a random line bet sec 28 and 33  
 Set temp. 1/4 sec. cor.  
 80.00 Intersect N and S. line 5 chs S of the cor of sec.  
 27, 28, 33 and 34, heretofore described,  
 thence S run  
 S 89 58' W. on a true line bet sec 28 and 33  
 Descend N.W. slope over rolling sandy mesa  
 land through scattering sage and greasewood.  
 brush undergrowth and bunch grass.  
 11.10 West edge of mesa leave rolling land bear  
 N.W. and S.E. descend abrupt rocky W.  
 slope of mesa over mountainous land bear  
 N.W. and S.E.  
 40.00 Set a cedar post 3ft. long 3 in sq. with  
 marked stone 24 ins. in the ground for 1/4  
 sec. cor, marked 1/4 S 28 on N. face, and S 33  
 on S face.  
 Dig pits 18x18x12 ins E and W. of post 3ft.  
 dia. and raise a mound of earth 3 1/2 ft. base  
 1 1/2 ft. high N. of cor.  
 53.00 Dry ravine course S.W. acc.  
 57.00 Top of low spur trail N.E and S.W. due.  
 61.50 Dry ravine at foot of descent 100 chs, wide  
 4 ft. deep course S.E. Leave mountainous land  
 bear N.W. and S.E. ascend S.E. slope over hilly  
 land. bear N.W. and S.E.

30

Chain

BOOK 2592

6300 Road bears NW and S.E.  
 6500 Level hilly land bears NW and S.E. ascend NE  
 slope over mountainous land bears NW and SE.  
 8000 The cor. of secs. 28, 29, 32 and 33, heretofore  
 Land hilly and mountainous. described.  
 Soil sandy and stony 3<sup>rd</sup> and 4<sup>th</sup> rate.  
 No timber.  
 Mountainous land. 6540 Chs.

January 23<sup>rd</sup> 1909

This 25<sup>th</sup> day of January 1909, I employ Arthur  
 A Beard to perform the duties of Chainman  
 No officer authorized to administer oaths other than  
 myself, being available, without great incon-  
 venience, delay and expense, I administered the  
 required preliminary oath.

Erduy E. Blair  
 U.S. Examiner of Surveys

January 25<sup>th</sup> 1909  
 At 8<sup>h</sup> 15<sup>m</sup> a.m. <sup>l.m.t.</sup> I set off 35° 52' N.  
 on the lat. arc 18° 57' S. on the decl. arc. and  
 determined a meridian with the solar at the  
 cor. of secs 28, 29, 32 and 33, heretofore described.  
 Thence I run

N 0° 03' W to cor. sec 28 and 29.  
 Descend N.E. slope over mountainous land through  
 sage and greasewood brush undergrowth 2 ft. high.  
 4.50 Dry ravine course E. ascend spur.  
 5.00 Top of spur bears N.E. and S.W. descend.  
 7.25 Dry ravine course N.E. ascend.  
 8.00 Top of spur bears N.E. and S.W. desc.  
 10.00 Dry ravine course N.E. ascend spur  
 13.75 Top of spur bears E. and W. desc.  
 18.50 Dry ravine course N.E. asc.  
 21.00 Top of spur. bears N.E. and S.W. desc.  
 28.00 Dry ravine 200 lbs. wide 3 ft. deep course S.E.  
 Ascend S.W. slope  
 37.30 Road bears NW and S.E.  
 40.00 Set an iron post - 3 ft. long 1 in in diam 26 in in

Chains

the ground for  $\frac{1}{4}$  sec. cor. marked on brass cap  
 1/4 S 29 on W. half and S 28 on E half.  
 Dig pits 18x18x12 ins N and S. of post. 3ft. dist.  
 and raise a mound of earth  $3\frac{1}{2}$  ft. base  $1\frac{1}{2}$   
 ft. high W of cor.

61.70 Pop of rocky spur bears East W. desc.

71.50 Dry ravine course S.W. ascend.

74.00 Pop of sand spur bears N.E. and S.W. desc.

78.75 Dry ravine course S.W. ascend. Entire scattering  
 Cedar timber bears East W.

80.00 Set a cedar post. 3ft. long. 4 ins sq. 24 ins. in  
 the ground for cor. of sec. 20, 21, 28 and 29, marked  
 T29N S21 on N.E. R18E. S28 on S.E. S 29 on S.W.  
 and S20 on N.W. faces, with 4 notches on E and  
 2 notches on S. edges, from which.

A cedar 6 ins. in diam bears  $N77\frac{1}{2}^{\circ}E$  48 lks. dist  
 marked T29N R18E S21 B.T.

A cedar 10 ins. in diam. bears  $S77^{\circ}E$  198 lks. dist.  
 marked T29N. R18E S28 B.T.

A cedar 10 ins. in diam. bears  $S48\frac{3}{4}^{\circ}W$  195 lks.  
 dist, marked T29N. R18E S. 29 B.T.

A cedar 12 ins. in diam bears  $N19\frac{1}{2}^{\circ}W$ . 143  
 lks. dist, marked T29N R18E. S. 20 B.T.

Land mountainous

Soil sandy and stony 3<sup>rd</sup> and 4<sup>th</sup> rate.

Number, Cedar

Mountainous land 80.00 Chs.

$N89^{\circ}58'E$  on a random line bet. sec. 21 and 28.

40.00 Set temp  $\frac{1}{4}$  sec. cor.

79.94 Intersect N and S line 5 lks N. of the cor. of  
 sec. 21, 22, 27 and 28, here in before described,  
 thence down

West. on a true line bet. sec. 21 and 28  
 Ascend E. slope over rolling sandy mesa land  
 through scattering cedar timber, sage and  
 greasewood bush undergrowth.

2.00 Pop of low sand ridge bears N and S. desc.  
 gradually over W. slope

BOOK 2592

- 5.00 Depression toward N and S. ascend.
- 10.50 Top of rocky ridge toward N and S. desc.
- 12.75 Dry ravine course N. asc
- 18.00 Top of ridge toward N and S. desc.
- 25.50 Dry ravine course N. ascend very gradually
- 39.97 Set a Cedar post 3 ft. long 3 ins. sq., 24 ins. in the ground for  $\frac{1}{4}$  sec. cor marked  $\frac{1}{4}$  S 21 on N. face and S 28 on S face, from which. A Cedar 15 ins. in diam toward N  $30^{\circ}$  E 198 lks. dist. marked  $\frac{1}{4}$  S 21 B.T.
- A Cedar 15 ins. in diam toward S  $21\frac{1}{4}^{\circ}$  E 282 lks. dist. marked  $\frac{1}{4}$  S. 28 B.T.
- 71.65 West edge of mesa toward rolling land toward N.W. and S.E., descend abruptly. Rocky W. slope of mesa over mountainous land toward N.W. and S.E.
- 79.94 The cor of sec 20, 21, 28 and 29, heretofore described. Land rolling and mountainous. Soil sandy and stony 3<sup>rd</sup> and 4<sup>th</sup> rate. Number Cedar. Mountainous land S. 29 Chs.
- 
- N  $0^{\circ} 03'$  W bet. sec 20 and 21, Ascend steep rocky S.W. slope of mesa over mountainous land through scattering cedar timber.
- 7.00 Top of mesa toward N.W. and S.E. leave mountainous land toward N.W. and S.E. enter rolling mesa land toward N.W. and S.E.
- 40.00 Set a Cedar post 3 ft. long 3 ins. sq., 24 ins. in the ground. for  $\frac{1}{4}$  sec. cor marked  $\frac{1}{4}$  S 20 on W face and S 21 on E face, from which. A Cedar 8 ins. in diam toward East. 64 lks. dist. marked  $\frac{1}{4}$  S 21 B.T.
- A Cedar 6 ins. in diam. toward S  $59\frac{3}{4}^{\circ}$  W 110 lks. dist. marked  $\frac{1}{4}$  S 20 B.T.
- 60.00 Top of sand ridge toward East W. desc.
- 68.90 Dry ravine course N.E. asc.
- 72.00 Peak of sand ridge toward N.E. and S.W. desc.
- 76.85 Dry ravine 20 lks wide 4 ft. deep course N.E. asc.

Chain

80.00 Set a cedar post 3 ft. long 4 ins sq. 24 ins in the ground for cor. of sec. 16, 17 20 and 21, marked T29N S. 16 on N.E. R18E S 21 on S.E. S 20 on S.W. and S 17 on N.W. faces, with 4 notches on E and 3 notches on S edges, from which.

A cedar 10 ins. in diam. bears N 28° E 220 lks. dist. marked T29N, R18E S 16 B.T.

A cedar 7 ins. in diam. bears S 57½° E 324 lks. dist. marked T29N, R18E S 21 B.T.

A cedar 6 ins. in diam. bears S 78½° W 242 lks. dist. marked T29N, R18E S 20 B.T. and

A cedar 8 ins. in diam. bears N 10¾° W 148 lks. dist. marked T29N, R18E S 17 B.T.

Land rolling and mountainous.

Soil sandy and stony 3<sup>rd</sup> and 4<sup>th</sup> rate. Much Cedar.

Mountainous land .7.00 Chd.

NOTE

At this cor. D. ran by 18° 57' S on the decl. arc and at 12<sup>h</sup> 12<sup>m</sup> 26<sup>sec</sup> p.m. limit observed the sun on the meridian and obtain on the lat. arc, a reading of 35° 54' N.

40.00 East on a random line bet. sec. 16 and 21  
 Septemp ¼ sec. cor.

79.94 Intersect N and S. line 3 lks. S. of the cor. of sec. 15, 16, 21 and 22, heretofore described, thence D run

S 89° 59' W on a true line bet. sec. 16 and 21.

Ascend abrupt rocky N.E. slope of mesa over mountainous land through scattering cedar timber and sage greasewood brush undergrowth and bunch grass.

2.00 Top of ascent on E edge of mesa bears N.W. and S.E. leave stony mountainous land bears N.W. and S.E. ascend N.E. slope over rolling sandy mesa land bears N.W. and S.E.

8.00 Leave timber bears N. and S.

24.75 Rocky ravine 400 lks. wide 20 ft. deep course N.E.

Leave rolling land bears N.E. and S.W. enter stony

34

Chain

BOOK 2592

- mountainous land bears N E and S.W.  
 36.50 Deep rocky ravine course N., and  
 39.97 Set a Cedar post 3 ft. long 3 ins. sq. with marked  
 stone 24 ins. in the ground for  $\frac{1}{4}$  sec. cor. marked  
 $\frac{1}{4}$  S 16 on N face and S 21 on S face  
 Raise a mound of stone 2 ft. base,  $1\frac{1}{2}$  ft. high N.  
 of cor. Pits impracticable  
 70.00 Set a Cedar timber bears N.W. and S.E.  
 79.94 The cor. of sec. 16, 17, 20 and 21, heretofore described.  
 Land rolling and mountainous.  
 Soil sandy and stony 3<sup>rd</sup> and 4<sup>th</sup> rate.  
 Timber Cedar.  
 Mountainous land. 57, 19 Chs

January 25<sup>th</sup> 1909

January 27<sup>th</sup> 1909 At 4<sup>h</sup> 00<sup>m</sup> p.m. l.m.t. - Det. off  
 35° 54' N. on the lat. arc. 18° 23' S on the decl. arc  
 and determine a meridian with the solar alt.  
 the cor. of sec. 16, 17, 20 and 21, heretofore described,  
 thence I run

- N 0° 03' W bet. sec. 16 and 17,  
 descend N. slope over hilly land bears N.E. and S.W.  
 through scattering Cedar timber, sage and greasewood  
 brush undergrowth and scattering bunch grass.  
 20.00 Run timber bears N.W. and S.E.  
 40.00 Set a cedar post 3 ft. long 3 ins. in diam. with  
 marked stone 24 ins. in the ground for  $\frac{1}{4}$  sec. cor.  
 marked  $\frac{1}{4}$  S 17 on W face and S 16 on E face  
 Dig pits 18x18x12 ins N and S. of post. 3 ft. dia  
 and raise a mound of earth 3 $\frac{1}{2}$  ft. base,  $1\frac{1}{2}$   
 ft. high. W. of cor.  
 80.00 Set a Cedar post 3 ft. long 4 ins. sq. with  
 marked stone 24 ins. in the ground, for cor.  
 of sec. 8, 9, 16 and 17. marked T 29 N, S 9 on N.E.  
 R 18 E S 16 on S.E. S 17 on S.W. and S 8 on N.W. faces  
 with 4 notches on E and S edges.  
 Dig pits 18x18x12 ins in each sec. 5 $\frac{1}{2}$  ft. dia  
 and raise a mound of earth 4 ft. base 2 ft.  
 high W. of cor.  
 Land hilly



BOOK 2592

Over rolling sandy land slopes to S. through  
sage and greasewood bush undergrowth and  
tough grass.

40.00 Set a cedar post 3 ft. long, 3 ins. sq. with  
marked stone 24 ins. in the ground for  $\frac{1}{4}$   
sec. cor. marked  $\frac{1}{4}$  S 8 on W face and S 9 on  
E face.

Dig pits 18x18x12 ins N and S of post 3 ft.  
diam. and raise a mound of earth  $3\frac{1}{2}$  ft. base  
 $1\frac{1}{2}$  ft. high W. of cor.

80.00 Set a cedar post 3 ft. long, 4 ins sq. with marked  
stone 24 ins. in the ground for cor. of sec. 4, 5  
8 and 9, marked  $\frac{1}{4}$  29 N, S 4 on N.E. T 18 E S 9,  
on S.E. S 8 on S.W. and S 5 on N.W. faces, with 4 notches  
on E. and 5 notches on S. edges.

Dig pits 18x18x12 ins. in each sec.  $5\frac{1}{2}$  ft. diam. and  
raise a mound of earth 4 ft. base, 2 ft. high, W.  
of cor.

Land rolling  
Soil sandy 3<sup>rd</sup> rate.  
No timber.

N 89° 59' E on a random line bet. sec. 4 and 9.  
40.00 Set temp  $\frac{1}{4}$  sec. cor.

79.96 Intersect N and S. line 5 lks N. of the cor. of  
secs. 3, 4, 9 and 10, heretofore described,  
thence S run

N 89° 59' W on a true line bet. sec. 4 and 9,  
over rolling sandy mesa land through Cedar timber  
sage and greasewood bush undergrowth.

3.00 Grad bear NE and SW.

7.00 Begin gradual descent on S.W. slope.

14.00 Leave timber bear NW. and SE.

39.00 Dry ravine 10 lks wide 3 ft. deep course SW.

39.98 Set a cedar post 3 ft. long, 3 ins. sq. with marked  
stone 24 ins. in the ground for  $\frac{1}{4}$  sec. cor  
marked  $\frac{1}{4}$  S 4 on N. face and S 9. on S. face  
Dig pits 18x18x12 ins. E and W. of post 3 ft.  
diam. and raise a mound of earth  $3\frac{1}{2}$  ft. base  
 $1\frac{1}{2}$  ft. high N. of cor.



Chain

79.96 The cor. of secs. 4, 5, 8 and 9, heretofore described.  
 Land rolling.  
 Soil sandy 2<sup>nd</sup> and 3<sup>rd</sup> rate.  
 Timber Cedar.

January 29<sup>th</sup> 1909

January 30<sup>th</sup> 1909  
 At 2<sup>h</sup> 30<sup>m</sup> p.m. l.m.t. & set off  
 35° 56' N, on the lat. arc. 17° 37' S on the decl.  
 arc and determine a meridian with the  
 solar at the cor. of secs 4, 5, 8 and 9, heretofore  
 described.  
 Thence I run

40.00 N 0° 03' W, on a true line bet. sec. 4 and 5.  
 Set temp. 4 sec. cor.

80.10 Intersect N. l. l. of N. 10 l. l. 89° 59' E  
 of sec. 4, 5, 32 and 33, recently estab. by me & described  
 Thence I run in Exterior Book "C"

S 0° 07' E on a true line bet. sec. 4 and 5.  
 Descend S slope on rolling sandy mesa land.  
 through sage and greasewood brush undergrowth  
 and bunch grass.

40.10 Set a cedar post 3 ft. long, 3 ins. dia., with  
 marked stone 24 ins. in the ground for 1/4 sec.  
 cor. marked 455 on W. face and 34 on E face  
 Dig pits 18x18x12 ins. N and S of post. 3 ft. dist.  
 and raise a mound of earth 3 1/2 ft. base 1 1/2  
 ft. high W. of cor.

80.10 The cor. of secs. 4, 5, 8 and 9, heretofore described.  
 Land rolling  
 Soil sandy 2<sup>nd</sup> and 3<sup>rd</sup> rate.  
 No timber

January 30<sup>th</sup> 1909

January 26<sup>th</sup> 1909. At 8<sup>h</sup> 00<sup>m</sup> a.m. l.m.t. set off 35° 51 1/2' N.  
 on the lat. arc. 18° 43' S. on the decl. arc. and determine  
 a meridian with the solar at the stand cor. of sec. 31  
 and 32. on the S l. l. of N. 10 l. l. recently re-estab. by me & described  
 Thence I run in Standard Book "C"

N 0° 03' W bet. sec. 31 and 32.

BOOK 2592

- Ascend S. slope of ridge from E and W. through scattering sage brush over hilly stony land.
- 15.00 Top of ridge from E and W. Descend N. slope
- 27.00 toward hilly land from NW and SE. descend abrupt rocky NE. slope over mountainous land.
- 40.00 Set a cedar post 3 ft. long, 3 ins sq., with marked stone 24 ins. in the ground for  $\frac{1}{4}$  sec. cor marked  $\frac{1}{4}$  S 31 on W face and S 32 on E face.
- Dig pits 18 x 18 x 12 ins N and S of post 3 ft. dist and raise a mound of earth 3  $\frac{1}{2}$  ft. base 1  $\frac{1}{2}$  ft. high W of cor.
- 45.00 Foot of descent on E. face of mesa, enter cedar timber from E and W. ascend abrupt - S.E. slope
- 50.00 Top of mesa from NE. and S.W. leave mountainous land and timber from NE. and S.W., enter rolling sandy mesa land from NE. and S.W.
- 70.00 Enter cedar timber from E and W.
- 80.00 Set a cedar post 3 ft. long 4 ins sq. 24 ins in the ground for cor. of sec. 29, 30, 31 and 32 - marked T 29 N. S 29. on NE. R18 E S 32. on S.E. S 31 on S.W. and S 30 on N.W. faces, with 5 notches on E. and 1 notch on S. edges. from which.
- A cedar 5 ins. in diam. from  $N 58 \frac{3}{4}^{\circ} E$  324 lks. dist. marked T 29 N. R18 E S 29 B.T.
- A cedar 5 ins. in diam from  $S 60 \frac{1}{4}^{\circ} E$  389 lks. dist marked T 29 N. R18 E. S 32 B.T.
- A cedar 6 ins. in diam from  $S 65 \frac{3}{4}^{\circ} W$  215 lks. dist. marked T 29 N. R18 E S 31 B.T.
- A cedar 4 ins. in diam from  $N 54^{\circ} W$  35 lks. dist. marked T 29 N. R18 E. S 30 B.T.
- Land hilly and mountainous,  
Soil sandy and stony 3<sup>rd</sup> and 4<sup>th</sup> rate.  
Timber Cedar,  
Mountainous land. 23.00 chs.

East on a random line bet. sec. 29 and 32  
 40.00 Set temp  $\frac{1}{4}$  sec. cor.  
 79.98 Intersect N. and S. line 5 lks. S. of the cor. of sec. 28, 29, 32, and 33, heretofore described.

Chains

Thence Drun

S 89° 58' W. on a true line bet. secs 29 and 32.

Around E. slope of mesa over sandy and stony land, through scattering sage brush and greasewood brush undergrowth and bunch grass.

11.00 Top of sand stone bluffs 30 ft. high bears N and S. enter scattering cedar timber bears N and S. ascend abruptly over mountainous land bears N and S.

35.00 Top of mesa on E. edge, leave mountainous land bears N and S, enter rolling sandy mesa land bears N and S.

39.99 Set a cedar post 3 ft. long, 3 ins. sq. 24 ins. in the ground for  $\frac{1}{4}$  sec. cor. marked  $\frac{1}{4}$  S 29. on N. face. and S 32 on S. face from which.

A cedar 5 ins. in diam. bears N 17 $\frac{3}{4}$ ° W 217 lks. dist. marked  $\frac{1}{4}$  S 29. B.T.

A cedar 5 ins. in diam bears S 42° E .194 lks. dist. marked  $\frac{1}{4}$  S 32. B.T.

79.98 The cor. of secs 29, 30, 31 and 32, herinbefore described. Land rolling and mountainous.

Soil sandy and stony 3<sup>rd</sup> and 4<sup>th</sup> rate  
 Pumber Cedar

mountainous land 24.00 Chs.

Wrap on a random line bet. secs 30 and 31

40.00 Set temp  $\frac{1}{4}$  sec. cor.

79.90 Intersect W. ldy. of No. 120 lks. N. of the witness cor. to cor. of secs. 25, 30, 31 and 36, recently estab. by me & described in Exterior Book "P"

Thence Drun

S 89° 58' E on a true line bet. secs 30 and 31, from true point for cor. of sec 25, 30, 31 and 36

Dry ravine

3.00 Leave ravine course S.E. - Around W slope of mesa over stony mountainous land bears N and S.

7.00 Top of sand after bears N.W. and S.E. desc.

10.25 Dry ravine course S.W. asc.

22.25 Top of rocky spur bears N.E. and S.W., enter scattering cedar timber bears N.E. and S.W. desc.

39.50 Dry ravine course S.W. asc.

39.90 Set a cedar post 3 ft. long 3 ins. in diam., 24

BOOK 2592

- irs. in the ground for  $\frac{1}{4}$  sec. cor marked  $\frac{1}{4}$  S 30  
on N. face and S 31 on S. face. from which  
A cedar 12 ins in diam. bears N 6° W 203 lks dist  
marked  $\frac{1}{4}$  S 30 B.T.
- A cedar 6 ins in diam bears S 11° W 122 lks. dist  
marked  $\frac{1}{4}$  S 31 B.T.
- 66.50 Top of cliff bears N. W. and S. E. are abruptly
- 70.00 Top of cliff on W edge of mesa, bears mountainous  
land bears N. W. and S. E., enter rolling sandy  
mesa land bears N. W. and S. E.
- 79.90 The cor of sec 29, 30, 31 and 32, heretofore described.  
Land rolling and mountainous.  
Soil sandy and stony 3<sup>rd</sup> and 4<sup>th</sup> rate.  
Pine or cedar  
Mountainous land. 62.50 Chs.
- 
- W 0° 03' W. Secs. 29. and 30.
- Over rolling sandy mesa land through scattering  
cedar and pinion pine timber and bunch grass.
- 4.00 bears timber bears N. W. and S. E.
- 40.00 Set a cedar post 3 ft. long, 3 ins. sq. with marked  
stone 24 ins. in the ground for  $\frac{1}{4}$  sec. cor. mkd.  
 $\frac{1}{4}$  S 30. on W face and S 29. on E face.  
Dig pits 18 x 18 x 12 ins N and S. of post. 3 ft. dist,  
and raise a mound of earth 3  $\frac{1}{2}$  ft. base 1  $\frac{1}{2}$   
ft. high W. of cor.
- 42.00 Begin gradual ascent over S. slope
- 70.00 Enter scattering cedar and pinion pine timber  
bears E and W.
- 80.00 Set a cedar post 3 ft. long 4 ins. sq. with marked  
stone 24 ins. in the ground for cor. of sec. 19  
20, 29 and 30 mkd. T 39 N 63° 0 on NE. R 18 E S 29 on SE. S 30 on SW  
and S 19 on NW face with 5 notches on E and 2 notches on S edge  
Raise a mound of stone 2 ft. base 1  $\frac{1}{2}$  ft. high. W of cor.  
Cul impracticable. No trees in limits.  
Land rolling.  
Soil sandy 2<sup>nd</sup> and 3<sup>rd</sup> rate.  
Timber pinion pine and cedar

Chains

41

- 40.00 Set temp.  $\frac{1}{4}$  sec. cor.
- 80.04 Intersect N and S. line at the cor. of sec. 20  
 21, 28, and 29, heretofore described,  
 Thence I run  
 N 89° 58' W. on a true line bet. sec. 20 and 29.  
 Descend SW slope over broken stony mountainous  
 land through scattering pine and cedar  
 timber
- 1.00 Dry ravine course S. E. asc.
- 4.00 Top of spur bears N. E. and S. W. desc
- 6.50 Dry ravine course S. asc.
- 7.00 Top of said spur bears N. and S. desc.
- 11.85 Dry ravine 100 lbs. wide 3 ft. deep. Course  
 S. asc N. E. slope.
- 25.00 Sand stone ledge 30 ft. high bears N. and S.
- 30.00 Leave mountainous land and timber bears N. E. and S. W. enter rolling land
- 40.02 Set a cedar post 3 ft. long 3 ins. sq. with marked  
 stone 24 ins. in the ground for  $\frac{1}{4}$  sec. cor. marked  
 $\frac{1}{4}$  S 20 on N. face and S 29 on S. face  
 Dig pits 18 x 18 x 12 ins. East W. of post 3 ft. dist  
 and raise a mound of earth  $3\frac{1}{2}$  ft. high, 11 ft.  
 high N. of cor.
- 60.85 Road bears N. W. and S. E.
- 74.00 Enter cedar timber bears N. E. and S. W.
- 80.04 The cor. of sec. 19, 20, 29 and 30, heretofore described.  
 Land rolling and mountainous.  
 Soil sandy and stony 3<sup>rd</sup> and 4<sup>th</sup> rate.  
 Timber Cedar.  
 Mountainous land. 30.00 chs.

NOTE Clouds obscured the sun at noon today rendering an  
 observation for latitude with the solar impossible.  
 January 26<sup>th</sup> 1909

- January 27<sup>th</sup> 1909 At 8<sup>h</sup> 15<sup>m</sup> am. Lunt I set off  
 35° 53' N. on the lab. arc. 18° 27' S. on the decl.  
 arc. and determine a meridian with the  
 solar at the cor. of sec. 19, 20, 29 and 30, heretofore  
 described.  
 Thence I run  
 N 89° 58' W. on a random line bet. sec. 19 and 30.
- 40.00 Set temp.  $\frac{1}{4}$  sec. cor.
- 79.84 Intersect the W. side of Twp. 5 lbs S. of the cor. of

42

Chains

BOOK 2592

- Secs. 19, 24, 25 and 30, recently estab. by me & described in  
Exterior Book "P".
- Thence from  
S 89° 56' E. on a true line bet. secs 19 and 30.
- Ascend W. slope of mesa over sandy and stony  
mountainous land through scattering sage  
and greasewood brush undergrowth and bunch grass
- 5.00 Top of spur bear N and S desc.
- 10.00 Dry ravine course N.W.
- 12.40 Same ravine course S.W. ascend
- 14.00 Top of sand spur bear N.E. and S.W. desc.
- 18.25 Dry ravine course S.W. ascend over ledges
- 24.00 Top of cliffs on W. edge of mesa, leave mountainous  
land bear N. and S. enter rolling land and cedar  
timber bear N. and S. ascend gradually
- 28.00 Top of mesa bear N. and S. desc. gently.
- 39.84 Set a cedar post 3 ft. long 3 ins. sq., 24 ins. in the  
ground for  $\frac{1}{4}$  sec. cor. marked  $\frac{1}{4}$  S 19 on N. face  
and S 30 on S face. from which.  
A cedar 4 ins. in diam. bear N 34  $\frac{3}{4}$  E 76 lks. dist  
marked  $\frac{1}{4}$  S 19 B.T.
- A cedar 7 ins. in diam. bear S 4  $\frac{3}{4}$  E 103 lks. dist,  
marked  $\frac{1}{4}$  S 30 B.T.
- 42.00 Bottom of depression bear N.E. and S.W. asc.
- 73.00 Top of sand ridge bear N.E. and S.W. desc
- 79.84 The cor. of secs. 19, 20, 29 and 30, heretofore described.  
Land rolling and mountainous.  
Soil sandy and stony 3<sup>rd</sup> and 4<sup>th</sup> rate.  
Timber Cedar.  
Mountainous land. 24.00 Ch.

N 0° 03' W. bet. secs. 19 and 20.

Ascend S slope over rolling sandy mesa land  
through sage and greasewood brush undergrowth  
and scattering cedar timber

- 40.00 Set a cedar post 3 ft. long 3 ins. sq. 24 ins. in  
the ground for  $\frac{1}{4}$  sec. cor. marked  $\frac{1}{4}$  S. 19 on W. face  
and S 20 on E face, from which.  
A cedar 5 ins. in diam. bear S 84° E 107 lks. dist  
marked  $\frac{1}{4}$  S. 20 B.T.

Chains

43

- A Cedar 8 ins. in diam. bear N.  $44\frac{3}{4}^{\circ}$  W 116 lbs. dist. marked  $\frac{1}{4}$  S 19 B.T.
- 65.00 Level timber bear N.E. and S.W.
- 80.00 Set a cedar post 3 ft. long 4 ins. sq. with marked stone 34 ins. in the ground for cor. of sec. of sec. 17, 18, 19 and 20 marked T 29 N S 17 on N.E. R 18 E S 20 on S.E. S 19 on S.W. and S 18 on N.W. face. with 5 notches on E and 3 notches on S. edges.
- Dig pits 18x18x12 ins. in each sec. 5  $\frac{1}{2}$  ft. dia. and raise a mound of earth 4 ft. base 2 ft. high. W of cor. Land rolling.
- Soil sandy 3<sup>rd</sup> rate.
- Timber Cedar
- NOTE On this cor. set off 18<sup>th</sup> 27' S. on the decl. arc. and at 12<sup>th</sup> 13<sup>th</sup> min. l.m. observe the sun on the meridian the resulting latitude being  $35^{\circ} 54' N$ .
- 
- 40.00 N  $89^{\circ} 58' E$  on a random line bet. sec. 17 and 20. Set temp  $\frac{1}{4}$  sec. cor.
- 80.12 Intersect N. and S. line 3 lbs. S of the cor. of sec. 16, 17, 20 and 21, heretofore described.
- Thence Drive
- S  $89^{\circ} 57' W$  on a true line bet. sec. 17 and 20.
- Ascend S.E. slope over low rolling sand hills through scattering cedar timber and Sage brush undergrowth and bunch grass
- 40.06 Set a cedar post 3 ft. long 3 ins. sq. 24 ins. in the ground for  $\frac{1}{4}$  sec. cor. marked  $\frac{1}{4}$  S 17 on N. face and S 20 on S. face. from which.
- A Cedar 8 ins. in diam. bear N  $11\frac{1}{4}^{\circ}$  W 274 lbs. dist. marked  $\frac{1}{4}$  S 17 B.T.
- A Cedar 4 ins. in diam. bear S  $83\frac{1}{2}^{\circ}$  W 92 lbs. dist. marked  $\frac{1}{4}$  S 20 B.T.
- 52.00 Top of mesa bear N.E. and S.W. desc. gradually over N.W. slope.
- 74.00 Level timber bear N and S.
- 80.12 The cor. of sec. 17, 18, 19 and 20, heretofore described.
- Land rolling
- Soil sandy 3<sup>rd</sup> rate.
- Timber Cedar.

44 Chain

BOOK

2592

40.00  $N 89^{\circ} 56' W$ . out a random line bet. sec 18 and 19  
 bet. trees  $\frac{1}{4}$  sec. cor.  
 79.80 Intersect  $W$ . side of  $N \frac{1}{2}$  at the cor. of sec. 13, 18, 19 and  
 24, recently estab. by me & described in Exterior Book "P"  
 Thence  $D$  run  
 $S 89^{\circ} 56' E$  out a true line bet. sec 18 and 19.  
 Descend  $E$  slope over hilly sandy land through scattering  
 cedar timber and sagebrush undergrowth  
 2.06 Dry ravine course  $S$ . asc.  
 3.80 Top of sand ridge bet  $N.E$  and  $SW$  dec.  
 5.80 Dry ravine course  $SW$ . asc  
 39.80 Set a cedar post 3 ft long, 3 ins. sq. 24 ins. in the  
 ground for  $\frac{1}{4}$  sec. cor. marked  $\frac{1}{4}$  S 18 on  $N$ . face and  
 S 19 on  $S$ . face from which  
 A cedar 8 ins. in diam bet  $N 69^{\circ} W$  265 lks. dist. marked  
 $\frac{1}{4}$  S 18 B.T.  
 A cedar 8 ins. in diam. bet  $S 73^{\circ} W$  231 lks. dist.  
 marked  $\frac{1}{4}$  S 19 B.T.  
 41.00 Leave timber bet  $N$  and  $S$ .  
 79.80 The cor. of sec 17, 18, 19 and 20, heretofore described.  
 Land hilly.  
 Soil sandy 3<sup>rd</sup> rate.  
 Timber Cedar

January 27 1909

Jan 29<sup>th</sup> 1909 At 8<sup>h</sup> 00<sup>m</sup> a.m. I met  $D$  bet  $N 35^{\circ} 54' N$ . out the  
 line are. 17<sup>th</sup> 56'  $S$ . out the decl. and determined a  
 meridian with the solar at the cor. of sec 17, 18, 19 and 20,  
 heretofore described.  
 Thence  $D$  run  
 $N 0^{\circ} 03' W$ . bet. sec 17 and 18.  
 Descend  $N.E$ . slope over rolling sandy land.  
 2.00 Foot of descent in depression before  $N.E$  and  $SW$  ascend gradually  
 13.00 Top of high sand ridge bet  $N.E$  and  $SW$ . Enter  
 scattering cedar timber bet  $N.E$  and  $SW$ . descend  
 gradually over  $N.W$ . slope  
 40.00 Set a cedar post 3 ft long, 3 ins. sq. 24 ins. in  
 the ground for  $\frac{1}{4}$  sec. cor. marked  $\frac{1}{4}$  S 18 on  $W$ . face  
 and S 17 on  $E$ . face from which  
 A Cedar 10 ins. in diam. bet  $N 70^{\circ} E$  365 lks.  
 dist. marked  $\frac{1}{4}$  S 17 B.T.  
 A Cedar 6 ins. in diam. bet  $N 41^{\circ} W$ . 186  
 lks. dist. marked  $\frac{1}{4}$  S 18 B.T.



chains

80.00 Set a cedar post 3 ft long 4 ins sq with marked  
 stone 24 ins. in the ground for cor. of sec.  
 7, 8, 17 and 18. marked T 29 N. S 8 on N.E. R 18 E S 17  
 on S.E. S 18 on S.W. and S 17 on N.W. faces. with 5  
 notches on E, and 4 notches on S. edges.  
 Dig pits 18x18x12 ins. in each sec. 5 ft deep and  
 raise a mound of earth 4 ft. high 2 ft. long.  
 W. of cor. No trees available  
 Land rolling  
 Soil sandy 3<sup>rd</sup> rate.  
 Timber Cedar.

40.00 Set temp  $\frac{1}{4}$  sec. cor.  
 79.98 Intersect N and S. line 3 lks. N. of the cor. of sec.  
 8, 9, 16 and 17, heretofore described,  
 Thence run  
 S 89° 58' W on a true line bet. sec. 8 and 17  
 ascend E. slope over rolling sandy mesa land through  
 sage brush and bunch grass.

35.00 Enter cedar timber land N.W. and S.E.  
 39.99 Set a cedar post 3 ft long 3 ins sq. 24 ins. in the  
 ground. for  $\frac{1}{4}$  sec. cor. marked  $\frac{1}{4}$  S 8 on N. face and  
 S 17 on S. face from which  
 A cedar 6 ins. in diam. bears N 13 $\frac{3}{4}$ ° E 235 lks.  
 dist. marked  $\frac{1}{4}$  S 8 B.T.  
 A cedar 8 ins. in diam bears S 60 $\frac{1}{4}$ ° E 87 lks. dist.  
 marked  $\frac{1}{4}$  S 17 B.T.

58.00 Top of high divide bears N.E. and S.W., bears timber  
 bears N.E. and S.W. desc. over N.W. slope

75.50 Dry ravine 25 lks. wide 3 ft. deep course N.E.  
 79.98 The cor. of sec. 7, 8, 17 and 18, heretofore described.  
 Land rolling  
 Soil sandy 3<sup>rd</sup> rate.  
 Timber Cedar.

NOTE At this cor. set off 17° 55' S on the decl arc and  
 at 12 $\frac{1}{4}$  pm. l. m. observe the sun on the meridian  
 the resulting latitude being 35° 55' N.

- N 89° 56' W on a random line bet. sec. 7 and 18  
40.00 Set temp  $\frac{1}{4}$  sec. cor.  
79.65 Intersect W. bdy. of Twp. at the cor. of sec. 7, 12, 13  
and 18, recently estab. by me & described in Exterior Book "P"  
Thence I run  
S 89° 56' E on a true line bet. sec. 7 and 18.  
Descend S.E. slope over rolling sandy land through  
scattering cedar timber and sage brush undergrowth  
and bunch grass.  
40.00 Leave timber tract N.E. and S.W.  
39.65 Set a cedar post 3 ft. long 3 ins. sq. with marked  
stone 24 ins. in the ground for  $\frac{1}{4}$  sec. cor. marked  
14 S 7 on N. face and S 18 on S face  
Dig pits 18 x 18 x 12 ins. E and W. of post 3 ft. dist.  
and raise a mound of earth 3  $\frac{1}{2}$  ft. base 1  $\frac{1}{2}$  ft.  
high N. of cor.  
67.50 Foot of descent in depression tract N.E. and S.W.  
drains N.E. asc. NW. slope.  
79.65 The cor. of sec. 7, 8, 17 and 18; heretofore described.  
Land rolling.  
Soil sandy 2<sup>nd</sup> and 3<sup>rd</sup> rate.  
Timber Cedar.

January 29<sup>th</sup> 1909

- January 20<sup>th</sup> <sup>1909</sup> Ap. 8<sup>h</sup> 15<sup>m</sup> am. C.M.L. - Dreb. off 35° 55' N.  
on the lab. arc 17° 40' 'S. on the decl. arc and  
determine a meridian with the solar ab. The cor.  
of sec. 7, 8, 17 and 18; heretofore described.  
Thence I run  
N 0° 03' W. bet. sec. 7 and 8  
Descend N.W. slope over rolling sandy mesa land  
through sage brush undergrowth and bunch grass  
15.00 Foot of descent in depression tract N.E. and S.W.  
drains N.E. ascend gradually over S.E. slope.  
40.00 Set a cedar post 3 ft. long. 3 ins. sq. with marked  
stone 24 ins. in the ground for  $\frac{1}{4}$  sec. cor. marked  
 $\frac{1}{4}$  S 7 on W face and S 8 on E face.  
Dig pits 18 x 18 x 12 ins. N and S of post. 3 ft. dist.  
and raise a mound of earth 3  $\frac{1}{2}$  ft. base 1  $\frac{1}{2}$  ft.  
high W. of cor.

Chain

67.00 Enter scattering cedar timber tract N.E. and S.W.

80.00 Set a cedar post 3ft. long 4 ins. sq. 24 ins. in the ground for cor. of sec. 5, 6, 7 and 8, marked T 29 N. S 5 on N.E. R 18 E S 8 on S.E. S 7 on S.W. and S 6 on N.W. faces with 5 notches on E and S edges from which.

A cedar 8 ins. in diam. bear N 79  $\frac{1}{4}$ ° E 34 lbs. dist. marked T 29 N. R 18 E S 5 B.T.

A cedar 6 ins. in diam. bear S 30  $\frac{1}{4}$ ° E 152 lbs. dist. marked T 29 N. R 18 E S 8 B.T.

A cedar 10 ins. in diam. bear S 15° W 13 lbs. dist. marked T 29 N. R 18 E S 7 B.T.

A cedar 8 ins. in diam. bear N 81  $\frac{3}{4}$ ° W 25 lbs. dist. marked T 29 N. R 18 E S 6 B.T.

Land rolling.

Soil sandy 2<sup>nd</sup> and 3<sup>rd</sup> rate.

Timber Cedar.

40.00 V 89° 58' E on a random line bet. sec. 5 and 8. Set temp.  $\frac{1}{4}$  sec. cor.

79.98 Intersect N. and S. line 5 lbs. N. of the cor. of sec. 4, 5, 8 and 9, heretofore described.

Thence Drum

Walk on a true line bet. sec. 5 and 8.

Ascend S.E. slope over rolling sandy land through scattering sage brush undergrowth and bunch grass.

20.00 Dry ravine 20 lbs. wide 3ft. deep. course S. arc.

39.99 Set a cedar post 3ft. long. 3 ins. sq. with mkt. stone 24 ins. in the ground for  $\frac{1}{4}$  sec. cor. marked  $\frac{1}{4}$  S 5 on N. face and S 8 on S. face.

Dig pits 18x18x12 ins. E and W. of post. 3ft. dist. and raise a mound of earth 3  $\frac{1}{2}$  ft. base, 1  $\frac{1}{2}$  ft. high N. of cor.

75.00 Enter scattering cedars tract N.E. and S.W.

79.98 The cor. of sec. 5, 6, 7 and 8, heretofore described.

Land rolling.

Soil sandy 2<sup>nd</sup> and 3<sup>rd</sup> rate.

48 Schavis

BOOK 2592

Pumkin Cedar.

40.00  $N 89^{\circ} 56' W$  on a random line bet. sec. 6 and 7  
Set temp  $\frac{1}{4}$  sec. cor.

79.60 Intersect W. ldy of Pp. 2 lks. S. of the cor. of  
sec. 1, 6, 7 and 12; recently estab. by me & described in  
Thence I run Exterior Book "P"

$S 89^{\circ} 55' E$  on a true line bet. sec. 6 and 7.

Ascend W. slope over rolling sandy land through  
scattered cedar timber and sage bush under-  
growth and bunch grass.

10.00 Top of low ridge bear N and S. descend over  
E. slope.

39.60 Set a cedar post 3 ft. long 3 ins. sq. 24 ins. in  
the ground for  $\frac{1}{4}$  sec. cor. marked  $\frac{1}{4}$  S 6 on N.  
face and S 7 on S. face, from which.

A Cedar 6 ins. in diam. bear  $N 84^{\circ} E$  70 lks.  
dist. marked  $\frac{1}{4}$  S 6 B.T.

A cedar 8 ins. in diam. bear  $S 14\frac{1}{2}^{\circ} W$  316 lks.  
dist marked  $\frac{1}{4}$  S 7 B.T.

79.60 The cor. of sec. 5, 6, 7 and 8, hereinbefore described.  
Land rolling.

Soil sandy 3<sup>rd</sup> rate.  
Pumkin Cedar.

$N 0^{\circ} 03' W$  on a random line bet. sec. 5 and 6.

40.00 Set temp  $\frac{1}{4}$  sec. cor.

80.16 Intersect N. ldy. of Pp. 20 lks.  <sup>$S 89^{\circ} 59' E$</sup>  of the cor. of sec. 5,  
6, 31, and 32; recently estab. by me & described in Exterior  
Thence I run Book "Q"

$S 0^{\circ} 12' E$  on a true line bet. sec. 5 and 6.

Descend S.E. slope over rolling sandy land  
through sage and greasewood bush undergrowth  
and bunch grass.

40.16 The point for the  $\frac{1}{4}$  sec. cor. falls in bed of dry  
creek at foot of descent course S.E. where natural

Chains

49

- causes would insure the destruction of the cor.  
 therefor I continue my line, ascend N.W. slope.
- 41.16 Set a Cedar post 3ft. long, 3 ins. sq with marked  
 stone 24 ins. in the ground for Witness cor. to  
 the 4 sec. Cor. marked W.C.  $\frac{1}{4}$  S 6 on W face and  
 S 5 on E face.  
 Dig pit 18 x 18 x 12 ins. N. and S of post 3ft.  
 deep, and raise a mound of earth 3  $\frac{1}{2}$  ft.  
 base 1  $\frac{1}{2}$  ft. high W. of cor.
- 60.00 Enter scattering Cedar timber bears N.W. and  
 S.E.
- 68.00 Top of low sand ridge bears N.E. and S.W.  
 descend gradually over S.E. slope.
- 80.16 The Cor. of sects 5, 6, 7 and 8, heretofore described  
 sand rolling.  
 Soil sandy 2<sup>nd</sup> and 3<sup>rd</sup> rate.  
 Timber Cedar.
- NOTE Clouds obscure the sun at noon today  
 rendering an observation for latitude impossible

January 20<sup>th</sup> 1909

General Description

The land in this township varies from level to  
 mountainous and the soil ranges from stony to  
 sandy loam, with the exception of the bottom  
 land along the sand washes and the mountainous  
 portion of the township the soil can nearly  
 all be classed as 3<sup>rd</sup> rate, is covered with a  
 luxuriant growth of bunch grass affording  
 excellent pasture for stock.

Pine and cedar is found scattered  
 over the hilly and mountainous portions of  
 the township, the trees however being too small  
 for uses other than fuel and posts.

Sand stone underlies the mesa portion of  
 the township in large bodies. It is soft  
 and crumbles away upon being exposed to  
 the weather and is unsuitable for building purposes.  
 No mineral was discovered in the township  
 but from surface indications in several places

BOOK 2592

It is quite probable that coal beds underlie portions of the township.

The township has very little water in it. There is one large spring in sec 25. at which place is located the Government Dipping plant for dipping the sheep belonging to the Hopi and Navajo Indians.

There are no permanent settlers in the township.

Jan. 30 - 1909

Sidney E. Blouch  
U.S. Examiner of Surveys

NOTE

Original affidavits in book v. of subdivision

U.S. EXAMINER OF SURVEYS

FINAL OATHS OF DEPUTY SURVEYOR AND HIS ASSISTANTS.

LIST OF NAMES.

A list of the names of the individuals employed by Sidney E. Polout  
 United States ~~Deputy Surveyor~~ <sup>Examiner of Surveys</sup>, to assist in running, measuring, and  
 marking the lines and corners described in the foregoing field notes of the ~~survey~~ <sup>and resurvey of</sup> the subdivision  
lines of Township No. 29 N., T. 18 E. of the Gila and Salt River Base and Meridian  
in the Territory of Arizona.  
 showing the respective capacities in which they acted: Van L. White Compassman  
Jay E. Jellicks and Ralph D. White and Chainman.  
Lafayette Jennings and Arthur A. Beard Chainman.  
Red L. Warner Moundman.  
~~Moundman.~~  
Chas. L. Shumway Axman.  
~~Axman.~~  
Harry Lake Kay Flagman.

FINAL OATH OF ASSISTANTS.

We hereby certify that we assisted \_\_\_\_\_  
 \_\_\_\_\_, United States Deputy Surveyor, in surveying all  
 those parts or portions of the \_\_\_\_\_  
 \_\_\_\_\_ of the \_\_\_\_\_  
 \_\_\_\_\_ meridian, \_\_\_\_\_ of \_\_\_\_\_, which are represented  
 in the foregoing field notes as having been surveyed by him and under his direction; and that said survey  
 has been in all respects, to the best of our knowledge and belief, well and faithfully surveyed, and the  
 corner monuments established, according to the instructions furnished by the United States Surveyor  
 General for \_\_\_\_\_

*See Subdivisional Book V*

\_\_\_\_\_, Chainman.  
 \_\_\_\_\_, Chainman.  
 \_\_\_\_\_, Moundman.  
 \_\_\_\_\_, Moundman.  
 \_\_\_\_\_, Axman.  
 \_\_\_\_\_, Axman.  
 \_\_\_\_\_, Flagman.

Subscribed and sworn to before me this \_\_\_\_\_ }  
 day of \_\_\_\_\_, 190 \_\_\_\_\_ }



52  
BOOK 2592

U.S. EXAMINER OF SURVEYS  
FINAL OATH OF UNITED STATES ~~DEPUTY SURVEYOR.~~

I, \_\_\_\_\_, United States Deputy Surveyor, do solemnly swear that, in pursuance of a contract received from \_\_\_\_\_ United States Surveyor General for \_\_\_\_\_, bearing date of the \_\_\_\_\_ day of \_\_\_\_\_, 190\_\_\_\_, I have well, faithfully, and truly, in my own proper person, and in strict conformity with the instructions furnished by the United States Surveyor General for \_\_\_\_\_, the Manual of Surveying Instructions, and the laws of the United States, surveyed all those parts or portions of \_\_\_\_\_ of the \_\_\_\_\_ meridian, in the \_\_\_\_\_ of \_\_\_\_\_, which are represented in the foregoing field notes as having been surveyed by me, and under my direction; and I do further solemnly swear that all the corners of said survey have been established and perpetuated in strict accordance with the Manual of Surveying Instructions, and the special written instructions of the United States Surveyor General for \_\_\_\_\_ and in the specific manner described in the field notes, and that the foregoing are the original field notes of such survey.

*See Subdivisional Book*

\_\_\_\_\_  
United States Deputy Surveyor.

Subscribed by said \_\_\_\_\_, and sworn to before me }  
this \_\_\_\_\_ day of \_\_\_\_\_, 190\_\_\_\_



APPROVAL.

OFFICE OF THE UNITED STATES SURVEYOR GENERAL,

*Phoenix, Arizona* APR 25<sup>1</sup>, 1904

The foregoing field notes of the survey <sup>and resurvey</sup> of the subdivision lines of  
Township 29 North, Range 18 East, of the  
Gila and Salt River Base and Meridian, Arizona

executed by Sidney E. Blunt, U.S. Examiner of Surveys  
under ~~the contract No.~~ Special Instructions from the Commissioner of the General Land Office, dated Oct. 2, 1907 and May 15th, 1908, having been critically examined, and the necessary corrections and explanations made, the said field notes, and the surveys they describe, are hereby approved.

Frank S. Ingalls  
United States Surveyor General.

I certify that the foregoing transcript of the field notes of the above described surveys in \_\_\_\_\_, has been correctly copied from the original notes on file in this office.

\_\_\_\_\_  
United States Surveyor General.