

Subdivisional
BOOK "ZD"

2598

FIELD NOTES BOOK 2608

OF THE ~~SURVEY OF THE~~

a portion of
Retracements and Re-survey of the Subdivisional
lines of Twp. No. 24 N., Range No. 18 East

Of the Gila and Salt River Basins and Meridian,

in the Territory of Arizona

EXECUTED
AS ~~CARRIED~~ BY

Sidney E. Blous, United States Examiner of Surveys
~~Deputy Surveyor~~

Special Instructions, from Commissioner of the General Land Office

Under ~~his Contract No. _____~~, dated Oct. 2nd 1907 and May 15th, 1908

Retracement
Re-Survey commenced April 27th, 1910

Retracement
Re-Survey completed May 12th, 1910

NAMES AND DUTIES OF ASSISTANTS.

Van L. White Compassman

Fred L. Warner Chairman

P. V. White Chairman

Chas R. Shumway Mundman

William R. Carson Flagman

18

BOOK 2608

INDEX DIAGRAM.

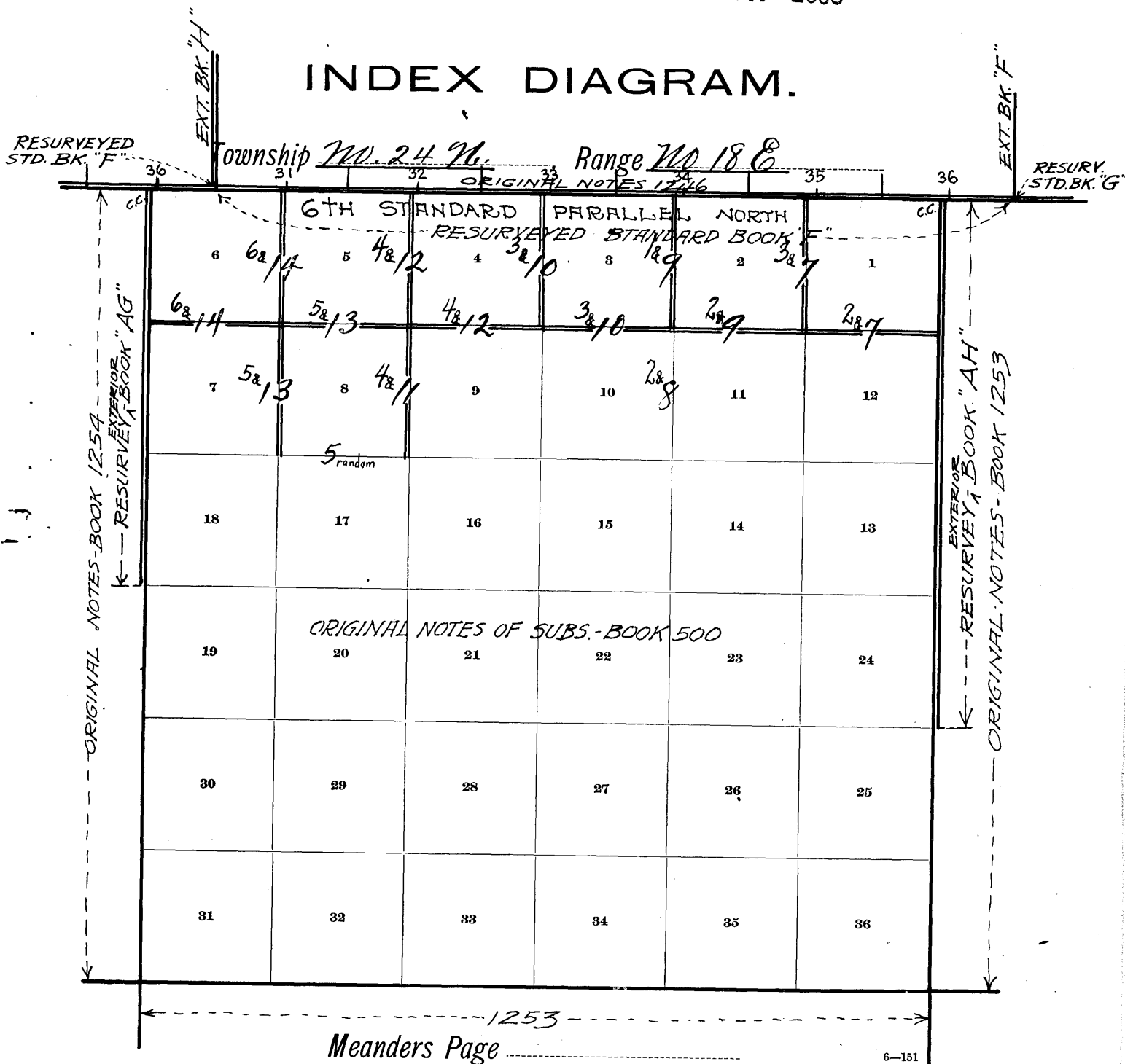

==== RESURVEYED

PRELIMINARY OATHS OF ASSISTANTS.

WE, Fred L. Warner and F. J. White

do solemnly swear that we will well and faithfully execute the duties of chainmen; that we will level the chain upon even and uneven ground, and plumb the tally pins, either by sticking or dropping the same; that we will report the true distances to all notable objects, and the true lengths of all lines that we assist in measuring, to the best of our skill and ability, and in accordance with instructions given us, in the ~~survey of~~

the Retracement and Re-survey ^{part of} of the Subdivision lines of Twp. 24 N., R. 18 E. S. & S. R. B. & M., Arizona

Fred L. Warner, Chainman.
F. J. White, Chainman.

Subscribed and sworn to before me this 26th day of April, 1910



Sidney E. Blout
U.S. Examiner of Surveys

WE, Chas. L. Shumway and Ralph C. Sampson

do solemnly swear that we will well and truly perform the duties of moundmen in the ^{re} establishment of corners, according to the instructions given us, to the best of our skill and ability, in the ~~survey of~~

Retracement and Re-survey ^{part of} of the Subdivision lines of Twp. 24 N., R. 18 East. S. & S. R. B. & M., Arizona.

Chas. L. Shumway, Moundman.
Ralph C. Sampson, Moundman.

Subscribed and sworn to before me this 26th day of April, 1910



Sidney E. Blout
U.S. Examiner of Surveys

WE, J. Bertram C. Brown

do solemnly swear that ~~we~~ will well and truly perform the duties of ~~axman~~ ^{re} in the establishment of corners and other duties, according to instructions given ^{me} ~~us~~ to the best of ^{my} ~~our~~ skill and ability, in the ~~survey of~~

Retracement and Re-survey ^{part of} of the Subdivision lines of Twp. 24 N., R. 18 E., S. & S. R. B. & M., Arizona

Bertram C. Brown, Axman.

Subscribed and sworn to before me this 6th day of May, 1910



Sidney E. Blout
U.S. Examiner of Surveys

I, William R. Carson

do solemnly swear that I will well and truly perform the duties of flagman according to instructions given me, to the best of my skill and ability, in the ~~survey of~~

Retracement and Re-survey ^{part of} of the Subdivision lines of Twp. 24 N., R. 18 E. S. & S. R. B. & M., Arizona.

William R. Carson, Flagman.

Subscribed and sworn to before me this 26th day of April, 1910



Sidney E. Blout
U.S. Examiner of Surveys

Retracement of Subdivision lines of T²⁴N⁶, R¹⁸E

Chain

I, having been unable to find the closing corners on the Sixth Standard Parallel North through Range 18 East. at the time of the retracement and resurvey of this line, now retrace and resurvey the necessary subdivision lines in T²⁴N⁶, R¹⁸E. to properly close the north tier of sections on the newly established line.

Survey commenced April 27th 1910 and executed with a W. & L. G. Surley Engineers Transit N^o 76. with a Burt Solar attachment, the horizontal limb being provided with one double vernier reading to single minutes of arc. The verniers of the latitude and declination arcs reading to 0'30" of arc.

I examine the adjustments of the transit and finding them correct, know from recent tests of the solar apparatus made by comparing the results of solar observations made during a.m. and p.m. hours with a meridian established by observations on Polaris that the instrument is in satisfactory adjustment.

I begin at the point for closing cor. of sec. 2 and 3 T²⁴N⁶, R¹⁸E., given in the original field notes furnished me by the U.S. Surveyor General as 4.72 Chs. west of the Stand. ^{1/4} Sec. cor. on the S. ldy. of Sec. 34, T²⁵N¹, R¹⁸E. recently re-established by me & described in Standard Book "F"
Latitude 35°30'35" N., Longitude 110°25' W.

April 27th 1910: At 7^h 30^m ^{l.m.t.} a.m. I set off 35°30' N. on the lat. arc; 13°37' N. on the decl. arc and determine a meridian with the solar at the above point. thence I retrace

South on a random line bet. sec. 2 and 3.

40.30 I make a diligent search for the old ^{1/4} sec. cor. which I fail to find.

82.70 Fall 124 lbs. W. of evident remains of ^{original} cor. of sec. 2, 3, 10, and 11. which is a stake greatly decayed lying on a mound of earth midway between tracks of two pits.

Set temp. point for cor. of sec. 2, 3, 10 and 11. at point where old stake is found.

a portion of the
Retracement of Subdivision lines of Twp. 24 N., R18 E.
Chains

BOOK 2608

Retrace ~~South on a random line bet. secs. 10 and 11~~
South on a random line bet. secs. 10 and 11
from the temp. point for cor. of secs. 2, 3, 10, and 11.
40.00 I make a diligent search for the old $\frac{1}{4}$ sec. cor.
which I fail to find
80.10 Fall 08 lks. W. of the old cor. of secs. 10, 11, 14 and 15
which is a basalt stone $24 \times 16 \times 10$ ins. above ground
firmly set, marked and witnessed as described
in the original field notes furnished me by the U.S.
Surveyor General.
Course of line back to the temp. point for cor. of
secs. 2, 3, 10 and 11 $N 0^{\circ} 03' W$.

Retrace
 $N 89^{\circ} 52' E$ on a random line bet. secs. 2 and 11, from
the temp. point set for cor. of secs. 2, 3, 10 and 11
40.00 I make a diligent search for the old $\frac{1}{4}$ sec.
cor. which I fail to find
79.94 Fall 18 lks. S. of the old cor. of secs. 1, 2, 11 and 12
which is a basalt stone $12 \times 8 \times 5$ ins. above ground
firmly set, marked and witnessed as described
in the original field notes furnished me
by the U.S. Surveyor General.
Course of line back to the temp. point for cor.
of secs. 2, 3, 10, and 11 $S 89^{\circ} 44' W$.

From original cor. of secs. 1, 2, 11 and 12, I retrace,
 $N 89^{\circ} 43' E$ on a random line bet. secs. 1 and 12.
40.00 I make a diligent search for the old $\frac{1}{4}$ sec.
cor. which I fail to find
79.52 Fall 97 lks. W. of evidence remains of the old cor.
of secs. 1, 6, 7 and 12, ^{on E. 1/4 of the 1/4} which is a cedar stake greatly
decayed, lying on a mound of earth.
Set temp. point for cor. of secs. 1, 6, 7 and 12, at
point where stake is found, ^{and hereafter re-establish this} cor. as described in Exterior Book "AH"
Course of line back to the Cor. of secs. 1, 2, 11 and 12
 $N 89^{\circ} 35' W$.

NOTE At the ^{original} cor. of secs. 1, 2, 11 and ^{heretofore described} 12, I set off
 $13^{\circ} 44' \frac{1}{2}$ W. on the decl. arc and at noon observed
the sun on the meridian and obtain on the
lat. arc a reading of $35^{\circ} 30' 76$.

a portion of
 Chain Retracement of the Subdivision lines of Twp 24 N., R 18 E.

- From the original cor. of secs. 1, 2, 11 and 12, I retrace North on a random line bet. secs. 1 and 2.
- 40.00 I make a diligent search for the old $\frac{1}{4}$ sec. cor. which I fail to find.
- 81.74 I intersect the 6th Stand. Parallel North 3.37 Chs. $N 89^{\circ} 40' W.$ of the Stand $\frac{1}{4}$ sec. cor. on the S. bdy. of sec. 35 ^{recently re-estab. by me & described in Standard Book "F"} and again make a diligent search for the old Closing cor. of secs. 1 and 2 without finding any trace of same.
- April 27th 1910.

- 1910
 April 28th Ch. 7^h 00^m a.m. ^{l.m.t.} I reb. off: $35^{\circ} 30' W.$ on the lat. arc.; $14^{\circ} 00\frac{1}{2}' W.$ on the decl. arc) and determine a meridian with the solar at the temp. point for cor. of secs. 2, 3, 10 and 11, ^{heretofore described} then I retrace $N 89^{\circ} 45' W.$ on a random line bet. sec. 3 and 10.
- 40.00 I make a diligent search for the old $\frac{1}{4}$ sec. cor. which I fail to find.
- 78.52 I set 73 lbs. ^{original} of the cor. of secs. 3, 4, 9 and 10. which is a basalt stone $12 \times 8 \times 4$ ins. above ground firmly set, marked and witnessed as described in the original field notes furnished me by the U.S. Surveyor General.
- Course of line back to the temp. point for cor. of secs. 2, 3, 10 and 11. $W 89^{\circ} 43' E.$

- From the original cor. of secs. 3, 4, 9 and 10 described above, I retrace North on a random line bet. secs. 3 and 4.
- 40.00 I make a diligent search for the old $\frac{1}{4}$ sec. cor. which is described as a post with pile and mound of earth, but fail to find any evidence of the cor.
- 83.19 I intersect the 6th Stand. Parallel North 2.11 Chs. $N 89^{\circ} 53' W.$ of the Stand $\frac{1}{4}$ sec. cor. on S. bdy. of sec. 33. ^{recently re-estab. by me & described in Standard Book "F"} Here I again make a diligent search for the old Closing cor. of secs. 3 and 4, which is described in the original field notes furnished me by the U.S. Surveyor General as a lime stone $16 \times 10 \times 4$ ins. with mound of stone alongside. without finding any evidence of the same.

Chain

From the original cor. of sec. 3, 4, 9 and 10, I retrace
N. 89° 57' W. on a random line bet. sec. 4 and 9.

40.00 I make a diligent search for the old $\frac{1}{4}$ sec. cor.
which I fail to find.

80.60 Fall 63 lbs. S. of evident remains of the old cor.
of sec. 4, 5, 8, and 9. which is a stake greatly decayed
marks nearly obliterated, with a trace of pits.

Course of line back to the cor. of sec. 3, 4, 9 and 10
S 89° 30' E.

From the original cor. of sec. 4, 5, 8 and 9 described above, I retrace,
North on a random line bet. sec. 4 and 5.

40.00 I make a diligent search for the old $\frac{1}{4}$ sec. cor.,
which is described in the original field notes
furnished me by the Surveyor General, as a marked
stone deposited 12 ins. in the ground, with pits 18x18x12
ins N. and S. of stone 5 $\frac{1}{2}$ ft. dist. and stake driven in
N. pit; but fail to find any evidence of same.

82.69 Intersect the 6th Standard Parallel. North 2.74 chs.

N 89° 53' W. of the Standard $\frac{1}{4}$ sec. Cor. on the S. bdy of
recently re-estab. by me & described in Standard Book "F"
sec. 32. \wedge Here I again make a diligent search for
the old closing cor. of sec. 4 and 5. which is
described in the original field notes, furnished
me by the Surveyor General, as a marked stone
deposited 12 ins in the ground, with post and
pits and mound, without finding any evidence
of same.

NOTE Clouds obscure the sun at noon today rendering
an observation for latitude impossible.

April 28th 1910.

1910

April 29th \wedge At 8^h 00^m a.m. ^{l.m.t.} I set off: 35° 30' N. on
the lat. arc: 14° 20' N. on the decl. arc and determined
a meridian with the solar at the old stake for
cor. of sec. 4, 5, 8 and 9, ^{heretofore described} thence I retrace

South on a random line bet. sec. 8 and 9.

40.00 I make a diligent search for the old $\frac{1}{4}$ sec. cor.
which I fail to find.

80.08 Fall 05 lbs. W. of the cor. of sec. 8, 9, 16 and 17
which is a basal stone 14x12x8 ins above ground
firmly set, marked and witnessed as described

BOOK 2608

in the original field notes furnished me by the Surveyor General.

Course of line back to stake for cor. of secs. 4, 5, 8 and 9. $N 0^{\circ} 02' W$.

From the original cor. of secs. 8, 9, 16 and 17 described above, I retrace, $N 89^{\circ} 49' W$ on a random line bet. secs. 8 and 17.

40.00 I make a diligent search for the old $\frac{1}{4}$ sec. cor. which I fail to find.

79.95 Fall 19 lbs. S. of the old cor. of secs. 7, 8, 17 and 18. which is a basalt stone $14 \times 8 \times 6$ ins. above ground firmly set, marked, and witnessed as described in the original field notes furnished me by the Surveyor General.

Course of line back to the cor. of secs. 8, 9, 16, and 17. $S 89^{\circ} 42' E$.

From the original cor. of secs. 7, 8, 17 and 18, described above, I retrace North on a random line bet. secs. 7 and 8.

40.39 Fall 60 lbs. W. of the old $\frac{1}{4}$ sec. cor. which is a basalt stone $10 \times 10 \times 6$ ins. above ground, firmly set, marked and witnessed as described in the original field notes furnished me by the Surveyor General.

Course of line back to the cor. of secs. 7, 8, 17 and 18. $S 0^{\circ} 51' W$.

From this $\frac{1}{4}$ sec. cor. I retrace

North on a random line bet. secs. 7 and 8.

39.94 Fall 18 lbs. W. of remains of old cor. of secs. 5, 6, 7 and 8. which I find to be a stake greatly decayed lying on a mound of earth.

Course of line back to the $\frac{1}{4}$ sec. cor. $S 0^{\circ} 15' W$.

NOTE At the above described original cor. of secs. 5, 6, 7 and 8 I set off $14^{\circ} 22' \frac{1}{2}$ N. on the decl. arc and at noon observe the sun on the meridian and obtain a reading of $35^{\circ} 30' 16$ on the lat. arc.

From the original cor. of secs. 5, 6, 7 and 8 above described, I retrace, $N 82^{\circ} 51' E$ on a random line bet. secs. 5 and 8.

40.00 I make a diligent search for the old $\frac{1}{4}$ sec. cor. which I fail to find.

79.77 Fall 77 lbs. N. of the old post for cor. of secs

BOOK 2608

4. 5. 8 and 9, heretofore described.

Course of line back to the point for cor. of secs. 5. 6. 7 and 8. N 89° 36' W.

From the original cor. of secs. 5, 6, 7 and 8, I retrace North on a random line bet. secs. 5 and 6. from temp point for cor. of secs. 5. 6. 7 and 8.

40.00 I make a diligent search for the old $\frac{1}{4}$ sec. cor. which is described in the original field notes furnished me by the Surveyor General as a sand stone 18x11x6 in. with a mound of stone along side. but fail to find any trace of same.

81.90 Intersect the 6th Stand. Parallel North 2.67 chs. N 89° 53' W. of the Stand $\frac{1}{4}$ Sec. Cor. on S. bdy of Sec. 31 T 25 N. R 18 E. ^{recently re-estab. by me & described in Standard Book "F"} Here I again make a diligent search for the old Closing Cor. of secs. 5 and 6. which is described in the original field notes furnished me by the Surveyor General. as a post with pits and mound of earth, but am unable to find any evidence of the original cor.

From the original cor. of secs. 5, 6, 7 and 8, I retrace

N 89° 47' W. on a random line bet. secs. 6 and 7.

40.00 I make a diligent search for the old $\frac{1}{4}$ sec. cor. which I fail to find

83.80 Fall 116 chs. N. of the Cor. of secs. 1. 6. 7 and 12. on W. bdy. of Twp. which I re-established April 6th 1910, and described in Exterior Book "AG".

Course of line back to point for cor. of secs. 5. 6. 7 and 8. N 89° 25' E.

April 29th 1910

Resurvey of Subdivision lines of Tp. 24 N. R. 18 E.

May 10th 1910: At 7^h 00^m A.M. ^{l.m.t.} set off $35^{\circ} 30' 76''$ on the lat. arc., $77^{\circ} 30' 2'' 76''$ on the decl. arc. and determine a meridian with the solar on the ^{old} cor. of sec. 1, 2, 11 and 12, ^{hereinbefore described.} thence I run

$S 89^{\circ} 35' E$ on a random line bet. sec. 1 and 12.

40.00 Set temp $\frac{1}{4}$ sec. cor.

79.52 Intersect the E. bdy. of Tp. at the Cor. of sec. 1, 6, 7 and 12, which I reestablished May 9th 1910 as described in Exterior Book "AH" thence I run

$N 89^{\circ} 35' W$ on a true line bet. sec. 1 and 12.

Over rolling sandy land through scattering greasewood brush undergrowth and bunch grass.

39.76 Set a cedar post 3 ft. long 3 ins. sq. with marked stone 24 ins. in the ground ^{pre-established} for $\frac{1}{4}$ sec. cor. marked $\frac{1}{4}$ S 1 on N. face and S $\frac{1}{2}$ on S. face.

Dig pits 18x18x12 ins. E and W. of post 3 ft. dia. and raise a mound of earth $3\frac{1}{2}$ ft. base, $1\frac{1}{2}$ ft. high. W. of cor.

79.53 The ^{old} Cor. of sec. 1, 2, 11 and 12, hereinbefore described.

Land rolling

Soil sandy 3rd rate.

No timber

North on true ^{line} bet. sec. 1 and 2, resurveying descend gradually over N.W. slope through scattering sage and greasewood brush undergrowth and bunch grass.

11.45 Branch of Corn Creek. 100 lbs. wide banks 8 ft. high course S.W. asc.

19.70 Top of rocky ridge 30 ft. above Corn Creek. head E and W. desc. gradually over N. slope.

40.00 Set a malpais stone 12x10x10 ins., 8 ins. in the ground ^{pre-established} for $\frac{1}{4}$ sec. cor. marked $\frac{1}{4}$ on W. face. Dig pits 18x18x12 ins N. and S. of post 3 ft. dia. and raise a mound of earth $3\frac{1}{2}$ ft. base, $1\frac{1}{2}$ ft. high W. of cor.

81.74 Intersect the 6th Stand. Parallel North. 3.39 Ch.

$N 89^{\circ} 40' W$ of the Stand $\frac{1}{4}$ sec. cor. on the S. bdy. of sec. 35 T. 25 N. R. 18 E., ^{recently re-established by me and} described in Standard Book "F"

Set a basalb. stone 20x8x5 ins, 16 ins. in the ground. ^{pre-established} for Closing Cor. of sec. 1 and 2, marked.

BOOK 2608

C.C. on S face. with 1 groove on E. and 5 grooves
on W. faces.
Raise a mound of stone 3 ft. base, 1 1/2 ft. high.
S. of cor. Pits impracticable.
Land rolling.
Soil sandy and stony 3rd rate.
No timber

At 10^h 30^m a.m. ^{l.m.t.} set off 35° 29' N. on the
lat. arc., 17° 32' N. on the decl. arc and determine
a meridian with the solar at the ^{orig.} cor. of sec.
10, 11, 14 and 15 ^{herein before described} thence ^{on true pine} resurvey
N 0° 03' W. bet. Secs. 10 and 11.

Descend N. slope over stony ^{mountainous} land through
scattering greasewood bush undergrowth.
40.05 Set a cedar post 3 ft. long, 4 ins sq. with marked
stone 24 ins. in the ground ^{re-established} for ⁴ sec. Cor marked
N 4 S 10 on W. face and S 11 on E. face.

Dig pits 18x18x12 ins. N. and S. of post. 3 ft. dia.
and raise a mound of earth 3 1/2 ft. base, 1 1/2 ft.
high W. of cor.

41.00 Pass mountainous land head E and W. Enter
rolling land.

56.75 Branch of Corn Creek, 50 lbs wide course N.W.
Ascend gradually over rolling land.

62.07 Old road head N.W. and S.E. leads to Trading
Post at Willow Springs.

80.10 Intersect the temporary point for Cor. of sec.
2, 3, 10 and 11. Set a h. time of retracement.
Destroy all evidence of the remains found of
the old Cor of sec. 2, 3, 10 and 11. and re establish
the cor. at the same place as follows.

Set a malapi stone 12x12x8 ins., 8 ins in the
ground ^{re-established} for ⁴ Cor. of sec. 2, 3, 10 and 11 marked
with 2 notches on E. and 5 notches on S. edged
Dig pits 18x18x12 ins in each sec. 5 1/2 ft. dia and
raise a mound of earth 4 ft. base, 2 ft. high W.
of cor.

Land rolling and mountainous.
Soil sandy and stony 3rd and 4th rate
No timber

Mountainous land 41.00 Chs.

NOTE At this Cor. I set off $77^{\circ}33'N$. on the decl. arc and at noon observed the sun on the meridian and obtain a reading of $35^{\circ}30'N$. on the latitude arc.

40.00 $N 89^{\circ}44' E$. on a random line bet. sec. 2 and 11
 Set temp $\frac{1}{4}$ sec. cor.

79.94 Intersect N. and S. line at the ^{orig.} Cor. of sec. 1, 2, 11 and 12, ^{hereinbefore described} ^{name} I resurvey

$S 89^{\circ}44' W$. on a true line bet. sec. 2 and 11

24.19 Over rolling sandy land through scattering sage and greasewood brush and bunch grass
 Branch of Corn Creek. 100 lbs wide Course S.W.

39.97 Set a basalt stone $12 \times 9 \times 6$ ins., 8 ins. in the ground
^{pre-established} for $\frac{1}{4}$ sec. cor., marked $\frac{1}{4}$ on N. face.

Dig pits $18 \times 18 \times 12$ ins. E and W. of stone 3 ft. dia.
 and raise a mound of earth $3\frac{1}{2}$ ft. base, $1\frac{1}{2}$ ft. high N. of cor.

79.94 ^{re-established} The Cor. of sec. 2, 3, 10 and 11, hereinbefore described.

Land rolling
 Soil sandy 3rd rate.
 No timber

North on ^{true line} bet. sec. 2 and 3, resurveying
 Over rolling sandy land through scattering sage and greasewood brush undergrowth and bunch grass.

40.00 Set a basalt stone $15 \times 8 \times 5$ ins., 10 ins. in the ground
^{re-established} for $\frac{1}{4}$ sec. cor., marked $\frac{1}{4}$ on W. face.

Dig pits $18 \times 18 \times 12$ ins. N. and S. of stone 3 ft. dia.
 and raise a mound of earth $3\frac{1}{2}$ ft. base $1\frac{1}{2}$ ft. high W. of cor.

82.70 Intersect the 6th Stand. Parallel North 3.48 Chs.

$N 89^{\circ}53' W$. of the Stand. $\frac{1}{4}$ sec. cor. on the S. side
 of sec. 34 T. 25 N., R. 18 E., ^{recently re-estab. by me and described} in Standard Book "F"

Set a basalt stone $18 \times 11 \times 6$ ins. 15 ins. in the ground
^{pre-established} for Closing Cor. of sec. 2 and 3. marked C.C. on S. face. with 2 grooves on E and 4 grooves on W. face.

Resurvey of the Subdivision lines of Twp 24 N., R18 E
Chain

BOOK 2608

Dig pits 24x18x12 ins crosswise on each line. E and W. 3 ft. and S. of stone 7 ft. dia. and raise a mound of earth 4 ft. base, 2 ft. high. S. of cor.
Land rolling
Soil sandy 3rd rate.
No timber

May 10th 1910

May 11th 1910 Ah 7^h 15^m a l.m.t. Det off 35° 30' N on the lat. arc 17° 46' N. on the decl arc. and determine a meridian with the solar ah. the ^{orig} cor. of sec. 3, 4, 9, and 10 ^{hereinbefore described} thence Drive

N 89° 43' E. on a random line bet. sec. 3 and 10.

40.00 Set temp. 1/4 sec. cor.

78.52 Intersect N. and S. line at the ^{re-established} cor. of sec. 2, 3, 10 and 11 ^{hereinbefore described} thence Drive

S 89° 43' W. on a true line bet. sec. 3 and 10.

Resced gradually over rolling sandy land through scattering sage and greasewood bush.

6.50 Old road bears N.W. and S.E.

39.26 Set a basal stone 14x8x6 ins. 10 ins. in the ground for ^{pre-established} 1/4 sec. cor. marked 1/4 on N. face.

Dig pits 18x18x12 ins E and W. of stone 3 ft. dia. and raise a mound of earth 3 1/2 ft. base, 1 1/2 ft. high N. of cor.

75.50 Dry sand wash in bend from N.E. to N.W.

78.52 The ^{orig} cor. of sec. 3, 4, 9, and 10, hereinbefore described.

Land rolling
Soil sandy 3rd rate.
No timber

North on true line bet. sec. 3 and 4, resurveying.

Over rolling sandy land through scattering sage and greasewood bush undergrowth and bunch grass.

33.00 Dry sand wash course N.W. acc.

40.00 Set a basal stone 12x10x6 ins. 8 ins. in the ground for ^{pre-established} 1/4 sec. cor. marked 1/4 on W. face.

Dig pits 18x18x12 ins. N. and S. of stone 3 ft. dia. and raise a mound of earth 3 1/2 ft. base 1 1/2 ft. high. W. of cor.

66.65 Old wood road bears N.W. and S.E.

Resurvey of the Subdivision lines of T₂₄N., R₁₈E.

83.19 Intersect the 6th Stand. Parallel North 2.13 Ch_W N 89° 53' W of the Stand 1/4 sec. cor. on the S. side of sec. 33. T₂₅N., R₁₈E., recently re-established by me & described in Standard Book "F"

Set a Cedar post 48 ins. long. 6 ins. sq. with a marked stone 36 ins. in the ground for ^{pre-established} closing cor. of sec. 3 and 4 marked. C.C. T₂₄N. R₁₈E on S., S 3 on E., and S 4 on W. faces, with 3 grooves on E and W. faces

Raise a mound of stone 2 ft. base, 1 1/2 ft. high S. of cor. Pits impracticable.

Land rolling

Soil sand 3rd and 4th rate.

No timber

At 9^h 30^m a.m. ^{l. mt.} Set off 35° 29' N. on the lat. arc: 17° 47' N. on the decl. arc. and determined a meridian with the solar at the ^{orig.} cor. of sec. 8. 9. 16 and 17. ^{hereinbefore described} thence, I resurvey

N 0° 02' W. ^{on true line} 1/4 sec. 8 and 9.

Descend gradually over N. slope through scattering sage and greasewood brush undergrowth and bunch grass.

40.04 Set a Cedar post. 36 ins long. 3 ins. sq. with marked stone 24 ins. in the ground for ^{pre-established} 1/4 sec. cor. marked 1/4 S 8 on W. face and S 9 on E. face.

Dig pits 18x18x12 ins. N and S. of post. 3 ft. dia. and raise a mound of earth 3 1/2 ft base 1 1/2 ft. high W. of cor.

64.25 Branch of Corn Creek 50 lbs. wide. banks. 30 ft. high course S.W.

80.08 Intersect the old stake for cor. of sec. 4. 5. 8 and 9. This cor being in a state of dilapidation I destroy all evidence of the old cor. and reestablish it in its original position as follows;

Set a basal stone 12x10x5 ins. 8 ins. in the ground for ^{re-established} cor. of sec. 4. 5. 8 and 9. marked with 4 notches on E and 5 notches on S. edges.

Dig pits 18x18x12 ins. in each sec. 5 1/2 ft. dia. and raise a mound of earth 4 ft. base, 2 ft. high W. of cor.

Resurvey of a portion of the subdivision lines of Twp 24 N., R 18 E
Chauw

BOOK 2608

Land rolling.
Soil sandy 3rd rate.
No timber

NOTE At this cor. I set off 17° 49' N. on the decl. arc and at noon observe the sun on the meridian and obtain a reading of 35° 29½' N. on the lat. arc.

40.00 S 89° 30' E on a random line bet. sec. 4 and 9. Set temp. ¼ sec. cor.

80.60 Intersect N. and S. line at the ^{orig.} cor. of sec. 3, 4, 9 and 10. ^{hereinbefore described} thence I resurvey

N 89° 30' W. on a true line bet. sec. 4 and 9. Descend gradually over S.W. slope through scattering sage and greasewood brush undergrowth and bunch grass.

40.30 Set a basalt stone 14 x 9 x 8 ins. 10 ins. in the ground ^{re-established} for ¼ sec. cor. marked ¼ on N. face.

46.10 Road from Winslow Arizona to Piacca Ariz ^{Pits impracticable} bears N.E. and S.W.

80.60 The ^{re-established} cor. of sec. 4, 5, 8 and 9, hereinbefore described.

Land rolling.
Soil sandy 3rd rate.
No timber

North on ^{true line} bet. sec. 4 and 5, resurveying. Over rolling sandy land through sage and greasewood brush undergrowth and bunch grass

40.00 Set a malphi stone 16 x 12 x 9 ins. 12 ins. in the ground ^{re-established} for ¼ sec. cor. marked ¼ on W. face.

Dig pits 18 x 18 x 12 ins. N. and S. of stone 3 ft. dist. and raise a mound of earth 3½ ft. base, 1½ ft. high W. of cor.

72.40 ^{dry sandy wash, course N.W.} 82.69 Intersect the 6th Stand Parallel North 282 chv.

N 89° 53' W. of the Stand. ¼ sec. cor on the story of sec. 32., ^{recently re-established by me & described in Standard Book "F"} T 25 N., R 18 E. Set a lime stone 14 x 8 x 5 ins. 10 ins. in the ground ^{re-established} for closing cor. of sec. 4 and 5, marked C.C. on S. face with 4 grooves on E and 2 grooves on W. faces.

a portion of Resurvey of the Subdivision lines of Twp 24 N., R18 E.

Chains

Raise a mound of stone 2 ft. base. 1 1/2 ft. high S of cov.
Pits impracticable
Land rolling.
Soil sandy 3rd rate.
No timber

May 11th 1910

May 12th 1910
At 7^h 00^m a.m. ^{l.m.t.} set off 35° 29' 76. out
the lat. arc: 18° 01 1/2 76 out the decl. arc. and determined
a meridian with the solar at the ^{original} 1/4 sec. cov. bet. sec.
7 and 8. ^{hereinbefore described} thence ^{on true line} resurvey
N 0° 15' E. bet. sec. 7 and 8 on North 1/2 mile
Descend N.W. slope over stony hilly land. through
scattering sage and greasewood bush.

7.00 Corn Creek 60 lbs. wide course S.W. arc.
39.94 Intersect remains of old cov. of sec. 5, 6, 7 and 8.
described in my retracement field notes.

Destroy all evidence of the cov and re establish
in the point where the old stake was found
lying on the mound of earth as follows:
Set a lime stone 22 x 12 x 5 ins. 16 ins. in the ground
^{re-established} for cov. of sec. 5, 6, 7 and 8. marked with 5 notches
on E. and S. edges.
Dig pits 18 x 18 x 12 ins. in each sec. 5 1/2 ft. dish and
raise a mound of earth 4 ft. base 2 ft. high W.
of cov.
Land hilly.
Soil sandy 3rd rate
No timber

89° 36' E. on a standard line bet. sec. 5 and 8.
40.00 Set temp. 1/4 sec. cov.
79.77 Intersect N. and S. line at the ^{re-established} cov. of sec. 4, 5, 8.
and ^{hereinbefore described} 7. thence ^{on true line} resurvey

N 89° 36' W. on a true line bet. sec. 5 and 8.
Over rolling sandy land through scattering
greasewood bush.
39.88 Set a lime stone 14 x 13 x 5 ins. 10 ins. in the ground
^{re-established} for 1/4 sec. cov. marked 1/4 on N. face.
Dig pits 18 x 18 x 12 ins E. and W. of stone 3 ft. dish and
raise a mound of earth 3 1/2 ft. base 1 1/2 ft. high N. of cov.

BOOK 2608

a portion of
Resurvey of the Subdivision lines of Twp 24 N., R 18 E,
Chain

79.77 ^{re-established} The ^{re-established} Cor. of secs 5, 6, 7 and 8, hereinbefore described.
Land rolling.
Soil sandy 3rd rate.
No timber.

40.00 S 89° 25' W. on a random line bet. secs. 6 and 7.
Set temp 1/4 sec. cor.

83.80 Intersect W. ldy. of Twp. at the cor. of secs 1, 6, 7 and 8, ^{recently re-established by me and described in Exterior Book "AG"} ~~12.1~~ thence ~~Drainway~~

N 89° 25' E on a true line bet. secs. 6 and 7.

Over level sandy land through sage and greasewood bush.

43.80 Set a sand stone 12 x 9 x 6 ins. 8 ins. in the ground ^{pre-established} for 1/4 sec. cor marked 1/4 on N. face.

Dig pits 18 x 18 x 12 ins. E and W. of stone 3 ft. dia. and raise a mound of earth 3 1/2 ft. base, 1 1/2 ft. high N. of cor.

83.80 ^{pre-established} The Cor. of secs. 5, 6, 7, and 8, hereinbefore described.

Land level.

Soil sandy 3rd rate.

No timber

North on ^{true line} bet. secs. 5 and 6, resurveying
Over rolling sandy land through scattering
sage and greasewood bush.

40.00 Set a link stone 14 x 8 x 5 ins. 10 ins. in the ground ^{pre-established} for 1/4 sec. cor. marked 1/4 on W. face.

Dig pits 18 x 18 x 12 ins N. and S. of stone 3 ft. dia. and raise a mound of earth 3 1/2 ft. base, 1 1/2 ft. high. W. of cor.

81.90 Intersect the 6th Stand. Parallel North 275 lbs.

N 89° 53' W. of the Stand 1/4 sec. cor. on S. ldy. of sec. 5, ^{recently re-established by me & described in Standard Book "F"} 31 T 25 N., R 18 E. ^{re-established} Set a link stone 22 x 20 x 3 ins.

17 ins. in the ground for ^{re-established} closing cor. of sec.

5 and 6. marked C.C. on S. face. with 5 grooves on E. and 1 groove on W. faces.

Raise a mound of stone 2 ft. base, 1 1/2 ft. high. S. of cor. Pits impracticable

Land rolling

Soil sandy 3rd rate.

a portion of
Resurvey of the Subdivision lines of Twp 24 N., R 18 E.
Chains

No timber

NOTE. At the ^{re-established} 1/4 Sec. Cor. L.S. seed, 6 and 7 Dec. aft 18° 04' 76.
on the decl arc and at noon observed the sun on
the meridian, and obtain on the lat. arc a reading
of 35° 29' 76.

May 12th 1910

- Sidney E. Blout -
U.S. Examiner of Surveys

206
17
BOOK 2808

U. S. EXAMINER OF SURVEYS
FINAL OATH OF UNITED STATES DEPUTY SURVEYOR

I, Sidney E. Blout, U. S. Examiner of Surveys,
solemnly swear that, in pursuance of ~~Special Instructions~~ Special Instructions from ~~the Commissioner of the~~
~~United States Surveyor General~~ General Land Office, bearing date of the
2nd day of Oct. 1907 and the 15th day of May, 1908, I have well, faithfully, and truly, in my own
proper person, and in strict conformity with the instructions furnished by the ~~Commissioner~~
~~of the General Land Office~~ General Land Office the Manual of Surveying Instructions, and the laws of the
United States, ~~retraced & resurveyed~~ retraced and re- all those parts or portions of The Subdivisional lines of
Twp. No. 24 North, Range No. 18 East

of the Gila and Salt
River Base and Meridian, in the Territory of Arizona, which are represented in the
foregoing field notes as having ~~been~~ retraced and resurveyed by me, and under my direction; and I do further solemnly
swear that all the corners of ~~said~~ retracement and re- survey have been ~~established~~ re- established and perpetuated in strict accordance with
the Manual of Surveying Instructions, and the special written instructions of the ~~United States Surveyor~~
~~General of the General Land Office~~ General Land Office and in the specific manner described in the field notes, and that
the foregoing are the original field ~~notes~~ retracement and re- notes of such survey, as ~~required~~

Sidney E. Blout
~~United States Deputy Surveyor~~
Examiner of Surveys

Subscribed by said Sidney E. Blout, and sworn to before me }
this 26th day of October, 1912

Frank Ingalls
SURVEYOR-GENERAL OF ARIZONA



APPROVAL.

OFFICE OF THE UNITED STATES SURVEYOR GENERAL,

Phoenix, Arizona, APR 25, 1914

The foregoing field notes of the ~~survey of~~ Retracement and Resurvey
of a portion
of the Subdivisional lines of Township No. 24 North, Range
No. 18 East, of the Gila and Salt River Base and Meridian,
Arizona

executed by Sidney E. Blout, U.S. Examiner of Surveys
under ~~Special Instructions~~ Special Instructions dated Oct. 2, 1907 & May 15, 1908, having been
critically examined, and the necessary corrections and explanations made, the said field notes, and the
surveys they describe, are hereby approved.

Frank Ingalls
United States Surveyor General
SURVEYOR-GENERAL OF ARIZONA

I certify that the foregoing transcript of the field notes of the above described surveys in
_____, has been correctly copied from the original notes on file in this office.

United States Surveyor General.

U.S. EXAMINER OF SURVEYS
FINAL OATHS OF DEPUTY SURVEYOR AND HIS ASSISTANTS.

BOOK 2608 14
205

LIST OF NAMES.

A list of the names of the individuals employed by Sidney E. Blough
U. S. Examiner of Surveys
United States Deputy Surveyor, to assist in running, measuring, and
marking the lines and corners described in the foregoing field notes of ~~the survey of~~ the Retracement
and Resurvey of the Subdivision lines of Twp. 24. No. 18 E. of the Gila and
Salt River Base and Meridian, in the Territory of Arizona.
showing the respective capacities in which they acted:

- | | | |
|--------------------------|--------------------|---------------------|
| <u>Fred L. Warner</u> | <u>David White</u> | <u>Compassman</u> |
| | | Chainman. |
| <u>N. Y. White</u> | | |
| | | Chainman. |
| <u>Chas. L. Shumway</u> | | |
| | | Moundman. |
| | | Moundman |
| <u>Bertram C. Broome</u> | | |
| | | Axman. |
| | | Axman |
| <u>William Carson</u> | | |
| | | Flagman. |

FINAL OATH OF ASSISTANTS.

We hereby certify that we assisted Sidney E. Blough
U. S. Examiner of Surveys
United States Deputy Surveyor, in ~~retracing and resurveying all~~
those parts or portions of the Subdivision
lines of Twp. No. 24. No. Range No. 18 East.
..... of the Gila and
Salt River Base and meridian, Territories of Arizona, which are represented
in the foregoing field notes as having been ~~retraced & resurveyed~~ retraced & resurveyed
and resurveyed have been in all respects, to the best of our knowledge and belief, well and faithfully executed, and the
corner monuments reestablished, according to the instructions furnished by the Commissioner
of the General Land Office.

- | | | |
|--------------------------|--------------------|-------------------|
| <u>Fred L. Warner</u> | <u>David White</u> | <u>Compassman</u> |
| | | Chainman. |
| <u>J. Y. White</u> | | |
| | | Chainman. |
| <u>Chas. L. Shumway</u> | | |
| | | Moundman. |
| <u>Ralph C. Sampson</u> | | |
| | | Moundman. |
| <u>Bertram C. Broome</u> | | |
| | | Axman. |
| | | Axman |
| <u>William Carson</u> | | |
| | | Flagman. |

Subscribed and sworn to before me this 28th
day of July, 1910



Sidney E. Blough
U.S. Examiner of Surveys