

Subdivisional
BOOK "ZE"

2609

UG 1.26.1912

207

FIELD NOTES

BOOK 2609

OF THE ~~SURVEY OF THE~~

a portion of

*Retracements and Re-survey of the Subdivision lines
of Twp. No. 24 N., Range No. 19 East.*

Of the Gila and Salt River Base and Meridian,

in the Territory of Arizona

EXECUTED
AS ~~CONDUCTED~~ BY

Sidney E. Blount, United States Examiner of Surveys
~~Deputy Surveyor~~

Special Instructions from Commissioner of the General Land Office
Under ~~his~~ Contract No. _____, dated Oct. 2nd 1907, and May 15th 1908

Retracements
Re-Survey commenced June 2nd _____, 1910

Retracements
Re-Survey completed June 4th _____, 1910

NAMES AND DUTIES OF ASSISTANTS.

<u>Van L. White</u>	<u>Compassman</u>
<u>Pred. L. Warner</u>	<u>Chairman</u>
<u>D. V. White</u>	<u>Chairman</u>
<u>Chas. L. Shumway</u>	<u>Moundman</u>
<u>William R. Carson</u>	<u>Plagman</u>

11

(18)

BOOK 2609

INDEX DIAGRAM.

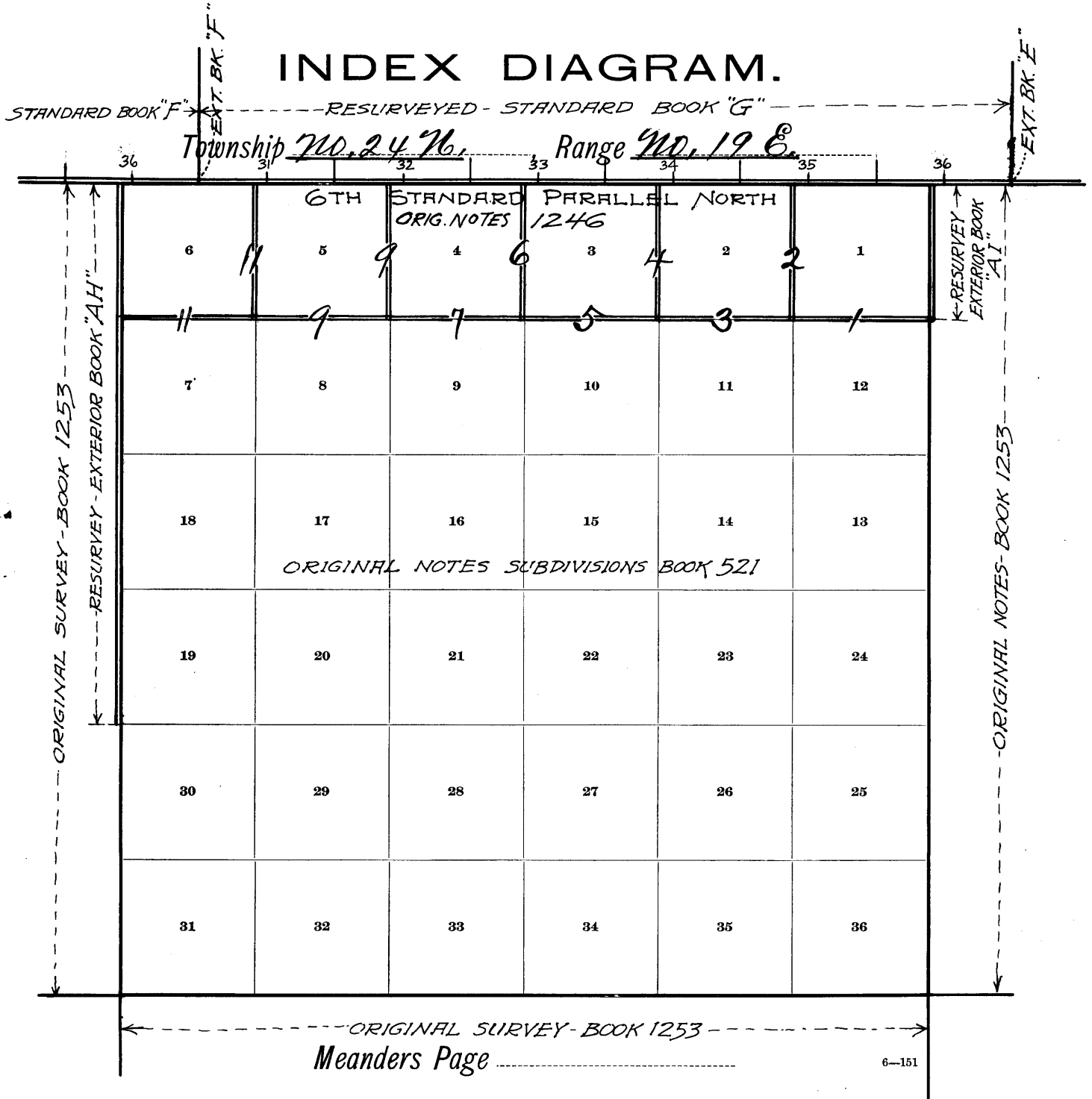

=====
RESURVEYED

PRELIMINARY OATHS OF ASSISTANTS.

We, Fred L. Warner and J. J. White

do solemnly swear that we will well and faithfully execute the duties of chainmen; that we will level the chain upon even and uneven ground, and plumb the tally pins, either by sticking or dropping the same; that we will report the true distances to all notable objects, and the true lengths of all lines that we assist in measuring, to the best of our skill and ability, and in accordance with instructions given us, in the

Retracement and Resurvey of the ^{part of} Subdivision lines of Twp. 24 N., R. 19 E., G. & S. R. B. & M., Arizona.

Fred L. Warner, Chainman.
J. J. White, Chainman.

Subscribed and sworn to before me this 1st day of June, 1910



Sidney E. Blouh
U.S. Examiner of Surveys

I, Chas. L. Shumway

do solemnly swear that I will well and truly perform the duties of moundman in the establishment of corners, according to the instructions given me to the best of my skill and ability, in the

Retracement and Resurvey of the ^{part of} Subdivision lines of Twp. 24 N., R. 19 E., G. & S. R. B. & M., Arizona.

Chas. L. Shumway, Moundman.

Subscribed and sworn to before me this 1st day of June, 1910



Sidney E. Blouh
U.S. Examiner of Surveys

~~We, _____ and _____ do solemnly swear that we will well and truly perform the duties of cornermen in the establishment of corners and other duties, according to instructions given us, to the best of our skill and ability, in the survey of _____~~

~~Subscribed and sworn to before me this _____ day of _____, 19____~~



I, William R. Carson

do solemnly swear that I will well and truly perform the duties of flagman according to instructions given me, to the best of my skill and ability, in the

Retracement and Resurvey of the ^{part of} Subdivision lines of Twp. 24 N., R. 19 E., G. & S. R. B. & M., Arizona.

William R. Carson Flagman.

Subscribed and sworn to before me this 1st day of June, 1910



Sidney E. Blouh
U.S. Examiner of Surveys

Being unable to find any of the old Closing Corners on the Sixth Standard Parallel North through Range 19 East. at the time I retraced and resurveyed this line through this range. I now retrace and resurvey the necessary Subdivision lines in T₂₄ N., R₁₉ E. to properly close the North tier of sections in this township on the newly established Parallel.

Sunny commenced June 2nd 1910 and executed with W. W. S. L. E. Garley engineers transit No. 76 with a Burt solar attachment. The horizontal limb is provided with one double vernier reading to single minutes of arc. The verniers of the latitude and declination arcs reading to 0'30" of arc.

For last complete test of instrument see field notes of Subdivision of T₂₅ N., R₁₉ E., Book "E"

I begin at the ^{original} Cor. of secs. 1, 6, 7 and 12. on the E. side of T₂₄ N., R₁₉ E. N. Latitude, 35° 29' 43" N. Longitude 110° 16' W. _{by the Surveyor General.}

At 9^h 30^m a.m. ^{L.M.T.} I set off 35° 30' N. on the lat. arc. 22° 09' N. on the decl. arc and determine a meridian with the solar. thence I retrace, 5.89° 51' W. on a random line bet. secs. 1 and 12.

40.00 I make a diligent search for the ^{original} 1/4 sec. cor. which I fail to find.

73.00 Fall 205 lbs. N. of the Cor. of secs. 1, 2, 11 and 12. which is a juniper ^{tree} 14 ins. in diam. marked T24N. S1 on N.E., R19E S12 on S.E., S11 on S.W., and S2 on N.W. faces. no cor. accessories visible.

Course of line back to the Cor. of secs. 1, 6, 7, and 12 N 88° 15' E.

I return to the ^{original} Cor. of secs. 1, 6, 7 and 12, ^{heretofore described} and resurvey this line as follows.

S 88° 15' W. on a true line bet. secs. 1 and 12. Ascend steep rocky S.E. slope over mountainous land.

23.00 Top of rocky ridge bears N. 15° E and S 15° W. Descend steep rocky N.W. slope

36.55 Set a basalt stone 14x8x8 ins. 10 ins. in the ^{reestablished} ground for 1/4 sec. Cor. marked 1/4 on N. face

BOOK 2609

Dig pits 18x18x12 ins E and W. of stone 3ft. dia. and raise a mound of earth 3 1/2 ft. base, 1 1/2 ft. high N. of Cor.
 73.10 The ^{original} Cor. of secs. 1, 2, 11, and 12, heretofore described.
 Land mountainous.
 Soil stony 3rd and 4th rate.
 Timber scattering cedar.

North: bet. secs 1 and 2, resurveying.
 Ascend S.E. slope over stony mountainous land through scattering cedar timber
 12.00 Top of spur bears N.E. and S.W. Leave mountainous land bears N.E. and S.W. Enter rolling land, desc.
 23.00 Leave timber bears N.E. and S.W.
 31.00 Dry ravine course W. are.
 38.00 Enter cedar timber bears E and W.
 40.00 I make a diligent search for the old 1/4 sec. cor which I fail to find
 Set a cedar post 3ft. long 5 ins. sq. 24 ins. in the ground for ^{re-established} 1/4 sec. cor. marked 1/4 S. 2 on W. face and S 1 on E. face. from which.
 A cedar 14 ins. in diam. bears N 80 1/2° W 105 lks. dist., marked 1/4 S 2 B.T.
 A cedar 10 ins. in diam. bears S 39 1/4° E 73 lks. dist. marked 1/4 S 1 B.T.
 45.00 Leave timber bears E and W.
 47.75 Road from Winslow Arizona to Keams Canyon Arizona bears N 40° E and S 40° W.
 79.00 Enter cedar timber bears E and W.
 80.58 Intersect the 6th Standard Parallel North.
 188 Ch. N 89° 47' W. of the Stand. 1/4 sec. cor on the S. ldy. of sec. 35 T. 25 N., R. 19 E., recently re-established ^{by find} and described in Standard Book "G"
 Set a basalt stone 18x14x6 ins. 12 ins. in the ground for ^{re-established} closing cor. of secs. 1 and 2., marked C.C. on S. face. with 1 groove on E. and 5 grooves on W. face. from which.
 A cedar 10 ins. in diam. bears S 86 3/4° E 215 lks. dist. marked T 24 N. R 19 E S 1 ^{CC} B.T.
 A cedar 5 ins in diam. bears S 44 1/2° W 166 lks. dist., marked T 24 N. R 19 E. S 2 ^{CC} B.T.
 No trace of original closing corner of sec. 1 and 2, can be found.
 Land rolling and mountainous.

Soil sandy and stony 3rd and 4th rate.
Timber Cedar
Mountainous land. 12.00 chs.

NOTE At this cor. I reb. off. $22^{\circ} 09\frac{1}{2}'$ N. on the decl. arc. and at noon observe the sun on the meridian and obtain on the lat. arc a reading of $35^{\circ} 30\frac{1}{2}'$ N.

41.00 From the original cor. of secs. 1, 2, 11 and 12 heretofore described, I retrace $N 89^{\circ} 53' W$ on a random line bet. sec. 2 and 11
The old $\frac{1}{4}$ sec. cor. which is a post greatly decayed with marks nearly obliterated & find lying on the ground 20 lbs. N. of line, but am unable to find any trace of pits or mound.
82.40 Fall 12 lbs S. of the ^{original} cor. of secs. 2, 3, 10 and 11 which is a cedar post, greatly decayed, with marks nearly obliterated lying on a mound of earth along side of allotted cor. post. set by Indian Allotting Agents in the allotment of lands in sec. 10. of this *Mp*. to the Navajo Indians. Trace of pits N.E., S.E., S.W. and N.W. of mound. Course of line back to the ^{original} cor. of secs. 1, 2, 11 and 12. $S 89^{\circ} 48' E.$

I return to the ^{original} cor. of secs. 1, 2, 11, and 12. thence I run, resurveying

$N 89^{\circ} 48' W$ on a true line bet. sec. 2 and 11
Ascend S.E. slope over stony mountainous land through scattering cedar timber
5.00 Top of ascent out spur 100 ft. above cor. bears N.E. and S.W. desc. steep N.W. slope. Leave timber.
22.90 Dry ravine at foot of descent. Course S.W., leave mountainous land bears N.E. and S.W. Enter stony hilly land. asc. S.E. slope.
24.30 Road from Winslow Arizona to Steam Canyon Arizona bears N.E. and S.W. Enter timber bears N. and S.
41.20 Set a lime stone $14 \times 12 \times 4$ ins., 10 ins. in the ^{re-established} ground for $\frac{1}{4}$ sec. cor. marked $\frac{1}{4}$ on N. face from which.
A Cedar 8 ins. in diam. bears $N 42^{\circ} W$ 188 lbs. dist. marked $\frac{1}{4}$ S 2 B.T.
A Cedar 10 ins. in diam bears $S 44^{\circ} 3/4' W$ 145 lbs. dist., marked $\frac{1}{4}$ S 11 B.T.
I destroy the old $\frac{1}{4}$ sec. cor. post found at this place

BOOK 2609

- 43.40 Top of ridge bears N.E. and S.W. desc.
 55.30 Dry ravine Course S.E. asc.
 66.50 Top of ridge bears N.E. and S.W. desc.
 82.40 The original corner of secs. 2, 3, 10 and 11, heretofore described.

This cor. being in a state of dilapidation I destroy all evidence of the old cor. and reestablish it as follows:

Set a basalt stone 20x18x6 ins. 16 ins. in the ground alongside of the allotment corner post found at this place. ^{re-established} for cor. of secs. 2, 3, 10 and 11, marked with 2 notches on E and 5 notches on S. edges from which.

A cedar 10 ins. in diam. bears S 45 1/4° W 246 lbs dist. marked T₂₄N., R₁₉E. S 10 B.T.

No other trees available.

Dig pits 18x18x12 ins in each sec. 5 1/2 ft. dist. and raise a mound of earth 4 ft. base 2 ft. high W. of cor.

Land hilly and mountainous.

Soil sandy and stony 3rd and 4th rate
 Timber Cedar.

Mountainous land. 22.90 Chs.

June 2nd 1910

June 3rd 1910 ^{l.m.t.} At 8^h 00^m a.m. I set off 35° 30' N. on the lab. arc., 22° 16' 1/2" N. on the decl. arc. and determine a meridian with the solar at the ^{re-established} cor. of secs 2, 3, 10 and 11 ^{above prescribed} three I run, resurveying

North. 1/4 sec. 2 and 3.

Corr rolling sandy land slopes to N.W. through scattering sage and greasewood brush.

40.00 I make a diligent search for the old 1/4 sec. cor. which I fail to find.

Set a basalt stone 16x12x8 ins, 12 ins. in the ground ^{re-established} for 1/4 sec. cor. marked 1/4 on W. face. from which.

A cedar 10 ins. in diam. bears S 49 1/2° W 222 lbs dist. marked 1/4 S. B.T. No other trees available.

Dig pits 18x18x12 ins. N. and S. of stone 3 ft. dist. and raise a mound of earth 3 1/2 ft. base, 1 1/2 ft. high W. of cor.

43.42 Dry sand wash in bed from N.W. to S.W.
 Enter scattering Cedar timber bears N.E. and S.W.

Retracement and Resurvey of ^{part of} the Subdivision lines of Twp 24 N., R 19 E. Chains

54.40 The same wash 40 lbs. wide Course S 30° W.

58.50 The same wash 40 lbs. wide Course S 15° E.
 Leads rolling land bears N.W. and S.E., Enter
 mountainous land. ascend steep rocky S.W. slope
 of mesa.

77.52 Top of ascent. on Cliffs on south edge of mesa
 bears N.W. and S.E. are gradually.

80.42 Intersect the 6th Standard Parallel North 4.23 Chs.
 N 89° 47' W. of the Stand. 1/4 sec. cor. on the S. side
 of sec. 34 T 25 N., R 19 E. ^{recently re-estab. by me and described in Standard Book "G"} See a basalt stone
 14x12x8 ins. 9 ins. in the ground ^{re-established} for closing cor. of
 sec. 2 and 3. marked C.C. on S. face. with 2
 grooves on E and 4 grooves on W. faces.
 Raise a mound of stone 2 ft. base 1 1/2 ft. high S.
 of cor. No trees suitable for bearing trees within
 the prescribed limits.
 Pits impracticable. No trace of original closing cor. ^{can be found}
 Land rolling and mountainous.
 Soil sandy and stony 3rd and 4th rate.
 Timber Cedar.
 Mountainous land. 21.92 Chs.

From the re-estab. cor. of secs. 2, 3, 10 and 11, heretofore described, I retrace
 S. 89°-48' W. on a random line bet. sec. 3 and 10.

38.40 Wall 17 lbs. S. of the old 1/4 sec. cor. which is a
 basalt stone 12x4x7 ins. above ground.
 Marked 1/4 on N. face,
 with a mound of stone 1 ft.
 base. 1 ft. high W. of cor.
 Indian Allotment Cor. seth along side of stone.
 Course of line back to the cor. of secs. 2, 3, 10 and 11
 S 89° 54' E.

I begin at the old 1/4 sec. cor. ^{just described} and retrace West

39.93 Wall 3 1/2 lbs. S. of the ^{original} cor. of secs. 3, 4, 9, and 10, which
 is a basalt stone 25x6x8 ins. above ground,
 firmly seth. marked with 3 notches on E, and 5
 notches on S. edges. No cor. accessories visible.
 Course of line back to the 1/4 sec. cor. S 89° 57' E.

I return to the ^{re-established} cor. of secs. 2, 3, 10 and 11, ^{heretofore described} and
 resurvey this line as follows:
 N 89° 57' W. on a true line bet. sec. 3 and 10

BOOK 2609

- Descend W. slope over rolling sandy land through sage and greasewood brush undergrowth and bunch grass.
- 2.50 Enter scattering cedar timber bears N. and S.
- 6.50 Dry sand wash 40 lbs. wide banks 3 ft. high. Course $S 30^{\circ} W$.
- 11.70 Dry sand wash 50 lbs. wide Course $S 15^{\circ} E$. asc. S.E. slope over hilly land.
- 34.30 Top of ridge bears N.W. and S.E. desc.
- 38.40 Intersect the old $\frac{1}{4}$ sec. cor. previously described. This cor. being improperly marked and insufficiently witnessed. Destroy the old stone and reestablish the cor. in the same place as follows: Set a basalt stone $16 \times 16 \times 6$ ins in the ground, for ^{re-established} $\frac{1}{4}$ sec. cor. marked $\frac{1}{4}$ on N. face. From which
- A Cedar 14 ins. in diam. bears $N 44^{\frac{3}{4}} E 53$ lbs. dist. marked $\frac{1}{4} S B T$.
- A cedar 17 ins. in diam. bears $S 81^{\frac{1}{2}} E 25$ lbs. dist. marked $\frac{1}{4} S 10 B.T$.
- 38.70 Dry sand wash 30 lbs. wide Course $S 40^{\circ} E$. Leave hilly land bears N.W. and S.E. Enter mountainous land. asc. abrupt rocky N.W. slope.
- 57.90 Top of rocky spur 300 ft. above cor. bears N.W. and S.E., leave timber bears N.E. and S.W. desc. steep W. slope
- 61.90 Dry ravine in bottom of canyon 150 ft. deep. Course $S 10^{\circ} W$. asc. abruptly.
- 76.40 Top of cliffs on spur bears $N 30^{\circ} E$ and $S 30^{\circ} W$. desc.
- 78.33 Intersect the ^{original} cor. of secs. 3, 4, 9, and 10, heretofore described. Do establish this cor. as follows: Raise a mound of stone 2 ft. base, $1\frac{1}{2}$ ft. high W. of cor. Land rolling, hilly, and mountainous. Soil sandy and stony 3rd and 4th rate. Timber Cedar.
- Mountainous land 39.63 Chs.
-
- North $\frac{1}{4}$ sec. 3 and 4, resurveying.
- Descend rocky N.W. slope over mountainous land.
- 0.10 Dry ravine Course $S 10^{\circ} W$. asc. abruptly.
- 11.00 Top of spur bears N.E. and S.W. desc.
- 22.30 Dry ravine Course N.E. asc. Enter scattering cedar timber bears E. and W.

- 24.00 Top of spur bears N.E. and S.W. desc.
- 33.10 Dry ravine Course N.E. asc.
- 38.00 Top of spur bears N.E. and S.W. desc.
- 40.00 The point for the 1/4 sec. cor. falls in bottom of dry ravine Course N80°E., I make a diligent search for the old 1/4 sec. cor. but am unable to find any evidence of it: therefore at
- 39.80 Set a basalt stone 16x12x6 ins., 12 ins. in the ground for witness cor. to the 1/4 sec. cor. marked W.C. 1/4 on W. face. from which
A Cedar 6 ins. in diam. bears N30 3/4° E 77 lks. dist, marked W.C. 1/4 S 3 B.T.
A Cedar 7 ins. in diam., bears N70 1/4° W. 67 lks. dist, marked W.C. 1/4 S 4 B.T.

NOTE At this cor. I set off 22°17' N. on the decl. arc and at noon observe the sun on the meridian and obtain a reading of 35°30' N. on the lat. arc.

- 40.05 Dry ravine Course N80°E asc.
- 42.50 Top of spur bears N.E. and S.W. desc.
- 53.25 Dry ravine Course S.W. asc.
- 71.00 Top of spur 400 ft. above ravine bears N.E. and S.W. desc NW. slope.
- 80.00 Dry ravine at foot of descent in Canyon. Course N80°W. asc.
- 80.58 Intersect the Sixth Standard Parallel North 2.61 Ch. N89°47' W. of the Stand. 1/4 sec. cor. on S. base of sec. 33, T²⁴N., R¹⁹E., ^{recently re-estab. by me and described on Standard Book 1808} Set a basalt stone 16x12x4 ins 12 ins. in the ground for ^{re-established} closing cor. of secs. 3 and 4 marked C.C. on S. face. with 3 grooves on E and W. faces. from which
A Cedar 16 ins. in diam. bears S45 1/4° E 48 lks. dist. marked T²⁴N., R¹⁹E., S^{CC} 3 B.T.
A Cedar 18 ins. in diam. bears S58°W 77 lks. dist, marked T²⁴N., R¹⁹E., S^{CC} 4 B.T. No trace of original closing. Land mountainous. corner of secs. 3 and 4, can be found.
Soil stony 4th rate.
Number Cedar

From the re-estab. cor. of secs. 3, 4, 9 and 10 heretofore described, I retrace, N89°45' W. on a random line bet. secs. 4 and 9.

BOOK 2609

- 40.00 Make a diligent search for the old $\frac{1}{4}$ sec. cor. which I fail to find.
- 80.08 Find 35 lbs. W. of the ^{original} cor. of secs. 4, 5, 8 and 9, which is a basalt stone $9 \times 8 \times 5$ ins. ^{above ground} ~~loosely set~~ marks nearly obliterated. No trace of ^{ground} of stone. From this cor., ^{re-established} Course of line back to the ^{re-established} cor. of secs. 3, 4, 9 and 10, is therefore, East
- I return to the ^{re-established} cor. of secs. 3, 4, 9, and 10, ^{heretofore described} and resurvey this line as follows.
- Walk on a true line bet. secs. 4 and 9.
- Descend NW. slope over stony mountainous land.
- 0.05 Dry ravine Course $S 10^{\circ} W.$ asc. abruptly
- 9.00 Top of spur 150 ft. above cor. head N. and S. desc.
- 10.00 Enter scattering cedar timber head N.E. and S.W.
- 15.65 Dry ravine Course S. asc.
- 17.00 Top of spur head N. and S. Leave mountainous land head N. and S. Enter rolling stony mesa land Leave timber head N. and S.
- 40.04 See a basalt stone $14 \times 10 \times 10$ ins. 10 ins. in the ^{re-established} ground for $\frac{1}{4}$ sec. cor. marked $\frac{1}{4}$ on N. face. Raise a mound of stone 2 ft. base $1\frac{1}{2}$ ft. high W. of cor. Pits impracticable
- 59.85 Dry rocky ravine 20 lbs. wide Course $S 35^{\circ} W.$ Enter scattering cedar timber head N.W. and S.E. asc.
- 63.50 Top of ridge head N.E. and S.W. Leave timber head N.E. and S.W. desc. gradually over rolling mesa land.
- 78.65 Top Cliffs 50 ft. high head N.W. and S.E. desc.
- 80.08 Intersect the ^{original} cor. of secs. 4, 5, 8 and 9, heretofore described This cor being loosely set and marks nearly obliterated, I destroy the old stone and re-establish the cor. in the same place as follows:
- See a basalt stone $22 \times 8 \times 8$ ins. 17 ins. in the ^{re-established} ground for ^{re-established} cor. of secs. 4, 5, 8 and 9, marked with 4 notches on E and 5 notches on S. edges.
- Raise a mound of stone 2 ft. base, $1\frac{1}{2}$ ft. high W. of cor. Pits impracticable
- Land rolling and mountainous.
- Soil stony 3rd and 4th rate.
- Timber Cedar

Mountainous land. 17.00 Chrs.

June 3rd 1910

June 4th ¹⁹¹⁰ Ah. 6^h 30^m a.m. ^{l.m.t.} set off 35° 30' N. on the
 Kah. arc 22° 24' W. on the decl. arc and determined
 a meridian with the solar alt. ^{re-established} the cor. of sec. 4, 5,
 8 and 9. ^{above described} thence I run, resurveying
 North bet. sec. 4 and 5.

Ascend sandstone cliffs.

3.00 Top of Cliffs 50 ft. above Cor. line N.W. and S.E. Enter
 rolling land.

37.70 Dry Gulch 10 lbs. wide 20 ft. deep course N 65° W. asc.

40.00 I make a diligent search for the old 1/4 sec. cor.
 which I fail to find. therefore I set a basal
 stone 14 x 9 x 6 ins. 10 ins. in the ground for ^{re-established} 1/4 sec.
 cor. marked 1/4 on W. face.

Raise a mound of stone 2 ft. base 1 1/2 ft. high W. of
 Cor., Pits impracticable

43.45 North edge of mesa, leave rolling land head
 E and W. Enter mountainous land and scattering
 cedar timber head E and W. descend abruptly
 rocky N. slope.

55.75 Foot of abrupt ^{descent} in dry sand wash 60 lbs. wide
 course N 85° W. asc. S.W. slope

80.64 Intersect the Sixth Standard Parallel North
 245 lbs. ON 89° 47' W. of the Stand 1/4 sec. cor. on
^{presently re-established by me and described in Standard Book "C"}
 the S. edge of Sec. 32. T 25 N. R 19 E. set a basal
 stone 26 x 14 x 4 ins. 20 ins. in the ground for
^{re-established} closing cor. of sec. 4 and 5. marked C.C. on
 S. face. with 4 grooves on E. and 2 grooves on W.
 face

Raise a mound of stone 2 ft. base 1 1/2 ft. high S.
 of Cor. Pits impracticable. No trees in limits
 No trace of original closing corner can be found.
 Land rolling and mountainous.

Soil sandy and stony 3rd and 4th rate.
 Timber Cedar.

Mountainous land. 37.19 Chrs.

From the re-established cor. of sec. 4, 5, 8 and 9, heretofore described, I retrace,
 S 89° 52' W. on a random line bet. sec. 5 and 8
 39.70 Fall 113 lbs. N. of the ^{original} 1/4 sec. cor. which is a

Retracement and Resurvey of ^{part of} the Subdivision lines of Twp 24 N. R 19 E.
10 Chains

BOOK 2609

Basalt. stone 6 x 10 x 6 ins. ^{above ground} loosely set. marked $\frac{1}{4}$ on N. face with no cor accessories. ^{is there} From this $\frac{1}{4}$ sec. cor. Course of line back to the ^{re-established} cor. of sec. 4, 5, 8 and 9 $N 88^{\circ} 16' E$.

I begin at the ^{original} $\frac{1}{4}$ sec. cor. ^{just described} and retrace $S 89^{\circ} 52' W$.
40.15 Fall 4 lks. N. of mound ^{depth} with trace of pits visible, the evident remains of the old cor. of sec. 5, 6, 7 and 8. Set temp. post in center of mound half way between N.E. and S.W. pits, for ^{temporary} cor. of sec. 5, 6, 7 and 8. Course of line back to the ^{original} $\frac{1}{4}$ sec. cor. ^{is therefore} $N 89^{\circ} 49' E$.

I return to the ^{re-established} cor. of sec. 4, 5, 8 and 9, ^{heretofore described.} and re survey this line as follows:

$S 88^{\circ} 16' W$. on a true line bet. sec. 5 and 8. Along steep S. slope over mountainous land. ridges and ravines.

39.72 Intersect the old $\frac{1}{4}$ sec. cor. ^{heretofore described.} This cor being in a state of dilapidation, I destroy all evidence of the original cor. and re establish it in the same place as follows. Set the same stone 13 ins in the ground. ^{re-established} for $\frac{1}{4}$ sec. cor. and raise a mound of stone 2 ft. base, $1\frac{1}{2}$ ft. high W. of cor. Pits impracticable.

Now this $\frac{1}{4}$ sec. cor. I run, resurveying $S 89^{\circ} 49' W$. bet. sec. 5 and 8 on true half mile.

61.75 Road to Willow Springs Trading post lead N. and S., leave mountainous land bear N and S. Enter rolling land

40.15 Intersect the temp. post set for cor. of sec. 5, 6, 7 and 8. Set a basalt. stone 17 x 14 x 10 ins. 13 ins. in the ground. ^{re-established} for cor. of sec. 5, 6, 7 and 8 marked with 5 notches on E and S. edges from which.

A Cedar 6 ins. in diam. bear $S 40^{\circ} E$ 148 lks. dist. marked T 24 N., R 19 E. S 8 B.T.

A Cedar 8 ins. in diam. bear $S 25\frac{1}{4}^{\circ} W$ 193. lks. dist. marked T 24 N., R 19 E. 37 B.T.

No other trees within limits

Dig pits 18 x 18 x 12 ins. in each sec. N.E. and N.W. of stone $5\frac{1}{2}$ ft. dist. and raise a mound of earth $3\frac{1}{2}$ ft. base, $1\frac{1}{2}$ ft. high W. of cor.

Land rolling and mountainous
Soil sandy and stony 3rd and 4th rate.
Numbers scattering along line

Mountainous land 61.75 chs.

NOTE

At this cor. I set off $22^{\circ} 24\frac{1}{2}'$ N. on the decl. arc. and at noon observe the sun on the meridian and obtain a reading of $35^{\circ} 30'$ N. on the lat. arc.

From the above cor., I retrace

$S 89^{\circ} 43' W.$ on a random line bet. sec. 6 and 7,

40.00 I make a diligent search for the old $\frac{1}{4}$ sec. cor. which I fail to find

79.20 Intersect W. ldy. of Twp. 42 lks. S. of the cor. of sec. 1, 6, 7 and 12. which I re established and described in Exp. Jour. Book "AH" May 9th 1910. ¹ thence I run, resurveying,

$S. 89^{\circ} 50' E.$ on a true line bet. sec. 6 and 7.

Ascend W. slope over rolling sandy land through sage and greasewood bush undergrowth

39.20 Set a basal stone $14 \times 10 \times 6$ ins, 10 ins in the ground. ^{re established} for $\frac{1}{4}$ sec. cor. marked $\frac{1}{4}$ on N. face. Dig pits $18 \times 18 \times 12$ ins East W. of stone 3 ft. dia. and raise a mound of earth $3\frac{1}{2}$ ft. base, $1\frac{1}{2}$ ft. high. N. of cor

59.20 Top of sand ridge bears N.E. and S.W. desc.

70.70 Dry sand wash 30 lks. wide course $S 30^{\circ} W.$ asc.

73.20 Top of sand ridge bears N.E. and S.W. desc.

76.70 Dry sand wash course $S 60^{\circ} W.$ asc.

79.20 ^{re-established} the cor. of sec. 5, 6, 7, and 8, hereinbefore described.

Land rolling.

Soil sandy $\frac{3}{4}$ and $\frac{4}{5}$ rate.

No timber

North bet. sec. 5 and 6, resurveying Descend N.W. slope over rolling sandy land through scattering sage and greasewood bush undergrowth.

2.10 Dry sand wash course S.W. asc.

6.00 Top of ridge bears N.E. and S.W. desc

39.00 Dry sand wash 125 lks. wide course $S 45^{\circ} W.$

40.00 The point for the $\frac{1}{4}$ sec. cor falls in bottom of dry sand wash.

I make a diligent search for the old $\frac{1}{4}$ sec.

BOOK 2609

Cor. which I fail to find, therefore I continue my line

4025 Leave sand wash. Enter scattering cedar timber bears N.E. and S.W.

4050 Set a basalt stone 18x16x12 ins. 15 ins. in the ground for witness cor. to the 1/4 sec. cor. marked W.C. 1/4 on W. face, from which
 A cedar 12 ins. in diam bears N 86 1/4° E 20 lbs. dist. marked W.C. 1/4 S 5 B.T.

A cedar 8 ins. in diam. bears S 43 3/4° W. 60 lbs. dist. marked W.C. 1/4 S 6 B.T.

8230 Intersect the Sixth Standard Parallel North 2.36 Chp. N 89° 47' W. of the Stand. 1/4 sec. cor. on S. side of Sec. 31 T₂₅N, R₁₉E. ^{recently re-established by me and described in Standard Book "G"} Set a basalt

^{re-established} stone 14x14x13 ins. 10 ins. in the ground, for closing cor. of sec. 5 and 6, marked C.C. on S face, with 5 grooves on E. and 1 groove on W. faces. from which

A cedar 6 ins. in diam. bears S 52 3/4° W. 305 lbs. dist. marked T₂₄N, R₁₉E. S 6 ^{CC} B.T.

No other trees within limits

Dig pits 24x18x12 ins. crosswise on each line E and W. 3 ft. and S. of stone 7 ft. dist. and raise a mound of earth 4 ft. base 2 ft. high. S. of cor. No trace of original closing corner can be found. Sand rolling.

Soil sandy 3rd and 4th rate.

Timber scattering cedar

June 4th 1910.

Sidney E. Blout
 U.S. Examiner of Surveys

U.S. EXAMINER OF SURVEYS
FINAL OATHS OF DEPUTY SURVEYOR AND HIS ASSISTANTS.

13

LIST OF NAMES.

BOOK 2609

A list of the names of the individuals employed by Sidney E. Blouh

U. S. Examiner of Surveys
United States to assist in running, measuring, and

marking the lines and corners described in the foregoing field notes of the Retracements and

Resurvey of the Subdivision lines of Twp No. 24 No. R. 19 East, S. & J. R. B. & M.

showing the respective capacities in which they acted: Arizona

Fred L. Warner Van L. White Compassman
....., Chairman.

N. J. White
....., Chairman.

Chas. L. Shumway
....., Moundman.

....., ~~Moundman~~

....., ~~Surveyor~~

....., ~~Surveyor~~

William R. Carson
....., Flagman.

FINAL OATH OF ASSISTANTS.

We hereby certify that we assisted Sidney E. Blouh

U. S. Examiner of Surveys
United States in

retracing and resurveying all
those parts or portions of the the Subdivision

lines of Twp No. 24 No. 1 Range 19 East.

..... of the Gila and

Salt River Base and Meridian, Territory of Arizona, which are represented

in the foregoing field notes as having been retraced and re- retracement and re-

has been in all respects, to the best of our knowledge and belief, well and faithfully executed and the

corner monuments established, according to the instructions furnished by the Commissioner

of the General Land Office. Van L. White Compassman

Fred L. Warner
....., Chairman.

N. J. White
....., Chairman.

Chas. L. Shumway
....., Moundman.

....., ~~Moundman~~

....., ~~Surveyor~~

William R. Carson
....., Flagman.

Subscribed and sworn to before me this 28th

day of July, 1910



Sidney E. Blouh
U.S. Examiner of Surveys

BOOK 2609

U. S. EXAMINER OF SURVEYS
FINAL OATH OF UNITED STATES ~~DEPUTY SURVEYOR~~

I, Sidney E. Blout, U. S. Examiner of Surveys, United States ~~Deputy Surveyor~~, do solemnly swear that, in pursuance of ~~Special Instructions~~ received from ~~the Commissioner of the United States Survey General Office~~, bearing dates of the 2nd day of Oct. 1907 and 15th day of May 1908, I have well, faithfully, and truly, in my own proper person, and in strict conformity with the instructions furnished by the ~~Commissioner~~ Commissioner of the ~~General Land Office~~, the Manual of Surveying Instructions, and the laws of the United States, ~~surveyed~~ retraced and re- all those parts or portions of The Subdivisional lines of Twp. No. 24 N. Range No. 19 East of

of the Gila and Salt River Base and meridian, in the Territory of Arizona, which are represented in the foregoing field notes as having been ~~surveyed~~ retraced and re- by me, and under my direction; and I do further solemnly swear that all the corners of ~~said survey~~ retracement and re- have been ~~established~~ re- and perpetuated in strict accordance with the Manual of Surveying Instructions, and the special written instructions of the ~~Commissioner~~ Commissioner of the ~~General Land Office~~ and in the specific manner described in the field notes, and that the foregoing are the original field notes of ~~such survey~~ such survey.

Sidney E. Blout
United States ~~Deputy Surveyor~~
Examiner of Surveys

Subscribed by said Sidney E. Blout, and sworn to before me }
this 26th day of October, 1912

Frank J. Ingalls
SURVEYOR-GENERAL OF ARIZONA



APPROVAL.

OFFICE OF THE UNITED STATES SURVEYOR GENERAL,

Phoenix, Arizona APR 25 1914

The foregoing field notes of the ~~Retracement and Resurvey of~~
Part of the Subdivision lines of
Township 24 North, Range 19 East, of the
Gila and Salt River Base and Meridian, Arizona

executed by Sidney E. Blout U.S. Examiner of Surveys
under Special Instructions from the Commissioner of the General Land Office, dated October 2, 1907 and May 15, 1908, having been critically examined, and the necessary corrections and explanations made, the said field notes, and the surveys they describe, are hereby approved.

Frank J. Ingalls
United States Surveyor General
SURVEYOR-GENERAL OF ARIZONA

I certify that the foregoing transcript of the field notes of the above-described surveys in _____ has been correctly copied from the original notes on file in this office.

United States Surveyor General