

BOOK "Y"

BOOK 2675

MAY 11 1914

FIELD NOTES

OF THE SURVEY OF THE

Subdivision Lines

Resurvey of the West Boundary

and Retracement and Resurvey of the North Boundary of
Township N^o 14 South, Range N^o 23 East

Of the Gila and Salt River Base and Meridian,

In the State of Arizona

EXECUTED BY

John F. Hesse

In the capacity of U. S. Surveyor, under instructions dated May 22nd 1912
issued by the United States Surveyor General to govern surveys included in
Group No. 18, which were approved by the Commissioner of the General Land
Office, June 20th, 1912, pursuant to authority contained in the Act of
Congress dated June 23rd, 1913

Survey Retracement & Resurvey commenced August 19, 1913

Survey Retracement & Resurvey completed September 5, 1913

BOOK 2675

INDEX DIAGRAM.

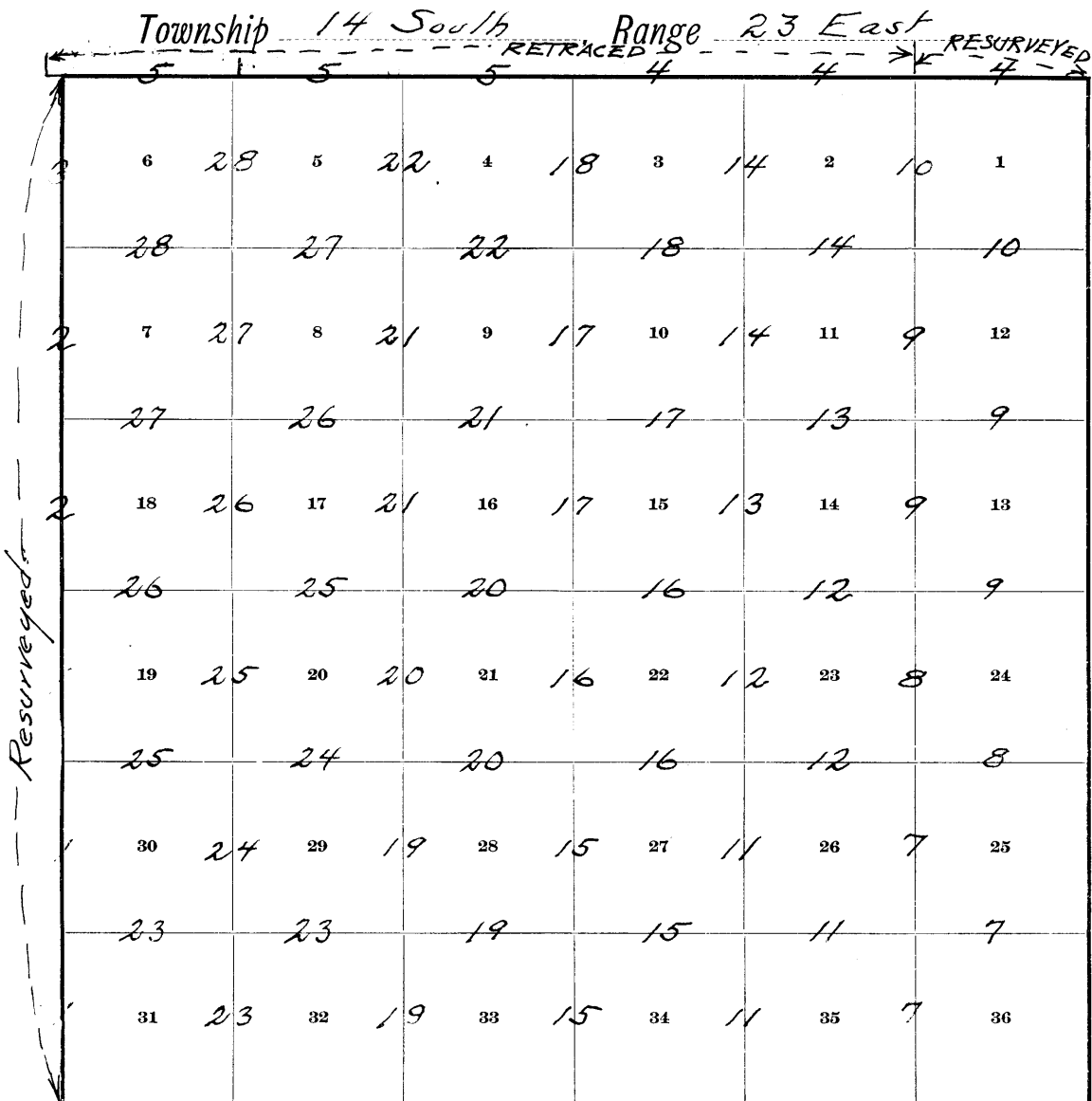

Resurvey of the West boundary of Tp. 14 S. Rg. 23 E.

Chains.

As the west boundary of Tp. 14 S. Rg. 23 E. runs between unsurveyed townships and is defective in alinement, measurement and position, I destroy the old line and resurvey it as follows;

August 27, 1913. At 7h. 00m. a.m., l.m.t., I set off 32° 09 1/2' N. on the lat. arc; 10° 11' N. on the decl. arc; and determine a meridian with the solar at the old cor. of Tps. 14 and 15 S., Rgs. 22 and 23 E. which has been described by me in Book "X"

Thence I run

North, bet. secs. 31 and 36. Over rolling hills.

5.20 Ridge, bears S. W. and N. E.

40.00 Set an iron post 3 ft. long, 1 in. diam., 26 ins. in the ground for reestab. of cor., marked on brass cap 1/4 S36 in W. S31 in E., and 1913 in S. half; and raise a mound of stone 2 ft. base 1 1/2 ft. high, W. of cor. Pits impracticable.

68.60 Cross wash, 30 lks. wide, course S. W.

80.00 Set an iron post 3 ft. long, 3 ins. diam., 24 ins. in the ground for reestab. of cor. of secs. 25, 30, 31 and 36, marked on brass cap

- T14S in N. and
- 1913 in S. half;
- R22ES25 in N. W.
- R23ES30 in N. E.
- S31 in S. E. and

S36 in S. W. quadrant; and raise a mound of stone 2 ft. base 1 1/2 ft. high, W. of cor. Pits impracticable. Land, hilly.

Soil, sandy loam mixed with rocks and gravel, 3rd. rate. No timber.

North, bet. secs. 25 and 30. Over hilly land.

40.00 Set an iron post 3 ft. long, 1 in. diam., 26 ins. in the ground for reestab. of cor., marked on brass cap 1/4 S25 in W. S30 in E. and 1913 in S. half; and raise a mound of stone 2 ft. base 1 1/2 ft. high, W. of cor. Pits impracticable.

74.80 Descend sharply.

80.00 Set an iron post 3 ft. long, 3 ins. diam., 24 ins. in the ground for reestab. of cor. of secs. 19, 24, 25 and 30, marked on brass cap

- T14S in N. and
- 1913 in S. half;
- R22ES24 in N. W.
- R23ES19 in N. E.
- S30 in S. E. and

S25 in S. W. quadrant; and raise a mound of stone 2 ft. base 1 1/2 ft. high, W. of cor. Pits impracticable. Land, hilly.

Soil, sandy loam, mixed with rocks and gravel, 3rd. rate. No timber.

NOTE: August 27. At this cor. I set off 10° 06' N. on the decl. arc; and observe the sun on the meridian at noon; the resulting lat. is 32° 11' N.

North, bet. secs. 19 and 24. Descend.

7.50 Over nearly level land.

36.50 Enter scattering brush.

40.00 Set an iron post 3 ft. long, 1 in. diam., 26 ins. in the ground for reestab. of cor., marked on brass cap 1/4 S24 in W. S19 in E. and 1913 in S. half; dig pits 18 x 18 x 12 ins. N. and S. of post 3 ft. dist., and raise a mound of earth 3 1/2 ft. base 1 1/2 ft. high, W. of cor. Pits impracticable.

Resurvey of the west boundary of Tp. 14 S. Rg. 23 E.

Chains.

- 74.60 Cross wash, 50 lks. wide, course N. W.
 80.00 Set an iron post 3 ft. long, 3 ins. diam., 24 ins. in the ground for reestablishment of cor. of secs. 13, 18, 19 and 24, marked on brass cap
 T14S in N. and
 1913 in S. half;
 R22ES13 in N. W.
 R23ES18 in N. E.
 S19 in S. E. and
 S24 in S. W. quadrant; dig pits 18 x 18 x 12 ins. in each sec. $5\frac{1}{2}$ ft. dist., and raise a mound of earth 4 ft. base 2 ft. high, W. of cor. Pits impracticable.
 Land, level and mountainous.
 Soil, sandy loam, dry, medium texture, 1st. rate; except S. 7.50 chs. which is rocky and gravelly; 3rd. rate.
 No timber.
-
- 40.00 North, bet. secs. 13 and 18.
 Over level land, through scattering brush.
 Set an iron post 3 ft. long, 1 in. diam., 26 ins. in the ground for reestablishment of cor., marked on brass cap $\frac{1}{4}$ S13 in W. and S18 in E. and 1913 in S. half; dig pits 18 x 18 x 12 ins. N. and S. of post 3 ft. dist., and raise a mound of earth $3\frac{1}{2}$ ft. base $1\frac{1}{2}$ ft. high, W. of cor. Pits impracticable.
- 41.70 Cross wash, 20 lks. wide, course N. E.
 56.10 Cross road, bears E. and W.
 62.50 Brush becomes dense.
 79.25 Cross road, bears E. and W.
 80.00 Set an iron post 3 ft. long, 3 ins. diam., 24 ins. in the ground for reestablishment of cor. of secs. 7, 12, 13 and 18, marked on brass cap
 T14S in N. and
 1913 in S. half;
 R22ES12 in N. W.
 R23ES7 in N. E.
 S18 in S. E. and
 S13 in S. W. quadrant; and raise a mound of stone 2 ft. base $1\frac{1}{2}$ ft. high, W. of cor. Pits impracticable.
 Land, level.
 Soil, sandy loam, dry, medium texture; 1st. rate.
 No timber.
 Undergrowth, mesquite and cactus.

August 27, 1913.

August 28, 1913; At 7h. 00m. a.m., 1.m.t., I set off $32^{\circ} 13'$ N. on the lat. arc; $9^{\circ} 50'$ N. on the decl. arc; and determine a meridian with the solar at the reestablishment of secs. 7, 12, 13 and 18, above described,

Thence I run,

North, bet. secs. 7 and 12.

- Over nearly level land, through dense brush.
 13.45 Cross wash, 12 lks. wide, course S. E. and brush becomes scattering.
 40.00 Set an iron post 3 ft. long, 1 in. diam., 26 ins. in the ground for reestablishment of cor., marked on brass cap $\frac{1}{4}$ S12 in W. S7 in E. and 1913 in S. half; and raise a mound of stone 2 ft. base $1\frac{1}{2}$ ft. high, W. of cor. Pits impracticable.
 80.00 Set an iron post 3 ft. long, 3 ins. diam., 24 ins. in the ground for reestablishment of cor. of secs. 1, 6, 7 and 12, marked on brass cap
 T14S in N. and
 1913 in S. half;
 R22ES1 in N. W.
 R23ES6 in N. E.
 S7 in S. E. and
 S12 in S. W. quadrant; and raise a mound of stone 2

Resurvey of the west boundary of Tp. 14 S. Rg. 23 E.

Chains.

ft. base 1 1/2 ft. high, W. of cor. Pits impracticable.
Land, nearly level.
Soil, sandy loam, mixed with rocks and gravel; 3rd. rate.
No timber.
Undergrowth, mesquite and cactus.

North, bet. secs. 1 and 6.
Ascending through scattering brush.

15.00 Ascent becomes steep.

40.00 Set an iron post 3 ft. long, 1 in. diam., 26 ins. in the ground for ~~estab. 1/4 sec. cor.~~ marked on brass cap 1/4 S1 in W., S6 in E. and 1913 in S. half; and raise a mound of stone 2 ft. base 1 1/2 ft. high, W. of cor. Pits impracticable.

NOTE: ~~At this cor.~~ At this cor. I set off 9° 44 1/2' N. on the decl. arc; and observe the sun on the meridian at noon, the resulting lat is 32° 14' N.

64.00 Cliffs 50 ft. high.

72.44 Intersect N. bdy. of Tp. 308 lks. N. 89° 42' E. of the old cor. of Tps. 13 and 14 S. Rgs. 22 and 23 E. a stone marked and witnessed as described by the surveyor general I cut out the 6 notches on the S. of the stone and move the mound of stone to the N. of the cor. At my point of intersection I set an iron post 3 ft. long, 3 ins. diam., 24 ins. in the ground for ~~estab. closing cor.~~ closing cor. of Tps. 14 S. Rgs. 22 and 23 E. marked on brass cap

CC S. of center

T13S R22E S36 R23E S31 in N. and

T14S 1913 in S. half;

S6 R23E in S. E. and

S1 R22E in S. W. quadrant; and raise a mound of stone

2 ft. base 1 1/2 ft. high, S. of cor. Pits impracticable.

Land, rough and mountainous.

Soil, rocky; 4th. rate.

No timber.

Undergrowth, mesquite and cactus.

NOTE: ~~At this cor.~~ In making the resurvey of this line I destroy all traces of the old 1/4 sec. and sec. cors. which were established for the west boundary of Tp. 14 S. Rg. 23 E.

August 28, 1913.

Retracement & Resurvey of the north boundary of Tp. 14 S. Rg. 23 E.

Chains.

- August 20; 1913;
 I commence at the cor. of Tps. 13 and 14 S. Rgs. 23 and 24 E. which is an iron post marked and witnessed as described by the surveyor general, recently reestab. by Thos. B. Matthews Under Group 25; Thence I run,
 West, bet secs. 1 and 36, on random line,
 Over nearly level land, through dense brush.
- 40.10 Fall 51 lks. N. of old $\frac{1}{4}$ sec. cor. remains of a mound of earth and traces of two pits. ^{DESTROY ALL TRACE OF OLD COR. AND} re-establish this cor. in the same place as follows:
 Set a limestone 18 x 8 x 8 ins. 12 ins. in the ground for $\frac{1}{4}$ sec. cor., marked $\frac{1}{4}$ on N. face; dig pits 18 x 18 x 12 ins. E. and W. of stone 3 ft. dist., and raise a mound of earth $3\frac{1}{2}$ ft. base $1\frac{1}{2}$ ft. high, N. of cor.
 True course & dist. of this $\frac{1}{2}$ mile is therefore S. $89^{\circ} 16'$ W., 40.10 chs.
 Thence From $\frac{1}{4}$ sec. cor. I run
 West, on random line, bet. sec. 1 and 36 on $W\frac{1}{2}$ mile.
- 40.18 Fall 37 lks. N. of old cor. of secs. 1, 2, 35 and 36, a stone marked and witnessed as described by the surveyor general.
 True course & dist. of this $\frac{1}{2}$ mile is therefore S. $89^{\circ} 28'$ W., 40.18 chs.
 Land, level.
 Soil, sandy loam, dry, medium texture; 1st. rate.
 No timber.
 Undergrowth, mesquite.

August 20, 1913.

- August 22; 1913;
 West, bet. secs. 2 and 35, on random line
 Over level land, through dense brush.
- 40.18 Fall 53 lks. N. of $\frac{1}{4}$ sec. cor., a stone marked and witnessed as described by the surveyor general.
 True course & dist. of this $\frac{1}{2}$ mile is therefore S. $89^{\circ} 14'$ W., 40.18 chs.
 Thence from $\frac{1}{4}$ sec. cor. I run
 West, on random line, bet. secs. 2 and 35 on $W\frac{1}{2}$ mile.
- 40.16 Fall 43 lks. N. of cor. of secs. 2, 3, 34 and 35, a stone marked and witnessed as described by the surveyor general.
 True course & dist. of this $\frac{1}{2}$ mile is therefore S. $89^{\circ} 23'$ W., 40.16 chs.
 Land, nearly level.
 Soil; E. half mile, sandy loam, dry, medium texture; 1st. rate. W. half mile sandy loam, mixed with rocks and gravel, 2nd. rate.
 No timber.
 Undergrowth, mesquite and catclaw.

August 22, 1913.

- August 25, 1913; At 7h. 00m. a.m., l.m.t., I set off $32^{\circ} 14\frac{1}{2}'$ N. on the lat. arc; $10^{\circ} 53'$ N. on the decl. arc; and determine a meridian with the solar at the old cor. of secs. 2, 3, 34, and 35, above described,
 Thence I run
 West, bet. secs. 3 and 34, on random line
 Over nearly level land, through dense brush.
- 7.10 Cross road, bears N. W. and S. E.
 16.60 Cross wash, 25 lks. wide, course S. E.
- 40.08 Fall 52 lks. N. of $\frac{1}{4}$ sec. cor. a stone marked and witnessed as described by the surveyor general.
 True course & dist. of this $\frac{1}{2}$ mile is therefore S. $89^{\circ} 15'$ W., 40.08 chs.
 Thence from $\frac{1}{4}$ sec. cor. I run
 West, on random line, bet. sec. 3 and 34 on $W\frac{1}{2}$ mile
 Ascending .
- 25.00 Ridge, bears N. W. and S. E., descend.
 40.00 Foot of ridge. Fall 6 lks. S. of cor. of secs. 3, 4, 33, and 34, which is a stone marked and witnessed as described by the surveyor general.
 True course & dist. of this $\frac{1}{2}$ mile is therefore S. $89^{\circ} 55'$ W., 40.00 chs.
 Land, level and mountainous.

BOOK 2675

Retracement of portion of North boundary of Tp. 14 S. Rg. 23 E.

Chains.

Soil, E. half mile, sandy loam, dry, medium texture, 1st. rate; W. half mile, rocky; 4th. rate.
No timber.
Undergrowth, catclaw and mesquite.

40.33 West, bet. secs. 4 and 33, on random line
Over nearly level land, through dense brush.
Fall 145 lks. N. of $\frac{1}{4}$ sec. cor., which is a stone marked and witnessed as described by the surveyor general.
True course & dist. of this $\frac{1}{2}$ mile is therefore S. $87^{\circ} 56'$ W., 40.36 chs.
Thence from $\frac{1}{4}$ sec. cor. I run

40.15 West, on random line, bet. secs. 4 and 33 on $W\frac{1}{2}$ mile
Fall 28 lks. N. of cor. of secs. 4, 5, 32 and 33, which is a stone marked and witnessed as described by the surveyor general.
True course & dist. of this $\frac{1}{2}$ mile is therefore S. $89^{\circ} 36'$ W., 40.15 chs.
Land, nearly level.
Soil, E. half mile, sandy loam, dry, medium texture, 1st. rate; W. half mile, rocky; 4th. rate.
No timber.
Undergrowth, catclaw and mesquite.

NOTE: ~~At this cor. I set off $10^{\circ} 47\frac{1}{2}'$ N. on the decl. arc; and observe the sun on the meridian at noon; the resulting lat. is $32^{\circ} 14\frac{1}{2}'$ N.~~

August 25, 1913.

August 26, 1913; At 7h. 00m. a.m., l.m.t., I set off $32^{\circ} 14\frac{1}{2}'$ N. on the lat. arc; $10^{\circ} 32'$ N. on the decl. arc; and determine a meridian with the solar at the $\frac{1}{4}$ cor. of secs. 4, 5, 32 and 33, above described,

Thence I run
West, bet. secs. 5 and 32, on random line
Descending.
2.20 Cross wash, 8 lks. wide, course S. E. and ascend.
39.96 Fall 90 lks. N. of $\frac{1}{4}$ sec. cor., which is a stone marked and witnessed as described by the surveyor general.
True course & dist. of this $\frac{1}{2}$ mile is therefore S. $88^{\circ} 43'$ W., 39.96 chs. I return to the old cor. of secs. 4, 5, 32 and 33, hereinbefore described, and run S. $88^{\circ} 43'$ W., bet. secs. 5 and 32, on true line,
2.20 Cross wash, 8 lks. wide, course S. E. ascend.
14.50 Intersect N. side line of Grand View Sur. No. 471, S. $62^{\circ} 47'$ E. 7.24 chs. from cor. No. 2.
34.52 Intersect S. side line of Antelope, Sur. No. 473, N. $65^{\circ} 18'$ W. 10.37 chs. from cor. No. 2.
39.96 The $\frac{1}{4}$ sec. cor., hereinbefore described.
Thence from $\frac{1}{4}$ sec. cor. I run
West, on random line, bet. secs. 5 and 32 on $W\frac{1}{2}$ mile.
10.20 Ridge, bears N. W. and S. E., descend.
20.30 Cross wash, 20 lks. wide, course S. E. ascend.
38.20 Fall 44 lks. N. of cor. of secs. 5, 6, 31 and 32 which is a stone marked and witnessed as described by the surveyor general.
True course & dist. of this $\frac{1}{2}$ mile is therefore S. $89^{\circ} 20'$ W., 38.20 chs.
Land, mountainous.
Soil, rocky; 4th. rate.
No timber.
Undergrowth, scattering mesquite and cactus.

NOTE: ~~At this cor. I set off $10^{\circ} 26\frac{1}{2}'$ N. on the decl. arc; and observe the sun on the meridian at noon; the resulting lat. is $32^{\circ} 14\frac{1}{2}'$ N.~~

West, bet. secs. 6 and 31, on random line,

Retracement of portion of North boundary of Tp. 14 S. Rg. 23 E.

Chains

Ascend along steep, rough, broken N. E. slope of mountain.
 19.20 Top of rough spur.
 30.40 Top of main ridge, bears N. W. and S. E., descend.
 40.25 Fall 39 lks. S. of $\frac{1}{4}$ sec. cor. a stone marked and
 witnessed as described by the surveyor general.
 True course & dist. of this $\frac{1}{2}$ mile is therefore N. 89° 26' W., 40.25 chs.
 Thence from $\frac{1}{4}$ sec. cor. I run
 West, on random line, bet. secs. 6 and 31 on $W\frac{1}{2}$ mile.
 52.80 Bottom of ravine, ascend. Course S.
 59.70 Ridge, bears N. and S., descend.
 63.80 Bottom of ravine, course S., ascend..
 69.20 Ridge, bears N. and S., descend.
 39.62 Fall 21 lks. N. of cor. of Tps. 13 and 14 S., Rg. 22 and 23 E. &
 hereinbefore described.
 True course & dist. of this $\frac{1}{2}$ mile is therefore S. 89° 42' W., 39.62 chs.
 Land, rough and mountainous.
 Soil, rocks; 4th. rate.
 Timber, scattering oak and juniper.

August 26, 1913.

BOOK 2675

Subdivision of Tp. 14 S. Rg. 23 E.

Chains.

Survey commenced August 19, 1913, and executed with a W. and L. E. Gurley transit, not numbered, with solar attachment. the horizontal limb is provided with one double vernier reading to single minutes of arc, which is also the least count of the verniers of the latitude and declination arcs.

The instrument was approved by the supervising surveyor August 28, 1912.

Survey I commence at the cor. of secs. 1, 2, 35 and 36 on the S. bdy. of the Tp., recently estab. by me as described in Book "X"

Thence I run

N. 0° 01' W. bet. secs. 35 and 36

Over nearly level land, through dense brush.

4.76 Cross road bears N. W. and S. E.

40.00 Set an iron post 3 ft. long, 1 in. diam., 26 ins. in the ground for 1/4 sec. cor., marked on brass cap 1/4 S35 in W., S36 in E. and 1913 in S. half; dig pits 18 x 18 x 12 ins. N. and S. of post 3 ft. dist., and raise a mound of earth 3 1/2 ft. base 1 1/2 ft. high, W. of cor.

41.36 Cross fence, bears E. and W.

70.16 Cross drain, 40 lks. wide, course S. E.

80.00 Set an iron post 3 ft. long, 2 ins. diam., 24 ins. in the ground for cor. of secs. 25, 26, 35 and 36, marked on brass cap

T14SR23E in N. and

1913 in S. half;

S26 in N. W.

S25 in N. E.

S36 in S. E. and

S35 in S. W. quadrant; dig pits 18 x 18 x 12 ins. in each sec. 5 1/2 ft. dist. and raise a mound of earth 4 ft. base 2 ft. high, W. of cor.

From this cor. Mrs. A. C. Sweeney house bears N. 80° 15' E.

Miss L. Thomas House bears N. 82° 30' E.

Miss M. Thomas house bears S. 87° E.

Mrs. S. W. Thomas house bears S. 87° E.

Land, level.

Soil sandy loam, medium texture, dry; 1st. rate.

No timber.

Undergrowth, mesquite.

40.00 S. 89° 41' E., on a random line, bet. secs. 25 and 36

Set temp. 1/4 sec. cor.

80.04 Intersect the East bdy. of the Tp., 7 lks. 50° 02' W. of the cor.

of secs. 25, 30, 31 and 36, an iron post, with brass cap, marked and witnessed as described by the Surveyor General recently reestab. by Thos. B. Matthews, U.S. Surveyor under current Group N° 25. Thence I run,

N. 89° 44' W., on a true line, bet. u. secs. 25 and 36

Over level land, through dense brush.

40.02 Set an iron post 3 ft. long, 1 in. diam., 26 ins. in the ground for 1/4 sec. cor., marked on brass cap 1/4 S25 in N. and S36 1913 in S. half; dig pits 18 x 18 x 12 ins. E. and W. of post 3 ft. dist, and raise a mound of earth 3 1/2 ft. base 1 1/2 ft. high, N. of cor.

80.04 The cor. of secs. 25, 26, 35, and 36, hereinbefore described.

Land, level.

Soil, sandy loam, dry, medium texture, 1st. rate.

No timber.

Undergrowth, mesquite.

N. 0° 01' W., bet. secs. 25 and 26

Over level land, through dense brush.

8.55 A point from which

Mrs. A. C. Sweeney house, bears S. 86° 40' E.

Miss L. Thomas house, bears S. 85° 50' E.

Miss M. Thomas house, bears S. 74° 55' E.

Mrs. S. W. Thomas house, bears S. 74° 30' E.

16.76 Brush becomes scattering.

Subdivision of Tp. 14 S. Rg. 23 E.

Chains.	
40.00	Set an iron post 3 ft. long, 1 in. diam. 26 ins. in the ground for $\frac{1}{4}$ sec. cor., marked on brass cap $\frac{1}{4}$ S26 in W. S25 in E. and 1913 in S. half; dig pits 18 x 18 x 12 ins. N. and S. of post 3 ft. dist., and raise a mound of earth $3\frac{1}{2}$ ft. base $1\frac{1}{2}$ ft. high, W. of cor.
54.56	Cross wash, 15 lks. wide, course S. E. and leave brush.
80.00	Set an iron post 3 ft. long, 2 ins. diam., 24 ins. in the ground for cor. of secs. 23, 24, 25, and 26, marked on brass cap T14SR23E in N. and 1913 in S. half; S23 in N. W. S24 in N. E. S25 in S. E. and S26 in S. W. quadrant; and raise a mound of stone 2 ft. base $1\frac{1}{2}$ ft. high, W. of cor. Pits impracticable. Land, level. Soil, sandy loam mixed with gravel, coarse texture, dry, 1st. rate. No timber. Undergrowth, mesquite.

	S. $89^{\circ} 44'$ E., on a random line, bet. secs. 24 and 25.
40.00	Set temp. $\frac{1}{4}$ sec. cor.
80.14	Intersect E. bdy. of the Tp., 22 lks. S. $6^{\circ} 02'$ W. of the cor. of secs. 19, 24, 25 and 30, an iron post with brass cap marked & witnessed as described by the Surveyor General, recently estab. by Thos. B. Matthews, U.S. Surveyor, under Group No. 25, Thence I run, N. $89^{\circ} 45'$ W., on a true line, bet. secs. 24 and 25. Over level land.
15.20	Enter dense brush.
28.00	Leave brush.
40.07	Set an iron post 3 ft. long, 1 in. diam., 26 ins. in the ground for $\frac{1}{4}$ sec. cor., marked on brass cap $\frac{1}{4}$ S24 in N. and S25 1913 in S. half; dig pits 18 x 18 x 12 ins. E. and W. of post 3 ft. dist., and raise a mound of earth $3\frac{1}{2}$ ft. base $1\frac{1}{2}$ ft. high, N. of cor.
80.14	The cor. of secs. 23, 24, 25, and 26, heretofore described. Land, level. Soil, sandy loam mixed with gravel, coarse texture, dry; 1st. rate. No timber. Undergrowth, mesquite.

	N. $0^{\circ} 01'$ W., bet. secs. 23 and 24.
	Over level land.
0.96	Cross fence, bears E. and W.
40.00	Set an iron post 3 ft. long, 1 in. diam., 26 ins. in the ground for $\frac{1}{4}$ sec. cor., marked on brass cap $\frac{1}{4}$ S23 in W. S24 in E. and 1913 in S. half; and raise a mound of stone 2 ft. base $1\frac{1}{2}$ ft. high, W. of cor. Pits impracticable.
59.80	Cross wash, 14 lks. wide, course S. E.
72.26	Cross road, bears N. W. and S. E.
80.00	Set an iron post 3 ft. long, 2 ins. diam., 24 ins. in the ground for cor. of secs. 13, 14, 23 and 24, marked on brass cap T14SR23E in N. and 1913 in S. half; S14 in N. W. an S13 in N. E. S24 in S. E. and S23 in S. W. quadrant; and raise a mound of stone 2 ft. base $1\frac{1}{2}$ ft. high, W. of cor. Pits impracticable. Land, level. Soil, sandy loam, mixed with gravel, coarse texture, dry; 1st. rate. No timber.

Subdivision of Tp. 14 S. Rg. 23 E.

Chains. S. 89° 45' E., on a random line, bet. secs. 13 and 24.
 40.00 Set temp. $\frac{1}{4}$ sec. cor.
 80.20 Intersect E. bdy. of Tp., 7 $\frac{1}{2}$ m. S. 0° 02' W. of the cor. of secs. 13, 18, 19 and 24, an iron post with brass cap marked & witnessed as described by the Surveyor General, recently reestab. by Thos. B. Matthews, U.S. Surveyor, under current Group N° 25, Thence I run, N. 89° 48' W., on a true line, bet. secs. 13 and 24
 Over level land,
 40.10 Set an iron post 3 ft. long, 1 in. diam., 26 ins. in the ground for $\frac{1}{4}$ sec. cor., marked on brass cap $\frac{1}{4}$ S13 in N. and S24 1913 in S. half; dig pits 18 x 18 x 12 ins. E. and W. of post 3 ft. dist., and raise a mound of aerth 3 $\frac{1}{2}$ ft. base 1 $\frac{1}{2}$ ft. high, N. of cor.
 80.20 The cor. of secs. 13, 14, 23 and 24, hereinbefore described.
 Land, level.
 Soil, sandy loam, mixed with gravel, coarse texture, dry; 1st. rate.
 No timber.

August 19, 1913.

August 20¹⁹¹³ At 7h. 00m. a.m., l.m.t., I set off 32° 12' N. on the lat. arc; 12° 34' N. on the decl. arc; and determine a meridian with the solar at the cor. of secs. 13, 14, 23 and 24, hereinbefore described,

Thence I run,
 N. 0° 01' W., bet. secs. 13 and 14.
 Over level land.
 35.61 Cross road, bears N. E. and S. W.
 40.00 Set an iron post 3 ft. long, 1 in. diam., 26 ins. in the ground for $\frac{1}{4}$ sec. cor., marked on brass cap $\frac{1}{4}$ S14 in W. S13 in E. and 1913 in S. half; and raise a mound of stone 2 ft. base 1 $\frac{1}{2}$ ft. high, W. of cor. Pits impracticable.
 80.00 Set an iron post 3 ft. long, 2 ins. diam., 24 ins. in the ground for cor. of secs. 11, 12, 13 and 14, marked on brass cap
 T14SR23E in N. half;
 1913 in S. half;
 S11 in N. W.
 S12 in N. E.
 S13 in S. E. and
 S14 in S. W. quadrant; and raise a mound of stone 2 ft. base 1 $\frac{1}{2}$ ft. high, W. of cor. Pits impracticable.
 Land, level.
 Soil, sandy loam mixed with gravel, coarse texture, dry; 1st. rate.
 No timber.

S. 89° 48' E., on a random line, bet. secs. 12 and 13.
 40.00 Set temp. $\frac{1}{4}$ sec. cor.
 80.28 Intersect E. bdy. of Tp., at the cor. of secs. 7, 12, 13 and 18, an iron post with brass cap marked & witnessed as described by the Surveyor General, recently reestab. by Thos. B. Matthews, U.S. Surveyor, under current Group N° 25, Thence I run, N. 89° 48' W., on a true line, bet. secs. 12 and 13.
 40.14 Set an iron post 3 ft. long, 1 in. diam., 26 ins. in the ground for $\frac{1}{4}$ sec. cor., marked on brass cap $\frac{1}{4}$ S12 in N. and S13 1913 in S. half; and raise a mound of stone 2 ft. base 1 $\frac{1}{2}$ ft. high, N. of cor. Pits impracticable.
 80.28 The cor. of secs. 11, 12, 13 and 14, hereinbefore described.
 Land, level.
 Soil, sandy loam mixed with gravel, coarse texture, dry; 1st. rate.
 No timber.

N. 0° 01' W., bet. secs. 11 and 12.

Subdivision of Tp. 14 S. Rg. 23 E.

- Chains.
- 40.00 Over nearly level land.
Set an iron post 3 ft. long, 1 in. diam., 26 ins. in the ground for $\frac{1}{4}$ sec. cor., marked on brass cap $\frac{1}{4}$ S11 in W. S12 in E. and 1913 in S. half; and raise a mound of stone 2 ft. base $1\frac{1}{2}$ ft. high, W. of cor. Pits impracticable.
- 43.86 Enter dense brush.
- 63.39 R. G. Gregg house, bears N. $13^{\circ} 30'$ E.
72. 76 Gross wash, 60 lks. wide, course S. E.
- 76.66 Cross road, bears N. W. and S. E. Leave brush.
- 80.00 Set an iron post 3 ft. long, 2 ins. diam., 24 ins. in the ground for cor. of secs. 1, 2, 11 and 12, marked on brass cap
T14SR23E in N. and
1913 in S. half;
S2 in N. W.
S1 in N. E.
S12 in S. E. and
S11 in S. W. quadrant; and raise a mound of stone 2 ft. base $1\frac{1}{2}$ ft. high, W. of cor. Pits impracticable.
Land, level.
Soil, sandy loam mixed with gravel, coarse texture, dry; 1st. rate.
No timber.
Undergrowth, mesquite.
From this cor. R. G. Gregg house, bears S. $28^{\circ} 45'$ E.
- NOTE: At this cor. I set off $12^{\circ} 28\frac{1}{2}'$ N. on the decl arc; and observe the sun on the meridian at noon; the resulting lat. is $32^{\circ} 13\frac{1}{2}'$ N.
-
- S. $89^{\circ} 48'$ E., on a random line, bet. secs. 1 and 12.
- 40.00 Set temp. $1\frac{1}{4}$ sec. cor. through dense brush.
- 80.32 Intersect E. bdy. of Tp., 23 lks. N. $0^{\circ} 04'$ E., of the cor. of secs. 1, 6, 7 and 12, an iron post with brass cap marked & witnessed as described by the Surveyor General recently reestab. by Thos. B. Matthews, U.S. Surveyor, under current Group No 25, Thence I run, N. $89^{\circ} 47'$ W., on a true line, bet. secs. 1 and 12.
- 40.16 Over level land.
Set an iron post 3 ft. long, 1 in. diam., 26 ins. in the ground for $\frac{1}{4}$ sec. cor., marked on brass cap $\frac{1}{4}$ S1 in N. and S12 1913 in S. half; dig pits 18 x 18 x 12 ins. E. and W. of post 3 ft. dist., and raise a mound of earth $3\frac{1}{2}$ ft. base $1\frac{1}{2}$ ft. high, N. of cor.
- 80.32 The cor. of secs. 1, 2, 11 and 12, ^{hereinbefore} described.
Land, level.
Soil, sandy loam mixed with gravel, coarse texture, dry; 1st. rate.
No timber.
-
- N. $0^{\circ} 01'$ W., bet. secs. 1 and 2, on a random line.
- 40.00 Set temp. $\frac{1}{4}$ sec. cor.
- 78.79 Intersect N. bdy. of the Tp., 15 lks. S $89^{\circ} 14'$ W. of the ^{old} cor. of secs. 1, 2, 35 and 36, ^{hereinbefore} described in my notes of Retracement & Resurvey of N. bdy. of T. 14 S. R. 23 E. Thence I run, S. $0^{\circ} 06'$ W., on a true line, bet. secs. 1 and 2.
- 20.69 Over level land, through scattering brush.
Cross road, bears E. and W.
- 38.79 Set an iron post 3 ft. long, 1 in. diam., 26 ins. in the ground for $\frac{1}{4}$ sec. cor., marked on brass cap $\frac{1}{4}$ S2 in W., S1 in E. and 1913 in S. half; and raise a mound of stone 2 ft. base $1\frac{1}{2}$ ft. high W. of cor. Pits impracticable.
- 63.00 Leave brush.
- 78.79 The cor. of secs. 1, 2, 11 and 12, ^{hereinbefore} described.
Land, level.
Soil, sandy loam mixed with rocks and gravel, medium texture, dry; 2nd. rate.
No timber.
Undergrowth, mesquite.

August 20, 1913

BOOK 2675

Subdivision of Tp. 14 S. Rg. 23 E.

Chains.

August 21¹⁹¹³ At 7h. 00m., a.m., l.m.t., I set off 32° 09½' N. on the lat. arc; 12° 14' N. on the decl. arc; and determine a meridian at the cor. of secs. 2, 3, 34 and 35 on the S. bdy. of the Tp., recently estab. by me as described in Book "X"

Thence I run, N. 0° 01' W., bet. secs. 34 and 35. Over level land, through dense brush. 40.00 Set an iron post 3 ft. long, 1 in. diam., 26 ins. in the ground for ¼ sec. cor., marked on brass cap ¼S34 in W. S35 in E. and 1913 in S. half; and raise a mound of stone 2 ft. base 1½ ft. high, W. of cor. Pits impracticable. 40.70 Cross wash, 60 lks. wide, course N. E. 70.50 Brush becomes scattering. 80.00 Set an iron post 3 ft. long, 2 ins. diam., 24 ins. in the ground for cor. of secs. 26, 27, 34 and 35, marked on brass cap T14SR23E in N. and 1913 in S. half; S27 in N. W. S26 in N. E. S35 in S. E. and S34 in S. W. quadrant; and raise a mound of stone 2 ft. base 1½ ft. high, W. of cor. Pits impracticable. Land, level. Soil, sandy loam, mixed with gravel, dry, coarse texture; 1st. rate. No timber. Undergrowth, mesquite.

S. 89° 41' E., on a random line, bet. secs. 26 and 35. 40.00 Set temp. ¼ sec. cor. 80.02 Intersect N. and S. line, at the cor. of secs. 25, 26, 35 and 36, hereinbefore described,

Thence I run, N. 89° 41' W., on a true line, bet. secs. 26 and 35. Over level land, through dense brush. 6.50 Brush becomes scattering. 38.95 Cross fence, bears N. and S.. 40.01 Set an iron post 3 ft. long, 1 in. diam., 26 ins. in the ground for ¼ sec. cor., marked on brass cap, ¼S26 in N. and S35 1913 in S. half; dig pits 18 x 18 x 12 ins. E. and W. of post 3 ft. dist., and raise a mound of earth 3½ ft. base 1½ ft. high, N. of cor. 46.60 Cross road, bears N. W. and S. E. 80.02 The cor. of secs. 26, 27, 34 and 35, hereinbefore described. Land, level. Soil, sandy loam, mixed with gravel, medium texture, 1st. rate. No timber. Undergrowth, mesquite and cactus.

N. 0° 01' W., bet. secs. 26 and 27 Over level land, through scattering brush. 40.00 Set an iron post 3 ft. long, 1 in. diam., 26 ins. in the ground for ¼ sec. cor., marked on brass cap ¼S27 in W. S26 in E. and 1913 in S. half; and raise a mound of stone 2 ft. base 1½ ft. high, W. of cor. Pits impracticable. 50.98 Cross wash, 12 lks. wide, course S. E. Leave brush. 80.00 Set an iron post 3 ft. long, 2 ins. diam., 24 ins. in the ground for cor. of secs. 22, 23, 26 and 27, marked on brass cap T14SR23E in N. and 1913 in S. half; S22 in N. W. S23 in N. E. S26 in S. E. and S27 in S. W. quadrant; dig pits 18 x 18 x 12 ins. in

Subdivision of Tp. 14 S. Rg. 23 E.

Chains.	
	each sec. $5\frac{1}{2}$ ft. dist., and raise a mound of earth 4 ft. base 2 ft. high, W. of cor. Land, level. Soil, sandy loam, mixed with gravel, coarse, dry, 1st. rate No timber. Undergrowth, mesquite and cactus.
NOTE:	At this cor. At this cor. I set off $12^{\circ} 08\frac{1}{2}'$ N. on the decl. arc; and observe the sun on the meridian at noon; the resulting lat. is $32^{\circ} 11'$ N.
	S. $89^{\circ} 41'$ E., on a random line, bet. secs. 23 and 26.
40.00	Set temp. $\frac{1}{4}$ sec. cor.
80.00	Intersect N. and S. line, at the cor. of secs. 23, 24, 25, and 26, hereinbefore described, Thence I run, N. $89^{\circ} 41'$ W., on a true line, bet. secs. 23 and 26. Over nearly level land.
38.80	Cross fence, bears N. and S.
40.00	Set an iron post 3 ft. long, 1 in. diam., 26 ins. in the ground for $\frac{1}{4}$ sec. cor., marked on brass cap $\frac{1}{4}$ S23 in N. and S26 1913 in S. half; dig pits 18 x 18 x 12 ins. E. and W. of post 3 ft. dist., and raise a mound of earth $3\frac{1}{2}$ ft. base $1\frac{1}{2}$ ft. high, N. of cor.
61.10	Cross road, bears N. W. and S. E.
72.90	Cross wash, 20 lks. wide, course S. E.
80.00	The cor. of secs. 22, 23, 26 and 27, hereinbefore described. Land, level. Soil, sandy loam mixed with gravel, caorse texture, dry; 1st. rate. No timber.
	N. $0^{\circ} 01'$ W., bet. secs. 22 and 23. Over level land.
8.45	Cross wash, 20 lks. wide, course S. E.
25.30	Cross road, bears N. W. and S. E.
40.00	Set an iron post 3 ft. long, 1 in. diam., 26 ins. in the ground for $\frac{1}{4}$ sec. cor., marked on brass cap $\frac{1}{4}$ S22 in W. S23 in E. and 1913 in S. half; and raise a mound of stone 2 ft. base $1\frac{1}{2}$ ft. high, W. of cor. Pits impracticable.
73.07	A point from which Wm. Morgan house, bears N. $65^{\circ} 15'$ W. windmill, bears N. $59^{\circ} 05'$ W.
80.00	Set an iron post 3 ft. long, 2 ins. diam., 24 ins. in the ground for cor. of secs. 14, 15, 22 and 23, marked on brass cap T14SR23E in N. and 1913 in S. half; S15 in N. W. S14 in N. E. S23 in S. E. and S22 in S. W. quadrant; and raise a mound of stone 2 ft. base $1\frac{1}{2}$ ft. high, W. of cor. Pits impracticable. From this cor. Wm. Morgan house bears N. $75^{\circ} 10'$ W. windmill bears N. $68^{\circ} 40'$ W.
	Land, level. Soil, sandy laom, mixed with gravel, coarse texture; dry; 2nd. rate. No timber. U
	S. $89^{\circ} 41'$ E., on a random line, bet. secs. 14 and 23.
40.00	Set temp. $\frac{1}{4}$ sec. cor.
80.06	Intersect N. and S. line, 5 lks. S. of the cor. of secs.

BOOK 2675

Subdivision of Tp. 14 S. Rg. 23 E.

Chains.

13, 14, 23 and 24, ~~hereinbefore~~ described,
 Thence I run
 N. 89° 43' W., on a true line, bet. secs. 14 and 23.
 Over nearly level land.
 6.70 Cross road, bears N. W. and S. E.
 15.35 Cross wash, 20 lks. wide, course E. E.
 40.03 Set an iron post 3 ft. long, 1 in. diam., 26 ins. in the
 ground for $\frac{1}{4}$ sec. cor., marked on brass cap $\frac{1}{4}$ S14 in N.
 and S23 1913 in S. half; and raise a mound of stone 2 ft.
 base $1\frac{1}{2}$ ft. high, N. of cor. Pits impracticable.
 80.06 The cor. of secs. 14, 15, 22 and 23, ~~hereinbefore~~ described.
 Land, level.
 Soil, sandy loam, mixed with gravel, coarse texture; dry;
 2nd. rate.
 No timber.

August 21, 1913,

August 22¹⁹¹³ At 7h. 00m. a.m., l.m.t., I set off 32° 12' N.
 on the lat. arc; 11° 54' N. on the decl. arc; and
 determine a meridian with the solar at the cor. of secs.
 14, 15, 22 and 23, ~~hereinbefore~~ described,
 Thence I run,
 N. 0° 01' W., bet. secs. 14 and 15.
 Over nearly level land,
 9.80 Enter dense brush.
 24.90 Cross road, bears N. W. and S. E.
 35.00 Leave brush.
 40.00 Set an iron post 3 ft. long, 1 in. diam., 26 ins. in the
 ground for $\frac{1}{4}$ sec. cor., marked on brass cap $\frac{1}{4}$ S15 in W.
 S14 in E. and 1913 in S. half; and raise a mound of stone
 2 ft. base $1\frac{1}{2}$ ft. high, W. of cor. Pits impracticable.
 46.50 Through scattering brush.
 58.05 Cross wash, 14 lks. wide, course S. E.
 80.00 Set an iron post 3 ft. long, 2 ins. diam., 24 ins. in the
 ground for cor. of secs. 10, 11, 14 and 15. marked on
 brass cap.
 T14SR23E in N. and
 1913 in S. half;
 S10 in N. W.
 S11 in N. E.
 S14 in S. E. and
 S15 in S. W. quadrant; and raise a mound of stone 2
 ft. base $1\frac{1}{2}$ ft. high, W. of cor. Pits impracticable.
 Land, level.
 Soil, sandy loam, mixed with gravel, dry, coarse texture;
 1st. rate.
 No timber.
 Undergrowth, mesquite and cactus.

S. 89° 43' E., on a random line, bet. secs. 11 and 14.
 40.00 Set temp. $\frac{1}{4}$ sec. cor.
 80.02 Intersect N. and S. line, 3 lks. N. of the cor. of secs,
 11, 12, 13 and 14, ~~hereinbefore~~ described,
 Thence I run,
 N. 89° 42' W., on a true line, bet. secs. 11 and 14.
 Over nearly level land through scattering brush.
 40.01 Set an iron post 3 ft. long, 1 in. diam., 26 ins. in the
 ground for $\frac{1}{4}$ sec. cor., marked on brass cap $\frac{1}{4}$ S11 in N.
 and S14 1913 in S. half; and raise a mound of stone 2
 ft. base $1\frac{1}{2}$ ft. high, N. of cor. Pits impracticable.
 51.50 Cross road, bears N. W. and S. E.
 80.02 The cor. of secs. 10, 11, 14 and 15, ~~hereinbefore~~ described.
 Land, level.
 Soil, sandy loam, dry, coarse texture; 2nd. rate.
 No timber.
 Undergrowth, mesquite and cactus.

Subdivision of Tp. 14 S. Rg. 23 E.

Chains.	N. 0° 01' W., bet. secs. 10 and 11. Over rolling land, through scattering brush.
40.00	Set an iron post 3 ft. long, 1 in. diam., 26 ins. in the ground for $\frac{1}{4}$ sec. cor., marked on brass cap $\frac{1}{4}$ S10 in W. S11 in E. and 1913 in S. half; and raise a mound of stone 2 ft. base $1\frac{1}{2}$ ft. high, W. of cor. Pits impracticable.
43.40	Cross road, bears N. W. and S. E.
80.00	Set an iron post 3 ft. long, 2 ins. diam., 24 ins. in the ground for cor. of secs. 2, 3, 10 and 11, marked on brass cap T14SR23E in N. and 1913 in S. half; S3 in N. W. S2 in N. E. S11 in S. E. and S10 in S. W. quadrant; and raise a mound of stone 2 ft. base $1\frac{1}{2}$ ft. high, W. of cor. Pits impracticable. Land, rolling, Soil, sandy loam, mixed with rocks and gravel; dry; coarse texture; 2nd. rate. No timber. Undergrowth, mesquite and cactus.
NOTE:	At this cor. I set off $11^{\circ} 48\frac{1}{2}'$ N. on the decl. arc; and observe the sun on the meridian at noon; the resulting lat. is $32^{\circ} 13\frac{1}{2}'$ N.
40.00	S. $89^{\circ} 42'$ E., on a random line, bet. secs. 2 and 11 Set temp. $\frac{1}{4}$ sec. cor.
79.98	Intersect N. and S. line, 3 lks. S. of the cor. of secs. 1, 2, 11 and 12, hereinbefore described, Thence I run, N. $89^{\circ} 43'$ W., bet. secs. 2 and 11. Over rolling land, through scattering brush.
4.30	Cross road, bears N. W. and S. E. and through dense brush.
11.00	Cross wash, 15 lks. wide, course S. E.
39.99	Set an iron post 3 ft. long, 1 in. diam., 26 ins. in the ground for $\frac{1}{4}$ sec. cor., marked on brass cap $\frac{1}{4}$ S2 in N. and S11 1913 in S. half; and raise a mound of stone 2 ft. base $1\frac{1}{2}$ ft. high, N. of cor. Pits impracticable.
62.50	Brush becomes scattering.
79.98	The cor. of secs. 2, 3, 10 and 11, hereinbefore described. Land, rolling, Soil, sandy loam mixed with rocks and gravel, dry, coarse texture; 2nd. rate. No timber. Undergrowth, mesquite.
40.00	N. 0° 01' W., on a random line, bet. secs. 2 and 3. Set temp. $\frac{1}{4}$ sec. cor.
77.47	Intersect N. bdy. of Tp., 18 lks. N $89^{\circ} 23'$ E. of the ^{old} cor. of secs. 2, 3, 34 and 35, hereinbefore described in my notes of Retracement & Resurvey of N. bdy. of T14 S. R. 23 E. Thence I run, S. 0° 09' E., on a true line, bet. secs. 2 and 3. Through dense brush, over rolling land.
2.62	Cross road, bears N. W. and S. E.
22.30	Cross road, bears N. E. and S. W.
37.47	Set an iron post 3 ft. long, 1 in. diam., 26 ins. in the ground for $\frac{1}{4}$ sec. cor., marked on brass cap $\frac{1}{4}$ S3 in W. S2 in E. and 1913 in S. half; dig pits 18 x 18 x 12 ins. N. and S. of post 3 ft. dist., and raise a mound of earth $3\frac{1}{2}$ ft. base $1\frac{1}{2}$ ft. high, W. of cor.
37.80	Brush becomes scattering.
77.47	The cor. of secs. 2, 3, 10 and 11, hereinbefore described. Land, rolling. Soil, sandy loam, dry, medium texture; 1st. rate. No timber. Undergrowth, mesquite and catclaw.

BOOK 2675

Subdivision of Tp. 14 S. Rg. 23 E.

Chains.

August 23¹⁹¹³ At 7h. 00m. a.m., l.m.t., I set off 32° 09½' N. on the lat. arc; 11° 33½' N. on the decl. arc; and determine a meridian with the solar at the cor. of secs. 3, 4, 33 and 34, on the S. bdy. of the Tp., recently estab. by me as described in Book "X", Thence I run

N. 0° 02' W., bet. secs. 33 and 34.
Over rolling land, through dense brush.
40.00 Set an iron post 3 ft. long, 1 in. diam., 26 ins. in the ground for ¼ sec. cor., marked on brass cap ¼ S33 in W. S34 in E. and 1913 in S. half; and raise a mound of earth 3½ ft. base 1½ ft. high, W. of cor. Pits impracticable.
80.00 Set an iron post 3 ft. long, 2 ins. diam., 24 ins. in the ground for cor. of secs. 27, 28, 33 and 34, marked on brass cap

T14SR23E in N. and 1913 in S. half;
S28 in N. W.
S27 in N. E.
S34 in S. E. and S33 in S. W. quadrant; dig pits 18 x 18 x 12 ins. in each sec. 5½ ft. dist., and raise a mound of earth 4 ft. base 2 ft. high, W. of cor.
Land, rolling.
Soil, sandy loam, mixed with rocks and gravel, dry, coarse texture; 2nd. rate.
No timber.
Undergrowth, mesquite and greasewood.

S. 89° 41' E., on a random line, bet. secs. 27 and 34.
40.00 Set temp. ¼ sec. cor.
79.96 Intersect N. and S. line, 2 lks. S. of the cor. of secs. 26, 27, 34 and 35, ~~hereinbefore~~ described,
Thence I run,

N. 89° 42' W., on a true line, bet. secs. 27 and 34.
Over nearly level land, through scattering brush.
39.98 Set an iron post 3 ft. long, 1 in. diam., 26 ins. in the ground for ¼ sec. cor., marked on brass cap ¼ S27 in N. and S34 1913 in S. half; dig pits 18 x 18 x 12 ins. E. and W. of post 3 ft. dist., and raise a mound of earth 3½ ft. base 1½ ft. high, N. of cor.

62.00 Brush becomes dense.
79.96 The cor. of secs. 27, 28, 33 and 34, ~~hereinbefore~~ described.
Land, level.
Soil, sandy loam, mixed with gravel and rocks, coarse texture, dry; 2nd. rate.
Undergrowth, mesquite and greasewood.

N. 0° 02' W., bet. secs. 27 and 28.
Over nearly level land, through dense brush.
40.00 Set an iron post 3 ft. long, 1 in. diam., 26 ins. in the ground for ¼ sec. cor., marked on brass cap ¼ S28 in W. S27 in E. and 1913 in S. half; and raise a mound of stone 2 ft. base 1½ ft. high, W. of cor. Pits impracticable.
52.50 Brush becomes scattering.
80.00 Set an iron post 3 ft. long, 2 ins. diam., 24 ins. in the ground for cor. of secs. 21, 22, 27 and 28, marked on brass cap
T14SR23E in N. and 1913 in S. half;
S21 in N. W.
S22 in N. E.
S27 in S. E. and S28 in S. W. quadrant; and raise a mound of stone 2 ft. base 1½ ft. high, W. of cor. Pits impracticable.
Land, level.
Soil, 1st. 52.50 chs. sandy, mixed with gravel and rocks,

Subdivision of Tp. 14 S. Rg. 23 E.

Chains	2nd. rate. N. 17.50 chs. sandy loam, dry, medium texture 1st. rate. No timber. Undergrowth, mesquite, and greasewood.
	S. 89° 42' E., on a random line, bet. secs. 22 and 27.
40.00	Set temp. $\frac{1}{4}$ sec. cor.
79.98	Intersect N. and S. line, 2 lks. N. of the cor. of secs. 22, 23, 26 and 27, hereinafter described, Thence I run, N 89° 41' W., on a true line, bet. secs. 22 and 27. Over nearly level land.
39.99	Set an iron post 3 ft. long, 1 in. diam., 26 ins. in the ground for $\frac{1}{4}$ sec. cor., marked on brass cap $\frac{1}{4}$ S22 in N. and S27 1913 ins. S. half; dig pits 18 x 18 x 12 ins. E. and W. of post 3 ft. dist., and raise a mound of earth $3\frac{1}{2}$ ft. base $1\frac{1}{2}$ ft. high, N. of cor.
48.00	Cross wash, 10 lks. wide, course S. E.
79.98	The cor. of secs. 21, 22, 27 and 28. hereinafter described Land, level. Soil, sandy loam mixed with gravel, coarse texture, dry; 1st. rate. No timber.
NOTE:	At this cor. I set off 11° 28' At this cor. I set off 11° 28 $\frac{1}{2}$ ' N. on the decl. arc; and observe the sun on the meridian at noon; the resulting lat. is 32° 11' N.
	N. 0° 02' W., bet. secs. 21 and 22. Over rolling land,
25.35	Cross wash, 15 lks. wide, course S. E.
40.00	Set an iron post 3 ft. long, 1 in. diam., 26 ins. in the ground for $\frac{1}{4}$ sec. cor., marked on brass cap $\frac{1}{4}$ S21 in W. S22 in E. and 1913 in S. half; dig pits 18 x 18 x 12 ins. N. and S. of post 3 ft. dist., and raise a mound of earth $3\frac{1}{2}$ ft. base $1\frac{1}{2}$ ft. high, W. of cor.
80.00	Set an iron post 3 ft. long, 2 ins. diam., 24 ins. in the ground for cor. of secs. 15, 16, 21 and 22, marked on brass cap T14SR23E in N. and 1913 in S. half; S16 in N. W. S15 in N. E. S22 in S. E. and S21 in S. W. quadrant; dig pits 18 x 18 x 12 ins. in each sec. $5\frac{1}{2}$ ft. dist., and raise a mound of earth 4 ft. base 2 ft. high, W. of cor. Land, level and rolling. Soil, sandy loam, mixed with gravel, coarse texture, dry; 1st. rate. No timber.
	S. 89° 41' E., on a random line, bet. secs. 15 and 22
40.00	Set temp. $\frac{1}{4}$ sec. cor.
79.92	Intersect N. and S. line, 5 lks. S. of the cor. of secs. 14, 15, 22 and 23, hereinafter described, Thence I run, N. 89° 43' W., on a true line, bet. secs. 15 and 22 Over level land.
28.20	Cross road, bears N. W. and S. E.
39.96	Set an iron post 3 ft. long, 1 in. diam., 26 ins. in the ground for $\frac{1}{4}$ sec. cor., marked on brass cap $\frac{1}{4}$ S15 in N. and S22 1913 in S. half; dig pits 18 x 18 x 12 ins. E. and W. of post 3 ft. dist., and raise a mound of earth $3\frac{1}{2}$ ft. base $1\frac{1}{2}$ ft. high, N. of cor.

BOOK 2675

Subdivision of Tp. 14 S. Rg. 23 E.

Chains.	
79.92	The cor. of secs. 15, 16, 21 and 22, hereinbefore described. Land, level. Soil, sandy loam, mixed with gravel, coarse texture, dry; 1st. rate. No timber.
	—————
	N. 0° 02' W., bet. secs. 15 and 16. Over level land.
7.60	Cross road, bears N. E. and S. W.
14.40	Cross wash, 25 lks. wide, course S. E. and ascend.
28.30	Ridge, bears E. and W., highest point of hill about 4.00 chs. west. Descend.
40.00	Set an iron post 3 ft. long, 1 in. diam., 26 ins. in the ground for $\frac{1}{4}$ sec. cor., marked on brass cap $\frac{1}{4}$ S16 in W. S15 in E. and 1913 in S. half; and raise a mound of stone 2 ft. base $1\frac{1}{2}$ ft. high, W. of cor. Pits impracticable. Thence over rolling land.
54.60	Cross wash, 25 lks. wide, course S. E..
80.00	Set an iron post 3 ft. long, 2 ins. diam., 24 ins. in the ground for cor. of secs. 9, 10, 15 and 16, marked on brass cap T14SR23E in N. and 1913 in S. half; S9 in N. W. S10 in N. E. S15 in S. E. and S16 in S. W. quadraht; and raise a mound of stone 2 ft. base $1\frac{1}{2}$ ft. high, W. of cor. Pits impracticable. Land, level, rolling and hilly. Soil, sandy loam mixed with gravel, coarse texture, dry; 1st. rate. except from 14.40 chs. to 40.00 chs. which is rocky; 4th. rate. No timber.
	—————
	S. 89° 43' E., on a random line, bet. secs. 10 and 15.
40.00	Set temp. $\frac{1}{4}$ sec. cor.
79.94	Intersect N. and S. line, 5 lks. N. of the cor. of secs. 10, 11, 14, and 15, hereinbefore described, Thence I run, N. 89° 41' W., bet. secs. 10 and 15.
	Over rolling land, through scattering brush.
39.97	Set an iron post 3 ft. long, 1 in. diam., 26 ins. in the ground for $\frac{1}{4}$ sec. cor., marked on brass cap $\frac{1}{4}$ S10 in N. and S15 1913 in S. half; and raise a mound of stone 2 ft. base $1\frac{1}{2}$ ft. high, N. of cor. Pits impracticable.
79.94	The cor. of secs. 9, 10, 15 and 16, hereinbefore described. Land, rolling. Soil, sandy loam, mixed with rocks and gravel, caarse texture, dry; 1st. rate. No timber. Undergrowth, mesquite and cactus.
	August 23, 1913.
	—————
	August 30, 1913;
	N. 0° 02' W., bet. secs. 9 and 10. Over rolling land.
40.00	Set an iron post 3 ft. long, 1 in. diam., 26 ins. in the ground for $\frac{1}{4}$ sec. cor., marked on brass cap $\frac{1}{4}$ S9 in W. S10 in E. and 1913 in S. half; dig pits 18 x 18 x 12 ins. N. and S. of post 3 ft. dist., and raise a mound of earth $3\frac{1}{2}$ ft. base $1\frac{1}{2}$ ft. high, W. of cor.
59.00	Enter scattering brush.

Subdivision of Tp. 14 S. Rg. 23 E.

- Chains.
80.00 Set an iron post 3 ft. long, 2 ins. diam., 24 ins. in the ground for cor. of secs. 3, 4, 9 and 10, marked on brass cap
T14SR23E in N. and
1913 in S. half;
S4 in N. W.
S3 in N. E.
S10 in S. E. and
S9 in S. W. quadrant; dig pits 18 x 18 x 12 ins. in each sec. $5\frac{1}{2}$ ft. dist., and raise a mound of earth 4 ft. base 2 ft. high, W. of cor.
Land, rolling.
Soil, sandy loam, mixed with rocks and gravel; medium texture, dry; 2nd. rate.
No timber.
Undergrowth, mesquite.
-
- 40.00 S. $89^{\circ} 41'$ E., on a random line, bet. secs. 3 and 10
Set temp. $\frac{1}{4}$ sec. cor.
79.90 Intersect N. and S. line, 9 lks. S. of the cor. of secs. 2, 3, 10 and 11, hereinbefore described,
Thence I run,
N. $89^{\circ} 45'$ W., bet. secs. 3 and 10 on a true line.
Overrolling land, through scattering brush.
35.20 Cross road, bears N. W. and S. E.
39.95 Set an iron post 3 ft. long, 1 in. diam., 26 ins. in the ground for $\frac{1}{4}$ sec. cor., marked on brass cap $\frac{1}{4}$ S3 in N. and S10 1913 in S. half; and raise a mound of stone 2 ft. base $1\frac{1}{2}$ ft. high, N. of cor. Pits impracticable.
79.90 The cor. of secs. 3, 4, 9, and 10, hereinbefore described.
Land, rolling.
soil, sandy loam mixed with gravel and rocks, coarse, dry; 2nd. rate.
No timber.
Undergrowth, mesquite.
-
- 40.00 N. $0^{\circ} 02'$ W., on a random line, bet. secs. 3 and 4.
Set temp. $\frac{1}{4}$ sec. cor.
76.66 Intersect the N. bdy. of the Tp., 38 lks. ~~S. $89^{\circ} 55'$ E.~~ ^{OLD} of the cor. of secs. 3, 4, 33 and 34, hereinbefore described in my notes of Retracement & Resurvey of N. Edge of T. 14 S. R. 23 E., Thence I run,
S. $0^{\circ} 19'$ E., on a true line, bet. secs. 3 and 4.
Over rolling land, through dense brush.
3.26 Cross wash, 30 lks. wide, course S. E.
11.65 Cross road, bears N. W. and S. E.
16.45 Brush becomes scattering.
36.66 Set an iron post 3 ft. long, 1 in. diam., 26 ins. in the ground for $\frac{1}{4}$ sec. cor., marked on brass cap $\frac{1}{4}$ S4 in W. S3 in E. and 1913 in S. half; dig pits 18 x 18 x 12 ins. N. and S. of post 3 ft. dist. and raise a mound of earth $3\frac{1}{2}$ ft. base $1\frac{1}{2}$ ft. high, W. of cor.
53.00 Cross road, bears N. E. and S. W.
76.66 The cor. of secs. 3, 4, 9 and 10, hereinbefore described.
Land, rolling.
Soil, sandy loam, mixed with rocks and gravel, coarse texture, dry; 2nd. rate.
No timber.
Undergrowth, mesquite and catclaw.

August 30, 1913

August 29¹⁹¹³ At 7h. 00m. a.m., l.m.t., I set off $32^{\circ} 09\frac{1}{2}'$ N. on the lat. arc; $9^{\circ} 29'$ N. on the decl. arc; and

Subdivision of Tp. 14 S. Rg. 23 E.

Chains.	
	determine a meridian with the solar, at the cor. of secs. 4, 5, 32 and 33, on the S. bdy. of the Tp., recently estab. by me as described in Book "X", Thence I run,
	N. 0° 02' W., bet. secs. 32 and 33
	Ascending rough S. E. slope of mountain.
39.00	Descend . E. slope.
40.00	Set an iron post 3 ft. long, 1 in. diam., 26 ins. in the ground for $\frac{1}{4}$ sec. cor., marked on brass cap $\frac{1}{4}$ S32 in W. S33 in E. and 1913 in S. half; and raise a mound of stone 2 ft. base $1\frac{1}{2}$ ft. high, W. of cor. Pits impracticable.
55.00	Ascend.
57.90	Spur, extends N. E., descend.
79.25	Cross wash, 18 lks. wide, course N. E., over rolling land.
80.00	Set an iron post 3 ft. long, 2 ins. diam., 24 ins. in the ground for cor. of secs. 28, 29, 32 and 33, marked on brass cap T14SR23E in N. and 1913 in S. half; S29 in N. W. S28 in N. E. S33 in S. E. and S32 in S. W. quadrant; and raise a mound of stone 2 ft. base $1\frac{1}{2}$ ft. high, W. of cor. Pits impracticable. Land, mountainous. Soil, rocky, 4th. rate. No timber.
40.00	S. 89° 41' E., on a random line, bet. secs. 28 and 33 Set temp. $\frac{1}{4}$ sec. cor.
80.08	Intersect N. and S. line, 5 lks. S. of the cor. of secs. 27, 28, 33 and 34, hereinbefore described, Thence I run, N. 89° 43' W., on a true line, bet. secs. 28 and 33. Over rolling land.
40.04	Set an iron post 3 ft. long; 1 in. diam., 26 ins. in the ground for $\frac{1}{4}$ sec. cor., marked on brass cap $\frac{1}{4}$ S28 in N. and S33 1913 in S. half; and raise a mound of stone 2 ft. base $1\frac{1}{2}$ ft. high, N. of cor. Pits impracticable.
70.00	Ascend.
75.20	Ridge bears N. E. and S. W., descend.
80.08	the cor. of secs. 28, 29, 32 and 33, hereinbefore described. Land, rolling and hilly. Soil, rocky and gravelly; 4th. rate. No timber.
	NOTE: At this cor. I set off 9° 23 $\frac{1}{2}$ ' N. on the decl. arc, and observe the sun on the meridian at noon; the resulting lat. is 32° 10 $\frac{1}{2}$ ' N.
	N. 0° 02' W., bet. secs. 28 and 29. Over rolling land, through scattering brush.
5.00	Brush becomes heavy.
40.00	Set an iron post 3 ft. long, 1 in. diam., 26 ins. in the ground for $\frac{1}{4}$ sec. cor., marked on brass cap $\frac{1}{4}$ S29 in W. S28 in E. and 1913. in S. half; and raise a mound of stone 2 ft. base $1\frac{1}{2}$ ft. high, W. of cor. Pits impracticable.
51.10	Cross wash, 15 lks. wide, course N. E.
78.20	Cross wash, 8 lks. wide, course N. E.
80.00	Set an iron post 3 ft. long, 2 ins. diam., 24 ins. in the ground for cor. of secs. 20, 21, 28 and 29, marked on brass cap T14SR23E in N. and 1913 in S. half; S20 in N. W. S21 in N. E. S28 in S. E. and S29 in S. W. quadrant; and raise a mound of stone 2 ft base $1\frac{1}{2}$ ft. high, W. of cor. Pits impracticable.

Subdivision of Tp. 14 S. Rg. 23 E.

- Chains. Land, rolling.
Soil, rocky and gravelly; 3rd. rate.
No timber.
Undergrowth, mesquite and cactus.
-
- 40.00 S. 89° 43' E., on a random line, bet. secs. 21 and 28.
Set temp. $\frac{1}{4}$ sec. cor.
80.04 Intersect N. and S. line, 3 lks. N. of the cor. of secs. 21, 22, 27 and 28, ~~hereinbefore~~ described,
Thence I run,
N. 89° 42' W., bet. secs. 21 and 28.
Over nearly level land, through dense brush.
40.02 Set an iron post 3 ft. long, 1 in. diam., 26 ins. in the ground for $\frac{1}{4}$ sec. cor., marked on brass cap $\frac{1}{4}$ S21 in N. and S28 1913 in S. half; and raise a mound of stone 2 ft. base $1\frac{1}{2}$ ft. high, N. of cor. Pits impracticable.
58.00 Cross wash, 15 lks. wide, course N. E.
80.04 The cor. of secs. 20, 21, 28 and 29, ~~hereinbefore~~ described
Land, nearly level.
Soil, sandy mixed with gravel and rocks; 3rd. rate.
No timber.
Undergrowth, mesquite and cactus.
-
- 40.00 N. 0° 02' W., bet. secs. 20 and 21.
Over rolling land, through dense brush.
Set an iron post 3 ft. long, 1 in. diam., 26 ins. in the ground for $\frac{1}{4}$ sec. cor., marked on brass cap $\frac{1}{4}$ S20 in W. and S21 in E. and 1913 in S. half; and raise a mound of stone 2 ft. base $1\frac{1}{2}$ ft. high, W. of cor. Pits impracticable.
49.58 Cross wash, 20 lks. wide, course E.
80.00 Set an iron post 3 ft. long, 2 ins. diam., 24 ins. in the ground for cor. of secs. 16, 17, 20 and 21, marked on brass cap
T14SR23E in N. and
1913 in S. half;
S17 in N. W.
S16 in N. E.
S21 in S. E. and
S20 in S. W. quadrant; dig pits 18 x 18 x 12 ins. in each sec. $5\frac{1}{2}$ ft. dist., and raise a mound of earth 4 ft. base 2 ft. high, W. of cor.
Land, rolling.
Soil, S. 50.00 chs. sandy, mixed with rocks and gravel; 2nd. rate; N. 30.00 chs. sandy loam mixed with gravel; coarse texture, dry, 1st. rate.
No timber.
Undergrowth, mesquite and cactus.

August 29, 1913.

- August 30¹⁹¹³; At 7h. 00m. a.m., l.m.t., I set off 32° 12' N. on the lat. arc; 9° 07 $\frac{1}{2}$ ' N. on the decl. arc; and determine a meridian with the solar at the cor. of secs. 16, 17, 20 and 21, ~~above~~ described.
Thence I run,
S. 89° 42' E., on a random line, bet. secs. 16 and 21.
40.00 Set temp. $\frac{1}{4}$ sec. cor.
80.00 Intersect N. and S. line, 2 lks. N. of the cor. of secs. 15, 16, 21 and 22, ~~hereinbefore~~ described,
Thence I run,
N. 89° 41' W., on a true line, bet. secs. 16 and 21.
Over level land, through scattering brush.
40.00 Set an iron post 3 ft. long, 1 in. diam., 26 ins. in the ground for $\frac{1}{4}$ sec. cor., marked on brass cap $\frac{1}{4}$ S16 in N.

BOOK 2675

Subdivision of Tp. 14 S. Rg. 23 E.

Chains.	
80.00	and S21 1913 in S. half; dig pits 18 x 18 x 12 ins. E. and W. of post, 3 ft. dist., and raise a mound of earth 3½ ft. base 1½ ft. high, N. of cor. The cor. of secs. 16, 17, 20 and 21, hereinbefore described. Land, level. Soil, sandy loam, mixed with gravel, dry, medium texture, 1st. rate. No timber. Undergrowth, mesquite and cactus.
13.50	N. 0° 02' W., bet. secs. 16 and 17. Over level land, through scattering brush. Cross draw, 2.00 chs. wide, course E.
18.30	Cross road, bears E. and W.
40.00	Set an iron post 3 ft. long, 1 in. diam., 26 ins. in the ground for ¼ sec. cor., marked on brass cap, ¼ S17 in W. S16 in E. and 1913 in S. half; and raise a mound of stone 2 ft. base 1½ ft. high, W. of cor. Pits impracticable.
80.00	Set an iron post 3 ft. long, 2 ins. diam, 24 ins. in the ground for cor. of secs. 8, 9, 16 and 17, marked on brass cap T14SR23E in N. and 1913 in S. half; S8 in N. W. S9 in N. E. S16 in S. E. and S17 in S. W. quadrant; dig pits 18 x 18 x 21 ins. in each sec. 5½ ft. dist., and raise a mound of earth 4 ft. base 2 ft. high, W. of cor. Land, level. Soil, sandy loam, dry, medium texture, mixed with gravel; 1st. rate. No timber. Undergrowth, mesquite and cactus.
40.00	S. 89° 41' E., on a random line, bet. secs. 9 and 16. Over rolling land, through scattering brush. Set temp. ¼ sec. cor.,
80.04	Intersect N. and S. line, 5 lks. S. of the cor. of secs. 9, 10, 15 and 16, hereinbefore described, Thence I run, N. 89° 43' W., on a true line, bet. secs. 9 and 16 Over rolling land, through scattering brush.
40.02	Set an iron post 3 ft. long, 1 in. diam., 26 ins. in the ground for ¼ sec. cor., marked on brass cap ¼ S9 in N. and S16 1913 in S. half; and raise a mound of stone 2 ft. base 1½ ft. high, N. of cor. Pits impracticable.
80.04	The cor. of secs. 8, 9, 16 and 17, hereinbefore described. Land, rolling. Soil, sandy loam, mixed with gravel, dry, medium texture; 1st. rate. No timber. Undergrowth, mesquite.
	August 30, 1913
25.00	September 1, 1913; N. 0° 02' W., bet. secs. 8 and 9. Over rolling land, through scattering brush. Cross draw, 150 lks. wide, course S. E.
40.00	Set an iron post 3 ft. long, 1 in. diam., 26 ins. in the ground for ¼ sec. cor., marked on brass cap ¼ S8 in W. S9 in E. and 1913 in S. half; dig pits 18 x 18 x 12 ins. N. and S. of post 3 ft. dist., and raise a mound of earth 3½ ft. base 1½ ft. high, W. of cor.
55.00	Brush becomes dense.

Subdivision of Tp. 14 S. Rg. 23 E.

Chains.	
60.90	Cross road, bears N. E. and S. W.
78.20	Low ridge bears E. and W. brush becomes scattering.
80.00	Set an iron post 3 ft. long, 2 ins. diam., 24 ins. in the ground for cor. of secs. 4, 5, 8 and 9, marked on brass cap T14SR23E in N. and 1913 in S. half; S5 in N. W. S4 in N. E. S9 in S. E. and S8 in S. W. quadrant; and raise a mound of stone 2 ft. base $1\frac{1}{2}$ ft. high, W. of cor. Pits impracticable. Land, rolling. Soil, sandy loam, mixed with gravel, dry, medium texture; 1st. rate; except N. 5.00 chs. which is rocky and 4th. rate. No timber. Undergrowth, mesquite and cactus.
40.00	S. $89^{\circ} 43'$ E., on a random line, bet. secs. 4 and 9 Set temp. $\frac{1}{4}$ sec. cor.,
80.02	Intersect N. and S. Line, 2 lks. S. of the cor. of secs. 3, 4, 9 and 10, hereinbefore described, Thence I run, N. $89^{\circ} 44'$ W., on a true line, bet. secs. 4 and 9. Over rolling land, through scattering brush.
40.01	Set an iron post 3 ft. long, 1 in. diam., 26 ins. in the ground for $\frac{1}{4}$ sec. cor., marked on brass cap $\frac{1}{4}$ S4 in N. and S9 1913 in S. half; dig pits 18 x 18 x 12 ins. E. and W. of post 3 ft. dist., and raise a mound of earth $3\frac{1}{2}$ ft. base $1\frac{1}{2}$ ft. high, N. of cor.
54.00	Cross road, bears N. E. and S. W.
66.80	Cross wash, 20 lks. wide, course S. E.
80.02	The cor. of secs. 4, 5, 8 and 9, hereinbefore described. Land, rolling. Soil, sandy loam, dry, medium texture; 1st. rate; except W. 13.00 chs. which is rocky; 4th. rate. No timber. Undergrowth, mesquite and cactus.
6.50	North, bet. secs. 4 and 5, on true line, Descending through scattering brush. Cross wash, 20 lks. wide, course S. E. ascend.
30.20	Ridge, bears N. W. and S. E. descend.
36.60	Cross draw, 200 lks. wide, course S. E. ascend.
40.00	Set an iron post 3 ft. long, 1 in. diam., 26 ins. in the ground for $\frac{1}{4}$ sec. cor., marked on brass cap $\frac{1}{4}$ S5 in W. S4 in E. and 1913 in S. half; and raise a mound of stone 2 ft. base $1\frac{1}{2}$ ft. high, W. of cor. Pits impracticable.
42.50	Ridge, bears N. W. and S. E., descend.
55.20	Brush becomes dense.
56.80	Intersect south side line of Ophir, Sur. No. 442 S. $67^{\circ} 30'$ E. 7.27 chs. from Cor. No. 6
66.60	Intersect north side line of Ophir, Sur. No. 442, S. $67^{\circ} 30'$ E. 2.77 chs. from Cor. No. 2
70.00	Leave brush.
70.50	Cross wash, 8 lks. wide, course S. E.
74.56	Intersect N. bdy. of Tp., N. $89^{\circ} 36'$ E., 92 lks. from the old cor. of secs. 4, 5, 32 and 33, hereinbefore described. I destroy the mound at this cor. and rebuild a mound of stone 2 ft. base $1\frac{1}{2}$ ft. high N. of cor. Pits impracticable. At point of intersection I set an iron post 3 ft. long, 2 ins. diam., 24 ins. in the ground for closing cor. of secs. 4 and 5, ^{T14SR23E} marked on brass cap CC S. of center;

Subdivision of Tp. 14 S. Rg. 23 E.

Chains.

T13SS32S33 in N,
 T14S 1913 in S, and
 R23E in W. half;
 S4 in S. E. and
 S5 in S. W. quadrant; and raise a mound of stone 2 ft.
 base $1\frac{1}{2}$ ft. high, S. of cor. Pits impracticable.
 Land, mountainous.
 Soil, rocky; 4th. rate.
 No timber.
 Undergrowth, mesquite, blackbrush and cactus.
 From this C C, U. S. M. M. No. 1 bears S. $69^{\circ} 34'$ W., 14.67
 chs. dist. September 1, 1913..

September 2¹⁹¹³ At 7h. 00m. a.m., l.m.t., I set off $32^{\circ} 09\frac{1}{2}'$
 N. on the lat. arc; $8^{\circ} 02\frac{1}{2}'$ N. on the decl. arc; and
 determine a meridian with the solar at the cor. of secs.
 5, 6, 31 and 32 on the S. bdy. of the Tp., recently estab. by me as described
 in Book "X", Thence I run

- N. $0^{\circ} 03'$ W., bet. secs. 31 and 32,
 Ascend steep rough S. slope.
- 5.00 Ridge, bears E. and W., descend along N. W. slope.
- 35.40 Cross wash, 8 lks. wide, course S. W. ascend.
- 40.00 Set an iron post 3 ft. long, 1 in. diam., 26 ins. in the
 ground for $\frac{1}{4}$ sec. cor., marked on brass cap $\frac{1}{4}$ S31 in W.
 S32 in E. and 1913 in S. half; and raise a mound of stone
 2 ft. base $1\frac{1}{2}$ ft. high, W. of cor. Pits impracticable.
- 60.40 Ridge, bears E. and W., descend.
- 80.00 Set an iron post 3 ft. long, 2 ins. diam., 24 ins. in the
 ground for cor. of secs. 29, 30, 31. and 32, marked on
 brass cap
 T14SR23E in N. and
 1913 in S. half;
 S30 in N. W.
 S29 in N. E.
 S32 in S. E. and
 S31 in S. W. quadrant; and raise a mound of stone 2
 ft. base $1\frac{1}{2}$ ft. high, W. of cor. Pits impracticable.
 Land, mountainous.
 Soil, rocky; 4th. rate.
 No timber.

- S. $89^{\circ} 41'$ E., on a random line, bet. secs. 29 and 32.
- 40.00 Set temp. $\frac{1}{4}$ sec. cor.
- 80.10 Intersect N. and S. line, 9 lks. S. of the cor. of secs.
 28, 29, 32 and 33, ~~hereinbefore~~ described,
 Thence I run,
 N. $89^{\circ} 45'$ W., on a true line, bet. secs, 29 and 32.
 Ascend steep E. slope.
- 35.40 Ridge, bears N. and S., descend.
- 40.05 Set an iron post 3 ft. long, 1 in. diam., 26 ins. in the
 ground for $\frac{1}{4}$ sec. cor., marked on brass cap $\frac{1}{4}$ S29 in N.
 and S32 1913 in S. half; and raise a mound of stone 2 ft.
 base $1\frac{1}{2}$ ft. high, N. of cor. Pits impracticable.
- 80.10 The cor. of secs. 29, 30, 31 and 32, ~~hereinbefore~~ described.
 Land, mountainous.
 Soil, rocky; 4th. rate.
 No timber.

NOTE: ~~September 1, 1913~~ At this cor. I set off $7^{\circ} 57'$ N. on the
 decl. arc; and observe the sun on the meridian at noon;
 the resulting lat. is $32^{\circ} 10\frac{1}{2}'$ N.

- N. $89^{\circ} 41'$ W., on a random line, bet. secs. 30 and 31.
- 40.00 Set temp. $\frac{1}{4}$ sec. cor.

Subdivision of Tp. 14 S. Rg. 23 E.

Chains.

- 76.19 Intersect W. bdy. of Tp., 2 lks. S. of the cor. of secs. 25, 30, 31 and 36, recently reestab. by me as hereinbefore described.
Thence I run,
S. 89° 40' E., on a true line, bet. secs. 30 and 31.
Over rolling land.
- 34.80 Cross wash, 30 lks. wide, course S. W., ascend.
- 36.19 Set an iron post 3 ft. long, 1 in. diam., 26 ins. in the ground for $\frac{1}{4}$ sec. cor., marked on brass cap $\frac{1}{4}$ S30 in N. and S31 1913 in S. half; and raise a mound of stone 2 ft. base $1\frac{1}{2}$ ft. high, N. of cor. Pits impracticable.
- 50.00 Ridge, bears N. W. and S. E., descend.
- 64.80 Cross wash, 12 lks. wide, course N. W. ascend.
- 76.19 The cor. of secs. 29, 30, 31 and 32, hereinbefore described.
Land, rolling and mountainous.
Soil, rocky 4th. rate.
No timber.
-
- N. 0° 03' W., bet. secs. 29 and 30
Ascending along S. W. slope.
- 40.00 Set an iron post 3 ft. long, 1 in. diam., 26 ins. in the ground for $\frac{1}{4}$ sec. cor., marked on brass cap $\frac{1}{4}$ S30 in W. S29 in E. and 1913 in S. half; and raise a mound of stone 2 ft. base $1\frac{1}{2}$ ft. high, W. of cor. Pits impracticable.
- 47.50 Ridge, bears N. W. and S. E., descend along N. E. slope.
- 80.00 Set an iron post 3 ft. long, 2 ins. diam., 24 ins. in the ground for cor. of secs. 19, 20, 29 and 30, marked on brass cap
T14SR23E in N. and
1913 in S. half;
S19 in N. W.
S20 in N. E.
S29 in S. E. and
S30 in S. W. quadrant; and raise a mound of stone 2 ft. base $1\frac{1}{2}$ ft. high, W. of cor. Pits impracticable.
Land, mountainous.
Soil, rocky; 4th. rate.
No timber.
- September 2, 1913.
-
- September 3¹⁹¹³ At 7h. 00m. a.m., l.m.t., I set off 32° 11' N. on the lat. arc; 7° 40 $\frac{1}{2}$ ' N. on the decl. arc; and determine a meridian with the solar at the cor. of secs. 19, 20, 29 and 30, above described.
Thence I run,
S. 89° 45' E., on a random line; bet. secs. 20 and 29
- 40.00 Set temp. $\frac{1}{4}$ sec. cor.
- 80.06 Intersect N. and S. line, 12 lks. N. of the cor. of secs. 20, 21, 28 and 29, hereinbefore described.
Thence I run,
N. 89° 40' W., on a true line, bet. secs. 20 and 29
Over rolling land, through dense brush.
- 22.90 Cross wash, 15 lks. wide, course N. E.
- 40.03 Set an iron post 3 ft. long, 1 in. diam., 26 ins. in the ground for $\frac{1}{4}$ sec. cor., marked on brass cap $\frac{1}{4}$ S20 in N. and S29 1913 in S. half; and raise a mound of stone 2 ft. base $1\frac{1}{2}$ ft. high, N. of cor. Pits impracticable.
- 70.00 Ascend E. slope of mountain.
- 80.03 The cor. of secs. 19, 20, 29 and 30, hereinbefore described.
Land, rolling and mountainous.
Soil, rocky; 4th. rate.
No timber.
Undergrowth mesquite.

BOOK 2675

Subdivision of Tp. 14 S. Rg. 23 E.

Chains.	N. 89° 40' W., on a random line, bet. secs. 19 and 30.
40.00	Set temp. $\frac{1}{4}$ sec. cor.
76.10	Intersect W. bdy. of Tp., 7 lks. N. of the cor. of secs. 19, 24, 25 and 30, recently reestab. by me as hereinbefore described, Thence I run, S. 89° 43' E., on a true line, bet. secs. 19 and 30. Ascend.
1.60	Ridge, bears N. and S., descend.
10.70	Cross wash, 50 lks. wide, course N. W., ascend.
36.10	Set an iron post 3 ft. long, 1 in. diam., 26 ins. in the ground for $\frac{1}{4}$ sec. cor., marked on brass cap $\frac{1}{4}$ S19 in N. and S30 1913 in S. half; and raise a mound of stone 2 ft. base $1\frac{1}{2}$ ft. high, N. of cor. Pits impracticable.
39.20	Ridge, bears N. E. and S. W., descend.
44.50	Cross wash, 15 lks. wide, course N., ascend.
61.10	Ridge, bears N. W. and S. E., descend.
67.30	Ascend
71.00	Descend E. slope.
76.10	The cor. of secs. 19, 20, 29 and 30, hereinbefore described. Land, mountainous. Soil, rocky; 4th. rate. No timber.
	<hr/>
	N. 0° 03' W., bet. secs. 19 and 20. Descend along N. E. slope.
23.00	Over rolling land.
40.00	Set an iron post 3 ft. long, 1 in. diam., 26 ins. in the ground for $\frac{1}{4}$ sec. cor., marked on brass cap $\frac{1}{4}$ S19 in W. and S20 in E. and 1913 in S. half; and raise a mound of stone 2 ft. base $1\frac{1}{2}$ ft. high, W. of cor. Pits impracticable.
80.00	Set an iron post 3 ft. long, 2 ins. diam., 24 ins. in the ground for cor. of secs. 17, 18, 19 and 20, marked on brass cap T14SR23E in N. and 1913 in S. half; S18 in N. W. S17 in N. E. S20 in S. E. and S19 in S. W. quadrant; dig pits 18 x 18 x 12 ins. in each sec. $5\frac{1}{2}$ ft. dist., and raise a mound of earth 4 ft. base 2 ft. high, W. of cor. Land, rolling and mountainous. Soil, rocky; 4th. rate. No timber.
NOTE:	See page 34. At this cor. I set off 7° 35' N. on the decl. arc; and observe the sun on the meridian at noon; the resulting lat. is 32° 12' N.
	<hr/>
	S. 89° 40' E., on a random line, bet. secs. 17 and 20.
40.00	Set temp. $\frac{1}{4}$ sec. cor.
79.96	Intersect N. and S. line, 7 lks. S. of the cor. of secs. 16, 17, 20 and 21, hereinbefore described, Thence I run, N. 89° 43' W., on a true line, bet. secs. 17 and 20. Over rolling land, through scattering brush.
39.98	Set an iron post 3 ft. long, 1 in. diam., 26 ins. in the ground for $\frac{1}{4}$ sec. cor., marked on brass cap $\frac{1}{4}$ S17 in N. and S20 1913 in S. half; dig pits 18 x 18 x 12 ins. E. and W. of post 3 ft. dist., and raise a mound of earth $3\frac{1}{2}$ ft. base $1\frac{1}{2}$ ft. high, N. of cor.
45.10	Top of low ridge, bears N. and S.
79.96	The cor. of secs. 17, 18, 19 and 20, hereinbefore described. Land, rolling. Soil, E. half mile sandy loam, dry, medium texture; 1st. rate. W. half mile rocky, 4th. rate. No timber.

Subdivision of Tp. 14 S. Rg. 23 E.

Chains.	
	N. 89° 43' W., on a random line, bet. secs. 18 and 19.
40.00	Set temp. $\frac{1}{4}$ sec. cor.
76.04	Intersect W. bdy. of Tp., 8 lks. S. of the cor. of secs. 13, 18, 19 and 24, recently reestab. by me as hereinbefore described, Thence I run, S. 89° 39' E., on a true line, bet. secs. 18 and 19. Over rolling land.
12.20	Top of low ridge, bears N. W. and S. E.
19.00	Through dense brush.
36.04	Set an iron post 3 ft. long, 1 in. diam., 26 ins. in the ground for $\frac{1}{4}$ sec. cor., marked on brass cap $\frac{1}{4}$ S18 in N. and S19 1913 in S. half; and raise a mound of stone 2 ft. base $1\frac{1}{2}$ ft. high, N. of cor. Pits impracticable.
76.04	The cor. of secs. 17, 18, 19 and 20, hereinbefore described. Land, rolling. Soil, sandy loam, dry, medium texture, 1st. rate; except from 7.00 chs. to 19.00 chs. which is rocky; 4th. rate. No timber. Undergrowth, mesquite.
	<hr/>
	N. 0° 03' W., bet. secs. 17 and 18. Over rolling land, through dense brush.
23.50	Cross draw, 150 lks. wide, course E.
34.88	Cross road, bears N. W. and S. E.
40.00	Set an iron post 3 ft. long, 1 in. diam., 26 ins. in the ground for $\frac{1}{4}$ sec. cor., marked on brass cap $\frac{1}{4}$ S18 in W. and S17 in E. and 1913 in S. half; and raise a mound of stone 2 ft. base $1\frac{1}{2}$ ft. high, W. of cor. Pits impracticable.
80.00	Set an iron post 3 ft. long, 2 ins. diam., 24 ins. in the ground for cor. of secs. 7, 8, 17 and 18, marked on brass cap T14SR23E in N. and 1913 in S. half; S7 in N. W. S8 in N. E. S17 in S. E. and S18 in S. W. quadrant; and raise a mound of stone 2 ft. base $1\frac{1}{2}$ ft. high, W. of cor. Pits impracticable. Land, rolling. Soil, sandy loam mixed with rocks and gravel; 2nd. rate. No timber. Undergrowth, mesquite and cactus.
	September 3, 1913.
	<hr/>
	September 4 ¹⁹¹³ At 7h. 00m. a.m., l.m.t., I set off 32° 13' N. on the lat. arc; 7° 18 $\frac{1}{2}$ ' N. on the decl. arc; and determine a meridian with the solar at the cor. of secs. 7, 8, 17, and 18, above described, Thence I run, S. 89° 43' E., on a random line, bet. secs. 8 and 17.
40.00	Set temp. $\frac{1}{4}$ sec. cor.
80.02	Intersect N. and S. line, 5 lks. N. of the cor. of secs. 8, 9, 16 and 17, hereinbefore described, Thence I run, N. 89° 41' W., on a true line, bet. secs. 8 and 17 Over rolling land, through scattering brush.
34.20	Cross wash, 10 lks. wide, course S. E.
40.01	Set an iron post 3 ft. long, 1 in. diam., 26 ins. in the ground for $\frac{1}{4}$ sec. cor., marked on brass cap $\frac{1}{4}$ S8 in N. and S17 1913 in S. half; and raise a mound of stone 2 ft. base $1\frac{1}{2}$ ft. high, N. of cor. Pits impracticable.
80.02	The cor. of secs. 7, 8, 17 and 18, hereinbefore described. Land, rolling. Soil, sandy loam, mixed with gravel; 2nd. rate. No timber.

BOOK 2675

Subdivision of Tp. 14 S. Rg. 23 E.

Chains.	
	N. 89° 39' W., on a random line, bet. secs. 7 and 18.
40.00	Set temp. $\frac{1}{4}$ sec. cor.
75.98	Intersect W. bdy. of Tp., 5 lks. N. of the cor. of secs. 7, 12, 13 and 18, recently reestab. by me as hereinbefore described
	Thence I run,
	S. 89° 41' E., on a true line, bet. secs. 7 and 18.
	Over rolling land, through dense brush.
21.90	Cross wash, 14 lks. wide, course S. E.
31.55	Cross road, bears N. E. and S. W.
35.98	Set an iron post 3 ft. long, 1 in. diam., 26 ins. in the ground for $\frac{1}{4}$ sec. cor., marked on brass cap $\frac{1}{4}$ S7 in N. and S18 1913 in S. half; and raise a mound of stone 2 ft. base $1\frac{1}{2}$ ft. high, N. of cor. Pits impracticable.
71.75	Cross wash, 15 lks. wide, course S. W.
75.98	The cor. of secs. 7, 8, 17 and 18, hereinbefore described.
	Land, rolling,
	Soil, sandy loam, mixed with rocks and gravel; 2nd. rate.
	No timber.
	Undergrowth, mesquite and cactus.
NOTE	September 4 At this cor. I set off 7° 12 $\frac{1}{2}$ ' N. on the decl. arc; and observe the sun on the meridian at noon; the resulting lat. is 32° 13' N.
	N. 0° 03' W., bet. secs. 7 and 8.
	Over rolling land, through dense brush.
7.00	Cross wash, 20 lks. wide, course S. W.
9.00	Cross road, bears E. and W.
11.60	Cross wash, noted above, 30 lks. wide, course S. E.
40.00	Set an iron post 3 ft. long, 1 in. diam., 26 ins. in the ground for $\frac{1}{4}$ sec. cor., marked on brass cap $\frac{1}{4}$ S7 in W. and S8 in E. and 1913 in S. half; and raise a mound of stone 2 ft. base $1\frac{1}{2}$ ft. high, W. of cor. Pits impracticable.
	Ascend along S. W. slope.
80.00	Set an iron post 3 ft. long, 2 ins. diam., 24 ins. in the ground for cor. of secs. 5, 6, 7 and 8, marked on brass cap
	T14SR23E in N. and
	1913 in S. half
	S6 in N. W.
	S5 in N. E.
	S8 in S. E. and
	S7 in S. W. quadrant; and raise amount of stone 2 ft. base $1\frac{1}{2}$ ft. high, W. of cor. Pits impracticable.
	Land, rolling and mountainous.
	Soil, rocky; 3rd. rate.
	No timber.
	Undergrowth, mesquite and cactus.
	S. 89° 41' E., on a random line, bet. secs. 5 and 8.
40.00	Set temp. $\frac{1}{4}$ sec. cor.
80.06	Intersect N. and S. line, 5 lks. S. of the cor. of secs. 4, 5, 8 and 9, hereinbefore described,
	Thence I run,
	N. 89° 43' W., on a true line, bet. secs. 5 and 8.
	Over rolling land, through scattering brush.
33.25	Cross wash, 14 lks. wide, course S, E., ascend.
40.03	Set an iron post 3 ft. long, 1 in. diam., 26 ins. in the ground for $\frac{1}{4}$ sec. cor., marked on brass cap $\frac{1}{4}$ S5 in N. and S8 1913 in S. half; and raise a mound of stone 2 ft. base $1\frac{1}{2}$ ft. high, N. of cor. Pits impracticable.
57.70	Ridge, bears S. E. and N. W., descend.
68.70	Cross wash, 20 lks. wide, course S. E., ascend.
77.00	Ridge, bears N. W. and S. E., descend.
80.06	The cor. of secs. 5, 6, 7, and 8, hereinbefore described.
	Land, rolling and mountainous.
	Soil, rocky; 4th. rate.
	No timber.

Subdivision of Tp. 14 S. Rg. 23 E.

Chains.

September 4, 1913.

September 5¹⁹¹³ At 7h. 00m. a.m., l.m.t., I set off $32^{\circ} 13\frac{1}{2}'$ N. on the lat. arc; $6^{\circ} 56\frac{1}{2}'$ N. on the decl. arc; and determine a meridian with the solar at the cor. of secs. 5, 6, 7, and 8, ~~hereinbefore described~~,

Thence I run,

N. $89^{\circ} 41'$ W., on a random line, bet. secs. 6 and 7.

40.00

Set temp. $\frac{1}{4}$ sec. cor..

75.90

Intersect W. bdy. of Tp. 7 lks. N. of the cor. of secs. 1, 6, 7 and 12, ~~recently reestab. by me as hereinbefore described~~

Thence I run

S. $89^{\circ} 44'$ E., on a true line, bet. secs. 6 and 7.

Over rolling land, through scattering brush.

3.10

Cross wash, 7 lks. wide, course S. W.

15.05

Cross wash, 10 lks. wide, course S. E.

35.90

Set an iron post 3 ft. long, 1 in. diam., 26 ins. in the ground for $\frac{1}{4}$ sec. cor., marked on brass cap $\frac{1}{4}$ S6 in N. and S7 1913 in S. half; and raise a mound of stone 2 ft. base $1\frac{1}{2}$ ft. high, N. of cor. Pits impracticable.

43.70

Cross wash, 20 lks. wide, course S. and ascend steep slope.

54.40

Ridge, bears N. W. and S. E., descend.

64.90

Cross wash, 10 lks. wide, course S. E., ascend.

70.20

Ridge, bears N. W. and S. E., descend.

75.90

The cor. of secs. 5, 6, 7 and 8, ~~hereinbefore described~~.

Land, rolling and mountainous..

Soil, rocky; 4th. rate.

No timber.

Undergrowth, mesquite and cactus.

North, bet. secs. 5 and 6, on true line.

Ascend.

4.00

Ridge, bears N. W. and S. E., descend.

9.50

Cross wash, 6 lks. wide, course E. and ascend rough S. E. slope.

40.00

Set an iron post 3 ft. long, 1 in. diam., 26 ins. in the ground for, $\frac{1}{4}$ sec. cor., marked on brass cap $\frac{1}{4}$ S6 in W. S5 in E. and 1913 in S. half; and raise a mound of stone 2 ft. base $1\frac{1}{2}$ ft. high, W. of cor. Pits impracticable.

69.90

Change to S. E. slope and descend.

72.89

Intersect N. bdy. of Tp. 94 lks. ~~N. $89^{\circ} 26'$ W. of the old cor.~~ ^{hereinbefore described} I destroy mound of stone at this old cor. and raise a mound of stone 2 ft. base $1\frac{1}{2}$ ft. high, N. of cor. Pits impracticable.

At point of intersection I

Set an iron post 3 ft. long, 2 ins. diam., 24 ins. in the ground for closing cor. of secs. 5 and 6, ^{T14S R23E} marked on brass cap

CC S. of center

T13SS31S32 in N,

T14S 1913 in S. and

R23E in W. half;

S5 in S. E. and

S6 in S. W. quadrant; from which

An oak 6 ins. diam., bears S. $29\frac{1}{2}^{\circ}$ E. 21 lks. dist., marked CCT14SR23ES5BT.

An oak 4 ins. diam., bears S. $25\frac{1}{4}^{\circ}$ W. 153 lks. dist., marked CCT14SR23ES6BT.

Land, mountainous.

Soil, rocky; 4th. rate.

Timber, sacttering oak.

September 5, 1913.

BOOK 2675

Subdivision of Tp. 14 S. Rg. 23 E.

Chains

GENERAL DESCRIPTION.

This township is mountainous in the extreme north and southwestern portions, the rest of the township is nearly level and the soil is generally a red sandy loam of medium texture and unknown depth capable of producing abundant crops with sufficient water. There is one copper mine, not working, in sec. 5. There is no timber or water in the township. There is one settler in sec. 12, two in sec. 25, two in sec. 36 and one in sec. 15.

John D. Hesse
U. S. Surveyor.

FINAL OATH OF UNITED STATES SURVEYOR.

I, John F. Hesse, U. S. Surveyor, do solemnly swear that, in pursuance of special instructions received from the U. S. Surveyor General for Arizona, far Group 18 bearing date of the 22nd day of May, 1912, I have well, faithfully, and truly, in my own proper person, and in strict conformity with said instructions, the Manual of Surveying Instructions, and the laws of the United States, surveyed all those parts or portions of the subdivision lines resurveyed the West boundary and retraced and resurveyed the North boundary of Township 14 South Range 23 East of the Gila and Salt River Base and Meridian, in the State of Arizona, which are represented in the foregoing field notes as having been executed by me, and under my direction; and I do further solemnly swear that all the corners of said survey, ^{retracement and resurvey} have been established, ^{or reestablished} and perpetuated in strict accordance with the Manual of Surveying Instructions, and the special written instructions of the U. S. Surveyor General for Arizona and in the specific manner described in the field notes, and that the foregoing are the original field notes of such survey ~~retracement and resurvey~~.

John F. Hesse
U. S. Surveyor.

Subscribed by said John F. Hesse, and sworn to before me }
this 11th day of May, 1914 }



Frank S. Ingalls
Surveyor General of Arizona

APPROVAL.

OFFICE OF THE UNITED STATES SURVEYOR GENERAL,

Phoenix, Arizona, July 21, 1914

The foregoing field notes of the survey of the Subdivision lines the Resurvey of the West bdy. and Retracement & Resurvey of the North bdy. of Township No 14 South, Range No 23 East of the Gila and Salt River Base and Meridian, Arizona.

executed by John F. Hesse, U.S. Surveyor under his special instructions dated May 22nd, 1912, having been critically examined, and the necessary corrections and explanations made, the said field notes, and the ^{retracements and resurveys} surveys, they describe, are hereby approved.

Frank S. Ingalls
U.S. Surveyor General of Arizona

~~I certify that the foregoing transcript of the field notes of the above described surveys in~~
~~has been correctly copied from the original notes on file in this office.~~