

2679

4-679

2679

Accepted - GLO letter "E"  
Apr. 28, 1915

Oct 11 - 1913

209

(1)

BOOK A  
Subdivisions BOOK 2679  
FIELD NOTES

OF THE SURVEY OF THE

Subdivision lines of

TOWNSHIP 23 NORTH, RANGE 5 WEST

Of the Gila & Salt River Base & Meridian,

In the State of ARIZONA

EXECUTED BY

H. N. BRADSTREET, U.S. Transitman and

WILLIAM B. KIMMEL, U.S. Surveyor.

~~In the capacity of U. S. Surveyor~~, under instructions dated October 18, 1912,  
issued by the United States Surveyor General to govern surveys included in  
Group No. 24, which were approved by the Commissioner of the General Land  
Office, November 5, 1912, pursuant to authority contained in the Act of  
Congress dated June 25, 1910.

Survey commenced December 10 ~, 1912

Survey completed " 16, 1912

(1A)

BOOK 2679

INDEX DIAGRAM.

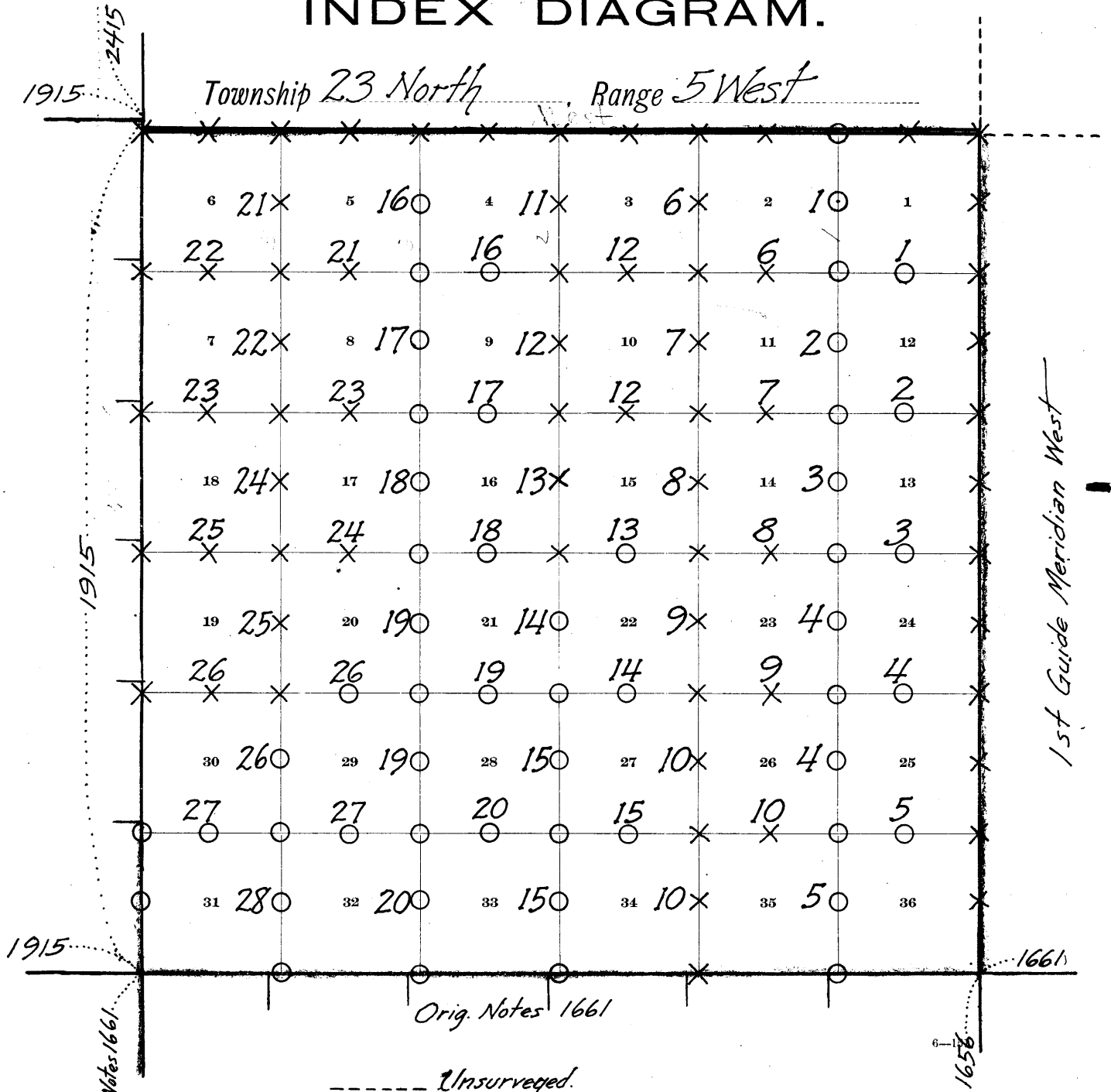

- Unsurveyed.
- X) Corners set by W.B. Kimmel
- O " " " H.N. Bradstreet
- Book "M" (EXTERIORS)
- Book "O" (RESURVEYS & RETRACEMENTS)
- Book "N" (STANDARD LINES)

Subdivision of Tp23N., R5W.

Chains. *NOTE: Initials "W.B.K." and "H.N.B." in the following notes indicate surveys made by William B. Kimmel, U.S. Surveyor and H.N. Bradstreet, U.S. Transitman, respectively.*

Survey commenced Dec. 10, 1912, and executed with Young and Sons Light Mountain Transits, Nos 7695 & 8541 with Smith Solar Attachment. For description of instruments; Certificate of Approval, and tests of adjustment, see book "O" page "1".

The south boundary of T23N R5W being out of limits for measurement and alignment, ~~We~~ *we* subdivide the township from North to South, and from East to West, placing the fractions against the south and west boundaries.

*H.N.B.* At 8h 20m. a.m. l.m.t., I set off 35° 25' N. on the lat. arc, 22° 53' S on the decl. arc, and determine a meridian at the cor. of secs. 1, 2, 35 & 36 on the N. bdy of the Tp. <sup>RECENTLY ESTAB. BY ME AND</sup> described in book "M" page "1". Thence I run, S0 1' E., bet. secs. 1 & 2.

Over rolling, rocky land, through dense cedar timber.

10.00 Desc. slight SE slope.

14.00 Leave cedar timber, brs. NE. & SW.

19.00 Draw, <sup>chrs wide</sup> course SW. Road in draw, brs. NE. & SW.

24.00 Enter timber, brs. NE. & SW. Asc slight NW slope.

25.46 Brush fence, brs. NE. & SW. Thence over level land.

37.50 Leave timber, brs. NW. & SE.

40.00 Set an iron post, 3 ft. long, 1 in. diam, 26 ins. in the ground, for  $\frac{1}{4}$  sec. cor., marked on brass cap, 1912;  $\frac{1}{4}$  S2 in W, and S1 in E. half; from which

A cedar, 36 ins. diam, brs. S63 $\frac{1}{2}$ ° W, 228 lks. dist., marked  $\frac{1}{4}$  S2 BT.

No other trees within limits; dig pits, 18 X 18 X 12 ins. N. & S. of stone, 3 ft. dist., and raise a mound of earth, 3 $\frac{1}{2}$  ft. base, 1 $\frac{1}{2}$  ft. high, W. of cor.

44.00 Enter heavy timber, brs. NE. & SW.

80.00 Set an iron post, 3 ft. long, 2 ins. diam, 24 ins. in the ground, for cor. of secs. 1, 2, 11 & 12, marked on brass cap, 1912;

T23N R5W in N. half;

S2 in NW.,

S1 in NE.,

S12 in SE, and

S11 in SW, quadrant; from which

A cedar limb, 6 ins. diam, brs. N64° E., .25 lks. dist., marked T23N R5W S1 BT.

A cedar, 14 ins. diam, brs. S52 $\frac{1}{2}$ ° E., 42 lks. dist., marked T23N R5W S12 BT.

A cedar, 14 ins. diam, brs. S62 $\frac{1}{2}$ ° W., 39 lks. dist., marked T23N R5W S11 BT.

A cedar, 8 ins. diam, brs. N60 $\frac{1}{2}$ ° W., 17 lks dist., marked T23N R5W S2 BT.

Land, level and rolling.

Soil, rocky 4th rate gumbo.

Timber, scattering and heavy cedar.

*NOTE:* At this cor., I set off 22° 55 $\frac{1}{2}$ ' S on the decl. arc, and ~~at hour.~~ *at hour.*, I observe the sun on the meridian; the resulting lat. is 35° 24 $\frac{1}{2}$ ' N, which is slightly higher than the true lat.

40.00 East, on a random line, bet secs. 1 & 12,

80.04 Set temp  $\frac{1}{4}$  sec. cor. (FIRST GUIDE MERIDIAN WEST)

Intersect the E. bdy of the Tp, 17 lks. S. of the cor. of secs. 1, 6, 7 & 12, which <sup>W.B.K.</sup> established Dec. 6, 1912, as described in Book, "N" page "4".

Thence I run

S89° 53' W, on a true line, bet., secs. 1 & 12.

Over rolling land, through dense cedar timber.

10.00 Desc. gentle W. slope, 50 ft

21.25 Draw, <sup>chrs in wide</sup> course SW. Asc SE. slope, 70 ft.

34.25 Top of ascent, thence over level land.

40.02 Set an iron post, 3 ft. long, 1 in. diam, 26 ins. in the ground, for  $\frac{1}{4}$  sec. cor., marked on brass cap, 1912;  $\frac{1}{4}$  S1 in N. and,

Chains.

41.56	S12 in S. half; from which, A cedar, 14 ins. <sup>n</sup> diam, brs. N50 $\frac{1}{2}$ ° W., 66 lks. dist., marked $\frac{1}{4}$ S1 BT.
80.04	A cedar, 10 ins. <sup>n</sup> diam, brs. S53° W., 50 lks. dist., marked $\frac{1}{4}$ S12 BT. Road, brs. S <sup>n</sup> & NE. The cor of secs. 1. 2 11 & 12, Land, level and rolling. Soil, rocky 4th rate gumbe. Timber, scrub cedar, with scattering pinion. Heavily timbered land, 80.00 chs.
26.52	S0° 1' E., bet. secs. 11 & 12. Over rolling land, through dense cedar timber.
31.70	Brush fence, brs. NE & SW. Desc. rocky SE. slope, 135 ft.
39.56	Bottom of ravine, <sup>70 lks wide</sup> course SW. Asc. rocky NW. slope.
40.00	End of asc. thence over level land. Set an iron post, 3 ft. long, 1 in. <sup>n</sup> diam, 26 ins. in the ground, for $\frac{1}{4}$ sec. cor., marked on brass cap, 1912; $\frac{1}{4}$ S11 in W, and S12 in E. half; from which A cedar, 8 ins. <sup>n</sup> diam, brs. N60 $\frac{1}{2}$ ° E., 67 lks. dist., marked $\frac{1}{4}$ S12 BT. A cedar, 15 ins. <sup>n</sup> diam, brs. S55° W., 98 lks. dist., marked $\frac{1}{4}$ S11 BT.
	Dec. 10, 1912.
	Dec. 11, 1912. At 8h. 03m. a.m., l.m.t., I set off 35° 24' N. on the lat. arc, 22° 57' S. on the decl. arc. and determine a meridian with the solar at the $\frac{1}{4}$ cor. bet. secs. 11 & 12, above described
68.00	Thence I continue S0° 1' E., bet. secs. 11 & 12, Desc. S. slope, 80 ft.
69.80	Brush fence, brs. ENE. & WSW.
74.00	Bottom of ravine, <sup>30 lks wide</sup> course WSW. Asc NW. slope, 125 ft.
78.00	Top of asc., thence over rolling land.
80.00	Set an iron post, 3 ft. long, 2 ins. <sup>n</sup> diam, 24 ins. in the ground for cor. of secs. 11, 12, 13 & 14, marked on brass cap, 1912; T23N R5W in N. half; S11 in NW, S12 in NE, S13 in SE, and S14 in SW. quadrant, from which A cedar, limb, 10 ins. <sup>n</sup> diam, brs. N63° E., 132 lks. dist., marked T23N R5W S12 BT. A cedar limb, 8 ins. <sup>n</sup> diam, brs. S51° E., 56 lks. dist., marked T23N R5W S13 BT. A cedar limb, 10 ins. <sup>n</sup> diam, brs, S53 $\frac{3}{4}$ ° W., 68 lks. dist., marked T23N R5W S14 BT. A cedar, 30 ins. <sup>n</sup> diam, brs. N22 $\frac{3}{4}$ ° W., 60 lks. dist., marked T23N R5W S11 BT. Land, rolling and mountainous. Soil, rocky 4th rate gumbo. Timber, heavy scrub cedar, and scattering pinion. Heavily timbered land, 80. chs. Mountainous land, 23 chs.
40.00	N89° 53' E., on a random line, bet. secs. 12 & 13
80.20	Set temp. $\frac{1}{4}$ sec. cor. (FIRST GUIDE MERIDIAN WEST) Intersect E. bdy. of Tp, 15 lks. N. of the cor. of secs. 7. 12, 13 & 18, estab. by <sup>W. RIMMEL</sup> Dec. 5, 1912 as described in Book "N", page 3 Thence I run, S89° 59' W., on a true line, bet. secs. 12 & 13. Desc. over rolling land, through dense cedar timber.
20.00	Draw, <sup>40 lks wide</sup> course NW. Asc. slightly.
40.10	Set an iron post, 3 ft. long, 1 in. <sup>n</sup> diam, 26 ins. in the ground, for $\frac{1}{4}$ sec. cor., marked on brass cap, 1912; $\frac{1}{4}$ S12 in N, and

## Chains.

- S13 in S. half; from which  
 A cedar, 24 ins. diam., brs. N40°E., 161 lks. dist.,  
 marked  $\frac{1}{4}$ S12 BT.  
 A cedar, 15 ins. diam., brs. S38 $\frac{3}{4}$ °W., 78 lks. dist.,  
 marked  $\frac{1}{4}$ S13 BT.
- 62.20 Draw, course NW.  
 80.20 The cor. of secs. 11, 12, 13 & 14.  
 Land rolling.  
 Soil, rocky 4th rate.  
 Timber, scattering and heavy scrub cedar.  
 Heavily timbered land, 70. chs.
- 
- S0°1'E., bet secs. 13 & 14.  
 Over rolling, rocky land, covered with scrub cedar.  
 14.00 Leave timber, brs. NE. & SW.  
 40.00 Set an iron post, 3 ft. long, 1 in. diam, 26 ins. in the  
 ground, for  $\frac{1}{4}$  sec. cor., marked on brass cap, 1912;  
 $\frac{1}{4}$ S14 in W., and  
 S13 in E. half;  
 and raise a mound of stone, 2 ft. base, 1 $\frac{1}{2}$  ft. high, W.  
 of cor. Pits impracticable.
- NOTE - At this cor. I set off 23°0 $\frac{1}{2}$ ' S. on the decl. arc,  
 and at noon, I observe the sun on the  
 meridian; the resulting lat. is 35°23' N, which is the  
 correct lat.
- 44.25 Wash, 20 lks. wide, 1 ft. deep, course W.  
 80.00 Set an iron post, 3 ft. long, 2 ins. diam, 24 ins. in the  
 ground, for cor. of secs. 13, 14, 23 & 24, marked on  
 brass cap, 1912;  
 T23N R5W in N. half;  
 S14 in NW.,  
 S13 in NE.,  
 S24 in SE, and  
 S23 in SW. quadrant;  
 Dig pits, 18 X 18 X 12 ins. in each sec, 5 $\frac{1}{2}$  ft. dist.;  
 And raise a mound of stone, 4 ft. base, 2 ft. high, W.  
 of cor.  
 Land, level and rolling.  
 Soil, rocky 4th rate gumbo.  
 Timber, heavy scrub cedar.  
 Heavily timbered land, 14 chs.
- 
- N89°59'E., on a random line, bet secs. 13 & 24.  
 40.00 Set temp  $\frac{1}{4}$  sec. cor.  
 80.37 Intersect the E. bdy. of the T<sup>(FIRST GUIDE MERIDIAN WEST)</sup> 24 lks. S. of the cor. of  
 secs. 13, 18, 19 & 24, established by <sup>KIMMEL</sup> Dec. 5, 1912 and described  
 in book "N", page 2.  
 Thence I run,  
 S89°49'W., on a true line, bet. secs. 13 & 24.  
 Over rolling rocky land, through dense cedar timber.
- 22.00 Desc. SW. slope, 60 ft.  
 29.75 Bottom of ravine, <sup>60 lks wide</sup> course S. Asc. E. slope, 100 ft., over  
 malpais rocks.
- 34.40 Top of asc., thence over level land.  
 40.185 Set an iron post, 3 ft. long, 1 in. diam, 26 ins. in the  
 ground, for  $\frac{1}{4}$  sec. cor., marked on brass cap, 1912;  
 $\frac{1}{4}$ S13 in N, and  
 S24 in S. half; from which  
 A cedar, limb, 10 ins. diam, brs. N52 $\frac{1}{4}$ °E., 48 lks. dist.,  
 marked  $\frac{1}{4}$ S13 BT.  
 A cedar limb, 10 ins. diam, brs. S24 $\frac{3}{4}$ °W., 40 lks. dist.,  
 marked  $\frac{1}{4}$ S24 BT.
- 44.00 Leave timber, brs. N. & S.  
 57.00 Draw, course SW.  
 80.37 The cor. of secs. 13, 14, 23 & 24.  
 Land level and rolling.  
 Soil, rocky 4th rate gumbo.  
 Timber, scattering and heavy cedar.

## Subdivision of T23N., R5W.

Chains.	
	Heavily timbered land, 30 chs.
40.00	<p>S0° 1'E., bet. secs. 23 &amp; 24.  Over rolling, rocky land. No timber.  Set an iron post, 3 ft. long, 1 in. in diam, 26 ins. in the ground, for <math>\frac{1}{4}</math> sec. cor., marked on brass cap, 1912;  <math>\frac{1}{4}</math>S23 in W, and  S24 in E. half;  Dig pits, 18 X 18 X 12 ins., N. &amp; S. of post, 3 ft. dist; and raise a mound of earth, <math>3\frac{1}{2}</math> ft. base, <math>1\frac{1}{2}</math> ft. high, W. of cor.  Dec. 11, 1912.</p>
57.50	Dec. 12 <sup>1912</sup> : At 7h. 30m. a.m., 1.m.t., I set off 22° 57 $\frac{1}{2}$ ' S
74.85	on the decl. arc, 35° 22' N. on the lat. arc, and determine a meridian with the solar at the $\frac{1}{4}$ sec. cor. bet. secs. 23 & 24. Thence I continue
80.00	<p>S0° 1'E., bet. secs. 23 &amp; 24.  Desc. SW. slope, 130 ft.  Gulch, <sup>50 lks. W. 200</sup> course SW. Asc NW. slope, 40 ft.  Set an iron post, 3 ft. long, 2 ins. in diam, 24 ins. in the ground, for cor. of secs. 23, 24, 25, &amp; 26, marked on brass cap 1912.  T23N R5W in N. half;  S23 in NW.,  S24 in NE.,  S25 in SE. and  S26 in SW. quadrant;  And raise a mound of stone, 2 ft. base <math>1\frac{1}{2}</math> ft. high, W. of cor. Pits impracticable.  Land, level and rolling.  Soil, rocky 4th rate gumbo.  No timber.</p>
40.00	N89° 49'E., on a random line, bet. secs. 24 & 25.
80.36	<p>Set temp. <math>\frac{1}{4}</math> sec. cor. (FIRST GUIDE MERIDIAN WEST)  Intersect E. bdy. of T<sub>23</sub>, 9 lks. N. of the cor. of secs. 19, 24, 25 &amp; 30, established by <sup>W. AKINNEL</sup> Dec. 4, 1912 and described in book "N", page 2,  Thence I run,  S89° 53' W., on a true line, bet secs. 24 &amp; 25.  Over level and rolling land, through dense cedar timber.</p>
25.00	Draw, course NNW. Asc. slightly along NE. slope.
40.18	<p>Set an iron post, 3 ft. long, 1 in. in diam, 26 ins. in the ground, for <math>\frac{1}{4}</math> sec. cor., marked on brass cap, 1912;  <math>\frac{1}{4}</math>S24 in N, and  S25 in S. half, from which  A cedar, 15 ins. in diam, brs. N52<math>\frac{1}{2}</math>° E., 111 lks. dist., marked <math>\frac{1}{4}</math>S24 BT.  A cedar, 10 ins. in diam, brs. S44<math>\frac{3}{4}</math>° W., 37-lks. dist., marked <math>\frac{1}{4}</math>S25 BT.</p>
42.80	Precipice, 40 ft. high, brs. NE. & SW. Continue desc. NW. slope, 120 ft. farther.
51.40	Foot of desc.; thence across valley.
60.00	Asc. E. slope, 170 ft.
71.60	Foot of cliff, 60 ft. high.
71.80	Top of ridge, brs. N. & S. Desc. 170 ft.
80.36	<p>The cor of secs. 23, 24, 25 &amp; 26.  Land, rolling and mountainous.  Soil, rocky 4th rate on slopes; in valley, sandy loam, 3rd rate.  Timber, heavy scrub cedar and scattering pinion.  Mountainous land, 23 chs.</p>
	<p>S0° 1'E., bet secs. 25 &amp; 26.  Over rough rocky land, no timber. Asc NW. slope; 45 ft.</p>

Subdivision of T23N. R5W.

Chains.

6.00 Top of ridge, brs. NNE. & SSW, thence along top of ridge.  
 10.00 Desc. very steep SE. slope over jagged rocks, 200 ft.  
 20.00 Bottom of desc. Thence across level valley.  
 25.00 Wash, 75 lks. wide, course W.  
 28.00 Asc NW. slope, 90 ft.  
 34.00 Top of asc.; thence over rolling land.  
 40.00 Set an iron post, 3 ft. long, 1 in. diam, 26 ins. in the ground, for  $\frac{1}{4}$  sec. cor., marked on brass cap, 1912;  $\frac{1}{4}$ S26 in W., and  $\frac{1}{4}$ S25 in E. half, from which:  
 A cedar, 30 ins. diam., brs. N56 $\frac{1}{2}$ ° E., 207 lks. dist., marked  $\frac{1}{4}$ S25 BT.  
 A cedar, 6 ins. dia., brs. S58 $\frac{1}{2}$ ° W., 92 lks. dist., marked  $\frac{1}{4}$ S26 BT.  
 Note: At this corner, I set off 23° 05' S. on the decl. arc, and I observe the sun on the meridian; the resulting lat. is 35° 21 $\frac{1}{2}$ ' N, which is only  $\frac{1}{4}$ ' greater than the correct lat.  
 60.00 Desc. S. slope, 55 ft.  
 68.95 Wash, 10 lks. wide, course W.  
 80.00 Set an iron post, 3 ft. long, 2 ins. diam, 24 ins. in the ground, for cor. of secs. 25, 26, 35 & 36, marked on brass cap, 1912;  
 T23N R5W in N  $\frac{1}{2}$   
 S26 in NW,  
 S25 in NE,  
 S36 in SE, and  
 S35 in SW quadrant;  
 and raise a mound of stone, 2 ft. base, 1 $\frac{1}{2}$  ft. high, W. of cor. Pits impracticable.  
 Land rolling and mountainous.  
 Soil, rocky 4th rate.  
 No timber.  
 Undergrowth, sagebrush.  
 Mountainous land, 26 chs.

40.00 N89° 53' E., on a random line, bet. secs. 25 & 36.  
 Set temp.  $\frac{1}{4}$  sec. cor. (FIRST GUIDE MERIDIAN WEST)  
 80.11 Intersect E. bdy. of Tps. 17 lks. S. of the cor. of secs. 25, 30, 31 & 36, established by W. R. KIMMEL Dec. 4, 1912 and, described in book "A", page 1.  
 Thence I run,  
 S89° 46' W., on a true line, bet. secs. 25 & 36.  
 Asc SE. slope, over very rough, rocky ground. No timber.  
 20.00 Top of asc., S. side of hill, 175 ft. above cor.  
 Desc. 90 ft., along SW. slope.  
 30.00 Foot of desc., thence over ground sloping slightly to W.  
 40.055 Set an iron post, 3 ft. long, 1 in. diam, 26 ins. in the ground, for  $\frac{1}{4}$  sec. cor., marked on brass cap, 1912;  $\frac{1}{4}$ S25 in N., and  $\frac{1}{4}$ S36 in S. half;  
 And raise a mound of stone, 2 ft. base, 1 $\frac{1}{2}$  ft. high, N. of cor. Pits impracticable.  
 53.35 Desc. steep W. slope, 180 ft., to  
 80.11 The cor. of secs. 25, 26, 35 & 36.  
 Land rolling and hilly.  
 Soil, rocky 4th rate.  
 No timber or undergrowth.

S0° 1' E., bet. secs. 35 & 36.  
 Over rolling land, no timber.  
 27.00 Wash, 25 lks. wide, course W. Asc. 125 ft.  
 32.00 Enter timber, brs. E & W.  
 40.00 Set an iron post, 3 ft. long, 1 in. diam, 26 ins. in the ground, for  $\frac{1}{4}$  sec. cor., marked on brass cap, 1912;  $\frac{1}{4}$ S35 in W., and  $\frac{1}{4}$ S36 in E. half;

## Subdivision of T23N, R5W.

Chains.

from which  
 A cedar, 36 ins.<sup>in</sup> diam, brs. N83 $\frac{1}{2}$ ° E., 105 lks, dist.,  
 marked  $\frac{1}{4}$ S36 BT.  
 A cedar, limb, 7 ins.<sup>in</sup> diam, brs. S54 $\frac{1}{2}$ ° W., 115 lks. dist.,  
 marked  $\frac{1}{4}$ S35 BT.  
 44.00 Leave timber, brs. E. & W.  
 46.00 Desc. S. slope, 100 ft.  
 54.00 Gulch, course W. Asc. N. slope 60 ft..  
 60.00 Top of ridge, brs. E. & W., desc. SW. slope, 80 ft.  
 80.07 Intersect the S. bdy. of the Tp. at a point from which the  
 corner of secs. 11 and 12, described in Book "O", page 4,  
 brs. S89° 50' W., 83 lks. dist.  
 At the point of intersection, I set an iron post, 3 ft.  
 long, 2 ins.<sup>in</sup> diam, 24 ins. in the ground, for closing  
 cor. of secs. 35 & 36, marked on brass cap, 1912;  
 CC, N. of center;  
 T23N in N. half;  
 T22N, S1 & S2 in S, and  
 R5W in W. half;  
 S35 in NW, and  
 S36 in NE. quadrant,  
 And raise a mound of stone, 2 ft. base, 1 $\frac{1}{2}$  ft. high, N.  
 of cor. Pits impracticable.  
 Land, rolling and mountainous.  
 Soil, very rocky 4th rate.  
 Timber, scattering cedar.  
 Mountainous land, 53 chs.

Dec. 12, 1912.

H.N.B.

W.B.K.

Dec. 11, 1912: At 8h. 23m. a.m., 1.m.t., I set off 35°  
 25' N. on the lat. arc, 22° 58 $\frac{1}{2}$ ' S. on the decl. arc, and  
 determine a meridian with the solar at the cor. of  
 secs. 2, 3, 34 & 35, on the N. bdy of the Tp, which  
 I established Dec. 10, 1912, described in Book "M" page 2.  
 Thence I run,  
 S0° 1' E., bet secs. 2 & 3,  
 Over gently rolling land, through scattering cedar timber  
 and sage brush.  
 26.80 Wash, 15 lks. wide, course W. Asc. N. slope, 30 ft.  
 32.00 Top of asc. Thence over level land.  
 40.00 Set an iron post, 3 ft. long, 1 in.<sup>in</sup> diam, 26 ins. in the  
 ground, for  $\frac{1}{4}$  sec. cor., marked on brass cap, 1912;  
 $\frac{1}{4}$ S3 in W., and  
 S2 in E. half; from which  
 A cedar, 8 ins.<sup>in</sup> diam, brs. N33° E., 132 lks. dist.,  
 marked  $\frac{1}{4}$ S2 BT.  
 No other trees within limits. Raise a mound of stone, 2 ft.  
 base, 1 $\frac{1}{2}$  ft. high, W. of cor. Pits impracticable.  
 61.47 Road, brs. NE & SW.  
 63.53 Old road, brs. NE & SW.  
 80.00 Set an iron post, 3 ft. long, 2 ins.<sup>in</sup> diam, 24 ins. in the  
 ground, for cor. of secs. 2, 3, 10 & 11, marked on brass  
 cap, 1912;  
 T23N R5W in N. half;  
 S3 in NW,  
 S2 in NE,  
 S11 in SE, and  
 S10 in SW. quadrant; from which  
 A cedar, 15 ins.<sup>in</sup> diam, brs. N. 5° W., 205 lks. dist.,  
 marked T23N R5W S3 BT.  
 No other trees within limits. Raise a mound of stone, 2  
 ft. base, 1 $\frac{1}{2}$  ft. high, W. of cor. Pits impracticable.  
 Land, level and rolling.  
 Soil, rocky 4th rate gumbo.  
 Timber scattering cedar.  
 Underbrush sagebrush.

40.00

East, on a random line, bet. secs. 2 & 11.  
 Set temp.  $\frac{1}{4}$  sec, cor.



Chains.	
80.14	Intersect N. & S. line, 16 lks. S. of the cor. of secs.
	1, 2, 11 & 12,
	Thence I run
	S89°53'W., on a true line, bet. secs. 2 & 11.
	Over rolling land, through scrub cedar timber.
40.07	Set an iron post, 3 ft. long, 1 in. diam, 26 ins. in
	the ground, for $\frac{1}{4}$ sec. cor., marked on brass cap, 1912;
	$\frac{1}{4}$ S2 in N., and
	S11 in S. half; from which
	A cedar, 5 ins. diam, brs. N13°W., 92 lks. dist.,
	marked $\frac{1}{4}$ S2 BT.
	A cedar, 8 ins. diam, brs. S44 $\frac{3}{4}$ °W., 195 lks. dist.,
	marked $\frac{1}{4}$ S11 BT.
54.70	Leave heavy timber, brs. NE. & SW.
80.14	The cor. of secs. 2, 3, 10 & 11.
	Land level and rolling.
	Soil, volcanic, rocky 4th rate.
	Timber, scattering cedar.
	Undergrowth, sagebrush.
NOTE	At this cor., I set off 23°0 $\frac{1}{2}$ 'S. on the decl. arc, and at
	meridian; the resulting lat. is 35°24 $\frac{1}{2}$ 'N, which is the
	correct lat.
	S0°1'E., bet. secs. 10 & 11.
	Over gently rolling, scattering cedar and sage brush
32.00	Desc South slope 55 ft.
40.00	Set an iron post, 3 ft. long, 1 in. diam, 26 ins in the
	ground, for $\frac{1}{4}$ sec. cor., marked on brass cap, 1912;
	$\frac{1}{4}$ S10 in W., and
	S11 in E. half; from which
	A cedar, 12 ins. diam, brs. N9°E., 139 lks. dist.,
	marked $\frac{1}{4}$ S11 BT.
	A cedar, 5 ins. diam, brs. S76 $\frac{1}{4}$ °W., 131 lks. dist.,
	marked $\frac{1}{4}$ S10 BT.
43.65	Wash, 5 lks. wide, course SW.; foot of desc; continue
	rolling.
71.20	Edge of ravine; desc. SW. slope, 117 ft.
77.73	Bottom of ravine, course NW. Asc cliffy NE. slope, 70 ft.
78.83	Top of perpendicular cliff, 25 ft. high.
80.00	Set an iron post, 3 ft. long, 2 ins. diam, 24 ins. in the
	ground, for cor. of secs. 10, 11, 14 & 15, marked
	on brass cap, 1912;
	T23N R5W in N half;
	S10 in NW,
	S11 in NE,
	S14 in SE, and
	S15 in SW. quadrant; from which
	A cedar, 12 ins. diam, brs. N70 $\frac{1}{2}$ °E., 79 lks. dist.,
	marked T23N R5W S11 BT.
	A cedar, 9 ins. diam, brs. S65 $\frac{1}{2}$ °E., 53 lks. dist.,
	marked T23N R5W S14 BT.
	A cedar, 9 ins. diam, brs. S. 82°W., 49 lks. dist.,
	marked T23N R5W S15 BT.
	A cedar, 10 ins. diam, brs. N75°W., 85 lks. dist.,
	marked T23N R5W S10 BT.
	Land, level and mountainous.
	Soil, volcanic, rocky, 4th rate.
	Timber, scattering scrub cedar,
	Undergrowth, sage brush.
	Mountainous land, 8 chs.
40.00	N89°53' E., on a random line, bet secs. 11 & 14.
80.06	Set temp. $\frac{1}{4}$ sec. cor.
	Intersect N. & S. line, 2 lks. N. of the cor. of secs. 11,
	12, 13 & 14,
	Thence I run

## Chains.

- S89°54'W., on a true line, bet. secs. 11 & 14.  
Desc NW.slope, 85 ft. over rocky ground, scattering cedar timber.
- 10.40 Foot of desc.; asc. NE.slope, 75 ft.  
16.15 Top of asc.; desc. NW.slope, 45 ft.  
23.50 Foot of desc., asc. NE.slope, 45 ft.  
32.00 Top of asc.; Desc. cliffy NW.slope.  
40.03 Set an iron post, 3 ft. long, 1 in. diam, 26 ins. in the ground, for  $\frac{1}{4}$  sec. cor., marked on brass cap, 1912;  
 $\frac{1}{4}$ S11 in N., and  
 $\frac{1}{4}$ S14 in S. half; from which  
A cedar, 24 ins. diam., brs. N28°E., 16 lks. dist., marked  $\frac{1}{4}$ S11 BT.  
A cedar, 7 ins. diam., brs South, 30 lks. dist., marked  $\frac{1}{4}$ S14 BT.
- 44.20 Foot of desc., asc. NE.slope 35 ft.  
48.20 Top of asc., desc. cliffy W.slope.  
60.60 Wash, course N. Thence over rolling land.  
80.06 The cor. of secs. 10, 11, 14 & 15.  
Land, hilly. Line runs along S. edge of ravine.  
Soil, volcanic, rocky. 4th rate.  
Timber, scrub cedar.
- 
- S0°1'E., bet. secs. 14 & 15.  
Over gently rolling land, through scattering cedar and sage brush.
- 40.00 Set an iron post, 3 ft. long, 1 in. diam, 26 ins. in the ground, for  $\frac{1}{4}$  sec. cor., marked on brass cap, 1912;  
 $\frac{1}{4}$ S15 in W., and  
 $\frac{1}{4}$ S14 in E. half;  
and raise a mound of stone, 2 ft. base, 1 $\frac{1}{2}$  ft. high, W. of cor. Pits impracticable.
- Dec 11., 1912.
- Dec 12<sup>1912</sup> At 7h55m a.m., l.m.t., I set off 35°23'N. on the lat. arc, 23°1 $\frac{1}{2}$ 'S. on the decl. arc, and determine a meridian with the solar at the ~~4~~<sup>2</sup> cor. bet. secs. 14 & 15, above described  
Thence I continue  
S0°1'E., bet. secs. 14 & 15.
- 50.00 Desc. S.slope, 60 ft.  
56.80 Gulch, course W. Asc. N.slope, 35 ft.  
63.90 Top of asc.; thence over rolling land.  
71.90 Desc. S.slope, 60 ft.  
80.00 Set an iron post, 3 ft. long, 2 ins. diam, 24 ins. in the ground, for cor. of secs. 14, 15, 22 & 23, marked on brass cap, 1912;  
T23N R5W in N. half;  
S15 in NW,  
S14 in N E,  
S23 in SE, and  
S22 in SW. quadrant,  
and raise a mound of stone, 2 ft. base, 1 $\frac{1}{2}$  ft. high, W. of cor. Pits impracticable.  
Land, level and rolling.  
Soil, volcanic, rocky. 4th rate.  
Timber, scattering cedar.  
Undergrowth, sagebrush.
- 
- N89°54'E., on a random line, bet. secs. 14 & 23.  
Set temp  $\frac{1}{4}$  sec. cor.  
40.00 Intersect N. & S. line, 25 lks. N. of the cor. of secs.  
80.00 13, 14, 23 & 24,  
Thence I run  
N89°55'W., on a true line, bet. secs. 14 & 23.  
Over rocky, rolling land, through scattering cedar and sagebrush.

Subdivision of T23N, R5W.

Chains.

40.00 Set an iron post, 3 ft. long, 1 in. diam., 26 ins. in the ground, for  $\frac{1}{4}$  sec. cor., marked on brass cap, 1912;  $\frac{1}{4}$ S14 in N., and S23 in S. half; from which  
 A cedar, 26 ins. diam., brs. N45 $\frac{1}{2}$ E., 237 lks. dist., marked  $\frac{1}{4}$ S14 BT.  
 A cedar, 14 ins. diam., brs. S59 $\frac{3}{4}$ W., 275 lks. dist., marked  $\frac{1}{4}$ S23 BT.  
 Desc NW. slope, 100 ft.

62.20 Wash, course SW.

80.00 The cor of secs. 14, 15, 22 & 23.  
 Land, level and rolling.  
 Soil, volcanic, 4th rate, rocky.  
 Timber, few scattering scrub cedars.  
 Undergrowth, sagebrush.

S0°1'E., bet. secs. 22 & 23.  
 Over gently rolling land, through scattering sagebrush; no timber.

13.00 Wash, course NW.

40 00 Set an iron post, 3 ft. long, 1 in. diam., 26 ins. in the ground, for  $\frac{1}{4}$  sec. cor., marked on brass cap, 1912;  $\frac{1}{4}$ S22 in W., and S23 in E. half ;  
 and raise a mound of stone, 2 ft. base, 1 $\frac{1}{2}$  ft. high, W. of cor. Pits impracticable.

52.00 Asc gentle N. slope. 25 ft.

60.00 Top of asc. Thence over level land.

80.00 Set an iron post, 3 ft. long, 2 ins. diam., 24 ins. in the ground, for cor of secs. 22, 23, 26 & 27, marked on brass cap, 1912;  
 T23N R5W in N. half;  
 S22 in NW,  
 S23 in NE.,  
 S26 in SE., and  
 S27 in SW. quadrant;  
 and raise a mound of stone, 2 ft. base, 1 $\frac{1}{2}$  ft. high, W. of cor. Pits impracticable.  
 Land level and rolling.  
 Soil, volcanic, rocky 4th rate.  
 No timber.  
 Undergrowth sagebrush.

S89°55'E., on a random line, bet. secs. 23 & 26.

40.00 Set temp.  $\frac{1}{4}$  sec. cor.

80.06 Intersect N. & S. line, 40 lks. S. of the cor. of secs. 23, 24, 25 & 26,

Thence I run  
 S89°48'W., on a true line, bet. secs. 23 & 26.  
 Desc NW. slope, over rocky ground; no timber or undergrowth.

10.35 Foot of desc., 70 ft. below cor. Wash, course SW. Asc. E. slope, 30 ft.

14.75 Top of rocky knoll. Desc W. slope, 45 ft.

29.20 Gulch, course S. Asc. E. slope, 105 ft.

40.03 Set an iron post, 3 ft. long, 1 in. diam., 26 ins. in the ground, for  $\frac{1}{4}$  sec. cor., marked on brass cap, 1912;  
 $\frac{1}{4}$ S23 in N. and S26 in S. half,  
 and raise a mound of stone, 2 ft. base, 1 $\frac{1}{2}$  ft. high, N. of cor. Pits impracticable.

40.20 Top of asc. Desc NW. slope, 120 ft.

58.80 Wash, course SW. Asc. SE. slope, 100 ft.

76.00 Top of asc.

80.06 The cor. of secs. 22, 23, 26 & 27.  
 Land, rolling and hilly.  
 Soil, volcanic, rocky 4th rate.

## Subdivision of T23N, R5W.

Chains.

No timber.  
Undergrowth, sagebrush.

S0°1'E., bet. secs. 26 & 27.  
Over gently rolling land, through sagebrush undergrowth.  
2.00 Desc. S. slope, 150 ft.  
12.00 Slope changes to SE.  
39.30 Wash, 30 lks. wide, course SW.  
40.00 Set an iron post, 3 ft. long, 1 in. diam, 26 ins. in the ground, for  $\frac{1}{4}$  sec. cor., marked on brass cap, 1912;  $\frac{1}{4}$ S27 in W, and S26 in E. half; and raise a mound of stone, 2 ft. base, 1 $\frac{1}{2}$  ft. high, W. of cor. Pits impracticable.  
48.00 Asc. NW. slope, 55 ft.  
58.00 Top of asc. Thence over rolling land.  
76.00 Desc. S. slope 35 ft.  
80.00 Set an iron post, 3 ft. long, 2 ins. diam, 24 ins. in the ground, for cor. of secs. 26, 27, 34 & 35, marked on brass cap, 1912; T23N R5W in N. half; S27 in NW, S26 in NE, S35 in SE, and S34 in SW. quadrant; and raise a mound of stone, 2 ft. base, 1 $\frac{1}{2}$  ft. high, W. of cor. Pits impracticable.  
Land, level and rolling.  
Soil, volcanic, rocky 4th rate.  
No timber.  
Undergrowth, sagebrush.  
At this cor. I set off 23°05'S. on the decl. arc, and at 23°05'S., hor. dist., I observe the sun on the meridian; the resulting lat is 35°21'N. which is the correct lat.

N89°48'E., on a random line, bet. secs. 26 & 35.  
40.00 Set temp.  $\frac{1}{4}$  sec. cor.  
80.30 Intersect N. & S. line, 40 lks. N. of the cor. of secs. 25, 26, 35 & 36,  
Thence I run  
N89°55'W., on a true line, bet. secs. 26 & 35.  
Over rolling rocky land, no timber.  
11.00 Draw, course SW. Enter cedar timber, brs. N. & S.  
26.00 Desc NW. slope, 50 ft.  
38.00 Draw, course NW. Leave timber, brs. N. & S.  
40.15 Set an iron post, 3 ft. long, 1 in. diam, 26 ins. in the ground, for  $\frac{1}{4}$  sec. cor., marked on brass cap, 1912;  $\frac{1}{4}$ S26 in N, and S35 in S. half, from which  
A cedar, 26 ins. diam, brs. S53°W., 25 lks. dist., marked  $\frac{1}{4}$ S35 BT. No other trees within limits. Raise a mound of stone, 2 ft base, 1 $\frac{1}{2}$  ft. high, N. of cor. Pits impracticable.  
53.20 Draw, course SW.  
80.30 The cor. of secs. 26, 27, 34 & 35.  
Land, level and rolling.  
Soil, very rocky 4th rate.  
Timber, scattering cedar.  
Undergrowth, sagebrush:

S0°1'E., bet. secs. 34 & 35.  
Over rolling land, through sagebrush undergrowth.  
8.00 Draw, course SW.  
20.00 Desc. SW. slope, 50 ft.  
31.90 Foot of desc. Thence over rolling land.  
40.00 Set an iron post, 3 ft. long, 1 in. diam, 26 ins. in the

Subdivision of T23N R5W.

Chains.

ground, for  $\frac{1}{4}$  sec. cor., marked on brass cap, 1912;  
 $\frac{1}{4}$ S34 in W., and  
 - S35 in E. half,  
 and raise a mound of stone, 2 ft. base,  $1\frac{1}{2}$  ft. high, W.  
 of cor. Pits impracticable.  
 60.25 Wash, 15 lks. wide, course NW. Asc NW. slope, 60 ft.  
 71.90 Top of asc.  
 78.70 Intersect the S. bdy. of the Tp. at a point from which  
 the corner of secs. 2 and 3, brs. N. 89° 08' W., 103 lks. dist.  
 This corner of secs. 2 and 3 is a stone, which is described by  
 H.N. BRADSTREET  
 in Book "O" page 3 .  
 At the point of intersection, set an iron post, 3 ft. long,  
 2 ins. diam, 24 ins. in the ground, for closing cor.  
 to secs. 34 & 35, marked on brass cap, 1912;  
 CC, N of center;  
 T23N in N,  
 T22N, S2 & S3 in S, and  
 R5W in W. half;  
 S34 in NW, and  
 S35 in NE. quadrant;  
 and raise a mound of stone, 2 ft. base,  $1\frac{1}{2}$  ft. high, N.  
 of cor. Pits impracticable.  
 Land, rolling.  
 Soil, volcanic, rocky 4th rate.  
 No timber.  
 Undergrowth, sagebrush.

Dec. 12, 1912

Dec. 13, 1912: At 8h. 10m. a.m. l.m.t., I set off 35° 25' N.  
 on the lat. arc, 23° 06' S. on the decl. arc, and determine  
 a meridian with the solar at the cor. of secs. 3, 34, 3  
 and 4, on the N. bdy of the Tp, which is established Dec 10, 1912, and  
 described in book "M" page 2 .  
 Thence I run  
 S0° 2' E., bet. secs. 3 & 4.  
 Over rolling land, through scattering cedar timber and  
 sagebrush undergrowth.  
 4.00 Desc. rocky S. slope, 70 ft.  
 6.95 Bottom of ravine, course W. Concrete dam brs. E, about 7  
 chs. Asc. N. slope, 180 ft.  
 10.30 Edge of ravine, brs. E. & W.  
 17.50 Top of asc. Thence over rolling land.  
 40.00 Set an iron post, 3 ft. long, 1 in. diam, 26 ins. in the  
 ground, for  $\frac{1}{4}$  sec. cor., marked on brass cap, 1912;  
 $\frac{1}{4}$ S4 in W., and  
 S3 in E. half;  
 and raise a mound of stone, 2 ft. base,  $1\frac{1}{2}$  ft. high, W.  
 of cor. Pits impracticable.  
 78.95 Wash, course E.  
 80.00 Set an iron post, 3 ft. long, 2 ins. diam, 24 ins. in the  
 ground, for cor. of secs. 3, 4, 9 & 10, marked on brass  
 cap, 1912;  
 T23N R5W in N. half;  
 S4 in NW,  
 S3 in NE,  
 S10 in SE, and  
 S9 in SW. quadrant;  
 and raise a mound of stone, 2 ft. base,  $1\frac{1}{2}$  ft. high, W.  
 of cor. Pits impracticable.  
 Rocky peak, brs. SW. about 12 chs. dist.  
 Land, rolling and mountainous.  
 Soil, rocky 4th rate,  
 Timber, few scattering cedar.  
 Undergrowth, sagebrush.

East, on a random line, bet. secs. 3 & 10.

## Subdivision of T23N, R5W.

Chains.	
40.00	Set temp. $\frac{1}{4}$ sec. cor.
80.00	Intersect N. & S. line, 1 lk. S. of the cor. of secs. 2, 3, 10 & 11,
	Thence I run
	West, on a true line, bet. secs. 3 & 10.
	Over rolling rocky land, no timber.
24.50	Road, brs. NE. & SW.
25.05	Wash, course SW.
40.00	Set an iron post, 3 ft. long, 1 in. diam, 26 ins. in the ground, for $\frac{1}{4}$ sec. cor., marked on brass cap, 1912;
	$\frac{1}{4}$ S 3 in N., and S 10 in S. half;
	And raise a mound of stone, 2 ft. base, $1\frac{1}{2}$ ft. high, N. of cor. Pits impracticable.
45.75	Wash, course SE. Thence over rolling land.
80.00	The cor. of secs. 3, 4, 9 & 10. Land, level and rolling. Soil, volcanic, very rocky 4th rate. No timber, Undergrowth, sagebrush.
16.00	S $0^{\circ} 2'$ E., bet. secs. 9 & 10. Over gently rolling land, through scattering cedar. Desc. SE. slope, 150 ft.
29.10	Wash, 5 lks. wide, course E. Asc. NE. slope 40 ft.
33.20	Spur ridge, brs. NE. & SW. Desc. SE. slope, 200 ft.
40.00	Set an iron post, 3 ft. long, 1 in. diam, 26 ins. in the ground, for $\frac{1}{4}$ sec. cor., marked on brass cap, 1912;
	$\frac{1}{4}$ S 9 in W., and S 10 in E. half,
	And raise a mound of stone, 2 ft. base, $1\frac{1}{2}$ ft. high, W. of cor. Pits impracticable.
63.25	Gulch, course SW. Asc NW. slope 110 ft.
77.75	Road, brs. NE. & SW.
80.00	Set an iron post, 3 ft. long, 2 ins. diam, 24 ins. in the ground, for cor. of secs. 9, 10, 15 & 16, marked on brass cap, 1912;
	T23N R5W in N. half;
	S 9 in NW,
	S 10 in NE,
	S 15 in SE, and
	S 16 in SW quadrant; from which
	A cedar, 16 ins. diam, brs. S $15\frac{3}{4}^{\circ}$ E., 98 lks. dist., marked T23N R5W S15 BT.
	A cedar, 12 ins. diam, brs. S $54\frac{1}{2}^{\circ}$ W., 254 lks. dist., marked T23N R5W S16 BT.
	No other trees within limits. Raise a mound of stone, 2 ft. base, $1\frac{1}{2}$ ft. high, W. of cor. Pits impracticable.
	Land, rolling and hilly.
	Soil, volcanic, very rocky 4th rate.
	Timber, scattering cedar.
	Undergrowth, sagebrush.
	At this point, I set off $23^{\circ} 09'$ S. on the decl. arc, and at noon, I observe the sun on the meridian; the resulting lat. is $35^{\circ} 23\frac{1}{2}'$ N. which is the correct lat.
40.00	East, on a random line, bet. secs. 10 & 15. Set temp. $\frac{1}{4}$ sec. cor.
79.80	Intersect the N. & S. line, 4 lks. N. of the cor. of secs. 10, 11, 14 & 15,
	Thence I run, N $89^{\circ} 58'$ W., on a true line, bet. secs. 10 & 15. Over rolling, rocky land, through scattering cedar timb- er.
6.00	Desc. W. slope, 60 ft.

Subdivision of T23N R5W.

Chains.

10.60 Wash, 5 lks. wide, course NW.  
 17.00 Wash in bottom of ravine, 20 lks. wide. course S75°W.  
 25.50 Wash, 10 lks. wide, course N80°W; in bottom of ravine.  
 37.50 Bottom of ravine. Asc. SE. slope  
 39.90 Set an iron post, 3 ft. long, 1 in.<sup>m</sup>diam, 26 ins. in the ground, for  $\frac{1}{4}$  sec. cor., marked on brass cap, 1912;  $\frac{1}{4}$ S10 in N. and, S15 in S. half;  
 And raise a mound of stone, 2 ft. base, 1 $\frac{1}{2}$  ft. high, N. of cor. Pits impracticable.  
 41.60 Edge of rim rock, continue asc.  
 48.30 Top of asc., 115 ft. above cor.  
 52.30 Desc. NW. slope, 130 ft.  
 56.20 Edge of rim rock.  
 61.10 Bottom of ravine, course S75°W. Asc. SE. slope, 110 ft.  
 69.80 Top of asc. Edge of rim rock. Thence over rolling land.  
 79.80 The cor of secs. 9, 10, 15 & 16.  
 Land, rolling and mountainous.  
 Soil, very rocky 4th rate; volcanic formation.  
 Timber, scrub cedar.  
 Undergrowth, sagebrush.  
 Mountainous land, 16 chs.

S0°2'E., bet. secs. 15 & 16.  
 Over rolling land, through scattering cedar timber.  
 8.00 Desc. S. slope, 120 ft.  
 11.70 Edge of rim rock, NW. & SE.  
 18.00 Bottom of ravine, course W. Asc. N. slope 95 ft.  
 25.45 Top of asc. Thence over rolling land.  
 40.00 Set an iron post, 3 ft. long, 1 in.<sup>m</sup>diam, 26 ins. in the ground, for  $\frac{1}{4}$  sec. cor., marked on brass cap, 1912;  $\frac{1}{4}$ S16 in W., and S15 in E. half;  
 and raise a mound of stone, 2 ft. base, 1 $\frac{1}{2}$  ft. high, W. of cor. Pits impracticable.  
 80.00 Set an iron post, 3 ft. long, 2 ins.<sup>m</sup>diam, 24 ins. in the ground, for cor. of secs. 15, 16, 21 & 22, marked on brass cap, 1912;  
 T23N R5W in N. half;  
 S16 in NW,  
 S15 in NE,  
 S22 in SE, and  
 S21 in SW. quadrant;  
 And raise a mound of stone, 2 ft. base, 1 $\frac{1}{2}$  ft. high, W. of cor. Pits impracticable.  
 Land, rolling and mountainous.  
 Soil, volcanic, very rocky 4th rate.  
 Timber, scattering cedar.  
 Undergrowth, sagebrush.

Dec. 13, 1912. W.B.K.

Dec. 14, 1912. H.N.B.  
 S89°58'E., on a random line, bet. secs. 15 & 22.  
 40.00 Set temp.  $\frac{1}{4}$  sec. cor.  
 80.06 Intersect N. & S. line, 17 lks. S. of the cor. of secs. 14, 15, 22 & 23,  
 Thence I run  
 S89°55'W, on a true line, bet. secs. 15 & 22.  
 Over rolling rocky land, through scattering cedar.  
 24.00 Gulch, course SW. Asc SE. slope, 50 ft.  
 30.00 Top of asc. Thence over level land.  
 40.03 Set an iron post, 3 ft. long, 1 in.<sup>m</sup>diam, 26 ins. in the ground, for  $\frac{1}{4}$  sec. cor., marked on brass cap, 1912;  $\frac{1}{4}$ S15 in N. and S22 in S. half; from which  
 A cedar limb, 14 ins.<sup>m</sup>diam, brs. N72 $\frac{1}{2}$ °E., 169 lks. dist., marked  $\frac{1}{4}$ S15 BT.

14

## Subdivision of T23N, R5W .

Chains.	
66.00 80.06	<p>A cedar, 17 ins.<sup>n</sup> diam, brs. S36<math>\frac{1}{4}</math>° W., 147 lks. dist., marked <math>\frac{1}{4}</math>S22 BT.            Desc. W. slope 40 ft.            Foot of desc. Thence over level land.            The cor. of secs. 15, 16, 21 &amp; 22.            Land level and rolling.            Soil rocky 4th rate gumbo.            Timber, scattering cedar.            Undergrowth, sagebrush.</p>
13.00 40.00	<p>S0° 2' E., bet. secs. 21 &amp; 22,            Over rolling rocky land, no timber.            Wash, 50 lks. wide, 3 ft. deep, course SW.            Set an iron post, 3 ft. long, 1 in.<sup>n</sup> diam, 26 ins. in the ground, for <math>\frac{1}{4}</math> sec. cor., marked on brass cap, 1912;  <math>\frac{1}{4}</math>S21 in W., and            S22 in E. half;            and raise a mound of stone, 2 ft. base, 1<math>\frac{1}{2}</math> ft. high, W. of cor. Pits impracticable.</p>
51.00	<p>Asc. gradually from cor.            Top of low ridge, brs. NE. &amp; SW. Desc. rocky S. slope, 50 ft.</p>
60.00	<p>Draw, course W.</p>
65.00	<p>Asc. NW. slope 50 ft</p>
71.00	<p>Top of hill.</p>
80.00	<p>Set an iron post, 3 ft. long, 2 ins.<sup>n</sup> diam, 24 ins. in the ground, for cor. of secs. 21, 22, 27 &amp; 28, marked on brass cap, 1912;            T23N R5W in N. half;            S21 in NW,            S22 in NE,            S27 in SE, and            S28 in SW. quadrant;            And raise a mound of stone, 2 ft. base, 1<math>\frac{1}{2}</math> ft. high, W. of cor. Pits impracticable.            Land, rolling.            Soil, rocky 4th rate.            No timber.            Undergrowth, sagebrush.            At this cor., I set off 23° 13' S. on the decl. arc, and at noon, I observe the sun on the meridian; the resulting lat is 35° 21<math>\frac{1}{2}</math>' N, which is only <math>\frac{1}{4}</math>' less than the correct lat.</p>
40.00 79.90	<p>N89° 55' E., on a random line, bet. secs. 22 and 27            Set temp. <math>\frac{1}{4}</math> sec. cor.            Intersect N. and S. line, 18 links N. of the cor. of secs. 22, 23, 26 &amp; 27,</p>
23.00 39.95	<p>Thence I run            N. 89° 57' W., on a true line, bet. secs. 22 and 27.            Desc. 145 ft., over rocky land.            Bottom of draw, course S. Ascend E. slope 175 ft.            Set an iron post, 3 ft. long, 1 inch in diam, 26 ins. in the ground, for <math>\frac{1}{4}</math> sec. cor., marked on brass cap, 1912;  <math>\frac{1}{4}</math> S22 in N., and            S. 27 in S. half;            and raise a mound of stone, 2 ft. base, 1<math>\frac{1}{2}</math> ft. high, N. of cor. Pits impracticable.</p>
40.20 65.00 75.00 79.90	<p>Top of ridge brs. NW. and SE.; desc. SW. slope 145 ft.            Draw, course W. NW.; ascend slight NE. slope.            Small spur ridge, brs. NW.; desc. SW. slope 20 ft.            The cor. of secs. 21, 22, 27, and 28.            Land, rolling and mountainous.            Soil, very rocky 4th rate.            No timber.            Undergrowth, sagebrush.</p>



Subdivision of T23N, R5W.

Chains.	
	S0° 2' E., bet. secs. 27 and 28. Over rolling rocky land, through sagebrush undergrowth, no timber.
4.75	Wash, 10 lks. wide, 3ft. deep, course W.; asc. N. slope 50 ft.
10.00	Top of asc.; desc. S. slope 100 ft.
33.00	Desc. <del>into</del> wash, 10 lks. wide, course S.
38.00	Leave wash brs. Set hence over level land
40.00	Set an iron post, 3 ft. long, 1 in. in diam, 26 ins. in the ground, for $\frac{1}{4}$ sec. cor., marked on brass cap, 1912; $\frac{1}{4}$ S28 in W. and $\frac{1}{4}$ S27 in E. half; raise a mound of stone, 2 ft. base, 1 $\frac{1}{2}$ ft. high, W. of cor. Pits impracticable.
80.00	Set an iron post 3 ft. long, 2 ins. in diam, 24 ins. in the ground, for cor. of secs. 27, 28, 33, and 34, marked on brass cap, 1912; T23N R5W in N. half; S28 in NW, S27 in NE, S34 in SE, and S33 in SW quadrant; And raise a mound of stone 2 ft. base, 1 $\frac{1}{2}$ ft. high, W. of cor. Pits impracticable. Land, level and rolling. Soil, rocky 4th rate on slopes; 3rd rate on level. No timber. Undergrowth, sagebrush.
40.00	S89° 57' E., on a random line, bet. secs. 27 and 34. Set temp. $\frac{1}{4}$ sec. cor.
79.92	Intersect N. and S. line 12 lks. S. of the cor. of secs. 26, 27, 34, and 35,
	Thence I run, S89° 58' W., on true line, bet. secs. 27 and 34. Over gently rolling land, through sagebrush undergrowth.
1.65	Wash, course S. Asc. E. slope 45 ft.
12.00	Top of asc. Desc. W. slope 25 ft.
22.00	Foot of desc., thence over level land.
39.96	Set an iron post 3 ft. long 1 in. in diam, 26 ins. in the ground, for $\frac{1}{4}$ sec. cor., marked on brass cap, 1912; $\frac{1}{4}$ S27 in N., and $\frac{1}{4}$ S34 in S. half; And raise a mound of stone, 2 ft. base, 1 $\frac{1}{2}$ ft. high, N. of cor. Pits impracticable.
72.80	Wash, 50 lks. wide, 10 ft. deep, course SW.
79.92	The cor. of secs. 27, 28, 33 and 34. Land, level and rolling. Soil, rocky, 4th rate on slopes; sandy loam, 3rd rate on level. No timber. Undergrowth, sagebrush.
	S0° 2' E. bet. secs. 33 and 34. Over level land, through sagebrush undergrowth, no timber.
6.00	Wash 50 lks. wide, 6 ft. deep, course W.
40.00	Set an iron post 3 ft. long 1 in. in diam, 26 ins. in the ground, for $\frac{1}{4}$ sec. cor., marked on brass cap, 1912; $\frac{1}{4}$ S33 in W. and $\frac{1}{4}$ S34 in E half; And raise a mound of stone, 2 ft. base, 1 $\frac{1}{2}$ ft. high, W. of cor. Pits impracticable.
55.00	Wash, course W.
78.21	Intersect the S. boundary of the Tp. at a point from which the corner of secs. 33 and 34, brs. N89° 16' W., 124 lks. distant This cor. was reestablished by me Dec. 3, 1912, as described in book "O", page 3 At the point of intersection, I set an iron post, 3 ft. long, 2 ins. in diam, 24 ins. in the ground, for closing cor. to secs. 33 and 34, <sup>T23N, R5W</sup> marked on brass cap, 1912; T23N in N, center, T22N, S4 and S8 in S., and

## Subdivision of T23N, R5W.

Chains	
	<p>R5W in W. half;  S33 in NW. and  S34 in NE. quadrant:  And raise a mound of stone, 2 ft. base, 1½ ft. high,  N. of cor. Pits impracticable.  Land level.  Soil, sandy loam 3rd rate.  No timber.  Undergrowth, sagebrush and cacti.  Dec. 14, 1912.</p>
	<p>Dec. 13, 1912: At 9 h. 35 m. a.m. l.m.t., I set off  35°25' N. on the lat. arc, 23°08' S. on the decl. arc,  and determine a meridian with the solar at the cor.  of secs. 32, 33, 4, and 5, on the N. bdy. of the Tp.,  established by W.E. Kimmel, Dec. 10, 1912, described in book "M", page  Thence I run,  S0°3' E. bet. secs. 4 and 5.  Over rolling rocky land, through scattering cedar  timber.</p>
11.10	Desc. steep, rocky SW. slope 295 ft. Leave timber brs. NW and SE.
24.00	Gulch, course W. Asc. steep, rocky N. slope 270 ft.
38.70	Edge of rim rock, thence over level land.
40.00	Set an iron post, 3 ft. long, 1 in. diam, 26 ins. in ground, for ¼ sec. cor., marked on brass cap, 1912; ¼ S5 in W. and ¼ S4 in E. half;
	And raise a mound of stone, 2 ft. base, 1½ ft. high, W. of cor. Pits impracticable. A cedar 15 ins. in diam, brs. N. 64° E, 428 lks. dist. marked ¼ S 4 BT.
50.00	Edge of rim rock. Desc. steep, rocky SW. slope 320 ft.
60.00	Bottom of desc. thence over level land.
76.32	Road, brs. NW and SE to Seligman.
79.25	Wash 50 lks. wide, 3 ft. deep, , course E.
80.00	Set an iron post 3 ft. long, 2 ins. diam, 24 ins. in the ground, for cor. of secs. 4, 5, 8, and 9, marked on brass cap, 1912; T23N R5W in N. half; S5 in NW, S4 in NE, S9 in SE, and S8 in SW. quadrant;
	And raise a mound of stone, 2 ft. base, 1½ ft. high, W. of corner. Pits impracticable. Land, level and mountainous. Soil, rocky, 4th rate. Timber, scattering cedar. Undergrowth, sagebrush.
34.00	East, on a random line, bet. secs. 4 and 9. The 40 chain <sup>point</sup> being inaccessible, I set a temp. ¼ Sec. cor. here.
80.25	Intersect N. and S. line 22 lks. N. of the Cor. of secs. 3, 4, 9, and 10,
	Thence I run N89° 51' W. on a true line, bet. secs. 4 and 9.
17.35	Asc. SE. slope 40 ft. over very rocky land.
37.45	Top of ascent, in saddle. Desc. SW. slope 320 ft.
40.125	Precipice, 50 ft. high. Thence along edge of precipice. Point for ¼ sec. cor. falls on side of precipice, in head of gulch, course NNW. Asc. NE. slope, 80 ft.
44.55	End of asc. Thence over rolling land.
46.255	Set an iron post, 3 ft. long, 1 in. diam, 26 ins. in the ground, for ¼ sec. cor., marked on brass cap, 1912; WC ¼ in E. half; S4 in NW, and S9 in SW. quadrant; from which

Subdivision of T23N.R5W.

Chains.

A cedar, 18 ins.<sup>in</sup> diam, brs. N12<sup>o</sup> W., 191 lks. dist., marked WC  $\frac{1}{4}$  S4E.

A cedar, 30 ins.<sup>in</sup> diam, brs. S2<sup>o</sup> E., 280 lks. dist., marked WC  $\frac{1}{4}$  S9 BT.

47.75 Top of spur, ridge, brs. N. & S., extends 4 chs. N. Desc. W. slope, 250 ft. Enter cedar timber, brs. N. & S.

52.45 Leave cedar timber, brs. NE. & SW.

63.25 End of desc., wash, 10 lks. wide, 3 ft. deep, course SW. Thence across level canyon bottom.

66.25 Wash, 50 lks. wide, 5 ft. deep, from NE. Thence in wash.

68.00 Leave wash, course SE.

76.10 Road, brs. NW. & SE.

80.25 The cor of secs. 4, 5, 8 & 9.  
Land, mountainous.  
Soil, rocky 4th rate.  
Timber, scattering cedar.  
Mountainous land, 63. chs.  
At this cor., I set off 23<sup>o</sup> 09' S. on the decl. arc, and at noon, I observe the sun on the meridian; the resulting lat. is 35<sup>o</sup> 24 $\frac{1}{2}$ ' N., which is slightly higher than the correct lat.

S0<sup>o</sup> 3' E., bet. secs. 8 & 9.  
Over rocky land, Asc.  
125 ft. from cor, along NE slope.

25.85 Top of asc., desc. SE. slope, 130 ft.

33.75 Enter scattering cedar timber, brs. E. & W.

40.00 Set an iron post, 3 ft. long, 1 in.<sup>in</sup> diam, 26 ins. in the ground, for  $\frac{1}{4}$  sec. cor., marked on brass cap, 1912;  $\frac{1}{4}$  S8 in W., and S9 in E. half, from which

A cedar branch, 10 ins.<sup>in</sup> diam, brs. S41 $\frac{1}{4}$  W., 124 lks. dist., marked  $\frac{1}{4}$  S8 BT.

No other trees within limits. Raise a mound of stone, 2 ft. base, 1 $\frac{1}{2}$  ft. high, W. of cor. Pits impracticable.

50.00 Foot of desc., draw, course SE. Thence along E skde of hill.

62.00 Asc. NE. slope of hill, 110 ft.

78.40 Top of asc., spur ridge extends 2 chs. E. Desc. SE. slope, 25 ft.

80.00 Set an iron post, 3 ft. long, 2 ins.<sup>in</sup> diam, 24 ins. in the ground, for cor. of secs. 8, 9, 16 & 17, marked on brass cap, 1912; T23N R5W in N. half; S8 in NW, S9 in NE, S16 in SE., and S17 in SW. quadrant; and raise a mound of stone, 2 ft base, 1 $\frac{1}{2}$  ft. high, W. of cor. Pits impracticable.  
Land, hilly.  
Soil, rocky 4th rate.  
Timber, scattering cedar.

The cor. of secs. 9, 10, 15 & 16, being plainly visible, I run for said cor.

40.00 S89<sup>o</sup> 57' E., on a random line, bet. sec. 9 & 16.  
Set temp.  $\frac{1}{4}$  sec. cor.

80.24 The cor. of secs. 9, 10, 15 & 16,  
Thence I run N89<sup>o</sup> 57' W., on a true line, bet. secs. 9 & 16.  
Over, level, rocky land, through sage brush undergrowth.  
Road, brs. NE and SW.  
27.25 Desc. W. slope 55 ft.  
34.00 Foot of desc.; thence over level land.  
40.12 Set an iron post, 3 ft. long, 1 in.<sup>in</sup> diam, 26 ins. in the ground, for  $\frac{1}{4}$  sec. cor., marked on brass cap, 1912;  $\frac{1}{4}$  S9 in N. half; S16 in S. half; And raise a mound of stone, 2 ft. base, 1 $\frac{1}{2}$  ft. high, N. of cor. Pits impracticable.

## Subdivision of T23N, R5W.

18  
Chains.

48.25	Wash 25 lks. wide, 2 ft. deep, course SW.
71.50	Wash 50 lks. wide, 7 ft. deep, course SW.
72.75	Road, brs. N. and S.
73.00	Asc. E. slope 125 ft.
80.24	Cor. of secs. 8, 9, 16, and 17. Land, level and rolling. Soil, rocky, 4th rate, and sandy loam, 3rd rate. No timber. Undergrowth, sagebrush.
7.95	SO° 3' E, bet. secs. 16 and 17. Desc. steep, rocky, SE. slope 140 ft. Wash 10 lks. wide, course SW. Thence over level land.
8.20	Road, brs. NE. and SW.
12.80	Wash, 50 lks., wide 7 ft., deep. course SW.
17.70	Leave level, asc. NW. slope 60 ft.
21.50	Top of ascent, thence over level land.
25.70	Desc. SW slope 75 ft.
30.15	Wash, 30 lks. wide, 5 ft. deep, course SW.
37.15	Road, brs. NE and SW. Asc. slightly.
40.00	Set an iron post, 3 ft. long, 1 in. diam., 26 ins. in the ground, for $\frac{1}{4}$ sec. cor., marked on brass cap, 1912; $\frac{1}{4}$ S17 in W. and S16 in E. half; And raised a mound of stone, 2 ft. base, $1\frac{1}{2}$ ft. high, W. of cor. Pits impracticable. Dec 13, 1912.
44.00	Dec. 14, 1912. At 7 h. 30 m. a.m. l.m. t. I set off 35° 23' N. on the lat. arc, 23° 5 $\frac{1}{2}$ ' S. on the decl. arc, and determined a meridian with the solar at the $\frac{1}{4}$ sec. cor. bet. 16 and 17, above described, Thence I continue SO° 3' E, bet. secs. 16 and 17, Asc. NW. slope 50 ft.
52.00	Top of asc., thence over rolling land.
80.00	Set an iron post, 3 ft. long, 2 ins. diam., 24 ins. in the ground, for cor. of secs. 16, 17, 20, and 21, marked on brass cap, 1912; T23N R5W in N. half. S17 in NW., S16 in NE., S21 in SE., and S20 in SW. quadrant. And raise a mound of stone, 2 ft. base, $1\frac{1}{2}$ ft. high., W. of cor. Pits impracticable. Land rolling and mountainous. Soil, rocky, 4th rate. No timber or undergrowth. Mountainous land, 13 chains.
40.00	S89° 57' E, on a random line, bet. secs. 16 and 21. Set temp. $\frac{1}{4}$ sec. cor.
80.22	Intersect N. and S. line, 2 lks. N. of the cor. of secs. 15, 16, 21 and 22, Thence I run N89° 56' W, on a true line, bet. secs. 16 and 21. Over rolling, rocky land, no timber.
40.11	Set an iron post, 3 ft. long, 1 in. diam., 26 ins. in the ground, for $\frac{1}{4}$ sec. cor., marked on brass cap, 1912; $\frac{1}{4}$ S16 in N. and S21 in S. half; And raise a mound of stone, 2 ft. base, $1\frac{1}{2}$ ft. high, N. of cor., Pits impracticable. From this cor. a corral and water tank, brs. S. 30° E., about 15 chains dist.
80.22	The cor. of secs. 16, 17, 20, and 21. Land, level and rolling. Soil, rocky 4th rate. No timber or undergrowth.

Dec. 14, 1912

Subdivision of T23N, R5W.

Chains. Dec. 15, 1912.  
 SO° 3' E, bet. secs. 20 and 21.  
 Over rolling, rocky land, through sagebrush under-  
 growth, no timber.  
 10.00 Small draw, course W.  
 15.00 Low ridge, brs. E. and W. Desc. S. slope 30 ft.  
 25.00 Foot of desc. thence over level land.  
 40.00 Set an iron post, 3 ft. long, 1 in. diam, 26 ins. in  
 the ground, for  $\frac{1}{4}$  sec. cor., marked on brass cap, 1912;  
 $\frac{1}{4}$  S20 in W. and  
 S21 in E. half;  
 Dig pits 18X18X 12 ins. N. and S. of post, 3 ft. dist.  
 and raise a mound of earth, 3  $\frac{1}{2}$  ft. base, 1  $\frac{1}{2}$  ft. high,  
 W. of cor.

NOTE: At 8 h. 30 m. a.m. l.m.t., I set off 35° 22' N on the  
 lat. arc, 23° 14' S on the decl. arc, and determine  
 a mer. with the solar at the  $\frac{1}{4}$  sec. cor. bet. secs. 20  
 and 21, above described

Thence I continue  
 SO° 3' E, bet. secs. 20 and 21,  
 62.50 Wash, 50 lks. wide, 2 ft. deep, course SW.  
 63.00 Road, brs. SW. and NE.  
 65.00 Asc. NW. slope, 35 ft.  
 75.00 Top of asc., thence over level land.  
 80.00 Set an iron post, 3 ft. long, 2 ins. diam, 24 in. in the  
 ground, for cor. of secs. 20, 21, 28, and 29, marked  
 on brass cap, 1912;  
 T23N R5W in N. half;  
 S20 in NW.,  
 S21 in NE.,  
 S28 in SE. and  
 S29 in SW. quadrant.  
 Dig pits, 18X18X12 ins. in each sec., 5  $\frac{1}{2}$  ft. dist.;  
 and raise a mound of earth, 4 ft. base, 2 ft. high,  
 W. of cor.  
 Land level and rolling.  
 Soil, good sandy loam, 3rd rate.  
 No timber.  
 Undergrowth, sagebrush and cacti.

40.00 S89° 56' E, on a random line, bet. secs. 21 and 28.  
 Set temp.  $\frac{1}{4}$  sec. cor.  
 80.34 Intersect N. and S. line, 9 lks. S. of the cor. of  
 secs. 21, 22, 27, and 28.,

Thence I run  
 West, on a true line, bet. secs. 21 and 28.  
 Over gently rolling, rocky land.  
 8.35 Wash in draw, 10 ft. wide, 3 ft. deep, course SW.  
 Asc. 55 ft.  
 15.00 Top of spur ridge, brs. N. and S. Desc. W. slope 40 ft.  
 30.00 Foot of desc.; thence over level land.  
 40.17 Set an iron post, 3 ft. long, and, 1 in. diam, 26 ins. in  
 the ground, for  $\frac{1}{4}$  sec. cor., marked on brass cap, 1912;  
 $\frac{1}{4}$  S 21 in N, and  
 S28 in S, half;  
 And raise a mound of stone, 2 ft. base, 1  $\frac{1}{2}$  ft. high,  
 N. cor. Pits impracticable.  
 80.34 The cor. of secs. 20, 21, 28 and 29.  
 Land, level and rolling.  
 Soil, sandy loam, 3rd rate, and rocky, 4th rate gumbo.  
 No timber.  
 Undergrowth, sagebrush and cacti. Fair grass.

NOTE: At this cor. I set off 23° 16' S. on the decl. arc,  
 and at noon. I observe the sun  
 on the meridian. The resulting lat. is 35° 21  $\frac{1}{2}$ ' N, which  
 is slightly less than the correct lat.

SO° 3' E, bet. secs. 28 and 29.  
 Over rolling, rocky land, sagebrush undergrowth.  
 7.00 Desc. S. slope 65 ft.  
 35.00 Foot of desc., thence over level land.  
 36.40 Wash 5 lks. wide, 2 ft. deep, course SW.

## Subdivision of T23N, R5W.

20

Chains

40.00

Set an iron post, 3 ft. long, 1 in.<sup>m</sup> diam, 26 ins. in the ground, for  $\frac{1}{4}$  sec. cor., marked on brass cap, 1912;  $\frac{1}{4}$ S29 in W. and  $\frac{1}{4}$ S28 in E. half;  
Dig pits, 18X18X12 ins, N. and S. of post., 3 ft. dist.; and raise a mound of earth,  $3\frac{1}{2}$  ft. base,  $1\frac{1}{2}$  ft. high, W. of cor.

45.75

Wash 50 lks. wide, 1 ft. deep, course SW.

47.00

Asc. NW. slope 45 ft.

80.00

Set an iron post, 3 ft. long, 2 ins.<sup>m</sup> diam, 24 ins. in the ground, for cor. of secs. 28, 29, 32 and 33., marked on brass cap, 1912; T23N R5W in N. half; S29 in NW., S28 in NE., S33 in SE. and S32 in SW. quadrant.

And raise a mound of stone, 2 ft. base,  $1\frac{1}{2}$  ft. high, W. of cor. Pits impracticable.

Land, level and rolling.

Soil, rocky, brown gumbo, 4th rate.

No timber.

Undergrowth, sagebrush and cacti. Fair grass.

40.00

East, on a random line, bet. secs. 28 and 33.

80.26

Set temp.  $\frac{1}{4}$  sec. cor.

The cor. of secs. 27, 28, 33, and 34.

Thence I run,

West, on a true line, bet. secs. 28 and 33.

Over rolling, rocky land, through sagebrush underbrush.

1.25

Wash, 25 lks. wide, 2 ft. deep, course SW., thence over level land.

40.13

Set an iron post, 3 ft. long, 1 in.<sup>m</sup> diam, 26 ins. in the ground, for  $\frac{1}{4}$  sec. cor. marked on brass cap, 1912;  $\frac{1}{4}$ S28 in N. and  $\frac{1}{4}$ S33 in S. half;

And raise a mound of stone, 2 ft. base,  $1\frac{1}{2}$  ft. high, N. of cor. Pits impracticable., thence over rolling land.

80.26

The cor. of secs. 28, 29, 32, and 33.

Land, level and rolling.

Soil, 4th rate, rocky, gumbo.

No timber.

Undergrowth, sagebrush and cacti, fair grass.

7.00

S0°3'E., bet. secs. 32 and 33, over rolling, rocky land.

20.00

Low spur ridge, brs. NE. and SW. Desc. S. slope 55 ft.

40.00

Foot of desc., thence over level land.

Set an iron post 3 ft. long, 1 in. in diam, 26 ins. in the ground, for  $\frac{1}{4}$  sec. cor., marked on brass cap, 1912;  $\frac{1}{4}$ S32 in W. and  $\frac{1}{4}$ S33 in E half;

And raise a mound of stone, 3 ft. base,  $1\frac{1}{2}$  ft. high, W. of cor. Pits impracticable.

60.00

Wash, 25 lks. wide, 3 ft. deep, course SW.

62.70

Wash, 25 lks. wide, 4 ft. deep, course SW.

77.78

Intersect S. bdy. of Tn., at a point from which the corner of secs. 4 and 5, brs. N. 89° 48' W, 126 lks. dist.

This corner, of secs. 4 and 5 is a stone which I described in book "O", page 2.

At the point of intersection, I set an iron post, 3 ft. long, 2 ins.<sup>m</sup> diam, 24 ins. in the ground, for closing cor. to secs. 32 and 33, marked on brass cap, 1912;

CC, N. of centre;

T23N in N.

T22N S4 and S5 in S. and R5W in W. Half;

S32 in NW. and

S33 in NE. quadrant;

And raise a mound of stone, 2 ft. base,  $1\frac{1}{2}$  ft. high, N. of cor. Pits impracticable.

Land, level and rolling.

Soil, sandy loam, 4th rate, rocky.

No timber.

Undergrowth, sagebrush and cacti. Fair grass.

H.N.B. Dec. 15, 1912

Subdivision of T23N, R5W.

<p>Chains. <i>W.B.K.</i></p> <p>2.60 6.75 10.00 20.00 25.60 37.80 40.00</p> <p>48.00 56.50 65.90 70.85 76.50 80.00</p>	<p>Dec. 14, 1912. At 8 h. 23 m. a.m. l.m.t., I set off 25° 25' N. on the lat. arc; 23° 11' S. on the decl. arc; and determine a meridian with the solar at the cor. of secs. 31, 32, 5, and 6, on the N. bdy. of the Tp., established by me Dec. 10, 1912, and described in book "M", page 4.</p> <p>Thence I run, S0° 3' E. bet. secs. 5 and 6. Over gently rolling land, through scattering cedar timber and sagebrush.</p> <p>Wash 30 lks. wide, course SE. Road, NW. and SE.</p> <p>Asc. NE. slope 60 ft. Spur ridge brs. E. and W. Desc. SE. slope 55 ft. Wash, course NE; asc. NW. slope 100 ft. Top of asc. Thence over rolling land. Set an iron post, 3 ft. long, 1 in. diam, 26 ins. in the ground, for ¼ sec. cor., marked on brass cap, 1912; ¼ S5 in W. and S5 in E. half; from which A cedar, 6 ins. diam, brs. S. 85¾ E, 126 lks. dist., marked ¼ S5 BT. A cedar, 5 ins. diam, brs. S. 83½ W, 166 lks. dist., marked ¼ S6 BT.</p> <p>Desc. SE. slope 50 ft. Gulch, course NE. Asc. NW. slope 55 ft. Spur ridge, brs. E, and W. Desc. SW. slope 65 ft. Wash, course NW., thence over rolling land. Wash, course NW. Set an iron post, 3 ft. long, 2 ins. diam, 24 ins. in the ground, for cor. of secs. 5, 6, 7, and 8, marked on brass cap, 1912; T23N R5W in N. half; S6 in NW., S5 in NE., S8 in SE. and S7 in SW. quadrant. and raise a mound of stone, 2 ft. base, 1½ ft. high, W. of cor. Pits impracticable. Land, rolling and hilly. Soil, volcanic, very rocky, 4th rate. Timber, scattering cedar.</p>
<p>40.00 80.08</p> <p>1.75 12.20 17.10 21.00</p> <p>40.04</p> <p>40.75 48.75 60.00 77.45 80.08</p>	<p>East, on a random line, bet. secs. 5 and 8. Set temp. ¼ sec. cor. Intersect N. and S. line, 4 lks. S. of the cor. of secs. 4, 5, 8, and 9.,</p> <p>Thence I run, S89° 58' W., on a true line, bet. secs. 5 and 8 Chino Wash, 60 lks. wide, course NE. Chino Wash, 60 lks. wide, course SE. Dry earth dam, brs. N. about 8 chains dist. Leave level land, asc. E. slope 330 ft. through scattering cedar timber. Set an iron post, 3 ft. long, 1 in. diam, 26 ins. in the ground, for ¼ sec. cor., marked on brass cap, 1912; ¼ S5 in N. and S8 in S. half; from which A cedar, 8 ins. diam, brs. N. 77° E. 24 lks. dist., marked ¼ S5 BT. A cedar, 12 ins. diam, brs. S35° E, 193 lks. dist., marked ¼ S8 BT.</p> <p>Spur ridge, brs. N. and S. Desc. W. slope 135 ft. A gulch, course N. Asc. NE. slope 170 ft. Spur ridge, brs. NW. and SE. Desc. NW. slope 170 ft. Wash, course NE. The cor. of secs. 5, 6, 7, and 8. Land, mountainous and hilly. Soil, volcanic, very rocky, 4th rate. Timber and undergrowth scattering and heavy cedar.</p>

## Subdivision of T23N, R5W.

Chains.	
	It being necessary to set a closing cor. on the W. bdy. of the Tp., I run, West, on a true line, bet. secs. 6 and 7 Over rolling land, through scattering cedar and dense undergrowth.
7.21	Gulch <sup>course</sup> NE.; asc. SE. slope 210 ft.
30.48	Spur ridge, brs. NE. and SW.; desc. NW. slope 65 ft. Leave undergrowth, brs. NE. and SW.
37.65	Draw <sup>course</sup> NE.; asc. NE. slope 70 ft.
40.00	Set an iron post, 3 ft. long, 1 in. <sup>in</sup> diam, 26 ins. in the ground, for $\frac{1}{4}$ sec. cor. marked on brass cap, 1912; $\frac{1}{4}$ S6 in N. and $\frac{1}{4}$ S7 in S. half;
	And raise a mound of stone, 2 ft. base, $1\frac{1}{2}$ ft. high, N. of cor. Pits impracticable.
45.00	Spur ridge, brs. N. and S. Desc. SW. slope 150 ft.
61.75	Foot of desc. Thence over level land.
65.75	Asc. E. slope, 135 ft.
73.60	Top knoll.; desc. NW. slope 45 ft.
78.55	Foot of desc. Asc. SE. slope.
79.22	Intersect the W. bdy. of the Tp., 3.59 chains, S. of the old cor. of secs. 1, 6, 7, and 12, which is a limestone 8X6X10 in. above ground, marked and witnessed as described by the Surveyor General.
	At the point of intersection, I set an iron post, 3 ft. long, 2 ins. <sup>in</sup> diam, 24 ins. in the ground, for closing cor. to secs. 6, and 7, marked on brass cap, 1912; CCW. of center.
	T23N in N.
	S1, S12, R6W in W. half;
	S6 in NE. and
	S7 <sup>R5W</sup> in SE. <del>quadrant</del> from which
	A cedar, 24 ins. <sup>in</sup> diam, brs. N. $49\frac{1}{4}^{\circ}$ E., 45 lks. dist., marked T23N R5W S6 BT.
	A cedar, 6 ins. <sup>in</sup> diam, brs. S $46\frac{1}{2}^{\circ}$ E., 197 lks. dist., marked T23N R5W S7 BT.
	Land, mountainous and hilly.
	Soil, volcanic, very rocky, 4th rate.
	Timber scrub cedar.
	Undergrowth, scrub cedar and sagebrush.
	Mountainous land 70 chains.

Chains.	
	NOTE: At the cor. of secs. 5, 6, 7 and 8, at noon I set off $23^{\circ}13'$ S. on the decl. arc and observe the sun on the meridian the resulting lat. is $35^{\circ}24\frac{1}{2}'$ N., which is slightly higher than the correct lat. Thence I run, $50^{\circ}3'E.$ , bet. secs. 7 and 8.
	Over rolling land, through scattering cedar timber and dense undergrowth.
4.00	Wash, 5 lks. wide, course NE.
5.60	Wash, 5 lks. wide, course NW. Asc. NE. slope 35 ft.
9.95	Top of asc. Thence over level land.
19.40	Wash, 5 lks. wide, course NE.; asc. NW. slope 85 ft.
33.85	Top of asc. Thence over rolling land.
39.75	Wash, 5 lks. wide, course NW. Asc. NW. slope 95 ft.
40.00	Set an iron post, 3 ft. long, 1 in. <sup>in</sup> diam, 26 ins. in the ground, for $\frac{1}{4}$ sec. cor., marked on brass cap, 1912; $\frac{1}{4}$ S7 in W. and $\frac{1}{4}$ S8 in E. half; from which
	A cedar, 8 ins. <sup>in</sup> diam, brs. S. $10^{\circ}$ E., 115 lks. dist., marked $\frac{1}{4}$ S8 BT.
	A cedar, 6 ins. <sup>in</sup> diam, brs. S. $24^{\circ}$ W., 270 lks. dist., marked $\frac{1}{4}$ S7 BT.
47.95	Spur ridge, brs. E. and W. Desc. S. slope 55 ft.
55.10	Gulch, course W. Asc. N. slope 35 ft.
57.80	Spur ridge, brs. E. and W. Desc. SW. slope 30 ft.
61.40	Gulch, course NW. Asc. NE. slope 30 ft.
63.80	Ridge, brs. NW. and SE. Desc. SW. slope 135 ft. Leave dense undergrowth, brs. NW. and SE.
74.40	Wash, 5 lks. wide, course SW.; thence along W. slope
80.00	Set an iron post, 3 ft. long, 2 ins. <sup>in</sup> diam, 24 ins. in the ground, for cor. of secs. 7, 8, 17, and 18, marked on brass cap, 1912;



## Subdivision of T23N, R5W.

Chains	
	T23N R5W in N. half; S7 in NW., S8 in NE., S17 in SE., and S18 in SW. quadrant; from which A cedar, 8 ins. <sup>m</sup> diam., brs. S. 19° E., 74 lks. dist. marked T23N R5W S17 BT. No other trees within limits. Raise a mound of stone, 2 ft. base, 1½ ft. high, W. of cor. Pits impracticable. Land, rolling and hilly. Soil, volcanic, very rocky, 4th rate. Timber, scrub cedar. Undergrowth, scrub cedar and sagebrush. Dec. 14, 1912.
	Dec. 15, 1912.
	N89° 58' E., on a random line, bet. secs. 8 and 17.
40.00	Set temp. ¼ sec. cor.
80.00	Intersect the N. and S. line, 19 lks. N. of the cor. of secs. 8, 9, 16 and 17,
	Thence I run N89° 54' W., on a true line, bet. secs. 8 and 17. Over rolling, rocky land, through dense cedar timber and undergrowth. Asc. SE. slope 50 ft.
18.00	Top of asc., thence along rocky, S. slope
24.00	Desc. SW. slope 35 ft.
27.50	Wash, course SE. Asc. SE. slope 50 ft.
31.95	Top of asc.
37.25	Head of draw, course S.
40.00	Set an iron post, 3 ft. long, 1 in. <sup>m</sup> diam., 26 ins. in the ground, for ¼ sec. cor., marked on brass cap, 1912; ¼ S8 in N. and ¼ S17 in S. half; from which A cedar, 5 ins. <sup>m</sup> diam., brs. N39° W., 122 lks. dist., marked ¼ S8 BT. A cedar, 10 ins. <sup>m</sup> diam., brs. S12° W., 95 lks. dist., marked ¼ S17 BT.
70.00	Desc. SW. slope 35 ft.
72.80	Draw, course S. Asc. SE. slope 30 ft.
77.95	Spur ridge, brs. N. and S.; thence over rolling land.
80.00	The cor. of secs. 7, 8, 17, and 18. Land, rolling and hilly. Soil, volcanic, very rocky, 4th rate. Timber, scrub cedar. Undergrowth, sagebrush.

NOTE: At 9 h. 30 m. a.m. l.m.t., I set off 35° 23½' N. on the  
lat. arc; 23° 15' S. on the decl. arc and determine a  
mer. at the cor. of secs. 7, 8, 17 and 18.

	Thence I run West, on a true line, bet. secs. 7 and 18, Over rolling, rocky land, through scattering cedar tim- ber and sagebrush undergrowth. Desc. SW. slope 205 ft.
10.80	Wash, 10 lks. wide, course S. Asc. SE. slope 25 ft.
13.50	Thence along rocky, S. slope.
19.90	Sandstone quarry, brs. S40° W about 16 chains dist.
32.05	Sandstone quarry, brs. S. 16° E.
38.65	Wash, 8 lks. wide, course SE.
40.00	Set an iron post, 3 ft. long, 1 in. <sup>m</sup> diam., 26 ins. in the ground, for ¼ sec. cor., marked on brass cap, 1912; ¼ S7 in N. and ¼ S18 in S. half; and raise a mound of stone, 2 ft. base, 1½ ft. high, N. of cor. Pits impracticable.
59.20	Wash, 3 lks. wide, course S.
73.40	Wash, 5 lks. wide, course SE.
79.13	Intersect the W. bdy. of the Tp., 3.56 chs. S. of the cor. of secs. 7, 12, 13 and 18, which is a sandstone 8X8X6 in. above ground, marked and witnessed as described by the Surveyor General. At the point of intersection, I set an iron post, 3 ft.

## Subdivision of T23N. R5W.

Chains	<p>long, 2 ins.<sup>in</sup> diam, 24 ins. in the ground, for closing cor. of secs. 7, and 18, marked on brass cap, 1912;  CC, W. of center  T23N in N.;  S12, S13, R6W in W. half;  S7 in NE. and  S18<sup>R5W</sup> in SE. quadrant;  And raise a mound of stone, 2 ft. base, 1½ ft. high, E. of cor. Pits impracticable.  Land, level and rolling.  Soil, very rocky, 4th rate, sandstone formation.  Timber, scrub cedar.  Undergrowth, scattering sagebrush.  Dec. 15, 1912.</p>
.95	Dec. 14, 1912.
9.50	SO° 3' E., bet. secs. 17 and 18.
35.75	Over rolling land, through scattering cedar, timber and sagebrush undergrowth.
40.00	Desc. S. slope 280 ft. Slope changes to SE. Chino Wash 30 lks. wide, course SW.
	Set an iron post, 3 ft. long, 1 in. <sup>in</sup> diam, 26 in. in the ground, for ¼ sec. cor., marked on brass cap, 1912; ¼ S18 in W. and ¼ S17 in E. half; And raise a mound of stone, 2 ft. base, 1½ ft. high, W. of cor. Pits impracticable. Dec. 14, 1912.
53.50	Dec. 15, 1912.
56.00	Road, brs. NW. and SE.
65.95	Asc. N. slope 50. ft..
80.00	Top of asc. ; thence over level land.
	Set an iron post, 3 ft. long, 2 ins. <sup>in</sup> diam, 24 ins. in the ground, for cor. of secs. 17, 18, 19, and 20, marked on brass cap, 1912; T23N R5W in N. half; S18 in NW., S17 in NE., S20 in SE., and S19 in SW. quadrant; from which A cedar, 16 ins. <sup>in</sup> diam, brs. N. 82° E., 128 lks. dist., marked T23N R5W S17 BT. A cedar, 10 ins. <sup>in</sup> diam, brs. N. 52° W., 151 lks. dist., marked T23N R5W S18 BT. No other trees within limits. Raise a mound of stone, 2 ft. base, 1½ ft. high, W. of cor. Pits impracticable. Land, rolling and mountainous. Soil, Volcanic, very rocky, 4th rate. Timber, scattering scrub cedar. Undergrowth, sagebrush. Mountainous land; 10 chains.
40.00	S89° 54' E., on a random line, bet. secs. 17, and 20.
79.90	Set temp. ¼ sec. cor. Intersect N. and S. line, 12 lks. S. of cor. of secs. 16, 17, 20 and 21, Thence I run, N89° 59' W., on a true line, bet. secs. 17 and 20.
33.60	Over rolling, rocky land, through sagebrush undergrowth.
39.95	Road, brs. N. and S. Set an iron post, 3 ft. long, 1 in. <sup>in</sup> diam, 26 ins. in the ground, for ¼ sec. cor., marked on brass cap, 1912; ¼ S17 in N. and ¼ S20 in S. half; And raise a mound of stone, 2 ft. base, 1½ ft. high, N. of cor. Pits impracticable. Wash, 2 lks. wide, course N. Old road, brs. N. and S. The cor. of secs. 17, 18, 19 and 20.
54.60	
55.15	
79.90	

Chains	<p>Land, level and rolling. Soil, rocky, 4th rate. No timber. Undergrowth, sagebrush.</p>
NOTE	<p>At the cor. of secs. 17, 18, 19. and 20, I set off 23°16'S. on the decl. arc; and at noon, I observed the sun on the meridian. The resulting lat. is 35°22½'N, which is slightly less than the correct lat.</p>
40.00	<p>West, on a true line, bet. secs. 18 and 19. Over rolling land, through scattering cedar timber. Set an iron post, 3 ft. long, 1 in. diam, 26 ins. in the ground, for ¼ sec. cor., marked on brass cap, 1912; S18 in N. and S19 in S. half; And raise a mound of stone, 2 ft. base, 1½ ft. high, N. of cor. Pits impracticable. Desc. NW. slope 130 ft. Foot of desc., thence over rolling land. Chino Wash, 55 lks. wide, course SW. Wire fence, brs. N. and S. Intersect the W. bdy. of the Tp., 3.45 chains S. of the cor. of secs. 13, 18, 19 and 24, which is a sandstone 12X6X6 in. above ground, marked and witnessed as described by the Sureveyor General. At the point of intersection, I set an iron post, 3 ft. long, 2 ins. diam, 24 ins. in the ground, for closing cor. of secs. 18 and 19, marked on brass cap, 1912; CC, W. of center T23N in N., S13, S24, R6W in W. half; S18 in NE. and S19 in SE. quadrant; And raise a mound of stone, 2 ft. base, 1½ ft. high, E. of cor. Pits impracticable. Land, rolling and hilly. Soil, rocky, 3rd and 4th rate. Timber, few scrub cedar trees. Undergrowth, sagebrush.</p>
61.90	
64.15	
77.99	
79.18	
40.00	<p>S0° 3'E, bet. secs. 19 and 20. Over gently rolling land, through scattering cedar and sagebrush undergrowth. Set an iron post, 3 ft. long, 1 in. diam, 26 ins. in the ground, for ¼ sec. cor., marked on brass cap, 1912; S19 in W. and S20 in E. half; And raise a mound of stone, 2 ft. base, 1½ ft. high, W. of cor. Pits impracticable. Desc. SE. slope 25 ft. Leave cedar timber, brs. E. and W. Foot of desc.; thence over level land. Road, brs. NE. and SW. Set an iron post, 3 ft. long, 2 ins. diam, 24 ins. in the ground, for cor. of secs. 19, 20, 29 and 30., marked on brass cap, 1912; T23N R5W in N. half: S19 in NW., S20 in NE., S29 in SE. and S30 in SW. quadrant. and raise a mound of stone, 2 ft. base, 1½ ft. high, W. of cor. Pits impracticable. Land, level and rolling. Soil, very rocky, 4th rate. Timber scattering scrub cedar. Undergrowth, sagebrush.</p>
64.00	
70.00	
79.08	
80.00	

## Subdivision of T23N, R5W.

*H.N.B.*  
 Chains 88° 59' E, on a random line, bet. secs. 20 and 29.  
 40.00 Set temp.  $\frac{1}{4}$  sec. cor.  
 79.92 Intersect the N. and S. line 2 lks. S. of the cor. of  
 secs. 20, 21, 28 and 29,  
 Thence I run  
 West, on a true line, bet. secs. 20 and 29  
 Desc. rocky, W. slope 80 ft. to sagebrush undergrowth.  
 15.00 Foot of desc.; thence over level land.  
 17.05 Road, brs. N. and S.  
 17.52 Wash, 10 lks. wide, 2 ft. deep, course SW.  
 23.95 Wash, 20 lks. wide, 1 ft. deep, course SW.  
 39.96 Set an iron post, 3 ft. long, 1 in. diam, 26 ins. in the  
 ground, for  $\frac{1}{4}$  sec. cor., marked on brass cap, 1912;  
 $\frac{1}{4}$ S20 in N. and  
 $\frac{1}{4}$ S29 in S. half;  
 Dig pits 18X18X12 ins., E. and W. of post, 3 ft. dist.,  
 and raise a mound of earth,  $3\frac{1}{2}$  ft. base,  $1\frac{1}{2}$  ft. high, N.  
 of cor.  
 79.00 Wash, course SW.  
 79.92 The cor. of secs. 19, 20, 29 and 30.  
 Land, level and rolling,  
 Soil, 3rd and 4th rate sandy loam, rocky in places.  
 No timber.  
 Undergrowth, sagebrush.

*H.N.B.*

*W.B.K.*  
 West, on a true line, bet. secs. 19 and 30  
 Over gently rolling land, through sagebrush undergrowth  
 Road, brs. NE. to SW.  
 .17 Asc. E. slope 55 ft.  
 6.00 Top of asc., thence over level land  
 21.95 Edge of rim rock, desc. W. slope 30 ft.  
 26.35 Foot of desc. Over level land.  
 33.85 Set an iron post, 3 ft. long, 1 in. diam, 26 ins. in  
 40.00 the ground, for  $\frac{1}{4}$  sec. cor., marked on brass cap, 1912;  
 $\frac{1}{4}$ S19 in N. and  
 $\frac{1}{4}$ S30 in S. half;  
 And raise a mound of stone, 2 ft. base,  $1\frac{1}{2}$  ft. high, N.  
 of cor. Pits impracticable.  
 46.00 Asc. a cliffy NE. slope 205 ft.  
 57.30 Top of rocky butte.  
 57.90 Desc. rocky NW. slope 130 ft.  
 66.95 Foot of desc.; thence over level land.  
 79.18 Intersect the W. bdy. of the Tp, 3.34 chs. S. of the <sup>OLD</sup> cor.  
 of secs. 19, 24, 25 and 30, which is a lava rock, 5X9X10 ins.,  
 above ground, marked and witnessed as described by the  
 Surveyor General.  
 At the point of intersection, set an iron post, 3 ft.  
 long, 2 ins. diam, 24 ins. in the ground, for closing  
 cor. of secs. 19 and 30, <sup>T23N, R5W</sup> marked on brass cap, 1912;  
 CC, W. of center  
 T23N in N.  
 S24, S25, R6W in W. half;  
 S19 in NE. and  
 S30 <sup>R5W</sup> in SE. quadrant;  
 And raise a mound of stone, 2 ft. base,  $1\frac{1}{2}$  ft. high,  
 E. of corner. Pits impracticable.  
 Land, rolling and mountainous.  
 Soil, rocky, 4th rate.  
 No timber.  
 Undergrowth, scattering sagebrush and cacti.  
 Dec. 15, 1912.

*W.B.K.*

*H.N.B.* Dec. 16, 1912, At 7h 55m a.m., l.m.t., I set off 35° 21 $\frac{1}{2}$ ' N.  
 on the lat. arc; 23° 15 $\frac{1}{2}$ ' S. on the decl. arc; and deter-  
 mine a meridian with the solar, at the cor. of secs. 19, 20,  
 29 and 30.  
 Thence I run,  
 S0° 3' E., bet secs. 29 and 30.  
 Over level land, through sagebrush undergrowth.  
 1.00 Wash, 10 lks. wide, 3 ft. deep, course SSW.  
 17.10 Wash, 20 lks. wide, 3 ft. deep, course SW.  
 40.00 Set an iron post, 3 ft. long, 1 in. diam, 26 ins. in the

Chains.

80.00

ground, for  $\frac{1}{4}$  sec. cor., marked on brass cap, 1912;  
 $\frac{1}{4}$ S30 in W. and  
 $\frac{1}{4}$ S29 in E. half;  
 And raise a mound of stone, 2 ft. base,  $1\frac{1}{2}$  ft. high, W.  
 of cor. Pits impracticable.  
 Set an iron post, 3 ft. long, 2 ins. in diam, 24 ins. in  
 the ground, for cor. of secs. 29, 30, 31 and 32, marked  
 on brass cap, 1912;  
 T23N R5W in N. half;  
 S30 in NW,  
 S29 in NE,  
 S32 in SE. and  
 S31 in SW. quadrant;  
 Dig pits, 18X18X12 ins., in each sec.,  $5\frac{1}{2}$  ft. dist.; and  
 raise a mound of earth, 4 ft. base, 2 ft. high, W of  
 cor.  
 Land, level and rolling.  
 Soil, sandy loam, 3rd and 4th rate, rocky in places.  
 No timber.  
 Undergrowth, sagebrush.

40.00

79.98

East, on a random line, bet. secs. 29 and 32.  
 Set temp.  $\frac{1}{4}$  sec. cor.  
 Intersect N. and S. line, 2 lks. N. of the cor. of  
 secs. 28, 29, 32, and 33,

39.99

79.98

Thence I run  
 N89° 59' W, on a true line, bet. secs. 29 and 32.  
 Over level land, no timber, through sagebrush under-  
 growth.  
 Set an iron post, 3 ft. long, 1 in. in diam, 26 ins. in  
 the ground, for  $\frac{1}{4}$  sec. cor., marked on brass cap, 1912;  
 $\frac{1}{4}$ S29 in N. and  
 S32 in S half;  
 Dig pits 18X18X12 ins., E. and W. of post, 3 ft. dist.,  
 and raise a mound of earth,  $3\frac{1}{2}$  ft. base  $1\frac{1}{2}$  ft. high.  
 N. of cor.  
 The cor. of secs. 29, 30, 31, and 32.  
 Land, level.  
 Soil, good sandy loam, 3rd rate.  
 No timber.  
 Undergrowth, sagebrush.

17.80

20.00

35.00

40.00

West, on a true line, bet. secs. 30 and 31  
 Over rolling land, through sagebrush undergrowth.  
 Road, brs. N. and S.  
 Asc. NE. slope 55 ft.  
 Top of hill, desc. W. slope.  
 Set an iron post, 3 ft. long, 1 in. in diam, 26 ins. in  
 the ground, for  $\frac{1}{4}$  sec. cor., marked on brass cap, 1912;  
 $\frac{1}{4}$ S30 in N. and  
 S31 in S. half;

46.00

60.00

79.21

And raise a mound of stone, 2 ft. base,  $1\frac{1}{2}$  ft. high,  
 N. of cor. Pits impracticable.  
 Gulch, course S., thence over rolling land.  
 Thence over level land.  
 Intersect the W. bdy. of the Tp., 3.31 chains S. 0° 2' E. of  
 the cor. of secs. 25, 30, 31 and 36,  
 which is a stone  
 8X6X6 in. above ground, marked and witnessed as  
 described by the Surveyor General.  
 At the point of intersection set an iron post, 3 ft.  
 long, 2 ins. in diam, 24 ins. in the ground, for closing  
 cor. of secs. 30 and 31, marked on brass cap, 1912;  
 CC, W. of center.  
 T23N in N.  
 S25, S36, R6W in W. half;  
 S30 in NE. and  
 S31 in SE. quadrant;  
 And raise a mound of stone, 2 ft. base  $1\frac{1}{2}$  ft. high, E.  
 of cor. Pits impracticable.  
 Land, level, rolling and hilly.

Chains.

Soil, rocky, 4th rate.  
No timber.  
Undergrowth, sagebrush.

- 40.00 S0°3'E, bet. secs. 31 and 32  
Over level land, <sup>through</sup> sagebrush undergrowth.  
Set an iron post, 3 ft. long, 1 in. diam, 26 ins. in the ground, for  $\frac{1}{4}$  sec. cor., marked on brass cap, 1912;  
 $\frac{1}{4}$ S31 in W. and  
S32 in E. half;  
Dig pits 18X18X12 ins., N. and S. of post, 3 ft. dist., and raise a mound of earth,  $3\frac{1}{2}$  ft. base,  $1\frac{1}{2}$  ft. high, W. of cor.
- 66.50 Wash, 25 lks. wide, 4 ft. deep, course SW.
- 71.40 Wash, 5 lks. wide, 4 ft. deep, course SW.
- 77.11 Intersect the S. bdy. of the Tp., at a point from which the cor. of secs. 5 and 6 <sup>T23N, R5W</sup> brs. N. 99° 20' W., 1.44 chains dist.  
This cor. reestablished Dec. 3, 1912 as described in book "O", page 2.  
At the point of intersection, I set an iron post 3 ft. long, 2 ins. in diam, 24 ins. in the ground, for closing cor. of secs. 31 and 32 <sup>T23N, R5W</sup> marked on brass cap, 1912;  
CC, N. of center.  
T23N in N.  
T22N S5 and S6 in S. and  
R5W in W. half;  
S31 in NW. and  
S32 in NE. quadrant;  
Dig pits 24X18X12 ins. crosswise on each line, E. and W. 3 ft. dist. and N. of post, 7 ft. dist., and raise a mound of earth, 4 ft. base, 2 ft. high, N. of cor.  
Land, level.  
Soil, good sandy loam, 3rd rate.  
No timber.  
Undergrowth sagebrush.

Dec. 16 1912.

H.N.B.

## General Description.

Generally rolling, covered with basalt boulders and patches of heavy scrub cedar. Soil mostly clay and gumbo. Drains to the SW. a few patches of good soil along Chino Wash. No settlers. Subsoil mostly caliche or hard pan.

*William B. Kimmel*

U. S. Surveyor.

*John B. Bradstreet*

U. S. Transitman.

FOR FINAL OATH OF UNITED STATES SURVEYOR. & TRANSITMAN

see Book " L "

(Subdivisions E 1/2 T.25 N., R.17 W.)

I, \_\_\_\_\_, U. S. Surveyor, do solemnly swear that, in pursuance of special instructions received from the U. S. Surveyor General for \_\_\_\_\_ bearing date of the \_\_\_\_\_ day of \_\_\_\_\_, 191\_\_\_\_, I have well, faithfully, and truly, in my own proper person, and in strict conformity with said instructions, the Manual of Surveying Instructions, and the laws of the United States, surveyed all those parts or portions of \_\_\_\_\_ of the \_\_\_\_\_ Meridian, in the State of \_\_\_\_\_, which are represented in the foregoing field notes as having been executed by me, and under my direction; and I do further solemnly swear that all the corners of said survey have been established and perpetuated in strict accordance with the Manual of Surveying Instructions, and the special written instructions of the U. S. Surveyor General for \_\_\_\_\_ and in the specific manner described in the field notes, and that the foregoing are the original field notes of such survey.

U. S. Surveyor.

Subscribed by said \_\_\_\_\_, and sworn to before me }  
 this \_\_\_\_\_ day of \_\_\_\_\_, 191\_\_\_\_



APPROVAL.

OFFICE OF THE UNITED STATES SURVEYOR GENERAL,

Phoenix Arizona OCT 5 1914, 191

The foregoing field notes of the survey of the Subdivision lines of  
 \_\_\_\_\_  
Township No.23 North Range No.5 West  
 \_\_\_\_\_  
of the Gila and Salt River Base and Meridian  
 \_\_\_\_\_  
Arizona

executed by William B.Kimmel, U.S.Surveyor & H.N.Bradstreet, U.S.Transitman  
 under ~~the~~ <sup>their</sup> special instructions dated October 18, 1912 for Group 24/401, having been critically examined, and the necessary corrections and explanations made, the said field notes, and the surveys they describe, are hereby approved.

*Frank Ingalls*  
 U. S. Surveyor General.  
 of Arizona

~~I certify that the foregoing transcript of the field notes of the above described surveys in~~  
 \_\_\_\_\_, has been correctly copied from the original notes on file in this office.

~~U. S. Surveyor General.~~