

2683

4-679

2683

UGL-1913  
Accepted GLO. letter "E"  
Apr. 28-1915 66

①

BOOK E  
Subdivisions  
FIELD NOTES

BOOK 2683

OF THE SURVEY OF THE

*Subdivision lines of*

*FRACTIONAL  
TOWNSHIP 22 NORTH, RANGE 6 WEST*

*of the Gila & Salt River Base & Meridian,*

*In the State of ARIZONA*

EXECUTED BY

*H. N. BRADSTREET, U.S. Transitman*

*&*

*WILLIAM B. KIMMEL, U.S. Surveyor*

*In the capacity of U.S. Surveyor, under instructions dated October 18, 1912,*

*issued by the United States Surveyor General to govern surveys included in  
Group No. 24, which were approved by the Commissioner of the General Land  
Office, November 5, 1912, pursuant to authority contained in the Act of  
Congress dated June 25, 1910.*

*Survey commenced January 31, 1913*

*Survey completed February 14, 1913*

BOOK 2683

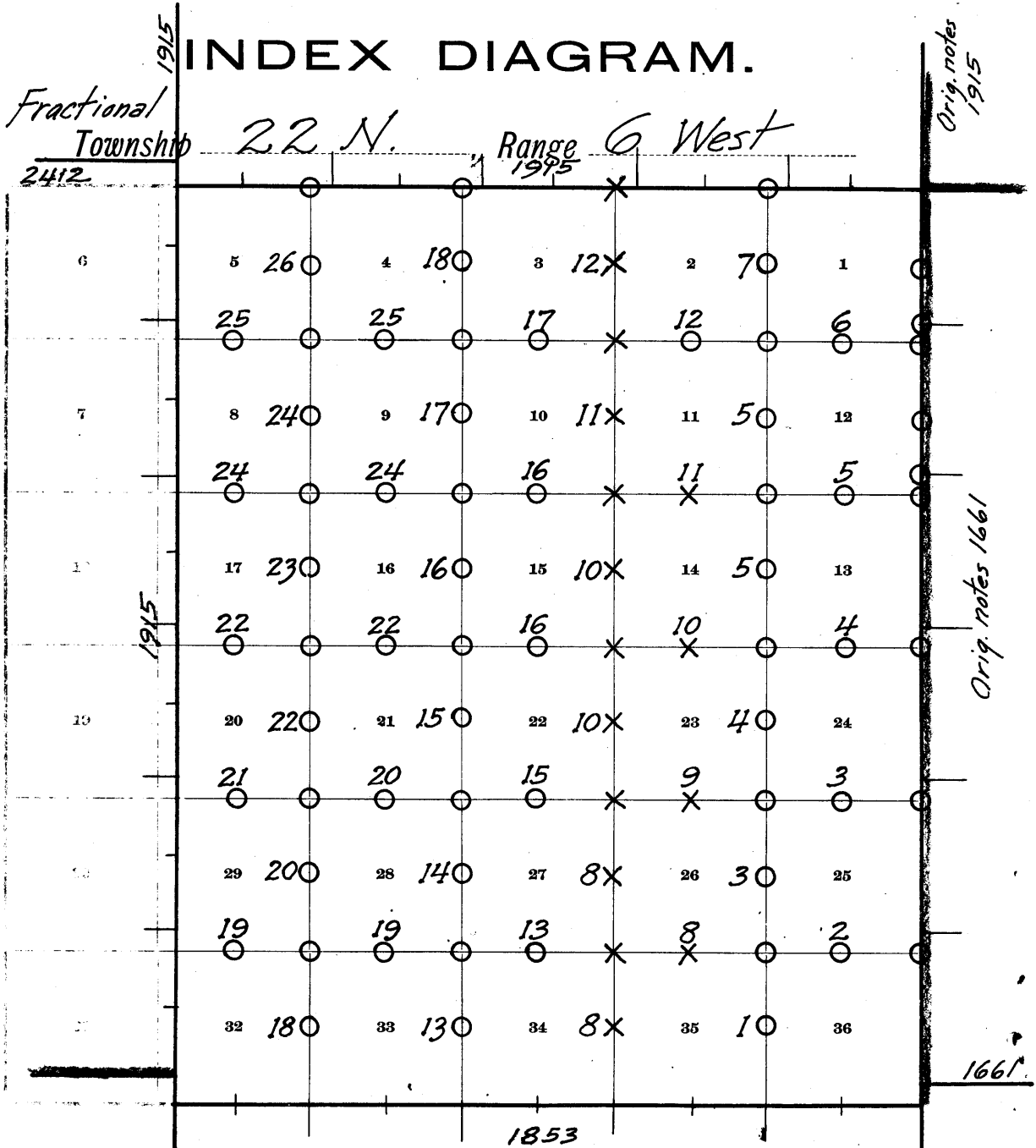

X Corners set by W.B. Kimmel  
 O " " " H.N. Bradstreet

— Book "M" (EXTERIORS)  
 — Book "O" (RESURVEYS & RETRACEMENTS)

FRACTIONAL  
Subdivision of T. 22 N., R. 6 W.

(18)

Chains

Survey commenced Jan. 31, 1913, and executed with Young and Sons Light Mountain Transits Nos. 7695 and 8541, with Smith Solar Attachments. For description of instruments and certificate of approval, see book "O", page 1.

We examine the adjustments of the transits and correct all errors: then to test the solar apparatuses, by comparing their indications, resulting from a.m. and p.m. observations, with a meridian determined by observations on Polaris, we proceed as follows:-

At our camp, in the SE.  $\frac{1}{4}$  of sec. 24, T. 22 N., R. 7 W., in lat.  $35^{\circ}16\frac{1}{2}'N.$ , long.  $112^{\circ}57'W.$ , at 10 hrs. 40 m. p. m., l.m.t., by our watches, which are set to correct local mean time, we observe Polaris at Western elongation, in accordance with the Manual of instructions, and mark a point in the line thus determined by a chaining pin stuck in the ground, 10 chs. N. of our station.

Feb. 1, 1913: At 7 hrs. 45 m. a.m., l.m.t., we set off the azimuth of Polaris,  $1^{\circ}25'$  to the East, and mark the meridian thus determined by a tack in a nub, 10 chs. N. of our station.

At 7 hrs. 59 m. a.m., l.m.t., we set off  $35^{\circ}16\frac{1}{2}'N.$  on the lat. arc;  $17^{\circ}06'S.$  on the decl. arc; and determine a mer. with transit No. 7695. The line thus determined brs.  $\frac{1}{2}'W.$  of the meridian determined by Polaris observation.

At 8 hrs. 3 m., a.m., l.m.t., using the same settings for the lat. and decl. arcs, we determine a meridian with transit No. 8541. The line thus determined coincides with the established meridian.

At 12 hrs. 14 m., p.m., l.m.t., we set off  $17^{\circ}4\frac{1}{2}'S.$  on the decl. arc; and observe the sun on the meridian; the resulting latitudes with both transits is  $35^{\circ}16\frac{1}{2}'N.$ , which is the correct lat.

At 3 hrs. 30 m., p.m., l.m.t., we set off  $35^{\circ}16\frac{1}{2}'N.$  on the lat. arc;  $17^{\circ}1\frac{1}{2}'S.$  on the decl. arc; and determine a mer. with transit No. 7695. The line thus determined brs.  $\frac{1}{2}'E.$  of the meridian determined by Polaris observation.

Using the same settings for the lat. and decl. arc, we determine a mer. with transit No. 8541, at 3 hrs. 35 m. p.m., l.m.t. The line thus determined coincides with the established meridian.

From these tests, we conclude that the adjustment of the transits are satisfactory. Feb. 1, 1913.

NOTE:- Initials "W.B.K." and "H.N.B." throughout the following notes, indicate surveys by William B. Kimmel, U.S. Surveyor and H.N. Bradstreet, U.S. Transitman, respectively.

H.N.B.

Feb. 3, 1913. At 8 hrs. 35 m., a.m., l.m.t., I set off  $35^{\circ}15'N.$  on the lat. arc;  $16^{\circ}31\frac{1}{2}'S.$  on the decl. arc; and determine a mer. with the solar at the cor. of secs. 1, 2, 35 and 36, on the south Bdy. of the Tp., which is a sandstone, 6 X 10 X 5 ins. above ground, marked and witnessed as described by the Surveyor General.

Thence I run,

North, on a sectional guide meridian, bet. secs. 35 and 36.

Asc. SE. slope, 280 ft., over limestone boulders, through scattering timber and undergrowth.

12.48 Foot of limestone cliff, 20 ft. high, brs. NE. and SW.

FRACTIONAL

Subdivision of T. 22 N., R. 6 W.

Chains

15.00	Top of asc.; east side of mountain. Desc. NE. slope, 335 ft.
28.00	Enter heavy timber, brs. NW. and SE.
34.00	Leave timber, brs. NW. and SE.
35.50	Foot of desc.; thence along level valley, brs. N.
38.	Broken dirt dam, brs. E. $1\frac{1}{2}$ chs. dist.
40.00	Set an iron post, 3 ft. long, 1 in. diam, 26 ins. in the ground, for $\frac{1}{4}$ sec. cor., marked on brass cap, 1913; $\frac{1}{4}$ S35 in W. and S36 in E. half; from which A pinion, 16 ins. diam, brs. S. $67\frac{3}{4}$ E., 807 lks. dist., marked $\frac{1}{4}$ S36 BT. A pinion, 20 ins. diam, brs. S. $34\frac{3}{4}$ W., 804 lks. dist., marked $\frac{1}{4}$ S35 BT.
80.00	Set an iron post, 3 ft. long, 2 ins. diam, 24 ins. in the ground, for cor. of secs. 25, 26, 35 and 36, marked on brass cap, 1913; T22N R6W in N. half; S26 in NW., S25 in NE., S36 in SE. and S35 in SW. quadrant; And raise a mound of stone, 2 ft. base, $1\frac{1}{2}$ ft. high, W. of cor. Pits impracticable. Land, mountainous and level. Soil, rocky 4th rate, limestone formation on mountain; gumbo, 3rd rate, rocky on flat. Timber, cedar and pinion. Undergrowth, scrub oak.
	Knowing that it will be necessary to set closing cors. against the E. bdy. of the Tp., I run East, on a true line, bet. secs. 25 and 36. Asc. W. slope, 150 ft.
22.00	Top of asc.; thence along S. slope.
26.00	Desc. slight SE. slope.
40.00	Set an iron post, 3 ft. long, 1 in. diam, 26 ins. in the ground, for $\frac{1}{4}$ sec. cor., marked on brass cap, 1913; $\frac{1}{4}$ S25 in N. and S36 in S. half; And raise mound of stone, 2 ft. base, $1\frac{1}{2}$ ft. high, N. of cor. Pits impracticable. Asc. W. slope, 30 ft. Desc. E. slope, 70 ft.
46.00	Intersect the E. bdy of the Tp., at a point from which the cor. of secs. 25, 30, 31 and 36, which is a stone, described in book "O", page 8, brs. N. $0^{\circ}22'W.$ , 4.47 chs. dist.
80.70	At the point of intersection, I set an iron post, 3 ft. long, 2 ins. dia., 24 ins. in the ground, for closing cor. of secs. 25 and 36, marked on brass cap, 1913; CC, E. of center; T22N in N., and S30, S31, R5W in E. half; S25 in NW., and S36, R6W in SW. quadrant; And raise a mound of stone, 2 ft. base, $1\frac{1}{2}$ ft. high, W. of cor. Pits impracticable. Land, rolling and hilly. Soil, sandy loam, 3rd rate, and rocky 4th rate gumbo. No timber, or undergrowth.
NOTE:	At this corner, I set off $16^{\circ}30'S.$ on the decl. arc; and at noon I observe the sun on the meridian; the resulting lat. is $35^{\circ}15\frac{1}{2}'N.$ , which is slightly less than the correct lat.

Chains.		
<p>8.00 40.00  68.00 74.00 80.00</p>	<p>North, on sectional guide meridian, bet. secs. 25 and 26. Over level land. Leave level land, thence over rolling land. Set an iron post, 3 ft. long, 1 in. <sup>indiam</sup>, 26 ins. in the ground, for <math>\frac{1}{4}</math> sec. cor., marked on brass cap, 1913; <math>\frac{1}{4}</math>S26 in W. and S25 in E. half; Dig pits, 18 X 18 X 12 ins., N. and S. of post, 3 ft. dist.; and raise a mound of earth, <math>3\frac{1}{2}</math> ft. base, <math>1\frac{1}{2}</math> ft. high, W. of cor. Asc. SW. slope, 40 ft. Enter scattering timber, brs. NW. and SE. Set an iron post, 3 ft. long, 2 ins. <sup>indiam</sup>, 24 ins. in the ground, for cor. of secs. 23, 24, 25 and 26, marked on brass cap, 1913; T22N R6W in N. half; S23 in NW., S24 in NE., S25 in SE. and S26 in SW. quadrant; from which A cedar, 10 ins. <sup>indiam</sup>, brs. N. <math>14\frac{1}{4}</math> E., 117 lks. dist., marked T22N R6W S24 BT. A cedar, 8 ins. <sup>indiam</sup>, brs. S. <math>58\frac{3}{4}</math> E., 20 lks. dist., marked T22N R6W S25 BT. A cedar, 8 ins. <sup>indiam</sup>, brs. S. <math>71\frac{1}{4}</math> W., 168 lks. dist., marked T22N R6W S26 BT. A cedar, 8 ins. <sup>indiam</sup>, brs. N. <math>50\frac{3}{4}</math> W., 150 lks. dist., marked T22N R6W S23 BT. Land, level and rolling. Soil, gumbo, 3rd rate. Timber, scattering scrub cedar.</p>	
<p>6.00 24.00 40.00  70.00 80.00 81.88</p>	<p>East, on a true line, bet. secs. 24 and 25. Asc. steep rocky W. slope, 70 ft., through scattering timber. Leave timber, brs. N. and S. Top of asc.; thence across level mesa. Set an iron post, 3 ft. long, 1 in. <sup>indiam</sup>, 26 ins. in the ground, for <math>\frac{1}{4}</math> sec. cor., marked on brass cap, 1913; <math>\frac{1}{4}</math>S24 in N. and S25 in S. half; And raise amount of stone, 2 ft. base, <math>1\frac{1}{2}</math> ft. high, N. of cor. Pits impracticable. Desc. SE. slope, 40 ft. Centre of draw, 2 chs. wide, course NE. Intersect the E. bdy. of the Tp., at a point from which the <sup>cor.</sup> of secs. 19, 24, 25 and 30, which is malpais stone, described in book "O", page 8, brs. N. <math>0^{\circ}40'</math> E., 4.72 chs. dist. At the point of intersection, I set an iron post, 3 ft. long, 2 ins. <sup>indiam</sup>, 24 ins. in the ground, for closing cor. of secs. 24 and 25, <sup>T22N R6W</sup> marked on brass cap, 1913; CC, E. of center; T22N in N. and S19, S30, R5W in E. half; S24 in NW. and S25, R6W in SW. quadrant; And raise amount of stone, 2 ft. base, <math>1\frac{1}{2}</math> ft. high, W. of cor. Pits impracticable.</p>	<p>Feb. 3, 1913.</p>
	<p>Feb. 4, 1913, At 8 hrs. 20 m. a.m., l.m.t., I set off <math>35^{\circ}16\frac{1}{2}'</math> N. on the lat. arc; <math>15^{\circ}13\frac{1}{2}'</math> S. on the decl. arc; and determine a meridian with the solar at the cor. secs. 23, 24, 25 and 26, Thence I run,</p>	

4

FRACTIONAL  
Subdivision of T. 22 N., R. 6 W.

Chains.

North, on sectional guide meridian, bet. secs. 23 and 24. Along, W. slope, through scattering timber.

6.00 Leave timber, brs. E. and W. Desc. NW. slope, 40 ft.

13.00 Gulch, 15 lks. wide, course W. Asc. SW. slope, 40 ft.

40.00 Set an iron post, 3 ft. long, 1 in. <sup>indian</sup>, 26 ins. in the ground, for  $\frac{1}{4}$  sec. cor., marked on brass cap, 1913;  $\frac{1}{4}$ S23 in W. and S24 in E. half; And raise a mound of stone, 2 ft. base, 1 $\frac{1}{2}$  ft. high, W. of cor. Pits impracticable.

44.00 Desc. NW. slope, 35 ft.

49.50 Wash, 15 lks. wide, 4 ft. deep, course W.

59.40 Wash, 5 lks. wide, 2 ft. deep, course W.

74.00 Broken dirt dam, brs. W. 6 chs. dist. Centre of wash, 1 ch. wide, course W.

80.00 Set an iron post, 3 ft. long, 2 ins. <sup>indian</sup>, 24 ins. in the ground, for cor. of secs. 13, 14, 23 and 24, marked on brass cap, 1913; T22N R6W in N. half; S14 in NW., S13 in NE., S24 in SE. and S23 in SW. quadr ant; And raise a mound of stone, 2 ft. base, 1 $\frac{1}{2}$  ft. high, W. of cor. Pits impracticable. Land, rolling. Soil, rocky 4th rate. Timber, scattering scrub cedar.

East, on a true line, bet. secs. 13 and 24. Over rolling land.

8.00 West end of broken dirt dam.

10.00 Centre of dam, brs. S. 1 ch. dist.

28.00 Centre of rocky wash, 1 ch. wide, course WSW.

32.00 Wash, 50 lks. wide, course NW.

36.00 Thence across mesa.

40.00 Set an iron post, 3 ft. long, 1 in. <sup>indian</sup>, 26 ins. in the ground, for  $\frac{1}{4}$  sec. cor., marked on brass cap, 1913;  $\frac{1}{4}$ S13 in N. and S24 in S. half; fr And raise a mound of stone, 2 ft. base, 1 $\frac{1}{2}$  ft. high, N. of cor. Pits impracticable.

78.00 Desc. very slight NE. slope.

82.63 Intersect the E. bdy. of the Tp. at a point from which the <sup>cor.</sup> of secs. 13, 14 and 24, which is a stone, described in book "O", page 7, brs. N. 0° 27' E., 5.01 chs. dist. At the point of intersection, I set an iron post, 3 ft. long, 2 ins. <sup>indian</sup>, 24 ins. in the ground, for closing cor. of secs. 13 and 24, <sup>T22N R6W</sup> marked on brass cap, 1913; CC, E. of center; T22N in N. and S18, S19, R5W in E. half; S13 in NW. and S24, R6W in SW. quadrant; Dig pits, 24 X 18 X 12 ins., crosswise on each line, N. and S. 3 ft., and W. <sup>of 200'</sup> 7 ft. dist.; and raise a mound of earth, 4 ft. base, 2 ft. high, W. of cor. Land, level and rolling. Soil, gravelly loam, 3rd rate; hardpan 8 ins. down. No timber, or undergrowth.

Chains

40.00 North, on sectional guide meridian, bet. secs. 13 and 14.  
Asc. rolling S. slope, 60 ft.  
Set an iron post, 3 ft. long, 1 in. diam., 26 ins. in the ground, for  $\frac{1}{4}$  sec. cor., marked on brass cap, 1913;  
 $\frac{1}{4}$ S14 in W. and  
 $\frac{1}{4}$ S13 in E. half;  
And raise a mound of stone, 2 ft. base,  $1\frac{1}{2}$  ft. high, W. of cor. Pits impracticable.  
Asc. S. slope of mountain, 250 ft.  
52.00 Gulch, 10 fks. wide, course SE.  
72.00 Top of mountain; thence across rocky mesa.  
80.00 Set an iron post, 3 ft. long, 2 ins. diam., 24 ins. in the ground, for cor. of secs. 11, 12, 13 and 14, marked on brass cap, 1913;  
T22N R6W in N. half;  
S11 in NW.,  
S12 in NE.,  
S13 in SE. and  
S14 in SW. quadrant;  
And raise a mound of stone, 2 ft. base,  $1\frac{1}{2}$  ft. high, W. of cor. Pits impracticable.  
Land, mountainous, and rolling.  
Soil, gumbo, 3rd and 4th rate, rocky on mountain.  
No timber, or undergrowth.

NOTE - At this corner, I set off  $16^{\circ}12'S.$  on the decl. arc; and at noon. I observe the sun on the meridian, the resulting lat. is  $35^{\circ}18\frac{1}{2}'N.$ , which is *slightly higher* than the correct lat.

5.00 East, on a true line, bet. secs. 12 and 13.  
Desc. E. slope, 30 ft.  
Head of gulch, 80 fks. wide, course SE. Asc. W. slope, 70 ft.  
15.00 Ridge, brs. NNW. and SSE. Desc. E. slope 230 ft.  
40.00 Set an iron post, 3 ft. long, 1 in. diam., 26 ins. in the ground, for  $\frac{1}{4}$  sec. cor., marked on brass cap, 1913;  
 $\frac{1}{4}$ S12 in N. and  
 $\frac{1}{4}$ S13 in S. half;  
And raise a mound of stone, 2 ft. base,  $1\frac{1}{2}$  ft. high, N. of cor. Pits impracticable.  
60.00 Foot of desc. Thence over level land.  
82.94 Intersect the E. bdy. of the Tp., at a point from which the cor. of secs. 7 and 18, T. 22 N., R. 5 W. reestablished by me Dec. 4, 1912, as described in book "O", page 111, brs. N.  $0^{\circ}16'E.$ , 5.24 chs. dist.  
At the point of intersection, I set an iron post, 3 ft. long, 2 ins. diam., 24 ins. in the ground, for Closing cor. of secs. 12 and 13, <sup>T. 22 N., R. 6 W.</sup> marked on brass cap, 1913;  
CC, E. of center;  
T22N in N. and  
S7, S18, R5W in E. half;  
S12 in NW. and  
S13, R6W in SW. quadrant;  
And raise a mound of stone, 2 ft. base,  $1\frac{1}{2}$  ft. high, W. of cor. Pits impracticable.  
Land, mountainous and rolling.  
Soil, rocky 4th rate.  
No timber or undergrowth.

40.00 North, on sectional guide meridian, bet. secs. 11 and 12.  
Over rolling, rocky mesa.  
Set an iron post, 3 ft. long, 1 in. diam., 26 ins. in the ground, for  $\frac{1}{4}$  sec. cor., marked on brass cap, 1913;

6

FRACTIONAL  
Subdivision of T. 22 N., R. 6 W.

Chains.

$\frac{1}{4}$ S11 in W. and  
S12 in E. half; from which  
A cedar, 8 ins. <sup>in</sup>diam, brs. S. 50° E., 90 lks. dist.,  
marked  $\frac{1}{4}$ S12 BT.  
A cedar, 6 ins. <sup>in</sup>diam, brs. N. 50° W., 157 lks. dist.,  
marked  $\frac{1}{4}$ S11 BT.

Feb. 4, 1913.

Feb. 5, 1913: At 8 hrs. 33 m., a.m., l.m.t., I set off  
35° 18 $\frac{1}{2}$ ' N. on the lat. arc; 15° 56' S. on the decl.  
arc; and determine a meridian with the solar at the  $\frac{1}{4}$  sec.  
sec. cor. bet. secs. 11 and 12, above described.

Thence I continue

North, on sectional guide meridian, bet. secs. 11 and  
12, on N $\frac{1}{2}$  mile.

Over rolling mesa.

44.00 Desc. NW. slope, 100 ft.

58.20 Gulch, 18 lks. wide, course NE. Asc. SE. slope, 70 ft.

64.00 Top of asc.; thence over rolling land.

80.00 Set an iron post, 3 ft. long, 2 ins. <sup>in</sup>diam, 24 ins. in the  
ground, for cor. of secs. 1, 2, 11 and 12, marked on  
brass cap, 1913;

T22N R6W in N. half;

S2 in NW.,

S1 in NE.,

S12 in SE. and

S11 in SW. quadrant; from which

A cedar, 10 ins. <sup>in</sup>diam, brs. S. 22 $\frac{1}{2}$ ° E., 94 lks. dist.,  
marked T22N R6W S12 BT. *No other trees within limits. Pits impracticable, therefore, I  
raise a mound of stone, 2 ft. base, 1 $\frac{1}{2}$  ft. high, W. of cor.*

Land, level and rolling.

Soil, very rocky 4th rate.

Timber, scattering scrub cedar.

East, on a true line, bet. secs. 1 and 12.

Over rolling mesa.

14.00 Desc. SE. slope, 100 ft.

34.00 Foot of steep desc.; leave rocks, brs. N. and S.

40.00 Set an iron post, 3 ft. long, 1 in. <sup>in</sup>diam, 26 ins. in the  
ground, for  $\frac{1}{4}$  sec. cor., marked on brass cap, 1913; $\frac{1}{4}$ S1 in N. and

S12 in S. half;

And raise a mound of stone, 2 ft. base, 1 $\frac{1}{2}$  ft. high, N.  
of cor. Pits impracticable.

82.00 Old cabin, brs. S. 2 chs. dist.

83.40 Intersect the E. bdy. of the Tp., at a point from which  
the cor. of secs. 6 and 7, T22N, R5W brs. N. 0° 16' E., 5.48 chs.  
dist. This cor. of secs. 6 and 7, T22N, R5W is reestablished Dec 4, 1912, as  
described in book "O", page 411.

At the point of intersection, I set an iron post, 3  
ft. long, 2 ins. dia., 24 ins. in the ground, for  
closing cor. of secs. 1 and 12, marked on brass cap, 1913;  
CC, E. of center;

T22N in N. and

S6, S7, R5W in E. half.

S1 in NW. and

S12, R6W in SW. quadrant;

Dig pits, 24 X 18 X 12 ins., N. and S. ~~of cor.~~, 3 ft.,  
and W. <sup>of post</sup>, 7 ft. dist.; and raise a mound of earth, 4  
ft. base, 2 ft. high, W. of cor.

Land, rolling and hilly.

Soil, sandy loam, 2nd rate; and rocky 4th rate.

No timber, or undergrowth.



Chains.

Sinde it will evidently be necessary to set closing corners on the north bdy. of the Tp., I run North, on sectional guide meridian bet. secs. 1 and 2. Across rolling mesa.

10.00 Leave mesa, desc. N. slope, 200 ft.

23.75 Gulch, 8 lks. wide, course NW.

40.00 Set an iron post, 3 ft. long, 1 in. diam, 26 ins. in the ground, for  $\frac{1}{4}$  sec. cor., marked on brass cap, 1913;  $\frac{1}{4}$ S2 in W. and S1 in E. half; And raise a mound of stone, 2 ft. base,  $1\frac{1}{2}$  ft. high, W. of cor. Pits impracticable.

Harvey House, brs. N.  $41^{\circ}26'E$ .  
 Reading Room, brs. N.  $40^{\circ}5'E$ .  
 A. T. & S. F. RR R. Round House, brs. N.  $51^{\circ}2'E$ .  
 Water tank, brs. N.  $55^{\circ}E$ .  
 Oil tank, brs. N.  $63^{\circ}43'E$ .  
 Machine Shop, brs. N.  $52^{\circ}45'E$ .  
 Small water tank, brs. N.  $45^{\circ}45'E$ .

63.25 Road, brs. E. and W. Foot of desc.

68.40 Edge of water, brs. E. and W. Dirt dam, with road across it, brs. N. & S. 10 chs. W. Water extends 15 chs. E. of line. It being impossible to chain across this body of water, I return to

65.31 From this point I set a flag <sup>on line</sup> on the other edge of the water, and run west 10. chs. From this point the flag brs. N.  $31^{\circ}56'E$ , which gives for the dist. 16.04 chs., making the plus to the flag

81.35 A point 125 lks. W. of the water's edge.

85.49 <sup>from which</sup> I intersect the North bdy. of the Tp., at a point the cor. of secs. 35 and 36, which is a malpais stone, 6 X 8 X 6 ins. above ground, marked and witnessed as described by the Surveyor General, brs. E. 3.73 chs. dist.

At the point of intersection, I set an iron post, 3 ft. long, 2 ins. diam, 24 ins. in the ground, for closing cor. of secs. 1 and 2, <sup>T22N. R. 6W.</sup> marked on brass cap, 1913; CC, S. of center; T22N R6W., S35, S36, in N. half; S1 in SE. and S2 in SW. quadrant; And raise a mound of stone, 2 ft. base,  $1\frac{1}{2}$  ft. high, S. of cor. Pits impracticable.

Harvey House, brs. N.  $84^{\circ}15'E$ .  
 Reading Room, brs. N.  $87^{\circ}30'E$ .  
 Round house, brs. S.  $80^{\circ}E$ .  
 Water standpipe, brs. S.  $78^{\circ}2'E$ .  
 Oil tank, brs. S.  $71^{\circ}E$ .  
 Machine shop, brs. S.  $74^{\circ}54'E$ .  
 Small water tank, brs. S.  $84^{\circ}5'E$ .  
 Land, rolling and mountainous.  
 Soil, gumbo, very rocky 4th rate.  
 No timber, or undergrowth.

Feb. 5, 1913.

H.N.B.

W.B.K.

Feb. 3, 1913: At 8 hrs. 32 m., a.m., l.m.t., I set off  $35^{\circ}15'N$ . on the lat. arc;  $16^{\circ}31\frac{1}{2}'S$ . on the decl. arc; and determine a meridian with the solar at the cor. of secs. 2, 3, 34 and 35, on the South Bdy. of the Tp., which is a sandstone, 6 X 12 X 6 ins. above ground, marked and witnessed as described by the Surveyor General.

Chains.	
	Thence I run N. 0° 1' W., bet. secs. 34 and 35. Over gently rolling land, through scattering timber and undergrowth.
40.00	Set an iron post, 3 ft. long, 1 in. in diam., 26 ins. in the ground, for $\frac{1}{4}$ sec. cor., marked on brass cap, 1913; $\frac{1}{4}$ S34 in W. and S35 in E. half; from which A cedar limb, 9 ins. in diam., brs. N. 36 $\frac{1}{2}$ ' E., 132 lks. dist., marked $\frac{1}{4}$ S35 BT. A cedar, 24 ins. in diam., brs. N. 2 $\frac{1}{2}$ ' W., 234 lks. dist., marked $\frac{1}{4}$ S34 BT.
44.40	Wash, 4 lks. wide, 2 ft. deep, course E.
52.00	Trail, brs. E. and W.
80.00	Set an iron post, 3 ft. long, 2 ins. in diam., 24 ins. in the ground, for cor. of secs. 26, 27, 34 and 35, marked on brass cap, 1913; T22N R6W in N. half: S27 in NW., S26 in NE., S35 in SE. and S34 in SW. quadrant; And raise a mound of stone, 2 ft. base, 1 $\frac{1}{2}$ ft. high, W. of cor. Pits impracticable. Land, level and rolling. Soil, 2nd and 3rd rate. Timber, very scattering scrub cedar. Undergrowth, rabbit brush.
40.00	<del>N89 58E</del> on a random line, bet. secs. 26 and 35. Set temp. $\frac{1}{4}$ sec. cor.
80.14	Intersect N. and S. line, 7 lks. N. of the cor. of secs. 25, 26, 35 and 36, where there is an iron post, as described before.
	Thence I run N. 89° 59' W., on a true line, bet. secs. 26 and 35. Over level land.
10.80	Trail, brs. N. and S.
22.80	Asc. SE. slope, 60 ft. <i>Dim road brs. N. and S.</i>
24.00	Enter timber, brs. N. and S.
32.00	Top of asc.; thence over rolling land.
40.07	Set an iron post, 3 ft. long, 1 in. in diam., 26 ins. in the ground, for $\frac{1}{4}$ sec. cor., marked on brass cap, 1913; $\frac{1}{4}$ S26 in N. and S35 in S. half; from which A pinion, 10 ins. in diam., brs. N. 24 $\frac{1}{2}$ ' E., 151 lks. dist., marked $\frac{1}{4}$ S26 BT. A cedar limb, 8 ins. in diam., brs. S. 75° E., 82 lks. dist., marked $\frac{1}{4}$ S35 BT.
80.14	The cor. of secs. 26, 27, 34 and 35. Land, level and rolling. Soil, sandy loam and gumbo, 2nd and 3rd rate. Timber, scrub cedar. Undergrowth, rabbit brush.
	N. 0° 1' W., bet. secs. 26 and 27. Over gently rolling land, through very scattering timber and undergrowth.
18.00	Asc. S. slope, 105 ft.
28.00	Spur ridge, brs. NW. and SE. Desc. NE. slope, 80 ft.
35.35	Gulch, course SE. Asc. SW. slope, 105 ft.

Chains.

40.00 Set an iron post, 3 ft. long, 1 in. <sup>in</sup>diam, 26 ins. in the ground, for  $\frac{1}{4}$  sec. cor., marked on brass cap, 1913;  $\frac{1}{4}$ S27 in W. and  $\frac{1}{4}$ S26 in E. half; from which

A cedar, 9 ins. <sup>in</sup>diam, brs. N.  $6\frac{1}{2}^{\circ}$  E., 197 lks. dist., marked  $\frac{1}{4}$ S26 BT.

A cedar, 20 ins. <sup>in</sup>diam, brs. N.  $15^{\circ}$  W., 200 lks. dist., marked  $\frac{1}{4}$ S27 BT.

46.00 Spur ridge, brs. NW. and SE. Desc. NE. slope, 75 ft.

58.00 Draw, course E. Thence over rolling land.

80.00 Set an iron post, 3 ft. long, 2 ins. dia., 24 ins. in the ground, for cor. of secs. 22, 23, 26 and 27, marked on brass cap, 1913; ~~the following in N. half;~~ S22 in NW., S23 in NE., S26 in SE. and S27 in SW. quadrant; from which

A cedar, 14 ins. <sup>in</sup>diam, brs. N.  $22\frac{1}{2}^{\circ}$  E., 241 lks. dist., marked T22N R6W S23 BT.

A cedar, 6 ins. <sup>in</sup>diam, brs. S.  $60^{\circ}$  E., 196 lks. dist., marked T22N R6W S26 BT.

A pinion, 5 ins. <sup>in</sup>diam, brs. S.  $87\frac{1}{4}^{\circ}$  W., 41 lks. dist., marked T22N R6W S27 BT.

A cedar, 24 ins. <sup>in</sup>diam, brs. N.  $63^{\circ}$  W., 297 lks. dist., marked T22N R6W S22 BT.

Land, rolling and hilly.  
Soil, sandy loam, 3rd and 4th rate.  
Timber, scrub cedar and scattering pinion.  
Undergrowth, rabbit brush and greasewood.

NOTE: At this corner, I set off  $16^{\circ}30'S$ . on the decl. arc; and at noon, I observe the sun on the meridian, the resulting lat. is  $35^{\circ}18\frac{1}{2}'N$ . which is the correct lat.

40.00 S.  $89^{\circ}59'E$ ., on a random line, bet. secs. 23 and 26. Set temp.  $\frac{1}{4}$  sec. cor.

80.06 Intersect N. and S. line, at the cor. of secs. 23, 24, 25 and 26, Thence I run

N.  $89^{\circ}59'W$ ., on a true line, bet. secs. 23 and 26.

Desc. W. slope, 40 ft. through scattering timber.

10.00 Leave timber, brs. N. and S.

20.00 Foot of desc.; thence over rolling land.

21.95 Old road, brs. N. and S.

24.00 Wash, 75 lks. wide,  $1\frac{1}{2}$  ft. deep, course SW.

40.03 Set an iron post, 3 ft. long, 1 in. <sup>in</sup>diam, 26 ins. in the ground, for  $\frac{1}{4}$  sec. cor., marked on brass cap, 1913;  $\frac{1}{4}$ S23 in N. and  $\frac{1}{4}$ S26 in S. half; from which

A cedar limb, 9 ins. <sup>in</sup>diam, brs. N.  $65^{\circ}$  E., 40 lks. dist., marked  $\frac{1}{4}$ S23 BT.

A cedar, 18 ins. <sup>in</sup>diam, brs. S.  $80\frac{1}{4}^{\circ}$  W., 520 lks. dist., marked  $\frac{1}{4}$ S26 BT.

Enter timber, brs. NE. and SW.

80.06 The cor. of secs. 22, 23, 26 and 27.  
Land, rolling.  
Soil, sandy loam and gumbo, 3rd and 4th rate.  
Timber, scrub cedar and pinion.  
Undergrowth, rabbit brush and greasewood.  
Feb. 3, 1913.

FRACTIONAL  
Subdivision of T. 22 N., R. 6 W.

Chains.

Feb. 4, 1913. At 8 hrs. 5 m., a.m., l.m.t., I set off  
35°16½'N. on the lat. arc; 16°13½'S. on the decl. arc;  
and determine a meridian with the solar at the cor. of secs.  
22, 23, 26 and 27,

Thence I run,  
N. 0° 1'W., bet. secs. 22 and 23.

Over gently rolling land, through scattering timber and  
undergrowth.

30.00 Leave timber, brs. NE. and SW.

40.00 Set an iron post, 3 ft. long, 1 in. indiam, 26 ins. in the  
ground, for ¼ sec. cor., marked on brass cap, 1913;  
¼S22 in W. and  
¼S23 in E. half;

And raise amount of stone, 2 ft. base, 1½ ft. high, W.  
of cor. Pits impracticable.

79.05 Dim road, brs. NW. and SE.

80.00 Set an iron post, 3 ft. long, 2 ins. indiam, 24 ins. in the  
ground, for cor. of secs. 14, 15, 22 and 23, marked  
on brass cap, 1913;

T22N R6W in N. half;  
S15 in NW.,  
S14 in NE.,  
S23 in SE. and  
S22 in SW. quadrant;

And raise a mound of stone, 2 ft. base, 1½ ft. high, W.  
of cor. Pits impracticable.

Land, level and rolling.

Soil, sandy loam and gumbo, 2nd rate.

Timber, scrub cedar and scattering pinion.

Undergrowth, rabbit brush.

S. 89° 59' E., on a random line, bet. secs. 14 and 23.

40.00 Set temp. ¼ sec. cor.

80.00 Intersect N. and S. line, 4 lks. N. of the cor. of secs.  
13, 14, 23 and 24, marked on brass cap, 1913;

Thence I run

N. 89° 57' W., on a true line, bet. secs. 14 and 23.

Over gently rolling land, through scattering undergrowth.

40.00 Set an iron post, 3 ft. long, 1 in. indiam, 26 ins. in the  
ground, for ¼ sec. cor., marked on brass cap, 1913;  
¼S14 in N. and  
¼S23 in S. half;

And raise amount of stone, 2 ft. base, 1½ ft. high, N.  
of cor. Pits impracticable.

80.00 The cor. of secs. 14, 15, 22 and 23.

Land, level and rolling.

Soil, first 40 chs., rocky 4th rate; last 40 chs.,  
sandy loam and gumbo, 2nd and 3rd rate.

Undergrowth, rabbit brush.

N. 0° 1'W., bet. secs. 14 and 15.

Over very gently rolling land, through scattering under-  
growth.

40.00 Set an iron post, 3 ft. long, 1 in. indiam, 26 ins. in  
the ground, for ¼ sec. cor., marked on brass cap, 1913;  
¼S15 in W. and  
¼S14 in E. half;

And raise a mound of stone, 2 ft. base, 1½ ft. high, W.  
of cor. Pits impracticable.

66.00 Asc. rocky SW. slope, 130 ft.

80.00 Set an iron post, 3 ft. long, 2 ins. indiam, 24 ins. in the

Chains	<p>ground, for cor. of secs. 10, 11, 14 and 15, marked on brass cap, 1913;  T22N R6W in N. half;  S10 in NW.,  S11 in NE.,  S14 in SE. and  S15 in SW. quadrant;  And raise a mound of stone, 2 ft. base, 1½ ft. high, W. of cor. Pits impracticable.  Land, rolling and hilly.  Soil, first 60 chs., sandy loam and gumbo, 2nd and 3rd rate; last 20 chs., very rocky 4th rate.  No timber.  Undergrowth, rabbit brush.</p> <p>NOTE- At this corner, I set off 16° 12' S. on the decl. arc; and at noon I observe the sun on the meridian, the resulting lat. is 35° 18½' N., which is slightly higher than the correct lat.</p>
40.00 80.00  32.00 40.00  74.00 80.00	<p>S. 89° 57' E., on a random line, bet. secs. 11 and 14.  Set temp. ¼ sec. cor.  Intersect N. and S. line, 23 lks. S. of the cor. of secs. 11, 12, 13 and 14,  Thence I run  S. 89° 53' W., on a true line, bet. secs. 11 and 14.  Over rolling land, through scattering undergrowth.  Gulch, course S. Asc. E. slope, 45 ft.  Set an iron post, 3 ft. long, 1 in. diam, 26 ins. in the ground, for ¼ sec. cor., marked on brass cap, 1913;  S11 in N. and  S14 in S. half;  And raise a mound of stone, 2 ft. base, 1½ ft. high, N. of cor. Pits impracticable.  Desc. SW. slope, 90 ft.  The cor. of secs. 10, 11, 14 and 15.  Land, rolling and hilly.  Soil, sandy loam, 2nd and 3rd rate, and rocky, 4th rate.  No timber.  Undergrowth, rabbit brush.</p>
10.00 14.00 18.50 25.80 38.00 40.00  54.20 65.30 38.00 78.00 80.00	<p>N. 0° 1' W., bet. secs. 10 and 11.  Asc. rocky SW. slope, 80 ft.  Top of asc.: brs. NW. and SE.  Desc. rocky NW. slope, 55 ft.  Head of gulch, course W. Asc. SW. slope, 20 ft.  Top of asc.: brs. NW. and SE.  Desc. N. slope, 160 ft.  Set an iron post, 3 ft. long, 1 in. diam, 26 ins. in the ground, for ¼ sec. cor., marked on brass cap, 1913;  S10 in W. and  S11 in E. half;  And raise a mound of stone, 2 ft. base, 1½ ft. high, W. of cor. Pits impracticable.  Gulch, course W. Asc. S. slope, 175 ft.  Top of asc.  Desc. NW. slope, 90 ft.  Foot of desc. ; thence along W. slope.  Set an iron post, 3 ft. long, 2 ins. diam, 24 ins. in the ground, for cor. of secs. 2, 3, 10 and 11, marked on brass cap, 1913;  T22N R6W in N. half;  S3 in NW.,  S2 in NE.,</p>

FRACTIONAL  
Subdivision of T. 22 N., R. 6 W.

12

Chains.

S11 in SE. and  
S10 in SW. quadrant;  
And raise a mound of stone, 2 ft. base, 1½ ft. high, W.  
of cor. Pits impracticable.  
Land, rolling and hilly.  
Soil, volcanic, very rocky 4th rate.  
No timber.  
Undergrowth, rabbit brush.

Feb. 4, 1913.

W.B.K.

Feb. 5, 1913. H.N.B.

40.00 N. 89° 53' E., on a random line, bet. secs. 2 and 11.  
79.79 Set temp. ¼ sec. cor.  
Intersect N. and S. line, 7 lks. N. of the cor. of secs.  
1, 2, 11 and 12, which is a lava stone, 8 X 8 X 6 ins. above ground, marked and witnessed as described by the Surveyor General.  
Thence I run  
S. 89° 56' W., on a true line, bet. secs. 2 and 11.  
Over rolling rocky mesa.  
39.895 Set an iron post, 3 ft. long, 1 in. diam., 26 ins. in the  
ground, for ¼ sec. cor., marked on brass cap, 1913;  
¼ S2 in N. and  
S11 in S. half; from which  
A cedar, 5 ins. diam., brs. N. 3¼ W., 219 lks. dist.,  
marked ¼ S2 BT.  
No other trees within limits. Raise a mound of stone,  
2 ft. base, 1½ ft. high, N. of cor. Pits impracticable.  
44.00 Desc. W. slope, 160 ft.  
58.00 Cent. of gulch, 20 lks. wide, course N. Asc. E. slope,  
85 ft.  
68.00 Ridge, brs. N. and S. Desc. slight NW. slope.  
79.79 The cor. of secs. 2, 3, 10 and 11.  
Land, rolling and mountainous.  
Soil, rocky 4th rate.  
No timber.  
Undergrowth, rabbit brush.

Feb 5, 1913.

H.N.B.

W.B.K.

Feb. 4, 1913.  
N. 0° 1' W., on a true line bet. secs. 2 and 3.  
Along W. slope. of ridge, brs. N. and S.  
8.00 Desc. N. slope, 105 ft.  
20.00 Foot of desc.; thence over rolling land.  
35.05 Road, brs. NE. and SW.  
40.00 Set an iron post, 3 ft. long, 1 in. diam., 26 ins. in the  
ground, for ¼ sec. cor., marked on brass cap, 1913;  
¼ S3 in W. and  
S2 in E. half;  
And raise a mound of stone, 2 ft. base, 1½ ft. high, W.  
of cor. Pits impracticable.  
70.90 Desc. N. slope, 40 ft.  
72.80 Bottom of Chino Wash.  
77.25 Main channel of Chino wash, 10 lks. wide, 5 ft. deep,  
course SW.  
80.00 Asc. N. slope, 40 ft.  
82.00 Top of asc.; thence over rolling land.  
85.50 Intersect the N. Bdy. of the Tp., 3.76 chs. W. of the cor.  
of secs. 2, 3, 34 and 35, which is a lava stone, 8 X 8  
X 6 ins. above ground, marked and witnessed as described  
by the Surveyor General.  
At the point of intersection, I set an iron post, 3 ft.  
long, 2 ins. diam., 24 ins. in the ground, for closing  
cor. of secs. 2, and 3, marked on brass cap, 1913;

Chains.

CC, S. of center;  
 T23N, R6W, S34, S35, in N. half;  
 S2 in SE. and  
 S3 in SW. quadrant;  
 And raise a mound of stone, 2 ft. base, 1½ ft. high, S.  
 of cor. Pits impracticable.  
 Land, rolling and hilly.  
 Soil, rocky 4th rate on hill; sandy loam and gumbo, 2nd  
 and 3rd rate on level.  
 No timber.  
 Undergrowth, rabbit brush.

Feb. 4, 1913.

W.B.K.

H.N.B.

Feb. 9, 1913 : At 2 hrs. 4 m., p.m., l.m.t., I set off  
 35°15'N. on the lat. arc; 14°37'S. on the decl. arc;  
 and determine a meridian with the solar at the cor. of  
 secs. 3, 4, 33 and 34, on the south bdy. of the Tp.,  
 which is a sandstone, 24 X 12 X 8 ins., in a mound  
 of stone, marked and witnessed as described by the  
 Surveyor General.

Thence I run  
 N. 0°1'W., bet. secs. 33 and 34.  
 Desc. rolling NW. slope, 40 ft, through scattering timber.  
 Centre of draw, 2 chs. wide, course SW. Asc. S. slope,  
 30 ft.

8.00  
 13.00  
 32.00  
 35.00  
 40.00  
 43.00  
 63.00  
 68.00  
 75.00  
 80.00

Top of asc.; thence over level land.  
 Desc. NW. slope, 40 ft.  
 Foot of desc.; thence over level land.  
 Set an iron post, 3 ft. long, 1 in. diam, 26 ins. in the  
 ground, for ¼ sec. cor., marked on brass cap, 1913;  
 ¼ S33 in W. and  
 S34 in E. half;  
 Dig pits, 18 X 18 X 12 ins., N. and S. of post, 3 ft.  
 dist.; and raise a mound of earth, 3½ ft. base, 1½ ft.  
 high, W. of cor.  
 Leave level land, asc. S. slope of mountain, 390 ft.  
 Top of asc.; thence over rolling land.  
 Desc. N. slope, 55 ft.  
 Gulch, 30 lks. wide, course W. Asc. S. slope, 40 ft.  
 Set an iron post, 3 ft. long, 2 ins. diam, 24 ins. in  
 the ground, for cor. of secs. 27, 28, 33 and 34, marked  
 on brass cap, 1913;  
 T22N R6W in N. half;  
 S28 in NW.,  
 S27 in NE.,  
 S34 in SE. and  
 S33 in SW. quadrant;  
 And raise a mound of stone, 2 ft. base, 1½ ft. high, W.  
 of cor. Pits impracticable.  
 Land, rolling and mountainous.  
 Soil, sandy loam, 3rd rate; and rocky 4th rate.  
 Timber, scrub cedar and pinion.  
 Undergrowth, buck brush.

40.00  
 80.16

N89°58'E, on a random line, bet. secs. 27 and 34.  
 Set temp. ¼ sec. cor.  
 Intersect N. and S. line, 2 lks. S. of the cor. of secs.  
 26, 27, 34, and 35,  
 Thence I run  
 S. 89°57'W., on a true line, bet. secs. 27 and 34.

14

FRACTIONAL  
Subdivision of T. 22 N., R. 6 W.

Chains.

Over gently rolling land, through scattering timber and undergrowth.

40.08 Set an iron post, 3 ft. long, 1 in. diam, 26 ins. in the ground, for  $\frac{1}{4}$  sec. cor., marked on brass cap, 1913;  $\frac{1}{4}$ S27 in N. and S34 in S. half; from which

A cedar, 6 ins. diam, brs. N.  $67\frac{1}{4}$  E., 130 lks. dist., marked  $\frac{1}{4}$ S27 BT.

A cedar, 8 ins. diam, brs. S.  $15\frac{1}{2}$  W., 31 lks. dist., marked  $\frac{1}{4}$ S34 BT.

46.00 Asc. rocky E. slope, 350 ft.

65.00 Top of asc.; thence over rolling land.

80.16 The cor. of secs. 27, 28, 33 and 34.

Land, rolling and mountainous.

Soil, sandy loam, 2nd and 3rd rate on flat; rocky 4th rate, limestone formation on mountain.

Timber, scrub cedar and pinion.

Undergrowth, rabbit brush and buck brush.

Feb. 9, 1913.

Feb. 10, 1913; At 7 hrs. 58 m., a.m., l.m.t., I set off  $35^{\circ}15\frac{1}{2}'$  N. on the flat arc;  $14^{\circ}21\frac{1}{2}'$  S. on the decl. arc; and determine a meridian with the solar at the cor. of secs. 27, 28, 33 and 34,

Thence I run

N.  $0^{\circ}1'$  W., bet. secs. 27 and 28.

Asc. S. slope, 35 ft., through scattering timber and dense undergrowth.

6.00 Ridge, brs. E. and W. Desc. N. slope, 75 ft.

18.00 Gulch, 30 lks. wide, course E. Asc. S. slope, 130 ft.

26.00 Top of asc.; thence over rolling land.

40.00 Set an iron post, 3 ft. long, 1 in. diam, 26 ins. in the ground, for  $\frac{1}{4}$  sec. cor., marked on brass cap, 1913;  $\frac{1}{4}$ S28 in W. and S27 in E. half;

And raise a mound of stone, 2 ft. base,  $1\frac{1}{2}$  ft. high, W. of cor. Pits impracticable.

42.00 Desc. NW. slope, 105 ft.

48.70 Gulch, 15 lks. wide, course NE. Asc. SE. slope, 60 ft.

55.00 Top of asc.; thence along E. slope.

65.00 Desc. NW. slope, 100 ft.

78.25 Draw, 1 ch. wide; course NE.

80.00 Set an iron post, 3 ft. long, 2 ins. dia., 24 ins. in the ground, for cor. of secs. 21, 22, 27 and 28, marked on brass cap, 1913;

T22N R6W in N. half;

S21 in NW.,

S22 in NE.,

S27 in SE. and

S28 in SW. quadrant; from which

A pinion, 8 ins. diam, brs. N.  $70^{\circ}$  E., 40 lks. dist., marked T22N R6W S28 BT.

A pinion, 8 ins. diam, brs. S.  $81\frac{1}{4}$  E., 55 lks. dist., marked T22N R6W S 27 BT.

A cedar, 22 ins. diam, brs. S.  $66^{\circ}$  W., 38 lks. dist., marked T22N R6W S28 BT.

A pinion, 7 ins. diam, brs. N.  $33\frac{1}{4}$  W., 81 lks. dist., marked T22N R6W S21 BT.

Land, rolling and mountainous.

Soil, rocky 4th rate, limestone formation.

Timber, scrub cedar and pinion.

Undergrowth, buck brush.



FRACTIONAL  
Subdivision of T. 22 N., R. 6 W.

Chains.

40.00 N. 89° 57' E., on a random line, bet. secs. 22 and 27.  
 Set temp. 1/4 sec. cor.  
 80.12 Intersect N. and S. line, 33 lks. N. of the cor. of secs. 22, 23, 26 and 27,  
 Thence I run  
 N. 89° 49' W., on a true line, bet. secs. 22 and 27.  
 Over rolling land, through scattering timber and undergrowth.  
 35.64 Draw, course NE. Asc. SE. slope, 35 ft.  
 40.06 Set an iron post, 3 ft. long, 1 in. indiam, 26 ins. in the ground, for 1/4 sec. cor., marked on brass cap, 1913; 1/4 S22 in N. and 1/4 S27 in S. half; from which  
 A cedar, 8 ins. indiam, brs. N. 45 1/4 E., 44 lks. dist., marked 1/4 S22 BT.  
 A cedar, 15 ins. indiam, brs. S. 50 1/4 W., 93 lks. dist., marked 1/4 S27 BT.  
 48.85 Draw, 75 lks. wide, course NE.  
 52.60 Draw, 75 lks. wide, course NE.  
 80.12 The cor. of secs. 21, 22, 27 and 28.  
 Land, rolling.  
 Soil, gumbo, 3rd and 4th rate.  
 Timber, scrub cedar and pinion.  
 Undergrowth, buck brush.  
 NOTE: At this corner, I set off 14° 19 1/2' S. on the decl. arc; and at noon, I observe the sun on the meridian; the resulting lat. is 35° 16 1/2' N., which is the correct lat.

18.25 N. 0° 1' W., bet. secs. 21 and 22.  
 Desc. NE. slope, 40 ft. through scattering timber.  
 Draw, 2 chs. wide, course NE.  
 40.00 Set an iron post, 3 ft. long, 1 in. indiam, 26 ins. in the ground, for 1/4 sec. cor., marked on brass cap, 1913; 1/4 S21 in W. and 1/4 S22 in E. half; from which  
 A pinion, 8 ins. indiam, brs. N. 59 1/2 E., 50 lks. dist., marked 1/4 S22 BT.  
 A cedar, 6 ins. indiam, brs. N. 77 3/4 W., 56 lks. dist., marked 1/4 S21 BT.  
 56.00 Desc. NW. slope, 40 ft.  
 60.00 Foot of desc.; thence over rolling land, drains. NE.  
 80.00 Set an iron post, 3 ft. long, 2 ins. indiam, 24 ins. in the ground, for cor. of secs. 15, 16, 21 and 22, marked on brass cap, 1913;  
 T22N R6W in N. half;  
 S16 in NW.,  
 S15 in NE.,  
 S22 in SE. and  
 S21 in SW. quadrant; from which  
 A cedar, 15 ins. indiam, brs. N. 38 3/4 E., 155 lks. dist., marked T22N R6W S15 BT.  
 A cedar, 6 ins. indiam, brs. S. 84 3/4 E., 233 lks. dist., marked T22N R6W S22 BT.  
 A cedar, 6 ins. indiam, brs. S. 35° W., 413 lks. dist., marked T22N R6W S21 BT.  
 A cedar, 9 ins. indiam, brs. N. 70° W., 278 lks. dist., marked T22N R6W S16 BT.  
 Land, rolling.  
 Soil, gumbo, 3rd rate.  
 Timber, scattering scrub cedar.

FRACTIONAL  
Subdivision of T. 22 N., R. 6 W.

Chains	
40.00 80.16	<p>S. 89° 49' E., on a random line, bet. secs. 15 and 22. Set temp. <math>\frac{1}{2}</math> sec. cor. Intersect N. and S. line, 12 lks. N. of the cor. of secs. 14, 15, 22 and 23, which is a part, but is not described.</p> <p>Thence I run N. 89° 44' W., on a true line, bet. secs. 15 and 22. Over gently rolling land, through scattering undergrowth. Dim road, brs. NW. and SE.</p>
1.40 40.08	<p>Set an iron post, 3 ft. long, 1 in. diam, 26 ins. in the ground, for <math>\frac{1}{4}</math> sec. cor., marked on brass cap, 1913; <math>\frac{1}{4}</math>S15 in N. and <math>\frac{1}{4}</math>S22 in S. half; Dig pits, 18 X 18 X 12 ins., E. and W. of post, 3 ft. dist.; and raise a mound of earth, 3<math>\frac{1}{2}</math> ft. base, 1<math>\frac{1}{2}</math> ft. high, N. of cor.</p>
45.00 80.16	<p>Enter scattering timber, brs. N. and S. The cor. of secs. 15, 16, 21 and 22. Land, rolling Soil, sandy loam and gumbo, 2nd and 3rd rate. Timber, scrub cedar. Undergrowth, rabbit brush.</p> <p style="text-align: right;">Feb. 10, 1913.</p>
20.00 40.00	<p>Feb. 14, 1913: At 7 hrs. 58 m. a.m., l.m.t., I set off 35° 17<math>\frac{1}{2}</math>' N. on the lat. arc; 13° 2<math>\frac{1}{2}</math>' S. on the decl. arc; and determine a meridian with the solar at the cor. of secs. 15, 16, 21 and 22, Thence I run N. 0° 1' W., bet. secs. 15 and 16. Over rolling land, through scattering timber and undergrowth.</p>
43.55 80.00	<p>Leave timber, brs. E. and W. Set an iron post, 3 ft. long, 1 in. diam, 26 ins. in the ground, for <math>\frac{1}{4}</math> sec. cor., marked on brass cap, 1913; <math>\frac{1}{4}</math>S16 in W. and S15 in E. half; from which A cedar, 8 ins. diam, brs. S. 44<math>\frac{3}{4}</math> E., 47 lks. dist., marked <math>\frac{1}{4}</math>S15 BT. No other trees within limits. Raise a mound of stone, 2 ft. base, 1<math>\frac{1}{2}</math> ft. high, W. of cor. Pits impracticable. Road to Seligman, brs. NE. and SW.</p>
40.00 80.09	<p>Set an iron post, 3 ft. long, 2 ins. diam, 24 ins. in the ground, for cor. of secs. 9, 10, 15 and 16, marked on brass cap, 1913; T22N R6W in N. half; S9 in NW., S10 in NE., S15 in SE. and S16 in SW. quadrant; And raise a mound of stone, 2 ft. base, 1<math>\frac{1}{2}</math> ft. high, W. of cor. Pits impracticable. Land, rolling. Soil, gumbo and sandy loam, 2nd and 3rd rate. Timber, scattering scrub cedar. Undergrowth, rabbit brush.</p>
40.00 80.09	<p>S. 89° 44' E., on a random line, bet. secs. 10 and 15. Set temp. <math>\frac{1}{4}</math> sec. cor. Intersect N. and S. line, 12 lks. S. of the cor. of secs. 10, 11, 14 and 15, which is a part, but is not described. Thence I run N. 89° 49' W., on a true line, bet. secs. 10 and 15.</p>

Chains.

Desc. rocky SW. slope, 250 ft.  
 24.00 Foot of desc.; brs. NW. and SE.; thence over rolling land.  
 38.00 Old road, brs. N. and S.  
 40.045 Set an iron post, 3 ft. long, 1 in. <sup>in</sup>diam., 26 ins. in the  
 ground, for  $\frac{1}{4}$  sec. cor., marked on brass cap, 1913;  
 $\frac{1}{4}$ S10 in N. and  
 $\frac{1}{4}$ S15 in S. half;  
 And raise a mound of stone, 2 ft. base,  $1\frac{1}{2}$  ft. high, N.  
 of cor. Pits impracticable.  
 56.90 Road to Seligman, brs. NE. and SW.  
 80.09 The cor. of secs. 9, 10, 15 and 16.  
 Land, mountainous and rolling.  
 Soil, sandy loam and gumbo, 3rd rate; and rocky 4th rate.  
 No timber.  
 Undergrowth, rabbit brush.

N.  $0^{\circ}1'W.$ , bet. secs. 9 and 10.  
 Over level land, through scattering undergrowth.  
 40.00 Set an iron post, 3 ft. long, 1 in. <sup>in</sup>diam., 26 ins. in the  
 ground, for  $\frac{1}{4}$  sec. cor., marked on brass cap, 1913;  
 $\frac{1}{4}$ S9 in W. and  
 $\frac{1}{4}$ S10 in E. half;  
 And raise a mound of stone, 2 ft. base,  $1\frac{1}{2}$  ft. high, W.  
 of cor. Pits impracticable.  
 56.75 Old road, brs. NE. and SW.  
 80.00 Set an iron post, 3 ft. long, 2 ins. <sup>in</sup>diam., 24 ins. in the  
 ground, for cor. of secs. 3, 4, 9 and 10, marked on  
 brass cap, 1913;  
 T22N R6W in N. half;  
 S4 in NW.,  
 S3 in NE.,  
 S10 in SE. and  
 S9 in SW. quadrant;  
 And raise a mound of stone, 2 ft. base,  $1\frac{1}{2}$  ft. high, W.  
 of cor. Pits impracticable.  
 Land, level and rolling.  
 Soil, sandy loam and gumbo, 3rd rate.  
 No timber.  
 Undergrowth, rabbit brush.

NOTE: At this corner, I set off  $12^{\circ}59\frac{1}{2}'S.$  on the decl. arc;  
 and at noon, I observe the sun  
 on the meridian; the resulting lat. is  $35^{\circ}19'N.$ , which is  
 slightly less than the correct lat.

S.  $89^{\circ}49'E.$ , on a random line, bet. secs. 3 and 10.  
 40.00 Set temp.  $\frac{1}{4}$  sec. cor.  
 80.01 Intersect N. and S. line, 4 lks. N. of the cor. of secs.  
 2, 3, 10 and 11,  
 Thence I run  
 N.  $89^{\circ}47'W.$ , on a true line, bet. secs. 3 and 10.  
 Desc. NW. slope, 100 ft.  
 10.00 Gulch, 30 lks. wide, course NW. Asc. NE. slope, 35 ft.  
 18.80 Ridge, brs. NW. and SE. Desc. SW. slope, 60 ft.  
 30.00 Foot of desc.; thence over rolling land.  
 33.95 Road to Seligman, brs. NE. and SW.  
 40.005 Set an iron post, 3 ft. long, 1 in. <sup>in</sup>diam., 26 ins. in the  
 ground, for  $\frac{1}{4}$  sec. cor., marked on brass cap, 1913;  
 $\frac{1}{4}$ S3 in N. and  
 $\frac{1}{4}$ S10 in S. half;  
 And raise a mound of stone, 2 ft. base,  $1\frac{1}{2}$  ft. high, N.  
 of cor. Pits impracticable.

FRACTIONAL  
Subdivision of T. 22 N., R. 6 W.

Chain.

44.75  
80.01

Old road, brs. NE. and SW.  
The cor. of secs. 3, 4, 9 and 10.  
Land, rolling and hilly.  
Soil, sandy loam and gumbo, 3 rd rate on flat; 4th rate, rocky on slopes.  
No timber, or undergrowth.

3.60  
4.00  
15.00  
32.00  
35.50  
40.00

N. 0° 1' W., on a true line, bet. secs. 3 and 4.  
Over rolling land.  
Rock wall of Chino Wash, 50 ft. high, brs. NE. and SW.  
Foot of wall; thence across wash, over level land.  
Main wash, 60 lks. wide, 8 ft. deep, course SW.  
Asc. rock wall, 50 ft. Brs. ENE. and WSW.  
Top of asc.; thence over rolling land.  
Set an iron post, 3 ft. long, 1 in. <sup>in</sup>diam, 26 ins. in the ground, for  $\frac{1}{4}$  sec. cor., marked on brass cap, 1913;  
 $\frac{1}{4}$ S4 in W. and  
S3 in E. half; from which  
A cedar limb, 5 ins. dia., brs. S. 87 $\frac{3}{4}$  E., 144 lks. dist., marked  $\frac{1}{4}$ S3 BT.  
A cedar limb, 5 ins. dia., brs. N. 46 $\frac{3}{4}$  W., 103 lks. dist., marked  $\frac{1}{4}$ S4 BT.  
Desc. slight NE. slope, 40 ft.  
Draw, 5 chs. wide, course SE.  
Asc. SW. slope, 30 ft.

62.00  
75.00  
85.29

Intersect the N. bdy. of the Tp., 3.71 chs. W. of the <sup>old</sup> cor. of secs. 3, 4, 33, and 34, which is a malpais stone, 5 X 8 X 8 ins. above ground, marked and witnessed as described by the Surveyor General. I destroy the bearing tree SW. of the cor.  
At the point of intersection, I set an iron post, 3 ft. long, 2 ins. <sup>in</sup>diam, 24 ins. in the ground, for closing cor. of secs. 3 and 4, <sup>T22N R6W</sup> marked on brass cap, 1913;  
CC, S. of center;  
T23N R6W, S33, S34, in N. half;  
S3 in SE. and  
S4 in SW. quadrant; from which  
A cedar limb, 8 ins. <sup>in</sup>diam, brs. S. 51 $\frac{1}{2}$  E., 290 lks. dist., marked T22N R6W S3 BT.  
A cedar limb, 8 ins. <sup>in</sup>diam, brs. S. 18 $\frac{1}{2}$  W., 202 lks. dist., marked T22N R6W S4 BT.  
Land, rolling and hilly.  
Soil, gumbo, 3rd and 4th rate.  
No timber, or undergrowth.

Feb. 14, 1913.

40.00  
64.00  
80.00

Feb. 11, 1913: At 8 hrs. 30 m. a.m., l.m.t., I set off 35° 15' N. on the decl. arc; 14° 12' S. on the decl. arc; and determine a meridian with the solar at the cor. of secs. 4, 5, 32 and 33, <sup>on the S. bdy. of the Tp.</sup> which is a limestone, 4 X 10 X 7 ins. above ground, marked and witnessed as described by the Surveyor General.  
Thence I run  
N. 0° 2' W., bet. secs. 32 and 33.  
Over rolling land.  
Set an iron post, 3 ft. long, 1 in. <sup>in</sup>diam, 26 ins. in the ground, for  $\frac{1}{4}$  sec. cor., marked on brass cap, 1913;  
 $\frac{1}{4}$ S32 in W. and  
S33 in E. half;  
And raise a mound of stone, 2 ft. base, 1 $\frac{1}{2}$  ft. high, W. of cor. Pits impracticable.  
Enter timber, brs. NW. and SE. Asc. SW. slope, 140 ft.  
Set an iron post, 3 ft. long, 2 ins. <sup>in</sup>diam, 24 ins. in the

FRACTIONAL  
Subdivision of T. 22 N. R. 6 W.

Chains.

ground, for cor. of secs. 28, 29, 32 and 33, marked on brass cap, 1913;  
 T22N R6W in N. half;  
 S29 in NW.,  
 S28 in NE.,  
 S33 in SE. and  
 S32 in SW. quadrant; from which  
 A cedar, 7 ins. diam, brs. N. 56½ E., 86 lks. dist., marked T22N R6W S28 BT.  
 A cedar, 6 ins. diam, brs. S. 31¼ E., 58 lks. dist., marked T22N R6W S33 BT.  
 A pinion, 6 ins. diam, brs. S. 13¾ W., 115 lks. dist., marked T22N R6W S32 BT.  
 A pinion, 7 ins. diam, brs. N. 82 W., 78 lks. dist., marked T22N R6W S29 BT.  
 Land, rolling and hilly.  
 Soil, gumbo, 3rd and 3th rate; rocky on hill.  
 Timber, scrub cedar and pinion.  
 Undergrowth, rabbit brush.

40.00 N89°58'E, on a random line, bet. secs. 28 and 33.  
 Set temp. ¼ sec. cor.  
 80.09 Intersect N. and S. line, 9 lks. N. of the cor. of secs. 27, 28, 33 and 34,  
 Thence I run  
 N. 89°58'W., on a true line, bet. secs. 28 and 33.  
 Along S. slope of ridge, brs. E. and W., through scattering timber and dense undergrowth.  
 24.00 Desc. SW. slope, 155 ft.  
 40.045 Set an iron post, 3 ft. long, 1 in. diam, 26 ins. in the ground, for ¼ sec. cor., marked on brass cap, 1913; ¼S28 in N. and ¼S33 in S. half; from which  
 A pinion, 6 ins. diam, brs. N. 15° W., 60 lks. dist., marked ¼S28 BT.  
 A pinion, 15 ins. diam, brs. S. 50° E., 85 lks. dist., marked ¼S33 BT.  
 45.25 Gulch, 20 lks. wide, course W.NW. Thence over broken N. slope.  
 50.00 Asc. NE. slope, 150 ft.  
 67.00 Ridge, brs. NW, and SE. Desc. SW. slope, 350 ft.  
 80.09 The cor. of secs. 28, 29, 32 and 33.  
 Land, mountainous and rolling.  
 Soil, rocky 4th rate, limestone formation.  
 Timber, scrub cedar and pinion.  
 Undergrowth, scrub oak and buck brush.  
 Mountainous land, 40.00 chs.

NOTE - At this corner, I set off 14' 00" S. on the decl. arc; and at noon, I observe the sun on the meridian, the resulting lat. is 35° 15½' N., which is slightly less than the correct lat.

40.00 ~~S89°58'W~~, on a random line, bet. <sup>frac.</sup>secs. 29 and 32.  
 Set temp. ¼ sec. cor.  
 68.45 Intersect W. bdy of Tp., at the <sup>old</sup> cor. of secs. 25, 29, 32 and 36, which is a limestone, 6x10x8 ins. above ground, marked and witnessed as described by the surveyor general.  
 Thence I run,  
 N. 89°58'E., on a true line, bet. <sup>frac.</sup>secs. 29 and 32.  
 Over rolling land,.

## Chains.

28.45 Set an iron post, 3 ft. long, 1 in. <sup>in</sup>diam, 26 ins. in the ground, for  $\frac{1}{4}$  sec. cor., marked on brass cap, 1913;  $\frac{1}{4}$ S29 in N. and S32 in S. half;  
And raise a mound of stone, 2 ft. base,  $1\frac{1}{2}$  ft. high, N. of cor. Pits impracticable.

34.50 Enter scattering timber, brs. N. and S.

49.00 Asc. W. slope, 110 ft.

68.45 The cor. of secs. 28, 29, 32 and 33.  
Land, rolling and hilly.  
Soil, sandy loam, 3rd rate, and rocky 4th rate.  
Timber, scrub cedar and pinion.  
Undergrowth, scrub oak.

N.  $0^{\circ}2'W.$ , bet. secs. 28 and 29.  
Over mountainous land, through scattering timber and dense undergrowth.  
Asc. SW. slope, 320 ft.

22.00 Ridge, brs. NW. and SE.;

23.00 Desc. NE. slope, 320 ft.

30.00 Enter heavy timber, brs. NW. and SE.

40.00 Set an iron post, 3 ft. long, 1 in. <sup>in</sup>diam, 26 ins. in the ground, for  $\frac{1}{4}$  sec. cor., marked on brass cap, 1913;  $\frac{1}{4}$ S29 in W. and S28 in E. half; from which  
A cedar, 6 ins. <sup>in</sup>diam, brs. S.  $79\frac{1}{2}^{\circ}E.$ , 24 lks. dist., marked  $\frac{1}{4}$ S28 BT.  
A pinion, 5 ins. <sup>in</sup>diam, brs. S.  $79\frac{1}{2}^{\circ}W.$ , 34 lks. dist., marked  $\frac{1}{4}$ S29 BT.

45.00 Leave timber, brs. E. and W.

56.00 Wash, 50 lks. wide, 6 ft. deep, course WNW.

70.00 Asc. S. slope, 255 ft.

80.00 Top of asc.; thence over rolling land. Enter scattering timber, brs. E. and W.

Set an iron post, 3 ft. long, 2 ins. <sup>in</sup>diam, 24 ins. in the ground, for cor. of secs. 20, 21, 28 and 29, marked on brass cap, 1913;  
T22N R6W in N. half;  
S20 in NW.,  
S21 in NE.,  
S28 in SE. and  
S29 in SW. quadrant; from which  
A cedar, 8 ins. <sup>in</sup>diam, brs. N.  $45\frac{1}{2}^{\circ}E.$ , 129 lks. dist., marked T22N R6W S21 BT.  
A cedar, 10 ins. <sup>in</sup>diam, brs. S.  $40\frac{1}{2}^{\circ}E.$ , 28 lks. dist., marked T22N R6W S28 BT.  
A cedar, 7 ins. <sup>in</sup>diam, brs. S.  $79\frac{1}{2}^{\circ}W.$ , 67 lks. dist., marked T22N R6W S29 BT.  
A pinion, 6 ins. <sup>in</sup>diam, brs. N.  $45\frac{3}{4}^{\circ}W.$ , 90 lks. dist., marked T22N R6W S20 BT.  
Land, mountainous and rolling.  
Soil, rocky 4th rate, limestone formation.  
Timber, scrub cedar and pinion.  
Undergrowth, buck brush.  
Mountainous land, 54 chs.

Feb. 11, 1913.

Feb. 12, 1913: At 8hrs. 4 m., a.m., l.m.t., I set off  $35^{\circ}16\frac{1}{2}'N.$  on the lat. arc;  $13^{\circ}42\frac{1}{2}'S.$  on the decl. arc; and determine a meridian with the solar at the cor. of secs. 20, 21, 28 and 29,  
Thence I run  
S.  $89^{\circ}58'E.$ , on a random line, bet. secs. 21 and 28.

FRACTIONAL  
Subdivision of T. 22 N., R. 6 W.

Chains.

40.00 Set temp.  $\frac{1}{4}$  sec. cor.

80.12 Intersect N. and S. line, 4 lks. N. of the cor. of secs. 21, 22, 27 and 28,

Thence I run  
N.  $89^{\circ}55'W.$ , on a true line, bet. secs. 21 and 28.  
Along rolling broken N. slope, through heavy timber.

13.00 Desc. NW. slope, 30 ft.

20.25 Centre of draw, 2 chs. wide, course NE. Asc. SE. slope, 50 ft.

25.00 Top of asc.; thence along N. slope.

28.00 Desc. NW. slope, 50 ft.

34.50 Centre of draw, 50 lks. wide, course NE. Asc. NE. slope, 50 ft.

40.06 Set an iron post, 3 ft. long, 1 in. diam, 26 ins. in the ground, for  $\frac{1}{4}$  sec. cor., marked on brass cap, 1913;  $\frac{1}{4}S21$  in N. and  $S28$  in S. half; from which  
A pinion, 10 ins. diam, brs. N.  $69^{\circ}\frac{1}{2}W.$ , 148 lks. dist., marked  $\frac{1}{4}S21$  BT.  
A cedar, 15 ins. diam, brs. S.  $40^{\circ}W.$ , 155 lks. dist., marked  $\frac{1}{4}S28$  BT.

Continue to asc. NE. slope, 50 ft.

50.00 Top of asc., thence over gently rolling land.

80.12 The cor. of secs. 20, 21, 28 and 29.  
Land, rolling and hilly.  
Soil, rocky 4th rate.  
Timber, scrub cedar and pinion.  
Undergrowth, buck brush.

40.00 S.  $89^{\circ}58'W.$ , on a random line, bet. <sup>frac.</sup>secs. 20 and 29.  
Set temp.  $\frac{1}{4}$  sec. cor.

68.39 Intersect the W. bdy. of the Tp., 14 lks. N. of the cor. of secs. 20, 24, 25 and 29, which is a limestone, 6x12x8 ins. above ground, marked and witnessed as described by the Surveyor General.

Thence I run  
N.  $89^{\circ}51'E.$ , on a true line, bet. <sup>frac.</sup>secs. 20 and 29.  
Over rolling land, drains W.

11.40 Road to Seligman, brs. NW. and SE.

14.10 Old road, brs. N. and S.

28.39 Set an iron post, 3 ft. long, 1 in. diam, 26 ins. in the ground, for  $\frac{1}{4}$  sec. cor., marked on brass cap, 1913;  $\frac{1}{4}S20$  in N. and  $S29$  in S. half; from which  
A pinion, 5 ins. diam, brs. N.  $15^{\circ}\frac{1}{2}W.$ , 21 lks. dist., marked  $\frac{1}{4}S20$  BT.  
A cedar, 6 ins. diam, brs. S.  $74^{\circ}\frac{3}{4}E.$ , 62 lks. dist., marked  $\frac{1}{4}S29$  BT.

Enter timber, brs. N. and S.

30.00 Asc. NW. slope, 280 ft.

48.00 Top of asc.; thence along N. slope of ridge, brs. E. and W.

64.00 Gulch, 5 lks. wide, course N.

68.39 The cor. of secs. 20, 21, 28 and 29.  
Land, rolling and mountainous.  
Soil, sandy loam, 3rd rate, on flat; rocky 4th rate on mountain.  
Timber, scrub cedar and pinion.  
Undergrowth, buck brush.

NOTE - At this corner, I set off  $13^{\circ}40'S.$  on the decl. arc; and at noon I observe the sun on the meridian; the resulting lat. is  $35^{\circ}16\frac{1}{2}'N.$ , which is the correct lat.

FRACTIONAL  
Subdivision of T. 22 N., R. 6 W.

Chains.	
	N. 0° 2' W., bet. secs. 20 and 21. Over rolling land, through scattering timber and undergrowth.
10.00	Desc. N. slope, 240 ft.
32.00	Foot of desc.; thence across canyon, course SW.
33.50	Road to Seligman, brs. NE. and SW.
34.00	Asc. S. slope, 100 ft.
40.00	Set an iron post, 3 ft. long, 1 in. <sup>in</sup> diam, 26 ins. in the ground, for $\frac{1}{4}$ sec. cor., marked on brass cap, 1913; $\frac{1}{4}$ S20 in W. and S21 in E. half; from which A cedar, 5 ins. <sup>in</sup> diam, brs. S. 88 $\frac{1}{4}$ ° E., 58 lks. dist., marked $\frac{1}{4}$ S 21 BT. A cedar, 6 ins. <sup>in</sup> diam, brs. N. 34 $\frac{1}{2}$ ° W., 36 lks. dist., marked $\frac{1}{4}$ S20 BT.
42.00	Top of asc.; ridge, brs. E. and W. Thence over rolling land.
48.00	Desc. N. slope, 70 ft.
66.00	Foot of desc.; thence over rolling land, draining NW.
80.00	Set an iron post, 3 ft. long, 2 ins. <sup>in</sup> diam, 24 ins. in the ground, for cor. of secs. 15, 17, 20 and 21, marked on brass cap, 1913; T22N R6W in N. half; S17 in NW., S15 in NE., S21 in SE. and S20 in SW. quadrant; from which A cedar, 8 ins. <sup>in</sup> diam, brs. N. 42 $\frac{1}{4}$ ° E., 145 lks. dist., marked T22N R6W S16 BT. A cedar, 10 ins. <sup>in</sup> diam, brs. S. 4 $\frac{3}{4}$ ° E., 170 lks. dist., marked T22N R6W S21 BT. A cedar, 6 ins. <sup>in</sup> diam, brs. S. 32° W., 87 lks. dist., marked T22N R6W S20 BT. A cedar, 15 ins. <sup>in</sup> diam, brs. N. 42° W., 206 lks. dist., marked T22N R6W S17 BT. Land, mountainous and rolling. Soil, rocky 4th rate, limestone formation. Timber, scrub cedar and pinion. Undergrowth, buck brush.
40.00	S. 89° 56' E., on a random line, bet. secs. 16 and 21. Set temp. $\frac{1}{4}$ sec. cor.
80.10	Intersect N. and S. line at the cor. of secs. 15, 16, 21 and 22; Thence I run N. 89° 56' W., on a true line, bet. secs. 16 and 21. Over rolling land, through very scattering timber. Road to Seligman, brs. NE. and SW.
29.55	Set an iron post, 3 ft. long, 1 in. <sup>in</sup> diam, 26 ins. in the ground, for $\frac{1}{4}$ sec. cor., marked on brass cap, 1913; $\frac{1}{4}$ S16 in N. and S21 in S. half; from which A cedar, 14 ins. <sup>in</sup> diam, brs. N. 37° E., 216 lks. dist., marked $\frac{1}{4}$ S16 BT. A cedar, 15 ins. <sup>in</sup> diam, brs. S. 67 $\frac{1}{2}$ ° E., 216 lks. dist., marked $\frac{1}{4}$ S21 BT.
40.05	
80.10	The cor. of secs. 16, 17, 20 and 21. Land, level and rolling. Soil, sandy loam and gumbo, 3 rd rate. Timber, scattering scrub cedar.
	S. 89° 51' W., on a random line, bet. <sup>frac.</sup> secs. 17 and 20.



Chains	
40.00	Set temp. $\frac{1}{4}$ sec. cor.
68.49	Intersect the W. bdy. of the Tp., 8 lks. S. of the <sup>old</sup> cor. of secs. 13, 17, 20 and 24, which is a malpais stone, 5x10x6 ins. above ground, marked and witnessed as described by the Surveyor General.
	Thence I run N. $89^{\circ}55'E.$ , on a true line, bet. <sup>frac.</sup> $\frac{1}{4}$ secs. 17 and 20.
1.40	Across Chino Wash.
4.50	Centre of Chino Wash, course SW.
8.50	Asc. rocky wall of Chino Wash, 80 ft.
22.00	Top of wall; continue to asc. W. slope, 40 ft.
	Top of asc. thence over rolling E. slope.
28.49	Enter scattering timber, brs. N. and S. Set an iron post, 3 ft. long, 1 in. <sup>indiam</sup> , 26 ins. in the ground, for $\frac{1}{4}$ sec. cor., marked on brass cap, 1913;
	$\frac{1}{4}$ S17 in N. and
	S20 in S. half; from which
	A cedar, 6 ins. <sup>indiam</sup> , brs. N. $41\frac{1}{2}$ W., 44 lks. dist., marked $\frac{1}{4}$ S17 BT.
	A cedar, 10 ins. <sup>indiam</sup> , brs. S. $5\frac{1}{2}$ W., 108 lks. dist., marked $\frac{1}{4}$ S20 BT.
42.50	Desc. gradual NE. slope, 40 ft.
	Centre of wash, 50 lks. wide, course NW.
53.50	Thence over rolling land.
68.49	Wash, 30 lks. wide, course NW.
	The cor. of secs. 16, 17, 20 and 21.
	Land, rolling.
	Soil, rocky gumbo, 3rd and 4th rate.
	Timber, scattering cedar.
2.00	N. $0^{\circ}2'W.$ , bet. secs. 16 and 17.
40.00	Over rolling land, through scattering timber.
	Leave timber, brs. E. and W.
	Set an iron post, 3 ft. long, 1 in. <sup>indiam</sup> , 26 ins. in the ground, for $\frac{1}{4}$ sec. cor., marked on brass cap, 1913;
	$\frac{1}{4}$ S17 in W. and
	S16 in E. half;
	Dig pits, 18x18x12 ins., N. and S. of post, 3 ft. dist., and raise a mound of earth, $3\frac{1}{2}$ ft. base, $1\frac{1}{2}$ ft. high, W. of cor.
	Feb. 12, 1913.
	Feb. 13, 1913: At 7hrs. 54 m., a.m., l.m.t., I set off
	$35^{\circ}18'N.$ on the lat. arc; $13^{\circ}22'S.$ on the decl. arc;
	and determine a meridian with the solar at the $\frac{1}{4}$ sec. cor
	bet. secs. 16 and 17, above described,
	Thence I continue
	N. $0^{\circ}2'W.$ , bet. secs. 16 and 17, on $N\frac{1}{2}$ mile
62.00	Over rolling land.
62.25	Rock wall of Chino Wash, 20 ft. high, brs. NE. and SW.
68.00	Foot of rock wall; thence across level land.
70.00	Main channel of Chino Wash, 45 lks. wide, 5 ft. deep, course SW.
74.00	Foot of rock wall of chino Wash, 40 ft. high, brs.
80.00	NE. and SW.
	Top of wall; thence over rolling land.
	Set an iron post, 3 ft. long, 2 ins. <sup>indiam</sup> , 24 ins. in the ground, for cor. of secs. 8, 9, 16 and 17, marked on brass cap, 1913;
	T22N R6W in N. half;
	S8 in NW.,
	S9 in NE.,
	S16 in SE. and
	S17 in SW. quadrant;

FRACTIONAL  
Subdivision of T. 22 N., R. 6 W.

Chains.

And raise a mound of stone, 2 ft. base, 1 1/2 ft. high, W. of cor. Pits impracticable.  
Land, level and rolling.  
Soil, sandy loam and gumbo; subsoil limestone and gravel at 18 ins.  
No timber or undergrowth.

40.00 S. 89° 56' E., on a random line, bet. secs. 9 and 16.  
Set temp. 1/4 sec. cor.  
80.16 Intersect N. and S. line, 9 lks. N. of the cor. of secs. 9, 10, 15 and 16.  
  
Thence I run  
N. 89° 52' W., on a true line, bet. secs. 9 and 16.  
Over rolling land.  
22.00 Wash, 15 lks. wide, course WSW.  
40.08 Set an iron post, 3 ft. long, 1 in. diam, 26 ins. in the ground, for 1/4 sec. cor., marked on brass cap, 1913; 1/4 S9 in N. and 1/4 S16 in S. half;  
And raise amount of stone, 2 ft. base, 1 1/2 ft. high, N. of cor. Pits impracticable.  
55.00 Centre of water hole, 3 chs. square, brs. N. 1 ch. dist. About 1 foot of water.  
57.10 Top of earth dam, 4 chs. long; brs. N. and S. Extends 1 ch. S. Belongs to J. W. Sullivan.  
65.00 Centre of same wash, course W. Thence across Chino Wash.  
66.00 Leave Chino Wash, course SW.; asc. gentle SE. slope.  
80.16 The cor. of secs. 8, 9, 16 and 17.  
Land, level and rolling.  
Soil, sandy loam and gumbo, 3rd rate.  
No timber, or undergrowth.

40.00 S. 89° 55' W., on a random line, bet. <sup>frac.</sup>secs. 8 and 17.  
Set temp. 1/4 sec. cor.  
68.49 Intersect the W. bdy. of the Tp., at the <sup>frac.</sup>cor. of secs. 8, 12, 13, and 17, which is a limestone, 6x9x6 ins. above ground, marked and witnessed as described by the Surveyor General.  
Thence I run  
N. 89° 55' E., on a true line, bet. <sup>frac.</sup>secs. 8 and 17.  
Over rolling land.  
28.49 Set an iron post, 3 ft. long, 1 in. diam, 26 ins. in the ground, for 1/4 sec. cor., marked on brass cap, 1913; 1/4 S8 in N. and 1/4 S17 in S. half;  
Dig pits, 18x18x12 ins., E. and W. of post, 3 ft. dist.; and raise a mound of earth, 3 1/2 ft. base, 1 1/2 ft. high, N. of cor.  
68.49 The cor. of secs. 8, 9, 16 and 17.  
Land, level and rolling.  
Soil, sandy loam and gumbo, 3rd rate.  
No timber, or undergrowth.

29.50 N. 0° 2' W., bet. secs. 8 and 9.  
Over rolling land.  
40.00 Road, Jone's Tank to Seligman, brs. NE. and SW.  
Set an iron post, 3 ft. long, 1 in. diam, 26 ins. in the ground, for 1/4 sec. cor., marked on brass cap, 1913; 1/4 S8 in W. and 1/4 S9 in E. half;

FRACTIONAL  
Subdivision of T. 22 N., R. 6 W.

<p>Chains 80.00</p>	<p>Dig pits, 18x18x12 ins., N. and S. of post, 3 ft. dist., and raise a mound of earth, 3½ ft. base, 1½ ft. high, W. of cor. Set an iron post, 3 ft. long, 2 ins. in diam., 24 ins. in the ground, for cor. of secs. 4, 5, 8 and 9, marked on brass cap, 1913; T22N R6W in N. half; S5 in NW., S4 in NE., S9 in SE. and S8 in SW. quadrant; And raise a mound of stone, 2 ft. base, 1½ ft. high, W. of cor. Pits impracticable. Land, level and rolling. Soil, gravelly loam and gumbo, 3rd rate. No timber, or undergrowth.</p>
<p>40.00 80.12 2.00 5.90 14.90 25.00 40.06 50.00 60.00 70.00 80.12</p>	<p>S. 89° 52' E., on a random line, bet. secs. 4 and 9. Set temp. ¼ sec. cor. Intersect N. and S. line, 2 lks. S. of the cor. of secs. 3, 4, 9 and 10, Thence I run N. 89° 53' W., on a true line, bet. secs. 4 and 9. Over rolling land. Rock wall of Chino Wash, 65 ft. high, brs. NE. and SW. Foot of wall; thence across level land. Wash, 60 lks. wide, 8 ft. deep, course SW. Wash, 25 lks. wide, 4 ft. deep, course ESE. Asc. NE. slope, 40 ft. Set an iron post, 3 ft. long, 1 in. in diam., 26 ins. in the ground, for ¼ sec. cor., marked on brass cap, 1913; ¼ S4 in N. and ¼ S9 in S. half; Dig pits, 18x18x12 ins., E. and W. of post, 3 ft. dist.; and raise a mound of earth, 3½ ft. base, 1½ ft. high, N. of cor. Asc. NE. slope, 40. ft. Top of asc.; thence over rolling land. Desc. W. slope, 35 ft. The cor. of secs. 4, 5, 8 and 9. Land, rolling and hilly. Soil, clay and gumbo, 3rd rate. No timber, or undergrowth.</p>
<p>40.00 68.42 8.50 28.42 68.42</p>	<p>S. 89° 55' W., on a random line, bet. <sup>frac.</sup>secs. 5 and 8. Set temp. ¼ sec. cor. Intersect W. bdy of Tp., 6 lks. S. of the <sup>old</sup> cor. of secs. 1, 5, 8 and 12, which is a malpais stone, 6x10x8 ins. above ground, marked and witnessed as described by the Surveyor General. Thence I run N. 89° 58' E., on a true line, bet. <sup>frac.</sup>secs. 5 and 8. Over rolling land. Deserted well brs. N. about 10 chs. dist. Set an iron post, 3 ft. long, 1 in. in dia., 26 ins. in the ground, for ¼ sec. cor., marked on brass cap, 1913; ¼ S5 in N. and ¼ S8 in S. half; And raise a mound of stone, 2 ft. base, 1½ ft. high, N. of cor. Pits impracticable. The cor. of secs. 4, 5, 8 and 9. Land, level and rolling.</p>

26

FRACTIONAL  
Subdivision of T. 22 N., R. 6 W.

Chains.

Soil, sandy loam and gumbo, 3rd rate.  
No timber, or undergrowth.

40.00

N. 0° 2' W., on a true line, bet. secs. 4 and 5.  
Over rolling land, ascending draw, course S.  
Set an iron post, 3 ft. long, 1 in. <sup>in</sup>diam., 26 ins. in  
the ground, for  $\frac{1}{4}$  sec. cor., marked on brass cap, 1913;  
 $\frac{1}{4}$ S5 in W. and  
S4 in E. half;  
Dig pits, 18x18x12 ins., N. and S. of post, 3 ft. dist.;  
and raise a mound of earth, 3 $\frac{1}{2}$  ft. base, 1 $\frac{1}{2}$  ft. high, W.  
of cor.

69.75

Road, brs. NE. and SW.

74.00

Road, brs. ENE. and WSW. Joins other road 8 chs. E.

Enter scattering timber, brs. E. and W.

85.07

Intersect the N. bdy. of the Tp., 3.82 chs. W. of the old  
cor. of secs. 4, 5, 32 and 33, which is a malpais  
stone, 5x8x6 ins. above ground, marked and witnessed  
as described by the Surveyor General.

I obliterate the markings on the bearing trees SE. and  
SW. of the cor.

At the point of intersection, I set an iron post, 3 ft.  
long, 2 ins. <sup>in</sup>diam., 24 ins. in the ground, for closing  
cor. of secs. 4 and 5, <sup>T22N R6W</sup> marked on brass cap, 1913;

CC, S. of center;

T23N, R6W, S32, S33, in N. half;

S4 in SE. and

S5 in SW. quadrant; from which

A cedar limb, 8 ins. <sup>in</sup>diam., brs. S. 35 $\frac{1}{2}$ ° E., 367 lks. dist.,  
marked T22N R6W S4 BT.

A cedar limb, 8 ins. <sup>in</sup>diam., brs. S. 13° W., 215 lks. dist.,  
marked T22N R6W S5 BT.

Land, level and rolling.

Soil, sandy loam and gumbo, 2nd rate.

Timber, scattering pinion.

No undergrowth.

Feb. 13, 1913.

H.N.B.

General Description.

Land, mostly rolling; mountainous in the SW. part. Patches  
of heavy scrub cedar and pinion. Soil loam and gumbo,  
1st to 4th rate. Lava and quartzite formation.  
Subsoil, limestone and hardpan. Drains to the S.  
No settlers.

*William B. Kimmel,*

U. S. Surveyor.

*Stan Bradstreet*

U.S. Transitman.

45  
BCC: 2683

27

For FINAL OATH OF UNITED STATES SURVEYOR &  
see Book "L"  
TRANSITMAN  
(Subdivision E 1/2 T.25N.R.17W.)

I, \_\_\_\_\_, U. S. Surveyor, do solemnly swear that, in pursuance of special instructions received from the U. S. Surveyor General for \_\_\_\_\_ bearing date of the \_\_\_\_\_ day of \_\_\_\_\_, 191 \_\_\_\_\_, I have well, faithfully, and truly, in my own proper person, and in strict conformity with said instructions, the Manual of Surveying Instructions, and the laws of the United States, surveyed all those parts or portions of \_\_\_\_\_ of the \_\_\_\_\_ Meridian, in the State of \_\_\_\_\_, which are represented in the foregoing field notes as having been executed by me, and under my direction; and I do further solemnly swear that all the corners of said survey have been established and perpetuated in strict accordance with the Manual of Surveying Instructions, and the special written instructions of the U. S. Surveyor General for \_\_\_\_\_ and in the specific manner described in the field notes, and that the foregoing are the original field notes of such survey.

U. S. Surveyor.

Subscribed by said \_\_\_\_\_, and sworn to before me }  
this \_\_\_\_\_ day of \_\_\_\_\_, 191 \_\_\_\_\_



APPROVAL.

OFFICE OF THE UNITED STATES SURVEYOR GENERAL,  
Phoenix Arizona OCT 5 1914, 191 \_\_\_\_\_

The foregoing field notes of the survey of the Subdivision lines of  
Fractional Township No.22 North , Range No.6 West  
of the Gila and Salt River Base and Meridian, Arizona

executed by William B.Kimmel, U.S.Surveyor and H.N.Bradstreet, U.S.Transitman under special instructions dated October 18 1912 for Group 24, #1, having been critically examined, and the necessary corrections and explanations made, the said field notes, and the surveys they describe, are hereby approved.

*Frank J. Ingalls*  
U. S. Surveyor General.  
of Arizona

I certify that the foregoing transcript of the field notes of the above described surveys in \_\_\_\_\_, has been correctly copied from the original notes on file in this office.

U. S. Surveyor General.