

616
OCT 1 - 1915
Accepted - G.L.O. letter "E"
Apr. 28 - 1915

2685

4-679

2685

BOOK "G"
Subdivisions
FIELD NOTES

BOOK 2685

(1)

OF THE SURVEY OF THE

Subdivision lines of

TOWNSHIP 21 NORTH, RANGE 8 WEST

of the Gila & Salt River Base & Meridian,

In the State of ARIZONA

EXECUTED BY

H. N. BRADSTREET, U.S. Transitman

&

WILLIAM B. KIMMEL, U.S. Surveyor

In the capacity of U.S. Surveyor, under instructions dated October 18, 1912, issued by the United States Surveyor General to govern surveys included in Group No. 24, which were approved by the Commissioner of the General Land Office, November 5, 1912, pursuant to authority contained in the Act of Congress dated June 25, 1910.

Survey commenced March 10, 1913

Survey completed " 16, 1913

BOOK 2685

INDEX DIAGRAM.

Township *21 North* Range *8 West*

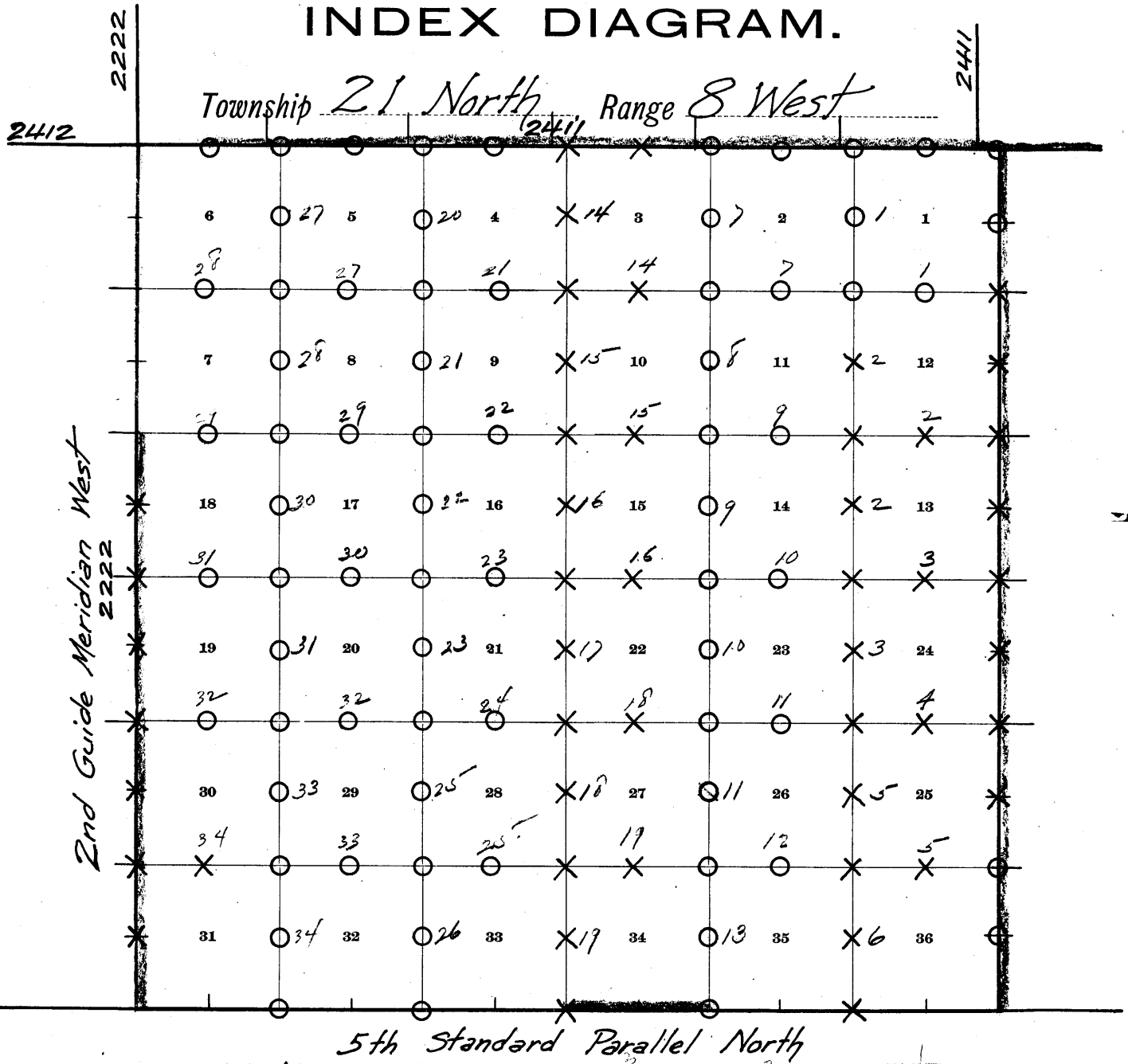

5th Standard Parallel North

- X Corners set by W.B. Kimmel
- O " " " " H.N. Bradstreet
- Book "M" (EXTERIORS)
- " " " " (RESURVEYS & RETRACEMENTS)

Subdivision of T.21 N., R.8 W.

13

Chains

Survey commenced Mar. 1, 1913, and executed with Young and Sons Light Mountain Transits Nos. 7695 and 8541, with Smith Solar Attachments. For description of instruments and Certificate of Approval, see book "O", page 1.

Knowing from recent and repeated tests of these transits on a meridian determined by Polaris observations that they are in adjustment, we proceed to the subdivision of

H.N.B. T21 N., R. 8 W. NOTE: Initials "W.B.K." and "H.N.B." indicate surveys by William B. Kimmel U.S. Surveyor, and H.N. Bradstreet, U.S. Transitman, respectively.

At 2 hrs. 10 m., p.m., l.m.t., I set off 35° 15' N. on the lat arc; 7° 32' S. on the decl. arc; and determine a meridian with the solar at the cor. of secs. 1 and 2, on the N. bdy. of the Tp. ~~reestablished by me this day~~ as described in book "O", page 2.

Thence I run S. 0° 1' E., bet. secs. 1 and 2. Over rolling land, through scattering undergrowth. Desc. S. slope, 35 ft. Road to Seligman, brs. NE. and SW. Foot of desc.; thence over level land. Set an iron post, 3 ft. long, 1 in. diam, 26 ins. in the ground, for 1/4 sec. cor., marked on brass cap, 1913; 1/2 S2 in W. and S1 in E. half; And raise a mound of stone, 2 ft. base, 1 1/2 ft. high, W. of cor. Pits impracticable.

8.00
8.15
16.00
40.00

Same road, brs. NW. and SE. Set an iron post, 3 ft. long, 2 ins. diam, 24 ins. in the ground, for cor. of secs. 1, 2, 11 and 12, marked on brass cap, 1913; T21N R8W in N. half; S2 in NW., S1 in NE., S12 in SE., and S11 in SW. quadrant; Dig pits, 18 X 18 X 12 ins. in each sec., 5 1/2 ft. dist.; and raise a mound of earth, 4 ft. base, 2 ft. high, W. of cor.

42.65
80.00

Land, level and rolling. Soil, brown, sandy loam; no subsoil at 2 ft. No timber. Undergrowth, rabbit brush.

N. 89° 57' E., on a random line, bet. secs. 1 and 12. Set temp. 1/4 sec. cor. Intersect E. bdy. of the Tp., 2 1/2 lks. S. of the cor. of secs. 1, 6, 7 and 12, ~~recently estab~~ by *W.B. Kimmel*, as described in book "M", page 30.

40.00
79.98

Thence I run S. 89° 53' W., on a true line, bet. secs. 1 and 12. Over level land. Set an iron post, 3 ft. long, 1 in. diam, 26 ins. in the ground, for 1/4 sec. cor., marked on brass cap, 1913; 1/2 S1 in N. and S12 in S. half; Dig pits, 18 X 18 X 12 ins., E. and W. of post, 3 ft. dist.; and raise a mound of earth, 3 1/2 ft. base, 1 1/2 ft. high, N. of cor.

39.99

Road to Seligman, brs. N. and S. The cor. of secs. 1, 2, 11, and 12. Land, level. Soil, dark brown loam, 2nd rate; no subsoil at 26 ins. No timber. Undergrowth, rabbit brush and greasewood.

69.50
79.98

Mar. 1, 1913.

H.N.B.

Subdivision of T. 21 N., R. 8 W.

<p>Chains.</p> <p>40.00</p> <p>70.75</p> <p>74.20</p> <p>80.00</p>	<p>W.B.K.</p> <p>March 2, 1913: At 7 hrs. 57m. a.m., l.m.t., I set off 35°14'N. on the lat. arc; 7°14'S. on the decl. arc; and determine a meridian with the solar at the cor. of secs. 1, 2, 11, and 12, at the cor. of secs. 1, 2, 11, and 12,</p> <p>Thence I run S.0°1'E., bet. secs. 11 and 12.</p> <p>Over gently rolling land, through scattering undergrowth.</p> <p>Set an iron post, 3 ft. long, 1 in. diam, 26 ins. in the ground, for $\frac{1}{4}$ sec. cor., marked on brass cap, 1913; S11 in W. and S12 in E. half;</p> <p>Dig pits, 18 X 18 X 12 ins., N. and S. of post, 3 ft. dist.; and raise a mound of earth, 3½ ft. base, 1½ ft. high, W. of cor.</p> <p>Enter scattering timber, brs. E. and W.</p> <p>Leave timber, brs. E. and W.</p> <p>Set an iron post, 3 ft. long, 2 ins. diam, 24 ins. in the ground, for cor. of secs. 11, 12, 13 and 14, marked on brass cap, 1913; T21N R8W in N. half; S11 in NW., S12 in NE., S13 in SE., and S14 in SW. quadrant;</p> <p>And raise a mound of stone, 2 ft. base, 1½ ft. high, W. of cor. Pits impracticable.</p> <p>Land level and rolling.</p> <p>Soil, sandy loam and gumbo, 2nd and 3rd rate.</p> <p>Timber, scattering scrub cedar.</p> <p>Undergrowth, rabbit brush and greasewood.</p>
<p>40.00</p> <p>79.84</p> <p>39.92</p> <p>57.80</p> <p>79.84</p>	<p>N. 89° 53'E., on a random line, bet. secs. 12 and 13.</p> <p>Set temp. $\frac{1}{4}$ sec. cor.</p> <p>Intersect E. bdy. of Tp., 5 lks. S. of the cor. of secs. 7, 12, 13 and 18, recently established by me as st, described in book "M", page 30.</p> <p>Thence I run S.89°51'W., on a true line, bet. secs. 12 and 13.</p> <p>Over level land, through scattering undergrowth.</p> <p>Set an iron post, 3 ft. long, 1 in. diam, 26 ins. in the ground, for $\frac{1}{4}$ sec. cor., marked on brass cap, 1913; S12 in N. and S13 in S. half;</p> <p>Dig pits, 18 X 18 X 12 ins., E. and W. of post, 3 ft. dist.; and raise a mound of earth, 3½ ft. base, 1½ ft. high, N. of cor.</p> <p>Road, brs. N. and S.</p> <p>The cor. of secs. 11, 12, 13 and 14.</p> <p>Land, level and rolling; drains E. for 1st 40 chs.</p> <p>Soil, sandy loam and gumbo, 2nd and 3rd rate.</p> <p>No timber.</p> <p>Undergrowth, rabbit brush and greasewood.</p> <p>NOTE: At this corner, I set off 7°11'S. on the decl. arc.; and at noon, I observe the sun on the meridian, the resulting lat. is 35°13'N., which is slightly less than the correct lat.</p>
<p>29.50</p>	<p>S.0°1'E., bet. secs. 13 and 14.</p> <p>Over gently rolling land, through scattering undergrowth.</p> <p>Enter scattering timber, brs. E. and W.</p>

Chains.

40.00 Set an iron post, 3 ft. long, 1 in.^m diam, 26 ins. in the ground, for $\frac{1}{4}$ sec. cor., marked on brass cap, 1913; $\frac{1}{4}$ S14 in W. and S13 in E. half; from which
 A cedar, 18 ins.^m diam, brs. S. 58° E., 164 lks. dst., marked $\frac{1}{4}$ S13 BT.
 A cedar, 20 ins.^m diam, brs. N. 9 $\frac{1}{2}$ ° W., 158 lks. dist., marked $\frac{1}{4}$ S14 BT.

62.00 Leave scattering timber, brs. NE. and SW.

80.00 Set an iron post, 3 ft. long, 2 ins.^m diam, 26 ins. in the ground, for cor. of secs. 13, 14, 23 and 24, marked on brass cap, 1913;
 T21N R8W in N. half;
 S14 in NW.,
 S13 in NE.,
 S24 in SE., and
 S23 in SW. quadrant;
 And raise a mound of stone, 2 ft. base, 1 $\frac{1}{2}$ ft. high, W. of cor. Pits impracticable.
 Land, level and rolling.
 Soil, 2nd and 3rd rate gumbo; last 20 chs. rocky.
 Timber, scrub cedar and pinion.
 Undergrowth, rabbit brush and greasewood.

40.00 N. 89° 51' E., on a random line, bet. secs. 13 and 24.
 Set temp. $\frac{1}{4}$ sec. cor.

79.90 Intersect the E. bdy. of the Tp., at the cor. of secs. 13, 18, 19 and 24, recently established by me as described in book "A", page 30.
 Thence I run
 S. 89° 51' W., on a true line, bet. secs. 13 and 24.
 Over gently rolling land, through scattering undergrowth.

37.30 Drain, 7 lks. wide, 2 ft. deep, course SW.

39.95 Set an iron post, 3 ft. long, 1 in.^m diam, 26 ins. in the ground, for $\frac{1}{4}$ sec. cor., marked on brass cap, 1913;
 $\frac{1}{4}$ S13 in N. and S24 in S. half;
 And raise a mound of stone, 2 ft. base, 1 $\frac{1}{2}$ ft. high, N. of cor. Pits impracticable.

76.60 Road, brs. NE. and SW.

79.90 The cor. of secs. 13, 14, 23 and 24.
 Land, level and rolling.
 Soil, 1st 60 chs., rocky 4th rate; last 20 chs, sandy loam and gumbo, 2nd and 3rd rate.
 No timber.
 Undergrowth, rabbit brush and greasewood.
 March 2nd, 1913.

March 3, 1913. At 7 hrs. 45 m. a.m., l.m.t., I set off 35 $\frac{1}{2}$ ' N. on the lat. arc; 6° 55 $\frac{1}{2}$ ' S. on the decl. arc; and determine a meridian with the solar at the cor. of secs. 13, 14, 23 and 24;
 Thence I run
 S. 0° 1' E., bet. secs. 23 and 24.
 Over gently rolling land, through scattering undergrowth.

7.15 Road, brs. NE. and SW.

40.00 Set an iron post, 3 ft. long, 1 in.^m diam, 26 ins. in the ground, for $\frac{1}{4}$ sec. cor., marked on brass cap, 1913;
 $\frac{1}{4}$ S23 in W. and S24 in E. half;
 Dig pits, 18 X 18 X 12 ins., N. and S. of post, 3 ft. dist., and raise a mound of earth, 3 $\frac{1}{2}$ ft. base, 1 $\frac{1}{2}$ ft. high, W. of cor.

4

Subdivision of T.21 N., R 8 W.

Chains.
 44.25 Drain, 5 lks. wide, 1 ft. deep, course E. Asc. NE. slope,
 55 ft. Enter scattering timber, brs. E. and W.
 58.00 Spur ridge, brs. E. and W. Desc. SE. slope, 90 ft.
 70.00 Foot of desc.;
 71.10 Draw, course E.
 74.00 Asc. N. slope, 40 ft.
 78.80 Top of kno¹. Desc. slight S. slope.
 80.00 Set an iron post, 3 ft. long, 2 ins.ⁿ diam, 24 ins. in
 the ground, for cor. or secs. 23, 24, 25 and 26,
 marked on brass cap, 1913;
 T21N R8W in N. half;
 S23 in NW.,
 S24 in NE.,
 S25 in SE., and
 S26 in SW. quadrant; from which
 A cedar, 7 ins.ⁿ diam, brs. N. 70³/₄° E., 51 lks. dist.,
 marked T21N R8W S24 BT.
 A piñon, 6 ins.ⁿ diam, brs. S. 63¹/₄° E., 41 lks. dist.,
 marked T21N R8W S25 BT.
 A piñon 8 ins.ⁿ diam, brs. S. 72³/₄° W., 57 lks. dist.,
 marked T21N R8W S26 BT.
 A cedar, 10 ins.ⁿ diam, brs. N. 40³/₄° W., 31 lks. dist.,
 marked T21N R8W S23 BT.
 Land, rolling and hilly.
 Soil, rocky 4th rate.
 Timber scrub cedar and piñon.
 Undergrowth, greasewood.

40.00 N. 89° 51' E., on a random line, bet. secs. 24 and 25.
 79.98 Set temp. ¹/₄ sec. cor.
 Intersect the E. bdy. of the Tp., 14 lks. N. of the cor.
 of secs. 19, 24, 25 and 30, recently established by us as
 described in book "M", page 31.
 Thence I run, on a true line, bet. secs. 24 and 25
 S 89° 57' W., on a true line, bet. secs. 24 and 25
 Over hilly land, through scattering timber.
 Asc. SE. slope, 30 ft.
 10.00 Top of asc.
 12.00 Desc. NW. slope, 40 ft.
 15.50 Gulch, course SW. Asc. SE. slope, 50 ft.
 22.00 Top of asc.; thence across rocky mesa.
 25.00 Desc. NW. slope, 120 ft.
 34.00 Foot of desc.; thence across rolling land.
 39.99 Set an iron post, 3 ft. long, 1 in.ⁿ diam, 26 ins. in
 the ground, for ¹/₄ sec. cor., marked on brass cap, 1913;
¹/₄ S24 in N. and
 S25 in S. half; from which
 A cedar, 24 ins.ⁿ diam, brs. N. 37¹/₂° W., 181 lks. dist.,
 marked ¹/₄ S24 BT.
 A cedar, 10 ins.ⁿ diam, brs. S 56° W., 58 lks. dist.,
 marked ¹/₄ S25 BT.
 50.45 Tank, brs. N. 45° E., 10 chs. dist.
 55.00 House, brs. S. 7° W., 375 lks. dist.
 50.45 Wash; 35 lks. wide, 5 ft. deep, course SW.
 55.65 Road, brs. NW. and SE.
 62.90 Road, brs. N. and S.
 74.00 Asc. E. slope, 40 ft.
 79.00 Top of asc.
 79.98 The cor. of secs. 23, 24, 25 and 26.
 Land, rolling and hilly.
 Soil, rocky 4th rate.
 Timber, scrub cedar and piñon.
 Undergrowth, greasewood.

NOTE:- At this corner, I set off 6° 48' S. on the decl. arc;
 and at noon, I observe the
 sun on the meridian, the resulting lat. is 35° 11¹/₂' N., which

Chains.		
	is slightly higher than the correct lat.	
	<p>S.0° 1'E., bet. secs. 25 and 26. Desc. S. slope, 60 ft., through scattering timber and undergrowth. 6.00 Foot of desc.; thence over rolling land. 9.50 Road, brs. NE. and SW. 22.00 Asc. rocky N. slope, 105 ft. 26.20 Top of rocky knoll; desc. rocky SE. slope, 120 ft. 33.50 Foot of desc; Leave scattering timber, brs. NE. and SW. 40.00 Set an iron post, 3 ft. long, 1 in. diam, 26 ins. in the ground, for ¼ sec. cor., marked on brass cap, 1913; ¼ S26 in W. and ¼ S25 in E. half; Dig pits, 18 X 18 X 12 ins., N. and S. of post, 3 ft. dist.; and raise a mound of earth, 3½ ft. base, 1½ ft. high, W. of cor. 50.00 Enter scattering timber, brs. E. and W. 66.65 Road, brs. NW. and SE. 74.00 Asc. NE. slope, 40 ft. 80.00 Set an iron post, 3 ft. long, 2 ins. diam, 24 ins. in the ground, for cor. of secs. 25, 26, 35 and 36, marked on brass cap, 1913; T21N R8W in N. half. S26 in NW., S25 in NE., S36 in SE., and S35 in SW. quadrant; from which A cedar, 8 ins. diam, brs. N.78° E., 188 lks. dist., marked T21N R8W S25 BT. A cedar, 12 ins. diam, brs. S.28¼° E., 192 lks. dist., marked T.21N R8W S36 BT. A cedar, 20 ins. diam, brs. S.18½° W., 232 lks. dist., marked T21N R8W S35 BT. A cedar, 10 ins. diam, brs. N.87¾° W., 66 lks. dist., marked T21N R8W S26 BT. Land, mountainous and hilly. Soil, rocky 4th rate. Timber scrub cedar and pinion. Undergrowth, greasewood.</p> <p style="text-align: right;">March 3, 1913.</p>	
	March 4, 1913.	
	<p>N.89° 57'E., on a random line, bet. secs. 25 and 36. 40.00 Set temp. ¼ sec. cor. 80.10 Intersect the E. bdy. of the Tp., 2 lks. N. of the cor. of secs. 25, 30, 31 and 36, recently estab. by H.N. Broadstreet as described in book "M", page 32. Thence I run S.89° 58'W., on a true line, bet. secs. 25 and 36. Over rolling land, through heavy timber. 2.10 Draw, course SE. Asc. rocky E. slope, 90 ft. 10.00 Top of asc.; thence across meaa. 40.05 Set an iron post, 3 ft. long, 1 in. diam, 26 ins. in the ground, for ¼ sec. cor., marked on brass cap, 1913; ¼ S25 in N. and ¼ S36 in S. half; from which A cedar, 16 ins. diam, brs. N.73½° W., 86 lks. dist., marked ¼ S25 BT. A cedar, 18 ins. diam, brs. S.83¾° E., 81 lks. dist., marked ¼ S36 BT. 53.65 Leave heavy timber, brs. NE. and SW. Desc. rocky W. slope, 345 ft. 66.10 Foot of desc.; thence across ^{rolling} land.</p>	

Chains.

67.95 Wash, 35 lks. wide, 4 ft. deep, course S.
 69.80 Road, brs. NE. and SW.
 74.10 Asc. NE. slope, 70 ft.
 80.10 The cor. of secs. 25, 26, 35 and 36.
 Land, rolling and mountainous.
 Soil, rocky 4th rate.
 Timber, scrub cedar and pinion.
 Undergrowth, greasewood.

NOTE: - At this corner, I set off $6^{\circ}25\frac{1}{2}'$ S. on the decl. arc; and at noon, I observe the sun on the meridian, the resulting lat. is $35^{\circ}10\frac{1}{2}'$ N., which is the correct lat.

NOTE: - At 2 hrs. 3 m., p.m., l.m.t., I set off $35^{\circ}10\frac{1}{2}'$ N. on the lat arc; $6^{\circ}23\frac{1}{2}'$ S. on the decl. arc; and determine a meridian with the solar at the cor. of secs. 25, 26, 35 and 36.
 Thence I run S. $0^{\circ}1'$ E., on a true line, bet. secs. 35 and 36.
 Ascend NE. slope, 35 ft., through scattering timber and undergrowth.
 4.00 Thence along E. slope.
 10.00 Asc. NE. slope, 50 ft.
 16.00 Spur ridge, brs. E. and W. Desc. SE. slope, 60 ft.
 26.00 Spur ridge, brs. NW. and SE. Desc. SW. slope, 55 ft.
 Enter heavy timber, brs. NW. and SE.
 36.00 Draw, course SE. Leave heavy, enter scattering timber, brs. NW. and SE.
 40.00 Set an iron post, 3 ft. long, 1 in. diam, 26 ins. in the ground, for $\frac{1}{4}$ sec. cor., marked on brass cap, 1913; $\frac{1}{4}$ S35 in W. and S36 in E. half; from which
 A cedar limb, 8 ins. diam, brs. S. 12° E., 225 lks. dist., marked $\frac{1}{4}$ S36 BT.
 A cedar, 10 ins. diam, brs. S. $45\frac{1}{4}^{\circ}$ W., 69 lks. dist., marked $\frac{1}{4}$ S35 BT.
 42.00 Spur ridge, brs. E. and W. Desc. SE. slope, 40 ft.
 48.00 Spur ridge, brs. NW. and SE. Desc. SW. slope, 35 ft.
 52.00 Foot of desc.; thence over rolling land.
 52.30 Wash, 20 lks. wide, 2 ft. deep, course NW.
 56.10 Road, brs. NE. and SW.
 65.00 Asc. NW. slope, 50 ft. Enter heavy timber, brs. NE. and SW.
 76.00 Spur ridge, brs. E. and W. Desc. SW. slope, 20 ft.
 78.94 Intersect the 5th Standard Parallel North, at a point from which the Standard cor. of secs. 35 and 36, which is a stone, 10 X 16 X 4 ins. above ground, marked and witnessed as described by the Surveyor General, brs. S. $89^{\circ}54'$ E., 1 lks dist.
 I obliterate all markings on the stone, and place the letters A P on the North face. I also destroy the markings on the bearing trees.
 At the point of intersection, I set an iron post, 3 ft. long, 2 ins. diam, 24 ins. in the ground, for Closing Cor. of secs. 35 and 36, marked on brass cap, 1913;
 CC, N. of centre;
 T21N in N.,
 T20N, S1, S2; in S. and
 R8W in W. half;
 S35 in NW. and
 S36 in NE. quadrant; from which
 A cedar, 14 ins. diam, brs. N. $37\frac{3}{4}^{\circ}$ E., 92 lks. dist., marked T21N R8W S36 BT.
 A pinion, 8 ins. diam, brs. N. $24\frac{1}{4}^{\circ}$ W., 77 lks. dist., marked T21N R8W S35 BT.
 Land, rolling

Chains.

Land, rolling and hilly.
Soil, rocky 4th rate.
Timber, scrub cedar and pinion pine.
Undergrowth, greasewood.

March 4, 1913.

W.B.K.

H.N.B.

March 2, 1913. At 2 hrs. 12 m., p.m., l.m.t., I set off 35°15' N. on the lat. arc; 7°09' S. on the decl. arc; and determine a meridian with the solar at the cor. of secs. 2 and 3, on the N. bdy. of the Tp. ~~reestablished by me this~~ ~~data~~ as described in book "O", page 23.

Thence I run S.0°1'E., bet. secs. 2 and 3.

Over level land, through scattering timber and undergrowth.

34.00
40.00

Enter heavy timber, brs. NW. and SE.
Set an iron post, 3 ft. long, 1 in. diam, 26 ins. in the ground, for 1/4 sec. cor., marked on brass cap, 1913; 1/4 S3 in W. and 1/4 S2 in E. half; from which
A cedar, 10 ins. diam, brs. S17 1/4° E., 32 lks. dist., marked 1/4 S2 BT.
A cedar, 16 ins. diam, brs. S.87° W., 11 lks. dist., marked 1/4 S3 BT.

54.00
56.00
80.00

Draw, 50 lks. wide, course NE.
Asc. N. slope, 50 ft.
Set an iron post, 3 ft. long, 2 ins. diam, 24 ins. in the ground, for cor. of secs. 2, 3, 10 and 11, marked on brass cap, 1913;
T21N R8W in N. half;
S3 in NW.,
S2 in NE.,
S11 in SE., and
S10 in SW. quadrant; from which
A cedar, 10 ins. diam, brs. N.85 1/2° E., 68 lks. dist., marked T21N R8W S2 BT.
A cedar limb, 5 ins. diam, brs. S.71 1/2° E., 115 lks. dist., marked T21N R8W S11 BT.
A cedar, 6 ins. diam, brs. S.20 1/2° W., 17 lks. dist., marked T21N R8W S10 BT.
A pinion, 10 ins. diam, brs. N.87 1/4° W., 45 lks. dist., marked T21N R8W S3 BT.

Land, level and rolling.
Soil rocky 4th rate.
Timber scrub cedar and pinion.
Undergrowth, scrub oak and buck brush.

Mar. 2, 1913.

March 3, 1913. At 7 hrs. 58 m., a.m., l.m.t., I set off 35°14' N. on the lat. arc; 6°51' S. on the decl. arc; and determine a meridian with the solar at the cor. of secs. 2, 3, 10 and 11.

Thence I run S.89°59'E., on a random line, bet. secs. 2 and 11.

40.00
80.01

Set temp. 1/4 sec. cor.
Intersect the N. and S. line, 2 lks. N. of the cor. of secs. 1, 2, 11 and 12, marked on brass cap, 1913.

Thence I run N.89°58'W., on a true line, bet. secs. 2 and 11.
Asc. gradual NE. slope, through heavy timber and scattering undergrowth.

20.00
39.20

Top of asc.; thence along N. slope.
Gulch, 10 lks. wide, course N.

Chains.

- 40.005 Set an iron post, 3 ft. long, 1 in.^m diam, 26 ins. in the ground, for $\frac{1}{4}$ sec. cor., marked on brass cap, 1913;
 $\frac{1}{4}$ S2 in N. and
 $\frac{1}{4}$ S11 in S. half; from which
 A cedar limb, 5 ins.^m diam, brs. N.44 $\frac{3}{4}$ ° W., 240 lks. dist., marked $\frac{1}{4}$ S2 BT.
 A cedar, 12 ins.^m diam, brs. S.22 $\frac{1}{2}$ ° E., 100 lks. dist., marked $\frac{1}{4}$ S11 BT.
- 80.01 The cor. of secs. 2, 3, 10 and 11.
 Land, rolling.
 Soil, rocky, 3rd and 4th rate.
 Timber, scrub cedar and pinion.
 Undergrowth, scrub oak and greasewood.
- NOTE - At this corner, I set off 6 $\frac{7}{8}$ 'S. on the decl. arc; and at noon, I observe the sun on the meridian, the resulting lat. is 35° 14' N., which is the correct lat.

- S.0° 1'E., bet. secs. 10 and 11.
 Over mountainous land, through heavy timber and dense undergrowth.
- 4.85 Gulch, 15 lks. wide, course NE. Asc. NE. slope, 190 ft.
 15.00 Cliff, brs. E. and W., 40 ft. high.
 22.50 Top of asc.; desc. SE. slope, 110 ft.
 30.30 Ravine, 70 lks. wide, course E. Asc. N. slope, 95 ft.
 40.00 Set an iron post, 3 ft. long, 1 in.^m diam, 26 ins. in the ground, for $\frac{1}{4}$ sec. cor., marked on brass cap, 1913;
 $\frac{1}{4}$ S10 in W. and
 $\frac{1}{4}$ S11 in E. half; from which.
 A cedar, 9 ins.^m diam, brs. N.82° E., 66 lks. dist., marked $\frac{1}{4}$ S11 BT.
 A pinion, 10 ins.^m diam, brs. S.18 $\frac{3}{4}$ ° W., 29 lks. dist., marked $\frac{1}{4}$ S10 BT.
 Continue to asc. N. slope, 305 ft.
 55.00 Top of asc.; thence along E. slope.
 62.00 Desc. SE. slope, 145 ft.
 80.00 Set an iron post, 3 ft. long, 2 ins.^m diam, 24 ins. in the ground, for cor. of secs. 10, 11, 14 and 15, marked on brass cap, 1913;
 T21N R8W in N. half;
 S10 in NW.,
 S11 in NE.,
 S14 in SE. and
 S15 in SW. quadrant; from which
 A cedar limb, 5 ins.^m diam, brs. N.72 $\frac{1}{2}$ ° E., 11 lks. dist., marked T21N R8W S11 BT.
 A pinion, 6 ins.^m diam, brs. S.35 $\frac{1}{2}$ ° E., 75 lks. dist., marked T21N R8W S14 BT.
 A cedar, 14 ins.^m diam, brs. S.68 $\frac{1}{2}$ ° W., 19 lks. dist., marked T21N R8W S15 BT.
 A pinion, 11 ins.^m diam, brs. N.18 $\frac{3}{4}$ ° W., 40 lks. dist., marked T21N R8W S10 BT.
 Land, mountainous.
 Soil, rocky 4th rate.
 Timber scrub cedar and pinion.
 Undergrowth, buck brush and scrub oak.

- 40.00 S.89° 58'E., on a random line, bet. secs. 11 and 14.
 Set temp. $\frac{1}{4}$ sec. cor.
- Mar. 3, 1913.
- Mar. 4, 1913. At 8 hrs. 4 m. a.m., l.m.t., I set off 35 $\frac{7}{13}$ 'N. on the lat. arc; 6° 28'S. on the decl. arc; and determine a meridian with the solar at the temp. $\frac{1}{4}$ sec. cor. bet. secs. 11 and 14,
 Thence I continue,

Subdivision of T. 21 N., R. 8 W.

Chains.

80.04 S. 89° 58' E., on a random line, bet. secs. 11 and 14.
Intersect N. and S. line, 16 lks. N. of the cor. of secs. 11, 12, 13 and 14,
Thence I run
N. 89° 51' W., on a true line, bet. secs. 11 and 14 .
Over rolling land, through heavy timber and dense undergrowth.
18.65 Wash, 20 lks. wide, 2 ft. deep, course ESE.
40.62 Set an iron post, 3 ft. long, 1 in. diam, 26 ins. in the ground, for 1/4 sec. cor., marked on brass cap, 1913;
1/4 S11 in N. and
1/4 S14 in S. half; from which
A cedar, 10 ins. diam, brs. N. 25 1/2° W., 12 lks. dist., marked 1/4 S11 BT.
A pinion, 7 ins. diam, brs. S. 40 1/2° W., 69 lks. dist., marked 1/4 S14 BT.
42.05 Gulch, 18 lks. wide, course NE. Asc. SE. slope, 375 ft.
69.75 Head of gulch, course SE.
80.04 The cor. of secs. 10, 11, 14 and 15.
Land, rolling and mountainous.
Soil, rocky 4th rate gumbo.
Timber, scrub cedar and pinion.
Undergrowth, buck brush, chaparral, and scrub oak.

S. 0° 1' E., bet. secs. 14 and 15.
Desc. S. slope, 145 ft. through heavy timber and dense undergrowth.
14.00 Gulch, 15 lks. wide, course SE. Asc. NE. slope, 50 ft.
26.20 Top of asc.; thence along E. slope.
34.00 Desc. slight S. slope.
40.00 Set an iron post, 3 ft. long, 1 in. diam, 26 ins. in the ground, for 1/4 sec. cor., marked on brass cap, 1913;
1/4 S15 in W. and
1/4 S14 in E. half; from which
A pinion, 6 ins. diam, brs. N. 58 1/4° E., 43 lks. dist., marked 1/4 S14 BT.
A cedar, 10 ins. diam, brs. N. 53 3/4° W., 24 lks. dist., marked 1/4 S15 BT.
NOTE:- At this corner, I set off 6° 25 1/2' S. on the decl. arc; and at noon, I observe the sun on the meridian, the resulting lat. is 35° 12 1/2' N., which is slightly less than the correct lat.
47.00 Desc. S. slope, 185 ft.
48.00 Desc. SW. slope,
78.40 Leave heavy, enter scattering timber.
80.00 Foot of desc.; wash, 30 lks. wide, 4 ft. deep, course E.
Set an iron post, 3 ft. long, 2 ins. diam, 24 ins. in the ground, for cor. of secs. 14, 15, 22 and 23, marked on brass cap, 1913;
T21N R8W in N. half;
S15 in NW.,
S14 in NE.,
S23 in SE., and
S22 in SW. quadrant; from which
A cedar, 36 ins. diam, brs. N. 63 1/4° E., 66 lks. dist., marked T21N R8W S14 BT.
A cedar, 16 ins. diam, brs. S. 60 1/4° E., 26 lks. dist., marked T21N R8W S23 BT.
A cedar, 24 ins. diam, brs. S. 22° W., 50 lks. dist., marked T21N R8W S22 BT.
A cedar limb, 8 ins. diam, brs. N. 60 1/4° W., 190 lks. dist., marked T21N R8W S15 BT.

10

Subdivision of T.21N R.8 W.

Chains.

Land, mountainous and hilly.
Soil, rocky 4th rate.
Timber, scrub cedar and pinion.
Undergrowth, chaparral, buck brush and scrub oak.

40.00 S. 89° 51' E., on a random line, bet. secs. 14 and 23.
Set temp. $\frac{1}{4}$ sec. cor.
79.85 Intersect the N. and S. line, 9 lks. S. of the cor. of
secs. 13, 14, 23 and 24, with an iron post, 3 ft.
long, 1 in. diam., 26 ins. in the ground, for $\frac{1}{4}$ sec. cor., marked on brass cap, 1913;
Thence I run
N. 89° 55' W., on a true line, bet. secs. 14 and 23.
Over rolling land, draining SE.
9.85 Enter timber, brs. N. and S.
39.925 Set an iron post, 3 ft. long, 1 in. diam., 26 ins. in the
ground, for $\frac{1}{4}$ sec. cor., marked on brass cap, 1913;
 $\frac{1}{4}$ S14 in N. and
S23 in S. half; from which
A pinion, 13 ins. diam., brs. N. 32° W., 61 lks. dist.,
marked $\frac{1}{4}$ S14 BT.
A pinion, 11 ins. diam., brs. S. 43 $\frac{1}{4}$ ° E., 91 lks. dist.,
marked $\frac{1}{4}$ S23 BT.
Asc. E. slope, 70 ft.
53.85 Asc. SE. slope.
63.20 Top of asc.; ridge, brs. NE. and SW. Desc. slight
SW. slope.
64.60 Draw, 3 chs. wide, course SE. Thence over rolling land.
66.00 Low ridge, brs. NW. and SE.
72.00 Wash, 10 lks. wide, 2 ft. deep, course SE.
74.55 Low, rocky ridge, brs. NW. and SE. Desc. slight SW. slope.
75.00 Wash, 30 lks. wide, 4 ft. deep, course SE.
79.85 The cor. of secs. 14, 15, 22 and 23.
Land, rolling.
Soil, gumbo, 3rd rate; rocky in places.
Timber, scrub cedar and pinion.
Undergrowth, scrub oak and buck brush.

Mar. 4, 1913.

March 5, 1913: At 7 hrs. 35' m. a.m., l.m.t., I set off
35° 12' N. on the lat arc; 6° 45' S. on the decl. arc;
and determine a meridian with the solar at the cor. of secs.
14, 15, 22 and 23,
Thence I run
S. 0° 1' E., bet. secs. 22 and 23.
Over rolling land, through scattering timber and
undergrowth.
10.00 Low ridge, brs. E. and W. Desc. SE. slope, 30 ft.
22.00 Leave timber, brs. E. and W.
22.65 Centre of draw, 3 chs. wide, course SE. Asc. slight NE.
slope.
26.00 Enter scattering timber, brs. E. and W.
34.00 Low ridge, brs. E. and W.
34.60 Desc. slight SE. slope.
36.95 Wash, 5 lks. wide, 1 ft. deep, course NE.
40.00 Set an iron post, 3 ft. long, 1 in. diam., 26 ins. in the
ground, for $\frac{1}{4}$ sec. cor., marked on brass cap, 1913;
 $\frac{1}{4}$ S22 in W. and
S23 in E. half; from which
A cedar, 8 ins. diam., brs. S. 40 $\frac{3}{4}$ ° E., 18 lks. dist.,
marked $\frac{1}{4}$ S23 BT.
A cedar, 7 ins. diam., brs. N. 74 $\frac{3}{4}$ ° W., 50 lks. dist.,
marked $\frac{1}{4}$ S22 BT.
44.00 To p of asc.; desc. slight SE. slope. Enter heavy timber.

Chains.	
52.00	Leave heavy, enter scattering timber.
56.00	Enter heavy timber, brs. E. and W.
61.00	Draw, 1 ch. wide, course NE. Asc. NE. slope, 30 ft.
64.00	Low ridge, brs. E. and W. Desc. SE. slope, 30 ft.
69.85	Gulch, 20 lks. wide, course E. Asc. N. slope, 150 ft.
80.00	Set an iron post, 3 ft. long, 2 ins. diam, 24 ins. in the ground, for cor. of secs. 22, 23, 26 and 27, marked on brass cap, 1913;
	T21N R8W in N. half;
	S22 in NW.,
	S23 in NE.,
	S26 in SE. and
	S27 in SW. quadrant; from which
	A pinion, 6 ins. diam, brs. N. 16 1/4° E., 29 lks., dist.,
	marked T21N R8W S23 BT.
	A pinion, 7 ins. diam, brs. S. 64 1/4° E., 25 lks. dist.,
	marked T21N R8W S26 BT.
	A pinion, 10 ins. diam, brs. S. 20 1/4° W., 16 lks. dist.,
	marked T21N R8W S27 BT.
	A pinion, 6 ins. diam, brs. N. 68° W., 58 lks. dist.,
	marked T21N R8W S22 BT.
	Land, rolling and hilly.
	Soil, rocky 4th rate.
	Timber scrub cedar and pinion.
	Undergrowth, scrub oak and buck brush.
NOTE-	At this corner, I set off 6° 2' S. on the decl. arc; and
	at noon, I observe the sun on
	the meridian, the resulting lat. is 35° 11 1/2' N., which is
	slightly higher than the correct lat.
40.00	S. 89° 55' E., on a random line, bet. secs. 23 and 26.
79.96	Set temp. 1/4 sec. cor.
	Intersect N. and S. line, 2 lks. N. of the cor. of secs. 23, 24, 25 and 26, marked on brass cap, 1913;
	Thence Iron
	N. 89° 54' W., on a true line, bet. secs. 23 and 26.
	Over rolling land, through scattering timber.
	Desc. SW. slope of knoll, 25 ft.
4.00	Centre of draw, 70 lks. wide, course S.
12.00	Low ridge, brs. N. and S. Desc. SW. slope, 40 ft.
19.55	Centre of draw, 2 chs. wide, course SE. Leave timber.
19.95	Road, brs. N. and S. Asc. E. slope, 25 ft.
22.00	Top of asc.; thence over rolling land. Enter timber.
39.98	Set an iron post, 3 ft. long, 1 in. diam, 26 ins. in the ground, for 1/4 sec. cor., marked on brass cap, 1913;
	1/4 S23 in N. and
	S26 in S. half; from which
	A cedar, 14 ins. diam, brs. N. 11 1/4° W., 164 lks. dist.,
	marked 1/4 S23 BT.
	A cedar, 5 ins. diam, brs. S. 24 1/4° W., 326 lks. dist.,
	marked 1/4 S26 BT.
47.25	Gulch, 15 lks. wide, course SE. Asc. gulch, course E.
50.00	Leave gulch, course E.
58.35	Draw, 2 chs. wide, course NE. Asc. very rocky E. slope, 200 ft. Enter heavy timber brs. E. and W.
79.96	The cor. of secs. 22, 23, 26 and 27.
	Land, mountainous and rolling.
	Soil, gumbo, 3rd and 4th rate; rocky.
	Timber, scrub cedar and pinion.
	Undergrowth, buck brush.
	S. 0° 1' E., bet. secs. 26 and 27.

Chains.

Desc. very rocky S. slope, 165 ft., through heavy timber and dense undergrowth.
 7.00 Desc. SE. slope.
 19.15 Gulch, 10 lks. wide, course SW.
 25.10 Gulch, 15 lks. wide, course SW. Asc. NW. slope, 45 ft.
 31.55 Ridge, brs. E. and W. Desc. S. slope, 115 ft.
 39.40 Gulch, 5 lks. wide, course S.SW.
 40.00 Set an iron post, 3 ft. long, 1 in. diam, 26 ins. in the ground, for $\frac{1}{4}$ sec. cor., marked on brass cap, 1913; $\frac{1}{4}$ S27 in W. and S26 in E. half; from which
 A cedar, 14 ins. diam, brs. N.55 $\frac{1}{2}$ ° E., 10 lks. dist., marked $\frac{1}{4}$ S26 BT.
 A pinion, 10 ins. diam, brs. S.24° W., 42 lks. dist., marked $\frac{1}{4}$ S27 BT.
 48.20 Bottom of desc.: draw, 1 ch. wide, course SE.
 48.50 Asc. slight NE. slope.
 54.00 Top of asc. thence along ridge, course brs. N. and S.
 56.00 Desc. S. slope, 30 ft.
 64.00 Leave timber, brs. E. and W. Foot of desc.
 73.25 Dim road, brs. NW. and SE.
 75.00 Wash, 10 lks. wide, 2 ft. deep, course SE. Asc. slight NE. slope.
 78.00 Enter scattering timber, brs. E. and W.
 80.00 Set an iron post, 3 ft. long, 2 ins. diam, 24 ins. in the ground, for cor. of secs. 26, 27, 34 and 35, marked on brass cap, 1913; T21N R8W in N. half; S27 in NW., S26 in NE., S35 in SE., and S34 in SW. quadrant; from which
 A cedar, 5 ins. diam, brs. N.61° E., 17 lks. dist., marked T21N R8W S26 BT.
 A cedar, 26 ins. diam, brs. S.44° E., 86 lks. dist., marked T21N R8W S35 BT.
 A cedar, 10 ins. diam, brs. S.64 $\frac{3}{4}$ ° W., 27 lks. dist., marked T21N R8W S34 BT.
 A cedar, 8 ins. diam, brs. N.13 $\frac{3}{4}$ ° W., 28 lks. dist., marked T21N R8W S22 BT.
 Land, rolling and mountainous.
 Soil rocky 4th rate.
 Timber, scrub cedar and pinion.
 Undergrowth, buck brush and scrub oak.

Mar. 5, 1913.

Mar. 7, 1913.
 S.89° 54' E., on a random line, bet. secs. 26 and 35.
 40.00 Set temp. $\frac{1}{4}$ sec. cor.
 80.01 Intersect N. and S. line, 7 lks. S. of the cor. of secs. 25, 26, 35 and 36, which is an iron post, 3 ft. long, 1 in. diam, 26 ins. in the ground, for $\frac{1}{4}$ sec. cor., marked on brass cap, 1913.
 Thence I run
 N.89° 57' W., on a true line, bet. secs. 26 and 35.
 Asc. NE. slope, 130 ft., through scattering timber and undergrowth.
 10.75 Ridge, brs. NW. and SE. Desc. SW. slope, 65 ft.
 21.50 Gulch, 30 lks. wide, course SE. Asc. NE. slope, 75 ft.
 30.00 Ridge, brs. NW. and SE. Desc. SW. slope, 30 ft.
 37.20 Draw, 1 ch. wide, course SW. Asc. E. slope, 35 ft.
 40.005 Set an iron post, 3 ft. long, 1 in. diam, 26 ins. in the ground, for $\frac{1}{4}$ sec. cor., marked on brass cap, 1913; $\frac{1}{4}$ S26 in N. and S35 in S. half; from which

Subdivision of T.21 N., R. 8 W.

Chains.

A pinion, 7 ins.^m diam, brs. N.42 $\frac{1}{4}$ ° W., 88 lks. dist., marked $\frac{1}{4}$ S26 BT.
 A cedar, 5 ins.^m diam, brs. S.15 $\frac{1}{2}$ ° E., 17 lks. dist., marked $\frac{1}{4}$ S35 BT.
 40.55 Ridge, brs. N. and S. Des. NW. slope, 215 ft.
 56.00 Foot of desc., thence over rolling land.
 68.00 Leave heavy timber, brs. N. and S.
 72.35 Road, brs. NW. and SE.
 74.70 Wash, 8 lks. wide, 30 ft. deep, course SE. Asc. slight NE. slope, 35 ft.
 80.01 The cor. of secs. 26, 27, 34 and 35.
 Land, rolling, and mountainous.
 Soil, very rocky 4th rate.
 Timber, scrub cedar and pinion.
 Undergrowth, buck brush and scrub oak.
 NOTE:- At this corner, I set off $\sqrt{5^{\circ}15\frac{1}{2}'S.}$ on the decl. arc; at noon, I observe the sun on the meridian, the resulting lat. is $35^{\circ}10\frac{1}{2}'N.$, which is the correct lat.

NOTE:- At 2 hrs. 15 m. p.m., l.m.t., I set off $35^{\circ}10\frac{1}{2}'N.$ on the lat. arc; $\sqrt{5^{\circ}13\frac{1}{2}'S.}$ on the decl. arc; and determine a meridian with the solar at the cor. of secs. 26, 27, 34 and 35.
 Thence I run S.0°1'E., on a true line, bet. secs. 34 and 35.
 Asc. very rocky NE. slope, through heavy timber and scattering undergrowth.
 6.00 Top of asc.; ridge brs. NW. and SE. Desc. SW. slope; 75 ft.
 18.00 Foot of desc.; thence across rolling land.
 20.00 Leave heavy, enter scattering timber.
 40.00 Set an iron post, 3 ft. long, 1 in.^m diam, 26 ins. in the ground, for $\frac{1}{4}$ sec. cor., marked on brass cap, 1913; $\frac{1}{4}$ S34 in W. and S35 in E. half; from which
 A cedar limb, 8 ins.^m diam, brs. S.81 $\frac{3}{4}$ ° E., 100 lks. dist., marked $\frac{1}{4}$ S35 BT.
 A cedar, 14 ins.^m diam, brs. N.78 $\frac{1}{2}$ ° W., 34 lks. dist., marked $\frac{1}{4}$ S34 BT.
 72.00 Enter heavy timber, brs. E. and W.
 78.93 Intersect the 5th Standard Parallel North, at a point from which the Standard Cor. of secs. 34 and 35, which is a limestone, 6 X 5 X 8 ins. above ground, marked S.C. on N. face, with 2 notches on E., and 4 notches on W. Edge; with one bearing tree SE. of stone; brs. West 105 lks. dist.
 I destroy all marking on the stone, and the markings on the tree SE. of the stone, and chisel the letters A P on North face of stone.
 At the point of intersection, I set an iron post, 3 ft. long, 2 ins.^m diam, 24 ins. in the ground, for closing cor. of secs. 34 and 35, marked on brass cap, 1913; CC, N. of centre.
 T21N in N.,
 T20N, S2, S3, in S. and R8W in W. half;
 S34 in NW., and S35 in NE. quadrant; from which
 A cedar, 7 ins.^m diam, brs. N31 $\frac{1}{4}$ ° E., 20 lks. dist., marked T21N R8W S35 BT.
 A pinion, 10 ins.^m diam, brs. N.78 $\frac{1}{2}$ ° W., 79 lks. dist., marked T21N R8W S34 BT.
 Land, rolling and hilly.
 Soil, rocky 4th rate on slope; black loam, 2nd rate

Chains

in flat.
 Timber, scrub cedar and pinion.
 Undergrowth, scrub oak and buck brush.
 Mar.7, 1913.

H.N.B.

W.B.K.

March 5, 1913, At 2 hrs. 15 m., p.m., l.m.t., I set off
 $35^{\circ}15'N.$ on the lat. arc; $\sqrt{6^{\circ}00'S.}$ on the decl. arc;
 and determine a meridian with the solar. at the cor. of secs.
 3 and 4, on the N. bdy., of the Tp. recently established by
 mes as described in book "O", page 24.

Thence I run

40.00 $S.0^{\circ}2'E.$, bet. secs. 3 and 4.
 Over level land, through heavy timber and dense undergrowth.
 Set an iron post, 3 ft. long, 1 in. diam, 26 ins. in the
 ground, for $\frac{1}{4}$ sec. cor., marked on brass cap, 1913;
 $\frac{1}{4}S4$ in W. and
 $S3$ in E. half; from which
 A cedar, 20 ins. diam, brs. $N.44^{\circ}E.$, 71 lks. dist., mark-
 ed $\frac{1}{4}S3$ BT.
 A cedar, 6 ins. diam, brs. $N67^{\circ}W.$, 46 lks. dist., mark-
 ed $\frac{1}{4}S4$ BT.
 44.75 Desc. SW. slope, 335 ft.
 67.00 Foot of desc., brs. NW. and SE.; continue over rolling
 land, sloping W.
 79.00 Draw, course NW.; asc. N. slope.
 80.00 Set an iron post, 3 ft. long, 2 ins. diam, 24 ins. in the
 ground, for cor. of secs. 3, 4, 9 and 10, marked on
 brass cap, 1913;
 $T21N R8W$ in N. half;
 $S4$ in NW.,
 $S3$ in NE.,
 $S10$ in SSE., and
 $S9$ in SW. quadrant; from which,
 A pinion, 18 ins. diam, brs: $N.30\frac{1}{2}^{\circ}E.$, 95 lks. dist.,
 marked $T21N R8W S3$ BT.
 A pinion, 18 ins. diam, brs. $S.74\frac{1}{2}^{\circ}E.$, 67 lks. dist.,
 marked $T.21N R8W S10$ BT.
 A cedar, 9 ins. diam, brs. $S.29^{\circ}W.$, 44 lks. dist.,
 marked $T21N R8W S9$ BT.
 A pinion, 8 ins. diam, brs. $N.75\frac{3}{4}^{\circ}W.$, 15 lks. dist., mark-
 ed $T21N R8W S4$ BT.
 Land, level and mountainous.
 Soil, rocky 4th rate gumbo.
 Timber, scrub cedar and pinion.
 Undergrowth, chaparral, and scrub oak.

40.00 $N.89^{\circ}59'E.$, on a random line, bet. secs. 3 and 10.
 Set temp. $\frac{1}{4}$ sec. cor.
 80.00 Intersect the N. and S. line, 5 lks. N. of the cor. of
 secs. 2, 3, 10 and 11, which is the line post, heretofore
 described.
 Thence I run
 $S.89^{\circ}52'W.$, on a true line, bet. secs. 3 and 10.
 Asc. slight NE. slope, through heavy timber and dense
 undergrowth.
 10.00 Top of asc.; desc. slight NW. slope.
 14.80 Draw, 50 lks. wide, course NW. Asc. NE. slope 25 ft.
 32.00 Top of asc.; desc. slight NW. slope.
 40.00 Set an iron post, 3 ft. long, 1 in. diam, 26 ins. in the
 ground, for $\frac{1}{4}$ sec. cor., marked on brass cap, 1913;
 $\frac{1}{4}S3$ in N. and
 $S10$ in S. half; from which
 A pinion, 9 ins. diam, brs. $N.13\frac{3}{4}^{\circ}E.$, 78 lks. dist.,
 marked $\frac{1}{4}S3$ BT.

Chains.

A cedar, 9 ins.ⁱⁿdiam, brs. S.48 $\frac{1}{4}$ °W., 13 lks. dist., marked $\frac{1}{4}$ S10 BT.
 Desc. W. slope, 45 ft.
 52.50 Draw, course N. Asc. E. slope, 70 ft.
 60.50 Ridge, brs. N. and S. Desc. W. slope, 355 ft.
 79.20 Draw, course NW.
 80.00 The cor. of secs, 3, 4, 9 and 10.
 Land, rolling and mountainous.
 Soil, rocky 4th rate.
 Timber, scrub cedar and pinion.
 Undergrowth, schapparal, buck brush and scrub oak.
 Mar.5, 1913.

March 6, 1913. At 8 hrs. 10 m., a.m., l.m.t., I set off 35°14'N. on the lat. arc; 5°42'S. on the decl. arc; and determine a meridian with the solar at the cor. of secs. 3, 4, 9 and 10.
 Thence I run
 ✓ S.0°2'E., bet. secs. 9 and 10.
 Asc. gradual NE. slope, 585 ft., through heavy timber and dense undergrowth.
 36.50 Top of asc.; brs. NW. and SE. Continue over rolling mesa.
 40.00 Set an iron post, 3 ft. long, 1 in.ⁱⁿdiam, 26 ins. in the ground, for $\frac{1}{4}$ sec. cor., marked on brass cap, 1913;
 $\frac{1}{4}$ S9 in W. and
 S10 in E. half; from which
 A cedar, 10 ins.ⁱⁿdiam, brs. S. 87°E., 8 lks. dist., marked $\frac{1}{4}$ S10 BT.
 A cedar, 7 ins.ⁱⁿdiam, brs. N.37° W., 22 lks. dist., marked $\frac{1}{4}$ S9 BT.
 63.00 Leave mesa, brs. N.20°W., and S.20°E.; desc. SW. slope, 215 ft.
 80.00 Set an iron post, 3 ft. long, 2 ins.ⁱⁿdiam, 24 ins. in the ground, for cor. of secs. 9, 10, 15 and 16, marked on brass cap, 1913;
 T21N R8W in N. half;
 S9 in NW.,
 S10 in NE.,
 S15 in SE. and
 S16 in SW. quadrant; from which
 A cedar, 28 ins.ⁱⁿdiam, brs. N.88°E., 55 lks. dist., marked T21N R8W S10 BT.
 A cedar, 26 ins.ⁱⁿdiam, brs. S.84 $\frac{3}{4}$ °E., 89 lks. dist., marked T21N R8W S15 BT.
 A pinion, 12 ins.ⁱⁿdiam, brs. S.26 $\frac{3}{4}$ °W., 80 lks. dist., marked T21N R8W S16 BT.
 A cedar, 26 ins.ⁱⁿdiam, brs. N.46°W., 17 lks. dist., marked T21N R8W S9 BT.
 Land, rolling and mountainous.
 Soil, rocky 4th rate.
 Timber, scrub cedar and pinion.
 Undergrowth, chaparral and scrub oak.

NOTE - At this corner, I set off 5°39'S. on the decl. arc; and at noon, I observe the sun on the meridian, the resulting lat. is 35°13'N. which is slightly less than the correct lat.

40.00 ✓ N.89°52'E., on a random line, bet. secs. 10 and 15.
 Set temp. $\frac{1}{4}$ sec. cor.
 80.00 Intersect the N. and S. line, 7 lks. S. of the cor. of secs. 10, 11, 14 and 15,
 Thence I run
 ✓ S.89°49'W., on a true line, bet. secs. 10 and 15.

16

Subdivision of T.21 N.; R. 8 W.

Chains.

Asc. very rocky SE. slope, 110 ft., through heavy timber and dense undergrowth.
 20.00 Top of asc., thence along slight S. slope.
 40.00 Set an iron post, 3 ft. long, 1 in.ⁿdiam, 26 ins. in the ground for $\frac{1}{4}$ sec. cor., marked on brass cap, 1913; $\frac{1}{4}$ S10 in N. and S15 in S. half; from which
 A cedar, 9 ins.ⁿdiam, brs. N.8°E., 32 lks.dist., marked $\frac{1}{4}$ S10 BT.
 A pinion, 6 ins.ⁿdiam, brs. S. 11 $\frac{1}{2}$ °W., 27 lks.dist., marked $\frac{1}{4}$ S15 BT.
 Thence over rolling land.
 72.00 Desc. SW. slope, 270 ft.
 80.00 The cor. of secs. 9, 10, 15 and 16.
 Land, rolling and mountainous.
 Soil, very rocky 4th rate.
 Timber, scrub cedar and pinion.
 Undergrowth, buck brush, scrub oak and chaparral.
 Mar. 6, 1913.

March 7, 1913. At 7 hrs. 58 m., a.m., l.m.t., I set off 35°13'N. on the lat. arc; 5°18 $\frac{1}{2}$ 'S. on the decl. arc; and determine a meridian with the solar at the cor. of secs. 9, 10, 15 and 16,
 Thence I run
 S. 0° 2'E., bet. secs. 15 and 16.
 Desc. SW. slope, 275 ft., through heavy timber and dense undergrowth.
 23.80 Draw, course NW. Asc. NE. slope, 405 ft.
 40.00 Set an iron post, 3 ft. long, 1 in.ⁿdiam, 26 ins. in the ground, for $\frac{1}{4}$ sec. cor., marked on brass cap, 1913; $\frac{1}{4}$ S16 in W. and S15 in E. half; from which
 A pinion, 12 ins.ⁿdiam, brs. N.48°E., 13 lks. dist., marked $\frac{1}{4}$ S15 BT.
 A pinion, 7 ins.ⁿdiam, brs. N.29°W., 48 lks.dist., marked $\frac{1}{4}$ S16 BT.
 42.60 Rocky ridge, brs. NW. and SE. Desc. SW. slope, 380 ft.
 80.00 Set an iron post, 3 ft. long, 2 ins.ⁿdiam, 24 ins. in the ground, for cor. of secs. 15, 16, 21 and 22, marked on brass cap, 1913;
 T21N R8W in N. half;
 S16 in NW.,
 S15 in NE.,
 S22 in SE., and
 S21 in SW. quadrant; from which
 A pinion, 7 ins.ⁿdiam, brs. N. 21 $\frac{1}{4}$ °E., 118 lks. dist., marked T21N R8W S15 BT.
 A cedar, 14 ins.ⁿdiam, brs. S. 52°E., 311 lks. dist., marked T21N R8W S22 BT.
 A cedar, 20 ins.ⁿdiam, brs. S. 13 $\frac{1}{4}$ °W., 278 lks. dist., marked T21N R8W S21 BT.
 A pinion, 10 ins.ⁿdiam, brs. N. 28 $\frac{3}{4}$ °W., 73 lks. dist., marked T21N R8W S16 BT.
 Land, mountainous.
 Soil, rocky 4th rate.
 Timber, scrub cedar and pinion.
 Undergrowth, scrub oak, buck brush and chaparral.

40.00 N. 89° 49'E., on a random line, bet. secs. 15 and 22.
 79.88 Set temp. $\frac{1}{4}$ sec. cor.
 Intersect the N. and S. line, 16 lks. S $\frac{1}{4}$ of the cor. of secs. 14,, 15, 22, and 23, marked on iron post,
 Thence I run
 S. 89° 42'W., on a true line, bet. secs. 15 and 22.

Subdivision of T. 21 N., R. 8 W.

Chains.

Over rolling land, through scattering timber and undergrowth.

16.00 Low ridge, brs. N. and S.

32.00 Draw, 80 lks. wide, course S.

36.00 Draw, 1 ch. wide, course S.

39.94 Set an iron post, 3 ft. long, 1 in. ⁱⁿdiam, 26 ins. in the ground, for $\frac{1}{4}$ sec. cor., marked on brass cap, 1913; $\frac{1}{4}$ S15 in N. and $\frac{1}{4}$ S22 in S. half; from which

A cedar, 28 ins. ⁱⁿdiam, brs. N. 42° W., 20 lks. dist., marked $\frac{1}{4}$ S15 BT.

A cedar, 28 ins. ⁱⁿdiam, brs. S. 53° E., 62 lks. dist., marked $\frac{1}{4}$ S22 BT.

Asc. E. slope, 90 ft.

61.85 Ridge, brs. NW. and SE. Desc. SW. slope, 85 ft.

69.85 Foot of desc.; thence over rolling land.

79.88 The cor. of secs. 15, 16, 21 and 22.

Land, rolling and hilly.

Soil, 3rd and 4th rate gumbo; rocky in places.

Timber, scrub cedar and pinion.

Undergrowth, scrub oak and chaparral.

NOTE: At this corner, I set off $\sqrt{5^{\circ} 15\frac{1}{2}' S.}$ on the decl. arc; and at noon, I observe the sun on the meridian, the resulting lat. is, $35^{\circ} 12\frac{1}{2}' N.$, which is slightly higher than the correct lat.

$\sqrt{S. 0^{\circ} 2' E.}$, bet. secs. 21 and 22.

Over mountainous land, through heavy timber and dense undergrowth.

1.35 Draw, 2 chs. wide, course W. Asc. N. slope, 170 ft.

12.00 Top of asc.; thence over rolling E. slope.

22.00 Desc. SW. slope, 245 ft.

33.20 Enter scattering timber; continue dense undergrowth.

36.50 Wash, 10 lks. wide, 4 ft. deep, course SW. Continue over rolling W. slope.

40.00 Set an iron post, 3 ft. long, 1 in. ⁱⁿdiam., 26 ins. in the ground, for $\frac{1}{4}$ sec. cor., marked on brass cap, 1913; $\frac{1}{4}$ S21 in W., and $\frac{1}{4}$ S22 in E. half; from which

A cedar, 30 ins. ⁱⁿdiam, brs. S. $5\frac{3}{4}^{\circ}$ E., 216 lks. dist., marked $\frac{1}{4}$ S22 BT.

A pinion, 7 ins. ⁱⁿdiam, brs. S. $50\frac{3}{4}^{\circ}$ W., 143 lks. dist., marked $\frac{1}{4}$ S21 BT.

48.00 Desc. SW. slope, 110 ft.

59.87 Trail, brs. NW. and SE.; foot of desc., brs. NW. and SE.

62.00 Asc. NE. slope, 175 ft.

73.60 Top of asc., desc. SE. slope, 45 ft.

80.00 Set an iron post, 3 ft. long, 2 ins. ⁱⁿdiam, 24 ins. in the ground, for cor. of secs. 21, 22, 27 and 28, marked on brass cap, 1913; T21N R8W in N. half; S21 in NW., S 22 in NE., S27 in SE., and S28 in SW. quadrant; from which

A pinion, 7 ins. ⁱⁿdiam, brs. N. $66\frac{1}{2}^{\circ}$ E., 110 lks. dist., marked T21N R8W S22 BT.

A pinion, 8 ins. ⁱⁿdiam, brs. S. $62\frac{3}{4}^{\circ}$ E., 75 lks. dist., marked T21N R8W S27BT.

A cedar, 12 ins. ⁱⁿdiam, brs. S. 51° W., 35 lks. dist., marked T21N R8W S28 BT.

A pinion, 8 ins. ⁱⁿdiam, brs. N. $48\frac{1}{4}^{\circ}$ W., 30 lks. dist., marked T21N R8W S21 BT.

Land, rolling and mountainous.

Subdivision of T.21 N., R. 8 W.

Chains.

Soil, rocky 4th rate.
 Timber, scrub cedar and pinion.
 Undergrowth, scrub oak.

March 7, 1913.

March 8, 1913. At 7 hrs. 53 m., a.m., 1^hm.t., I set off
 $35^{\circ}11\frac{1}{2}'N.$ on the lat. arc; $4^{\circ}55'S.$ on the decl. arc;
 and determine a meridian with the solar at the cor. of
 secs. 21, 22, 27 and 28.

Thence I run

40.00 $N.89^{\circ}42'E.$, on a random line, bet. secs. 22 and 27.
 Set temp. $\frac{1}{4}$ sec. cor.

80.02 Intersect N. and S. line, 40 lks. N. of the cor. of secs.
 22, 23, 26 and 27, which is an iron post, marked $\frac{1}{4}S22$

Thence I run

16.00 $S.89^{\circ}59'W.$, on a true line, bet. secs. 22 and 27.
 Asc. N. slope, 125 ft., through heavy timber and dense
 undergrowth.

20.00 Top of asc.; thence along ridge, brs. NW. and SE.

28.00 Begin desc. slight SW. slope, 230 ft.

40.01 Desc. steep SW. slope.

Set an iron post, 3 ft. long, 1 in. diam, 26 ins. in the
 ground, for $\frac{1}{4}$ sec. cor., marked on brass cap, 1913;
 $\frac{1}{4}S22$ in N. and

$S27$ in S. half; from which

A pinion, 6 ins. diam, brs. $N.13\frac{1}{4}W.$, 40 lks. dist.,
 marked $\frac{1}{4}S22 B.$

A cedar, 7 ins. diam, brs. $S.54^{\circ}E.$, 33 lks. dist.,
 marked $\frac{1}{4}S27 BT.$

Continue to desc. SW. slope, 160 ft.

42.00 Gulch, 10 lks. wide, course SW. Continue desc.

51.00 Cabin, brs. S. about 13 chs. dist.

54.00 Tank brs. S. about 12 chs. dist.

60.40 Draw, 1 ch. wide, course SE. Asc. NE. slope, 170 ft.

68.00 Leave heavy timber, enter scattering timber, brs. N. and S.
 Thence along. N. slope.

74.00 Gulch, 5 lks. wide,, course NE. Asc. SE. slope.

80.02 The cor. of secs. 21, 22, 27 and 28.

Land, hilly and mountainous.

Soil, rocky 4th rate.

Timber, scrub cedar and pinion.

Undergrowth, scrub oak and buck brush.

NOTE: - At this corner, I set off $4^{\circ}52'S.$ on the decl arc; and at noon, I observe the sun on the meridian, the resulting lat. is $35^{\circ}11'N.$ which is slightly less than the correct lat.

$S.0^{\circ}2'E.$, bet. secs. 27 and 28.

Over rolling land, through scattering timber and dense
 undergrowth.

3.70 Draw, course NE. Asc. NW. slope, 75 ft.

10.00 Ridge, brs. NE. and SW. Desc. SE. slope, 155 ft.

19.10 Draw, course SE. Asc. NE. slope, 55 ft.

23.55 Rocky spur ridge, brs. NW. and SE. Desc. SW. slope, 140ft.

38.00 Foot of desc.; thence over rolling land.

40.00 Set an iron post, 3 ft. long, 1 in. diam, 26 ins. in
 the ground, for $\frac{1}{4}$ sec. cor., marked on brass cap, 1913;
 $\frac{1}{4}S28$ in W. and

$S27$ in E. half; from which

A cedar, 10 ins. diam, brs. $N.22\frac{3}{4}E.$, 32 lks. dist.,
 marked $\frac{1}{4}S27 BT.$

A cedar, 12 ins. diam, brs. $S.21\frac{3}{4}W.$, 47 lks. dist.,
 marked $\frac{1}{4}S28 BT.$

Chains.

48.75 Wash, 8 lks. wide, 5 ft. deep, course W.
 51.70 Asc. NW. slope, 155 ft. Enter heavy timber, brs. E. and W
 65.75 Top of asc.; desc. SW. slope, 90 ft.
 80.00 Set an iron post, 3 ft. long, 2 ins. diam, 24 ins. in
 the ground, for cor. of secs. 27, 28, 33, and 34,
 marked on brass cap, 1913;
 T21N R8W in N. half:
 S28 in NW.,
 S27 in NE.,
 S34 in SE., and
 S33 in SW. quadrant; from which
 A pinion, 6 ins. diam, brs. N.18 $\frac{3}{4}$ °E., 101 lks. dist.,
 marked T21N R8W S27 BT.
 A cedar, 30 ins. diam, brs. S.67°E., 75 lks. dist.,
 marked T21N R8W S34 BT.
 A pinion, 9 ins. diam, brs. S.48°W., 16 lks. dist.,
 marked T21N R8W S33 BT.
 A cedar, 16 ins. diam, brs. N.20°W., 51 lks. dist.,
 marked T21N R8W S28 BT.
 Land, mountainous.
 Soil, rocky, 2nd to 4th rate.
 Timber, scrub cedar and pinion.
 Undergrowth, chaparral buck brush and scrub cedar.
 Mar. 8, 1913.

Mar. 9, 1913.
 ✓ N. 89° 59' E., on a random line, bet. secs. 27 and 34.
 40.00 Set temp. $\frac{1}{4}$ sec. cor.
 80.10 Intersect N. and S. line, 2 lks. S. of the cor. of secs.
 26, 27, 34 and 35, marked on brass cap, 1913;
 Thence I run
 ✓ S. 89° 58' W., on a true line, bet. secs. 27 and 34.
 Asc. NE. slope, 95 ft. through heavy timber and scatter-
 ing undergrowth.
 13.00 Top of ridge, brs. E. and W. Asc. SE. slope, 60 ft.
 20.00 Ridge, brs. N. and S. Desc. SW. slope, 110 ft.
 38.65 Draw, course SW.; asc. slight SE. slope.
 40.05 Set an iron post, 3 ft. long, 1 in. diam, 26 ins. in the
 ground, for $\frac{1}{4}$ sec. cor. marked on brass cap, 1913;
 $\frac{1}{4}$ S27 in N. and
 $\frac{1}{4}$ S34 in S. half; from which
 A cedar, 9 ins. diam, brs. N.40° E., 42 lks. dist.,
 marked $\frac{1}{4}$ S27 BT.
 A cedar, 16 ins. diam, brs. S.59° E., 26 lks. dist.,
 marked $\frac{1}{4}$ S34 BT.
 Thence over rolling land.
 68.10 Asc. SW. slope, 150 ft.
 80.10 The cor. of secs. 27, 28, 33 and 34.
 Land; rolling and mountainous.
 Soil, 2nd and 3rd rate, rocky in places.
 Timber, scrub cedar and pinion.
 Undergrowth, scrub oak and buck brush.

✓ S. 0° 2' E., bet. secs. 33 and 34.
 Desc. SW. slope, 85 ft., through heavy timber and dense
 undergrowth.
 20.00 Foot of desc.; thence over rolling land, sloping S.
 40.00 Set an iron post, 3 ft. long, 1 in. diam, 26 ins. in the
 ground, for $\frac{1}{4}$ sec. cor., marked on brass cap, 1913;
 $\frac{1}{4}$ S33 in W., and
 $\frac{1}{4}$ S34 in E. half; from which
 A cedar, 10 ins. diam, brs. East, 13 lks. dist.,
 marked $\frac{1}{4}$ S34 BT.
 A pinion, 7 ins. diam, brs. N.80° W., 14 lks. dist.,

Chains.

marked $\frac{1}{4}$ S33 BT.
 64.00 Leave timber, brs. NW. and SE.
 70.50 Road, brs. NW. and SE.
 79.21 Intersect the 5th Standard Parallel North, at a point from which the ⁰standard cor. of secs. 33 and 34, which is a stone, 5 X 15 X 5 ins. above ground, marked and witnessed as described by the Surveyor General, brs. S.89°15'W., 130 lks. dist. I destroy all markings on the stone, and mark the letters A P on the North face. At the point of intersection, I set an iron post, 3 ft. long, 2 ins. ⁿdiam, 24 ins. in the ground, for cor. closing cor. of secs. 33 and 34, marked on brass cap, 1913; CC, N. of center.
 T21N in N.
 T20N, S3, S4, in S.; and
 R8W in W. half;
 S33 in NW. and
 S34 in NE. quadrant;
 And raise a mound of stone, 2 ft. base, 1 $\frac{1}{2}$ ft. high, N. of cor. Pit is impracticable. No trees available.
 Land, rolling.
 Soil, gravelly, 2nd to 4th rate.
 Timber, scrub cedar and pinion.
 Undergrowth, chaparral, scrub oak and buck brush.
 Mar. 9, 1913.

W.B.K.

H.N.B

March, 8, 1913. At 2 hrs 0mp.m., l.m.t., I set off 35°15'N. on the lat. arc; 4°50'S. on the decl. arc; and determine a meridian with the solar at the cor. of secs. 4 and 5 on the N. bdy. of the Tp. re-established by me this day as described in book "O", page 25.
 Thence I run
 S.0°3'E., bet. secs. 4 and 5.
 40.00 Over level land, through scattering timber.
 Set an iron post, 3 ft. long, 1 in. ⁿdiam, 26 ins. in the ground, for $\frac{1}{4}$ sec. cor., marked on brass cap, 1913; $\frac{1}{4}$ S5 in W. and
 S4 in E. half; from which
 A cedar, 6 ins. ⁿdiam, brs. S.88 $\frac{1}{2}$ ° E., 430 lks. dist., marked $\frac{1}{4}$ S4 BT.
 A cedar, 9 ins. ⁿdiam, brs. N.84 $\frac{1}{2}$ ° W., 499 lks. dist., marked $\frac{1}{4}$ S5 BT.
 80.00 Set an iron post, 3 ft. long, 2 ins. dia., 24 ins. in the ground, for cor. of secs. 4, 5, 8 and 9, marked on brass cap, 1913;
 T21N R8W in N. half;
 S5 in NW.,
 S4 in NE.,
 S9 in SE., and
 S8 in SW. quadrant; from which
 A cedar, 12 ins. ⁿdiam, brs. S.28 $\frac{1}{4}$ ° E., 375 lks. dist., marked T21N R8W S9 BT.
 A cedar, 14 ins. ⁿdiam, brs. S.76 $\frac{1}{2}$ ° W., 150 lks. dist., marked T21N R8W S8 BT.
 A cedar, 9 ins. ⁿdiam, brs. N.56 $\frac{3}{4}$ ° W., 171 lks. dist., marked T21N R8W S5 BT. No other tree available.
 Dig a pit, 18x18x12 ins., NE. of post, 5 $\frac{1}{2}$ ft. dist.; and raise a mound of earth, 4 ft. base, 2 ft. high, W. of cor.
 Land, level.
 Soil, moist brown and black sandy loam, 2nd rate.
 Timber, scattering scrub cedar.

Subdivision of T.21 N., R. 8 W.

Chains.

40.00 East $\frac{1}{4}$ sec. cor., on a random line, bet. secs. 4 and 9.
 Set temp. $\frac{1}{4}$ sec. cor.
 80.04 Intersect the N. and S. line, 9 lks North of ^{the cor. of} secs. 3, 4, 9 and 10,
 Thence I run
 N.89° 55' W., on a true line, bet. secs. 4 and 9.
 Over rolling land, sloping N., through heavy timber and dense undergrowth.
 2.00 Asc. NE. slope, 45 ft.
 10.00 Top of asc.; continue over rolling N. slope.
 24.00 Desc. SW. slope, 70 ft.
 32.90 Draw, course NW. Continue over rolling N. slope.
 40.02 Set an iron post, 3 ft. long, 1 in. diam, 26 ins. in the ground, for $\frac{1}{4}$ sec. cor., marked on brass cap, 1913; $\frac{1}{4}$ S4 in N. and S9 in S. half; from which
 A cedar, 10 ins. diam, brs. N.7° W., 77 lks. dist., marked $\frac{1}{4}$ S4 BT.
 A pinion, 10 ins. diam, brs. S.58° E., 25 lks. dist., marked $\frac{1}{4}$ S9 BT.
 Thence over gently rolling land, sloping W.
 80.04 The cor. of secs. 4, 5, 8 and 9.
 Land, rolling and hilly.
 Soil, black, sandy loam, 2nd rate.
 Timber, scrub cedar and pinion.
 Undergrowth, greasewood.

March, 8, 1913.

Mar. 9, 1913. At 8 hrs. 15 m., a.m., l.m.t., I set off 35 $\frac{1}{4}$ ' N. on the lat. arc; 4° 31 $\frac{1}{2}$ ' S. on the decl. arc; and determine a meridian with the solar at the cor. of secs. 4, 5, 8 and 9,
 Thence I run
 S.0° 3' E., bet. secs. 8 and 9.
 Over rolling land, through scattering timber and undergrowth.
 40.00 Set an iron post, 3 ft. long, 1 in. diam, 26 ins. in the ground, for $\frac{1}{4}$ sec. cor., marked on brass cap, 1913; $\frac{1}{4}$ S8 in W. and S9 in E. half; from which
 A cedar, 24 ins. diam, brs. S. 88° E., 35 lks. dist., marked $\frac{1}{4}$ S9 BT.
 A cedar, 48 ins. diam, brs. N.84 $\frac{1}{2}$ ° W., 84 lks. dist., marked $\frac{1}{4}$ S8 BT.
 80.00 Set an iron post, 3 ft. long, 2 ins. diam., 24 ins. in the ground, for cor. of secs. 8, 9, 16 and 17, marked on brass cap, 1913;
 T21N R8W in N. half;
 S8 in NW.,
 S9 in NE.,
 S16 in SE. and
 S17 in SW. quadrant; from which
 A cedar limb, 6 ins. diam, brs. N.72° E., 120 lks. dist., marked T21N R8W S9 BT.
 A cedar, 17 ins. diam, brs. S45 $\frac{1}{2}$ ° E., 137 lks. dist., marked T21N R8W S16 BT.
 A cedar, 14 ins. diam, brs. S.80 $\frac{3}{4}$ ° W., 95 lks. dist., marked T21N R8W S17 BT.
 A cedar, 7 ins. diam, brs. N.15 $\frac{3}{4}$ ° W., 33 lks. dist., marked T21N R8W S8 BT.
 Land, lev. et.
 Soil, sancy loam, 2nd rate.
 Timber, scrub cedar.
 Undergrowth, greasewood.

Subdivision of T.21 N., R. 8 W.

Chains S.89°55'E., on a random line, bet. secs. 9 and 16.
 40.00 Set temp. 1/4 sec. cor.
 80.02 Intersect the N. and S. line, 12 lks. S. of the cor. of
 secs. 9, 10, 15 and 16, which is an iron post, herein-
 before described.
 Thence I run
 ✓ S.89°59'W., on a true line, bet. secs. 9 and 16.
 Desc. SW. slope, 325 ft.; through heavy timber and dense
 undergrowth
 25.40 Foot of desc. brs. NW and SE.
 28.70 Leave timber, brs. NW. and SE.
 31.50 Trail, brs. NW. and SE.
 32.50 Enter heavy timber, brs. NW. and SE.
 40.01 Set an iron post, 3 ft. long, 1 in.^m diam, 26 ins. in the
 ground, for 1/4 sec. cor., marked on brass cap, 1913;
 1/4 S9 in N. and
 S16 in S. half; from which
 A cedar, 11 ins.^m diam, brs. N.11 1/4 E., 9 lks. dist.,
 marked 1/4 S9 BT.
 A cedar, 24 ins.^m diam, brs. S.33 1/4 W., 12 lks. dist.,
 marked 1/4 S16 BT.
 Thence over gently rolling land.
 80.02 The cor. of secs. 8, 9, 16 and 17.
 Land, mountainous and rolling.
 Soil, rocky 4th rate on slopes; sandy loam, 2nd rate on
 flat.
 Timber, scrub cedar and pinion.
 Undergrowth, chaparral, scrub oak and buck brush.
 NOTE- At this corner, I set off 4° 29' S. on the decl. arc;
 at the same time, and at a proper distance, I observe the sun
 on the meridian, the resulting lat. is 35° 13' N., which is
 slightly less than the correct lat.

✓ S.0° 3' E., bet. secs. 16 and 17.
 Over gently rolling land, through scattering timber and
 undergrowth.
 14.50 Draw, 2 chs. wide, course NW. Asc. NE. slope, 165 ft.
 18.00 Enter heavy timber, brs. E. and W.
 26.00 Top of asc.; thence along E. slope.
 32.50 Gulch, 10 lks. wide, course NE. Asc. N. slope.
 38.00 Ridge, brs. E. and W. Desc. SE. slope 20. ft.
 40.00 Set an iron post, 3 ft. long, 1 in.^m diam, 26 ins. in the
 ground, for 1/4 sec. cor., marked on brass cap, 1913;
 1/4 S17 in W. and
 S16 in E. half; from which
 A pinion, 13 ins.^m diam, brs. S.69 1/4 E., 51 lks. dist.,
 marked 1/4 S16 BT.
 A pinion, 6 ins.^m diam, brs. S. 57 1/4 W., 10 lks. dist.,
 marked 1/4 S17 BT.
 Continue to desc. S. slope, 70 ft.
 47.00 Desc., SW. slope, 45 ft.
 55.50 Wash, 20 lks. wide, 3 ft. deep, course SW. Asc. NW. slope,
 95 ft.
 63.25 NW. end. of ridge, brs. NW. and SE. Desc. SW. slope,
 45 ft.
 67.00 Gulch, 20 lks. wide, course NW. Asc. N. slope, 235 ft.
 80.00 Set an iron post, 3 ft. long, 2 ins.^m diam, 24 ins. in
 the ground, for cor. of secs. 16, 17, 20 and 21,
 marked on brass cap, 1913;
 T21N, R8W in N. half;
 S17 in NW.,
 S16 in NE.,
 S21 in SE., and
 S20 in SW. quadrant; from which

Chains.

A cedar, 8 ins.ⁱⁿdiam, brs. N.48 $\frac{1}{2}$ ° E., 9 lks. dist., marked T21N R8W S16 BT.
 A pinion, 8 ins.ⁱⁿdiam, brs. S.29 $\frac{1}{4}$ ° E., 57 lks. dist., marked T21N R8W S21 BT.
 A pinion, 7 ins.ⁱⁿdiam., brs. S.57 $\frac{1}{4}$ ° W., 10 lks dist., marked T21N R8W S20 BT.
 A pinion, 8 ins.ⁱⁿdiam, brs. N.31 $\frac{1}{4}$ ° W., 50 lks. dist., marked T21N R8W S17 BT.
 Land, rolling and mountainous.
 Soil, sandy loam, 2nd rate on flat; rocky 4th rate on slopes.
 Timber, scrub cedar and pinion.
 Undergrowth, scrub oak and buck brush.

40.00 N.89° 59' E., on a random line, bet. secs. 16 and 21.
 79.92 Set temp. $\frac{1}{4}$ sec. cor.
 Intersect the N. and S. line, 16 lks. S. of the cor. of secs. 15, 16, 21 and 22,
 Thence I run
 S. 89° 52' W., on a true line, bet. secs. 16 and 21.
 Over rolling land, through heavy timber and dense undergrowth.
 24.00 Leave timber and undergrowth, brs. N. and S.
 24.85 Plow furrow, drains. S.
 24.90 Trail, brs. N. and S.
 28.90 Plow furrow, drains SE.
 35.00 Enter heavy timber, and dense undergrowth, brs. NE. and SE.
 39.96 Set an iron post, 3 ft. long, 1 in.ⁱⁿdiam, 26 ins. in the ground, for $\frac{1}{4}$ sec. cor., marked on brass cap, 9/13; $\frac{1}{4}$ S16 in N. and S21 in S. half; from which
 A cedar, 12 ins.ⁱⁿdiam, brs. N.42 $\frac{1}{4}$ ° W., 50 lks. dist., marked $\frac{1}{4}$ S16 BT.
 A pinion, 14 ins.ⁱⁿdiam, brs. S.2° W., 54 lks. dist., marked $\frac{1}{4}$ S21 BT.
 Asc. NE. slope, 210 ft.
 64.00 Top of asc.; thence along E. slope.
 79.92 The cor. of secs. 16, 17, 20 and 21.
 Land, rolling and mountainous.
 Soil, sandy loam, 3rd rate; and rocky 4th rate.
 Timber, scrub cedar and pinion.
 Undergrowth, scrub oak and chaparral.
 March 9, 1913.

March 10, 1913. At 8 hrs. 3 m., a.m., l.m.t., I set off 35°12' N. on the lat. arc; $\sqrt{4}$ ° 8 $\frac{1}{2}$ ' S. on the decl. arc; and determine a meridian with the solaa at the cor. of secs. 16, 17, 20 and 21,
 Thence I run
 S. 0° 3' E., bet. secs. 20 and 21.
 Across top of ridge, through heavy timber and dense undergrowth.
 4.00 Asc. NE. slope, 120 ft.
 15.00 Ridge, brs. NW. and SE. Desc. SE. slope, 225 ft.
 17.90 Precipice, 50 ft. high, brs. WNW. and ESE.
 25.85 Bottom of desc.; thence along W. slope of ridge.
 33.00 Desc. SW. slope, 80 ft.
 39.80 Gulch, 20 lks. wide, course SW.
 40.00 Set an iron post, 3 ft. long, 1 in.ⁱⁿdiam, 26 ins. in the ground, for $\frac{1}{4}$ sec. cor., marked on brass cap, 9/13; $\frac{1}{4}$ S20 in W. and S21 in E. half; from which

Subdivision of T.21 N., R. 8 W.

Chains.	<p>A cedar, 10 ins.^m diam, brs. S.78$\frac{3}{4}$° E., 8 lks. dist., marked $\frac{1}{4}$S21 BT.</p> <p>A cedar limb, 8 ins.^m diam, brs. N.81$\frac{1}{4}$° W., 66 lks. dist., marked $\frac{1}{4}$S20 BT.</p> <p>Thence along rolling broken W. slope.</p> <p>Wash, 8 lks wide, 1 ft. deep, course SW. Asc. N. slope, 80 ft.</p> <p>Set an iron post, 3 ft. long, 2 ins.^m diam, 24 ins. in the ground, for cor. of secs. 20, 21, 28 and 29, marked on brass cap 913;</p> <p>T21N R8W in N. half;</p> <p>S20 in NW.,</p> <p>S21 in NE.,</p> <p>S28 in SE., and</p> <p>S29 in SW. quadrant; from which</p> <p>A cedar, 24 ins.^m diam, brs. N.32$\frac{1}{2}$° E., 146 lks. dist., marked T21N R8W S21 BT.</p> <p>A cedar, 10 ins.^m diam, brs. S.64$\frac{1}{4}$° E., 70 lks. dist., marked T21N R8W S28 BT.</p> <p>A cedar, 15 ins.^m diam, brs. S.39$\frac{1}{2}$° W., 108 lks. dist., marked T21N R8W S29 BT.</p> <p>A cedar, 6 ins.^m diam, brs. N.73° W., 166 lks. dist., marked T21N R8W S20 BT.</p> <p>Land, rolling and mountainous.</p> <p>Soil, rocky 4th rate.</p> <p>Timber, scrub cedar and pinion.</p> <p>Und ergrowth, buck brush and scrub oak.</p>
40.00	<p>N.89° 52' E., on a random line, bet. secs. 21 and 28.</p> <p>Set temp $\frac{1}{4}$ sec. cor.</p>
79.68	<p>Intersect N. and S. line, 28 lks. S. of the cor. of secs. 21, 22, 27 and 28, where is an iron post, marked on brass cap 913.</p> <p>Thence I run</p> <p>S.89° 40' W., on a true line, bet. secs. 21 and 28.</p> <p>Asc. SE. slope, 165 ft., through scattering timber and dense undergrowth.</p>
10.50	<p>Spur ridge, brs. NE. and SW. Thence along N. slope.</p>
14.00	<p>Desc. NW. slope, 60 ft.</p>
21.61	<p>Head of draw, course NE. Asc. SE. slope, 40 ft.</p>
27.60	<p>Ridge, brs. NW. and SE. Desc. rocky SW. slope, 155 ft.</p>
39.84	<p>Set an iron post, 3 ft. long, 1 in.^m diam, 26 ins. in the ground, for $\frac{1}{4}$ sec. cor., marked on brass cap 913;</p> <p>$\frac{1}{4}$S21 in N. and</p> <p>S28 in S. half; from which</p> <p>A cedar, 7 ins.^m diam, brs. S.46° W., 114 lks. dist., marked $\frac{1}{4}$S28 BT.</p> <p>No other trees within limits. Raise a mound of stone, 2 ft. base, 1$\frac{1}{2}$ ft. high, N. of cor. Pits impracticable.</p> <p>Desc. W. slope, 105 ft.</p>
45.20	<p>Gulch, 40 lks. wide, course SW. Asc. SE. slope, 100 ft.</p>
51.70	<p>Ridge, brs. NE. and SW. Desc. NW. slope, 100 ft.</p>
58.70	<p>Gulch, 20 lks. wide, course SW. Asc. slight SE. slope.</p>
60.00	<p>Low ridge, brs. NE. and SW. Desc. slight SW. slope.</p>
61.90	<p>Gulch, 15 lks. wide, course S. Asc. SE. slope 105 ft.</p>
67.70	<p>Top of acc.; ridge, brs. NE. and SW. Thence along S. slope.</p>
74.00	<p>Ridge, brs. NE. and SW. thence along N. slope.</p>
79.68	<p>The cor. of secs. 20, 21, 28 and 29.</p> <p>Land, hilly and mountainous.</p> <p>Soil, rocky 4th rate.</p> <p>Timber, scattering scrub cedar and pinion.</p> <p>Undergrowth, scrub oak and buck brush.</p>
NOTE:	<p>At this corner, I set off 4° 5$\frac{1}{2}$' S. on the decl. arc; and at noon, I observe the sun on the meridian, the resulting lat. is 35° 11$\frac{1}{2}$' N., which is slightly higher than the correct lat.</p>

Subdivision of T. 21 N., R. 8 W.

Chains.

✓ S. 0° 3' E., bet. secs. 28 and 29.
 Asc. N. slope, 50 ft. through scattering timber, and undergrowth.
 3.00 Top of asc.; desc. SW. slope, 230 ft.
 14.00 Desc. S. slope.
 26.00 Draw, 1 ch. wide, course W. Thence over rolling land.
 34.00 Low ridge, brs. NE. and SW. Desc. SW. slope, 20 ft.
 40.00 Set an iron post, 3 ft. long, 1 in. diam, 26 ins. in the ground, for ¼ sec. cor., marked on brass cap, 1913; ¼ S 29 in W., and S 28 in E. half; from which
 A cedar, 6 ins. diam, brs. N. 85½° E., 247 lks. dist., marked ¼ S 28 BT.
 A cedar, limb, 12 ins. diam, brs. N. 78½° W., 108 lks. dist., marked ¼ S 29 BT.
 Desc. SW. slope, 40 ft.
 48.30 Draw, 2 chs. wide, course SW.
 52.00 Asc. NW. slope, 70 ft.
 60.00 Top of asc.; thence along W. slope of ridge, bearing N. and S.
 80.00 Set an iron post, 3 ft. long, 2 ins. diam, 24 ins. in the ground, for cor. of secs. 28, 29, 32 and 33, marked on brass cap, 1913; T 21 N R 8 W in N. half; S 29 in NW., S 28 in NE., S 33 in SE. and S 32 in SW. quadrant; from which
 A cedar, 8 ins. diam, brs. N. 60° E., 89 lks. dist., marked T 21 N R 8 W S 28 BT.
 A cedar, 17 ins. diam, brs. S. 41¼° E., 21 lks. dist., marked T 21 N R 8 W S 33 BT.
 A pinion, 7 ins. diam, brs. S. 37¾° W., 122 lks. dist., marked T 21 N R 8 W S 32 BT.
 A cedar, 15 ins. diam, brs. N. 75½° W., 47 lks. dist., marked T 21 N R 8 W S 29 BT.
 Land, rolling and mountainous.
 Soil, very rocky 4th rate.
 Timber, scrub cedar and pinion.
 Undergrowth, scrub oak and buck brush.

Mar. 10, 1913.

March, 16, 1913. At 9 hrs. 6 m. a.m., l.m.t., I set off 35° 10½' N. on the lat. arc; 1° 46½' S. on the decl. arc; and determine a meridian with the solar at the cor. of secs. 28, 29, 32 and 33,
 Thence I run
 40.00 N. 89° 40' E., on a random line, bet. secs. 28 and 33.
 79.57 Set temp. ¼ sec. cor.
 Intersect N. and S. line, 2 lks. N. of the cor. of secs. 27, 28, 33 and 34,
 Thence I run
 10.00 S. 89° 41' W., on a true line, bet. secs. 28 and 33.
 12.85 Desc. SW. slope, 90 ft., through heavy timber and dense undergrowth.
 16.70 Leave heavy timber, brs. N. and S.
 20.00 Fence, brs. N. and S.
 Draw, course S. Asc. E. slope, 90 ft.
 Enter heavy timber and dense undergrowth., brs. N. and S.
 Tank brs. S. about 6 chs.
 21.85 Fence brs. N. and S.
 34.00 Spur ridge, brs. NE. and SW. Desc. NW. slope, 35 ft.
 39.785 Set an iron post, 3 ft. long, 1 in. diam, 26 ins. in the ground, for ¼ sec. cor., marked on brass cap, 1913;

Chains.

$\frac{1}{4}$ S28 in N. and
 S33 in S. half; from which
 A cedar, 9 ins. diam, brs. N. 78° E., 71 lks. dist.,
 marked $\frac{1}{4}$ S28 BT.
 A cedar, 7 ins. diam, brs. S. 17 $\frac{1}{2}$ ° E., 50 lks. dist.,
 marked $\frac{1}{4}$ S33 BT.
 Continue to desc. NW. slope, 30 ft.
 50.00 Bottom of desc.; thence over rolling land.
 74.00 Ridge, brs. N. and S. Desc. very rocky W. slope, 80 ft.
 79.57 The cor. of secs. 28, 29, 32 and 33.
 Land, rolling and hilly.
 Soil, gumbo, 2nd to 4th rate, rocky in places.
 Timber, scrub cedar and pinion.
 Undergrowth, scrub oak.

✓ S. 0° 3' E., on a true line, bet. secs. 32 and 33.
 Along W. slope of ridge, through scattering timber and
 dense undergrowth.
 10.00 Asc. NW. slope, 60 ft.
 28.00 Top of asc., desc. rocky SW. slope.
 34.00 Gulch, 5 lks. wide, course W. Asc. NW. slope, 30 ft.
 38.00 Highest Point on ridge. Desc. SW. slope, 230 ft.
 Rim rock, brs. NW. and. ESE.
 40.00 Set an iron post, 3 ft. long, 1 in. diam, 26 ins. in the
 ground, for $\frac{1}{4}$ sec. cor., marked on brass cap, 1913;
 $\frac{1}{4}$ S32 in W., and
 S33 in E. half;
 And raise a mound of stone, 2 ft. base, 1 $\frac{1}{2}$ ft. high, W.
 of cor. Pits impracticable. No trees available.
 60.00 Foot of desc.; brs. NW. and SE.
 62.00 Leave timber, brs. NW. and SE. Thence across flat.
 79.13 Intersect the 5th Standard Parallel North, at a point
 from which the standard cor. of secs. 32 and 33, brs.
 S. 89° 50' W, 308 lks. dist., which is
 I found an old post, badly decayed and lying on the ground,
 marked S32, with 2 notches on it. There were no
 evidences of any pits, or mound, and all the trees
 in the vicinity had been chopped and burned down.
 I destroy the markings on the post, and place the letters
 A.P upon it, and reset it in the ground.
 At the point of intersection, I set an iron post, 3 ft.
 long, 2 ins. diam, 24 ins. in the ground, for closing
 cor. of secs. 32 and 33, marked on brass cap, 1913;
 CC, N. of center.
 T21N in N.,
 T20N, S4, S5, in S. and
 R8W in W. half;
 S32 in NW., and
 S33 in NE. quadrant;
 Dig pits, 24 X 18 X 12, crosswise on each line, E and W,
 3 ft., and N. of post, 7 ft. dist.; and raise a mound
 of earth, 4 ft. base, 2 ft. high, N. of cor. No trees available.
 Land, rolling and mountainous.
 Soil, rocky 4th rate on slopes; 2nd rate sandy loam
 on flat.
 Timber, scrub cedar and pinion.
 Undergrowth, buck brush and scrub oak.

Mar. 16, 1913.

Mar. 11, 1913. At 10h. 0m. a.m., l.m.t., I set off 35° 15' N
 on the lat. arc, 3° 43 $\frac{1}{2}$ ' S. on the decl. arc, and deter-
 mine a meridian with the solar at the cor. of secs. 5 and 6,
 on the N. Bdy. of the Tp., ~~reestablished by me this day as~~

Chains.

described in book "O", page 26.

Thence I run

S.0 3'E., bet. secs. 5 and 6.

Over level land.

40.00

Set an iron post, 3 ft. long, 1 in. diam, 26 ins. in the ground, for 1/4 sec. cor., marked on brass cap, 1913; 1/4 S6 in W. and

S5 in E. half; from which

A cedar, 6 ins. diam, brs. S.58 3/4 W., 219 lks. dist., marked 1/4 S6 BT.

No other trees within limits. Dig pits, 18 X 18 X 12 ins., N. and S. of post, 3 ft. dist., and raise a mound of earth, 3 1/2 ft. base, 1 1/2 ft. high, W. of cor.

60.00

Enter scattering timber, brs. NW. and SE.

80.00

Set an iron post, 3 ft. long, 2 in. diam, 24 ins. in the ground, for cor. of secs. 5, 6, 7 and 8, marked on brass cap, 1913;

T21N R8W in N. half;

S6 in NW.,

S5 in NE.,

S8 in SE., and

S7 in SW. quadrant; from which

A cedar, 10 ins. diam, brs. N.88 3/4 E., 154 lks. dist., marked T21N R8W S5 BT.

A cedar, 14 ins. diam, brs. S.26 E., 264 lks. dist., marked T21N R8W S8 BT.

A cedar, 30 ins. diam, brs. S.80 1/4 W., 83 lks. dist., marked T21N R8W S7 BT.

A cedar, 12 ins. diam, brs. N.32 W., 165 lks. dist., marked T21N R8W S6 BT.

Land, level.

Soil, sandy loam, 2nd and 3rd rate.

Timber, scrub cedar and pinion.

Undergrowth, buck brush.

NOTE: - At this corner, I set off 3° 42' S. on the decl. arc; and at noon, I observe the sun on the meridian, the resulting lat. is 35° 14' N., which is the correct lat.

S.89° 58' E., on a random line, bet. secs. 5 and 8.

40.00

Set temp. 1/4 sec. cor.

80.04

Intersect N. and S. line, 14 lks. N. of the cor. of secs. 4, 5, 8 and 9,

Thence I run

N.89° 52' W., on a true line, bet. secs. 5 and 8.

Over rolling land, through scattering timber and undergrowth.

6.05

Leave timber, brs. N and S.

40.02

Set an iron post, 3 ft. long, 1 in. diam, 26 ins. in the ground, for 1/4 sec. cor., marked on brass cap, 1913; 1/4 S5 in N. and

S8 in S. half; from which

A cedar, 17 ins. diam, brs. N.37 3/4 W., 187 lks. dist., marked 1/4 S5 BT.

A cedar, 36 ins. diam, brs. S.47 1/4 W., 207 lks. dist., marked 1/4 S8 BT.

42.00

Enter timber, brs. N. and S.

58.00

Leave scattering timber, brs. N. and S.

63.30

Wash, 5 lks. wide, 1 ft. deep, course NW.

70.00

Enter timber, brs. NW. and SE.

80.04

The cor. of secs. 5, 6, 7 and 8.

Land, level.

<p>Chains.</p>	<p>Soil, sandy loam, 2nd and 3rd rate. Timber, scrub cedar. Undergrowth, scrub oak .</p> <p style="text-align: right;">Mar. 11, 1913.</p>
<p>40.00 84.09</p> <p>5.25 44.09</p> <p>50.35 84.09</p>	<p>Mar. 13, 1913. At. 8 hrs. 45 m., a.m., l.m.t., I set off 35°14'N. on the lat. arc; 2°57½'S. on the decl. arc; and determine a meridian with the solar at the cor. of secs. 5, 6, 7 and 8. Thence I run West, on a random line, bet. secs. 6 and 7. Set temp. ¼ sec. cor. (2nd Guide Meridian West) Intersect the W. bdy. of the Tpx 2 lks. N. of the ^{old} cor. of secs. 1, 6, 7 and 12, which is an iron post, 3 ins. dia., 12 ins. above ground, marked ^{ON BRASS CAP} and witnessed as described by the Surveyor General. Thence I run N.89° 59'E., on a true line, bet. secs. 6 and 7. Over rolling land, through heavy timber and scattering undergrowth. Draw, 50 lks. wide, course NW. Set an iron post, 3 ft. long, 1 in.^mdiam, 26 ins. in the ground, for ¼ sec. cor., marked on brass cap, 1913, ¼S6 in N. and S7 in S. half; from which A cedar, 28 ins.^mdiam, brs. N.18¾°E., 34 lks. dist., marked ¼S6 BT. A cedar, 18 ins.^mdiam, brs. S.17¼°E., 71 lks. dist., marked ¼S7 BT. Wash, 15 lks. wide, 1 ft. deep, course NE. The cor. of secs. 5, 6, 7 and 8. Land, rolling. Soil, gumbo, rocky, 3rd and 4th rate. Timber, scrub cedar and pinion. Undergrowth, scrub oak.</p> <p><i>NOTE</i> - The sky being overcast at noon, an observation for lat. was impossible.</p>
<p>40.00</p> <p>70.00 80.00</p>	<p>S.0°3'E., bet. secs. 7 and 8. Over gently rolling land, through s cattering timber and undergrowth. Set an iron post, 3 ft. long, 1 in.^mdiam, 26 ins. in the ground, for ¼ sec. cor., marked on brass cap, 1913; ¼S7 in W. and S8 in E. half; from which A cedar, 18 ins.^mdiam, brs. S.82°E., 45 lks. dist., marked ¼S8 BT. A cedar, 20 ins.^mdiam, brs. S.67¾°W., 98 lks. dist., marked ¼S7 BT. Asc. ONE. slope, 45 ft. Set an iron post, 3 ft. long, 2 ins.^mdiam, 24 ins. in the ground, for cor. of secs. 7, 8, 17 and 18, marked on brass cap, 1913; T21N R8W in N. half; S7 in NW., S8 in NE., S17 in SE., and S18 in SW. quadrant; from which A pinion, 8 ins.^mdiam, brs. N.65½°E., 85 lks. dist., marked T21N R8W S8 BT. A cedar, 10 ins.^mdiam, brs. S.32°E., 83 lks. dist., marked T21N R8W S17 BT. A cedar, 8 ins.^mdiam, brs. S.30°W., 91 lks. dist., marked T21N R8W S18 BT.</p>

Subdivision of T.21 N., R.8 W.

Chains.

A cedar, 9 ins.ⁿ diam., brs. N.50 $\frac{3}{4}$ °W., 20 lks. dist., marked T21N R8W S7 BT.
 Land, level and rolling.
 Soil, gumbo and sandyloam, 2nd to 4th rate.
 Timber, scrub cedar and pinion.
 Undergrowth, scrub oak and buck brush.
 Undergrowth, scrub oak and buck brush. Mar .13, 1913.

March 14, 1913. At. 8 hrs. 10 m., a.m., 1.m.t., I set off 35°14'N. on the lat. arc; 2°34'S. on the decl. arc; and determine a meridian with the solar at the cor. of secs. 7, 8, 17 and 18.

Thence I run

40.00 S.89°52'E., on a random line, bet. secs. 8 and 17.
 Set temp. $\frac{1}{4}$ sec. cor.
 80.20 Intersect N. and S. line, 5 lks. N. of the cor. of secs. 8, 9, 16 and 17,

Thence I run

40.10 N.89°50'W., on a true line, bet. secs. 8 and 17.
 Over gently rolling land, through scattering timber and undergrowth.

Set an iron post, 3 ft. long, 1 in.ⁿ diam., 26 ins. in the ground, for $\frac{1}{4}$ sec. cor., marked on brass cap, 1913; $\frac{1}{4}$ S8 in N. and S17 in S. half; from which

A cedar, 16 ins.ⁿ diam., brs. N.7 $\frac{3}{4}$ °W., 64 lks. dist., marked $\frac{1}{4}$ S8 BT.

A cedar, 10 ins.ⁿ diam., brs. S.12°E., 92 lks. dist., marked $\frac{1}{4}$ S17 BT.

58.00 Low ridge, brs. N.E. and SW. Desc. NW. slope, 30 ft.

61.30 Gulch, 8 lks. wide, course N. Asc. NE. slope, 40 ft.

80.20 The cor. of secs. 7, 8, 17 and 18.

Land, rolling.

Soil, rocky 4th rate gumbo; and sandy loam, 2nd and 3rd rate.

Timber, scrub cedar and pinion.

Undergrowth, scrub oak and buck brush.

40.00 S.89°59'W., on a random line, bet. secs. 7 and 18.
 Set temp. $\frac{1}{4}$ sec. cor.

84.02 Intersect the W. Bdy. of the T²¹, 26 lks. N. of the ^{old} cor. of secs. 7, 12 13 and 18, which is an iron post, 3 ins dia., 12 ins. above ground, marked ^{ON BRASS CAP} and witnessed as described by the Surveyor General.

Thence I run

5.50 N.89°48'E., on a true line, bet. secs. 7 and 18.
 22.00 Asc. SW. slope, 80 ft. through scattering timber and dense undergrowth.

Ridge, brs. NW. and SE. Desc. E. slope, 160 ft.

30.00 Foot of desc.; thence along N. slope.

44.02 Desc. gradual E. slope, 70 ft.

Set an iron post, 3 ft. long, 1 in.ⁿ diam., 26 ins. in the ground, for $\frac{1}{4}$ sec. cor., marked on brass cap, 1913; $\frac{1}{4}$ S7 in N. and S18 in S. half; from which

A cedar, 12 ins.ⁿ diam., brs. N.50 $\frac{3}{4}$ °W., 73 lks. dist., marked $\frac{1}{4}$ S7 BT.

A cedar, 10 ins.ⁿ diam., brs. S.37 $\frac{3}{4}$ °W., 33 lks. dist., marked $\frac{1}{4}$ S18 BT.

84.02 The cor. of secs. 7, 8, 17 and 18.

Land rolling and mountainous.

Soil, rocky 4th rate.

Timber, scrub cedar and pinion.

Undergrowth, scrub oak and buck brush.

Chains.

NOTE - At the cor. of secs. 7, 8, 17 and 18, I set off $2^{\circ}31'S$ on the decl. arc; and at noon, I observe the sun on the meridian, the resulting lat is $35^{\circ}13'N$., which is slightly less than the correct lat. $S.0^{\circ}3'E$., bet. secs. 17 and 18.

Over gently rolling land, through heavy timber and scattering undergrowth.

20.00 Desc. SW. slope, 70 ft.

26.00 Gulch, 7 lks. wide, course SE. Continue desc.

36.00 Leave timber, brs. NW. and SE.

37.00 Foot of desc.; thence over rolling land.

37.80 Draw, 4 chs. wide, course SW.

40.00 Set an iron post, 3 ft. long, 1 in. diam, 26 ins. in the ground, for $\frac{1}{4}$ sec. cor., marked on brass cap, 1913; $\frac{1}{4}$ S18 in W. and S17 in E. half; from which

A cedar, 24 ins. diam, brs. $N.68\frac{3}{4}^{\circ}E$., 169 lks. dist., marked $\frac{1}{4}$ S17 BT.

A cedar, 18 ins. diam, brs. $N.53\frac{3}{4}^{\circ}W$., 254 lks. dist., marked $\frac{1}{4}$ S18 BT.

42.00 Asc. Slight NW. slope, . Enter heavy timber, brs. E. and W.

54.00 Low ridge, brs. E. and W. Desc. SW. slope, 40 ft.

64.00 Leave timber, brs. NW. and SE. Thence over level land.

76.00 Enter scattering timber, brs. E. and W.

80.00 Set an iron post, 3 ft. long, 2 ins. diam, 24 ins. in the ground, for cor. of secs. 17, 18, 19 and 20, marked on brass cap, 1913; T21N R8W in N. half; S18 in NW., S17 in NE., S20 in SE., and S19 in SW. quadrant; from which

A pinion, 16 ins. diam, brs. $N.36^{\circ}E$., 126 lks. dist., marked T21N R8W S17 BT.

A cedar, 42 ins. diam, brs. $S.13\frac{1}{2}^{\circ}E$., 106 lks. dist., marked T21N R8W S20 BT.

A cedar, 20 ins. diam, brs. $S.56\frac{1}{4}^{\circ}W$., 211 lks. dist., marked T21N R8W S19 BT.

A cedar, 24 ins. diam, brs. $N.34\frac{3}{4}^{\circ}W$., 402 lks. dist., marked T21N R8W S18 BT.

Land, rolling and hilly.

Soil, gumbo and sandy loam, 2nd to 4th rate; rocky on slopes.

Timber, scrub cedar and pinion.

Undergrowth, scrub oak and buck brush.

Mar. 14, 1913.

Mar. 15, 1913.

40.00 $S.89^{\circ}50'E$., on a random line, bet. secs. 17 and 20.

80.26 Set temp. $\frac{1}{4}$ sec. cor.

Intersect N. and S. line, 2 lks. N. of the cor. of secs. 16, 17, 20 and 21, which is a true line, marked on brass cap, 1913.

Thence I run

$N.89^{\circ}49'W$., on a true line, bet. secs. 17 and 20.

Along N. slope, through heavy timber and dense undergrowth.

6.25 Desc. SW. slope, 330 ft.

25.55 Ravine, 50 lks. wide, course NW. Asc. NE. slope, 30 ft.

28.25 Top of asc.; desc. NW. slope, 65 ft.

36.25 Same ravine, 55 lks. wide, course SW. Asc. SE. slope, 40 ft.

40.13 Set an iron post, 3 ft. long, 1 in. diam, 26 ins. in the ground, for $\frac{1}{4}$ sec. cor., marked on brass cap, 1913; $\frac{1}{4}$ S17 in N. and S20 in S. half; from which

A cedar, 12 ins. diam, brs. $N.44\frac{1}{2}^{\circ}W$., 32 lks. dist., marked $\frac{1}{4}$ S17 BT.

Chains.

57.25 A cedar, 6 ins.^m diam, brs. S.39 $\frac{1}{2}$ ° E., 16 lks. dist.,
 marked $\frac{1}{4}$ S20 BT.
 80.26 Top of asc.; desc. SW slope, 65 ft.
 The cor. of secs. 17, 18, 19 and 20.
 Land, mountainous and hilly.
 Soil, very rocky 4th rate.
 Timber, scrub cedar and pinion.
 Undergrowth, scrub oak and buck brush.

NOTE: At 10^h10^m. a.m., l.m.t., I set off 35° 12' N. on the lat.
 arc; 2° 9' S. on the decl. arc; and determine a meridian
 with the solar at the cor. of secs. 17, 18, 19 and 20.
 Thence I run
 40.00 S.89° 48' W., on a random line, bet. secs. 18 and 19.
 Set temp. $\frac{1}{4}$ sec. cor. (2nd Guide Meridian West)
 84.02 Intersect the W. Bdy. of the Tpy, 9 lks. SW of the cor.
 secs. 13, 18, 19 and 24, reestablished yesterday by W.B.Kimmel, as
 described in book O, page 35.
 Thence I run
 N.89° 52' E., on a true line, bet. secs. 18 and 19.
 Over rolling land, through scattering timber and under-
 growth h.
 30.00 Leave timber, brs. N. and S. Thence across draw.
 32.05 Wash, 8 lks. wide, 3 ft. deep, course SW.
 42.00 Leave level land, asc. SW. slope, 270 ft. Enter timber, brs. NW & SE.
 44.02 Set an iron post, 3 ft. long, 1 in.^m diam, 26 ins. in
 the ground, for $\frac{1}{4}$ sec. cor., marked on brass cap, 1913;
 $\frac{1}{4}$ S18 in N. and
 S19 in S. half; from which
 A cedar, 13 ins.^m diam, brs. N.29 $\frac{1}{2}$ ° E., 57 lks. dist.,
 marked $\frac{1}{4}$ S18 BT.
 A pinion, 7 ins.^m diam, brs. S.68 $\frac{1}{2}$ ° W., 39 lks. dist.,
 marked $\frac{1}{4}$ S19 BT.
 62.00, Ridge, brs. NW. and SE. Desc. NE. slope, 220 ft.
 79.00 Foot of desc; thence over rolling land.
 82.00 Leave timber, brs. N. and S.
 84.02 The cor. of secs. 17, 18, 19 and 20.
 Land, level rolling and mountainous.
 Soil, gumbo, 3rd rate on flat; rocky 4th rate on slopes.
 Timber, scrub cedar and pinion.
 Undergrowth, buck brush and scrub oak.

NOTE: At this corner, I set off 2° 7 $\frac{1}{2}$ ' S. on the decl. arc;
 and at noon, I observe the
 sun on the meridian, the resulting lat. is 35° 12' N.,
 which is slightly less than the correct lat.

7.00 S.0° 3' E., bet. secs. 19 and 20.
 Over level land.
 Enter scattering timber, brs. NW. and S. Asc. NW. slope,
 70 ft.
 15.00 Rocky ridge, brs. E. and W. Desc. S. slope, 135 ft.
 36.00 Foot of desc.; thence over level land.
 40.00 Set an iron post, 3 ft. long, 1 in.^m diam, 26 ins. in the
 ground, for $\frac{1}{4}$ sec. cor., marked on brass cap, 1913;
 $\frac{1}{4}$ S19 in W. and
 S20 in E. half; from which
 A cedar limb, 10 ins.^m diam, brs. S.59 $\frac{1}{2}$ ° E., 117 lks.
 dist., marked $\frac{1}{4}$ S20 BT.
 A cedar, 10 ins.^m diam, brs. S.83° W., 65 lks. dist.,
 marked $\frac{1}{4}$ S19 BT.
 55.00 Leave timber, brs. NE. and SW.

Subdivision of T.21 N., R. 8 W.

Chains.

80.00

Set an iron post, 3 ft. long, 2 ins. ⁱⁿdiam, 24 ins. in the ground, for cor. of secs. 19, 20, 29 and 30, marked on brass cap, 1913;
 T21N R8W in N. half;
 S19 in NW.,
 S20 in NE.,
 S29 in SE. and
 S30 in SW. quadrant; from which
 A cedar, 22 ins. ⁱⁿdiam, brs. N88 $\frac{3}{4}$ ° E., 93 lks. dist., marked T21N R8W S20 BT.
 A cedar, 48 ins. ⁱⁿdiam, brs. S.28 $\frac{3}{4}$ ° E., 262 lks. dist., marked T21N R8W S29 BT.
 A cedar limb, 18 ins. ⁱⁿdiam, brs. S.42 $\frac{1}{4}$ ° W., 267 lks. dist., marked T21N R8W S30 BT.
 No other trees within limits. Dig a pit, 18 X 18 X 12 ins., NW. of post, 5 $\frac{1}{2}$ ft. dist.; and raise a mound of earth, 4 ft. base, 2 ft. high, W. of cor.
 Land, rolling and hilly.
 Soil, clayey loam,; rocky in places, 3rd and 4th rate.
 Timber, scrub cedar and pinion.
 Undergrowth, scrub oak. Fair gamma grass.

40.00

S.89°49'E., on a random line, bet. secs. 20 and 29.

80.30

Set temp. $\frac{1}{4}$ sec. cor.
 Intersect N. and S. line, 9 lks. S. of the cor. of secs. 20, 21, 28 and 29, marked on iron post, 1913.

Thence I run

N.89°53'W., on a true line, bet. secs. 20 and 29.

Along rocky N. slope, through scattering timber, and undergrowth.

2.00

Desc. NW. slope, 170 ft.

18.00

Foot of desc.; thence over level land.

40.15

Set an iron post, 3 ft. long, 1 in. ⁱⁿdiam, 26 ins. in the ground, for $\frac{1}{4}$ sec. cor., marked on brass cap, 1913;
 $\frac{1}{4}$ S20 in N. and
 $\frac{1}{4}$ S29 in S. half;

Dig pits, 18 X 18 X 12 ins., E. and W. of post, 3 ft. dist., and raise a mound of earth, 3 $\frac{1}{2}$ ft. base, 1 $\frac{1}{2}$ ft. high, N. of cor. No trees available.

80.30

The cor. of secs. 20, 19, 29 and 30.

Land, level and mountainous.

Soil, gumbo, 3rd rate.

Timber, scrub cedar and pinion.

Undergrowth, scrub oak.

40.00

S.89°52'W., on a random line, bet. secs. 19 and 30

84.01

Set temp. $\frac{1}{4}$ sec. cor. (2nd Guide Meridian West)
 Intersect the W. bdy. of the Twp, 12 lks. S. $\frac{1}{4}$ E. of the cor. of secs. 19, 24, 25 and 30, reestablished yesterday by W.B. Kimmel as described in book "O", page 35.

Thence I run

N.89°57'E., on a true line, bet. secs. 19 and 30.

Over level land.

18.00

Enter timber, brs. N. and S. Asc. W. slope, 70 ft.

28.00

Low ridge, brs. N. and S. Desc. gradual E. slope, 80 ft.

44.01

Set an iron post, 3 ft. long, 1 in. ⁱⁿdiam, 26 ins. in the ground, for $\frac{1}{4}$ sec. cor., marked on brass cap, 1913;
 $\frac{1}{4}$ S19 in N. and
 $\frac{1}{4}$ S30 in S. half; from which

A cedar, 8 ins. ⁱⁿdiam, brs. N.43 $\frac{1}{4}$ ° W., 100 lks. dist., marked $\frac{1}{4}$ S19 BT.

Subdivision of T.21 N., R. 8 W.

Chains.	<p>A cedar, 6 ins.ⁿ diam, brs. S28$\frac{1}{4}$°W., 54 lks. dist., marked $\frac{1}{4}$S30 BT.</p> <p>52.00 Leave timber, brs. N. and S. Across Valley.</p> <p>84.01 The cor. of secs. 19, 20, 29 and 30.</p> <p>Land, level, rolling, and hilly.</p> <p>Soil, gumbo, 3rd rate on flat; rocky 4th rate on slopes.</p> <p>Timber, scrub cedar and pinion.</p> <p>Undergrowth, scrub oak.</p> <p style="text-align: right;">Mar. 15, 1913.</p>
	<p>March, 16, 1913. At 7hrs. 50 m., a.m., l.m.t., I set off 35°11$\frac{1}{2}$'N. on the lat. arc; $\sqrt{1}$°47'S. on the decl. arc; and determine a meridian with the solar at the cor. of secs. 19, 20, 29 and 30,</p> <p>Thence I run</p> <p>S.0°3'E., bet. secs. 29 and 30.</p> <p>Over level land, through scattering timber.</p> <p>18.00 Leave timber, brs. E. and W.</p> <p>36.00 Enter timber, brs. NE and SW.</p> <p>40.00 Set an iron post, 3 ft. long, 1 in.ⁿ diam, 26 ins. in the ground, for $\frac{1}{4}$ sec. cor., marked on brass cap, 1913; $\frac{1}{4}$S30 in W. and S29 in E. half: from which</p> <p>A cedar limb, 10 ins.ⁿ diam, brs. N.88$\frac{1}{4}$°E., 125 lks. dist., marked $\frac{1}{4}$S29 BT.</p> <p>A pinion, 8 ins.ⁿ diam, brs. N.54$\frac{1}{2}$°W., 140 lks. dist., marked $\frac{1}{4}$S30 BT.</p> <p>58.00 Leave timber, brs. NE. and SW.</p> <p>71.35 Wash, 10 lks. wide, 2 ft. deep, course SW.</p> <p>76.00 Enter scattering timber, brs. NE. and SW.</p> <p>80.00 Set an iron post, 3 ft. long, 2 ins.ⁿ diam, 24 ins. in the ground, for cor. of secs. 29, 30, 31 and 32, marked on brass cap, 1913;</p> <p>T21N R8W in N. half;</p> <p>S30 in NW.,</p> <p>S29 in NE.,</p> <p>S32 in SE. and</p> <p>S31 in SW. quadrant; from which</p> <p>A cedar, 5 ins.ⁿ diam, brs. N.66$\frac{1}{4}$°E., 221 lks. dist., marked T21N R8W S29 BT.</p> <p>A cedar, 18 ins.ⁿ diam, brs. S.73°E., 194 lks. dist., marked T21N R8W S32 BT.</p> <p>A cedar, 36 ins.ⁿ diam, brs. S.14°W., 254 lks. dist., marked T21N R8W S31 BT.</p> <p>A cedar, 10 ins.ⁿ diam, brs. N.60$\frac{1}{4}$°W., 234 lks. dist., marked T21N R8W S30 BT.</p> <p>Land, level and rolling.</p> <p>Soil, sandy loam and gumbo, 2nd to 4th rate.</p> <p>Timber scrub cedar and pinion.</p> <p>Undergrowth, scrub oak.</p>
	<p>S.89°53'E., on a random line, bet. secs. 29 and 32.</p> <p>40.00 Set temp. $\frac{1}{4}$ sec. cor.</p> <p>80.31 Intersect N. and S. line, 7 lks. N. of the cor. of secs. 28, 29, 32 and 33,</p> <p>Thence I run</p> <p>N.89°50'W., on a true line, bet. secs. 29 and 32.</p> <p>Desc. rocky W. slope, 105 ft., through scattering timber and dense undergrowth.</p> <p>8.00 Foot of desc: thence over level land. Leave timber and undergrowth, brs. N. and S.</p> <p>22.95 Wash, 5 lks. wide, 1 ft. deep, course S.</p> <p>26.00 Enter scattering timber, brs. NE. and SW.</p>

Chains.	
40.155	<p>Set an iron post, 3 ft. long, 1 in.^mdiam, 26 ins. in the ground, for $\frac{1}{4}$ sec. cor., marked on brass cap, 1913; $\frac{1}{4}$S29 in N. and S32 in S. half; And raise a mound of stone, 2 ft. base, $1\frac{1}{2}$ ft. high, N. of cor. Pits impracticable. No trees available.</p>
52.30	Leave timber, brs. N. and S
66.00	Draw, 3 chs. wide, course S.
77.30	Enter timber, brs. NW. and SE.
80.31	<p>The cor. of secs. 29, 30, 31 and 32. Land, level rolling and hilly. Soil, rocky 4th rate on slopes; sandy loam and gumbo in flat, 2nd to 4th rate. Timber, scrub cedar and pinion. Undergrowth, buck brush and scrub oak.</p>
H.N.B.	
40.00	<p>W.B.K. ✓ S.89°57'W., on a random line, bet. secs. 30 and 31. Set temp. $\frac{1}{4}$ sec. cor. (2nd Guide Meridian West)</p>
83.77	<p>Intersect the W. bdy of the Tpt. 5 lks. S. of the cor. of secs. 25, 30, 31 and 36, recently reestablished by me as described in book "O", page 34.</p>
	Thence I run
6.90	N.89°59'E., on a true line, bet. secs. 30 and 31.
7.80	Over rolling land.
10.00	Trails, br. N. and S.
21.60	Road, brs. NW. and SE.
22.50	Enter scattering timber, brs. NW. and SW.
38.00	Trails, br. NE. and SW.
43.78	Wash, 6 lks. wide, 6 ins. deep, course SW.
58.45	Leave timber, brs. NE. and SE.
77.35	Set an iron post, 3 ft. long, 1 in. ^m diam, 26 ins. in the ground, for $\frac{1}{4}$ sec. cor., marked on brass cap, 1913; $\frac{1}{4}$ S30 in N. and S31 in S. half;
83.77	<p>And raise a mound of stone, 2 ft. base, $1\frac{1}{2}$ ft. high, N. of cor. Pits impracticable. No trees available.</p>
58.45	Trails, br. N. and S.
77.35	Wash, 22 lks. wide, 2 ft. deep, course SW.
83.77	The cor. of secs. 29, 30, 31 and 32.
	Land rolling.
	Soil, gumbo and clay, 2nd and 3rd rate.
	Timber, scrub cedar and pinion.
W.B.K.	
H.N.B.	
2.00	<p>S.0°3'E., bet. secs. 31 and 32. Over gently rolling land, through scattering timber.</p>
16.75	Leave timber, brs. E. and W.
40.00	Wash, 6 lks. wide, 1 ft. deep, course SW.
	Set an iron post, 3 ft. long, 1 in. ^m diam, 26 ins. in the ground, for $\frac{1}{4}$ sec. cor., marked on brass cap, 1913; $\frac{1}{4}$ S31 in W. and S32 in E. half;
	Dig pits, 18 X 18 X 12 ins., N. and S. of post, 3 ft. dist.; and raise a mound of earth, $3\frac{1}{2}$ ft. base, $1\frac{1}{2}$ ft. high, W. of cor. No trees available.
80.58	<p>Intersect the 5th Standard Parallel North, at a point from which the Standard Cor. of secs. 31 and 32, which is a tree, marked and witnessed as described by the Surveyor General, brs. S.88°48'W. 2.94 chs. dist.</p>
	I destroy all the markings on the tree, and place the letters A P upon it.
	At the point of intersection, I set an iron post, 3 ft. long, 2 ins. ^m diam, 24 ins. in the ground, for closing

Chains.

cor. of secs. 31 and 32, marked on brass cap, 1913;
 CC, N. of center.
 T21N in N.,
 T20N, S5, S6, in S. and
 R8W in W. half; S31 in NW, and S32 in NE quadrant;
 Dig pits, 24 X 18 X 12 ins., crosswise on each line, E.
 and W., 3 ft., and N. of post, 7 ft. dist; and raise
 a mound of earth, 4 ft. base, 2 ft. high, N. of cor.
 Land, level and rolling. No trees available.
 Soil, black loam, 2nd and 3rd rate.
 Timber, scattering cedar.

Mar. 16, 1913.

H.N.B.

General Description.

Land, level, rolling and mountainous. Soil, clay, gumbo
 and sandy loam; rocky, 2nd to 4th rate. Timber, scrub
 cedar and pinion. Undergrowth, scrub oak, chaparral,
 and buck brush. There are no settlers. The township drains
 S.

Note: I changed all old standard quarter section corners
 on the Fifth Standard Parallel North within this
 Range to Angle Points by the same method as herein-
 before described for the old standard section
 corners on said line.

William B. Kimmel.

U. S. Surveyor.

Subscribed

U. S. Transitman.

155 2685
BCO

(36)

For FINAL OATH OF UNITED STATES SURVEYOR & TRANSITMAN
see Book " L "
(Subdivision E $\frac{1}{2}$ T.25 N., R.17 W.)

I, _____, U. S. Surveyor, do solemnly swear that, in pursuance
of special instructions received from the U. S. Surveyor General for _____
bearing date of the _____ day of _____, 191 _____, I have well, faithfully, and truly,
in my own proper person, and in strict conformity with said instructions, the Manual of Surveying
Instructions, and the laws of the United States, surveyed all those parts or portions of _____
_____ of the _____
_____ Meridian, in the State of _____, which are represented in
the foregoing field notes as having been executed by me, and under my direction; and I do further
solemnly swear that all the corners of said survey have been established and perpetuated in strict accord-
ance with the Manual of Surveying Instructions, and the special written instructions of the U. S. Surveyor
General for _____ and in the specific manner described in the field notes, and that
the foregoing are the original field notes of such survey.

U. S. Surveyor.

Subscribed by said _____, and sworn to before me }
this _____ day of _____, 191 _____ }



APPROVAL.

OFFICE OF THE UNITED STATES SURVEYOR GENERAL,
Phoenix Arizona OCT 5 _____, 1914

The foregoing field notes of the survey of the Subdivision lines of _____

Township No. 21 North, Range No. 8n West

of the Gila and Salt River Base and Meridian, Arizona

executed by William B. Kimmel, U.S. Surveyor & H.N. Bradstreet, U.S. Transitman
under ~~the~~ ^{their} special instructions dated October 18, 1912 for Group 24, ~~and~~, having been
critically examined, and the necessary corrections and explanations made, the said field notes, and the
surveys they describe, are hereby approved.

Frank S. Ingalls
U. S. Surveyor General.
of Arizona

~~I certify that the foregoing transcript of the field notes of the above described surveys in _____
_____ has been correctly copied from the original notes on file in this office.~~