

BOOK "K"
Subdivisions
FIELD NOTES

OF THE SURVEY OF THE

Subdivision lines of

TOWNSHIP 24 NORTH, RANGE 11 WEST

of the Gila & Salt River Base & Meridian,

In the State of ARIZONA

EXECUTED BY

H. N. BRADSTREET, U.S. Transitman

&

WILLIAM B. KIMMEL, U.S. Surveyor

In the capacity of U. S. Surveyor, under instructions dated October 18, 1912,

issued by the United States Surveyor General to govern surveys included in

Group No. 24, which were approved by the Commissioner of the General Land

Office, November 5, 1912, pursuant to authority contained in the Act of

Congress dated June, 1910

Survey commenced May 5, 1913

Survey completed " 15, 1913

(A)

BOOK 2689

BOOK 2689

INDEX DIAGRAM.

Township 24 North, Range 11 West

HUALPAT INDIAN RESERVATION

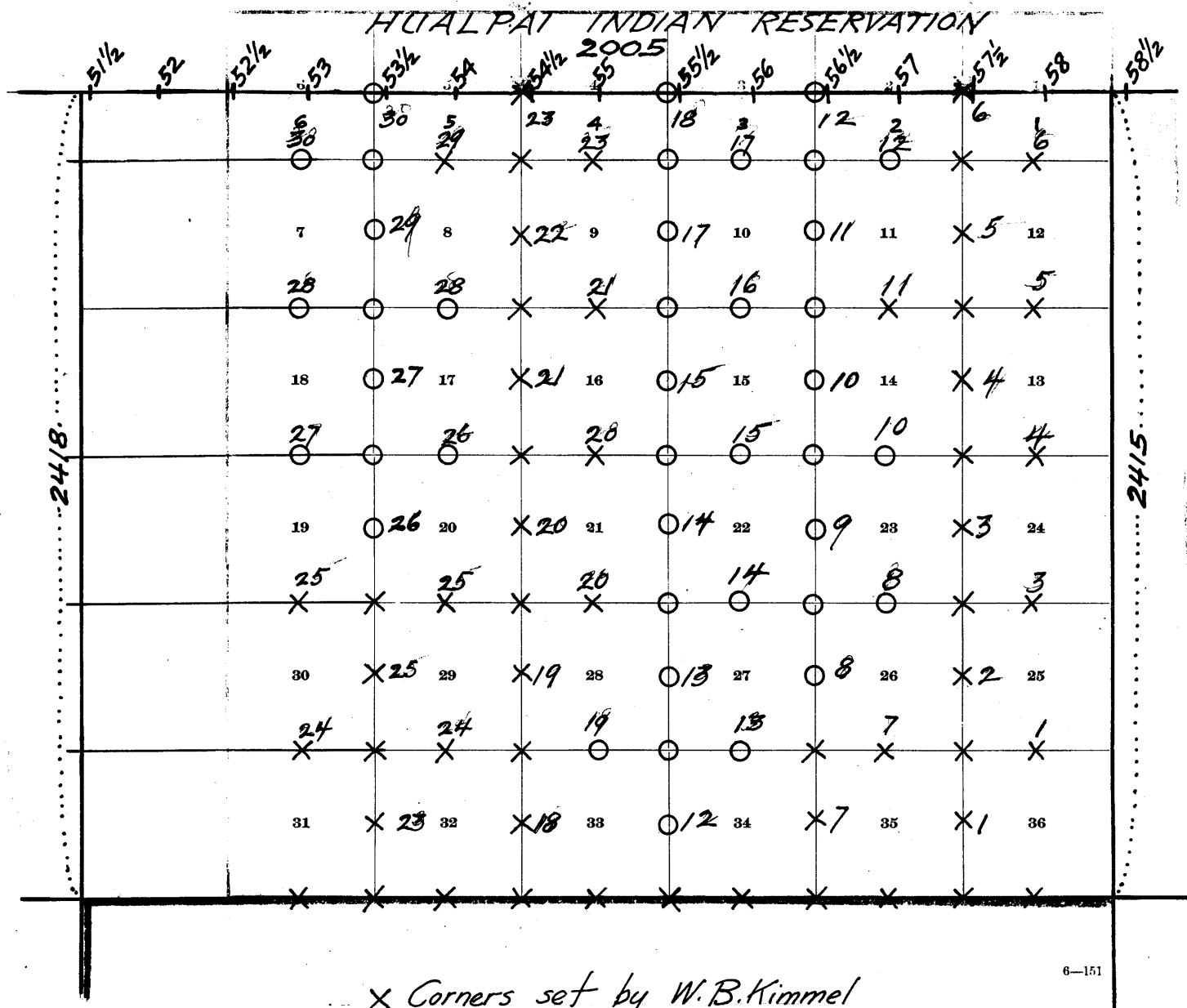

X Corners set by W.B. Kimmel
 O " " " H.N. Bradstreet
 — Book "M"

Subdivision of T. 24 N., R. 11 W.

Chains.

Survey commenced May 5, 1913, and executed with Young & Sons Light Mountain Transits, Nos. 7695 and 8541, with Smith Solar Attachments. For description of instruments and certificate of approval, see book "O", page 1.

Knowing from recent and repeated observations on a mer. established by Polaris observations, that these transits are in adjustment, we proceed to the subdivision of T. 24 N., R. 11 W.

NOTE: Initials "W.B.K." and "H.N.B." throughout the following notes indicate surveys by W.B. Kimmel, U.S. Surveyor and H.N. Bradstreet, U.S. Transitman, respectively, May 5, 1913.

W.B.K.

May 7, 1913. At 8 hrs. 30 m. a.m., l.m.t., I set off 35° 25' N. on the lat. arc; 16° 47' N. on the decl. arc; and determine a meridian with the solar, at the cor. of secs. 1, 2, 35 and 36, on the S. bdy. of the Tp., recently established by me as described in book "M", page 53.

Thence I run

N. 0° 1' W., bet. secs. 35 and 36.

Asc. rocky, SE. slope 100 ft., through heavy timber and dense undergrowth.

10.00

Top of asc. brs. NE. and SW. Thence over rolling mesa.

24.00

Desc. NW. slope, 265 ft.

40.00

Set an iron post, 3 ft. long, 1 in. diam., 26 ins. in the ground, for 1/4 sec. cor., marked on brass cap, 1913;

1/4 S35 in W. and

S36 in E. half; from which

A cedar, 10 ins. diam., brs. S. 9 1/4° E., 57 lks. dist., marked 1/4 S36 BT.

A cedar, 12 ins. diam., brs. N. 66° W., 24 lks. dist., marked 1/4 S35 BT.

43.90

Gulch, course NE. Asc. SE. slope, 70 ft.

52.00

Spur ridge, brs. E. and W. Desc. NE. slope 35 ft.

57.00

Gulch, course E. Asc. S. slope, 220 ft.

71.00

Ridge, brs. NE. and SW. Desc. N. slope 120 ft.

80.00

Set an iron post, 3 ft. long, 2 ins. diam., 24 ins. in the ground, for cor. of secs. 25, 26, 35 and 36; marked on brass cap, 1913;

T24N R11W in N. half;

S26 in NW.,

S25 in NE.,

S36 in SE. and

S35 in SW. quadrant; from which

A pinion, 7 ins. diam., brs. N. 56° E., 28 lks. dist., marked T24N R11W S25 BT.

A pinion, 9 ins. diam., brs. S. 74° E., 27 lks. dist., marked T24N R11W S36 BT.

A pinion, 10 ins. diam., brs. S. 82° W., 20 lks. dist., marked T24N R11W S35 BT.

A pinion, 12 ins. diam., brs. N. 25° W. 59 lks. dist., marked T24N R11W S26 BT.

Land, mountainous.

Soil, rocky, 4th rate.

Timber, scrub cedar and pinion.

Undergrowth, scrub oak and buck brush.

NOTE: At this corner I set off 16° 49' N. on the decl. arc;

and at horizon I observe the sun

on the meridian. The resulting lat. is 35° 26' N., which is

slightly less than the correct lat.

40.00

S. 89° 57' E., on a random line, bet. secs. 25 and 26.

79.90

Set temp. 1/4 sec. cor. Intersect the E. bdy. of the Tp., 12 lks. S. of the cor. of secs. 25, 30, 31 and 36, which is an iron post,

3 ins. diam., 12 ins. above ground, marked and witnessed as described by the Surveyor General.

Thence I run,

S. 89° 58' W., on a true line, bet. secs. 25 and 36.

Along rolling N. slope, through heavy timber and dense undergrowth.

11.40

Draw, course NE. Asc. NE. slope, 160 ft.

Chains	
25.90	Ridge, brs. N. and S. Desc. W. slope 280 ft.
39.95	Set an iron post, 3 ft. long, 1 in. diam, 25 ins. in the ground, for $\frac{1}{4}$ sec. cor., marked on brass cap, 1913; $\frac{1}{4}$ S25 in N. and $\frac{1}{4}$ S36 in S. half; from which
	A cedar, 6 ins. diam, brs. N. 47° E., 100 lks. dist., marked $\frac{1}{4}$ S25 BT.
	A cedar, 8 ins. diam, brs. S. 37 $\frac{1}{2}$ ° W., 59 lks. dist., marked $\frac{1}{4}$ S36 BT.
48.65	Gulch, course N. Asc. E. slope, 345 ft.
49.30	Trail, brs. N. and S.
69.90	Spur ridge, brs. NE. and SW. Desc. NW. slope 70 ft.
79.90	The cor. of secs. 25, 26, 35 and 36. Land, mountainous. Soil, rocky 4th rate. Timber, cedar and pinion. Undergrowth, buck brush and scrub oak.
	May 7, 1913.
	May 8, 1913, At 9 hrs. 30 m. a.m., l.m.t., I set off 35° 26' N. on the lat. arc; 17° 4' N. on the decl. arc; and determine a meridian with the solar, at the cor. of secs. 25, 26, 35 and 36, Thence I run N. 0° 1' W., bet. secs. 25 and 26. Desc. broken. N. slope 375 ft., through heavy timber and dense undergrowth.
31.00	Gulch, course NW. Asc. W. slope 90 ft. Leave heavy, enter scattering timber and undergrowth.
40.00	Set an iron post, 3 ft. long, 1 in. diam, 26 ins. in the ground, for $\frac{1}{4}$ sec. cor. marked on brass cap, 1913; $\frac{1}{4}$ S26 in W. and $\frac{1}{4}$ S25 in E. half; from which, A cedar limb, 5 ins. diam, brs. S. 16° E., 128 lks. dist., marked $\frac{1}{4}$ S25 BT. A cedar, 10 ins. diam, brs. S. 2° W. 92 lks. dist., marked $\frac{1}{4}$ S26 BT.
49.25	Wash, 9 lks. wide, 6 ft. deep, course SW. Asc. rocky, SE. slope, 375 ft.
50.15	Trail, brs. NE. and SW.
62.00	Asc. S. slope.
69.30	Rocky ridge, brs. E. and W. Desc. N. slope 105 ft.
77.00	Enter heavy timber, brs. E. and W.
80.00	Set an iron post, 3 ft. long, 2 ins. diam, 24 ins. in the ground, for cor. of secs. 23, 24, 25 and 26, marked on brass cap, 1913; T24N R11W in N. half; S23 in NW., S24 in NE., S25 in SE. and S26 in SW. quadrant; from which A pinion, 7 ins. diam, brs. N. 14 $\frac{1}{4}$ ° E. 49 lks. dist., marked T24N R11W S24 BT. A pinion, 9 ins. diam, brs. S. 67° E., 56 lks. dist., marked T24N R11W S25 BT. A pinion, 9 ins. diam, brs. S. 41° W., 37 lks. dist., marked T24N R11W S26 BT. A pinion, 6 ins. diam, brs. N. 23 $\frac{1}{2}$ ° W., 38 lks. dist., marked T24N R11W S23 BT. Land, mountainous. Soil, rocky 4th rate. Timber, cedar and pinion. Undergrowth, buck brush and scrub oak.
	NOTE - At this corner, I set off 17° 5 $\frac{1}{2}$ ' N. on the decl. arc; and at noon, I observe the sun on the meridian. The resulting lat. is 35° 27' N., which is correct.

Subdivision of T. 24 N., R. 11 W.

Chains

N. 89° 58' E., on a random line, bet. secs. 24 and 25.
 40.00 Set temp. $\frac{1}{4}$ sec cor.
 79.80 Intersect E. bdy. of Tp., at the ^{1st} cor. of secs. 19, 24, 25 and 30, which is an iron post, 3 ins. in diam., 12 ins. above ground, marked ^N and ^{BRASS CAP} and witnessed as described by the Surveyor General.

Thence I run,
 S. 89° 58' W., on a true line, bet. secs. 24 and 25.
 Over rolling land.

3.30 Wash, 20 lks. wide, 4 ft. deep, course NW.
 9.80 Enter timber, brs. NW. and SE.
 17.80 Top of asc. Desc. NW slope, 45 ft.
 22.50 Same wash, 22 lks. wide, 4 ft. deep, course S. 60° W.
 29.30 Same wash, 15 lks. wide, 4 ft. deep, course NW.
 35.05 Same wash, 30 lks. wide, 1 ft. deep, course SW.
 36.30 Trail, brs. NE. and SW.
 39.90 Set an iron post, 3 ft. long, 1 in. in diam., 26 ins. in the ground, for $\frac{1}{4}$ sec. cor., marked on brass cap, 1913; $\frac{1}{4}$ S24 in N. and $\frac{1}{4}$ S25 in S. half; from which
 A cedar, 20 ins. in diam., brs. S. 12° W., 148 lks. dist., marked $\frac{1}{4}$ S25 BT.
 No other trees within limits. Raise a mound of stone, 2 ft. base, 1 $\frac{1}{2}$ ft. high, N. of cor. Pits impracticable.

48.00 Enter heavy timber and undergrowth, brs. N. and S.
 Asc. NE. slope 85 ft.
 52.00 Dry earth tank, brs. S. about 14 chs. dist.
 60.00 Spur ridge, brs. NW. and SE. Desc. SW. slope 30 ft.
 65.00 Gulch, course SE. Asc. NE. slope 65 ft.
 74.00 Top of asc. Thence along N. slope.
 79.80 The cor. of secs. 23, 24, 25, and 26.
 Land, rolling and hilly.
 Soil, rocky, clay and gumbo, 2nd to 4th rate.
 Timber, cedar and pinion.
 Undergrowth, scrub oak and buck brush.
 May 8, 1913.

May 9, 1913, At 8 hrs. 20 m. a.m., l.m.t., I set off
 $\sqrt{35^{\circ} 27'}$ N. on the lat. arc; $\sqrt{17^{\circ} 19\frac{1}{2}'}$ N. on the decl. arc; and determine a meridian with the solar, at the cor. of secs. 23, 24, 25 and 26,
 Thence I run,
 N. 0° 1' W., bet. secs. 23 and 24. Desc. N. slope 40 ft. through heavy timber and dense undergrowth.
 2.20 Gulch, course E. Asc. S. slope 240 ft.
 10.00 Leave heavy, enter scattering timber and undergrowth.
 18.00 Top of asc. Thence along E. slope.
 25.50 Ridge, brs. NE. and SW. Desc. NW. slope 270 ft.
 40.00 Set an iron post, 3 ft. long, 1 in. in diam., 26 ins. in the ground, for $\frac{1}{4}$ sec. cor., marked on brass cap, 1913; $\frac{1}{4}$ S23 in W. and $\frac{1}{4}$ S24 in E. half; from which
 A cedar, 12 ins. in diam., brs. S. 44 $\frac{1}{2}$ ° E., 113 lks. dist., marked $\frac{1}{4}$ S24 BT.
 A cedar, 14 ins. in diam., brs. S. 26 $\frac{1}{4}$ ° W., 266 lks. dist., marked $\frac{1}{4}$ S23 BT.

41.00 Draw, course NE. Thence along rolling E. slope.
 46.00 Desc. NE. slope.
 55.00 Same draw, course NW. Thence along rolling W. slope.
 80.00 Set an iron post, 3 ft. long, 2 ins. in diam., 24 ins. in the ground, for cor. of secs. 13, 14, 23 and 24, marked on brass cap, ¹⁹¹³T24N R11W in N. half;
 S14 in NW.,
 S13 in NE.,
 S24 in SE. and
 S23 in SW. quadrant; from which
 A cedar, 18 ins. in diam., brs. N. 61° E., 178 lks. dist., marked T24N R11W S13 BT.
 A pinion, 16 ins. in diam., brs. S. 74 $\frac{1}{2}$ ° E., 150 lks. dist., marked T24N R11W S24 BT.

Chains.	
	<p>A cedar, 20 insⁿ diam, brs. S. 16° W., 336 lks. dist., marked T24N R11W S23 BT.</p> <p>A cedar, 16 insⁿ diam, brs. N. 17½° W., 133 lks. dist., marked T24N R11W S14 BT.</p> <p>Land, mountainous and rolling.</p> <p>Soil, rocky, clay and gumbo; 2nd to 4th rate.</p> <p>Timber, cedar and pinion.</p> <p>Undergrowth, buck brush and scrub oak.</p>
40.00	N. 89° 58' E., on a random line, bet. sees. 13 and 24.
79.90	Set temp. ¼ sec. cor.
	Intersect E. bdy. of Tp., 9 lks. N. of the ^{old} cor. of sees. 13, 18, 19 and 24, which is an iron post, 3 ins. in diam, 12 ins above ground, marked ^{on brass cap} and witnessed as described by the Surveyor General.
	Thence I run
	N. 89° 58' W., on a true line, bet. sees. 13 and 24.
	Desc. NW. slope 55 ft., through scattering timber and dense undergrowth.
9.15	Draw, course N. Asc. E. slope, 130 ft.
17.90	Asc. NE slope,
34.90	Ridge, brs. N. and S. Desc. W. slope 50 ft.
39.95	Set an iron post, 3 ft. long, 1 in ⁿ diam, 26 ins in the ground, for ¼ sec. cor., marked on brass cap, 1913; ½ S13 in N. and ½ S24 in S. half; from which
	A cedar, 18 ins ⁿ diam, brs. N. 81½° W., 63 lks. dist., marked ½ S13 BT.
	A cedar, 12 ins ⁿ diam, brs. S. 57½° W., 159 lks. dist., marked ½ S24 BT.
42.65	Gulch, course N. Asc. E. slope 70 ft.
48.90	Ridge, brs. N. and S. Leave dense undergrowth, brs. N. and S. Desc. W. slope 160 ft.
55.90	Desc. NW. slope.
63.90	Foot of desc. Thence over rolling land.
79.90	The cor. of sees. 13, 14, 23 and 24.
	Land, rolling and hilly.
	Soil, rocky, clay and gumbo, 2nd th 4th rate.
	Timber, cedar and pinion.
	Undergrowth, buck brush and scrub oak.
	<i>NOTE.</i> - At this corner, I set off 17° 21½' N. on the decl. arc; and at horizon, ... I observe the sun on the meridian. The resulting lat. is 35° 28' N. which is only slightly higher than the correct lat.
	N. 0° 1' W., bet. sees. 13 and 14.
	Over rolling land, through scattering timber and undergrowth.
8.00	Draw, course N. 15° E.
40.00	Set an iron post, 3 ft. long, 1 in ⁿ diam, 26 ins. in the ground, for ¼ sec. cor., marked on brass cap, 1913; ½ S14 in W. and ½ S13 in E. half; from which
	A pinion, 6 ins ⁿ diam, brs. S. 74° E., 31 lks. dist., marked ½ S13 BT.
	A pinion, 9 ins ⁿ diam, brs. N. 83½° W., 91 lks. dist., marked ½ S14 BT.
50.00	Desc. N slope 100 ft.
64.00	Leave timber, brs. E. and W.
68.00	Enter flat, brs. E. and W.
69.50	Trail, brs. E. and W.
75.90	Road, brs. E. and W.
80.00	Set an iron post, 3 ft. long, 2 ins ⁿ diam, 24 ins. in the ground, for cor. of sees. 11, 12, 13 and 14, marked on brass cap, 1913; T24N R11W in N. half; S11 in NW., S12 in NE., S13 in SE. and S14 in SW. quadrant; from which,

Subdivision of T. 24 N. R. 11 W.

Chains

A cedar, 30 ins. in diam, brs. N. 80° E., 95 lks. dist., marked T24N R11W S12 BT.
 A cedar, 18 ins. in diam, brs. N. 45° W., 290 lks. dist., marked T24N R11W S11 BT.
 No other trees within limits. Raise a mound of stone, 2 ft. base, 1½ ft. high, W. of cor. Pits impracticable.
 Land, rolling.
 Soil, clay and gumbo, 2nd and 3rd rate.
 Timber, cedar and pinion.
 Undergrowth, scrub oak.

May 9, 1913.

May 10, 1913, At 8 hrs. 10 m. a.m., l.m.t., I set off
 ✓ 35° 28½' N. on the lat. arc; ✓ 17° 35' N. on the decl. arc;
 and determine a meridian with the solar, at the cor. of
 secs. 11, 12, 13 and 14, above described

Thence I run

S. 89° 58' E., on a random line, bet. secs. 12 and 13.

Set temp. ¼ sec. cor.

Intersect the E. bdy. of the Tp., 4 lks. S. of the ^{old} cor.

of secs. 7, 12, 13 and 18, which is an iron post,
 3 ins. in diam, 12 ins. above ground, marked ^{on} brass cap,
 and witnessed
 as described by the Surveyor General.

Thence I run,

West, on a true line, bet. secs. 12 and 13.

Over rolling land.

Enter timber, brs. NW. and SE.

Leave timber, brs. NE. and SW.

Enter flat, brs. N. and SW.

Set an iron post, 3 ft. long, 1 in. in diam, 26 ins. in the
 ground, for ¼ sec. cor., marked on brass cap, 1913;
 ¼ S12 in N. and
 S13 in S. half;

And raise a mound of stone, 2 ft. base, 1½ ft. high,
 N. of cor. Pits impracticable. *No bearing trees within limits.*

Wash, 3 lks. wide, 1 ft. deep, course NE.

Road, brs. NE. and SW.

Leave flat, brs. N. 60° E. and S. 60° W.

Enter timber and undergrowth, brs. NE. and SW.

Leave timber and undergrowth, brs. N. and S. Enter flat.

The cor. of secs. 11, 12, 13 and 14.

Land, level and rolling.

Soil, clay and gumbo, 2nd and 3rd rate.

Timber, scrub cedar.

Undergrowth, scrub oak.

N. 0° 1' W., bet. secs. 11 and 12.

Asc. gradual S. slope 360 ft.

Leave flat.

Asc. S. slope, enter scattering timber and dense under-
 growth, brs. E. and W.

Set an iron post, 3 ft. long, 1 in. in diam, 26 ins. in
 the ground, for ¼ sec. cor., marked on brass cap, 1913;
 ¼ S11 in W. and
 S12 in E. half; from which

A pinion, 12 ins. in diam, brs. S. 67° E., 194 lks. dist.,
 marked ¼ S12 BT.

A cedar, 9 ins. in diam, brs. S. 22¼° W., 67 lks. dist.,
 marked ¼ S11 BT.

Top of asc. brs. E. and W. Continue over rolling mesa,
 draining E.

Set an iron post, 3 ft. long, 2 ins. in diam, 24 ins. in
 the ground, for cor. of secs. 1, 2, 11 and 12,
 marked on brass cap, 1913;

T24N R11W in N. half;

S2 in NW.,

S1 in NE.,

S12 in SE. and

S11 in SW. quadrant; from which,

40.00

79.99

7.00

18.00

29.00

39.995

52.00

52.35

57.00

60.00

79.00

79.99

1.00

18.00

40.00

48.00

80.00

Chains	<p>A cedar, 15 ins.ⁿ diam, brs. N. $16\frac{3}{4}^{\circ}$ E., 276 lks. dist., marked T24N R11W S1 BT.</p> <p>A cedar, 15 ins.ⁿ diam, brs. S. $72\frac{1}{4}^{\circ}$ E., 428 lks. dist., marked T24N R11W S12 BT.</p> <p>A cedar, 16 ins.ⁿ diam, brs. S. $10\frac{1}{2}^{\circ}$ W., 134 lks. dist., marked T24N R11W S11 BT.</p> <p>A cedar, 20 ins.ⁿ diam, brs. N. $53\frac{1}{4}^{\circ}$ W., 65 lks. dist., marked T24N R11W S2 BT.</p> <p>Land, rolling and hilly. Soil, 3rd and 4th rate, gumbo. Timber, scrub cedar and pinion. Undergrowth, buck brush and scrub oak.</p> <p>NOTE: - At this corner, I set off $17^{\circ}37\frac{1}{2}'$ N. on the decl. arc; and at adon the meridian, I observe the sun on the meridian. The resulting lat. is $35^{\circ}29\frac{1}{2}'$ N., which is slightly less than the correct lat.</p>
40.00 79.93 12.75 39.965 54.80 79.93	<p>East, on a random line, bet. secs. 1 and 12. Set temp. $\frac{1}{4}$ sec. cor. Intersect the E. bdy. of the Tp., 4 lks. S. of the ^{1st} cor. of secs. 1, 6, 7 and 12, which is an iron post, 3 ins. in diam, 12 ins. above ground, marked ^{on BRASS CAP} and witnessed as described by the Surveyor General. Thence I run S. $89^{\circ}58'$ W. on a true line, bet. secs. 1 and 12. Overrolling land, through scattering timber and dense undergrowth. Trail, brs. NW. and SE. Set an iron post, 3 ft. long, 1 in.ⁿ diam, 26 ins. in the ground, for $\frac{1}{4}$ sec. cor., marked on brass cap, 1913; $\frac{1}{4}$S1 in N. and S12 in S. half; from which A cedar, 18 ins.ⁿ diam, brs. N. $19\frac{3}{4}^{\circ}$ E., 132 lks. dist., marked $\frac{1}{4}$S1 BT. A pinion, 16 ins.ⁿ diam, brs. S. $71\frac{3}{4}^{\circ}$ W., 112 lks. dist., marked $\frac{1}{4}$S12 BT. Trail, brs. N. and S. The cor. of secs. 1, 2, 11 and 12. Land, rolling. Soil, rocky, 4th rate. Timber, cedar and pinion. Undergrowth, buck brush and scrub oak.</p>
4.00 10.00 22.00 36.60	<p>It being necessary to set closing cors. on the N. bdy. of the Tp., against the Hualpai Indian Reservation, I run N. $0^{\circ}1'$ W., on a true line, bet. secs. 1 and 2. Over rolling mesa, through scattering timber and dense undergrowth. Asc. SE. slope, 55 ft. Enter heavy timber, brs. E. and W. Spur ridge, brs. NE. and SW. Desc. NW. slope 90 ft. Foot of descent, brs. NE. and SW. Thence over rolling land. Leave heavy timber, enter scattering timber, brs. NE. and SW. Intersect the S. bdy. of the Hualpai Indian Reservation, 120 lks. W. of the $57\frac{1}{2}$ mile cor., which is a stone 10 X 12 X 9 ins. above ground, marked H I R on N. and P L on S. faces, with a mound of stone, 3 ft. base, 2 ft. high, E. of cor. At the point of intersection, I set an iron post, 3 ft. long, 2 ins.ⁿ diam, 24 ins. in the ground, for closing cor. of secs. 1 and 2, marked on brass cap, 1913; CC, N. of center. H I R in N. and T24N R11W in S. half; S1 in SE. and S2 in SW. quadrant; from which,</p>

Subdivision of T. 24 N., R. 11 W.

Chains

A cedar, 28 insⁱⁿ diam, brs. S. 17° E., 436 lks. dist., marked T24N R11W S1 BT.
 A cedar, 9 insⁱⁿ diam, brs. S. 50° W., 22 lks. dist., marked T24N R11W S2 BT.
 Land, rolling and hilly.
 Soil, rocky, clay and gumbo, 3rd and 4th rate.
 Timber, cedar and pinion.
 Undergrowth, scrub oak and buck brush.
 May 10, 1913.

May 6, 1913, At 2 hrs. 10 m. p.m., l.m.t., I set off 35° 25' N. on the lat. arc; 16° 34' N. on the decl. arc; and determine a meridian with the solar, at the cor^{of} of secs 2, 3, 34 and 35, on the S. bdy. of the Tp., ~~correctly established by mosaic~~ described in book "M", page 53.

20.00
 40.00
 63.00
 73.00
 74.00
 74.35
 76.75
 77.75
 78.30
 80.00

Thence I run N. 0° 1' W., bet. secs. 34 and 35.
 Over rolling land, through scattering timber and undergrowth.
 Leave timber and undergrowth, brs. E. and W.
 Set an iron post, 3 ft. long, 1 in.ⁱⁿ diam, 26 ins. in the ground, for $\frac{1}{4}$ sec. cor., marked on brass cap, 1913; $\frac{1}{4}$ S34 in W., and S35 in E. half.
 And raise a mound of stone, 2 ft. base, 1 $\frac{1}{2}$ ft. high, W. of cor. Pits impracticable. *No bearing trees within limits.*
 Enter heavy timber, brs. E. and W. Desc. NW. slope, 115 ft.
 Top of precipices, bear NE. and SW. Enter scattering timber.
 Foot of precipices, bear NE. and SW.
 Foot of desc., brs. NE. and SW. Thence over level land.
 Enter wash, 2 ft. deep, course SW.
 Leave wash, course SW.
 Trail, bear NE. and SW.
 Set an iron post, 3 ft. long, 2 ins.ⁱⁿ diam, 24 ins. in the ground, for cor. of secs. 26, 27, 34 and 35, marked on brass cap, 1913; T24N R11W in N. half; S27 in NW., S26 in NE., S35 in SE. and S34 in SW. quadrant; from which
 A cedar limb, 6 insⁱⁿ diam, brs. N. 42° E., 135 lks. dist., marked T24N R11W S26 BT.
 A cedar, 16 insⁱⁿ diam, brs. S. 6° W., 56 lks. dist., marked T24N R11W S34 BT.
 No other trees within limits. Raise a mound of stone, 2 ft. base, 1 $\frac{1}{2}$ ft. high, W. of cor. Pits impracticable.
 Land, rolling.
 Soil, gumbo, 3rd and 4th rate, rocky.
 Timber, cedar and pinion.
 Undergrowth, scrub oak.

40.00
 79.66
 8.00
 18.80
 29.00
 39.83

S. 89° 57' E., on a random line, bet. secs. 26 and 35.
 Set temp. $\frac{1}{4}$ sec. cor.
 Intersect N. and S. line, 30 lks. N. of the cor. of secs. 25, 26, 35 and 36, marked on brass cap, 1913.
 Thence I run N. 89° 44' W., on a true line, bet. secs. 26 and 35.
 Asc. NE. slope, 70 ft., through heavy timber and dense undergrowth.
 Spur ridge, brs. N. and S. Desc. NW. slope 285 ft.
 Gulch, course N. Asc. NE. slope, 275 ft.
 Spur ridge, brs. N. and S. Desc. NW. slope, 300 ft.
 Set an iron post, 3 ft. long, 1 in.ⁱⁿ diam, 26 ins. in the ground, for $\frac{1}{4}$ sec. cor., marked on brass cap, 1913; $\frac{1}{4}$ S26 in N. and S35 in S. half; from which,

Chains

A pinion, 9 ins.ⁱⁿ diam, brs. N. 46° W. 64 lks. dist., marked $\frac{1}{4}$ S26 BT.

A pinion, 14 ins.ⁱⁿ diam, brs. S. 26 $\frac{1}{2}$ ° W., 26 lks. dist., marked $\frac{1}{4}$ S35 BT.

44.40 Gulch, course N. Asc. NE. slope, 100 ft.

48.65 Top of asc. Desc. NW. slope 290 ft.

56.00 Wire fence brs. N. and S.

74.00 Leave heavy timber and dense undergrowth, brs. NE. and SW.

76.00 Foot of desc.; thence over rolling land.

77.45 Enter wash, 2 ft. deep, course SW.

78.00 Leave wash, course SW. Trails brs. NE. and SW.

79.66 The cor. of secs. 26, 27, 34 and 35.
Land, mountainous.
Soil, rocky, 4th rate.
Timber, cedar and pinion.
Undergrowth, buck brush and scrub oak.

May 6, 1913. W.B.K.

H.N.B.

May 8, 1913, At 7 hrs. 54 m. a.m., l.m.t., I set off $\sqrt{35^{\circ}26'}$ N. on the lat. arc; $\sqrt{17^{\circ}3'}$ N. on the decl. arc; and determine a meridian with the solar, at the cor. of secs. 34, 35, 26 and 27.

Thence I run

N. 0° 1' W., bet. secs. 26 and 27.

4.00 Asc. SE. slope, 55 ft.

8.00 Top of asc. Enter scattering timber, brs. E. and W.

34.00 Asc. S. slope 525 ft.

40.00 Top of rocky cliff; thence over rolling land.

Set an iron post, 3 ft. long, 1 in.ⁱⁿ diam, 26 ins. in the ground, for $\frac{1}{4}$ sec. cor., marked on brass cap, 1913; $\frac{1}{4}$ S27 in W. and S26 in E. half; from which

A cedar, 12 ins.ⁱⁿ diam, brs. N. 82 $\frac{1}{2}$ ° E., 63 lks. dist., marked $\frac{1}{4}$ S26 BT.

A pinion, 9 ins.ⁱⁿ diam, brs. N. 79 $\frac{1}{2}$ ° W., 48 lks. dist., marked $\frac{1}{4}$ S27 BT.

54.00 Desc. NE. slope, 175 ft.

80.00 Set an iron post, 3 ft. long, 2 ins. dia., 24 ins. in the ground, for cor. of secs. 22, 23, 26 and 27, marked on brass cap, 1913; T24N R11W in N. half; S22 in NW., S23 in NE., S26 in SE. and S27 in SW. quadrant; from which

A pinion, 11 ins.ⁱⁿ diam, brs. N. 29° E., 34 lks. dist., marked T24N R11W S23 BT.

A pinion, 6 ins.ⁱⁿ diam, brs. S. 43 $\frac{3}{4}$ ° E., 69 lks. dist., marked T24N R11W S26 BT.

A pinion limb, 6 ins.ⁱⁿ diam, brs. S. 88° W., 296 lks. dist., marked T24N R11W S27 BT.

A pinion, 12 ins.ⁱⁿ diam, brs. N. 20 $\frac{1}{2}$ ° W., 56 lks. dist., marked T24N R11W S22 BT.

Land, mountainous and rolling.
Soil, very rocky, 4th rate, limestone formation.
Timber, scrub cedar and pinion,
Undergrowth, buck brush and scrub oak.

40.00 S. 89° 44' E., on a random line, bet. secs. 23 and 26.

80.08 Set temp. $\frac{1}{4}$ sec. cor.

Intersect N. and S. line, 12 lks. N. of the cor. of secs. 23, 24, 25 and 26, marked on brass cap, 1913.

Thence I run,

N. 89° 39' W., on a true line, bet. secs. 23 and 26.

Along, N. slope, through heavy timber.

8.10 Gulch, 10 lks. wide, course NE. Asc. SE. slope 250 ft., through dense undergrowth.

40.04 Set an iron post, 3 ft. long, 1 in.ⁱⁿ diam, 26 ins. in the ground, for $\frac{1}{4}$ sec. cor., marked on brass cap, 1913; $\frac{1}{4}$ S23 in N. and S26 in S. half; from which,

Subdivision of T. 24 N., R. 11 W.

Chains

A cedar, 8 ins^m diam, brs. N. 56° W., 104 lks. dist., marked $\frac{1}{4}$ S23 BT.
 A pinion, 12 ins^m diam, brs. S. 61 $\frac{1}{4}$ ° W., 88 lks. dist., marked $\frac{1}{4}$ S26 BT.
 44.00 End of asc. Thence over level land, across ridge, bearing N. and S.
 50.00 Desc. W. slope, 260 ft.
 60.00 Gulch, 50 lks. wide, course NW. Thence along N. slope.
 64.00 Gulch, 70 lks. wide, course N. Asc. NE slope 110 ft.
 69.00 Spur ridge, brs. N. and S.; extends 4 chs. N. Desc. W. slope 180 ft.
 76.00 Canyon 50 lks. wide, course N. Asc. NE slope 95 ft.
 80.08 The cor. of secs. 22, 23, 26 and 27.
 Land, mountainous.
 Soil, rocky, 4th rate.
 Timber, scrub cedar and pinion.
 Undergrowth, scrub oak and buck brush.
 NOTE: - At this corner, I set off: 17° 5 $\frac{1}{2}$ ' N. on the decl. arc; and at noon ~~on the decl. arc~~, I observe the sun on the meridian. The resulting lat. is 35° 27' N., which is correct.

N. 0° 1' W., bet. secs. 22 and 23.
 Desc. NE. slope, 105 ft., through scattering timber.
 11.00 Gulch, 15 lks. wide, course E. Asc. SE. slope 20 ft.
 14.00 Desc. NE. slope 85 ft.
 26.00 End of desc. Thence along E. slope
 34.00 Canyon 50 lks. wide, course NW. Asc. SW. slope 75 ft.
 40.00 Set an iron post, 3 ft. long, 1 in^m diam, 26 ins. in the ground, for $\frac{1}{4}$ sec. cor., marked on brass cap, 1913; $\frac{1}{4}$ S22 in W. and S23 in E. half; from which
 A pinion, 5 ins^m diam, brs. N. 82 $\frac{1}{2}$ ° E., 71 lks. dist., marked $\frac{1}{4}$ S23 BT.
 A pinion, 7 ins^m diam, brs. N. 77 $\frac{3}{4}$ ° W., 20 lks. dist., marked $\frac{1}{4}$ S22 BT.
 May 8, 1913.
 May 9, 1913. At 8 hrs. 58 m. a.m., l.m.t., I set off $\sqrt{35^{\circ} 27\frac{1}{2}'}$ N. on the lat. arc; $\sqrt{17^{\circ} 19\frac{1}{2}'}$ N. on the decl. arc; and determine a meridian with the solar, at the $\frac{1}{4}$ sec. cor. bet. secs. 22 and 23, above described.
 Thence I continue
 N. 0° 1' W., bet. secs. 22 and 23.
 Along W. slope.
 44.00 Desc. NW. slope 110 ft.
 60.00 Foot of desc. Draw, 3 chs. wide, course NW. Asc. slight SW. slope.
 80.00 Set an iron post, 3 ft. long, 2 ins^m diam, 24 ins. in the ground, for cor. of secs. 14, 15, 22 and 23, marked on brass cap, 1913;
 T24N R11W in N. half;
 S15 in NW.,
 S14 in NE.,
 S23 in SE., and
 S22 in SW. quadrant; from which
 A cedar, limb, 8 ins^m diam, brs. N. 55 $\frac{1}{4}$ ° E., 46 lks. dist., marked T24N R11W S14 BT.
 A pinion, 5 ins^m diam, brs. S. 52 $\frac{1}{2}$ ° E., 91 lks. dist., marked T24N R11W S23 BT.
 A pinion limb, 5 ins^m diam, brs. S. 47 $\frac{1}{2}$ ° W., 16 lks. dist., marked T24N R11W S22 BT.
 A pinion, 15 ins^m diam, brs. N. 46 $\frac{1}{2}$ ° W., 9 lks. dist., marked T24N R11W S15 BT.
 Land, mountainous and hilly.
 Soil, rocky, 4th rate.
 Timber, scrub cedar and pinion.
 Undergrowth, scrub oak and buck brush.

S. 89° 39' E., on a random line, bet. secs. 14 and 23.
 40.00 Set temp. $\frac{1}{4}$ sec. cor.
 79.96 Intersect N. and S. line, 37 lks. S. of the cor. of secs.

Chains	
	13, 14, 23 and 24, with to iron post , bearing to the line
	Thence I run,
	N. $89^{\circ}55'$ W., on a true line, bet. secs. 14 and 23.
	Over level land, through scattering timber.
14.65	Asc. E. slope 215 ft.
39.45	Spur ridge, brs. 4 chs. N.
39.98	Set an iron post, 3 ft. long, 1 in. in diam, 26 ins. in the ground, for $\frac{1}{4}$ sec. cor., marked on brass cap, 1913; $\frac{1}{4}$ S14 in N. and $\frac{1}{4}$ S23 in S. half; from which
	A cedar limb, 12 ins in diam, brs. N. $8\frac{1}{2}^{\circ}$ W., 111 lks. dist., marked $\frac{1}{4}$ S14 BT.
	A cedar, 12 ins in diam, brs. S. $22\frac{1}{4}^{\circ}$ W., 65 lks. dist., marked $\frac{1}{4}$ S23 BT.
	Desc. NW. slope 300 ft.
58.00	Foot of desc. Leave timber, brs. NE. and SW.
66.00	Draw, 3 chs. wide, course N.
76.00	Draw, 2 chs. wide, course NE.
77.00	Enter timber, brs. NE. and SW.
79.96	The cor. of secs. 14, 15, 22 and 23.
	Land, rolling and mountainous.
	Soil, 3rd and 4th rate, gumbo.
	Timber, scattering cedar and pinion.
	Undergrowth, scrub oak and buck brush.
	NOTE: At this corner, I set off $17^{\circ}21\frac{1}{2}'$ N. on the decl. arc; and at noon on the meridian , I observe the sun on the meridian. The resulting lat. is $35^{\circ}28'$ N., which is slightly higher than the correct lat.
	N. $0^{\circ}1'$ W., bet. secs. 14 and 15.
	Along E. slope, through heavy timber.
4.00	Desc. NW. slope 35 ft.
24.00	Foot of desc. Thence along W. slope.
32.00	Desc. N. slope, 45 ft.
37.50	Centre of draw, 2 chs. wide, course W. Asc. S. slope, 210 ft.
40.00	Set an iron post, 3 ft. long, 1 in. in diam, 26 ins. in the ground, for $\frac{1}{4}$ sec. cor., marked on brass cap, 1913; $\frac{1}{4}$ S15 in W. and $\frac{1}{4}$ S14 in E. half; from which
	A cedar, limb, 10 ins in diam, brs. N. $71\frac{1}{2}^{\circ}$ E., 75 lks. dist., marked $\frac{1}{4}$ S14 BT.
	A pinion, 9 ins in diam, brs. N. 37° W., 94 lks. dist., marked $\frac{1}{4}$ S15 BT.
55.00	Top of asc. Spur ridge extends 6 chs. W. Desc. NW. slope 185 ft.
70.00	Gulch, 15 lks. wide, course NW.
76.00	Leave timber, brs. NE. and SW.
77.30	Road, brs. NE. and SW.
79.00	Trail, brs. NE. and SW.
80.00	Set an iron post, 3 ft. long, 2 ins in diam, 24 ins. in the ground, for cor. of secs. 10, 11, 14 and 15, marked on brass cap, 1913; T24N R11W in N. half; S10 in NW., S11 in NE., S14 in SE., and S15 in SW. quadrant; from which
	A cedar limb, 15 ins in diam, brs. S. $70\frac{3}{4}^{\circ}$ E., 300 lks. dist., marked T24N R11W S14 BT.
	No other trees within limits. Raise a mound of stone, 2 ft. base, $1\frac{1}{2}$ ft. high, W. of cor. Pits impracticable.
	Land, rolling and mountainous.
	Soil, rocky, gumbo, 3rd and 4th rate.
	Timber, scrub cedar and pinion.
	Undergrowth, buck brush and scrub oak.

Subdivision of T. 24 N., R. 11 W.

Chains

W.B.K.
 S. 89° 55' E., on a random line, bet. secs. 11 and 14.
 Set temp. $\frac{1}{4}$ sec. cor.
 Intersect N. and S. line, 14 lks. S. of the cor. of secs. 11, 12, 13 and 14,

 Thence I run
 S. 89° 59' W., on a true line, bet. secs. 11 and 14.
 Over level land.
 Enter rolling land, brs. NE. and SW. Slope S.
 Enter scattering timber and undergrowth, brs. NE. and SW.
 Asc. E. slope, 35 ft.
 Spur ridge, brs. N. and S. Desc. W. slope, 70 ft.
 Set an iron post, 3 ft. long, 1 in. diam., 26 ins. in the ground, for $\frac{1}{4}$ sec. cor., marked on brass cap, 1913;
 $\frac{1}{4}$ S11 in N. and
 $\frac{1}{4}$ S14 in S. half; from which
 A cedar, 40 ins. diam., brs. N. 48° W., 144 lks. dist., marked $\frac{1}{4}$ S11 BT.
 A cedar, 14 ins. diam., brs. S. 2 $\frac{1}{4}$ ° E., 139 lks. dist., marked $\frac{1}{4}$ S14 BT.
 A dry tank, brs. S. about 9 chs. dist.,
 Enter flat, brs. N. and S.
 The cor. of secs. 10, 11, 14 and 15.
 Land, level and rolling.
 Soil, rocky, 4th rate, gumbo.
 Timber, cedar and pinion.
 Undergrowth, buck brush and scrub oak. *W.B.K.*
 May 9, 1913.

40.00
 79.86

 2.00
 4.00
 24.00
 30.00
 39.93

 48.00
 79.86

H.N.B.
 May 10, 1913, At 7 hrs. 55 m. a.m., l.m.t., I set off
 35° 28 $\frac{1}{2}$ ' N. on the lat. arc; 17° 35' N. on the decl.
 arc; and determine a meridian with the solar, at the cor.
 of secs. 10, 11, 14 and 15,
 Thence I run
 N. 0° 1' W., bet. secs. 10, and 11.
 Over level land.
 Asc. SE. slope 70 ft. Enter scattering timber, brs.
 E. and W.
 End of asc. Thence along E. slope.
 Gulch, 20 lks. wide, course SE. Asc. SE. slope 350 ft.
 Gulch, 15 lks. wide, course SE. Asc. S. slope
 Set an iron post, 3 ft. long, 1 in. diam., 26 ins. in the ground, for $\frac{1}{4}$ sec. cor., marked on brass cap, 1913;
 $\frac{1}{4}$ S10 in W. and
 $\frac{1}{4}$ S11 in E. half; from which
 A pinion, 9 ins. diam., brs. N. 25° E., 25 lks. dist., marked $\frac{1}{4}$ S11 BT.
 A pinion, 10 ins. diam., brs. N. 63 $\frac{1}{2}$ ° W., 58 lks. dist., marked $\frac{1}{4}$ S10 BT.
 Ridge, brs. E. and W. Thence over rolling land.
 Desc. NE. slope 50 ft.
 Set an iron post, 3 ft. long, 2 ins. diam., 24 ins. in the ground, for cor. of secs. 2, 3, 10 and 11, marked on brass cap, 1913;
 T24N R11W in N. half;
 S3 in NW.,
 S2 in NE.,
 S11 in SE. and
 S10 in SW. quadrant; from which
 A pinion, 7 ins. diam., brs. N. 29 $\frac{1}{4}$ ° E., 6 lks. dist., marked T24N R11W S2 BT.
 A cedar limb, 10 ins. diam., brs. S. 46 $\frac{3}{4}$ ° E., 32 lks. dist., marked T24N R11W S11 BT.
 A cedar, 18 ins. diam., brs. S. 66° W., 18 lks. dist., marked T24N R11W S10 BT.
 A cedar, 13 ins. diam., brs. N. 71 $\frac{1}{2}$ ° W., 127 lks. dist., marked T24N R11W S3 BT.
 Land, rolling and mountainous.
 Soil, rocky, 4th rate.
 Timber, scrub cedar and pinion.
 Undergrowth, buck brush and scrub oak.

6.00
 11.00
 19.00
 25.00
 40.00

 76.00
 80.00

40.00 N. $89^{\circ}59'$ E., on a random line, bet. secs. 2 and 11.
 Set temp. $\frac{1}{4}$ sec. cor.
 80.12 Intersect N. and S. line, 7 lks. S. of the cor. of secs.
 1, 2, 11 and 12,
 Thence I run,
 S. $89^{\circ}56'$ W., on a true line, bet. secs. 2 and 11.
 Over rolling land, through scattering timber.
 8.15 Low ridge, brs. N. and S.
 17.00 Draw, 2 chs. wide, course SW. Thence along S. slope.
 32.00 Desc. SW. slope, 60 ft.
 38.00 Enter draw, course W.
 40.06 Set an iron post, 3 ft. long, 1 in. diam., 26 ins. in
 the ground, for $\frac{1}{4}$ sec. cor., marked on brass cap, 1913;
 $\frac{1}{4}$ S2 in N. and
 S11 in S. half; from which
 A cedar, 7 ins. diam., brs. N. $47\frac{1}{2}^{\circ}$ W., 60 lks. dist.,
 marked $\frac{1}{4}$ S2 BT.
 A cedar, 10 ins. diam., brs. S. $15\frac{1}{2}^{\circ}$ W., 28 lks. dist.,
 marked $\frac{1}{4}$ S11 BT.
 47.00 Draw, 2 chs. wide, course S. Asc. SE. slope, 50 ft.
 56.00 Asc. E. slope.
 60.00 Ridge, brs. NW. and SE. Thence over rolling land.
 80.12 The cor. of secs. 2, 3, 10 and 11.
 Land, rolling and hilly.
 Soil, rocky, 4th rate.
 Timber, scrub cedar and pinion.
 Undergrowth, buck brush and scrub oak.
 NOTE - At this point, I set off $17^{\circ}37\frac{1}{2}'$ N. on the decl.
 arc; and at noon, I observe
 the sun on the meridian. The resulting lat. is $35^{\circ}29\frac{1}{2}'$ N.,
 which is slightly less than the correct lat.

N. $0^{\circ}1'$ W., on a true line, bet. secs. 2 and 3.
 Desc. NE. slope, 30 ft., through heavy timber.
 2.00 Draw, 2 chs. wide, course E. Asc. SE. slope, 35 ft.
 8.00 End of asc. Spur ridge extends 2 chs. W. Desc. NW. slope,
 90 ft.
 23.40 End of desc. Centre of draw, 3 chs. wide. Asc. SE. slope
 40 ft.
 29.00 Ridge, brs. E. and W. Desc. NW. slope 40 ft.
 35.75 Wash 24 lks. wide, 2 ft. deep, course NE.
 36.54 Intersect S. bdy. of Hualpai Indian Reservation, .114 lks.
 W. of the $56\frac{1}{2}$ mile cor., which is a limestone, 5X8X8
 ins. above ground, marked and witnessed as described
 by the Surveyor General.
 At the point of intersection I set an iron post, 3 ft.
 long, 2 ins. diam., 24 ins. in the ground for closing
 cor. of secs. 2 and 3, marked on brass cap, 1913;
 CC. N. of centre.
 H I R. in N. and
 T24N R11W in S. half;
 S2 in SE. and
 S3 in SW. quadrant; from which
 A cedar, 6 ins. diam., brs. $S30\frac{1}{4}^{\circ}$ E., 61 lks. dist.,
 marked T24N R11W S2 BT.
 A cedar, 12 ins. diam., brs. S. $55\frac{1}{2}^{\circ}$ W. 16 lks. dist.,
 marked T24N R11W S3 BT.
 Land, rolling.
 Soil, rocky, 4th rate.
 Timber, scrub cedar and pinion.
 Undergrowth, buck brush and scrub oak.

May 10, 1913.

May 7, 1913. At 8 hrs. 30 m. a.m., l.m.t., I set off
 $35^{\circ}25'$ N. on the lat. arc; $16^{\circ}47'$ N. on the decl. arc;
 and determine a meridian with the solar, at the cor. of
 secs. 3, 4, 33 and 34, on the S. bdy. of the Tp., recently
 established by W.B. Kimball as described in book "M", page 52.
 Thence I run
 N. $0^{\circ}2'$ W. bet. secs. 33 and 34.

Subdivision of T. 24 N., R. 11 W.

Chains

6.00 Over rolling land, through scattering cedar timber.
 31.00 Leave timber, brs. E. and W.
 40.00 Wash, 5 lks. wide, 6 ins. deep, course NW.
 Set an iron post, 3 ft. long, 1 in. diam, 26 ins. in the ground, for $\frac{1}{4}$ sec. cor., marked on brass cap, 1913; $\frac{1}{4}$ S33 in W. and S34 in E. half;
 And raise a mound of stone, 2 ft. base, $1\frac{1}{2}$ ft. high, W. of cor. Pits impracticable. *No bearing trees within limits.*
 60.50 Center of draw, 2 chs. wide, course NW.
 64.00 Low ridge, brs. E. and W. Desc. NW. slope 65 ft.
 72.00 End of desc. Thence across draw, course NW.
 79.25 Leave draw, asc. SW. slope.
 80.00 Set an iron post, 3 ft. long, 2 ins. diam, 24 ins. in the ground, for cor. of secs. 27, 28, 33 and 34, marked on brass cap, 1913; T24N R11W in N. half; S28 in NW., S27 in NE., S34 in SE. and S33 in SW. quadrant;
 And raise a mound of stone, 2 ft. base, $1\frac{1}{2}$ ft. high, W. of cor. Pits impracticable. *No bearing trees within limits.*
 Land, rolling.
 Soil, 3rd rate, gumbo, subsoil hard pan at 1 ft. depth.
 Timber, scattering cedar.
 Undergrowth, scrub oak.

40.00 S. $89^{\circ}57'$ E., on a random line, bet. secs. 27 and 34.
 80.23 Set temp. $\frac{1}{4}$ sec. cor.
 Intersect N. and S. line, 28 lks. S. of the cor. of secs. 26, 27, 34 and 35,
 Thence I run,
 S. $89^{\circ}51'$ W., on a true line, bet. secs. 27 and 34.
 Asc. SE. slope 40 ft., through scattering timber and dense undergrowth.
 2.25 Top of asc. Thence along broken S. slope.
 5.00 Gulch, 10 lks. wide, course SW.
 7.75 Gulch, 15 lks. wide, course SW.
 24.00 Gulch, 40 lks. wide, course S. Leave scattering timber, brs. N. and S.
 32.75 Gulch, 5 lks. wide, course SW.
 40.115 Set an iron post, 3 ft. long, 1 in. diam, 26 ins. in the ground, for $\frac{1}{4}$ sec. cor., marked on brass cap, 1913; $\frac{1}{4}$ S27 in N. and S34 in S. half; from which
 A pinion, 13 ins. diam, brs. N. $27\frac{1}{2}^{\circ}$ W., 76 lks. dist., marked $\frac{1}{4}$ S27 BT.
 No other trees within limits. Raise a mound of stone, 2 ft. base, $1\frac{1}{2}$ ft. high, N. of cor. Pits impracticable.
 50.00 Desc. SW. slope, 40 ft.
 70.00 Foot of desc. Draw, course NW.
 80.23 The cor. of secs. 27, 28, 33 and 34.
 Land, rolling.
 Soil, rocky, 4th rate.
 Timber, scrub cedar and pinion.
 Undergrowth, scrub oak.

NOTE: At this corner, I set off $16^{\circ}49'$ N. on the decl. arc; and at noon, I observe the sun on the meridian. The resulting lat. is $35^{\circ}26'$ N. which is slightly less than the correct lat.

N. $0^{\circ}2'$ W., bet. secs. 27 and 28.
 Asc. SW. slope, 60 ft.
 5.50 Ridge, brs. E. and W. Desc. N. slope 45 ft.
 9.00 Draw, 2 chs. wide, course W. Asp. SW. slope 65 ft.
 24.00 Enter scattering timber, brs. E. and W.
 28.00 End of asc. Thence along W. slope.
 36.00 Desc. NW. slope 35 ft.

Chains	
40.00	Set an iron post, 3 ft. long, 1 in. diam, 26 ins. in the ground, for $\frac{1}{4}$ sec. cor., marked on brass cap, 1913; $\frac{1}{4}$ S28 in W. and S27 in E. half; from which
	A pinion, 6 ins. diam, brs. N. $41\frac{1}{2}^{\circ}$ E., 56 lks. dist., marked $\frac{1}{4}$ S27 BT.
	A pinion, 5 ins. diam, brs. N. $68\frac{3}{4}^{\circ}$ W.; 33 lks. dist., marked $\frac{1}{4}$ S28 BT.
44.00	Canyon 1 ch. wide, course SW. Asc. S. slope 230 ft.
48.00	Slope, changes to SE.
49.00	Cliff 30 ft. high, brs. NE. and SW.
51.25	Two strand wire fence, brs. NW. and SE.
62.00	Rocky cliff, 20 ft. high, brs. E. and W.
65.30	S. edge of box canyon, 75 ft. deep, course E.
69.00	N. edge of canyon. Asc. slight SE. slope.
80.00	Set an iron post, 3 ft. long, 2 ins. diam, 24 ins. in the ground, for cor. of secs. 21, 22, 27 and 28, marked on brass cap, 1913;
	T24N R11W in N. half;
	S21 in NW.,
	S22 in NE.,
	S27 in SE. and
	S28 in SW. quadrant; from which
	A cedar, 7 ins. diam, brs. N. 32° E., 50 lks. dist., marked T24N R11W S22 BT.
	A pinion, 7 ins. diam, brs. S. $84\frac{1}{2}^{\circ}$ E., 111 lks. dist., marked T24N R11W S27 BT.
	A cedar limb, 5 ins. diam, brs. S. 18° W., 82 lks. dist., marked T24 N R11W S28 BT.
	A cedar limb, 6 ins. diam, brs. N. 61° W. 91 lks. dist., marked T24N R11W S21 BT.
	Land, mountainous and hilly.
	Soil, rocky, 4th rate.
	Timber, scrub cedar and pinion.
	Undergrowth, buck brush.
40.00	N. $89^{\circ} 51'$ E., on a random line, bet. secs. 22 and 27.
80.08	Set temp. $\frac{1}{4}$ sec. cor.
	Intersect N. and S. line, 37 lks. N. of the cor. of secs. 22, 23, 26 and 27, marked on brass cap, 1913;
	Thence run
	N. $89^{\circ} 53'$ W., on a true line, bet. secs. 22 and 27.
	Asc. NE. slope, 195 ft, through scattering undergrowth.
7.00	Enter scattering timber, brs. N. and S.
12.00	Ridge, brs. N. and S.
14.00	Desc. W. slope, 350 ft.
36.00	Foot of desc. brs. N. and S., thence over rolling land.
40.04	Set an iron post, 3 ft. long, 1 in. diam, 26 ins. in the ground, for $\frac{1}{4}$ sec. cor., marked on brass cap, 1913;
	$\frac{1}{4}$ S22 in N. and
	S27 in S. half; from which
	A cedar limb, 8 ins. diam, brs. N. 83° W., 168 lks. dist., marked $\frac{1}{4}$ S22 BT.
	A pinion, 10 ins. diam, brs. S. $35\frac{3}{4}^{\circ}$ W., 172 lks. dist., marked $\frac{1}{4}$ S27 BT.
50.00	Leave timber, brs. N. and S.
60.00	Trail, brs. NE. and SW.
76.00	Enter timber, brs. NE. and SW.
80.08	The cor. of secs. 21, 22, 27 and 28.
	Land, rolling and mountainous.
	Soil, 3rd rate, sandy loam on flat, rocky, 4th rate on slopes.
	Timber, scrub cedar and pinion.
	Undergrowth, scrub oak and buck brush.
18.75	N. $0^{\circ} 2'$ W., bet. secs. 21 and 22.
	Asc. S. slope through scattering timber.
38.00	Spur ridge, brs. E. and W., 275 ft. above cor. Desc. NE. slope, 290 ft.
	Leave timber, brs. E. and W., Thence across draw, course NE.

Subdivision of T. 24 N., R. 11 W.

Chains 40.00	<p>Set an iron post, 3 ft. long, 1 in.ⁱⁿ diam., 26 ins. in the ground, for $\frac{1}{4}$ sec. cor., marked on brass cap, 1913; $\frac{1}{4}$S21 in W. and S22 in E. half; from which</p> <p>A pinion limb, 6 ins.ⁱⁿ diam., brs. N. 39$\frac{3}{4}$° E., 155 lks. dist., marked $\frac{1}{4}$S22 BT.</p> <p>A pinion, 15 ins.ⁱⁿ diam., brs. S. 88$\frac{3}{4}$° W., 145 lks. dist., marked $\frac{1}{4}$S21 BT.</p>
59.00	<p style="text-align: right;">May 7, 1913.</p> <p>May 12, 1913, At 9 hrs. 3 m. a.m., l.m.t., I set off 35° 27$\frac{1}{2}$' N. on the lat. arc; 18° 6$\frac{1}{2}$' N. on the decl. arc; and determine a meridian with the solar, at the $\frac{1}{4}$ sec. cor. bet. secs. 21 and 22, above described</p> <p>Thence I continue N. 0° 2' W., bet. secs. 21 and 22.</p> <p>Leave draw, asc. S. slope, through scattering timber. Ridge brs. E. and W., extends E. 6 chs.; is 370 ft. above $\frac{1}{4}$ sec. cor.</p> <p>Enter heavy timber, brs. E. and W. Desc. NE. slope, 280 ft.</p>
80.00	<p>Set an iron post, 3 ft. long, 2 ins.ⁱⁿ diam., 24 ins. in the ground, for cor. of secs. 15, 16, 21 and 22, marked on brass cap, 1913; T24N R11W in N. half; S16 in NW. S15 in NE., S22 in SE. and S21 in SW. quadrant;</p> <p>And raise a mound of stone, 2 ft. base, 1$\frac{1}{2}$ ft. high, W. of cor. No suitable trees within limits. Pits impracticable.</p> <p>Land, mountainous. Soil, rocky, 4th rate. Timber, scrub cedar and pinion. Undergrowth, buck brush and scrub oak.</p>
40.00 80.13	<p>S 89° 53' E. on a random line, bet. secs. 15 and 22. Set temp. $\frac{1}{4}$ sec. cor.,</p> <p>Intersect N. and S. line, at the cor. of secs. 14, 15, 22 and 23.,</p>
2.00 23.00	<p>Thence I run N. 89° 53' W., on a true line, bet. secs. 15 and 22. Over rolling land, through heavy timber.</p> <p>Desc. gentle NW. slope, 40 ft.</p> <p>Center of draw, 2 chs. wide, course N. Asc. NE. slope, 70 ft.</p>
40.065	<p>Set an iron post, 3 ft. long, 1 in.ⁱⁿ diam., 26 ins. in the ground, for $\frac{1}{4}$ sec. cor., marked on brass cap, 1913; $\frac{1}{4}$S15 in N. and S22 in S. half; from which</p> <p>A pinion, 13 ins.ⁱⁿ diam., brs. N. 88$\frac{3}{4}$° E., 34 lks. dist., marked $\frac{1}{4}$S15 BT.</p> <p>A cedar, 6 ins.ⁱⁿ diam., brs. S. 31$\frac{1}{4}$° E., 68 lks. dist., marked $\frac{1}{4}$S22 BT.</p>
55.00 59.00	<p>Desc. NW. slope, 65 ft.</p> <p>Center of draw, 70 lks. wide, course NE., Asc. NE. slope, 145 ft.</p>
64.00	<p>Top of asc. Thence along N. slope.</p>
70.00	<p>Desc. SW. slope 45 ft.</p>
75.70	<p>Gulch, 10 lks. wide, course NW. Thence along N. slope.</p>
80.13	<p>The cor. of secs. 15, 16, 21 and 22.</p> <p>Land, mountainous and hilly. Soil, rocky, 4th rate. Timber, scrub cedar and pinion. Undergrowth, buck brush and scrub oak.</p>
11.00 31.50	<p>N. 0° 2' W., bet. secs. 15 and 16.</p> <p>Desc. NW. slope 330 ft., through heavy timber.</p> <p>Two strand, wire fence, brs. NW. and SE.</p> <p>Gulch, 60 lks. wide, course SW. Leave timber, brs.</p>

59.

Chains	
	NE. and SW.
33.00	Road, brs. NE. and SW. Asc. SE. slope.
38.00	Enter scattering timber, brs E. and W.
40.00	Set an iron post, 3 ft. long, 1 in. diam, 26 ins. in the ground, for $\frac{1}{4}$ sec. cor., marked on brass cap, 1913; $\frac{1}{4}$ S16 in W. and S15 in E. half; from which
	A pinion, 6 ins. diam, brs. S. 85° E., 69 lks. dist., marked $\frac{1}{4}$ S15 BT.
	A pinion, 8 ins. diam, brs. S. $22\frac{3}{4}^{\circ}$ W., 100 lks. dist., marked $\frac{1}{4}$ S16 BT.
51.80	Limestone cliff, 30 ft. high.
54.50	Limestone cliff, 12 ft. high.
55.00	Ridge, brs. E. and W., 475 ft. above gulch. Desc. NE. slope 115 ft.
59.50	Canyon, 50 lks. wide, course NE. Asc. SE. slope, 210 ft.
78.00	Spur ridge, brs. NE. and SW. Extends 6 chs. NE. Desc. NW. slope 20 ft.
80.00	Set an iron post, 3 ft. long, 2 ins. diam, 24 ins. in the ground, for cor. of sees. 9, 10, 15 and 16, marked on brass cap, 1913; T24N R11W in N. half; S9 in NW., S10 in NE., S15 in SE., and S16 in SW. quadrant; from which
	A pinion, 6 ins. diam, brs. S. $24\frac{3}{4}^{\circ}$ E., 43 lks. dist., marked T24N R11W S15 BT.
	No other trees within limits. Raise a mound of stone, 2 ft. base, $1\frac{1}{2}$ ft. high, W. of cor. Pits impracticable.
	Land, mountainous.
	Soil, rocky, 4thrate.
	Timber, scrub cedar and pinion.
	Undergrowth, scrub oak.
40.00	S. $89^{\circ}53'$ E. on a random line bet. sees. 10 and 15. Set temp. $\frac{1}{4}$ sec. cor.
80.02	Intersect N. and S. line, 14 lks. S. of the cor. of sees. 10, 11, 14 and 15, marked on brass cap, 1913; Thence I run
	N. $89^{\circ}59'$ W., on a true line, bet. sees. 10 and 15. Over level land.
4.00	Asc. SE. slope 125 ft. Enter timber, brs. NE. and SW.
14.00	Spur ridge, brs. NE. and SW., extends 6 chs. SW. Desc. SW. slope 70 ft.
20.00	End of desc. Thence along S. slope.
26.00	Desc. SW. slope 40 ft.
29.00	Wash, 30 lks. wide, 4 ft. deep, course SE.
33.00	Asc. E. slope, 50 ft.
40.01	Set an iron post, 3 ft. long, 1 in. diam, 26 ins. in the ground, for $\frac{1}{4}$ sec. cor., marked on brass cap, 1913; $\frac{1}{4}$ S10 in N. and S15 in S. half; from which
	A pinion, 12 ins. diam, brs. N. $31\frac{1}{2}^{\circ}$ W., 39 lks. dist., marked $\frac{1}{4}$ S10 BT.
	A pinion, 6 ins. diam, brs. S. 31° W., 63 lks. dist., marked $\frac{1}{4}$ S15 BT.
	Continue to asc. E. slope 200 ft.
49.45	Limestone cliff, 15 ft. high, brs. N. and S.
51.00	Spur ridge, brs. NE. and SW., extends 2 chs. NE. Desc. W. slope 220 ft.
62.00	Canyon, 1 ch. wide, course N. Asc. E. slope, 375 ft.
77.50	Spur ridge, extends 3 chs. NE. Desc. NW. slope, 30 ft.
80.02	The cor. of sees. 9, 10, 15 and 16. Land, mountainous. Soil, rocky, 4thrate. Timber, scrub cedar and pinion. Undergrowth, scrub oak and buck brush.

May 12, 1913.

Subdivision of T. 24 N., R. 11 W.

Chains.	<p>May 13, 1913, At 8 hrs. 45 m. a.m., l.m.t., I set off $\sqrt{35^{\circ} 28\frac{1}{2}'}$ N. on the lat. arc; $18^{\circ} 21\frac{1}{2}'$ N. on the decl. arc; and determine a meridian with the solar, at the cor. of secs 9, 10, 15 and 16, Thence I run, N. $0^{\circ} 2'$ W., bet. secs. 9 and 10. Desc. NW. slope, 275 ft. through scattering timber. Canyon 50 lks. wide, course NE. Asc. SE. slope 130 ft. Ridge, brs. NE. and SW. Desc. NW. slope 110 ft. Gulch, 50 lks. wide, course NE. Asc. SE. slope 25 ft. E. end of low ridge, brs. E. and W. Desc. NE. slope 20 ft. Set an iron post, 3 ft. long, 1 in. diam, 26 ins. in the ground, for $\frac{1}{4}$ sec. cor., marked on brass cap, 1913; $\frac{1}{4}$S9 in W. and S10 in E. half; from which A pinion, 5 ins. diam, brs. S. 7° E., 41 lks. dist., marked $\frac{1}{4}$S10 BT. A pinion, 6 ins. diam, brs. S. 26° W., 24 lks. dist., marked $\frac{1}{4}$S9 BT. Canyon, 70 lks. wide, course SE. Asc. SW. slope, 240 ft. End of asc.; W. end of spur ridge, brs. E. and W. Desc. NW slope 30 ft. Gulch, 15 lks. wide, course SW. Asc. SE. slope 60 ft. E. end of spur ridge, Thence along E. slope. Asc. S. slope 130 ft. Ridge, brs. E. and W. Desc. slight NW. slope. Set an iron post, 3 ft. long, 2 ins. diam, 24 ins. in the ground, for cor. of secs. 3, 4, 9 and 10., marked on brass cap, 1913; T24N R11W in N. half; S4 in NW., S3 in NE., S10 in SE. and S9 in SW. quadrant; from which A pinion, 12 ins. diam, brs. N. $17\frac{1}{4}^{\circ}$ E., 80 lks. dist., marked T24N R11W S3 BT. A pinion, 13 ins. diam, brs. S. 38° E., 61 lks. dist., marked T24N R11W S10 BT. A cedar, 6 ins. diam, brs. S. $10\frac{1}{2}^{\circ}$ W., 126 lks. dist., marked T24N R11W S9 BT. A cedar, 7 ins. diam, brs. N. 37° W., 31 lks. dist., marked T24N R11W S4 BT. Land, mountainous. Soil, rocky, 4th rate, limestone formation. Timber, scrub cedar and pinion. Undergrowth, buck brush and scrub oak.</p>
40.00 79.93	<p>S. $89^{\circ} 59'$ E., on a random line, bet. secs. 3 and 10. Set temp. $\frac{1}{4}$ sec. cor. Intersect N. and S. line, 7 lks. S. of the cor. of secs. 2, 3, 10 and 11, marked on brass cap, 1913.</p>
6.00 12.00 22.50 39.965	<p>Thence I run, S. $89^{\circ} 58'$ W., on a true line, bet. secs. 3 and 10. Along N. slope, through scattering timber and undergrowth. Low ridge, brs. N. and S. Desc. NW. slope, 50 ft. Center of draw, 1 ch. wide, course NE. Asc. SE. slope 30 ft. Thence over rolling land. Set an iron post, 3 ft. long, 1 in. diam, 26 ins. in the ground, for $\frac{1}{4}$ sec. cor., marked on brass cap, 1913; $\frac{1}{4}$S3 in N. and S10 in S. half; from which A cedar, 16 ins. diam, brs. N. 9° E., 46 lks. dist., marked $\frac{1}{4}$S3 BT. A cedar, 8 ins. diam, brs. S. $41\frac{1}{4}^{\circ}$ E., 176 lks. dist., marked $\frac{1}{4}$S10 BT.</p>
50.00 56.00 66.00	<p>Asc. slight SE. slope, 35 ft. Top of asc. Thence along low ridge, brs. NE. and SW. Draw, 50 lks. wide, course NE. Asc. SE. slope 70 ft.</p>

Chains
77.00
79.93

Ridge, brs. NE. and SW. Thence over rolling land.
The cor. of secs 3, 4, 9 and 10.
Land, rolling and hilly.
Soil, rocky, 4th rate.
Timber, scrub cedar and pinion.

NOTE - At this corner I set off $18^{\circ}23'$ N. on the decl. arc;
and at horizon ~~5-7-7-7-7-7-7-7~~, I observe the
sun on the meridian. The resulting lat. is $35^{\circ}29\frac{1}{2}'$ N.,
which is $21'$ less than the correct lat.

4.20
10.00
22.00
25.00
31.00
36.46

N. $0^{\circ}2'$ W., bet. secs. 3 and 4.
Desc. NW. slope, 60 ft., through scattering timber and undergrowth.
Center of draw, 50 lks. wide, course NE.
Thence along E. slope.
Draw, course E. Asc. S. slope 70 ft.
Spur ridge, extends 2 chs. W. Desc. N. slope 30 ft.
Draw, 40 lks. wide, course NE. Asc. SE. slope 40 ft.
Ridge, brs. E. and W. Desc. NE. slope 70 ft.
Intersect S. bdy. of Hualpai Indian Reservation 131 lks. W. of the $55\frac{1}{2}$ mile cor., which is a limestone boulder in place, $36 \times 24 \times 10$ ins. above ground, marked and witnessed as described by Surveyor General.
At the point of intersection, I set an iron post, 3 ft. long, 2 ins. diam, 24 ins. in the ground, for closing cor. of secs 3 and 4, marked on brass cap, 1913;
CC, N. of center.,
H I R in N. and
T24N R11W in S. half;
S3 in SE., and
S4 in SW. quadrant; from which
A pinion, 9 ins. diam, brs. S. $75\frac{3}{4}^{\circ}$ E., 9 lks. dist., marked T24N R11W S3 BT.
A pinion, 20 ins. diam, brs. S. $54\frac{3}{4}^{\circ}$ W., 177 lks. dist., marked T24N R11W S4 BT.
Land, rolling and hilly.
Soil, rocky, 4th rate.
Timber, scrub cedar and pinion.
Undergrowth, buck brush and scrub oak.

H.N.B.
May 13, 1913.

8.95
14.75
32.00
40.00
46.70
47.00
76.00
80.00

W.B.K.
May 5, 1913, At 3 hrs. 10 m. p.m., l.m.t., I set off $35^{\circ}25'$ N. on the lat. arc; $16^{\circ}17\frac{1}{2}'$ N. on the decl. arc; and determine a meridian with the solar, at the cor. of secs 4, 5, 32 and 33, on the S. bdy. of the Tp., recently established by me, as described in book "M", page 52.
Thence I run,
N. $0^{\circ}3'$ W., bet. secs. 32 and 33.
Over rolling land, draining W.
Wash, 3 lks. wide, 1 ft. deep, course NW.
Trails, brs. NW. and SE.
Asc. S. slope, 35 ft.
Spur ridge, brs. E. and W.
Set an iron post, 3 ft. long, 1 in. diam, 26 ins. in the ground, for $\frac{1}{4}$ sec. cor., marked on brass cap, 1913;
 $\frac{1}{4}$ S32 in W. and
S33 in E. half;
And raise a mound of stone, 2 ft. base, $1\frac{1}{2}$ ft. high, W. of cor. Pits impracticable. *No bearing trees within limits.*
Desc. W. slope 30 ft.
Trail, brs. E. and W.
Draw, course W. Asc. S. slope 100 ft.
Ridge, brs. E. and W. Desc. NW slope.
Set an iron post, 3 ft. long, 2 ins. diam, 24 ins. in the ground, for cor. of secs. 28, 29, 32 and 33, marked on brass cap, 1913;
T24N R11W in N. half;
S29 in NW.,
S28 in NE.,

Subdivision of T. 24 N., R. 11 W.

Chains

S33 in SE. and
 S32 in SW. quadrant;
 And raise a mound of stone, 2 ft. base, 1½ ft. high, W.
 of cor., Pits Impracticable. *No bearing trees within limits.*
 Land, rolling.
 Soil, gravelly, gumbo and clay, 2nd and 3rd rate.
 No timber or undergrowth.

W.B.K.

H.N.B.

40.00
79.92

S. 89° 57' E., on a random line, bet. secs. 28 and 33.
 Set temp. ¼ sec. cor.
 Intersect N. and S. line, 16 lks. S. of the cor. of
 secs. 27, 28, 33 and 34,

Thence I run
 S89° 56' W., on a true line, bet. secs. 28 and 33.

27.15
34.00
39.00
39.96

Across draw,
 Road, brs. NW. and SE. Leave draw, asc. NE. slope 35 ft.
 Top of asc. Thence along N. slope.
 Gulch, 5 lks. wide, course N.
 Set an iron post, 3 ft. long, 1 in. diam., 26 ins. in
 the ground, for ¼ sec. cor., marked on brass cap, 1913;

¼ S28 in N. and
 S33 in S. half; from which,
 A cedar, 18 ins. diam., brs. S. 71½° W., 176 lks. dist.,
 marked ¼ S33 BT.

No other trees within limits. Raise a mound of stone,
 2 ft. base, 1½ ft. high, N. of cor. Pits impracticable.
 Thence over rolling land.

79.92

The cor. of secs. 28, 29, 32 and 33.
 Land, level and rolling.
 Soil, 3rd rate, limestone formation.
 No timber or undergrowth.

May 5, 1913. H.N.B.

W.B.K.

May 13, 1913. At 7 hrs. 59 m. a.m., l.m.t., I set off
 √35° 26' N. on the lat. arc; √18° 21' N. on the decl. arc,
 and determine a meridian with the solar, at the cor. of
 secs. 28, 29, 32 and 33,

Thence I run,
 N. 0° 3' W., bet. secs. 28 and 29.

5.50
6.00
13.00
13.50
22.80
29.00

Over rolling land, draining W.
 Road, brs. NE. and SW.
 Desc. N. slope 35 ft.
 Enter flat, brs. NW. and SE.
 Road, brs. NW. and SE.
 Road, brs. E. and W.
 Leave level land, brs. E. and W. Thence across rolling
 land, drains W.

40.00

Set an iron post, 3 ft. long, 1 in. diam., 26 ins. in the
 ground, for ¼ sec. cor., marked on brass cap, 1913;
 ¼ S29 in W. and
 S28 in E. half;

And raise a mound of stone, 2 ft. base, 1½ ft. high,
 W. of cor. Pits impracticable.

80.00

Set an iron post, 3 ft. long, 2 ins. diam., 24 ins. in
 the ground, for cor. of secs. 20, 21, 28 and 29,
 marked on brass cap, 1913;
 T24N R11W in N. half;
 S20 in NW.,
 S21 in NE.,
 S28 in SE. and
 S29 in SW. quadrant;

And raise a mound of stone, 2 ft. base, 1½ ft. high,
 W. of cor. Pits impracticable. *No bearing trees within limits.*
 Land, level and rolling.
 Soil, clay and gumbo, gravelly; 2nd and 3rd rate.
 No timber or undergrowth.

Subdivision of T. 24 N., R. 11 W.

Chains.

40.00 N. 89° 56' E., on a random line, bet. secs. 21 and 28.
 Set temp. $\frac{1}{4}$ sec. cor.
 79.94 Intersect N. and S. line, 33 lks. S. of the cor.,
 of secs. 21, 22, 27 and 28, which is on a true line,
 Thence I run,
 S. 89° 42' W., on a true line, bet. secs. 21 and 28.
 Over rolling land, through scattering timber.
 39.97 Set an iron post, 3 ft. long, 1 in. diam, 26 ins. in
 the ground, for $\frac{1}{4}$ sec. cor., marked on brass cap, 1913;
 $\frac{1}{4}$ S21 in N. and
 S28 in S. half; from which
 A pinion, 7 ins. diam, brs. N. 42° E., 52 lks. dist.,
 marked $\frac{1}{4}$ S21 BT.
 A pinion, 8 ins. diam, brs. S. 69° E., 25 lks. dist.,
 marked $\frac{1}{4}$ S28 BT.
 43.00 Spur ridge, brs. N. and SW. Desc. W. slope, 430 ft.
 70.00 Leave timber, and undergrowth, brs. N. and S.
 79.94 The cor. of secs 20, 21, 28 and 29.
 Land, rolling and mountainous.
 Soil, rocky, clay and gumbo, 2nd to 4th rate.
 Timber, cedar and pinion.
 Undergrowth, buck brush.
 NOTE- At this corner, I set off 18° 23' N. on the decl. arc;
 and at horizon, I observe the
 sun on the meridian. The resulting lat. is 35° 27' N., which
 is correct.

40.00 N. 0° 3' W., bet. secs. 20 and 21.
 Over rolling land, draining W.
 Set an iron post, 3 ft. long, 1 in. diam, 26 ins. in the
 ground, for $\frac{1}{4}$ sec. cor., marked on brass cap, 1913;
 $\frac{1}{4}$ S20 in W. and
 S21 in E. half;
 And raise a mound of stone, 2 ft. base, 1½ ft. high,
 W. of cor. Pits impracticable. *No bearing trees within limits.*
 61.75 Road, brs. NE, and SW.
 66.80 Draw, course SW. Asc. SE. slope 30 ft.
 72.00 Top of asc. Thence over rollin land.
 80.00 Set an iron post, 3 ft. long, 2 ins. diam, 24 ins. in
 the ground, for cor. of secs. 16, 17, 20 and 21,
 marked on brass cap, 1913;
 T24N R11W in N. half;
 S17 in NW.,
 S16 in NE.,
 S21 in SE. and
 S20 in SW. quadrant;
 And raise a mound of stone, 2 ft. base, 1½ ft. high,
 W. of cor. Pits impracticable. *No bearing trees within limits.*
 Land, rolling.
 Soil, gravelly, clay and gumbo; 2nd and 3rd rate.
 No timber or undergrowth.

40.00 N. 89° 42' E., on a random line bet. secs. 16 and 21.
 Set temp. $\frac{1}{4}$ sec. cor.
 79.78 Intersect N. and S. line, 19 lks. N. of the cor. of
 secs. 15, 16, 21 and 22, which is on a true line,
 Thence I run,
 S. 89° 50' W., on a true line, bet. secs. 16 and 21.
 Desc. NW. slope 315 ft., through heavy timber and dense
 undergrowth.
 16.00 Gulch, 15 lks. wide, course N. Leave heavy, enter
 scattering timber, brs. ENE. and WSW.
 39.89 Set an iron post, 3 ft. long, 1 in. diam, 26 ins. in
 the ground, for $\frac{1}{4}$ sec. cor., marked on brass cap, 1913;
 $\frac{1}{4}$ S16 in N. and
 S21 in S. half; from which

Subdivision of T. 24 N., R. 11 W.

Chains.

A pinion, 16 ins. diam, brs. N. 44° W., 143 lks. dist., marked $\frac{1}{4}$ S16 BT.

A pinion, 16 ins. diam, brs. S. 21° E., 38 lks. dist., marked $\frac{1}{4}$ S21 BT.

44.00 Leave scattering timber and undergrowth, brs. N. and S.

54.00 Dry tank, brs. N., about 10 chs. dist.,

58.00 Road, brs. NE. and SW.

60.00 Draw, course SW., Asc. SE. slope, 30 ft.

79.78 The cor. of secs. 16, 17, 20 and 21.
Land, mountainous and rolling.
Soil, clay and gumbo, gravelly and rocky, 2nd to 4th rate.
Timber, cedar and pinion.
Undergrowth, scrub oak and buck brush.

26.00 N. 0° 3' W., bet. secs. 16 and 17.
Asc. rolling SE. slope 145 ft.

30.00 Ridge, brs. NE. and SW. Desc. N. slope 20 ft.

33.00 Foot of desc. Asc. S. slope, 675 ft.

40.00 Dim road, brs. E. and W.
Set an iron post, 3 ft. long, 1 in. diam, 26 ins. in the ground, for $\frac{1}{4}$ sec. cor., marked on brass cap, 1913; $\frac{1}{4}$ S17 in W. and S16 in E. half;
And raise a mound of stone, 2 ft. base, 1 $\frac{1}{2}$ ft. high, W. of cor. Pits impracticable. *No bearing trees within limits.*

May 13, 1913.

May 14, 1913, At 8 hrs. 22 m. a.m., l.m.t., I set off $\sqrt{35^{\circ}28\frac{1}{2}'}$ N. on the lat. arc; $18^{\circ}36'$ N. on the decl. arc; and determine a meridian with the solar, at the $\frac{1}{4}$ sec. cor. bet. secs. 16 and 17, above described
Thence I continue

44.00 N. 0° 3' W., bet. secs. 16 and 17.
Enter scattering timber and dense undergrowth, brs. E. and W. Asc. rocky S. slope.

69.50 Ridge, brs. E. and W. Desc. N. slope, 55 ft.

78.50 Head of gulch, course E.

80.00 Set an iron post, 3 ft. long, 2 ins. diam, 24 ins. in the ground, for cor. of secs. 8, 9, 16 and 17, marked on brass cap, 1913;
T24N R11W in N. half;
S8 in NW.,
S9 in NE.,
S16 in SE. and
S17 in SW. quadrant; from which

A pinion, 14 ins. diam, brs. N. 11 $\frac{1}{2}$ ° E., 164 lks. dist., marked T24N R11W S9 BT.

A pinion, 9 ins. diam, brs. S. 72° W., 176 lks. dist., marked T24N R11W S16 BT.

A pinion, 12 ins. diam, brs. S. 68 $\frac{3}{4}$ ° W., 151 lks. dist., marked T24N R11W S17 BT.

A pinion, 12 ins. diam, brs. N. 41° W., 86 lks. dist., marked T24N R11W S8 BT.

Land, rolling and mountainous.
Soil, rocky, gumbo, 4th rate.
Timber, cedar and pinion.
Undergrowth, buck brush and scrub oak.

NOTE: At this corner, I set off $18^{\circ}38'$ N. on the decl. arc; and at noon, I observe the sun on the meridian. The resulting lat. is $35^{\circ}28\frac{1}{2}'$ N. which is slightly less than the correct lat.

40.00 N. 89° 50' E., on a random line, bet. secs. 9 and 16.
Set temp. $\frac{1}{4}$ sec. cor.

79.86 Intersect the N. and S. line, 16 lks. S. of the cor. of secs. 9, 10, 15 and 16.

Thence I run,
S. 89° 43' W., on a true line, bet. secs. 9 and 16.

Chains.

5.10 Desc. NW. slope, 140 ft., through scattering timber.
 8.90 Gulch, 50 lks. wide, course N. Asc. NE. slope 60 ft.
 19.60 Top of asc. Desc. NW. slope 80 ft.
 27.90 Canyon, 60 lks. wide, course NE. Asc. SE. slope 240 ft.
 35.00 Ridge, brs. NE and SW. Desc. NW. slope 25 ft.
 39.93 Head of gulch, course NE. A spring down the gulch about 10 chs. dist.
 Set an iron post, 3 ft. long, 1 in. diam, 26 ins. in the ground, for $\frac{1}{4}$ sec. cor., marked on brass cap, 1913; $\frac{1}{4}$ S9 in N. and $\frac{1}{4}$ S16 in S. half; from which
 A pinion, 12 ins. diam, brs. N. $55\frac{1}{4}^{\circ}$ W., 66 lks. dist., marked $\frac{1}{4}$ S9 BT.
 A cedar, 10 ins. diam, brs. S. 6° E., 18 lks. dist., marked $\frac{1}{4}$ S16 BT.
 42.00 Ridge, 50 ft. above cor., brs. NE and SW. Desc. W. slope 30 ft.
 75.50 Gulch, course NE., Asc. SE. slope 60 ft.
 79.86 The cor. of secs. 8, 9, 16 and 17.
 Land, mountainous.
 Soil, rocky, 4th rate.
 Timber, cedar and pinion.
 Undergrowth, buck brush.

May 14, 1913.

May 15, 1913, At 8 hrs. 43 m. a.m., l.m.t., I set off $\sqrt{35^{\circ}28\frac{1}{2}'}$ N. on the lat. arc; $18^{\circ}50\frac{1}{2}'$ N. on the decl. arc; and determine a meridian with the solar, at the cor. of secs. 8, 9, 16 and 17.

Thence I run,

N. $0^{\circ}3'$ W., bet. secs. 8 and 9.

Asc. SE. slope 45 ft., through scattering timber and dense undergrowth.

7.00 Ridge, brs. E and W. Desc. N. slope 20 ft.

10.60 Draw, course E. Asc. S. slope 90 ft.

23.00 Ridge, brs. E and W. Desc. N. slope, 275 ft.

40.00 Set an iron post, 3 ft. long, 1 in. diam, 26 ins. in the ground, for $\frac{1}{4}$ sec. cor., marked on brass cap, 1913; $\frac{1}{4}$ S8 in W. and $\frac{1}{4}$ S9 in E. half; from which

A pinion, 6 ins. diam, brs. N. 85° E., 113 lks. dist., marked $\frac{1}{4}$ S9 BT.

A pinion, 12 ins. diam, brs. N. $30\frac{3}{4}^{\circ}$ W., 172 lks. dist., marked $\frac{1}{4}$ S8 BT.

43.60 Gulch, course E. Asc. S. slope, 200 ft.

64.00 Ridge, brs. NE and SW. Desc. NW. slope, 445 ft.

80.00 Set an iron post, 3 ft. long, 2 ins. diam, 24 ins. in the ground, for cor. of secs. 4, 5, 8 and 9, marked on brass cap, 1913;

T24N R11W in N. half;

S5 in NW.,

S4 in NE.,

S9 in SE. and

S8 in SW. quadrant; from which

A cedar, 18 ins. diam, brs. N. $66\frac{1}{2}^{\circ}$ E., 84 lks. dist., marked T24N R11W S4 BT.

A pinion, 8 ins. diam, brs. S. $66\frac{1}{2}^{\circ}$ E., 53 lks. dist., marked T24N R11W S9 BT.

A cedar, 6 ins. diam, brs. S. 33° W., 20 lks. dist., marked T24N R11W S8 BT.

A pinion, 9 ins. diam, brs. N. $55\frac{3}{4}^{\circ}$ W., 93 lks. dist., marked T24N R11W S5 BT.

Land, mountainous.

Soil, rocky, 4th rate.

Timber, cedar and pinion.

Undergrowth, buck brush and scrub oak.

N. $89^{\circ}43'$ E., on a random line, bet. secs. 4 and 9.

40.00 Set temp. $\frac{1}{4}$ sec. cor.

79.81 Intersect N and S. line, 2 lks. S. of the cor. of secs. 3, 4, 9 and 10.

Subdivision of T. 24 N., R. 11 W.

Chains.

Thence I run
 S. 89° 42' W. on a true line bet. secs. 4 and 9.
 Over rolling land, through heavy timber,
 Low ridge, brs. NW. and SE. Desc. SW. slope 110 ft.
 Gulch, 15 lks. wide, course SW. Thence along S. slope,
 Desc. SW. slope, 70 ft.
 Gulch, 30 lks. wide, course SE. Asc. NE. slope 65 ft.
 Set an iron post, 3 ft. long, 1 in. diam; 26 ins. in t
 the ground, for ¼ sec. cor., marked on brass cap, 1913;
 ¼ S4 in N. and
 S9 in S. half; from which,
 A cedar, 10 ins. diam, brs. N. 21½° E., 71 lks. dist.,
 marked ¼ S4 BT.
 A cedar, 18 ins. diam, brs. S. 30° E., 19 lks. dist.,
 marked ¼ S9 BT.
 Thence along N. slope.
 Head of draw, course NE. Asc. E. slope 70 ft.
 Ridge, brs. N. and S. Desc. rocky. NW. slope, 445 ft.
 The cor. of secs. 4, 5, 8 and 9.

4.00
10.00
24.00
30.00
39.905

43.00
50.00
79.81

Land, mountainous.
 Soil, rocky, 4th rate.
 Timber, cedar and pinion.
 Undergrowth, buck brush and scrub oak.
 NOTE: At this corner, I set off 18° 52' N. on the decl. arc;
 and at noon, I observe the
 sun on the meridian. The resulting lat. is 35° 29½' N.,
 which is slightly less than the correct lat.

N. 0° 3' W., bet. secs. 4 and 5.
 Desc. 200 ft., over rolling N. slope, through scattering
 timber and undergrowth.
 Draw, course NW. Thence along W. slope.
 Leave timber, brs. E. and W.
 Intersect the S. bdy. of the Hualpai Indian Reservation,
 150 lks. W. of the 54½ mile cor., which is a stone,
 8X8X12 ins above ground, marked and witnessed as
 described by the Surveyor General.
 At the point of intersection I set an iron post, 3 ft.
 long, 2 ins. diam, 24 ins. in the ground, for closing
 cor. of secs. 4 and 5, marked on brass cap, 1913;
 CC, N. of centre;
 H.I R in N. and
 T24N R11W in S. half;
 S. 4 in SE. and
 S5 in SW. quadrant;
 And raise a mound of stone, 2 ft. base, 1½ ft. high,
 S. of cor. Pits impracticable. *No bearing trees within limits.*
 Land, rolling.
 Soil, rocky 4th rate.
 Timber, cedar and pinion.
 Undergrowth, buck brush and scrub oak.

27.60
29.00
36.76

May 15, 1913.

May 12, 1913. At 7 hrs. 50 m. a.m., l.m.t., I set off
 35° 25' N. on the lat. arc; 18° 6' N. on the decl.
 arc; and determine a meridian with the solar, at the cor.
 of secs 5, 6, 31 and 32, on the S. bdy. of the Tp.,
 recently established by me as described in book, "M", page 51.
 Thence I run,
 N. 0° 3' W., bet. secs. 31 and 32.
 Over rolling land, draining NW.
 Set an iron post, 3 ft. long, 1 in. diam, 26 ins. in
 the ground, for ¼ sec. cor., marked on brass cap, 1913;
 ¼ S31 in W. and
 S32 in E. half;
 And raise a mound of stone, 2 ft. base, 1½ ft. high,
 W. of cor. Pits impracticable. *No bearing trees within limits.*
 Trail, brs. NW. and SE.

40.00
41.90

67

<p>Chains 44.30 48.20 49.40 56.00 62.20 80.00</p>	<p>Trail bears E. and W. Wash, 12 lks. wide, 4 ft. deep, course W. Trail, brs. E. and W. Asc. S. slope, 40 ft. Top of asc. Continue over rolling land, drains W. Road, brs. E. and W. Set an iron post, 3 ft. long, 2 ins. ⁱⁿdiam, 24 ins. in the ground, for cor. of secs. 29, 30, 31 and 32, marked on brass cap, 1913; T24N R11W in N. half; S30 in NW., S29 in NE., S32 in SE., and S31 in SW. quadrant; And raise a mound of stone, 2 ft. base, 1½ ft. high, W. of cor. Pits impracticable. <i>No bearing trees within limits.</i> Land, rolling. Soil, gravelly, clay and gumbo. No timber or undergrowth.</p>
<p>40.00 80.10 11.90 40.05 80.10</p>	<p>S.89°57'E., on a random line, bet. secs. 29 and 32. Set temp. ¼ sec. cor. Intersect N. and S. line, 28 lks. S. of the cor. of secs. 28, 29, 32 and 33, marked on brass cap, 1913; Thence I run S.89°51'W., on a true line, bet. secs. 29 and 32. Over rolling land, Road, brs. N.60°E., and S.60°W. Set an iron post, 3 ft. long, 1 in. ⁱⁿdiam, 26 ins. in the ground, for ¼ sec. cor., marked on brass cap, 1913; S29 in N. and S32 in S. half; And raise a mound of stone, 2 ft. base, 1½ ft. high, N. of cor. Pits impracticable. <i>No bearing trees within limits.</i> The cor. of secs. 29, 30, 31 and 32. Land, rolling. Soil, gravelly, clay and gumbo, 2nd and 3rd rate. No timber, or undergrowth.</p>
<p>40.00 163.54 6.00 10.55 17.50 33.00 36.75 45.55 51.65 69.80 91.10 113.40 115.55 123.54 163.54</p>	<p>N.89°57'W., on a random line, bet. secs. 30 and 31. Set temp. ¼ sec. cor. Intersect W. bdy of T₂₄, 5 lks. N. of the ^{old} cor. of secs. 25, 30, 31 and 36, which is an iron post, 3 ins. ⁱⁿdiam, 12 ins. above ground, marked ^{on brass cap} and witnessed as described by the Surveyor General. Thence I run S.89°58'E., on a true line, bet. secs. 30 and 31. Over rolling land, through scattering timber. Leave timber, brs. N. and S. Draw, course NW. Low spur ridge, brs. N. and S. Desc. NE. slope, 40 ft. Foot of desc., thence over rolling land. Trail, brs NW. and SE. Wash, 115 lks. wide, 4 ft. deep, course NW. Wash, 25 lks. wide, 3 ft. deep, course S.70 W. Road, brs. N. and S. Tank brs. S. about 18 chs. dist. Wash, 3 lks. wide, 1 ft. deep, course N.60°W. Road, brs. NE. and SW. Wash, 3 lks. wide, 10 ins. deep, course SW. Trail, brs NE. and SW. Set an iron post, 3 ft. long, 1 in. ⁱⁿdiam, 26 ins. in the ground, for ¼ sec. cor., marked on brass cap, 1913; S30 in N. and S31 in S. half; And raise a mound of stone, 2 ft. base, 1½ ft. high, N. of cor. Pits impracticable. <i>No bearing trees within limits.</i> The cor. of secs. 29, 30, 31 and 32. Land, rolling. Soil, gravelly, clay and gumbo, 2nd and 3rd rate. Timber, scattering cedar.</p>

NOTE - At this corner, I set off 18°8'N., on the decl. arc, and

Subdivision of T. 24 N., R. 11 W.

Chains.

at noon — — — — —, I observe the sun on the meridian, the resulting lat. is $35^{\circ}26'N.$, which is slightly less than the correct lat.

40.00 $N.0^{\circ}3'W.$, bet. secs. 29 and 30.
Over rolling land, draining W.
Set an iron post, 3 ft. long, 1 in. ⁱⁿdiam, 26 ins. in the ground, for $\frac{1}{4}$ sec. cor., marked on brass cap, 1913;
 $\frac{1}{4}$ S30 in W. and
S29 in E. half;
And raise a mound of stone, 2 ft. base, $1\frac{1}{2}$ ft high, W. of cor. Pits impracticable. *No bearing trees within limits.*

42.60 Trail, brs. NE. and SW.
61.60 Trail, brs. E. and W.
70.00 Trail, brs. NW. and SE.
78.30 Road, brs. NE. and SW.
80.00 Set an iron post, 3 ft. long, 2 ins. ⁱⁿdiam, 24 ins. in the ground, for cor. of secs. 19, 20, 29 and 30, marked on brass cap, 1913;
T24N R11W in N. half;
S19 in NW.,
S20 in NE.,
S29 in SE., and
S30 in SW. quadrant;
And raise a mound of stone, 2 ft. base, $1\frac{1}{2}$ ft. high, W. of cor. Pits impracticable. *No bearing trees within limits.*
Land, rolling.
Soil, clay and gumbo, gravelly, 2nd and 3rd rate.
No timber, or undergrowth.

40.00 $N.89^{\circ}51'E.$, on a random line, bet. secs. 20 and 29.
Set temp. $\frac{1}{4}$ sec. cor.
80.02 Intersect N. and S. line, 2 lks N. of the cor. of secs. 20, 21, 28 and 29,

Thence I run
S. $89^{\circ}52'W.$, on a true line, bet. secs. 20 and 29.
Over gently rolling land, slopes W.
40.01 Set an iron post, 3 ft. long, 1 in. ⁱⁿdiam, 26 ins. in the ground, for $\frac{1}{4}$ sec. cor., marked on brass cap, 1913;
 $\frac{1}{4}$ S20 in N. and
S29 in S. half;
And raise a mound of stone, 2 ft. base, $1\frac{1}{2}$ ft. high, N. of cor. Pits impracticable. *No bearing trees within limits.*

53.20 Dim road, brs. NW. and SE.
78.15 Road, brs. NE. and SW.
80.02 The cor. of secs. 20, 19, 29 and 30.
Land, rolling.
Soil, clay and gumbo, 2nd and 3rd rate.
No timber or undergrowth.

40.00 $N.89^{\circ}58'W.$, on a random line, bet. secs. 19 and 30.
Set temp. $\frac{1}{4}$ sec. cor.
183.47 Intersect the W. bdy. of the Tp., 28 lks. N. of the ^{old} cor. Of secs. 19, 24, 25 and 30, which is an iron post, 3 ins. ⁱⁿdiam, 12 ins. above ground, marked ^{on} BRASS CAP and witnessed as described by the Surveyor General.

Thence I run,
N. $89^{\circ}56'E.$, on a true line, bet. 19 and 30.
Over rolling land.

2.10 Trail, brs. NW. and SE.
5.10 S. end of dam, brs. N. $5^{\circ}E.$; below tank.
6.50 Tank brs. N. 2 chs. dist.,
21.50 Wash, 45 lks. wide, 1 ft. deep, course N. $80^{\circ}W.$ Enter level land.

62.10 Trail, brs. N. $80^{\circ}W.$ and S. $80^{\circ}E.$
72.00 Road, brs. N. $15^{\circ}E.$ and S. $15^{\circ}W.$
79.50 Leave level land, thence over rolling land.

Chains.
 123.47 Set an iron post, 3 ft. long, 1 in. in diam., 26 ins. in the ground, for $\frac{1}{4}$ sec. cor., marked on brass cap, 1913; $\frac{1}{4}$ S19 in N. and S30 in S. half;
 And raise a mound of stone, 2 ft. base, $1\frac{1}{2}$ ft. high, N. of cor. Pits impracticable. *No bearing trees within limits.*
 150.50 Trail, brs. NW. and SE.
 163.47 The cor. of secs. 19, 20, 29 and 30.
 Land, rolling.
 Soil, clay and gumbo, gravelly, 2nd and 3rd rate.
 No timber or undergrowth.

W.B.K.

H.N.B.

May 14, 1913, At 7 hrs. 54 m. a.m., l.m.t., I set off $\sqrt{35^{\circ}27'}$ N. on the lat. arc; $\sqrt{18^{\circ}36'}$ N. on the decl. arc; and determine a meridian with the solar, at the cor. of secs. 19, 20, 29 and 30,
 Thence I run,
 $\sqrt{N. 0^{\circ}3'}$ W., bet. sections 19 and 20.
 Over rolling land.
 31.20 Trail, brs. E. and W.
 40.00 Set an iron post, 3 ft. long, 1 in. in diam., 26 ins. in the ground, for $\frac{1}{4}$ sec. cor., marked on brass cap, 1913; $\frac{1}{4}$ S19 in W. and S20 in E. half;
 And raise a mound of stone, 2 ft. base, $1\frac{1}{2}$ ft. high, W. of cor. Pits impracticable. *No bearing trees within limits.*
 58.00 Head of draw, course W. Asc. SW. slope, 56 ft.
 67.00 Low spur ridge, extends 4 chs. W. Thence over rolling land.
 80.00 Set an iron post, 3 ft. long, 2 ins. in diam., 24 ins. in the ground, for cor. of secs. 17, 18, 19 and 20. marked on brass cap, 1913;
 T24N R11W in N. half;
 S18 in NW.,
 S17 in NE.,
 S20 in SE. and
 S19 in SW. quadrant;
 And raise a mound of stone, 2 ft. base, $1\frac{1}{2}$ ft. high, W. of cor. Pits impracticable. *No bearing trees within limits.*
 Land, rolling.
 Soil, gravelly, 2nd and 3rd rate.
 No timber or undergrowth.

40.00 N. $89^{\circ}52'E.$, on a random line, bet. secs. 17 and 20.
 80.00 Set temp. $\frac{1}{4}$ sec. cor.
 Intersect N. and S. line, 12 lks. N. of the cor. of secs. 16, 17, 20, and 21,
 Thence I run,
 $\sqrt{S89^{\circ}57'}$ W., on a true line, bet. secs. 17 and 20.
 Over rolling, Sh., slope, ascending gradually.
 26.00 Low ridge, brs. NE. and SW. Desc. NW. slope.
 40.00 Set an iron post, 3 ft. long, 1 in. in diam., 26 ins. in the ground, for $\frac{1}{4}$ sec. cor., marked on brass cap, 1913; $\frac{1}{4}$ S17 in N. and S20 in S. half;
 And raise a mound of stone, 2 ft. base, $1\frac{1}{2}$ ft. high, N. of cor. Pits impracticable. *No bearing trees within limits.*
 80.00 The cor. of secs. 17, 18, 19 and 20.
 Land, rolling.
 Soil, sandy loam, 2nd and 3rd rate.
 No timber or undergrowth.

Chains.

40.00 S. 89°56' W., on a random line, bet. secs. 18 and 19.
Set temp. $\frac{1}{4}$ sec. cor.

163.20 Intersect W. bdy. of Tp., 28 lks. S. of the ^{old} cor. of
secs. 13, 18, 19 and 24, which is an iron post, 3
ins. in diam, 12 ins. above ground, marked ^{on} ^{brass} cap, and witnessed
as described by the Surveyor General.

Thence I run

S. 89°58' E. on a true line bet. secs. 18 and 19.
Over rolling land.

1.20 Draw, 50 lks. wide, course NW.

9.20 Low ridge, brs. N. and S.

31.20 Draw, 1 ch. wide, course NW.

51.20 Trail, brs. N. and S.

55.20 Low ridge, brs. NW. and SE.

65.00 Low ridge, brs. N. and S.

75.00 Low ridge, brs. NW. and SE.

87.07 Draw, 1 ch. wide, course NW.

91.00 Low ridge, brs. NW. and SE.

99.20 Road, brs. N. and S.

103.20 Low ridge, brs. NW. and SE.

105.00 Draw, 50 lks. wide, course N.

123.20 Set an iron post, 3 ft. long, 1 in. in diam, 26 ins. in
the ground, for $\frac{1}{4}$ sec. cor., marked on brass cap, 1913;
 $\frac{1}{4}$ S18 in N. and
S19 in S. half;
And raise a mound of stone, 2 ft. base, 1 $\frac{1}{2}$ ft. high,
N. of cor. Pits impracticable. *No bearing trees within limits.*

124.45 Old road, brs. NW. and SE.

145.20 Trail, brs. NE. and SW.

163.20 The cor. of secs. 17, 18, 19 and 20.
Land, level and rolling.
Soil, gravelly loam; subsoil hard pan at 1 ft. depth.
No timber or undergrowth. ✓

NOTE - At this corner I set off 18°38' N. on the decl. arc;
and at home, ~~.....~~, I observe the
sun on the meridian. The resulting lat. is 35°28' N.,
which is slightly higher than the correct lat.

N. 0° 3' W., bet. secs. 17 and 18.
Over rolling land.

6.00 Draw, 2 chs. wide, course W. Asc. SW. slope, 45 ft.

16.00 Ridge, brs. E. and W. Desc. slight NW. slope.

21.00 Draw, 50 lks. wide, course W. Asc. S. slope,

25.00 Low ridge, brs. E. and W. Desc. N. slope 50 ft.

30.00 Foot of desc.

31.50 Center of draw, 3 chs. wide, course W.

33.00 Asc. S. slope, 35 ft.

37.00 Low ridge, brs. E. and W. Thence over rolling land.

40.00 Set an iron post, 3 ft. long, 1 in. in diam, 26 ins. in
the ground, for $\frac{1}{4}$ sec. cor., marked on brass cap, 1913;
 $\frac{1}{4}$ S18 in W. and
S17 in E. half; from which
A cedar, 5 ins. in diam, brs. S. 70° E., 188 lks. dist.,
marked $\frac{1}{4}$ S17 BT.
A cedar, 12 ins. in diam, brs. S. 62 $\frac{1}{2}$ ° W., 192 lks. dist.,
marked $\frac{1}{4}$ S18 BT.

42.00 Asc. S. slope, 35 ft.

46.00 Ridge, brs. E. and W. Desc. NW. slope 30 ft.

50.00 End of desc. Thence along W. slope.

62.45 Old road, brs. NW. and SE.

70.00 Asc. SW. slope 45 ft.

74.50 Spur ridge, brs. E. and W. Extends 3 chs. W.

76.65 Draw, 50 lks. wide, course NW.

78.90 Wash, 10 lks. wide, course W.

78.65 Wash, 15 lks. wide, course W.

80.00 Set an iron post, 3 ft. long, 2 ins. in diam, 24 ins. in
the ground, for cor. of secs. 7, 8, 17 and 18,
marked on brass cap, 1913;
T24N R11W in N. half;
S7 in NW.,
S8 in NE.,

	<p>S17 in SE. and S18 in SW. quadrant; from which A pinion, 6 ins. in diam., brs. S. 62$\frac{1}{4}$° E., 138 lks. dist., marked T24N R11W S17 BT. No other trees within limits. Raise a mound of stone, 2 ft. base, 1$\frac{1}{2}$ ft. high, W. of cor. Pits impracticable. Land, level and rolling. Soil, gravelly loam, 3rd rate; subsoil, hard pan at 1 ft. depth. No timber or undergrowth.</p>
40.00 79.85	<p>N. 89° 57' E., on a random line, bet. secs. 8 and 17. Set temp. $\frac{1}{4}$ sec. cor. Intersect N. and S. line, 7 lks. S. of the cor. of secs. 8, 9, 16 and 17,</p>
7.00 38.00 39.925	<p>Thence I run, S. 89° 54' W., on a true line, bet. secs. 8 and 17. Asc. SE. slope, 35 ft., through scattering timber and dense undergrowth. Ridge, brs. NW. and SE. Desc. NW. slope 615 ft. Foot of desc. Thence along S. slope. Set an iron post, 3 ft. long, 1 in. in diam., 26 ins. in the ground, for $\frac{1}{4}$ sec. cor., marked on brass cap, 1913; $\frac{1}{4}$S8 in N. and S17 in S. half; from which A pinion, 6 ins. in diam., brs. N. 5° W., 147 lks. dist., marked $\frac{1}{4}$S8 BT. A pinion, 8 ins. in diam., brs. S. 38$\frac{1}{4}$° E., 98 lks. dist., marked $\frac{1}{4}$S17 BT.</p>
44.15 46.00 51.85 52.85 55.85 61.85 67.55 69.35 78.00 79.85	<p>Gulch, 15 lks. wide, course S. Gulch, 15 lks. wide, course S. Gulch, 20 lks. wide, course S. Ridge, brs. N. and S. Desc. SW. slope 60 ft. Gulch, 25 lks. wide, course S. Asc. slight SE. slope. End of asc. Desc. W. slope 65 ft. Gulch, 10 lks. wide, course SW. Desc. SW. slope, 90 ft. Leave timber, brs. NW. and SE. The cor. of secs. 7, 8, 17 and 18. Land, rolling and mountainous. Soil, rocky, 4th rate. Timber, scrub cedar and pinion. Undergrowth, buckbrush and scrub oak.</p>
40.00 163.18	<p>N. 89° 58' W., on a random line, bet. secs. 7 and 18. Set temp. $\frac{1}{4}$ sec. cor. Intersect W. bdy. of Tp., 10 lks. N. of the cor. of secs. 7, 12, 13 and 18, which is an iron post, 3 ins. in diam., 12 ins. above ground, marked ^{ON BRASS CAP} and witnessed as described by the Surveyor General.</p>
5.20 21.20 83.18 95.85 101.20 118.00 121.40 123.18	<p>Thence I run, East, on a true line, bet. secs. 7, and 18. Over rolling land. Desc. slight NE. slope 50 ft. Centre of draw, 2 chs. wide, course NW. Head of draw, 1 ch. wide, course SW. Asc. W. slope 100 ft. Cherokee Station, brs. N. 51° 27' W. Ridge, brs. N. and S. Desc. NE. slope, 90 ft. Draw, 4 chs. wide, course NE. Road, brs. N. and S. Set an iron post, 3 ft. long, 1 in. in diam., 26 ins. in the ground, for $\frac{1}{4}$ sec. cor., marked on brass cap, 1913; $\frac{1}{4}$S7 in N. and S18 in S. half; And raise a mound of stone, 2 ft. base, 1$\frac{1}{2}$ ft. high, N. of cor. Pits impracticable.</p>
125.90 129.10	<p>Old road, brs. NW. and SE., in wash, 20 lks. wide, course NW. Asc. W. slope, 40 ft.</p>

Chains.

131.80 Rocky cliff, 20 ft. high, brs. N. and S.
 131.90 Top of cliff. Thence over rolling land.
 150.20 Wash, 15 lks. wide, course SW.
 163.18 The cor. of secs. 7, 8, 17 and 18.
 Land, rolling and hilly.
 Soil, 3rd and 4th rate.
 No timber or undergrowth.

May 14, 1913.

May 15, 1913. At 8 hrs. 13 m. a.m., l.m.t., I set off
 35° 28½' N. on the lat. arc; 18° 50' N. on the decl.
 arc; and determine a meridian with the solar, at the cor.
 of secs. 7, 8, 17 and 18,

Thence I run,
 N. 0° 3' W., bet. secs. 7 and 8.
 Asc. SW. slope, through scattering timber.

13.65 Foot of cliff, 120 ft. high.
 14.00 Top of cliff, brs. NW. and SE., 280 ft. above cor.
 Thence along W. slope of mountain.
 17.30 S. side of box canyon, 100 ft. deep.
 20.30 N. side of canyon; thence along SW. slope.
 22.00 Slope changes to W.
 24.30 Wash, 30 lks. wide, 2 ft. deep, course W.
 28.00 Gulch, 60 lks. wide, 4 ft. deep, course W.
 31.00 Gulch, 50 lks. wide, 6 ft. deep, course W.
 40.00 Set an iron post, 3 ft. long, 1 in. diam., 26 ins. in
 the ground, for ¼ sec. cor., marked on brass cap, 1913;
 S7 in W. and
 S8 in E. half;
 And raise a mound of stone, 2 ft. base, 1½ ft. high,
 W. of cor. Pits impracticable. *No bearing trees within limits.*
 44.00 Desc. NW. slope 50 ft.
 47.00 Head of gulch, 50 lks. wide, course W. Thence along W.
 slope.
 52.00 Desc. NW. slope, 40 ft.
 56.00 Gulch, 20 lks. wide, course W. Asc. SW. slope 30 ft.
 58.25 Ridge, brs. E. and W. Desc. NW. slope 20 ft.
 60.00 Gulch, 20 lks. wide, course W. Asc. SW. slope 30 ft.
 63.80 Ridge, brs. E. and W. Desc. NW. slope 30 ft.
 66.00 Gulch, 15 lks. wide, course W. Asc. SW. slope, 20 ft.
 68.00 End of asc. Thence along W. slope.
 76.00 Desc. NW. slope, 60 ft.
 78.60 Gulch, 10 lks. wide, course NW. Thence along W. slope.
 80.00 Set an iron post, 3 ft. long, 2 ins. diam., 24 ins. in
 the ground, for cor. of secs. 5, 6, 7 and 8 marked
 on brass cap, 1913;
 T24N R11W in N. half;
 S6 in NW.,
 S5 in NE.,
 S8 in SE. and
 S7 in SW. quadrant; from which,
 A pinion limb, 7 ins. diam., brs. N. 39° E., 79 lks.
 dist., marked T24N R11W S5 BT.
 A cedar, 6 ins. diam., brs. S. 41½° E., 40 lks. dist.,
 marked T24N R11W S8 BT.
 A pinion, 8 ins. diam., brs. S. 59° W., 180 lks. dist.,
 marked T24N R11W S7 BT.
 A pinion, 10 ins. diam., brs. N. 17½° W., 94 lks. dist.,
 marked T24N R11W S6 BT.
 Land, mountainous.
 Soil, rocky, 4th rate.
 Timber, scrub cedar and pinion.
 Undergrowth, buck brush and scrub oak. H.N.B.

W.D.M. N. 89° 54' E., on a random line, bet. secs. 5 and 8.

40.00 Set temp. ¼ sec. cor.
 79.96 Intersect N. and S. line, 5 lks. S. of the cor. of secs.
 4, 5, 8 and 9,
 Thence I run,
 S. 89° 52' W., on a true line, bet. secs. 5 and 8.
 Over rolling land; sloping N., through scattering timber
 and undergrowth.

4.00	Draw, course N. Asc. rocky, NE. slope 575 ft.
5.00	Enter heavy timber and dense undergrowth, brs. N. and S.
39.98	Set an iron post, 3 ft. long, 1 in. diam, 26 ins in the ground, for $\frac{1}{4}$ sec. cor., marked on brass cap, 1913; $\frac{1}{4}$ S5 in N. and S8 in S. half; from which A cedar, 14 ins diam, brs. N. 71 E., 17 lks. dist., marked $\frac{1}{4}$ S5 BT. A pinion, 8 ins diam, brs. S. 44 E., 81 lks. dist., marked $\frac{1}{4}$ S8 BT.
50.00	Top of high, rocky, point. Desc. steep, rocky, NW. slope 600 ft. Leave heavy, enter scattering timber, brs. N. and S.
79.96	The cor. of secs. 5, 6, 7, and 8. Land, mountainous. Soil, rocky, 4th rate. Timber, cedar and pinion. Undergrowth, scrub oak and buck brush.
<i>W.B.K.</i>	
<i>H.N.B.</i>	
40.00	West, on a random line, bet. secs. 6 and 7. Set temp. $\frac{1}{4}$ sec. cor.
163.00	Intersect W. bdy. of Tp., 14 lks. N. of the cor. of secs. 1, 6, 7 and 12, which is an iron post, 3 ins diam, 12 ins. above ground, marked ^{BRASS CAP} and witnessed as described by the Surveyor General. Thence I run, N. 89° 57' E., on a true line, bet. secs. 6 and 7. Over level land.
1.35	Road, Hackberry to Peach Springs, brs. NNE. and SSW.
11.40	Five strand, wire fence, on Railroad right of way, brs. S. 33° 55' W. and N. 33° 55' E.
13.80	Ditch, 5 lks. wide, course S. 33° 55' W.
14.25	Telegraph line, brs. S. 33° 55' W. and N. 33° 55' E.
14.80	Side track, brs. S. 33° 55' W. and N. 33° 55' E.
15.04	Main line A. T. & S. F. R. R., brs. N. 33° 55' E. and S. 33° 55' W.
15.80	Ditch, 8 lks wide, course N. 33° 55' E.
16.73	Telegraph line, parallel to Railroad track.
18.70	Five strand, wire fence on Railroad right of way, parallel to Railroad track.
25.35	Cherokee Railroad station brs. S. 53° 43' W.
39.00	Leave level land, thence over rolling land.
123.00	Set an iron post, 3 ft. long, 1 in. diam, 26 ins. in the ground, for $\frac{1}{4}$ sec. cor., marked on brass cap, 1913; $\frac{1}{4}$ S6 in N. and S7 in S. half; And raise a mound of stone, 2 ft. base, 1 1/2 ft. high, N. of cor. Pits impracticable. <i>No bearing trees within limits.</i>
134.00	Old road, brs. NE. and SW.
135.40	Road, brs. NE. and SW. Asc. NW. slope, 110 ft.
143.00	Enter timber, brs. N. and S.
159.00	End of asc. N. end of spur ridge. Desc. NE. slope, 35 ft.
161.00	Gulch, course NW. Asc. W. slope 30.
163.00	The cor. of secs. 5, 6, 7 and 8. Land, rolling and hilly. Soil, rocky and gravelly clay and gumbo, 2nd to 4th rate. Timber, cedar and pinion. Undergrowth, scrub oak and buck brush.
7.50	N. 0° 3' W., on a true line, bet. secs. 5 and 6. Along, W. slope, through scattering timber.
10.40	Gulch, 5 lks. wide, course SW. Asc. SE. slope, 25 ft.
14.00	Ridge, brs. E. and W. Desc. NW. slope, 70 ft.
14.00	Gulch, 20 lks. wide, course NW. Thence along W. slope.
16.00	Gulch, 10 lks. wide, course W.
20.00	Ridge, brs. E. and W.
30.00	Leave timber, brs. NE. and SW. Thence over level land.
36.94	Intersect the S. bdy. of the Hualpai Indian Reservation, 184 lks. W. of the 53 1/2 mile cor., which is a limestone 6 X 10 X 8 ins. above ground, marked and witnessed as described by the Surveyor General.

Subdivision of T. 24 N., R. 11 W.

Chains.

At the point of intersection, I set an iron post, 3 ft. long, 2 ins. diam., 24 ins. in the ground, for closing cor. of secs. 5 and 6, marked on brass cap, 1913; CC, N. of center;
 H I R in N. and
 T24N R11W in S. half;
 S5 in SE. and
 S6 in SW. quadrant;
 And raise a mound of stone, 2 ft. base, 1½ ft. high, S. of cor. Pits impracticable. *No bearing trees within limits.*
 Land, rolling and hilly.
 Soil, rocky, 3rd and 4th rate.
 Timber, cedar and pinion.
 Undergrowth, buck brush and scrub oak.

H.N.B.
May 15, 1913.

General Description.

The Tp. is mountainous in the North, Center, and South East, and rolling in the West and South West. The mountains are covered with scrub cedar and pinion trees, while the plains are mostly barren.
 The soil on the plains is sandy loam and gumbo, 2nd to 4th rate; on the mountains, rocky 4th rate.
 There is a spring in sec. 9, and a tank in sec. 7, ^{sec. 19} and sec. 31. Cherokee station is in sec. 7. There are no settlers.

William B. Kimmel.

U. S. Surveyor.

Samuel M. ...

U. S. Transitman.

Boundaries of T. 24 N., R. 11 W.

Latitudes, Departures and Closing Errors.

Line designated.	True Bearing	Dist.	Latitudes		Departures	
			N. Chains.	S. Chains.	E. Chains.	W. Chains.
South boundary	N. 89° 57' W.	563.42	.49	.		563.42
West "	North	436.80	436.80			
North " (S. bdy. Hualpai Ind. Res.)	East	563.70			563.70	
East boundary	South	436.77		436.77		
Convergency.					.56	
Totals.			437.29	436.77	564.26	563.42
			436.77		563.42	
Error in lat.			.52		.84	

Error in Dep. →

William B. Kimmel.

U. S. Surveyor.

Sam Broadstreet

U. S. Transitman.

for FINAL OATH OF UNITED STATES SURVEYOR.

see Book "L "

(Subdivision of E 1/2 of T 25 N., R.17 W.) & TRANSITMAN

I, _____, U. S. Surveyor, do solemnly swear that, in pursuance of special instructions received from the U. S. Surveyor General for _____ bearing date of the _____ day of _____, 191 _____, I have well, faithfully and truly, in my own proper person, and in strict conformity with said instructions, the Manual of Surveying Instructions, and the laws of the United States, surveyed all those parts or portions of _____ of the _____ Meridian, in the State of _____, which are represented in the foregoing field notes as having been executed by me, and under my direction; and I do further solemnly swear that all the corners of said survey have been established and perpetuated in strict accordance with the Manual of Surveying Instructions, and the special written instructions of the U. S. Surveyor General for _____, and in the specific manner described in the field notes, and that the foregoing are the original field notes of such survey.

U. S. Surveyor.

Subscribed by said _____, and sworn to before me }
 this _____ day of _____, 191 _____ }



APPROVAL.

OFFICE OF THE UNITED STATES SURVEYOR GENERAL,

Phoenix Arizona OCT 5 1914

The foregoing field notes of the survey of _____
 the Subdivision lines of _____
 Township No.24 North, Range No.11 West
 of the Gila and Salt River Base and Meridian, Arizona

executed by William B. Kimmel, U.S. Surveyor & H.N. Bradstreet, U.S. Transitman
 under ~~the~~ ^{their} special instructions dated October 18 1912 for Group 244, having been critically examined, and the necessary corrections and explanations made, the said field notes, and the surveys they describe, are hereby approved.

Frank S. Ingalls
 U. S. Surveyor General.
 of Arizona

I certify that the foregoing transcript of the field notes of the above described surveys in _____, has been correctly copied from the original notes on file in this office.

U. S. Surveyor General.