

2717

4-679

Book "E"

BOOK 2717

Subdivisions

orig. 1
SEP 2- 1914

FIELD NOTES

OF THE SURVEY OF

PART OF THE

Subdivision lines of

Township 9 South Range 24 East

Of the Gila and Salt River Base and Meridian,

In the State of Arizona

EXECUTED BY

Thomas B. Matthews,

In the capacity of U. S. Surveyor, under instructions dated September 24, 1912, issued by the United States Surveyor General to govern surveys included in Group No. 22, which were approved by the Commissioner of the General Land Office, October 3, 1912, pursuant to authority contained in the Act of Congress dated August 23, 1912.

Survey commenced April 22, 1913

Survey completed April 22, 1913

BOOK 2717

INDEX DIAGRAM.

Township *9 South*, Range *24 East*

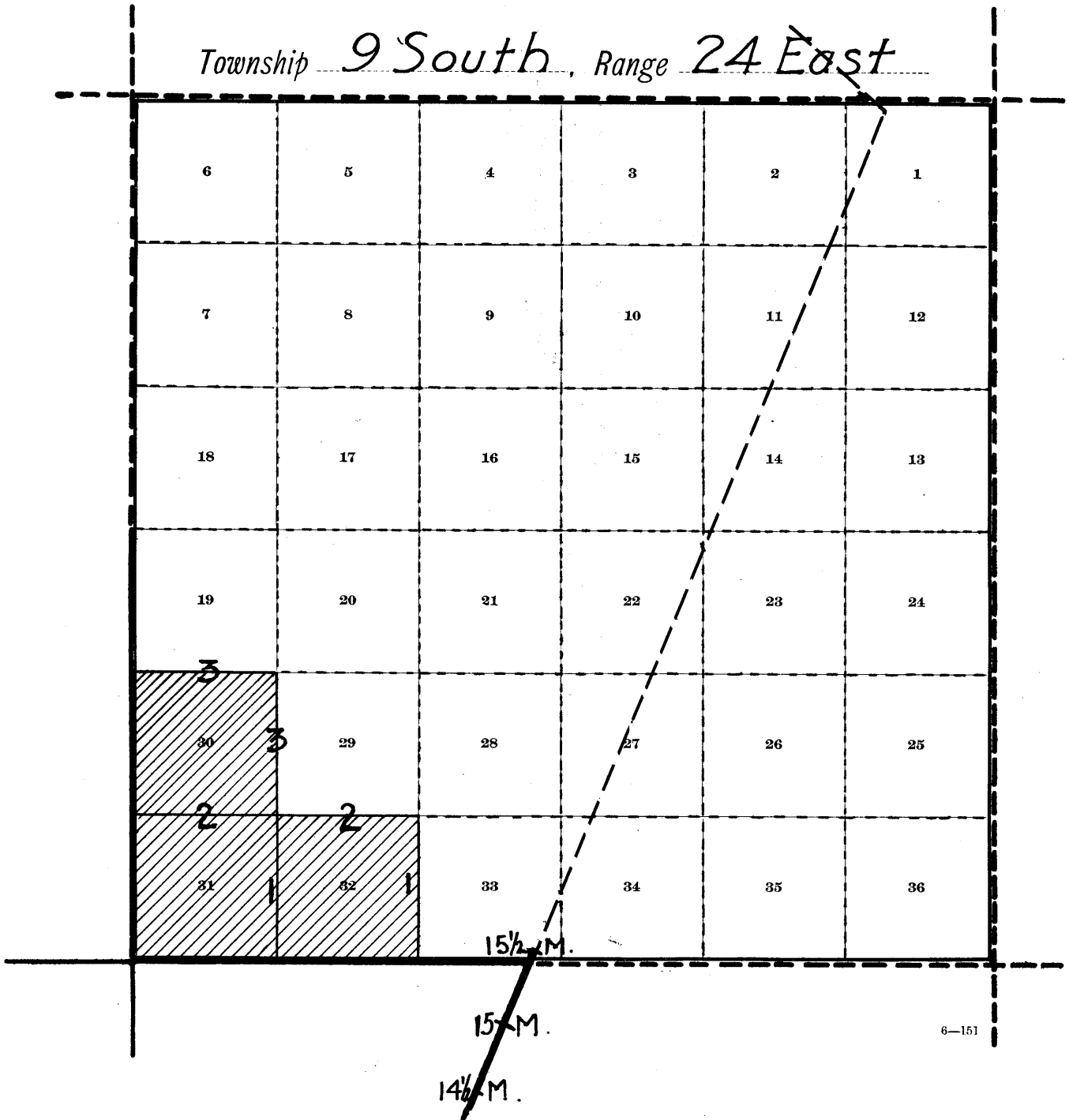

6-151



Notes in Book "D"
 " " " "C"
 " " " "A"

Unsurveyed Lines
 Pages of this book indexed
 in Red figures

Hatched portion of diagram indicates
 Subdivisions surveyed under this group.

SUBDIVISION OF TOWNSHIP 9 SOUTH, RANGE 24 EAST

Survey commenced April 22nd, 1913 and executed by Thomas B. Matthews, U. S. Surveyor, with Young & Sons Light Mountain Transit No. 8430, previously described in Bks. A, B & C. I examine adjustment of the transit and find them to be correct, and know from recent test of the solar apparatus, by comparing its indication resulting from solar observations, made during a.m. and p.m. hours, with a meridian established by observation on Polaris, at elongation, that the instrument is in satisfactory adjustment.

7 h. 30 m., a.m. l.m.t., I set off $12^{\circ} 08\frac{1}{2}'$ N. on decl. arc, $32^{\circ} 35\frac{1}{2}'$ on lat. arc and determine a mer. with the solar at the cor. of secs. 4, 5, 32 & 33, on S. bdy. of Tp., previously established by me, & described in Book D.

Thence I run
N. $0^{\circ} 02'$ W. bet. secs. 32 & 33
Over rolling rocky land, through mesquite brush 2 to 5 ft. high

12.00 Rocky wash 50 lks. wide, 10 ft. deep, course S.W.
27.00 Dry rocky wash 1 ch. wide, 15 lks. deep, course S.W.
35.00 Dry rocky wash 1 ch. wide, 15 ft. deep, course S. 60° W.
40.00 Set an iron post 3 ft. long, 1 in. in dia., 26 ins. in the ground for $\frac{1}{4}$ sec. cor., with a brass cap marked $\frac{1}{4}$ S 32 in W., S 33 in E. & 1913 in S. half, from which
An oak 20 ins. in dia. bears S. 20° W. 247 lks. dist. marked $\frac{1}{4}$ S 32 B T
No more trees in dist. Pits impracticable.
Raise mound of stone 3 ft. base 3 ft. high W. of cor.
44.50 Rocky wash 25 lks. wide, 6 ft. deep, course S.W.
55.00 Dry rocky wash 1 ch. wide, 15 ft. deep, course S.W.
80.00 Set an iron post 3 ft. long, 2 ins. in dia., 24 ins. in the ground for cor. of secs. 28, 29, 32 & 33, with a brass cap marked T 9 S R 24 E in N. & 1913 in S. half, S 29 in N.W., S 28 in N.E., S 33 in S.E. & S 32 in S.W. quadrant.
Raise mound of stone 3 ft. base 3 ft. high W. of cor. Pits Land rolling. (impracticable.)
Soil rocky.
Scattering grass, mesquite brush 3 to 5 ft. high.
Scattering trees around $\frac{1}{4}$ sec. cor.

From the cor. of secs. 5, 6, 31 & 32 on S. bdy. of Tp. previously established by me, and described in Book "D."
I run
N. $0^{\circ} 03'$ W. bet. secs. 31 & 32
Over slightly rolling land through mesquite brush & scattering yuccas 3 to 8 ft. high

4.00 Dry wash 50 lks. wide, 4 ft. deep, course West.
12.00 Dry wash 10 lks. wide, 3 ft. deep, course West.
13.00 Wagon road, bears E. & W.
14.00 Dry wash 50 lks. wide, 15 ft. deep, course S. 60° W.
18.00 Wagon road, bears E. & W.
23.00 Dry wash 50 lks. wide, 2 ft. deep, course S. 60° W.
35.00 Rocky wash 1 ch. wide, 6 ft. deep, stream good cold clear water 10 lks. wide, 1 ft. deep, courss S. 60° W.
40.00 Set an iron post 3 ft. long 1 in. in dia., 26 ins. in the ground for $\frac{1}{4}$ sec. cor., with a brass cap marked $\frac{1}{4}$ S 31 in W., S 32 in E. & 1913 in S. half, from which
R sycamore 20 ins. in dia. bears S. $63\frac{1}{2}^{\circ}$ E. 257 lks. dist. marked $\frac{1}{4}$ S 32 B T
No more trees in dist. Pits impracticable.
Raise mound of stone 3 ft. base 3 ft. high W. of cor.
41.50 Wash 1 ch. wide, 3 ft. deep, stream of clear cold water, 10 lks. wide, 1 ft. deep, course West.
60.50 Dry wash 15 lks. wide, 3 ft. deep, course S. 60° W.
75.25 Dry wash 1 ch. wide, 6 ft. deep, course West.
79.00 Dry wash 75 lks. wide, 10 ft. deep, course West.
80.00 Set an iron post 3 ft. long, 2 ins. in dia., 24 ins. in ground for cor. of secs. 29, 30, 31 & 32, with a brass cap marked T 9 S R 24 E in N. & 1913 in S. half, S 30 in N.W., S 29 in N.E., S 32 in S.E. & S 31 in S.W. quadrant.
Dig pits 18 x 18 x 12 ins. in each sec. $5\frac{1}{2}$ ft. dist. & raise mound of earth 4 ft. base 2 ft. high W. of cor.

Partial
SUBDIVISION OF TOWNSHIP 9 SOUTH, RANGE 24 EAST

- Land level & rolling.
Soil dark sandy loam, 2 to 3 ft. deep, medium to coarse texture.
Mesquite brush 3 to 5 ft. high, yuccas 3 to 8 ft. high.
Scattering grass.
Scattering timber along creek close to $\frac{1}{4}$ sec. cor.
-
- Thence I run
East on random line bet. secs. 29 & 32
Over rolling rocky land, through scattering mesquite brush 3 to 4 ft. high
40.00 Set temp. $\frac{1}{4}$ sec. cor.
79.98 Fall 3 lks. S. of cor. of secs. 28, 29, 32 & 33, hereinbefore described.
- Thence I run
S. $89^{\circ} 59'$ W. on true line bet. secs. 29 & 32
Descending W. slope over rolling, rocky land
4.00 Dry rocky wash 50 lks. wide, 10 ft. deep, course S. 80° W.
24.00 Dry rocky wash 50 lks. wide, 6 ft. deep, course S 30° W.
24.00 Wash 20 lks. wide, 6 ft. deep, stream good clear water, 5 lks. wide, 1 ft. deep, course S. 60° W.
31.00 Creek 75 lks. wide, 6 ft. deep, course S. 30° W., stream clear cold water 25 lks. wide, 2 ft. deep.
38.50 Dry wash 50 lks. wide, 3 ft. deep, course S. 60° W.
39.99 Set an iron post 3 ft. long, 1 in. in dia, 26 ins. in the ground for $\frac{1}{4}$ sec. cor., with a brass cap marked $\frac{1}{4}$ S 29 in N. & S 32 1913 in S. half. Pits impracticable.
41.00 Raise mound of stone 3 ft. base 3 ft. high N. of cor.
68.00 Dry wash 60 lks. wide, 10 ft. deep, course S. 30° W.
79.00 Rocky wash 1 ch. wide, 10 ft. deep, course N. 60° W.
79.00 Dry wash 75 lks. wide, 6 ft. deep, course S. 60° W.
79.98 The cor. of secs. 29, 30, 31 & 32, hereinbefore described.
- Land rolling
Soil very rocky
Scattering mesquite brush 3 to 5 ft. high, short grass
Scattering timber along banks of creek
At the above described cor. I set off $12^{\circ} 12'$ N. on decl. arc and at 11 h. 58 m. 34 s., a.m., l.m.t. observe the sun on the mer. and obtain a reading of $32^{\circ} 36\frac{1}{2}'$ on lat. arc.
-
- The cor. of secs. 25, 30, 31 & 36, being plainly visible, I run
West on true line for said cor. bet. secs. 30 & 31
Over slightly rolling land, through mesquite brush 3 to 5 ft. high
19.50 Wagon road, bears N. 30° E., S. 30° W.
30.00 Dry wash 20 lks. wide, 2 ft. deep, course S. 30° W.
35.00 Dry wash 1 ch. wide, 15 lks. deep, course S. 60° W.
40.00 Set an iron post 3 ft. long, 1 in. in dia, 26 ins. in the ground for $\frac{1}{4}$ sec. cor., with a brass cap marked $\frac{1}{4}$ S 30 in N. & S 31 1913 in S. half. of post
Dig pits 18 x 18 x 12 ins. E. & W. 3 ft. dist. & raise mound of earth $3\frac{1}{2}$ ft. base $1\frac{1}{2}$ ft. high N. of cor.
41.00 Wagon road, bears N. 30° E., S. 30° W.
45.00 Dry, rocky wash, 1 ch. wide, 8 ft. deep, course S. 30° W.
55.00 Dry wash 10 lks. wide, 2 ft. deep, course South.
61.00 Dry rocky wash 1 ch. wide, 6 ft. deep, course S. 30° W.
65.00 Dry wash 1 ch. wide, 3 ft. deep, course S. 30° W.
79.46 Intersect W. bdy. of T. at the cor. of secs. 25, 30, 31 & 36, previously established by me, and described in Book D.
- Land level & rolling.
Soil loose sandy loam, 18 to 24 ins. deep, medium to fine texture on gravel sub-soil
Mesquite brush 3 to 5 ft. high, short grass
No timber.
-

Partial SUBDIVISION OF TOWNSHIP 9 SOUTH, RANGE 20 EAST.

	From the cor. of secs. 29, 30, 31 & 32, hereinbefore described
	I run
	N. 0° 03' W. bet. secs. 29 & 30
	Over rolling, rocky land, through mesquite brush 3 to 5 ft. high
7.00	Dry wash 30 lks. wide, 2 ft. deep, course West.
33.00	Dry shallow wash, 10 lks. wide, course S. 30° W.
34.00	Dry wash 30 lks. wide, 6 ft. deep, course S, 30° W.
40.00	Set an iron post 3 ft. long, 1 in. in dia., 26 ins. in the ground for $\frac{1}{4}$ sec. cor., with a brass cap marked S 30 in W., S 29 in E. & 1913 in S. half, from which
	A post oak 20 ins. in dia. bears N. 15 $\frac{1}{2}$ ° E. 104 lks. dist. marked $\frac{1}{4}$ S 29 B T
	A post oak 6 ins. in dia. bears S. 89 $\frac{1}{2}$ ° W. 140 lks. dist. marked $\frac{1}{4}$ S 30 B T
41.00	Dry wash 50 lks. wide, 3 ft. deep, course S. 60° W.
52.00	Dry wash 50 lks. wide, 15 ft. deep, course S. 60° W.
	Leave mesquite brush, bears E. & W.
75.00	Foot of Graham Mt., bears N.W. & S. E., thence ascend steep rocky S.W. slope 150 ft. to cor.
80.00	Set an iron post 3 ft. long, 2 ins. in dia., 24 ins. in the ground for cor. of secs. 19, 20, 29 & 30, with a brass cap marked T 9 S R 24 E in N. & 1913 in S. half, S 19 in N.W., S 20 in N.E., S 29 in S.E. & S 30 in S.W. quadrant. Pits imprac.
	Raise mound of stone 3 ft. base 2 ft. high W. of cor.
	Land rolling & mountainous
	Soil rocky
	Scattering grass, mesquite brush 3 to 5 ft. high
	Scattering trees around $\frac{1}{4}$ sec. cor.

	Thence I run
	West on random line bet. secs. 19 & 30
40.00	Set temp. $\frac{1}{4}$ sec. cor.
79.50	Intersect W. bdy. of Tp. 8 lks. S. of cor. of secs. 19, 24, 25 & 30, previously established by me & described in Book D.
	Thence I run
	S. 89° 57' E. on true line bet. secs. 19 & 30
	Over rolling rocky land, through mesquite brush 4 to 6 ft. high
5.50	Dry rocky wash 25 lks. wide, 10 ft. deep, course South
29.00	Dry rocky wash 1 ch. wide, 20 ft. deep, course South.
33.00	Dry rocky wash 50 lks. wide, 15 ft. deep, course South.
39.00	Dry rocky wash 50 lks. wide, 12 ft. deep, course South.
39.50	Point for $\frac{1}{4}$ sec. cor. falls on solid bed-rock, impracticable to set iron post, put a cross (X) in surface of bed-rock in true cor. point.
39.60	Set an iron post 3 ft. long, 1 in. in dia., 26 ins. in the ground for Witness cor. to $\frac{1}{4}$ sec. cor., with a brass cap marked W C, W. of center, $\frac{1}{4}$ S 19 in N. & S 30 1913 in S. half.
	Raise a mound of stone Pits impracticable.
	3 feet base 3 feet high North of Witness Corner.
49.00	Dry wash 1 ch. wide, 15 ft. deep, course S. 30° W.
51.00	Dry rocky wash, 1 ch. wide, 15 ft. deep, course S.W.
59.00	Dry rocky wash 75 lks. wide, 10 ft. deep, course S. 30° E.
67.50	Dry rocky wash. 50 lks. wide, 3 ft. deep, course South.
71.50	Dry rocky wash 50 lks. wide, 3 ft. deep, course South.
74.50	Foot of Mt. Graham, bears N.W. & S.E., thence ascend rocky slope 125 ft. to cor.
79.50	The cor. of secs. 19, 20, 29 & 30, hereinbefore described.
	Land rolling & mountainous
	Soil very rocky
	Good grass, scattering mesquite brush, 3 to 7 ft. high.
	Scattering oak trees along banks of washes

April 22nd, 1913.

Partial

SUBDIVISIONS OF TOWNSHIP 9 SOUTH, RANGE 24 EAST.

GENERAL DESCRIPTION.

Except for section 31, and a part of the SE. quarters of sections 30 and 32, the surveyed portion of this township in Section Tp. consists of rolling, very rocky land, suitable only for grazing. There are a scattering scrub-oak trees along the washes and creeks. Practically all of the area is covered with a growth of mesquite brush, ranging from 3 to 7 ft. high.

Sec. 31 and a part of the S.E. $\frac{1}{4}$ of secs. 30 & 32 is slightly rolling. The soil is good sandy loam and can be irrigated by diverting the water from the creek that flows through this part of the Tp.

There are no settlers nor improvements of any kind in the surveyed portion of this township.

Thomas B. Matthews

U. S. Surveyor.

CERTIFICATE OF ASSISTANTS.
(same applies to Books "F" and "G")

BOOK 2717

We, the undersigned, hereby certify upon honor that we assisted, to the best of our skill and ability,

Thomas B. Matthews, U. S. Surveyor, during the periods and in the capacities stated opposite our several signatures, in surveying all those parts or portions of *subdivision lines of Twp 20 R. 23 & 24 E. & Twp 10 N R 24 E lying within the abandoned military reservation of Fort Grant*

of the *Gila & Salt River* Meridian, in the State of *Arizona* and those in Books "F" and "G" which are represented in the foregoing field notes as having been executed by him, and under his direction; and that said surveys have been, in all respects, to the best of our knowledge and belief, well and faithfully executed.

NAME.	PERIOD OF SERVICE.		CAPACITY.
	BEGUN.	ENDED.	
<i>William Lester</i>	<i>April 2-1913</i>	<i>April 29 1913</i>	<i>Chairman</i>
<i>R. J. Ruffin</i>	<i>April 2 1913</i>	<i>April 29 1913</i>	<i>Chairman</i>
<i>W. J. McFar</i>	<i>April 2 1913</i>	<i>" 26 1913</i>	<i>Mounds Man</i>
<i>C. R. Fisher</i>	<i>April 2 1913</i>	<i>" 29 1913</i>	<i>Flag man</i>
<i>Edward Dittmar</i>	<i>Dec 2 1913</i>	<i>Dec 20 1913</i>	<i>Chairman</i>
<i>H. H. Palmer</i>	<i>Dec 2 1913</i>	<i>Dec 20 1913</i>	<i>Chairman</i>
<i>E. H. Tenley</i>	<i>Dec 2 1913</i>	<i>Dec 20 1913</i>	<i>Flagman</i>
<i>R. B. Hart</i>	<i>Dec 2 1913</i>	<i>Dec 20 1913</i>	<i>Cox man</i>
<i>Geo Adcock</i>	<i>Dec 2 1913</i>	<i>Dec 20 1913</i>	<i>Mounds Man</i>
<i>Edward Dittmar</i>	<i>July 12 1914</i>	<i>July 14 1914</i>	<i>Chairman</i>
<i>R. B. Hart</i>	<i>July 12 1914</i>	<i>July 14 1914</i>	<i>Chairman</i>
<i>Vinton Hays</i>	<i>July 12 1914</i>	<i>July 14 1914</i>	<i>Flagman</i>
<i>Geo Adcock</i>	<i>July 12 1914</i>	<i>July 14 1914</i>	<i>Mounds man</i>
<i>R. W. Sprinkle</i>	<i>April 27 1913</i>	<i>April 29 1913</i>	<i>Mounds Man</i>

Subscribed and certified to before me on the dates of the final service as shown above.

Thomas B. Matthews
U. S. Surveyor.

BOOK 2717

FINAL OATH OF UNITED STATES SURVEYOR.
same applies to Books "F" and "G"

I, Thomas B. Matthews, U. S. Surveyor, do solemnly swear that, in pursuance of special instructions received from the U. S. Surveyor General for Arizona for Group 22, bearing date of the 24 th day of September, 1912, I have well, faithfully, and truly, in my own proper person, and in strict conformity with said instructions, the Manual of Surveying, Instructions, and the laws of the United States, surveyed all those parts or portions of the subdivision lines of Tps. 9 South, Rs. 23 and 24 East and Tp. 10 South, R. 24 East, lying within the Abandoned Ft. Grant Military Reservation

of the Gila and Salt River Base and Meridian, in the State of Arizona, which are represented in the foregoing field notes and those in Books "F" and "G" as having been executed by me, and under my direction; and I do further solemnly swear that all the corners of said surveys have been established and perpetuated in strict accordance with the Manual of Surveying Instructions, and the special written instructions of the U. S. Surveyor General for Arizona for Group 22 and in the specific manner described in the field notes, and that the foregoing and those in Books "F" and "G" are the original field notes of such surveys

Thomas B. Matthews
U. S. Surveyor.

Subscribed by said Thomas B. Matthews, and sworn to before me }
this 8 th day of December, 1914

Frank S. Ingalls
Surveyor General of Arizona.



APPROVAL.

OFFICE OF THE UNITED STATES SURVEYOR GENERAL,
Phoenix, Arizona, March 20, 1915

The foregoing field notes of the survey of of part of the Subdivision lines of Township No. 9 South Range No. 24 East of the Gila and Salt River Base and Meridian, Arizona

executed by Thomas B. Matthews, U.S. Surveyor under his special instructions dated September 24 1912 for Group 22, having been critically examined, and the necessary corrections and explanations made, the said field notes, and the surveys they describe, are hereby approved.

Frank S. Ingalls
U. S. Surveyor General.
of Arizona.

I certify that the foregoing transcript of the field notes of the above described surveys in has been correctly copied from the original notes on file in this office.

U. S. Surveyor General.