

2719

4-679

Book "G"

BOOK 2719

Subdivisions

FIELD NOTES

OF THE SURVEY OF THE

PART OF THE

subdivision lines of

Township 9 South Range 23 East

Of the Gila and Salt River Base and Meridian,

In the State of Arizona

EXECUTED BY

Thomas B. Matthews,

In the capacity of U. S. Surveyor, under instructions dated September 24, 1912, issued by the United States Surveyor General to govern surveys included in Group No. 22, which were approved by the Commissioner of the General Land Office, October 3, 1912, pursuant to authority contained in the Act of Congress dated August 23, 1912.

Survey commenced April 25, 1913

Survey completed April 29, 1913

145
orig. (1)

SEP 2-1914

BOOK 2719

INDEX DIAGRAM.

Township 9 South $\frac{1}{2}$ Range 23 East

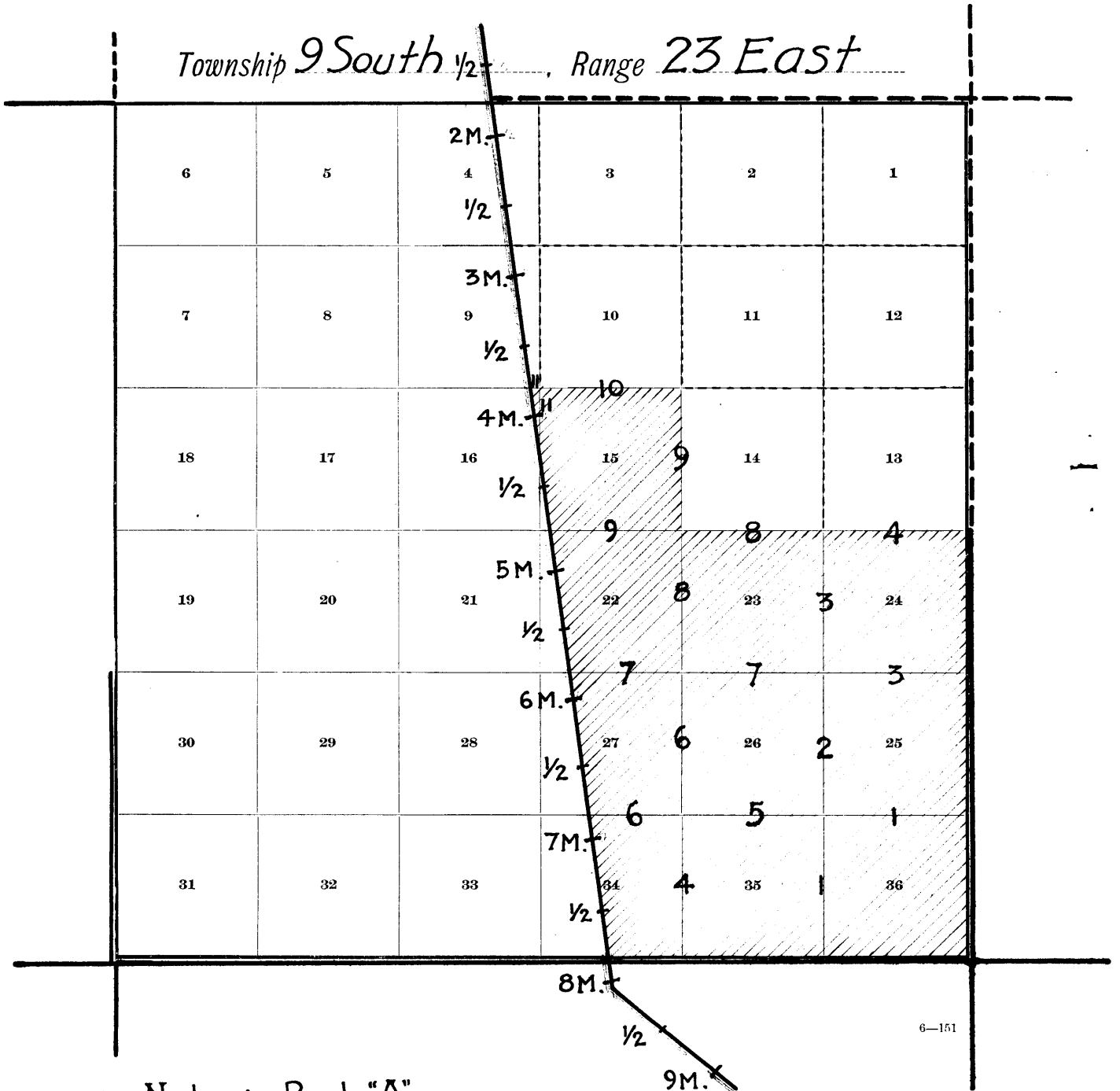

6-151

- Notes in Book "A"
- " " " "D"
- " " " "C"

 Unsurveyed Lines

Pages of this book indexed
in Red figures

3

*Hatched portion of diagram
indicates Subs. surveyed under this Gp.*

Subdivision of Part of Township 9 South, Range 23 East. 1.6

Chains.

Survey commenced April 25th, 1913, and executed by Thomas B. Matthews, U. S. Surveyor, with Young and Sons' light mountain transit No. 8480, previously in Bks. A, B, & C. I examine the adjustments of the transit, and find them to be correct, and know from recent tests of the solar apparatus, by comparing its indications resulting from solar observations made during a.m. and p.m. hours, with a meridian established by observation on Polaris, at elongation, that the instrument is in satisfactory adjustment.

At 7h. 30m. a.m., l.m.t., I set off 13°08½' N. on the decl. arc; 32°35½' on lat. arc, and determine a meridian with the solar at the cor. of secs. 1, 2, 35 and 36, on south bdy. of township, previously reestablished by me, and described in Book "C."

The magnetic bearing of the meridian thus established at 7h. 30m. a.m., l.m.t., is N. 12° 55' W.; the angle thus determined gives the magnetic decl. 12° 55' E.

Thence I run, N. 0° 01' W., bet. secs. 35 and 36. Ascending gentle SW. slope, through mesquite brush, 4 to 8 ft. high.

20.00 Wagon road bears N. 30° E., and S. 30° W.
40.00 Set an iron post 3 ft. long, 1 in. in diam., 26 ins. in the ground, for ¼ sec. cor., with a brass cap, marked S 35 in W., S 36 in E., and 1913 in S. half; dig pits 18x18x12 ins., N. and S. of post 3 ft. dist., and raise a mound of earth 3½ ft. base, 1½ ft. high, W. of cor.

40.10 Wagon road brs. N. 30° E., and S. 30° W.
50.50 Dry wash, 15 lks. wide, 2 ft. deep, course S. 60° W.
68.00 Small irrigation ditch, 15 lks. wide, 2 ft. deep, course S. 30° W.

77.00 Wagon road brs. N. 30° E., and S. 30° W.
80.00 Set an iron post 3 ft. long, 2 ins. in diam., 24 ins. in the ground, for cor. of secs. 25, 26, 35 and 36, with a brass cap, marked, T 9 S R 23 E in N., and 1913 in S. half; S 26 in NW., S 25 in NE., S. 36 in SE., and S 35 in SW. quadrant; from which, A sycamore, 14 ins. in diam., brs. N. 88½° W., 485 lks. dist., marked T 9 S R 23 E S 26 B T. A mesquite, 10 ins. in diam., brs. N. 74½° E., 45 lks. dist., marked T 9 S R 23 E S 25 B T. A mesquite, 6 ins. in diam., brs. S. 36° E., 35 lks. dist., marked T 9 S R 23 E S 36 B T. A sycamore, 24 ins. in diam., brs. S. 62° W., 637 lks. dist., marked T 9 S R 23 E S 35 B T.

Land, level and rolling. Soil, loose, red sandy loam, 2 to 3 ft. deep. Mesquite brush and yuccas, 3 to 12 ft. high. Timber along Bonita Creek at north end of line.

40.00 Thence I run, East, on a random line, bet. secs. 25 and 36.
79.96 Set temp. ¼ sec. cor. Intersect east bdy. of Tp., at the cor. of secs. 25, 30, 31 and 36, previously established by me, and described in Book "D."
Thence I run,

2. Subdivision of part of Township 9 South, Range 23 East.

Chains.

- West, on a true line, bet. secs. 25 and 36.
Over slightly rolling land.
- 15.00 Dry wash, 15 lks. wide, 1 ft. deep, course south.
- 24.50 Wagon road, brs. N. and S.
- 28.00 Wagon road brs. N. and S.
- 31.00 SE cor. of enclosure of Ft. Grant brs. N. 1° W. NE cor. of inclosure of Ft. Grant brs. N. 17 $\frac{1}{2}$ ° E., old Powder magazine brs. N. 50° E.
- 39.98 Set an iron post 3 ft. long, 1 in. in diam., 26 ins. in the ground for $\frac{1}{4}$ sec. cor., with a brass cap, marked
 $\frac{1}{4}$ S 25 in N., and
S 36 1913 in S. half;
dig pits 18x18x12 ins. E. and W. of post 3 ft. dist., and raise a mound of earth 3 $\frac{1}{2}$ ft. base, 1 $\frac{1}{2}$ ft. high, north of cor.
- 42.00 Wagon road brs. N. 30° E., and S. 30° W.
- 46.00 Dry wash, 10 lks. wide, 1 ft. deep, course S. 30° W.
- 55.50 Wagon road brs. N. 30° E. and S. 30° W.
- 57.00 Old wagon road brs. N. and S., SE cor. of garden patch brs. N. 7 chs. dist.; this garden contains about 8 acres in area.
- 58.00 Dry wash, 30 lks. wide, 2 ft. deep, course S. 30° W.
- 62.00 Dry wash, 25 lks. wide, 2 ft. deep, course S. 30° W.
- 69.00 Dry wash, 25 lks. wide, 3 ft. deep, course S. 30° W.
- 76.00 Small irrigation ditch, 15 lks. wide, 2 ft. deep, course S. 30° W.
- 79.00 Wagon road, brs. N. 30° E., and S. 30° W.
- 79.96 Cor. of secs. 25, 26, 35 and 36, hereinbefore described.
Land, level and rolling.
Soil, loose, red sandy loam, medium texture, 18 to 30 ins. deep.
Dense growth of mesquite brush, 5 to 10 ft. high.
Scattering trees along creek at west end of line.
Note: From the cor. of secs. 25, 30, 31 and 36 on east bdy. of Tp. SE cor. of inclosure of Ft. Grant brs. N. 51° W. NE cor. of inclosure of Ft. Grant bears N. 22 $\frac{1}{2}$ ° W.; also powder magazine brs. N. 52 $\frac{1}{2}$ ° W.

- Thence I run,
N. 0° 01' W., bet. secs. 25 and 26.
Over slightly rolling land.
- 4.50 Bonita Creek, 50 lks. wide, 2 ft. deep, clear cold water, course west, banks 3 ft. high.
- 9.00 Dry wash, 50 lks. wide, 6 ft. deep, course west.
- 29.50 Wagon road brs. N. 30° E., and S. 30° W.
- 36.00 Old wagon road, brs. E. and W.
- 39.50 Dry wash, 15 lks. wide, 1 ft. deep, course S. 60° W.
- 40.00 Set an iron post 3 ft. long, 1 in. in diam., 26 ins. in the ground, for $\frac{1}{4}$ sec. cor., with a brass cap, marked
 $\frac{1}{4}$ S 26 in W.,
S 25 in E., and
1913 in S. half; pits impracticable.
raise a mound of stone 3 ft. base, 3 ft. high, west of cor.
- 44.00 Wagon road, brs. N. 60° E., and S. 60° W.; thence over rolling rocky land, ascending south slope.
- 80.00 Set an iron post 3 ft. long, 2 ins. in diam., 24 ins. in the ground, for cor. of secs. 23, 24, 25 and 26, with a brass cap, marked,
T 9 S R 23 E in N., and
1913 in S. half;
S 23 in NW.,
S 24 in NE.,
S 25 in SE., and
S 26 in SW. quadrant;
raise a mound of stone 3 ft. base, 3 ft. high, W. of cor.
Pits impracticable.
Land, rolling.
Soil, south half loose sandy loam, medium to coarse tex-

Subdivision of part of Township 9 South, Range 23 East. 3.

Chains

ture, 18 to 30 ins. deep; north half, rocky.
 Scattering grass, mesquite brush, 5 to 8 ft. high.
 Timber, along creek at south end of line.
 At the above described cor., I set off $13^{\circ} 11\frac{1}{2}'$ N. on the
 decl. arc, and at 12h. 2m. 1sec. p.m., l.m.t., observe
 the sun on the meridian, and obtain a reading of 32°
 $37\frac{1}{2}'$ on lat. arc.

 Thence I run,
 East, on random line, bet. secs. 24 and 25.

40.00
80.06

Set temp. $\frac{1}{4}$ sec. cor.
 Intersect east bdy. of Tp., 5 lks. south of cor. of secs. 19,
 24, 25 and 30, previously established by me, as de-
 scribed in Book "D."

Thence I run,
 S. $89^{\circ} 58'$ W., on a true line, bet. secs. 24 and 25.
 Over rolling rocky land, through scattering mesquite brush
 4 to 7 ft. high.

12.00
14.00
23.00
33.00
40.03

Dry rocky wash, 50 lks. wide, 6 ft. deep, course S. 30° W.
 Dry rocky wash, 1 ch. wide, 15 ft. deep, course S. 30° W.
 Dry rocky wash, 25 lks. wide, 2 ft. deep, course S. 30° W.
 Wagon road, brs. N. and S.

Set an iron post 3 ft. long, 1 in. in diam., 26 ins. in the
 ground for $\frac{1}{4}$ sec. cor., with a brass cap, marked,
 $\frac{1}{4}$ S 24 in N., and
 S 25 1913 in S. half; from which,
 A post oak, 14 ins. in diam., brs. N. $6\frac{1}{2}^{\circ}$ W., 141
 lks. dist., marked $\frac{1}{4}$ S 24 B T.
 A sycamore, 20 ins. in diam., brs. S. 36° E., 72
 lks. dist., marked $\frac{1}{4}$ S 25 B T.

41.00
56.00
80.06

Bonita Creek, 50 lks. wide, $1\frac{1}{2}$ ft. deep, clear cold water
 swift current, course south, banks, 10 ft. high.
 Dry wash, 1 ch. wide, 6 ft. deep, course S. 30° W.
 The cor. of secs. 23, 24, 25 and 26, hereinbefore described.
 Land, rolling.
 Soil, rocky.
 Scattering grass, mesquite brush, 4 to 8 ft. high.
 Timber along bank of Bonita Creek.

 Thence I run,
 N. $0^{\circ} 01'$ W., bet. secs. 23 and 24.
 Ascending rocky S. slope, through mesquite brush, 4 to 8
 ft. high.

3.00
10.50
18.00
40.00

Dry wash, 15 lks. wide, 1 ft. deep, course S. 60° W.
 Small creek, 15 lks. wide, 1 ft. deep, clear cold water,
 course SW.
 Rocky wash, 25 lks. wide, 6 ft. deep, course SW.
 Set an iron post 3 ft. long, 1 in. in diam., 26 ins. in
 the ground for $\frac{1}{4}$ sec. cor., with a brass cap, marked
 $\frac{1}{4}$ S 23 in W.,
 S 24 in E., and
 1913 in S. half; pits impracticable.
 raise a mound of stone 3 ft. base, 3 ft. high, west of
 cor.

45.00
49.00
63.00
66.00
75.00
80.00

Rocky gulch, 1 ch. wide, 30 ft. deep, course S. 80° W.
 Rocky wash, 50 lks. wide, 6 ft. deep, course west; begin
 ascent of steep rocky S. slope, 200 ft.
 Top of ridge, brs. E. and W., thence descend N. slope, 100
 feet.
 Foot of ridge, dry wash, 20 lks. wide, 2 ft. deep, course
 S. 60° E.
 Dry wash, 15 lks. wide, 1 ft. deep, course S. 30° E.
 Set an iron post 3 ft. long, 2 ins. in diam., 24 ins. in
 the ground, for cor. of secs. 13, 14, 23 and 24, with
 a brass cap, marked,

4. Subdivision of part of Township 9 South, Range 23 East.
Chains.

T 9 S R 23 E in N., and
1913 in S. half;
S 14 in NW.,
S 13 in NE.,
S 24 in SE., and
S 23 in SW. quadrant; from which,
A black jack, 8 ins. in diam., brs. N. $38\frac{1}{2}^{\circ}$ W., 212
lks. dist., marked T 9 S R 23 E S 14 B T.
A black jack, 14 ins. in diam., brs. N. 20° E., 527
lks. dist., marked T 9 S R 23 E S 13 B T.
No more trees in dist. Raise a mound of stone 3 ft. base,
3 ft. high, west of cor. Pits impracticable.
Land, rolling and mountainous.
Soil, very rocky.
Scattering grass, mesquite brush, 4 to 8 ft. high.
Scattering timber along bank of creek, and at north end
of line.

Thence I run,
N. $89^{\circ} 58'$ E., on random line, bet. secs. 13 and 24.
40.00 Set temp. $\frac{1}{4}$ sec. cor.
80.26 Intersect east bdy. of Tp., 17 lks. north of cor. of secs.
13, 18, 19 and 24, previously established by me, and de-
scribed in Book "D."
Thence I run,
N. $89^{\circ} 55'$ W., on true line, bet. secs. 13 and 24.
Over rough, mountainous land, ascending steep, rocky east
slope, through scattering scrub oak timber.
5.00 Top of ridge brs. N. and S.; thence descend rocky west
slope, 500 ft.
14.00 Rocky gulch, 2 chs. wide, 50 ft. deep, course S. 30° W.
40.13 Set an iron post 3 ft. long, 1 in. in diam., 26 ins. in
the ground, for $\frac{1}{4}$ sec. cor., with brass cap, marked,
 $\frac{1}{4}$ S 13 in N., and
S 24, 1913 in S. half; from which,
A white oak, 8 ins. in diam., brs. N. 74° W., 196
lks. dist., marked $\frac{1}{4}$ S 13 B T.
A black jack 4 ins. in diam., brs. S. $17\frac{1}{2}^{\circ}$ W., 53
lks. dist., marked $\frac{1}{4}$ S 24 B T.
44.00 Foot of descent, rocky gulch, 1 ch. wide, 30 ft. deep,
course S. 60° W., thence over rolling rocky land.
49.00 Rocky wash, 1 ch. wide, 15 ft. deep, course south.
51.00 Rocky wash, 1 ch. wide, 15 ft. deep, course south.
60.00 Creek, 50 lks. wide, 1 ft. deep, course south; clear cold
water, banks, 20 ft. high.
80.26 The cor. of secs. 13, 14, 23 and 24, hereinbefore described.
Land, rolling and mountainous.
Soil, very rocky.
Scattering grass.
Scrub oak timber and scattering junipers.
April 25th, 1913.

April 26th, 1913: At 7h. 30m. a.m., l.m.t., I set off 13°
28' N. on decl. arc; $32^{\circ} 35\frac{1}{2}'$ on lat. arc, and determine
a meridian with the solar at the cor. of secs. 2, 3, 34 and
35 on south bdy. of Tp., previously reestablished by me,
and described in Book "C."
Thence I run,
N. $0^{\circ} 01'$ W., bet. secs. 34 and 35.
Over slightly rolling, prairie land, through scattering
yuccas, 4 to 8 ft. high.
10.00 Dry wash, 50 lks. wide, 2 ft. deep, course S. 30° E.
15.25 Dry wash, 50 lks. wide, 3 ft. deep, course S. 60° E.
34.50 Dry wash, 15 lks. wide, 4 ft. deep, course west.
40.00 Set an iron post, 3 ft. long, 1 in. in diam., 26 ins. in

Subdivision of part of Township 9 South, Range 23 East. 5.

Chains.

- the ground, for $\frac{1}{4}$ sec.cor., with brass cap, marked,
 $\frac{1}{4}$ S 34 in W.,
S 35 in E., and
1913 in S.half; from which,
A sycamore, 30 ins. in diam., brs.S. $76\frac{1}{2}^{\circ}$ W.,255
lks.dist., marked $\frac{1}{4}$ S 34 B T.
No more trees in limits.
Dig pits 18x18x12 ins., N.and S. of post 3 ft. dist., and
raise a mound of earth $3\frac{1}{2}$ ft.base, $1\frac{1}{2}$ ft. high, west
of cor.
- 45.50 Dry wash, 15 lks.wide, 3 ft.deep, course S. 30° W.
70.50 Small creek, 40 lks.wide, 1 ft. deep, clear cold water,
course S. 30° W., banks, 3 ft. high.
- 80.00 Set an iron post, 3 ft.long, 2 ins. in diam., 24 ins. in
the ground, for cor.of secs. 26,27, 34 and 35 , with
a brass cap, marked,
T 9 S R 23 E in N., and
1913 in S.half;
S 27 in NW.,
S 26 in NE.,
S 35 in SE., and
S 34 in SW.quadrant;
dig pits 18x18x12 ins., in each sec. $5\frac{1}{2}$ ft. dist.,and
raise a mound of earth 4 ft.base, 2 ft.high, west of
cor.
Land,level and rolling.
Soil, loose, red sandy loam, 18 to 24 ins. deep on clay
subsoil, medium texture.
Good gramma and bunch grass, scattering yuccas, 4 to 8 ft.
high.
Scattering trees along banks of creek.

- 40.00 Thence I run,
N. $89^{\circ}58'$ E., on random line, bet. secs.26 and 35.
Set temp. $\frac{1}{4}$ sec.cor.
- 80.12 Fall 15 lks.north of cor.of secs.25,26, 35 and 36, herein-
before described.
Thence I run,
N. $89^{\circ}56'$ W., on true line, bet. secs. 26 and 35.
Over slightly rolling land.
- 2.00 Wagon road brs.N. 30° E., and S. 30° W.
5.50 Bonita Creek,40 lks.wide, 2 ft. deep, clear cold water,
course S. 15° W.; low banks.
- 11.00 Wagon road brs.N. 30° E. and S. 30° W.
14.50 Wash, 10 lks.wide, 1 ft. deep, course S. 30° W.
40.06 Set an iron post 3 ft.long, 1 in. indiam., 26 ins. in
the ground, for $\frac{1}{4}$ sec.cor., with a brass cap, marked
 $\frac{1}{4}$ S 26 in N., and
S 35, 1913 in S.half;
dig pits 18x18x12 ins., E.and W. of post, 3 ft.dist.,
and raise a mound of earth $3\frac{1}{2}$ ft. base, $1\frac{1}{2}$ ft. high,
N.of cor.
- 46.00 Dry wash, 50 lks.wide, 1 ft. deep, course S. 30° W.
54.50 Dry wash, 10 lks.wide, 1 ft. deep, course S. 60° W.
61.00 Dry wash, 10 lks.wide, 1 ft. deep, course S. 15° W.
72.00 Small creek, clear cold water, 30 lks.wide, 1 ft. deep,
course S. 30° W., banks, 3 ft. high.
- 80.12 The cor.of secs.26,27, 34 and 35,hereinbefore described.
Land, level and rolling.
Soil, loose, red sandy loam, medium to fine texture, 18 to
24 ins. deep on clay subsoil.
Good gramma grass, scattering yuccas, 4 to 8 ft.high;mes-
quite brush, 4 to 6 ft.high.
Scattering sycamore, cottonwood and oak timber along
creeks.

6. Subdivision of part of Township 9 South, Range 23 East.

Chains.

Thence I run,
West, on true line, bet. secs. 27 and 34.
Over level land, through scattering yuccas, 4 to 8 ft. high.

40.00 Set an iron post 3 ft. long, 1 in. in diam., 26 ins. in the ground, for $\frac{1}{4}$ sec. cor., with a brass cap, marked
 $\frac{1}{4}$ S 27 in N., and
S 34 1913 in S. half;
dig pits 18x18x12 ins., E. and W. of post 3 ft. dist., and raise a mound of earth $3\frac{1}{2}$ ft. base, $1\frac{1}{2}$ ft. high, N. of cor.

50.87 Intersect west bdy. of Ft. Grant Reservation, 14.67 chs. N. $7^{\circ}24'$ W. of witness cor. to 7th mile cor. established by me, as described in Book "A."
At the above described point of intersection, I set an iron post 3 ft. long, 2 ins. in diam., 24 ins. in the ground for closing cor. of secs. 27 and 34, with a brass cap, marked,
C C W of center,
T 9 S R 23 E in N., and
1913 in S. half;
S 27 in NE., and
S 34 in SE. sector;
dig pits 24x18x12 ins., crosswise on each line, N. and S. 3 ft. and E. of post 7 ft. dist., and raise a mound of earth 4 ft. base, 2 ft. high, E. of cor.

Land, level.
Soil, loose, red, sandy loam, 18 to 24 ins. deep on clay subsoil.
Good gramma grass, scattering yuccas, 4 to 8 ft. high.
At the above described cor., I set off $13^{\circ}31'$ N. on the decl. arc; and at 12h. 2m., 11secs. p.m., 1.m.t., I observe the sun on the meridian, and obtain a reading of $32^{\circ}36\frac{1}{2}'$ on the lat. arc.

From the cor. of secs. 26, 27, 34 and 35, I run,
N. $0^{\circ}01'$ W. bet. secs. 26 and 27.
Ascending gentle south slope, through yuccas, 4 to 8 ft. high.

9.00 Dry wash, 15 lks. wide, 1 ft. deep, course S. 60° W.
30.00 Dry wash, 50 lks. wide, 1 ft. deep, course W.
Leave yuccas brs. E and W.

33.00 Wagon road, brs. E and W.
38.00 Dry wash, 25 lks. wide, 1 ft. deep, course S. 30° W.
40.00 Set an iron post 3 ft. long, 1 in. in diam., 26 ins. in the ground, for $\frac{1}{4}$ sec. cor., with a brass cap, marked,
 $\frac{1}{4}$ S 27 in W.,
S 26 in E., and
1913 in S. half;
dig pits 18x18x12 ins., N. and S. of post, 3 ft. dist., and raise a mound of earth $3\frac{1}{2}$ ft. base, $1\frac{1}{2}$ ft. high, W. of cor.

60.00 Wagon road, brs. N. 60° E., and S. 60° W.
71.00 Dry wash, 50 lks. wide, 10 ft. deep, course west.
80.00 Set an iron post 3 ft. long, 2 ins. in diam., 24 ins. in the ground, for cor. of secs. 22, 23, 26 and 27, with a brass cap, marked,
T 9 S R 23 E in N., and
1913 in S. half;
S 22 in NW.,
S 23 in NE.,
S 26 in SE., and
S 27 in SW. quadrant;
dig pits 18x18x12 ins., in each sec. $5\frac{1}{2}$ ft. dist., and raise a mound of earth 4 ft. base, 2 ft. high, west of cor.

Land, level and rolling.
Soil, loose, red sandy loam, 18 to 24 ins. deep on clay subsoil.

Subdivision of part of Township 9 South, Range 23 East. 7.

Chains,

Good gramma-grass, yuecas 4 to 8 ft. high.
No timber.

40.00 Thence I run,
80.10 S. 89° 56' E., on a random line, bet. secs. 23 and 26.
Set temp. 1/4 sec. cor.
Fall 14 lks. north of cor. of sees. 23, 24, 25 and 26, here-
inbefore described.

Thence I run,
N. 89° 50' W., on true line, bet. secs. 23 and 26.
Over rolling, rocky land.
1.00 Dry rocky wash, 50 lks. wide, 6 ft. deep, course south.
14.50 Small creek, 20 lks. wide, 2 ft. deep, clear water, course
S. 60° W., banks 6 ft. high.
25.00 Dry wash, 50 lks. wide, 6 ft. deep, course S. 30° W.
32.00 Dry rocky wash, 1 ch. wide, 15 ft. deep, course S. 30° W.
40.05 Set an iron post 3 ft. long, 1 in. in diam., 26 ins. in
the ground, for 1/4 sec. cor., with a brass cap, marked,
1/4 S 23 in N., and
S 26, 1913 in S. half; pits impracticable.
raise mound of stone 3 ft. base, 3 ft. high, north of
cor.

44.50 Dry wash, 10 lks. wide, 2 ft. deep, course S. 30° W.
69.00 Dry wash, 1 ch. wide, 3 ft. deep, course S. 30° W.
80.10 Cor. of secs. 22, 23, 26 and 27, hereinbefore described.
Land, rolling.
Soil, rocky.
Scattering grass, mesquite brush, 3 to 5 ft. high; seat-
tering timber along banks of creek.

Thence I run,
West, on true line, bet. secs. 22 and 27.
Over rolling land, through yuecas, 4 to 8 ft. high.
6.00 Dry rocky wash, 50 lks. wide, 4 ft. deep, course S. 60° W.
27.00 Dry wash, 50 lks. wide, 4 ft. deep, course S. 60° W.
32.00 Dry sandy wash, 25 lks. wide, course S. 30° W.
38.00 Dry wash, 15 lks. wide, 3 ft. deep, course S. 30° W.
40.00 Set an iron post 3 ft. long, 1 in. in diam., 26 ins. in
the ground for 1/4 sec. cor., with a brass cap, marked
1/4 S 22 in N., and
S 27 1913 in S. half;
dig pits 18x18x12 ins., E. and W. of post 3 ft. dist.,
and raise a mound of earth 3 1/2 ft. base, 1 1/2 ft. high,
north of cor.

61.39 Intersect west bdy. of Ft. Grant Military Reservation,
16.05 chs. N. 7° 24' W. of 6th. mile cor. established
by me, and described in Book "A."
At the above point of intersection, I set an iron post 3
ft. long, 2 ins. in diam., 24 ins. in the ground for
closing cor. of secs. 22 and 27, with a brass cap, mark-
ed,

C C W of center,
T 9 S R 23 E in N., and
1913 in S. half;
S 22 in NE., and
S 27 in SE. sector;

dig pits 24x18x12 ins. crosswise on each line N. and S.
3 ft. and E. of post 7 ft. dist., and raise a mound of
earth 4 ft. base, 2 ft. high, E. of cor.

Land, level and rolling.
Soil, rocky from 0 to 20 chs.; from 20 chs. to intersec-
tion of Reservation bdy. loose, gravelly sandy
loam, 12 to 18 ins. deep on clay subsoil.

8. Subdivision of part of Township 9 South Range 23 East.
Chains.

Good grass, scattering yuccas and mesquite brush, 3 to 8 ft. high.
No timber.

April 26th, 1913.

April 28, 1913: At 8h. Om. a.m., l.m.t., I set off $14^{\circ} 06\frac{1}{2}'$ N. on decl. arc; $32^{\circ} 37\frac{1}{2}'$ on lat. arc, and determine a meridian with the solar at the cor. of secs. 22, 23, 26 and 27, hereinbefore described.

Thence I run,
N. $0^{\circ} 01'$ W. bet. secs. 22 and 23.

Over rolling land, through scattering mesquite brush, 3 to 5 ft. high.

14.00 Dry wash, 15 lks. wide, 2 ft. deep, course S. 30° W.

18.00 Dry wash, 50 lks. wide, 3 ft. deep, course S. 30° W.; thence begin ascent of gentle S. slope, over very rocky land.

40.00 Set an iron post 3 ft. long, 1 in. in diam., 26 ins. in the ground for $\frac{1}{4}$ sec. cor., with a brass cap, marked,

$\frac{1}{4}$ S 22 in W.,

S 23 in E., and

1913 in S. half; pits impracticable.

raise a mound of stone 3 ft. base, 3 ft. high, west of cor.

45.00 Dry wash, 25 lks. wide, 6 ft. deep, course S. 60° E.

48.00 Dry wash, 25 lks. wide, 4 ft. deep, course S. 60° E.

80.00 Set an iron post 3 ft. long, 2 ins. in diam., 24 ins. in the ground, for cor. of secs. 14, 15, 22 and 23, with a brass cap, marked,

T 9 S R 23 E in N., and

1913 in S. half;

S 15 in NW.,

S 14 in NE.,

S 23 in SE., and

S 22 in SW. quadrant; pits impracticable.

Raise a mound of stone 3 ft. base, 3 ft. high, west of cor.
Land, rolling.

Soil, rocky.

Scattering grass; scattering mesquite brush, 3 to 5 ft. high.

No timber.

Thence I run,
S. $89^{\circ} 50'$ E., on random line, bet. secs. 14 and 23.

40.00 Set temp. $\frac{1}{4}$ sec. cor.

80.00 Intersect cor. of secs. 13, 14, 23 and 24, hereinbefore described.

Thence I run,

N. $89^{\circ} 50'$ W., on true line, bet. secs. 14 and 23.

Over rolling, rocky land.

1.00 Dry rocky wash, 25 lks. wide, 1 ft. deep, course S. 30° E.

9.00 Dry rocky wash, 1 ch. wide, 10 ft. deep, course south; thence ascend steep rocky east slope, 200 ft.

20.00 Summit of ridge, brs. N. and S.; thence descend west slope, 300 ft.

30.00 Base of steep rocky descent, dry wash 50 lks. wide, 10 lks. deep, course S. 60° W., thence over rolling, rocky land.

39.00 Rocky wash, 1 ch. wide, 10 ft. deep, course S. 30° W.

40.00 Set an iron post 3 ft. long, 1 in. in diam., 26 ins. in the ground, for $\frac{1}{4}$ sec. cor., with a brass cap, marked,

$\frac{1}{4}$ S 14 in W., and

S 23 1913 in S. half; from which,

A white oak, brs. N. $32\frac{3}{4}^{\circ}$ E., 266 lks. dist., marked $\frac{1}{4}$ S 14 B T.

No more trees within dist. Pits impracticable.

Raise a mound of stone 3 ft. base, 2 $\frac{1}{2}$ ft. high, north of

Subdivision of part of Township 9 South, Range 23 East, 9.

Chains.

cor.
 40.10 Dry wash, 10 lks.wide, 2 ft.deep, course S.10° E.
 42.00 Dry wash, 20 lks.wide, 6 ft. deep, course S.30° W.
 44.00 Dry rocky wash 20 lks.wide, 6 ft.deep, course S.30°W.
 45.63 Line passes bet. two boulders 3½ ft. high, 3 ft. square
 1½ ft. apart.
 54.00 Rocky gulch, 1 ch.wide, 20 ft. deep, course S.30° W.
 58.00 Dry rocky wash, 50 lks.wide, 4 ft. deep, course south.
 74.00 Dry wash, 15 lks.wide, 3 ft. deep, course south.
 80.00 The cor.of sees.14,15,22 and 23, hereinbefore described.
 Land, rolling and mountainous.
 Soil, rocky.
 Good mountain grass.
 No timber.
 At the above described cor., I set off 14° 09'N.on the
 decl.arc, and at 12h. 2m. 31 secs. p.m., l.m.t., observe
 the sun on the meridian, and obtain a reading of 32°
 38½' on the lat.arc.

Thence I run,
 West, on true line, bet. secs.15 and 22.
 Over rolling, rocky land.
 10.00 Dry rocky wash 25 lks.wide, 6 ft. deep, course south.
 14.00 Dry rocky wash, 25 lks.wide, 6 ft. deep, course S.30°W.
 20.00 Dry rocky wash, 1 ch.wide, 30 ft. deep,course S.30°W.
 39.50 Dry wash,10 lks.wide, 2 ft.deep, course S.30° W.
 40.00 Set an iron post 3 ft.long, 1 in. in diam., 26 ins. in
 the ground, for ¼ sec.cor., with a brass cap, marked
 ¼ S 15 in N., and
 S 22 1913 in S-half; pits impracticable.
 Raise a mound of stone 3 ft.base, 3 ft.high, north of cor.
 44.00 Dry rocky wash, 15 lks.wide, 3 ft. deep, course S.30°W.
 51.00 Dry wash, 15 lks.wide, 2 ft. deep, course S.30° W.
 62.00 Rocky gulch, 2 chs.wide, 30 ft. deep, course south.
 71.00 Dry rocky wash,17 lks.wide, 2 ft. deep, course S.30°W.
 71.66 Intersect west bdy.of Ft.Grant Military Reservation,
 16.88 chs. N.7°24'W. of witness cor. for 5th mile cor.,
 established by me, as described in Book "A."
 At the above described point of intersection, I set an
 iron post 3 ft.long, 2 ins. in diam., 24 ins. in the
 ground for closing cor. of secs. 15 and 22, with a
 brass cap, marked
 C C W of center,
 T 9 S R 23 E in N., and
 1913 in S-half;
 S 15 in NE., and
 S 22 in SE. sectors; pits impracticable.
 Raise mound of stone 3 ft.base, 3 ft. high, E.of cor.
 Land, rolling.
 Soil, very rocky.
 Good grass; no timber.

April 28th, 1913.

April 29th, 1913: At 8h. 30m., a.m.,l.m.t., I set off
 14°25½'N. on decl.arc; 32°38½' on lat.arc, and deter-
 mine a meridian with the solar at the cor.of secs.14,
 15,22 and 23, hereinbefore described.

Thence I run,
 N.0°01'W., bet. secs.14 and 15.
 Ascending rocky south slope.
 19.00 Dry rocky wash 15 lks.wide, 3 ft. deep, course S.60°E.
 40.00 Set an iron post 3 ft.long, 1 in. in diam., 26 ins. in
 the ground, for ¼ sec.cor., with brass cap, marked
 ¼ S 15 inW.,
 S 14 in E., and
 1913 in S-half; pits impracticable.
 Raise a mound of stone 3 ft.base, 3 ft.high,west of cor.

10. Subdivision of part of Township 9 South, Range 23 East.

Chains.

- 50.50 Dry rocky wash, 1 ch. wide, 15 ft. deep, course S.60°W.
 55.00 Dry rocky wash, 50 lks. wide, 15 ft. deep, course S.30°E.
 65.00 Dry rocky wash, 1 ch. wide, 15 ft. deep, course S.60°W.
 75.00 Enter scattering oak timber, brs. E. and W.
 80.00 Set an iron post 3 ft. long, 2 ins. in diam., 24 ins. in the ground, for cor. of secs. 10, 11, 14 and 15, with a brass cap, marked,
 T 9 S R 23 E in N., and
 1913 in S. half;
 S 10 in NW.,
 S 11 in NE.,
 S 14 in SE., and
 S 15 in SW. quadrant; from which,
 A black jack, 14 ins. in diam., brs. N. 14½°W.,
 175 lks. dist., marked T 9 S R 23 E S 10 B T.
 A black jack, 8 ins. in diam., brs. N. 62°E., 115
 lks. dist., marked T 9 S R 23 E S 11 B T.
 A black jack, 10 ins. in diam., brs. S. 54°E.,
 152 lks. dist., marked T 9 S R 23 E S 14 B T.
 A black jack, 10 ins. in diam., brs. S. 10°W., 78
 lks. dist., marked T 9 S R 23 E S 15 B T.

Land, rolling.

Soil, very rocky.

Good grass.

Scattering scrub oak and black jack timber at north end of line.

Thence I run,

West, on true line, bet. secs. 10 and 15.

Over rolling, very rocky land, through scattering timber.

- 5.00 Dry rocky wash, 1 ch. wide, 15 ft. deep, course S.30°W.
 18.00 Dry rocky wash, 1 ch. wide, 20 ft. deep, course S.30°W.
 37.00 Dry rocky wash, 1 ch. wide, 15 ft. deep, course S.30°W.
 40.00 Set an iron post 3 ft. long, 1 in. in diam., 26 ins. in the ground, for ¼ sec. cor., with a brass cap, marked
 ¼ S 10 in N., and
 S 15 1913 in S. half; from which,
 A black jack, 14 ins. in diam., brs. N. 14½°W.,
 120 lks. dist., marked ¼ S 10 B T.
 A black jack, 24 ins. in diam., brs. S. 49°W.,
 38 lks. dist., marked ¼ S 15 B T.
 45.00 Dry rocky wash, 1 ch. wide, 15 ft. deep, course S.60°W.
 59.00 Dry rocky wash, 1 ch. wide, 15 ft. deep, course S.60°W.
 62.00 Dry rocky wash, 1 ch. wide, 15 ft. deep, course S.30°W.
 71.00 Dry rocky wash, 15 lks. wide, 3 ft. deep, course south.
 Leave timber, brs. N. and S., thence ascend rocky east slope, 40 ft.
 75.00 Top of small knoll, thence descend W. slope, 30 ft. to cor.
 80.00 Set an iron post 3 ft. long, 2 ins. in diam., 24 ins. in the ground, for cor. of secs. 9, 10, 15 and 16, with a brass cap, marked,
 T 9 S R 23 E in N., and
 1913 in S. half;
 S 9 in NW.,
 S 10 in NE.,
 S 15 in SE., and
 S 16 in SW. quadrant; from which,
 A white oak, 8 ins. in diam., brs. N. 84½°E., 258
 lks. dist., marked T 9 S R 23 E S 10 B T.
 A white oak, 10 ins. in diam., brs. S. 43½°W.,
 113 lks. dist., marked T 9 S R 23 E S 16 B T.
 No more trees in dist. Pits impracticable.
 Raise a mound of stone 3 ft. base, 2½ ft. high, west of cor.
 Land, rolling.
 Soil, very rocky.

Subdivision of part of Township 9 South, Range 23 East, 11.

Chains.

Scattering grass.
Scattering scrub oak and black jack timber.
At the above described cor., I set off 14° 28' N. on the decl. arc, and at 12h. 2m. 40 secs. p.m., l.m.t., observe the sun on the meridian, and obtain a reading of 32° 39' on the lat. arc.

9.00
14.91

Thence, I run,
S. 0° 02' E., on true line, bet. secs. 15 and 16.
Over rolling, very rocky land.
Dry rocky wash, 50 lks. wide, 15 ft. deep, course S. 60° W.
Intersect west bdy. of Ft. Grant Military Reservation, 260 lks. N. 72° 24' W. of the 4th mile cor. established by me as described in Book "A."
At the above described point of intersection, I set an iron post 3 ft. long, 2 ins. in diam., 24 ins. in the ground, for C C of secs. 15 and 16, with a brass cap, marked,
C C W of center,
T 9 S R 23 E in N., and
1913 in S. half;
S 16 in NW., and
S 15 in NE. sector; from which,
Apost oak, 20 ins. in diam., brs. S. 77½° E., 49 lks. dist., marked T 9 S R 23 E S 15 B T.
No trees within dist. in sec. 16. Pits impracticable.
Raise a mound of stone 3 ft. base, 3 ft. high, north of cor.
Land, rolling.
Soil, very rocky.
Scattering grass.
Scrub oak, and black jack timber along wash, at south end of line.

1.96

From the cor. of secs. 9, 10, 15 and 16, hereinbefore described, I run,
West, on true line, bet. secs. 9 and 16.
Descending rocky west slope, 20 ft.
Intersect west bdy. of Ft. Grant Military Reservation 17.67 chs. N. 7° 24' W., of 4th mile cor., established by me, as described in Book "A."
At the above point of intersection, I set an iron post, 3 ft. long, 2 ins. in diam., 24 ins. in the ground, for C C of secs. 9 and 16, with a brass cap, marked
C C W of center,
T 9 S R 23 E in N., and
1913 in S. half;
S 9 in NE., and
S 16 in SE. sector. Pits impracticable.
Raise a mound of stone 3 ft. base, 3 ft. high, E. of cor.
Land, rolling.
Soil, very rocky.
Scattering grass.
No timber.

April 29th, 1913.

GENERAL DESCRIPTION.

This township consists of rolling, rocky land on slopes at foot of Mt. Graham, suitable only for grazing, except for the south half of secs. 25 and 26, and frac. sec. 27, and all of fractional sec. 34 and secs. 35 and 36.

12. Subdivision of part of Township 9 South, Range 23 East.
Chains.

The land in the last mentioned sections lays slightly rolling, practically all of which can be cultivated. The soil in this portion of the township is a very rich sandy loam, ranging in depth from 18 to 36 ins.

The two creeks which flow through this portion of the township from off the slopes of Mt. Graham afford water through the greater part of the year, and this water can easily be diverted for the purpose of irrigating this portion of the township.

The buildings of Old Ft. Grant, which was established about 1875, are situated about the center of sec. 25. All improvements connected with this old Fort are within sec. 25. There is a windmill and well in sec. 22, which belongs to a rancher living just outside the Military Reservation.

There are no other improvements of any kind in this township, and there are no settlers residing thereon except the State Reform School, which occupies the buildings of old Fort Grant.

Thomas B. Matthews

U.S. Surveyor.

FINAL OATH OF UNITED STATES SURVEYOR.

See Book "E."

I, _____, U. S. Surveyor, do solemnly swear that, in pursuance of special instructions received from the U. S. Surveyor General for _____ bearing date of the _____ day of _____, 191 _____, I have well, faithfully, and truly, in my own proper person, and in strict conformity with said instructions, the Manual of Surveying Instructions, and the laws of the United States, surveyed all those parts or portions of _____

_____ of the _____ Meridian, in the State of _____, which are represented in the foregoing field notes as having been executed by me, and under my direction; and I do further solemnly swear that all the corners of said survey have been established and perpetuated in strict accordance with the Manual of Surveying Instructions, and the special written instructions of the U. S. Surveyor General for _____ and in the specific manner described in the field notes, and that the foregoing are the original field notes of such survey.

U. S. Surveyor.

Subscribed by said _____, and sworn to before me }
this _____ day of _____, 191 _____



APPROVAL.

OFFICE OF THE UNITED STATES SURVEYOR GENERAL,

Phoenix, Arizona, March 20, 1915.

The foregoing field notes of the survey of _____ part of the _____ Subdivision lines of Township 9 South, Range 23 East, of the Gila and Salt River Base and Meridian, Arizona,

executed by _____ Thomas B. Matthews, U. S. Surveyor, under his special instructions dated _____ September 24, _____, 191 2, having been critically examined, and the necessary corrections and explanations made, the said field notes, and the surveys they describe, are hereby approved.

Frank S. Ingalls

Surveyor General of Arizona.

I certify that the foregoing transcript of the field notes of the above-described surveys in _____ Book "G," _____, has been correctly copied from the original notes on file in this office.