

"Book "B"

Retracement &amp; Resurvey of Standard Lines

## FIELD NOTES

BOOK 2736

of the RETRACEMENT  
and RESURVEY OF THEFIRST STANDARD PARALLEL SOUTH thru Rs.3 & 4 & part of 5 East,  
( Pages 1 to 15 incl. )SECOND STANDARD PARALLEL SOUTH thru Range 13 East,  
( Pages 17 to 20 incl. )

and

of the same Parallel thru Range 8 East  
( Pages 21 to 24 incl. )

Of the Gila and Salt River Base and Meridian,

In the State of Arizona

## EXECUTED BY

Jesse B. Wright

and

William H. Elliott,

In the capacity of U. S. Surveyors, under instructions dated May 28th, 1913,  
issued by the United States Surveyor General to govern surveys included in  
Group No. 30, which were approved by the Commissioner of the General Land  
Office, June 6, 1913, pursuant to authority contained in the Act of  
August 23, 1912 and  
Congress dated June 23, 1913.

Re Survey commenced June 24, 1913.

Re Survey completed October 13, 1913.

# INDEX DIAGRAM.

Township \_\_\_\_\_, Range \_\_\_\_\_

6	5	4	3	2	1
7	8	9	10	11	12
18	17	16	15	14	13
19	20	21	22	23	24
30	29	28	27	26	25
31	32	33	34	35	36

# INDEX DIAGRAM

Gp. 30-Ariz.

BOOK 2736

- Exterior lines to be found in this Book (Indexed)
- " " " " " " " " Book "A" this group
- " " " " " " " " " "C" " "
- Previous Surveys

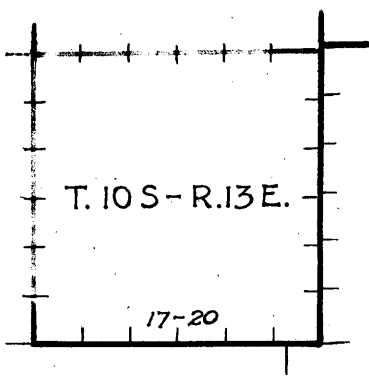
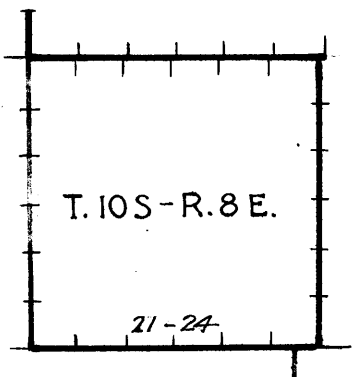
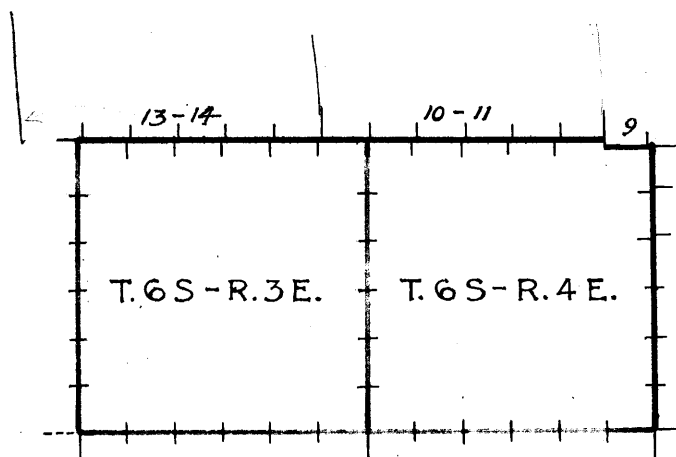

Camp, 14 miles North of  
Tucson, Arizona. July 20, 1913.

U. S. Surveyor General,  
Phoenix, Arizona.

Sir : -

I beg to submit herewith enclosed the field notes of the re-surveys and retracements along the 1st. Std. Parallel South, through Rs. 3 & 4, and along S. bdy. of sec. 31, of R. 5 E., as made by William H. Elliott and myself. Great care and pains has been taken to find and locate the old corners in their original positions, as near as possible, as the locations of many settlers was dependent thereon.

The true corners as re-established however varies greatly from the locations made by the settlers who appear to have been sincere in their belief that no old corners existed in the locality other than that from which they based their locations.

At the request of Mr. Mark Putnam, one of those most interested in the locations, I went over some of the land locations in T. 5 S., R. 4 E., and noted as follows :-

George Putnam, located in S.  $\frac{1}{2}$  of sec. 30, has well, pumping plant, house, and about 80 acres of land, cleared, ploughed, fenced and ditched for irrigation.

Mark Putnam, in S.  $\frac{1}{2}$  of sec. 29, has well, pumping plant, house and barn, and about 80 acres of land cleared, ploughed, fenced, and ditched for irrigation.

Jacob G. Lambet, in E.  $\frac{1}{2}$  of sec. 31, has house, and about 60 acres of land, cleared, ploughed, planted and ditched for irrigation.

A canal for carrying about 3000 miners inches of water has been constructed for  $3\frac{1}{2}$  miles from Quijotoa wash, for irrigating the above lands.

H. G. Lemon, in sec. 31, W.  $\frac{1}{2}$ , has about 30 acres of land, cleared, ploughed and fenced.

Other settlers were noted as follows:, who have built dwelling houses, and cleared from 30 to 40 acres each on their claims, living on them and working on them at date of my observations: *July 6, 1913.*

Mrs. Lucy Lands, in W.  $\frac{1}{2}$  of sec. 27.

C. L. Thompson, in E.  $\frac{1}{2}$  of sec. 34.

J. C. Thompson, in W.  $\frac{1}{2}$  of sec. 34.

C. L. Stearns, in NE.  $\frac{1}{4}$  of sec. 33.

John Vallianecourt, in NE.  $\frac{1}{4}$  of sec. 35. and

Ruben Shearer, in W.  $\frac{1}{2}$  of sec. 26.

It is the desire of the above settlers that I place the above facts before your for your consideration and future reference.

My belief is that but few, if any of the orig. corners of the subdivision lines of Tps. 5 S., Rs. 3 & 4 & 5 E. are in existence, and that a re-survey of these Tps. will be necessary before any of the settlers therein can be definitely located.

Most respectfully,

*Jose B. Wright*  
U. S. Surveyor.

**Chains.**

Surveys under Group No. 30, Ariz. commenced June 23, 1913, and executed jointly by Jesse B. Wright and William H. Elliott, U. S. Surveyors, Wright using transit No. 8145, and Elliott using transit No. 8492, with transit No. 6460 for emergencies, all instruments being light mountransits made by Young & Son's, with Smith patent solar attachments on side, the horizontal limbs having two double verniers placed opposite to each other, each vernier reading to single minutes of arc, which is also the least reading of the verniers of the latitude and declination arcs of the solars.

For convenience, the instruments are designated by their respective numbers as 8145, 8492, and 6460.

At 11h 45m a.m., at our temporary camp, which is located near the Standard cor. of Tps. 5 S., Rs. 3 & 4 E., in lat.  $32^{\circ}56'28''$  N., long.  $111^{\circ}59'48''$  W., we examine, test, and adjust the levels, the standards, and lines of collimation of the transits, and also the latitude arcs, the solar lines and lenses of the solar attachments; then, in order to test the solar apparatus by comparing the results of observations on the sun, for meridian, made during a.m. & p.m. hours, with a true meridian determined by observations on Polaris, we proceed as follows :

At 12h 01m 51s p.m., l.m.t., we set off  $23^{\circ}26\frac{1}{2}'$  N. on the decl. arcs, and observe the sun on the meridian. The resulting lat. as given by each instrument is  $32^{\circ}57'$  N., (our camp being somewhat north of the 1st Std. Par. S., as developed later.) this result showing that the relative adjustments of the verniers of the latitude and declination arcs are correct.

At 3h p.m., l.m.t., we set off  $23^{\circ}27'$  N. on the decl. arcs, and our observed lat.  $32^{\circ}57'$  N. on the lat. arcs, and determine meridians with the solars and mark the meridians thus determined by small tacks in a stake driven firmly in the ground 5 chs. N. of our station, points marked a, b, and c, for 8145, 8492, and 6460 respectively.

At 7h 22m p.m., l.m.t., we observe Polaris at lower culmination, and mark the meridian thus determined by a tack in the stake 5 chs. N. of our station, marking this point P. June 23, 1913.

June 24, 1913.

At 4h a.m., l.m.t., we make an observation on Polaris with each instrument, and by calculation deduce the following :

Polaris at upper culmination this day at 7h 20m a. m.  
Time of observation of Polaris, ----- 4h 0m a. m.  
Hour angle of Polaris at observation, --- 3h 20m., which reduced to degrees =  $50^{\circ}$

Azimuth of Polaris at long. this date, lat. and long. =  $1^{\circ}23' = 83'$ ;  $\sin. 50^{\circ} \times 83' = .76604 \times 83' = 62.6'$ , or  $1^{\circ}02\frac{1}{2}'$  about, = azimuth of Polaris at time of observation, 4h a.m., which agrees with tabulated azimuth from Ephemeris.

Therefore, from our line of observation we set off  $1^{\circ}02\frac{1}{2}'$  to the West, and find that the true meridian thus determined agrees with that determined by observation on Polaris on preceding evening, line point P, which falls .40 ins. W., .40 ins. W., and .60 ins. W. respectively, of points a, b, and c.

At 7h a.m., l.m. t., we set off  $23^{\circ}26\frac{1}{2}'$  N. on the decl. arcs, and  $32^{\circ}57'$  N. on the lat. arcs, and determine meridians with the solars, and mark the meridians thus determined by tacks in the stake 5 chs. N. of our station, marked a', b', and c' for 8145, 8492, and 6460 respectively, which points fall .60 ins. W., .50 ins. W., and .75 ins. E. respectively, of the true meridian point P as determined by observation on Polaris. Therefore, by p.m. & a.m. hours observations the transits give following results :

8145,  $20''$  E., and  $30''$  W. of true meridian,  
8492,  $20''$  E., and  $26''$  W. of true meridian,  
6460,  $30''$  E., and  $40''$  E. of true meridian; therefore we conclude that the instruments are in satisfactory adjustment.

## 4 Retraacement of 1st Std. Parallel South, through Range 4 East.

Chains. June 24, 1913  
(PRELIMINARY). (Initials J. B. W., and W. H. E. designate lines as run by Jesse B. Wright and William H. Elliott, respectively). J. B. W.

At the supposed Std. cor. of Tps. 5 S., Rs. 3 & 4 E., as pointed out by one of the settlers of the locality, which is a mesquite post 4 ins. in diam., with 6 grooves on E. & W. faces, but being apparently only about 4 years old, which was, as was learned, established by private surveyor,

At 8h a.m., l.m.t., I set off  $23^{\circ}26\frac{1}{2}'$  N. on the decl. arc, and  $32^{\circ}56\frac{1}{2}'$  N. on the lat. arc, and determine a meridian with the solar. Thence I retrace East, on supposed S. bdy. Sec. 31. Var.  $14^{\circ}$  E.

40.00 Find new stake 3 lks. to N. of line; no trace of old cor. found, after diligent search.

80.00 Find new stake 5 lks. S. of line., no trace of original std cor. found after diligent search.

-----

East, on supposed S. bdy. sec. 32.

40.00 Find new stake 3 lks. to S. of line, no trace of orig. std. cor. found after diligent search.

80.00 Find new stake 5 lks. to S. of line, no trace of orig. std. cor. found after diligent search.

-----

East, on supposed S. bdy. sec. 33.

40.00 Find new stake 5 lks. to S. of line. No trace of old cor.

80.00 Find new stake 6 lks. to S. of line, no trace of orig. std. cor. found after diligent search.

-----

East, on supposed S. bdy. sec. 34.

40.00 No trace of orig. std. cor. found after diligent search. Set temp. cor.

87.69 Find evident remains of orig. std. cor. 8.72 chs. to N. of line, which is an old mesquite post, properly marked as described by the Surveyor General.

-----

From the above described old cor., I retrace, East, on S. bdy. sec. 35.

39.87 Find evident remains of old std.  $\frac{1}{4}$  sec. cor. 43 lks. to S. of line, which is an old mesquite post properly marked as described by the Surveyor General.

Thence I run, East.

39.60 Find evident remains of orig. std. cor. 175 lks. to S. of line, which is an old mesquite post properly marked as described by the Surveyor General.

-----

From the above described old cor. I run, East, on S. bdy. sec. 36.

40.00 Find no trace of orig. std. cor., after diligent search. Set temp. stake on line and continue East.

80.00 Find an old Std. cor. of Tps. 5 S., Rs. 4 & 5 E., which brs.  $S.47^{\circ}05'$  W. 9.34 chs. dist. from my 80 ch. pt., this old cor. being an old mesquite post of about 25 years standing, properly marked as described by the Surveyor General.

June 24, 1913.

J.B.W.

Retracement of 1st Std. Parallel South, thru part of Range 5 E. 5

Chains. J.B.W. June 25, 1913.  
 At 8h a.m., l.m.t., at the old Std. cor. of Tps. 5 S.,  
 Rs. 4 & 5 E., hereinbefore described,  
 I set off 23°25' N. on the decl. arc, and 32°56½' N. on  
 the lat. arc, and determine a meridian with the solar.  
 Thence I run,  
 East, on S. bdy. of Sec. 31.  
 40.00 Find old stake lying on ground, properly marked, as  
 described by the Surveyor General. No other traces of cor.  
 80.04 Find evident remains of Std. cor. of secs. 31 & 32,  
 81 lks. to N. of line, from which the old closing  
 cor. of Tps. 6 S., Rs. 4 & 5 E. brs. East, 130 lks.  
 dist, which is an old stake properly marked as described  
 by the Surveyor General. True course & dist. of this mile  
 is therefore, N.89°25'E., 80.04 chs.  
 Supplemental retracements.  
 In order to further verify the location this Std. cor.,  
 and also of the old closing cor. of Tps. 6 S., Rs. 4 &  
 5 E., I proceed to the ¼ sec. cor. bet. secs. 7 & 8,  
 of T. 6 S., R. 5 E., which is an old stake properly  
 marked and which was easily located by reason of a fence  
 cornering nearby.  
 Thence I run,  
 North.  
 40.00 No trace of the orig. cor. of secs. 5, 6, 7 & 8 found  
 after diligent search. Set temp. stake to mark this  
 point.  
 Thence I run,  
 West.  
 39.90 Find old ¼ sec. cor. 56 lks. to N. of line, which is an  
 old stake properly marked, from which I run,  
 West.  
 39.08 Find orig. cor. of secs. 1, 6, 7 & 12, 80 lks. to N. of line,  
 which is an old stake properly marked as described by  
 the Surveyor General.  
 From this old cor. I run,  
 North.  
 40.31 Old ¼ sec. cor. brs. East, 64 lks. dist., which is an  
 old mesquite post, properly marked as described by  
 the Surveyor General.  
 From this old cor. I run,  
 North, continuing measurement.  
 82.78 The orig. closing cor. of Tps. 6 S., Rs. 4 & 5 E.  
 brs. East, 66 lks. dist., as hereinbefore described.  
 It is therefore evident that this is the true closing  
 cor. of Tps. 6 S., Rs. 4 & 5 E., and that the remains  
 of an old stake 130 lks. to the West of the closing  
 cor. is the true cor. point of secs. 31 & 32,  
 of Tp. 5 S., R. 5 E., on 1st Std. Parallel South.

June 25, 1913.

J. B. W.

6

Re-ascertainment of 1st Std. Parallel South, through Range 33<sup>4</sup> East.

Chains.

June 24, 1913. At 8h. a.m., l.m.t., W. H. E.  
At the supposed Std. cor. of Tps. 5 S., Rs. 3 & 4 E.,  
I set off  $23^{\circ}26\frac{1}{2}'$  N. on the decl. arc, and  $32^{\circ}56\frac{1}{2}'$  N. on  
the lat. arc, and determine a meridian with the solar.  
Thence I retrace,  
West, on supposed line of 1st Std. Parallel South,  
setting temporary stakes at intervals of 40 chs.  
and making diligent search at these points for some  
evidence or trace of the orig. Standard corners.  
Continued this line West, for a distance of 6 miles,  
no trace of any old corners found.

June 24, 1913.

## Supplemental retracements.

June 25, 1913.

At 8h a.m., l.m.t., at the supposed cor. of secs. 21, 22,  
27 & 28, of T. 5 S., R. 3 E., as pointed out by a  
settler of the vicinity, which is a stake of about 3  
years standing,

I set off  $23^{\circ}25'$  N. on the decl. arc, and  $32^{\circ}58'$  N. on  
the lat. arc, and determine a meridian with the solar.  
Thence I run,

West, for a distance of 3 miles, finding new corners on  
this line as set by private surveyor. No trace of  
any original cor. found at any point after diligent  
search.

At 3 miles dist. on this line, at a new stake of about  
3 years standing, supposed cor. of secs. 19, 24, 25 & 30,  
from which I run,

North, along W. bdy. of T. 5 S., R. 3 E., making  
diligent search at intervals of 40 chs. for  
some trace of original corners from to base location  
or re-establishment of other corners to the south.  
Find no trace of any old stakes, new corners being  
along this line set by private survey, from which  
the settlers of the locality have based their locations.  
Evidence of pits being found at the cors. of secs. 7,  
12, 13 & 18, and at cor. of secs. 1, 6, 7 & 12, the  
age or origin of same being questionable.

From the supposed cor. of secs. 19, 24, 25 & 30,  
above described, I run,  
South, Var.  $14^{\circ}$  E.

setting temporary stakes at intervals of 40 chs.  
and making diligent search at these points for some  
trace of original corners, finding no trace or evidence  
of any old corners.

160.00

Set temporary stake for point on supposed 1st std. Par. S.  
June 25, 1913.

There being at hand no further evidence of original  
corners along the West bdy. of T. 5 S., R. 3 E., other  
than as above described, and since many settlers in the  
locality have based their locations upon these corners,  
it seems consistent with requirements to run a random  
line along the 1st Std. Parallel S. from the Std. cor.  
of Tps. 5 S., Rs. 4 & 5 E., as located by J. B. Wright,  
and hereinbefore described, connecting with a line  
along the West bdy. of T. 5 S., R. 3 E., at the stake  
set at the 160.00 ch. point above located.

W. H. E.



Retracement of 1st Std. Parallel South, through Rs. 3 & 4 East. 7

Chains.

W. H. E.  
 June 28, 1913.  
 At 8h a.m., l.m.t. at the old Std. cor. of Tps. 5 S., Rs. 4 & 5 E., as located by J. B. Wright, and hereinbefore described,  
 I set off 23°18½' N. on the decl. arc, and 32°56½' N. on the lat. arc, and determine a meridian with the solar. Thence I run, on a calculated bearing from connections, N. 88°35' W. on a random line, along the South bdy. of T. 5 S., R. 4 E., setting temporary stakes at intervals of 40 and 50 chs., and making diligent search for original corners along and near the line. No old corners found.  
 June 28, 1913.

W. H. E.

-----  
 W. H. E. Through Range 3 East.  
 June 29, 1913.  
 At 8h a.m., l.m.t., at my temporary cor. of Tps. 5 S., Rs. 3 & 4 E., on random line,  
 I set off 23°16' N. on the decl. arc, and 32°56½' N. on the lat. arc, and determine a meridian with the solar. Thence I run, on random line,  
 N. 88°35' W., setting temporary stakes at intervals of 40 chs., and searching for original corners.  
 At 4 miles, or 320 chs. on this random line,  
 The orig. Std. cor. of secs. 32 & 33, T. 5 S., R. 3 E. brs. S. 31°53' E., 13.25 chs. dist., which is an old mesquite post, lying on old mound, with remains of pits E. W. & N.; this post, being marked and witnessed as described by the Surveyor General, and from all appearances is beyond question the original Std. cor. of secs. 32 & 33.

From the original cor., as above described, I run,  
 West, on random line, on S. bdy. of sec. 32.  
 40.02 Find old ¼ sec. cor. 3 lks. to S. of line marked as described by the Surveyor General, being an old mesquite post.  
 80.02 Find old Std. cor. of secs. 31 & 32 lying on ground, an old mesquite post, marked as described by the Surveyor General, 5 lks. to S. of line.

From this old cor. I run,  
 West, on S. bdy. of sec. 31.  
 40.02 Find old Std. ¼ sec. cor., properly marked, and old mesquite, post, as described by the Surveyor General.  
 80.04 The orig. Std. cor. of Tps. 5 S., Rs. 2 & 3 E. brs. South, 8 lks. dist., which is an old mesquite post, properly marked, as described by the Surveyor General.

I return to the orig. Std. cor. of secs. 32 & 33, T. 5 S., R. 3 E. above described, and run thence,  
 East, on random line, on S. bdy. of sec. 33.  
 40.05 Find orig. std. ¼ sec. cor. lying on ground to N. of line.  
 80.05 Find orig. std. cor. of secs. 33 & 34, 23 lks. to N. of line, lying on ground, which is an old mesquite post, properly marked, as described by the Surveyor General.  
 ( An old mesquite post, properly marked, as described by the Surveyor General. )

From the old Std. cor. of secs. 33 & 34, above described, I run,  
 East, on S. bdy. of sec. 34.  
 40.00 No trace of orig. ¼ sec. cor. found after diligent search.  
 80.00 No trace of orig. Std. cor. of secs. 34 & 35 found after diligent search.

East, on S. bdy. of sec. 35.  
 40.00 No trace of orig. ¼ sec. cor. found after diligent search.  
 80.10 Find orig. Std. cor. of secs. 35 & 36, 47 lks. to N. of line, which is an old mesquite post, marked and witnessed as described by the Surveyor General.

## Retracement of 1st Std. Parallel South, through Rs. 3 &amp; 4 East.

Chains.	From the orig. Std. cor. of secs. 35 & 36, Above described, I run, East, on S. bdy. of sec. 36.
40.00	Find orig. Std. $\frac{1}{4}$ sec. cor. lying on ground a little to N. of line, an old mesquite post, properly marked as described by the Surveyor General.
80.00	Find orig. Std. cor. of Tps. 5 S., Rs. 3 & 4 E. 20 lks. to N. of line, which is an old mesquite post, properly marked, as described by the Surveyor General.
<u>Note</u>	From this orig. cor., the "Supposed Std. cor.", from which we initiated our retracements on June 24th, brs. S. 36° W. 12.42 chs. dist. June 29, 1913. W.H.E
	W.H.E. Through Range 4 East. July 1, 1913.
	At 8h a.m., l.m.t., at the orig. Std. cor. of Tps. 5 S., Rs. 3 & 4 E., hereinbefore described, I set off 23°08 $\frac{1}{2}$ ' N. on the decl. arc, and 32°56 $\frac{1}{2}$ ' N. on the lat. arc, and determine a meridian with the solar. thence I retrace, East, on S. bdy. sec. 31, T. 5 S., R. 4 E.
40.00	The orig. Std. $\frac{1}{4}$ sec. cor. brs. North, 11 lks. dist., an old mesquite post, marked and witnessed as described by the Surveyor General. Thence I run, East.
40.00	The orig. Std. cor. of secs. 31 & 32 brs. North, 16 lks. dist., an old post, lying on ground, marked as described by the Surveyor General.
	-----
	From the above old Std. cor., I run, East, on random line, on S. bdy. of sec. 32.
40.00	The orig. Std. $\frac{1}{4}$ sec. cor. brs. North, 17 lks. dist., an old post lying on ground, with remains of pits, marked as described by the Surveyor General. Thence I run, East.
40.04	The orig. Std. cor. of secs. 32 & 33 brs. South, 33 lks. dist., an old post lying on ground, marked as described by the Surveyor General.
	-----
	Thence from the above described old cor., I run, East, on random line, on S. bdy. of sec. 33.
40.04	The orig. std. $\frac{1}{4}$ sec. cor. brs. South, 32 lks. dist., an old mesquite post, marked as described by the Surveyor General, , from which I run, East.
40.00	No trace of orig. Std. cor. of secs. 33 & 34 found, after diligent search. Set temp. cor., and run thence, East on random line, on S. bdy. of Sec. 34.
40.08	The orig. Std. $\frac{1}{4}$ sec. cor. brs. South, 5 lks. dist., an old mesquite post, lying on ground, marked as described by the Surveyor General, from which I run, East.
40.04	The orig. Std. cor. of secs. 34 & 35 brs. S., 32 lks. dist., an old mesquite post, (standing 2 ft. above ground,) marked as described by the Surveyor General.
	-----
	From the above described cor., I run, East, on random line, on S. bdy. of Sec. 35.
39.87	The orig. Std. $\frac{1}{4}$ sec. cor. brs. South, 42 lks. dist., an old post marked as described by the Surveyor General. Thence I run, East.
39:60	The orig. Std. Cor. secs. 35 & 36 brs. South 175 lks. dist., marked as described by the Surveyor General.
	-----
	From the above described old cor., I run, East, on a random line, on S. bdy. of Sec. 36.
40.00	No trace of orig. $\frac{1}{4}$ sec. cor. found after diligent search.
73.06	Find an old post, properly marked as described by the Surveyor General, which is evidently the older, and original Std. cor. of Tps. 5 S., Rs. 4 & 5 E., as set in 1868. The old Std. cor. of Tps. 5 S., Rs. 4 & 5 E., as discovered by J. B. Wright brs. South, 635 lks. dist., being evidently the cor. re-established in 1887. July 1, 1913. W.H.E

Chains

July 2, 1913. W. H. E.  
 From the retracements as given and developments thereof, it appears that the re-establishment of the 1st Std. Parallel S., along S. bdy. of Sec. 31, of T. 5 S., R. 5 E. as made in 1887 is erroneous; but having no other evidence than as portrayed on the ground, it is deemed advisable to re-establish the corners as found along the S. bdrs. of Tps. 5 S., Rs. 3 & 4 E., and along the S. bdy. of Sec. 31 of T. 5 S., R. 5 E., in their present positions; therefore, as these old corners are in a very dilapidated condition, and the markings thereon being almost obliterated, I proceed to set new corners at the original positions.  
 The old Std. cor. of Tps. 5 S., Rs. 4 & 5 E., re-established in 1887, and located by J. B. Wright on June 24th, I re-establish in original position as follows:  
 Set an iron post 3 ft. long, 3 ins. in diam., 24 ins. in the ground for Std. Tp. cor. T. 5 S., R. 5 E., marked on brass cap, S C, and T 5 S, in N. half, R 5 E S 31 in NE. quad.  
 dig pits 36 x 36 x 12 ins. E. & N. of cor. 8 ft. dist., and raise a mound of earth 5 ft. base, 2½ ft. high NE. of cor.

1st Std. Par. S., through R. 5 E.  
 At 7h. a. m., 1. m. t., at the cor. above described, I set off 23° 05' N. on the decl. arc, and 32° 56½' N. on the lat. arc, and determine a meridian with the solar. Thence I run, on a true line, as per retracement hereinbefore noted  
 N. 89° 25' E., on S. bdy. of sec. 31, T. 5 S., R. 5 E.  
 Over gently rolling valley, through dense mesquite, greasewood, palo christo, and sage brush. Var. 14° E.  
 Difference bet. measurements of 40.02 chs. by 2 sets of chainmen is 2 lks. position of middle point,  
 by 1st set, 40.03 chs.,  
 by 2nd set, 40.01 chs., the mean of which is  
 40.02 Re-establish Std. ¼ sec. cor. as follows:  
 Set an iron post 3 ft. long, 1 in. in dia. 26 ins. in the ground for Std. ¼ sec. cor., marked on brass cap, ¼ S 31 in N. half;  
 1913 on S. rim,  
 dig pits 18 x 18 x 12 ins. E. & W. of cor. 3 ft. dist., and raise a mound of earth 3½ ft. base, 1½ ft. high N. of cor.

Difference bet. measurements of 80.04 chs. by 2 sets of chainmen is 4 lks.; position of middle point,  
 by 1st set, 80.06 chs.,  
 by 2nd set, 80.02 chs.; the mean of which is  
 80.04 At original cor. point, hereinbefore described, I re-establish Std. sec. cor. as follows:  
 Set an iron post 3 ft. long, 3 ins. in dia., 24 ins. in the ground for re-established Std. cor. of secs. 31 & 32, marked on brass cap, T 5 S. R 5 E, in N. half; 1913 on S. rim, S 31 in NW., and S 32 in NE. quad.;  
 dig pits 24 x 18 x 12 ins., crosswise on each line, E. & W. 3 ft., and N. of cor. 7 ft. dist., and raise a mound of earth 4 ft. base, 2 ft. high N. of cor.  
 Land, rolling.  
 Soil, 2nd rate, gravelly, sandy, loose, dry.  
 Mesquite, greasewood, sage brush, palo christo, sparse grass.

I return to the Std. cor. of T. 5 S., R. 5 E., hereinbefore described, and at the old cor. discovered 6.35 chs. North of this point, establish Std. cor. of Tp. 5 S., R. 4 E. in same place as follows:

## 10. Re-survey of 1st Std. Parallel South in Range 4 East.

Chains

- Set a mesquite post 3 ft. long, 6 ins. in diam. lower portion charred, and set 2 ft. in the ground, squared at top and marked S C, T 5 S, on N., and R 4 E, S 36 on W. faces, with 6 grooves on N. & W. faces. (Mesquite post being used at this point for reason that I lack one iron post). Destroy old cor. dig pits 36 x 36 x 12 ins. N. & W. of cor. 8 ft. dist. and raise a mound of earth 5 ft. base 2 ft. high NW. of cor.
- 
- From the SE. cor. of T. 5 S., R. 4 E., just established and described by me, I run,  
 30.30 West, on a true line, on S. bdy. of Sec. 36, land rolling. Wash, 30 lks. wide, course N., enter dense brush. As the point to re-establish the Std.  $\frac{1}{4}$  sec. cor. falls in wash, at  
 36.23 Set an iron post 3 ft. long, 1 in. in diam. 26 ins. in the ground for witness cor. to re-established  $\frac{1}{4}$  sec. cor. marked on brass cap, 1913 on S. rim, W C  $\frac{1}{4}$  in W. half, and S 36 in NE. quad.; dig pits 18 x 18 x 12 ins. E & W. of cor. 3 ft. dist. and raise a mound of earth 3 $\frac{1}{2}$  ft. base, 1 $\frac{1}{2}$  ft. high N. of cor.  
 36.53 Wash, 20 lks. wide, course NW. Point for Std.  $\frac{1}{4}$  sec. cor.  
 41.50 Wash, 20 lks. wide, course NW.  
 60.00 Road, brs. N. & S.  
 73.06 Old Std. sec. cor. hereinbefore described which I destroy and re-establish in same place as follows:  
 Set an iron post 3 ft. long, 3 ins. in diam. 24 ins. in the ground for Std. cor. of secs. 35 & 36, marked on brass cap, T 5 S R 4 E, in N. half, 1913 on S. rim, S 35 in NW., and S 36 in NE. quad.; dig pits 24 x 12 x 12 ins., crosswise on each line, E&W. 3 ft., and N. of cor. 7 ft. dist., and raise a mound of earth 4 ft. base, 2 ft. high N. of cor.  
 Land, rolling.  
 Soil 2nd rate, sandy, loamy, loose, dry.  
 Mesquite, greasewood, sage brush, sparse grass.
- 
- N. 87° 28' W., on a true line on S. bdy. of sec. 35. Over rolling land, through dense brush.  
 39.64 Old Std.  $\frac{1}{4}$  sec. cor. hereinbefore described which I destroy and re-establish in same place as follows:  
 Set an iron post 3 ft. long, 1 in. in diam. 26 ins. in the ground for Std.  $\frac{1}{4}$  sec. cor., marked on brass cap, 1913 on S. rim,  $\frac{1}{4}$  S 35 in N. half; dig pits 18 x 18 x 12 ins. E. & W. of cor. 3 ft. dist., and raise a mound of earth 3 $\frac{1}{2}$  ft. base, 1 $\frac{1}{2}$  ft. high N. of cor.  
 Thence I run, on true line,  
 N. 89° 24' W.  
 39.87 Old Std. sec. cor., hereinbefore described which I destroy and re-establish in same place as follows:  
 Set an iron post 3 ft. long, 3 ins. in diam. 24 ins. in the ground for Std. cor. of secs. 34 & 35, marked on brass cap, T 5 S R 4 E, in N. half, 1913 on S. rim, S 34 in NW., and S 35 in NE. quad.; dig pits 24 x 18 x 12 ins. crosswise on each line E & W. 3 ft., and N. of cor. 7 ft. dist., and raise a mound of earth 4 $\frac{1}{2}$  ft. base, 2 ft. high N. of cor.  
 No trees in limits of sufficient size for bearings.  
 At this cor., at noon, I set off 23° 03 $\frac{1}{2}$ ' N. on the decl. arc, and observe the sun on the meridian.  
 The resulting lat. is 32° 56' N.  
 Land, rolling gently.  
 Soil, 2nd rate, sandy, loose, dry.  
 Mesquite, greasewood, sage brush, sparse grass.

## Resurvey of 1st. Std. Parallel South, through Range 4 East. 11

Chains	
	N. 89° 32' W., on a true line on S. bdy. of sec. 34. Over gently rolling land, through dense greasewood.
40.04	Old Std. $\frac{1}{4}$ sec. cor. hereinbefore described which I destroy and reestablish in same place as follows: Set an iron post 3 ft. long, 1 in. in diam. 26 ins. in the ground for Std. $\frac{1}{4}$ sec. cor., marked on brass cap, 1913 on S. rim, $\frac{1}{4}$ S 34 in N. half; dig pits 18 x 18 x 12 ins., E. & W. of cor. 3 ft. dist., and raise a mound of earth 3 $\frac{1}{2}$ ft. base, 1 $\frac{1}{2}$ ft. high N. of cor. Thence I run,
40.04	N. 89° 56' W., on true line Re-establish Std. sec. cor. as follows: Set an iron post 3 ft. long, 3 ins. in diam. 24 ins. in the ground for Std. cor. of secs. 33 & 34, marked on brass cap, T 5 S R 4 E, in N. half, 1913 on S. rim, S 33 in NW., and S 34 in NE. quad.; dig pits 24 x 12 x 12 ins. crosswise on each line, E & W. 3 ft. and N. of cor. 7 ft. dist., and raise a mound of earth 4 ft. base, 2 ft. high, N. of cor. Land, rolling. Soil, 2nd rate, sandy. Greasewood, mesquite.
	-----
	N. 89° 56' W., on a true line, on S. bdy. of sec. 33, Over gently rolling valley, through dense brush.
2.00	Road, brs. NE. & SW.
8.00	Irrigation ditch <del>course</del> N., 10 lks. wide.
17.70	Road, brs. N. & S.
20.40	Wash, 30 lks. wide, course NE.
24.25	Wash, 10 lks. wide, course N.
40.04	Old Std. $\frac{1}{4}$ sec. cor. hereinbefore described which I destroy and re-establish in same place as follows: Set an iron post 3 ft. long, 1 in. in diam. 26 ins. in the ground for Std. $\frac{1}{4}$ sec. cor., marked on brass cap, $\frac{1}{4}$ S 33 in N. half; 1913 on S. rim, dig pits 18 x 18 x 12 ins. E. & W. of cor. 3 ft. dist. and raise a mound of earth 3 $\frac{1}{2}$ ft. base, 1 $\frac{1}{2}$ ft. high, N. of cor. Thence I run N. 89° 32' W. on true line,
6.96	Road, brs. NW. & SE.
18.96	Road, brs. NW. & SE.
40.04	Old Std. Sec. cor. hereinbefore described which I destroy and re-establish in same place as follows; Set an iron post 3 ft. long, 3 ins. in diam. 24 ins. in the ground for Std. cor. of secs. 32 & 33, marked on brass cap, T 5 S R 4 E, in N. half, 1913 on S. rim, S 32 in NW., and S 33 in NE. quad.; from which, A mesquite tree 6 ins. diam. brs. N. 80 $\frac{1}{2}$ ° E. 109 lks. dist., marked T 5 S R 4 E S 33 B T. A mesquite tree 8 ins. diam. brs. N. 28 $\frac{1}{2}$ ° W. 283 lks. dist., marked T 5 S R 4 E S 32 B T. Land, gently rolling. Soil, 2nd rate, sandy, loamy, loose. Greasewood, mesquite, sage brush, sparse grass.
	-----
	N. 89° 32' W., on a true line, on S. bdy. of sec. 32. Over gently undulating valley, through dense brush.
18.50	Road, brs. N. & S.
40.04	Old Std. $\frac{1}{4}$ sec. cor. hereinbefore described which I destroy and re-establish in same place as follows: Set an iron post 3 ft. long, 1 in. in diam. 26 ins. in the ground for Std. $\frac{1}{4}$ sec. cor., marked on brass cap, 1913 on S. rim, $\frac{1}{4}$ S 32 in N. half; dig pits 18 x 18 x 12 ins., E. & W. of cor. 3 ft. dist. and raise a mound of earth 3 $\frac{1}{2}$ ft. base, 1 $\frac{1}{2}$ ft. high N. of cor. Thence I run, on true line, S. 89° 45' W.

## 12. Re-survey of 1st Std. Parallel South, through Range 4 East

Chains

7.15 Irrigation ditch, 10 lks. wide, course N.  
 40.00 Old Std. Sec. cor. hereinbefore described which I destroy and re-establish in same place as follows:  
 Set an iron post 3 ft. long, 3 ins. in diam. 24 ins. in the ground for Std. cor. of secs. 31 & 32, marked on brass cap, T 5 S R 4 E, in N. half, 1913 on S. rim, S 31 in NW., and S 32 in NE. quad.;  
 dig pits 24 x 18 x 12 ins., crosswise on each line, E. & W. 3 ft. and N. of cor. 7 ft. dist. and raise a mound of earth 4 ft. base, 2 ft. high N. of cor.  
 Land, rolling.  
 Soil, 2nd rate, sandy, loose, dry.  
 Mesquite and sage brush, greasewood, poor grass.

S. 89° 46' W., on a true line, on S. bdy. of sec. 31.  
 Over gently rolling valley, through dense brush.  
 7.50 Irrigation ditch, 10 lks. wide, course N.  
 13.20 Road, brs. NE. & SW.  
 28.00 Road, brs. NE. & SW.  
 40.00 Old Std.  $\frac{1}{4}$  sec. cor. hereinbefore described which I destroy and re-establish in same place as follows:  
 Set an iron post 3 ft. long, 1 in. in diam. 26 ins. in the ground for Std.  $\frac{1}{4}$  sec. cor., marked on brass cap,  $\frac{1}{4}$  S 31 in N. half; 1913 on S. rim,  
 dig pits 18 x 18 x 12 ins. E. & W. of cor. 3 ft. dist. and raise a mound of earth 3 $\frac{1}{2}$  ft. base, 1 $\frac{1}{2}$  ft. high N. of cor.  
 Thence I run,  
 S. 89° 51' W.  
 40.00 Old Std. Tp. cor. hereinbefore described which I destroy and re-establish in same place as follows:  
 Set an iron post 3 ft. long, 3 ins. in diam. 24 ins. in the ground for Std. cor. of Tps. 5 S., Rs. 3 & 4 E., marked on brass cap, 1913 on S. rim,  
 T 5 S in N. half;  
 R 3 E S 36 in NW., and  
 R 4 E S 31 in NE. quad.;  
 dig pits 30 x 24 x 12 ins. crosswise on each line, E. & W., 4 ft., and N. of cor. 8 ft. dist., and raise a mound of earth 5 ft. base, 2 $\frac{1}{2}$  ft. high N. of cor.  
 Land, gently rolling.  
 Soil, 2nd rate, sandy, loamy, loose, dry.  
 Mesquite, greasewood, sage brush, sparse grass.

July 2, 1913.

W. H. E.

Re-survey of 1st Std. Parallel South, through Range 3 East. 13

Chains	
	<p>W. H. E.            July 3, 1913.            At 7h., a. m., 1. m. t., at the Std. cor. of Tps. 5 S., Rs. 3 &amp; 4, E., re-established by me and hereinbefore described,            I set off 23° 00' N. on the decl. arc, and 32° 56½' N. on the lat. arc, and determine a meridian with the solar.            Thence I run,            S. 89° 51' W., on a true line on S. bdy. Sec. 36.            Over gently rolling land, through dense brush.</p>
16.00	Road, brs. NE. & SW.
40.00	<p>The old Std. ¼ sec. cor., hereinbefore described, which I destroy and re-establish in same place as follows:            Set an iron post 3 ft. long, 1 in. in diam., 26 ins. in the ground for std. ¼ sec. cor., marked on brass cap, ¼ S 36 in N. half; 1913 on S. rim,            dig pits 18 x 18 x 12 ins. E. &amp; W. of cor. 3 ft. dist., and raise a mound of earth 3½ ft. base, 1½ ft. high N. of cor.</p>
66.00	Eastman's irrigation ditch, 5 lks. wide, course NW.
68.00	Road, brs. NW. & SE.
80.00	<p>The old Std. sec. cor., hereinbefore described, which I destroy and re-establish in same place as follows:            Set an iron post 3 ft. long, 3 ins. in diam. 24 ins. in the ground for Std. cor. of secs. 35 &amp; 36, marked on brass cap, T 5 S R 3 E, in N. half; 1913 on S. rim, S 35 in NW., and S 36 in NE. quad.; dig pits 24 x 18 x 12 ins. crosswise on each line E. &amp; W. 3 ft. and N. of cor. 7 ft. dist., and raise a mound of earth 4 ft. base 2 ft high N. of cor.            Land, level, gently rolling.            Soil, 2nd rate, sandy, loamy, loose, dry.            Greasewood, mesquite, sage brush, sparse grass.</p>
-----	
	<p>S. 89° 50' W., on a true line, on S. bdy. of sec. 35.            Over gently rolling land, through dense brush.</p>
12.00	Road, brs. NW. & SE.
14.50	Road, brs. NW. & SE.
40.025	<p>Re-establish Std. ¼ sec. cor. as follows:            Set an iron post 3 ft. long, 1 in. in diam. 26 ins. in the ground for std. ¼ sec. cor., marked on brass cap, 1913 on S. rim, ¼ S 35 in N. half;            dig pits 18 x 18 x 12 ins. E. &amp; W. of cor. 3 ft. dist., and raise a mound of earth 3½ ft. base, 1½ ft. high N. of cor.</p>
49.20	Road, brs. N. & S.
64.70	Road, brs. NE. & SW.
80.05	<p>Re-establish Std. sec. cor. as follows: (Lacking one iron post to complete the resurvey of this line).            Set a mesquite post 3 ft. long, 6 ins. in diam. 24 ins. in the ground, for std. cor. of secs. 34 &amp; 35, squared at top; and marked            S C T 5 S R 3 E, on N.            S 34 on W., and            S 35 in E. faces, with 2 grooves in E. and 4 grooves on W. faces;            dig pits 24 x 18 x 12 ins., crosswise on each line, E. and W. 3 ft., and N. of cor. 7 ft. dist., and raise a mound of earth 4 ft. base, 2 ft. high N. of cor.            Land, level, gently rolling.            Soil, 2nd rate, sandy, loose, loamy, dry.            Mesquite, greasewood, sage brush, cacti, sparse grass.</p>
-----	
	<p>S. 89° 50' W. on a true line, on S. bdy. of sec. 34.            Over gently rolling valley, through dense brush.</p>
40.025	<p>Re-establish Std. ¼ sec. cor. as follows:            Set an iron post 3 ft. long, 1 in. in diam. 26 ins. in the ground for Std. ¼ sec. cor., marked on brass cap, 1913 on S. rim,</p>

## 14. Re-Survey of 1st Std. Parallel South, through Range 3 East.

Chains

- $\frac{1}{4}$  S 34 in N. half;
- dig pits 18 x 18 x 12 ins. E. & W. of cor. 3 ft. dist.,  
and raise a mound of earth  $3\frac{1}{2}$  ft. base,  $1\frac{1}{2}$  ft. high N.  
of cor.
- 50.00 Road, brs. NW. & SE.  
55.50 Road, brs. NW. & SE.  
80.05 The old Std. cor. of secs. 33 & 34, hereinbefore described,  
which I destroy & re-establish in same place as follows:  
Set an iron post 3 ft. long, 3 ins. in diam. 24 ins. in  
the ground for Std. cor. of secs. 33 & 34, marked on  
brass cap, T 5 S R 3 E, in N. half; 1913 on S. rim,  
S 33 in NW., and  
S 34 in NE. quad.;
- dig pits 24 x 18 x 12 ins. crosswise on each line E.&W.  
of cor. 3 ft. and N. of cor. 7 ft. dist., and raise a  
mound of earth 4 ft. base, 2 ft. high, N. of cor.
- Land, rolling.  
Soil, 2nd rate, sandy, loamy, loose, dry, heavy.  
Mesquite, greasewood, sage brush, sparse grass.  
At this cor., at noon I set off  $22^{\circ} 59'$  N. on the decl.  
arc, and observe the sun on the meridian.  
The resulting lat. is  $32^{\circ} 56\frac{1}{2}'$  N.
- 

- S.  $89^{\circ} 50'$  W., on a true line, on S. bdy. of sec. 33.  
Over gently rolling land, through dense brush.
- 23.00 Road, brs. NE. & SW.  
36.00 Road, brs. N. & S.  
40.025 The old Std.  $\frac{1}{4}$  sec. cor., hereinbefore described, which  
I destroy and re-establish same as follows:  
Set an iron post 3 ft. long, 1 in. in diam. 26 ins. in  
the ground for Std.  $\frac{1}{4}$  sec. cor., marked on brass cap,  
 $\frac{1}{4}$  S 33 in N. half; 1913 on S. rim,  
dig pits 18 x 18 x 12 ins. E. & W. of cor. 3 ft. dist.,  
and raise a mound of earth  $3\frac{1}{2}$  ft. base,  $1\frac{1}{2}$  ft. high, N.  
of cor.
- 80.05 The old Std. sec. cor. hereinbefore described, which I de-  
stroy and re-establish in same place as follows:  
Set an iron post 3 ft. long, 3 ins. in diam. 24 ins. in  
the ground for std. cor. of secs. 32 & 33, marked on  
brass cap, T 5 S R 3 E, in N. half; 1913 on S. rim,  
S 32 in NW., and  
S 33 in NE. quad.;
- dig pits 24 x 18 x 12 ins., crosswise on each line, E.&  
W. 3 ft. and N. of cor. 7 ft. dist., and raise a mound  
of earth 4 ft. base, 2 ft. high N. of cor.
- Land, rolling gently.  
Soil, 2nd rate, sandy, loose, dry, loamy, heavy.  
Mesquite, greasewood, sage brush, sparse grass.
- 

- S.  $89^{\circ} 58'$  W., on a true line, on S. bdy. of sec. 32.  
Over gently undulating land, through dense brush.
- 40.02 The old Std.  $\frac{1}{4}$  sec. cor., hereinbefore described, which I  
destroy and re-establish in same place as follows:  
Set an iron post 3 ft. long, 1 in. in diam. 26 ins. in  
the ground for std.  $\frac{1}{4}$  sec. cor., marked on brass cap,  
 $\frac{1}{4}$  S 32 in N. half; 1913 on S. rim,  
dig pits 18 x 18 x 12 ins. E. & W. of cor. 3 ft. dist.,  
and raise a mound of earth  $3\frac{1}{2}$  ft. base,  $1\frac{1}{2}$  ft. high N.  
of cor.
- 80.02 The old Std. sec. cor. hereinbefore described, which I de-  
stroy and re-establish in same place as follows:  
Set an iron post 3 ft. long, 3 ins. in diam. 24 ins. in  
the ground for std. cor. of secs. 31 & 32, marked on  
brass cap, T 5 S R 3 E, in N. half, S. 31 in NW., and  
S 32 in NE. quad.; 1913 on S. rim,  
dig pits 24 x 18 x 12 ins. crosswise on each line, E & W  
3 ft. and N. of cor. 7 ft. dist., and raise a mound of  
earth 4 ft. base, 2 ft. high N. of cor.
- Land, gently rolling. Soil, 2nd rate, sandy, loose, dry.  
Mesquite, greasewood, sparse grass.



Re-survey of 1st Std. Parallel South, through Range 3 East. 15.

Chains.

West, on a true line, on S. bdy. of Sec. 31.  
 Over gently rolling land, through scattering brush.  
 40.02 The old Standard  $\frac{1}{4}$  sec. cor., hereinbefore described, which I  
 destroy and reestablish in the same place as follows:  
 Set an iron post 3 ft. long, 1 in. in diam., 26 ins. in  
 the ground for std.  $\frac{1}{4}$  sec. cor., marked on brass cap,  
 $\frac{1}{4}$  S 31 in N. half; 1913 on S. rim,  
 dig pits 18x18x12 ins. E. & W. of cor. 3 ft. dist., and  
 raise a mound of earth  $3\frac{1}{2}$  ft. base,  $1\frac{1}{2}$  ft. high N. of cor.  
 Thence I run, S.  $89^{\circ}58'$  W., on a true line  
 40.02 The old Standard Tp. cor., hereinbefore described, which I  
 destroy and reestablish in the same place as follows:

Set an iron post 3 ft. long, 3 ins. in diam. 24 ins. in  
 the ground for std. cor. of Tps. 5 S., Rs. 2 & 3 E.,  
 marked on brass cap, 1913 on S. rim,  
 T 5 S in N. half,  
 R 2 E S 36 in NW., and  
 R 3 E S 31 in NE. quad.;  
 dig pits 36x24x12 ins., crosswise on each line, E. & W.  
 4 ft., and N. of cor. 8 ft. dist., and  
 raise a mound of earth 5 ft. base  $2\frac{1}{2}$  ft. high N. of cor.  
 Land, gently rolling, level.

Soil, 2nd rate, sandy, loamy, loose, dry.  
 Mesquite, greasewood, sage brush, sparse grass.

Note -- From this cor., the temporary stake as set by me on  
 June 25th, at 160.00 chs. S. of the supposed cor. of  
 secs. 19, 24, 25 & 30, on W. bdy. of T. 5 S., R. 3 E.,  
 brs. N.  $6^{\circ}47'$  E., 11.27 chs. dist.

July 3, 1913 W.H.E.

General Description.

The 1st Std. Parallel South, through Rs. 3 & 4 E. as  
 re-surveyed, runs over a smooth or gently rolling  
 valley, covered with mesquite, greasewood, and sage brush  
 brush. The soil is a loose sandy loam, fertile and  
 light, and produces well when watered.

Explanatory note.

The re-survey of the 1st Std. Par. S., through Rs. 3 & 4  
 E., and the discovery of nearly all of the original  
 corners thereon in their original positions as nearly  
 as possible, has resulted in greatly confusing the  
 settlers in Tps. 5 S., Rs. 3 & 4 E., who had based  
 their locations, improvements, such as wells, houses  
 fences, cleared lands, etc. upon corners located by  
 private surveyors, and by two parties who differ  
 greatly, both from the orig. std. corners, and also  
 from each other.

It appears that about ten settlers in the SW. part of  
 T. 5 S., R. 3 E. were located according to measurements  
 brought from corners on the west bdy. of T. 5 S., R. 3 E.,  
 the authenticity of which was doubtful, as shown in our  
 retracements.

Many settlers in the SW. part of T. 5 S., R. 4 E. were  
 located by lines and measurements based from the old  
 std. cor. at SW. cor. of sec. 31, of T. 5 S., R. 5 E.,  
 as this old cor. was a well known corner, being a  
 mesquite post 3 ft. above ground, about 6 ins. diam.  
 with well preserved markings.

The alinement and measurement of the private surveys  
 from this cor. appear to be excellent, cors. being  
 set at theoretic points or intervals of 40 and 80 chs.  
 About 8 miles of canals are built along these lines.

July 3, 1913.

*Jesse B. Wright*  
*William B. Elliott*

## Re-survey of 2nd Std. Parallel S., through R. 13 E. 17

## Chains.

- July 23, 1913. J. B. Wright.  
 Re-survey of 2nd Std. Par. S., Through R. 13 E. commenced July 23, 1913, and executed by Jesse B. Wright, U. S. Surveyor, with Young & Son's light mountain transit No. 8145, with Smith patent solar attachment on side, as hereinbefore described. (See field test and adjustment on page 3 of this Book.)
- At 8h a.m., l.m.t., at the Std. cor. of Tps. 10 S., Rs. 13 & 14 E., which is a post 4 ins. sq., 4 ft. above ground, marked and witnessed as described by the Surveyor General, Lat.  $32^{\circ}30'25''$  N., long.  $110^{\circ}56'39''$  W., I set off  $20^{\circ}08\frac{1}{2}'$  N. on the decl. arc, and  $32^{\circ}30\frac{1}{2}'$  N. on the lat. arc, and determine a meridian with the solar. The above described cor. is now in a good state of preservation, and well marked, from which,
- brs. S.  $3^{\circ}10'$  E., about ten miles dist.  
 A large stone monument on East butte of Tortillita Mts. brs. S.  $79^{\circ}10'$  W., about 8 miles dist.  
 A butte towards N. end of Mt. Lemon, Catalina Mts., brs. N.  $89^{\circ}49'$  E., about 20 miles dist.  
 A round butte near E. end of Black Mts. brs. N.  $6^{\circ}15'$  E., about 15 miles dist.
- Thence from above cor., I run, as per field notes and instructions furnished by the Surveyor General, S.  $89^{\circ}51'$  W., on S. bdy. of sec. 36, T. 10 S., R. 13 E. Var.  $13^{\circ}30'$  E.
- Over broken, heavily rolling land, through dense cacti, sage brush, catclaw.
- 7.95 Road, brs. NW. & SE.  
 12.20 Wash, 20 lks. wide, course SE.  
 30.00 Enter draw, course SE.  
 37.64 To old std.  $\frac{1}{4}$  sec. cor., which is a granite stone, 10x5x6 ins. above ground, marked and witnessed as described by the Surveyor General, which cor. I destroy.
- 38.50 Wash, 50 lks. wide, course SE.  
 40.00 Set an iron post 3 ft. long, 1 in. in diam. 26 ins. in the ground for reestab. Std. sec. cor. marked on brass cap, 1913 on S. rim,  $\frac{1}{4}$  S 36 in N. half; no bearings available. dig pits 18x18x12 ins. E. & W. of cor. 3 ft. dist., and raise a mound of earth  $3\frac{1}{2}$  ft. base,  $1\frac{1}{2}$  ft. high N. of cor.
- 42.60 Wash, 30 lks. wide, course SSE.  
 44.60 Wash, 60 lks. wide, course SSE.  
 46.00 Leave draw, asc. grad.  
 61.03 Closing cor. of Tps. 11 S., Rs. 13 & 14 E., on line, which is a granite stone 10x6x6 ins. above ground, marked and witnessed as described by the Surveyor General.
- 75.30 To old Std. cor. of secs. 35 & 36, which is a redwood post 4 ins. sq., 4 ft. above ground, in mound of stone, marked as described by the Surveyor General. I destroy the original markings on this cor., and re-mark for standard angle point, A P, T 10 S R 13 E, S 36, on N. face, rebuild mound of stone 4 ft. base 2 ft. high around post.
- From this standard angle point, I run, West, continuing measurement.
- Difference bet. measurements of 80 chs. by 2 sets of chainmen is 4 lks., position of middle point,  
 by 1st set, 80.02 chs.,  
 by 2nd set, 79.98 chs., the mean of which is
- 80.00 Set an iron post 3 ft. long, 3 ins. in diam. 24 ins. in the ground for reestab. Std. sec. cor. 35 & 36, marked on brass cap, T 10 S R 13 E, in N. half, 1913 on S. rim, S 35 in NW., and S 36 in NE. quad.; from which, A catclaw tree 4 ins. diam. brs. N.  $41^{\circ}$  E. 33 lks. dist., marked T 10 S R 13 E S 36 S C B T.
- No other bearings available,  
 dig pits 24x18x12 ins. crosswise on each line, E. & W. 3 ft., and N. of cor. 7 ft. dist., and raise a mound of earth 4 ft. base, 2 ft. high N. of cor. Land, rolling. Soil, 3rd rate, gravelly. Catclaw, cacti.

## Re-survey of 2nd Std. Parallel S., through R. 13 E.

Chains.	
	West, on S. bdy. of Sec. 35. Over rolling land, through dense brush.
30.70	Wash, 20 lks. wide, course SSE.
35.53	Remains of old $\frac{1}{4}$ sec. cor., brs. North 20 lks. dist., which I destroy.
	Difference bet. measurements of 40 chs. by 2 sets of chainmen is 2 lks.; position of middle point, by 1st set, 39.99 chs., by 2nd set, 40.01 chs., the mean of which is
40.00	Set an iron post 3 ft. long, 1 in. in diam. 26 ins. in the ground for reestab. $\frac{1}{4}$ sec. cor. marked on brass cap, 1913 on S. rim, $\frac{1}{4}$ S 35 in N. half, from which, A paloverde tree 10 ins. diam. brs. N. 80° W. 98 lks. dist., marked S C $\frac{1}{4}$ S 35 B T. dig pits 18x18x12 ins. E. & W. of cor. 3 ft. dist., and raise a mound of earth $3\frac{1}{2}$ ft. base, $1\frac{1}{2}$ ft. high N. of cor.
64.00	Wash, 10 lks. wide, course SSE.
75.82	Remains of old std. sec. cor. brs. North, 33 lks. dist., which I destroy.
	Difference bet. measurements of 80 chs. by 2 sets of chainmen is 6 lks.; position of middle point, by 1st set, 80.03 chs., by 2nd set, 79.97 chs., the mean of which is
80.00	Set an iron post 3 ft. long, 3 ins. in diam. 24 ins. in the ground for reestab. $\frac{1}{4}$ sec. cor. secs. 34 & 35, marked on brass cap, T 10 S R 13 E, in N. half, 1913 on S. rim, S 34 in NW., and S 35 in NE. quad.; from which, A paloverde tree 8 ins. diam. brs. N. 7° E. 70 lks. dist., marked S C T 10 S R 13 E S 35 B T. No other trees available, pits impracticable, raise a mound of stone 2 ft. base, $1\frac{1}{2}$ ft. high N. of cor. Land, broken, heavily rolling. Soil, 3rd rate, gravelly, dry. Mesquite, catclaw, paloverde, cacti, sparse grass.

	West, on S. bdy. of sec. 34. Over heavily rolling land, asc. grad., through dense brush.
28.50	Wash, 20 lks. wide, course SE.
36.00	Old Std. $\frac{1}{4}$ sec. cor. brs. north, 28 lks. dist., which I destroy.
	Difference bet. measurements of 40 chs. by 2 sets of chainmen is 4 lks., position of middle point, by 1st set, 39.98 chs., by 2nd set 40.02 chs.; the mean of which is
40.00	Set an iron post 3 ft. long, 1 in. in diam. 26 ins. in the ground for reestab. $\frac{1}{4}$ sec. cor. marked on brass cap, 1913 on S. rim, $\frac{1}{4}$ S 34 in N. half; from which, A mesquite tree 10 ins. diam. brs. N. 64° W. 22 lks. dist., marked S C $\frac{1}{4}$ S 34 B T. dig pits 18x18x12 ins. E. & W. of cor. 3 ft. dist., and raise a mound of earth $3\frac{1}{2}$ ft. base, $1\frac{1}{2}$ ft. high N. of cor. At this cor., at noon, I set off 20° 06' N. on the decl. arc, and observe the sun on the meridian. The resulting lat. is 32° 30' N.
50.00	Wash, 60 lks. wide, course ESE.
61.10	Old road, brs. NW. & SE.
73.40	Wash, 30 lks. wide, course SE.
78.43	Old Std. cor. of secs. 33 & 34 brs. N. 16 lks. dist., which I destroy.
	Difference bet. measurements of 80 chs by 2 sets of chainmen is 4 lks.; position of middle point, by 1st set, 79.98 chs., by 2nd set, 80.02 chs., the mean of which is
80.00	Set an iron post 3 ft. long, 3 ins. in diam. 24 ins. in the ground for reestab. $\frac{1}{4}$ sec. cor. secs 33 & 34, marked on brass cap, T 10 S R 13 E, in N. half, 1913 on S. rim, S 33 in NW., and S 34 in NE. quad., from which, A mesquite tree 6 ins. diam. brs. N. 76° E. 52 lks. dist., marked S C T 10 S R 13 E S 34 B T. A paloverde tree 14 ins. diam. brs. N. 76° W. 57 lks. dist., marked S C T 10 S R 13 E S 33 B T. Land, rolling. Soil, 3rd rate, gravelly. Mesquite, cacti.

## Re-survey of 2nd Std. Parallel S., through R. 13 E. 19

- Chains.
- west, on S. bdy. of Sec. 33.  
Over heavily rolling, broken land, asc. grad. through dense brush.
- Difference bet. measurements of 40 chs. by 2 sets of chainmen is 4 lks.; position of middle point,  
by 1st set, 39.98 chs.,  
by 2nd set, 40.02 chs., the mean of which is
- 40.00 Set an iron post 3 ft. long, 1 in. in diam. 26 ins. in the ground for reestab. Std.  $\frac{1}{4}$  sec. cor. marked on brass cap, 1913 on S. rim,  $\frac{1}{4}$  S. 33 in N. half; from which, A paloverde tree 8 ins. diam. brs. N. 12° E. 92 lks. dist., marked S C  $\frac{1}{4}$  S 33 B T.  
dig pits 18x18x12 ins. E. & W. of cor. 3 ft. dist., and raise a mound of earth  $3\frac{1}{2}$  ft. base,  $1\frac{1}{2}$  ft. high N. of cor.  
No trace of old Std.  $\frac{1}{4}$  sec. cor. could be found.
- 50.00 Asc. steep.  
57.00 Spur brs. N. & S. desc. steep.
- 61.75 Foot, brs. NE. & SSW, wash, 20 lks. wide, course NE.  
69.75 Wash, 30 lks. wide, course NE.  
77.00 Wash, 61 lks. wide, course ENE.
- Difference bet. measurements of 80 chs. by 2 sets of chainmen is 8 lks.; position of middle point,  
by 1st set, 79.96 chs.,  
by 2nd set, 80.04 chs.; the mean of which is
- 80.00 Set an iron post 3 ft. long, 3 ins. in diam. 24 ins. in the ground for reestab. Std. cor. secs 32 & 33, marked on brass cap, T 10 S R 13 E, in N. half, 1913 on S. rim, S 32 in NW., and S 33 in NE. quad.; from which,  
A mesquite tree 8 ins. diam. brs. N. 19 $\frac{1}{4}$ ° E. 182 lks. dist., marked S C T 10 S R 13 E S 33 B T.  
A mesquite tree 14 ins. diam. brs. N. 24° W. 164 lks. dist., marked S C T 10 S R 13 E S 32 B T.
- Land, heavily rolling. Soil, 3rd rate, gravelly, dry. Mesquite, catclaw, cacti, buck brush, fair grass.  
No trace of old cor. found. July 23, 1913.  
Mon. on E. butte of Tortillita Mts. brs. S. 6° 50' W. J.B.W.  
J. B. W.  
July 24, 1913.  
At 8h a.m., l.m.t., at the std. cor. of secs. 32 & 33, above described,  
I set off 19° 56 $\frac{1}{2}$ ' N. on the decl. arc, and 32° 30 $\frac{1}{2}$ ' N. on the lat. arc, and determine a meridian with the solar. Thence I run,  
West, on S. bdy. of sec. 32.  
Over rolling land, asc. grad. in wide draw, through dense brush.
- 7.50 Wash, 30 lks. wide, course ENE.  
17.50 Wash, 50 lks. wide, course ENE.  
25.50 Gulch, 20 lks. wide, course SE.  
30.00 Asc. steep E. slope of Tortillita Mts.  
35.00 Abandoned ranch house brs. North, about  $\frac{1}{2}$  mile dist., located near head of gulch, course SE.
- Difference bet. measurements of 40 chs. by 2 sets of chainmen is 6 lks.; position of middle point,  
by 1st set, 39.97 chs.,  
by 2nd set, 40.03 chs., the mean of which is
- 40.00 Set an iron post 3 ft. long, 1 in. in diam. 26 ins. in the ground for reestab. Std.  $\frac{1}{4}$  sec. cor. marked on brass cap, 1913, on S. rim,  $\frac{1}{4}$  S 32 in N. half; no bearings available. Pits imprac. raise a mound of stone 2 ft. base,  $1\frac{1}{2}$  ft. high N. of cor.
- 58.23 Spur, brs. SSE. & NNW., desc. steep.  
71.00 Gulch, 40 lks. wide, course SSE., near head, asc.
- Difference bet. measurements of 80 chs. by 2 sets of chainmen is 8 lks.; position of middle point,  
by 1st set, 79.96 chs.,  
by 2nd set, 80.04 chs., the mean of which is
- 80.00 Set an iron post 3 ft. long, 3 ins. in diam. 10 ins. in the ground on bed-rock, in mound of stone for reestab. Std. cor. of secs. 31 & 32, marked on brass cap, 1913 on S. rim, T 10 S R 13 E, in N. half, S 31 in NW., and S 32 in NE. quad.; Pits impracticable.  
raise a mound of stone 2 ft. base,  $1\frac{1}{2}$  ft. high N. of cor.  
Land, rolling, mts. Soil, 3rd rate, gravelly. Mesquite, cacti.

- Chains. No trace of the old  $\frac{1}{4}$  cor. on S. bdy. of sec. 32, nor of old std. cor. of secs. 31 & 32 could be found. West, on S. bdy. of sec. 31.  
Over mts. land, asc.
- 1.00 Low saddle, top of main divide of Tortillita Mts., brs. NNE. & SSW., desc. through scrub oak, cacti.
- 8.00 Desc. steep.
- 31.00 Gulch, 50 lks. wide, course SSW., asc. steep.
- 39.50 Spur, brs. SSW. & NNE., desc. steep.  
Difference bet. measurements of 40 chs. by 2 sets of chainmen is 6 lks.; position of middle point,  
by 1st set, 39.97 chs.,  
by 2nd set, 40.03 chs.; the mean of which is
- 40.00 Set an iron post 3 ft. long, 1 in. in diam. 26 ins. in the ground for reestab. ~~St. sec. cor.~~ marked on brass cap, 1913 on S. rim,  $\frac{1}{4}$  S 31 in N. half; No bearings available, pits impracticable. Raise a md. of stone 2 ft. base  $\frac{1}{4}$  ft. N. of cor. An abandoned ranch house, with well, corral, brs. S.  $22^{\circ}$  E., about 20 chs. dist. No trace of old std.  $\frac{1}{4}$  sec. cor. found after diligent search.  
Desc. from cor.
- 42.00 Gulch, 50 lks. wide, course SSW., near head, asc.
- 50.00 Spur, brs. S. & N., desc.
- 62.70 Gulch, 60 lks. wide, course SW., asc. steep.
- 74.00 Spur, brs. S. & N., desc. steep.  
Difference bet. measurements of 80 chs. by 2 sets of chainmen is 10 lks.; position of middle point,  
by 1st set, 79.95 chs.,  
by 2nd set, 80.05 chs.; the mean of which is
- 80.00 Set an iron post 3 ft. long, 3 ins. in diam. 24 ins. in the ground for reestab. ~~St. cor.~~ Ts. 10 S., Rs. 12 & 13 E., marked on brass cap, 1913 on S. rim,  
T 10 S, in N. half,  
R 12 E S 36 in NW., and  
R 13 E S 31 in NE. quad.;  
No bearings available. pits impracticable.  
Raise a mound of stone 3 ft. base 2 ft. high N. of cor. from which,  
Picacho peak brs. S.  $32^{\circ}06'$  W.  
A small round butte on ridge, brs. S.  $69^{\circ}30'$  W., about 30 chs. dist.  
A round butte of Tortillita Mts. brs. S.  $6^{\circ}10'$  E., about 2 miles dist.  
Land, mts., broken, rough.  
Soil, 3rd rate, stony, gravelly, dry.  
Mesquite, paloverde, scrub oak, buck brush, cacti, few desert willows in gulches, sparse grass.  
No trace of the old std. cor. of Tps. 10 S., Rs. 12 & 13 E. found after diligent search.  
At this cor., at noon, I set off  $19^{\circ}53\frac{1}{2}'$  N. on the decl. arc, and observe the sun on the meridian.  
The resulting lat. is  $32^{\circ}30\frac{1}{2}'$  N.  
Magnetic variation at this cor. is  $13^{\circ}40'$  E.

J. B. W.

## General Description.

The 2nd Std. Parallel South, through Range 13 E. runs over a broken, rolling country, rising gradually from the east to the top of the Tortillita Mts., at 5 miles, descending thence to the Tp. cor. to the west. The land to the south is in general mts., except the east two tiers of secs. of T. 11 S., R. 13 E., which should be subdivided. There is no living water, nor timber along or near the line. The land to the SW. of std. cor. of Tps. 10 S., R. 13 E. is rough and mountainous, trending into the valley of the Santa Cruz at from four to five miles distance.

July 24, 1913.

*Jesse B. Wright*  
U. S. Surveyor.

## Re-survey of 2nd Std. Parallel South, through Range 8 East.

Chains. J. B. W.  
Oct. 13, 1913.

An examination of the line of the 2nd Std. Parallel South, through R. 10 East develops the fact that nearly all the corners on this line are obliterated. Therefore, I begin at the Std. Closing cor. of Tps. 10 S., Rs. 8 & 9 E., which is a malpais stone 8x6x6 ins. above ground, marked and witnessed as described by the Surveyor General, which cor. I change to refer to Tps. 10 S., Rs. 8 & 9 E., by re-marking with 6 grooves on E., W., & N. faces, and rebuild the mound of stone 2 ft. base, 1½ ft. high N. of cor. (I destroy the old Std. Cor. of T. 10 S., R. 8 E., which is 3.15 chs. to the S., and proceed to re-survey the 2nd Std. Par. S., due west from the cor. above described.)

At 9h a.m., l.m.t., at the cor. of Tps. 10 S., Rs. 8 & 9 E., above described,  
I set off 7°42' S. on the decl. arc, and 32°30½' N. on the lat. arc, and determine a meridian with the solar. Thence I run,  
West, on true line of 2nd Std. Par. S., on S. bdy. of Sec. 36, T. 10 S., R. 8 E.  
Var. 14°15' E.

Over broken, heavily rolling land, desc. through dense paloverde, greasewood, cacti, fair grass.

5.70 Gulch, 20 lks. wide, course NW.  
38.15 Set closing cor. of Tps. 11 S., Rs. 8 & 9 E., on line, as described in book "C," in connection with field notes of W. bdy. of T. 11 S., R. 9 E.  
38.70 Gulch, 60 lks. wide, course N.  
Difference bet. measurements of 40 chs. by 2 sets of chainmen is 4 lks.; position of middle point,  
by 1st set, 40.02 chs.,  
by 2nd set, 39.98 chs., the mean of which is

40.00 Set an iron post 3 ft. long, 1 in. in diam. 26 ins. in the ground for reestab. Std. sec. cor. marked on brass cap, 1913 on S. rim, ¼ S 36 in N. half; from which,  
A paloverde tree 8 ins. diam. brs. N. 73° W. 48 lks. dist., marked S C ¼ S 36 B T.  
A paloverde tree 12 ins. diam. brs. N. 53° E. 89 lks. dist., marked S C ¼ S 36 B T.

40.05 Orig. Std. sec. cor. brs. South, 174 lks. dist., which I destroy.

41.20 Wash, 20 lks. wide, course N.  
50.50 Wash, 15 lks. wide, course N.  
55.00 Asc. steep E. slope.  
69.00 Top of rocky spur, brs. SE. & NW., thence alone S. slope.  
72.00 Asc. E. slope.  
76.00 Rocky ridge, brs. N. & S., desc. NW. slope.  
Difference bet. measurements of 80 chs. by 2 sets of chainmen is 6 lks.; position of middle point,  
by 1st set, 80.03 chs.,  
by 2nd set, 79.97 chs., the mean of which is

80.00 Set an iron post 3 ft. long, 3 ins. in diam. 24 ins. in the ground for reestab. Std. cor. secs. 35 & 36, marked on brass cap, T 10 S R 8 E, in N. half, 1913 on S. rim, S 35 in NW., and S 36 in NE. quad.; from which,  
A paloverde tree 10 ins. diam. brs. N. 24° E. 40 lks. dist., marked S C T 10 S R 8 E S 36 B T.  
A paloverde tree 12 ins. diam. brs. N. 41° W. 27 lks. dist., marked S C T 10 S R 8 E S 35 B T.

Land, broken, rolling, mts.  
Soil, 3rd rate, gravelly, stony, dry.  
Paloverde, greasewood, cacti, sparse grass.

## Re-survey of 2nd Standard Parallel South, through Range 8 East.

Chains.	
	West, on S. bdy. of Sec. 35. Over mts. land, along steep N. slope.
0.13	Orig. Std. cor. brs. south, 154 lks. dist., which I destroy.
0.60	Head of Gulch, course N., asc. NE. slope.
4.50	Spur, brs. NW. & SE., desc. SW. slope.
16.00	Gulch, 20 lks. wide, course WNW., foot of main slope, brs. NW. & SE.
30.80	Wash, 90 lks. wide, course NNE. Difference bet. measurements of 40 chs. by 2 sets of chainmen is 2 lks.; position of middle point, by 1st set, 40.01 chs., by 2nd set, 39.99 chs.; the mean of which is
40.00	Set an iron post 3 ft. long, 1 in. in diam. 26 ins. in the ground for reestab. St. cor. sec. 35, marked on brass cap, 1913 on S. rim, S C $\frac{1}{4}$ S 35 in N. half; from which, A paloverde tree 7 ins. diam. brs. N. 14° E. 49 lks. dist., marked S C $\frac{1}{4}$ S 35 B T. A paloverde tree 6 ins. diam. brs. N. 51° W. 92 lks. dist., marked S C $\frac{1}{4}$ S 35 B T. No trace of orig. std. $\frac{1}{4}$ sec. cor. found after diligent search.
47.64	Telephone line, Silver Bell mine to Sasco Smelter, brs. NE. & SW.
50.18	Telegraph line, Silver Bell to Red rock, brs. NE. & SW.
50.80	Centre of single track of Ariz. Southern Railroad, brs. N. 43° 40' E. & S. 43° 40' W.
51.60	Road, brs. NE. & SW., Silver Bell to Red Rock & Sasco. Difference bet. measurements of 80 chs. by 2 sets of chainmen is 2 lks.; position of middle point, by 1st set, 80.01 chs., by 2nd set, 79.99 chs.; the mean of which is
80.00	Set an iron post 3 ft. long, 3 ins. in diam. 24 ins. in the ground for reestab. St. cor. sec. 34 & 35, marked on brass cap, T 10 S R 8 E, in N. half, 1913 on S. rim, S 34 in NW., and S 35 in NE. quad.; from which, An ironwood tree 10 ins. diam. brs. N. 40 $\frac{1}{2}$ ° E. 89 lks. dist., marked S C T 10 S R 8 E S 35 B T. A paloverde tree 8 ins. diam. brs. N. 42 $\frac{1}{2}$ ° W. 47 lks. dist., marked S C T 10 S R 8 E S 34 B T. Land, mts., rolling. Soil, 3rd rate, stony, gravelly, dry. Paloverde, ironwood, greasewood, cacti, sparse grass. At this cor., at noon, I set off 7° 45' S. on the decl. arc, and observe the sun on the meridian. The resulting lat. is 32° 33' N. <u>No trace of old cor. found after diligent search.</u>
	West, on S. bdy. of sec. 34. Over gently rolling land, through dense brush.
2.60	Road, brs. N. & S. Difference bet. measurements of 40 chs. by 2 sets of chainmen is 2 lks.; position of middle point, by 1st set, 39.99 chs., by 2nd set, 40.01 chs.; the mean of which is
40.00	Set an iron post 3 ft. long, 1 in. in diam. 26 ins. in the ground for reestab. St. cor. sec. 34, marked on brass cap, 1913 on S. rim, S C $\frac{1}{4}$ S 34 in N. half; from which, A paloverde tree 6 ins. diam. brs. N. 50° E. 42 lks. dist., marked S C $\frac{1}{4}$ S 34 B T. A paloverde tree 6 ins. diam. brs. N. 36 $\frac{3}{4}$ ° W. 41 lks. dist., marked S C $\frac{1}{4}$ S 34 B T.
50.00	Wash, 10 lks. wide, course NNW. Measurements of 80 chs. by the 2 sets of chainmen being identical, at
80.00	Set an iron post 3 ft. long, 3 ins. in diam. 24 ins. in the ground for reestab. St. cor. sec. 33 & 34, marked on brass cap, T 10 S R 8 E, in N. half, 1913 on S. rim, S 33 in NW., and S 34 in NE. quad.; from which, A paloverde tree 10 ins. diam. brs. N. 39 $\frac{1}{4}$ ° E. 93 lks. dist., marked S C T 10 S R 8 E S 34 B T. An ironwood tree 10 ins. diam. brs. N. 78 $\frac{1}{2}$ ° W. 65 lks. dist., marked S C T 10 S R 8 E S 33 B T. Land, rolling. Soil, 3rd rate, gravelly. Dense brush.

## Re-survey of 2nd Standard Parallel South, through Range 8 East.

Chains.	West, on South bdy. of sec. 33. Over gently rolling land, through dense brush.
25.60	Road, brs. NE. & SW.
34.90	Wash, 20 lks. wide, course NW. Difference bet. measurements of 40 chs. by 2 sets of chainmen is 2 lks.; position of middle point, by 1st set, 39.99 chs., by 2nd set, 40.01 chs.; the mean of which is
40.00	Set an iron post 3 ft. long, 1 in. in diam. 26 ins. in the ground for reestab. std. cor., marked on brass cap, 1913 on S. rim, $\frac{1}{4}$ S 33 in N. half, from which, A paloverde tree 6 ins. diam. brs. N. $44\frac{3}{4}^{\circ}$ E. 201 lks. dist., marked S C $\frac{1}{4}$ S 33 B T. A paloverde tree 8 ins. diam. brs. N. $85^{\circ}$ W. 222 lks. dist., marked S C $\frac{1}{4}$ S 33 B T.
58.30	Wash, 20 lks. wide, course NW.
74.40	Wash, 20 lks. wide, course NW. Difference bet. measurements of 80 chs. by 2 sets of chainmen is 4 lks.; position of middle point, by 1st set, 80.02 chs., by 2nd set, 79.98 chs.; the mean of which is
80.00	Set an iron post 3 ft. long, 3 ins. in diam. 24 ins. in the ground for reestab. std. cor. of secs. 32 & 33, marked on brass cap, T 10 S R 8 E, in N. half, 1913 on S. rim, S 32 in NW., and S 33 in NE. quad.; from which, A paloverde tree 10 ins. diam. brs. N. $39^{\circ}$ E. 210 lks. dist., marked S C T 10 S R 8 E S 33 B T. A paloverde tree 10 ins. diam. brs. N. $38^{\circ}$ W. 337 lks. dist., marked S C T 10 S R 8 E S 32 B T. Land, rolling. Soil, 3rd rate, sandy, gravelly, dry. Paloverde, ironwood, mesquite, cacti, sparse grass. No trace of any old cors. found at this and last two corners, after diligent search.
	West, on S. bdy. of sec. 32. Over gently rolling land, through dense brush.
37.05	Old road, brs. NNE. & SSW. The measurements of 40 chs. by 2 sets of chainmen being identical, at
40.00	Set an iron post 3 ft. long, 1 in. in diam. 26 ins. in the ground for reestab. std. cor., marked on brass cap, 1913 on S. rim, $\frac{1}{4}$ S 32 in N. half; from which, A paloverde tree 12 ins. diam. brs. N. $84^{\circ}$ E. 335 lks. dist., marked S C $\frac{1}{4}$ S 32 B T. A paloverde tree 8 ins. diam. brs. N. $63^{\circ}$ W. 386 lks. dist., marked S C $\frac{1}{4}$ S 32 B T. Difference bet. measurements of 80 chs. by 2 sets of chainmen is 2 lks.; position of middle point, by 1st set, 80.01 chs., by 2nd set, 79.99 chs.; the mean of which is
80.00	Set an iron post 3 ft. long, 3 ins. in diam. 24 ins. in the ground for reestab. std. cor. of secs. 31 & 32, marked on brass cap, T 10 S R 8 E, in N. half, 1913 on S. rim, S 31 in NW., and S 32 in NE. quad.; from which, An ironwood tree 6 ins. diam. brs. N. $87^{\circ}$ E. 102 lks. dist., marked S C T 10 S R 8 E S 32 B T. A paloverde tree 12 ins. diam. brs. N. $46^{\circ}$ W. 107 lks. dist., marked S C T 10 S R 8 E S 31 B T. Land, rolling. Soil, 3rd rate, gravelly, sandy, loose, dry. Paloverde, mesquite, ironwood, greasewood, cacti, fair grass in places.



## 24 Re-survey of 2nd Standard Parallel South, through Range 8 East.

Chains.	West, on S. bdy. of Sec. 31. Over rolling land, through dense brush. Measurements of 40 chs. by 2 sets of chainmen being identical, at
40.00	Set an iron post 3 ft. long, 1 in. in diam. 26 ins. in the ground, for reestab. std. $\frac{1}{4}$ sec. cor., marked on brass cap, 1913 on S. rim, $\frac{1}{4}$ S 31 in N. half; from which, An ironwood tree 20 ins. diam. brs. N. $53^{\circ}$ E. 22 lks. dist., marked S C $\frac{1}{4}$ S 31 B T. An ironwood tree 6 ins. diam. brs. N. $18^{\circ}$ W. 159 lks. dist., marked S C $\frac{1}{4}$ S 31 B T.
46.60	Road, brs. NW. & SE.
48.20	Wash, 30 lks. wide, course N.
50.00	Wash, 20 lks. wide, course N.
	Difference bet. measurements of 79.98 chs. by 2 sets of chainmen is 2 lks.; position of middle point, by 1st set, 79.99 chs.; by 2nd set, 79.97 chs.; the mean of which is
79.98	Find orig. std. cor. of Tps. 10 S., Rs. 7 & 8 E., 2 <sup>d</sup> S. South, 5.99 chs. dist., which is a post, marked and witnessed as described by the Surveyor General, which cor. I change to refer to T. 10 S., R. 7 E., only. Set an iron post 3 ft. long, 3 ins. in diam. 24 ins. in the ground for std. closing cor. of T. 10 S., R. 8 E., marked on brass cap, 1913 on S. rim, C C, W. of centre, T 10 S in N. and R 7 E S 36 in W. half, R 8 E S 31 in NE. quad.; from which, A paloverde tree 12 ins. diam. brs. N. $57^{\circ}$ E. 106 lks. dist., marked S C C C T 10 S R 8 E S 31 B T. Raise a mound of stone 2 ft. base, $1\frac{1}{2}$ ft. high NE. of cor. Quajote peak brs. N. $50^{\circ}40'$ W. High rocky peak at N. end of Silver Bell Mts., brs. S. $52^{\circ}30'$ E. Silver Bell Peak brs. S. $32^{\circ}48'$ E. Lone volcanic butte in plain, brs. N. $58\frac{1}{2}^{\circ}$ E., about 60 chs. dist. Land, rolling. Soil, 3rd rate, gravelly, dry, loose. Mesquite, paloverde, ironwood, greasewood, cacti. sparse native grass. Oct. 13, 1913.

## General Description.

The 2nd Std. Par. S., through R. 8 E. as re-surveyed by me runs over broken land towards the east, trending into smooth, or gently rolling plain towards the west.

The land to the south rises gradually to the rough spurs and riges from the Silver Bell Mts., about 4 miles to the South.

There is no water or timber along or near the line. The soil is a granite gravel in the foot hills, trending into sandy loam in the plain.

Oct. 13, 1913.

*Jesse B. Wright*  
U. S. Surveyor.

CERTIFICATE OF ASSISTANTS.

We, the undersigned, hereby certify upon honor that we assisted, to the best of our skill and ability,  
William H. Elliott, U. S. Surveyor, during the periods and in the capacities  
 stated opposite our several signatures, in surveying all those parts or portions of

Survey, Re-survey and retracements of Standard Lines

under

Group No. 30

South and East

of the Gila & Salt River Base & Meridian, in the State of Arizona

which are represented in the foregoing field notes as having been executed by him, and under his direc-  
 tion; and that said resurveys and retracements have been, in all respects, to the best of our knowledge and belief, well and  
 faithfully executed.

NAME.	PERIOD OF SERVICE.		CAPACITY.
	BEGUN.	ENDED.	
<i>Frank Biederhoff</i>	June 22, 1913.	Sept. 8, 1913.	Chainman.
<i>Chas H. Shimpson</i>	June 22, 1913.	Sept. 8, 1913.	Chainman.
<i>William H. Estep</i>	June 22, 1913.	Nov. 20, 1913.	Flagman.
<i>Rolla Rickhart</i>	June 22, 1913.	August 15, 1913.	Axeman.
<i>Daniel J. Blankinsky</i>	June 22, 1913.	Nov. 20, 1913.	Moundman.
<i>Carl Witten</i>	Aug. 16, 1913.	Sept. 8, 1913.	Axeman.
<i>J. W. Fish</i>	Sept. 9, 1913.	Nov. 19, 1913.	Chainman.
<i>William G. Brewster</i>	Sept. 9, 1913.	Nov. 20, 1913.	Chainman.
<i>Charles W. Spies</i>	Sept. 9, 1913.	Sept. 30, 1913.	Axeman.
<i>Boyd Crowder</i>	Oct. 2, 1913.	Nov. 19, 1913.	Axeman.

Subscribed and certified to before me on the dates of the final service as shown above.

*William H. Elliott*

U. S. Surveyor.

108 (26)

BOOK 2736

# FINAL OATH OF UNITED STATES SURVEYOR.

I, William H. Elliott, U. S. Surveyor, do solemnly swear that, in pursuance of special instructions received from the U. S. Surveyor General for Arizona bearing date of the 28th day of May, 1913, I have well, faithfully, and truly, in my own proper person, and in strict conformity with said instructions, the Manual of Surveying Instructions, and the laws of the United States, surveyed all those parts or portions of

## Retracements and resurveys of Standard Lines

under

Group No. 30

South and East of the Gila and Salt

River Base and Meridian, in the State of Arizona, which are represented in the foregoing field notes as having been executed by me, and under my direction; and I do further solemnly swear that all the corners of said retracements and resurveys have been established and perpetuated in strict accordance with the Manual of Surveying Instructions, and the special written instructions of the U. S. Surveyor General for Arizona and in the specific manner described in the field notes, and that the foregoing are the original field notes of such retracements and resurveys.

*William H. Elliott*

U. S. Surveyor.

Subscribed by said William H. Elliott, and sworn to before me }  
this 4<sup>th</sup> day of December, 1914

*Geo W. Veston*

United States Commissioner  
at Yuma



## APPROVAL.

OFFICE OF THE UNITED STATES SURVEYOR GENERAL,

....., 191

The foregoing field notes of the survey of

executed by .....  
under his special instructions dated ....., 191 , having been critically examined, and the necessary corrections and explanations made, the said field notes, and the surveys they describe, are hereby approved.

.....  
U. S. Surveyor General.

I certify that the foregoing transcript of the field notes of the above-described surveys in .....  
....., has been correctly copied from the original notes on file in this office.

.....  
U. S. Surveyor General.

BOOK 2736

**CERTIFICATE OF ASSISTANTS.**

We, the undersigned, hereby certify upon honor that we assisted, to the best of our skill and ability,  
**Jesse B. Wright**, U. S. Surveyor, during the periods and in the capacities  
 stated opposite our several signatures, in surveying all those parts or portions of

Original surveys, re-surveys, and retracements of Standard Lines

under

Group No. 30

South and East

of the **Gila and Salt River Base & Meridian**, in the State of **Arizona**

which are represented in the foregoing field notes as having been executed by him, and under his direc-  
 Resurveys and retracements  
 tion; and that said **have** been, in all respects, to the best of our knowledge and belief, well and  
 faithfully executed.

NAME.	PERIOD OF SERVICE.		CAPACITY.
	BEGUN.	ENDED.	
<i>Frank J. McSherry</i>	June 22, 1913.	Nov. 20, 1913.	Chainman.
<i>Walter Picknell</i>	June 22, 1913.	Aug. 31, 1913.	Chainman.
<i>Raymond March</i>	June 22, 1913.	Nov. 20, 1913.	Chainman.
<i>Thomas E. Hottel</i>	June 22, 1913.	Nov. 20, 1913.	Chairman.
<i>James J. Moran</i>	June 22, 1913.	Aug. 24, 1913.	Moundman.
<i>Leo Westfield</i>	Aug. 28, 1913.	Nov. 19, 1913.	Chainman.
<i>John P. Lipps</i>	Sept. 1, 1913.	Sept. 8, 1913.	Axeman.
<i>John W. Daily</i>	Sept. 9, 1913.	Sept. 30, 1913.	Chainman.
<i>Clairmont</i>	Oct. 2, 1913.	Nov. 19, 1913.	Chainman.

Subscribed and certified to before me on the dates of the final service as shown above.  
 \* Note:- Two sets of chainmen drawn from above parties  
 only on days as needed on surveys of Standard Lines.

*Jesse B. Wright*  
 U. S. Surveyor.

28  
BOOK 2736

FINAL OATH OF UNITED STATES SURVEYOR.

I, Jesse B. Wright, U. S. Surveyor, do solemnly swear that, in pursuance of special instructions received from the U. S. Surveyor General for Arizona bearing date of the 28th day of May, 1913, I have well, faithfully, and truly, in my own proper person, and in strict conformity with said instructions, the Manual of Surveying Instructions, and the laws of the United States, surveyed all those parts or portions of \_\_\_\_\_

re-surveys and retracements of Standard Lines  
under  
Group No. 30  
South and East of the Gila and Salt River Base and Meridian, in the State of Arizona, which are represented in the foregoing field notes as having been executed by me, and under my direction; and I do further solemnly swear that all the corners of said resurveys and retracements have been established and perpetuated in strict accordance with the Manual of Surveying Instructions, and the special written instructions of the U. S. Surveyor General for Arizona and in the specific manner described in the field notes, and that the foregoing are the original field notes of such resurveys and retracements.

*Jesse B. Wright*  
U. S. Surveyor.

Subscribed by said Jesse B. Wright, and sworn to before me }  
this 3rd day of February, 191x

*Frank Ingalls*  
Surveyor General of Arizona



APPROVAL.

OFFICE OF THE UNITED STATES SURVEYOR GENERAL,

*Phoenix, Ariz, DECEMBER 30, 1914*

The foregoing field notes of the ~~survey of~~ Retracement and Resurvey of the First Standard Parallel South through Ranges 3, 4 and part of 5 East  
and Resurvey of the 2nd Standard Parallel South through Ranges 8 and 13 East of the  
Gila and Salt River Base and Meridian  
in the State of Arizona

executed by Jesse B. Wright and William H. Elliott U.S. Surveyors under ~~his~~ special instructions ~~dated~~ for Group #30 dated May 28, 1913, having been critically examined, and the necessary corrections and explanations made, the said field notes, and the surveys they describe, are hereby approved.

*Frank Ingalls*  
U. S. Surveyor General.  
of Arizona.

~~I certify that the foregoing transcript of the field notes of the above-described surveys in \_\_\_\_\_, has been correctly copied from the original notes on file in this office.~~