

(1)

Book "D"
Subdivisions
FIELD NOTES

BOOK 2769

OF THE SURVEY OF THE

PART OF THE SUBDIVISION LINES

and RESURVEY of

PART OF THE WEST BOUNDARY OF

FRACTIONAL TOWNSHIP 4 NORTH, RANGE 32 EAST

Of the Gila and Salt River Base and Meridian,

In the State of ARIZONA

EXECUTED BY

WILLIAM B. KIMMEL

In the capacity of U. S. Surveyor, under instructions dated August 9, 1912, issued by the United States Surveyor General to govern surveys included in Group No. 26, which were approved by the Commissioner of the General Land Office, August 19, 1912, pursuant to authority contained in the Act of Congress dated June 23, 1913.

Survey & ReSurvey commenced September 10, 1913

Survey & ReSurvey completed September 19, 1913

Book "D"

BOOK 2769

INDEX DIAGRAM.

Frac. 1
Township 4 North, Range 32 East

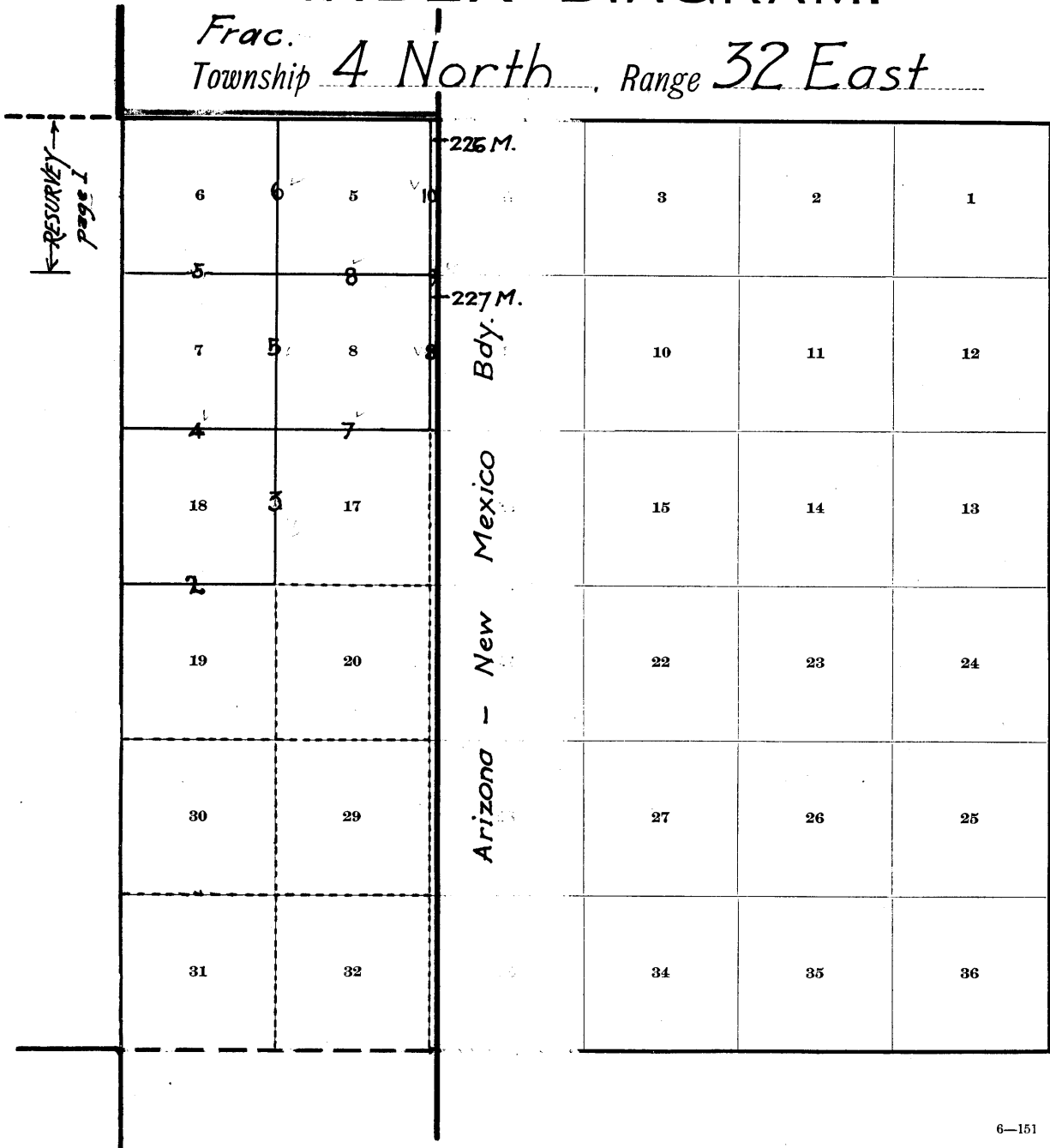

6-151

- Notes in Book "A", this Group
- Surveyed
- Unsurveyed

Chains.

Resurvey commenced Sept. 16, 1913, and executed with Young and Sons light mountain transit No. 8541, with Smith's solar attachment. For description of instrument and Certificate of Approval, see Book "A."

Knowing from recent and repeated tests of my instrument on a meridian established by observations on Polaris at elongation that it is in correct adjustment, I proceeded to the resurvey of part of the west boundary of fractional T. 4 N., R. 32 E. west of sec. 6.

At 8h. 3m. a.m., l.m.t., I set off $33^{\circ} 42\frac{1}{2}'$ N. on the lat. arc; $2^{\circ} 44'$ N. on the decl. arc; and determine a meridian with the solar at the original cor. of secs. 1, 6, 7 and 12, on the West bdy. of frac. T. 4 N., R. 32 E., which is a stone 10x8x9 ins., above ground, marked and witnessed as described by the Surveyor General.

Thence I run,

North, bet. secs. 1 and 6.

Descend NE. slope, 20 ft., through heavy timber, and dense undergrowth.

2.00 Gulch, course SE. Ascend SW. slope 30 ft.
 5.00 Low ridge, brs. E. and W. Descend NW. slope, 50 ft.
 12.00 Draw, course NE. Thence over rolling land.
 23.00 Canyon, course NE. Ascend SE. slope, 75 ft.
 39.83 From this point, a stone poorly set, 12x8x9 ins., above ground, marked and witnessed as described by the Surveyor General, evidently being the original $\frac{1}{4}$ sec. cor. brs. west 3 lks. dist. I destroy all evidence of this corner.

40.00 Set an iron post 3 ft. long, 1 in. in diam., 26 ins. in the ground, for reestablished $\frac{1}{4}$ sec. cor., marked on brass cap,

1913 in S. rim,
 $\frac{1}{4}$ S 1 in W., and

S 6 in E. half; from which,

A pine, 9 ins. in diam., brs. N. 9° E., 90 lks. dist., marked $\frac{1}{4}$ S 6 B T.

A pine, 30 ins. in diam., brs. N. 46° W., 111 lks. dist., marked $\frac{1}{4}$ S 1 B T.

Thence over rolling land.

61.00 Ridge, brs. E. and W. Descend north slope, 585 ft.

79.90 From this point, an unreported township cor., which is a rock, 3 ft. square, 2 ft. high, marked and witnessed in accordance with the Manual of Instructions, brs. West 12 lks. dist. I destroy this old cor.

80.00 Set an iron post 3 ft. long, 3 ins. in diam., 24 ins. in the ground, for reestablished cor. of T. 4 N., R. 31 E. and frac. T. 4 N., R. 32 E. and original cor. to frac. T. 4 N., R. 31 & 32, E., marked on brass cap,

1913 in S. rim,

T $4\frac{1}{2}$ N in N.,

R 32 E in E.,

T 4 N in S., and

R 31 E in W. half;

S 36 in NW.,

S 31 in NE.,

S 6 in SE., and

S 1 in SW. quadrant; from which,

A pine, 10 ins. in diam., brs. N. $58\frac{1}{2}^{\circ}$ E., 62 lks. dist., marked T $4\frac{1}{2}$ N R 32 E S 31 B T.

A pine 28 ins. in diam., brs. S 63° E., 34 lks. dist., marked T 4 N R 32 E S 6 B T.

A pine, 12 ins. in diam., brs. S. $75\frac{1}{2}^{\circ}$ W., 99 lks. dist., marked T 4 N R 31 E S 1 B T.

A pine, 11 ins. in diam., brs. N. $44\frac{1}{2}^{\circ}$ W., 98 lks. dist., marked T $4\frac{1}{2}$ N R 31 E S 36 B T.

Land, level, rolling, mountainous and hilly.

Soil, rocky, 4th rate.

Timber, heavy pine and oak.

Undergrowth, scrub oak and locust.

Mountainous land, 42 chs.

Sept. 16, 1913.

2. Partial Subdivision of frac. Township 4 North Range 32 East.

Chains.

Survey commenced Sept. 10, 1913, and executed with Young and Sons' light mountain transit No. 8541, with Smith Solar Attachment. For description of instrument, and Certificate of Approval, see Book "A."

At 4h. p.m., l.m.t., I set off $4^{\circ}55'$ N. on the decl. arc; $33^{\circ}41'$ N. on lat. arc; and determine a meridian with the solar at the original cor. of secs. 13, 18, 19 and 24, on the west bdy. of the township, which is a stone 8x8x6 ins. above ground, marked and witnessed as described by the Surveyor General, and mark a point in the meridian thus determined by a tack driven in a stake, firmly set 5 chs. north of my station.

Occupying the same station, at 8h. 16m., p.m., l. m.t., I observe Polaris at eastern elongation, by the method of double reversals, marking the mid point of the two points thus determined by a tack driven in a stake, 5 chs. north of my station.

Sept. 10, 1913.

Sept. 11, 1913: At 7h. 45m. a.m., l.m.t., I turn off the azimuth of Polaris, $1^{\circ}23\frac{1}{2}'$ to the left, and find that the meridian thus determined falls on the tack established from observation with the solar the evening before.

At 7h. 59m., a.m., l.m.t., I set off $33^{\circ}41'$ N. on the lat. arc; $4^{\circ}40'$ N. on the decl. arc, and determine a meridian with the solar. A point in the meridian thus determined coincides with the meridian determined by observations on Polaris. I therefore conclude that the adjustments of the solar are correct.

Measurements in this township and others under this group were made with a two-chain steel tape, and clinometer, with reductions to the horizontal. Occasional measurements as shown in the notes, were made by triangulation, in which case the requirements of the Manual as to size of angle and length of base were followed whenever possible. Some measurements were made by stadia. It was found by repeated tests that the interval was two chains, and this value held good throughout all the field work, one foot on the rod corresponding to two chains distance.

From the original cor. of secs. 13, 18, 19 and 24, above described, I run,

- East, on a true line, bet. secs. 18 and 19.
 Over rocky gravel river bottom, subject to overflow.
 Road brs. NE. to Alpine and Luna, and SW. to Clifton.
 5.60 Enter Blue River, course NW.
 6.00 Leave Blue River.
 6.85 Telephone line brs. NW. and SE.
 13.50 Blue River 20 lks. wide, course SW.
 14.60 Leave River bottom; ascend west slope, 475 ft.
 16.00 Gulch, course NW.
 19.75 End of ascent; rocky point of hill, 50 lks. S. Descend NE. slope, 15 ft.
 31.25 End of descent; low pass in hill, 30 lks. south. Ascend NW. slope, 35 ft.
 32.00 Ridge, brs. N. and W. Descend NE. slope, 130 ft.
 36.00 Gulch, course NW. Ascend S. slope, 150 ft.
 39.50 Set an iron post, 3 ft. long 1 in. in diam., 26 ins. in the ground, for $\frac{1}{4}$ sec. cor., marked on brass cap,
 40.00 1913 on S. rim;
 $\frac{1}{4}$ S 18 in N., and
 S 19 in S. half; from which,
 A cedar, 9 ins. in diam., brs. N. 43° W., 13 lks. dist., marked $\frac{1}{4}$ S 18 B T.
 A pine 10 ins. in diam., brs. S. 69° E., 17 lks. dist., marked, $\frac{1}{4}$ S 19 B T.
 46.00 Spur ridge, brs. NW. Descend NE. slope, 100 ft.
 49.50 Canyon, course NE. Ascend NW. slope, 10 ft.
 50.60 Thence along broken north slope.
 51.50 Ridge, brs. NE.; enter canyon, course E.
 53.00 Leave canyon, course NE. Ascend NW. slope, 25 ft.

Chains.

54.00 Spur ridge, brs.NE. Descend SE. slope, 20 ft.
 56.00 Gulch, course N. Ascend NW. slope, 55 ft.
 57.50 Spur ridge, brs.N. Thence along rocky north slope.
 60.00 Canyon, course NW. Ascend SW. slope, 430 ft., over rough broken cliffs.
 80.00 Point for sec.cor. falls on slide rock; impracticable to set post; therefore, I run, N.0°1' E., 23 lks., and Set an iron post, 3 ft.long, 2 ins. in diam., 24 ins. in the ground, for witness cor. to cor.of secs.17,18,19 and 20, marked on brass cap,
 1913 on S.rim;
 WC S of center,
 T 4 N R 32 E in N.half;
 S 18 in NW.,
 S 17 in NE.,
 S 20 in SE., and
 S 19 in SW.quadrant; from which,
 A juniper, 15 ins.in diam., brs.N.66½°E., 62 lks.dist., marked W C T 4 N R 32 E S 17 B T.
 A pine, 12 ins. in diam., brs.S.61°E., 61 lks. dist., marked W C T 4 N R 32 E S 20 B T.
 A pine, 9 ins. in diam., brs.S.83½°W., 16 lks. dist., marked W C T 4 N R 32 E S 19 B T.
 A juniper, 8 ins. in diam., brs.N.39½°W., 120 lks.dist., marked W C T 4 N R 32 E S 18 B T.

Land, level, rolling and mountainous.
 Soil, rocky, 4th rate.
 Timber, heavy pine and fir.
 Undergrowth, dense scrub oak.
 Mountainous land, 58 chs.

Note: The sky was overcast at noon, making an observation for latitude impossible.

Sept.11, 1913.

Sept.12,1913: At 8h. 45m., a.m.; 1.m.t., I set off 33°41' N. on the lat.arc; 4°16' N. on the decl.arc; and determine a meridian with the solar at the witness cor. to cor.of secs.17,18,19 and 20, above described.

Thence I run, from cor.point, N.0°18E., bet secs.17 and 18.

Ascend steep SW. slope, 330 ft., thro.heavy timber and dense un-
 Witness second to govt. of secs.17,18,19 and 20. (dergrowth.)

0.23
 13.10 Spur ridge, brs.west. Descend NW. slope, 720 ft.
 20.00 Canyon, course NW.
 28.00 Thence along west slope.
 32.00 Descend NW. slope.
 40.00 Set an iron post, 3 ft.long, 1 in. in diam., 26 ins. in the ground, for ¼ sec.cor., marked on brass cap,
 1913 in S.rim,
 ¼ S 18 in W., and
 S 17 in E.half; from which,
 A pine, 10 ins. in diam., brs.N.20½°E., 30 lks. dist., marked ¼ S 17 B T.
 A pine, 26 ins. in diam., brs.S.72½° W., 59 lks.dist., marked ¼ S 18 B T.

46.00 Gulch, course NW.
 48.00 Thence along broken west slope.
 50.00 Descend NW. slope, 400 ft.
 61.50 Canyon, course west. Ascend SW. slope, 70 ft.
 64.53 Spur ridge, brs.SW. Descend NW. slope, 120 ft.
 70.25 Gulch, course NW. Ascend SW. slope, 115 ft.
 76.00 Spur ridge, brs.west. Descend NW. slope, 120 ft.
 76.10 A pine, 26 ins. diam., on line.
 80.00 Set an iron post, 3 ft.long, 2 ins. in diam., 24 ins. in ground, for cor.of secs.7,8,17 and 18, marked on brass cap,
 1913 on S.rim;

4. Partial Subdivision of frac. Township 4 North Range 32 East.

Chains.

T 4 N R 32 E in N. half;
 S 7 in NW.,
 S 8 in NE.,
 S 17 in SE., and
 S 18 in SW. quadrant; from which,
 A pine, 8 ins. in diam., brs. N. $45\frac{1}{2}^{\circ}$ E., 75 lks.
 dist., marked T 4 N R 32 E S 8 B T.
 A pine, 22 ins. in diam., brs. S. 70° E., 50 lks.
 dist., marked T 4 N R 32 E S 17 B T.
 A pine, 28 ins. in diam., brs. S. 40° W., 66 lks.
 dist., marked T 4 N R 32 E S 18 B T.
 A pine, 8 ins. in diam., brs. N. $49\frac{1}{2}^{\circ}$ W., 110
 lks. dist., marked T 4 N R 32 E S 7 B T.

Land, mountainous.
 Soil, rocky, 4th rate.
 Timber, heavy pine, juniper and fir.
 Undergrowth, dense scrub oak and locust.
 Mountainous land, 80 chs.
Note: The sky was overcast at noon, making an observation
 for lat. impossible.

Sept. 12, 1913.

Sept. 13, 1913: At 8h. 5 m., a.m., l.m.t., I set off 33°
 $42'$ N. on the lat. arc; $3^{\circ}54'$ N. on the decl. arc, and
 determine a meridian with the solar at the cor. of secs.
 7, 8, 17 and 18, above described.

Thence I run,
 West, on random line, bet. secs. 7 and 18.

40.00
 79.60

Set temp. $\frac{1}{4}$ sec. cor.
 Intersect the west bdy. of the township, 5 lks. south of
 the original cor. of secs. 7, 12, 13 and 18, which is
 a stone 8x10x12 ins., above ground, marked and witness-
 ed as described by the Surveyor General.

Thence I run,
 S. $89^{\circ}58'$ E., on true line, bet. secs. 7 and 18.

.60
 4.60
 21.00
 37.60
 39.60
 39.80

Gulch, course SE. Ascend west slope, 5h ft.
 Spur brs. SW. Thence along broken south slope.
 Descend SE. slope, 400 ft.
 West bank of canyon, course south.
 East bank of canyon, course south.
 Set an iron post 3 ft. long, 1 in. in diam., 26 ins. in
 the ground, for $\frac{1}{4}$ sec. cor., marked on brass cap,

1913 on S. rim,
 $\frac{1}{4}$ S 7 in N., and

S 18 in S. half; from which,
 A pine, 5 ins. in diam., brs. N. $60\frac{1}{2}^{\circ}$ E., 88
 lks. dist., marked $\frac{1}{4}$ S 7 B T.
 A pine, 6 ins. in diam., brs. S. $77\frac{3}{4}^{\circ}$ E., 116
 lks. dist., marked $\frac{1}{4}$ S 18 B T.

46.60
 49.60
 52.50

End of descent, gulch course SE. Ascend SW. slope, 20 ft.
 Spur ridge, brs. SE. Descend NE. slope 55 ft.
 Steiner's cabin (vacant) brs. N. 2 chs. dist., Enter
 Blue River bottom.

53.40
 55.60
 59.60
 61.40
 62.60

Rail fence, brs. NE. and SW.
 Rail fence, brs. N. and S.
 Blue River 25 lks. wide, course S.
 Road brs. NW. to Alpine and Luna, and SE. to Clifton.
 Leave river bottom, brs. NE. and SW. Ascend NW. slope,
 375 ft.

77.60
 79.60

Canyon, course NW.
 The cor. of secs. 7, 8, 17 and 18.
Note: At this cor., I set off $3^{\circ}50'$ N. on the decl. arc;
 and at noon, observe the sun on the meridian; the re-
 sulting lat. is $33^{\circ}42'$ N.

Land, level, rolling and mountainous.
 Soil, rocky, 4th rate.
 Timber, heavy pine, fir, cedar and willow.
 Undergrowth, dense scrub oak and locust.
 Mountainous land, 58 chs.

Partial Subdivision of frac. Township 4 North, Range 32 East. 5.

Chains.

- N. 0°1' E., bet. secs. 7 and 8.
- Ascend SW. slope, 16 ft., through heavy timber and dense undergrowth.
- 1.40 End of ascent; spur ridge, brs. SW. Descend NW. slope, 50 ft.
- 4.75 End of descent; canyon, course west; ascend SE. slope, 25 ft.
- 6.50 End of ascent; spur brs. SW.; descend NW. slope, 110 ft.
- 10.75 End of descent; canyon course west. Ascend SW. slope, 140 ft.
- 15.25 End of ascent; spur ridge brs. W. Descend NE. slope, 360 ft.
- 24.50 Gulch, course NW.
- 25.50 Ridge, brs. west.
- 31.00 Gulch, course NW.
- 34.25 South edge of Blue River, 60 lks. wide, course SW.
- 36.00 Road brs. NE. to Luna and Alpine, and SW. to Clifton.
- 40.00 Point for 1/4 sec. cor., falls in river. Dry channel.
- 40.30 Set an iron post, 3 ft. long, 1 in. in dia. 26 ins. in the ground for witness cor. to 1/4 sec. cor., marked on brass cap,
 - 1913 on S. rim;
 - W C 1/4 N. of center,
 - S 8 in SE., and
 - S 7 in SW. quadrant; from which,
 - A pine, 18 ins. in diam., brs. N. 13 1/2° E., 62 lks. dist., marked W C 1/4 S 8 B T.
 - A pine, 14 ins. in diam., brs. N. 11 1/2° W., 21 lks. dist., marked W C 1/4 S 7 B T.
- 43.00 Leave river bottom. Ascend SW. slope, 365 ft.
- 46.00 Gulch, course SE. Ascend SW. slope.
- 52.00 Ridge brs. NW. and SE.
- 59.00 Gulch, course SE.
- 66.00 End of ascent; thence along east slope.
- 74.00 Descend NE. slope, 175 ft.
- 78.00 End of descent; canyon, course east. Ascend south slope.
- 79.50 Set an iron post, 3 ft. long, 2 ins. in diam., 24 ins. in the ground, for witness cor. to cor. of secs. 5, 6, 7 and 8. marked on brass cap,
 - 1913 in S. rim,
 - W C S of center, T 4 N R 32 E in N. half;
 - S 6 in NW.,
 - S 5 in NE.,
 - S 8 in SE., and
 - S 7 in SW. quadrant; from which,
 - A pine, 20 ins. in diam., brs. N. 82° E., 68 lks. dist., marked W C T 4 N R 32 E S 5 B T.
 - A pine, 8 ins. in diam., brs. S. 75 1/2° E., 22 lks. dist., marked W C T 4 N R 32 E S 8 B T.
 - A pine, 10 ins. in diam., brs. S. 19 1/2° W., 100 lks. dist. marked W C T 4 N R 32 E S 7 B T.
 - A pine, 9 ins. in diam., brs. N. 49° W., 11 lks. dist., marked W C T 4 N R 32 E S 6 B T.
- 80.00 Point for sec. cor. falls on precipice, where it could not be established.

Land, rolling and hilly.
 Soil, rocky, 4th rate.
 Timber, willow, and cottonwood.
 Undergrowth, scrub oak and locust.

From the point for the cor. of secs. 5, 6, 7 and 8, a run, N. 89° 58' W., on random line, bet. secs. 6 and 7.

- 40.00 Set temp. 1/4 sec. cor.
- 80.00 Intersect the west bdy. of the Tp., 30 lks. north of the original cor. of secs. 1, 6, 7 and 12, which is a stone 10x8x9 ins. above ground, marked and witnessed as described by the Surveyor General.

Thence I run,
 N. 89° 49' E., on true line, bet. secs. 6 and 7.
 Descend NE. slope, 120 ft., through heavy timber and dense undergrowth.

6. Partial Subdivision of frac. Township 4 North, Range 32 E.

Chains.

- 4.30 Draw, course NE. Ascend NW. slope, 25 ft.
 8.25 Ridge, brs. NE and SW. Descend slight NE. slope, 320 ft.
 39.83 A stone 9x9x9 ins., above ground, unaccepted $\frac{1}{4}$ sec. cor., marked and witnessed as described by the Surveyor General. I destroy all evidence of this old cor.
 40.00 Set an iron post, 3 ft. long, 1 in. in diam., 26 ins. in the ground, for $\frac{1}{4}$ sec. cor., marked on brass cap, 1913 on S. rim;
 $\frac{1}{4}$ S 6 in N., and
 S 7 in S. half; from which,
 A juniper, 15 ins. in diam., brs. N. 16° W., 16 lks. dist., marked $\frac{1}{4}$ S 6 B T.
 A pine, 10 ins. in diam., brs. S. 45° W., 6 lks. dist., marked $\frac{1}{4}$ S 7 B T.
 40.10 Ascend SW. slope 20 ft.
 43.30 Spur ridge, brs. SE. Descend east slope, 65 ft.
 48.30 Draw, course SE. Ascend slight SW. slope, 20 ft.
 51.00 Spur ridge, brs. SE. Descend E. slope, 66 ft.
 53.30 Gulch, course SE. Ascend SW. slope, 20 ft.
 55.25 Ridge brs. NW. and SE. Descend east slope, 55 ft.
 57.80 Canyon, course south. Ascend SW. slope, 45 ft.
 61.30 Low spur ridge brs. S. Descend SE. slope, 275 ft.
 74.30 Old unaccepted $\frac{1}{4}$ sec. cor. as described. Destroy all evidence of it.
 80.00 Point for the cor. of secs. 5, 6, 7 and 8, on precipice. Land, rolling and hilly. Soil, rocky, 4th rate. Timber, pine, fir, juniper. Undergrowth, dense oak and locust.
 Sept. 13, 1913.
-
- Sept. 15, 1913: At 8h. 3m., a.m., l.m.t., I set off 33° 42 $\frac{1}{2}$ ' N. on the lat. arc; 3° 8' N. on the decl. arc; and determine a meridian with the solar at the point for cor. of secs. 5, 6, 7 and 8.
 Thence I run,
 N. 0° 1' E., on a random line, bet. secs. 5 and 6.
 40.00 Set temp. $\frac{1}{4}$ sec. cor.
 80.02 Intersect the north hdy. of the township, 19 lks. west of the cor. of secs. 5, 6, 31 and 32, established by me as described in Book "A."
 Thence I run,
 S. 0° 09' W., on a true line, bet. secs. 5 and 6.
 Ascend NE. slope, 95 ft., through heavy timber and dense undergrowth.
 7.00 Trail, brs. NE. and SW.
 9.00 End of ascent; spur ridge, brs. SW. Descend SE. slope, 83 ft.
 13.00 Gulch, course NE. Ascend rolling NW. slope, 210 ft.
 34.00 End of ascent; ridge brs. E. and W. Descend SW. slope, 20 ft.
 36.00 Gulch, course NW. Ascend NE. slope, 45 ft.
 40.02 Set an iron post 3 ft. long, 1 in. in diam., 26 ins. in the ground, for $\frac{1}{4}$ sec. cor., marked with brass cap, 1913 on S. rim,
 $\frac{1}{4}$ S 6 in W., and
 S 5 in E. half; from which,
 A pine, 12 ins. in diam., brs. N. 47° E., 10 lks. dist., marked $\frac{1}{4}$ S 5 B T.
 A pine, 10 ins. in diam., brs. S. 78° W. 27 lks. dist., marked $\frac{1}{4}$ S 6 B T.
 40.75 Descend SE. slope, 240 ft.
 44.00 Gulch, course SE. Continue descent.
 48.50 End of descent; canyon course east; ascend NE. slope, 95 ft.
 52.00 Descend SE. slope, 230 ft.
 59.50 Canyon, course SE. Ascend NE. slope, 110 ft.
 64.00 Ridge, brs. E. and W. Descend SE. slope, 240 ft.
 79.25 Top of cliffs, brs. E. and W.

Partial Subdivision of frac. Township 4 North, Range 32 East. 7.

Chains.

80.02 The point for cor. of secs. 5, 6, 7 and 8.
 Land, mountainous and hilly.
 Soil, rocky, 4th rate.
 Timber, heavy pine and oak.
 Undergrowth, scrub oak and locust.
 Mountainous land, 70 chs.
 Note: The sky was overcast at noon, making an observation for latitude impossible.
 Sept. 15, 1913.

Sept. 18, 1913: At 8h. 10m., a.m., l.m.t., I set off 33° 42' N. on the lat. arc; 1° 58' N. on the decl. arc; and determine a meridian with the solar at the cor. of secs. 7, 8, 17 and 18, hereinbefore described.
 Thence I run,
 East, on true line, bet. secs. 8 and 17.
 Ascend west slope, 70 ft., through heavy timber and dense undergrowth.
 3.60 Ridge, brs. N. and S. Descend NE. slope, 80 ft.
 10.25 Canyon, course NW. Ascend SW. slope, 685 ft.
 13.00 Spur ridge, brs. NW. Ascend NW. slope.
 20.00 Ascend west slope.
 32.00 Ascend NW. slope.
 36.55 Top of conical hill. Descend east slope, on ridge, 25 ft.
 40.00 Set an iron post, 3 ft. long, 1 in. in dia., 26 ins. in the ground, for 1/4 sec. cor., marked on brass cap,
 1913 in S. rim,
 S 8 in N., and
 S 17 in S. half; from which,
 A pine, 14 ins. in diam., brs. N. 73° E., 66 lks. dist., marked 1/4 S 8 B T.
 A pine, 10 ins. in diam., brs. S. 68 1/2° E., 64 lks. dist., marked 1/4 S 17 B T.
 Canyon, course NW. heads 3 chs. north.
 Canyon, course SW., heads 1 ch. south.
 Thence along north slope of ridge.
 41.11 Landslide, brs. NW. and SE. Ascend west slope, 415 ft.
 49.25 Upper side of landslide, brs. NE. and SE. Ascend NW. slope.
 53.50 End of ascent; descend NE. slope, 110 ft.; 70 lks. south to rock cliff, highest point of mountain.
 55.00 Canyon, course north.
 63.00 Canyon, course NW. Ascend SW. slope 190 ft.
 71.00 End of ascent; spur ridge, brs. NW. Descend NE. slope 140 ft.
 76.00 Canyon, course north; ascend NW. slope, 70 ft.
 80.00 Set an iron post, 3 ft. long, 2 ins. in diam., 24 ins. in the ground for cor. of secs. 8, 9, 16 and 17, marked on brass cap,
 1913 on S. rim,
 T 4 N R 32 E in N. half;
 S 8 in NW.,
 S 9 in NE.,
 S 16 in SE., and
 S 17 in SW. quadrant; from which,
 A pine, 16 ins. in diam., brs. N. 18° E., 88 lks. dist., marked T 4 N R 32 E S 9 B T.
 A pine, 8 ins. in diam., brs. S. 40° E., 16 lks. dist., marked T 4 N R 32 E S 16 B T.
 A pine, 10 ins. diam., brs. S. 42° W., 20 lks. dist., marked T 4 N R 32 E S 17 B T.
 A pine, 18 ins. in diam., brs. N. 22° W., 68 lks. dist., marked T 4 N R 32 E S 8 B T.
 Note: At this cor., at noon, I set off 1° 54' N. on the decl. arc; and observe the sun on the meridian; the resulting lat. is 33° 42' N.
 Land, mountainous.
 Soil, rocky, 4th rate.
 Timber, heavy pine, fir and oak.

8. Partial Subdivision of Township 4 North, Range 32 E.

Chains.

Mountainous land, 80.00 chs.
Undergrowth, dense scrub oak, locust and buck brush.

- N.0°1'E., bet. sec. 8, and frac. sec. 9.
Descend north slope, 670 ft., through heavy timber and dense undergrowth.
- 19.00 End of descent; canyon, course NW. Ascend SW. slope, 15 ft.
24.00 Thence along west slope.
31.00 Canyon, course west; ascend SW. slope, 180 ft.
37.00 End of ascent; ridge brs. E. and W. Descend NE. slope, 275 feet.
- 40.00 Set an iron post, 3 ft. long, 1 in. in diam., 26 ins. in the ground, for $\frac{1}{4}$ sec. cor., marked on brass cap,
1913 in S. rim,
 $\frac{1}{4}$ S 8 in W., and
S 9 in E. half; from which,
A fir, 10 ins. in diam., brs. S. 88 $\frac{1}{2}$ ° E., 24 lks. dist., marked $\frac{1}{4}$ S 9 B T.
A fir, 6 ins. in diam., brs. N. 21° W., 19 lks. dist., marked $\frac{1}{4}$ S 8 B T.
- 47.00 Canyon, course NW. Thence along west slope.
55.50 Gulch, course west. Ascend SW. slope. 155 ft.
60.00 End of ascent; spur ridge, brs. W. Descend NW. slope, 381 feet.
- 80.00 Set an iron post, 3 ft. long, 2 ins. in diam., 24 ins. in the ground, for cor. of secs. 4, 5, 8 and 9, marked on brass cap,
1913 in S. rim,
T 4 N R 32 E in N. half;
S 5 in NW.,
S 4 in NE.
S 9 in SE.; and
S 8 in SW. quadrant; from which,
A pine, 16 ins. in diam., brs. N. 75 $\frac{1}{2}$ ° E., 70 lks. dist., marked T 4 N R 32 E S 4 B T.
A pine, 18 ins. in diam., brs. S. 38° E., 60 lks. dist., marked T 4 N R 32 E S 9 B T.
An oak, 6 ins. in diam., brs. S. 61 $\frac{1}{2}$ ° W., 38 lks. dist., marked T 4 N R 32 E S 8 B T.
A pine, 28 ins. in diam., brs. N. 51 $\frac{1}{2}$ ° W., 58 lks. dist., marked T 4 N R 32 E S 5 B T.
- Land, mountainous.
Soil, rocky, 4th rate.
Timber, heavy pine, fir and oak.
Undergrowth, dense scrub oak, and locust.
Mountainous land, 80 chs.

- West, on random line, bet. secs. 5 and 8.
- 40.00 Set temp. $\frac{1}{4}$ sec. cor.
80.38 Intersect N. and S. line, 2 lks. north of the point for cor. of secs. 5, 6, 7 and 8, hereinbefore described.
Thence I run,
N. 89° 59' E., on a true line, bet. secs. 5 and 8.
Along south slope, through heavy timber and dense undergrowth.
- 2.80 Descend SE. slope, 30 ft.
4.75 Canyon, course SW. Ascend SW. slope, 45 ft.
8.00 Rocky spur ridge, brs. NW. and SE. Descend east slope, 135 ft.
- 13.50 Canyon, course south; ascend west slope, 135 ft.
19.80 Rocky ridge, brs. N. and S. Descend SE. slope, 95 ft.
24.60 Gulch, course south. Ascend SW. slope, 16 ft.
29.00 Spur ridge, brs. south. Descend SE. slope, 95 ft.
34.10 From this point, a stone 9x8x9 ins., above ground, marked $\frac{1}{4}$ on N., and witnessed by bearing trees, as described

Partial Subdivision of frac. Township 4 North, Range 32 E. 9.

Chains.

- by the Surveyor General, brs. south 2 lks. dist. I destroy all evidence of this corner, and obliterate the markings on the bearing trees.
- 35.25 Gulch, course SE. Ascend SW slope, 15 ft.
- 36.00 Thence along slight south slope.
- 38.00 Spur ridge, brs. SE. Descend NE. slope, 111 ft.
- 40.19 Set an iron post, 3 ft. long, 1 in. in diam., 26 ins. in the ground, for $\frac{1}{4}$ sec. cor., marked on brass cap, 1913 in S. rim; $\frac{1}{4}$ S 5 in N., and S 8 in S. half; from which,
 - A pine 18 ins. in diam., brs. N. $55\frac{1}{2}^{\circ}$ W., 62 lks. dist., marked $\frac{1}{4}$ S 5 B T.
 - A juniper, 10 ins. in diam., brs. S. 52° W., 40 lks. dist., marked $\frac{1}{4}$ S 8 B T.
- 42.00 Forest Service Telephone line, brs. N. and S.
- 43.75 Foot of descent.
- 45.40 Blue River, 65 lks. wide, course S.
- 51.70 Wash, course SE.
- 52.80 Road brs. NW. to Alpine and Luna, and SE. to Clifton. Ascend SW. slope, 55 ft.
- 59.00 Granite spur ridge, extends 2 chs. NW. Descend NE. slope 55 ft.
- 61.00 Enter Blue River bottom.
- 69.00 Wash, course NW. Leave Blue River bottom; ascend NW. slope, 70 ft.
- 74.00 Spur ridge, brs. NW. and SE. Descend NE. slope, 25 ft.
- 74.60 Gulch, course NW. Ascend SW. slope, 55 ft.
- 77.70 Spur ridge, brs. NW. Descend NE. slope, 40 ft.
- 80.38 The cor. of secs. 4, 5, 8 and 9. Land, mountainous and hilly. Soil, rocky, 4th rate. Timber, willow, cottonwood and fir. Undergrowth, dense oak.

Sept. 18, 1913.

Sept. 19, 1913: At 9h. 5m. a.m., l.m.t., I set off $33^{\circ}42\frac{1}{2}'$ N. on the al. arc; $1^{\circ}34'$ N. on the decl. arc, and determine a meridian with the solar at the cor. of secs. 4, 5, 8 and 9.

- Thence I run, East, on a true line bet. frac. secs. 4 and 9. Descend NE. slope, 30 ft., through heavy timber and scattering undergrowth.
- 1.60 Canyon, course NW. Ascend SW. slope, 30 ft.
- 3.01 Set an iron post, 3 ft. long, 2 ins. in diam., 24 ins. in the ground, for closing cor. of frac. secs. 4 and 9, marked on brass cap, 1913 in S. rim; C C W of center, N M on E. half; T 4 N S 4 in NW., R 32 E S 9 in SW. quadrant; from which,
 - A pine, 36 ins. in diam., brs. S. 34° W., 12 lks. dist., marked C C T 4 N R 32 E S 9 B T.
 - A pine, 10 ins. in diam., brs. N. $50\frac{1}{2}^{\circ}$ W., 59 lks. dist., marked C C T 4 N R 32 E S 4 B T.
- From this cor., the 227 mile cor., on the bdy. between Arizona and New Mexico, which is a stone, 14x6x16 ins. set in a mound of stone, marked and witnessed as described by the Surveyor General, brs. S. $0^{\circ}05'$ W., 10.91 chs. dist.
- I destroy all trace of the unaccepted C C, 83 lks. S. of my corner, which is a stone marked and witnessed as described by the Surveyor General.
- Land, rolling. Soil, rocky, 4th rate. Timber, heavy pine and oak. Undergrowth, scattering scrub oak.

10. Partial Subdivision of frac. Township 4 North, Range 32 E.

Chains.

N.0° 1' E., on a random line, bet. sec.5, and frac.sec.4.
 40.00 Set temp. $\frac{1}{4}$ sec.cor.
 80.21 Intersect the N.bdy. of the Tp., 2 lks.east of the cor.
 of secs. 4,5,32 and 33, established by me, as de-
 scribed in Book "A."
 Thence I run,
 South, on a true line, bet. secs 5 and frac.sec.4.
 Over level land, through Blue River bottom.
 4.36 Road, brs.E.and W.
 7.61 Bend in river, course SW. from NW.
 11.45 Blue River, 60 lks.wide, 3 ins. deep, course SE.
 15.01 Leave river bottom, brs.NW. and SE.
 15.50 Old log fence, brs.W. and NE.
 Ascend NE. slope, 280 ft.
 20.20 Ascend N. slope.
 29.80 Rocky spur brs.E.and W. Descend SE. slope, 55 ft.
 34.80 Rocky spur brs.NW. and SE. Descend SW. slope, 145 ft.
 40.21 Set an iron post, 3 ft. long, 1 in. in diam., 26 ins. in
 the ground, for $\frac{1}{4}$ sec.cor., marked on brass cap,
 1913 in S.rim,
 $\frac{1}{4}$ S 5 in W., and
 S 4 in E.half; from which,
 A pine, 28 ins. in diam., brs.N.70 $\frac{1}{2}$ °E. 33
 lks.dist., marked $\frac{1}{4}$ S 4 B T.
 A pine, 26 ins. in diam., brs.N.19°W., 94
 lks.dist., marked $\frac{1}{4}$ S 5 B T.
 Ascend.
 44.20 Top of ascent; descend SW. slope, 115 ft.
 50.90 A pine, 35 ins. diam., on line.
 52.90 Pine 40 ins. diam., on line.
 60.60 Old road, brs. E.and W. Enter bottom.
 62.20 Vacant cabins, br. east 7 chs.dist.
 62.70 Old rail fence, brs.E.and W.
 65.05 Road brs.NE. to Luna and A.pine, and SW. to Clifton.
 66.70 Blue river 20 lks.wide, 6 ins. deep, clear water, gravelly
 bottom, course west. Leave bottom land, brs.E.and W.
 Ascend N. slope, 100 ft.
 71.00 Top of ascent; descend SW. slope, 55 ft.
 77.06 Gulch, course NW. Ascend NE. slope, 40 ft.
 80.21 The cor.of secs.4,5,8 and 9.
 Land,level, rolling and hilly.
 Soil, 1st and 4th rate.
 Timber, pine, fir, oak, cottonwood and willows.
 Undergrowth, scrub oak.

Sept.19, 1913.

GENERAL DESCRIPTION.

The township is mountainous, of very rocky granite forma-
 tion. There are small patches of good loam along
 Blue River bottom. The mountains are covered with
 pine, oak, and juniper timber. Cottonwood, walnut, and
 ash are found along Blue River. Some of this timber
 is suitable for sawing. There are no settlers in this
 township.

11

BOOK 112769

BOUNDARIES OF SURVEYED PORTION OF
 Fractional Township 4 North, Range 32 East
 Latitudes, departures and closing errors.

Line designated.	True bearing.	Dist. chs.	Latitudes.		Departures.	
			N. chs.	S. chs.	E. chs.	W. chs.
S. bdy. secs. 4, 8, 18	West.	163.01				163.01
West bdy. of Tp.	North	240.00	240.00			
North bdy. of Tp.	East	163.06			163.06	
East bdy. of Ariz.	S. 0° 6' W.	9.91		9.91		.02
	S. 0° 5' W.	70.42		70.42		.10
E. bdy. secs. 8 & 18	S. 0° 1' W.	160.00		160.00		.05
Convergency.					.07	
Totals.			240.00	240.33	163.13	163.18
				240.00		163.13
Error in lat.			0.33		Error dep. 0.05	

William B. Himmel.

U. S. Surveyor.

CERTIFICATE OF ASSISTANTS.

[Applies to notes in Books D, E, F, G, H, I, J, K, L, M, N, O, P, Q, R and S)

We, the undersigned, hereby certify upon honor that we assisted, to the best of our skill and ability, William B. Kimmel, U. S. Surveyor, during the periods and in the capacities stated opposite our several signatures, in surveying all those parts or portions of the subdivision lines of T. 1 N., R. 28 E., Ts. 4 & 4 1/2 N., R. 32 E., T. 13 S., R. 27 E., Ts. 1, 4, 5, 8, & 14 S., R. 28 E., Ts. 5 & 15 S., R. 29 E., Ts. 3 & 15 S. R. 30 E. and Ts. 8, 12 & 17 S., R. 32 E. of the Gila and Salt River Base and Meridian, in the State of Arizona & in retracing or resurveying all those parts or portions of the boundaries of said township

which are represented in the foregoing field notes & those in Books E, F, G, H, I, J, K, L, M, N, O, P, Q, R and S as having been executed by him, and under his direction; and that said surveys, retracements and resurveys have been, in all respects, to the best of our knowledge and belief, well and faithfully executed.

Table with columns: NAME, PERIOD OF SERVICE (BEGUN, ENDED), CAPACITY. Rows include names like O D Bray, L B Wilson, Geo Sutherland, etc., with their respective dates and roles.

Subscribed and certified to before me on the dates of the final service as shown above.

William B. Kimmel, U. S. Surveyor.

FINAL OATH OF UNITED STATES SURVEYOR.
(Applies to Books D,E,F,G,H,I,J,K,L,M,N,O,P,Q,R AND S)

I, William B. Kimmel, U. S. Surveyor, do solemnly swear that, in pursuance of special instructions received from the U. S. Surveyor General for Arizona for Group 26 dated: Aug. 25, 1910, Aug. 9, 1912, Sept. 19, 1912, Feb. 18, 1913, April 11, 1913, and Dec. 30, 1913 and June 9, 1914, I have well, faithfully, and truly, in my own proper person, and in strict conformity with said instructions, the Manual of Surveying Instructions, and the laws of the United States, surveyed all those parts or portions of the Subdivision lines of T. 1 N., R. 28 E., Ts. 4 & 4 1/2 N., R. 32 E., T. 13 S., R. 27 E., Ts. 1, 4, 5, 8, & 14 S., R. 28 E., Ts. 5 & 15 S., R. 29 E., Ts. 3 & 15 S., R. 30 E. and Ts. 8, 12 & 17 S., R. 32 E. of the Gila and Salt River Base and Meridian in the State of Arizona and ~~retraced or resurveyed the bdrs. of said tps. which are represented in the foregoing field notes & those in Books E, F, G, H, I, J, K, L, M, N, O, P, Q, R and S~~ as having been executed by me, and under my direction; and I do further solemnly swear that all the corners of said surveys, retracements and resurveys ~~have been established or reestablished and perpetuated in strict accordance with the Manual of Surveying Instructions, and the special written instructions of the U. S. Surveyor General for Arizona for Group 26~~ and in the specific manner described in the field notes, and that the foregoing ~~and notes in Books E, F, G, H, I, J, K, L, M, N, O, P, Q, R & S~~ are the original field notes of such surveys, retracements and resurveys.

William B. Kimmel.
U. S. Surveyor.

Subscribed by said William B. Kimmel and sworn to before me }
this 4th day of March, 1915



Frank S. Ingalls
SURVEYOR-GENERAL OF ARIZONA

APPROVAL.

OFFICE OF THE UNITED STATES SURVEYOR GENERAL,
Phoenix, Arizona, June 19, 1915

The foregoing field notes of the survey of Part of the Subdivision lines of Fractional Township No. 4 North, Range No. 32 East of the Gila and Salt River Base and Meridian in the State of Arizona and Resurvey of part of the West bdy. of said township

executed by William B. Kimmel U.S. Surveyor under his special instructions dated August 9, 1912 for Group 26, ~~401~~, having been critically examined, and the necessary corrections and explanations made, the said field notes, and the surveys ~~and resurvey they describe~~ are hereby approved.

Frank S. Ingalls
U. S. Surveyor General.
of Arizona.

~~I certify that the foregoing transcript of the field notes of the above described surveys in~~
~~has been correctly copied from the original notes on file in this office.~~