

2781

4-679

2781

153

(1)

Book "P"  
Subdivisions  
FIELD NOTES

BOOK 2781

OF THE SURVEY OF

PART OF THE

SUBDIVISION LINES OF

TOWNSHIP 15 SOUTH RANGE 29 EAST

AND RETRACEMENT OF

PART OF THE

SOUTH AND EAST BDRS.

OF THE CAMP BOWIE MILITARY RESERVATION (ABANDONED)

IN T.15 S., R.29 E.

Of the Gila and Salt River Base and Meridian,

In the State of ARIZONA

EXECUTED BY

WILLIAM B. KIMMEL

In the capacity of U. S. Surveyor, under instructions dated December 30, 1913,

issued by the United States Surveyor General to govern surveys included in

Group No. 26, which were approved by the Commissioner of the General Land

Office, January 9, 1914, pursuant to authority contained in the Act of

Congress dated August 1, 1914.

Survey commenced August 18, 1914

Survey completed September 6, 1914

# Book "P"

BOOK 2781

## INDEX DIAGRAM.

Township *15 South*, Range *29 East*

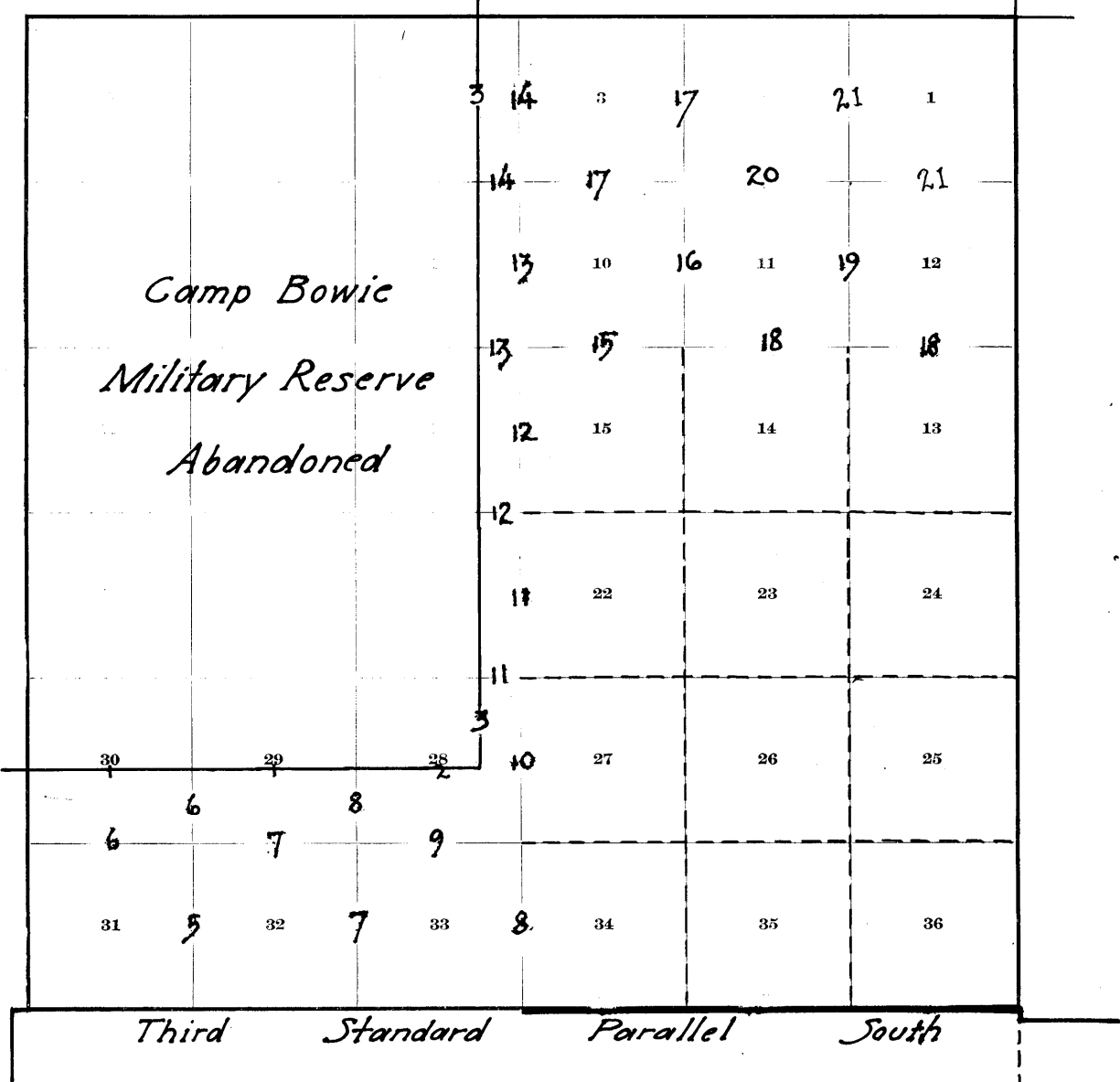

6-151

\_\_\_\_\_ Lines surveyed  
 - - - - - " unsurveyed  
 \_\_\_\_\_ Notes in Book "B"

(Abandoned)

Retracement of South bdy. Camp Bowie Mil. Res. in T. 15 S., R. 29 E.

1581

Chains.

Survey commenced Aug. 18, 1914, and executed with a Young and Sons' light mountain transit, No. 8541. For description of instrument and certificate of approval, see Book "A."

As it was too cloudy for Polaris observation, last night, and knowing from recent and repeated tests of the transit that it is in correct adjustment, I test the stadia wire interval, by setting rod 6.016 chs. from the instrument, the rod reading is 3.000 ft., which is correct.

Aug. 18, 1914: At 10h. a.m., l.m.t., I set off 32° 5½' N. on the lat. arc; 13° 14' N. on the decl. arc; and determine with the solar a meridian at the closing cor. at the intersection of south bdy. of the Camp Bowie Military Reservation, with the Range line, bet. Rs. 28 and 29 E. which is a stone 4x6x8 ins. above ground, firmly set & marked, 6 grooves on E. and W. faces, C C on the N., and P L on the S. face; with a mound of stone, north of cor.

Thence I run, East, on a random line, on the south bdy. of the Camp Bowie Military Reservation, Abandoned, through sec. 30 of T. 15 S., R. 29 E.

- 21.73 Over rolling land, through scattering undergrowth. Fall 3 lks. south of 6½ mile cor., a stone 10x6x8 ins. above ground, firmly set, marked, 6½ M on W., C B M R A on N., and P L on S. face, with a mound of stone west. A windmill brs. N. 43° E. from this cor.
  - 28.00 Wash, 75 lks. wide, 3 ft. deep, course SE.
  - 30.00 Trail, brs. N. and S.
  - 50.50 Draw, course NW. Ascend west slope, 140 ft.
  - 60.00 Windmill, brs. N. 52° W.
  - 61.00 Spur slopes SE.; descend NE' slope, 15 ft.
  - 62.63 Fall 9 lks. S. of 7 mile cor., a stone 12x6x10 ins. above ground; firmly set, marked 7 M on W., C B M R A on N., and P L on S. face, with a mound of stone west of cor.
  - 64.00 Draw, course SE.; ascend S. slope
  - 70.00 Ascend west slope.
  - 79.00 Spur ridge, slopes SE.; 230 ft. above draw; descend. NE. slope; 25 ft. to
  - 80.72 Fall 12 lks. S. of closing cor. of frac. secs. 29 and 30, within Camp Bowie Military Reservation, a stone 14x8x18 ins. above ground, firmly set, marked with 5 grooves on the east, C C on the N., and P L on S. face, with a mound of stone N. of corner.
- Therefore, the true course and distance of this line on south bdy. of frac. sec. 30, within Camp Bowie Military Reservation is N. 89° 55' E., 80.72 chs.

Thence I run, East, on a random line, through sec. 29, Descend NE' slope, 155 ft., through scattering undergrowth, to

- 6.00 Draw, course SE.; continue along rolling S' slope.
- 12.00 Descend E. slope, 120 ft. to
- 19.40 Wash, 30 lks. wide, 4 ft. deep, course S.; continue over rolling land, drains S.
- 21.47 Fall 1 lk. S. of 7½ mile cor., a stone 8x10x9 ins. above ground firmly set, marked 7½ M on W., C B M R A on N., and

## 2. Retracement of S.bdy. Camp Bowie Mil.Res.(abandoned) in T.15S.R29E.

Chains.

- P L on S.face, with a mound of stone west of cor.  
 Note: Clouds obscure the sun at noon this day, rendering an observation for latitude impossible.
- 33.25 Wash, 15 lks.wide, 3 ft. deep, course south.  
 36.50 Wash, 20 lks.wide, 3 ft.deep, course S.; ascend SW. slope, 150 ft.to  
 60.00 Top of ascent; continue along rolling south slope.  
 61.50 Fall 4 lks.south of 8 mile cor., a stone 18x10x10 ins. above ground, firmly set, marked  
     8 M on W.,  
     C B A M R on the N., and  
     P L on S. face, with a mound of stone west of cor.
- 73.75 Draw, course S.; ascend SW. slope, 75 ft. to  
 79.77 Fall 5 lks.south of closing cor.frac.secs.28 and 29, within Camp Bowie Military Reservation abandoned, a stone 9x10x14 ins. above ground, firmly set, marked 4 grooves on W.,  
     C C on N., and  
     P L on S.face, with a mound of stone N.of cor. Therefore, the true course and dist. of this line south of frac.sec.29, within Camp Bowie Military Reservation, abandoned, is N.89°58'E., 79.77 chs.
- 
- Thence I run,  
 East, on a random line, in sec.28.  
 Ascend SW. slope, through scattering undergrowth.
- 2.50 Spur slopes south; ascend south slope.  
 4.75 Draw, course SW.  
 12.25 Draw, course SW.; ascend SW. slope.  
 18.00 Top of ascent, 125 ft. above cor.; descend SE. slope.  
 21.68 Fall 1 lk. south of 8½ mile cor., a stone 6x12x10 ins., above ground, firmly set, marked,  
     8½ M on W.,  
     C B A M R on N., and  
     P L on S. face, with a mound of stone, west of cor.
- 24.25 Draw, course SW., 125 ft. below 18 ch. point; continue along rolling S. slope.  
 30.75 Draw, course SW.; enter scattering timber, brs.N.and S.; ascend 25 ft. to  
 31.85 Spur, slopes south.  
 34.80 Draw, course SW.; ascend 25 ft. to  
 35.50 Spur slopes N.  
 35.80 Draw, course NW.; ascend 30 ft.to  
 39.75 Spur slopes S.  
 42.00 Draw, course SW.; ascend rolling NW. slope.  
 49.50 Draw, course N.  
 59.40 Draw, course NW.; ascend SW. slope.  
 61.66 162 ft. above draw at 42 ch.point, Fall 4 lks.south of 9 mile cor., a stone 14x8x12 ins., above ground, firmly set, marked,  
     9 M on W.,  
     C B A M R on N., and  
     P L on S. face;
- with a mound of stone, west of cor.  
 62.26 Fall 4 lks.south of SE. cor. of Camp Bowie Military Reservation, a post 8 ins. sq., 6 ft. above ground, marked C B A M R on N.face, SE face C B A M R on W.face, with a mound of stone NW. of cor.  
 Therefore, the true course and distance of this line S. of frac.sec.28 within C B M R A is N.89°58'E., 62.26 chs.

Aug.18,1914.

Retracement of part of East bdy. of C.B.M.R.A. in T. 15S R. 29E. 3.

Chains.

August 19, 1914:  
 From SE. cor., I run,  
 North, on a random line, on the east bdy. of the Camp  
 Bowie Military Reservation (Abandoned) in sec. 28.  
 Ascend SW. slope, through scattering timber and under-  
 growth.

6.45 Draw, course SW.  
 11.55 Spur slopes SW.  
 14.95 Draw, course SW.  
 23.20 Spur slopes west; ascend west slope.  
 33.00 Ridge, main divide between Sulphur Springs and San Simon  
 valleys, brs. NW and SE., 475 ft. above SE. cor. of  
 Camp Bowie Military Reservation abandoned; enter heavy  
 timber, bears same as ridge; descend NE. slopes, 10ft. to

34.00 Ridge, brs. E. and W.; descend N. slope.  
 38.95 Fall 2 lks. east of 9½ mile cor., a stone 6x14x16 ins.  
 above ground, firmly set, marked,  
 C B A M R on W.,  
 9½ on S., and  
 P L on E. face; with bearing trees as de-  
 scribed by the Surveyor General.

42.87 Fall 2 lks. east of closing corner of frac. secs. 21 and 28,  
 within Camp Bowie Military Reservation, Abandoned, a  
 stone 5x9x10 ins. above ground, firmly set, marked  
 C C on W.,  
 P L on E., and  
 2 grooves on S. face;  
 with a mound of stone west of cor., and bearing trees  
 as described by the Surveyor General.

Therefore, the true course and distance of this line  
 east of frac. sec. 28 within Camp Bowie Military Reserva-  
 tion Abandoned, is N. 0° 2' W., 42.87 chs.  
 August 19, 1914.

-----

Aug. 24, 1914:  
 From the intersection of the east bdy. of the Camp Bowie  
 Military Reservation, Abandoned, with the north bdy.  
 of T. 15 S., R. 29 E., which is marked by a stone 10x7x8  
 ins. above ground, marked,  
 C C on W.,  
 P L on E., and  
 6 grooves on N. and S. faces, with a mound  
 of stone west of cor., I run,  
 South, on random line on the east bdy. of the Camp Bowie  
 Military Reservation, Abandoned, through sec. 4, T. 15 S.,  
 R. 29 E.

Over rolling land, through dense undergrowth.

4.50 Intersect the 13½ mile cor. a stone, 5x14x9 ins. above  
 ground, firmly set, marked  
 C B A M R on the W.,  
 P L on the E., and  
 13½ M on S. face, with a mound of stone S.  
 of cor.

5.65 Old wagon road, brs. NW. and SE.  
 7.70 Wagon road, brs. NW. and SE.  
 20.15 Old wagon road, brs. E. and W.  
 30.00 Wash, 12 lks. wide, 1 ft. deep, course NW.  
 32.00 Foot of mountain, brs. NE. and SW.; ascend NW. slope, through  
 scattering undergrowth.

44.15 Fall 1 lk. west of 13 mile cor., a stone 36x18x18 ins., lay-  
 ing on the ground, marked  
 X on top,  
 C B A M R on W.,  
 P L on E., and  
 13 M on S. face, with a mound of stone south  
 of cor.

57.50 Spur ridge, slopes NE., 400 ft. above 32 ch. point; descend  
 along rolling east slope, 25 ft. to

4. Retracement of part of E. bdy. of C.B.M.R.A. in T.15 S R29 E.

Chains,  
 64.00 Foot of descent; ascend NE. slope.  
 79.19 Fall 2 lks. west of closing cor. of frac. secs. 4 and 9, within Camp Bowie Military Reservation, Abandoned, a stone 6x110x14 ins. above ground, firmly set, marked  
 C C on W.,  
 P L on E., and  
 5 grooves on the S. face, with a mound of stone, west of corner.  
 Therefore, the true course and distance of this line, through sec. 4, is S. 0° 1' E., 79.19 chs.  
 Aug. 24, 1914.

Boundaries of Township 15 South, Range 29 East.  
 (Outside the Camp Bowie Military Reservation (Abandoned))

Latitudes, departures and closing errors.

Line designated.	True course.	Dist.	Latitudes.		Departures.	
			N.	S.	E.	W.
South bdy. of Tp. (3rd. Std. Par. S.)	West,	401.00				401.00
	N. 87° 50' W.	40.38	1.53			40.35
	N. 89° 48' W.	39.55	.14			39.55
West bdy. of Tp.	North,	116.43	116.43			
South bdy. of C.B.M.R.A.	N. 89° 55' E.	80.72	.12		80.72	
	N. 89° 58' E.	142.03	.08		142.03	
East bdy. of C.B.M.R.A.	N. 0° 2' W.	42.87	42.87			.02
	North,	240.78	240.78			
	N. 0° 1' W.	79.19	79.19			.02
North bdy. of Tp.	East,	258.14			258.14	
East bdy. of Tp.	S. 0° 19' E.	20.69		20.69	.11	
	South,	461.08		461.08		
Convergency,					.29	
Totals, -----			481.14	481.77	481.29	480.94
				481.14	480.94	
Error in latitude, -----				0.63		
Error in departure, -----					-0.35	

Partial Subdivision of Township 15 South, Range 29 East. 5.

Chains.

Survey commenced Aug. 20, 1914, and executed with a Young and Sons' light mountain transit, No. 8541. For description of instrument, see Book "A."

August 19, 1914: At my camp, near the marble quarry in sec. 20, T. 15 S., R. 29 E., latitude, 32° 6 1/2' N.; longitude, 109° 23' W., I set off 32° 6 1/2' N. on the lat. arc; 12° 50' N. on the decl. arc, and at 5h. 15m. p.m., l.m.t., determine with the solar a meridian, and mark a point thereon by setting a flag firmly in the ground, about 4 chs. north of my station.

August 19, 1914: At 8h. 51m. p.m., by my watch, which is correct l.m.t., I observe Polaris, in accordance with the Manual of Instructions, and mark a point in the line thus determined, on a peg driven in the ground, about 4 chs. north of my station.

Aug. 19, 1914.

August 20, 1914; At 6h. 25m., a.m., l.m.t., I lay off the azimuth of Polaris, 1° 20' to the west, which is the azimuth corresponding to an hour angle of 6h. 46m., the point falling on flag set by solar observation yesterday.

At 6h. 30m. a.m., l.m.t., I set off 32° 6 1/2' N. on the lat. arc; 12° 40' N. on the decl. arc; and determine with the solar a meridian, which agrees with the Polaris observation.

The magnetic decl. of the true meridian at 6h. 30m. a.m., is 12° 35' E.

Aug. 20, 1914.

Aug. 26, 1914. At 9h. a.m., l.m.t., I set off 32° 4 1/2' N. on the lat. arc; 10° 34 1/2' N. on the decl. arc; and determine with the solar a meridian at the original standard corner of secs. 31 and 32, on south bdy. of Tp. (3rd. Standard Parallel S.), which is a stone 4x12x10 ins. above ground, firmly set, marked 5 notches on E., 1 notch on west edge, and S C on N. face, with a mound of stone north of cor.

Thence I run,

N. 0° 1' E. bet. secs. 31 and 32.

Over rolling land, through scattering undergrowth.

- 2.00 Draw, course SW.; ascend SE. slope, 60 ft. to
- 11.15 Spur slopes SW.; descend NW. slope, 50 ft. to
- 16.40 Draw, course west; ascend S. slope, 25 ft. to
- 17.75 Rocky point, slopes west; descend SW. slope, 20 ft. to
- 23.50 Draw, course SW.; ascend SE. slope, 80 ft. to
- 27.00 Prospect hole, about 40 lks. E.
- 33.80 Spur ridge, slopes SW.; continue over rolling land, drains west.
- 40.00 Set an iron post 3 ft. long, 1 in. in diam., 26 ins. in the ground, for 1/4 sec. cor., marked on brass cap, 1914 on S. rim, 1/4 S 35 on W., and S 32 on E. half; raise a mound of stone 2 ft. base, 1 1/2 ft. high, west of cor. Pits impracticable.
- 48.25 Wash, 15 lks. wide 3 ft. deep, course west.
- 56.00 Wash, 25 lks. wide, 3 ft. deep, course SW.
- 62.60 Wash, 8 lks. wide, 3 ft. deep, course NW.
- 67.30 Wash, 125 lks. wide, 5 ft. deep, course NW.
- 75.70 Wash, 40 lks. wide, 3 ft. deep, course SW.
- 80.00 Set an iron post, 3 ft. long, 2 ins. in diam., 18 ins. in the ground, on hardpan, supported by a mound of stone for the cor. of secs. 29, 30, 31 and 32, marked on brass cap, 1914 on S. rim, T 15 S S 30 in NW., R 29 E S 29 in NE., S 32 in SE., and S 31 in SW. quadrant; raise a mound of stone 2 ft. base, 1 1/2 ft. high, W. of cor. Pits impracticable.

6. Partial Subdivision of Township 15 South Range 29 East

Chains.

Land, rolling.  
Soil, sandy loam, and gumbo, gravelly, 2nd and 3rd rate.  
No timber. Undergrowth, scattering scrub oak and mesquite.

West, on a random line, bet. secs. 30 and 31.

40.00 Set temp. 1/4 sec. cor.

80.16 Intersect the west bdy. of the Tp., 12 lks. south of true point for cor. or 148 lks. north of the witness cor. to cor. of secs. 25, 30, 31 and 36, which is a stone 8x6x7 ins. above ground, firmly set, marked

W C on N. face. with 1 notch on S., and 5 notches on N. edges, with a mound of stone west of cor. This witness cor. is set 160 lks. S. of true point for cor. Thence I run, from the true point for the cor.

S. 89° 55' E. on a true line, bet. secs. 30 and 31.

40.16 Over rolling land, through very scattering undergrowth. Set an iron post, 3 ft. long, 1 in. in diam., 26 ins. in the ground, for 1/4 sec. cor., marked on brass cap, 1914 on S rim, 1/4 S 30 on N., and S 31 on S. half;

raise a mound of stone 2 ft. base, 1 1/2 ft. high, north of corner. Pits impracticable.

62.80 Wash, 10 lks. wide, 2 ft. deep, course S.

72.00 Wash, 10 lks. wide, 2 ft. deep, course SW.

80.16 The cor. of secs. 29, 30, 31 and 32.

Land, rolling.  
Soil, sandy loam and gumbo, gravelly 1st to 3rd rate.  
No timber.  
Undergrowth, a very little mesquite.

Knowing from my retracement of the south bdy. of the Camp Bowie Military Reservation, Abandoned, in Range 29 E., that a closing corner will be necessary for frac. secs. 29 and 30, outside Camp Bowie Military Reservation, Abandoned, I run, from the cor. of secs. 29, 30, 31 and 32, N. 0° 1' E., on a true line, bet. frac. secs. 29 and 30, outside the Camp Bowie Military Reservation, Abandoned Ascend SW. slope, 200 ft., through scattering undergrowth, to

14.00 Spur, slopes east; descend NE. slope, 65 ft. to

22.25 Draw, course SE.; ascend south slope.

27.00 Ascend SW. slope.

35.00 Spur, slopes SE., 250 ft. above draw; thence along east slope.

36.58 Intersect the South bdy. of the Camp Bowie Military Reservation, Abandoned, S. 89° 55' W., 59 lks. dist., from closing cor. of frac. secs. 29 and 30, within Camp Bowie Military Reservation, Abandoned, a stone, marked and witnessed as hereinbefore described in my notes of retracement of Reservation boundary,

At point of intersection, I set an iron post, 3 ft. long, 2 ins. in diam., on bedrock, supported by a mound of stone, for closing corner of frac. secs. 29 and 30, outside the Camp Bowie Military Reservation, Abandoned, marked on brass cap,

1914 on S. rim, & as shown below,

T 15 S R 29 E

C B A M R

S 30 | S 29

C | C

S 30 | S 29

raise a mound of stone 2 ft. base, 1 1/2 ft. high, south of corner. Pits impracticable.

Note: Aug. 26, 1914: At this corner I set off 10° 31 1/2' N. on the decl. arc; and at apparent noon, observe the sun on the meridian; the resulting lat. is 32° 6' N.

Land, hilly. Soil, sandy loam, gumbo & rocky, 2nd to 4th rate  
No timber. Undergrowth, scattering mesquite & catclaw.



Partial Subdivision of Township 15 South, Range 29 East. 7.  
Chains.

Aug. 27, 1914: At 9h. a.m., l.m.t., I set off  $32^{\circ} 4\frac{1}{2}' N.$  on the lat. arc;  $10^{\circ} 14' N.$  on the decl. arc; and determine with the solar a meridian at the original standard corner of secs. 32 and 33, on south bdy. of Tp. (3rd. Standard Parallel South) which is a post 4 ins. sq., protruding 2 ft. from a mound of stone, marked and witnessed as described by the Surveyor General.

Thence I run,  
 $N. 0^{\circ} 1' E.$ , bet. secs. 32 and 33.  
 Over rolling land, through scattering undergrowth.  
 Wash, 15 lks. wide, 2 ft. deep, course SW.  
 Draw, course SW.; ascend SE. slope, 110 ft. to  
 Spur slopes SW.; descend NW. slope, 55 ft. to  
 Draw, course SW.; ascend SE. slope, 95 ft. to  
 Spur, slopes SW.; descend NW. slope.  
 Set an iron post 3 ft. long, 1 in. in diam., 26 ins. in the ground, for  $\frac{1}{4}$  sec. cor., marked on brass cap,  
 1914 on S. rim,  
 $\frac{1}{4}$  S 32 on W., and  
 S 33 on E. half; from which,  
 An oak limb, 12 ins. in diam., brs.  $N. 42\frac{1}{2}^{\circ} W.$ , 142 lks. dist., marked  $\frac{1}{4}$  S 32 B T.  
 No other trees within limits; raise a mound of stone 2 ft. base,  $1\frac{1}{2}$  ft. high, west of corner.  
 Pits impracticable.  
 Draw, course SW., 40 ft. below spur; ascend SE. slope.  
 Draw, course SE.; ascend.  
 Spur ridge, slopes SE., 570 ft. above draw, at 42.40 chs point. Descend NE. slope; enter timber brs. NW. and SE.  
 Set an iron post 3 ft. long, 2 ins. in diam., 24 ins. in the ground, for the cor. of secs. 28, 29, 32 and 33, marked on brass cap,  
 1914 on S. rim,  
 T 15 S S 29 in NW.,  
 R 29 E S 28 in NE.,  
 S 33 in SE., and  
 S 32 in SW. quadrant; from which,  
 A pine, 6 ins. in diam., brs.  $N. 55\frac{1}{4}^{\circ} E.$ , 110 lks. dist., marked T 15 S R 29 E S 28 B T.  
 A pine, 10 ins. in diam., bears  $S. 19^{\circ} E.$ , 81 lks. dist., marked T 15 S R 29 E S 33 B T.  
 A pine, 7 ins. in diam., brs.  $S. 12\frac{3}{4}^{\circ} W.$ , 112 lks. dist., marked T 15 S R 29 E S 32 B T.  
 Amountain mahogany, 4 ins. in diam., brs.  $N. 39\frac{1}{4}^{\circ} W.$ , 96 lks. dist., marked T 15 S R 29 E S 29 B T.

Land, rolling and mountainous.  
 Soil, sandy loam, gumbo and rocky, lime formation, 2nd to 4th rate.  
 Timber, scattering, with patches of heavy pine, cedar and juniper.  
 Undergrowth, scattering, with patches of dense scrub oak, mesquite, catclaw and mahogany.

Aug. 27, 1914.

Aug. 26, 1914:  
 West, on a random line, bet. secs. 29 and 32.  
 Set temp.  $\frac{1}{4}$  sec. cor.  
 Intersect the N. and S. line, 30 lks. south of the cor. to secs. 29, 30, 31 and 32.  
 Thence I run,  
 $S. 89^{\circ} 47' E.$ , on a true line, bet. secs. 29 and 32.  
 Over rolling land, through scattering undergrowth.  
 Wash, 30 lks. wide, 1 ft. deep, course south; ascend west slope, 105 ft. to  
 Spur slopes south; descend SE. slope, 45 ft. to  
 Draw, course south; continue over rolling S. slope.

40.00  
 80.14  
 2.50  
 12.00  
 17.75

## 8. Partial Subdivision of Township 15 South, Range 29 E.

Chains.

- 28.75 Draw, course SW.; ascend NW. slope.  
40.07 Set an iron post, 3 ft. long, 1 in. in diam., 26 ins. in the ground, for  $\frac{1}{4}$  sec. cor., marked on brass cap, 1914 on S. rim,  $\frac{1}{4}$  S 29 on N., and S 32 on S. half; raise a mound of stone 2 ft. base,  $1\frac{1}{2}$  ft. high, north of cor. Pits impracticable.
- 50.37 Fall 50 lks. south of cor. No. 4 of the Bowie Marble Placer, Mineral Survey No. 2742, which is a stone, 9x5x12 ins. above ground, firmly set, marked B-4-2742, on N. face, with a mound of stone south of corner.
- 55.85 Draw, course NW.  
67.65 Draw, course NW.  
75.40 Draw, course NW.  
79.50 Spur, slopes NE., 695 ft. above 28.75 ch. point; descend NE. slope.
- 80.14 The cor. of secs. 28, 29, 32 and 33, 8 ft. below spur. Land, rolling and mountainous. Soil, sandy loam, gumbo and rocky, lime formation; 1st to 4th rate. Timber, scattering with patches of heavy pine, oak, cedar and juniper. Undergrowth, scattering, with patches of dense scrub oak, mesquite, catclaw, and mahogany.  
Aug. 26 and 27, 1914.
- 
- The closing corner of frac. secs. 28 and 29, within Camp Bowie Military Reservation, Abandoned, on the south bdy. of the Camp Bowie Military Reservation, Abandoned, being plainly visible, I run, from cor. of secs. 28, 29, 32 and 33, N.  $0^{\circ}20'$  E., on a true line, bet. frac. secs. 28 and 29, outside Camp Bowie Military Reservation, Abandoned. Descend NE. slope, through scattering timber and undergrowth.
- 3.50 Spur slopes NE.; descend NW. slope.  
10.00 Draw, course NW., 325 ft. below cor.; ascend SW. slope.  
10.61 Fall 14 lks. west of cor. No. 18 of the Bowie Marble Placer, Mineral Survey No. 2742, which is a stone 6x12x14 ins. above ground, firmly set, marked B 18-2742, with a mound of stone west of corner.  
18.00 Spur slopes NW., 50 ft. above draw; descend north slope, 150 ft.  
21.85 Vacant cabin about 4 chs. west.  
22.00 Gulch, course west; ascend SW. slope.  
22.85 Windmill, about 5 chs. east.  
30.40 Draw, course SW.  
30.64 Fall 3 lks. west of cor. No. 1 of the Bowie Marble Placer, Mineral Survey No. 2742, a stone 6x10x12 ins. above ground, firmly set, marked B 1-2742 with a mound of stone west of cor.  
36.99 Intersect the closing corner of frac. secs. 28 and 29, within Camp Bowie Military Reservation, abandoned on the south boundary of the said Reservation, which is a stone, marked and witnessed as hereinbefore described. Land, mountainous. Soil, rocky, lime formation, 2nd to 4th rate. Timber, scattering oak, pine, cedar and juniper. Undergrowth, scattering with patches of dense scrub oak, mesquite and catclaw.  
Aug. 27, 1914.
- 

Aug. 20, 1914:

From the original standard corner of secs. 33 and 34 on south bdy. of Tp. (3rd. Standard Parallel South), which is a cedar post, 5 ins. square, protruding 2 ft. from

## Partial S. bdivision of Township 15 South, Range 29 East 9.

Chains.

a mound of stone, marked and witnessed as described by the Surveyor General; I run, N.0°2'E., bet. secs. 33 and 34. Ascend along east slope, through scattering timber and undergrowth.

4.50 Draw, course SE.; ascend south slope.

18.60 Ridge, brs. NE and SW., 230 ft. above cor.; descend along west slope, 50 ft. to

30.75 Draw, course SW.; ascend SW. slope.

40.00 Set an iron post, 3 ft. long, 1 in. in diam., 26 ins. in the ground, for  $\frac{1}{4}$  sec. cor., marked on brass cap, 1914 on S. rim,  $\frac{1}{4}$  S 33 on W., and S 34 on E. half; from which,

A pine, 12 ins. in diam., brs. S. 45° E., 195 lks. dist., marked  $\frac{1}{4}$  S 34 B T.

A juniper, 8 ins. in diam., brs. N. 34° W., 125 lks. dist., marked  $\frac{1}{4}$  S 33 B T.

Spur ridge, slopes SW.; ascend west slope.

46.90 Draw, course SW.; ascend SW. slope.

52.00 Rocky point slopes west, 255 ft. above 30.75 ch. point; descend NW. slope, 120 ft. to

56.30 Draw, course west; ascend south slope, 20 ft. to

59.20 Spur, slopes west; descend N. slope, 60 ft. to

63.00 Draw, course NW.; ascend SW. slope, 90 ft. to

72.00 Top of ascent; descend NW. slope, 50 ft. to

78.20 Draw, course SW.; ascend SW. slope.

80.00 Set an iron post, 3 ft. long 2 ins. in diam., 24 ins. in the ground for the cor. of secs. 27, 28, 33 and 34, marked on brass cap, 1914 on S. rim, T 15 S S 28 in NW., R 29 E S 27 in NE., S 34 in SE., and S 33 in SW. quadrant; from which,

An oak, 6 ins. in diam., brs. S. 47 $\frac{1}{2}$ ° W., 35 lks. dist., marked T 15 S R 29 E S 33 B T.

No other trees available. Raise a mound of stone 2 ft. base, 1 $\frac{1}{2}$  ft. high, west of corner.

Pits impracticable.

Land, mountainous.

Soil, rocky, igneous and lime formation, 3rd and 4th rate, Timber, scattering, with patches of heavy pine, cedar, oak and juniper.

Undergrowth, scattering with patches of dense scrub oak, mesquite and catclaw.

Aug. 20 and 27, 1914.

-----

40.00 West, on a random line, bet. secs. 28 and 33.

79.70 Set temp.  $\frac{1}{4}$  sec. cor. Intersect the N. and S. line, 16 lks. S. of the cor. of secs. 28, 29, 32 and 33. Thence I run, S. 89° 53' E., on a true line, bet. secs. 28 and 33. Descend NE. slope, through scattering timber and undergrowth.

8.25 Draw, course NE.

19.95 Gulch, course NW., 320 ft. below cor.; ascend SW. slope, 30 ft. to

24.50 Spur, slopes NW. Note: At this point, Aug. 27, 1914, I set off 10° 11' N. on the decl. arc; and at apparent noon observe the sun on the meridian; the resulting lat. is 32° 5 $\frac{1}{2}$ ' N.

25.20 Descend NE. slope, 20 ft. to

39.85 Gulch, course NW.; ascend SW. slope. Set an iron post, 3 ft. long, 1 in. in diam., 26 ins. in the ground, for  $\frac{1}{4}$  sec. cor., marked on brass cap,

10. Partial S<sup>h</sup> division of Township 15 South, Range 29 East.

Chains

1914 on S rim,  
 $\frac{1}{4}$  S 28 on N., and  
 S 33 on S. half; from which,  
 An oak, 10 ins. in diam., brs. N.  $6\frac{1}{2}^{\circ}$  W., 45 lks.  
 dist., marked  $\frac{1}{4}$  S 28 B T.  
 An oak, 9 ins. in diam., brs. S.  $72\frac{1}{2}^{\circ}$  W., 108  
 lks. dist., marked  $\frac{1}{4}$  S 33 B T.  
 64.55 Spur slopes SW., 580 ft. above gulch; descend SE. slope.  
 69.95 Draw, course SE.  
 72.20 Draw, course SE.  
 74.65 Draw, course S., 145 ft. below spur; ascend SW. slope.  
 79.70 The cor. of secs. 27, 28, 33 and 34, 75 ft. above last draw.  
 Land, mountainous and rolling.  
 Soil, rocky, igneous and lime formation, 2nd to 4th rate.  
 Timber, scattering with patches of heavy oak, pine, cedar  
 and juniper.  
 Undergrowth, scattering with patches of dense scrub oak,  
 mesquite and catclaw.  
 Aug. 27, 1914.

Aug. 21, 1914: At 8h. 10m., a.m., l.m.t., I set off  $32^{\circ}$   
 $5\frac{1}{2}'$  N. on the lat. arc;  $12^{\circ} 17'$  N. on the decl. arc, and  
 determine with the solar a meridian at the cor. of  
 secs. 27, 28, 33 and 34.  
 Thence I run,  
 N.  $0^{\circ} 2'$  E., bet. secs. 27 and 28.  
 Ascend SW. slope, through scattering timber and undergrowth.  
 4.00 Draw, course SW.  
 11.25 Ridge main divide between Sulphur Springs Valley and San  
 Simon Valley; brs. E. and W., 150 ft. above cor.; descend  
 north slope, 385 ft. to  
 22.20 Gulch, course NE.; ascend SE. slope, 30 ft. to  
 26.15 Spur, slopes NE.; descend NE. slope, 110 ft. to  
 33.80 Gulch, course east; ascend south slope.  
 40.00 Set an iron post, 3 ft. long, 1 in. in diam., 26 ins. in  
 the ground, for  $\frac{1}{4}$  sec. cor., marked on brass cap,  
 1914 on S. rim,  
 $\frac{1}{4}$  S 28 on W., and  
 S 27 on E. half; from which,  
 A cedar, 6 ins. in diam., brs. S.  $10^{\circ}$  W., 152  
 lks. dist., marked  $\frac{1}{4}$  S 28 B T.  
 No other trees available. Raise a mound of stone 2 ft.  
 base,  $1\frac{1}{2}$  ft. high, west of cor. Pits impracticable.  
 46.80 Spur ridge, slopes east, 465 ft. above gulch; descend NE.  
 slope, 50 ft.  
 50.30 Old wire fence, brs. NW. and SE.  
 50.50 Head of draw, course SE.; ascend SE. slope, 100 ft. to  
 58.55 Spur slopes east; descend NE. slope.  
 70.00 Gulch, course NE.; ascend SE. slope.  
 80.00 Set an iron post, 3 ft. long, 2 ins. in diam., 18 ins. in  
 the ground, on bedrock, supported by a mound of stone,  
 for the corner of secs. 21, 22, 27 and 28, marked on  
 brass cap,  
 1914 on S. rim,  
 T 15 S S 21 in NW.,  
 R 29 E S 22 on NE.,  
 S 27 in SE., and  
 S 28 in SW. quadrant;  
 raise a mound of stone 2 ft. base,  $1\frac{1}{2}$  ft. high, west of  
 corner. Pits impracticable.  
 Land, mountainous.  
 Soil, rocky, igneous formation, 3rd and 4th rate,  
 Timber, scattering with patches of heavy pine, oak, cedar  
 and juniper.  
 Undergrowth, scattering with patches of dense scrub oak,  
 mesquite and catclaw.  
 Aug. 21 and 27, 1914.

Partial Subdivision of Township 15 South Range 29 East. 11.

Chains.

17.49 West, on a random line, bet. frac. secs. 21 and 28, outside Camp Bowie Military Reservation, Abandoned. Intersect the east bdy. of the Camp Bowie Military Reservation, Abandoned, 4 lks. north of closing cor. of frac. secs. 21 and 28, within Camp Bowie Military Reservation, Abandoned, which is a stone 5x9x10 ins., above ground, marked and witnessed as hereinbefore described.

Thence I run, N. 89° 52' E., on a true line, bet. frac. secs. 21 and 28, outside of Camp Bowie Military Reservation, Abandoned. Ascend west slope, through scattering timber and undergrowth.

5.50 Ascend north slope.

11.50 Ridge, brs. NE and SW.; ascend south slope.

15.25 Top of ascent, 250 ft. above closing corner; descend SE. slope.

17.49 The cor. of secs. 21, 22, 27 and 28, 50 ft. below 15.25 ch. point.

Land, mountainous.  
Soil, rocky, igneous formation, 4th rate.  
Timber, scattering pine, oak, and cedar.  
Undergrowth, scattering scrub oak, mesquite and catclaw.  
Aug. 19 and 27, 1914.

---

Aug. 21, 1914:  
N. 0° 2' E., bet. secs. 21 and 22.  
Ascend SE. slope, 60 ft. through scattering undergrowth to

3.00 Ridge, brs. E and W.; peak brs. west about 2 chs. dist. Note: At this point, Aug. 21, 1914, I set off 12° 14' N. on the decl. arc, and at apparent noon, observe the sun on the meridian; the resulting lat. is 32° 6' N.

Descend NE. slope.

12.60 Ridge, brs. NE and SW.; descend NW. slope.

23.70 Head of draw, course NW.

28.50 Draw, course NW., 620 ft. below cor.; ascend SW. slope, 70 ft. to

38.85 Spur, slopes west; descend N. slope.

40.00 Set an iron post 3 ft. long, 1 in. in diam., 26 ins. in the ground, for 1/4 sec. cor., marked on brass cap, 1914 on S. rim, 1/4 S 21 on W., and S 22 on E. half; from which,  
An oak, 7 ins. in diam., brs. N. 61 1/2° E., 69 lks. dist., marked 1/4 S 22 B T.  
An oak, 8 ins. in diam., brs. S. 5° W., 64 lks. dist., marked 1/4 S 21 B T.

45.00 Draw, course west, 125 ft. below spur; ascend S. slope, 80 ft. to

49.10 Spur slopes west; descend N. slope, 50 ft. to

51.20 Draw, course NW.; ascend SW. slope, 100 ft. to

58.60 Spur slopes west; descend N. slope, 60 ft. to

62.00 Draw, course NW.; ascend SW. slope, 195 ft. to

70.00 Rocky spur, slopes west; descend rocky NW. slope.

80.00 Set an iron post 3 ft. long, 2 ins. in diam., 14 ins. in the ground, on bed rock, supported by a mound of stone, 440 ft. below spur, for the cor. of secs. 15, 16, 21 and 22, marked on brass cap, 1914 on S. rim, T 15 S S 16 in NW., R 29 E S 15 in NE., S 22 in SE., and S 21 in SW. quadrant; raise a mound of stone 2 ft. base, 1 1/2 ft. high, west of cor. Pits impracticable.

Land, mountainous.  
Soil, rocky, igneous formation, 3rd and 4th rate.

## 12. Partial Subdivision of Township 15 South, Range 29 East.

Chains.

- Timber, scattering oak, cedar and juniper.  
Undergrowth, scattering scrub oak, and catclaw.  
Aug. 21, and 25, 1914.
- 
- West, on a random line, bet. frac. secs. 16 and 21, outside Camp Bowie Military Reservation, Abandoned.  
Stadia across steep broken cliffy N. slope, rod reading 5.975 ft., ratio 1 ft. = 2.00 chs., focal constant, 1.025 ft.; angle of depression, = 5°; the distance is therefore  $5.975 \times 2 \times .9924 + .016 = 11.88$  chs.
- 17.60 Intersect the East bdy. of the Camp Bowie Military Reservation, Abandoned, 6 lks. north of the closing cor. of frac. secs. 16 and 21, within Camp Bowie Military Reservation, Abandoned, which is a stone, marked and witnessed as described by the Surveyor General.  
Thence I run,  
N. 89° 48' E., on a true line, bet. frac. secs. 16 and 21, outside Camp Bowie Military Reservation, Abandoned.  
Descend E slope, 20 ft. through scattering timber and undergrowth.
- .70 Wagon road, brs. N. and S.  
1.00 Emmigrant canyon, course NE.; ascend west slope, 140 ft.  
1.30 Pipe line, brs. N. and S.  
5.60 Rocky spur, slopes north.  
Pump house, belongs to Arizona Marble Company, brs. N. 37° E., about 7 chs. dist.  
Thence across steep broken cliffy north slope, ascending 70 ft. to
- 17.60 The cor. of secs. 15, 16, 21 and 22,  
Land, mountainous.  
Soil, rocky, granite formation, 4th rate,  
Timber, scattering sycamore and walnut along canyon,  
oak and cedar on mountainous.  
Undergrowth, scattering scrub oak, and catclaw.  
Aug. 25, 1914.
- 
- Aug. 22, 1914: Test stadia this morning, and found it correct; at 7h. a.m., l.m.t., I set off 32° 7' N. on the lat. arc; 11° 59' N. on the decl. arc; and determine with the solar a meridian at the cor. of secs. 15, 16, 21 and 22.
- Thence I run,  
N. 0° 2' E., bet. secs. 15 and 16.  
Across rocky cliffy, Emmigrant Canyon, through scattering timber and undergrowth.  
Stadia across canyon, about 300 ft. deep, course NE.; a small stream of water in bottom, flows NE., rod reading 11.276 ft., ratio 1 ft. = 2.00 chs., focal constant, 1.025 ft., angle of depression = 9°; the distance is therefore  $11.276 \times 2 \times .9755 + .016 = 22.01$  chs.
- 22.01 Rod point, 5 lks. E. of wagon road, which brs. SW., and N. 10° W., 230 ft. below cor., continue along steep east slope.
- 28.00 Wagon road to Marble Quarry, brs. NE. and SW.; ascend SE. slope, 130 ft. to
- 34.00 Top of ascent; descend NE. slope, 70 ft. to
- 39.80 Draw, course E.; ascend SE. slope.
- 40.00 Set an iron post 3 ft. long, 1 in. in diam., 18 ins. in the ground, on bed rock, supported by a mound of stone, for 4 sec. cor., marked on brass cap,  
1914 on S. rim,  
 $\frac{1}{4}$  S 16 on W., and  
S 15 on E. half; from which,  
An oak, 6 ins. in diam., brs. S. 46 $\frac{1}{2}$ ° E., 18 lks. dist., marked  $\frac{1}{4}$  S 15 B T.

Partial Subdivision of Township 15 South, Range 29 East. 13.

Chains.

An oak, 12 ins. in diam., brs. S.  $81\frac{1}{2}^{\circ}$  W., 49 lks. dist., marked  $\frac{1}{4}$  S 16 B T.

43.50 Spur, slopes east, 50 ft. above draw; descend NE. slope, 50 ft. to

50.50 Gulch, course SE.; ascend south slope, 240 ft. to

58.00 Spur, slopes east; continue along east slope.

63.70 Head of draw, course SE.; ascend SE. slope, 60 ft. to

72.00 Spur slopes east; descend NE. slope, 100 ft. to

80.00 Set an iron post, 3 ft. long, 2 ins. in diam., 24 ins. in the ground, for the cor. of secs. 9, 10, 15 and 16, marked on brass cap,  
 1914 on S. rim,  
 T 15 S S 9 in NW.,  
 R 29 E S 10 in NE.,  
 S 15 in SE., and  
 S 16 in SW. quadrant; from which,  
 An oak, 9 ins. in diam., brs. N.  $6\frac{1}{2}^{\circ}$  E., 56 lks. dist., marked T 15 S R 29 E S 10 B T.  
 An oak, 10 ins. in diam., brs. S.  $78\frac{3}{4}^{\circ}$  E., 41 lks. dist., marked T 15 S R 29 E S 15 B T.  
 An oak, 12 ins. in diam., brs. S.  $62\frac{3}{4}^{\circ}$  W., 118 lks. dist., marked T 15 S R 29 E S 16 B T.  
 An oak, 10 ins. in diam., brs. N.  $25\frac{1}{2}^{\circ}$  W., 91 lks. dist., marked T 15 S R 29 E S 9 B T.

Land, mountainous.  
 Soil, rocky, granite formation, 3rd and 4th rate.  
 Timber, scattering oak, cedar and juniper.  
 Undergrowth, scattering, with patches of dense scrub oak, mesquite and catclaw.  
 Aug. 22 and 25, 1914.

17.66 West, on a random line, bet. frac. secs. 9 and 16, outside Camp Bowie Military Reservation, Abandoned.

Intersect the East bdy. of the Camp Bowie Military Reservation, Abandoned, 8 lks. north of the closing cor. of frac. secs. 9 and 16, within Camp Bowie Military Reservation, Abandoned, which is a stone 16x10x18 ins. above ground, firmly set, marked and witnessed as described by the Surveyor General.

Thence I run,  
 N.  $89^{\circ}45'$  E., on a true line, bet. frac. secs. 9 and 16, outside Camp Bowie Military Reservation, Abandoned.

Descend east slope, 25 ft., through scattering timber and undergrowth, to

4.00 Draw, course N.; ascend NW. slope, 75 ft. to

12.45 Ridge, brs. N. and S.; descend NE. slope, 85 ft. to

17.66 The cor. of secs. 9, 10, 15 and 16.

Land, mountainous.  
 Soil, rocky, granite formation, 4th rate.  
 Timber, scattering oak, cedar and juniper.  
 Undergrowth, scattering scrub oak, mesquite and catclaw.  
 Aug. 25, 1914.

Aug. 22, 1914:  
 N.  $0^{\circ}2'$  E., bet. secs. 9 and 10.  
 Descend NE. slope, 200 ft., through scattering timber and undergrowth, to

15.50 Head of draw, course east; ascend SE. slope, 60 ft. to

30.00 Top of ascent; continue along east slope.

40.00 Set an iron post, 3 ft. long, 1 in. in diam., 8 ins. in the ground, on bedrock, supported by a mound of stone, for  $\frac{1}{4}$  sec. cor., marked on brass cap,  
 1914 on S. rim,  
 $\frac{1}{4}$  S 9 on W., and  
 S 10 on E. half;

14. Partial S<sup>U</sup>bdivision of Township 15 South, Range 29 E.

Chains

- raise a mound of stone, 2 ft. base,  $1\frac{1}{2}$  ft. high, west of corner. Pits impracticable.
- 58.00 Spur, slopes NE.; descend NW slope.
- 72.00 Top of cliff, 85 ft. high, brs. NE. and SW.
- 73.00 Foot of cliff, canyon, brs. NE., 400 ft. below spur; descend over rocky, cliffy east slope, 140 ft. to
- 79.00 Rocky canyon, course NW.; ascend rocky cliffy west slope, 25 ft. to
- 80.00 Set an iron post 3 ft. long, 2 ins. in diam., 24 ins. in the ground, for the cor. of secs. 3, 4, 9 and 10, marked on brass cap,  
 1914 on S rim,  
 T 15 S S 4 in NW.,  
 R 29 E S 3 in NE.,  
 S 10 in SE., and  
 S 9 in SW quadrant; from which,  
 An oak, 5 ins. in diam., brs. N.  $25\frac{3}{4}^{\circ}$  E., 66 lks. dist., marked T 15 S R 29 E S 3 B T.  
 An oak, 10 ins. in diam., brs. S.  $1^{\circ}$  E., 22 lks. dist., marked T 15 S R 29 E S 10 B T.  
 An oak, 6 ins. in diam., brs. N.  $79\frac{1}{2}^{\circ}$  W., 48 lks. dist., marked T 15 S R 29 E S 4 B T.
- No other tree available. Raise a mound of stone 2 ft. base,  $1\frac{1}{2}$  ft. high, west of cor. Pits impracticable.
- Land, mountainous.  
 Soil, rocky, granite formation, 3rd and 4th rate,  
 Timber, scattering oak, cedar and juniper.  
 Undergrowth, scattering with patches of dense scrub oak, mesquite and catclaw.
- Aug. 22 and 25, 1914.

- Aug. 24, 1914:  
 West, on a random line, bet. frac. secs. 4 and 9, outside Camp Bowie Military Reservation, Abandoned.
- 17.84 Intersect the east bdy. of the Camp Bowie Military Reservation, 1 link south of closing corner of frac. secs. 4 and 9, within Camp Bowie Military Reservation, Abandoned, which is a stone 6x10x14 ins. above ground, marked and witnessed as hereinbefore described.
- Thence I run,  
 S.  $89^{\circ}59'$  E., on a true line, bet. frac. secs. 4 and 9, outside Camp Bowie Military Reservation.
- Descend NE. slope, through scattering timber and undergrowth.
- 8.00 Rocky spur, slopes north; descend east slope.
- 17.00 Canyon, course NW., 440 ft. below cor.; ascend west slope, 40 ft. to
- 17.84 The cor. of secs. 3, 4, 9 and 10.  
 Land, mountainous.  
 Soil, rocky, granite formation, 4th rate.  
 Timber, scattering oak and cedar.  
 Undergrowth, scattering with patches of dense scrub oak, mesquite and catclaw.
- Aug. 24, 1914.

- Aug. 22, 1914:  
 N.  $0^{\circ}2'$  E., on a random line, bet. secs. 3 and 4.
- 40.00 Set temp.  $\frac{1}{4}$  sec. cor.
- 79.21 Intersect the north bdy. of the Tp., 16 lks. west of the corner of secs. 3, 4, 33 and 34, which is an iron post, 3 ins. in diam., with brass cap, 12 ins. above ground, marked and witnessed as described by the Surveyor General.
- Thence I run,  
 S.  $0^{\circ}9'$  W., on a true line, bet. secs. 3 and 4.  
 Over rolling land, through dense undergrowth.



Partial Subdivision of Township 15 South, Range 29 East. 15.

Chains.	
1.85	Wash, 15 lks.wide, 30 ins. deep, course NW.
3.40	Old wagon road, brs.E. and W.
5.10	Wash, 10 lks.wide, 2 ft. deep, course NW.
18.90	Old wagon road brs.E. and W.
22.00	Wagon road, brs.NW. and SE.
22.75	Emmigrant Wash, 125 lks.wide, 1 ft. deep, course NW.
24.00	Foot of mountain, brs.NW. and SE.; ascend east slope, 160 ft. to
37.75	Top of ascent; descend east slope, 80 ft.
39.21	Set an iron post, 3 ft.long, 1 in. in diam., 12 ins.in the ground, on bed rock, supported by a mound of stone for $\frac{1}{4}$ sec.cor., marked on brass cap, 1914 on S.rim, $\frac{1}{4}$ S 4 on W., and S 3 on E.half; raise a mound of stone 2 ft.base, $1\frac{1}{2}$ ft. high,west of corner. Pits impracticable.
51.50	Draw, course east; continue along east slope.
51.75	Apiary belonging to Tom Riggs, brs.east, about 3 chs.
57.40	Draw, course NE.; ascend rocky E' slope, 175 ft.to
75.50	Rocky canyon, brs.NE. Ascend NW. slope, 150 ft. to
79.21	The cor.of secs.3,4,9 and 10. Land, rolling and mountainous. Soil, on mountain rocky, granite formation, 3rd and 4th rate; balance, sandy loam and gumbo, gravelly, 2nd and 3rd rate. Undergrowth, dense mesquite and catclaw. Aug.22 and 24, 1914.
-----	
	From the cor.of secs. 9,10,15 and 16, hereinbefore described, I run, East, on a true line, bet. secs.10 and 15. Descend NE. slope, through scattering timber and undergrowth.
20.00	Draw, course NE.
22.80	Wire fence, brs.N. and S.
24.50	Draw, course NE., 550 ft. below cor.; ascend NW. slope, 120 ft. to
29.10	Spur, slopes NE.; descend SE. slope.
38.00	Descend east slope.
40.00	Set an iron post, 3 ftlong, 1 in. in diam., 26 ins. in the ground, for $\frac{1}{4}$ sec.cor., marked on brass cap, 1914 on S.rim, $\frac{1}{4}$ S 10 in N., and S 15 in S.half; raise a mound of stone 2 ft. base, $1\frac{1}{2}$ ft. high, north of cor. Pits impracticable. Aug.25, 1914.
	Aug.29, 1914: At 9h. a.m., l.m.t., I set off $32^{\circ}8'N$ . on the lat.arc; $9^{\circ}31' N$ .on the decl.arc; and determine with the solar a meridian at this $\frac{1}{4}$ sec.cor.
46.00	Wash, 15 lks.wide, 2 ft. deep, course NE.; foot of mountain brs.NE. and S., 265 ft. below spur; thence over rolling land, drains north.
47.47	Wire fence brs.N.and S.
48.25	Emmigrant Wash, 200 lks.wide, 15 ft. deep, course N.
57.40	Wagon road to Marble Quarry, brs.N.and S.
58.00	Windmill belonging to the Riggs Cattle Company, brs.N. $27^{\circ}W$ ., about 10 chs.dist.
66.00	Foot of mountain brs.N.and S.; ascend W. slope, 200 ft.to
73.50	Spur, slopes N.; thence along north slope.
77.00	Descend NE. slope, 50 ft. to
79.95	Rocky gulch, course NW.
80.00	True point for cor. of secs. 10,11,14 and 15. Unsafe place. To establish cor.; therefore continue east to
80.25	Set an iron post 3 ft.long, 2 ins. in diam., 22 ins. in the ground, on bed rock, supported by a mound of stone, for witness cor.to cor.of secs.10,11,14 and 15, marked on brass cap,

## 16. Partial Subdivision of Township 15 South Range 29 East

Chains.

1914 on S.rim,  
 W C E of center,  
 T 15 S S 10 in NW.,  
 R 29 E S 11 in NE.,  
 S 14 in SE., and  
 S 15 in SW.quadrant; from which,  
 An oak; 12 ins. in diam., brs.N.18 $\frac{1}{4}$ °E., 109  
 lks.dist., marked W C T 15 S R 29 E S 11 B T.  
 An oak, 5 ins. in diam., brs.S.75 $\frac{1}{2}$ °E., 22  
 lks.dist., marked W C T 15 S R 29 E S 14 B T.  
 A cedar limb 4 ins.in diam.,brs.S.32°W., 92 lks.  
 dist.,marked W C T 15 S R 29 E S 15 B T.  
 An oak, 8 ins. in diam., brs.N.36°W., 206 lks.  
 dist., marked W C T 15 S R 29 E S 10 B T.

Land, rolling and mountainous.  
 Soil on mountains, rocky, granite formation, 3rd and 4th  
 rate; balance, sandy loam, gravelly, 1st and 2nd rate.  
 Timber, scattering oak, cedar and juniper.  
 Undergrowth, scattering with patches of dense scrub oak,  
 mesquite and catclaw.

N.0°2' E., bet. secs.10 and 11, from the true point for  
 the cor.of secs. 10,11,14 and 15, 25 lks.west of the  
 witness corner.  
 Descend NW. slope, 125 ft., through scattering timber and  
 undergrowth, to  
 8.00 Foot of mountain, brs.NE and SW.; leave timber, brs.  
 NE. and SW; continue over rolling land, drains NW.;  
 descending.  
 20.65 Draw, course NW.  
 40.00 Set an iron post 3 ft.long, 1 in. in diam., 26 ins. in  
 the ground for  $\frac{1}{4}$  sec.cor., marked on brass cap,  
 1914 on S.rim,  
 $\frac{1}{4}$  S 10 in W., and  
 S 11 in E.half; raise a mound of stone 2  
 ft.base, 1 $\frac{1}{2}$  ft. high, west of corner. Pits imprac-  
 ticable. 150 ft. below 8 chain pt.; continue gently  
 rolling.  
 40.95 Wash, 8 lks.wide, 2 ft. deep, course NE.  
 43.20 Same wash, course NW.  
 44.90 Same wash, course NE.  
 57.00 Wash, 5 lks.wide, 3 ft. deep, course NE.  
 60.30 Wagon road, brs.NE. and SW.  
 77.00 Wagon road brs.NE and SW.  
 80.00 Set an iron post 3 ft.long, 2 ins. in diam., 24 ins. in  
 the ground, for the cor. of secs. 2,3,10 and 11,marked  
 on brass cap,  
 1914 on S.rim,  
 T 15 S S 3 in NW.,  
 R 29 E S 2 in NE.,  
 S 11 in SE., and  
 S 10 in SW.quadrant;  
 raise a mound of stone 2 ft. base, 1 $\frac{1}{2}$  ft. high,west of  
 corner. Pits impracticable.  
 Land, mountainous and rolling.  
 Soil on mountain, rocky, granite formation, 4th rate;bal-  
 ance, sandy loam, gravelly, 1st to 3rd rate.  
 Timber, scattering oak and cedar.  
 Undergrowth, scattering, with patches of dense scrub oak,  
 mesquite and catclaw.

40.00 West, on a random line, bet. secs.3 and 10.  
 Set temp. $\frac{1}{4}$  sec.cor.  
 80.10 Intersect the N.and S. line, 7 lks.S.of the cor. of secs.  
 3,4,9 and 10.

Partial Subdivision of Township 15 South, Range 29 East. 17.

Chains.

Thence I run,  
 S.89°57'E., on a true line, bet. secs. 3 and 10.  
 Ascend west slope, 75 ft., through scattering timber and  
 dense undergrowth, to  
 4.00 Spur slopes north; descend NE. slope, 325 ft. to  
 16.00 Foot of mountain brs.NW and S.; continue over rolling  
 land.  
 21.30 Wagon road, brs.N. and S.  
 25.60 Emmigrant wash, 125 lks.wide, 3 ft. deep, course NW.  
 26.85 Foot of hill, brs.NW. and SE.; ascend west slope, 240 ft.  
 40.05 Set an iron post 3 ft. long, 1 in. in diam., 26 ins. in  
 the ground, for  $\frac{1}{4}$  sec.cor., marked on brass cap,  
 1914 on S.rim,  
 $\frac{1}{4}$  S 3 on N., and  
 S 10 on S.half;  
 raise a mound of stone 2 ft. base,  $1\frac{1}{2}$  ft. high, north  
 of corner. Pits impracticable.  
 40.35 Ridge, brs.N.and S.; thence over rolling north slope.  
 46.35 Spur, slopes NE.; descend east slope.  
 51.60 Head of draw, course SE.; descend SE. slope.  
 55.85 Head of draw, course SE.  
 71.80 Foot of hill, brs.NE. and SW., 200 ft. below spur. Wash,  
 30 lks.wide, 2 ft. deep, course NE.; continue over  
 over rolling land.  
 75.85 Wash, 35 lks.wide, 3 ft. deep, course N.  
 78.40 Wash, 10 lks.wide, 18 ins. deep, course N.  
 80.10 The cor.of secs.2,3, 10 and 11.  
 Note: Aug.29,1914: At this corner I set off  $9^{\circ}28\frac{1}{2}'N.$  on  
 the decl.arc; and at apparent noon, observe the sun  
 on the meridian; the resulting lat.is  $32^{\circ}9'N.$   
 Land, rolling, hilly and mountainous.  
 Soil, sandy loam, gumbo, gravelly and rocky, 2nd to 4th  
 rate.  
 Timber, scattering oak and cedar.  
 Undergrowth, scattering with patches of dense scrub oak,  
 mesquite and catclaw.

40.00 N.0°2' E., on a random line, bet. secs.2 and 3.  
 Set temp. $\frac{1}{4}$  sec.cor.  
 79.29 Intersect the north bdy. of the Tp., 9 lks.east of the cor.,  
 of secs. 2,3, 34 and 35, which is an iron post, 3  
 ins. in diam., with brass cap, 12 ins. above ground,  
 marked and witnessed as described by the (Surveyor  
 General.  
 Thence I run,  
 S. 0°2' E., on a true line, bet. secs. 2 and 3.  
 Over rolling land, through scattering undergrowth.  
 25.60 Old wagon road, brs.NW and SE.  
 34.55 Old wagon road, brs.NW and SE.  
 39.29 Set an iron post 3 ft. long, 1 in. in diam., 26 ins. in  
 the ground, for  $\frac{1}{4}$  sec.cor., marked on brass cap,  
 1914 on S.rim,  
 $\frac{1}{4}$  S 3 on W., and  
 S 2 on E.half;  
 raise a mound of stone 2 ft. base,  $1\frac{1}{2}$  ft. high, west of  
 corner. Pits impracticable.  
 47.80 Wash, 125 lks.wide, 4 ft. deep, course NW.  
 52.40 Wash, 65 lks.wide, 4 ft. deep, course NW.  
 61.75 Point of spur, slopes NE., 20 ft. high.  
 67.40 Wash, 15 lks.wide, 2 ft. deep, course NE.  
 72.50 Wash, 6 lks.wide, 2 ft. deep, course NE.  
 79.29 The cor.of secs.2,3,10 and 11.  
 Land, rolling.  
 Soil, sandy loam, and gumbo, gravelly, 1st to 3rd rate.  
 No timber.  
 Undergrowth, scattering with patches of dense catclaw  
 and mesquite.

Aug. 29, 1914.

## 18. Partial Subdivision of Township 15 South, Range 29 East.

Chains

Aug. 31, 1914: At 7h. 30m., a.m., l.m.t., I set off  $32^{\circ} 8' N.$  on the lat. arc;  $8^{\circ} 50\frac{1}{2}' N.$  on the decl. arc; and determine a meridian with the solar at the true point for the cor. of secs. 10, 11, 14 and 15.

Thence I run,

East, on a true line, bet. secs. 11 and 14.

Ascend rocky NW. slope, 90 ft., through scattering timber and undergrowth,

0.25 Witness cor. to cor. of secs. 10, 11, 14 and 15, hereinbefore described.

5.00 Top of ascent; continue along rolling rocky N. slope.

17.45 Gulch, course NW.; ascend SW. slope.

22.05 Triangulation point, line flag on top of broken cliffs; impossible to chain over; lay off a base  $N. 20^{\circ} 58' E.$ , 701 lks. to a point, from which the flag on top of cliffs bears  $S. 60^{\circ} 13' E.$ ; therefore, the dist. is  $\sin. 29^{\circ} 47'$ :  $701 :: 81^{\circ} 11'$ ; X, or  $.98818 \times 701 \div .49672 = 13.95$  chs., which added to 22.05 chs. makes,

36.00 Flag point at top of broken cliffs, about 200 ft. high, bears N. and S.; ascend over broken granite cliffs, slope NW.

39.00 Spur ridge, slopes north, 850 ft. above gulch; descend NE. slope, 30 ft.

40.00 Set an iron post, 3 ft. long, 1 in. in diam., 8 ins. in the ground, on bedrock, supported by a mound of stone, for  $\frac{1}{4}$  sec. cor., marked on brass cap,

1914 on S. rim,

$\frac{1}{4}$  S 11 on N., and

S 14 on S. half;

raise a mound of stone 2 ft. base,  $1\frac{1}{2}$  ft. high, north of corner. Pits impracticable.

42.00 Foot of descent; ascend NW. slope, 90 ft. to

47.00 Rocky point, slopes north; descend NE. slope, 360 ft. to

60.55 Canyon, course NE.; ascend NW. slope, 200 ft. to

78.25 Rocky spur ridge, slopes north; descend NE. slope, 25 ft. to

80.00 Set an iron post 3 ft. long, 2 ins. in diam., 6 ins. in the ground, on bed rock, supported by a mound of stone for the cor. of secs. 11, 12, 13 and 14, marked on brass cap,

1914 on S. rim,

T 15 S S 11 in NW.,

R 29 E S 12 in NE.

S 13 in SE., and

S 14 in SW. quadrant; from which,

An oak, 10 ins. in diam., brs.  $N. 61\frac{1}{2}^{\circ} E.$ , 42 lks. dist., marked T 15 S R 29 E S 12 B T.

An oak, 12 ins. in diam., brs.  $S. 5\frac{1}{4}^{\circ} E.$ , 54 lks. dist., marked T 15 S R 29 E S 13 B T.

An oak, 5 ins. in diam., brs.  $S. 70^{\circ} W.$ , 75 lks. dist., marked T 15 S R 29 E S 14 B T.

An oak, 5 ins. in diam., brs.  $N. 78\frac{1}{2}^{\circ} W.$ , 45 lks. dist., marked T 15 S R 29 E S 11 B T.

Note: Aug. 31, 1914: At this cor., I set off  $8^{\circ} 45\frac{1}{2}' N.$  on the decl. arc, and at apparent noon, observe the sun on the meridian; the resulting lat. is  $32^{\circ} 8' N.$

Land, mountainous.

Soil, rocky, granite formation, 4th rate.

Timber, scattering oak, cedar and juniper.

Undergrowth, scattering with patches of dense scrub oak, mesquite, mahogany, manzanita and catclaw.

East, on a true line, bet. secs. 12 and 13.

Descend NE. slope, 140 ft. through scattering timber and undergrowth, to

4.35 Rocky canyon, course N.; ascend west slope, 40 ft. to

5.90 Rock spur slopes north; descend NE. slope, 40 ft. to

6.65 Gulch, course NW.; ascend NW. slope, 120 ft. to

12.40 Rocky spur; descend, NE. slope, 75 ft. to

Partial Subdivision of Township 15 South, Range 29 East. 19.

Chains.

16.80 Gulch, course NW.; ascend SW. slope, 490 ft. to  
27.25 Rocky spur ridge, slopes north; descend NE. slope, 520  
ft. into canyon.

40.00 Set an iron post 3 ft. long, 1 in. in diam., 26 ins. in  
the ground, for  $\frac{1}{4}$  sec. cor., marked on brass cap,  
1914 on S. rim,  
 $\frac{1}{4}$  S 12 in N., and  
S 13 in S. half; from which,  
An oak, 7 ins. in diam., brs. N. 1° W., 170 lks.  
dist., marked  $\frac{1}{4}$  S 12 B T.

No other trees available. Raise a mound of stone 2 ft.  
base,  $1\frac{1}{2}$  ft. high, north of cor. Pits impracticable.

45.95 Canyon, course NE.; ascend NW. slope, 260 ft. to  
54.65 Spur slopes north; descend NE. slope, 200 ft. to  
60.35 Gulch, course NW.; ascend NW. slope, 200 ft. to  
76.00 Ridge, brs. NE. and SW.; descend SE. slope, 25 ft. to  
80.50 Intersect the east bdy. of the Tp., 22.53 chs. north of  
the cor. of secs. 7 and 18, T. 15 S., R. 30 E., reestab-  
lished by me, as described in Book "Q."

Oct. 6, 1914: At point of intersection, set an iron post,  
3 ft. long, 2 ins. in diam., 20 ins. in the ground, on  
bedrock, supported by a mound of stone, for closing  
corner of secs. 12 and 13, marked on brass cap,

1914 on S. rim,  
C C E. of center,  
T 15 S in N., and  
S 7, S 18 R 30 E in E. half;  
S 12 in NW., and  
S 13, R 29 E in SW. quadrant;

raise a mound of stone 2 ft. base,  $1\frac{1}{2}$  ft. high, west of  
cor. Pits impracticable.

Land, mountainous.

Soil, rocky, granite formation, 4th rate.

Timber, scattering oak, cedar and juniper.

Undergrowth, scattering, with patches of dense scrub oak,  
mahogany and manzanita.

Aug. 31 and Oct. 6, 1914.

Sept. 2, 1914: At 7h. a.m., l.m.t., I set off 32° 8' N. on  
the lat. arc; 8° 8' N. on the decl. arc; and determine  
with the solar a meridian at the cor. of secs. 11, 12,  
13 and 14.

Thence I run,  
N. 0° 3' E., bet. secs. 11 and 12.

Descend NE. slope, through scattering timber and under-  
growth.

33.00 Canyon, course NW.; descend along west slope.

40.00 Set an iron post, 3 ft. long, 1 in. in diam., 26 ins. in  
the ground, for  $\frac{1}{4}$  sec. cor., marked on brass cap,  
1914 on S. rim,  
 $\frac{1}{4}$  S 11 on W., and  
S 12 on E. half; from which,

An oak, 8 ins. in diam., brs. N. 51 $\frac{1}{2}$ ° E., 112 lks.  
dist., marked  $\frac{1}{4}$  S 12 B T.

An oak, 8 ins. in diam., brs. S. 86° W., 65 lks.  
dist., marked  $\frac{1}{4}$  S 11 B T.

48.00 Gulch, course NW., foot of mountain, brs. NE. and SW., 750  
ft. below sec. cor.; continue over rolling N. slope;  
descend 220 ft.

51.60 Wire fence brs. NE. and SW.

80.00 Set an iron post, 3 ft. long, 2 ins. in diam., 20 ins. in  
the ground, on bedrock, supported by a mound of stone  
for the cor. of secs. 1, 2, 11 and 12, marked on brass  
cap,

1914 on S. rim,  
C C E. of center,  
T 15 S in N., and  
S 7, S 18 R 30 E in E. half;  
S 12 in NW., and  
S 13, R 29 E in SW. quadrant;

20. Partial Subdivision of Township 15 South, Range 29 East.  
Chains.

1914 on S. rim,  
T 12 S S 2 in NW.,  
R 29 E S 1 in NE.,  
S 12 in SE., and  
S 11 in SW. quadrant;

raise a mound of stone, 2 ft. base,  $1\frac{1}{2}$  ft. high,  
west of corner.

Pits impracticable.

Land, mountainous and rolling.

Soil, granite formation, 3rd and 4th rate.

Timber, scattering oak, cedar and juniper.

Undergrowth, scattering, with patches of dense scrub oak,  
manzanita, mesquite and catclaw.

Sept. 2, 1914.

- West, on a random line, bet. secs. 2 and 11.  
40.00 Set temp.  $\frac{1}{4}$  sec. cor.  
80.01 Intersect the N. and S. line, 21 links south of the cor.  
of secs. 2, 3, 10 and 11.  
Thence I run,  
S.  $89^{\circ}51'$  E., on a true line, bet. secs. 2 and 11.  
Over rolling land, through scattering undergrowth.  
.90 Wagon road, brs. NE. and SW.  
11.60 Wash, 10 lks. wide, 1 ft. deep, course NE.  
14.35 Wagon road, brs. NE. and SW.  
20.75 Wash, 30 lks. wide, 2 ft. deep, course NE.  
34.25 Wash, 125 lks. wide, 3 ft. deep, course NE.  
40.005 Set an iron post 3 ft. long, 1 in. in diam., 26 ins. in  
the ground, for  $\frac{1}{4}$  sec. cor., marked on brass cap,  
1914 on S. rim,  
 $\frac{1}{4}$  S 2 in N., and  
S 11 in S. half;  
raise a mound of stone, 2 ft. base,  $1\frac{1}{2}$  ft. high, north  
of corner.  
Pits impracticable.  
42.00 Wire fence brs. N. and S.

Partial subdivision of T. 15 S., R. 29 E.

Chains

45.30 Draw, course NE.  
 52.25 Draw, course NW.  
 69.70 Draw, course NE.  
 76.00 Draw, course NE.  
 80.01 The cor. of secs. 1, 2, 11 and 12.  
 Land, rolling.  
 Soil, sandy loam, gumbo, gravelly, rocky, 1st to 3rd rate.  
 Undergrowth, scattering with patches of dense mesquite  
 and catclaw.

Aug. 29 and Sept. 2, 1914.

Sept. 2, 1914.

N. 0° 3' E. on a random line bet. secs. 1 and 2.  
 40.00 Set temp. 1/4 sec. cor.  
 39.58 Intersect the N. bdy. of the Tp., 2 lks. E. of the cor.  
 of secs. 1, 2, 35 and 36, an iron post, 3 ins. in diam.,  
 with brass cap, 12 ins. above ground, marked and witnessed  
 as described by the Surveyor General.  
 Thence I run  
 S. 0° 2' W., on a true line bet. secs. 1 and 2.  
 Over rolling land, through scattering undergrowth.  
 3.60 Wash. 20 lks. wide, 4 ft. deep, course NE.  
 39.58 Set an iron post 3 ft. long, 1 in. in diam., 26 ins. in  
 the ground, for 1/4 sec. cor., marked on brass cap, 1914  
 on S. rim,  
 1/2 S1 on W. and  
 S1 on E. half; raise a mound of stone 2 ft.  
 base, 1 1/2 ft. high, W. of cor., pits impracticable.  
 47.35 Wagon road, bears E. and W.  
 47.93 Wire fence, bears E. and W.  
 48.35 Wagon road, bears E. and W.  
 55.00 Draw, course E., ascend gradual N. slope, 100 ft. to  
 79.58 The cor. of secs. 1, 2, 11 and 12, 100 ft. above cor.  
 Land, rolling.  
 Soil, sandy loam, gumbo, gravelly, rocky, 1st to 3rd rate.  
 Undergrowth, scattering with patches of dense mesquite  
 and catclaw.

Sept. 2, 1914.

East on a true line bet. secs. 1 and 12.  
 Over rolling land, through scattering undergrowth.  
 27.00 Vacant house, belonging to the Riggs Cattle Co., bears  
 North, about 6 chs. dist., known as the KL ranch.  
 28.00 Windmill, bears North, about 7 chs. dist.,  
 Gulch, course NW., Note: At this point,  
 Sept. 2, 1914; I set off 8° 2' N. on the decl. arc; and  
 at apparent noon, observe the sun on the meridian; the  
 resulting lat. is 32° 9' N., which is the correct lat.  
 Foot of mountain, bears N. and S., ascend W. slope, 325 ft.  
 40.00 Set an iron post 3 ft. long, 1 in. in diam., 12 ins. in  
 the ground, on bed rock, supported by a mound of stone,  
 for 1/4 sec. cor., marked on brass cap, 1914 on S. rim  
 1/2 S1 on N. and  
 S12 on S. half; raise a mound of stone 2 ft.  
 base, 1 1/2 ft. high, N. of cor., pits impracticable.  
 48.00 Spur ridge, slopes N., descend East slope, 180 ft. to  
 59.25 Gulch, course NE., ascend NW. slope 30 ft.  
 61.00 Wire fence, bears NW. and SE.  
 69.25 Water trough and small earth tank with water, bears N.  
 about 7 chs.  
 70.00 Spur, slopes N., descend East slope, 60 ft. to  
 72.50 Gulch, course N., ascend NW. slope, 60 ft. to  
 80.42 Intersect the E. bdy. of the Tp. 22.78 chs. North of  
 the cor. of secs. 6 and 7, T. 15 S., R. 30 E., reestab-  
 lished by me as described in Book 10.

Oct. 6, 1914.

At point of intersection set an iron post 3 ft. long,  
 2 ins. in diam., 24 ins. in the ground, marked above  
 for closing cor. to secs. 1 and 12, marked on brass  
 cap, 1914 on S. rim,

Chains

CC E. of center;  
 T15S in N. and  
 S6 S7 R30E in E. half;  
 S1 in NW. and  
 S12 R09E in SW. quadrant; raise a mound of stone  
 2 ft. base,  $1\frac{1}{2}$  ft high, W. of cor., pits impracticable.  
 Land, rolling and mountainous.  
 Soil, gravelly and rocky, granite formation, 3rd and 4th  
 rate.  
 Undergrowth, scattering with patches of dense mesquite and  
 catclaw.

Sept. 2, &amp; Oct. 6, 1914.

## General description.

This township contains nearly every variety of land from plains to mountains, and the soil ranges from sandy loam to rocks. The soil on the mountains is rocky 4th rate, the remainder is sandy loam mixed with gravel, 1st to 3rd rate. The mountains are part of the Chiricahua Range.

Oak, cedar and juniper timber on the mountains, some of the gulches have sycamore, cottonwood, ash and walnut.

There is a little indication of mineral in the Southwestern part of this township.

There are no settlers in that portion of this township in this survey.

*William B. Kimmel*

U.S. Surveyor.



178  
23  
BOOK 2781

For FINAL OATH OF UNITED STATES SURVEYOR.  
See Book " D "

I, \_\_\_\_\_, U. S. Surveyor, do solemnly swear that, in pursuance of special instructions received from the U. S. Surveyor General for \_\_\_\_\_ bearing date of the \_\_\_\_\_ day of \_\_\_\_\_, 191 \_\_\_\_\_, I have well, faithfully and truly, in my own proper person, and in strict conformity with said instructions, the Manual of Surveying Instructions, and the laws of the United States, surveyed all those parts or portions of \_\_\_\_\_ of the \_\_\_\_\_ Meridian, in the State of \_\_\_\_\_, which are represented in the foregoing field notes as having been executed by me, and under my direction; and I do further solemnly swear that all the corners of said survey have been established and perpetuated in strict accordance with the Manual of Surveying Instructions, and the special written instructions of the U. S. Surveyor General for \_\_\_\_\_ and in the specific manner described in the field notes, and that the foregoing are the original field notes of such survey.

U. S. Surveyor.

Subscribed by said \_\_\_\_\_, and sworn to before me }  
this \_\_\_\_\_ day of \_\_\_\_\_, 191 \_\_\_\_\_



APPROVAL.

OFFICE OF THE UNITED STATES SURVEYOR GENERAL,

Phoenix Arizona June 19 \_\_\_\_\_, 191 5

The foregoing field notes of the survey of part of the Subdivision Lines  
of Township 15 South Range 29 East and Retracement of part  
of the South & East bdrs. of the Camp Bowie Military  
Reservation (Abandoned) in Township 15 South Range 29 East  
of the Gila & Salt River Base & Meridian, in the State of Arizona.

executed by William B. Kimmel U.S. Surveyor  
under his special instructions dated December 30, 1913 for Group 26, ~~##~~, having been critically examined, and the necessary corrections and explanations made, the said field notes, and the & retracements surveys they describe, are hereby approved.

*Frank S. Ingalls*

Surveyor General.  
of Arizona.

~~I certify that the foregoing transcript of the field notes of the above described surveys in \_\_\_\_\_, has been correctly copied from the original notes on file in this office.~~