

Book "R"
Subdivisions
FIELD NOTES

BOOK 2783

OF THE SURVEY OF THE

COMPLETION OF THE

SUBDIVISION LINES OF

AND RESURVEY OF THE

WEST BOUNDARY OF

FRAC. TOWNSHIP NO. 17 SOUTH RANGE NO. 32 EAST

Of the Gila and Salt River Base and Meridian,

In the State of ARIZONA

EXECUTED BY

WILLIAM B. KIMMEL

In the capacity of U. S. Surveyor, under instructions dated December 30, 1913,
issued by the United States Surveyor General to govern surveys included in
Group No. 26, which were approved by the Commissioner of the General Land
Office, January 9, 1914, pursuant to authority contained in the Act of
Congress dated August 1, 1914.

Survey & Resurvey commenced October 8, 1914

Survey & Resurvey completed October 16, 1914

1A

BOOK 2783

BOOK "R"

INDEX DIAGRAM.

Fractional

Township 17 South, Range 32 East

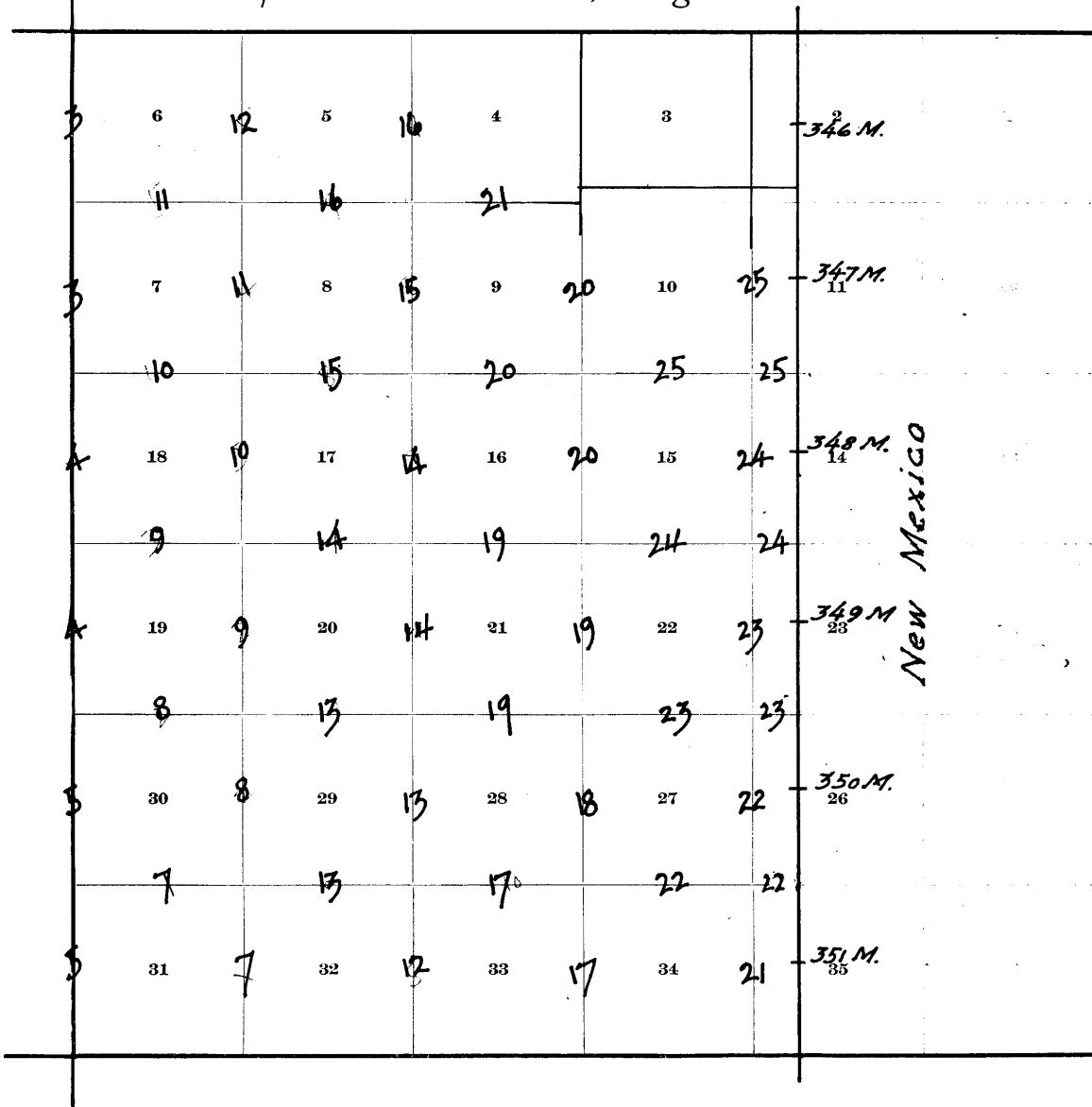

———— Accepted surveys

Retracement of the West bdy. of frac. Tp. 17 S., R. 32 East.
Chains.

- Survey commenced Oct. 8, 1914, and executed with a Young and Sons' slight mountain transit No. 8588. For description and tests of instrument, see Book "A."
- Oct. 8, 1914: At 8h. a.m., l.m.t., I set off $31^{\circ} 54' N.$ on the lat. arc; $5^{\circ} 41\frac{1}{2}' S.$ on the decl. arc; and determine with the solar a meridian at the original cor. of Ts. 17 and 18 S., Rs. 31 and 32 E., which is a stone $9 \times 16 \times 12$ ins. above ground, firmly set, marked and witnessed, as described by the Surveyor General.
- Thence I run,
North, on a random line, bet. secs. 31 and 36.
- 39.82 Fall 12 lks. east of original $\frac{1}{4}$ sec. cor., a stone $6 \times 5 \times 9$ ins. above ground, loosely set, marked $\frac{1}{4}$ on W. face, under fence, brs. N. and S. True course and dist. of south $\frac{1}{2}$ mile bet. secs. 31 and 36 is therefore $S. 0^{\circ} 10' E.$, 39.82 chs.
- Thence I run,
North, on a random line, bet. secs. 31 and 36.
- 40.00 No corner found; set temp. cor. for secs. 25, 30, 31 and 36.
- Continue measurement on random line, north bet. secs. 25 and 30.
- 80.00 No cor. found. Set temp. $\frac{1}{4}$ sec. cor.
- Continue measurement on random line north.
- 120.15 Fall 91 lks. west of original cor. of secs. 19, 24, 25 and 30, a stone $18 \times 12 \times 10$ ins., in a small mound of stone, marked 2 notches on the S. edge. No other marks discernable. True course and distant of line, bet. secs. 25 and 30 is therefore $S. 0^{\circ} 26' W.$, 80.10 chs. and of $N. \frac{1}{2}$ mile bet. secs. 31 and 36 is $S. 0^{\circ} 26' W.$, 40.05 chs.
- Note: Oct. 8, 1914: At this corner I set off $5^{\circ} 46' S.$ on the decl. arc; and at apparent noon, observe the sun; on the meridian; the resulting lat. is $31^{\circ} 55\frac{1}{2}' N.$
- Thence I run,
North, on random line, bet. secs. 19 and 24.
- 40.00 No corner found; set temp. $\frac{1}{4}$ sec. cor.
- 81.91 Fall 9 lks. west of original cor. of secs. 13, 18, 19 and 24, a stone $9 \times 5 \times 2$ ins. in a mound of stone, marked with 3 notches on N. and S. edges.
- True course and dist. of this mile is therefore $S. 0^{\circ} 4' W.$, 81.91 chs.
- Thence I run,
North, on a random line bet. secs. 13 and 18.
- 40.70 Fall 52 lks. west of the original $\frac{1}{4}$ sec. cor., a stone $10 \times 8 \times 3$ ins. in a mound of stone, marked $\frac{1}{4}$ on W. face.
- True course and dist. of south $\frac{1}{2}$ mile bet. secs. 13 and 18 is therefore $S. 0^{\circ} 44' W.$ 40.70 chs.
- Thence I run,
North on random line, on $N. \frac{1}{2}$ mile, bet. secs. 13 and 18.
- 40.74 Fall 79 lks. W. of original cor. of secs. 7, 12, 13 and 18, a stone $6 \times 4 \times 6$ ins. above ground, marked with 4 notches on S. and 2 notches on N. edge.
- True course and dist. of $N. \frac{1}{2}$ mile, bet. secs. 13 and 18 is therefore $S. 1^{\circ} 7' W.$, 40.75 chs.
- Thence I run,
North, on a random line, bet. secs. 7 and 12.
- 40.83 Fall 7 lks. west of original $\frac{1}{4}$ sec. cor., a stone $4 \times 6 \times 9$ ins. above ground, marked $\frac{1}{4}$ on W. face.
- True course and dist. of $S. \frac{1}{2}$ mile bet. secs. 7 and 12 is therefore $S. 0^{\circ} 6' W.$, 40.83 chs.
- Oct. 8, 1914.
- Oct. 9, 1914: Note: At 8h. a.m., l.m.t., I set off $31^{\circ} 58' N.$ on the lat. arc; $6^{\circ} 04\frac{1}{2}' S.$ on the decl. arc, and determine with a the solar a meridian at the original $\frac{1}{4}$ sec. cor. bet. secs. 7 and 12, above described.
- Thence I run,
North, on a random line, bet. secs. 7 and 12, on north half mile.
- 40.00 No corner found; set temp. cor. for secs. 1, 6, 7 and 12, and continue measurement on random line, north, bet. secs. 1 and 6.
- 80.00

2. Retracement of West bdy. of Frac. Township 17 S., R. 32 E.

Chains.

80.00 No corner found; set temp. $\frac{1}{4}$ sec. cor.
 122,40 Fall 96 lks. east of the cor. of Ts. 16 and 17 S., Rs. 31 and
 32 E., an iron post 3 ins. in diam., 12 ins. above
 ground, with brass cap, marked, and witnessed as de-
 scribed by the Surveyor General, reestablished by John
 F. Hesse, U.S. Surveyor, in May 1913, under instructions
 for Group 18.
 True course and dist. of north $\frac{1}{2}$ mile, bet. secs. 7 and 12,
 is therefore S. $0^{\circ}27'$ E., 40.80 chs., and of mile bet,
 secs. 1 and 6, S. $0^{\circ}27'$ E., 81.60 chs.
 Oct. 9, 1914.

Resurvey of the West bdy. of frac. Township 17 South Range 32 E. 3.

Chains.

Oct. 9, 1914:
From the cor. of Ts. 16 and 17 S., Rs. 31 and 32 E., hereinbefore described, I run, (as per result of retracement, hereinbefore noted),
S. 0° 27' E., on a true line, on E. bdy. of sec. 1, T. 17 S., R. 31 E.

28.10
40.80

Over rolling land, through dense undergrowth.
Wash, 70 lks. wide, 3 ft. deep, course east.
Set an iron post, 3 ft. long, 1 in. in diam., 26 ins. in the ground, for reestablished $\frac{1}{4}$ sec. cor., marked on brass cap,

1914 on S. rim,
 $\frac{1}{4}$ S 1 on W., and
S 6 in E. half;

raise a mound of stone 2 ft. base, $1\frac{1}{2}$ ft. high, west of corner. Pits impracticable.

41.40
48.20
81.60

Wash, 8 lks. wide, 18 ins. deep, course NE.
Wash, 10 lks. wide, 2 ft. deep, course NE.
Set an iron post, 3 ft. long, 3 ins. in diam., 24 ins. in the ground, for the reestablished cor. of secs. 1 and 12, T 17 S., R. 31 E., marked on brass cap,

1914 on S. rim,
T 17 S on N., and
R 32 E S 6 S 7 in E. half;
S 1 in NW., and
S 12 R 31 E in SW. quadrant;

raise a mound of stone 2 ft. base, $1\frac{1}{2}$ ft. high, west of corner. Pits impracticable.

Land, rolling.
Soil, sandy loam, gumbo, gravelly, 1st to 3rd rate.
No timber.
Undergrowth, dense mesquite, catclaw and greasewood.

S. 0° 27' E., on a true line, on east bdy. of sec. 12, T. 17 S., R. 31 E.

1.85
40.80

Over rolling land, through dense undergrowth.
Old wagon road brs. NE and SW.
The original $\frac{1}{4}$ sec. cor., hereinbefore described, alongside of which, I set an iron post 3 ft. long, 1 in. in diam., 20 ins. in the ground, on harapan, supported by a mound of stone, for reestablished $\frac{1}{4}$ sec. cor., marked on brass cap,

1914 on S. rim,
 $\frac{1}{4}$ S 12 on W., and
S 7 on E. half;

raise a mound of stone 2 ft. base, $1\frac{1}{2}$ ft. high, west of corner. Pits impracticable.

Thence I run,
S. 0° 6' W., on a true line, on S. $\frac{1}{2}$ mile of E. bdy. of sec. 12.
Over gently rolling land, through dense undergrowth.

20.30
40.83

Old wagon road brs. NE and SW.
The original cor. of secs. 7, 12, 13 and 18, hereinbefore described, alongside of which I set an iron post, 3 ft. long, 3 ins. in diam., 24 ins. in the ground, for reestablished cor. of secs. 12 and 13, T. 17 S., R. 31 E., marked on brass cap,

1914 on S. rim,
T 17 S in N., and
R 32 E S 7, S 18 in E. half;
S 12 in NW., and
S 13 R 31 E in SW. quadrant;

raise a mound of stone 2 ft. base, $1\frac{1}{2}$ ft. high, west of corner. Pits impracticable.

Land, gently rolling.
Soil, sandy loam, gumbo, stony 2nd and 3rd rate,
No timber.
Undergrowth, scattering with patches of dense mesquite, catclaw, and greasewood.

Resurvey of West bdy. of frac. Township 17 S., R. 32 E.

Chains

- S.1° 7' W., on a true line, on E. bdy. of sec. 13, T. 17 S., R. 31 E.
 Over gently rolling land, through scattering undergrowth.
 40.75 The original $\frac{1}{4}$ sec. cor., hereinbefore described, alongside of which,
 I set an iron post 3 ft. long, 1 in. in diam., 18 ins. in the ground, on hardpan, supported by a mound of stone, for reestablished $\frac{1}{4}$ sec. cor., marked on brass cap,
 1914 on S. rim,
 $\frac{1}{4}$ S 13 on W., and
 S 18 on E. half;
 raise a mound of stone 2 ft. base, 1 $\frac{1}{2}$ ft. high, west of corner. Pits impracticable.
 Thence I run,
 12.50 S.0° 44' W., on a true line, on south $\frac{1}{2}$ mile of east bdy. of sec. 13.
 40.70 Wagon road brs. NE. and SW.
 The original cor. of secs. 13, 18, 19 and 24, hereinbefore described, alongside of which I set an iron post 3 ft. long, 3 ins. in diam., 24 ins. in the ground, for the cor. of secs. 13 and 24, T. 17 S., R. 31 E., marked on brass cap,
 1914 on S. rim,
 T 17 S in N., and
 R 32 E S 18 S 19 in E. half;
 S 13 in NW.,
 S 24 R 32 E in SW. quadrant;
 raise a mound of stone 2 ft. base, 1 $\frac{1}{2}$ ft. high, west of corner. Pits impracticable.
 Land, gently rolling.
 Soil, sandy loam, gumbo, stony, 2nd and 3rd rate,
 No timber.
 Undergrowth, scattering with patches of dense mesquite, catclaw and greasewood.
-
- 10.00 S0° 4' W., on a true line on east bdy. of sec. 24.
 Over rolling land, through dense undergrowth.
 20.00 Wash, 18 lks. wide, 2 ft. deep, course NE.
 40.955 Wire fence brs. E. and W., belongs to J. Reay.
 Set an iron post 3 ft. long, 1 in. in diam., 26 ins. in the ground, for reestablished $\frac{1}{4}$ sec. cor., marked on brass cap,
 1914 on S. rim,
 $\frac{1}{4}$ S 24 on W., and
 S 19 on E. half;
 raise a mound of stone, 2 ft. base, 1 $\frac{1}{2}$ ft. high, west of corner. Pits impracticable.
- 42.80 Old wagon road, brs. E. and W.
 43.00 Wire fence brs. E. and W.
 45.40 Old wagon road, brs. NE. and SW.
 54.00 Ditch, 2 ft. wide, course NE.
 62.60 Old wagon road, brs. NE. and SW.
 64.00 Wire fence brs. NE. and SW., belongs to J. Reay.
 64.50 Dim wagon road, brs. NE. and SW.
 76.00 Old channel of Cave Creek, 110 lks. wide, course NE.
 78.00 Old channel of Cave Creek, 220 lks. wide, course NE.
 81.91 The original cor. of secs. 19, 24, 25 and 30, hereinbefore described, alongside of which, I set an iron post, 3 ft. long, 3 ins. in diam., 24 ins. in the ground, for reestablished cor. of secs. 19, 24, 25 and 30, marked on brass cap,
 1914 on S. rim,
 T 17 S in N. half;
 R 31 E S 24 in NW.,
 R 32 E S 19 in NE.,
 S 30 in SE., and
 S 25 in SW. quadrant; from which,

Resurvey of West bdy. of frac. Township 17 S., R. 32 East. 5.

Chains.

	<p>A sycamore, 7 ins. in diam., brs. N. $73\frac{3}{4}^{\circ}$ E., 294 lks. dist., marked T 17 S R 32 E S 19 B T. A walnut, 8 ins. in diam., brs. N. 70° W., 76 lks. dist., marked T 17 S R 31 E S 24 B T. A willow, 6 ins. in diam., brs. S. $63\frac{1}{2}^{\circ}$ W., 150 lks. dist., marked T 17 S R 31 E S 25 B T. No other trees within limits; raise a mound of stone 2 ft. base, $\frac{1}{2}$ ft. high, west of cor. Pits impracticable. Land, rolling. Soil, sandy loam, gumbo, gravelly and stony, 2d and 3rd rate. Timber, scattering sycamore, cottonwood, walnut, ash and willow along Cave Creek. Undergrowth, dense mesquite, catclaw and greasewood.</p> <hr/> <p>S. $0^{\circ} 26' W.$, on a true line, bet. secs. 25 and 30. Over rolling land, through dense undergrowth. 5.25 Cave Creek, 40 lks. wide, 1 ft. deep, clear water, stony bottom, course NE. 10.50 Wagon road, brs. NE and SW. 14.50 Ditch, 6 ft. wide, course NE. 40.05 Set an iron post, 3 ft. long, 1 in. in diam., 26 ins. in the ground, for reestablished $\frac{1}{4}$ sec. cor., marked on brass cap, 1914 on S. rim, $\frac{1}{4}$ S 25 on W., and S 30 on E. half; raise a mound of stone 2 ft. base, $1\frac{1}{2}$ ft. high, west of corner. Pits impracticable. 57.90 Wagon road, brs. NW and SE. 63.70 Wagon road brs. E. to Rodeo and west to Paradise. 64.20 Cor. of fence, brs. west about 30 lks. dist.; fence brs. west and south. 64.50 Wagon road brs. NW and SE. 70.25 Wagon road brs. NE and SW. 78.50 Wagon road brs. NE and SW. 80.10 Set an iron post 3 ft. long, 3 ins. in diam., 24 ins. in the ground, for reestablished cor. of secs. 25, 30, 31 and 36, marked on brass cap, 1914 on S. rim, T 17 S in N. half; R 31 E S 25 in NW., R 32 E S 30 in NE., S 31 in SE., and S 36 in SW. quadrant; raise a mound of stone 2 ft. base, $1\frac{1}{2}$ ft. high, west of cor., Pits impracticable. J. L. Eaton's house brs. N. 73° E., about 6 chs. dist. Land, rolling. Soil, sandy loam, gumbo, gravelly and stony, 2nd and 3rd rate. Timber, scattering sycamore, cottonwood, walnut, ash, cedar and willow along Cave Creek. Undergrowth, dense mesquite, catclaw and greasewood.</p> <hr/> <p>S. $0^{\circ} 26' W.$, on a true line, bet. secs. 31 and 36. Over rolling land, through scattering undergrowth. .04 Wire fence brs. NE and SW. .34 Corner of fence, brs. west 28 lks. dist.; fence, brs. W., S., and NE.; fence continues south near line. .80 Water from cienega, 20 lks. wide, 22 ins. deep, flows W. 4.70 Wire fence, brs. E and W. 11.85 Wash, 30 lks. wide, 3 ft. deep, course NE. 12.15 Foot of ridge, brs. NE and SW.; ascend NW. slope. 33.25 Limestone ridge, brs. NE and SW., 425 ft. above foot; desc. S. slope.</p>
--	--

6. Resurvey of West bdy. of frac. Township 17 South, Range 32 E.

Chains.

40.05 The original $\frac{1}{4}$ sec. cor. hereinbefore described, alongside of which I set an iron post 3 ft. long, 1 in. in diam., 20 ins. in the ground, on bed rock, supported by a mound of stone, under fence, brs. N. and S., for reestab. $\frac{1}{4}$ sec. cor., marked on brass cap, 1914 on S. rim, $\frac{1}{4}$ S 36 in W., and S 31 on E. half; raise a mound of stone 2 ft. base, $1\frac{1}{2}$ ft. high, west of corner, Pits impracticable.

Thence I run, S. $0^{\circ}10'$ E., on a true line, on S. $\frac{1}{2}$ mile, bet. secs. 31 and 36.

12.50 Gulch, course east, 325 ft. below ridge; ascend N. slope.

16.90 Telephone line, brs. S. 65° E., to Rodeo, and N. 65° W. to Paradise.

26.00 Spur, slopes NE., 130 ft. above gulch; descend SE. slope.

33.80 Draw, course NE., 40 ft. below spur, ascend NE. slope.

39.82 Spur, slopes NE., 85 ft. above draw.

The original cor. of Ts. 17 and 18 S., Rs. 31 and 32 E., which is a stone 9x16x12 ins. above ground, firmly set, marked and witnessed as described by the Surveyor General.

Land, rolling and mountainous.
Soil, stony, lime formation, 2nd to 4th rate.
Timber, scattering cedar and oak.
Undergrowth, scattering with patches of dense scrub oak, mesquite, catclaw and greasewood.

Oct. 9, 1914.

Boundaries of frac. Township 17 South, Range 32 East.
Latitudes, departures, and closing errors.

Line designated.	True course.	Dist.	Latitudes.		Departures.	
			N.	S.	E.	W.
West bdy.	N. $0^{\circ}10'$ W.	39.82	39.82			.12
	N. $0^{\circ}26'$ E.	120.15	120.15		.91	
	N. $0^{\circ}04'$ E.	81.91	81.91		.09	
	N. $0^{\circ}44'$ E.	40.70	40.70		.52	
	N. $1^{\circ}07'$ E.	40.75	40.74		.79	
	N. $0^{\circ}06'$ E.	40.83	40.83		.07	
	N. $0^{\circ}27'$ W.	122.40	122.40			.96
North bdy., East.	340.83				340.83	
East bdy., (E. bdy. of Ariz)	S. $0^{\circ}02'$ W.	42.82		42.82		.02
	S. $0^{\circ}06'$ W.	80.00		80.00		.14
South bdy., South.	364.75			364.75		
South bdy., West.	341.44					341.44
Convergency,					.32	
Totals, -----			486.55	487.57	343.53	342.68
				486.55	342.68	
Error in latitude, -----				1.02		
Error in departure, -----					0.85	

Subdivision of Completion of frac. Township 17 South, Range 32 East.

Chains.

Survey commenced Oct. 12, 1914, and executed with a Young and Sons' light mountain transit, No. 8588; for description and test of instrument, see Book "A."

Oct. 12, 1914: At 8h. a.m., l.m.t., I set off 31°54' N. on the lat. arc; 7°12½' S. on the decl. arc; and determine with the solar meridian at the original cor. of secs. 5, 6, 31 and 32 on south bdy. of Tp., which is a stone 10x9x6 ins. above ground, firmly set, marked and witnessed as described by the Surveyor General.

Thence I run,
N. 0°10' E., bet. secs. 31 and 32.
Over rolling land, through dense undergrowth.

19.80 Wash, 20 lks. wide, 4 ft. deep, course NE.
26.00 Wash, 25 lks. wide, 3 ft. deep, course SE.
35.00 Wash, 40 lks. wide, 2 ft. deep, course NE.
39.50 Wash, 10 lks. wide, 2 ft. deep, course E.
40.00 Set an iron post, 3 ft. long, 1 in. in diam., 26 ins. in the ground, for ¼ sec. cor., marked on brass cap,
1914 on S. rim,
¼ S 31 in W., and
S 32 in E. half;
raise a mound of stone 2 ft. base, 1½ ft. high, west of corner. Pits impracticable.

45.75 Wagon road brs. NW. to Paradise, and SE. to Rodeo.
46.00 Leave dense; enter scattering undergrowth, brs. NW. and SE.
48.45 Old wagon road, brs. NW. and SE.
59.60 Wash, 40 lks. wide, 1 ft. deep, course SE.
80.00 Set an iron post, 3 ft. long, 2 ins. in diam., 24 ins. in the ground, for the cor. of secs. 29, 30, 31 and 32, marked on brass cap,
1914 on S. rim,
T 17 S S 30 in NW.,
R 32 E S 29 in NE.,
S 32 in SE., and
S 31 in SW. quadrant;
raise a mound of stone 2 ft. base, 1½ ft. high, west of cor. Pits impracticable.

Land, rolling.
Soil, sandy loam, gumbo, gravelly and stony, 2nd to 4th rate.
No timber,
Undergrowth, south 46 chs., dense; north 34 chs. scattering mesquite and catclaw.

West, on a random line, bet. secs. 30 and 31.
40.00 Set temp. ¼ sec. cor.
80.04 Intersect the west bdy. of the Tp., 14 lks. north of the corner of secs. 25, 30, 31 and 36, reestablished by me, as hereinbefore described,
Thence I run,
N. 89°54' E., on a true line, bet. secs. 30 and 31.
Over gently rolling land, through scattering undergrowth.

.02 Wire fence, brs. NE and SW.
3.25 Wire fence brs. N. and S.
4.00 J. L. Eaton's house, about 100 lks. north.
6.50 Wire fence, brs. N. and S.
9.80 Wire fence, brs. N. and S.
15.15 Wire fence, brs. NW and SE.
16.35 Wagon road, brs. NW and SE.
18.30 Wagon road, brs. NW. to Paradise and SE. to Rodeo.
40.02 Set an iron post, 3 ft. long, 1 in. in diam., 26 ins. in the ground, for ¼ sec. cor. marked on brass cap,
1914 on S. rim,
¼ S 30 on N., and
S 31 on S. half;
raise a mound of stone, 2 ft. base, 1½ ft. high, N. of cor. Pits impracticable.

8. Completion of frac. Township 17 South, Range 32 East.

Chains.

- 80.04 The cor. of secs. 29, 30, 31 and 32.
Land rolling.
Soil, sandy loam, gumbo, gravelly, stony, 2nd to 4th rate.
No timber.
Undergrowth, scattering with patches of dense mesquite and catclaw.
-
- N. 0° 10' E., bet. secs. 29 and 30.
Over gently rolling land, through scattering undergrowth.
3.20 Wash, 10 lks. wide, 2 ft. deep, course NE.
22.15 Old wagon road, brs. NW. and SE.
23.70 Wagon road brs. NE. and SW.
32.15 Wash, 8 lks. wide, 2 ft. deep, course NE.
40.00 Set an iron post, 3 ft. long, 1 in. in diam., 26 ins. in the ground, for $\frac{1}{4}$ sec. cor., marked on brass cap,
1914 on S. rim,
 $\frac{1}{4}$ S 30 on W., and
S 29 on E. half;
raise a mound of stone 2 ft. base, $1\frac{1}{2}$ ft. high, west of corner. Pits impracticable.
- 66.00 Enter dense undergrowth, brs. E. and W.
80.00 Set an iron post, 3 ft. long, 2 ins. in diam., 24 ins. in the ground, for cor. of secs. 19, 20, 29 and 30, marked on brass cap,
1914 on S. rim, T 17 S S 19 in NW.,
R 32 E S 29 in NE.,
S 29 in SE., and
S 30 in SW. quadrant;
raise a mound of stone 2 ft. base, $1\frac{1}{2}$ ft. high, west of cor. Pits impracticable.
- Land, rolling.
Soil, sandy loam, gumbo, gravelly, stony, 2nd to 4th rate.
No timber.
Undergrowth, south 66 chs. scattering; north 14 chs., dense mesquite and catclaw.
-
- S. 89° 54' W., on a random line, bet. secs. 19 and 30.
40.00 Set temp. $\frac{1}{4}$ sec. cor.
79.74 Intersect the west bdy. of the Tp., 19 lks. south of the cor. of secs. 19, 24, 25 and 30, reestablished by me, as hereinbefore described.
- Thence I run,
S. 89° 58' E., on a true line, bet. secs. 19 and 30.
Over gently rolling land, through dense undergrowth.
4.00 Cave Creek, 20 lks. wide, 14 ins. deep, clear water, stony bottom, course NE.
- 15.75 Wagon road, brs. NE. and SW.
16.60 Ditch, 6 ft. wide, course NE.
39.87 Set an iron post 3 ft. long, 1 in. in diam., 26 ins. in the ground, for $\frac{1}{4}$ sec. cor., marked on brass cap,
1914 on S. rim,
 $\frac{1}{4}$ S 19 on N., and
S 30 in S. half;
raise a mound of stone 2 ft. base, $1\frac{1}{2}$ ft. high, north of cor. Pits impracticable.
- 79.74 The cor. of secs. 19, 20, 29 and 30.
Land, rolling.
Soil, sandy loam, gumbo, gravelly, stony, 2nd to 4th rate.
Timber, scattering sycamore, cottonwood and ash along Cave Creek.
Undergrowth, dense mesquite, catclaw, quail and greasewood.
-

Completion of Subdivision of frac. Township 17 S., Range 32 E. 9.

Chains.		
	N. 0° 10' E., bet. secs. 19 and 20.	
40.00	Over gently rolling land, through dense undergrowth, Set an iron post, 3 ft. long, 1 in. in diam., 26 ins. in the ground, for $\frac{1}{4}$ sec. cor., marked on brass cap, 1914 on S. rim, $\frac{1}{4}$ S 19 on W., and S 20 on E. half; raise a mound of stone 2 ft. base, $1\frac{1}{2}$ ft. high, west of corner. Pits impracticable.	
46.50	Ditch, 6 ft. wide, course NE.	
55.80	Wash, 120 lks. wide, 5 ft. deep, course NE.	
69.50	Wagon road brs. NE. and SW.	
78.00	Old channel of Cave Creek, 70 lks. wide, 30 ins. deep, course NE.	
80.00	Set an iron post, 3 ft. long, 2 ins. in diam., 24 ins. in the ground, for the cor. of secs. 17, 18, 19 and 20, marked on brass cap, 1914 on S. rim, T 17 S S 18 in NW., R 32 E S 17 in NE., S 20 in SE., and S 19 in SW. quadrant; raise a mound of stone 2 ft. base, $1\frac{1}{2}$ ft. high, west of corner. Pits impracticable.	
	<u>Note:</u> Oct. 12, 1914: At this cor., I set off 7° 17' S. on the decl. arc, and at apparent noon, observe the sun on the meridian; the resulting lat. is 31° 56 $\frac{1}{2}$ ' N.	
	Land, rolling.	
	Soil, sandy loam, gumbo, gravelly, stony, 2d to 4th rate.	
	Timber, scattering cottonwood and willow along Cave Creek.	
	Undergrowth, dense mesquite, catclaw, greasewood and quail brush.	
	Knowing from my resurvey of the west bdy. of this Tp. that a closing corner will be necessary for secs. 18 and 19, T. 17 S., R. 32 E., I run,	
	West on a true line, bet. secs. 18 and 19.	
	Over gently rolling land, through dense undergrowth.	
.45	Enter old channel of Cave Creek, course NE.	
5.60	Cave Creek, 15 lks. wide, 4 ins. deep, clear water, stony bottom, flows NE.	
6.40	Leave Creek channel, course NE.	
29.15	Wagon road brs. NE. and SW.	
31.85	Ditch, 5 ft. wide, course NE.	
40.00	Set an iron post, 3 ft. long, 1 in. in diam., 14 ins. in the ground, on hardpan, supported by a mound of stone, for $\frac{1}{4}$ sec. cor. marked on brass cap, 1914 on S. rim, $\frac{1}{4}$ S 18 on N., and S 19 on S. half;	
	raise a mound of stone 2 ft. base, $1\frac{1}{2}$ ft. high, N. of cor. Pits impracticable.	
66:15	Wash, 10 lks. wide, 1 ft. deep, course NE.	
70.00	Enter scattering undergrowth, brs. NE. and SW.	
79.92	Intersect the west bdy. of the Tp., S. 0° 4' W., 198 lks. dist., from the cor. of secs. 13 and 24, T. 17 S., R. 31 E., reestablished by me, as hereinbefore described.	
	At point of intersection, set an iron post 3 ft. long, 2 ins. in diam., 16 ins. in the ground, on hardpan, supported by a mound of stone for closing cor. of secs. 18 and 19, marked on brass cap, 1914 on S. rim,	
	C C W of center,	
	T 17 S in N., and	
	S 13, S 24 & 31 E in W. half;	
	S 18 in NE., and	
	S 19 & R 32 E in SE. quadrant; raise a	

10. Completion of Subdivision of frac. Township 17 S., R. 32 E.

Chains.

mound of stone 2 ft. base, $1\frac{1}{2}$ ft. high, east of cor. Pits impracticable.

Land, rolling.

Soil, sandy loam, gumbo, gravelly, stony, 2nd to 4th rate. Timber, scattering cottonwood and willow along Cave Creek; Undergrowth, east 70 chs., dense; west 9.92 chs. scattering. mesquite, catclaw, greasewood and quail brush.

N.0°10'E., bet. secs. 17 and 18.
Over gently rolling land, through dense undergrowth.
.70 Enter old channel of Cave Creek, course NE.
1.45 Cave Creek, 20 lks. wide, 2 ins. deep, clear water, stony bottom, flows NE.
6.40 Leave creek channel, course NE.
18.00 Enter scattering undergrowth, brs. NE. and SW.
40.00 Set an iron post, 3 ft. long, 1 in. in diam., 20 ins. in the ground, on hardpan, supported by a mound of stone, for $\frac{1}{4}$ sec. cor., marked on brass cap,
1914 on S. rim,
 $\frac{1}{4}$ S 18 on W., and
S 17 on E. half;
raise a mound of stone 2 ft. base, $1\frac{1}{2}$ ft. high, west of cor. Pits impracticable.
41.40 Wagon road, brs. NE. and SW.
41.85 Ditch, 7 ft. wide, course NE.
77.25 Wash, 175 lks. wide, 4 ft. deep, course NE.
80.00 Set an iron post, 3 ft. long, 2 ins. in diam., 18 ins. in the ground, on hardpan, supported by a mound of stone, for the cor. of secs. 7, 8, 17 and 18, marked on brass cap,
1914 on S. rim,
T 17 S S 7 in NW.,
R 32 E S 8 in NE.,
S 17 in SE., and
S 18 in SW. quadrant;
raise a mound of stone, 2 ft. base, $1\frac{1}{2}$ ft. high, west of cor. Pits impracticable.
Land, rolling.
Soil, sandy loam, gumbo, gravelly, stony, 2nd to 4th rate. Timber, scattering cottonwood and willow along Cave Creek. Undergrowth, south 18 chs. dense; north, 62 chs. scattering mesquite, catclaw, greasewood and quail brush.

West, on a true line, bet. secs. 7 and 18.
Over gently rolling land, through scattering undergrowth.
40.00 Set an iron post 3 ft. long, 1 in. in diam., 20 ins. in the ground, on hardpan, supported by a mound of stone for $\frac{1}{4}$ sec. cor., marked on brass cap,
1914 on S. rim,
 $\frac{1}{4}$ S 7 on N., and
S 18 on S. half;
raise a mound of stone 2 ft. base, $1\frac{1}{2}$ ft. high, north of cor. Pits impracticable.
40.20 Wagon road, brs. NE. and SW.
78.93 Intersect the west bdy. of the Tp., S.1° 7' W., 345 lks. dist. from the cor. of secs. 12 and 13, T. 17 S., R. 31 E., reestablished by me, as hereinbefore described.
At point of intersection, set an iron post 3 ft. long, 2 ins. in diam., 24 ins. in the ground, for closing cor. of secs. 7 and 18, marked on brass cap,
1914 on S. rim,
C C W of center,
T 17 S in N., and
S 12 S 13 R 31 E in W. half;
S 7 in NE., and
S 18 in SE. quadrant;

Completion of Subdivision of frac. Township 17 South Range 32 E. 11

Chains.

raise a mound of stone 2 ft. base, 1½ ft. high E. of cor. Pits impracticable.
 Land, rolling.
 Soil, sandy loam, gumbo, gravelly, stony, 2nd and 4th rate.
 No timber.
 Undergrowth, scattering mesquite and catclaw.

40.00

N.0°10'E., bet. secs. 7 and 8.
 Over gently rolling land, through scattering undergrowth.
 Set an iron post 3 ft. long, 1 in. in diam., 12 ins. in the ground, on hardpan, supported by a mound of stone, for ¼ sec. cor., marked on brass cap,
 1914 on S rim,
 ¼ S 7 on W., and
 S 8 on E. half;

52.30
80.00

raise a mound of stone 2 ft. base, 1½ ft. high, W. of corner. Pits impracticable.
 Wagon road, brs. NE. and SW.
 Set an iron post, 3 ft. long, 2 ins. in diam., 24 ins. in the ground, for the cor. of secs. 5, 6, 7 and 8, marked on brass cap,
 1914 on S rim,
 T 17 S S 6 in NW.,
 R 32 E S 5 in NE.
 S 8 in SE., and
 S 7 in SW. quadrant;
 raise a mound of stone 2 ft. base, 1½ ft. high, west of cor. Pits impracticable.

Land, rolling.
 Soil, sandy loam, gumbo, gravelly, 2nd and 3rd rate.
 No timber.
 Undergrowth, scattering with patches of dense mesquite and catclaw.

Oct. 12, 1914.

12.00
40.00

Oct. 16, 1914; At the cor. of secs. 5, 6, 7 and 8, I set off 8° 46½'S. on the decl. arc; and at apparent noon, observe the sun on the meridian; the resulting lat. 31°58½'N.

Thence I run,
 West, on a true line, bet. secs. 6 and 7.
 Over gently rolling land, through scattering undergrowth.
 Enter dense undergrowth, brs. NE. and SW.

Set an iron post 3 ft. long, 1 in. in diam., 26 ins. in the ground, for ¼ sec. cor., marked on brass cap,
 1914 on S rim,
 ¼ S 6 on N., and
 S 7 on S. half;

62.60
79.37

raise a mound of stone, 2 ft. base, 1½ ft. high, N. of corner. Pits impracticable.
 Wash, 10 lks. wide, 2 ft. deep, course NE.
 Intersect the west bdy. of the Tp., S. 0°27'E., 507 lks. dist., from the cor. of secs. 1 and 12, T. 17 S., R. 31 E. reestablished by me, as hereinbefore described.

At point of intersection, set an iron post 3 ft. long, 2 ins. in diam., 24 ins. in the ground, for closing cor. of secs. 6 and 7, marked on brass cap,

1914 on S rim,
 C C W of center,
 T 17 S in N., and
 S 1, S 12 R 31 E in W. half;
 S 6 in NE., and
 S 7, R 32 E in SE. quadrant;

raise a mound of stone 2 ft. base, 1½ ft. high, E. of cor. Pits impracticable.

12. Completion of Subdivision of frac. Township 17 S., R. 32 E.

Chains.	<p>Land, rolling. Soil, sandy loam, gumbo, gravelly, 2nd and 3rd rate. No timber. Undergrowth, east 12 chs., scattering; west 67.37 chs., dense mesquite, catclaw and greasewood.</p>
40.00	N.0°10'E., on a random line, bet. secs. 5 and 6.
86.71	Set temp. $\frac{1}{4}$ sec.cor. Intersect the north bdy. of the Tp., 26 lks.east of the corner of secs.5,6,31 and 32. which is an iron post 3 ins. in diam., 12 ins. above ground, with a brass cap, marked and witnessed as described by the Surveyor General.
46.71	Thence I run, S.0°10'E., on a true line, bet. secs.5 and 6. Over gently rolling land, through dense undergrowth. Set an iron post 3 ft.long, 1 in. in diam., 26 ins. in the ground, for $\frac{1}{4}$ sec.cor., marked on brass cap, 1914 on S.rim, $\frac{1}{4}$ S6 on W., and S 5 in E.half; raise a mound of stone, 2 ft.base, 1 $\frac{1}{2}$ ft. high, west of cor. Pits impracticable.
67.00	Old wagon road, brs.NE and SW.
72.70	Enter scattering undergrowth, brs.NE and SW.
86.71	The cor.of secs.5,6,7 and 8. Land, rolling. Soil, sandy loam, gumbo, gravelly, 2nd and 3rd rate. No timber. Undergrowth, north 72.70 chs. dense; south 14 chs., scattering mesquite, catclaw and greasewood. Oct.16, 1914.
6.40	Oct. 13, 1914: At 8h.20m., a.m., l.m.t., I set off 31°54' N.on the lat.arc; 77°36 $\frac{1}{2}$ ' S.on the decl.arc; and determine a meridian with the solar at the original cor. of secs.4,5,32 and 33, on south bdy.of Tp., which is a stone 12x6x6 ins. above ground, firmly set, marked and witnessed as described by the Surveyor General.
13.10	Thence I run, N.0°11' E. bet. secs. 32 and 33. Over gently rolling land, through scattering undergrowth. Wash, 10 lks.wider, 2 ft. deep, course SE.
40.00	Wagon road, brs.NW and SE. Set an iron post 3 ft.long, 1 in. in diam., 26 ins. in the ground, for $\frac{1}{4}$ sec.cor., marked on brass cap, 1914 on S.rim, $\frac{1}{4}$ S 32 on W., and S 33 on E.half; raise a mound of stone 2 ft.base, 1 $\frac{1}{2}$ ft. high, west of cor. Pits impracticable.
80.00	Set an iron post 3 ft. long, 2 ins. in diam., 24 ins. in the ground, for the cor.of secs. 28,29, 32 and 33, marked on brass cap, 1914 on S rim, T 17 S S 29 in NW., R 32 E S 28 in NE., S 33 in SE., and S 32 in SW.quadrant; raise a mound of stone 2 ft.base, 1 $\frac{1}{2}$ ft. high, west of corner. Pits impracticable.
	Land, rolling. Soil, sandy loam, gumbo, gravelly, stony, 2nd to 4th rate. No timber. Undergrowth, scattering, with patches of dense mesquite, catclaw and greasewood.

Completion of Subdivision of frac. Township 17 S. R 32 E. 13.

Chains.	
40.00	West, on a random line, bet. secs. 29 and 32. Set temp. $\frac{1}{4}$ sec. cor.
80.15	Intersect the N. and S. line, 9 lks. S. of the cor. of secs. 29, 30, 31 and 32. Thence I run, S. $89^{\circ}56'$ E., on a true line, bet. secs. 29 and 32. Over gently rolling land, through scattering undergrowth.
40.075	Set an iron post 3 ft. long, 1 in. in diam., 26 ins. in the ground, for $\frac{1}{4}$ sec. cor., marked on brass cap, 1914 on S rim, $\frac{1}{4}$ S 29 on N., and S 32 on S. half; raise a mound of stone 2 ft. base, $1\frac{1}{2}$ ft. high, N. of cor. Pits impracticable.
80.15	The cor. of secs. 28, 29, 32 and 33. Land, rolling. Soil, sandy loam, gumbo, gravelly, stony, 2nd to 4th rate. No timber. Undergrowth, scattering with patches of dense mesquite, catclaw and greasewood.

16.90	N. $0^{\circ}11'$ E., bet. secs. 28 and 29. Over gently rolling land, through scattering undergrowth. Wash, 8 lks. wide, 2 ft. deep, course SE.
40.00	Set an iron post, 3 ft. long, 1 in. in diam., 26 ins. in the ground, for $\frac{1}{4}$ sec. cor., marked on brass cap, 1914 on S rim, $\frac{1}{4}$ S 29 on W., and S 28 on E. half; raise a mound of stone 2 ft. base, $1\frac{1}{2}$ ft. high, W. of corner. Pits impracticable.
43.60	Old wagon road, brs. NE and SW.
80.00	Set an iron post 3 ft. long, 2 ins. in diam., 24 ins. in the ground, for the cor. of secs. 20, 21, 28 and 29, marked on brass cap, 1914 on S rim, T 17 S S 20 in NW., R 32 E S 21 in NE., S 28 in SE., and S 29 in SW. quadrant; raise a mound of stone 2 ft. base, $1\frac{1}{2}$ ft. high, west of cor. Pits impracticable. Land, rolling. Soil, sandy loam, gumbo, gravelly, stony, 2nd to 4th rate. No timber. Undergrowth, scattering with patches of dense mesquite.

40.00	N. $89^{\circ}56'$ W., on a random line, bet. secs. 20 and 29. Set temp. $\frac{1}{4}$ sec. cor.
80.14	Intersect the N. and S. line, 5 lks. N. of the cor. of secs. 19, 20, 29 and 30. Thence I run, S. $89^{\circ}58'$ E., on a true line, bet. secs. 20 and 29. Over gently rolling land, through dense undergrowth. Enter scattering undergrowth, brs. NE and SW.
26.00	Set an iron post, 3 ft. long, 1 in. in diam., 26 ins. in the ground, for $\frac{1}{4}$ sec. cor., marked on brass cap, 1914 on S rim, $\frac{1}{4}$ S 20 in N. and S 29 in S. half;
40.07	raise a mound of stone 2 ft. base, $1\frac{1}{2}$ ft. high, north of cor. Pits impracticable.
80.14	The cor. of secs. 20, 21, 28 and 29. Land rolling. Soil, sandy loam, gumbo, gravelly, stony, 2nd to 4th rate. No timber.

14. Completion of Subdivision of frac. Township 17 S. R. 32 E.

Chains.

Undergrowth, west 26 chs. dense; east 54 chs. scattering mesquite, catclaw and greasewood.

40.00 N. $0^{\circ} 11' E.$, bet. secs. 20 and 21.
Over gently rolling land, through scattering undergrowth.
Set an iron post, 3 ft. long, 1 in. in diam., 26 ins. in the ground, for $\frac{1}{4}$ sec. cor., marked on brass cap, 1914 on S. rim, $\frac{1}{4}$ S 20 on W., and S 21 on E. half;
raise a mound of stone 2 ft. base, $1\frac{1}{2}$ ft. high, west of corner. Pits impracticable.

69.65 Wash, 35 lks. wide, 2 ft. deep, course NE.

80.00 Set an iron post, 3 ft. long, 2 ins. in diam., 24 ins. in the ground, for the cor. of secs. 16, 17, 20 and 21, marked on brass cap, 1914 on S. rim, T 17 S S 17 in NW., R 32 E S 16 in NE., S 21 in SE., and S 20 in SW. quadrant; raise a mound of stone 2 ft. base, $1\frac{1}{2}$ ft. high, west of cor. Pits impracticable.
Oct. 13, 1914; At this cor., I set off $7^{\circ} 39\frac{1}{2}' S.$ on the decl. arc, and at apparent noon, observe the sun on the meridian; the resulting lat. is $31^{\circ} 56\frac{1}{2}' N.$
Land, rolling.
Soil, sandy loam, gumbo, gravelly, stony, 2nd to 4th rate.
No timber.
Undergrowth, scattering with patches of dense mesquite and catclaw.

40.00 N. $89^{\circ} 58' W.$, on a random line, bet. secs. 17 and 20.
Set temp. $\frac{1}{4}$ sec. cor.

80.17 Intersect the N. and S. line, at the cor. of secs. 17, 18, 19 and 20.
Thence I run,
S. $89^{\circ} 58' E.$, on a true line, bet. secs. 17 and 20.
Over gently rolling land, through dense undergrowth.

.60 Old channel of Cave Creek, 70 lks. wide, 4 ft. deep, course NE.

10.30 Wagon road brs. NE. and SW.

28.00 Enter scattering undergrowth, brs. NE and SW.

40.085 Set an iron post, 3 ft. long, 1 in. in diam., 26 ins. in the ground, for $\frac{1}{4}$ sec. cor., marked on brass cap, 1914 on S. rim, $\frac{1}{4}$ S 17 on N., and S 20 on S. half;
raise a mound of stone 2 ft. base, $1\frac{1}{2}$ ft. high, N. of cor. Pits impracticable.

54.10 Wash, 6 lks. wide, 2 ft. deep, course NE.

80.17 The cor. of secs. 16, 17, 20 and 21.
Land, rolling.
Soil, sandy loam, gumbo, gravelly, stony, 2nd to 4th rate.
No timber.
Undergrowth, west 28 chs., dense; east 52.17 chs, scattering mesquite, catclaw and greasewood.

14.35 N. $0^{\circ} 11' E.$, bet. secs. 16 and 17.
Over gently rolling land, through scattering undergrowth.
Wash, 10 lks. wide, 2 ft. deep, course NE.

40.00 Set an iron post 3 ft. long, 1 in. in diam., 26 ins. in

Completion of Subdivision of frac. Township 17 S. 2 R. 32 E. 15.

Chains.

the ground, for $\frac{1}{4}$ sec. cor., marked on brass cap,
 1914 on S. rim,
 $\frac{1}{4}$ S 17 on W., and
 S 16 on E. half;
 raise a mound of stone, 2 ft. base, $1\frac{1}{2}$ ft. high, W. of
 cor. Pits impracticable.

48.55 Wagon road, brs. NE. and SW.
 64.45 Wash, 35 lks. wide, 2 ft. deep, course NE.
 72.65 Wash, 12 lks. wide, 2 ft. deep, course NE.
 80.00 Set an iron post 3 ft. long, 2 ins. in diam., 24 ins. in
 the ground, for the cor. of secs. 8, 9, 16 and 17, marked
 on brass cap,
 1914 on S. rim,
 T 17 S S 8 in NW.,
 R 32 E S 9 in NE.,
 S 16 in SE., and
 S 17 in SW. quadrant;
 raise a mound of stone 2 ft. base, $1\frac{1}{2}$ ft. high, W. of
 cor. Pits impracticable.

Land, rolling.
 Soil, sandy loam, gumbo, gravelly, stony, 2nd to 4th rate,
 No timber.
 Undergrowth, scattering mesquite and catclaw.

40.00 N. $89^{\circ}58'$ W., on a random line, bet. secs. 8 and 17.
 Set temp. $\frac{1}{4}$ sec. cor.
 80.12 Intersect the N. and S. line, 12 lks. south of the cor. of
 secs. 7, 8, 17 and 18.
 Thence 1 run,
 S. $89^{\circ}53'$ E., on a true line, bet. secs. 8 and 17.
 Over gently rolling land, through scattering undergrowth.
 4.65 Wash, 250 lks. wide, 3 ft. deep, course NE.
 29.80 Ditch, 6 ft. wide, course NE.
 30.20 Wagon road brs. NE. and SW.
 40.06 Set an iron post, 3 ft. long, 1 in. in diam., 26 ins. in
 the ground, for $\frac{1}{4}$ sec. cor., marked on brass cap,
 1914 on S. rim,
 $\frac{1}{4}$ S 8 in N., and
 S 17 on S. half;
 raise a mound of stone 2 ft. base, $1\frac{1}{2}$ ft. high, north
 of cor. Pits impracticable.

65.45 Wash, 30 lks. wide, 3 ft. deep, course north.
 67.20 Cave Creek, dry channel, 320 lks. wide, 2 ft. deep, course
 NE.
 74.90 Wash, 50 lks. wide, 2 ft. deep, course NE.
 79.20 Wash, 45 lks. wide, 2 ft. deep, course NE.
 80.12 The cor. of secs. 8, 9, 16 and 17.
 Land, rolling.
 Soil, sandy loam, gumbo, gravelly, stony, 2nd to 4th rate.
 No timber.
 Undergrowth, scattering with patches of dense mesquite,
 and catclaw.

Oct. 13, 1914.

Oct. 14, 1914.
 N. $0^{\circ}11'$ E., bet. secs. 8 and 9.
 Over gently rolling land, through scattering undergrowth.
 .40 Wash, 50 lks. wide, 2 ft. deep, course NE.
 6.00 Wash, 25 lks. wide, 3 ft. deep, course NE.
 22.65 Dry channel of Cave Creek, 335 lks. wide, 3 ft. deep,
 course NE.
 40.00 Set an iron post 3 ft. long, 1 in. in diam., 26 ins. in
 the ground, for $\frac{1}{4}$ sec. cor., marked on brass cap,
 1914 on S. rim,
 $\frac{1}{4}$ S 8 on W., and
 S 9 on E. half;

16. Completion of Subdivision of frac. Township 17 S 2R 32 E.

Chains.	
	raise a mound of stone 2 ft. base, $1\frac{1}{2}$ ft. high, west of cor. Pits impracticable.
62.30	Old wagon road, brs. NE. and SW.
62.70	Ditch, 5 ft. wide, course NE.
80.00	Set an iron post, 3 ft. long, 2 ins. in diam., 24 ins. in the ground, for the cor. of secs. 4, 5, 8 and 9, marked on brass cap,
	1914 on S rim,
	T 17 S S 5 in NW.,
	R 32 E S 4 in NE.,
	S 9 in SE., and
	S 8 in SW. quadrant;
	raise a mound of stone 2 ft. base, $1\frac{1}{2}$ ft. high, west of corner. Pits impracticable.
	Land, rolling.
	Soil, sandy loam, gumbo, gravelly, stony, 2nd to 4th rate.
	No timber.
	Undergrowth, scattering with patches of dense mesquite
	and catclaw, willows along Cave Creek channel.
	Oct. 14, 1914.
	Oct. 16, 1914:
	N. $89^{\circ}53'$ W., on a random line, bet. secs. 5 and 8.
40.00	Set temp. $\frac{1}{4}$ sec. cor.
80.06	Intersect the N. and S. line, 7 lks. north of the cor. of secs. 5, 6, 7 and 8.
	Thence I run,
	S. $89^{\circ}56'$ E., on a true line, bet. secs. 5 and 8.
21.35	Over gently rolling land, through scattering undergrowth.
40.03	Wagon road brs. NE. and SW.
	Set an iron post, 3 ft. long, 1 in. in diam., 26 ins. in the ground, for $\frac{1}{4}$ sec. cor., marked on brass cap,
	1914 on S rim,
	$\frac{1}{4}$ S 5 on N., and
	S 8 on S. half;
	raise a mound of stone 2 ft. base, $1\frac{1}{2}$ ft. high, north of cor.
	Pits impracticable.
80.06	The cor. of secs. 4, 5, 8 and 9.
	Land, rolling.
	Soil, sandy loam, gumbo, gravelly, stony, 2nd to 4th rate.
	No timber.
	Undergrowth, scattering with patches of dense mesquite,
	catclaw, and greasewood.
	Oct. 16, 1914.
	Oct. 14, 1914:
	N. $0^{\circ}11'$ E., on a random line, bet. secs. 4 and 5.
40.00	Set temp. $\frac{1}{4}$ sec. cor.
86.90	Intersect the north bdy. of the Tp., 21 lks. east of the cor. of secs. 4, 5, 32 and 33, which is an iron post, 3 ins. in diam., 12 ins. above ground, with brass cap, marked and witnessed as described by the Surveyor General.
	Thence I run,
	S. $0^{\circ}02'$ W., on a true line, bet. secs. 4 and 5.
	Over gently rolling land, through dense undergrowth.
5.85	Old wagon road brs. NE. and SW.
46.90	Set an iron post 3 ft. long, 1 in. in diam., 26 ins. in the ground, for $\frac{1}{4}$ sec. cor., marked on brass cap,
	1914 on S rim,
	$\frac{1}{4}$ S 5 on W., and
	S 4 on E. half;
	raise a mound of stone 2 ft. base, $1\frac{1}{2}$ ft. high, west of corner. Pits impracticable.
48.10	Wagon road, brs. NE. and SW.

Completion of Subdivision of frac. Township 17 S. R. 32 E. 17.

Chains.

67.00 Enter scattering undergrowth, brs. E and W.
86.90 The cor. of secs. 4, 5, 8 and 9.
Land, rolling.
Soil, sandy loam, gumbo, gravelly, stony, 2nd to 4th rate.
No timber.
Undergrowth, north 67 chs. dense; south 19.90 chs., scattering mesquite, catclaw and greasewood.

At 7h. 30m. a.m., l.m.t., set off $31^{\circ}54'$ N. on the lat. arc; $7^{\circ}58'$ S. on the decl. arc; and determine a meridian with the solar at the cor. of secs. 3, 4, 33 and 34, on the south bdy. of the Tp., which is a stone 10x8x6 ins., above ground, firmly set, marked and witnessed as described by the Surveyor General.

Thence I run,
N. $0^{\circ}11'$ E., bet. secs. 33 and 34.
Over level land, through scattering undergrowth.

12.60 Wash, 10 lks. wide, 2 ft. deep, course SE.
40.00 Set an iron post 3 ft. long, 1 in. in diam., 26 ins. in the ground, for $\frac{1}{4}$ sec. cor., marked on brass cap,
1914 on S. rim,
 $\frac{1}{4}$ S 33 on W., and
S 34 on E. half;
raise a mound of stone 2 ft. base, $1\frac{1}{2}$ ft. high, west of corner. Pits impracticable.

45.50 Wash, 8 lks. wide, 3 ft. deep, course SE.
80.00 Set an iron post 3 ft. long, 2 ins. in diam., 24 ins. in the ground, for the corner of secs. 27, 28, 33 and 34, marked on brass cap,
1914 on S. rim,
T 17 S S 28 in NW.,
R 32 E S 27 in NE.,
S 34 in SE., and
S 33 in SW. quadrant;
raise a mound of stone 2 ft. base, $1\frac{1}{2}$ ft. high, west of corner. Pits impracticable.

Land, level.
Soil, sandy loam, gumbo, gravelly, 1st to 3rd rate.
No timber.
Undergrowth, scattering, with patches of dense mesquite, catclaw and greasewood.

40.00 West, on a random line, bet. secs. 28 and 33.
Set temp. $\frac{1}{4}$ sec. cor.
80.15 Intersect the N. and S. line, 2 lks. north of the corner of secs. 28, 29, 32 and 33.
Thence I run,
N. $89^{\circ}59'$ E., on a true line, bet. secs. 28 and 33.
Over level land, through scattering undergrowth,
40.075 Set an iron post 3 ft. long, 1 in. in diam., 26 ins. in the ground, for $\frac{1}{4}$ sec. cor., marked on brass cap,
1914 on S. rim,
 $\frac{1}{4}$ S 28 on N., and
S 33 on S. half;
raise a mound of stone 2 ft. base, $1\frac{1}{2}$ ft. high, north of corner.
Pits impracticable.

80.15 The corner of secs. 27, 28, 33 and 34.
Land, level.
Soil, sandy loam, gumbo, gravelly, 1st to 3rd rate.
No timber.
undergrowth, scattering with patches of dense mesquite,

18. Completion of Subdivision of Township 17 S., R. 32 E.

Chains.

catclaw and greasewood.

40.00

N. 0°11' E., between secs. 27 and 28.
 Over level land, through scattering undergrowth.
 Set an iron post, 3 ft. long, 1 in. in diam., 26 ins.
 in the ground, for $\frac{1}{4}$ sec. cor., marked on brass cap,
 1914 on S. rim,
 $\frac{1}{4}$ S 28 on W., and
 S 27 on E. half;

raise a mound of stone 2 ft. base, $1\frac{1}{2}$ ft. high, west
 of corner. Pits impracticable.

74.80

Wash, 6 lks. wide, 18 ins. deep, course NE.

75.55

Wagon road, brs. NE and SW.

80.00

Set an iron post, 3 ft. long, 2 ins. in diam., 24 ins.
 in the ground, for the corner of secs. 21, 22, 27 and
 28, marked on brass cap,

1914 on S. rim,
 T 17 S S 21 in NW.,
 R 32 E S 22 in NE.,
 S 27 in SE., and
 S 28 in SW. quadrant;

raise a mound of stone 2 ft. base, $1\frac{1}{2}$ ft. high, west
 of corner.

Pits impracticable.

Land, level.

Soil, sandy loam, gumbo, gravelly, 1st and 3rd rate.

No timber.

Undergrowth, scattering with patches of dense mesquite,
 catclaw and greasewood.

Completion of Subdivision of Trac, T. 17 S., R. 32 E.

40.00
80.11

S. 89° 59' W., on a random line bet. secs. 21 and 28.
Set temp. 1/4 sec. cor.
Intersect the N. and S. line, 5 lks. N. of the cor. of
secs. 20, 21, 28 and 29.

40.055

Thence I run
N. 89° 57' E., on a true line bet. secs. 21 and 28.
Over level land, through scattering undergrowth.
Set an iron post 3 ft. long, 1 in. in diam., 26 ins. in
the ground, for 1/4 sec. cor., marked on brass cap; 1914
on S. rim,

80.11

1/4 S21 on N. and
1/4 S28 on S. half; raise a mound of stone, 2 ft.
base, 1 1/2 ft. high, N. of cor., pits impracticable.
The cor. of secs. 21, 22, 27 and 28.
Land, level,
Soil, sandy loam, gumbo, gravelly, 1st to 3rd rate.
No timber.
Undergrowth, scattering with patches of dense mesquite,
catclaw and greasewood.

40.00

N. 0° 11' E., bet. secs. 21 and 22.
Over level land, through scattering undergrowth.
Set an iron post 3 ft. long, 1 in in diam., 26 ins. in
the ground, for 1/4 sec. cor., marked on brass cap; 1914
on S. rim,

80.00

1/4 S21 on W. and
1/4 S22 on E. half; raise a mound of stone 2
ft. base, 1 1/2 ft. high, W. of cor., pits impracticable.
Set and iron post 3 ft. long, 2 ins. in diam., 24 ins. in
the ground, for the cor. of secs., 15, 16, 21 and 22,
marked on brass cap; 1914 on S. rim,
T17S S16 in NW.,
R32E S15 in NE.,
S22 in SE. and
S21 in SW. quadrant; raise a mound of stone, 2 ft.
base, 1 1/2 ft. high, W. of cor., pits impracticable.
Land, level.
Soil, sandy loam, gumbo, gravelly, 1st to 3rd rate.
No timber.
Undergrowth, scattering with patches of dense mesquite,
catclaw and greasewood.

40.00

80.10

S. 89° 57' W. on a random line bet. secs. 16 and 21.
Set temp. 1/4 sec. cor.
Intersect the N. and S. line, at the cor. of secs. 16,
17, 20 and 21.

40.05

Thence I run
N. 89° 57' E., on a true line bet. secs. 16 and 21.
Over level land, through scattering undergrowth.
Set an iron post 3 ft. long, 1 in. in diam., 26 ins. on
the ground, for 1/4 sec. cor., marked on brass cap; 1914
on S. rim,

80.10

1/4 S16 on N. and
1/4 S21 on S. half; raise a mound of stone, 2 ft.
base, 1 1/2 ft. high, N. of cor., pits impracticable.
The cor. of secs. 15, 16, 21 and 22.
Land, level.
Soil, sandy loam, gumbo, gravelly, 1st to 3rd rate.
No timber.
Undergrowth, scattering, with patches of dense mesquite,
catclaw and greasewood.

Note: Oct. 14, 1914. At the corner of sections
15, 16, 21 & 22 I set off 8° 2' S. on the decl. arc; and
at apparent noon, observe the sun on the meridian, the
resulting lat. is 31° 56 1/2' N., which is the correct
lat.
Thence I run,

16 20 of Completion of Subdivision of frac. T. 17 S., R. 32 E. Chains

40.00 N. 0° 11' E., bet. sec. 15 and 16.
 Over level land, through scattering undergrowth.
 Set an iron post 3 ft. long, 1 in. in diam., 26 ins. in the ground, for $\frac{1}{4}$ sec. cor., marked on brass cap; 1914 on S. rim,
 $\frac{1}{4}$ S16 on W. and S15 on E. half; raise a mound of stone, 2 ft. base, $1\frac{1}{2}$ ft. high, W. of cor., pits impracticable.
 52.00 Wash, 8 lks. wide, 2 ft. deep, course NE.
 52.10 Wagon road, bears MW. and SE.
 80.00 Set an iron post 3 ft. long, 2 ins. in diam., 24 ins. in the ground, for the cor. of secs. 9, 10, 15 and 16, marked on brass cap; 1914 on S. rim,
 T17S S9 in NW.,
 R32E S10 in NE.,
 S15 in SE. and S16 in SW. quadrant; raise a mound of stone 2 ft. base, $1\frac{1}{2}$ ft. high, W. of cor., pits impracticable.
 Land, level.
 Soil, sandy loam, gumbo, gravelly, 1st to 3rd rate.
 No timber.
 Undergrowth, scattering with patches of dense mesquite, catclaw and greasewood.

Oct. 14, 1914.

40.00 S. 89° 57' W., on a random line bet. secs. 9 and 16.
 Set temp. $\frac{1}{4}$ sec. cor.
 80.07 Intersect the N. and S. line, 10 lks. S. of the cor. of secs. 8, 9, 16 and 17,
 Thence I run S. 89° 59' E., on a true line bet. secs. 9 and 16.
 Over level land, through scattering undergrowth.
 2.55 Wash, 6 lks. wide, 18 ins. deep, course NE.
 7.90 Wash, 15 lks. wide, 1 ft. deep, course NE.
 12.90 Wash, 12 lks. wide, 2 ft. deep, course NE.
 20.15 Old wagon road, bears NE. and SW.
 22.20 Wash, 10 lks. wide, 1 ft. deep, course NE.
 26.90 Ditch, 4 ft. wide, course N.
 40.035 Set an iron post 3 ft. long, 1 in. in diam., 26 ins. in the ground, for $\frac{1}{4}$ sec. cor., marked on brass cap; 1914 on S. rim,
 $\frac{1}{4}$ S9 on N. and S16 on S. half; raise a mound of stone 2 ft. base, $1\frac{1}{2}$ ft. high, N. of cor., pits impracticable.
 49.45 Wagon road, bears NE. and SW.
 51.65 Old wagon road, bears NW. and SE.
 80.07 The cor. of secs. 9, 10, 15 and 16.
 Land, level.
 Soil, sandy loam, gumbo, gravelly, 1st and 2nd rate.
 No timber.
 Undergrowth, scattering with patches of dense mesquite, catclaw and greasewood.

Oct. 14, 1914.

Oct. 16, 1914; at 7h 40m a.m., l.m.t., set off 31° 57 $\frac{1}{2}$ ' N. on the lat. arc; 8° 41' S. on the decl. arc; and determine with the solar a meridian at the cor. of secs. 9, 10, 15 and 16, the spring cor. of secs. 8, 9 and 10 being plainly visible, I run for said cor.
 N. 0° 5' E., on a true line bet. secs. 9 and 10.
 Over level land, through scattering undergrowth.
 7.60 Wash, 6 lks. wide, 18 ins. deep, course NE.
 20.00 Wagon road, bears NE. and SW.
 30.80 Wash, 6 lks. wide, 2 ft. deep, course NE.
 35.90 Wagon road, bears NE. and SW.
 40.00 Set an iron post 3 ft. long, 1 in. in diam., 26 ins. in the ground, for $\frac{1}{4}$ sec. cor., marked on brass cap; 1914 on S. rim,
 $\frac{1}{4}$ S9 on W. and S10 on E. half; raise a mound of stone, 2 ft. base, $1\frac{1}{2}$ ft. high, W. of cor., pits impracticable.

Completion of Subdivision of frac. T. 17 S., R. 32 E.

47.70 Wash, 5 lks. wide, 2 ft. deep, course NE.
 56.40 Wash, 5 lks. wide, 1 ft. deep, course NE.
 66.75 Wire fence, bears E. and W., cor. of fence about 35 lks. W., from which fence bears N. and E.
 80.00 Set an iron post 3 ft. long, 2 ins. in diam., 24 ins. in the ground, for the cor. of secs. 4 and 9, marked on brass cap; 1914 on S. rim,
 T17S R32E in N. and
 S3 S10 in E. half;
 S4 in NW. and
 S9 in SW. quadrant; raise a mound of stone 2 ft. base, $1\frac{1}{2}$ ft. high, W. of cor., pits impracticable.
 86.93 The cor. of secs. 3, 4, 9 & 10, which is an iron post 2 ins. in diam. with brass cap, 12 ins. above ground under fence, brs. N. & S. mkd. & witnessed as described by the U.S. Surveyor General, remark this post for the cor. of secs. 3 and 10 and rebuild mound of stone E. of cor.
 Land, level.
 Soil, sandy loam, gumbo, gravelly, 1st and 2nd rate.
 No timber.
 Undergrowth, scattering with patches of dense mesquite, catclaw and greasewood.

N. $89^{\circ} 59'$ W., on a random line bet. secs. 4 and 9.
 40.00 Set temp. $\frac{1}{4}$ sec. cor.
 80.05 Intersect the N. and S. line, 2 lks. N. of the cor. of sec. 4, 5, 8 and 9.
 Thence I run
 East on a true line bet. secs. 4 and 9.
 14.25 Ditch, 5 ft. wide, course NE.
 15.30 Old wagon road, bears NE. and SW.
 35.20 Wash, 6 lks. wide, 1 ft. deep, course NE.
 40.025 Set an iron post 3 ft. long, 1 in. in diam., 26 ins. in the ground, for $\frac{1}{4}$ sec. cor., marked on brass cap; 1914 on S. rim,
 $\frac{1}{4}$ S4 on N. and
 S9 on S. half; raise a mound of stone, 2 ft. base, $1\frac{1}{2}$ ft. high, N. of cor., pits impracticable.
 43.00 Wash, 100 lks. wide, 3 ft. deep, course NE.
 52.00 Dry bed of Cave creek, 55 lks. wide, 2 ft. deep, course NE.
 64.50 Wash, 30 lks. wide, 2 ft. deep, course NE.
 67.10 Old wagon road, bears NE. and SW.
 79.90 Wire fence, bears N. and S.
 80.05 The cor. of secs. 4 and 9.
 Land, level.
 Soil, sandy loam, gumbo, gravelly, 1st and 2nd rate.
 No timber.
 Undergrowth, scattering with patches of dense mesquite, catclaw and greasewood.

Oct. 16, 1914.

Oct. 15, 1914; at 8h a.m., l.m.t., I set off $31^{\circ} 54'$ N. on the lat. arc; $8^{\circ} 26'$ S. on the decl. arc; and determine with the solar a meridian at orig. cor. of secs. 2, 3, 34 & 35 on S. side of T. 17 S., which is a stone 12x10x8 ins. above ground, marked and witnessed as described by the U.S. Surveyor General.
 Thence I run
 N. $0^{\circ} 12'$ E., bet. sec. 34 and frac. sec. 35.
 Over level land, through scattering undergrowth.
 40.00 Set an iron post 3 ft. long, 1 in. in diam., 26 ins. in the ground, for $\frac{1}{4}$ sec. cor., marked on brass cap; 1914 on S. rim,
 $\frac{1}{4}$ S34 on W. and
 S35 on E. half; raise a mound of stone 2 ft. base, $1\frac{1}{2}$ ft. high, W. of cor., pits impracticable.
 80.00 Set an iron post 3 ft. long, 2 ins. in diam., 24 ins. in the ground, for the cor. of secs. 26, 27, 34 and 35,

22

Completion of Subdivision of frac. T. 17 S., R. 32 E.

Chains

	<p>marked on brass cap; 1914 on S. rim, T17S S27 in NW., R32E S26 in NE., S35 in SE. and S34 in SW. quadrant; raise a mound of stone 2 ft. base, $1\frac{1}{2}$ ft. high, W. of cor., pits impracticable. Land, level. Soil, sandy loam, gumbo, gravelly, 1st to 3rd rate. No timber. Undergrowth, scattering with patches of dense mesquite, catclaw and greasewood.</p>
40.00	<p>West on a random line bet. secs. 27 and 34. Set temp. $\frac{1}{4}$ sec. cor.,</p>
80.10	<p>Intersect the N. and S. line, 33 lks. S. of the cor. of secs. 27, 28, 33 and 34. Thence I run</p>
40.05	<p>S. $89^{\circ} 46'$ E., on a true line bet. secs. 27 and 34. Over level land, through scattering undergrowth. Set an iron post 3 ft. long, 1 in. in diam., 26 ins. in the ground, for $\frac{1}{4}$ sec. cor., marked on brass cap; 1914 on S. rim,</p>
80.10	<p>$\frac{1}{4}$ S27 on N. and S34 on S. half; dig pits 18x18x12 ins. E. and W. of post; 3 ft. dist., and raise a mound of earth, $3\frac{1}{2}$ ft. base, $1\frac{1}{2}$ ft. high, N. of cor. The cor. of secs. 26, 27, 34 and 35. Land, level. Soil, sandy loam, gumbo, gravelly, 1st to 3rd rate. No timber. Undergrowth, scattering with patches of dense mesquite, catclaw and greasewood.</p>
21.25	<p>frac. East, on a true line, bet. secs. 26 and 35. Over level land, through scattering undergrowth. Intersect the E. bdy. of Ariz. 35, 34 chs. N. of the 351 mile stone which is a stone 10x8x6 ins. above ground, firmly set, marked, 351M on N., NM on E. and AT on top. At point of intersection set an iron post 3 ft. long 2 ins. in diam., 24 ins. in the ground, for closing cor. of frac. secs; 26 and 35, marked on brass cap; 1914 on S. rim, CC W. of center; NM in E. half; T17S S26 in NW. and R32E S35 in SW. quadrant; raise a mound of stone 3 ft. base, 2 ft. high, W. of cor., pits impracticable. Land, level. Soil, sandy loam, gumbo, gravelly, 1st and 2nd. rate. No timber. Undergrowth, scattering with patches of dense mesquite, catclaw and greasewood.</p>
40.00	<p>N. $0^{\circ} 12'$ E., bet. sec. 27, and frac. sec. 26. Over level land, through scattering undergrowth. Set an iron post 3 ft. long, 1 in. in diam., 26 ins. in the ground, for $\frac{1}{4}$ sec. cor., marked on brass cap; 1914 on S. rim,</p>
80.00	<p>$\frac{1}{4}$ S27 on W. and S26 on E. half; raise a mound of stone 2 ft. base, $1\frac{1}{2}$ ft. high, W. of cor., pits impracticable. Set an iron post 3 ft. long, 2 in. in diam., 24 ins. in the ground, for the cor. of secs. 22, 23, 26 and 27, marked on brass cap; 1914 on S. rim, T17S S22 in NW., R32E S23 in NE., S26 in SE. and S27 in SW. quadrant; raise a mound of stone 2 ft.</p>

Completion of Subdivision of frac. T. 17 S., R. 32 E.

Chains

base, 1 1/2 ft. high, W. of cor., pits impracticable.
 Land, level.
 Soil, sandy loam, gumbo, gravelly, 1st to 3rd rate.
 No timber.
 Undergrowth, scattering with patches of dense mesquite,
 catclaw and greasewood.
 Oct. 15, 1914.

40.00 N. 89° 46' W., on a random line bet. secs. 22 and 27.
 80.11 Set temp. 1/4 sec. cor.
 Intersect the N. and S. line, 2 lks. S. of the cor. of
 secs. 21, 22, 27 and 28,
 Thence I run
 10.70 S. 89° 45' E., on a true line bet. secs. 22 and 27.
 40.055 Over level land, through scattering undergrowth.
 Wagon road, bears NE. and SW.
 Set an iron post 3 ft. long, 1 in. in diam., 26 ins. in
 the ground, for 1/4 sec. cor., marked on brass cap; 1914
 on S. rim,
 1/4 S22 on N. and
 S27 on S. half; raise a mound of stone, 2 ft.

80.11 base, 1 1/2 ft. high, N. of cor., pits impracticable.
 The cor. of secs. 22, 23, 26 and 27.
 Land, level.
 Soil, sandy loam, gumbo, gravelly, 1st and 2nd rate.
 No timber.
 Undergrowth, scattering with patches of dense mesquite,
 catclaw and greasewood.
 Oct. 15, 1914.

frac.
 21.05 East on a true line bet. secs. 23 and 26.
 Over level land, through scattering undergrowth.
 Intersect the E. bdy. of Ariz., 35.38 chs. N. of the 350
 mile cor., which is a stone 10x10x9 ins. above ground,
 firmly set, marked 350 on N. and NM on E.
 At point of intersection set an iron post 3 ft. long, 2
 ins. in diam., 24 ins. in the ground, for closing corner
 frac. secs. 23 & 26, marked on brass cap; 1914 on S. rim,
 CC W. of center;
 NM in E. half;
 T17S S23 in NW. and
 R32E S26 in SW. quadrant; raise a mound of stone
 3 ft. base, 2 ft. high, W. of cor., pits impracticable.
 Land, level.
 Soil, sandy loam, gumbo, gravelly, 1st and 2nd rate.
 No timber.
 Undergrowth, scattering with patches of dense mesquite,
 catclaw and greasewood.
 Oct. 15, 1914.

24.00 N. 0° 12' E., bet. sec. 22 and frac. sec. 23.
 40.00 Over level land, through scattering undergrowth,
 Wagon road, bears NE. and SW.
 Set an iron post 3 ft. long, 1 in. in diam., 26 ins. in
 the ground, for 1/4 sec. cor., marked on brass cap; 1914
 on S. rim,
 1/4 S22 on W. and
 S23 on E. half; raise a mound of stone 2 ft.
 80.00 base, 1 1/2 ft. high, W. of cor., pits impracticable.
 Set an iron post 3 ft. long, 2 ins. in diam., 24 ins. in
 the ground, for the cor. of secs. 14, 15, 22 and 23;
 marked on brass cap; 1914 on S. rim,
 T17S S15 in NW.,
 R32E S14 in NE.,
 S23 in SE. and
 S22 in SW. quadrant; raise a mound of stone 2 ft.
 base, 1 1/2 ft. high, W. of cor., pits impracticable.
 Land, level.
 Soil, sandy loam, gumbo, gravelly, 1st and 2nd rate.
 No timber.
 Undergrowth, scattering with patches of dense mesquite,

* Completion of Subdivision of frac. T. 17 S., R 32 E.

Chains

catclaw and greasewood.

40.00 N. 89° 45' W., on a random line bet. secs. 15 and 22.
Set temp. $\frac{1}{4}$ sec. cor.

80.10 Intersect the N. and S. line, 7 lks. S. of the cor. of secs. 15, 16, 21 and 22,
Thence I run
S. 89° 42' E., on a true line bet. secs. 15 and 22.
Over rolling land, through scattering undergrowth.

40.05 Set an iron post 3 ft. long, 1 in. in diam., 26 ins. in the ground, for $\frac{1}{4}$ sec. cor., marked on brass cap; 1914 on S. rim,
 $\frac{1}{4}$ S15 on N. and
S22 on S. half; raise a mound of stone 2 ft. base, $1\frac{1}{2}$ ft. high, N. of cor., pits impracticable.

80.10 The cor. of secs. 14, 15, 22 and 23.
Note: Oct. 15, 1914. At this cor., I set off 8° 24 $\frac{1}{2}$ ' S. on the decl. arc, and at apparent noon, observe the sun on the meridian; the resulting lat. is 31° 56 $\frac{1}{2}$ ' N.
Land, level. scattering, with patches of dense mesquite, catclaw and greasewood. Oct. 15, 1914.

20.88 East, on a true line, bet. ^{frac.}secs. 14 and 23.
Over level land, through scattering undergrowth.
Intersect the E. bdy. of Ariz., 35.42 chs. N. of the 349 mile cor., which is a stone 6x9x8 ins. above ground, firmly set, marked 349 on N., NM on E., ARIZ on W. and 32 WL on S.
At point of intersection set an iron post 3 ft. long, 2 ins. in diam., 24 ins. on the ground, for (closing cor. of secs. 14 and 23, marked on brass cap; 1914 on S. rim,
CC W. of center;
NM in E. half;
T17S S14 in NW. and
R32E S23 in SW. quadrant; raise a mound of stone, 3 ft. base, 2 ft. high, W. of cor., pits impracticable.
Land, level.
Soil, sandy loam, gumbo, gravelly, 1st and 2nd rate.
No timber.
Undergrowth, scattering mesquite, catclaw and greasewood. Oct. 15, 1914.

26.00 N. 0° 12' E., bet. sec. 15, and frac. sec. 14.
Over level land, through scattering undergrowth.
Wagon road, bears NW. and SE.

40.00 Set an iron post 3 ft. long, 1 in. in diam., 26 ins. in the ground, for $\frac{1}{4}$ sec. cor., marked on brass cap; 1914 on S. rim,
 $\frac{1}{4}$ S15 on W. and
S14 on E. half; dig pits 18x18x12 ins. N. and S. of post, 3 ft. dist., and raise a mound of earth 3 $\frac{1}{2}$ ft. base, $1\frac{1}{2}$ ft. high, W. of cor.,

80.00 Set an iron post 3 ft. long, 2 ins. in diam., 24 ins. in the ground, for the cor. of secs. 10, 11, 14 and 15, marked on brass cap; 1914 on S. rim,
T17S S10 in NW.,
R32E S11 in NE.,
S14 in SE. and
S15 in SW. quadrant; raise a mound of stone, 2 ft. base, $1\frac{1}{2}$ ft. high, W. of cor., pits impracticable.
Land, level.
Soil, sandy loam, gumbo, gravelly, 1st and 2nd rate.
No timber.
Undergrowth, scattering with patches of dense mesquite, catclaw and greasewood. Oct. 15, 1914.

Completion of
Subdivision of Frac. T. 17 S., R. 32 E.

Chains

40.00	N. 89° 42' W., on a random line bet. secs. 10 and 15.
80.04	Set temp. 1/4 sec. cor. Intersect the N. and S. line, 2 lks. N. of the cor. of secs. 9, 10, 15 and 16, Thence I run
40.02	S. 89° 43' E., on a true line, bet. secs. 10 and 15. Over level land, through scattering undergrowth. Set an iron post 3 ft. long, 1 in. in diam., 26 ins. in the ground, for 1/4 sec. cor., marked on brass cap 1914 on S. rim, 1/4 S10 on N. and S15 on S. half; raise a mound of stone 2 ft. base, 1 1/2 ft. high, N. of cor., pit impracticable.
71.85	Wash, 20 lks. wide, 2 ft. deep, course NE.
80.04	The cor. of secs. 10, 11, 14 and 15. Land, level. Soil, sandy loam, gumbo, gravelly, 1st and 2nd rate. No timber. Undergrowth, scattering with patches of dense mesquite, catclaw and greasewood.
<hr/>	
20.81	East on a true line bet. frac. sec. 11 & 14. Over level land, through scattering undergrowth. Intersect the E. bdy. of Ariz., 35.47 chs. N. of the 348 mile cor., which is a stone 10x10x10 ins. above ground, firmly set, marked 348 on N., NM on E. and ARIZ on W. At point of intersection set an iron post 3 ft. long 2 in diam., 24 ins. in the ground, for closing cor. of secs 11 and 14, marked on brass cap; 1914 on S. rim, CC W. of center, N Main E. half, T17SS11 in NW. & R32ES14 in SW. quad. Raise mound of stone, 3 ft. base, 2 ft. high, W. of cor. Pit imprac. and Land, level RS611, sandy loam gumbo, 1st & 2nd rate. No timber. Undergrowth, scattering mesquite, catclaw & greasewood.
<hr/>	
11.90	Origin cor. of secs 2, 3, 10 & 11 being plainly visible, I run for said cor. N. 0° 10' E., on true line, bet. sec. 10 & frac. sec. 11 Over level land, through scattering, undergrowth.
40.00	Wash, 8 lks. wide, 2 ft. deep, course NE. Set an iron post, 3 ft. long, 1 in. in diam., 26 ins. in ground, for 1/4 sec. cor., marked on brass cap, 1914 on S. rim, 1/4 S10 on W. & S11 on E. half. Raise mound of stone, 2 ft. base, 1 1/2 ft. h., high, W. of cor. Pit impracticable.
44.80	Wash, 12 lks. wide, 2 ft. deep, course NE.
48.25	Old wagon road, brs. E. & W. continuing on undergrowth.
167.05	Wagon road, brs. NE & SW. 2 ft. deep, course E.
467.25	Wire fence, brs. E. & W. SE cor. of same, brs. E. 6 lks. ins. in
87.30	Cor. of secs. 2, 3, 10 and 11, which is an iron post 2 ins. in diam., with brass cap, 12 ins. above ground (under wire fence bearing N. & S.) marked and witnessed as described by the Surveyor General. Oct. 15, 1914.
<hr/>	
44.80	Wash, 12 lks. wide, 2 ft. deep, course NE.
48.25	Old wagon road, brs. E. & W. continuing on undergrowth.
167.05	Wagon road, brs. NE & SW. 2 ft. deep, course E.
467.25	Wire fence, brs. E. & W. SE cor. of same, brs. E. 6 lks. ins. in
87.30	Cor. of secs. 2, 3, 10 and 11, which is an iron post 2 ins. in diam., with brass cap, 12 ins. above ground (under wire fence bearing N. & S.) marked and witnessed as described by the Surveyor General. Oct. 15, 1914.
<hr/>	
GENERAL DESCRIPTION.	
This frac. township is rolling in the western half, and level in the eastern half, being on the western edge of the San Simon Valley, draining NE. from the foothills of the Chiricahua Mts. Cave Creek extends NE. thru. secs. 19, 17, 8, 9, 4 & 3 with running water in secs. 19 and 17. Soil is mostly a sandy loam, 1st to 3rd rate. No timber, ex- cept scattering along Cave Creek, Undergrowth of mes- quite, greasewood, catclaw and quail brush over entire township. Settlers are located in secs. 19 and 30. Undergrowth, scattering with patches of dense mesquite, catclaw and greasewood.	
<hr/>	

William B. Himmel,
U.S. Surveyor.

246

26 BOOK 2783

FOR FINAL OATH OF UNITED STATES SURVEYOR.
See Book "D."

I, _____, U. S. Surveyor, do solemnly swear that, in pursuance of special instructions received from the U. S. Surveyor General for _____ bearing date of the _____ day of _____, 191 _____, I have well, faithfully, and truly, in my own proper person, and in strict conformity with said instructions, the Manual of Surveying Instructions, and the laws of the United States, surveyed all those parts or portions of _____ of the _____ Meridian, in the State of _____, which are represented in the foregoing field notes as having been executed by me, and under my direction; and I do further solemnly swear that all the corners of said survey have been established and perpetuated in strict accordance with the Manual of Surveying Instructions, and the special written instructions of the U. S. Surveyor General for _____ and in the specific manner described in the field notes, and that the foregoing are the original field notes of such survey.

U. S. Surveyor.

Subscribed by said _____, and sworn to before me }
this _____ day of _____, 191 _____ }



APPROVAL.

OFFICE OF THE UNITED STATES SURVEYOR GENERAL,

Phoenix Arizona June 19 _____, 191 5

The foregoing field notes of the survey of _____ the Completion of the
Subdivision lines

and Resurvey of the West bdy. of Fractional Township 17 South,
Range 32 East of the Gila and Salt River Base and Meridian
in the State of Arizona

executed by William B. Kimmel U.S. Surveyor

under his special instructions dated December 30, 1913 for Group 26, ~~191~~ having been critically examined, and the necessary corrections and explanations made, the said field notes, and the surveys & resurveys they describe, are hereby approved.

Frank S. Ingalls

Surveyor General.
of Arizona.

I certify that the foregoing transcript of the field notes of the above described surveys in _____, has been correctly copied from the original notes on file in this office.

U. S. Surveyor General.