

2817
4-679

SEP. 17 1914

Book "ZA"

Subdivisions

BOOK 2817

FIELD NOTES

OF THE SURVEY OF *PART OF THE*

*Subdivision Lines of
Township 4 South - Range 8 West*

Of the Gila and Salt River Base and Meridian,

Arizona.

In the State of _____

EXECUTED BY

Jesse B. Wright,

and

John F. Hesse,

In the capacity of U. S. Surveyors, under instructions dated Feb. 10, 1914.

issued by the United States Surveyor General to govern surveys included in

Group No. 32, which were approved by the Commissioner of the General Land

Office, February 20, 1914, pursuant to authority contained in the Act of

Congress dated August 1, 1914.

Survey commenced July 7, 1914

Survey completed July 10, 1914

2817

190
IA

Book "ZA"

BOOK 2817

INDEX DIAGRAM.

Township 4 South, Range 8 West

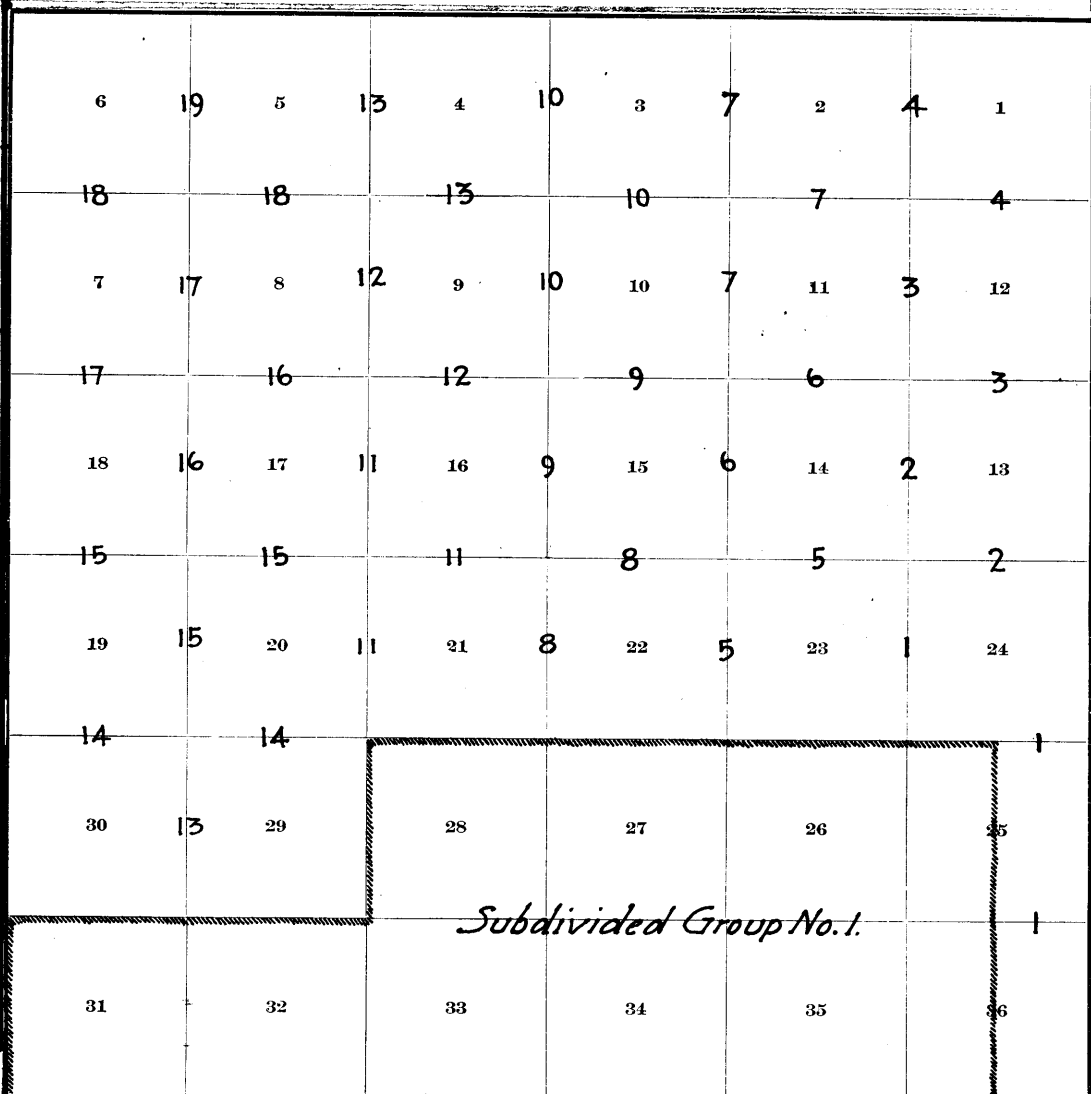

Resurveyed

Notes in Book "A" this Group

_____ " " " "B" " "
 _____ " " " "D" " "

_____ Surveyed

----- Unsurveyed

Partial Subdivision of T. 4 S., R. 8 W.

1B

Chains.

Survey completed by Jesse B. Wright and John F. Hesse, U. S. Surveyors, using Young & Son's light mountain transits Nos. 7084 and 8588 respectively, described in book "A".

Knowing from recent and repeated tests made on a true meridian established from observation of Polaris that the instruments are in correct adjustment, we proceed as follows: -

(Initials J. B. W. and J. F. H. indicate lines as run by Wright and Hesse, respectively.) J. B. W.

July 8, 1914.

At 8h a.m., l.m.t., at the cor. of secs. 25, 30, 31 & 36, on the E. bdy. of the Tp., established as described by me, as described in book "A",

I set off 22°33' N. on the decl. arc, and 33°01½' N. on the lat. arc, and determine a meridian with the solar. Thence I run,

West, on a random line, bet. secs. 25 & 36.

40.14 The orig. ¼ sec. cor. brs. North, 2 lks. dist., which is an iron post, marked and witnessed as described by the Surveyor General, whence I run, S. 89°58' E. on a true line, bet. secs. 25 & 36, on E½ mile. Over rolling land, through dense brush.

20.00 Asc.

40.14 To cor. of secs. 25, 30, 31 & 36, on E. bdy. of Tp. Land, level, rolling. Soil, 1st & 2nd rate, sandy, gravelly. Greasewood, mesquite, cacti, sage brush.

From the Cor. of secs. 19, 24, 25 & 30, on E. bdy. of Tp., established by me, as described in book "A";

I run,

N. 89°58' W. on a random line, bet. secs. 24 & 25.

39.92 The orig. ¼ sec. cor. brs. North, 9 lks. dist., which is an iron post, marked and witnessed as described by the Surveyor General, whence I run, S. 89°50' E., on a true line bet. secs. 24 & 25, on E½ mile. Over mts. land, asc. grad.

0.70 Wash, 30 lks. wide, course WNW.

20.00 Asc. steep.

25.00 Top of rocky ridge, brs. NNW. & SSE., desc. steep.

39.92 To cor. of secs. 19, 24, 25 & 30, on E. bdy. of Tp. Land, mts. Soil, 3rd rate, gravelly, stony. Greasewood, scrub mesquite, cacti.

From orig. cor. of secs. 23, 24, 25 & 26, which is an iron post, marked and witnessed as described by the Surveyor General, I run,

N. 0° 1' W. bet. secs. 23 & 24.

Over level valley, through dense mesquite.

14.90 Road, brs. NW. & SE.

40.00 Set an iron post 3 ft. long, 1 in. in diam. 26 ins. in the ground for ¼ sec. cor., marked on brass cap, ¼ S 23 in W., and ¼ S 24 in E. half, 1914 on S. rim;

No trees available.

Dig pits 18x18x12 ins. N. & S. of cor. 3 ft. dist., and raise a mound of earth 3½ ft. base, 1½ ft. high W. of cor.

74.60 Wash, 20 lks. wide, course NW.

80.00 Set an iron post 3 ft. long, 2 ins. in diam. 24 ins. in the ground for cor. of secs. 13, 14, 23 & 24, marked on brass cap, 1914 on S. rim,

T 4 S R 8 W, in N. half,

S 14 in NW., S 13 in NE.,

S 24 in SE., and S 23 in SW. quad.; from which,

A mesquite tree 12 ins. diam. brs. N. 10° E. 23 lks. dist., marked T 4 S R 8 W S 13 B T.

A mesquite tree 6 ins. diam. brs. S. 35° E. 40 lks. dist., marked T 4 S R 8 W S 24 B T.

A mesquite tree 14 ins. diam. brs. S. 50° W. 22 lks. dist., marked T 4 S R 8 W S 23 B T.

A mesquite tree 4 ins. diam. brs. N. 49° W. 65 lks. dist., marked T 4 S R 8 W S 14 B T.

Land, level. Soil, 1st rate, sandy. Dense mesquite.

Chains.	
	S. $89^{\circ}55'$ E. on a random line bet. secs. 13 & 24.
40.00	Set temp. $\frac{1}{4}$ sec. cor.
79.90	Intersect E. bdy. of Tp. 7 lks. N. of cor. of secs. 13, 18, 19 & 24, established by me, as described in book "A", whence I run, N. $89^{\circ}52'$ W., on a true line, bet. secs. 13 & 24. Over rolling land, asc. grad.
5.00	Top of hill, brs. N. & S., asc. grad. along SSE. slope.
15.21	Top of ridge, brs. N. & S., desc.
32.80	Gulch, 30 lks. wide, course SW.
34.00	Gulch, 20 lks. wide, course S.
39.95	Set an iron post 3 ft. long, 1 in. in diam. 26 ins. in the ground for $\frac{1}{4}$ sec. cor., marked on brass cap, 1914 on S. rim, $\frac{1}{4}$ S 13 in N., and S 24 in S. half, Rita impracticable raise a mound of stone 2 ft. base, $1\frac{1}{2}$ ft. high N. of cor.
65.00	Enter valley or plain, brs. N. & S.
76.35	Wash, 30 lks. wide, course NW.
79.90	To cor. of secs. 13, 14, 23 & 24. Land, mts., level, rolling. Soil, 3rd rate, sandy, gravelly, stony, dry. Greasewood, cacti, mesquite.
	Note: At this cor., at noon, I set off $22^{\circ}31'$ N. on the decl. arc, and observe the sun on the meridian. The resulting lat. is $33^{\circ}04'$ N.
	<hr/> N. $0^{\circ} 1'$ W., bet. secs. 13 and 14. Over level land through dense mesquite,
5.00	Wash, 30 lks. wide, course NW.
24.00	Road, brs. N. & SW., thence along W. side of same.
40.00	Set an iron post 3 ft. long, 1 in. in diam. 26 ins. in the ground for $\frac{1}{4}$ sec. cor., marked on brass cap, $\frac{1}{4}$ S 14 in W., and S 13 in E. half, 1914 on S. rim; from which, A mesquite tree 12 ins. diam. brs. S. 43° W. 97 lks. dist., marked $\frac{1}{4}$ S 14 B T. A mesquite tree 30 ins. diam. brs. N. $52\frac{3}{4}^{\circ}$ E. 186 lks. dist., marked $\frac{1}{4}$ S 13 B T.
54.70	Canal, 15 lks. wide, 4 ft. deep, course SW.
56.40	S. Bank of Gila River, brs. WSW. & ENE., enter land subject to overflow, in old river bed.
80.00	On small rise, on gravel bed, Set an iron post 3 ft. long, 2 ins. in diam. 24 ins. in the ground for cor. of secs. 11, 12, 13 & 14, marked on brass cap, 1914 on S. rim, T 4 S R 8 W, in N. half, S 11 in NW., S 12 in NE., S 13 in SE., and S 14 in SW. quad.; no trees near. Dig pits $18 \times 18 \times 12$ ins. in each sec. $5\frac{1}{2}$ ft. dist., and raise a mound of earth 4 ft. base 2 ft. high W. of cor. This cor. may be destroyed during some high flood, but may remain in this place for years. No point available suitable for setting a witness corner. Land, rolling, level. Soil, sandy, loose, 1st rate. Greasewood, mesquite, arrowweed.

Chains.

- S. 89°52' E., on a random line bet. secs. 12 & 13.
- 40.00 Set temp. $\frac{1}{4}$ sec. cor.
- 79.92 Intersect cor. of secs. 7, 12, 13 & 18, on the
E. bdy. of Tp., established by me, as described
in book "A", whence I run,
N. 89°52' W., on a true line bet. secs. 12 & 13.
Over level land, through dense brush, large paloverde
trees and cottonwoods.
Point for $\frac{1}{4}$ sec. cor. will fall in river bed, therefore at
- 36.26 Set an iron post 3 ft. long, 1 in. in diam. 26 ins. in
the ground for witness cor. to $\frac{1}{4}$ sec. cor., marked on
brass cap, 1914 on S. rim,
W C $\frac{1}{4}$ W. of centre,
S 12 in NE., and
S 13 in SE. quad.; from which,
A paloverde tree 10 ins. diam. brs. N. 80° E. 208 lks. dist.,
marked $\frac{1}{4}$ S 12 W C B T.
Monument on lone volcanic hill, brs. S. 7° E.; another bearing to which
is given from cor. of secs. 13, 18, 19 & 24, on E. bdy. of Tp.
No other trees near. Dig pits 18x18x12 ins. E. & W. of cor.
3 ft. dist. & raise a mound of earth, $3\frac{1}{2}$ ft. base, $1\frac{1}{2}$ ft. high,
True point for $\frac{1}{4}$ sec. cor. 3 ft. base, $1\frac{1}{2}$ ft. high (N. of cor.)
- 39.96
- 37.00 Bank of river, W. end of island, old bed runs to WSW., and
S., present bed runs to NNE. & NE, around point of
island, enter Gila river, lower bottom, subject to
overflow, leave cottonwood and paloverde.
- 79.92 To cor. of secs. 11, 12, 13 & 14.
Land, level.
Soil, 1st & 2nd rate, sandy, loose.
Arrowweed, Paloverde, cottonwood, mesquite.

- N. 0° 1' W. bet. secs. 11 & 12.
Over level land, in old river bed.
- 9.00 Enter main channel of Gila River, course SW.
- 40.00 Point for $\frac{1}{4}$ sec. cor. falls in river bed.
- 49.00 N. bank of Gila River, 20 ft. high, brs. ENE. & WSW., asc.
- 52.00 Set an iron post 3 ft. long, 1 in. in diam. 26 ins. in
the ground for witness cor. to $\frac{1}{4}$ sec. cor., marked on
brass cap, 1914 on S. rim,
W C $\frac{1}{4}$ S. of centre,
S 11 in SW., and
S 12 in SE. quad.; no trees near.
Dig pits 18x18x12 ins. N. & S. of cor. 3 ft. dist., and
raise a mound of earth $3\frac{1}{2}$ ft. base, $1\frac{1}{2}$ ft. high W. of cor.
Asc. grad. from cor.
- 80.00 Set an iron post 3 ft. long, 2 ins. in diam. 24 ins. in
the ground for cor. of secs. 1, 2, 11 & 12, marked on
brass cap, 1914 on S. rim,
T 4 S R 8 W, in N. half,
S 2 in NW.,
S 1 in NE.,
S 12 in SE., and
S 11 in SW. quad.; from which,
An ironwood tree 6 ins. diam. brs. N. 58° W. 171 lks. dist.,
marked T 4 S R 8 W S 2 B T.
An ironwood tree 6 ins. diam. brs. N. 6° E. 88 lks. dist.,
marked T 4 S R 8 W S 1 B T.
An ironwood tree 8 ins. diam. brs. S. 52° W. 210 lks. dist.,
marked T 4 S R 8 W S 12 B T.
An ironwood tree 10 ins. diam. brs. S. 28° W. 150 lks. dist.,
marked T 4 S R 8 W S 11 B T.
- Land, level, rolling.
Soil, 2nd rate, sandy, gravelly.
Arrowweed, greasewood, ironwood, cacti.

4 Partial Subdivision of T. 4 S., R. 8 W.

Chains.

S. 89°52' E. on a random line bet. secs. 1 & 12.
 40.00 Set temp. $\frac{1}{4}$ sec. cor.
 79.98 Intersect E. bdy. of Tp. 2 lks. N. of cor. of secs. 1, 6, 7 & 12, established by me, as described in book "A", whence I run,
 N. 89°51' W. on a true line bet. secs. 1 & 12.
 Over rolling, hilly land, through scattering brush, desc.
 3.40 Wash, 20 lks. wide, course S., asc.
 7.60 Wash, 20 lks. wide, course S., asc.
 12.30 Top of rise, S. side of S. end of spur, brs. S. & N., desc.
 20.00 Foot, brs. NW. & SE., enter flat.
 34.90 Wash, 20 lks. wide, course SW.
 39.99 Set an iron post 3 ft. long, 1 in. in diam. 26 ins. in the ground for $\frac{1}{4}$ sec. cor., marked on brass cap, $\frac{1}{4}$ S 1 in N., and S 12 in S. half, 1914 on S. rim; dig pits 18x18x12 ins. E. & W. of cor. 3 ft. dist., and raise a mound of earth $3\frac{1}{2}$ ft. base, $1\frac{1}{2}$ ft. high N. of cor.
 75.98 Middle of draw, 8 chs. wide, course SSW.
 79.98 To cor. of secs. 1, 2, 11 & 12.
 Land, hilly, rolling, level.
 Soil, 2nd rate, gravelly, dry.
 Greasewood, sage brush, few cacti.

N. 0° 1' W. on a random line, bet. secs. 1 & 2.
 40.00 Set temp. $\frac{1}{4}$ sec. cor.
 79.90 Intersect N. bdy. of Tp. 2 $\frac{1}{4}$ lks. W. of cor. of secs. 1, 2, 35 & 36, established by me, as described in book "A", whence I run,
 South, on a true line bet. secs. 1 & 2.
 Over rolling land, desc. gently, through scattering brush, near E. rim of small low mesa.
 39.90 Set an iron post 3 ft. long, 1 in. in diam. 26 ins. in the ground for $\frac{1}{4}$ sec. cor., marked on brass cap, 1914 on S. rim, $\frac{1}{4}$ S 2 in W., and S 1 in E. half, Pits impracticable.
 raise a mound of stone 2 ft. base, $1\frac{1}{2}$ ft. high W. of cor.
 58.90 Desc. from mesa, brs. NNE. & SSW.
 73.60 Road, Phoenix To Yuma, brs. NNE. & SW.
 79.90 To cor. of secs. 1, 2, 11 & 12.
 Land, rolling, level.
 Soil, 2nd & 3rd rate, sandy, gravelly, dry.
 Greasewood, sage brush, scrub mesquite, cacti.
 July 8, 1914.

Chains.

July 9, 1914.

At 7h a.m., l.m.t., at the cor. point of secs. 22, 23, 26 & 27, located by me by running N. 89°59' W. 18.96 chs. from the witness cor. to this cor., an iron post, marked and witnessed as described by the Surveyor General,

I set off 22°26' N. on the decl. arc, and 33°03' N. on the lat. arc, and determine a meridian with the solar. Thence I run, from the cor. pt. above noted, N. 0° 1' W. bet. secs. 22 & 23.

40.00 Over level river bottom, barren sandy land. Point for 1/4 sec. cor. falls in Bed of Gila River, which extends nearly throughout this mile, course SW.

70.00 Leave main river bed, enter land subject to overflow, sandy, barren gravel beds.

80.00 On solid gravel bed, no land within 20 chs. suitable to set witness cor., therefore as a cor. at this point will remain undisturbed for years,

Set an iron post 3 ft. long, 2 ins. in diam. 34 ins. in the ground, top left nearly flush with surface, post set in bed of boulders; for cor. of secs. 14, 15, 22 & 23, marked on brass cap, 1914 on S. rim,

- T 4 S R 8 W, in N. half,
- S 15 in NW.,
- S 14 in NE.,
- S 23 in SE., and
- S 22 in SW. quad.; from which,

A mesquite tree 8 ins. diam. brs. S. 12 1/2° W. 80 lks. dist., marked T 4 S R 8 W S 22 B T.

A cottonwood tree 30 ins. diam. brs. N. 59 1/2° W. 223 lks. dist., marked T 4 S R 8 W S 15 B T.

No other trees available. Pits impracticable.

Raise a mound of stone 2 ft. base, 1 1/2 ft. high W. of cor. Land, level.

Soil, 2nd rate, sandy, loose.

Greasewood, arrowweed, few cottonwoods and mesquites.

40.00 S. 89°59' E. on a random line bet. secs. 14 & 23. Set temp, 1/4 sec. cor.

80.00 Intersect N. & S. line 14 lks. N. of cor. of secs. 13, 14, 23 & 24, hereinbefore described, whence I run, N. 89°53' W. on a true line bet. secs. 14 & 23.

Over level land, through dense mesquite.

5.70 Road, brs. N. & S.

22.35 Road, brs. NNW. & SSE.

27.70 Canal, 15 lks. wide, 4 ft. deep, course SW.,

40.00 Set an iron post 3 ft. long, 1 in. in diam. 26 ins. in the ground for 1/4 sec. cor., marked on brass cap, 1/4 S 14 in N., and S 23 in S. half, 1914 on S. rim;

dig pits 18x18x12 ins. E. & W. of cor. 3 ft. dist., and raise a mound of earth 3 1/2 ft. base, 1 1/2 ft. high N. of cor.

42.00 Enter main bed of Gila River, course SW.

71.00 Leave main river bed, thence over gravel bottom, subject to overflow.

80.00 To cor. of secs. 14, 15, 22 & 23.

Land, level.

Soil, 1st & 2nd rate, loamy, sandy.

Greasewood, mesquite, arrowweed, few cottonwoods along river.

- Chains.
- N. $0^{\circ} 1'$ W. bet. secs. 14 & 15.
Over level land, sandy, gravelly, subject to overflow.
- 29.00 N. bank of Gila River, brs. WSW. & ENE., asc. abruptly 15 ft. Thence over fine level land.
- 40.00 Set an iron post 3 ft. long, 1 in. in diam. 26 ins. in the ground for $\frac{1}{4}$ sec. cor., marked on brass cap,
 $\frac{1}{4}$ S 15 in W., and
S 14 in E. half, 1914 on S. rim,
dig pits 18x18x12 ins. N. & S. of cor. 3 ft. dist., and raise a mound of earth $3\frac{1}{2}$ ft. base, $1\frac{1}{2}$ ft. high W. of cor.
- 58.80 Road, Phoenix to Yuma, brs. E. & W.
- 59.00 Wire fence, brs. E. & W., cors. 80 lks. E. to N., enter cleared land about 5 acres, extends 10 chs. E., and 80 lks. E.
- 62.30 Wire fence, brs. E. & W., enter dense mesquite jungle.
- 80.00 Set an iron post 3 ft. long, 2 ins. in diam. 24 ins. in the ground for cor. of secs. 10, 11, 14 & 15, marked on brass cap, 1914 on S. rim,
T 4 S R 8 W, in N. half,
S 10 in NW.,
S 11 in NE.,
S 14 in SE., and
S 15 in SW. quad.; from which,
A mesquite tree 8 ins. diam. brs. N. 34° W. 20 lks. dist., marked T 4 S R 8 W S 10 B T.
A mesquite tree 9 ins. diam. brs. N. $60\frac{1}{2}^{\circ}$ E. 51 lks. dist., marked T 4 S R 8 W S 11 B T.
A mesquite tree 9 ins. diam. brs. S. 29° E. 40 lks. dist., marked T 4 S R 8 W S 14 B T.
A mesquite tree 6 ins. diam. brs. S. 9° W. 30 lks. dist., marked T 4 S R 8 W S 15 B T.
- Land, level. Soil, 1st rate, loamy, sandy.
Arrowweed, greasewood, mesquite, few cottonwoods along river.
-
- S. $89^{\circ} 53'$ E. on a random line bet. secs. 11 & 14.
- 40.00 Set temp. $\frac{1}{4}$ sec. cor.
- 80.02 Intersect N. & S. line 2 lks. S. of cor. of secs. 11, 12, 13 & 14, hereinbefore described, whence $\frac{1}{4}$ run,
- N. $89^{\circ} 54'$ W. on a true line bet. secs. 11 & 14.
Over level land, in old river bottom, through dense arrowweed.
- 5.00 Enter main river bed, course SW.
- 29.00 W. bank of Gila River, brs. SW. & NE., asc. abruptly 10 ft.
- 31.50 Main road, Phoenix to Yuma, brs. NE. & SW., enter dense mesquite jungle.
- 40.01 Set an iron post 3 ft. long, 1 in. in diam. 26 ins. in the ground for $\frac{1}{4}$ sec. cor., marked on brass cap,
 $\frac{1}{4}$ S 11 in N., and
S 14 in S. half, 1914 on S. rim; from which,
A mesquite tree 14 ins. diam. brs. N. 66° W. 27 lks. dist., marked $\frac{1}{4}$ S 11 B T.
A mesquite tree 9 ins. diam. brs. S. 40° W. 156 lks. dist., marked $\frac{1}{4}$ S 14 B T.
- Note: At this cor., at noon, I set off $22^{\circ} 24'$ N. on the decl. arc, and observe the sun on the meridian.
The resulting lat. is $33^{\circ} 05'$ N.
- 45.00 House of L. S. Streit brs. South, 10 chs. dist.,
- 80.02 To cor. of secs. 10, 11, 14 & 15.
Land, level.
Soil, 1st rate, loamy, loose, dry, sandy.
Arrowweed, mesquite.

July 9, 1914.

Partial Subdivision of T. 4 S., R. 8 W.

Chains.

July 10, 1914.
 At 6h a.m., l.m.t., at the cor. of secs. 10, 11, 14 & 15,
 I set off 22°19½' N. on the decl. arc, and 33°05' N. on
 the lat. arc, and determine a meridian with the solar.
 Thence I run,
 N. 0° 1' W. bet. secs. 10 & 11.
 Over gently rolling land, through dense mesquite.
 1.50 Leave dense brush, brs. NE. & W., asc. gently.
 40.00 Set an iron post 3 ft. long, 1 in. in diam. 26 ins. in
 the ground for ¼ sec. cor., marked on brass cap,
 ¼ S 10 in W., and
 S 11 in E. half, 1914 on S. rim,
 dig pits 18x18x12 ins. N. & S. of cor. 3 ft. dist., and
 raise a mound of earth 3½ ft. base, 1½ ft. high W. of cor.
 61.70 New Road, Phoenix to Yuma, brs. SW. & NE.
 80.00 Set an iron post 3 ft. long, 2 ins. in diam. 24 ins. in
 the ground for cor. of secs. 2, 3, 10 & 11, marked on
 brass cap, 1914 on S. rim,
 T 4 S R 8 W, in N. half,
 S 3 in NW.,
 S 2 in NE.,
 S 11 in SE., and
 S 10 in SW. quad.; no trees available.
 Dig pits 18x18x12 ins. in each sec. 5½ ft. dist., and
 raise a mound of earth 4 ft. base 2 ft. high W. of cor.
 Land, level, rolling.
 Soil, 2nd rate, sandy, gravelly, dry, loose.
 Mesquite, greasewood, few cacti.

40.00 S. 89°54' E. on a random line bet. secs. 2 & 11.
 Set temp. ¼ sec. cor.
 80.04 Intersect N. & S. line 9 lks. S. of cor. of secs. 1, 2,
 11 & 12, hereinbefore described, whence I run,
 N. 89°58' W. on a true line bet. secs. 2 & 11.
 Over gently rolling land, drains S., through dense brush.
 14.00 Main road, Phoenix to Yuma, brs. WSW. & ENE.
 20.00 Wash, 20 lks. wide, course S.
 33.00 Small spur, near S. pt., brs. S. & N.,
 40.02 Set an iron post 3 ft. long, 1 in. in diam. 26 ins. in
 the ground for ¼ sec. cor., marked on brass cap,
 ¼ S 2 in N., and S 11 in S. half,
 1914 on S. rim; no trees available.
 Dig pits 18x18x12 ins. E. & W. of cor. 3 ft. dist., and
 raise a mound of earth 3½ ft. base, 1½ ft. high N. of cor.
 41.00 Enter draw broken by many washes, course S.
 66.70 Leave draw.
 80.04 To cor. of secs. 2, 3, 10 & 11.
 Land, rolling. Soil, 2nd rate, loamy, sandy, dry.
 Greasewood, scrub mesquite, few cacti.

40.00 N. 0° 1' W. on a random line bet. secs. 2 & 3.
 Set temp. ¼ sec. cor.
 79.90 Intersect cor. of secs. 2, 3, 34 & 35, on N. bdy. of Tp.,
 estab. by me as described in book "A". Thence I run,
 S. 0° 1' E. on a true line bet. secs. 2 & 3.
 Over rolling land, through scattering brush.
 15.00 Wash, 2 chs. wide, course SE.
 39.90 Set an iron post 3 ft. long, 1 in. in diam. 26 ins. in
 the ground for ¼ sec. cor., marked on brass cap,
 ¼ S 3 in W., and
 S 2 in E. half, 1914 on S. rim; from which,
 A paloverde tree 12 ins. diam. brs. S. 38° E. 120 lks. dist.,
 marked ¼ S 2 B T.
 A catclaw tree 7 ins. diam. brs. S. 2° W. 61 lks. dist.,
 marked ¼ S 3 B T.
 79.90 To cor. of secs. 2, 3, 10 & 11.
 Land, rolling. Soil, 2nd rate, sandy, gravelly.
 Greasewood, scrub mesquite, few cacti.

July 10, 1914.

Chains.

July 7, 1914.

At 8h a.m., l.m.t., at the cor. point of secs. 21, 22, 27 & 28, described by the Surveyor General, as being 40 chs. N. 0° 2' W. of the true pt. for $\frac{1}{4}$ sec. cor. bet. secs. 27 & 28.

I set off 22° 39 $\frac{1}{2}$ ' N. on the decl. arc, and 33° 03' N. on the lat. arc, and determine a meridian with the solar. Thence I run,

N. 0° 2' W. bet. secs. 21 & 22.

Over level land, in river bed, through dense arrowweed.

30.00 Leave river bottom, brs. WSW. & ENE.

40.00 Set an iron post 3 ft. long, 1 in. in diam. 26 ins. in the ground for $\frac{1}{4}$ sec. cor., marked on brass cap,

$\frac{1}{4}$ S 21 in W., and

S 22 in E. half, 1914 on S. rim; from which,

A cottonwood tree 6 ins. diam. brs. N. 74° W. 29 lks. dist., marked $\frac{1}{4}$ S 21 B T.

A cottonwood tree 6 ins. diam. brs. S. 58° E. 6 lks. dist., marked $\frac{1}{4}$ S 22 B T.

61.47 Wire fence, brs. E. & W., enter cleared land, brs. east, about 15 chs., and west, about 5 chs.

68.90 Wire fence, brs. E. & W., leave cleared land.

80.00 Set an iron post 3 ft. long, 2 ins. in diam. 24 ins. in the ground for cor. of secs. 15, 16, 21 & 22, marked on brass cap, 1914 on S. rim,

T 4 S R 8 W, in N. half,

S 16 in NW.,

S 15 in NE.,

S 22 in SE., and

S 21 in SW. quad.;

dig pits 1' x 18' x 12 ins. in each sec. 5 $\frac{1}{2}$ ft. dist., and raise a mound of earth 4 ft. base 2 ft. high W. of cor.

Land, level. Soil, 1st and 2nd rate, sandy, loamy. Arrowweed, mesquite, cottonwood.

July 7, 1914.

July 9, 1914, continued.

S. 89° 58' E. on a random line bet. secs. 15 & 22.

40.00 Set temp. $\frac{1}{4}$ sec. cor.

80.26 Intersect N. & S. line 18 lks. N. of cor. of secs. 14, 15, 22 & 23, herein before described, whence I run, N. 89° 50' W. on a true line bet. secs. 15 & 22.

Over level land, through dense arrowweed, in old river bed, land subject to overflow.

40.13 Set an iron post 3 ft. long, 1 in. in diam. 26 ins. in the ground for $\frac{1}{4}$ sec. cor., marked on brass cap, 1914 on S. rim, $\frac{1}{4}$ S 15 in N., and

S 22 in S. half; from which,

A cottonwood tree 7 ins. diam. brs. N. 83° W. 208 lks. dist., marked $\frac{1}{4}$ S 15 B T.

An elm tree 10 ins. diam. brs. S. 72 $\frac{3}{4}$ ° W. 316 lks. dist., marked $\frac{1}{4}$ S 22 B T.

House of J. W. Utz brs. N. 28° 30' E., 20 chs. dist.

67.67 Road, brs. NNE. & SSW.

80.26 To cor. of secs. 15, 16, 21 & 22.

Land, level.

Soil, 2nd rate, sandy, gravelly, stony.

Arrowweed, few cottonwoods and mesquites.

July 9, 1914.

Partial Subdivision of T. 4 S., R. 8 W.

Chains.

1914

July 7, continued.

N. 0° 2' W. bet. secs. 15 & 16.

Over level land, in old river bed, through dense arrowweed.

6.50 Main N. bank of Gila River, 10 ft. high, brs. WSW. & ENE., enter dense mesquite.

15.15 Main road, Phoenix to Yuma, brs. WSW. & ENE.

31.30 Road, brs. E. & W.

40.00 Set an iron post 3 ft. long, 1 in. in diam. 26 ins. in the ground for 1/4 sec. cor., marked on brass cap, 1/4 S 16 in W., and

S 15 in E. half, 1914 on S. rim; from which,

A mesquite tree 20 ins. diam. brs. N. 4 3/4° E. 295 lks. dist., marked 1/4 S 15 B T.

A mesquite tree 14 ins. diam. brs. S. 6 1/2° W. 96 lks. dist., marked 1/4 S 16 B T.

80.00 Set an iron post 3 ft. long, 2 ins. in diam. 24 ins. in the ground for cor. of secs. 9, 10, 15 & 16, marked on brass cap, 1914 on S. rim,

T 4 S R 8 W, in N. half,

S 9 in NW.,

S 10 in NE.,

S 15 in SE., and

S 16 in SW. quad.; from which,

A paloverde tree 10 ins. diam. brs. N. 1° W. 195 lks. dist., marked T 4 S R 8 W S 9 B T.

A mesquite tree 16 ins. diam. brs. N. 65° E. 250 lks. dist., marked T 4 S R 8 W S 10 B T.

A mesquite tree 6 ins. diam. brs. S. 53 1/2° E. 54 lks. dist., marked T 4 S R 8 W S 15 B T.

A mesquite tree 8 ins. diam. brs. S. 75 1/4° W. 222 lks. dist., marked T 4 S R 8 W S 16 B T.

Land, level.

Soil, 1st rate, sandy, loamy.

Arrowweed, mesquite, cottonwood.

July 7, 1914.

1914

July 9, continued.

S. 89° 50' E. on a random line bet. secs. 10 & 15.

40.00 Set temp. 1/4 sec. cor.

80.24 Intersect N. & S. line 2 lks. S. of cor. of secs.

10, 11, 14 & 15, hereinbefore described, whence I run,

N. 89° 51' W. on a true line bet. secs. 10 & 15.

Over gently rolling land, through dense brush.

40.10 Wash, 70 lks. wide, course S.

40.12 Point for 1/4 sec. cor. falls in wash.

41.05 Set an iron post 3 ft. long, 1 in. in diam. 26 ins. in the ground for witness cor. to 1/4 sec. cor., marked on brass cap, 1914 on S. rim,

W C 1/4 E. of centre,

S 10 in NW., and

S 15 in SW. quad.; from which,

A paloverde tree 36 ins. diam. brs. N. 5 1/4° E. 66 lks. dist., marked 1/4 S 10 W C B T.

A paloverde tree 10 ins. diam. brs. S. 37 1/2° W. 36 lks. dist., marked 1/4 S 15 W C B T.

50.00 House of Jay Frederick brs. South, about 30 chs. dist.

80.24 To cor. of secs. 9, 10, 15 & 16.

Land, rolling, level.

Soil, 2nd rate, sandy, gravelly, dry.

Mesquite, paloverde, greasewood, cacti.

July 9, 1914.

Chains.

- July 7, 1914
 continued.
 N. 0° 2' W. bet. secs. 9 & 10.
 Over rolling land, through scattering brush.
 19.00 New road, Phoenix to Yuma, brs. NE. & SW.
 40.00 Set an iron post 3 ft. long, 1 in. in diam. 26 ins. in
 the ground for $\frac{1}{4}$ sec. cor., marked on brass cap,
 $\frac{1}{4}$ S 9 in W., and
 S 10 in E. half; 1914 on S. rim,
 Dig pits 18x18x12 ins. N. & S. of cor. 3 ft. dist., and
 raise a mound of earth $3\frac{1}{2}$ ft. base, $1\frac{1}{2}$ ft. high W. of cor.
 42.80 Wash, 1 ch. wide, course SE.
 80.00 Set an iron post 3 ft. long, 2 ins. in diam. 24 ins. in
 the ground for cor. of secs. 3, 4, 9 & 10, marked on
 brass cap, 1914 on S. rim,
 T 4 S R 8 W, in N. half,
 S 4 in NW.,
 S 3 in NE.,
 S 10 in SE., and
 S 9 in SW. quad.; Pits impracticable.
 Raise a mound of stone 2 ft. base, $1\frac{1}{2}$ ft. high W. of cor.
 Land, rolling.
 Soil, 2nd rate, sandy, gravelly.
 Greasewood, cacti, scrub mesquite.
 July 7, 1914.
-
- July 10, 1914
 continued.
 S. 89° 51' E. on a random line bet. secs. 3 & 10.
 40.00 Set temp. $\frac{1}{4}$ sec. cor.
 80.24 Intersect cor. of secs. 2, 3, 10 & 11, hereinbefore described,
 whence I run,
 N. 89° 51' W. on a true line bet. secs. 3 & 10.
 Over rolling land, through scattering brush.
 19.20 Wash, 40 lks. wide, course SE.
 40.12 Set an iron post 3 ft. long, 1 in. in diam. 26 ins. in
 the ground for $\frac{1}{4}$ sec. cor., marked on brass cap, 1914 on
 S. rim, $\frac{1}{4}$ S 3 in N., and
 S 10 in S. half, Pits impracticable.
 Raise a mound of stone 2 ft. base, $1\frac{1}{2}$ ft. high N. of cor.
 73.50 Wash, 50 lks. wide, course S.
 80.24 To cor. of secs. 3, 4, 9 & 10.
 Land, rolling. Soil, 1st & 2nd rate, loamy, sandy, gravelly.
 Greasewood, scrub mesquite, cacti.
 July 10, 1914.
-
- July 7, 1914
 concluded.
 N. 0° 2' W. on a random line bet. secs. 3 & 4.
 40.00 Set temp. $\frac{1}{4}$ sec. cor.
 79.71 Intersect N. bdy. of Tp. 16 lks. W. of cor. of secs. 3, 4, 33
 & 34, estab. by me as described in book "A", whence I run,
 S. 0° 5' W. on a true line bet. secs. 3 & 4.
 Over rolling land, through scattering brush.
 39.71 Set an iron post 3 ft. long, 1 in. in diam. 26 ins. in
 the ground for $\frac{1}{4}$ sec. cor., marked on brass cap,
 $\frac{1}{4}$ S 4 in W., and S 3 in E. half, 1914 on S. rim;
 from which,
 A paloverde tree 6 ins. diam. brs. N. 54 $\frac{3}{4}$ ° W. 91 lks. dist.,
 marked $\frac{1}{4}$ S 4 B T.
 A paloverde tree 12 ins. diam. brs. S. 21 $\frac{1}{2}$ ° E. 252 lks. dist.,
 marked $\frac{1}{4}$ S 3 B T.
 72.20 Wash, 1 ch. wide, course ESE.
 79.71 To cor. of secs. 3, 4, 9 & 10.
 Land, rolling. Soil, 2nd rate, gravelly.
 Greasewood, paloverde, scrub mesquite, cacti.
 July 7, 1914.

General Description.

The SE. portion of this Tp. lies on good land S. of the Gila River. The NE. portion lies N. of the river, some good bottom land, very fertile lying on both sides of the river. L.S. Streit, Jay Frederick, and J.W. Utz have located in secs. 14, 15, and 16, and have built houses, wells, cleared and fenced land, and cultivated small tracts on their claims.

Jesse B. Wright

U. S. Surveyor.

Partial Subdivision of Tr. 4 S. Rg. 8 W.

Chains J.F.H. From original cor. of secs. 20, 21, 28 and 29, which is an iron post with brass cap, marked & witnessed as described N. 0° 02' W. bet. secs. 20 and 21. (by the Surv. Gen., I run, Over rolling land, through dense brush.

17.50 Cross wash 20 lks. wide course S. E.

40.00 Set an iron post 3 ft. long, 1 in. diam., 26 ins. in the ground for $\frac{1}{4}$ sec. cor., marked on brass cap $\frac{1}{4}$ S20 in W. S21 in E. and 1914 in S. half; dig pits 18 x 18 x 12 ins. N. and S. of cor. 3 ft. dist; and raise a mound of earth $3\frac{1}{2}$ ft. base $1\frac{1}{2}$ ft. high. W. of cor.

48.75 Cross road bears E. and W.

80.00 Set an iron post 3 ft. long, 2 ins. diam., 24 ins. in the ground for the cor. of secs. 16, 17, 20, and 21, marked on brass cap
 T4SR8W in N. and 1914 in S half;
 S17 in N. W.
 S16 in N. E.
 S21 in S. E. and S20 in S. W. quadrant; dig pits 18 x 18 x 12 ins. in each sec. $5\frac{1}{2}$ ft. dist; and raise a mound of earth 4 ft. base 2 ft. high, W. of cor.
 Land, rolling.
 Soil, sandy, gravelly, small rocks, 3rd rate.
 No timber.
 Undergrowth, paloverde, greasewood, mesquite, and cactus.

40.00 N. 89° 59' E. on a random line bet. secs. 16 and 21.
 Set temp. $\frac{1}{4}$ sec. cor.

80.26 Intersect N. and S. line 26 lks. N. of the cor. of secs. 15, 16, 21 and 22, estab. by J.B.W. as hereinbefore described Thence I run

12.00 N. 89° 50' W. on a true line bet. secs. 16 and 21.
 Over leveling land, through dense brush.
 Leave level bottom land, bears NE and SW rate.

34.35 Cross Yuma, Phoenix road bears N. E. and S. W.

40.00 Rolling land, 3rd rate soil.

40.13 Set an iron post 3 ft. long, 1 in. diam., 26 ins. in the ground for $\frac{1}{4}$ sec. cor., marked on brass cap, $\frac{1}{4}$ S16 in N. and S21 1914 in S. half; and raise a mound of stone 2 ft. base $1\frac{1}{2}$ ft. high, N. of cor. Pits impracticable.

52.00 Cross road bears N. E. and S. W.

80.26 The cor. of secs. 16, 17, 20, and 21.
 Land, level and rolling.
 Soil, 1st and 3rd rate. Sandy and gravelly.
 No timber.
 Undergrowth, paloverde, mesquite, and greasewood.
 July, 7, 1914.

1914
 July, 8th At 7^h a.m. l.m.t., I set off 33° 04' N. on the lat. arc; 32° 33 $\frac{1}{2}$ ' N. on the decl. arc; and determine a meridian with the solar at the cor. of secs. 16, 17, 20, and 21.
 Thence I run

N. 0° 02' W. bet. secs. 16, and 17:
 Over rolling land, through dense brush.

40.00 Set an iron post 3 ft. long, 1 in. diam., 26 ins. in the ground for $\frac{1}{4}$ sec. cor., marked on brass cap $\frac{1}{4}$ S17 in W. S16 in E. and 1914 in S. half; from which
 A Paloverde 6 ins. diam., bears N. 15° W. 160 lks. dist., marked $\frac{1}{4}$ S17BT.
 A Paloverde, 8 ins. diam., bears S. 55° E. 95 lks. dist., marked $\frac{1}{4}$ S16BT.

74.60 Cross wash 10 lks. wide course S. E.

80.00 Set an iron post 3 ft. long 2 ins. diam., 24 ins. in the ground for the cor. of secs. 8, 9, 16, and 17., marked on brass cap
 T4SR8W in N. and 1914 in S. half;
 S8 in N. W.

Partial Subdivision of T_p.4 S. R_g.8 W.

Chain

S9 in N. E.
 S16 in S. E. and
 S17 in S. W. quadrant; from which
 A Paloverde 6 ins. diam., bears N.70°W. 210 lks.
 dist., marked T4SR8WS8BT.
 A Paloverde 8 ins. diam., bears N.6¼°E. 348 lks.
 dist., marked T4SR8WS9BT.
 A Paloverde 8 ins. diam., bears S.77¼°E. 136 lks.
 dist., marked T4SR8WS16BT.
 A Paloverde 8 ins. diam., bears S.27¼°W. 131 lks.
 dist., marked T4SR8WS17BT.

Land, rolling.

Soil, sandy, gravelly, rocky 3rd rate.

No timber.

Undergrowth, greasewood, paloverde, and mesquite.

40.00 S.89°50'E. on a random line bet. secs.9 and 16.
 Set temp. ¼ sec. cor.
 80.36 Intersect N. and S. line 2 lks. N. of the cor. of secs.
 9, 10, 15, and 16, estab. by J.B.W. as hereinbefore described
 Thence I run
 N.89°49'W. on a true line bet. secs. 9 and 16.
 Over rolling land, through dense brush.
 21.00 Cross road bears N. E. and S. W.
 40.18 Set an iron post 3 ft. long, 1 in. diam., 26 ins. in the
 ground for ¼ sec. cor., marked on brass cap ¼S9 in N.
 S16 1914 in S. half; from which
 A Paloverde 10 ins. diam., bears N.38½°E. 93 lks.
 dist., marked ¼S9BT.
 A Paloverde 12 ins. diam., bears S.50¼°E. 260 lks.
 dist., marked, ¼S16BT.
 80.36 The cor. of secs. 8, 9, 16, and 17.
 Land, rolling.
 Soil, sandy gravelly, rocky 3rd rate.
 No timber.
 Undergrowth, paloverde, ironwood, and greasewood.

40.00 N.0°02'W. bet. secs, 8 and 9.
 Over rolling land, through dense brush.
 Set an iron post 3 ft. long, 1 in. diam. 26 ins. in the
 ground for ¼ sec. cor., marked on brass cap, ¼S8 in W.
 S9 in E. and 1914 in S. half; from which
 A Paloverde 12 ins. diam. bears N.22½°W. 144 lks.
 dist., marked ¼S8BT.
 A Paloverde 14 ins. diam., bears N.53½°E. 240 lks.
 dist., marked ¼S9BT.
 41.80 Cross wash 20 lks. wide course S. E.
 80.00 Set an iron post 3 ft. long, 2 ins. diam., 24 ins. in the
 ground for the cor. of secs.4, 5, 8, and 9. marked on
 brass cap
 T4SR8W in N. and
 1914 in S. half;
 S5 in N. W.
 S4 in N. E.
 S9 in S. E. and
 S8 in S. W. quadrant; from which
 A Paloverde 8 ins. diam., bears S53½°W. 204 lks.
 dist., marked T4SR8WS8BT. No other bearings
 available; raise a mound of stone 3 ft. base 1½ ft. high
 W. of cor. Pits impracticable.
 Land, rolling.
 Soil, sandy, gravelly, rocky, 3rd rate.
 No timber.
 Undergrowth, paloverde, greasewood, and mesquite.

Note: July, 8: At this cor. I set off 22°31½'N. on the decl.
 arc and observe the sun on the meridian at noon; the
 resulting lat. is 33°06'N.

Partial Subdivision of T_p.4 S. R_g. 8 W.

Chains	
	S. 89°49'E. on a random line bet. secs 4 and 9.
40.00	Set temp. $\frac{1}{4}$ sec. cor.
80.26	Intersect N. and S. line 9 lks. S. of the cor. of secs. 3, 4, 9, and 10., estab. by J.B.W. as hereinbefore described, Thence I run.
	N. 89°53' W. on a true line bet. secs. 4 and 9.
	Over rolling land, through dense brush.
26.25	Cross wash 15 lks. wide course S. E.
40.13	Set an iron post 3 ft. long, 1 in. diam., 26 ins. in the ground for $\frac{1}{4}$ sec. cor., marked on brass cap $\frac{1}{4}$ S4 in N. and S ₁₉₁₄ in S. half; dig pits 18 x 18 x 12 ins. E. and W. of post 3 ft. dist., and raise a mound of earth $3\frac{1}{2}$ ft. base $1\frac{1}{2}$ ft. high N. of cor.
65.20	Cross wash 15 lks. wide course S. E.
73.25	Cross wash 15 lks. wide course S. E.
80.26	The cor. of secs. 4, 5, 8, and 9. Land, rolling. Soil, sandy, gravelly, rocky 3rd rate. No timber. Undergrowth, paloverde, greasewood, and ironwood.

	N. 0°02' W. on a random line bet. secs. 4 and 5.
40.00	Set temp. $\frac{1}{4}$ sec. cor.
79.54	Intersect N. bdy. of Tp. 35 lks. W. of the cor. of secs. 4, 5, 32, and 33., estab. by J.B.W. as described in book "A" Thence I run
	S. 0°13' W. on a true line bet. secs. 4 and 5.
	Over rolling land, through dense brush.
26.75	Cross wash 125 lks. wide course S. E.
39.54	Set an iron post 3 ft. long, 1 in. diam., 26 ins. in the ground for $\frac{1}{4}$ sec. cor. marked on brass cap $\frac{1}{4}$ S5 in W. S4 in E. and 1914 in S. half; dig pits 18 x 18 x 12 ins. N. and S. of post 3 ft. dist., and raise a mound of earth $3\frac{1}{2}$ ft. base $1\frac{1}{2}$ ft. high W. of cor.
70.55	Cross wash 15 lks wide course S. E.
79.54	The cor. of secs. 4, 5, 8, and 9. Land, rolling. Soil, sandy, gravelly, rocky, 3rd rate. No timber. Undergrowth, paloverde, greasewood, and ironwood. July, 8, 1914.

	1914 July, 7; At 7h a.m. l.m.t., I set off 33°02 $\frac{1}{2}$ ' N. on the lat. arc; 22°40' N. on the decl. arc; and determine a meridian with the solar at the orig. cor. of secs. 29, 30, 31 and 32, an iron post with brass cap, mkd & witnessed as described by the Surv. N0°03' W. bet. secs. 29 and 30. (Gen., Thence I run, Over rolling hills, through dense brush. ascend.
5.20	Top of ridge bears N. W. and S. E. descend.
27.00	Cross wash 20 lks. wide course E. Bottom of descent.
40.00	Set an iron post 3 ft. long, 1 in. diam., 26 ins. in the ground for the $\frac{1}{4}$ sec. cor., marked on brass cap $\frac{1}{4}$ S30 in W. S29 in E. and 1914 in S. half; and raise a mound of stone 2 ft. base $1\frac{1}{2}$ ft. high W. of cor. Pits impracticable.
80.00	Set an iron post 3 ft. long, 2 ins. diam., 24 ins. in the ground for the cor. of secs. of 19, 20, 29, and 30. marked on brass cap T4SR8W in N. and 1914 in S. half; S19 in N. W. S20 in N. E. S29 in S. E. and S30 in S. W. quadrant; from which A Paloverde 8 ins diam. bears N. 36° W. 201 lks. dist., marked T4SR8WS19BT. No other bearings available; Raise a mound of stone 2 ft. base $1\frac{1}{2}$ ft. high W. of post. Pits impracticable.

Partial Subdivision of Tp.48 Rg.8 W.

chains.

Land, rolling hills.
Soil, Rocky, 4th rate.
No timber.
Undergrowth, paloverde, greasewood and cactus.

40.00 S. 80°59'E. on a random line bet. secs. 20 and 29.
Set temp. & sec. cor. orig.
80.48 Intersect N. and S. line at the cor. of secs. 20, 21, 28,
and 29, which is an iron post, marked & witnessed as
described by the Surveyor general, Thence I run,
N. 89°59'W on a true line bet. secs 20 and 29.
Over rolling land, through dense brush.
29.95 Cross road bears N.W. and S. E.
36.28 Cross wash 15 lks. wide course S.
40.24 Set an iron post 3 ft. long, 1 in. diam., 26 ins. in the
ground for $\frac{1}{4}$ sec. cor., marked on brass cap $\frac{1}{4}$ S20 in N.
and S29 1914 in S. half; and raise a mound of stone 2 ft.
base $\frac{1}{2}$ ft. high on N. of cor. Pits impracticable.
63.98 Cross wash 100 lks. wide course S.
75.48 Soil 3rd rate.
80.48 The cor. of secs. 19, 20, 29, and 30.
Land, rolling.
Soil, sandy and small rocks, 3rd and 4th rate.
No timber.
Undergrowth, paloverde, and greasewood.

West, on a true line, bet. secs. 19 and 30.
Over rolling land, through dense brush.
40.00 Set an iron post 3 ft. long, 1 in. diam. 26 ins. in the
ground for $\frac{1}{4}$ sec. cor., marked on brass cap $\frac{1}{4}$ S19 in N.
S30 1914 in S. half; and raise a mound of stone 2 ft. base
 $\frac{1}{2}$ ft. high on N. of cor. Pits impracticable.
50.00 Ascend steep S. E. slope of ridge.
80.00 Top of main ridge bears N. and S. Steep descent to cor.
83.69 Intersect W. hdy. of the Tp. 23.91 lks. S. of the cor.
of secs. 124 and 25, T. 4 S., R. 9 W., estab. by me as described in book "B"
At point of intersection, I set an iron post 3 ft. long
2 ins. diam., 24 ins. in the ground for closing cor. of
secs. 19 and 30., marked on brass cap,
CC E. of center.
T48 in N. and
1914 in S half;
S24 in N.W.
S19 in N. E.
S30 R8W in S. E. and
S25 R9W in S.W. quadrant; raise a mound of stone
2 ft. base $\frac{1}{2}$ ft. high, E. of cor. Pits impracticable.
Land, rolling to 50 chs. thence mountainous.
Soil, rocky 4th rate.
No timber.

Note: Undergrowth, Baloverde, greasewood, and ocatilla.
July, 7: At this cor., I set off 22°38' N. on the decl.
arc; and observe the sun on the meridian at noon; the
resulting lat. is 33°03' N.

July, 7, 1914.

1914
July, 9 At this cor., I set off 33°03' N on the lat.
arc; 23°27' N. on the decl. arc; and determine a meridian
with the solar at the cor. of secs. 19, 20, 29, and 30.
Thence I run
N0°02'W. bet. secs. 19 and 30.
Over rolling land through dense brush.
27.50 Leave rolling land 4th rate soil for level 1st rate.

Partial Subdivision of Tp. 4 S., R. 8 W.

Chains	
40.00	Set an iron post 3 ft. long, 1 in. diam., 26 ins. in the ground for $\frac{1}{4}$ sec. cor., marked on brass cap $\frac{1}{4}$ S19, in W. S20 in E. and 1914 in S. half; dig pits 18 x 18 x 12 ins. N. and S. of cor. 3 ft. dist., and raise a mound of earth $3\frac{1}{2}$ ft. base $1\frac{1}{2}$ ft. high W. of cor.
80.00	Set an iron post 3 ft. long, 2 ins. diam., 34 ins. in the ground for the cor. of secs. 17, 18, 19, and 20, marked on brass cap T4SR8W in N. and 1914 in S. half S18 in N.W. S17 in N.E. S20 in S. E. and S19 in S. W. quadrant; from which A Paloverde 8 ins. diam., bears N. $72\frac{3}{4}^{\circ}$ W. 5275 lks. dist., marked T4SR8WS18BT. An Ironwood 7 ins. diam., bears N. $48\frac{1}{2}^{\circ}$ E. 187 lks. dist., marked T4SR8WS17BT. A Paloverde 8 ins. diam., bears S. $72\frac{1}{4}^{\circ}$ E. 178 lks. dist., marked T4SR8WS20BT. An Ironwood 8 ins. in diam., bears S. $14\frac{1}{4}^{\circ}$ W. 120 lks. dist., marked T4SR8WS19BT. Land, level and rolling. Soil, sandy and rocky 1st and 4th rate. No timber. Undergrowth, paloverde, ironwood and greasewood.
40.00	✓ S. $89^{\circ}59'$ E. on a random line bet, secs. 17 and 20. Set temp. $\frac{1}{4}$ sec. cor.
80.38	Intersect N. and S. line 5 lks. N. of the cor. of secs. 16, 17, 20, and 21. Thence I run
35.17	✓ N. $89^{\circ}57'$ W. on a true line bet. secs. 17 and 20. Over folling land, through dense brush.
40.19	Cross road bears N. and S. Set an iron post 3 ft. long, 1 in. diam., 26 ins. in the ground for $\frac{1}{4}$ sec. cor., marked on brass cap $\frac{1}{4}$ S17 in N. and S20 1914 in S. half; from which A Paloverde 5 ins. diam., bears N. $69\frac{1}{2}^{\circ}$ W. 12 lks. dist., marked $\frac{1}{4}$ S17 BT. No other bearings available; dig pits 18 x 18 x 12 ins. E. and W. of cor. 3 ft. dist., and raise a mound of earth, $3\frac{1}{2}$ ft. base $1\frac{1}{2}$ ft high N. of cor.
48.00	Soil 1st rate.
59.60	Cross road bears N.W. and S.E.
71.60	Cross wash 160 lks. wide course S. E.
80.38	The cor. of secs. 17, 18, 19, and 20. Land, folling. Soil, sandy, gravelly with few small rocks 1st and 3rd rate. No timber. Undergrowth, paloverde, ironwood, and greasewood.
35.76	West on a true line, bet. secs. 18 and 19. Over level land, through dense brush. Cross wash 20 lks. wide course N.E. mountainous. Ascend S. E. slope of ridge.
40.00	Set an iron post 3 ft. long, 1 in. diam., 26 ins. in the ground for $\frac{1}{4}$ sec. cor., marked on brass cap $\frac{1}{4}$ S18 in N. and S19 1914 in S. half; and raise a mound of stone 2 ft. base $1\frac{1}{2}$ ft. high, N. of cor. Pits impracticable.
66.26	Top of ridge bears N.E. and S.W. descend.
71.76	Cross wash 20 lks. wide course N. E.
83.56	Intersect W. bdy. of Tp. 23.90 chs. S. of the cor. of secs. 13 and 24, T. 4 S., R. 9 W., estab. by me as described in book "B"

Partial Subdivision of Tp. 48g. R. 8 W.

Chains.

At the point of intersection, I set an iron post, 3 ft. long 2 ins. diam., 24 ins. in the ground for closing cor. of secs. 18 and 19., marked on brass cap,

CC E, of center,

T4S in N. and

1914 in S. half;

S13 in N. W.

S18 in N. E.

S19 R8W in S. E.

S24 R9W in S. W. quadrant; and raise a mound of

stone 2 ft. base $1\frac{1}{2}$ ft. high, E. of cor. Pits impracticable.

Land, level and mountainous.

Soil, 1st and 4th rate.

No timber.

Undergrowth, paloverde, greasewood, and ironwood.

N0°03'W. bet. secs. 17 and 18.

Over rolling land, through dense brush.

3.80

Cross wash 60 lks. wide course S. E.

40.00

Set an iron post 3 ft. long 1 in., diam., 26 ins. in the ground for $\frac{1}{4}$ sec. cor., marked on brass cap $\frac{1}{4}$ S18 in W.

S17 in E. and 1914 in S. half; from which

A Paloverde 9 in. diam. bears S. 24 $\frac{1}{4}$ °E. 43 lks.

dist., marked $\frac{1}{4}$ S17BT. No other bearings available.

Dig pits 18 x 18 x 12 ins. N. and S. of cor 3 ft. dist.

and raise a mound of earth $3\frac{1}{2}$ ft. base $1\frac{1}{2}$ ft. high,

W. of cor.

60.80

Cross road, bears N. W. and S. E.

80.00

Set an iron post 3 ft. long 2 ins. diam., 24 ins. in the ground for the cor. of secs. 7, 8, 17, and 18. marked on brass cap

T4SR8W in N. and

1914 in S. half;

S7 in N. W.

S8 in N. E.

S17 in S. E. and

S18 in S. W. quadrant; from which

A Paloverde 8 ins. diam., bears N. 73 $\frac{1}{2}$ °W. 175 lks.

dist., marked T4SR8WS7BT.

A Paloverde 6 in. diam., bears N. 43 $\frac{1}{4}$ °E. 530 lks.

dist., marked T4SR8WS8BT.

A Paloverde 6 in. diam., bears S. 3 $\frac{1}{2}$ °E. 72 lks.

dist., marked T4SR8WS17BT.

A Paloverde 5 in. diam., bears S. 39 $\frac{1}{4}$ °W. 167 lks.

dist., marked T4SR8WS18BT.

Land, rolling.

Soil, sandy, gravelly 2nd rate.

No timber.

Undergrowth, paloverde, greasewood, and mesquite.

Note: July, 9: At this cor. I set off 22°24 $\frac{1}{2}$ 'N. on the decl arc; and observe the sun on the meridian at noon; the resulting lat. is 33°05'N.

S. 89°57'E. on a random line bet. secs. 8 and 17.

40.00

Set temp. $\frac{1}{4}$ sec. cor,

80.35

Intersect N. and S. line 5 lks. N. of the cor. of secs. 8, 9, 16, and 17.

Thence I run

N. 89°55'W. on a true line bet. secs. 8 and 17.

Over rolling land, through dense brush.

2.85

Cross wash 15 lks. wide course S. E.

40.175

Set an iron post 3 ft. long, 1 in. diam., 26 ins. in the ground for $\frac{1}{4}$ sec. cor., marked on brass cap $\frac{1}{4}$ S8 in N.

and S17 1914 in S. half; and raise a mound of stone 2 ft.

Chains	
80x35	<p>base $1\frac{1}{2}$ ft. high, N. of cor. Pits impracticable. The cor. of secs. 7, 8, 17 and 18. Land, rolling. Soil, sandy gravelly, rocky, 3rd rate. No timber. Undergrowth, greasewood, paloverde, and ironwood.</p>
6.40	West, on a true line, bet. secs. 7 and 18.
22.80	Over rolling land, through dense brush.
40.00	Cross old road, b _{rs} . N. and S.
	Cross wash 25 lks. wide course S. W.
	Set an iron post 3 ft. long, 1 in. diam., 26 ins. in the ground for $\frac{1}{4}$ sec. cor. marked on brass cap $\frac{1}{4}$ S7 in N. and S18 1914 in S. half; from which
	A Paloverde 7 in. diam., bears N. $16\frac{1}{2}^{\circ}$ E. 59 lks. dist., marked $\frac{1}{4}$ S7BT.
	A Paloverde 7 in diam., bears S. $44\frac{1}{4}^{\circ}$ W. 7 lks. dist., marked $\frac{1}{4}$ S18BT.
83.45	Intersect W. bdy. of T _p .23.97 chs. S. of the cor. of secs. 12 & 13, T.4 S., R.9 W., estab. by me as described in book "B" At the point of intersection I set an iron post 3 ft. long 2 ins. diam., 24 ins. in the ground for closing cor. of secs. 7 and 18., marked on brass cap
	CC E. of center,
	T48 in N. and
	1914 in S half;
	S12 in N.W.
	S7 in N. E.
	S18 R8W in S. E. and
	S15 R9W in S. W. quadrant; and raise a mound
	of stone, 2 ft. base, $1\frac{1}{2}$ ft. high, E. of cor. Pits impracticable.
	Land, rolling.
	Soil, sandy gravelly, 2nd rate.
	No timber.
	Undergrowth, paloverde, greasewood, ironwood and mesquite.
	July, 9, 1914.
	1914
	July, 10: At 7h a.m., l.m.t. I set off $33^{\circ}05'$ N. on the lat. arc; $22^{\circ}20'$ N. on the decl. arc; and determine a meridian with the solar at the cor. of secs. 7, 8, 17 and 17.
	Thence I run
	N. $0^{\circ}03'$ W. bet. secs. 7 and 8.
	Over rolling land, through dense brush.
40.00	Set an iron post 3 ft. long, 1 in. diam., 26 ins. in the ground for $\frac{1}{4}$ sec. cor. marked on brass cap $\frac{1}{4}$ S7 in W.
	S8 in E. and 1914 in S. half; and raise a mound of stone
	2 ft. base $1\frac{1}{2}$ ft. high, W. of cor., pits impracticable.
40.80	Cross road bears N. W. and S. E.
80.00	Set an iron post, 3 ft. long, 2 ins. diam., 24 ins. in the ground for the cor. of secs. 5, 6, 7, and 8. marked on brass cap,
	T4SR8W in N. and
	1914 in S. half;
	S6 in N. W.
	S5 in N. E.
	S8 in S. E. and
	S7 in S. W. quadrant; from which
	A Mesquite 4 in diam., bears N. 58° W. 184 lks. dist., marked T4SR8WS6BT.
	A Paloverde 6 in. diam., bears N. $80\frac{1}{4}^{\circ}$ E. 26 lks/ dist., marked T4SR8WS5BT.
	A Paloverde 10 in. diam., bears S. 18° E. 202 lks. dist., marked T4SR8WS6BT.
	A Paloverde 7 in. diam., bears S 43° W/ 180 lks. dist., marked T4SR8WS7BT.

Partial Subdivision of Tr. 4 S. Rg. 8 W.

Chains	
	Land, rolling. Soil, sandy, gravelly, with few small rocks 2nd rate. No timber. Undergrowth, paloverde, greasewood, mesquite, and ironwood.
40.00	S. 89° 55' E. on a random line bet. secs. 5 and 8. Set temp. $\frac{1}{4}$ sec. cor.
80.30	Intersect N. and S. line 25 lks. S. of the cor. of secs. 4, 5, 8, and 9. Thence I run
29.85	S. 89° 54' W. on a true line bet. secs. 5 and 8. Over rolling land, through dense brush.
40.15	Cross wash 20 lks. wide course S. E. Set an iron post 3 ft. long, 1 in. diam., 26 ins. in the ground for $\frac{1}{4}$ sec. cor. marked on brass cap $\frac{1}{4}$ S5 in N. and S8 1914 in S. half; and raise a mound of stone 3 ft. base $\frac{1}{2}$ ft. high, N. of cor. Pits impracticable.
63.80	Cross wash 20 lks wide course S.
80.30	The cor of secs. 5, 6, 7, and 8. Land, rolling. Soil, sandy rocky, 4th rate. No timber. Undergrowth, paloverde, greasewood, and ironwood.
22.55	West on a true line, bet. secs. 6 & 7 Over rolling land, through dense brush.
40.00	Cross road bears N. and S. Set an iron post 3 ft. long, 1 in. diam., 26 ins. in the ground for $\frac{1}{4}$ sec. cor., marked on brass cap $\frac{1}{4}$ S6 in N. and S7 1914 in S. half; from which A Paloverde 7 ins. diam., bears N. 56 $\frac{1}{2}$ ° W. 88 lks. dist., marked $\frac{1}{4}$ S6B. No other bearings available. Dig pits 18 x 18 x 12 ins. E. and W. of post. 3 ft. dist. and raise a mound of earth 3 $\frac{1}{2}$ ft. base $\frac{1}{2}$ ft. high, N. of cor.
41.80	Cross wash, 30 lks. wide, course S.
83.50	Intersect W. bdy. of Tp. 23.99 chs. S. of the cor. of secs. 1 & 12, T. 4 S., R. 9 W., estab. by me as described in book "B". At the point of intersection set an iron post 3 ft. long, 3 ins. diam., 24 ins. in the ground for the closing cor. of sec. 6 and 7. marked on brass cap CC E. of center, T48 in N. and 1914 in S. half; S1 in N. W. S6 in N. E. S7 188W in S. E. S12 89W in S. W. quadrant; and raise a mound of stone 3 ft. base $\frac{1}{2}$ ft. high, E. of cor. Pits impracticable. Land rolling. Soil, sandy, rocky, gravelly 3rd rate. No timber. Undergrowth, paloverde, greasewood and mesquite.

W. 1/4 Sec. 6

Partial Subdivision of Tp. 4 S. Rg. 8 W.

Chains

40.00 NO°03'W. on a random line bet, secs. 5 and 6.
 Set temp. $\frac{1}{4}$ sec. cor.
 79.51 Intersect N. bdy. of Tp. 49 lks. W. of cor. of secs. 5,
 6, 71 and 72., estab. by J.B.W. as described in book "A"
 Thence I run
 S. 0°18'W. on a true line bet. secs. 5 and 6.
 Over rolling land, through dense brush.
 25.00 Cross wash 10 lks. wide course S. E.
 39.51 Set an iron post 3 ft. long, 1 in. diam., 26 ins. in the
 ground for $\frac{1}{4}$ sec. cor., marked on brass cap $\frac{1}{8}$ 6 in W.
 85 in E, and 1914 in S. half; dig pits 18 x 18 x 12 ins.
 N. and S. of cor. 3 ft. dist; and raise a mound of earth
 3 $\frac{1}{2}$ ft. base 1 $\frac{1}{2}$ ft. high W. of cor.
 79.51 The cor. of secs. 5, 6, 7, and 8.
 Land, rolling.
 Soil, Rocky 4 th rate.
 No timber.
 Undergrowth, paloverde, ironwood, mesquite, and greasewood.
 Note: July, 10: At this cor. I set off $\sqrt{22^{\circ}17\frac{1}{2}'N}$. on the decl.
 arc; and observe the sun on the meridian at noon; the
 resulting lat. is $23^{\circ}06'N$.
 July, 10, 1914.

GENERAL DESCRIPTION.

This township is level in the south and rolling in the north. The soil of the secs. lying along the Gila River is a rich sandy loam, very fertile. The Gila River runs through the township from N. E. to S. W. but carries no water except in the wet season. There is no timber in the township except a few cottonwoods along the river. There are no settlers in the western part of the township.

John P. Kesse
 U. S. Surveyor.

FOR FINAL OATH OF UNITED STATES SURVEYOR.
See Book "E"

I, _____, U. S. Surveyor, do solemnly swear that, in pursuance of special instructions received from the U. S. Surveyor General for _____ bearing date of the _____ day of _____, 191____, I have well, faithfully, and truly, in my own proper person, and in strict conformity with said instructions, the Manual of Surveying Instructions, and the laws of the United States, surveyed all those parts or portions of _____ of the _____ Meridian, in the State of _____, which are represented in the foregoing field notes as having been executed by me, and under my direction; and I do further solemnly swear that all the corners of said survey have been established and perpetuated in strict accordance with the Manual of Surveying Instructions, and the special written instructions of the U. S. Surveyor General for _____ and in the specific manner described in the field notes, and that the foregoing are the original field notes of such survey.

U. S. Surveyor.

Subscribed by said _____, and sworn to before me }
this _____ day of _____, 191____



APPROVAL.

OFFICE OF THE UNITED STATES SURVEYOR GENERAL,

Phoenix Ariz. Aug 27, 1915

The foregoing field notes of the survey of *Part of the*

*Subdivision lines of
Township 4 South - Range 8 West
of the Gila & Salt River Base & Meridian
in the State of Arizona*

executed by *Jesse B. Wright and John F. Hesse, U.S. Surveyors*
under ~~the~~ ^{their} special instructions dated *Feb. 10, 1914 for Group 32*, ~~the~~, having been critically examined, and the necessary corrections and explanations made, the said field notes, and the surveys they describe, are hereby approved.

Frank S. Ingalls
U. S. Surveyor General.
OF ARIZONA.

I certify that the foregoing transcript of the field notes of the above-described surveys in _____, has been correctly copied from the original notes on file in this office.

U. S. Surveyor General.