

Book "A"  
(Exteriors)

## FIELD NOTES

OF THE SURVEY OF

Part of the South bdy. of Township 15 North, Range 5 West

Part of the East bdy. of Township 14 North, Range 6 West

Part of the East bdy. of Township 13 North, Range 7 West

———— West bdy. of Township 13 North, Range 7 West

Part of the South bdy. of Township 14 North, Range 7 West

———— West bdy. of Township 14 North, Range 7 West

Part of the East bdy. of Township 14 North, Range 7 West

———— North bdy. of Township 14 North, Range 7 West

———— East bdy. of Township 15 North, Range 7 West

East and West bdrs. of Fractional Tp. 14½ North, Range 7 West

Part of the South bdy. of Township 15 North, Range 6 West

Part of the North bdy. of Township 14 North, Range 6 West

———— South bdy. of Township 15 North, Range 7 West

Of the Gila and Salt River Base and Meridian,

In the State of ARIZONA

EXECUTED BY

JOHN F. HESSE

In the capacity of U. S. Surveyor, under instructions dated September 26, 1914,

issued by the United States Surveyor General to govern surveys included in

Group No. 37, which were approved by the Commissioner of the General Land

Office, October 3, 1914

Survey commenced January 19, 1915

Survey completed July 9, 1915

Book "A"

# INDEX DIAGRAM.

*See Special Index.*

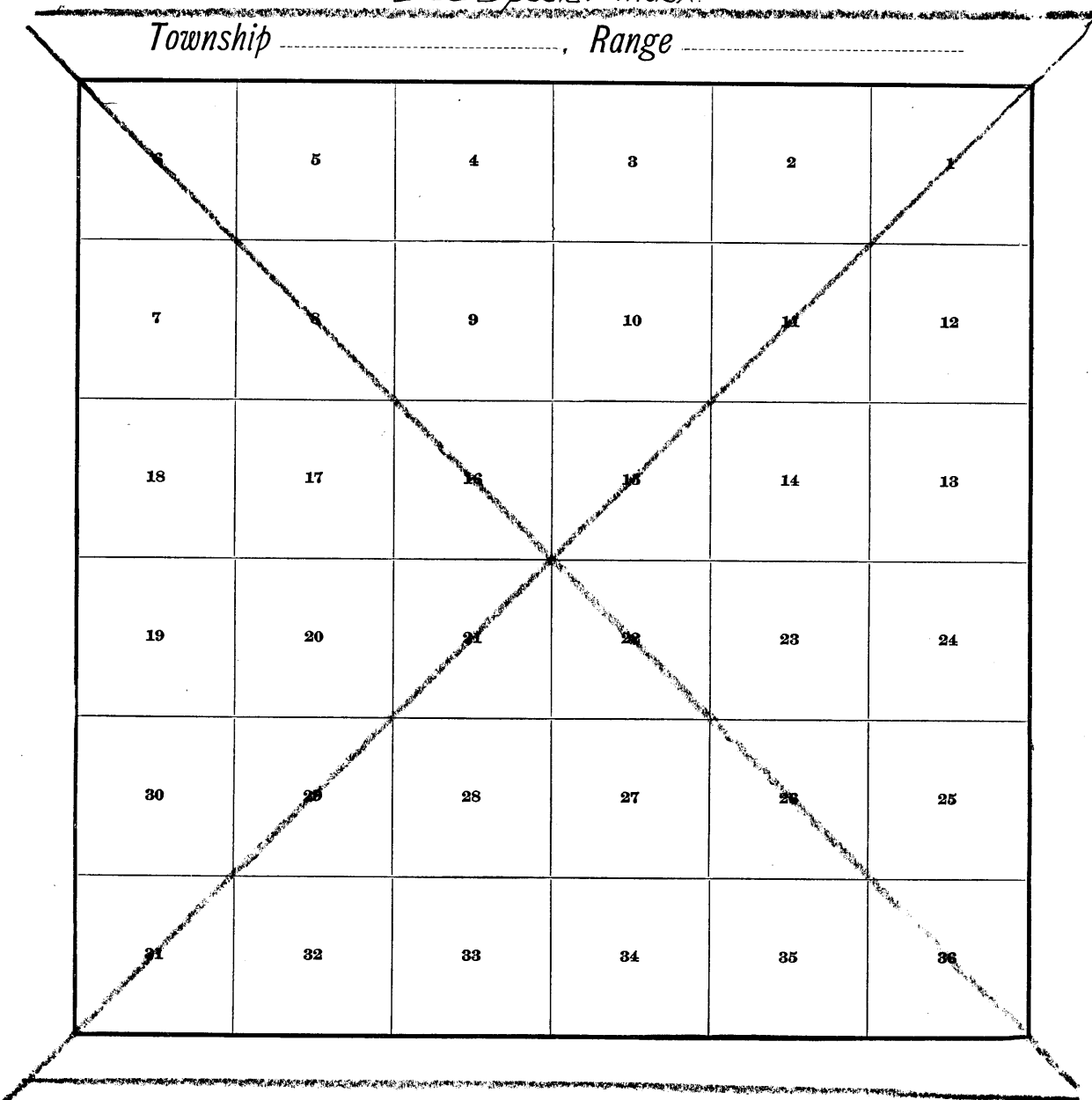

# Book "A"

~ (Exteriors) ~

## Group 37

### • INDEX ~ DIAGRAM •

BOOK 2864

- Notes in this book (indexed)
- Retracements & Resurveys ~ this Group.
- - - - Subdivisional surveys ~ this group.
- Accepted surveys.
- - - - Unsurveyed Township Boundaries.

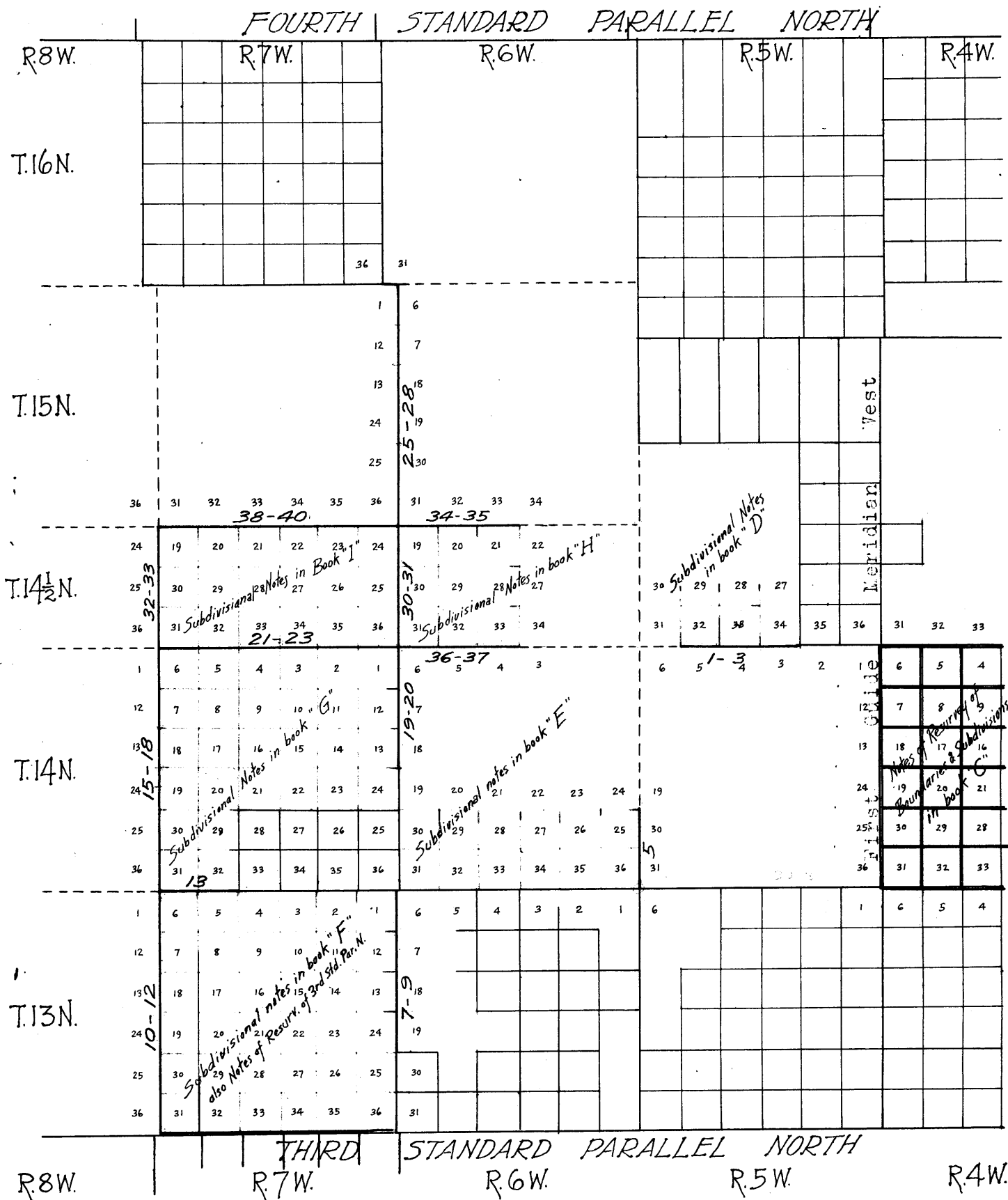

Subdivisional Notes in Book "I" 28 Notes 27 26 25 24

Subdivisional Notes in Book "H" 28 Notes 27 26 25 24

Subdivisional Notes in Book "D" 30 29 28 27

Subdivisional Notes in Book "E" 19-20 21 22 23 24

Subdivisional Notes in Book "G" 16 15 14 13

Subdivisional Notes in Book "F" also Notes of Resurv. of 3rd Std. Par. N. 15 16 17 18 19 20 21 22 23 24

Notes of Retracements & Subdivisions in Book "C" 18 17 16 15 14 13 12 11 10 9 8 7 6 5 4

## Fractional South boundary of Tp. 15 N. Rg. 5 W. 1A

Chains.

Survey commenced January 19, 1915, and executed with an A lietz light mountain transit, No. 6166, with solar attachment. The horizontal limb is provided with two double verniers placed opposite to each other, reading to single minutes of arc, which is also the least count of the verniers of the latitude and declination arcs; The instrument was approved by the Assistant Supervisor of Surveys for Arizona and California, conditional upon satisfactory field tests, September 28, 1914.

I examine the adjustments of the transit, and find them correct, then, to test the solar apparatus, by comparing its indications, resulting from solar observations made during a.m. and p.m. hours, with a meridian determined by observations on Polaris, I proceed as follows:

At my camp, which is located near the center of sec. 33 Tp. 15 N. Rg. 5 W.; latitude  $34^{\circ} 35' 42''$  N.; longitude  $112^{\circ} 47' 20''$  W.; At 11h.33M. p.m. by my watch which has correct l.m.t., I observe Polaris at western elongation in accordance with Manual of Instructions, and mark a point in the line thus determined, on a peg driven in the ground 5 chs. N. of my station.

January 19, 1915.

January 20, 1915; At 7h. 30m. a.m., l.m.t., I lay off the azimuth of Polaris,  $1^{\circ} 23'$  to the east, and mark the meridian thus determined, by cutting a small groove in a stone firmly set in the ground 5 chs. N. of my station.

At 7h. 45m. a.m., l.m.t., I set off  $34^{\circ} 35\frac{1}{2}'$  N. on the lat. arc;  $20^{\circ} 12\frac{1}{2}'$  S. on the decl. arc; and mark a point in the meridian determined with the solar, by a cross on the stone already set 5 chs. N. of my station; this mark falls 0.1 ins. west of the meridian established by the Polaris observation.

The magnetic bearing of the true meridian at 8h. 00m. a. m. is N.  $15^{\circ} 30'$  W.; the angle thus determined gives the mag. decl.  $15^{\circ} 30'$  E.

I commence at the cor. of secs. 2, 3, 34 and 35, on the S. bdy. of the Tp. which is a granite rock in place, marked and witnessed as described by the surveyor general.

Thence I run

West bet. secs. 3 and 34.

Descend over country broken with huge granite rocks through dense brush and scattering timber.

12.06 Road bears N. W. and S. E.

17.00 Wash 15 lks. wide course N. W.

34.60 Wash 20 lks. wide course N.

40.00 Set an iron post 3 ft. long, 1 in. diam., 26 ins. in the ground for  $\frac{1}{4}$  sec. cor., marked on brass cap

1915 on S. rim;

$\frac{1}{4}$ S34 in N. and

S3 in S. half; from which

A cedar 10 ins. diam., bears N.  $65^{\circ}$  E. 108 lks. dist., marked  $\frac{1}{4}$ S34BT.

A juniper 18 ins. diam., bears S.  $45^{\circ}$  E. 27 lks. dist., marked  $\frac{1}{4}$ S3BT

45.00 Ascend steep E. slope.

49.80 Top of rocky peak, descend.

56.00 Wash 20 lks. wide course N. W. ascend.

75.00 Ridge bears N. and S. descend.

80.00 Set an iron post 3 ft. long, 3 ins. diam., in a mound of stone for cor. of secs. 3, 4, 33 and 34, marked on brass cap

1915 on S. rim;

T15N in N.

T14N in S. and

R6W in W. half;

S33 in N. W.

S34 in N. E.

## Fractional South boundary of Tp. 15 N. Rg. 5 W.

Chains.

S3 in S. E. and  
 S4 in S. W. quadrant; from which  
 A pinon 16 ins. diam., bears N. 10° W. 76  
 lks. dist., marked T15NR5WS33BT.  
 A pinon 14 ins. diam., bears S. 63° W. 231  
 lks. dist., marked T14NR5WS4BT.

No other bearings available. Raise a mound of stone  
 2 ft. base 1½ ft. high, W. of cor. Pits impracticable.  
 Land, rough and mountainous. Huge granite boulders.  
 Soil, rocky; 4th. rate.  
 Timber, scattering cedar and pinon.  
 Undergrowth, oak and manzanita.  
 Poor grass.  
 January 20; At this cor. I set off 20° 12' S. on the decl.  
 arc; and observe the sun on the meridian at noon; the  
 resulting lat. is 34° 35½' N.

West bet. secs. 4 and 33.

Descend over huge granite boulders, through scattering  
 timber and dense brush.

7.50 Wash 30 lks. wide course N. ascend.

14.58 Spur hrs. N. Desc.

21.94 Sycamore Creek course N. 4 lks. wide 2 ins. deep. Clear  
 running water.

40.00 Set an iron post 3 ft. long, 1 in. diam., 26 ins. in the  
 ground for ¼ sec. cor., marked on brass cap

1915 on S. rim;

¼S33 in N. and

S4 in S. half; from which

An oak 6 ins. diam., bears N. 4° W. 53  
 lks. dist., marked ¼S33BT.

A pinon 8 ins. diam., bears S. 38° W. 56  
 lks. dist., marked ¼S4BT.

47.00 Spur hrs. N. Along N. slope of mountain, descending.  
 leave timber and brush becomes scattering.

60.00 Swale and ascend.

68.00 Along N. slope.

80.00 Set an iron post 3 ft. long, 3 ins. diam., 24 ins. in the  
 ground for cor. of secs. 4, 5, 32 and 33, marked on brass  
 brass cap

1915 on S. rim;

T15N in N.

T14N in S. and

R5W in W. half;

S32 in N. W.

S33 in N. E.

S4 in S. E. and

S5 in S. W. quadrant; from which

A cedar 14 ins. diam., bears S. 58½° E. 249  
 lks. dist., marked T14NR5WS4BT.

A cedar 10 ins. diam., bears S. 70° W. 73  
 lks. dist., marked T14NR5WS5BT.

No other bearings available. Raise a mound of stone  
 2 ft. base 1½ ft. high, W. of cor. Pits impracticable.

From this cor. F. Lajeunesse house bears N. 6° 15' E.

Land, rough and mountainous.

Soil, rocky; 4th. rate.

Timber, scattering cedar and pinon.

Undergrowth, oak and manzanita.

Poor grass.

January 20; At 4h. 15m. p.m., l.m.t., I set off 34° 35½'  
 N. on the lat. arc; 20° 06' S. on the decl. arc; and  
 determine a meridian with the solar at the S. end of  
 my meridian in camp, established by the Polaris  
 observation. and mark the meridian thus determined by  
 cutting a small groove in the stone set 5 chs. N. of  
 my station; this mark falls 0.2 ins. east of the mer-  
 idian established by the Polaris observation.

January 20, 1915.

Fractional South boundary of Tp. 15 N. Rg. 5 W.

Chains.

January 24, 1915; At 8h. 30m. a.m., l.m.t., I set off  $34^{\circ} 35\frac{1}{2}'$  N. on the lat. arc;  $19^{\circ} 19'$  S. on the decl. arc; and determine a meridian with the solar at the cor. of secs. 4, 5, 32 and 33

Thence I run  
 West bet. secs. 5 and 32.  
 Along N. slope, gradually ascending through scattering brush.

40.00 Set an iron post 3 ft. long, 1 in. diam., 26 ins. in the ground for  $\frac{1}{4}$  sec. cor., marked on brass cap  
 1915 on S. rim;  
 $\frac{1}{4}$ S32 in N. and  
 S5 in S. half; and raise a mound of stone 2 ft. base  $1\frac{1}{2}$  ft. high, N. of cor. Pits impracticable.

45.00 Top of ascent. descend gradually.

50.00 Descend steep S. W. slope.

63.30 Wash 20 lks. wide course N. W.

67.50 Wash 20 lks. wide course N. W. ascend.

80.00 Set an iron post 3 ft. long, 3 ins. diam., 24 ins. in the ground for cor. of secs. 5, 6, 31 and 32, marked on brass cap  
 1915 on S. rim;  
 T15N in N.  
 T14N in S. and  
 R5W in W. half;  
 S31 in N. W.  
 S32 in N. E.  
 S5 in S. E. and  
 S6 in S. W. quadrant; from which  
 A cedar 26 ins. diam., bears S.  $83\frac{1}{2}^{\circ}$  E. 386 lks. dist., marked T14NR5WS5BT.  
 A cedar 12 ins. diam., bears S.  $48\frac{1}{4}^{\circ}$  W. 43 lks. dist., marked T14NR5WS6BT.

No other bearings available. Raise a mound of stone 2 ft. base  $1\frac{1}{2}$  ft. high, W. of cor. Pits impracticable.

Land, mountainous.  
 Soil, rocky; 4th. rate.  
 Timber, a few cedars.  
 Undergrowth, oak.  
 Poor grass.

January 24, 1915.

Boundaries of secs. 32 and 33, Township 15 N., R. 5 West. Latitudes, departures and closing errors.

Line designated.	True bearing.	Dist.	Latitudes.		Departures.	
			N.	S.	E.	W.
			Chs.	Chs.	Chs.	Chs.
S. bdy. of Tp 15 N.	East	160.00			160.00	
E. bdy. sec. 33	N. $0^{\circ} 02' W.$	80.00	80.00			.05
N. bdy. sec. 33 & 32	S. $89^{\circ} 59' W.$	79.98		.02		79.98
	S. $89^{\circ} 56' W.$	80.04		.09		80.04
W. bdy. sec. 32	S. $0^{\circ} 03' E.$	80.00		80.00	.07	
	Totals.		80.00	80.11	160.07	160.07
				80.00	160.07	
			Error in lat.	.11	.00	Error in dep.

GENERAL DESCRIPTION.

This township is rough and mountainous. and the soil is rocky and worthless except in the narrow valleys. The township is well watered and has a fair growth of cedar timber.

*John P. Hesse*  
 U. S. Surveyor.

## Fractional East boundary of Tp. 14 N. Rg. 6 W.

5

Chains.	<p>February 1, 1915; At 8h. 30m. a.m., l.m.t., I set off <math>34^{\circ} 30'</math> N. on the lat. arc; <math>17^{\circ} 14\frac{1}{2}'</math> S. on the decl. arc; and determine a meridian with the solar at the cor. of Tps. 13 and 14 N. Rgs. 5 and 6 W. which is a stone firmly set in the ground, marked and witnessed as described by the surveyor general.</p> <p>Thence I run North bet. secs. 31 and 36. Over rolling top of mesa, covered with loose volcanic rock.</p> <p>39.21 Wash 10 lks. wide course S. W.</p> <p>40.00 Set an iron post 3 ft. long, 1 in. diam., 26 ins. in the ground for <math>\frac{1}{4}</math> sec. cor., marked on brass cap 1915 on S. rim; <math>\frac{1}{4}</math>S36 in W. and S31 in E. half; and raise a mound of stone 2 ft. base <math>1\frac{1}{2}</math> ft. high, W. of cor. Pits impracticable.</p> <p>52.28 Wash 10 lks. wide course S. W.</p> <p>80.00 Set an iron post 3 ft. long, 3 ins. diam., 24 ins. in the ground for cor. of secs. 25, 30, 31 and 36, marked on brass cap 1915 on S. rim; T14N in N. half; R6WS25 in N. W. R5WS30 in N. E. S31 in S. E. and S36 in S. W. quadrant; and raise a mound of stone 2 ft. base <math>1\frac{1}{2}</math> ft. high, W. of cor. Pits impracticable.</p> <p>Land, rolling top of mesa. Volcanic formation. Soil, rocky; 4th. rate. No timber. Poor grass.</p> <p>February 1; At this cor. I set off <math>17^{\circ} 13'</math> S. on the decl. arc; and observe the sun on the meridian at noon; the resulting lat. is <math>34^{\circ} 30'</math> N.</p>
16.50	<p>North bet. secs. 25 and 30. Over rolling top of mesa covered with loose volcanic rock.</p> <p>40.00 Wash 20 lks. wide course S. W.</p> <p>Set an iron post 3 ft. long, 1 in. diam., 26 ins. in the ground for <math>\frac{1}{4}</math> sec. cor., marked on brass cap 1915 on S. rim; <math>\frac{1}{4}</math>S25 in W. and S30 in E. half; and raise a mound of stone 2 ft. base <math>1\frac{1}{2}</math> ft. high, W. of cor. Pits impracticable.</p> <p>80.00 Set an iron post 3 ft. long, 3 ins. diam., 24 ins. in the ground for cor. of secs. 19, 24, 25 and 30, marked on brass cap 1915 on S. rim; T14N in N. half; R6WS24 in N. W. R5WS19 in N. E. S30 in S. E. and S25 in S. W. quadrant; from which A cedar 24 ins. diam., bears N. <math>16\frac{1}{2}^{\circ}</math> W. 104 lks. dist., marked T14NR6WS24BT.</p> <p>No other bearings available. Raise a mound of stone 2 ft. base <math>1\frac{1}{2}</math> ft. high, W. of cor. Pits impracticable. 150 ft. above cor. of secs. 25, 30, 31 and 36. Land, rolling top of mesa. Volcanic formation. Soil, rocky; 4th. rate. No timber. Poor grass.</p>

February 1, 1915.

6

Part of the East 1/2 of Sec. 14, T. 14 N., R. 6 W.

Chains.		Boundaries of Subdivided portions of T. 14 N., R. 6 W. Latitudes, departures and closing errors.					
Line designated.	True bearing.	Dist.	Latitudes.		Departures.		
			N. Chs.	S. Chs.	E. Chs.	W. Chs.	
S. bdy. of Tp. 14 N.	East.	479.50			479.50		
E. bdy. of Tp. 6 W.	North.	160.00	160.00				
Subdivisional Boundary	S. 89° 53' W.	79.92		.07		79.92	
	S. 89° 49' W.	80.30		.26		80.30	
	S. 89° 49' W.	80.08		.26		80.08	
	N. 89° 59' W.	80.16	.02			80.16	
	S. 89° 55' W.	79.80		.12		79.80	
	S. 89° 59' W.	79.16		.02		79.16	
W. bdy. of Tp. 6 W.	South.	160.00		160.00			
Convergency.						.17	
Totals.			160.02	160.73	479.50	479.59	
				160.02	Error	479.50	
			Error in lat.		.71	in dep. .09	

GENERAL DESCRIPTION.

This township is mountainous, and the soil generally rocky and worthless. There is no permanent water in the township.

*John P. Hesse*  
U. S. Surveyor.



Chains.

Survey commenced February 14, 1915, and executed with an A. Lietz light mountain transit, No. 6166, with solar attachment, The horizontal limb is provided with two double verniers placed opposite to each other, reading to single minutes of arc, which is also the least count of the verniers of the latitude and declination arcs; The instrument was approved by the Assistant Supervisor of surveys for Arizona and California, conditional upon satisfactory field tests, September 28, 1914.

I examine the adjustments of the transit, and correct the level and collimation errors; then, to test the solar apparatus, by comparing its indications, resulting from solar observations made during a.m. and p.m. hours, with a meridian determined by observations on Polaris, I proceed as follows:

At my camp, which is located at the cor. of secs. 25, 30, 31 and 36 on the E. bdy. of Tp. 13 N. Rg. 7 W.; latitude  $34^{\circ} 25' 40''$  N.; longitude  $112^{\circ} 56' 16''$  W.; I set off  $34^{\circ} 25\frac{1}{2}'$  N. on the lat. arc;  $13^{\circ} 05'$  S. on the decl. arc; and at 4h. 00m. p.m., l.m.t., determine with the solar a meridian and mark a point thereof, on a stone firmly set in the ground, 5 chs. N. of my station.

At 9h. 50m. p.m. by my watch which has correct l.m.t., I observe Polaris at western elongation, in accordance with Manual of Instructions, and mark a point in the line thus determined, on a peg driven in the ground 5 chs. N. of my station.

February 14, 1915.

February 15, 1915: At 7h. 30m. a.m., l.m.t., I lay off the azimuth of Polaris,  $1^{\circ} 23'$  to the east, and mark the meridian thus determined, by cutting a small groove in the stone set February 14, on which the meridian falls 0.2 ins. east of the mark determined by the solar.

At 8h. 00m. a.m., l.m.t., I set off  $34^{\circ} 25\frac{1}{2}'$  N. on the lat. arc;  $12^{\circ} 51\frac{1}{2}'$  S. on the decl. arc; and mark a point in the meridian determined with the solar, by a cross on the stone already set 5 chs. N. of my station; this mark falls 0.2 ins. east of the meridian established by the Polaris observation.

The solar apparatus, by p.m. and a.m. observations, defines positions for meridians, respectively about 0'11" west and east of the meridian established by the Polaris observations; therefore, I conclude that the adjustments of the instrument are satisfactory.

The magnetic bearing of the true meridian at 8h. 10m. a.m. is  $N. 15^{\circ} 30' W.$ ; the angle thus determined gives the mag. decl.  $15^{\circ} 30' E.$

The cor. of secs. 19, 24, 25 and 30 on the E. bdy. of Tp. 13 N. Rg. 7 W. is an iron post 3 ins. diam., 12 ins. above ground, with brass cap, marked and witnessed as described by the surveyor general.

Thence I run

North on a random line, along the E. bdy. of Tp. 13 N. Rg. 7 W. setting temp.  $\frac{1}{4}$  sec. and sec. cors. at intervals of 40.00 chs.; and, at 321.83 chs., intersect the S. bdy. of Tp. 14 N. Rg. 7 W. 241 lks. W. of the cor. of Tps. 13 and 14 N. Rgs. 6 and 7 W. which is a stone firmly set, marked and witnessed as described by the surveyor general. I obliterate notches on S. of stone and move mound of stone N. of cor.

As the point of intersection of the two lines falls on bank of wash, on land subject to overflow, I run S. 65 lks. and

Set an iron post 3 ft. long, 3 ins. diam., 24 ins. in the ground for witness cor. to closing cor. of Tps. 13 N. Rgs. 6 and 7 W., marked on brass cap

## 8. Completion of East boundary of Tp. 13 N. Rg. 7 W.

Chains.

1915 on S. rim;  
 WCCC S. of center;  
 T14NR7WS36 R6WS31 in N. and  
 T13N in S. half;  
 S6R6W in S. E. and  
 S1R7W in S. W. quadrant; and raise a mound of  
 stone 2 ft. base  $1\frac{1}{2}$  ft. high, S. of cor. Pits impracti-  
 cable.

February 15, 16, 17, 1915.

February 18, 1915: At 9h. 00m. a.m., l.m.t., I set off  $34^{\circ}$   
 $30'$  N. on the lat. arc;  $11^{\circ} 49'$  S. on the decl. arc; and  
 determine a meridian with the solar at the true point  
 for the closing cor. of Tps. 13 N. Rgs. 6 and 7 W.

Thence I run

S. bet. secs. 1 and 6.

.65 The witness cor. to closing cor. of Tps. 13 N. Rgs. 6 and 7 W.,  
 hereinbefore described.

Ascend rough N. slope of mountain.

41.83 Set an iron post 3 ft. long, 26 ins. in the ground for  $\frac{1}{4}$  sec. cor., marked on brass cap

1915 on S. rim;

 $\frac{1}{4}$ S1 in W. and

S6 in E. half; and raise a mound of stone 2 ft.  
 base  $1\frac{1}{2}$  ft. high, W. of cor. Pits impracticable.

705 ft. above closing cor.

81.83 Set an iron post 3 ft. long, 3 ins. diam., 24 ins. in the  
 ground for cor. of secs. 1, 6, 7 and 12, marked on  
 brass cap

1915 on S. rim;

T13N in N. half;

R7WS1 in N. W.

R6WS6 in N. E.

S7 in S. E. and

S12 in S. W. quadrant; and raise a mound of stone  
 2 ft. base  $1\frac{1}{2}$  ft. high, W. of cor. Pits impracticable.

1545 ft. above closing cor.

Land, mountainous. Granite formation.

Soil, rocky; 4th. rate.

No timber.

Undergrowth, oak and catclaw.

Poor grass.

South bet. secs. 7 and 12.

Ascend.

6.53 Top of Bismarck Mtn. 15 ft. above cor. descend.

40.00 Point for  $\frac{1}{4}$  sec. cor. falls on steep rock slope where it  
 cannot be securely established.

42.00 Set an iron post 3 ft. long, 1 in. diam., 26 ins. in the  
 ground for witness cor. to  $\frac{1}{4}$  sec. cor., marked on brass cap

1915 on S. rim;

WC  $\frac{1}{4}$  in S. half;

S12 in N. W. and

S7 in N. E. quadrant; and raise a mound of stone 2  
 ft. base  $1\frac{1}{2}$  ft. high, W. of cor. Pits impracticable.

59.90 Wash 20 lks. wide, 616 ft. below mountain top, course S.E.

Ascend.

80.00 Set an iron post 3 ft. long, 3 ins. diam., 24 ins. in the  
 ground for cor. of secs. 7, 12, 13 and 18, marked on  
 brass cap

1915 on S. rim;

T13N in N. half;

R7WS12 in N. W.

R6WS7 in N. E.

S18 in S. E. and

## Completion of East boundary of Tp. 13 N. Rg. 7 W.

Chains.

S13 in S. W. quadrant; and raise a mound of stone 2 ft. base  $1\frac{1}{2}$  ft. high, W. of cor. Pits impracticable.  
 February 18: At this cor. I set off  $11^{\circ} 47'$  S. on the decl. arc; and observe the sun on the meridian at noon; the resulting lat. is  $34^{\circ} 28'$  N.  
 Land mountainous. Granite formation.  
 Soil, rocky, 4th. rate.  
 No timber.  
 Undergrowth, oak and catclaw.  
 Poor grass.

South bet. secs. 13 and 18.  
 Ascending.  
 17.67 Ridge, 304 ft. above wash, bears E. and W. descend.  
 35.00 Wash 20 lks. wide, 149 ft. below ridge, course E. Ascend.  
 40.00 Set an iron post 3 ft. long, 1 in. diam., 26 ins. in the ground for  $\frac{1}{4}$  sec. cor., marked on brass cap  
      $\frac{1}{4}$  1915 on S. rim;  
      $\frac{1}{4}$  S13 in W. and  
     S18 in E. half; and raise a mound of stone 2 ft. base  $1\frac{1}{2}$  ft. high, W. of cor. Pits impracticable.  
 47.55 Point of rocky ridge. 196 ft. above wash, bears W. descend.  
 62.82 Wash 10 lks. wide, 294 ft. below ridge, course N. W. ascend.  
 70.71 Top of rocky Knoll, 287 ft. above wash, descend.  
 80.00 Set an iron post 3 ft. long, 3 ins. diam., 24 ins. in the ground for cor. of secs. 13, 18, 19 and 24, marked on brass cap  
     1915 on S. rim;  
     T13N in N. half;  
     R7WS13 in N. W.  
     R6WS18 in N. E.  
     S19 in S. E. and  
     S24 in S. W. quadrant; and raise a mound of stone 2 ft. base  $1\frac{1}{2}$  ft. high, W. of cor. Pits impracticable.  
 Land, mountainous. Granite formation.  
 Soil, rocky; 4th. rate.  
 No timber.  
 Undergrowth, oak and catclaw.  
 Poor grass.

South bet. secs. 19 and 24.  
 1.65 Wash 10 lks. wide, 170 ft. below knoll, course N. W. Ascend.  
 18.09 Spur 151 ft. above wash, brs. SW, Descend.  
 40.00 Set an iron post 3 ft. long, 1 in. diam., 26 ins. in the ground for  $\frac{1}{4}$  sec. cor., marked on brass cap  
     1915 on S. rim;  
      $\frac{1}{4}$  S24 in W. and  
     S19 in E. half; and raise a mound of stone 2 ft. base  $1\frac{1}{2}$  ft. high, W. of cor. Pits impracticable.  
 56.34 Wash 10 lks. wide course S. W. 45 ft. below spur. Ascend.  
 67.20 Ridge bears N. E. and S. W. 154 ft. above wash. Descend.  
 80.00 The cor. of secs. 19, 24, 25 and 30, hereinbefore described. 149 ft. below ridge.  
 Land, mountainous. Granite formation.  
 Soil, rocky; 4th. rate.  
 No timber.  
 Undergrowth, oak.  
 Poor grass.

February 18, 1915.

10

West boundary of Tp. 13 N. Rg. 7 W.

Chains.

March 6, 1915.  
 The standard cor. of Tps. 13 N. Rgs. 7 and 8 W. is an iron post 3 ins. diam., 12 ins. above ground, with brass cap, marked and witnessed as described by the surveyor general.  
 Thence I run  
 North bet. secs. 31 and 36.  
 Ascend.  
 2.38 Ridge bears E. and W. 27 ft. above cor.  
 17.94 310 ft. below ridge. ascend.  
 27.24 Ridge bears W. and S. E. 113 ft. Descend.  
 40.00 Set an iron post 3 ft. long, 1 in. diam., 26 ins. in the ground for  $\frac{1}{4}$  sec. cor., marked on brass cap  
     1915 on S. rim;  
      $\frac{1}{4}$ S36 in W. and  
     S31 in E. half; and raise a mound of stone 2 ft. base  $1\frac{1}{2}$  ft. high, W. of cor. Pits impracticable.  
 71.50 Wash 20 lks. wide course N. W. 719 ft. below ridge.  
 Ascend.  
 75.50 Ridge bears E. and W. 75 ft. above wash. Descend.  
 80.00 Set an iron post 3 ft. long, 3 ins. diam., 24 ins. in the ground for cor. of secs. 25, 30, 31 and 36, marked on brass cap  
     1915 on S. rim; T13N in N. half;  
     R8WS25 in N. W.  
     R7WS30 in N. E.  
     S31 in S. E. and  
     S36 in S. W. quadrant; and raise a mound of stone 2 ft. base  $1\frac{1}{2}$  ft. high, W. of cor. Pits impracticable.  
 Land, mountainous. Granite formation.  
 Soil, rocky; 4th. rate.  
 No timber.  
 Undergrowth, scattering Oak and mtn. mahogany.  
 Poor grass.

March 6, 1915.

March 11; 1915: At 7h. 30m. a.m., 1.m.t., I set off  $34^{\circ}$   $25\frac{1}{2}'$  N. on the lat. arc;  $3^{\circ} 56\frac{1}{2}'$  S. on the decl. arc; and determine a meridian with the solar at the cor. of secs. 25, 30, 31 and 36  
 Thence I run  
 North bet. secs. 25 and 30.  
 Descend, through scattering brush.  
 0.74 Wash, 20 lks. wide course N. W. 41 ft. below ridge. Ascend  
 25.45 Top round hill, 288 ft. above wash. Descend.  
 36.00 Wash, 15 lks. wide course N. W. 312 ft. below hill.  
 Along W. slope of high ridge.  
 40.00 Set an iron post 3 ft. long, 1 in. diam., in a mound of stone, for  $\frac{1}{4}$  sec. cor., marked on brass cap  
     1915 on S. rim;  
      $\frac{1}{4}$ S25 in W. and  
     S30 in E. half; and raise a mound of stone 2 ft. base  $1\frac{1}{2}$  ft. high, W. of cor. Pits impracticable.  
 78.50 Wash, 10 lks. wide course N. W. 141 ft. below last wash.  
 Along S. W. slope.  
 80.00 Set an iron post 3 ft. long, 3 ins. diam., 24 ins. in the ground for cor. of secs. 19, 24, 25 and 30, marked on brass cap  
     1915 on S. rim; T13N in N. half;  
     R8WS24 in N. W.  
     R7WS19 in N. E.  
     S30 in S. E. and  
     S25 in S. W. quadrant; and raise a mound of stone 2 ft. base  $1\frac{1}{2}$  ft. high, W. of cor. Pits impracticable.  
 Land, mountainous. Granite formation.  
 Soil, rocky; 4th. rate.  
 No timber.  
 Undergrowth, paloverde and catclaw.

Chains.

March 11: At this cor. I set off  $3^{\circ} 53\frac{1}{2}'$  S. on the decl. arc; and observe the sun on the meridian at noon; the resulting lat. is  $34^{\circ} 26\frac{1}{2}'$  N.

North bet. secs. 19 and 24.

Along S. W. slope, through scattering brush.

40.00 Set an iron post 3 ft. long, 1 in. diam., 26 ins. in the ground for  $\frac{1}{4}$  sec. cor., marked on brass cap

1915 on S. rim;

$\frac{1}{4}$ S24 in W. and

S19 in E. half; and raise a mound of stone 2 ft.

base  $1\frac{1}{2}$  ft. high, W. of cor. Pits impracticable.

45.30 Ridge, bears N. W. and S. E. 14 ft. below wash. Descend N. E. slope.

80.00 Set an iron post 3 ft. long, 3 ins. diam., 24 ins. in the ground for cor. of secs. 13, 18, 19 and 24, marked on brass cap

1915 on S. rim; T13N in N. half;

R8WS13 in N. W.

R7WS18 in N. E.

S19 in S. E. and

S24 in S. W. quadrant; and raise a mound of stone

2 ft. base  $1\frac{1}{2}$  ft. high, W. of cor. Pits impracticable.

Land, mountainous.

Soil, rocky; 4th. rate.

No timber.

Undergrowth, paloverde and catclaw.

Poor grass.

March 11, 1915.

March 26, 1915.

North, bet. secs. 13 and 18.

Descend rough N. E. slope. through dense brush.

22.08 Road, bears N. W. and S. E.

27.25 Wash, 40 lks. wide course N. W. 581 ft. below ridge.

34.85 Telephone line, bears N. W. and S. E.

36.65 Wash, 40 lks. wide course N. E.

39.25 Set an iron post 3 ft. long, 1 in. diam., 26 ins. in the ground for witness cor. to  $\frac{1}{4}$  sec. cor, marked on brass cap,

1915 on S. rim;

WC $\frac{1}{4}$  in N. half;

S18 in S. E. and

S13 in S. W. quadrant; and raise a mound of stone

2 ft. base  $1\frac{1}{2}$  ft. high, W. of cor. Pits impracticable.

40.00 Point for  $\frac{1}{4}$  sec. cor. falls in wash. Imprac. to set iron post.

41.50 Same wash, 40 lks. wide course N. W. and over rolling land.

80.00 Set an iron post 3 ft. long, 3 ins. diam., 24 ins. in the ground for cor. of secs. 7, 12, 13 and 18, marked on brass cap,

1915 on S. rim;

T13N in N. half;

R8WS12 in N. W.

R7WS7 in N. E.

S18 in S. E. and

S13 in S. W. quadrant; and raise a mound of stone

2 ft. base  $1\frac{1}{2}$  ft. high, W. of cor. Pits impracticable.

Land, mountainous and rolling.

Soil, rocky; 4th. rate.

No timber.

Undergrowth, paloverde and catclaw.

Poor grass.

March 26, 1915.

Chains.

- April 6, 1915; At 7h. 30m. a.m., l.m.t., I set off  $34^{\circ} 28\frac{1}{2}'$  N. on the lat. arc;  $6^{\circ} 13'$  N. on the decl. arc; and determine a meridian with the solar at the cor. of secs. 7, 12, 13 and 18
- Thence I run  
North, bet. secs. 7 and 12.  
Over rolling hilly land at foot of W. slope, through dense brush.
- 40.00 Set an iron post 3 ft. long, 1 in. diam., 26 ins. in the ground for  $\frac{1}{4}$  sec. cor., marked on brass cap  
1915 on S. rim;  
 $\frac{1}{2}$ S12 in W. and  
S7 in E. half; and raise a mound of stone 2 ft. base  $1\frac{1}{2}$  ft. high, W. of cor. Pits impracticable.
- 48.93 Wash, 40 lks. wide course S. W. ascend rough S. W. slope.
- 80.00 Set an iron post 3 ft. long, 3 ins. diam., in a mound of stone, for cor. of secs. 1, 6, 7 and 12, marked on brass cap  
1915 on S. rim;  
T13N. in N. half;  
R8WS1 in N. W.  
R7WS6 in N. E.  
S7 in S. E. and  
S12 in S. W. quadrant; and raise a mound of stone 2 ft. base  $1\frac{1}{2}$  ft. high, W. of cor. Pits impracticable.  
Land, mountainous and hilly.  
Soil, rocky; 4th. rate.  
No timber.  
Undergrowth, paloverde and catclaw.  
Fair grass.
- April 6: At this cor. I set off  $6^{\circ} 16\frac{1}{2}'$  N. on the decl. arc; and observe the sun on the meridian at noon; the resulting lat. is  $34^{\circ} 29'$  N.
- 
- North bet. secs. 1 and 6.  
Ascend through dense brush.
- 11.25 Ridge, bears E. and W. 274 ft. above wash. Descend.
- 29.35 Santa Maria River, 100 lks. wide course S. W., Clear water 6 ins. deep. 253 ft. below ridge.
- 31.45 Santa Maria River, 100 lks. wide course S. E. Ascend.
- 40.00 Set an iron post 3 ft. long, 1 in. diam., 20 ins. in the ground, in a mound of stone, for  $\frac{1}{4}$  sec. cor., marked on brass cap  
1915 on S. rim;  
 $\frac{1}{2}$ S1 in W. and  
S6 in E. half; and raise a mound of stone 2 ft. base  $1\frac{1}{2}$  ft. high, W. of cor. Pits impracticable.
- 49.35 Spur brs. W. 109 ft. above river. Descend.
- 58.50 Wash 50 lks. wide course W. 100 ft. below ridge & over level land.
- 80.00 Set temp. Tp. cor. at this point April 6, 1915.
- 80.00 April 7, 1915. When surveying completion of S. bdy. of Tp. 14 N., R. 7 W. I fall 2.65 chs. N. of this temp. Tp. cor. therefore  
Set an iron post 3 ft. long, 3 ins. in diam., 24 ins. in the ground for cor. of Ts. 13 and 14 N., Rs. 7 and 8 W., marked on brass cap. 1915 in S. rim,  
T14 N in N.,  
R8WS1 in E.,  
T13 N in S., and  
S36 in E. R. 8 W in W. half; S 36 in NW., S 31 in NE.,  
S36 in S. E. S 6 in SE., and  
S1 in S. W. quadrant; and raise a mound of stone 2 ft. base  $1\frac{1}{2}$  ft. high, S. of cor. Pits impracticable.  
Land, level and mountainous.  
Soil, S. 60.00 chs. rocky; 4th. rate. N. 22.65 chs. sandy loam, dry, medium texture; 1st. rate.  
No timber.  
Undergrowth, paloverde, catclaw and cactus.  
Poor grass.

April 7, 1915.

Chains.

- April 7, 1915: At 7h. 00m. a.m., l.m.t., I set off  $34^{\circ} 30'$  N. on the lat. arc;  $6^{\circ} 35\frac{1}{2}'$  N. on the decl. arc; and determine a meridian with the solar at the cor. of secs. 32 and 33 on the S. bdy. of Tp. 14 N., Rg. 7 W., which is a stone, firmly set in the ground originally established for four secs., but changed by me to refer to secs. 32 and 33 only, as described in field notes of the survey of the Subdivision lines of T. 13 N., R. 7 W., in Book "F," of this group.
- Thence I run,  
West, on south bdy. of sec. 32.  
Descend rough NW. slope.
- 40.00 Set an iron post 3 ft. long, 1 in. in diam., in a mound of stone for  $\frac{1}{4}$  sec. cor., marked on brass cap  
1915 in S. rim;  
 $\frac{1}{4}$  S 32 in N. half; and raise a mound of stone  
2 ft. base,  $1\frac{1}{2}$  ft. high, N. of cor. Pits impracticable.
- 40.27 327 ft. below cor. Ascend SE. slope.
- 53.00 Ridge brs. NE. and SW. 193 ft. above 40.27 chain point,  
and along SW. slope.
- 73.75 Ridge brs. NE. and SW. 75 ft. below last ridge.  
Descend NW. slope.
- 80.00 Set an iron post 3 ft. long, 3 ins. in diam., 24 ins. in the ground for cor. of secs. 31 and 32, marked on brass cap, 1915 on S. rim;  
T 14 N in N.,  
S 5 S 6 T 13 N in S., and  
R 7 W in W half;  
S 31 in NW., and  
S 32 in NE. quadrant; and raise a mound of stone 2 ft. base,  $1\frac{1}{2}$  ft. high, N. of cor. Pits impracticable.
- Land, mountainous.  
Soil, rocky, 4th rate.  
No timber.  
Undergrowth, palo verde and catclaw.  
Fair grass.
- April 7: At this cor., I set off  $6^{\circ} 39'$  N. on the decl. arc; and observe the sun on the meridian at noon; the resulting lat. is  $34^{\circ} 31' N.$
- 
- West, bet. secs. 6 and 31.  
Descend NW. slope, through scattering brush.
- 21.48 Wash, 10 lks. wide, course SW. 446 ft. below ridge, and along SE. slope.
- 32.20 Ascend.
- 39.95 Over mesa, 30 ft. above wash.
- 40.00 Set an iron post 3 ft. long, 1 in. in diam., 26 ins. in the ground for  $\frac{1}{4}$  sec. cor., marked on brass cap,  
1915 in S. rim;  
 $\frac{1}{4}$  S 31 in N. half; and raise a mound of stone 2 ft. base,  $1\frac{1}{2}$  ft. high, N. of cor. Pits impracticable.
- 59.20 Descend.
- 66.50 179 ft. below mesa. Over level land.
- 77.53 The cor. of Ts. 13 and 14 N., Rs. 7 and 8 W., hereinbefore described.
- Land, mountainous and level.  
Soil, 0 to 66.50 chs., rocky, 4th rate; 66.50 to 77.53 chs. sandy loam, dry, medium texture; 1st rate.  
No timber.  
Undergrowth, palo verde, catclaw and mesquite.  
Poor grass.

April 7, 1915.

14 Fractional South Boundary of Tp. 14 N., R. 7 W.

Boundaries of Township 13 North, Range 7 West.  
 Latitudes, departures and closing errors.

Line designated.	True bearing.	Dist.	Latitudes		Departures	
			N.	S.	E.	W.
South bdy. (3rd Std.Par.N)	East,	476.65			476.65	
East bdy.of Tp.	North,	481.83	481.83			
North bdy.of Tp.	West,	475.12				475.12
West bdy.of Tp.	South,	482.65		482.65		
Convergency						.50
Totals,			481.83	482.65	476.65	475.62
				<u>481.83</u>	<u>475.62</u>	
Error in latitude,				.82		
Error in departure,					1.03	

GENERAL DESCRIPTION.

This township is rough and mountainous, and the soil is rocky and worthless.  
 There is no timber or water in the township.



Chains.

Survey commenced April 9, 1915, and executed with an A. Lietz light mountain transit, No. 6166, with solar attachment. The horizontal limb is provided with two double verniers placed opposite to each other, reading to single minutes of arc, which is also the least count of the verniers of the latitude and declination arcs; The instrument was approved by the Assistant Supervisor of Surveys for Arizona and California, conditional upon satisfactory field tests, September 28, 1914. I examine the adjustments of the transit, and find them correct; then, to test the solar apparatus, by comparing its indications, resulting from solar observations made during a.m. and p.m. hours, with a meridian determined by observations on Polaris, I proceed as follows: At the cor. of Tps. 13 and 14 N. Rgs. 7 and 8 W.; latitude  $34^{\circ} 30' 03''$  N.; longitude  $113^{\circ} 02' 34''$  W.; I set off  $34^{\circ} 30'$  N. on the lat. arc;  $7^{\circ} 30'$  N. on the decl. arc; and at 5h. 00m. p.m., l.m.t., determine with the solar a meridian and mark a point thereof, on a stone firmly set in the ground, 5 chs. N. of my station. At 6h. 17m. p.m. by my watch which has correct l.m.t., I observe Polaris at western elongation, in accordance with Manual of Instructions, and mark a point in the line thus determined, on a peg driven in the ground 5 chs. N. of my station.

April 9, 1915.

April 10, 1915; At 6h. 30m. a.m., l.m.t., I lay off the azimuth of Polaris,  $1^{\circ} 23'$  to the east, and mark the meridian thus determined, by cutting a small groove in the stone set April 9, on which the meridian falls 0.1 east of the mark determined by the solar. At 7h. 00m. a.m., l.m.t., I set off  $34^{\circ} 30'$  N. on the lat. arc;  $7^{\circ} 43'$  N. on the decl. arc; and mark a point in the meridian determined with the solar, by a cross on the stone already set 5 chs. N. of my station; this mark falls 0.2 ins. east of the meridian established by the Polaris observation. The solar apparatus, by p.m. and a.m. observations, defines positions for meridians, respectively about  $0'5''$  west and  $0'11''$  east of the meridian established by the Polaris observations; therefore, I conclude that the adjustments of the instrument are satisfactory. The magnetic bearing of the true meridian at 7h. 10m. a.m. is N.  $15^{\circ} 30'$  W.; the angle thus determined gives the mag. decl.  $15^{\circ} 30'$  E. From the cor. of Tps. 13 and 14 N. Rgs. 7 and 8 W., hereinbefore described

I run  
 North bet. secs. 31 and 36.  
 Over level land, through scattering brush.  
 15.10 Santa Maria River 60 lks. wide course S. W., clear running water 6 ins. deep. Ascend rough S. E. slope.  
 20.71 Spur, brs. E. 36 ft. above river. Descend.  
 22.69 Wash 20 lks. wide course S. E. 64 ft. below spur. Ascend  
 40.00 Set an iron post 3 ft. long, 1 in. diam., 26 ins. in the ground for  $\frac{1}{4}$  sec. cor., marked on brass cap  
     1915 on S. rim;  
      $\frac{1}{4}$ S36 in W. and  
     S31 in E. half; and raise a mound of stone 2 ft. base  $1\frac{1}{2}$  ft. high, W. of cor. Pits impracticable.  
 64.50 Ridge, bears N. E. and S. W. 459 ft. above wash. Descend.  
 80.00 Set an iron post 3 ft. long, 3 ins. diam., 24 ins. in the ground for cor. of secs. 25, 30, 31 and 36, marked on brass cap  
     1915 on S. rim;  
     T14N in N. half;

16

West boundary of Tp. 14 N. Rg. 7 W.

Chains.

	<p>R8WS25 in N. W.  R7WS30 in N. E.  S31 in S. E. and  S36 in S. W. quadrant; and raise a mound of stone  2 ft. base <math>1\frac{1}{2}</math> ft. high, W. of cor. Pits impracticable.  Land, mountainous and level.  Soil, 0 to 14.00 chs. sandy loam, dry, medium texture;  1st. rate. 14.00 to 80.00 chs. rocky; 4th. rate.  No timber.  Undergrowth, paloverde, catclaw and cactus.  Poor grass.  April 10; At this cor. I set off <math>7^{\circ} 46\frac{1}{2}'</math> N. on the decl.  arc; and observe the sun on the meridian at noon; the  resulting lat. is <math>34^{\circ} 31'</math> N.</p>
11.79	<p>North bet. secs. 25 and 30.  Descend, through scattering brush.  Wash 10 lks. wide course S. W. 95 ft. below cor. Ascend  over broken country.</p>
40.00	<p>Set an iron post 3 ft. long, 1 in. diam., 10 ins. in the  ground in a mound of stone, for <math>\frac{1}{4}</math> sec. cor., marked on  brass cap  1915 on S. rim;  <math>\frac{1}{4}</math>S25 in W. and  S30 in E. half; and raise a mound of stone 2 ft.  base <math>1\frac{1}{2}</math> ft. high, W. of cor. Pits impracticable.</p>
80.00	<p>Set an iron post 3 ft. long, 3 ins. diam., in a mound of  stone for cor. of secs. 19, 24, 25 and 30, marked on  brass cap  1915 on S. rim;  R8WS24 in N. W.  R7WS19 in N. E.  S30 in S. E. and  S25 in S. W. quadrant;  T14N in N. half; and raise a mound of stone 2 ft.  base <math>1\frac{1}{2}</math> ft. high, W. of cor. Pits impracticable.  Land, mountainous.  Soil, rocky; 4th. rate.  No timber.  Undergrowth, paloverde, catclaw and cactus.  Poor grass.</p>
	April 10, 1915.
	<p>April 15, 1915; At 7h. 00m. a.m., l.m.t., I set off <math>34^{\circ}</math>  <math>32'</math> N. on the lat. arc; <math>9^{\circ} 32\frac{1}{2}'</math> N. on the decl. arc;  and determine a meridian with the solar at the cor. of  secs. 19, 24, 25 and 30 on the ... of the Tp.  Thence I run  North bet. secs. 19 and 24  Ascend over broken country, through dense brush.</p>
36.65	<p>Spur, <del>brs.</del> E. 101 ft. above cor. descend N. E. slope.</p>
40.00	<p>Set an iron post 3 ft. long, 1 in. diam., 26 ins. in the  ground for <math>\frac{1}{4}</math> sec. cor., marked on brass cap  1915 on S. rim;  <math>\frac{1}{4}</math>S24 in W. and  S19 in E. half; and raise a mound of stone 2 ft.  base <math>1\frac{1}{2}</math> ft. high, W. of cor. Pits impracticable.</p>
49.62	<p>Wash, 80 lks. wide course S. E. 123 ft. below spur.  Brush becomes scattering.</p>
52.25	<p>Road, bears N. W. and S. E.</p>
56.81	<p>Wash 80 lks. wide course S. W.</p>
62.41	<p>Spur, <del>brs.</del> E. 20 ft. above wash.</p>
64.37	<p>Wash, 80 lks. wide course S. E. 10 ft. below spur. Ascend.</p>
80.00	<p>Set an iron post 3 ft. long, 3 ins. diam., in a mound of  stone for cor. of secs. 13, 18, 19 and 24, marked on</p>

Chains.

brass cap  
 1915 on S. rim;  
 T14N in N. half;  
 R8WS13 in N. W.  
 R7WS18 in N. E.  
 S19 in S. E. and  
 S24 in S. W. quadrant; and raise a mound of stone  
 2 ft. base  $1\frac{1}{2}$  ft. high, W. of cor. Pits impracticable.  
 119 ft. above wash.  
 Land, mountainous.  
 Soil, rocky; 4th. rate.  
 No timber.  
 Undergrowth, paloverde, catclaw and cactus.  
 Poor grass.  
 April 15: At this cor I set off  $9^{\circ} 36'$  N. on the decl.  
 arc; and observe the sun on the meridian at noon; the  
 resulting lat. is  $34^{\circ} 32\frac{1}{2}'$  N.

North bet. secs. 13 and 18.

Ascend, through scattering brush.

40.00 Set an iron post 3 ft. long, 1 in. diam., in a mound of  
 stone for  $\frac{1}{4}$  sec. cor., marked on brass cap  
 1915 on S. rim;  
 $\frac{1}{4}$ S13 in W. and  
 S18 in E. half; and raise a mound of stone 2 ft.  
 base  $1\frac{1}{2}$  ft. high, W. of cor. Pits impracticable.

42.80 Edge of mesa 217 ft. above cor. and over mesa.

80.00 Set an iron post 3 ft. long, 3 ins. diam., 24 ins. in the  
 ground for cor. of secs. 7, 12, 13 and 18, marked on  
 brass cap  
 1915 on S. rim;  
 T14N in N. half;  
 R8WS12 in N. W.  
 R7WS7 in N. E.  
 S18 in S. E. and  
 S13 in S. W. quadrant; and raise a mound of stone  
 2 ft. base  $1\frac{1}{2}$  ft. high, W. of cor. Pits impracticable.  
 Land, mountainous.  
 Soil, rocky; 4th. rate.  
 No timber.  
 Undergrowth, paloverde, catclaw and cactus.  
 Poor grass.

April 15, 1915.

May 10, 1915; At 7h. 00m. a.m., l.m.t., I set off  $34^{\circ} 33\frac{1}{2}'$   
 N. on the lat. arc;  $17^{\circ} 27\frac{1}{2}'$  N. on the decl. arc; and  
 determine a meridian with the solar at the cor. of secs.  
 7, 12, 13 and 18, on the west boundary of the section.  
 Thence I run.

North bet. secs. 7 and 12.

Over rolling mesa land.

18.17 Wire fence bears N. E. and S. W.

29.52 Wire fence bears N. W. and S. E.

40.00 Set an iron post 3 ft. long, 1 in. diam., 26 ins. in the  
 ground for  $\frac{1}{4}$  sec. cor., marked on brass cap  
 1915 on S. rim;  
 $\frac{1}{4}$ S12 in W. and  
 S7 in E. half; and raise a mound of stone 2 ft.  
 base  $1\frac{1}{2}$  ft. high, W. of cor. Pits impracticable.  
 Ascend.

55.57 Spur, brs. SE. 386 ft. above cor. descend.

57.76 Wash, 15 lks. wide course S. E. 22 ft. below spur, ascend.

80.00 Set an iron post 3 ft. long, 3 ins. diam., 24 ins. in the  
 ground for cor. of secs. 1, 6, 7 and 12, marked on  
 brass cap

18

West boundary of Tp. 14 N. Rg. 7 W.

Chains.

1915 on S. rim;  
 T14N in N. half;  
 R8WS1 in N. W.  
 R7WS6 in N. E.  
 S7 in S. E. and  
 S12 in S. W. quadrant; and raise a mound of stone  
 2 ft. base  $1\frac{1}{2}$  ft. high, W. of cor. Pits impracticable.  
 203 ft. above wash.  
 Land, mountainous.  
 Soil, rocky; 4th. rate.  
 No timber.  
 Undergrowth, paloverde, catclaw and cactus.  
 May 10; At this cor. I set off  $17^{\circ} 30'$  N. on the decl.  
 arc; and observe the sun on the meridian at noon; the  
 resulting lat. is  $34^{\circ} 34\frac{1}{2}'$  N.

North bet. secs. 1 and 6.

Ascend, through scattering brush.

40.00 Set an iron post 3 ft. long, 1 in. diam., 26 ins. in the  
 ground for  $\frac{1}{4}$  sec. cor., marked on brass cap

1915 on S. rim;

$\frac{1}{4}$ S1 in W. and

S6 in E. half; and raise a mound of stone 2 ft.

base  $1\frac{1}{2}$  ft. high, W. of cor. Pits impracticable.

44.05 Spur, bears S. W. 843 ft. above cor. High peak about 12 chs.  
 N. E. Shipp Mountain. Descend.

80.00 Set an iron post 3 ft. long, 3 ins. diam., 24 ins. in the  
 ground for cor. of Tps. 14 and  $14\frac{1}{2}$ N. Rgs. 7 and 8 W.  
 marked on brass cap

1915 on S. rim;

T14 $\frac{1}{2}$ N in N.

R7W in E.

T14N in S. and

R8W in W. half;

S36 in N. W.

S31 in N. E.

S6 in S. E. and

S1 in S. W. quadrant; and raise a mound of stone

2 ft. base  $1\frac{1}{2}$  ft. high, S. of cor. Pits impracticable.

432 ft. below spur.

Land, mountainous.

Soil, rocky; 4th. rate.

No timber.

Undergrowth, mtn. mahogany, oak and catclaw.

Poor grass.

May 10, 1915.

Chains. April 22, 1915: At 7h. 00m. a.m., l.m.t., I set off  $34^{\circ} 32\frac{1}{2}'$  N. on the lat. arc;  $11^{\circ} 59\frac{1}{2}'$  N. on the decl. arc; and determine a meridian with the solar at the cor. of secs. 13, 18, 19 and 24 on the east Bdy. of the Tp. which is a stone firmly set in the ground, marked and witnessed as described by the surveyor general.

Thence I run  
North bet. secs. 13 and 18.  
Ascend through scattering brush.

15.73 Ridge bears E. and W. 325 ft. above cor. Descend.  
40.00 Set an iron post 3 ft. long, 1 in. diam., 26 ins. in the ground for  $\frac{1}{4}$  sec. cor., marked on brass cap  
1915 on S. rim;  
 $\frac{1}{4}$ S13 in W. and  
S18 in E. half; and raise a mound of stone 3 ft. base  $1\frac{1}{2}$  ft. high, W. of cor. Pits impracticable.

59.66 Wash 30 lks. wide course N. W. 559 ft. below ridge. Ascend.

65.09 Ridge bears N. W. and S. E. 113 ft. above wash. Descend.  
80.00 Set an iron post 3 ft. long, 3 ins. diam., in a mound of stone for cor. of secs. 7, 12, 13 and 18, marked on brass cap  
1915 on S. rim;  
T14N in N. half;  
R7WS12 in N. W.  
R6WS7 in N. E.  
S18 in S. E. and  
S13 in S. W. quadrant; and raise a mound of stone 2 ft. base  $1\frac{1}{2}$  ft. high, W. of cor. Pits impracticable.  
331 ft. below ridge.  
Land, mountainous.  
Soil, rocky; 4th. rate.  
No timber.  
Undergrowth, paloverde, catclaw and cactus.  
Poor grass.

April 22: At this cor. I set off  $12^{\circ} 03\frac{1}{2}'$  N. on the decl. arc; and observe the sun on the meridian at noon; the resulting lat. is  $31^{\circ} 33\frac{1}{2}'$  N.

North bet. secs. 7 and 12.  
Descend, through scattering brush.

4.13 Wash 60 lks. wide course W. 42 ft. below cor. Ascend.  
21.59 Ridge bears E. and W. 250 ft. above wash. Descend.  
28.98 Wash 20 lks. wide course W. 108 ft. below ridge. Ascend.  
40.00 Set an iron post 3 ft. long, 1 in. diam., 26 ins. in the ground for  $\frac{1}{4}$  sec. cor., marked on brass cap  
1915 on S. rim;  
 $\frac{1}{4}$ S12 in W. and  
S7 in E. half; and raise a mound of stone 2 ft. base  $1\frac{1}{2}$  ft. high, W. of cor. Pits impracticable.

80.00 Set an iron post 3 ft. long, 3 ins. diam., 24 ins. in the ground for cor. of secs. 1, 6, 7 and 12, marked on brass cap  
1915 on S. rim;  
T14N in N. half;  
R7WS1 in N. W.  
R8WS6 in N. E.  
S7 in S. E. and  
S12 in S. W. quadrant; and raise a mound of stone 2 ft. base  $1\frac{1}{2}$  ft. high, W. of cor. Pits impracticable.  
100 ft. above wash.  
Land, mountainous.  
Soil, rocky, 4th. rate.  
No timber.  
Undergrowth, paloverde, catclaw and cactus.  
Poor grass.

April 22, 1915.

20 North half of East boundary of Tn. 14 N. Rg. 7 W.

Chains. May 6, 1915: At 7h. 00m. a.m., l.m.t., I set off  $34^{\circ} 34\frac{1}{2}'$  N. on the lat. arc;  $16^{\circ} 21\frac{1}{2}'$  N. on the decl. arc; and determine a meridian with the solar at the cor. of secs. 1, 6, 7 and 12, on the T. 14 N. Rg. 7 W.

Thence I run  
North bet. secs. 1 and 6.  
Ascend through scattering brush.

40.00 Point for  $\frac{1}{4}$  sec. cor. falls on precipitous slope where it cannot be permanently established.

41.72 Ridge bears E. and W. 750 ft. above cor. At this point I Set an iron post 3 ft. long, 1 in. diam., in a mound of stone for witness cor.  $\frac{1}{4}$  sec. cor., marked on brass cap  
1915 on S. rim;  
WC $\frac{1}{4}$  in S. half;  
S1 in N. W. and  
S6 in N. E. quadrant; and raise a mound of stone  
2 ft. base  $1\frac{1}{2}$  ft. high, W. of cor. Pits impracticable.

80.00 Descend.  
Set an iron post 3 ft. long, 3 ins. diam., 24 ins. in the ground for cor. of  $\frac{1}{4}$  sec. cor., marked on brass cap  
1915 on S. rim;  
T14 $\frac{1}{2}$ N in N.  
R6W in E.  
T14N in S. and  
R7W in W. half;  
S36 in N. W.  
S31 in N. E.  
S6 in S. E. and  
S1 in S. W. quadrant; and raise a mound of stone  
2 ft. base  $1\frac{1}{2}$  ft. high, S. of cor. Pits impracticable.  
596 ft. below ridge.  
Land, mountainous.  
Soil, rocky; 4th. rate.  
Nottimber.  
Undergrowth, palo verde, oak and catclaw.  
Poor grass.

May 6, 1915.

North boundary of Tp. 14 N. Rg. 7 W.

Chains.

May 6, 1915:  
 I commence at the cor. of Tps. 14 and 14 $\frac{1}{2}$  N. Rgs. 6 and 7 W., hereinbefore described  
 Thence I run  
 West on a random line on N. bdy. of Tp. 14 N. Rg. 7 W. setting temp.  $\frac{1}{4}$  sec. and sec. cors. at intervals of 40.00 chs. and, at 477.40 chs. intersect W. bdy. of Tp. 14 N. Rg. 7 W. 14 lks. S. of the cor. of Tps. 14 and 14 $\frac{1}{2}$  N. Rgs. 7 and 8 W. hereinbefore described. The falling answers to a correction of 1' per mile S. counting from the N. W. cor. of the Tp.

May 6, 7, 8, 9, 11, 1915.

May 12, 1915; At 7h. 00m. a.m., l.m.t., I set off 34° 35 $\frac{1}{2}$ ' N. on the lat. arc; 17° 58 $\frac{1}{2}$ ' N. on the decl. arc; and determine a meridian with the solar at the cor. of Tps. 14 and 14 $\frac{1}{2}$  N. Rgs. 7 and 8 W. hereinbefore described.  
 Thence I run  
 S. 89° 59' E. bet. secs. 6 and 31, marking and blazing true line.  
 Descend along N. E. slope of mountain, through dense brush.

37.40 Set an iron post 3 ft. long, 1 in. diam., 10 ins. in the ground, in a mound of stone, for  $\frac{1}{4}$  sec. cor., marked on brass cap  
 1915 on S. rim;  
 $\frac{1}{4}$ S31 in N. and  
 S6 in S. half; and raise a mound of stone 2 ft. base 1 $\frac{1}{2}$  ft. high, N. of cor. Pits impracticable.

61.64 Wash, 15 lks. wide course S. E. 680 ft. below cor. Ascend.  
 66.00 Spur, 26 ft. above wash. Descend. Brush scattering.  
 71.34 Creek 10 lks. wide course S. Clear running water 6 ins. deep. 98 ft. below spur. Ascend.

77.40 Set an iron post 3 ft. long, 3 ins. diam., 24 ins. in the ground for cor. of secs. 5, 6, 31 and 32, marked on brass cap  
 1915 on S. rim;  
 T14 $\frac{1}{2}$ N in N.  
 T14N in S. and  
 R7W in W. half;  
 S31 in N. W.  
 S32 in N. E.  
 S5 in S. E. and  
 S6 in S. W. quadrant; and raise a mound of stone 2 ft. base 1 $\frac{1}{2}$  ft. high, W. of cor. Pits impracticable.  
 113 ft. above wash.  
 Land mountainous.  
 Soil, rocky; 4th. rate.  
 No timber  
 Undergrowth, oak, mtn. mahogany and catclaw.

S. 89° 59' E. bet. secs. 5 and 32.  
 Ascend steep W. slope, through scattering brush.

12.19 Ridge bears N. and S. 370 ft. above cor. Descend.  
 32.38 Wash 15 lks. wide course S. 451 ft. below ridge. Ascend.  
 40.00 Set an iron post 3 ft. long, 1 in. diam., 26 ins. in the ground for  $\frac{1}{4}$  sec. cor., marked on brass cap  
 1915 on S. rim;  
 $\frac{1}{4}$ S32 in N. and  
 S5 in S. half; and raise a mound of stone 2 ft. base 1 $\frac{1}{2}$  ft. high, N. of cor. Pits impracticable.

57.45 Ridge bears N. and S. 506 ft. above wash. Descend.  
 80.00 Set an iron post 3 ft. long, 3 ins. diam., 24 ins. in the ground for cor. of secs. 4, 5, 32 and 33, marked on brass cap  
 1915 on S. rim;

22

## North boundary of Tp. 14 N. Rg. 7 W.

Chains.

T14 $\frac{1}{2}$ N in N.  
 T14N in S. and  
 R7W in W. half;  
 S32 in N. W.  
 S33 in N. E.  
 S4 in S. E. and  
 S5 in S. W. quadrant; and raise a mound of stone 2  
 ft. base 1 $\frac{1}{2}$  ft. high, W. of cor. Pits impracticable.  
 124 ft. below ridge.  
 Land, mountainous.  
 Soil, rocky; 4th. rate.  
 No timber.  
 Undergrowth, oak, mtn. mahogany and catclaw.

---

S. 89° 59' E. bet. secs. 4 and 33.  
 Descend, through scattering brush.  
 14.80 Wash 15 lks. wide course S. E. 58 ft. below cor. Ascend.  
 34.69 Ridge bears N. and S. descend. 160 ft. above wash.  
 40.00 Set an iron post 3 ft. long, 1 in. diam., 26 ins. in the  
 ground for  $\frac{1}{4}$  sec. cor., marked on brass cap  
 1915 on S. rim;  
 $\frac{1}{4}$ S33 in N. and  
 S4 in S. half; and raise a mound of stone 2 ft.  
 base 1 $\frac{1}{2}$  ft. high, N. of cor. Pits impracticable.  
 72.70 Wash 15 lks. wide course S. 452 ft. below ridge. Ascend.  
 80.00 Set an iron post 3 ft. long, 3 ins. diam., 24 ins. in the  
 ground for cor. of secs. 3, 4, 33 and 34, marked on  
 brass cap  
 1915 on S. rim;  
 T14 $\frac{1}{2}$ N in N.  
 T14N in S. and  
 R7W in W. half;  
 S33 in N. W.  
 S34 in N. E.  
 S3 in S. E. and  
 S4 in S. W. quadrant; and raise a mound of stone  
 2 ft. base 1 $\frac{1}{2}$  ft. high, W. of cor. Pits impracticable.  
 This cor. is on spur brs. SW. 130 ft. above wash.  
 Land, mountainous.  
 Soil, rocky; 4th. rate.  
 No timber.  
 Undergrowth, oak, catclaw and laurel.

May 12, 1915.

May 13, 1915: At 7h. 00m. a.m., l.m.t., I set off 34°  
 35 $\frac{1}{2}$ ' N. on the lat. arc; 18° 14' N. on the decl. arc;  
 and determine a meridian with the solar at the cor. of  
 secs. 3, 4, 33 and 34.  
 Thence I run S. 89° 59' E. bet. secs. 3 and 34.  
 Descending, through dense brush.  
 11.00 Wash 20 lks. wide course S. E. 218 ft. below cor. Ascend.  
 14.50 51 ft. above wash, and along broken general S. slope,  
 ascending.  
 40.00 Set an iron post 3 ft. long, 1 in. diam., 26 ins. in the  
 ground for  $\frac{1}{4}$  sec. cor., marked on brass cap  
 1915 on S. rim;  
 $\frac{1}{4}$ S34 in N. and  
 S3 in S. half; and raise a mound of stone 2 ft.  
 base 1 $\frac{1}{2}$  ft. high, N. of cor. Pits impracticable.  
 79.90 Set an iron post 3 ft. long, 3 ins. diam., 24 ins. in the  
 ground for witness cor. at cor. of secs. 2, 3, 34 and 35,  
 marked on brass cap  
 1915 on S. rim;  
 WC N. of center;



Chains.	
80.00	<p>T14<math>\frac{1}{2}</math>N in N.  T14N in S. and  R7W in W. half;  S34 in N. W.  S35 in N. E.  S2 in S. E. and  S3 in S. W. quadrant; and raise a mound of stone 2  ft. base 1<math>\frac{1}{2}</math> ft. high, W. of cor. Pits impracticable.  True point for cor. of secs. 2, 3, 34 and 35, falls on  edge of slide where there would be difficulty in estab-  lishing it in a permanent manner.  492 ft. above wash.  Land, mountainous.  Soil, rocky; 4th. rate.  No timber.  Undergrowth, oak and catclaw.  Poor grass.</p>
18.74	<p>S. 89° 59' E. bet. secs. 2 and 35.  From true point for cor.  Along broken general S. slope, through scattering brush.  Wash 15 lks. wide course S. E. 48 ft. below cor.  Ascend.</p>
40.00	<p>Set an iron post 3 ft. long, 1 in. diam., 26 ins. in the  ground for <math>\frac{1}{4}</math> sec. cor., marked on brass cap  1915 on S. rim;  <math>\frac{1}{4}</math>S35 in N. and  S2 in S. half; and raise a mound of stone 2 ft.  base 1<math>\frac{1}{2}</math> ft. high, N. of cor. Pits impracticable.</p>
62.80	<p>Spur, brs. S. 34 ft. above wash.  Descend.</p>
80.00	<p>Set an iron post 3 ft. long, 3 ins. diam., 24 ins. in the  ground for cor. of secs. 1, 2, 35 and 36, marked on  brass cap  1915 on S. rim;  T14<math>\frac{1}{2}</math>N in N.  T14N in S. and  R7W in W. half;  S35 in N. W.  S36 in N. E.  S1 in S. E. and  S2 in S. W. quadrant; and raise a mound of stone  2 ft. base 1<math>\frac{1}{2}</math> ft. high, W. of cor. Pits impracticable.  297 ft. below spur.  Land, mountainous.  Soil, rocky; 4th. rate.  No timber.  Undergrowth, catclaw and oak.  Poor grass.</p>
2.40	<p>S. 89° 59' E. bet. secs. 1 and 36.  Descend, through scattering brush.  Creek 20 lks. wide course S. clear running water 6 ins.  deep. 43 ft. below cor.</p>
5.42	<p>Road bears N. and S.</p>
5.72	<p>Ridge bears N. and S. 57 ft. above creek.  Descend.</p>
10.97	<p>Sycamore Creek 50 lks. wide course S. clear running water  6 ins. deep. 170 ft. below ridge.  Ascend.</p>
40.00	<p>Set an iron post 3 ft. long, 1 in. diam., 26 ins. in the  ground for <math>\frac{1}{4}</math> sec. cor., marked on brass cap  1915 on S. rim;  <math>\frac{1}{4}</math>S36 in N. and  S1 in S. half; and raise a mound of stone 2 ft.</p>

Chains.  
80.00

base  $1\frac{1}{2}$  ft. high, N. of cor. Pits impracticable.  
The cor. of Tps. 14 and  $14\frac{1}{2}$  N. Rgs. 6 and 7 W. hereinbefore described.  
823 ft. above Sycamore Creek.  
Land, mountainous.  
Soil, rocky; 4th. rate.  
No timber.  
Undergrowth, oak, catclaw and paloverde.  
Poor grass.

May 13, 1915.

Boundaries of Tp. 14 N. Rg. 7 W.  
Latitudes, departures and closing errors.

Line designated	True bearing.	Dist.	Latitudes.		Departures.	
			N.	S.	E.	W.
			Chs.	Chs.	Chs.	Chs.
S. bdy. of Tp.,	West	477.53				477.53
W. Bdy. of Tp.,	North.	480.00	480.00			
N. bdy. of Tp.,	S. $89^{\circ}59'E.$	477.40		.14	477.40	
E. Bdy. of Tp.,	South.	480.00		480.00		
Convergency					.50	
Totals			480.00	480.14	477.90	477.53
				480.00	477.53	
			Error in lat.,		.14	
			Error in dep.			.37

GENERAL DESCRIPTION.

This township is rough and mountainous and the soil is generally rocky and worthless. There is no timber in the township. Sycamore Creek flows through the township from N. E. to S. W. joining with Kirkland Creek to form the Santa Maria River. There are no settlers in the unsurveyed portion of the township.

*John P. Hesse*  
U. S. Surveyor.

East boundary of Tn. 15 N. Rg. 7 W.

Chains.

May 27, 1915: At 7h. 00m. a.m., l.m.t., I set off 34° 35½' N. on the lat. arc; 21° 12' N. on the decl. arc; and determine a meridian with the solar at the cor. of Tps. 14 and 14½ N. Rgs. 6 and 7 W. hereinbefore described

Thence I run

North on a random line along the E. bdys. of Tps. 14½ and 15N . Rg. 7 W. setting temp. ¼ sec. and sec. cors. at intervals of 40.00 chs. and at 708.00 chs., intersect the S. bdy. of Tp. 16 N. Rg. 6 W. 35.55 chs. E. of the cor. of Tps. 15 and 16 N. Rgs. 6 and 7 W., which is a rock in place, marked and witnessed as described by the surveyor general. I obliterate grooves S. of cross and bearing trees S. of line and move mound of stone N. of cor., in order to change this cor. to refer to Tps. on the N. only, and at point of intersection,

Set an iron post 3 ft. long, 3 ins. diam., 24 ins. in the ground for closing cor. of Tps. 15 N. Rgs. 6 and 7 W. marked on brass cap

1915 on S. rim;

CC S. of center;

T16N R7W S36 R6W S31 in N. and

T15 N in S. half;

S6 R6W in S. E. and

S1 R7W in S. W. quadrant; and raise a mound of stone

2 ft. base 1½ ft. high, S. of cor. Pits impracticable.

May 27, 28, 29, 31, June 1, 1915.

June 3, 1915: At 2h. 00m. p.m., l.m.t., I set off 34° 43' N. on the lat. arc; 22° 16½' N. on the decl. arc; and determine a meridian with the solar at the closing cor. of Tps. 15 N. Rgs. 6 and 7 W. hereinbefore described.

Thence I run

South bet. secs. 1 and 6, marking and blazing true line. Descend rough S. slope through dense brush.

28.50 Creek 5 lks. wide course E. clear running water 3 ins. deep. 340 ft. below closing cor.

Ascend.

40.00 Set an iron post 3 ft. long, 1 in. diam., 26 ins. in the ground for ¼ sec. cor., marked on brass cap

1915 on S. rim;

¼S1 in W. and

S6 in E. half; from which

An oak 10 ins. diam., bears S. 85° E. 34 lks. dist., marked ¼S6BT.

An oak 14 ins. diam., bears S. 34¾° W. 37 lks. dist., marked ¼S1BT.

58.51 Edge of mesa 294 ft. above creek, and over top of mesa through dense timber and brush.

80.00 Set an iron post 3 ft. long, 3 ins. diam., 24 ins. in the ground for cor. of secs. 1, 6, 7 and 12, marked on brass cap

1915 on S. rim;

T15N in N. half;

R7WS1 in N. W.

R6WS6 in N. E.

S7 in S. E. and

S12 in S. W. quadrant; from which

A cedar 10 ins. diam., bears N. 70½° W. 33 lks. dist., marked T15NR7WS1BT.

A cedar 6 ins. diam., bears N. 15° E. 53 lks. dist., marked T15NR6WS6BT.

A cedar 8 ins. diam., bears S. 12° E. 31 lks. dist., marked T15NR6WS7BT.

A pinon 10 ins. diam., bears S. 71¾° W. 146 lks. dist., marked T15NR7WS12BT.

Land, level and mountainous.

Chains.

Soil, rocky; 4th. rate.  
 Timber, Cedar, pinon, oak and sycamore.  
 Undergrowth, oak and manzanita, and laurel.

June 3, 1915.

June 4, 1915: At 7h. 00m. a.m., l.m.t., I set off  $34^{\circ}$   
 $42'$  N. on the lat. arc;  $22^{\circ} 22\frac{1}{2}'$  N. on the decl. arc;  
 and determine a meridian with the solar at the cor. of  
 secs. 1, 6, 7 and 12. on the S. slope of mesa.

Thence I run

South bet. secs. 7 and 12.

Over nearly level mesa, through dense timber and brush.

40.00 Set an iron post 3 ft. long, 1 in. diam., in a mound of  
 stone for  $\frac{1}{4}$  sec. cor., marked on brass cap

1915 on S. rim;

 $\frac{1}{4}$ S12 in W. and

S7 in E. half; from which

A cedar 6 ins. diam., bears S.  $77\frac{3}{4}^{\circ}$  E. 21 lks.  
 dist., marked  $\frac{1}{4}$ S7BT.

A cedar 8 ins. diam., bears S.  $37\frac{1}{2}^{\circ}$  W. 22 lks.  
 dist., marked  $\frac{1}{4}$ S12BT.

43.88 Edge of mesa. I mark a point on line by a peg driven in t  
 the ground. Descend steep S. slope. Timber becomes  
 very scattering.

58.90 Creek 15 lks. wide course E. clear running water 3 ins.  
 deep. 382 ft. below mesa.

59.90 Creek 20 lks. wide course E. clear running water 3 ins.  
 deep.

Ascend rough N. slope.

71.80 Spur bears E. Point of mesa 100 lks. west. 332 ft. above  
 creek. Descend.

80.00 Set an iron post 3 ft. long, 3 ins. diam., in a mound of  
 stone for cor. of secs. 7, 12, 13, and 18, marked on  
 brass cap

1915 on S. rim;

T15N in N. half;

R7WS12 in N. W.

R6WS7 in N. E.

S18 in S. E. and

S13 in S. W. quadrant; and raise a mound of stone

2 ft. base  $1\frac{1}{2}$  ft. high, W. of cor. Pits impracticable.  
 189 ft. below spur.

Land, mountainous.

Soil, rocky; 4th. rate.

Timber, cedar and pinon.

Undergrowth, oak, laurel and manzanita.

Poor grass.

June 4; At this cor. I set off  $22^{\circ} 23'$  N. on the decl.  
 arc; and observe the sun on the meridian at noon; the  
 resulting lat. is  $34^{\circ} 41'$  N.

June 5, 1915:

To test the alinement of this bdy. I proceed as follows:  
 I set my transit over peg on line at 43.88 pt. on edge of  
 mesa, established June 4, from which point my sights on  
 the random line south of this point are visible.

At 2h. 42m. a.m., I observe Polaris at eastern elonga-  
 tion in accordance with Manual of Instructions, and set  
 off the azimuth of Polaris  $1^{\circ} 24'$  to the west, and mark  
 the meridian thus determined by a peg driven firmly in  
 the ground 4 chs. N. of my station.

At 6h. 00m. a.m., l.m.t., I deflect from this meridian  
 to my sights on random line and find that the random  
 line varies less than 1' in arc from the meridian deter-  
 mined by the Polaris observation.

Chains.

At 7h. 00m. a.m., l.m.t., I set off  $34^{\circ} 41'$  N. on the lat. arc;  $22^{\circ} 29\frac{1}{2}'$  N. on the decl. arc; and determine a meridian with the solar at the cor. of secs. 7, 12, 13 and 18.

Thence I run South bet. secs. 13 and 18. Descend rough S. E. slope through scattering brush and timber.

27.35 134 ft. below cor. Ascend.

36.25 Spur, brs. SW. 74 ft. above 27.35 chn. pt. Descend.

40.00 Set an iron post 3 ft. long, 1 in. diam., 10 ins. in the ground in a mound of stone, for  $\frac{1}{4}$  sec. cor., marked on brass cap  
 1915 on S. rim;  
 $\frac{1}{4}$ S13 in W. and  
 S18 in E. half; and raise a mound of stone 2 ft. base  $1\frac{1}{2}$  ft. high, W. of cor. Pits impracticable.

67.30 298 ft. below spur. Ascend.

77.80 Spur, brs. SE. 17 ft. above 67.30 chn. point. Descend.

80.00 Set an iron post 3 ft. long, 3 ins. diam., 24 ins. in the ground for cor. of secs. 13, 18, 19 and 24, marked on brass cap  
 1915 on S. rim;  
 T15N in N. half;  
 R7WS13 in N. W.  
 R6WS18 in N. E.  
 S19 in S. E. and  
 S24 in S. W. quadrant; and raise a mound of stone 2 ft. base  $1\frac{1}{2}$  ft. high, W. of cor. Pits impracticable.

93 ft. below spur.  
 Land, mountainous.  
 Soil, rocky; 4th. rate.  
 Timber, a few scattering cedars.  
 Undergrowth, catclaw, laurel and oak.  
 June 5: At this cor. I set off  $22^{\circ} 30'$  N. on the decl. arc; and observe the sun on the meridian at noon; the resulting lat. is  $34^{\circ} 40\frac{1}{2}'$  N.

South, bet. secs. 19 and 24. Descend through dense brush.

3.60 30 ft. below cor. Ascend.

14.00 Spur, brs. SE. 40 ft. above 3.60 chn. point. Descend.

21.84 Creek 10 lks. wide course S. W. clear running water 2 ins. deep. 244vft. below spur. Ascend.

24.00 Spur, brs. SW. 94 ft. above creek. Descend.

27.40 Creek 10 lks. wide course S. E. clear running water 2 ins. deep. 200 ft. below spur. Ascend.

40.00 Set an iron post 3 ft. long, 1 in. diam., in a mound of stone for  $\frac{1}{4}$  sec. cor., marked on brass cap  
 1915 on S. rim;  
 $\frac{1}{4}$ S24 in W. and  
 S19 in E. half; and raise a mound of stone 2 ft. base  $1\frac{1}{2}$  ft. high, W. of cor. Pits impracticable.

40.60 Brush becomes scattering.

47.30 Spur, brs. SE. 281 ft. above creek. Descend.

55.20 Wash 25 lks. wide course S. E. 130 ft. below spur. Ascend.

66.75 Spur, brs. SE. 68 ft. above wash. Descend.

80.00 Set an iron post 3 ft. long, 3 ins. diam., 24 ins. in the ground for cor. of secs. 19, 24, 25 and 30, marked on brass cap  
 1915 on S. rim;  
 T15N in N. half;  
 R7WS24 in N. W.  
 R6WS19 in N. E.  
 S30 in S. E. and  
 S25 in S. W. quadrant; from which  
 A cedar 10 ins. diam., bears N.  $16\frac{1}{4}^{\circ}$  W. 77 lks. dist., marked T15NR7WS24BT.

28  
Chains.

## East boundary of Tp. 15 N. Rg. 7 W.

A cedar 4 ins. diam., bears S.  $16\frac{1}{4}^{\circ}$  W. 28 lks. dist., marked T15NR7WS25BT.

No other bearings available. Raise a mound of stone 2 ft. base  $1\frac{1}{2}$  ft. high, W. of cor. Pits impracticable. 165 ft. below spur.

Land, mountainous.

Soil, rocky; 4th. rate.

Timber, a few scattering cedars.

Undergrowth, oak, catclaw and laurel.

Poor grass.

June 5, 1915.

June 7, 1915: At 7h. 00m. a.m., l.m.t., I set off  $34^{\circ} 39\frac{1}{2}'$  N. on the lat. arc;  $22^{\circ} 42\frac{1}{2}'$  N. on the decl. arc; and determine a meridian with the solar at the cor. of secs. 19, 24, 25 and 30,

Thence I run

South bet. secs. 25 and 30

Descend, through scattering brush.

9.04 Wash 10 lks. wide course S. E. 36 ft. below cor.

17.30 Wash 25 lks. wide course S. E. 86 ft. below cor.

24.22 Spur, brs. E. 20 ft. above wash.

29.20 Wash 15 lks. wide course S. E. 179 ft. below spur.

40.00 Set an iron post 3 ft. long, 1 in. diam., 26 ins. in the ground for  $\frac{1}{4}$  sec. cor., marked on brass cap  
1915 on S. rim;  
 $\frac{1}{4}$ S25 in W. and  
S30 in E. half; from which

A cottonwood 12 ins. diam., bears S.  $74^{\circ}$  W. 122 lks. dist., marked  $\frac{1}{4}$ S25BT.

No other bearings available. Raise a mound of stone 2 ft. base  $1\frac{1}{2}$  ft. high, W. of cor. Pits impracticable.

40.45 Wash 20 lks. wide course E. 325 ft. below spur, and along broken E. slope.

48.62 Wash 15 lks. wide course E.

59.20 Wash 15 lks. wide course E.

64.90 Spur, brs. E. 70 ft. above Wash.

74.75 Wash, 15 lks. wide course E. 60 ft. below spur.

80.00 Set an iron post 3 ft. long, 3 ins. diam., 24 ins. in the ground for cor. of secs. 25, 30, 31 and 36, marked on brass cap

1915 on S. rim;

T15N in N. half;

R7WS25 in N. W.

R6WS30 in N. E.

S31 in S. E. and

S36 in S. W. quadrant; and raise a mound of stone 2 ft. base  $1\frac{1}{2}$  ft. high, W. of cor. Pits impracticable. 70 ft. above wash.

Land, mountainous.

Soil, rocky; 4th. rate.

No timber.

Undergrowth, oak, laurel and catclaw.

Poor grass.

June 7; At this cor. I set off  $22^{\circ} 43'$  N. on the decl. arc; and observe the sun on the meridian at noon; the resulting lat. is  $34^{\circ} 38\frac{1}{2}'$  N.

South bet. secs. 31 and 36.

Along rough E. slope through scattering brush.

3.00 Wash 40 lks. wide course S. E. 30 ft. below cor.

5.40 Spur, brs. SE. 83 ft. above wash.

14.90 Wash 40 lks. wide course S. E. 111 ft. below spur.

28.30 Wash 25 lks. wide course E. 156 ft. below spur.

36.74 Wash 10 lks. wide course E. 196 ft. below spur. Ascend.

East boundary of Tn. 15 N. Rg. 7 W.

Chains. 40.00	Set an iron post 3 ft. long, 1 in. diam., 6 ins. in the ground in a mound of stone for $\frac{1}{4}$ sec. cor., marked on brass cap 1915 on S. rim; $\frac{1}{4}$ S36 in W. and S31 in E. half; and raise a mound of stone 2 ft. base $1\frac{1}{2}$ ft. high, W. of cor. Pits impracticable.
44.75	Spur, brs. E. 308 ft. above wash. and along broken E. slope.
80.00	Set an iron post 3ft. long, 3 ins. diam., 14 ins. in the ground in a mound of stone, for cor. of Tps. $14\frac{1}{2}$ and 15 N. Rgs. 6 and 7 W., marked on brass cap 1915 on S. rim; T15N in N. R6W in E. T14 $\frac{1}{2}$ N in S. and R7W in W. half; S36 in N. W. S31 in N. E. S19 in S. E. and S24 in S. W. quadrant; from which A cedar 18 ins. diam., bears N. $39\frac{3}{4}^{\circ}$ W. 142 lks. dist., marked T15NR7WS36BT. A laurel 4 ins. diam., bears N. $36\frac{1}{2}^{\circ}$ E. 130 lks. dist., marked T15NR6WS31BT. A cedar 12 ins. diam., bears S $37\frac{1}{2}^{\circ}$ E. 76 lks. dist., marked T14 $\frac{1}{2}$ NR6WS19BT. A cedar 12 ins. diam., bears S. $30\frac{1}{4}^{\circ}$ W. 60 lks. dist., marked T14 $\frac{1}{2}$ NR6WS24BT.

Land, mountainous.  
Soil, rocky; 4th. rate.  
Timber, a very few scattering cedars.  
Undergrowth, oak, catclaw and laurel.  
Poor grass.

June 7, 1915.

30 East boundary of fractional Tp. 14 $\frac{1}{2}$ N. Rg. 7 W.

Chains.	<p>June 8, 1915; At 7h. 00m. a.m., l.m.t., I set off 34° 37<math>\frac{1}{2}</math>' N. on the lat. arc; 22° 48<math>\frac{1}{2}</math>' N. on the decl. arc; and determine a meridian with the solar at the cor. of Tps. 14<math>\frac{1}{2}</math> and 15 N. Rgs. 6 and 7 W. hereinbefore described</p> <p>Thence I run            South bet. secs. 19 and 24.            Along general E. slope through scattering brush.            Spur, brs E. 30 ft. above cor. Descend S. E. slope.            1.00            18.24 Wash 30 lks. wide course S. E. 345 ft. below spur.            21.40 Wash 35 lks. wide course S. E. 500 ft. below spur.            28.00 Set an iron post 3 ft. long, 1 in. diam., 26 ins. in the ground for <math>\frac{1}{4}</math> sec. cor., marked on brass cap                1915 on S. rim;                <math>\frac{1}{4}</math>S24 in W. and                S19 in E. half; and raise a mound of stone 2 ft. base 1<math>\frac{1}{2}</math> ft. high, W. of cor. Pits impracticable.            68.00 Set an iron post 3 ft. long, 3 ins. diam., 24 ins. in the ground for cor. of secs. 19, 24, 25 and 30, marked on brass cap                1915 on S. rim;                T14<math>\frac{1}{2}</math>N in N. half;                R7WS24 in N. W.                R6WS19 in N. E.                S30 in S. E. and                S25 in S. W. quadrant; and raise a mound of stone 2 ft. base 1<math>\frac{1}{2}</math> ft. high, W. of cor. Pits impracticable.            Land, mountainous.            Soil, rocky; 4th. rate.            No timber.            Undergrowth, oak and laurel.            76 ft. above wash.            From this cor, T. Anderson house bears S. 36° 33' E.</p> <hr/> <p>South bet. secs. 25 and 30.            Descending along S. E. slope through scattering brush.            4.45 Wash 25 lks. wide course S. E. 61 ft. below cor.            20.12 Road bears E. and W.            24.54 Wash 25 lks. wide course S. E. 98 ft. below cor.            40.00 Set an iron post 3 ft. long, 1 in. diam., 26 ins. in the ground for <math>\frac{1}{4}</math> sec. cor., marked on brass cap                1915 on S. rim;                <math>\frac{1}{4}</math>S25 in W. and                S30 in E. half; and raise a mound of stone 2 ft. base 1<math>\frac{1}{2}</math> ft. high, W. of cor. Pits impracticable.            48.41 Sycamore Creek 80 lks. wide course S. W. clear running wa                water 6 ins. deep. 125 ft. below cor.            Ascend.            50.86 T. Anderson house bears N. 45° 51' E.            57.44 Wash 25 lks. wide course W.            80.00 Set an iron post 3 ft. long, 3 ins. diam., 24 ins. in the ground for cor. of secs. 25, 30, 31 and 36, marked on brass cap                1915 on S. rim;                T14<math>\frac{1}{2}</math>N in N. half;                R7WS25 in N. W.                R6WS30 in N. E.                S31 in S. E. and                S36 in S. W. quadrant; and raise a mound of stone 2 ft. base 1<math>\frac{1}{2}</math> ft. high, W. of cor. Pits impracticable.            254 ft. above Sycamore Creek.            Land, mountainous.            Soil, rocky; 4th. rate.            No timber.            Undergrowth, oak and laurel.            Poor grass.            June 8: At this cor. I set off 22° 48<math>\frac{1}{2}</math>' N. on the decl. arc; and observe the sun on the meridian at noon the resulting lat. is 34° 36' N.</p>
---------	--



Chains.

40.00 South bet. secs. 31 and 36.  
 Ascend rough N. slope through scattering brush.  
 Set an iron post 3 ft. long, 1 in. diam., 26 ins. in the  
 ground for  $\frac{1}{4}$  sec. cor., marked on brass cap  
 1915 on S. rim;  
 $\frac{1}{4}$ S36 in W. and  
 S31 in E. half; and raise a mound of stone 2 ft.  
 base  $1\frac{1}{2}$  ft. high, W. of cor. Pits impracticable.

80.00 The cor. of Tps. 14 and 14 $\frac{1}{2}$  N. Rgs. 6 and 7 W. hereinbefore  
 described.  
 478 ft. above sec. cor.  
 Land, mountainous.  
 Soil, rocky; 4th. rate.  
 No timber.  
 Undergrowth, oak, laurel and catclaw.  
 Poor grass.

June 8, 1915.

## Chains.

July 3, 1915; The solar attachment on my transit having been injured beyond possibility of repair in the field, At 7h. 00m. a.m., l.m.t., I pick up my line at the cor. of Tps. 14 and 14 $\frac{1}{2}$  N. Rgs. 7 and 8 W. from sights established in running the W. bdy. of Tp. 14 N. Rg. 7 W. and from the cor. of Tps. 14 and 14 $\frac{1}{2}$  N. Rgs. 7 and 8 W. hereinbefore described  
I run with fore and back sights.  
North bet. secs. 31 and 36.  
Descend through scattering brush.

2.00 Ascend S. E. slope.

10.00 Spur, b<sub>rs</sub>E. 83 ft. above cor. and along general E. slope.

40.00 Spur, b<sub>rs</sub>E. 19 ft. below last spur.  
Set an iron post 3 ft. long, 1 in. diam., 10 ins. in the ground in a mound of stone for  $\frac{1}{4}$  sec. cor., marked on brass cap  
1915 on S. rim;  
 $\frac{1}{4}$ S36 in W. and  
S31 in E. half; and raise a mound of stone 2 ft. base  $1\frac{1}{2}$  ft. high, W. of cor. Pits impracticable.

45.50 Wash, 10 lks. wide course E. 30 ft. below spur.

57.00 Wash, 10 lks. wide course E. 18 ft. below last wash.

80.00 Set an iron post 3 ft. long, 3 ins. diam., 24 ins. in the ground, for cor. of secs. 25, 30, 31 and 36, marked on brass cap  
1915 on S. rim;  
T14 $\frac{1}{2}$ N in N. half;  
B8WS25 in N. W.  
R7WS30 in N. E.  
S31 in S. E. and  
S36 in S. W. quadrant; and raise a mound of stone 2 ft. base  $1\frac{1}{2}$  ft. high, W. of cor. Pits impracticable.  
95 ft. below wash.  
Land, mountainous.  
Soil, rocky; 4th. rate.  
No timber.  
Undergrowth, oak, laurel and mahogany.  
Poor grass.

July 3, 1915.

July 8, 1915; At 7h. 00m. a.m., l.m.t., I pick up my transit line at the cor. of secs. 25, 30, 31 and 36 of the W. bdy. of Tp. 14 $\frac{1}{2}$  N. Rg. 7 W.  
Thence I run  
North bet. secs. 25 and 30.  
Along steep rough E. slope, through scattering brush.

8.30 Wash 10 lks. wide course E. 102 ft. below cor.

20.08 Spur, b<sub>rs</sub>E. 228 ft. above wash, Descend N. E. slope.

40.00 Set an iron post 3 ft. long, 1 in. diam., 26 ins. in the ground for  $\frac{1}{4}$  sec. cor., marked on brass cap  
1915 on S. rim;  
 $\frac{1}{4}$ S25 in W. and  
S30 in E. half; and raise a mound of stone 2 ft. base  $1\frac{1}{2}$  ft. high, W. of cor. Pits impracticable.

43.94 Wash 50 lks. wide course S. E. 229 ft. below spur.  
Ascend.

50.20 Along rough W. slope.

80.00 Set an iron post 3 ft. long, 3 ins. diam., 24 ins. in the ground for cor. of secs. 19, 24, 25 and 30, marked on brass cap  
1915 on S. rim;  
T14 $\frac{1}{2}$ N in N. half;  
R8WS24 in N. W.  
R7WS19 in N. E.  
S30 in S. E. and  
S25 in S. W. quadrant; and raise a mound of stone 2 ft. base  $1\frac{1}{2}$  ft. high, W. of cor. Pits impracticable.  
160 ft. above wash.

West boundary of frac. Township 14 $\frac{1}{2}$  North, Range 7 West. 33.

Chains.

Land, mountainous.  
Soil, rocky, 4th rate.  
No timber.  
Undergrowth, oak, laurel and mountain mahogany.

-----  
North, bet. secs. 19 and 24.  
Along rough west slope, ascending through scattering brush.

- 18.00 126 ft. above cor. Descend.
- 32.05 Wash, 50 lks. wide, course SW., 62 ft. below 18.00 chain point; ascend.
- 40.00 Set an iron post 3 ft. long, 1 in. in diam., 20 ins. in the ground in a mound of stone for  $\frac{1}{4}$  sec. cor., marked on brass cap,  
  - 1915 in S. rim;
  - $\frac{1}{4}$  S 24 in W., and
  - S 19 in E. half;
 and raise a mound of stone 2 ft. base, 1 $\frac{1}{2}$  ft. high, W. of cor. Pits impracticable.
- 59.00 Spur, brs. SE. 325 ft. above wash; descend.
- 68.00 (Length of E. bdy. of Tp., bet. secs. 19 and 24). Set temp. Tp. cor. at this point July 8, 1915.  
 July 9, 1915. When surveying S. bdy. of T. 15 N., R. 7 W. fall 3 lks. south of this temp. Tp. cor.; therefore, at
- 67.97 Set an iron post 3 ft. long, 3 ins. in diam., 12 ins. in the ground in a mound of stone, for cor. of Ts. 14 $\frac{1}{2}$  and 15 N., Rs. 7 and 8 W., marked on brass cap,  
  - 1915 in S. rim;
  - T 15 N in N.,
  - R 7 W in E.,
  - T 14 $\frac{1}{2}$  N in S., and
  - R 8 W in W. half;
  - S 36 in NW.,
  - S 31 in NE.,
  - S 19 in SE.; and
  - S 24 in SW. quadrant;
 and raise a mound of stone 2 ft. base, 1 $\frac{1}{2}$  ft. high, S. of cor. Pits impracticable.  
 231 ft. below spur.  
 Land, mountainous.  
 Soil, rocky, 4th rate.  
 No timber.  
 Undergrowth, oak, laurel and mountain mahogany.  
 July 8, 1915.

-----

## 34. West half of South bdy. of Township 15 North, Range 6 West.

Chains.

- June 9, 1915: At 7h.00m. a.m., l.n.t., I set off  $34^{\circ}37\frac{1}{2}'$  N. on the lat. arc;  $22^{\circ}54'$  N. on the decl. arc; and determine a meridian with the solar at the cor. of Ts. 14 $\frac{1}{2}$  and 15 N., Rs. 6 and 7 W., hereinbefore described.
- Thence I run,  
East, bet. secs. 19 and 31.  
Descend through scattering brush and timber.
- 7.00 Loco Creek, 20 lks. wide, course S. Clear running water 6 ins. deep, 308 ft. below Tp. cor. Ascend.
- 27.15 Wash, 10 lks. wide, course SW.
- 40.00 Set an iron post 3 ft. long, 1 in. in diam., 26 ins. in the ground for  $\frac{1}{4}$  sec. cor., marked on brass cap,  
1915 in S. rim;  
 $\frac{1}{4}$  S 31 in N., and  
S 19 in S. half; from which,  
A cedar, 5 ins. in diam., brs. N.  $26^{\circ}$  W., 57 lks. dist., marked  $\frac{1}{4}$  S 31 B T.  
A cedar, 14 ins. in diam., brs. S.  $7\frac{1}{2}^{\circ}$  W., 22 lks. dist., marked  $\frac{1}{4}$  S 19 B T.
- 240 ft. above Loco Creek; thence along south slope.
- 49.20 Wash, 5 lks. wide, course S. 23 ft. below  $\frac{1}{4}$  sec. cor.
- 51.58 Wash, 15 lks. wide, course S. 30 ft. below last wash.
- 62.81 Spur, brs. SW 61 ft. above wash.
- 72.48 Spur, brs. S. 26 ft. above last spur. Descend steep east slope.
- 80.00 Set an iron post 3 ft. long, 3 ins. in diam., 24 ins. in the ground for cor. of secs. 19, 20, 31 and 32, marked on brass cap,  
1915 in S. rim,  
T 15 N in N.,  
T 14 $\frac{1}{2}$  N in S., and  
R 6 W in W. half;  
S 31 in NW.,  
S 32 in NE.,  
S 20 in SE., and  
S 19 in SW. quadrant;  
and raise a mound of stone 2 ft. base, 1 $\frac{1}{2}$  ft. high, W. of cor. Pits impracticable.
- 160 ft. below spur.  
Land, mountainous. Soil rocky, 4th rate.  
Timber, a few cedars.  
Undergrowth, oak, laurel and catclaw. Poor grass.
- June 9: At this cor. I set off  $22^{\circ}54'$  N. on the decl. arc; and observe the sun on the meridian at noon; the resulting lat. is  $34^{\circ}37\frac{1}{2}'$  N.
- 
- East, bet. secs. 20 and 32.  
Descend steep E. slope, through scattering timber and brush.
- 13.93 Smith Canyon Creek, 25 lks. wide, course S.; clear running water, 12 ins. deep, 419 ft. below cor.  
Ascend steep west slope.
- 24.00 Ridge, brs. N. and S.: 265 ft. above creek. Descend.
- 38.48 Wash, 5 lks. wide, course NW. 166 ft. below ridge.
- 40.00 Set an iron post 3 ft. long, 1 in. in diam., 6 ins. in the ground in a mound of stone, for  $\frac{1}{4}$  sec. cor., marked on brass cap, 1915 in S. rim;  
 $\frac{1}{4}$  S 32 in N., and  
S 20 in S. half; from which,  
A cedar, 18 ins. in diam., brs. N.  $1\frac{1}{4}^{\circ}$  E., 150 lks. dist., marked  $\frac{1}{4}$  S 32 B T.  
A cedar, 18 ins. in diam., brs. S.  $83\frac{1}{4}^{\circ}$  E., 145 lks. dist., marked  $\frac{1}{4}$  S 20 B T.
- 47.28 Along broken S. slope, gradually descending.
- 54.06 Wash, 15 lks. wide, course S.
- 73.46 Wash, 10 lks. wide, course S. 125 ft. below ridge.

Chains.

80.00

Set an iron post 3 ft. long, 3 ins. diam., 24 ins. in the ground for cor. of secs. 20, 21, 32 and 33, marked on brass cap

1915 on S. rim;  
 T15N in N.  
 T14 $\frac{1}{2}$ N in S. and  
 R6W in W. half;  
 S32 in N. W.  
 S33 in N. E.  
 S21 in S. E. and  
 S20 in S. W. quadrant; and raise a mound of stone 2 ft. base 1 $\frac{1}{2}$  ft. high, W. of cor. Pits impracticable.  
 21 ft. above wash.  
 Land, mountainous.  
 Soil, rocky; 4th. rate.  
 No timber.  
 Undergrowth, oak laurel and catclaw.  
 Poor grass.

June 9, 1915.

June 17, 1915.

East bet. secs. 33 and 21.  
 Along broken S. slope, gradually descending through dense brush and scattering timber.

30.93

Cottonwood Creek 10 lks. wide course S. W. clear running water 3 ins. deep. 144 ft. below cor. Ascend.

40.00

Set an iron post 3 ft. long, 1 in. diam., 26 ins. in the ground for  $\frac{1}{4}$  sec. cor., marked on brass cap

1915 on S. rim;  
 $\frac{1}{4}$ S33 in N. and  
 S21 in S. half; and raise a mound of stone 2 ft. base 1 $\frac{1}{2}$  ft. high, N. of cor. Pits impracticable.

51.02

Spur, bears N. Descend.

80.00

Set an iron post 3 ft. long, 3 ins. diam., 18 ins. in the ground in a mound of stone, for cor. of secs. 21, 22, 33 and 34, marked on brass cap

1915 on S. rim;  
 T15N in N.  
 T14 $\frac{1}{2}$ N in S. and  
 R6W in W. half;  
 S33 in N. W.  
 S34 in N. E.  
 S22 in S. E. and  
 S21 in S. W. quadrant; and raise a mound of stone 2 ft. base 1 $\frac{1}{2}$  ft. high, W. of cor. Pits impracticable.  
 514 ft. above creek.  
 Land, mountainous.  
 Soil, rocky; 4th. rate.  
 Timber, scattering cedars.  
 Undergrowth, oak, laurel and catclaw.  
 Poor grass.

June 17, 1915.

Chains.

June 10, 1915; At 7h. 00m. a.m., l.m.t., I set off  $34^{\circ} 35\frac{1}{2}'$  N. on the lat. arc;  $22^{\circ} 59'$  N. on the decl. arc; and determine a meridian with the solar at the cor. of Tps. 14 and  $14\frac{1}{2}$  N. Rgs. 6 and 7 W. hereinbefore described

Thence I run

East bet. secs. 6 and 31

Along broken N. slope through dense brush.

40.00 Set an iron post 3 ft. long, 1 in. diam., 26 ins. in the ground for  $\frac{1}{4}$  sec. cor., marked on brass cap

1915 on S. rim;

$\frac{1}{4}$ S31 in N. and

S6 in S. half; and raise a mound of stone 2 ft.

base  $1\frac{1}{2}$  ft. high, N. of cor. Pits impracticable.

78.42 Along S. slope of ridge.

80.00 Set an iron post 3 ft. long, 3 ins. diam., in a mound of stone for cor. of secs. 5, 6, 31 and 32, marked on brass cap

1915 on S. rim;

T14 $\frac{1}{2}$ N in N.

T14N in S. and

R6W in W. half;

S31 in N. W.

S32 in N. E.

S5 in S. E. and

S6 in S. W. quadrant; and raise a mound of stone

2 ft. base  $1\frac{1}{2}$  ft. high, W. of cor. Pits impracticable.

Land, mountainous.

Soil, rocky; 4th. rate.

No timber.

Undergrowth, oak, laurel, catclaw and mesquite.

Poor grass.

11 ft. above Tp. cor.

June 10; At this cor. I set off  $22^{\circ} 59'$  N. on the decl. arc; and observe the sun on the meridian at noon; the resulting lat. is  $34^{\circ} 35\frac{1}{2}'$  N.

June 10, 1915.

June 14, 1915; At 7h. 00m. a.m., l.m.t., I set off  $34^{\circ} 35\frac{1}{2}'$  N. on the lat. arc;  $23^{\circ} 15'$  N. on the decl. arc; and determine a meridian with the solar at the cor. of secs. 5, 6, 31 and 32

Thence I run

East bet. secs. 5 and 32.

Along rough S. slope through dense brush.

33.80 93 ft. below cor. Ascend steep N. W. slope.

40.00 Set an iron post 3 ft. long, 1 in. diam., 26 ins. in the ground for  $\frac{1}{4}$  sec. cor., marked on brass cap

1915 on S. rim;

$\frac{1}{4}$ S32 in N. and

S5 in S. half; and raise a mound of stone 2 ft.

base  $1\frac{1}{2}$  ft. high, N. of cor. Pits impracticable.

51.63 Top of mesa 320 ft. above 33.80 chn. point. Over rolling top of mesa. Leave brush.

77.98 Descend steep N. E. slope, through dense brush.

80.00 Set an iron post 3 ft. long, 3 ins. diam., 24 ins. in the ground for cor. of secs. 4, 5, 32 and 33, marked on brass cap

1915 on S. rim;

T14 $\frac{1}{2}$ N in N.

T14N in S. and

R6W in W. half;

S32 in N. W.

S33 in N. E.

S4 in S. E. and

S5 in S. W. quadrant; and raise a mound of stone

2 ft. base  $1\frac{1}{2}$  ft. high, W. of cor. Pits impracticable.

West half of North bdy. of Township 14 North, Range 6 West. 37.

Chains.  
 81 ft. below rim of mesa.  
 Land, mountainous. Soil, rocky, 4th rate.  
 Timber, a very few cedars.  
 Undergrowth, oak, laurel and catclaw. Poor grass.  
 June 14, 1915.

---

40.00 June 18, 1915: At 8h.00m.a.m., l.m.t., I set off  $34^{\circ}35\frac{1}{2}'N.$  on the lat.arc;  $23^{\circ}24\frac{1}{2}'N.$  on the decl.arc; and determine a meridian with the solar at the cor. of secs. 4, 5, 32 and 33. Thence I run, East, bet. secs. 4 and 33. Descending along steep broken NE. slope, through dense brush.

63.40 Set an iron post 3 ft. long, 1 in. in diam., 26 ins. in the ground for  $\frac{1}{2}$  sec. cor., marked on brass cap, 1915 in S. rim;  $\frac{1}{2}$  S 33 in N., and S 4 in S. half; and raise a mound of stone 2 ft. base,  $1\frac{1}{2}$  ft. high, N. of cor. Pits impracticable.

30.00 Wash, 40 lks. wide, course NW. 1060 ft. below cor. Ascend SW. slope. Set an iron post 3 ft. long, 3 ins. in diam., in a mound of stone for cor. of secs. 3, 4, 33 and 34, marked on brass cap, 1915 on S. rim; T 14 N in N., T 14 N in S., and R 6 W in W. half; S 33 in NW., S 34 in NE., S 3 in SE., and S 4 in SW. quadrant; and raise a mound of stone 2 ft. base,  $1\frac{1}{2}$  ft. high, W. of cor. Pits impracticable. 176 ft. above wash. Land, mountainous. Soil, rocky, 4th rate. No timber. Undergrowth, oak, catclaw and laurel. Poor grass. June 18: At this cor., I set off  $23^{\circ}24\frac{1}{2}'N.$  on the decl.arc; and observe the sun on the meridian at noon; the resulting lat. is  $34^{\circ}35\frac{1}{2}'N.$  June 18, 1915.

West half of frac. Township  $14\frac{1}{2}$  North, Range 6 W. Latitudes, departures, and closing errors.

Line designated.	True bearing.	Dist.	Latitudes.		Departures.	
			N.	S.	E.	W..
South bdy. of Tp.	East,	240.00			240.00	
Subdivisional bdy.	N. $0^{\circ}02'E.$	160.00	160.00		.10	
	N. $0^{\circ}03'E.$	67.90	67.90		.06	
North bdy. of Tp.	West,	240.00				240.00
East bdy. of Tp.	South,	228.00		228.00		
Convergency,						.12
Totals,			227.90	228.00	240.16	240.12
Error in latitude,				.10		
Error in departure,					.04	

Frac. Tp.  $14\frac{1}{2}$  North, Range 6 West. GENERAL DESCRIPTION.

This township is rough and mountainous, and the soil is rocky and worthless. The township is well watered. There is one settler in the township.

## 38. South boundary of Township 15 North, Range 7 West.

Chains.

- June 23, 1915: At 7h.00m. a.m., l.m.t., I set off  $34^{\circ} 37\frac{1}{2}'$  N. on the lat. arc;  $23^{\circ} 28'$  N. on the decl. arc; and determine a meridian with the solar at the cor. of Ts.  $14\frac{1}{2}$  and 15 N., Rs. 6 and 7 W., hereinbefore described.
- Thence I run,  
West, bet. secs. 24 and 36.  
Ascend through scattering timber and brush.  
Ridge, brs. N. and S.; descend. 166 ft. above cor.  
7.53 Spur, brs. S. 17 ft. below ridge.  
8.82 30 ft. below spur; ascend.  
20.50 Ridge brs. N. and S. 239 ft. above wash; descend.  
39.45 Set an iron post 3 ft. long, 1 in. in diam., 26 ins. in the  
40.00 ground for  $\frac{1}{4}$  sec. cor., marked on brass cap,  
1915 in S. rim;  
 $\frac{1}{4}$  S 36 in N., and  
S 24 in S. half; from which,  
A cedar, 12 ins. in diam., brs. N.  $19\frac{1}{2}^{\circ}$  W., 198 lks.  
dist., marked  $\frac{1}{4}$  S 36 B T.  
A cedar 12 ins. in diam., brs. S.  $8\frac{3}{4}^{\circ}$  W., 300 lks.  
dist., marked  $\frac{1}{4}$  S 24 B T.
- 50.65 Wash, 10 lks. wide, course SW., 96 ft. below ridge.  
Ascend.  
52.70 Spur, brs. SW. 90 ft. above wash; ascend.  
53.80 Along SW. slope.  
80.00 Set an iron post 3 ft. long, 3 ins. in diam., 24 ins. in  
the ground for cor. of secs. 23, 24, 35 and 36, marked  
on brass cap,  
1915 in S. rim;  
T 15 N in N.,  
T  $14\frac{1}{2}$  N in S., and  
R 7 W in W. half;  
S 35 in NW.,  
S 36 in NE.,  
S 24 in SE., and  
S 23 in SW. quadrant; and raise a mound  
of stone 2 ft. base,  $1\frac{1}{2}$  ft. high, W. of cor. Pits  
impracticable.  
185 ft. below spur.  
Land, mountainous.  
Soil, rocky, 4th rate.  
No timber.  
Undergrowth, oak and catclaw.
- June 23, 1915: At this cor., I set off  $23^{\circ} 27'$  N. on the  
decl. arc; and observe the sun on the meridian at  
noon; the resulting lat. is  $34^{\circ} 37\frac{1}{2}'$  N.
- 
- West, bet. secs. 23 and 35.  
Descend SW. slope, through scattering timber and brush.  
22.44 Spur, brs. SW. 230 ft. below cor.  
40.00 Set an iron post 3 ft. long, 1 in. in diam., 26 ins. in  
the ground for  $\frac{1}{4}$  sec. cor., marked on brass cap,  
1915 on S. rim;  
 $\frac{1}{4}$  S 35 in N., and  
S 23 in S. half; and raise a mound of  
stones 2 ft. base,  $1\frac{1}{2}$  ft. high, N. of cor. Pits imprac-  
ticable.
- 44.60 Wash, 50 lks. wide, course S. 265 ft. below spur; ascend.  
52.50 Spur, brs. S. 81 ft. above wash. Descend.  
56.27 Wash, 25 lks. wide, course SE., 40 ft. below spur. Ascend.  
78.58 Spur, brs. SE. 248 ft. above wash.  
80.00 Set an iron post 3 ft. long, 3 ins. in diam., 24 ins. in  
the ground for cor. of secs. 22, 23, 34 and 35, marked on  
brass cap, 1915 in S. rim;  
T 15 N in N.,  
T  $14\frac{1}{2}$  N in S., and  
R 7 W in W. half;  
S 34 in NW.,  
S 35 in NE.,



Chains.

S23 in S. E. and  
 S22 in S. W. quadrant; and raise a mound of stone  
 2 ft. base  $1\frac{1}{2}$  ft. high, W. of cor. Pits impracticable.  
 10 ft. below spur.  
 Land, mountainous.  
 Soil, rocky; 4th. rate.  
 Timber, a very few scattering cedars.  
 Undergrowth, oak and mtn. mahogany.  
 Poor grass.

June 23, 1915.

June 30, 1915: At 7h. 00m. a.m., l.m.t., I pick up my  
 line at the cor. of secs. 22, 23, 34 and 35 on the  
 S. side of the road. from sights established  
 in running the S. bdys. of secs. 35 and 36  
 Thence I run with fore and back sights.

West on tangent bet. secs. 22 and 34  
 Along general S. slope through dense brush.  
 24.80 Spur, brs. SE. 103 ft. above cor.  
 38.80 Wash 20 lks. wide course S. E. 30 ft. below spur.  
 40.00 Set an iron post 3 ft. long, 1 in. diam., 26 ins. in the  
 ground for  $\frac{1}{4}$  sec. cor., marked on brass cap  
 1915 on S. rim;  
 $\frac{1}{4}$ S34 in N. and  
 S22 in S. half; and raise a mound of stone 2 ft.  
 base  $1\frac{1}{2}$  ft. high, N. of cor. Pits impracticable.  
 74.00 Spur, brs. SE. 148 ft. above wash.  
 80.00 N. 1 lk. from the tangent.  
 Set an iron post 3 ft. long, 3 ins. diam., 15 ins. in the  
 ground in a mound of stone for cor. of secs. 21, 22, 33  
 and 34, marked on brass cap  
 1915 on S. rim;  
 T15N in N.  
 T14 $\frac{1}{2}$ N in S. and  
 R7W in W. half;  
 S33 in N. W.  
 S34 in N. E.  
 S22 in S. E. and  
 S21 in S. W. quadrant; and raise a mound of stone  
 2 ft. base  $1\frac{1}{2}$  ft. high, W. of cor. Pits impracticable.  
 9 ft. below spur.  
 Land, mountainous.  
 Soil, rocky; 4th. rate.  
 No timber.  
 Undergrowth, oak and laurel.  
 Poor grass.

West on the tangent bet. secs. 21 and 33.  
 Along rough general S. slope through dense brush.  
 14.50 Spur, brs. SE. 245 ft. above cor.  
 18.00 Wash 10 lks. wide course S. E. 30 ft. below spur.  
 40.00 N. 2.3 lks. from the tangent.  
 Set an iron post 3 ft. long, 1 in. diam., 8 ins. in the  
 ground in a mound of stone, for  $\frac{1}{4}$  sec. cor., marked on  
 brass cap  
 1915 on S. rim;  
 $\frac{1}{4}$ S33 in N. and  
 S21 in S. half; and raise a mound of stone 2 ft.  
 base  $1\frac{1}{2}$  ft. high, N. of cor. Pits impracticable.  
 46.30 Spur, brs. SE. 197 ft. above wash.  
 66.52 Wash 50 lks. wide course S. E. 262 ft. below spur.  
 72.05 Spur, brs. SE. 197 ft. above wash.  
 80.00 N. 4.1 lks. from the tangent,  
 Set an iron post 3 ft. long, 3 ins. diam., 24 ins. in the  
 ground for cor. of secs. 20, 21, 32 and 33, marked on

Chains.

brass cap  
 1915 on S. rim;  
 T15N in N.  
 T14 $\frac{1}{2}$ N in S. and  
 R7W in W. half;  
 S32 in N. W.  
 S33 in N. E.  
 S21 in S. E. and  
 S20 in S. W. quadrant; and raise a mound of stone  
 2 ft. base 1 $\frac{1}{2}$  ft. high, W. of cor. Pits impracticable.  
 31 ft. above spur.  
 Land, mountainous.  
 Soil, rocky; 4th. rate.  
 No timber.  
 Undergrowth, oak and laurel.

June 30, 1915.

July 9, 1915. At 7h. 00m. a.m., l.m.t., I pick up my  
 transit line at the cor. of secs. 20, 21, 32 and 33,  
 on the S. boundary of Tp. 15 N. Rg. 7 W.

Thence I run

West on the tangent bet. secs. 20 and 32.

Along S. slope through dense brush.

3.85 Wash 20 lks. wide course S. E. 34 ft. below cor.  
 13.40 Ridge bears N. and S. 176 ft. above wash. Descend.  
 38.80 Wash 20 lks. wide course S. E. 76 ft. below ridge.

Ascend.

40.00 N. 6.4 lks. from the tangent,  
 Set an iron post 3 ft. long, 1 in. diam., 26 ins. in the  
 ground for  $\frac{1}{4}$  sec. cor., marked on brass cap  
 1915 on S. rim;  
 $\frac{1}{4}$ S32 in N. and  
 S20 in S. half; and raise a mound of stone 2 ft.  
 base 1 $\frac{1}{2}$  ft. high, N. of cor. Pits impracticable.  
 80.00 N. 9.3 lks. from the tangent,  
 Set an iron post 3 ft. long, 3 ins. diam., 24 ins. in the  
 ground for cor. of secs. 19, 20, 31 and 32, marked on  
 brass cap

1915 on S. rim;

T15N in N. half;

T14 $\frac{1}{2}$ N in S and

R7W in W. half;

S31 in N. W.

S32 in N. E.

S20 in S. E. and

S19 in S. W. quadrant; from which

A cedar 9 ins. diam., bears N. 28 $\frac{3}{4}$ ° W. 80  
 lks. dist., marked T15NR7WS31BT.

A cedar 10 ins. diam., bears N. 47 $\frac{1}{4}$ ° E. 495  
 lks. dist., marked T15NR7WS32BT.

A cedar 10 ins. diam., bears S. 28 $\frac{1}{2}$ ° E. 200  
 lks. dist., marked T14 $\frac{1}{2}$ NR7WS20BT.

A cedar 10 ins. diam., bears S. 23 $\frac{3}{4}$ ° W. 281  
 lks. dist., marked T14 $\frac{1}{2}$ NR7WS19BT.

402 ft. above wash.

Land, mountainous.

Soil, rocky; 4th. rate.

Timber, a few cedars.

Undergrowth, oak, laurel and mtn. mahogany.

West on the tangent bet. secs. 19 and 31.

Ascend, through dense brush.

1.50 Ridge bears N. and S. 14 ft. above cor. Descend.

40.00 N. 12.5 lks. from the tangent,

Set an iron post 3 ft. long, 1 in diam, in a mound of

South boundary of Township 15 North, Range 7 West. 41.

Chains.

stone, for  $\frac{1}{4}$  sec.cor., marked on brass cap,  
 1915 on S.rim;  
 $\frac{1}{2}$  S 31 in N., and  
 $\frac{1}{2}$  S 19 in S.half;  
 and raise a mound of stone 2 ft.base,  $1\frac{1}{2}$  ft. high, N.of  
 cor. Pits impracticable.  
 65.50 Wash, 25 lks.wide, course S.228 ft. below ridge; ascend.  
 69.70 Wire fence, brs.NE. and SW.  
 70.45 Wire fence brs.NW. and SE.  
 77.42 N. 16.3 lks. from the tangent.  
 The cor.of Ts.14 $\frac{1}{2}$  and 15 N., Rs. 7 and 8 W., hereinbefore  
 described.  
 109 ft.above wash.  
 Land, mountainous.  
 Soil, rocky, 4th rate.  
 No timber.  
 Undergrowth, oak, laurel and mountain mahogany.  
 July 9, 1915.

Boundaries of Frac Township 14 $\frac{1}{2}$  N., Range 7 West.  
 Latitudes, departures and closing errors.

Line desig- nated.	True bearing.	Dist.	Latitudes.		Departures.	
			N.	S.	E.	W.
South bdy..	S.89°59'E.	477.40		.14	477.40	
East bdy..	North,	228.00	228.00			
North bdy..	West,	477.42				477.42
West bdy..	South,	227.97		227.97		
Convergency,						.24
Totals,			228.00	228.11	477.40	477.66
				228.00		477.40
<u>Error in latitude.</u>				.11		
<u>Error in departure.</u>						..26

Frac. Township 14 $\frac{1}{2}$  N., R. 7 West.  
GENERAL DESCRIPTION.

This township is rough and mountainous, and the soil is  
 rocky and worthless. Sycamore Creek flows through the  
 SE.cor.of the Township. There are no settlers in the  
 township.

*John P. Hesse*  
 U. S. Surveyor.

## CERTIFICATE OF ASSISTANTS.

We, the undersigned, hereby certify upon honor that we assisted, to the best of our skill and ability, John F. Hesse, U. S. Surveyor, during the periods and in the capacities stated opposite our several signatures, in surveying all those parts or portions of the South bdy. of T.14 N., R.5 W., the East & North bdrs. of T.14 N., R.6 W., the East and West bdrs. of T.13 N., R.7 W., the South, West, East and North bdrs. of T.14 N., R.7 W.; the East and South bdrs. of T.15 N., R.7 W.; the East and West bdrs. of Prac. T.14 N., R.7 W., and the South bdy. of T.15 N., R. 6 W.,

of the Gila and Salt River Base & Meridian, in the State of Arizona.

which are represented in the foregoing field notes as having been executed by him, and under his direction; and that said survey has been, in all respects, to the best of our knowledge and belief, well and faithfully executed.

NAME.	PERIOD OF SERVICE.		CAPACITY.
	BEGUN.	ENDED.	
F. G. Ayers	Oct. 3, 1914	Dec. 30, 1914	Chairman
F. H. Spurnfeld	Oct. 5, 1914	Jan 25, 1915	Chairman Plagman Assman
T. Y. White	Nov. 12, 1914	Feb. 20, 1915	Cornerman
B. J. Kenney	Nov. 11, 1914	Mar. 4, 1915	Chairman
Everett B. White	Oct. 3, 1914	Mar. 10, 1915	Plagman
L. A. Brown	Feb. 13, 1915	Apr. 27, 1915	Assman Chairman
P. R. Henderson	Apr. 28, 1915	May 19, 1915	Chairman
H. D. McNeil	March 11, 1915	June 8, 1915	Plagman
H. E. Bennett	March 4, 1915	June 26, 1915	Cornerman
E. H. Purdy	May 27, 1915	July 17, 1915	Chairman
Ralph Brown	March 11, 1915	July 17, 1915	Assman Plagman
Elmer Keefer	June 15, 1915	July 17, 1915	Assman Cornerman
W. Bryan Moss	June 26, 1915	July 13, 1915	Chairman Assman
F. G. Ayers	Jan 24, 1915	July 17, 1915	Chairman

Subscribed and certified to before me on the dates of the final service as shown above.

*John F. Hesse*  
U. S. Surveyor.

FINAL OATH OF UNITED STATES SURVEYOR.

I, John F. Hesse, U. S. Surveyor, do solemnly swear that, in pursuance of special instructions received from the U. S. Surveyor General for Arizona for Group 37 bearing date of the 26th day of September, 1914, I have well, faithfully, and truly, in my own proper person, and in strict conformity with said instructions, the Manual of Surveying Instructions, and the laws of the United States, surveyed all those parts or portions of the South bdy. of T.15 N., R.5 W., the East and North bdrs. of T.14 N., R.6 W., the East & West bdrs. of T.13 N., R.7 W., the South, West, East and North bdrs. of T.14 N., R.7 W., the East and South bdrs. of T.15 N., R.7 W., the East and West bdrs. of frac. T.14 1/2 N., R.7 W., and the South bdy. of T.15 N., R.6 W., of the Gila and Salt River Base & Meridian, in the State of Arizona, which are represented in the foregoing field notes as having been executed by me, and under my direction; and I do further solemnly swear that all the corners of said survey have been established and perpetuated in strict accordance with the Manual of Surveying Instructions, and the special written instructions of the U. S. Surveyor General for Arizona, for Group 37, and in the specific manner described in the field notes, and that the foregoing are the original field notes of such survey.

*John F. Hesse*  
U. S. Surveyor.

Subscribed by said John F. Hesse, and sworn to before me }  
this 16th day of October, 1915

*Frank S. Ingalls*  
SURVEYOR GENERAL OF ARIZONA



APPROVAL.

OFFICE OF THE UNITED STATES SURVEYOR GENERAL,  
Phoenix, Arizona, **FEB 18**, 1916

The foregoing field notes of the survey of part of the South bdy. of T.15 N., R.5 W., part of the South bdy. of T.15 N., R.6 W., the East and South bdrs. of T.15 N., R.7 W.; parts of the East and North bdrs. of T.14 N., R.6 W.; the West, North, and parts of the South and East bdrs. of T.14 N., R.7 W., the East and West bdrs. of frac. T.14 1/2 N., R.7 W., and West and part of the East bdy. of T.13 N., R.7 W., of the Gila and Salt River Base and Meridian, Arizona, executed by John F. Hesse, U. S. Surveyor, under his special instructions dated September 26, 1914, for Group 37, having been critically examined, and the necessary corrections and explanations made, the said field notes, and the surveys they describe, are hereby approved.

*Frank S. Ingalls*  
Surveyor General,  
of Arizona,

~~I certify that the foregoing transcript of the field notes of the above described surveys in~~  
~~Book "A", "U", has been correctly copied from the original notes on file in this office.~~