

2872

4-679

BOOK 2872

Book "I."
Subdivisions

FIELD NOTES

OF THE SURVEY OF THE

Subdivision Lines of frac. Township 14¹/₂ North, Range 7 West.

Of the Gila and Salt River Base and Meridian,

In the State of Arizona.

EXECUTED BY

John F. Hesse,

U. S. Surveyor.

In the capacity of U. S. Surveyor, under instructions dated Sept. 26, 1914, issued by the United States Surveyor General to govern surveys included in Group No. 37, which were approved by the Commissioner of the General Land Office, October 3, 1914.

Survey commenced June 22, 1915

Survey completed July 10, 1915.

BOOK 2872

Book "I."

INDEX DIAGRAM.

Frac1. Township 14¹/₂ North, Range 7 West.

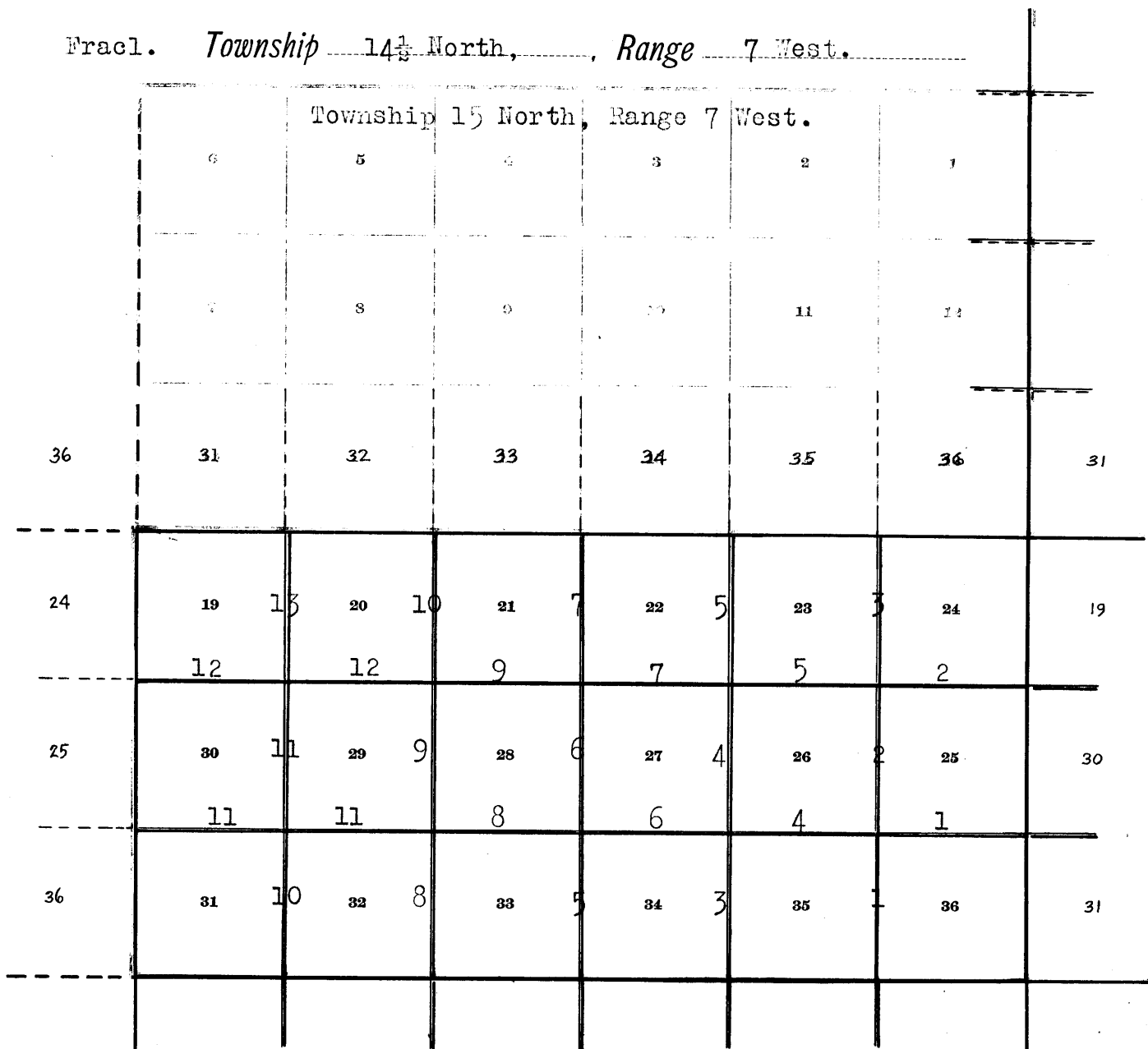

6-151

———— Notes in this book (indexed)

———— Notes in Book "H"

———— Notes in Book "G"

———— Notes in Book "F"

----- Unsurveyed Lines.

Chains.

Survey commenced June 22, 1915, and executed with an A. Lietz light mountain transit, No. 6166 with solar attachment. The horizontal limb is provided with two double verniers placed opposite to each other, reading to single minutes of arc, which is also the least count of the verniers of the latitude and declination arcs. The instrument was approved by the Assistant Supervisor of Surveys for Arizona and California, conditional upon satisfactory field tests, September 28, 1914. For description of field tests of the adjustments of the transit and solar, see notes of the subdivision of frac1 Tp. 14 1/2 N. Rg. 6 W..

June 22, 1915; At 7h. 00m. a.m., l.m.t., I set off 34° 35 1/2' N. on the lat. arc; 23° 28' N. on the decl. arc; and determine a meridian with the solar at the cor. of secs. 1, 2, 35 and 36 on the S. bdy. of the Tp., established by me, as described in Book "A."

Thence I run N. 0° 01' W. bet. secs. 35 and 36.

Descending N. E. slope through scattering brush.

16.15 Creek 10 lks. wide course S. E., 47 ft. below cor., clear running water 4 ins. deep.

26.85 Same creek 10 lks. wide course S. W.

40.00 Set an iron post 3 ft. long, 1 in. diam., 26 ins. in the ground for 1/4 sec. cor., marked on brass cap

1915 on S. rim;
1/4 S35 in W. and
S36 in E. half; and raise a mound of stone 2 ft. base 1 1/2 ft. high, W. of cor. Pits impracticable.

49.69 Same creek 10 lks. wide course S. E. Ascend gradually.

54.64 Road bears N. W. and S. E.

80.00 Set an iron post 3 ft. long, 2 ins. diam., 24 ins. in the ground, for cor. of secs. 25, 26, 35 and 36, marked on brass cap

1915 on S. rim;
T14 1/2 NR7W in N. half;
S25 in N. W.
S26 in N. E.
S36 in S. E. and
S35 in S. W. quadrant; and raise a mound of stone

2 ft. base, 1 1/2 ft. high, W. of cor. Pits impracticable.

Land, mountainous, and rolling.

Soil, rocky; 4th. rate.

Timber, sycamore along creek.

Undergrowth, oak and mesquite.

Poor grass.

64 ft. above creek.

S. 89° 59' E. on random line bet. secs. 25 and 36.

40.00 Set temp. 1/4 sec. cor.,

79.90 Intersect E. bdy. of Tp. 2 lks. S. of cor. of secs. 25, 30, 31, and 36, established by me as described in Book "A."

Thence I run

West on a true line bet. secs. 25 and 36.

Descend through scattering brush.

28.36 Sycamore Creek 50 lks. wide course S. W. 291 ft. below cor., clear running water, 6 ins. deep. Ascend.

39.95 Set an iron post 3 ft. long, 1 in. diam., 26 ins. in the ground for 1/4 sec. cor., marked on brass cap

1915 on S. rim;
1/4 S25 in N. and
S36 in S. half; and raise a mound of stone 2 ft. b base 1 1/2 ft. high, N. of cor. Pits impracticable.

48.20 62 ft. above creek, over rolling land.

59.41 Road bears N. W. and S. E.

79.90 The cor. of secs. 25, 26, 35 and 36.

Land, rolling and mountainous.

Soil, rocky; 4th. rate.

No timber.

Undergrowth, oak, mesquite and catclaw.

2

Subdivision of frac1. Tp. 14 $\frac{1}{2}$ N. Rg. 7 W.

Chains.

June 22; At this cor. I set off 23° 27 $\frac{1}{2}$ ' N. on the decl. arc; and observe the sun on the meridian at noon; the resulting lat. is 34° 30' N.

- N. 0° 01' W. bet. secs. 25 and 26.
Ascend gradually, scattering brush.
- 4.00 Ridge bears E. and W. 29 ft. above cor. Descend gradually over broken land.
- 32.98 Road bears N. W. and S. E.
- 39.60 Road bears N. E. and S. W.
- 40.00 Set an iron post 3 ft. long, 1 in. diam., 26 ins. in the ground for $\frac{1}{4}$ sec. cor., marked on brass cap
1915 on S. rim;
 $\frac{1}{4}$ S26 in W. and
S25 in E. half; and raise a mound of stone 2 ft. base $1\frac{1}{2}$ ft. high, W. of cor. Pits impracticable.
- 42.13 Wash 10 lks. wide course S. W. Ascend. 69 ft. below ridge.
- 80.00 Set an iron post 3 ft. long, 2 in. diam., 24 ins. in the ground for cor. of secs. 23, 24, 25 and 26, marked on brass cap
1915 on S. rim;
T14 $\frac{1}{2}$ NR7W in N. half;
S23 in N. W.
S24 in N. E.
S25 in S. E. and
S26 in S. W. quadrant; and raise a mound of stone 2 ft. base $1\frac{1}{2}$ ft. high, W. of cor. Pits impracticable.
301 ft. above wash.
Land, mountainous.
Soil, rocky; 4th. rate.
No timber.
Undergrowth, oak, mesquite and catclaw.

June 22, 1915.

- June 24, 1915; At 7h. 00m. a.m., l.m.t., I set off 34° 37' N. on the lat. arc; 23° 27' N. on the decl. arc; and determine a meridian with the solar at the cor. of secs. 23, 24, 25 and 26
Thence I run
East on a random line bet. secs. 24 and 25.
- 40.00 Set temp. $\frac{1}{4}$ sec. cor.
- 79.85 Intersect E. bdy. of Tp. 7 lks. N. of the cor. of secs. 19, 24, 25 and 30. established by me as described in Book "A"
Thence I run
N. 89° 57' W. bet. secs. 24 and 25, on a true line.
Ascend gradually along general S. E. slope, through scattering brush.
- 4.53 Wash 10 lks. wide course S. E.
- 7.25 Spur, brs. SE.
- 24.55 Spur, brs. S.
- 26.53 Wash 10 lks. wide course S. E.
- 34.15 Spur, brs. S.
- 38.35 Wash 10 lks. wide course S. E.
- 39.92 $\frac{1}{2}$ Set a schist stone 16 x 14 x 6 ins. 11 ins. in the ground for $\frac{1}{4}$ sec. cor., marked $\frac{1}{4}$ on N. face; and raise a mound of stone 2 ft. base $1\frac{1}{2}$ ft. high, N. of cor. Pits impracticable.
- 51.21 Ridge bears N. and S. 167 ft. above E. bdy. descend.
- 59.31 Wash 10 lks. wide course S; 77 ft. below ridge. Ascend.
- 72.35 Ridge bears N. and S. 170 ft. above wash. descend.
- 79.85 The cor. of secs. 23, 24, 25 and 26.
59 ft. below ridge.
Land, mountainous.

Subdivision of frac. Tp. 14 $\frac{1}{2}$ N. Rg. 7 W.

Chains.

Soil, rocky; 4th. rate.
 No timber.
 Undergrowth, oak, catclaw and laurel.
 June 24; At this cor. I set off 23° 26' N. on the decl. arc; and observe the sun on the meridian at noon; the resulting lat. is 34° 37' N.

N. 0° 01' W. on a random line bet. secs. 23 and 24.
 40.00 Set temp. $\frac{1}{4}$ sec. cor.
 68.05 Intersect N. bdy. of Tp. at the cor. of secs. 23, 24, 35 and 36; established by me as described in Book "A." Thence I run
 S. 0° 01' E. on a true line bet. secs. 23 and 24.
 Descend S. W. slope through scattering brush.
 27.43 Wash 15 lks. wide course S. W. 294 ft. below cor. ascend.
 28.05 Set an iron post 3 ft. long, 1 in. diam., 26 ins. in the ground for $\frac{1}{4}$ sec. cor., marked on brass cap
 1915 on S. rim;
 $\frac{1}{4}$ S23 in W. and
 S24 in E. half; and raise a mound of stone 2 ft. base $1\frac{1}{2}$ ft. high, W. of cor. Pits impracticable.
 33.05 Spur, brs. W. 63 ft. above wash. descend.
 44.85 Wash 10 lks. wide course W. 154 ft. below spur. Ascend.
 55.41 Spur, brs. SW. 235 ft. above wash. Descend.
 68.05 The cor. of secs. 23, 24, 25 and 26.
 112 ft. below spur.
 Land, mountainous.
 Soil, rocky; 4th. rate.
 No timber.
 Undergrowth, oak, catclaw and mesquite.

June 24, 1915.

June 25, 1915; At 7h. 00m. a.m., l.m.t., I set off 34° 35 $\frac{1}{2}$ ' N. on the lat. arc; 23° 26' N. on the decl. arc; and determine a meridian with the solar at the cor. of secs. 2, 3, 34 and 35 on the S. bdy. of the Tp established by me, as described in Book "A." Thence I run:
 N. 0° 01' W. bet. secs. 34 and 35.
 From true point for cor.
 Ascend through scattering brush.
 20.00 Ridge bears E. and W. 173 ft. above cor. Descend.
 40.00 Set an iron post 3 ft. long, 1 in. diam., 26 ins. in the ground for $\frac{1}{4}$ sec. cor., marked on brass cap
 1915 on S. rim;
 $\frac{1}{4}$ S34 in W. and
 S35 in E. half; and raise a mound of stone 2 ft. base $1\frac{1}{2}$ ft. high, W. of cor. Pits impracticable.
 52.06 Wash 15 lks. wide course E. 352 ft. below ridge. Ascend.
 55.91 Spur, brs. E. 64 ft. above wash. Descend.
 63.33 Wash 10 lks. wide course S. E. 66 ft. below spur. Ascend.
 80.00 Set an iron post 3 ft. long, 2 ins. diam., 24 ins. in the ground for cor. of secs. 26, 27, 34 and 35, marked on brass cap
 1915 on S. rim;
 T14 $\frac{1}{2}$ NR7W in N. half;
 S27 in N. W.
 S26 in N. E.
 S35 in S. E. and
 S34 in S. W. quadrant; and raise a mound of stone 2 ft. base $1\frac{1}{2}$ ft. high, W. of cor. Pits impracticable.
 164 ft. above wash.
 Land, mountainous.
 Soil, rocky; 4th. rate.
 No timber.

4. Subdivision of Tp. 14 $\frac{1}{2}$ N. Rg. 7 W.

Chains.

Undergrowth, oak.

- S. 89° 59' E. on a random line bet. secs. 26 and 35.
- 40.00 Set temp. $\frac{1}{4}$ sec. cor.
 - 80.20 Intersect N. and S. line 2 lks. S. of the cor. of secs. 25, 26, 35 and 36,
Thence I run
West on a true line bet. secs. 26 and 35.
Over rolling land, through dense brush.
 - 37.12 Wash 50 lks. wide course S. E. water in holes.
 - 40.10 Set an iron post 3 ft. long, 1 in. diam., 26 ins. in the ground for $\frac{1}{4}$ sec. cor., marked on brass cap
1915 on S. rim;
 $\frac{1}{4}$ S26 in N. and
S35 in S. half; and raise a mound of stone 2 ft. base $1\frac{1}{2}$ ft. high, N. of cor. Pits impracticable.
Ascend.
 - 60.20 Wash 10 lks. wide course S. E.
 - 80.20 The cor. of secs. 26, 27, 34 and 35.
Land, mountainous, and rolling.
Soil, rocky; 4th. rate.
No timber.
Undergrowth, mesquite and oak.
June 25; At this cor. I set off 23° 25' N. on the decl. arc; and observe the sun on the meridian at noon; the resulting lat. is 34° 36' N.
207 ft. above wash at 37.12 chs.

- N. 0° 01' W. bet. secs. 26 and 27.
Ascend through scattering brush.
- 2.00 15 ft. above cor. descend along general N. E. slope.
 - 25.37 Wash 10 lks. wide course E.
 - 32.40 Frame house, empty, bears E. 1.71 chs.
 - 40.00 Set an iron post 3 ft. long, 1 in. diam., 20 ins. in the ground, in a mound of stone, for $\frac{1}{4}$ sec. cor., marked on brass cap
1915 on S. rim;
 $\frac{1}{4}$ S27 in W. and
S26 in E. half; from which
A cottonwood 24 ins. diam., bears S. 6 $\frac{1}{2}$ ° E.
150 lks. dist., marked $\frac{1}{4}$ S26BT.
A cottonwood 14 ins. diam., bears S. 73 $\frac{1}{2}$ ° W.
100 lks. dist., marked $\frac{1}{4}$ S27BT.
 - 40.81 Wash 50 lks. wide course S. E. 208 ft. below 2.00 chn. pt.
Ascend.
 - 59.61 Spur, hrs. SE. 187 ft. above wash. Descend.
 - 63.60 23 ft. below spur. Ascend.
 - 80.00 Set an iron post 3 ft. long, 2 ins. diam., 24 ins. in the ground for cor. of secs. 22, 23, 26 and 27, marked on brass cap
1915 on S. rim;
 $\frac{1}{4}$ 14 $\frac{1}{2}$ NR7W in N. half;
S22 in N. W.
S23 in N. E.
S26 in S. E. and
S27 in S. W. quadrant; and raise a mound of stone 2 ft. base $1\frac{1}{2}$ ft. high, W. of cor. Pits impracticable.
128 ft. above 63.60 chn. point.
Land, mountainous.
Soil, rocky; 4th. rate.
Wmber, a few cottonwoods along wash.
Undergrowth, oak and catclaw.

June 25, 1915.

Subdivision of fracl. Tp. 14 1/2 N. Rg. 7 W.

Chains.

June 26, 1915; The solar attachment on my transit being injured, I determine a meridian, at the cor. of secs. 22, 23, 26 and 27, from sights established in running the line bet. secs. 26 and 27.

Thence I run
 East on a random line bet. secs. 23 and 26.

40.00 Set temp. 1/4 sec. cor.
 80.16 Intersect N. and S. line 4 lks. N. of the cor. of secs. 23, 24, 25 and 26.

Thence I run
 N. 89° 58' W. on a true line bet. secs. 23 and 26.
 Along rough general S. slope of mountains, through scattering brush.

9.00 Wash 10 lks. wide course S. W. 213 ft. below cor. Ascend.
 14.90 Spur, brs. SW. 85 ft. above wash. Descend.
 16.80 Wash 10 lks. wide course S. W. 27 ft. below spur.
 21.78 Spur, brs. S. 32 ft. above wash.
 40.08 Set an iron post 3 ft. long, 1 in. diam., 26 ins. in the ground for 1/4 sec. cor., marked on brass cap
 1915 on S. rim;
 1/4 S23 in N. and
 S26 in S. half; and raise a mound of stone 2 ft. base 1 1/2 ft. high, N. of cor. Pits impracticable.

43.68 Wash 20 lks. wide course S. W. 126 ft. below spur. Ascend.
 53.67 Spur, brs. SW. 34 ft. above wash. Descend.
 58.16 Wash 5 lks. wide course S. 50 ft. below spur. Ascend.
 74.75 Spur, brs. S. 375 ft. above wash. Descend.
 80.16 The cor. of secs. 22, 23, 26 and 27.
 Land, mountainous.
 Soil, rocky; 4th. rate.
 No timber.
 Undergrowth, oak, laurel, catclaw.
 86 ft. below spur.

N. 0° 01' W. on a random line bet. secs. 22 and 23.

40.00 Set temp. 1/4 sec. cor.
 68.06 Intersect N. bdy. of Tp. 7 lks. W. of the cor. of secs. 22, 23, 34 and 35, established by me as described in Book "A." Thence I run,
 S. 0° 02' W. on a true line bet. secs. 22 and 23.
 Along on top of spur, brs. SE. through scattering brush.

16.57 Descend.
 25.43 Wash 25 lks. wide course E. 127 ft. below spub. Ascend.
 28.06 Set an iron post 3 ft. long, 1 in. diam., 26 ins. in the ground for 1/4 sec. cor., marked on brass cap
 1915 on S. rim;
 1/4 S22 in W. and
 S23 in E. half; and raise a mound of stone 2 ft. base 1 1/2 ft. high, W. of cor. Pits impracticable.

35.95 Ridge bears E. and W. 352 ft. above wash. Descend.
 68.06 The cor. of secs. 22, 23, 26 and 27.
 424 ft. below ridge.
 Land, mountainous.
 Soil, rocky; 4th. rate.
 No timber.
 Undergrowth, oak, laurel and manzanita.

June 26, 1915.

June 28, 1915; At 7h. 00m. a.m., l.m.t., I pick up my line at the cor. of secs. 3, 4, 33 and 34 on the S. bdy. of the Tp. from sights established in running the S. bdy. of the Tp., said cor. established by me, as described in Book "A."

Thence I run
 N. 0° 02' W. bet. secs. 33 and 34.
 Descend steep N. slope through dense brush.

6

Subdivision of frac. Tp. 14 $\frac{1}{2}$ N. Rg. 7 W.

Chains.

- 2.80 Wash 10 lks. wide course S. W. 96 ft. below cor. Ascend, brush becomes scattering.
- 18.28 Ridge bears E. and W. 182 ft. above wash. Descend.
- 32.80 Wash 15 lks. wide course N. E. 182 ft. below ridge. Ascend.
- 40.00 Set an iron post 3 ft. long, 1 in. diam., 26 ins. in the ground for $\frac{1}{4}$ sec. cor., marked on brass cap
1915 on S. rim;
 $\frac{1}{4}$ S33 in W. and
S34 in E. half; and raise a mound of stone 2 ft. base $1\frac{1}{2}$ ft. high, W. of cor. Pits impracticable.
- 40.10 Spur, 15 ft. above wash, brs NE. Descend.
- 44.10 Wash 10 lks. wide course N. E. 99 ft. below spur.
- 70.00 Spur, brs SE. 225 ft. above wash. descend.
- 73.92 Wire fence bears N. W. and S. E.
- 80.00 Set an iron post 3 ft. long, 2 ins. diam., 24 ins. in the ground for cor. of secs. 27, 28, 33 and 34, marked on brass cap
1915 on S. rim;
T14 $\frac{1}{2}$ NR7W in N. half;
S28 in N. W.
S27 in N. E.
S34 in S. E. and
S33 in S. W. quadrant; and raise a mound of stone 2 ft. base $1\frac{1}{2}$ ft. high, W. of cor. Pits impracticable.
- Land, mountainous.
Soil, rocky; 4th. rate.
No timber.
Undergrowth, oak, manzanita and catclaw.
78 ft. below spur.

- S. 89° 59' E. on a random line bet. secs. 27 and 34.
- 40.00 Set temp. $\frac{1}{4}$ sec. cor.
- 80.18 Intersect N. and S. line 7 lks. S. of the cor. of secs. 26, 27, 34 and 35.
- Thence I run
S. 89° 58' W. on a true line bet. secs. 27 and 34.
Along N. slope of broken ridge, through scattering brush.
- 9.17 Wash 20 lks. wide course N. W. 90 ft. below cor.
- 23.40 Spur, brs N. 30 ft. above wash.
- 29.25 Wire fence bears N. E. and S. W.
- 32.81 Wash 25 lks. wide course N. E. 65 ft. below spur.
- 40.09 Set an iron post 3 ft. long, 1 in. diam., 26 ins. in the ground for $\frac{1}{4}$ sec. cor., marked on brass cap
1915 on S. rim;
 $\frac{1}{4}$ S27 in N. and
S34 in S. half; and raise a mound of stone 2 ft. base $1\frac{1}{2}$ ft. high, N. of cor. Pits impracticable.
- 44.44 Wash 10 lks. wide course S. E.
- 72.35 Spur, brs SE. 383 ft. above wash.
- 80.18 The cor. of secs. 27, 28, 33 and 34.
88 ft. below spur.
Land, mountainous.
Soil, rocky; 4th. rate.
No timber.
Undergrowth, oak, laurel, masquite, catclaw.

June 28, 1915.

- June 29, 1915; At 7h. 00m. a.m., l.m.t., I pick up my line at the cor. of secs. 27, 28, 33 and 34.
- Thence I run
N. 0° 02' W. bet. secs. 27 and 28.
Along general E. slope through scattering brush.
- 16.70 Spur, brs SE. 40 ft. above cor.
- 30.73 Wash 10 lks. wide course S. E. 123 ft. below spur.

Chains.

40.00 Set an iron post 3 ft. long, 1 in. diam., 14 ins. in the ground, in a mound of stone, for 1/4 sec. cor., marked on brass cap
 1915 on S. rim;
 1/4 S28 in W. and
 S27 in E. half; and raise a mound of stone 2 ft. base 1 1/2 ft. high, W. of cor. Pits impracticable.

41.47 Spur, brs. E. 325 ft. above wash.

57.66 Wash 10 lks. wide course S. E. 86 ft. below spur.

61.50 Spur, brs. SE. 154 ft. above wash.

69.75 Wash 10 lks. wide course S. E. 10 ft. below spur.

76.65 Spur, brs. SE. 37 ft. above wash.

80.00 Set an iron post 3 ft. long, 2 ins. diam., 24 ins. in the ground for cor. of secs. 21, 22, 27 and 28, marked on brass cap
 1915 on S. rim;
 T14 1/2 NR7W in N. half;
 S21 in N. W.
 S22 in N. E.
 S27 in S. E. and
 S28 in S. W. quadrant; and raise a mound of stone 2 ft. base 1 1/2 ft. high, W. of cor. Pits impracticable.
 50 ft. below spur.
 Land, mountainous.
 Soil, rocky; 4th. rate.
 No timber.
 Undergrowth, oak, laurel and catclaw.

N. 89° 58' E. on a random line bet. secs. 22 and 27.

40.00 Set temp. 1/4 sec. cor.

80.28 Intersect N. and S. line 2 lks. S. of the cor. of secs. 22, 23, 26 and 27.
 Thence I run
 S. 89° 57' W. on a true line bet. secs. 22 and 27.
 Descend through scattering brush.

14.47 Wash 15 lks. wide course S. W. 53 ft. below cor.

17.00 Wash 15 lks. wide course S. E. 133 ft. below cor. Ascend.

40.14 Set an iron post 3 ft. long, 1 in. diam., 26 ins. in the ground for 1/4 sec. cor., marked on brass cap
 1915 on S. rim;
 1/4 S22 in N. and
 S27 in S. half; and raise a mound of earth 2 ft. base 1 1/2 ft. N. of cor. Pits impracticable.

40.32 Spur, brs. S. 189 ft. above wash.

48.88 Wash 50 lks. wide course S. 165 ft. below spur. Ascend.

80.28 The cor. of secs. 21, 22, 27 and 28.
 567 ft. above wash.
 Land, mountainous.
 Soil, rocky; 4th. rate.
 No timber.
 Undergrowth, oak, laurel and catclaw.

June 29, 1915.

July 6, 1915.

N. 0° 02' W. bet. secs. 21 and 22 on a random line.

40.00 Set temp. 1/4 sec. cor.

40.25 From this point line descends very rough slope broken with cliffs and impossible to chain, therefore I triangulate as follows;
 Set flag at this point and set flagman on line N. 0° 02' W. on N. bdy of Tp. I go to point on line on N. bdy. of Tp. and lay off a base S. 89° 58' W. 12.00 chs. and from this point angle to flag on line S. is 66° 38' then 12.00 X tan. 66° 38' (2.31456)=27.77

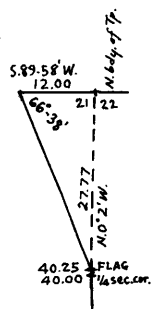

40.25 FLAG
40.00 1/4 sec. cor.

8

Subdivision of frac1 Tp. 14 $\frac{1}{2}$ N. Rg. 7 W.

Chains.

- 27.77 + 40.25 = 68.02
 68.02 Intersect N. bdy. of Tp. 12 lks. W. of the cor. of secs. 21, 22, 33 and 34, estab. by me as described in Book "A"
 Thence I run
 S. 0° 04' W. on a true line bet. secs. 21 and 22.
 Descend through dense brush.
 2.60 Wash 30 lks. wide course E. 45 ft. below cor. Ascend rocky, precipitous N. slope.
 27.77 Triangulation point. Ascend gradually.
 28.02 Set an iron post 3 ft. long, 1 in. diam., 8 ins. in the ground in a mound of stone for $\frac{1}{4}$ sec. cor., marked on brass cap
 1915 on S. rim;
 $\frac{1}{4}$ S21 in W. and
 S22 in E. half; and raise a mound of stone 2 ft. base $1\frac{1}{2}$ ft. high, W. of cor. Pits impracticable.
 45.60 Ridge bears E. and W. descend.
 56.84 Wash 20 lks. wide course S. E. 326 ft. below ridge. Ascend.
 68.02 The cor. of secs. 21, 22, 27 and 28.
 Land, mountainous.
 Soil, rocky; 4th. rate.
 No timber.
 Undergrowth, oak, laurel and mtn. mahogany.
 30 ft. above wash.

July 6, 1915.

July 1, 1915; At 7h. 00m. a.m., l.m.t., I pick up my line at the cor. of secs. 4, 5, 32 and 33 on the S. bdy. of the Tp. from sights established in running the S. bdy. of the Tp. said cor. estab. by me, as described in Book "A."

- Thence I run
 N. 0° 02' W. bet. secs. 32 and 33.
 Ascend gradually through scattering brush.
 30.00 Ascent becomes steep.
 40.00 Set an iron post 3 ft. long, 1 in. diam., 26 ins. in the ground for $\frac{1}{4}$ sec. cor., marked on brass cap
 1915 on S. rim;
 $\frac{1}{4}$ S32 in W. and
 S33 in E. half; and raise a mound of stone 2 ft. base $1\frac{1}{2}$ ft. high, W. of cor. Pits impracticable.
 51.80 Over rolling top of mesa. 472 ft. above 30.00 chn. point.
 63.80 Descend.
 80.00 Set an iron post 3 ft. long, 2 ins. diam., 18 ins. in the ground, in a mound of stone, for cor. of secs. 28, 29, 32 and 33, marked on brass cap
 1915 on S. rim;
 T14 $\frac{1}{2}$ NR7W in N. half;
 S29 in N. W.
 S28 in N. E.
 S33 in S. E. and
 S32 in S. W. quadrant; and raise a mound of stone 2 ft. base $1\frac{1}{2}$ ft. high, W. of cor. Pits impracticable.
 Land, mountainous.
 Soil, rocky; 4th. rate.
 No timber.
 Undergrowth, oak, laurel and mtn. mahogany.
 184 ft. below mesa.

- 40.00 S. 89° 59' E. on a random line bet. secs. 28 and 33.
 Set temp. $\frac{1}{4}$ sec. cor.
 80.12 Intersect N. and S. line 5 lks. S. of the cor. of secs. 27, 28, 33 and 34.
 Thence I run
 S. 89° 59' W. on a true line bet. secs. 28 and 33.
 Ascend, through scattering brush.

Subdivision of frac1. Tp. 14 1/2 N. Rg. 7 W.

Chains,
 22.50 Wire fence bears N. and S.
 40.06 Set an iron post 3 ft. long, 1 in. diam., 26 ins. in the ground for 1/4 sec. cor., marked on brass cap
 1915 on S. rim;
 1/4 S28 in N. and S33 in S. half; and raise a mound of stone 2 ft. base 1 1/2 ft. high, W. of cor. Pits impracticable.
 45.70 Rim of mesa 800 ft. above cor. and over rolling top of mesa.
 64.55 Descend N. W. slope.
 80.12 The cor. of secs. 28, 29, 32 and 33.
 108 ft. below mesa.
 Land, mountainous.
 Soil, rocky; 4th. rate.
 No timber.
 Undergrowth, oak, laurel and mtn. mahogany.

N. 0° 02' W. bet. secs. 28 and 29.
 Ascending over broken land, through scattering brush.
 28.80 Ridge bears N. W. and S. E. 226 ft. above cpr. Descend.
 40.00 Set an iron post 3 ft. long, 1 in. diam., in a mound of stone for 1/4 sec. cor., marked on brass cap
 1915 on S. rim;
 1/4 S29 in W. and S28 in E. half; and raise a mound of stone 2 ft. base 1 1/2 ft. high, W. of cor. Pits impracticable.
 46 ft. below ridge.

July 1, 1915.

July 6, 1915; At 7h. 00m. a.m., 1.m.t, I pick up my line at the 1/4 sec. cor., bet. secs. 28 and 29
 Thence I run
 N. 0° 02' W., continuing measurement,
 Ascend,
 80.00 Ridge bears E. and W. 432 ft. above 1/4 sec. cor.
 Set an iron post 3 ft. long, 2 ins. diam., 10 ins. in the ground, in a mound of stone, for cor. of secs. 20, 21, 28 and 29, marked on brass cap
 1915 on S. rim;
 T14 1/2 NR7W in N. half;
 S20 in N. W.
 S21 in N. E.
 S28 in S. E. and S29 in S. W. quadrant; and raise a mound of stone 2 ft. base 1 1/2 ft. high, W. of cor. Pits impracticable.
 Land, mountainous.
 Soil, rocky; 4th. rate.
 No timber.
 Undergrowth, oak, laurel and mtn. mahogany.

N. 89° 59' E. on a random line bet. secs. 21 and 28.
 40.00 Set temp. 1/4 sec. cor.
 80.24 Intersect N. and S. line 2 lks. S. of the cor. of secs. 21, 22, 27 and 28.
 Thence I run.
 S. 89° 58' W. on a true line bet. secs. 21 and 28.
 Ascend S. E. slope, through scattering brush.
 40.12 Set an iron post 3 ft. long, 1 in. diam., in a mound of stone for 1/4 sec. cor., marked on brass cap
 1915 on S. rim;
 1/4 S21 in N. and S28 in S. half; and raise a mound of stone 2 ft. base 1 1/2 ft. high, N. of cor. Pits impracticable.
 80.24 The cor. of secs. 20, 21, 28 and 29.
 On top ridge 252 ft. above cor. of secs. 21, 22, 27 and 28.
 Land, mountainous.

Chains.

Soil, rocky; 4th. rate.
No timber.
Undergrowth, oak, laurel and mahogany.

July 6, 1915.

July 7, 1915.

- N. 0° 02' W. on a random line bet. secs. 20 and 21.
40.00 Set temp. $\frac{1}{4}$ sec. cor.
68.02 Intersect N. bdy. of Tp. 7 lks. W. of the cor. of secs. 20, 21, 32 and 33, established by me as described in Book "A".
Thence I run
S. 0° 01' W. on a true line bet. secs. 20 and 21.
Descend, through dense brush.
2.96 Wash 25 lks. wide course E. 20 ft. below cor. Ascend.
11.34 Ridge E. and W. descend.
23.73 Wash 25 lks. wide course E. ascend. 304 ft. below ridge.
27.02 Set an iron post 3 ft. long, 1 in. diam., 26 ins. in the ground for W. C. to $\frac{1}{4}$ sec. cor., marked on brass cap
1915 on S. rim;
WC $\frac{1}{4}$ S. of center;
S20 in N. W. and
S21 in N. E. quadrant; and raise a mound of stone 2 ft. base 1 $\frac{1}{2}$ ft. high, W. of cor. Pits impracticable.
28.02 Point for $\frac{1}{4}$ sec. cor., falls in wash 25 lks. wide course N. E.
68.02 The cor. of secs. 20, 21, 28 and 29.
Land, mountainous.
Soil, rocky; 4th. rate.
No timber.
Undergrowth, oak, laurel and manzanita.
457 ft. above wash.

July 7, 1915.

July 2, 1915; At 7h. 00m. a.m., l.m.t., I pick up my line at the cor. of secs. 5, 6, 31 and 32 on the S. bdy. of the Tp. from sights established in running the S. bdy. of the Tp., said cor. established by me as described in (Book "A.")
Thence I run

- N. 0° 03' W. bet. secs. 31 and 32.
Ascend along W. slope, through scattering brush.
40.00 Set an iron post 3 ft. long, 1 in. diam., 26 ins. in the ground for $\frac{1}{4}$ sec. cor., marked on brass cap
1915 on S. rim;
 $\frac{1}{4}$ S31 in W. and
S32 in E. half; and raise a mound of stone 2 ft. base 1 $\frac{1}{2}$ ft. high, W. of cor. Pits impracticable.
48.84 Ridge bears N. W. and S. E. 411 ft. above cor. and along E. slope ascending.
64.84 Spur, hrs SE. 15 ft. above ridge. Descend.
69.75 Wash 15 lks. wide course S. E. ascend. 127 ft. below spur.
80.00 Set an iron post 3 ft. long, 2 ins. diam., 24 ins. in the ground for cor. of secs. 29; 30, 31 and 32, marked on brass cap
1915 on S. rim;
T14 $\frac{1}{2}$ NR7W in N. half;
S30 in N. W.
S29 in N. E.
S32 in S. E. and
S31 in S. W. quadrant; and raise a mound of stone 2 ft. base 1 $\frac{1}{2}$ ft. high, W. of cor. Pits impracticable.
Land, mountainous.
Soil, rocky; 4th. rate.
No timber.
Undergrowth, oak, laurel and mtn. mahogany.
97 ft. above wash.

Subdivision of frac1. Tp. 14 1/2 N. Rg. 7 W.

Chains.

S. 89° 59' E. on a random line bet. secs. 29 and 32.

40.00 Set temp. 1/4 sec. cor.

80.18 Intersect N. and S. lines 2 lks. N. of the cor. of secs. 28, 29, 32 and 33,
Thence I run
N. 89° 58' W. on a true line bet. secs. 29 and 32.
Descending through dense brush.

8.09 Wash 10 lks. wide course S. W. and over rocky broken land. 15 ft. below cor.

15.69 Wash 5 lks. wide course S. 88 ft. above wash. Ascend.

26.81 Spur, brs. S. 133 ft. above wash. Descend. Scattering brush.

36.48 Wash 20 lks. wide course S. Ascend.

40.09 Set an iron post 3 ft. long, 1 in. diam., 26 ins. in the ground for 1/4 sec. cor., marked on brass cap
1915 on S. rim;
1/4 S29 in N. and
S32 in S. half; and raise a mound of stone 2 ft. base 1 1/2 ft. high, N. of cor. Pits impracticable.

44.00 Spur, brs. S. 171 ft. above wash. Descend.

52.29 Wash 25 lks. wide course S. 330 ft. below spur. Ascend.

78.00 Spur, brs. S. 212 ft. above wash. Descend.

80.18 The cor. of secs. 29, 30, 31 and 32.
Land, mountainous.
Soil, rocky; 4th. rate.
No timber.
Undergrowth, oak, laurel and mtn. mahogany.
57 ft. below spur.

July 2, 1915.

July 3, 1915.

N. 89° 59' W. on a random line bet. secs. 30 and 31.

40.00 Set temp. 1/4 sec. cor.

77.20 Intersect W. bdy. of Tp. 2 lks. S. of the cor. of secs. 25, 30, 31 and 36, estab. by me as described in Book "A".
Thence I run
S. 89° 58' E. on a true line bet. secs. 30 and 31.
Descend steep W. slope through scattering brush.

16.31 Wash 10 lks. wide course N. E.

30.16 Wash 25 lks. wide course S. E. 494 ft. below cor. Ascend.

36.70 Set an iron post 3 ft. long, 1 in. diam., 26 ins. in the ground for wit. cor. for 1/4 sec. cor., marked on brass cap
1915 on S. rim;
WC 1/4 in E. half;
S30 in N. W. and
S31 in S. W. quadrant; and raise a mound of stone 2 ft. base 1 1/2 ft. high, N. of cor. Pits impracticable.

37.20 True point for 1/4 sec. cor., falls in wash 10 lks. wide course S. W.

61.00 Ridge bears N. and S. 240 ft. above cor. Descend.

73.09 Wash 10 lks. wide course S. 250 ft. below ridge. Ascend.

77.20 The cor. of secs. 29, 30, 31 and 32.
Land, mountainous.
Soil, rocky; 4th. rate.
No timber.
Undergrowth, oak, laurel and mtn. mahogany.
40 ft. above wash.

July 3, 1915.

July 7, 1915; At 7h. 00m. a.m., 1.m.t., I pick up my line at the cor. of secs. 29, 30, 31 and 32.
Thence I run
N. 0° 03' W. bet. secs. 29 and 30.
Ascend through scattering brush.

9.72 Ridge bears E. and W. descend. 126 ft. above cor.

12

Subdivision of frac1. Tp. 14 $\frac{1}{2}$ N. Rg. 7 W.

Chains.

- 25.70 Wash 10 lks. wide course S. E. 137 ft. below ridge.
Ascend general S. E. slope.
- 36.00 Spur, brs. SE. 132 ft. above wash.
- 39.79 Wash 10 lks. wide course S. E. 31 ft. below spur.
- 40.00 Set an iron post 3 ft. long, 1 in. diam., 20 ins. in the
ground in a mound of stone, for $\frac{1}{4}$ sec. cor., marked on
brass cap
1915 on S. rim;
 $\frac{1}{4}$ S30 in W. and
S29 in E. half; and raise a mound of stone 2 ft.
base $1\frac{1}{2}$ ft. high, W. of cor. Pits impracticable.
- 51.04 Ridge bears E. and W. Descend. 294 ft. above wash.
- 56.85 Wash 50 lks. wide course N. E. 155 ft. below ridge.
Ascend.
- 80.00 Set an iron post 3 ft. long, 2 ins. diam., in a mound of
stone, for cor. of secs. 19, 20, 29 and 30, marked on
brass cap
1915 on S. rim;
T14 $\frac{1}{2}$ NR7W in N. half;
S19 in N. W.
S20 in N. E.
S29 in S. E. and
S30 in S. W. quadrant; from which
A cedar 10 ins. diam., bears N. 7° W. 127
lks. dist., marked T14 $\frac{1}{2}$ NR7WS19BT.
No other bearings available. Raise a mound of stone
2 ft. base $1\frac{1}{2}$ ft. high, W. of cor. Pits impracticable.
Land, mountainous.
Soil, rocky; 4th. rate.
No timber.
Undergrowth, oak, laurel and mtn. mahogany.
88 ft. above wash.

- S. 89° 58' E. on a random line bet. secs. 20 and 29.
- 40.00 Set temp. $\frac{1}{4}$ sec. cor.
- 80.24 Intersect N. and S. line 9 lks. S. of the cor. of secs.
20, 21, 28 and 29.
Thence I run
S. 89° 58' W. on a true line bet. secs. 20 and 29.
Along on top of high ridge, through scattering brush.
- 17.00 Descend along N. slope.
- 40.12 Set an iron post 3 ft. long, 1 in. diam., 10 ins. in the
ground, in a mound of stone, for $\frac{1}{4}$ sec. cor., marked on
brass cap
1915 on S. rim;
 $\frac{1}{4}$ S20 in N. and
S29 in S. half; and raise a mound of stone 2 ft.
base $1\frac{1}{2}$ ft. high, N. of cor. Pits impracticable.
- 56.05 Wash 50 lks. wide course N. E. 50 ft. below ridge.
Ascend.
- 80.24 The cor. of secs. 19, 20, 29 and 30.
Land, mountainous.
Soil, rocky; 4th. rate.
No timber.
Undergrowth, oak, laurel and mtn. mahogany.
160 ft. above wash.

July 7, 1915.

- July 10, 1915: At 7h. 00m. a.m., l.m.t., I pick up my line
at the cor. of secs. 19, 20, 29 and 30.
Thence I run
N. 89° 58' W. on a random line bet. secs. 19 and 30.
- 40.00 Set temp. $\frac{1}{4}$ sec. cor.
- 77.30 I intersect the W. bdy. of Tp. 9 lks. N. of the cor. of secs.
19, 24, 25 and 30, established by me, as described in
Book "A."

Subdivision of fracl. Tp. 14 $\frac{1}{2}$ N. Rg. 7 W.

Chains.

Thence I run
 N. 89° 58' E. on a true line bet. secs. 19 and 30.
 Ascend through dense brush.
 27.60 Ridge bears N. and S. 444 ft. above cor. Brush becomes
 scattering, descend.
 32.00 73 ft. below ridge. Ascend.
 37.30 Set an iron post 3 ft. long, 1 in. diam., in a mound of
 stone for $\frac{1}{4}$ sec. cor., marked on brass cap
 1915 on S. rim;
 $\frac{1}{4}$ S19 in N. and
 S30 in S. half; and raise a mound of stone 2 ft.
 base $1\frac{1}{2}$ ft. high, N. of cor. Pits impracticable.
 41.80 Ridge bears N. and S. 34 ft. above 32.00 chn. point.
 Descend.
 77.30 The cor. of secs. 19, 20, 29 and 30.
 178 ft. below ridge.
 Land, mountainous.
 Soil, rocky; 4th. rate.
 No timber.
 Undergrowth, oak, laurel and mtn. mahogany.

N. 0° 03' W. on a random line bet. secs. 19 and 20.
 40.00 Set temp. $\frac{1}{4}$ sec. cor.
 67.91 Intersect N. bdy. of Tp. 17 lks. W. of the cor. of secs.
 19, 20, 31 and 32, established by me as described in Book "A"
 Thence I run
 S. 0° 05' W. on a true line bet. secs. 19 and 20.
 Along rough broken E. slope, through scattering brush.
 27.91 Set an iron post 3 ft. long, 1 in. diam., 10 ins. in the
 ground, in a mound of stone, for $\frac{1}{4}$ sec. cor., marked on
 brass cap
 1915 on S. rim;
 $\frac{1}{4}$ S19 in W. and
 S20 in E. half; and raise a mound of stone 2 ft.
 base $1\frac{1}{2}$ ft. high, W. of cor. Pits impracticable.
 67.91 The cor. of secs. 19, 20, 29 and 30.
 Land, mountainous.
 Soil, rocky; 4th. rate.
 No timber.
 Undergrowth, oak, laurel and mtn. mahogany.

July 10, 1915.

GENERAL DESCRIPTION.

This township is rough and mountainous, and the soil is
 rocky and worthless, excepting about 30 acres in the N.
 W. cor. of sec. 36, which is a sandy loam, and very
 fertile. Sycamore Creek runs through the S. E. cor. of
 the township. There are no settlers in the township.
 The township is covered with a fair growth of oak brush
 but no timber.

John P. Hesse
 U. S. Surveyor.

260

14

BOOK 174

For **FINAL OATH OF UNITED STATES SURVEYOR.**

See Book "B" of this Group.

I, _____, U. S. Surveyor, do solemnly swear that, in pursuance of special instructions received from the U. S. Surveyor General for _____ bearing date of the _____ day of _____, 191 _____, I have well, faithfully, and truly, in my own proper person, and in strict conformity with said instructions, the Manual of Surveying Instructions, and the laws of the United States, surveyed all those parts or portions of _____ of the _____ Meridian, in the State of _____, which are represented in the foregoing field notes as having been executed by me, and under my direction; and I do further solemnly swear that all the corners of said survey have been established and perpetuated in strict accordance with the Manual of Surveying Instructions, and the special written instructions of the U. S. Surveyor General for _____ and in the specific manner described in the field notes, and that the foregoing are the original field notes of such survey.

U. S. Surveyor.

Subscribed by said _____, and sworn to before me }
this _____ day of _____, 191 _____ }



APPROVAL.

OFFICE OF THE UNITED STATES SURVEYOR GENERAL,

Phoenix, Arizona, **FEB 18**, 191 **6**.

The foregoing field notes of the survey of _____
Subdivision Lines of _____

Fractional Township 14 $\frac{1}{2}$ North, Range 7 West,

of the Gila and Salt River Base & Meridian, in the State of Arizona,

executed by John E. Hesse, U. S. Surveyor,
under his special instructions dated September 26, 1914, for Group 37, 191 _____, having been critically examined, and the necessary corrections and explanations made, the said field notes, and the surveys they describe, are hereby approved.

Surveyor General.
of Arizona.

I certify that the foregoing transcript of the field notes of the above described surveys in _____, has been correctly copied from the original notes on file in this office.