

2893

MAR 5-1917

239

4-679

MAR 19 1917

Book "C"  
(Subdivisions)

BOOK 2893

# FIELD NOTES

OF THE SURVEY OF THE

PARTIAL SUBDIVISION

OF

TOWNSHIP 10 SOUTH, RANGE 2 EAST.

2893

Of the Gila and Salt River Base and Meridian,

In the State of Arizona.

## EXECUTED BY

W. H. Thorn, U. S. Surveyor,

and

W. K. Kierulff, U. S. Transitman,

~~In the capacity of U. S. Surveyor~~, under instructions dated July 29, 1914,  
issued by the United States Surveyor General to govern surveys included in  
Group No. 38, which were approved by the Commissioner of the General Land  
Office, September 5, 1914.

Survey commenced November 30, 1914.

Survey completed December 21, 1914.

2893

1A

Book "C"  
(Subdivisions)

Group 38 ~ Arizona.

BOOK 2893

INDEX DIAGRAM.

		Township 10 South					Range 2 East.				
31-33-46		6	29	5	20	4	15	3	2	1	
31-34-43		29		28		20					
		7	28	8	19	9	14	10	11	12	
31-35-51		27		27		19		14			
		18	26	17	18	16	13	15	9	14	
31-36-57		26		25		16		13	9	5	
		19	25	20	17	21	12	22	8	23	
31-37-47		23		23		17		12	8	4	
		30	22	29	16	28	11	27	7	26	
31-38-15		22		21		16		11	7	3	
		31	21	32	15	33	10	34	6	35	
31-39-22											

RESURVEYED  
2ND STANDARD PARALLEL SOUTH

- Subdivision lines surveyed under this group.
- Standard lines - Notes in Book "A"
- Township bdrs. - Notes in Book "B"
- Unsurveyed.

# DIAGRAM

SHOWING THE RESPECTIVE SURVEYS  
OF SUBDIVISION LINES EXECUTED  
BY EACH SURVEYOR AND TRANSITMAN  
UNDER INSTRUCTIONS FOR

**GROUP 38, ARIZONA**

executed by W.H. THORN  
 U.S. Surveyor  
 executed by W.M. LEWIS  
 U.S. Transitman  
 executed by M.M. LEWIS  
 U.S. Transitman

BOOK 2893

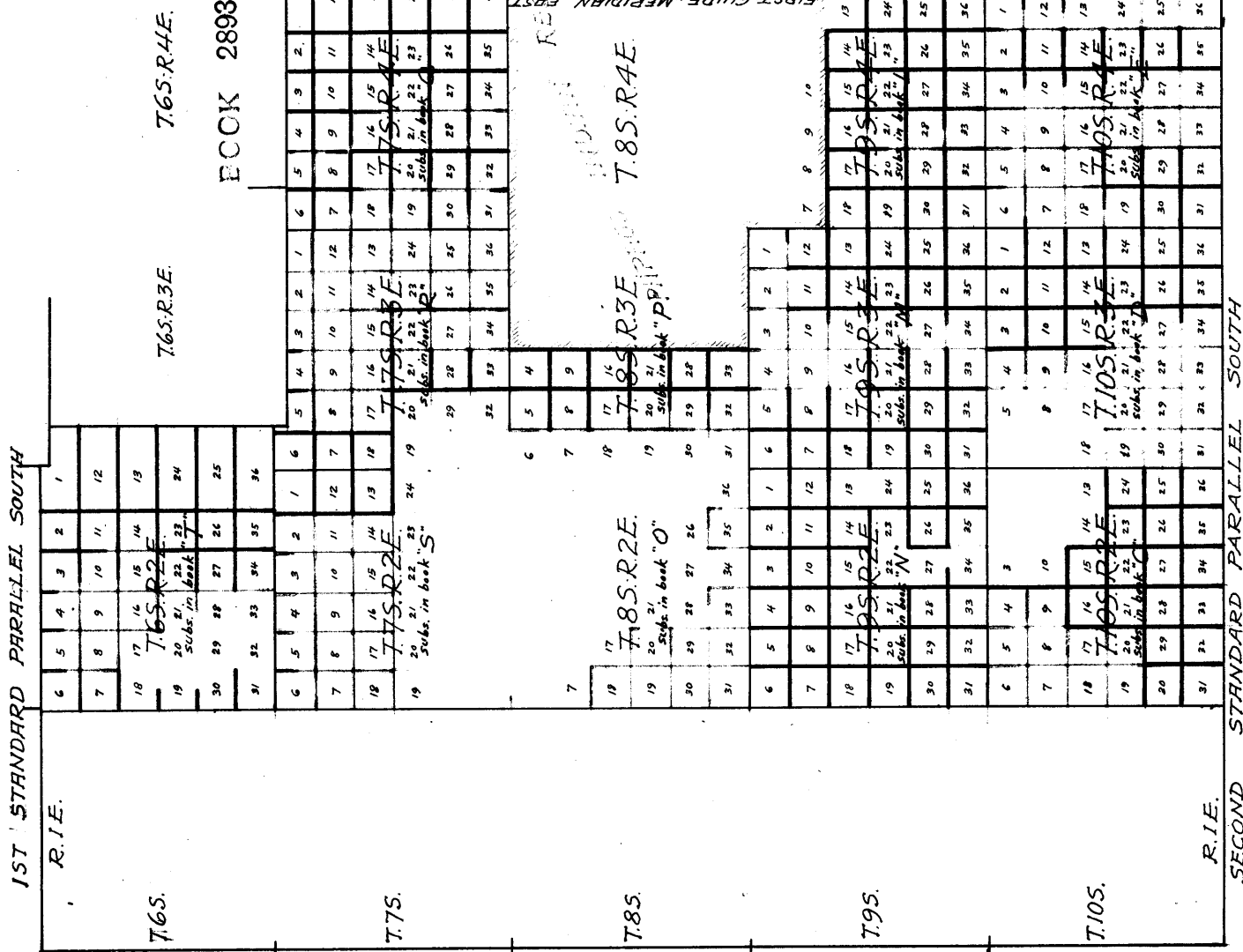

2.

BOOK 2893

FINAL CERTIFICATE OF U. S. SURVEYOR AND TRANSITMEN.

We, the undersigned, hereby certify on honor that, in pursuance of special instructions received from the U.S. Surveyor General for Arizona, bearing date of July 29, 1914, we have well, faithfully and truly, in our own proper persons, and in strict conformity with said instructions, the Manual of Surveying Instructions, and the laws of the United States, surveyed all those parts or portions of

G R O U P 38

which are represented on the diagram on the reverse hereof as having severally been executed by us, and under our direction; and we do further certify on honor that all the corners of said survey have been established and perpetuated in strict accordance with the Manual of Surveying Instructions, and the special written instructions of the U.S. Surveyor General for Arizona, and in the specific manner described in our respective field notes.

W. H. Hoover U. S. Surveyor. M. D. Smith U. S. Transitman.  
M. M. Lewis U. S. Transitman.

Chains.

W.H.Thorn, U.S.Surveyor.

Survey commenced November 30, 1914, and executed with a Young and Sons' light mountain transit No.8592, described in Book "A."

I examine the adjustments of the transit; also the adjustments of the solar apparatus, and find them in good adjustment.

December 7, 1914.

At 8h. am. l.m.t., I set off 32°30' N.on the lat.arc; 22° 31'S.on the decl.arc, and determine a meridian with the solar at the standard cor.of secs.35 and 36, on the S bdy.of the Tp.(2nd.Standard Parallel S.) reestablished by me, as described in Book "A."

Thence I run, N.0°01'W. bet. secs.35 and 36.

Over slightly rolling land.

20.80 Dry wash, 40 lks.wide, 3 ft.banks, course N.10°E.

28.70 Dry wash, 10 lks.wide, 1 ft. banks, course N.80°E.

40.00 True point for 1/4 sec.cor. falls in dry wash, 90 lks.wide, 2 ft.banks, course N.40°E. Impracticable to establish 1/4 sec.cor. at this point; therefore, at

41.40 Set an iron post 3 ft.long, 1 in. in diam., 26 ins. in the ground for witness cor.to 1/4 sec.cor., with brass cap, marked,

W C on S.,  
1/4 S 35 on W., and  
S 36 on E.half;  
1914 on S.rim;

from which,

A mesquite, 5 ins.in diam., brs.N.9°30'W., 92 lks. dist., marked W C 1/4 S 35 B T.

No other trees within limits. Dig pits 18x18x12 ins.N. and S.of cor.3 ft. dist., and raise a mound of earth 3 1/2 ft. base, 1 1/2 ft. high W.of cor.

52.70 Road brs. N.30°W. and S.30°E.

56.00 Dry wash, 15 lks.wide, 2 ft.banks, course N.80°E.

79.30 Dry wash, 20 lks.wide, 2 ft.banks, course N.80°E.

80.00 Set an iron post 3 ft.long, 2 ins. in diam., 24 ins. in the ground for cor.of secs. 25, 26, 35 and 36, with brass cap, marked,

T 10 S S 26 in NW.,  
R 2 E, S 25 in NE.,  
S 36 in SE., and  
S 35 in SW. quadrants;  
1914 in S rim;

dig pits 18x18x12 ins., in each sec.5 1/2 ft. dist., and raise a mound of earth 4 ft.base, 2 ft.high, W.of cor.

Land, slightly rolling.

Soil, sandy loam and gravel, 2nd rate.

Timber, palo verde, mesquite, ironwood and catclaw.

Undergrowth, greasewood brush, ocotillo and giant cactus.

-----  
East, on a random line, bet. secs.25 and 36.

40.00 Set temp. 1/4 sec.cor.

80.02 Intersect E.bdy.of Tp., 5 lks.S.of the cor.of secs.25, 30, 31 and 36, established by W.K. Kierulff, U.S.Transitman, as described in Book "B."

Thence I run,

S.89°58'W., on a true line, bet. secs.25 and 36.

Over rolling land.

30.75 Dry wash, 45 lks.wide, 2 ft.banks, course N.40°E.

40.01 Set an iron post 3 ft.long, 1 in. in diam., 26 ins. in the ground for 1/4 sec.cor., with brass cap, marked,

1/4 S 25 on N., and  
S 36 on S.half;  
1914 on S.rim;

dig pits 18x18x12 ins., E.and W.of cor. 3 ft. dist., and raise a mound of earth 3 1/2 ft. base, 1 1/2 ft. high, N. of cor.

## 4. Partial Subdivision of Township 10 South, Range 2 East.

Chains.

43.00 Road bears N. and S.  $10^{\circ}$ E.  
 45.00 Dry wash, 20 lks.wide, 2 ft.banks, course N.  $10^{\circ}$ E.  
 52.35 Dry wash, 80 lks.wide, 3 ft. banks, course N.  $40^{\circ}$ E.  
 67.30 Dry wash, 25 lks.wide, 4 ft. banks, course N.  
 74.70 Dry wash, 15 lks.wide, 3 ft. banks, course N.  $70^{\circ}$ E.  
 80.02 The cor. of secs. 25, 26, 35 and 36.  
 Land, rolling.  
 Soil, sandy loam, gravelly and rock, 3rd rate.  
 Timber, palo verde, mesquite, ironwood and catclaw.  
 Undergrowth, greasewood brush; ocotillo and giant cactus.

N.  $0^{\circ}$  01' W. bet. secs. 25 and 26.

Over rolling land.

5.00 Road to Casa Grande brs. N.  $40^{\circ}$ E. and S.  $40^{\circ}$ W.  
 18.60 Road brs. N.  $15^{\circ}$  E., and S.  $15^{\circ}$  W.  
 22.10 Dry wash, 20 lks.wide, 2 ft. banks, course N.  $80^{\circ}$ E.  
 27.00 Indian hut brs. E. 8 chs. dist.; small field north of hut.  
 31.90 Road brs. N.  $50^{\circ}$ W. and S.  $50^{\circ}$ E.  
 32.60 Dry wash, 20 lks.wide, 2 ft.banks, course N.  $80^{\circ}$ E.  
 40.00 Set an iron post 3 ft.long, 1 in. in diam., 26 ins. in the ground for  $\frac{1}{4}$  sec.cor., with brass cap, marked  
      $\frac{1}{4}$  S 26 on W., and  
      $\frac{1}{4}$  S 25 on E.half;  
     1914 on S.rim;  
 dig pits 18x18x12 ins., N.and S.of cor. 3 ft. dist., and raise a mound of earth  $3\frac{1}{2}$  ft. base,  $1\frac{1}{2}$  ft. high, W.of cor.  
 42.30 Dry wash, 15 lks.wide, 3 ft.banks, course E.  
 49.70 Dry wash, 80 lks.wide, 5 ft.banks, course S  $70^{\circ}$ E.  
 80.00 Set an iron post 3 ft.long, 2 ins. in diam., 18 ins. in the ground. (Could not set deeper on account of solid rock). Build a mound of stone 3 ft.base, 1 ft. high around post for cor.of secs. 23, 24, 25 and 26, with brass cap, marked

T 10 S S 23 in NW.,

R 2 E S 24 in NE.,

S 25 in SE., and

S 26 in SW.quadrant,

1914 on S.rim; from which,

An ironwood, 5 ins. in diam., brs. N.  $30^{\circ}15'$ E.,  
 56 lks.dist., marked T 10 S R 2 E S 24 B T.

A palo verde 10 ins. in diam., brs. S.  $23^{\circ}$ E., 84  
 lks.dist., marked T 10 S R 2 E S 25 B T.

An ironwood 10 ins. in diam., brs. N.  $82^{\circ}45'$ W. 208  
 lks.dist., marked T 10 S R 2 E S 23 B T.

No other trees within limits. Build a mound of stone  
 3 ft. base, 2 ft. high, W.of cor.

At this cor. I set off  $22^{\circ}34'$ S. on the decl. arc; and at  
 11h. 51m. a.m., l.m.t., I observe the sun on the meri-  
 dian. The resulting lat. is  $32^{\circ}32'$  N.

Land, rolling.

Soil, gravelly and rocky, 3rd rate.

Timber, palo verde, ironwood, mesquite and catclaw.

Undergrowth, greasewood brush, ocotillo and giant cactus.

East, on a random line, bet. secs. 24 and 25.

40.00 Set temp.  $\frac{1}{4}$  sec.cor.

79.94 Intersect East bdy. of Tp., 6 lks. N. of the cor. of secs. 19,  
 24, 25 and 30, established by W.K. Kierulff, U.S. Tran-  
 sitman, as described in Book "B."

Thence I run,

N.  $89^{\circ}57'$ W., on a true line, bet. secs. 24 and 25.

Over rolling land.

9.50 Dry wash, 20 lks.wide, 3 ft.banks, course S.  $30^{\circ}$ E.

23.20 Dry wash, 20 lks.wide, 3 ft. banks, course S  $40^{\circ}$ E.

31.10 Dry wash, 15 lks.wide, 3 ft. banks, course S.  $10^{\circ}$ E.

39.97 Set an iron post 3 ft long, 1 in. in diam., 20 ins. in  
 the ground (could not set deeper on account of solid

## Partial Subdivision of Township 10 South, Range 2 East. 5.

## Chains.

- rock). Build a mound of stone 2 ft. base, 6 ins. high around post for  $\frac{1}{4}$  sec. cor., with brass cap, marked 1914 on S. rim,  
 $\frac{1}{4}$  S 24 on N., and  
 S 25 on S. half;  
 build a mound of stone 3 ft. base,  $2\frac{1}{2}$  ft. high, N. of cor.
- 45.00 Dry wash, 15 lks. wide, 2 ft. banks, course S.  
 54.00 Dry wash, 20 lks. wide, 3 ft. banks, course S.  
 66.00 Dry wash, 10 lks. wide, 3 ft. banks, course S.  
 79.94 The cor. of secs. 23, 24, 25 and 26.  
 Land, rolling.  
 Soil, gravelly, 3rd rate.  
 Timber, palo verde, ironwood and catclaw.  
 Undergrowth, greasewood brush, ocotillo and giant cactus.  
 At this cor. at 2h. 23m. p.m., l.m.t., I observe Polaris at eastern elongation, and lay off the azimuth of Polaris  $1^{\circ}22'$  to the west. A flag set at the cor. of secs. 25, 26, 35 and 36 brs. S.  $0^{\circ}01'E$ . thus proving that the solar apparatus is in good adjustment.
- 
- N.  $0^{\circ}01'W$ ., bet. secs. 23 and 24.  
 Over rolling land.  
 Ascend over gradual S. slope.
- 21.00 Dry wash, 15 lks. wide, 3 ft. banks, course S.  $10^{\circ}W$ .  
 26.50 Dry wash, 15 lks. wide, 4 ft. banks, course SE.  
 30.00 Re-cross same dry wash, course SW.  
 40.00 Set an iron post 3 ft. long, 1 in. in diam., 26 ins. in the ground for  $\frac{1}{4}$  sec. cor., with brass cap, marked  
 $\frac{1}{4}$  S 23 on W., and  
 S 24 on E. half;  
 1914 in S. rim;  
 build a mound of stone, 3 ft. base, 2 ft. high, W. of cor.
- 80.00 Set an iron post 3 ft. long, 2 ins. in diam., 12 ins. in the ground (could not set deeper on account of solid rock). Build a mound of stone 3 ft. base,  $1\frac{1}{2}$  ft. high, around post for cor. of secs. 13, 14, 23 and 24, with brass cap, marked  
 T 10 S 14 in NW.;  
 R 2 E, S 13 in NE.,  
 S 24 in SE., and  
 S 23 in SW. quadrants;  
 1914 on S. rim;  
 build a mound of stone 3 ft. base, 2 ft. high, W. of cor.  
 Land, rolling.  
 Soil, gravelly and rocky, 3rd rate.  
 Timber, palo verde, ironwood and catclaw.  
 Undergrowth, greasewood brush, ocotillo and giant cactus;  
 cholla.
- December 7, 1914.
- 
- December 8, 1914.  
 East on a random line, bet. secs. 13 and 24.
- 40.00 Set temp.  $\frac{1}{4}$  sec. cor.  
 79.96 Intersect E. bdy. of Tp., 10 lks. N. of the cor. of secs. 13, 18, 19 and 24, established by W. K. Kierulff, U.S. Transitman, as described in Book "B."  
 Thence I run,  
 N.  $89^{\circ}56'W$ ., on a true line, bet. secs. 13 and 24.  
 Over rolling land.  
 Descend SW. slope of low ridge.
- 4.90 Ravine, 30 lks. wide, 4 ft. deep, course S.  $20^{\circ}E$ .  
 Ascend NE. slope of low hill.
- 10.00 Change to N. slope.  
 15.00 Enter rolling land.  
 25.60 Ravine, 30 lks. wide, 5 ft. deep, course S.  $10^{\circ}E$ .  
 32.70 Ravine, 30 lks. wide, 5 ft. deep, course S.  $45^{\circ}E$ .  
 36.80 Ravine, 40 lks. wide, 6 ft. banks, course S.  $50^{\circ}E$ .

## 6. Partial Subdivision of Township 10 South, Range 2 East.

Chains.

39.98 Set an iron post 3 ft. long, 1 in. in diam., 6 ins. in the ground (could not set deeper on account of solid stone). Build a mound of stone 3 ft. base, 2 $\frac{1}{2}$  ft. high, around post for  $\frac{1}{4}$  sec. cor., with brass cap, marked  
 1914 on S. rim;  
 $\frac{1}{4}$  S 13 on N., and  
 $\frac{1}{4}$  S 24 on S. half;  
 build a mound of stone 2 ft. base, 1 ft. high, N. of cor.

45.00 Ravine, 20 lks. wide, 4 ft. deep, course S. 20° E.

55.20 Dry wash, 15 lks. wide, 3 ft. banks, course S.

61.30 Dry wash, 20 lks. wide, 4 ft. banks, course S.

73.10 Road brs. N 30° W. and S. 30° E.

79.96 The cor. of secs. 13, 14, 23 and 24.  
 From this cor. rough and broken mountains 650 to 750 ft. high, which are neither agricultural nor grazing, bear N. about 20.00 chs. Discontinue survey of east two tiers of secs. at this cor.  
 Land, rolling and hilly.  
 Soil, gravelly and rocky; surface covered with loose rock, 3rd rate.  
 Timber, palo verde, ironwood and catclaw.  
 Undergrowth, greasewood brush, ocotillo; giant cactus and cholla.

December 8, 1914.

December 8, 1914.

At 8h. am. 1.m.t., I set off 32° 30 $\frac{1}{2}$ ' N. on the lat. arc; 22° 38' S. on the decl. arc, and determine a meridian with the solar at the standard cor. of secs. 34 and 35 on the S. bdy. of the Tp. (2nd. Standard Parallel South) reestablished by me as described in Book "A."

Thence I run,

N. 0° 01' W., bet. secs. 34 and 35.

Over rolling land.

6.00 Dry wash, 25 lks. wide, 3 ft. banks, course N 70° E.

9.40 Road brs. N 40° E. and S. 45° W.

10.60 Road brs. N. 20° E. and S. 45° W.

19.20 Dry wash, 20 lks. wide, 3 ft. banks, course N 50° E.

27.00 Dry wash, 10 lks. wide, 2 ft. banks, course N. 40° E.

40.00 Set an iron post 3 ft. long, 1 in. in diam., 26 ins. in the ground, for  $\frac{1}{4}$  sec. cor., with brass cap, marked  
 $\frac{1}{4}$  S 34 on W., and  
 $\frac{1}{4}$  S 35 on E. half;  
 1914 on S. rim;  
 dig pits 18x18x12 ins., N. and S. of cor. 3 ft. dist., and raise a mound of earth 3 $\frac{1}{2}$  ft. base, 1 $\frac{1}{2}$  ft. high, W. of cor.

43.70 Dry wash, 20 lks. wide, 3 ft. banks, course N. 20° E.

49.10 Dry wash, 30 lks. wide, 4 ft. banks, course N. 30° E.

68.50 Dry wash, 10 lks. wide, 1 ft. banks, course N. 30° E.

80.00 Set an iron post 3 ft. long, 2 ins. in diam., 18 ins. in the ground (could not set deeper on account of solid rock). Build a mound of earth and stone 3 ft. base, 1 ft. high around post for cor. of secs. 26, 27, 34 and 35, with brass cap, marked  
 T 10 S S 27 in NW.,  
 R 2 E S 26 in NE.,  
 S 35 in SE., and  
 S 34 in SW. quadrants;  
 1914 on S. rim;  
 dig pits 18x18x12 ins., in each sec. 5 $\frac{1}{2}$  ft. dist., and raise a mound of earth 4 ft. base, 2 ft. high, W. of cor.  
 Land, rolling.  
 Soil, gravelly and rocky, 3rd rate.  
 Timber, palo verde, ironwood and catclaw.  
 Undergrowth, greasewood brush, ocotillo and giant cactus.



## Partial Subdivision of Township 10 South, Range 2 East. 7.

Chains.	
	East on a random line, bet. secs. 26 and 35.
40.00	Set temp. $\frac{1}{4}$ sec. cor.
79.99	Intersect N. and S. line, 3 lks. S. of the cor. of secs. 25, 26, 35 and 36.
	Thence I run,
	S. $89^{\circ}59'$ W., on a true line, bet. secs. 26 and 35.
	Over slightly rolling land.
3.50	Road brs. N. and S. $10^{\circ}$ W.
5.30	Road to Casa Grande brs. N. $50^{\circ}$ E. and S. $50^{\circ}$ W.
7.10	Dry wash, 50 lks. wide, 4 ft. banks, course N. $40^{\circ}$ E.
35.00	Dry wash, 10 lks. wide, 2 ft. banks, course N. $20^{\circ}$ E.
39.995	Set an iron post 3 ft. long, 1 in. in diam., 26 ins. in the ground for $\frac{1}{4}$ sec. cor., with brass cap, marked 1914 on S. rim; $\frac{1}{4}$ S 26 on N., and $\frac{1}{4}$ S 35 on S. half; dig pits 18x18x12 ins., E. and W. of cor. 3 ft. dist., and raise a mound of earth, $3\frac{1}{2}$ ft. base, $1\frac{1}{2}$ ft. high, N. of cor.
50.00	Road brs. N. $20^{\circ}$ E. and S. $10^{\circ}$ W.
52.50	Enter dry wash; 40 lks. wide; 2 ft. banks; course N. $60^{\circ}$ E.
55.50	Leave dry wash.
57.10	Dry wash, 40 lks. wide, 2 ft. banks, course N. $80^{\circ}$ E.
72.65	Dry wash, 30 lks. wide, 4 ft. banks, course N. $20^{\circ}$ E.
79.99	The cor. of secs. 26, 27, 34 and 35. Land, slightly rolling. Soil, sandy loam and gravel, 2nd rate. Timber, palo verde, ironwood and catclaw. Undergrowth, greasewood brush, ocotillo and giant cactus.
-----	
	N. $0^{\circ}01'$ W., on a true line, bet. secs. 26 and 27.
	Over rolling land.
6.80	Dry wash, 15 lks. wide, 2 ft. banks, course N. $70^{\circ}$ E.
9.80	Dry wash, 20 lks. wide, 4 ft. banks, course N. $80^{\circ}$ E.
13.05	Dry wash, 30 lks. wide, 4 ft. banks, course N. $80^{\circ}$ E.
25.10	Dry wash, 15 lks. wide, 3 ft. banks, course N. $30^{\circ}$ E.
35.80	Dry wash, 15 lks. wide, 3 ft. banks, course N. $30^{\circ}$ E.
40.00	Set an iron post 3 ft. long, 1 in. in diam., 26 ins. in the ground, for $\frac{1}{4}$ sec. cor., with brass cap, marked $\frac{1}{4}$ S 27 on W., and $\frac{1}{4}$ S 26 on E. half; 1914 on S. rim; dig pits 18x18x12 ins., N. and S. of cor., 3 ft. dist., and raise a mound of earth $3\frac{1}{2}$ ft. base, $1\frac{1}{2}$ ft. high, W. of cor.
41.20	Road brs. N. $45^{\circ}$ E. and S. $60^{\circ}$ W.
49.30	Dry wash, 60 lks. wide, 3 ft. banks, course N. $80^{\circ}$ E.
53.80	Road, brs. N. $70^{\circ}$ E. and S. $70^{\circ}$ W.
58.00	Small field bears E, 12 chs. dist.
62.00	Indian hut at S. end of the village brs. E. 8.00 chs. dist.
67.30	Dry wash, 20 lks. wide, 1 ft. banks, course S. $80^{\circ}$ E.
80.00	Set an iron post 3 ft. long, 2 ins. in diam., 24 ins. in the ground for cor. of secs. 22, 23, 26 and 27, with brass cap, marked, T 10 S S 22 in NW., R 2 E S 23 in NE., S 26 in SE., and S 27 in SW. quadrants; 1914 on S. rim; dig pits 18x18x12 ins. in each sec. $5\frac{1}{2}$ ft. dist., and raise a mound of earth 4 ft. base, 2 ft. high, W. of cor. Cor. is located near the center of an Indian village of 36 huts. Land, rolling. Soil, sandy loam, 2nd rate. Timber, palo verde, ironwood, mesquite and catclaw. Undergrowth, greasewood brush, ocotillo and giant cactus.
-----	

## 8 Partial Subdivision of Township 10 South Range 2 East.

Chains.

- East, on a random line, bet. secs. 23 and 26.  
 40.00 Set temp.  $\frac{1}{4}$  sec. cor.  
 80.02 Intersect N. and S. line, 4 lks. N. of the cor. of secs. 23, 24, 25 and 26.  
 Thence I run,  
 N.  $89^{\circ} 58' W.$ , on a true line, bet. secs. 23 and 26.  
 Over rolling land.  
 2.20 Dry wash, 15 lks. wide, 3 ft. banks, course S.  $25^{\circ} W.$   
 19.10 Dry wash, 20 lks. wide, 4 ft. banks, course S.  $10^{\circ} E.$   
 22.60 Dry wash, 10 lks. wide, 2 ft. banks, course S.  $50^{\circ} E.$   
 24.00 Road brs. N.  $40^{\circ} W.$  and S.  $40^{\circ} E.$   
 40.01 Set an iron post 3 ft. long, 1 in. in diam., 26 ins. in the ground for  $\frac{1}{4}$  sec. cor., with brass cap, marked  
     1914 on S. rim;  
      $\frac{1}{4}$  S 23 on N., and  
     S 26 on S. half;  
     dig pits 18x18x12 ins., E. and W. of cor. 3 ft. dist., and raise a mound of earth,  $3\frac{1}{2}$  ft. base,  $1\frac{1}{2}$  ft. high, N. of cor.  
 52.50 Dry wash, 90 lks. wide, 6 ft. banks, course S.  $20^{\circ} E.$   
 68.40 Road brs. S.  $30^{\circ} E.$  and N.  $30^{\circ} W.$   
 75.00 Indian hut on line.  
 80.02 The cor. of secs. 22, 23, 26 and 27.  
 Land, rolling.  
 Soil, sandy loam and gravel, 3rd rate.  
 Timber, palo verde, mesquite, ironwood and catclaw.  
 Undergrowth, greasewood brush, ocotillo and giant cactus.
- 
- N.  $0^{\circ} 01' W.$ , bet. secs. 22 and 23.  
 Over level land.  
 14.40 Dry wash, 90 lks. wide, 6 ft. deep, course S.  $80^{\circ} E.$   
 18.00 Road N.  $60^{\circ} W.$  and S.  $40^{\circ} E.$   
 20.00 Well brs. W. 6.00 chs. dist.  
 23.00 Indian hut on line.  
 24.00 Indian hut brs. E. 60 lks. dist.  
 35.00 Indian hut at N. end of village brs. E. 6 chs. dist.  
 40.00 Set an iron post 3 ft. long, 1 in. in diam., 26 ins. in the ground, for  $\frac{1}{4}$  sec. cor., with brass cap, marked,  
      $\frac{1}{4}$  S 22 on W., and  
     S 23 on E. half;  
     1914 on S. rim;  
     no trees within limits. Dig pits 18x18x12 ins., N. and S. of cor. 3 ft. dist., and raise a mound of earth  $3\frac{1}{2}$  ft. base,  $1\frac{1}{2}$  ft. high, W. of cor.  
 Ascend gradual S. slope.  
 46.00 Road brs. N.  $60^{\circ} E.$  and S.  $10^{\circ} W.$   
 68.00 Dry wash, 20 lks. wide, 4 ft. banks, course S.  $10^{\circ} E.$   
 80.00 Set an iron post 3 ft. long, 2 ins. in diam., 24 ins. in the ground for cor. of secs. 14, 15, 22 and 23, with brass cap, marked,  
     T 10 S 15 in NW.,  
     R 2 E S 14 in NE.,  
     S 23 in SE., and  
     S 22 in SW. quadrants;  
     1914 on S. rim;  
     dig pits 18x18x12 ins., in each sec.  $5\frac{1}{2}$  ft. dist., and raise a mound of earth 4 ft. base, 2 ft. high, W. of cor.  
 Land, level.  
 40.00 Soil, sandy loam, 1st rate on S. half; gravelly, 2nd rate on N. half.  
 Timber, palo verde, mesquite, ironwood and catclaw.  
 Undergrowth, greasewood brush, ocotillo and giant cactus.
- 
- East, on a random line, bet. secs. 14 and 23.  
 40.00 Set temp.  $\frac{1}{4}$  sec. cor.  
 80.04 Intersect N. and S. line, 2 lks. S. of the cor. of secs. 13, 14, 23 and 24.

Partial Subdivision of Township 10 South, Range 2 East. 9.

Chains.

Thence I run,  
 S.89°59'W., on a true line, bet. secs.14 and 23.  
 Over rolling land.

41.00 Road brs.N.60°E. and S.60°W.  
 16.60 Ravine, 30 lks.wide, 5 ft.deep, course S.20°W.  
 23.00 Ravine, 20 lks.wide, 5 ft. deep, course S.20°W.  
 40.02 Set an iron post 3 ft.long, 1 in. in diam.,12 ins. in the  
 ground (could not set deeper on account of solid rock).  
 Build a mound of stone 3 ft. base, 2 ft. high around post  
 for  $\frac{1}{4}$  sec.cor., with brass cap, marked,  
 1914 on S.rim;  
 $\frac{1}{4}$  S 14 on N., and  
 $\frac{1}{4}$  S 23 on S.half;  
 build a mound of stone 3 ft. base, 2 ft. high N.of cor.

41.60 Ravine, 30 lks.wide, 5 ft. deep, course S.20° W.  
 55.80 Dry wash, 15 lks.wide. 3 ft.banks, course S.10°E.  
 65.00 Dry wash, 10 lks.wide, 2 ft. banks, course S.10°E.  
 73.00 Dry wash, 15 lks.wide. 3 ft.banks,course south.  
 80.04 The cor.of secs. 14,15,22 and 23.  
 Land, rolling.  
 Soil, gravelly and rocky, 3rd rate.  
 Timber, palo verde, ironwood and catclaw.  
 Undergrowth, greasewood brush, ocotillo and giant cactus.  
 December 8, 1914.

December 12, 1914.

At 1h.00m. p.m.,l.m.t., I set off 32° 33' N.on the lat. arc; 23°03'S. on the decl.arc, and determine a meridian with the solar at the cor.of secs.14,15,22 and 23.

Thence I run,  
 N.0°01'W. bet. secs.14 and 15.  
 Over rolling land.

6.20 Ravine, 20 lks.wide, 5 ft.deep, course S.30°W.  
 21.80 Road brs.N.30°E. and S.20°W.  
 37.50 Road brs.N.40°E. and S.40°W.  
 40.00 Set an iron post 3 ft.long, 1 in. in diam., 26 ins. in  
 the ground for  $\frac{1}{4}$  sec.cor., with brass cap, marked  
 $\frac{1}{4}$  S 15 on W., and  
 $\frac{1}{4}$  S 14 on E.half;  
 1914 on S.rim;  
 dig pits 18x18x12 ins., N.and S.of cor. 3 ft. dist.,  
 and raise a mound of earth  $3\frac{1}{2}$  ft. base,  $1\frac{1}{2}$  ft. high,W.  
 of cor. From this cor.,  
 Copperosity Mine shaft brs.N.71°30'E.  
 48.20 Ravine, 100 lks.wide, 16 ft. deep, course S.50°W.  
 70.35 Copperosity Mine shaft brs.S.43°35'E.  
 79.00 Ravine, 100 lks.wide, 16 ft.deep,course S.70°W.  
 80.00 Set an iron post 3 ft.long, 2 ins. in diam.,24 ins. in  
 the.ground for cor.of secs.10,11,14 and 15, with  
 brass cap, marked,  
 T 10S, S 10 in NW.,  
 R 2 E, S 11 in NE.,  
 S 14 in SE., and  
 S 15 in SW. quadrants;  
 1914 on S.rim;  
 no trees within limits. Dig pits 18x18x12 ins.,in  
 each sec. $5\frac{1}{2}$  ft. dist., and raise a mound of earth  
 4 ft.base, 2 ft. high,W.of cor.  
 From this cor., rough and broken mountains 650 to 750 ft.  
 high, which are neither agricultural nor grazing bear  
 N.about 20 chs. and E. about 25 chs. Therefore, I do  
 not continue survey either north or east of this cor.  
 Land,rolling.  
 Soil, gravelly and rocky, 3rd rate.  
 Timber, scrub palo verde, ironwood and catclaw.  
 Undergrowth, greasewood brush,ocotillo and giant cactus.  
 December 12, 1914.

## 10. Reestablishment of U.S. Min. Mon. No. 2, Casa Grande Mining Dist. Ariz.

## Chains.

December 13, 1914. After diligent search am unable to find the post originally set as U.S.M.M.No.2 Casa Grande Mining District, but find a conglomerate quartzite rock, marked U.S.M.M.No.2 B P on E. face. At point S.31°05'E., 88 ft. dist. from this rock, I find a circle of stone. As this bearing and distance agrees with the original description of the monument, this is evidently the base of the mound originally raised around the post.

The NW. palo verde bearing tree has been destroyed and the SW. bearing tree dead. I reestablish the mineral monument in center of circle of stone as follows: I set a gas pipe 5 ft. long, 2 ins. in diam., 6 ins. in the ground, and build a mound of stone 5 ft. base, 3½ ft. high around the post for U.S.M.M.No.2, Casa Grande Mining District, marked

U.S M M on N.,  
No.2 on E., and  
C G D on S. face.

At 3h. p.m., l.m.t., I set off 32° 33½' N. on the lat. arc; 23°07'S. on the decl. arc, and determine a meridian with the solar.

The ¼ sec. cor. of secs. 14 and 15 brs. S. 69°25'W., 24.62 chs. dist.

December 13, 1914.

-----  
Partial Subdivision of Township 10 South, Range 2 East.

December 9, 1914:

At 8h.30m. a.m., l.m.t., I set off 32°30½' N. on the lat. arc; 22°45'S. on the decl. arc, and determine a meridian with the solar at the standard cor. of secs. 33 and 34, on the S. bdy. of the Tp. (2nd. Standard Parallel South) reestablished by me as described in Book "A."

Thence I run,  
N.0°02'W., bet. secs. 33 and 34.

Over hilly land.

- 11.20 Ravine, 30 lks. wide, 6 ft. deep, course S.80°E.  
11.50 Prospect shaft 40 ft. deep, brs. E.60 lks. dist.  
19.80 Prospect shaft brs. E.7 chs. dist.  
26.10 Ravine, 20 lks. wide, 4 ft. deep, course E.  
30.70 Ravine, 15 lks. wide, 4 ft. deep, course E.  
36.05 Road brs. E. and W.  
38.00 Ascend S. slope of hill, 80 ft. high, 18.00 chs. long.  
40.00 Set an iron post 3 ft. long, 1 in. in diam., 12 ins. in the ground (could not set deeper on account of solid rock); build a mound of stone 3 ft. base, 1½ ft. high, around post for ¼ sec. cor., with brass cap, marked  
¼ S 33 on W., and  
S 34 on E. half;  
1914 on S. rim.

43.80 Build mound of stone 3 ft. base, 2 ft. high, W. of cor. Top of hill, which extends 8 chs. W. and 10.00 chs. E. Descend N. slope 100 ft. to

53.00 Dry wash, 20 lks. wide, 2 ft. banks, course S.80°E.

Ascend S. slope of hill. Ascend 175 ft. to

61.70 Top of hill, brs. E. and W.

Build a mound of stone 3 ft. base, 2½ ft. high on line at this point. Descend 170 ft. to

77.85 Dry wash, 15 lks. wide, 4 ft. banks, course N.80°E.

80.00 Set an iron post 3 ft. long, 2 ins. in diam., 24 ins. in the ground for cor. of secs. 27, 28, 33 and 34, with brass cap, marked

T 10 S S 28 in NW.,  
R 2 E, S 27 in NE.,  
S 34 in SE., and  
S 33 in SW. quadrants;  
1914 in S rim;

dig pits 18x18x12 ins., in each sec. 5½ ft. dist., and raise a mound of earth 4 ft. base, 2 ft. high, W. of cor.

Land, hilly.

Soil, rocky and gravelly, 3rd rate.

Partial Subdivision of Township 10 South Range 2 East 11

Chains.

Timber, palo verde, ironwood and catclaw.  
Undergrowth, greasewood brush, ocotillo and giant cactus;  
cholla.  
Sec. 33 is well prospected.

40.00 East, on a random line, bet. secs.27 and 34.  
Set temp.  $\frac{1}{4}$  sec.cor.  
79.95 Intersect N.and S. line, 3 lks.S.of the cor.of secs.26.27,  
34 and 35.  
Thence I run,  
S $89^{\circ}59'$ W., on a true line, bet. secs.27 and 34.  
Over rolling land.  
6.60 Dry wash, 10 lks.wide, 1 ft. banks, course N.40 $^{\circ}$ E.  
15.20 Dry wash, 20 lks.wide, 2 ft.banks, course N.70 $^{\circ}$ E.  
20.60 Road brs.N.and S.  
20.65 Dry wash, 30 lks.wide, 2 ft. banks, course N.40 $^{\circ}$ E.  
34.00 Dry wash, 15 lks.wide, 2 ft.banks, course N.30 $^{\circ}$ E.  
39.975 Set an iron post 3 ft.long, 1 in. in diam., 26 ins. in the  
ground for  $\frac{1}{4}$  sec.cor., with brass cap, marked  
1914 on S.rim,  
 $\frac{1}{4}$  S 27 on N., and  
S 34 on S.half;  
dig pits 18x18x12 ins., E.and W. of cor. 3 ft. dist.,  
and raise a mound of earth 3 $\frac{1}{2}$  ft. base, 1 $\frac{1}{2}$  ft. high, N.  
of cor.  
45.35 Top of low hill brs.N.40 $^{\circ}$ E. and S.40 $^{\circ}$ W.  
55.80 Top of low hill, brs.N.40 $^{\circ}$ E. and S.40 $^{\circ}$ W.  
62.80 Top of low hill brs.N.40 $^{\circ}$ E. and S.40 $^{\circ}$ W.  
68.60 Old road brs.N.60 $^{\circ}$ E. and S.15 $^{\circ}$ W.  
70.00 Indian clay diggings for pottery brs.S. about 15.00 chs.  
dist.  
75.20 Ravine, 15 lks.wide, 4 ft.banks, course N.70 $^{\circ}$ E.  
79.95 The cor.of secs.27,28,33 and 34.

Land, rolling.  
Soil, gravelly, 3rd rate.  
Timber, palo verde, ironwood and mesquite; catclaw.  
Undergrowth, greasewood brush.  
Ocotillo and giant cactus.  
At this cor. I set off 22 $^{\circ}$ 47'S. on the decl.arc, and at  
1h.52m. a.m., 1.m.t., I observe the sun on the meridian;  
the resulting lat.is 32 $^{\circ}$ 31' N.

N.0 $^{\circ}$ 02'W., bet. secs.27 and 28.  
Over level land.  
18.60 Dry wash, 20 lks.wide, 4 ft.banks, course E.  
40.00 Set an iron post 3 ft.long, 1 in. in diam., 26 ins. in the  
ground for  $\frac{1}{4}$  sec.cor., with brass cap, marked  
 $\frac{1}{4}$  S 28 on W., and  
S 27 on E.half;  
1914 on S.rim;  
dig pits 18x18x12 ins., N.and S.of cor.3 ft. dist., and  
raise a mound of earth 3 $\frac{1}{2}$  ft. base, 1 $\frac{1}{2}$  ft. high, W.of  
cor.  
44.10 Dry wash, 15 lks.wide, 3 ft.banks, course E.  
52.40 Dry wash, 20 lks.wide, 2 ft.banks, course S.80 $^{\circ}$ E.  
57.20 Dry wash, 60 lks.wide, 3 ft.banks, course E.  
80.00 Set an iron post 3 ft.long, 2 ins. in diam., 24 ins. in  
the ground for cor.of secs.21,22,27 and 28, with brass  
cap, marked  
T 10 S, S 21 in NW.,  
R 2 E, S 22 in NE.,  
S. 27 in SE., and  
S 28 in SW. quadrants;  
1914 on S.rim;  
dig pits 18x18x12 ins. in each sec.5 $\frac{1}{2}$  ft. dist., and  
raise a mound of earth 4 ft.base, 2 ft.high, W.of cor.  
Land, level.

## 12. Partial Subdivision of Township 10 South, Range 2 East

Chains.	
	Soil, sandy loam, 1st rate. Timber, palo verde, ironwood and catclaw. Undergrowth, greasewood brush. Ocotillo, giant cactus and cholla.
	-----
	East, on a random line, bet. secs. 22 and 27.
40.00	Set temp. $\frac{1}{4}$ sec. cor.
79.94	Intersect N. and S. line, 2 lks. N. of the cor. of secs. 22, 23, 26 and 27. Thence I run, N. $89^{\circ}59'W.$ , on a true line bet. secs. 22 and 27. Over nearly level land.
20.60	Dry wash, 15 lks. wide, 2 ft. banks, course S- $60^{\circ}E.$
39.97	Set an iron post 3 ft. long, 1 in. in diam., 6 ins. in the ground (could not set deeper on account of solid rock); build a mound of stone 3 ft. base, 2 ft. high around post for $\frac{1}{4}$ sec. cor., with brass cap, marked 1914 on S. rim; $\frac{1}{4}$ S 22 on N., and S 27 on S. half; build a mound of stone 3 ft. base, $2\frac{1}{2}$ ft. high, N. of cor.
44.00	Ascend NE. slope of hill, covered with malpais boulders.
60.00	Top of hill, brs. N. $20^{\circ}W.$ and S. $20^{\circ}E.$ Ascent of 210 ft. Descend W. slope.
71.60	Foot of hill. Enter level land.
71.80	Dry wash, 15 lks. wide, 2 ft. banks, course N. $40^{\circ}E.$
79.94	The cor. of secs. 21, 22, 27 and 28. Land, hilly and level. Soil, on level, sandy loam, 2nd rate. In hills rocky and gravelly, 3rd and 4th rate. Timber, scrub palo verde, ironwood, mesquite and catclaw. Undergrowth, greasewood brush. Ocotillo, giant cactus and cholla.
	-----
	N. $0^{\circ}02'W.$ , bet. secs. 21 and 22. Over level land.
3.30	Road, brs. N. $80^{\circ}E.$ and S. $70^{\circ}W.$
12.90	Dry wash, 40 lks. wide, 2 ft. banks, course east.
15.00	Ascend 40 ft. over W. end of hill, which is 15 chs. long and 200 ft. high.
26.50	Descend over NW. slope.
33.00	Enter level land.
40.00	Set an iron post 3 ft. long, 1 in. in diam., 26 ins. in the ground for $\frac{1}{4}$ sec. cor., with brass cap, marked $\frac{1}{4}$ S 21 on W., and S 22 on E. half; 1914 on S. rim; dig pits 18x18x12 ins., N. and S. of cor. 3 ft. dist., and raise a mound of earth, $3\frac{1}{2}$ ft. base, $1\frac{1}{2}$ ft. high, W. of cor.
47.70	Dry wash, 15 lks. wide, 1 ft. banks, course east.
54.90	Road to Maricopa brs. N. $45^{\circ}W.$ and S. $45^{\circ}E.$ Small hill 40 ft. high, 6.00 chs. in diam., brs. W. 3 chs. dist.
68.20	Ascend S. slope of hill.
80.00	Set an iron post 3 ft. long, 2 ins. in diam., in a mound of stone 4 ft. base, $2\frac{1}{2}$ ft. high for cor. of secs. 15, 16, 21 and 22, with brass cap, marked T 10 S S 16 in NW., R 2 E S. 15 in NE., S 22 in S., and S 21 in SW. quadrants; 1914 in S. rim; build a mound of stone 3 ft. base, 2 ft. high, W. of cor.

Partial Subdivision of Township 10 South, Range 2 East. 13.

Chains

Cliffs 150 ft. high, bear N. 50 lks., and E. and W. of cor.  
 4.00 chs. dist.  
 Land, hilly and level.  
 Soil on level, sandy loam, 2nd rate. In hills rocky and  
 gravelly, 3rd and 4th rate.  
 Timber, palo verde, ironwood and mesquite.  
 Undergrowth, greasewood brush, ocotillo and giant cactus;  
 cholla.

December 9, 1914.

December 14, 1914.  
 At 8h. a.m., l.m.t., I set off 23°09'S. on the decl. arc;  
 32°33' on the lat. arc, and determine a meridian with  
 the solar at the cor. of secs. 15, 16, 21 and 22.

Thence I run,  
 East, on a random line, bet. secs. 15 and 22.  
 40.00 Set temp.  $\frac{1}{4}$  sec. cor.  
 79.96 Intersect the cor. of secs. 14, 15, 22 and 23.  
 Thence I run,  
 West, on a true line, bet. secs. 15 and 22.  
 Over hilly and rolling land.  
 2.50 Dry wash, 20 lks. wide, 5 ft. banks, course S. 10° W.  
 4.80 Road brs. NE. and S.  
 13.90 Ravine, 20 lks. wide, 5 ft. deep, course S.  
 25.00 Tanks bear S. 15.00 chs. dist.  
 31.30 Ravine, 40 lks. wide, 8 ft. deep, course S.  
 36.90 Ravine, 30 lks. wide, 6 ft. deep, course S.  
 39.98 Set an iron post 3 ft. long, 1 in. in diam., 26 ins. in  
 the ground for  $\frac{1}{4}$  sec. cor., with brass cap, marked  
 $\frac{1}{4}$  S. 15 on N., and  
 $\frac{1}{4}$  S. 22 on S. half;  
 1914 on S. rim;  
 dig pits 18x18x12 ins., E. and W. of cor. 3 ft. dist.,  
 and raise a mound of earth  $3\frac{1}{2}$  ft. base,  $1\frac{1}{2}$  ft. high, N.  
 of cor.  
 48.10 Dry wash, 120 lks. wide, 5 ft. banks, course S. 50° E.  
 50.00 Ascend NE. slope of hill.  
 75.20 Top of cliff 150 ft. high.  
 79.96 The cor. of secs. 15, 16, 21 and 22.  
 Land, hilly and rolling.  
 Soil, gravelly and rocky, 3rd and 4th rate.  
 Timber, scrub palo verde, ironwood and catclaw.  
 Undergrowth, greasewood brush.  
 Ocotillo and giant cactus.

N. 0°02' W., bet. secs. 15 and 16.  
 Over hilly and level land.  
 Ascend over cliffs 100 to 150 ft. high.  
 2.32 Top of cliff. Descend N. slope, over cliffs 100 ft. high.  
 Altitude, 380 ft. above level.

16.00 Foot of hill; enter level land.  
 22.50 Dry wash, 100 lks. wide, 5 ft. banks, course S. 80° E.  
 40.00 Set an iron post 3 ft. long, 1 in. in diam., 26 ins. in  
 the ground for  $\frac{1}{4}$  sec. cor., with brass cap, marked  
 $\frac{1}{4}$  S. 16 on W., and  
 $\frac{1}{4}$  S. 15 on E. half;  
 1914 on S. rim;  
 dig pits 18x18x12 ins., N. and S. of cor., 3 ft. dist.,  
 and raise a mound of earth  $3\frac{1}{2}$  ft. base,  $1\frac{1}{2}$  ft. high,  
 W. of cor.  
 50.60 Ravine, 40 lks. wide, 6 ft. deep, course S. 10° E.  
 67.40 Ravine, 30 lks. wide, 6 ft. deep, course S. 10° E.  
 80.00 Set an iron post 3 ft. long, 2 ins. in diam., 24 ins. in  
 the ground for cor. of secs. 9, 10, 15 and 16, with brass  
 cap, marked

## 14. Partial Subdivision of Township 10 South, Range 2 East.

Chains

	<p>T 10 S 9 in NW., R 2 E, S 10 in NE., S 15 in SE., and S 16 in SW. quadrant; 1914 on S rim; from which An ironwood 6 ins. in diam., brs. S. 85°15'E., 80 lks. dist., marked T 10 S R 2 E S 15 B T. An ironwood, 5 ins. in diam., brs. N. 67°15'W., 39 lks. dist., marked T 10 S R 2 E S 9 B T. No other trees within limits. Dig pits 18x18x12 ins., in each sec. 5½ ft. dist., and raise a mound of earth 4 ft. base, 2 ft. high, W. of cor. Land, hilly and rolling. Soil, gravelly and rocky, 3rd and 4th rate. Timber, scrub palo verde, ironwood and catclaw. Undergrowth, greasewood brush. Giant cactus.</p> <p style="text-align: right;">December 14, 1914.</p>
	<p>December 16, 1914: East, on a random line, bet. secs. 10 and 15. Set temp. ¼ sec. cor. Intersect N. and S. line, 8 lks. S. of the cor. of secs. 10, 11, 14 and 15. Thence I run, S. 89°57'W. on a true line, bet. secs. 10 and 15. Over rolling land.</p>
40.00	
79.96	
11.40	Ravine, 40 lks. wide, 5 ft. deep, course S. 20°W.
39.25	Ravine, 30 lks. wide, 5 ft. deep, course S. 20°W.
39.98	Set an iron post 3 ft. long, 1 in. in diam., 26 ins. in the ground for ¼ sec. cor., with brass cap, marked 1914 on S rim; ¼ S 10 on N., and ¼ S 15 on S. half; dig pits 18x18x12 ins., E. and W. of cor., 3 ft. dist., and raise a mound of earth 3½ ft. base, 1½ ft. high, N. of cor.
50.90	Ravine, 40 lks. wide, 5 ft. deep, course S.
55.20	Road brs. N. and S.
66.00	Ravine, 25 lks. wide, 4 ft. deep, course S. 10°W.
79.96	The cor. of secs. 9, 10, 15 and 16. Land, rolling. Soil, gravelly and rocky, 3rd rate. Timber, scrub palo verde, ironwood and catclaw. Undergrowth, greasewood brush. Ocotillo and giant cactus. At this cor., I set off 23°18'S. on the decl. arc. and at 11h. 54m. a.m., 1.m.t., I observe the sun on the meri- dian, the resulting lat. being 32°34' N.
	<p>N. 0°02'W., bet. secs. 9 and 10. Over rolling land.</p>
7.15	Ravine, 30 lks. wide, 3 ft. banks, course S. 80°W.
20.00	Ravine, 20 lks. wide, 4 ft. deep, course S. 50°W.
25.20	Ravine, 40 lks. wide, 6 ft. deep, course S. 50°W.
32.40	Road, brs. E. and W. Ascend rocky S. slope of hill.
40.00	Set an iron post 3 ft. long, 1 in. in diam., 8 ins. in the ground (could not set deeper on account of solid rock); build a mound of stone 3 ft. base 2 ft. high, around post for ¼ sec. cor., with brass cap, marked ¼ S 9 on W., and ¼ S 10 on E. half; 1914 on S. rim; build a mound of stone 3 ft. base, 2 ft. high, W. of cor.
49.70	Top of ridge 260 ft. high, extending W. 20 chs.
54.30	Ravine, 20 lks. wide, 4 ft. deep, course N. 70°W.



## Partial Subdivision of Township 10 South Range 2 East 15

Chains.

- 57.35 Ascend SW. slope.  
 71.25 Top of spur, brs. E. and W. Descend N. slope.  
 80.00 Foot of hill; enter rolling land.  
 Set an iron post 3 ft. long, 2 ins. in diam., 24 ins. in the ground for cor. of secs. 3, 4, 9 and 10, with brass cap, marked  
 T 10 S, S 4 in NW.,  
 R 2 E, S 3 in NE.,  
 S 10 in SE., and  
 S 9 in SW. quadrants;  
 1914 in S. rim;  
 dig pits 18x18x12 ins., in each sec. 5½ ft. dist., and raise a mound of earth 4 ft. base, 2 ft. high, W. of cor. Land, rolling and mountainous.  
 Soil, gravelly and rocky, 3rd and 4th rate.  
 Timber, scrub palo verde, ironwood and catclaw.  
 Undergrowth, greasewood brush.  
 Ocotillo and giant cactus, cholla.
- 
- 40.00 North, on a random line, bet. secs. 3 and 4.  
 80.15 Set temp. ¼ sec. cor.  
 Intersect N. bdy. of Tp., 8 lks. W. of the cor. of secs. 3, 4, 33 and 34, established by W. K. Kierulff, U. S. Transitman, as described in Book "B."  
 Thence I run,  
 S. 0° 03' W., on a true line, bet. secs. 3 and 4.  
 Over rolling land.  
 4.95 Ravine, 40 lks. wide, 5 ft. banks, course W.  
 15.55 Old road, brs. E. and W.  
 27.50 Ravine, 40 lks. wide, 6 ft. deep, course S. 80° W.  
 40.15 Set an iron post 3 ft. long, 1 in. in diam., 26 ins. in the ground for ¼ sec. cor., with brass cap, marked,  
 ¼ S 4 on W., and  
 S 3 on E. half;  
 1914 on S. rim;  
 build a mound of stone 3 ft. base, 2½ ft. high, W. of cor.  
 42.80 Ravine, 30 lks. wide, 6 ft. deep, course S. 80° W.  
 59.50 Dry wash, 40 lks. wide, 4 ft. banks, course S. 30° W.  
 76.70 Dry wash, 40 lks. wide, 4 ft. banks, course W.  
 80.15 The cor. of secs. 3, 4, 9 and 10.  
 Land, rolling; surface very rocky.  
 Soil, volcanic ash, gravelly, 3rd rate.  
 Timber, scrub palo verde, ironwood and catclaw.  
 December 16, 1914.
- 
- December 10, 1914.  
 At 8h. 30m. a.m., l.m.t., I set off 32° 30½' N. on the lat. arc; 22° 51' S. on the decl. arc, and determine a meridian with the solar at the standard cor. of secs. 32 and 33 on the S. bdy. of the Tp. (2nd. Stand. Parallel S.) re-established by me, as described in Book "A."  
 Thence I run,  
 N. 0° 02' W., bet. secs. 32 and 33  
 Over hilly land; along NW. slope.  
 9.80 Ravine, 15 lks. wide, 3 ft. deep, course E.  
 12.30 Change to West slope.  
 16.45 Build a mound of stone 3 ft. base, 2 ft. high, on line at this point.  
 Descend NE. slope.  
 23.40 Foot of descent; ravine 15 lks. wide, 4 ft. deep, course N. 40° E.  
 Ascend over E. end of small hill.  
 28.30 Ravine, 20 lks. wide, 10 ft. deep, course N. 30° W.  
 Ascend over W. end of hill.  
 40.00 Set an iron post 3 ft. long, 1 in. in diam., 12 ins. in the ground (could not set deeper on account of solid rock); build a mound of stone 3 ft. base, 1½ ft. high.

## 16. Partial Subdivision of Township 10 South, Range 2 East.

Chains	<p>around post for <math>\frac{1}{4}</math> sec.cor., with brass cap, marked  <math>\frac{1}{4}</math> S 32 on W., and  S 33 on E.half;  1914 on S rim;  build a mound of stone 3 ft.base, 2 ft.high,W.of cor.</p>
42.70	Descend NW. slope.
52.55	Ravine, 20 lks.wide, 4 ft.deep, course N.10°E.
60.00	Enter rolling land.
80.00	Set an iron post 3 ft.long, 2 ins. in diam.,12 ins. in the ground (could not set deeper on account of solid rock); build a mound of earth and stone 3 ft. base,2 ft.high around post for cor.of secs.28,29,32 and 33, with brass cap, marked T 10 S S 29 in NW., R 2 ES 28 in NE., S 33 in SE., and S 32 in SW. quadrants; 1914 on S rim; dig pits 18x18x12 ins., in each sec.5 $\frac{1}{2}$ ft. dist.,and raise a mound of earth 4 ft. base, 2 ft. high,W.of cor.
	Land, hilly. Soil, gravelly and rocky, 3rd and 4th rate, Timber, scrub palo verde, ironwood and catclaw. Undergrowth, greasewood, ocotillo giant cactus and cholla.
	-----
	East, on a random line, bet. secs.28 and 33.
40.00	Set temp. $\frac{1}{4}$ sec.cor.
80.11	Intersect N.and S. line, 3 lks.S.of the cor.of secs.27, 28,33 and 34. Thence I run, S 89°59'W., on a true line, bet. secs.28 and 33. Over rolling land, through dense brush.
40.055	Set an iron post 3 ft.long, 1 in. in diam., 18 ins. in the ground (could not set deeper on account of solid rock); build a mound of stone 2 ft.base, 1 ft.high around post for $\frac{1}{4}$ sec.cor.with brass cap, marked, 1914 on S.rim. $\frac{1}{4}$ S 28 on N., and S 33 on S.half; dig pits 18x18x12 ins., E.and W.of cor. 3 ft. dist., and raise a mound of earth 3 $\frac{1}{2}$ ft. base, 1 $\frac{1}{2}$ ft. high, N.of cor.
56.00	Ravine,15 lks.wide, 3 ft.deep,course N.40°E.
67.20	Dry wash, 40 lks.wide, 6 ft.banks, course N.40°E.
74.00	Dry wash,10 lks.wide, 3 ft.banks,course N.60°E.
80.11	The cor.of secs.28,29,32 and 33. Land, rolling. Soil, gravelly and rocky, 3rd rate. Timber, palo verde, ironwood and catclaw. Undergrowth, greasewood brush,ocotillo and giant cactus.
	-----
	N.0° 02' W., bet. secs.28 and 29. Over rolling land.
5.00	Ravine, 20 lks.wide, 3 ft. deep, course N.50°E.
28.40	Dry wash, 25 lks.wide, 4 ft.banks,course N.40°E.
38.00	Dry wash, 40 lks.wide, 3 ft.banks, course N.40°E.
40.00	Set an iron post, 3 ft.long, 1 in. in diam., 26 ins. in the ground, for $\frac{1}{4}$ sec.cor., with brass cap, marked $\frac{1}{4}$ S 29 in W., and S 28 in E.half; 1914 on S.rim; dig pits 18x18x12 ins., N.and S. of cor. 3 ft. dist., and raise a mound of earth 3 $\frac{1}{2}$ ft. base, 1 $\frac{1}{2}$ ft. high, W.of cor.
44.00	Road brs. N.50°E. and S.50° W.
58.60	Dry wash, 20 lks.wide, 4 ft. banks, course N.80°E.

Chains

77.70 Dry wash, 40 lks.wide, 3 ft. banks, course east.  
 80.00 Set an iron post 3 ft.long, 2 ins. in diam., 24 ins. in the ground for cor.of secs. 20,21,28 and 29, with brass cap, marked  
     T 10 S S 20 in NW.,  
     R 2 E, S 21 in NE.,  
     S 28 in SE., and  
     S 29 in SW.quadrants;  
     1914 in S.rim;  
 dig pits 18x18x12 ins. in each sec. 5½ ft. dist., and raise a mound of earth 4 ft. base, 2 ft.high, W.of cor. Land, rolling to 20.00 chs. Thence level.  
 Soil, ~~sandy~~; gravelly, 3rd rate.  
 Level, sandy loam, 2nd rate.  
 Timber, palo verde, mesquite, ironwood and catclaw.  
 Undergrowth, greasewood brush, ocotillo and giant cactus.

East, on a random line, bet. secs.21 and 28.  
 40.00 Set temp.¼ sec.cor.  
 79.98 Intersect N.and S line, 2 lks.S.of the cor.of secs.21,22, 27 and 28.  
 Thence I run,  
 S.89°59'W., on a true line, bet. secs.21 and 28.  
 Over level land.  
 7.25 Road, brs.N.70°E. and S.70°W.  
 39.99 Set an iron post 3 ft.long, 1 in. in diam.,26 ins. in the ground for ¼ sec.cor., with brass cap, marked  
     ¼ S 21 on N., and  
     S 28 on S.half;  
     1914 in S.rim;  
 dig pits 18x18x12 ins., E.and W.of cor. 3 ft. dist., and raise a mound of earth 3½ ft. base, 1½ ft. high, N.of cor.  
 79.98 The cor.of secs.20,21,28 and 29.  
 Land, level.  
 Soil, sandy loam and gravel, 2nd rate.  
 Timber, palo verde, mesquite and ironwood.  
 Undergrowth, greasewood brush.  
 Ocotillo, giant cactus and cholla.  
 December 10,1914.

December 11, 1914.  
 At 8h. a.m.,l.m.t., I set off 32° 32'N.on the lat.arc; 22°55'S.on the decl.arc, and determine a meridian with the solar at the cor.of secs.20,21,28 and 29.  
 Thence I run,  
 N.0°02'W., bet. secs.20 and 21.  
 Over level land.  
 Ascend gradual S.slope.  
 22.40 Ravine, 20 lks.wide, 3 ft. deep, course S.30° E.  
 40.00 Set an iron post 3 ft. long, 1 in. in diam., 26 ins. in the ground for ¼ sec.cor., with brass cap, marked  
     ¼ S 20 on W., and  
     S 21 on E. half;  
     1914 on S.rim;  
 build a mound of stone 3 ft. base, 2 ft. high,W. of cor.  
 Foot of rocky hills, brs. E.and W.  
 50.00 Ravine, 30 lks.wide, 6 ft. deep, course S.10°E.  
 Ascend S.slope.  
 67.35 Saddle divide, 650 ft. ascent. Build a mound of stone 4 ft.base, 2½ ft. high, on line at this point.  
 Descend NW slope.  
 80.00 Set an iron post 3 ft. long, 2 ins.in diam., 6 ins. in the ground (could not set deeper on account of solid rock); build a mound of stone 3 ft. base,2½ ft. high around post for cor.of secs.16,17,20 and 21, with brass cap, marked,  
     T 10 S S 17 in NW.,  
     R 2 E, S 16 in NE.,

## 18. Partial Subdivision of Township 10 South, Range 2 East.

Chains

- S 21 in SE., and  
S 20 in SW. quadrants;  
1914 on S rim;  
build a mound of stone 3 ft. base, 2 ft. high, N. of cor.  
Impossible to build mound on W. on account of high rocks.  
Land, level on south half; mountainous on north half.  
Soil, on level, gravelly, 3rd rate. In mountains, rocky,  
4th rate.  
Timber, scrub palo verde and ironwood.  
Undergrowth, greasewood brush. Ocotillo and giant cactus.
- 
- East, on a random line, bet. secs. 16 and 21.  
40.00 Set temp.  $\frac{1}{4}$  sec. cor.  
80.00 Intersect N. and S. line, 3 lks. S. of cor. of secs. 15, 16, 21  
and 22.  
Thence I run,  
S.  $89^{\circ}59'$  W., on a true line, bet. secs. 16 and 21.  
Over hilly land.  
Ascend over high cliffs.  
5.00 Top of cliffs, 100 to 150 ft. high.  
Descend W. slope.  
12.00 Foot of hill; enter level land.  
18.30 Road brs. N.  $40^{\circ}$  W. and S.  $30^{\circ}$  E.  
27.80 Leave level land and enter hills.  
Ascend over point of hill.  
40.00 Set an iron post 3 ft. long, 1 in. in diam., 12 ins. in  
the ground (could not set deeper on account of solid  
rock); build a mound of stone 3 ft. base, 2 ft. high  
around post for  $\frac{1}{4}$  sec. cor., with brass cap, marked  
1914 on S. rim;  
 $\frac{1}{4}$  S 16 on N., and  
S 21 on S. half;  
build a mound of stone 3 ft. base, 2 ft. high, N. of cor.  
46.50 Dry wash, 15 lks. wide, 1 ft. banks, course S- $75^{\circ}$  E.  
49.70 Ascend NE. slope.  
65.25 Ravine, 30 lks. wide, 6 ft. deep, course N.  $40^{\circ}$  E.  
74.20 Ravine, 30 lks. wide, 4 ft. deep, course N.  
78.90 Top of spur.  
Descend steep W. slope.  
80.00 The cor. of secs. 16, 17, 20 and 21.  
Land, hilly.  
Soil, gravelly and rocky, 3rd and 4th rate.  
Timber, none.  
Undergrowth, mesquite and greasewood brush.  
Ocotillo and cholla and giant cactus.  
December 11, 1914.
- 
- December 16, 1914:  
At 8h. a.m., l.m.t., I set off  $32^{\circ}33'$  N. on the lat. arc;  $23^{\circ}$   
 $16'$  S. on the decl. arc, and determine a meridian with  
the solar at the cor. of secs. 16, 17, 20 and 21.  
Thence I run,  
N.  $0^{\circ}02'$  W. bet. secs. 16 and 17.  
Over hilly land.  
Descend over rocky NW. slope.  
19.84 Ravine, 30 lks. wide, 4 ft. deep, course N.  $10^{\circ}$  E.  
22.64 Ravine, 20 lks. wide, 4 ft. deep, course N.  $10^{\circ}$  E.  
40.00 Set an iron post 3 ft. long, 1 in. in diam., in a mound of  
stone 4 ft. base,  $2\frac{1}{2}$  ft. high for  $\frac{1}{4}$  sec. cor., with  
brass cap, marked,  
 $\frac{1}{4}$  S 17 on W., and  
S 16 on E. half;  
1914 on S. rim;  
not a sufficient amount of stone to build another mound.  
42.40 Enter rolling land.  
57.80 Dry wash, 20 lks. wide, 2 ft. banks, course E.  
67.36 Top of low hill, brs. E. and W.  
78.60 Road brs. N.  $60^{\circ}$  W. and S.  $60^{\circ}$  E.

Partial Subdivision of Township 10 South, Range 2 East. 19.

Chains.

80.00 Set an iron post 3 ft. long, 2 ins. in diam., 24 ins. in the ground for cor. of secs. 8, 9, 16 and 17, with brass cap, marked  
 T10 S S 8 in NW.,  
 R 2 E, S 9 in NE.,  
 S 16 in SE., and  
 S 17 in SW. quadrants;  
 1914 on S rim;  
 dig pits 18x18x12 ins., in each sec. 5 1/2 ft. dist., and raise a mound of earth, 4 ft. base, 2 ft. high, W. of cor. Land, hilly to 45 chs.; thence level.  
 Soil, gravelly and rocky, 3rd and 4th rate.  
 Timber, scrub palo verde, ironwood and catclaw; greasewood.

-----  
 East, on a random line, bet. secs. 9 and 16.  
 40.00 Set temp. 1/4 sec. cor.  
 79.99 Intersect N. and S line, 8 lks. S. of the cor. of secs. 9, 10, 15 and 16.  
 Thence I run,  
 S 89° 57' W., on a true line, bet. secs. 9 and 16.  
 Over rolling land.  
 5.00 Ravine, 30 lks. wide, 5 ft. deep, course S. 20° W.  
 10.90 Ravine, 20 lks. wide, 4 ft. banks, course S. 10° W.  
 21.00 Ravine, 30 lks. wide, 5 ft. deep, course S.  
 28.50 Ravine, 60 lks. wide, 10 ft. deep, course S. 10° W.  
 38.50 Ravine, 20 lks. wide, 4 ft. deep, course S.  
 39.99 Set an iron post 3 ft. long, 1 in. in diam., 26 ins. in the ground for 1/4 sec. cor., with brass cap, marked  
 1914 on S. rim,  
 1/4 S 9 on N., and  
 S 16 on S. half;  
 dig pits 18x18x12 ins., E. and W. of cor. 3 ft. dist., and raise a mound of earth 3 1/2 ft. base, 1 1/2 ft. high, N. of cor.  
 45.20 Ravine, 30 lks. wide, 5 ft. deep, course S.  
 53.20 Ravine, 40 lks. wide, 5 ft. deep, course S.  
 65.00 Dry wash, 80 lks. wide, 5 ft. banks, course SE.  
 79.99 The cor. of secs. 8, 9, 16 and 17.  
 Land, rolling.  
 Soil, volcanic ash; gravel and rocks, 3rd rate.  
 Timber, scrub palo verde, ironwood and catclaw.  
 Undergrowth, greasewood brush; ocotillo and giant cactus.  
 December 16, 1914.

-----  
 December 20, 1914:  
 At 10h. a.m., l.m.t., I set off 23° 25' S. on the decl. arc; 32° 34' N. on the lat. arc, and determine a meridian with the solar at the cor. of secs. 8, 9, 16 and 17.  
 Thence I run,  
 N. 0° 02' W., bet. secs. 8 and 9.  
 Over rolling land.  
 3.40 Dry wash, 20 lks. wide, 3 ft. banks, course east.  
 20.00 Enter level land.  
 29.20 Dry wash, 15 lks. wide, 4 ft. banks, course E.  
 40.00 Set an iron post 3 ft. long, 1 in. in diam., 26 ins. in the ground for 1/4 sec. cor., with brass cap, marked  
 1/4 S 8 on W., and  
 S 9 on E half;  
 1914 on S. rim;  
 dig pits 18x18x12 ins. N. and S. of cor. 3 ft. dist., and raise a mound of earth 3 1/2 ft. base, 1 1/2 ft. high, W. of cor.  
 40.80 Dry wash, 50 lks. wide, 8 ft. banks, course S. 20° E.  
 50.00 Enter rolling land.  
 54.30 Dry wash, 15 lks. wide, 2 ft. banks, course S. 50° W.  
 68.70 Road, brs. N. 50° E. & S. 50° W.  
 80.00 Set an iron post 3 ft. long, 2 ins. in diam., 24 ins. in the ground for cor. of secs. 4, 5, 8 and 9, with brass cap, marked  
 T 10 S S 5 in NW.,

## 20. Partial Subdivision of Township 10 South, Range 2 East

Chains.

- R 2 E, S 4 in NE.,  
S 9 in SE., and  
S 8 in SW. quadrants;  
1914 on S.rim;  
dig pits 18x18x12 ins., in each sec. 5½ ft. dist., and  
raise a mound of earth 4 ft. base, 2 ft. high, W. of cor.  
Land, 0 to 20 chs. rolling; level from 20 to 50 chs.  
Soil, on level sandy loam, 2nd rate; rolling, gravelly and  
rocky, 4th rate.  
Timber, scrub palo verde, ironwood.  
Undergrowth, scattering greasewood; ocotillo.
- 
- East, on a random line, bet. secs. 4 and 9.  
40.00 Set temp. ¼ sec. cor.  
79.95 Intersect N. and S. line, 1 link N. of the cor. of secs. 3, 4,  
9 and 10.  
Thence I run,  
West, on a true line, bet. secs. 4 and 9.  
Over rolling land.  
5.25 Dry wash 60 lks. wide, 3 ft. banks, course S. 50° W.  
18.65 Ravine, 20 lks. wide, 4 ft. banks, course S.  
27.35 Top of low hill.  
35.50 Ravine, 15 lks. wide, 3 ft. deep, course S. 40° W.  
39.975 Set an iron post 3 ft. long, 1 in. in diam., 26 ins. in the  
ground for ¼ sec. cor., with brass cap, marked  
1914 on S.rim;  
¼ S 4 on N., and  
S 9 on S. half;  
build a mound of stone 3 ft. base, 2 ft. high, N. of cor.  
Pits impracticable.  
50.70 Ravine, 15 lks. wide, 4 ft. deep, course S. 20° W.  
70.00 Dry wash, 20 lks. wide, 5 ft. banks, course S. 30° W.  
71.45 Road brs. N. 20° E. and S. 30° W.  
79.95 The cor. of secs. 4, 5, 8 and 9.  
Land, rolling.  
Soil, volcanic ash, rocky and gravelly, 3rd rate.  
Timber, scattering scrub palo verde, ironwood and catclaw.  
Undergrowth, greasewood brush, ocotillo, cholla and giant  
cactus.
- 
- N. 0° 02' W., on a random line, bet. secs. 4 and 5.  
40.00 Set temp. ¼ sec. cor.  
80.10 Intersect N. bdy. of the Tp., 5 lks. W. of the cor. of secs.  
4, 5, 32 and 33, established by W. K. Kierulff, U. S. Trans-  
sitman, as described in Book "B."  
Thence I run,  
South, on a true line, bet. secs. 4 and 5.  
Over rolling land, over N. slope of low hill. Ascend 46  
ft. to  
12.70 Top of ascent. Thence over S. slope. Descend 110 ft. to  
39.95 Foot of descent.  
40.10 Set an iron post 3 ft. long, 1 in. in diam., 26 ins. in  
the ground for ¼ sec. cor., with brass cap, marked  
¼ S 5 on W., and  
S 4 on E. half;  
1914 on S.rim;  
build a mound of stone 3 ft. base, 2½ ft. high, W. of cor.  
Pits impracticable.  
61.60 Dry wash, 20 lks. wide, 2 ft. banks, course S. 40° W.  
80.10 The cor. of secs. 4, 5, 8 and 9.  
Land, rolling.  
Soil, gravelly and rocky on the N. half; volcanic, ash and  
rock, 3rd rate on S. half; Hills covered with mal-  
pais rock.  
Timber, scattering scrub, palo verde, ironwood and cat-  
claw.  
Undergrowth, greasewood brush; ocotillo, cholla and giant  
cactus. Dec. 20, 1914.
-

Chains.

- November 30, 1914; continued:  
 From the Standard cor. of secs. 31 and 32, on the south bdy. of the Tp. (2nd Standard Parallel South) reestablished by me as described in Book "A," I run,  
 N.0°03'W., bet. secs. 31 and 32.  
 Over hilly land.  
 Ascend steep S slope.
- 3.13 Top of ridge, brs. N.80°E. and S.80°W. Build a mound of stone, 3 ft. base, 2 ft. high, at this point on line.  
 Descend NE slope.
- 28.20 Enter rolling land.
- 40.00 Set an iron post 3 ft. long, 1 in. in diam., 26 ins. in the ground for  $\frac{1}{4}$  sec. cor., with brass cap, marked,  
 $\frac{1}{4}$  S 31 on W., and  
 S 32 on E. half;  
 1914 on S. rim;  
 dig pits 18x18x12 ins., N. and S. of cor., 3 ft. dist., and raise a mound of earth and stone 3 ft. base, 2 ft. high, W. of cor.  
 Descend gradual N. slope.
- 58.00 Ravine 20 lks. wide, 4 ft. deep, course N.30°E.
- 80.00 Set an iron post 3 ft. long, 2 ins. in diam., 24 ins. in the ground for cor. of secs. 29, 30, 31 and 32, with brass cap, marked  
 T 10 S 30 in NW.,  
 R 2 E, S 29 in NE.,  
 S 32 in SE., and  
 S 31 in SW. quadrants;  
 1914 on S. rim; from which,  
 An ironwood, 12 ins. in diam., brs. N.7°15'E.,  
 112 lks. dist., marked T 10 S R 2 E S 29 B T.  
 An ironwood, 8 ins. in diam., brs. S.78°30'E., 68  
 lks. dist., marked T 10 S R 2 E S 32 B T.  
 An ironwood, 8 ins. in diam., brs. S.59°W., 55  
 lks. dist., marked T 10 S R 2 E S 31 B T.  
 An ironwood, 6 ins. in diam., brs. N.88°30'W.,  
 35 lks. dist., marked T 10 S R 2 E S 30 B T.
- Land, hilly and rolling.  
 Soil, gravelly and rocky, 3rd and 4th rate.  
 Timber, palo verde, ironwood and catclaw.  
 Undergrowth, greasewood brush, ocotillo and giant cactus.  
 November 30, 1914.
- 
- December 15, 1914:  
 At 8h. a.m., l.m.t., I set off 23°12'S., on the decl. arc;  
 32°31'N. on the lat. arc, and determine a meridian with  
 the solar at the cor. of secs. 29, 30, 31 and 32.  
 Thence I run,  
 East, on a random line, bet. secs. 29 and 32.
- 40.00 Set temp.  $\frac{1}{4}$  sec. cor.
- 80.04 Intersect N. and S. line, 5 lks. S. of the cor. of secs. 28,  
 29, 32 and 33.  
 Thence I run,  
 S.89°58'W., on a true line, bet. secs. 29 and 32.  
 Over level land, through dense brush.
- 1.80 Ravine, 30 lks. wide, 6 ft. deep, course N.10°E.
- 14.30 Ravine, 40 lks. wide, 6 ft. deep, course N.
- 17.80 Ravine, 30 lks. wide, 5 ft. deep, course N.
- 32.40 Ravine, 20 lks. wide, 4 ft. deep, course N.10°E.
- 40.02 Set an iron post 3 ft. long, 1 in. in diam., 26 ins. in the ground for  $\frac{1}{4}$  sec. cor., with brass cap marked,  
 1914 on S. rim;  
 $\frac{1}{4}$  S 29 on N., and  
 S 32 on S. half;  
 dig pits 18x18x12 ins., E. and W. of cor. 3 ft. dist., and raise a mound of earth  $3\frac{1}{2}$  ft. base,  $1\frac{1}{2}$  ft. high, N. of cor.
- 49.80 Ravine, 30 lks. wide, 6 ft. deep, course N.10°E.
- 52.50 Ravine, 20 lks. wide, 4 ft. deep, course N.20°E.
- 55.20 Ravine, 25 lks. wide, 5 ft. deep, course N.30°E.

## 22. Partial Subdivision of Township 10 South, Range 2 East.

Chains.	
69.45	Ravine, 25 lks. wide, 5 ft. deep, course N.30°E.
80.04	The cor. of secs. 29, 30, 31 and 32. Land, rolling. Soil, gravelly and rocky, 3rd rate. Timber, palo verde, ironwood and catclaw. Undergrowth, greasewood brush.
-----	
40.00	West, on a random line bet. secs. 30 and 31. Set temp. $\frac{1}{4}$ sec. cor.
79.92	Intersect W. bdy. of Tp., 2 lks. N. of the cor. of secs. 25, 30, 31 and 36, established by W. K. Kierulff, U.S. Transitman, as described in Book "B." Thence I run, N.89°59'E., on a true line, bet. secs. 30 and 31. Over rolling land. Descend gradual NE. slope.
37.20	Ravine, 20 lks. wide, 4 ft. deep, course N.10°E.
39.92	Set an iron post 3 ft. long, 1 in. in diam., 12 ins. in the ground (could not set deeper on account of solid rock). Build a mound of stone 3 ft. base, $1\frac{1}{2}$ ft. high around post for $\frac{1}{4}$ sec. cor., with brass cap, marked, 1914 on S. rim; $\frac{1}{4}$ S 30 on N., and S 31 on S. half; dig pits 18x18x12 ins. E. and W. of cor. 3 ft. dist., and raise a mound of earth $3\frac{1}{2}$ ft. base, $1\frac{1}{2}$ ft. high, N. of cor.
42.65	Ravine, 40 lks. wide, 5 ft. deep, course N.30°E.
49.60	Ravine, 15 lks. wide, 4 ft. deep, course N.10°E.
75.05	Ravine, 30 lks. wide, 3 ft. deep, course N.30°E.
79.92	The cor. of secs. 29, 30, 31 and 32. Land, rolling. Soil, gravelly and rocky, 3rd rate. Timber, palo verde, ironwood and catclaw. Undergrowth, greasewood brush, ocotillo and giant cactus.
-----	
	N.0°03' W., bet. secs. 29 and 30. Over rolling land.
4.50	Ravine, 30 lks. wide, 4 ft. deep, course N.60°E.
10.00	Old road, brs. N.70°E. and S.80°W.
24.00	Ravine, 40 lks. wide, 4 ft. deep, course N.50°E.
37.80	Ravine, 20 lks. wide, 3 ft. deep, course N.80°E.
40.00	Set an iron post 3 ft. long, 1 in. in diam., 26 ins. in the ground, for $\frac{1}{4}$ sec. cor., with brass cap, marked $\frac{1}{4}$ S 30 on W., and S 29 on E. half; 1914 on S. rim; build a mound of stone 3 ft. base, 2 ft. high, W. of cor. Pits impracticable.
41.30	Dry wash, 30 lks. wide, 1 ft. banks, course N.80°E.
42.30	Dry wash, 40 lks. wide, 1 ft. banks, course N.85°E. Ascend over low hill, which is about 8 chs. long and 45 ft. high.
48.45	Foot of hill; dry wash, 15 lks. wide, 1 ft. banks, course N.85°E.
75.15	Ravine, 25 lks. wide, 5 ft. banks, course east.
80.00	Set an iron post 3 ft. long, 2 ins. in diam., 24 ins. in the ground, for cor. of secs. 19, 20, 29 and 30, with brass cap, marked T 10 S S19 in NW., R 2 E S 20 in NE., S 29 in SE., and S 30 in SW. quadrants; 1914 on S. rim; dig pits 18x18x12 ins., in each sec. $5\frac{1}{2}$ ft. dist., and raise a mound of earth 4 ft. base, 2 ft. high, W. of cor. Land, rolling. Soil, gravelly and rocky, caliche 1 ft.; 3rd rate. Timber, palo verde, ironwood and catclaw.



Chains

Undergrowth, greasewood brush.  
Ocotillo, cholla and giant cactus.

-----

East, on a random line, bet. secs. 20 and 29.  
40.00 Set temp.  $\frac{1}{4}$  sec. cor.  
80.04 Intersect N. and S. line, 2 lks. S. of the cor. of secs. 20,  
21, 28 and 29.  
Thence I run,  
S.  $89^{\circ} 59'$  W., on a true line, bet. secs. 20 and 29.  
Over slightly rolling land.  
5.20 Dry wash, 20 lks. wide, 2 ft. banks, course S.  $70^{\circ}$  E.  
26.30 Dry wash, 15 lks. wide, 1 ft. banks, course N.  $80^{\circ}$  E.  
40.02 Set an iron post, 3 ft. long, 1 in. in diam., 26 ins. in  
the ground, for  $\frac{1}{4}$  sec. cor., with brass cap, marked  
1914 on S. rim;  
 $\frac{1}{4}$  S 20 on N., and  
S 29 on S. half;  
dig pits 18x18x12 ins., E. and W. of cor. 3 ft. dist.,  
and raise a mound of earth,  $3\frac{1}{2}$  ft. base,  $1\frac{1}{2}$  ft. high,  
N. of cor.  
56.00 Dry wash, 20 lks. wide, 4 ft. banks, course S.  $70^{\circ}$  E.  
59.80 Dry wash, 15 lks. wide, 1 ft. banks, course N.  $80^{\circ}$  E.  
63.25 Dry wash, 15 lks. wide, 1 ft. banks, course S.  $80^{\circ}$  E.  
80.04 The cor. of secs. 19, 20, 29 and 30.  
Land, slightly rolling.  
Soil, sandy loam, 2nd rate.  
Timber, palo verde, ironwood, mesquite and catclaw.  
Undergrowth, greasewood brush, ocotillo and giant cactus.

-----

West, on a random line, bet. secs. 19 and 30.  
40.00 Set temp.  $\frac{1}{4}$  sec. cor.  
79.83 Intersect W. bdy. of Tp., 3 lks. S. of the cor. of secs.  
19, 24, 25 and 30, established by W. K. Kierulff, U.S.  
Transitman, as described in Book "B."  
Thence I run,  
S.  $89^{\circ} 59'$  E., on a true line, bet. secs. 19 and 30.  
Over hilly land.  
Along N. slope of hill.  
39.83 Set an iron post 3 ft. long, 1 in. in diam., 12 ins. in  
the ground (could not set deeper on account of solid  
rock); build a mound of stone 3 ft. base, 2 ft. high  
around post for  $\frac{1}{4}$  sec. cor., with brass cap, marked,  
1914 on S. rim;  
 $\frac{1}{4}$  S 19 on N., and  
S 30 on S. half;  
build a mound of stone 3 ft. base, 2 ft. high, N. of cor.  
Thence over rough, broken N. slope.  
72.45 Descend NE. slope.  
79.83 The cor. of secs. 19, 20, 29 and 30.  
Land, hilly.  
Soil, gravelly and rocky, 3rd and 4th rate.  
Timber, scrub palo verde, ironwood and catclaw.  
Undergrowth, greasewood brush, ocotillo, cholla and giant  
cactus.

December 15, 1914.  
W.H.T.

Partial Subdivision of T.10 S.,R.2 E.

Chains

W.K.Kierulff, U.S. Transitman,  
Survey commenced Dec. 16, 1914, and executed with a Young  
and Son's light mountain transit No.8492, described  
in book "A".

From recent and repeated field tests, I know the transit  
and solar attachment to be in satisfactory adjustment.  
At 9h., a.m., l.m.t., I set off 32° 32' N. on the lat. arc;  
23° 17' S. on the decl. arc. and determine a mer. with  
the solar at the cor. of secs. 19, 20, 29 and 30.

Thence I run  
N. 0° 3' W. bet. secs. 19 and 20.  
Over rolling land through scattering timber and under-  
growth.

11.25 Wash, 20 lks. wide, 2 ft. deep, course, SE.  
16.00 Wash, 20 lks. wide, 2 ft. deep, course, SE.  
28.00 Asc. S. slope, 242 ft. to  
40.00 Set an iron post 3 ft. long, 1 in. in diam., 12 ins. in  
the ground to solid rock, in a mound of stone, 2½ ft.  
base, 2 ft. high, for ¼ sec. cor. with brass cap mkd.  
¼ S 19 on W. and  
S 20 on E. half,  
1914 on S. rim.

Pits impracticable.  
Build a mound of stone, 3 ft. base, 2 ft. high W. of cor.  
Asc. S. slope, 90 ft. to  
40.50 Top of ridge, brs. E. and W. in saddle, desc. N. slope,  
85 ft. to

45.50 Change to W. slope.  
52.50 Desc. N. slope, 176 ft. to  
74.75 Ravine 200 lks. wide, 30 ft. deep, course, NW.  
80.00 Set an iron post 3 ft. long, 2 ins. in diam., 12 ins. in  
the ground to solid rock, in a mound of stone, 3 ft.  
base, 2 ft. high, for cor. of secs. 17, 18, 19 and  
20 with brass cap mkd.  
T 10 S R 2 E on N. half,  
S 17 in NE.  
S 20 in SE.  
S 19 in SW., and  
S 18 in NW. quadrants,  
1914 on S. rim.

Pits impracticable.  
Build a mound of stone, 3 ft. base, 2 ft. high W. of cor.  
Land, rolling and hilly.  
Soil, stony, 4th rate.  
Timber, scattering palo verde and iron wood.  
Undergrowth, greasewood brush, ocotillos and cacti.

40.00 East on a random line bet. secs. 17 and 20.  
Set temp. ¼ sec. cor.  
80.06 Intersect N. and S. line, 1 lk. S. of cor. of secs. 16,  
17, 20 and 21.

Thence I run  
West on a true line bet. secs. 17 and 20.  
Over mountainous land, broken N. slope.

37.50 Desc. W. slope, 90 ft. to  
40.03 Set an iron post 3 ft. long, 1 in. in diam., 6 ins. in  
the ground to solid rock, in a mound of stone, 3 ft.  
base, 2½ ft. high, for ¼ sec. cor. with brass cap mkd.  
¼ S 17 on N. and  
S 20 on S. half,  
1914 on S. rim.

Pits impracticable.  
Build a mound of stone, 3 ft. base, 2 ft. high N. of cor.  
46.31 Wash, 20 lks. wide, 1 ft. deep, course, N.  
Foot of descent; asc. E. slope, 113 ft. to  
52.56 Along N. and gradual NW. slope; desc. 40 ft. to  
80.06 Cor. of secs. 17, 18, 19 and 20.

Land, hilly.  
Soil, stony, 4th rate.  
Timber, scattering palo verde.  
Undergrowth, ocotillos and cacti.

26.

Partial subdivision of T.10 S., R.2 E.

Chains

	At this cor. I set off 23° 18' S. on the decl. arc; and at apparent noon observe the sun on the mer.; the resulting lat. is 32° 33' N.
	West on a random line bet. secs. 18 and 19.
40.00	Set temp. $\frac{1}{4}$ sec. cor.
79.78	Intersect W. bdy. of tp. 1 lk. S. of cor. of secs. 13, 18, 19 and 24, established by me and described in book "B".
	Thence I run
	East on a true line bet. secs. 18 and 19.
	Over hilly land, through scattering undergrowth.
Asc. .18	Asc. SW. slope, to
	Top of spur brs. NW. and SE.
Desc 14.78	Desc. NE. slope, 60 ft. to
	Wash, 50 lks. wide, 2 ft. deep, course, NW.
	Asc. SW. slope, 75 ft. to
25.25	Top of ridge, brs. NW. and SE.
	Desc. NE. slope, 75 ft. to
34.75	Wash, 25 lks. wide, 3 ft. deep, course, NW.
	Asc. W. slope.
39.78	Set an iron post 3 ft. long, 1 in. in diam., 12 ins. in the ground to solid rock, in a mound of stone, 2 ft. base, 2 ft. high, for $\frac{1}{4}$ sec. cor. with brass cap mkd. $\frac{1}{4}$ S 18 on N. and S 19 on S. half, 1914 on S. rim.
	Pits impracticable.
	Build a mound of stone, 3 ft. base, 2 ft. high N. of cor.
	Top of spur ridge, brs. N. and S.
	Desc. E. slope, 60 ft. to
47.78	Wash, 30 lks. wide, 3 ft. deep, course, N.
	Asc. W. slope.
54.75	Top of spur brs. N. and S.
	Desc. E. slope, 60 ft. to
61.75	Wash, 50 lks. wide, 5 ft. deep, course, N.
	Asc. W. slope, 75 ft. to
67.78	Top of ridge, brs. N. and S. Descend E. slope, 100 ft.
73.70	Wash, course N., 50 lks. wide, Ascend.
79.78	Cor. of secs. 17, 18, 19 and 20.
	Land, hilly.
	Soil, stony, 4th rate.
	Timber, scattering palo verde.
	Undergrowth, ocotillos and cacti.
	N. 0° 3' W. bet. secs. 17 and 18.
	Over rolling broken land, general N. slope, through scattering timber and undergrowth.
	Desc. NW. slope, 50 ft. to
5.50	Wash, 50 lks. wide, 5 ft. deep, course, NW.
	Asc. SE. slope, 75 ft. to
14.00	Top of spur, slopes, NE. Desc. NW. slope, 155 ft. to
37.50	Wash, 40 lks. wide, 4 ft. deep, course, NE.
	Thence Over rolling land, general N. slope.
40.00	Set an iron post 3 ft. long, 1 in. in diam., 18 ins. in the ground to solid rock, in a mound of stone, 3 ft. base, $1\frac{1}{2}$ ft. high for $\frac{1}{4}$ sec. cor. with brass cap mkd. $\frac{1}{4}$ S 18 on W. and S 17 on E. half, 1914 on S. rim.
	Build a mound of stone, 3 ft. base, 2 ft. high W. of cor.
46.80	Wash, 100 lks. wide, 8 ft. deep, course, NE.
52.49	A mesquite post, 3 ins. square, $1\frac{1}{2}$ ft. above ground, in a mound of stone, 3 ft. base, 2 ft. high, mkd. T 10 S on NE., R 2 E on SE., and R. 1 E on NW., with 2 notches on N. and 4 notches on S. edges, brs. S. 9° 12' W. 4.75 chs. dist.
69.30	Wash, 25 lks. wide, 3 ft. deep, course, N. 80° E.
80.00	Set an iron post 3 ft. long, 2 ins. in diam., 12 ins. in the ground, to solid rock, in a mound of stone, 2 ft.

Partial subdivision of T.10 S., R.2 E.

Chains

base, 1 1/2 ft. high, for cor. of secs. 7, 8, 17 and 18, with brass cap mkd.

T 10 S R 2 E on N. half,  
S 8 in NE.  
S 17 in SE.  
S 18 in SW. and  
S 7 in NW. quadrants,  
1914 on S. rim.

Build a mound of stone, 3 ft. base, 2 ft. high W. of cor. Land, rolling and hilly, with general N. slope. Soil, stony, 4th rate. Timber, palo verde, and iron wood. Undergrowth, greasewood brush, ocotillos and cacti. Dec. 16, 1914.

Dec. 20, 1914, at 10h., a.m., 1.m.t., I set off 32° 34' N. on the lat. arc; 23° 25' S. on the decl. arc; and determine a mer. with the solar, at the cor. of secs. 7, 8, 17 and 18.

Thence I run East on a random line bet. secs. 8 and 17.

40.00  
80.06

Set temp. 1/4 sec. cor.  
Intersect N. and S. line, 8 lks. N. of cor. of secs. 8, 9, 16 and 17.

Thence I run N. 89° 57' W. on a true line bet. secs. 8 and 17.

Over rolling land, with general N. slope, through scattering timber and undergrowth,

1.55  
27.66

Road, brs. NW and SE.  
A palo verde post, 4 ins. square, in a mound of stone, 2 1/2 ft. base, 2 ft. high, mkd. E.E.C.M.T.D on W. face, brs. N. 34 lks. dist.

33.05  
40.03

Wash, 20 lks. wide, 2 ft. deep, course, NE.  
Set an iron post, 3 ft. long, 1 in. in diam., 26 ins. in the ground for 1/4 sec. cor. with brass cap mkd.  
1/4 S 8 on N. and  
S 17 on S. half,  
1914 on S. rim.

50.66

Build a mound of stone, 3 ft. base, 2 ft. high N. of cor. A palo verde post, 4 ins. square, in a mound of stone, 3 ft. base, 2 ft. high, mkd. S W C M T D on NE. face, brs. S. 100 lks. dist.

A palo verde post, 4 ins. square, in a mound of stone, 3 ft. base, 2 ft. high mkd. S E C G on NW. face, brs. S 75 lks. dist.

73.55  
80.06

Wash, 25 lks. wide, 1 ft. deep, course, NE.  
Cor. of secs. 7, 8, 17 and 18.  
Land, rolling.  
Soil, gravelly, 3rd rate.  
Timber, scattering palo verde and iron wood.  
Undergrowth, greasewood brush, ocotillos and cacti.

West on a random line bet. secs. 7 and 18.

40.00  
79.67

Set temp. 1/4 sec. cor.  
Intersect W. bdy. of tp. 6 lks. N. of cor. of secs. 7, 12, 13 and 18, established by me and described in book "B".

Thence I run N. 89° 57' E. on a true line bet. secs. 7 and 18. Over rolling land, through scattering timber and undergrowth.

4.67  
8.42  
37.17  
39.67

Road, brs. NE. and SW.  
Indian hut brs. 15 lks. N.  
Wash, 10 lks. wide, 1 ft. deep, course, N.  
Set an iron post 3 ft. long, 1 in. in diam., 2 ins. in the ground for 1/4 sec. cor. with brass cap mkd.  
1/4 S 7 on N. and  
S 18 on S. half,  
1914 on S. rim.

Dig pits 18 X 18 X 12 ins. E. and W. of cor. 3 ft. dist.

Chains	
	and raise a mound of earth $3\frac{1}{2}$ ft. base, $1\frac{1}{2}$ ft. high N. of cor.
46.67	Wash, 30 lks. wide, $\frac{1}{2}$ ft. deep, course, N. $10^{\circ}$ W.
57.67	Asc. gradual W. slope, 50 ft. to Top of ascent; desc. E. slope, 50 ft. to
65.07	Wash, 20 lks. wide, 1 ft. deep, course, N.
79.67	Cor. of secs. 7, 8, 17 and 18. Land, rolling. Soil, gravelly, 3rd rate. Timber, scattering palo verde and iron wood. Undergrowth, greasewood brush and ocotillos.
<hr/>	
	N. $0^{\circ}$ 3' W. bet. secs. 7 and 8. Over rolling land, through scattering timber and undergrowth.
2.40	Wash, 15 lks. wide, 1 ft. deep, course, N. $80^{\circ}$ E.
35.00	Enter level land, brs. E. and W.
38.50	Road, brs. N. $65^{\circ}$ E. and S. $65^{\circ}$ E.
40.00	Set an iron post, 3 ft. long, 1 in. in diam., 26 ins. in the ground for $\frac{1}{4}$ sec. cor. with brass cap mkd. $\frac{1}{4}$ S 7 on W. and S 8 on E. half, 1914 on S. rim.
	Dig pits 18 X 18 X 12 ins. N. and S. of cor. 3 ft. dist. and raise a mound of earth $3\frac{1}{2}$ ft. base, $1\frac{1}{2}$ ft. high W. of cor.
50.75	Road, brs. NW. and SE.
80.00	Set an iron post 3 ft. long, 2 ins. in diam., 24 ins. in the ground for cor. of secs. 5, 6, 7 and 8, with brass cap mkd. T 10 S R 2 E on N. half, S 5 in NE. S 8 in SE. S 7 in SW. and S 6 in NW. quadrants, 1914 on S. rim.
	Dig pits 18 X 18 X 12 ins. in each sec. $5\frac{1}{2}$ ft. dist. and raised a mound of earth 4 ft. base, 2 ft. high W. of cor. Land, level, and rolling. Soil, gravelly, 3rd rate on S. half; adobe, 1st rate on N. half. Undergrowth, greasewood brush. At this cor. I set off $23^{\circ}$ 25' S. on the decl. arc; and at apparent noon observe the sun on the mer.; the resulting lat. is $32^{\circ}$ 35' N. Dec. 20, 1914.
<hr/>	
	Dec. 21, 1914, at 9h., a.m., l.m.t., I set off $32^{\circ}$ 35' N. on the lat. arc; $23^{\circ}$ 25' S. on the decl. arc, and determine a mer. with the solar, at the cor. of secs. 5, 6, 7, and 8.
	Thence I run East on a random line bet. secs. 5 and 8.
40.00	Set temp. $\frac{1}{4}$ sec. cor.
80.02	Intersect N. and S. line, 7 lks. S. of cor. of secs. 4, 5, 8 and 9. Thence I run S. $89^{\circ}$ 57' W. on a true line bet. secs. 5 and 8.
8.00	Over level land, through scattering undergrowth,
34.00	Wash, 75 lks. wide, 8 ft. deep, course, S.
40.01	Wash, 30 lks. wide, 8 ft. deep, course, S.
	True point for $\frac{1}{4}$ sec. cor. falls in wash, 100 lks. wide, 8 ft. deep, course, S. $80^{\circ}$ E., therefore at
39.83	Set an iron post 3 ft. long, 1 in. in diam., 26 ins. in the ground for W.C. to $\frac{1}{4}$ sec. cor. with brass cap mkd. W C $\frac{1}{4}$ S 5 on N. and S 8 on S. half, 1914 on S. rim.
	Dig pits 18 X 18 X 12 ins. E. and W. of cor. 3 ft. dist.

Partial subdivision of T.10 S., R.2 E.

Chains	and raise a mound of earth, 3½ ft. base, 1½ ft. high N. of cor.
80.02	Cor. of secs. 5, 6, 7 and 8. Land, level. Soil, adobe, and gravel, 2nd and 3rd rates. Timber, scattering palo verde and ironwood. Undergrowth, greasewood brush.
40.00	West on a random line bet. secs. 6 and 7.
79.64	Set temp. ¼ sec. cor. Intersect W. bdy. of tp. 7 lks. N. of cor. of secs. 1, 6, 7 and 12, established by me and described in book "B".
15.64	Thence I run
30.80	N. 89° 57' E. on a true line bet. secs. 6 and 7.
39.64	Over level land, through scattering undergrowth.
	Wash, 50 lks. wide, 10 ft. deep, course, NE.
	Road, brs. NE. and SW.
	Set an iron post 3 ft. long, 1 in. in diam., 26 ins. in the ground for ¼ sec. cor. with brass cap mkd.
	¼ S 6 on N. and
	S 7 on S. half,
	1914 on S. rim.
	Dig pits 18 X 18 X 12 ins. E. and W. of cor. 3 ft. dist.
	and raise a mound of earth 3½ ft. base, 1½ ft. high
	N. of cor.
60.14	Road, brs. NW. and SE.
68.64	Road, brs. N. and S.
79.64	Cor. of secs. 5, 6, 7 and 8.
	Land, level.
	Soil, adobe, 1st rate.
	Timber, none.
	Undergrowth, greasewood brush.
40.00	N. 0° 3' W. on a random line bet. secs. 5 and 6.
79.98	Set temp. ¼ sec. cor.
	Intersect N. bdy. of tp. 4 lks. W. of cor. of secs. 5, 6, 31 and 32, established by me and described in book "B".
	Thence I run
	S. 0° 1' E. on a true line bet. secs. 5 and 6.
	Over level land, through scattering undergrowth.
11.48	Road, brs. N.60° E. and S.60° W.
12.00	Asc. N. slope, 120 ft. to
22.50	Top of small round hill, covered with malpais stone.
	Desc. S. slope, 125 ft. to
37.00	Change to level land.
39.98	Set an iron post 3 ft. long, 1 in. in diam., 26 ins. in the ground for ¼ sec. cor. with brass cap mkd.
	¼ S 6 on W. and
	S 5 on E. half,
	1914 on S. rim.
	Dig pits 18 X 18 X 12 ins. N. and S. of cor. 3 ft. dist.
	and raise a mound of earth, 3½ ft. base, 1½ ft. high
	W. of cor.
49.00	Wash, 75 lks. wide, 10 ft. deep, course, E.
79.98	Cor. of secs. 5, 6, 7 and 8.
	Land, level.
	Soil, adobe, 2nd rate.
	No timber.
	Undergrowth. greasewood brush and scrub palo verde.
	W. K. K. Dec. 21, 1914.

GENERAL DESCRIPTION:

The SE. and NW. portion of this township is nearly level, covered with greasewood and palo verde brush, giant cactus and other cacti. The NE. portion is very mountainous, bare rock, lime-stone and granite formation. The Copperosity mine is located in sec. 14, not in operation. The SW. portion is hilly and rocky. There is an Indian settlement in sec. 22. A good well is located in sec. 22.

Very little grass. No settlers.

---

FOR CERTIFICATES

~~FINAL OATH~~ OF UNITED STATES SURVEYOR,  
AND UNITED STATES TRANSITMAN

See page 2 of this book

31 2693  
BOOK

I, \_\_\_\_\_, U. S. Surveyor, do solemnly swear that, in pursuance of special instructions received from the U. S. Surveyor General for \_\_\_\_\_ bearing date of the \_\_\_\_\_ day of \_\_\_\_\_, 191 \_\_\_\_\_, I have well, faithfully, and truly, in my own proper person, and in strict conformity with said instructions, the Manual of Surveying Instructions, and the laws of the United States, surveyed all those parts or portions of \_\_\_\_\_ of the \_\_\_\_\_ Meridian, in the State of \_\_\_\_\_, which are represented in the foregoing field notes as having been executed by me, and under my direction; and I do further solemnly swear that all the corners of said survey have been established and perpetuated in strict accordance with the Manual of Surveying Instructions, and the special written instructions of the U. S. Surveyor General for \_\_\_\_\_ and in the specific manner described in the field notes, and that the foregoing are the original field notes of such survey.

\_\_\_\_\_  
U. S. Surveyor.

Subscribed by said \_\_\_\_\_, and sworn to before me }  
this \_\_\_\_\_ day of \_\_\_\_\_, 191 \_\_\_\_\_



APPROVAL.

OFFICE OF THE UNITED STATES SURVEYOR GENERAL,

Phoenix Ariz. MAR 19 \_\_\_\_\_, 1917.

The foregoing field notes of the survey of part of the \_\_\_\_\_

Subdivision lines of \_\_\_\_\_

Township 10 South Range 2 East  
of the Gila and Salt River Base & Meridian, in the State of Arizona

executed by W. H. Thorn U.S. Surveyor and W. K. Kierulff U.S. Transitman  
under his special instructions dated July 29, 1914 for Group 38 Arizona, 191 \_\_\_\_\_, having been critically examined, and the necessary corrections and explanations made, the said field notes, and the surveys they describe, are hereby approved.

U. S. Surveyor General  
of Arizona

I certify that the foregoing transcript of the field notes of the above described surveys in \_\_\_\_\_  
\_\_\_\_\_, has been correctly copied from the original notes on file in this office.