

BOOK "O" BOOK 2926
FIELD NOTES

OF THE SURVEY OF THE

Subdivision Lines of

Fractional Township 16½ North-Range 16 West

of the Gila & Salt River Base & Meridian,

In the State of Arizona

EXECUTED BY

Irving W. Stoddard, U.S. Surveyor

and

R. D. Armstrong, U.S. Transitman

~~In the capacity of U.S. Surveyor~~, under instructions dated Dec 28, 1914,

issued by the United States Surveyor General to govern surveys included in

Group No. 41, which were approved by the Commissioner of the General Land

Office, Jan. 22, 1915, pursuant to authority contained in the Act of

~~Congress dated _____, 1911~~

Survey commenced May 18, 1915

Survey completed " 25, 1915

6-151

Subsented under assignment instructions dated Jan. 28, 1915.

MA

Book "O"

BOOK 2926

INDEX DIAGRAM.

Frac'l Township 16 1/2 North, Range 16 West

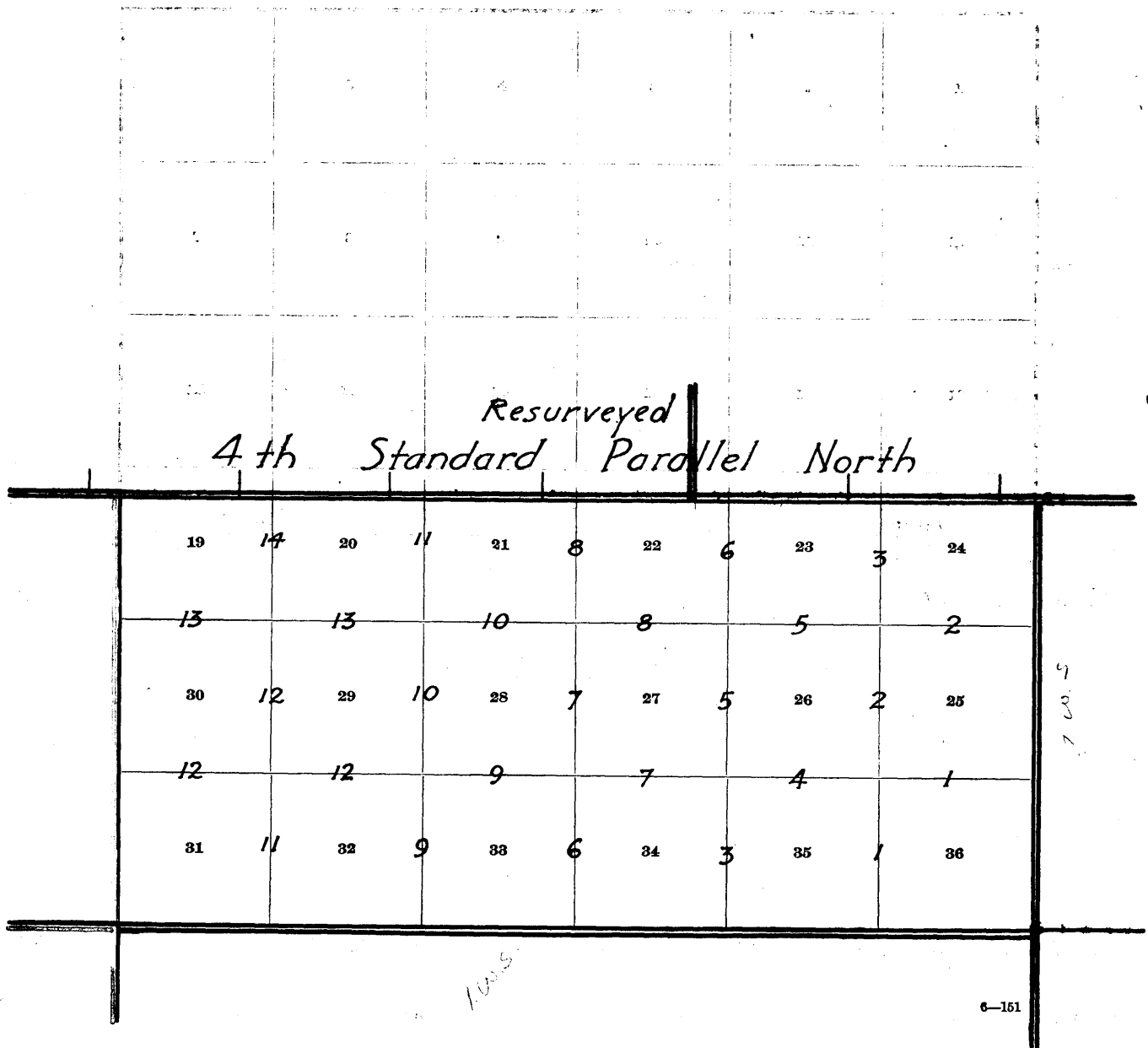

- Notes in Book "A"
- Surveyed under Gp. 42
- " " " 46

Subdivision of Fractional T. 16 $\frac{1}{2}$ N., R. 16 W.

Chains.

Survey commenced May 18, 1915, and executed jointly by Irving W. Stoddard, U. S. Surveyor, and R. D. Armstrong, U. S. Transitman, with Young and Sons' light mountain transits, Nos. 8485 and 8531 with Smith Solar Attachments. For description of instruments, and certificate of approval, see Book "A".

In the following field notes, the initials I. W. S. and R. D. A. refer to Irving W. Stoddard, U. S. Surveyor, and R. D. Armstrong, U. S. Transitman, respectively. Knowing from recent and repeated tests of our instruments upon a meridian established by observation of Polaris at elongation, that they are in adjustment, we proceed to the subdivision of Fractional T. 16 $\frac{1}{2}$ N., R. 16 W.
I. W. S. & R. D. A.

R. D. A.

At 8 hrs. 3 m., a.m., l.m.t., I set off 34° 46' N. on the lat. arc; 19° 25' N. on the decl. arc; and determine a meridian with the solar at the cor. of secs. 1, 2, 35 and 36 on the S. bdy of the Tp., which is an iron post, established by I. W. S., as described in Book "A".

Thence I run

N. 0° 1' W., bet. secs. 35 and 36.

Along W. slope, in Cow Creek Canyon, through scattering undergrowth.

18.00 Two cottonwood trees in Cow Creek Canyon br. W. 2 chs. dist.

35.00 Enter Cow Creek, course S.

39.00 Leave Cow Creek, course S. Asc. SE. slope to

40.00 Set an iron post, 3 ft. long, 1 in. diam., 26 ins. in the ground, for $\frac{1}{4}$ sec. cor., marked on brass cap
1915 on S. rim;
 $\frac{1}{2}$ S35 in W. and
S36 in E. half;

and raise a mound of stone, 2 ft. base, 1 $\frac{1}{2}$ ft. high, W. of cor. Pits impracticable.

55.00 Thence along E. slope.

65.20 Gulch, course SE. Asc. SE. slope, 85 ft.

79.20 Gulch, course E.

80.00 Set an iron post, 3 ft. long, 2 ins. diam., 24 ins. in the ground, for cor. of secs. 25, 26, 35 and 36, marked on brass cap

T16 $\frac{1}{2}$ N R16W in N. half;
S26 in NW.,
S25 in NE.,
S36 in SE. and
S35 in SW. quadrant;

and raise a mound of stone, 2 ft. base, 1 $\frac{1}{2}$ ft. high, W. of cor. Pits impracticable.

Land, mountainous.

Soil, rocky 4th rate.

No timber.

Undergrowth, scrub oak, deer brush and cacti.

Cracker grass.

May 18, 1915: The sky was overcast at noon making an observation for lat. impossible.

40.00 S. 89° 54' E., on a random line, bet. secs. 25 and 36. Set temp. $\frac{1}{4}$ sec. cor.

79.74 Intersect E. bdy. of Tp., 35 lks. S. of the cor. of secs. 25, 30, 31 and 36, which is an iron post, established by I. W. S., as described in Book "A".

Thence I run

S. 89° 51' W., on a true line, bet. secs. 25 and 36.

Over mountainous land, through scattering undergrowth, and timber.

Desc. W. slope, 955 ft.

24.80 Gulch, course WNW. Continue desc.

2. Subdivision of Fractional T. 16 1/2 N., R. 16 W.

Chains.
 ✓ 39.87 Set an iron post, 3ft. long, 1 in. diam., 26 ins. in the ground, for 1/4 sec. cor., marked on brass cap
 1915 on S. rim;
 1/4 S25 in N. and
 S36 in S. half;
 and raise a mound of stone, 2 ft. base, 1 1/2 ft. high, N. of cor. Pits impracticable.
 Desc. W. slope, 390 ft. to
 69.25 Cow Creek, course S. Asc. SE. slope, 55 ft. to
 ✓ 79.74 The cor. of secs. 25, 26, 35 and 36.
 Land, mountainous.
 Soil, rocky 4th rate.
 Timber, juniper.
 Undergrowth, laurel, deer brush, and scrub oak.
 May 18, 1915.

May 20, 1915.
 N.0° 1' W., bet. secs. 25 and 26.
 Over mountainous land, through scattering timber and undergrowth.
 Asc. S. slope, 55 ft. to
 3.00 Spur, brs. E. Desc. N. slope, 25 ft. to
 5.00 Gulch, 50 lks. wide, course E. Asc. SE. slope, 255 ft.
 25.00 Gulch, 5 lks. wide, course E. Asc. SW. slope.
 35.00 Spur, brs. SE. Desc. NE. slope, 120 ft.
 40.00 Set an iron post, 3ft. long, 1 in. diam., 26 ins. in the ground, for 1/4 sec. cor., marked on brass cap
 1915 on S. rim;
 1/4 S26 in W. and
 S25 in E. half;
 and raise a mound of stone, 2 ft. base, 1 1/2 ft. high, W. of cor. Pits impracticable.
 51.00 Gulch, 5 lks. wide, course SE. Asc. S. slope, 400 ft. to
 66.00 Ridge, brs. NE. and SW. Desc. NW. slope, 110 ft. to
 80.00 Set an iron post, 3 ft. long, 2 ins. diam., 24 ins. in the ground, for cor. of secs. 23, 24, 25 and 26, marked on brass cap
 1915 on S. rim;
 T16 1/2 N R16 W in N. half;
 S23 in NW.,
 S24 in NE.,
 S25 in SE. and
 S26 in SW. quadrant;
 and raise a mound of stone, 2 ft. base, 1 1/2 ft. high, W. of cor. Pits impracticable.
 Land, mountainous.
 Soil, rocky 4th rate.
 Timber, juniper.
 Undergrowth, cacti.
 May 20, 1915.

May 21, 1915: At 7 hrs. 56 m., a.m., l.m.t., I set off
 34° 48' N. on the lat. arc; 20° 4' N. on the decl. arc;
 and determine a meridian with the solar at the cor. of
 secs. 23, 24, 25 and 26.
 Thence I run
 N.89° 51' E., on a random line, bet. secs. 24 and 25.
 40.00 Set temp. 1/4 sec. cor.
 ✓ 79.70 Intersect E. bdy. of Tp., 2 lks. S. of the cor. of secs.
 19, 24, 25 and 30, which is an iron post, established
 by I. W. S., as described in Book "A".
 Thence I run
 S.89° 50' W., on a true line, bet. secs. 24 and 25.
 Over mountainous land, through scattering timber and under-
 growth.
 Desc. NW. slope, 495 ft. to

Subdivision of Fractional T. 16 $\frac{1}{2}$ N., R. 16 W.

Chains.
 31.70 Gulch, 10 lks. wide, course SW. Thence along S. slope.
 ✓39.85 Set an iron post, 3 ft. long, 1 in. diam., 26 ins. in the ground, for $\frac{1}{4}$ sec. cor., marked on brass cap
 1915 on S. rim;
 $\frac{1}{4}$ S24 in N. and
 S25 in S. half;
 and raise a mound of stone, 2 ft. base, 1 $\frac{1}{2}$ ft. high, N. of cor., Pits impracticable.
 44.20 Spur, brs. S. Desc. SW. slope, 60 ft. to
 47.70 Gulch, 10 lks. wide, course S. Asc. E. slope, 580 ft. to
 69.70 Ridge, brs. NE. and SW. Desc. NW. slope, 320 ft. to
 ✓79.70 The cor. of secs. 23, 24, 25 and 26.
 Land, mountainous.
 Soil, rocky 4th rate.
 Timber, juniper.
 Undergrowth, cacti.

N.0° 1' W., on a true line, bet. secs. 23 and 24.
 Over mountainous land, through scattering timber and undergrowth.
 Desc. NW. slope, 50 ft. to
 4.00 Gulch, 5 lks. wide, course W. Asc. SW. slope, 75 ft. to
 10.00 Spur, brs. W. Desc. NW. slope, 180 ft. to
 21.00 Gulch, 5 lks. wide, course W. Asc. SW. slope, 50 ft. to
 26.00 Spur, brs. W. Desc. N. slope, 190 ft. to
 33.50 Gulch, 10 lks. wide, course W. Asc. SW. slope, 575 ft. t
 40.00 Set an iron post, 3 ft. long, 1 in. diam., 26 ins. in the ground, for $\frac{1}{4}$ sec. cor., marked on brass cap
 1915 on S. rim;
 $\frac{1}{4}$ S23 in W. and
 S24 in E. half;
 and raise a mound of stone, 2 ft. base, 1 $\frac{1}{2}$ ft. high, W. of cor. Pits impracticable.
 Continue to asc. SW. slope.
 65.10 Intersect the 4th Standard Parallel North, 7.86 chs. E. of the standard cor. of secs. 31 and 32, T. 17 N., R. 16 W., which is an iron post, properly set, marked and witnessed as described by the Surveyor-General.
 At the point of intersection, I set an iron post, 3 ft. long, 2 ins. diam., 24 ins. in the ground,, for closing cor. of secs. 23, and 24, marked on brass cap
 1915 on S. rim;
 CC S. of center;
 T17N R15W, S31, S32 in N. and
 T16 $\frac{1}{2}$ N R16W in S. half;
 S24 in SE. and
 S23 in SW. quadrant;
 and raise a mound of stone, 2 ft. base, 1 $\frac{1}{2}$ ft. high, S. of cor. Pits impracticable.
 Land, mountainous.
 Soil, rocky 4th rate.
 Timber, juniper.
 Undergrowth, cacti.

May 21, 1915.

May 19, 1915: At 9 hrs. 55 m., a.m., l.m.t., I set off 34° 46' N. on the lat. arc; 19° 39' N. on the decl. arc; and determine a meridian with the solar at the cor. of secs. 2, 3, 34 and 35, on the S. bdy. of the Tp., which is a cross on a granite boulder, established by I. W. S., as described in Book "A".
 Thence I run
 N.0° 1' W., bet. secs. 34 and 35.
 Over mountainous land, through scattering timber and undergrowth.

4. Subdivision of Fractional T. 16 $\frac{1}{2}$ N., R. 16 W.

Chains.

- Asc. SW. slope, 350 ft.
 18.00 Spur, brs. SW. Continue asc.
 23.00 Spur, brs. W. Continue asc.
 36.00 Spur, brs. W. Desc. N. slope, 380 ft.
 40.00 Set a granite stone, 18 X 10 X 6 ins., 12 ins. in the ground, for $\frac{1}{4}$ sec. cor., marked $\frac{1}{4}$ on W. face; and raise a mound of stone, 2 ft. base, $1\frac{1}{2}$ ft. high, W. of cor. Pits impracticable.
 47.00 Gulch, course NW. Asc. SW. slope, 115 ft. to
 59.00 Spur, brs. NW. Desc. NE. slope, 625 ft. to
 76.00 Gulch, course W.
 80.00 Set an iron post, 3 ft. long, 2 ins. diam., 24 ins. in the ground, for cor. of secs. 26, 27, 34 and 35, marked on brass cap
 1915 on S. rim;
 T16 $\frac{1}{2}$ N R16W in N. half;
 S27 in NW.,
 S26 in NE.,
 S35 in SE. and
 S34 in SW. quadrant;
 and raise a mound of stone, 2 ft. base, $1\frac{1}{2}$ ft. high, W. of cor. Pits impracticable.
 Land, mountainous.
 Soil, rocky 4th rate.
 Timber, juniper.
 Undergrowth, cacti.
 May 19, 1915: At this cor., I set off 19° 40' N. on the decl. arc; and at apparent noon, I observe the sun on the meridian; the resulting lat. is 34° 47' N.
-
- S. 89° 54' E., on a random line, bet. secs. 26 and 35.
 40.00 Set temp. $\frac{1}{4}$ sec. cor.
 79.80 Intersect N. and S. line, 21 lks. S. of the cor. of secs. 25, 26, 35 and 36,
 Thence I run
 S. 89° 57' W., on a true line, bet. secs. 26 and 35.
 Over mountainous land, through scattering timber and undergrowth.
 Asc. SE. slope, 555 ft.
 8.50 Gulch, course SE. Continue ascent.
 36.00 Ridge, brs. N. and S. Thence along N. slope.
 39.90 Set an iron post, 3 ft. long, 1 in. diam., 26 ins. in the ground, for $\frac{1}{4}$ sec. cor., marked on brass cap
 1915 on S. rim;
 $\frac{1}{4}$ S26 in N. and
 S35 in S. half;
 and raise a mound of stone, 2 ft. base, $1\frac{1}{2}$ ft. high, N. of cor. Pits impracticable.
 50.00 Spur, brs. N. Desc. NW. slope 555 ft.
 69.00 Spur, brs. NW. Desc. SW. slope,
 79.80 The cor. of secs. 26, 27, 34 and 35.
 Land, mountainous.
 Soil, rocky 4th rate.
 Timber, juniper.
 Undergrowth, cacti.

May 19, 1915.

Subdivision of Fractional T. 16 $\frac{1}{2}$ N., R. 16 W.

Chains.	<p>May 20, 1915: At 8 hrs. 4 m., a.m., l.m.t., I set off 34° 47' N. on the lat. arc; 19° 51' N. on the decl. arc; and determine a meridian with the solar at the cor. of secs. 26, 27, 34 and 35.</p> <p>Thence I run N.0° 1' W., bet. secs. 26 and 27. Over mountainous land, through scattering timber and undergrowth.</p> <p>Asc. S. s slope, 20 ft. to 2:50 Spur, brs. W. Desc. N. slope, 90 ft. to 12.00 Gulch, course W. Asc. SW. slope, 445 ft. 40.00 Set an iron post, 3 ft. long, 1 in. diam., 26 ins. in the ground, for $\frac{1}{4}$ sec. cor., marked on brass cap 1915 on S. rim; $\frac{1}{4}$S27 in W. and S26 in E. half; and raise a mound of stone, 2 ft. base, 1$\frac{1}{2}$ ft. high, W. of cor. Pits impracticable.</p> <p>46.00 Ridge, brs. E. and W. Desc. NW. slope, 675 ft. to 80.00 Set an iron post, 3 ft. long, 2 ins. diam., 24 ins. in the ground, for cor. of secs. 22, 23, 26 and 27, marked on brass cap 1915 on S. rim; T16$\frac{1}{2}$N R16W in N. half; S22 in NW., S23 in NE., S26 in SE. and S27 in SW. quadrant; and raise a mound of stone, 2 ft. base, 1$\frac{1}{2}$ ft. high, W. of cor. Pits impracticable.</p> <p>Land, mountainous. Soil, rocky, 4th rate. Timber, juniper. Undergrowth, chapparal.</p>
40.00 79.84	<p>N.89° 57' E., on a random line, bet. secs. 23 and 26. Set temp. $\frac{1}{4}$ sec. cor. Intersect N. and S. line, 11 lks. N. of the cor. of secs. 23, 24, 25 and 26, Thence I run N.89° 58' W., on a true line, bet. secs. 23 and 26. Over mountainous land, through scattering timber and undergrowth.</p> <p>Desc. NW. slope, 720 ft. 13.85 Spur, brs. NW. Desc. SW. slope. 37.85 Gulch, 5 lks. wide, course NW. Asc. NE. slope, 50 ft. 39.92 Set an iron post, 3 ft. long, 1 in. diam., 26 ins. in the ground, for $\frac{1}{4}$ sec. cor., marked on brass cap 1915 on S. rim; $\frac{1}{4}$S23 in N. and S26 in S. half; and raise a mound of stone, 2 ft. base, 1$\frac{1}{2}$ ft. high, N. of cor. Pits impracticable.</p> <p>52.85 Spur, brs. N. Desc. NW. slope, 375 ft. 75.85 Spur, brs. N. Continue desc. 77.85 Gulch, course N. 79.84 The cor. of secs. 22, 23, 26 and 27. Land, mountainous. Soil, rocky, 4th rate. Timber, juniper. Undergrowth, scrub oak.</p> <p>May 20, 1915: At this point, I set off 19° 53' N. on the decl. arc; and at apparent noon, I observe the sun on the meridian; the resulting lat. is 34° 48' N. May 20, 1915.</p>

6 Subdivision of Fractional T. 16 $\frac{1}{2}$ N., R. 16 W. 3.

Chains.

May 22, 1915: At 8 hrs. 55 m., a.m., l.m.t., I set off 34° 48' N. on the lat. arc; 20° 16 $\frac{1}{2}$ ' N. on the decl. arc; and determine a meridian with the solar at the cor. of secs. 22, 23, 26 and 27.

Thence I run N.0° 1' W., on a true line, bet. secs. 22 and 23. Over mountainous land, through scattering timber and undergrowth.

Desc. NW. slope, 100 ft. to Gulch, 20 lks. wide, course W. Asc. SW. slope, 80 ft. to Spur, brs. W. Desc. NW. slope, 60 ft. to Gulch, 10 lks. wide, course SW. Asc. SW. slope, 420 ft.

40.00 Set an iron post, 3 ft.; long, 1 in. diam., 26 ins. in the ground, for $\frac{1}{4}$ sec. cor., marked on brass cap
1915 on S. rim;
 $\frac{1}{4}$ S22 in W. and
S23 in E. half;
and raise a mound of stone, 2 ft. base, 1 $\frac{1}{2}$ ft. high, W. of cor. Pits impracticable.

49.00 Ridge, brs. SW. Desc. N. slope, 330 ft. to
65.34 Intersect the 4th Standard Parallel North, 7.64 chs. E. of the standard cor. of Tps. 17 N., Rs. 15 and 16 W., which is an iron post, properly set, marked and witnessed as described by the Surveyor-General.

At the point of intersection, I set an iron post, 3 ft. long, 2 ins. diam., 24 ins. in the ground, for closing cor. of secs. 22 and 23, marked on brass cap
1915 on S. rim;
CC S. of center;
T17N, R16W, S36, R15W, S31 in N. and
T16 $\frac{1}{2}$ N R16W. in S. half;
S23 in SE. and
S22 in SW. quadrant;
and raise a mound of stone, 2 ft. base, 1 $\frac{1}{2}$ ft. high, S. of cor. Pits impracticable.

Land, mountainous.
Soil, rocky 4th rate.
Timber, juniper.
Undergrowth, cacti and scrub oak.

R. D. A.

I. W. S.
At 8 hrs. 58 m., a.m., l.m.t., I set off 34° 46' N. on the lat. arc; 20° 16 $\frac{1}{2}$ ' N. on the decl. arc; and determine a meridian with the solar at the cor. of secs. 3, 4, 33 and 34, on the S. bdy. of the Tp., which is an iron post, established by me, as described in Book "A".

Thence I run N.0° 2' W., bet. secs. 33 and 34. Over mountainous land, through scattering undergrowth.

14.90 Asc. SSW. slope, 275 ft. to
40.00 Spur, brs. W. Desc. NNW. slope, 440 ft. to
Set an iron post, 3 ft. long, 1 in. diam., 26 ins. in the ground, for $\frac{1}{4}$ sec. cor., marked on brass cap
1915 on S. rim;
 $\frac{1}{4}$ S33 in W. and
S34 in E. half;
and raise a mound of stone, 2 ft. base, 1 $\frac{1}{2}$ ft. high, W. of cor. Pits impracticable.

58.70 Thence along W. slope,
79.60 Gulch, course W.
80.00 Canyon, course W. Water 1 lk. wide, 2 ins. deep.
Set an iron post, 3 ft. long, 2 ins. diam., 20 ins. in the ground, on solid rock, supported by a mound of stone, for cor. of secs. 27, 28, 33 and 34, marked on brass cap
1915 on S. rim;
T16 $\frac{1}{2}$ N R16W in N. half;
S28 in NW.,

Subdivision of Fractional T. 16 1/2 N., R. 16 W.

7.

Chains.

S27 in NE.,
 S34 in SE. and
 S33 in SW. quadrant;
 and raise a mound of stone, 2 ft. base, 1 1/2 ft. high,
 W. of cor. Pits impracticable.
 Land, mountainous.
 Soil, rocky 4th rate.
 No timber.
 Undergrowth, cacti.

40.00 S. 89° 54' E., on a random line, bet. secs. 27 and 34.
 Set temp. 1/4 sec. cor.
 79.76 Intersect N. and S. line, 2 lks. N. of the cor. of secs.
 26, 27, 34 and 35.
 Thence I run
 N. 89° 53' W., on a true line, bet. secs. 27 and 34.
 Over mountainous land, through scattering undergrowth.
 Desc. W. slope, 455 ft.
 11.75 Gulch, course NW.
 19.75 Fork of gulches, one from NE. and one from SE. Desc. in
 gulch.
 24.75 Top of mountain brs. N. 30 chs. dist.
 39.88 Point for 1/4 sec. cor. falls on a round boulder, about 6 ft.
 in diam. Mark 1/4 on N. side of boulder, and raise a mound
 of stone, 2 ft. base, 1 1/2 ft. high, 6 ft. N. of cor.,
 on another boulder.
 40.75 Gulch 1 1/2 chs. N. of line.
 45.54 Balanced rock, 30 ft. high, 3 chs. N. of line.
 78.95 Canyon, course WSW. Clear water, 1 lk. wide, 1 in. deep,
 course WSW.
 79.76 The cor. of secs. 27, 28, 33 and 34.
 Land, mountainous.
 Soil, massive granite boulders.
 Undergrowth, scrub oak.
 No timber.
 May 22, 1915: At this cor., I set off 20° 17 1/2' N. on the
 decl. arc; and at apparent noon, I observe the sun on
 the meridian; the resulting lat. is 34° 47' N.

N. 0° 2' W., bet. secs. 27 and 28.
 Over mountainous land, through scattering undergrowth.
 Asc. SSE. slope, 245 ft. to
 7.80 Spur, brs. E. Desc. NE. slope, 105 ft. to
 18.80 Asc. WSW. slope, 115 ft. to
 40.00 Set an iron post, 3 ft. long, 1 in. diam., 26 ins. in the
 ground, for 1/4 sec. cor., marked on brass cap
 1915 on S. rim;
 1/4 S28 in W. and
 S27 in E. half;
 and raise a mound of stone, 2 ft. base, 1 1/2 ft. high,
 W. of cor. Pits impracticable.
 Asc. SW. slope, 200 ft. to
 52.00 Desc. NW. slope, 345 ft.
 56.00 Draw, course WNW.
 60.80 Desc. N. slope.
 80.00 Set an iron post, 3 ft. long, 2 ins. diam., 24 ins. in the
 ground, for cor. of secs. 21, 22, 27 and 28, marked on
 brass cap
 1915 on S. rim;
 T16 1/2 N R16 W in N. half;
 S21 in NW.,
 S22 in NE.,
 S27 in SE. and
 S28 in SW. quadrant;

8. Subdivision of Fractional T. 16 $\frac{1}{2}$ N., R. 16 W.

Chains.

and raise a mound of stone, 2 ft. base, 1 $\frac{1}{2}$ ft. high,
W. of cor. Pits impracticable.
Land, mountainous.
Soil, rocky 4th rate.
No timber.
Undergrowth, scrub oak and cacti.

I. W. S.
May 22, 1915.

May 24, 1915: R. D. A.

At 8 hrs. 3 m., a.m., l.m.t., I set off 34° 48' N. on the
lat. arc; 20° 39 $\frac{1}{2}$ ' N. on the decl. arc; and determine
a meridian with the solar at the cor. of secs. 21, 22,
27 and 28.

Thence I run

S.89° 53' E., on a random line, bet. secs. 22 and 27.

40.00 Set temp. $\frac{1}{4}$ sec. cor.

79.58 Intersect N. and S. line, 2 lks. S. of the cor. of secs.
22, 23, 26 and 27.

Thence I run

N.89° 54' W., on a true line, bet. secs. 22 and 27.

Over mountainous land, through scattering timber and
undergrowth.

Asc. NE. slope, 80 ft. to

20.00 Desc. NW. slope, 220 ft.

35.00 Spur, brs. NW. Desc. SW. slope.

39.79 Set an iron post, 3 ft. long, 1 in. diam., 26 ins. in the
ground, for $\frac{1}{4}$ sec. cor., marked on brass cap
1915 on S. rim;
 $\frac{1}{4}$ S22 in N. and
S27 in S. half;

and raise a mound of stone, 2 ft. base, 1 $\frac{1}{2}$ ft. high,
N. of cor. Pits impracticable.

44.00 Gulch, 5 lks. wide, course NW. Thence along N. slope.

53.00 Desc. NW. slope, 390 ft. to

79.58 The cor. of secs. 21, 22, 27 and 28,

Land, mountainous.
Soil, rocky 4th rate.
Timber, juniper.
Undergrowth, cacti.

May 24, 1915.
R. D. A.

May 22, 1915.

I. W. S.

N.0° 2' W., on a true line, bet. secs. 21 and 22.

Over rolling land, through undergrowth.

6.50 Draw, course WSW. Asc. S. slope, 155 ft. to

17.85 Desc. N. slope, 155 ft. to

40.00 Set an iron post, 3 ft. long, 1 in. diam., 26 ins. in the
ground, for $\frac{1}{4}$ sec. cor., marked on brass cap
1915 on S. rim;
 $\frac{1}{4}$ S21 in W. and
S22 in E. half;

and raise a mound of stone, 2 ft. base, 1 $\frac{1}{2}$ ft. high,
W. of cor. Pits impracticable.

50.20 Wash, course W.

59.60 Gulch, course SW.

65.37 Intersect the 4th Standard Parallel North, 7.76 chs. E. of
the standard cor. of secs. 35 and 36, T. 17 N., R. 16
W., which is an iron post, properly set, marked and
witnessed as described by the Surveyor-General.

Chains.

At the point of intersection, I set an iron post, 3 ft. long, 2 ins. diam., 24 ins. in the ground, for closing cor. of secs. 21 and 22, marked on brass cap
 1915 on S. rim;
 CC S. of center;
 T17N R16W, S35, S36 in N. and
 T16 1/2 N R16W in S. half;
 S22 in SE. and
 S21 in SW. quadrant;
 and raise a mound of stone, 2ft. base, 1 1/2 ft. high, S. of cor. Pits impracticable.
 Land, rolling.
 Soil, sandy loam, 1st and 2nd rate.
 No timber.
 Undergrowth, yucca and cacti.

I. W. S.
May 22, 1915.

40.00

May 24, 1915: R. D. A.
 From the cor. of secs. 4, 5, 32 and 33, on the S. bdy. of the Tp., which is an iron post, established by I. W. S., as described in Book "A", I run
 N.0° 2' W., bet. secs. 32 and 33.
 Over level land, through scattering timber and undergrowth.
 Set an iron post, 3 ft. long, 1 in. diam., 26 ins. in the ground, for 1/4 sec. cor., marked on brass cap
 1915 on S. rim;
 1/4 S32 in W. and
 S33 in E. half;

80.00

and raise a mound of stone, 2 ft. base, 1 1/2 ft. high, W. of cor. Pits impracticable.
 Set an iron post, 3 ft. long, 2 ins. diam., 24 ins. in the ground, for cor. of secs. 28, 29, 32 and 33, marked on brass cap
 1915 on S. rim;
 T16 1/2 N R16W in N. half;
 S29 in NW.,
 S28 in NE.,
 S33 in SE. and
 S32 in SW. quadrant;
 dig pits, 18 X 18 X 12 ins., in each sec., 5 1/2 ft. dist.;
 and raise a mound of earth, 4 ft. base, 2 ft. high, W. of cor.
 Land, level.
 Soil, 3rd rate.
 Timber, scattering juniper.
 Undergrowth, cacti.

40.00

79.94

S.89° 54' E., on a random line, bet. secs. 28 and 33.
 Set temp. 1/4 sec. cor.,
 Intersect N. and S. line, 2 lks. N. of the cor. of secs. 27, 28, 33 and 34.

10.00

39.97

Thence I run
 N.89° 53' W. on a true line, bet. secs. 28 and 33.
 Over rolling land, through scattering timber and undergrowth.
 Asc. E. slope, 120 ft. to
 Spur, brs. S. Desc. W. slope, 120 ft. to
 Set an iron post, 3 ft. long, 1 in. diam., 26 ins. in the ground, for 1/4 sec. cor., marked on brass cap
 1915 on S. rim;
 1/4 S28 in N. and
 S33 in S. half;

10 Subdivision of Fractional T. 16 $\frac{1}{2}$ N., R. 16 W.

Chains.	<p>and raise a mound of stone, 2 ft. base, 1$\frac{1}{2}$ ft. high, N. of cor. Pits impracticable.</p> <p>79.94 The cor. of secs. 28, 29, 32 and 33. Land, level and rolling. Soil, 4th rate. Timber, juniper. Undergrowth, yucca and cacti.</p> <p>May 24, 1915: At this cor., I set off 20° 41' N. on the lat. arc; and at apparent noon, I observe the sun on the meridian; the resulting lat. is 34° 47' N.</p>
40.00	<p>N. 0° 2' W., bet. secs. 28 and 29. Over level land, through scattering timber and undergrowth. Set an iron post, 3 ft. long, 1 in. diam., 26 ins. in the ground, for $\frac{1}{4}$ sec. cor., marked on brass cap 1915 on S. rim; $\frac{1}{4}$S29 in W. and S28 in E. half; dig pits, 18 X 18 X 12 ins., N. and S. of post, 3 ft. dist.; and raise a mound of earth, 3$\frac{1}{2}$ ft. base, 1$\frac{1}{2}$ ft. high, W. of cor.</p>
73.30	Road, bts. NW. and SE.
80.00	<p>Set an iron post, 3 ft. long, 2 ins. diam., 24 ins. in the ground, for cor. of secs. 20, 21, 28 and 29, marked on brass cap 1915 on S. rim; T16$\frac{1}{2}$N R16W in N. half; S20 in NW., S21 in NE., S28 in SE. and S29 in SW. quadrant; dig pits, 18 X 18 X 12 ins., in each sec., 5$\frac{1}{2}$ ft. dist.; and raise a mound of earth, 4 ft. base, 2 ft. high, W. of cor. Land, level. Soil, 3rd rate. Timber, juniper. Undergrowth, cacti.</p>
40.00	S. 89° 53' E., on a random line, bet. secs. 21 and 28. Set temp. $\frac{1}{4}$ sec. cor.
79.88	Intersect N. and S. line, 4 lks. N. of the cor. of secs. 21, 22, 27 and 28.
	Thence I run
	N. 89° 51' W., on a true line, bet. secs. 21 and 28.
	Over mountainous land, through scattering timber and undergrowth.
17.00	Desc. NW. slope, 95 ft. to
32.00	Gulch, 5 lks. wide, course SW. Asc. SE. slope, 100 ft. to Spur, brs. SW. Desc. SW. slope, 115 ft.
39.94	Set an iron post, 3 ft. long, 1 in. diam., 26 ins. in the ground, for $\frac{1}{4}$ sec. cor., marked on brass cap 1915 on S. rim; $\frac{1}{4}$ S21 in N. and S28 in S. half;
	and raise a mound of stone, 2 ft. base, 1 $\frac{1}{2}$ ft. high, N. of cor. Pits impracticable.
40.50	Gulch, 5 lks. wide, course SW. Asc. SE. slope, 75 ft. to
45.00	Spur, brs. SW. Desc. SW. slope, 150 ft. to
70.00	Foot of desc.; brs. NE. and SW. Thence over level land.
79.88	The cor. of secs. 20, 21, 28 and 29. Land, level and mountainous. Soil, 4th rate. Timber, juniper.

Subdivision of Fractional T. 16 $\frac{1}{2}$ N., R. 16 W. 11.

Chains.	Undergrowth, cacti.	R.D.A. May 24, 1915.
---------	---------------------	-------------------------

40.00	I.W.S. May 25, 1915. N.0° 2' W., on a true line, bet. secs. 20 and 21. Over level land, through scattering timber and undergrowth. Set an iron post, 3 ft. long, 1 in. diam., 26 ins. in the ground, for $\frac{1}{4}$ sec. cor., marked on brass cap 1915 on S. rim; $\frac{1}{2}$ S20 in W. and S21 in E. half; and raise a mound of stone, 2 ft. base, 1 $\frac{1}{2}$ ft. high, W. of cor. Pits impracticable.	
64.92	Intersect the 4th Standard Parallel North, 8.10 chs. E. of the standard cor. of secs. 34 and 35, which is an iron post, properly set, marked and witnessed as described by the Surveyor-General. At the point of intersection, I set an iron post, 3 ft. long, 2 ins. diam., 24 ins. in the ground, for closing cor. of secs. 20 and 21, marked on brass cap 1915 on S. rim; CC S. of center; T17N R16W, S34, S35 in N. and T16 $\frac{1}{2}$ N R16W in S. half; S21 in SE. and S20 in SW. quadrant; and raise a mound of stone, 2 ft. base, 1 $\frac{1}{2}$ ft. high, S. of cor. Pits impracticable. Land, level. Soil, 3rd rate. Timber, juniper. Undergrowth, yucca and cacti.	I.W.S. May 25, 1915.

40.00	R.D.A. May 24, 1915. From the cor. of secs. 5, 6, 31 and 32, on the S. bdy. of the Tp., which is an iron post, established by I. W. S. as described in Book "A"., I run N.0° 3' W., bet. secs. 31 and 32. Over level land, through scattering timber and undergrowth. Set an iron post, 3 ft. long, 1 in. diam., 26 ins. in the ground, for $\frac{1}{4}$ sec. cor., marked on brass cap 1915 on S. rim; $\frac{1}{2}$ S31 in W. and S32 in E. half; dig pits, 18 X 18 X 12 ins., N. and S. of post, 3 ft. dist.; and raise a mound of earth, 3 $\frac{1}{2}$ ft. base, 1 $\frac{1}{2}$ ft. high, W. of cor.	
45.00	Wash, 50 lks. wide, course SW.	
80.00	Set an iron post, 3 ft. long, 2 ins. diam., 24 ins. in the ground, for cor. of secs. 29, 30, 31 and 32, marked on brass cap 1915 on S. rim; T16 $\frac{1}{2}$ N R16W in N. half; S30 in NW., S29 in NE., S32 in SE. and S31 in SW. quadrant; and raise a mound of stone, 2 ft. base, 1 $\frac{1}{2}$ ft. high, W. of cor. Pits impracticable.	

Chains.

Land, level.
Soil, 3rd rate.
Timber, juniper.
Undergrowth, yucca and cacti.

40.00

S.89° 54' E., on a random line, bet. secs. 29 and 32.
Set temp. $\frac{1}{4}$ sec. cor.

79.88

Intersect N. and S. line, at the cor. of secs. 28, 29, 32 and 33.

Thence I run

N.89° 54' W., on a true line, bet. secs. 29 and 32.

Over level land, through scattering undergrowth.

2.40

Road, brs. NW. and SE.

39.94

Set an iron post, 3 ft. long, 1 in. diam., 26 ins. in the ground, for $\frac{1}{4}$ sec. cor., marked on brass cap

1915 on S. rim;

$\frac{1}{4}$ S29 in N. and

S32 in S. half;

dig pits, 18 X 18 X 12 ins., E. and W. of post, 3 ft.

dist.; and raise a mound of earth, 3 $\frac{1}{2}$ ft. base, 1 $\frac{1}{2}$ ft.

high, N. of cor.

79.88

The cor. of secs. 29, 30, 31 and 32.

Land, level.

Soil, 3rd rate.

Timber, none.

Undergrowth, yucca and cacti.

R.D.A. May 24, 1915.

I.W.S.

May 25, 1915: At 7 hrs. 54 m., a.m., 1.m.t., I set off 34° 47' N. on the lat. arc; 20° 50 $\frac{1}{2}$ ' N. on the decl. arc; and determine a meridian with the solar at the cor. of secs. 29, 30, 31 and 32.

Thence I run

N.89° 54' W., on a random line, bet. secs. 30 and 31.

40.00

Set temp. $\frac{1}{4}$ sec. cor.

79.55

Intersect the W. bdy. of the Tp., 7 lks. N. of the cor. of secs. 25, 30, 31 and 36, which is an iron post, properly set, marked and witnessed as described by the Surveyor-General.

Thence I run

S.89° 57' E., on a true line, bet. secs. 30 and 31.

Over level land, through scattering undergrowth.

39.55

Set an iron post, 3 ft. long, 1 in. diam., 26 ins. in the ground, for $\frac{1}{4}$ sec. cor., marked on brass cap

1915 on S. rim;

$\frac{1}{4}$ S30 in N. and

S31 in S. half;

and raise a mound of stone, 2 ft. base, 1 $\frac{1}{2}$ ft. high,

N. of cor. Pits impracticable.

79.55

The cor. of secs. 29, 30, 31 and 32.

Land, level.

Soil, 3rd rate.

No timber.

Undergrowth, yucca and cacti.

N.0° 3' W., bet. secs. 29 and 30.

Over level land, through scattering undergrowth.

40.00

Set an iron post, 3 ft. long, 1 in. diam., 26 ins. in the ground, for $\frac{1}{4}$ sec. cor., marked on brass cap

Subdivision of Fractional T. 16¹/₂ N., R. 16 W. 13.

<p>Chains.</p> <p>80.00</p>	<p>1915 on S. rim; $\frac{1}{4}$S30 in W. and S29 in E. half; and raise a mound of stone, 2 ft. base, $1\frac{1}{2}$ ft. high, W. of cor. Pits impracticable. Set an iron post, 3 ft. long, 2 ins. diam., 24 ins. in the ground, for cor. of secs. 19, 20, 29 and 30, marked on brass cap</p> <p>1915 on S. rim; T16¹/₂N R16W in N. half; S19 in NW., S20 in NE., S29 in SE. and S30 in SW. quadrant; and raise a mound of stone, 2 ft. base, $1\frac{1}{2}$ ft. high, W. of cor. Pits impracticable. Land, level. Soil, 3rd rate. No timber. Undergrowth, yucca and cacti.</p>
<p>40.00</p> <p>79.90</p> <p>18.50</p> <p>39.95</p> <p>79.90</p>	<p>S.89° 54' E., on a random line, bet. secs. 20 and 29. Set temp. $\frac{1}{4}$ sec. cor. Intersect N. and S. line, 9 lks. N. of the cor. of secs. 20, 21, 28 and 29. Thence I run N.89°50' W., on a true line, bet. secs. 20 and 29. Over level land, through scattering undergrowth. Road, brs. N. and S. Set an iron post, 3 ft. long, 1 in. diam., 26 ins. in the ground, for $\frac{1}{4}$ sec. cor., marked on brass cap</p> <p>1915 on S. rim; $\frac{1}{4}$S20 in N. and S29 in S. half; and raise a mound of stone, 2 ft. base, $1\frac{1}{2}$ ft. high, N. of cor. Pits impracticable. The cor. of secs. 19, 20, 29 and 30. Land, level. Soil, 3rd rate. No timber. Undergrowth, yucca and cacti. May 25, 1915: The sky was overcast at noon making an observation for lat. impossible.</p>
<p>40.00</p> <p>79.20</p> <p>39.20</p> <p>79.20</p>	<p>N.89° 57' W., on a random line, bet. secs. 19 and 30. Set temp. $\frac{1}{4}$ sec. cor. Intersect W. bdy. of Tp., 2 lks. N. of the cor. of secs. 19, 24, 25 and 30, which is an iron post, properly set, marked and witnessed as described by the Surveyor- General. Thence I run S.89° 58' E., on a random line, bet. secs. 19 and 30. Over level land, through scattering undergrowth. Set an iron post, 3 ft. long, 1 in. diam., 26 ins. in the ground, for $\frac{1}{4}$ sec. cor., marked on brass cap</p> <p>1915 on S. rim; $\frac{1}{4}$S19 in N. and S30 in S. half; and raise a mound of stone, 2 ft. base, $1\frac{1}{2}$ ft. high, N. of cor. Pits impracticable. The cor. of secs. 19, 20, 29 and 30. Land, level. Soil, 3rd rate. No timber. Undergrowth, yucca and cacti.</p>

Chains

40.00 N60° 3' W., on a true line, bet. secs. 19 and 20.
Over level land, through scattering timber and undergrowth.
Set an iron post, 3 ft. long, 1 in. diam., 26 ins. in the
ground, for $\frac{1}{4}$ sec. cor., marked on brass cap
1915 on S. rim;
 $\frac{1}{4}$ S19 in W. and
S20 in E. half;
and raise a mound of stone, 2 ft. base, 1 $\frac{1}{2}$ ft. high,
W. of cor. Pits impracticable.

64.54 Intersect the 4th Standard Parallel North, 8.02 chs. E. of
the standard cor. of secs. 33 and 34, T. 17 N., R. 16
W., which is an iron post, properly set, marked and
witnessed as described by the Surveyor-General.
At the point of intersection, I set an iron post, 3 ft.
long, 2 ins. diam., 24 ins. in the ground, for closing
cor. of secs. 19 and 20, marked on brass cap
1915 on S. rim;
CC S. of center;
T17N R16W, S33, S34 in N. and
T16 $\frac{1}{2}$ N R16W in S. half;
S20 in SE. and
S19 in SW. quadrant;
and raise a mound of stone, 2 ft. base, 1 $\frac{1}{2}$ ft. high,
S. of cor. Pits impracticable.
Land, level.
Soil, 3rd rate.
Timber, juniper.
Undergrowth, yucca and cacti.

I. W. S.
May 25, 1915.

General Description.

The eastern portion of this fraction lies in the Hualpais mountains. The western portin is on the flat. The mountains are very steep and rocky, but not so boulder strewn as those in the Tp. south. The western protion is sparsely covered with greasewood, yucca and cacti, with a few juniper trees. Cow Creek flows through the SE. cor. of the Tp. There are seep springs in most of the large gulches on the W. slope of the hills. Soil of the hills, rocky 3rd and 4th rate. Soil on flats, sandy, 2nd and 3rd rate. No settlers and no mineral.

U. S. Surveyor.

U. S. Landman.

118
15
BOOK 2926

For FINAL OATH OF UNITED STATES SURVEYOR.

See Book "B."

I, _____, U. S. Surveyor, do solemnly swear that, in pursuance of special instructions received from the U. S. Surveyor General for _____ bearing date of the _____ day of _____, 191____, I have well, faithfully, and truly, in my own proper person, and in strict conformity with said instructions, the Manual of Surveying Instructions, and the laws of the United States, surveyed all those parts or portions of _____ of the _____ Meridian, in the State of _____, which are represented in the foregoing field notes as having been executed by me, and under my direction; and I do further solemnly swear that all the corners of said survey have been established and perpetuated in strict accordance with the Manual of Surveying Instructions, and the special written instructions of the U. S. Surveyor General for _____ and in the specific manner described in the field notes, and that the foregoing are the original field notes of such survey.

U. S. Surveyor.

Subscribed by said _____, and sworn to before me }
 this _____ day of _____, 191____



APPROVAL.

OFFICE OF THE UNITED STATES SURVEYOR GENERAL,

Phoenix, Ariz., February 15, 1917.

The foregoing field notes of the survey of _____ the _____

Subdivision Lines of frac. Township 16 1/2 North, Range 16 West,
Gila and Salt River Base and Meridian, Arizona,

executed by Irving W. Stoddard, U.S. Surveyor, & R.D. Armstrong, U.S. Transitman under his special instructions dated December 28, 1914, for Group 41, having been critically examined, and the necessary corrections and explanations made, the said field notes, and the surveys they describe, are hereby approved.

Surveyor General of Arizona.

~~I certify that the foregoing transcript of the field notes of the above-described surveys in~~
~~Book "O,"~~ has been correctly copied from the original notes on file in this office.

~~Surveyor General of Arizona.~~