

BOOK "R"  
FIELD NOTES

OF THE SURVEY OF THE

Subdivision Lines of  
Fractional  
Township 16 1/2 North - Range 14 West

of the Gila & Salt River Base & Meridian,  
In the State of Arizona.

EXECUTED BY

Carl Dyson, U.S. Transitman.

~~In the capacity of U. S. Surveyor~~, under instructions dated Dec 28, 1914,  
issued by the United States Surveyor General to govern surveys included in  
Group No. 41, which were approved by the Commissioner of the General Land  
Office, Jan 22, 1915.

Survey commenced June 3, 1915

Survey completed June 14, 1915

and executed under assignment instructions dated Apr. 1<sup>st</sup> / 10, 1915.

2529

2529

202  
1B

# Book "R"

BOOK 2929

## INDEX DIAGRAM.

Township  $16\frac{1}{2}$  North, Range 14 West

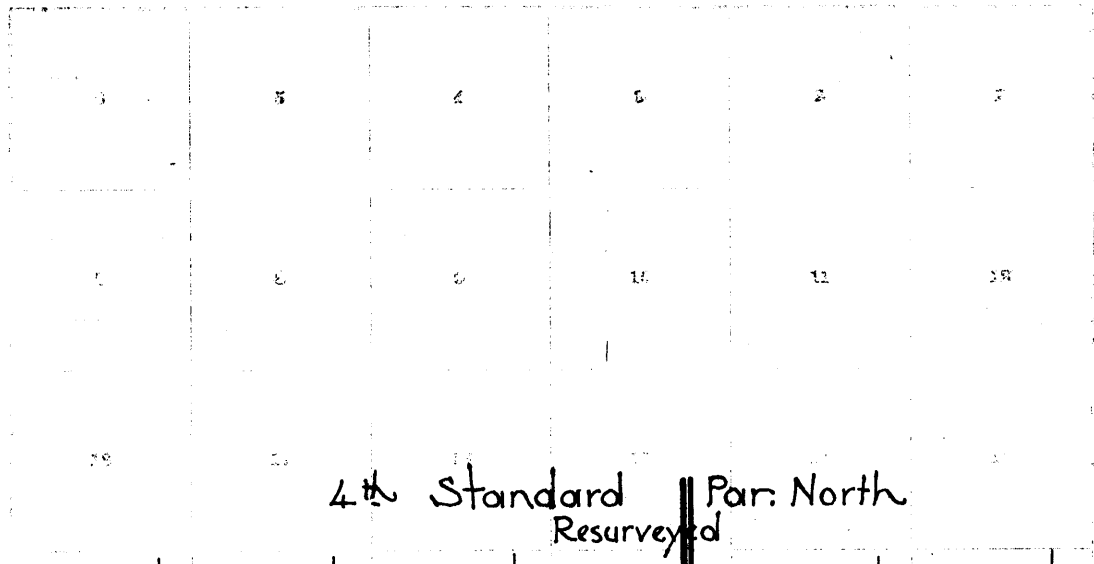

4<sup>th</sup> Standard Par. North  
Resurveyed

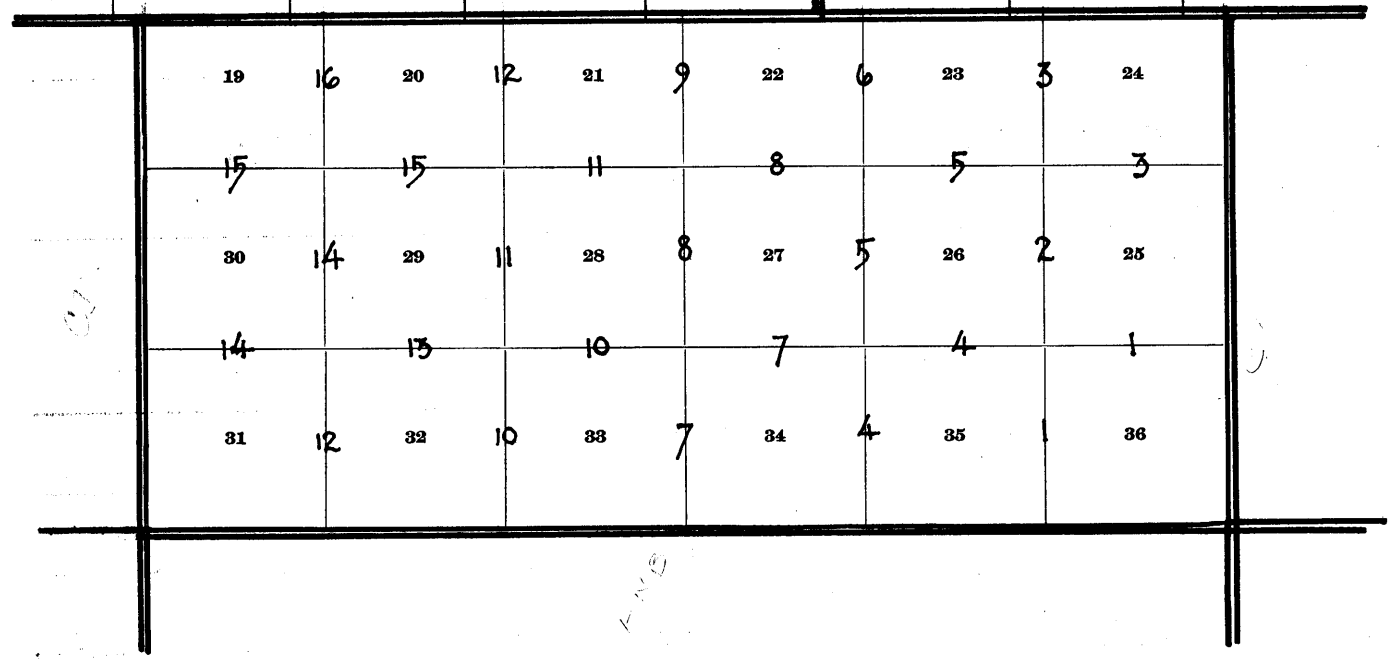

- Notes in Book "A".
- Surveyed under Gp. 46.

W 713

Subdivision of Fractional T. 16 1/2 N., R. 14 W.

1. C

Chains.

Survey commenced June 3, 1915, and executed by Carl Dyson, U. S. Transitman, with Young and Sons' light mountain transit No. 8539, with Smith solar attachment. For description of instrument and certificate of approval, see subdivision of T. 15 N., R. 13 W. For tests of adjustment, see North Bdy. of T. 16 N., R. 13 W.

In the following field notes, the initials H. N. B. and C. D. refer to H. N. Bradstreet and Carl Dyson, U. S. Transitmen, respectively.

June 12, 1915: At 8 hrs. 30 m., a.m., l.m.t., I set off 34° 46' N. on the lat. arc; 23° 7 1/2' N. on the decl. arc; and determine a meridian with the solar at the cor. of secs. 1, 2, 35 and 36, on the S. bdy. of the Tp., which is an iron post, established by H. N. B., as described in Book "A".

Thence I run N.0° 1' W., bet. secs. 35 and 36. Over rolling land, through scattering undergrowth. Desc. 40 ft. to

- 2.00 Center of wash, 3 chs. wide, course SE. Asc. SW. slope to
- 8.00 Spur, brs. SE. Desc. to
- 10.00 Draw, course SE. Asc. 20 ft. to
- 15.00 Spur, brs. SE. Desc. 30 ft. to
- 17.80 Wash, course SE. Asc. 30 ft. to
- 21.60 Spur, brs. SE. Desc. to
- 27.00 Center of wash, 1 ch. wide, course SE. Asc. 40 ft. to
- 27.65 Spur, brs. SE. Desc. 35 ft. to
- 29.50 Wash, course SE. Asc. 55 ft. to
- 33.30 Spur, brs. SE. Desc. 10 ft. to
- 37.00 Wash, course SE. Asc. 40 ft. to
- 40.00 Set an iron post, 3 ft. long, 1 in. diam., 26 ins. in the ground, for 1/4 sec. cor., marked on brass cap
  - 1915 on S. rim;
  - S35 1/4 in W. and
  - S36 in E. half;
 and raise a mound of stone, 2 ft. base, 1 1/2 ft. high, W. of cor. Pits impracticable.
- 43.60 Spur, brs. SE. Desc. 15 ft. to
- 45.00 Wash, course SE. Asc. 20 ft. to
- 48.20 Spur, brs. SE. Desc. slightly to
- 74.00 Wash, course SE. Asc. slightly to
- 77.34 Desc. 25 ft. to
- 80.00 Set an iron post, 3 ft. long, 2 ins. diam., 24 ins. in the ground, for cor. of secs. 25, 26, 35 and 36, marked on brass cap
  - 1915 on S. rim;
  - T16 1/2 N R14 W in N. half;
  - S26 in NW.,
  - S25 in NE.,
  - S36 in SE. and
  - S35 in SW. quadrant;
 and raise a mound of stone, 2 ft. base, 1 1/2 ft. high, W. of cor. Pits impracticable.

Land, rolling.  
Soil, rocky; 3rd rate.  
No timber.  
Undergrowth, greasewood, palo verde, ocotillo and scrub cedar.

June 12, 1915.

- 40.00 June 14, 1915.
- 79.97 N. 89° 59' E., on a random line, bet. secs. 25 and 36. Set temp. 1/4 sec. cor. Intersect E. bdy. of Tp., 9 lks. W. of the cor. of secs. 25 and 36, which is an iron post, established by me, as described in Book "A".
- Thence I run N. 89° 57' W., on a true line, bet. secs. 25 and 36.

2. Subdivision of Fractional T. 16 $\frac{1}{2}$  N., R. 14 W. 2.

Chains.

Over rolling land, through scattering undergrowth.  
 Along N. slope of spur to  
 3.70 Desc. NW. slope, 35 ft. to  
 10.00 Thence along S. edge of wash, course ENE. Comes from W.  
 27.00 Leave S. edge of wash, course E. Comes from NW. Asc. NE.  
 slope, 70 ft. to  
 35.00 Desc. to  
 37.50 Draw, course ENE.  
 39.98 $\frac{1}{2}$  Set an iron post, 3 ft. long, 1 in. diam., 26 ins. in the  
 ground, for  $\frac{1}{4}$  sec. cor., marked on brass cap  
 1915 on S. rim;  
 $\frac{1}{4}$ S25 in N. and  
 S36 in S. half;  
 and raise a mound of stone, 2 ft. base, 1 $\frac{1}{2}$  ft. high,  
 N. of cor. Pits impracticable.  
 43.00 Asc. slight NE. slope, 95 ft. to  
 63.50 Desc. slightly to  
 65.00 Head of wash, course SE. Asc. 75 ft. to  
 79.97 The cor. of secs. 25, 26, 35 and 36.  
 Land, rolling.  
 Soil, rocky; 3rd rate.  
 No timber.  
 Undergrowth, greasewood, palo verde, ocatilla, scrub cedar  
 and cacti.  
 June 14, 1915.

June 12, 1915.  
 N.0° 1' W., bet. secs. 25 and 26.  
 Over rolling land, through scattering undergrowth.  
 Desc. NW. slope, 50 ft. to  
 4.20 Wash, course NE. Asc. 20 ft. to  
 9.00 Spur, brs. NE. Desc. 30 ft. to  
 13.00 Enter wash, course E.  
 23.00 Leave wash, course E. Asc. S. slope, 65 ft. to  
 26.00 Spur, brs. E. Desc. 15 ft. to  
 30.80 Draw, course E. Asc. slightly to  
 38.70 Spur, brs. E. Desc. 25 ft. to  
 40.00 Set an iron post, 3 ft. long, 1 in. diam., 26 ins. in the  
 ground, for  $\frac{1}{4}$  sec. cor., marked on brass cap  
 1915 on S. rim;  
 S26  $\frac{1}{4}$  in W. and  
 S25 in E. half;  
 and raise a mound of stone, 2 ft. base, 1 $\frac{1}{2}$  ft. high,  
 W. of cor. Pits impracticable.  
 June 12, 1915: At this cor., I set off 23° 8' N. on the  
 decl. arc; and at apparent noon, I observe the sun on  
 the meridian; the resulting lat. is 34° 47 $\frac{1}{2}$ ' N.  
 Thence over level land.  
 55.00 Wash, course E.  
 67.50 Wash, course E.  
 70.00 Wash, course E.  
 72.50 Desc. 40 ft. to  
 75.00 Wash, course E. Asc. 10 ft. to  
 80.00 Set an iron post, 3 ft. long, 2 ins. diam., 24 ins. in the  
 ground, for cor. of secs. 23, 24, 25 and 26, marked on  
 brass cap  
 1915 on S. rim;  
 T16 $\frac{1}{2}$ N R14W in N. half;  
 S23 in NW.,  
 S24 in NE.,  
 S25 in SE. and  
 S26 in SW. quadrant;  
 and raise a mound of stone, 2 ft. base, 1 $\frac{1}{2}$  ft. high,  
 W. of cor. Pits impracticable.  
 Land, rolling and level.  
 Soil, rocky; 3rd rate.  
 No timber.  
 Undergrowth, greasewood, palo verde, ocatilla and scrub  
 cedar.  
 June 12, 1915.

Subdivision of Fractional T. 16 $\frac{1}{2}$  N., R. 14 W. 3.

Chains.

June 14, 1915.

S.89° 57' E., on a random line, bet. secs. 24 and 25.

40.00 Set temp.  $\frac{1}{4}$  sec. cor.

80.03 Intersect E. bdy. of Tp., 2 lks. S. of the cor. of secs. 24 and 25, which is an iron post, established by me, as described in Book "A".

Thence I run

N.89° 58' W., on a true line, bet. secs. 24 and 25.

Over rolling land, through scattering undergrowth.

12.40 Old road, brs.NE. and SW.

25.00 Wash, course NE.

40.01 $\frac{1}{2}$  Set an iron post, 3 ft. long, 1 in. diam., 26 ins. in the ground, for  $\frac{1}{4}$  sec. cor., marked on brass cap

1915 on S. rim;

$\frac{1}{4}$ S24 in N. and

S25 in S. half;

dig pits, 18 X 18 X 12 ins., E. and W. of post, 3 ft. dist.; and raise a mound of earth, 3 $\frac{1}{2}$  ft. base, 1 $\frac{1}{2}$  ft. high, N. of cor.

70.00 Wash, course NE. Asc. 65 ft. to

80.03 The cor. of secs. 23, 24, 25 and 26.

Land, rolling.

Soil, rocky; 3rd rate.

No timber.

Undergrowth, greasewood, palo verde, ocotilla, scrub cedar and cacti.

June 14, 1915.

June 12, 1915.

N.0° 1' W., on a true line, bet. secs. 23 and 24.

Over rolling land, through scattering undergrowth.

Along slight E. slope.

2.50 Wash, course E.

15.00 Wash, course E.

17.00 Wash, course E.

23.00 Wash, course E.

40.00 Set an iron post, 3 ft. long, 1 in. diam., 26 ins. in the ground, for  $\frac{1}{4}$  sec. cor., marked on brass cap

1915 on S. rim;

S23  $\frac{1}{4}$  in W. and

S24 in E. half;

dig pits, 18 X 18 X 12 ins., N. and S. of post, 3 ft. dist.; and raise a mound of earth, 3 $\frac{1}{2}$  ft. base, 1 $\frac{1}{2}$  ft. high, W. of cor.

65.38 Intersect Fourth Standard Parallel North, 4.98 chs. E. of the std. cor. of secs. 31 and 32, T. 17 N., R. 13 W., which is an iron post, properly set, marked and witnessed as described by the Surveyor-General.

At the point of intersection, set an iron post, 3 ft. long, 2 ins. diam., 24 ins. in the ground, for closing cor. of secs. 23 and 24, marked on brass cap

1915 on S. rim;

CC S. of center;

T17N R13W, S31, S32 in N. and

T16 $\frac{1}{2}$ N R14W in S. half;

S24 in SE. and

S23 in SW. quadrant;

and raise a mound of stone, 2 ft. base, 1 $\frac{1}{2}$  ft. high, S. of cor. Pits impracticable.

Land, rolling; drains E.

Soil, rocky; 3rd rate.

No timber.

Undergrowth, greasewood, palo verde, ocotilla, scrub cedar and cacti.

June 14, 1915.

4. Subdivision of Fractional T. 16 $\frac{1}{2}$  N., R. 14 W.

Chains.

June 11, 1915: At 8 hrs. 4 m., a.m., l.m.t., I set off 34° 46' N. on the lat. arc; 23° 3 $\frac{1}{2}$ ' N. on the decl. arc; and determine a meridian with the solar at the cor. of secs. 2, 3, 34 and 35, on the S. bdy. of the Tp., which is an iron post, established by H. N. B., as described in Book "A".

Thence I run N.0° 1' W., bet. secs. 34 and 35.  
Over rolling land, through scattering undergrowth.

Desc. to  
.50 Wash, course E. Asc. SE. slope, 60 ft. to  
5.00 Desc. to  
7.20 Wash, course SE.  
10.35 Wash, course SE. Asc. 35 ft. to  
13.35 Spur, brs. SE. Desc. 25 ft. to  
16.00 Draw, course SE. Asc. S. slope, 80 ft. to  
19.65 Spur, brs. SE. Desc. 25 ft. to  
22.50 Center of wash, 1 ch. wide, course SE. Asc. S. slope, 190 ft. to  
40.00 Ridge, brs. NW. and SE.  
Set an iron post, 3 ft. long, 1 in. diam., 26 ins. in the ground, for  $\frac{1}{4}$  sec. cor., marked on brass cap  
1915 on S. rim;  
S34  $\frac{1}{4}$  in W. and  
S35 in E. half;  
and raise a mound of stone, 2 ft. base, 1 $\frac{1}{2}$  ft. high, W. of cor. Pits impracticable.

46.55 Desc. 50 ft. to  
49.75 Gulch, course E. Asc. S. slope, 70 ft. to  
55.70 Spur, brs. E. Desc. 55 ft. to  
61.00 Wash, course SE. Asc. S. slope, 35 ft. to  
68.30 Spur, brs. NE. Desc. N. slope, 90 ft. to  
80.00 Draw, course NE.  
Set an iron post, 3 ft. long, 2 ins. diam., 24 ins. in the ground, for cor. of secs. 26, 27, 34 and 35, marked on brass cap  
1915 on S. rim;  
T16 $\frac{1}{2}$ N R14W in N. half;  
S27 in NW.,  
S26 in NE.,  
S35 in SE. and  
S34 in SW. quadrant;  
and raise a mound of stone, 2 ft. base, 1 $\frac{1}{2}$  ft. high, W. of cor. Pits impracticable.

Land, rolling.  
Soil, rocky; 4th rate.  
No timber.  
Undergrowth, greasewood, palo verde, ocotillo, scrub cedar and cacti.

June 11, 1915.

June 12, 1915.  
N.89° 59' E., on a random line, bet. secs. 26 and 35.  
40.00 Set temp.  $\frac{1}{4}$  sec. cor.  
80.00 Intersect N. and S. line, 11 lks. S. of the cor. of secs. 25, 26, 35 and 36.  
Thence I run S.89° 54' W., on a true line, bet. secs. 26 and 35.  
Over rolling land, through scattering undergrowth.

Desc. NW. slope to  
7.00 Wash, course NE. Asc. SE. slope, 90 ft. to  
18.40 Spur, brs. NE. Desc. NW. slope, 55 ft. to  
23.50 Wash, course NE. Asc. SE. slope, 55 ft. to  
29.75 Spur, brs. NE. Desc. NW. slope, 25 ft. to  
32.70 Wash, course NE. Asc. SE. slope to  
35.90 Spur, brs. NE. Desc. to  
39.00 Wash, course NE. Asc. 135 ft.  
40.00 Set an iron post, 3 ft. long, 1 in. diam., 26 ins. in the ground, for  $\frac{1}{4}$  sec. cor., marked on brass cap

Subdivision of Fractional T. 16 $\frac{1}{2}$  N., R. 14 W. 5.

Chains.

1915 on S. rim;  
 $\frac{1}{4}$ S26 in N. and  
 S35 in S. half;  
 and raise a mound of stone, 2 ft. base, 1 $\frac{1}{2}$  ft. high,  
 N. of cor. Pits impracticable.

59.85 Spur, brs. NE. Desc. NW. slope, 45 ft. to  
 65.00 Wash, course NE. Asc. SE. slope, 35 ft. to  
 68.60 Spur, brs. NE. Desc. to  
 71.00 Wash, course NE. Asc. 40 ft. to  
 76.25 Spur, brs. NE. Desc. to.  
 80.00 The cor. of secs. 26, 27, 34 and 35.  
 Land, rolling.  
 Soil, rocky; 3rd rate.  
 No timber.  
 Undergrowth, greasewood, palo verde, ocetilla, scrub cedar  
 and cacti.

June 12, 1915.

June 11, 1915.  
 N.0° 1' W., bet. secs. 26 and 27.  
 Over rolling land, through scattering undergrowth.  
 Asc. 35 ft. to

2.88 Spur, brs. NE. Desc. NW. slope, 55 ft. to  
 9.90 Wash, course NE. Asc. SE. slope, 75 ft. to  
 17.00 Spur, brs. E. Desc. N. slope, 135 ft. to  
 31.50 Enter wash, course E.  
 37.50 Leave wash, course E. Asc. S. slope, 145 ft.  
 40.00 Set an iron post, 3 ft. long, 1 in. diam., 26 ins. in the  
 ground, for  $\frac{1}{4}$  sec. cor., marked on brass cap

1915 on S. rim;  
 S27  $\frac{1}{4}$  in W. and  
 S26 in E. half;  
 and raise a mound of stone, 2 ft. base, 1 $\frac{1}{2}$  ft. high,  
 W. of cor. Pits impracticable.  
 Asc. SW. slope to

48.20 Spur, brs. SE. Desc. NE. slope to  
 59.00 Wash, course SE. Asc. SW. slope to  
 63.45 Spur, brs. SE. Desc. NE. slope to  
 73.50 Wash, course SE. Asc. S. slope, 115 ft. to  
 80.00 Spur, brs. NE.

Set an iron post, 3 ft. long, 2 ins. diam., 24 ins. in the  
 ground, for cor. of secs. 22, 23, 26 and 27, marked on  
 brass cap

1915 on S. rim;  
 T16 $\frac{1}{2}$ N R14W in N. half;  
 S22 in NW.,  
 S23 in NE.,  
 S26 in SE. and  
 S27 in SW. quadrant;  
 and raise a mound of stone, 2 ft. base, 1 $\frac{1}{2}$  ft. high,  
 W. of cor. Pits impracticable.  
 Land, rolling.  
 Soil, rocky; 3rd rate.  
 No timber.  
 Undergrowth, yucca, greasewood, palo verde, ocetilla and  
 scrub cedar.

June 11, 1915: At this cor., I set off 23° 3 $\frac{1}{2}$ ' N. on the  
 decl. arc; and at apparent noon, I observe the sun on  
 the meridian; the resulting lat. is 34° 48' N.  
 June 11, 1915.

June 12, 1915:  
 N.89° 54' E., on a random line, bet. secs. 23 and 26.  
 40.00 Set temp.  $\frac{1}{4}$  sec. cor.  
 80.00 Intersect N. and S. line, 2 lks. N. of the cor. of secs.

6. Subdivision of Fractional T. 16 $\frac{1}{2}$  N., R. 14 W.

Chains.

23, 24, 25 and 26.  
Thence I run  
S. 89° 55' W., on a true line, bet. secs. 23 and 26.  
Over rolling land, through scattering undergrowth.  
Asc. slightly to

2.00 Desc. to  
5.00 Wash, course NE. Asc. SE. slope, 60 ft. to  
13.75 Desc. to  
16.00 Wash, course NE. Asc. 40 ft. to  
23.00 Desc. to  
24.00 Wash, course NE. Asc. 70 ft. to  
31.00 Spur, brs. NE. Desc. slightly to  
34.80 Asc. 145 ft.  
40.00 Set an iron post, 3 ft. long, 1 in. diam., 26 ins. in the  
ground, for  $\frac{1}{4}$  sec. cor., marked on brass cap  
1915 on S. rim;  
 $\frac{1}{4}$ S23 in N. and  
S26 in S. half;  
and raise a mound of stone, 2 ft. base, 1 $\frac{1}{2}$  ft. high,  
N. of cor. Pits impracticable.

55.00 Spur, brs. SE. Desc. SW. slope to  
59.85 Wash, course SE. Asc. E. slope, 150 ft. to  
77.00 Spur, brs. NE. Desc. to  
80.00 The cor. of secs. 22, 23, 26 and 27.  
Land, rolling.  
Soil, rocky; 3rd rate.  
No timber.  
Undergrowth, greasewood, palo verde, ocatillo and scrub  
cedar.

June 12, 1915.

June 11, 1915.  
N. 0° 1' W., on a true line, bet. secs. 22 and 23.  
Over rolling hills, through scattering undergrowth.  
Desc. NE. slope, 160 ft. to

13.00 Wash, course NE. Asc. SE. slope, 45 ft. to  
20.90 Spur, brs. NE. Desc. 45 ft. to  
24.70 Head of wash, course NE. Asc. SE. slope, 30 ft. to  
32.00 Spur, brs. NE. Desc. NW. slope, 165 ft.  
40.00 Set an iron post, 3 ft. long, 1 in. diam., 26 ins. in the  
ground, for  $\frac{1}{4}$  sec. cor., marked on brass cap  
1915 on S. rim;  
S22  $\frac{1}{4}$  in W. and  
S23 in E. half;  
and raise a mound of stone, 2 ft. base, 1 $\frac{1}{2}$  ft. high,  
W. of cor. Pits impracticable.

63.00 Desc. on spur, brs. NNE.  
Center of wash, 1.50 chs. wide, course E. Asc. slightly  
to

65.55 Intersect Fourth Standard Parallel North, 4.92 chs. E. of  
the std. cor. of Eps. 17 N., Rs. 13 and 14 W., which  
is an iron post, properly set, marked and witnessed as  
described by the Surveyor-General.  
At the point of intersection, set an iron post, 3 ft. long,  
2 ins. diam., 10 ins. in the ground, on solid rock, in  
a mound of stone, for closing cor. of secs. 22 and 23,  
marked on brass cap  
1915 on S. rim;  
CC S. of center;  
T17N, R14W S36, R13W S31 in N. and  
T16 $\frac{1}{2}$ N R14W in S. half;  
S23 in SE. and  
S22 in SW. quadrant;  
and raise a mound of stone, 2 ft. base, 1 $\frac{1}{2}$  ft. high,  
S. of cor. Pits impracticable.  
Land, rolling hills.  
Soil, rocky; 3rd rate.  
No timber



Subdivision of Fractional T. 16<sup>1</sup>/<sub>2</sub> N., R. 14 W. 7.

Chains.

Undergrowth, greasewood, palo verde, ocatillo, scrub cedar and cacti.  
June 11, 1915.

June 10, 1915; At 7 hrs. 30 m., a.m., l.m.t., I set off 34° 46' N. on the lat. arc; 22° 58<sup>1</sup>/<sub>2</sub>' N. on the decl. arc; and determine a meridian with the solar at the cor. of secs. 3, 4, 33 and 34, on the S. bdy. of the Tp., which is an iron post, established by H. M. B., as described in Book "A".

Thence I run  
N.0° 2' W., bet. secs. 33 and 34.  
Over mountainous land, through scattering undergrowth.  
Asc. 65 ft., on spur, brs. S., to  
Desc. N. slope, 125 ft. to  
Gulch, course E. Asc. S. slope, 170 ft. to  
Spur, brs. E. Desc. N. slope, 180 ft. to  
Center of wash, 2.50 chs. wide, course SE. Asc. SW. slope,  
365 ft.

8.80  
14.00  
21.43  
31.25

Set an iron post, 3 ft. long, 1 in. diam., 26 ins. in the ground, for <sup>1</sup>/<sub>4</sub> sec. cor., marked on brass cap  
1915 on S. rim;  
S33 <sup>1</sup>/<sub>4</sub> in W. and  
S34 in E. half;  
and raise a mound of stone, 2 ft. base, 1<sup>1</sup>/<sub>2</sub> ft. high, W. of cor. Pits impracticable.

47.00  
56.00  
61.55  
71.65  
80.00

Ridge, brs. E. and W. Desc. N. slope, 105 ft. to  
Gulch, course SE. Asc. SW. slope, 120 ft. to  
Spur, brs. SE. Desc. NE. slope, 145 ft. to  
Gulch, course E. Asc. S. slope, 65 ft. to  
Set an iron post, 3 ft. long, 2 ins. diam., 24 ins. in the ground, for cor. of secs. 27, 28, 33 and 34, marked on brass cap

1915 on S. rim;  
T16<sup>1</sup>/<sub>2</sub>N R14W in N. half;  
S28 in NW.,  
S27 in NE.,  
S34 in SE. and  
S33 in SW. quadrant;

and raise a mound of stone, 2 ft. base, 1<sup>1</sup>/<sub>2</sub> ft. high, W. of cor. Pits impracticable.

Land, mountainous.  
Soil, rocky; 4th rate.  
No timber.

Undergrowth, greasewood, palo verde, ocatillo, scrub cedar and cacti.  
June 10, 1915.

June 11, 1915:  
N.89° 59' E., on a random line, bet. secs. 27 and 34.  
Set temp. <sup>1</sup>/<sub>4</sub> sec. cor.  
Intersect N. and S. line, 16 lks. N. of the cor. of secs. 26, 27, 34 and 35.

40.00  
80.05

Thence I run  
N.89° 54' W., on a true line, bet. secs. 27 and 34.  
Over rolling hills, through scattering undergrowth.  
Asc. SE. slope, 40 ft. to  
Spur, brs. NE. Desc. NW. slope, 95 ft. to  
Wash, course NE.  
Wash, course SE. Asc. 90 ft. to  
Spur, brs. SE. Desc. SW. slope, 30 ft. to  
Wash, course SE. Asc. E. slope, 120 ft.

2.30  
14.30  
20.00  
24.80  
35.00  
40.02<sup>1</sup>/<sub>2</sub>

Set an iron post, 3 ft. long, 1 in. diam., 26 ins. in the ground, for <sup>1</sup>/<sub>4</sub> sec. cor., marked on brass cap  
1915 on S. rim;

8. Subdivision of Fractional T. 16 $\frac{1}{2}$  N., R. 14 W.

Chains.

$\frac{1}{4}$ S27 in N. and  
 $\frac{1}{4}$ S34 in S. half;  
 and raise a mound of stone, 2 ft. base, 1 $\frac{1}{2}$  ft. high,  
 N. of cor. Pits impracticable.  
 48.05 Spur, brs. SE. Desc. SW. slope, 165 ft. to  
 63.75 Gulch, course S. Asc. E. slope, 100 ft. to  
 72.00 Ridge, brs. NW. and SE. Desc. SW. slope, 175 ft. to  
 78.00 Gulch, course S. Asc. E. slope to  
 80.05 The cor. of secs. 27, 28, 33 and 34.  
 Land, rolling hills.  
 Soil, rocky; 4th rate.  
 No timber.  
 Undergrowth, greasewood, palo verde, ocetille, scrub cedar  
 and cacti.  
 June 11, 1915.

June 10, 1915.  
 N.0° 2' W., bet. secs. 27 and 28.  
 Over broken and rolling hills, through scattering under-  
 growth.  
 Desc. NE. slope to  
 2.80 Gulch, course SE. Asc. SW. slope, 250 ft. to  
 20.00 Ridge, brs. NW. and SE. Desc. NE. slope, 235 ft.  
 40.00 Set an iron post, 3 ft. long, 1 in. diam., 26 ins. in the  
 ground, for  $\frac{1}{4}$  sec. cor., marked on brass cap  
 1915 on S. rim;  
 S28  $\frac{1}{4}$  in W. and  
 S27 in E. half;  
 and raise a mound of stone, 2 ft. base, 1 $\frac{1}{2}$  ft. high,  
 W. of cor. Pits impracticable.  
 45.00 Center of draw, 4 chs. wide, course SE. Asc. S. slope,  
 295 ft. to  
 63.80 Ridge, brs. E. and W. Desc. N. slope, 130 ft. to  
 73.70 Draw, course E. Asc. S. slope, 115 ft. to  
 80.00 Spur, brs. E.  
 Set an iron post, 3 ft. long, 2 ins. diam., 24 ins. in the  
 ground, for cor. of secs. 21, 22, 27 and 28, marked on  
 brass cap  
 1915 on S. rim;  
 T16 $\frac{1}{2}$ N R14W in N. half;  
 S21 in NW.,  
 S22 in NE.,  
 S27 in SE. and  
 S28 in SW. quadrant;  
 and raise a mound of stone, 2 ft. base, 1 $\frac{1}{2}$  ft. high,  
 W. of cor. Pits impracticable.  
 Land, broken and mountainous.  
 Soil, rocky; 4th rate.  
 No timber.  
 Undergrowth, greasewood, palo verde, ocetille, scrub cedar  
 and cacti.  
 June 10, 1915.

June 11, 1915.  
 S.89° 54' E., on a random line, bet. secs. 22 and 27.  
 40.00 Set temp.  $\frac{1}{4}$  sec. cor.  
 80.13 Intersect N. and S. line, 16 lks. S. of the cor. of secs.  
 22, 23, 26 and 27.  
 Thence I run  
 S.89° 59' W., on a true line, bet. secs. 22 and 27.  
 Over mountainous land, through scattering undergrowth.  
 Desc. SW. slope, 30 ft. to  
 5.00 Asc. E. slope, 65 ft. to  
 11.25 Spur, brs. S. SE. Desc. SW. slope, 45 ft. to  
 18.00 Gulch, course S. Asc. W. slope, 75 ft. to

Subdivision of Fractional T. 16 $\frac{1}{2}$  N., R. 14 W. 9.

Chains.

23.65 Spur, brs. S. Desc. SW. slope, 50 ft. to  
 28.00 Gulch, course S. Asc. SE. slope to  
 31.30 Spur, brs. S. Desc. W. slope, 20 ft. to  
 35.00 Gulch, course S. Asc. E. slope, 120 ft. to  
 40.06 $\frac{1}{2}$  Set an iron post, 3 ft. long, 1 in. diam., 26 ins. in the  
 ground, for  $\frac{1}{4}$  sec. cor., marked on brass cap  
 1915 on S. rim;  
 $\frac{1}{4}$ S22 in N. and  
 S27 in S. half;  
 and raise a mound of stone, 2 ft. base, 1 $\frac{1}{2}$  ft. high,  
 N. of cor. Pits impracticable.  
 43.80 Spur, brs. SE. Desc. SW. slope, 115 ft. to  
 53.00 Gulch, course S. Asc. NE. slope, 85 ft. to  
 58.20 Spur, brs. SE. Desc. 140 ft. to  
 69.25 Draw, course SE. Asc. E. slope, 205 ft. to  
 80.13 The cor. of secs. 21, 22, 27 and 28.  
 Land, mountainous.  
 Soil, rocky; 4th rate.  
 No timber.  
 Undergrowth, greasewood, palo verde, ocatillo, scrub cedar  
 and cacti.  
 June 11, 1915.

June 10, 1915.  
 N.0° 2' W., on a true line, bet. secs. 21 and 22.  
 Over mountainous land, through scattering undergrowth.  
 Desc. NE. slope, 175 ft. to  
 9.65 Draw, course SE. Asc. S. slope, 130 ft. to  
 17.00 Spur, brs. SE. Desc. NE. slope, 140 ft. to  
 25.00 Draw, course E. Asc. SE. slope, 30 ft. to  
 33.60 Spur, brs. E. Desc. NE. slope, 75 ft. to  
 38.60 Draw, course SE. Asc. SW. slope, 35 ft.  
 40.00 Set an iron post, 3 ft. long, 1 in. diam., 26 ins. in the  
 ground, for  $\frac{1}{4}$  sec. cor., marked on brass cap  
 1915 on S. rim;  
 S21  $\frac{1}{4}$  in W. and  
 S22 in E. half;  
 and raise a mound of stone, 2 ft. base, 1 $\frac{1}{2}$  ft. high,  
 W. of cor. Pits impracticable.  
 41.65 Spur, brs. SE. Desc. NE. slope, 135 ft. to  
 47.00 Center of wash, 3 chs. wide, course SE. Asc. SW. slope,  
 175 ft. to  
 65.65 Intersect Fourth Standard Parallel North, 4.78 chs. E. of  
 the std. cor. of secs. 35 and 36, T. 17 N., R. 14 W.,  
 which is an iron post, properly set, marked and witness-  
 ed as described by the Surveyor-General.  
 At the point of intersection, set an iron post, 3 ft. long,  
 2 ins. diam., 24 ins. in the ground, for closing cor.  
 of secs. 21 and 22, marked on brass cap  
 1915 on S. rim;  
 T17N R14W, S35, S36 in N. and  
 T16 $\frac{1}{2}$ N in S. half;  
 S22 in SE. and  
 S21 in SW. quadrant;  
 and raise a mound of stone, 2 ft. base, 1 $\frac{1}{2}$  ft. high,  
 S. of cor. Pits impracticable.  
 Land, mountainous.  
 Soil, rocky; 4th rate.  
 No timber.  
 Undergrowth, greasewood, palo verde, ocatilla, scrub cedar  
 and cacti.  
 June 10, 1915.

June 5, 1915: At 8 hrs. 4 m., a.m., l.m.t., I set off 34°  
 46' N. on the lat. arc; 22° 29 $\frac{1}{2}$ ' N. on the decl. arc;

10. Sundivision of Fractional T. 16 $\frac{1}{2}$  N., R. 14 W.

Chains.	
	and determine a meridian with the solar at the cor. of secs. 4, 5, 32 and 33, on the S. bdy. of the Tp., which is an iron post, established by H. N. B., as described in Book "A".
	Thence I run
	N.0° 2' W., bet. secs. 32 and 33.
	Over mountainous land, through scattering undergrowth.
	Desc. NE. slope, 100 ft.
.25	Road, brs. E. to Signal, and W. to San Francisco Mine and Cedar.
19.80	Wash, 3 lks. wide, course SE. Asc. S. slope, 60 ft. to
23.20	Spur, brs. SE. Desc. N. slope to
25.40	Wash, 5 lks. wide, course SE. Asc. S. slope, 100 ft. to
32.55	Ridge, brs. E. and W. Desc. N. slope, 175 ft.
40.00	Set an iron post, 3 ft. long, 1 in. diam., 26 ins. in the ground, for $\frac{1}{4}$ sec. cor., marked on brass cap
	1915 on S. rim;
	S32 $\frac{1}{4}$ in W. and
	S33 in E. half;
	and raise a mound of stone, 2 ft. base, 1 $\frac{1}{2}$ ft. high, W. of cor. Pits impracticable.
50.76	Wash, 15 lks. wide, course E. Asc. 30 ft. to
54.00	Point of spur, extends 3. chs. E. Desc. 55 ft. to
59.80	Stream of water, 3 lks. wide, 2 ins. deep, in center of wash, 70 lks. wide, course SE. Asc. S. slope, 250 ft. to
70.00	Ridge, brs. NW. and SE. Desc. N. slope, 95 ft. to
80.00	Set an iron post, 3 ft. long, 2 ins. diam., 24 ins. in the ground, for cor. of secs. 28, 29, 32 and 33, marked on brass cap
	1915 on S. rim;
	T16 $\frac{1}{2}$ N R14W in N. half;
	S29 in NW.,
	S28 in NE.,
	S33 in SE. and
	S32 in SW. quadrant;
	and raise a mound of stone, 2 ft. base, 1 $\frac{1}{2}$ ft. high, W. of cor. Pits impracticable.
	Land, mountainous.
	Soil, rocky; 4th rate.
	No timber.
	Undergrowth, greasewood, palo verde, scrub oak and scrub cedar.
	June 5, 1915.
	June 10, 1915.
40.00	N.89° 59' E., on a random line, bet. secs. 28 and 33.
79.86	Set temp. $\frac{1}{4}$ sec. cor.
	Intersect N. and S. line, 16 lks. N. of the cor. of secs. 27, 28, 33, and 34.
	Thence I run
	N.89° 54' W., on a true line, bet. secs. 28 and 33.
	Over rocky, rolling hills, through scattering undergrowth.
	Asc. NE. slope, 95 ft. to
3.80	Spur, brs. SE. Desc. SW. slope, 85 ft. to
15.00	Gulch, course S. Thence along S. slope to
25.00	Gulch, course SE. Asc. NE. slope, 350 ft.
39.93	Set an iron post, 3 ft. long, 1 in. diam., 26 ins. in the ground, for $\frac{1}{4}$ sec. cor., marked on brass cap
	1915 on S. rim;
	$\frac{1}{4}$ S28 in N. and
	S33 in S. half;
	and raise a mound of stone, 2 ft. base, 1 $\frac{1}{2}$ ft. high, N. of cor. Pits impracticable.
	Thence asc. along N. slope to
75.00	Desc. NW. slope, 50 ft. to
79.86	The cor. of secs. 28, 29, 32 and 33.
	Land, rolling.
	Soil, rocky; 4th rate.

Subdivision of Fractional T. 16 $\frac{1}{2}$  N., R. 14 W. 11.

Chains.

No timber.  
 Undergrowth, greasewood, palo verde, ocatilla, scrub cedar and scrub oak.  
 June 10, 1915; At this cor., I set off 22° 59' N. on the decl. arc; and at apparent noon, I observe the sun on the meridian; the resulting lat. is 34° 47' N.  
 June 10, 1915.

June 9, 1915: At 8 hrs. 10 m., a.m., l.m.t., I set off 34° 47' N. on the lat. arc; 22° 53 $\frac{1}{2}$ ' N. on the decl. arc; and determine a meridian with the solar at the cor. of secs. 28, 29, 32 and 33. Thence I run N.0° 2' W., bet. secs. 28 and 29.  
 Over mountainous land, through scattering undergrowth.  
 Desc. N. slope, 45 ft. to  
 2.92 Gulch, 35 ft. deep, course NE. Asc. SE. slope, 80 ft. to  
 11.10 Spur, brs. E. Desc. N. slope, 50 ft. to  
 17.20 Gulch, course SE. Asc. S. slope, 215 ft. to  
 37.00 Ridge, brs. NW. and SE. Desc. NE. slope, 45 ft.  
 40.00 Set an iron post, 3 ft. long, 1 in. diam., 26 ins. in the ground, for  $\frac{1}{4}$  sec. cor., marked on brass cap  
 1915 on S. rim;  
 S29  $\frac{1}{4}$  in W. and  
 S28 in E. half;  
 and raise a mound of stone, 2 ft. base, 1 $\frac{1}{2}$  ft. high, W. of cor. Pits impracticable.  
 42.50 Head of wash, course SE. Asc. SW. slope, 125 ft. to  
 51.30 Ridge, brs. NW. and SE. Desc. N. slope, 260 ft. to  
 64.63 Center of gulch, 1 ch. wide, course NE. Asc. along E. end of spur, 20 ft., to  
 72.50 Desc. 35 ft. to  
 74.90 Center of gulch, 1 ch. wide, course SE. Asc. SW. slope, 75 ft. to  
 80.00 Set an iron post, 3 ft. long, 2 ins. diam., 24 ins. in the ground, for cor. of secs. 26, 27, 28 and 29, marked on brass cap  
 1915 on S. rim;  
 T16 $\frac{1}{2}$ N R14W in N. half;  
 S20 in NW.,  
 S21 in NE.,  
 S28 in SE. and  
 S29 in SW. quadrant;  
 and raise a mound of stone, 2 ft. base, 1 $\frac{1}{2}$  ft. high, W. of cor. Pits impracticable.  
 Land, mountainous.  
 Soil, rocky; 4th rate.  
 No timber.  
 Undergrowth, greasewood, palo verde, ocatilla, scrub oak and scrub cedar.  
 June 9, 1915.

June 10, 1915.  
 S. 89° 54' E., on a random line, bet. secs. 21 and 28,  
 40.00 Set temp.  $\frac{1}{4}$  sec. cor.  
 80.00 Intersect N. and S. line, 2 lks. S. of the cor. of secs. 21, 22, 27 and 28.  
 Thence I run  
 N. 89° 55' W., on a true line, bet. secs. 21 and 28.  
 Over rolling, rocky hills, through scattering undergrowth.  
 Asc. 210 ft., along S. slope of ridge, to  
 30.00 Ridge, brs. ENE. and WSW. Desc. slightly, along N. slope  
 40.00 Set an iron post, 3 ft. long, 1 in. diam., 26 ins. in the ground, for  $\frac{1}{4}$  sec. cor., marked on brass cap  
 1915 on S. rim;  
 $\frac{1}{4}$ S21 in N. and

12. Subdivision of Fractional T. 16 $\frac{1}{2}$  N., R. 14 W.

Chains.	
47.50 60.00 72.00 80.00	<p style="text-align: center;">S28 in S. half;            and raise a mound of stone, 2 ft. base, 1<math>\frac{1}{2}</math> ft. high,            N. of cor. Pits impracticable.            Desc. NW. slope, 70 ft. to            Head of wash, course NE. Asc. NE. slope to            Ridge, brs. NW. and SE. Desc. SW. slope to            The cor. of secs. 20, 21, 28 and 29.            Land, rolling hills.            Soil, rocky; 3rd rate.            No timber.            Undergrowth, greasewood, palo verde, ocatilla, scrub oak            and scrub cedar.</p> <p style="text-align: right;">June 10, 1915.</p>
10.83 11.30 22.55 29.45 40.00  41.15 54.00 59.50 65.36	<p>June 9, 1915.            N.0° 2' W., on a true line, bet. secs. 20 and 21.            Over mountainous land, through scattering undergrowth.            Asc. SW. slope, 220 ft. to            Ridge, brs. NW. and SE. Desc. to            Head of gulch, course NE. Asc. SE. slope, 65 ft. to            Desc. NE. slope to            Gulch, course E. Asc. SE. slope, 180 ft.            Set an iron post, 3 ft. long, 1 in. diam., 10 ins. in the            ground, on solid rock, in a mound of stone, 3 ft. base,            for <math>\frac{1}{4}</math> sec. cor., marked on brass cap                1915 on S. rim;                S20 <math>\frac{1}{4}</math> in W. and                S21 in E. half;            and raise a mound of stone, 2 ft. base, 1<math>\frac{1}{2}</math> ft. high,            W. of cor. Pits impracticable.            Spur, brs. E. Desc. NE. slope, 270 ft. to            Gulch, course E. Asc. S. slope, 65 ft. to            Spur, brs. E. Desc. N. slope, 65 ft. to            Intersect Fourth Standard Parallel North, 4.67 chs. E. of            the std. cor. of secs. 34 and 35, T. 17 N., R. 14 W.,            which is an iron post, properly set, marked and witness-            ed as described by the Surveyor-General.            At the point of intersection, set an iron post, 3 ft. long,            2 ins. diam., 24 ins. in the ground, for closing cor.            of secs. 20 and 21, marked on brass cap                1915 on S. rim;                CC S. of center;                T17N R14W, S34, S35 in N. half;                T16<math>\frac{1}{2}</math>N R14W in S. half;                S21 in SE. and                S20 in SW. quadrant;            and raise a mound of stone, 2 ft. base, 1<math>\frac{1}{2}</math> ft. high,            S. of cor. Pits impracticable.            Land, mountainous.            Soil, rocky; 4th rate.            No timber.            Undergrowth, greasewood, palo verde, ocatilla, scrub oak            and scrub cedar.            June 9, 1915: At this cor., I set off 22° 54' N. on the            decl. arc; and at apparent noon, I observe the sun on            the meridian; the resulting lat. is 34° 48<math>\frac{1}{2}</math>' N.  <p style="text-align: right;">June 19, 1915.</p> </p>
	<p>June 3, 1915: At 8 hrs. 53 m., a.m., l.m.t., I set off            34° 46' N. on the lat. arc; 22° 15' N. on the decl.            arc; and determine a meridian with the solar at the            cor. of secs. 5, 6, 31 and 32, on the S. bdy. of the            Tp., which is an iron post, established by me, as            described in Book "A".            Thence I run            N.0° 3' W., bet. secs. 31 and 32.</p>

Subdivision of Fractional T. 16 $\frac{1}{2}$  N., R. 14 W. 13.

Chains.	
	Over rolling land, through scattering undergrowth. Asc. slightly to
1.70	Desc. 40 ft. to
3.90	Gulch, 8 lks. wide, course SE. Asc. SW. slope, 65 ft. to
12.10	Spur, brs. SE. Desc. NE. slope, 175 ft. to
30.00	Gulch, 5 lks. wide, course NE. Continue to desc. NE. slope to
34.85	Wash, 5 lks. wide, course NE.
40.00	Set an iron post, 3 ft. long, 1 in. diam., 26 ins. in the ground, for $\frac{1}{4}$ sec. cor., marked on brass cap 1915 on S. rim; S31 $\frac{1}{4}$ in W. and S32 in E. half; and raise a mound of stone, 2 ft. base, 1 $\frac{1}{2}$ ft. high, W. of cor. Pits impracticable.
44.30	Road, brs. E. to Signal and W. to Cedar.
51.95	Wash, 6 lks. wide, course NE.
60.75	Desc. N. slope to
65.70	Stream, 2 lks. wide, in center of draw, 1 ch. wide, course NE. Asc. SW. slope, 30 ft. to
80.00	Set an iron post, 3 ft. long, 2 ins. diam., 24 ins. in the ground, for cor. of secs. 29, 30, 31 and 32, marked on brass cap 1915 on S. rim; T16 $\frac{1}{2}$ N R14W in N. half; S30 in NW., S29 in NE., S32 in SE. and S31 in SW. quadrant; and raise a mound of stone, 2 ft. base, 1 $\frac{1}{2}$ ft. high, W. of cor. Pits impracticable.
	Land, rolling. Soil, rocky; 3rd rate. No timber. Undergrowth, greasewood, palo verde, scrub oak and scrub cedar. June 3, 1915: At this cor., I set off 22° 15 $\frac{1}{2}$ ' N. on the decl. arc; and at apparent noon, I observe the sun on the meridian; the resulting lat. is 34° 47' N. June 3, 1915.
40.00	June 5, 1915: N.89° 59' E., on a random line, bet. secs. 29 and 32. Set temp. $\frac{1}{4}$ sec. cor.
79.97	Intersect N. and S. line, 12 lks. N. of the cor. of secs. 28, 29, 32 and 33. Thence I run N.89° 56' W., on a true line, bet. secs. 29 and 32. Over rolling land, through scattering undergrowth. Desc. NW. slope to
1.78	Wash, 10 lks. wide, course NE. Asc. 25 ft. to
5.00	Point of spur, extends 1.50 chs. SE. Desc. SW. slope to
8.10	Same wash, 10 lks. wide, course SE. Thence along N. slope to
16.70	Same wash, course NE. Thence along S. slope to
36.60	Same wash, course S. Asc. E. slope, 95 ft.
39.98 $\frac{1}{2}$	Set an iron post, 3 ft. long, 1 in. diam., 26 ins. in the ground, for $\frac{1}{4}$ sec. cor., marked on brass cap 1915 on S. rim; $\frac{1}{2}$ S29 in N. and S32 in S. half; and raise a mound of stone, 2 ft. base, 1 $\frac{1}{2}$ ft. high, N. of cor. Pits impracticable.
50.00	Ridge, brs. N. and SE. Desc. W. slope, 60 ft. to
52.57	Wash, 8 lks. wide, course S. Asc. E. slope, 170 ft. to
63.23	Ridge, brs. N. and S. Desc. W. slope, 170 ft. to
79.97	The cor. of secs. 29, 30, 31 and 32. Land, rolling. Soil, rocky; 3rd and 4th rate.

14. Subdivision of Fractional T. 16 $\frac{1}{2}$  N., R. 14 W.

Chains.	
	<p>No timber. Undergrowth, palo verde, scrub oak and scrub cedar. June 5, 1915: At this cor., I set off 22° 30' N. on the decl. arc; and at apparent noon, I observe the sun on the meridian; the resulting lat. is 34° 47' N. June 5, 1915.</p>
	<p>June 3, 1915: S. 89° 59' W., on a random line, bet. secs. 30 and 31. Set temp. <math>\frac{1}{4}</math> sec. cor. 77.55 Intersect W. bdy. of Tp., 3 lks. N. of the cor. of secs. 25, 30, 31 and 36, which is an iron post, established by me, as described in Book "A". Thence I run N. 89° 58' E., on a true line, bet. secs. 30 and 31. Over rolling land, through scattering undergrowth. Desc. slightly to .55 Wash, 20 lks. wide, course NE. Asc. to 2.50 Desc. NE. slope, slong spur ridge, to 19.65 Wash, 15 lks. wide, course SE. Asc. slight SW. slope to 24.15 Spur, brs. SE. Desc. 60 ft. to 28.85 Wash, 7 lks. wide, course SE. Asc. slight SW. slope to 31.15 Spur, brs. NW. and SE. Desc. NE. slope, 80 ft. 37.55 Set an iron post, 3 ft. long, 1 in. diam., 26 ins. in the ground, for <math>\frac{1}{4}</math> sec. cor., marked on brass cap 1915 on S. rim; <math>\frac{1}{4}</math>S30 in N. and S31 in S. half; and raise a mound of stone, 2 ft. base, 1<math>\frac{1}{2}</math> ft. high, N. of cor. Pits impracticable. 47.05 Wash, 10 lks. wide, course SE. Asc. slightly to 47.90 Desc. 35 ft. 55.05 Old road, brs. NE. and SW. 61.70 Wash, 12 lks. wide, course SE. 66.05 Wash, 5 lks. wide, course S. Asc. to 77.55 The cor. of secs. 29, 30, 31 and 32. Land, rolling. Soil, rocky; 3rd rate. No timber. Undergrowth, greasewood, palo verde, ocotillo, scrub oak and scrub cedar. June 3, 1915.</p>
	<p>June 5, 1915. N. 0° 3' W., bet. secs. 29 and 30. Over rolling land, through scattering undergrowth. Asc. SW. slope, 535 ft. 21.55 Head of gulch, course SW. Continue asc. to 34.45 Ridge, brs. E. and W. Desc. N. slope, 410 ft. 40.00 Set an iron post, 3 ft. long, 1 in. diam., 26 ins. in the ground, for <math>\frac{1}{4}</math> sec. cor., marked on brass cap 1915 on S. rim; S30 <math>\frac{1}{4}</math> in W. and S29 in E. half; and raise a mound of stone, 2 ft. base, 1<math>\frac{1}{2}</math> ft. high, W. of cor. Pits impracticable. 52.35 Prospect hole, brs. W. 50 lks. dist. 60.90 Old road, brs. E. and W. 62.28 Wash, 20 lks. wide, course E. Asc. S. slope, 35 ft. to 65.00 Spur, extends 6. chs. E. Desc. slightly to 66.05 Wash, course SE. Asc. SW. slope, 160 ft. 70.00 Prospect hole, brs. E. 25 lks. dist. 80.00 Set an iron post, 3 ft. long, 2 ins. diam., 24 ins. in the ground, for cor. of secs. 19, 20, 29 and 30, marked on brass cap 1915 on S. rim;</p>



Subdivision of Fractional T. 16 $\frac{1}{2}$  N., R. 14 W.

15.

Chains.

	<p>T16<math>\frac{1}{2}</math>N R14W in N. half;                  S19 in NW.,                  S20 in NE.,                  S29 in SE. and                  S30 in SW. quadrant;                  and raise a mound of stone, 2 ft. base, 1<math>\frac{1}{2}</math> ft. high,                  W. of cor. Pits impracticable.                  Land, rolling.                  Soil, rocky; 3rd rate.                  No timber.                  Undergrowth, greasewood, palo verde, ocetille, scrub oak                  and scrub cedar.</p>
40.00	<p>June 9, 1915.                  S.89° 56' E., on a random line, bet. secs. 20 and 29.                  Set temp. <math>\frac{1}{4}</math> sec. cor.</p>
80.15	<p>Intersect N. and S. line, 11 lks. S. of the cor. of secs.                  20, 21 28 and 29.                  Thence I run                  S.89° 59' W., on a true line, bet. secs. 20 and 29.                  Over rolling land, through scattering undergrowth.                  Desc. SW. slope, 25 ft. to                  Draw, course SE. Asc. NE. slope, 255 ft. to                  Spur, from main ridge, brs. NE. Desc. 25 ft. to                  Gulch, course NE. Asc. NE. slope, 180 ft. to                  Main ridge, brs. NW. and SE. Desc. SW. slope.                  Set an iron post, 3 ft. long, 1 in. diam., 26 ins. in the                  ground, for <math>\frac{1}{4}</math> sec. cor., marked on brass cap                  1915 on S. rim;  <math>\frac{1}{4}</math>S20 in N. and                  S29 in S. half;                  and raise a mound of stone, 2 ft. base, 1<math>\frac{1}{2}</math> ft. high,                  N. of cor. Pits impracticable.</p>
8.00	<p>Draw, course SE. Asc. NE. slope, 255 ft. to</p>
26.00	<p>Spur, from main ridge, brs. NE. Desc. 25 ft. to</p>
29.43	<p>Gulch, course NE. Asc. NE. slope, 180 ft. to</p>
39.13	<p>Main ridge, brs. NW. and SE. Desc. SW. slope.</p>
40.07 $\frac{1}{2}$	<p>Set an iron post, 3 ft. long, 1 in. diam., 26 ins. in the                  ground, for <math>\frac{1}{4}</math> sec. cor., marked on brass cap                  1915 on S. rim;  <math>\frac{1}{4}</math>S20 in N. and                  S29 in S. half;                  and raise a mound of stone, 2 ft. base, 1<math>\frac{1}{2}</math> ft. high,                  N. of cor. Pits impracticable.</p>
44.00	<p>Gulch, course S. Thence along S. slope to</p>
46.00	<p>Desc. SW. slope, 45 ft. to</p>
50.00	<p>Draw, course SE. Asc. NE. slope, 300 ft. to</p>
78.40	<p>Ridge, brs. NW. and SE. Desc. SW. slope to</p>
80.15	<p>The cor. of secs. 19, 20, 29 and 30.                  Land, rolling and mountainous.                  Soil, rocky; 4th rate.                  No timber.                  Undergrowth, greasewood, palo verde, ocetille, scrub oak                  and cacti.</p>
40.00	<p>S.89° 58' W., on a random line, bet. secs. 19 and 30.                  Set temp. <math>\frac{1}{4}</math> sec. cor.</p>
77.55	<p>Intersect W. bdy. of Tp., 21 lks. S. of the cor. of secs.                  19, 24, 25 and 30, which is an iron post, established                  by me, as described in Book "A".                  Thence I run                  S.89° 53' E., on a true line, bet. secs. 19 and 30.                  Over mountainous land, through scattering undergrowth.                  Wash, 10 lks. wide, course SE. Asc. 145 ft. to</p>
4.00	<p>Wash, 10 lks. wide, course SE. Asc. 145 ft. to</p>
13.15	<p>Spur, brs. S. Desc. 380 ft.</p>
37.55	<p>Set an iron post, 3 ft. long, 1 in. diam., 26 ins. in the                  ground, for <math>\frac{1}{4}</math> sec. cor., marked on brass cap                  1915 on S. rim;  <math>\frac{1}{4}</math>S19 in N. and                  S30 in S. half;                  and raise a mound of stone, 2 ft. base, 1<math>\frac{1}{2}</math> ft. high,                  N. of cor. Pits impracticable.</p>
48.55	<p>Asc, SW. slope, 35 ft. to</p>

16. Subdivision of Fractional T. 16 $\frac{1}{2}$  N. R. 14 W.

## Chains.

52.90 Spur, brs. SE. Desc. NE. slope, 120 ft. to  
 58.20 Gulch, course SE. Asc. W. slope, 105 ft. to  
 63.85 Spur, brs. S. Desc. SE. slope to  
 69.15 Gulch, course S. Asc. W. slope, 80 ft. to  
 75.05 Spur, brs. S. Desc. SE. slope, 40 ft. to  
 77.55 The cor. of secs. 19, 20, 29 and 30.  
 Land, mountainous.  
 Soil, rocky; 4th rate.  
 No timber.  
 Undergrowth, greasewood, palo verde, ocatilla, scrub oak  
 and scrub cedar.

June 9, 1915.

June 5, 1915.

N.0° 3' W., on a true line, bet. secs. 19 and 20.  
 Over mountainous land, through scattering undergrowth.  
 Asc. SW. slope, 65 ft. to

5.00 Ridge, brs. NW. and SE. Desc. NE. slope, 65 ft. to  
 10.40 Wash, 10 lks. wide, course SE. Asc. SW. slope, 215 ft. to  
 25.00 Spur, brs. NW. and SE. Desc. N. slope, 115 ft. to  
 30.90 Head of wash, course NE. Asc. SE. slope, 75 ft.  
 40.00 Set an iron post, 3 ft. long, 1 in. diam., 26 ins. in the  
 ground, for  $\frac{1}{4}$  sec. cor., marked on brass cap

1915 on S. rim;  
 S19  $\frac{1}{4}$  in W. and  
 S20 in E. half;

and raise a mound of stone, 2 ft. base, 1 $\frac{1}{2}$  ft. high,  
 W. of cor. Pits impracticable.

44.00 Spur, brs. E. Desc. NW. slope, 90 ft. to  
 49.23 Wash, 30 lks. wide, course NE. Asc. SE. slope, 265 ft.  
 60.50 Head of gulch, course SE. Asc. S. slope to  
 65.56 Intersect Fourth Standard Parallel North, 4.59 chs. E. of  
 the std. cor. of secs. 33 and 34, T. 17 N., R. 14 W.,  
 which is an iron post, properly set, marked and witness-  
 ed as described by the Surveyor-General.

At the point of intersection, set an iron post, 3 ft. long,  
 2 ins. diam., 24 ins. in the ground, for closing cor.  
 of secs. 19 and 20, marked on brass cap

1915 on S. rim;  
 CC S. of center;  
 T17N R14W, S33, S34 in N. and  
 T16 $\frac{1}{2}$ N in S. half;  
 S20 in SE. and  
 S19 in SW. quadrant;

and raise a mound of stone, 2 ft. base, 1 $\frac{1}{2}$  ft. high,  
 S. of cor. Pits impracticable.

Land, mountainous.  
 Soil, rocky; 4th rate.  
 No timber.

Undergrowth, greasewood, palo verde, ocatilla, scrub oak  
 and scrub cedar.

C. D.  
 June 5, 1915.

## GENERAL DESCRIPTION.

This fractional Tp. lies on the eastern slope of the  
 Hualpai Mountains. It consists of rocky land, and is  
 covered with a scattering growth of palo verde, greasewood,  
 scrub oak and scrub cedar undergrowth.

There are no settlers in the Tp.

220  
BOOK 2929

17 For FINAL OATH OF UNITED STATES SURVEYOR.

See Book "B."

I, \_\_\_\_\_, U. S. Surveyor, do solemnly swear that, in pursuance of special instructions received from the U. S. Surveyor General for \_\_\_\_\_ bearing date of the \_\_\_\_\_ day of \_\_\_\_\_, 191 \_\_\_\_\_, I have well, faithfully, and truly, in my own proper person, and in strict conformity with said instructions, the Manual of Surveying Instructions, and the laws of the United States, surveyed all those parts or portions of \_\_\_\_\_ of the \_\_\_\_\_ Meridian, in the State of \_\_\_\_\_, which are represented in the foregoing field notes as having been executed by me, and under my direction; and I do further solemnly swear that all the corners of said survey have been established and perpetuated in strict accordance with the Manual of Surveying Instructions, and the special written instructions of the U. S. Surveyor General for \_\_\_\_\_ and in the specific manner described in the field notes, and that the foregoing are the original field notes of such survey.

U. S. Surveyor.

Subscribed by said \_\_\_\_\_, and sworn to before me }  
 this \_\_\_\_\_ day of \_\_\_\_\_, 191 \_\_\_\_\_



APPROVAL.

OFFICE OF THE UNITED STATES SURVEYOR GENERAL,

Phoenix, Arizona, February 15, 1917.

The foregoing field notes of the survey of the \_\_\_\_\_

Subdivision Lines of Township 16 1/2 North, Range 14 West,

of the Gila and Salt River Base and Meridian, Arizona,

executed by Carl Dyson, U. S. Transitman,  
 under his special instructions dated December 28, 1914, for Group 41, having been critically examined, and the necessary corrections and explanations made, the said field notes, and the surveys they describe, are hereby approved.

*Frank P. Frost*

Surveyor General of Arizona.

~~I certify that the foregoing transcript of the field notes of the above-described surveys in \_\_\_\_\_ Book "R," \_\_\_\_\_, has been correctly copied from the original notes on file in this office.~~

Surveyor General of Arizona