

Book "V" 2954

4-679

①

Subdivisions

BOOK 2954

FIELD NOTES

OF THE SURVEY OF THE

SUBDIVISION LINES OF

FRACTIONAL TOWNSHIP 16 NORTH, RANGE 20 $\frac{1}{2}$ WEST

2954

Of the Gila and Salt River Base and Meridian,

In the State of Arizona

EXECUTED BY

Albert Smith Jr., U.S. Surveyor

2954

and

Ray D. Armstrong, U.S. Transitman

~~In the capacity of U.S. Surveyor~~, under instructions dated December 28, 1914,

issued by the United States Surveyor General to govern surveys included in

Group No. 42, which were approved by the Commissioner of the General Land

Office, January 22, 1915

Survey commenced March 17, 1916

Survey completed March 23, 1916

INDEX DIAGRAM.

Township _____, Range _____

6	5	4	3	2	1
7	8	9	10	11	12
18	17	16	15	14	13
19	20	21	22	23	24
30	29	28	27	26	25
31	32	33	34	35	36

Book "V"
Group 42, Arizona.
INDEX DIAGRAM

BOOK 2954 **1A**

(Subdivisions)
FRACTIONAL TOWNSHIP 16 NORTH, RANGE 20 1/2 WEST

FRAC. T. 16 N. - R. 21 W.

FRAC. T. 15 N. - R. 21 W.

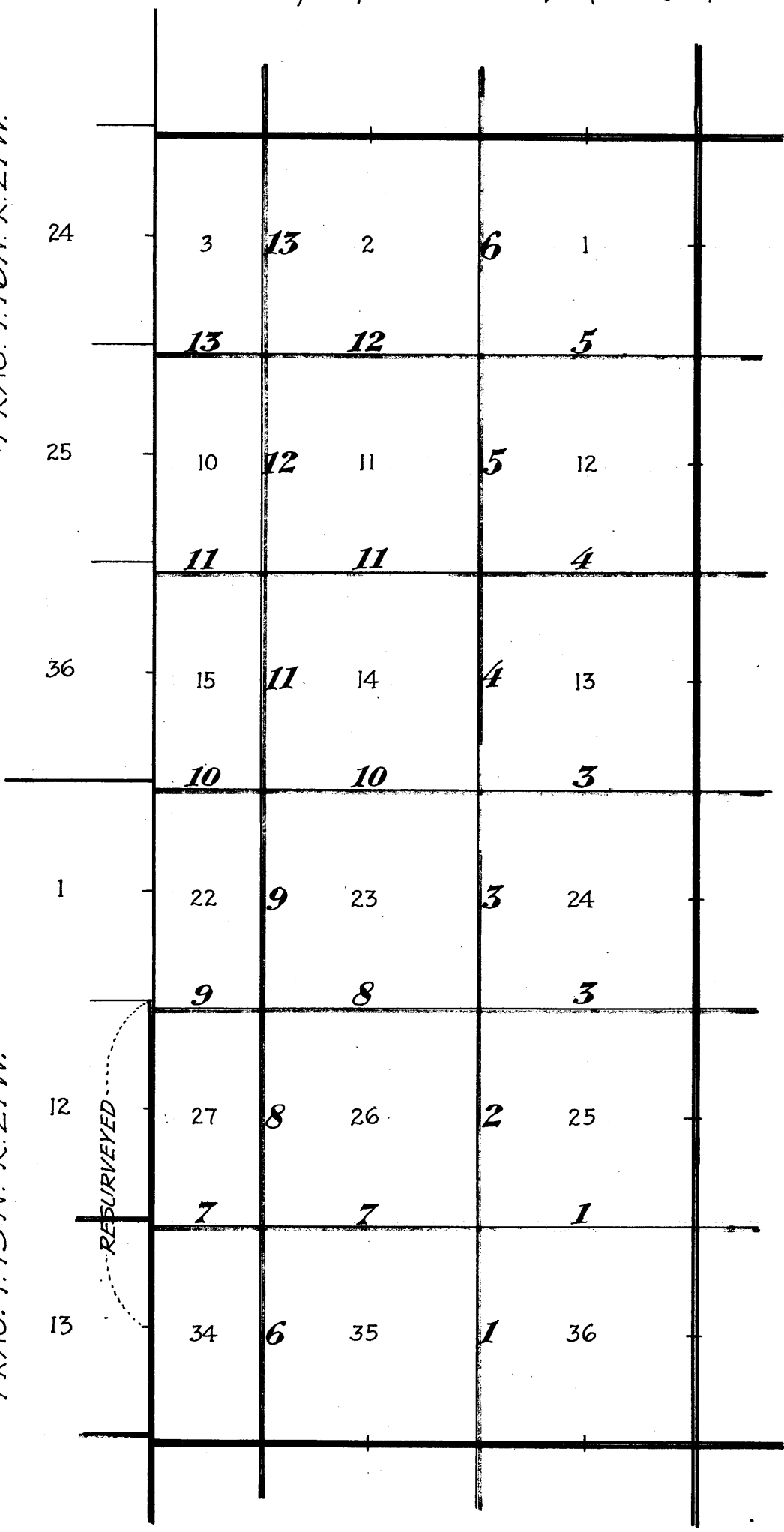

———— Township Exteriors. Notes in Book "A"

———— Subdivision lines surveyed under this Group.

———— Accepted surveys.

Subdivision of Fractional T. 16 N., R. 20 $\frac{1}{2}$ W. (13)

Chains.

Survey commenced Mar. 17, 1916, and executed jointly by Albert Smith, Jr., U. S. Surveyor, and Ray D. Armstrong, U. S. Transitman, with Young and Sons' light mountain transits Nos. 8583 and 8396, respectively, with Smith solar attachments. For description of instruments and certificate of approval, see subdivision of T. 13 N., R. 20 $\frac{1}{2}$ W., in book "F". For tests of adjustment, see subdivision of T. 16 N., R. 19 W. in book "S".

In the following field notes, the initials A. S. and R. D. A. refer to Albert Smith, Jr., U. S. Surveyor, and Ray D. Armstrong, U. S. Transitman, respectively.

A. S. and R. D. A.

R. D. A.

At 8 hrs. 0 m., a.m., l.m.t., I set off 34° 41' N. on the lat. arc; 1° 16 $\frac{1}{2}$ ' S. on the decl. arc; and determine a meridian with the solar at the cor. of secs. 1, 2, 35 and 36, on the S. bdy. of the Tp., which is a stone, 18 X 10 X 6 ins. above ground, established by Otis Ross, U. S. Surveyor, as described in Book "A".

Thence I run

N. 0° 1' W., bet. secs. 35 and 36.

Over mountainous land, through dense undergrowth.

Asc. 90 ft. to

6.90 Ridge, brs. E. and W. Desc. 310 ft. to

15.20 Thence over rolling land.

33.70 Wash, 15 lks. wide, course NW. Asc. 125 ft.

40.00 Set an iron post, 3 ft. long, 1 in. diam., 26 ins. in the ground, for $\frac{1}{4}$ sec. cor., marked on brass cap

1916 on S. rim;

 $\frac{1}{4}$ S35 in W. and

S36 in E. half;

and raise a mound of stone, 2 ft. base, 1 $\frac{1}{2}$ ft. high, W. of cor.

47.50 Desc. 75 ft. to

55.65 Asc. 20 ft. to

56.30 Spur, slopes W. Desc. NW. slope, 25 ft. to

60.55 Gulch, course W. Asc. 80 ft. to

66.40 Spur, slopes NW. Desc. 75 ft. to

75.20 Center of wash, 2 chs. wide, course NW. Asc. 30 ft. to

80.00 Set an iron post, 3 ft. long, 2 ins. diam., 10 ins. in the ground, on bed rock, 20 ins. in a mound of stone, for cor. of secs. 25, 26, 35 and 36, marked on brass cap

1916 on S. rim;

T16N R20 $\frac{1}{2}$ W in N. half;

S26 in NW.,

S25 in NE.,

S36 in SE. and

S35 in SW. quadrant;

and raise a mound of stone, 2 ft. base, 1 $\frac{1}{2}$ ft. high, W. of cor.

Land, rolling and mountainous.

Soil, rocky; 4th rate.

No timber.

Undergrowth, greasewood and palo verde.

40.00 East on a random line, bet. secs. 25 and 36.

80.06 Set temp. $\frac{1}{4}$ sec. cor.

Intersect E. bdy. of Tp., 21 lks. N. of the cor. of secs. 25, 30, 31 and 36, which is an iron post, established by A. S., as described in Book "A".

Thence I run

N. 89° 51' W., on a true line, bet. secs. 25 and 36.

Over broken and mountainous land, through dense undergrowth.

Asc. 75 ft. to

9.50 Spur, slopes N. Desc. NW. slope, 165 ft.

40.03 Set an iron post, 3 ft. long, 1 in. diam., 26 ins. in the ground, for $\frac{1}{4}$ sec. cor., marked on brass cap

1916 on S. rim;

 $\frac{1}{4}$ S25 in N. and

2.

Subdivision of Fractional T. 16 N., R20 $\frac{1}{2}$ W.

Chains.

	<p>S36 in S. half; and raise a mound of stone, 2 ft. base, 1$\frac{1}{2}$ ft. high, N. of cor.</p>
40.65	Center of wash, 60 lks. wide, course NW. Asc. 30 ft. to
50.00	Desc. 30 ft. to
55.00	Asc. 35 ft. to
57.60	Desc. 40 ft. to
59.80	Asc. 25 ft. to
62.30	Desc. 85 ft. to
69.60	Asc. 25 ft. to
80.06	The cor. of secs. 25, 26, 35 and 36. Land, broken and mountainous. Soil, rocky; 4th rate. No timber. Undergrowth, greasewood and palo verde. Mar. 17, 1916: At this cor., I set off 1° 13 $\frac{1}{2}$ ' S. on the decl. arc; and at apparent noon, I observe the sun on the meridian; the resulting lat. is 34° 42' N. R. D. A.
	<p>Mar. 18, 1916: A. S. At 9 hrs. 55 m., a.m., l.m.t., I set off 34° 42' N. on the lat. arc; 0° 50$\frac{1}{2}$' S. on the decl. arc; and determine a meridian with the solar at the cor. of secs. 25, 26, 35 and 36. Thence I run N.0° 1' W., bet. secs. 25 and 26. Over mountainous land, through dense undergrowth. Asc. 105 ft. to 8.20 Ridge, brs. E. and W. Desc. NW. slope, 140 ft. to 29.55 Asc. 30 ft. to 34.50 Desc. 65 ft. to 39.80 Wash, 25 lks. wide, course NW. Asc. 70 ft. 40.00 Point for $\frac{1}{4}$ sec. cor. falls on ledge rock, where it is impossible to establish cor. 41.00 Set an iron post, 3 ft. long, 1 in. diam., 26 ins. in the ground, for witness cor. to $\frac{1}{4}$ sec. cor., marked on brass cap 1916 on S. rim; $\frac{1}{4}$S26 in W., S25 in E. and WC in S. half; and raise a mound of stone, 2 ft. base, 1$\frac{1}{2}$ ft. high, W. of cor. 49.45 Desc. 55 ft. to 54.85 Asc. 35 ft. to 63.50 Hill, brs. NW. and SE. Desc. NE. slope, 140 ft. to 74.60 Foot of desc.; thence over rolling land, brs. E. and W. 80.00 Set an iron post, 3 ft. long, 2 ins. diam., 24 ins. in the ground, for cor. of secs. 23, 24, 25 and 26, marked on brass cap 1916 on S. rim; 116N R20$\frac{1}{2}$W in N. half; S23 in NW, S24 in NE., S25 in SE. and S26 in SW. quadrant; and raise a mound of stone, 2 ft. base, 1$\frac{1}{2}$ ft. high, W. of cor. Land, mountainous and rolling. Soil, rocky; 4th rate. No timber. Undergrowth, greasewood and palo verde. Mar. 18, 1916: At this cor., I set off 0° 50' S. on the decl. arc; and at apparent noon, I observe the sun on the meridian; the resulting lat. is 34° 42$\frac{1}{2}$' N.</p>

Subdivision of Fractional T. 16 N., R. 20 1/2 W.

3.

<p>Chains. 40.00 80.06 40.03 78.25 80.06</p>	<p>S.89° 51' E., on a random line, bet. secs. 24 and 25. Set temp. 1/4 sec. cor. Intersect E. bdy. of Tp., 19 lks. S. of the cor. of secs. 19, 24, 25 and 30, which is an iron post, established by me, as described in Book "A". Thence I run N.89° 59' W., on a true line, bet. secs. 24 and 25. Over rolling land, through dense undergrowth. Set an iron post, 3 ft. long, 1 in. diam., 26 ins. in the ground, for 1/4 sec. cor., marked on brass cap 1916 on S. rim; 1/4 S24 in N. and S25 in S. half; and raise a mound of stone, 2 ft. base, 1 1/2 ft. high, N. of cor. Center of wash, 1 ch. wide, course NW. The cor. of secs. 23, 24, 25 and 26. Land, rolling desert. Soil, gravel; 3rd rate. No timber. Undergrowth, greasewood.</p>
<p>2.30 6.00 15.00 17.05 25.00 40.00 80.00</p>	<p>N.0° 1' W., bet. secs. 23 and 24. Over rolling, broken land, through dense undergrowth. Center of wash, 1 ch. wide, course NW. Asc. 25 ft. to Desc. 45 ft. to Asc. 25 ft. to Desc. 40 ft. to Thence over rolling land. Set an iron post, 3 ft. long, 1 in. diam., 26 ins. in the ground, for 1/4 sec. cor., marked on brass cap 1916 on S. rim; 1/4 S23 in W. and S24 in E. half; and raise a mound of stone, 2 ft. base, 1 1/2 ft. high, W. of cor. Set an iron post, 3 ft. long, 2 ins. diam., 26 ins. in the ground, for cor. of secs. 13, 14, 23 and 24, marked on brass cap 1916 on S. rim; T16N R20 1/2 W in N. half; S14 in NW., S13 in NE., S24 in SE. and S23 in SW. quadrant; dig pits, 18 X 18 X 12 ins., in each sec., 5 1/2 ft. dist.; and raise a mound of stone, 2 ft. base, 1 1/2 ft. high, W. of cor. Land, rolling and broken. Soil, gravel; 3rd rate. No timber. Undergrowth, greasewood.</p>
<p>40.00 80.16</p>	<p>Mar. 20, 1916: At 7 hrs. 30 m., a.m., l.m.t., I set off 34° 43 1/2' N. on the lat. arc; 0° 6' S on the decl. arc; and determine a meridian with the solar at the cor. of secs. 13, 14, 23 and 24. Thence I run S.89° 59' E., on a random line, bet. secs. 13 and 24. Set temp. 1/4 sec. cor. Intersect E. bdy. of Tp., 7 lks. N. of the cor. of secs. 13, 18, 19 and 24, which is an iron post, established by me, as described in Book "A". Thence I run N.89° 56' W., on a true line, bet. secs. 13 and 24.</p>

March 18, 1916.

4. Subdivision of Fractional T. 16 N., R. 20 $\frac{1}{2}$ W.

Chains.	
	Over rolling land, through dense undergrowth.
1.15	Center of wash, 60 lks. wide, 100 ft. deep, course N.
10.15	Center of wash, 60 lks. wide, 100 ft. deep, course NW.
40.08	Set an iron post, 3 ft. long, 1 in. diam., 26 ins. in the ground, for $\frac{1}{4}$ sec. cor., marked on brass cap
	1916 on S. rim;
	$\frac{1}{4}$ S13 in N. and
	S24 in S. half;
	and raise a mound of stone, 2 ft. base, 1 $\frac{1}{2}$ ft. high,
	N. of cor.
61.05	Center of wash, 60 lks. wide, course N.
80.16	The cor. of secs. 13, 14, 23 and 24.
	Land, rolling desert.
	Soil, sandy; 2nd rate.
	No timber.
	Undergrowth, greasewood.
	N.0° 1' W., bet. secs. 13 and 14.
	Over rolling land, through dense undergrowth.
13.80	National "Old Trails" Highway, brs. E. and W.
31.50	Center of wash, 1 ch. wide, course NW.
36.00	"Old Trails" Highway, brs. NW. and SE.
40.00	Set an iron post, 3 ft. long, 1 in. diam., 28 ins. in the ground, for $\frac{1}{4}$ sec. cor., marked on brass cap
	1916 on S. rim;
	$\frac{1}{4}$ S14 in W. and
	S13 in E. half;
	and raise a mound of stone, 2 ft. base, 1 $\frac{1}{2}$ ft. high,
	W. of cor.
45.90	"Old Trails" Highway, brs. NE. and SW.
51.00	Center of wash, 1 ch. wide, course NE.
80.00	Set an iron post, 3 ft. long, 2 ins. diam., 28 ins. in the ground, for cor. of secs. 11, 12, 13 and 14, marked on brass cap
	1916 on S. rim;
	T16N R20 $\frac{1}{2}$ W in N. half;
	S11 in NW.,
	S12 in NE.,
	S13 in SE. and
	S14 in SW. quadrant;
	and raise a mound of stone, 2 ft. base, 1 $\frac{1}{2}$ ft. high,
	W. of cor.
	Land, rolling desert.
	Soil, sandy; 2nd rate.
	No timber.
	Undergrowth, greasewood.
	Mar. 20, 1916: The sky was overcast at noon, making an observation for lat. impossible.
	Mar. 21, 1916: Cloudy; no sun; Run back and foresight line, from line previously established.
	S.89° 56' E., on a random line, bet. secs. 12 and 13.
40.00	Set temp. $\frac{1}{4}$ sec. cor.
80.16	Intersect E. bdy. of Tp., 23 lks. N. of the cor. of secs. 7, 12, 13 and 18, which is an iron post, established by me, as described in Book "A".
	Thence I run
	N.89° 46' W., on a true line, bet. secs. 12 and 13.
	Over level land, through dense undergrowth.
14.80	Center of wash, 75 lks. wide, course NW.
40.08	Set an iron post, 3 ft. long, 1 in. diam., 30 ins. in the ground, for $\frac{1}{4}$ sec. cor., marked on brass cap
	1916 on S. rim;
	$\frac{1}{4}$ S12 in N. and
	S13 in S. half;

Chains
 and raise a mound of stone, 2 ft. base, 1 1/2 ft. high,
 N. of cor.
 41.20 Center of wash, 75 lks. wide, course N.75° W.
 70.00 Center of wash, 60 lks. wide, course N.
 80.16 The cor. of secs. 11, 12, 13 and 14.
 Land, level.
 Soil, sandy; 2nd rate.
 No timber.
 Undergrowth, greasewood.

N.0° 1' W., bet. secs. 11 and 12.
 Over rolling land, through dense undergrowth.
 2.40 Center of wash, 1.50 chs. wide, course S.80° W.
 29.50 Center of wash, 2 chs. wide, course W.
 35.19 Main track A. T. and S. F.R.R. brs. N.76° 8' W. and S.76°
 8' E.
 35.90 Telegraph line, brs. N.76° 8' W. and S.76° 8' E.
 37.20 Telegraph line, brs. N.76° 8' W. and S.76° 8' E.
 40.00 Set an iron post, 3 ft. long, 1 in. diam., 28 ins. in the
 ground, for 1/4 sec. cor., marked on brass cap
 1916 on S. rim;
 1/4 S11 in W. and
 S12 in E. half;
 and raise a mound of stone, 2 ft. base, 1 1/2 ft. high,
 W. of cor.
 80.00 Set an iron post, 3 ft. long, 2 ins. diam., 28 ins. in the
 ground, for cor. of secs. 1, 2, 11 and 12, marked on
 brass cap
 1916 on S. rim;
 T16N R20 1/2 W in N. half;
 S2 in NW.,
 S1 in NE.,
 S12 in SE. and
 S11 in SW. quadrant;
 and raise a mound of stone, 2 ft. base, 1 1/2 ft. high,
 W. of cor.
 Land, rolling desert.
 Soil, sand; 2nd rate.
 No timber.
 Undergrowth, palo verde, greasewood, sagebrush and cat-
 claw.
 Mar. 21, 1916: The sky was overcast at noon, making an
 observation for lat. impossible.

S.89° 46' E., on a random line, bet. secs. 1 and 12.
 40.00 Set temp. 1/4 sec. cor.
 80.18 Intersect E. bdy. of Tp., at the cor. of secs. 1, 6, 7 and
 12, which is an iron post, established by me, as describ-
 ed in Book "A".
 Thence I run
 N.89° 46' W., on a true line, bet. secs. 1 and 12.
 Over rolling land, through dense undergrowth.
 40.09 Set an iron post, 3 ft. long, 1 in. diam., 28 ins. in the
 ground, for 1/4 sec. cor., marked on brass cap
 1916 on S. rim;
 1/4 S1 in N. and
 S12 in S. half;
 and raise a mound of stone, 2 ft. base, 1 1/2 ft. high,
 N. of cor.
 80.18 The cor. of secs. 1, 2, 11 and 12.
 Land, rolling desert.
 Soil, sand; 3rd rate.
 No timber.
 Undergrowth, greasewood.

6.

Subdivision of Fractional T. 16 N., R. 20 $\frac{1}{2}$ W.

Chains.

40.00	N.0° 1' W., on a random line, bet. secs. 1 and 2. Set temp. $\frac{1}{4}$ sec. cor.
79.78	Intersect N. bdy. of Tp., 18 lks. W. of the cor. of secs. 1, 2, 35 and 36, which is an iron post, established by me, as described in Book "A". Thence I run S.0° 7' W., on a true line, bet. secs. 1 and 2. Over rolling land, through dense undergrowth.
39.78	Set an iron post, 3 ft. long, 1 in. diam., 28 ins. in the ground, for $\frac{1}{4}$ sec. cor., marked on brass cap 1916 on S. rim; $\frac{1}{4}$ S2 in W. and S1 in E. half; dig pits, 18 X 18 X 12 ins., N. and S. of post, 3 ft. dist.; and raise a mound of earth, 3 $\frac{1}{2}$ ft. base, 1 $\frac{1}{2}$ ft. high, W. of cor.
77.60	Center of wash, 70 lks. wide, 30 ft. deep, course W.
79.78	The cor. of secs. 1, 2, 11 and 12. Land, rolling. Soil, sandy; 2nd rate. No timber. Undergrowth, greasewood and sagebrush.
	A. S. Mar. 21, 1916.
	Mar. 17, 1916: R. D. A. From the cor. of secs. 2, 3, 34 and 35, on the S. bdy. of the Tp., which is a malpais stone, 6 X 9 X 12 ins. above ground, established by Otis Ross, U. S. Surveyor, as described in Book "A", I run N.0° 1' W., bet. sec. 35 and frac. sec. 34. Over mountainous land, through dense undergrowth. Desc. to
8.40	Draw, course SE. Asc. 120 ft. to
17.20	Butte. Desc. 260 ft. to
30.20	Asc. to
31.00	Desc. 85 ft. to
37.35	Draw, course NW. Road, brs. NW. and SE. Asc. 80 ft.
40.00	Set an iron post, 3 ft. long, 1 in. diam., 15 ins. in the ground, on bed rock, 10 ins. in a mound of stone, for $\frac{1}{4}$ sec. cor., marked on brass cap 1916 on S. rim; $\frac{1}{4}$ S34 in W. and S35 in E. half; and raise a mound of stone, 2 ft. base, 1 $\frac{1}{2}$ ft. high, W. of cor.
	From this cor., butte brs. S.63 $\frac{1}{2}$ ° E., 15 chs. dist. Butte brs. S.36° E., 20 chs. dist. Butte brs. S.13° E.
43.50	Desc. 35 ft. to
55.20	Asc. 40 ft. to
56.80	From this point, peak brs. E. 15 chs. dist. Peak brs. S.70° E., 25 chs. dist. Thence over rolling land.
61.50	Trail, brs. NW. and SE.
66.10	Trail, brs. NW. and SE. Desc. 40 ft. to
75.00	Asc. 20 ft. to
79.30	Desc. 20 ft. to
80.00	Set an iron post, 3 ft. long, 2 ins. diam., 17 ins. in the ground, on bed rock, 10 ins. in a mound of stone, for cor. of secs. 26, 27, 34 and 35, marked on brass cap 1916 on S. rim; T16N R20 $\frac{1}{2}$ W in N. half; S27 in NW., S26 in NE., S35 in SE. and S34 in SW. quadrant; and raise a mound of stone, 2 ft. base, 1 $\frac{1}{2}$ ft. high, W. of cor.

Subdivision of Fractional T. 16 N., R. 20 1/2 W. 7.

Chains.

Land, mountainous and rolling.
Soil, rocky; 4th rate.
No timber.
Undergrowth, greasewood.

40.00
79.90

East on a random line, bet. secs. 26 and 35.
Set temp. 1/4 sec. cor.
Intersect N. and S. line, 26 lks. N. of the cor. of secs.
25, 26, 35 and 36.

6.00
28.80
38.45
39.95

Thence I run
N. 89° 49' W., on a true line, bet. secs. 26 and 35.
Over mountainous land, through dense undergrowth.
Desc. 70 ft. to
Gulch, course NW. Asc. 90 ft. to
Spur, slopes SW. Desc. 155 ft. to
Asc. 30 ft. to
Point for 1/4 sec. cor. falls on granite hill. Impossible
to set post full depth, dig pits, or find rock for
mound.

46.40
54.80
69.50
79.90

Set an iron post, 3 ft. long, 1 in. diam., 8 ins. in the
ground, on bed rock, in a mound of fine gravel, for 1/4
sec. cor., marked on brass cap
1916 on S. rim;
1/4 S26 in N. and
S35 in S. half;
Desc. 70 ft. to
Wash, 50 lks. wide, course S. Asc. 30 ft. to
Desc. 230 ft. to
Center of wash, 1.50 chs. wide, course NW. Thence over
rolling land.
The cor. of secs. 26, 27, 34 and 35.
Land, rolling and mountainous.
Soil, rocky; 4th rate.
No timber.
Undergrowth, greasewood and palo verde.

Mar. 17, 1916.

5.00
9.90
24.30
24.75
25.55
39.03

Mar. 20, 1916: At 9 hrs. 0 m., a.m., l.m.t., I set off
34° 42' N. on the lat. arc; 0° 6' S. on the decl. arc;
and determine a meridian with the solar at the cor. of
secs. 26, 27, 34 and 35.
Thence I run
West on a true line, bet. frac. secs. 27 and 34.
Over mountainous land, through dense undergrowth.
Asc. 55 ft. to
Desc. to
Wash, course SW. Road, in wash, brs. NE. and SW. Asc.
85 ft. to
Desc. 20 ft. to
Asc. 10 ft. to
Desc. 125 ft. to
Intersect the E. bdy. of a Frac., T. 15 N., R. 21 W., 2.66
chs. S. of the cor. of secs. 12 and 13, which is a stone,
8 X 10 X 6 ins. above ground, re-established by Otis
Ross, U. S. Surveyor, as described in Book "A".
At the point of intersection, set an iron post, 3 ft. long,
2 ins. diam., on solid rock, in a mound of stone, for
closing cor. of fractional secs, 27 and 34, marked on
brass cap
1916 on S. rim;
CC W. of center;
T16N R20 1/2 W in N. half;
S27 in NE. and
S34 in SE. quadrant;
and raise a mound of stone, 2 ft. base, 1 1/2 ft. high,

8. Subdivision of Fractional T. 16 N., R. 20 $\frac{1}{2}$ W.

Chains.	
	<p>E. of cor. Land, mountainous. Soil, rocky; 4th rate. No timber. Undergrowth, greasewood and palo verde.</p>
2.75	<p>N.0° 1' W., bet. secs. 26 and frac. sec. 27. Over mountainous land, through dense undergrowth. Wash, course SW. Road in wash, brs. NE. and SW. Asc. 145 ft. to</p>
20.00	Ridge, brs. NW. and SE. Desc. 65 ft. to
29.60	Asc. 25 ft. to
34.60	Desc. 50 ft.
40.00	<p>Set an iron post, 3 ft. long, 1 in. diam., 14 ins. in the ground, on solid rock, in a mound of stone, for $\frac{1}{4}$ sec. cor., marked on brass cap 1916 on S. rim; $\frac{1}{4}$S27 in W. and S26 in E. half; and raise a mound of stone, 2 ft. base, 1$\frac{1}{2}$ ft. high, W. of cor.</p>
44.38	<p>Mar. 20, 1916: At this cor., I set off 0° 2$\frac{1}{2}$' S. on the decl. arc; and at apparent noon, I observe the sun on the meridian; the resulting lat. is 34° 42' N.</p>
50.80	Draw, 50 lks. wide, course NW. Asc. 45 ft. to
59.80	Desc. 30 ft. to
60.95	Asc. 20 ft. to
60.95	Desc. 95 ft. to
72.22	Gulch, 30 lks. wide, course W. Asc. 80 ft. to
74.20	Desc. 10 ft. to
74.65	Asc. 45 ft. to
77.60	Spur, slopes W. Desc. 25 ft. to
80.00	<p>Set an iron post, 3 ft. long, 2 ins. diam., 26 ins. in the ground, for cor. of secs. 22, 23, 26 and 27, marked on brass cap 1916 on S. rim; T16N R20$\frac{1}{2}$W in N. half; S22 in NW., S23 in NE., S26 in SE. and S27 in SW. quadrant; and raise a mound of stone, 2 ft. base, 1$\frac{1}{2}$ ft. high, W. of cor.</p>
	<p>Land, mountainous. Soil, rocky; 4th rate. No timber. Undergrowth, greasewood and palo verde.</p> <p style="text-align: right;">R. D.A.</p>
40.00	<p>A. S. and R. D. A. S.89° 49' E., on a random line, bet. secs. 23 and 26. Set temp. $\frac{1}{4}$ sec. cor.</p>
79.90	<p>Intersect N. and S. line, 2 lks. S. of the cor. of secs. 23, 24, 25 and 26. Thence I run</p>
36.70	<p>N.89° 50' W., on a true line, bet. secs. 23 and 26. Over rolling and broken land, through dense undergrowth. Road, brs. N. and S.</p>
39.95	<p>Set an iron post, 3 ft. long, 1 in. diam., 20 ins. in the ground, for $\frac{1}{4}$ sec. cor., marked on brass cap 1916 on S. rim; $\frac{1}{4}$S23 in N. and S26 in S. half; and raise a mound of stone, 2 ft. base, 1$\frac{1}{2}$ ft. high, N. of cor.</p>
43.50	Asc. 15 ft. to

Subdivision of Fractional T. 16 N., R. 20 1/2 W.

9.

Chains.

47.70
71.90
79.90

Spur, slopes NW. Desc. 105 ft. to
Wash, course SW. Thence over rolling land.
The cor. of secs. 22, 23, 26 and 27.
Land, rolling and broken.
Soil, rocky; 4th rate.
No timber.
Undergrowth, greasewood.

Mar. 20, 1916.
A. S. and R. D. A.

Mar. 21, 1916: R. D. A.
At 8 hrs. 5 m., a.m., l.m.t., I set off 34° 42 1/2' N. on the
lat. arc; 0° 18' N. on the decl. arc; and determine a
meridian with the solar at the cor. of secs. 22, 23, 26
and 27.

Thence I run
West on a true line, bet. frac. secs. 22 and 27.
Over broken land, through scattering undergrowth.

.65
8.30
11.55
14.75
19.65
39.04

Asc. 15 ft. to
Desc. 95 ft. to
Center of wash, 1 ch. wide, course SW. Asc. 25 ft. to
Spur, slopes SW. Desc. 60 ft. to
Gulch, 20 lks. wide, course NW. Asc. 50 ft. to
Spur, slopes NW. Desc. 120 ft. to
Intersect E. bdy. of frac. T. 15 N., R. 21 W., 2.67 chs.
S. of the cor. of secs. 1 and 12, which is a stone, 4
X 8 X 16 ins., above ground, marked and witnessed as
described by the Surveyor-General.

At the point of intersection, set an iron post, 3 ft. long,
2 ins. diam., 24 ins. in the ground, for closing cor.
of fractional secs. 22 and 27, marked on brass cap

1916 on S. rim;
CC W. of center;
T16N R20 1/2 W in N. half;
S22 in NE., and
S27 in SE. quadrant;

and raise a mound of stone, 2 ft. base, 1 1/2 ft. high,
E. of cor.

Land, mountainous and broken.
Soil, rocky; 3rd and 4th rate.
No timber.
Undergrowth, greasewood.

N. 0° 1' W., bet. secs. 23 and frac. sec. 22.
Over broken land, through scattering undergrowth.

5.50
12.80
25.00
26.90
39.85
40.00

Desc. 45 ft. to
Enter wash, course SW.
Leave wash, course SW.
Asc. 10 ft. to
Spur, slopes W. Desc. 75 ft. to
Gulch, 20 lks. wide, course NW. Asc. 20 ft.
Set an iron post, 3 ft. long, 1 in. diam., 26 ins. in the
ground, for 1/4 sec. cor., marked on brass cap

1916 on S. rim;
1/4 S22 in W. and
S23 in E. half;

and raise a mound of stone, 2 ft. base, 1 1/2 ft. high,
W. of cor.

44.90
59.80
66.70
72.20
80.00

Ridge, brs. E. and W. Desc. 45 ft. to
Enter wash, course NW.
Leave wash, course NW. Thence over level land.
Road, brs. NW. and SE.
Set an iron post, 3 ft. long, 2 ins. diam., 26 ins. in the
ground, for cor. of secs. 14, 15, 22 and 23, marked on
brass cap

1916 on S. rim;

10. Subdivision of Fractional T. 16 N., R. 20 $\frac{1}{2}$ W.

Chains.	
	<p>T16N R20$\frac{1}{2}$W in N. half; S15 in NW, S14 in NE; S23 in SE. and S22 in SW. quadrant; dig pits, 18 X 18 X 12 ins., in each sec., 5$\frac{1}{2}$ ft. dist.; and raise a mound of earth, 4 ft. base, 2 ft. high, W. of cor. Land, rolling and broken. Soil, 2nd and 3rd rate. No timber. Undergrowth, greasewood.</p> <p style="text-align: right;">R. D. A. Mar. 21, 1916.</p>
<p>40.00 80.00 40.00 80.00</p>	<p>Mar. 18, 1916: A. S. and R. D. A. S. 89° 50' E., on a random line, bet. secs. 14 and 23. Set temp. $\frac{1}{4}$ sec. cor. Intersect N. and S. line, at the cor. of secs. 13, 14, 23 and 24. Thence I run N. 89° 50' W., on a true line, bet. secs. 14 and 23. Over rolling land, through dense undergrowth. Set an iron post, 3 ft. long; 1 in. diam., 26 ins. in the ground, for $\frac{1}{4}$ sec. cor., marked on brass cap 1916 on S. rim; $\frac{1}{4}$S14 in N. and S23 in S. half; and raise a mound of stone, 2 ft. base, 1$\frac{1}{2}$ ft. high, N. of cor. The cor. of secs. 14, 15, 22 and 23. Land, rolling desert. Soil, sandy; 2nd rate. No timber. Undergrowth, greasewood.</p> <p style="text-align: right;">Mar. 21, 1916. A. S. and R. D. A.</p>
<p>7.80 38.85</p>	<p>Mar. 21, 1916: R. D. A. West on a true line, bet. frac. secs. 15 and 22. Over rolling and level land, through dense undergrowth. Road, brs. NW. and SE. Intersect E. bdy. of frac., T. 15 N., R. 21 W., 2.50 chs. S. of cor. of frac. T. 15 and 16 N., R. 21 W.. which is a stone, 14 X 10 X 6 ins. above ground, marked and witnessed as described by the Surveyor-General. At the point of intersection, set an iron post; 3 ft. long, 2 ins. diam., 24 ins. in the ground, for closing cor. of fractional secs. 15 and 22, marked on brass cap 1916 on S. rim; CC W. of center; T16N R20$\frac{1}{2}$W in N. half; S15 in NE., and S22 in SE. quadrant; and raise a mound of stone, 2 ft. base, 1$\frac{1}{2}$ ft. high, E. of cor. Land, level and rolling. Soil, 2nd and 3rd rate. No timber. Undergrowth, greasewood and sagebrush. Mar. 21, 1916: At this cor., I set off 0° 21' N. on the decl. arc; and at apparent noon, I observe the sun on the meridian; the resulting lat. is 34° 43$\frac{1}{2}$' N.</p>

Subdivision of Fractional T. 16 N., R. 20 1/2 W. 11.

Chains. N. 0° 1' W., bet. sec. 14 and frac. sec. 15.
 Over level land, through dense undergrowth.
 40.00 Set an iron post, 3 ft. long, 1 in. diam., 26 ins. in the
 ground, for 1/4 sec. cor., marked on brass cap
 1916 on S. rim;
 1/4 S15 in W. and
 S14 in E. half;
 dig pits, 18 X 18 X 12 ins., N. and S. of post, 3 ft.
 dist.; and raise a mound of earth, 3/8 ft. base, 1 1/2 ft.
 high, W. of cor.
 46.50 "Old Trails" Highway, brs. NW. and SE.
 80.00 Set an iron post, 3 ft. long, 2 ins. diam., 26 ins. in the
 ground, for cor. of secs. 10, 11, 14 and 15, marked on
 brass cap
 1916 on S. rim;
 T16N R20 1/2 W in N. half;
 S10 in NW.,
 S11 in NE.,
 S14 in SE. and
 S15 in SW. quadrant;
 and raise a mound of stone, 2 ft. base, 1 1/2 ft. high,
 W. of cor.
 Land, level.
 Soil, sandy; 2nd and 3rd rate.
 No timber.
 Undergrowth, greasewood and sagebrush.
 R. D. A.
 Mar. 21, 1916.

40.00 Mar. 20, 1916: A. S. and R.D.A.
 S. 89° 50' E., on a random line, bet. secs. 11 and 14.
 Set temp. 1/4 sec. cor.
 80.00 Intersect N. and S. line, 2 lks. S. of the cor. of secs.
 11, 12, 13 and 14.
 Thence I run
 N. 89° 51' W., on a true line, bet. secs. 11 and 14.
 Over level land, through scattering undergrowth.
 4.00 Enter wash, course W. Comes from NE.
 19.00 Leave wash, course NW.
 40.00 Set an iron post, 3 ft. long, 1 in. diam., 26 ins. in the
 ground, for 1/4 sec. cor., marked on brass cap
 1916 on S. rim;
 1/4 S11 in N. and
 S14 in S. half;
 and raise a mound of stone, 2 ft. base, 1 1/2 ft. high,
 N. of cor.
 42.00 Center of wash, 1 ch. wide, course NW.
 50.15 Asc. 110 ft. to
 60.50 Top of asc; thence over level land.
 80.00 The cor. of secs. 10, 11, 14 and 15.
 Land, level and rolling.
 Soil, sandy; 2nd and 3rd rate.
 No timber.
 Undergrowth, greasewood.
 Mar. 21, 1916.
 A. S. and R. D. A.

38.78 Mar. 22, 1916: R. D. A.
 At 8 hrs. 4 m., a.m., l.m.t., I set off 34° 44 1/2' N. on the
 lat. arc; 0° 41 1/2' N. on the decl. arc; and determine
 a meridian with the solar at the cor. of secs. 10, 11,
 14 and 15.
 Thence I run
 West on a true line, bet. frac. secs. 10 and 15.
 Over rolling land, through dense undergrowth.
 Intersect E. bdy. of frac., T. 16 N., R. 21 W., 2.61 chs.

12.

Subdivision of Fractional T. 16 N., R. 20 $\frac{1}{2}$ W.

Chains.

S. of the cor. of secs. 25 and 36, which is a granite stone, 6 X 6 X 4 ins. above ground, marked and witnessed as described by the Surveyor-General.

At the point of intersection, set an iron post, 3 ft. long, 2 ins. diam., 26 ins. in the ground, for closing cor. of fractional secs. 10 and 15, marked on brass cap

1916 on S. rim;
CC W. of center;
T16N R20 $\frac{1}{2}$ W in N. half;
S10 in NE and
S15 in SE: quadrant;

and raise a mound of stone, 2 ft. base, 1 $\frac{1}{2}$ ft. high, E. of cor.

Land, rolling desert.

Soil, sandy; 3rd rate.

No timber.

Undergrowth, greasewood, ocotillo and cacti.

N.0° 1' W., bet. sec. 11 and frac. sec. 10.

Over rolling land, through dense undergrowth.

20.00 Center of wash, 1.50 chs. wide, course W.

36.00 Center of wash, 2 chs. wide, course W.

40.00 Set an iron post, 3 ft. long, 1 in. diam., 26 ins. in the ground, for $\frac{1}{4}$ sec. cor., marked on brass cap

1916 on S. rim;
 $\frac{1}{4}$ S10 in W. and
S11 in E. half;

and raise a mound of stone, 2 ft. base, 1 $\frac{1}{2}$ ft. high, W. of cor.

52.60 Telegraph line, brs. SE. and SW.

53.00 Main track A. T. and S. F. R. R., on curve, brs. SE. and SW.

55.40 Telegraph line, brs. SE. and SW.

80.00 Set an iron post, 3 ft. long, 2 ins. diam., 26 ins. in the ground, for cor. of secs. 2, 3, 10 and 11, marked on brass cap

1916 on S. rim;
T16N R20 $\frac{1}{2}$ W in N. half;
S3 in NW.,
S2 in NE.,
S11 in SE. and
S10 in SW. quadrant;

and raise a mound of stone, 2 ft. base, 1 $\frac{1}{2}$ ft. high, W. of cor.

Land, rolling.

Soil, sandy; 3rd rate.

No timber.

Undergrowth, greasewood and palo verde.

Mar. 22, 1916: At this cor., I set off 0° 45' N. on the decl. arc; and at apparent noon, I observe the sun on the meridian; the resulting lat. is 34° 45' N.

R. D. A.

Mar. 22, 1916.

Mar. 21, 1916: A. S. and R. D. A.

S.89° 51' W., on a random line, bet. secs. 2 and 11.

40.00 Set temp. $\frac{1}{4}$ sec. cor.

80.04 Intersect N. and S. line, 5 lks. S. of the cor. of secs. 1, 2, 11 and 12.

Thence I run

N.89° 53' W., on a true line, bet. secs. 2 and 11.

Over rolling land, through scattering undergrowth.

25.00 Center of wash, 60 lks. wide, course S.

40.02 Set an iron post, 3 ft. long, 1 in. diam., 26 ins. in the ground, for $\frac{1}{4}$ sec. cor., marked on brass cap

Subdivision of Fractional T. 16 N., R. 20 1/2 W. 13.

Chains.

1916 on S. rim;
 1/4 S2 in N. and
 S11 in S. half;
 and raise a mound of stone, 2 ft. base, 1 1/2 ft. high,
 N. of cor.
 80.04 The cor. of secs. 2, 3, 10 and 11.
 Land, rolling desert.
 Soil, sandy; 3rd rate.
 No timber.
 Undergrowth, greasewood.

Mar. 22, 1916.
A. S. and R. D. A.

38.83 Mar. 22, 1916, R.D.A.
 West on a true line, bet. frac. secs. 3 and 10.
 Over rolling land, through scattering undergrowth.
 Intersect E. bdy. of frac. T. 16 N., R. 20 1/2 W., 2.87 chs. S. of true
 pt. for cor. of secs. 19, 24, 25 & 30, witnessed 1 ch. S. by a
 Malpais stone, 8 x 5 ins. above ground, and 80 lks. S. 89° 56'
 W. by a lava stone 10 x 6 ins. above ground, both wks. as abo-
 ing mks. and witnessed as described by the Surveyor General.
 At the point of intersection, set an iron post, 3 ft. long,
 2 ins. diam., 24 ins. in the ground, for closing cor.
 of fractional secs. 3 and 10, marked on brass cap

1916 on S. rim;
 CC W. of center;
 T16N R20 1/2 W in N. half;
 S3 in NE. and
 S10 in SE. quadrant;
 and raise a mound of stone, 2 ft. base, 1 1/2 ft. high,
 E. of cor.
 Land, rolling desert.
 Soil, sandy; 3rd rate.
 No timber.
 Undergrowth, greasewood and cacti.

Mar. 22, 1916.

40.00 Mar. 23, 1916; At 8 hrs. 5 m., a.m., l.m.t., I set off
 34° 45' N. on the lat. arc; 1° 5' N. on the decl. arc;
 and determine a meridian with the solar at the cor. of
 secs. 2, 3, 10 and 11.

79.50 Thence I run
 N. 0° 1' W., on a random line, bet. sec. 2 and frac. sec. 3.
 Set temp. 1/4 sec. cor.

Intersect N. bdy. of Tp., 8 lks. W. of the cor. of secs.
 2, 3, 34 and 35, which is an iron post, established by
 me, as described in Book "A".

39.50 Thence I run
 S. 0° 2' W., on a true line, bet. sec. 2 and frac. sec. 3.
 Over rolling land, through dense undergrowth.

Set an iron post, 3 ft. long, 1 in. diam., 26 ins. in the
 ground, for 1/4 sec. cor., marked on brass cap

1916 on S. rim;
 1/4 S3 in W. and
 S2 in E. half;
 dig pits, 18 X 18 X 12 ins., N. and S. of post, 3 ft.
 dist.; and raise a mound of earth, 3 1/2 ft. base, 1 1/2 ft.
 high, W. of cor.

79.50 The cor. of secs. 2, 3, 10 and 11.
 Land, rolling desert.
 Soil, sandy; 3rd rate.
 No timber.
 Undergrowth, greasewood.

Mar. 23, 1916.
R. D. A.

14.

Subdivision of Fractional T. 16 N., R. 20 $\frac{1}{2}$ W.

GENERAL DESCRIPTION.

The southern part of this fractional township is mountainous; the remainder is level and rolling. The soil varies from rocky, 4th rate in the southern part, to sandy, 2nd rate, in the northern part. There is no timber in the township. Undergrowth consists of greasewood, palo-verde, sagebrush and cacti.

The main line of the Atchison, Topeka and Santa Fe R. R. crosses the northern part of the township from east to west. The national "Old Trails" Highway runs easterly and westerly through the center of the township.

There are no settlers nor is there any water in the township.

W. E. Sawyer.

U. S. Treasurer.

222
15

For Certificate of U.S. Surveyor and U.S. Transitman
see page II, Book "B" of this Group.

FINAL OATH OF UNITED STATES SURVEYOR.

BOOK 295A

I, _____, U. S. Surveyor, do solemnly swear that, in pursuance of special instructions received from the U. S. Surveyor General for _____ bearing date of the _____ day of _____, 191____, I have well, faithfully, and truly, in my own proper person, and in strict conformity with said instructions, the Manual of Surveying Instructions, and the laws of the United States, surveyed all those parts or portions of _____ of the _____ Meridian, in the State of _____, which are represented in the foregoing field notes as having been executed by me, and under my direction; and I do further solemnly swear that all the corners of said survey have been established and perpetuated in strict accordance with the Manual of Surveying Instructions, and the special written instructions of the U. S. Surveyor General for _____ and in the specific manner described in the field notes, and that the foregoing are the original field notes of such survey.

U. S. Surveyor.

Subscribed by said _____, and sworn to before me }
this _____ day of _____, 191____



APPROVAL.

OFFICE OF THE UNITED STATES SURVEYOR GENERAL,

Phoenix Arizona April 10, 1917.

The foregoing field notes of the survey of the _____
Subdivision lines of
Fractional Township 16 North, Range 20 1/2 West
of the Gila & Salt River Base & Meridian
in the State of Arizona

executed by Albert Smith Jr., U.S. Surveyor & Ray D. Armstrong, U.S. Transitman under special instructions dated December 28, 1914 for Group 42 Arizona having been critically examined, and the necessary corrections and explanations made, the said field notes, and the surveys they describe, are hereby approved.

Surveyor General.
of Arizona.

~~I certify that the foregoing transcript of the field notes of the above described surveys in _____, has been correctly copied from the original notes on file in this office.~~