

2971

Book "F."

4-679

BOOK 2971

FIELD NOTES

re-
OF THE SURVEY OF part of

East Boundary, and

Survey of

Completion of Subdivision Lines of

TOWNSHIP 14 SOUTH, RANGE 26 EAST,

Of the Gila and Salt River Base and Meridian,

In the State of Arizona.

EXECUTED BY

Thomas B. Matthews.

In the capacity of U. S. Surveyor, under instructions dated June 3, 1915,
issued by the United States Surveyor General to govern surveys included in
Group No. 35, which were approved by the Commissioner of the General Land
Office, June 17, 1915.

Resurvey & Survey commenced June 29, 1915.

Resurvey & Survey completed July 12, 1915.

2971

1915

1A

Book "F." 2971
Group 35 - Arizona.

BOOK 2971

INDEX DIAGRAM.

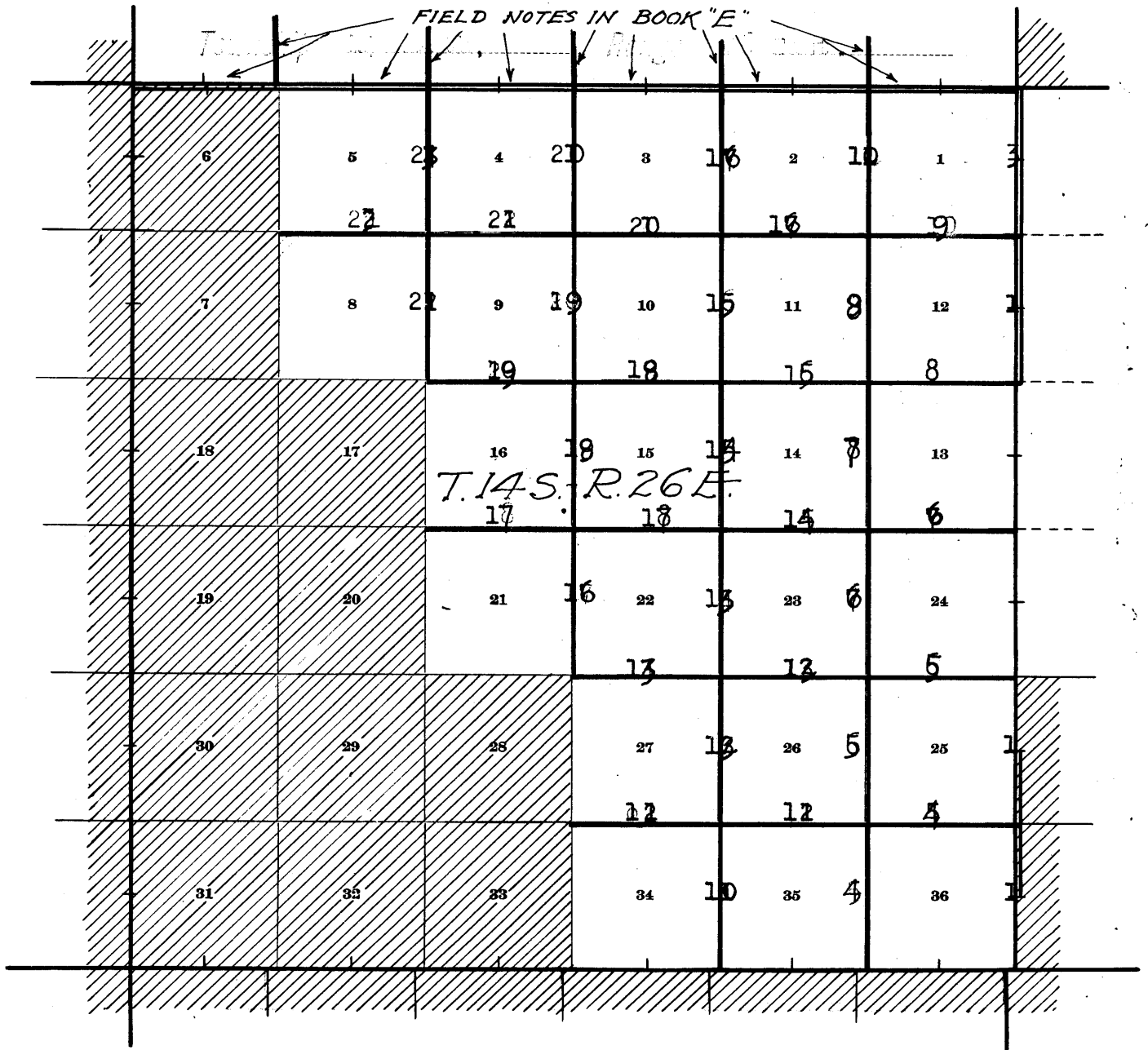

- Subdivision lines surveyed under this group.
- ===== Township boundaries resurveyed under this group.
- Accepted surveys.
- Unsurveyed.
- ////// Area subdivided as per accepted plats on file.

~ DATE DIAGRAM ~
 Book "F" Group 35 Ariz.
 TOWNSHIP 14 SOUTH - RANGE 26 EAST

June 30-1915	June 30-1915	June 30-1915	June 12-1915	June 12-1915	June 12-1915	
	5 July 8-1915	4 July 6-1915	3 July 9-1915	2 July 10-1915	1 July 12-1915	RESURV. July 12-1915
	8 July 8-1915	9 July 8-1915	10 July 8-1915	11 July 7-1915	12 July 7-1915	RESURV. July 12-1915
		16 July 6-1915	15 July 5-1915	14 July 3-1915	13 July 3-1915	
		21 July 6-1915	22 July 5-1915	23 July 3-1915	24 July 1-1915	
			27 July 2-1915	26 July 1-1915	25 June 29-1915	RESURV. June 29-1915
			34 July 2-1915	35 June 29-1915	36	

Resurvey of portion of East bdy. of T.14 S., R. 26 East.

1C

Chains.

- Survey commenced June 28, 1915, and executed with a Young & Son's light mountain transit No. 8586, with solar attachment. For description of instrument, and certificate of approval see Book "A."
- Knowing from recent and repeated tests of this instrument on a meridian established by observations on Polaris, that it is in satisfactory adjustment, I proceed as follows:
- From the reestablished $\frac{1}{4}$ sec. cor. of secs. 31 and 36, which is a granite stone, 6x6x6 ins. above ground, firmly set, marked $\frac{1}{4}$ on W. face, and witnessed by mound of stone 2 ft. base, $1\frac{1}{2}$ ft. high, W. of cor.,
- 40.00 North, on a random line, bet. secs. 31 and 36 (North half) No trace of the reestablished cor. of secs. 25, 30, 31 and 36 can be found after diligent search.
- Therefore, I continue my random line and measurement.
- 80.22 North, bet. secs. 25 and 30 (South half). Fall 8 lks. E. of the reestablished $\frac{1}{4}$ sec. cor., which is a basalt stone, 10x8x6 ins. above ground, firmly set, marked $\frac{1}{4}$ on W. face, and witnessed by mound of stone 2 ft. base, $1\frac{1}{2}$ ft. high, W. of cor. Therefore, the true course and dist. of the line back to the reestablished $\frac{1}{4}$ sec. cor. bet. secs. 31 and 36, is S $0^{\circ}3'E.$, 80.22 chs. Therefore, resurvey this portion of Tp. bdy. as follows:
- S. $0^{\circ}3'E.$, on a true line, bet. secs. 25 and 30 (south half).
- Over slightly rolling land, through scattering undergrowth.
- 10.00 Wash, 15 lks. wide, 5 ft. deep, course NW.
- 36.00 Wash, 50 lks. wide, 10 ft. deep, course NW.
- 38.00 Mascot and Western Railway brs. S. $62\frac{1}{2}^{\circ}E.$ and N. $62\frac{1}{2}^{\circ}W.$
- 40.11 (Proportional dist.) Set a granite stone, 16x12x8 ins., 11 ins. in the ground for reestablished cor. of secs. 25, 30, 31 and 36, marked with 1 notch on S. and 5 notches on N. edge, and raise a mound of stone, 3 ft. base, 3 ft. high, W. of cor.
- Land, rolling.
Soil, thin and rocky, coarse texture, 6 to 12 ins. deep.
No timber.
Undergrowth, scattering mesquite and catclaw, 4 to 6 ft. high.
-
- S. $0^{\circ}3'E.$, on a true line, bet. secs. 31 and 36 (North half)
- Over rolling land, through scattering undergrowth.
- 3.00 Wash, 40 lks. wide, 5 ft. deep, course NW.
- 7.05 Wagon road brs. NW. and SE.
- 13.97 Wire fence brs. NW. and SE.
- 31.89 Wash, 15 lks. wide, 3 ft. deep, course SW.
- 40.11 Intersect the reestablished $\frac{1}{4}$ sec. cor., hereinbefore described.
- Land, rolling and mountainous.
Soil, thin and rocky.
No timber.
Undergrowth, scattering mesquite and catclaw.
-
- From the original cor. of secs. 7, 12, 13 and 18, which is a limestone, 24x16x8 ins., supported in a mound of stone, marked with 4 notches on S. and 2 notches on N. edges, and witnessed by mound of stone 2 ft. base, $1\frac{1}{2}$ ft. high, W. of cor.
- 38.87 North, on a random line, bet. secs. 7 and 12. A point 6 lks. W. of the original $\frac{1}{4}$ sec. cor., which is a granite stone, 10x14x5 ins., above ground, firmly set, marked and witnessed as described by the Surveyor General.
- 77.93 Continue random line and measurement. A point 16 lks. E. of the original cor. of secs. 1, 6, 7 and 12, which is a granite stone, 12x10x6 ins. above ground, firmly set, marked and witnessed as described by the

2. Resurvey of portion of E. bdy. of Township 14 S., R. 26 E.

Chains.

Surveyor General.

The line bet. secs. 7 and 12, being defective for measurement, I continue my random line and measurement bet. secs. 1 and 6.

- 115.13 A point 5 lks. E. of the original $\frac{1}{4}$ sec. cor., which is a granite stone, 18x10x14 ins., supported in a mound of earth. Continue random line and measurement.
- 157.01 A point 32 lks. east of original witness cor. to cor. of Ts. 13 and 14 S., Rs. 26 and 27 E., which is a granite stone 12x12x6 ins. above ground, marked and witnessed as described by the Surveyor General.
- 162.01 Continue random line and measurement
Fall 32 lks. E. of cor. of Ts. 13 and 14 S., Rs. 26 and 27 E., which is an iron post 3 ins. in diam., with brass cap, marked and witnessed as described by the surveyor general (established by William B. Kimmel, U.S.S. in June 1914, under Group 26). This falling gives the true course and dist. for Tp. bdy. east of secs. 12 and 1 of N. 0° 7' W. 162.01 chs. No accepted surveyed subdivision lines being tied to this portion of the Tp. bdy. I proceed to an independent resurvey of the same as follows: Return to the original cor. of secs. 7, 12, 13 and 18 hereinbefore described.

Thence

N. 0° 7' W., on a true line bet. secs. 7 and 12, through scattering timber and undergrowth.

Descend steep rocky N. slope, through scattering undergrowth.

- 12.99 Foot of descent, 495 ft. below cor.
Wash, 20 lks. wide, course NW.
- 23.25 Ascend steep rocky SW. slope, 390 ft. to
Ridge, brs. E and W. slopes W. Descend rocky N. slope,
540 ft. to
- 35.82 Wash, 30 lks. wide, course W. Ascend rocky S. slope, 113
ft. to
- 40.00 Set an iron post 3 ft. long, 1 in. in diam., 26 ins. in
the ground for reestablished $\frac{1}{4}$ sec. cor. marked on brass
cap,
S 12 $\frac{1}{2}$ S 7
1915

from which,

A post oak, 16 ins. in diam., brs. S. 62 $\frac{1}{2}$ ° E., 126
lks. dist., marked $\frac{1}{4}$ S 7 B T.

No other trees within limits.

From this cor., the original $\frac{1}{4}$ sec. cor. brs. S. 7° E., 114
lks. dist., I destroy all trace of this old cor.

Continue ascent from the cor. 328 ft. to

- 49.23 Spur slopes W. Descend along rocky NW. slope, 78 ft. to
56.38 Gulch, 10 lks. wide, course W. Ascend along steep rocky
SW. slope, 210 ft. to

63.45 Ridge brs. NW. and SE. Descend NE slope, 350 ft. to

77.93 Intersect original cor. of secs. 1, 6, 7 and 12, hereinbe-
fore described, which I destroy.

- 80.00 Set a granite stone, 18x8x6 ins., 12 ins. in the ground,
for reestab cor. of secs. 1, 6, 7 and 12, marked with 1 notch on
N. and 5 notches on S. faces, from which,

A post oak, 16 ins. diam., brs. N. 39 $\frac{1}{2}$ ° E., 65 lks.
dist., marked T 14 S R 27 E S 6 B T.

A post oak, 14 ins. diam., brs. S. 68 $\frac{1}{2}$ ° E., 68 lks.
dist., marked T 14 S R 27 E S 7 B T.

A post oak, 14 ins. diam., brs. S. 10 $\frac{1}{2}$ ° W., 76 lks.
dist., marked T 14 S R 26 E S 12 B T.

A post oak, 15 ins. diam., brs. N. 79 $\frac{1}{2}$ ° W., 103 lks.
dist., marked T 14 S R 26 E S 1 B T.

Land, mountainous.

Soil, thin and rocky.

Timber, scattering juniper and oak.

Undergrowth, scattering scrub oak.

Resurvey of a portion of East bdy. of Township 14 South Range 26E. 3

Chains

N.0° 7' W., on a true line, bet. secs. 1 and 6.
 Descend steep rocky slope, 310 ft. to
 9.53 Gold gulch, 1 chain wide, 5 ft. deep, stream cold clear
 water, 10 lks. wide, 6 ins. deep, course NW.
 10.91 Old wagon road, brs. NW. and SE. Ascend steep rocky SW.
 slope, 154 ft. to
 21.30 Spur, slopes W. Descend N. slope, 107 ft. to
 25.70 Gulch, 50 lks. wide, course NW. Ascend SW. slope.
 32.38 Small spring clear cold water, brs. E. 1 ch. 70 ft. below
 spur; ascend 51 ft. to
 36.50 Spur slopes W. Descend 65 ft. to cor.
 40.00 Set an iron post 3 ft. long, 1 in. in diam., 26 ins. in
 the ground, for reestablished $\frac{1}{4}$ sec. cor., marked on
 brass cap,

S 1 | S 6
 1915

from which,
 A white oak, 14 ins. diam., brs. S. 59° E., 118 lks.
 dist., marked $\frac{1}{4}$ S 6 B T.
 No other trees within limits. Raise a mound of stone,
 3 ft. base, 2 $\frac{1}{2}$ ft. high, W. of cor.
 From this cor., the original $\frac{1}{4}$ sec. cor. brs. S. 24° E., 4.88
 chs. dist., I destroy all trace of this cor.
 Ascend along SW. slope, 113 ft. to
 44.70 Ridge, brs. NW. and SE. Descend along NW. slope, 229 ft. to
 48.42 Gulch, 10 lks. wide, course NW. Ascend along W. slope, 21
 ft. to
 52.38 Spur, slopes NW. Descend N. slope, 250 ft. to
 77.01 Intersect the original witness cor. to the cor. of Ts. 13
 and 14 S., Rs. 26 and 27 E. hereinbefore described.
 Thence descend 250 ft. to
 82.01 Intersect the cor. of Ts. 13 and 14 S., Rs. 26 and 27 E.
 on very steep rocky N. slope.
 Land, mountainous.
 Soil, thin and rocky.
 Timber, scattering juniper and oak.
 Undergrowth, scattering scrub oak.
 Scattering short grass.

Boundaries of portion of Township 14 S., R. 26 E.
 Subdivided under this Group.
 Latitudes, departures, and closing errors.

Line designated.	True bearing.	Dist.	Latitudes.		Departures.	
			N.	S	E.	W.
South boundary,	N. 89° 55' W.	240.00	.35			240.00
Subdivisional boundary	N. 0° 2' W.	160.00	160.00			.09
	N. 89° 50' W.	80.00	.23			80.00
	N. 0° 2' W.	160.00	160.00			.09
	N. 89° 48' W.	80.00	.28			80.10
	N. 0° 3' W.	80.00	80.00			.07
	N. 0° 15' E.	80.30	80.30		.35	
North Tp. bdy.	S. 89° 56' E.	399.14		.46	399.14	
East Tp. bdy.	S. 0° 7' E.	162.01		162.01	.33	
	South,	200.00		200.00		
	S. 0° 3' E.	80.22		80.22	.07	
	South,	40.00		40.00		
Convergency,					.39	
Totals.			481.16	482.69	400.28	400.35
				481.16		400.28
Error in latitude.			1.53			
Error in departure.					.07	

1. Completion of Subdivision of Township 14 South, Range 26 E.

Chains.

Survey executed with a Young and Son's light mountain transit No. 8586, with solar attachment. For description of instrument and certificates of approval see Book "A." Knowing from recent and repeated field tests of this instrument on a meridian established by observation on Polaris that it is in satisfactory adjustment, I proceed as follows:

From the reestablished cor. of secs. 35 and 36 on the S. bdy. of Tp., which is a basalt stone, 8x12x6 ins. above ground firmly set, marked with 5 notches on W. and 1 notch on E. edge, and witnessed by mound of stone 2 ft. base, 1 1/8 ft. high, N. of cor.
 N. 0° 1' W., bet. secs. 35 and 36.
 Over rolling land. Ascend 14 ft. to Flat topped low ridge brs. E. and W.
 2.29 Wash, 15 lks. wide, 3 ft. deep, course SW.
 13.84 Wash, 20 lks. wide, 2 ft. deep, course SW. Ascend 183 ft.
 17.99 to
 35.72 Spur, slopes SE.; thence along E. slope to
 40.00 Set an iron post 3 ft. long, 1 in. in diam., 26 ins. in the ground, for 1/4 sec. cor., marked on brass cap,

$$\begin{array}{c} \frac{1}{4} \\ S \ 35 \ S 36 \\ 1915 \end{array}$$

and raise a mound of stone, 3 ft. base, 3 ft. high, W. of cor. Thence over rocky mountainous land.
 Ascend S. slope, from cor, 83 ft. to
 50.86 Top of rocky knoll brs. E. and W. Descend N. slope, 160 ft. to
 80.00 Set an iron post, 3 ft. long, 2 ins. in diam., 24 ins. in the ground, for cor. of secs. 25, 26, 35 and 36, marked on brass cap,

$$\begin{array}{c} T14S \ R26E \\ S26 \ S25 \\ \hline S35 \ S36 \\ 1915 \end{array}$$

and raise a mound of stone, 3 ft. base, 23 ft. high, W. of cor.
 Land, rolling and mountainous.
 Soil, thin and rocky, coarse texture.
 No timber.
 No undergrowth.
 Scattering short grass.

 S. 89° 55' E., on a random line, bet. secs. 25 and 36.
 40.00 Set temp. 1/4 sec. cor.
 79.94 Intersect E. bdy. of Tp., 3 lks. N. of cor. of secs. 25, 30, 31 and 36, reestablished by me, and hereinbefore described.

Thence
 N. 89° 54' W., on a true line, bet. secs. 25 and 36.
 Over rolling land, through scattering undergrowth.
 5.40 Wagon road from Wilcox to Dos Cabezas brs. NE. and SW.
 7.20 Wash, 50 lks. wide, 4 ft. deep, course NW.
 25.00 Main wagon road from Wilcox to Dos Cabezas brs. NW. and SE.
 39.97 Set an iron post 3 ft. long, 1 in. in diam., 26 ins. in the ground, for 1/4 sec. cor., marked on brass cap,

$$\begin{array}{c} \frac{1}{4} \ S \ 25 \\ S \ 36 \\ 1915 \end{array}$$

and raise a mound of stone, 3 ft. base, 2 1/8 ft. high, N. of cor.
 Thence over mountainous land.

Completion of Subdivision of Township 14 South Range 26 East. 5

Chains.

56.52 Ascend steep rocky NE. slope, 132 ft. to
 Rocky ridge, brs.NE. and SW. Descend NW. slope, 190 ft. to
 74.71 Shallow wash, 15 lks.wide, course NE. Ascend NE. slope.
 23 ft. to
 79.94 The cor. of secs. 25, 26, 35 and 36.
 Land, rolling and mountainous.
 Soil, thin and rocky, coarse texture.
 No timber.
 Undergrowth, scattering mesquite and catclaw.
 Scattering short grass.

N.0° 1'W., bet. secs. 25 and 26.
 Over rough, mountainous land, through scattering under-
 growth.

Descend gentle N. slope, 23 ft. to
 3.17 Telephone line, brs.NW. and SE.
 4.43 Wagon road from Wilcox to Dos Cabezas, brs.NW. and SE.
 7.79 Wash, 40 lks.wide, 4 ft. deep, course NW. Foot of descent.
 Thence over level land.
 10.24 Telephone line, brs.NW. and SE.
 13.26 Mascot and Western Railway, brs.N. 74 $\frac{3}{4}$ °E. and S. 74 $\frac{3}{4}$ °W.
 Ascend SW. slope of mountain 421 ft.
 14.97 From this point a house brs.N. 66 $\frac{3}{4}$ °E.
 35.86 Top of rocky ridge, brs.NW. and SE. From this point, house
 brs. S 78°E. Descend 46 ft. to
 40.00 Set an iron post 3 ft. long, 1 in. in diam., 26 ins. in the
 ground, for $\frac{1}{4}$ sec. cor., marked on brass cap,

S26 | S25
 1915

and raise a mound of stone 3 ft. base, 2 $\frac{1}{2}$ ft. high, W.
 of cor. Descend 28 ft. to
 44.97 Rocky wash, 10 lks.wide, 3 ft. deep, course SE. Ascend
 SW. slope, 202 ft. to
 52.66 Rocky spur, slopes SE. Descend NE. slope, 350 ft. to cor.
 73.49 Rocky wash, 20 lks.wide, 2 ft. deep, course SE.
 80.00 Set an iron post, 3 ft. long, 2 ins. in diam., 24 ins. in
 the ground, for cor. of secs. 23, 24, 25 and 26, marked
 on brass cap,

T14S R26E
 S23 | S24
 S26 | S25
 1915

and raise a mound of stone, 3 ft. base, 3 ft. high,
 W. of cor.
 Land, rough and mountainous.
 Soil, thin and rocky, coarse texture.
 No timber.
 Undergrowth, scattering mesquite and catclaw.
 Scattering short grass.

S.89° 54' E., on a random line, bet. secs. 24 and 25.
 40.00 Set temp. $\frac{1}{4}$ sec. cor.
 80.06 Intersect E. bdy. of Tp. 40 lks. S. of reestablished cor.
 of secs. 19, 24, 25 and 30, which is a basalt stone,
 10x12x12 ins. above ground, firmly set, marked with
 2 notches on S. and 4 notches on N. edge, and witnessed
 by mound of stone 2 ft. base, 1 $\frac{1}{2}$ ft. high, W. of cor.
 Thence
 S.89° 50' W. on a true line, bet. secs. 24 and 25.
 Over rolling land.

6. Completion of Subdivision of Township 14 South, Range 26 E.

Chains.

5.27 Ascend SE. slope, 74 ft. to
 Top of small rocky spur, slopes SW.
 From this point, house brs. S. 29° W. Descend W. slope, to
 11.47 Wash, 40 lks. wide, course SW. Ascend 67 ft. to
 16.50 Descend slight W. slope.
 40.03 Set an iron post 3 ft. long, 1 in. in diam., 26 ins. in
 the ground, for $\frac{1}{4}$ sec. cor., marked on brass cap,

$\frac{1}{4}$ S 24
 S 25
 1915

and raise a mound of stone, 3 ft. base, 2 ft. high, N. of
 cor.

41.25 Wash, 50 lks. wide, 3 ft. deep, course SW.
 59.50 Wire fence brs. NW. and SE.
 60.25 House brs. S. 15 $\frac{1}{2}$ ° E.
 62.01 Wash, 20 lks. wide, 1 ft. deep, course SW.
 71.07 Dim wagon road, brs. N. and S.
 73.37 Wash, 20 lks. wide, 5 ft. deep, course S. Ascend 23 ft. to
 80.06 The cor. of secs. 23, 24, 25 and 26.
 Land, rolling.
 Soil, thin and rocky.
 No timber.
 Undergrowth, none.
 Scattering short grass.

N. 0° 1' W., bet. secs. 23 and 24.
 Over nearly level land, through scattering undergrowth.
 1.58 Wash, 15 lks. wide, 1 ft. deep, course SE.
 33.90 Wagon road brs. NW. and SE.
 40.00 Set an iron post, 3 ft. long, 1 in. in diam., 26 ins.
 in the ground, for $\frac{1}{4}$ sec. cor., marked on brass cap,

$\frac{1}{4}$
 S23 | S24
 1915

and raise a mound of stone, 3 ft. base, 3 ft. high,
 W. of cor.

55.00 Foot of low ridge; leave nearly level land; ascend 41 ft.
 to
 61.97 Summit of isolated ridge brs. NW. and SE. Descend NE.
 slope, 34 ft. to
 71.62 Wash, 60 lks. wide, 3 ft. deep, course NW. Thence over
 level land.
 80.00 Set an iron post, 3 ft. long, 2 ins. in diam., 24 ins. in
 the ground, for cor. of secs. 13, 14, 23 and 24, marked
 on brass cap,

T14S R26E
 S14 | S13
 S23 | S24
 1915

and raise a mound of stone, 3 ft. base, 3 ft high, W.
 of cor.

Land, rolling and nearly level.
 Soil, thin and rocky.
 No timber.
 Undergrowth, scattering mesquite and catclaw.
 Short grass.

N. 89° 50' E., on a random line, bet. secs. 13 and 24.
 40.00 Set temp. $\frac{1}{4}$ sec. cor.
 79.85 Intersect E. bdy. of Tp. 14 lks. N. of reestablished cor. of

Chains.

secs. 13, 18, 19 and 24, which is a granite stone, 18x12x10 ins. above ground, loosely set, marked with 3 notches on N. and S. edges, and witnessed by mound of stone, W. of cor.
 I reset this stone, at same place, 12 ins. in the ground, and rebuild mound of stone, 3 ft. base, 2 ft. high, W. of cor.
 Thence
 S. 89° 56' W., on a true line, bet. secs. 13 and 24.
 Descend rocky SW. slope, 30 ft. to
 3.42 Gulch, 50 lks. wide, course SW, Ascend SE. slope, 40 ft. to
 5.54 Spur, slopes S. Descend along SW. slope, 420 ft. to $\frac{1}{4}$ sec. cor.
 24.37 Cedar Springs watering trough on line.
 34.90 Gulch, 20 lks. wide, course SW.
 39.92 $\frac{1}{2}$ Set an iron post, 3 ft. long, 1 in. in diam., 26 ins. in the ground, for $\frac{1}{4}$ sec. cor., marked on brass cap,

S 13
 S 24
 1915

and raise a mound of stone, 3 ft. base, 2 ft high, N. of cor. Descend W. slope, 310 ft. to
 79.85 The cor. of secs. 13, 14, 23 and 24.
 Land, mountainous.
 Soil, thin and rocky.
 Timber, scattering oak and juniper.
 No undergrowth.
 Scattering short grass.

N. 0° 1' W. bet. secs. 13 and 14.
 Over mountainous land, through scattering undergrowth.
 3.80 Gulch, 20 lks. wide, 8 ft. deep, course NW.
 8.20 Gulch, 50 lks. wide, 12 ft. deep, course W. Ascend 330 ft. to
 40.00 Set an iron post, 3 ft. long, 1 in. in diam., 26 ins. in the ground, for $\frac{1}{4}$ sec. cor., marked on brass cap,

S14 | S13
 1915

and raise a mound of stone, 3 ft. base, 3 ft. high, W. of cor. Ascend 350 ft. to top of ridge.
 47.50 Dim wagon road brs. NE. and SW.
 50.09 Gulch, 40 lks. wide, 1 ft. deep, course SE.
 70.41 Ridge, brs. E. and W. Descend N $\frac{1}{2}$ slope, 177 ft. to
 80.00 Set an iron post, 3 ft. long, 2 ins. in diam., 24 ins. in the ground, for cor. of secs. 11, 12, 13 and 14, marked on brass cap,

T14S R26E
 S11 | S12
 S14 | S13
 1915

and raise a mound of stone, 3 ft. base, 3 ft high, W. of cor.
 Land, mountainous.
 Soil, thin and rocky.
 No timber.
 Scattering mesquite.
 Short grass.

8. Completion of the Subdivision of Township 14 S., R. 26 E./

Chains.

- N. 89° 56' E. on a random line, bet. secs. 12 and 13.
 40.00 Set temp. $\frac{1}{4}$ sec. cor.
 79.95 Intersect E bdy. of Tp., 44 lks. N. of original cor. of secs. 7, 12, 13 and 18, hereinbefore described.
 Thence
 N. 89° 45' W., on a true line, bet. secs. 12 and 13.
 Descend along steep rocky NW. slope.
 34.40 Spur, slopes NW.; continue descent.
 39.97 $\frac{1}{2}$ Set an iron post, 3 ft. long, 1 in. in diam., 26 ins. in the ground, for $\frac{1}{4}$ sec. cor., marked on brass cap,
- $\frac{1}{4}$ S 12
 $\frac{1}{4}$ S 13
 1915
- from which,
 A white oak, 24 ins. in diam., brs. S. 21 $\frac{3}{4}$ ° E.,
 31 lks. dist., marked $\frac{1}{4}$ S 13 B T.
 A white oak, 22 ins. in diam., brs. N. 87 $\frac{1}{2}$ ° W.,
 162 lks. dist., marked $\frac{1}{4}$ S 12 B T.
 Continue descent.
 65.27 Foot of descent 1370 ft. below E bdy. of Tp. small dry wash, course N. Ascend NE. slope, 34 ft. to
 73.06 Spur, slopes N. Descend NW. slope, 106 ft. to
 79.95 The cor. of secs. 11, 12, 13 and 14.
 Land, mountainous.
 Soil, thin and rocky.
 Timber, scattering juniper and oak.
 Undergrowth, scattering scrub oak.
 Short grass.
 From this cor. U.S.L.M. No. 2371 brs. N. 12° 55' E.
-
- N. 0° 1' W., bet. secs. 11 and 12.
 Over mountainous land.
 Descend NW. slope, 80 ft. to
 4.66 Foot of descent.
 Wagon road brs. NE. and SW.
 6.15 Wash, 30 lks. wide, 5 ft. deep, course SW. Ascend gentle SW. slope, 29 ft. to
 13.23 Wash, 70 lks. wide, 10 ft. deep, course SW. Ascend steep rocky SE. slope.
 22.97 Wash, 15 lks. wide, 2 ft. deep, course SE.
 40.00 Set an iron post, 3 ft. long, 1 in. in diam., 26 ins. in the ground, for $\frac{1}{4}$ sec. cor., marked on brass cap,
- $\frac{1}{4}$
 S 11 | S 12
 1915
- and raise a mound of stone, 3 ft. base, 3 ft. high, W. of cor. From this cor. U.S.L.M. No. 2371 brs. N. 40 $\frac{1}{2}$ ° E.
 56.24 Intersect S. end line of patented mining claim (McGregor lode) survey No. 2371 at a point 44 lks. N. 65° 21' W. from cor. No. 1, which is a pine post, 3 ft. long and 4 ins. square firmly set in a mound of stone, marked and witnessed as described by the Surveyor General. Thence over patented mineral land.
 64.13 SE. end of ridge, slopes E. 1102 ft. above 13.23 chain point. Descend along NE. slope, 200 ft. to cor.
 77.30 Intersect W. side line of patented mining claim (McGregor lode) survey No. 2371 at a point 3.53 chs. S. 24° 39' W. from cor. No. 3, which is a pine post, 3 ft. long, 4 ins. square, firmly set, marked and witnessed as described by the Surveyor General. Leave patented mineral land.
 80.00 Set an iron post, 3 ft. long, 2 ins. in diam., 24 ins. in the ground, for cor. of secs. 1, 2, 11 and 12, marked on brass cap,

Completion of the Subdivision of Township 14 S., R. 26 E. 9

Chains

T14 S R26E
S2 | S 1

S11 | S12
1915

and raise a mound of stone, 3 ft. base, 3 ft. high, W. of cor.
Land, mountainous.
Soil, thin and rocky.
No timber. No undergrowth.
Short grass.

- 40.00 S. 89°45'E. on a random line, bet. secs. 1 and 12. Set temp. $\frac{1}{4}$ sec. cor.
- 80.15 Intersect E. bdy. of Tp., 14 lks. N. of cor. of secs. 1, 6, 7 and 12, reestablished by me, and hereinbefore described. Thence N. 89°39'W., on a true line, bet. secs. 1 and 12. Ascend NE. slope, through scattering scrub oak trees, 84 ft. to
- 7.80 N. end of ridge, slopes N. Descend W. slope.
- 20.62 Rocky gulch, 50 lks. wide, 3 ft. deep, course NW. Continue descent.
- 39.39 Intersect N. end line of patented mining claim (Copper Gance lode) Survey No. 2371 at a point 54 links S. 60° 6'E. from cor. No. 2, which is a pine post 3 ft. long, 4 ins. square, firmly set in a mound of stone, marked and witnessed as described by the Surveyor General. Thence over patented mineral land.
- 40.07 Set an iron post, 3 ft. long, 1 in. in diam., 26 ins. in the ground, for $\frac{1}{4}$ sec. cor., marked on brass cap,

$\frac{1}{4}$ S 1
S 12
1915

- and raise a mound of stone, 3 ft. base, 3 ft. high, N. of cor.
- 42.30 Foot of descent, 570 ft. below N. end of ridge at 7.80 chain point. Wagon road brs. NE. and SW. Ascend E. slope, 100 ft. to
- 50.00 Ridge, brs. N. and S.
- 50.47 Intersect west side line of patented mining claim (McGinty lode) Survey No. 2371, at a point 535 chs. S. 28°W. from cor. No. 3, which is a pine post 3 ft. long, 4 ins. square, firmly set, marked and witnessed as described by the Surveyor General. Leave patented mineral land. Descend NW slope, 176 ft. to
- 58.42 Intersect E. side line of patented mining claim (Morgan lode) Survey No. 2371 at a point 9.35 chs. S. 4°50'E. of cor. No. 3, which is a pine post, 3 ft. long, 4 ins. square, firmly set in a mound of stone, marked and witnessed as described by the Surveyor General. Thence across said claim
- 60.34 Wash, 25 lks. wide, 3 ft. deep, course N., at foot of descent. Ascend NE. slope, 332 ft. to
- 64.07 Intersect N. end line of same mining claim at a point 6.22 chs. N. 28°E. of cor. No. 2, which is a pine post, 3 ft. long, 4 ins. square, firmly set in a mound of stone marked and witnessed as described by the Surveyor General. Leave patented mining claim.
- 67.47 Intersect E. side line of patented mining claim (John Bull lode) Survey No. 2371 at a point 85 lks. S. 4°50'E. from cor. No. 4, which is a pine post 3 ft. long, 4 ins. square, firmly set in a mound of stone, marked and witnessed as described by the Surveyor General. Thence across said claim.
- 68.40 Wash, 15 lks. wide, 3 ft. deep, course NE.
- 76.95 Intersect W side line of same claim, at a point 7 lks. S. 4°50'E. from cor. No. 3, which is a pine post, 3 ft. long,

10. Completion of the Subdivision of T. 14 S. R. 26 E.

Chains.	
	4 ins. square, marked and witnessed as described by the Surveyor General. Leave patented mining claim.
77.49	Intersect N. end line of patented mining claim. (McGregor lode) Survey No. 2371 at a point 1.25 chs. S 65°21'E. from cor. No. 3, hereinbefore described. Thence across said claim.
78.91	Intersect W. side line of same claim at a point 58 lks. S. 24° 39' W. from cor. No. 3, hereinbefore described. Leave patented mining claim.
80.15	The cor. of secs. 1, 2, 11 and 12. Land, mountainous. Soil, thin and rocky. Short grass. Scattering scrub oak on E. half of mile.

	N. 0°1' W., on a random line, bet. secs. 1 and 2.
40.00	Set temp. $\frac{1}{4}$ sec. cor.
81.34	Intersect N. bdy. of Tp., 9 lks. E. of the cor. of secs. 1, 2, 35 and 36, reestablished by me and described in Book "E." Thence
	S. 0°5' E. on a true line, bet. secs. 1 and 2. Ascend along NW. slope, through scattering undergrowth, 150 ft. to
14.63	Ridge, brs. NE. and SW. Descend SE. slope, 150 ft. to
26.63	Jos. F. Wineman's cabin, brs. N. 45° E.
36.68	Gulch, 55 lks. wide, 15 ft. deep, course NE. Ascend NW slope, of ridge.
41.34	Set an iron post $\frac{3}{4}$ ft. long, 1 in. in diam., 26 ins. in the ground for $\frac{1}{4}$ sec. cor., marked on brass cap,
	S2 S1 1915
	from which
	A juniper, 14 ins. diam., brs. S. 64 $\frac{1}{4}$ ° E., 78 lks. dist., marked $\frac{1}{4}$ S 1 B T.
	No other trees within limits.
42.65	Raise a mound of stone 3 ft. base, 3 ft. high, W. of cor. Jos. F. Wineman's cabin, brs. N. 21° E.
44.75	Top of ridge, brs. NE. and SW. 250 ft. above gulch at 36.68 ch. point. Descend SE. slope, 48 ft. to
51.84	Wash, 20 lks. wide, 2 ft. deep, course NE. Ascend N. slope, 200 ft. to
59.84	Ridge, brs. NE. and SW. Descend 200 ft. to
67.60	Rocky wash, 25 lks. wide, 2 ft. deep, course NE. Ascend 205 ft. to
73.86	Rocky spur, slopes NE. Ascend along NE. slope, 80 ft. to
81.34	The cor. of secs. 1, 2, 11 and 12. Land, mountainous. Soil, thin and rocky. Timber, scattering juniper. Undergrowth, scrub oak. Short grass.

	From the reestablished cor. of secs. 34 and 35, on the S. bdy. of Tp., which is a granite stone 10x10x12 ins. above ground, firmly set, marked with 4 notches on W. and 2 notches on E. edges, and witnessed by mound of stone 3 ft. base, 2 ft. high, N. of cor.,
	N. 0°1' W., bet. secs. 34 and 35.
	Over rolling land, through scattering undergrowth.
10.00	Wash, 20 lks. wide, 1 ft. deep, course SW. Ascend S. slope.
22.35	Wash, 15 lks. wide, 1 ft. deep, course SW. Continue ascent.
35.67	Ridge, brs. NE. and SW. 240 ft. above wash. at 10.00 ch. point. Ridge, extends 10 chs. W. of line. Descend NW slope, 115 ft.
40.00	Set an iron post, $\frac{3}{4}$ ft. long, 1 in. in diam., 26 ins. in the ground for $\frac{1}{4}$ sec. cor., marked on brass cap,
	S34 S35 1915

Completion of the Subdivision of Township 14 S. R. 26 E. 11.

Chains.

and raise a mound of stone, 3 ft. base, 3 ft. high, W. of cor.
 49.96 Foot of descent; thence over level prairie land, through scattering undergrowth.
 73.56 Wagon road brs. NE. and SW.
 80.00 Set an iron post 3 ft. long, 2 ins. in diam., 24 ins. in the ground, for cor. of secs. 26, 27, 34 and 35, marked on brass cap,

T14S R26E
 S27 | S26
 S34 | S35
 1915

and raise a mound of stone, 3 ft. base, 3 ft. high, W. of cor.
 Land, rolling and level.
 Soil, south, 50 chs. thin and rocky; north, 30 chs. light sandy loam, coarse texture, 10 to 12 ins. deep.
 No timber.
 Undergrowth, scattering mesquite and catclaw.
 Short grass.

40.00 S. 89° 55' E., on a random line, bet. secs. 26 and 35.
 Set temp. $\frac{1}{4}$ sec. cor.
 80.11 Intersect N. and S. line, 5 lks. S. of cor. of secs. 25, 26, 35 and 36.
 Thence
 N. 89° 57' W., on a true line, bet. secs. 26 and 35.
 Over rolling land, through scattering undergrowth.
 Descend gradual slope, 40 ft. to
 5.00 Foot of descent, brs. NE. and SW. Thence over level land.
 18.66 Wash, 50 lks. wide, 3 ft. deep, course SW.
 35.10 Wash, 50 lks. wide, 4 ft. deep, course W.; thence along N. side of wash.
 40.05 $\frac{1}{2}$ Set an iron post, 3 ft. long, 1 in. in diam., 26 ins. in the ground for $\frac{1}{4}$ sec. cor., marked on brass cap,

$\frac{1}{4}$ S 26
 S 35
 1915

and raise a mound of stone, 3 ft. base, 3 ft. high, N. of cor.
 58.41 Same wash, 70 lks. wide, 5 ft. deep, course WNW.
 65.11 Wagon road brs. NE. and SW.
 80.11 The cor. of secs. 26, 27, 34 and 35.
 Land, rolling and level.
 Soil, sandy, coarse texture, 12 to 18 ins. deep.
 No timber.
 Undergrowth, scattering mesquite and catclaw.
 Scattering short grass.

40.00 N. 89° 55' W., on a random line, bet. secs. 27 and 34.
 Set temp. $\frac{1}{4}$ sec. cor.
 80.00 Fall 19 lks. S. of the original cor. of secs. 27, 28, 33 and 34, which is a quartz stone, 10x10x8 ins. above ground, firmly set, marked and witnessed as described by the Surveyor General.
 Thence
 S. 89° 47' E., on a true line, bet. secs. 27 and 34.
 Descend gentle E. slope, through scattering undergrowth.
 40.00 Set an iron post, 3 ft. long, 1 in. in diam., 26 ins. in the ground, for $\frac{1}{4}$ sec. cor., marked on brass cap,

$\frac{1}{4}$ S 27
 S 34
 1915

12. Completion of the Subdivision of Township 14 South, R. 26 E.

Chains.

80.00 and raise a mound of stone, 3 ft. base, 2 ft. high, N. of cor.
 Thence over level land.
 The cor. of secs. 26, 27, 34 and 35.
 Land, level.
 Soil, light, sandy loam, coarse texture, 12 to 18 ins. deep.
 No timber.
 Undergrowth, scattering mesquite and catclaw, 4 to 6 ft. high.
 Short grass.

7.00 N. 0° 1' W., bet. secs. 26 and 27.
 18.15 Over level land, through scattering undergrowth.
 18.60 Wash, 50 lks. wide, course W.
 21.50 Wagon road from Wilcox to Dos Cabezas, brs. NW. and SE.
 28.46 Telephone line, brs. NW. and SE.
 Mascot and Western Railway brs. N. 73 1/4° W., and S. 73 1/4° E.
 Telephone line, brs. E. and W. Foot of hill brs. E. and W.
 Leave level land.
 38.12 Thence ascend SW. slope, 150 ft. to
 Top of hill, brs. E. 3 chs. dist. Descend NW slope, 150 ft. to
 40.00 Set an iron post, 3 ft. long, 1 in. in diam., 26 ins. in the ground for 1/4 sec. cor., marked on brass cap,
 S27 | S26
 1915

53.85 and raise a mound of stone 3 ft. base, 2 1/2 ft. high, W. of cor.
 Wash, 20 lks. wide, 3 ft. deep, course NW. Foot of slope.
 Thence over level land.
 80.00 Set an iron post 3 ft. long, 2 ins. diam., 24 ins. in the ground, for cor. of secs. 22, 23, 26 and 27, marked on brass cap,
 T14S R26E
 S22 | S23
 S27 | S26
 1915

and raise a mound of stone, 3 ft. base, 2 1/2 ft. high, W. of cor.
 Land, rolling and level.
 Soil, from 28 chs. to 54 chs. thin and rocky, remainder, light, sandy, coarse texture.
 No timber.
 Undergrowth, scattering mesquite and catclaw.
 Short grass.

40.00 S. 89° 57' E., on a random line, bet. secs. 23 and 26.
 79.93 Set temp. 1/4 sec. cor.
 Intersect N. and S line, 5 lks. S. of cor. of secs. 23, 24, 25, and 26.
 Thence
 N. 89° 59' W., on a true line, bet. secs. 23 and 26.
 27.14 Ascend rocky NE. slope, 330 ft. to
 Rocky ridge, brs. NW. and SE. Descend SW. slope.
 39.96 1/2 Set an iron post, 3 ft. long, 1 in. in diam., 26 ins. in the ground, for 1/4 sec. cor., marked on brass cap,
 S 23
 S 26
 1915

42.59 and raise a mound of stone, 3 ft. base, 2 1/2 ft. high, N. of cor. Continue descent of SW. slope.
 Gulch, 20 lks. wide, 10 ft. deep, course SW. Continue

Chains.

60.00 descent.
Foot of descent, brs. NW. and SE. 650 ft. below top of ridge at 27.14 chs. point. Thence over level land.
79.93 The cor. of secs. 22, 23, 26 and 27.
Land, mountainous, and level.
Soil, thin and rocky.
No timber.
No undergrowth.
Short grass.

40.00 N. 89° 47' W., on a random line, bet. secs. 22 and 27.
Set temp. $\frac{1}{4}$ sec. cor.
79.95 Intersect N. and S^W line, 7 lks. S. of original cor. of secs. 21, 22, 27 and 28, which is a granite stone, 10x9x6 ins., above ground, firmly set, marked and witnessed, as described by the Surveyor General.

Thence
39.97 $\frac{1}{2}$ S 89° 44' E., on a true line, bet. secs. 22 and 27.
Over level land, through scattering undergrowth.
Set an iron post 3 ft. long, 1 in. in diam., 26 ins. in the ground, for $\frac{1}{4}$ sec. cor., marked on brass cap,

$\frac{1}{4}$ S 22
S 27
1915

79.95 and raise a mound of stone, 3 ft. base, 2 ft. high, N. of cor.
The cor. of secs. 22, 23, 26 and 27.
Land, level.
Soil, light, sandy loam, coarse texture, 12 to 18 ins. deep.
No timber.
Undergrowth, scattering mesquite and catclaw.
Short grass.

20.00 N. 0° 1' W., bet. secs. 22 and 23.
Over level land, through scattering undergrowth.
Foot of slope, brs. NW. and SE. Leave level land; ascend 200 ft. to
31.44 Spur, slopes NW. Descend NW. slope, 115 ft. to $\frac{1}{4}$ sec. cor.
37.70 Wash, 20 lks. wide, 2 ft. deep, course NW. Continue descent.
40.00 Set an iron post, 3 ft. long, 1 in. in diam., 26 ins. in the ground, for $\frac{1}{4}$ sec. cor., marked on brass cap,

$\frac{1}{4}$
S 22 | S 23
1915

59.57 and raise a mound of stone, 3 ft. base, 2 $\frac{1}{2}$ ft. high, W. of cor. Ascend 250 ft. to
76.72 Spur slopes NW. Descend 226 ft. to
Wash, 80 lks. wide, 4 ft. deep, course NW. Thence over level land.
80.00 Set an iron post 3 ft. long, 2 ins. in diam., 24 ins. in the ground, for cor. of secs. 14, 15, 22 and 23, marked on brass cap,

T14S R26E
S15 | S14
S22 | S23
1915

and raise a mound of stone 3 ft. base, 3 ft. high, W. of cor.
Land, mountainous and level.

14. Completion of the Subdivision of T. 14 S., R. 26 E.

Chains.

Soil, thin and rocky.
No timber.
Undergrowth, scattering mesquite and catclaw.
Short grass.

40.00 S 89°59'E., on a random line, bet. secs.14 and 23.
Set temp. $\frac{1}{4}$ sec.cor.
79.98 Intersect N.and S. line, 7 lks.N.of cor.of secs.13,14,23
and 24.

Thence
N.89°56'W., on a true line, bet. secs.14 and 23.
Over rolling land, through scattering undergrowth. Descend
46 ft.to
10.00 Wash, 80 lks.wide, 10 ft. deep, course WSW. Ascend 30 ft.
to
24.00 Spur slopes SW. Descend gradually to
39.99 Set an iron post 3 ft.long, 1 in. in diam., 26 ins. in
the ground, for $\frac{1}{4}$ sec.cor., marked on brass cap,

S 14
S 23
1915

and raise a mound of stone, 3 ft. base, 2 ft. high,N.
of cor. Thence over level land.
43.20 Dim wagon road, brs.N and S.
79.98 The cor.of secs.14,15,22 and 23.
Land,rolling and level.
Soil, thin and rocky.
No timber.
Undergrowth, scattering mesquite and catclaw.
Short grass.

N.0°1'W., bet. secs. 14 and 15.
Over rolling, rocky land, through scattering undergrowth.
Ascend SW. slope.
15.09 Wagon road brs.NE. and SW.
35.00 Wash, 25 lks.wide, 2 ft. deep, course SW. Continue ascent
of SW.slope.
40.00 Set an iron post, 3 ft.long, 1 in. in diam., 26 ins. on
the ground, for $\frac{1}{4}$ sec.cor., marked on brass cap,

S15 | S14
1915

and raise a mound of stone, 3 ft. base, 2 $\frac{1}{2}$ ft.high, W.
of cor. Continue ascent.
54.00 Wash, 40 lks.wide, 4 ft. deep, course SW. Continue ascent.
80.00 Set an iron post, 3 ft.long, 2 ins.in diam., 24 ins. in
the ground, for cor.of secs.10,11,14 and 15, marked
on brass cap,

T.14S R26E
S10 | S11
S15 | S14
1915

and raise a mound of stone, 3 ft. base, 2 $\frac{1}{2}$ ft. high,W.
of cor.
Land, rolling SW.slope.
Soil,thin and rocky.
No timber.
Undergrowth, scattering mesquite and catclaw.
Short grass.

Completion of the Subdivision of Township 14 S. R. 26 E. 25.

Chains. S.89°56'E., on a random line, bet. secs.11 and 14.
 40.00 Set temp. $\frac{1}{4}$ sec.cor.
 79.68 Intersect N.and S. line, 23 lks.S.of the cor.of secs.11,12,
 13 and 14.
 Thence
 S.89°54'W., on a true line, bet. secs. 11 and 14.
 Over mountainous land.
 Descend NW. slope, 124 ft.to
 5.10 Wash, 50 lks.wide, 3 ft. deep, course SW. Road in bed
 of this wash, brs.NE. and SW.
 Thence along rocky S.slope.
 39.84 Set an iron post 3 ft.long, 1 in. in diam., 26 ins. in
 the ground, for $\frac{1}{4}$ sec.cor., marked on brass cap,

S 11
 S 14
 1915

and raise a mound of stone, 3 ft.base, 3 ft.high,N.of
 cor.
 78.90 Dim road brs.N.and S.
 79.68 The cor.of secs.10,11,14 and 15.
 Land, mountainous.
 Soil,thin and rocky.
 No timber.
 No undergrowth.
 Scattering short grass.

N.0°1'W., bet. secs. 10 and 11.
 Over rolling land.
 9.50 Wash,30,lks.wide, 5 ft. deep, course NW.
 18.10 Dim wagon road, brs.NW. and SE. Leave rolling land. Enter
 mountainous land. Ascend SW.slope, 110 ft.to
 29.86 Spur slopes W. Thence along NW. slope, descending.
 30.30 Mitchell's house brs.N.49°W. in a fenced enclosure con-
 taining about 15 acres.
 40.00 Set an iron post, 3 ft.long, 1 in. in diam., 26 ins. in
 the ground, for $\frac{1}{4}$ sec.cor., marked on brass cap,

S10|S11
 1915

and raise a mound of stone, 3 ft. base, 3 ft.high,W.
 of cor.
 40.83 Wire fence brs.E and W. connects on the west with Mitch-
 ell's fenced land.
 50.00 Rocky gulch, 50 lks.wide, 15 ft. deep, course SW.
 Ascend S.slope, 790 ft. to sec.cor.
 52.46 Pipe line, brs. E.and W. extends from concrete reservoir,
 W.10 chs.dist. to spring E. about 15 chs.dist.
 80.00 Set an iron post, 3 ft.long, 2 ins. in diam., 14 ins. in
 the ground to solid rock, in a mound of stone, for cor.
 of secs. 2,3,10 and 11, marked on brass cap,

T14S R26E
 S3 | S2
 S10 | S11
 1915

from which,
 A cedar, 26 ins. in diam., brs.S~84°E.,112
 lks.dist., marked T 14 S R 26 E S 11 BT.
 No other trees within limits.
 Raise a mound of stone, 3 ft. base, 3 ft. high, W.of cor.
 Land, rolling and mountainous.
 Soil, thin and rocky.
 No timber.
 No undergrowth,
 Scattering short grass.

Chains.

N.89° 54' E., on a random line, bet. secs.2 and 11.
 40.00 Set temp. $\frac{1}{4}$ sec.cor.
 79.58 Intersect N.and S. line, 20 lks.S.of cor.of secs. 1,2,
 11 and 12.

Thence
 S.89°45'W., on a true line, bet. secs.2 and 11.
 Ascend NE. slope, 350 ft.to
 19.60 Dos Cabezas ridge, brs.NW. and SE. Descend W. slope,
 985 ft.to
 39.79 Set an iron post 3 ft.long, 1 in. in diam., 26 ins. in
 the ground, for $\frac{1}{4}$ sec.cor., marked on brass cap,

$\frac{1}{4}$ S 2
 S 11
 1915

and raise a mound of stone, 2 ft.base, 2 ft.high,N.of
 cor.
 62.15 Gulch, 50 lks.wide, 10 ft. deep, course SW. Ascend 375
 ft.to
 78.10 Spur slopes S. Thence along SW.slope; descend 50 ft.to
 79.58 The cor.of secs.2,3,10 and 11.
 Land, mountainous.
 Soil, thin and rocky.
 No timber.
 No undergrowth.
 Scattering growth of short grass.

N.0° 1'W., on a random line, bet. secs. 2 and 3.
 40.00 Set temp. $\frac{1}{4}$ sec.cor.
 81.73 Intersect N. bdy. of Tp. 12 lks. E of reestablished cor.
 of secs. 2,3, 34 and 35, described in Book "E."
 Thence
 S.0°7'E., on a true line, bet. secs. 2 and 3.
 Over mountainous land.
 Ascend NE. slope 625 ft.to top of ridge.
 5.09 Wire fence brs.NW. and SE.
 8.03 Wire fence hrs.NE. and SW.
 13.40 Gulch, 15 lks.wide, 3 ft. deep, course NE.
 25.37 Dos Cabezas ridge brs.NW. and SE. Descend SW.slope,
 377 ft.
 41.73 Set an iron post, 3 ft.long, 1 in. in diam., 26 ins. in
 the ground for $\frac{1}{4}$ sec.cor., marked on brass cap,

$\frac{1}{4}$
 S 3 | S 2
 1915

and raise a mound of stone, 2 ft.base, 2 ft.high,W.
 of cor.
 46.10 Wash, 15 lks.wide, 3 ft.deep, course SW. Ascend NW.slope
 185 ft.to
 59.92 Rocky knoll. Descend 288 ft. to
 81.73 The cor.of secs.2,3,10 and 11.
 Land, mountainous.
 Soil, thin and rocky.
 No timber.
 No undergrowth.
 Short grass.

From the original cor.of secs. 21,22,27 and 28,herein-
 before described.
 N.0° 2'W., bet. secs. 21 and 22.
 Over level land, through scattering undergrowth.
 40.00 Set an iron post, 3 ft.long, 1 in. india., 26 ins. in
 the ground, for $\frac{1}{4}$ sec.cor., marked on brass cap,

Completion of the Subdivision of T.14 S., R26 E. 17.

Chains.

$$\frac{1}{4}$$

S21		S22
1915		

49.85 and raise a mound of stone, 3 ft. base, 3 ft. high, W.
of cor.
80.00 Wagon road brs. NE. and SW.
Set an iron post, 3 ft. long, 2 ins. in diam., 24 ins. in
the ground, for cor. of secs. 15, 16, 21 and 22, marked
on brass cap,

T14S R26E		
S16		S15
S21		S22
1915		

and raise a mound of stone, 3 ft. base, 3 ft. high,
W. of cor.
Land, level.
Soil, light, sandy loam, coarse texture, 12 to 18 ins.
deep.
No timber.
Undergrowth, mesquite and catclaw, 3 to 4 ft. high.

40.00 S. 89° 44' E., on a random line, bet. secs. 15 and 22.
Set temp. $\frac{1}{4}$ sec. cor.

79.94 Intersect N. and S. line, 7 lks. N. of cor. of secs. 14, 15,
22 and 23.

Thence

N. 89° 41' W., on a true line, bet. secs. 15 and 22.

Over level land, through dense undergrowth.

3.60 Wash, 60 lks. wide, 5 ft. deep, course NW.

32.50 Wagon road, brs. NE. and SW.

39.97 Point for $\frac{1}{4}$ sec. cor. falls in bend of wash from ENE. to
WNW. Impracticable to set cor. at this point; there-
fore, at

41.07 Set an iron post 3 ft. long, 1 in. in diam., 26 ins. in
the ground, for witness cor. to $\frac{1}{4}$ sec. cor., marked
on brass cap,

S 15	WC
S 22	
1915	

76.40 and raise a mound of stone, 3 ft. base. 2 $\frac{1}{2}$ ft. high,
N. of cor.

Old wagon road brs. NW. and SE.

79.94 The cor. of secs. 15, 16, 21 and 22.

Land, level.

Soil, light, sandy loam, coarse texture, 12 to 18 ins. deep.

No timber.

Undergrowth, scattering mesquite and catclaw, 6 to 8 ft.
high.

Scattering short grass.

40.00 N. 89° 50' W., on a random line, bet. secs. 16 and 21.
Set temp. $\frac{1}{4}$ sec. cor.

80.11 Intersect N. and S. line, 12 lks. S. of the original cor.
of secs. 16, 17, 20 and 21, which is a granite stone
8x6x6 ins. above ground, firmly set, marked and wit-
nessed as described by the Surveyor General.

Thence

S. 89° 45' E., on a true line, bet. secs. 16 and 21.

Over level land, through scattering undergrowth.

2.00 Road brs. NE. and SW.

9.17 Old wagon road brs. NE. and SW.

40.05 Set an iron post 3 ft. long, 1 in. in diam., 26 ins. in

18. Completion of the Subdivision of Township 14 South Range 26 E

Chains.

the ground, for $\frac{1}{4}$ sec.cor., marked on brass cap

$\frac{1}{4}$ S 16
S 21
1915

and raise a mound of stone, 3 ft. base, $2\frac{1}{2}$ ft. high, N.of cor.

46.80 Old wagon road brs.NW. and SE.
75.90 Old wagon road brs.NW. and SE.
80.11 The cor.of secs.15,16,21 and 22.
Land,level.
Soil, light, sandy loam, coarse texture, 12 to 18 ins. deep.
No timber.
Undergrowth, scattering mesquite and catclaw, 4 to 6 ft.h high.
Scattering short grass.

N.0°2'W. bet. secs. 15 and 16.

Over level land,through scattering undergrowth.

.75 Old wagon road,brs. NW. and SE.
1.50 Wash, 20 lks.wide, 3 ft. deep, course W.
8.00 Rocky wash,70 lks.wide,3 ft.deep,course W.
22.40 Rocky wash,150 lks.wide, 3 ft. deep,course W.
40.00 Set an iron post,3 ft.long,1 in.in diam.,26 ins.in the ground, for $\frac{1}{4}$ sec.cor., marked on brass cap,

$\frac{1}{4}$
S16|S15
1915

and raise a mound of stone, $2\frac{1}{2}$ ft.base, 2 ft.high,W. of cor.

47.00 Wash, 20 lks.wide, 3 ft. deep, course NW.
80.00 Set an iron post, 3 ft.long, 2 ins. in diam., 24 ins. in the ground, for cor.of secs.9,10,15 and 16, marked on brass cap,

T14S R26E
S 9|S 10
S16|S15
1915

and raise a mound of stone, 3 ft. base. 3 ft. high,W. of cor.

Land level.
Soil, light, sandy loam, coarse texture,12 to 18 ins.deep.
No timber.
Undergrowth, mesquite and catclaw, 4 to 5 ft.high.
Short grass.

Thence

40.00 S.89° 41' E., on a random line, bet. secs.10 and 15.
79.93 Set temp. $\frac{1}{4}$ sec.cor.
Intersect N.and S. line, 3 lks.S. of cor.of secs.10,11,14 and 15.

Thence

39.96 $\frac{1}{2}$ N.89°42' W.,on a true line, bet. secs.10 and 15.
Over gently rolling land.
Descend W. slope, through scattering undergrowth.
Set an iron post, 3 ft.long, 1 in. in diam., 26 ins. in the ground, for $\frac{1}{4}$ sec.cor., marked on brass cap,

$\frac{1}{4}$ S 10
S.15
1915

Completion of the Subdivision of Township 14 South Range 26 E. 19

Chains

and raise a mound of stone, 3 ft. base, 3 ft. high, N. of cor.
 56.40 Wash, 30 lks. wide, 5 ft. deep, course SW.
 78.70 Same wash, 40 lks. wide, 4 ft. deep, course NW.
 79.93 The cor. of secs. 9, 10, 15 and 16.
 Land, rolling.
 Soil, light, sandy loam, coarse texture, 12 to 18 ins. deep.
 No timber.
 Undergrowth, scattering mesquite and catclaw, 4 to 6 ft. high.
 Scattering short grass.

N. 89° 45' W. on a random line, bet. secs. 9 and 16.
 40.00 Set temp. $\frac{1}{4}$ sec. cor.
 80.09 Intersect N. and S. line, 9 lks. S. of original cor. of secs. 8, 9, 16 and 17, which is a malpais stone, 5x8x6 ins. above ground, firmly set, marked and witnessed as described by the Surveyor General.
 Thence I
 S. 89° 41' E., on a true line, bet. secs. 9 and 16.
 Over slightly rolling land.
 Ascend gentle W. slope, through scattering undergrowth.
 .60 Dim wagon road brs. NW. and SE.
 11.89 Wagon road brs. NE. and SW.
 27.74 Wash, 40 lks. wide, 5 ft. deep, course SW.
 40.04 $\frac{1}{2}$ Set an iron post 3 ft. long, 1 in. in diam., 26 ins. in the ground, for $\frac{1}{4}$ sec. cor., marked on brass cap,

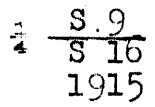

and raise a mound of stone, 2 ft. base, 2 ft. high, N. of cor.
 70.00 Wash, 20 lks. wide, 3 ft. deep, course SW.
 80.09 The cor. of secs. 9, 10, 15 and 16.
 Land, slightly rolling.
 Soil, light, sandy loam, coarse texture, 12 to 18 ins. deep.
 No timber.
 Undergrowth, mesquite and catclaw, 4 to 6 ft. high.
 Scattering short grass.

N. 0° 2' W., bet. secs. 9 and 10.
 Over rolling land, through scattering undergrowth.
 .40 Wash, 30 lks. wide, 2 ft. deep, course W.
 7.55 Rocky wash, 20 lks. wide, 2 ft. deep, course W.
 18.50 Rocky wash, 10 lks. wide, 1 ft. deep, course W.
 22.50 Wagon road, brs. E. and W.
 33.30 Wash, 30 lks. wide, 3 ft. deep, course W.
 40.00 Set an iron post, 3 ft. long, 1 in. in diam., 26 ins. in the ground, for $\frac{1}{4}$ sec. cor., marked on brass cap,

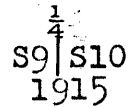

and raise a mound of stone, 3 ft. base, 2 ft. high, W. of cor.
 55.39 Rocky wash, 10 lks. wide, 1 ft. deep, course SW.
 60.55 Rocky wash, 10 lks. wide, 1 ft. deep, course SW.
 66.13 Rocky wash, 40 lks. wide, 8 ft. deep, course SW.
 80.00 Set an iron post 3 ft. long, 2 ins. in diam., 24 ins. in the ground, for the cor. of secs. 3, 4, 9 and 10, marked on brass cap,

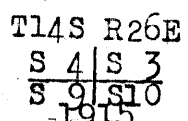

20. Completion of the Subdivision of Township 14 S. R. 26 E.

Chains.	<p>and raise a mound of stone, 3 ft. base, 2½ ft. high, W. of cor. Land, rolling. Soil, sandy and rocky, coarse texture, 10 to 12 ins. deep. No timber. Undergrowth, mesquite and catclaw, 4 to 5 ft. high. Short grass.</p>
40.00 79.84	<p>S.89°42'E., on a random line, bet. secs.3 and 10. Set temp.¼ sec.cor. Intersect the cor.of secs. 2,3, 10 and 11. Thence N.89° 42' W., on a true line, bet. secs.3 and 10. Over mountainous land. Ascend steep rocky SE. slope. Spur, slopes SW. Descend SW. slope. Rocky gulch, 40 lks.wide, course SW. Continue descent. Set an iron post, 3 ft.long, 1 in. in diam., 26 ins. in the ground, for ¼ sec.cor., marked on brass cap,</p>
8.57 33.50 39.92	<p style="text-align: center;"> $\frac{1}{4} \frac{S 3}{S 10}$ 1915 </p>
67.77 79.84	<p>and raise a mound of stone 3 ft. base, 3 ft. high, N. of cor. Continue descent over SW. slope. Rocky wash, 70 lks.wide, 8 ft. deep, course SW. Continue descent. The cor.of secs.3,4,9 and 10, 1010 ft. below spur at 8.57 chain point. Land, mountainous. Soil, thin and rocky. No timber. No undergrowth. Scattering short grass.</p>
40.00 81.32	<p>N.0° 2'W., on a random line, bet. secs. 3 and 4. Set temp.¼ sec.cor. Intersect N. bdy. of Tp.26 lks.E. of reestablished cor.of secs. 3,4,33 and 34, described in Book "E." Thence</p>
14.57 18.42 31.80 38.45 41.32	<p>S.0° 13' E., on a true line, bet. secs.3 and 4. Over mountainous land. Descend SE. slope, 410 ft.to Gulch, 50 lks.wide, 10 ft.deep, course SW. Ascend NW. slope, 170 ft. to top of ridge. Old wagon road, brs.NE. and SW. Ridge, brs.NE. and SW. slopes SW. Descend SE.slope,140 ft. to Rocky wash, 20 lks.wide, 3 ft. deep, course SW. Ascend NW. slope, 50 ft.to summit of spur. Set an iron post 3 ft.long, 1 in. in diam., 16 ins. in the ground, to solid rock, in a mound of stone, for ¼ sec.cor., marked on brass cap,</p>
45.28 74.53 81.32	<p style="text-align: center;"> $\frac{1}{4} \frac{S4 S3}{1915}$ </p> <p>and raise a mound of stone 3 ft. base, 3 ft. high, W. of cor. Summit of spur slopes W. Descend SW. slope, 480 ft. to cor. Wash, 15 lks.wide, 3 ft. deep, course SW. Continue descent. The cor.of secs.3,4,9 and 10. Land, mountainous. Soil, thin and rocky. No timber. No undergrowth. Short grass.</p>

Completion of the Subdivision of Township 14 S., R. 26 E. 21.

Chains.

From the original cor. of secs.8,9,16 and 17, hereinbefore described,

N.0°2'W., bet. secs.8 and 9.

Over level land, through scattering undergrowth.

Dim wagon road, brs.NW. and SE.

.75
40.00 Set an iron post 3 ft.long, 1 in. in diam., 26 ins. in the ground, for $\frac{1}{4}$ sec.cor., marked on brass cap,

$\frac{1}{4}$
S 8 | S 9
1915

and raise a mound of stone, 2 $\frac{1}{2}$ ft. base, 2ft. high,W. of cor.

80.00 Set an iron post, 3 ft.long, 2 ins. in diam., 24 ins. in the ground, for cor.of secs.4,5, 8 and 9, marked on brass cap,

T14 S R26 E
S 5 | S 4
S 8 | S 9
1915

and raise a mound of stone, 3 ft. base, 2 ft. high,W. of cor.

Land,level.

Soil, light, sandy loam, coarse texture, 12 to 18 ins. deep.

No timber.

Undergrowth, mesquite and catclaw.

Short grass.

S. 89° 41' E., on a random line, bet. secs.4 and 9.

40.00 Set temp. $\frac{1}{4}$ sec.cor.

80.04 Intersect N.and S. line, 3 lks.N.of cor.of secs.3,4,9 and 10.

Thence

N.89°40'W.,on a true line, bet. secs.4 and 9.

40:00 Over rolling land.

Descend gentle SW.slope, through scattering undergrowth.

12.54 Enter wash, 40 lks.wide, course W.;thence through bed of wash, to

30.10 Leave wash, course SW.

38.14 Wash, 30 lks.wide, 3 ft. deep, course SW.

40.02 Set an iron post, 3 ft. long, 1 in. in diam., 26 ins. in the ground, for $\frac{1}{4}$ sec.cor., marked on brass cap,

$\frac{1}{4}$ S 4
S 9
1915

and raise a mound of stone, 2 ft. base, 1 $\frac{1}{2}$ ft. high,N. of cor.

55.06 Wash, 50 lks.wide, 4 ft. deep, course SW.

80.04 The cor.of secs.4,5,8 and 9.

Land, rolling.

Soil, light, sandy loam, coarse texture, 12 to 18 ins. deep.

No timber.

Undergrowth, mesquite and catclaw; 4 to 6 ft. high.

Short grass.

The original cor. of secs.5,6,7 and 8, being plainly visible,

N.89° 39' W., on a random line, bet. secs. 5 and 8,for said cor.

22. Completion of the Subdivision of Township 14 South, Range 26 E

Chains.

40.00 Set temp. $\frac{1}{4}$ sec. cor.
 79.78 Intersect the original cor. of secs. 5, 6, 7 and 8, which is a pine post, 18x4x4 ins. above ground, with marks nearly obliterated. Pits and mound obliterated. This cor. being in a dilapidated condition, I destroy all trace of it, and reestablish it in the same place as follows:
 Set an iron post, 3 ft. long, 2 ins. in diam., 24 ins. in the ground, for cor. of secs. 5, 6, 7 and 8, marked on brass cap,

T14S R26E
 S 6 | S 5
 S 7 | S 8
 1915

dig pits, 18x18x12 ins. in each sec. $5\frac{1}{2}$ ft. dist., and raise a mound of earth, 4 ft. base, 2 ft. high, W. of cor.

Thence

S. $89^{\circ} 39'$ E. on a true line, bet. secs. 5 and 8.

Over level land, through scattering undergrowth.

39.89 Set an iron post, 3 ft. long, 1 in. in diam., 26 ins. in the ground, for $\frac{1}{4}$ sec. cor., marked on brass cap,

$\frac{1}{4}$ S 5
 S 8
 1915

dig pits, 18x18x12 ins., E. and W. of post, 3 ft. dist., and raise a mound of earth, $3\frac{1}{2}$ ft. base, $1\frac{1}{2}$ ft. high, N. of cor.

78.00 Wash, 50 lks. wide, 2 ft. deep, course SW.

79.78 The cor. of secs. 4, 5, 8 and 9.

Land, level.

Soil, light, sandy loam, coarse texture, 12 to 18 ins. deep.

No timber.

Undergrowth, scattering mesquite and catclaw, 4 to 6 ft. high.

Scattering short grass.

N. $0^{\circ} 2'$ W., on a random line, bet. secs. 4 and 5.

40.00 Set temp. $\frac{1}{4}$ sec. cor.

80.64 Intersect the N. bdy. of Tp. 26 lks. E. of the reestablished cor. of secs. 4, 5, 32 and 33, described in Book "E."

Thence

S. $0^{\circ} 13'$ E. on a true line, bet. secs. 4 & 5. Over rolling land.

Ascend 40 ft. along W. slope.

2.62 Rocky wash, 8 lks. wide, 1 ft. deep, course W.

9.30 Spur slopes W.; descend SW. slope, 80 ft. to

15.54 Wash, 40 lks. wide, 2 ft. deep, course SW. Descend gentle SW. slope.

40.64 Set an iron post, 3 ft. long, 1 in. in diam.; 26 ins. in the ground, for $\frac{1}{4}$ sec. cor., marked on brass cap,

$\frac{1}{4}$
 S 5 | S 4
 1915

and raise a mound of stone, 3 ft. base, 2 ft. high, W. of cor.

78.54 Wash, 50 lks. wide, 2 ft. deep, course SW.

80.64 The cor. of secs. 4, 5, 8 and 9.

Land, rolling.

Soil, thin and rocky.

No timber.

Undergrowth, mesquite and catclaw, 3 to 6 ft. high.

Short grass.

GENERAL DESCRIPTION.

This township consists of rolling land in its western half, and rough and mountainous land in its eastern half. The soil in the west half is a coarse sandy loam, ranging in depth from 12 to 18 ins. That in the east half is thin and rocky. Practically all of the township produces a growth of short grass, which, in addition to a growth of mesquite brush, 4 to 6 ft. high, affords good grazing for stock.

A scattering growth of scrub oak and juniper trees, suitable for posts & fuel was found on the mountains in the east half of this township.

Three springs of water were found in this township; they are located as follows: in the SW $\frac{1}{4}$ of the NW $\frac{1}{4}$ of sec. 11, in the SW $\frac{1}{4}$ of the SE $\frac{1}{4}$ of sec. 13, and in the SW $\frac{1}{4}$ of the NW $\frac{1}{4}$ of sec. 25.

The Mascot and Western Railway crosses the southern part of this township.

A great deal of prospecting has been done along the Dos Cabezas Mountains, in the eastern half of this township.

Top Mitchell has a small cattle ranch in sec. 11. There is also an unoccupied house in sec. 25.

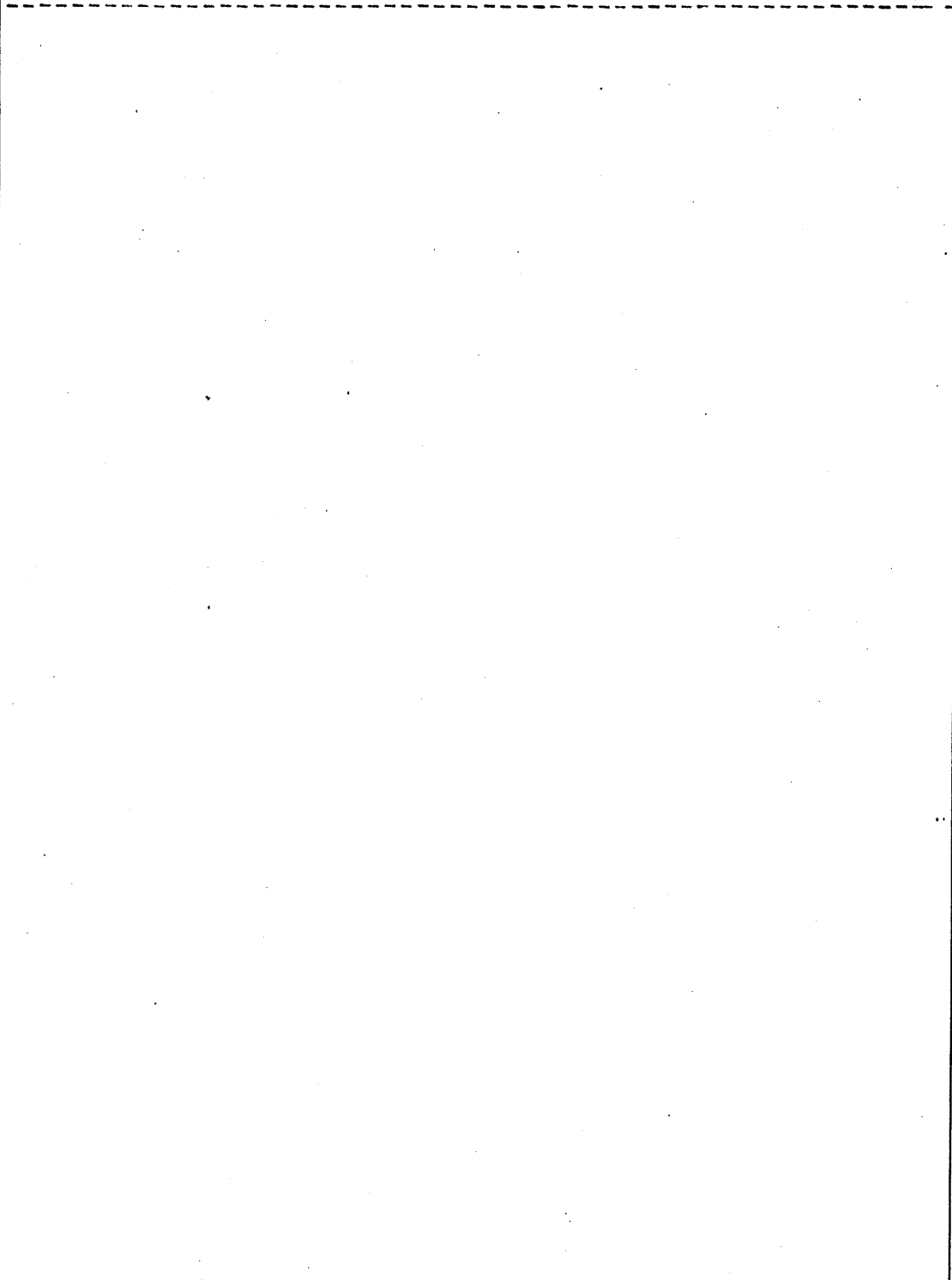

CERTIFICATE OF UNITED STATES SURVEYOR.

BOOK 2971

I, Thomas B. Matthews, U. S. Surveyor, hereby certify on honor, that, in pursuance of special instructions received from the United States Surveyor General for Arizona for Group 35, Arizona, bearing date of the 3rd day of June, 1915, I have well, faithfully, and truly, in my own proper person, and in strict conformity with said instructions, the Manual of Surveying Instructions, and the laws of the United States, resurveyed all those parts or portions of the East boundary, and surveyed all those parts or portions of the Subdivision lines of Township 14 South, Range 26 East,

of the Gila and Salt River Base and Meridian, in the State of Arizona, which are represented in the foregoing field notes as having been executed by me, and under my direction; and I do further certify on honor, that all the corners of said resurvey and survey have been reestablished or established and perpetuated in strict accordance with the Manual of Surveying Instructions, and the special written instructions of the U. S. Surveyor General for Group 35, Arizona, and in the specific manner described in the field notes, and that the foregoing are the original field notes of such resurvey and survey.

Thomas B. Matthews
U. S. Surveyor.

A P P R O V A L .

OFFICE OF UNITED STATES SURVEYOR-GENERAL.

Phoenix Arizona Sept. 18. 1917.

The foregoing field notes of the resurvey of the East boundary, and Survey of the completion of the Subdivision lines of

TOWNSHIP 14 SOUTH, RANGE 26 EAST,

of the Gila and Salt River Base and Meridian, in the State of Arizona, executed by Thomas B. Matthews, U. S. Surveyor, under his special instructions dated June 3, 1915, for Group 35, Arizona, having been critically examined, and the necessary corrections and explanations made, the said field notes, and the resurveys and surveys they describe, are hereby approved.

Frank D. Frost
U. S. Surveyor General of Arizona.