

2983

4-679

Book "G."

BOOK 2983

Subdivisions

FIELD NOTES

RE-
OF THE SURVEY OF PART

of the

SUBDIVISION LINES OF

TOWNSHIP 10 NORTH, RANGE 19 EAST.

Of the Gila and Salt River Base and Meridian,

In the State of Arizona.

EXECUTED BY

Sidney E. Blout,

In the capacity of U. S. Surveyor, under instructions dated December 16, 1914,
issued by the United States Surveyor General to govern surveys included in
Group No. 40, which were approved by the Commissioner of the General Land
Office, January 27, 1914.

Re- Survey commenced May 19, 1915.

Re- Survey completed June 6, 1915.

2983

2983

23

1

1A

Book "G"

Group 40 - - - Arizona.

BOOK 2983

Book "G."

INDEX DIAGRAM.

Township 10 North, Range 19 East.

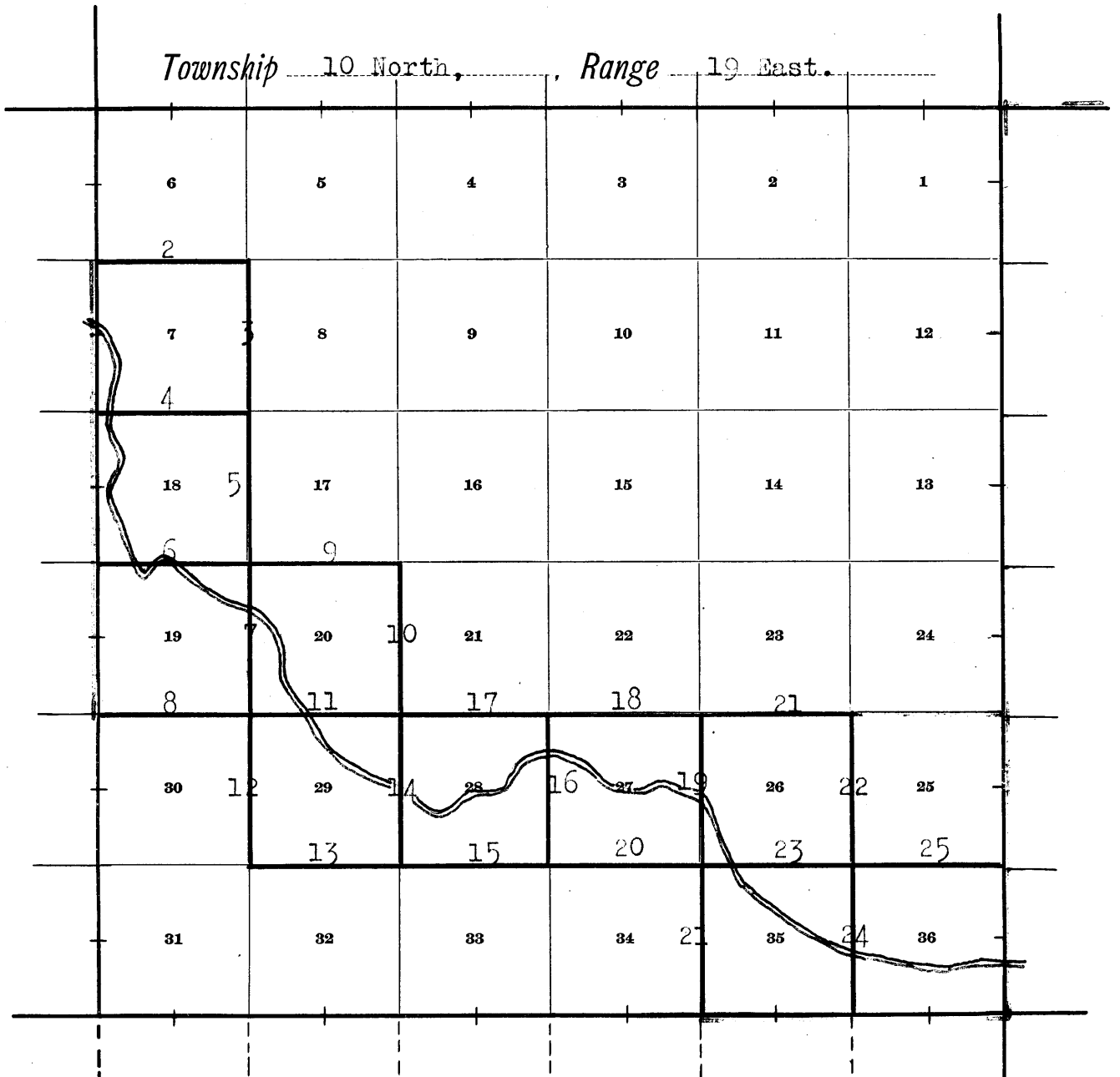

6-151

Subdivision lines retraced or resurveyed.
Notes in this book.

Township boundaries retraced or resurveyed
Notes in Book "A."

North bdy. of Ft. Apache Indian Reservation retraced.
Notes in Book "B."

Accepted surveys.

Unsurveyed lines.

Chains.

Resurvey commenced May 19, 1915, and executed with a Young and Sons' light mountain transit No. 10, described in book "A."

I examine the adjustments of the transit and correct slight errors of the plate levels and line of collimation; then, in order to test the solar apparatus by comparing its indications resulting from solar observations made during a.m. and p.m. hours with a meridian established by observations on Polaris, I proceed as follows:

At my camp, which is located near the cor. of secs. 1, 2, 35 and 36, Ts. 11 and 12 N., R. 18 E.; latitude, $34^{\circ}16\frac{1}{2}'N.$; longitude, $110^{\circ}23'45''W.$, I set off $34^{\circ}16\frac{1}{2}'N.$ on the lat. arc; $19^{\circ}42\frac{1}{2}'N.$ on the decl. arc, and determine a meridian with the solar, and mark a point thereof by a tack driven in a stake set firmly in the ground, 5 chs. N. of my instrument.

At 6h. 52m. p.m., by my watch, which is correct local mean time, I observe Polaris in accordance with instructions in the Manual, and mark the direction thus determined by a tally pin driven in a stake set in the ground, 5 chs. N. of my instrument.

Time of observation May 19, 1915,	6h. 52m. p.m.
Time of U.C. Polaris May 19, 1915 for the meridian of Greenwich, civil date and mean time	9h. 44.4m. a.m.
Correction to local meridian (subtract)	<u>1.2</u>
U.C. Polaris May 19, local meridian	9 43.2
Hour angle of Polaris at observation	9h. 08.8m.
Azimuth of Polaris	$0^{\circ}55.3'$ West.

May 19, 1915.

May 20, 1915. At 6h. a.m., I lay off the azimuth of Polaris $0^{\circ}55.3'$ to the east, and mark the meridian thus determined by a tally pin driven in the stake set last evening on which the meridian falls 0.4 ins. E. of the point determined by the solar.

At 6h. 57m. a.m., l.m.t., I set off $34^{\circ}16\frac{1}{2}'N.$ on the lat. arc; $19^{\circ}38'N.$ on the decl. arc, and determine a meridian with the solar, and mark a point thereof by a nail driven in the stake already set 5 chs. N. of my instrument. This point falls 0.5 ins. E. of the meridian established by the Polaris observation.

The solar apparatus by p.m. and a.m. observations defines positions for meridians respectively about $0'20''$ west and $0'26''$ east of the meridian established by the Polaris observation; therefore, I conclude that the adjustments of the instrument are satisfactory.

The magnetic bearing of the true meridian at 7 a.m. is $N.14^{\circ}10'W.$; the angle thus determined gives the magnetic decl. $14^{\circ}10'E.$

A 5 chain steel tape and clinometer are the instruments employed in the determination of all distances measured in this resurvey.

I begin at the old cor. of secs. 1, 6, 7 and 12, on W. bdy. of Tp., which is a sandstone $12 \times 10 \times 3$ ins. above ground, loosely set, marks almost obliterated, witnessed by one of the old bearing trees SE. of cor.

No trace can be found of the other bearing trees. Latitude at this cor. $34^{\circ}15'40''N.$; longitude, $110^{\circ}22'42''W.$

This cor. being in a state of dilapidation, I destroy and reestablish it in same place as follows:

Set an iron post 3 ft. long, 3 ins. in diam., 24 ins. in the ground for cor. of secs. 1, 6, 7 and 12, marked on brass cap,

- T 10 N in N., and
- 1915 in S. half;
- R 18 E S 1 in NW.,
- R 19 E S 6 in NE.,

2 Partial Resurvey of the Subdivision lines of T 10 N R 10 E

Chains

- S 7 in SE., and
S 12 in SW. quadrant; from which original bearing tree,
A pine, 16 ins. in diam., brs. S. $58^{\circ}E.$, 84 lks. dist.) marked T 10 N R 19 E S 7 B T.
- Establish new bearing trees as follows:
A pine, 10 ins. in diam., brs. N. $44^{\circ}E.$, 122 lks. dist., which I mark T 10 N R 19 E S 6 B T.
A pine, 14 ins. in diam., brs. S. $19\frac{1}{2}^{\circ}W.$, 74 lks. dist., which I mark T 10 N R 18 E S 12 B T.
A pine, 16 ins. in diam., brs. N. $21\frac{1}{2}^{\circ}W.$, 67 lks. dist., which I mark T 10 N R 18 E S 1 B T.
- At 8h. 45m. a.m., l.m.t., I set off $34^{\circ}15\frac{1}{2}'N.$ on the lat. arc; $19^{\circ}50\frac{1}{2}'N.$ on the decl. arc, and determine a meridian with the solar at the above described cor.
- Thence
N. $89^{\circ}45'E.$, on a random line, bet. secs. 6 and 7.
- 39.45 I make a diligent search for the old $\frac{1}{4}$ sec. cor., but can find no trace of it; therefore, continue line and measurement.
- 81.04 Fall 131 lks. S. of the old cor. of secs. 5, 6, 7 and 8, which is a sandstone $14 \times 10 \times 6$ ins. loosely set, marked and witnessed as described by the surveyor general. True course and dist. of line bet. secs. 6 and 7 is therefore S. $88^{\circ}50'W.$, 81.06 chs. This cor. being in a dilapidated condition, I reestablish it in same place as follows:
Reset the same stone, 10 ins. in the ground for cor. of secs. 5, 6, 7 and 8, marked with 5 notches on E. and S. edges, from which the original bearing trees:
An oak, 6 ins. in diam., brs. N. $38\frac{1}{2}^{\circ}E.$, 35 lks. dist., marked T 10 N R 19 E S 5 B T.
A pine, 10 ins. in diam., brs. S. $48\frac{1}{2}^{\circ}E.$, 59 lks. dist., marked T 10 N R 19 E S 8 B T. (this tree is dead).
A pine, 12 ins. in diam., brs. S. $38\frac{1}{2}^{\circ}E.$, 49 lks. dist., marked T 10 N R 19 E S 8 B T.
An oak, 6 ins. in diam., brs. S. $32^{\circ}W.$, 21 lks. dist., marked T 10 N R 19 E S 7 B T.
A pine, 12 ins. in diam., brs. N. $72\frac{1}{2}^{\circ}W.$, 68 lks. dist., marked T 10 N R 19 E S 6 B T.
- May 20, 1915.
May 21, 1915. At 9h. 56 $\frac{1}{2}$ m. a.m., l.m.t., I set off $34^{\circ}15\frac{1}{2}'N.$ on the lat. arc; $20^{\circ}04\frac{1}{2}'N.$ on the decl. arc; and determine a meridian with the solar at the above described cor.
- Thence
S. $88^{\circ}50'W.$ on a true line, bet. secs. 6 and 7.
Descend NW slope of spur, 100 ft. over stony, mountainous land, through heavy pine timber and brush.
- 15.00 Center of dry ravine, 15 lks. wide, course north; ascend E. slope of spur, 116 ft.
- 35.00 Top of spur, brs. N. and S.; descend W. slope, 121 ft.
- 40.81 (Proportional dist.) Set an iron post 3 ft. long, 1 in. in diam., 26 ins. in the ground for reestablished $\frac{1}{4}$ sec. cor., marked on brass cap,
 $\frac{1}{4}$ S 6 in N., and
S 7, 1915 in S. half; from which
A juniper 12 ins. in diam., brs. N. $51\frac{1}{2}^{\circ}E.$, 29 lks. dist., marked $\frac{1}{4}$ S 6 B T.
A pine, 12 ins. in diam., brs. S. $19\frac{3}{4}^{\circ}W.$, 6 lks. dist., marked $\frac{1}{4}$ S 7 B T.
- 48.27 Dry ravine, 10 lks. wide, course north; ascend 107 ft.
- 56.00 Top of spur, brs. N. and S.; descend W. slope, 90 ft.
- 65.17 Dry ravine, 10 lks. wide, course N. $10^{\circ}E.$; ascend 99 ft.
- 76.00 Top of spur, brs. N. $30^{\circ}E.$ and S. $30^{\circ}W.$; descend 82 ft.
- 81.06 Intersect the cor. of secs. 1, 6, 7 and 12, on W. bdy. of Tp., reestablished by me, as hereinbefore described. Land, mountainous, spurs steep, rocky, covered with oak and juniper brush.

Partial Resurvey of the Subdivision lines of T.10 N., R.19 E. 3.

Chains.

Soil, poor, dry stony clay loam 4 to 8 ins. deep on clay and sand stone subsoil.
May 21, 1915.

May 20, 1915. At 9h. 56¹/₂m. a.m., l.m.t., I set off 34° 15' N. on the lat.arc; 19° 51' N. on the decl.arc, and determine a meridian with the solar at the reestablished cor. of secs. 5, 6, 7 and 8.

Thence, South, on a random line, bet. secs. 7 and 8.

40.12 Fall 21 lks. W. of the old $\frac{1}{4}$ sec. cor., which is a sandstone 15x10x8 ins. lying on a mound of stone, marked and witnessed as described by the surveyor general. True course and dist. of N. $\frac{1}{2}$ bet. secs. 7 and 8 is therefore S. 0° 18' E., 40.12 chs.

From old $\frac{1}{4}$ sec. cor. described above, South, on a random line on S. $\frac{1}{2}$ bet. secs. 7 and 8.

39.95 Fall 5 lks. E. of the old cor. of secs. 7, 8, 17 and 18, which is a sandstone 10x10x2 ins. loosely set, marks almost obliterated, witnessed as described by the surveyor general.

True course and dist. of S. $\frac{1}{2}$ bet. secs. 7 and 8, is therefore S. 0° 4' W., 39.95 chs.

This cor. being in a dilapidated condition, I destroy and reestablish in same place as follows:

Set an iron post 3 ft. long, 2 ins. in diam., 24 ins. in the ground for cor. of secs. 7, 8, 17 and 18, marked on brass cap,

- T 10 N R 19 E in N., and
- 1915 in S. half;
- S 7 in NW.,
- S 8 in NE.,
- S 17 in SE. 1 and
- S 18 in SW. quadrant; from which the old

bearing trees

- A pine, 12 ins. in diam., brs. N. 65 $\frac{1}{2}$ ° E., 168 lks. dist., marked T 10 N R 19 E S 8 B T.
- A pine 24 ins. in diam., brs. S. 16 $\frac{1}{2}$ ° E., 131 lks. dist., marked T 10 N R 19 E S 17 B T.
- A pine, 12 ins. in diam., brs. S. 79 $\frac{1}{2}$ ° W., 43 lks. dist., marked T 10 N R 19 E S 18 B T.
- A pine, 8 ins. in diam., brs. N. 59 $\frac{1}{2}$ ° W., 75 lks. dist., marked T 10 N R 19 E S 7 B T.

At this cor., I set off 19° 52' N. on the decl. arc; and at apparent noon, observe the sun on the meridian, the resulting latitude being 34° 14 $\frac{1}{2}$ ' N.

May 20, 1915.

May 21, 1915. At 12h. 56¹/₂m. p.m., l.m.t., I set off 34° 14 $\frac{1}{2}$ ' N., on the lat. arc; 20° 06' N. on the decl. arc, and determine a meridian with the solar at the reestablished cor. of secs. 5, 6, 7 and 8.

Thence, S. 0° 18' E., on a true line, bet. secs. 7 and 8.

Ascend S. slope over stony, mountainous land, through heavy pine and juniper timber and brush.

- 3.00 Top of spur, 30 ft. above cor. brs. E. and W.; descend 128 ft.
- 21.85 Dry ravine, 15 lks. wide, course N. 60° E.; ascend 54 ft.
- 30.00 Top of spur, brs. E. and W.; descend 79 ft.
- 40.12 Intersect the old $\frac{1}{4}$ sec. cor. hereinbefore described, which I destroy, and reestablish in the same place as follows:

Reset the old stone 10 ins. in the ground for $\frac{1}{4}$ sec. cor., marked $\frac{1}{4}$ on W. face, from which the old bearing trees:

- An oak, 12 ins. in diam., brs. N. 44 $\frac{1}{2}$ ° E., 42 lks. dist., marked $\frac{1}{4}$ S 8 B T.
- A pine, 14 ins. in diam., brs. S. 58° E., 45 lks. dist., marked $\frac{1}{4}$ S 8 BT.

Thence, S. 0° 04' W., on a true line, on S. $\frac{1}{2}$, bet. secs. 6 and 8.

Over mountainous land, continuing descent from spurs.

- 2.85 Dry ravine, 15 lks. wide, course N. 60° E.; ascend NE. slope, 125 ft.

4. Partial Resurvey of the Subdivision lines of T. 10 N., R. 19 E.

- Chains.
 17.00 Top of spur, brs. N.40°E. and S.40°W.; descend. 93 ft.
 39.95 Intersect the reestablished cor. of secs. 7, 8, 17 and 18, hereinbefore described.
 Land, mountainous, spurs steep, rocky, covered with heavy juniper and cedar brush.
 Soil, stony, clay loam 2 to 6 ins. deep on clay and sand subsoil.
 Timber, oak, juniper and pine.
 May 21, 1915.
-
- May 20, 1915. At 1h. 26 $\frac{1}{2}$ m. p.m., l.m.t., I set off 34° 14 $\frac{3}{4}$ ' N. on lat. arc; 19° 52' N. on decl. arc; and determine a meridian with the solar at the reestablished cor. of secs. 7, 8, 17 and 18.
 Thence,
 S. 89° 51' W., on a random line, bet. secs. 7 and 18.
 39.90 Fall 14 lks. N. of the old $\frac{1}{4}$ sec. cor., which is a granite stone 12x10x6 ins., loosely set in a mound of stone, marked $\frac{1}{4}$ on N. face, witnessed as described by the surveyor general.
 True course and dist. of E. $\frac{1}{2}$ bet. secs. 7 and 18 is therefore N. 89° 39' E., 39.90 chs.
 From old $\frac{1}{4}$ sec. cor. described above
 S. 89° 51' W., on a random line on W. $\frac{1}{2}$, bet. secs. 7 and 18.
 41.61 Fall 125 lks. N. of the old cor. of secs. 7, 12, 13, and 18, on W. bdy. of Tp., which is a sandstone 14x10x5 ins. loosely set in a mound of stone, marked with 1 notch on N. and 4 notches on S. edges, witnessed by three of the bearing trees (original):
 True course and dist. of W. $\frac{1}{2}$ bet. secs. 7 and 18 is therefore N. 88° 08' E., 41.63 chs.
 May 20, 1915.
 May 21, 1915. At 1h. 56 $\frac{1}{2}$ m. p.m., l.m.t., I set off 34° 14 $\frac{3}{4}$ ' N. on the lat. arc; 20° 18 $\frac{1}{2}$ ' N. on the decl. arc, and determine a meridian with the solar at the reestablished cor. of secs. 7, 12, 13 and 18 on W. bdy. of Tp., described in Book "A."
 Thence,
 N. 88° 08' E., on a true line on W. $\frac{1}{2}$, bet. secs. 7 and 18.
 Ascend W. slope of the "Mogollon Rim" 15 ft. over stony, mountainous land, through heavy pine and cedar timber and brush.
 4.60 Top of the "Mogollon Rim" brs. N. and S.; descend.
 6.29 Intersect the N. bdy. of the Fort Apache Indian Reservation 4.40 chs. S. 0° 02' E. of Angle point No. 679, which is a pine 16 ins. in diam., marked and witnessed, as described by the surveyor general.
 At the point of intersection, set an iron post 3 ft. long, 2 ins. in diam., 24 ins. in the ground for reestablished closing cor. of secs. 7 and 18, marked on brass cap,
 C C E of center,
 T 10 N R 19 E in N.,
 1915 in S., and FAIR on W. half;
 S 7 in NE., and
 S 18 in SW. sector.
 From this cor. the unaccepted closing cor. of secs. 7 and 18, by Deputy Charles E. Perkins, under Contract No. 40, bears S. 0° 02' E. 7 lks. dist. I destroy all trace of this cor., and the marks on the bearing trees to same.
 6.51 Wire fence along N. bdy. of the Indian Reservation, brs. N. and S.
 13.36 Dry ravine, 15 lks. wide, course S. 30° E.; ascend 75 ft.
 25.61 Top of spur, brs. N. 60° W. and S. 60° E.; descend 72 ft.
 41.63 Intersect the old $\frac{1}{4}$ sec. cor. hereinbefore described, which I destroy and reestablish in the same place as follows:
 Reset the same stone, 8 ins. in the ground for $\frac{1}{4}$ sec. cor., from which the original bearing trees:
 An oak, 12 ins. in diam., brs. N. 67° 06' W., 97 lks. dist., marked $\frac{1}{4}$ S 7 B T.

Partial Resurvey of the Subdivision lines of T.10 N., R.19 E. 5.

Chains.

An oak, 12 ins. in diam., brs. S. 44 1/2° W., 51 lks. dist., marked 1/4 S 18 B T.

Thence N. 89° 39' E., on a true line, on E. 1/2, bet. secs. 7 and 18. Over mountainous land, continuing descent from spur.

18.43 Dry bed of fork of the Cottonwood wash, 30 lks. wide, course S. 70° E.; ascend 101 ft.

29.03 Top of spur, brs. N. and S.; descend 28 ft.

33.70 Dry ravine, 6 lks. wide, course south; ascend 69 ft.

39.90 Intersect the reestablished cor. of secs. 7, 8, 17 and 18, hereinbefore described.

Land, mountainous, spurs steep and rocky.

Soil, poor, dry, stony clay loam 2 to 8 ins. deep on clay and stone subsoil.

Timber, oak, juniper, cedar and pine.

May 21, 1915.

May 24, 1915. At 8h. 27m. a.m., l.m.t., I set off 34° 14 1/2' N. on the lat. arc; 29° 40' N. on the decl. arc, and determine a meridian with the solar at the reestablished cor. of secs. 7, 8, 17 and 18.

Thence,

South, on a random line, bet. secs. 17 and 18.

39.70 Fall 26 lks. E. of the old 1/4 sec. cor., which is a sandstone 10x6x3 ins., loosely set in a mound of stone, marks almost obliterated, and witnessed by the two original bearing trees.

True course and dist. of N. 1/2 bet. secs. 17 and 18 is therefore N. 0° 23' E., 39.70 chs.

From old 1/4 sec. cor. described above,

S. on a random line on S. 1/2, bet. secs. 17 and 18.

40.22 Fall 6 lks. W. of the old cor. of secs. 17, 18, 19 and 20, which is a sandstone 12x10x8 ins. loosely set, marked with 5 grooves on E. and 3 grooves on S. faces; witnessed as described by the surveyor general.

True course and dist. of S. 1/2, bet. secs. 17 and 18 is therefore N. 0° 5' W., 40.22 chs.

This cor. being poorly set, and insufficiently witnessed, I destroy and reestablish in same place, as follows:

Set an iron post 3 ft. long, 2 ins. in diam., 24 ins. in the ground for cor. of secs. 17, 18, 19 and 20, marked on brass cap,

- T 10 N R 19 E in N.,
- 1915 in S. half;
- S 18 in NW.,
- S 17 in NE.,
- S 20 in SE., and
- S 19 in SW. quadrant; from which original

bearing trees,

A pine, 20 ins. in diam., brs. N. 17° E., 36 lks. dist., marked T 10 N R 19 E S 17 B T.

An oak, 8 ins. in diam., brs. S. 59° E., 108 lks. dist., marked T 10 N R 19 E S 20 B T.

Establish new bearing trees as follows:

A pine, 14 ins. in diam., brs. S. 79 1/2° W., 76 lks. dist., which I mark T 10 N R 19 E S 19 B T.

A juniper, 6 ins. in diam., brs. N. 34 1/2° W., 99 lks. dist., which I mark T 10 R 19 E S 18 B T.

Thence

N. 0° 05' W., on a true line, on S. 1/2, bet. secs. 17 and 18. Ascend over SE. slope, 57 ft. over stony, mountainous land, through heavy pine timber.

5.00 Top of spur, brs. N. 40° E. and S. 40° W., descend 208 ft.

38.10 Branch of the Cottonwood wash, 15 lks. wide, course N. 20° W.; ascend 23 ft.

40.22 Intersect the old 1/4 sec. cor. hereinbefore described, which I destroy, and reestablish in the same place as follows:

Set an iron post 3 ft. long, 2 in. in diam., 26 ins. in the ground for 1/4 sec. cor., marked on brass cap,

6. Partial Resurvey of the Subdivision lines of T.10 N., R.19 E.

Chains

- Set an iron post 3 ft. long, 1 in. in diam., 26 ins. in the ground for $\frac{1}{4}$ sec. cor., marked on brass cap,
 $\frac{1}{4}$ S 18 in W.,
 $\frac{1}{4}$ S 17 in E., and
 1915 in S. half; from which original bearing trees,
 An oak, 10 ins. in diam., brs. N. $80\frac{1}{2}^{\circ}$ W., 78 lks. dist., marked $\frac{1}{4}$ S 18 B T.
 A pine, 12 ins. in diam., brs. S. 60° E., 54 lks. dist., marked $\frac{1}{4}$ S 17 B T.
- Thence
 N. $0^{\circ}22'E.$, on a true line, on N. $\frac{1}{2}$, bet. secs. 17 and 18.
 Over mountainous land, ascend.
- 2.00 Top of spur, brs. NE. and SW.; descend 23 ft.
 8.30 Dry ravine, 30 lks. wide, course N. 60° E.; ascend 24 ft.
 15.00 Top of spur, brs. E. and W.; descend 24 ft.
 19.20 Branch of the Cottonwood wash, 20 lks. wide, course S. 70° E.; ascend 100 ft.
 39.70 Intersect the reestablished cor. of secs. 7, 8, 17 and 18, hereinbefore described.
 Land, mountainous.
 Soil, poor, dry stony clay loam, 2 to 6 ins. deep on dry stony, clay subsoil.
 Timber, oak, juniper and pine.
-
- From reestablished cor. of secs. 17, 18, 19 and 20, hereinbefore described,
 N. $89^{\circ}52'W.$ on a random line, bet. secs. 18 and 19.
- 40.00 I make a diligent search for the old $\frac{1}{4}$ sec. cor., which I fail to find; therefore, continue line and measurement.
- 81.89 Fall 211 lks. N. of the old cor. of secs. 13, 18, 19 and 24, on W. bdy. of Tp., described in Book "A,"
 True course and dist. of line bet. secs. 18 and 19 is therefore N. $88^{\circ}39'E.$, 81.91 chs. Thence
 N. $88^{\circ}39'E.$ on a true line, bet. secs. 18 and 19.
 Ascend W. slope of the Mogollon Rim, 30 ft., through heavy pine timber, & cedar & juniper brush undergrowth.
- 18.90 Top of asp. on rim, brs. N. & S.; thence over nearly level land.
 23.05 Wire fence along N. bdy. of Ft. Apache Indian Res. brs. N. 20° W. & S. 20° E.
- 23.27 Intersect the N. bdy. of the Fort Apache Indian Reservation, 3.71 chs. S. $30^{\circ}15'E.$ of angle point No. 670, which is a dead pine, marked and witnessed as described by the surveyor general. At the point of intersection,
 Set an iron post 3 ft. long, 2 ins. in diam., 24 ins. in the ground for reestablished closing cor. of secs. 18 and 19, marked on brass cap,
 C C E of center,
 T 10 N, R 19 E in N., and
 FAIR, 1915 in S half,
 S 18 in NW., and
 S 19 in SE. sector.
- From this cor., the unaccepted closing cor. of secs. 18 and 19 set by Deputy Charles E. Perkins, under Contract No. 40 brs. S. $50^{\circ}15'E.$, 69 lks. dist. I destroy all trace of this closing cor., and the marks on the bearing trees to same.
- 25.90 Wire fence along N. bdy. of the Fort Apache Indian Reservation, brs. N. 80° E. and S. 80° W.
- 30.57 Intersect N. bdy. of the Fort Apache Indian Reservation 1.88 chs. S. $64^{\circ}32'W.$ of angle point No. 668, which is a pine, 18 ins. in diam., marked and witnessed as described by the surveyor general. At the point of intersection,
 Set an iron post 3 ft. long, 2 ins. in diam., 24 ins. in the ground for reestablished closing cor. of secs. 18 and 19, marked on brass cap,
 C C W of center,
 T 10 N, R 19 E in N., and
 FAIR, 1915 in S half;

Partial Resurvey of the Subdivision lines of T.10 N. R.19 E. 7.

Chains.

S 18 in NE., and
S 19 in SW. sector.

From this cor. the unaccepted closing cor. of secs. 18 and 19, set by Deputy Charles E. Perkins, under Contract No. 40 brs. S. 64° 32' W., 116 lks. dist. I destroy all trace of this closing cor., and the marks on the bearing trees to same.

36.00 Descend over SE. slope, 25 ft.

40.69 (Proportional dist.) Set an iron post 3 ft. long, 1 in. in diam., 26 ins. in the ground for $\frac{1}{4}$ sec. cor., marked on brass cap,
S 18 in N., and
S 19; 1915 in S half; from which
A pine, 24 ins. in diam., brs. N. 44° E., 62 lks. dist., marked $\frac{1}{4}$ S 18 B T.
An oak, 20 ins. in diam., brs. S. 13° W., 42 lks. dist., marked $\frac{1}{4}$ S 19 B T.

At this cor., I set off 20° 41' N. on the decl. arc, and at noon, apparent time, observe the sun on the meridian, and obtain a reading of 34° 14' N. on the lat. arc.

From this cor., the unaccepted $\frac{1}{4}$ sec. cor., bet. secs. 18 and 19, set by Deputy Charles E. Perkins, brs. S. 81° 55' E., 127 lks. dist. I destroy all trace of this cor., and the marks on the bearing trees to same.

41.50 Foot of descent on S. slope; ascend SW. slope 20 ft.

47.30 Top of ascent on the Mogollon Rim, brs. N. and S.; thence descend over NE. slope, 70 ft.

47.45 Intersect N. bdy. of the Fort Apache Indian Reservation, 2 lks. N. 87° 33' W., of Angle Point No. 666, which is a pine, 12 ins. in diam., marked as described by the surveyor general. At the point of intersection, set an iron post 3 ft. long, 2 ins. in diam., 24 ins. in the ground, for reestablished closing cor. of secs. 18 and 19, marked on brass cap,
C C E of center,
T 10 N, R 19 E in N., and
FAIR, 1915 in S. half;
S 18 in NW., and
S 19 in SE. sector.

From this cor., the unaccepted closing cor. of secs. 18 and 19, set by Deputy Charles E. Perkins, under Contract No. 40 brs. S. 56° E. 76 lks. dist. I destroy all trace of this closing cor., and the marks on the bearing trees to same.

68.79 Dry ravine 6 lks. wide, course N. 40° W.; ascend 77 ft.

81.91 Intersect the reestablished cor. of secs. 17, 18, 19 and 20, hereinbefore described.

Land, mountainous.
Soil, poor stony clay loam, underlaid with dry stony clay subsoil.
Timber, oak, juniper, cedar and pine.

May 24, 1915.

May 27, 1915. At 7h. 42m. a.m., l.m.t., I set off 34° 14' N. on the lat. arc; 21° 12' N. on the decl. arc, and determine a meridian with the solar at the reestablished cor. of secs. 17, 18, 19 and 20.

Thence,
South, on a random line, bet. secs. 19 and 20.

39.90 Fall 32 lks. E. of the old $\frac{1}{4}$ sec. cor., which is a sandstone 12x12x6 ins. loosely set, marks almost obliterated, witnessed by the two original bearing trees. True course and dist. of N. $\frac{1}{2}$ bet. secs. 19 and 20 is therefore N. 0° 28' E., 39.90 chs.

From old $\frac{1}{4}$ sec. cor., described above
South; on a random line on S. $\frac{1}{2}$, bet. secs. 19 and 20.

39.99 Fall 72 lks. W. of the reestablished cor. of secs. 19, 20, 29 and 30, hereinafter described. True course and dist. of S. $\frac{1}{2}$ bet. secs. 19 and 20 is therefore N. 1° 2' W., 40.00 chs.

8. Partial Resurvey of the Subdivision lines of T.10 N., R.19 E.

Chains.

Thence, N.1°02'W., on a true line, on S. 1/2, bet. secs. 19 and 20. Descend NW. slope of spur, over stony, mountainous land, through heavy pine and cedar timber, 90 ft.

8.10 Dry ravine, 10 lks. wide, course S. 70° W.; ascend 285 ft.

14.30 Top of spur, brs. N. 70° W. and S. 70° E.; descend 90 ft.

40.00 Intersect the old 1/4 sec. cor. hereinbefore described, which I destroy, and reestablish in the same place as follows:

Set an iron post 3 ft. long, 1 in. in diam., 26 ins. in the ground for 1/4 sec. cor., marked on brass cap,

1/4 S 19 in W.,

1/4 S 20 in E., and

1915 in S. half; from which original bearing trees,

An oak, 6 ins. in diam., brs. N. 68° E., 36 lks. dist., marked 1/4 S 20 B T.

A pine, 14 ins. in diam., brs. N. 77° W., 16 lks. dist., marked 1/4 S 19 B T.

Thence

N. 0° 28' E. on a true line, on N. 1/2, bet. secs. 19 and 20.

Over mountainous land, continuing descent from spur.

0.70 Dry ravine, 8 lks. wide, course S. 60° W.; ascend 110 ft.

8.90 Top of rocky spur, brs. NE. and SW.; descend 19 ft.

15.45 Dry ravine, 10 lks. wide, course S. 70° W.; ascend 130 ft.

21.72 Intersect the N. bdy. of the Fort Apache Indian Reservation

6.18 chs. N. 74° 14' W. of Angle point No. 662, which is a pine, 14 ins. in diam., marked as described by the surveyor general. At the point of intersection,

Set an iron post 3 ft. long, 2 ins. in diam., 24 ins. in the ground for reestablished closing cor. of secs. 19 and 20, marked on brass cap,

C C N of center,

T 10 N, R 19 E in N., and

FAIR, 1915 in S. half;

S 19 in NW., and

S 20 in SE. sector.

At this cor., I set off 21° 13 1/2' N. on the decl. arc; and at noon, apparent time, May 27, 1915, observe the sun on the meridian; the resulting lat. being 34° 13 1/2' N.

From this cor., the unaccepted closing cor. of secs. 19 and 20 set by Deputy Charles E. Perkins, brs. S. 74° 14' E., 51 lks. dist. I destroy all trace of this cor., and the marks on the bearing trees to same.

21.78 Wire fence along N. bdy. of the Indian Reservation brs. N. 74° W. and S. 74° E., at top of ascent on the Mogollon Rim, brs. N. 75° W. and S. 75° E.; thence along top of spur brs. N. and S.; not much change in elevation.

39.90 Intersect the reestablished cor. of secs. 17, 18, 19 and 20, hereinbefore described.

Land, mountainous, spurs with steep rocky slopes, covered with juniper brush undergrowth.

Soil, poor dry stony clay loam, on clay and stone subsoil. Timber, juniper, oak, cedar and pine.

May 27, 1915.

May 25, 1915: At 2h. 27m. p.m., l.m.t., I set off 34° 13' N. on the lat. arc; 20° 53 1/2' N. on the decl. arc; and determine a meridian with the solar at the reestablished cor. of secs. 19, 20, 29 and 30, hereinafter described.

Thence

S. 89° 55' W., on a random line, bet. secs. 19 and 30.

40.00 I make a diligent search for the old 1/4 sec. cor., which I am unable to find; therefore, continue line and measurement.

82.53 Fall 188 lks. N. of the old cor. of secs. 19, 24, 25 and 30, on W. bdy. of Tp., which is a sandstone in place, 60x48x24 ins. above ground, marked and witnessed as described by the surveyor general.

True course and dist. of line bet. secs. 19 and 30 is therefore N. 88° 37' E., 82.55 chs.

Partial Resurvey of the Subdivision lines of T.10 N., R.19 E. 9

Chains.	
	Thence N.88°37'E., on a true line, bet. secs.19 and 30. Ascend W.slope of spur, 32 ft., over stony, mountainous land, through pine timber.
2.53	Top of spur, brs.N. and S.20°W.; descend 120 ft.
11.83	Dry ravine, 15 lks.wide, course S.10°E.; ascend 235 ft.
24.53	Top of spur, brs.N.25°W. and S.20°E.; descend.
34.88	Rock ledge 10 ft.high, brs.N.40°E. and S.10°W.
39.73	Dry ravine, in bottom of canyon, 15 lks.wide, course S.10°E.; ascend 271 ft.
41.16	(Proportional dist.) Set a sandstone 18x12x8 ins., 12 ins. in the ground for reestablished $\frac{1}{4}$ sec.cor., marked $\frac{1}{4}$ S 19 on N. and S 30 on S faces.
	No trees suitable for bearing trees within limits; raise a mound of stone 2 ft.base, 1 $\frac{1}{2}$ ft. high, N.of cor. Pits impracticable.
	This cor.is on steep, rocky W.slope of spur.
51.18	Top of spur, brs.N.20°E. and S.20°W.; descend 150 ft.
61.73	Dry ravine, 10 lks.wide at foot of descent in canyon, course S.20°W.; ascend 220 ft.
82.55	Intersect the reestablished cor.of secs.19,20,29 and 30, hereinafter described.
	Land, rough mountains, washed on slopes, rocky. Soil, poor dry, stony clay loam 4 to 6 ins. deep on clay and sandstone subsoil.
	Timber, oak, juniper, cedar and pine.
	May 25, 1915.

	May 24, 1915. At 2h.12m. p.m., 1.m.t., I set off 34°14' N.on the lat.arc; 20°42 $\frac{1}{2}$ 'N. on the decl.arc, and determine a meridian with the solar at the reestablished cor. of secs. 17,18,19 and 20.
	Thence,
40.17	N.89°54'E., on a random line, bet. secs.17 and 20. Fall 8 lks.S. of the old $\frac{1}{4}$ sec.cor. which is a sandstone 10x6x10 ins. loosely set in a mound of stone, marks almost obliterated, witnessed by the two original bearing trees.
	True course and dist. of W. $\frac{1}{2}$ bet.secs. 17 and 20 is therefore S.89°47' W., 40.17 chs.
	From old $\frac{1}{4}$ sec.cor. described above,
39.29	N.89°54'E. on random line on E half, bet. secs.17 and 20. Fall 56 lks.S. of the old cor.of secs.16,17,20 and 21, which is a granite stone 4x5x5 ins., loosely set, marked with 4 notches on E. and 2 notches on S.edges, witnessed by the 4 original bearing trees,
	True course and dist. of E. $\frac{1}{2}$ bet.secs.17 and 20 is therefore S.89°05'W., 39.30 chs.
	This cor.being in a state of dilapidation, I destroy, and reestablish it in the same place as follows:
	Set an iron post 3 ft.long, 2 ins. in diam., 24ins. in the ground for cor.of secs.16,17,20 and 21, marked on brass cap,
	T 10 N R 19 E in N., and 1915 in S.half; S 17 in NW., S 16 in NE., S 21 in SE., and S 20 in SW. quadrant; from which original
	bearing trees,
	A pine, 16 ins. in diam., brs.N.29 $\frac{1}{2}$ °E., 52 lks. dist., marked T 10 N R 19 E S 16 B T.
	A pine, 10 ins. in diam., brs.S.37°E., 66 lks. dist., marked T 10 N R 19 E S 21 B T.
	A pine, 14 ins. in diam., brs.S.7 $\frac{1}{2}$ °W., 96 lks. dist., marked T 10 N R 19 E S 20 B T.
	A pine, 24 ins. in diam., brs.N.36 $\frac{1}{2}$ °W., 96 lks. dist., marked T 10 N R 19 E S 17 B T.
	Thence
	S.89°05'W., on a true line, bet. secs.17 and 20. Descend NW. slope, over stony mountainous land, through heavy pine timber.128 ft.

10. Partial Resurvey of the Subdivision lines of T. 10 N. R. 19 E

Chains.

21.15 Cottonwood wash, 30 lks. wide, course north; ascend 25 ft.

34.30 Top of spur, brs. N. 40° E.; descend 20 ft.

38.80 Dry ravine, 5 lks. wide, course N. 10° W.; ascend 70 ft.

39.30 Intersect the old $\frac{1}{4}$ sec. cor. hereinbefore described, which I destroy, and reestablish in the same place as follows:
Set an iron post 3 ft. long, 1 in. in diam., 26 ins. in the ground for $\frac{1}{4}$ sec. cor., marked on brass cap,
 $\frac{1}{4}$ S. 17 in N., and
S 20, 1915 in S. half; from which,
A pine, 24 ins. in diam., brs. N. $5\frac{1}{4}^{\circ}$ W., 66 lks. dist., marked $\frac{1}{4}$ S 17 B T.
A pine, 24 ins. in diam., brs. S. $15\frac{1}{2}^{\circ}$ W., 16 lks. dist., marked $\frac{1}{4}$ S 20 B T. This tree is dead.

Establish a new bearing tree:
A pine, 18 ins. in diam., brs. S. 42° W., 86 lks. dist., which I mark $\frac{1}{4}$ S 20 B T.

Thence,
S. $89^{\circ} 47'$ W., on a true line on W. $\frac{1}{2}$, bet. secs. 17 and 20. Over mountainous land; ascend.

6.77 Top of spur, brs. N. and S.; descend 30 ft.

15.32 Dry ravine, 10 lks. wide, course N. 40° E.; ascend 154 ft.

40.17 Intersect the reestablished cor. of secs. 17, 18, 19 and 20, hereinbefore described.
Land, mountainous, spurs steep, washed on slopes, rocky. Soil, poor, dry clay loam on stone and clay subsoil. Timber, oak and pine.

May 24, 1915.

May 25, 1915. At 6h. 27m. a.m., l.m.t., I set off $34^{\circ} 14'$ N. on the lat. arc; $20^{\circ} 51\frac{1}{2}'$ N. on the decl. arc, and determine a meridian with the solar at the reestablished cor. of secs. 16, 17, 20 and 21, hereinbefore described.

Thence,
South, on a random line, bet. secs. 20 and 21.

40.06 Fall 4 lks. E. of the old $\frac{1}{4}$ sec. cor., which is a sandstone $10 \times 6 \times 5$ ins. lying on the top of a mound of stone, marked $\frac{1}{4}$, witnessed by the two original bearing trees.
True course and dist. of N. $\frac{1}{2}$ bet. secs. 20 and 21 is therefore N. $0^{\circ} 3'$ E., 40.06 chs.
From old $\frac{1}{4}$ sec. cor., described above,
South, on a random line, on S. half, bet. secs. 20 and 21.

40.04 Fall 9 lks. E. of the old cor. of secs. 20, 21, 28 and 29, which is a sandstone $6 \times 7 \times 5$ ins. loosely set, marked with 4 notches on E. and 2 notches on S. edges, witnessed by the four original bearing trees.
True course and dist. of S. $\frac{1}{2}$, bet. secs. 20 and 21 is therefore N. $0^{\circ} 8'$ E., 40.04 chs.
This cor. being in a dilapidated condition, I destroy and reestablish it in the same place as follows:
Set an iron post 3 ft. long, 2 ins. in diam., 24 ins. in the ground; for cor. of secs. 20, 21, 28 and 29, marked on brass cap,
T 10 N R 19 E in N., and
1915 in S. half;
S 20 in NW.,
S 21 in NE.,
S 28 in SE., and
S 29 in SW. quadrant; from which original bearing trees,
A pine, 14 ins. in diam., brs. N. 74° E., 60 lks. dist., marked T 10 N R 19 E S 21 B T.
A pine, 24 ins. in diam., brs. S. 42° E., 51 lks. dist., marked T 10 N R 19 E S 28 B T.
A stump brs. S. $20\frac{1}{2}^{\circ}$ W., 69 lks. dist., marked B T.
A pine, 16 ins. in diam., brs. N. $30\frac{1}{2}^{\circ}$ W., 38 lks. dist., marked T 10 N R 19 E S 20 B T.

Establish a new bearing tree,
A pine, 12 ins. in diam., brs. S. 25° W., 67 lks. dist., which I mark T 10 N R 19 E S 29 B T.

Partial Resurvey of the Subdivision lines of Township 10 N. R. 19 E. 11

Chains.	
	Thence, N.0°8'E., on a true line, on S.½, bet. secs.20 and 21. Descend NE.slope, over stony, mountainous land, through heavy pine timber 30 ft.
21.64	Head of Cottonwood wash, 25 lks.wide, course N.10°W., ascend 29 ft.
30.04	Top of spur, brs. NW. and SE.; descend 8 ft.
32.64	Dry ravine, 10 lks.wide, course S.70°W.; ascend 76 ft.
40.04	Intersect the old ¼ sec.cor., hereinbefore described, which I destroy, and reestablish in the same place as follows: Set an iron post, 3 ft.long, 1 in. in diam., 26 ins. in the ground for ¼ sec.for., marked on brass cap, S 20 in W., S 21 in E., and 1915 in S.half; from which original bearing trees, A pine, 24 ins. in diam., brs.S.45½°E., 36 lks. dist., marked ¼ S 21 B T. A pine, 16 ins. in diam., brs.S.16½°W., 21 lks. dist., marked ¼ S 20 B T.
	Thence, N.0° 03'E., on a true line, on N.½, bet.secs.20 and 21. Over mountainous land, continuing ascent.
1.00	Top of spur, brs.N.60°W. and S.60°E.; descend 41 ft.
10.91	Dry ravine, 15 lks.wide, course west; ascend 41 ft.
21.06	Top of spur, brs.E.and W.; descend 50 ft.
34.54	Dry ravine, 10 lks.wide, course S.70°W.; ascend 92 ft.
40.06	Intersect the reestablished cor.of secs.16,17,20 and 21, hereinbefore described. Land, mountainous, drains to the north. Soil, poor dry, stony clay loam 4 to 8 ins.deep on stone and dry clay subsoil. Timber, oak, juniper and pine.

	From reestablished cor.of secs. 20,21, 28 and 29, N.89°45'W., on a random line, bet. secs.20 and 29.
40.11	Fall 19 lks.N.of the old ¼ sec.cor., which is a sandstone 6x5x3 ins., loosely set, marks almost obliterated, wit- nessed by the two original bearing trees. True course and dist.of E.½, bet. secs.20 and 29 is there- fore N.89° 58'E., 40.11 chs.
	From old ¼ sec.cor. described above, N.89°45'W., on a random line, on W.½, bet. secs.20 and 29.
38.80	Fall 78 lks.N of the old cor.of secs.19,20,29 and 30, which is a sandstone 6x6x4 ins. above ground, loosely set, marks almost obliterated, witnessed by the four original bearing trees. True course and dist. of W.½ bet. secs.20 and 29, is there- fore N.89°06'E., 38.81 chs. This cor.being in a dilapidated condition, I destroy, and reestablish it in the same place as follows: Set an iron post 3 ft.long, 2 ins. in diam., 24 ins. in the ground, for cor.of secs. 19,20,29 and 30, marked on brass cap, T 10 N R 19 E in N., and 1915 in S.half; S 19 in NW., S 20 in NE., S 29 in SE., and S 30 in SW. quadrant; from which, the orig- inal bearing trees: A pine, 28 ins. in diam., brs.N.48°E., 25 lks. dist., marked T 10 N R 19 E S 20 B T. An oak, 12 ins. in diam., brs.S.25¾°E., 75 lks. dist., marked T 10 N R 19 E S 29 B T. A pine, 24 ins. in diam., brs.S.64¾°W., 100 lks. dist., marked T 10 N R 19 E S 30 B T. A pine, 20 ins. in diam., brs.N. 8°W., 76 lks. dist., marked T 10 N R 19 E S 19 B T.
	Thence,

12. Partial Resurvey of the Subdivision lines of T. 10 N. R. 19 E.

Chains.	
	N.89°06'E., on a true line, on W. $\frac{1}{2}$, bet. secs. 20 and 29. Ascend NW. slope of spur, over stony, mountainous land, through heavy pine timber and brush, 97 ft.
15.65	Top of spur, brs. N.60°E. and S.60°W.; descend 29 ft.
21.35	Dry ravine, 5 lks. wide, course S.10°W., ascend 130 ft.
32.30	Top of rim, brs. N.30°W. and S.40°E.; descend gradually about 15 ft.
33.44	Wire fence along N. bdy. of the Fort Apache Indian Reservation, brs. N.10°W. and S.10°E.
33.68	Intersect N. bdy. of the Fort Apache Indian Reservation, 4.48 chs. S.24°45' E. of Angle point No. 656, which is a pine 18 ins. in diam., marked as described by the surveyor general. At the point of intersection, set an iron post 3 ft. long, 2 ins. in diam., 24 ins. in the ground for reestablished closing cor. of secs. 20 and 29, marked on brass cap, C C E of center, T 10 N R 19 E in N., and 1915 in S. half; S 20 in NW., S 29 in SE., and FAIR in SW. sector.
	From this cor. the unaccepted closing cor. of secs. 20 and 29 set by Deputy Charles E. Perkins, under contract No. 40, brs. S.24°45'E., 60 lks. dist. I destroy all trace of this cor., and the marks on the bearing trees to same.
38.81	Intersect the old $\frac{1}{2}$ sec. cor. hereinbefore described, which I destroy, and reestablish in the same place as follows: Set an iron post 3 ft. long, 1 in. in diam., 26 ins. in the ground, for $\frac{1}{2}$ sec. cor., marked on brass cap, S 20 in N., and S 29, 1915 in S. half; from which the original bearing trees, A pine, 10 ins. in diam., brs. N.57 $\frac{1}{2}$ °E., 14 lks. dist., marked $\frac{1}{4}$ S 20 B T. A pine, 12 ins. in diam., brs. S.39°E., 30 lks. dist., marked $\frac{1}{4}$ S 29 B T.
	From this cor., the unaccepted $\frac{1}{2}$ sec. cor., bet. secs. 20 and 29, set by Deputy Charles E. Perkins, brs. S.45 $\frac{1}{2}$ °E., 76 lks. dist.; I destroy all trace of this cor., and the marks on the bearing trees to the same.
	Thence, N.89°58'E., on a true line, on E. half, bet. secs. 20 and 29. Over mountainous land, descending.
6.06	Dry ravine, 8 lks. wide, course north; ascend 46 ft.
40.11	Intersect the reestablished cor. of secs. 20, 21, 28 and 29, hereinbefore described. Land, mountainous, spurs rocky covered with brush. Soil, poor dry stony clay loam 3 to 8 ins. deep on dry stony clay subsoil. Timber, oak, juniper and pine. Clouds obscure the sun at noon on this day, rendering an observation for latitude impossible. May 25, 1915.

	May 28, 1915. At 7h.12m., a.m., l.m.t., I set off 34°13' N. on the lat. arc; 21°22 $\frac{1}{2}$ ' N. on the decl. arc, and determine a meridian with the solar at the reestablished cor. of secs. 19, 20, 29 and 30.
	Thence, South, on a random line, bet. secs. 29 and 30.
40.07	Fall 36 lks. E. of the old $\frac{1}{2}$ sec. cor., which is a sandstone 12x10x8 ins., loosely set in a mound of stone, marked $\frac{1}{4}$ on W. face, and witnessed by the two original bearing trees. True course and dist. of N. $\frac{1}{2}$ bet. secs. 29 and 30 is therefore N.0° 31'E., 40.07 chs.

Partial Resurvey of the Subdivision lines of T.10 N. R.19 E. 13

Chains.

40.00 From old $\frac{1}{4}$ sec.cor. described above, South, on a random line, on S. half, bet. secs.29 and 30. Fall 51 lks.W.of the old cor.of secs.29,30,31 and 32, which is a sandstone 12x12x8 ins., loosely set, marked with 5 notches on E. and 1 notch on S. edges, and witnessed by the four original bearing trees. True course and dist. of S. $\frac{1}{2}$ bet. secs.29 and 30 is therefore N.0° 44'W., 40.00 chs. This cor. being in a state of dilapidation, I reestablish it in same place as follows: Reset the same stone, 8 ins. in the ground for cor.of secs.29,30,31 and 32, from which the original bearing trees,
 A pine, 10 ins. in diam., brs.N.61 $\frac{1}{2}$ °E., 35 lks. dist., marked T 10 N R 19 E S 29 B T.
 A pine, 12 ins. in diam., brs.S.29 $\frac{3}{4}$ °E., 71 lks. dist., marked T 10 N R 19 E S 32 B T.
 A pine, 12 ins. in diam., brs.S.35°W., 87 lks. dist., marked T 10 N R 19 E S 31 B T.
 A pine, 14 ins. in diam., brs.N.38 $\frac{1}{2}$ °W., 50 lks. dist., marked T 10 N R 19 E S 30 B T.

Thence, N.0°44'W., on a true line, on S. $\frac{1}{2}$, bet.secs.29 and 30. Ascend S.slope of spur, over stony, mountainous land, through heavy pine and oak timber and brush, 64 ft.

13.45 Top of spur, brs.E.and W.; descend 20 ft.
 16.80 Dry ravine, 10 lks.wide, course S.20°E.; ascend 205 ft.
 30.00 Top of spur brs.N.50°W. and S.30°E.; descend 200 ft.
 40.00 Intersect the old $\frac{1}{4}$ sec.cor., hereimbefore described, which I reestablish in same place, as follows: Reset the same stone 8 ins. in the ground for $\frac{1}{4}$ sec.cor., from which the original bearing trees,
 A pine, 24 ins. in diam., brs.N.34 $\frac{3}{4}$ °E., 36 lks. dist., marked $\frac{1}{4}$ S B T.
 An oak, 10 ins. in diam., brs.S.37°E., 55 lks. dist., marked $\frac{1}{4}$ S B T.

These trees are both dead; therefore, I establish two new bearing trees:
 A pine, 30 ins. in diam., brs. S.46 $\frac{3}{4}$ °E., 86 lks. dist., which I mark $\frac{1}{4}$ S 29 B T.
 A pine, 16 ins. in diam., brs.S.55 $\frac{1}{4}$ °W., 80 lks.dist., which I mark $\frac{1}{4}$ S 30 B T.

Thence N.0°31'E. on a true line on N. $\frac{1}{2}$, bet.secs.29 and 30. Over mountainous land, continuing descent from spur.

11.00 Dry ravine, 20 lks.wide, course N.70°W.; ascend 37 ft.
 14.07 Top of spur, brs.NE. and SW.; descend 15 ft.
 14.77 Dry ravine, 10 lks.wide, course S. 40°W.; ascend 300 ft.
 35.00 Top of spur, brs.N.40°E. and S.40°W.; descend 48 ft.
 40.07 Intersect the reestablished cor. of secs.19,20,29 and 30, hereinbefore described.

Land, rough mountains, spurs steep, rocky, covered with oak and juniper brush.
 Soil, poor, dry stony clay loam, 4 to 8 ins. deep, on dry stony clay subsoil.
 Timber, oak, juniper and pine.

40.12 From reestablished cor.of secs. 29,30,31 and 32, S.89°53'E., on a random line, bet. secs. 29 and 32. Fall 13 lks.S. of the old $\frac{1}{4}$ sec.cor., which is a sandstone 14x10x4 ins., loosely set, marked $\frac{1}{4}$ on N.face; and witnessed by the two original bearing trees; True course and dist.of W. $\frac{1}{2}$, bet.secs.29 and 32 is therefore S.89°56'W., 40.12 chs.

40.55 From old $\frac{1}{4}$ sec.cor. described, S.89°53'E. on a random line on E. $\frac{1}{2}$, bet. secs.29 and 32. Fall 28 lks.S. of the old cor.of secs.28,29,32 and 33, which is a sandstone 16x14x8 ins. loosely set, marked with 4 notches on E. and 1 notch on S. edges, witnessed by three original bearing trees. True course and dist.of E.half bet. secs.29 and 32 is therefore S.89°43'W.40.55 chs.

14. Partial Resurvey of the Subdivision lines of T. 10 N. R. 19 E.

Chains,

This cor. being in a dilapidated condition, I reestablish it in same place, as follows:
 Reset the same stone, 12 ins. in the ground for cor. of secs. 28, 29, 32 and 33, from which the original bearing trees,
 An oak, 10 ins. in diam., brs. N. 20° E., 51 lks. dist., marked T 10 N R 19 E S 28 B T.
 An oak, 4 ins. in diam., brs. S. 69° E., 50 lks. dist., marked T 10 N R 19 E S 33 B T.
 A pine, 12 ins. in diam., brs. N. 63° W., 54 lks. dist., marked T 10 N R 19 E S 29 B T.
 Establish as a new bearing tree,
 A pine, 8 ins. in diam., brs. S. 59½° W., 142 lks. dist., which I mark T 10 N R 19 E S 32 B T.

Thence,
 S. 89° 43' W., on a true line, on E. ½, bet. secs. 29 and 32. Ascend SE. slope of spur, over stony, mountainous land, through heavy pine and juniper timber and brush, 50 ft.
 8.55 Top of spur, brs. N. 20° E. and S. 40° W.; descend 52 ft.
 17.25 Dry ravine, 5 lks. wide, course N. 50° W.; ascend 30 ft.
 20.55 Top of spur, brs. N. 30° W. and S. 60° E.; descend 185 ft.
 40.55 Intersect the old ¼ sec. cor., hereinbefore described. I reestablish this cor. as follows:

Reset the same stone, 10 ins. in the ground for ¼ sec. cor., marked ¼ S on N. face, from which the original bearing trees,
 An oak, (dead) 6 ins. in diam., brs. N. 20½° E., 22 lks. dist., marked ¼ S 29 B T.
 An oak, 12 ins. in diam., brs. S. 7° E., 45 lks. dist., marked ¼ S 32 B T. Establish as a new bearing tree
 A pine, 10 ins. in diam., brs. N. 44° E., 50 lks. dist., which I mark ¼ S 29 B T.

Thence,
 S. 89° 56' W. on a true line, on W. half, bet. secs. 29 and 32. Over mountainous land, continuing descent from spur.
 10.12 Dry ravine 5 lks. wide, course S. 30° W.; ascend 85 ft.
 21.62 Top of spur, brs. S. 10° E.; descend 210 ft.
 36.72 Dry ravine, 10 lks. wide, course S. 20° E.; ascend 82 ft.
 40.12 Intersect the reestablished cor. of secs. 29, 30, 31 and 32, hereinbefore described.

Land, mountainous, spurs steep rocky, covered with juniper and oak brush.
 Soil, poor, stony clay loam.
 Timber, oak, juniper and pine.
 At the above described cor. I set off 21° 23½' N., on the decl. arc, and at noon apparent time, May 28, 1915, observe the sun on the meridian, the resulting lat. being 34° 12' N.

From reestablished cor. of secs. 28, 29, 32 and 33,
 North, on a random line, bet. secs. 28 and 29,
 40.32 Fall 156 lks. E. of the old ¼ sec. cor., which is an oak post, 3 ins. sq., 26 ins. long, marks almost obliterated, set in center of mound of earth, witnessed by the two original bearing trees.
 True course and dist. of S. ½, bet. secs. 28 and 29 is therefore S. 2° 13' E., 40.35 chs.

From old ¼ sec. cor. described above,
 North, on a random line on N. ½, bet. secs. 28 and 29.
 40.10 Fall 5 lks. E. of the reestablished cor. of secs. 20, 21, 28 and 29, hereinbefore described.
 True course and dist. of N. ½ bet. secs. 28 and 29 is therefore S. 0° 4' E., 40.10 chs.

Thence
 S. 0° 04' E., on a true line, on N. ½, bet. secs. 28 and 29. Ascend N. slope, over mountainous land, through heavy pine timber.
 38.84 Intersect N. bdy. of the Fort Apache Indian Reservation, 86 lks. S. 60° 22' E. of Angle point No. 649, which is a pine 30 ins. in diam., marked as described by the surveyor general.

Partial Resurvey of the Subdivision lines of T 10 N R 19 E 15

Chains.

At the point of intersection, set an iron post 3 ft. long, 2 ins. in diam., 24 ins. in the ground for reestablished closing cor. of secs. 28 and 29, marked on brass cap, C C N of center, T 10 N R 19 E in N., and FAIR, 1915 in S half; S 29 in NW., and S 28 in SE. sector.

From this cor., the unaccepted closing cor. of secs. 28 and 29, set by Deputy Charles E. Perkins, under contract No. 40 brs. N. 60° 22' W., 6 lks. dist.; I destroy all trace of this closing cor., and the marks on the bearing trees to same.

38.92 Wire fence along N. bdy. of Indian Reservation brs. N. 70° W. and S. 70° E.; top of Mogollon Rim; descend 112 ft.

40.10 Intersect the old 1/4 sec. cor., hereinbefore described, which I destroy, and reestablish in the same place as follows:

Set an iron post 3 ft. long, 1 in. in diam., 26 ins. in the ground, for 1/4 sec. cor., marked on brass cap,

S 29 in W., S 28 in E., and

1915 in S. half; from which the original

- bearing trees,
- A pine, 26 ins. in diam., brs. S. 73° E., 42 lks. dist., marked 1/4 S 28 B T.
- A pine, 10 ins. in diam., brs. S. 81° W., 83 lks. dist., marked 1/4 S 29 B T.

Thence S. 2° 13' E. on a true line on S. 1/2, bet. secs. 28 and 29. Over mountainous land; descend.

40.35 Intersect the reestablished cor. of secs. 28, 29, 32 and 33, hereinbefore described.

Land, mountainous, spurs steep, rocky, covered with juniper and oak brush.

Soil, poor dry, stony clay loam, about 6 ins. deep on dry clay and stone.

Timber, oak, juniper, cedar, and pine.

May 28, 1915.

May 31, 1915. At 8h. 56.4m. a.m., l.m.t., I set off 34° 12' N. on the lat. arc; 21° 50 1/2' N. on the decl. arc; and determine a meridian with the solar at the reestablished cor. of secs. 28, 29, 32 and 33.

Thence, S. 89° 39' E., on a random line, bet. secs. 28 and 33.

39.93 Fall 8 lks. S. of the old 1/4 sec. cor., which is a flint stone 16x12x10 ins. lying on a mound of stone, marked 1/4 on N. face, witnessed by two bearing trees.

True course and dist. of W. 1/2, bet. secs. 28 and 33 is therefore N. 89° 46' W., 39.93 chs.

From old 1/4 sec. cor. described above, S. 89° 39' E. on a random line on E. 1/2, bet. secs. 28 and 33.

39.30 Fall 13 lks. S. of the old cor. of secs. 27, 28, 33 and 34, which is a sandstone 12x10x8 ins., loosely set in a mound of stone, marked with 3 notches on E. and 1 notch on S. edges, and witnessed by two original bearing trees.

True course and dist. of E. 1/2 bet. secs. 28 and 33 is therefore N. 89° 50' W., 39.30 chs.

This cor. being in a dilapidated condition, I reestablish it in same place, as follows:

Reset the same stone, 8 ins. in the ground for cor. of secs. 27, 28, 33 and 34, from which the original bearing trees,

An oak, 12 ins. in diam., brs. S. 36° E., 94 lks. dist., marked T 10 N R 19 E S 34 B T.

An oak, 10 ins. in diam., brs. N. 26 1/2° W., 48 lks. dist., marked T 10 N R 19 E S 28 B T.

No other trees suitable for bearing trees available; raise a mound of stone 2 ft. base, 1 1/2 ft. high, W. of cor. Pits impracticable.

16. Partial resurvey of the Subdivision lines of T.10 N.R.19E.

Chains.

- At this cor., apparent noon, May 31, I set off $21^{\circ}51\frac{1}{2}'N$. on the decl. arc, and observe the sun on the meridian; the resulting latitude being $34^{\circ}12' N$.
- Thence,
N. $89^{\circ}50'W$., on a true line, bet. secs. 28 and 33.
Ascend steep rocky E. slope of spur, 231 ft. over mountainous land, through oak, juniper, and pine timber and dense brush undergrowth.
- 9.30 Top of spur, brs. N. and S.; descend 132 ft.
17.85 Dry ravine, 6 lks. wide in bottom of canyon, course south; ascend 162 ft.
25.30 Top of spur, brs. N. $20^{\circ}E$. and S. $20^{\circ}W$.; descend 110 ft.
30.30 Dry ravine, 6 lks. wide at ft. of descent in canyon; course S. $30^{\circ}E$. ascend 127 ft.
37.30 Top of spur, brs. N. and S.; descend 142 ft. as described. I re-
39.30 Intersect the old $\frac{1}{4}$ sec. cor. hereinbefore described. I re-establish this cor. in same place, as follows:
Reset the same stone, 12 ins. in the ground for $\frac{1}{4}$ sec. cor. from which the original bearing trees,
A pine, 24 ins. in diam., brs. N. $47\frac{1}{2}^{\circ}E$., 35 lks. dist., marked $\frac{1}{4}$ S 28 B T.
A pine, 20 ins. in diam., brs. S. $32\frac{1}{2}^{\circ}E$., 43 lks. dist., marked $\frac{1}{4}$ S 33 B T.
- Thence,
N. $89^{\circ}46'W$., on a true line on W. $\frac{1}{2}$, bet. secs. 28 and 33.
Over mountainous land, continuing descent from spur.
- 5.85 Dry ravine, 15 lks. wide at foot of descent in canyon, course S. $10^{\circ}E$.; ascend 180 ft.
14.95 Top of spur, brs. N. $10^{\circ}W$. and S. $10^{\circ}E$.; descend 110 ft.
39.93 Intersect the cor. of secs. 28, 29, 32 and 33.
Land, rough mountains.
Soil, stony clay loam of very little value.
Timber, oak, juniper, cedar and pine.
-
- From reestablished cor. of secs. 27, 28, 33 and 34,
North, on a random line, bet. secs. 27 and 28.
- 40.00 I make a diligent search for the old $\frac{1}{4}$ sec. cor., but am unable to find any trace; therefore continue my line and measurement.
- 80.65 Fall 70 lks. E. of the old cor. of secs. 21, 22, 27 and 28, which is a granite stone $12 \times 10 \times 6$ ins. above ground, loosely set, marked with 3 notches on E. and 2 notches on S edges, and witnessed by three of the original bearing trees.
True course and dist. of line bet. secs. 27 and 28 is therefore S. $0^{\circ}30'E$., 80.65 chs.
I reestablish this cor. in same place, as follows:
Reset the same stone, 10 ins. in the ground for cor. of secs. 21, 22, 27 and 28, from which cor. original bearing trees,
A pine, (dead) brs. N. $37\frac{1}{2}^{\circ}E$., 28 lks. dist., marked T 10 N R 19 E S 22 B T.
A pine, 16 ins. in diam., brs. S. $51\frac{1}{2}^{\circ}W$., 45 lks. dist., marked T 10 N R 19 E S 28 B T.
A pine, 24 ins. in diam., brs. N. $31\frac{1}{2}^{\circ}W$., 120 lks. dist., marked T 10 N R 19 E S 21 B T.
- Establish as new bearing trees:
A pine, 20 ins. in diam., brs. S. $41\frac{1}{2}^{\circ}E$., 25 lks. dist., which I mark T 10 N R 19 E S 27 B T.
A pine, 16 ins. in diam., brs. N. $85\frac{1}{2}^{\circ}E$., 57 lks. dist., which I mark T 10 N R 19 E S 22 B T.
- Thence,
S. $0^{\circ}30'E$., on a true line, bet. secs. 27 and 28.
Ascend NW slope, over stony, mountainous land, through heavy pine timber.
- 15.60 Intersect N. bdy. of the Fort Apache Indian Reservation 1.43 chs. S. $89^{\circ}12'E$. of Angle Point No. 636, which is a pine, 8 ins. in diam., marked and witnessed as described by the surveyor general. At the point of intersection,
Set an iron post 3 ft. long, 2 ins. in diam., 24 ins. in

Partial Resurvey of the Subdivision lines of T.10 N. R.19 E. 17

Chains

the ground for closing cor. of secs. 27 and 28, marked on brass cap,

C C N of center,
T 10 N R 19 E in N.,
FAIR, 1915 in S. half;
S 28 in NW., and
S 27 in SE. sector.

From this cor. the closing cor. of secs. 27 and 28 set by Deputy Charles E. Perkins, under Contract No. 40, brs. N. 89° 12' W., 10 lks. dist. I destroy all trace of this closing cor., and the marks on bearing trees to same.

15.61 Wire fence along N. bdy. of Indian Reservation, brs. E. and W.

15.75 Top of the Mogollon Rim, 58 ft. above the cor. of secs. 21, 22, 27 and 28, brs. E. and W.; Descend S. slope, 154 ft. over broken stony land, through oak brush undergrowth.

40.32 Set an iron post 3 ft. long, 1 in. in diam., 26 ins. in the ground for 1/4 sec. cor., marked on brass cap,

1/4 S 28 in W.,
1/4 S 27 in E., and
1915 in S. half; from which

A pine, 10 ins. in diam., brs. N. 50 1/4° E., 43 lks. dist., marked 1/4 S 27 B T.
A pine, 18 ins. in diam., brs. S. 56° W., 53 lks. dist., marked 1/4 S 28 B T.

40.75 Dry ravine, 5 lks. wide, course S. 60° E.; ascend 54 ft.

57.05 Top of spur, brs. E. and W.; descend 152 ft.

80.65 Intersect the reestablished cor. of secs. 27, 28, 33 and 34, hereinbefore described.

Land, mountainous; spurs with steep rocky slopes, covered with oak brush.

Soil, poor, dry stony clay loam, 3 to 6 ins. deep, on stony clay subsoil.

Timber, oak, juniper and pine.

May 31, 1915.

June 1, 1915. At 7h. 12 1/2 m., a.m., l.m.t., I set off 34° 13' N. on the lat. arc; 21° 58' N. on the decl. arc, and determine a meridian with the solar at the reestablished cor. of secs. 20, 21, 28 and 29.

Thence, S. 89° 53' E. on a random line, bet. secs. 21 and 28.

40.10 Fall 6 lks. N. of the old 1/4 sec. cor., which is an oak post 3 ins. in diam., 28 ins. above ground, greatly decayed, marked 1/4 S on N. face, and witnessed by the two original bearing trees.

True course and dist. of W. 1/2, bet. secs. 21 and 28 is therefore N. 89° 48' W., 40.10 chs.

From old 1/4 sec. cor. described above, S. 89° 53' E. on a random line on E. 1/2 bet. secs. 21 and 28.

40.12 Fall 2 lks. N. of the reestablished cor. of secs. 21, 22, 27 and 28, hereinbefore described.

True course and dist. of E. half, bet. secs. 21 and 28 is therefore N. 89° 51' W., 40.12 chs.

Thence, N. 89° 51' W., on a true line, on E. 1/2, bet. secs. 21 and 28.

Descend NW. slope 3 ft., over stony, mountainous land, through heavy pine timber.

1.36 Dry ravine, 15 lks. wide, course N. 10° E.; ascend 34 ft.

35.15 Top of spur, brs. N. and S.; descend gradually over W. slope, 96 ft.

40.12 Intersect the old 1/4 sec. cor. hereinbefore described, which I destroy, and reestablish in the same place as follows:

Set an iron post 3 ft. long, 1 in. in diam., 26 ins. in the ground, for 1/4 sec. cor., marked on brass cap,

1/4 S 21 in N., and
S 28, 1915 in S. half; from which the original bearing trees,

A pine, 24 ins. in diam., brs. N. 31 1/2° W., 82 lks. dist., marked 1/4 S 21 B T.

18. Partial Resurvey of the Subdivision lines of T.10 N., R.19 E.

Chains.

A pine, 22 ins. in diam., brs. S. $71\frac{1}{2}^{\circ}$ E., 24 lks.
lks. dist., marked $\frac{1}{4}$ S 28 B T.

Thence

N. $89^{\circ}48'$ W., on a true line on W. $\frac{1}{2}$, bet. secs. 21 and 28.
Over mountainous land, continuing descent from spur.

22.55 Branch of the Cottonwood wash, 15 lks. wide, course N. 40° W.;
ascend 12 ft.

27.63 Top of spur, brs. N. 30° W.; descend 12 ft.

31.20 Dry ravine, 10 lks. wide, course north; ascend 105 ft.

40.10 Intersect the reestablished cor. of secs. 20, 21, 28 and 29,
hereinbefore described.

Land, mountainous.

Soil, stony, 3rd rate.

Timber, pine and oak.

40.11 From reestablished cor. of secs. 21, 22, 27 and 28,
N. $89^{\circ}47'$ E. on a random line, bet. secs. 22 and 27.
Fall 12 lks. N. of the old $\frac{1}{4}$ sec. cor., which is an oak post,
3 ins. sq., 24 ins. above ground, greatly decayed,
marked $\frac{1}{4}$ on N. face, and witnessed by the two original
bearing trees.

True course and dist. of W. $\frac{1}{2}$ bet. secs. 22 and 27 is there-
fore S. $89^{\circ}57'$ W., 40.11 chs.

From old $\frac{1}{4}$ sec. cor. described above,

40.16 N. $89^{\circ}47'$ E., on a random line, on E. half bet. secs. 22 and
27.

Fall 30 lks. N. of the old cor. of secs. 22, 23, 26 and 27,
which is a sandstone 14x10x6 ins. above ground, loosely
set, marked with 2 grooves on E. and S. faces; witnessed
by the four original bearing trees.

True course and dist. of E. $\frac{1}{2}$ bet. secs. 22 and 27 is
therefore N. $89^{\circ}47'$ W., 40.16 chs.

This cor. being in a dilapidated condition, I reestablish
it in same place as follows:

Reset the same stone, 10 ins. in the ground for cor. of
secs. 22, 23, 26 and 27, from which the original bearing
trees,

A juniper, 12 ins. in diam., brs. N. $9\frac{1}{2}^{\circ}$ E., 52 lks.
dist., marked T 10 N R 19 E S 23 B T.

A pine, 20 ins. in diam., brs. S. $47\frac{1}{2}^{\circ}$ E., 114 lks.
dist., marked T 10 N R 19 E S 26 B T.

A pine, 28 ins. in diam., brs. S. 48° W., 20 lks.
dist., marked T 10 N R 19 E S 27 B T.

A pine, 10 ins. in diam., brs. N. $34\frac{1}{2}^{\circ}$ W., 88 lks.
dist., marked T 10 N R 19 E S 22 B T.

At this cor., I set off $21^{\circ}59'$ N. on the decl. arc, and at
noon, apparent time, observe the sun on the meridian,
and obtain a reading of $34^{\circ}13'$ N. on the decl. arc.

Thence,

N. $89^{\circ}47'$ W. on a true line, on E. $\frac{1}{2}$, bet. secs. 22 and 27.
Ascend SE. slope, over stony, mountainous land, through
heavy pine and juniper timber.

8.16 Top of spur, 40 ft. above cor., brs. N. 20° E. and S. 20° W.;
descend 32 ft.

22.15 Dry ravine, 10 lks. wide, course S. 40° W.; ascend 85 ft.

30.66 Top of spur, brs. NE. and SW.; descend 59 ft.

40.16 Intersect the old $\frac{1}{4}$ sec. cor., hereinbefore described, which
I destroy, and reestablish in the same place as fol-
lows:

Set an iron post 3 ft. long, 1 in. in diam., 26 ins. in
the ground for $\frac{1}{4}$ sec. cor., marked on brass cap,
 $\frac{1}{4}$ S 22 in N., and
S 27, 1915 in S half; from which the

original bearing trees

A pine, 22 ins. in diam., brs. N. 57° E., 47 lks.
dist., marked $\frac{1}{4}$ S 22 B T.

A pine, 20 ins. in diam., brs. S. 82° E., 44 lks.
dist., marked $\frac{1}{4}$ S 27 B T.

Thence

Partial Resurvey of the subdivision lines of T.10 N., R.19 E. 19

Chains.

S. $89^{\circ}57'W.$, on a true line, on $W.\frac{1}{2}$, bet. secs.22 and 27. Over mountainous land, continuing descent from spur.
 5.09 Dry ravine, 20 lks.wide, course $N.20^{\circ}W.$; ascend 10 ft.
 6.84 Top of ascent on spur, brs. $N.20^{\circ}W.$ and $S.20^{\circ}E.$; descend 8 ft.
 9.00 Dry ravine, 10 lks.wide, course $N.$; ascend 6 ft.
 25.11 Point of spur, brs. $N.20^{\circ}E.$ and south; descend 6 ft.
 40.11 Intersect the reestablished cor. of secs. 21,22,27 and 28, hereinbefore described.
 Land, mountainous, drains to the NW.
 Soil, sandy and stony clay loam 4 to 10 ins. deep, on dry stony clay subsoil.
 Timber, oak, juniper and pine.

 From reestablished cor. of secs. 22,23,26 and 27, South, on a random line, bet. secs.26 and 27.
 40.24 Fall 12 lks.E. of the old $\frac{1}{4}$ sec.cor., which is a pine post, greatly decayed with marks almost obliterated, witnessed by the two original bearing trees.
 The course and dist. of $N.\frac{1}{2}$, bet. secs.26 and 27 is therefore $N.0^{\circ}10'E.$, 40.24 chs.

From old $\frac{1}{4}$ sec.cor., described above,
 South, on a random line on $S.\frac{1}{2}$, bet. secs.26 and 27.
 40.25 Fall 6 lks. E. of the old cor. of secs. 26,27,34 and 35, which is a granite stone 12x8x5 ins., loosely set in a mound of stone, witnessed by the three original bearing trees.
 True course and dist. of $S.\frac{1}{2}$ bet. secs.26 and 27 is therefore $N.0^{\circ}5'E.$, 40.25 chs.

This cor. being in a dilapidated condition, I reestablish it in the same place as follows:

Reset the same stone, 8 ins. in the ground for cor. of secs.26,27,34 and 35, from which the original bearing trees,

- A pine, 24 ins. in diam., brs. $N.17\frac{3}{4}^{\circ}E.$, 58 lks. dist., marked T 10 N R 19 E S 26 B T.
- An oak, 6 ins. in diam., brs. $S.52^{\circ}E.$, 52 lks. dist., marked T 10 N R 19 E S 35 B T.
- An oak, 12 ins. in diam., brs. $S.52^{\circ}W.$, 58 lks. dist., marked T 10 N R 19 E S 34 B T.

No other trees suitable for bearing trees within limits; raise a mound of stone 2 ft. base, $1\frac{1}{2}$ ft. high, W. of cor. Pits impracticable.

Thence
 $N.0^{\circ}05'E.$, on a true line on S half, bet. secs.26 and 27. Ascend SW. slope, over stony, mountainous land, through heavy pine and juniper timber and brush.

35.00 Top of ascent on the Mogollan Rim, 116 ft. above the cor. brs. $N.70^{\circ}W.$ and $S.70^{\circ}E.$; thence over rolling, stony land on top of rim.

35.31 Wire fence along N. bdy. of the Fort Apache Indian Reservation brs. $N.70^{\circ}W.$ and $S.70^{\circ}E.$

35.35 Intersect the North bdy. of the Fort Apache Indian Reservation 1.97 chs. $N.62^{\circ}20'W.$ of Angle point No.623, which is a pine 10 ins. in diam., marked as described by the surveyor general.

At the point of intersection, set an iron post 3 ft. long, 2 ins. in diam., 24 ins. in the ground for reestablished closing cor. of secs.26 and 27, marked on brass cap,

- CC N of center,
- T 10 N, R 19 E in N.,
- FAIR, 1915 in S half;
- S 27 in NW., and
- S 26 in SE. sector.

From this cor., the unaccepted closing cor. of secs.26 and 27, set by Deputy Charles E. Perkins, under Contract No.40, brs. $N.62^{\circ}20'W.$, 2 lks. dist. I destroy all trace of this closing cor., and the marks on the bearing trees to same.

20. Partial Resurvey of the Subdivision lines of T 10N R 10E

Chains

- 35.71 Road from Showlow to Forestdale brs. N.70°W. and S.70°E.
 40.25 Intersect the old $\frac{1}{4}$ sec. cor., hereinbefore described, which I destroy, and reestablish in the same place as follows:
 Set an iron post 3 ft. long, 1 in. in diam., 26 ins. in the ground for $\frac{1}{4}$ sec. cor., marked on brass cap,
 $\frac{1}{4}$ S 27 in W.,
 $\frac{1}{4}$ S 26 in E., and
 1915 in S. half; from which the original bearing trees,
 A pine, 24 ins. in diam., brs. N.83°E., 33 lks. dist., marked $\frac{1}{4}$ S 26 B T.
 A pine, 24 ins. in diam., brs. S 55 $\frac{1}{2}$ °W., 21 lks. dist., marked $\frac{1}{4}$ S 27 B T.
- Thence,
 N.0°10'E., on a true line on N. $\frac{1}{2}$, bet. secs. 26 and 27.
 Over mountainous land; descend.
- 22.75 Dry ravine, 30 ft. below top of Rim, course east; ascend 40 ft.
- 40.24 Intersect the reestablished cor. of secs. 22, 23, 26 and 27, hereinbefore described.
 Land, mountainous.
 Soil, stony clay loam, 3 to 8 ins. deep on stone and clay subsoil.
 Timber, oak, juniper and pine.
-
- From reestablished cor. of secs. 26, 27, 34 and 35,
 S.89°50'W. on a random line, bet. secs. 27 and 34.
- 40.02 Fall 8 lks. S. of the old $\frac{1}{4}$ sec. cor., which is a sandstone 26x12x10 ins., loosely set, marked and witnessed as described by the surveyor-general.
 True course and dist. of E. $\frac{1}{2}$ bet. secs. 27 and 34 is therefore N.89° 57'E., 40.02 chs.
 From old $\frac{1}{4}$ sec. cor., described above,
 S.89°50'W., on a random line on W. $\frac{1}{2}$, bet. secs. 27 and 34.
- 39.33 Fall 8 lks. S. of the reestablished cor. of secs. 27, 28, 33 and 34, hereinbefore described.
 True course and dist. of W. $\frac{1}{2}$ bet. secs. 27 and 34 is therefore N.89° 57'E., 39.33 chs.
- Thence,
 N.89° 57'E., on a true line on W. $\frac{1}{2}$, bet. secs. 27 and 34.
 Descend E. slope, 12 ft. over stony, mountainous land, through pine and oak timber and brush.
- 1.53 Bottom of canyon, course S.20°W.; ascend 230 ft.
 15.30 Top of spur, brs. N.10°E. and S.10°W.; descend 113 ft.
 21.18 Dry ravine, 10 lks. wide at foot of descent in canyon, course S.20°W.; ascend 141 ft.
 27.33 Top of spur, brs. N.20°E. and S.20°W.; descend 63 ft.
 36.20 Dry ravine, 8 lks. wide in bottom of canyon, course south; ascend 182 ft.
- 39.33 Intersect the old $\frac{1}{4}$ sec. cor., hereinbefore described, which I destroy, and reestablish in the same place as follows:
 Reset the same stone, 20 ins. in the ground for $\frac{1}{4}$ sec. cor., marked $\frac{1}{4}$ S on N. face, from which original bearing tree
 An oak, 8 ins. in diam., brs. S.2°W., 8 lks. dist., marked $\frac{1}{4}$ S 34 B T., and original bearing rock,
 A sandstone 6x3x5 ft. above ground, brs. N.9°E., 10 lks. dist., marked with a cross (x) B R.
- Thence,
 N.89°57'E., on a true line on E. half, bet. secs. 27 and 34.
 Over mountainous land; ascend.
- 0.57 Sandstone ledge 8 ft. high, brs. N.60°W. and S.60°E.
 10.02 Top of spur, brs. N. and S.; descend 80 ft.
 24.17 Dry ravine, 10 lks. wide, at foot of descent in canyon, course S.10°W.; ascend 110 ft.
- 40.02 Intersect the reestablished cor. of secs. 26, 27, 34 and 35, hereinbefore described.
 Land, mountainous, spurs, steep, rocky, covered with heavy oak and juniper brush.
 Soil, poor, dry stony clay loam, 6 ins. deep, on clay sub-

Partial Resurvey of Subdivision lines of Township 10 N.R.19 E. 21

Chains.

soil.
Timber oak, juniper and pine.

June 1, 1915.

June 4, 1915. At 3h. 13m. p.m., l.m.t., I set off 34°12' N. on the lat.arc; 22°24' N. on the decl.arc, and determine a meridian with the solar at the reestablished cor.of secs. 2, 3, 34 and 35 on S.bdy.of Tp., described in Book "A."

Thence,
North, on a random line, bet. secs. 34 and 35.

40.00 I make a diligent search for the old $\frac{1}{4}$ sec.cor., but can find no trace of it; therefore, continue line
80.40 Fall 85 lks.E. of the reestablished cor.of secs.26, 27, 34 and 35, hereinbefore described.
True course and dist. of line bet. secs. 34 and 35 is therefore S. 0°36' E., 80.40 chs.

Thence
S. 0°36' E. on a true line, bet. secs. 34 and 35.
Ascend NW. slope, over stony, mountainous land, through heavy pine and oak timber and brush.

25.00 Top of spur, 36 ft. above cor. brs.N.40°E. and S.40°W.; descend 143 ft.

40.20 Set a sandstone 16x12x10 ins., 12 ins. in the ground for $\frac{1}{4}$ sec.cor., marked $\frac{1}{4}$ S 34 on W., and S 35 on E.face; raise a mound of stone 2 ft.base, 1 $\frac{1}{2}$ ft. high, W.of cor. No trees suitable for bearing trees within limits. Pits impracticable.

69.70 Dry ravine, incanyon, 10 lks.wide, course S.10°W.; ascend 25 ft.

71.60 Road from Showlow to Forestdale, Arizona, brs.N.20°E. and S.20°W.

74.10 Top of spur, brs.N.20°E. and S.20°W.; descend 18 ft.

80.40 Reestablished cor.of secs. 2, 3, 34 and 35, on S.bdy.of Tp., described in Book "A."
Land, mountainous, spurs steep, rocky, covered with oak and juniper timber and brush.
Soil, poor, dry, stony clay loam, 6 ins. deep on dry stony clay subsoil.
Timber, oak, juniper and pine/

June 4, 1915. At 6h. 43m., a.m., l.m.t., I set off 34° 13' N. on the lat.arc; 22°22' N. on the decl.arc; and determine a meridian with the solar at the reestablished cor.of secs. 22, 23, 26 and 27.

Thence
S. 89°49'E., on a random line, bet. secs. 23 and 26.

40.12 Fall 9 lks.S.of the old $\frac{1}{4}$ sec.cor., which is an oak post 3 ins. in diam., 20 ins. above ground greatly decayed, marks almost obliterated, witnessed by two original bearing trees.
True course and dist.of W half bet. secs. 23 and 26 is therefore N.89°57'W., 40.12 chs.

From old $\frac{1}{4}$ sec.cor. described above,
S 89°49'E. on a random line on E $\frac{1}{2}$, bet. secs. 23 and 26.

40.77 Fall 33 lks.N.of the old cor.of secs. 23, 24, 25 and 26, which is a sandstone 12x10x2 ins., loosely set, marked with 1 notch on E. and 2 notches on S. edges, witnessed by the four original bearing trees.
True course and dist. of E. $\frac{1}{2}$, bet. secs. 23 and 26 is therefore N. 89° 21' W., 40.77 chs.

This cor.being in a dilapidated condition, I destroy same and reestablish it in same place as follows:
Set an iron post, 3 ft.long, 2 ins. in diam., 24 ins.in the ground for cor.of secs.23, 24, 25 and 26, marked on brass cap,

T 10 N, R 19 E in N., and
1915 in S half;

22. Partial Resurvey of the Subdivision lines of T. 10 N., R. 10 E.

Chains.

- S 23 in NW.,
 S 24 in NE.,
 S 25 in SE., and
 S 26 in SW. quadrants; from which the original bearing trees,
 A dead oak, 8 ins. in diam., brs. N. 63° E., 51 lks. dist., marked T 10 N R 19 E S 24 B T.
 A pine, 20 ins. in diam., brs. S. 35½° E., 47 lks. dist., marked T 10 N R 19 E S 25 B T.
 A pine, 22 ins. in diam., brs. S. 59¼° W., 64 lks. dist., marked T 10 N R 19 E S 26 B T.
 An oak, 12 ins. in diam., brs. N. 50¼° W., 64 lks. dist., marked T 10 N R 19 E S 23 B T.
- Establish a new bearing tree,
 A pine, 28 ins. in diam., brs. N. 14½° E., 48 lks. dist., which I mark T 10 N R 19 E S 24 B T.
- Thence,
 N. 89° 21' W., on a true line on E. ½, bet. secs. 23 and 26.
 Descend NW. slope, over stony, mountainous land, 17 ft.
 2.77 Dry ravine, 6 lks. wide, course N. 30° E.; ascend 96 ft.
 23.00 Top of spur, brs. N. and S.; descend 40 ft.
 40.77 Intersect the old ¼ sec. cor., hereinbefore described, which I destroy, and reestablish in the same place as follows:
 Set an iron post 3 ft. long, 1 in. in diam., 26 ins. in the ground for ¼ sec. cor., marked on brass cap,
 ¼ S 23 in N., and
 S 26 1915 in S. half; from which the original bearing trees,
 A pine, 30 ins. in diam., brs. N. 0½° E., 39 lks. dist., marked ¼ S 23 B T.
 An oak, 8 ins. in diam., brs. S. 6¼° E., 64 lks. dist., marked ¼ S 26 B T.
- Thence
 N. 89° 57' W., on a true line on W. ½, bet. secs. 23 and 26.
 Over mountainous land; descend.
 11.12 Dry ravine, 20 lks. wide, course N. 40° E.; ascend 126 ft.
 40.12 Intersect the reestablished cor. of secs. 22, 23, 26 and 27, hereinbefore described.
 Land, mountainous.
 Soil, stony, 3rd rate.
 Timber, oak and pine.
-
- From reestablished cor. of secs. 23, 24, 25 and 26,
 South, on a random line, bet. secs. 25 and 26.
 40.27 Fall 46 lks. E. of the old ¼ sec. cor., which is a sandstone 10x8x6 ins., loosely set, marks almost obliterated, and witnessed by the two original bearing trees.
 True course and dist. of N. ½, bet. secs. 25 and 26 is therefore N. 0° 39' E., 40.27 chs.
 From old ¼ sec. cor. described above,
 South, on a random line on S ½, bet. secs. 25 and 26.
 40.27 Fall 29 lks. E. of the old cor. of secs. 25, 26, 35 and 36, which is a sandstone 10x10x5 ins., loosely set, marked with 1 notch on E. and S. edges, and witnessed by the four original bearing trees.
 True course and dist. of S. ½ bet. secs. 25 and 26 is therefore N. 0° 25' E., 40.27 chs.
 This cor. being in a dilapidated condition, I destroy and reestablish it in same place as follows:
 Set an iron post, 3 ft. long, 2 ins. in diam., 24 ins. in the ground for cor. of secs. 25, 26, 35 and 36, marked on brass cap,
 T 10 N R 19 E in N., and
 1915 in S. half;
 S 26 in NW.,
 S 25 in NE.,
 S 36 in SE., and
 S 35 in SW. quadrant; from which the original bearing trees,

Partial Resurvey of the Subdivision lines of T.10 N. R.19 E. 23

chains.

- An oak, 12 ins. in diam., brs. N. 57 1/2° E., 37 lks. dist., marked T 10 N R 19 E S 25 B T.
- A pine, 12 ins. in diam., brs. S. 45 1/2° E., 88 lks. dist., marked T 10 N R 19 E S 36 B T.
- A pine, 30 ins. in diam., brs. S. 65° W., 82 lks. dist., marked T 10 N R 19 E S 35 B T.
- A pine, 14 ins. in diam., brs. N. 55° W., 68 lks. dist., marked T 10 N R 19 E S 26 B T.

Thence, N. 0° 25' E., on a true line on S. 1/2, bet. secs. 25 and 26. Descend NW slope, 40 ft., over stony, mountainous land, through heavy pine and oak timber and brush.

40.27 Intersect the old 1/4 sec. cor. hereinbefore described, which I destroy, and reestablish in the same place as follows: Set an iron post 3 ft. long, 1 in. in diam., 26 ins. in the ground for 1/4 sec. cor., marked on brass cap, 1/4 S 26 in W., 1/4 S 25 in E., and 1915 in S. half; from which the original bearing trees,

- A pine, 28 ins. in diam., brs. N. 74° E., 25 lks. dist., marked 1/4 S 25 B T.
- A pine, 20 ins. in diam., brs. S. 85 1/4° W., 89 lks. dist., marked 1/4 S 26 B T.

At this cor., I set off 22° 23' N. on the decl. arc, and at noon, apparent time, June 4, 1915, observe the sun on the meridian, and obtain a reading of 34° 13' N. on the lat. arc.

Thence, N. 0° 39' E., on a true line, on N. 1/2, bet. secs. 25 and 26. Over mountainous land; descend.

1.42 Dry ravine, 20 lks. wide, course N. 70° E.; ascend 145 ft.
2.77 Road from Pinedale to Cibicu, Arizona, brs. N. 60° E. and S. 60° W.

23.27 Top of spur, brs. N. 60° E. and S. 60° W.; descend 50 ft.

40.27 Intersect the reestablished cor. of secs. 23, 24, 25 and 26, hereinbefore described.

Land, mountainous; spurs steep rocky, covered with loose stone and brush.

Soil, poor dry, stony clay loam, 4 to 8 ins. deep on clay subsoil.

Timber, oak, juniper and pine.

June 4, 1915.

June 6, 1915. At 7h. 43.3m. a.m., l.m.t., I set off 34° 12' N. on the lat. arc; 22° 36' N. on the decl. arc, and determine a meridian with the solar at the reestablished cor. of secs. 25, 26, 35 and 36.

Thence, S. 89° 47' W., on a random line, bet. secs. 26 and 35.

40.24 Fall 70 lks. S. of the old 1/4 sec. cor., which is a sandstone 18x12x12 ins., loosely set, marked 1/4 S on N. face, and witnessed by the two original bearing trees.

True course and dist. of E. 1/2, bet. secs. 26 and 35 is therefore S. 89° 13' E., 40.24 chs.

From old 1/4 sec. cor. described above,

40.25 S. 89° 47' W., on a random line, on W. 1/2, bet. secs. 26 and 35. Fall 9 lks. S. of the reestablished cor. of secs. 26, 27, 34 and 35.

True course and dist. of W. 1/2 bet. secs. 26 and 35 is therefore N. 89° 55' E., 40.25 chs.

Thence, N. 89° 55' E., on a true line, on W. 1/2, bet. secs. 26 and 35.

Ascend W. slope, 25 ft., over stony, mountainous land, through oak, juniper and pine timber and brush.

6.00 Top of the Mogollon Rim, brs. NW. and SE.; descend 15 ft.

17.26 Wire fence along N. bdy. of the Fort Apache Indian Reservation, brs. N. 40° W. and S. 40° E.

17.32 Intersect the N. bdy. of the Fort Apache Indian Reservation 4.63 chs. S. 33° 33' E. of Angle Point No. 620, which is a pine, 28 ins. in diam., marked and witnessed as described

24. Partial Resurvey of the Subdivision lines of T.10 N., R.19 E.

Chains.

- by the surveyor general. At the point of intersection I set an iron post 3 ft. long, 2 ins. in diam., 24 ins. in the ground for reestablished closing cor. of secs. 26 and 35, marked on brass cap,
 C C E of center,
 T 10 N R 19 E in N., and
 1915 in S. half;
 S 26 in NE., and
 S 35 in SW. sector.
- From this cor., the unaccepted closing cor. of secs. 26 and 35, set by Deputy Charles E. Perkins, under Contract No. 40, brs. S. $33^{\circ}33'E.$, 23 lks. dist.; I destroy all trace of this closing cor., and the marks on the bearing trees to same.
- 37.00 Road from Pinedale to Cibicu, Arizona, brs. N. and S.
 40.25 Intersect the old $\frac{1}{4}$ sec. cor. hereinbefore described, which I reestablish in same place, as follows:
 Reset the same stone, 14 ins. in the ground for $\frac{1}{4}$ sec. cor., from which the original bearing trees,
 The stump of pine, 8 ins. in diam., brs. N. $61^{\circ}E.$, 45 lks. dist., marked $\frac{1}{4}$ S B T.
 A pine, 12 ins. in diam., brs. S. $36\frac{1}{2}^{\circ}E.$, 50 lks. dist., marked $\frac{1}{4}$ S 35 B T.
 Establish a new bearing tree:
 A pine, 12 ins. in diam., brs. N. $46^{\circ}E.$, 45 lks. dist., marked $\frac{1}{4}$ S 26 B T.
- Thence,
 S $89^{\circ}13'E.$, on a true line on E. half, bet. secs. 26 and 35.
- 11.00 Dry ravine, 10 lks. wide, course north; ascend 34 ft.
 11.30 Road from Pinedale to Cibicu, Arizona, brs. N. and S.
 20.00 Top of spur, brs. N. and S.; descend 24 ft.
 34.25 Wash, 15 lks. wide, course N. Ascend W. slope.
 40.24 Intersect the reestablished cor. of secs. 25, 26, 35 and 36, hereinbefore described.
- Land, mountainous.
 Soil, stony, 3rd rate.
 Timber, oak, juniper and pine.

June 6, 1915.

- June 4, 1915. From reestablished cor. of secs. 25, 26, 35 & 36, South, on a random line, bet. secs. 35 and 36.
- 40.12 Fall 6 lks. W. of the old $\frac{1}{4}$ sec. cor., which is a sandstone 12x10x6 ins. loosely set in a mound of stone, marked $\frac{1}{4}$ S on N. face, and witnessed by the two original bearing trees.
 True course and dist. of N. $\frac{1}{2}$ bet. secs. 35 and 36 is therefore N. $0^{\circ}5'W.$, 40.12 chs.
 From old $\frac{1}{4}$ sec. cor., described above,
 South, on a random line on S. $\frac{1}{2}$, bet. secs. 35 and 36.
- 39.77 Fall 52 lks. W. of the old cor. of secs. 1, 2, 35 and 36, on the S. bdy. of Tp., which is a sandstone 12x6x4 ins. above ground, loosely set, marked with 1 notch on E. and 5 notches on W. edges, and witnessed by the three original bearing trees.
 True course and dist. of S. $\frac{1}{2}$, bet. secs. 35 and 36 is therefore N. $0^{\circ}45'W.$, 39.77 chs.
 This cor. being in a dilapidated condition, I reestablish it in same place, as follows:
 Reset the same stone 8 ins. in the ground for cor. of secs. 1, 2, 35 and 36, from which original bearing trees
 An oak, 10 ins. in diam., brs. N. $32\frac{1}{2}^{\circ}E.$, 70 lks. dist., marked T 10 N R 19 E S 36 B T.
 A pine, 12 ins. in diam., brs. S. $32\frac{1}{2}^{\circ}W.$, 88 lks. dist., marked T 9 N R 19 E S 2 B T.
 An oak, 30 ins. in diam., brs. N. $42\frac{1}{2}^{\circ}W.$, 66 lks. dist., marked T 10 N R 19 E S 35 B T.
 Establish new bearing tree in same place, brs. S. $23^{\circ}E.$, 120 lks. dist.
 A pine, 24 ins. in diam., brs. S. $23^{\circ}E.$, 120 lks. dist., marked T 9 N R 19 E S 1 B T.
- Thence,
 Thence,

Partial Resurvey of the Subdivision lines of T. 10 N. R. 19 E. 25

Chains

N. 0° 45' W. on a true line, on S $\frac{1}{2}$, bet. secs. 35 and 36. Descend NW slope, over stony, mountainous land, through heavy pine and oak timber and brush.

6.57 Dry ravine, 8 lks. wide, 75 ft. below cor.; course S 70° W.; ascend SE. slope, 155 ft.

32.04 Intersect the N. bdy. of the Fort Apache Indian Reservation 1.24 chs. N. 72° 21' W. of Angle point No. 612, which is a juniper, 16 ins. in diam., marked as described by the surveyor general.

At the point of intersection, I set an iron post 3 ft. long, 2 ins. in diam., 24 ins. in the ground for reestablished closing cor. of secs. 35 and 36, marked on brass cap,

C C N. of center,
T 10 N R 19 E in N., and
1915 in S. half;
S 36 in NE., and
S 35 in SW. sector.

From this cor., the unaccepted closing cor. of secs. 35 and 36, set by Deputy Charles E. Perkins, under Contract No. 40, brs. N. 72° 12' W., 11 lks. dist., I destroy all trace of this closing cor., and the marks on the bearing trees to same.

32.27 Top of ascent on the Mogollon Rim, brs. N. 70° W. and S. 70° E.; descend NE. slope about 20 ft.

32.29 Wire fence along N. bdy. of the Indian Reservation, brs. N. 79° W. and S 70° E.

39.77 Intersect the old $\frac{1}{4}$ sec. cor., hereinbefore described, which I destroy, and reestablish in the same place as follows:

Reset the same stone 8 ins. in the ground for $\frac{1}{4}$ sec. cor., from which the original bearing trees,

A pine, 26 ins. in diam., brs. N. 85° E., 9 lks. dist., marked $\frac{1}{4}$ S 36 B T.
An oak, 8 ins. in diam., brs. N. 83° W., 81 lks. dist., marked $\frac{1}{4}$ S 35 B T.

Thence,
N. 0° 05' W., on a true line, on N. $\frac{1}{2}$, bet. secs. 35 and 36. Over mountainous land; descend.

30.47 Dry ravine, 15 lks. wide, course N. 30° W.; ascend 49 ft.

35.03 Top of spur, brs. N. 30° W and S. 30° E.; descend 24 ft.

40.12 Intersect the reestablished cor. of secs. 25, 26, 35 and 36, hereinbefore described.

Land, mountainous, covered with loose stone.
Soil, stony, 3rd rate.
Timber, pine, oak and juniper.

June 4, 1915.

June 6, 1915. At 10h. 58.3m. a.m., l.m.t., I set off 34° 12' N. on the lat. arc; 22° 36' N. on the decl. arc, and determine a meridian with the solar at the reestablished cor. of secs. 25, 26, 35 and 36.

Thence,
N. 89° 53' E., on a random line, bet. secs. 25 and 36.

40.38 Fall 65 lks. N. of the old $\frac{1}{4}$ sec. cor., which is a sandstone 10x10x5 ins., loosely set, marked $\frac{1}{4}$ on N. face, and witnessed by one of the original bearing trees.

True course and dist. of W. $\frac{1}{2}$, bet. secs. 35 and 36 is therefore N. 89° 11' W., 40.38 chs.

Clouds obscure the sun at noon today rendering an observation for latitude impossible.

From old $\frac{1}{4}$ sec. cor. described above,
N. 89° 53' E., on a random line, on E. $\frac{1}{2}$, bet. secs. 25 and 36.

41.18 Fall 97 lks. S. of the old cor. of secs. 25, 30, 31 and 36 on E. bdy. of Tp., which is a sandstone 8x8x12 ins., loosely set, witnessed as described by the surveyor general.

True course and dist. of E. $\frac{1}{2}$ bet. secs. 25 and 36 is therefore S. 88° 32' W., 41.19 chs.

Thence,
S. 88° 32' W., on a true line, on E. half; bet. secs. 25 and 36.

Chains.

- Descend W'slope, 10 ft., over stony, mountainous land, through heavy pine and oak timber.
- 12.53 Dry ravine, 8 lks. wide, course north; ascend 95 ft.
- 36.18 Top of spur, brs. N. and S.; descend 11 ft.
- 41.19 Intersect the old $\frac{1}{4}$ sec. cor., hereinbefore described, which I destroy, and reestablish in the same place as follows:
Set an iron post 3 ft. long, 1 in. in diam., 26 ins. in the ground for $\frac{1}{4}$ sec. cor., marked on brass cap,
S 25 in N, and
S 36, 1915 in S. half, from which the original bearing tree,
An oak, 12 ins. in diam., brs. S. 50° W., 54 lks. dist., marked $\frac{1}{4}$ S 36 B T.
Establish a new bearing tree,
A pine, 12 ins. in diam., brs. N. 59 $\frac{1}{2}$ ° E., 52 lks. dist., marked $\frac{1}{4}$ S 25 B T.
- Thence
N. 89° 11' W., on a true line, on W. $\frac{1}{2}$, bet. secs. 25 and 36.
- 13.58 Dry ravine, 10 lks. wide, course north; ascend 69 ft.
- 22.38 Top of spur, brs. N. and S.; descend 29 ft.
- 40.38 Intersect the reestablished cor. of secs. 25, 26, 35 and 36, hereinbefore described.
- Land, mountainous, spurs steep, rocky, covered with brush. Soil, poor, dry stony loam, 3 to 8 ins. deep, on clay subsoil and limestone ledges.
Timber, oak, juniper and pine.

June 6, 1915.

GENERAL DESCRIPTION.

That portion of this township resurveyed by me includes only those sections traversed by the north bdy. of the Fort Apache Indian Reservation, which follows along the top of the rim of the Mogollon Mesa.

The land embraced in each of the resurveyed sections is practically all of a mountainous character. South of the top of the rim, the land breaks off abruptly into deep rocky canyons which drain to the south into White River and its tributaries; north of the top of the rim, the land slopes more gradually in a northeasterly direction towards the Little Colorado River, which drains the entire country lying north of this divide.

The soil of practically all the land in the resurveyed sections is a stony clay loam, mostly 3rd rate, and is covered with a good growth of various kinds of grasses, which furnish abundant pasture for horses, cattle and sheep during the summer and fall months. There are no springs or other living water in any of the sections, and no settlers residing on the land.

Boundaries of Resurveyed portion of T.10 N., R. 19 E.
 Latitudes, departures, and closing errors.

Line designated.	Course.	Dist.	Latitudes.		Departures.	
			N.	S.	E.	W.
South bdy.	S.89°53'W.	40.38		.08		40.38
	N.89°59'W.	40.25	.01			40.25
	S.89°57'W.	39.78		.03		39.78
	West.	40.40				40.40
Subdivisional bdy.	N.0°36'W.	80.40	80.40			.85
	S.89°57'W.	79.35		.07		79.35
	N.89°50'W.	39.30	.11			39.30
	N.89°46'W.	39.93	.16			39.93
	S.89°43'W.	40.55		.20		40.55
	S.89°56'W.	40.12		.05		40.12
	N.0°44'W.	40.00	40.00			.51
	N.0°31'E.	40.07	40.07		.36	
West boundary	S.88°37'W.	82.55		2.00		82.53
	N.0°9'E.	40.17	40.17		.10	
	N.0°7'E.	39.78	39.78		.08	
	N.0°26'E.	40.27	40.27		.30	
	N.0°29'E.	39.95	39.95		.34	
	N.0°31'E.	39.95	39.95		.36	
Subdivisional bdy.	N.0°6'E.	40.20	40.20		.07	
	N.88°50'E.	81.06	1.66		81.04	
	S.0°18'E.	40.12		40.12	.21	
	S.0°04'W.	39.95		39.95		.05
	S.0°23'W.	39.70		39.70		.26
	S.0°5'E.	40.22		40.22	.06	
	N.89°47'E.	40.17	.15		40.17	
	N.89°05'E.	39.30	.63		39.29	
	S.0°3'W.	40.06		40.06		.04
	S.0°8'W.	40.04		40.04		.09
	S.89°48'E.	40.10		.14	40.10	
	S.89°51'E.	40.12		.10	40.12	
	N.89°57'E.	40.11	.03		40.11	
	S.89°47'E.	40.16		.15	40.16	
	S.89°57'E.	40.12		.04	40.12	
	S.89°21'E.	40.77		.46	40.77	
S.0°39'W.	40.27		40.27		.46	
S.0°25'W.	40.27		40.27		.29	
S.89°11'E.	40.38		.57	40.38		
N.88°32'E.	41.19	1.05		41.18		
East bdy.	S.0°27'W.	40.16		40.16		.31
	S.0°22'W.	40.18		40.18		.26
Convergency.					.13	
Totals,			404.59	404.86	485.45	485.71
				404.59		485.45
Error in latitude,			-----		0.27	
Error in departure,			-----			0.26

30
28

CERTIFICATE
For ~~FINAL OATH~~ OF UNITED STATES SURVEYOR.
See Book "D" of this Group.

1883
....., U. S. Surveyor, do solemnly swear that, in pursuance
of special instructions received from the U. S. Surveyor General for
bearing date of the day of, 191, I have well, faithfully, and truly,
in my own proper person, and in strict conformity with said instructions, the Manual of Surveying
Instructions, and the laws of the United States, surveyed all those parts or portions of

..... of the
..... Meridian, in the State of, which are represented in
the foregoing field notes as having been executed by me, and under my direction; and I do further
solemnly swear that all the corners of said survey have been established and perpetuated in strict accord-
ance with the Manual of Surveying Instructions, and the special written instructions of the U. S. Surveyor
General for and in the specific manner described in the field notes, and that
the foregoing are the original field notes of such survey.

.....
U. S. Surveyor.

Subscribed by said, and sworn to before me }
this day of, 191



APPROVAL.

OFFICE OF THE UNITED STATES SURVEYOR GENERAL,

Phoenix, Arizona, Sept. 19, 1917.

The foregoing field notes of the ^{re-} survey of part of the

Subdivision Lines of

Township 10 North, Range 19 East,

of the Gila and Salt River Base and Meridian, in the State of Arizona,
executed by Sidney E. Blout, U. S. Surveyor,
under his special instructions dated December 16, 1914, for Group 40, having been
critically examined, and the necessary corrections and explanations made, the said field notes, and the
resurveys they describe, are hereby approved.

U. S. Surveyor General.

I certify that the foregoing transcript of the field notes of the above-described surveys in
..... has been correctly copied from the original notes on file in this office.