

3070

Book "J"

4-679

ORIGIN 1918

BOOK 3070

FIELD NOTES

RE-
OF THE SURVEY OF PART

of the

East Bdy. of TOWNSHIP 32 NORTH, RANGE 5 WEST,

and Survey of

8th Standard Parallel North, thru part of Range 5 West,

Fracl. West boundary, of TOWNSHIP 32 NORTH, RANGE 5 WEST,

Fracl. Subdivision Lines of

TOWNSHIP 32 NORTH, RANGE 5 WEST,

TOWNSHIP 32 NORTH, RANGE 6 WEST,

Of the Gila and Salt River Base and Meridian,

In the State of Arizona.

EXECUTED BY

W. H. Thorn, U. S. Surveyor,

and

Heber P. Purington, U.S. Transitman,

~~In the capacity of U. S. Surveyor~~, under instructions dated March 4, 1915,

issued by the United States Surveyor General to govern surveys included in
Group No. 53, which were approved by the Commissioner of the General Land
Office, December 14, 1915.

Survey commenced March 29, 1917.

Survey completed April 7, 1917

Executed under Assignment
Instructions dated September 28, 1916 and December 18, 1916.

3070

3070

1A

3070

Book "J"

Group 53 - - - Arizona.

BOOK 3070

INDEX DIAGRAM.

T.33N.-R.5W.

8th Standard Parallel North

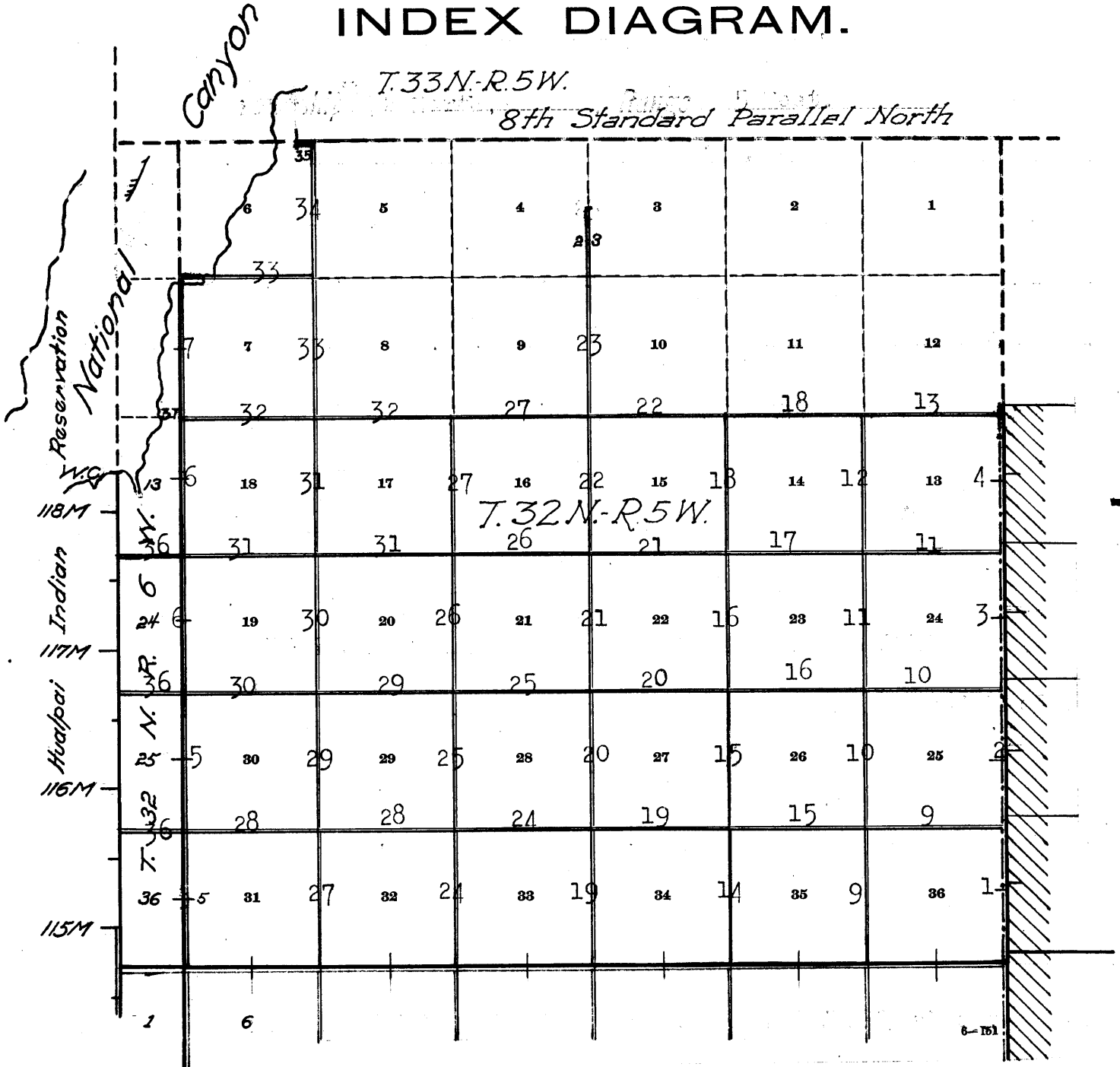

- Lines retraced under this Group. Notes in Book "I".
- Lines surveyed under this Group. Notes in this Book.
- Lines resurveyed under this Group. Notes in this Book.
- Lines surveyed under this Group. Notes in Book "I".
- Lines resurveyed under this Group. Notes in Book "I".
- Accepted surveys.
- Unsurveyed.
- Area subdivided as per accepted plats on file.

407
BOOK 3070 /

Resurvey of part of the E. Bdy. of T. 32 N., R. 5 W.
 Survey of Part of the 8th Standard Parallel North thru Range 5 West.
 Fracl. W. Bdy. of T. 32 N., R. 5 W.
 Fracl. Subdivision Lines of T. 32 N., R. 5 W.
 Fracl. Subdivision Lines of T. 32 N., R. 6 W. 13

Chains

Survey executed by W. H. Thorn, U. S. Surveyor, using a Young and Sons light mountain transit No. 8592, with Smith solar attachment, and Heber P. Purington, U. S. Transitman, using a Young and Sons light mountain transit No. 8533, with Smith solar attachment.

For complete description of transits and solar attachments together with a record of approval, see beginning of notes in books "A" and "G".

Examination of the adjustments of the transits was made, and level and collimation errors corrected. From recent and repeated field tests of the solar attachments on a meridian established by observations on Polaris, they are known to be in satisfactory adjustment. For a record of tests, see beginning of notes in books "A" and "G".

During the surveys, frequent tests were made to insure the accuracy of the solar attachments.

Clinometers and five-chain steel tapes were the instruments employed in determining all distances.

--oOo--

Resurvey of part of E. Bdy. of T. 32 N., R. 5 W.

From the cor. of Ts. 31 and 32 N., R. 5 W., described in book "I",

N. 0° 4' W., on E. bdy. of sec. 36.

Over rolling land, through scattering timber and undergrowth.

1.48 The original cor. of Ts. 31 and 32 N., Rs. 4 and 5 W., which is a limestone, properly set, mkd. and witnessed as described by the Surveyor General. I destroy the NW. and SW. bearing trees.

Thence continue measurement

N. 0° 3' E.

Asc. gradual slope.

25.50 Top of slope brs. NE. and SW.

31.50 Over broken W. slope.

40.00 Set an iron post, 3 ft. long, 1 in. diam., 26 ins. in the ground, for $\frac{1}{4}$ sec. cor., mkd. on brass cap

$\frac{1}{4}$
S36
1917

from which,

A cedar, 4 ins. diam., brs. S. 62° W.

149 lks. dist. mkd. $\frac{1}{4}$ S 36 B T.

A cedar, 5 ins. diam., brs. N. 52 $\frac{1}{2}$ ° W.

9 lks. dist. mkd. $\frac{1}{4}$ S 36 B T.

41.31 The original $\frac{1}{4}$ sec. cor., which is a limestone, properly set, mkd. and witnessed as described by the Surveyor General. I destroy bearing tree W. of cor., obliterate the markings on W. face and mark $\frac{1}{4}$ S31 on E. face of stone.

N. 0° 11' W., continuing measurement.

Asc. 54 ft. to

47.70 Desc. gradual N. slope.

64.60 Desc. NW. slope, 150 ft. to

80.00 Set an iron post, 3 ft. long, 2 ins. diam., 24 ins. in a mound of stone, for cor. of secs. 25 and 36, mkd. on brass cap

2 Resurvey of part of E. Bdy. of T. 32 N. R. 5 W.

Chains

T32N
S25
S36
R 5W
1917

from which,
A cedar, 5 ins. diam., brs. S. 79° W.
84 lks. dist. mkd. T 32 N R 5 W S 36 B T.
A cedar, 4 ins. diam., brs. N. 45° W.
25 lks. dist. mkd. T 32 N R 5 W S 25 B T.

Land, rolling.
Soil, 2nd and 3rd rate.
Timber, scattering cedar.
Undergrowth, algerita and sagebrush.
Grass.

1.22 N. 0° 11' W. on E. bdy. of sec. 25.
Over rolling land, through scattering timber and undergrowth.
The original cor. of secs. 25, 30, 31 and 36, which is a limestone, properly set, mkd. and witnessed as described by the Surveyor General. I destroy the NW. and SW. bearing trees.

•Thence
Continue measurement
N. 0° 18' W.
2.80 Gulch, course N, 50° E. Asc. 46 ft.
7.20 Low spur slopes N. 60° E. Desc. 31 ft. to
13.80 Gulch, course, N. 60° E. Asc. 40 ft. to
21.90 Spur slopes E. Desc. 46 ft. to
28.30 Gulch, course S. 80° E.
40:00 Set an iron post, 3 ft. long, 1 in. diam., 12 ins. in the ground, in a mound of stone, for $\frac{1}{4}$ sec. cor., mkd. on brass cap

S25
↑
1917

40.79 from which,
A cedar, 4 ins. diam., brs. S. 52° W.
30 lks. dist. mkd. $\frac{1}{4}$ S 25 B T.
A cedar, (original B.T.) 4 ins. diam., brs.
N. 21° W. 88 lks. dist. mkd. $\frac{1}{4}$ S 25 B T.
The original $\frac{1}{4}$ sec. cor., which is a limestone, properly set, mkd. and witnessed as described by the Surveyor General. I obliterate the markings on W. face and mark $\frac{1}{4}$ S30 on E. face of stone.

N. 0° 15' E., continuing measurement.
Asc. 31 ft. to
42.79 Spur slopes E. Desc. gradual NE. slope.
47.00 Asc. 68 ft. to
62.20 Top of ridge brs. NE. and SW. Desc. gradual slope to
80.00 Set an iron post, 3 ft. long, 2 ins. diam., 18 ins. in the ground, in a mound of stone, for cor. of secs. 24 and 25, mkd. on brass cap

T32N
S24
S25
R 5W
1917

from which,
A cedar, 10 ins. diam., brs. S. 21° W.
325 lks. dist. mkd. T 32 N R 5 W S25 B T.

Resurvey of part of E. bdy. of T. 32 N. R. 5 W. 3

Chains

A cedar, (old NW. tree) 10 ins. diam., brs. N. 41° W
 130 lks. dist. mkd. T 32 N R 5 W S 24 B T.
 Land, gently rolling.
 Soil, 2nd and 3rd rate.
 Timber, scattering cedar.
 Undergrowth, algerita and sagebrush.
 Grass.

N. 0° 15' E. on E. bdy. of sec. 24.
 Over rolling land, through scattering timber and under-
 growth.
 .75 The original cor. of secs. 19, 24, 25 and 30, which is a
 limestone, properly set, mkd. and witnessed as de-
 scribed by the Surveyor General. I destroy the SE.
 bearing tree.
 Thence continue measurement
 N. 0° 3' E.
 Desc. gradual NW. slope of draw.
 12.25 Road brs. S. 60° W. and N. 80° E. to Supai Indian Village.
 15.00 Asc. gradual slope.
 35.75 Spur slopes NW.
 40.00 Set an iron post, 3 ft. long, 1 in. diam., 12 ins. in the
 ground, in a mound of stone, for $\frac{1}{4}$ sec. cor., mkd. on
 brass cap.

$\frac{1}{4}$
 S24
 1917

from which,
 A cedar, 9 ins. diam., brs. S. 43° W.
 341 lks. dist. mkd. $\frac{1}{4}$ S 24 B T.
 No other trees within limits.
 Dig pits, 18 X 18 X 12 ins., N. and S. of post, 3 ft. dist.
 40.80 The original $\frac{1}{4}$ sec. cor., which is a limestone, properly
 set, mkd. and witnessed as described by the Surveyor
 General. I obliterate markings on W. face and mark
 $\frac{1}{4}$ on E. face of stone.
 N. 0° 10' E., continuing measurement.
 Desc. gradual slope 85 ft. to
 60.80 Gulch, near head, course N. 70° W. Asc. 120 ft. to
 80.00 Set an iron post, 3 ft. long, 2 ins. diam., 6 ins. in the
 ground, in a mound of stone, for cor. of secs. 13 and
 24, mkd. on brass cap

T32N
 S13
 — S24
 R 5W
 1917

from which,
 A cedar, 10 ins. diam., brs. S. 54° W.
 105 lks. dist. mkd. T 32 N R 5 W S 24 B T.
 A cedar, (old NW. B.T.) 8 ins. diam., brs. N. 48° W.
 168 lks. dist. mkd. T 32 N R 5 W S 13 B T.
 Land, rolling.
 Soil, 2nd and 3rd rate.
 Timber, cedar.
 Undergrowth, sagebrush.
 Grass.

4 Resurvey of part of E. bdy. of sec. 13, T. 32 N., R. 5 W.

Chains

N. 0° 10' E. on E. bdy. of sec. 13.
Over rolling land, through very scattering timber, and undergrowth.

.71 The original cor. of secs. 13, 18, 19 and 24, which is a limestone, properly set, mkd. and witnessed as described by the Surveyor General.
Thence continue measurement
N. 0° 12' E.
Desc. gradual slope.

24.40 Draw, course N. 10° W.
40.00 Set an iron post, 3 ft. long, 1 in. diam., 26 ins. in a mound of stone, for $\frac{1}{4}$ sec. cor., mkd. on brass cap

S13
1917

from which,
A cedar, 5 ins. diam., brs. S. 4° W.
332 lks. dist. mkd. $\frac{1}{4}$ S 13 B T.

No other trees within limits.

40.75 Raise a mound of stone, 3 ft. base, 2 ft. high, W. of cor. The original $\frac{1}{4}$ sec. cor., which is a limestone, properly set, mkd. and witnessed as described by the Surveyor General. I obliterate the marking on W. face and mark $\frac{1}{4}$ S18 on E. face of stone.
N. 0° 11' E., continuing measurement.

63.15 Ravine, 4 chs. wide, 40 ft. deep, course N. 40° E.
70.75 Thence along low ridge brs. N. 20° E. and S. 20° W.
80.00 Set an iron post, 3 ft. long, 2 ins. diam., 6 ins. in the ground, in a mound of stone, for cor. of secs. 12 and 13, mkd. on brass cap

T32N
S12
S13
R 5W
1917

from which,
A cedar, 6 ins. diam., brs. S. 2° W.
230 lks. dist. mkd. T 32 N R 5 W S 13 B T.
A cedar, 10 ins. diam., brs. N. 40° W.
190 lks. dist. mkd. T 32 N R 5 W S 12 B T.

Land, rolling.
Soil, 2nd and 3rd rate.
Timber, cedar.
Undergrowth, sagebrush.
Grass.

.70 N. 0° 11' E. on E. bdy. of sec. 12 to the original cor. of secs. 7, 12, 13 and 18.
Over rolling land, through scattering timber.
The original cor. of secs. 7, 12, 13 and 18, which is a limestone, properly set, mkd. and witnessed as described by the Surveyor General. I destroy SW. bearing tree.

Land, rolling.
Soil, 2nd rate.
Timber, cedar.
Undergrowth, sagebrush.
Grass.

Fracl. West Bdy. of T. 32 N. R. 5 W.

5

Chains

From the cor. of Ts. 31 and 32 N., R. 5 and 6 W., described in book 111.

North bet. secs. 31 and 36.

Over gently rolling land, through scattering timber and undergrowth.

40.00 Set an iron post, 3 ft. long, 1 in. diam., 12 ins. in the ground, in a mound of stone, for 1/4 sec. cor., mkd. on brass cap.

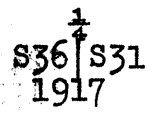

and raise a mound of stone, 3 ft. base, 1 1/2 ft. high, W. of cor.

Thence along gradual SE. slope.

70.00 Low ridge brs. N. 20° E. and S. 20° W.

80.00 Set an iron post, 3 ft. long, 2 ins. diam., 24 ins. in the ground, for cor. of secs. 25, 30, 31 and 36, mkd. on brass cap

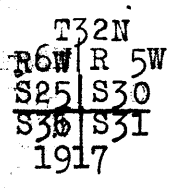

dig pits, 18 X 18 X 12 ins., in each sec., 5 1/2 ft. dist.

Land, gently rolling.

Soil, sandy clay, limestone formation, 2nd rate.

Timber, very scattering cedar.

Undergrowth, sagebrush.

Grass.

North bet. secs. 25 and 30.

Over gently rolling land, through scattering timber and undergrowth.

28.30 Draw, course N. 30° E. Asc. gradual SE. slope.

40.00 Set an iron post, 3 ft. long, 1 in. diam., 26 ins. in the ground, for 1/4 sec. cor., mkd. on brass cap

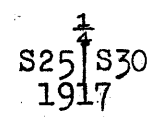

dig pits, 18 X 18 X 12 ins., N. and S. of post, 3 ft. dist.

60.00 Draw, course E.

80.00 Set an iron post, 3 ft. long, 2 ins. diam., 18 ins. in the ground, in a mound of stone, for cor. of secs. 19, 24, 25 and 30, mkd. on brass cap

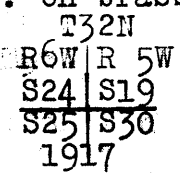

and raise a mound of stone, 3 ft. base, 2 ft. high, W. of cor.

Land, gently rolling.

Soil, sandy clay, stony and rocky, limestone formation, 2nd rate.

Timber, scattering cedar.

Undergrowth, sagebrush.

Grass.

Chains

North bet. secs. 19 and 24.
Over gently rolling land, through scattering timber and undergrowth.

5.00

Asc. gradual SE. slope.
Head of draw, course S. 70° E.

25.00

Top of slope. Thence over gradual W. slope.

40.00

Set an iron post, 3 ft. long, 1 in. diam., 26 ins. in the ground, for 1/4 sec. cor., mkd. on brass cap

1/4
S24 | S19
1917

from which,

A cedar, 16 ins. diam., brs. N. 42° E.
251 lks. dist. mkd. 1/4 S 19 B T.

A cedar, 12 ins. diam., brs. N. 8° W.
159 lks. dist. mkd. 1/4 S 24 B T.

80.00

Set an iron post, 3 ft. long, 2 ins. diam., 24 ins. in the ground, for cor. of secs. 13, 18, 19 and 24, mkd. on brass cap

T32N
R5W | R5W
S13 | S18
S24 | S19
1917

from which,

A cedar, 6 ins. diam., brs. N. 2° E.
52 lks. dist. mkd. T 32 N R 5 W S 18 B T.

A cedar, 4 ins. diam., brs. S. 14° E.
33 lks. dist. mkd. T 32 N R 5 W S 19 B T.

A cedar, 3 ins. diam., brs. S. 73 1/2° W.
9 lks. dist. mkd. T 32 N R 6 W S 24 B T.

A cedar, 8 ins. diam., brs. N. 24° W.
86 lks. dist. mkd. T 32 N R 6 W S 13 B T.

Land, gently rolling.

Soil, sandy clay, stony, limestone formation, 2nd rate.

Timber, cedar.

Undergrowth, sagebrush.

Grass.

North bet. secs. 13 and 18.

Over gently rolling land, through very scattering timber and undergrowth. General drainage, W.

40.00

Set an iron post, 3 ft. long, 1 in. diam., 6 ins. in the ground, in a mound of stone, for 1/4 sec. cor., mkd. on brass cap

1/4
S13 | S18
1917

and raise a mound of stone, 3 ft. base, 2 ft. high, W. of cor.

59.40

Draw, course, N. 80° W.

80.00

Set an iron post, 3 ft. long, 2 ins. diam., 18 ins. in the ground, in a mound of stone, for cor. of secs. 7, 12, 13 and 18, mkd. on brass cap

T32N
R6W | R5W
S12 | S7
S13 | S18
1917

from which,

A cedar, 5 ins. diam., brs. N. 83° E.

189 lks. dist. mkd. T 32 N R 5 W S 7 B T.

Chains.

A cedar, 6 ins. diam., brs. S.75 $\frac{1}{2}$ °E.,
 140 lks. dist., marked T32N R5W S18 BT.
 A cedar, 7 ins. diam., brs. S.55°W.,
 135 lks. dist., marked T32N R6W S13 BT.
 A cedar, 4 ins. diam., brs. N.24°W.,
 17 lks. dist., marked T32N R6W S12 BT.

Land, gently rolling.
 Soil, sandy clay, stony and rocky, limestone formation,
 3rd rate.
 Timber, cedar.
 Undergrowth, sagebrush
 Grass.

Note:- From the cor. of secs. 7, 12, 13 and 18, the W. C.
 to the 118 $\frac{1}{2}$ M. cor. on the E. bdy. of the Hualpai
 Indian Reservation, which is a limestone, properly
 set, marked and witnessed as described by the Surveyor-
 General, brs. S.49°23'W.

32.80
40.00

North bet. secs. 7 and 12.
 Over gently rolling land, through scattering timber and
 undergrowth.
 Draw, course N.70°W.
 Set an iron post, 3 ft. long, 1 in. diam., 26 ins. in the
 ground, for $\frac{1}{4}$ sec. cor., marked on brass cap

S12 | S 7
 |
 1917

from which

A cedar, 6 ins. diam., brs. S.86°E.,
 77 lks. dist., marked $\frac{1}{4}$ S7 BT.
 A cedar, 18 ins. diam., brs. N.3 $\frac{1}{2}$ °W.,
 529 lks. dist., marked $\frac{1}{4}$ S12 BT.

53.80
58.96
78.70

Draw, course W.
 Along edge of National Canyon, to
 Rim of canyon, brs. NE. and SW. Canyon is 300 to 400 ft.
 deep.
 Set an iron post, 3 ft. long, 2 ins. diam., 12 ins. in the
 ground, in a mound of stone, for witness cor. to cor.
 of secs. 1, 6, 7 and 12, marked on brass cap

T32N
 R6W | R5W
 S 1 | S 6

 S12 | S 7
 |
 W | C
 1917

from which

A cedar, 5 ins. diam., brs. S.66°E.,
 177 lks. dist., marked WC T32N R5W S7 BT.
 A cedar, 4 ins. diam., brs. S.5 $\frac{1}{2}$ °W.,
 67 lks. dist., marked WC T32N R6W S12 BT.

80.00

No other trees within limits.
 Raise a mound of stone, 3 ft. base, 2 ft. high, W. of cor.
 True point for cor. of secs. 1, 6, 7 and 12 falls in
 canyon.
 Land, gently rolling.
 Soil, sandy clay, stony and rocky, limestone formation,
 3rd rate.
 Timber, scattering cedar.
 Undergrowth, algerita and sagebrush.
 Grass.

Subdivision of a portion of T. 32 N. R. 5 W. 9

Chains

From the cor. of secs. 1, 2, 35 and 36, S. bdy. of Tp., described in book "I", N. 0° 1' W. bet. secs. 35 and 36.
 Over gradual NE. slope, through scattering timber and undergrowth.
 6.00 Bottom of draw, course N. 60° E.. Thence along E. slope.
 25.00 Low saddle. Desc. gradual slope.
 29.50 Road brs. NW. and SE.
 38.00 Draw, course E.
 40.00 Set an iron post, 3 ft. long, 1 in. diam., 18 ins. in the ground, in a mound of stone, for $\frac{1}{4}$ sec. cor., mkd. on brass cap

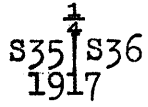

from which,

- A cedar, 3 ins. diam., brs. S. 79° 10' E.
64 lks. dist. mkd. $\frac{1}{4}$ S 36 B T.
- A cedar, 3 ins. diam., brs. N. 87° 50' W.
84 lks. dist. mkd. $\frac{1}{4}$ S 35 B T.

57.60 Road brs. NW. to Bishop's tank and SE.
 75.00 Desc. very gradual N. slope.
 80.00 Set an iron post, 3 ft. long, 2 ins. diam., 24 ins. in the ground, for cor. of secs. 25, 26, 35 and 36, mkd. on brass cap

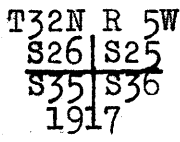

from which,

- A cedar, 5 ins. diam., brs. N. 83 $\frac{1}{2}$ ° E. E.
240 lks. dist. mkd. T 32 N R 5 W S 25 B T.
- A cedar, 13 ins. diam., brs. S. 20° 5' E.
270 lks. dist. mkd. T 32 N R 5 W S 36 B T.
- A cedar, 12 ins. diam., brs. S. 76° 20' W.
265 lks. dist. mkd. T 32 N R 5 W S 35 B T.
- A cedar, 6 ins. diam., brs. N. 76° W.
500 lks. dist. mkd. T 32 N R 5 W S 26 B T.

Land, gently rolling.
 Soil, sandy loam, 1st rate.
 Timber, cedar.
 Undergrowth, sagebrush.
 Grass.

40.00 East on a random line bet. secs. 25 and 36.
 79.99 Set temp. $\frac{1}{4}$ sec. cor.
 Intersect. E. bdy. of Tp., 23 lks. S. of the cor. of secs. 25 and 36, hereinbefore described.

Thence S. 89° 50' W. on a true line bet. secs. 25 and 36.
 Over gently rolling land, through scattering timber and undergrowth.

5.00 Desc. gradual NW. slope to Bottom of draw, course NE. Asc. gradual slope.
 27.00 Desc. gradual slope to Bottom of side of draw, course S. Asc. gradual E. slope.
 32.00 Bottom of side of draw, course S. Asc. gradual E. slope.
 39.99 $\frac{1}{2}$ Set an iron post, 3 ft. long, 1 in. diam., 15 ins. in the ground, in a mound of stone, for $\frac{1}{4}$ sec. cor., mkd. on brass cap

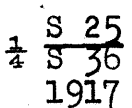

10... Subdivision of a portion of T. 32 N. R. 5 W.

Chains

from which,
 A cedar, 4 ins. diam., brs. N. $1\frac{1}{2}^{\circ}$ W.
 67 lks. dist. mkd. $\frac{1}{4}$ S 25 B T.
 A cedar, 3 ins. diam., brs. S. $86^{\circ} 40'$ E.
 165 lks. dist. mkd. $\frac{1}{4}$ S 36 B T.
 50.60 Draw, course SW.
 72.30 Road brs. N. to Supai Indian Village and S.
 79.99 The cor. of secs. 25, 26, 35 and 36.
 Land, gently rolling.
 Soil, 2nd rate.
 Timber, cedar.
 Undergrowth, sagebrush.
 Grass.

N. $0^{\circ} 1'$ W. bet. secs. 25 and 26.
 Over gradual SW. slope, through scattering timber and
 undergrowth.
 12.00 Top of ascent. Desc. gradual slope to
 21.00 Asc. gradual slope to
 30.00 Top of slope brs. N. and S.
 40.00 Set an iron post, 3 ft. long, 1 in. diam., 24 ins. in the
 ground, for $\frac{1}{4}$ sec. cor., mkd. on brass cap

$\frac{1}{4}$
 S26 | S25
 1917

from which,
 A cedar, 8 ins. diam., brs. S. $17\frac{3}{4}^{\circ}$ E.
 540 lks. dist. mkd. $\frac{1}{4}$ S 25 B T.
 A cedar, 3 ins. diam., brs. S. $10\frac{1}{4}^{\circ}$ W.
 476 lks. dist. mkd. $\frac{1}{4}$ S 26 B T.
 Asc. gradual S. slope.
 50.50 Top of slope brs. E. and W. Desc. gradual NE. slope to
 80.00 Set an iron post, 3 ft. long, 2 ins. diam., 24 ins. in the
 ground, for cor. of secs. 23, 24, 25 and 26, mkd. on
 brass cap

T32N R 5W
 S23 | S24
 S26 | S25
 1917

from which,
 A cedar, 5 ins. diam., brs. N. 69° E.
 90 lks. dist. mkd. T 32 N R 5 W S 24 B T.
 A cedar, 8 ins. diam., brs. S. 3° E.
 70 lks. dist. mkd. T 32 N R 5 W S 25 B T.
 A cedar, 4 ins. diam., brs. S. $26^{\circ} 35'$ W.
 150 lks. dist. mkd. T 32 N R 5 W S 26 B T.
 A cedar, 6 ins. diam., brs. N. $23^{\circ} 40'$ W.
 85 lks. dist. mkd. T 32 N R 5 W S 23 B T.
 Land, gently rolling.
 Soil, 2nd rate.
 Timber, cedar.
 Undergrowth, sagebrush.
 Grass.

40.00 East on a random line bet. secs. 24 and 25.
 80.17 Set temp. $\frac{1}{4}$ sec. cor.
 Intersect E. bdy. of Tp., 28 lks. S. of cor. of secs.
 24 and 25, hereinbefore described.
 Thence
 S. $89^{\circ} 48'$ W. on a true line bet. secs. 24 and 25.
 Over gently rolling land, through scattering timber and
 undergrowth.

Subdivision of a Portion of T. 32 N., R. 5 W. 11.

Chains.

40.08 $\frac{1}{2}$ Asc. gradual slope.
Set an iron post, 3 ft. long, 1 in. diam., 26 ins. in the ground, for $\frac{1}{4}$ sec. cor., marked on brass cap

S24
 $\frac{1}{4}$ S25
1917

from which

A cedar, 7 ins. diam., brs. N.76°E.,
416 lks. dist., marked $\frac{1}{4}$ S24 BT.

A cedar, 8 ins. diam., brs. S.15°10'E.,
325 lks. dist., marked $\frac{1}{4}$ S25 BT.

56.80 Desc. gradual slope to
80.17 Road, brs. NE. to Supai Indian Village and SW.
The cor. of secs. 23, 24, 25 and 26.

Land, gently rolling.

Soil, 2nd rate.

Timber, scattering cedar.

Undergrowth, sagebrush.

Grass.

N.0°1'W., bet. secs. 23 and 24.

Over gently rolling land, through scattering timber and undergrowth.

Along gradual E. slope.

30.00 Top of gentle slope, brs. E. and W. Desc. gradual slope to

40.00 Set an iron post, 3 ft. long, 1 in. diam., 26 ins. in the ground, for $\frac{1}{4}$ sec. cor., marked on brass cap

$\frac{1}{4}$
S23 | S24
1917

from which

A cedar, 8 ins. diam., brs. S.5°E.,
110 lks. dist., marked $\frac{1}{4}$ S24 BT.

A cedar, 7 ins. diam., brs. N.45 $\frac{1}{2}$ °W.,
193 lks. dist., marked $\frac{1}{4}$ S23 BT.

80.00 Desc. gradual N. slope.

Set an iron post, 3 ft. long, 2 ins. diam., 24 ins. in the ground, for cor. of secs. 13, 14, 23 and 24, marked on brass cap

T32N R5W
S14 | S13
S23 | S24
1917

from which

A cedar, 6 ins. diam., brs. N.59°40'E.,
90 lks. dist., marked T32N R5W S13 BT.

A cedar, 5 ins. diam., brs. S.64°E.,
140 lks. dist., marked T32N R5W S24 BT.

A cedar, 3 ins. diam., brs. S.59°40'W.,
97 lks. dist., marked T32N R5W S23 BT.

A cedar, 6 ins. diam., brs. N.27°10'W.,
40 lks. dist., marked T32N R5W S14 BT.

Land, gently rolling.

Soil, 2nd rate.

Timber, cedar.

Undergrowth, sagebrush.

Grass.

40.00 East on a random line, bet. secs. 13 and 24.

80.43 Set temp. $\frac{1}{4}$ sec. cor.

Intersect E. bdy. of Tp., 28 lks. S. of the cor. of secs. 13 and 24, hereinbefore described.

Thence

S.89°48'W., on a true line, bet. secs. 13 and 24.

Over gently rolling land, through scattering timber and undergrowth.

30.40 Desc. gradual SW. slope to

Intersection of two draws, course N., from S. and SE.

Asc. gradual slope to

12. Subdivision of a Portion of T. 32 N., R. 5 W.

Chains. Top of ascent.
 35.40 Top of ascent.
 40.21 1/2 Set an iron post, 3 ft. long, 1 in. diam., 24 ins. in the ground, in a mound of stone, for 1/4 sec. cor., marked on brass cap

$$\frac{1}{4} \frac{S13}{S24}$$
 1917

from which
 A cedar, 4 ins. diam., brs. N.77°20'W.,
 147 lks. dist., marked 1/4 S13 BT.
 A cedar, 4 ins. diam., brs. S.23°0'W.,
 135 lks. dist., marked 1/4 S24 BT.

Asc. gradual NE. slope to
 52.00 Desc. gradual slope.
 52.90 Draw, course NE. Asc. gradual E. slope.
 76.90 Top of slope, brs. N. and S. Desc. gradual W. slope.
 80.43 The cor. of secs. 13, 14, 23 and 24.
 Land, rolling.
 Soil, 2nd rate.
 Timber, cedar.
 Undergrowth, sagebrush.
 Grass.

N.0°1'W., bet. secs. 13 and 14.
 Over gently rolling W. slope, through scattering timber and undergrowth.

30.46 Set a flag for triangulation
 36.00 Bottom of draw, course W.
 40.00 Set an iron post, 3 ft. long, 1 in. diam., 3 ins. in the ground, in a mound of stone, for 1/4 sec. cor., marked on brass cap

$$\frac{1}{4} \frac{S14 \mid S13}{1917}$$

from which
 A cedar, 3 ins. diam., brs. S.12 1/2°E.,
 53 lks. dist., marked 1/4 S13 BT.
 A cedar, 6 ins. diam., brs. S.47°W.,
 53 lks. dist., marked 1/4 S14 BT.

40.03 Rim of canyon, 600 to 800 ft. deep, brs. NE. and SW. Course of canyon is NE. I set a flag ahead on line.

To determine distance across canyon, I proceed as follows:
 From the triangulation point at 30.46 chs., I measure a base S.70°20 1/2'E., 22.68 chs., from E. end of which flag set at 30.46 ch. point and other flag subtend an angle of 48°34'50". The distance triangulated is given by

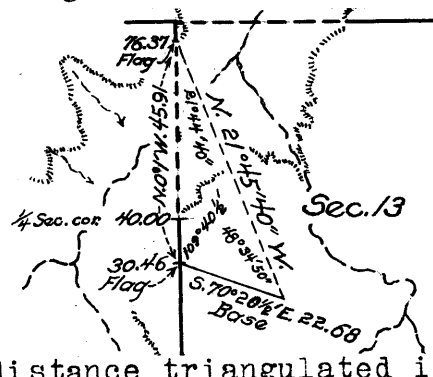

$$\frac{\text{base} \times \sin. 48^{\circ}34'50''}{\sin. 21^{\circ}44'40''} \text{ or } \frac{22.68 \times .74988}{.37047} = 45.91 \text{ chs.}$$

45.91 chs. + 30.46 chs. = 76.37 chs.
 76.37 N. edge of canyon, brs. NE. and SW. Course of canyon, NE.
 80.00 Set an iron post, 3 ft. long, 2 ins. diam., 24 ins. in the ground, for cor. of secs. 11, 12, 13 and 14, marked on brass cap

$$\frac{T32N \ R5W}{S11 \mid S12}$$

$$\frac{S14 \mid S13}{1917}$$

Chains.

from which

- A cedar, 3 ins. diam., brs. N.21°40'E.,
74 lks. dist., marked T32N R5W S12 BT.
- A cedar, 4 ins. diam., brs. S.70°25'E.,
71 lks. dist., marked T32N R5W S13 BT.
- A cedar, 8 ins. diam., brs. S.47°50'W.,
86 lks. dist., marked T32N R5W S14 BT.
- A cedar, 5 ins. diam., brs. N.64°10'W.,
190 lks. dist., marked T32N R5W S11 BT.

Land, gently rolling to canyon.
Soil, 3rd and 4th rates.
Timber, cedar.
Undergrowth, sagebrush.
Grass.

N.89°50'E., on a random line, bet. secs. 12 and 13.
Impossible to chain across canyon. The distance is determined by the following triangulation: A flag is

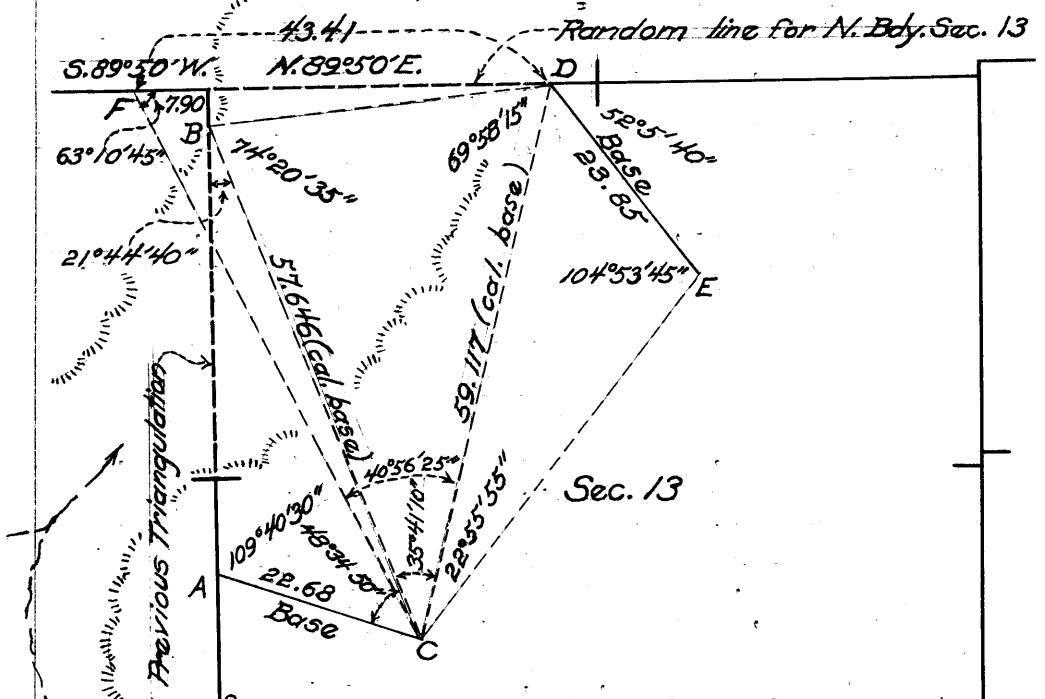

set N.89°50'E., on opposite side of canyon (see diagram, flag "D"). All points having been preserved on previous triangulation bet. secs. 13 and 14, line BC (see diagram) is calculated as follows:

$$BC = \frac{22.68 \times \sin. 109^{\circ}40'30''}{\sin. 21^{\circ}44'40''} \text{ or}$$

$$= \frac{22.68 \times .94162}{.37047} = 57.646 \text{ chs.}$$

From point "C", angle subtended by flags "B" and "D" is 35°41'10". From point "B", angle subtended by flags "C" and "D" is measured and found to be 74°20'35". The sum of the angles of triangle BCD is 180°; therefore angle BDC is 69°58'15". Line CD is calculated as follows:

$$CD = \frac{57.646 \times \sin. 74^{\circ}20'35''}{\sin. 69^{\circ}58'15''}$$

$$= \frac{57.646 \times .9629}{.939515} = 59.081 \text{ chs.}$$

As a check for this distance, instrument is set up at point "D", and an angle of 52°5'40" is turned off to the right (south) of random bearing N.89°50'E., and a base measured, 23.85 chs. (see diagram) line DE). From point E., flags "C" and "D" subtend an angle of 104°53'45". From point "C", flags "D" and "E" subtend an angle of 22°55'55". Line CD is calculated as follows:

$$CD = \frac{23.85 \times \sin. 104^{\circ}53'45''}{\sin. 22^{\circ}55'55''}$$

$$= \frac{23.85 \times .9664}{.38964} = 59.154 \text{ chs.}$$

14.

Subdivision of a Portion of T. 32 N., R. 5 W.

Chains.

The average of the calculated lengths of line CD is

$$\frac{59.081 + 59.154}{2} = 59.117 \text{ chs.},$$

which distance is used as a base for the final triangulation. A flag is set S. 89° 50' W. of cor. of secs. 11, 12, 13 and 14, 7.90 chs. dist. (see diagram, flag "F".) From point "C" the angle subtended by flags "D" and "F" is 40° 56' 25". From point "F", the angle subtended by flags "C" and "D" is 63° 10' 45". In triangle CDF (see diagram) the line DF is calculated as follows:

$$\begin{aligned} DF &= \frac{59.117 \times \sin. 40^\circ 56' 25''}{\sin. 63^\circ 10' 45''} \\ &= \frac{59.117 \times .65527}{.89242} = 43.407 \text{ chs.} \end{aligned}$$

$$43.41 - 7.90 =$$

35.51 Triangulation point. Rim of canyon.

40.00 Set temp. $\frac{1}{4}$ sec. cor.

80.49 Intersect E. bdy. of Tp., 7 lks. S. of the cor. of secs. 12 and 13, hereinbefore described.

Thence

S. 89° 47' W., on a true line, bet. secs. 12 and 13.

Over rolling land, through scattering timber.

30.00 Canyon, course N.

40.24 $\frac{1}{2}$ Set an iron post, 3 ft. long, 1 in. diam., 18 ins. in the ground, in a mound of stone, for $\frac{1}{4}$ sec. cor., marked on brass cap
$$\begin{array}{r} \frac{1}{4} \text{ S12} \\ \frac{1}{4} \text{ S13} \\ 1917 \end{array}$$

from which

A cedar, 5 ins. diam., brs. N. 49° 40' E.,

78 lks. dist., marked $\frac{1}{4}$ S12 BT.

A cedar, 6 ins. diam., brs. S. 24° 40' W.,

225 lks. dist., marked $\frac{1}{4}$ S13 BT.

44.98 Rim of canyon, about 600 ft. deep, brs. NE. and SW. Course of canyon, NE.

80.00 Rim of canyon.

80.49 The cor. of secs. 11, 12, 13 and 14.

Land, rolling and mountainous.

Soil, 3rd and 4th rates.

Timber, cedar.

From the cor. of secs. 2, 3, 34 and 35, S. bdy. of Tp., described in Book "I",

N. 0° 1' W., bet. secs. 34 and 35.

Over rolling land, through scattering timber and undergrowth. Asc. gradual SW. slope.

18.00 Top of slope, brs. E. and W. Desc. N. slope to

24.00 Draw, course NE. Thence along NE. slope.

39.00 Draw, 2 chs. wide, course E.

40.00 Set an iron post, 3 ft. long, 1 in. diam., 26 ins. in the ground, for $\frac{1}{4}$ sec. cor., marked on brass cap
$$\begin{array}{r} \text{S34} \text{ S35} \\ 1917 \end{array}$$

from which

A cedar, 7 ins. diam., brs. N. 12 $\frac{3}{4}$ ° E.,267 lks. dist., marked $\frac{1}{4}$ S35 BT.

A cedar, 9 ins. diam., brs. N. 63° 25' W.,

360 lks. dist., marked $\frac{1}{4}$ S34 BT.

Asc. gradual slope to

52.00 Desc. gradual slope to

63.00 Bottom of draw, course NE.

75.00 Draw, course NE.

80.00 Set an iron post, 3 ft. long, 2 ins. diam., 24 ins. in the ground, for cor. of secs. 26, 27, 34 and 35, marked on brass cap

Subdivision of a portion of T. 32 N. R. 5 W. 15

Chains

T32N R 5W
S27|S26
S34|S35
1917

from which,
A cedar, 10 ins. diam., brs. N. 28³/₄° E.
267 lks. dist. mkd. T 32 N R 5 W S 26 B T.
A cedar, 11 ins. diam., brs. S. 63° 20' E.
122 lks. dist. mkd. T 32 N R 5 W S 35 BT
A cedar, 6 ins. diam., brs. S. 25¹/₂° W.
100 lks. dist. mkd. T 32 N R 5 W S 34 B T.
A cedar, 12 ins. diam., brs. N. 39° 25' W.
124 lks. dist. mkd. T 32 N R 5 W S 27 B T.

Land, rolling.
Soil, red, sandy loam, 1st rate.
Timber, cedar.
Undergrowth, algerita.

40.00 East on a random line bet. secs. 26 and 35.
79.97 Set temp. ¹/₄ sec. cor.
Intersect N. and S. line, 23 lks. S. of cor. of secs. 25,
26, 35 and 36.

Thence
S. 89° 50' W. on a true line bet. secs. 26 and 35.
Over rolling land, through scattering timber.
20.00 Bottom of draw, course NE.
39.98¹/₂ Set an iron post, 3 ft. long, 1 in. diam., 18 ins. in the
ground, in a mound of stone, for ¹/₄ sec. cor., mkd. on
brass cap

¹/₄ S 26
¹/₄ S 35
1917

from which,
A cedar, 6 ins. diam., brs. N. 62° 5' W.
440 lks. dist. mkd. ¹/₄ S 26 B T.
A cedar, 8 ins. diam., brs. S. 86° 55' E.
340 lks. dist. mkd. ¹/₄ S 35 B T.
Asc. gradual SE. slope.
57.40 Top of slope brs. N. and S. Desc. gradual W. slope to
79.97 The cor. of secs. 26, 27, 34 and 35.
Land, rolling.
Soil, 1st rate.
Timber, cedar.
Undergrowth, algerita.
Grass.

N. 0° 1' W. bet. secs. 26 and 27.
Over rolling land, through scattering cedar.
Asc. gradual slope.
5.00 Top of slope. Desc. gradual slope.
7.50 Draw, course NE.
40.00 Set an iron post, 3 ft. long, 1 in. diam., 26 ins. in the
ground, for ¹/₄ sec. cor., mkd. on brass cap

¹/₄ S27|S26
1917

from which,
A cedar, 3 ins. diam., brs. S. 69¹/₂° E.
133 lks. dist. mkd. ¹/₄ S 26 B T.

16. Subdivision of a portion of T. 32 N. R. 5 W.

Chains

75.00 A cedar, 12 ins. diam., brs. S. 22° 25' W.
 80.00 247 lks. dist. mkd. $\frac{1}{4}$ S 27 B T.
 Thence along E. slope.
 Desc. S. side of draw, course NW.
 Set an iron post, 3 ft. long, 2 ins. diam., 4 ins. in the
 ground, in a mound of stone, for cor. of secs. 22, 23,
 26 and 27; mkd. on brass cap

T32N R 5W
 S22 | S23
 S27 | S26
 1917

from which,
 A cedar, 15 ins. diam., brs. N. 86° E.
 () lks. dist. mkd. T 32 N R 5 W S 23 B T.
 No other trees within limits.
 Raise a mound of stone, 2 ft. base, 1½ ft. high, W. of cor.
 Land, rolling.
 Soil, 3rd rate.
 Timber, cedar.
 Grass.

40.00 East on a random line bet. secs. 23 and 26.
 79.92 Set temp. $\frac{1}{4}$ sec. cor.
 Intersect N. and S. line, 14 lks. S. of cor. of secs.
 23, 24, 25 and 26.
 Thence
 S. 89° 54' W. on a true line bet. secs. 23 and 26.
 Over rolling land, through scattering timber.
 Asc. gradual slope;
 14.90 Top of slope. Desc. gradual W. slope.
 39.96 Set an iron post, 3 ft. long, 1 in. diam., 26 ins. in the
 ground, for $\frac{1}{4}$ sec. cor., mkd. on brass cap

$\frac{1}{4}$ S 23
 $\frac{1}{4}$ S 26
 1917

from which,
 A cedar, 10 ins. diam., brs. N. 38½° E.
 115 lks. dist. mkd. $\frac{1}{4}$ S 23 B T.
 A cedar, 15 ins. diam., brs. S. 17° 10' W.
 39 lks. dist. mkd. $\frac{1}{4}$ S. 26 B T.

45.90 Desc. gradual slope to
 71.80 Draw, course NW.
 79.92 Draw, course SW. Desc. gradual SW. slope to
 The cor. of secs. 22, 23, 26 and 27.
 Land, rolling.
 Soil, 1st rate.
 Timber, cedar.

21.50 N. 0° 1' W. bet. secs. 22 and 23.
 40.00 Over gently rolling land, through scattering cedar.
 Asc. gradual SW. slope.
 Top of slope. Desc. NE. slope.
 Set an iron post, 3 ft. long, 1 in. diam., 26 ins. in the
 ground, in a mound of stone, for $\frac{1}{4}$ sec. cor., mkd. on
 brass cap

$\frac{1}{4}$
 S22 | S23
 1917

Subdivision of a Portion of T. 32 N., R. 5 W.

17.

Chains.

and raise a mound of stone, 2 ft. base, $1\frac{1}{2}$ ft. high, W. of cor.
 Desc. gradual NE. slope to
 46.60 Draw, course NE. Asc. 75 ft., in wash, comes from N.
 61.80 Leave wash, comes from NNW.
 63.00 Top of ascent; desc. 75 ft. to
 78.20 Bottom of draw, course E.
 80.00 Set an iron post, 3 ft. long, 2 ins. diam., 20 ins. in the ground, in a mound of stone, for cor. of secs. 14, 15, 22 and 23, marked on brass cap

T32N	R5W
S15	S14
<hr/>	
S22	S23
1917	

from which

A cedar, 3 ins. diam., brs. N.24°25'E.,
 122 lks. dist., marked T32N R5W S14 BT.
 A cedar, 8 ins. diam., brs. S.64°20'E.,
 130 lks. dist., marked T32N R5W S23 BT.
 A cedar, 4 ins. diam., brs. S.8°20'W.,
 160 lks. dist., marked T32N R5W S22 BT.
 A cedar, 2 ins. diam., brs. N.66°50'W.,
 170 lks. dist., marked T32N R5W S15 BT.

Land, gently rolling.

Soil, 3rd rate.

Timber, cedar.

Undergrowth, algerita and sagebrush.

Grass.

40.00 East on a random line, bet. secs. 14 and 23.
 80.00 Set temp. $\frac{1}{4}$ sec. cor.
 80.00 Intersect N. and S. line, 16 lks. S. of the cor. of secs. 13, 14, 23 and 24.

Thence

S.89°53'W., on a true line, bet. secs. 14 and 23.
 Over rolling land, through scattering timber.
 Desc. 96 ft. to
 17.00 Bottom of draw, course NE. Asc. gradual slope, 73 ft., to
 24.00 Desc. gradual NW. slope, 110 ft. to
 39.00 Bottom of draw, course W.
 40.00 Set an iron post, 3 ft. long, 1 in. diam., 26 ins. in the ground, for $\frac{1}{4}$ sec. cor., marked on brass cap

$\frac{1}{4}$	S14
<hr/>	
$\frac{1}{4}$	S23
1917	

from which

A cedar, 8 ins. diam., brs. N.87 $\frac{1}{2}$ °E.,
 28 lks. dist., marked $\frac{1}{4}$ S14 BT.
 A cedar, 8 ins. diam., brs. S.88°40'E.,
 23 lks. dist., marked $\frac{1}{4}$ S23 BT.

45.00 Bottom of draw, course N. Asc. 145 ft. to
 55.00 Desc. 113 ft. to
 70.00 Bottom of draw, course SE. Asc. 60 ft. to
 80.00 The cor. of secs. 14, 15, 22 and 23.
 Land, rolling.
 Soil, 2nd rate.
 Timber, cedar.

18.

Subdivision of a Portion of T. 32 N., R. 5 W.

Chains.

N.0°1'W., bet. secs. 14 and 15.
 Over rolling land, through scattering timber and undergrowth.
 Asc. gradual slope to
 3.00 Small draw, course E. Asc. 40 ft. to
 16.30 Top of ridge, brs. NW. and SE. Desc. N. slope, 45 ft. to
 25.00 Thence over rolling land.
 32.50 Draw, course SE.
 40.00 Set an iron post, 3 ft. long, 1 in. diam., 26 ins. in the ground, for $\frac{1}{4}$ sec. cor., marked on brass cap

$\frac{1}{4}$
 S15 | S14
 1917

from which

A cedar, 4 ins. diam., brs. N.52 $\frac{1}{2}$ °E.,
 135 lks. dist., marked $\frac{1}{4}$ S14 BT.
 A cedar, 3 ins. diam., brs. N.62 $\frac{1}{2}$ °W.,
 205 lks. dist., marked $\frac{1}{4}$ S15 BT.

Asc. 63 ft. to
 41.50 Top of slope, brs. E. and W. Desc. gradual slope.
 80.00 Set an iron post, 3 ft. long, 2 ins. diam., 24 ins. in the ground, for cor. of secs. 10, 11, 14 and 15, marked on brass cap

T32N R5W
 S10 | S11
 ———
 S15 | S14
 1917

dig pits, 1° X 18 X 12 ins., in each sec., 5 $\frac{1}{2}$ ft. dist.
 Land, rolling.
 Soil, red sandy loam, 1st rate.
 Timber, cedar.
 Undergrowth, sagebrush.

40.00 East on a random line, bet. secs. 11 and 14.
 Set temp. $\frac{1}{4}$ sec. cor.
 80.10 Intersect N. and S. line, 16 lks. S. of the cor. of secs. 11, 12, 13 and 14.
 Thence
 S.89°53'W., on a true line, bet. secs. 11 and 14.
 Over rolling land, through scattering timber.
 Asc. 113 ft. to
 10.00 Desc. 87 ft. to
 20.00 Thence over gently rolling land.
 22.60 Bottom of draw, course S. Asc. 42 ft. to
 25.10 Top of ridge, brs. N. and S. Desc. 2° ft. to
 32.10 Bottom of draw, course NE. Asc. 52 ft. to
 37.60 Edge of canyon, brs. N. and S. Asc. 53 ft. to
 40.05 Set an iron post, 3 ft. long, 1 in. diam., 4 ins. in the ground, in a mound of stone, for $\frac{1}{4}$ sec. cor., marked on brass cap

$\frac{1}{4}$ S11
 ———
 $\frac{1}{4}$ S14
 1917

from which

A cedar, 8 ins. diam., brs. N.10°E.,
 240 lks. dist., marked $\frac{1}{4}$ S11 BT.
 A cedar, 3 ins. diam., brs. S.34 $\frac{1}{2}$ °E.,
 26 lks. dist., marked $\frac{1}{4}$ S14 BT.

Asc. gradual NE. slope.
 80.10 The cor. of secs. 10, 11, 14 and 15.
 Land, rolling and mountainous.
 Soil, 2nd rate.
 Timber, cedar.

Subdivision of a portion of T. 32 N., R. 5 W. 19

Chains

From the cor. of secs. 3, 4, 33 and 34, S. bdy. of Tp., described in book "I", N. 0° 2' W. bet. secs. 33 and 34. Over gently rolling land, through very scattering cedar timber; gradual E. and SE. slope.

26.70
31.70
40.00

Desc. 40 ft. to Thence over gently rolling land. Set an iron post, 3 ft. long, 1 in. diam., 26 ins. in the ground, for $\frac{1}{4}$ sec. cor., mkd. on brass cap.

$\frac{1}{4}$
S33 | S34
1917

from which,

- A cedar, 5 ins. diam., brs. S. 75 $\frac{1}{2}$ ° E. 76 lks. dist. mkd. $\frac{1}{4}$ S 34 B T.
- A cedar, 6 ins. diam., brs. N. 10 $\frac{1}{2}$ ° W. 28 lks. dist. mkd. $\frac{1}{4}$ S 33 B T.

42.70
77.50
80.00

Asc. 50 ft. to Desc. 91 ft. to Draw, course N. 10° W. Set an iron post, 3 ft. long, 2 ins. diam., 24 ins. in the ground, for cor. of secs. 27, 28, 33 and 34, mkd. on brass cap

T32N R 5W
S28 | S27
S33 | S34
1917

from which,

- A cedar, 5 ins. diam., brs. N. 4° E. 231 lks. dist. mkd. T 32 N R 5 W S 27 B T.
- A cedar, 6 ins. diam., brs. S. 35 $\frac{1}{2}$ ° E. 246 lks. dist. mkd. T 32 N R 5 W S 34 B T.

No other trees within limits. Raise a mound of stone, 2 ft. base, 2 ft. high, W. of cor. Land, gently rolling. Soil, sandy clay, stony limestone formation, 3rd rate. Timber, scattering cedar. Undergrowth, sagebrush. Grass.

40.00
80.01

East on a random line bet. secs. 27 and 34. Set temp. $\frac{1}{4}$ sec. cor. Intersect N. and S. line, 23 lks. S. of the cor. of secs. 26, 27, 34 and 35.

Thence S. 89° 50' W. on a true line bet. secs. 27 and 34. Over rolling land, through scattering cedar timber and undergrowth.

21.40
40.00 $\frac{1}{2}$

Asc. gradual E. slope. Top of slope brs. N. and S. Desc. gradual W. slope. Set an iron post, 3 ft. long, 1 in. diam., 26 ins. in the ground, for $\frac{1}{4}$ sec. cor., mkd. on brass cap

$\frac{1}{4}$ S 27
S 34
1917

from which,

- A cedar, 8 ins. diam., brs. N. 16 $\frac{1}{4}$ ° E. 233 lks. dist. mkd. $\frac{1}{4}$ S 27 B T.
- A cedar, 6 ins. diam., brs. S. 49° 40' E. 77 lks. dist. mkd. $\frac{1}{4}$ S 34 B T.

70.00
80.00

Desc. gradual W. slope to Top of slope brs. E. and W. Desc. gradual W. slope to The cor. of secs. 27, 28, 33 and 34.

20 ... Subdivision of a portion of ... T. 32 N., R. 5 W.

Chains

Land, rolling.
Soil, 2nd rate.
Timber, scattering cedar.
Undergrowth, algerita.

N. 0° 2' W. bet. secs. 27 and 28.
Over gently rolling land, through scattering cedar timber and undergrowth.

40.00 Through draw, 6 to 12 chs. wide, course N.
Set an iron post, 3 ft. long, 1 in. diam., 26 ins. in the ground, for $\frac{1}{4}$ sec. cor., mkd. on brass cap

S 28 | S 27
1917

from which,

A cedar, 6 ins. diam., brs. N. 8 $\frac{1}{2}$ ° E.
242 lks. dist. mkd. $\frac{1}{4}$ S 27 B T.

A cedar, 4 ins. diam., brs. N. 22° W.
340 lks. dist. mkd. $\frac{1}{4}$ S 28 B T.

41.00 Leave draw, course N. 20° W.
Thence over broken W. slope.

69.00 Draw, course N. 10° E.

80.00 Set an iron post, 3 ft. long, 2 ins. diam., 24 ins. in the ground, for cor. of secs. 21, 22, 27 and 28, mkd. on brass cap

T32N R 5W
S21 | S22
S28 | S27
1917

and raise a mound of stone, 3 ft. base, 2 ft. high, W. of cor.

Land, gently rolling.
Soil, sandy clay, stony, limestone formation, 3rd rate.
Undergrowth, sagebrush.
Grass.
Timber, scattering cedar.

East on a random line bet. secs. 22 and 27.

40.00 Set temp. $\frac{1}{4}$ sec. cor.

80.01 Intersect N. and S. line, 16 lks. S. of cor. of secs. 22, 23, 26 and 27.

Thence

S. 89° 53' W. on a true line bet. secs. 22 and 27.

Over rolling land, through scattering cedar timber and undergrowth.

Desc. gradual slope to

3.30 Draw, course NW. Asc. gradual slope to

6.00 Top of slope brs. N. and S. Asc. steep slope 32 ft. to

19.00 Top of low ridge brs. NW. and SE.

Thence over rolling land.

24.00 Draw, course N.

40.00 $\frac{1}{4}$ Set an iron post, 3 ft. long, 1 in. diam., 12 ins. in the ground, in a mound of stone, for $\frac{1}{4}$ sec. cor., mkd. on brass cap

$\frac{1}{4}$ S 22
S 27
1917

from which,

A cedar, 3 ins. diam., brs. N. 14° E.
193 lks. dist. mkd. $\frac{1}{4}$ S 22 B T.

Subdivision of a portion of T. 32 N. R. 5 W. 21

Chains
 60.00 A cedar, 8 ins. diam., brs. S. 54° E.
 73.60 350 lks. dist. mkd. $\frac{1}{4}$ S 27 B T.
 80.01 Desc. gradual W. slope.
 Draw, course N.
 The cor. of secs. 21, 22, 27 and 28.
 Land, gently rolling.
 Soil, 2nd rate.
 Timber, scattering cedar.
 Undergrowth, algerita.

N. 0° 2' W. bet. secs. 21 and 22.
 Over rolling land, through scattering cedar timber and
 undergrowth.
 Asc. gradual slope.
 1.20 Draw, course N. 30° E.
 8.10 Draw, course S. 70° E.
 18.00 Dam brs. E. 15 chs. dist. Known as Bishop's Tank.
 20.80 Draw, course S. 60° E.
 40.00 Set an iron post, 3 ft. long, 1 in. diam., 18 ins. in the
 ground, for $\frac{1}{4}$ sec. cor., mkd. on brass cap

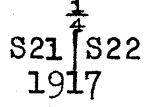

from which,
 A cedar, 6 ins. diam., brs. N. 11° E.
 240 lks. dist. mkd. $\frac{1}{4}$ S 22 B T.
 A cedar, 4 ins. diam., brs. N. 66° W.
 47 lks. dist. mkd. $\frac{1}{4}$ S 21 B T.
 50.70 Over broken E. slope. Asc. gradual slope, 91 ft. to
 73.40 Top of ascent. Thence over rolling land.
 80.00 Set an iron post, 3 ft. long, 2 ins. diam., 24 ins. in the
 ground, for cor. of secs. 15, 16, 21 and 22, mkd. on
 brass cap

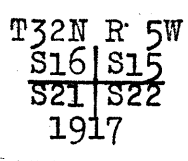

from which,
 A cedar, 5 ins. diam., brs. N. 0° 10' E.
 343 lks. dist. mkd. T 32 N R 5 W S 15 B T.
 No other trees within limits.
 Raise a mound of stone, 3 ft. base, 2 ft. high, W. of cor.
 Land, rolling.
 Soil, sandy clay, stony, limestone formation, 3rd rate.
 Timber, scattering cedar.
 Undergrowth, sagebrush.
 Grass.

40.00 East on a random line bet. secs. 15 and 22.
 80.05 Set temp. $\frac{1}{4}$ sec. cor.
 Intersect N. and S. line, 28 lks. S. of cor. of secs.
 14, 15, 22 and 23.
 Thence
 S. 89° 48' W. on a true line bet. secs. 15 and 22.
 Over rolling land, through very scattering timber.
 Desc. gradual slope.
 6.00 Bottom of draw, near head, course E. Asc. gradual E. slope
 76 ft. to

22 Subdivision of a portion of T. 32 N., R. 5 W.

Chains
40.02 1/2

Set an iron post, 3 ft. long, 1 in. diam., 26 ins. in the ground, for 1/4 sec. cor., mkd. on brass cap

1/4 S 15
S 22
1917

dig pits, 18 X 18 X 12 ins., E. and W. of post, 3 ft. dist.

49.00 Asc. SE. slope, 68 ft. to Top of low ridge brs. NE. and SW. Desc. 85 ft. to

70.50 Bottom of draw, course S. Asc. E. slope 95 ft. to

80.05 The cor. of secs. 15, 16, 21 and 22.

Land, rolling.
Soil, 2nd rate.
Timber, very scattering cedar.
Undergrowth, algerita.

14.60 N. 0° 2' W. bet. secs. 15 and 16.
Over gently rolling land, through sagebrush.

32.90 Head of draw, course N. 30° W.

40.00 Head of draw, course N. 80° E.

Set an iron post, 3 ft. long, 1 in. diam., 12 ins. in the ground, in a mound of stone, for 1/4 sec. cor., mkd. on brass cap

1
S16 | S15
1917

and raise a mound of stone, 3 ft. base, 2 ft. high, W. of cor.

50.00 Desc. gradual N. slope.

80.00 Set an iron post, 3 ft. long, 2 ins. diam., 24 ins. in the ground, for cor. of secs. 9, 10, 15 and 16, mkd. on brass cap

T32N R 5W
S 9 | S10
S16 | S15
1917

and raise a mound of stone, 3 ft. base, 2 ft. high, W. of cor.

Land, gently rolling.
Soil, sandy clay, stony, limestone formation, 3rd rate.
Timber, none.
Undergrowth, sagebrush.
Grass.

40.00 East on a random line bet. secs. 10 and 15.

80.10 Set temp. 1/4 sec. cor.

Intersect N. and S. line, at the cor. of secs. 10, 11, 14 and 15.

Thence

West on a true line bet. secs. 10 and 15.

Over gently rolling land, through scattering undergrowth.

Asc. very gradual slope.

29.50 Draw, course NE.

40.05 Set an iron post, 3 ft. long, 1 in. diam., 22 ins. in the ground, in a mound of stone, for 1/4 sec. cor., mkd. on brass cap

Subdivision of a portion of T. 32 N., R. 5 W., 23

Chains

$\frac{1}{4}$ S 10
S 15
1917

80.10 dig pits, 18 X 18 X 12 ins., E. and W. of post, 3 ft. dist.
The cor. of secs. 9, 10, 15 and 16.
Land, gently rolling.
Soil, 2nd rate.
Timber, none.
Undergrowth, sagebrush.
Grass.

29.20 N. 0° 2' W. bet. secs. 9 and 10.
Over gently rolling land, through scattering undergrowth.
40.00 Draw, near head course N. 30° E.
Set an iron post, 3 ft. long, 1 in. diam., 12 ins. in the ground, in a mound of stone, for $\frac{1}{4}$ sec. cor., marked on brass cap

$\frac{1}{4}$
S 9 | S 10
1917

80.00 and raise a mound of stone, 3 ft. base, 2 ft. high, W. of cor.
Set an iron post, 3 ft. long, 2 ins. diam., 24 ins. in the ground, for cor. of secs. 3, 4, 9 and 10, mkd. on brass cap

T32N R 5W
S 4 | S 3
S 9 | S 10
1917

and raise a mound of stone, 3 ft. base, 2 ft. high, W. of cor.
Land, gently rolling.
Soil, sandy clay, stony limestone formation, 3rd rate.
No timber.
Undergrowth, sagebrush.
Grass.

24.80 N. 0° 2' W. bet. secs. 3 and 4.
Over gently rolling land, through scattering cedar timber and sagebrush.
40.00 Draw, course N. 80° E.
Set an iron post, 3 ft. long, 1 in. diam., 26 ins. in the ground, for $\frac{1}{4}$ sec. cor., mkd. on brass cap

$\frac{1}{4}$
S 4 | S 3
1917

from which,
A cedar, 5 ins. diam., brs. N. 1 $\frac{3}{4}$ ° E.
254 lks. dist. mkd. $\frac{1}{4}$ S 3 B T.
A cedar, 6 ins. diam., brs. S. 76 $\frac{1}{4}$ ° W.
234 lks. dist. mkd. $\frac{1}{4}$ S 4 B T.
Line discontinued at this point.
Land, gently rolling.
Soil, sandy clay, gravelly, stony, limestone formation, 3rd rate.
Timber, scattering cedar.
Undergrowth, sagebrush.
Grass.

24 Subdivision of a portion of T. 32 N. R. 5 W.

Chains

From the cor. of secs. 4, 5, 32 and 33, S. bdy. of Tp.,
described in book "I",
N. $0^{\circ} 3'$ W. bet. secs. 32 and 33.
Over rolling land, through very scattering cedar timber
and undergrowth.

9.10

Draw, near head course N. 30° W.

40.00

Set an iron post, 3 ft. long, 1 in. diam., 26 ins. in the
ground, for $\frac{1}{4}$ sec. cor., mkd. on brass cap
$$\begin{array}{c} \frac{1}{4} \\ \hline S32 | S33 \\ 1917 \end{array}$$

from which,

A cedar, 5 ins. diam., brs. N. 46° E.
241 lks. dist. mkd. $\frac{1}{4}$ S 33 B T.A cedar, 6 ins. diam., brs. N. 24° W.
229 lks. dist. mkd. $\frac{1}{4}$ S 32 B T.

63.80

Draw, course N. 10° W.

74.60

Draw, course N. 20° E.

80.00

Set an iron post, 3 ft. long, 1 in. diam., 24 ins. in a
mound of stone, for cor. of secs. 28, 29, 32 and 33,
mkd. on brass cap
$$\begin{array}{c} T32N R 5W \\ \hline S29 | S28 \\ \hline S32 | S33 \\ 1917 \end{array}$$
and raise a mound of stone, 3 ft. base, 2 ft. high,
W. of cor.

Soil, sandy clay stony, limestone formation, 3rd rate.

Timber, very scattering cedar.

Undergrowth, sagebrush.

Grass.

Land, rolling.

40.00

East on a random line bet. secs. 28 and 33.

80.06

Set temp. $\frac{1}{4}$ sec. cor.Intersect N. and S. line, 35 lks. S. of cor. of secs.
27, 28, 33 and 34.

Thence

S. $89^{\circ} 45'$ W. on a true line bet. secs. 28 and 33.

Over rolling land, through very scattering cedar timber.

1.20

Draw, course N. Asc. gradual slope.

40.03

Set an iron post, 3 ft. long, 1 in. diam., 26 ins. in the
ground, for $\frac{1}{4}$ sec. cor., mkd. on brass cap.
$$\begin{array}{c} \frac{1}{4} S 28 \\ \hline \frac{1}{4} S 33 \\ 1917 \end{array}$$

from which,

A cedar, 10 ins. diam., brs. N. 75° E.
113 lks. dist. mkd. $\frac{1}{4}$ S 28 B T.A cedar, 8 ins. diam., brs. S. 39° E.
149 lks. dist. mkd. $\frac{1}{4}$ S 33 B T.

43.00

Top of ascent. Desc. gradual NW. slope.

76.40

Draw, course N. 20° E.

80.06

The cor. of secs. 28, 29, 32 and 33.

Land, rolling.

Soil, sandy clay, stony, limestone formation, 3rd rate.

Timber, scattering cedar.

Undergrowth, sagebrush and algerita.

Grass.

Subdivision of a portion of T. 32 N., R. 5 W. 25.

Chains.

N.0°3'W.. bet. secs. 28 and 29.
 Over rolling land, through scattering cedar timber and undergrowth.
 Asc. gradual SE. slope.
 8.00 Low spur, slopes N.80°E. Desc. gradual slope to
 19.10 Draw, course W. Asc. gradual slope to
 21.90 Spur, slopes W. Desc. gradual slope to
 27.70 Draw, course N.30°E. Asc. SE. slope.
 40.00 Set an iron post, 3 ft. long, 1 in. diam., 26 ins. in a mound of stone, for $\frac{1}{4}$ sec. cor., marked on brass cap

$\frac{1}{4}$
 S29 | S28
 1917

from which

A cedar, 6 ins. diam., brs. N.45 $\frac{1}{2}$ °E.,
 52 lks. dist., marked $\frac{1}{4}$ S28 BT.
 A cedar, 16 ins. diam., brs. N.20 $\frac{1}{2}$ °W.,
 124 lks. dist., marked $\frac{1}{4}$ S29 BT.

62.50 Draw, course E.
 80.00 Set an iron post, 3 ft. long, 2 ins. diam., 24 ins. in the ground, for cor. of secs. 20, 21, 28 and 29, marked on brass cap

T32N | R5W
 S20 | S21
 S29 | S28
 1917

from which

A cedar, 10 ins. diam., brs. N.56°E.,
 440 lks. dist., marked T32N R5W S21 BT.
 A cedar, 8 ins. diam., brs. S.32°W.,
 258 lks. dist., marked T32N R5W S29 BT.

No other trees within limits. Raise a mound of stone, 3 ft. base, 2 ft. high, W. of cor.

Land, rolling.
 Soil, sandy clay, stony, limestone formation, 3rd rate.
 Timber, scattering cedar.
 Undergrowth, algerita and sagebrush.
 Grass.

40.00 East on a random line, bet. secs. 21 and 28.
 80.12 Set temp. $\frac{1}{4}$ sec. cor.
 Intersect N. and S. line, 37 lks. S. of the cor. of secs. 21, 22, 27 and 28.

Thence
 S.89°44'W., on a true line, bet. secs. 21 and 28.
 Over rolling land, through scattering timber and undergrowth.

15.00 Draw, 1.50 chs. wide, course NE.
 33.20 Draw, course S.40°E.
 40.06 Set an iron post, 3 ft. long, 1 in. diam., 26 ins. in the ground, for $\frac{1}{4}$ sec. cor., marked on brass cap

$\frac{1}{4}$ S21
 S28
 1917

from which

A cedar, 6 ins. diam., brs. N.86°W.,
 111 lks. dist., marked $\frac{1}{4}$ S21 BT.
 A cedar, 4 ins. diam., brs. S.13°W.,
 50 lks. dist., marked $\frac{1}{4}$ S28 BT.

56.00 Asc. gradual slope to
 65.40 Desc. gradual slope 50 ft. to
 75.00 Draw, course S.30°E. Thence over rolling land.
 80.12 Draw, course S.60°E.
 The cor. of secs. 20, 21, 28 and 29.

Land, rolling.
 Soil, sandy clay, stony limestone formation, 3rd rate.

26. Subdivision of a portion of T. 32 N., R. 5 W.

Chains.

Timber, scattering cedar.
Undergrowth, algerita and sagebrush.
Grass.

N.0°3'W., bet. secs. 20 and 21.

Over rolling land, through scattering cedar timber and undergrowth.

4.20 Draw, course SE.

37.40 Draw, near head, course E.

40.00 Set an iron post, 3 ft. long, 1 in. diam., 18 ins. in the ground, in a mound of stone, for $\frac{1}{4}$ sec. cor., marked on brass cap
$$\begin{array}{c} \frac{1}{4} \\ S20 | S21 \\ 1917 \end{array}$$

and raise a mound of stone, 3 ft. base, 2 ft. high, W. of cor.

Asc. gradual slope.

60.00 Top of ascent, brs. N.80°W. and S.80°E.

Thence over rolling land.

80.00 Set an iron post, 3 ft. long, 2 ins. diam., 24 ins. in the ground, for cor. of secs. 16, 17, 20 and 21, marked on brass cap

$$\begin{array}{c} T32N R5W \\ S17 | S16 \\ \hline S20 | S21 \\ 1917 \end{array}$$
dig pits, 18 X 18 X 12 ins., in each sec., $5\frac{1}{2}$ ft. dist. Land, rolling.

Soil, sandy clay, stony, limestone formation, 3rd rate.

Timber, scattering cedar.

Undergrowth, sagebrush.

Grass.

East on a random line, bet. secs. 16 and 21.

40.00 Set temp. $\frac{1}{4}$ sec. cor.

80.16 Intersect N. and S. line, 46 lks. S. of the cor. of secs. 15, 16, 21 and 22.

Thence

S.89°40'W., on a true line, bet. secs. 16 and 21.

Over gently rolling land, through scattering cedar timber and undergrowth.

40.08 Set an iron post, 3 ft. long, 1 in. diam., 18 ins. in the ground, in a mound of stone, for $\frac{1}{4}$ sec. cor., marked on brass cap
$$\begin{array}{c} S16 \\ \frac{1}{4} S21 \\ 1917 \end{array}$$

from which

A cedar, 12 ins. diam., brs. N.12°E.,

311 lks. dist., marked S16 BT.

No other trees within limits. Dig pits, 18 X 18 X 12 ins. E. and W. of post, 3 ft. dist.

51.00 Draw, near head, course N.

80.16 The cor. of secs. 16, 17, 20 and 21.

Land, gently rolling.

Soil, sandy clay, limestone formation, 2nd rate.

Timber, scattering cedar.

Undergrowth, sagebrush. Grass.

Subdivision of a portion of T. 32 N., R. 5 W. 27

Chains

N. 0° 3' W. bet. secs. 16 and 17.
 Over gently rolling land, through sagebrush.
 20.00 Draw, course N. 30° W.
 40.00 Set an iron post, 3 ft. long, 1 in. diam., 26 ins. in the ground, for 1/4 sec. cor., mkd. on brass cap

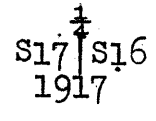

dig pits, 18 X 18 X 12 ins., N. and S. of post, 3 ft. dist.
 80.00 Set an iron post, 3ft. long, 2 ins. diam., 24 ins. in the ground, for cor. of secs. 8, 9, 16 and 17, mkd. on brass cap

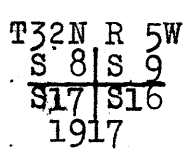

dig pits, 18 X 18 X 12 ins., in each sec., 5 1/2 ft. dist.
 Land, rolling.
 Soil, sandy clay, limestone formation, 2nd rate.
 No timber.
 Undergrowth, sagebrush.
 Grass.

40.00 East on a random line bet. secs. 9 and 16.
 Set temp. 1/4 sec. cor.
 80.14 Intersect N. and S. line, 44 lks. S. of cor. of secs. 9, 10, 15 and 16.
 Thence
 S. 89° 41' W. on a true line bet. secs. 9 and 16.
 Over gently rolling land, through sagebrush.
 Asc. gradual NE. slope.
 20.00 Top of slope brs. N. 10° W. and S. 10° E.
 40.07 Set an iron post, 3 ft. long, 1 in. diam., 26 ins. in the ground, for 1/4 sec. cor., mkd. on brass cap

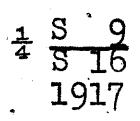

dig pits, 18 X 18 X 12 ins., E. and W. of post, 3 ft. dist.
 50.00 Draw, course N. 40° W.
 80.14 The cor. of secs. 8, 9, 16 and 17.
 Land, gently rolling.
 Soil, sandy clay, limestone formation, 2nd rate.
 No timber.
 Undergrowth, sagebrush.
 Grass.

From the cor. of secs. 5, 6, 31 and 32, S. bdy. of Tp., described in book "I",
 N. 0° 3' W. bet. secs. 31 and 32.
 Over gently rolling land, through very scattering timber.
 34.10 Draw, course, N. 70° E.
 40.00 Set an iron post, 3 ft. long, 1 in. diam., 26 ins. in the ground, for 1/4 sec. cor., mkd. on brass cap

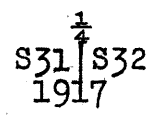

28. Subdivision of portion of T. 32 N. R. 5 W.

Chains

from which,

A cedar, 5 ins. diam., brs. N. 18 1/2° E.
112 lks. dist. mkd. 1/4 S 32 B T.

A cedar, 10 ins. diam., brs. N. 65 1/4° W.
209 lks. dist. mkd. 1/4 S 31 B T.

75.00
80.00

Draw, course N. 80° E.
Set an iron post, 3 ft. long, 2 ins. diam., 24 ins. in the ground, for cor. of secs. 29, 30, 31 and 32, mkd. on brass cap

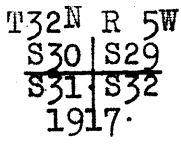

from which,

A cedar, 14 ins. diam., brs. N. 76 1/2° E.
141 lks. dist. mkd. T 32 N R 5 W S 29 B T.

A cedar, 12 ins. diam., brs. S. 49° E.
147 lks. dist. mkd. T 32 N R 5 W S 32 B T.

A cedar, 12 ins. diam., brs. S. 10 1/2° W.
208 lks. dist. mkd. T 32 N R 5 W S 31 B T.

A dead cedar, 8 ins. diam., brs. N. 89° W.
56 lks. dist. mkd. T 32 N R 5 W S 30 B T.

Land, gently rolling.
Soil, sandy clay, gravelly, stony limestone formation, 2nd rate.
Timber, scattering cedar.
Undergrowth, algerita and sagebrush.
Grass.

40.00
79.96

East on a random line bet. secs. 29 and 32.
Set temp. 1/4 sec. cor.
Intersect N. and S. line, 18 lks. S. of cor. of secs. 28, 29, 32 and 33.

Thence
S. 89° 52' W. on a true line bet. secs. 29 and 32.
Over rolling land, through very scattering cedar timber and undergrowth.

26.00
39.98

Asc. gradual SE. slope, 103 ft. to
Spur slopes N. 30° E. Desc. NW. slope.
Set an iron post, 3 ft. long, 1 in. diam., 26 ins. in the ground, for 1/4 sec. cor., mkd. on brass cap

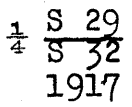

dig pits, 18 X 18 X 12 ins., E. and W. of post, 3 ft. dist.

42.20
79.96

Draw, course N. 30° E. Asc. SE. slope, 78 ft. to
The cor. of secs. 29, 30, 31 and 32.
Land, rolling.
Soil, sandy clay, stony, limestone formation, 3rd rate.
Timber, scattering cedar.
Undergrowth, sagebrush.
Grass.

40.00
77.46

West on a random line bet. secs. 30 and 31.
Set temp. 1/4 sec. cor.
Intersect W. bdy. of Tp., 18 lks. N. of cor. of secs. 25, 30, 31 and 36, hereinbefore described.
Thence
N. 89° 52' E. on a true line bet. secs. 30 and 31.
Over gently rolling land, through scattering cedar timber.

Subdivision of a portion of T. 32 N. R. 5 W. 29

Chains
29.55
37.46

Draw, course N. 30° E.
Set an iron post, 3 ft. long, 1 in. diam., 26 ins. in the ground, for 1/4 sec. cor., mkd. on brass cap

1/4 S 30
1/4 S 31
1917

from which,
A cedar, 10 ins. diam., brs. N. 67° W.
257 lks. dist. mkd. 1/4 S 30 B T.
A cedar, 14 ins. diam., brs. S. 86 1/2° W.
406 lks. dist. mkd. 1/4 S 31 B T.

77.46

The cor. of secs. 29, 30, 31 and 32.
Land, gently rolling.
Soil, sandy clay, stony, limestone formation, 2nd rate.
Timber, scattering cedar.
Undergrowth, algerita and sagebrush.
Grass.

15.00
40.00

N. 0° 3' W. bet. secs. 29 and 30.
Over gently rolling land, through scattering cedar.
Asc. gradual slope.
Top of slope. Desc. gradual N. and NW. slope.
Set an iron post, 3 ft. long, 1 in. diam., 14 ins. in the ground, in a mound of stone, for 1/4 sec. cor., mkd. on brass cap

S30 S29
1917

80.00

dig pits, 18 X 18 X 12 ins., N. and S. of post, 3 ft. dist.
Set an iron post, 3 ft. long, 2 ins. diam., 24 ins. in the ground, for cor. of secs. 19, 20, 29 and 30, mkd. on brass cap

T32N R 5W
S19 S20
S30 S29
1917

dig pits, 18 X 18 X 12 ins., in each sec., 5 1/2 ft. dist.
Land, gently rolling.
Soil, sandy clay, stony, limestone formation, 2nd rate.
Timber, scattering cedar.
Undergrowth, algerita and sagebrush.
Grass.

40.00
79.92

East on a random line bet. secs. 20 and 29.
Set temp. 1/4 sec. cor.
Intersect N. and S. line, 20 lks. S. of cor. of secs. 20, 21, 28 and 29.

Thence
S. 89° 51' W. on a true line bet. secs. 20 and 29.
Over rolling land, through scattering cedar timber and undergrowth.

12.50
39.96

Asc. E. slope, 106 ft. to
Top of ascent. Thence over gradual NE. slope.
Set an iron post, 3 ft. long, 1 in. diam., 12 ins. in the ground, in a mound of stone, for 1/4 sec. cor., mkd. on brass cap

1/4 S 20
1/4 S 29
1917

30 E. Subdivision of a portion of T. 32 N. R. 5 W.

Chains

from which,

A cedar, 8 ins. diam., brs. N. 46 1/2° E.
106 lks. dist. mkd. 1/4 S. 20 B T.

No other trees within limits.

Raise a mound of stone, 3 ft. base, 1 1/2 ft. high, N. of cor.

55.00

Desc. gradual W. slope.

79.92

The cor. of secs. 19, 20, 29 and 30.

Land, rolling.

Soil, sandy clay, stony, limestone formation, 3rd rate.

Timber, scattering cedar.

Undergrowth, sagebrush.

Grass.

40.00

S. 89° 50' W. on a random line, bet. secs. 19 and 30.

77.37

Set temp. 1/4 sec. cor.

Intersect W. bdy. of Tp., at the cor. of secs. 19, 24, 25 and 30, hereinbefore described.

Thence

N. 89° 50' E. on a true line bet. secs. 19 and 30.

Over gently rolling land, through very scattering cedar timber and undergrowth.

12.30

Draw, near head, course S. 50° E.

36.20

Draw, course N. 40° E.

37.37

Set an iron post, 3 ft. long, 1 in. diam., 26 ins. in the ground, for 1/4 sec. cor., mkd. on brass cap

1/4 S 19
1/4 S 30
1917

dig pits, 18 X 18 X 12 ins., E. and W. of post, 3 ft. dist.

71.00

Draw, course N. 40° E.

77.37

The cor. of secs. 19, 20, 29 and 30.

Land, gently rolling.

Soil, sandy clay, stony, limestone formation, 2nd rate.

Timber, very scattering cedar.

Undergrowth, sagebrush.

Grass.

13.40

N. 0° 3' W. bet. secs. 19 and 20.

40.00

Over gently rolling land, through sagebrush.

Draw, course N. 10° E.

Set an iron post, 3 ft. long, 1 in. diam., 26 ins. in the ground, for 1/4 sec. cor., mkd. on brass cap

1/4
S19 | S20
1917

dig pits, 18 X 18 X 12 ins., N. and S. of post, 3 ft. dist.

47.30

Draw, course NE.

80.00

Set an iron post, 3 ft. long, 2 ins. diam., 18 ins. in the ground, in a mound of stone, for cor. of secs. 17, 18, 19 and 20, mkd. on brass cap

T32N R 5W
S18 | S17
S19 | S20
1917

Subdivision of a portion of T. 32 N., R. 5 W. 31.

Chains.

dig pits, 18 X 18 X 12 ins., in each sec., 5½ ft. dist.
 Land, gently rolling.
 Soil, sandy clay, stony, limestone formation, 3rd rate.
 Timber, scattering cedar.
 Undergrowth, sagebrush.
 Grass.

40.00 East on a random line, bet. secs. 17 and 20.
 79.96 Set temp. ¼ sec. cor.
 Intersect N. and S. line, 16 lks. S. of the cor. of secs.
 16, 17, 20 and 21.

Thence
 S.89°53'W., on a true line, bet. secs. 17 and 20.
 Over gently rolling land, through scattering sagebrush.
 4.50 Draw, near head, course N.30°W.
 39.98 Set an iron post, 3 ft. long, 1 in. diam., 26 ins. in a
 mound of stone, for ¼ sec. cor., marked on brass cap

1 S17
 ¼ S20
 1917

and raise a mound of stone, 2 ft. base, 1½ ft. high, N.
 of cor.
 71.90 Desc. gradual W. slope.
 79.96 Draw, course N.10°W.
 The cor. of secs. 17, 18, 19 and 20.
 Land, gently rolling.
 Soil, sandy clay, stony, limestone formation, 2nd rate.
 No timber.
 Undergrowth, sagebrush.
 Grass.

40.00 West on a random line, bet. secs. 18 and 19.
 77.29 Set temp. ¼ sec. cor.
 Intersect W. bdy. of T., 18 lks. N. of the cor. of secs.
 13, 18, 19 and 24, hereinbefore described.

Thence
 N.89°52'E., on a true line, bet. secs. 18 and 19.
 Over gently rolling land, through scattering timber and
 undergrowth.

12.29 Leave scattering timber, brs. N. and S. Desc. gradual
 slope, 50 ft.
 26.69 Draw, course N.40°E..
 37.29 Set an iron post, 3 ft. long, 1 in. diam., 26 ins. in the
 ground, for ¼ sec. cor., marked on brass cap

1 S18
 ¼ S19
 1917

and raise a mound of stone. 3 ft. base, 2 ft. high, N.
 of cor.
 77.29 Desc. gradual E. and NE. slopes.
 The cor. of secs. 17, 18, 19 and 20.
 Land, gently rolling.
 Soil, sandy clay, stony, limestone formation, 2nd rate.
 Timber, very scattering cedar to 12.29 chs.
 Undergrowth, sagebrush.
 Grass.

N.0°3'W., bet. secs. 17 and 18.
 Over gently rolling land, through undergrowth.

32. Subdivision of a portion of T. 32 N., R. 5 W.

Chains.

20.10 Along gentle E. slope.
 Draw, course N.20°W.
 40.00 Set an iron post, 3 ft. long, 1 in. diam., 12 ins. in the ground, in a mound of stone, for $\frac{1}{4}$ sec. cor., marked on brass cap

$$\begin{array}{c} \frac{1}{4} \\ S18 | S17 \\ \hline 1917 \end{array}$$

and raise a mound of stone, 3 ft. base, 1 $\frac{1}{2}$ ft. high, W. of cor.

47.00 Draw, course N.10°E.
 80.00 Set an iron post, 3 ft. long, 2 ins. diam., 18 ins. in the ground, in a mound of stone, for cor. of secs. 7, 8, 17 and 18, marked on brass cap

$$\begin{array}{c} T32N R5W \\ S 7 | S 8 \\ \hline S18 | S17 \\ \hline 1917 \end{array}$$

and raise a mound of stone, 3 ft. base, 1 $\frac{1}{2}$ ft. high, W. of cor.

Land, gently rolling.
 Soil, sandy clay, stony, limestone formation, 2nd rate.
 Timber, none.
 Undergrowth, sagebrush.
 Grass.

40.00 East on a random line, bet. secs. 8 and 17.
 Set temp. $\frac{1}{4}$ sec. cor.
 80.04 Intersect N. and S. line, 18 lks. S. of the cor. of secs. 8, 9, 16 and 17.

Thence
 S.89°52'W., on a true line, bet. secs. 8 and 17.
 Over nearly level land, through undergrowth.

35.00 Draw, course N.30°W.
 40.02 Set an iron post, 3 ft. long, 1 in. diam., 18 ins. in the ground, in a mound of stone, for $\frac{1}{4}$ sec. cor., marked on brass cap

$$\begin{array}{c} \frac{1}{4} S 8. \\ \hline S17 \\ \hline 1917 \end{array}$$

dig pits, 18 X 18 X 12 ins., E. and W. of post, 3 ft. dist.

71.40 Draw, course N.
 80.04 The cor. of secs. 7, 8, 17 and 18.
 Land, nearly level.
 Soil, sandy clay, stony, limestone formation, 2nd rate.
 No timber.
 Undergrowth, sagebrush.
 Grass.

40.00 West on a random line, bet. secs. 7 and 18.
 Set temp. $\frac{1}{4}$ sec. cor.
 77.20 Intersect W. bdy. of Tp., 23 lks. N. of the cor. of secs. 7, 12, 13 and 18, hereinbefore described.

Thence
 N.89°50'E., on a true line, bet. secs. 7 and 18.
 Over gently rolling land, through scattering timber and undergrowth. Asc. gradual W. slope.

12.20 Thence over gently rolling land.
 37.20 Set an iron post, 3 ft. long, 1 in. diam., 26 ins. in the ground, for $\frac{1}{4}$ sec. cor., marked on brass cap

Subdivision of a Portion of T. 32 N., R. 5 W.

Chains.

$\frac{1}{4}$ S 7
S 18
1917

from which

A cedar, 6 ins. diam., brs. N.27°E.,
190 lks. dist., marked $\frac{1}{4}$ S7 BT.

A cedar, 7 ins. diam., brs. S.76°W.,
307 lks. dist., marked $\frac{1}{4}$ S18 BT.

47.20 Enter open rolling land. Desc. gradual SE. slope.

66.00 Draw, course N.50°E.

77.20 The cor. of secs. 7, 8, 17 and 18.

Land, gently rolling.

Soil, sandy clay, stony, limestone formation, 2nd rate.

Timber, very scattering cedar.

Undergrowth, sagebrush.

Grass.

N.0°3'W., bet. secs. 7 and 8.

Over gently rolling land, through scattering undergrowth.

10.20 Draw, course N.30°E.

32.40 Draw, course E.

40.00 Set an iron post, 3 ft. long, 1 in. diam., 26 ins. in the
ground, for $\frac{1}{4}$ sec. cor., marked on brass cap

$\frac{1}{4}$
S 7 | S 8
1917

dig pits, 18 X 18 X 12 ins., N. and S. of post, 3 ft.
dist.

Asc. gradual slope.

70.00 Top of slope, brs. N.30°E. and S.30°W.

80.00 Set an iron post, 3 ft. long, 2 ins. diam., 12 ins. in the
ground, in a mound of stone, for cor. of secs. 5, 6, 7
and 8, marked on brass cap

T32N R5W
S 6 | S 5
S 7 | S 8
1917

and raise a mound of stone, 2 $\frac{1}{2}$ ft. base, 2 ft. high, W.
of cor.

Land, gently rolling.

Soil, sandy clay, stony, limestone formation, 2nd rate.

No timber.

Undergrowth, sagebrush.

Grass.

West on a random line, bet. secs. 6 and 7.

40.00 Set temp. $\frac{1}{4}$ sec. cor.

63.20 Rim of canyon near the junction of the Grand and National
Canyons. At this point I offset south, 1.30 chs.

Thence continue measurement.

West on offset line.

77.14 Intersect W. bdy. of Tp., 105 lks. S. of true point for
cor. of secs. 1, 6, 7 and 12 (25 lks. N. of witness
cor. to cor. of secs. 1, 6, 7 and 12, hereinbefore
described).

Thence, from the witness cor.,

N.89°49'E., on offset line, parallel to rim of National
Canyon, which bears N. about 1 ch. dist. Canyon walls
are perpendicular and 300 to 400 ft. deep; course of
canyon, E. Over gently rolling land.

13.94 On offset line, offset north 1.30 chs., to true line, bet.
secs. 6 and 7.

34.

Subdivision of a Portion of T. 32 N., R. 5 W.

Chains.

At this point, canyon rim brs. W. and N.30°E.

Thence

N.89°49'E., on a true line, bet. secs. 6 and 7.

Over gently rolling land, through scattering timber and undergrowth.

Asc. gradual slope.

27.10

Top of ascent, brs. N.20°E. and S. Desc. gradually.

37.14

Set an iron post, 3 ft. long, 1 in. diam., 26 ins. in the ground, for $\frac{1}{4}$ sec. cor., marked on brass cap
$$\begin{array}{r} \frac{1}{4} S 6 \\ \frac{1}{4} S 7 \\ 1917 \end{array}$$

from which

A cedar, 14 ins. diam., brs. S.29 $\frac{1}{2}$ °W.,141 lks. dist., marked $\frac{1}{4}$ S7 BT.

No other trees within limits.

Dig pits, 18 X 18 X 12 ins., E. and W. of post, 3 ft. dist.

42.10

Leave scattering timber, brs. N.10°E. and S.

71.10

Draw, course N.30°E.

77.14

The cor. of secs. 5, 6, 7 and 8.

Land, gently rolling.

Soil, sandy clay, stony, limestone formation, 2nd rate.

Timber, scattering cedar to 42.10 chs.

Undergrowth, sagebrush.

Grass.

N.0°3'W., on a true line, bet. secs. 5 and 6.

Over gently rolling land, through scattering undergrowth.

Desc. gradual slope to

6.50

Draw, course N.60°E. Asc. gradual slope to

30.00

Desc. gradual slope to

38.00

Draw, 50 lks. wide, course E.

40.00

Set an iron post, 3 ft. long, 1 in. diam., 6 ins. in the ground, in a mound of stone, for $\frac{1}{4}$ sec. cor., marked on brass cap
$$\begin{array}{r} \frac{1}{4} \\ S 6 \frac{1}{2} S 5 \\ 1917 \end{array}$$
and raise a mound of stone, 2 $\frac{1}{2}$ ft. base, 2 ft. high, W. of cor.

Asc. gently slope.

81.20

(80.00 chs. + southing of S. bdy.) Theoretical point of intersection with 8th Standard Parallel North, at which point

Set an iron post, 3 ft. long, 2 ins. diam., 24 ins. in the ground, for closing cor. of secs. 5 and 6, marked on brass cap

$$\begin{array}{r} T33N R5W \\ S32 \\ S 6 \frac{1}{2} S 5 \\ T32N R5W \\ C | C \\ 1917 \end{array}$$
and raise a mound of stone, 2 $\frac{1}{2}$ ft. base, 2 ft. high, S. of cor.

Land, gently rolling.

Soil, sandy clay, stony, limestone formation, 3rd rate.

No timber.

Undergrowth, sagebrush.

Grass.

Chains.

8.43 From the closing cor. of secs. 5 and 6, T. 32 N., R. 5 W., hereinbefore described,
West on S. bdy. of sec. 32.
Over rolling land, through scattering undergrowth.
Set an iron post, 3 ft. long, 3 ins. diam., 12 ins. in the ground, in a mound of stone, for standard cor. of secs. 31 and 32, T. 33 N., R. 5 W., marked on brass cap

S C
T33N | R5W
S31 | S32

1917

from which

A cedar, 4 ins. diam., brs. N. 78° W.,
149 lks, dist., marked SC, T33N R5W S31 BT.

No other trees within limits.

Raise a mound of stone, 3 ft. base, 2 ft. high, N. of cor. Land, rolling.

Soil, rocky, limestone formation, 3rd rate.

No timber.

Undergrowth, sagebrush.

Grass.

GENERAL DESCRIPTION.

The portion of T. 32 N., R. 5 W. surveyed under this Group consists of rolling and gently rolling land, covered with a scanty growth of cedar timber and a dense growth of sagebrush. The soil is a shallow, sandy clay, stony and rocky, of limestone, sandstone and quartz formations.

The township drains to the north.

There are no settlers. A road, almost impassable for wagons, leads through the south east corner of the township, northward to the Supai Indian Village.

A dam, called Bishop's Tank, is located in the south west quarter of sec. 22.

Boundaries of Portion of T. 32 N., R. 5 W.
surveyed under this Group.

Latitudes, departures and closing errors.

Line designated.	True bearing.	Dist.	Latitudes.		Departures.	
			N.	S.	E.	W.
South Boundary	S. 89° 50' W.	477.56	chs.	chs.	chs.	chs.
West Boundary	North	400.00	400.00			
Subdivisional Boundary	N. 89° 49' E.	77.14	.26		77.14	
	S. 0° 3' E.	80.00		80.00	.07	
	N. 89° 52' E.	80.04	.19		80.04	
	N. 89° 41' E.	80.14	.44		80.14	
	East	80.10			80.10	
	N. 89° 53' E.	80.10	.16		80.10	
East Boundary.	N. 89° 47' E.	80.49	.30		80.49	
	S. 0° 11' W.	39.25		39.25		.13
	S. 0° 12' W.	40.04		40.04		.14
	S. 0° 10' W.	39.91		39.91		.12
	S. 0° 3' W.	40.05		40.05		.04
	S. 0° 15' W.	39.96		39.96		.18
	S. 0° 18' E.	39.57		39.57	.21	
	S. 0° 11' E.	39.91		39.91	.13	
S. 0° 3' W.	39.83		39.83		.04	
S. 0° 4' E.	1.48		1.48	.07		
Convergency					.36	
Totals			401.35	401.40	478.78	478.21
Error in latitude				401.35	478.21	
Error in departure				.05		.57

36. Fracl. Subdivision of T. 32 N., R. 6 W.

Chains.

From the cor. of secs. 25, 30, 31 and 36, W. bdy. of T. 32 N., R. 5 W., hereinbefore described, West bet. secs. 25 and 36. Over gently rolling land, through scattering undergrowth. Draw, course N.
 5.00 Draw, course N.40°E.
 22.30 Intersect E. bdy. of Hualpai Indian Reservation, 17.77 chs. N. of the 115½ mile cor., which is a limestone, properly set, marked and witnessed as described by the Surveyor-General.
 34.48 At the point of intersection Set an iron post, 3 ft. long, 2 ins. diam., 18 ins. in the ground, in a mound of stone, for closing cor. of secs. 25 and 36, marked on brass cap

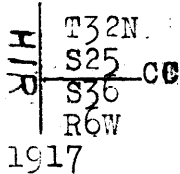

from which
 A cedar, 7 ins. diam., brs. N.68°E., 312 lks. dist., marked T32N R6W S25 CC BT.
 A cedar, 6 ins. diam., brs. S.31½°E., 153 lks. dist., marked T32N R6W S36 CC BT.
 Land gently rolling.
 Soil, sandy clay, stony, limestone formation, 2nd rate.
 Timber, very scattering cedar, 20 chs. to 34.48 chs.
 Undergrowth, sagebrush.
 Grass.

From the cor. of secs. 19, 24, 25 and 30, W. bdy. of T. 32 N., R. 5 W., hereinbefore described, West bet. secs. 24 and 25. Over gently rolling land, through scattering timber and undergrowth. Asc. gradual SE. slope. Top of ascent.
 28.00 Intersect E. bdy. of Hualpai Indian Reservation, 17.56 chs. N. of the 116½ M. cor., which is a limestone, properly set, marked and witnessed as described by the Surveyor-General.
 34.31 At the point of intersection, Set an iron post, 3 ft. long, 2 ins. diam., 6 ins. in the ground, in a mound of stone, for closing cor. of secs. 24 and 25, marked on brass cap

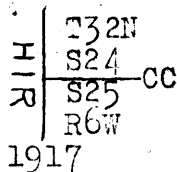

from which
 A cedar, 6 ins. diam., brs. S.33°E., 399 lks. dist., marked T32N R6W S25 CC BT.
 No other trees within limits.
 Raise a mound of stone, 2 ft. base, 1½ ft. high, E. of cor.
 Land, gently rolling.
 Soil, sandy clay, stony, limestone formation, 3rd rate.
 Timber, scattering cedar.
 Undergrowth, sagebrush.
 Grass.

From the cor. of secs. 13, 18, 19 and 24, W. bdy. of T. 32 N., R. 5 W., hereinbefore described,

Fract. Subdivision of T. 32 N. R. 6 W. 37

Chains

West bet. secs. 13 and 24.
 Over gently rolling land, through scattering cedar timber.
 26.30 Right rim of gulch, course N. Desc. 80 ft. to
 31.10 Bottom of gulch. Asc. 50 ft. to
 34.15 Intersect E. bdy. of Hualpai Indian Reservation, 22.80
 chs. S. of the 118 mile cor., which is a limestone
 properly set, mkd. and witnessed as described by the
 Surveyor General.
 At the point of intersection,
 Set an iron post, 3 ft. long, 2 ins. diam., 24 ins. in a
 mound of stone, for closing cor. of secs.
 13 and 24, mkd. on brass cap

T32N
 HIR S13
 S24 CC
 R 6W
 1917

and raise a mound of stone, 3 ft. base, 2 ft. high,
 E. of cor.
 Land, gently rolling.
 Soil, sandy clay, stony, limestone formation, 3rd rate.
 No timber.
 Undergrowth, sagebrush.
 Grass.

Note:-At the 117 $\frac{1}{2}$ mile cor., I take the following bearing
 trees.
 A cedar, 14 ins. diam., brs. S. 77 $\frac{1}{2}$ ° W.
 75 lks. dist. mkd. H I R 117 $\frac{1}{2}$ ° B T.
 A cedar, 6 ins. diam., brs. N. 56° W.
 73 lks. dist. mkd. H I R 117 $\frac{1}{2}$ ° B T.

10.91 From the cor. of secs. 7, 12, 13 and 18, W. bdy. of T.
 32 N., R. 5 W., hereinbefore described,
 West bet. secs. 12 and 13.
 Over nearly level land, through scattering cedar.
 Desc. gentle W. slope.
 Rim of National Canyon, 400 to 500 ft. deep.
 Raise a mound of stone, 3 ft. base, 2 ft. high.
 From this point the 118 $\frac{1}{2}$ mile cor. on the E. bdy. of the
 Hualpai Indian Reservation brs. S. 38° W.

GENERAL DESCRIPTION

The portion of this township surveyed is gently rolling
 land, covered with very scattering timber and under-
 growth. The National Canyon, which has perpendicular
 walls, 300 to 400 ft. deep, prevents the completion of
 the subdivision lying outside the Hualpai Indian Reservation.
 The soil is sandy clay, stony, limestone formation, 3rd
 rate. The land is unsettled. There is no water.

Boundaries of Surveyed Portion of T. 32 N., R. 6 W.

Latitudes, departures and closing errors.

Line designated.	True bearing.	Dist. chs.	Latitudes.		Departures.	
			N. chs.	S. chs.	E. chs.	W. chs.
South Boundary.	West.	34.57				34.57
West Boundary (Hualpai Indian Reservation)	N. 0° 4' W. North	22.06 217.20	22.06 217.20			.02
Subdivisional North Boundary	East	34.15			34.15	
East Boundary	South	240.00		240.00		
Convergency						.02
Totals.			239.26	240.00 239.26	34.17	34.59 34.17
Error in latitude				.74		
Error in departure						.42

BOOK 3070

Book "J"
Group 53 - - - - Arizona.
Township 32 North, Range 5 West.
Township 32 North, Range 6 West.

DATE DIAGRAM.

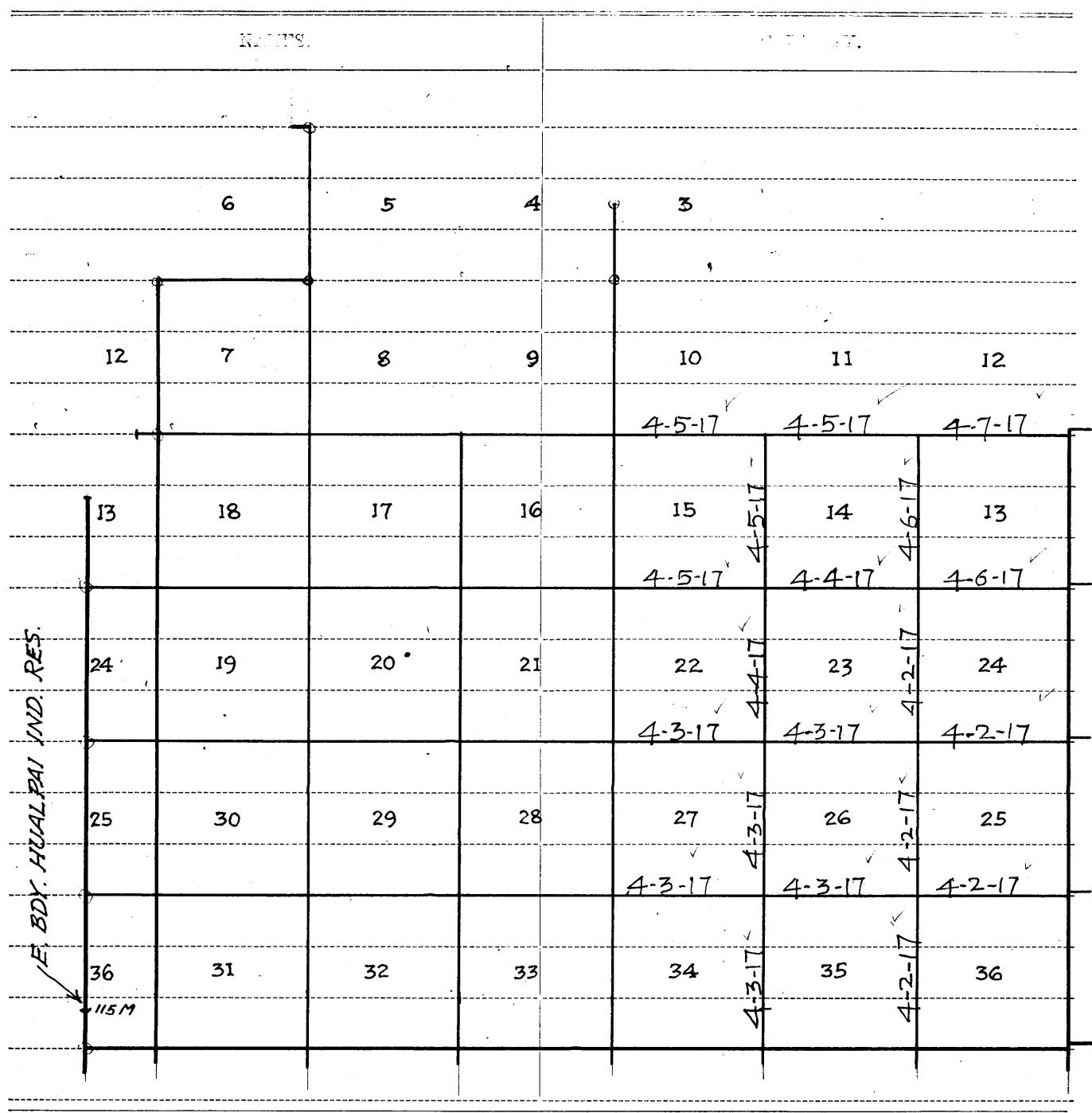

6-2764

Surveys executed on dates shown on above diagram by
Heber P. Purington, U. S. Transitman.
For names and duties of assistants to Heber P. Purington,
U. S. Transitman, see Book "A".

CERTIFICATE OF UNITED STATES TRANSITMAN.

BOOK 3070

I, Heber P. Purington, U.S. Transitman, hereby certify upon honor that, in pursuance of special instructions received from the U. S. Surveyor General for Group 53, Arizona, bearing date of the 4th day of March, 1915, I have well, faithfully, and truly in my own proper person, and in strict conformity with said instructions, the Manual of Surveying Instructions, and the laws of the United States, surveyed all those parts or portions of the subdivision lines of

TOWNSHIP 32 NORTH, RANGE 5 WEST

of the Gila and Salt River Base and Meridian, in the State of Arizona, and by diagram on reverse hereof the foregoing field notes as having been executed by me, and under my direction; and that all the corners of said survey have been established and perpetuated in strict accordance with the Manual of Surveying Instructions, and the special written instructions of the U. S. Surveyor General for Group 53, Arizona, and in the specific manner described in the field notes, and that the foregoing are the original field notes of such survey.

Heber P. Purington 1-11-18
U.S. Transitman.

APPROVAL.

OFFICE OF THE UNITED STATES SURVEYOR GENERAL,

191

The foregoing field notes of the survey of

executed by

under his special instructions dated, 191, having been critically examined, and the necessary corrections and explanations made, the said field notes, and the surveys they describe, are hereby approved.

U.S. Surveyor General.

I certify that the foregoing transcript of the field notes of the above-described surveys in, has been correctly copied from the original notes on file in this office.

U. S. Surveyor General.

BOOK 3070

Book "J"

Group 53- - - Arizona.

Township 32 North, Range 5 West
Township 32 North, Range 6 West.

DATE DIAGRAM.

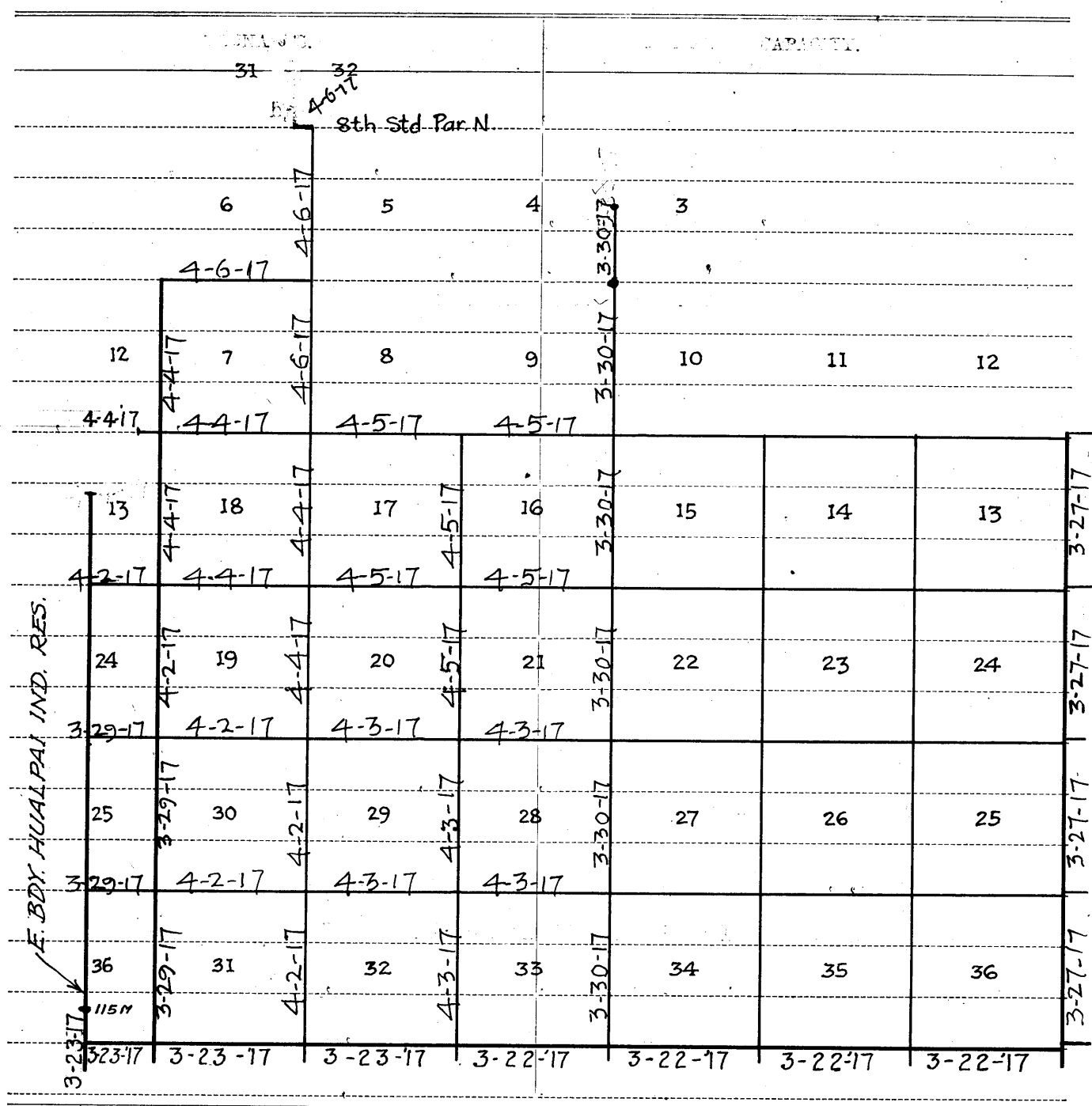

6-2764

Surveys executed on dates shown on above diagram by W. H. Thorn, U.S. Surveyor.

For names and duties of assistants to W. H. Thorn, U. S. Surveyor, see Book "F".

CERTIFICATE OF UNITED STATES SURVEYOR.

BOOK 609

I, W. H. Thorn, U. S. Surveyor, hereby certify upon honor that, in pursuance of special instructions received from the U. S. Surveyor General for Group 53, Arizona, bearing date of the 4th day of March, 1915, I have well, faithfully, and truly in my own proper person, and in strict conformity with said instructions, the Manual of Surveying Instructions, and the laws of the United States, ^{re-} surveyed all those parts or portions of the East boundary, and Surveyed all those parts or portions of the 8th Standard Parallel North thru part of Range 5 West, the West bdy. and Subdivision lines of

TOWNSHIP 32 NORTH, RANGE 5 WEST, and

TOWNSHIP 32 NORTH, RANGE 6 WEST,

of the Gila and Salt River Base and Meridian, in the State of Arizona, which are represented in and by diagram on reverse hereof the foregoing field notes as having been executed by me, and under my direction; and that all the corners of resurvey & said survey have been established and perpetuated in strict accordance with the Manual of Surveying Instructions, and the special written instructions of the U. S. Surveyor General for Group 53, Arizona, and in the specific manner described in the field notes, and that the foregoing are the original field notes of re- such survey, and survey,

W. H. Thorn

U. S. Surveyor.

APPROVAL.

OFFICE OF THE UNITED STATES SURVEYOR GENERAL,

Phoenix, Arizona, October 25, 1918

^{re-}
The foregoing field notes of the survey of part of the East bdy. of Township 32 North, Range 5 West, Survey of 8th. Std. Parallel N. thru part of R. 5 W., Fracl. West bdy. and fracl. subdivision lines of

TOWNSHIP 32 NORTH, RANGE 5 WEST, and

Fracl. Subdivision lines of TOWNSHIP 32 NORTH, RANGE 6 WEST,

of the Gila and Salt River Base and Meridian, in the State of Arizona, executed by W. H. Thorn, U. S. Surveyor and Heber P. Purington, U. S. Transitman, under ~~his~~ special instructions dated March 4, 1915, for Group 53, Arizona, ^{resurveys &} having been critically examined, and the necessary corrections and explanations made, the said field notes, and the surveys they describe, are hereby approved.

Frank P. Purington

U. S. Surveyor General.

I certify that the foregoing transcript of the field notes of the above described surveys in _____
_____ has been correctly copied from the original notes on file in this office.

U. S. Surveyor General.