

3097

Book "D"
4-679

JAN 5 1918
FEB 10 1918

BOOK 3097

FIELD NOTES

OF THE SURVEY OF THE

COMPLETION OF THE

WEST BOUNDARY

and

SUBDIVISION LINES

and RETRACEMENT OF

PART OF THE SUBDIVISION LINES OF

TOWNSHIP 27 NORTH, RANGE 5 EAST,

Of the Gila and Salt River Base and Meridian,

In the State of Arizona.

EXECUTED BY

Thomas B. Matthews, U. S. Surveyor,

and

Deane J. Wolff, U. S. Transitman,

~~In the capacity of U. S. Surveyor~~, under instructions dated March 8, 1915,

issued by the United States Surveyor General to govern surveys included in

Group No. 55, which were approved by the Commissioner of the General Land

Office, December 14, 1915.

Retracement & Survey commenced May 30, 1916.

Retracement & Survey completed June 7, 1916.

Executed under Assignment
Instructions dated Apr. 13 & 22, 1916.

3097

3097

1A

3097





Book "D"

Group 55, - - - Arizona.

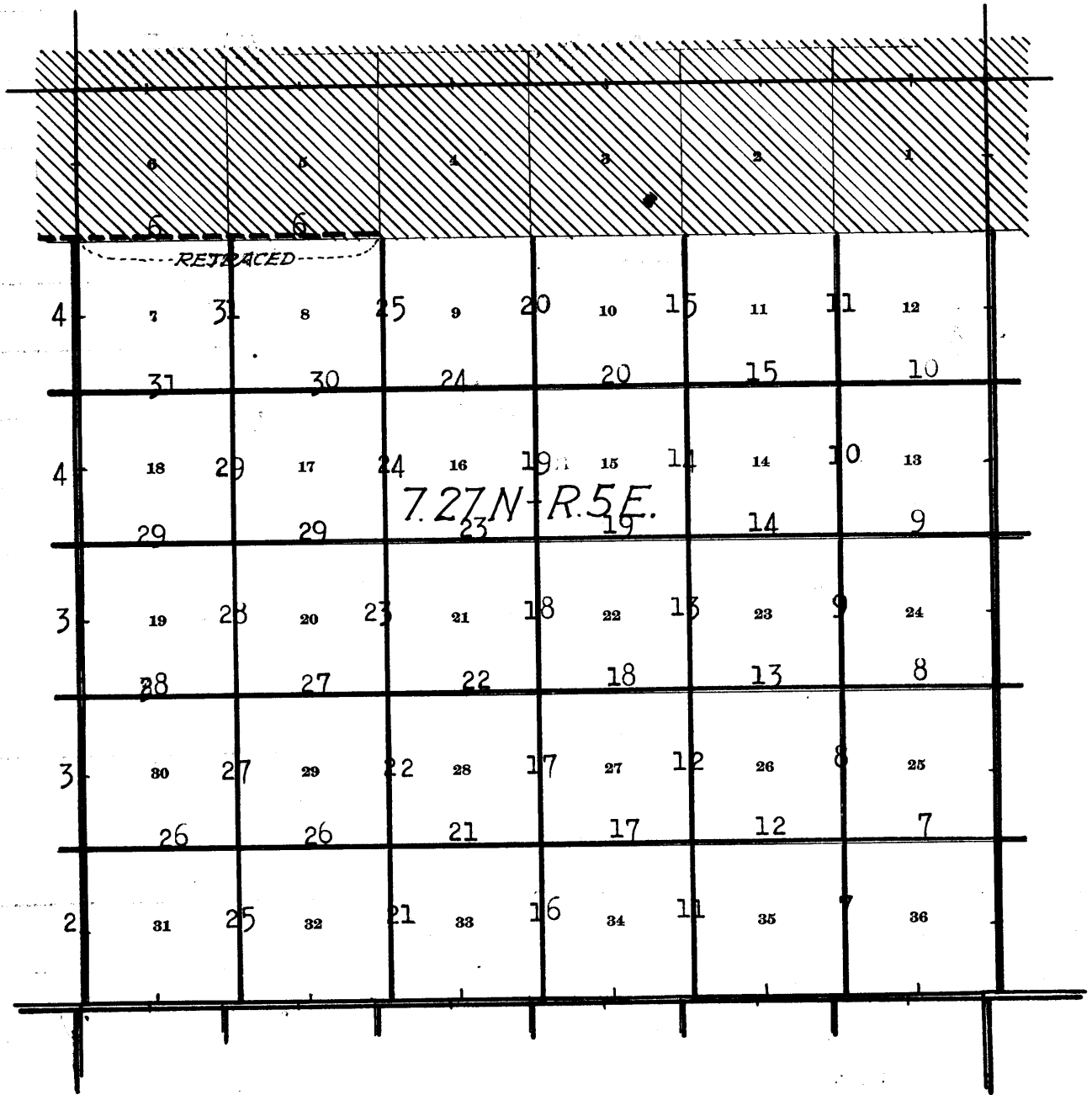
BOOK 3097

INDEX DIAGRAM.



-  Lines surveyed under this group.
-  Lines ^{retraced or} resurveyed under this group.
-  Accepted surveys.
-  Areas surveyed as per accepted plats on file.

SURVEY OF THE

COMPLETION OF THE WEST BOUNDARY AND SUBDIVISION

LINES,

AND RETRACEMENT OF

PART OF THE SUBDIVISION LINES OF

TOWNSHIP 27 NORTH, RANGE 5 EAST,

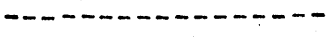

Retracement and surveys hereinafter described, executed on dates shown on diagram on page 33 hereof, by Thomas B. Matthews, U. S. Surveyor, and Deane J. Wolff, U. S. Transitman, using Buff and Buff Transit No. 10124, and Young and Sons' light mountain transit No. 8535, respectively, described in Book "A."

2. Survey of Completion of West Boundary of T. 27 N., R. 5 E.

Chains.

From the cor. of secs. 1, 6, 7 and 12, on the W. bdy. of the Tp., which is a limestone, 14 X 10 X 9 ins. above ground, firmly set, marked and witnessed as described by the Surveyor-General.

South on a random line, along the W. bdy. of T. 27 N., R. 5 E., setting temp. $\frac{1}{4}$ sec. and sec. cors at intervals of 40.00 chs.; and at 401.18 chs., intersect the N. bdy. of T. 26 N., R. 5 E., 3.72 chs. S. $89^{\circ} 51'$ E. of the cor. of Ts. 26 N., Rs. 4 and 5 E., which is an iron post, described in Book "B."

At the point of intersection, set an iron post, 3 ft. long, 3 ins. diam., 24 ins. in the ground, for cor. of Ts. 27 N., Rs. 4 and 5 E., marked on brass cap

T27N	
R4E	R5E
S36	S31
S6	
T26N R5E	

From which

A pinion, 8 ins. diam., brs. N. $23\frac{1}{2}^{\circ}$ E., 34 lks. dist., marked T27N R5E S31 BT.

A cedar, 14 ins. diam., brs. N. $47\frac{1}{2}^{\circ}$ W., 9 lks. dist., marked T27N R4E S36 BT.

Thence

North on a true line, bet. secs. 31 and 36.

Over rolling land, through scattering timber and undergrowth.

12.46

Small draw, course E.

40.00

Set an iron post, 3 ft. long, 1 in. diam., 26 ins. in the ground, for $\frac{1}{4}$ sec. cor., marked on brass cap

S36	S31
1916	

From which

A pinion, 10 ins. diam., brs. N. $61\frac{1}{2}^{\circ}$ E., 59 lks. dist., marked $\frac{1}{4}$ S31 BT.

A pinion, 10 ins. diam., brs. N. $66\frac{1}{2}^{\circ}$ W., 39 lks. dist., marked $\frac{1}{4}$ S36 BT.

80.00

Set an iron post, 3 ft. long, 3 ins. diam., 24 ins. in the ground, for cor. of secs. 25, 30, 31 and 36, marked on brass cap

T27N	
R4E	R5E
S25	S30
S36	S31
1916	

From which

A cedar, 24 ins. diam., brs. N. 87° E., 202 lks. dist., marked T27N R5E S30 BT.

A cedar, 25 ins. diam., brs. S. $65\frac{3}{4}^{\circ}$ E., 74 lks. dist., marked T27N R5E S31 BT.

A cedar, 8 ins. diam., brs. S. $49\frac{1}{2}^{\circ}$ W., 287 lks. dist., marked T27N R4E S36 BT.

A cedar, 12 ins. diam., brs. N. $52\frac{1}{2}^{\circ}$ W., 165 lks. dist., marked T27N R4E S25 BT.

Land, level and rolling.

Soil, coarse, 26 ins. deep.

Timber, scattering cedar and pinion.

Undergrowth, sagebrush and Brigham brush, 1 ft. high.

Fair grass.

Survey of Completion of West Boundary of T. 27 N., R. 5 E., S. 3.

Chains.

40.00 North on a true line, bet. secs. 25 and 30.
Over level land, through scattering timber and undergrowth.
Set an iron post, 3 ft. long, 1 in. diam., 26 ins. in the ground, for $\frac{1}{4}$ sec. cor., marked on brass cap

$\frac{1}{4}$ S25 | S30
1916

From which

A cedar, 12 ins. diam., brs. N.86 $\frac{1}{2}$ ° E., 120 lks. dist., marked $\frac{1}{4}$ S30 BT.

A pinion, 10 ins. diam., brs. S.53° W., 88 lks. dist., marked $\frac{1}{4}$ S25 BT.

80.00 Set an iron post, 3 ft. long, 3 ins. diam., 24 ins. in the ground, for cor. of secs. 19, 24, 25 and 30, marked on brass cap

T27N
R4E R5E
S24 | S19
S25 | S30
1916

From which

A pinion, 8 ins. diam., brs. N.48 $\frac{1}{2}$ ° E., 209 lks. dist., marked T27N R5E S19 BT.

A cedar, 8 ins. diam., brs. S.76 $\frac{1}{2}$ ° E., 203 lks. dist., marked T27N R5E S30 BT.

A pinion, 10 ins. diam., brs. S.33 $\frac{1}{2}$ ° W., 272 lks. dist., marked T27N R4E S25 BT.

A cedar, 10 ins. diam., brs. N.10 $\frac{1}{2}$ ° W., 247 lks. dist., marked T27N R4E S24 BT.

Land, level.

Soil, coarse, 20 ins. deep.

Timber, scattering cedar and pinion.

Undergrowth, sagebrush and Brigham brush, 1 ft. high.

Fair grass.

21.00 North on a true line, bet. secs. 19 and 24.
Over level land, through scattering timber and undergrowth.
Leave timber.
30.00 Draw, course SW.
36.00 Enter timber.
40.00 Set an iron post, 3 ft. long, 1 in. diam., 26 ins. in the ground, for $\frac{1}{4}$ sec. cor., marked on brass cap

$\frac{1}{4}$ S24 | S19
1916

From which

A pinion, 14 ins. diam., brs. N.46 $\frac{1}{2}$ ° E., 194 lks. dist., marked $\frac{1}{4}$ S19 BT.

A pinion, 28 ins. diam., brs. S.47 $\frac{1}{2}$ ° W., 200 lks. dist., marked $\frac{1}{4}$ S24 BT.

60.00 Draw, course SW.

80.00 Set an iron post, 3 ft. long, 3 ins. diam., 18 ins. in the ground, in a mound of stone, for cor. of secs. 13, 18, 19 and 24, marked on brass cap

T27N
R4E R5E
S13 | S18
S24 | S19
1916

From which

A pinion, 8 ins. diam., brs. N.42 $\frac{1}{2}$ ° E., 170 lks. dist., marked T27N R5E S18 BT.

4. Survey of Completion of West Boundary of T. 27 N., R. 5 E.

Chains.

A pinion, 8 ins. diam., brs. S.37° E., 97 lks. dist., marked T27N R5E S19 BT.
 A pinion, 9 ins. diam., brs. S.4° W., 213 lks. dist., marked T27N R4E S24 BT.
 A pinion, 20 ins. diam., brs. N.26° W., 299 lks. dist., marked T27N R4E S13 BT.
 Land, level.
 Soil, coarse texture, 26 ins. deep.
 Timber, scattering cedar and pinion.
 Undergrowth, sagebrush and Brigham brush 1 ft. high.
 Fair grass.

17.50
40.00

North on a true line, bet. secs. 13 and 18.
 Over level land, through scattering timber and undergrowth.
 Draw, 2 chs. wide, 10 ft. deep, course E.
 Set an iron post, 3 ft. long, 1 in. diam., 26 ins. in the ground, for $\frac{1}{4}$ sec. cor., marked on brass cap

$\frac{1}{4}$ S13 | S18
1916

76.00
80.00

From which
 A pinion, 12 ins. diam., brs. N.40° E., 28 lks. dist., marked $\frac{1}{4}$ S18 BT.
 A pinion, 10 ins. diam., brs. S.85° W., 25 lks. dist., marked $\frac{1}{4}$ S13 BT.
 Leave timber.
 Set an iron post, 3 ft. long, 3 ins. diam., 24 ins. in the ground, for cor. of secs. 7, 12, 13 and 18, marked on brass cap

T27N
R4E R5E
S12 | S 7
S13 | S18
1916

Dig pits, 18 X 18 X 12 ins., in each sec., 5 $\frac{1}{2}$ ft. dist.; and raise a mound of earth, 4 ft. base, 2 ft. high, W. of cor.

Land, level.
 Soil, coarse texture, 26 ins. deep.
 Timber, cedar and pinion.
 Undergrowth, sagebrush and Brigham brush, 1 ft. high.
 Fair grass.

18.00
30.00
40.00

North on a true line, bet. secs. 7 and 12.
 Over level land, through scattering undergrowth.
 Enter timber.
 Draw, course SW.
 Set an iron post, 3 ft. long, 1 in. diam., 26 ins. in the ground, for $\frac{1}{4}$ sec. cor., marked on brass cap

$\frac{1}{4}$ S12 | S 7
1916

47.00
76.00
81.18

From which
 A pinion, 9 ins. diam., brs. N.80 $\frac{1}{2}$ ° E., 88 lks. dist., marked $\frac{1}{4}$ S7 BT.
 A pinion, 8 ins. diam., brs. S.74 $\frac{3}{4}$ ° W., 100 lks. dist., marked $\frac{1}{4}$ S12 BT.
 Small draw, course SW.
 Small draw, course W.
 Intersect the original cor. of secs. 1, 6, 7 and 12.
 Land, level.

Survey of Completion of West bdy. of Township 27 N., R. 5 E. 5

Chains.
 Soil, coarse texture, 26 ins. deep,
 Timber, scrub cedar and pinon.
 Undergrowth, sage brush.
 Fair grass.

Boundaries of that portion of T. 27 N., R. 5 E.
 subdivided under this group.

Latitudes, departures, and closing errors.

Line designated.	True bearing.	Dist.	Latitudes.		Departures.	
			N.	S.	E.	W.
South boundary,	S. 89° 48' W. N. 89° 51' W.	11.40 468.93	1.23	.04		11.40 468.93
West boundary,	North,	401.18	401.18			
Subdivisional boundary,	N. 89° 30' E.	38.70	.34		38.70	
	N. 89° 50' E.	40.04	.12		40.04	
	N. 89° 35' E.	40.01	.29		40.01	
	N. 89° 32' E.	40.05	.33		40.05	
	N. 89° 58' E.	80.00	.05		80.00	
	S. 89° 58' E.	80.00		.05	80.00	
	S. 89° 59' E.	80.00		.02	80.00	
East boundary,	South,	403.86		403.86		
Convergency,					.43	
<u>Totals,</u>			<u>403.54</u>	<u>403.97</u>	<u>479.23</u>	<u>480.33</u>
				<u>403.54</u>		<u>479.23</u>
<u>Error in latitude,</u>				<u>0.43</u>		
<u>Error in departure,</u>					<u>1.10</u>	

6. Retracement of part of Subdivision lines of T. 27 N. R. 5 E.

Chains.	
	<p>From the original cor. of secs. 1, 6, 7 and 12, on the W. bdy. of the 1st, which is a limestone, 14x10x9 ins. above ground firmly set, marked and witnessed as described by the surveyor general, N. 89° 30' E., on a true line, on S. bdy. of sec. 6. Over gently rolling land, thru. scattering timber.</p>
10.00	Small draw, course SW.
38.70	Intersect the 1 st sec. cor., which is a limestone, 12x15x7 ins. above ground, firmly set, marked and witnessed as described by the surveyor general. Now refers to sec. 6 only.
	Thence, N. 89° 50' E., on a true line, on E. $\frac{1}{2}$ of S. bdy. of sec. 6. Over gently rolling land, thru. scattering timber.
26.00	Small draw, course NE.
40.04	Intersect the original cor. of secs. 5, 6, 7 and 8, which is a limestone, 10x10x8 ins. above ground, firmly set, marked and witnessed as described by the surveyor general. Change this cor. to refer to secs. 5 and 6 only, by changing the markings on the SE. tree to read as follows: T27 N R5E S7 BT. Land, gently rolling. Soil, coarse texture, 26 ins. deep. Timber, scrub cedar and pinon. Undergrowth, none. Fair grass.

	<p>From the cor. of secs. 5 and 6, N. 89° 35' E., on a true line, on S. bdy. of sec. 5. Over level land, thru. scattering timber and undergrowth.</p>
15.00	Small draw, course SW.
40.01	Intersect the 1 st sec. cor., which is a limestone, 12x10x8 ins., above ground, firmly set, marked and witnessed as described by the surveyor general. Now refers to sec. 5 only.
	Thence, N. 89° 32' E., on a true line, on E. $\frac{1}{2}$ of S. bdy. of sec. 5. Over level land, thru. scattering timber and undergrowth.
40.05	Intersect the true point for original cor. of secs. 4, 5, 8 and 9, as determined by position of mound of earth in which post originally stood, and bearings and distances from four bearing trees. The original cor., a pinon post, 4 ft. long, 4 ins. in diam. was lying on the ground. Reestablish the cor. in its original position, as follows: Set the original pinon post, 4 ft. long, 4 ins. in diam., 16 ins. in the ground, in a mound of stone, for cor. of secs. 4 and 5, marked T27N S4 in NE., and R5E S5 in NW. face; with 4 notches on E. and 5 notches on S. edges, and re-mark the SE. bearing tree to read as follows: T27N R5E S8BT. Land, level. Soil, thin and rocky. Timber, cedar and pinon. Undergrowth, sage brush. Fair grass.

Survey of Completion of Subdivision of T. 27 N., R. 5 E. 7.

Chains.

Survey commenced and executed with Tuff and Buff light mountain transit No. 10,127, and Young and Sons' light mountain transit No. 3555, each instrument being equipped with United States aneroid. For description of instruments, certificates of approval, and tests of accuracy, see Book "A".

From the cor. of secs. 35 and 36, on the S. bdy. of the Tp., which is an iron post, described in Book "B"; N.0° 1' W., bet. secs. 35 and 36.

Over gently rolling land, through scattering timber and undergrowth.

10.00

Desc. 25 ft. to

25.00

Draw, course S.75° E. Asc. 25 ft. to

40.00

Set an iron post, 3 ft. long, 1 in. diam., 22 ins. in the ground, in a mound of stone, for 1/4 sec. cor., marked on brass cap

1/4 S35 | S36

1916

From which

A pinion, 12 ins. diam., brs. N.77° E., 116 lks. dist., marked 1/4 S36 BT.

A pinion, 12 ins. diam., brs. S.10 1/2° W., 41 lks. dist., marked 1/4 S35 BT.

80.00

Set an iron post, 3 ft. long, 2 ins. diam., in a mound of stone, for cor. of secs. 25, 26, 35 and 36, marked on brass cap

T27N R5E
S26 | S25

S35 | S36
1916

From which

A pinion, 12 ins diam., brs. N.45° E., 92 lks. dist., marked T27N R5E S25 BT.

A pinion, 7 ins. diam., brs. S.53 1/2° W., 34 lks. dist., marked T27N R5E S36 BT.

A pinion, 6 ins. diam., brs. S.17 3/4° W., 91 lks. dist., marked T27N R5E S35 BT.

A pinion, 14 ins. diam., brs. N.69° W., 123 lks. dist., marked T27N R5E S26 BT.

Land, gently rolling.

Soil, loose, rocky, yellow loam, over limestone formation.

Timber, pinion and juniper.

Undergrowth, sagebrush.

40.00

S.89° 51' E., on a random line, bet. secs. 25 and 36.

79.93

Set temp. 1/4 sec. cor.

Intersect E. bdy. of Tp., 3 lks. N. of the cor. of secs. 25, 30, 31 and 36, which is an iron post, described in Book "U".

Thence

N.89° 50' W., on a true line, bet. secs. 25 and 36.

Over gently rolling land, through scattering timber and undergrowth.

16.40

Road, brs. N.10° E. and S.

39.96 1/2

Set an iron post, 3 ft. long, 1 in. diam., 26 ins. in the ground, for 1/4 sec. cor., marked on brass cap

1/4 S25
S36

1916

From which

A pinion, 24 ins. diam., brs. N.19 1/2° E., 121 lks. dist., marked 1/4 S25 BT.

A pinion, 16 ins. diam., brs. S.33 1/4° E., 108 lks. dist., marked 1/4 S36 BT.

8. Completion of Subdivision of Township 27 North, Range 5 East.

Chains.	
51.95	Enter heavy timber, brs. NE. and S.
79.93	The cor. of secs. 25, 26, 35 and 36. Land, gently rolling. Soil, loose, rocky, yellow loam; over limestone formation. Timber, pinion and juniper. Undergrowth, sagebrush.
	N.0° 1' W., bet. secs. 25 and 26. Over gently rolling land, through heavy timber and undergrowth.
11.40	Desc. 25 ft. to
19.00	Draw, course S.75° E. Asc. 30 ft. to
24.00	Thence over gently rolling land.
40.00	Set an iron post, 3 ft. long, 1 in. diam., 26 ins. in the ground, for $\frac{1}{4}$ sec. cor., marked on brass cap
	$\frac{1}{4}$ S26 S25 1916
	From which A pinion, 16 ins. diam., brs. S.65° E., 18 lks. dist., marked $\frac{1}{4}$ S25 BT. A pinion, 12 ins. diam., brs. N.80° W., 68 lks. dist., marked $\frac{1}{4}$ S26 BT.
67.40	Desc. 25 ft. to
72.40	Draw, course E. Asc. 40 ft. to
79.15	Thence over gently rolling land.
80.00	Set an iron post, 3 ft. long, 2 ins. diam., 12 ins. in the ground, in a mound of stone, for cor. of secs. 23, 24, 25 and 26, marked on brass cap
	T27N R5E S23 S24 — — S26 S25 1916
	From which A pinion, 14 ins. diam., brs. N.71 $\frac{1}{2}$ ° E., 208 lks. dist., marked T27N R5ES24 BT. A pinion, 10 ins. diam., brs. S.60 $\frac{1}{2}$ ° E., 162 lks. dist., marked T27N R5E S25 BT. A juniper, 12 ins. diam., brs. S.47° W., 41 lks. dist., marked T27N R5E S26 BT. A pinion, 10 ins. diam., brs. N.62° W., 34 lks. dist., marked T27N R5E S23 BT. Land, gently rolling and rolling. Soil, loose, rocky, yellow loam, over limestone formation. Timber, pinion and juniper. Undergrowth, sagebrush.
40.00	S.89° 50' E., on a random line, bet. secs. 24 and 25. Set temp. $\frac{1}{4}$ sec. cor.
79.90	Intersect E. bdy. of Tp., 11 lks. S. of the cor. of secs. 19, 24, 25 and 30, which is an iron post, described in Book "C". Thence N.89° 55' W., on a true line, bet. secs. 24 and 25. Over gently rolling land, through scattering timber and undergrowth.
8.30	Road, brs. N.10° E., and S.10° W.
29.90	Enter heavy timber, brs. N. and S.
39.95	Set an iron post, 3 ft. long, 1 in. diam., 26 ins. in the ground, for $\frac{1}{4}$ sec. cor., marked on brass cap

Completion of subdivision of Township 27 North, Range 5 East, 9

Chains.

1/4 S24
S25
1916

From which
 A pinion, 12 ins. diam., brs. N.30° W., 110 lks. dist., marked 1/4 S24 BT.
 A pinion, 10 ins. diam., brs. S.50 1/2° E., 44 lks. dist., marked 1/4 S25 BT.

51.90 Leave heavy, enter scattering timber, brs. NW. and SE.
 55.00 Old road, brs. NW. and SE.
 79.90 The cor. of secs. 23, 24, 25 and 26.
 Land, gently rolling.
 Soil, loose, rocky, yellow loam, over limestone formation
 Timber, pinion and juniper.
 Undergrowth, sagebrush.

N.0° 1' W., bet. secs. 23 and 24.
 Over gently rolling land, through scattering timber and undergrowth.

37.50 Old road, brs. N.75° W. and S.75° E.
 40.00 Set an iron post, 3 ft. long, 1 in. diam., in a mound of stone, for 1/4 sec. cor., marked on brass cap

1/4 S23 | S24
1916

From which
 A pinion, 8 ins. diam., brs. S.8° E., 80 lks. dist., marked 1/4 S24 BT.
 A pinion, 16 ins diam., brs. S.5 1/4° W., 46 lks. dist., marked 1/4 S23 BT.

78.00 Enter heavy timber, brs. E. and W.
 80.00 Set an iron post, 3 ft. long, 2 ins. diam., 18 ins. in the ground, in a mound of stone, for cor. of secs. 13, 14, 23 and 24, marked on brass cap

T27N | R5E
S14 | S13
S23 | S24
1916

From which
 A pinion, 10 ins. diam., brs. N.64 1/2° E., 133 lks. dist., marked T27N R5E S13 BT.
 A pinion, 12 ins. diam., brs. S.88° E., 81 lks. dist., marked T27N R5E S24 BT.
 A pinion, 14 ins. diam., brs. S.35 1/2° W., 26 lks. dist., marked T27N R5E S23 BT.
 A pinion, 8 ins. diam., brs. N.61° W., 68 lks. dist., marked T27N R5E S14 BT.

Land, gently rolling.
 Soil, loose, rocky, yellow loam, over limestone formation.
 Timber, pinion and juniper.
 Undergrowth, sagebrush.

40.00 S.89° 55' E., on a random line, bet secs. 13 and 24.
 79.90 Set temp. 1/2 sec. cor.
 Intersect E. bdy. of Tp., 9 lks. N. of the cor. of secs. 13, 18, 19 and 24, which is an iron post, described in Book "C".
 Thence
 N.89° 51' W., on a true line, bet. secs. 13 and 24.
 Over gently rolling land, through scattering timber and undergrowth.

10. Completion of Subdivision of T. 27 N., R. 5 E.

Chains. 39.95	<p>Set an iron post, 3 ft. long, 1 in. diam., 26 ins. in the ground, for $\frac{1}{4}$ sec. cor., marked on brass cap</p> <p style="text-align: center;"> $\frac{1}{4}$S13 $\frac{1}{4}$S24 1916 </p> <p>From which A pinion, 12 ins. diam., brs. N.19$\frac{3}{4}$° E., 193 lks. dist., marked $\frac{1}{4}$S13 BT. A juniper, 12 ins. diam., brs. S.51° E., 170 lks. dist., marked $\frac{1}{4}$S24 BT.</p>
66.90 79.90	<p>Leave scattering, enter heavy timber, brs. NE. and SW. The cor. of secs. 13, 14, 23 and 24. Land, gently rolling. Soil, loose, rocky, yellow loam, over limestone formation. Timber, pinion and juniper. Undergrowth, sagebrush.</p>
13.60 31.60 40.00	<p>N.0° 1' W., bet. secs. 13 and 14. Over gently rolling land, through heavy timber and undergrowth. Desc. 100 ft. to Draw, course NE. Road in draw, brs. NE. and SW. Asc. 65 ft. Set an iron post, 3 ft. long, 1 in. diam., 14 ins. in the ground, in a mound of stone, for $\frac{1}{4}$ sec. cor., marked on brass cap</p> <p style="text-align: center;"> $\frac{1}{4}$S14 S13 1916 </p> <p>From which A pinion, 4 ins. diam., brs. N.53° E., 172 lks. dist., marked $\frac{1}{4}$S13 BT. A pinion, 10 ins. diam., brs. N.44$\frac{1}{4}$° W., 61 lks. dist., marked $\frac{1}{4}$S14 BT.</p>
55.00 80.00	<p>Edge of mesa, brs. NE. and SW. Thence over gently rolling land. Set an iron post, 3 ft. long, 2 ins. diam., 14 ins. in the ground, in a mound of stone, for cor. of secs. 11, 12, 13 and 14, marked on brass cap</p> <p style="text-align: center;"> T27N R5E S11 S12 S14 S13 1916 </p> <p>From which A pinion, 12 ins. diam., brs. N.28$\frac{1}{4}$° E., 138 lks. dist., marked T27N R5E S12 BT. A pinion, 10 ins. diam., brs. S.69$\frac{3}{4}$° E., 120 lks. dist., marked T27N R5E S13 BT. A pinion, 8 ins. diam., brs. S.60$\frac{1}{2}$° W., 77 lks. dist., marked T27N R5E S14 BT. A pinion, 18 ins. diam., brs. N.10$\frac{3}{4}$° W., 80 lks. dist., marked T27N R5E S11 BT.</p> <p>Land, rolling and gently rolling. Soil, loose, rocky, yellow loam, over limestone formation. Timber, pinion and juniper Undergrowth, sagebrush.</p>
40.00 79.93	<p>S.89° 51' E., on a random line, bet. secs. 12 and 13. Set temp. $\frac{1}{4}$ sec. cor. Intersect E.bdy. of Tp., at the cor. of secs. 7, 12, 13 and 18, which is an iron post, described in Book "C". Thence</p>

Completion of Subdivision of T. 27 N., R. 5 E. 11.

Chains.

N.89° 51' W., on a true line, bet. secs. 12 and 13.
 Over gently rolling land, through scattering undergrowth
 and heavy timber.
 Asc. 30 ft. to
 9.90 Thence over gently rolling land.
 29.90 Asc. to
 39.96 1/2 Spur, slopes SE.
 Set an iron post, 3 ft. long, 1 in. diam., 18 ins. in the
 ground, in a mound of stone, for 1/4 sec. cor., marked on
 brass cap

1/4 S12
 S13
 1916

From which
 A pinion, 12 ins. diam., brs. N.5 1/4° W., 100 lks. dist.,
 marked 1/4 S12 BT.
 A pinion, 10 ins. diam., brs. S.36° W., 237 lks. dist.,
 marked 1/4 S13 BT.
 Desc. 40 ft. to
 44.95 Gulch, 1 ch. wide, course SE. Asc. 75 ft. to
 64.95 Edge of mesa, brs. N. and S. Thence over gently rolling
 land.
 79.93 The cor. of secs. 11, 12, 13 and 14.
 Land, rolling and gently rolling.
 Soil, loose, rocky loam, limestone formation.
 Timber, pinion and juniper.
 Undergrowth, sagebrush.
 Short grass.

40.00 N.0° 1' W., on a random line, bet. secs. 11 and 12.
 Set temp. 1/4 sec. cor.
 83.49 Fall 16 lks. E. of original cor. of secs. 11 and 12,
 which is a limestone, 12 X 11 X 5 ins. aboveground,
 firmly set, marked and witnessed as described by the
 Surveyor-General.

Thence
 S.0° 8' E., on a true line, bet. secs. 11 and 12.
 Over gently rolling land, through scattering timber and
 undergrowth.
 28.50 Leave scattering, enter heavy timber, brs. NE. and SW.
 43.49 Set an iron post, 3 ft. long, 1 in. diam., 26 ins. in the
 ground, for 1/4 sec. cor., marked on brass cap

1/4 S11 | S12
 1916

From which
 A pinion, 8 ins. diam., brs. N.88 1/2° E., 77 lks. dist.,
 marked 1/4 S12 BT.
 A pinion, 10 ins. diam., brs. S.69 1/2° W., 80 lks. dist.,
 marked 1/4 S11 BT.
 44.50 Edge of mesa, brs. NW. and SE. Continue over gently
 rolling land.
 83.49 The cor. of secs. 11, 12, 13 and 14.
 Land, gently rolling.
 Soil, loose, rocky loam, limestone formation.
 Timber, cedar and pinion.
 Undergrowth, sagebrush.

40.00 From the cor. of secs. 34 and 35, on the S. bdy. of the
 Tp., which is an iron post, described in Book "B.",
 N.0° 1' W., bet. secs. 34 and 35.
 Over level land, through scattering timber and undergrowth.
 Draw, course SE.
 Set an iron post, 3 ft. long, 1 in. diam., 26 ins. in the

12. Completion of Subdivision of T. 27 N., R. 5 E.

Chains.

ground, for 1/4 sec. cor., marked on brass cap

1/4 S34 | S35
1916

80.00

And raise a mound of stone, 2 ft. base, 2 1/2 ft. high, W. of cor.
Set an iron post, 3 ft. long, 2 ins. diam., 26 ins. in the ground, for cor. of secs. 26, 27, 34 and 35, marked on brass cap

T27N R5E
S27 | S26
S34 | S35
1916

From which

- A pinion, 12 ins. diam., brs. N.22 1/4° E., 106 lks. dist., marked T27N R5E S26 BT.
- A pinion, 24 ins. diam., brs. S.59° E., 35 lks. dist., marked T27N R5E S35 BT.
- A pinion, 8 ins. diam., brs. S.30 3/4° W., 43 lks. dist., marked T27N R5E S34 BT.
- A cedar, 10 ins. diam., brs. N.50° W., 96 lks. dist., marked T27N R5E S27 BT.

Land, slightly rolling.
Soil, coarse texture, 26 ins. deep.
Timber, scattering cedar and pinion.
Undergrowth, sagebrush 1 ft. high, and broom weed 1 ft. high.
Fair grass.

40.00

S.89° 51' E., on a random line, bet. secs. 26 and 35.

80.00

Set temp. 1/4 sec. cor.
Intersect N. and S. line, 14 lks. S. of the cor. of secs. 25, 26, 35 and 36.

Thence

40.00

N.89° 57' W., on a true line, bet. secs. 26 and 35.
Over level land, through scattering timber and undergrowth.
Set an iron post, 3 ft. long, 1 in. diam., 26 ins. in the ground, for 1/4 sec. cor., marked on brass cap

1/4 S26
S35
1916

80.00

The cor. of secs. 26, 27, 34 and 35.
Land, level.
Soil, coarse texture, 26 ins. deep.
Timber, scrub cedar and pinion.
Undergrowth, sagebrush 1 ft. high, and broom weed 1 ft. high.
Fair grass.

40.00

N.0° 1' W., bet. secs. 26 and 27.
Over level land, through scattering timber and undergrowth.
Set an iron post, 3 ft long, 1 in. diam., 26 ins. in the ground, for 1/4 sec. cor., marked on brass cap

1/4 S27 | S26
1916

Completion of Subdivision of T. 27 N., R. 5 E. 13.

<p>Chains.</p> <p>80.00</p>	<p>From which A pinion, 8 ins. diam., brs. S.71½° E., 16 lks. dist., marked ¼S26 BT. A cedar, 8 ins. diam., brs. S.63.° W., 41 lks. dist., marked ¼S27 BT. Set an iron post, 3 ft. long, 2 ins. diam., 26 ins. in the ground, for cor. of secs. 22, 23, 26 and 27, marked on brass cap</p> <p style="text-align: center;"> T27N R5E S22 S23 — — S27 S26 1916 </p> <p>From which A pinion, 10 ins. diam., brs. N.67° E., 189 lks. dist., marked T27N R5E S23 BT. A pinion, 12 ins. diam., brs. S.53½° E., 59 lks. dist., marked T27N R5E S26 BT. A pinion, 10 ins. diam., brs. S.16½° W., 88 lks. dist., marked T27N R5E S27 BT. A pinion, 10 ins. diam., brs. N.30° W., 334 lks. dist., marked T27N R5E S22 BT. Land, level. Soil, coarse, 26 ins. deep. Timber, scattering cedar and pinion. Undergrowth, sagebrush 14 ins. high, and broom weed 10 ins. high. Fair grass.</p>
<p>40.00</p> <p>79.88</p> <p>14.90</p> <p>19.90</p> <p>39.94</p>	<p>S.89° 57' E., on a random line, bet. secs. 23 and 26. Set temp. ¼ sec. cor. Intersect N. and S. line, 5 lks. S. of the cor. of secs. 23, 24, 25 and 26. Thence N.89° 59' W., on a true line, bet. secs. 23 and 26. Over gently rolling land, through scattering timber and undergrowth. Draw, course SE. Asc. 25 ft. to Thence over gently rolling land. Set an iron post, 3 ft. long, 1 in. diam., 26 ins. in the ground, for ¼sec. cor., marked on brass cap</p> <p style="text-align: center;"> ¼S23 — S26 1916 </p>
<p>47.90</p> <p>58.90</p> <p>79.88</p>	<p>From which A pinion, 8 ins. diam., brs. N.38° W., 128 lks. dist., marked ¼S23 BT. A pinion, 10 ins. diam., brs. S.21½° E., 76 lks. dist., marked ¼S26 BT. Leave timber. Enter timber. The cor. of secs. 22, 23, 26 and 27 Land, gently rolling. Soil, coarse texture, 26 ins. deep. Timber, scattering cedar and pinion. Undergrowth, sagebrush, holly brush and broom weed. Fair grass.</p>
<p>40.00</p>	<p>N.0° 1' W., bet. secs. 22 and 23. Over gently rolling land, through scattering timber and undergrowth. Set an iron post, 3 ft. long, 1 in. diam., 26 ins. in the ground, for ¼ sec. cor., marked on brass cap</p>

14. Completion of Subdivision of T. 27 N., R. 5 E.

Chains.

1/4 S22 | S23
1916

From which
A pinion, 12 ins. diam., brs. N.16 1/2° E., 110 lks. dist., marked 1/4 S23 BT.
A pinion, 14 ins. diam., brs. S.52 1/2° W., 73 lks. dist., marked 1/4 S22 BT.
50.00 S. rim of draw, brs. NE. and SW.
57.00 Draw, course NE.
80.00 Set an iron post, 3 ft. long, 2 ins. diam., 26 ins. in the ground, for cor. of secs. 14, 15, 22 and 23, marked on brass cap

T27N R5E
S15 | S14
S22 | S23
1916

And raise a mound of stone, 3 ft. base, 3 ft. high, W. of cor.
Land, slightly rolling.
Soil, coarse texture, 26 ins. deep.
Timber, scattering cedar and pinion.
Undergrowth, broom weed 1 ft. high.
Fair grass.

40.00 S.89° 59' E., on a random line, bet. secs. 14 and 23.
79.89 Set temp. 1/4 sec. cor.
Intersect N. and S. line, 2 lks. N. of the cor. of secs. 13, 14, 23 and 24.

Thence
N.89° 58' W., on a true line, bet. secs. 14 and 23.
Over rolling land, through scattering timber and undergrowth.

16.70 Old road, brs. N. and S.
34.90 Draw, course NE.
39.94 1/2 Set an iron post, 3 ft. long, 1 in. diam., 26 ins. in the ground, for 1/4 sec. cor., marked on brass cap

1/4 S14
S23
1916

From which
A pinion, 16 ins. diam., brs. N.5 1/2° E., 207 lks. dist., marked 1/4 S14 BT.
A pinion, 16 ins. diam., brs. S.34 1/2° E., 207 lks. dist., marked 1/4 S23 BT.

56.90 Rim of draw, brs. NE. and SW. Desc. 25 ft. to
71.10 Draw, course NE.
79.89 The cor. of secs. 14, 15, 22 and 23.

Land, rolling.
Soil, thin and rocky;.
Timber, pinion and cedar.
Undergrowth, sagebrush and broom weed.
Fair grass.

N.0° 1' W., bet. secs. 14 and 15.
Over gently rolling land, through scattering timber and undergrowth.

Asc. 20 ft. to
7.28 N. rim of draw, brs. NE. and SW.
33.00 Draw, course NE.
40.00 Set an iron post, 3 ft. long, 1 in. diam., in a mound of stone, for 1/4 sec. cor., marked on brass cap

Completion of Subdivision of T. 27 N., R. 5 E. ^{BOOK} 3097

Chains. $\frac{1}{4}$ S15 | S14
1916

From which
 A pinion, 12 ins. diam., brs. N.33 $\frac{3}{4}$ ° E., 47 lks. dist., marked $\frac{1}{4}$ S14 BT.
 A pinion, 8 ins. diam., brs. N.66 $\frac{1}{4}$ ° W., 32 lks. dist., marked $\frac{1}{4}$ S15 BT.

54.95 Small draw, course NE.
 80.00 Set an iron post, 3 ft. long, 2 ins. diam., on bed rock, in a mound of stone, for cor. of secs. 10, 11, 14 and 15, marked on brass cap

T27N R5E
 S10 | S11
 S15 | S14
 1916

From which
 A pinion, 12 ins. diam., brs. N.21° E., 8.1 lks. dist., marked T27N R5E S11 BT.
 A pinion, 18 ins. diam., brs. S.87 $\frac{1}{2}$ ° E., 93 lks. dist., marked T27N R5E S14 BT.
 A pinion, 12 ins. diam., brs. N.71 $\frac{1}{2}$ ° W., 47 lks. dist., marked T27N R5E S10 BT.
 A pinion, 12 ins. diam., brs. S.33 $\frac{3}{4}$ ° W., 160 lks. dist., marked T27N R5E S15 BT.

Land, slightly rolling.
 Soil, thin and rocky; limestone subsoil.
 Timber, cedar and pinion.
 Undergrowth, sagebrush, holly and buck brush.
 Fair grass. Broom weed 1 ft. high.

40.00 S.89° 58' E., on a random line, bet. secs. 11 and 14.
 79.82 Set temp. $\frac{1}{4}$ sec. cor.
 Intersect N. and S. line, 7 lks. S. of the cor. of secs. 11, 12, 13 and 14.
 Thence
 39.91 S.89° 59' W., on a true line, bet. secs. 11 and 14.
 Over rolling land, through scattering timber and undergrowth.
 Set an iron post, 3 ft. long, 1 in. diam., 18 ins. in the ground, in a mound of stone, for $\frac{1}{4}$ sec. cor., marked on brass cap

$\frac{1}{4}$ S11
 S14
 1916

From which
 A pinion, 12 ins. diam., brs. N.9° E., 68 lks. dist., marked $\frac{1}{4}$ S11 BT.
 A pinion, 12 ins. diam., brs. S.40 $\frac{1}{2}$ ° E., 40 lks. dist., marked $\frac{1}{4}$ S14 BT.

45.00 Draw, 5 chs. wide, course SE.
 76.10 Wide, shallow draw, course SE. Old stage road, brs. NW. and SE.
 79.82 The cor. of secs. 10, 11, 14 and 15.
 Land, rolling.
 Soil, thin and rocky.
 Timber, cedar and pinion.
 Undergrowth, sagebrush 1 ft. high.
 Fair grass.

40.00 N.0° 1' W., on a random line, bet. secs. 10 and 11.
 83.18 Set temp. $\frac{1}{4}$ sec. cor.
 Fall 63 lks. S.89° 59' E. of the true point for original cor. of secs. 2, 3, 10 and 11, determined from the two original bearing

16. Completion of Subdivision of T. 27 N., R. 5 E.

Chains.

trees. The original pinion post, badly decayed, was lying on the ground. I reestablish this cor. as follows:

Set a limestone, 16 X 8 X 6 ins., 11 ins. in the ground, for cor. of secs. 2 and 3, marked with 2 notches on E. and 5 notches on S. edge; and raise a mound of stone, 2 ft. base, 1½ ft. high, N. of cor.

At the point of intersection, set an iron post, 3 ft. long, 2 ins. diam., 24 ins. in the ground, for closing cor. of secs. 10 and 11, marked on brass cap

T27N R5E
S 2

S10|S11
C C
1916

From which

A pinion, 14 ins. diam., brs. S.79½° E., 263 lks. dist., marked T27N R5E S10 CCBT.

A pinion, 8 ins. diam., brs. S.52½° W., 293 lks. dist., T27N R5E S10 CC.BT.

Thence

S.0° 1' E., on a true line, bet. secs. 10 and 11.

Over gently rolling land, through scattering timber and undergrowth.

43.18 Set an iron post, 3 ft. long, 1 in. diam., 26 ins. in the ground, for ¼ sec. cor., marked on brass cap

¼S10 | S11

1916

From which

A pinion, 30 ins. diam., brs. N.62° E., 87 lks. dist., marked ¼S11 BT.

A pinion, 20 ins. diam., brs. S.77° W., 108 lks. dist., marked ¼S10 BT.

68.20 Enter draw, course SE.

78.20 Center of draw, course SE. Old stage road, brs. NW. and SE.

83.18 The cor. of secs. 10, 11, 14 and 15.

Land, slightly rolling.

Soil, thin and rocky.

Timber, cedar and pinion.

Undergrowth, sagebrush and holly brush.

Fair grass.

From the cor. of secs. 33 and 34, on the S. bdy. of the Tp., which is an iron post, described in Book "B:" N.0° 2' W., bet. secs. 33 and 34.

Over level land, through scattering timber and undergrowth.

40.00 Set an iron post, 3 ft. long, 1 in. diam., 26 ins. in the ground, for ¼ sec. cor., marked on brass cap

¼S33 | S34

1916

From which

A cedar, 12 ins. diam., brs. N.38° E., 247 lks. dist., marked ¼S34 BT.

A pinion, 16 ins. diam., brs. N.83° W., 264 lks. dist., marked ¼S33 BT.

80.00 Set an iron post, 3 ft. long, 2 ins. diam., 26 ins. in the ground, for cor. of secs. 27, 28, 33 and 34, marked on brass cap

Completion of Subdivision of T. 27 N., R. 5 E. 17.

Chains.

T27N R5E
S28 S27
<u>S33 S34</u>
1916

From which
 A pinion, 14 ins. diam., brs. N.40° E., 104 lks. dist., marked T27N R5E S27 BT.
 A pinion, 16 ins. diam., brs. S.7¼° E., 306 lks. dist., marked T27N R5E S34 BT.
 A pinion, 16 ins. diam., brs. S.1½° W., 280 lks. dist., marked T27N R5E S33 BT.
 A cedar, 18 ins. diam., brs. N.42¾° W., 308 lks. dist., marked T27N R5E S28 BT.

Land, level.
 Soil, coarse texture, 26 ins. deep.
 Timber, scattering cedar and pinion.
 Undergrowth, sagebrush 18 ins. high and brook weed 1 ft. high.
 Fair grass.

40.00 S.89° 51' E., on a random line, bet. secs. 27 and 34.
 Set temp. ¼ sec. cor.
 80.02 Intersect N. and S. line, 3 lks. S. of the cor. of secs. 26, 27, 34 and 35.
 Thence
 40.01 N.89° 52' W., on a true line, bet. secs. 27 and 34.
 Over level land, through scattering timber and undergrowth.
 Set an iron post, 3 ft. long, 1 in. diam, 26 ins. in the ground, for ¼ sec. cor., marked on brass cap

¼S27
<u>S34</u>
1916

80.02 From which
 A pinion, 9 ins. diam., brs. N.69¼° E., 124 lks. dist., marked ¼S27 BT.
 A pinion, 12 ins. diam., brs. S.39° E., 118 lks. dist., marked ¼S34 BT.
 The cor. of secs. 27, 28, 33 and 34.
 Land, level.
 Soil, coarse texture, 26 ins. deep.
 Timber, cedar and pinion.
 Undergrowth, broom weed, 1 ft. high.

40.00 N.0° 2' W., bet. secs. 27 and 28.
 Over level land, through scattering timber and undergrowth.
 Set an iron post, 3 ft. long, 1 in. diam., 26 ins. in the ground, for ¼ sec. cor., marked on brass cap

¼S28 S27
1916

75.00 From which
 A pinion, 22 ins. diam., brs. N.1° E., 259 lks. dist., marked ¼S27 BT.
 A pinion, 24 ins. diam., brs. N.16½° W., 299 lks. dist., marked ¼S28 BT.
 80.00 Draw, 3 chs. wide, course SE.
 Set an iron post, 3 ft. long, 2 ins. diam., 24 ins. in the ground, for cor. of secs. 21, 22, 27 and 28, marked on brass cap

18.

Completion of Subdivision of T. 27 N., R. 5 E.

Chains.

T27N R5E	
S21	S22
<hr/>	
S28	S27
1916	

From which

A pinion, 26 ins. diam., brs. N.87 $\frac{1}{2}$ ° E., 98 lks. dist., marked T27N R5E S22 BT.

A cedar, 10 ins. diam., brs. S.16 $\frac{1}{2}$ ° E., 438 lks. dist., marked T27N R5E S27 BT.

A cedar, 6 ins. diam., brs. S.62 $\frac{3}{4}$ ° W., 72 lks. dist., marked T27N R5E S28 BT.

A pinion, 24 ins. diam., brs. N.66 $\frac{3}{4}$ ° W., 133 lks. dist., marked T27N R5E S21 BT.

Land, slightly rolling.

Soil, coarse texture, 20 to 26 ins. deep.

Timber, scattering cedar and pinion.

Undergrowth, broom weed 1 ft. high.

Fair grass.

40.00

S.89° 52' E., on a random line, bet. secs. 22 and 27.

80.00

Set temp. $\frac{1}{4}$ sec. cor.

Intersect the corner of sections 22, 23, 26 and 27.

Thence

N.89° 52' W., on a true line, bet. secs. 22 and 27.

Over slightly rolling land, through scattering timber and undergrowth.

40.00

Set an ironpost, 3 ft. long, 1 in. diam., 6 ins. in the ground, in a mound of stone, for $\frac{1}{4}$ sec. cor., marked on brass cap

$\frac{1}{4}$ S22	
S27	
<hr/>	
1916	

From which

A pinion, 8 ins. diam., brs. N.3° E., 79 lks. dist., marked $\frac{1}{4}$ S22 BT.

A pinion, 8 ins. diam., brs. S.14 $\frac{1}{2}$ ° W., 84 lks. dist., marked $\frac{1}{4}$ S27 BT.

47.70

Draw, 5 chs. wide, course NE.

80.00

The cor. of secs. 21, 22, 27 and 28.

Land, slightly rolling.

Soil, coarse texture, 18 to 26 ins. deep.

Timber, cedar and pinion.

Undergrowth, broom weed, 1 ft. high.

Fair grass.

40.00

N.0° 2' W., bet. secs. 21 and 22.

Over slightly rolling land, through scattering timber and undergrowth.

Set an iron post, 3 ft. long, 1 in. diam., 26 ins. in the ground, for $\frac{1}{4}$ sec. cor., marked on brass cap

$\frac{1}{4}$ S21	S22
<hr/>	
1916	

From which

A pinion, 12 ins. diam., brs. S.33° E., 38 lks. dist., marked $\frac{1}{4}$ S22.

Completion of Subdivision of T. 27 N., R. 5 E. 19.

Chains.

80.00 A pinion, 14 ins. diam., brs. S.87³° W., 336 lks. dist., marked $\frac{1}{4}$ S21 BT.
 Set an iron post, 3 ft. long, 2 ins. diam., 26 ins. in the ground, for cor. of secs. 15, 16, 21 and 22, marked on brass cap

T27N R5E
 S16 | S15
 S21 | S22
 1916

From which
 A pinion, 6 ins. diam., brs. N.28° E., 93 lks. dist., marked T27N R5E S15 BT.
 A pinion, 10 ins. diam., brs. S.28¹° E., 152 lks. dist., marked T27N R5E S22 BT.
 A cedar, 24 ins. diam., brs. S.4° W., 167 lks. dist., marked T27N R5E S21 BT.
 A cedar, 24 ins. diam., brs. N.25¹° W., 152 lks. dist., marked T27N R5E S16 BT.
 Land, gently rolling.
 Soil, loose, rocky, yellow loam, over limestone formation.
 Timber, juniper and cedar.
 Undergrowth, sagebrush.

40.00 S.89° 52' E., on a random line, bet. secs. 15 and 22.
 Set temp. $\frac{1}{4}$ sec. cor.
 79.93 Intersect N. and S. line, 16 lks. N. of the cor. of secs. 14, 15, 22 and 23.

Thence
 N.89° 45' W., on a true line, bet. secs. 15 and 22.
 Over gently rolling land, through scattering timber.
 9.95 Leave scattering, enter heavy timber, brs. NE. and S.
 39.96¹ Set an iron post, 3 ft. long, 1 in. diam., 26 ins. in the ground, for $\frac{1}{4}$ sec. cor., marked on brass cap

$\frac{1}{4}$ S15
 S22
 1916

79.93 From which
 A pinion, 8 ins. diam., brs. N.9° W., 79 lks. dist., marked $\frac{1}{4}$ S15 BT.
 A pinion, 8 ins. diam., brs. S.35° E., 6 lks. dist., marked $\frac{1}{4}$ S22 BT.
 The cor. of secs. 15, 16, 21 and 22.
 Land, gently rolling.
 Soil, loose, rocky, yellow loam, over limestone formation.
 Timber, pinion and juniper.
 No undergrowth.

40.00- N.0° 2' W., bet. secs. 15 and 16.
 Over gently rolling land, through scattering timber and undergrowth.
 Set an iron post, 3 ft. long, 1 in. diam., 26 ins. in the ground, for $\frac{1}{4}$ sec. cor., marked on brass cap

$\frac{1}{4}$ S16 | S15
 1916

48.00 From which
 A juniper, 14 ins. diam., brs. S.69¹° E., 227 lks. dist., marked $\frac{1}{4}$ S15 BT.
 A juniper, 12 ins. diam., brs. S.82° W., 99 lks. dist., marked $\frac{1}{4}$ S16 BT.
 Leave scattering, enter heavy timber, brs. NW. and SE.

20. Completion of Subdivision of T. 27 N., R. 5 E.

Chains.
80.00 Set an iron post, 3 ft. long, 2 ins. diam., 26 ins. in the ground, for cor. of secs. 9, 10, 15 and 16, marked on brass cap

T27N R5E
S 9 | S10

S16 | S15
1916

From which
A pinion, 6 ins. diam., brs. N.88½° E., 166 lks. dist., marked T27N R5E S10 BT.
A pinion, 10 ins. diam., brs. S.32½° E., 110 lks. dist., marked T27N R5E S15 BT.
A pinion, 10 ins. diam., brs. S.85° W., 237 lks. dist., marked T27N R5E S16 BT.
A juniper, 8 ins. diam., brs. N.36½° W., 119 lks. dist., marked T27N R5E S9 BT.
Land, gently rolling.
Soil, loose, yellow, rocky loam, over limestone formation.
Timber, pinion and juniper.
Undergrowth, sagebrush.

40.00 S.89° 45' E., on a random line, bet. secs. 10 and 15.
Set temp. ¼ sec. cor.
80.00 Intersect N. and S. line, 2 lks. N. of the cor. of secs. 10, 11, 14 and 15.
Thence
N.89° 44' W., on a true line, bet. secs. 10 and 15.
Over gently rolling land, through scattering timber and undergrowth.
40.00 Set an iron post, 3 ft. long, 1 in. diam., 20 ins. in the ground, in a mound of stone, for ¼ sec. cor., marked on brass cap

¼S10

S15
1916

From which
A pinion, 8 ins. diam., brs. N.20° E., 64 lks. dist., marked ¼S10 BT.
A pinion, 9 ins. diam., brs. S.59° W., 47 lks. dist., marked ¼S15 BT.
60.00 Desc. 45 ft. to
70.00 Draw, course SE. Thence over gently rolling land.
80.00 The cor. of secs. 9, 10, 15 and 16.
Land, gently rolling.
Soil, loose, rocky, yellow loam, over limestone formation.
Timber, pinion and juniper.
Undergrowth, sagebrush.

10.00 Knowing that it will be necessary to set a closing cor. on the S.bdy. of sec. 3, run
40.00 N.0° 2' W., on a true line, bet. secs. 9 and 10.
Over gently rolling land, through heavy timber and undergrowth.
Draw, course SE.
Set an iron post, 3 ft. long, 1 in. diam., 26 ins. in the ground, for ¼ sec. cor., marked on brass cap

¼S 9 | S10
1916

Completion of Subdivision of T. 27 N., R. 5 E. 21.

Chains.

70.00 From which
 82.88 A juniper, 7 ins. diam., brs. N.59½° E., 66 lks dist., marked ¼S10 BT.
 A pinion, 10 ins. diam., brs. N.45° W., 47 lks. dist., marked ¼S9 BT.
 Leave heavy timber, brs. NW. and SE.
 Intersect S. bdy. of sec. 3, .89 chs. S.89°58'E. of orig. cor. of secs. 3, 4, 9 and 10, which is a limestone, 5 X 14 X 20 ins., firmly set, marked and witnessed as described by the Surveyor-General.
 At the point of intersection, set an iron post, 3 ft. long, 2 ins. diam., 26 ins. in the ground, for closing cor. of secs. 9 and 10, marked on brass cap

T27N R5E
 S 3
 ———
 C C
 S 9 | S10
 1916

And raise a mound of stone, 3 ft. base, 3 ft. high, S. of cor.
 Land, gently rolling.
 Soil, loose, red, sandy loam, over limestone formation.
 Timber, juniper and pinion.
 Undergrowth, sagebrush.

40.00 From the cor. of secs. 32 and 33, on the S. bdy. of the Tp., which is an iron post, described in Book "B", N.0° 3' W., bet. secs. 32 and 33.
 Over gently rolling land, through scattering timber.
 Set an iron post, 3 ft. long, 1 in. diam., 26 ins. in the ground, for ¼ sec. cor., marked on brass cap

¼S32 | S33
 1916

60.00 From which
 80.00 A cedar, 24 ins. diam., brs. S.67½° E., 18 lks. dist., marked ¼S33 BT.
 A cedar, 10 ins. diam., brs. N.23° W., 180 lks. dist., marked ¼S32 BT.
 Leave scattering timber, brs. NW. and SE.
 Set an iron post, 3 ft. long, 2 ins. diam., 26 ins. in the ground, for cor. of secs. 28, 29, 32 and 33, marked on brass cap

T27N R5E
 S29 | S28
 ———
 S32 | S33
 1916

Dig pits, 18 X 18 X 12 ins., in each sec., 5½ ft. dist.; and raise a mound of earth, 3½ ft. base, 1½ ft. high, W. of cor.
 Land, gently rolling.
 Soil, loose, rocky, yellow loam, limestone formation.
 Timber, pinion and juniper.
 No undergrowth.

40.00 S.89° 51' E., on a random line, bet. secs. 28 and 33.
 80.12 Set temp. ¼ sec. cor.
 Intersect the corner of sections 27, 28 and 33 and 34, 28, 33 and 34.
 Thence

22.

Completion of Subdivision of T. 27 N., R. 5 E.

<p>Chains.</p> <p>40.06</p> <p>65.10</p> <p>80.12</p>	<p>N.89° 51' W., on a true line, bet. secs. 28 and 33. Over gently rolling land, through scattering timber. Set an iron post, 3 ft. long, 1 in. diam., 26 ins. in the ground, for $\frac{1}{4}$ sec. cor., marked on brass cap</p> <p style="text-align: center;"> $\frac{1}{4}$S28 $\frac{1}{4}$S33 1916 </p> <p>From which A pinion, 10 ins. diam., brs. N.5$\frac{1}{2}$° W., 216 lks. dist., marked $\frac{1}{4}$S28 BT. A pinion, 14 ins. diam., brs. S.33$\frac{3}{4}$° W., 340 lks. dist., marked $\frac{1}{4}$S33 BT.</p> <p>Leave timber, brs. N. and S. The cor. of secs. 28, 29, 32 and 33. Land, gently rolling. Soil, loose, rocky, yellow loam, limestone and malpais formation. Timber, pinion and juniper. No undergrowth.</p>	
<p>40.00</p> <p>45.00</p> <p>80.00</p>	<p>N.0° 3' W., bet. secs. 28 and 29. Over gently rolling land, through Set an iron post, 3 ft. long, 1 in. diam., 26 ins. in the ground, for $\frac{1}{4}$ sec. cor., marked on brass cap</p> <p style="text-align: center;"> $\frac{1}{4}$S29 S28 1916 </p> <p>From which A cedar, 6 ins. diam., brs. S.22$\frac{1}{2}$° E., 212 lks. dist., marked $\frac{1}{4}$S28 BT. A cedar, 18 ins. diam., brs. N.51$\frac{1}{4}$° W., 338 lks. dist., marked $\frac{1}{4}$S29 BT.</p> <p>Enter scattering timber, brs. NW. and SE. Set an iron post, 3 ft. long, 2 ins. diam., 20 ins. in the ground, in a mound of stone, for cor. of secs. 20, 21, 28 and 29, marked on brass cap</p> <p style="text-align: center;"> T27N R5E S20 S21 $\frac{1}{4}$S29 S28 1916 </p> <p>From which A cedar, 8 ins. diam., brs. N.9° E., 133 lks. distt, marked T27N R5E S21 BT. A cedar, 10 ins. diam., brs. S.60$\frac{1}{4}$° E., 136 lks. dist., marked T27N R5E S28 BT. Nother trees within limits. Raise a mound of stone, 5 ft. base, 3 ft. high, W. of cor. Land, gently rolling. Soil, loose, gravelly, yellow loam, limestone formation. Timber, juniper and cedar. No undergrowth.</p>	
<p>40.00</p> <p>80.20</p>	<p>S.89° 51' E., on a random line, bet. secs. 21 and 28. Set temp. $\frac{1}{4}$ sec. cor. Intersect N. and S. line, 7 lks. S. of the cor. of secs. 21, 22, 27 and 28. Thence N.89° 54' W., on a true line, bet. secs. 21 and 28. Over gently rolling land, through heavy timber.</p>	

Completion of Subdivision of T. 27 N., R. 5 E. 23.

Chains.

25.20 Leave heavy, enter scattering timber, brs. N. and S.
40.10 Set an iron post, 3 ft. long, 1 in. diam., 26 ins. in the ground, for 1/4 sec. cor., marked on brass cap

1/4 S21
S28
1916

From which
A cedar, 9 ins. diam., brs. N.56° W., 172 lks. dist., marked 1/4 S21 BT.
A pinion, 10 ins. diam., brs. S.83 1/2° W., 240 lks. dist., marked 1/4 S28 BT.

80.20 The cor. of secs. 20, 21, 28 and 29.
Land, gently rolling.
Soil, loose, rocky, yellow loam, over limestone formation.
Timber, juniper and cedar.
No undergrowth.

40.00 N.0° 3' W., bet. secs. 20 and 21.
Over gently rolling land, through scattering timber.
Set an iron post, 3 ft. long, 1 in. diam., 26 ins. in the ground, for 1/4 sec. cor., marked on brass cap

1/4 S20 | S21
1916

From which
A cedar, 9 ins. diam., brs. N.45° E., 161 lks. dist., marked 1/4 S21 BT.
A cedar, 10 ins. diam., brs. N.3 1/4° W., 255 lks. dist., marked 1/4 S20 BT.

80.00 Set an iron post, 3 ft. long, 2 ins. diam., 26 ins. in the ground, for cor. of secs. 16, 17, 20 and 21, marked on brass cap

T27N R5E
S17 | S16
S20 | S21
1916

Dig pits, 18 X 18 X 12 ins., in each sec. 5 1/2 ft. dist., and raise a mound of earth, 4 ft. base, 2 ft. high, W. of cor.
Land, gently rolling.
Soil, loose, rocky, yellow loam, limestone formation.
Timber, pinion and cedar.
No undergrowth.
Short gramma grass.

40.00 S.89° 54' E., on a random line, bet. secs. 16 and 21.
Set temp. 1/4 sec. cor.
80.08 Intersect E. and S. line, at the cor. of secs. 15, 16, 21 and 22.

Thence
N.89° 54' W., on a true line, bet. secs. 16 and 21.
Over gently rolling land, through scattering timber, and undergrowth.

40.04 Set an iron post, 3 ft. long, 1 in. diam., 26 ins. in the ground, for 1/4 sec. cor., marked on brass cap

1/4 S16
S21
1916

24. Completion of Subdivision of T. 27 N., R. 5 E.

Chains.

- From which
 A juniper, 7 ins. diam., brs. N.5½° E., 128 lks. dist.,
 marked ¼S16 BT.
 A juniper, 6 ins. diam., brs. S.1° E., 89 lks. dist.,
 marked ¼S21 BT.
- 46.10 Enter heavy timber, brs. N. and S.
 58.10 Leave heavy, enter scattering timber, brs. NE. and S.
 80.08 The cor. of secs. 16, 17, 20 and 21.
 Land, gently rolling.
 Soil, loose, yellow, rocky loam, over limestone formation.
 Timber, pinion and juniper.
 Undergrowth, sagebrush.
- N.0° 3' W., bet. secs. 16 and 17.
 Over gently rolling land, through scattering timber and
 undergrowth.
 40.00 Set an iron post, 3 ft. long, 1 in. diam., 26 ins. in the
 ground, for ¼ sec. cor., marked on brass cap
- | | | |
|------|--|-----|
| ¼S17 | | S16 |
| 1916 | | |
- From which
 A juniper, 14 ins. diam., brs. S.48½° E., 133 lks. dist.,
 marked ¼S16 BT.
 A juniper, 20 ins. diam., brs. S.39° W., 320 lks. dist.,
 marked ¼S17 BT.
- 80.00 set an iron post, 3 ft. long, 2 ins. in diam., 26 ins. in
 the ground for cor. of secs. 8, 9, 16 and 17, marked
 on brass cap,
- | | |
|------------|-----|
| T27N R 5 E | |
| S 8 | S 9 |
| S17 | S16 |
| 1916 | |
- Dig pits 18x18x12 ins., in each sec. 5½ ft. dist., and
 raise a mound of earth 4 ft. base, 2 ft. high, W. of cor.
 Land, gently rolling.
 Soil, loose, yellow rocky loam, over limestone formation.
 Timber, pinon and juniper.
 Undergrowth, sage brush.
- 40.00 S.89° 54' E., on a random line, bet. secs. 9 and 16.
 Set temp. ¼ sec. cor.
 79.91 Intersect N. and S. line, 9 lks. N. of the cor. of secs.
 9, 10, 15 and 16.
 Thence
 N.89° 50' W., on a true line, bet. secs. 9 and 16.
 Over gently rolling land, through heavy timber and scatter-
 ing undergrowth.
 39.95½ Set an iron post, 3 ft. long, 1 in. diam., 26 ins. in the
 ground, for ¼ sec. cor., marked on brass cap

Completion of Subdivision of T. 27 N., R. 5 E. 25.

Chains.

$\frac{1}{4}$ S 9
S 16
1916

From which
 A pinion, 10 ins. diam., brs. N.55 $\frac{1}{4}$ ° E., 62 lks. dist., marked $\frac{1}{4}$ S9 BT.
 A pinion, 10 ins. diam., brs. S.16 $\frac{1}{2}$ ° W., 48 lks. dist., marked $\frac{1}{4}$ S16 BT.

74.90 Leave heavy timber, brs. NW. and SE.
 79.91 The cor. of secs.8, 9, 16 and 17.
 Land, gently rolling.
 Soil, dark red, sandy loam, over limestone formation.
 Timber, pinion and juniper.
 Undergrowth, sagebrush.

7.00 N.0° 3' W., on a true line, bet. secs. 8 and 9.
 Over level land, through scattering timber and undergrowth.
 Draw, course SE.
 40.00 Set an iron post, 3 ft. long, 1 in. diam., on bed rock, in a mound of stone, for $\frac{1}{4}$ sec. cor., marked on brass cap

$\frac{1}{4}$ S 8 | S 9
1916

From which
 A pinion, 10 ins. diam., brs. S.86 $\frac{1}{2}$ ° E., 8 lks. dist., marked $\frac{1}{4}$ S9 BT.
 A pinion, 8 ins. diam., brs. N.30 $\frac{1}{4}$ ° W., 30 lks. dist., marked $\frac{1}{4}$ S8 BT.

82.61 Intersect S. bdy. of sec. 4., 1.18 chs. N.89° 58' E. of the reestablished cor. of secs. 4 and 5, hereinbefore described.
 At the point of intersection, set an iron post, 3 ft. long, 2 ins. diam., 18 ins. in the ground, in a mound of stone, for closing cor. of secs. 8 and 9, marked on brass cap

T27N R5E
S 4
C | C
S 8 | S 9
1916

From which
 A cedar, 12 ins diam., brs. S.44 $\frac{1}{4}$ ° E., 111 lks. dist., marked T27N R5E S9 CC BT.
 A cedar, 10 ins. diam., brs. S.31° W., 125 lks. dist., marked T27N R5E S8 CC BT.

Land, slightly rolling.
 Soil, coarse texture, thin and rocky.
 Timber, cedar and pinion.
 Undergrowth, Brigham brush, sagebrush and holly.
 Good grass.

23.50 From the cor. of secs. 31 and 32, on the S. bdy. of the Tp., which is an iron post, described in Book "B,"
 40.00 N.0° 3' W., bet. secs. 31 and 32.
 Over gently rolling land, through scattering timber and undergrowth.
 Leave timber.
 Set an iron post, 3 ft. long, 1 in. diam., 16 ins. in the ground, in a mound of stone, for $\frac{1}{4}$ sec. cor., marked on brass cap

26.

Completion of Subdivision of T. 27 N., R. 5 E.

Chains.

$\frac{1}{2}$ S31 | S32
1916

56.00 And raise a mound of stone, 3 ft. base, 3 ft. high, W. of cor.
80.00 Draw, course NW. Enter timber.
Set an iron post, 3 ft. long, 2 ins. diam., 26 ins. in the ground, for cor. of secs. 29, 30, 31 and 32, marked on brass cap

T27N R5E
S30 | S29
S31 | S32
1916

From which
A pinion, 12 ins. diam., brs. N.73 $\frac{1}{4}$ ° E., 129 lks. dist., marked T27N R5E S29 BT.
A pinion, 8 ins. diam., brs. S.42° E., 56 lks. dist., marked T27N R5E S32 BT.
A pinion, 22 ins. diam., brs. S.24° W., 49 lks. dist., marked T27N R5E S31 BT.
A pinion, 12 ins. diam., brs. N.52 $\frac{1}{2}$ ° W., 112 lks. dist., marked T27N R5E S30 BT.
Land, slightly rolling.
Soil, coarse texture, 26 ins. deep.
Timber, cedar and pinion.
Undergrowth, sagebrush and holly brush.
Fair grass.

40.00 S.89° 51' E., on a random line, bet. secs. 29 and 32.
79.98 Set temp. $\frac{1}{4}$ sec. cor.
Intersect N. and S. line, 14 lks. S. of the cor. of secs. 28, 29, 32 and 33.

Thence
N.89° 57' W., on a true line, bet. secs. 29 and 32.
Over gently rolling land, through scattering timber and undergrowth.

39.99 Set an iron post, 3 ft. long, 1 in. diam., 26 ins. in the ground, for $\frac{1}{4}$ sec. cor., marked on brass cap

$\frac{1}{4}$ S29
S32
1916

76.00 From which
79.98 A juniper, 14 ins. diam., brs. N.10 $\frac{1}{2}$ ° E., 342 lks. dist., marked $\frac{1}{4}$ S29 BT.
A juniper, 6 ins. diam., brs. S.68° W., 324 lks. dist., marked $\frac{1}{4}$ S32 BT.
Enter heavy timber, brs. NW. and SE.
The cor. of secs. 29, 30, 31 and 32.
Land, gently rolling.
Soil, loose, rocky loam, over limestone formation.
Timber, pinion and juniper.
Undergrowth, sagebrush.

40.00 N.89° 51' W., on a random line, bet. secs. 30 and 31.
80.00 Set temp. $\frac{1}{4}$ sec. cor.
Intersect W. bdy. of Tp., 4 lks. S. of the cor. of secs. 25, 30, 31 and 36, which is an iron post, hereinbefore described.

Thence
S.89° 49' E., on a true line, bet. secs. 30 and 31.
Over gently rolling land, through scattering timber and undergrowth.

Completion of Subdivision of T. 27 N., R. 5 E. 27.

Chains.
 35.00 Leave scattering, enter heavy timber, brs. N. and SW.
 40.00 Set an iron post, 3 ft. long, 1 in. diam., 26 ins. in the ground, for $\frac{1}{4}$ sec. cor., marked on brass cap

$\frac{1}{4}$ S30
 S31
 1916

From which
 A pinion, 14 ins. diam., brs. N.25 $\frac{1}{2}$ ° W., 25 lks. dist., marked $\frac{1}{4}$ S30 BT.
 A pinion, 10 ins. diam., brs. S.7° W., 58 lks. dist., marked $\frac{1}{4}$ S31 BT.

80.00 The cor. of secs. 29, 30, 31 and 32.
 Land, gently rolling.
 Soil, loose, rocky loam, limestone formation.
 Timber, pinion and juniper.
 Undergrowth, sagebrush.

17.70 N.0° 3' W., bet. secs. 29 and 30.
 21.75 Over level land, through scattering undergrowth.
 27.99 Enter scattering timber, .
 40.00 Enter draw, course NW.
 Leave draw, course NW.
 Set an iron post, 3 ft. long, 1 in. diam., 26 ins. in the ground, for $\frac{1}{4}$ sec. cor., marked on brass cap

$\frac{1}{4}$ S30 | S29
 1916

From which
 A pinion, 14 ins. diam., brs. N.4° E., 245 lks. dist., marked $\frac{1}{4}$ S29 BT.
 A pinion, 12 ins. diam., brs. N.38° W., 102 lks. dist., marked $\frac{1}{4}$ S30 BT.

65.00 Leave scattering timber.
 75.00 Draw, course NW.
 80.00 Set an iron post, 3 ft. long, 2 ins. diam., 16 ins. in the ground, in a mound of stone, for cor. of secs. 19, 20, 29 and 30, marked on brass cap

T27N R5E
 S19 | S20
 S30 | S29
 1916

From which
 A cedar, 8 ins. diam., brs. N.52° W., 124 lks. dist., marked T27N R5E S19 BT.
 No other trees within limits. Raise a mound of stone, 3 ft. base, 3 ft. high, W. of cor.
 Land, slightly rolling.
 Soil, coarse, 26 ins. deep.
 Timber, scattering cedar and pinion.
 Undergrowth, sagebrush and holly.
 Fair grass.

40.00 S.89° 57' E., on a random line, bet. secs. 20 and 29.
 79.83 Set temp. $\frac{1}{4}$ sec. cor.
 Intersect N. and S. line, 12 lks. N. of the cor. of secs. 20, 21, 28 and 29.
 Thence
 N.89° 52' W., on a true line, bet. secs. 20 and 29.
 Over gently rolling land, through scattering timber and undergrowth.

28. Completion of Subdivision of T. 27 N., R. 5 E.

Chains. 39.91½ Set an iron post, 3 ft. long, 1 in. diam., 26 ins. in the ground, for ¼ sec. cor., marked on brass cap

¼S20
S29
1916

And raise a mound of stone, 2 ft. base, 1½ ft. high, N. of cor.

79.83 The cor. of secs. 19, 20, 29 and 30. Land, gently rolling. Soil, loose, dark, sandy loam, over limestone formation. Timber, pinion and juniper. Undergrowth, sagebrush.

40.00 N.89° 49' W., on a random line, bet. secs. 19 and 30. Set temp. ¼ sec. cor.

80.00 Intersect W. bdy. of T., 3 lks. N. of the cor. of secs. 19, 24, 25 and 30, which is an iron post, described hereinbefore.

Thence S.89° 50' E., on a true line, bet. secs. 19 and 30. Over gently rolling land, through heavy timber and scattering undergrowth.

5.00 Leave heavy timber. Thence through burnt over timber.

40.00 Set an iron post, 3 ft. long, 1 in. diam., 26 ins. in the ground, for ¼ sec. cor., marked on brass cap

¼S19
S30
1916

No live bearing trees within limits. Raise a mound of stone, 2 ft. base, 1½ ft. high, N. of cor.

75.00 Leave burnt timber, brs. NW. and SE.

80.00 The cor. of secs. 19, 20, 29 and 30.

Land, gently rolling. Soil, loose, red, sandy loam, over limestone formation. Timber, cedar and pinion. Undergrowth, sagebrush.

N.0° 3' W., bet. secs. 19 and 20. Over level land, through scattering undergrowth.

40.00 Set an iron post, 3 ft. long, 1 in. diam., 26 ins. in the ground, for ¼ sec. cor., marked on brass cap

¼S19 | S20
1916

And raise a mound of stone, 2 ft. base, 2½ ft. high, W. of cor.

77.00 Draw, course SW.

80.00 Set an iron post, 3 ft. long, 2 ins. diam., 26 ins. in the ground, for cor. of secs. 17, 18, 19 and 20, marked on brass cap

T27N R5E
S18 | S17
S19 | S20
1916

From which A pinion, 24 ins. diam., brs. N.12° E., 169 lks. dist., marked T27N R5E S17 BT.

No other trees within limits. Raise a mound of stone, 3 ft. base, 3 ft. high, W. of cor.

30.

Completion of Subdivision of T. 27 N., R. 5 E.

Chains.	
30.00	Enter scattering timber.
40.00	Set an iron post, 3 ft. long, 1 in. diam., 26 ins. in the ground, for $\frac{1}{4}$ sec. cor., marked on brass cap
	$\frac{1}{4}$ S18 S17 1916
	From which
	A pinion, 10 ins. diam., brs. S.17 $\frac{1}{4}$ ° E., 192 lks. dist., marked $\frac{1}{4}$ S17 BT.
	A pinion, 16 ins. diam., brs. N.74 $\frac{3}{4}$ ° W., 65 lks. dist., marked $\frac{1}{4}$ S18 BT.
43.00	Draw, course SE.
47.00	Leave scattering timber.
50.00	Draw, course SW.
55.00	Enter scattering timber.
80.00	Set an iron post, 3 ft. long, 2 ins. diam., 26 ins. in the ground, for cor. of secs. 7, 8, 17 and 18, marked on brass cap
	T27N R5E S7 S8 --- S18 S17 1916
	From which
	A pinion, 9 ins. diam., brs. N.1 $\frac{1}{4}$ ° E., 153 lks. dist., marked T27N R5E S8 BT.
	A pinion, 18 ins. diam., brs. S.38 $\frac{1}{2}$ ° E., 28 lks. dist., marked T27N R5E S17 BT.
	A pinion, 12 ins. diam., brs. S.30° W., 50 lks. dist., marked T27N R5E S18 BT.
	A pinion, 10 ins. diam., brs. N.67 $\frac{1}{4}$ ° W., 35 lks. dist., marked T27N R5E S7 BT.
	Land, slightly rolling.
	Soil, coarse texture, 26 ins. deep.
	Timber, cedar and pinion.
	Undergrowth, sagebrush, holly brush and brook weed.
	Fair grass.
40.00	S.89° 58' E., on a random line, bet. secs. 8 and 17.
79.93	Set temp. $\frac{1}{4}$ sec. cor.
	Intersect N. and S. line, 9 lks. N. of the cor. of secs. 8, 9, 16 and 17.
	Thence
	N.89° 54' W., on a true line, bet. secs. 8 and 17.
	Over gently rolling land, through scattering undergrowth.
11.45	Enter timber.
39.96 $\frac{1}{2}$	Set an iron post, 3 ft. long, 1 in. diam., 26 ins. in the ground, for $\frac{1}{4}$ sec. cor., marked on brass cap
	$\frac{1}{4}$ S 8 --- S17 1916
	A pinion, 8 ins. diam., brs. N. 38° W., 88 lks. dist., marked $\frac{1}{4}$ S8 BT.
	A pinion, 6 ins. diam., brs. S.30 $\frac{3}{4}$ ° W., 46 lks. dist., marked $\frac{1}{4}$ S17 BT.
69.95	Draw, course SW.
79.93	The cor. of secs. 7, 8, 17 and 18.
	Land, gently rolling.
	Soil, coarse texture, 26 ins. deep.
	Timber, cedar and pinion.
	Undergrowth, sagebrush.
	Fair grass.

Completion of Subdivision of T. 27 N., R. 5 E. 31.

Chains.

40.00 N.89° 42' W., on a random line, bet. secs. 7 and 18.
 Set temp. $\frac{1}{4}$ sec. cor.
 80.26 Intersect W. bdy. of Tp., 21 lks. N. of the cor. of secs. 7, 12, 13 and 18, which is an iron post, described hereinbefore.

Thence

S.89° 51' E., on a true line, bet. secs. 7 and 18.
 Over gently rolling land, through scattering timber and undergrowth.
 40.26 Set an iron post, 3 ft. long, 1 in. diam., 26 ins. in the ground, for $\frac{1}{4}$ sec. cor., marked on brass cap

$\frac{1}{4}$ S 7
 $\frac{1}{4}$ S 18
 1916

From which

A pinion, 12 ins. diam., brs. N.80° W., 289 lks. dist., marked $\frac{1}{4}$ S7 BT.
 A pinion, 10 ins. diam., brs. S.45° W., 309 lks. dist., marked $\frac{1}{4}$ S18 BT.

40.50 Draw, course SW.
 80.26 The cor. of secs. 7, 8, 17 and 18.

Land, slightly rolling.
 Soil, coarse texture, 26 ins. deep.
 Timber, cedar and pinion.
 Undergrowth, sagebrush and holly brush.
 Fair grass.

N.0° 3' W., on a true line, bet. secs. 7 and 8.
 Over gently rolling land, through scattering timber and undergrowth.

40.00 Set an iron post, 3 ft. long, 1 in. diam., 26 ins. in the ground, for $\frac{1}{4}$ sec. cor., marked on brass cap

$\frac{1}{4}$ S 7 | S 8
 1916

From which

A pinion, 8 ins. diam., brs. S.51 $\frac{1}{2}$ ° E., 75 lks. dist., marked $\frac{1}{4}$ S8 BT.
 A pinion, 10 ins. diam., brs. S.72 $\frac{1}{2}$ ° W., 151 lks. dist., marked $\frac{1}{4}$ S7 BT.

59.80 Draw, course NW.
 72.80 Draw, course SW.

81.80 Intersect S. bdy. of sec. 5, 1.31 chs. N.89° 35' E. of the cor. of secs. 5 and 6, which is a limestone, hereinbefore described.

At the point of intersection, set an iron post, 3 ft. long, 2 ins. diam., 24 ins. in the ground, for closing cor. of secs. 7 and 8, marked on brass cap

T27N R5E
 S 5
 $\frac{1}{4}$ S 7 | S 8
 C C
 1916

From which

A pinion, 12 ins. diam., brs. S.83° E., 14 lks. dist., marked T27N R5E S8 CCBT.
 A pinion, 14 ins. diam., brs. S.57 $\frac{1}{2}$ ° W., 46 lks. dist., marked T27N R5E S7 CCBT.

Chains.

Land, gently rolling.
 Soil, coarse texture, 22 ins. deep.
 Timber, cedar and pinion.
 Undergrowth, sagebrush and Brigham brush.
 Fair grass.

General Description.

This township consists of level or gently rolling land, covered with a growth of scattering scrub cedar, juniper and pinion timber, and sagebrush, holly brush and broom weed undergrowth. The drainage is easterly. There are no settlers. The soil is a loose, rocky loam, varying in depth from 16 to 26 ins., over limestone subsoil.

Diagram showing the respective surveys executed by Thomas B. Matthews, U.S.S., and Deane J. Wolff, U.S.T., under instructions for Group No. 55, Arizona.

Book "D"

Township 27 North, Range 5 East,

BOOK 3097

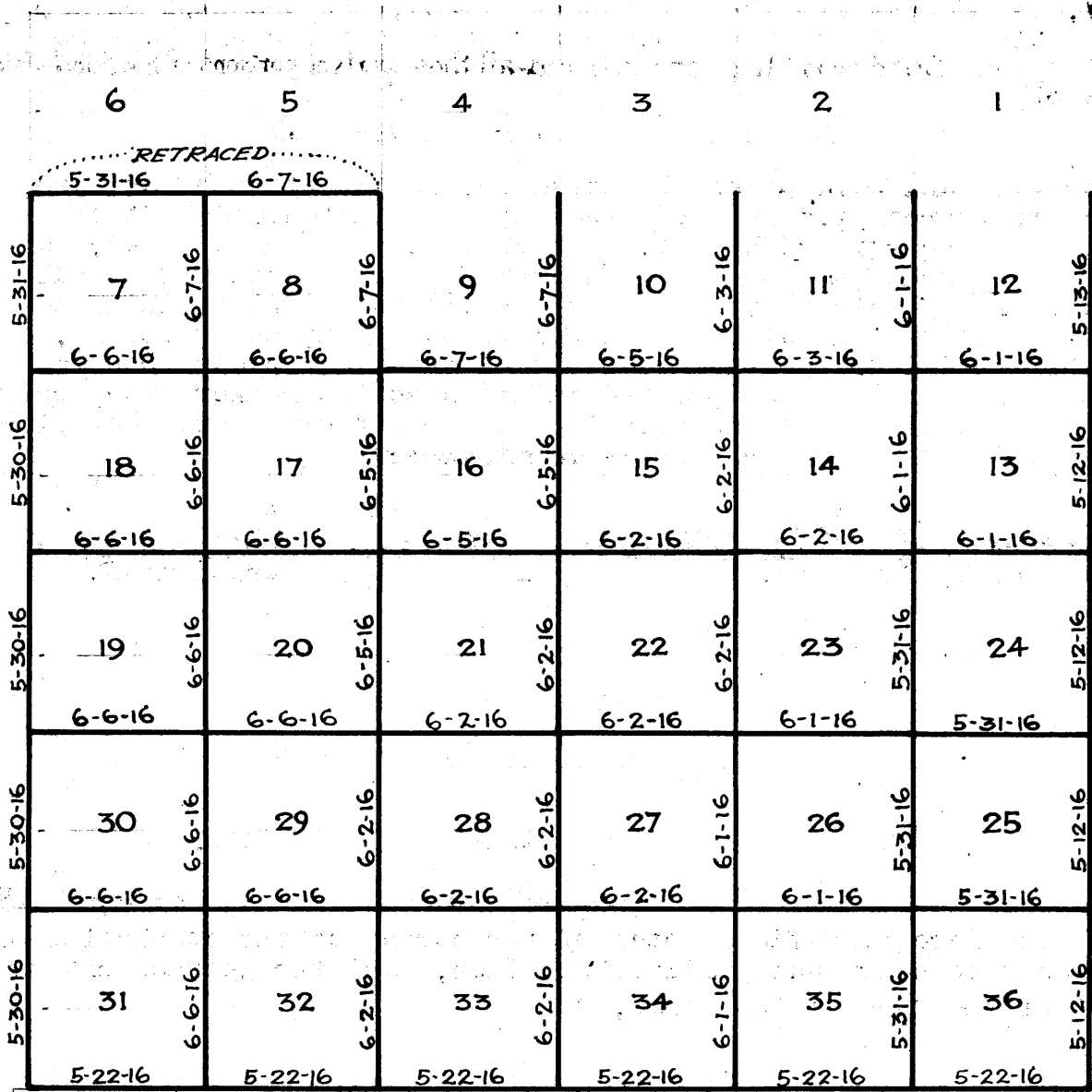

Blue lines indicate surveys by Thomas B. Matthews, U.S.S. on the various dates shown.

Red lines indicate surveys by Deane J. Wolff, U.S.T. on the various dates shown.

BOOK 3097

CERTIFICATES OF U. S. SURVEYOR AND U. S. TRANSITMAN.

We, Thomas B. Matthews and Deane J. Wolff, U. S. Surveyor, and U. S. Transitman, respectfully, hereby certify on honor that, in pursuance of special instructions received from the U. S. Surveyor General for Arizona for Group No. 55, Arizona, hearing date of the 8th day of March, 1915, we have well, faithfully, and truly, in our own proper persons, and in strict conformity with said instructions, the Manual of Surveying Instructions, and the laws of the United States, surveyed all those parts or portions of the West boundary and Subdivision lines and Retraced all these parts or portions of the Subdivision Lines of

TOWNSHIP 27 NORTH, RANGE 5 EAST,

of the Gila and Salt River and Meridian, in the State of Arizona, which are represented in the foregoing field notes, and by the diagram on the reverse hereof, as having been executed by us, and under our direction; and we do further certify on honor that all the corners of said survey have been established and perpetuated in strict accordance with the Manual of Surveying Instructions, and the special written instructions of the U. S. Surveyor General of Arizona for Group No. 55, and in the specific manner described in our respective field notes, and that the foregoing are the original field notes of such surveys and retracements.

Thomas B. Matthews
U. S. Surveyor.

Deane J. Wolff
U. S. Transitman.

A P P R O V A L .

OFFICE OF THE UNITED STATES SURVEYOR GENERAL,

Phoenix, Arizona, SEP 28 1918.

The foregoing field notes of the survey of the completion of the West boundary and Subdivision lines, and the Retracement of part of the Subdivision lines, of

TOWNSHIP 27 NORTH, RANGE 5 EAST,

of the Gila and Salt River Base and Meridian, in the State of Arizona, executed by Thomas B. Matthews, U. S. Surveyor, and Deane J. Wolff, U. S. Transitman, under special instructions, dated March 8, 1915 for Group No. 55, Arizona, having been critically examined, and the necessary corrections and explanations made, the said field notes, and the surveys they describe are hereby approved.

Frank P. Frost
U. S. Surveyor General of Arizona.

~~I certify that the foregoing transcript of the field notes of the above-described surveys in Book "D," of Group 55, has been correctly copied from the original notes on file in this office.~~

~~U. S. Surveyor General of Arizona.~~