

3172

Book "A."

4-679

BOOK 3172

17th Feb 1915

FIELD NOTES

Re-
OF THE SURVEY OF THE

EAST BOUNDARY, and

PART OF NORTH BOUNDARY

and the

SURVEY OF

PART OF NORTH BOUNDARY, and

SUBDIVISION LINES, and

MEANDERS OF THE LEFT BANK OF THE COLORADO RIVER, WITHIN

FRACL. TOWNSHIP 5 SOUTH, RANGE 22 WEST,

Of the Gila and Salt River Base and Meridian,

In the State of Arizona.

EXECUTED BY

William B. Kimmel,

In the capacity of U. S. Surveyor, under instructions dated February 5, 1915, issued by the United States Surveyor General to govern surveys included in Group No. 47, which were approved by the Commissioner of the General Land Office, February 23, 1915.

Resurvey & Survey commenced March 19, 1915.

Resurvey & Survey completed April 10, 1915.

Executed under Assignment
Instructions dated Feb. 27-1915.

3172

3172

Book "A."

Group 47 - - Arizona,

See Special Index Diagram.

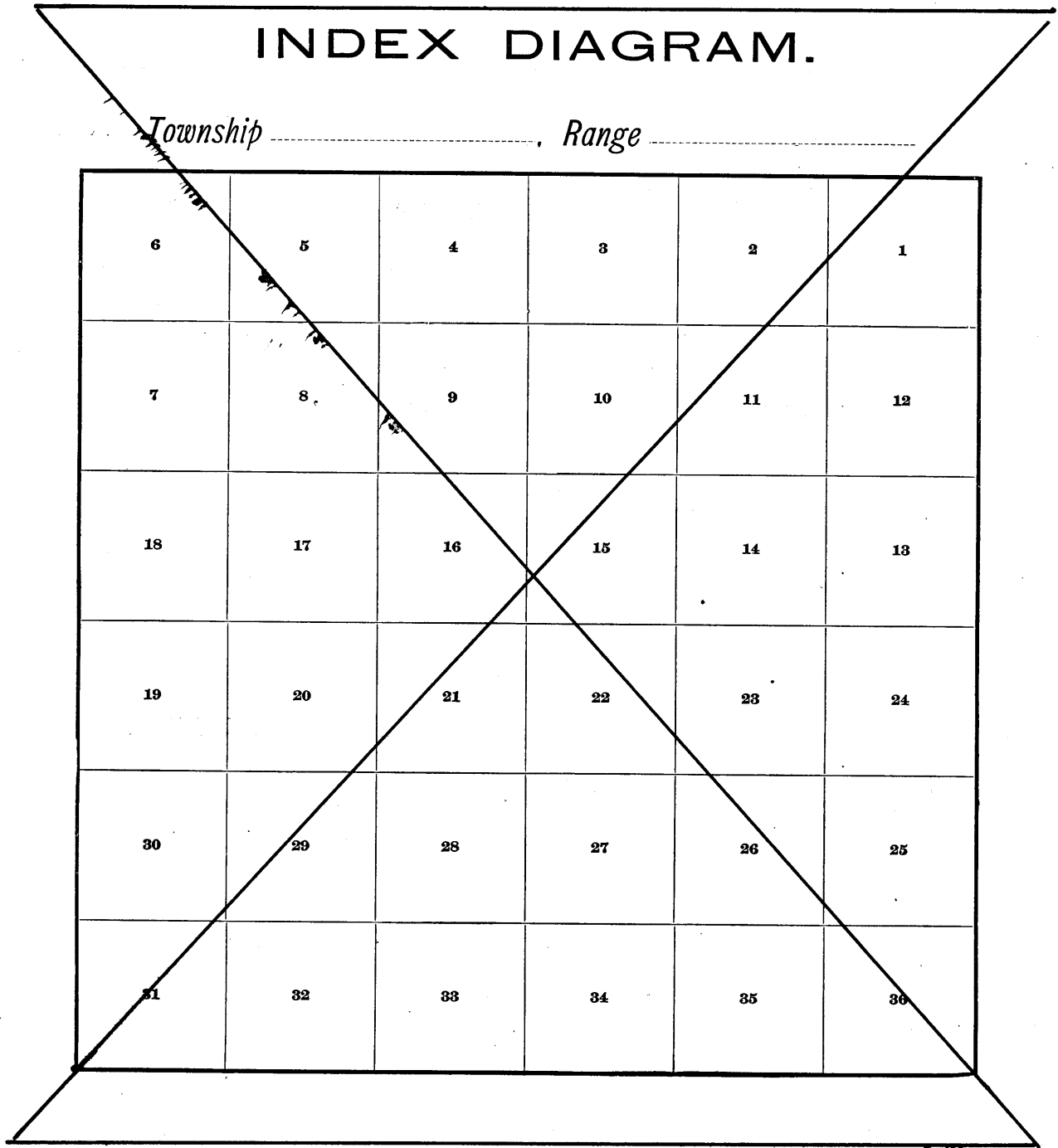

• INDEX ~ DIAGRAM •

"3172"

~ Book "A" Group No 47 Ariz.

IA

FRACTIONAL T.5S.-R.22W.

BOOK 3172

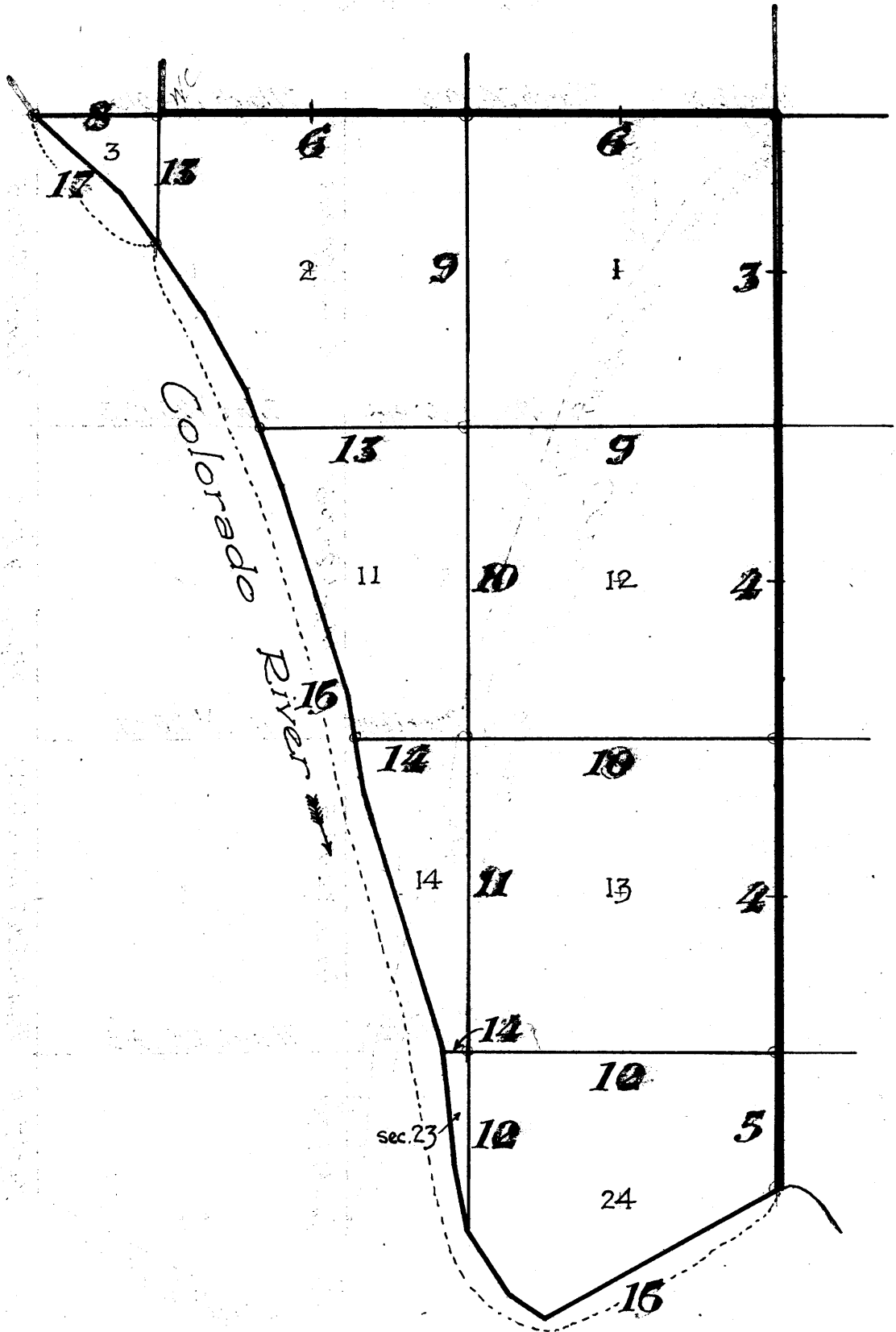

- Surveyed under this Group. Notes in this book. 3172
- Resurveyed under this Group. Notes in this book. 3172
- Surveyed under this Group. Notes in book "B". 3173
- Resurveyed under this Group. Notes in book "B". 3173
- Accepted surveys.

Book "A"

GROUP 47 ARIZONA

FRACTIONAL T. 5 S. R. 22 W.

DATE DIAGRAM

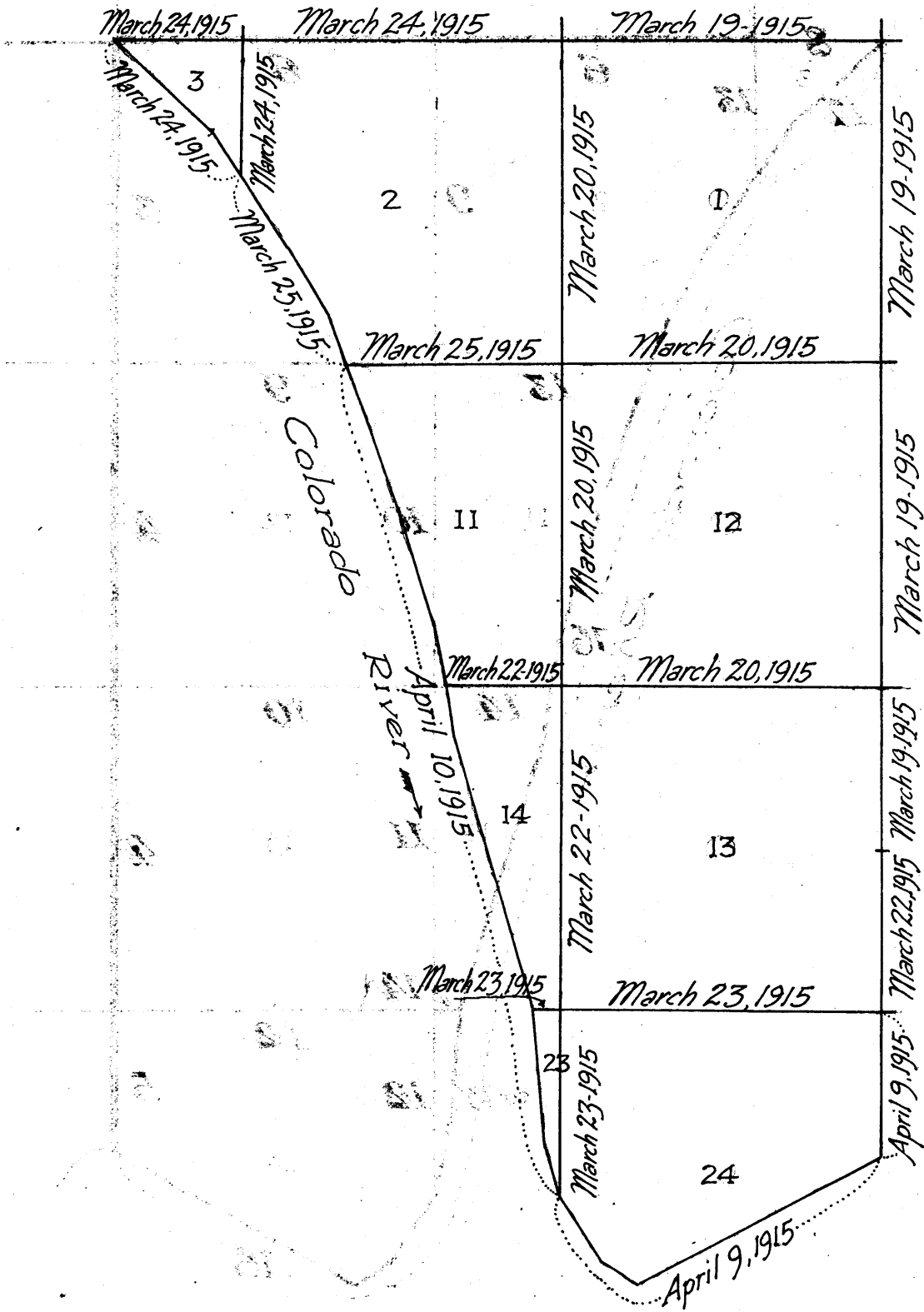

Surveys & Resurveys executed on dates shown on above diagram, by William B. Kimmel, U.S. Surveyor.

Chains

Surveys and resurveys herein described were executed by William B. Kimmel, U. S. Surveyor, on the dates shown on diagram on page 2 of this book, using a Young and Son's light mountain transit No. 8523, with solar attachment. The horizontal limb is provided with two double verniers, placed opposite to each other, and reading to single minutes of arc, which is also the least count of the verniers of the latitude and declination arcs.

The instrument was examined, tested on the true meridian at Phoenix, Arizona, found correct, and approved by the U.S. Assistant Supervisor of Surveys, Mar. 10, 1915.

Mar. 16, 1915, I examine the adjustments of the transit, and correct the level and collimation errors; then to test the solar apparatus by comparing its indications resulting from observations made during a.m. and p.m. hours, on a meridian established by observations on Polaris, I proceed as follows:

At a point near camp, in the SE $\frac{1}{4}$ of sec. 34, T. 4 S., R. 22 W., at 7h. 50m., p.m., l.m.t., I observe Polaris at western elongation, in accordance with instructions in the Manual of Surveying, and lay off the azimuth, 1° 21' to the east. I mark the meridian thus determined by a wooden peg driven firmly in the ground 5 chs. N. of my station.

Mar. 17, 1915. At 1h. 53m., a.m., l.m.t., I observe Polaris at lower culmination for latitude. Angle of elevation at lower culmination = 31° 53'. 31° 53' + 90° - 88° 51' 25" (Polaris decl.) = 33° 11' 45" N. latitude.

Longitude taken from map = 114° 28 $\frac{1}{2}$ ' W.

At 7h. a.m., l.m.t., I set off 33° 11 $\frac{1}{2}$ ' N. on the latitude arc; 1° 34 $\frac{1}{2}$ ' S. on the decl. arc, and determine a meridian with the solar. The meridian thus determined falls within 1' in azimuth of the meridian established by observations on Polaris.

At 5h. p.m., l.m.t., I set off 33° 11 $\frac{1}{2}$ ' N. on the lat. arc; 1° 24 $\frac{1}{2}$ ' S. on the decl. arc; and determine a meridian with the solar. The meridian thus determined falls within 1' in azimuth of the meridian established by observations on Polaris.

Observations made every hour between the hours of 7 a.m. and 5 p.m. give similar results. I therefore conclude that the adjustments of the transit and solar attachment are satisfactory.

From the original cor. of Ts. 4 and 5 S., R. 21 W., T. 4 S., R. 22 W., and fracl. T 5 S., R. 22 W., which is a lava stone 6x7x9 ins. above ground, firmly set, marked and witnessed, as described by the Surveyor General, with pits almost obliterated; reestablish this cor. by raising a mound of stone, 2 ft. base, 1 $\frac{1}{2}$ ft. high, S. of cor.

Thence, S. 0° 8' E., on a true line, bet. secs. 1 and 6.

Over level mesa land, through scattering timber and undergrowth.

- 6.40 Wash, 5 lks. wide, 1 ft. deep, course SW.
- 17.20 Leave mesa, enter rolling land, brs. NE. and SW.
- 28.20 Descend over rolling land, 30 ft. to
- 40.41 The original $\frac{1}{4}$ sec. cor., a stone 10x5x6 ins. above ground, firmly set, marked and witnessed as described by the surveyor general. Reestablish by raising a mound of stone, 2 ft. base, 1 $\frac{1}{2}$ ft. high, W. of cor. Distance of this half mile being out of limits the $\frac{1}{4}$ sec. cor. now refers to sec. 6, T. 5 S., R. 21 E. only.
- 3.30 Thence S. 0° 1' W. on W. bdy. of sec. 6 (S. $\frac{1}{2}$).
- 3.89 Wash, 70 lks. wide, 2 ft. deep, course SW.
- Ascend NW slope, 36 ft. to
- 11.51 Descend over rolling land, 29 ft. to

4. Dependent resurvey of the E. bdy. of T.5 S., R. 22 W.

- Chains
29.46 Wash, 15 lks.wide, 2 ft. deep, course SW. Enter level washed land.
39.50 Point of previous location of cor.of secs.1,6,7 and 12 falls in wash, 35 lks.wide, 2 ft. deep, course SW.(located by measurements from old bearing trees)
Diligent search in this vicinity fails to reveal any trace of the original stone.
39.00 Set an iron post, 3 ft.long, 3 ins. in diam, 24 ins. in the ground for witness cor. to reestablished cor.of secs. 1,6,7 and 12, marked on brass cap,

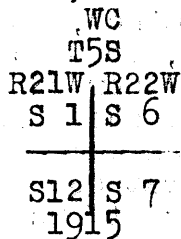

and raise a mound of stone, 2 ft.base, 1½ ft. high,W. of cor.
Land, rolling.
Soil, rocky, 4th rate.
Timber, scattering palo verde and ironwood.
Undergrowth, dense greasewood.

From true point for reestablished cor.of secs.1, 6, 7 and 12,
S.0°09'E., on a true line, bet. secs. 7 and 12.
Over level washed land, through scattering timber and undergrowth.

- 1.50 Wash, 30 lks.wide, 2 ft. deep, course W.
8.90 Wash, 35 lks.wide, 2 ft. deep, course SW.
18.10 Wash, 35 lks.wide, 2 ft. deep, course SW.
20.95 Leave level land and timber. Ascend N.slope, 13 ft.to
31.50 Enter rolling land.
40.11 The original ¼ sec.cor., a stone 10x10x6 ins. above ground, firmly set, marked and witnessed as described by the surveyor general. Pits almost obliterated. Reestablish cor.by raising a mound of stone, 2 ft. base, 1½ ft.high,W.of cor.
Thence,
S.0°2'E., bet. secs.7 and 12 (S.¼).
21.42 Wash, 20 lks.wide, 2 ft. deep, course SW.
40.01 The original cor.of secs. 7,12,13 and 18,which is a stone 16x10x5 ins. in a mound of stone, firmly set, marked and witnessed as described by the surveyor general.
Land, level and rolling.
Soil, rocky, 4th rate,
Timber, scattering palo verde and ironwood.
Undergrowth, dense growth of greasewood.
No grass.

S.0°18'E., on a true line, bet. secs.13 and 18.
Over rolling land, through scattering timber and undergrowth.

- 8.09 Enter wash, course SW.
18.89 Leave wash, course SW.
26.21 Wash, 10 lks.wide, 2 ft. deep, course SW.
28.58 Spur brs.west about 3 chs;dist.
30.15 Enter wash, course west.
37.15 Leave wash, course west.
39.94 The original ¼ sec.cor., which is a stone, 16x9x6 ins. above ground, in a mound of stone, firmly set,marked and witnessed as described by the surveyor general.
Thence
South,on a true line, bet. secs. 13 and 18 (S.¼).
Descend over gradual rolling land.

Dependent Resurvey of E. bdy. of fracl. Tp. 5 S., R. 22 W. 5.

Chains.

28.00 Enter river bottom land, brs. NE. and SW.
 31.90 Wagon road brs. NW. to Parker and SE. to Yuma.
 40.00 No trace of original cor. of secs. 13, 18, and fracl. secs. 19 and 24 can be found.
 Set an iron post 3 ft. long, 3 ins. in diam., 24 ins. in the ground, for reestablished cor. of secs. 13, 18, and fracl. secs. 19 and 24, marked on brass cap,

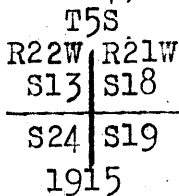

and raise a mound of stone, 2 ft. base, 1½ ft. high, W. of cor.
 Land, rolling and level; bottom land, subject to overflow.
 Soil, 10 chs. rocky, 4th rate; remainder sandy, 2nd rate.
 Timber, scattering palo verde.
 Undergrowth, scattering greasewood, dense arrowweed and mesquite.
 No grass.

20.00 South, on a true line bet. fracl. secs. 19 and 24.
 Over level river bottom land, through dense undergrowth.
 No trace can be found of original meander cor. of fracl. secs. 19 and 24.
 35.00 Left bank of Colorado river, brs. SW. and SE.
 At point of intersection,
 Set an iron post, 3 ft. long, 1 in. in diam., 26 ins. in the ground, for reestablished meander cor. of fracl. secs. 19 and 24, marked on brass cap,

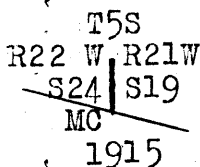

from which,
 A willow, 9 ins. in diam., brs. N. 60° E., 12 lks. dist., marked T 5 S R 21 W S 19 M C B T.
 A willow, 8 ins. in diam., brs. N. 35½° W., 30 lks. dist., marked T 5 S R 22 W S 24 M C B T.
 Land, level bottom land, subject to overflow.
 Soil, sandy, 2nd rate.
 No timber.
 Undergrowth, dense arrowweed and mesquite.
 No grass.

Independent Resurvey of part of N bdy. of fracl. T.5 S. R.22 W.

Chains.	<p>From the reestablished cor. of T.4 and 5 S., R.21 W., T.4 S., R.22 W. and fracl. T.5 S., R.22 W., hereinbefore described, West, on a true line, bet. secs. 1 and 36.</p> <p>Over mesa, brs. NE. and SW., through scattering undergrowth.</p> <p>6.50 Leave mesa, brs. NE. and SW.</p> <p>Descend NW. slope, 42 ft. to</p> <p>11.94 Gulch, course SW. Ascend SE. slope to</p> <p>13.94 Point of spur, slopes SW. Descend gradual slope to</p> <p>15.78 Enter wash, course SW.</p> <p>17.18 Leave wash, course SW.</p> <p>Foot of bluff, 30 ft. high, brs. NE. and SW.</p> <p>Ascend 17 ft. to</p> <p>17.72 Top of bluff, 20 ft. high, brs. NE. and SW.</p> <p>Thence over rolling land.</p> <p>20.34 Enter wash, course SW.</p> <p>31.08 Leave wash, course SW.</p> <p>Foot of bluff, 50 ft. high, brs. N. and S. Ascend gradual slope to</p> <p>31.72 Top of bluff; thence over rolling land.</p> <p>38.91 The original $\frac{1}{4}$ sec. cor., marked and witnessed as described by the surveyor general, brs. S. 17 lks. dist. Destroy all trace of this cor.</p> <p>40.00 Set an iron post, 3 ft. long, 1 in. in diam., 26 ins. in the ground, for reestablished $\frac{1}{4}$ sec. cor., marked on brass cap,</p> <div style="text-align: center;"> $\frac{1}{4} S 36$ <hr style="width: 50px; margin: auto;"/> $S 1$ 1915 </div> <p>and raise a mound of stone, 2 ft. base, $1\frac{1}{2}$ ft. high, N. of cor.</p> <p>45.15 Wash, 80 lks. wide, 2 ft. deep, course S. Ascend steep NE. slope, over lava formation.</p> <p>50.46 Top of ascent; thence over rolling land; ascend gradual slope.</p> <p>56.14 Ridge, brs. NE. and SW. Descend NW. slope, 36 ft. to</p> <p>61.16 Wash, 35 lks. wide, 2 ft. deep, course SW.</p> <p>79.97 The original cor. of secs. 1, 2, 35 and 36, marked, witnessed and described by the surveyor general, brs. S. 19 lks. dist. Destroy all trace of this cor.</p> <p>80.00 Set an iron post 3 ft. long, 3 ins. in diam., 24 ins. in the ground, for reestablished cor. of secs. 1, 35, 36, and fracl. sec. 2, marked on brass cap,</p> <div style="text-align: center;"> <table border="1" style="margin: auto;"> <tr> <td colspan="2">T4S R22W</td> </tr> <tr> <td>S35</td> <td>S36</td> </tr> <tr> <td colspan="2" style="text-align: center;">S 1 S 2</td> </tr> <tr> <td colspan="2" style="text-align: center;">T5S</td> </tr> </table> 1915 </div> <p>and raise a mound of stone, 2 ft. base, $1\frac{1}{2}$ ft. high, W. of cor.</p> <p>Land, rolling and hilly.</p> <p>Timber, scattering willow.</p> <p>Undergrowth, dense arrowweed and mesquite.</p> <p>Soil, rocky, 4th rate.</p> <p>No grass.</p> <hr style="border-top: 1px dashed black;"/> <p>West, on a true line, bet. sec. 35, and fracl. sec. 2.</p> <p>Over rolling hills, through scattering timber and undergrowth.</p> <p>Descend 15 ft. to</p> <p>3.95 Gulch, course SW.</p> <p>23.84 Gulch, course SW.</p>	T4S R22W		S35	S36	S 1 S 2		T5S	
T4S R22W									
S35	S36								
S 1 S 2									
T5S									

Independent resurvey of part of N. bdy. of frac. T. 5 S., R. 22 W. 7.

Chains

24.62 Foot of bluff, brs. SW. and NE.
 25.20 Top of bluff; descend 50 ft. to
 29.13 Gulch, course SW.
 33.95 Enter wash, course S.
 36.25 Leave wash, course S.
 38.97 The original $\frac{1}{4}$ sec. cor., which is a stone, 6x8x18 ins. above ground, firmly set, marked and witnessed as described by the surveyor general, brs. S. 21 lks. dist. Destroy all trace of this cor.
 40.00 Set an iron post 3 ft. long, 1 in. in diam., 26 ins. in the ground for reestablished $\frac{1}{4}$ sec. cor., marked on brass cap,

$\frac{1}{4}$ S 35

S 2

1915

and raise a mound of stone, 2 ft. base, 1 $\frac{1}{2}$ ft. high, N. of cor.

Descend 46 ft. to

54.33 Gulch, course S.
 69.40 Enter wash and river bottom, course SW.
 78.79 The original cor. of secs. 2, 3, 34 and 35, as marked, witnessed and described by the surveyor general, brs. S. 31 lks. dist. Destroy all trace of this cor.
 80.00 True point for reestablishment of cor. of sec. 35 and frac. secs. 2, 3, and 34, falls in insecure place in wash; therefore, at a point 3.30 chs. N. 0° 1' W. of true point, Set an iron post, 3 ft. long, 3 ins. in diam., 24 ins. in the ground for witness cor. to reestablished cor. of sec. 35, and frac. secs. 2, 3, and 34, marked on brass cap,

T4S
 S34 | S35
 W C

R22W S 31 S 2
 T5S

1915

and raise a mound of stone, 2 ft. base, 1 $\frac{1}{2}$ ft. high, W. of cor.

This cor. is set at foot of bluffs, which bear E. and W. Original survey of this Tp. bdy. did not extend W. of this cor. Land, rolling hills.

Soil, rocky, 4th rate.

No timber.

Undergrowth, dense arrow weed, mesquite and willow.

No grass.



8. Survey of part of N. bdy. of fracl. T. 5 S., R. 22 W.

Chains From true point for reestablished cor. of sec. 35, and fracl. secs. 2, 3, and 34, hereinbefore described, West, on a true line, bet. fracl. secs. 3 and 34. Over wash land, through scattering timber and undergrowth. Road brs. N. to Parker and S. to Yuma.

5.95 Leave timber, brs. NE and SW.

10.00 Wash, brs. NE. and SW.

15.00 Leave river bottom, brs. NE. and SE. Ascend NE. slope.

18.00 Spur, slopes SE. Descend over rolling land.

31.00 Enter dense undergrowth, brs. NW. and SE.

32.30 Left bank of Colorado river, brs. N. 50° W. and S. 48 $\frac{3}{4}$ ° E. True point for meander cor., falls on land subject to flood and overflow; therefore at

30.50 Set an iron post, 3 ft. long, 1 in. in diam., 26 ins. in the ground, for witness cor. to meander cor. of fracl. secs. 3 and 34, marked on brass cap,

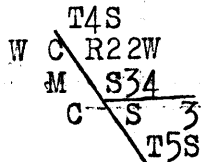

1915

and raise a mound of stone, 2 ft. base, 1 $\frac{1}{2}$ ft. high, E. of cor.

Land, rolling and level river bottom.

Soil, rocky, 4th rate and silt, 2nd rate.

Timber, scattering palo verde and ironwood.

Undergrowth, dense arrowweed, mesquite and willow.

No grass.

Subdivision of fracl. Township 5 South, Range 22 West. 9.

Chains.

From reestablished cor. of secs. 1, 35, 36 and fracl. sec. 2, on N. bdy. of Tp. hereinbefore described, S. 0°5'E., bet. sec. 1, and fracl. sec. 2. Over rolling land, through scattering undergrowth. Wash, 10 lks. wide, course SW. Set an iron post, 3 ft. long, 1 in. in diam., 26 ins. in the ground, for $\frac{1}{4}$ sec. cor., marked on brass cap,

23.45
40.00

$\frac{1}{4}$ S 2 | S 1
1915

and raise a mound of stone, 2 ft. base, 1 $\frac{1}{2}$ ft. high, W. of cor.

44.98
55.83
57.46
58.82
62.45
75.95
80.00

Enter wash, course SW. Enter scattering timber. Leave wash and timber, course of wash SW. Ascend N. slope 22 ft. to Point of spur, slopes SE. Descend SW. slope, 22 ft. to Enter level land. Enter wash, 3 ft. deep, course SW. Leave wash, course SW. Set an iron post 3 ft. long, 2 ins. in diam., 24 ins. in the ground, for cor. of secs. 1, 12, and fracl. secs. 2 and 11, marked on brass cap,

T5S
S 2 | S 1
R22W ———
S11 | S12
1915

and raise a mound of stone, 2 ft. base, 1 $\frac{1}{2}$ ft. high, W. of cor.

Land, rolling.
Soil, rocky, 4th rate.
Timber, scattering palo verde and ironwood.
Undergrowth, greasewood.
No grass.

40.00
79.98

East, on a random line, bet. secs. 1 and 12. Set temp. $\frac{1}{4}$ sec. cor. Intersect E. bdy. of Tp., 1 lk. N. of true point for reestablished cor. of secs. 1, 6, 7 and 12, hereinbefore described.

Thence, West, on a true line, bet. secs. 1 and 12. Over rolling land, through scattering timber and undergrowth.

2.21
6.31
11.02
17.51
20.40
27.22
39.99

Wash, 2 ft. deep, course SW. from N. Enter wash, 3 ft. deep, course SW. Leave wash, course SW. Ascend gradual slope to Ridge, brs. N. and S. Descend 20 ft. to Enter wash, course SW. Leave wash, course SW. Set an iron post, 3 ft. long, 1 in. in diam., 26 ins. in the ground, for $\frac{1}{4}$ sec. cor., marked on brass cap,

S $\frac{1}{4}$
S 12
1915

and raise a mound of stone, 2 ft. base, 1 $\frac{1}{2}$ ft. high, N. of cor.

54.52
56.08
59.63

Over nearly level land. Descend 38 ft. to Wash, 30 lks. wide, 3 ft. deep, course SW.

10. Subdivision of fracl. Township 5 South, Range 22 West.

62.08 Wash, 50 lks.wide, 2 ft. deep, course S.
 79.98 The cor.of secs.1,12, and fracl.secs.2 and 11.
 Land,level and rolling.
 Soil,rocky,4th rate.
 Timber, scattering palo verde and ironwood.
 Undergrowth, dense greasewood and catclaw.

S.0°5'E., bet.sec.12, and fracl.sec.11.
 Over level wash land, through scattering undergrowth.
 17.90 Wash, 150 lks.wide, 4 ft.deep, course SW.
 21.60 Enter wash, 4 ft.deep, course W.
 24.10 Leave wash, course SW. Ascend NW.slope, 38 ft. to
 26.97 Top of slope, thence, over rolling land.
 39.34 Wagon road brs.SE. and NW.extends N.to Barker & S.to Yuma.
 Enter Colorado river bottom, through dense undergrowth.
 40.00 Set an iron post, 3 ft.long, 1 in. in diam., 26 ins. in
 the ground, for $\frac{1}{4}$ sec.cor., marked on brass cap,

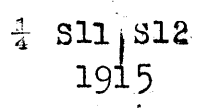

from which,
 A mesquite limb, 6 ins. in diam., brs.S.19 $\frac{1}{2}$ °E.
 246 lks.dist., marked $\frac{1}{4}$ S 12 B T.
 A willow, 8 ins.in diam., brs.N.81 $\frac{1}{2}$ °W., 173 lks.
 dist., marked $\frac{1}{4}$ S 11 B T.

66.50 Enter slough, 60 lks.wide, 1 to 2 ft.deep, brs.N.20°W.and
 S.20°E.
 69.60 Leave slough.
 73.05 Enter slough, 60 lks.wide, brs.NW. and SE.
 74.35 Leave slough.
 80.00 Set an iron post, 3 ft.long, 2 ins. in diam., 24 ins. in
 in the ground, for cor.of secs. 12,13, and fracl.secs.
 11 and 14, marked on brass cap,

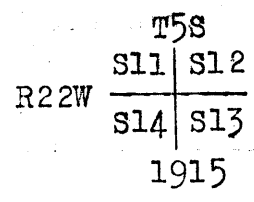

from which,
 A willow, 8 ins.diam., brs.N.27 $\frac{1}{2}$ °E., 273 lks.dist.,
 marked T 5 S R 22 W S 12 B T.
 A willow, 6 ins.diam., brs.S.62 $\frac{1}{4}$ °E., 353 lks.dist.,
 marked T 5 S R 22 W S 13 B T.
 A willow, 6 ins.diam., brs.S.56°W., 157 lks.dist.,
 marked T 5 S R 22 W S 14 B T.
 A willow, 6 ins.diam., brs.N.66 $\frac{1}{2}$ °W., 108 lks.dist.,
 marked T 5 S R 22 W S 11 B T.

Land,rolling and level.
 Soil,rocky and sandy,4th and 2nd rates.
 Timber, scattering palo verde, ironwood and willow.
 Undergrowth, greasewood, arrowweed and mesquite.
 No grass.

40.00 East, on a random line, bet.secs.12 and 13.
 80.05 Set temp. $\frac{1}{4}$ sec.cor.
 Intersect E.bdy.of Tp., 4 lks.N.of original cor.of secs.
 7,12,13 and 18, hereinbefore described.
 Thence,
 N.89°58'W., on a true line, bet. secs.12 and 13.
 Over rolling land, through scattering undergrowth.
 Descend 23 ft.to
 3.68 Enter wash, course S.
 9.07 Leave wash, course S.
 12.27 Enter wash, course S.
 15.05 Leave wash, course S.

Subdivision of Fract. Township 5 South Range 22 West 11

39.98 Wagon road brs. NW. and SE.
 40.02 1/2 Set an iron post, 3 ft. long, 1 in. in diam., 26 ins. in ground, for
 sec. cor. mkd. on brass cap, S. 12
 Wagon road, brs. NW. and SE.
 40.00 1/2 Set an iron post, 3 ft. long, 1 in. in diam., 26 ins. in ground, for
 sec. cor. mkd. on brass cap, S. 13
 1915 and raise a mound of
 stone, 2 ft. base, 1 1/2 ft. high, N. of cor., S. 13
 53.30 Wagon road, brs. NW. and SE. extends N. to Parker, & S. to Yuma.
 69.65 Old wagon road, brs. NE. and SW.
 70.50 Enter dense undergrowth.
 71.30 Enter river bottom.
 72.15 Slough, 50 lks. wide, 1 to 2 ft. deep, brs. N. and S.
 76.25 Enter slough, brs. S. 20° E. and N. 20° W.
 76.95 Leave slough.
 80.05 The cor. of secs. 12, 13, and fract. secs. 11 and 14.
 Land, rolling and level.
 Soil, rocky, 4th rate and level, sandy, 1st rate.
 Timber, scattering palo verde and willow.
 Undergrowth, dense arrow weed, greasewood and mesquite.
 No grass.

S. 0° 5' E., bet. sec. 13 and fract. sec. 14.
 Over gently rolling land, through scattering timber and
 dense undergrowth.

26.60 Pole fence, brs. NE. and SW.
 27.65 Enter slough, brs. SE. and NW.
 32.30 S. edge of slough, brs. SE. and NW.
 40.00 True point for 1/4 sec. cor. falls in insecure place, subject
 to flood; therefore, at a point, 3.25 chs. E.,
 Set an iron post, 3 ft. long, 1 in. in diam., 26 ins. in
 the ground, for witness cor. to 1/4 sec. cor., marked on
 brass cap,

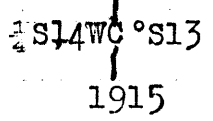

from which,
 A cottonwood, 6 ins. diam., brs. N. 15° E., 147
 lks. dist., mkd. W C 1/4 S 13 B T.
 A mesquite, 10 ins. diam., brs. S. 11 1/2° W., 50 lks.
 dist., mkd. W C 1/4 S 13 B T.

42.00 Enter slough, brs. NE. and SW.
 45.00 Leave slough; enter dense willow timber, brs. NE. and SW.
 63.40 Leave dense timber; enter scattering timber.
 71.60 Cottonwood tree, 12 ins. in diam., on line.
 80.00 Set an iron post, 3 ft. long, 2 ins. diam., 24 ins. in the
 ground, for cor. of sec. 13, and fract. secs. 14, 23 and 24,
 marked on brass cap,

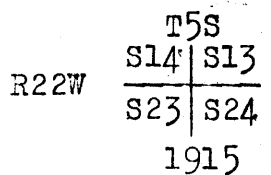

from which,
 A cottonwood, 7 ins. diam., brs. N. 65 1/2° E., 150 lks.
 dist., marked T 5 S R 22 W S 13 B T.
 A cottonwood, 5 ins. diam., brs. S. 57 1/2° E., 97 lks.
 dist., marked T 5 S R 22 W S 24 B T.
 A cottonwood, 4 ins. diam., brs. S. 10° W., 170 lks.
 dist., marked T 5 S R 22 W S 23 B T.
 A cottonwood, 4 ins. diam., brs. N. 22 1/2° W., 130 lks.
 dist., marked T 5 S R 22 W S 14 B T.

Land, gently rolling and level.
 Soil, silt, 2nd rate.
 Timber, cottonwood and willow.
 Undergrowth, dense arrowweed, willow and mesquite.

12. Subdivision of Fracl. Township 5 South, Range 22 West.

Chains.

S.89° 58'E., on a random line, bet.sec.13,and fracl.sec.24.

40.00 Set temp. $\frac{1}{4}$ sec.cor.

80.10 Intersect E bdy.of Tp., 9 lks.S.of cor.of secs.13,18,and fracl.secs.19 and 24, hereinbefore described.

Thence,
S.89° 58'W., on a true line, bet.sec.13 and fracl.sec.24.

Over gently rolling land, through scattering timber and dense undergrowth, along river bottom..

5.68 Leave river bottom; thence over rolling land.

29.49 Enter river bottom, brs.N.and S.

40.05 Set an iron post, 3 ft.long, 1 in. in diam., 26 ins. in the ground, for $\frac{1}{4}$ sec.cor., marked on brass cap,

S 13
 $\frac{1}{4}$

S 24
1915

from which

A mesquite, 6 ins.diam., brs.N.75 $\frac{1}{2}$ °W.,110 lks. dist.,marked $\frac{1}{4}$ S 13 B T.

A mesquite,6 ins.diam., brs.S.38 $\frac{1}{2}$ °W.,84 lks. dist., marked $\frac{1}{4}$ S 24 B T.

45.10 Enter cottonwood and willow timber.

49.50 Enter slough, brs.NW. and SE.

52.00 Leave slough.

77.60 Leave cottonwood and willow timber, brs.N.and S.

80.10 The cor.of sec.13,and fracl.secs.14,23 and 24.
Land, level and gently rolling.
Soil, sandy silt, 2nd rate.
Timber, cottonwood, willow and mesquite.
Undergrowth, greasewood, arrowweed and mesquite.
No grass.

S.0°5'E., bet. fracl.secs. 23 and 24.
Over level bottom land, through dense undergrowth and timber.

40.00 Set an iron post 3 ft.long, 1 in. in diam., 26 ins. in the ground, for $\frac{1}{4}$ sec.cor., marked on brass cap,

$\frac{1}{4}$ S23 | S24
1915

from which,

A willow,7 ins.in diam., brs.S.61°E., 43 lks. dist., marked $\frac{1}{4}$ S 24 B T.

A cottonwood, 5 ins. in diam., brs.N.7°W.,9 lks dist., marked $\frac{1}{4}$ S 23 B T.

44.40 Set an iron post 3 ft.long, 2 ins. in diam., 24 ins. in the ground, for meander cor. of fracl.secs.23 and 24, marked on brass cap,

T5SR22W
S23 | S24
M | C
1915

from which,

A willow,11 ins.diam.,brs.S.80°E.,74 lks.dist., marked T 5 S R 22 W S 24 M C B T.

A cottonwood,6 ins.diam.,brs.N.18 $\frac{1}{2}$ °W.,41 lks. dist.,marked T 5 S R 22 W S 23 M C B T.

44.75 Left bank of Colorado river, brs.N/8 $\frac{1}{2}$ °W. and S.32°E.
Land, level bottom.
Soil, silt, sandy, 2nd rate.
Timber, cottonwood, willow and mesquite.
Undergrowth, dense arrow weed. No grass.

Subdivision of fracl. Township 5 South, Range 22 West. 13.

Chains.

From the true point for cor. of sec. 35, and fracl. secs. 2, 3, and 34 on N. bdy. of Tp., witnessed as hereinbefore described.
 S. 0° 5' E., bet. fracl. secs. 2 and 3.
 Over river bottom land, through scattering timber and dense undergrowth.
 7.50 Leave land, subject to wash and timber, brs. E. and W.
 18.60 Road, brs. N. 20° W. and S. 20° E. extends N. to Parker & S. to Yuma.
 31.80 Set an iron post, 3 ft. long, 1 in. in diam., 26 ins. in the ground, for meander cor. of fracl. secs. 2 and 3, marked on brass cap,

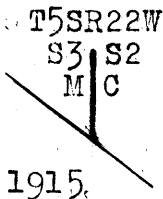

from which,
 A willow, 10 ins. diam., brs. N. 25 1/2° E., 292 lks. dist., mkd. T 5 S R 22 W S 2 M C B T.
 A willow, 10 ins. diam., brs. N. 71 1/4° W., 44 lks. dist., mkd. T 5 S R 22 W S 3 M C B T.
 32.10 Left bank of Colorado river, 15 ft. high, brs. NW. and SE. Land, level bottom. Soil, sandy silt, 2nd rate. Timber, scattering willow, cottonwood and mesquite. Undergrowth, dense arrowweed and mesquite. No grass.

From cor. of secs. 1, 12, and fracl. secs. 2 and 11, West, on a true line, bet. fracl. secs. 2 and 11. Over level bottom land, through scattering timber and dense undergrowth.

1.70 Enter wash, course SW.
 4.00 Enter scattering palo verde, brs. NE. and SW.
 12.80 Leave scattering palo verde, brs. NE. and SW.
 12.90 Leave wash, course SW.
 14.10 Road brs. NW. and SE. extends N. to Parker, and S. to Yuma.
 22.00 Enter dense undergrowth, brs. N. and S.
 24.85 Old wire fence, brs. NW. and SE.
 26.00 Enter river bottom, brs. NW. and SE.
 40.00 Set an iron post, 3 ft. long, 1 in. in diam., 26 ins. in the ground, for 1/4 sec. cor., marked on brass cap,

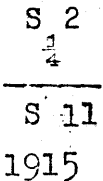

from which,
 A willow, 10 ins. diam., brs. N. 28° W., 212 lks. dist., marked 1/4 S 2 B T.
 A willow, 4 ins. diam., brs. S. 37 1/2° E., 30 lks. dist., marked 1/4 S 11 B T.
 52.80 Set an iron post, 3 ft. long, 1 in. in diam., 26 ins. in the ground, for meander cor. of fracl. secs. 2 and 11, marked on brass cap,

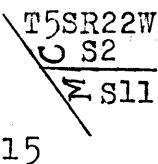

from which,
 A willow, 5 ins. diam., brs. N. 71° E., 163 lks. dist., mkd. T 5 S R 22 W S 2 M C B T.
 A willow, 10 ins. diam., brs. S. 2° E., 57 lks. dist., mkd. T 5 S R 22 W S 11 M C B T.

14. Subdivision of fracl. Township 5 South Range 22 W.

Chains.

53.00 Left bank of Colorado river, 10 ft. high, brs. NW. and SE.
Land, level bottom.
Soil, sandy silt, 2nd rate.
Timber, scattering palo verde, mesquite, cottonwood and willow.
Undergrowth, dense arrowweed and mesquite.
No grass.

West, on a true line, bet. fractional secs. 11 and 14.
Over level bottom land, through scattering timber and dense undergrowth.

28.30 True point for meander cor. falls in insecure place, therefore, at

27.20 Set an iron post, 3 ft. long, 2 ins. diam., 24 ins. in the ground, for witness cor. to meander cor. of fracl. secs. 11 and 14, marked on brass cap,

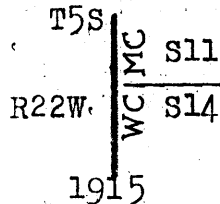

from which,

A cottonwood, 9 ins. diam., brs. N. 87° E., 249 lks. dist., mkd. W C T 5 R 22 W S 11 M C B T.

A cottonwood, 8 ins. diam., brs. S. 13° E., 329 lks. dist., mkd. W C T 5 S R 22 W S 14 M C B T.

28.45 Left bank of Colorado river, brs. NW. and SE.
Land, level bottom.
Soil, sandy silt, 2nd rate.
Timber, scattering willow, cottonwood and mesquite.
Undergrowth, dense arrowweed.
No grass.

West, on a true line, bet. fracl. secs. 14 and 23.
Over level bottom land, through scattering timber and undergrowth.

5.70 Set an iron post, 3 ft. long, 2 ins. in diam., 24 ins. in the ground, for M. C. of fracl. secs. 14 and 23, marked on brass cap,

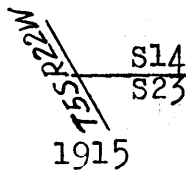

dig a pit, 36x36x12 ins., 8 ft. E. of post, and raise a mound of earth, 4 ft. base, 2 ft. high, E. of cor.

Thence across sand bar to

12.95 Left bank of Colorado river, brs. NW. and SE.
Land, level bottom.
Soil, sandy silt, 2nd rate.
Timber, scattering willow and cottonwood.
Undergrowth, dense arrowweed and cottonwood.
No grass.

Subdivision of fracl. Township 5 South, Range 22 West. 15.

Chains.

GENERAL DESCRIPTION.

This fractional township contains rolling and level land. The level land is mainly in the Colorado river bottom, and is subject to overflow in flood seasons. The soil in the rolling portion is mainly rocky, 4th rate, unfit for cultivation. The soil in the river bottom is a sandy silt, 1st and 2nd rate, suitable for agricultural purposes. Timber on the rolling land is a scattering growth of palo verde and ironwood, and on the bottom land, scattering cottonwood and willow, and mesquite. The undergrowth of greasewood, arrowweed, mesquite and catclaw is dense over the entire township. No indications of mineral in the township, and no settlers.

Remains of the same tract
 as in the original plat
 of the same township

16. Meanders of left bank of Colorado river within fracl. T.5SR22W.

Chains.

Meanders of left bank of Colorado river, up stream.

At the meander cor. of fracl. secs. 19 and 24, T.5 S. R.21 W.,
and fracl. T.5 S., R.22 W., hereinbefore described.

Thence with meanders in fracl. sec. 24.

Through dense undergrowth.

S. 61° W., 69.00 chs. Bank 8 ft. high.

N. 54 $\frac{3}{4}$ ° W., 10.00 "

N. 32° W., 22.00 " To the meander cor. of fracl. secs. 23
and 24.

Land, river bottom.

Soil, silt, 2nd rate.

Undergrowth, dense arrowweed and mesquite.

No grass.

Thence in fracl. sec. 23.

Through dense undergrowth.

N. 8 $\frac{1}{2}$ ° W., 17.00 chs. Bank 8 ft. high.

N. 6 $\frac{3}{4}$ ° W., 27.80 " To the meander cor. of fracl. secs.
14 and 23.

Land, river bottom.

Soil, silt, 2nd rate.

Scattering timber.

Undergrowth, dense arrowweed and mesquite.

Thence in fracl. sec. 14.

Through dense undergrowth.

N. 17 $\frac{1}{2}$ ° W., 68.00 chs. Bank 8 ft. high.

N. 9° W., 15.35 " To the true point for meander cor. of
fracl. secs. 11 and 14, witnessed as
hereinbefore described.

Land, river bottom.

Soil, silt, 2nd rate.

Undergrowth, dense arrowweed and mesquite.

No grass.

Thence in fracl. sec. 11.

Through dense undergrowth.

N. 13° W., 11.00 chs. Bank 8 ft. high.

N. 17° W., 55.00 chs.

N. 20° W., 17.50 chs. To the meander cor. of fracl. secs.
2 and 11.

Land, river bottom.

Soil, silt, 2nd rate.

Scattering timber.

Undergrowth, dense arrowweed and mesquite.

No grass.

Thence in fracl. sec. 2.

Through dense undergrowth.

N. 17 $\frac{1}{2}$ ° W., 8.40 chs.

N. 29° W., 25.00 chs. Bank 10 ft. high.

N. 34 $\frac{3}{4}$ ° W., 22.40 chs. To the meander cor. of fracl. secs. 2 and
3.

Land, river bottom.

Soil, silt, 2nd rate.

No timber.

Undergrowth, dense arrowweed, mesquite and willow.

No grass.

Meanders of Left bank of Colorado river within fracl T5SR22W 17

Chains.

Meanders of left bank of Colorado river, upstream.
 Thence in fracl. sec. 3.
 Through dense undergrowth.
 N. 38° W., 14.00 chs. Bank 10 ft. high.
 At 14.00 chs., wash, 130 lks. wide, 10 ft. deep, course W. Water backs in from river about 100 ft. east.
 N. 48° W., 31.50 chs. True point for meander cor. of fracl. secs. 3 and 34. WC M.C. brs. E. of true point, 1.80 chs. dist.

Land, river bottom.
 Soil, silt, 2nd rate.
 No timber.
 Undergrowth, dense arrowweed, mesquite and willow.
 No grass.

Boundaries of Fracl. Tp. 5 S., R. 22 W.
 Latitudes, departures, and closing errors.

Line designated.	Course.	Dist.	Latitudes.		Departures.	
			N.	S.	E.	W.
East bdy.,	North,	75.00	75.00			
	N. 0° 18' W.	39.94	39.94			.21
	N. 0° 2' W.	40.01	40.01			.02
	N. 0° 9' W.	40.11	40.11			.11
	N. 0° 1' E.	39.50	39.50		.01	
North bdy.	West,	192.30				.09
Meanders of Left bank of Colo. River.	Various	Various		257.37	192.66	
Convergency,						.07
Totals,			274.97	275.37	192.67	192.80
Error in latitude,				274.97		192.67
Error in departure,				0.40		0.13

BOOK 3172

CERTIFICATE OF UNITED STATES SURVEYOR.

I, William B. Kimmel, U. S. Surveyor, hereby certify upon honor that, in pursuance of special instructions received from the U. S. Surveyor General for Group 47, Arizona, bearing date of the 5th day of February, 1915, I have well, faithfully, and truly in my own proper person, and in strict conformity with said instructions, the Manual of Surveying Instructions, and the laws of the United States ^{re-} surveyed all those parts or portions of the East, and North boundaries, and surveyed all those parts or portions of the North bdy., and Subdivision lines, and Meanders of the Left bank of the Colorado river, within fracl. Township 5 South, Range 22 West, of the Gila and Salt River Base and Meridian, in the State of Arizona, which are represented in the foregoing field notes as having been executed by me, and under my direction; and that all the corners of said survey have been established and perpetuated in strict accordance with the Manual of Surveying Instructions, and the special written instructions of the U. S. Surveyor General for Group 47, Arizona, and in the specific manner described in the field notes, and that the foregoing are the original field notes of ^{re-} such survey. and survey.

William B. Kimmel.
U. S. Surveyor.

APPROVAL.

OFFICE OF THE UNITED STATES SURVEYOR GENERAL,

Phoenix, Arizona, March 20, 1918.

The foregoing field notes of the ^{re-} survey of the East and part of the North boundaries, and the Survey of Part of the North bdy., Subdivision lines, and Meanders of the left bank of the Colorado river, within fracl. Township 5 South, Range 22 West, of the Gila and Salt River Base and Meridian, in the State of Arizona,

executed by William B. Kimmel, U. S. Surveyor, under his special instructions dated February 5, 1915, for Group 47, Arizona, having been critically examined, and the necessary corrections and explanations made, the said field notes, and the ^{resurveys &} surveys they describe, are hereby approved.

Frank B. Frost
U. S. Surveyor General.

I certify that the foregoing transcript of the field notes of the above described surveys in has been correctly copied from the original notes on file in this office.