

3184

*Old title  
for filing*

Book "M."  
4-679

(1)

BOOK 3184

# FIELD NOTES

OF THE RETRACEMENT OF

PORTION OF SOUTH BOUNDARY

of

FRAC. TOWNSHIP 2 NORTH, RANGE 23 WEST.

and SURVEY of

SUBDIVISION LINES &

PORTION of SOUTH BDY. OF

FRAC. TOWNSHIP 2 NORTH, RANGE 23 WEST.

and

MEANDERS OF THE LEFT BANK OF THE COLORADO RIVER,

WITHIN FRAC. TOWNSHIP 2 NORTH, RANGE 23 WEST.

*Of the* Gila and Salt River Base and Meridian,

*In the State of* Arizona.

EXECUTED BY

William B. Kimmel.

*In the capacity of U. S. Surveyor*, under instructions dated February 5., 1915.,  
*issued by the United States Surveyor General to govern surveys included in*  
*Group No. 47*, which were approved by the Commissioner of the General Land  
*Office, February 23.*, 1915.

Retracement & Survey commenced May 16., 1916.

Retracement & Survey completed Feby. 19., 1917.

Executed under Assignment  
Instructions dated Feb. 27, 1915 & Dec. 9, 1915.

3184

3184

3184  
Book "M."

Group 47-- Arizona.

BOOK 3184

See Special Index Diagram.

# INDEX DIAGRAM.

Township 2 North, Range 23 West.

6	5	4	3	2	1
7	8	9	10	11	12
18	17	16	15	14	13
19	20	21	22	23	24
30	29	28	27	26	25
31	32	33	34	35	36
			1	1	1

3184  
Book "M"

Group 47 - - - - Arizona.

Fractional Township 2 North, Range 23 West.

BOOK 3184

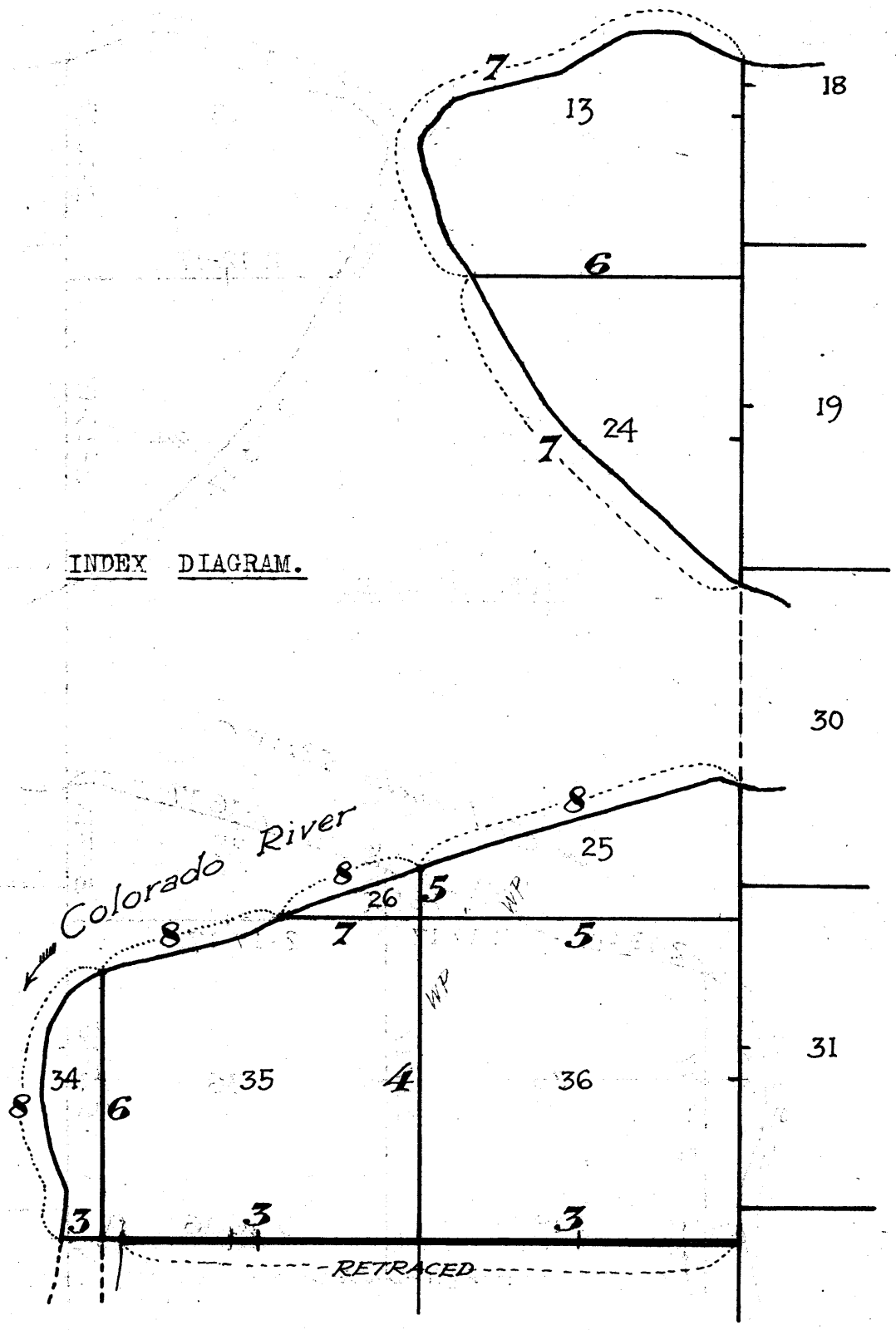

INDEX DIAGRAM.

- Surveyed under this Group. Notes in this Book. 3184
- Retraced under this Group. Notes in this Book. 3184
- Surveyed under this Group. Notes in Book "L." 3183
- Accepted surveys.
- - - - - Unsurveyed.

Book "M."

BOOK 3184

Group 47- - - - Arizona.

Fracl. Township 2 North, Range 23 West.

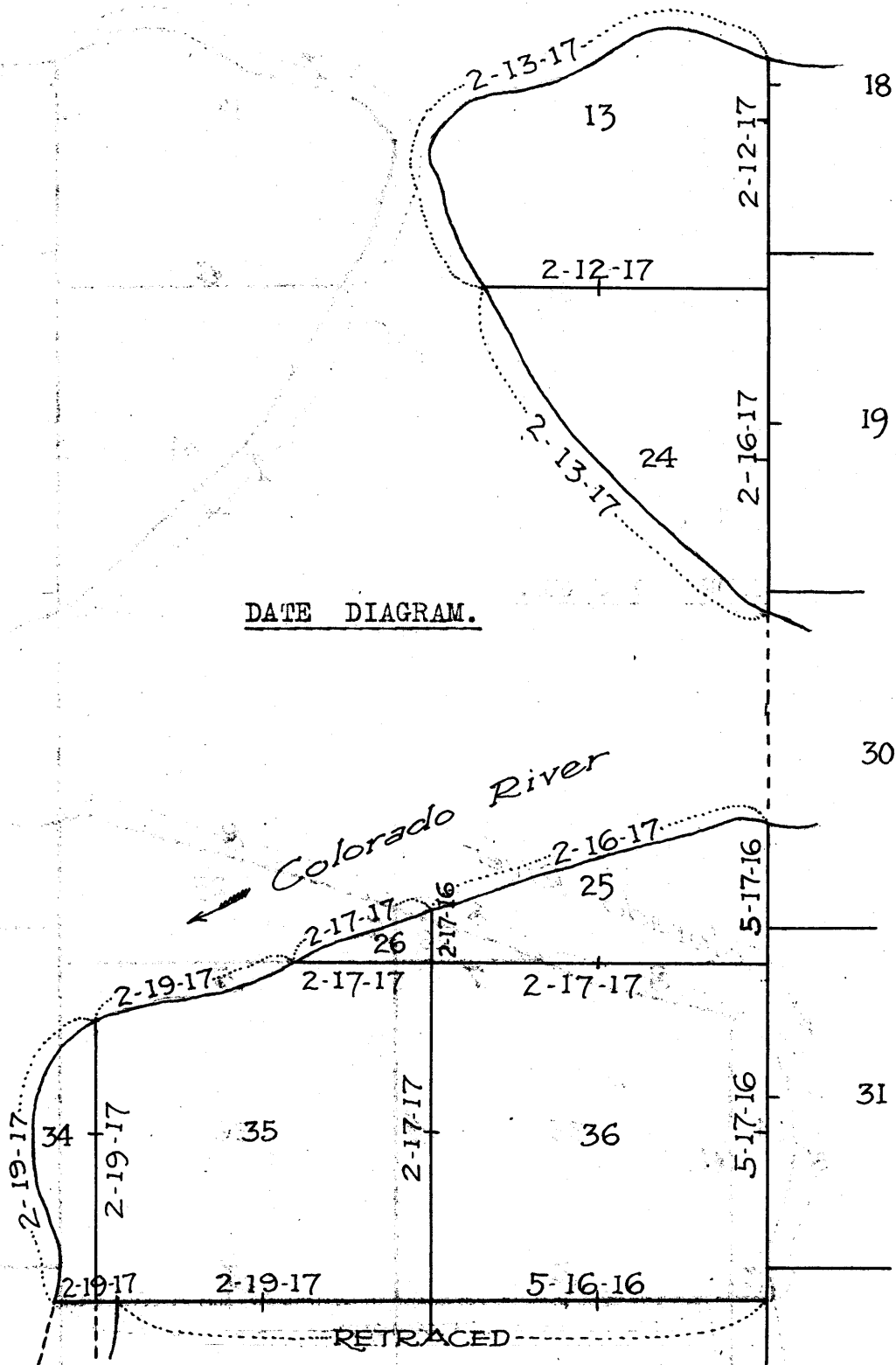

DATE DIAGRAM.

Retracements and Surveys executed on dates shown on above diagram, by  
William B. Kimmel, U.S. Surveyor.

Retracement of part of South bdy. of fracl. T. 2 North, Range 23 W. 3

Chains.

Retracements and surveys hereinafter described were executed by William B. Kimmel, U. S. Surveyor, on dates shown on diagram on page 2 of this book, using a Young and Son's light mountain transit No. 8523, with solar attachment, described in Book "A."

From recent and repeated field tests of the transit and solar attachment made during a.m. and p.m. hours on a meridian established by observations on Polaris, they are known to be in satisfactory adjustment.

Preliminary to commencing the subdivision of fracl. T. 2 N., R. 23 W., I retrace on the S. bdy. of Tp., as follows: From the cor. of fracl. Ts. 1 and 2 N., R. 23 W., described in Book "L."

39.99 N. 89° 59' W., bet. secs. 1 and 36. Intersect the original 1/4 sec. cor., which is a stone 7x6x6 ins. above ground, firmly set, marked and witnessed, as described by the surveyor general.

39.99 Thence, N. 89° 56' W., bet. secs. 1 and 36 (W. 1/2). Intersect original cor. of secs. 1, 2, 35 and 36, which is a stone 4x6x8 ins. above ground, firmly set, marked and witnessed, as described by the surveyor general.

39.81 N. 89° 53' W., bet. secs. 2 and 35. Intersect original 1/4 sec. cor., which is a stone, 8x8x8 ins. above ground, firmly set, marked and witnessed as described by the surveyor general.

36.00 Thence, West, bet. secs. 2 and 35 (W. 1/2). After diligent search in this vicinity, find no trace of the original meander cor. of fracl. secs. 2 and 35.

Survey of part of South bdy. of fracl. T. 2 N., R. 23 West.

From a point 36.00 chs. west of 1/4 sec. cor. of secs. 2 and 35, which was the termination of the original survey of this Tp. bdy.,

West, on true line, bet. secs. 2 and 35, measuring from 1/4 sec. cor. completing W. half of line, bet. said secs.

40.00 Set an iron post 3 ft. long, 1 in. in diam., 26 ins. in the ground, for cor. of secs. 2, and fracl. secs. 3, 34, and 35, marked on brass cap,

T 2N R23W  
S34 | S35  
S 3 | S 2  
1917

from which,

- A cottonwood, 14 ins. in diam., brs. N. 41 1/2° E., 48 lks. dist., marked T 2 N R 23 W S 35 B T.
- A willow, 12 ins. in diam., brs. S. 81 1/4° E., 46 lks. dist., marked T 1 N R 23 W S 2 B T.
- A willow, 8 ins. in diam., brs. S. 62° W., 19 lks. dist., marked T 1 N R 23 W S 3 B T.
- A cottonwood, 9 ins. in diam., brs. N. 85° W., 12 lks. dist., marked T 2 N R 23 W S 34 B T.

Land, level river bottom.

Soil, 2nd rate.

Timber, dense willow and scattering cottonwood.

Undergrowth, dense arrow weed.

West, bet. fracl. secs. 3 and 34.

Over land. subject to overflow, through dense undergrowth

4. Part of South bdy. of Fracl. Township 2 North Range 23 West.

Chains.

10.00 and timber.  
Set an iron post 3 ft. long, 1 in. in diam., 26 ins. in the ground, for meander cor. of fracl. secs. 4 and 33, marked on brass cap,

T2NR23W  
M|S34  
S3  
1917

from which,

A cottonwood, 9 ins. in diam., brs. N. 63° E., 49 lks. dist., marked T 2 N R 23 W S 34 M C B T.

A willow, 5 ins. diam., brs. S. 22° E., 15 lks. dist., marked T 2 N R 23 W S 3 M C B T.

10.10 Channel of Colorado river, deep water about 3 chs. wide, co. SE. Land, level river bottom. Soil, 2nd rate. Timber, dense willow and scattering cottonwood. Undergrowth, dense arrow weed.

-----  
Subdivision of fracl. Township 2 North, Range 23 W.  
-----

From the original cor. of secs. 1, 2, 36, and fracl. sec. 35, on S. bdy. of Tp., hereinbefore described, N. 0° 1' W., bet. sec. 36 and fracl. sec. 35.

Over rolling, broken mesa, thru scattering timber & undergrowth.

10.05 Enter wash valley, brs. NW. and SE.

14.05 Shallow wash, 1 ch. wide, course NW.

30.75 Shallow wash, 2 chs. wide, course NW.

33.20 Leave wash valley, brs. NW. and SE.

40.00 Set an iron post 3 ft. long, 1 in. in diam., 26 ins. in the ground, for 1/4 sec. cor., marked on brass cap,

S35 1/2 | S36  
1916

and raise a mound of stone, 2 ft. base, 1 1/2 ft. high, W. of cor.

45.30 Rocky wash, 45 lks. wide, course SW.

56.10 Ravine, course W. Ascend gradual slope to

59.00 Spur, slopes NW.

64.60 Set an iron post 3 ft. long, 1 in. in diam., 26 ins. in ground, for witness point, marked on brass cap,

WP  
S35 1/2 | S36  
64.60  
1916

and raise a mound of stone, 2 ft. base, 1 1/2 ft. high, W. of point.

Note: This point is on a rocky point sloping NE. about 25 ft. above river bottom land.

65.00 Enter dense timber and undergrowth, brs. NE. and SW.

71.00 Enter slough, 1 ch. wide, course S. 20° W.

75.00 Leave slough.

80.00 Set an iron post, 3 ft. long, 1 in. diam., (no 2 in. posts available), 24 ins. in ground, for cor. of sec. 36, and fracl. secs. 25, 26 and 35, marked on brass cap,

T 2 N R 23 W  
S26 | S25  
S35 | S36  
1917

from which,

A cottonwood brs. N. 60 1/2° E., 16 lks. dist., marked T 2 N R 23 W S 25 B T.

A cottonwood, brs. S. 45° E., 22 lks. dist., marked T 2 N R 23 W S 36 B T.

A willow, brs. S. 1/4 25 1/4° W., 24 lks. dist., marked T 2 N R 23 W S 35 B T.

A willow, brs. N. 73 1/2° W., 21 lks. dist., marked T 2 N R 23 W S 26 B T.

Land, rolling and level bottom land. Soil, 2nd & 3rd rate. Timber, dense willow and scattering cottonwood. Undergrowth, dense arrow weed.

Subdivision of Fracl. T. 2 N., R. 23 W.

Chains

East on a random line bet. sec. 36, and fracl. sec. 25.  
 40.00 Set temp.  $\frac{1}{4}$  sec. cor.  
 79.94 Intersect E. bdy. of Tp., at the cor. of sec. 36, & fracl. sec. 25, described in book "L".  
 Thence  
 West on a true line bet. sec. 36, and fracl. sec. 25.  
 Over rolling mesa sloping NW, through timber and undergrowth.  
 9.50 Ravine, .4 ft. deep, course NW.  
 32.00 Leave mesa brs. NW. and SE. Desc. SW. slope, 93 ft. to  
 35.30 Rocky draw course NW.  
 39.97 Set an iron post, 3 ft. long, 1 in. diam., 26 ins. in the ground, for  $\frac{1}{4}$  sec. cor., mkd. on brass cap

S 25  
 $\frac{1}{4}$   
 S 36  
 1916

from which,

An iron wood, 14 ins. diam., brs. N. 29° E.  
 155 lks. dist. mkd.  $\frac{1}{4}$  S 25 B T.  
 An iron wood, 12 ins. diam., brs. S. 78° E.  
 127 lks. dist. mkd.  $\frac{1}{4}$  S 36 B T.  
 46.55 Enter draw brs. NE. and SW. course W.  
 55.60 Shallow wash, 1 ch. wide, course NW.  
 66.90 Set an iron post, 3 ft. long, 1 in. diam., 26 ins. in the ground, for witness point, mkd. on brass cap

S 25  
 WP 66.90 C 'S  
 S 36  
 1916

and raise a mound of stone, 2 ft. base, 1  $\frac{1}{2}$  ft. high, N. of point.

This point is on a rocky point sloping NW. 10 ft. above bottom land.

66.95 Enter dense timber and undergrowth, brs. N. and S.  
 67.20 Enter land, subject to overflow, brs. N. and S.  
 77.75 Slough 1 ch. wide, course S.  
 79.94 The cor. of sec. 36 & fracl. secs. 25, 26, and 35,

Land, rolling and level river bottom.  
 Soil, 2nd and 3rd rates.  
 Timber, palo verde, iron wood, cottonwood and willow.  
 Undergrowth, greasewood and dense arrow weed.

N. 0° 1' W. bet. fracl. secs. 25 and 26.  
 Over bottom land, subject to overflow, through dense timber and undergrowth.

12.20 Set an iron post, 3 ft. long, 1 in. diam., 26 ins. in the ground, for meander cor. of fracl. secs. 25 and 26, mkd. on brass cap

T2NR23W  
 MC  
 S26 | S25  
 1917

from which,

A cottonwood, 9 ins. diam., brs. S. 75  $\frac{1}{2}$ ° E.  
 101 lks. dist. mkd. T 2 N R 23 W S 25 M C B T.  
 A cottonwood, 8 ins. diam., brs. S. 15  $\frac{3}{4}$ ° W.  
 54 lks. dist. mkd. T 2 N R 23 W S 26 M C B T.  
 Land, level river bottom.  
 Soil, 2nd rate.  
 Timber, dense willow and cottonwood.  
 Undergrowth, dense arrow weed.

## Subdivision of Fracl. T. 2 N. R. 23 W.

Chains

From the cor. of fracl. secs. 13 and 24, on E. bdy. of Tp.,  
as described in book "L",  
West on a true line bet. fracl. secs. 13 and 24.  
Over land subject to overflow, through dense timber and  
undergrowth.

35.50 Leave cottonwood and willow timber brs. NE. and SW.  
Slough 3.50 chs. wide, course SW.

40.00 Set an iron post, 3 ft. long, 1 in. diam., 26 ins. in  
the ground, for  $\frac{1}{4}$  sec. cor., mkd. on brass cap

S 13  
 $\frac{1}{4}$   
S 24  
1917

from which,

A cottonwood, 12 ins. diam., brs. N.  $81\frac{3}{4}^{\circ}$  E.  
525 lks. dist. mkd.  $\frac{1}{4}$  S 13 B T.

A cottonwood, 10 ins. diam., brs. S.  $86\frac{1}{2}^{\circ}$  E.  
471 lks. dist. mkd.  $\frac{1}{4}$  S 24 B T.

67.10 Set an iron post, 3 ft. long, 1 in. diam., 26 ins. in  
the ground, for meander cor. of fracl. secs. 13 and  
24, mkd. on brass cap

T2NR23W  
S 13  
 $\frac{1}{4}$  S 24  
1917

dig a pit, 36 X 36 X 12 ins., E. of cor., 8 ft. dist.  
and raise a mound of earth, 4 ft. base, 2 ft. high,  
E. of cor.

Land, level river bottom.

Soil, 2nd rate.

Timber, dense willow and scattering cottonwood.

Undergrowth, dense arrow weed.

From cor. of sec. 2, and fracl. secs. 3, 34 and 35, on S. bdy. of Tp.,  
hereinbefore described,

N.  $0^{\circ}$  1' W. bet. fracl. secs. 34 and 35.

Over land, subject to overflow, through dense timber and  
undergrowth.

40.00 Set an iron post, 3 ft. long, 1 in. diam., 26 ins. in the  
ground, for  $\frac{1}{4}$  sec. cor., mkd. on brass cap

S 34  $\frac{1}{4}$  | S 35  
1917

from which,

A willow 6 ins. diam., brs. N.  $7^{\circ}$  E.

11 lks. dist. mkd.  $\frac{1}{4}$  S 35 B T.

A willow, 5 ins. diam., brs. N.  $71^{\circ}$  W.

9 lks. dist. mkd.  $\frac{1}{4}$  S 34 B T.

66.40 Set an iron post, 3 ft. long, 1 in. diam., 26 ins. in  
the ground, for meander cor. of fracl. secs. 34 and  
35, mkd. on brass cap

T2NR23W  
MC  
S 34 | S 35  
1917

from which,

A willow, 5 ins. diam., brs. S.  $10\frac{1}{2}^{\circ}$  E.

18 lks. dist. mkd. T 2 N R 23 W S 35 M C B T.

A willow, 5 ins. diam., brs. S.  $47\frac{3}{4}^{\circ}$  W.

42 lks. dist. mkd. T 2 N R 23 W S 34 M C B T.

Land, level river bottom.

Soil, 2nd rate. Timber, dense willow and scattering  
cottonwood. Undergrowth, dense arrow weed.



Subdivision of Fract. T. 2 N. R. 23 W.

Chains

35.00

From the cor. of secs 36, and fract. secs. 25, 26 and 35, as hereinbefore described.  
 West on a true line bet. fract. secs. 26 and 35.  
 Over level river bottom land, through dense timber and undergrowth.  
 Set an iron post, 3 ft. long, 1 in. diam., 26 ins. in the ground, for meander cor. of fract. secs. 26 and 35, mkd. on brass cap

T2NR23W

~~MC S26~~  
 S35  
 1917

from which,  
 A willow, 7 ins. diam., brs. N. 72 1/2° E.  
 6 lks. dist. mkd. T 2 N R 23 W S 26 M C B T.  
 A willow 6 ins. diam., brs. S. 2° W.  
 21 lks. dist. mkd. T 2 N R 23 W S 35 M C B T.

Land, level river bottom.  
 Soil, 2nd rate.  
 Timber, dense willow and scattering cottonwood.  
 Undergrowth, dense arrow weed.

Meanders of Left Bank of Colorado River within fract. Township 2 N., R. 23 W.

Meanders of the left bank of Colorado River, down stream.

From the meander cor. of fract. secs. 13 and 18, on the E. bdy. of the Tp., as described in book "L",  
 Thence with meanders in fract. sec. 13, thru scattering timber.

- N. 62 1/4° W. 15.00 chs. Over land subject to overflow.
- N. 84 1/2° W. 8.20 "
- S. 84 1/2° W. 6.70 "
- S. 62° W. 7.50 "
- S. 59° W. 13.00 "
- S. 77 1/4° W. 16.00 "
- S. 63 1/2° W. 13.00 "
- S. 42° W. 10.00 "
- S. 15 1/4° E. 26.00 "
- S. 36 1/4° E. 10.00 " To the meander cor. of fract. secs. 13 and 24.

Land, level river bottom.  
 Soil, 2nd rate.  
 Timber, dense willow and scattering cottonwood.  
 Undergrowth, dense arrow weed.

Thence in fract. sec. 24.  
 Over level bottom land, through dense timber and undergrowth.

- S. 36 1/4° E. 15.00 chs. Over land subject to overflow.
- S. 42 1/2° E. 8.70 " At 7.00 chs. a slough 1 ch. wide, from N.
- S. 21 1/4° E. 10.00 " ✓ "
- S. 38 1/4° E. 8.00 " ✓ "
- S. 25 1/4° E. 18.40 " ✓ "
- S. 26 1/4° E. 18.00 " ✓ "
- S. 43 1/4° E. 4.10 " ✓ "
- S. 37 1/2° E. 5.90 " ✓ "
- S. 45° E. 2.60 " ✓ "
- S. 57° E. 9.00 " ✓ "
- S. 66° E. 2.00 " ✓ "

Meanders of left bank of Colorado River  
within fraction T. 2 N. R. 23 W.

S.  $79^{\circ}$  E. 12.00 chs.  
S.  $66\frac{1}{2}^{\circ}$  E. 3.00 " To the meander cor. of fracl. secs.  
.24 and 30, on E. bdy. of Tp., describ-  
in Book "L."  
Land, level bottom.  
Soil, 2nd rate.  
Timber, dense willow and scattering cottonwood.  
Undergrowth, dense arrow weed.

From the meander cor. of fracl. secs. 25 and 30, on  
the E. bdy. of Tp., as described in book "L",  
Thence with meanders in fracl. sec. 25.  
Over level bottom land, through dense timber and under-  
growth.  
N.  $76\frac{3}{4}^{\circ}$  W. 5.30 chs. Along bluff, 20ft. to 80 ft. high.  
S.  $74^{\circ}$  W. 66.00 " At 5.00 chs. leave bluff to SW.  
Enter land subject to overflow.  
S.  $70^{\circ}$  W. 12.00 chs. At 25 lks. head of slough 70 lks.  
wide, course SW.  
To meander cor. of fracl. secs.  
25 and 26.  
Land, level river bottom.  
Soil, 2nd rate.  
Timber, dense willow and scattering cottonwood.  
Undergrowth, dense arrow weed.

Thence in fracl. sec. 26.  
Over level bottom land, through dense timber and under-  
growth.  
S.  $70\frac{1}{4}^{\circ}$  W. 37.10 chs. Over land subject to overflow.  
To the meander cor. of fracl.  
secs. 26 and 35.  
Land, level bottom.  
Soil, 2nd rate.  
Timber, dense willow and scattering cottonwood.  
Undergrowth, dense arrow weed.

Thence in fracl. sec. 35.  
Over level bottom land, through dense timber and under-  
growth.  
S.  $70^{\circ}$  W. 24.00 chs. Over land, subject to overflow.  
S.  $76\frac{1}{4}^{\circ}$  W. 23.00 chs. To the meander cor. of fracl.  
secs. 34 and 35.  
Land, level bottom.  
Soil, 2nd rate.  
Timber, dense willow and scattering cottonwood.  
Undergrowth, dense arrow weed.

Thence in fracl. sec. 34.  
Over level bottom land, through dense timber and under-  
growth.  
S.  $65\frac{1}{4}^{\circ}$  W. 8.70 chs. Over land subject to overflow.  
S.  $33\frac{1}{4}^{\circ}$  W. 11.00 " "  
S.  $5\frac{1}{4}^{\circ}$  W. 10.00 " " From this station, head of low  
island covered with timber and  
undergrowth brs. W. about 4.00  
chs. dist.  
S.  $3^{\circ}$  W. 8.00 " "  
S.  $8\frac{3}{4}^{\circ}$  E. 8.70 " "

Meanders of left bank of Colorado River,

within fract. T. 2 N. R. 23 W.

S. 18° E. 16.00 chs.  
 S. 4 $\frac{1}{2}$ ° W. 12.00 " To the meander cor. of fract. secs. 3 and 34 on the S. bdy. of Tp., hereinbefore described.

Land, level bottom.  
 Soil, 2nd rate.  
 Timber, dense willow and scattering cottonwood.  
 Undergrowth, dense arrow weed.

GENERAL DESCRIPTION.

This township rendered fract. by the Colorado river, is composed of two classes of surface, rolling and level, the level land being river bottom land, subject to overflow. A bend in the course of the river cuts the township into two parts, the northern portion being entirely in the level river bottom, and the southern portion being partly in the river bottom, and partly on a rolling mesa above the river.

The soil over the level land is gravelly, 2nd rate, and that on the rolling land is rocky, 3rd rate.

The timber is a scattering growth of palo verde and ironwood over the rolling land, and a dense growth of willow and scattering cottonwood over the level land.

The undergrowth is greasewood over the rolling land, and dense arrowweed over the level land. There is no permanent running water except that in the Colorado river.

There are no settlers, no improvements, no roads, and no mineral indications in the township. Since the original survey of the S. bdy. of this township in 1901, the channel of the river has changed in such manner as to increase the length of said boundary, and give additional area to this township, and the one adjoining on the south.

Boundaries of fracl. Township 2 North, Range 23 West,  
Latitudes, departures, and closing errors.

North Portion.

Line designated.	Bearing.	Dist.	Latitudes.		Departures.	
			N.	S.	E.	W.
Meanders left bank of Colo. river.	Various	Various	7.72	137.15	79.99	79.83
East bdy. of Tp.	North,	129.30	129.30			
Convergency,						.01
Totals,			137.02	137.15	79.99	79.84
				137.02	79.84	
Error in latitude,				0.13		
Error in departure,					0.15	

South Portion.

Line designated.	Bearing.	Dist.	Latitudes.		Departures.	
			N.	S.	E.	W.
Meanders Left Bank of Colo. river.	Various	Various	1.21	114.77	6.26	176.05
	East,	50.00			50.00	
South boundary of Tp.,	S. 89° 53' E	39.81		.08	39.81	
	S. 89° 56' E	39.99		.05	39.99	
	S. 89° 59' E	39.99		.01	39.99	
East boundary of Tp.,	North,	113.30	113.30			
Convergency,						.03
Totals,			114.51	114.91	176.05	176.08
				114.51		176.05
Error in latitude,				0.40		
Error in departure,						0.03

220

BOOK 3184

CERTIFICATE OF UNITED STATES SURVEYOR.

I, William B. Kimmel, U. S. Surveyor, hereby certify upon honor that, in pursuance of special instructions received from the U. S. Surveyor General for Group 47, Arizona, bearing date of the 5th day of February, 1915, I have well, faithfully, and truly in my own proper person, and in strict conformity with said instructions, the Manual of Surveying Instructions, and the laws of the United States, ~~surveyed~~ <sup>retraced</sup> all those parts or portions of the South boundary, and Surveyed all those parts or portions of the Subdivision lines, and South boundary, and the Meanders of the Left Bank of the Colorado River, within fracl. TOWNSHIP 2 NORTH, RANGE 23 WEST, of the Gila and Salt River Base and Meridian, in the State of Arizona, which are represented in the foregoing field notes as having been executed by me, and under my direction; and that all the corners of <sup>retracement and</sup> said ~~survey~~ have been established and perpetuated in strict accordance with the Manual of Surveying Instructions, and the special written instructions of the U. S. Surveyor General for Group 47, Arizona, and in the specific manner described in the field notes, and that the foregoing are the original field notes of such ~~survey~~ <sup>retracement and survey</sup>.

*William B. Kimmel*  
U. S. Surveyor.

APPROVAL.

OFFICE OF THE UNITED STATES SURVEYOR GENERAL,

Phoenix, Arizona, March 20, 1918'

The foregoing field notes of the ~~survey~~ <sup>retracement</sup> of portion of South boundary ~~and survey~~ of Subdivision lines, ~~and~~ portion of South bdy., and Meanders of the left bank of the Colorado River, within fracl. TOWNSHIP 2 NORTH, RANGE 23 WEST, of the Gila and Salt River Base and Meridian, in the State of Arizona, executed by William B. Kimmel, U. S. Surveyor, under his special instructions dated Feb. 5, 1915, for Group 47, Arizona, having been critically examined, and the necessary corrections and explanations made, the said field notes, and the <sup>retracement &</sup> ~~surveys~~ they describe, are hereby approved.

*Frank A. Frost*  
U. S. Surveyor General.

~~I certify that the foregoing transcript of the field notes of the above described surveys in~~  
~~has been correctly copied from the original notes on file in this office.~~

U. S. Surveyor General.