

3188

1910

Book "B"
4-679

BOOK 3188

FIELD NOTES

OF THE SURVEY OF PART

of the

SUBDIVISION LINES

of

TOWNSHIP 10 SOUTH, RANGE 16 EAST,

Of the Gila and Salt River Base and Meridian,

In the State of Arizona.

EXECUTED BY

John F. Hesse,

In the capacity of U. S. Surveyor, under instructions dated October 1, 1915,
issued by the United States Surveyor General to govern surveys included in
Group No. 57, which were approved by the Commissioner of the General Land
Office, November 30, 1915.

Survey commenced November 20, 1915.

Survey completed November 28, 1915.

Executed under Assignment
Instructions dated Oct. 18, 1915.

3188

3188

BOOK 3188

3188

Book "B"

Group 57 - - - Arizona.

INDEX DIAGRAM.

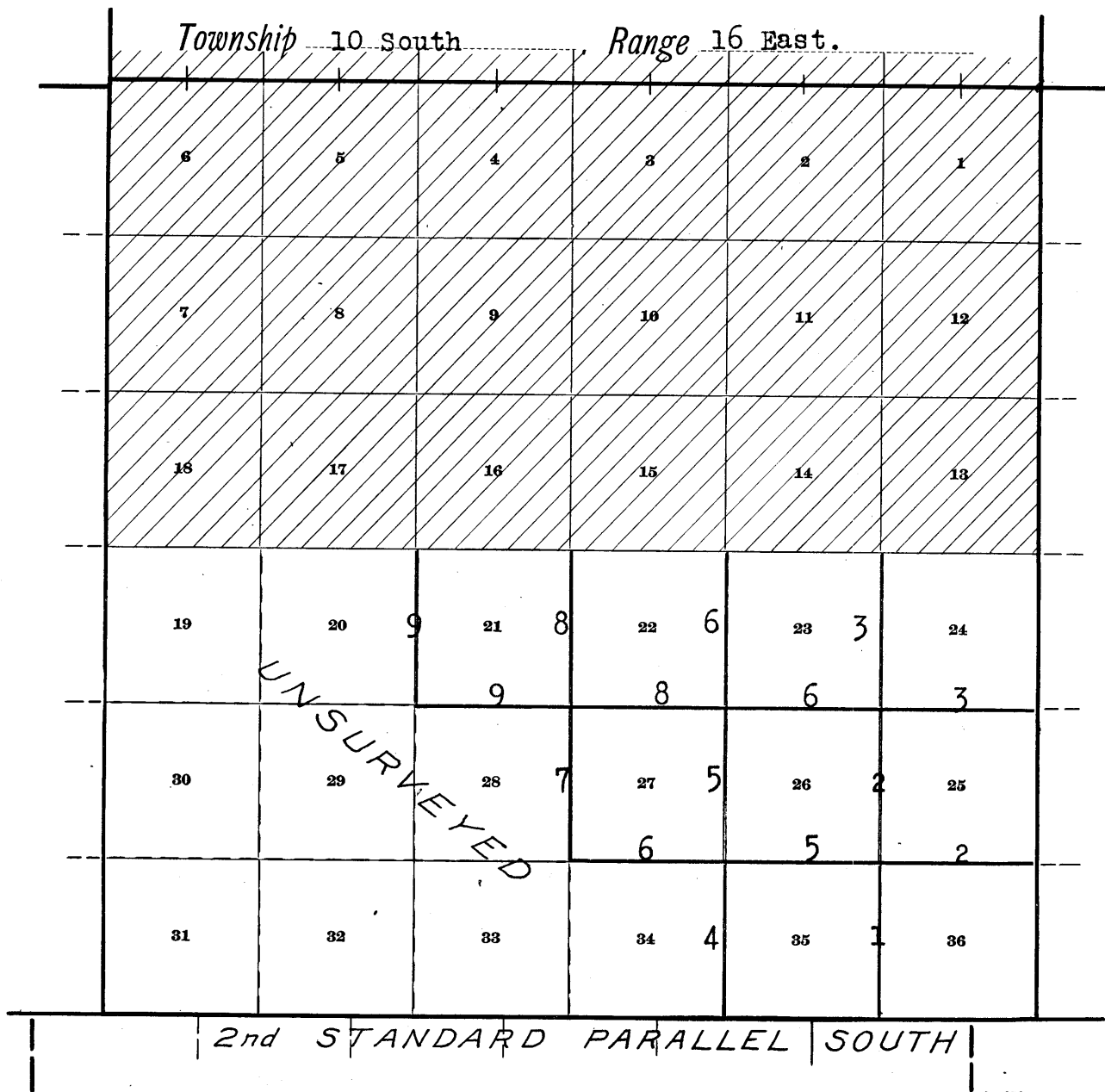

— Subdivision lines surveyed under this group.

 Areas surveyed, as per accepted plats on file.

--- Unsurveyed lines.

— Accepted surveys.

Survey of part of Subdivision of T. 10 S. R. 16 E.

Chains. Surveys executed by John F. Hesse, U.S. Surveyor, on dates shown on diagram on page 11 hereof, using an A. Lietz light mountain transit no. 6166 with solar attachment. The horizontal limb is provided with two double verniers placed opposite to each other, reading to single minutes of arc, which is also the least count of the verniers of the latitude and declination arcs.

The instrument was approved by the Assistant Supervisor of Surveys for Arizona and California, October 18, 1915, conditional upon satisfactory field tests. November 17, 1915.

I examine the adjustments of the transit, and correct all errors; then, to test the solar apparatus, by comparing its indications, resulting from solar observations made during a.m. and p.m. hours, with a meridian determined by observations on Polaris, I proceed as follows: At my camp which is located near the cor. of secs. 15, 16, 21 and 22, T. 10 S. R. 16 E.; latitude 32° 33' 01" N., longitude 110° 42' 24" W.; I set off 32° 33' N. on the lat. arc; 18° 52' S. on the decl. arc; and, at 4h. oom. p.m., l.m.t., determine with the solar a meridian and mark a point thereof, on a stone firmly set in the ground, 5 chs. N. of my station.

November 18, 1915.

At 3h. 43m. a.m. by my watch, which has correct l.m.t., I observe Polaris at western elongation in accordance with Manual of Instructions, and mark a point in the line thus determined, on a peg driven in the ground, 5 chs. N. of my stations

At 7h. 45m. a.m., l.m.t., I lay off the azimuth of Polaris, 1° 21' to the east, and mark the meridian thus determined, by cutting a small groove in the stone set November 17, on which the meridian falls 0.3 ins. east of the mark determined by the solar.

At 8h. 00m. a.m., l.m.t., I set off 32° 33' N. on the lat. arc; 19° 01½' S. on the decl. arc; and mark a point in the meridian determined with the solar, by a cross on the stone already set 5 chs. N. of my station; this mark falls 0.2 ins. east of the meridian established by the Polaris observation.

The solar apparatus by p.m. and a.m. observations, defines positions for meridians, respectively about 0' 16" west and 0' 11" east of the meridian established by the Polaris observations; therefore I conclude that the adjustments of the instrument are satisfactory.

The magnetic bearing of the true meridian at 8h. 05m. a.m., is N. 14° 00' W.; the angle thus determined gives the mag. decl. 14° 00' E.

From the standard cor. of secs. 35 and 36, on the south boundary of the Ep. (2nd Standard Parallel South), which is a quartz stone, 10x8x6 ins. above ground, firmly set, marked and witnessed, as described by the Surveyor General,

N. 0° 09' W. bet. secs. 35 and 36. On top of ridge, through scattering brush.

- 10.00 Descend.
- 18.95 Wash, 20 lks. wide, course NE. 150 ft. below ridge.
- 19.95 Point of ridge, bears NE. 20 ft. above wash.
- 20.95 Wash, 20 lks. wide, course NE. 27 ft. below point of ridge. Ascend.
- 38.00 Ridge, bears NE. and SW. 180 ft. above wash. Descend.
- 40.00 Set an iron post, 3 ft. long, 26 ins. in the ground, 1 in. diam., for ¼ sec. cor., marked on brass cap

2 Survey of part of Subdivision of T. 19 S. R. 16 E.

Chains.	
	$\frac{1}{4}$ S35 S36 1915 and raise a mound of stone, 2 ft. base, $1\frac{1}{2}$ ft. high, W. of cor.
48.74	Wash, 10 lks. wide, course NE. 188 ft. below ridge. Ascend.
60.00	Ridge, bears NE. and SW. 215 ft. above wash. Descend.
78.00	Set an iron post, 3 ft. long, 2 ins. diam., 24 ins. in the ground, for witness cor. to cor. of secs. 25, 26, 35 & 36 marked on brass cap,
	T10S R16E S26 S25 W C S35 S36 1915 and raise a mound of stone, 2 ft. base, $1\frac{1}{2}$ ft. high, W. of cor.
80.00	Point for cor. of secs. 25, 26, 35 and 36, falls in wash, 50 lks. wide, course SE. 221 ft. below ridge. Land, mountainous. Soil, rocky; 4th. rate. No timber. Undergrowth, mesquite and catclaw. Good grass.
	East on a random line, bet. secs. 25 and 36, from true point for cor.
40.00	Set temp. $\frac{1}{4}$ sec. cor.
80.06	Intersect E. bdy. of Tp. 10 lks. S. of the cor. of secs. 25, 30, 31 and 36, which is a granite stone 14 x 10 x 8 ins. above ground, firmly set, marked and witnessed as described by the surveyor general. Thence S. $89^{\circ} 56'$ W. on a true line, bet. secs. 25 and 36. Descend NW. slope, through scattering brush.
7.34	Wash, 15 lks. wide, course NE. 50 ft. below cor. Ascend.
20.65	Ridge, bears NE. and SW. 150 ft. above wash, Descend.
33.65	Wash, 20 lks. wide, course NE. 160 ft. below ridge. Ascend.
40.03	Set an iron post, 3 ft. long, 1 in. diam., 26 ins. in the ground, for $\frac{1}{4}$ sec. cor., marked on brass cap
	S25 $\frac{1}{4}$ S36 1915 and raise a mound of stone, 2 ft. base, $1\frac{1}{2}$ ft. high, N. of cor.
45.34	Ridge, bears NE. and SW. 157 ft. above wash. Descend.
52.35	Wash, 50 lks. wide, course NE. 127 ft. below ridge, and over rolling land, in bottom of narrow valley.
80.06	The true point for cor. of secs. 25, 26, 35 and 36. Land, mountainous and rolling. Soil, rocky; 4th. rate. No timber. Undergrowth, mesquite and catclaw. Good grass.
	N. $0^{\circ} 09'$ W. bet. secs. 25 and 26, from true point for cor. Ascend, through scattering brush.
10.15	Ridge, bears NE. and SW. 128 ft. above cor. Descend.
15.70	Wash, 10 lks. wide, course E. 84 ft. below ridge. Ascend.
23.15	Ridge, bears E. and W. 111 ft. above wash. Descend.
34.05	Wash, 10 lks. wide, course E. 105 ft. below ridge. Ascend.
40.00	Set an iron post, 3 ft. long, 1 in. diam., 26 ins. in the ground, for $\frac{1}{4}$ sec. cor., marked on brass cap

Chains.

1/4 S26 | S25
1915

and raise a mound of stone, 2 ft. base, 1 1/2 ft. high, W. of cor.

40.15 Ridge, bears E. and W. 100 ft. above wash. Descend.

49.00 100 ft. below ridge, Ascend.

57.80 Ridge, bears E. and W. 106 ft. above 49.00 chn. point. Descend.

66.05 Wash, 15 lks. wide, course E. 77 ft. below ridge, Ascend.

69.08 Ridge, bears E. and W. 32 ft. above wash. Descend.

72.40 Wash, 10 lks. wide, course E. 51 ft. below ridge. Ascend.

80.00 Set an iron post, 3 ft. long, 2 ins. diam., 24 ins. in the ground, for cor. of secs. 23, 24, 25 and 26, marked on brass cap

T10S R16E
S23 | S24
S26 | S25
1915

and raise a mound of stone 2 ft. base, 1 1/2 ft. high, W. of cor.

115 ft. above wash.

Land, mountainous.

Soil, rocky; 4th. rate.

No timber.

Undergrowth, mesquite and catclaw.

Good grass.

N. 89° 56' E. on a random line bet. secs. 24 and 25.

40.00 Set temp. 1/4 sec. cor.

80.12 Intersect E. bdy. of Tp. 22 lks. N. of the cor. of secs. 19, 24, 25 and 30, which is a granite stone 12 x 10 x 9 ins. above ground, firmly set, marked and witnessed as described by the surveyor general.

Thence

N. 89° 50' W. on a true line, bet. secs. 24 and 25.

Descend, through scattering brush.

0.70 Wash, 20 lks. wide, course NE. 15 ft. below cor. Ascend gradually.

18.37 Same wash, 20 lks. wide, course SE.

37.55 Spur, slopes NE, 137 ft. above 0.70 ch. point. Descend along NW. slope.

40.06 Set an iron post, 3 ft. long, 1 in. diam., 26 ins. in the ground, for 1/4 sec. cor., marked on brass cap

S24
1/4
S25
1915

and raise a mound of stone, 2 ft. base, 1 1/2 ft. high, N. of cor.

48.90 Wash, 10 lks. wide, course NE. 53 ft. below spur. Ascend.

80.12 The cor. of secs. 23, 24, 25 and 26.

190 ft. above wash.

Land, mountainous.

Soil, rocky; 4th. rate.

No timber.

Undergrowth.

mesquite and catclaw.

Good grass.

N. 0° 09' W. on a random line, bet. secs. 23 and 24.

40.00 Set temp. 1/4 sec. cor.

79.60 Intersect E. and W. line, 1 lk. E. of the cor. of secs. 13, 14, 23 and 24, which is a porphyry stone 10 x 10 x 10 ins. above ground, firmly set, marked and witnessed

4 Survey of part of 1. Subdivision of T. 10 S. R. 16 E.

Chains

as described by the surveyor general.
 Thence
 S. $0^{\circ} 09'$ E. on a true line, bet. secs. 23 and 24.
 Ascend, through scattering brush.
 6.30 Spur E. 40 ft. above cor. Descend rolling SE. slope.
 39.80 Set an iron post, 3 ft. long, 1 in. diam., 26 ins. in the
 ground, for $\frac{1}{4}$ sec. cor., marked on brass cap
 $\frac{1}{4}$ S23|S24
 1915
 and raise a mound of stone, 2 ft. base, $1\frac{1}{2}$ ft. high, W.
 of cor.
 44.84 Wire fence, bears NE. and SW.
 46.77 Creek, 10 lks. wide, course NE. clear running water 3 ins.
 deep. Bottom of Peppersauce Canyon, 196 ft. below spur.
 Ascend.
 49.65 Wire fence, bears NE. and SW.
 71.50 Ridge, bears NE. and SW. 382 ft. above creek. Descend.
 79.60 The cor. of secs. 23, 24, 25 and 26.
 20 ft. below ridge.
 Land, mountainous.
 Soil, rocky; 4th. rate.
 No timber.
 Undergrowth, catclaw and mesquite.
 Poor grass.

From the Standard cor. of secs. 34 & 35, on the S. bdy. of the Tp.,
 (2nd. Standard Par. S) which is a granite stone 20 x 12 x
 5 ins. lying on top of ground, poorly marked SC on N.
 with 4 grooves on W. and 2 grooves on E. faces; I set
 stone 15 ins. in the ground and remark SC on N., with
 4 grooves on W. and 2 grooves on E. faces; and raise a
 mound of stone, 2 ft. base, $1\frac{1}{2}$ ft. high, N. of cor.

N. $0^{\circ} 09'$ W. bet. secs. 34 and 35.
 Descend, through scattering brush.
 15.10 Wash, 20 lks. wide, course NE. 157 ft. below cor. Ascend.
 29.25 Ridge, bears NE. and SW. 213 ft. above wash. Descend.
 37.48 Wash, 10 lks. wide, course NE. 161 ft. below ridge. Ascend.
 40.00 Set an iron post, 3 ft. long, 1 in. diam., 26 ins. in the
 ground, for $\frac{1}{4}$ sec. cor., marked on brass cap
 $\frac{1}{4}$ S34|S35
 1915
 and raise a mound of stone, 2 ft. base, $1\frac{1}{2}$ ft. high, W.
 of cor.
 43.45 Ridge, bears E. and W. 130 ft. above wash. Descend.
 48.37 Wash, 10 lks. wide, course NE. 115 ft. below ridge. Ascend.
 53.20 Ridge, bears E. and W. 102 ft. above wash. Descend. Wire
 fence, bears $N0^{\circ} 30'$ E. and S. $0^{\circ} 30'$ W.
 62.40 Wash, 15 lks. wide course NE. 150 ft. below ridge. Ascend.
 71.74 Ridge, bears NE. and SW. 102 ft. above wash. Descend.
 77.59 Wash, 15 lks. wide, course E. 111 ft. below ridge. Ascend.
 80.00 Set an iron post, 3 ft. long, 2 ins. diam., 24 ins. in
 the ground, for cor. of secs. 26, 27, 34 and 35, marked
 on brass cap

T10S R16E
 S27|S26
 S34|S35
 1915

and raise a mound of stone, 2 ft. base, $1\frac{1}{2}$ ft. high, W.
 of cor.
 40 ft. above wash.
 Land, mountainous.
 Soil, rocky; 4th. rate.
 No timber.
 Undergrowth, mesquite and catclaw.
 Good grass.

Chains.

East on a random line, bet. secs. 26 and 35.
 40.00 Set temp. $\frac{1}{4}$ sec. cor.
 80.04 Intersect N. and S. line 5 lks. S. of the true point for cor. of secs. 25, 26, 35 and 36.
 Thence
 S. $89^{\circ} 58'$ W. on a true line bet. secs. 26 and 35, from true point for cor.
 Along in wash, 50 lks. wide course E.
 3.50 Leave wash, bears NW. and through scattering brush.
 21.40 Wash 30 lks. wide, course SE.
 34.65 Same wash, 12 lks. wide, course NE. Ascend SE. slope.
 40.02 Set an iron post, 3 ft. long, 1 in. diam., 26 ins. in the ground, for $\frac{1}{4}$ sec. cor., marked on brass cap

$$\begin{array}{r} S26 \\ \frac{1}{4} \\ \hline S35 \\ 1915 \end{array}$$
 and raise a mound of stone, 2 ft. base, $1\frac{1}{2}$ ft. high, N. of cor.
 56.60 Ridge, bears NE. and SW. 203 ft. above wash. Descend.
 66.40 Wash, 18 lks. wide, course NE. 101 ft. below ridge. and along S. slope, gradually ascending.
 79.89 Wire fence, bears N. and S.
 80.04 The cor. of secs. 26, 27, 34 and 35.
 60 ft. above wash.
 Land, mountainous.
 Soil, rocky; 4th. rate.
 No timber.
 Undergrowth, mesquite and catclaw.
 Good grass.

N. $0^{\circ} 09'$ W. bet. secs. 26 and 27.
 Ascend, through scattering brush.
 4.25 Ridge, bears NE. and SW. 75 ft. above cor. Descend.
 22.10 Wash, 30 lks. wide, course NE. 167 ft. below ridge. Ascend.
 30.50 Ridge, bears NE. and SW. 144 ft. above wash. Descend.
 30.50 Wire fence, bears N. $0^{\circ} 30'$ W. and S. $0^{\circ} 30'$ E.
 39.00 Wash, 50 lks. wide, course NE. 230 ft. below ridge. Asc.
 40.00 Set an iron post, 3 ft. long, 1 in. diam., 26 ins. in the ground, for $\frac{1}{4}$ sec. cor., marked on brass cap

$$\begin{array}{r} \frac{1}{4} S27 | S26 \\ 1915 \end{array}$$
 and raise a mound of stone, 2 ft. base, $1\frac{1}{2}$ ft. high, W. of cor.
 41.00 Over nearly level land, 40 ft. above wash.
 55.00 Descend.
 56.35 Corral fence, bears E. and W.
 58.00 Corral fence, bears E. and W., frame house, empty, bears West 3.50 chs.
 58.54 Wash, in bottom of Peppersauce Canyon, 25 lks. wide, course E. 50 ft. below 55.00 chn. point. Ascend.
 80.00 Set an iron post, 3 ft. long, 2 ins. diam., 24 ins. in the ground, for cor. of secs. 22, 23, 26 and 27, marked on brass cap

$$\begin{array}{r} T10S R16E \\ S22 | S23 \\ S27 | S26 \\ 1915 \end{array}$$
 and raise a mound of stone, 2 ft. base, $1\frac{1}{2}$ ft. high, W. of cor.
 301 ft. above wash.
 Land, mountainous.
 Soil, rocky; 4th. rate.
 No timber.
 Undergrowth, mesquite and catclaw.
 Good grass.

6 Survey of part of 1. Subdivision of T. 10 S. R. 16 E.

Chains.	
40.00	N. 89° 58' E. on a random line, bet. secs. 23 and 26. Set temp. $\frac{1}{4}$ sec. cor.
80.06	Intersect N. and S. line, 9 lks. S. of the cor. of secs. 23, 24, 25 and 26. Thence S. 89° 54' W. on a true line, bet. secs. 23 and 26. Along on top ridge, bears NE. and SW. through scattering brush.
21.80	Descend NW. slope.
40.03	Set an iron post, 3 ft. long, 1 in. diam., 26 ins. in the ground, for $\frac{1}{4}$ sec. cor., marked on brass cap S23 $\frac{1}{4}$ S26 1915
	and raise a mound of stone, 2 ft. base, $1\frac{1}{2}$ ft. high, N. of cor.
51.70	Creek, 10 lks. wide, course NE. clear running water, 2 ins. deep. 200 ft. below cor. Ascend.
80.06	The cor. of secs. 22, 23, 26 and 27. 293 ft. above creek. Land, mountainous. Soil, rocky; 4th. rate. Timber, a few sycamores along creek. Undergrowth, mesquite and catclaw. Fair grass.
40.00	N. 0° 09' W. on a random line, bet. secs. 22 and 23. Set temp. $\frac{1}{4}$ sec. cor.
79.80	Intersect E. and W. line, 1 lk. W. of the cor. of secs. 14, 15, 22 and 23, which is a porphyry stone 8 x 6 x 4 ins. above ground, firmly set, marked and witnessed as described by the surveyor general. Thence S. 0° 09' E. on a true line, bet. secs. 22 and 23. Over rolling hilly land, through dense brush.
17.00	Wash, 25 lks. wide, course NE.
25.00	Ascend. Brush becomes scattering.
32.02	Spur, slopes E. 103 ft. above wash; descend.
39.90	Set an iron post, 3 ft. long, 1 in. diam., 26 ins. in the ground, for $\frac{1}{4}$ sec. cor., marked on brass cap $\frac{1}{4}$ S22 S23 1915
	and raise a mound of stone, 2 ft. base, $1\frac{1}{2}$ ft. high, W. of cor.
48.50	60 ft. below spur, Ascend. Spur, slopes W. 40 ft. above $\frac{1}{4}$ sec. cor. Descend.
60.90	Wash, 40 lks. wide, course NE. 86 ft. below spur. Ascend.
75.50	Ridge, bears NE. and SW. 156 ft. above wash. Descend.
79.80	The cor. of secs. 22, 23, 26 and 27. 20 ft. below ridge. Land, mountainous. Soil, rocky; 4th. rate. No timber. Undergrowth, mesquite and catclaw. Fair grass.
11.30	From cor. of secs. 26, 27, 34 and 35, West, on a true line, bet. secs. 27 and 34. Ascend along SE. slope, through scattering brush.
18.40	Ridge, bears NE. and SW. 95 ft. above cor. Descend.
30.20	Wash, 10 lks. wide, course NE. 75 ft. below ridge. Ascend.
37.43	Ridge, bears NE. and SW. 143 ft. above wash. Descend. Set an iron post, 3 ft. long, 1 in. diam., 26 ins. in the ground for witness cor. to $\frac{1}{4}$ sec. cor., marked on brass cap S27 WC $\frac{1}{4}$ S34 1915

Survey of part of the Subdivision of T. 10 S. R. 16 E.

Chains.	<p>from which</p> <p>An oak, 4 ins. diam., bears N. 72° E. 41 lks. dist., marked WC$\frac{1}{4}$S27BT</p> <p>An oak, 5 ins. diam., bears S. 57$\frac{1}{2}$° E. 42 lks. dist., marked WC$\frac{1}{4}$S34BT</p> <p>40.00 Point for $\frac{1}{4}$ sec. cor. falls in wash, 30 lks. wide, course NE. 136 ft. below ridge. Ascend.</p> <p>64.40 Spur, slopes S 211 ft. above wash; descend.</p> <p>70.80 Wash, 15 lks. wide, course SE. 75 ft. below spur. Ascend through scattering timber, bears NW. and SE.</p> <p>80.00 Set an iron post, 3 ft. long, 2 ins. diam., 24 ins. in the ground, for cor. of secs. 27, 28, 33 and 34, marked on brass cap</p> <p style="text-align: center;">T10S R16E S28 S27 S33 S34 1915</p> <p>from which</p> <p>An oak, 10 ins. diam., bears N. 31° W. 28 lks. dist., marked T10SR16ES28BT</p> <p>An oak, 5 ins. diam., bears N. 17$\frac{1}{2}$° E. 67 lks. dist., marked T10SR16ES27BT</p> <p>An oak, 8 ins. diam., bears S. 40$\frac{3}{4}$° E. 115 lks. dist., marked T10SR16ES34BT</p> <p>An oak, 24 ins. diam., bears S. 27$\frac{1}{4}$° W. 293 lks. dist., marked T10SR16ES33BT</p> <p>138 ft. above wash. Land, mountainous. Soil, rocky; 4th. rate. No timber, except a few oaks on N. slopes. Undergrowth, mesquite and catclaw</p>
---------	--

1.00	N. 0° 10' W. bet. secs. 27 and 28.
12.38	Along E. slope of mountain, through scattering oaks. Spur, slopes E. 10 ft. above cor.
14.80	Wash, 20 lks. wide, course SE. 72 ft. below spur. Leave oaks bearing NE. and SW. Ascend.
20.25	Ridge, bears E. and W. 57 ft. above wash. Descend.
23.70	Wash, 15 lks. wide, course E. 83 ft. below ridge. Ascend.
31.00	Ridge, bears E. and W., 34 ft. above wash. Descend.
40.00	Wash, 25 lks. wide, course NE. 112 ft. below ridge. Asc. Set an iron post, 3 ft. long, 1 in. diam., 26 ins. in the ground, for $\frac{1}{4}$ sec. cor., marked on brass cap
	$\frac{1}{4}$ S28 S27 1915
	and raise a mound of stone, 2 ft. base, 1 $\frac{1}{2}$ ft. high, W. of cor.
42.20	Ridge, bears NE. and SW. 118 ft. above wash. Descend.
55.80	Creek in bottom of Peppersauce Canyon, 10 lks. wide, 2 ins. deep, clear running water, course E. Ascend.
71.92	Ridge bears E. and W. 269 ft. above creek. Descend.
74.21	R. S. Brady house bears N. 22 $\frac{3}{4}$ ° E.
80.00	Set an iron post, 3 ft. long, 2 ins. diam., 24 ins. in the ground, for cor. of secs. 21, 22, 27 and 28, marked on brass cap
	T10S R16E S21 S22 S28 S27 1915
	and raise a mound of stone, 2 ft. base, 1 $\frac{1}{2}$ ft. high, W. of cor.
	50 ft. below ridge. Land, mountainous. Soil, rocky; 4th. rate. Timber, A few oaks on N. slopes, and a few sycamores along creek. Undergrowth, oak, catclaw and mesquite.

8 Survey of part of Subdivision of T. 10 S. R. 16 E.

Chains.	
	Good grass.
40.00	East on a random line, bet. secs. 22 and 27. Set temp. $\frac{1}{4}$ sec. cor.
80.02	Intersect N. and S. line, 5 lks. S. of the cor. of secs. 22, 23, 26 and 27. Thence S. $89^{\circ} 58'$ W. on a true line, bet. secs. 22 and 27. Ascend SE. slope, through scattering brush.
0.30	Wire fence, bears N. and S.
5.00	Along on top of ridge, 20 ft. above cor.
33.00	Descend gradually along N. slope.
40.01	Set an iron post, 3 ft. long, 1 in. diam., 26 ins. in the ground, for $\frac{1}{4}$ sec. cor., marked on brass cap S22 $\frac{1}{4}$ S27 1915
	from which An oak, 10 ins. diam., bears N. $16\frac{1}{4}^{\circ}$ W. 117 lks. dist., marked $\frac{1}{4}$ S22BT An oak, 14 ins. diam., bears S. $5\frac{3}{4}^{\circ}$ E. 308 lks. lks. dist., marked $\frac{1}{4}$ S27BT
80.02	The cor. of secs. 21, 22, 27 and 28. 40 ft. below ridge. Land, mountainous. Soil, rocky; 4th. rate. No timber. Undergrowth, mesquite, catclaw and oak. Fair grass.
40.00	N. $0^{\circ} 10'$ W. on a random line, bet. secs. 21 and 22. Set temp. $\frac{1}{4}$ sec. cor.
79.82	Intersect E. and W. line, 7 lks. E. of the cor. of secs. 15, 16, 21 and 22, which is a granite stone, 8 x 8 x 6 ins. above ground, firmly set, marked and witnessed as described by the surveyor general. Thence S. $0^{\circ} 13'$ E. on a true line, bet. secs. 21 and 22. Over rolling hilly land, through dense brush.
19.00	Fence, N. side of corral, bears E. and W.
19.90	Fence, S. side of corral, bears E. and W.
24.00	Wash, 50 lks. wide, course NE. Ascend.
39.91	Set an iron post, 3 ft. long, 1 in. diam., 26 ins. in the ground, for $\frac{1}{4}$ sec. cor., marked on brass cap $\frac{1}{4}$ S21 S22 1915
	from which An oak, 14 ins. diam., bears N. 24° W. 147 lks. dist., marked $\frac{1}{4}$ S21BT An oak, 8 ins. diam., bears N. $47\frac{1}{2}^{\circ}$ E. 169 lks. dist., marked $\frac{1}{4}$ S22BT
48.60	Wire fence, bears NW. and SE.
49.16	Road, bears SE. to Brady's ranch and NW. to Oracle.
50.60	Ridge, bears E. and W. 199 ft. above wash. Brush becomes scattering. Descend.
51.60	R. S. Brady house bears S. $64^{\circ} 46'$ E.
64.00	Wash, 10 lks. wide, course NE. 50 ft. below ridge. Ascend.
68.90	Ridge, bears E. and W. 45 ft. above wash. Descend.
74.50	Wash, 10 lks. wide, course E. 60 ft. below ridge. Ascend.
79.82	The cor. of secs. 21, 22, 27 and 28. 110 ft. above wash. Land, mountainous. Soil, rocky; 4th. rate.

Chains.

No timber.
Undergrowth, mesquite and catclaw.
Fair grass.

West bet. secs. 21 and 28.
Along N. slope, through scattering brush.

9.00 Ascend.
13.30 Ridge, bears NE. and SW. 50 ft. above cor. Descend.
22.60 Wash, 10 lks. wide, course NE. Ascend along SW. slope. 36 ft. below ridge.

40.00 Set an iron post, 3 ft. long, 1 in. diam., 26 ins. in the ground, for $\frac{1}{4}$ sec. cor., marked on brass cap
S21
 $\frac{1}{4}$
S28
1915

and raise a mound of stone, 2 ft. base, $1\frac{1}{2}$ ft. high, N. of cor.

71.50 Ridge, bears NE. and SW. 388 ft. above wash. Descend, through scattering oaks.

80.00 Set an iron post, 3 ft. long, 2 ins. diam., 24 ins. in the ground, for cor. of secs. 20, 21, 28 and 29, marked on brass cap

T10S R16E
S20|S21
S29|S28
1915

from which

An oak, 14 ins. diam., bears N. $15\frac{1}{2}^\circ$ W. 56

lks. dist., marked T10SR16ES20BT

An oak, 12 ins. diam., bears N. $56\frac{1}{4}^\circ$ E. 47

lks. dist., marked T10SR16ES21BT

An oak, 7 ins. diam., bears S. $50\frac{3}{4}^\circ$ E. 14

lks. dist., marked T10SR16ES28BT

An oak, 10 ins. diam., bears S. 17° W. 70

lks. dist., marked T10SR16ES29BT

158 ft. below ridge.
Land, mountainous.
Soil, rocky; 4th. rate.
Timber, a few oaks.
Undergrowth, mesquite and catclaw.
Fair grass.

40.00 N. $0^\circ 10'$ W. on a random line, bet. secs. 20 and 21.
Set temp. $\frac{1}{4}$ sec. cor.

79.88 Intersect E. and W. line, 12 lks. E. of the cor. of secs. 16, 17, 20 and 21, which is a quartz stone, 12 x 10 x 8 ins. above ground, firmly set, marked and witnessed as described by the surveyor general.

Thence

S. $0^\circ 15'$ E. on a true line, bet. secs. 20 and 21.

Over rolling hilly land, through dense brush and scattering oak timber.

8.36 Wash, 15 lks. wide, course NE. Ascend.

31.85 Spur, slopes NE., 159 ft. above wash. Descend.

39.96 Point for $\frac{1}{4}$ sec. cor., falls in wash, 20 lks. wide, course NE. 90 ft. below spur. Ascend.

40.44 Set an iron post, 3 ft. long, 1 in. diam., 26 ins. in the ground, for witness cor. to $\frac{1}{4}$ sec. cor., marked on brass cap,

S20|S21
 $\frac{1}{4}$
WC
1915

from which

10 survey of part of. Subdivision of T. 10 S. R. 16 E.

Chains.

An oak, 14 ins. diam., bears S. 22° E. 54 lks. dist., marked WC $\frac{1}{4}$ S21BT
 A mesquite, 7 ins. diam., bears S. 50 $\frac{3}{4}$ ° W. 116 lks. dist., marked WC $\frac{1}{4}$ S20BT

40.97 Old road, bears NE. and SW.
 57.97 Ridge, bears NE. and SW. 323 ft. above wash. And from this point U. S. M. M. No. 4 Old Hat Mining District, bears N. 61° 00' W. 77.71 chs. dist. Descend.
 79.20 Wash, 10 lks. wide, course NE. 85 ft. below ridge. Ascend.
 79.88 The cor. of secs. 20, 21, 28 and 29, 17 ft. above wash.
 Land, mountainous.
 Soil, rocky; 4th. rate.
 Timber, scattering oaks.
 Undergrowth, mesquite and catclaw.
 Fair grass.

GENERAL DESCRIPTION.

This township is located near the foot of the east slope of the Santa Catalina Mts., and is mountainous and the soil, generally rocky. Clear running water is found in the bottom of Peppersauce Canyon, which runs through secs. 23, 24, 26 and 27. There is a scattering growth of oak in the western part of this survey. Good grass grows in all the secs. surveyed. There is one settler in sec. 22.

Boundaries of that portion of T. 10 S., R. 16 E. subdivided under this Group.

Latitudes, departures, and closing errors.

Line designated.	True bearing.	Dist.	Latitudes.		Departures.	
			N.	S.	E.	W.
South boundary, (2nd. Std. Par. S.)	West,	160.00				160.00
Subdivisional boundary	N. 0° 9' W.	80.00	80.00			.21
	West,	80.00				80.00
	N. 0° 10' W.	80.00	80.00			.23
	West,	80.00				80.00
	N. 0° 15' W.	79.88	79.88			.35
East boundary	N. 89° 59' E.	320.00	.09		320.00	
Convergency	S. 0° 8' E.	240.00		240.00	.56	
	Totals,		239.97	249.00	320.68	320.79
				239.97		320.68
	Error in latitude,			0.03		
	Error in departure					0.11

Book "B"

Group 57 - - - Arizona.

Township 10 South, Range 16 East.

DATE DIAGRAM.

6	5	4	3	2	1
7	8	9	10	11	12
18	17	16 <i>T.10S.</i>	15 <i>R.16E.</i>	14	13
19	20	21	22	23	24
	<i>11-26-15</i>	<i>11-24-15</i>	<i>11-24-15</i>	<i>11-22-15</i>	<i>11-22-15</i>
30	29	28	27	26	25
		<i>11-28-15</i>	<i>11-23-15</i>	<i>11-21-15</i>	<i>11-20-15</i>
31	32	33	34	35	36
			<i>11-21-15</i>	<i>11-20-15</i>	

2nd. Std. Parallel South

Surveys executed on dates as shown on diagram above,
by John F. Hesse, U. S. Surveyor.

BOOK 3188

CERTIFICATE
FINAL OATH OF UNITED STATES SURVEYOR.

I, John E. Hesse, U.S. Surveyor, ~~U. S. Surveyor~~, hereby certify upon honor, do solemnly swear that, in pursuance of special instructions received from the U. S. Surveyor General for Group 57, Arizona, bearing date of the 1st day of October, 1915, I have well, faithfully, and truly, in my own proper person, and in strict conformity with said instructions, the Manual of Surveying Instructions, and the laws of the United States, surveyed all those parts or portions of the subdivision lines of TOWNSHIP 10 SOUTH, RANGE 16 EAST,

of the Gila and Salt River Base and Meridian, in the State of Arizona, which are represented in the foregoing field notes as having been executed by me, and under my direction; and ~~I do further solemnly swear~~ that all the corners of said survey have been established and perpetuated in strict accordance with the Manual of Surveying Instructions, and the special written instructions of the U. S. Surveyor General for Group 57, Arizona, and in the specific manner described in the field notes, and that the foregoing are the original field notes of such survey.

John E. Hesse
U. S. Surveyor.

Subscribed by said _____, and sworn to before me }
~~this~~ day of _____, 1915



APPROVAL.

OFFICE OF THE UNITED STATES SURVEYOR GENERAL,
Phoenix, Arizona, October 14, 1918.

The foregoing field notes of the survey of parts of the subdivision lines of TOWNSHIP 10 SOUTH, RANGE 16 EAST,

of the Gila and Salt River Base and Meridian, in the State of Arizona, executed by John E. Hesse, U. S. Surveyor, under his special instructions dated October 1st, 1915, for Group 57, Arizona, having been critically examined, and the necessary corrections and explanations made, the said field notes, and the surveys they describe, are hereby approved.

Frank O. Frost
U. S. Surveyor General.

I certify that the foregoing transcript of the field notes of the above described surveys in _____, ~~has been correctly copied from the original notes on file in this office.~~