

3219

Book "F"
4-679

127
①

OK 3219

FIELD NOTES

OF THE SURVEY OF THE

West boundary, and

Part of the Subdivision lines, and

Part of the Meanders of the Left Bank of Little Colorado river, within

TOWNSHIP 24 NORTH, RANGE 11 EAST,

Of the Gila and Salt River Base and Meridian,

In the State of Arizona.

EXECUTED BY

Thomas B. Matthews.

In the capacity of U. S. Surveyor, under Special Instructions dated Dec. 17, 1915, issued by the United States Surveyor General to govern surveys included in Group No. 68, which were approved by the Commissioner of the General Land Office, Jan. 7, 1916, and Assignment Instructions dated Feb. 3, 1916.

Survey commenced March 25, 1916

Survey completed April 4, 1916

3219

3219

3219
Book "F"

BOOK 3219

Group 68 - - - Arizona.

SEE SPECIAL INDEX DIAGRAM.

INDEX DIAGRAM.

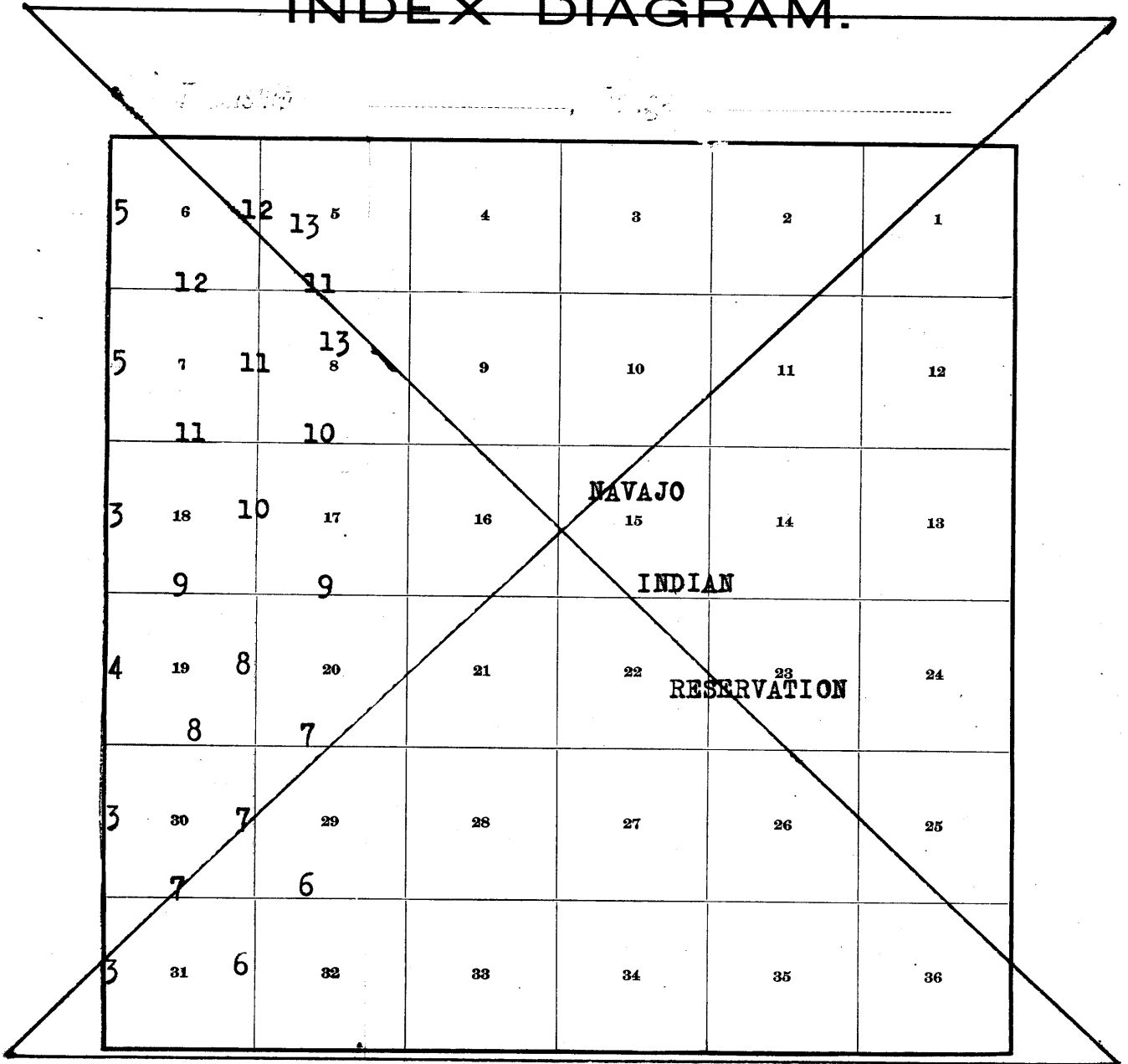

Book "F." 3219
 Group 68 Arizona
 INDEX DIAGRAM

BOOK 3219

129
 1A

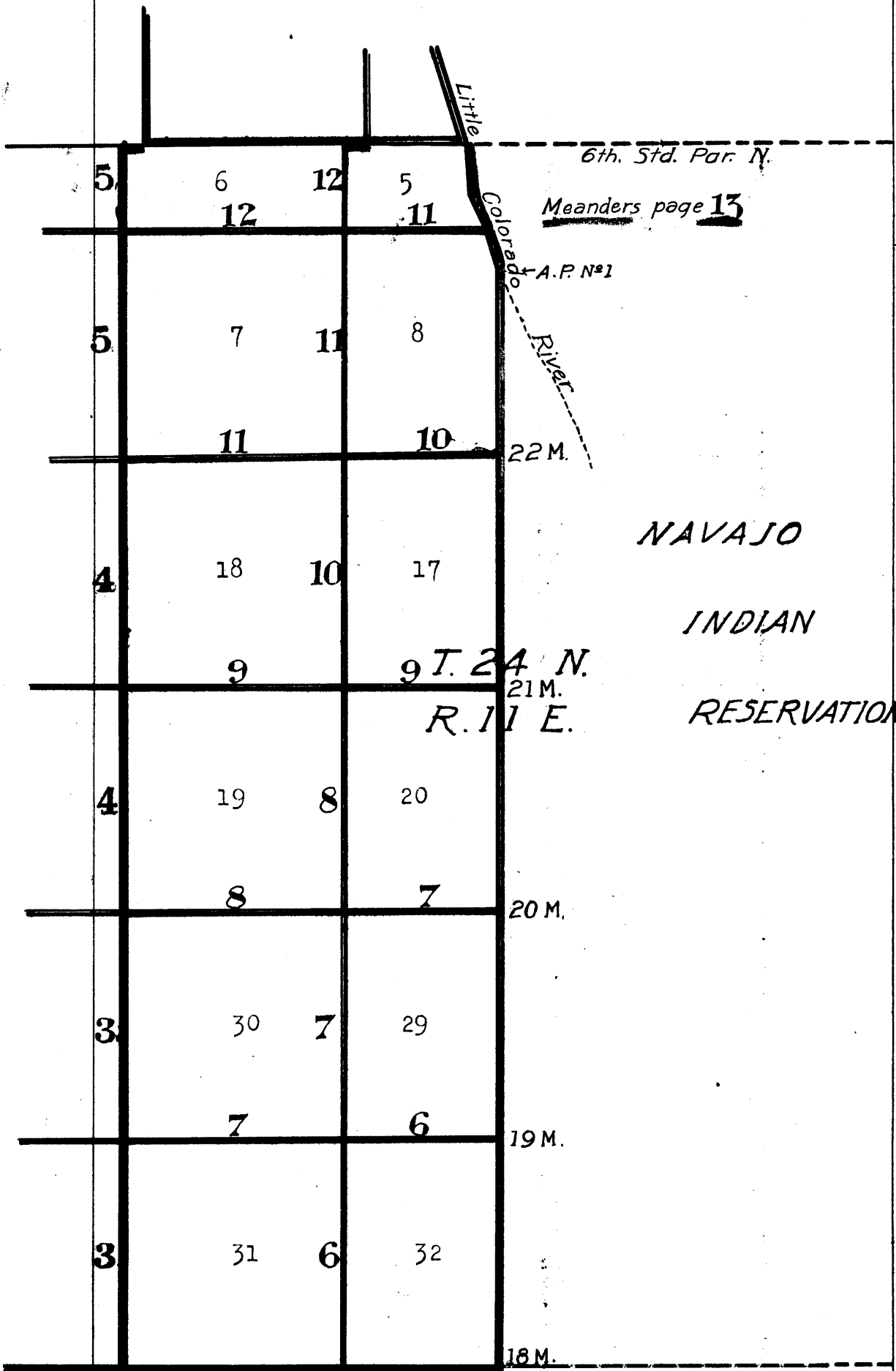

- Lines surveyed under this group, notes in this book. 3219
- Lines surveyed under this group, notes in Book "A." 3214
- Lines surveyed under this group, notes in Book "B." 3215
- Lines surveyed under this group, notes in Book "C." 3218
- Lines surveyed under this group, notes in Book "G." 3220
- Accepted surveys.
- Unsurveyed.
- Executed under current Group 68.

Group 68 Arizona
DATE DIAGRAM

BOOK 3219

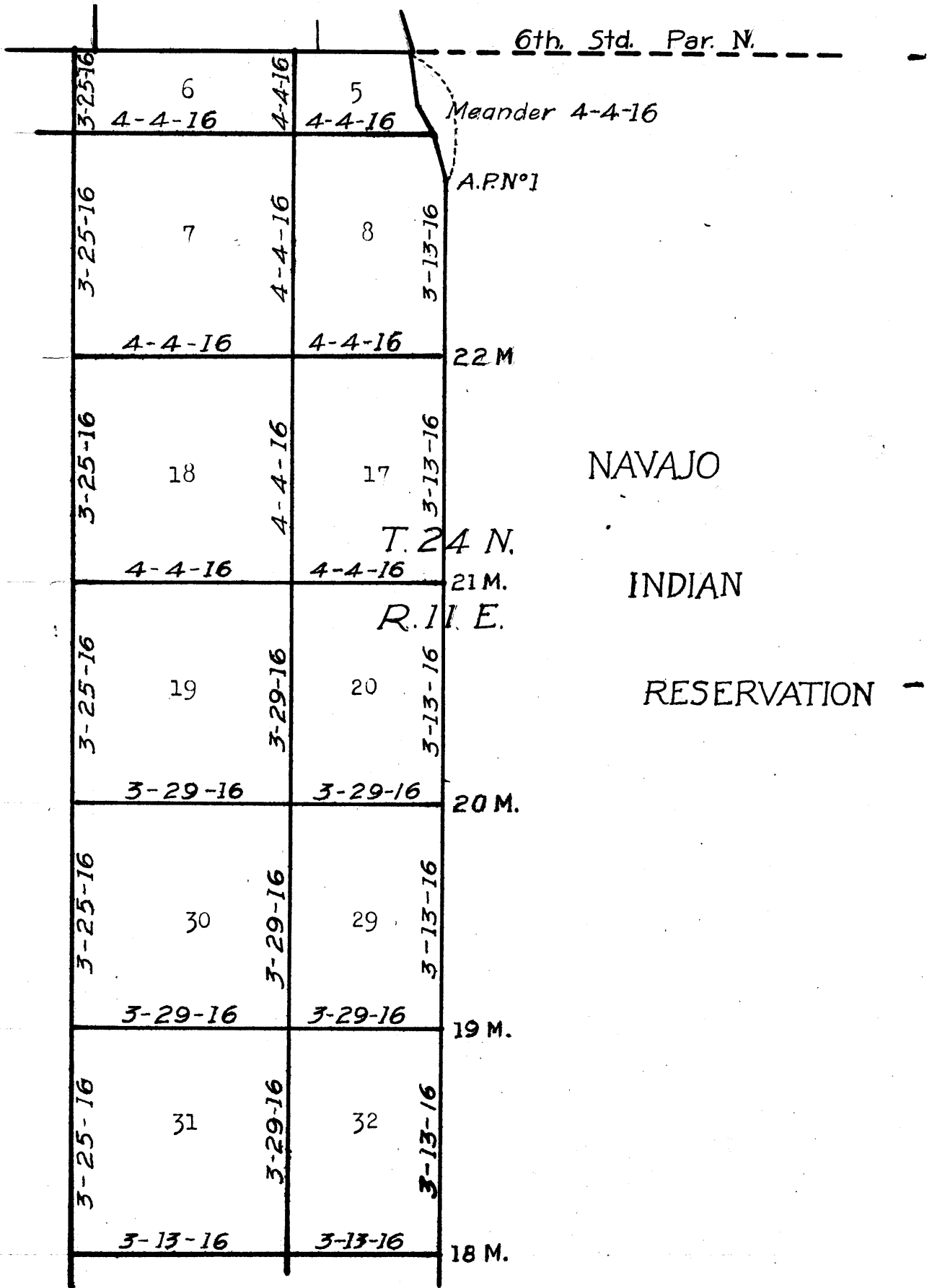

Surveys executed by Thomas B. Matthews, U.S. Surveyor,
on various dates shown hereon.

Survey of West boundary of Township 24 North, Range 11 East, and Part of the Subdivision lines, and Meanders of the Left Bank of the Little Colorado River, within Township 24 North, Range 11 East.

Chains Surveys executed on dates shown on diagram on page 2 of this book, by Thos. B. Matthews, U.S. surveyor, using a Buff and Buff light mountain transit No. 10124 described in Book "A".

From recent and repeated field tests of the transit and solar attachment, on a meridian determined by observations on Polaris, the adjustments are known to be satisfactory.

West Bdy. of T24 N., R. 11 E.

From the cor. of T's. 23 and 24 N., Rs. 10 and 11 E., described in Book "D," North bet. secs. 31 and 36.

Over gently rolling land, through scattering undergrowth. Wire fence brs. NE. and SW.
7.50
40.00 Set an iron post, 3 ft. long, 1 in. diam., 16 ins. in the ground, in a mound of stone, for $\frac{1}{4}$ sec. cor., mkd. on brass cap

T24N
R10E R11E
S36 | S31
1916

and raise a mound of stone, 3 ft. base, 3 ft. high, W. of cor.

43.70 Rocky wash, 2 chs. wide, course NE.
80.00 Set an iron post, 3 ft. long, 3 ins. diam., 24 ins. in the ground, for cor. of secs. 25, 30, 31 and 36, mkd. on brass cap

T24N
R10E R11E
S25 | S30
S36 | S31
1916

dig pits, 18 X 18 X 12 ins., in each sec., $5\frac{1}{2}$ ft. dist.; and raise a mound of earth, 4 ft. base, 2 ft. high, W. of cor.

Land, gently rolling.
Soil, thin and rocky.
No timber.
Undergrowth, brigham brush, shadscale and soap weed.
Sparse growth of grass.

North bet. secs. 25 and 30.

40.00 Over gently rolling land, through scattering undergrowth. Set an iron post, 3 ft. long, 1 in. diam., 24 ins. in the ground, for $\frac{1}{4}$ sec. cor., mkd. on brass cap

T24N
R10E R11E
S25 | S30
1916

and raise a mound of stone, 3 ft. base, 3 ft. high, W. of cor.

80.00 Set an iron post, 3 ft. long, 3 ins. diam., 24 ins. in the ground, for cor. of secs. 19, 24, 25 and 30, mkd. on brass cap

T24N
R10E R11E
S24 | S19
S25 | S30
1916

Survey of West boundary of Township. 24 N. R. 11 E.

Chains

dig pits, 18 X 18 X 12 ins., in each sec., 5 1/2 ft. dist.; and raise a mound of earth, 4 ft. base, 2 ft. high, W. of cor.
Land, gently rolling.
Soil, thin cinders, rocky subsoil.
No timber.
Undergrowth, rabbit brush, shadscale and brigham brush.
Fair grass.

40.00 North bet. secs. 19 and 24.
Over gently rolling land, through scattering undergrowth.
Set an iron post, 3 ft. long, 1 in. diam., 10 ins. in the ground, in a mound of stone, for 1/4 sec. cor., mkd. on brass cap

S24 | S19
1916

79.02 and raise a mound of stone, 3 ft. base, 3 ft. high, W. of cor.
80.00 Rim of mesa brs. E. and W. 29 ft. high.
Set an iron post, 3 ft. long, 3 ins. diam., 18 ins. in the ground, in a mound of stone, for cor. of secs. 13, 18, 19 and 24, mkd. on brass cap

T24N
R10E R11E
S13 | S18
S24 | S19
1916

and raise a mound of stone, 3 ft. base, 3 ft. high, W. of cor.
Land, gently rolling.
Soil, thin, rocky subsoil.
No timber.
Undergrowth, rabbit brush, brigham brush and shadscale.
Sparse growth of grass.

20.00 North bet. secs. 13 and 18.
40.00 Over gently rolling land, through scattering undergrowth.
Draw, 2 chs. wide, course NE.
Set an iron post, 3 ft. long, 1 in. diam., 18 ins. in the ground, for 1/4 sec. cor., mkd. on brass cap

S13 | S18
1916

80.00 and raise a mound of stone, 3 ft. base, 3 ft. high, W. of cor.
Set an iron post, 3 ft. long, 3 ins. diam., 24 ins. in the ground, for cor. of secs. 7, 12, 13 and 18, mkd. on brass cap

T24N
R10E R11E
S12 | S 7
S13 | S18
1916

dig pits, 18 X 18 X 12 ins., in each sec., 5 1/2 ft. dist.; and raise a mound of earth, 4 ft. base, 2 ft. high, W. of cor.
Land, rolling.

Chains

Soil, thin cinders, rock subsoil.
No timber.
Undergrowth, rabbit brush, shadscale and brigham brush.
Sparse growth of grass.

40.00 North bet. secs. 7 and 12.
Over gently rolling land, through scattering undergrowth.
Set an iron post, 3 ft. long, 1 in. diam., 12 ins. in the ground, in a mound of stone, for $\frac{1}{4}$ sec. cor., mkd. on brass cap

S12 | S 7
1916

48.20 and raise a mound of stone, 3 ft. base, 3 ft. high, W. of cor.

60.20 South rim of canyon 15 ft. deep, course NE.

80.00 North rim of canyon.

Set an iron post, 3 ft. long, 3 ins. diam., 14 ins. in the ground, in a mound of stone, for cor. of secs. 7 and 12, and frac. secs. 1 and 6, marked on brass cap,

T24 N
R10E R11E
S 1 | S 6
S12 | S 7
1916

dig pits, 18 X 18 X 12 ins., in each sec., $5\frac{1}{2}$ ft. dist.; and raise a mound of earth, 4 ft. base, 2 ft. high, W. of cor.

Land, gently rolling.

Soil, coarse gravel and cinders, rocky subsoil.

No timber.

Undergrowth, scattering rabbit brush and brigham brush.

Fair grass.

30.82 North bet. frac. secs. 1 and 6.
Over gently rolling prairie land, through scattering undergrowth.
Intersect 6th Standard Parallel N., 8.91 chs. W. of orig. standard cor. of Ts. 25 N., Rs. 10 and 11 E., which is a limestone, 9 X 14 X 5 ins., firmly set, mkd. and witnessed as described by the Surveyor General.

At the point of intersection,

Set an iron post, 3 ft. long, 3 ins. diam., 24 ins. in the ground, for closing cor. of T_s 24 N., R_s 10 and 11 E., marked on brass cap.

T25N R10E
S36
C | C
S 1 | S 6
R10E R11E
T24N
1916

and raise a mound of stone, 3 ft. base, 3 ft. high, S. of cor.

Land, gently rolling.

Soil, thin cinders, rocky subsoil.

No timber.

Undergrowth, scattering rabbit brush and brigham brush.

Fair grass.

6

Survey of part of Subdivision lines of T. 24 N., R. 11 E.

Chains	From the cor. of secs. 6 and 31 and fracl. secs. 5 & 32, on S. bdy. of township, described in Book "D,"
	N. 0° 1' E. bet. sec. 31 and fracl. sec. 32.
	Over gently rolling land, through scattering undergrowth.
2.50	Top of rocky ledge brs. E. and W.
25.00	Asc. 38 ft. to
31.68	Top of rocky point slopes E.
35.00	Asc. 23 ft. to
40.00	Set an iron post, 3 ft. long, 1 in. diam., 26 ins. in the ground, for $\frac{1}{4}$ sec. cor., mkd. on brass cap
	$\frac{1}{4}$ S31 S32 1916
	dig pits, 18 X 18 X 12 ins., N. and S. of post, 3 ft. dist.; and raise a mound of earth, $3\frac{1}{2}$ ft. base, $1\frac{1}{2}$ ft. high, W. of cor.
	Asc. 114 ft. to
57.93	Top of spur slopes NE. From this point, Grand Falls on the Little Colorado River brs. N. $89\frac{3}{4}$ ° E. Tolcharo Mission brs. S. 69 ° E. Water tank at Leupp brs. S. 58 ° $35'$ E. Desc. N. slope, 170 ft. to
72.20	Ledge of rock brs. E. and W. Ravine course E. Asc. to
75.89	Top of spur brs. E. and W. Desc. 63 ft. to
80.00	Set an iron post, 3 ft. long, 2 ins. diam., 24 ins. in the ground, for cor. of secs. 30 and 31 and fracl. secs. 29 and 32, mkd. on brass cap
	T24N R11E S30 S29 S31 S32 1916
	dig pits, 18 X 18 X 12 ins., in each sec., $5\frac{1}{2}$ ft. dist.; and raise a mound of earth, 4 ft. base, 2 ft. high, W. of cor.
	Land, rolling hills.
	Soil, coarse gravel and cinders, 26 ins. deep.
	No timber.
	Undergrowth, scattering rabbit brush.
	Fair grass.
	E. boundary
	East on a random line bet. fracl. secs. 29 and 32.
40.00	Set temp. $\frac{1}{4}$ sec. cor.
55.12	Intersect W. bdy. of Navajo Indian Reservation, 4 lks. S. of the 19 mile post thereof; also, cor. of fracl. secs. 29 and 32, described in book "A"
	Thence
	S. 89 ° $57'$ W. on a true line bet. fracl. secs. 29 and 32.
	Over rolling land, through scattering undergrowth.
15.12	Set an iron post, 3 ft. long, 1 in. diam., 26 ins. in the ground, for $\frac{1}{4}$ sec. cor., mkd. on brass cap
	$\frac{1}{4}$ S 29 $\frac{1}{4}$ S 32 1916
	dig pits, 18 X 18 X 12 ins., E. and W. of post, 3 ft. dist.; and raise a mound of earth, $3\frac{1}{2}$ ft. base, $1\frac{1}{2}$ ft. high, N. of cor.
25.00	Asc. 201 ft. to
47.63	Top of spur slopes NE. Desc. 23 ft. to
55.12	The cor. of secs. 30 and 31 and fracl. secs. 29 and 32.
	Land, rolling and hilly.
	Soil, coarse gravel, cinders and rock.
	No timber.
	Undergrowth, schadscale and rabbit brush.
	Fair grass.

Part of Subdivision Lines of T. 24 N. R. 11 E. 7

Chains	<p>From the cor. of secs. 30 and 31 and frac. secs. 29 and 32, the cor. of secs. 25, 30, 31 and 36, being plainly visible, N. 89° 58' W. on a random line for dist. only, bet. secs. 30 and 31.</p> <p>40.00 Set temp. $\frac{1}{4}$ sec. cor. 79.98 Intersect W. bdy. of Tp., at the cor. of secs. 25, 30, 31 and 36, hereinbefore described.</p> <p>Thence S. 89° 58' E. on a true line bet. secs. 30 and 31. Over rolling land, through scattering undergrowth.</p> <p>39.99 Set an iron post, 3 ft. long, 1 in. diam., 26 ins. in the ground, for $\frac{1}{4}$ sec. cor., mkd. on brass cap</p> $\begin{array}{r} \frac{1}{4} \text{ S } 30 \\ \frac{1}{4} \text{ S } 31 \\ \hline 1916 \end{array}$ <p>dig pits, 18 X 18 X 12 ins., E. and W. of post, 3 ft. dist.; and raise a mound of earth, $3\frac{1}{2}$ ft. base, $1\frac{1}{2}$ ft. high, N. of cor.</p> <p>55.00 Asc. 149 ft. to 79.98 The cor. of secs. 30 and 31 and frac. secs. 29 and 32. Land, rolling. Soil, coarse gravel and cinders, 26 ins. deep. No timber. Undergrowth, scattering brigham brush and rabbit brush. Good grass.</p> <hr/> <p>N. 0° 1' E. bet. sec. 30 and frac. sec. 29. Over rolling hilly land, through scattering undergrowth. Desc. 177 ft. to</p> <p>19.71 Foot of slope. Thence over gently rolling land. 40.00 Set an iron post, 3 ft. long, 1 in. diam., 26 ins. in the ground, for $\frac{1}{4}$ sec. cor., mkd. on brass cap</p> $\begin{array}{r} \frac{1}{4} \\ \text{S30} \text{S29} \\ \hline 1916 \end{array}$ <p>dig pits, 18 X 18 X 12 ins., N. and S. of post, 3 ft. dist.; and raise a mound of earth, $3\frac{1}{2}$ ft. base, $1\frac{1}{2}$ ft. high, W. of cor.</p> <p>80.00 Set an iron post, 3 ft. long, 2 ins. diam., 12 ins. in the ground, in a mound of stone, for cor. of secs. 19 and 30 and frac. secs. 20 and 29, mkd. on brass cap</p> $\begin{array}{r} \text{T24N R11E} \\ \text{S19} \text{S20} \\ \hline \text{S30} \text{S29} \\ \hline 1916 \end{array}$ <p>and raise a mound of stone, 3 ft. base, 3 ft. high, W. of cor. Land, rolling. Soil, thin with rocky subsoil. No timber. Undergrowth, scattering schadscale and rabbit brush. Fair grass.</p> <hr/> <p>East on a random line bet. frac. secs. 20 and 29. Set temp. $\frac{1}{4}$ sec. cor. 40.00 Intersect W. bdy. of Navajo Indian Reservation, 12 lks. 54.98 S. of the 20 mile post thereof; also cor. of frac. secs. 20 and 29., described in book "A" Thence</p>
--------	---

8 Part of Subdivision lines of T. 24 N. R. 11 E.

Chains	S. 89° 52' W. on a true line bet. fracl. secs. 20 and 29. Over rolling land, through scattering undergrowth. Old indian ruins bear N. 6 ft. dist.
10.65	
14.98	Set an iron post, 3 ft. long, 1 in. diam., 26 ins. in the ground, for $\frac{1}{4}$ sec. cor., mkd. on brass cap
	$\begin{array}{r} \frac{1}{4} \text{ S } 20 \\ \frac{1}{4} \text{ S } 29 \\ \hline 1916 \end{array}$
	dig pits, 18 X 18 X 12 ins., E. and W. of post, 3 ft. dist.; and raise a mound of earth, $3\frac{1}{2}$ ft. base, $1\frac{1}{2}$ ft. high, N. of cor.
32.00	Small ledge of rock brs. NE. and SW.
54.98	The cor. of secs. 19 and 30 and fracl. secs. 20 and 29. Land, rolling. Soil, thin and rocky. No timber. Undergrowth, scattering rabbit and sagebrush. Fair grass.
	West on a random line bet. secs. 19 and 30.
40.00	Set temp. $\frac{1}{4}$ sec. cor.
80.00	Intersect W. bdy. of Tp., 11 lks. S. of cor. of secs. 19, 24, 25 and 30, hereinbefore described.
	Thence
	S. 89° 55' E. on a true line bet. secs. 19 and 30. Over rolling land, through scattering undergrowth.
40.00	Set an iron post, 3 ft. long, 1 in. diam., 20 ins. in the ground, in a mound of stone, for $\frac{1}{4}$ sec. cor., mkd. on brass cap
	$\begin{array}{r} \frac{1}{4} \text{ S } 19 \\ \frac{1}{4} \text{ S } 30 \\ \hline 1916 \end{array}$
	and raise a mound of stone, 3 ft. base, 3 ft. high, N. of cor.
42.52	Desc. gradual slope.
78.50	Rocky ledge brs. N. and S.
80.00	The cor. of secs. 19 and 30 and fracl. secs. 20 and 29. Land, rolling. Soil, thin and rocky. No timber. Undergrowth, scattering brigham brush, buck brush. Fair grass.
	N. 0° 1' E. bet. sec. 19 and fracl. sec. 20. Over rolling land, through scattering undergrowth.
27.50	Rim-rock, 15 ft. high, brs. NE. and SW.
40.00	Set an iron post, 3 ft. long, 1 in. diam., 26 ins. in the ground, for $\frac{1}{4}$ sec. cor., mkd. on brass cap
	$\begin{array}{r} \frac{1}{4} \\ \text{S19} \text{S20} \\ \hline 1916 \end{array}$
	dig pits, 18 X 18 X 12 ins., N. and S. of post, 3 ft. dist.; and raise a mound of earth, $3\frac{1}{2}$ ft. base, $1\frac{1}{2}$ ft. high, W. of cor.
70.00	Dry sandy wash, 50 lks. wide, course NE.
74.22	Rim-rock 40 ft. high, brs. NE. and SW. Asc. onto mesa.
80.00	Set an iron post, 3 ft. long, 3 ins. diam., 8 ins. in the ground, for cor. of secs. 18 and 19 and fracl. secs. 17 and 20, mkd. on brass cap

Part of Subdivision ~~of~~ T. 24 N., R. 11 E.

Chains

T24N R11E
S18 | S17
S19 | S20
1916

and raise a mound of stone, 3 ft. base, 3 ft. high,
W. of cor.
Land, rolling.
Soil, thin except cinder deposits.
No timber.
Undergrowth, brighambrush, rabbit brush and schadscale
brush.
Sparse growth of grass.

40.00 East on a random line bet. fracl. secs. 17 and 20.
Set temp. 1/4 sec. cor.
54.92 Intersect W. bdy. of Navajo Indian Reservation, 12 lks.
S. of 21 mile post thereof; also cor. of fracl. secs.
17 and 20, described in Book "A."
Thence
S. 89° 52' W. on a true line bet. fracl. secs. 17 and 20.
Over rolling land, through scattering undergrowth.
Asc. 20 ft. to
3.10 Rim-rock brs. N. and SE.
14.92 Set an iron post, 3 ft. long, 1 in. diam., 26 ins. in the
ground, for 1/4 sec. cor., mkd. on brass cap

1/4 S 17
1/4 S 20
1916

dig pits, 18 X 18 X 12 ins., E. and W. of post, 3 ft.
dist.; and raise a mound of earth, 3 1/2 ft. base, 1 1/2 ft.
high, N. of cor.
26.70 E. rim-rock of small canyon brs. N. and S. Desc. 17 ft. to
28.70 Bottom of small canyon, course N. Asc. 16 ft. to
31.80 W. rim-rock brs. N. and S.
38.10 E. rim-rock of canyon brs. NE. and SW. Desc. 52 ft. to
40.36 Bottom of canyon, course NE. Asc. 50 ft. to
50.00 NW. rim-rock of canyon brs. NE. and SW.
54.92 The cor. of secs. 18 and 19 and fracl. secs. 17 and 20.
Land, rolling and hilly.
Soil, thin, cinders, rocky subsoil.
No timber.
Undergrowth, rabbit brush, brigham brush.
Fair grass.

40.00 West on a random line bet. secs. 18 and 19.
Set temp. 1/4 sec. cor.
79.99 Intersect W. bdy. of Tp., at the cor. of secs. 13, 18,
19 and 24, hereinbefore described.
Thence
East on a true line bet. secs. 18 and 19.
Over rolling land, through scattering undergrowth.
5.00 Old indian ruins bear S. 175 lks. dist.
6.20 Top of small flat knoll. Desc. 55 ft. to
25.00 Thence over gently rolling land.
39.99 1/2 Set an iron post, 3 ft. long, 1 in. diam., 26 ins. in the
ground, for 1/4 sec. cor., mkd. on brass cap

1/4 S 18
1/4 S 19
1916

dig pits, 18 X 18 X 12 ins., E. and W. of post, 3 ft.
dist.; and raise a mound of earth, 3 1/2 ft. base, 1 1/2 ft.
high, N. of cor.

10 Part of Subdivision Lines of T. 24 N. R. 11 E.

Chains

79.99

The cor. of secs. 18 and 19 and fracl. secs. 17 and 20.
Land, rolling.
Soil, thin, rocky subsoil.
No timber.
Undergrowth, rabbit brush and buck brush.
Good grass.

40.00

N. 0° 1' E. bet. sec. 18 and fracl. sec. 17.
Over gently rolling land, through scattering undergrowth.
Set an iron post, 3 ft. long, 1 in. diam., 10 ins. in the
ground, in a mound of stone, for $\frac{1}{4}$ sec. cor., mkd. on
brass cap.

$$\begin{array}{c} \frac{1}{4} \\ S18 | S17 \\ 1916 \end{array}$$

80.00

and raise a mound of stone, 3 ft. base, 3 ft. high,
W. of cor.
Set an iron post, 3 ft. long, 2 ins. diam., 18 ins. in the
ground, in a mound of stone, for cor. of secs. 7 and
18 and fracl. secs. 8 and 17, mkd. on brass cap

$$\begin{array}{c} T24N R11E \\ S 7 | S 8 \\ S18 | S17 \\ 1916 \end{array}$$

and raise a mound of stone, 3 ft. base, 2 $\frac{1}{2}$ ft. high,
W. of cor.
Land, gently rolling prairie.
Soil, thin and rocky.
No timber.
Undergrowth, rabbit brush and brigham brush.
Fair grass.

40.00

54.87

East on a random line bet. fracl. secs. 8 and 17.
Set temp. $\frac{1}{4}$ sec. cor.
Intersect W. bdy. of Navajo Indian Reservation, 16 lks.
S. of 22 mile post thereof; also, cor. of fracl. secs.
8 and 17, described in book "A"

14.87

Thence
S. 89° 50' W. on a true line bet. fracl. secs. 8 and 17.
Over rolling land, through scattering undergrowth.
Set an iron post, 3 ft. long, 1 in. diam., 18 ins. in the
ground, in a mound of stone, for $\frac{1}{4}$ sec. cor., mkd. on
brass cap

$$\begin{array}{c} \frac{1}{4} S 8 \\ S 17 \\ 1916 \end{array}$$

23.00

23.50

29.20

54.87

and raise a mound of stone, 3 ft. base, 3 ft. high,
N. of cor.
Rim-rock brs. NE. and SW. Desc. 23 ft. to
Bottom of small canyon. Asc. 35 ft. to
Rim-rock brs. NE. and SW.
The cor. of secs. 7 and 18 and fracl. secs. 8 and 17.
Land, gently rolling and broken.
Soil, thin and rocky.
No timber.
Undergrowth, brigham brush and rabbit brush.
Fair grass.

Part of Subdivision lines of T. 24 N., R. 11 E. 11

Chains
 40:00 West on a random line bet. secs. 7 and 18.
 Set temp. $\frac{1}{4}$ sec. cor.
 79.96 Intersect W. bdy. of Tp., 6 lks. S. of cor. of secs. 7, 12, 13 and 18, hereinbefore described.
 Thence
 S. $89^{\circ} 57'$ E. on a true line bet. secs. 7 and 18.
 Over rolling land, through scattering undergrowth.
 19.00 W. rim of flat point.
 20.00 Top of flat point.
 31.10 Rocky rim brs. NE. and SW.
 39.98 Set an iron post, 3 ft. long, 1 in. diam., 26 ins. in the ground, for $\frac{1}{4}$ sec. cor., mkd. on brass cap

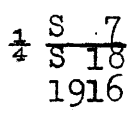

and raise a mound of stone, 3 ft. base, $2\frac{1}{2}$ ft. high, N. of cor.
 62.56 W. rim of canyon brs. NE. and SW. Desc. into
 63.66 Bottom of small canyon course NE. Asc. to
 66.10 E. rim of small canyon brs. NE. and SW.
 79.96 The cor. of secs. 7 and 18 and frac. secs. 8 and 17. Land, rolling and broken. Soil, thin and rocky. No timber. Undergrowth, scattering brigham brush, rabbit brush. Fair grass.

40.00 N. $0^{\circ} 1'$ E. bet. sec. 7 and frac. sec. 8. Over level land, through scattering undergrowth. Set an iron post, 3 ft. long, 1 in. diam., 10 ins. in the ground, in a mound of stone, for $\frac{1}{4}$ sec. cor. mkd. on brass cap

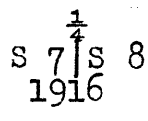

80.00 and raise a mound of stone, 3 ft. base, 3 ft. high, W. of cor. Set an iron post, 3 ft. long, 2 ins. diam., 14 ins. in the ground, in a mound of stone, for cor. of sec. 7, and frac. secs. 5, 6, and 8, marked on brass cap,

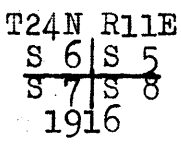

and raise a mound of stone, 3 ft. base, 3 ft. high, W. of cor. Land, level. Soil, thin, cinders in hollows, sandstone subsoil. No timber. Undergrowth, brigham brush, rabbit brush. Sparse growth of grass.

1.30 N. $89^{\circ} 57'$ E. on a true line bet. frac. secs. 5 and 8. Over nearly level land, through scattering undergrowth.
 26.70 Wagon road brs. NW. and SE.
 27.84 W. rim of small canyon brs. N. and S.
 28.90 Bottom of canyon, 40 ft. deep, course N.
 40.00 E. rim of canyon brs. N. and S. Set an iron post, 3 ft. long, 1 in. diam., 15 ins. in the ground, in a mound of stone, for $\frac{1}{4}$ sec. cor., mkd. on

12 Part of Subdivision, lines of T. 24 N., R. 11 E.

Chains

brass cap

1/4 S 5
S 8
1916

- 48.00 Top of W. rim of the Little Colorado River brs. NW. and SE. Desc. 153 ft. to
- 50.67 Left bank of the Little Colorado River. Impractical to set meander cor. on account of loose sand, therefore at
- 48.87 Set an iron post, 3 ft. long, 2 ins. diam., 26 ins. in the ground, for witness cor. to meander cor. of fracl. secs. 5 and 8, mkd. on brass cap

T24N
R11E
S 5 WC
S 8 MC
1916

and raise a mound of stone, 2 ft. base, 1 1/2 ft. high, W. of cor.
Land, rolling and broken.
Soil, thin, cinders in hollows.
No timber.
Undergrowth, brigham brush and sagebrush.
Fair grass.

- 40.00 From cor. of sec. 7, and fracl. secs. 5, 6, and 8, West on a random line bet. sec. 7, and fracl. sec. 6. Set temp. 1/4 sec. cor.
- 80.06 Intersect W. bdy. of Tp., 16 lks. S. of cor. of secs. 7, and 12, and fracl. secs. 1 and 6, hereinbefore described. Thence S. 89° 53' E. on a true line bet. sec. 7, and fracl. sec. 6. Over gently rolling land, through scattering undergrowth.
- 28.40 W. rim of draw brs. NE. and SW.
- 32.55 Bottom of draw, course NE.
- 36.00 E. rim of draw, brs. NE. and SW.
- 40.03 Set an iron post, 3 ft. long, 1 in. diam., 26 ins. in the ground, for 1/4 sec. cor., mkd. on brass cap

1/4 S 6
S 7
1916

- 80.06 and raise a mound of stone, 3 ft. base, 3 ft. high, N. of cor.
Thence over nearly level land.
The cor. of sec. 7, and fracl. secs. 5, 6, and 8.
Land, rolling and level.
Soil, thin, cinders in hollows, sandstone subsoil.
No timber.
Undergrowth, scattering brigham brush, rabbit brush.
Sparse growth of grass.

- 2.00 N. 0° 1' E. on a true line, bet. fracl. sec. 5 and 6. Over gently rolling land, through scattering undergrowth. Wagon road brs. NW. and SE.
- 30.99 Intersect 6th standard parallel N., 8.93 chs. W. of the standard cor. of sec. 31 and fracl. sec. 32, T. 25 N., R. 11 E., which is an iron post, 3 ins. diam., properly set, mkd. and witnessed as described by the Surveyor General under current Group No. 66.

Part of Subdivision lines of T. 24 N., R. 11 E.

Chains

At the point of intersection,
Set an iron post, 3 ft. long, 2 ins. diam., 12 ins. in
the ground, in a mound of stone, for closing cor.
of fracl. secs. 5 and 6, marked on brass cap,

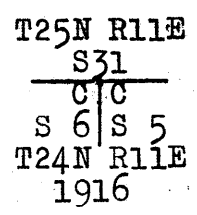

and raise a mound of stone, 3 ft. base, 3 ft. high,
S. of cor.
Land, rolling and broken.
Soil, thin cinders in hollows.
No timber.
Undergrowth, scattering brigham brush, and sagebrush.
Sparse growth of grass.

Part of the
Meanders of Left Bank of Little Colorado River
Within T. 24 N., R. 11 E.

From the true point for the meander cor. of
fracl. sec. 8 and the Navajo Indian Reservation, at
the intersection of the W. bdy. of the N. I. R.
with the left bank of the Little Colorado River,
2.38 chs. N. of witness cor. to said meander cor., de-
scribed in Book "A,"

Thence with meanders in fracl. sec. 8, downstream.
Along sandy bank of river.
N. 12 $\frac{1}{2}$ ° W. 15.20 chs. Banks 4 to 6 ft. high.
N. 13° 56' W. 2.80 chs. To meander cor. of fracl. secs.
5 and 8, hereinbefore described.
Vertical rim-rock 150 ft. high,
brs. NW. and SE.

Land, rolling along river.
Soil, sandy and rocky.
No timber.
Undergrowth, willow and cottonwood brush.

Thence with meanders in fracl. sec. 5, down stream.
Along sandy river bank.
N. 21 $\frac{1}{4}$ ° W. 11.80 chs.
N. 3° 50' W. 19.95 " To the standard meander cor. on
S. bdy. of sec. 32, T. 25 N., R.
11 E., which is an iron post, 3
ins. diam., 6 ins. above ground,
mkd. and witnessed as described
by the Surveyor General under
current Group No. 66.

Land, gently rolling along river.
Soil, loose sand.
No timber.
Undergrowth, scattering willow and cottonwood brush.
Sparse growth of grass.

Boundaries of that portion of Township 24 North, Range 11 East, outside of the Navajo Indian Reservation.

LATITUDES, DEPARTURES, AND CLOSING ERRORS.

Line designated.	True bearing.	Dist.	Latitudes.		Departures.	
			N.	S.	E.	W.
South Tp. bdy.,	S. 89° 57' W.,	135.00	430.82	.12		135.00
West Tp. bdy.,	North,	430.82				
North Tp. bdy. (6th. Std. Par. N)	East,	125.20			125.20	
Meanders of Left bank of Little Colo. river, (E. bdy.),	Various,	Various,		48.46	9.57	
West bdy. of NA- VAJO IND. RES. (E. bdy.),	South,	382.52		382.52		
Convergency,					.12	
Totals,			430.82	431.10	134.89	135.00
				430.82		134.89
Error in latitude,			----- 0.28			
Error in departure,			-----		0.11	

General Description.

This township, situated in the north central portion of the State of Arizona, is traversed by the Little Colorado river, and the greater portion of the township lies within the Navajo Indian Reservation. The subdivision of the township as described in the foregoing notes is confined to that portion situated outside the Reservation. The surface is mostly rolling and hilly, with general drainage NE. The soil is thin and rocky, mixed with cinders, except along the river, where it is sandy. There is no timber, and the undergrowth of brigham brush, shadscale, soapweed and rabbit brush is scattering. Scattering undergrowth of willow and cottonwood along the river.

No permanent running water exists except in Little Colorado river. No evidence of valuable mineral deposits could be found. No settlers or improvements in the portion of township surveyed. Several groups of Indian ruins are located in various parts of the township. One road NW. and SE., passes thru. the northern part of the surveyed portion. Grand Falls on the Little Colorado river is situated within the Navajo Indian Reservation in the unsurveyed portion of the Tp.

Book "F."
4-680

BOOK 3212

FIELD ASSISTANTS. TO
Thomas B. Matthews, U. S. Surveyor,
Group 68.

NAMES.	CAPACITY.
Vergil Bell,	1st chainman
Ernest Darough,	2nd chainman
Chris. C. Lee,	Cornerman,
Ray Adcock,	Cornerman,
R. A. Lane,	Axman and 2nd chainman,
Alfred C. England,	Flagman.

144
BOOK 3219
16

For CERTIFICATE OF UNITED STATES SURVEYOR.
see Book "B."

I, _____, U. S. Surveyor, hereby certify upon honor that, in pursuance of special instructions received from the U. S. Surveyor General for _____ bearing date of the _____ day of _____, 191____, I have well, faithfully, and truly in my own proper person, and in strict conformity with said instructions, the Manual of Surveying Instructions, and the laws of the United States, surveyed all those parts or portions of _____ of the _____ Meridian, in the State of _____, which are represented in the foregoing field notes as having been executed by me, and under my direction; and that all the corners of said survey have been established and perpetuated in strict accordance with the Manual of Surveying Instructions, and the special written instructions of the U. S. Surveyor General for _____ and in the specific manner described in the field notes, and that the foregoing are the original field notes of such survey.

U. S. Surveyor.

APPROVAL.

OFFICE OF THE UNITED STATES SURVEYOR GENERAL,

Phoenix, Arizona, January 15, 1919

The foregoing field notes of the survey of the _____ West boundary, and _____ Part of the Subdivision lines, and part of the Meanders of the left bank of the Little Colorado River, within TOWNSHIP 24 NORTH, RANGE 11 EAST,

of the Gila and Salt River Base and Meridian, in the State of Arizona, executed by Thomas B. Matthews, U. S. Surveyor, under his special instructions dated Dec. 17, 1915, for Group 68, Arizona, having been critically examined, and the necessary corrections and explanations made, the said field notes, and the surveys they describe, are hereby approved.

Frank Q. Frost
U. S. Surveyor General.

~~I certify that the foregoing transcript of the field notes of the above described surveys in _____ has been correctly copied from the original notes on file in this office.~~

~~U. S. Surveyor General.~~