

3220

Book "G"
4-679

JAN 1 1916

BOOK 3220

FIELD NOTES

RESURVEY OF

3220

Portions of the East bdy. of

TOWNSHIP 24 NORTH, RANGE 9 EAST,

and SURVEY of

Subdivision lines of

TOWNSHIP 24 NORTH, RANGE 10 EAST,

Of the Gila and Salt River Base and Meridian,

In the State of Arizona.

EXECUTED BY

Thomas B. Matthews, U.S. Surveyor,

and

Jos. C. Clark, U.S. Transitman,

In the capacity of U.S. Surveyor, under Special Instructions dated Dec. 17, 1915, issued by the United States Surveyor General to govern surveys included in Group No. 68, which were approved by the Commissioner of the General Land Office, Jan. 7, 1916, and Assignment Instructions dated Feb. 3, 1916

3220

Resurvey & Survey commenced March 27, 1916

Resurvey & Survey completed April 5, 1916

1A

3220
Book "G"

Group 68 - - - Arizona.

BOOK 3220

INDEX DIAGRAM.

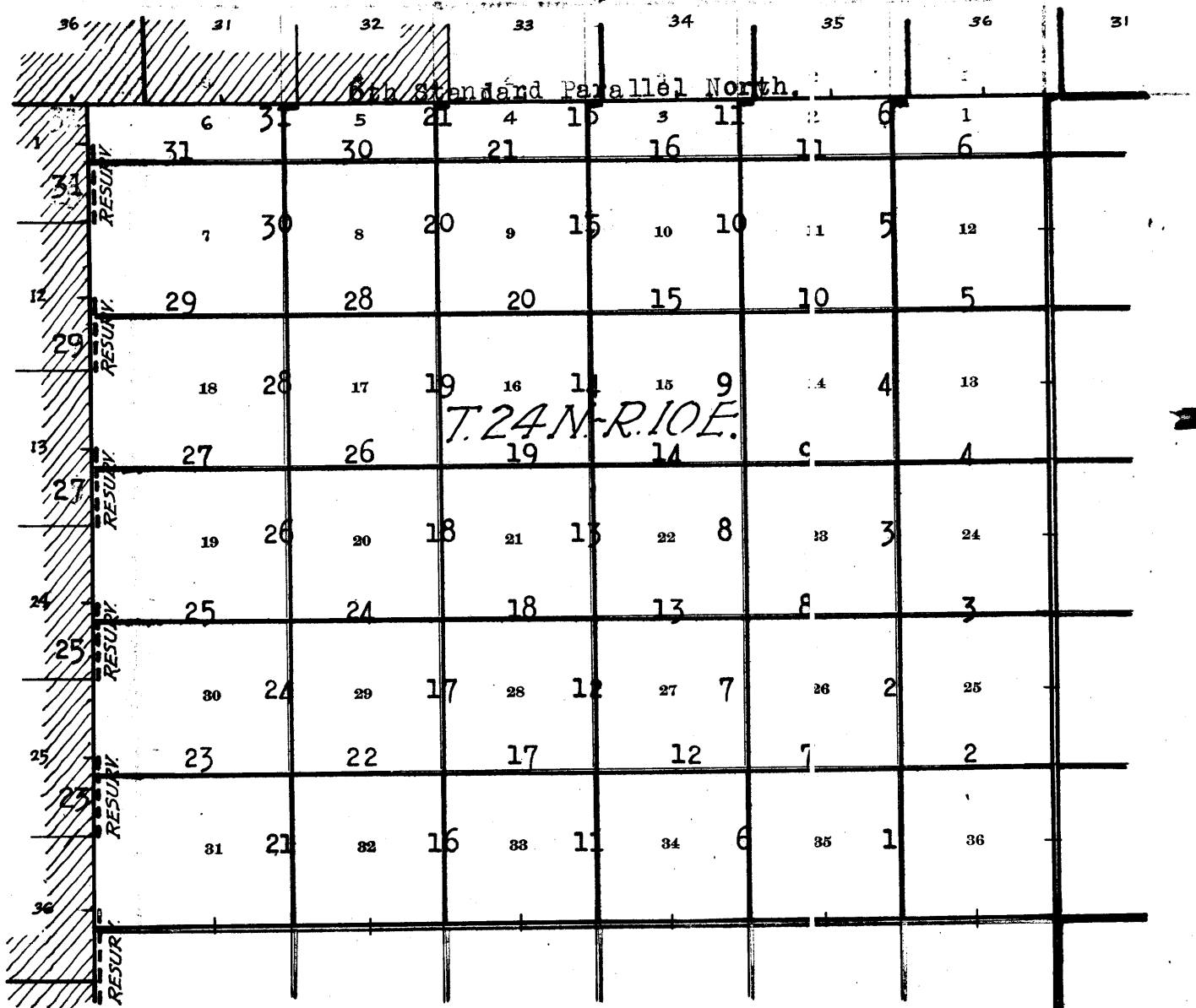

- Lines surveyed under this group, notes in this Book. ³²²⁰
- Lines retraced or resur. under this group, notes in this book. ³²²⁰
- Lines surveyed under this group, notes in Book "D." ³²¹⁷
- Lines surveyed under this group, notes in Book "E." ³²¹⁸
- Lines retr. or resur. under this group, notes in Book "E." ³²¹⁸
- Lines surveyed under this group, notes in Book "F." ³²¹⁹
- Accepted surveys.
- Executed under current Group No. 66.
- //// Areas surveyed as per accepted plats on file.

Survey of Subdivision of Township 24 North, Range 10 East, and
Resurvey of portions of S. bdy. of Township 24 North, Range 9 East.

16

Chains.

Work executed by Thomas B. Matthews, U.S. Surveyor, and Joseph C. Clark, U.S. Transitman, using Buff and Buff light mountain transit No. 10124, and Young and Sons' light mountain transit No. 8535, respectively, on the dates shown on the diagram on page 34 of this book. For description of instruments, see beginning of notes in Books "A" and "B."

Mar. 25, 1916. At a point near camp, location hereinbefore described, examine the adjustments of Young and Sons' light mountain transit No. 8535, and find them to be correct. Then, to test the adjustments of the solar attachment by comparing its indications resulting from solar observations made during a.m. and p.m. hours, on a meridian established by observations on Polaris, proceed as follows:

At 7h. 14m. p.m., l.m.t., observe Polaris at western elongation, and mark a point in the line thus determined by a tack in a stake set firmly in the ground, 5 chs. N. of station.

Mar. 26. At 8h. a.m., l.m.t., turn off the azimuth of Polaris $1^{\circ}23\frac{1}{2}'$ to the east, and mark a point in the meridian thus determined by a tack in a stake set firmly in the ground, 5 chs. N. of station.

Observations made with the solar attachment during a.m. and p.m. hours, defines positions for the meridian, $30''$ E, and $30''$ W., respectively, of the meridian established by observations on Polaris. Therefore, conclude that the adjustments of the transit and solar attachment are satisfactory.

Examine the adjustments of the Buff and Buff transit No. 10124, and find them to be correct. Then to test the adjustments of the solar attachment by comparing its indications resulting from solar observations made during a.m. and p.m. hours, on a meridian established by observations on Polaris, proceed as follows:

April 1, 1916. At a point near camp, in sec. 28, T. 24 N., R. 10 E., latitude, $35^{\circ}27'N.$; longitude, $111^{\circ}21'W.$, at 6h. 47m. p.m., l.m.t., observe Polaris at western elongation, in accordance with the Manual of Surveying Instructions, and mark the line thus determined by a tack in a wooden peg set firmly in the ground, 5 chs. N. of station.

April 2, 1916. At 8h. a.m. l.m.t., turn off $1^{\circ}23\frac{1}{2}'$ to the east, and mark a point in the meridian thus determined by a tack in a stake set firmly in the ground 5 chs. N. of station.

At this time, turn off $35^{\circ}27'N.$ on the latitude arc; $4^{\circ}59'N.$ on the decl. arc, and determine a meridian with the solar. The meridian thus determined coincides with the meridian, established by observations on Polaris.

At 4h. p.m., l.m.t., turn off $35^{\circ}27'N.$ on the latitude arc; $5^{\circ}7'N.$ on the decl. arc, and determine a meridian with the solar. The meridian thus determined coincides with the meridian established by observations on Polaris. Therefore, conclude, that the adjustments of the transit and solar attachment are satisfactory.

Five chain steel tapes and clinometers were the instruments employed in determining all distances.

From the cor. of secs. 1, 2, 35 and 36, on S. bdy. of Tp., described in Book "E,"

N. $0^{\circ}1'W.$, bet. secs. 35 and 36.

Over gently rolling land, covered with black cinders and undergrowth.

40.00 Set an iron post, 3 ft. long, 1 in. in diam., 26 ins. in the ground, for a sec. cor., marked on brass cap,

2. Subdivision of Township 24 North, Range 10 East.

Chains

$\frac{1}{4}$
 S35 | S36
 1916

80.00 Dig pits, 18x18x12 ins., N. and S. of post, 3 ft. dist., and raise a mound of earth, $3\frac{1}{2}$ ft. base, $1\frac{1}{2}$ ft. high, W. of cor.
 Set an iron post, 3 ft. long, 2 ins. in diam., 24 ins. in the ground, for cor. of secs. 25, 26, 35 and 36, marked on brass cap,

T24N R10E
 S26 | S25
 S35 | S36
 1916

Dig pits, 18x18x12 ins., in each sec. $5\frac{1}{2}$ ft. dist., and raise a mound of earth, 4 ft. base, 2 ft. high, W. of cor. Land, gently rolling. ^{subsoil}
 Soil, dark loam and red clay; black cinder surface, medium texture. \sphericalangle 20 ins. deep
 No timber.
 Undergrowth, rabbit brush and mountain rush.
 Poor. grass. Drainage E.

40.00 East, on a random line, bet. secs. 25 and 36.
 80.01 Set temp. $\frac{1}{4}$ sec. cor.
 Intersect E. bdy. of Tp., 2 lks. N. of cor. of secs. 25, 30, 31 and 36, described in Book "F."
 Thence,
 N. $89^{\circ}59'$ W., on true line, bet. secs. 25 and 36.
 40.00 $\frac{1}{2}$ Over gently rolling land, thru. scattering rabbit brush.
 Set an iron post 3 ft. long, 1 in. in diam., 26 ins. in the ground, for $\frac{1}{4}$ sec. cor., marked on brass cap,

$\frac{1}{4}$ S. 25
 S. 36
 1916

80.01 dig pits, 18x18x12 ins., E. and W. of post, 3 ft. dist., and raise a mound of earth, $3\frac{1}{2}$ ft. base, $1\frac{1}{2}$ ft. high, N. of cor.
 The cor. of secs. 25, 26, 35 and 36.
 Land, gently rolling. 20 ins. deep to a red clay subsoil
 Soil, dark clay loam, coarse texture, with cinder surface.
 No timber.
 Undergrowth, rabbit brush and mountain rush.
 Poor grass. Drainage E.

16.00 N. $0^{\circ}1'$ W., bet. secs. 25 and 26.
 Over gently rolling land, thru. scattering undergrowth.
 20.40 Foot of slope, brs. E. and W. Ascend S. slope, 85 ft. to rolling lava bench.
 Edge of lava land, brs. E. and W. Continue over broken E. edge of lava land.
 40.00 Set an iron post 3 ft. long, 1 in. in diam., 26 ins. in the ground, for $\frac{1}{4}$ sec. cor., marked on brass cap,

S26 | S25
 1916

and raise a mound of stone, 2 ft. base, $1\frac{1}{2}$ ft. high,

Subdivision of T. 24 N. R. 10 E.

Chains

W. of cor.
Continue ascending and descending along E. edge of lava bench.

55.00 Asc. 62 ft. to
80.00 Set an iron post, 3 ft. long, 2 ins. diam., 24 ins. in the ground, for cor. of secs. 23, 24, 25 and 26, mkd. on brass cap

T24N R10E
S23|S24
S26|S25
1916

and raise a mound of stone, 2 ft. base, 1½ ft. high, W. of cor.
Land, rolling and broken.
Soil, poor, rocky, and black cinders on surface.
No timber.
Undergrowth, rabbit brush and mountain rush, and oose.
No grass. Drainage E.

40.00 East on a random line bet. secs: 24 and 25.
80.08 Set temp. ¼ sec. cor.
Intersect E. bdy. of Tp., 12 lks. N. of cor. of secs. 19, 24, 25 and 30, described in Book "F".
Thence
N. 89° 55' W. on a true line bet. secs. 24 and 25.
Over gently rolling land, through scattering undergrowth.

40.04 Set an iron post, 3 ft. long, 1 in. diam., 26 ins. in the ground, for ¼ sec. cor., mkd. on brass cap

¼ S 24
S 25
1916

dig pits, 18 X 18 X 12 ins., E. and W. of post, 3 ft. dist.; and raise a mound of earth, 3½ ft. base, 1½ ft. high, N. of cor.
From this point, old ruins of stone house brs. N. 11° W. (near Little Roden Springs.)

55.00 Foot of slope brs. N. and S. Asc. 153 ft.
65.00 Edge of lava bench brs. N. and S.
80.08 The cor. of secs. 23, 24, 25 and 26.
Land, rolling and rough.
Soil, black cinders and rocky, with red and dark clay loam.
No timber.
Undergrowth, rabbit brush and mountain rush.
Fair grass.

40.00 N. 0° 1' W. bet. secs. 23 and 24.
Over rolling lava land, through medium growth of undergrowth.

Set an iron post, 3 ft. long, 1 in. diam., 10 ins. in the ground, in a mound of stone, for ¼ sec. cor., mkd. on brass cap

¼
S23|S24
1916

and raise a mound of stone, 2 ft. base 1½ft. high, W. of cor.

51.80 Edge of lava brs. SE. and NW. Desc. NE. slope, 177 ft. to
64.00 Foot of slope brs. SE. and NW. Thence over level land.
80.00 Set an iron post, 3 ft. long, 2 ins. diam., 24 ins. in the ground, for cor. of secs. 13, 14, 23 and 24, mkd. on

4

Subdivision of T. 24 N., R. 10 E.

Chains

brass cap

T24N R10E
 S14 | S13
 S23 | S24
 1916

and raise a mound of stone, 2 ft. base, 1½ ft. high, W. of cor.

Land, rolling and broken.

Soil, dark clay loam and rocky with cinder surface.

No timber.

Undergrowth, rabbit brush and mountain brush.

Poor grass.

East on a random line bet. secs. 13 and 24.

40.00 Set temp. ¼ sec. cor.

80.19 Intersect E. bdy. of Tp., 9 lks. N. of cor. of secs. 13, 18, 19 and 24, described in Book "F".

From this cor., old ruins of stone house at Little Roden Springs, brs. S. 36¼° W.

Thence

N. 89° 56' W. on a true line bet. secs. 13 and 24.

Over gently rolling land, through scattering undergrowth.

40.09½ Set an iron post, 3 ft. long, 1 in. diam., 26 ins. in the ground, for ¼ sec. cor., mkd. on brass cap

¼ S 13
 S 24
 1916

dig pits, 18 X 18 X 12 ins., E. and W. of post, 3 ft. dist.; and raise a mound of earth, 3½ ft. base, 1½ ft. high, N. of cor.

80.19 The cor. of secs. 13, 14, 23 and 24.

Land, gently rolling, almost level.

Soil, poor, black loam, 12 ins. deep, red clay subsoil; black cinder surface.

No timber.

Undergrowth, rabbit brush and mountain brush.

No grass.

N. 0° 1' W. bet. secs. 13 and 14.

40.00 Over nearly level land, through scattering undergrowth.

Set an iron post, 3 ft. long, 1 in. diam., 26 ins. in the ground, for ¼ sec. cor., mkd. on brass cap.

¼
 S14 | S13
 1916

and raise a mound of stone, 2 ft. base, 1½ ft. high, W. of cor.

80.00 Set an iron post, 3 ft. long, 2 ins. diam., 24 ins. in the ground, for cor. of secs. 11, 12, 13 and 14, mkd. on brass cap

T24N R10E
 S11 | S12
 S14 | S13
 1916

and raise a mound of stone, 2 ft. base, 2 ft. high, W. of cor.

Land, nearly level.

Soil, dark clay loam, with black cinder surface.

Chains

Undergrowth, rabbit brush and mountain rush.
No timber.
No grass.

40.00 East on a random line bet. secs. 12 and 13.
80.38 Set temp. $\frac{1}{4}$ sec. cor.
Intersect E. bdy. of Tp., 5 lks. S. of cor. of secs. 7,
12, 13 and 18, described in Book "F".

Thence
S. 89° 58' W. on a true line bet. secs. 12 and 13.
Over rolling land, through scattering timber and under-
growth.

34.00 E. edge of wash, bears NE. and SW.
38.48 Center of wash, course NE.

40.19 Set an iron post, 3 ft. long, 1 in. diam., 9 ins. in the
ground, in a mound of stone, for $\frac{1}{4}$ sec. cor., mkd. on
brass cap

$\frac{1}{4}$ S 12
S 13
1916

from which,

A cedar, 12 ins. diam., brs. N. 37° W.
299 lks. dist.; mkd. $\frac{1}{4}$ S 12 B T.

A cedar, 9 ins. diam., brs. S. 3 $\frac{1}{4}$ ° W.
319 lks. dist.; mkd. $\frac{1}{4}$ S 13 B T.

49.00 Asc. 29 ft. to
W. edge of wash brs. NE. and SW. Thence over nearly
level land.

80.38 The cor. of secs. 11, 12, 13 and 14.
Land, nearly level.
Soil, poor, black cinders 10 ins. deep on red granite.
Timber, few scattering cedar trees.
Undergrowth, rabbit brush and mountain rush.
Sparse grass.

Formation, lava and red granite. Drainage NE.

29.00 N. 0° 1' W. bet. secs. 11 and 12.
Over gently rolling land, through scattering undergrowth.
Old stone house 14 X 30 ft. brs. W. 485 lks. dist. Spring
brs. W. 5.25 chs. dist.

38.40 Draw, course NE. for 7 chs. thence NW.

40.00 Set an iron post, 3 ft. long, 1 in. diam., 26 ins. in the
ground, for $\frac{1}{4}$ sec. cor., mkd. on brass cap

$\frac{1}{4}$
S 11 | S 12
1916

and raise a mound of stone, 2 ft. base, 2 ft. high,
W. of cor.

70.00 Thence over nearly level land.

80.00 Swale, course NE.

Set an iron post, 3 ft. long, 2 ins. diam., 24 ins. in the
ground, for cor. of secs. 11 and 12, and fract. secs. 1
and 2, marked on brass cap,

T24N R10E
S 2 | S 1
S 11 | S 12
1916

and raise a mound of stone, 2 $\frac{1}{2}$ ft. base, 2 $\frac{1}{2}$ ft. high,
W. of cor.

Land, gently rolling.
Soil, poor, black cinders, 5 to 10 ins. deep, on red clay
subsoil.

Chains

No timber.
Undergrowth, rabbit brush and mountain rush.
Fair grass. Drainage NE.
Formation, lava and red granite.

40.00 East on a random line bet. sec. 12, and fracl. sec. 1.
80.38 Set temp. $\frac{1}{4}$ sec. cor.
Intersect E. bdy. of Tp., 7 lks. S. of cor. of secs. 7 and 12, and 7 fracl. secs. 1 and 6, described in Book "F."

Thence
40.19 S. 89° 57' W. on a true line bet. sec. 12 and fracl. sec. 1.
Over nearly level land, through scattering undergrowth.
Set an iron post, 3 ft. long, 1 in. diam., 14 ins. in the ground, in a mound of stone, for $\frac{1}{4}$ sec. cor., mkd. on brass cap

$\frac{1}{4}$ S 1
S 12
1916

and raise a mound of stone, 2 ft. base, $1\frac{1}{2}$ ft. high, N. of cor.
55.38 Over rolling land.
74.40 Swale, course NE.
80.38 The cor. of secs. 11 and 12, and fracl. secs. 1 and 2.

Land, rolling. 10 ins. deep. subsoil.
Soil, dark clay loam, cinder surface, lying on red clay
No timber.
Undergrowth, rabbit brush and mountain rush.
Fair grass.
Formation, lava and red granite. Drainage NE.

31.04 N. 0° 1' W. on a true line bet. fracl. secs. 1 and 2.
Over gently rolling land, through scattering undergrowth.
Intersect 6th Standard Parallel N., 9.10 chs. N. 89° 54' W. of the original standard cor. of secs. 35 and 36, which is a red granite stone, 12x4x7 ins. above ground, firmly set, marked & witnessed as described by the surveyor general.
At the point of intersection
Set an iron post, 3 ft. long, 2 ins. diam., 24 ins. in the ground, for closing cor. of fracl. secs. 1 and 2, marked on brass cap,

T25N R10E
S35 | S36
C | C
S 2 | S 1
1916

and raise a mound of stone, 3 ft. base, $1\frac{1}{2}$ ft. high, S. of cor.
From this point orig. standard cor. of secs. 35 and 36 and orig. standard $\frac{1}{4}$ sec. cor. of sec. 35 are plainly visible, the true course between said cors. being N. 89° 54' W.
Land, nearly level. 12 ins. deep, to red clay subsoil
Soil, dark clay loam, coarse texture, cinder surface.
No timber.
Undergrowth, rabbit brush and mountain rush.
Fair grass.
Formation, lava and red granite. Drainage NE.

From the cor. of secs. ^{2,3} 34 & 35, on S. bdy. of Tp., described in Book "E",
N. 0° 1' W. bet. secs. 34 and 35.

Subdivision of T. 24 N., R. 10 E.

Chains

Over rolling land, through scattering undergrowth.
Dsc. 64 ft.

15.00 Foot of slope brs. E. and W. Thence over level swale.

32.00 Foot of slope brs. E. and W. Asc. 78 ft. to

40.00 Set an iron post, 3 ft. long, 1 in. diam., 26 ins. in the ground, for 1/4 sec. cor., mkd. on brass cap

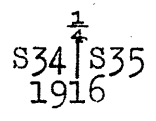

and raise a mound of stone, 2 ft. base, 1 1/2 ft. high, W. of cor. Dasc. gradual slope, 62 ft.

80.00 Set an iron post, 3 ft. long, 2 ins. diam., 24 ins. in the ground, for cor. of secs. 26, 27, 34 and 35, mkd. on brass cap

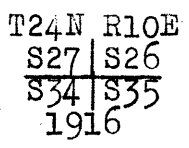

and raise a mound of stone, 2 ft. base, 1 1/2 ft. high, W. of cor.

Land, rolling. 2 ft. deep
Soil, poor, dark loamy, rocky and black cinders on surface.
Subsoil, red clay.

Timber, a few scattering cedars.
Undergrowth, scattering rabbit brush and mountain rush.
Grass, good.

Drainage NE.

40.00 East on a random line bet. secs. 26 and 35.

Set temp. 1/4 sec. cor.

80.04 Intersect N. and S. line, 9 lks. N. of cor. of secs. 25, 26, 35 and 36.

Thence N. 89° 56' W. on a true line bet. secs. 26 and 35.

Over rolling land, nearly level, through scattering undergrowth.

15.00 Asc. E. slope, 180 ft. to

34.00 Edge of bench brs. N. and S.

40.02 Set an iron post, 3 ft. long, 1 in. diam., 26 ins. in the ground, for 1/4 sec. cor., mkd. on brass cap

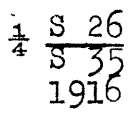

dig pits, 18 X 18 X 12 ins., E. and W. of post, 3 ft. dist.; and raise a mound of earth, 4 ft. base, 2 ft. high, N. of cor.

60.00 Asc. 91 ft. to, Edge of bench brs. NE. and SW.

80.04 The cor. of secs. 26, 27, 34 and 35.

Land, rolling and rough.
Timber, a few scattering cedars.
Undergrowth, scattering rabbit brush.
Soil, dark loam, rocky, with black cinders on surface; subsoil, red clay.
Poor grass.

Drainage E.

40.00 N. 0° 1' W. bet. secs. 26 and 27.
Over nearly level land, through scattering undergrowth.
Set an iron post, 3 ft. long, 1 in. diam., 26 ins. in the ground, for 1/4 sec. cor., mkd. on brass cap

8

Subdivision of T. 24 N., R. 10 E.

Chains

$\frac{1}{4}$
S27 | S26
1916

80.00 and raise a mound of stone, 2 ft. base, 1½ ft. high, W. of cor.
Set an iron post, 3 ft. long, 2 ins. diam., 24 ins. in the ground, for cor. of secs. 22, 23, 26 and 27, mkd. on brass cap

T24N R10E
S22 | S23
S27 | S26
1916

and raise a mound of stone, 2 ft. base, 1½ ft. high, W. of cor.
Land, gently rolling.
Soil, poor, sandy clay, loam, rocky and dry, 26 ins. deep.
No timber.
Undergrowth, scattering rabbit brush, and mountain rush.
Good grass.

40.00 East on a random line bet. secs. 23 and 26.
Set temp. ¼ sec. cor.
80.06 Intersect N. and S. line, 2 lks N. of cor. of secs. 23, 24, 25 and 26.

Thence
N. 89° 59' W. on a true line bet. secs. 23 and 26.
Over rolling land, through scattering undergrowth.
15.00 Foot of slope brs. N. and S. Asc. gradual slope, 150 ft.
39.00 Rim brs. N. and S. Thence over rolling land.
40.03 Set an iron post, 3 ft. long, 1 in. diam., 26 ins. in the ground, for ¼ sec. cor., mkd. on brass cap

$\frac{1}{4}$ S 23
S 26
1916

80.06 and raise a mound of stone, 2 ft. base, 1½ ft. high, N. of cor.
The cor. of secs. 22, 23, 26 and 27.
Land, rolling.
Soil, poor, sandy clay, loam, rocky and dry, 26 ins. deep.
No timber.
Undergrowth, scattering rabbit brush and mountain rush.
Good grass.

40.00 N. 0° 1' W. bet. secs. 22 and 23.
Over nearly level land, through scattering undergrowth.
Set an iron post, 3 ft. long, 1 in. diam., 26 ins. in the ground, for ¼ sec. cor., mkd. on brass cap

$\frac{1}{4}$
S22 | S23
1916

80.00 and raise a mound of stone, 2 ft. base, 1½ ft. high, W. of cor.
Set an iron post, 3 ft. long, 2 ins. diam., 10 ins. in the ground, in a mound of stone, for cor. of secs. 14, 15, 22 and 23, mkd. on brass cap

T24N R10E
S15 | S14
S22 | S23
1916

Subdivision of T. 24 N., R. 10 E.

Chains

and raise a mound of stone, 2 ft. base, 1½ ft. high,
W. of cor.
Land, gently rolling, almost level.
Soil, sandy clay loam, and rocky, 26 ins. deep, with dry
black cinder surface.
No timber.
Undergrowth, scattering rabbit brush, and mountain rush.
Good grass.

40.00 East on a random line bet. secs. 14 and 23.
80.18 Set temp. ¼ sec. cor.
Intersect N. and S. line, 9 lks. N. of cor. of secs. 13,
14, 23 and 24.
Thence
N. 89° 56' W. on a true line bet. secs. 14 and 23.
11.80 Over rolling land, through scattering undergrowth.
18.70 Foot of slope brs. N. and S. Asc. 258 ft. to
Edge of bench or mesa brs. N. and S. Thence over rolling
land to
30.00 Asc. 52 ft. to
39.20 Edge of lava rim brs. NW. and SE.
40.09 Set an iron post, 3 ft. long, 1 in. diam., 26 ins. in the
ground, for ¼ sec. cor., mkd. on brass cap

¼ S 14
S 23
1916

and raise a mound of stone, 2 ft. base, 1½ ft. high,
N. of cor.
Asc. gradual slope.
55.20 Draw course N
80.18 The cor. of secs. 14, 15, 22 and 23.
Land, rolling and rough.
Soil, dark loam, gravelly on surface with cinders.
No timber.
Undergrowth, scattering rabbit brush, and mountain rush.
Good grass.
Drainage NE.

12.50 N. 0° 1' W. bet. secs. 14 and 15.
40.00 Over rolling land, through scattering rabbit brush.
Rocky point 15 ft. high.
Set an iron post, 3 ft. long, 1 in. diam., 26 ins. in the
ground, for ¼ sec. cor., mkd. on brass cap

¼ S15 | S14
1916

and raise a mound of stone, 2 ft. base, 1½ ft. high,
W. of cor.
Asc. gradual slope.
43.00 Rim-rock brs. N. and SE. Desc. NE. slope to mesa.
48.00 Foot of slope brs. NW. and SE. 69 ft. below ¼ sec. cor.
80.00 Set an iron post, 3 ft. long, 2 ins. diam., 24 ins. in the
ground, for cor. of secs. 10, 11, 14 and 15, mkd. on
brass cap

T24N R10E
S10 | S11
S15 | S14
1916

from which
A cedar, 10 ins. diam., brs. N. 69¾° E.
359 lks. dist.; mkd. T 24 N R 10 E S 11 B T.
No other trees within limits.

10

Subdivision of T. 24 N., R. 10 E.

Chains

Dig pits, 18 X 18 X 12 ins., in each sec., 5 1/2 ft. dist. and raise a mound of earth, 4 ft. base, 1 1/2 ft. high, W. of cor.

Land, rolling and benchy. 2 ft. deep

Soil, dark loam, rocky and coarse, black cinders on surface, yellow clay subsoil.

No timber.

Undergrowth, rabbit brush and mountain rush.

Fair grass.

Lava formation. Drainage NE.

East on a random line bet. secs. 11 and 14.

40.00 Set temp. 1/4 sec. cor.

80.04 Intersect N. and S. line, 6 lks. S. of cor. of secs. 11, 12, 13 and 14.

Thence

S. 89° 57' W. on a true line bet. secs. 11 and 14.

Over rolling land, through scattering undergrowth.

Asc. NE. slope, 260 ft. to

33.50 Rim-rock on edge of mesa brs. NW. and SW.

40.02 Set an iron post, 3 ft. long, 1 in. diam., 26 ins. in the ground, for 1/4 sec. cor., mkd. on brass cap

1/4 S 11
S 14
1916

and raise a mound of stone, 2 ft. base, 1 1/2 ft. high, N. of cor.

80.04 The cor. of secs. 10, 11, 14 and 15.

Land, rolling and level.

Soil, black cinders and loam, 12 ins. deep, subsoil, rocky clay loam.

Timber, scattering cedar and walnut.

Undergrowth, rabbit brush and mountain rush.

Good grass.

Lava formation. Drainage N.

N. 0° 1' W. bet. secs. 10 and 11.

Over level land, through scattering undergrowth.

36.50 Rim-rock on edge of mesa brs. E. and W. Desc. N. slope 52 ft.

40.00 Set an iron post, 3 ft. long, 1 in. diam., 26 ins. in the ground, for 1/4 sec. cor., mkd. on brass cap

1/4 S 10 | S 11
1916

and raise a mound of stone, 2 ft. base, 2 ft. high, W. of cor.

Desc. 148 ft. to

50.00 Foot of slope brs. E. and W. Thence over nearly level land.

80.00 Set an iron post, 3 ft. long, 2 ins. diam., 24 ins. in the ground, for cor. of secs. 10 and 11, and fract. secs. 2 and 3, marked on brass cap,

T24N R10E
S 3 | S 2
S 10 | S 11
1916

and raise a mound of stone, 2 ft. base, 2 ft. high, W. of cor.

Land, level and broken.

Soil, poor, black cinders and loam, 12 ins. deep, subsoil, clay and rocky loam.

Subdivision of T. 24 N., R. 10 E.

Chains

Timber, scattering cedar and walnut.
Undergrowth, rabbit brush and mountain rush.
Fair grass.

40.00 East on a random line bet. sec. 11, and frac. sec. 2.
Set temp. $\frac{1}{4}$ sec. cor.
80.00 Intersect N. and S. line, 6 lks. N. of cor. of secs. 11, & 12, and frac. secs. 1 and 2.
Thence
N. $89^{\circ} 57'$ W, on a true line bet. sec. 11, and frac. sec. 2.
Over rolling land, through scattering undergrowth.
Asc. 70 ft. to
26.80 Spur slopes NE. 20 chs. dist. Desc. gradual slope.
35.00 Head of draw, course NE. Asc. gradual slope.
40.00 Set an iron post, 3 ft. long, 1 in. diam., 26 ins. in a mound of stone, for $\frac{1}{4}$ sec. cor., mkd on brass cap

$\frac{1}{4}$ S 2
S 11
1916

and raise a mound of stone, 2 ft. base, $1\frac{1}{2}$ ft. high,
N. of cor. This cor. is located on top of low, rocky
43.60 Desc. gradual slope. spur, projecting N. 5 chs.
47.00 Draw, course NE. Asc. 56 ft. to
80.00 Edge of mesa brs. NE. and SW.
The cor. of secs. 10 and 11, and frac. secs. 2 and 3.
Land, rolling and level.
Soil, poor, black cinders and loam, 12 ins. deep, subsoil,
clay and rocky loam.
Timber, scattering cedar and walnut.
Undergrowth, rabbit brush and mountain rush.
Fair grass.

31.11 N. $0^{\circ} 1'$ W. on a true line, bet. frac. secs. 2 and 3.
Over gently rolling land, through scattering rabbit brush.
Intersect 6th Standard Parallel N., 9.15 chs. W. of the
original std. cor. of secs. 34 & 35, which is a lava rock, set,
8x8x6 ins. above ground, firmly set, marked and witnessed
as described by the surveyor general for Group T. 24 N.
At the point of intersection,
Set an iron post, 3 ft. long, 2 ins. diam., 24 ins. in
the ground, for closing cor. of frac. secs. 2 and 3,
marked on brass cap,

T25N R10E
S34 | S35
C | C
S 3 | S 2
1916

and raise a mound of stone, $2\frac{1}{2}$ ft. base, 2 ft. high,
S. of cor.
Land, almost level.
Soil, dark cinders and rocky loam.
Timber, scattering cedar and walnut.
Undergrowth, scattering rabbit brush and mountain rush.
Fair grass.

From the cor. of secs. 3, 4, 33 and 34, ^{on} S. bdy. of Tp.,
described in Book "R",
N. $0^{\circ} 2'$ W. bet. secs. 33 and 34.

12

Subdivision of T. 24 N., R. 10 E.

Chains

5.00 Over rolling land, through scattering timber and undergrowth.
 Rocky point or small knoll. Desc. gradual slope.
 40.00 Set an iron post, 3 ft. long, 1 in. diam., 26 ins. in the ground
 ground, for $\frac{1}{4}$ sec. cor., mkd. on brass cap

$\frac{1}{4}$
 S33 | S34
 1916

from which,

A cedar, 7 ins. diam., brs. S. $24\frac{1}{2}^{\circ}$ E.
 107 lks. dist.; mkd. $\frac{1}{4}$ S 34 B T.

A cedar, 10 ins. diam., brs. S. 10° W.
 90 lks. dist.; mkd. $\frac{1}{4}$ S 33 B T.

80.00 Set an iron post, 3 ft. long, 2 ins. diam., 24 ins. in the
 ground, for cor. of secs. 27, 28, 33 and 34, mkd. on
 brass cap

T24N R10E
 S28 | S27
 S33 | S34
 1916

from which,

A cedar, 8 ins. diam., brs. N. 38° W.
 165 lks. dist.; mkd. T 24 N R 10 E S 28 B T.

No other trees within limits:

Raise a mound of stone, 2 ft. base, $1\frac{1}{2}$ ft. high, W. of cor.
 Land, rolling.

Soil, dark loam, gravelly surface, clay subsoil.

Timber, scattering scrub cedar.

Undergrowth, rabbit brush, and mountain rush.

Good grass.

40.00 East on a random line bet. secs. 27 and 34.
 Set temp. $\frac{1}{4}$ sec. cor.

80.00 Intersect ~~the~~ ~~line~~ ~~and~~ ~~the~~ ~~cor.~~ ~~of~~ ~~secs.~~ ~~26,~~ ~~27,~~
 34 and 35.

Thence

West on a true line bet. secs. 27 and 34.

Over rolling land, through scattering undergrowth.

Asc. 54 ft. to

5.00 Thence over nearly level land to

10.00 Desc. 42 ft.

40.00 Set an iron post, 3 ft. long, 1 in. diam., 26 ins. in the
 ground, for $\frac{1}{4}$ sec. cor., mkd. on brass cap

$\frac{1}{4}$ S 27
 S 34
 1916

and raise a mound of stone, 2 ft. base, $1\frac{1}{2}$ ft. high,
 N. of cor.

80.00 The cor. of secs. 27, 28, 33 and 34.

Land, rolling, broken by piles of lava rock.

Soil, fair, dark loam, rocky and coarse in texture, with
yellow clay subsoil.

No timber.

Undergrowth, scattering rabbit brush, and mountain rush.

Good grass.

40.00 N. 0° 2' W. bet. secs. 27 and 28.

Over rolling land, through scattering undergrowth.

40.00 Set an iron post, 3 ft. long, 1 in. diam., 26 ins. in the
 ground, for $\frac{1}{4}$ sec. cor., mkd. on brass cap

S28 | S27
 1916

Chains

dig pits, 18 X 18 X 12 ins., N. and S. of post, 3 ft. dist.; and raise a mound of earth, 3 1/2 ft. base, 1 1/2 ft. high, W. of cor.

80.00 Set an iron post, 3 ft. long, 2 ins. diam., 20 ins in the ground, in a mound of stone, for cor. of secs. 21, 22, 27 and 28, mkd. on brass cap

T24N R10E
S21 | S22
S28 | S27
1916

and raise a mound of stone, 2 ft base, 1 1/2 ft. high, W. of cor.

Land, rolling, broken by piles of lava rock.
Soil, fair, dark loam, rocky and coarse in texture, yellow clay subsoil.
No timber.
Undergrowth, scattering rabbit brush and mountain rush.
Good grass.

40.00 East on a random line, bet. secs. 22 and 27.
Set temp. 1/4 sec. cor.

80.00 Intersect N. and S. line, 1 lk. S. of cor. of secs. 22, 23, 26 and 27.

Thence

West on a true line bet. secs. 22 and 27.

40.00 Over nearly level land, through scattering undergrowth.

Set an iron post, 3 ft. long, 1 in. diam., 26 ins. in the ground, for 1/4 sec. cor., mkd. on brass cap

1/4 S 22
S 27
1916

and raise a mound of stone, 2 ft. base, 1 1/2 ft. high, N. of cor.

80.00 The cor. of secs. 21, 22, 27 and 28.

Land, rolling.
Soil, fair, dark loam, rocky and coarse in texture, yellow clay subsoil.
No timber.
Undergrowth, scattering rabbit brush and mountain rush.
Good grass.

N. 0° 2' W. bet. secs. 21 and 22.

40.00 Over nearly level land, through scattering undergrowth.

Set an iron post, 3 ft. long, 1 in. diam., 26 ins. in the ground, for 1/4 sec. cor., mkd. on brass cap

1/4
S21 | S22
1916

and raise a mound of stone, 2 ft. base, 1 1/2 ft. high, W. of cor.

80.00 Set an iron post, 3 ft. long, 2 ins. diam., 24 ins. in the ground, for cor. of secs. 15, 16, 21 and 22, mkd. on brass cap

T24N R10E
S16 | S15
S21 | S22
1916

14

Subdivision of T. 24 N. R. 10 E.

Chains

from which,
 A cedar, 5 ins. diam., brs. N. 14° W.
 117 lks. dist.; mkd. T 24 N. R 10 E S 16 B T.
 No other trees within limits.
 Raise a mound of stone, 2 ft. base, 1½ ft. high, W. of cor.
 Land, nearly level.
 Soil, poor, dark loam, rocky coarse texture, yellow clay
 subsoil.
 Timber, scattering scrub cedar.
 Undergrowth, scattering rabbit brush and mountain rush.
 Good grass.

East on a random line bet. secs. 15 and 22.
 40.00 Set temp. ¼ sec. cor.
 79.98 Intersect N. and S. line, 1 lk. N. of cor. of secs.
 14, 15, 22 and 23.
 Thence
 West on a true line bet. secs. 15 and 22.
 Over gently rolling land, through scattering timber and
 undergrowth.
 39.99 Set an iron post, 3 ft. long, 1 in. diam., 26 ins in the
 ground, for ¼ sec. cor., mkd. on brass cap

¼ S 15
 S 22
 1916

and raise a mound of stone, 2 ft. base, 1½ ft. high,
 N. of cor.
 79.98 The cor. of secs. 15, 16, 21 and 22.
 Land, gently rolling.
 Soil, poor, dark loam, rocky coarse texture, yellow clay
 subsoil.
 Timber, scattering scrub cedar.
 Undergrowth, scattering rabbit brush and mountain rush.
 Good grass.

N. 0° 2' W. bet. secs. 15 and 16.
 Over nearly level land, through scattering timber and
 undergrowth.
 40.00 Set an iron post, 3 ft. long, 1 in. diam., 26 ins. in the
 ground, for ¼ sec. cor., mkd. on brass cap

¼
 S16 | S15
 1916

and raise a mound of stone, 2½ ft. base, 2 ft. high,
 W. of cor.
 80.00 Set an iron post, 3 ft. long, 2 ins. diam., 24 ins. in the
 ground, for cor. of secs. 9, 10, 15 and 16, mkd. on
 brass cap

T24N R10E
 S 9 | S10
 S16 | S15
 1916

and raise a mound of stone, 2½ ft. base, 2 ft. high,
 W. of cor.
 Land, gently rolling.
 Soil, fair, black sandy loam, 26 ins. deep, rocky and coarse
 in texture, with black cinder surface; yellow subsoil.
 Timber, scattering scrub cedar.
 Undergrowth, scattering rabbit brush.
 Good grass.

Subdivision of T. 24 N. R. 10 E.

Chains

East on a random line bet. secs. 10 and 15.
 40.00 Set temp. $\frac{1}{4}$ sec. cor.
 79.96 Intersect N. and S. line, 5 lks. S. of cor. of secs. 10, 11, 14 and 15.
 Thence
 S. $89^{\circ} 58'$ W. on a true line bet. secs. 10 and 15.
 Over level land, through scattering timber and undergrowth.
 15.00 Foot of rocky slope brs. NW. and SE. Asc. 17 ft. to
 20.00 Spur slopes N. for 8 chs. dist. Desc. gradually over rolling land.
 32.00 Bottom of draw, 18 ft. deep, course N. Asc. gradual slope.
 39.98 Set an iron post, 3 ft. long, 1 in. diam., 26 ins. in the ground, for $\frac{1}{4}$ sec. cor., mkd. on brass cap

$\frac{1}{4}$ S 10
 S 15
 1916

and raise a mound of stone, $2\frac{1}{2}$ ft. base, 2 ft. high, N. of cor.
 Asc. NE. slope, 64 ft. to
 48.00 Edge of mesa brs. NW. and SE.
 64.00 Rocky point on line. Desc. gradual slope, 45 ft.
 79.96 The cor. of secs. 9, 10, 15 and 16.
 Land, level and rolling.
 Soil, poor, black cinders and loam, 12 ins. deep, subsoil, rocky clay loam.
 Timber, scattering cedar and walnut.
 Undergrowth, rabbit brush and mountain rush.
 Good grass.
 Lava formation. Drainage N.

N. $0^{\circ} 2'$ W. bet. secs. 9 and 10.
 Over rolling land, through scattering undergrowth.
 Asc. 29 ft. to
 6.60 Rocky point. Desc. N. slope, 61 ft. to
 9.80 Bottom of draw, course N. 30° E.
 13.00 Desc. 52 ft. to
 20.00 Over gently rolling land.
 40.00 Set an iron post, 3 ft. long, 1 in. diam., 26 ins. in the ground, for $\frac{1}{4}$ sec. cor., mkd. on brass cap

$\frac{1}{4}$
 S 9 | S 10
 1916

and raise a mound of stone, $2\frac{1}{2}$ ft. base, 2 ft. high, W. of cor.
 Desc. 63 ft. to
 56.00 Rim brs. NW. and SE. Desc. NE. slope 70 ft. to
 65.00 Foot of slope brs. NW. and SE. Thence over level land.
 80.00 Set an iron post, 3 ft. long, 2 ins. diam., 24 ins. in the ground, for cor. of secs. 9 and 10, and frac. secs. 3 and 4, marked on brass cap,

T24N R10E
 S 4 | S 3
 S 9 | S 10
 1916

dig pits, 18 X 18 X 12 ins., in each sec., $5\frac{1}{2}$ ft. dist.; and raise a mound of earth, 4 ft. base, 2 ft. high, W. of cor.
 Land, rolling and broken.
 Soil, poor, black cinders with loam; subsoil, clay loam.
 Timber, scattering cedar and walnut.
 Undergrowth, scattering rabbit brush and mountain rush.
 Good grass. Lava formation. Drainage NE.

16

Subdivision of T. 24 N. R. 10 E.

Chains

East on a random line bet. sec. 10, and frac. sec. 3.
 40.00 Set temp. $\frac{1}{4}$ sec. cor.
 80.00 Intersect N. and S. line, 2 lks. S. of cor. of secs. 10, and 11, and frac. secs. 2 and 3.
 Thence
 15.00 S. $89^{\circ} 59'$ W. on a true line bet. sec. 10, and frac. sec. 3.
 Foot of slope brs. NE. and SW. Asc. SE. slope, 160 ft. to
 19.00 Edge of rim-rock brs. NE. and SW. Thence over level land.
 40.00 Set an iron post, 3 ft. long, 1 in. diam., 26 ins. in the ground, for $\frac{1}{4}$ sec. cor., mkd. on brass cap

$$\begin{array}{r} \frac{1}{4} S 3 \\ S 10 \\ 1916 \end{array}$$

and raise a mound of stone, 2 ft. base, 2 ft. high, N. of cor.
 80.00 The cor. of secs. 9 and 10, and frac. secs. 3 and 4.
 Land, rolling and level $\frac{1}{2}$ ft. deep
 Soil, poor, dark loam, cinder surface, clay subsoil.
 Timber, very scattering cedar and walnut.
 Undergrowth, scattering rabbit brush and mountain rush.
 Good grass.
 Lava formation. Drainage NE.

N. $0^{\circ} 2'$ W. on a true line, bet. frac. secs. 3 and 4.
 Over level bench, through scattering undergrowth.
 31.21 Intersect 6th Standard Parallel N., 9.28 chs. W. of the original std. cor. of secs. 33 and 34, a lava rock, 16x6x7 ins. above ground, firmly set, marked and witnessed, as described by the surveyor general. S. of cor. Group No. 66.
 At the point of intersection
 Set an iron post, 3 ft. long, 2 ins. diam., 24 ins. in the ground, for closing cor. of frac. secs. 3 and 4, marked on brass cap,

$$\begin{array}{r} T25N R10E \\ S33 | S34 \\ \hline D | C \\ S 4 | S 3 \\ T24N \\ 1916 \end{array}$$

and raise a mound of stone, 2 ft. base, $1\frac{1}{2}$ ft. high, S. of cor.
 Land, gently rolling.
 Soil, poor, dark cinders and loam, gravelly and coarse texture; subsoil, clay.
 Timber, very scattering cedar and walnut.
 Undergrowth, scattering rabbit brush and mountain rush.
 Good grass.

From the cor. of secs. 4, 5, 32 and 33, ^{on} S. bdy. of Tp., described in Book "E",
 N. $0^{\circ} 3'$ W. bet. secs. 32 and 33.
 Over almost level land, through scattering timber and undergrowth.
 40.00 Set an iron post, 3 ft. long, 1 in. dian., 26 ins. in the ground, for $\frac{1}{4}$ sec. cor., mkd. on brass cap

$$\begin{array}{r} \frac{1}{4} \\ S32 | S33 \\ 1916 \end{array}$$

from which,

Subdivision of T. 24 N. R. 10 E.

Chains

80.00 A cedar, 9 ins. diam., brs. N. 77° E.
 269 lks. dist.; mkd. $\frac{1}{4}$ S 33 B T.
 A cedar, 10 ins. diam., brs. N. 75° W.
 40 lks. dist.; mkd. $\frac{1}{4}$ S 32 B T.
 Set an iron post, 3 ft. long, 2 ins. diam., 24 ins. in the
 ground, for cor. of secs. 28, 29, 32 and 33, mkd. on
 brass cap

T24N R10E
 S29|S28
 S32|S33
 1916

from which,
 A cedar, 7 ins. diam., brs. S. 10 $\frac{3}{4}$ ° E.
 260 lks. dist.; mkd. T 24 N R 10 E S 33 B T.
 A cedar, 7 ins. diam., brs. S. 5 $\frac{3}{4}$ ° W.
 274 lks. dist.; mkd. T 24 N R 10 E S 32 B T.
 No other trees within limits.
 Raise a mound of stone, 3 ft. base, 3 ft. high, W. of cor.
 Land, gently rolling.
 Soil, poor, light clay loam, rocky and gravelly, 26 ins.
 deep.
 Timber, scattering cedar.
 Undergrowth, scattering rabbit brush.
 Good grass.

40.00 East on a random line bet. secs. 28 and 33.
 Set temp. $\frac{1}{4}$ sec. cor.
 80.02 Intersect N. and S. line, 16 lks. N. of cor. of secs.
 27, 28, 33 and 34.
 Thence
 N. 89° 53' W. on a true line bet. secs. 28 and 33.
 Over nearly level land, through scattering timber and
 undergrowth.
 30.00 Water hole for stock brs. S. 8 chs. dist.
 39.00 Water hole for stock brs. N. 15 chs. dist.
 40.01 Set an iron post, 3 ft. long, 1 in. diam., 12 ins. in the
 ground, for $\frac{1}{4}$ sec. cor., mkd. on brass cap
 and in a mound of
 stone $\frac{1}{4}$ S 28
 S 33
 1916

80.02 from which,
 A cedar, 6 ins. diam., brs. N. 64 $\frac{1}{4}$ ° E.
 253 lks. dist.; mkd. $\frac{1}{4}$ S 28 B T.
 A cedar, 6 ins. diam., brs. S. 16 $\frac{1}{2}$ ° W.
 517 lks. dist.; mkd. $\frac{1}{4}$ S 33 B T.
 The cor. of secs. 28, 29, 32 and 33.
 Land, gently rolling.
 Soil, poor light clay- loam, rocky and gravelly.
 Timber, scattering cedar.
 Undergrowth, scattering rabbit brush.
 Good grass.

40.00 N. 0° 3' W. bet. secs. 28 and 29.
 Over nearly level land, through scattering timber and
 undergrowth.
 Set an iron post, 3 ft. long, 1 in. diam., 26 ins. in
 the ground, for $\frac{1}{4}$ sec. cor., mkd. on brass cap
 $\frac{1}{4}$
 S29|S28
 1916

18

Subdivision of T. 24 N., R. 10 E.

Chains

80.00 and raise a mound of stone, 2 ft. base, 1½ ft. high, W. of cor.
Set an iron post, 3 ft. long, 2 ins. diam., 24 ins. in the ground, for cor. of secs. 20, 21, 28 and 29, mkd. on brass cap

T24N R10E
S20|S21
S29|S28
1916

and raise a mound of stone, 3 ft. base, 2 ft. high, W. of cor.
Land, gently rolling, nearly level.
Soil, fair, dark loam, coarse and rocky in texture.
Timber, scattering scrub cedar.
Undergrowth, scattering rabbit brush.
Good grass.

40.00 East on a random line bet. secs. 21 and 28.
Set temp. ¼ sec. cor.
80.00 Intersect N. and S. line, 21 lks. N. of cor. of secs. 21, 22, 27 and 28.

Thence
N. 89° 51' W. on a true line bet. secs. 21 and 28.
Over nearly level land, through scattering timber and undergrowth.

40.00 Set an iron post, 3 ft. long, 1 in. diam., 26 ins. in the ground, for ¼ sec. cor., mkd. on brass cap

¼ S 21
S 28
1916

63.00 and raise a mound of stone, 2 ft. base, 1½ ft. high, N. of cor.
80.00 N. end of rocky point.
The cor. of secs. 20, 21, 28 and 29.
Land, gently rolling, nearly level.
Soil, fair, dark loam, coarse and rocky in texture.
Timber, very scattering scrub cedar.
Undergrowth, scattering rabbit brush.
Good grass.

40.00 N. 0° 3' W. bet. secs. 20 and 21.
Over nearly level land, through scattering timber and undergrowth.
Set an iron post, 3 ft. long, 1 in. diam., 26 ins. in the ground, for ¼ sec. cor., mkd. on brass cap

¼
S20|S21
1916

from which,

- A cedar, 5 ins. diam., brs. S. 22½° E.
121 lks. dist.; mkd. ¼ S 21 B T.
- A cedar, 7 ins. diam., brs. S. 79° W.
86 lks. dist.; mkd. ¼ S 20 B T.

80.00 Set an iron post, 3 ft. long, 2 ins. diam., 24 ins. in the ground, for cor. of secs. 16, 17, 20 and 21, mkd. on brass cap

T24N R10E
S17|S16
S20|S21
1916

Subdivision of T. 24 N. R. 10 E.

Chains

dig pits, 18 X 18 X 12 ins., in each sec., 5½ ft. dist.; and raise a mound of earth, 4 ft. base, 2 ft. high, W. of cor.
 Land, nearly level.
 Soil, dark cinders and loam, subsoil of yellow clay.
Timber, scattering scrubby cedars.
 Undergrowth, scattering rabbit brush and mountain rush.
 Good grass.
Lava formation.

40.00 East on a random line bet. secs. 16 and 21.
 Set temp. ¼ sec. cor.
 80.02 Intersect N. and S. line, 13 lks. N. of cor. of secs. 15, 16, 21 and 22.

Thence
 N. 89° 54' W. on a true line bet. secs. 16 and 21.
 Over nearly level land, through scattering timber and undergrowth.

40.01 Set an iron post, 3 ft. long, 1 in. diam., 26 ins. in the ground, for ¼ sec. cor., mkd. on brass cap

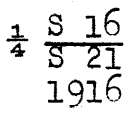

and raise a mound of stone, 2 ft. base, 1½ ft. high, N. of cor.

80.02 The cor. of secs. 16, 17, 20 and 21.
 Land, nearly level.
 Soil, dark cinders and loam, subsoil of yellow clay.
 Timber, scattering cedar.
 Undergrowth, scattering rabbit brush and mountain rush.
 Good grass.

40.00 N. 0° 3' W. bet. secs. 16 and 17.
 Over gently rolling land, through scattering undergrowth.
 Set an iron post, 3 ft. long, 1 in. diam., 26 ins. in the ground, for ¼ sec. cor., mkd. on brass cap

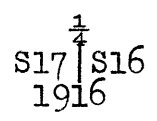

80.00 dig pits, 18 X 18 X 12 ins., N. and S. of post, 3 ft. dist.; and raise a mound of earth, 3½ ft. base, 1½ ft. high, W. of cor.
 Set an iron post, 3 ft. long, 2 ins. diam., 24 ins. in the ground, for cor. of secs. 8, 9, 16 and 17, mkd. on brass cap

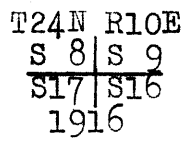

from which,
 A cedar, 10 ins. diam., brs. N. 61° W.
 212 lks. dist.; mkd. T 24 N R10 E S 8 B T.
 Raise a mound of stone, 3 ft. base, 2 ft. high, W. of cor. No other trees within limits.
 Land, nearly level.
 Soil, dark loam with cinders, 2 ft. deep yellow clay subsoil.
 Timber, scattering cedar.
 Undergrowth, scattering rabbit brush and mountain rush.
 Good grass. Drainage NW.

20

Subdivision of T. 24 N. R. 10 E.

Chains

East on a random line bet. secs. 9 and 16.
 40.00 Set temp. $\frac{1}{4}$ sec. cor.
 80.06 Intersect N. and S. line, 2 lks. N. of cor. of secs. 9,
 10, 15 and 16.
 Thence
 N. $89^{\circ} 59'$ W. on a true line bet. secs. 9 and 16.
 Over rolling broken land, through scattering undergrowth
 and timber.
 1.50 Draw, course NE. for 3 chs. thence NW.
 Asc. gradual slope.
 40.03 Set an iron post, 3 ft. long, 1 in. diam., 26 ins. in the
 ground, for $\frac{1}{4}$ sec. cor., mkd. on brass cap

$$\begin{array}{r} \frac{1}{4} \text{ S } 9 \\ \text{S } 16 \\ \hline 1916 \end{array}$$

from which,
 A cedar, 6 ins. diam., brs. N. $55\frac{1}{4}^{\circ}$ W.
 295 lks. dist.; mkd. $\frac{1}{4}$ S 9 B T.

No other trees within limits.
 67.20 Raise a mound of stone, 2 ft. base, $1\frac{1}{2}$ ft. high, N. of cor.
 End of rolling mesa brs. SW. and NE. Desc. NW. slope,
 92 ft.

80.06 The cor. of secs. 8, 9, 16 and 17.
 Land, rolling. 2 ft. deep
 Soil, poor, dark cinders and loam, clay subsoil, coarse and
 rocky.
 Timber, scattering cedar.
 Undergrowth, scattering rabbit brush.
 Good grass.
 Lava formation.

N. $0^{\circ} 3'$ W. bet. secs. 8 and 9.
 Over rolling land, through scattering undergrowth, and
 timber.
 Desc. NW. slope, 135 ft. to
 35.00 Foot of slope brs. NE. and SW. Thence over mesa.
 40.00 Set an iron post, 3 ft. long, 1 in. diam., 26 ins. in the
 ground, for $\frac{1}{4}$ sec. cor., mkd. on brass cap

$$\begin{array}{r} \frac{1}{4} \\ \text{S } 8 \text{ S } 9 \\ \hline 1916 \end{array}$$

dig pits, 18 X 18 X 12 ins., N. and S. of post, 3 ft.
 dist.; and raise a mound of earth, $3\frac{1}{2}$ ft. base, $1\frac{1}{2}$ ft.
 high, W. of cor.
 80.00 Set an iron post, 3 ft. long, 2 ins. diam., 24 ins. in the
 ground, for cor. of secs. 8 and 9, and fract. secs. 4
 and 5, marked on brass cap,

$$\begin{array}{r} \text{T 24 N R 10 E} \\ \text{S } 5 \text{ S } 4 \\ \text{S } 8 \text{ S } 9 \\ \hline 1916 \end{array}$$

from which,
 A cedar, 7 ins. diam., brs. S. $35\frac{3}{4}^{\circ}$ W.
 316 lks. dist.; mkd. T 24 N R 10 E S 8 B T.

No other trees within limits.
 Raise a mound of stone, 3 ft. base, 2 ft. high, W. of cor.
 Land, rolling and level. 2 ft. deep
 Soil, poor, dark cinders and loam, clay subsoil, coarse
 and rocky.
 Timber, scattering cedar.
 Undergrowth, scattering rabbit brush.
 Good grass.

Chains

East on a random line, bet. sec. 9, and fracl. sec. 4.
 40.00 Set temp. $\frac{1}{4}$ sec. cor.
 80.06 Intersect N. and S. line, 4 lks S. of cor. of secs. 9 and 10, and fracl. secs. 3 and 4.
 Thence
 S. $89^{\circ} 58'$ W. on a true line bet. sec. 9, and fracl. sec. 4.
 Over rolling land, through scattering timber and undergrowth.
 5.00 Foot of slope brs. NW. and SE. Asc. 46 ft. to
 10.00 Bench brs. NW. and SE. Desc. gradual slope.
 35.00 Low spur slopes N. for 2 chs. to edge of bench.
 40.03 Set an iron post, 3 ft. long, 1 in. diam., 26 ins. in the ground, for $\frac{1}{4}$ sec. cor., mkd. on brass cap

$$\begin{array}{r} \frac{1}{4} \text{ S } 4 \\ \hline \frac{1}{4} \text{ S } 9 \\ 1916 \end{array}$$

from which,

A cedar, 9 ins. diam., brs. N. $89\frac{1}{4}^{\circ}$ W.
 182 lks. dist.; mkd. $\frac{1}{4}$ S 4 B T.

No other trees within limits.
 Raise a mound of stone, $2\frac{1}{2}$ ft. base, 2 ft. high, N. of cor. over bench land.

45.00 Edge of bench brs. NE. and SW. Desc. 46 ft. to
 50.00 Thence over mesa.
 80.06 The cor. of secs. 8 and 9, and fracl. secs. 4 and 5.
 Land, rolling.
 Soil, dark loam and cinders, yellow clay subsoil, coarse and rocky.
 Timber, scattering cedar.
 Undergrowth, scattering rabbit brush.
 Good grass.

N. $0^{\circ} 3'$ W., on a true line, bet. fracl. secs. 4 and 5.

Over gently rolling mesa, through scattering undergrowth.
 17.50 Edge of mesa brs. NE. and SW. Desc. N. slope, 112 ft.
 31.18 Intersect 6th Standard Parallel N., 9.16 chs. W. of original std. cor. of secs. 32 and 33, which is a lava rock, 7 X 8 X 5 ins. ^{above ground} properly set, mkd. and witnessed as described by the Surveyor General

At the point of intersection
 Set an iron post, 3 ft. long, 2 ins. diam., 24 ins. in the ground, for closing cor. of fracl. secs. 4 and 5, marked on brass cap;

$$\begin{array}{r} \text{T25N R10E} \\ \hline \text{S32 | S33} \\ \hline \text{C | C} \\ \hline \text{S 5 | S 4} \\ 1916 \end{array}$$

and raise a mound of stone, 3 ft. base, 2 ft. high, S. of cor.

Land, rolling.
 Soil, dark loam and cinders, subsoil, clay, rocky and coarse.
 Timber, scattering cedar.
 Undergrowth, scattering rabbit brush.
 Good grass.

From the cor. of secs. 5, 6, 31 and 32 ^{on} S. bdy. of Tp., described in Book "E",
 N. $0^{\circ} 3'$ W. bet. secs. 31 and 32.

22

Subdivision of T. 24 N. R. 10 E.

Chains

40.00 Over gently rolling prairie land, through scattering undergrowth.
Set an iron post, 3 ft. long, 1 in. diam., 26 ins. in the ground, for $\frac{1}{4}$ sec. cor., mkd. on brass cap

$\frac{1}{4}$
S31 | S32
1916

from which,

A cedar, 8 ins. diam., brs. N. $56\frac{1}{4}^\circ$ W.
250 lks. dist.; mkd. $\frac{1}{4}$ S 31 B T.

No other trees within limits.

Dig pits, 18 X 18 X 12 ins., N. and S. of post, 3 ft. dist.; and raise a mound of earth, $3\frac{1}{2}$ ft. base, $1\frac{1}{2}$ ft. high, W. of cor.

80.00 Thence through scattering cedar and juniper timber.
Set an iron post, 3 ft. long, 2 ins. diam., 24 ins. in the ground, for cor. of secs. 29, 30, 31 and 32, mkd. on brass cap

T24N R10E
S30 | S29
S31 | S32
1916

from which,

A cedar, 8 ins. diam., brs. N. $38\frac{1}{4}^\circ$ E.
142 lks. dist.; mkd. T 24 N R 10 E S 29 B T.

No other trees within limits.

Dig pits, 18 X 18 X 12 ins., in each sec., $5\frac{1}{2}$ ft. dist.; and raise a mound of earth, 4 ft. base, 2 ft. high, W. of cor.

Land, gently rolling.
Soil, coarse gravel.
Timber, scattering scrub cedar.
Undergrowth, sagebrush.
Good grass.

40.00 East on a random line bet. secs. 29 and 32.
Set temp. $\frac{1}{4}$ sec. cor.
79.91 Intersect N. and S. line, 11 lks. N. of cor. of secs. 28, 29, 32 and 33.

Thence

N. $89^\circ 55'$ W. on a true line bet. secs. 29 and 32.

Over gently rolling land, through scattering timber and undergrowth.

35.00 Rim of mesa brs. N. and S. Desc. 52 ft.
39.95 $\frac{1}{2}$ Set an iron post, 3 ft. long, 1 in. diam., 26 ins. in the ground, for $\frac{1}{4}$ sec. cor., mkd. on brass cap

$\frac{1}{4}$ S 29
S 32
1916

from which,

A cedar, 6 ins. diam., brs. S. $59\frac{1}{4}^\circ$ E.
238 lks. dist.; mkd. $\frac{1}{4}$ S 32 B T.

No other trees within limits.

Dig pits, 18 X 18 X 12 ins., E. and W. of post, 3 ft. dist.; and raise a mound of earth, $3\frac{1}{2}$ ft. base, $1\frac{1}{2}$ ft. high, N. of cor.

56.40 Wagon road brs. NW. and SE. in bottom of draw, course SW.
79.91 The cor. of secs. 29, 30, 31 and 32.
Land, rolling.
Soil, coarse gravel and rock.
Timber, scattering scrub cedar.
Undergrowth, sagebrush.
Good grass.

Chains

West on a true line bet. secs. 30 and 31.
Over gently rolling land, through scattering timber and undergrowth.

33.50
40.00

Draw, 70 lks. wide, course NE.
Set an iron post, 3 ft. long, 1 in. diam., 26 ins. in the ground, for $\frac{1}{4}$ sec. cor., mkd. on brass cap

$\frac{1}{4}$ S 30
 $\frac{1}{4}$ S 31
1916

from which,

A cedar, 5 ins. diam., brs. N. $47\frac{1}{2}^\circ$ W.
114 lks. dist.; mkd. $\frac{1}{4}$ S 30 B T.

A cedar, 5 ins. diam., brs. S. $48\frac{1}{4}^\circ$ W.
96 lks. dist.; mkd. $\frac{1}{4}$ S 31 B T.

101.08

Intersect E. bdy. of T. 24 N., R. 9 E., 11.23 chs. S. $0^\circ 12'$ E. of the $\frac{1}{4}$ sec. cor. of sec. 25, hereinafter described.

At the point of intersection,

Set an iron post, 3 ft. long, 2 ins. diam., 26 ins. in the ground, for closing cor. of secs. 30 and 31, mkd. on brass cap

T24N
T24N | R10E
S25 | S30 CC
R 9E | S31
1916

from which,

A cedar, 10 ins. diam., brs. S. $33\frac{3}{4}^\circ$ E.
64 lks. dist.; mkd. T 24 N R 10 E S 31 C C B T.

A cedar, 10 ins. diam., brs. N. $26\frac{1}{2}^\circ$ E.
25 lks. dist.; mkd. T 24 N R 10 E S 30 C C B T.

Land, gently rolling.
Soil, coarse gravel.
Timber, scattering scrub cedar.
Undergrowth, scattering sagebrush.
Good grass.

Resurvey of South $\frac{1}{2}$ of E. Bdy. of Sec. 25, T. 24 N., R. 9 E.

From the original $\frac{1}{4}$ sec. cor. of secs. 25 and 30, which is a malpais stone, 8 X 10 X 6 ins. above ground, firmly set, mkd. and witnessed as described by the Surveyor General,

39.98

South on a random line along E. bdy. of sec. 25, (S. half).
Fall 14 lks. W. of the original cor. of secs. 25, 30, 31 and 36, which is a malpais stone, 6 X 8 X 4 ins. above ground, firmly set, mkd. and witnessed as described by the Surveyor General.

Reestablish this cor. to refer to secs. 25 and 36, T. 24 N. R. 9 E. and by destroying marks on NE. and SE. bearing trees. No other change necessary. 30 to S 31 on the bearing tree.

Thence
N. $0^\circ 12'$ W. on a true line along E. bdy. sec. 25, (S. half).
Over gently rolling land, through scattering timber and undergrowth.

39.98

Intersect original $\frac{1}{4}$ sec. cor., hereinbefore described.
Change this cor. to refer to sec. 25 only, by destroying marking on NE. bearing tree. No other change necessary.
Land, nearly level. Soil, coarse gravel and rock.
Timber, scrub cedar. Undergrowth, sage brush.
Good grass.

24 Subdivision of T. 24 N. R. 10 E.

Chains From cor. of secs. 29, 30, 31 and 32,
 N. 0° 3' W. bet. secs. 29 and 30.
 Over gently rolling land, through scattering timber and
 undergrowth;

40.00 Set an iron post, 3 ft. long, 1 in. diam., 26 ins. in the
 ground, for 1/4 sec. cor., mkd. on brass cap

1/4
 S30 | S29
 1916

from which,

A cedar, 5 ins. diam., brs. S. 79° E.

39 lks. dist.; mkd. 1/4 S 29 E T.

A cedar, 7 ins. diam., brs. N. 5 1/2° W.

212 lks. dist.; mkd. 1/4 S 30 B T.

80.00 Set an iron post, 3 ft. long, 2 ins. diam., 24 ins. in the
 ground, for cor. of secs. 19, 20, 29 and 30, mkd. on
 brass cap

T24N R10E
 S19 | S20
 S30 | S29
 1916

from which,

A cedar, 8 ins. diam., brs. N. 53 1/2° E.

93 lks. dist.; mkd. T 24 N E 10 E S 20 B T.

No other trees within limits.

Dig pits, 18 X 18 X 12 ins., in each sec., 5 1/2 ft. dist.;
 and raise a mound of earth, 4 ft. base, 2 ft. high,
 W. of cor.

Land, gently rolling.

Soil, coarse gravel and sand rock.

Timber, scrub cedar.

Undergrowth, scattering sagebrush.

Good grass.

40.00 East on a random line bet. secs. 20 and 29.

Set temp. 1/4 sec. cor.

79.83 Intersect the corner of secs. 20, 21, 28 and 29, 20, 21,
 and 29.

Thence

West on a true line bet. secs. 20 and 29.

Over gently rolling land, through scattering timber and
 undergrowth.

39.91 1/2 Set an iron post, 3 ft. long, 1 in. diam., 26 ins. in the
 ground, for 1/4 sec. cor., mkd. on brass cap

1/4 S 20
 S 29
 1916

from which,

A cedar, 8 ins. diam., brs. S. 82 1/4° E.

154 lks. dist.; mkd. 1/4 S 29 B T.

No other trees within limits.

Dig pits, 18 X 18 X 12 ins., E. and W. of post, 3 ft.
 dist.; and raise a mound of earth, 3 1/2 ft. base, 1 1/2 ft.
 high, N. of cor.

56.15 Rim of mesa brs. N. and S. Desc. 91 ft. to

65.00 Draw, 3 chs. wide, course N. Thence over gently rolling
 land.

69.50 Wagon road brs. NW. and SE.

79.83 The cor. of secs. 19, 20, 29 and 30.

Land, rolling.

Soil, coarse gravel, cinders and rock.

Timber, scattering cedar.

Undergrowth, sagebrush.

Good grass.

Subdivision of T. 24 N., R. 10 E.

Chains

West on a true line bet. secs. 19 and 30.
 Over rolling land, through scattering scrub cedar and juniper timber.

40.00 Set an iron post, 3 ft. long, 1 in. diam., 26 ins. in the ground, for $\frac{1}{4}$ sec. cor., mkd. on brass cap

$\frac{1}{4}$ S 19
 $\frac{1}{4}$ S 30
 1916

from which,
 A cedar, 8 ins. diam., brs. S. $89\frac{1}{2}^\circ$ E.
 122 lks. dist.; mkd. $\frac{1}{4}$ S 30 B T.

No other trees within limits.
 Dig pits, 18 X 18 X 12 ins., E. & W. of post, 3 ft. dist., and raise mound of earth, $3\frac{1}{2}$ ft. base, $1\frac{1}{2}$ ft. high, N. of cor.

58.23 Wagon road brs. NE. and SW.
 65.00 Draw near head, course NE. SE. rim brs. NE. and SW.
 85.00 SW. rim of draw.
 101.14 Intersect E. bdy. of Tp. 24 N., R. 9 E., 11.10 chs. S. of the $\frac{1}{4}$ sec. cor. of sec. 24, hereinafter described.

At the point of intersection,
 Set an iron post, 3 ft. long, 2 ins. diam., 24 ins. in the ground, for closing cor. of secs. 19 and 30, mkd. on brass cap

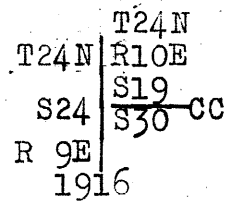

from which,
 A cedar, 8 ins. diam., brs. N. $88\frac{1}{4}^\circ$ E.
 324 lks. dist.; mkd. T 24 N R 10 E S 19 C C B T.

A cedar, 5 ins. diam., brs. S. $43\frac{1}{4}^\circ$ E.
 170 lks. dist.; mkd. T 24 N R 10 E S 30 C C B T.

Land, gently rolling.
 Soil, coarse gravel, cinders and rock.
 Timber, scattering scrub cedar.
 Undergrowth, rabbit brush.
 Good grass.

Resurvey of South $\frac{1}{2}$ of E. Bdy. Sec. 24, T. 24 N., R. 9 E.

From the original $\frac{1}{4}$ sec. cor. of secs. 19 and 24, which is a malpais stone, 6 X 8 X 4 ins. above ground, firmly set, mkd. and witnessed as described by the Surveyor General.

39.98 South on a random line along E. bdy. of sec. 24, (S. half).
 Intersect the original cor. of secs. 19, 24, 25 and 30, which is a malpais stone, 8 X 6 X 6 ins., above ground, firmly set, mkd. and witnessed as described by the Surveyor General.

Reestablish this cor. to refer to secs. 24 & 25, T. 24 N., R. 9 E., only, by destroying marks on NE. & SE. bearing trees. No other change necessary.

Thence, bearing true.

Thence
 North on a true line along E. bdy. sec. 24, (S. half).
 Over rolling land, through scattering timber and brush.

39.98 Intersect original $\frac{1}{4}$ sec. cor., hereinbefore described. Now refers to sec. 24 only. No change necessary.

Land, rolling. Soil, coarse gravel, cinders and rock.
 Timber, scattering cedar. Undergrowth, rabbit brush.
 Good grass.

26

Subdivision of T. 24 N., R. 10 E.

Chains from cor. of secs. 19, 20, 29 and 30.
N. 0° 3' W. bet. secs. 19 and 20.
Over nearly level land, through scattering timber and undergrowth.

40.00 Set an iron post, 3 ft. long, 1 in. diam., 26 ins. in the ground, for 1/4 sec. cor., mkd. on brass cap

1/4
S19 | S20
1916

from which,

A cedar, 4 ins. diam., brs. N. 18° E.
18 lks. dist.; mkd. 1/4 S 20 B T.

A cedar, 7 ins. diam., brs. S. 12 3/4° W.
63 lks. dist.; mkd. 1/4 S 19 B T.

75.35 Wagon road brs. NE. and SW.

80.00 Set an iron post, 3 ft. long, 2 ins. diam., 24 ins. in the ground, for cor. of secs. 17, 18, 19 and 20, mkd. on brass cap

T24N R10E
S18 | S17
S19 | S20
1916

from which,

A cedar, 6 ins. diam., brs. N. 87° W.
290 lks. dist.; mkd. T 24 N R 10 E S 18 B T.

No other trees within limits.

Dig pits, 18 X 18 X 12 ins., in each sec., 5 1/2 ft. dist.; and raise a mound of earth, 4 ft. base, 2 ft. high, W. of cor.

Land, nearly level.

Soil, coarse, gravelly.

Timber, scattering cedar.

Undergrowth, scattering rabbit brush.

Good grass.

40.00 East on a random line bet. secs. 17 and 20.

Set temp. 1/4 sec. cor.

79.73 Intersect N. and S. line, 10 lks. N. of cor. of secs. 16, 17, 20 and 21, mkd. on brass cap

Thence

N. 89° 56' W. on a true line bet. secs. 17 and 20.

Over gently rolling land, through scattering timber and undergrowth.

39.86 1/2 Set an iron post, 3 ft. long, 1 in. diam., 26 ins. in the ground, for 1/4 sec. cor., mkd. on brass cap

1/4 S 17
1/4 S 20
1916

from which,

A cedar, 6 ins. diam., brs. N. 63 3/4° W.
275 lks. dist.; mkd. 1/4 S 17 B T.

No other trees within limits.

Dig pits, 18 X 18 X 12 ins., E. and W. of post, 3 ft. dist.; and raise a mound of earth, 3 1/2 ft. base, 1 1/2 ft. high, N. of cor.

54.80 Rim of mesa brs. N. and S. Desc. 78 ft. to

62.80 Draw, 1 ch. wide, course NE.

66.00 Wagon road brs. N. and S.

77.00 Dim wagon road brs. NE. and SW.

79.73 The cor. of secs. 17, 18, 19 and 20.

Land, gently rolling.

Soil, coarse cinders and rock.--Timber, scattering cedar.

Undergrowth, sagebrush.--Good grass.

Chains

West on a true line bet. secs. 18 and 19.
Over gently rolling land, through scattering timber and undergrowth.

26.75 Draw, 1 ch. wide, course NE.

40.00 Set an iron post, 3 ft. long, 1 in. diam., 26 ins. in the ground, for $\frac{1}{4}$ sec. cor., mkd. on brass cap

$\frac{1}{4}$ S 18
S 19
1916

dig pits, 18 X 18 X 12 ins., E. and W. of post, 3 ft. dist.; and raise a mound of earth, $3\frac{1}{2}$ ft. base, $1\frac{1}{2}$ ft. high, N. of cor.

50.00 Draw, 2 chs. wide, course NE.

54.90 Asc. gradual E. slope of mesa, 57 ft. to

63.90 Rim of mesa brs. NE. and SW. Thence over mesa.

101.26 Intersect E. bdy. of T. 24 N. R. 9 E., 10.96 chs. S. 0° 9' E. of the $\frac{1}{4}$ sec. cor. of sec. 13; hereinafter described.

At the point of intersection

Set an iron post, 3 ft. long, 2 ins. diam., 24 ins. in the ground, for closing cor. of secs. 18 and 19, mkd. on brass cap

T24N
T24N | R10E
S13 | S18
R 9E | S19-CC
1916

dig pits, 24 X 18 X 12 ins., crosswise on each line, N. and S. 3 ft. and E. of post, 7 ft. dist.; and raise a mound of earth, 4 ft. base, 2 ft. high, E. of cor.

Land, rolling.

Soil, coarse gravel and rock.

Timber, scattering cedar.

Undergrowth, buck brush and rabbit brush.

Good grass.

Resurvey of South $\frac{1}{4}$ of E. Bdy. Sec. 13, T. 24 N., R. 9 E.

From the original $\frac{1}{4}$ sec. cor. of secs. 13 and 18, which is a malpais stone, 10 X 8 X 6 ins., above ground, firmly set, mkd. and witnessed as described by the Surveyor General.

39.96 South on a random line along E. bdy. of sec. 13, (S. half) .
Fall 10 lks. W. of the original cor. of secs. 13, 18, 19 and 24, which is a malpais stone, 8 X 6 X 5 ins. above ground, firmly set, mkd. and witnessed as described by the Surveyor General.

Reestablish this cor. to refer to secs 13 and 18, T. 24 N., R. 9 E. only by destroying marks on NE and SE bearing trees, and by filling in the pits E of line.

Thence, . . .

N. 0° 9' W. on a true line along E. bdy. of sec. 13, (S. half)
Over rolling land, through scattering timber and brush.

33.44 Rim of mesa brs. NE. and SW. Desc. 29 ft.

39.96 Intersect orig. $\frac{1}{4}$ sec. cor. hereinbefore described. Change this cor. to refer to sec. 13, only, by destroying markings on NE bearing tree. No other change necessary.

Land, rolling. Soil, coarse gravel and cinders.

timber, scattering cedar.

Undergrowth, rabbit brush and buck brush.

Good grass.

28. Subdivision of T. 24 N. R. 10 E.

Chains From cor. of secs. 17, 18, 19 and 20,
N. 0° 3' W. bet. secs. 17 and 18.
Over rolling land, through scattering timber and brush.
Desc. gradual slope to
10.62 Draw, 150 lks. wide, course NE.
40.00 Set an iron post, 3 ft. long, 1 in. diam., 26 ins. in the
ground, for $\frac{1}{4}$ sec. cor., mkd. on brass cap

$\frac{1}{4}$
S18 | S17
1916

dig pits, 18 X 18 X 12 ins., N. and S. of post 3 ft.
dist.; and raise a mound of earth, $2\frac{1}{2}$ ft. base, $1\frac{1}{2}$ ft.
high, W. of cor.
63.78 Draw, 1 ch. wide, course NE.
80.00 Set an iron post, 3 ft. long, 2 ins. diam., 24 ins. in the
ground, for cor. of secs. 7, 8, 17 and 18, mkd. on brass
cap

T24 N R10 E
S 7 | S 8
S18 | S17
1916

from which,
A cedar, 5 ins. diam., brs. N. 47° E.
202 lks. dist.; mkd. T 24 N R 10 E S 8 B T.
A cedar, 6 ins. diam., brs. S. 40 $\frac{1}{2}$ ° W.
290 lks. dist.; mkd. T 24 N R 10 E S 18 B T.

No other trees within limits.
Raise a mound of stone, 3 ft. base, 3 ft. high, W. of cor.
Land, rolling and broken.
Soil, coarse, gravel and cinders with rock.
Timber, scattering scrub cedar.
Undergrowth, scrub cedar and rabbit brush.
Fair grass.

40.00 East on a random line bet. secs. 8 and 17.
Set temp. $\frac{1}{4}$ sec. cor.
79.68 Intersect N. and S. line, 26 lks. N. of cor. of secs.
8, 9, 16 and 17.

Thence
N. 89° 49' W. on a true line bet. secs. 8 and 17.
Over rolling land, through scattering timber and brush.
Desc. gradual NW. slope.
17.00 Foot of descent brs. NE. and SW. 65 ft. below sec. cor.
25.00 Draw, course N. Asc. gradual NE. slope, 40 ft.
39.84 Set an iron post, 3 ft. long, 1 in. diam., 26 ins. in the
ground, for $\frac{1}{4}$ sec. cor., mkd. on brass cap

$\frac{1}{4}$ S 8
S 17
1916

and raise a mound of stone, 3 ft. base, $2\frac{1}{2}$ ft. high,
N. of cor.
Desc. gradual slope 34 ft. to
46.10 Draw, course NE. Asc. gentle slope, 34 ft.
50.00 Spur slopes NE. for 5 chs. dist. Thence along N. slope.
60.00 Swale course NE. Asc. gradual SE. slope, 57 ft.
72.00 Road brs. NE. and SW. to Hizer Springs.
75.00 Spur slopes NE. for 40 chs. dist. Desc. gradual W. slope.
79.68 The cor. of secs. 7, 8, 17 and 18.
Land, rolling.
Soil, poor, black cindery loam, clay subsoil.
Timber, scattering cedar.
Undergrowth, rabbit brush and mountain brush.
Poor grass.

Chains

West on a true line bet. secs. 7 and 18.
 Over rolling land, through scattering timber and undergrowth.
 Desc. gradual slope.
 19.99 Draw, 1 ch. wide, course NE. Asc. E. slope of mesa, 130 ft.
 32.65 Top of rocky spur or knoll.
 34.84 Rim of mesa brs. NE and SW.
 40.00 Set an iron post, 3 ft. long, 1 in. diam., 26 ins. in the ground, for $\frac{1}{4}$ sec. cor., mkd. on brass cap

$\frac{1}{4}$ S 7
 S 18
 1916

dig pits, 18 X 18 X 12 ins., E. and W. of post, 3 ft. dist.; and raise a mound of earth, $3\frac{1}{2}$ ft. base, $1\frac{1}{2}$ ft. high, N. of cor.

95.00 Asc. gradual slope to
 99.55 Top of rim of second mesa brs. NE. and SW.
 101.15 Intersect E. bdy. of T. 24 N., R. 9 E., 19.95 chs. S. of the $\frac{1}{4}$ sec. cor. of sec. 12., herein after, described.
 At the point of intersection
 Set an iron post, 3 ft. long, 2 ins. diam., 26 ins. in the ground, for closing cor. of secs. 7 and 18, mkd. on brass cap

T24N
 T24N | R10E
 S12 | S 7 CC
 R 9E | S18
 1916

from which,
 A cedar, 8 ins. diam., brs. N. 57° E.
 178 lks. dist.; mkd. T 24 N R 10 E S 7 C C B T.
 A cedar, 5 ins. diam., brs. S. 57° E.
 213 lks. dist.; mkd. T 24 N R 10 E S 18 C C B T.

Land, rolling and broken.
 Soil, coarse gravel, cinders and rock.
 Timber, scattering cedar.
 Undergrowth, buck brush and rabbit brush.
 Good grass.

Resurvey of South $\frac{1}{2}$ of E. Bdy. Sec. 12, T. 24 N., R. 9 E.

From the original $\frac{1}{4}$ sec. cor. of secs. 7 and 12, which is a malpais stone, 7 X 10 X 6 ins. above ground, firmly set, mkd. and witnessed as described by the Surveyor General,
 40.00 South on a random line on E. bdy. of sec. 12, (S. half) Intersect the original cor. of secs. 7, 12, 13 and 18, which is a malpais stone, 8 X 14 X 4 ins. above ground, firmly set, mkd. and witnessed as described by the Surveyor General.

Reestablish this cor. to refer to secs. 12 and 13, T. 24 N., R. 9 E. only, by destroying marks to NE & SE, bearing trees. No other change necessary.

Thence, south, to
 40.00 North on a true line, on E. bdy. of sec. 12 (S. half). Over rolling land, thru scattering timber and undergrowth. Intersect original $\frac{1}{4}$ sec. cor. herein before described. Now refers to sec. 12 only. No change necessary.
 40.00 the original $\frac{1}{4}$ sec. cor. is hereafter described.

Land, gently rolling.
 Soil, coarse gravel and cinders.
 Timber, scattering cedar.
 Undergrowth, rabbit brush and buck brush.
 Good grass.

30

Subdivision of T. 24 N., R. 10 E.

Chains From cor. of secs. 7, 8, 17 and 18.
 N. 0° 3' W. bet. secs. 7 and 8:
 Over rolling land, through scattering timber and under-
 growth.
 5.60 Draw, 20 lks. wide, course NE. Asc. gradual slope.
 13.90 Top of gentle ascent brs. NE. and SW. Desc. 63 ft.
 28.35 Rim-rock brs. NE. and SW. Desc. 90 ft. to
 32.60 Bottom of canyon, 2 chs. wide, course NE.
 40.00 Set an iron post, 3 ft. long, 1 in. diam., 26 ins. in the
 ground, for $\frac{1}{4}$ sec. cor., mkd. on brass cap

$\frac{1}{4}$
 S 7 | S 8
 1916

dig pits, 18 X 18 X 12 ins., N. and S. of post, 3 ft.
 dist.; and raise a mound of earth, $\frac{1}{2}$ ft. base, $1\frac{1}{2}$ ft.
 high, W. of cor.
 44.89 Asc. 55 ft. to
 59.00 Rim-rock brs. NE. and S. Asc. gentle E. slope of mesa.
 69.84 Canyon, 150 lks. wide, 69 ft. deep, course NE.
 Dim wagon road brs. NE. and SW. Asc. Rocky E. slope,
 151 ft.
 80.00 Set an iron post, 3 ft. long, 2 ins. diam., 20 ins. in the
 ground, in a mound of stone, for cor. of secs. 7 and 8
 and fracl. secs. 5 and 6, marked on brass cap,

T24N R10E
 S 6 | S 5
 S 7 | S 8
 1916

and raise a mound of stone, 3 ft. base, 3 ft. high,
 W. of cor.
 Land, rolling and broken.
 Soil, coarse grave, cinders and rock.
 Timber, scattering cedar.
 Undergrowth, buck brush and rabbit brush.
 Fair grass.

40.00 East on a true line bet. sec. 8, and fracl. sec. 5.
 Set temp. $\frac{1}{4}$ sec. cor.
 79.86 Intersect N. and S. line, 34 lks. N. of cor. of secs.
 8 and 9, and fracl. secs. 4 and 5.
 Thence
 N. 89° 45' W. on a true line bet. sec. 8, and fracl. sec. 5.
 Over rolling mesa, through scattering timber and under-
 growth.
 8.80 Edge of mesa brs. SW. and NE. Desc. W. slope, 90 ft. to
 15.00 Foot of slope brs. NE. and SW.
 Bottom of hollow, course NE. Thence over gently rolling
 land.
 39.93 Set an iron post, 3 ft. long, 1 in. diam., 26 ins. in the
 ground, for $\frac{1}{4}$ sec. cor., mkd. on brass cap

$\frac{1}{4}$ S 5
 S 8
 1916

and raise a mound of stone, 3 ft. base, 2 ft. high,
 N. of cor.
 55.65 Road brs. N. 10° E. and S. 10° W. to Hizer Srptings.
 68.00 Foot of slope brs. NE. and SW. Asc. E. slope, 205 ft.
 79.86 The cor. of secs. 7 and 8, and fracl. secs. 5 and 6.
 Land, rolling and broken.
 Soil, poor, black cinders; subsoil, rocky clay loam.
 Timber, scattering cedar.
 Undergrowth, rabbit brush and mountain rush.
 Fair grass.

Chains.

West, on a true line, bet. secs 7 and frac1.sec.6.
Over rolling land, thru scattering timber and undergrowth.
Ascend 102 ft. to

- 3.00 Top of rim-rock; thence over nearly level land.
- 40.00 Set an iron post, 3 ft. long, 1 in. in diam., 26 ins. in the ground, for $\frac{1}{4}$ sec. cor., marked on brass cap,

$\frac{1}{4}$ S 6
 S 7
 1916

from which,

- A cedar, 4 ins. in diam., brs. N. 1° W., 54 lks. dist., marked $\frac{1}{4}$ S 6 B T.
- A cedar, 4 ins. in diam., brs. S. 20 $\frac{1}{2}$ ° E., 30 lks. dist., marked $\frac{1}{4}$ S 7 B T.

- 100.87 Intersect E. bdy. of T. 24 N. R. 9 E., 10.83 chs. S. of the $\frac{1}{4}$ sec. cor. of sec. 1, hereinafter described.

At the point of intersection,
Set an iron post, 3 ft. long, 2 ins. in diam., 24 ins. in the ground, for closing cor. of sec. 7, and frac1.sec. 6, marked on brass cap,

T24N
 T24N | R10E
 S 1 | S 6 CC
 R9 E | S 7
 1916

Dig pits, 24x18x12 ins., crosswise off each line, N. and S. 3 ft., and E. of post, 7 ft. dist., and raise a mound of earth, 4 ft. base, 2 ft. high, E. of cor.

Land, rolling and nearly level.
Soil, coarse gravel and cinders.
Timber, scattering cedar.
Undergrowth, sage brush.
Good grass.

Resurvey of South $\frac{1}{2}$ of E. bdy. of sec. 1, T. 24 N., R. 9 E.

From the original cor. of secs. 1, 6, 7 and 12, which is a malpais stone, 8x8x5 ins. above ground, firmly set, marked and witnessed, as described by the surveyor general, North, on random line on E. bdy. of sec. 1 (S. half).

- 40.00 Intersect the original $\frac{1}{4}$ sec. cor., which is a malpais stone, 10x10x8 ins. above ground, firmly set, marked and witnessed as described by the surveyor general. Change this cor. to refer to sec. 1 only, by destroying marking on NE. bearing tree. No other change necessary.

Thence,
South, on true line, on E. bdy. of sec. 1 (S. half).
Over nearly level land, thru scattering timber and undergrowth.

- 40.00 Intersect the original cor. of secs. 1, 6, 7 and 12, hereinbefore described.

Change this cor. to refer to secs. 1 and 12 only, by filling in the pits E. of line. No other change necessary.
Land, nearly level.
Soil, coarse cinders.
Timber, scattering cedar.
Undergrowth, scattering buck brush and sage brush.
Good grass.

32 Subdivision of Township 24 North Range 10 East

Chains.

From cor. of secs. 7 and 8, and fracl. secs. 5 and 6, N. 0° 3' W., on a true line, bet. fracl. secs. 5 and 6. Over rolling land, thru. scattering timber and undergrowth. Ascend 97 ft. to
 8.00 Rim-rock, brs. NE. and SW. Ascend gradual slope to
 9.85 Top of mesa; thence over level land.
 24.24 North rim of mesa, brs. NW. and SE. Descend 131 ft.
 30.88 Intersect 6th. Standard Parallel North, 9.01 chs. W. of the original standard cor. of secs. 31 and 32, which is a malpais stone, 4x4x6 ins., above ground, firmly set, marked and witnessed, as described by the surveyor general.
 At the point of intersection, Set an iron post, 3 ft. long, 2 ins. in diam., 24 ins. in the ground, for closing cor. of fracl. secs. 5 and 6, marked on brass cap,

T25N R10E
 S31 | S32
 C | C
 S 6 | S 5
 1916

and raise a mound of stone, 3 ft. base, 3 ft. high, S. of cor.
 Land, rolling and broken.
 Soil, coarse gravel, cinders and rock.
 Timber, scattering scrub cedar.
 Undergrowth, buck brush and rabbit brush.
 Fair grass.

GENERAL DESCRIPTION.

This township is in the north central portion of the State of Arizona, at the northeastern foot of the San Francisco mountains on the watershed of the Little Colorado river, which stream is located about two miles NE. from the NE. cor. of the township. The surface is rolling, except where broken by isolated spurs, knolls and lava ledges. The soil is a dark clay loam, coarse texture, mixed with either coarse gravel and rock, or black cinders, and could mostly be classed as 3rd and 4th rate. There is no dense growth of timber, there being scattering cedar over most of the surface, with some portions devoid of timber. The undergrowth, consisting of sage brush, rabbit brush, buck brush and mountain rush, is also scattering. There is no permanent running water in the Tp., although there are two intermittent springs, one in sec. 11, and one in sec. 24, known as Little Roden Springs. Ruins of stone houses, observed at each of these springs, and a fence in SE. 1/4 of sec. 36, are the only improvements in the township. No evidence of valuable mineral deposits could be found. No settlers are located within the boundaries. One road traverses the township, extending N. and S., thru. the western part.

Boundaries of Township 24 North, Range 10 East.
Latitudes, departures, and closing errors.

Line designated.	True bearing.	Dist.	Latitudes.		Departures.	
			N.	S.	E.	W.
South boundary,	West,	501.05				501.05
West boundary,	N.0°4' W.	11.38	11.38			.01
	North,	40.00	40.00			
	N.0°12' W.	39.98	39.98			.14
	North,	119.98	119.98			
	N.0°9' W.,	39.96	39.96			.10
North,	180.26	180.26				
North boundary, (6th.Std.Par.N)	East,	460.59			460.59	
	S.89°54'E.	40.00		.07	50.00	
East boundary,	South,	430.82		430.82		
Convergency,						.48
Totals,			431.56	430.89	501.07	501.30
			430.89			501.07
Errors in latitude,			0.67			
Errors in departure,						0.23

DATE DIAGRAM.

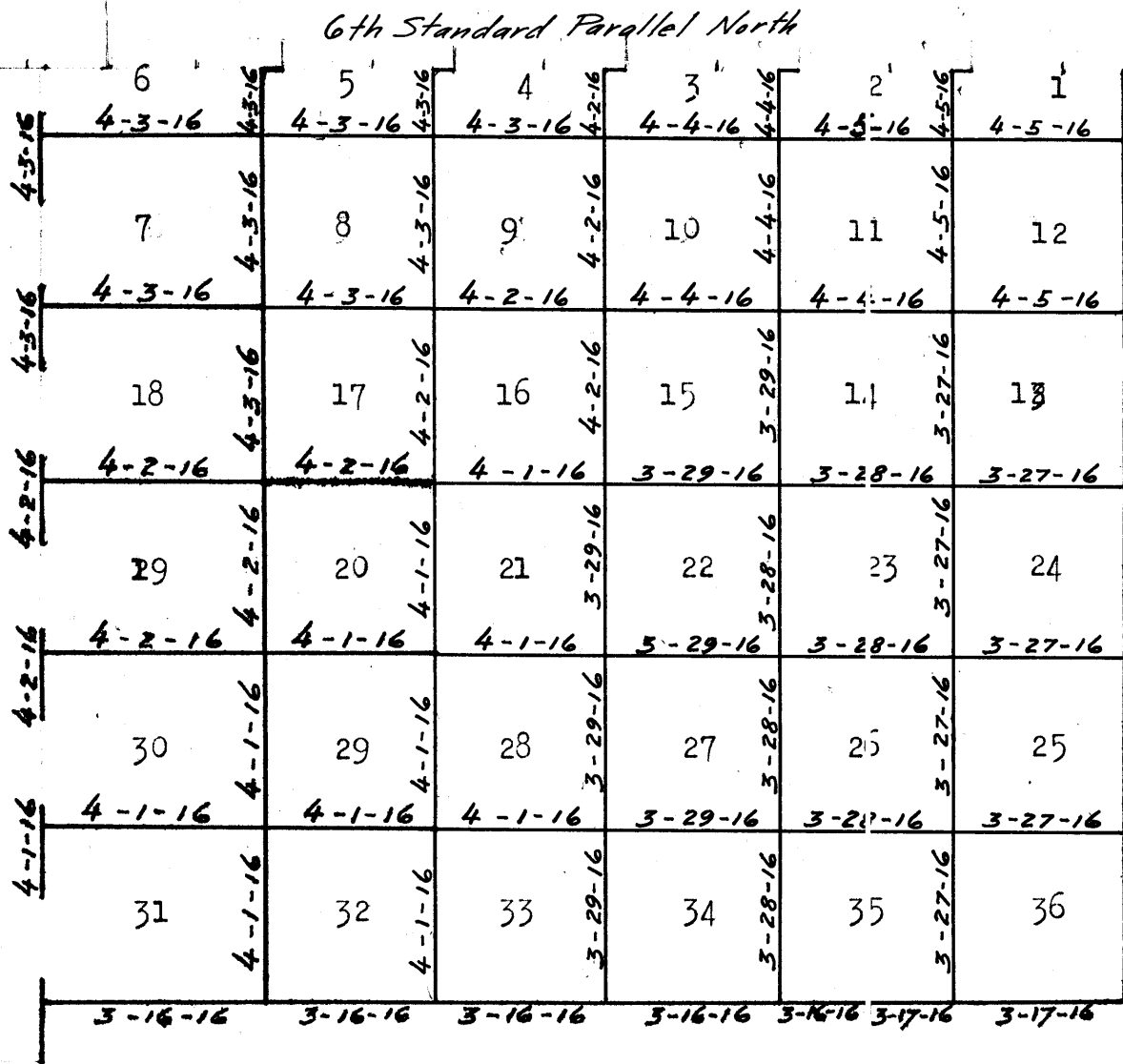

Lines dated in red, surveyed by Thomas B. Matthews, U.S. Surveyor.

Lines dated in black, surveyed by Joseph C. Clark, U.S. Transitman.

