

3246

123

Book "E"

4-679

BOOK 3246

(Subdivisions)

JAN 27 1915

FIELD NOTES

OF THE SURVEY OF THE

SUBDIVISION LINES

of

TOWNSHIP 26 NORTH, RANGE 20 WEST,

and

Part of the Subdivision Lines of

TOWNSHIP 26 NORTH, RANGE 21 WEST,

Of the Gila and Salt River Base and Meridian,

In the State of Arizona.

EXECUTED BY

H. G. Bardsley, U. S. Surveyor,

and

Royston C. Durnford, U.S. Transitman,

~~In the capacity of U. S. Surveyor~~, under instructions dated January 7, 1915, issued by the United States Surveyor General to govern surveys included in Group No. 45, which were approved by the Commissioner of the General Land Office, January 26, 1915.

Survey commenced March 9, 1915.

Survey completed April 19, 1915.

Executed under Assignment
Instructions dated Jan. 31, 1915.

3246

3246

124
1A

Book

Group 45 - - - Arizona.

SEE SPECIAL INDEX DIAGRAM.

INDEX DIAGRAM.

Township 26 North, Range 20 West.

6	27	5	20	4	15	3	10	2	5	1
27	26		19		14		10		5	
7	26	8	19	9	14	10	9	11	4	12
25	25		18		13		9		4	
18	25	17	18	16	13	15	8	14	3	13
24	24		17		13		8		3	
19	23	20	17	21	12	22	7	23	2	24
23	22		17		12		7		2	
30	22	29	16	28	11	27	6	26	2	25
21	21		16		11		6		1	
31	20	32	15	33	10	34	5	35	1	36

BOOK 3246

Book "E"
Group 45- - - Arizona.

SPECIAL INDEX DIAGRAM.

PART I.

<p>T.26N.,R.21W. Index Diagram on Page 2</p>	<p>T.26 N.R.20W. See Index Diagram below</p>
--	--

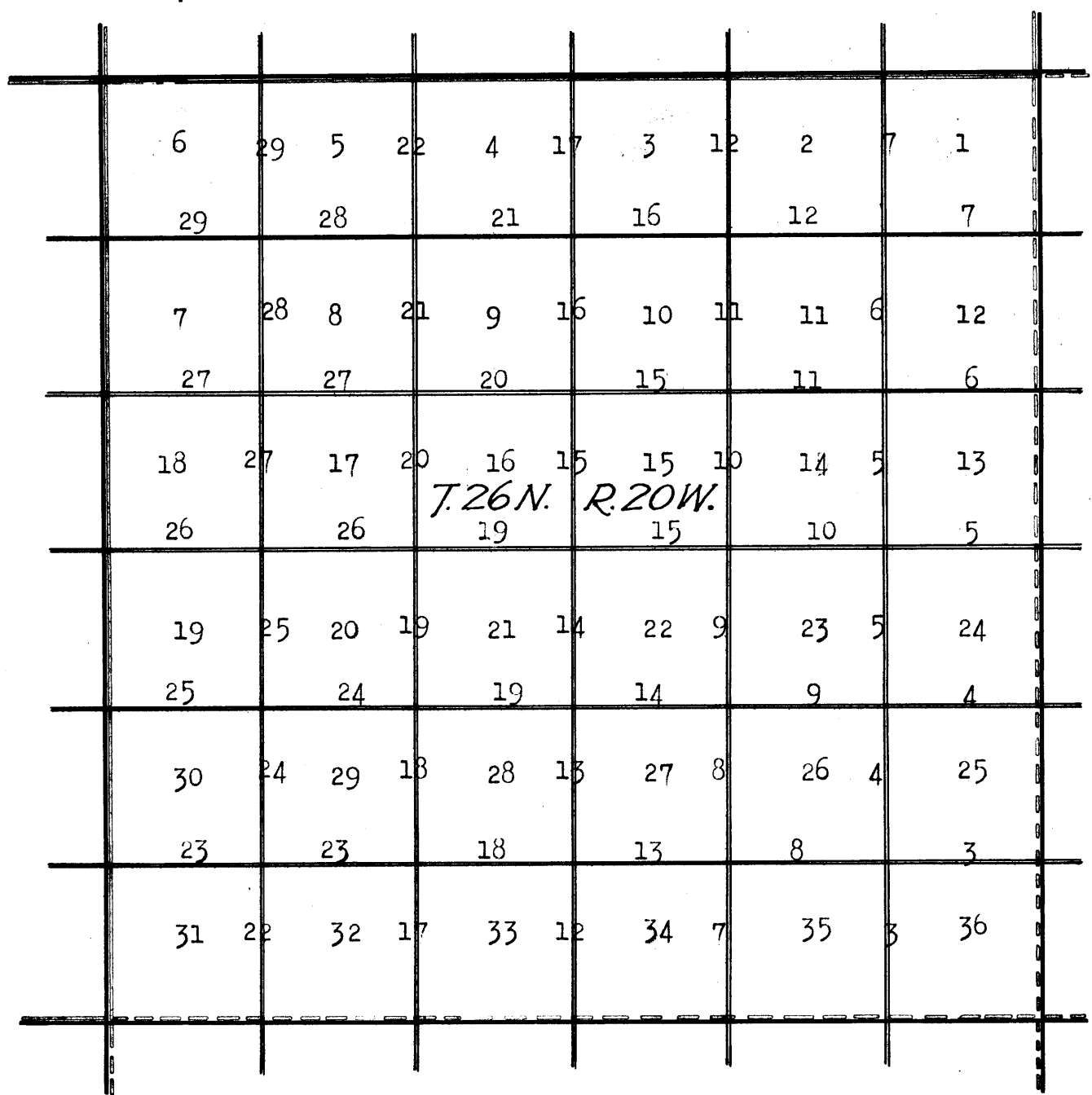

- Subdivision lines surveyed under this group.
- Township boundaries surveyed under this group.
Notes in Book "A."
- Township boundaries resurveyed under this group.
Notes in Book "A."

2.

Book "E"
 Group 45 - - - Arizona.
SPECIAL INDEX DIAGRAM.

PART II.

BOOK 3246

6	5	53	4	47	3	41	2	36	1
			52		46		41		35
7	8	52	9	46	10	40	11	35	12
			51		45		40		34
18	17	51	16	45	15	39	14	34	13
58	57	<i>T.26N. R.21W.</i>			44		39		33
			50						
19	57	20	49	21	44	22	38	23	33
56		56		49		43		38	
30	55	29	48	28	43	27	37	26	32
55		54		48		42		37	
31	53	32	47	33	42	34	36	35	31

- Subdivision lines surveyed under this group.
- Township boundaries surveyed under this group.
Notes in Book "A."
- Township boundaries resurveyed under this group.
Notes in Book "A."
- Unsurveyed.

Chains.

Survey commenced Mar. 9., 1915, and executed jointly by H. G. Bardsley, U. S. Surveyor, and Royston C. Durnford, U. S. Transitman, with Young and Sons' light mountain transits Nos. 8532 and 8526, respectively described in Book "A." Dates of survey shown on diagrams on pages 61 and 63 thereof approved, see Book "A."

In the following field notes, the initials "H.G.B." and "R.C.D." are inserted at the beginning, and ending of those portions describing the surveys executed by H.G. Bardsley, U.S. Surveyor and R.C. Durnford, U.S. Transitman respectively and established by observations on Polaris. Knowing from recent and repeated tests of our instruments on a meridian established by observations on Polaris at elongation that they are in good adjustment we proceed as follows:

R.C.D. Apr. 13, 1915, a.m., 1 set off 33° 35' N. on At 7h 30m a.m. 1 set off 35° 35' N. on the lat. arc; 8° 49' N. on the decl. arc, and determined a meridian with the solar at the reestablished cor. of secs. 1, 2, 35 and 36 on the S. bdy. of the Tp., described in Book "A."

Thence N. 0° 1' W., bet. secs. 35 and 36.
 Over level land, through scattering undergrowth.
 40.00 Set an iron post, 3 ft. long, 1 in. diam., 26 ins. in the ground, for 1/4 sec. cor., marked on brass cap
 1915 on S. rim;
 1/4 S35 in W. and
 S36 in E. half;
 and raise a mound of stone, 2 ft. base, 1 1/2 ft. high, W. of cor.

50.70 Center of wash, 60 lks. wide, 1 1/2 ft. deep, course NW.
 80.00 Set an iron post, 3 ft. long, 2 ins. diam., 24 ins. in the ground, for cor. of secs. 25, 26, 35 and 36, marked on brass cap
 1915 on S. rim;
 T26N R20W in N. half;
 S26 in NW.,
 S25 in NE.,
 S36 in SE. and
 S35 in SW. quadrant;
 and raise a mound of stone, 2 ft. base, 1 1/2 ft. high, W. of cor.

Land, level.
 Soil, gravelly and stony; 3rd rate.
 No timber.
 Undergrowth, greasewood.

40.00 N. 89° 59' E., on a random line, bet. secs. 25 and 36.
 79.98 Set temp. 1/4 sec. cor.
 Intersect E. bdy. of Tp., 2 lks. N. of the cor. of secs. 25, 30, 31 and 36, described in Book "A." established by H.G.B., U.S. Surveyor, and R.C.D., U.S. Transitman, on Apr. 13, 1915.

Thence
 West on a true line, bet. secs. 25 and 36.
 Over gently rolling land, through scattering undergrowth.
 1.88 Wash 50 lks. wide, 2 ft. deep, course SW.
 39.99 Set an iron post, 3 ft. long, 1 in. diam., 26 ins. in the ground, for 1/4 sec. cor., marked on brass cap
 1915 on S. rim;
 1/4 S25 in N. and
 S36 in S. half;
 and raise a mound of stone, 2 ft. base, 1 1/2 ft. high, N. of cor.

79.98 The cor. of secs. 25, 26, 35 and 36.
 Land, gently rolling.
 Soil, gravelly and stony; 3rd rate.
 No timber.
 Undergrowth, greasewood and yucca.

Subdivision of T. 26 N., R. 20 W.

Chains.

N.0° 1' W., bet. secs. 25 and 26.
 Over rolling land, through scattering undergrowth.
 40.00 Set an iron post, 3 ft. long, 1 in. diam., 26 ins. in the
 ground, for $\frac{1}{4}$ sec. cor., marked on brass cap
 1915 on S. rim;
 $\frac{1}{4}$ S26 in W. and
 S25 in E. half;
 and raise a mound of stone, 2 ft. base, $1\frac{1}{2}$ ft. high,
 W. of cor. Site impracticable.
 66.70 Wash, 40 lks. wide, 2 ft. deep, course NW.
 80.00 Set an iron post, 3 ft. long, 2 ins. diam., 24 ins. in the
 ground, for cor. of secs. 23, 24, 25 and 26, marked on
 brass cap
 1915 on S. rim;
 T26N R20W in N. half;
 S23 in NW.,
 S24 in NE.,
 S25 in SE. and
 S26 in SW. quadrant;
 and raise a mound of stone, 2 ft. base, $1\frac{1}{2}$ ft. high,
 W. of cor. Site impracticable.
 Land, rolling.
 Soil, gravelly and stony; 3rd rate.
 No timber.
 Undergrowth, greasewood and yucca.

East on a random line, bet. secs. 24 and 25.
 40.00 Set temp. $\frac{1}{4}$ sec. cor.
 80.10 Intersect E. bdy. of Tp., 2 lks. N. of the reestablished
 cor. of secs. 19, 24, 25 and 30, described in Book "A."
 Thence,
 N.89° 59' W., on a true line, bet. secs. 24 and 25.
 Over mountainous land, through scattering undergrowth.
 Asc. 230 ft. to
 16.90 Rocky spur, slopes SE. Desc. 365 ft. to
 40.05 Set an iron post, 3 ft. long, 1 in. diam., 26 ins. in the
 ground, for $\frac{1}{4}$ sec. cor., marked on brass cap
 1915 on S. rim;
 $\frac{1}{4}$ S24 in N. and
 S25 in S. half;
 and raise a mound of stone, 2 ft. base, $1\frac{1}{2}$ ft. high,
 N. of cor. Site impracticable.
 Leave mountainous land, thence over rolling land.
 80.10 The cor. of secs. 23, 24, 25 and 26.
 Land, rolling and mountainous.
 Soil, stony; 4th rate.
 No timber.
 Undergrowth, greasewood and yucca.

N.0° 1' W., bet. secs. 23 and 24.
 Over rolling land, through scattering undergrowth.
 40.00 Set an iron post, 3 ft. long, 1 in. diam., 26 ins. in the
 ground, for $\frac{1}{4}$ sec. cor., marked on brass cap
 1915 on S. rim;
 $\frac{1}{4}$ S23 in W. and
 S24 in E. half;
 and raise a mound of stone, 2 ft. base, $1\frac{1}{2}$ ft. high,
 W. of cor. Site impracticable.
 80.00 Set an iron post, 3 ft. long, 2 ins. diam., 24 ins. in the
 ground, for cor. of secs. 13, 14, 23 and 24, marked on
 brass cap
 1915 on S. rim;
 T26N R20W in N. half;

Chains.	
	<p>S14 in NW., S13 in NE., S24 in SE. and S23 in SW. quadrant; and raise a mound of stone, 2 ft. base, 1½ ft. high, W. of cor. Pits impracticable. Land, rolling. Soil, gravelly and stony; 3rd rate. No timber. Undergrowth, greasewood and yucca.</p>
40.00	S.89° 59' E., on a random line, bet. secs. 13 and 24.
79.98	Set temp. ¼ sec. cor. ^{reestab.} Intersect E. bdy. of Tp., 5 lks. N. of the cor. of secs. 13, 18, 19 and 24, as described in Book "A" post, established of H. G. B., as described in Book "A".
	Thence, I run N.89° 57' W., on a true line, bet. secs. 13 and 24. Over mountainous land, through scattering undergrowth. Asc. 120 ft. to 7.58 Desc. 250 ft. to 20.23 Asc. 15 ft. to 27.73 Ridge, brs. N. and S. Desc. 150 ft. to 39.99 Set an iron post, 3 ft. long, 1 in. diam., 26 ins. in the ground, for ¼ sec. cor., marked on brass cap 1915 on S. rim; ¼ S13 in N. and S24 in S. half; and raise a mound of stone, 2 ft. base, 1½ ft. high, N. of cor. Pits impracticable.
79.98	Leave mountainous land, thence over rolling land. The cor. of secs. 13, 14, 23 and 24. Land, rolling and mountainous. Soil, gravelly and stony; 3rd rate. No timber. Undergrowth, greasewood and yucca.
	R. C. D. 1977, 1978, 1979.
	H. G. B.
	N.0° 1' W., bet. secs. 13 and 14. Over rolling land, through scattering undergrowth.
2.50	Wash, 20 lks. wide, course W.
20.00	Wash, 5 lks. wide, course S.40° W.
40.00	Set an iron post, 3 ft. long, 1 in. diam., 26 ins. in the ground, for ¼ sec. cor., marked on brass cap 1915 on S. rim; ¼ S14 in W. and S13 in E. half; and raise a mound of stone, 2 ft. base, 1½ ft. high, W. of cor. Pits impracticable.
61.00	Wash, 30 lks. wide, course S.75° W. Asc. 70 ft. to
68.50	Ridge, brs. NE. and SW. Desc. 80 ft. to
73.55	Wash, 5 lks. wide, course N.50° W.
78.05	Wash, 10 lks. wide, course S.30° W.
80.00	Set an iron post, 3 ft. long, 2 ins. diam., 24 ins. in the ground, for cor. of secs. 11, 12, 13 and 14, marked on brass cap 1915 on S. rim; T26N R20W in N. half; S11 in NW., S12 in NE., S13 in SE. and S14 in SW. quadrant; and raise a mound of stone, 2 ft. base, 1½ ft. high, W. of cor. Pits impracticable.

Chains.	
	Land, rolling. Soil, stony; 4th rate. No timber. Undergrowth, greasewood.
40.00	S.89° 57' E., on a random line, bet. secs. 12 and 13. Set temp. $\frac{1}{4}$ sec. cor.
80.06	Intersect E. bdy. of Tp., at the reestablished cor. of secs. 7, 12, 13 and 18, described in Book "A", described in Book "B". Thence, N.89° 57' W., on a true line, bet. secs. 12 and 13. Over mountainous land, through scattering undergrowth. Desc. 180 ft. to 13.10 Asc. 130 ft. to 27.30 Desc. 160 ft. to 40.03 Set an iron post, 3 ft. long, 1 in. diam., 26 ins. in the ground, for $\frac{1}{4}$ sec. cor., marked on brass cap 1915 on S. rim; $\frac{1}{4}$ S12 in N. and S13 in S. half; and raise a mound of stone, 2 ft. base, 1 $\frac{1}{2}$ ft. high, N. of cor. <i>Dist. inoperative.</i> Asc. 100 ft. to 45.40 Desc. 65 ft. to 50.45 Gulch, 5 lks. wide, course N.20° W. Asc. slightly to 52.25 Ridge, slopes N.30° W. Desc. 370 ft. to 73.55 Wash, 30 lks. wide, course SW. 75.05 Wash, 50 lks. wide, course S.65° W. 80.06 The cor. of secs. 11, 12, 13 and 14. Land, mountainous. Soil, stony; 4th rate. No timber. Undergrowth, greasewood.
9.60	N.0° 1' W., bet. secs. 11 and 12. Over mountainous land, through scattering undergrowth. Wash, 40 lks. wide, course S.80° W.
18.50	Wash, 10 lks. wide, course W. Asc. 110 ft. to
29.05	Desc. 125 ft. to
37.60	Wash, 30 lks. wide, course N.75° W. Asc. 25 ft.
40.00	Set an iron post, 3 ft. long, 1 in. diam., 26 ins. in the ground, for $\frac{1}{4}$ sec. cor., marked on brass cap 1915 on S. rim; $\frac{1}{4}$ S11 in W. and S12 in E. half; and raise a mound of stone, 2 ft. base, 1 $\frac{1}{2}$ ft. high, W. of cor. <i>Dist. inoperative.</i> 45.00 Desc. slightly to 45.50 Wash, 20 lks. wide, course S.50° W. 48.00 Wash, 40 lks. wide, course S.30° W. Asc. 535 ft. to 75.70 Desc. slightly to 80.00 Set an iron post, 3 ft. long, 2 ins. diam., 24 ins. in the ground, for cor. of secs. 1, 2, 11 and 12, marked on brass cap 1915 on S. rim; #26N R20W in N. half; S2 in NW., S1 in NE., S12 in SE. and S11 in SW. quadrant; and raise a mound of stone, 2 ft. base, 1 $\frac{1}{2}$ ft. high, W. of cor. <i>Dist. inoperative.</i> Land, mountainous. Soil, stony; 4th rate. No timber.

Chains. Undergrowth, greasewood.
 H. G. B.
 R. C. D.
 S. 89° 57' E., on a random line, bet. secs. 1 and 12.
 40.00 Set temp. $\frac{1}{4}$ sec. cor.
 80.00 Intersect E. bdy. of Tn., 7 lks. S. of the reestablished
 cor. of secs. 11, 6, 17 and 12, as described in Book "A" by
 H. G. B., as described in Book "B".
 Thence, 100.00
 West on a true line, bet. secs. 1 and 12.
 Over mountainous land, through scattering undergrowth.
 Asc. 125 ft. to
 15.00 Low ridge, brs. N. and S. Desc. 170 ft. to
 30.00 Gulch, course N. Asc. 110 ft.
 40.00 Set an iron post, 3 ft. long, 1 in. diam., in a mound of
 stone, for $\frac{1}{4}$ sec. cor., marked on brass cap
 1915 on S. rim;
 $\frac{1}{4}$ S1 in W. and
 S12 in S. half;
 and raise a mound of stone, 2 ft. base, 1 $\frac{1}{2}$ ft. high,
 N. of cor.
 57.00 Ridge, brs. N. and S. Desc. 135 ft. to
 80.00 The cor. of secs. 1, 2, 11 and 12.
 Land, mountainous.
 Soil, stony; 4th rate.
 No timber.
 Undergrowth, greasewood and yucca.
 R. C. D.

H. G. B.
 N. 0° 1' W., on a random line, bet. secs. 1 and 2.
 40.00 Set temp. $\frac{1}{4}$ sec. cor
 80.00 Intersect N. bdy. of Tn., at the cor. of secs. 1, 2, 35 and
 36, described in Book "A" established by H. G. B., as described
 in Book "B".
 Thence, 100.00
 S. 0° 1' E., on a true line, bet. secs. 1 and 2.
 Over mountainous land, through scattering undergrowth.
 Asc. 245 ft. to
 20.10 Desc. 15 ft. to
 25.10 Asc. 115 ft.
 40.00 Set an iron post, 3 ft. long, 1 in. diam., 26 ins. in the
 ground, for $\frac{1}{4}$ sec. cor., marked on brass cap
 1915 on S. rim;
 $\frac{1}{4}$ S2 in W. and
 S1 in E. half;
 and raise a mound of stone, 2 ft. base, 1 $\frac{1}{2}$ ft. high,
 W. of cor.
 50.30 Desc. slightly to
 55.30 Asc. 170 ft. to
 80.00 The cor. of secs. 1, 2, 11 and 12.
 Land, mountainous.
 Soil, stony; 4th rate.
 No timber.
 Undergrowth, greasewood.
 H. G. B.

R. C. D.
 From the reestablished cor. of secs. 2, 3, 34 & 35 on S. bdy. of

162
132

8

Subdivision of T. 26 N., R. 20 W.

Chains.

the Tp., described in Book "A", established by E. C. ...
 N.0° 1' W., bet. secs. 34 and 35.
 Over level land, through scattering undergrowth.
 10.40 Wash, 30 lks. wide, 1½ ft. deep, course NW.
 18.60 Telephone line, brs. N.11° 20' W., and S.11° 20' E.
 23.70 Dim road, brs. N.11° W. and S.11° E.
 40.00 Set an iron post, 3 ft. long, 1 in. diam., 26 ins. in the
 ground, for ¼ sec. cor., marked on brass cap
 1915 on S. rim;
 ¼S34 in W. and
 S35 in E. half;
 dig pits, 18 X 18 X 12 ins., N. and S. of post, 3 ft.
 dist.; and raise a mound of earth, 3½ ft. base, 1½ ft.
 high, W. of cor.
 42.40 Old road, brs. NW. and SE.
 80.00 Set an iron post, 3 ft. long, 2 ins. diam., 24 ins. in the
 ground, for cor. of secs. 26, 27, 34 and 35, marked on
 brass cap
 1915 on S. rim;
 T26N R20W in N. half;
 S27 in NW.,
 S26 in NE.,
 S35 in SE. and
 S34 in SW. quadrant;
 dig pits, 18 X 18 X 12 ins., in each sec., 5½ ft. dist.;
 and raise a mound of earth, 4 ft. base, 2 ft. high,
 W. of cor.
 Land, level.
 Soil, sandy; 3rd rate.
 No timber.
 Undergrowth, greasewood and yucca.
 Apr. 13, 1915: At this cor., I set off 20 poles N. on the
 26th sec. and at equal dist. to serve the same as
 the section; the road being 20' to 30' E.

N.89° 59' E., on a random line, bet. secs. 26 and 35.
 40.00 Set temp. ¼ sec. cor.
 79.88 Intersect N. and S. line, 4 lks. N. of the cor. of secs.
 25, 26, 35 and 36.
 Thence
 N.89° 59' W., on a true line, bet. secs. 26 and 35.
 Over rolling land, through scattering undergrowth.
 39.94 Set an iron post, 3 ft. long, 1 in. diam., 20 ins. in the
 ground, for ¼ sec. cor., marked on brass cap
 1915 on S. rim;
 ¼S20 in N. and
 S35 in S. half;
 and raise a mound of stone, 2 ft. base, 1½ ft. high,
 N. of cor.
 54.38 Wash, 30 lks. wide, 1½ ft. deep, course NW.
 59.88 Telephone line, brs. N.27½° W., and S.27½° E.
 65.78 Traveled road, brs. N. and S.
 79.88 The cor. of secs. 26, 27, 34 and 35.
 Land, rolling.
 Soil, gravelly and stony;
 No timber.
 Undergrowth, greasewood and yucca.
 Apr. 13, 1915.

N.0° 1' W., bet. secs. 26 and 27.
 Over level land, through scattering undergrowth.
 40.00 Set an iron post, 3 ft. long, 1 in. diam., 26 ins. in the
 ground, for ¼ sec. cor., marked on brass cap
 1915 on S. rim;
 ¼S27 in W. and

Chains.	
	<p>S26 in E. half; dig pits, 18 X 18 X 12 ins., N. and S. of post, 3 ft. dist.; and raise a mound of earth, 3½ ft. base, 1½ ft. high, W. of cor.</p>
41.00	Dim road, brs. NW. and SE.
51.80	Telephone line, brs. N.15½° W. and S.15½° E.
65.40	Traveled road, brs. NW. and SE.
80.00	Set an iron post, 3 ft. long, 2 ins. diam., 24 ins. in the ground, for cor. of secs.22, 23, 26 and 27, marked on brass cap
	<p>1915 on S. rim; T26N R20W in N. half; S22 in NW., S23 in NE., S26 in SE. and S27 in SW. quadrant;</p>
	<p>dig pits, 18 X 18 X 12 ins., in each sec., 5½ ft. dist.; and raise a mound of earth, 4 ft. base, 2 ft. high, W. of cor.</p>
	Land, level.
	Soil, sandy; 3rd rate.
	No timber.
	Undergrowth, greasewood.
	Apr. 15, 1915: At this point I set 371° 30' on the sec. line; and on the same day I observe the angle on the meridian; the distance bet. is 95° 37' 15".
40.00	S.89° 59' E., on a random line, bet. secs. 23 and 26.
79.86	Set temp. ¼ sec. cor.
	Intersect N. and S. line, 5 lks. S. of the cor. of secs. 23, 24, 25 and 26.
	Thence
	S.89° 59' W., on a true line, bet. secs. 23 and 26.
	Over rolling land, through scattering undergrowth.
14.26	Wash, 40 lks. wide, 1½ ft. deep, course NW.
39.93	Set an iron post, 3 ft. long, 1 in. diam., 26 ins. in the ground, for ¼ sec. cor., marked on brass cap
	<p>1915 on S. rim; ¼S23 in W. and S26 in S. half;</p>
	and raise a mound of stone, 2 ft. base, 1½ ft. high, N. of cor.
79.86	The cor. of secs. 22, 23, 26 and 27.
	Land, rolling.
	Soil, gravelly and stony; 3rd rate.
	No timber.
	Undergrowth, greasewood and yucca.
	R. C. D. Apr. 15, 1915.
	H. G. B.
	N.0° 1' W., bet. secs. 22 and 23.
	Over level land, through scattering undergrowth.
2.00	Wash, 20 lks. wide, course N.85° W.
12.00	Wash, 20 lks. wide, course N.75° W.
18.00	Wash, 10 lks. wide, course N.60° W.
20.00	Wash, 5 lks. wide, course N.75° W.
40.00	Set an iron post, 3 ft. long, 1 in. diam., 26 ins. in the ground, for ¼ sec. cor., marked on brass cap
	<p>1915 on S. rim; ¼S22 in W. and S23 in E. half;</p>
	dig pits, 18 X 18 X 12 ins., N. and S. of post, 3 ft. dist.; and raise a mound of earth, 3½ ft. base, 1½ ft. high, W. of cor.
80.00	Set an iron post, 3 ft. long, 2 ins. diam., 24 ins. in the

.10

Subdivision of T. 26 N., R. 20 W.

Chains.

ground, for cor. of secs. 14, 15, 22 and 23, marked on brass cap

1915 on S. rim;
T26N R20W in N. half;
S15 in NW.,
S14 in NE.,
S23 in SE. and
S22 in SW. quadrant;

dig pits, 18 X 18 X 12 ins., in each sec., 5½ ft. dist.;
and raise a mound of earth, 4 ft. base, 2 ft. high,
W. of cor.

Land, level.
Soil, gravel; 3rd rate.
No timber.
Undergrowth, greasewood.

Apr. 16, 1913: At this cor., I set an iron post, 3 ft. long, 1 in. diam., 26 ins. in the ground, for ¼ sec. cor., marked on brass cap. The resulting course is S. 89° 59' E. 12 lks.

40.00
79.88

N. 89° 59' E., on a random line, bet. secs. 14 and 23.
Set temp. ¼ sec. cor.
Intersect N. and S. line, 12 lks. N. of the cor. of secs. 13, 14, 23 and 24.

Thence
N. 89° 56' W., on a true line, bet. secs. 14 and 23.
Over level land, through scattering undergrowth.

7.88
16.88
39.94

Wash, 5 lks. wide, course S. 75° W.
Wash, 10 lks. wide, course S. 75° W.
Set an iron post, 3 ft. long, 1 in. diam., 26 ins. in the ground, for ¼ sec. cor., marked on brass cap

1915 on S. rim;
¼ S14 in N. and
S23 in S. half;

dig pits, 18 X 18 X 12 ins., E. and W. of post, 3 ft. dist.; and raise a mound of earth, 3½ ft. base, 1½ ft. high, N. of cor.

79.88

The cor. of secs. 14, 15, 22 and 23.
Land, level.
Soil, gravel; 3rd rate.
No timber.
Undergrowth, greasewood.

H. G. B.

20.00

Apr. 16, 1913: R. C. D.
N. 0° 1' W., bet. secs. 14 and 15.
Over rolling land, through scattering undergrowth.
Set an iron post, 3 ft. long, 1 in. diam., 26 ins. in the ground, for ¼ sec. cor., marked on brass cap

1915 on S. rim;
¼ S15 in W. and
S14 in E. half;

and raise a mound of stone, 2 ft. base, 1½ ft. high, W. of cor. This impracticable.

75.20
80.00

Wash, 3 lks. wide, 1½ ft. deep, course W.
Set an iron post, 3 ft. long, 2 ins. diam., 24 ins. in the ground, for cor. of secs. 10, 11, 14 and 15, marked on brass cap

1915 on S. rim;
T26N R20W in N. half;
S10 in NW.,
S11 in NE.,
S14 in SE. and
S15 in SW. quadrant;

and raise a mound of stone, 2 ft. base, 1½ ft. high, W. of cor. This impracticable.

Chains.

Land, rolling.
Soil, gravelly and stony; 3rd rate.
No timber.
Undergrowth, greasewood and yucca.

Cor. 10, 1915.

Apr. 17, 1915: At 8 hrs. 0 m., a.m., l.m.t., I set off
35° 39' N. on the lat. arc; 10° 15½' N. on the decl.
arc; and determine a meridian with the solar at the
cor. of secs. 10, 11, 14 and 15.

Thence
S.89° 56' E., on a random line, bet. secs. 11 and 14.

40.00
79.90

Set temp. ¼ sec. cor.
Intersect N. and S. line, 9 lks. N. of the cor. of secs.
11, 12, 13 and 14.

Thence
N.89° 52' W., on a true line, bet. secs. 11 and 14.
Over rolling land, through scattering undergrowth.

39.95

Set an iron post, 3 ft. long, 1 in. diam., 26 ins. in the
ground, for ¼ sec. cor., marked on brass cap
1915 on S. rim;
¼S11 in N. and
S14 in S. half;
and raise a mound of stone, 2 ft. base, 1½ ft. high,
N. of cor.

48.10
79.90

Wash, 30 lks. wide, 2 ft. deep, course SW.
The cor. of secs. 10, 11, 14 and 15.

Land, rolling.
Soil, stony; 4th rate.
No timber.
Undergrowth, greasewood and yucca.

N.0° 1' W., bet. secs. 10 and 11.
Over rolling land, through scattering undergrowth.
Leave rolling land, enter mountainous land. Asc. 50 ft.
to

30.00
40.00

Low spur, slopes W.
Set an iron post, 3 ft. long, 1 in. diam., 26 ins. in the
ground, for ¼ sec. cor., marked on brass cap
1915 on S. rim;
¼S10 in W. and
S11 in E. half;

and raise a mound of stone, 2 ft. base, 1½ ft. high,
W. of cor.

Desc. 155 ft. to

65.00
80.00

Asc. 30 ft. to
Set an iron post, 3 ft. long, 2 ins. diam., 24 ins. in the
ground, for cor. of secs. 2, 3, 10 and 11, marked on
brass cap

1915 on S. rim;
T26N R20W in N. half;
S3 in NW.,
S2 in NE.,
S11 in SE. and
S10 in SW. quadrant;

and raise a mound of stone, 2 ft. base, 1½ ft. high,
W. of cor.

Land, rolling and mountainous.
Soil, stony; 4th rate.
No timber.
Undergrowth, greasewood.

Apr. 17, 1915: At this cor., I set off 10° 18½' N. on the
decl. arc; and at sundown upon, I observe the sun on
the meridian; the resulting lat. is 35° 40' N.

#6-
136

Subdivision of T. 26 N., R. 20 W.

Chains.	
40.00	S. 89° 52' E., on a random line, bet. secs. 2 and 11. Set temp. $\frac{1}{4}$ sec. cor.
79.90	Intersect N. and S. line, 16 lks. N. of the cor. of secs. 1, 2, 11 and 12. Thence
39.95	N. 89° 45' W., on a true line, bet. secs. 2 and 11. Over mountainous land, through scattering undergrowth. Desc. 755 ft. Set an iron post, 3 ft. long, 1 in. diam., in a mound of stone, for $\frac{1}{4}$ sec. cor., marked on brass cap 1915 on S. rim; $\frac{1}{4}$ S2 in N. and S11 in S. half; and raise a mound of stone, 2 ft. base, $1\frac{1}{2}$ ft. high, N. of cor.
61.90	Gulch, course NW. Asc. 45 ft. to
67.40	Point of ridge, slopes N. Desc. 115 ft. to
79.90	The cor. of secs. 2, 3, 10 and 11. Land, mountainous. Soil, stony; 4th rate. No timber. Undergrowth, greasewood.
40.00	N. 0° 1' W., on a random line, bet. secs. 2 and 3. Set temp. $\frac{1}{4}$ sec. cor.
79.80	Intersect N. bdy. of Tp., 16 lks. E. of the cor. of secs. 2, 3, 34 and 35, described in Book "A." Thence
19.20	S. 0° 8' E., on a true line, bet. secs. 2 and 3. Over mountainous land, through scattering undergrowth. Desc. 85 ft. to
24.10	Gulch, course SW.
38.80	Gulch, course SE. Asc. 120 ft. to
39.80	Low ridge, brs. NE. and SW. Desc. 200 ft. Set an iron post, 3 ft. long, 1 in. diam., 26 ins. in the ground, for $\frac{1}{4}$ sec. cor., marked on brass cap 1915 on S. rim; $\frac{1}{4}$ S3 in W. and S2 in E. half; and raise a mound of stone, 2 ft. base, $1\frac{1}{2}$ ft. high, W. of cor.
58.50	Wash, 20 lks. wide, 2 ft. deep, course SW. Thence over rolling land.
79.80	The cor. of secs. 2, 3, 10 and 11. Land, rolling and mountainous. Soil, stony; 4th rate. No timber. Undergrowth, greasewood, yucca and cacti.
40 00	Apr. 15, 1915: At 7 hrs. 0 m., a.m., l.m.t., I set off 35° 35 $\frac{1}{2}$ ' N. on the lat. arc; 9° 32 $\frac{1}{2}$ ' N. on the decl. arc; and determine a meridian with the solar at the reestablished cor. of secs. 3, 4, 33 and 34, described in Book "A." An iron post, established by ... as described in Book "B". Thence N. 0° 2' W., bet. secs. 33 and 34. Over rolling land, through scattering undergrowth. Set an iron post, 3 ft. long, 1 in. diam., 26 ins. in the ground, for $\frac{1}{4}$ sec. cor., marked on brass cap 1915 on S. rim; $\frac{1}{4}$ S33 in W. and S34 in E. half; dig pits, 18 X 18 X 12 ins., N. and S. of post, 3 ft.

Chains.

80.00 dist.; and raise a mound of earth, $3\frac{1}{2}$ ft. base, $1\frac{1}{2}$ ft. high, W. of cor.
 Set an iron post, 3 ft. long, 2 ins. diam., 24 ins. in the ground, for cor. of secs. 27, 28, 33 and 34, marked on brass cap
 1915 on S. rim;
 T26N R20W in N. half;
 S28 in NW.,
 S27 in NE.,
 S34 in SE. and
 S33 in SW. quadrant;
 dig pits, 18 X 18 X 12 ins., in each sec., $5\frac{1}{2}$ ft. dist.; and raise a mound of earth, 4 ft. base, 2 ft. high, W. of cor.
 Land, rolling.
 Soil, sandy and gravelly; 3rd rate.
 No timber.
 Undergrowth, greasewood.

40.00 N. $89^{\circ} 59'$ E., on a random line, bet. secs. 27 and 34.
 Set temp. $\frac{1}{4}$ sec. cor.
 80.08 Intersect N. and S. line, 4 lks. N. of the cor. of secs. 26, 27, 34 and 35.

Thence
 N. $89^{\circ} 59'$ W., on a true line, bet. secs. 27 and 34.
 Over level land, through scattering undergrowth.
 11.18 Telephone line, brs. N. $11^{\circ} 20'$ W. and S. $11^{\circ} 20'$ E.
 34.48 Old road, brs. NW. and SE.
 39.38 Sacramento Wash, 40 lks. wide, 2 ft. deep, course N.
 40.04 Point for $\frac{1}{4}$ sec. cor. falls in wash, course N.
 40.54 Set an iron post, 3 ft. long, 1 in. diam., 26 ins. in the ground, for witness cor. to $\frac{1}{4}$ sec. cor., marked on brass cap

1915 on S. rim;
 WC in E.,
 $\frac{1}{4}$ S27 in N. and
 S34 in S. half;
 and raise a mound of stone, 2 ft. base, $1\frac{1}{2}$ ft. high, N. of cor.
 80.08 The cor. of secs. 27, 28, 33 and 34.
 Land, level.
 Soil, sandy and gravelly; 3rd rate.
 No timber.
 Undergrowth, greasewood.

R. C. D.
1915, 1917.

1915, 1917: H. G. B.
 N. $0^{\circ} 2'$ W., bet. secs. 27 and 28.
 Over level land, through scattering undergrowth.
 24.70 Telephone line, brs. N. $78^{\circ} 50'$ E. and S. $78^{\circ} 50'$ W.
 38.00 Wash, 3 lks. wide, course E.
 40.00 Set an iron post, 3 ft. long, 1 in. diam., 26 ins. in the ground, for $\frac{1}{4}$ sec. cor., marked on brass cap
 1915 on S. rim;
 $\frac{1}{4}$ S28 in W. and
 S27 in E. half;
 dig pits, 18 X 18 X 12 ins., N. and S. of post, 3 ft. dist.; and raise a mound of earth, $3\frac{1}{2}$ ft. base, $1\frac{1}{2}$ ft. high, W. of cor.
 52.00 Road, brs. N. 40° W., and S. 40° E.
 80.00 Set an iron post, 3 ft. long, 2 ins. diam., 24 ins. in the ground, for cor. of secs. 21, 22, 27 and 28, marked on brass cap
 1915 on S. rim;
 T26N R20W in N. half;

Subdivision of T. 26 N., R. 20 W.

Chains.

	<p>S21 in NW., S22 in NE., S27 in SE. and S28 in SW. quadrant; dig pits, 18 X 18 X 12 ins., in each sec., $5\frac{1}{2}$ ft. dist.; and raise a mound of earth, 4 ft. base, 2 ft. high, W. of cor. Land, level. Soil, sandy loam; 2nd rate. No timber. Undergrowth, greasewood and cacti.</p>
40.00	S. $89^{\circ} 59'$ E., on a random line, bet. secs. 22 and 27.
80.18	Set temp. $\frac{1}{4}$ sec. cor. Intersect N. and S. line, 2 lks. N. of the cor. of secs. 22, 23, 26 and 27. Thence
3.83	N. $89^{\circ} 58'$ W., on a true line, bet. secs. 22 and 27. Over level land, through scattering undergrowth.
7.54	Road, brs. N. $14^{\circ} 53'$ W., and S. $14^{\circ} 53'$ E.
27.38	Telephone line, brs. N. $14^{\circ} 53'$ W., and S. $14^{\circ} 53'$ E.
28.00	Road, brs. N. $11^{\circ} 12'$ W. and S. $11^{\circ} 12'$ E.
40.09	Telephone line, brs. N. $11^{\circ} 12'$ W. and S. $11^{\circ} 12'$ E. Set an iron post, 3 ft. long, 1 in. diam., 26 ins. in the ground, for $\frac{1}{4}$ sec. cor., marked on brass cap 1915 on S. rim; $\frac{1}{4}$ S22 in N. and S27 in S. half; dig pits, 18 X 18 X 12 ins., E. and W. of post, 3 ft. dist.; and raise a mound of earth, $3\frac{1}{2}$ ft. base, $1\frac{1}{2}$ ft. high, N. of cor.
54.88	Center of Sacramento Wash, 60 lks. wide, course N. 15° E.
80.18	The cor. of secs. 21, 22, 27 and 28. Land, level. Soil, sandy loam; 2nd rate. No timber. Undergrowth, greasewood.
	H. G. B.
	R. C. D.
40.00	N. $0^{\circ} 2'$ W., bet. secs. 21 and 22. Over level land, through scattering undergrowth. Set an iron post, 3 ft. long, 1 in. diam., 26 ins. in the ground, for $\frac{1}{4}$ sec. cor., marked on brass cap 1915 on S. rim; $\frac{1}{4}$ S21 in W. and S22 in E. half; dig pits, 18 X 18 X 12 ins., N. and S. of post, 3 ft. dist.; and raise a mound of earth, $3\frac{1}{2}$ ft. base, $1\frac{1}{2}$ ft. high, W. of cor
80.00	Set an iron post, 3 ft. long, 2 ins. diam., 24 ins. in the ground, for cor. of secs. 15, 16, 21 and 22, marked on brass cap 1915 on S. rim; T26N R20W in N. half; S16 in NW., S15 in NE., S22 in SE. and S21 in SW. quadrant; dig pits, 18 X 18 X 12 ins., in each sec., $5\frac{1}{2}$ ft. dist.; and raise a mound of earth, 4 ft. base, 2 ft. high, W. of cor. Land, level. Soil, sandy; 3rd rate. No timber.

Chains.

Undergrowth, greasewood.

40.00 S. 89° 58' E., on a random line, bet. secs. 15 and 22.
Set temp. 1/4 sec. cor.

80.20 Intersect the corner of secs. 14, 15, 22 and 23.

Thence, I ran

N. 89° 58' W., on a true line, bet. secs. 15 and 22.

Over level land, through scattering undergrowth.

5.00 Dim road, brs. NW. and SE.

15.10 Traveled road, brs. NW. and SE.

29.00 Telephone line, brs. N. 15 1/2° W. and S. 15 1/2° E.

40.10 Set an iron post, 3 ft. long, 1 in. diam., 26 ins. in the ground, for 1/4 sec. cor., marked on brass cap

1915 on S. rim;

1/4 S15 in N. and

S22 in S. half;

and raise a mound of stone, 2 ft. base, 1 1/2 ft. high, N. of cor.

43.30 Dim road, brs. NW. and SE.

43.90 Telephone line, brs. N. 11° 20' W., and S. 11° 20' E.

64.90 Sacramento Wash, 30 lks. wide, 2 ft. deep, course N.

80.20 The cor. of secs. 15, 16, 21 and 22.

Land, level.

Soil, sandy and gravelly; 3rd rate.

No timber.

Undergrowth, greasewood.

Apr. 15, 1915.

Apr. 16, 1915.

N. 0° 2' W., bet. secs. 15 and 16.

Over level land, through scattering undergrowth.

25.90 Sacramento wash, 40 lks. wide, 3 ft. deep, course NW.

40.00 Set an iron post, 3 ft. long, 1 in. diam., 26 ins. in the ground, for 1/4 sec. cor., marked on brass cap

1915 on S. rim;

1/4 S16 in W. and

S15 in E. half;

dig pits, 18 X 18 X 12 ins., N. and S. of post, 3 ft. dist.; and raise a mound of earth, 3 1/2 ft. base, 1 1/2 ft. high, W. of cor.

80.00 Set an iron post, 3 ft. long, 2 ins. diam., 24 ins. in the ground, for cor. of secs. 9, 10, 15 and 16, marked on brass cap

1915 on S. rim;

T26N R20W in N. half;

S9 in NW.,

S10 in NE.,

S15 in SE. and

S16 in SW. quadrant;

dig pits, 18 X 18 X 12 ins., in each sec., 5 1/2 ft. dist.; and raise a mound of earth, 4 ft. base, 2 ft. high, W. of cor.

Land, level.

Soil, sandy; 3rd rate.

No timber.

Undergrowth, greasewood.

40.00 S. 89° 58' E., on a random line, bet. secs. 10 and 15.
Set temp. 1/4 sec. cor.

80.06 Intersect N. and S. line, 2 lks. N. of the cor. of secs. 10, 11, 14 and 15.

Thence I ran

N. 89° 57' W., on a true line, bet. secs. 10 and 15.

Chains.

25.86 Wash, 20 lks. wide, 2 ft. deep, course NW.
 40.03 Set an iron post, 3 ft. long, 1 in. diam., 26 ins. in the ground, for $\frac{1}{4}$ sec. cor., marked on brass cap
 1915 on S. rim;
 $\frac{1}{4}$ S10 in N. and
 S15 in S. half;
 and raise a mound of stone, 2 ft. base, $1\frac{1}{2}$ ft. high, N. of cor. This is practicable.

52.06 Traveled road, brs. NW. and SE. Telephone line, brs. N.15 $\frac{1}{2}$ ° W. and S.15 $\frac{1}{2}$ ° E.
 59.35 Dim road, brs. NE. and SW.
 59.56 Telephone line, brs. N.11° 20' W. and S.11° 20' E.
 80.06 The cor. of secs. 9, 10, 15 and 16.
 Land, rolling.
 Soil, gravelly and stony; 3rd rate.
 No timber.
 Undergrowth, greasewood.

R. C. D.
Apr. 10, 1915.

Apr. 27, 1915: H. G. B.
 N.0° 2' W., bet. secs. 9 and 10.
 Over level land, through scattering undergrowth.
 40.00 Set an iron post, 3 ft. long, 1 in. diam., 26 ins. in the ground, for $\frac{1}{4}$ sec. cor., marked on brass cap
 1915 on S. rim;
 $\frac{1}{4}$ S9 in W. and
 S10 in E. half;
 dig pits, 18 X 18 X 12 ins., N. and S. of post, 3 ft. dist.; and raise a mound of earth, $3\frac{1}{2}$ ft. base, $1\frac{1}{2}$ ft. high, W. of cor.

43.65 Road, brs. N.45° E. and S.45° W.
 80.00 Set an iron post, 3 ft. long, 2 ins. diam., 24 ins. in the ground, for cor. of secs. 3, 4, 9 and 10, marked on brass cap
 1915 on S. rim;
 T26N R20W in N. half;
 S4 in NW.,
 S3 in NE.,
 S10 in SE. and
 S9 in SW. quadrant;
 dig pits, 18 X 18 X 12 ins., in each sec., $5\frac{1}{2}$ ft. dist.; and raise a mound of earth, 4 ft. base, 2 ft. high, W. of cor.
 Land, level.
 Soil, gravelly; 3rd rate.
 No timber.
 Undergrowth, greasewood.

H. G. B.

R. C. D.
 S.89° 57' E., on a random line, bet. secs. 3 and 10.
 40.00 Set temp. $\frac{1}{4}$ sec. cor.
 80.10 Intersect N. and S. line, 2 lks. N. of the cor. of secs. 2, 3, 10 and 11.

Thence
 N.89° 56' W., on a true line, bet. secs. 3 and 10.
 Over level land, through scattering undergrowth.
 40.05 Set an iron post, 3 ft. long, 1 in. diam., 26 ins. in the ground, for $\frac{1}{4}$ sec. cor., marked on brass cap
 1915 on S. rim;
 $\frac{1}{4}$ S3 in N. and
 S10 in S. half;
 dig pits, 18 X 18 X 12 ins., E. and W. of post, 3 ft. dist.; and raise a mound of earth, $3\frac{1}{2}$ ft. base, $1\frac{1}{2}$ ft. high, N. of cor.

Subdivision of T. 26 N., R. 20 W.

Chains.

71.70 Telephone line, brs. N.15 $\frac{1}{2}$ ° W. and S.15 $\frac{1}{2}$ ° E.
 73.10 Traveled road, brs. NW. and SE.
 75.60 Telephone line, brs. N.11° 20' W. and S.11° 20' E. Four-
 teen chs. N. of line, brs. N.9° E. and S. 11° 20' E.
 76.30 Old road, brs. NW. and SE.
 80.10 The cor. of secs. 3, 4, 9 and 10.
 Land, level.
 Soil, stony; 4th rate.
 No timber.
 Undergrowth, greasewood and yucca.

R. C. D.

H. G. B.
 The cor. of secs. 3, 4, 33 and 34 being plainly visible,
 I run for said cor. from last sec. cor.
 North on a random line, bet. secs. 3 and 4.
 40.00 Set temp. $\frac{1}{4}$ sec. cor.
 79.88 Intersect N. bdy. of Tp., at the cor. of secs. 3, 4, 33
 and 34, described in Book "A", established by me,
 as described in Book "B".
 Thence I run
 South on a true line, bet. secs. 3 and 4.
 Over level land, through scattering undergrowth.
 1.88 Wash, 20 lks. wide, course W.
 11.28 Road, brs. N.15° W. and S.15° E.
 13.18 Wash, 20 lks. wide, course S.40° W.
 15.88 Wash, 10 lks. wide, course S.40° W.
 18.78 Wash, 10 lks. wide, course S.40° W.
 34.78 Wash, 10 lks. wide, course S.30° W.
 37.88 Wash, 5 lks. wide, course S.40° W.
 39.88 Set an iron post, 3 ft. long, 1 in. diam., 26 ins. in the
 ground, for $\frac{1}{4}$ sec. cor., marked on brass cap
 1915 on S. rim;
 $\frac{1}{4}$ S4 in W. and
 S3 in E. half;
 and raise a mound of stone, 2 ft. base, 1 $\frac{1}{2}$ ft. high,
 W. of cor.
 48.18 Telephone line, brs. N.14° 57' W. and S.14° 57' E.
 49.88 Wash, 4 lks. wide, course S.20° W.
 79.88 The cor. of secs. 3, 4, 9 and 10.
 Land, level.
 Soil, gravel; 3rd rate.
 No timber.
 Undergrowth, greasewood.

Apr. 17, 1915

Apr. 15, 1915: At 7 hrs. 4 m., a.m., l.m.t., I set off
 35° 35 $\frac{1}{2}$ ' N. on the decl. arc; 9° 32 $\frac{1}{2}$ ' N. on the decl.
 arc; and determine a meridian with the solar at the
 reestablished cor. of secs. 14, 15, 32 and 33 on the S. bdy.
 of the Tp., described in Book "A", established by me, as
 described in Book "B".
 Thence, I run
 N.0° 3' W., bet. secs. 32 and 33.
 Over level land, through scattering undergrowth.
 10.40 Road, brs. N.60° W. and S.60° E.
 40.00 Set an iron post, 3 ft. long, 1 in. diam., 26 ins. in the
 ground, for $\frac{1}{4}$ sec. cor., marked on brass cap
 1915 on S. rim;
 $\frac{1}{4}$ S32 in W. and
 S33 in E. half;
 dig pits, 18 X 18 X 12 ins., N. and S. of post, 3 ft.
 dist.; and raise a mound of earth, 3 $\frac{1}{2}$ ft. base, 1 $\frac{1}{2}$ ft.
 high, W. of cor.
 41.00 Wash, 5 lks. wide, course N.10° E.
 58.00 Road, brs. N.40° W. and S.40° E.
 60.00 Wash, 20 lks. wide, course E.

18

Subdivision of T. 26 N., R. 20 W.

Chains.

80.00

Set an iron post, 3 ft. long, 2 ins. diam., 24 ins. in the ground, for cor. of secs. 28, 29, 32 and 33, marked on brass cap

1915 on S. rim;
T26N R20W in N. half;
S29 in NW.,
S28 in NE.,
S33 in SE. and
S32 in SW. quadrant;

dig pits, 18 X 18 X 12 ins., in each sec., 5 1/2 ft. dist.; and raise a mound of earth, 4 ft. base, 2 ft. high, W. of cor.

Land, level.

Soil, gravel; 3rd rate.

No timber.

Undergrowth, greasewood.

40.00

The cor. of secs. 27, 28, 33 and 34 being plainly visible, I run for said cor. from last sec. cor.

S.89° 52' E., on a random line, bet. secs. 28 and 33.

Set temp. 1/4 sec. cor.

80.00

Intersect the corner of secs. 27, 28, 33 and 34. Thence

Thence

N.89° 52' W., on a true line, bet. secs. 28 and 33.

Over level land, through scattering undergrowth.

40.00

Set an iron post, 3 ft. long, 1 in. diam., 26 ins. in the ground, for 1/4 sec. cor., marked on brass cap

1915 on S. rim;
1/4 S28 in N. and
S33 in S. half;

dig pits, 18 X 18 X 12 ins., E. and W. of post, 3 ft. dist.; and raise a mound of earth, 3 1/2 ft. base, 1 1/2 ft. high, N. of cor.

46.00

Wash, 15 lks. wide, course N.50° E.

54.00

Wash, 20 lks. wide, course N.50° E.

80.00

The cor. of secs. 28, 29, 32 and 33.

Land, level.

Soil, gravel; 3rd rate.

No timber.

Undergrowth, greasewood.

H. G. B.

Apr. 13, 1915.

Apr. 13, 1915: R. C. D.

N.0° 2' W., bet. secs. 28 and 29.

Over rolling land, through scattering undergrowth.

9.60

Telephone line, brs. N.78 1/2° E. and S.78 1/2° W.

21.70

Wash, 40 lks. wide, 1 1/2 ft. deep, course NE.

40.00

Set an iron post, 3 ft. long, 1 in. diam., 26 ins. in the ground, for 1/4 sec. cor., marked on brass cap

1915 on S. rim;
1/4 S29 in W. and
S28 in E. half;

dig pits, 18 X 18 X 12 ins., N. and S. of post, 3 ft. dist.; and raise a mound of earth, 3 1/2 ft. base, 1 1/2 ft. high, W. of cor.

80.00

Shallow wash, course NE.

Set an iron post, 3 ft. long, 2 ins. diam., 24 ins. in the ground, for cor. of secs. 20, 21, 28 and 29, marked on brass cap

1915 on S. rim;
T26N R20W in N. half;
S20 in NW.,
S21 in NE.,
S28 in SE. and
S29 in SW. quadrant;

Chains.

and raise a mound of stone, 2 ft. base, 1 1/2 ft. high, W. of cor. Ditch impracticable.
Land, rolling.
Soil, gravelly and stony; 3rd rate.
No timber.
Undergrowth, greasewood and cacti.

40.00 S.89° 52' E., on a random line, bet. secs. 21 and 28.
80.04 Set temp. 1/4 sec. cor.
Intersect N. and S. line, 11 lks. S. of the cor. of secs. 21, 22, 27 and 28.

Thence
N.89° 57' W., on a true line, bet. secs. 21 and 28.
24.90 Over rolling land, through scattering undergrowth.
40.02 Traveled road, brs. NW. and SE.
Set an iron post, 3 ft. long, 1 in. diam., 26 ins. in the ground, for 1/4 sec. cor., marked on brass cap
1915 on S. rim;
1/4 S21 in N. and
S28 in S. half;
dig pits, 18 X 18 X 12 ins., E. and W. of post, 3 ft. dist.; and raise a mound of earth, 3 1/2 ft. base, 1 1/2 ft. high, N. of cor.

80.04 The cor. of secs. 20, 21, 28 and 29.
Land, rolling.
Soil, sandy; 3rd rate.
No timber.
Undergrowth, greasewood and buck brush.

40.00 N.0° 3' W., bet. secs. 20 and 21.
Over rolling land, through scattering undergrowth.
Set an iron post, 3 ft. long, 1 in. diam., 26 ins. in the ground, for 1/4 sec. cor., marked on brass cap
1915 on S. rim;
1/4 S20 in W. and
S21 in E. half;
dig pits, 18 X 18 X 12 ins., N. and S. of post, 3 ft. dist.; and raise a mound of earth, 3 1/2 ft. base, 1 1/2 ft. high, W. of cor.

57.50 Traveled road, brs. NW. and SE.
80.00 Set an iron post, 3 ft. long, 2 ins. diam., 24 ins. in the ground, for cor. of secs. 16, 17, 20 and 21, marked on brass cap
1915 on S. rim;
T26N R20W in N. half;
S17 in NW.,
S16 in NE.,
S21 in SE. and
S20 in SW. quadrant;
dig pits, 18 X 18 X 12 ins., in each sec., 5 1/2 ft. dist.; and raise a mound of earth, 4 ft. base, 2 ft. high, W. of cor.

Land, rolling.
Soil, sand and gravel; 3rd rate.
No timber.
Undergrowth, greasewood.
Apr. 1, 1915: At this cor., I set off 98° 57 1/2' N. on the sec. arc; and at apparent noon, I observed the sun on the meridian; the resulting lat. is 35° 50' N.

40.00 S.89° 57' E., on a random line, bet. secs. 16 and 21.
80.00 Set temp. 1/4 sec. cor.
Intersect N. and S. line, 2 lks. S. of the cor. of secs.

T. 20

Subdivision of T. 26 N., R. 20 W.

Chains.

40.00	<p>15, 16, 21 and 22. Thence I run N.89° 58' W., on a true line, bet. secs. 16 and 21. Over level land, through scattering undergrowth. Set an iron post, 3 ft. long, 1 in. diam., 26 ins. in the ground, for $\frac{1}{4}$ sec. cor., marked on brass cap 1915 on S. rim; $\frac{1}{4}$S16 in N. and S21 in S. half; dig pits, 18 X 18 X 12 ins., E. and W. of post, 3 ft. dist.; and raise a mound of earth, $3\frac{1}{2}$ ft. base, $1\frac{1}{2}$ ft. high, N. of cor.</p>
80.00	<p>The cor. of secs. 16, 17, 20 and 21. Land, level. Soil, sandy; 3rd rate. No timber. Undergrowth, greasewood.</p> <p style="text-align: right;">R. C. D. Apr. 16, 1915.</p>
.84	<p>Apr. 17, 1915: H. G. B. N.0° 3' W., bet. secs. 16 and 17. Over level land, through scattering undergrowth.</p>
40.00	<p>Road, brs. N.45° E. and S. 45° W. Set an iron post, 3 ft. long, 1 in. diam., 26 ins. in the ground, for $\frac{1}{4}$ sec. cor., marked on brass cap 1915 on S. rim; $\frac{1}{4}$S17 in W. and S16 in E. half; dig pits, 18 X 18 X 12 ins., N. and S. of post, 3 ft. dist.; and raise a mound of earth, $3\frac{1}{2}$ ft. base, $1\frac{1}{2}$ ft. high, W. of cor.</p>
80.00	<p>Set an iron post, 3 ft. long, 2 ins. diam., 24 ins. in the ground, for cor. of secs. 8, 9, 16 and 17, marked on brass cap 1915 on S. rim; T26N R20W in N. half; S8 in NW., S9 in NE., S16 in SE. and S17 in SW. quadrant; dig pits, 18 X 18 X 12 ins., in each sec., $5\frac{1}{2}$ ft. dist.; and raise a mound of earth, 4 ft. base, 2 ft. high, W. of cor. Land, level. Soil, sand and gravel; 3rd rate. No timber. Undergrowth, greasewood.</p>
40.00	<p>The cor. of secs. 9, 10, 15 and 16 being plainly visible, I run for said cor., from last sec. cor. S.89° 55' E., on a random line, bet. secs. 9 and 16.</p>
80.06	<p>Set temp. $\frac{1}{4}$ sec. cor. Intersect the corner of secs. 9, 10, 15 and 16, N. 15 and 16.</p>
26.95	<p>Thence, I run N.89° 55' W., on a true line, bet. secs. 9 and 16. Over level land, through scattering undergrowth.</p>
36.05	<p>Road, brs. N.45° E. and S. 45° W.</p>
40.03	<p>Wash, 10 lks. wide, course N.75° W. Set an iron post, 3 ft. long, 1 in. diam., 26 ins. in the ground, for $\frac{1}{4}$ sec. cor., marked on brass cap 1915 on S. rim; $\frac{1}{4}$S9 in N. and S16 in S. half; and raise a mound of stone, 2 ft. base, $1\frac{1}{2}$ ft. high,</p>

Chains.

N. of cor. Site inaccessible
 42.15 Enter Sacramento Wash, course N.25° W.
 44.40 Leave Sacramento Wash, course N.25° W.
 80.06 The cor. of secs. 8, 9, 16 and 17.
 Land, level.
 Soil, gravel; 3rd rate.
 No timber.
 Undergrowth, greasewood.

N.0° 3' W., bet. secs. 8 and 9.
 Over level land, through scattering undergrowth.
 18.10 Wash, 5 lks. wide, course N.30° W.
 22.40 Wash, 5 lks. wide, course N.30° W.
 36.50 Wash, 5 lks. wide, course NW.
 40.00 Set an iron post, 3 ft. long, 1 in. diam., 26 ins. in the
 ground, for 1/4 sec. cor., marked on brass cap
 1915 on S. rim;
 1/4 S8 in W. and
 S9 in E. half;
 dig pits, 18 X 18 X 12 ins., N. and S. of post, 3 ft.
 dist.; and raise a mound of earth, 3 1/2 ft. base, 1 1/2 ft.
 high, W. of cor.
 55.00 Center of Sacramento Wash, 95 lks. wide, course N.25° W.
 61.50 Wash, 5 lks. wide, course NW.
 66.40 Wash, 5 lks. wide, course NW.
 80.00 Set an iron post, 3 ft. long, 2 ins. diam., 24 ins. in the
 ground, for cor. of secs. 4, 5, 8 and 9, marked on
 brass cap
 1915 on S. rim;
 T26N R20W in N. half;
 S5 in NW.,
 S4 in NE.,
 S9 in SE. and
 S8 in SW. quadrant;
 dig pits, 18 X 18 X 12 ins., in each sec., 5 1/2 ft. dist.;
 and raise a mound of earth, 4 ft. base, 2 ft. high,
 W. of cor.
 Land, level.
 Soil, gravel; 3rd rate.
 No timber.
 Undergrowth, greasewood.

S.89° 55' E., on a random line, bet. secs. 4 and 9.
 40.00 Set temp. 1/4 sec. cor.
 80.00 Intersect N. and S. line, 7 lks. S. of the cor. of secs.
 3, 4, 9 and 10.
 Thence
 N.89° 58' W., on a true line, bet. secs. 4 and 9.
 Over level land, through scattering undergrowth,
 10.20 Wash, 6 lks. wide, course S.
 25.15 Wash, 2 lks. wide, course SW.
 40.00 Set an iron post, 3 ft. long, 1 in. diam., 26 ins. in the
 ground, for 1/4 sec. cor., marked on brass cap
 1915 on S. rim;
 1/4 S4 in N. and
 S9 in S. half;
 dig pits, 18 X 18 X 12 ins., E. and W. of post, 3 ft.
 dist.; and raise a mound of earth, 3 1/2 ft. base, 1 1/2 ft.
 high, N. of cor.
 46.70 Wash, 4 lks. wide, course S.60° W.
 51.00 Wash, 5 lks. wide, course S.40° W.
 57.00 Wash, 5 lks. wide, course S.65° W.
 70.60 Wash, 5 lks. wide, course S.75° W.
 75.00 Wash, 5 lks. wide, course N.60° W.

146

Chains.

80.00

The cor. of secs. 4, 5, 8 and 9.

Land, level.

Soil, gravel; 3rd rate.

No timber.

Undergrowth, greasewood.

Apr. 17, 1915: At this cor. I set off $10^{\circ}18\frac{1}{2}'$ N. on the decl. arc; and at a point upon, I observe the sun on the meridian; the resulting lat. is $35^{\circ}40'$ N.

40.00

79.90

The cor. of secs. 4, 5, 32 and 33 being plainly visible, I run for said cor. from last sec. cor.

N. $0^{\circ}2'$ E., on a random line, bet. secs. 4 and 5.

Set temp. $\frac{1}{4}$ sec. cor.

Intersect N. bdy. of Tp., at the cor. of secs. 4, 5, 32 and 33, described in Book "A" established by me, as described in Book "B".

Thence I run

S. $0^{\circ}2'$ W., on a true line, bet. secs. 4 and 5.

Over level land, through scattering undergrowth.

39.90

Set an iron post, 3 ft. long, 1 in. diam., 26 ins. in the ground, for $\frac{1}{4}$ sec. cor., marked on brass cap

1915 on S. rim;

$\frac{1}{4}$ S5 in W. and

S4 in E. half;

and raise a mound of stone, 2 ft. base, $1\frac{1}{2}$ ft. high,

W. of cor. Pins in ground.

40.70

74.90

79.90

Wash, 20 lks. wide, course S. 85° W.

Wash, 5 lks. wide, course N. 30° W.

The cor. of secs. 4, 5, 8 and 9.

Land, level.

Soil, gravel; 3rd rate.

No timber.

Undergrowth, greasewood.

Apr. 17, 1915.

Mar. 9, 1915; At 7 hrs. 30 m., a.m., l.m.t., I set off $35^{\circ}35\frac{1}{2}'$ N. on the lat. arc; $4^{\circ}43'$ S. on the decl. arc; and determine a meridian with the solar at the reestablished cor. of secs. 5, 6, 31 and 32 on S. bdy. of Tp., described in Book "A" established by me, as described in Book "B".

Thence I run

N. $0^{\circ}3'$ W., bet. secs. 31 and 32.

Over rolling land, through scattering undergrowth.

5.50

8.50

19.20

21.80

30.10

40.00

Wash, course E.

Center of wash, 1 ch. wide, course E.

Wash, 50 lks. wide, course E.

Wash, 40 lks. wide, course E.

Wash, 50 lks. wide, course E.

Set an iron post, 3 ft. long, 1 in. diam., 26 ins. in the ground, for $\frac{1}{4}$ sec. cor., marked on brass cap

1915 on S. rim;

$\frac{1}{4}$ S31 in W. and

S32 in E. half;

and raise a mound of stone, 2 ft. base, $1\frac{1}{2}$ ft. high,

W. of cor. Pins in ground.

41.90

47.90

49.70

56.50

66.70

72.50

76.50

80 00

Wash, 20 lks. wide, course E.

Road, brs. NW. and SE.

Center of wash, 1 ch. wide, course NE.

Center of wash, 1 ch. wide, course E.

Wash, 30 lks. wide, course E.

Telephone line, brs. N. $75^{\circ}45'$ E., and S. $75^{\circ}45'$ W. to Kemple's Camp.

Center of wash, 60 lks. wide, course E.

Set an iron post, 3 ft. long, 2 ins. diam., 24 ins. in the

Chains.

ground, for cor. of secs. 29, 30, 31 and 32, marked on brass cap

1915 on S. rim;
T26N R20W in N. half;
S30 in NW.,
S29 in NE.,
S32 in SE. and
S31 in SW. quadrant;

and raise a mound of stone, 2 ft. base, 1 1/2 ft. high, W. of cor. Site impracticable.

Land, rolling.

Soil, 3rd rate.

No timber.

Undergrowth, greasewood and cacti.

From this cor., Mill, Kemple's Camp, brs. S.70° 28' W.

Tunnel brs. S.71° 48' W.

H. G. B.
Mar. 2, 1915.

R. C. D.

Apr. 16, 1915: At 7 hrs. 0 m., a.m., l.m.t., I set off 35° 36 1/2' N. on the lat. arc; 9° 53 1/2' N. on the decl. arc; and determine a meridian with the solar at the cor. of secs. 29, 30, 31 and 32.

Thence, true

N.89° 59' E., on a random line, bet. secs. 29 and 32.

40.00

Set temp. 1/4 sec. cor.

79.94

Intersect the corner of secs. 28, 29, 32 and 33.

Thence, true

S.89° 59' W., on a true line, bet. secs. 29 and 32.

5.85

Over rolling land, through scattering undergrowth.

22.45

Wash, 30 lks. wide, 1 1/2 ft. deep, course NE.

39.97

Traveled road, brs. NE. and SW.

Set an iron post, 3 ft. long, 1 in. diam., 26 ins. in the ground, for 1/4 sec. cor., marked on brass cap

1915 on S. rim;
1/4 S29 in N. and
S32 in S. half;

and raise a mound of stone, 2 ft. base, 1 1/2 ft. high, N. of cor. Site impracticable.

42.54

Telephone line, brs. N.78 1/2° E., and S.78 1/2° W., to Kemple's Camp.

57.04

Wash, 10 lks. wide, 2 ft. deep, course NW.

79.94

The cor. of secs. 29, 30, 31 and 32.

Land, rolling.

Soil, gravelly and stony; 4th rate.

No timber.

Undergrowth, greasewood.

R. C. D.
Mar. 2, 1915.

Mar. 2, 1915: H. G. B.

S.89° 59' W., on a random line, bet. secs. 30 and 31.

40.00

Set temp. 1/4 sec. cor.

79.40

Intersect W. bdy. of Twp., 2 lks. S. of the cor. of secs. 25, 30, 31 and 36, described in Book "A.", also described in Book "C".

Thence, true

East on a true line, bet. secs. 30 and 31.

9.70

Over rolling land, through scattering undergrowth.

19.16

Road, brs. NE. and SW.

33.20

Forks of road, br. NW. and SE.; and NE. and SE.

34.03

Wash, 20 lks. wide, course NE.

39.40

Road, brs. NE. and SW.

Set an iron post, 3 ft. long, 1 in. diam., 26 ins. in the ground, for 1/4 sec. cor., marked on brass cap

148

Chains.

1915 on S. rim;
 1/4 S30 in N. and
 S31 in S. half;
 and raise a mound of stone, 2 ft. base, 1 1/2 ft. high,
 N. of cor. ~~Site in sec. 29.~~
 From this cor., Mill, Memple's Camp, brs. S.37° W.
 Tunnel brs. S.44 1/2° W.
 40.10 Wash, 20 lks. wide, course NE.
 47.90 Wash, 20 lks. wide, course NE.
 50.40 Center of wash, 75 lks. wide, course NE.
 58.30 Center of wash, 1 ch. wide, course NE.
 72.10 Center of wash, 2 chs. wide, course NE.
 75.90 Center of wash, 1 ch. wide, course NE.
 79.40 The cor. of secs. 29, 30, 31 and 32.
 Land, rolling.
 Soil, 4th rate.
 No timber.
 Undergrowth, greasewood and cacti.

N.0° 3' W., bet. secs. 29 and 30.
 Over rolling land, through scattering undergrowth.
 4.00 Center of wash, 1 ch. wide, course NE.
 12.60 Wash, 40 lks. wide, course NE.
 21.00 Wash, 20 lks. wide, course NE.
 25.50 Wash, 20 lks. wide, course NE.
 27.25 Road, brs. E. and W.
 33.20 Wash, 20 lks. wide, course E.
 35.20 Road, brs. NE. and SW.
 40.00 Set an iron post, 3 ft. long, 1 in. diam., 26 ins. in the
 ground, for 1/4 sec. cor., marked on brass cap
 1915 on S. rim;
 1/4 S30 in W. and
 S29 in E. half;
 dig pits, 18 X 18 X 12 ins., N. and S. of post, 3 ft.
 dist.; and raise a mound of earth, 3 1/2 ft. base, 1 1/2 ft.
 high, W. of cor.
 54.00 Wash, 20 lks. wide, course NE.
 55.50 Road, brs. NW. and SE.
 80.00 Set an iron post, 3 ft. long, 2 ins. diam., 24 ins. in the
 ground, for cor. of secs. 19, 20, 29 and 30, marked on
 brass cap
 1915 on S. rim;
 T26N R20W in N. half;
 S19 in NW.,
 S20 in NE.,
 S29 in SE. and
 S30 in SW. quadrant;
 and raise a mound of stone, 2 ft. base, 1 1/2 ft. high,
 W. of cor. ~~Site in sec. 29.~~
 Land, rolling.
 Soil, gravelly; 3rd rate.
 No timber.
 Undergrowth, greasewood and cacti.

Mar. 2, 1915: At this cor., I set off 40.00' on the
 sec. line; and 50' perpendicular thereon, to locate the
 the corner of the section; and 1/4 sec. cor.
 H. G. B.
 Mar. 2, 1915.

Apr. 16, 1915: R. C. D.
 N.89° 59' E., on a random line, bet. secs. 20 and 29.
 40.00 Set temp. 1/4 sec. cor.
 80.04 Intersect N. and S. line, 12 lks. N. of the cor. of secs.
 20, 21, 28 and 29.
 Thence
 N.89° 56' W., on a true line, bet. secs. 20 and 29.

Chains.
 40.02 Over rolling land, through scattering undergrowth.
 Set an iron post, 3 ft. long, 1 in. diam., 26 ins. in the ground, for $\frac{1}{4}$ sec. cor., marked on brass cap
 1915 on S. rim;
 $\frac{1}{4}$ S20 in N. and
 S29 in S. half;
 and raise a mound of stone, 2 ft. base, $1\frac{1}{2}$ ft. high, N. of cor.
 48.50 Dim road, brs. NE. and SW.
 80.04 The cor. of secs. 19, 20, 29 and 30.
 Land, rolling.
 Soil, sandy and stony; 4th rate.
 No timber.
 Undergrowth, greasewood and buck brush.
 R. C. D.
 Apr. 11, 1915.

West on a random line, bet. secs. 19 and 30.
 40.00 Set temp. $\frac{1}{4}$ sec. cor.
 79:35 Intersect W. bdy. of Twp., 5 lks. N. of the cor. of secs. 19, 24, 25 and 30, described in Book "A.", and bisected by sec. 28 located in Book "C".
 Thence, 1 run
 N. $89^{\circ} 58'$ E., on a true line, bet. secs. 19 and 30.
 Over mountainous land, through scattering undergrowth.
 Desc. 360 ft. to
 18.35 Foot of desc.; brs. NE. and SW. Thence over rolling land.
 39.31 Wash, 10 lks. wide, course NE.
 39.35 Set an iron post, 3 ft. long, 1 in. diam., 26 ins. in the ground, for $\frac{1}{4}$ sec. cor., marked on brass cap
 1915 on S. rim;
 $\frac{1}{4}$ S19 in N. and
 S30 in S. half;
 and raise a mound of stone, 2 ft. base, $1\frac{1}{2}$ ft. high, N. of cor.
 58.65 Road, brs. NW. and SE.
 61.85 Wash, 20 lks. wide, course NE.
 65.65 Road, brs. NW. and SE.
 78.35 Wash, 10 lks. wide, course NE.
 79.35 The cor. of secs. 19, 20, 29 and 30.
 Land, rolling and mountainous.
 Soil, gravelly; 3rd rate.
 No timber.
 Undergrowth, greasewood and cacti.

N. $0^{\circ} 3'$ W., bet. secs. 19 and 20.
 Over rolling land, through scattering undergrowth.
 1.00 Wash, 20 lks. wide, course NE.
 10.00 Wash, 20 lks. wide, course NE.
 40.00 Set an iron post, 3 ft. long, 1 in. diam., 26 ins. in the ground, for $\frac{1}{4}$ sec. cor., marked on brass cap
 1915 on S. rim;
 $\frac{1}{4}$ S19 in W. and
 S20 in E. half;
 dig pits, 18 X 18 X 12 ins., N. and S. of post, 3 ft. dist.; and raise a mound of earth, $3\frac{1}{2}$ ft. base, $1\frac{1}{2}$ ft. high, W. of cor.
 42.20 Road, brs. E. and W.
 80:00 Set an iron post, 3 ft. long, 2 ins. diam., 24 ins. in the ground, for cor. of secs. 17, 18, 19 and 20, marked on brass cap
 1915 on S. rim;
 T26N R20W in N. half;
 S18 in NW.,
 S17 in NE.,
 S20 in SE. and
 S19 in SW. quadrant;

Chains.

dig pits, 18 X 18 X 12 ins., in each sec., $5\frac{1}{2}$ ft. dist.;
and raise a mound of earth, 4 ft. base, 2 ft. high,
W. of cor.
Land, slightly rolling.
Soil, 2nd rate.
No timber.
Undergrowth, greasewood and cacti.

Mar. 9, 1915.

40.00
80.06

Apr. 17, 1915: At 8 hrs. 5 m., a.m., l.m.t., I set off
 $35^{\circ} 38'$ N. on the lat. arc; $10^{\circ} 15\frac{1}{2}'$ N. on the decl.
arc; and determine a meridian with the solar at the
cor. of secs. 17, 18, 19 and 20.
The cor. of secs. 16, 17, 20 and 21 being plainly visible
I run for said cor. from last sec. cor.
S. $89^{\circ} 50'$ E., on a random line, bet. secs. 17 and 20.
Set temp. $\frac{1}{4}$ sec. cor.
Intersect the corner of secs. 16, 17, 20 and 21.

.26
22.76
29.66
40.03

Thence I run
N. $89^{\circ} 50'$ W., on a true line, bet. secs. 17 and 20.
Over level land, through scattering undergrowth.
Road, brs. N. 45° E. and S. 45° W.
Road, brs. N. 60° W. and S. 60° E.
Wash, 3 lks. wide, course N.
Set an iron post, 3 ft. long, 1 in. diam., 26 ins. in the
ground, for $\frac{1}{4}$ sec. cor., marked on brass cap
1915 on S. rim;
 $\frac{1}{4}$ S17 in N. and
S20 in S. half;
dig pits, 18 X 18 X 12 ins., E. and W. of post, 3 ft.
dist.; and raise a mound of earth, $3\frac{1}{2}$ ft. base, $1\frac{1}{2}$ ft.
high, N. of cor.

80.06

The cor. of secs. 17, 18, 19 and 20.
Land, level.
Soil, gravel; 3rd rate.
No timber.
Undergrowth, greasewood

Apr. 17, 1915.

40.00
79.29

Mar. 9, 1915.
The cor. of secs. 13, 18, 19 and 24 being plainly visible
I run for said cor. from last sec. cor.
West on a random line, bet. secs. 18 and 19.
Set temp. $\frac{1}{4}$ sec. cor.
Intersect W. bdy. of Tn., at the cor. of secs. 13, 18, 19
and 24, described in Book "A." established by me, as
described in Book "A."

24.49
39.29

Thence, I run
East on a true line, bet. secs. 18 and 19.
Over rolling land, through scattering undergrowth.
Wash, 12 lks. wide, course NE.
Set an iron post, 3 ft. long, 1 in. diam., 26 ins. in the
ground, for $\frac{1}{4}$ sec. cor., marked on brass cap
1915 on S. rim;
 $\frac{1}{4}$ S18 in N. and
S19 in S. half;
dig pits, 18 X 18 X 12 ins., E. and W. of post, 3 ft.
dist.; and raise a mound of earth, $3\frac{1}{2}$ ft. base, $1\frac{1}{2}$ ft.
high, N. of cor.

42.19
79.29

Wash, 15 lks. wide, course NE.
The cor. of secs. 17, 18, 19 and 20.
Land, rolling.
Soil, 3rd rate.
No timber.
Undergrowth, greasewood and cacti.

Mar. 9, 1915.

Chains.

N.0° 3' W., bet. secs. 17 and 18.
 Over level land, through scattering undergrowth.
 20.10 Wash, 5 lks. wide, course NE.
 34.60 Wash, 10 lks. wide, course NE.
 40.00 Set an iron post, 3 ft. long, 1 in. diam., 26 ins. in the
 ground, for $\frac{1}{4}$ sec. cor., marked on brass cap
 1915 on S. rim;
 $\frac{1}{4}$ S18 in W. and
 S17 in E. half;
 dig pits, 18 X 18 X 12 ins., N. and S. of post, 3 ft.
 dist.; and raise a mound of earth, $3\frac{1}{2}$ ft. base, $1\frac{1}{2}$ ft.
 high, W. of cor.
 51.00 Wash, 5 lks. wide, course N.30° E.
 59.58 Road, brs. NW. and SE.
 80.00 Set an iron post, 3 ft. long, 2 ins. diam., 24 ins. in the
 ground, for cor. of secs. 7, 8, 17 and 18, marked on
 brass cap
 1915 on S. rim;
 T26N R20W in W. half;
 S7 in NW.,
 S8 in NE.,
 S17 in SE. and
 S18 in SW. quadrant;
 dig pits, 18 X 18 X 12 ins., in each sec., $5\frac{1}{2}$ ft. dist.;
 and raise a mound of earth, 4 ft. base, 2 ft. high,
 W. of cor.
 Land, level.
 Soil, gravel; 3rd rate.
 No timber.
 Undergrowth, greasewood.

The cor. of secs. 8, 9, 16 and 17 being plainly visible,
 I run for said cor. from last sec. cor.
 S.89° 53' E., on a random line, bet. secs. 8 and 17.
 40.00 Set temp. $\frac{1}{4}$ sec. cor.
 80.00 Intersect the corner of secs. 8, 9, 16 and 17.
 Thence I run
 N.89° 53' W., on a true line, bet. secs. 8 and 17.
 37.00 Wash, 5 lks. wide, course N.50° W.
 40.00 Set an iron post, 3 ft. long, 1 in. diam., 26 ins. in the
 ground, for $\frac{1}{4}$ sec. cor., marked on brass cap
 1915 on S. rim;
 $\frac{1}{4}$ S8 in N. and
 S17 in S. half;
 dig pits, 18 X 18 X 12 ins., E. and W. of post, 3 ft.
 dist; and raise a mound of earth, $3\frac{1}{2}$ ft. base, $1\frac{1}{2}$ ft.
 high, N. of cor.
 61.50 Wash, 20 lks. wide, course N.
 80.00 The cor. of secs. 7, 8 17 and 18.
 Land, level.
 Soil, gravel; 3rd rate.
 No timber.
 Undergrowth, greasewood.

The cor. of secs. 7, 12, 13 and 18 being plainly visible,
 I run for said cor., from last sec. cor.
 N.89° 59' W., on a random line, bet. secs. 7 and 18.
 40.00 Set temp. $\frac{1}{4}$ sec. cor.
 79.10 Intersect W. bdy. of Tp. at the cor. of secs. 7, 12, 13
 and 18, described in Book "A." and by cor. as
 described in Book "C."
 Thence I run
 S.89° 59' E., on a true line, bet. secs. 7 and 18.
 Over level land, through scattering undergrowth.

Chains.

29.80 Wash, 5 lks. wide, course NE.
 39.10 Set an iron post, 3 ft. long, 1 in. diam., 26 ins. in the ground, for $\frac{1}{4}$ sec. cor., marked on brass cap
 1915 on S. rim;
 $\frac{1}{4}$ S7 in N. and
 S18 in S. half;
 dig pits, 18 X 18 X 12 ins., E. and W. of post, 3 ft. dist.; and raise a mound of earth, $3\frac{1}{2}$ ft. base, $1\frac{1}{2}$ ft. high, N. of cor.
 56.60 Wash, 20 lks. wide, course N.30° E.
 60.90 Road, brs. N.50° W. and S.50° E.
 79.10 The cor. of secs. 7, 8, 17 and 18.
 Land, level.
 Soil, gravel; 3rd rate.
 No timber.
 Undergrowth, greasewood.

Apr. 17, 1915.

Apr. 19, 1915: At 8 hrs. 0 m., a.m., l.m.t., I set off 35° 39' N. on the lat. arc; 10° 57 $\frac{1}{2}$ ' N. on the decl. arc; and determine a meridian with the solar at the cor. of secs. 7, 8, 17 and 18.

Thence
 N.0° 3' W., bet. secs. 7 and 8.

Over level land, through scattering undergrowth.

40.00 Set an iron post, 3 ft. long, 1 in. diam., 26 ins. in the ground, for $\frac{1}{4}$ sec. cor., marked on brass cap
 1915 on S. rim;
 $\frac{1}{4}$ S7 in W. and
 S8 in E. half;

dig pits, 18 X 18 X 12 ins., N. and S. of post, 3 ft. dist.; and raise a mound of earth, $3\frac{1}{2}$ ft. base, $1\frac{1}{2}$ ft. high, W. of cor.

40.15 Wash, 3 lks. wide, course N.30° E.

55.00 Wash, 2 lks. wide, course N.20° E.

60.00 Wash, 20 lks. wide, course N.20° W.

68.70 Wash, 20 lks. wide, course N.40° W.

80.00 Set an iron post, 3 ft. long, 2 ins. diam., 24 ins. in the ground, for cor. of secs. 5, 6, 7 and 8, marked on brass cap

1915 on S. rim;
 T26N R20W in N. half;
 S6 in NW.,
 S5 in NE.,
 S8 in SE. and
 S7 in SW. quadrant;

dig pits, 18 X 18 X 12 ins., in each sec., $5\frac{1}{2}$ ft. dist.; and raise a mound of earth, 4 ft. base, 2 ft. high, W. of cor.

Land, level.

Soil, gravel; 3rd rate.

No timber.

Undergrowth, greasewood.

The cor. of secs. 4, 5, 8 and 9 being plainly visible,

I run for said cor. from last sec. cor.

S.89° 57' E., on a random line, bet. secs. 5 and 8.

40.00 Set temp. $\frac{1}{4}$ sec. cor.

79.96 Intersect the corner of secs. 4, 5, 8 and 9.

Thence,

N, 89° 57' W., on a true line, bet. secs. 5 and 8.

Over level land, through scattering undergrowth.

15.16 Center of Sacramento Wash, 90 lks. wide, course N.50° W.

39.98 Set an iron post, 3 ft. long, 1 in. diam., 26 ins. in the

Chains.	<p>ground, for $\frac{1}{4}$ sec. cor., marked on brass cap 1915 on S. rim; $\frac{1}{4}$S5 in N. and S8 in S. half; dig pits, 18 X 18 X 12 ins., E. and W. of post, 3 ft. dist.; and raise a mound of earth, $3\frac{1}{2}$ ft. base, $1\frac{1}{2}$ ft. high, N. of cor.</p> <p>41.96 Wash, 3 lks. wide, course N.10° W. 66.96 Wash, 4 lks. wide, course N.5° W. 79.96 The cor. of secs. 5, 6, 7 and 8. Land, level. Soil, gravel; 3rd rate. No timber. Undergrowth, greasewood.</p>
40.00	<p>The cor. of secs. 1, 6, 7 and 12, being plainly visible, I run for said cor. from last sec. cor. S.89° 53' W., on a random line, bet. secs. 6 and 7. Set temp. $\frac{1}{4}$ sec. cor.</p> <p>79.15 Intersect W. bdy. of Tp., at the cor. of secs. 1, 6, 7 and 12, described in Book "A." established by me, as described in Book "A".</p> <p>Thence I run N.89° 53' E., on a true line, bet. secs. 6 and 7. Over level land, through scattering undergrowth.</p> <p>5.95 Wash, 10 lks. wide, course NE. 25.15 Wash, 20 lks. wide, course NE. 39.15 Set an iron post, 3 ft. long, 1 in. diam., 26 ins. in the ground, for $\frac{1}{4}$ sec. cor., marked on brass cap 1915 on S. rim; $\frac{1}{4}$S6 in N. and S7 in S. half; dig pits, 18 X 18 X 12 ins., E. and W. of post, 3 ft. dist.; and raise a mound of earth, $3\frac{1}{2}$ ft. base, $1\frac{1}{2}$ ft. high, N. of cor.</p> <p>49.15 Wash, 3 lks. wide, course NE. 76.15 Center of wash, 60 lks. wide, course N. 79.15 The cor. of secs. 5, 6, 7 and 8. Land, level. Soil, gravel; 3rd rate. No timber. Undergrowth, greasewood.</p>
40.00	<p>The cor. of secs. 5, 6, 31 and 32 being plainly visible, I run for said cor. from last sec. cor. N.0° 8' E., on a random line, bet. secs. 5 and 6. Set temp. $\frac{1}{4}$ sec. cor.</p> <p>79.90 Intersect N. bdy. of Tp., at the cor. of secs. 5, 6, 31 and 32, described in Book "A." established by me, as described in Book "A".</p> <p>Thence I run S.0° 8' W., on a true line, bet. secs. 5 and 6. Over level land, through scattering undergrowth.</p> <p>.90 Wash, 5 lks. wide, course N.50° W. 13.80 Enter Sacramento Wash, course N.40° W. 15.40 Leave Sacramento Wash, course N.40° W. 22.80 Wash, 10 lks. wide, course NW. 39.90 Set an iron post, 3 ft. long, 1 in. diam., 26 ins. in the ground, for $\frac{1}{4}$ sec. cor., marked on brass cap 1915 on S. rim; $\frac{1}{4}$S6 in W. and S5 in E. half; dig pits, 18 X 18 X 12 ins., N. and S. of post, 3 ft. dist.; and raise a mound of earth, $3\frac{1}{2}$ ft. base, $1\frac{1}{2}$ ft. high, W. of cor.</p>

Chains.

- 49.90 Wash, 5 lks. wide, course W.
 - 66.90 Wash, 5 lks. wide, course N.75° W.
 - 79.90 The cor. of secs. 5, 6, 7 and 8.
- Land, level.
Soil, gravel; 3rd rate.
No timber.
Undergrowth, greasewood.

H. G. B.
Apr. 19, 1911.

GENERAL DESCRIPTION.

This township consists of level and rolling land, except for the NE. corner, which is mountainous. The vegetation is yucca, greasewood and cacti. There is no timber. The soil varies from sandy, 2nd rate, to rocky; 4th rate.

Many shallow washes traverse the Tp., most of which lead into Sacramento Wash, which flows northwesterly through the township.

There are many dim, sand blown roads in the township, connecting with main roads, which lead to Whitehills and Gold Basin.

Two telephone lines cross the township, with a branch line leading to Kemple's camp, in the NW. quarter of sec. 31.

H. G. B.

H. G. B.

Chains.

Survey commenced Apr. 1, 1915, and executed jointly by H. G. Bardsley, U. S. Surveyor, and Royston C. Durnford, U. S. Transitman, with Young and Sons' light mountain transits Nos. 8532 and 8526, respectively, described in book "A" in the following field notes, the initials "H.G. B." and "R.C.D." are inserted at the beginning and ending of those portions describing the surveys executed by R. C. D. Refer to H. G. Bardsley, U. S. Surveyor, and Royston C. Durnford, U. S. Transitman, respectively. Knowing from recent and repeated tests of our instruments on a meridian established by observations on Polaris at elongation, that they are in good adjustment, we proceed as follows:

Date of survey shown on pages 61 and 63 hereof. R. C. D. R. C. D. April 1, 1915,

At 4 hrs. 0 m., p.m., l.m.t., I set off 35° 35½' N. on the lat. arc; 4° 26' N. on the decl. arc; and determine a meridian with the solar at the cor. of secs. 1, 2, 35 and 36, on the S. bdy. of the Tp., described in Book "A."

Thence N. 0° 1' W., bet. secs. 35 and 36. Over mountainous land, through scattering undergrowth. Desc. 110 ft. to

- 6.25 Gulch, course NE. Asc. 40 ft. to
- 7.75 Low ridge, brs. NE. and SW. Desc. 110 ft. to
- 17.50 Gulch, course E.
- 22.00 Gulch, course SE. Asc. 105 ft. to
- 28.90 Low ridge, brs. E. and W. Desc. 150 ft. to
- 40.00 Gulch, course E.

Set an iron post, 3 ft. long, 1 in. diam., 26 ins. in the ground, for ¼ sec. cor., marked on brass cap
 1915 on S. rim;
 1835 in W. and
 S36 in E. half;

and raise a mound of stone, 2 ft. base, 1½ ft. high, W. of cor.

- 46.15 Asc. 95 ft. to
- 49.80 Desc. 50 ft.
- 54.80 Mining shaft, brs. E. 2 chs. dist.
- 61.80 Asc. 125 ft. to
- 74.25 Ridge, brs. NE. and SW. Desc. 140 ft. to
- 80.00 Asc. 30 ft. to

Set an iron post, 3 ft. long, 2 ins. diam., 24 ins. in the ground, for cor. of secs. 25, 26, 35 and 36, marked on brass cap

1915 on S. rim;
 T26N R21W in E. half;
 S26 in NE.,
 S25 in NE.,
 S36 in SE. and
 S35 in SW. quadrant;

and raise a mound of stone, 2 ft. base, 1½ ft. high, W. of cor.

Land, mountainous.
 Soil, stony; 4th rate.
 No timber.
 Undergrowth, greasewood and cacti.

Apr. 2, 1915: At 8 hrs. 4 m., a.m., l.m.t., I set off 35° 36½' N. on the lat. arc; 4° 41½' N. on the decl. arc; and determine a meridian with the solar at the cor. of secs. 25, 26, 35 and 36.

Thence, I N. 89° 58' E., on a random line, bet. secs. 25 and 30.

- 40.00 Set temp. ¼ sec. cor.
- 80.00 Intersect E. bdy. of Tp., at the cor. of secs. 25, 30, 31 and 36, described in Book "A."

32.

Partial Subdivision of T. 26 N., R. 21 W.

Chains.

Thence
S.89° 58' W., on a true line, bet. secs. 25 and 36.
Over mountainous land, through scattering undergrowth.
1.90 Dim road, brs. NE. and SW. Asc. 45 ft. to
12.65 Desc. 15 ft. to
15.15 Asc. 45 ft. to
21.60 Desc. slightly to
25.10 Asc. 865 ft.
39.80 Dim road, brs. NE. and SW.
40.00 Set an iron post, 3 ft. long, 1 in. diam., 26 ins. in the
ground, for $\frac{1}{4}$ sec. cor., marked on brass cap
1915 on S. rim;
 $\frac{1}{4}$ S25 in N. and
S36 in S. half;
and raise a mound of stone, 2 ft. base, 1 $\frac{1}{2}$ ft. high,
N. of cor.
72.50 From this cor., spring brs. N.27° W., 15.00 chs. dist.
80.00 Top of asc.; spur, slopes S. Desc. SW. slope, 145 ft. to
The cor. of secs. 25, 26, 35 and 36.
Land, mountainous.
Soil, stony; 4th rate.
No timber.
Undergrowth, greasewood and cacti.

N.0° 1' W., bet. secs. 25 and 26.
Over mountainous land, through scattering undergrowth.
Asc. 90 ft. to
2.45 Desc. 75 ft. to
9.55 Asc. 20 ft. to
12.10 Desc. 85 ft. to
14.10 Asc. 90 ft. to
16.55 Desc. 240 ft.
40.00 Set an iron post, 3 ft. long, 1 in. diam., 26 ins. in the
ground, for $\frac{1}{4}$ sec. cor., marked on brass cap
1915 on S. rim;
 $\frac{1}{4}$ S26 in W. and
S25 in E. half;
and raise a mound of stone, 2 ft. base, 1 $\frac{1}{2}$ ft. high,
W. of cor.
45.00 Asc. 45 ft. to
51.95 Desc. 20 ft. to
54.95 Asc. 260 ft. to
70.75 Desc. 155 ft. to
80.00 Set an iron post, 3 ft. long, 2 ins. diam., 24 ins. in the
ground, for cor. of secs. 23, 24, 25 and 26, marked on
brass cap
1915 on S. rim;
T26N R21W in N. half;
S23 in NW.,
S24 in NE.,
S25 in SE. and
S26 in SW. quadrant;
and raise a mound of stone, 2 ft. base, 1 $\frac{1}{2}$ ft. high,
W. of cor.
Land, mountainous.
Soil, stony; 4th rate.
No timber.
Undergrowth, greasewood and cacti.

Chains.

Apr. 5, 1915: At 8 hrs. 7 m⁷, a.m., l.m.t., I set off
 35° 37½' N. on the lat. arc; 5° 50½' N. on the decl.
 arc; and determine a meridian with the solar at the cor.
 of secs. 23, 24, 25 and 26.

Thence
 N.89° 58' E., on a random line, bet. secs. 24 and 25.

40.00 Set temp. ¼ sec. cor.

79.90 Intersect E. bdy. of Tp., 7½ lks. S. of the cor. of secs.
 19, 24, 25 and 30, described in Book "A.", as defined
 by the C. S., as described in Book "B."

Thence
 S.89° 55' W., on a true line, bet. secs. 24 and 25.
 Over mountainous land, through scattering undergrowth.

Asc. 165 ft. to
 16.20 Desc. 415 ft. to
 34.90 Gulch, course N.10° W. Asc. 1170 ft.

39.95 Set an iron post, 3 ft. long, 1 in. diam., 26 ins. in the
 ground, for ¼ sec. cor., marked on brass cap
 1915 on S. rim;
 ¼ S24 in N. and
 S25 in S. half;
 and raise a mound of stone, 2 ft. base, 1½ ft. high,
 N. of cor.

70.90 Ridge, brs. N. and S. Desc. 270 ft. to
 79.90 The cor. of secs. 23, 24, 25 and 26.
 Land, mountainous.
 Soil, stony; 4th rate.
 No timber.
 Undergrowth, greasewood and cacti.

N.0° 1' W., bet. secs. 23 and 24.
 Over mountainous land, through scattering undergrowth.
 Asc. SW. slope, over cliffs, 290 ft. to
 22.70 Ridge, brs. NW. and SE. Desc. 910 ft.

40.00 Set an iron post, 3 ft. long, 1 in. diam., in a mound of
 stone, for ¼ sec. cor., marked on brass cap
 1915 on S. rim;
 ¼ S23 in W. and
 S24 in E. half;
 and raise a mound of stone, 2 ft. base, 1½ ft. high,
 W. of cor.

80.00 Set an iron post, 3 ft. long, 2 ins. diam., 24 ins. in the
 ground, for cor. of secs. 13, 14, 23 and 24, marked on
 brass cap
 1915 on S. rim;
 T26N R21W in N. half;
 S14 in NW.,
 S13 in NE.,
 S24 in SE. and
 S23 in SW. quadrant;
 and raise a mound of stone, 2 ft. base, 1½ ft. high,
 W. of cor.

Land, mountainous.
 Soil, stony; 4th rate.
 No timber.
 Undergrowth, greasewood and cacti.

Apr. 5, 1915: At 8 hrs. 7 m⁷, a.m., l.m.t., I set off
 35° 37½' N. on the lat. arc; 5° 50½' N. on the decl.
 arc; and determine a meridian with the solar at the cor.
 of secs. 13, 14, 23 and 24.

N.89° 55' E., on a random line, bet. secs. 13 and 24.
 40.00 Set temp. ¼ sec. cor.

79.82 Intersect E. bdy. of Tp., 7½ lks. S. of the cor. of secs.
 13, 18, 19 and 24, described in Book "A.", as defined
 by the C. S., as described in Book "B."

Thence
 S.89° 52' W., on a true line, bet. secs. 13 and 24.

34. Partial Subdivision of Tp. 1. 26 N., R. 21 W.

Chains.

27.72 Over rolling land, through scattering undergrowth.
 Traveled road, brs. NW. and SE.
 39.91 Set an iron post, 3 ft. long, 1 in. diam., 26 ins. in the
 ground, for $\frac{1}{4}$ sec. cor., marked on brass cap
 1915 on S. rim;
 $\frac{1}{4}$ S13 in N. and
 S24 in S. half;
 and raise a mound of stone, 2 ft. base, 1 $\frac{1}{2}$ ft. high,
 N. of cor.
 Asc. to
 64.62 Low rocky spur, slopes N. Desc. to
 79.82 The cor. of secs. 13, 14, 23 and 24.
 Land, rolling.
 Soil, gravelly; 3rd rate.
 No timber.
 Undergrowth, greasewood and buck brush.

R. C. D.

22.65 H. G. B.
 40.00 N. 0° 1' W., bet. secs. 13 and 14.
 Over rolling land, through scattering undergrowth.
 Road, brs. NW. and SE.
 Set an iron post, 3 ft. long, 1 in. diam., 26 ins. in the
 ground, for $\frac{1}{4}$ sec. cor., marked on brass cap
 1915 on S. rim;
 $\frac{1}{4}$ S14 in W. and
 S13 in E. half;
 and raise a mound of stone, 2 ft. base, 1 $\frac{1}{2}$ ft. high,
 W. of cor.
 49.50 Wash, 20 lks. wide, course E.
 56.00 Wash, 20 lks. wide, course E.
 60.00 Wash, 20 lks. wide, course E.
 62.00 Wash, 20 lks. wide, course E.
 80.00 Set an iron post, 3 ft. long, 2 ins. diam., 24 ins. in the
 ground, for cor. of secs. 11, 12, 13 and 14, marked on
 brass cap
 1915 on S. rim;
 T26N R21W in N. half;
 S11 in NW.,
 S12 in NE.,
 S13 in SE. and
 S14 in SW. quadrant;
 and raise a mound of stone, 2 ft. base, 1 $\frac{1}{2}$ ft. high,
 W. of cor.
 Land, rolling.
 Soil, stony; 4th rate.
 No timber.
 Undergrowth, greasewood and cacti.

40.00 The cor. of secs. 7, 12, 13 and 18 being plainly visible,
 I run for said cor. from last sec. cor.
 N. 89° 52' E., on a random line, bet. secs. 12 and 13.
 79.82 Set temp. $\frac{1}{4}$ sec. cor.
 Intersect E. bdy. of Tp., at the cor. of secs. 7, 12, 13
 and 18, described in Book "A.",
 Thence
 S. 89° 52' W., on a true line, bet. secs. 12 and 13.
 39.91 Over rolling land, through scattering undergrowth.
 Set an iron post, 3 ft. long, 1 in. diam., 26 ins. in the
 ground, for $\frac{1}{4}$ sec. cor., marked on brass cap
 1915 on S. rim;
 $\frac{1}{4}$ S12 in N. and

Partial Subdivision of T. 26 N., R. 21 W. 35.

Chains.	
79.82	S13 in S. half; and raise a mound of stone, 2 ft. base, 1½ ft. high, N. of cor. The cor. of secs. 11, 12, 13 and 14. Land, rolling. Soil, gravel; 3rd rate. No timber. Undergrowth, greasewood.
30.00 40.00 40.60 66.00 68.00 80.00	N.0° 1' W., bet. secs. 11 and 12. Over level land, through scattering undergrowth. Wash, course NE. Set an iron post, 3 ft. long, 1 in. diam., 26 ins. in the ground, for ¼ sec. cor., marked on brass cap 1915 on S. rim; ¼S11 in W. and S12 in E. half; and raise a mound of stone, 2 ft. base, 1½ ft. high, W. of cor. Wash, 40 lks. wide, course E. Road, brs. N.20° E. and S.20° W. Wash, 10 lks. wide, course E. Set an iron post, 3 ft. long, 2 ins. diam., 24 ins. in the ground, for cor. of secs. 1, 2, 11 and 12, marked on brass cap 1915 on S. rim; T26N R21W in N. half; S2 in NW., S1 in NE., S12 in SE. and S11 in SW. quadrant; and raise a mound of stone, 2 ft. base, 1½ ft. high, W. of cor. Land, level. Soil, gravel; 3rd rate. No timber. Undergrowth, greasewood.
40.00 79.78 5.42 6.28 39.89 45.00 48.00 54.60 60.80 73.78 79.78	The cor. of secs. 1, 6, 7 and 12 being plainly visible, I run for said cor. from last sec. cor. S.89° 56' E., on a random line, bet. secs. 1 and 12. Set temp. ¼ sec. cor. Intersect E. bdy. of Tp., at the cor. of secs. 1, 6, 7 and 12, described in Book "A," Thence, N.89° 56' W., on a true line, bet. secs. 1 and 12. Over level land, through scattering undergrowth. Road, brs. NW. and SE. Wash, 10 lks. wide, course N. Set an iron post, 3 ft. long, 1 in. diam., 26 ins. in the ground, for ¼ sec. cor., marked on brass cap 1915 on S. rim; ¼S1 in N. and S12 in S. half; and raise a mound of stone, 2 ft. base, 1½ ft. high, N. of cor. Wash, 15 lks. wide, course NE. Wash, 10 lks. wide, course NE. Road, brs. N. and S. Wash, 10 lks. wide, course NE. Wash, 10 lks. wide, course NE. The cor. of secs. 1, 2, 11 and 12. Land, level. Soil, gravel; 3rd rate. No timber. Undergrowth, greasewood.

36.

Partial Subdivision of T. 26 N., R. 21 W.

Chains

The cor. of secs. 1, 2, 35 and 36 being plainly visible,
I run for said cor. from last sec. cor.
N.0° 9' W., on a random line, bet. secs. 1 and 2.
40.00 Set temp. $\frac{1}{4}$ sec. cor.
79.87 Intersect N. bdy. of Tp., at the cor. of secs. 1, 2, 35
and 36, described in Book "A."
Thence,
S.0° 9' E., on a true line, bet. secs. 1 and 2.
Over rolling land, through scattering undergrowth.
31.85 Wash, 35 lks. wide, course N.40° E.
39.87 Set an iron post, 3 ft. long, 1 in. diam., 26 ins. in the
ground, for $\frac{1}{4}$ sec. cor., marked on brass cap
1915 on S. rim;
 $\frac{1}{4}$ S2 in W. and
S1 in E. half;
and raise a mound of stone, 2 ft. base, 1 $\frac{1}{2}$ ft. high,
W. of cor.
50.85 Wash, 10 lks. wide, course N.30° E.
53.85 Wash, 20 lks. wide, course N.50° E.
59.25 Wash, 20 lks. wide, course N.40° E.
79.87 The cor. of secs. 1, 2, 11 and 12.
Land, rolling.
Soil, gravel; 3rd rate.
No timber.
Undergrowth, greasewood.

H. G. B.

Apr. 3, 1915: R. C. D.
At 9 hrs. 0 m., a.m., l.m.t., I set off 35° 35 $\frac{1}{2}$ ' N. on the
lat. arc; 5° 5 $\frac{1}{2}$ ' N. on the decl. arc; and determine a
meridian with the solar at the cor. of secs. 2, 3, 34
and 35, on the S. bdy. of the Tp., described in Book
"A".
Thence,
N.0° 1' W., bet. secs. 34 and 35.
Over mountainous land, through scattering undergrowth.
Desc. 125 ft. to
9.75 Asc. 40 ft. to
15.87 Desc. 245 ft. to
29.20 Asc. 70 ft.
37.60 Dim road, brs. NW. and SE.
40.00 Set an iron post, 3 ft. long, 1 in. diam., 26 ins. in the
ground, for $\frac{1}{4}$ sec. cor., marked on brass cap
1915 on S. rim;
 $\frac{1}{4}$ S34 in W. and
S35 in E. half;
and raise a mound of stone, 2 ft. base, 1 $\frac{1}{2}$ ft. high,
W. of cor.
Desc. 365 ft. to
59.35 Asc. 20 ft. to
66.35 Desc. 35 ft. to
74.27 Asc. 40 ft. to
80.00 Set an iron post, 3 ft. long, 2 ins. diam., 24 ins. in the
ground, for cor. of secs. 26, 27, 34 and 35, marked on
brass cap
1915 on S. rim;
T26N R21W in N. half;
S27 in NW.,
S26 in NE.,
S35 in SE. and
S34 in SW. quadrant;
and raise a mound of stone, 2 ft. base, 1 $\frac{1}{2}$ ft. high,
W. of cor.
Land, mountainous.
Soil, stony; 4th rate.
No timber.
Undergrowth, greasewood.

Partial Subdivision of T. 26 N., R. 21 W. 37.

Chains.	
	From this cor., house brs. N.24 $\frac{1}{2}$ ° W., 13.74 chs. dist.
40.00	N.89° 58' E., on a random line, bet. secs. 26 and 35.
80.00	Set temp. $\frac{1}{4}$ sec. cor. Intersect the corner of secs. 25, 26, 35 and 36.
	Thence, S.89° 58' W., on a true line, bet. secs. 26 and 35. Over rolling and mountainous land, through scattering undergrowth.
15.20	Desc. 155 ft. to Gulch, course NW. Asc. 60 ft. to
28.55	Desc. 15 ft. to
30.00	Asc. 25 ft. to
33.40	Desc. 25 ft. to
35.00	Asc. 120 ft.
40.00	Set an iron post, 3 ft. long, 1 in. diam., 26 ins. in the ground, for $\frac{1}{4}$ sec. cor., marked on brass cap 1915 on S. rim; S26 in N. and S35 in S. half; and raise a mound of stone, 2 ft. base, 1 $\frac{1}{2}$ ft. high, N. of cor.
43.40	Rocky spur, slopes W. Desc. 135 ft. to
51.35	Asc. 90 ft. to
55.60	Desc. 80 ft. to
69.50	Gulch, course N.20° E. Asc. 95 ft.
70.90	Old road, brs. N.10° W., and South.
79.50	Low spur, brs. NE. and SW. Desc. to
80.00	The cor. of secs. 26, 27, 34 and 35, Land, rolling and mountainous. Soil, stony; 4th rate. No timber. Undergrowth, greasewood.
	Apr. 3, 1914: At this cor., I set off 5' R. C. D.
	H. G. B. N.0° 1' W., bet. secs. 26 and 27. Over heavily rolling land, through scattering undergrowth. Desc. 140 ft.
11.80	Road, brs. E. and W.
12.50	Center of wash, 1 ch. wide, course E. Old mill, brs. E. 3 chs. dist. Asc. 55 ft.
12.90	Road, brs. NE. and SW.
17.70	Ridge, brs. E. and W. Desc. 395 ft.
40.00	Set an iron post, 3 ft. long, 1 in. diam., 26 ins. in the ground, for $\frac{1}{4}$ sec. cor., marked on brass cap 1915 on S. rim; $\frac{1}{4}$ S27 in W. and S26 in E. half; and raise a mound of stone, 2 ft. base, 1 $\frac{1}{2}$ ft. high, W. of cor.
63.00	Road, brs. NW. and SE.
72.25	Same road, brs. NE. and SW.
75.50	Same road, brs. NW. and SE.
80.00	Set an iron post, 3 ft. long, 2 ins. diam., 24 ins. in the ground, for cor. of secs. 22, 23, 26 and 27, marked on brass cap 1915 on S. rim; T26N R21W in N. half; S22 in NW., S23 in NE., S26 in SE. and

38.

Partial Subdivision of T. 26 N., R. 21 W.

Chains.	
	<p>S27 in SW. quadrant; and raise a mound of stone, 2 ft. base, 1½ ft. high, W. of cor. Pile in</p> <p>Land, heavily rolling; Soil, stony; 4th rate. No timber. Undergrowth, greasewood and cacti.</p> <p style="text-align: right;">H. G. B.</p>
40.00	R. C. D.
79.90	N.89° 58' E., on a random line, bet. secs. 23 and 26. Set temp. ¼ sec. cor. Intersect the corner of secs. 23, 24, 25 and 26, 27, 28, 29 and 30.
	Thence, I
	S.89° 58' W., on a true line, bet. secs. 23 and 26. Over rolling and mountainous land, through scattering undergrowth.
	Desc. 240 ft. to
13.30	Wash, course N. Asc. 25 ft. to
18.75	Desc. 65 ft. to
28.70	Asc. 40 ft. to
31.65	Desc. 20 ft. to
35.65	Asc. slightly to
34.65	Desc. slightly to
39.95	Set an iron post, 3 ft. long, 1 in. diam., 26 ins. in the ground, for ¼ sec. cor., marked on brass cap 1915 on S. rim; ¼ S23 in N. and S26 in S. half; and raise a mound of stone, 2 ft. base, 1½ ft. high, N. of cor. Pile in
	Thence over rolling land.
56.50	Wash, course N.
74.20	Road, brs. N. and S.
79.90	The cor. of secs. 22, 23, 26 and 27. Land, rolling and mountainous. Soil, stony and gravelly; 3rd rate. No timber. Undergrowth, greasewood and cacti.
	R. C. D. Apr. 3, 1915.
	Apr. 6, 1915: H. G. B. At 8 hrs. 0 m., a.m., l.m.t., I set off 35° 37½' N. on the lat. arc; 6° 13½' N. on the decl. arc; and determine a meridian with the solar at the cor. of secs. 22, 23, 26 and 27.
	Thence I
	N.0° 1' W., bet. secs. 22 and 23. Over rolling land, through scattering undergrowth. Desc. 185 ft.
5.50	Road, brs. NE. and SW.
40.00	Set an iron post, 3 ft. long, 1 in. diam., 26 ins. in the ground, for ¼ sec. cor., marked on brass cap 1915 on S. rim; ¼ S22 in W. and S23 in E. half; and raise a mound of stone, 2 ft. base, 1½ ft. high, W. of cor. Pile in
	From this cor., Mocking Bird Mill brs. N.59° 20' W. Bunk House brs. N.53° 35' W. Assay Office brs. N.50° 20' W. Cook House brs. N.49° 25' W.
	Asc. 25 ft. to
45.00	Desc. 15 ft. to
51.00	Wash, course NW. Asc. 25 ft. to

Chains.

57.50 Top of butte. Desc. 75 ft. to
 64.90 Wash, course N.40° E. Asc. slightly to
 80.00 Set an iron post, 3 ft. long, 2 ins. diam., 24 ins. in the
 ground, for cor. of secs. 14, 15, 22 and 23, marked on
 brass cap
 1915 on S. rim;
 T26N R21W in N. half;
 S15 in NW.,
 S14 in NE.,
 S23 in SE. and
 S22 in SW. quadrant;
 and raise a mound of stone, 2 ft. base, 1½ ft. high,
 W. of cor.
 Land, heavily rolling.
 Soil, stony; 4th rate.
 No timber.
 Undergrowth, greasewood.

40.00 N.89° 58' E., on a random line, bet. secs. 14 and 23.
 Set temp. ¼ sec. cor.
 80.00 Intersect N. and S. line, 28 lks. N. of the cor. of secs.
 13, 14, 23 and 24.
 Thence
 N.89° 50' W., on a true line, bet. secs. 14 and 23.
 Over mountainous land, through scattering undergrowth.
 Desc. to
 15.00 Asc. 520 ft. to
 34.80 Desc. 85 ft. to
 36.75 Gulch, course N. Asc. 155 ft.
 40.00 Set an iron post, 3 ft. long, 1 in. diam., in a mound of
 stone, for ¼ sec. cor., marked on brass cap
 1915 on S. rim;
 ¼S14 in N. and
 S23 in S. half;
 and raise a mound of stone, 2 ft. base, 1½ ft. high,
 N. of cor.
 43.55 Ridge, brs. N. and S. Desc. 305 ft. to
 50.85 Asc. to
 51.70 Spur, slopes S. Desc. 245 ft.
 68.40 Road, brs. N. and S.
 69.90 Road, brs. N. and S.
 71.60 Wash, course N. Asc. 90 ft. to
 80.00 The cor. of secs. 14, 15, 22 and 23.
 Land, mountainous.
 Soil, stony; 4th rate.
 No timber.
 Undergrowth, greasewood.

H. C. B.

N. 0° 1' W., bet. secs. 14 and 15.
 Over rolling land, through scattering undergrowth.
 Desc. N. slope, 125 ft. to
 32.20 Traveled road, brs. E. and W.
 40.00 Set an iron post, 3 ft. long, 1 in. diam., in a mound of
 stone, for ¼ sec. cor., marked on brass cap
 1915 on S. rim;
 ¼S15 in W. and
 S14 in E. half;
 and raise a mound of stone, 2 ft. base, 1½ ft. high,
 W. of cor.
 53.40 Dim road, brs. NW. and SE.
 61.00 Shaft brs. S.62½° W., 6.60 chs. dist.
 80.00 Set an iron post, 3 ft. long, 2 ins. diam., 24 ins. in the
 ground, for cor. of secs. 10, 11, 14 and 15, marked on

40. Partial-Subdivision of T. 26 N., R. 21 W.

chains.

brass cap
 1915 on S. rim;
 T26N R21W in N. half;
 S10 in NW.,
 S11 in NE.,
 S14 in SE. and
 S15 in SW. quadrant;
 and raise a mound of stone, 2 ft. base, 1½ ft. high,
 W. of cor. ~~Dim road, brs. NE. and SW.~~
 Land, rolling.
 Soil, stony and gravelly; 3rd rate.
 No timber.
 Undergrowth, greasewood and yucca.

40.00 S.89° 50' E., on a random line, bet. secs. 11 and 14.
 79.88 Set temp. ¼ sec. cor.
 Intersect N. and S. line, 7 lks. S. of the cor. of secs.
 11, 12, 13 and 14.
 Thence
 N.89° 53' W., on a true line, bet. secs. 11 and 14.
 29.78 Over rolling land, through scattering undergrowth.
 Dim road, brs. NE. and SW.
 39.94 Set an iron post, 3 ft. long, 1 in. diam., 26 ins. in the
 ground, for ¼ sec. cor., marked on brass cap
 1915 on S. rim;
 ¼S11 in N. and
 S14 in S. half;
 and raise a mound of stone, 2 ft. base, 1½ ft. high,
 N. of cor. ~~Dim road, brs. NE. and SW.~~
 55.88 Wash, 3 ft. deep, course N.
 79.88 The cor. of secs. 10, 11, 14 and 15.
 Land, rolling.
 Soil, gravelly and stony; 4th rate.
 No timber.
 Undergrowth, greasewood and yucca.

R. C. D.
Apr. 3, 1910.

~~Sec. 2, 3, 10, 11; H. G. B.~~
 N.0° 1' W., bet. secs. 10 and 11.
 Over rolling land, through scattering undergrowth.
 4.00 Wash, 10 lks. wide, course N.20° E.
 9.00 Wash, 10 lks. wide, course N.40° E.
 18.50 Road, brs. NE. and SW.
 40.00 Set an iron post, 3 ft. long, 1 in. diam., 26 ins. in the
 ground, for ¼ sec. cor., marked on brass cap
 1915 on S. rim;
 ¼S10 in W. and
 S11 in E. half;
 and raise a mound of stone, 2 ft. base, 1½ ft. high,
 W. of cor. ~~Dim road, brs. NE. and SW.~~
 45.00 Wash, 50 lks. wide, course N.80° E.
 51.00 Wash, 10 lks. wide, course E.
 75.00 Wash, 20 lks. wide, course N.15° E.
 80.00 Set an iron post, 3 ft. long, 2 ins. diam., 24 ins. in the
 ground, for cor. of secs. 2, 3, 10 and 11, marked on
 brass cap
 1915 on S. rim;
 T26N R21W in N. half;
 S3 in NW.,
 S2 in NE.,
 S11 in SE. and
 S10 in SW. quadrant;
 and raise a mound of stone, 2 ft. base, 1½ ft. high,
 W. of cor. ~~Dim road, brs. NE. and SW.~~
 Land, rolling.

Partial Subdivision of T. 26 N., R. 21 W.

chains.

Soil, stony; 3rd rate.
No timber.
Undergrowth, greasewood, yucca and cacti.

40.00
79.86

The cor. of secs. 1, 2, 11 and 12 being plainly visible,
I run for said cor. from last sec. cor.
S.89° 56' E., on a random line, bet. secs. 2 and 11.
Set temp. $\frac{1}{4}$ sec. cor.
Intersect the corner of secs. 1, 2, 11 and 12,

10.86
31.86
36.86
39.93

Thence,
N.89° 56' W., on a true line, bet. secs. 2 and 11.
Over rolling land, through scattering undergrowth.
Wash, 10 lks. wide, course N.50° E.
Wash, 35 lks. wide, course NE.
Wash, 20 lks. wide, course N.30° E.
Set an iron post, 3 ft. long, 1 in. diam., 26 ins. in the
ground, for $\frac{1}{4}$ sec. cor., marked on brass cap
1915 on S. rim;
182 in N. and
111 in S. half;

45.86
51.86
73.36
75.36
78.36
79.86

and raise a mound of stone, 2 ft. base, 1 $\frac{1}{2}$ ft. high,
N. of cor.
Wash, 10 lks. wide, course N.10° E.
Wash, 20 lks. wide, course N.
Wash, 20 lks. wide, course N.
Wash, 20 lks. wide, course N.
Wash, 20 lks. wide, course N.15° E.
The cor. of secs. 1, 2, 11 and 12.
Land, level and rolling.
Soil, gravel; 3rd rate.
No timber.
Undergrowth, greasewood, yucca and cacti.

40.00
79.75

The cor. of secs. 2, 3, 34 and 35 being plainly visible,
I run for said cor. from last sec. cor.
N.0° 12' W., on a random line, bet. secs. 2 and 3.
Set temp. $\frac{1}{4}$ sec. cor.
Intersect N. bdy. of Tn., at the cor. of secs. 2, 3, 34
and 35, described in Book "A."

20.75
39.75

Thence,
S.0° 12' E., on a true line, bet. secs. 2 and 3.
Over level land, through scattering undergrowth.
Wash, 30 lks. wide, course NE.
Set an iron post, 3 ft. long, 1 in. diam., 26 ins. in the
ground, for $\frac{1}{4}$ sec. cor., marked on brass cap
1915 on S. rim;
183 in W. and
S2 in E. half;

60.75
79.75

and raise a mound of stone, 2 ft. base, 1 $\frac{1}{2}$ ft. high,
W. of cor.
Wash, 10 lks. wide, course N.20° E.
The cor. of secs. 2, 3, 10 and 11.
Land, level.
Soil, gravel; 3rd rate.
No timber.
Undergrowth, greasewood.

Apr. 3, 1915: At 9 hrs. 4 m., a.m., 1.m.t., I set off
35° 35 $\frac{1}{2}$ ' N. on the lat. arc; 5° 5 $\frac{1}{2}$ ' E. on the decl.

42.

Partial Subdivision of T. 26 N., R. 21 W.

Chains.

arc; and determine a meridian with the solar at the cor. of secs. 3, 4, 33 and 34, on the S. bdy. of the Tp., described in Book "A."

Thence, 120° 21' W., bet. secs. 33 and 34.

Over mountainous land, through brush.

Desc. 270 ft. to

14.33 Asc. 40 ft. to

17.30 Desc. 255 ft. to

33.77 Asc. 30 ft. to

37.23 Desc. 180 ft.

40.00 Set an iron post, 3 ft. long, 1 in. diam., in a mound of stone, for 1/4 sec. cor., marked on brass cap

1915 on S. rim;

1/4 S33 in W. and

S34 in E. half;

and raise a mound of stone, 2 ft. base, 1 1/2 ft. high, W. of cor.

48.40 Gulch, 30 lks. wide, course W. Asc. 90 ft. to

51.55 Ridge, brs. NW. and SE. Desc. 210 ft. to

64.05 Asc. 75 ft. to

66.85 Desc. 85 ft. to

80.00 Set an iron post, 3 ft. long, 2 ins. diam., 24 ins. in the ground, for cor. of secs. 27, 28, 33 and 34, marked on brass cap

1915 on S. rim;

T26N R21W in N. half;

S28 in NW.,

S27 in NE.,

S34 in SE. and

S33 in SW. quadrant;

and raise a mound of stone, 2 ft. base, 1 1/2 ft. high, W. of cor.

Land, mountainous.

Soil, stony; 4th rate.

No timber.

Undergrowth, none.

40.00 N. 89° 58' E., on a random line, bet. secs. 27 and 34, Set temp. 1/4 sec. cor.

80.10 Intersect N. and S. line, 7 lks. N. of the cor. of secs. 26, 27, 34 and 35.

Thence, 120° 21' W., bet. secs. 27 and 34.

N. 89° 59' W., on a true line, bet. secs. 27 and 34.

Over mountainous land, through scattering undergrowth.

Desc. slightly.

6.45 Road, brs. N. and S.

12.85 Wash, 20 lks. wide, course NE. Asc. 285 ft.

40.05 Set an iron post, 3 ft. long, 1 in. diam., in a mound of stone, for 1/4 sec. cor., marked on brass cap

1915 on S. rim;

1/4 S27 in N. and

S34 in S. half;

and raise a mound of stone, 2 ft. base, 1 1/2 ft. high, N. of cor.

45.25 Ridge, brs. N. and S. Desc. 255 ft. to

70.66 Asc. 110 ft. to

75.45 Ridge, brs. NW. and SE. Desc. 100 ft. to

80.10 The cor. of secs. 27, 28, 33 and 34.

Land, mountainous.

Soil, stony; 4th rate.

No timber.

Undergrowth, greasewood.

Apr. 3, 1914: About 1/2 mile N. of cor.; about 1/2 mile W. of cor. 1st. obsequy ston.

Apr. 3, 1914: About 1/2 mile N. of cor.; about 1/2 mile W. of cor. 1st. obsequy ston.

Apr. 3, 1914.

Chains.

N.0° 2' W., bet. secs. 27 and 28,
 Over mountainous land, through scattering undergrowth.
 Asc. 25 ft. to
 2.50 Desc. 230 ft. to
 5.50 Center of wash, 60 lks. wide, course W. Asc. 190 ft. to
 20.30 Ridge, brs. NW. and SE. Desc. 135 ft. to
 29.45 Wash, course NW. Asc. 55 ft. to
 32.45 Spur, slopes NW. Desc. to
 36.45 Gulch, course NW. Asc. 30 ft.
 40.00 Set an iron post, 3 ft. long, 1 in. diam., 26 ins. in the
 ground, for $\frac{1}{4}$ sec. cor., marked on brass cap
 1915 on S. rim;
 $\frac{1}{4}$ S28 in W. and
 S27 in E. half;
 and raise a mound of stone, 2 ft. base, 1 $\frac{1}{2}$ ft. high,
 W. of cor. Pits impracticable.
 40.75 Spur, slopes NW. Desc. to
 46.75 Wash, course NW. Asc. 120 ft. to
 54.40 Desc. 175 ft. to
 64.10 Wash, course W. Asc. 135 ft. to
 72.25 Ridge, brs. NW. and SE. Desc. 50 ft. to
 80.00 Set an iron post, 3 ft. long, 2 ins. diam., 24 ins. in the
 ground, for cor. of secs. 21, 22, 27 and 28, marked on
 brass cap
 1915 on S. rim;
 T26N R21W in N. half;
 S21 in NW.,
 S22 in NE.,
 S27 in SE. and
 S28 in SW. quadrant;
 and raise a mound of stone, 2 ft. base, 1 $\frac{1}{2}$ ft. high,
 W. of cor. Pits impracticable.
 Land, mountainous.
 Soil, stony; 4th rate.
 No timber.
 Undergrowth, greasewood.

S.89° 59' E., on a random line, bet. secs. 22 and 27.
 40.00 Set temp. $\frac{1}{4}$ sec. cor.
 79.98 Intersect N. and S. line, 7 lks. S. of the cor. of secs.
 22, 23, 26 and 27.
 Thence
 S.89° 58' W., on a true line, bet. secs. 22 and 27.
 Over mountainous land, through scattering undergrowth.
 Along N. slope.
 3.20 Road, brs. N. and S.
 10.25 Wash, course N.
 16.00 Wash, course N.
 26.15 Wash, course N. Asc. 95 ft. to
 35.50 Desc. 30 ft.
 39.99 Set an iron post, 3 ft. long, 1 in. diam., 26 ins. in the
 ground, for $\frac{1}{4}$ sec. cor., marked on brass cap
 1915 on S. rim;
 $\frac{1}{4}$ S22 in N. and
 S27 in S. half;
 and raise a mound of stone, 2 ft. base, 1 $\frac{1}{2}$ ft. high,
 N. of cor. Pits impracticable.
 42.95 Wash, course NE. Asc. 75 ft. to
 57.85 Desc. 35 ft. to
 60.30 Wash, 10 lks. wide, course N. Asc. 200 ft. to
 79.98 The cor. of secs. 21, 22, 27 and 28.
 Land, mountainous.
 Soil, stony; 4th rate.
 No timber.
 Undergrowth, greasewood.

Partial Subdivision of T. 26 N., R. 21 W.

Chains.

N. 0° 2' W., bet. secs. 21 and 22.
Over rolling and mountainous land, through scattering undergrowth.
Desc. 65 ft. to
4.90 Asc. 55 ft. to
9.00 Low ridge, brs. NE. and SW. Desc. 270 ft.
40.00 Set an iron post, 3 ft. long, 1 in. diam., 26 ins. in the ground, for $\frac{1}{4}$ sec. cor., marked on brass cap
1915 on S. rim;
 $\frac{1}{4}$ S21 in W. and
S22 in E. half;
and raise a mound of stone, 2 ft. base, $1\frac{1}{2}$ ft. high, W. of cor. ~~Site inaccessible.~~
42.00 Gulch, course NE. Asc. 10 ft. to
52.00 Desc. 50 ft. to
53.90 Gulch, course NW.
56.60 Same gulch, course NE.
67.50 Same gulch, course NW.
71.30 Same gulch, course NE. Asc. 35 ft. to
74.70 Desc. 65 ft. to
80.00 Set an iron post, 3 ft. long, 2 ins. diam., in a mound of stone, for cor. of secs. 15, 16, 21 and 22, marked on brass cap
1915 on S. rim;
T26N R21W in N. half;
S16 in NW.,
S15 in NE.,
S22 in SE. and
S21 in SW. quadrant;
and raise a mound of stone, 2 ft. base, $1\frac{1}{2}$ ft. high, W. of cor. ~~Site inaccessible.~~
Land, rolling and mountainous.
Soil, stony; 4th rate.
No timber.
Undergrowth, greasewood.

40.00 N. 89° 58' E., on a random line, bet. secs. 15 and 22.
Set temp. $\frac{1}{4}$ sec. cor.
80.00 Intersect N. and S. line, 11 lks. S. of the cor. of secs 14, 15, 22 and 23.
Thence
S. 89° 53' W., on a true line, bet. secs. 15 and 22.
Over rolling land, through scattering undergrowth.
Asc. 45 ft. to
2.10 Low ridge, brs. N. and S. Desc. 105 ft. to
15.00 Wash, course N.
16.20 Dim road, brs. N. and S.
40.00 Set an iron post, 3 ft. long, 1 in. diam., 26 ins. in the ground, for $\frac{1}{4}$ sec. cor., marked on brass cap
1915 on S. rim;
 $\frac{1}{4}$ S15 in N. and
S22 in S. half;
and raise a mound of stone, 2 ft. base, $1\frac{1}{2}$ ft. high, N. of cor. ~~Site inaccessible.~~
From this cor., Mocking Bird Mill brs. S. 5 $\frac{1}{4}$ ° W.
Cook house brs. S. 32° W.
Bunk house brs. S. 77 $\frac{1}{2}$ ° W.
Assay office brs. N. 86° W.
At this cor., I set a 6" x 30" I. on the
level here; and at apparent noon, I observed the sun on
the meridian; and resulting lat. is 39° 56' N.
46.20 Traveled road, brs. N. and SW.
45.70 Corner of fence brs. 20 lks. S.
60.00 Wash, course NE. Thence along N. slope.
80.00 The cor. of secs. 15, 16, 21 and 22.
Land, rolling.
Soil, stony; 4th rate.
No timber.

Chains.

Undergrowth, greasewood. R. C. D.

H. G. B.
N.0° 2' W., bet. secs. 15 and 16.

Over heavily rolling land, through scattering undergrowth.
Asc. slightly to

- 1.75 Desc. 125 ft. to
- 14.75 Wash, 2 lks. wide, course N.30° E. Asc. slightly to
- 21.25 Spur, slopes N.60° E. Desc. 45 ft. to
- 29.75 Wash, 4 lks. wide, course E. Asc. 15 ft. to
- 31.75 Low spur, slopes E. Desc. 15 ft. to
- 34.75 Wash, 3 lks. wide, course N.60° E. Asc. 15 ft. to
- 36.25 Spur, slopes N.40° E. Desc. 20 ft.
- 40.00 Set an iron post, 3 ft. long, 1 in. diam., 26 ins. in the ground, for 1/4 sec. cor., marked on brass cap

1915 on S. rim;
1/4 S16 in W. and
S15 in E. half;

and raise a mound of stone, 2 ft. base, 1 1/2 ft. high, W. of cor.

- 45.00 Wash, 4 lks. wide, course E. Asc. 80 ft. to
- 50.65 Spur, slopes N.60° E. Desc. 100 ft. to
- 60.75 Wash, 10 lks. wide, course E. Asc. 25 ft. to
- 64.75 Spur, slopes E. Desc. 40 ft. to
- 69.70 Wash, 15 lks. wide, course S.75° E. Asc. to
- 76.40 Spur, slopes E. Desc. to
- 80.00 Set an iron post, 3 ft. long, 2 ins. diam., 24 ins. in the ground, for cor. of secs. 9, 10, 15 and 16, marked on brass cap

1915 on S. rim;
T26N R21W in N. half;
S9 in NW.,
S10 in NE.,
S15 in SE. and
S16 in SW. quadrant;

and raise a mound of stone, 2 ft. base, 1 1/2 ft. high, W. of cor.

Land, heavily rolling.
Soil, 4th rate.
No timber.

Undergrowth, greasewood.
The cor. of secs. 10, 11, 14 and 15 being plainly visible
I run for said cor. from last sec. cor.
N.89° 56' E., on a random line, bet. secs. 10 and 15.

- 40.00 Set temp. 1/4 sec. cor.
- 80.06 Intersect the corner of secs. 10, 11, 14 and 15.

Thence, 1/4 sec. cor.
S.89° 56' W., on a true line, bet. secs. 10 and 15.
Over rolling land, through scattering undergrowth.

- 5.05 Wash, 10 lks. wide, course N.20° E.
- 8.75 Road, brs. NE. and SW.
- 14.55 Wash, 10 lks. wide, course N.
- 21.05 Wash, 2 lks. wide, course N.
- 37.45 Road, brs. NW. and SE.
- 40.03 Set an iron post, 3 ft. long, 1 in. diam., 26 ins. in the ground, for 1/4 sec. cor., marked on brass cap

1915 on S. rim;
1/4 S10 in N. and
S15 in S. half;

and raise a mound of stone, 2 ft. base, 1 1/2 ft. high, N. of cor.

- Asc. gradually to
- 25.05 Desc. to
- 64.20 Wash, 3 lks. wide, course N.

46.

Partial Subdivision of T. 26 N., R. 21 W.

Chains.

69.15 Wash, 2 lks. wide, course S.40° E. Asc. 45 ft. to
 72.55 Spur, slopes S.15° E. Desc. 40 ft. to
 74.05 Wash, 2 lks. wide, course S. Asc. to
 80.06 The cor. of secs. 9, 10, 15 and 16.
 Land, rolling.
 Soil, gravel; 3rd rate.
 No timber.
 Undergrowth, greasewood.

Apr. 9, 1915: At 8 hrs. 0 m., a.m., l.m.t., I set off
 35° 39' N. on the lat. arc; 7° 21' N. on the decl. arc;
 and determine a meridian with the solar at the cor. of
 secs. 9, 10, 15 and 16.

Thence I run

N.0° 2' W., bet. secs. 9 and 10.

Over heavily rolling land, through scattering undergrowth.
 Asc. 10 ft. to

1.00 Spur, slopes E. Desc. 110 ft. to
 12.75 Wash, 10 lks. wide, course E. Asc. 20 ft. to
 16.25 Spur, slopes E. Desc. 30 ft. to
 19.70 Wash, 5 lks. wide, course N.30° E. Asc. 65 ft. to
 27.60 Desc. 100 ft. to
 34.50 Wash, 10 lks. wide, course N.30° E. Asc. slightly to
 40.00 Set an iron post, 3 ft. long, 1 in. diam., 26 ins. in the
 ground, for $\frac{1}{4}$ sec. cor., marked on brass cap
 1915 on S. rim;
 $\frac{1}{2}$ S9 in W. and
 S10 in E. half;

and raise a mound of stone, 2 ft. base, 1 $\frac{1}{2}$ ft. high,
 W. of cor. *Site impracticable.*

Desc. 70 ft. to

49.90 Wash, 30 lks. wide, course NE. Asc. 20 ft. to

54.83 Spur, slopes E. Desc.

55.80 Road, brs. NW. and SE.

65.00 Wash, 5 lks. wide, course NE. Asc. to

80.00 Set an iron post, 3 ft. long, 2 ins. diam., 24 ins. in the
 ground, for cor. of secs. 3, 4, 9 and 10, marked on
 brass cap

1915 on S. rim;
 T26N R21W in N. half;
 S4 in NW.,
 S3 in NE.,
 S10 in SE. and
 S9 in SW. quadrant;

and raise a mound of stone, 2 ft. base, 1 $\frac{1}{2}$ ft. high,
 W. of cor. *Site impracticable.*

Land, heavily rolling.

Soil, stony; 4th rate.

No timber.

Undergrowth, greasewood.

The cor. of secs. 2, 3, 10 and 11 being plainly visible,
 I run for said cor. from last sec. cor.

N.89° 55' E., on a random line, bet. secs. 3 and 10.

40.00 Set temp. $\frac{1}{4}$ sec. cor.

80.00 Intersect the corner of secs. 2, 3, 10 and 11.

Thence I run

S.89° 55' W., on a true line, bet. secs. 3 and 10.

Over rolling land, through scattering undergrowth.

15.00 Wash, 10 lks. wide, course N.60° E.

25.00 Wash, 10 lks. wide, course N.75° E.

40.00 Set an iron post, 3 ft. long, 1 in. diam., 26 ins. in the

Partial Subdivision of T. 26 N., R. 21 W.

17.

Chains.

ground, for $\frac{1}{4}$ sec. cor., marked on brass cap
 1915 on S. rim;
 $\frac{1}{4}$ S3 in N. and
 S10 in S. half;
 and raise a mound of stone, 2 ft. base, $1\frac{1}{2}$ ft. high,
 N. of cor. ~~in immediate vicinity.~~
 67.00 Wash, 30 lks. wide, course N.30° E.
 80.00 The cor. of secs. 3, 4, 9 and 10.
 Land, rolling.
 Soil, stony; 4th rate.
 No timber.
 Undergrowth, greasewood.

40.00 N.0° 2' W., on a random line, bet. secs. 3 and 4.
 Set temp. $\frac{1}{4}$ sec. cor.
 79.80 Intersect N. bdy. of Tp., 5 lks. E. of the cor. of secs.
 3, 4, 33 and 34, described in Book "A."
 Thence
 S.0° 4' E., on a true line, bet. secs. 3 and 4.
 Over heavily rolling land, through scattering undergrowth.
 Desc. 120 ft. to
 5.35 Wash, 4 lks. wide, course S.20° W. Asc. to
 5.85 Desc. 110 ft. to
 15.20 Wash, 50 lks. wide, course SE. Asc. to
 15.70 Spur, brs. SE. Desc. to
 16.95 Wash, 20 lks. wide, course E. Asc. 255 ft. to
 27.85 Spur, brs. E. Desc. 210 ft.
 39.80 Set an iron post, 3 ft. long, 1 in. diam., 26 ins. in the
 ground, for $\frac{1}{4}$ sec. cor., marked on brass cap
 1915 on S. rim;
 $\frac{1}{4}$ S4 in W. and
 S3 in E. half;
 and raise a mound of stone, 2 ft. base, $1\frac{1}{2}$ ft. high,
 W. of cor.
 42.80 Wash, 20 lks. wide, course S.85° E. Thence along E. slope.
 47.30 Wash, 50 lks. wide, course E. Asc. 280 ft. to
 66.20 Spur, slopes E. Desc. 165 ft. to
 72.80 Wash, 3 lks. wide, course S.60° E. Asc. to
 73.80 Spur, slopes E. Desc. 50 ft. to
 79.80 The cor. of secs. 3, 4, 9 and 10.
 Land, mountainous and heavily rolling.
 Soil, stony; 4th rate.
 No timber.
 Undergrowth, greasewood.

Apr. 5, 1915: At 8 hrs. 3 m., a.m., 1.m.t., I set off 35°
 35 $\frac{1}{2}$ ' E. on the lat. arc; 5° 50 $\frac{1}{2}$ ' N. on the decl. arc;
 and determine a meridian with the solar at the cor. of
 secs. 4, 5, 32 and 33, on Sth bdy. of Tp., described in
 Book "A."
 Thence
 N.0° 3' W., bet. secs. 32 and 33.
 Over mountainous land, through scattering undergrowth.
 Asc. 175 ft. to
 8.40 Gulch, 20 lks. wide, course NW. Asc. 95 ft. to
 14.45 Desc. 30 ft. to
 19.45 Asc. 14 ft. to
 20.95 Desc. 170 ft. to
 29.50 Gulch, 10 lks. wide, course W. Asc. 30 ft. to
 33.00 Desc. to
 37.50 Center of wash, 1.20 chs. wide, course W. Thence over
 rolling land.

48. Partial Subdivision of T. 26 N., R. 21 W.

Chains
40.00 Set an iron post, 3 ft. long, 1 in. diam., 26 ins. in the ground, for $\frac{1}{4}$ sec. cor., marked on brass cap
1915 on S. rim;
 $\frac{1}{4}$ S32 in W. and
S33 in E. half;
and raise a mound of stone, 2 ft. base, $1\frac{1}{2}$ ft. high, W. of cor. ~~Pin~~
64.00 Wash, 20 lks. wide, course W.
69.80 Wash, 40 lks. wide, course W.
74.60 Wash, 20 lks. wide, course W. Asc. 50 ft. to
77.50 Desc. 55 ft. to
80.00 Set an iron post, 3 ft. long, 2 ins. diam., 24 ins. in the ground, for cor. of secs. 28, 29, 32 and 33, marked on brass cap
1915 on S. rim;
T26N R21W in N. half;
S29 in NW.,
S28 in NE.,
S33 in SE. and
S32 in SW. quadrant;
and raise a mound of stone, 2 ft. base, $1\frac{1}{2}$ ft. high, W. of cor. ~~Pin~~
Land, mountainous and rolling.
Soil, stony; 4th rate.
No timber.
Undergrowth, greasewood.

40.00 N.89° 58' E., on a random line, bet. secs. 28 and 33.
Set temp. $\frac{1}{4}$ sec. cor.
79.96 Intersect N. and S. line, 5 lks. S. of the cor. of secs. 27, 28, 33 and 34.
Thence
S.89° 56' W, on a true line, bet. secs. 28 and 33.
Over mountainous land, through scattering undergrowth.
Desc. 140 ft. to
6.45 Wash, 3 lks. wide, course SW. Asc. 115 ft. to
17.15 Desc. 40 ft. to
20.60 Asc. 80 ft. to
23.95 Desc.
39.98 Set an iron post, 3 ft. long, 1 in. diam., 26 ins. in the ground, for $\frac{1}{4}$ sec. cor., marked on brass cap
1915 on S. rim;
 $\frac{1}{4}$ S28 in N. and
S33 in S. half;
and raise a mound of stone, 2 ft. base, $1\frac{1}{2}$ ft. high, N. of cor. ~~Pin~~
53.75 Gulch, 30 lks. wide, course NW. Asc. to.
54.95 Desc. 195 ft. to
79.96 The cor. of secs. 28, 29, 32 and 33.
Land, mountainous.
Soil, stony; 4th rate.
No timber.
Undergrowth, greasewood.

H. G. B.

A. C. 1917: R. C. D.
N.0° 3' W., bet. secs. 28 and 29.
Over mountainous land, through scattering undergrowth.
Along broken W. slope, ascending 70 ft. to
11.60 Ridge, brs. E. and W. Desc. 140 ft. to
14.70 Gulch, course W. Asc. 100 ft. to
19.45 Desc. 85 ft. to
24.20 Asc. 55 ft. to
28.00 Desc. 55 ft. to
33.95 Asc. 35 ft. to
35.45 Desc. 35 ft. to

Partial Subdivision of T. 26 N., R. 21 W.

Chains.

38.85
40.00

Asc. 85 ft.
Set an iron post, 3 ft. long, 1 in. diam., 26 ins. in the ground, for $\frac{1}{4}$ sec. cor., marked on brass cap
1915 on S. rim;
 $\frac{1}{4}$ S29 in W. and
S28 in E. half;
and raise a mound of stone, 2 ft. base, $1\frac{1}{2}$ ft. high, W. of cor.

45.90
53.90
77.80
80.00

Spur, slopes SW. Desc. 175 ft. to
Gulch, course W. Asc. 140 ft. to
Desc. 40 ft. to
Set an iron post, 3 ft. long, 2 ins. diam., 24 ins. in the ground, for cor. of secs. 20, 21, 28 and 29, marked on brass cap
1915 on S. rim;
T26N R21W in N. half;
S20 in NW.,
S21 in NE.,
S28 in SE. and
S29 in SW. quadrant;
and raise a mound of stone, 2 ft. base, $1\frac{1}{2}$ ft. high, W. of cor.

Land, mountainous.
Soil, stony; 4th rate.
No timber
Undergrowth, greasewood.

Apr. 7, 1915: At 8 hrs. 0 m., a.m., l.m.t., I set off $35^{\circ} 37\frac{1}{2}'$ N. on the lat. arc; $6^{\circ} 36'$ N. on the decl. arc; and determine a meridian with the solar at the cor. of secs. 20, 21, 28 and 29.

40.00
79.90

Thence, $N. 89^{\circ} 56'$ E., on a random line, bet. secs. 21 and 28.
Set temp. $\frac{1}{4}$ sec. cor.
Intersect N. and S. line, 4 lks. N. of the cor. of secs. 21, 22, 27 and 28.

6.90
20.40
23.90
39.95

Thence, $S. 89^{\circ} 58'$ W., on a true line, bet. secs. 21 and 28.
Over mountainous land, through scattering undergrowth.
Asc. 55 ft. to
Low ridge, brs. N. and S. Desc. 180 ft. to
Asc. 25 ft. to
Low ridge, brs. NW. and SE. Desc. 280 ft.
Set an iron post, 3 ft. long, 1 in. diam., 26 ins. in the ground, for $\frac{1}{4}$ sec. cor., marked on brass cap
1915 on S. rim;
 $\frac{1}{4}$ S21 in N. and
S28 in S. half;
and raise a mound of stone, 2 ft. base, $1\frac{1}{2}$ ft. high, N. of cor.

50.65
55.60
77.50
79.190

Asc. 45 ft. to
Desc. 335 ft. to
Gulch, course $N. 10^{\circ} W.$ Asc. W. slope to
The cor. of secs. 20, 21, 28 and 29.
Land, mountainous.
Soil, stony; 4th rate.
No timber.
Undergrowth, greasewood.

R. C. D.

H.G.B.

Apr. 8, 1915: At 9 hrs. 32 m., a.m., l.m.t., I set off $35^{\circ} 37\frac{1}{2}'$ N. on the lat. arc; $6^{\circ} 59\frac{1}{2}'$ N. on the decl. arc; and determine a meridian with the solar at the cor. of secs. 20, 21, 28 and 29.

500. Partial Subdivision of T. 26 N., R. 21 W.

Chains.

Thence
N.0° 3' W., bet. secs. 20 and 21.
Over rolling and mountainous land, through scattering under-
growth.
Desc. to
7.00 Center of wash, 1 ch. wide, course W. Asc. 15 ft. to
11.50 Desc. 85 ft. to
14.75 Wash, 5 lks. wide, course S.75° W. Asc. 55 ft. to
17.10 Spur, brs. W. Desc. 65 ft. to
19.40 Wash, 10 lks. wide, course W. Asc. 25 ft. to
21.85 Spur, slopes W. Desc. 80 ft. to
24.30 Wash, 30 lks. wide, course W. Asc. 40 ft. to
30.25 Spur, slopes W. Desc. 30 ft. to
32.00 Wash, 4 lks. wide, course W. Asc. 15 ft. to
35.00 Spur, slopes S.80° W. Desc. 75 ft.
40.00 Set an iron post, 3 ft. long, 1 in. diam., 26 ins. in the
ground, for $\frac{1}{4}$ sec. cor., marked on brass cap
1915 on S. rim;
 $\frac{1}{4}$ S20 in W. and
S21 in E. half;
and raise a mound of stone, 2 ft. base, $1\frac{1}{2}$ ft. high,
W. of cor.
43.70 Wash, 10 lks. wide, course W. Asc. 75 ft. to
49.85 Spur, slopes S.60° W. Desc. to
52.85 Wash, course S.20° W. Asc. 25 ft. to
54.80 Spur, slopes S.75° W. Desc. 90 ft. to
59.60 Wash, course W. Asc. 25 ft. to
61.55 Spur, slopes W. Desc. 25 ft. to
62.55 Wash, 5 lks. wide, course W. Asc. 40 ft. to
67.45 Ridge, brs. E. and W. Desc. 100 ft. to
74.30 Wash, 5 lks. wide, course S.75° W. Asc. 10 ft. to
75.70 Spur, brs. E. Desc. 10 ft. to
76.70 Wash, course S.40° W. Asc. to
80.00 Set an iron post, 3 ft. long, 2 ins. diam., 24 ins. in the
ground, for cor. of secs. 16, 17, 20 and 21, marked on
brass cap
1915 on S. rim;
T26N R21W in N. half;
S17 in NW.,
S16 in NE.,
S21 in SE. and
S20 in SW. quadrant;
and raise a mound of stone, 2 ft. base, $1\frac{1}{2}$ ft. high,
W. of cor.
Land, rolling and mountainous.
Soil stony; 4th rate.
No timber.
Undergrowth, greasewood.

40.00 N.89° 58' E., on a random line, bet. secs. 16 and 21.
Set temp. $\frac{1}{4}$ sec. cor.
80.04 Intersect N. and S. line, 28 lks. N. of the cor. of secs.
15, 16, 21 and 22.
Thence
N.89° 50' W., on a true line, bet. secs. 16 and 21.
Over mountainous land, through scattering undergrowth.
Asc. 155 ft. to
12.25 Spur, brs. N.85° E. Desc. 130 ft. to
20.25 Gulch, 2 lks. wide, course N. Asc. 85 ft. to
25.25 Spur, brs. N. Desc. 30 ft. to
28.25 Wash, 2 lks. wide, course N. Asc. 30 ft. to
29.25 Ridge, brs. N. and S. Desc. 75 ft. to
34.15 Wash, 15 lks. wide, course N.60° W. Asc. 115 ft.
40.02 Set an iron post, 3 ft. long, 1 in. diam., 26 ins. in the
ground, for $\frac{1}{4}$ sec. cor., marked on brass cap
1915 on S. rim;
 $\frac{1}{4}$ S16 in N. and
S21 in S. half;
and raise a mound of stone, 2 ft. base, $1\frac{1}{2}$ ft. high,

Chains.

N. of cor.

42.50 Spur, slopes N.15° W. Desc. 135 ft. to

49.15 Wash, 10 lks. wide, course N.15° W. Asc. 100 ft. to

52.55 Spur, slopes N. Desc. to

56.00 Gulch, course N. Asc. 105 ft. to

59.30 Spur, slopes N.60° W. Desc. 245 ft.

64.55 Spur, slopes S.75° W. Continue desc. to

70.15 Gulch, 2 lks. wide, course S.75° W. Asc. to

72.65 Spur, slopes S.60° W. Desc. 45 ft. to

76.05 Wash, 2 lks. wide, course S. Asc. 45 ft. to

80.04 The cor. of secs. 16, 17, 20 and 21.

Land, mountainous.

Soil, stony; 4th rate.

No timoer.

Undergrowth, greasewood.

H. C. B.

R. C. D.

N.0° 3' W., bet. secs. 16 and 17.

Over mountainous land, through scattering undergrowth.

Asc. 70 ft., along broken W. slope, to

8.80 Spur, slopes W. Desc. 175 ft. to

25.20 Gulch, course W. Asc. 65 ft. to

30.80 Desc. 30 ft. to

34.30 Asc. 115 ft.

40.00 Set an iron post, 3 ft. long, 1 in. diam., 26 ins. in the ground, for $\frac{1}{4}$ sec. cor., marked on brass cap

1915 on S. rim;

S17 in W. and

S16 in E. half;

and raise a mound of stone, 2 ft. base, 1 $\frac{1}{2}$ ft. high,

W. of cor.

45.00 Desc. 60 ft. to

49.85 Asc. 40 ft. to

53.50 Desc. 55 ft. to

59.65 Asc. 25 ft. to

62.15 Desc. 20 ft. to

64.65 Asc. 85 ft. to

70.50 Desc. 40 ft. to

74.45 Asc. 20 ft. to

77.85 Desc. slightly to

80.00 Set an iron post, 3 ft. long, 2 ins. diam., 24 ins. in the ground, for cor. of secs. 8, 9, 16 and 17, marked on brass cap

1915 on S. rim;

T26N R21W in N. half;

S8 in NW.,

S9 in NE.,

S16 in SE. and

S17 in SW. quadrant;

and raise a mound of stone, 2 ft. base, 1 $\frac{1}{2}$ ft. high,

W. of cor.

Land, mountainous.

Soil, stony; 4th rate.

No timber.

Undergrowth, greasewood.

R. C. D.

H. G. B.

S.89° 50' E., on a random line, bet. secs. 9 and 16.

40.00 Set temp. $\frac{1}{4}$ sec. cor.

79.96 Intersect the corner of secs. 9, 10, 15 and 16.

Thence,

N.89° 50' W., on a true line, bet. secs. 9 and 16.

176

52. Partial Subdivision of T. 26 N., R. 21 W.

Chains.

Over mountainous land, through scattering undergrowth.
 Asc. 40 ft. to
 5.00 Spur, slopes N. Desc. 95 ft. to
 14.90 Wash, 5 lks. wide, course N. Asc. 370 ft.
 39.98 Set an iron post, 3 ft. long, 1 in. diam., 26 ins. in the
 ground, for $\frac{1}{4}$ sec. cor., marked on brass cap
 1915 on S. rim;
 $\frac{1}{4}$ S9 in N. and
 S16 in S. half;
 and raise a mound of stone, 2 ft. base, $1\frac{1}{2}$ ft. high,
 N. of cor.
 54.10 Top of mountain, brs. N. and S. Desc. 465 ft. to
 79.96 The cor. of secs. 8, 9, 16 and 17.
 Land, mountainous.
 Soil, stony; 4th rate.
 No timber.
 Undergrowth, greasewood.

H. G. B.

Apr. 10, 1915

Apr. 10, 1915: R. C. D.
 At 8 hrs. 0 m. a.m., l.m.t., I set off $35^{\circ} 39'$ N. on the
 lat. arc; $17^{\circ} 43'$ N. on the decl. arc; and determine
 a meridian with the solar at the cor. of secs. 8, 9, 16
 and 17.

Thence

N. $0^{\circ} 3'$ W., bet. secs. 8 and 9.

Over rolling mountains, through scattering undergrowth.

Asc. 230 ft., along broken W. slope, to

19.90 Ridge, brs. E. and W. Desc. 180 ft. to

25.50 Gulch, course W. Asc. 75 ft. to

30.55 Desc. 50 ft. to

33.95 Asc. 310 ft.

40.00 Set an iron post, 3 ft. long, 1 in. diam., in a mound of
stone, for $\frac{1}{4}$ sec. cor., marked on brass cap

1915 on S. rim;

$\frac{1}{4}$ S8 in W. and

S9 in E. half;

and raise a mound of stone, 2 ft. base, $1\frac{1}{2}$ ft. high,

W. of cor.

52.30 Spur, slopes W. Desc. 250 ft. to

69.20 Asc. 105 ft. to

80.00 Set an iron post, 3 ft. long, 2 ins. diam., in a mound of
stone, for cor. of secs. 4, 5, 8 and 9, marked on
brass cap

1915 on S. rim;

T26N R21W in N. half;

S5 in NW.,

S4 in NE.,

S9 in SE. and

S8 in SW. quadrant;

and raise a mound of stone, 2 ft. base, $1\frac{1}{2}$ ft. high,

W. of cor.

Land, rolling mountains.

Soil, stony; 4th rate.

No timber.

Undergrowth, greasewood.

S. $89^{\circ} 50'$ E., on a random line, bet. secs. 4 and 9.

40.00 Set temp. $\frac{1}{4}$ sec. cor.

79.94 Intersect the corner of secs. 3, 4, 9 and 10.

Thence

N. $89^{\circ} 50'$ W., on a true line, bet. secs. 4 and 9.

Over rolling mountains, through scattering undergrowth.

Asc. 30 ft. to

10.15 Desc. 15 ft. to

Partial Subdivision of T. 26 N., R. 21 W.

Chains.

15.15 Asc. 135 ft.
 17.65 Traveled road, brs. NW. and SE.
 30.95 Desc. 45 ft. to
 34.95 Asc. 20 ft. to
 37.95 Desc. slightly.
 39.97 Set an iron post, 3 ft. long, 1 in. diam., 26 ins. in the ground, for $\frac{1}{4}$ sec. cor., marked on brass cap
 1915 on S. rim;
 $\frac{1}{4}$ S4 in N. and
 S9 in S. half;
 and raise a mound of stone, 2 ft. base, 1 $\frac{1}{2}$ ft. high, N. of cor.

47.75 Gulch, course SE. Asc. 260 ft. to
 74.75 Ridge, brs. N. and S. Desc. 120 ft. to
 79.94 The cor. of secs. 4, 5, 8 and 9.
 Land, rolling mountains.
 Soil, stony; 4th rate.
 No timber.
 Undergrowth, greasewood and cacti.

40.00 N.0° 2' W., on a random line, bet. secs. 4 and 5.
 Set temp. $\frac{1}{4}$ sec. cor.
 79.70 Intersect N. ody. of Tp., 5 lks. E. of the cor. of secs. 4, 5, 32 and 33, described in Book "A."
 Thence,
 S.0° 4' E., on a true line, bet. secs. 4 and 5.
 Over rolling mountains, through scattering undergrowth.
 Asc. 25 ft. to
 3.20 Desc. slightly to
 5.20 Asc. 85 ft. to
 14.70 Top of small butte. Desc. 195 ft. to
 29.70 Gulch, course SW. Dim road in gulch, brs. NE. and SW.
 Asc. 25 ft. to
 35.20 Desc. 45 ft. to
 39.70 Set an iron post, 3 ft. long, 1 in. diam., in a mound of stone, for $\frac{1}{4}$ sec. cor., marked on brass cap
 1915 on S. rim;
 $\frac{1}{4}$ S5 in W. and
 S4 in E. half;
 and raise a mound of stone, 2 ft. base, 1 $\frac{1}{2}$ ft. high, W. of cor.

Apr. 25, 1915: At 9 hrs. 0 m., a.m., I set off
 35° 35 $\frac{1}{2}$ ' N. on the lat. arc; 6° 14' N. on the decl. arc; and determine a meridian with the solar at the cor. of secs. 5, 6, 31 and 32, on the S. ody. of the Tp., described in Book "A."

Asc. 65 ft. to
 48.50 Desc. 65 ft. to
 51.50 Gulch, course W. Dim road in gulch, brs. E. and W.
 Asc. 90 ft. to
 60.05 Desc. 25 ft. to
 64.90 Asc. 95 ft. to
 73.20 Desc. slightly to
 74.70 Asc. to
 79.70 The cor. of secs. 4, 5, 8 and 9.
 Land, rolling mountains.
 Soil, stony; 4th rate.
 No timber.
 Undergrowth, greasewood.

Apr. 6, 1915: At 9 hrs. 0 m., a.m., I set off
 35° 35 $\frac{1}{2}$ ' N. on the lat. arc; 6° 14' N. on the decl. arc; and determine a meridian with the solar at the cor. of secs. 5, 6, 31 and 32, on the S. ody. of the Tp., described in Book "A."

178

64. Partial Subdivision of T. 26 N., R. 21 W.

Chains.

Thence
N.0° 3' W., bet. secs. 31 and 32.
Over rolling land, through scattering undergrowth.
Asc. 25 ft. to
1.70 Desc. 55 ft. to
11.50 Gulch, course W. Asc. 85 ft. to
27.30 Low spur, slopes W. Desc. 35 ft. to
29.80 Gulch, course W. Asc. 35 ft. to
38.65 Desc. 20 ft. to
40.00 Set an iron post, 3 ft. long, 1 in. diam., 26 ins. in the
ground, for $\frac{1}{4}$ sec. cor., marked on brass cap
1915 on S. rim;
 $\frac{1}{4}$ S31 in W. and
S32 in E. half;
and raise a mound of stone, 2 ft. base, 1 $\frac{1}{2}$ ft. high,
W. of cor.
Asc. 80 ft. to
51.70 Desc. 50 ft. to
54.80 Gulch, course W. Asc. 40 ft. to
61.15 Desc. 50 ft. to
69.70 Asc. 60 ft. to
72.40 Desc. 25 ft. to
80.00 Set an iron post, 3 ft. long, 2 ins. diam., 24 ins. in the
ground, for cor. of secs. 29, 30, 31 and 32, marked on
brass cap
1915 on S. rim;
T26N R21W in N. half;
S30 in NW,
S29 in NE.,
S32 in SE. and
S31 in SW. quadrant;
and raise a mound of stone, 2 ft. base, 1 $\frac{1}{2}$ ft. high,
W. of cor. Pits impracticable.
Land, rolling.
Soil, stony; 4th rate.
No timber.
Undergrowth, greasewood.
Apr. 6, 1915: At this cor., I set off 30 10' 11" in the
Sec. 29; and at another place, I observed the
of the line; the cor. is at a distance of 35' 30" from the

40.00 N.89° 58' E., on a random line, bet. secs. 29 and 32.
Set temp. $\frac{1}{4}$ sec. cor.
80.00 Intersect the corner of secs. 28, 29, 32 and 33, 29, 32
of 25.
Thence,
S.89° 58' W., on a true line, bet. secs. 29 and 32.
Over rolling land, through scattering undergrowth.
Desc. 140 ft. to
20.85 Asc. 30 ft. to
23.15 Desc. 90 ft. to
25.50 Asc. 50 ft. to
29.00 Desc. 215 ft. to
40.00 Gulch, course NW.
Set an iron post, 3 ft. long, 1 in. diam., 26 ins. in the
ground, for $\frac{1}{4}$ sec. cor., marked on brass cap
1915 on S. rim;
 $\frac{1}{4}$ S29 in N. and
S32 in S. half;
and raise a mound of stone, 2 ft. base, 1 $\frac{1}{2}$ ft. high,
N. of cor. Pits impracticable.
Asc. 15 ft. to
43.00 Desc. 215 ft.
54.50 Enter gulch, course W. Comes from N.70° E.
79.00 Leave gulch, course N.80° W. Asc. to
80.00 The cor. of secs. 29, 30, 31 and 32.
Land, rolling.
Soil, stony; 4th rate.
No timber.

Casains.

Undergrowth, greasewood.

R. C. D.

H. G. B.
 S.89° 58' W., on a random line, bet. secs. 30 and 31.
 40.00 Set temp. $\frac{1}{4}$ sec. cor.
 79.40 Intersect W. bdy. of Tp., 7 lks. S. of the cor. of secs.
 25, 30, 31 and 36, described in Book "A."
 Thence
 S.89° 59' E., on a true line, bet. secs. 30 and 31.
 Over mountainous land, through scattering undergrowth.
 Asc. 110 ft. to
 10.00 Spur, brs. S.75° W. Desc. to
 15.00 Gulch, 10 lks. wide, course S.60° W. Asc. 130 ft. to
 28.64 Spur, brs. S. Desc. 100 ft. to
 34.40 Gulch, course S.60° W. Asc. 65 ft. to
 38.30 Spur, brs. N. Desc. 15 ft.
 39.40 Set an iron post, 3 ft. long, 1 in. diam., 26 ins. in the
 ground, for $\frac{1}{4}$ sec. cor., marked on brass cap
 1915 on S. rim;
 $\frac{1}{4}$ S30 in N. and
 S31 in S. half;
 and raise a mound of stone, 2 ft. base, 1 $\frac{1}{2}$ ft. high,
 N. of cor.
 55.50 Wash, course S. Asc. 60 ft. to
 63.80 Ridge, brs. N. and S. Desc. 40 ft. to
 69.80 Asc. 70 ft. to
 75.25 Ridge, brs. N. and S. Desc. to
 79.40 The cor. of secs. 29, 30, 31 and 32.

Land, mountainous.
Soil, stony; 4th rate.
No timber.
Undergrowth, greasewood.

Apr. 7, 1915: At this cor., a set of 26 ins. in the
ground, marked on brass cap, 1915 on S. rim;
 $\frac{1}{4}$ S30 in W. and
S29 in E. half.

N.0° 3' W., bet. secs. 29 and 30.
 Over mountainous land, through scattering undergrowth.
 Desc. to
 1.70 Wash, 10 lks. wide, course W. Asc. slightly to
 10.00 Spur, brs. E. and W. Desc. 70 ft. to
 12.80 Wash, course N.30° W. Asc. 30 ft. to
 28.00 Saddle in ridge, brs. E. and W. Desc. 35 ft. to
 30.65 Wash, 10 lks. wide, course W.
 35.90 Wash, 6 lks. wide, course W. Asc. 45 ft.
 40.00 Set an iron post, 3 ft. long, 1 in. diam., 26 ins. in the
 ground, for $\frac{1}{4}$ sec. cor., marked on brass cap
 1915 on S. rim;
 $\frac{1}{4}$ S30 in W. and
 S29 in E. half;
 and raise a mound of stone, 2 ft. base, 1 $\frac{1}{2}$ ft. high,
 W. of cor.
 41.20 Spur, slopes W. Desc. 40 ft. to
 42.80 Wash, course W. Asc. 100 ft. to
 54.60 Ridge, brs. N.40° W. and S.40° E. Desc. 180 ft. to
 59.85 Wash, 10 lks. wide, course W. Asc. 170 ft. to
 72.50 Ridge, brs. E. and W. Desc. 105 ft. to
 76.50 Wash, 10 lks. wide, course N.25° W. Asc. to
 80.00 Set an iron post, 3 ft. long, 2 ins. diam., 24 ins. in the
 ground, for cor. of secs. 19, 20, 29 and 30, marked on
 brass cap
 1915 on S. rim;
 T26N R21W in N. half;

56.

Partial Subdivision of T. 26 N., R. 21 W.

Chains.

S19 in NW.,
 S20 in NE.,
 S29 in SE. and
 S30 in SW. quadrant;
 and raise a mound of stone, 2 ft. base, 1½ ft. high,
 W. of cor. ~~of secs. 19, 20, 29 and 30.~~
 Land, mountainous.
 Soil, stony; 4th rate.
 No timber.
 Undergrowth, greasewood.

40.00 N. 89° 58' E., on a random line, bet. secs. 20 and 29.
 Set temp. ¼ sec. cor.
 80.00 Intersect N. and S. line, 24 lks. S. of the cor. of secs.
 20, 21, 28 and 29.
 Thence
 S. 89° 48' W., on a true line, bet. secs. 20 and 29.
 Over mountainous land, through scattering undergrowth.
 Asc. 35 ft. to
 6.05 Spur, slopes N. Desc. 90 ft. to
 10.85 Gulch, 4 lks. wide, course N. Asc. 45 ft. to
 17.55 Spur, slopes N. Desc. 65 ft. to
 20.30 Gulch, course N. Asc. 40 ft. to
 22.80 Spur, slopes N. Desc. 190 ft. to
 34.20 Gulch, 20 lks. wide, course NW. Asc. 55 ft. to
 38.45 Desc. 55 ft.
 40.00 Set an iron post, 3 ft. long, 1 in. diam., 26 ins. in the
 ground, for ¼ sec. cor., marked on brass cap
 1915 on S. rim;
 ¼ S20 in N. and
 S29 in S. half;
 and raise a mound of stone, 2 ft. base, 1½ ft. high,
 N. of cor. ~~of secs. 19, 20, 29 and 30.~~
 41.65 Gulch, course NW. Asc. 45 ft. to
 46.80 Spur, slopes NW. Desc. 80 ft. to
 53.00 Gulch, course N. 30° W. Asc. 50 ft. to
 55.90 Spur, slopes N. Desc. 140 ft. to
 60.65 Gulch, course NW. Asc. 45 ft. to
 68.55 Spur, slopes N. Desc. 50 ft. to
 74.70 Gulch, course N. Asc. to
 80.00 The cor. of secs. 19, 20, 29 and 30.
 Land, mountainous.
 Soil, stony; 4th rate.
 No timber.
 Undergrowth, greasewood.

H. G. B.

R. C. D.
 40.00 N. 89° 59' W., on a random line, bet. secs. 19 and 30.
 Set temp. ¼ sec. cor.
 79.31 Intersect W. bdy. of Tp., at the cor. of secs. 19, 24, 25
 and 30, described in Book "A,"
 Thence,
 S. 89° 59' E., on a true line, bet. secs. 19 and 30.
 Over rolling mountains, through scattering undergrowth.
 Asc. slightly to
 3.15 Desc. 15 ft. to
 10.40 Asc. 190 ft. to
 21.00 Ridge, brs. N. and S. Desc. 80 ft. to
 24.50 Asc. 75 ft. to
 27.90 S. point of ledge. Desc. 85 ft. to
 34.35 Asc. 175 ft.
 39.31 Set an iron post, 3 ft. long, 1 in. diam., in a mound of
 stone, for ¼ sec. cor., marked on brass cap

Chains.

1915 on S. rim;
 1/4 S19 in N. and
 S30 in S. half;
 and raise a mound of stone, 2 ft. base, 1 1/2 ft. high,
 N. of cor.

48.05 Desc. 35 ft. to
 49.30 Gulch, course SW. Asc. 150 ft. to
 59.30 Low ridge, brs. NW. and SE. Desc. 105 ft. to
 66.70 Gulch, course NW.
 68.30 Same gulch, course SW. Asc. 135 ft. to
 79.31 The cor. of secs. 19, 20, 29 and 30.
 Land, mountainous.
 Soil, stony; 4th rate.
 No timber.
 Undergrowth, greasewood and cacti.

Apr. 9, 1915: At 8 hrs. 0 m., a.m., l.m.t., I set off
 35° 37 1/2' N. on the lat. arc; 7° 21' N. on the decl.
 arc; and determine a meridian with the solar at the
 cor. of secs. 19, 20, 29 and 30.

Thence
 N.0° 3' W., bet. secs. 19 and 20.
 Over rolling mountains, through scattering undergrowth.
 Desc. 15 ft. to
 10.00 Asc. 45 ft. to
 15.00 Desc. 85 ft. to
 24.90 Asc. 15 ft. to
 29.90 Desc. 35 ft. to
 33.40 Gulch, course W. Asc. 10 ft. to
 36.25 Desc. 25 ft. to
 40.00 Set an iron post, 3 ft. long, 1 in. diam., in a mound of
 stone, for 1/4 sec. cor., marked on brass cap

1915 on S. rim;
 1/4 S19 in W. and
 S20 in E. half;
 and raise a mound of stone, 2 ft. base, 1 1/2 ft. high,
 W. of cor.

Asc. 25 ft. to
 43.70 Desc. 25 ft. to
 45.00 Asc. 40 ft. to
 57.90 Desc. 30 ft. to
 59.80 Asc. slightly to
 80.00 Set an iron post, 3 ft. long, 2 ins. diam., in a mound of
 stone, for cor. of secs. 17, 18, 19 and 20, marked on
 brass cap

1915 on S. rim;
 T26N R21W in N. half;
 S18 in NW.,
 S17 in NE.,
 S20 in SE. and
 S19 in SW. quadrant;

and raise a mound of stone, 2 ft. base, 1 1/2 ft. high,
 W. of cor.
 Land, rolling mountains.
 Soil, stony; 4th rate.
 No timber.
 Undergrowth, greasewood, yucca and cacti.

N.89° 48' E., on a random line, bet. secs. 17 and 20.
 40.00 Set temp. 1/4 sec. cor.
 79.90 Intersect N. and S. line, 4 lks. N. of the cor. of secs.
 16, 17, 20 and 21.
 Thence
 S.89° 50' W., on a true line, bet. secs. 17 and 20.

182

Chains.

Over rolling mountains, through scattering undergrowth.
 Desc. 205 ft. to
 9.90 Gulch, course NW. Asc. 40 ft. to
 13.15 Desc. 30 ft. to
 20.10 Asc. slightly to
 24.10 Desc. 300 ft.
 39.95 Set an iron post, 3 ft. long, 1 in. diam., 26 ins. in the
 ground, for $\frac{1}{4}$ sec. cor., marked on brass cap
 1915 on S. rim;
 $\frac{1}{4}$ S17 in N. and
 S20 in S. half;
 and raise a mound of stone, 2 ft. base, $1\frac{1}{2}$ ft. high,
 N. of cor.
 Continue desc. to
 79.90 The cor. of secs 17, 18, 19 and 20.
 Land, rolling mountains.
 Soil, stony; 4th rate.
 No timber.
 Undergrowth, greasewood.

N. $89^{\circ} 59'$ W., on a random line, bet. secs. 18 and 19.
 40.00 Set temp. $\frac{1}{4}$ sec. cor.
 79.25 Intersect W. bdy of T. pine, 2 lks. N. of the cor. of secs.
 13, 18, 19 and 24, described in Book 11A.,
 Thence,
 East on a true line, bet. secs. 18 and 19.
 Over rolling mountains, through scattering undergrowth.
 Asc. 300 ft.
 39.25 Set an iron post, 3 ft. long, 1 in. diam., in a mound of
 stone, for $\frac{1}{4}$ sec. cor., marked on brass cap
 1915 on S. rim;
 $\frac{1}{4}$ S18 in N. and
 S19 in S. half;
 and raise a mound of stone, 2 ft. base, $1\frac{1}{2}$ ft. high,
 N. of cor.
 51.50 Enter wash, course NW. Comes from E. Asc. in wash.
 57.10 Leave wash, course W. Comes from NE. Asc. to
 61.95 Spur, brs. N. Desc. 65 ft. to
 64.25 Enter same wash, course NW. Comes from E. Asc. 125 ft.
 69.75 Leave wash, course W. Comes from NE. Asc. to
 78.25 Desc. 10 ft. to
 79.25 The cor. of secs. 17, 18, 19 and 20.
 Land, rolling mountains.
 Soil, stony; 4th rate.
 No timber.
 Undergrowth, greasewood.

App. S. 115: At this cor. set 2nd 2nd 2nd 2nd 2nd 2nd 2nd 2nd 2nd 2nd
 2nd 2nd 2nd 2nd 2nd 2nd 2nd 2nd 2nd 2nd
 2nd 2nd 2nd 2nd 2nd 2nd 2nd 2nd 2nd 2nd
 R. C. D.
 1915, 1915.

GENERAL DESCRIPTION.

This township is very rough and hilly, except for the
 northeast corner, which is rolling land. The drainage in
 the southern part of the township is largely to the west
 and northwest, but in the northern part, the drainage is
 easterly and westerly from a central range of mountains
 running north and south. The soil consists of sand,
 gravel and stone, the latter predominating. Vegetation
 is greasewood and cacti. There is no timber.
 U. S. L. M. No. 1101, Minnesota District, is located
 in the northeast quarter of sec. 4. Mocking Bird Mill,
 Assay Office, Cook House and Bunk House are located near

the line between secs. 15 and 22. There are a few deserted cabins in the township, but no settlers. There is a spring in the south-east quarter of sec. 25.

6	5	4	3	2	1
			4-17-15	4-17-15	4-17-15
7	8	9	10	11	12
			4-16-15	4-17-15	
18	17	16	15	14	13
		FIELD ASSISTANTS T.26N. P.20W.			
		4-16-15	4-15-15		4-15-15
19	20	21	22	23	24
	4-16-15	4-16-15		4-15-15	4-13-15
30	29	28	27	26	25
	4-16-15		4-15-15	4-13-15	4-13-15
31	32	33	34	35	36
		4-15-15	4-13-15	4-13-15	

Surveys executed on dates shown on these diagrams by Royston C. Durnford, U.S. Transitman.

	6	5	4	3	2	1
			4-10-15			
	7	8	9	10	11	12
					4-7-15	
	18	17	16	15	14	13
	4-9-15	4-9-15	T.26N. P.21W.	4-7-15		4-5-15
4-8-15	19	20	21	22	23	24
4-8-15	4-9-15		4-7-15		4-3-15	4-5-15
4-8-15	30	29	28	27	26	25
		4-6-15			4-3-15	4-2-15
	31	32	33	34	35	36
	4-6-15			4-3-15	4-1-15	
	3-3-15	3-3-15	3-3-15	3-26-15	3-26-15	3-26-15

186

BOOK 3246

62

CERTIFICATE OF UNITED STATES ~~SURVEYOR~~ ^{TRANSITMAN}

Transitman,

I, Royston C. Durhford, U. S. ~~Surveyor~~, hereby certify upon honor that, in pursuance

of special instructions received from the U. S. Surveyor General for Group 45, Arizona,

bearing date of the 7th day of January, 1915, I have well, faithfully, and truly

in my own proper person, and in strict conformity with said instructions, the Manual of Surveying Instruc-

tions, and the laws of the United States, surveyed all those parts or portions of the

Subdivision lines of

TOWNSHIP 26 NORTH, RANGE 20 WEST, and

TOWNSHIP 26 NORTH, RANGE 21 WEST,

of the Gila and Salt

River Base and Meridian, in the State of Arizona, which are represented by

the diagrams on the reverse hereof and in

the foregoing field notes as having been executed by me, and under my direction; and that all the corners of

said survey have been established and perpetuated in strict accordance with the Manual of Surveying Instruc-

tions, and the special written instructions of the U. S. Surveyor General for Group 45, Arizona,

and in the specific manner described in the field notes, and that the foregoing are the original field notes of

such survey.

Royston C. Durhford
U. S. Surveyor
Transitman.

APPROVAL.

OFFICE OF THE UNITED STATES SURVEYOR GENERAL,

....., 191

The foregoing field notes of the survey of

executed by

under his special instructions dated, 191 , having been

critically examined, and the necessary corrections and explanations made, the said field notes, and the surveys

they describe, are hereby approved.

.....
U. S. Surveyor General.

I certify that the foregoing transcript of the field notes of the above-described surveys in

....., has been correctly copied from the original notes on file in this office.

.....
U. S. Surveyor General.

	4-16-15	4-16-15	4-16-15	4-16-15	4-16-15	4-16-15
4-2-15	6 4-19-15	5 4-19-15	4 4-17-15	3 4-17-15	2 4-15-15	1 4-13-15
4-2-15	7 4-17-15	8 4-17-15	9 4-17-15	10 4-17-15	11 4-15-15	12 4-15-15
3-8-15	18 3-9-15	17 4-17-15	FIELD ASSISTANTS. 16 15 <i>T.26N. R.20W</i>		14 4-15-15	13 4-13-15
3-8-15	19 3-9-15	20	21	22 4-15-15	23	24 4-13-15 RESURVEYED
3-8-15	30 3-9-15	29	28 4-15-15	27	26	25 4-13-15
3-8-15	31 3-9-15	32 4-15-15	33	34	35	36 4-13-15
	2-25-15	2-25-15	2-25-15	2-25-15	2-25-15	2-25-15

RESURVEYED

Surveys executed on dates shown on these diagrams by H.G. Bardsley, U.S. Surveyor.

			4-2-15	4-2-15	4-2-15	4-2-15
	6	5	4 4-9-15	3 4-9-15	2 4-8-15	1 4-6-15
	7	8	9 4-9-15	10 4-8-15	11 4-6-15	12 4-6-15
	18	17	16 4-8-15	15 4-8-15	14 4-6-15	13 4-6-15
	19	20 4-7-15	21	22 4-5-15	23	24
	30 4-7-15	29	28 4-5-15	27 4-3-15	26	25
4-7-15	31	32 4-5-15	33 4-3-15	34	35	36 3-8-15

58

64
BOOK 3246

CERTIFICATE OF UNITED STATES SURVEYOR.

I, H. G. Bardsley, U. S. Surveyor, hereby certify upon honor that, in pursuance of special instructions received from the U. S. Surveyor General for Group 45, Arizona, bearing date of the 7th day of January, 1915, I have well, faithfully, and truly in my own proper person, and in strict conformity with said instructions, the Manual of Surveying Instructions, and the laws of the United States, surveyed all those parts or portions of the Subdivision Lines, of

TOWNSHIP 26 NORTH, RANGE 20 WEST, and
TOWNSHIP 26 NORTH, RANGE 21 WEST,

of the Gila and Salt

River Base and Meridian, in the State of Arizona, which are represented by the diagrams on the reverse hereof and in the foregoing field notes as having been executed by me, and under my direction; and that all the corners of said survey have been established and perpetuated in strict accordance with the Manual of Surveying Instructions, and the special written instructions of the U. S. Surveyor General for Group 45, Arizona, and in the specific manner described in the field notes, and that the foregoing are the original field notes of such survey.

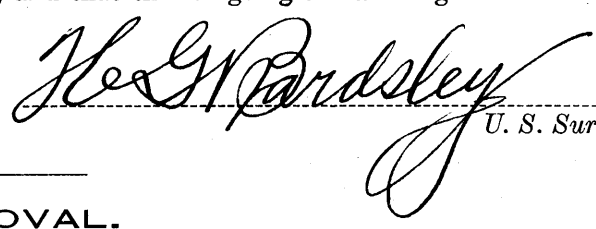
U. S. Surveyor.

APPROVAL.

OFFICE OF THE UNITED STATES SURVEYOR GENERAL,

Phoenix, Arizona, March 17, 1919

The foregoing field notes of the survey of the Subdivision lines of

TOWNSHIP 26 NORTH, RANGE 20 WEST, and

Part of the Subdivision lines of TOWNSHIP 26 NORTH, RANGE 21 WEST,

of the Gila and Salt River Base and Meridian, in the State of Arizona, executed by H. G. Bardsley, U. S. Surveyor, and Royston C. Durnford, U. S. Transitman, under ~~his~~ special instructions dated Jan. 7, 1915, for Group 45, Arizona, ~~and~~ having been critically examined, and the necessary corrections and explanations made, the said field notes, and the surveys they describe, are hereby approved.

U. S. Surveyor General.

~~I certify that the foregoing transcript of the field notes of the above described surveys in~~
~~has been correctly copied from the original notes on file in this office.~~

~~U. S. Surveyor General.~~