

3247

1891

Book "F"

4-679

(Subdivisions)

JAN 13 1915

JAN 13 1915

FIELD NOTES

BOOK 3247

OF THE SURVEY OF PART

of the

SUBDIVISION LINES

of

TOWNSHIP 27 NORTH, RANGE 20 WEST,

and

TOWNSHIP 27 NORTH, RANGE 21 WEST,

Of the Gila and Salt River Base and Meridian,

In the State of Arizona.

EXECUTED BY

H. G. Bardsley, U. S. Surveyor,

and

Royston C. Durnford, U. S. Transit man.

~~In the capacity of U. S. Surveyor~~, under instructions dated January 7,, 1915.,
issued by the United States Surveyor General to govern surveys included in
Group No. 45, which were approved by the Commissioner of the General Land
Office, January 26,, 1915.

Survey commenced April 10,, 1915.

Survey completed April 23,, 1915.

Executed under Assignment
Instructions dated Jan. 31, 1915.

3247

3247

1A 190

Book "F"

Group, 45----Arizona

BOOK 3247

INDEX DIAGRAM.

Township 27 North, Range 20 West.

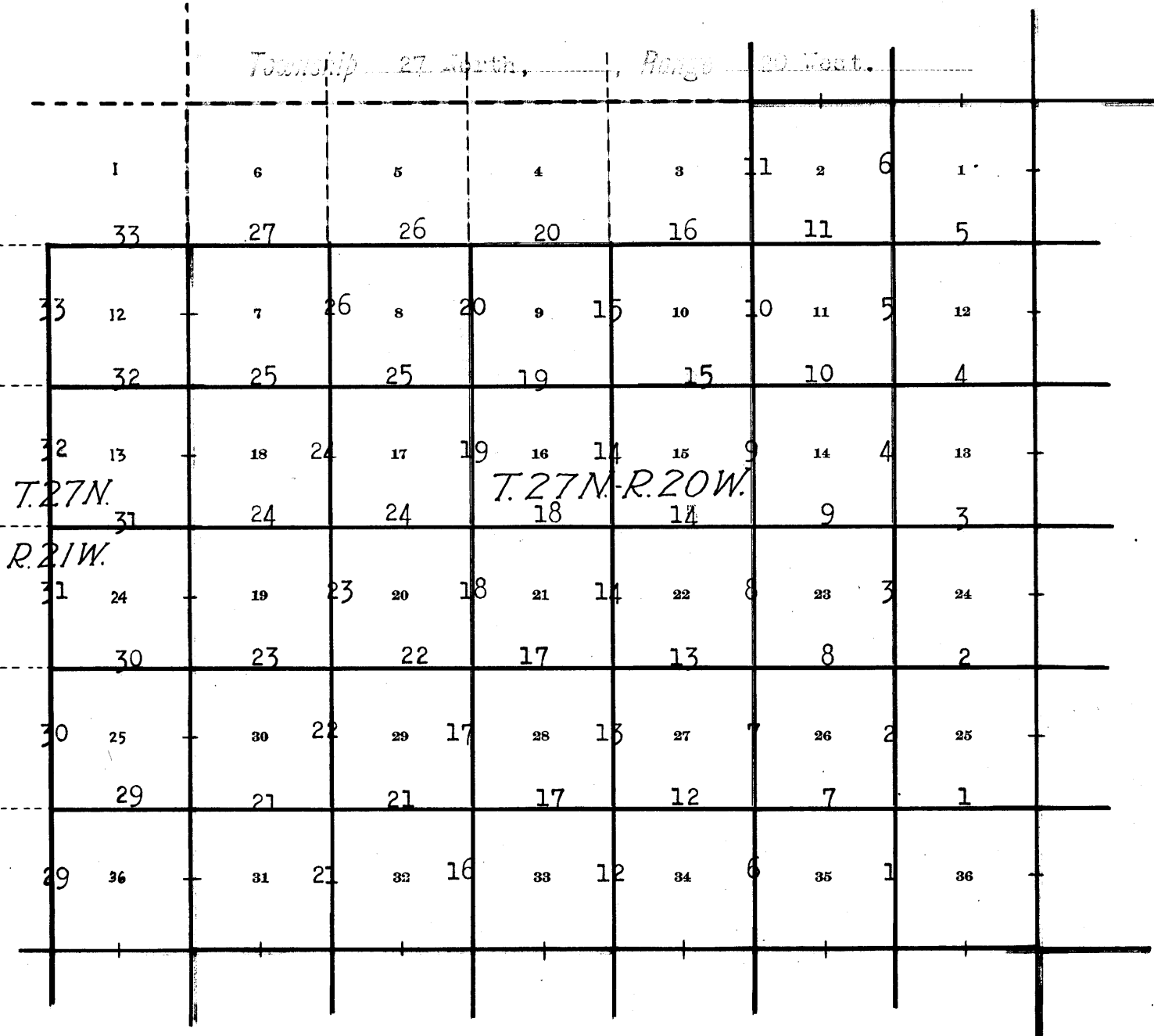

- Subdivision lines surveyed under this group.
- Township bdrs. surveyed under this group.
Notes in Book "A."
- Township bdrs. resurveyed under this group.
Notes in Book "A."
- - - - -** Unsurveyed.

Partial Subdivision of T. 27 N., R. 20 W.

1. B

Chains.

Survey executed on dates shown on pages 35 & 37 hereof, by H. G. Bardsley, U. S. Surveyor, and Royston C. Durnford, U. S. Transitman, with Young and Sons' light mountain transits Nos. 8532 and 8526, respectively, described in Book "A." attachments. For description of instruments and in the following field notes, the initials "H.G.B." and "R. C. D." are inserted at the beginning and ending of those portions describing the surveys executed by H. G. Bardsley, U. S. Surveyor, and Royston C. Durnford, U. S. Transitman, respectively; and repeated tests of our instruments knowing from recent and repeated tests of our instruments on a meridian established by observations on Polaris at elongation, that they are in good adjustment, we proceed as follows:

Apr. 21, 1915: R. C. D.

At 7 hrs. 30 m., a.m., l.m.t., I set off 35° 41' N. on the lat. arc; 11° 39' N. on the decl. arc; and determine a meridian with the solar at the cor. of secs. 1, 2, 35 and 36, on the S. bdy. of the Tp., described in Book "A." page, established by H. G. B., as described in Book "C".

Thence I run

N. 0° 1' W., bet. secs. 35 and 36.

Over mountainous land, through scattering undergrowth.

Desc. to

7.00

Gulch, course W. Asc. 100 ft. to

22.90

Low ridge, brs. E. and W. Desc. 165 ft. to

37.50

Foot of descent. Thence over level land.

40.00

Set an iron post, 3 ft. long, 1 in. diam., 26 ins. in the ground, for 1/4 sec. cor., marked on brass cap

1915 on S. rim;

1/4 S35 in W. and

S36 in E. half;

and raise a mound of stone, 2 ft. base, 1 1/2 ft. high, W. of cor. Site impracticable.

48.00

Center of wash, 1 ch. wide, 20 ins. deep, course W.

80.00

Set an iron post, 3 ft. long, 2 ins. diam., 24 ins. in the ground, for cor. of secs. 25, 26, 35 and 36, marked on brass cap

1915 on S. rim;

T27N R20W in N. half;

S26 in NW.,

S25 in NE.,

S36 in SE. and

S35 in SW. quadrant;

and raise a mound of stone, 2 ft. base, 1 1/2 ft. high, W. of cor. Site impracticable.

Land, level and mountainous.

Soil, stony; 4th rate.

No timber.

Undergrowth, greasewood and cacti.

S. 89° 54' E., on a random line, bet. secs. 25 and 36.

40.00

Set temp. 1/4 sec. cor.

80.00

Intersect E. bdy. of Tp., 7 lks. N. of the cor. of secs. 25, 30, 31 and 36, described in Book "A.", established by H. G. B., as described in Book "C".

Thence I run

N. 89° 51' W., on a true line, bet. secs. 25 and 36.

Over mountainous land, through scattering undergrowth.

Asc. 115 ft. to

32.20

Low ridge, brs. NW. and SE. Desc. 285 ft.

40.00

Set an iron post, 3 ft. long, 1 in. diam., in a mound of stone, for 1/4 sec. cor., marked on brass cap

1915 on S. rim;

1/4 S25 in N. and

S36 in S. half;

and raise a mound of stone, 2 ft. base, 1 1/2 ft. high, N. of cor. Site impracticable.

57.50

Foot of descent. Thence over level land.

2. Partial Subdivision of T. 27 N., R. 20 W.

Chains.
 67.40 Center of wash, 1 ch. wide, 20 ins. deep, course SW.
 80.00 The cor. of secs. 25, 26, 35 and 36.
 Land, level and mountainous.
 Soil, gravelly and stony; 3rd rate.
 No timber.
 Undergrowth, greasewood and yucca.

R. C. D.
 Apr. 21, 1915.

Apr. 22, 1915: H. G. B.
 At 8 hrs. 0 m., a.m., l.m.t., I set off 35° 41½' N. on the
 lat. arc; 11° 59½' N. on the decl. arc; and determine
 a meridian with the solar at the cor. of secs. 25, 26
 35 and 36.
 Thence I run
 N.0° 1' W., bet. secs. 25 and 26.
 Over level land, through scattering undergrowth.
 16.40 Leave level land. Asc. 245 ft., over mountainous land to
 33.35 Ridge, brs. E. and W. Desc. 185 ft.
 40.00 Set an iron post, 3 ft. long, 1 in. diam., 26 ins. in the
 ground, for ¼ sec. cor., marked on brass cap
 1915 on S. rim;
 ¼S26 in W. and
 S25 in E. half;
 and raise a mound of stone, 2 ft. base, 1½ ft. high,
 W. of cor. Pits impracticable.
 48.10 Gulch, 15 lks. wide, course S.20° E. Asc. 405 ft. to
 80.00 Set an iron post, 3 ft. long, 2 ins. diam., 24 ins. in the
 ground, for cor. of secs. 23, 24, 25 and 26, marked on
 brass cap
 1915 on S. rim;
 T27N R20W in N. half;
 S23 in NW.,
 S24 in NE.,
 S25 in SE. and
 S26 in SW. quadrant;
 and raise a mound of stone, 2 ft. base, 1½ ft. high,
 W. of cor. Pits impracticable.
 Land, level and mountainous.
 Soil, stony; 4th rate.
 No timber.
 Undergrowth, greasewood.

40.00 S.89° 51' E., on a random line, bet. secs. 24 and 25.
 Set temp. ¼ sec. cor.
 79.96 Intersect E. bdy. of Tp., 7 lks. S. of the cor. of secs.
 19, 24, 25 and 30, described in Book "A", established
 by me, as described in Book "C".
 Thence I run
 N.89° 54' W., on a true line, bet. secs. 24 and 25.
 Over mountainous land, through scattering undergrowth.
 Asc. to
 6.60 Ridge, brs. N. and S. Desc. 230 ft. to
 18.75 Gulch, 20 lks. wide, course SW. Asc. 355 ft. to
 36.95 Ridge, brs. N. and S. Desc. 315 ft.
 39.98 Set an iron post, 3 ft. long, 1 in. diam., in a mound of
 stone, for ¼ sec. cor., marked on brass cap
 1915 on S. rim;
 ¼S24 in N. and
 S25 in S. half;
 and raise a mound of stone, 2 ft. base, 1½ ft. high,
 N. of cor. Pits impracticable.
 55.40 Gulch, 20 lks. wide, course S. Asc. 160 ft. to
 62.00 Ridge, brs. N. and S. Desc. 110 ft. to
 67.55 Gulch, 15 lks. wide, course S. Asc. 295 ft. to

Partial Subdivision of T. 27 N. R. 20 W.

3.

Chains.
79.96

The cor. of secs. 23, 24, 25 and 26.
Land, mountainous.
Soil, stony; 4th rate.
No timber.
Undergrowth, greasewood.
Apr. 22, 1915: At this point, I set off 10° 25' N. on the
decl. line; and at present noon, I observe shadow on
the gnomon and resulting lat. is 35° 42' N.

12.90
38.80
40.00

45.00
48.00
51.00
54.00
56.45
66.40
73.90
80.00

N.0° 1' W., bet. secs. 23 and 24.
Over mountainous land, through scattering undergrowth.
Asc. 90 ft. to
Ridge, brs. NE. and SW. Desc. 430 ft. to
Gulch, 5 lks. wide, course N.20° W. Thence along W. slope.
Set an iron post, 3 ft. long, 1 in. diam., 26 ins. in the
ground, for 1/4 sec. cor., marked on brass cap
1915 on S. rim;
1/4 S23 in W. and
S24 in E. half;
and raise a mound of stone, 2 ft. base, 1 1/2 ft. high,
W. of cor.
Gulch, 10 lks. wide, course W. Asc. to
Spur, slopes W. Desc. 30 ft. to
Gulch, 10 lks. wide, course W.
Gulch, 10 lks. wide, course W. Asc. 20 ft. to
Spur, slopes W. Desc. 80 ft. to
Gulch, 10 lks. wide, course N.80° W. Thence along W. slope.
Gulch, 10 lks. wide, course W.
Set an iron post, 3 ft. long, 2 ins. diam., 24 ins. in the
ground, for cor. of secs. 13, 14, 23 and 24, marked on
brass cap
1915 on S. rim;
T27N R20W in N. half;
S14 in NW.,
S13 in NE.,
S24 in SE. and
S23 in SW. quadrant;
and raise a mound of stone, 2 ft. base, 1 1/2 ft. high,
W. of cor.
Land, mountainous.
Soil, stony; 4th rate.
No timber.
Undergrowth, greasewood.

40.00
79.92

10.70
15.25
31.75
37.45
39.96

47.90
79.92

S.89° 54' E., on a random line, bet. secs. 13 and 24.
Set temp. 1/4 sec. cor.
Intersect E. bdy. of Tp., 14 lks. S. of the cor. of secs.
13, 18, 19 and 24, described in Book "A" published
by me, as recorded in Book "B".
Thence
West on a true line, bet. secs. 13 and 24.
Over mountainous land, through scattering undergrowth.
Asc. to
Desc. to
Gulch, 30 lks. wide, course NE. Asc. 305 ft. to
Ridge, brs. N. and S. Desc. 30 ft. to
Gulch, 5 lks. wide, course SE. Asc. 30 ft.
Set an iron post, 3 ft. long, 1 in. diam., in a mound of
stone, for 1/4 sec. cor., marked on brass cap
1915 on S. rim;
1/4 S13 in N. and
S24 in S. half;
and raise a mound of stone, 2 ft. base, 1 1/2 ft. high,
N. of cor.
Ridge, brs. N.80° W. and S. 80° E. Desc. 700 ft. to
The cor. of secs. 13, 14, 23 and 24.

4. Partial Subdivision of T. 27 N. R. 20 W.

Chains.

Land, mountainous.
Soil, stony; 4th rate.
No timber.
Undergrowth, greasewood.

N.0° 1' W., bet. secs. 13 and 14.
Over mountainous land, through scattering undergrowth.
Desc. 30 ft. to
5.00 Gulch, 20 lks. wide, course SW. Asc. 185 ft. to
11.96 Ridge, brs. N.20° E. and S.20° W. Desc. 25 ft. to
21.45 Gulch, 5 lks. wide, course W. Asc. 100 ft. to
29.35 Ridge, brs. E. and W. Desc. 160 ft. to
34.65 Gulch, 10 lks. wide, course W. Thence along W. slope to
38.50 Gulch, 2 lks. wide, course W. Asc. 85 ft.
40.00 Set an iron post, 3 ft. long, 1 in. diam., in a mound of
stone, for $\frac{1}{4}$ sec. cor., marked on brass cap
1915 on S. rim;
 $\frac{1}{4}$ S14 in W. and
S13 in E. half;
and raise a mound of stone, 2 ft. base, $1\frac{1}{2}$ ft. high,
W. of cor. *Site impracticable.*

40.05 Road, brs. E. and W.
47.00 Low spur, slopes W. Desc. 200 ft.
63.90 Telephone line, brs. E. and W.
65.00 School house, brs. W. 4.50 chs. dist.
65.40 Main street of Whitehills brs. E. and W.
67.00 Gulch, course W. Asc. 170 ft.
69.10 Telephone line, brs. N.62° E. and S.62° W.
78.51 Low spur, slopes W. Desc. 45 ft. to
80.00 Set an iron post, 3 ft. long, 2 ins. diam., 24 ins. in the
ground, for cor. of secs. 11, 12, 13 and 14, marked on
brass cap
1915 on S. rim;
T27N R20W in N. half;
S11 in NW.,
S12 in NE.,
S13 in SE. and
S14 in SW. quadrant;
and raise a mound of stone, 2 ft. base, $1\frac{1}{2}$ ft. high,
W. of cor. *Site impracticable.*

Land, mountainous.
Soil, stony; 4th rate.
No timber.
Undergrowth, greasewood.
From this cor., U. S. L. M. No. 1256, which is a 6 X 6 in.
post, set in a large mound of stone, scribed U. S. L. M.
1256 brs. N.57° 20' E., 14.14 chs. dist. From this
monument, a stone, marked U. S. L. M. brs. W. $6\frac{1}{2}$ lks.
dist.

H. G. B.

Apr. 23, 1915.

R. C. D.
Apr. 23, 1915: At 7 hrs. Om., a.m., l.m.t., I set off
35° 44' N. on the lat. arc; 12° 19 $\frac{1}{2}$ ' N. on the decl.
arc; and determine a meridian with the solar at the
cor. of secs. 11, 12, 13 and 14.
Thence I ran
East on a random line, bet. secs. 12 and 13.
40.00 Set temp. $\frac{1}{4}$ sec. cor.
80.00 Intersect E. bdy. of Tp., 5 lks. S. of the cor. of secs.
7, 12, 13 and 18, described in Book 2488, established
by H. G. B., as described in Book 2488.
Thence I ran
S.89° 58' W., on a true line, bet. secs. 12 and 13.
Over mountainous land, through scattering undergrowth.

Partial Subdivision of T. 27 N. R. 20 W. 5.

Chains. Asc. 300 ft. to
 30.50 Ridge, brs. N. and S. Reservoir brs. S.48° W. Desc. 475 ft.
 40.00 Set an iron post, 3 ft. long, 1 in. diam., in a mound of stone, for $\frac{1}{4}$ sec. cor., marked on brass cap
 1915 on S. rim;
 $\frac{1}{4}$ S12 in N. and
 S13 in S. half;
 and raise a mound of stone, 2 ft. base, $1\frac{1}{2}$ ft. high, N. of cor. ~~See map on file.~~
 55.20 Asc. 60 ft. to
 63.10 Desc. 35 ft. to
 65.00 Asc. 15 ft.
 65.90 Old mill brs. S. 20 lks. dist.
 75.00 Low ridge, brs. NE. and SW. Old road, brs. NW. and S. Reservoir brs. S.48° E. Desc. 30 ft. to
 80.00 The cor. of secs. 11, 12, 13 and 14.
 Land, mountainous.
 Soil, stony; 4th rate.
 No timber.
 Undergrowth, greasewood.

N.0° 1' W., bet. secs. 11 and 12.
 Over mountainous land, through scattering undergrowth.
 Desc. 25 ft.
 2.30 Mining shaft brs. W. 20 lks. dist.
 4.20 Old road, brs. NW. and SE.
 5.00 Asc. 85 ft. to
 14.90 Low spur, slopes W. Desc. 110 ft. to
 24.70 Gulch, course W. Asc. 75 ft. to
 32.10 Desc. 40 ft. to
 34.55 Asc. 130 ft.
 40.00 Set an iron post, 3 ft. long, 1 in. diam., in a mound of stone, for $\frac{1}{4}$ sec. cor., marked on brass cap
 1915 on S. rim;
 $\frac{1}{4}$ S11 in W. and
 S12 in E. half;
 and raise a mound of stone, 2 ft. base, $1\frac{1}{2}$ ft. high, W. of cor. ~~See map on file.~~
 46.75 Desc. 35 ft. to
 49.70 Asc. 45 ft. to
 56.35 Desc. 50 ft. to
 59.45 Asc. 115 ft. to
 65.85 Desc. 20 ft. to
 69.15 Asc. 90 ft. to
 77.00 Ridge, brs. NW. and SE. Desc. 65 ft. to
 80.00 Set an iron post, 3 ft. long, 2 ins. diam., in a mound of stone, for cor. of secs. 1, 2, 11 and 12, marked on brass cap
 1915 on S. rim;
 T27N R20W in N. half;
 S2 in NW.,
 S1 in NE.,
 S12 in SE. and
 S11 in SW. quadrant;
 and raise a mound of stone, 2 ft. base, $1\frac{1}{2}$ ft. high, W. of cor. ~~See map on file.~~
 Land, mountainous.
 Soil, stony ; 4th rate.
 No timber.
 Undergrowth, greasewood and yucca.

R. C. D.

H. G. B.
 N.89° 58' E., on a random line, bet. secs. 1 and 12.
 40.00 Set temp. $\frac{1}{4}$ sec. cor.

6. Partial Subdivision of T. 27 N., R. 20 W.

Chains.
79.92 Intersect E. bdy. of Tp., 5 lks. S. of the cor. of secs. 1, 6, 7 and 12, described in Book "A", established by me, as described in Book "C".
Thence, I run
S. 89° 56' W., on a true line, bet. secs. 1 and 12.
Over rolling land, through scattering undergrowth.
Desc. to
17.00 Center of wash, 60 lks. wide, course N. 80° W. Asc. 25 ft. to
22.75 Desc.
39.96 Set an iron post, 3 ft. long, 1 in. diam., 26 ins. in the ground, for $\frac{1}{4}$ sec. cor., marked on brass cap
1915 on S. rim;
 $\frac{1}{4}$ S1 in N. and
S12 in S. half;
and raise a mound of stone, 2 ft. base, 1 $\frac{1}{2}$ ft. high, W. of cor. ~~115 ft. to~~
54.00 Wash, 10 lks. wide, course N. Asc. 20 ft. to
56.75 Desc. 55 ft. to
64.00 Wash, 10 lks. wide, course N. Asc. 115 ft. to
77.80 Desc. 25 ft. to
79.92 The cor. of secs. 1, 2, 11 and 12.
Land, rolling.
Soil, stony; 4th rate.
No timber.
Undergrowth, greasewood.

H. G. B.

R. C. D.
N. 0° 1' W., on a random line, bet. secs. 1 and 2.
40.00 Set temp. $\frac{1}{4}$ sec. cor.
80.16 Intersect W. bdy. of Tp., 4 lks. E. of the cor. of secs. 1, 2, 35 and 36, described in Book "A", established by H. G. B., as described in Book "C".
Thence, I run
S. 0° 3' E., on a true line, bet. secs. 1 and 2.
Over rolling land, through scattering undergrowth.
6.05 Dim. road, brs. NE. and SW.
13.90 Dim road, brs. E. and W.
19.75 Wash, 30 lks. wide, 2 ft. deep, course W.
40.16 Set an iron post, 3 ft. long, 1 in. diam., 26 ins. in the ground, for $\frac{1}{4}$ sec. cor., marked on brass cap
1915 on S. rim;
 $\frac{1}{4}$ S2 in W. and
S1 in E. half;
dig pits, 18 X 18 X 12 ins., N. and S. of post, 3 ft. dist.; and raise a mound of earth, 3 $\frac{1}{2}$ ft. base, 1 $\frac{1}{2}$ ft. high, W. of cor.
51.05 Old road, brs. E. and W.
61.45 Wash, 40 lks. wide, 2 ft. deep, course NW. Asc. 135 ft. to
80.16 The cor. of secs. 1, 2, 11 and 12.
Land, rolling.
Soil, gravelly; 3rd rate.
No timber.
Undergrowth, greasewood.

Apr. 23, 1915: At this cor., I set off 12° 22' N. on the back-sight; and at a great distance, I observe the sun on the meridian; the resulting lat. is 35° 45' N.

R. C. D.

Apr. 23, 1915.

Apr. 21, 1915: H. G. B.

From the cor. of secs. 2, 3, 34 and 35, on the S. bdy. of the Tp., described in Book "A", established by me, as described in Book "C", I run
N. 0° 1' W., bet. secs. 34 and 35.

Partial Subdivision of T. 27 N., R. 20 W.

7.

Chains.

Over rolling land, through scattering undergrowth.
 Asc. 255 ft. to
 17.55 Ridge, brs. E. and W. Desc. 255 ft.
 40.00 Set an iron post, 3 ft. long, 1 in. diam., 26 ins. in the
 ground, for $\frac{1}{4}$ sec. cor., marked on brass cap
 1915 on S. rim;
 $\frac{1}{4}$ S34 in W. and
 S35 in E. half;
 and raise a mound of stone, 2 ft. base, $1\frac{1}{2}$ ft. high,
 W. of cor. ~~Practically~~
 40.50 Center of wash, 1 ch. wide, course W. Thence over level
 land.
 47.30 Center of wash, 1.50 chs. wide, course W.
 55.70 Center of wash, 80 lks. wide, course W.
 80.00 Set an iron post, 3 ft. long, 2 ins. diam., 24 ins. in the
 ground, for cor. of secs. 26, 27, 34 and 35, marked on
 brass cap
 1915 on S. rim;
 T27N R20W in N. half;
 S27 in NW.,
 S26 in NE.,
 S35 in SE. and
 S34 in SW. quadrant;
 and raise a mound of stone, 2 ft. base, $1\frac{1}{2}$ ft. high,
 W. of cor. ~~Practically~~
 Land, level and rolling.
 Soil, stony; 4th rate.
 No timber.
 Undergrowth, greasewood and yucca.
 H. G. B.

R. C. D.
 S.89° 54' E., on a random line, bet. secs. 26 and 35.
 40.00 Set temp. $\frac{1}{4}$ sec. cor.
 80.06 Intersect the corner of secs. 25, 26, 35 and 36,
 and 36.
 Thence, Iron
 N.89° 54' W., on a true line, bet. secs. 26 and 35.
 Over level land, through scattering undergrowth.
 12.50 Leave level land. Asc. 205 ft. to
 25.00 Spur, slopes SE. Thence along S. slope.
 40.03 Set an iron post, 3 ft. long, 1 in. diam., 26 ins. in the
 ground, for $\frac{1}{4}$ sec. cor., marked on brass cap
 1915 on S. rim;
 $\frac{1}{4}$ S26 in N. and
 S35 in S. half;
 and raise a mound of stone, 2 ft. base, $1\frac{1}{2}$ ft. high,
 N. of cor. ~~Practically~~
 42.50 Spur, slopes SW. Desc. 220 ft. to
 60.00 Foot of desc. Leave mountainous land, thence over level land.
 80.06 The cor. of secs. 26, 27, 34 and 35.
 Land, level and mountainous.
 Soil, stony; 4th rate.
 No timber.
 Undergrowth, greasewood, cacti and yucca.
 Apr. 21, 1915: At this cor., I set off 119.42' N. on the
 decl. line; and at a point near, I observe the sun on
 the meridian; the resulting lat. is 35° 41' N.
 R. C. D.

H. G. B.
 N.0° 1' W., bet. secs. 26 and 27.
 Over level land, through scattering undergrowth.
 40.00 Set an iron post, 3 ft. long, 1 in. diam., 26 ins. in the
 ground, for $\frac{1}{4}$ sec. cor., marked on brass cap
 1915 on S. rim;
 $\frac{1}{4}$ S27 in W. and

8. Partial Subdivision of T. 27 N., R. 20 W.

Chains.

80.00 S26 in E. half;
and raise a mound of stone, 2 ft. base, 1½ ft. high,
W. of cor. ~~Disc impracticable.~~
Set an iron post, 3 ft. long, 2 ins. diam., 24 ins. in the
ground, for cor. of secs. 22, 23, 26 and 27, marked on
brass cap

1915 on S. rim;
T27N R20W in N. half;
S22 in NW.,
S23 in NE.,
S26 in SE. and
S27 in SW. quadrant;
and raise a mound of stone, 2 ft. base, 1½ ft. high,
W. of cor. ~~Disc impracticable.~~
Land, level.
Soil, stony; 4th rate.
No timber.
Undergrowth, greasewood and yucca.
Apr. 21, 1915: At this cor., I set off 11° 42' E. on the
reel, and on a separate reel, I observed the sun on
the meridian; the resulting ang. is 55° 42' E.
H. G. B.

40.00 R. C. D.
S.89° 54' E., on a random line, bet. secs. 23 and 26.
Set temp. ¼ sec. cor.

80.04 Intersect the corner of secs. 23, 24, 25 and 26. 24, 25
and 26.
Thence, I run
N.89° 54' W., on a true line, bet. secs. 23 and 26.
Over mountainous and rolling land, through scattering
undergrowth.
Along S. slope to
10.00 Ridge, brs. NE. and SW. Desc. 550 ft.

40.02 Set an iron post, 3 ft. long, 1 in. diam., 26 ins. in the
ground, for ¼ sec. cor., marked on brass cap

1915 on S. rim;
¼S23 in N. and
S26 in S. half;
and raise a mound of stone, 2 ft. base, 1½ ft. high,
N. of cor. ~~Disc impracticable.~~

50.00 Foot of desc. Thence over level land.

80.04 The cor. of secs. 22, 23, 26 and 27.
Land, level and mountainous.
Soil, stony; 4th rate.
No timber.
Undergrowth, yucca, greasewood and buck brush.
R. C. D.

H. G. B.
N.0° 1' W., bet. secs. 22 and 23.
Over level land, through scattering undergrowth.

21.90 Wash, 25 lks. wide, course W.

30.00 Road, brs. NE. to Whitehills and SW. to Chloride.

37.00 Wash, 30 lks. wide, course SW.

38.90 Telephone line, iron poles, brs. N.28° 36' E. to White-
hills, and S.28° 36' W. to Chloride.

40.00 Set an iron post, 3 ft. long, 1 in. diam., 26 ins. in the
ground, for ¼ sec. cor., marked on brass cap

1915 on S. rim;
¼S22 in W. and
S23 in E. half;
and raise a mound of stone, 2 ft. base, 1½ ft. high,
W. of cor. ~~Disc impracticable.~~

45.75 Wash, 40 lks. wide, course W.

53.30 Road, brs. E. and W.

Partial Subdivision of T. 27 N., R. 20 W. 9.

Chains.
80.00

Set an iron post, 3 ft. long, 2 ins. diam., 24 ins. in the ground, for cor. of secs. 14, 15, 22 and 23, marked on brass cap

1915 on S. rim;
T27N R20W in N. half;
S15 in NW.,
S14 in NE.,
S23 in SE. and
S22 in SW. quadrant;

and raise a mound of stone, 2 ft. base, 1½ ft. high, W. of cor.

Land, level.
Soil, stony; 3rd rate.
No timber.
Undergrowth, greasewood and yucca.

H. G. B.
Apr. 22, 1915.

40.00
79.98

Apr. 22, 1915: R. C. D.
S. 89° 54' E., on a random line, bet. secs. 14 and 23.
Set temp. ¼ sec. cor.

Intersect the corner of secs. 13, 14, 23 and 24, 14, 23
Thence,
N. 89° 54' W., on a true line, bet. secs. 14 and 23.
Over gently rolling land, through scattering undergrowth.
Gulch, course SW.

4.40
39.99

Set an iron post, 3 ft. long, 1 in. diam., 26 ins. in the ground, for ¼ sec. cor., marked on brass cap

1915 on S. rim;
¼ S14 in N. and
S23 in S. half;

and raise a mound of stone, 2 ft. base, 1½ ft. high, N. of cor.

54.00 Traveled road, brs. NE. to Whitehills and SW.
56.38 Telephone line, brs. N. 29° E. to Whitehills and S. 29° E. to Chloride.
79.98 The cor. of secs. 14, 15, 22 and 23.
Land, gently rolling.
Soil, gravelly and stony; 3rd rate.
No timber.
Undergrowth, greasewood and yucca.

R. C. D.
Apr. 22, 1915.

16.60
35.67
35.90
38.08
40.00

Apr. 22, 1915: H. G. B.
N. 0° 1' W., bet. secs. 14 and 15.
Over level land, through scattering undergrowth.
Wash, 25 lks. wide, course W.

Telephone line, 2 wires, brs. N. 18° E. to Gold Basin and S. 18° W. to Chloride.

Old road, brs. NE. and SW.
Road, brs. NE. to White Hills, and SW. to Gold Bug Mill.

Set an iron post, 3 ft. long, 1 in. diam., 26 ins. in the ground, for ¼ sec. cor., marked on brass cap

1915 on S. rim;
¼ S15 in W. and
S14 in E. half;

and raise a mound of stone, 2 ft. base, 1½ ft. high, W. of cor.

From this cor., Whitehills brs. N. 72° E.
Mill brs. S. 84° 45' E.
Mt. Wilson brs. N. 32° 40' W.

48.00 Old road, brs. NE. and SW.
51.40 Wash, 10 lks. wide, course W.
80.00 Set an iron post, 3 ft. long, 2 ins. diam., 24 ins. in the

10. Partial Subdivision of T. 27 N. R. 20 W.

Chains.

ground, for cor. of secs. 10, 11, 14 and 15, marked on brass cap

- 1915 on S. rim;
- T27N R20W in N. half;
- S10 in NW.,
- S11 in NE.,
- S14 in SE. and
- S15 in SW. quadrant;

and raise a mound of stone, 2 ft. base, 1½ ft. high, W. of cor. ~~Site impracticable.~~

Land, level.

Soil, gravel; 3rd rate.

No timber.

Undergrowth, greasewood and yucca.

From this cor., Whitehills brs. S.70° 55' E.

Mill brs. S.53° 15' E.

Mt. Wilson brs. N.33° 25' W.

H. G. B.

Apr. 21, 1915.

Apr. 23, 1915: R. C. D.

S.89° 54' E., on a random line, bet. secs. 11 and 14.

40.00 Set temp. ¼ sec. cor.

80.14 Intersect N. and S. line, 2 lks. S. of the cor. of secs. 11, 12, 13 and 14.

Thence

N.89° 55' W., on a true line, bet. secs. 11 and 14.

Over mountainous land, through scattering undergrowth.

Desc. 220 ft.

12.30 Grand Army Mine, brs. N.23° W.

29.60 Graded road, brs. N.45° E. and S.30° E.

30.30 Telephone line, brs. NE. and SW.

Grand Army Mine brs. N.60° E.

Leave mountainous land, thence over level land.

35.80 Old road, brs. N. and S.

40.07 Set an iron post, 3 ft. long, 1 in. diam., 26 ins. in the ground, for ¼ sec. cor., marked on brass cap

1915 on S. rim;

¼S11 in N. and

S14 in S. half;

and raise a mound of stone, 2 ft. base, 1½ ft. high, N. of cor.

58.60 Two wire telephone line, brs. N.54° 56' W., and S.54° 56' E.

61.00 Road, brs. NW. and SE.

62.40 Road, brs. NW. and SE. Forks of road 60 lks. S. of line,

66.85 Two wire telephone line, brs. N.14° 49' E. to Gold Basin, and S.14° 49' W. to Chloride. Two chs. N. of line, brs. N.6° 4' W., and S.14° 49' W.

80.14 The cor. of secs. 10, 11, 14 and 15.

Land, level and mountainous.

Soil, stony; 4th rate.

No timber.

Undergrowth, yucca, cacti and buck brush.

R. C. D.

Apr. 23, 1915.

Apr. 21, 1915: H. G. B.

N.0° 1' W., bet. secs. 10 and 11.

Over level land, through scattering undergrowth.

6.20 Road, brs. NW. and SE. to Whitehills.

10.80 Wash, 20 lks. wide, course W.

16.90 Road, brs. NW. to Gold Basin, and SE. to Whitehills.

30.90 Wash, 50 lks. wide, course SW.

40.00 Set an iron post, 3 ft. long, 1 in. diam., 26 ins. in the

Chains.

ground, for $\frac{1}{4}$ sec. cor., marked on brass cap
 1915 on S. rim;
 $\frac{1}{4}$ S10 in W. and
 S11 in E. half;
 and raise a mound of stone, 2 ft. base, $1\frac{1}{2}$ ft. high,
 W. of cor. ~~...~~

41.40 Wash, 20 lks. wide, course SW.
 45.68 Road, brs. NE. to Gold Basin, and SW. to Whitehills.
 80.00 Set an iron post, 3 ft. long, 2 ins. diam., 24 ins. in the
 ground, for cor. of secs. 2, 3, 10 and 11, marked on
 brass cap
 1915 on S. rim;
 T27N R20W in N. half;
 S3 in NW.,
 S2 in NE.,
 S11 in SE. and
 S10 in SW. quadrant;
 dig pits, 18 X 18 X 12 ins., in each sec., $5\frac{1}{2}$ ft. dist.;
 and raise a mound of earth, 4 ft. base, 2 ft. high,
 W. of cor.
 Land, level.
 Soil, gravel; 3rd rate.
 No timber.
 Undergrowth, greasewood, yucca and cacti.
 Apr. 21, 1915.

Apr. 23, 1915.
 S.89° 55' E., on a random line, bet. secs. 2 and 11.
 40.00 Set temp. $\frac{1}{4}$ sec. cor.
 80.08 Intersect N. and S. line, 2 lks. S. of the cor. of secs.
 1, 2, 11 and 12.
 Thence
 N.89° 56' W., on a true line, bet. secs. 2 and 11.
 Over mountainous land, through scattering undergrowth.
 Asc. to
 1.50 Desc. 225 ft. to
 9.95 Wash, 15 lks. wide, course S.10° W. Asc. 40 ft. to
 14.55 Spur, slopes S. Desc. 65 ft. to
 19.25 Wash, 5 lks. wide, course S.10° W. Asc. 35 ft. to
 23.00 Desc. 180 ft.
 40.04 Set an iron post, 3 ft. long, 1 in. diam., 26 ins. in the
 ground, for $\frac{1}{4}$ sec. cor., marked on brass cap
 1915 on S. rim;
 $\frac{1}{4}$ S2 in N. and
 S11 in S. half;
 and raise a mound of stone, 2 ft. base, $1\frac{1}{2}$ ft. high,
 N. of cor. ~~...~~

46.30 Wash, 20 lks. wide, course SW. Thence over level land.
 57.00 Wash, 10 lks. wide, course SW.
 72.20 Road, brs. N. to Gold Basin, and S. to Whitehills.
 73.43 Two wire telephone line, brs. N.6° 4' W. to Gold Basin,
 and S.6° 4' E. to Chloride.
 80.08 The cor. of secs. 2, 3, 10 and 11.
 Land, level and mountainous.
 Soil, stony; 3rd rate.
 No timber.
 Undergrowth, greasewood.
 H. G. B.

R. C. D.
 N.0° 1' W., on a random line, bet. secs. 2 and 3.
 40.00 Set temp. $\frac{1}{4}$ sec. cor.
 80.00 Intersect N. bdy. of Tp., 2 lks. W. of the cor. of secs.
 2, 3, 34 and 35, described in Book "A." ~~...~~
 Thence

12. Partial Subdivision of T. 27 N., R. 20 W.

Chains. South on a true line, bet. secs. 2 and 3.
Over gently rolling land, through scattering undergrowth.
40.00 Set an iron post, 3 ft. long, 1 in. diam., 26 ins. in the
ground, for $\frac{1}{4}$ sec. cor., marked on brass cap
1915 on S. rim;
 $\frac{1}{4}$ S3 in W. and
S2 in E. half;
and raise a mound of stone, 2 ft. base, $1\frac{1}{2}$ ft. high,
W. of cor. *Ditto impracticable.*
43.00 Wash, 25 lks. wide, course W.
80.00 The cor. of secs. 2, 3, 10 and 11.
Land, gently rolling.
Soil, gravelly; 3rd rate.
No timber.
Undergrowth, greasewood, yucca and cacti.

Apr. 25, 1915.

Apr. 18, 1915.
From the cor. of secs. 3, 4, 33 and 34, on the S. bdy. of
the Tp., described in Book "A." published by U. S. G.
as described in Book "C", 1911.
N.0° 2' W., bet. secs. 33 and 34.
Over rolling land, through scattering undergrowth.
9.60 Wash, 30 lks. wide, $1\frac{1}{2}$ ft. deep, course NW.
12.00 Road, brs. NE. to Whitehills, and SW.
32.30 Telephone line, brs. N.14° E. to Whitehills and S.14° W.
to Chloride.
40.00 Set an iron post, 3 ft. long, 1 in. diam., 26 ins. in the
ground, for $\frac{1}{4}$ sec. cor., marked on brass cap
1915 on S. rim;
 $\frac{1}{4}$ S33 in W. and
S34 in E. half;
and raise a mound of stone, 2 ft. base, $1\frac{1}{2}$ ft. high,
W. of cor. *Ditto impracticable.*
52.00 Wash, 30 lks. wide, 2 ft. deep, course W.
80.00 Set an iron post, 3 ft. long, 2 ins. diam., 24 ins. in the
ground, for cor. of secs. 27, 28, 33 and 34, marked on
brass cap
1915 on S. rim;
T27N R20W in N. half;
S28 in NW.,
S27 in NE.,
S34 in SE. and
S33 in SW. quadrant;
and raise a mound of stone, 2 ft. base, $1\frac{1}{2}$ ft. high,
W. of cor. *Ditto impracticable.*
Land, rolling.
Soil, gravelly and stony; 3rd rate.
No timber.
Undergrowth, greasewood and yucca.

Apr. 18, 1915.

Apr. 22, 1915.
S.89° 54' E., on a random line, bet. secs. 27 and 34.
40.00 Set temp. $\frac{1}{4}$ sec. cor.
79.96 Intersect the corner of secs. 26, 27, 34 and 35, 27, 34
and 35.
Thence
N.89° 54' W., on a true line, bet. secs. 27 and 34.
39.98 Set an iron post, 3 ft. long, 1 in. diam., 26 ins. in the
ground, for $\frac{1}{4}$ sec. cor., marked on brass cap
1915 on S. rim;
 $\frac{1}{4}$ S27 in N. and
S34 in S. half;
and raise a mound of stone, 2 ft. base, $1\frac{1}{2}$ ft. high,
N. of cor. *Ditto impracticable.*

Partial Subdivision of T. 27 N., R. 20 W. 13.

Chains.

48.80 Telephone line, brs. N.10° E. to Gold Basin and S.10°W. to Chloride.

57.00 Traveled road, brs. NE. to Whitehills and SW.

64.90 Telephone line, brs. N.29° E. to Whitehills and S.29° W. to Chloride.

79.96 The cor. of secs. 27, 28, 33 and 34.
Land, rolling.
Soil, gravelly and stony; 3rd rate.
No timber.
Undergrowth, greasewood, yucca and buck brush.
Dec. 21, 1915.

Apr. 10, 1915.
N.0° 2' W., bet. secs. 27 and 28.
Over rolling land, through scattering undergrowth.

40.00 Set an iron post, 3 ft. long, 1 in. diam., 26 ins. in the ground, for $\frac{1}{4}$ sec. cor., marked on brass cap
1915 on S. rim;
 $\frac{1}{4}$ S28 in W. and
S27 in E. half;
and raise a mound of stone, 2 ft. base, 1 $\frac{1}{2}$ ft. high, W. of cor.

50.00 Center of wash, 80 lks. wide, 4 ft. deep, course NW.

80.00 Set an iron post, 3 ft. long, 2 ins. diam., 24 ins. in the ground, for cor. of secs. 21, 22, 27 and 28, marked on brass cap
1915 on S. rim;
T27N R20W in N. half;
S21 in NW.,
S22 in NE.,
S27 in SE. and
S28 in SW. quadrant;
and raise a mound of stone, 2 ft. base, 1 $\frac{1}{2}$ ft. high, W. of cor.
Land, rolling.
Soil, stony and gravelly; 3rd rate.
No timber.
Undergrowth, greasewood, yucca and cacti.
Dec. 19, 1915.

Apr. 27, 1915.
S89° 54' E., on a random line, bet. secs. 22 and 27.

40.00 Set temp. $\frac{1}{4}$ sec. cor.

79.90 Intersect the corner of secs. 22, 23, 26 and 27, 28, 33 and 34.
Thence, 1 in.
N.89° 54' W., on a true line, bet. secs. 22 and 27.
Over rolling land, through scattering undergrowth.

11.50 Traveled road, brs. NE. to Whitehills and SW.

21.00 Telephone line, brs. N.29° E. to Whitehills and S.29° W. to Chloride.

33.40 Telephone line, brs. N.10° E. to Gold Basin, and S.10° W. to Chloride.

39.95 Set an iron post, 3 ft. long, 1 in. diam., 26 ins. in the ground, for $\frac{1}{4}$ sec. cor., marked on brass cap
1915 on S. rim;
 $\frac{1}{4}$ S22 in N. and
S27 in S. half;
and raise a mound of stone, 2 ft. base, 1 $\frac{1}{2}$ ft. high, N. of cor.

62.10 Wash, 40 lks, wide, 6 ft. deep, course NW.

79.90 The cor. of secs. 21, 22, 27 and 28.
Land, rolling.
Soil, sandy and stony; 3rd rate.
No timber.
Undergrowth, greasewood, yucca and buck brush.

14. Partial Subdivision of T. 27 N., R. 20 W.

Chains,	Apr. 21, 1915.
	<p>N.0° 2' W., bet. secs. 21 and 22. Over rolling land, through scattering undergrowth. 40.00 Set an iron post, 3 ft. long, 1 in. diam., 26 ins. in the ground, for $\frac{1}{4}$ sec. cor., marked on brass cap 1915 on S. rim; $\frac{1}{4}$S21 in W. and S22 in E. half; and raise a mound of stone, 2 ft. base, 1$\frac{1}{2}$ ft. high, W. of cor. <i>Site impracticable.</i> 42.80 Center of wash, 80 lks. wide, 3 ft. deep, course W. 79.20 Road, brs. N.72° E. to Whitehills and S.72° W. to Gold Bug Mill. 80.00 Set an iron post, 3 ft. long, 2 ins. diam., 24 ins. in the ground, for cor. of secs. 15, 16, 21 and 22, marked on brass cap 1915 on S. rim; T27N R20W in N. half; S16 in NW., S15 in NE., S22 in SE. and S21 in SW. quadrant; and raise a mound of stone, 2 ft. base, 1$\frac{1}{2}$ ft. high, W. of cor. <i>Site impracticable.</i> Land, rolling. Soil, stony; 4th rate. No timber. Undergrowth, greasewood and yucca.</p>
	<p>Apr. 22, 1915. S.89° 54' E., on a random line, bet. secs. 15 and 22. 40.00 Set temp. $\frac{1}{4}$ sec. cor. 80.00 Intersect N. and S. line, 4 lks. N. of the cor. of secs. 14, 15, 22 and 23. Thence N.89° 52' W., on a true line, bet. secs. 15 and 22. Over gently rolling land, through scattering undergrowth. 11.70 Telephone line, brs. N.18° E. to Gold Basin and S.18° W. to Chloride. 20.40 Old road, brs. NE. and SW. 40.00 Set an iron post, 3 ft. long, 1 in. diam., 26 ins. in the ground, for $\frac{1}{4}$ sec. cor., marked on brass cap 1915 on S. rim; $\frac{1}{4}$S15 in N. and S22 in S. half; and raise a mound of stone, 2 ft. base, 1$\frac{1}{2}$ ft. high, N. of cor. <i>Site impracticable.</i> 78.00 Old road, brs. N.72° E. to Whitehills and S.72° W. to Gold Bug Mill. 80.00 The cor. of secs. 15, 16, 21 and 22. Land, gently rolling. Soil, gravelly and stony; 3rd rate. No timber. Undergrowth, greasewood and yucca.</p>
	<p>Apr. 22, 1915. N.0° 2' W., bet. secs. 15 and 16. Over level land, through scattering undergrowth. 40.00 Set an iron post, 3 ft. long, 1 in. diam., 26 ins. in the</p>

Chains.

80.00 ground, for $\frac{1}{4}$ sec. cor., marked on brass cap
 1915 on S. rim;
 $\frac{1}{4}$ S16 in W. and
 S15 in E. half;
 and raise a mound of stone, 2 ft. base, $1\frac{1}{2}$ ft. high,
 W. of cor. ~~Dim impr. visible.~~
 Set an iron post, 3 ft. long, 2 ins. diam., 24 ins. in the
 ground, for cor. of secs. 9, 10, 15 and 16, marked on
 brass cap
 1915 on S. rim;
 T27N R20W in N. half;
 S9 in NW.,
 S10 in NE.,
 S15 in SE. and
 S16 in SW. quadrant;
 dig pits, 18 X 18 X 12 ins., in each sec., $5\frac{1}{2}$ ft. dist.;
 and raise a mound of earth, 4 ft. base, 2 ft. high,
 W. of cor.
 Land, level.
 Soil, gravelly and stony; 4th rate.
 No timber.
 Undergrowth, greasewood and yucca.

R. C. D.
Apr. 25, 1915.

40.00 Apr. 25, 1915: H. G. B.
 80.00 The cor. of secs. 10, 11, 14 and 15 being plainly visible,
 I run for said cor. from last sec. cor.
 S.89° 45' E., on a random line, bet. secs. 10 and 15.
 Set temp. $\frac{1}{4}$ sec. cor.
 Intersect the corner of secs. 10, 11, 14, and 15. 10, 11, 14
 and 15.
 Thence, 1 in.
 N.89° 45' W., on a true line, bet. secs. 10 and 15.
 Over level land, through scattering undergrowth.
 Wash, 40 lks. wide, course SW.
 23.80 Set an iron post, 3 ft. long, 1 in. diam., 26 ins. in the
 40.00 ground, for $\frac{1}{4}$ sec. cor., marked on brass cap
 1915 on S. rim;
 $\frac{1}{4}$ S10 in N. and
 S15 in S. half;
 and raise a mound of stone, 2 ft. base, $1\frac{1}{2}$ ft. high,
 N. of cor. ~~Dim impr. visible.~~
 43.30 Wash, 20 lks. wide, course SW.
 64.15 Dim road, brs. N. and S.
 80.00 The cor. of secs. 9, 10, 15 and 16.
 Land, level.
 Soil, gravel; 3rd rate.
 No timber.
 Undergrowth, greasewood.

H. G. B.
Apr. 25, 1915.

35.80 Apr. 25, 1915: R. C. D.
 40.00 N.0° 2' W., bet. secs. 9 and 10,
 Over rolling land, through scattering undergrowth.
 Old road, brs. E. and W.
 Set an iron post, 3 ft. long, 1 in. diam., 26 ins. in the
 ground, for $\frac{1}{4}$ sec. cor., marked on brass cap
 1915 on S. rim;
 $\frac{1}{4}$ S9 in W. and
 S10 in E. half;
 and raise a mound of stone, 2 ft. base, $1\frac{1}{2}$ ft. high,
 W. of cor. ~~Dim impr. visible.~~
 80.00 Set an iron post, 3 ft. long, 2 ins. diam., 24 ins. in the
 ground, for cor. of secs. 3, 4, 9 and 10, marked on

16. Partial Subdivision of T. 27 N., R. 20 W.

chains.

brass cap

1915 on S. rim;
T27N R20W in N. half;
S4 in NW.,
S3 in NE.,
S10 in SE. and
S9 in SW. quadrant;

and raise a mound of stone, 2 ft. base, 1 1/2 ft. high,
W. of cor. ~~Site impracticable.~~

Land, rolling.

Soil, gravelly and stony; 3rd rate.

No timber.

Undergrowth, greasewood, yucca and buck brush.

R. C. D.

Apr. 20, 1915.

Apr. 23, 1915: H. G. B.

The cor. of secs. 2, 3, 10 and 11 being plainly visible,
I run for said cor. from last sec. cor.

S.89° 51' E., on a random line, bet. secs. 3 and 10.

40.00 Set temp. 1/4 sec. cor.

80.00 Intersect the corner of secs. 2, 3, 10 and 11. ~~2, 3, 10~~
~~and 11.~~

Thence, I run

N.89° 51' W., on a true line, bet. secs. 3 and 10.

Over level land, through scattering undergrowth.

29.90 Wash, 30 lks. wide, course SW.

40.00 Set an iron post, 3 ft. long, 1 in. diam., 26 ins. in the
ground, for 1/4 sec. cor., marked on brass cap

1915 on S. rim;
1/4 S3 in N. and
S10 in S. half;

dig pits, 18 X 18 X 12 ins., E. and W. of post, 3 ft.
dist.; and raise a mound of earth, 3 1/2 ft. base, 1 1/2 ft.
high, N. of cor.

60.80 Road, brs. N. and S.

80.00 The cor. of secs. 3, 4, 9 and 10.

Land, level.

Soil, gravel; 3rd rate.

No timber.

Undergrowth, greasewood.

H. G. B.

Apr. 23, 1915.

Apr. 20, 1915: R. C. D.

At 7 hrs. 0 m., a.m., l.m.t., I set off 35° 41' N. on the
lat. arc; 11° 18 1/2' N. on the decl. arc; and determine
a meridian with the solar at the cor. of secs. 2, 3,
32 and 33, on the S. bdy. of the Tp., described in Book
"A", established by H. G. B., as described in Book

Thence, I run

N.0° 3' W., bet. secs. 32 and 33.

Over gently rolling land, through scattering undergrowth.

26.90 Wash, 30 lks. wide, 1 1/2 ft. deep, course W.

40.00 Set an iron post, 3 ft. long, 1 in. diam., 26 ins. in the
ground, for 1/4 sec. cor., marked on brass cap

1915 on S. rim;
1/4 S32 in W. and
S33 in E. half;

and raise a mound of stone, 2 ft. base, 1 1/2 ft. high,
W. of cor. ~~Site impracticable.~~

80.00 Set an iron post, 3 ft. long, 2 ins. diam., 24 ins. in the
ground, for cor. of secs. 28, 29, 32 and 33, marked on
brass cap

1915 on S. rim;
T27N R20W in N. half;

Chains.

S29 in NW ,
 S28 in NE ;,
 S33 in SE. and
 S32 in SW. quadrant;
 and raise a mound of stone, 2 ft. base, 1½ ft. high,
 W. of cor. ~~with impracticable~~.
 Land, gently rolling.
 Soil, gravelly and stony; 3rd rate.
 No timber.
 Undergrowth, greasewood and yucca.
 Apr. 20, 1915.

Apr. 20, 1915.
 S.89° 54' E., on a random line, bet. secs. 28 and 33.
 40.00 Set temp. ¼ sec. cor.
 80.08 Intersect the corner of secs. 27, 28, 32 and 34, of T. 27 N., R. 20 W. and S. 34.
 Thence, ~~to~~
 N.89° 54' W., on a true line, bet. secs. 28 and 33.
 40.04 Over level land, through scattering undergrowth.
 Set an iron post, 3 ft. long, 1 in. diam., 26 ins. in the ground, for ¼ sec. cor., marked on brass cap
 1915 on S. rim;
 ¼ S28 in N. and
 S33 in S. half;
 and raise a mound of stone, 2 ft. base, 1½ ft. high,
 N. of cor. ~~with impracticable~~.
 80.08 The cor. of secs. 28, 29, 32 and 33.
 Land, level.
 Soil, gravelly and stony; 3rd rate.
 No timber.
 Undergrowth, greasewood and yucca.
 Apr. 22, 1915.

Apr. 20, 1915.
 N.0° 3' W., bet. secs. 28 and 29.
 Over gently rolling land, through scattering undergrowth.
 37.50 Dim road, brs. NE. and SW.
 40.00 Set an iron post, 3 ft. long, 1 in. diam., 26 ins. in the ground, for ¼ sec. cor., marked on brass cap
 1915 on S. rim;
 ¼ S29 in W. and
 S28 in E. half;
 and raise a mound of stone, 2 ft. base, 1½ ft. high,
 W. of cor. ~~with impracticable~~.
 80.00 Set an iron post, 3 ft. long, 2 ins. diam., 24 ins. in the ground, for cor. of secs. 20, 21, 28 and 29, marked on brass cap
 1915 on S. rim;
 T27N R20W in N. half;
 S20 in NW ,
 S21 in NE ,
 S28 in SE. and
 S29 in SW. quadrant;
 and raise a mound of stone, 2 ft. base, 1½ ft. high,
 W. of cor. ~~with impracticable~~.
 Land, gently rolling.
 Soil, gravelly and stony; 3rd rate.
 No timber.
 Undergrowth, greasewood and yucca.
 Apr. 20, 1915.

Apr. 21, 1915.
 S.89° 54' E., on a random line, bet. secs. 21 and 28.

18. Partial Subdivision of T. 27 N., R. 20 W.

Chains.
 40.00 Set temp. $\frac{1}{4}$ sec. cor.
 80.04 Intersect the corner of secs. 21, 22, 27 and 28, 1, 22, 27 and 28.
 Thence, I run
 N. $89^{\circ} 54'$ W., on a true line, bet. secs. 21 and 28.
 Over gently rolling land, through scattering undergrowth.
 40.02 Set an iron post, 3 ft. long, 1 in. diam., 26 ins. in the ground, for $\frac{1}{4}$ sec. cor., marked on brass cap
 1915 on S. rim;
 $\frac{1}{4}$ S21 in N. and
 S28 in S. half;
 and raise a mound of stone, 2 ft. base, $1\frac{1}{2}$ ft. high,
 N. of cor. *Not in practice.*
 53.25 Dim road, brs. N. 30° E. and S. 30° W.
 80.04 The cor. of secs. 20, 21, 28 and 29.
 Land, gently rolling.
 Soil, gravelly and stony; 3rd rate.
 No timber.
 Undergrowth, greasewood and yucca.
 Apr. 22, 1915.

Apr. 22, 1915.
 N. $0^{\circ} 3'$ W., bet. secs. 20 and 21.
 Over gently rolling land, through scattering undergrowth.
 12.90 Dim road, brs. NE. and SW.
 40.00 Set an iron post, 3 ft. long, 1 in. diam., 26 ins. in the ground, for $\frac{1}{4}$ sec. cor., marked on brass cap
 1915 on S. rim;
 $\frac{1}{4}$ S20 in W. and
 S21 in E. half;
 and raise a mound of stone, 2 ft. base, $1\frac{1}{2}$ ft. high,
 W. of cor. *Not in practice.*
 44.10 Road, brs. N. 72° E. to Whitehills and S. 72° W. to Gold Bug Mill.
 80.00 Set an iron post, 3 ft. long, 2 ins. diam., 24 ins. in the ground, for cor. of secs. 16, 17, 20 and 21, marked on brass cap
 1915 on S. rim;
 T27N R20W in N. half;
 S17 in NW.,
 S16 in NE.,
 S21 in SE: and
 S20 in SW. quadrant;
 and raise a mound of stone, 2 ft. base, $1\frac{1}{2}$ ft. high,
 W. of cor. *Not in practice.*
 Land, gently rolling.
 Soil, sandy, gravelly and stony; 3rd rate.
 No timber.
 Undergrowth, greasewood and yucca.
 Apr. 22, 1915.
 R. C. D.

Apr. 23, 1915: H. G. B.
 At 7 hrs. 3 m., a.m., l.m.t., I set off $35^{\circ} 43\frac{1}{2}'$ N. on the lat. arc; $12^{\circ} 19\frac{1}{2}'$ N. on the decl. arc; and determine a meridian with the solar at the cor. of secs. 16, 17, 20 and 21.
 The cor. of secs. 15, 16, 21 and 22 being plainly visible.
 I run for said cor. from last sec. cor.
 S. $89^{\circ} 50'$ E., on a random line, bet. secs. 16 and 21.
 40.00 Set temp. $\frac{1}{4}$ sec. cor.
 79.92 Intersect the corner of secs. 15, 16, 21 and 22, 16, 21 and 22.
 Thence, I run
 N. $89^{\circ} 50'$ W., on a true line, bet. secs. 16 and 21.
 Over level land, through scattering undergrowth.
 39.96 Set an iron post, 3 ft. long, 1 in. diam., 26 ins. in the

Partial Subdivision of T. 27 N., R. 20 W. 19.

Chains.

ground, for $\frac{1}{4}$ sec. cor., marked on brass cap
 1915 on S. rim;
 $\frac{1}{4}$ S16 in N. and
 S21 in S. half;
 and raise a mound of stone, 2 ft. base, $1\frac{1}{2}$ ft. high,
 N. of cor.

43.80 Wash, 5 lks. wide, course S.75° W.
 53.40 Center of wash, 90 lks. wide, course NW.
 68.00 Wash, 50 lks. wide, course NW.
 79.92 The cor. of secs. 16, 17, 20 and 21.
 Land, level.
 Soil, gravel; 3rd rate.
 No timber.
 Undergrowth; greasewood.

H. G. B.
 Apr. 25, 1915.

Apr. 25, 1915: R. C. D.
 N.0° 3' W., bet. secs. 16 and 17.
 Over gently rolling land, through scattering undergrowth.

8.40 Center of wash, 80 lks. wide, 2 ft. deep, course NW.
 40.00 Set an iron post, 3 ft. long, 1 in. diam., 26 ins. in the
 ground, for $\frac{1}{4}$ sec. cor., marked on brass cap
 1915 on S. rim;
 $\frac{1}{4}$ S17 in W. and
 S16 in E. half;
 and raise a mound of stone, 2 ft. base, $1\frac{1}{2}$ ft. high,
 W. of cor.

48.00 Wash, 20 lks. wide, $1\frac{1}{2}$ ft. deep, course W.
 80.00 Set an iron post, 3 ft. long, 2 in. diam., 24 ins. in the
 ground, for cor. of secs. 4, 5, 8 and 9, marked on
 brass cap
 1915 on S. rim;
 T27N R20W in N. half;
 S8 in NW.,
 S9 in NE.,
 S16 in SE. and
 S17 in SW. quadrant;
 and raise a mound of stone, 2 ft. base, $1\frac{1}{2}$ ft. high,
 W. of cor.

Land, gently rolling.
 Soil, sandy, gravelly and stony; 3rd rate.
 No timber.
 Undergrowth, greasewood and yucca.

R. C. D.
 Apr. 25, 1915.

Apr. 25, 1915: H. G. B.
 The cor. of secs. 9, 10, 15 and 16 being plainly visible,
 I run for said cor. from last sec. cor.
 S.89° 53' E., on a random line, bet. secs. 9 and 16.

40.00 Set temp. $\frac{1}{4}$ sec. cor.
 80.04 Intersect the corner of secs. 9, 10, 15 and 16,
 on a true line.
 Thence, I run
 N.89° 53' W., on a true line, bet. secs. 9 and 16.
 Over level land, through scattering undergrowth.

40.02 Set an iron post, 3 ft. long, 1 in. diam., 26 ins. in the
 ground, for $\frac{1}{4}$ sec. cor., marked on brass cap
 1915 on S. rim;
 $\frac{1}{4}$ S9 in N. and
 S16 in S. half;
 dig pits, 18 X 18 X 12 ins., E. and W. of post, 3 ft.
 dist.; and raise a mound of earth, $3\frac{1}{2}$ ft. base, $1\frac{1}{2}$ ft.
 high, N. of cor.

80.04 The cor. of secs. 8, 9, 16 and 17.

210

20. Partial Subdivision of T. 27 N., R. 20 W.

Chains.

Land, level.
 Soil, sandy loam; 2nd rate.
 No timber.
 Undergrowth, greasewood, yucca and cacti.
 H. G. B.
 Apr. 23, 1915.

40.00

Apr. 23, 1915: R. C. D.
 N. 0° 3' W., bet. secs. 8 and 9.
 Over gently rolling land, through scattering undergrowth.
 Set an iron post, 3 ft. long, 1 in. diam., 26 ins. in the
 ground, for $\frac{1}{4}$ sec. cor., marked on brass cap
 1915 on S. rim;
 $\frac{1}{4}$ S8 in W. and
 S9 in E. half;
 and raise a mound of stone, 2 ft. base, 1 $\frac{1}{2}$ ft. high,
 W. of cor. ~~1915 on S. rim.~~

60.40

Traveled road, brs. NW. and SE. to Whitehills.

80.00

Set an iron post, 3 ft. long, 2 ins. diam., 24 ins. in the
 ground, for cor. of secs. 4, 5, 8 and 9, marked on brass
 cap
 1915 on S. rim;
 T27N R20W in N. half;
 S5 in NW.,
 S4 in NE.,
 S9 in SE. and
 S8 in SW. quadrant;

and raise a mound of stone, 2 ft. base, 1 $\frac{1}{2}$ ft. high,
 W. of cor. ~~1915 on S. rim.~~
 Land, gently rolling.
 Soil, gravelly; 3rd rate.
 No timber.
 Undergrowth, greasewood and yucca.

Apr. 23, 1915: At this cor., I set off 11° 21' N. on the
 deal. arc; and at apparent noon, I observe the sun on
 the meridian; the resulting lat. is 33° 45' N.

40.00

The cor. of secs. 3, 4, 9 and 10 being plainly visible,
 I run for said cor. from last sec. cor.

80.00

S. 89° 54' E., on a random line, bet. secs. 4 and 9
 Set temp. $\frac{1}{4}$ sec. cor.
 Intersect the corner of, secs. 3, 4, 9 and 10. 3, 4, 9
 and 10.

40.00

Thence, I run
 N. 89° 54' W., on a true line, bet. secs. 4 and 9.
 Over gently rolling land, through scattering undergrowth.
 Set an iron post, 3 ft. long, 1 in. diam., 26 ins. in the
 ground, for $\frac{1}{4}$ sec. cor., marked on brass cap
 1915 on S. rim;
 $\frac{1}{4}$ S4 in N. and
 S9 in S. half;

80.00

and raise a mound of stone, 2 ft. base, 1 $\frac{1}{2}$ ft. high,
 N. of cor. ~~1915 on S. rim.~~
 The cor. of secs. 4, 5, 8 and 9.
 Land, gently rolling.
 Soil, gravelly and stony; 3rd rate.
 No timber.
 Undergrowth, greasewood and yucca.

R. C. D.
 Apr. 23, 1915.

Apr. 19, 1915: H. G. B.
 From the cor. of secs. 5, 6, 31 and 32, on the S. bdy. of

Chains.

the Tp., described in Book "A." and located by us, as described in Book "A.", 1 run.

N.0° 3' W., bet. secs. 31 and 32.
 Over level land, through scattering undergrowth.
 3.50 Wash, 10 lks. wide, course W.
 40.00 Set an iron post, 3 ft. long, 1 in. diam., 26 ins. in the ground, for $\frac{1}{4}$ sec. cor., marked on brass cap
 1915 on S. rim;
 $\frac{1}{4}$ S31 in W. and
 S32 in E. half;
 dig pits, 18 X 18 X 12 ins., N. and S. of post, 3 ft. dist.; and raise a mound of earth, $3\frac{1}{2}$ ft. base, $1\frac{1}{2}$ ft. high, W. of cor.
 45.00 Wash, 3 lks. wide, course W.
 63.50 Wash, 3 lks. wide, course W.
 80.00 Set an iron post, 3 ft. long, 2 ins. diam., 24 ins. in the ground, for cor. of secs. 29, 30, 31 and 32, marked on brass cap
 1915 on S. rim;
 T27N R20W in N. half;
 S30 in NW.,
 S29 in NE.,
 S32 in SE. and
 S31 in SW. quadrant;
 dig pits, 18 X 18 X 12 ins., in each sec., $5\frac{1}{2}$ ft. dist.; and raise a mound of earth, 4 ft. base, 2 ft. high, W. of cor.
 Land, level.
 Soil, gravel; 3rd rate.
 No timber.
 Undergrowth, greasewood.
 Apr. 18, 1915: At this cor., I set off 21° 11' N. on the local mer; and at apparent noon, I observed the sun on the meridian; the resulting alt. is 55° 41' N.
 H. G. B.
 Apr. 19, 1915.

Apr. 18, 1915: R. C. D.
 S.89° 54' E., on a random line, bet. secs. 29 and 32.
 40.00 Set temp. $\frac{1}{4}$ sec. cor.
 79.94 Intersect N. and S. line, 9 lks. S. of the cor. of secs. 28, 29, 32 and 33.
 Thence
 N.89° 58' W., on a true line, bet. secs. 29 and 32.
 Over level land, through scattering undergrowth.
 6.60 Dim road, brs. NE. and SW.
 39.97 Set an iron post, 3 ft. long, 1 in. diam., 26 ins. in the ground, for $\frac{1}{4}$ sec. cor., marked on brass cap
 1915 on S. rim;
 $\frac{1}{4}$ S29 in N. and
 S32 in S. half;
 and raise a mound of stone, 2 ft. base, $1\frac{1}{2}$ ft. high, N. of cor.
 79.94 The cor. of secs. 29, 30, 31 and 32.
 Land, level.
 Soil, gravelly and stony; 3rd rate.
 No timber.
 Undergrowth, greasewood and yucca.

N.89° 54' W., on a random line, bet. secs. 30 and 31.
 40.00 Set temp. $\frac{1}{4}$ sec. cor.
 79.38 Intersect W. bdy. of Tp., 14 lks. N. of the cor. of secs. 25, 30, 31 and 36, described in Book "A." and located by us, as described in Book "A.".
 Thence
 East on a true line, bet. secs. 30 and 31.

22. Partial Subdivision of T. 27 N., R. 20 W.

Chains.	
5.90 19.10 37.80 39.38	<p>Over level land, through scattering undergrowth. Center of Sacramento Wash, 1 ch. wide, 2 ft. deep, course N. Wash, 30 lks. wide, 1½ ft. deep, course N. Road, brs. N. and S. Set an iron post, 3 ft. long, 1 in. diam., 26 ins. in the ground, for ¼ sec. cor., marked on brass cap 1915 on S. rim; ¼S30 in N. and S31 in S. half; and raise a mound of stone, 2 ft. base, 1½ ft. high, N. of cor. This is practicable.</p>
79.38	<p>The cor. of secs. 29, 30, 31 and 32. Land, level. Soil, gravelly; 3rd rate. No timber. Undergrowth, greasewood. R. C. D. Apr. 22, 1915.</p>
10.00 18.00 40.00 40.60 80.00	<p>Apr. 18, 1915: H. G. B. N.0° 3' W., bet. secs. 29 and 30. Over level land, through scattering undergrowth. Wash, 5 lks. wide, course W. Wash, 15 lks. wide, course N.75° W. Set an iron post, 3 ft. long, 1 in. diam., 26 ins. in the ground, for ¼ sec. cor., marked on brass cap 1915 on S. rim; ¼S30 in W. and S29 in E. half; dig pits, 18 X 18 X 12 ins., N. and S. of post, 3 ft. dist.; and raise a mound of earth, 3½ ft. base, 1½ ft. high, W. of cor. Wash, 5 lks. wide, course W. Set an iron post, 3 ft. long, 2 ins. diam., 24 ins. in the ground, for cor. of secs. 19, 20, 29 and 30, marked on brass cap 1915 on S. rim; T27N R20W in N. half; S19 in NW., S20 in NE., S20 in SE. and ¼S30 in SW. quadrant; dig pits, 18 X 18 X 12 ins., in each sec., 5½ ft. dist.; and raise a mound of earth, 4 ft. base, 2 ft. high, W. of cor. Land, level. Soil, gravel; 3rd rate. No timber. Undergrowth, greasewood. H. G. B. Apr. 18, 1915.</p>
40.00 79.88 24.38 39.94	<p>Apr. 22, 1915: R. C. D. The cor. of secs. 20, 21, 28 and 29 being plainly visible. I run for said cor. from last sec. cor. S.89° 54' E., on a random line, bet. secs. 20 and 29. Set temp. ¼ sec. cor. Intersect the corner of secs. 20, 21, 28 and 29. Thence, E. 200 N.89° 54' W., on a true line, bet. secs. 20 and 29. Over level land, through scattering undergrowth. Dim road, brs. NE. and SW. Set an iron post, 3 ft. long, 1 in. diam., 26 ins. in the ground, for ¼ sec. cor., marked on brass cap 1915 on S. rim;</p>

Chains.

- $\frac{1}{4}$ S20 in N. and
 $\frac{1}{4}$ S29 in S. half;
 dig pits, 18 X 18 X 12 ins., E. and W. of post, 3 ft.
 dist.; and raise a mound of earth, $3\frac{1}{2}$ ft. base, $1\frac{1}{2}$ ft.
 high, N. of cor.
- 42.38 Old road, brs. N. and S.
 79.88 The cor. of secs. 19, 20, 29 and 30.
 Land, level.
 Soil, sandy and gravelly; 3rd rate.
 No timber.
 Undergrowth, greasewood and yucca.
- Apr. 22, 1915: In this cor., I ran out line 24' N. on the
 each. side; and at each end, I placed the sun on
 the horizon: the resulting line is $59^{\circ} 42'$ N.
- The cor. of secs. 19, 24, 25 and 30 being plainly visible,
 I run for said cor. from last sec. cor.
 S. $89^{\circ} 55'$ W., on a random line, bet. secs. 19 and 30.
 40.00 Set temp. $\frac{1}{4}$ sec. cor.
 79.30 Intersect W. bdy. of Tp., at the cor. of secs. 19, 24, 25
 and 30, described in Book "A." and located by S. 19, 24,
 and 30 in Book "A."
- Thence
 N. $89^{\circ} 55'$ E., on a true line, bet. secs. 19 and 30.
 Over level land, through scattering undergrowth.
- 39.30 Set an iron post, 3 ft. long, 1 in. diam., 26 ins. in the
 ground, for $\frac{1}{4}$ sec. cor., marked on brass cap
 1915 on S. rim;
 $\frac{1}{4}$ S19 in N. and
 $\frac{1}{4}$ S30 in S. half;
 dig pits, 18 X 18 X 12 ins., E. and W. of post, 3 ft.
 dist.; and raise a mound of earth, $3\frac{1}{2}$ ft. base, $1\frac{1}{2}$ ft.
 high, N. of cor.
- 55.30 Old road, brs. N. 72° E. to Whitehills and S. 72° W. to Gold
 Bug Mill.
- 60.70 Dim road, brs. NE. and SW.
 79.30 The cor. of secs. 19, 20, 29 and 30.
 Land, level.
 Soil, sandy and gravelly; 3rd rate.
 No timber.
 Undergrowth, greasewood and yucca.
- Apr. 22, 1915: H. G. B.
 N. $0^{\circ} 3'$ W., bet. secs. 19 and 20.
 Over level land, through scattering undergrowth.
- 10.00 Road, brs. N. 72° E. to Whitehills and S. 72° W. to Gold
 Bug Mill and Whight Mountain Mines.
- 40.00 Set an iron post, 3 ft. long, 1 in. diam., 26 ins. in the
 ground, for $\frac{1}{4}$ sec. cor., marked on brass cap
 1915 on S. rim;
 $\frac{1}{4}$ S19 in W. and
 $\frac{1}{4}$ S20 in E. half;
 dig pits, 18 X 18 X 12 ins., N. and S. of post, 3 ft.
 dist.; and raise a mound of earth, $3\frac{1}{2}$ ft. base, $1\frac{1}{2}$ ft.
 high, W. of cor.
- 80.00 Set an iron post, 3 ft. long, 2 ins. diam., 24 ins. in the
 ground, for cor. of secs. 17, 18, 19 and 20, marked on
 brass cap
 1915 on S. rim;
 T27N R20W in N. half;
 S18 in NW.,
 S17 in NE.,
 S20 in SE. and
 S19 in SW. quadrant;
- R. C. D.

24. Partial Subdivision of T. 27 N., R. 20 W.

Chains.

dig pits, 18 X 18 X 12 ins., in each sec., 5 1/2 ft. dist.; and raise a mound of earth, 4 ft. base, 2 ft. high, W. of cor.
Land, level.
Soil, gravel; 3rd rate.
No timber.
Undergrowth, greasewood.

Apr. 23, 1915.
The cor. of secs. 16, 17, 20 and 21 being plainly visible. I run for said cor. from last sec. cor.

40.00 S.89° 55' E., on a random line, bet. secs. 17 and 20.

79.96 Set temp. 1/4 sec. cor.
Intersect the corner of secs. 16, 17, 20 and 21.

Thence, I run N.89° 55' W., on a true line, bet. secs. 17 and 20.

39.98 Over level land, through scattering undergrowth. Set an iron post, 3 ft. long, 1 in. diam., 26 ins. in the ground, for 1/4 sec. cor., marked on brass cap

1915 on S. rim;
1/4 S17 in N. and
S20 in S. half;

dig pits, 18 X 18 X 12 ins., E. and W. of post, 3 ft. dist.; and raise a mound of earth, 3 1/2 ft. base, 1 1/2 ft. high, N. of cor.

71.50 Road, brs. N.50° W. and S.50° E.

79.96 The cor. of secs. 17, 18, 19 and 20.

Land, level.
Soil, gravel; 3rd rate.
No timber.
Undergrowth, greasewood.

The cor. of secs. 13, 18, 19 and 24 being plainly visible. I run for said cor. from last sec. cor.

40.00 West on a random line, bet. secs. 18 and 19.

79.20 Set temp. 1/4 sec. cor.

Intersect W.bdy. of Tp., at the cor. of secs. 13, 18, 19 and 24, described in Book "A", established by me, as described in Book "C".

Thence, I run East on a true line, bet. secs. 18 and 19.

39.20 Over level land, through scattering undergrowth. Set an iron post, 3 ft. long, 1 in. diam., 26 ins. in the ground, for 1/4 sec. cor., marked on brass cap

1915 on S. rim;
1/4 S18 in N. and
S19 in S. half;

dig pits, 18 X 18 X 12 ins., E. and W. of post, 3 ft. dist.; and raise a mound of earth, 3 1/2 ft. base, 1 1/2 ft. high, N. of cor.

79.20 The cor. of secs. 17, 18, 19 and 20.

Land, level.
Soil, sandy loam; 2nd rate.
No timber.
Undergrowth, greasewood.

Apr. 23, 1915.
N.0° 3' W., bet. secs. 17 and 18.
Over level land, through scattering undergrowth.

19.70 Road, brs. N.20° W. and S.20° E.

29.00 Wash, 3 lks. wide, course W.

Partial Subdivision of T. 27 N., R. 29 W.

Chains.
40.00 Set an iron post, 3 ft. long, 1 in. diam., 26 ins. in the ground, for $\frac{1}{4}$ sec. cor., marked on brass cap
1915 on S. rim;
 $\frac{1}{4}$ S18 in W. and
S17 in E. half;
dig pits, 18 X 18 X 12 ins., N. and S. of post, 3 ft. dist.; and raise a mound of earth, $3\frac{1}{2}$ ft. base, $1\frac{1}{2}$ ft. high, W. of cor.

40.75 Wash, 3 lks. wide, course W.
53.20 Wash, 15 lks. wide, course N.80° W.
56.00 Enter wash, course N.60° W.
57.50 Leave wash, course N.60° W.
80.00 Set an iron post, 3 ft. long, 2 ins. diam., 24 ins. in the ground, for cor. of secs. 7, 8, 17 and 18, marked on brass cap
1915 on S. rim;
T27N R20W in N. half;
S7 in NW.,
S8 in NE.,
S17 in SE. and
S18 in SW. quadrant;
dig pits, 18 X 18 X 12 ins., in each sec., $5\frac{1}{2}$ ft. dist.; and raise a mound of earth, 4 ft. base, 2 ft. high, W. of cor.
Land, level.
Soil, gravel; 3rd rate.
No timber.
Undergrowth, greasewood.

Apr. 27, 1917.
The cor. of secs. 8, 9, 16 and 17 being plainly visible,
I run for said cor. from last sec. cor.
S.89° 54' E., on a random line, bet. secs. 8 and 17.

40.00 Set temp. $\frac{1}{4}$ sec. cor.
80.00 Intersect the corner of secs. 8, 9, 16 and 17.
Thence, I run
N.89° 54' W., on a true line, bet. secs. 8 and 17.
Over level land, through scattering undergrowth.

40.00 Set an iron post, 3 ft. long, 1 in. diam., 26 ins. in the ground, for $\frac{1}{4}$ sec. cor., marked on brass cap
1915 on S. rim;
 $\frac{1}{4}$ S8 in N. and
S17 in S. half;
dig pits, 18 X 18 X 12 ins., E. and W. of post, 3 ft. dist.; and raise a mound of earth, $3\frac{1}{2}$ ft. base, $1\frac{1}{2}$ ft. high, N. of cor.

80.00 The cor. of secs. 7, 8, 17 and 18.
Land, level.
Soil, sandy loam; 2nd rate.
No timber.
Undergrowth, greasewood and yucca.

The cor. of secs. 7, 12, 13 and 18 being plainly visible,
I run for said cor. from last sec. cor.
West on a random line, bet. secs. 7 and 18.

40.00 Set temp. $\frac{1}{4}$ sec. cor.
79.11 Intersect W. bdy. of Tp., at the cor. of secs. 7, 12, 13 and 18, described in Book "11", ...
Thence, I run
East on a true line, bet. secs. 7 and 18.
Over level land, through scattering undergrowth.

34.30 Center of wash, 60 lks. wide, course NW.
39.11 Set an iron post, 3 ft. long, 1 in. diam., 26 ins. in the

26. Partial Subdivision of T. 27 N., R. 20 W.

Chains.

ground, for 1/4 sec. cor., marked on brass cap
1915 on S. rim;
1/4 S7 in N. and
S18 in S. half;
dig pits, 18 X 18 X 12 ins., E. and W. of post, 3 ft.
dist.; and raise a mound of earth, 3 1/2 ft. base, 1 1/2 ft.
high, N. of cor.

47.40 Wash, 30 lks. wide, course NW.
79.11 The cor. of secs. 7, 8, 17 and 18.
Land, level.
Soill sandy loam; 2nd rate.
No timber.
Undergrowth, greasewood.

Apr. 25, 1915.

N. 0° 31' W., bet. secs. 7 and 8.
Over level land, through scattering undergrowth.

20.00 Wash, 3 lks. wide, course W.
40.00 Set an iron post, 3 ft. long, 1 in. diam., 26 ins. in the
ground, for 1/4 sec. cor., marked on brass cap
1915 on S. rim;
1/4 S7 in W. and
S8 in E. half;
dig pits, 18 X 18 X 12 ins., N. and S. of post, 3 ft.
dist.; and raise a mound of earth, 3 1/2 ft. base, 1 1/2 ft.
high, W. of cor.

43.60 Road, brs. NE. and SW.
50.00 Wash, 4 lks. wide, course W.
80.00 Set an iron post, 3 ft. long, 2 ins. diam., 24 ins. in the
ground, for cor. of secs. 5, 6, 7 and 8, marked on
brass cap
1915 on S. rim;
T27N R20W in N. half;
S6 in NW.,
S5 in NE.,
S8 in SE. and
S7 in SW. quadrant;
dig pits, 18 X 18 X 12 ins., in each sec., 5 1/2 ft. dist.;
and raise a mound of earth, 4 ft. base, 2 ft. high,
W. of cor.
Land, level.
Soil, gravel; 3rd rate.
No timber.
Undergrowth, greasewood.

H. G. B.
Apr. 25, 1915.

Apr. 25, 1915: R. C. D.
The cor. of secs. 4, 5, 8 and 9 being plainly visible, I
run for said cor. from last sec. cor.

S. 89° 54' E., on a random line, bet. secs. 5 and 8.
40.00 Set temp. 1/4 sec. cor.
80.08 Intersect the corner of secs. 4, 5, 8 and 9.

Thence,
N. 89° 54' W., on a true line, bet. secs. 5 and 8.
Over gently rolling land, through scattering undergrowth.

40.04 Set an iron post, 3 ft. long, 1 in. diam., 26 ins. in the
ground, for 1/4 sec. cor., marked on brass cap
1915 on S. rim;
1/4 S5 in N. and
S8 in S. half;
dig pits, 18 X 18 X 12 ins., E. and W. of post, 3 ft.
dist.; and raise a mound of earth, 3 1/2 ft. base, 1 1/2 ft.
high, N. of cor.

60.00 Traveled road, brs. NW. and SE.

Chains.
80.04

The cor. of secs. 5, 6, 7 and 8.
Land, gently rolling.
Soil, gravelly and stony; 3rd rate.
No timber.
Undergrowth, greasewood and yucca.

R. C. D.

40.00
79.00

Apr. 21, 1913: H. G. B.
The cor. of secs. 1, 6, 7 and 12 being plainly visible,
I run for said cor. from last sec. cor.
West on a random line, bet. secs. 6 and 7.
Set temp. $\frac{1}{4}$ sec. cor.
Intersect W. bdy. of Tp., at the cor. of secs. 1, 6, 7
and 12, described in Book "A." and "B." by me, as
described in Book "C."

16.50
39.00

Thence I run
East on a true line, bet. secs. 6 and 7.
Over level land, through scattering undergrowth.
Road, brs. N.40° W. and S.40° E.
Set an iron post, 3 ft. long, 1 in. diam., 26 ins. in the
ground, for $\frac{1}{4}$ sec. cor., marked on brass cap
1915 on S. rim;
486 in N. and
S7 in S. half;
dig pits, 18 X 18 X 12 ins., E. and W. of post, 3 ft.
dist.; and raise a mound of earth, $3\frac{1}{2}$ ft. base, $1\frac{1}{2}$ ft.
high, N. of cor.

79.00

The cor. of secs. 5, 6, 7 and 8.
Land, level.
Soil, gravel; 3rd rate.
No timber.
Undergrowth, greasewood.

H. G. B.

Apr. 21, 1913

GENERAL DESCRIPTION.

The western portion of the township is level, sandy land, the eastern two miles lying in a range of lava and granite hills, which extend from south to north through the entire township. The soil of the western portion is very sandy, and is covered with yucca and greasewood undergrowth; the eastern portion is solid stone, and mineralized in the northern part. There is no water in the township. The town of Whitehills is in the north eastern quarter of sec. 14, and is now deserted. There are a large number of mining claims located here, and a fair sized mill for treating ores. There are about fifty wooden houses, and a system for supplying water has been installed, the water being brought from a spring in T. 28 N., R. 19 W. There is no timber in the township, and but scant growth of grass.

H. G. B.

Apr. 21, 1913

Partial Subdivision of T. 27 N., R. 21 W.

Chains.

Survey executed on dates shown on pages 35 & 37 hereof, by H. G. Bardsley, U. S. Surveyor, and Royston C. Durnford, U. S. Transitman, with Young and Sons' light mountain transits Nos. 8532 and 8526, respectively, described in Book "A."

The initials "H.G.B." and "R.C.D." are inserted at the beginning and ending of those portions of the notes executed by "H.G. Bardsley, U.S. Surveyor, and Royston C. Durnford, U.S. Transitman, respectively.

Knowing from recent and repeated tests of our instruments on a meridian established by observations on Polaris at elongation, that they are in good adjustment, we proceed as follows:

H. G. B.
 From the cor. of secs. 1, 2, 35 and 36, on the S. bdy. of the Tp., described in Book "A."

N.0° 1' W., bet. secs. 35 and 36.
 Over level land, through scattering undergrowth.
 Wash, 5 lks. wide, course NE.
 Road, brs. NW. and SE.
 Wash, 15 lks. wide, course N.40° E.
 Set an iron post, 3 ft. long, 1 in. diam., 26 ins. in the ground, for $\frac{1}{4}$ sec. cor., marked on brass cap
 1915 on S. rim;
 $\frac{1}{4}$ S35 in W. and
 S36 in E. half;
 dig pits, 18 X 18 X 12 ins., N. and S. of post, 3 ft. dist.; and raise a mound of earth, $3\frac{1}{2}$ ft. base, $1\frac{1}{2}$ ft. high, W. of cor.

Wash, 40 lks. wide, course N.30° E.
 Road, brs. NE. and SW.
 Wash, 10 lks. wide, course N.40° E.
 Set an iron post, 3 ft. long, 2 ins. diam., 24 ins. in the ground, for cor. of secs. 25, 26, 35 and 36, marked on brass cap
 1915 on S. rim;
 T27N R21W in N. half;
 S26 in NW.,
 S25 in NE.,
 S36 in SE. and
 S35 in SW. quadrant;
 dig pits, 18 X 18 X 12 ins., in each sec., $5\frac{1}{2}$ ft. dist.; and raise a mound of earth, 4 ft. base, 2 ft. high, W. of cor.

Land, level.
 Soil, gravel; 3rd rate.
 No timber.
 Undergrowth, greasewood.

H. G. B.
 Apr. 12, 1912

R. C. D.
 N.89° 58' E., on a random line, bet. secs. 25 and 36.
 Set temp. $\frac{1}{4}$ sec. cor.
 Intersect E. bdy. of Tp., 7 lks. S. of the cor. of secs. 25, 30, 31 and 36, described in Book "A."

Thence,
 S.89° 55' W., on a true line, bet. secs. 25 and 36.
 Over gently rolling land, through scattering undergrowth.
 Set an iron post, 3 ft. long, 1 in. diam., 26 ins. in the ground, for $\frac{1}{4}$ sec. cor., marked on brass cap
 1915 on S. rim;
 $\frac{1}{4}$ S25 in N. and
 S36 in S. half;
 dig pits, 18 X 18 X 12 ins., E. and W. of post, 3 ft. dist.; and raise a mound of earth, $3\frac{1}{2}$ ft. base, $1\frac{1}{2}$ ft.

6.50
 7.70
 34.00
 40.00
 49.00
 50.50
 55.00
 80.00

40.00
 79.90
 39.95

Chains.
 61.00 high, N. of cor.
 Dim road, brs. NW. and SE.
 79.90 The cor. of secs. 25, 26, 35 and 36.
 Land, gently rolling.
 Soil, gravelly; 3rd rate.
 No timber.
 Undergrowth, greasewood and buck brush.
 R. C. D.
 Apr. 22, 1915.

Apr. 10, 1915: H. C. B.
 N. 0° 1' W., bet. secs. 25 and 26.
 Over level land, through scattering undergrowth.
 6.00 Wash, 5 lks. wide, course NE.
 25.00 Road, brs. E. to Whitehills and W. to Whight Mountain Mine.
 40.00 Set an iron post, 3 ft. long, 1 in. diam., 26 ins. in the
 ground, for $\frac{1}{4}$ sec. cor., marked on brass cap
 1915 on S. rim;
 $\frac{1}{4}$ S26 in W. and
 S25 in E. half;
 dig pits, 18 X 18 X 12 ins., N. and S. of post, 3 ft.
 dist.; and raise a mound of earth, $3\frac{1}{2}$ ft. base, $1\frac{1}{2}$ ft.
 high, W. of cor.
 44.00 Wash, 2 lks. wide, course NE.
 52.00 Wash, 10 lks. wide, course NE
 61.00 Wash, 50 lks. wide, course N. 40° E.
 70.00 Wash, 15 lks. wide, course E.
 74.25 Wash, 20 lks. wide, course E.
 78.50 Wash, 10 lks. wide, course E.
 80.00 Set an iron post, 3 ft. long, 2 ins. diam., 24 ins. in the
 ground, for cor. of secs. 23, 24, 25 and 26, marked on
 brass cap
 1915 on S. rim;
 T27N R21W in N. half;
 S23 in NW,
 S24 in NE,
 S25 in SE: and
 S26 in SW. quadrant;
 dig pits, 18 X 18 X 12 ins., in each sec., $5\frac{1}{2}$ ft. dist.;
 and raise a mound of earth, 4 ft. base, 2 ft. high,
 W. of cor.
 Land, level.
 Soil, gravel; 3rd rate.
 No timber.
 Undergrowth, greasewood.
 H. C. B.
 Apr. 10, 1915.

Apr. 22, 1915: R. C. D.
 N. 89° 55' E., on a random line, bet. secs. 24 and 25.
 40.00 Set temp. $\frac{1}{4}$ sec. cor.
 79.94 Intersect E. bdy. of Tp., 7 lks. N. of the cor. of secs.
 19, 24, 25 and 30, described in Book "A."
 Thence,
 S. 89° 58' W., on a true line, bet. secs. 24 and 25.
 Over gently rolling land, through scattering undergrowth.
 6.94 Center of Sacramento Wash, 60 lks. wide, 2 ft. deep, course
 N.
 39.97 Set an iron post, 3 ft. long, 1 in. diam., 26 ins. in the
 ground, for $\frac{1}{4}$ sec. cor., marked on brass cap
 1915 on S. rim;
 $\frac{1}{4}$ S24 in N. and
 S25 in S. half;
 dig pits, 18 X 18 X 12 ins., E. and W. of post, 3 ft.
 dist.; and raise a mound of earth, $3\frac{1}{2}$ ft. base, $1\frac{1}{2}$ ft.

Chains.	
79.96	<p>high, N. of cor. The cor. of secs. 13, 14, 23 and 24. Land, level. Soil, sandy; 2nd rate. No timber. Undergrowth, greasewood.</p>
36.00	<p>N.0° 1' W., bet. secs. 13 and 14. Over level land, through scattering undergrowth.</p>
40.00	<p>Wash, 10 lks. wide, course NE. Set an iron post, 3 ft. long, 1 in. diam., 26 ins. in the ground, for $\frac{1}{4}$ sec. cor., marked on brass cap 1915 on S. rim; $\frac{1}{4}$S14 in W. and S13 in E. half; dig pits, 18 X 18 X 12 ins., N. and S. of post, 3 ft. dist.; and raise a mound of earth, $3\frac{1}{2}$ ft. base, $1\frac{1}{2}$ ft. high, W. of cor.</p>
54.00	<p>Wash, 10 lks. wide, course NE.</p>
64.00	<p>Wash, 30 lks. wide, course NE.</p>
64.60	<p>Wash, 5 lks. wide, course NE.</p>
79.00	<p>Wash, 20 lks. wide, course NE.</p>
80.00	<p>Set an iron post, 3 ft. long, 2 ins. diam., 24 ins. in the ground, for cor. of secs. 11, 12, 13 and 14, marked on brass cap 1915 on S. rim; T27N R21W in N. half; S11 in NW., S12 in NE., S13 in SE. and S14 in SW. quadrant; dig pits, 18 X 18 X 12 ins., in each sec., $5\frac{1}{2}$ ft. dist.; and raise a mound of earth, 4 ft. base, 2 ft. high, W. of cor. Land, level. Soil, gravel; 3rd rate. No timber. Undergrowth, greasewood.</p>
40.00	<p>The cor. of secs. 7, 12, 13 and 18 being plainly visible, I run for said cor., from last sec. cor. East on a random line, bet. secs. 12 and 13.</p>
80.04	<p>Set temp. $\frac{1}{4}$ sec. cor. Intersect E. bdy. of Tp. at the cor. of secs. 7, 12, 13 and 18, described in Book "A."</p>
17.45	<p>Thence West on a true line, bet. secs. 13 and 12. Over level land, through scattering undergrowth.</p>
28.15	<p>Road, brs. NE. and SW.</p>
37.15	<p>Center of wash, 80 lks. wide, course N.</p>
40.02	<p>Center of branch of Sacramento Wash, 1 ch. wide, course N. Set an iron post, 3 ft. long, 1 in. diam., 26 ins. in the ground, for $\frac{1}{4}$ sec. cor., marked on brass cap 1915 on S. rim; $\frac{1}{4}$S12 in N. and S13 in S. half; and raise a mound of stone, 2 ft. base, $1\frac{1}{2}$ ft. high, N. of cor.</p>
41.55	<p>Center of Sacramento Wash, 1 ch. wide, course N.</p>
47.35	<p>Wash, 30 lks. wide, course N.</p>
80.04	<p>The cor. of secs. 11, 12, 13 and 14.</p>

OOK 3247

Partial Subdivision of T. 27 N., R. 21 W.

33

Chains.	
	Land, level. Soil, gravel; 3rd rate. No timber. Undergrowth, greasewood.
	N.0° 1' W., bet. secs. 11 and 12. Over level land, through scattering undergrowth.
1.00	Wash, 10 lks. wide, course NE.
30.00	Road, brs. NW. and SE.
35.00	Wash, 15 lks. wide, course N.75° E.
40.00	Set an iron post, 3 ft. long, 1 in. diam., 26 ins. in the ground, for $\frac{1}{4}$ sec. cor., marked on brass cap 1915 on S. rim; $\frac{1}{4}$ S11 in N. and S12 in E. half; dig pits, 18 X 18 X 12 ins., N. and S. of post, 3 ft. dist.; and raise a mound of earth, $3\frac{1}{2}$ ft. base, $1\frac{1}{2}$ ft. high, W. of cor.
55.50	Wash, 15 lks. wide, course N.30° E.
80.00	Set an iron post, 3 ft. long, 2 ins. diam., 24 ins. in the ground, for cor. of secs. 1, 2, 11 and 12, marked on brass cap 1915 on S. rim; T27N R21W in N. half; S2 in NW., S1 in NE., S12 in SE. and S11 in SW. quadrant; dig pits, 18 X 18 X 12 ins., in each sec., $5\frac{1}{2}$ ft. dist.; and raise a mound of earth, 4 ft. base, 2 ft. high, W. of cor.
	Land, level. Soil, gravel; 3rd rate. No timber. Undergrowth, greasewood.
	East on a random line, bet. secs. 1 and 12.
40.00	Set temp. $\frac{1}{4}$ sec. cor.
80.00	Intersect E. bdy. of Tp., at the cor. of secs. 1, 6, 7 and 12, described in Book "A." Thence
	West on a true line, bet. secs. 1 and 12. Over level land, through scattering undergrowth.
36.00	Wash, 10 lks. wide, course N.60° W.
39.60	Wash, 5 lks. wide, course N.60° W.
40.00	Set an iron post, 3 ft. long, 1 in. diam., 26 ins. in the ground, for $\frac{1}{4}$ sec. cor., marked on brass cap 1915 on S. rim; $\frac{1}{4}$ S1 in N. and S12 in S. half; dig pits, 18 X 18 X 12 ins., E. and W. of post, 3 ft. dist.; and raise a mound of earth, $3\frac{1}{2}$ ft. base, $1\frac{1}{2}$ ft. high, W. of cor.
41.00	Wash, 5 lks. wide, course N.75° W.
61.00	Center of Sacramento Wash, 95 lks. wide, course N.
66.00	Wash, 5 lks. wide, course N.75° E.
79.00	Wash, 4 lks. wide, course N.75° E.
80.00	The cor. of secs. 1, 2, 11 and 12. Land, level. Soil, gravel; 3rd rate. No timber. Undergrowth, greasewood.

34

Partial Subdivision of T. 27 N., R. 21 W.

Chains.

H. G. B.
Sept. 23, 1917.

GENERAL DESCRIPTION.

The sections subdivided in this Tp. consist of level land, covered with greasewood undergrowth. The soil is sand and gravel, 3rd rate. All the drainage is to the Sacramento Wash, which traverses the Tp. in a northerly direction.

There are no settlers, nor is there any water in these sections.

BOOK 3247

Book "F"

Group 45 - Arizona.

~ DATE DIAGRAM ~

Surveys executed on dates shown on this diagram by Royston C. Dornford, U.S. Transitman.

NAME.

DATE.

						4-16-15	
1	6	5	4	3	4-23-15	2	1
		4-20-15	4-20-15			4-23-15	
12	7	8	9	10		11	12
		4-20-15	4-20-15			4-23-15	4-23-15
13	18	17	16	15		14	13
T. 27N.		4-20-15	T. 27N. 4-20-15	R. 20W. 4-22-15		4-22-15	
R. 21W. 24	19	20	21	22		23	24
4-22-15	4-22-15	4-22-15	4-22-15	4-21-15		4-21-15	
25	30	29	28	27		26	25
4-22-15	4-22-15	4-22-15	4-22-15	4-21-15		4-21-15	4-21-15
36	31	32	33	34		35	36
		4-20-15	4-19-15			4-21-15	

226
OK 3247
36

TRANSITMAN
CERTIFICATE OF UNITED STATES ~~SURVEYOR~~

I, Royston C. Durnford, ^{Transitman}~~U. S. Surveyor~~, hereby certify upon honor that, in pursuance of special instructions received from the U. S. Surveyor General for Group 45, Arizona, bearing date of the 7th day of January, 1915 I have well, faithfully, and truly in my own proper person, and in strict conformity with said instructions, the Manual of Surveying Instructions, and the laws of the United States, surveyed all those parts or portions of the Subdivision lines of

TOWNSHIP 27 NORTH, RANGE 20 WEST, and
TOWNSHIP 27 NORTH, RANGE 21 WEST,

of the Gila and Salt River Base and Meridian, in the State of Arizona, which are represented by the diagram on the reverse hereof and in the foregoing field notes as having been executed by me, and under my direction; and that all the corners of said survey have been established and perpetuated in strict accordance with the Manual of Surveying Instructions, and the special written instructions of the U. S. Surveyor General for Group 45, Arizona, and in the specific manner described in the field notes, and that the foregoing are the original field notes of such survey.

Royston C. Durnford
U. S. Surveyor
Transitman

APPROVAL.

OFFICE OF THE UNITED STATES SURVEYOR GENERAL,

....., 191

The foregoing field notes of the survey of

executed by under his special instructions dated, 191 , having been critically examined, and the necessary corrections and explanations made, the said field notes, and the surveys they describe, are hereby approved.

.....
U. S. Surveyor General.

I certify that the foregoing transcript of the field notes of the above-described surveys in , has been correctly copied from the original notes on file in this office.

.....
U. S. Surveyor General.

Book "F"

Group 45 - Arizona

OK 3247

~ DATE DIAGRAM ~

Surveys executed on dates shown on this diagram by H.G. Bardsley, U.S. Surveyor.

							4-21-15	
	1	6	5	4	3	2	1	
	4-10-15	4-19-15	4-20-15		4-23-15	4-23-15	4-23-15	
4-10-15	12	7	8	9	10	11	12	4-20-15
	4-23-15	4-23-15	4-23-15	4-23-15	4-23-15			4-20-15
4-10-15	13	18	17	16	15	14	13	4-20-15
	4-23-15	4-23-15	4-23-15	4-23-15	4-23-15	4-22-15	4-22-15	4-20-15
4-10-15	24	19	20	21	22	23	24	4-20-15
	4-10-15	4-19-15			4-21-15	4-22-15	4-22-15	4-20-15
4-10-15	25	30	29	28	27	26	25	4-20-15
	4-10-15	4-19-15			4-21-15	4-22-15		4-20-15
4-10-15	36	31	32	33	34	35	36	4-20-15
	4-10-15	4-19-15			4-21-15			4-20-15
	4-2-15	4-16-15	4-16-15	4-16-15	4-16-15	4-16-15	4-16-15	

T.27N.

T.27N.

R.20W.

R.21W.

228

38
OK 3247

CERTIFICATE OF UNITED STATES SURVEYOR.

I, H. G. Bardsley, U. S. Surveyor, hereby certify upon honor that, in pursuance of special instructions received from the U. S. Surveyor General for Group 45, Arizona, bearing date of the 7th day of January, 1915, I have well, faithfully, and truly in my own proper person, and in strict conformity with said instructions, the Manual of Surveying Instructions, and the laws of the United States, surveyed all those parts or portions of the Subdivision lines of

TOWNSHIP 27 NORTH, RANGE 20 WEST, and
TOWNSHIP 27 NORTH, RANGE 21 WEST,

of the Gila and Salt

River Base and Meridian, in the State of Arizona, which are represented by the diagram on the reverse hereof and in the foregoing field notes as having been executed by me, and under my direction; and that all the corners of said survey have been established and perpetuated in strict accordance with the Manual of Surveying Instructions, and the special written instructions of the U. S. Surveyor General for Group 45, Arizona, and in the specific manner described in the field notes, and that the foregoing are the original field notes of such survey.

H. G. Bardsley
U. S. Surveyor.

APPROVAL.

OFFICE OF THE UNITED STATES SURVEYOR GENERAL,

Phoenix, Arizona, March 17, 1919

The foregoing field notes of the survey of part of the

Subdivision Lines of TOWNSHIP 27 NORTH, RANGE 20 WEST, and
" TOWNSHIP 27 NORTH, RANGE 21 WEST,

of the Gila and Salt River Base and Meridian, in the State of Arizona,

executed by H. G. Bardsley, U. S. Surveyor, and Royston C. Durnford, U. S. Transitman, under ~~his~~ special instructions dated January 7, 1915, for Group 45, Arizona, having been critically examined, and the necessary corrections and explanations made, the said field notes, and the surveys they describe, are hereby approved.

Frank A. Frost
U. S. Surveyor General.

~~I certify that the foregoing transcript of the field notes of the above described surveys in~~
~~has been correctly copied from the original notes on file in this office.~~

U. S. Surveyor General.