

3251

139

Book "J"

4-679

BOOK 3251

(Subdivisions)

FIELD NOTES

OF THE SURVEY OF THE

Completion of the Subdivision lines of

TOWNSHIP 28 NORTH, RANGE 17 WEST,

and of the Survey of

All of the Subdivision lines of

TOWNSHIP 28 NORTH, RANGE 18 WEST,

and RESURVEY of

Part of the Subdivision Lines of

TOWNSHIP 28 NORTH, RANGE 17 WEST,

Of the Gila and Salt River Base and Meridian,

In the State of Arizona.

EXECUTED BY

E. J. Lange, U. S. Surveyor,

and

S. Frank Walters, U. S. Transitman,

~~In the capacity of U. S. Surveyor~~, under instructions dated January 7, 1915, issued by the United States Surveyor General to govern surveys included in Group No. 45, which were approved by the Commissioner of the General Land Office, January 28, 1915.

Survey & Re Survey commenced February 9, 1916.

Survey & Re Survey completed March 24, 1916.

Executed under Assignment
Instructions dated Nov. 29, 1915 and Dec. 10, 1915.

3251

3251

Book "J"

Group 45 - - - Arizona.

SEE SPECIAL INDEX DIAGRAM.

INDEX DIAGRAM.

Township _____, Range _____

6	5	4	3	2	1
7	8	9	10	11	12
18	17	16	15	14	13
19	20	21	22	23	24
30	29	28	27	26	25
31	32	33	34	35	36

BOOK 3251

Book "J"

Group 45 - - Arizona.

SPECIAL INDEX DIAGRAM.

PART I.

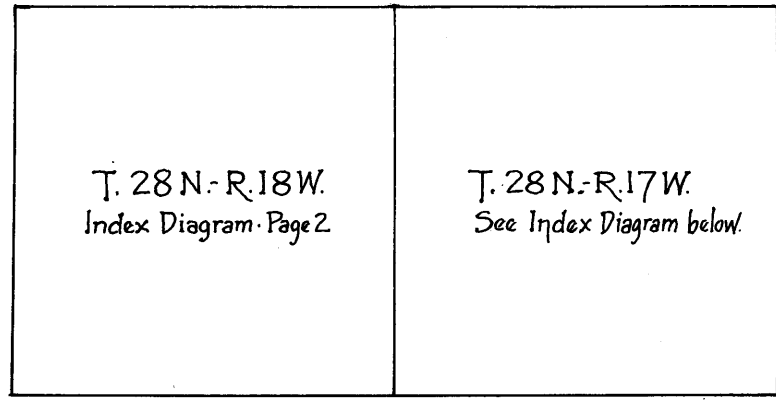

Area surveyed as per accepted plats on file.

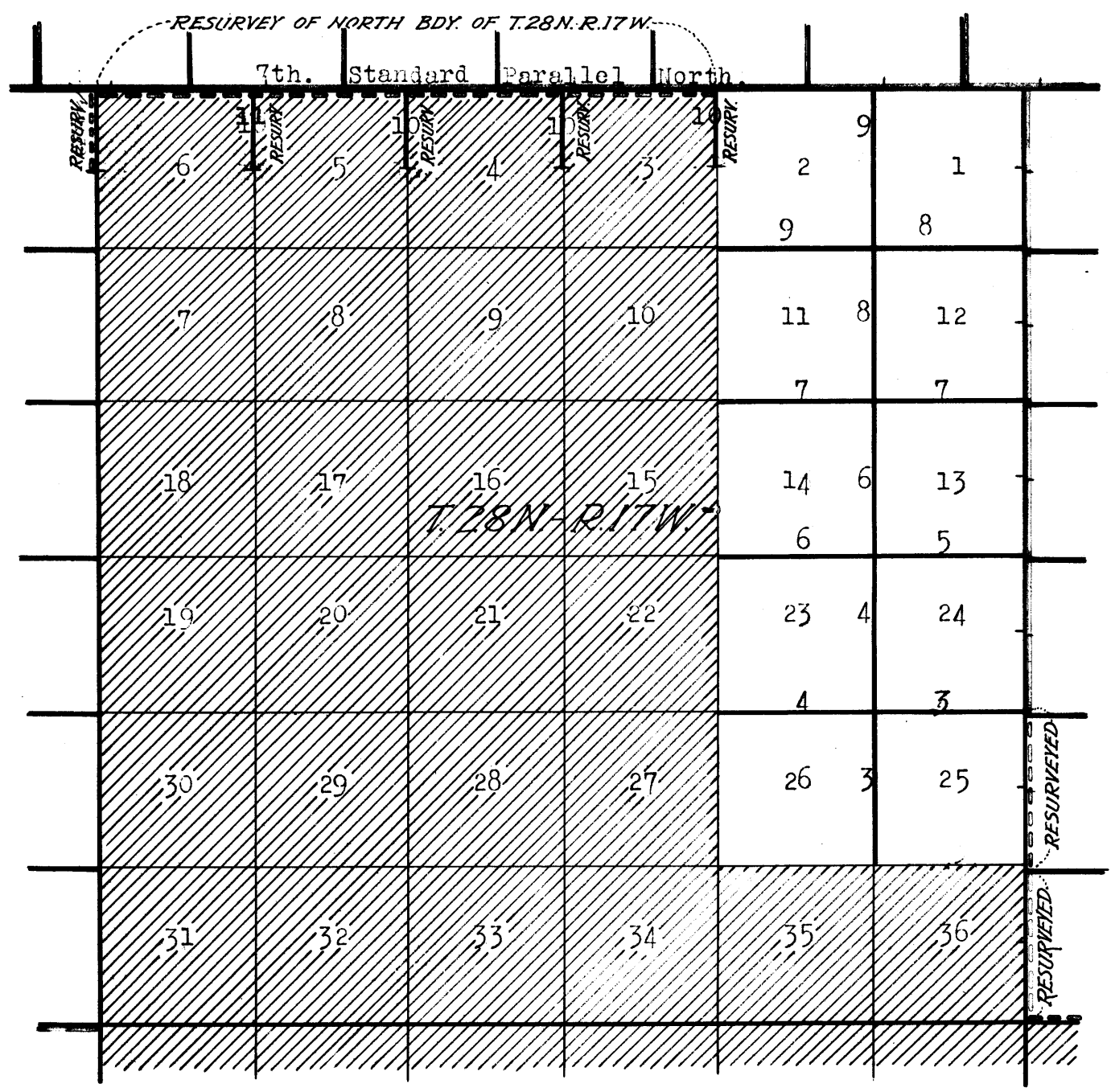

- Subdivision lines surveyed ^{or resurveyed} under this group.
- Township bdrs. surveyed under this group.
Notes in Book "A."
- Township bdrs. retraced or resurveyed under this group.
Notes in Book "A."
- Standard lines surveyed under this group.
Notes in Book "A."
- Accepted surveys.

Book "J"

Group 45 - - Arizona.

SPECIAL INDEX DIAGRAM.

PART II.

BOOK 3251

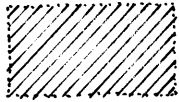

Area surveyed as per accepted plats on file.

7th. Standard Parallel North.										
6	43	5	35	4	28	3	23	2	17	1
42		42		34		28		22		17
7	41	8	33	9	27	10	22	11	16	12
41		40		33		27		21		16
18	40	17	32	16	26	15	21	14	15	13
40		39		32		26		20		15
19	38	20	31	21	25	22	20	23	15	24
38		37		31		25		19		14
30	37	29	30	28	24	27	19	26	14	25
36		36		30		24		18		13
31	35	32	29	33	23	34	18	35	15	36

T.28N.-R.18W.

Subdivision lines surveyed under this group.

Township boundaries surveyed under this group.
Notes in Book "A"

Township bds. retraced or surveyed under this group.
Notes in Book "A"

Standard lines surveyed under this group.
Notes in book "A".

Accepted surveys.

Completion of Subdivision of T. 28 N., R. 17 W.

Chains.

Survey commenced Feb. 24, 1916, and executed jointly by E. J. Lange, U. S. Surveyor, and S. Frank Walters, U. S. Transitman, with Young and Sons' light mountain transits Nos. 8524 and 8489, respectively, both of which instruments are described with records of approval and tests, in book "As of this group" of approval, and the initials "E. J. L." and "S. F. W." are hereinafter inserted at the beginning and ending of those portions of the field notes describing the surveys executed by E. J. Lange, U. S. Surveyor, and S. Frank Walters, U. S. Transitman, respectively.

Knowing from recent and repeated tests of our instruments on a meridian established by observations on Polaris at elongation, that they are in good adjustment, we proceed to the subdivision of T. 27 N., R. 10 W., as follows:

Dates of survey shown on pages 45 and 47 hereof.
 E. J. L.
 At 8 hrs. 0 m., a.m., l.m.t., I set off 35° 47' N. on the lat. arc; 9° 45' S. on the decl. arc; and determine a meridian with the solar at the cor. of secs. 25, 26, 35 and 36, which is an iron post, 2 ins. diam., properly set, marked and witnessed as described by the Surveyor-General.

12.22
 24.80
 40.00

Thence
 N. 0° 1' W., bet. secs. 25 and 26.
 Over mountainous land, through scattering undergrowth.
 Asc. 320 ft. to
 Ridge, brs. E. and W. Desc. 220 ft. to
 Wash, course W. Thence over rolling land, along W. slope.
 Set an iron post, 3 ft. long, 1 in. diam., in a mound of stone, for $\frac{1}{4}$ sec. cor., marked on brass cap
 1916 on S. rim;
 S26 in W. and
 S25 in E. half;
 and raise a mound of stone, 2 ft. base, 1 $\frac{1}{2}$ ft. high, W. of cor.

54.30
 79.00
 80.00

From this cor., open cistern, 75 X 50 lks., at intake of pipe line, brs. N. 31 $\frac{1}{2}$ ° W.
 Wash, course S. 70° W.
 Open cistern brs. S. 58° W.
 Set an iron post, 3 ft. long, 2 ins. diam., in a mound of stone, for cor. of secs. 23, 24, 25 and 26, marked on brass cap
 1916 on S. rim;
 T28N R17W in N. half;
 S23 in NW.,
 S24 in NE.,
 S25 in SE. and
 S26 in SW. quadrant;
 and raise amount of stone, 2 ft. base, 1 $\frac{1}{2}$ ft. high, W. of cor.

Land, rolling and mountainous.
 Soil, rocky; 4th rate.
 No timber.
 Undergrowth, yucca, sagebrush, and cacti.

Feb. 24, 1916. At 10:30 a.m., l.m.t., I set off 35° 47' N. on the lat. arc; 9° 23' S. on the decl. arc; and determine a meridian with the solar at the cor. of secs. 23, 24, 25 and 26.

40.00
 80.38

Feb. 25, 1916. At 8 hrs. 3 m., a.m., l.m.t., I set off 35° 47' N. on the lat. arc; 9° 23' S. on the decl. arc; and determine a meridian with the solar at the cor. of secs. 23, 24, 25 and 26.
 Thence
 S. 89° 57' E., on a random line, bet. secs. 24 and 25.
 Set temp. $\frac{1}{4}$ sec. cor.
 Intersect E. bdy. of Tp., 28 lks. S. of the reestablished cor. of secs. 24 and 25, described in Book "AINS. 5124", properly set, marked and witnessed as described by the

4. Completion of Subdivision of T. 28 N., R. 17 W.

Chains.

Thence I run

S.89° 51' W., on a true line, bet. secs. 24 and 25.
Over mountainous land, through scattering undergrowth.

Asc. 25 ft. to

2.55 Rocky spur, slopes S.30° W. Desc. 710 ft. to

23.80 Gulch, course S.60° W. Asc. 110 ft.

40.19 Set an iron post, 3 ft. long, 1 in. diam., in a mound of
stone, for $\frac{1}{4}$ sec. cor., marked on brass cap

1916 on S. rim;

S24 $\frac{1}{4}$ in N. and

S25 in S. half;

and raise a mound of stone, 2 ft. base, 1 $\frac{1}{2}$ ft. high,
N. of cor.

48.85 Spur, slopes SW. Desc. 360 ft. to

66.40 Asc. 25 ft. to

71.40 Spur, slopes S. Desc. 255 ft. to

80.38 The cor. of secs. 23, 24, 25 and 26.

Land, mountainous.

Soil, rocky; 4 th rate.

No timber.

Undergrowth, pinion, cedar and sagebrush.

Feb. 17, 1916. The sky was overcast at noon, making an
observation of the sun impossible.

E. J. L.

Thence I run

N.89° 58' W., on a random line, bet. secs. 23 and 26.

40.00 Set temp; $\frac{1}{4}$ sec. cor.80.37 Intersect N. and S. line, 16 lks. N. of the cor. of secs.
22, 23, 26 and 27, which is an iron post, 2 ins. diam.,
properly set, marked and witnessed as described by the
Surveyor-General.

Thence I run

N.89° 55' E., on a true line, bet. secs. 23 and 26.

Over mountainous land, thro ugh scattering undergrowth.

Asc. 390 ft. to

9.49 Desc. 30 ft. to

18.85 Asc. 205 ft. to

29.27 Spur, slopes NE. Desc. 170 ft.

40.18 $\frac{1}{2}$ Set an iron post, 3 ft. long, 1 in. diam., in a mound of
stone, for $\frac{1}{4}$ sec. cor., marked on brass cap

1916 on S. rim;

S23 $\frac{1}{4}$ in N. and

S26 in S. half;

and raise a mound of stone, 2 ft. base, 1 $\frac{1}{2}$ ft. high,
N. of cor.

44.75 Asc. 45 ft. to

47.85 Spur, slopes SE. Desc. 325 ft. to

69.24 Wash, course S. Asc. 70 ft.

70.34 Pipe line, brs. N. and S.

80.37 The cor. of secs. 23, 24, 25 and 26.

Land, mountainous.

Soil, rocky, 4th rate.

No timber.

Undergrowth, scrub oak, pinion and yucca.

E. J. L.

S. F. W.

N.0° 1' W., bet. secs. 23 and 24.

Over mountainous land, through scattering undergrowth.

Asc. 200 ft. to

10.20 Spur, slopes W. Desc. 65 ft. to

19.15 Gulch, course W. Asc. 30 ft. to

24.20 Spur, slopes SW. Desc. 20 ft. to

27.20 Gulch, course SW. Pipe line in gulch, brs. NE. and SW.

Completion of Subdivision of T. 28 N., R. 17 W. 5

Chains.	<p>Asc. 90 ft. to 33.00 Spur, slopes SW. Desc. 15 ft. to 38.10 Gulch, course SW. Pipe line in gulch, brs. NE. and SW. Asc. 350 ft. 40.00 Set an iron post, 3 ft. long, 1 in. diam., 26 ins. in the ground, for $\frac{1}{4}$ sec. cor., marked on brass cap 1916 on S. rim; S23 $\frac{1}{4}$ in W. and S24 in E. half; and raise a mound of stone, 2 ft. base, $1\frac{1}{2}$ ft. high, W. of cor. 45.00 Spring, intake of pipe line, brs. E. about 4 chs. dist. 62.10 Spur, slopes SE. Desc. 20 ft. to 70.15 Asc. 85 ft. to 77.00 Spur, slopes NW. Desc. 15 ft. to 80.00 Set an iron post, 3 ft. long, 2 ins. diam., 24 ins. in the ground, for cor. of secs. 13, 14, 23 and 24, marked on brass cap 1916 on S. rim; T28N R17W in N. half; S14 in NW., S13 in NE., S24 in SE. and S23 in SW. quadrant; and raise a mound of stone, 2 ft. base, $1\frac{1}{2}$ ft. high, W. of cor. Land, mountainous. Soil, rocky; 4th rate. No timber. Undergrowth, yucca, sagebrush, cat claw and cacti. Some grass. Feb. 24, 1916: At this cor. I set off 35° 48' N. on the decl. arc; and on adjacent 200' I observe the sun on the meridian; the resulting lat. is 35° 48' N. Feb. 24, 1916.</p>
<p>40.00 80.48 5.50 40.24 46.75 58.00 80.48</p>	<p>Feb. 25, 1916. At 9 hrs. 58 m., a.m., l.m.t., I set off 35° 48' N. on the lat. arc; 9° 22' S. on the decl. arc; and determine a meridian with the solar at the cor. of secs. 13, 14, 23 and 24. Thence I run N. 89° 51' E., on a random line, bet. secs. 24 and 13. Set temp. $\frac{1}{4}$ sec. cor. Intersect E. Bdy. of Tp., 21 lks. N. of the cor. of secs. 13, and 24, which is an iron post, established by E. J. L., as described in Book "A." Thence I run West on a true line, bet. secs. 13 and 24. Over mountainous land, through scattering undergrowth. Asc. 70 ft. to Main divide, brs. NW. and SE. Desc. 1290 ft. Set an iron post, 3 ft. long, 1 in. diam., 26 ins. in the ground, for $\frac{1}{4}$ sec. cor., marked on brass cap 1916 on S. rim; S13 $\frac{1}{4}$ in N. and S24 in S. half; and raise a mound of stone, 2 ft. base, $1\frac{1}{2}$ ft. high, N. of cor. Rocky gulch, course SW. Asc. 270 ft. to Ridge, brs. NE. and SW. Desc. 820 ft. to The cor. of secs. 13, 14, 23 and 24. Land, mountainous. Soil, rocky; 4th rate. Timber, cedar and pinion. Undergrowth, yucca, cat claw, sagebrush, scrub oak and cacti. Feb. 25, 1916. The air was exceedingly clear, making an observation for lat. impossible. Feb. 25, 1916.</p>

Completion of Subdivision of T. 28 N., R. 17 W.

Chains.

S. 89° 55' W., on a random line, bet. secs. 14 and 23.
 40.00 Set temp. $\frac{1}{4}$ sec. cor.
 80.33 Intersect N. and S. line, 11 lks. S. of the cor. of secs. 14, 15, 22 and 23, which is an iron post, 2 ins. diam., properly set, marked and witnessed as described by the Surveyor-General.
 Thence
 East on a true line, bet. secs. 14 and 23.
 Over mountainous land, through scattering undergrowth.
 Asc. 80 ft. to
 5.80 Spur, slopes S. Desc. 240 ft. to
 18.30 Gulch, course S. Asc. 290 ft.
 40.16 $\frac{1}{2}$ Set an iron post, 3 ft. long, 1 in. diam., 26 ins. in the ground, for $\frac{1}{4}$ sec. cor., marked on brass cap
 1916 on S. rim;
 S14 $\frac{1}{4}$ in N. and
 S23 in S. half;
 and raise a mound of stone, 2 ft. base, 1 $\frac{1}{2}$ ft. high, N. of cor.
 52.00 Top of asc.; desc. 35 ft. to
 53.89 Rocky canyon, course SW. Asc. 230 ft. to
 72.55 Desc. 15 ft. to
 74.52 Gulch, course SW. Asc. 170 ft. to
 80.33 The cor. of secs. 13, 14, 23 and 24.
 Land, mountainous.
 Soil, rocky; 4th rate.
 No timber.
 Undergrowth, yucca, cat claw and cacti.

Feb. 28, 1916: At 2 hrs. 4 m., p.m., l.m.t., I set off 35° 48 $\frac{1}{2}$ ' N. on the lat. arc; 8° 11' S. on the decl. arc; and determine a meridian with the solar at the cor. of secs. 13, 14, 23 and 24.

Thence
 N. 0° 1' W., bet. secs. 13 and 14.
 Over mountainous land, through scattering undergrowth.
 Asc. 1300 ft.
 40.00 Set an iron post, 3 ft. long, 1 in. diam., 26 ins. in the ground, for $\frac{1}{4}$ sec. cor., marked on brass cap
 1916 on S. rim;
 S14 $\frac{1}{4}$ in W. and
 S13 in E. half;
 and raise a mound of stone, 2 ft. base, 1 $\frac{1}{2}$ ft. high, W. of cor.
 Continue to ascend.
 49.72 Enter scattering timber, brs. NE. and SW. Ridge, brs. NE. and SW. Desc. 570 ft. to
 68.00 Gulch, course SW. Asc. 75 ft. to
 80.00 Set an iron post, 3 ft. long, 2 ins. diam., 24 ins. in the ground, for cor. of secs. 11, 12, 13 and 14, marked on brass cap
 1916 on S. rim;
 T28N R17W in N. half;
 S11 in NW.,
 S12 in NE.,
 S13 in SE. and
 S14 in SW. quadrant;
 and raise a mound of stone, 2 ft. base, 1 $\frac{1}{2}$ ft. high, W. of cor.
 Land, mountainous.
 Soil, rocky; 4th rate.
 Timber, scrub cedar and pinion.
 Undergrowth, yucca, scrub oak, sagebrush and cacti.
 Some bunch grass.

Completion of Subdivision of T. 28 N., R. 17 W.

Chains.	
	Feb. 29, 1916: At 9 hrs. 5 m., a.m., l.m.t., I set off 35° 49½' N. on the lat. arc; 7° 53' S. on the decl. arc; and determine a meridian with the solar at the cor. of secs. 11, 12, 13 and 14.
	Thence
	East on a random line, bet. secs. 12 and 13.
20.00	Set temp. point. Storm prevented further work today.
	Mar. 1, 1916: At 8 hrs. 54 m., a.m., l.m.t., I set off 35° 49½' N. on the lat. arc; 7° 30½' S. on the decl. arc; and determine a meridian with the solar at the temp. point above described.
	Thence I continue
	East on a random line, bet. secs. 12 and 13.
40.00	Set temp. ¼ sec. cor.
80.45	Intersect E. bdy. of Tp., 2 lks. S. of the cor. of secs. 12 and 13, which is an iron post, established by E. J. L., as described in Book "A."
	Thence
	S. 89° 59' W., on a true line, bet. secs. 12 and 13.
	Over mountainous land, through scattering timber and undergrowth.
	Desc. 320 ft. to
14.30	Gulch, course NW. Asc. 570 ft.
40.22½	Set an iron post, 3 ft. long, 1 in. diam., 26 ins. in the ground, for ¼ sec. cor., marked on brass cap 1916 on S. rim; S12 ¼ in N. and S13 in S. half; and raise a mound of stone, 2 ft. base, 1½ ft. high, N. of cor.
50.80	Desc. 30 ft. to
53.25	Asc. 370 ft. to
70.45	Spur, slopes NW. Desc. 330 ft. to
80.45	The cor. of secs. 11, 12, 13 and 14.
	Land, mountainous.
	Soil, rocky; 4th rate.
	Timber, scrub cedar and pinion.
	Undergrowth, yucca, sagebrush, cat claw and cacti.
	West on a random line, bet secs. 11 and 14.
40.00	Set temp. ¼ sec. cor.
80.48	Intersect N. and S. line, 23 lks. S. of the cor. of secs. 10, 11, 14 and 15, which is a 2 in. iron post, with brass cap, marked & witnessed as described by Surveyor Gen'l. S. 89° 50' E., on a true line, bet. secs. 11 and 14.
	Thence
	Over mountainous land, through scattering undergrowth.
	Asc. 550 ft. to
32.90	Spur, brs. NW. Desc. 335 ft.
40.24	Set an iron post, 3 ft. long, 1 in. diam., 26 ins. in the ground, for ¼ sec. cor., marked on brass cap 1916 on S. rim; S11 ¼ in N. and S14 in S. half; and raise a mound of stone, 2 ft. base, 1½ ft. high, N. of cor.
53.40	Gulch, course NW. Asc. 765 ft. to
80.48	The cor. of secs. 11, 12, 13 and 14.
	Land, mountainous.
	Soil, rocky; 4th rate.
	No timber.
	Undergrowth, yucca, cat claw and cacti.
	Mar. 1, 1916: At this cor. I set off 35° 49½' N. on the lat. arc; 7° 30½' S. on the decl. arc; and determine a meridian with the solar at the cor. of secs. 11, 12, 13 and 14.

Chains.

- Mar. 2, 1916: At 9 hrs. 4 m., a.m., l.m.t., I set off $35^{\circ} 49\frac{1}{2}'$ N. on the lat. arc; $7^{\circ} 7\frac{1}{2}'$ S. on the decl. arc; and determine a meridian with the solar at the cor. of secs. 11, 12, 13 and 14.
- Thence
N. $0^{\circ} 1'$ W., bet. secs. 11 and 12.
Over mountainous land, through scattering timber and undergrowth.
Asc. 90 ft. to
4.75 Desc. 45 ft. to
9.70 Asc. 15 ft. to
10.70 Spur, slopes W. Desc. 966 ft.
40.00 Set an iron post, 3 ft. long, 1 in. diam., 26 ins. in the ground, for $\frac{1}{4}$ sec. cor., marked on brass cap
1916 on S. rim;
S11 $\frac{1}{4}$ in W. and
S12 in E. half;
and raise a mound of stone, 2 ft. base, $1\frac{1}{2}$ ft. high, W. of cor.
- 47.76 Wash, course NW. Thence over rolling land.
80.00 Set an iron post, 3 ft. long, 2 ins. diam., 24 ins. in the ground, for cor. of secs. 1, 2, 11 and 12, marked on brass cap
1916 on S. rim;
T28N R17W in N. half;
S2 in NW.,
S1 in NE.,
S12 in SE. and
S11 in SW. quadrant;
dig pits, 18 X 18 X 12 ins., in each sec., $5\frac{1}{2}$ ft. dist.;
and raise a mound of earth, 4 ft. base, 2 ft. high, W. of cor.
- Land, mountainous and rolling.
Soil, 2nd and 4th rate.
Timber, scrub pinion and cedar.
Undergrowth, yucca, cat claw and cacti.
Some bunch grass.
-
- 40.00 N. $89^{\circ} 59'$ E., on a random line, bet. secs. 1 and 12.
Set temp. $\frac{1}{4}$ sec. cor.
80.33 Intersect E. bdy. of Tp. 35 lks. S. of the cor. of secs. 1, and 12, which is an iron post, established by E. J. L., as described in Book "A".
Thence,
S. $89^{\circ} 44'$ W., on a true line, bet. secs. 1 and 12.
Over mountainous land, through scattering undergrowth.
Desc. 205 ft. to
10.00 Gulch, course SW. Asc. 175 ft. to
18.00 Spur, slopes SW. Desc. along S. slope, 1095 ft.
40.16 $\frac{1}{2}$ Set an iron post, 3 ft. long, 1 in. diam., 26 ins. on the ground, for $\frac{1}{4}$ sec. cor., marked on brass cap
1916 on S. rim;
S1 $\frac{1}{4}$ in N. and
S12 in S. half;
and raise a mound of stone, 2 ft. base, $1\frac{1}{2}$ ft. high, N. of cor.
- 80.33 Cor. falls on spur, slopes S. Continue descent to
The cor. of secs. 1, 2, 11 and 12.
Land, mountainous.
Soil, rocky; 4th rate.
No timber.
Undergrowth, yucca, cat claw and cacti.
Mar. 2, 1916: At this cor., I set off $7^{\circ} 5'$ on the decl. arc; and at apparent noon, I observe the sun on the meridian; the resulting lat. is $35^{\circ} 54\frac{1}{2}'$ N.

Completion of Subdivision of Township 28 North, Range 17 West. 9

Chains.

40.00 N. 89° 50' W., on a random line, bet. secs. 2 and 11.
Set temp. $\frac{1}{2}$ sec. cor.

80.40 Intersect N. and S. line, 11 lks. S. of the cor. of secs. 2, 3, 10 and 11, a 2 in. iron post, with brass cap, mkd. & witnessed as described by the surveyor general. Thence S. 89° 45' E., on a true line, bet. secs. 2 and 11.
Over level land, thru. scattering undergrowth.

22.60 Road brs. NE and SW.

40.20 Set an iron post, 3 ft. long, 1 in. in diam., 26 ins. in the ground, for $\frac{1}{4}$ sec. cor., marked on brass cap,
1916 on S. rim;
S 2 $\frac{1}{4}$ in N., and
S 11 in S. half;
dig pits, 18x18x12 ins., E. and W. of post, 3 ft. dist., and raise a mound of earth 3 $\frac{1}{2}$ ft. base, 1 $\frac{1}{2}$ ft. high, N. of cor.

80.40 The cor. of secs. 1, 2, 11 and 12.
Land, level.
Soil, 2nd and 4th rate.
No timber.
Undergrowth, yucca, catclaw and cacti.
Some bunch grass.

N. 0° 1' W., on a true line, bet. secs. 1 and 2.
Over mountainous land, thru. scattering undergrowth.
Ascend 55 ft. to

11.30 Descend 30 ft. to

14.90 Ascend 155 ft. to

34.70 Spur, slopes W. Descend 90 ft.

40.00 Set an iron post, 3 ft. long, 1 in. in diam., 26 ins. in the ground, for $\frac{1}{4}$ sec. cor., marked on brass cap,
1916 on S. rim,
S 2 $\frac{1}{4}$ in W., and
S 1 in E. half;
and raise a mound of stone, 2 ft. base, 1 $\frac{1}{2}$ ft. high, W. of cor.

45.00 From this point, a spring brs. E. 5 chs. dist.

45.76 Wash, course W. Ascend 125 ft. to

54.50 Spur, slopes W. Descend 110 ft.

64.92 Road brs. NE and SW.

80.45 Intersect the Seventh Standard Parallel North, 7.13 chs. W. of the standard $\frac{1}{4}$ sec. cor. of sec. 36, T. 29 N., R. 17 W., described in Book "A."
At the point of intersection, set an iron post, 3 ft. long, 2 ins. in diam., 24 ins. in the ground, for closing cor. of secs. 1 and 2, marked on brass cap,
1916 on S. rim,
T29N R17W S36 in N., and
CC in S. half;
S 1 R17W in SE., and
S 2 T28N in SW. quadrant;
and raise a mound of stone, 2 ft. base, 1 $\frac{1}{2}$ ft. high, S. of cor.
Land, mountainous.
Soil, 2nd and 4th rate.
No timber.
Undergrowth, yucca, catclaw and cacti.
Some grass. S.F.W.

10 Resurvey of part of the Subdivision lines of T.28 N., R.17 W.

Chains.

S.E.W.

From the $\frac{1}{4}$ sec.cor., bet.secs.2 and 3, which is an iron post, 1 in. in diam., properly set, marked and witnessed, as described by the surveyor general,

N.0°1'W., on a true line, bet.secs.2 and 3 (north half).
Topographical features not measured.

40.00

Intersect the 7th. Standard Parallel North, 7.53 chs.W. of the standard $\frac{1}{4}$ sec.cor. of sec.35, T.29 N., R.17 W. described in Book "A.". At point of intersection, Set an iron post 3ft.long, 2 ins.in diam., 24 ins. in the ground, for closing cor. of secs.2 and 3, marked on brass cap,

T29N R17W

S 35

S 3	S 2
T28N	R17W

C C

1916

dig pits 24x18x12 ins.crosswise on each line E. and W.3 ft. and S. of post 7 ft. dist., and raise a mound of earth 4 ft. base, 2 ft. high, S. of cor.

Land, rolling.

Soil, gravelly, 3rd rate.

No timber. Undergrowth, scattering greasewood and cacti.

S.E.W.

E.J.L.

From the $\frac{1}{4}$ sec.cor., bet. secs. 3 and 4, which is an iron post, 1 in. in diam., properly set, marked and witnessed, as described by the surveyor general,

N.0°3'W., on a true line, bet. secs.3 and 4 (North half).
Topographical features not measured.

40.03

Intersect the Seventh Standard Parallel North, 7.07 chs. W. of the standard $\frac{1}{4}$ sec.cor. of sec.34, T.29 N., R.17 W., which is an iron post, established by me, as described in Book "A." At point of intersection, Set an iron post 3 ft. long, 2 ins. in diam., 24 ins. in the ground, for closing cor. of secs.3 and 4, marked on brass cap,

T29N R17W

S34

S4	S3
T28N	R17W

C C

1916

and raise a mound of stone, 2 ft. base, 1½ ft. high, S. of cor.

Land, rolling.

Soil, gravelly, 3rd rate.

No timber,

Undergrowth, scattering greasewood and cacti.

From the $\frac{1}{4}$ sec.cor. bet. secs.4 and 5, which is an iron post, 1 in. in diam., properly set, marked and witnessed as described by the surveyor general,

N.0°1'W., on a true line, bet.secs.4 and 5 (North half).
Topographical features not measured.

40.28

Intersect the Seventh Standard Parallel North, 6.80 chs. W. of the Standard $\frac{1}{4}$ sec.cor. of sec.33, T.29 N., R.17 W., which is an iron post, established by me, as described in Book "A."

At point of intersection,

Set an iron post, 3 ft. long, 2 ins. in diam., 24 ins. in the ground, for closing cor. of secs. 4 and 5, marked on brass cap,

Resurvey of part of the Subdivision lines of T.28N.,R.17 W. 11

Chains.

T29N R17W	
S33	
S 5	S 4
T28N	R17W
C	C
1916	

and raise a mound of stone, 2 ft. base, 1½ ft. high, S. of cor.

Land, rolling.

Soil, gravelly, 3rd rate.

No timber.

Undergrowth, scattering greasewood and cacti.

From the ¼ sec. cor., bet. secs. 5 and 6, which is an iron post, 1 in. in diam., properly set, marked and witnessed, as described by the surveyor general, N.0°2'W., on a true line, bet. secs. 5 and 6 (North half). Topographical features not measured.

40.43 Intersect the Seventh Standard Parallel North, 6.55 chs. W. of the standard ¼ sec. cor. of sec. 32, T.29 N., R.17 W., which is an iron post, established by me, as described in Book "A."

At point of intersection,

Set an iron post 3 ft. long, 2 ins. in diam., 24 ins. in the ground, for closing cor. of secs. 5 and 6, marked on brass cap.

T29N R17W	
S32	
S 6	S 5
T28N	R17W
C	C
1916	

and raise a mound of stone, 2 ft. base, 1½ ft. high, S. of cor.

Land, rolling and mountainous.

Soil, rocky and gravelly, 3rd rate.

No timber.

Scattering undergrowth of cactus and greasewood.
E.J.L.

GENERAL DESCRIPTION.

With the exception of a portion of secs. 2 and 11, which are level and rolling, the land in this township is very mountainous. It is covered with a scattering growth of pinon and cedar timber, as well as yucca, catclaw and cacti undergrowth.

The soil is rocky, 3rd and 4th rate, and is suitable for slight grazing only.

There are no settlers in the township. Water is found in secs. 1, 24 and 26.

--	--	--	--

Subdivision of T. 28 N., R. 18 W.

Chains.

Survey commenced Feb. 9, 1916, and executed jointly by E. J. Lange, U. S. Surveyor, and S. Frank Walters, U. S. Transitman, with Young and Sons' light mountain transits Nos. 8524 and 8489, respectively, described in Book "A". Dates of execution shown on pages 45 & 47 hereof. Lists of adjustments, and certificates of approval, see The initials "E. J. L." and "S. F. W." are inserted at the beginning and ending of those portions of the notes describing the surveys executed refer by E. J. Lange, U. S. Surveyor, and S. Frank Walters, U. S. Transitman, respectively.

Knowing from recent and repeated tests of the instruments on a meridian established by observations on Polaris at elongation, demonstrate that they are in satisfactory adjustment, the subdivision of T. 28 N., R. 18 W., as follows:
E. J. L. and S. F. W.

E. J. L. Feb. 14, 1916.
At 8 hrs. 8 m., a.m., l.m.t., I set off 35° 46' N. on the lat. arc; 13° 17' S. on the decl. arc; and determine a meridian with the solar at the cor. of secs. 1, 2, 35 and 36, on the S. bdy. of the Tp., which is an iron post, established by H. G. Bardsley, U. S. Surveyor, as described in Book "A".

Thence
N. 0° 1' W., bet. secs. 35 and 36.
Over gently rolling land, through dense undergrowth.
40.00 Set an iron post, 3 ft. long, 1 in. diam., 26 ins. in the ground, for 1/4 sec. cor., marked on brass cap
1916 on S. rim;
S35 1/4 in W. and
S36 in E. half;
dig pits, 18 X 18 X 12 ins., N. and S. of post, 3 ft. dist.; and raise a mound of earth, 3 1/2 ft. base, 1 1/2 ft. high, W. of cor.

42.60 Wash, course NE.

67.80 Wash, course NE.

80.00 Set an iron post, 3 ft. long, 2 ins. diam., 24 ins. in the ground, for cor. of secs. 25, 26, 35 and 36, marked on brass cap

1916 on S. rim;
T28 N R18 W in N. half;
S26 in NW.,
S25 in NE.,
S36 in SE. and
S35 in SW. quadrant;

dig pits, 18 X 18 X 12 ins., in each sec., 5 1/2 ft. dist.; and raise a mound of earth, 4 ft. base, 2 ft. high, W. of cor.

Land, gently rolling.
Soil, sandy loam; 1st rate.
No timber.
Undergrowth, greasewood, yucca and cacti.

40.00 N. 89° 55' E., on a random line, bet. secs. 25 and 36.
Set temp. 1/4 sec. cor.

80.06 Intersect E. bdy. of Tp., 5 lks. N. of the cor. of secs. 25, 30, 31 and 36, which is an iron post, 3 ins. diam., properly set, marked and witnessed as described by the Surveyor-General.

Thence
S. 89° 57' W., on a true line, bet. secs. 25 and 36.
Over gently rolling land, through dense undergrowth.

3.70 Road, brs. N. 20° E. and S. 20° W.

40.03 Set an iron post, 3 ft. long, 1 in. diam., 26 ins. in the ground, for 1/4 sec. cor., marked on brass cap

1916 on S. rim;
S25 1/4 in N. and
S36 in S. half;

dig pits, 18 X 18 X 12 ins., E. and W. of post, 3 ft.

14

Subdivision of T. 28 N., R. 18 W.

Chains.	dist.; and raise a mound of earth, $3\frac{1}{2}$ ft. base, $1\frac{1}{2}$ ft. high, N. of cor.
80.06	The cor. of secs. 25, 26, 35 and 36. Land, gently rolling. Soil, sandy loam; 1st rate. No timber. Undergrowth, yucca, greasewood, and cacti.
40.00	Feb. 15, 1916: At 8 hrs. 30 m., a.m., l.m.t., I set off $35^{\circ} 47'$ N. on the lat. arc; $12^{\circ} 56\frac{1}{2}'$ S. on the decl. arc; and determine a meridian with the solar at the cor. of secs. 25, 26, 35 and 36. Thence N. $0^{\circ} 1'$ W., bet. secs. 25 and 26. Over gently rolling land, through scattering undergrowth. Set an iron post, 3 ft. long, 1 in. diam., 26 ins. in the ground, for $\frac{1}{4}$ sec. cor., marked on brass cap 1916 on S. rim; S26 $\frac{1}{4}$ in W. and S25 in E. half; dig pits, 18 X 18 X 12 ins., N. and S. of post, 3 ft. dist.; and raise a mound of earth, $3\frac{1}{2}$ ft. base, $1\frac{1}{2}$ ft. high, W. of cor.
67.50	Road, brs. N. 60° E. to Grigg's Ferry and S. 60° W. to Cyclopic.
80.00	Set an iron post, 3 ft. long, 2 ins. diam., 24 ins. in the ground, for cor. of secs. 23, 24, 25 and 26, marked on brass cap 1916 on S. rim; T28N R18W in N. half; S23 in NW., S24 in NE., S25 in SE. and S26 in SW. quadrant; dig pits, 18 X 18 X 12 ins., in each sec., $5\frac{1}{2}$ ft. dist. and raise a mound of earth, 4 ft. base, 2 ft. high, W. of cor. Land, gently rolling. Soil, sandy loam, 2nd rate. No timber. Undergrowth, yucca, cacti and greasewood.
40.00	N. $89^{\circ} 57'$ E., on a random line, bet. secs. 24 and 25. Set temp. $\frac{1}{4}$ sec. cor.
80.05	Intersect E. bdy. of Tp., 11 lks. S. of the cor. of secs. 19, 24, 25 and 30, which is an iron post, 3 ins. diam., properly set, marked and witnessed as described by the Surveyor-General.
40.02 $\frac{1}{2}$	Thence S. $89^{\circ} 52'$ W., on a true line, bet. secs. 24 and 25. Over gently rolling land, through dense undergrowth. Set an iron post, 3 ft. long, 1 in. diam., 24 ins. in the ground, for $\frac{1}{4}$ sec. cor., marked on brass cap 1916 on S. rim; S24 $\frac{1}{4}$ in N. and S25 in S. half; dig pits, 18 X 18 X 12 ins., E. and W. of post, 3 ft. dist.; and raise a mound of earth, $3\frac{1}{2}$ ft. base, $1\frac{1}{2}$ ft. high, N. of cor.
73.95	Road, brs. N. 40° E. to Grigg's Ferry and S. 40° W. to Cyclopic.
80.05	The cor. of secs. 23, 24, 25 and 26. Land, gently rolling. Soil, sandy loam; 2nd rate. No timber.

Subdivision of Township 28 North, Range 18 West. 15.

Chains.
 Undergrowth, greasewood, yucca and cacti.

N.0°1'W., bet. secs. 23 and 24.
 Over level land, thru dense undergrowth.
 40.00 Set an iron post, 3 ft. long, 1 in. in diam., 24 ins. in the ground, for $\frac{1}{4}$ sec. cor., marked on brass cap,
 1916 on S. rim;
 S23 $\frac{1}{4}$ in W., and
 S24 in E. half;
 dig pits 18x18x12 ins., N. and S. of post, 3 ft. dist., and raise a mound of earth $3\frac{1}{2}$ ft. base, $1\frac{1}{2}$ ft. high, W. of cor.

63.30 Wash, course E.
 74.30 Wash, course NE.
 80.00 Set an iron post, 3 ft. long, 2 ins. in diam., 24 ins. in the ground, for cor. of secs. 13, 14, 23 and 24, marked on brass cap,
 1916 on S. rim;
 T28N R18W in N. half;
 S14 in NW.,
 S13 in NE.,
 S24 in SE., and
 S23 in SW. quadrant;
 dig pits, 18x18x12 ins., in each sec. $5\frac{1}{2}$ ft. dist., and raise a mound of earth, 4 ft. base, 2 ft. high, W. of cor.
 Land, level.
 Soil, sandy loam, 2nd rate.
 No timber.
 Undergrowth, greasewood, yucca and cacti.

N.89° 52'E., on a random line, bet. secs. 13 and 24.
 40.00 Set temp. $\frac{1}{4}$ sec. cor.
 80.02 Intersect E. bdy. of Tp., 16 lks. S. of the cor. of secs. 13, 18, 19 and 24, which is an iron post, 3 ins. in diam., properly set, marked and witnessed as described by the Surveyor General.
 Thence,
 S.89° 45' W., on a true line, bet. secs. 13 and 24.
 Over gently rolling land; thru scattering undergrowth.
 35.60 Road hrs. N.45°E. to Grigg's Ferry, and S.45° W. to Cyclopic.
 35.90 Wash, course N. 45° E.
 40.01 Set an iron post 3 ft. long, 1 in. in diam., 24 ins. in the ground, for $\frac{1}{4}$ sec. cor., marked on brass cap,
 1916 on S. rim;
 S13 $\frac{1}{4}$ in N., and
 S24 in S. half;
 dig pits, 18x18x12 ins., E. and W. of post, 3 ft. dist., and raise a mound of earth, $3\frac{1}{2}$ ft. base, $1\frac{1}{2}$ ft. high, N. of cor.

67.30 Wash, course NE.
 80.02 The cor. of secs. 13, 14, 23 and 24.
 Land, gently rolling.
 Soil, gravelly, 2nd rate.
 No timber.
 Undergrowth, yucca and greasewood.

N.0°1' W., bet. secs. 13 and 14.
 Over gently rolling land, thru scattering undergrowth.
 11.80 Road hrs. NE and SW.
 19.20 Wash, course N. 70°E.
 26.00 Wash, course E.
 40.00 Set an iron post, 3 ft. long, 1 in. in diam., 24 ins. in the ground, for $\frac{1}{4}$ sec. cor., marked on brass cap,
 1916 on S. rim;
 S14 $\frac{1}{4}$ in W., and
 S13 in E. half;

16. Subdivision of Township 28 North, Range 18 West.

Chains.

Dig pits, 18x18x12 ins., N. and S. of post, 3 ft. dist., and raise a mound of earth, 3½ ft. base, 1½ ft. high, W. of cor.

51.00 Wash, course N. 60°E.

58.70 Road brs. N. 80°W. and S. 80°E.

80.00 Set an iron post 3 ft. long, 2 ins. in diam., 24 ins. in the ground, for cor. of secs. 11, 12, 13 and 14, marked on brass cap,

1916 on S. rim;
T28N R18W in N. half;
S11 in NW.,
S12 in NE.,
S13 in SE., and
S14 in SW. quadrant;

dig pits 18x18x12 ins., in each sec. 5½ ft. dist., and raise a mound of earth, 4 ft. base, 2 ft. high, W. of cor.

Land, gently rolling.

Soil, sandy loam, 1st rate.

No timber.

Undergrowth, greasewood, yucca and cacti.

N. 89° 45' E., on a random line, bet. secs. 12 and 13.

40.00 Set temp. ¼ sec. cor.

80.04 Intersect E. bdy. of Tp., 26 lks. N. of the cor. of secs. 7, 12, 13 and 18, which is an iron post, 3 ins. in diam., properly set, marked and witnessed as described by the Surveyor General.

From this cor. U.S.L.M. No. 2517 brs. S. 11° 46' W., 26.55 chs. dist. From said mineral monument, Cor. No. 1 of "O.K. Millsite" Mineral Survey No. 2517 B. brs. N. 29° 46' E.; 6.79 chs. dist.

From cor. of secs. 7, 12, 13 and 18,

S. 89° 56' W., on a true line, bet. secs. 12 and 13.

Over gently rolling land, thru. scattering undergrowth.

10.05 O.K. or Gold Basin Mill, brs. S. 12 chs. dist.

11.95 Road brs. N. 30° W. to Grigg's Ferry, and S. 30° E. to Cyclopic and Gold Basin.

18.05 Main Wash, course N. 20° W.

40.02 Set an iron post, 3 ft. long, 1 in. in diam., 24 ins. in the ground, for ¼ sec. cor., marked on brass cap,

1916 on S. rim;
S12 ¼ in N., and
S13 in S. half;

Dig pits 18x18x12 ins., E. and W. of post, 3 ft. dist., and raise a mound of earth 3½ ft. base, 1½ ft. high, N. of cor.

49.75 Wash, course N. 80° E.

58.45 Wash, course N. 80° E.

80.04 The cor. of secs. 11, 12, 13 and 14.

Land, gently rolling.

Soil, sandy loam, 1st rate.

No timber.

Undergrowth, yucca, greasewood, catclaw and cacti.

N. 0° 1' W., bet. secs. 11 and 12.

Over gently rolling land, thru. scattering undergrowth.

0.70 Wash, course N. 70° E.

10.80 Wash, course N. 80° E.

22.60 Wash, course N. 70° E.

Subdivision of T. 28 N., R. 18 W.

<p>Chains. 36.30 40.00 55.00 78.00 80.00</p>	<p>Wash, course N.60° E. Set an iron post, 3 ft. long, 1 in. diam., 24 ins. in the ground, for $\frac{1}{4}$ sec. cor., marked on brass cap 1916 on S. rim; S11 $\frac{1}{4}$ in N. and S12 in N. half; dig pits, 18 X 18 X 12 ins., N. and S. of post, 3 ft. dist.; and raise a mound of earth, $3\frac{1}{2}$ ft. base, $1\frac{1}{2}$ ft. high, W. of cor. Wash, course N.80° E. Wash, course NE. Set an iron post, 3 ft. long, 2 ins. diam., 16 ins. in the ground, in a mound of stone, for cor. of secs. 1, 2, 11 and 12, marked on brass cap 1916 on S. rim; T28N R18W in N. half; S2 in NW., S1 in NE., S12 in SE. and S11 in SW. quadrant; and raise a mound of stone, 2 ft. base, $1\frac{1}{2}$ ft. high, W. of cor. Land, gently rolling. Soil, sandy and gravelly; 2nd rate. No timber. Undergrowth, yucca, greasewood, cat claw and cacti.</p>
<p>40.00 80.06 38.95 40.03 48.45 63.85 79.45 80.06</p>	<p>N.89° 56' E., on a random line, bet. secs. 1 and 12. Set temp. $\frac{1}{4}$ sec. cor. Intersect E. bdy. of Tp., at the cor. of secs. 1, 6, 7 and 12, which is an iron post, 3 ins. diam., properly set, marked and witnessed as described by the Surveyor-General. Thence S.89° 56' W., on a true line, bet. secs. 1 and 12. Over gently rolling land, through scattering undergrowth. Road, brs. N. to Grigg's Ferry and S. to Gold Basin and Cyclopic. Set an iron post, 3 ft. long, 1 in. diam., 24 ins. in the ground, for $\frac{1}{4}$ sec. cor., marked on brass cap 1916 on S. rim; S1 $\frac{1}{4}$ in N. and S12 in S. half; dig pits, 18 X 18 X 12 ins., E. and W. of post, 3 ft. dist.; and raise a mound of earth, $3\frac{1}{2}$ ft. base, $1\frac{1}{2}$ ft. high, N. of cor. Wash, course N.20° W. Wash, course NE. Wash, course NE. The cor. of secs. 1, 2, 11 and 12. Land, gently rolling. Soil, sandy and gravelly; 2nd rate. No timber. Undergrowth, greasewood, yucca, cat claw and cacti.</p>
<p>20.00 40.00</p>	<p>N.0° 1' W., on a true line, bet. secs. 1 and 2. Over gently rolling land, through scattering undergrowth. Wash, course E. Set an iron post, 3 ft. long, 1 in. diam., 16 ins. in the ground, in a mound of stone, for $\frac{1}{4}$ sec. cor., marked on brass cap 1916 on S. rim; S2 $\frac{1}{4}$ in W. and S1 in E. half; and raise a mound of stone, 2 ft. base, $1\frac{1}{2}$ ft. high, W. of cor.</p>

Chains.

80.15 Intersect Seventh Standard Parallel North, 5.04 chs. W. of the standard $\frac{1}{4}$ sec. cor. of sec. 36, which is an iron post, established by me, as described in Book "A".
 At the point of intersection, set an iron post, 3 ft. long, 2 ins. diam., 24 ins. in the ground, for closing cor. of secs. 1 and 2, marked on brass cap
 1916 on S. rim;
 T29N R18W S36 in N. and
 CC in S. half;
 S1 R18W in SE. and
 S2 T28N in SW. quadrant;
 and raise a mound of stone, 2 ft. base, $1\frac{1}{2}$ ft. high, W. of cor.
 Land, gently rolling.
 Soil, sand and gravel; 2nd rate.
 No timber.
 Undergrowth, greasewood, yucca, rabbit brush and cacti.

From the cor. of secs. 2, 3, 34 and 35, on the S. bdy. of the Tp., which is an iron post, established by H. G. Bardsley, U. S. Surveyor, as described in Book "A",

N.0° 1' W., bet. secs. 34 and 35.
 Over rolling land, through scattering undergrowth.
 2.10 Road, brs. N.30° E. to Gold Basin and Grigg's Ferry and S.30° W.
 5.00 Same road, brs. N.30° W. and S.30° E.
 8.30 Main road, brs. N.70° E. and S.70° W.
 Wash, course E. Asc. slightly to
 14.50 Spur, slopes E. Desc. 100 ft. to
 25.00 Thence over level land.
 40.00 Set an iron post, 3 ft. long, 1 in. diam., 26 ins. in the ground, for $\frac{1}{4}$ sec. cor., marked on brass cap
 1916 on S. rim;
 S34 $\frac{1}{4}$ in. W. and
 S35 in E. half;
 and raise a mound of stone, 2 ft. base, $1\frac{1}{2}$ ft. high, W. of cor.
 59.60 Wash, course S.80° E. Enter rolling land. Ascend 40 ft.
 72.30 Spur, slopes E. Desc. 10 ft. to
 80.00 Set an iron post, 3 ft. long, 2 ins. diam., 24 ins. in the ground, for cor. of secs. 26, 27, 34 and 35, marked on brass cap

1916 on S. rim;
 T28N R18W in N. half;
 S27 in NW.,
 S26 in NE.,
 S35 in SE. and
 S34 in SW. quadrant;
 and raise a mound of stone, 2 ft. base, $1\frac{1}{2}$ ft. high, W. of cor.
 Land, level and rolling.
 Soil, sandy and rocky; 2nd rate.
 No timber
 Undergrowth, yucca, greasewood, rabbit brush and cacti.
 Feb. 14, 1916: At this cor., I set out 13' 14" S. on the decl. arc; and as separate mark, I observe the same in the direction; the resulting int. is 35' 47" N.

40.00 N.89° 55' E., on a random line, bet. secs. 26 and 35.
 Set temp. $\frac{1}{4}$ sec. cor.
 80.04 Intersect N. and S. line, at the cor. of secs. 25, 26, 35 and 36.
 Thence
 S.89° 55' W., on a true line, bet. secs. 26 and 35.

Chains.

Over gently rolling land, ascending E. slope, through scattering undergrowth.

8.65 Head of wash, course NE60° E.

29.05 Road, brs. NE. to Gold Basin and Grigg's Ferry, and SE. to Cyclopic.

34.85 Head of wash, course NE.

40.02 Set an iron post, 3 ft. long, 1 in. diam., 26 ins. in the ground, for $\frac{1}{4}$ sec. cor., marked on brass cap
 1916 on S. rim;
 S26 $\frac{1}{4}$ in N. and
 S35 in S. half;
 and raise a mound of stone, 2 ft. base, 1 $\frac{1}{2}$ ft. high, N. of cor.

71.35 Road, brs. N. and S.

80.04 The cor. of secs. 26, 27, 34 and 35.
 Land, gently rolling.
 Soil, sandy; 2nd rate.
 No timber.
 Undergrowth, greasewood, yucca, rabbit brush and cacti.

N.0° 1' W., bet. secs. 26 and 27.
 Desc. slightly, over gently rolling land, through scattering undergrowth.

2.05 Wash, course E.

40.00 Set an iron post, 3 ft. long, 1 in. diam., 26 ins. in the ground, for $\frac{1}{4}$ sec. cor., marked on brass cap
 1916 on S. rim;
 S27 $\frac{1}{4}$ in W. and
 S26 in E. half;
 and raise a mound of stone, 2 ft. base, 1 $\frac{1}{2}$ ft. high, W. of cor.

46.55 Wash, course NE.

50.45 Wash, course NE.

80.00 Set an iron post, 3 ft. long, 2 ins. diam., 24 ins. in the ground, for cor. of secs. 22, 23, 26 and 27, marked on brass cap
 1916 on S. rim;
 T28N R18W in N. half;
 S22 in NW.,
 S23 in NE.,
 S26 in SE. and
 S27 in SW. quadrant;
 and raise a mound of stone, 2 ft. base, 1 $\frac{1}{2}$ ft. high, W. of cor.

Land, gently rolling.
 Soil, sandy loam, 1st rate.
 No timber.
 Undergrowth, greasewood, yucca, rabbit brush and cacti.

40.00 N.89° 55' E., on a random line, bet. secs. 23 and 26.
 Set temp. $\frac{1}{4}$ sec. cor.

80.04 Intersect N. and S. line, 5 lks. N. of the cor. of secs. 23, 24, 25 and 26.
 Thence
 S.89° 57' W., on a true line, bet. secs. 23 and 26.
 Asc. slightly, over gently rolling land, through scattering undergrowth.

40.02 Set an iron post, 3 ft. long, 1 in. diam., 20 ins. in the ground, for $\frac{1}{4}$ sec. cor., marked on brass cap
 1916 on S. rim;
 S23 $\frac{1}{4}$ in N. and
 S26 in S. half;
 and raise a mound of stone, 2 ft. base, 1 $\frac{1}{2}$ ft. high,

Chains.	
	N. of cor.
53.80	Wash, course NE.
57.00	Road, brs. N. and S.
80.04	The cor. of secs. 22, 23, 26 and 27. Land, gently rolling. Soil, sandy loam; 2nd rate. No timber. Undergrowth, greasewood, yucca, cat claw and rabbit brush.
	Feb. 17, 1916: At 9 hrs. 4 m., a.m., l.m.t., I set off 35° 47½' N. on the lat. arc; 12° 15' S. on the decl. arc; and determine a meridian with the solar at the cor. of secs. 22, 23, 26 and 27. Thence N.0° 1' W., bet. secs. 22 and 23. Over gently rolling land, through scattering undergrowth.
7.60	Wash, course N.80° E.
37.20	Wash, course N.70° E.
40.00	Set an iron post, 3 ft. long, 1 in. diam., 24 ins. in the ground, for ¼ sec. cor., marked on brass cap 1916 on S. rim; S22 ¼ in W. and S23 in E. half; and raise a mound of stone, 2 ft. base, 1½ ft. high, W. of cor.
43.75	Road, brs. N.60° E. and S.60° W.
59.70	Wash, course N.60° E.
63.60	Road, brs. E. and W.
74.00	Wash, course N.80° E.
80.00	Set an iron post, 3 ft. long, 2 ins. diam., 24 ins. in the ground, for cor. of secs. 14, 15, 22 and 23, marked on brass cap 1916 on S. rim; T28N R18 W in N. half; S15 in NW., S14 in NE., S23 in SE. and S22 in SW. quadrant; and raise a mound of stone, 2 ft. base, 1½ ft. high, W. of cor. Land, gently rolling. Soil, sandy loam; 1st rate. No timber. Undergrowth, greasewood, yucca, rabbit brush and cacti.
	N.89° 57' E., on a random line, bet. secs. 14 and 23.
40.00	Set temp. ¼ sec. cor.
80.00	Intersect N. and S. line, 21 lks. N. of the cor. of secs. 13, 14, 23 and 24. Thence N.89° 54' W., on a true line, bet. secs. 14 and 23. Asc. gradually, over gently rolling land, through scattering undergrowth.
19.60	Road, brs. NE. and SW.
39.80	Wash, course NE.
40.00	Set an iron post, 3 ft. long, 1 in. diam., 24 ins. in the ground, for ¼ sec. cor., marked on brass cap 1916 on S. rim; S14 ¼ in N. and S23 in S. half; and raise a mound of stone, 2 ft. base, 1½ ft. high, N. of cor.
64.80	Wash, course N.75° E.
80.00	The cor. of secs. 14, 15, 22 and 23. Land, gently rolling. Soil, sandy loam; 1st rate.

Chains.

No timber.
Undergrowth, greasewood, yucca, rabbit brush, and cacti.
E. J. L.

S. F. W.
N. 0° 1' W., bet. secs. 14 and 15.
Over level land, through scattering undergrowth.

14.90
29.90
31.90
40.00

Enter rolling land. Ascend.
Spur, slopes E. Desc. to
Wash, course NE. Thence over level land.
Set an iron post, 3 ft. long, 1 in. diam., 26 ins. in the
ground, for 1/4 sec. cor., marked on brass cap
1916 on S. rim;
S15 1/4 in W. and
S14 in E. half;
and raise a mound of stone, 2 ft. base, 1 1/2 ft. high, W.
of cor.

46.20
56.90
64.90
76.90
80.00

Road, brs. NE. and SW.
Wash, course E.
Enter wash, course SE.
Leave wash, course SE. Road, brs. NW. to Cyclopic, and
SE. to Gold Basin.
Set an iron post, 3 ft. long, 2 ins. diam., 18 ins. in the
ground, in a mound of stone, for cor. of secs. 10, 11,
14 and 15, marked on brass cap
1916 on S. rim;
T28N R18W in N. half;
S10 in NW.,
S11 in NE.,
S14 in SE. and
S15 in SW. quadrant;
and raise a mound of stone, 2 ft. base, 1 1/2 ft. high, W.
of cor.

Land, level and rolling.
Soil, 2nd and 4th rate.
No timber.
Undergrowth, yucca, greasewood, ocotillo, cat claw and
cacti.

S. F. W.

Feb. 18, 1916: E. J. L.
At 8 hrs. 3 m., a.m., l.m.t., I set off 35° 49 1/2' N. on the
lat. arc; 11° 54' S. on the decl. arc; and determine a
meridian with the solar at the cor. of secs. 10, 11, 14
and 15.

40.00
79.88

Thence
S. 89° 54' E., on a random line, bet. secs. 11 and 14.
Set temp. 1/4 sec. cor.
Intersect N. and S. line, 23 lks. S. of the cor. of secs.
11, 12, 13 and 14.

3.50
39.94

Thence
S. 89° 56' W., on a true line, bet. secs. 11 and 14.
Over gently rolling land, scattering undergrowth.
Wash, course NE. Asc. gradually to
Set an iron post, 3 ft. long, 1 in. diam., 26 ins. in the
ground, for 1/4 sec. cor., marked on brass cap
1916 on S. rim;
S11 1/4 in N. and
S14 in S. half;
dig pits, 18 X 18 X 12 ins., E. and W. of post, 3 ft.
dist.; and raise a mound of earth, 3 1/2 ft. base, 1 1/2 ft.
high, N. of cor.

45.60
60.00
79.88

Wash, course N. 80° E.
Same wash, course S. 70° E.
The cor. of secs. 10, 11, 14 and 15.

Chains.

Land, gently rolling.
Soil, sand and gravel; 2nd rate.
No timber.
Undergrowth, yucca, greasewood, rabbit brush and cacti.

N.0° 1' W., bet. secs. 10 and 11.
Over gently rolling land, through scattering undergrowth.

1.80 Wash, course S.80° E.
11.40 Wash, course S.80° E.
23.00 Wash, course N.80° E.
39.60 Wash, course N.70° E.
40.00 Set an iron post, 3 ft. long, 1 in. diam., 26 ins. in the ground, for $\frac{1}{4}$ sec. cor., marked on brass cap

1916 on S. rim;
S10 $\frac{1}{4}$ in W. and
S11 in E. half;

and raise a mound of stone, 2 ft. base, 1 $\frac{1}{2}$ ft. high, W. of cor.

Asc. 40 ft. to
47.50 Spur, slopes E. Desc. 50 ft. to
52.40 Wash, course NE. Thence along rolling E. slope.
67.90 Wash, course NE.
74.50 Wash, course NE.
80.00 Set an iron post, 3 ft. long, 2 ins. diam., 24 ins. in the ground, for cor. of secs. 2, 3, 10 and 11, marked on brass cap

1916 on S. rim;
T28N R18W in N. half;
S3 in NW.,
S2 in NE.,
S11 in SE. and
S10 in SW. quadrant;

and raise a mound of stone, 2 ft. base, 1 $\frac{1}{2}$ ft. high, W. of cor.

Land, gently rolling.
Soil, sand and gravel; 2nd rate.
No timber.
Undergrowth, yucca, greasewood, cat claw, rabbit brush and cacti.

40.00 N.89° 56' E., on a random line, bet. secs. 2 and 11.
Set temp. $\frac{1}{4}$ sec. cor.
80.00 Intersect N. and S. line, 2 lks. N. of the cor. of secs. 1, 2, 11 and 12.
Thence
S.89° 57' W., on a true line, bet. secs. 2 and 11.
Asc. gradually, over gently rolling land, through scattering undergrowth.

24.50 Wash, course N.70° E.
40.00 Set an iron post, 3 ft. long, 1 in. diam., 20 ins. in the ground, for $\frac{1}{4}$ sec. cor., marked on brass cap

1916 on S. rim;
S2 $\frac{1}{4}$ in N. and
S11 in S. half;

and raise a mound of stone, 2 ft. base, 1 $\frac{1}{2}$ ft. high, N. of cor.

63.70 Wash, course NE.
69.00 Wash, course NE.
74.30 Wash, course NE.
79.50 Wash, course N.30° E.
80.00 The cor. of secs. 2, 3, 10 and 11.
Land, gently rolling.
Soil, sand and gravel; 2nd rate.
No timber.
Undergrowth, yucca, greasewood, cat claw and cacti.

Subdivision of T. 28 N., R. 18 W.

Chains.

Feb. 14, 1916: At this cor., I set off 35° 46' N. on the lat. arc; and at apparent 13° 17' S. on the decl. arc; and determine a meridian; the resulting line is 285 ft. long.

3.30
40.00

N.0° 1' W., on a true line, bet. secs. 2 and 3.
Over gently rolling land, through scattering undergrowth.
Wash, course NE.
Set an iron post, 3 ft. long, 1 in. diam., 20 ins. in the ground, for 1/4 sec. cor., marked on brass cap
1916 on S. rim;
S3 1/4 in W. and
S2 in E. half;
and raise a mound of stone, 2 ft. base, 1 1/2 ft. high, W. of cor.

55.30
80.32

Wash, course NE.
Intersect Seventh Standard Parallel North, 5.14 chs. W. of the standard 1/4 sec. cor. of sec. 35, which is an iron post, established by me, as described in Book "A."
At the point of intersection, set an iron post, 3 ft. long, 2 ins. diam., 24 ins. in the ground, for closing cor. of secs. 2 and 3, marked on brass cap
1916 on S. rim;
T29N R18W S35 in N. and
CC in S. half;
S2 R18W in SE. and
S3 T28N in SW. quadrant;
and raise a mound of stone, 2 ft. base, 1 1/2 ft. high, S. of cor.
Land, gently rolling.
Soil, sand and gravel; 2nd rate.
No timber.
Undergrowth, greasewood, yucca, cat claw and cacti.

E. J. L.

2.50
37.07
40.00

Feb. 14, 1916: S. F. W.
At 8 hrs. 5 m., a.m., l.m.t., I set off 35° 46' N. on the lat. arc; 13° 17' S. on the decl. arc; and determine a meridian with the solar at the cor. of secs. 3, 4, 33 and 34, on the S. bdy. of the Tp., which is an iron post, established by H. G. Bardsley, U. S. Surveyor, as described in Book "A."

Thence, I run
N.0° 2' W., bet. secs. 33 and 34.
Over mountainous land, through scattering undergrowth.
Asc. 285 ft.

Road, brs. NW. and SE.
Spur, slopes SW. Desc. 20 ft. to
Set an iron post, 3 ft. long, 1 in. diam., 26 ins. in the ground, for 1/4 sec. cor., marked on brass cap
1916 on S. rim;
S33 1/4 in W. and
S34 in E. half;
and raise a mound of stone, 2 ft. base, 1 1/2 ft. high, W. of cor.

69.20
80.00

Asc. 195 ft. to
Spur, brs. E. and W. Desc. 125 ft. to
Set an iron post, 3 ft. long, 2 ins. diam., 24 ins. in the ground, for cor. of secs. 27, 28, 33 and 34, marked on brass cap
1916 on S. rim;
T28NR18W in N. half;
S28 in NW.,
S27 in NE.,
S34 in SE. and
S33 in SW. quadrant;

21.

Subdivision of T. 28 R., R18 W.

Chains.

and raise a mound of stone, 2 ft. base, 1½ ft. high,
W. of cor.

Land, mountainous.
Soil, 2nd and 4th rate.
No timber.
Undergrowth, yucca, greasewood, cat claw, and cacti.
Some bunch grass.

S. F. W.

E. J. L.

40.00 N.89° 55' E., on a random line, bet. secs. 27 and 34.
Set temp. ¼ sec. cor.
80.06 Intersect N. and S. line, 2 lks. N. of the cor. of secs.
26, 27, 34 and 35.
Thence
S.89° 56' W., on a true line, bet. secs. 27 and 34.
Over mountainous land, through scattering undergrowth.
Asc. 135 ft. to
7.00 Spur, slopes S. Desc. 60 ft. to
13.10 Gulch, course SE. Thence along rocky S. slope.
19.70 Gulch, course S.30° E. Asc. 135 ft. to
24.50 Saddle in ridge, brs. NE. and SW. Thence along N. slope.
34.25 Spur, slopes N.20° E. Desc. 70 ft.
40.03 Set an iron post, 3 ft. long, 1 in. diam., 24 ins. in the
ground, for ¼ sec. cor., marked on brass cap

1916 on S. rim;
S27 ¼ in N. and
S34 in S. half;

and raise a mound of stone, 2 ft. base, 1½ ft. high,
W. of cor.

43.20 Wash, course N.35° E. Asc. 255 ft. to
69.60 Spur, slopes N.20° E. Desc. 50 ft. to
75.00 Asc. 50 ft. to
80.06 The cor. of secs. 27, 28, 33 and 34.

Land, mountainous.
Soil, rocky; 4th rate.
No timber.
Undergrowth, yucca and cacti.

E. J. L.

S. F. W.

N.0° 2' W., bet. secs. 27 and 28.
Over mountainous land, through scattering undergrowth.
Desc. 150 ft. to

6.60 Wash, course NE. Asc. 240 ft. to
22.00 Spur, slopes NE. Desc. 180 ft. to
29.49 Gulch, course E. Asc. 45 ft. to
34.00 Spur, slopes E. Desc. 220 ft.
40.00 Set an iron post, 3 ft. long, 1 in. diam., 26 ins. in the
ground, for ¼ sec. cor., marked on brass cap

1916 on S. rim;
S28 ¼ in W. and
S27 in E. half;

and raise a mound of stone, 2 ft. base, 1½ ft. high,
W. of cor.

45.00 Continue desc. to
Foot of desc.; thence over level land.

51.80 Wash, course NE.
64.00 Wash, course NE. Asc. 45 ft. to
71.80 Spur, slopes E. Desc. 20 ft.
79.53 Road, brs. NE. and SW.

80.00 Set an iron post, 3 ft. long, 2 ins. diam., 24 ins. in the
ground, for cor. of secs. 21, 22, 27 and 28, marked on
brass cap

1916 on S. rim;
T28N R18W in N. half;
S21 in NW.,
S22 in NE.,

Subdivision of T. 28 N., R. 18 W.

Chains.

S27 in SE. and
 S28 in SW. quadrant;
 and raise a mound of stone, 2 ft. base, 1½ ft. high, W.
 of cor.
 From this cor., U. S. L. M. No. 2518, Gold Basin District,
 which is a granite stone, 24 X 16 X 12 ins. above ground,
 marked and witnessed as described by the Surveyor-Gen-
 eral, brs. N.30° 50' W., 21.02 chs. dist.
 Land, mountainous.
 Soil, rocky, 3rd rate.
 No timber.
 Undergrowth, yucca and cacti.
 S. F. W.

40.00 E. J. L.
 80.05 N.89° 56' E., on a random line, bet. secs. 22 and 27.
 Set temp. ¼ sec. cor.
 Intersect N. and S. line, 14 lks. N. of the cor. of secs.
 22, 23, 26 and 27.
 Thence
 N.89° 58' W., on a true line, bet. secs. 22 and 27.
 Over gently rolling land, through scattering undergrowth.
 20.44 Wash, course NE.
 40.02½ Set an iron post, 3 ft. long, 1 in. diam., 24 ins. in the
 ground, for ¼ sec. cor., marked on brass cap
 1916 on S. rim;
 S22 ¼ in N. and
 S27 in S. half;
 and raise a mound of stone, 2 ft. base, 1½ ft. high,
 N. of cor.
 65.00 Wash, course NE.
 80.05 The cor. of secs. 221, 22, 27 and 28.
 Land, gently rolling.
 Soil, sandy and gravelly; 2nd rate.
 No timber.
 Undergrowth, greasewood, yucca, cat claw and cacti.
 E. J. L.

Feb. 17, 1916: S. F. W.
 At 9 hrs. 2 m., a.m., 1. m. t., I set off 35° 47½' N. on the
 lat. arc; 12° 15' S. on the decl..arc; and determine a
 meridian with the solar at the cor. of secs. 21, 22, 27
 and 28.
 Thence
 N.0° 2' W., bet. secs. 21 and 22.
 Over mountainous land, through scattering undergrowth.
 Desc. to
 1.00 Wash, course SE. Asc. 70 ft. to
 15.00 Spur, slopes NE. Desc. 115 ft.
 35.84 Wash, course SE. Asc. 30 ft. to
 40.00 Set an iron post, 3 ft. long, 1 in. diam., 26 ins. in the
 ground, for ¼ sec. cor., marked on brass cap
 1916 on S. rim;
 S21 ¼ in W. and
 S22 in E. half;
 and raise a mound of stone, 2 ft. base, 1½ ft. high, W.
 of cor.
 4 Desc. 45 ft. to
 45.00 Asc. 255 ft. to
 79.00 Spur, brs. NW. and SE. Desc. slightly
 80.00 Set an iron post, 3 ft. long, 2 ins. diam., 24 ins. in the
 ground, for cor. of secs. 15, 16, 21 and 22, marked on
 brass cap
 1916 on S. rim;

Subdivision of T. 28 N., R. 18 W.

Chains.

T28N R18W in N. half;
S16 in NW.,
S15 in NE.,
S22 in SE. and
S21 in SW. quadrant;

and raise a mound of stone, 2 ft. base, 1½ ft. high, W. of cor.

Land, mountainous.

Soil, rocky, 3rd rate.

No timber.

Undergrowth, greasewood, yucca, cat claw and cacti.

Feb. 19, 1916.

At 9 hrs. 5 m., a.m., l.m.t., I set off 35° 48½' N. on the lat. arc; 11° 33' S. on the decl. arc; and determine a meridian with the solar at the cor. of secs. 15, 16, 21 and 22.

Thence

S.89° 58' E., on a random line, bet. secs. 15 and 22.

40.00 Set temp. ¼ sec. cor.

79.87 Intersect N. and S. line, 7 lks. N. of the cor. of secs. 14, 15, 22 and 23.

Thence

N.89° 55' W., on a true line, bet. secs. 15 and 22.

Over level land, through scattering undergrowth.

15.00 Leave level, enter mountainous land. Asc. 80 ft. to

24.90 Desc. 35 ft. to

28.87 Gulch, course SE. Asc. 400 ft.

39.93½ Set an iron post, 3 ft. long, 1 in. diam., 26 ins. in the ground, for ¼ sec. cor., marked on brass cap

1916 on S. rim;

S15 ¼ in N. and

S22 in S. half;

and raise a mound of stone, 2 ft. base, 1½ ft. high, N. of cor.

50.70 Spur, slopes ESE. Desc. 85 ft. to

55.67 Gulch, course SE. Asc. 95 ft. to

61.75 Spur, slopes SE. Desc. 135 ft. to

70.00 Gulch, course N. Asc. 45 ft. to

79.87 The cor. of secs. 15, 16, 21 and 22.

Land, mountainous and level.

Soil, rocky; 3rd rate.

No timber.

Undergrowth, greasewood, yucca, cat claw and cacti.

N.0° 2' W., bet. secs. 15 and 16.

Over rolling and mountainous land, through scattering undergrowth.

Desc. 65 ft.

7.90 Gulch, course E. Asc. 100 ft. to

11.20 Spur, slopes NE. Desc. 140 ft. to

19.35 Gulch, course E. Asc. 50 ft. to

22.50 Spur, slopes E. Desc. 45 ft. to

24.86 Gulch, course NE. Asc. 50 ft. to

30.30 Spur, slopes NE. Desc. 130 ft. to

35.94 Gulch, course SE. Asc. 200 ft.

40.00 Set an iron post, 3 ft. long, 1 in. diam., 26 ins. in the ground, for ¼ sec. cor., marked on brass cap

1916 on S. rim;

S16 ¼ in W. and

S15 in E. half;

and raise a mound of stone, 2 ft. base, 1½ ft. high, W. of cor.

Subdivision of T. 28 N., R. 18 W.

<p>Chains. 47.70 69.63 76.16 76.70 80.00</p>	<p>Ridge, brs. NE. and SW. Desc. 410 ft. to Enter wash, course NE. Road, brs. NE. to Gold Basin and SW. to Cyclopic. Leave wash, course NE. Asc. 25 ft. to Set an iron post, 3 ft. long, 2 ins. diam., 24 ins. in the ground, for cor. of secs. 9, 10, 15 and 16, marked on brass cap 1916 on S. rim; T28N R18W in N. half; S9 in NW., S10 in NE., S15 insSE. and S16 in SW. quadrant; and raise a mound of stone, 2 ft. base, 1½ ft. high, W of cor. Land, rolling and mountainous. Soil, rocky, 4th rate. No timber. Undergrowth, yucca, cat claw, greasewood and cacti. Some bunch grass.</p>
<p>40.00 80.24 17.25 26.85 30.75 35.25 40.12 48.24 76.25 80.24</p>	<p>S.89° 55' E., on a random line, bet. secs. 10 and 15. Set temp. ¼ sec. cor. Intersect N. and S. line, 21 lks. S. of the cor. of secs. 10, 11, 14 and 15. Thence, S.89° 56' W., on a true line, bet. secs. 10 and 15. Over level land, through scattering undergrowth. Road, brs. NW. to Cyclopic and SE. to Gold Basin. Road, brs. NE. to Gold Basin and SW. to Cyclopic. Road, brs. NW. and SE. Enter wash, course SE. Comes from W. Set an iron post, 3 ft. long, 1 in. diam., 26 ins. in the ground, for ¼ sec. cor., marked on brass cap 1916 on S. rim; S10 ¼ in N. and S15 in S. half; and raise a mound of stone, 2 ft. base, 1½ ft. high, N of cor. Road, brs. NE. to Cyclopic and SW. to Gold Basin. Leave wash, course E. Comes from SW. Road, brs. NE. to Gold Basin and SW. to Cyclopic. The cor. of secs. 9, 10, 15 and 16. Land, level. Soil, 2nd and 4th rates. No timber. Undergrowth, yucca, greasewood, cat claw, ocotillo and cacti. Some bunch grass. S. F. W.</p>
<p>1.90 15.30 20.00 34.10 40.00</p>	<p>Feb. 19, 1916. E. J. L. At 9 hrs. 0 m., a.m., l.m.t., I set off 35° 49½' N. on the lat. arc; 11° 33' S. on the decl. arc; and determine a meridian with the solar at the cor. of secs. 9, 10, 15 and 16. Thence N.0° 2' W., bet. secs. 9 and 10. Over mountainous land, through scattering undergrowth. Desc. to Wash, course S.70° E. Asc. 230 ft. to Spur, slopes S.30° W. Desc. slightly to Asc. 355 ft. to Spur, slopes SE. Desc. 110 ft. Set an iron post, 3 ft. long, 1 in. diam., in a mound of</p>

Chains.

stone, for $\frac{1}{4}$ sec. cor., marked on brass cap
 1916 on S. rim;
 S9 $\frac{1}{2}$ in W. and
 S10 in E. half;
 and raise a mound of stone, 2 ft. base, $1\frac{1}{2}$ ft. high, W.
 of cor.
 40.50 Gulch, course N.60° E. Asc. 65 ft. to
 49.65 Ridge, brs. NW. and SE. Desc. 100 ft. to
 52.70 Gulch, course E. Asc. 120 ft. to
 57.00 Ridge, brs. E. and SW. Desc. to
 64.10 Gulch, course NE. Asc. to
 70.50 Spur, slopes N. Desc. on spur to
 80.00 Set an iron post, 3 ft. long, 2 ins. diam., in a mound of
 stone, for cor. of secs. 3, 4, 9 and 10, marked on
 brass cap
 1916 on S. rim;
 T28N R18W in N. half;
 S4 in NW.,
 S3 in NE.,
 S10 in SE. and
 S 9 in SW. quadrant;
 and raise a mound of stone, 2 ft. base, $1\frac{1}{2}$ ft. high, W.
 of cor.
 Land, mountainous.
 Soil, rocky, 3rd rate.
 No timber.
 Undergrowth, yucca and cacti.

N.89° 56' E., on a random line, bet. secs. 3 and 10.
 40.00 Set temp. $\frac{1}{4}$ sec. cor.
 80.00 Intersect N. and S. line, 9 lks. N. of the cor. of secs.
 2, 3, 10 and 11.
 Thence
 West on a true line, bet. secs. 3 and 10.
 Over rolling and mountainous land, through scattering
 undergrowth.
 13.20 Wash, course NE. Asc. 50 ft. to
 28.70 Spur, slopes N. Desc. 60 ft. to
 37.30 Wash, course NE. Asc. 100 ft.
 40.00 Set an iron post, 3 ft. long, 1 in. diam., 26 ins. in the
 ground, for $\frac{1}{4}$ sec. cor., marked on brass cap
 1916 on S. rim;
 S3 $\frac{1}{2}$ in N. and
 S10 in S. half;
 and raise a mound of stone, 2 ft. base, $1\frac{1}{2}$ ft. high, N.
 of cor.
 47.30 Spur, slopes NE. Desc. W. slope to
 58.70 Gulch, course NE. Asc. 395 ft. to
 80.00 The cor. of secs. 3, 4, 9 and 10.
 Land, mountainous and rolling.
 Soil, rocky, 3rd rate;
 No timber.
 Undergrowth, greasewood and cacti.

N.0° 2' W., on a true line, bet. secs. 3 and 4.
 Over mountainous land, through scattering undergrowth.
 It being impossible to chain from this cor., I set a flag
 ahead on line, and measure a base, N.86° 54' E., 10.00
 chs., from the end of which the flag brs. N.15° 58' W.
 The distance to the flag is obtained from the following
 proportion:-

$$\sin. 15^\circ 56' : \sin. 77^\circ 08' :: 10.00 : X$$

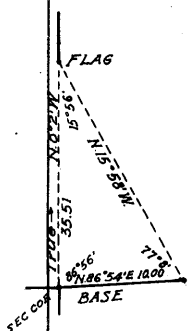

Chains.

$$X = \frac{.97489 \times 10.00}{.27452} = 35.51 \text{ chs.}$$

The approximate topography from the cor. of secs. 3, 4, 9 and 10 to the 35.51 ch. point is as follows:
 Desc. steep rocky N. slope, 200 ft. to
 11.40 Gulch, course NW. Asc. to
 15.50 Spur, slopes NW. Desc. to
 20.00 Gulch, course N.70° W. Thence desc. gradual NW. slope, 50 ft. to

35.51 Triangulation point. Thence over rolling land.
 40.00 Set an iron post, 3 ft. long, 1 in. diam., 26 ins. in the ground, for 1/4 sec. cor., marked on brass cap

1916 on S. rim;
 S4 1/4 in W. and
 S3 in E. half;

and raise a mound of stone, 2 ft. base, 1 1/2 ft. high, W. of cor.

45.00 Gulch, course N.60° E.

80.32 Intersect Seventh Standard Parallel North, 5.18 chs. W. of the standard 1/4 sec. cor. of sec. 34, which is an iron post, established by me, as described in Book "A". At the point of intersection, set an iron post, 3 ft. long, 2 ins. diam., 24 ins. in the ground, for closing cor. of secs. 3 and 4, marked on brass cap

1916 on S. rim;
 T29N R18W S34 in N. and
 CC in S. half;
 S3 R18W in SE. and
 S4 T28N in SW. quadrant;

and raise a mound of stone, 2 ft. base, 1 1/2 ft. high, S. of cor.

Land, rolling and mountainous.
 Soil, rocky; 3rd rate and sandy, 2nd rate.
 No timber.
 Undergrowth, yucca, eat claw, greasewood, rabbit brush and cacti.

Feb. 10, 1916: At 8 hrs. 54 M., a.m., l.m.t., I set off 35° 46' N. on the lat. arc; 14° 35 1/2' S' on the decl. arc; and determine a meridian with the solar at the cor. of secs. 4, 5, 32 and 33, which is an iron post, established by H. G. Bardsley, U. S. Surveyor, as described in Book "A!"

Thence I run
 N.0° 3' W., bet. secs. 32 and 33.

3.00 Over rolling land, through scattering undergrowth.
 Road, brs. NW. to Cyclopic and SE. to Chloride.

16.80 Road, brs. E. to Gold Basin, and W. to Cyclopic.

40.00 Set an iron post, 3 ft. long, 1 in. diam., 26 ins. in the ground, for 1/4 sec. cor., marked on brass cap

1916 on S. rim;
 S32 1/4 in W. and
 S33 in E. half;

dig pits, 18 X 18 X 12 ins., N. and S. of post, 3 ft. dist.; and raise a mound of earth, 3 1/2 ft. base, 1 1/2 ft. high, high, W. of cor.

59.55 Wash, course SE. Road in wash, brs. NW. and SE.

80.00 Set an iron post, 3 ft. long, 2 ins. diam., 24 ins. in the ground, for cor. of secs. 28, 29, 32 and 33, marked on brass cap

1916 on S. rim;
 T28NR18W in N. half;
 S29 in NW.,
 S28 in NE.,
 S33 in SE. and
 S32 in SW. quadrant;

and raise a mound of stone, 2 ft. base, 1 1/2 ft. high, W. of cor.

30.

Subdivision of T. 28 N., R. 18 W.

Chains.

Land, rolling.
Soil, sandy and stony; 2nd rate.
No timber.
Undergrowth, yucca, greasewood, sagebrush and cacti.
E. J. L.

Feb. 15, 1916: S. F. W.
At 8 hrs. 32 m., a.m., l.m.t., I set off 35° 47' N. on
the lat. arc; 12° 56½' S. on the decl. arc; and deter-
mine a meridian with the solar at the cor. of secs.
28, 29, 32 and 33.

40.00 Thence
N. 89° 55' E., on a random line, bet. secs. 28 and 33.
Set temp. ¼ sec. cor.
80.09 Intersect N. and S. line, 2 lks. N. of the cor. of secs.
27, 28, 33 and 34.

Thence
S. 89° 56' W., on a true line, bet. secs. 28 and 33.
Over mountainous land, through scattering undergrowth.
Asc. 35 ft. to
2.50 Spur, slopes NW. Desc. 30 ft. to
9.55 Wash, course NE. Asc. 225 ft. to
30.20 Spur, brs. N. and S. Desc. 40 ft. to
38.10 Wash, course S. Asc. 70 ft.

80.04½ Set an iron post, 3 ft. long, 1 in. diam., 26 ins. in the
ground, for ¼ sec. cor., marked on brass cap
1916 on S. rim;
S28 ¼ in N. and
S33 in S. half;
and raise a mound of stone, 2 ft. base, 1½ ft. high,
N. of cor.

45.90 Spur, slopes SE. Desc. 45 ft. to
48.90 Wash, course S. Asc. 220 ft. to
62.50 Spur, slopes SW. Desc. 215 ft. to
80.09 The cor. of secs. 28, 29, 32 and 33.

Land, mountainous.
Soil, 2nd and 4th rate.
No timber.
Undergrowth, yucca, cat claw, greasewood and cacti.
Some bunch grass.

S. F. W.

E. J. L.
N. 0° 3' W., bet. secs. 28 and 29.
Over rolling land, through scattering undergrowth.
Asc. 215 ft. to

33.20 Desc. 260 ft.
40.00 Set an iron post, 3 ft. long, 1 in. diam., in a mound of
stone, for ¼ sec. cor., marked on brass cap
1916 on S. rim;
S29 ¼ in W. and
S28 in E. half;
and raise a mound of stone, 2 ft. base, 1½ ft. high,
W. of cor.

52.44 Wash, course NE. Thence along broken E. slope. Asc. 15
ft. to
55.45 Desc. 45 ft. to
59.40 Asc. 20 ft. to
62.35 Desc. 30 ft. to
69.35 Asc. 55 ft. to
72.20 Desc. 20 ft. to
74.80 Asc. 75 ft. to

Subdivision of T. 28 N., R. 18 W.

Chains.

78.55 Desc. 10 ft. to
 80.00 Set an iron post, 3 ft. long, 2 ins. diam., in a mound of stone, for cor. of secs. 20, 21, 28 and 29, marked on brass cap
 1916 on S. rim;
 T28 N R18W in N. half:
 S20 in NW.,
 S21 in NE.,
 S28 in SE. and
 S29 in SW. quadrant;
 and raise a mound of stone, 2 ft. base, 1½ ft. high, W. of cor.
 Land, rolling and mountainous.
 Soil, sandy, clay and loam; 2nd rate
 No timber.
 Undergrowth, yucca, cat claw, greasewood and sagebrush.
 E. J. L.

S. F. W.

40.00 N. 89° 56' E., on a random line, bet. secs. 21 and 28.
 Set temp. ¼ sec. cor.
 80.26 Intersect N. and S. line, 9 lks. N. of the cor. of secs. 21, 22, 27 and 28.
 Thence
 West on a true line, bet. secs. 21 and 28.
 Over mountainous land, through scattering undergrowth.
 Asc. 170 ft.
 1.10 Road, brs. NW. and SE.
 13.20 Spur, slopes NE. Desc. 75 ft. to
 20.00 Wash, course NE. Asc. in wash.
 23.11 Road, brs. NE. and SW.
 27.30 Road, brs. NW. and SE.
 35.00 Leave wash, course E. Comes from NW. Asc. 415 ft.
 40.13 Set an iron post, 3 ft. long, 1 in. diam., 26 ins. in the ground, for ¼ sec. cor., marked on brass cap
 1916 on S. rim;
 S21 ¼ in N. and
 S28 in S. half;
 and raise a mound of stone, 2 ft. base, 1½ ft. high, N. of cor.
 51.78 Same wash, course NE. Road in wash, brs. NE. and SW. Continue ascent.
 55.00 Mine dump brs. NW. 4. chs. dist.
 80.26 The cor. of secs. 20, 21, 28 and 29.
 Land, mountainous.
 Soil, 2nd and 4th rate.
 No timber.
 Undergrowth, yucca, cat claw, greasewood and cacti.
 Some bunch grass.

N. 0° 3' W., bet. secs. 20 and 21.
 Over mountainous land, through scattering undergrowth
 Asc. 230 ft. to
 26.70 Ridge, brs. NE. and SW. Desc. 405 ft.
 40.00 Set an iron post, 3 ft. long, 1 in. diam., 26 ins. in the ground, for ¼ sec. cor., marked on brass cap
 1916 on S. rim;
 S20 ¼ in W. and
 S21 in E. half;
 and raise a mound of stone, 2 ft. base, 1½ ft. high, W. of cor.
 45.17 Wash, course NE. Asc. 285 ft. to
 61.00 Spur, slopes SE. Desc. 185 ft. to

Chains.

68.81 Wash, course NE. Asc. 35 ft. to
 71.76 Spur, slopes NE. Desc. 125 ft. to
 80.00 Set an iron post, 3 ft. long, 2 ins. diam., 24 ins. in the ground, for cor. of secs. 16, 17, 20 and 21, marked on brass cap

1916 on S. rim;
 T28N R18W in N. half;
 S17 in NW.,
 S16 in NE.,
 S21 in SE. and
 S20 in SW. quadrant;

and raise a mound of stone, 2 ft. base, 1½ ft. high, W. of cor.

Land, mountainous.

Soil, rocky; 3rd rate.

No timber.

Undergrowth, greasewood, yucca and ca cti.

See p. 15, 1916: At this cor., T and R lines are marked on the ground and an iron post, 3 ft. long, 1 in. diam., 26 ins. in the ground, for ¼ sec. cor., marked on brass cap.

40.00 East on a random line, bet. secs. 16 and 21.
 Set temp. ¼ sec. cor.
 80.26 Intersect N. and S. line, 24 lks. S. of the cor. of secs. 15, 16, 21 and 22.

Thence S.89° 50' W., on a true line, bet. secs. 16 and 21.

Over mountainous land, through scattering undergrowth.

Asc. 55 ft. to

6.50 Spur, brs. NW. and SE. Desc. 40 ft. to

9.85 Asc. 55 ft. to

12.75 Desc. 20 ft. to

14.75 Asc. 120 ft. to

30.60 Ridge, brs. NE. and SW. Desc. 125 ft. to

38.44 Gulch, course NE. Asc. 75 ft.

40.13 Set an iron post, 3 ft. long, 1 in. diam., 26 ins. in the ground, for ¼ sec. cor., marked on brass cap

1916 on S. rim;
 S16 ¼ in N. and
 S21 in S. half;

and raise a mound of stone, 2 ft. base, 1½ ft. high, N. of cor.

46.40 Spur, slopes NE. Desc. 20 ft. to

50.40 Wash, course NE. Asc. 130 ft. to

56.60 Desc. 40 ft. to

64.55 Asc. 40 ft. to

66.50 Spur, slopes NE. Desc. 55 ft. to

75.30 Wash, course NE. Asc. 30 ft. to

80.26 The cor. of secs. 16, 17, 20 and 21.

Land, mountainous.

Soil, rocky; 3rd rate.

No timber.

Undergrowth, greasewood, yucca, cat claw and cacti.

N.0° 3' W., bet. secs. 16 and 17,
 Over mountainous land, through scattering undergrowth.

Desc. 120 ft. to

13.35 Wash, course NE. Asc. to

20.35 Desc. 70 ft. to

30.25 Asc. 30 ft. to

38.25 Desc. 45 ft.

40.00 Set an iron post, 3 ft. long, 1 in. diam., in a mound of

Chains.

stone, for $\frac{1}{4}$ sec. cor., marked on brass cap.
 1916 on S. rim;
 S17 $\frac{1}{4}$ in W. and
 S16 in E. half;
 and raise a mound of stone, 2 ft. base, $1\frac{1}{2}$ ft. high,
 W. of cor.

45.40 Wash, course NE. Road in wash, brs. NE. to Gold Basin and
 SW. to Cyclopic. Asc. 15 ft. to

48.35 Desc. 50 ft. to

53.35 Wash, course NE. Asc. 20 ft. to

58.35 Desc. 15 ft. to

60.35 Center of wash, 1.50 chs. wide, course SE. Asc. 30 ft. to

68.80 Desc. 50 ft.

74.45 Road, brs. NW. and SE.

80.00 Set an iron post, 3 ft. long, 2 ins. diam., 24 ins. in the
 ground, for cor. of secs. 8, 9, 16 and 17, marked on
 brass cap
 1916 on S. rim;
 T28N R18W in N. half;
 S8 in NW.,
 S9 in NE.,
 S16 in SE. and
 S17 in SW. quadrant;
 and raise a mound of stone, 2 ft. base, $1\frac{1}{2}$ ft. high,
 W. of cor.

Land, mountainous.
 Soil, rocky; 3rd rate.
 No timber.
 Undergrowth, yucca, greasewood, cat claw and cacti.

40.00 N. $89^{\circ} 50'$ E., on a random line, bet. secs. 9 and 16.
 Set temp. $\frac{1}{4}$ sec. cor.

80.39 Intersect N. and S. line, 11 lks. N. of the cor. of secs.
 9, 10, 15 and 16.
 Thence
 S. $89^{\circ} 55'$ W., on a true line, bet. secs. 9 and 16.
 Over mountainous land, through scattering undergrowth.
 Asc. 85 ft. to

11.90 Desc. 15 ft. to

14.85 Asc. 130 ft. to

21.60 Spur, slopes SW. Desc. 120 ft. to

29.85 Wash, course S. Asc. 175 ft.

40.19 $\frac{1}{2}$ Set an iron post, 3 ft. long, 1 in. diam., 26 ins. in the
 ground, for $\frac{1}{4}$ sec. cor., marked on brass cap
 1916 on S. rim;
 S9 $\frac{1}{4}$ in N. and
 S16 in S. half;
 and raise a mound of stone, 2 ft. base, $1\frac{1}{2}$ ft. high,
 N. of cor.

40.50 Spur, slopes SE. Desc. 150 ft. to

49.71 Wash, course SE. Thence over level land.

59.71 Enter wash, course SE. Comes from W.

75.00 Leave wash, course E. Comes from NW.

80.39 The cor. of secs. 8, 9, 16 and 17.
 Land, level and mountainous.
 Soil, 2nd and 4th rate.
 No timber.
 Undergrowth, greasewood, yucca, cat claw and cacti.
 Some grass.

N. $0^{\circ} 3'$ W., bet. secs. 8 and 9.

34

Subdivision of T. 28 N., R. 18 W.

Chains.

	Over rolling land, through scattering undergrowth. Desc. to
1.00	Wash, course SE. Asc. 30 ft. to
4.00	Desc. 30 ft. to
10.00	Asc. 100 ft. to
26.85	Desc. slightly to
39.86	Wash, course SE. Asc. 295 ft.
40.00	Set an iron post, 3 ft. long, 1 in. diam., 26 ins. in the ground, for $\frac{1}{4}$ sec. cor., marked on brass cap 1916 on S. rim; S8 $\frac{1}{4}$ in W. and S9 in E. half; and raise a mound of stone, 2 ft. base, $1\frac{1}{2}$ ft. high, W. of cor.
60.95	Ridge, brs. NW. and SE. Desc. 285 ft. to
74.45	Gulch, course NE. Asc. 65 ft. to
80.00	Set an iron post, 3 ft. long, 2 ins. diam., 24 ins. in the ground, for cor. of secs. 4, 5, 8 and 9, marked on brass cap 1916 on S. rim; T28N R18W in N. half; S5 in NW., S4 in NE., S9 in SE. and S8 in SW. quadrant; and raise a mound of stone, 2 ft. base, $1\frac{1}{2}$ ft. high, W. of cor. Land, rolling. Soil, 2nd and 4th rate. No timber. Undergrowth, greasewood, yucca, cat claw and cacti. S. F. W.
	E. J. L.
40.00	N.89° 55' E., on a random line, bet. secs. 4 and 9. Set temp. $\frac{1}{4}$ sec. cor.
80.20	Intersect N. and S. line, at the cor. of secs. 3, 4, 9 and 10. Thence S.89° 55' W., on a true line, bet. secs. 4 and 9. Over mountainous land, through scattering undergrowth. Desc. 110 ft. to
8.60	Gulch, course N. Asc. slightly to
10.00	Desc. 110 ft. to
14.50	Gulch, course N.30° E. Asc. 205 ft. to
21.90	Spur, slopes N. Desc. 140 ft. to
28.80	Gulch, course NE. Asc. 160 ft. to
34.60	Spur, slopes NE. Desc. 50 ft.
40.10	Set an iron post, 3 ft. long, 1 in. diam., in a mound of stone, for $\frac{1}{4}$ sec. cor., marked on brass cap 1916 on S. rim; S4 $\frac{1}{4}$ in N. and S9 in S. half; and raise a mound of stone, 2 ft. base, $1\frac{1}{2}$ ft. high, N. of cor.
45.00	Asc. 35 ft. to
47.30	Spur, slopes N. Desc. 65 ft. to
55.00	Asc. 25 ft. to
57.00	Desc. 40 ft. to
60.70	Wash, course NE. Asc. 145 ft. to
74.40	Desc. to
75.50	Gulch, course NE. Asc. 65 ft. to
80.20	The cor. of secs. 4, 5, 8 and 9. Land, mountainous. Soil, rocky; 3rd rate. No timber. Undergrowth, yucca and cacti.

Chains.

N.0° 3' W., on a true line, bet. secs. 4 and 5.
Over mountainous land, through scattering undergrowth.
Desc. to

- 1.20 Gulch, course S.70° E. Asc. 240 ft. to
- 13.85 Spur, slopes NE. Desc. 85 ft. to
- 20.10 Gulch, course E. Asc. 80 ft. to
- 24.25 Spur, slopes E. Desc. 100 ft. to
- 39.70 Gulch, course E. Asc. 40 ft. to
- 40.00 Set an iron post, 3 ft. long, 1 in. diam., in a mound of

stone, for 1/4 sec. cor., marked on brass cap
1916 on S. rim;
S5 1/4 in W. and
S4 in E. half;

and raise a mound of stone, 2 ft. base, 1 1/2 ft. high, W. of cor.

- 43.70 Spur, slopes E. Desc. 115 ft. to
- 48.65 Gulch, course N.70° E. Asc. 580 ft. to
- 68.00 Spur, slopes NE. Desc. 105 ft. to
- 80.38 Intersect Seventh Standard Parallel North, 5.45 chs. W. of

the standard 1/4 sec. cor. of sec. 33, which is an iron

post, established by me, as described in Book "A."

At the point of intersection, set an iron post, 3 ft. long,

2 ins. diam., 24 ins. in the ground, for closing cor.

of secs. 4 and 5, marked on brass cap

1916 on S. rim;
T29N R18W S33 in N. and

CC in S. half;
S4 R18W in SE. and

S5 T28N in SW. quadrant;

and raise a mound of stone, 2 ft. base, 1 1/2 ft. high, S. of cor.

Land, mountainous.
Soil, rocky, 4th rate.
No timber.
Undergrowth, greasewood, yucca and rabbit brush.

Feb. 9, 1916.
At 8 hrs. 55 M. a.m., l.m.t., I set off 35° 46' N. on the lat. arc; 14° 55' S. on the decl. arc; and determine a meridian with the solar at the cor. of secs. 5, 6, 31 and 32, on the S. bdy. of the Tp., which is an iron post, established by H. C. Bardsley, U. S. Surveyor, as described in Book "A."

Thence
N.0° 3' W., bet. secs. 31 and 32.
Over rolling land, through scattering undergrowth.

- Asc. 35 ft. to
- 3.50 Ridge, brs. E. and W. Desc. 105 ft. to
- 17.80 Wash, course E. Thence over gently rolling land.
- 23.00 Wash, course E.
- 40.00 Set an iron post, 3 ft. long, 1 in. diam., 26 ins. in the

ground, for 1/4 sec. cor., marked on brass cap

1916 on S. rim;

S31 1/4 in W. and

S32 in E. half;

and raise a mound of stone, 2 ft. base, 1 1/2 ft. high, W. of cor.

- 55.00 Asc. 90 ft. to
- 63.20 Spur, slopes SE. Desc. 55 ft.
- 73.05 Road, brs. NW. to Cyclopic and SE. to Chloride.
- 74.40 Wash, course S.80° E. Asc. 15 ft. to
- 80.00 set an iron post, 3 ft. long, 2 ins. diam., 24 ins. in the

ground, for cor. of secs. 29, 30, 31 and 32, marked on brass cap

1916 on S. rim;

T28N R18W in N. half;

S30 in NW.,
S29 in NE.,
S32 in SE. and

Chains.	
	<p>S31 in SW. quadrant; and raise a mound of stone, 2 ft. base, 1½ ft. high, W. of cor.</p> <p>Land, rolling and gently rolling. Soil, sandy, gravelly and rocky; 3rd rate. No timber. Undergrowth, yucca.</p>
40.00	N.89° 55' E., on a random line, bet. secs. 29 and 32.
80.03	Set temp. ¼ sec. cor. Intersect N. and S. line, 11 lks. N. of the cor. of secs. 28, 29, 32 and 33.
9.50	Thence West on a true line, bet. secs. 29 and 32. Over gently rolling land, through scattering undergrowth. Wash, course S. Road in wash, brs. N. to Cyclopic and S. to Gold Basin. Asc. 145 ft. to
30.15	Desc. 55 ft. to
34.55	Wash, course S. Asc. 70 ft.
40.01½	Set an iron post, 3 ft. long, 1 in. diam., 26 ins. in the ground, for ¼ sec. cor., marked on brass cap 1916 on S. rim; S29 ¼ in N. and S32 in S. half; and raise a mound of stone, 2 ft. base, 1½ ft. high, N. of cor.
42.65	Desc. 20 ft. to
51.10	Wash, course SE. Asc. 25 ft. to
64.00	Desc. 10 ft. to
65.00	Asc. 45 ft. to
80.03	The cor. of secs. 29, 30, 31 and 32. Land, rolling and gently rolling. Soil, sandy, stony loam; 3rd rate No timber. Undergrowth, cactus, yucca, sagebrush and greasewood.
40.00	S.89° 55' W., on a random line, bet. secs. 30 and 31.
77.70	Set temp. ¼ sec. cor. Intersect W. bdy. of Tp., 2 lks. N. of the cor. of secs. 25, 30, 31 and 36, which is an iron post, described in Book "A."
	Thence N.89° 54' E., on a true line, bet. secs. 30 and 31. Over gently rolling land, through scattering undergrowth. Asc. to
7.00	Spur, slopes N.30° E. Desc. 120 ft. to
17.70	Wash, course S.20° E. Thence over gently rolling land.
23.40	Wash, course S.30° E. Asc. to
27.70	Spur, slopes S.30° E. Desc. 65 ft.
37.70	Set an iron post, 3 ft. long, 1 in. diam., 26 ins. in the ground, for ¼ sec. cor., marked on brass cap 1916 on S. rim; S30 ¼ in N. and S31 in S. half; and raise a mound of stone, 2 ft. base, 1½ ft. high, N. of cor.
43.70	Wash, course N.20° E. Asc.
58.40	From this point, Cyclopic Mill brs. N.27° W., 18 chs. dist. Cabins br. N.12° W., 22 chs. dist., respectively. Barn, brs. N.23° W., 26 chs. dist.
58.70	Spur, slopes N. Desc. 170 ft.

Subdivision of T. 28 N., R. 18 W.

Chains.

71.20 Road, brs. NW. to Cyclopic and SE. to Chloride and Gold Basin.
 72.70 Wash, course SE. Asc. to
 77.70 The cor. of secs. 29, 30, 31 and 32.
 Land, rolling and gently rolling.
 Soil, sandy and rocky, 3rd rate.
 No timber.
 Undergrowth, rabbit brush and yucca.

N.0° 3' W., bet. secs. 29 and 30.
 Over gently rolling land, through scattering undergrowth.
 12.90 Road, brs. E. to Chloride and W. to Cyclopic.
 14.60 Wash, course SE.
 40.00 Set an iron post, 3 ft. long, 1 in. diam., 26 ins. in the ground, for 1/4 sec. cor., marked on brass cap
 1916 on S. rim;
 S30 1/2 in W. and
 S29 in E. half;
 dig pits, 18 X 18 X 12 ins., N. and S. of post, 3 ft. dist.; and raise a mound of earth, 3 1/2 ft. base, 1 1/2 ft. high, W. of cor.
 42.55 Wash, course SE. Asc. 155 ft.
 51.90 Road, brs. E. and W. to Cyclopic.
 64.30 Desc. 70 ft. to
 70.20 Asc. 65 ft. to
 73.15 Spur, slopes SE. Desc. 40 ft. to
 80.00 Set an iron post, 3 ft. long, 2 ins. diam., 24 ins. in the ground, for cor. of secs. 19, 20, 29 and 30, marked on brass cap
 1916 on S. rim;
 T28N R18W in N. half;
 S19 in NW.,
 S20 in NE.,
 S29 in SE. and
 S30 in SW. quadrant;
 and raise a mound of stone, 2 ft. base, 1 1/2 ft. high, W. of cor.
 From this cor., U. S. M. M. No. 1, Gold Basin Mining District, which is a wooden stake, 4 ins. square, projecting 3 ft. out of a mound of stone, 4 ft. square, 6 ft. high, brs. S.55° 53' E., 31.56 chs. dist. This stake is marked U. S. M. M. No. 1 G. B. M. D. 6681.
 Land, rolling and gently rolling.
 Soil, rocky, 3rd rate.
 No timber.
 Undergrowth, rabbit brush and yucca.

40.00 East on a random line, bet. secs. 20 and 29.
 Set temp. 1/4 sec. cor.
 79.97 Intersect N. and S. line, 5 lks. S. of the cor. of secs. 20, 21, 28 and 29.
 Thence
 S.89° 58' W., on a true line, bet. secs. 20 and 29.
 Over mountainous land, through scattering undergrowth.
 Asc. 390 ft. to
 18.50 Spur, brs. N. and S. Desc. 100 ft. to
 23.80 Asc. 85 ft. to
 30.65 Desc. 85 ft. to
 39.00 Wash, course NW. Road, in wash, brs. NW. and SE. Asc. 115 ft.
 39.98 1/2 Set an iron post, 3 ft. long, 1 in. diam., in a mound of stone, for 1/4 sec. cor., marked on brass cap
 1916 on S. rim;

<p>Chains.</p> <p>53.85</p> <p>62.75</p> <p>74.65</p> <p>76.41</p> <p>79.97</p>	<p>S20 $\frac{1}{4}$ in N. and S29 in S. half; and raise a mound of stone, 2 ft. base, $1\frac{1}{2}$ ft. high, N. of cor.</p> <p>Desc. 75 ft. to</p> <p>Wash, course NE. Asc. 120 ft. to</p> <p>Desc. 20 ft. to</p> <p>Wash, course SE. Road in wash, brs. NW. and SE. to Gold Basin. Asc. to</p> <p>The cor. of secs. 19, 20, 29 and 30. Land, mountainous and rolling. Soil, rocky, 3rd rate. No timber. Undergrowth, yucca and rabbit brush.</p>
<p>40.00</p> <p>77.59</p> <p>13.70</p> <p>17.65</p> <p>20.90</p> <p>32.55</p> <p>37.59</p>	<p>Feb. 11, 1916. At 9 hrs. 58 m., a.m., l.m.t., I set off 35° 47$\frac{1}{2}$' N. on the lat. arc; 14° 16' S. on the decl. arc; and determine a meridian with the solar at the cor. of secs. 19, 20, 29 and 30.</p> <p>Thence</p> <p>S.89° 54' W., on a random line, bet. secs. 19 and 30.</p> <p>Set temp. $\frac{1}{4}$ sec. cor.</p> <p>Intersect W. bdy. of Tp., 14 lks. S. of the cor. of secs. 19, 24, 25 and 30, which is an iron post, described in Book "A."</p> <p>Thence</p> <p>East on a true line, bet. secs. 19 and 30. Over mountainous land, through scattering undergrowth.</p> <p>Desc. 155 ft. to</p> <p>Wash, course SE. Asc. to</p> <p>Desc. 25 ft.</p> <p>Road, brs. N. and S. Asc. 50 ft. to</p> <p>Spur, slopes NW. Desc. 135 ft.</p> <p>Set an iron post, 3 ft. long, 1 in. diam., 26 ins. in the ground, for $\frac{1}{4}$ sec. cor., marked on brass cap 1916 on S. rim; S19 $\frac{1}{4}$ in N. and S30 in S. half; and raise a mound of stone, 2 ft. base, $1\frac{1}{2}$ ft. high, N. of cor.</p>
<p>38.60</p> <p>42.60</p> <p>58.80</p> <p>64.80</p> <p>67.70</p> <p>72.60</p> <p>77.59</p>	<p>Wash, course NE. Road in wash, brs. NE. to Gold Basin and SW. to Cyclopic. Asc. 180 ft.</p> <p>Ranch house brs. S. 10 chs. dist.</p> <p>Spur, slopes NE. Desc. 80 ft. to</p> <p>Wash, course NE. Asc. 35 ft. to</p> <p>Desc. 85 ft.</p> <p>Mine tunnel brs. N. 5 chs. dist.</p> <p>The cor. of secs. 19, 20, 29 and 30. Land, mountainous. Soil, rocky, 3rd rate. No timber. Undergrowth, yucca and rabbit brush.</p>
<p>1.50</p> <p>8.85</p> <p>29.25</p> <p>34.20</p> <p>38.55</p> <p>40.00</p>	<p>N.0° 3' W., bet. secs. 19 and 20. Over mountainous land, through scattering undergrowth.</p> <p>Desc. 15 ft. to</p> <p>Wash, course SE. Road in wash, brs. NW. and SE. Asc. 115 ft.</p> <p>Spur, slopes SE. Desc. 300 ft. to</p> <p>Wash, course SE. Asc. 25 ft. to</p> <p>Spur, slopes W. Desc. 50 ft. to</p> <p>Wash, course NE. Road in wash, brs. NE. to Gold Basin and SW. to Cyclopic. Asc. 30 ft.</p> <p>Set an iron post, 3 ft. long, 1 in. diam., 26 ins. in the ground, for $\frac{1}{4}$ sec. cor., marked on brass cap</p>

Subdivision of T. 28 N., R. 18 W.

Chains.

1916 on S. rim;
 S19 $\frac{1}{4}$ in W. and
 S20 in E. half;
 dig pits, 18 X 18 X 12 ins. N. and S. of post, 3 ft. dist.; and raise a mound of earth, $3\frac{1}{2}$ ft. base, $1\frac{1}{2}$ ft. high, W. of cor.
 At this cor., I set off $14^{\circ} 14'$ S. on the decl. arc; and at apparent noon, I observe the sun on the meridian; the resulting lat. is $35^{\circ} 48'$ N.
 45.00 Spur, slopes E. Desc. 55 ft. to
 49.83 Wash, course SE. Asc. 155 ft. to
 55.40 Spur, slopes SE. Desc. 105 ft. to
 61.12 Wash, course NE. Asc. 180 ft. to
 76.33 Spur, slopes NE. Desc. 165 ft. to
 80.00 Set an iron post, 3 ft. long, 2 ins. diam., 24 ins. in the ground, for cor. of secs. 17, 18, 19 and 20, marked on brass cap

1916 on S. rim;
 T28N R18W in N. half;
 S18 in NW.,
 S17 in NE.,
 S20 in SE. and
 S19 in SW. quadrant;
 and raise a mound of stone, 2 ft. base, $1\frac{1}{2}$ ft. high, W. of cor.
 Land, mountainous.
 Soil, rocky, 4th rate.
 No timber.
 Undergrowth, rabbit brush and yucca.

E. J. L.

S. F. W.
 N. $89^{\circ} 58'$ E., on a random line, bet. secs. 17 and 20.
 40.00 Set temp. $\frac{1}{4}$ sec. cor.
 79.78 Intersect N. and S. line, 19 lks. N. of the cor. of secs. 16, 17, 20 and 21.
 Thence
 N. $89^{\circ} 54'$ W., on a true line, bet. secs. 17 and 20.
 Over mountainous land, through scattering undergrowth.
 Asc. 160 ft. to
 11.25 Desc. 30 ft. to
 14.70 Asc. 105 ft. to
 18.40 Spur, slopes NE. Desc. 120 ft. to
 26.53 Wash, course N. Asc. 270 ft.
 39.89 Set an iron post, 3 ft. long, 1 in. diam., 26 ins. in the ground, for $\frac{1}{4}$ sec. cor., marked on brass cap

1916 on S. rim;
 S17 $\frac{1}{4}$ in N. and
 S20 in S. half;
 and raise a mound of stone, 2 ft. base, $1\frac{1}{2}$ ft. high, N. of cor.
 46.70 Spur, slopes NE. Desc. 220 ft. to
 53.92 Wash, 150 lks. wide, course N. Road in wash, brs. N. to Gold Basin and S. to Cyclopic. Asc. 70 ft. to
 60.85 Desc. 40 ft. to
 63.75 Asc. 245 ft. to
 77.80 Desc. 20 ft. to
 79.78 The cor. of secs. 17, 18, 19 and 20.
 Land, mountainous.
 Soil, rocky; 3rd rate.
 No timber.
 Undergrowth, yucca, cactus, black brush, cat claw, Spanish dagger, greasewood.
 Some bunch grass.

S. F. W.

40

Subdivision of T. 28 N. R. 18 W.

Chains.

40.00

77.48

6.00

37.48

45.85

48.80

55.35

67.90

77.48

E. J. L.
 West on a random line, bet. secs. 18 and 19.
 Set temp. $\frac{1}{4}$ sec. cor.
 Intersect W. bdy. of To., 7 lks. N. of the cor. of secs. 13, 18, 19 and 24, which is an iron post, described in Book "A."
 Thence
 N. $89^{\circ} 57'$ E., on a true line, bet. secs. 18 and 19.
 Over mountainous land, through scattering undergrowth.
 Asc. 85 ft. to
 Spur, slopes NE. Desc. 325 ft.
 Set an iron post, 3 ft. long, 1 in. diam., 26 ins. in the ground, for $\frac{1}{4}$ sec. cor., marked on brass cap
 1916 on S. rim;
 S18 $\frac{1}{4}$ in N. and
 S19 in S. half;
 and raise a mound of stone, 2 ft. base, $1\frac{1}{2}$ ft. high, N. of cor.
 Wash, course N. Asc. 55 ft. to
 Spur, slopes NE. Desc. 105 ft. to
 Wash, course NE. Asc. 240 ft. to
 Spur, slopes NE. Desc. 175 ft. to
 The cor. of secs. 17, 18, 19 and 20.
 Land, mountainous.
 Soil, rocky,; 3rd rate.
 No timber.
 Undergrowth, rabbit brush and yucca. E. J. L.

7.35

14.20

32.16

40.00

46.90

64.33

78.30

80.00

S. F. W.
 N. $0^{\circ} 3'$ W., bet. secs. 17 and 18.
 Over mountainous land, through scattering undergrowth.
 Desc. 205 ft. to
 Draw, course NE. Asc. 180 ft. to
 Spur, slopes NE. Desc. 320 ft. to
 Wash, course SE. Asc. 325 ft. to
 Set an iron post, 3 ft. long, 1 in. diam., 26 ins. in the ground, for $\frac{1}{4}$ sec. cor., marked on brass cap
 1916 on S. rim;
 S18 $\frac{1}{4}$ in W. and
 S17 in E. half;
 and raise a mound of stone, 2 ft. base, $1\frac{1}{2}$ ft. high, W. of cor.
 Spur, brs. NW. and SE. Desc. 360 ft. to
 Wash, course E.; asc. 290 ft. to
 Spur, slopes SE. Desc. to
 Set an iron post, 3 ft. long, 2 ins. diam., 24 ins. in the ground, for cor. of secs. 7, 8, 17 and 18, marked on brass cap
 1916 on S. rim;
 T28N R18 W in N. half;
 S7 in NW.,
 S8 in NE.,
 S17 in SE. and
 S18 in SW. quadrant;
 and raise a mound of stone, 2 ft. base, $1\frac{1}{2}$ ft. high, W. of cor.
 Land, mountainous.
 Soil, rocky, 4th rate.
 No timber.
 Undergrowth, yucca, cat claw, black brush, cat claw, Spanish dagger and greasewood.
 Some bunch grass.

Feb 18, 1916: At 9 hrs. 58 m., a.m., l.m.t., I set off $35^{\circ} 49\frac{1}{2}'$ N. on the lat. arc; $11^{\circ} 53'$ S. on the decl. arc; and determine a meridian with the solar at the cor. of secs. 7, 8, 17 and 18.

Subdivision of T. 28 N., R. 18 W.

Chains.

40.00 Thence S.89° 54' E., on a random line, bet. secs. 8 and 17.
 79.80 Set temp. $\frac{1}{4}$ sec. cor.
 Intersect N. and S. line, 14 lks. N. of the cor. of secs. 8, 9, 16 and 17.
 Thence N.89° 48' W., on a true line, bet. secs. 8 and 17.
 39.90 Over gently rolling land, through scattering undergrowth.
 The true point for $\frac{1}{4}$ sec. cor. falls in wash, 50 lks. wide, course NE.
 40.31 Set an iron post, 3 ft. long, 1 in. diam., 26 ins. in the ground, for witness cor. to $\frac{1}{4}$ sec. cor., marked on brass cap
 1916 on S. rim;
 W C in E. half;
 S8 in NW. and
 S17 in SW. quadrant;
 and raise a mound of stone, 2 ft. base, 1 $\frac{1}{2}$ ft. high, N. of cor.
 79.80 Asc. 435 ft., overmountainous land.
 The cor. of secs. 7, 8, 17 and 18.
 Land, gently rolling and mountainous.
 Soil, 2nd and 4th rates.
 No timber.
 Undergrowth, yucca, black brush, cat claw, cactus, Spanish dagger.
 Some grass.

March 24, 1916: At 10 hrs. 5 m., a.m., l.m.t., I set off 35° 49 $\frac{1}{2}$ ' N. on the lat. arc; 1° 30 $\frac{1}{2}$ ' N. on the decl. arc; and determine a meridian with the solar at the cor. of secs. 7, 8, 17 and 18.
 Thence S.89° 57' W., on a random line, bet. secs. 7 and 18.
 40.00 Set temp. $\frac{1}{4}$ sec. cor.
 77.33 Intersect W. bdy. of Tp., 16 lks. N. of the cor. of secs. 7, 12, 13 and 18, which is an iron post, described in Book "A."
 Thence N.89° 50' E., on a true line, bet. secs. 7 and 18.
 Over mountainous land, through scattering undergrowth.
 Asc. 615 ft. to
 15.84 Spur, slopes NW. Desc. 150 ft. to
 24.38 Draw, course NW Asc. 185 ft. to
 31.87 Ridge, brs. N. and S. Desc. 250 ft. t
 37.33 Set an iron post, 3 ft. long, 1 in. diam., 20 ins. in the ground, for $\frac{1}{4}$ sec. cor., marked on brass cap
 1916 on S. rim;
 S7 $\frac{1}{2}$ in N. and
 S18 in S. half;
 and raise a mound of stone, 2 ft. base, 1 $\frac{1}{2}$ ft. high, N. of cor.
 37.35 Draw, course SE. Asc. 260 ft. to
 48.36 Spur, slopes SE. Desc. 250 ft. to
 77.33 The cor. of secs. 7, 8, 17 and 18.
 Land, mountainous.
 Soil, rocky, 4th rate.
 No timber.
 Undergrowth, cactus, yucca and black brush.

March 22, 1916: At 8 hrs. 5 m., a.m., l.m.t., I set off 35° 49 $\frac{1}{2}$ ' N. on the lat. arc; 0° 41 $\frac{1}{2}$ ' N. on the decl. arc; and determine a meridian with the solar at the cor. of secs. 7, 8, 17 and 18. Thence, N.0° 3' W., bet. secs. 7 and 8.
 Over rolling land, through scattering undergrowth.
 Desc. 95 ft. to
 10.65 Asc. 30 ft. to

42

Subdivision of T. 28 N., R. 18 W.

Chains.	
13.65	Desc. 50 ft. to
20.10	Wash, course SE. Asc. 165 ft. to
30.25	Spur, slopes SE. Desc. 155 ft.
40.00	Set an iron post, 3 ft. long, 1 in. diam., 26 ins. in the ground, for $\frac{1}{4}$ sec. cor., marked on brass cap 1916 on S. rim; S7 $\frac{1}{4}$ in W. and S8 in E. half; and raise a mound of stone, 2 ft. base, 1 $\frac{1}{2}$ ft. high, W. of cor.
40.70	Draw, course N.60° W. Asc. 50 ft. to
50.70	Desc. 75 ft. to
55.55	Asc. 105 ft. to
63.90	Spur, slopes NW. Desc. 135 ft. to
73.15	Wash, course NW. Asc. 120 ft. to
80.00	Set an iron post, 3 ft. long, 2 ins. diam., 24 ins. in the ground, for cor. of secs. 5, 6, 7 and 8, marked on brass cap 1916 on S. rim; T28N R18W in N. half; S6 in NW. S5 in NE.; S8 in SE. and S7 in SW. quadrant; and raise a mound of stone, 2 ft. base, 1 $\frac{1}{2}$ ft. high, W. of cor. Land, rolling and mountainous, Soil, rocky, 3rd and 4th rates. No timber. Undergrowth, yucca, cat claw, back brush, cactus, Spanish dagger. Some bunch grass.
40.00	S.89° 48' E., on a random line, bet. secs. 5 and 8. Set temp. $\frac{1}{4}$ sec. cor.
80.00	Intersect N. and S. line, 40 lks. S. of the cor. of secs. 4, 5, 8 and 9. Thence S.89° 55' W., on a true line, bet. secs. 5 and 8. Over mountainous land, through scattering undergrowth. Asc. 790 ft. to
29.00	Ridge, brs. NW. and SE. Desc. 375 ft.
40.00	Set an iron post, 3 ft. long, 1 in. diam., 26 ins. in the ground, for $\frac{1}{4}$ sec. cor., marked on brass cap 1916 on S. rim; S5 $\frac{1}{4}$ in N. and S8 in S. half; and raise a mound of stone, 2 ft. base, 1 $\frac{1}{2}$ ft. high, N. of cor.
53.50	Draw, course SW. Asc. 75 ft. to
59.45	Desc. 80 ft. to
64.30	Asc. 80 ft. to
74.20	Desc. 20 ft. to
80.00	The cor. of secs. 5, 6, 7 and 8. Land, mountainous. Soil, rocky; 4th rate. No timber. Undergrowth, yucca, black brush, cactus, cat claw, Spanish dagger. Some bunch grass.
40.00	S.89° 50' W., on a random line, bet. secs. 6 and 7. Set temp. $\frac{1}{4}$ sec. cor.

Chains.

77.15

Intersect W. bdy. of Tp., 14 lks. S. of the cor. of secs. 1, 6, 7 and 12, which is an iron post, described in Book "A."

hence

N. 89° 56' E., on a true line, bet. secs. 6 and 7.

Over rolling and mountainous land, through scattering undergrowth.

Asc. 50 ft. to

9.95

Desc. 30 ft. to

14.75

Asc. 90 ft. to

22.56

Spur, slopes N. Desc. 435 ft.

37.15

Set an iron post, 3 ft. long, 1 in. diam., 26 ins. in the ground, for $\frac{1}{4}$ sec. cor., marked on brass cap

1916 on S. rim;

S6 $\frac{1}{2}$ in N. and

S7 in S. half;

and raise a mound of stone, 2 ft. base, 1 $\frac{1}{2}$ ft. high, N. of cor.

70.70

Wash, course NW. Asc. 165 ft. to

77.15

The cor. of secs. 5, 6, 7 and 8.

Land, rolling and mountainous.

Soil, rocky, 2nd and 4th rates.

No timber.

Undergrowth, yucca, cat claw, black brush, cactus and Spanish bayonet.

Some bunch grass.

N. 0° 3' W., on a true line, bet. secs. 5 and 6.

Over rolling and mountainous land, through scattering undergrowth.

Asc. 15 ft. to

2.00

Spur, slopes NW. Desc. 200 ft. to

13.57

Wash, course NW. Asc. 25 ft. to

23.05

Spur, slopes NW. Desc. 30 ft. to

25.50

Wash, course NW. Asc. 50 ft. to

31.00

Desc. 35 ft. to

34.50

Asc. 70 ft. to

40.00

Set an iron post, 3 ft. long, 1 in. diam., 26 ins. in the ground, for $\frac{1}{4}$ sec. cor., marked on brass cap

1916 on S. rim;

S6 $\frac{1}{2}$ in W. and

S5 in E. half;

and raise a mound of stone, 2 ft. base, 1 $\frac{1}{2}$ ft. high, W. of cor.

Desc. 25 ft. to

45.00

Asc. 250 ft. to

62.00

Spur, slopes NW. Desc. 60 ft. to

64.20

Asc. 30 ft. to

70.70

Ridge, brs. E. and W. Desc. 285 ft. to

80.37

Intersect Seventh Standard Parallel North, 5.40 chs. W.

of the standard $\frac{1}{4}$ sec. cor. of sec. 31, which is an

iron post, established by E. J. L., as described in Book "A."

At the point of intersection, set an iron post, 3 ft. long, 2 ins. diam., 24 ins. in the ground, for closing cor.

of secs. 5 and 6, marked on brass cap

1916 on S. rim;

T29N R18W S36 in N. and

CC in S. half;

S5 R18W in SE. and

S6 T28N in SW. quadrant;

and raise a mound of stone, 2 ft. base, 1 $\frac{1}{2}$ ft. high, S. of cor.

Land, rolling and mountainous.

Soil, rocky, 4th rate.

Chains.

No timber.
Undergrowth, yucca, cat claw, cactus, black brush and Spanish Dagger.
Some bunch grass.

S.F.W.

GENERAL DESCRIPTION.

This township contains mountainous, rolling and level land. The west half is mountainous and rolling, and the east half is rolling with scattered small areas of level surface. The soil of the east half is mostly a sandy and gravelly loam, 1st and 2nd rate, and of the west half is rocky, 3rd and 4th rate. There is no timber, but a scattering undergrowth of yucca, catclaw, cacti, greasewood and sage brush covers all parts. Bunch grass exists in scattered sections. There is no permanent running water. Valuable mineral exists in all parts, and a number of mining claims are now located in various parts of the township. The mining camp of Cyclopic is located in sec. 30, and the buildings of said camp, and a house in the northern part of same section are the only improvements in the township. No settlers are located within the township. Several roads give access to nearly all parts of the township, except the northwestern part.

7th Standard Parallel North

6	5	4	3	2	1
				3-2-16	3-2-16
7	8	9	10	11	12
				3-1-16	3-1-16
18	17	16	15	14	13
NAMES		T.28N. R.17W.		2-24-16	2-25-16
19	20	21	22	23	24
30	29	28	27	26	25
31	32	33	34	35	36

45

3-5-16 RESURV.
 3-3-16
 3-2-16
 3-1-16
 2-23-16
 2-24-16
 2-24-16
 3-8-17 RESURVEYED
 3-8-17
 3-19-17
 3-19-17

Surveys executed on dates shown on these diagrams by S. Frank Walters, U.S. Transitman.

7th Standard Parallel North

6	5	4	3	2	1
3-22-16	2-19-16				
7	8	9	10	11	12
3-24-16	2-18-16	2-19-16	2-17-16		
18	17	16	15	14	13
2-18-16	2-15-16	T.28N. R.18W.	2-19-16		
19	20	21	22	23	24
	2-15-16	2-14-16			
30	29	28	27	26	25
		2-15-16			
31	32	33	34	35	36
		2-14-16			

3-10-16
 2-3-16
 2-3-16
 2-3-16
 2-2-16
 2-2-16

3-22-16
 3-22-16
 2-19-16
 2-18-16
 2-18-16
 2-15-16
 2-15-16

2-19-16
 2-19-16
 2-17-16
 2-17-16
 2-17-16
 2-14-16
 2-14-16

6-27-1

CERTIFICATE OF UNITED STATES ~~SURVEYOR~~ TRANSITMAN

I, S^r Frank Walters, ~~U. S. Surveyor~~ ^{Transitman}, hereby certify upon honor that, in pursuance of special instructions received from the U. S. Surveyor General for Group 45, Arizona, bearing date of the 7th day of January, 1915, I have well, faithfully, and truly in my own proper person, and in strict conformity with said instructions, the Manual of Surveying Instructions, and the laws of the United States, surveyed all those parts or portions of the Subdivision lines of TOWNSHIP 28 NORTH, RANGE 17 WEST, and TOWNSHIP 28 NORTH, RANGE 18 WEST, and Resurveyed all those parts or portions of the Subdivision lines of TOWNSHIP 28 NORTH, RANGE 17 WEST, of the Gila and Salt River Base & Meridian, in the State of Arizona, which are represented by the diagram on the reverse hereof and in the foregoing field notes as having been executed by me, and under my direction; and that all the corners of said survey have been established and perpetuated in strict accordance with the Manual of Surveying Instructions, and the special written instructions of the U. S. Surveyor General for Group 45, Arizona, and in the specific manner described in the field notes, and that the foregoing are the original field notes of such survey and resurvey.

Frank Walters
U.S. Transitman.

APPROVAL.

OFFICE OF THE UNITED STATES SURVEYOR GENERAL,

....., 191

The foregoing field notes of the survey of

executed by
under his special instructions dated, 191 , having been critically examined, and the necessary corrections and explanations made, the said field notes, and the surveys they describe, are hereby approved.

.....
U. S. Surveyor General.

I certify that the foregoing transcript of the field notes of the above-described surveys in
....., has been correctly copied from the original notes on file in this office.

.....
U. S. Surveyor General.

3-6-16	3-6-16	7th. Standard Parallel North	3-6-16	3-6-16	2-28-16	2-28-16	5-3-16
RESURV. 3-6-16 6	RESURV. 3-6-16 5	RESURV. 3-6-16 4	RESURV. 3-6-16 3	2	1		
7	8	9	10	11	12		
18	17	FIELD ASSISTANTS. T.28N. R.17W.		14	13		
19	20	21	22	23	24		
30	29	28	27	26	25		
31	32	33	34	35	36		

47
BOOK 3251

3-1-16
2-29-16
2-29-16

Surveys executed on dates shown on these diagrams by E. J. Lange, U.S. Surveyor.

3-8-16	3-8-16	7th. Standard Parallel North	3-7-16	3-7-16	3-7-16	3-7-16	3-6-16
6	5	4	3	2	1	RESURV. 3-6-16	
7	8	9	10	11	12		
18	17	T.28N. R.18W.		14	13		
19	20	21	22	23	24		
30	29	28	27	26	25		
31	32	33	34	35	36		

6-2761

188

48

BOOK 3251

CERTIFICATE OF UNITED STATES SURVEYOR.

I, E. J. Lange, U. S. Surveyor, hereby certify upon honor that, in pursuance of special instructions received from the U. S. Surveyor General for Group 45, Arizona, bearing date of the 7th day of January, 1915, I have well, faithfully, and truly in my own proper person, and in strict conformity with said instructions, the Manual of Surveying Instructions, and the laws of the United States, surveyed all those parts or portions of the Subdivision lines of Township 28 North, Range 17 West, and Township 28 North, Range 18 West, of the Gila and Salt River Base and Meridian, in the State of Arizona, which are represented by the diagrams on the reverse hereof and in the foregoing field notes as having been executed by me, and under my direction; and that all the corners of said survey have been established and perpetuated in strict accordance with the Manual of Surveying Instructions, and the special written instructions of the U. S. Surveyor General for Group 45, Arizona, and in the specific manner described in the field notes, and that the foregoing are the original field notes of such survey.

E. J. Lange

U. S. Surveyor.

APPROVAL.

OFFICE OF THE UNITED STATES SURVEYOR GENERAL,

Phoenix, Arizona. March 17, 1919.

The foregoing field notes of the survey of the Completion of the Subdivision lines of TOWNSHIP 28 NORTH, RANGE 17 WEST, and All of the Subdivision lines of TOWNSHIP 28 NORTH, RANGE 18 WEST, and of the Resurvey of part of the Subdivision Lines of TOWNSHIP 28 NORTH, RANGE 17 WEST, of the Gila and Salt River Base and Meridian, in the State of Arizona, executed by E. J. Lange, U. S. Surveyor, and S. Frank Walters, U. S. Transitman, under his special instructions dated Jan. 7, 1915, for Group 45, Arizona, 191, having been critically examined, and the necessary corrections and explanations made, the said field notes, and the surveys & resurveys they describe, are hereby approved.

James R. [Signature]

U. S. Surveyor General.

I certify that the foregoing transcript of the field notes of the above described surveys in [redacted] has been correctly copied from the original notes on file in this office.

U. S. Surveyor General.