

Book "A"

4-679

BOOK 3299

FIELD NOTES

OF THE RETRACEMENT OF

Part of the Subdivision lines of T.20 S., R.28 E.,

and RESURVEY of

East bdy. of Township 20 South, Range 28 East (partial)

South bdy. of Township 19 South, Range 28 East (complete), and

Fourth Standard Parallel South, thru West half of Range

28 East, and

SURVEY of

Completion of Subdivision Lines of Township 20 South,

Range 28 East,

Of the Gila and Salt River Base and Meridian,

In the State of Arizona.

EXECUTED BY

Sidney E. Blout,

In the capacity of U. S. Surveyor, under instructions dated November 8, 1915, issued by the United States Surveyor General to govern surveys included in Group No. 64, which were approved by the Commissioner of the General Land Office, November 23, 1915.

Retracement,
Resurvey & Survey commenced February 14, 1916.

Retracement,
Resurvey & Survey completed March 7, 1916.

Executed under Assignment
Instructions dated Jan. 14, 1916.

3299

3299





3299
Book "A"

Group 64 - - - Arizona.

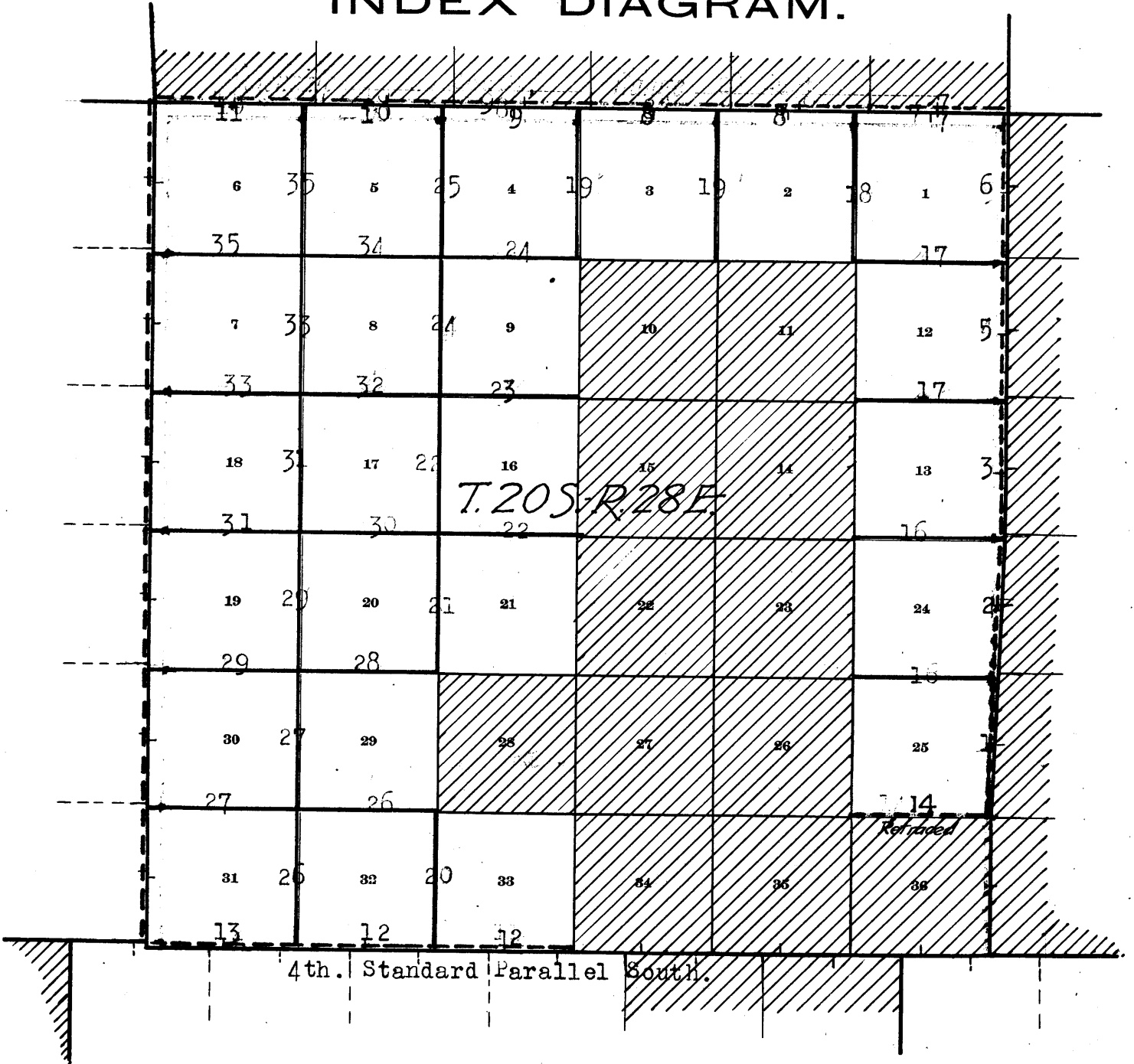
BOOK 3299

INDEX DIAGRAM.



-  Lines surveyed under this group.
-  Lines retraced or resurveyed under this group.
-  Accepted surveys.
-  Unsurveyed lines.
-  Area surveyed as per accepted plats on file.

Chains

Retracements, resurveys and surveys hereinafter described were executed by Sidney E. Blout, U.S. Surveyor, on dates shown on diagram on page 38 hereof, using a Buff light mountain transit No. 9793 with Smith solar attachment. The horizontal limb is provided with two double verniers, placed opposite to each other, reading to single minutes of arc, which is also the least count of the verniers of the latitude and declination arcs. The instrument was examined, tested on the Federal Building meridian, Phoenix, Arizona, was found correct, and was approved by the Assistant Supervisor of Surveys for the District of Arizona, January 25, 1916.

Examine the adjustments of the transit, and correct slight errors of the levels and line of collimation; then, in order to test the solar apparatus, by comparing its indications, resulting from solar observations made during a.m. and p.m. hours, with a meridian established by observations on Polaris, proceed as follows:

At camp, which is located near the cor. of secs. 26, 27, 34 and 35, T.20 S., R.28 E.; latitude, $31^{\circ} 39\frac{1}{2}' N.$; longitude, $109^{\circ} 28' 40'' W.$ At 9h. 57.6m. p.m. by watch, which is correct local mean time, observe Polaris at western elongation in accordance with instructions in the Manual, and mark the direction thus determined by a tally pin driven in a stake set firmly in the ground 5.00 chs. N. of instrument.

February 12, 1916.

February 13, 1916. At 7h. 45m. a.m., l.m.t., lay off the azimuth of Polaris $1^{\circ} 20'$ to the east, and mark the meridian thus determined by a tally pin driven in a stake set firmly in the ground, 5.00 chs. N. of instrument.

At 8h. 14m. a.m., l.m.t. set off $31^{\circ} 39\frac{1}{2}' N.$ on the lat. arc; $13^{\circ} 37' S.$ on the decl. arc, and determine a meridian with the solar, and mark a point thereon by a tack driven in the stake already set 5.00 chs. N. of instrument; this point falls 0.4 ins. E of the meridian established by the Polaris observation.

At 12h. 14m. p.m., l.m.t., set off $13^{\circ} 35' S.$ on the decl. arc; and observe the sun on the meridian; the resulting latitude is $31^{\circ} 39'$

At 3h. 14m. p.m., l.m.t., set off $31^{\circ} 39\frac{1}{2}' N.$ on the lat. arc; $13^{\circ} 32' S.$ on the decl. arc, and determine a meridian with the solar, and mark a point thereon by a tack driven in the stake already set 5.00 chs. N. of instrument; this point falls 0.6 ins. W. of the meridian established by the Polaris observation.

The solar apparatus by a.m. and p.m. observations, defines positions for meridians, respectively about $0' 21''$ east and $0' 31''$ west of the meridian established by the Polaris observation; therefore, conclude that the adjustments of the instrument are satisfactory.

The magnetic bearing of the meridian at 8 a.m. is $N. 13^{\circ} W.$; the angle thus determined gives the magnetic declination $N. 13^{\circ} E.$

February 13, 1916.

Resurvey of part of East bdy. of T. 20 S., R. 28 East.

From the original cor. of secs. 25, 30, 31 and 36 on E. bdy. of Tp., a granite stone 12x12x4 ins. above ground, firmly set, marked and witnessed as described by the surveyor general,

N. $29^{\circ} 24' E.$ on a true line, bet. secs. 25 and 30. Over hilly land, thru scattering timber.

.15 Ravine, 10 lks. wide, course $N. 60^{\circ} W.$ Ascend 17 ft. on SW. slope.

3.00 Spur, slopes $N. 60^{\circ} W.$ 17 ft. on NE. slope.

9.40 Ravine, 5 lks. wide, course $W.$ Ascend 37 ft. on S. slope.

10.80 Spur, slopes $W.$ Descend 24 ft. on N. slope.

12.15 Ravine, 10 lks. wide, course $S. 70^{\circ} W.$ Ascend 95 ft. on SE.

2. Resurvey of part of E. bdy. of Township 20 South, Range 28 E.

Chains.

- slope.
- 17.60 Spur slopes S. 50°W. Descend 37 ft. on NW. slope.
- 20.25 Ravine, 10 lks. wide, course S. 50°W. Ascend 60 ft. on SE. slope.
- 26.00 Spur, slopes N. 60°W. and S. 60°W. Descend 103 ft. on NE. slope.
- 31.40 Ravine, 10 lks. wide, course west. Ascend 73 ft. on S. slope.
- 33.50 Spur, slopes west. Descend 91 ft. on N. slope.
- 35.50 Foot of steep descent in bottom, along ravine.
- 37.25 Ravine, 25 lks. wide, course S. 70°W. Ascend 114 ft. on S. slope.
- 40.26 (40.22 chs. N. of E. and W. line, thru. cor. of secs. 25, 30, 31 and 36) Intersect the original $\frac{1}{4}$ sec. cor., a granite stone 14x6x6 ins., loosely set, marks nearly obliterated; no corner accessories. Destroy this cor., and reestablish it in the same place as follows:
Set an iron post 3 ft. long, 1 in. in diam., 26 ins. in the ground for $\frac{1}{4}$ sec. cor. of secs. 25 and 30, marked on brass cap,

S25	S30
-----	-----

1916

- Raise a mound of stone 2 ft. base, 1½ ft. high, W. of cor.
- 41.50 Road brs. N. 50°E. and S. 50°W.
- 45.85 Road brs. N. 30°E. and S. 30°W.
- 61.00 Ridge, brs. N. 30°E. and S. 30°W. Descend 81 ft. over NW. slope.
- 76.25 Ravine, 10 lks. wide, course N. 70°W. Ascend 23 ft. on SW. slope.
- 77.50 Ridge, brs. NW. and SE. Descend 12 ft. on N. slope.
- 78.40 Rocky ravine, 10 lks. wide, course W. Ascend 144 ft. on SW. slope.
- 80.07 (39.81 chs. N. 2° 24' E. from $\frac{1}{4}$ sec. cor., and 80.00 chs. N. of E. and W. line, thru. cor. of secs. 25, 30, 31 and 36),
Set an iron post 3 ft. long, 3 ins. in diam., 24 ins. in the ground for reestablished cor. of secs. 24 and 25 only, marked on brass cap,

T20S	S24
S25	R28E

1916

Raise a mound of stone, 2 ft. base, 1½ ft. high, W. of cor.
Land, broken and hilly.
Soil, rocky, 4th rate.
Timber, scattering oak, juniper and cedar.
No undergrowth.
Good grass.

- N. 2° 24' E., on true line, on E. bdy. of sec. 24.
Over hilly land, thru. scattering timber..
- .47 (40.28 chs. N. 2° 24' E. from $\frac{1}{4}$ sec. cor.) Intersect original cor. of secs. 19, 24, 25 and 30, a granite stone 12x10x8 ins. above ground, loosely set, marks almost obliterated. No cor. accessories.
Destroy all trace of the old cor., and reestablish it in the same place as follows:
Set an iron post 3 ft. long, 3 ins. in diam., 24 ins. in the ground for cor. of secs. 19 and 30 only, marked on brass cap,

T20S	S19
S30	R29E

1916

Resurvey of part of the E. bdy. of T. 20 S., R. 26 E. 3.

Chains.

- Raise a mound of stone, 2 ft. base, 1½ ft. high, E. of cor. Thence, N.0° 40' E. on true line, continuing measurement of E. bdy. of sec. 24.
- 5.50 Ridge, brs. E. and W. Descend 65 ft. on N. slope.
- 7.45 Road brs. N. 20° W. and S. 20° E.
- 13.70 Road brs. N. 60° E. and west.
- 16.90 Ravine, 15 lks. wide, course N. 70° W. Ascend 15 ft. on SW. slope.
- 24.70 Spur, slopes S. 70° W. Descend 14 ft.
- 26.95 Rocky ravine, 15 lks. wide, course S. 40° W. Ascend 147 ft. on SE. slope.
- 33.20 Foot of abrupt ascent, brs. N. 20° E. and S. 60° W.
- 39.50 Ridge, brs. N. 30° E. and S. 30° W. Descend along NW. slope.
- 40.00 Set an iron post 3 ft. long, 1 in. in diam., 10 ins. in the ground, supported by a mound of stone, for reestablished ¼ sec. cor. of sec. 24 only, marked on brass cap,

½ S24

1916

- 41.03 Raise a mound of stone, 2 ft. base, 1½ ft. high, W. of cor. (40.56 chs. N. 0° 40' E. from cor. of secs. 19 and 30) Intersect original ¼ sec. cor. of secs. 19 and 24, a granite stone 12x10x6 ins. above ground, firmly set, marked and witnessed as described by the surveyor general. Reestablish this cor. to refer to sec. 19 only by moving the mound of stone from W. to E. of cor. No change in markings necessary. No bearing trees.

Thence, N. 0° 39' E., on a true line, continuing measurement of E. bdy. of sec. 24.

- Over mountainous land. Descend 169 ft. on NW. slope.
- 48.80 Top of bluff, 20 ft. high, brs. N. 70° W. and S. 70° E., extends 5.00 chs. W. and 4.00 chs. E. of line.
- 49.10 Foot of same bluff, brs. N. 70° W. and S. 70° E.
- 50.00 Top of bluff, 30 ft. high, brs. N. 70° W. and S. 70° E., extends E. 4.00 chs. and W. about 5.00 chs. dist.
- 50.70 Foot of same bluff, brs. E. and W.
- 54.90 Wash, 10 lks. wide, course S. 70° W. Ascend 29 ft. on SE. slope.
- 60.00 Spur, slopes SW. Descend 22 ft. on NW. slope.
- 62.75 Ravine, 30 lks. wide, course S. 70° W. Ascend 91 ft. on SE. slope.
- 77.80 Ridge, brs. E. and N. 70° W. Descend 33 ft. on NE. slope.
- 80.00 Set an iron post 3 ft. long, 3 ins. in diam., 24 ins. in the ground, for reestablished cor. of secs. 13 and 24, only, marked on brass cap,

T20S

S13

S24

R28E

1916

Raise a mound of stone 2 ft. base, 1½ ft. high, W. of cor. Land, broken, hilly and mountainous. Soil, dry, stony, clay loam, 3rd and 4th rate. Timber, scattering oak and cedar. Undergrowth, scattering manzanita. Good grass.

- N. 0° 39' E., on a true line, on E. bdy. of sec. 13. Over hilly and broken land, thru scattering timber and undergrowth. Descend over NE. slope.
- 1.93 (40.90 chs. N. 0° 39' E. from ¼ sec. cor. of sec. 19) Intersect original cor. of secs. 13, 18, 19 and 24, a granite stone 12x6x5 ins., loosely set, marked as described by the surveyor general. The mound of stone described as a

Resurvey of part of the East bdy. of T 20 S. R 28 E.

Chains

cor. accessory is almost destroyed. Destroy the old cor., and reestablish it in the same place as follows:
Set an iron post 3 ft. long, 3 ins. in diam., 24 ins. in the ground for cor. of secs. 18 and 19 only, marked on brass cap,

T20S
S18
S19
R29E

1916

Raise a mound of stone 2 ft. base, 1½ ft. high, E. of cor. Thence, N. 0° 15' E., on a true line, continuing measurement of E. bdy. of sec. 13.

- 3.72 Ravine, 10 lks. wide, course N. 40° W. Ascend 24 ft. on SW. slope.
- 19.62 Spur, slopes W. Descend 25 ft. on N. slope.
- 21.10 Ravine, 10 lks. wide, course W. Ascend 34 ft. on S. slope.
- 29.72 Spur, slopes N. 60° W. Descend 71 ft. on NE. slope.
- 35.15 Ravine, 20 lks. wide, course N. 70° W. Ascend 39 ft. on SW. slope.
- 40.00 Set an iron post, 3 ft. long, 1 in. in diam., 26 ins. in the ground for reestablished ¼ sec. cor. of sec. 13 only, marked on brass cap,

¼ S13

1916

Raise a mound of stone 2 ft. base, 1½ ft. high, W. of cor.

- 40.52 Wire fence brs. E. and W.
- 42.32 (40.39 chs. N. 0° 15' E. from cor. of secs. 18 and 19) Intersect original ¼ sec. cor. of secs. 13 and 18, a granite stone 12x6x6 ins. above ground, firmly set, marked and witnessed as described by the surveyor general. Reestablish this cor. to refer to sec. 18 only, by moving mound of stone from W. to E. of cor. No change in marking necessary. No bearing trees.
- Thence, N. 10° 53' E., on a true line, continuing measurement of E. bdy. of sec. 13.
- 43.80 Spur, slopes W. Descend 17 ft. on NW. slope.
- 50.72 Ravine, 15 lks. wide, course S. 10° W. Ascend 188 ft. on SE. slope.
- 59.80 High ridge, brs. N. 70° E. and S. 60° W. Descend 168 ft. over NW. slope.
- 71.87 Ravine, 10 lks. wide, course W. Ascend 28 ft. on SW. slope.
- 78.82 Spur, slopes W. Descend 30 ft. on N. slope.
- 79.52 Ravine, 20 lks. wide, course W. Ascend 15 ft. on SW. slope.
- 80.00 Set an iron post 3 ft. long, 3 ins. in diam., 24 ins. in the ground, for reestablished cor. of secs. 12 and 13 only, marked on brass cap,

T20S
S12
S13
R28E

1916

Raise a mound of stone, 2 ft. base, 1½ ft. high, W. of cor. Land, hilly and broken. Soil, rocky, and 4th rate. Timber, scattering oak, juniper and cedar. Undergrowth, scattering manzanita. Good growth of bunch grass.

Resurvey of the East bdy. of Township 20 South, Range 28 East. 5

Chains.

N. 0° 53' E. on a true line, on E. bdy. of sec. 12.
Over hilly, broken and mountainous land, thru scattering timber and undergrowth.

- 2.64 (40.32 chs. N. 0° 53' E. from $\frac{1}{4}$ sec. cor. of sec. 18) Intersect original cor. of secs. 7, 12, 13 and 18, a granite stone, 12x8x4 ins. above ground, loosely set, marked as described by the surveyor general. No accessories. Destroy all trace of this cor., and reestablish it in the same place as follows:
Set an iron post 3 ft. long, 3 ins. in diam., 24 ins. in the ground, for cor. of secs. 7 and 18 only, marked on brass cap,

T20S
 37
 S18
 R29E

1916

Raise a mound of stone 2 ft. base, 1½ ft. high, E. of cor. Thence,

N. 0° 29' E. on a true line, continuing measurement of E. bdy. of sec. 12.

- 6.65 Spur, slopes S. 10° E. Descend 20 ft., over NE. slope.
- 9.35 Ravine, 10 lks. wide, course S. 20° E. Ascend 83 ft. on SW. slope.
- 15.65 Ridge, brs. N. 50° E. and S. 60° W. Descend 113 ft. on NW. slope.
- 26.17 Ravine, 20 lks. wide, course N. 40° W. Ascend 75 ft. on SW. slope.
- 34.65 Spur, slopes N. 20° W. Descend 87 ft. on NE. slope.
- 40.00 Set an iron post, 3 ft. long, 1 in. in diam., in a mound of stone for reestablished $\frac{1}{4}$ sec. cor. of sec. 12 only, marked on brass cap,

$\frac{1}{4}$ S12

1916

- 42.64 Raise a mound of stone 2 ft. base, 1½ ft. high, W. of cor. No trace of original $\frac{1}{4}$ sec. cor. of secs. 7 and 12 can be found after diligent search; therefore at

- 43.26 (40.62 chs. N. 0° 29' E. from cor. of secs. 7 and 18, and 40.62 chs. S. 0° 29' W. from cor. of secs. 6 and 7) Set an iron post 3 ft. long, 1 in. in diam., in a mound of stone for reestablished $\frac{1}{4}$ sec. cor. of sec. 7 only, marked on brass cap,

$\frac{1}{4}$ S7

1916

Raise a mound of stone 2 ft. base, 1½ ft. high, E. of cor. Road brs. N. 60° W. and S. 60° E.

- 45.05
- 46.55 Ravine, 20 lks. wide, course N. 70° W. Ascend 90 ft. on SW. slope.
- 57.65 Spur, slopes S. 70° W. Descend 49 ft. on NW. slope.
- 63.90 Ravine, 6 lks. wide, course S. 60° W. Ascend 150 ft. on SE. slope.
- 80.00 Set an iron post, 3 ft. long, 3 ins. in diam., 24 ins. in the ground for reestablished cor. of secs. 1 and 12, only, marked on brass cap,

T20S
 S 1
 S12
 R28E

1916

Raise a mound of stone, 2 ft. base, 1½ ft. high, W. of cor. Land, hilly, broken and mountainous.

6. Resurvey of part of the Ebdy. of T. 20 S., R. 28 E.

Chains.

Soil, dry, rocky clay loam about 6 ins. deep, on rocky dry, clay subsoil.

Timber, scattering oak, cedar and juniper.

Undergrowth, scattering manzanita.

Good growth bunch grass.

-
- N. 0° 29' E. on a true line, on E. bdy. of sec. 1.
Over hilly and broken land, thru, scattering timber and undergrowth. Ascend SW. slope.
- 3.88 (40.62 chs. N. 0° 29' E. from reestablished $\frac{1}{4}$ sec. cor. of sec. 7) Intersect original cor. of secs. 1, 6, 7 and 12, a granite stone 8x8x14 ins., loosely set in a small mound of stone, marks almost obliterated. The old mound of stone described as a cor. accessory is nearly destroyed. Destroy all trace of the old cor., and reestablish it in the same place as follows:
Reset the same stone 8 ins. in the ground for cor. of secs. 6 and 7 only, marked with 5 notches on S. and 1 notch on N. edges; raise a mound of stone 2 ft. base, 1 $\frac{1}{2}$ ft. high, E. of cor.
- Thence,
N. 0° 34' E. on a true line, continuing measurement of E. bdy. of sec. 1.
- 7.40 Ridge, brs. N. 60° W. and S. 50° E. Descend 146 ft. on NE. slope.
- 7.90 Slope changes from steep to abrupt.
- 14.30 Foot of abrupt descent; enter flat, brs. E. and W.
- 17.75 Creek, 30 lks. wide, cross stream of clear water 10 lks. wide 4 ins. deep, course S. 60° W.
- 18.00 Leave flat brs. E. and W. Ascend 37 ft. on SE. slope.
- 23.40 Spur, slopes E. Descend 30 ft. on N. slope.
- 25.06 Road brs. N. 60° W. and S. 60° E. in draw, 3.00 chs. wide, course S. 60° E. Ascend 48 ft. on S. slope.
- 31.38 Spur, slopes S. 70° W. Descend 28 ft. on NW. slope.
- 40.00 Set an iron post 3 ft. long, 1 in. in diam., 26 ins. in the ground, for reestablished $\frac{1}{4}$ sec. cor. of sec. 1 only, marked on brass cap,

S1

1916

- 40.88 Raise a mound of earth 2 ft. base, 1 $\frac{1}{2}$ ft. high, W. of cor. Ravine, 5 lks. wide, course N. 60° W. Ascend 117 ft. on SW. slope.
- 44.09 (40.21 chs. N. 0° 34' E. from cor. of secs. 6 and 7) Intersect original $\frac{1}{4}$ sec. cor. of secs. 1 and 6, a granite stone 12x12x6 ins. above ground, firmly set, marked as described by the surveyor general. No cor. accessories. Reestablish this cor. to refer to sec. 6 only by raising a mound of stone 2 ft. base, 1 $\frac{1}{2}$ ft. high, E. of cor. No change in marking necessary. No bearing trees.
- Thence,
N. 0° 49' E. on a true line, continuing measurement of E. bdy. of sec. 1.
- 44.64 Wire fence brs. N. 30° W. and S. 30° E.
- 60.09 Spur, slopes N. 40° W. Descend 173 ft. on NE. slope.
- 68.10 Foot of descent, brs. NW. and SE. Enter level bottom land.
- 71.10 White Water Creek, 50 lks. wide, course west. Ascend 12 ft. over S. slope.
- 82.60 Leave timber, brs. N. 70° E. and S. 70° W.
- 84.35 (40.26 chs. N. 0° 49' E. from $\frac{1}{4}$ sec. cor. of sec. 6) Intersect original cor. of Ts. 19 and 20 S., Rs. 28 and 29 E., a granite stone 14x8x8 ins., loosely set, marks nearly obliterated. Destroy all traces of the old cor., and reestablish it in the same place as follows:
Set an iron post 3 ft. long, 3 ins. in diam., 24 ins. in the ground, for cor. of Ts. 19 and 20 S., Rs. 28 and 29 E., marked on brass cap,

Resurvey of part of E. bdy. of Township 20 South, Range 28 East. 7

Chains.

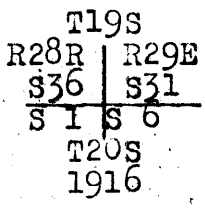

Raise a mound of stone 2 ft. base, 1½ ft. high, S. of cor.
 Land, hilly, broken, level and mountainous.
 Soil, rocky, 3rd and 4th rate.
 Timber, scattering oak, pinon cedar and juniper.
 Undergrowth, scattering manzanita and scrub oak.
 Good growth bunch grass.

Resurvey of S. bdy. of Township 19 South, Range 28 East.

From the reestablished cor. of Ts. 19 and 20 S., Rs. 28 and 29 E., hereinbefore described.
 N. 89° 48' W., on a true line, on S. bdy. of sec. 36.
 Over rolling and hilly land, thru. scattering timber.
 Ascend 92 ft. on SE. slope.

1.47 Wire fence brs. N. 20° E. and S. 20° W.
 18.00 Ridge, brs. N. 50° E. and W. Thence along top of same. Descend 179 ft.
 39.98 Intersect original ¼ sec. cor. of secs. 1 and 36, a granite stone, 16x6x6 ins., loosely set, marked "1/4" on N. face. No trace of pits and the mound of earth is only faintly visible on the N. Destroy all visible remains of said mound, and reestablish this cor. in its original position as follows:
 Reset the same stone, 8 ins. in the ground, with marking to the N. for ¼ sec. cor. of sec. 36 only, and raise a mound of stone, 2 ft. base, 1½ ft. high, N. of cor. No bearing trees. No change made in marking on stone. Thence,
 N. 89° 45' W., on a true line, continuing measurement of S. bdy. of sec. 36.

50.00 Leave top of ridge, brs. N. 60° W. from E. Descend SW. slope.
 70.00 Foot of descent, brs. N. 60° W. and S. 60° E. Enter level bottom land.
 79.75 Road brs. N. and S.
 79.85 (39.87 chs: N. 89° 45' W. from ¼ sec. cor.) Intersect original cor. of secs. 1, 2, 35 and 36, a granite stone 16x12x8 ins., loosely set, marked with 1 notch on E. and 5 notches on W. edge, from which the original bearing trees bear as follows:
 An oak, 36 ins. in diam., brs. N. 76½° W., 113 lks. dist., marked T 19 S R 28 E S 35 B T.
 An oak, 30 ins. in diam., brs. S. 30° E., 154 lks. dist., marked T 20 S R 28 E S 1 B T., and
 An oak, 14 ins. in diam., brs. S. 50° W., 157 lks. dist., marked T 20 S R 28 E S 2 B T.
 Pits 18x18x12 ins., bear NE., SE., SW. and NW., 5½ ft. dist. from stone, and a mound of earth 4 ft. base, 2 ft. high, W. of cor.
 Reestablish this cor. to refer to secs. 35 and 36 only by obliterating the sec. number markings on the SE. and SW. bearing trees, filling in the pits SE. and SW. of cor., destroying the mound of earth, W. of cor., and by raising a mound of earth 2 ft. base, 1½ ft. high, N. of cor.
 Land, rolling, hilly and level.
 Soil, gravelly and rocky 2nd and 3rd rate.
 Timber, scattering oak.
 No undergrowth.
 Good grass.

8 Resurvey of the South bdy. of Township 19 S., R. 28 E.

Chains.

- N.89° 41' W., on a true line, on S. bdy. of sec. 35.
Over rolling, sandy valley land.
- 1.20 Wire fence brs. N.60°W. and S.60°E.
2.60 Right bank of wash, 4 ft. high, brs. N.20°W. and S.20°E.
3.30 Center of same wash, course N.20°W.
4.00 Left bank of same wash, 4 ft. high, brs. N.20°W. and S.20°E.
- 9.10 Dry creek, 10 lks. wide, course N.10°W.
9.70 Road brs. N.10°W. and S.10°E.
- 13.00 Dry creek, 25 lks. wide, course north; leave rolling land, brs. N. and S. Ascend 157 ft. on E. slope.
22.00 Ridge, brs. N.10°W. and S.20°E. Descend 146 ft. on SW. slope.
38.60 Ravine, 10 lks. wide, course N.50°W. Ascend 23 ft. on NE. slope.
40.26 Intersect original $\frac{1}{4}$ sec. cor. of secs. 2 and 35, a granite stone, 14x8x8 ins., loosely set, marked $\frac{1}{4}$ on N. face. No trace of original pits and mound of stone. Reestablish this cor. to refer to sec. 35 only, by resetting the same stone, 10 ins. in the ground in its original position, with marking to the north, and raise a mound of stone, 2 ft. base, 1 $\frac{1}{2}$ ft. high, N. of cor. No change made in marking on stone. No bearing trees. From this cor., the SE. cor. of wire fence brs. NW. 10 lks. dist.
- Thence,
N.89° 57' W., on a true line, continuing measurement of S. bdy. of sec. 35.
- 49.25 Ridge, brs. NE. and SW. Descend 23 ft. on NW. slope.
59.25 Ravine, 20 lks. wide, course N.30°E. Ascend 46 ft. on SE. slope.
63.55 Road to Douglas, Arizona, brs. N.20°E. and S.10°W.
70.30 Ridge, brs. N.40°W. and S.30°E. Descend 10 ft. over SW. slope.
79.45 Draw, 150 lks. wide, course NW. Ascend.
80.40 (40.14 chs. N.89°57'W. from $\frac{1}{4}$ sec. cor.) Intersect original cor. of secs. 2, 3, 34 and 35, a granite stone 14x12x6 ins., loosely set, marked with 2 notches on E., and 4 notches on W. edges. Original pits NE., SE., SW. and NW. of post, and mound of earth W. of cor. are only faintly visible. Reestablish this cor. to refer to secs. 34 and 35 only as follows:
Reset the same stone, 10 ins. in the ground in its original position, with marking to the E. and W., and no change made in same. Obliterate all trace of the pits SE. and SW. of cor.; destroy the remains of mound W. of cor.; enlarge the pits NE. and NW. of cor. to 24x24x12 ins., and raise a mound of earth 4 ft. base, 2 ft. high, N. of cor. 6 ft. dist.
Land, rolling and hilly.
Soil, gravelly and rocky clay loam, 3rd rate, about 12 ins. deep on dry clay subsoil.
No timber.
No undergrowth.
Good grass.

- S.89°57'W., on a true line, on S. bdy. of sec. 34.
Over rolling and hilly land.
Ascend 13 ft. on NE. slope.
- 10.00 Spur, slopes N. Descend on NW. slope.
40.07 Intersect original $\frac{1}{4}$ sec. cor. of secs. 3 and 34, a granite stone, 12x10x4 ins., loosely set, marked "1" on N. face. No trace of original pits and mound. Reestablish this cor. to refer to sec. 34 only as follows:
Reset the same stone, 8 ins. in the ground, with marking to the north, and no change made in same. Raise a mound of stone, 2 ft. base, 1 $\frac{1}{2}$ ft. high, N. of cor.
Thence,
N.89°59'W., on a true line, continuing measurement of S. bdy. of sec. 34.

Recovery of the South bdy. of Township 19 South, Range 28 East. 9

Chains.

Over rolling land.

40.57 Draw, 150 lks.wide, course S. 60°W. Ascend 19 ft. on SE. slope.

49:00 Ridge, brs.N.and S. Descend 15 ft. on W.slope.

73.07 Draw, 200 lks.wide, course N.50°W. Ascend 6 ft. on NE. slope.

80.18 (40.11 chs.N.89°59' W. from 1/4 sec.cor.) Intersect original cor.of secs.3,4,33 and 34, a granite stone 8x10x10 ins. above ground, firmly set, marked with 3 notches on E. and W.edges, with pits 18x18x12 ins., NE.,SE.,SW. and NW.of stone, 5 1/2 ft. dist., and a mound of earth 4 ft. base, 2 ft.high,W.of cor.

From cor.,

An oak, 6 ins.in diam., brs.S.16 1/2°E., 190 lks. dist., marked T20S R28E S3BT.

An oak, 16 ins.in diam., brs.S.13 3/4°W., 112 lks. dist., marked T20S R28E S4BT.

Reestablish the cor. to refer to secs.33 and 34 only, by filling the pits SE. and SW.of cor., destroying the mound W.of cor., enlarging the pits NE. and NW.of cor. to 24x24x12 ins., raising a mound of earth 4 ft. base, 2 ft.high,N.of cor., and obliterating the section number markings on the original bearing trees.

Land, rolling and hilly.

Soil, rocky, 3rd rate.

No timber, or undergrowth.

Good grass.

N.89°51'W., on a true line, on S.bdy.of sec.33.

Over rolling and hilly land, thru.scattering undergrowth. Ascend 34 ft. on NE.slope.

10.00 Ridge, brs.N.40°W. and S.50°E. Descend 94 ft.on SW.slope.

15.45 Road from Douglas, Arizona, brs.N.and S.

15.60 Wire fence brs.N. and S.

17.50 Foot of descent; enter nearly level bottom land.

18.15 Wash, 25 lks.wide, course N.

25.85 Wash, 15 lks.wide, course N.10°W.

39.70 Intersect the original 1/4 sec.cor. of secs.4 and 33, a granite stone.15x10x6 ins., loosely set, marked "1" on N.face, with pits 18x18x12 ins., E.and W.of stone 3 ft.dist., and a mound of earth 3 1/2 ft. base, 1 1/2 ft. high,N.of cor. No bearing trees.

Reestablish this cor. to refer to sec.33 only, by resetting the same stone, 9 ins. in the ground, with marking to the north. No change in the marking or accessories necessary.

Thence,

N.89° 54' W., on a true line, continuing measurement of S.bdy. of sec.33.

40.06 Wire fence brs.N. and S.

40.46 Road, brs.N.and S.

41.00 Road brs.N.50°W. and S.40°E.

43.90 Wire fence brs.N* and S.

45.25 A house brs.S. about 20 lks.

45.76 Wire fence, brs.N. and S.

46.46 Wire fence brs.N.and S.

48.50 Wash, 20 lks.wide, course N.10°E.

51.20 Wash, 20 lks.wide, course N.10°E. Ascend 132 ft.on SE. slope.

54.40 Road, brs.N.10°E. and S.10°W.

76.70 Ridge, brs.N.30°E. and S:30°W. Descend 11 ft. on NW.slope.

80.02 (40.32 chs. N.89°54'W. from 1/4 sec.cor.) Intersect original cor.of secs.4,5,32 and 33, a limestone 14x10x4 ins., loosely set,marked with 4 notches on E. and 2 notches on W.edges, from which,

An oak, 8 ins. in diam., brs.N.4 1/4°E., 143 lks. dist., marked T 19 S R 28 E S 33 B T.

A juniper, 24 ins. in diam., brs.N.86 1/2°W., 195 lks.dist., marked T 19 S R 28 E S 32 B T.,

10/ Resurvey of the S. bdy. of Township 19 South Range 28 East

Chains.

An oak, 14 ins. in diam., brs. S. $7\frac{1}{2}^{\circ}$ E., 35 lks. dist., marked T 20 S R 28 E S 4 B T.
 A mound of earth is raised W. of cor.
 Reestablish this cor. to refer to secs. 32 and 33 only, by resetting the same stone, 10 ins. in the ground in its original position, with marking to the E. and W. as originally placed and unchanged, destroying the mound on the W., raising a mound of earth 2 ft. base, $1\frac{1}{2}$ ft. high, N. of cor., and obliterating the section number marking on the original SE. bearing tree.
 Land, rolling, hilly and nearly level.
 Soil, sandy and gravelly, 1st, 2nd and 3rd rate.
 No timber or undergrowth.
 Good grass.

- S. $89^{\circ}32'$ W., on a true line, on S. bdy. of sec. 32.
 Over rolling, mountainous land, thru. scattering timber and undergrowth. Descend NW. slope.
- 2.20 Head of ravine, 5 lks. wide, course N. 40° E. Ascend 52 ft. on SE. slope.
 - 6.25 Ridge, brs. N. 10° E. and S. 30° W. Descend 129 ft. on SW. slope.
 - 18.18 Wire fence brs. N. and S.
 - 20.90 Wash, 20 lks. wide, course N. 15° E. Ascend 870 ft. on SE. slope.
 - 24.90 Wire fence, brs. N. 60° W. and S. 60° E.
 - 27.00 Spur, slopes N. 40° E. Descend 20 ft. on NW. slope.
 - 28.35 Ravine, 15 lks. wide, course N. 40° E. Ascend 45 ft. on SE. slope.
 - 39.94 Intersect the original $\frac{1}{4}$ sec. cor. of secs. 5 and 32, a granite stone, 14x10x6 ins., loosely set, marked "1" on N. face, with mound of stone 2 ft. base, $1\frac{1}{2}$ ft. high, N. of cor., and one bearing tree, an oak, 14 ins. in diam. N. $65\frac{1}{2}^{\circ}$ W., 198 lks. dist., marked $\frac{1}{4}$ S B T."
 Reestablish this cor. to refer to sec. 32 only by resetting the same stone, 9 ins. in the ground in its original position, with marking to the N., marking unchanged. Change marking on bearing tree to read " $\frac{1}{4}$ S 32 B T."
 No other change in cor. necessary.
 Thence,
 N. $88^{\circ}46'$ W., on a true line, continuing measurement of S. bdy. of sec. 32.
 - 41.95 Spur, slopes N. 30° E. Descend 23 ft. on NW. slope.
 - 44.35 Ravine, 15 lks. wide, course N. 30° E. Ascend 80 ft. on SE. slope.
 - 56.95 Spur, slopes N. 30° E. Descend 10 ft. to
 - 64.00 Head of ravine, course N. 30° E. Ascend 25 ft.
 - 70.80 Top of mountain brs. N. 40° E. and S. 40° W. Descend 142 ft. on NW. slope.
 - 79.38 (39.44 chs. N. $88^{\circ}46'$ W. from $\frac{1}{4}$ sec. cor.) Intersect the original cor. of secs. 45, 6, 31 and 32, a granite stone, 10x10x6 ins. above ground, firmly set, marked with 5 notches on E. and 1 notch on W. edge, and witnessed by four bearing trees as follows:
 An oak, 18 ins. in diam., brs. N. $14\frac{1}{2}^{\circ}$ W., 141 lks. dist., marked T 19 S R 28 E S 31 B T.
 An oak, 10 ins. in diam., brs. N. $39\frac{1}{2}^{\circ}$ E., 66 lks. dist., marked T 19 S R 28 E S 32 B T.
 An oak, 8 ins. in diam., brs. S. $68\frac{1}{2}^{\circ}$ E., 72 lks. dist., marked T 20 S R 28 E S 5 B T.
 An oak, 12 ins. in diam., brs. S. $15\frac{1}{2}^{\circ}$ W., 133 lks. dist., marked T 20 S R 28 E S 6 B T.
 Reestablish this cor. to refer to secs. 31 and 32 only by obliterating section number markings on the SE. and SW. bearing trees described above. No other change necessary.
 Land, rolling and mountainous.
 Soil, gravelly and rocky, 3rd and 4th rate.
 Timber, scattering oak and cedar.
 Undergrowth, scattering greasewood. Good grass.

Resurvey of S. bdy. of Township 19 South, Range 28 East. 11.

Chains.

- N.89° 31'W. on a true line on S. bdy. of sec.31.
Over mountainous land, thru scattering timber.
Descend 802 ft. over NW. slope.
 - 39.48 Intersect the original $\frac{1}{4}$ sec.cor. of secs.6 and 31, a granite stone 12x8x4 ins., loosely set, marked "1/4" on N. face, and witnessed by remains of mound of stone, N. of cor. Reestablish this cor. to refer to sec.31 only by resetting the same stone, 8 ins. in the ground, in its original position with marking to the N., marking unchanged. As the original mound is in a delapidated condition, rebuild it 2 ft. base, 1 1/2 ft. high, in same place. No bearing trees.
 - Thence,
N.89° 39' W., on a true line, continuing measurement of S. bdy. of sec.31.
 - 48.50 Begin steep, rocky descent, over SW. slope, into canyon.
 - 58.00 Foot of descent in canyon, course N.10°E.
 - 58.13 Road hrs. N. and S.
 - 59.10 Dry bed of creek, 50 lks. wide, course N.10°E. Ascend 250 ft. on abrupt rocky SE. slope of spur.
 - 68.20 Spur, slopes N. and S.60°E. Descend 63 ft. over SW. slope.
 - 74.00 Foot of descent in draw, course SE. Ascend 192 ft. on NE. slope.
 - 92.58 Intersect original cor. of Ts.19 and 20 S., R.28 E., a malpais stone 16x12x8 ins., above ground, firmly set, marked with 6 notches on each edge and witnessed by mound of stone W. of cor.
- Land, mountainous.
Soil, rocky, 3rd and 4th rate.
Timber, scattering oak.
No undergrowth.
Good growth of bunchgrass.
-

12

Resurvey of the Fourth Std. Parallel S., thru part of R. 28 E.

chains.

- From original standard cor. of secs. 33 and 34 on S. bdy. of T. 20 S., R. 28 E., a granite stone, 12x10x6 ins. above ground, firmly set, marked with 3 notches on E. and W. edges, and witnessed by a mound of stone N. of cor., West, on true line, on S. bdy. of sec. 33.
- Over hilly land, thru scattering timber and undergrowth.
- 3.00 Ridge, brs. N. and S. 40° E. Descend 12 ft. over SW. slope.
- 16.40 Wash, 20 lks. wide, course S. 30° E. Road in same to Douglas, Arizona, brs. N. 30° W. and S. 30° E. Ascend 14 ft. on NE. slope.
- 19.20 Gravelly spur, slopes S. Descend 15 ft. on W. slope.
- 20.40 Road to Douglas, Arizona, bears N. 20° W. and S. 20° E.
- 20.70 Wash, 30 lks. wide, course S. 25° E. Ascend 63 ft. on NE. slope.
- 30.00 Spur, slopes N. 60° E. Descend 29 ft. on NW. slope.
- 35.50 Wash, 15 lks. wide, course N. 20° E. Ascend 98 ft. on SE. slope.
- 40.00 Set an iron post, 3 ft. long, 1 in. in diam., 26 ins. in the ground, for reestablished standard cor. of sec. 33, marked on brass cap.

S C
S 33
 1916

- Raise a mound of stone 2 ft. base, 1½ ft. high, N. of cor. From this cor. the original standard sec. cor., a granite stone 10x10x4 ins. above ground, firmly set, marked and witnessed as described by the surveyor general, brs. N. 87° 52' W., 6.73 chs. dist. Destroy all trace of this old cor.
- 55.25 Top of ascent on N. slope of gravelly ridge, brs. N. 80° E. and S. 80° W. Descend 87 ft. over NW. slope.
- 58.95 Ravine, 6 lks. wide, course N. Ascend 149 ft. on W. slope.
- 69.75 Ridge, brs. N. 60° W. and S. 70° E. Descend 18 ft. over SW. slope.
- 74.33 Ravine, 5 lks. wide, course S. 50° E. Ascend 16 ft. on NE. slope.
- 76.95 Road brs. N. 10° W. and S. 10° E.
- 77.25 Spur slopes S. 20° E. Descend 185 ft. over SW. slope.
- 80.00 Set an iron post, 3 ft. long, 3 ins. in diam., 24 ins. in the ground, for reestablished standard cor. of secs. 32 and 33, marked on brass cap.

S C
 T20S | R28E
S32 | S33
 1916

Raise a mound of stone 2 ft. base, 1½ ft. high, N. of cor. From this cor., the original standard sec. cor., a granite stone 12x6x6 ins., above ground, firmly set, marked and witnessed as described by the surveyor general, bears N. 82° 35' W. 7.13 chs. dist. Destroy all traces of this old cor.

Land, hilly and broken.
 Soil, gravelly and rocky, 3rd and 4th rate.
 Timber, scattering oak and juniper.
 Undergrowth, scattering greasewood.
 Light growth bunch grass.

- West, on a true line on S. bdy. of sec. 32.
- Over hilly land, thru scattering timber and undergrowth.
- 2.15 Wash, 20 lks. wide, course south. Ascend 8 ft. on E. slope.
- 2.75 Spur, slopes S. 10° E. Descend 8 ft., over SW. slope.
- 11.03 Wash, 100 lks. wide, course south. Ascend 23 ft. on E. slope.
- 15.10 Spur, slopes S. 30° E. Descend 14 ft. on SW. slope.
- 19.50 Ravine, 15 lks. wide, course S. 60° E. Ascend 247 ft. over

Resurvey of the Fourth Standard Par. S. thru part of R. 28 E. 13

Chains.

E. slope of the Swisshelm Mountains.

- 40.00 Set an iron post 3 ft. long, 1 in. in diam., 26 ins. in the ground for reestablished standard $\frac{1}{4}$ sec. cor. of sec. 32, marked on brass cap,

S C
1/4 S 32

1916

Raise a mound of stone 2 ft. base, $1\frac{1}{2}$ ft. high, N. of cor. From this cor. the original standard $\frac{1}{4}$ sec. cor., a limestone $14 \times 10 \times 8$ ins. above ground, loosely set, marked and witnessed as described by the surveyor general, brs. N. $87^{\circ} 39' W.$, 7.27 chs. dist. Destroy all traces of this old cor.

- 40.10 Spur, slopes S. $50^{\circ} E.$ Descend 10 ft. on SW. slope.
- 45.50 Ravine, 10 lks. wide, course S. $30^{\circ} E.$ Ascend 22 ft. on NE. slope.
- 46.80 Spur, slopes S. $30^{\circ} E.$ Descend SW. slope.
- 47.86 Ravine, 15 lks. wide, course S. $30^{\circ} E.$ Ascend 696 ft. on NE. slope.

72.35 Main ridge of the Swisshelm Mountains, brs. N. $10^{\circ} W.$ and S. Descend 231 ft. over W. slope.

- 80.00 Set an iron post, 3 ft. long, 3 ins. in diam., 24 ins. in the ground for reestablished standard cor. of secs. 32 and 32, marked on brass cap,

S C
T20S | R28E
S31 | S32

1916

Raise a mound of stone 2 ft. base, $1\frac{1}{2}$ ft. high, N. of cor. From this cor., the original standard cor. of secs. 31 and 32, a limestone $12 \times 8 \times 8$ ins. above ground, firmly set, marked and witnessed as described by the surveyor general bears N. $84^{\circ} 54' W.$, 8.01 chs. dist., Destroy all traces of this old cor.

Land, hilly and mountainous.
Soil, gravelly and rocky, 3rd and 4th rate.
Timber, scattering oak and juniper.
Undergrowth, scattering greasewood, manzanita and mountain mahogany.
Good growth bunch grass.

West, on a true line, on S. bdy. of sec. 31.

- 8.28 Over mountainous land, thru scattering undergrowth. Ravine, 10 lks. wide, course S. $30^{\circ} W.$ Ascend 40 ft. on SE. slope.
- 10.30 Spur, slopes S. $30^{\circ} W.$ Descend 66 ft., over NW. slope.
- 15.78 Ravine, 15 lks. wide, course S. $40^{\circ} E.$ Ascend 317 ft. on NE. slope.
- 26.00 High rocky ridge, brs. N. and S. $10^{\circ} E.$ Descend 302 ft., over NW. slope.
- 35.08 Ravine, 20 lks. wide, course S. $10^{\circ} E.$ Ascend 328 ft. on NE. slope.
- 40.00 Set an iron post, 3 ft. long, 1 in. in diam., 26 ins. in the ground, for reestablished standard $\frac{1}{4}$ sec. cor. of sec. 31, marked on brass cap,

S C
1/4 S 31

1916

Raise a mound of stone, 2 ft. base, $1\frac{1}{2}$ ft. high, N. of cor. No trace of the original standard $\frac{1}{4}$ sec. cor. can be found after diligent search.

- 46.28 Rocky spur, slopes S. $30^{\circ} E.$ Descend 273 ft. on SW. slope.
- 47.35 Perpendicular limestone cliff, 30 ft. high, brs. N. and S.

14. Resurvey of the Fourth Standard Parallel S. thru part of R28E

Chains.

- 60.00 Ravine, 20 lks.wide, course south. Ascend 224 ft. on E. slope.
- 68.30 High rocky spur, slopes S.20°W. Descend 787 ft. over NW.slope.
- 89.52 Intersect N.and S. line, 1.60 chs. S.of standard cor.of T. 20 S., Rs.27 and 28 E., which was reestablished in 1913, and is an iron post 3 ins. indiam., 12 ins. above ground, with brass cap, marked

SC T20S
R27E | R28E
S36 | S31

1913

and witnessed by a mound of stone, N.of cor. Reestablish this cor. to refer to T.20 S.,R.27 E. only by changing marking on brass cap, to read

SC T20S
R27E |
S36 |

1913

and by moving the mound of stone from N.of cor. to NW. of cor. 8 ft. dist.

At point 1.60 chs.S.from this cor.,
Set an iron post, 3 ft.long, 3 ins. in diam., 24 ins. in the ground, for closing cor. of T.20 S.,R.28 E., marked on brass cap.

T20S
R28E
S31 SC
 CC

1916

Raise a mound of stone 2 ft. base, 1½ ft. high, E. of cor. land, mountainous.
Soil, gravelly and rocky, 3rd and 4th rate.
No timber.
Undergrowth, scattering manzanita, mountain mahogany and greasewood.
Good growth of bunch grass.

Retracement of part of the Subdivision lines of T.20SR28E.

- 40.16 From original cor. of secs. 25, 26, 35 and 36, a granite stone, 8x6x7 ins. above ground, firmly set, marked with 1 notch on S. and E. edges, and witnessed by marked trees NE., SE. and SW. of cor., East, on a random line, bet. secs. 25 and 36 (W. ½)
- 40.16 Fall 6 lks. N. of original ¼ sec. cor., a granite stone 12x10 x 8 ins. above ground, firmly set, marked "1" on N. face, and witnessed by a mound of stone, N. of cor. True course and dist. of W. ½ bet. secs. 25 and 36 is therefore N.89° 55' W., 40.16 chs. Thence,
- 38.52 East, on a random line, bet. secs. 25 and 36 (E. ½).
- 38.52 Fall 9 lks. S. of original cor. of secs. 25, 30, 31 and 36 on E. bdy. of Tp., hereinbefore described. True course and dist. of E. ½ bet. secs. 25 and 36 is therefore S.89° 52' W., 38.52 chs.

Boundaries of that portion of T.20 S., R.28 E., subdivided under this Group.							
Latitudes, departures, and closing errors.							
Line designated.	True Course.	Dist.	Latitudes.		Departures.		
			N.	S.	E.	W.	
South boundary, (4th. Std. Par. S)	West,	249.52					249.52
West boundary,	North, N. 0° 12' E.	1.60 484.48	1.60 484.48			1.69	
North boundary,	S. 89° 39' E.	53.10		.32	53.10		
	S. 89° 31' E.	39.48		.33	39.48		
	S. 88° 46' E.	39.44		.85	39.43		
	N. 89° 32' E.	39.94	.33		39.94		
	S. 89° 54' E.	40.32		.07	40.32		
	S. 89° 51' E.	39.70		.10	39.70		
	S. 89° 59' E.	40.11		.01	40.11		
	N. 89° 57' E.	40.07	.03		40.07		
	S. 89° 57' E.	40.14		.03	40.14		
	S. 89° 41' E.	40.26		.22	40.26		
	S. 89° 45' E.	39.87		.17	39.87		
S. 89° 48' E.	39.98		.14	39.98			
East boundary,	S. 0° 49' W.	40.26		40.26		.57	
	S. 0° 34' W.	40.21		40.21		.40	
	S. 0° 29' W.	81.24		81.24		.69	
	S. 0° 53' W.	40.32		40.32		.62	
	S. 0° 15' W.	40.39		40.39		.18	
	S. 0° 39' W.	40.90		40.90		.46	
	S. 0° 40' W.	40.56		40.56		.47	
	S. 2° 24' W.	80.54		80.47		3.37	
Subdivisional boundary,	S. 89° 52' W.	38.52		.09		38.52	
	N. 89° 55' W.	40.16	.06			40.16	
	N. 0° 1' W.	320.00	320.00			.09	
	S. 89° 58' W.	80.08		.05		80.08	
	West,	80.00				80.00	
	S. 0° 2' E.	240.00		240.00		.14	
	N. 89° 55' W.	79.92	.12			79.92	
	S. 0° 2' E.	80.00		80.00		.05	
	East,	80.00			80.00	.05	
S. 0° 2' E.	80.00		80.00		.05		
Convergency,					.30		
Totals,			806.62	806.73	574.63	575.05	
				806.62		574.63	
Error in latitude,			0.11				
Error in departure,						0.42	

16. Survey of Completion of Subdivision lines of T. 20 S. R. 28 W.

Chains.	From original cor. of secs. 23, 24, 25 and 26, a granite stone, 18x10x8 ins. above ground, firmly set, marked with 2 notches on S. and 1 notch on E. edge, and witnessed by mound of stone W. of cor.
40.00	East, on a random line, bet. secs. 24 and 25.
82.00	Set temp. $\frac{1}{4}$ sec. cor.
	Intersect E. bdy. of Tp., 6 lks. N. of the reestablished cor. of secs. 24 and 25, hereinbefore described.
	Thence,
	N. $89^{\circ} 58' W.$, on a true line, bet. secs. 24 and 25.
	Over hilly, rolling and broken land, thru scattering timber.
	Descend 15 ft. on NW. slope.
4.60	Ravine, 10 lks. wide, course S. $20^{\circ} W.$ Ascend SE. slope.
17.60	Ridge, brs. N. $50^{\circ} E.$ and S. $35^{\circ} W.$ Descend 129 ft. on NW. slope.
21.25	Ravine, 15 lks. wide, course N. $30^{\circ} W.$ Ascend 20 ft. on E. slope.
33.95	Spur, slopes NE. Descend 23 ft. on NW. slope.
35.30	Ravine, 25 lks. wide, course S. $50^{\circ} W.$
37.05	Ravine, 20 lks. wide, course north. Ascend 11 ft.
37.50	Spur, slopes N. Descend 27 ft.
39.10	Ravine, 25 lks. wide, course S. $30^{\circ} W.$ Ascend 9 ft.
42.00	Set an iron post, 3 ft. long, 1 in. in diam., 26 ins. in the ground, for $\frac{1}{4}$ sec. cor., marked on brass cap,
	<u>$\frac{1}{4}$ S 24</u>
	S 25
	1916
	Raise a mound of stone, 2 ft. base, $1\frac{1}{2}$ ft. high, N. of cor.
45.00	Spur, slopes SW. Descend 13 ft. on NW. slope.
59.80	Ravine, 15 lks. wide, course S. $30^{\circ} W.$ Ascend 30 ft.
67.50	Spur, slopes SW. Descend 30 ft. on NW. slope.
74.23	Ravine, 10 lks. wide, course S. $30^{\circ} E.$ Ascend 32 ft.
77.00	Spur, slopes S. $50^{\circ} W.$ from N. $20^{\circ} E.$ Descend 30 ft. on NW. slope.
78.80	Road brs. N. $10^{\circ} E.$ and south.
82.00	The original cor. of secs. 23, 24, 25 and 26.
	Land, hilly, rolling and broken.
	Soil, gravelly and rocky, 3rd and 4th rate.
	Timber, scattering oak, juniper and cedar.
	No undergrowth.
	Good grass.

	From the true point for original cor. of secs. 13, 14, 23 and 24,
	S. $89^{\circ} 58' E.$, on a random line, bet. secs. 13 and 24.
40.00	Set temp. $\frac{1}{4}$ sec. cor.
82.68	Intersect the E. bdy. of Tp., 14 lks. N. of the reestablished cor. of secs. 13 and 24, hereinbefore described.
	Thence,
	N. $89^{\circ} 52' W.$, on a true line, bet. secs. 13 and 24.
	Over rolling and mountainous land, thru scattering timber and undergrowth. Ascend 36 ft. on NE. slope.
4.00	Spur, slopes N. $10^{\circ} E.$ Descend 12 ft. on NW. slope.
8.80	Head of ravine, 5 lks. wide, course north. Ascend 47 ft. on E. slope.
13.00	Ridge, brs. N. $10^{\circ} W.$ and S. $30^{\circ} E.$ Descend 128 ft. on SW. slope.
27.65	Ravine, 5 lks. wide, course N. $70^{\circ} W.$ Ascend 56 ft.
42.68	Set an iron post 3 ft. long, 1 in. in diam., 26 ins. in the ground, for $\frac{1}{4}$ sec. cor., marked on brass cap,
	<u>$\frac{1}{4}$ S 13</u>
	S 24
	1916
	Raise a mound of stone 2 ft. base, $1\frac{1}{2}$ ft. high, N. of cor.
43.42	Ridge, brs. N. $70^{\circ} W.$ and S. $50^{\circ} E.$ Thence along S. slope.
51.95	Spur, slopes S. $50^{\circ} W.$ Descend 124 ft. on NW. slope.
61.92	Ravine, 8 lks. wide, course S. $10^{\circ} W.$ Ascend 35 ft. on SE. slope.

Completion of Subdivision of Township 20 South Range 28 East 17

Chains.

- 67.42 Spur, slopes S. Descend 38 ft. on W. slope.
 - 77.00 Enter ravine, 20 lks. wide, course west from NE.
 - 80.17 Leave ravine, course N. 60° W. from E.
 - 81.77 Same ravine, 20 lks. wide, course S. 70° W.
 - 82.68 The point for original cor. of secs. 13, 14, 23 and 24, witnessed 50 lks. N. 0° 1' W. by a granite stone, properly marked and witnessed.
- Land, rolling and mountainous.
Soil, rocky, 4th rate.
Timber, scattering oak, juniper and cedar.
No undergrowth.
Good grass.

From the original cor. of secs. 11, 12, 13, and 14, a granite stone 10x6x10 ins. above ground, firmly set, marked with 4 notches on S. and 1 notch on E. edge, and witnessed by mound of stone W. of cor.,

- S. 89° 52' E., on a random line, bet. secs. 12 and 13.
- 40.00 Set temp. $\frac{1}{4}$ sec. cor.
- 83.39 Intersect E. bdy. of Tp. 8 lks. S. of the reestablished cor. of secs. 12 and 13, hereinbefore described.

Thence,
N. 89° 55' W. on a true line, bet. secs. 12 and 13.
Over rolling and mountainous land, thru scattering timber.
Descend W. slope.

- 1.25 Ravine, 10 lks. wide, course S. Ascend 28 ft.
- 5.40 Spur, slopes S. 20° E. Descend 15 ft.
- 10.10 Ravine, 6 lks. wide, course S. 30° E. Ascend 130 ft.
- 18.40 Ridge, brs. N. 30° E. and S. 40° W. Descend NW. slope, 207 ft.
- 34.05 Ravine, 10 lks. wide, course S. 10° W. Ascend 46 ft.
- 41.10 Spur, slopes S. Descend 14 ft.
- 43.39 Set an iron post, 3 ft. long, 1 in. in diam., 26 ins. in the ground, for $\frac{1}{4}$ sec. cor., marked on brass cap,

S 12
S 13
1916

- 46.10 Raise a mound of stone, 2 ft. base, $1\frac{1}{2}$ ft. high, N. of cor. Ravine, 15 lks. wide, course south. Ascend 69 ft. in E. slope.

- 59.40 Ridge, brs. N. 40° E. and S. 40° W. Descend 77 ft.
- 66.10 Ravine, 10 lks. wide, course S. 20° W. Ascend 77 ft. on SE. slope.

- 72.479.40 Ridge, brs. N. 40° E. and S. 40° W. Descend 37 ft. on NW. slope.

- 83.00 Wire fence, brs. N. and S.
- 83.39 The original cor. of secs. 11, 12, 13 and 14.

Land, rolling and mountainous.
Rocky soil, clay loam, 4 to 10 ins. deep, 4th rate.
Timber, scattering oak, juniper and cedar.
No undergrowth.
Good grass.

From the original cor. of secs. 1, 2, 11 and 12, a granite stone 6x6x6 ins. above ground, firmly set, marked with 5 notches on S. and 1 notch on E. edges, and witnessed by a mound of stone, W. of cor.,

- S. 89° 55' E., on a random line, bet. secs. 1 and 12.
- 40.00 Set temp. $\frac{1}{4}$ sec. cor.
- 84.15 Intersect E. bdy. of Tp., 25 lks. N. of the reestablished cor. of secs. 1 and 12, hereinbefore described.

Thence,
N. 89° 44' W., on a true line, bet. secs. 1 and 12.
Over rolling and mountainous land, thru scattering timber.
Descend NW. slope.

- 8.80 Ravine, 10 lks. wide, course N. 20° E. Ascend 32 ft. over SE. slope.
- 28.35 Ridge, brs. SE. and W. Descend along top of same.

18. Completion of Subdivision of Township 20 South, Range 28 E.

Chains.

- 40.15 Descend over SW. slope, of ridge.
- 44.15 Set an iron post, 3 ft. long, 1 in. indiam., 26 ins. in the ground, for $\frac{1}{2}$ sec. cor., marked on brass cap,

S 1
S 12
1916

- 56.15 Raise a mound of stone, 2 ft. base, $1\frac{1}{2}$ ft. high, N. of cor. Spur slopes S. 30° W. Descend 133 ft. on steep NW. slope.
- 70.35 Ravine, 15 lks. wide, course S. 40° W. Ascend 46 ft. on SE. slope.
- 78.15 Spur, slopes S. 50° W. Descend 63 ft. on NW. slope.
- 83.63 Wire fence brs. N. and S.
- 84.15 The original cor. of secs. 1, 2, 11 and 12. Land, rolling and mountainous. Soil, dry, stony clay loam, 6 ins. deep, 4th rate. Timber, scattering oak. No undergrowth. Good grass.

N. $0^\circ 01'$ W. on a true line, bet. secs. 1 and 2. Over rolling land mountainous land. Descend 15 ft. on NW. slope.

- 1.20 Draw, 100 lks. wide, course S. 30° W. Ascend 94 ft. on SE. slope.
- 16.00 Ridge, brs. N. 40° W. and E. Descend 57 ft. on NE. slope.
- 32.00 Ravine, 20 lks. wide, course W. Ascend 69 ft. on SW. slope.
- 40.00 Set an iron post 3 ft. long, 1 in. in diam., 20 ins. in the ground, supported by a mound of stone, for $\frac{1}{2}$ sec. cor., marked on brass cap,

S 2 | S 1
1916

- 43.85 Raise a mound of stone 2 ft. base, $1\frac{1}{2}$ ft. high, W. of cor. This cor. is situated on top of spur, sloping W. Descend 37 ft. on N. slope.
- 43.85 Wash, 50 lks. wide, course S. 70° W. Ascend 70 ft. on SW. slope.
- 52.00 Ridge, brs. N. 40° W. and S. 70° E. Descend 133 ft. on NE. slope.
- 66.00 Foot of descent, leave mountainous land, brs. N. 20° W. and S. 20° E. Enter level gravelly valley land, and scattering timber.
- 72.00 Creek, 30 lks. wide, clear water, 3 ins. deep, on gravelly bottom, course N. 20° W.
- 75.80 Wash, 15 lks. wide, 3 ft. deep, course N. 20° W.
- 80.15 Road brs. N. 20° W. and S. 20° E.
- 84.28 Intersect the N. bdy. of Tp., 5.06 chs. N. $89^\circ 41'$ W. from re-established cor. of secs. 35 and 36, T. 19 S., R. 28 E. here- in before described. At the point of intersection, Set an iron post, 3 ft. long, 2 ins. in diam., 24 ins. in the ground, for closing cor. of secs. 1 and 2, marked on brass cap.,

T 19 S R 28 E
S 35
S 2 | S 1
T 20 S | R 28 E
C C
1916

Raise a mound of stone 2 ft. base, $1\frac{1}{2}$ ft. high S. of cor. Land, rolling, level and mountainous. Soil, dry stony clay loam, 6 to 10 ins deep, 2nd and 3rd rate. No timber, except in N. 18 chs. No undergrowth. Good grass.

Completion of Subdivision of Township 20 South, Range 28 East, 19

Chains.

From the original cor. of secs. 2, 3, 10 and 11, a granite stone, 6x6x4 ins. above ground, firmly set, marked with 5 notches on S. and 2 notches on E. edge, and witnessed by a mound of stone, W. of cor.,
 N. 0° 01' W., on a true line, bet. secs. 2 and 3.
 Over rolling and hilly land. Descend 5 ft. on NW. slope.
 1.00 Draw, 150 lks. wide, course S. 30° W. Ascend 40 ft. on SE. slope.
 13.00 Ridge, brs. N. 60° W. and E. Descend 40 ft. on NE. slope.
 19.00 Draw, 200 lks. wide, course N. 70° E. Ascend 38 ft. on SW. slope.
 26.00 Spur, slopes S. 80° W. Descend 35 ft. on NW. slope.
 32.20 Draw, 150 lks. wide, course S. 50° W. Ascend 40 ft. on SE. slope.
 38.60 Ridge, brs. N. 70° W. and E. Descend 62 ft. on NE. slope.
 40.00 Set an iron post, 3 ft. long, 1 in. in diam., 26 ins. in the ground, for sec. cor., marked on brass cap,

S3 | S2
 1916

Raise a mound of stone, 2 ft. base, 1 1/2 ft. high, W. of cor.
 45.50 Road to Douglas, Arizona, brs. N. 50° E. and S. 70° W.
 48.45 Ravine, 25 lks. wide, course N. 70° W.; leave rolling and hilly land, brs. NW. and SE.; enter level land.
 50.50 Wire fence brs. N. 70° W. and S. 70° E.
 61.24 Wire fence brs. N. 70° W. and S. 70° E. at NE. cor. of cultivated field brs. S. 10° W. and W. extends S. about 10 chs., and W. about 15 chs. dist.
 62.80 Wash, 20 lks. wide, course S. 50° W.; leave level land, brs. NE. and SW.; enter rolling and hilly land; ascend 109 ft. on SE. slope.
 80.00 Ridge, brs. E. and W. Descend 6 ft. on N. slope.
 84.24 Intersect N. bdy. of Tp. 4.67 chs. S. 89° 57' W., from re-established cor. of secs. 34 and 35, T. 19 S., R. 28 E., hereinbefore described.
 At the point of intersection,
 Set an iron post, 3 ft. long, 2 ins. in diam., 24 ins. in the ground, for closing cor. of secs. 2 and 3, marked on brass cap,

T19S R28E
 S34
 S 3 | S 2
 T20S | R28E
 C C
 1916

Raise a mound of stone, 2 ft. base, 1 1/2 ft. high, S. of cor.
 Land, rolling, hilly and level.
 Soil, dry, stony clay loam about 6 ins. deep, 2nd and 3rd rate.
 No timber, or undergrowth.
 Good grass.

From the original cor. of secs. 3, 4, 9 and 10, a granite stone, 12x12x4 ins. above ground, firmly set, marked with 5 notches on S. and 3 notches on E. edge and witnessed by a mound of stone, W. of cor.,
 N. 0° 02' W. on a true line, bet. secs. 3 and 4.
 Over rolling and hilly land.
 3.70 Wash, 8 lks. wide, course S. 60° E. Ascend 6 ft. on SE. slope.
 15.00 Spur, slopes E. Descend 28 ft. on NE. slope.
 23.00 Draw, 100 lks. wide, course NE. Ascend 18 ft. on SE. slope.
 28.00 Spur, slopes E. Descend 23 ft. on N. slope.
 34.00 Foot of descent; leave hilly land, brs. NW. and SE.; enter level sandy land, brs. N. 10° W. and S. 10° E.
 39.80 Road brs. N. 10° W. and S. 10° E.

20 Completion of subdivision of Township 20 South Range 28 E.

Chains

40.00 Set an iron post, 3 ft. long, 1 in. in diam., 26 ins. in the ground, for $\frac{1}{4}$ sec.cor., marked on brass cap,

S4 | S3
1916

Raise a mound of stone, 2 ft. base, $1\frac{1}{2}$ ft. high, W. of cor. From this cor.,

A house brs. N.52°30'W., about 8.00 chs. dist.

- 41.00 Enter wash, course N.10°W.
 43.70 Road brs. N.40°W. and S.40°E.
 44.50 Leave wash:
 52.02 Wire fence brs. N.60°E. and S.60°W.
 53.50 Wash, 25 lks. wide, 4 ft. deep, course N.20°W.
 54.10 Enter cultivated field, brs. N.70°W., 20 chs., and S.10°E. about 10 chs. dist.
 58.00 Leave cultivated land, brs. E. and W.; extends E. about 3 chs., and W. about 8 chs. dist.
 61.30 Wire fence brs. N.20°W. and S.20°E.
 61.60 Road to Douglas, Arizona, from White Water, Arizona, brs. N.20°W. and S.20°E.
 62.00 Leave level land, brs. N.20°W. and S.20°E. Enter rolling land; ascend 115 ft. on SW. slope.
 80.50 Ridge, brs. N.50°W. and S.50°E. Descend 58 ft. over NE. slope.
 84.34 Intersect N. bdy. of Tp. 4.70 chs. N.89°51'W. from reestablished cor. of secs. 33 and 34, T.19 S., R.28 E., hereinbefore described.
 At point of intersection,
 Set an iron post, 3 ft. long, 2 ins. in diam., 24 ins. in the ground, for closing cor. of secs. 3 and 4, marked on brass cap,

T19S R28E
S33
S4 | S3
T20S | R28E
C C
1916

Raise a mound of stone, 2 ft. base, $1\frac{1}{2}$ ft. high, S. of cor. Land, rolling, hilly and level.
 Soil, dry, sandy and gravelly loam, 4 to 12 ins. deep, 2nd and 3rd rate.
 No timber or undergrowth.
 Good grass.

- From the reestablished standard cor. of secs. 32 and 33 on S. bdy. of Tp. (4th. Standard Parallel S.) hereinbefore described,
 N.0°02'W. on a random line, bet. secs. 32 and 33.
- 40.00 Set temp. $\frac{1}{4}$ sec. cor.
 80.26 Intersect E. and W. line, 11 lks. E. of the original cor. of secs. 28, 29, 32 and 33, a granite stone, 8x6x6 ins. above ground, firmly set, marked with 4 notches on E. and 1 notch on S. edge, and witnessed by a mound of stone, W. of cor.
 Thence,
 S.0°07'E., on a true line, bet. secs. 32 and 33.
 Over rolling and hilly land, thru. scattering timber and undergrowth. Ascend.
- .40 Road, on top of ridge, brs. E. and W. Desc. 42 ft. on S. slope.
 5.06 Ravine, 150 lks. wide, course S.40°E. Ascend 34 ft. on N. slope.
 15.25 Ridge, brs. E. and W. Descend 39 ft. on S. slope.
 25.00 Wash, 15 lks. wide, course S.10°E. Ascend 13 ft. on N. slope.
 27.25 Ridge, brs. E. and W. Descend 42 ft. on SW. slope.

Completion of Subdivision of Township 20 South, Range 28 East. 21

Chains.

- 32.45 Ravine, 15 lks.wide, course S.70°E. Ascend 136ft. on N. slope.
- 40.00 Ridge, brs.E. and W. Descend 89 ft. on S.slope.
- 40.13 Set an iron post, 3 ft.long, 1 in. in diam., 17' ins. in the ground, supported by a mound of stone, for $\frac{1}{4}$ sec.cor., marked on brass cap,

$\frac{1}{4}$ S32 | S33
1916

- 46.61 Raise a mound of stone, 2 ft.base, 1 $\frac{1}{2}$ ft. high, W.of cor. Ravine, 10 lks.wide, course S.60°E. Ascend 18 ft.on NE. slope.
- 47.80 Spur, slopes E. Descend 21 ft. on S.slope.
- 48.96 Ravine, 10 lks.wide, course E. Ascend 49 ft. on N. slope.
- 60.26 Ridge, brs.N.20°W. and S.20°E. Descend 53 ft.on SW.slope.
- 65.81 Ravine, 5 lks.wide, course S.40°E. Ascend 50 ft. on NE. slope.
- 71.56 Road brs.N.20°W. and S.10°E. on top of ridge, bearing NW. and SE.
- 80.26 The reestablished standard cor. of secs. 32 and 33, on s. bdy.of Tp.(4th.Standard Parallel South) here inbefore described.
Land, rolling, hilly and broken.
Soil, rocky clay loam, 3rd and 4th rate.
Timber, scattering oak and cedar.
Undergrowth, scattering manzanita, mountain mahogany and greasewood.
Good grass.

From the original cor. of secs. 20, 21, 28 and 29, a granite stone, 14x10x10 ins. above ground, firmly set, marked with 4 notches on E. and 2 on the S. edge, and witnessed by 4 bearing trees NE., SE. and SW., and NW. of cor., and a mound of stone, W. of cor., N.0° 02' W., bet. secs. 20 and 21.

- Over hilly and broken land, thru. scattering timber and undergrowth. Ascend 23 ft. on SW.slope.
- 5.00 Ridge, brs.N.20°W. and S.60°E. Descend 48 ft. on NE. slope.
- 11.10 Ravine, 10 lks.wide, course S.50°E. Ascend 35 ft. on SW. slope.
- 37.20 Road brs.N.30°W. and S.20°E. on top of ridge, brs.N.30°W. and S.30°E. Descend 20 ft. on NE.slope.
- 38.65 Ravine, 10 lks.wide, course E. Ascend 25 ft. on S.slope.
- 39.30 Road brs.N.60°E. and S.60°W.
- 40.00 Set an iron post, 3 ft.long, 1 in. in diam., 26 ins. in the ground, for $\frac{1}{4}$ sec.cor., marked on brass cap,

$\frac{1}{4}$ S20 | S21
1916

- Raise a mound of stone, 2 ft.base, 1 $\frac{1}{2}$ ft. high, W.of cor.
- 45.50 Road, brs.E. and W
- 50.00 Ridge, brs.E. and W. Descend 32 ft. on N.slope.
- 53.50 Ravine, 15 lks.wide, course E. Ascend 46 ft. on S.slope.
- 59.80 Ridge, brs.N.70°W. and S.70°E. Descend 73 ft. on NE.slope.
- 67.00 Ravine, 15 lks.wide, course S.70°E. Ascend 153 ft. on SW. slope.
- 76.80 Ridge, brs.N.60°W. and S.60°E. Descend 66 ft. on NE.slope.
- 79.80 Wire fence brs.E. and W. about 50 lks.E. of SW.fence cor.
- 80.00 Set an iron post 3 ft.long, 2 ins. in diam., 24 ins. in the ground, for cor.of secs.16,17,20 and 21, marked on brass cap,

22 22. Completion of
Subdivision of Township 20 South, Range 28 East.

Chains.

T20S | R28E
S17 | S16
S20 | S21
1916

Raise a mound of stone, 2 ft. base, 1½ ft. high, W. of cor.
Land, hilly and broken.
Soil, dry, stony clay loam about 8 ins. deep, 3rd and 4th
rate.
Timber, scattering oak and cedar.
Undergrowth, scattering cedar, greasewood and mountain
mahogany.
Light growth bunch grass.

- 40.00 East, on a random line, bet. secs. 16 and 21.
- 80.18 Set temp. ¼ sec. cor.
- Intersect N. and S. line, 8 lks. N. of the original cor. of
secs. 15, 16, 21 and 22, a granite stone 8x8x6 ins. above
ground, firmly set, marked with 3 notches on E. and S.
edges, and witnessed by a mound of stone W. of cor.
- Thence,
N. 89° 57' W., on a true line, bet. secs. 16 and 21.
Over rolling and hilly land, thru scattering timber and
undergrowth., Ascend NE. slope.
- 1.20 Old corral brs. N. about 350 lks. dist.
- 2.92 Wire fence brs. N. and S.
- 40.09 Set an iron post, 3 ft. long, 1 in. in diam., 26 ins. in
the ground, for ¼ sec. cor., marked on brass cap

S 16
S 21
1916

- 45.18 Raise a mound of stone, 2 ft. base, 1½ ft. high, N. of cor.
Ridge, brs. N. 60° W. and S. 60° E. Descend 20 ft. over SW.
slope.
- 71.55 Wash, 10 lks. wide, course SE. Ascend 61 ft. on NE. slope.
- 80.18 The cor. of secs. 16, 17, 20 and 21.
Land, rolling and hilly.
Soil, dry, stony, clay loam, abot 8 ins. deep, 2nd and 3rd
rate.
Timber, scattering oak and cedar.
Undergrowth, scattering mesquite and greasewood.
Good grass.

- N. 0° 02' W., bet. secs. 16 and 17.
Over rolling land, thru scattering timber and undergrowth.
Descend 30 ft. on NE. slope.
- 1.20 Wash, 10 lks. wide, course S. 70° E. Ascend 68 ft. on SW.
slope.
- 6.40 Ridge, brs. N. 70° W. and S. 70° E. Descend 124 ft. on NE.
slope.
- 15.90 Wash, 15 lks. wide, course east. Ascend 27 ft. on S. slope.
- 21.00 Ridge, brs. E. and W. Descend 26 ft. on N. slope.
- 25.30 Wash, 10 lks. wide, course S. 60° E. Ascend 20 ft. on S.
slope.
- 29.00 Ridge, brs. E. and W. Descend 17 ft. on N. slope.
- 40.00 Set an iron post, 3 ft. long, 1 in. in diam., 18 ins. in the
ground, supported by a mound of stone, for ¼ sec. cor.,
marked on brass cap.

S17 | S16
1916

- 41.90 Raise a mound of stone, 2 ft. base, 1½ ft. high, W. of cor.
Spur, slopes S. 60° E. Descend 71 ft. on NE. slope.

Completion of Subdivision of Township 20 South, Range 28 East. 23

Chains.

- 47.85 Wash, 20 lks.wide, course S.70°E. Ascend 20 ft. on SW. slope.
 51.86 Road brs.N.70°W. and S.60°E.
 52.00 Spur, slopes SE. Descend 12 ft.
 53.70 Wash, 10 lks.wide, course S.60°E. Ascend 63 ft. on SW. slope.
 68.00 Ridge, brs.N.60°W. and E. Descend 40 ft. on NE.slope.
 71.55 Draw, 50 lks.wide, course N.60°E. Ascend 30 ft.on SE. slope.
 76.50 Ridge, brs.N.50°E. and descend 63 ft. on NW. slope.
 78.15 Wire fence bfs.N.40°E. and S.40°W.
 80.00 Set an iron post, 3 ft.long, 2 ins. in diam., 24 ins. in the ground for cor.of secs. 8,9,16 and 17, marked on brass cap,

T20S R28E	
S 8	S 9
S17	S16
1916	

Raise a mound of stone 2 ft.base, 1½ ft. high,W.of cor. Land, hilly and rolling.
 Soil, gravelly and rocky, 2nd and 3rd rate.
 Timber, scattering oak, juniper and cedar.
 Undergrowth, scattering mesquite and greasewood,
 Good grass.

- S.89°57'E., on a random line, bet. secs. 9 and 16.
 40.00 Set temp. ¼ sec.cor.
 80.16 Intersect N. and S. line, 12 lks.N.of the original cor. of secs. 9,10,15 and 16, a limestone, 12x10x4 ins. above ground, firmly set, marked with 4 notches on S. and 3 notches on E. edge,and witnessed by a mound of stone W.of cor.
 Thence,
 N.89°52'W., on a true line, bet. secs.9 and 16.
 Over rolling and hilly land,thru.scattering timber. Descend NW.slope.
 4.66 Draw, 200 lks.wide,course N.10°E. Ascend 15 ft.on NE. slope.
 12.40 Spur, slopes S.60°E.Descend 10 ft.on SW.slope.
 14.80 Draw, 100 lks.wide, course S.60°E. Ascend 102 ft.on NE. slope.
 25.16 Ridge, brs.N.10°E. and S. Descend 55 ft.on W.slope.
 28.35 Draw, 100 lks.wide,course N.Ascend 21 ft. on E.slope.
 29.66 Spur, slopes N.10°W. Descend 57 ft. on SW.slope.
 40.08 Set an iron post 3 ft.long, 1 in. in diam., 26 ins.in the ground, for ¼ sec.cor., marked on brass cap,

¼ S 9
S 16
1916

- 52.16 Raise a mound of stone 2 ft.base, 1½ ft. high,N.of cor. Center of draw, 150 lks.wide, course N. 30°E.; enter flat,brs.N.30°E. and S.30°W.
 60.65 Leave flat, brs.N. and S. Ascend 46 ft. on E.slope.
 70.15 Spur, slopes N. 70°E. Descend 18 ft. on NW.slope.
 73.05 Road brs.N.40°E. and S.40°W.
 75.16 Same road, brs.N.60°W. and S.60°E.
 80.16 The cor.of secs.8,9,16 and 17.
 Land, rolling, level and hilly.
 Soil, dry,rocky clay loam about 8 ins. deep, 3rd rate.
 Timber, scattering oak.
 No undergrowth.
 Good grass.

Completion of Subdivision of Township 20 South, Range 28 East.

Chains

- N. 0° 02' W., bet. secs. 8 and 9.
Over hilly land, thru scattering timber. Descend 5 ft. on NW slope.
- .10 Road, brs. E. and W.
- .55 Wash, 15 lks. wide, course N. 70° E. Ascend 246 ft. on SW slope.
- 21.00 Ridge, brs. N. 40° W. and S. 40° E. Descend 317 ft. on NE slope.
- 36.70 Wash, 20 lks. wide, course E. Ascend 15 ft. on S. slope.
- 39.55 Spur, slopes S. 40° E. Descend 12 ft. on NE slope.
- 40.00 Set an iron post 3 ft. long, 1 in. in diam., 26 ins. in the ground, for $\frac{1}{4}$ sec. cor., marked on brass cap,

188 | 89

1916

- Raise a mound of stone. 2 ft. base, 1 $\frac{1}{2}$ ft. high, W. of cor. From this cor., Ed. Stanford's house brs. S. 77° 00' E. about 10 chs. dist.
- 40.30 Ravine, 10 lks. wide, course S. 10° E. Ascend 139 ft. on SW slope.
- 51.50 Ridge, brs. N. 50° E. and S. 50° W. Descend 106 ft. on NW slope.
- 67.70 Draw, 100 lks. wide, course N. 40° E. Ascend 4 ft. on SE slope.
- 69.50 Spur, slopes N. 40° E. Descend 6 ft. on NW slope.
- 71.20 Draw, 100 lks. wide, course E. Ascend 98 ft. on S. slope.
- 79.40 Ridge, brs. N. 60° E. and S. 60° W. Descend 20 ft. on NW slope.
- 80.00 Set an iron post, 3 ft. long, 2 ins. in diam., 24 ins. in the ground, for cor. of secs. 4, 5, 8 and 9, marked on brass cap,

T20S | R28E

S 5 | S 4

S 8 | S 9

1916

Raise a mound of stone, 2 ft. base, 1 $\frac{1}{2}$ ft. high, W. of cor. Land, hilly and rolling. Soil, dry, rocky clay loam, about 6 ins. deep, 4th rate. Timber, scattering oak and cedar. Undergrowth, scattering mesquite, manzanita and skunk brush. Good grass.

- S. 89° 52' E. on a random line, bet. secs. 4 and 9.
- 40.00 Set temp. $\frac{1}{4}$ sec. cor.
- 80.10 Intersect N. and S. line, 23 lks. S. of the original cor. of secs. 3, 4, 9 and 10, hereinbefore described.
- Thence,
- S. 89° 58' W., on a true line, bet. secs. 4 and 9. Over rolling and hilly land, thru scattering timber and undergrowth. Ascend 130 ft. on SE slope.
- 18.00 Ridge, brs. N. 30° E. and S. 40° W. Descend 109 ft. on NW slope.
- 31.40 Foot of descent; leave hilly land, brs. N. 40° E. and S. 20° W.; enter level land.
- 35.60 Wash, 25 lks. wide, 4 ft. deep, course N. 10° E.
- 36.40 A point 10 lks. S. of SW. cor. of wire fence.
- 37.10 Road, brs. N. 10° E. and S.
- 40.05 Set an iron post, 3 ft. long, 1 in. in diam., 26 ins. in the ground for $\frac{1}{4}$ sec. cor., marked on brass cap,

18 | 4

S 9

1916

Chains.

Raise a mound of stone, 2 ft. base, 1½ ft. high, N. of cor.

42.00 Leave level land, brs. N. 10°E. and S. 10°W.; enter hilly land.

Ascend 98 ft. on SE. slope.

50.30 Ridge, brs. No. 10°E. and S. 10°W. Descend 46 ft. on NW. slope.

54.90 Ravine, 10 lks. wide, 4 ft. deep, course N. Ascend 11 ft. on E. slope.

57.10 Spur, slopes N. 20°E. Descend 15 ft. on NW. slope.

61.10 Draw, 75 lks. wide, course N. 40°E. Ascend 146 ft. on SE. slope.

78.80 Ridge, brs. NE. and SW. Descend 6 ft. along top of same.

80.10 The cor. of secs. 4, 5, 8 and 9.
Land, rolling, level and hilly.
Soil, dry, rocky, clay loam, about 8 ins. deep, 2nd and 3rd rate.
Timber, scattering oak.
No undergrowth.
Good grass.

N. 0° 02' W. on a true line, bet. secs. 4 and 5.
Over hilly land, thru. scattering timber. Descend 126 ft. on NE. slope.

7.45 Wire fence brs. E. and W.

10.00 Draw, 100 lks., course N. 60°E. Ascend 52 ft. on SE. slope.

23.00 Spur, slopes N. 60°E. Descend 109 ft. on NW. slope.

33.40 Wash, 10 lks. wide, course E. Ascend 69 ft. on S. slope.

35.60 Road brs. E. and W.

40.00 Set an iron post, 3 ft. long, 1 in. in diam., 26 ins. in the ground, for ¼ sec. cor., marked on brass cap,

T19S | S4

1916

43.70 Raise a mound of stone, 2 ft. base, 1½ ft. high, W. of cor. Ridge, brs. N. 20°W. and S. 60°E. Descend 46 ft. on NE. slope.

55.90 Wash, 5 lks. wide, 4 ft. deep, course S. 70°E. Ascend 24 ft. on SW. slope.

61.00 Spur, slopes S. 70°E. Descend 33 ft. on NE. slope.

64.75 Wash, 5 lks. wide, course E. Ascend 90 ft. on S. slope.

72.50 Ridge, brs. N. 10°E. and S. 30°W. Ascend along W. slope of same.

82.75 Same ridge, brs. N. 10°W. and S. 10°E. Descend 21 ft. on NE. slope.

84.20 Wire fence brs. E. and W.

84.60 Intersect N. bdy. of Tp., 4.60 chs. S. 89° 32' W. from re-established cor. of secs. 32 and 33. hereinbefore described.
At the point of intersection, set an iron post, 3 ft. long, 2 ins. in diam., 24 ins. in the ground for closing cor. of secs. 4 and 5, marked on brass cap

T19S R28E

S32

.S5 | S4
T20S R28E

C | C

1916

Raise a mound of stone, 2 ft. base, 1½ ft. high, S. of cor.
Land, hilly and mountainous.
Soil, dry, rocky clay loam, about 8 ins. deep, 3rd and 4th rate.
Timber, scattering oak.
No undergrowth.
Good grass.

26 Completion of
Subdivision of Township 20 South, Range 28 East.

Chains.

- From reestablished std. cor. of secs. 31 and 32 on S. bdy. of Tp. (4th. Standard Parallel South) here in before described,
N. 0° 03' W., bet. secs. 31 and 32.
Over mountainous land, thru. scattering timber and undergrowth; ascend 365 ft. on SW. slope.
- 15.75 Main ridge of the Swisshelm mountains, brs. N. 20° W. and S. 20° E. Descend 74 ft. on NE. slope.
- 20.70 Head of gulch, 10 lks. wide, course N. 70° E. Ascend 34 ft. on SE. slope.
- 25.00 Spur, slopes E. Descend 63 ft. on N. slope.
- 28.00 Head of gulch, 6 lks. wide, course N. 70° E. Ascend 19 ft. on SE. slope.
- 33.00 Spur, slopes N. 70° E. Descend 324 ft. on NE. slope.
- 40.00 Set an iron post, 3 ft. long, 1 in. in diam., 18 ins. in the ground, supported by a mound of stone for $\frac{1}{4}$ sec. cor., marked on brass cap,

S31 | S32

1916

- 45.50 Raise a mound of stone, 2 ft. base, 1 $\frac{1}{2}$ ft. high, W. of cor. Ravine, 15 lks. wide. course E. Ascend 62 ft. on SE. slope.
- 52.00 Spur, slopes N. 60° E. Descend 132 ft. on NW. slope.
- 56.87 Ravine, 10 lks. wide, course N. 60° E. Ascend 66 ft. on SE. slope.
- 65.00 Spur, slopes N. 60° E. Descend 190 ft. on NW. slope.
- 72.00 Ravine, 15 lks. wide, course N. 60° E. Ascend 13 ft. on SE. slope.
- 73.00 Spur, slopes E. Descend 21 ft. on N. slope.
- 73.90 Ravine, 15 lks. wide, course S. 60° E. Ascend 192 ft. on SW. slope.
- 80.00 Set an iron post, 3 ft. long, 2 ins. in diam., 10 ins. in the ground, supported by a mound of stone, for cor. of secs. 29.30, 31 and 32, marked on brass cap,

T20S | R28E

S30 | S29

S31 | S32

1916

Raise a mound of stone, 2 ft. base, 1 $\frac{1}{2}$ ft. high, W. of cor. Land, mountainous. Soil, rocky, 3 to 8 ins. deep, 4th rate. Timber, oak, cedar, and pinon. Dense on N. slope. Scattering elsewhere. Undergrowth, scattering mountain mahogany, buck brush, yucca and soto. Good grass.

- 40.00 East, on a random line, bet. secs. 29 and 32. Set temp. $\frac{1}{4}$ sec. cor.
- 79.70 Intersect N. and S. line, 28 lks. S. of the original cor. of secs. 28, 29, 32 and 33, here in before described. Thence, S. 89° 48' W., on a true line, bet. secs. 29 and 32. Over mountainous land, through scattering timber and undergrowth. Ascend along top of ridge.
- .70 Road brs. N. 20° W. and S. 40° E.
- 18.00 Leave top of ridge, brs. E. and SW. Desc. 15 ft. on NW. slope.
- 20.60 Wash, 15 lks. wide, course N. 50° W.
- 24.40 Same wash, course S. 30° E. Ascend 108 ft. on NE. slope,
- 32.16 Mine shaft, 4 ft. square, 10 ft. deep, bears N. 5 lks. dist.
- 36.40 Spur, slopes N. 60° E. Descend 3 ft. over SW. slope.
- 37.00 Ravine, 6 lks. wide, course N. 60° E. Ascend 629 ft. on SE. slope.
- 39.85 Set an iron post, 3 ft. long, 1 in. in diam., 26 ins. in the ground, for $\frac{1}{4}$ sec. cor., marked on brass cap,

Completion of
Subdivision of Township 20 South, Range 28 East. 27

Chains.

1/4 S 29
S 32
1916

- 51.00 Raise a mound of stone 2 ft. base, 1 1/2 ft. high, N. of cor. Spur, slopes N. 50° E. Thence on N. slope of spur; ascending.
- 60.00 Same spur, slopes S. 70° E. from N. 70° W.; thence on S. slope of spur, ascending.
- 79.70 The cor. of secs. 29, 30, 31 and 32.
Land, mountainous.
Soil, rocky, 3rd and 4th rate.
Timber, scattering oak and cedar.
Undergrowth, scattering greasewood.

West, on a true line, bet. secs. 30 and 31.
Over mountainous land, thru. scattering timber and undergrowth. Ascend 601 ft. on S. slope.

- 30.00 Spur, slopes NE. Descend 20 ft. over NW. slope.
- 33.60 Ravine, 5 lks. wide, course N. 20° E. Ascend 225 ft. on steep E. slope.
- 39.85 Main ridge of the Swisshelm Mountains, brs. N. 10° W. and S. 20° E. Descend 10 ft. on steep SW. slope to
- 40.00 Set an iron post 3 ft. long, 1 in. in diam., 8 ins. in the ground, supported by a mound of stone, for 1/4 sec. cor. marked on brass cap,

1/4 S 30
S 31
1916

- 47.85 Raise a mound of stone 2 ft. base, 1 1/2 ft. high, N. of cor. Descend 232 ft. on steep SW. slope.
Head of ravine, 15 lks. wide, course S. Ascend 60 ft. on E. slope.
- 53.80 Spur, slopes S. 20° W. Descend 368 ft. on steep NW. slope.
- 61.45 Ravine, 10 lks. wide, course S. 60° W. Ascend 17 ft. on SE. slope.
- 67.70 Spur, slopes S. 30° W. Descend 370 ft. on NW. slope.
- 79.30 Ravine, 20 lks. wide, course S. 60° W. Ascend 61 ft. on SE. slope.
- 83.25 Sour, slopes S. 20° W. Descend 66 ft. on NW. slope.
- 89.12 Intersect W. bdy. of Tp. 145 lks. S. 0° 12' W. of the reestablished cor. of secs. 25 and 36, T. 20 S., R. 27 E. described in Book "B." of this group.
At point of intersection, set an iron post, 3 ft. long, 2 ins. in diam., 24 ins. in the ground, for closing cor. of secs. 30 and 31, marked on brass cap.

T20S	T20S
R27N	S30
	-----CC
S36	S31
	R28E
	1916

Raise a mound of stone 2 ft. base, 1 1/2 ft. high, E. of cor.
Land, mountainous.
Soil, rocky, 4th rate.
Timber, scattering oak, juniper, cedar and pinon.
Undergrowth, scattering catclaw, buck brush and mountain mahogany.
Good grass.

From cor. of secs. 29, 30, 31 and 32.,
N. 0° 03' W., bet. secs. 29 and 30.
Over mountainous land, thru. scattering timber, and undergrowth. Ascend 79 ft. on steep SE. slope.

Completion of
28. Subdivision of Township 20 South Range 28 East

- Chains.
- 3.70 Spur, slopes E. Descend 366 ft. on NE.slope.
- 20.50 Ravine, 10 lks.wide, course N.60°E. Ascend 25 ft.on SE.slope.
- 26.00 Spur, slopes N.70°E. Descend 85 ft. on NW.slope.
- 28.95 Wash, 20 lks.wide, course N.70°E. Ascend 113 ft. on SE.slope.
- 36.00 Rocky spur, slopes E. Descend 147 ft. on N.slope.
- 40.00 Set an iron post 3 ft.long, 1 in. in diam., 26 ins. in the ground for $\frac{1}{4}$ sec.cor., marked on brass cap,

S30 | S29
1916

- 43.40 Raise a mound of stone, 2 ft. base, 1 $\frac{1}{2}$ ft. high, W. of cor. Ravine, 10 lks. wide, course E. Ascend 96 ft. on S.slope.
- 50.00 Rocky spur, slopes S.70°E. Descend 32 ft. on NE.slope.
- 51.90 An open cut 20 ft. long, 3 ft. deep, and a shaft 5 ft. sq., 6 ft. deep, brs.E. 30 lks.dist.
- 56.45 Ravine, 15 lks.wide, course E. Ascend 16 ft. on S.slope.
- 60.00 Spur, slopes E. Descend 18 ft. on N.slope.
- 62.50 Ravine, 10 lks.wide, course N.70°E. Ascend 18 ft. on SE.slope.
- 64.50 Spur, slopes E. Descend 91 ft. on N.slope.
- 70.65 Ravine, 15 lks.wide, course S.70°E. Ascend 101 ft. on SW.slope.
- 80.00 Set an iron post 3 ft. long, 2 ins. in diam., 14 ins. in the ground, supported by a mound of stone, for cor, of secs. 19, 20, 29 and 30, marked on brass cap,

T20S | R28E
S19 | S20
S30 | S29
1916

Raise a mound of stone, 2 ft. base, 1 $\frac{1}{2}$ ft. high, W. of cor. Land, mountainous.
Soil, dry, rocky clay loam, 3 to 6 ins. deep, 4th rate.
Timber, scattering oak, juniper and pinon.
Undergrowth, scattering mountain mahogany, buck brush, skunk brush, soto and cacti.
Good grass.

- 40.00 N.89°48'E., on a random line, bet. secs.20 and 29. Set temp. $\frac{1}{4}$ sec. cor.
- 79.90 Intersect N. and S line, 16 lks.S. of the original cor. of secs. 20, 21, 28 and 29, hereinbefore described. Thence, S.89° 41' W., on a true line, bet. secs.20 and 29. Over mountainous land, thru scattering timber and underbrush. Descend 10 ft. on SW.slope.
- .10 Ravine, 10 lks.wide, course S. 30°E. Ascend 15 ft. on NE.slope.
- 2.90 Spur, slopes S.60°E. Descend 27 ft. on SW.slope.
- 7.65 Wash, 15 lks.wide, course S.60°E. Ascend 130 ft. on NE.slope.
- 9.40 Road brs. N.50°W. and S.60°E.
- 23.70 Wire fence, brs. N.60°W. and S.60°E.
- 25.40 Ridge, brs. N.50°W. and S.50°E. Descend 8 ft. on SW.slope.
- 38.14 Wire fence brs. N.30°E. and S.30°W.
- 39.95 Set an iron post, 3 ft. long, 1 in. in diam., 26 ins. in the ground for $\frac{1}{4}$ sec.cor., marked on brass cap,

S 20
S 29
1916

Raise a mound of stone, 2 ft. base, 1 $\frac{1}{2}$ ft. high, N. of cor. Leonard Albertson's house bears N.45°E., about 15 chs. dist.

Completion of Subdivision lines of T.20 S., R.28 E. 29

Chains.

- 44.30 Ravine, 10 lks.wide, course S.60°E. Ascend 236 ft. on NE. slope.
- 79.90 The cor.of secs. 19,20, 29 and 30.
Land, mountainous.
Soil, dry, rocky clay loam, about 6 ins. deep, 3rd and 4th rate.
Timber, scattering oak, cedar, juniper and pinon.
Undergrowth, scattering buck brush and cacti.
Good grass.

West, on a true line, bet. secs.19 and 30.
Over mountainous land, thru.scattering timber and undergrowth. Descend 61 ft. on SW.slope.

- 3.90 Ravine, 10 lks.wide, course S.10°E. Ascend 402 ft. on SE.slope.
- 28.00 Spur, slopes N.60°E. Descend 87 ft. on NW.slope.
- 36.70 Ravine, 15 lks.wide, course N.70°E. Ascend 101 ft.on SE.slope.
- 40.00 Set an iron post 3 ft.long, 1 in. in diam., 26 ins. in the ground for 1/4 sec.cor., marked on brass cap,

S 19
S 30
1916

- 45.00 Raise a mound of stone 2 ft.base; 1 1/2 ft. high, N.of cor. Spur, slopes S.20°E. Descend 15 ft. on SW.slope.
- 47.15 Ravine, 10 lks.wide, course S. 50°E. Ascend 438 ft. on NE. slope.
- 70.30 Spur, slopes N. Descend 17 ft. on W. slope.
- 75.90 Ravine, 10 lks.wide, course N.60°E. Ascend 110 ft, on SE. slope.
- 80.20 Spur, slopes S. Descend 10 ft. on W.slope.
- 82.05 Ravine, 6 lks.wide, course S. Ascend 171 ft.on E.slope.
- 88.60 Intersect W bdy.of Tp., 158 lks.S.0° 12'W. of the reestablished cor. of secs. 24 and 25, T.20 S., R.27 E., described in Book "B." of this group.

At point of intersection,
Set an iron post, 3 ft. long, 2 ins. in diam., 24 ins. in the ground, for closing cor. of secs.19 and 30, marked on brass cap,

T20S | T20S
R27E | S19 --- CC
S25 | S30
R28E
1916

Raise a mound of stone, 2 ft.base, 1 1/2 ft. high, E. of cor.
Land, mountainous.
Soil. rocky, 3rd and 4th rate.
Timber, scattering oak, juniper and cedar.
Undergrowth, scattering mountain mahogany and buck brush.
Good grass.

From cor. of secs. 19,20, 29 and 30,
N.0°03' W., bet. secs. 19 and 20.
Over mountainous land, thru.scattering timber and undergrowth. Descend 81 ft. on NE. slope.

- 6.00 Ravine, 8 lks.wide, course S.30°E. Ascend 169 ft. on SW. slope.
- 13.00 Spur, slopes E. Descend 153 ft. on N.slope.
- 18.60 Ravine, 10 lks.wide, course E. Ascend 178 ft.on S.slope.
- 27.00 Spur, slopes E. Descend 161 ft. on N.slope.
- 36.45 Ravine, 10 lks.wide, course E. Ascend 14 ft. on S.slope.
- 39.00 Spur, slopes S. 50°E. Descend 16 ft. on NE.slope.
- 40.00 Set an iron post, 3 ft.long, 1 in. in diam., 26 ins. in

30. Completion of Township 20 South Range 28 East

Chains.

the ground, for $\frac{1}{4}$ sec.cor., marked on brass cap,

$\frac{1}{4}$ S19 | S20

1916

40.70 Raise a mound of stone 2 ft. base, $1\frac{1}{2}$ ft. high, W.of cor. Ravine, 15 lks.wide, course S.50°E. Ascend 71 ft. on SW. slope.

44.50 Spur, slopes N.70°E. Descend 71 ft. on N.slope.

49.10 Ravine, 5 lks.wide, course E. Ascend 164 ft. on S.slope.

60.00 Ridge, brs.E. and W. Descend 140 ft. on N.slope.

65.40 Ravine, 6 lks.wide, course N.70°E. Ascend 123 ft. on SE. slope.

72.00 Ridge, brs.N.60°E. and S.60°W. Descend 163 on NW.slope.

78.70 Ravine, 8 lks.wide, course N.60°E. Ascend 75 ft. on SE. slope.

80.00 Set an iron post, 3 ft.long, 2 ins. in diam., 24 ins. in the ground, for cor.of secs:17,18,19 and 20, marked on brass cap,

T20S | R28E
S18 | S17
S19 | S20

1916

Raise a mound of stone, 2 ft.base, $1\frac{1}{2}$ ft. high,W.of cor. Land, mountainous.

Soil, stony, 3rd and 4th rate.

Timber, scattering oak and cedar.

Undergrowth, scattering buck brush.

Good grass.

oo-----

40.00 N.89°41'E., on a random line, bet. secs.17 and 20. Set temp. $\frac{1}{4}$ sec.cor.

79.84 Intersect N. and S. line, 3 lks.N.of the cor.of secs.16,17, 20 and 21.

Thence,

S.89°42'W. on a true line, bet. secs.17 and 20.

Over mountainous land, thru.scattering timber and undergrowth. Ascend NE.slope.

9.80 Ridge, brs.N. 40°W. and S.60°E. Descend 69 ft. on SW.sone.

25.08 Ravine, 8 lks.wide, course S.60°E. Ascend 155 ft. on NE. slope.

39.15 Ridge, brs.N.40°E. and S.60°W. Descend 56 ft. on NW.slope.

39.92 Set an iron post 3 ft.long, 1 in. in diam., 26 ins. in the ground, for $\frac{1}{4}$ sec.cor., marked on brass cap.

$\frac{1}{4}$ S 17

S 20

1916

46.00 Raise a mound of stone, 2 ft. base, $1\frac{1}{2}$ ft. high,N.of cor. Ravine, 10 lks.wide, course N.40°E. Ascend 60 ft. on SE. slope.

49.85 Spur, slopes N.60°E. Descend 50 ft. on NW.slope.

56.39 Ravine, 10 lks.wide, course N.30° E. Ascend 166 ft.on SE. slope.

68.84 Spur, slopes N.60°E. Descend 65 ft. on NW.slope.

78.95 Ravine, 10 lks.wide, course N.40°E. Ascend 20 ft. on SE. slope.

79.84 The cor.of sdc.17,18,19 and 20.

Land, mountainous.

Soil, rocky, 3rd and 4th rate.

Timber, scattering oak and cedar.

Undergrowth, scattering buck brush.

Good grass.

oo-----

Completion of Township 20 South, Range 28 East. 31.

- Chains
- West, on a true line, bet. secs. 18 and 19.
- Over mountainous land, thru scattering timber and undergrowth. Ascend 218 ft. on SE. slope.
- 11.00 Ridge, brs. N. 70° E. and W.; thence along top of same, ascending.
- 18.00 Leave top of ridge, brs. S. 50° W. and E. Descend 185 ft. on NW. slope.
- 29.80 Ravine, 10 lks. wide, course N. 60° E. Ascend 50 ft. on SE. slope.
- 33.00 Spur, slopes S. Descend 23 ft. on W. slope.
- 34.40 Ravine, 6 lks. wide, course S. 20° E. Ascend 239 ft. on NE. slope.
- 40.00 Set an iron post, 3 ft. long, 1 in. in diam., 26 ins. in the ground, for 1/4 sec. cor., marked on brass cap,

S 18
 S 19
 1916

- 48.77 Raise a mound of stone, 2 ft. base, 1 1/2 ft. high, N. of cor. Trail, brs. N. 10° E. and S.
- 49.00 Spur, slopes N. Descend 103 ft. on W. slope.
- 60.55 Ravine, 10 lks. wide, course N. Ascend 65 ft. on E. slope.
- 65.50 Spur, slopes N. 20° E. Descend 12 ft. on NW. slope.
- 72.00 Ravine, 20 lks. wide, course N. 10° E. Ascend 418 ft. on SE. slope.
- 78.25 Rock ledge 20 ft. high, brs. N. 70° E., 100 lks., and S. 70° W., 2 chs. dist.
- 86.75 Rocky spur, brs. N. 20° E. and S. 20° W. Descend 72 ft. on NW. slope.
- 88.34 Intersect the W. bdy. of Tp. 148 lks. S. 0° 12' W. of the re-established cor. of secs. 13 and 24, T. 20 S., R. 27 E., described in Book "B" of this Group.
At point of intersection, set an iron post, 3 ft. long, 2 ins. in diam., 24 ins. in the ground, for closing cor. of secs. 18 and 19, marked on brass cap,

T20S	T20S	
R27E	S18	
S24	S19	CC

 1916

Raise a mound of stone, 2 ft. base, 1 1/2 ft. high, E. of cor. Land, mountainous.
 Soil, dry, rocky clay loam, about 8 ins. deep, 3rd and 4th rate.
 Timber, scattering oak and cedar.
 Undergrowth, scattering buck brush.
 Good grass.

-
- From cor. of secs. 17, 18, 19 and 20, N. 0° 03' W., bet. secs. 17 and 18.
 - Over mountainous land, thru scattering timber and undergrowth. Ascend 112 ft. on SE. slope.
 - 11.00 Ridge, brs. N. 50° E. and S. 40° W. Descend 165 ft. on NW. slope.
 - 21.90 Ravine, 15 lks. wide, course N. 20° E. Ascend 46 ft. on SE. slope.
 - 30.00 Spur, slopes E. Descend 78 ft. on N. slope.
 - 33.85 Ravine, 8 lks. wide, course N. 60° E. Ascend 63 ft. on SE. slope.
 - 39.00 Spur, brs. N. 20° E. Descend 90 ft. on NW. slope.
 - 40.00 Set an iron post, 3 ft. long, 1 in. in diam., 10 ins. in the ground, supported by a mound of stone, for 1/4 sec. cor., marked on brass cap,

Chains.

1/2 S 18 | S 17
1916

- 46.75 Raise a mound of stone, 2 ft. base, 1 1/2 ft. high, W. of cor. Wash, 10 lks. wide, course E. Ascend 73 ft. on S. slope.
- 57.35 Road brs. N. 60° E. and S. 40° W.
- 58.00 Ridge, brs. N. 30° E. and S. 40° W. Descend 133 ft. on NW. slope.
- 69.25 Ravine, 5 lks. wide, course N. 40° W. Ascend 38 ft. on SW. slope.
- 74.00 Spur, slopes N. 50° W. Descend 60 ft. on NE. slope.
- 79.70 Draw, 100 lks. wide, course N. 60° W. Ascend 4 ft. on SW. slope.
- 80.00 Set an iron post, 3 ft. long, 2 ins. in diam., 24 ins. in the ground, for cor. of secs. 7, 8, 17 and 18, marked on brass cap,

T 20 S | R 28 E
S 7 | S 8
S 18 | S 17
1916

Raise a mound of stone, 2 ft. base, 1 1/2 ft. high, W. of cor. Land, mountainous. Soil, rocky, clay loam, about 8 ins. deep, 4th rate. Timber, scattering oak & cedar. Undergrowth, scattering buck brush. Good grass.

- 40.00 N. 89° 42' E., on a random line, bet. secs. 8 and 17. Set temp. 1/4 sec. cor.
- 79.92 Intersect. N. and S. line, 14 lks. N. of the cor. of secs. 8, 9, 16 and 17. Thence, S. 89° 48' W., on a true line, bet. secs. 8 and 17. Over rolling and hilly land, thru. scattering timber and undergrowth.
- 6.80 Wash, 10 lks. wide, course N. 20° E. Ascend 41 ft. on SE. slope.
- 6.85 Road brs. N. 20° E. and S. 20° W.
- 18.00 Low ridge, brs. N. 60° E. and S. 60° W. Descend 5 ft. on NW. slope.
- 25.63 Road brs. N. 20° W. and S. 40° E.
- 27.00 Wash, 15 lks. wide, 5 ft. deep, course N. Ascend E. slope.
- 39.96 Set an iron post, 3 ft. long, 1 in. in diam., 26 ins. in the ground, for 1/4 sec. cor., marked on brass cap,

1/2 S 8
S 17
1916

Dig pits 18x18x12 ins., E. and W. of post, 3 ft. dist., and raise a mound of earth, 3 1/2 ft. base, 1 1/2 ft. high, N. of cor.

- 56.00 Ridge, brs. N. 20° E. and S. Descend 25 ft. on NW. slope.
- 61.00 Draw, 100 lks. wide, course N. 20° E. Ascend 26 ft. on SE. slope.
- 67.30 Road brs. N. 10° E. and S. 10° W.
- 77.70 Ridge, brs. N. 10° E. and S. 10° W. Descend 73 ft. on NW. slope.
- 79.92 The cor. of secs. 7, 8, 17 and 18. Land, rolling and hilly. Soil, dry, rocky clay loam, 3rd rate. Timber, scattering oak and cedar. Undergrowth, scattering buck brush. Good grass.

Completion of Subdivision of Township 20 South Range 28 East 33

Chains.

- West, on a true line, bet. secs.7 and 18.
Over rolling, hilly land, thru scattering timber and undergrowth. Descend 4 ft. on SW. slope.
- .75 Draw, 100 lks. wide, course N.60°W. Ascend 15 ft. on NE. slope.
- 4.10 Spur, slopes N.60°W. Descend 20 ft. on SW. slope.
- 5.30 Wash, 6 lks. wide, course N.30°W. Ascend 52 ft. on NE. slope.
- 15.00 Ridge, brs. N.30°W. and S.20°E. Descend 62 ft. on SW. slope.
- 22.40 Wash, 20 lks. wide, course N.10°W. Ascend 39 ft. on NE. slope.
- 27.50 Spur, slopes N.10°W. Descend 37 ft. on SW. slope.
- 31.90 Wash, 10 lks. wide, course N. east. 25 ft. on E. slope.
- 33.50 Road, brs. N.10°W. and S.
- 34.00 Ridge, brs. N.10°W. and S.10°E. Descend 20 ft. on W. slope.
- 36.90 Road brs. N.10°E. and S.10°W.
- 40.00 Set an iron post, 3 ft. long, 1 in. in diam., 26 ins. in the ground, for $\frac{1}{2}$ sec. cor., marked on brass cap,

S 7
 S 18
 1916

- 41.40 Raise a mound of stone, 2 ft. base, 1 1/2 ft. high, N. of cor. Draw, 60 lks. wide, course N.50°E. Ascend 74 ft. on SE. slope.
- 51.00 Spur, slopes N. Descend 53 ft. on SE. slope.
- 59.90 Ravine, 10 lks. wide, course N.10°W. Ascend 35 ft. on NE. slope.
- 61.50 Spur, slopes N. Descend 45 ft. on W. slope.
- 63.20 Ravine, 6 lks. wide, course N. Ascend 8 ft. on E. slope.
- 68.00 Spur, slopes N.20°E. Descend 28 ft. on NW. slope.
- 69.65 Ravine, 20 lks. wide, course N.30°E. Ascend 103 ft. on SE. slope.
- 81.00 Spur, slopes S. Descend 41 ft. on W. slope.
- 84.40 Ravine, 5 lks. wide, course S.10°E. Ascend 39 ft. on NE. slope.
- 88.02 Intersect W. bdy. of Tp., 153 lks. S. 0° 12' W. of the reestablished cor. of secs. 12 and 13, described in Book "B." of this group.
At point of intersection,
Set an iron post, 3 ft. long, 2 ins. in diam., 10 ins. in the ground, supported by a mound of stone, for closing cor. of secs. 7 and 18, marked on brass cap,

T20S	T20S
R27E	S7 CC
S13	S18
	R28E

 1916

Raise a mound of stone, 2 ft. base, 1 1/2 ft. high, E. of cor.
 Land, rolling and hilly.
 Soil, rocky and gravelly 4 to 8 ins. deep, 4th rate,
 Timber, scattering oak and cedar.
 Undergrowth, scattering buck brush.
 Light growth of bunch grass.

-
- From cor. of secs. 7, 8, 17 and 18,
N. 0° 03' W., bet. secs. 7 and 8.
Over rolling and mountainous land, thru scattering timber and undergrowth. Ascend 35 ft. on SE. slope.
 - 4.60 Spur, slopes N.60°W. Descend 42 ft. on SW. slope.
 - 8.40 Draw, 6 lks. wide, course N.70°W. Ascend 52 ft. on S. slope.
 - 14.30 Road brs. N.70°W. and S.70°E. on top of ridge, brs. N.60°W. and S.70°E. Descend 53 ft. on NE. slope.
 - 23.55 Draw, 100 lks. wide, course N.60°W. Ascend 29 ft. on SW. slope.

34 Completion of Subdivision of Township 20 South Range 28 E.

Chains.

- 30.00 Spur, slopes N.60°W. Descend 67 ft. on NE.slope.
- 36.50 Draw, 150 lks.wide, course N.70°W. Ascend 22 ft.on SW.slope.
- 39.50 Spur, slopes N.60°W. Descend 29 ft. on NE.slope.
- 40.00 Set an iron post, 3 ft.long, 1 in. in diam., 14 ins. in the ground, supported by a mound of stone, for $\frac{1}{4}$ sec.cor., marked on brass cap,

S7 | S8
1916

- 45.20 Raise a mound of stone, 2 ft.base, 1 $\frac{1}{2}$ ft. high,W.of cor. Road brs.N.60°E. and W. in draw, 200 lks.wide,course W. Ascend 29 ft. on S.slope.
- 48.50 Spur,slopes W. Descend 22 ft. on N.slope.
- 50.00 Ravine, 10 lks.wide,course W. Ascend 42 ft. on SW.slope.
- 53.00 Spur, slopes W. Descend 27 ft. on N.slope.
- 54.95 Ravine, 15 lks.wide, course S.70°W. Ascend 50 ft. on SW.slope.
- 58.50 Spur, slopes S. 70°W. Descend 17 ft. on NW.slope.
- 69.25 Ravine, 6 lks.wide, course W. Ascend 50 ft. on S.slope.
- 75.00 Spur, slopes S.60°W. Descend 18 ft. on NW.slope.
- 79.10 Ravine, 10 lks.wide, course S.60°W. Ascend 38 ft. on SW.slope.
- 80.00 Set an iron post 3 ft.long, 2 ins. in diam., 18 ins. in the ground, supported by a mound of stone, for cor.of secs.5,6,7 and 8, marked on brass cap,

T20S | R28E
S 6 | S 5
S 7 | S 8
1916

Raise a mound of stone, 2 ft.base, 1 $\frac{1}{2}$ ft. high,W.of cor.
Land, rolling and mountainous.
Soil, dry, rocky, clay loam, about 8 ins.deep,4th rate.
Timber, scattering oak and cedar.
Undergrowth, scattering buck brush.
Good grass.

-
- 40.00 N.89°48'E. on a random line, bet.secs. 5 and 8. Set temp. $\frac{1}{2}$ sec.cor.
 - 80.00 Intersect N. and S. line 8 lks.S. of the cor.of secs.4,5, 8 and 9.
Thence,
S.89° 45'W., on a true line, bet. secs. 5 and 8.
Over mountainous land, thru.scattering timber and undergrowth. Ascend 12 ft. on N.slope.
 - 2.00 Spur,slopes N. 30°W. Descend 87 ft. on SW.slope.
 - 14.00 Draw, 200 lks.wide, course north. Ascend 300 ft. on E.slope.
 - 36.00 Spur, slopes N.20°W. Descend 266 ft. on NW.slope.
 - 40.00 Set an iron post, 3 ft.long, 1 in. in diam., 26 ins. in the ground, for $\frac{1}{4}$ sec.cor., marked on brass cap,

$\frac{1}{4}$ S 5
S 8
1916

- 49.30 Raise a mound of stone,2 ft.base,1 $\frac{1}{2}$ ft. high,N.of cor. Ravine, 20 lks.wide, course N.30°E. Ascend 255 ft.on SE.slope.
- 65.00 Ridge, brs.N.10°W. and S.30°E. Descend 150 ft. on SW.slope.
- 77.20 Ravine, 6 lks.wide, course S.70°W. Ascend 15 ft. on SE.slope.
- 80.00 The cor.of secs. 5,6,7 and 8.
Land, mountainous.

Completion of Subdivision of Township 20 South Range 28 East. 35

Chains.

Soil, rocky, 4th rate.
Timber, scattering oak and cedar.
Undergrowth, scattering buck brush.
Good grass.

West, on a true line, bet. secs. 6 and 7.
Over mountainous land, thru scattering timber and undergrowth. Descend 64 ft. on SW. slope.

- 9.10 Ravine, 10 lks. wide, course N.10°W. Ascend 105 ft. on NE. slope.
- 20.00 Spur, slopes S.10°W. Descend 182 ft. on SW. slope.
- 40.00 Set an iron post, 3 ft. long, 1 in. in diam., 26 ins. in the ground, for $\frac{1}{4}$ sec. cor., marked on brass cap,

S 6
S 7
1916

- 41.85 Raise a mound of stone, 2 ft. base, 1 $\frac{1}{2}$ ft. high, N. of cor. Road, brs. N. and S.
- 43.70 Wash, 100 lks. wide, course N.10° W. Ascend 131 ft. on NE. slope.
- 54.00 Ridge, brs. N. and S. Descend 105 ft. on W. slope.
- 54.30 Road, brs. N. and S.
- 66.60 Wash, 25 lks. wide, course N.10° E. Ascend 188 ft. on SE. slope.
- 69.70 Road brs. N.10°E. and S.20°W.
- 79.80 Road brs. N.40°E. and S.30°W.
- 82.20 Road brs. N.20°E. and S.10°W.
- 83.40 Ridge, brs. N.20°E. and S.20°W. Descend 48 ft. on NW. slope.
- 87.20 Ravine, 10 lks. wide, course N. 10°E. Ascend 9 ft. on SE. slope.
- 87.60 Intersect W. bdy. of T_{p.} 155 lks. S. 0°12' W. of reestablished cor. of secs. 10 & 12, T. 20 S., R. 27 E., described in Book "B" of this group.
At point of intersection, set an iron post, 3 ft. long, 2 ins. in diam., 24 ins. in the ground, for closing cor. of secs. 6 and 7, marked on brass cap,

T20S T20S
R27E S6 CC
S12 S7
R28E
1916

Raise a mound of stone, 2 ft. base, 1 $\frac{1}{2}$ ft. high, E. of cor. Land, mountainous.
Soil, dry, rocky loam, about 6 ins. deep, 4th rate.
Timber, scattering oak and cedar.
Undergrowth, scattering buck brush.
Good grass.

From cor. of secs. 5, 6, 7 and 8,
N.0° 03' W., on true line, bet. secs. 5 and 6.
Over mountainous land, thru scattering timber and undergrowth. Asc. 108 ft. on SW. slope.

- 11.00 Spur, slopes N.60°W. Descend 149 ft. on NE. slope.
- 23.25 Ravine, 10 lks. wide, course N.50°W. Ascend 225 ft. on SW. slope.
- 39.00 Spur, slopes N.60°W. Descend 98 ft. on NE. slope.
- 40.00 Set an iron post, 3 ft. long, 1 in. in diam., 10 ins. in the ground, supported by a mound of stone, for $\frac{1}{4}$ sec. cor., marked on brass cap,

Chains

s 6 | s 5
1916

- Raise a mound of stone, 2 ft. base, 1½ ft. high, W. of corner.
- 52.90 Ravine, 10 lks. wide, course W. Ascend 69 ft. on SW. slope.
- 62.00 Spur, slopes N. 60° W. Descend 49 ft. on NE. slope.
- 68.25 Ravine, 10 lks. wide, course W. Ascend 232 ft. on SW. slope.
- 82.68 Ridge, brs. N. 60° W. and S. 60° E. Descend 20 ft. on N. slope.
- From this point, Taylor's house brs. N. 67° 35' W., about 45 chs. dist.
- 85.42 Intersect the N. bdy. of Tp., 536 lks. N. 89° 31' W. from reestablished cor. of secs. 31 and 32, T. 19 S., R. 28 E., hereinbefore described.
- At point of intersection,
Set an iron post, 3 ft. long, 2 ins. in diam., 24 ins. in the ground, for closing cor. of secs. 5 and 6, marked on brass cap,

T19S R28E
S31
s 6 | s 5
T20S R28E
C C
1916

Raise a mound of stone, 2 ft. base, 1½ ft. high, S. of cor.
Land, mountainous.
Soil, stony, 3rd and 4th rate.
Timber, scattering oak.
Good growth bunch grass.

GENERAL DESCRIPTION.

The portion of the township surveyed, as described in the foregoing notes is for the most part, of a mountainous character, with some level land in the sections along the north boundary. The soil ranges from rich sandy loam to stony clay loam on the steep mountain spurs of the Swisshelm mountains.
The eastern and western portions of the township are covered with a scattering growth of scrub oak timber, suitable only for fuel purposes. The entire township is covered with a good growth of nutritious grasses, which renders the land valuable for grazing purposes,
wells which have been sunk by the settlers is practically

the only source of water in the township.
 There is one settler in sec.3, two in sec.4,
 one in sec.9, one in sec.20, and one in sec.21.
 There are patented mining claims in the western part of
 sec.6, and indications in various other parts of the
 township of valuable mineral deposits.

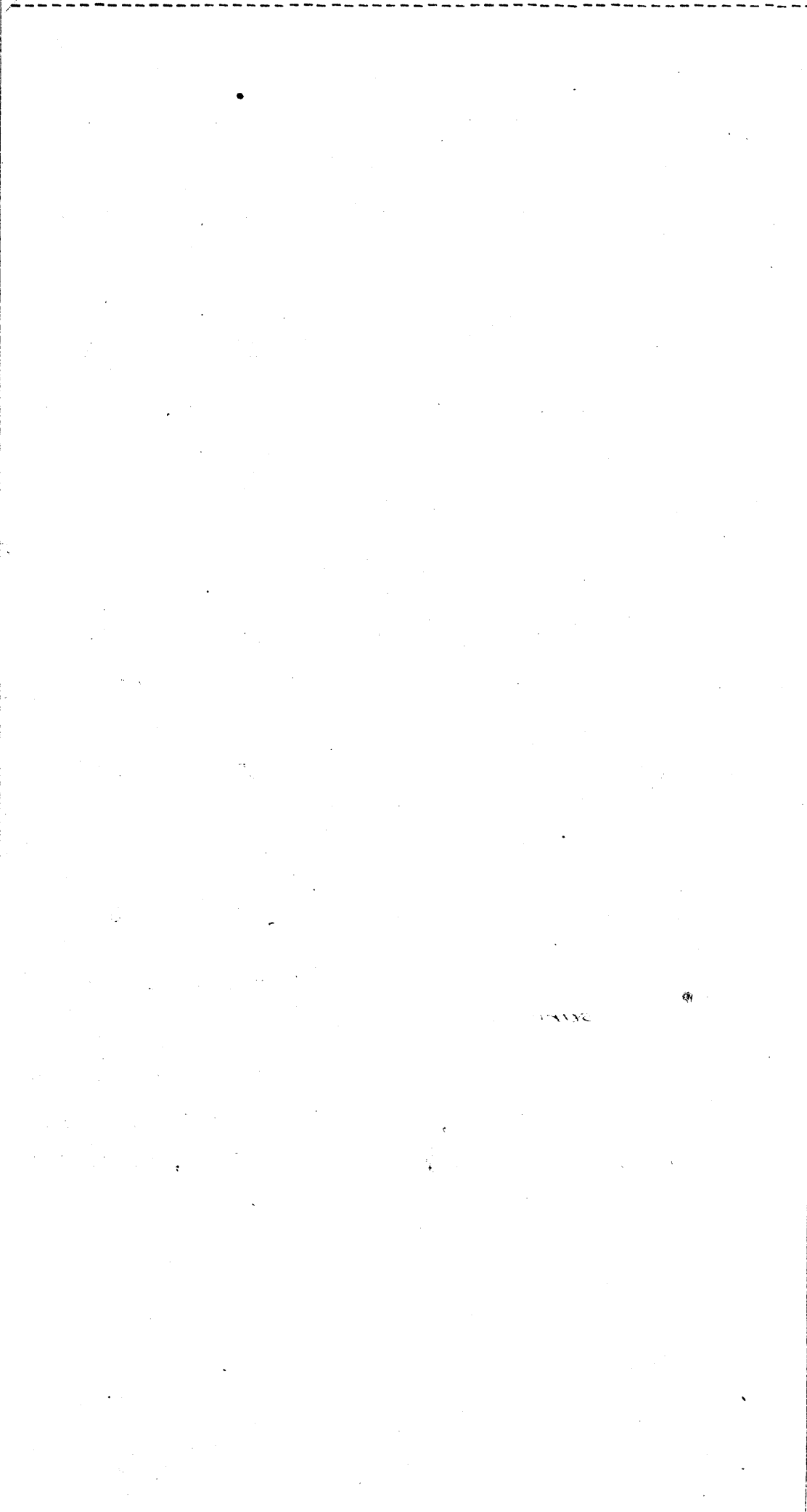

Book "A"
 Group 64 - - - Arizona.
 T. 20 S., R. 28 E.
 Date Diagram.

Resurveyed

	2-24-16	2-24-16	2-18-16	2-18-16	2-18-16	2-18-16	
<i>Resurveyed</i>	3-1-16	3-3-16	2-24-16	2-24-16	2-24-16	2-17-16	2-15-16
	6	5	4	3	2	1	
	3-7-16, 3-3-16	3-3-16	2-23-16			2-17-16	
	3-1-16	3-3-16	2-23-16				2-15-16
	7	8	9	10	11	12	
	3-7-16	3-2-16	2-23-16			2-17-16	
	3-6-16	3-2-16	2-23-16				2-14-16
	18	17	16	15	14	13	<i>Resurveyed</i>
	3-7-16	3-2-16	2-23-16			2-16-16	
	3-6-16	3-2-16	2-22-16				2-14-16
	19	20	21	22	23	24	
	3-7-16	2-27-16				2-16-16	
	3-4-16	2-27-16					2-14-16
	30	29	28	27	26	25	
	2-27-16	2-26-16				2-16-16	
	3-4-16	2-26-16	2-22-16			<i>Retraced</i>	
	31	32	33	34	35	36	
	2-19-16	2-19-16	2-19-16	<i>4th Standard Parallel South.</i>			
	<i>Resurveyed</i>						

Retracements, resurveys and surveys executed on dates shown above, by Sidney E. Blout, U. S. Surveyor.

Book "A"
Group 64 - - Arizona.

4-680

BOOK 3299

FIELD ASSISTANTS. to

Sidney E. Blout, U. S. Surveyor.

NAMES.	CAPACITY.
T. Y. White,	1st chainman,
G. A. McEnnis,	2nd chainman,
W. E. Ditmars,	2nd chainman and moundman,
Roy White,	flagman,
Tim Murtaugh,	Moundman,
George S. Henry,	Axman,
Wm. Workman,	Flagman and moundman,
A. L. Lance,	Moundman,
Charlie Mathews,	Axman.

CERTIFICATE OF UNITED STATES SURVEYOR.

I, Sidney E. Blout, U. S. Surveyor, hereby certify upon honor that, in pursuance of special instructions received from the U. S. Surveyor General, for Group 64, Arizona, bearing date of the 8th day of November, 1915, I have well, faithfully, and truly in my own proper person, and in strict conformity with said instructions, the Manual of Surveying Instructions, and the laws of the United States, ~~surveyed~~ ^{retraced} all those parts or portions of the Subdivision lines of TOWNSHIP 20 SOUTH, RANGE 28 EAST, and Resurveyed all those parts or portions of the E. bdy. of TOWNSHIP 20 SOUTH, RANGE 28 EAST, South bdy. of TOWNSHIP 19 SOUTH, RANGE 28 EAST, & 4th. Standard Par. S. thru West half of Range 28 E., and surveyed all those parts or portions of the Subdivision lines of Township 20 South, Range 28 East,

of the Gila and Salt River Base and Meridian, in the State of Arizona, which are represented in the foregoing field notes ^{and by diagram on page 38 hereof} as having been executed by me, and under my direction; and that all the corners of said ~~survey~~ ^{retracement, resurvey and survey} have been established and perpetuated in strict accordance with the Manual of Surveying Instructions, and the special written instructions of the U. S. Surveyor General, for Group 64, Arizona, and in the specific manner described in the field notes, and that the foregoing are the original field notes of such ~~survey~~ ^{retracement, resurvey and survey}.

Sidney E. Blout
U. S. Surveyor.

APPROVAL.

OFFICE OF THE UNITED STATES SURVEYOR GENERAL,

Phoenix Ariz. June 10th, 1919.

The foregoing field notes of the ~~survey of~~ ^{retracement} of part of the Subdivision of Township 20 South, Range 28 East, and Resurvey of part of East Township 20 South, Range 28 East, ~~all of~~ ^{all of} South bdy. of Township 19 South, Range 28 East, and Fourth Standard Parallel South, thru West half of Range 28 East, and Survey of Completion of Subdivision lines of Township 20 South, Range 28 East, of the Gila and Salt River Base and Meridian, in the State of Arizona, executed by Sidney E. Blout, U. S. Surveyor, under his special instructions dated Nov. 8, 1915, for Group 64, Arizona, having been critically examined, and the necessary corrections and explanations made, the said field notes, and the ~~surveys~~ ^{retracements, resurveys and surveys} they describe, are hereby approved.

Frank J. Smith
U. S. Surveyor General.

~~I certify that the foregoing transcript of the field notes of the above described surveys in~~
~~has been correctly copied from the original notes on file in this office.~~

U. S. Surveyor General.