

BOOK 3321

# FIELD NOTES

OF THE SURVEY OF THE

Part of the West boundary,

North boundary, and part of the East boundary, and

Meanders of the left bank of the Colorado River within

TOWNSHIP 30 NORTH, RANGE 17 WEST,

and

East, and part of the North boundary,

subdivision lines, and

Meanders of the left bank of the Colorado river within,

FRACL. TOWNSHIP 31 NORTH, RANGE 17 WEST,

Of the Gila and Salt River Base and Meridian,

In the State of Arizona,

EXECUTED BY

S. Frank Walters and James C. Hooper,

U.S. Transitmen,

~~In the capacity of U. S. Surveyor~~, under Special Instructions dated October 14, 1916, issued by the United States Surveyor General to govern surveys included in Group No. 77, which were approved by the Commissioner of the General Land Office, October 26, 1916, and Assignment Instructions dated Feb'y. 23, 1917.

Survey commenced March 22, 1917

Survey completed April 14, 1917

3321

SEE SPECIAL INDEX DIAGRAM.

# INDEX DIAGRAM

Township ..... , Range .....

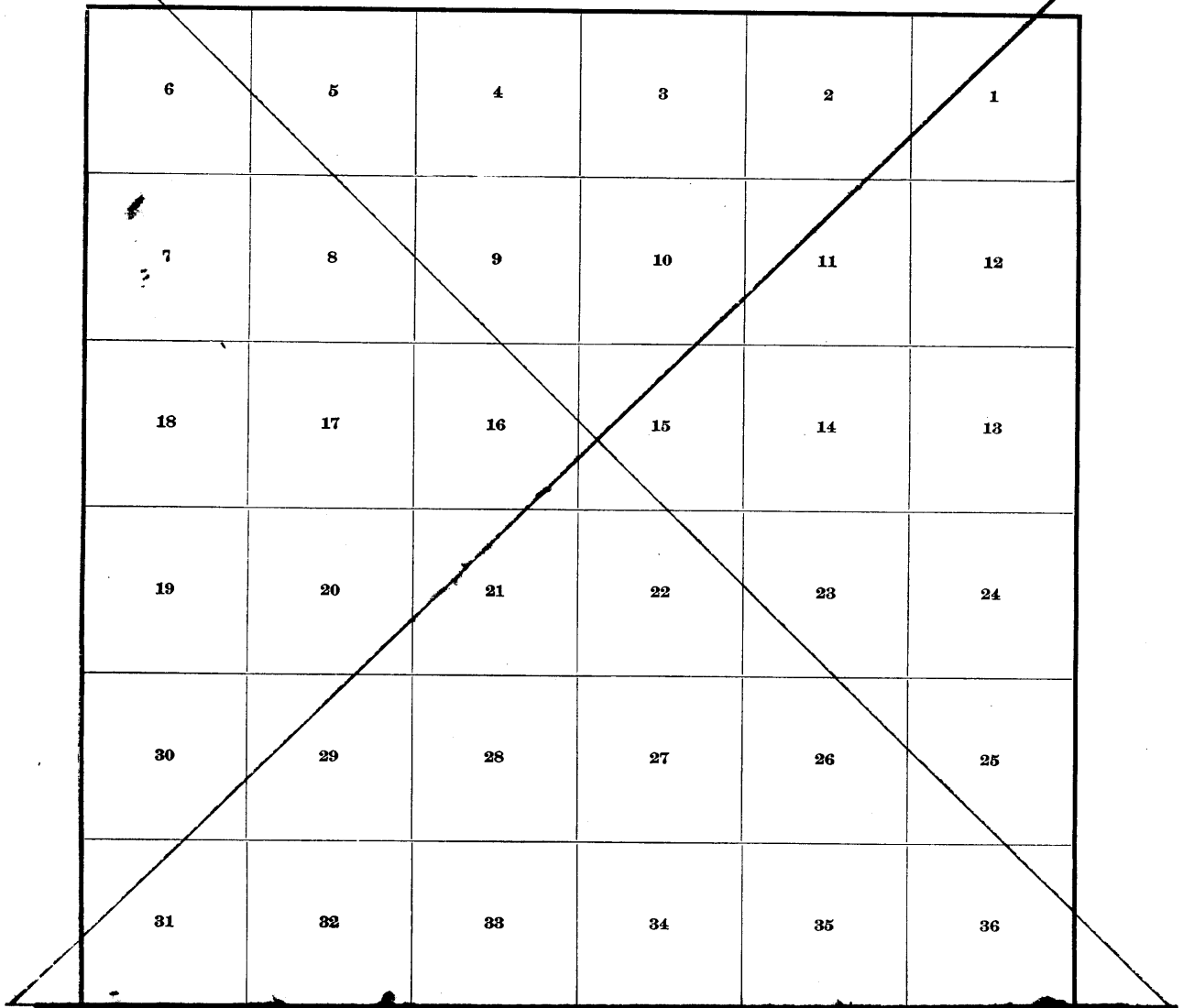

# INDEX DIAGRAM

Group 77 ~ Arizona

BOOK 3321

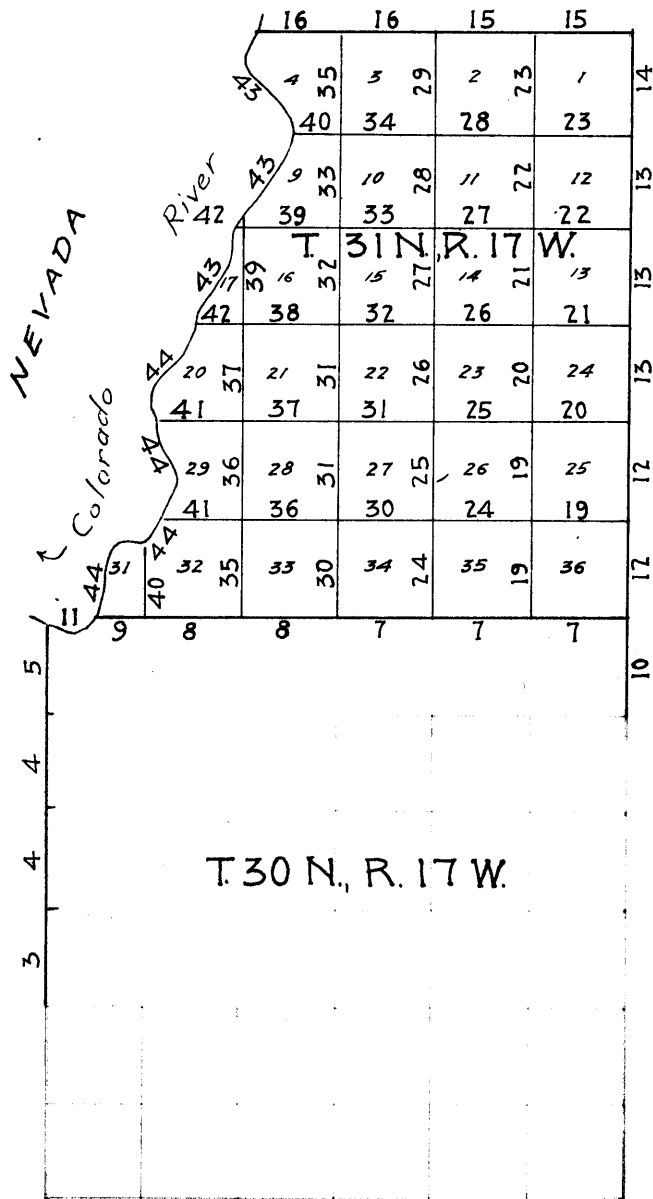

— Lines surveyed under this group, notes in this book.

— Lines surveyed under current group No. 45.

BOOK 3321

33 34 35 36 31

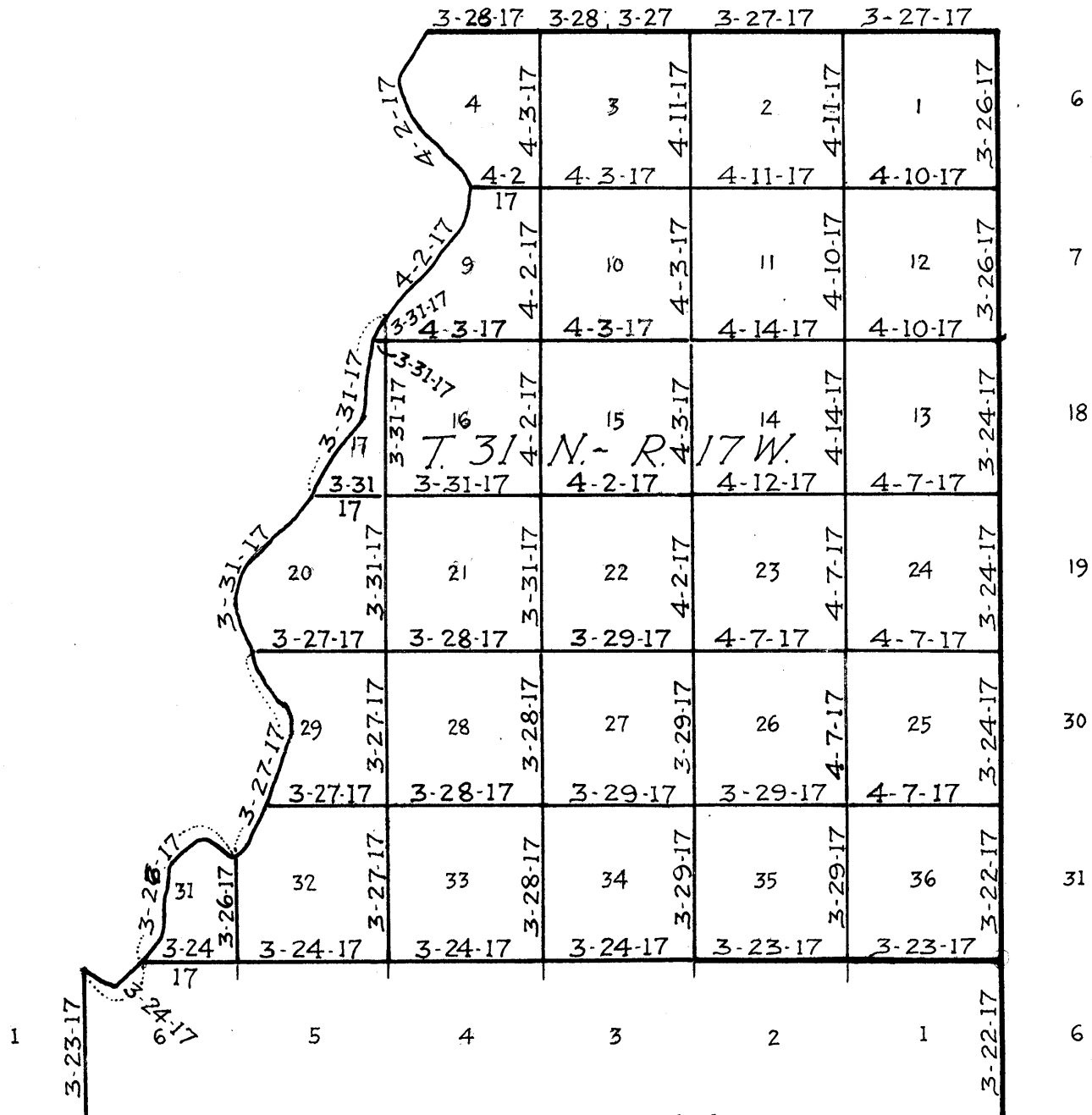

T. 30 N. - R. 17 W.

DATE DIAGRAM

Group 77 - Ariz.

Lines dated in Black surveyed on such dates by S. Frank Walters  
 U.S. Transitman.  
 Lines dated in Red surveyed on such dates by James C. Hooper  
 U.S. Transitman.

1  
12  
13  
24

## Completion of the West Boundary of T. 30 N., R. 17 W. 3

Chains.

Survey of Group 77, executed on dates shown on diagram on page 2 hereof, by S. Frank Walters & James C. Hooper, U.S. Transitmen, using a Buff solar transit No. 9985, and Young & Sons light mountain transit No. 8489 respectively. They were approved for use on this Group by the Assistant Supervisor of Surveys for Arizona and California, conditional upon satisfactory field tests, on February 23, 1917.

In the survey of this Group 5 ch. tapes were used, slope measurements were made on broken and sloping ground, vertical angles were read with clinometers, and the correct horizontal distances were recorded for every item of topography.

We examine the adjustments of the transits and correct all errors; then, to test each solar apparatus, by comparing its indications, resulting from solar observations made during a.m. and p.m. hours, with a meridian determined by observations on Polaris at elongation, we proceed as follows:

March 24, 1917: At our camp in the SE. quarter of sec. 31, T. 31 N., R. 17 W., in lat.  $36^{\circ} 2' N.$ , long.  $114^{\circ} 7' W.$ , at 7 hrs. 17 m., p.m., l.m.t., by our watches, which are set to correct local mean time, we observe Polaris at western elongation, in accordance with the Manual of Instructions, and mark a point in the lines thus determined, on pegs driven in the ground, 5 chs. N. of our stations.

March 24, 1917

March 25, 1917: At 7 hrs. 45 m., a.m., l.m.t., we lay off the azimuth of Polaris,  $1^{\circ} 24'$  to the east, and mark a point in each meridian thus determined by a tack in a stake driven in the ground, 5 chs. N. of our stations.

At 9 hrs. 0 m., a.m., l.m.t., we set off  $36^{\circ} 2' N.$  on the lat. arcs;  $1^{\circ} 47\frac{1}{2}' N.$  on the declination arcs; and determine a meridian with each solar. The lines thus determined depart less than 1' from the true meridian determined by observations on Polaris at elongation.

At apparent noon, we set off  $1^{\circ} 50' N.$  on the decl. arcs; and observe the sun on the meridian; the resulting lat. with each solar is  $36^{\circ} 2' N.$

At 3 hrs. 0 m., p.m., l.m.t., we set off  $36^{\circ} 2' N.$  on the lat. arcs;  $1^{\circ} 53\frac{1}{2}' N.$  on the decl. arcs; and determine a meridian with each instrument. The lines thus determined depart less than 1' from the true meridian determined by observations on Polaris at elongation.

The solar apparatus, by a.m. and p.m. observations, define positions for meridians which depart less than 1' from the true meridian; therefore, we conclude that they are in satisfactory adjustment.

The magnetic bearing of the true meridian, at 8 hrs. 30 m. a.m., is N.  $16^{\circ} 30' W.$ ; the angle thus determined gives the mag. decl.  $16^{\circ} 30' E.$

From the cor. of secs. 19, 24, 25 and 30, on the W. bdy. of T. 30 N., R. 17 W., which is an iron post, described in the field notes of current Group No. 45,

North bet. secs. 19 and 24.

Over mountainous land, through scattering undergrowth. Desc. 195 ft.

7.94 Ravine, course N.  $70^{\circ} E.$  Asc. 205 ft.

22.87 Ridge, brs. E. and W. Desc. 60 ft.

26.75 Ravine, course E. Asc. 95 ft.

34.09 Spur, slopes E. Desc. 105 ft.

38.72 Ravine, course E. Asc. 85 ft.

40.00 Set an iron post, 3 ft. long, 1 in. diam., on bed rock, in a mound of stone, for  $\frac{1}{4}$  sec. cor., marked on brass cap

Chains.

S24 | S19  
1917

And raise a mound of stone, 3 1/2 ft. base, 2 ft. high, W. of cor.

- 52.64 Spur, slopes N.40° E. Desc. 150 ft.
- 60.86 Ravine, course N.10° E. Asc. 150 ft.
- 75.01 Spur, slopes N.70° E. Desc. 120 ft.
- 78.79 Ravine, course E. Asc. 30 ft.

80.00 Set an iron post, 3 ft. long, 3 ins. diam., on bed rock, in a mound of stone, for cor. of secs. 13, 18, 19 and 24, marked on brass cap

T30N  
R18W | R17W  
S13 | S18  
-----  
S24 | S19  
1917

And raise a mound of stone, 2 ft. base, 1 1/2 ft. high, W. of cor.

Land, mountainous.  
Soil, rocky, 4th rate.  
No timber.  
Undergrowth, greasewood and cactus.

North bet. secs. 13 and 18.  
Over mountainous land, through scattering undergrowth.  
Asc. 240 ft.

- 12.62 Ridge, brs. N.70° E. and S.70° W. Desc. 100 ft.
- 27.45 Ravine, course N.50° E. Asc. 65 ft.
- 36.95 Spur, slopes N.40° E. Desc. 185 ft.

40.00 Set an iron post, 3 ft. long, 1 in. diam., on bed rock, in a mound of stone, for 1/4 sec. cor., marked on brass cap

1/4  
S13 | S18  
1917

And raise a mound of stone, 3 ft. base, 2 ft. high, W. of cor.

- 47.42 Ravine, course E. Asc. 280 ft.
- 62.73 Divide, brs. N. and S.20° W. Desc. on divide.
- 79.20 Leave divide, brs. N.30° E. and S. Continue descent.
- 80.00 Set an iron post, 3 ft. long, 3 ins. diam., 12 ins. in the ground, in a mound of stone, for cor. of secs. 7, 12, 13 and 18, marked on brass cap

T30N  
R18W | R17W  
S12 | S 7  
-----  
S13 | S18  
1917

And raise a mound of stone, 3 ft. base, 2 ft. high, W. of cor.

Land, mountainous.  
Soil, rocky, .4th rate.  
No timber.  
Undergrowth, greasewood and cat claw.

North bet. secs. 7 and 12.  
Over mountainous land, through scattering undergrowth.  
Desc. 425 ft.

Completion of West Boundary of T. 30 N., R. 17 W.

Chains.

33.63 Ravine, course N.30° E. Asc. 60 ft.  
 39.15 Spur, slopes N.50° E. Desc. 210 ft.  
 40.00 Set an iron post, 3 ft. long, 1 in. diam., on bed rock, in a mound of stone, for  $\frac{1}{4}$  sec. cor., marked on brass cap

$\frac{1}{4}$   
 S12 | S 7  
 1917

And raise a mound of stone, 3 ft. base, 2 ft. high, W. of cor.

48.71 Ravine, course N.40° W. Asc. 40 ft.  
 60.57 Spur, slopes N.60° W. Desc. 130 ft.  
 68.38 Ravine, course N.50° W. Asc. 35 ft.  
 73.29 Spur, slopes W. Desc. 35 ft.  
 77.78 Ravine, course W. Asc. 30 ft.  
 80.00 Set an iron post, 3 ft. long, 3 ins. diam., 6 ins. in the ground, in a mound of stone for cor. of secs. 1, 6, 7 and 12, marked on brass cap

T30N  
 R18W | R17W  
 S11 | S 6  
 S12 | S 7  
 1917

And raise a mound of stone, 3 ft. base, 2 ft. high, W. of cor.

Land, mountainous.  
 Soil, rocky, 4th rate.  
 No timber.  
 Undergrowth, greasewood.

North bet. secs. 1 and 6.  
 Over mountainous land, through scattering undergrowth.  
 Asc. 30 ft.

4.98 Spur, slopes W. Desc. 30 ft.  
 6.08 Ravine, course W. Asc. 55 ft.  
 8.26 Spur, slopes W. Desc. 35 ft.  
 11.11 Ravine, course S.80° W. Asc. 345 ft.  
 28.35 Spur, slopes N.80° E. Desc. 400 ft.  
 40:00 Set an iron post, 3 ft. long, 1 in. diam., 8 ins. in the ground, in a mound of stone, for  $\frac{1}{4}$  sec. cor., marked on brass cap

$\frac{1}{4}$   
 S 1 | S 6  
 1917

And raise a mound of stone, 3 ft. base, 2 ft. high, W. of cor.

48.70 Ravine, course E. Asc. 115 ft.  
 56.54 Spur, slopes W. Desc. 680 ft.  
 73.10 Top of cliff, brs. E. and W. Continue descent.  
 78.27 Set an iron post, 3 ft. long, 3 ins. diam., 6 ins. in the ground, in a mound of stone, on the left bank of the Colorado River, at mean high water mark, for meander cor. of fracl. secs. 1 and 6, marked on brass cap

M | C  
 S 1 | S 6  
 R18W | R17W  
 T30N  
 1917

And raise a mound of stone, 4 ft. base, 3 ft. high, S. of cor.

78.77. Left bank of the Colorado River, brs. N.55° 15' W. and S.

Chains.

S.55° 15' E. At this point, the river is 130 ft. wide,  
in a steep, rocky canyon.  
Land, mountainous.  
Soil, rocky, 4th rate.  
No timber.  
Undergrowth, greasewood.



North boundary of Tract. Township 30 North, Range 17 West. 7

Chains.

Knowing that a meander cor. will be necessary on the N.bdy. of Tp., commence at the cor. of Ts. 30 and 31 N., Rs. 16 and 17 W., which is an iron post, hereinafter described.

Thence,  
West, on a true line, bet. secs. 1 and 36.  
Over rolling land, thru scattering undergrowth.  
38.00 Draw, course S. 30°E.  
40.00 Set an iron post, 3 ft. long, 1 in. in diam., 26 ins. in the ground, for 1/4 sec. cor., marked on brass cap,

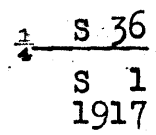

80.00 No stone available. Pits impracticable.  
Set an iron post, 3 ft. long, 3 ins. in diam. 8 ins. in the ground, in a mound of stone, for cor. of secs. 1, 2, 35, and 36, marked on brass cap,

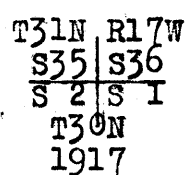

and raise a mound of stone 2 ft. base, 1 1/2 ft. high, W. of cor.  
Land, rolling and gently rolling.  
Soil, sandy, 3rd rate.  
No timber.  
Undergrowth, greasewood and yucca.

10.00 West, on a true line, bet. secs. 2 and 35.  
16.00 Over gently rolling land, thru scattering undergrowth.  
Ascend 30 ft.  
40.00 Low ridge, brs. N. 60°E. and S. 60°W. Descend gradually.  
Set an iron post, 3 ft. long, 1 in. in diam., 14 ins. in the ground, in a mound of stone, for 1/4 sec. cor., marked on brass cap,

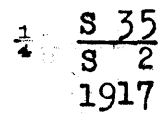

55.00 Dig pits, 18x18x12 ins. E. and W. of post, 3 ft. dist.  
Ascend 45 ft.  
65.50 Descend 375 ft.  
80.00 Set an iron post, 3 ft. long, 3 ins. in diam., in a mound of stone, for cor. of secs. 2, 3, 34 and 35, marked on brass cap,



and raise a mound of stone, 2 ft. base, 1 1/2 ft. high, W. of cor.  
Land, gently rolling and mountainous.  
Soil, sandy, 3rd rate; and rocky, 4th rate.  
No timber.  
Undergrowth, yucca and cactus.

8.80 West, on a true line, bet. secs. 3 and 34.  
9.85 Over mountainous land, thru scattering undergrowth.  
Descend 150 ft.  
Ravine, course N. 70°W. Ascend 50 ft.  
Spur, slopes N. Descend 115 ft.

8. North bdy of ~~Sec.~~ Township 30 North, Range 17 West

Chains.

- 12.70 Ravine, course NW. Comes from N.70°E. Ascend 80 ft.
- 15.35 Spur, slopes N. Descend 565 ft.
- 40.00 Set an iron post, 3 ft. long, 1 in. in diam., 8 ins. in the ground, in a mound of stone, for  $\frac{1}{4}$  sec.cor., marked on brass cap,

$\frac{1}{4}$  S 34  
 S 3  
 1917

and raise a mound of stone, 3 ft. base, 2 ft. high, N. of cor.

- 52.65 Road, brs. N.20°W. and S.20°E.
- 56.20 Wash, 1 chain wide, 1 ft. deep, course N.20°W. Ascend 340 ft.
- 73.25 Ridge, brs. N. and S. Descend 125 ft.
- 80.00 Set an iron post, 3 ft. long, 3 ins. in diam., in a mound of stone, for cor. of secs. 3, 4, 33 and 34, marked on brass cap,

T31N R17W  
 S33 | S34  
 S 4 | S 3  
 1917

and raise a mound of stone, 3 ft. base, 2 ft. high, W. of cor.

Land, mountainous.  
 Soil, sandy and rocky, 4th rate.  
 No timber.  
 Undergrowth, greasewood and catclaw.

West, on a true line, bet. secs. 4 and 33.  
 Over mountainous land, thru. scattering undergrowth.  
 Descend 175 ft.

- 4.95 Ravine, course S. 60°W. Ascend.
- 9.95 Spur, slopes S. Descend 30 ft.
- 10.95 Ravine, course S. 20°E. Ascend 75 ft.
- 14.90 Spur, slopes S. 20°E. Descend 70 ft.
- 22.45 Ravine, course S. 40°E. Ascend 145 ft.
- 26.95 Top of knoll, brs. N. and S. Descend 495 ft.
- 40.00 Set an iron post, 3 ft. long, 1 in. in diam., 10 ins. in the ground, in a mound of stone, for  $\frac{1}{4}$  sec.cor., marked on brass cap,

$\frac{1}{4}$  S 33  
 S 4  
 1917

and raise a mound of stone, 3 ft. base, 2 ft. high, N. of cor.

- 55.35 Ravine, course S. 40°W. Ascend 35 ft.
- 60.45 Spur, slopes S. Descend 110 ft.
- 67.15 Ravine, course N. 20° W. Ascend 25 ft.
- 70.30 Spur, slopes N. 20°W. Descend 30 ft.
- 80.00 Set an iron post, 3 ft. long, 3 ins. in diam., in a mound of stone, for cor. of secs. 4, 5, 32 and 33, marked on brass cap,

T31N, R17W  
 S32 | S33  
 S 5 | S 4  
 T30N  
 1917

and raise a mound of stone, 3 $\frac{1}{2}$  ft. base, 2 $\frac{1}{2}$  ft. high, W. of cor.

Land, mountainous.  
 Soil, rocky, 4th rate.  
 No timber.  
 Undergrowth, greasewood.

West, on a true line, bet. secs. 5 and 32.  
 Over mountainous land, thru. scattering undergrowth.  
 Descend 25 ft.

- 4.85 Ravine, course N. 10°W. Ascend 95 ft.

North boundary of Township 30 North, Range 17 West. 9.

Chains.

- 15.85 Ridge, brs. N. and S. Descend 510 ft.
- 31.50 Right bank of Hualpai wash, brs. N. and S.
- 37.50 Road brs. N. 20° W. to Gregg's Ferry, and S. 20° E. to Gold Basin in Hualpai wash, course N.
- 38.30 Left bank of Hualpai wash, brs. N. and S. Ascend 140 ft.
- 40.00 Set an iron post, 3 ft. long, 1 in. in diam., 6 ins. in the ground, in a mound of stone, for 1/4 sec. cor., marked on brass cap,

1/4 S 32  
 S 5  
 1917

and raise a mound of stone, 3 ft. base, 2 ft. high, N. of cor.

- 50.55 Spur, slopes N. 20° E. Descend 50 ft.
- 53.45 Ravine, course N. 30° E. Ascend 195 ft.
- 64.55 Spur, slopes N. Descend 65 ft.
- 80.00 Set an iron post, 3 ft. long, 3 ins. in diam., 8 ins. in the ground, in a mound of stone, for cor. of secs. 5, 6, 31 and 32, marked on brass cap,

T31N R17W  
 S31 | S32  
 S 6 | S 5  
 T30N  
 1917

and raise a mound of stone, 3 ft. base, 2 ft. high, W. of cor.

Land, mountainous.  
 Soil, rocky, 4th rate.  
 No timber.  
 Undergrowth, greasewood and catclaw.

-----  
 West, on a true line, bet. secs. 6 and 31.  
 Over mountainous land, thru. scattering undergrowth.  
 Descend 95 ft.

- 8.70 Ravine, course N. Ascend 65 ft.
- 16.40 Spur, slopes N. Descend 65 ft.
- 20.25 Thence over gently rolling land.
- 24.75 Spur, slopes N. 30° W. Descend 110 ft.
- 28.40 Ravine, course N. 10° W. Ascend 255 ft.
- 36.55 Top of cliff, brs. N. and S. Descend 425 ft.
- 40.00 Set an iron post, 3 ft. long, 1 in. in diam., 6 ins. in the ground, in a mound of stone, for 1/4 sec. cor., marked on brass cap,

1/4 S 31  
 S 6  
 1917

and raise a mound of stone 3 ft base, 2 ft. high, N. of cor.

- 48.27 Set an iron post, 3 ft. long, 3 ins. in diam., 6 ins. in the ground, in a mound of stone, on the left bank of the Colorado river, at mean high water mark, for meander cor. of fracl. secs. 6 and 31, marked on brass cap,

MC / T31N  
 S31  
 S 6  
 T30N  
 1917

and raise a mound of stone, 3 1/2 ft. base, 3 ft. high, E. of cor.

Land, mountainous. Soil, rocky 4th rate.  
 No timber. Undergrowth, catclaw and greasewood.

10. Completion of East bdy. of Township 30 North, Range 17 West.

Chains.

From the cor. of secs. 1, 6, 7 and 12, on the E. bdy. of the Tp., which is an iron post, described in the field notes of current Group No. 45, North, bet. secs. 1 and 6. Over level land, thru. scattering undergrowth, in draw, course N.

- 18.50 Leave draw, course NE. Ascend gradually 40 ft.
- 35.00 Descend 25 ft.
- 40.00 Set an iron post, 3 ft. long, 1 in. in diam., in a mound of stone, for  $\frac{1}{4}$  sec. cor., marked on brass cap,

$\frac{1}{4}$   
 S 1 | S 6  
 1917

and raise a mound of stone 2 ft. base,  $1\frac{1}{2}$  ft. high, W. of cor.

- 55.00 Wash, course E. Ascend 80 ft.
- 80.00 Set an iron post, 3 ft. long, 3 ins. in diam., 10 ins. in the ground, in a mound of stone, for cor. of Ts. 30 and 31 N., Rs. 16 and 17 W., marked on brass cap,

T31N  
 R17W | R16W  
 S36 | S31  
 S 1 | S 6  
 T30N  
 1917

and raise a mound of stone, 2 ft. base,  $1\frac{1}{2}$  ft. high, W. of cor.  
 Land, level and rolling.  
 Soil, rocky, sandy and gravelly, 3rd rate.  
 No timber.  
 Undergrowth, greasewood and yucca.

---

Meanders in Township 30 North, Range 17 West. 11

Meanders of the left bank of the Colorado river, up stream.  
 I commence at the meander cor. of fracl. secs. 1 and 6, on the West bdy. of the Tp., which is an iron post, hereinbefore described.  
 Thence, with meanders in sec. 6.  
 Along steep rocky N. slope.

S.  $55\frac{1}{4}^{\circ}$  E., 17.00 chs.  
 N.  $49\frac{1}{2}^{\circ}$  E., 4.60 chs. At 3.20 chs. ravine, course N.  $50^{\circ}$  W. At end of course, spur slopes W.

N.  $60\frac{1}{4}^{\circ}$  E. 8.40 chs.  
 N.  $54\frac{1}{2}^{\circ}$  E., 6.90 chs. To the meander cor. bet. fracl. secs. 6 and 31, which is an iron post hereinbefore described.

Land, rolling.  
 Soil, rocky, 4th rate.  
 No timber.  
 Undergrowth, greasewood, catclaw and mesquite.

Boundaries of Township 30 North, Range 17 West.  
 Latitudes, departures and closing errors.

Line designated.	True bearing.	Dist.	Latitudes.		Departures.	
			N.	S.	E.	W.
South boundary,	S. $89^{\circ}58'$ W.	479.60		.28		479.60
West boundary,	North,	478.27	478.27			
Meanders,			11.17	9.69	30.38	
North boundary,	East,	448.27			448.27	
East boundary,	South,	480.00		480.00		
Convergency,					.53	
<u>Totals.</u>			489.44	489.97	479.18	479.60
<u>Error in latitude,</u>				489.44		479.18
<u>Error in departure,</u>				.53		.42

12. East boundary of fract. Township 31 North, Range 17 West.

Chains.

Survey executed with Buff solar transit No.9985, with Smith solar attachment.

I commence at the cor. of Ts. 30 and 31 N., Rs.16 and 17 W., which is an iron post, hereinbefore described.

Thence, North, bet. secs. 31 and 36. Over gently rolling land, thru. scattering undergrowth.

10.00

Descend 25 ft.

15.00

Draw, course N.70° E.

40.00

Set an iron post, 3 ft.long, 1 in. in diam., 14 ins. in the ground, in a mound of stone, for  $\frac{1}{4}$  sec.cor., marked on brass cap,



and raise a mound of stone, 2 ft. base, 1 1/2 ft. high, W. of cor.

58.00

Draw, course E. Ascend 25 ft.

65.00

Thence over gently rolling land.

75.00

Draw, course E.

80.00

Set an iron post, 3 ft.long, 3 ins. in diam., 24 ins. in the ground, for cor.of secs. 25,30, 31 and 36, marked on brass cap,

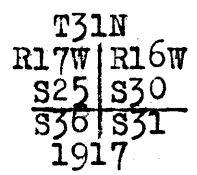

and raise a mound of stone, 2 ft. base, 1 1/2 ft. high, W. of cor.

Land, rolling and gently rolling.

Soil, 3rd rate.

No timber.

Undergrowth, yucca and greasewood.

North, bet. secs.25 and 30.

Over gently rolling land, thru.scattering undergrowth.

25.00

Draw, course E.

40.00

Set an iron post, 3 ft.long, 1 in. in diam., 20 ins. in the ground, for  $\frac{1}{4}$  sec.cor., marked on brass cap,

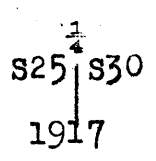

80.00

Dig pits, 18x18x12 ins., N.and S.of post, 3 ft. dist., Set an iron post, 3 ft.long, 3 ins. in diam., 24 ins. in the ground, for cor.of secs.19,24,25 and 30, marked on brass cap,

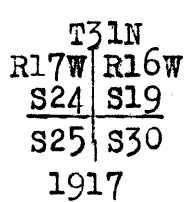

Dig pits 18x18x12 ins., in each sec.5 1/2 ft. dist.

Land, rolling and gently rolling.

Soil, gravelly, 3rd rate.

No timber.

Undergrowth, greasewood and yucca.

Chains.

40.00 North bet. secs. 19 and 24.  
Over level land, through scattering undergrowth.  
Set an iron post, 3 ft. long, 1 in. diam., 24 ins. in the ground, for  $\frac{1}{4}$  sec. cor., marked on brass cap

$\frac{1}{4}$   
S24 | S19  
1917

80.00 Dig pits, 18 X 18 X 12 ins., N. and S. of post, 3 ft. dist.  
Set an iron post, 3 ft. long, 2 ins. diam., 24 ins. in the ground, for cor. of secs. 13, 18, 19 and 24, marked on brass cap

T31N  
R17W | R16W  
S13 | S18  

---

S24 | S19  
1917

Dig pits, 18 X 18 X 12 ins., in each sec.,  $5\frac{1}{2}$  ft. dist.  
Land, level.  
Soil, sandy and gravelly, 2nd and 3rd rates.  
No timber.  
Undergrowth, yucca and greasewood.

35.00 North bet. secs. 13 and 18.  
Over level land, through scattering undergrowth.  
40.00 Enter rolling land, brs. E. and W.  
Set an iron post, 3 ft. long, 1 in. diam., in a mound of stone, for  $\frac{1}{4}$  sec. cor., marked on brass cap

$\frac{1}{4}$   
S13 | S18  
1917

51.00 And raise a mound of stone, 2 ft. base,  $1\frac{1}{2}$  ft. high, W. of cor.  
60.00 Draw, course S.60° E. Asc. 30 ft.  
70.00 Thence over gently rolling land.  
80.00 Set an iron post, 3 ft. long, 2 ins. diam., in a mound of stone, for cor. of secs. 7, 12, 13 and 18, marked on brass cap

T31N  
R17W | R16W  
S12 | S17  

---

S13 | S18  
1917

And raise a mound of stone, 2 ft. base,  $1\frac{1}{2}$  ft. high, W. of cor.  
Land, level, gently rolling and rolling.  
Soil, sandy, gravelly and rocky, 2nd and 3rd rates.  
No timber.  
Undergrowth, greasewood and yucca.

3.30 North bet. secs. 7 and 12.  
10.00 Over rolling land, through scattering undergrowth.  
Draw, course S.60° E. Asc. 30 ft.  
40.00 Thence over gently rolling land.  
Set an iron post, 3 ft. long, 1 in. diam., in a mound of stone, for  $\frac{1}{4}$  sec. cor., marked on brass cap

Chains.

$\frac{1}{4}$   
S12 | S 7  
1917

And raise a mound of stone, 2 ft. base,  $1\frac{1}{2}$  ft. high, W. of cor.

63.60 Rim rock, 20 ft. high, brs. N.40° E. and S.40° W. Desc. 235 ft.

80.00 Set an iron post, 3 ft. long, 2 ins. diam., in a mound of stone, for cor. of secs. 1, 6, 7 and 12, marked on brass cap

T31N  
R17W | R16W  
S 1 | S 6  
S12 | S 7  
1917

And raise a mound of stone, 2 ft. base,  $1\frac{1}{2}$  ft. high, W. of cor.

Land, gently rolling, rolling and mountainous.  
Soil, rocky, 4th rate; and sandy and gravelly, 2nd and 3rd rates.

No timber.  
Undergrowth, yucca and greasewood.

North bet. secs. 1 and 6.  
Over mountainous land, through scattering undergrowth.  
Desc. 220 ft.

15.85 Gulch, course N.70° W. Asc. 30 ft.

17.85 Desc. 30 ft.

19.30 Asc. 30 ft.

22.80 Spur, slopes NW. Desc. 170 ft.

27.80 Point of same spur, slopes NE. Continue descent.

40.00 Set an iron post, 3 ft. long, 1 in. diam., in a mound of stone, for  $\frac{1}{4}$  sec. cor., marked on brass cap

$\frac{1}{4}$   
S 1 | S 6  
1917

And raise a mound of stone, 2 ft. base,  $1\frac{1}{2}$  ft. high, W. of cor.

45.00 Draw, course N.70° E. Asc. 125 ft.

56.10 Spur, slopes E. Desc. 75 ft.

61.00 Gulch, course S.80° E. Asc. 150 ft.

68.40 Spur, slopes E. Desc. 55 ft.

73.00 Gulch, course SE. Asc. 95 ft.

80.00 Set an iron post, 3 ft. long, 3 ins. diam., in a mound of stone, for cor. of Ts. 31 and 32 N., Rs. 16 and 17 W., marked on brass cap

T32N  
R17W | R16W  
S36 | S31  
S 1 | S 6  
T31N  
1917

And raise a mound of stone, 2 ft. base,  $1\frac{1}{2}$  ft. high, S. of cor.

Land, mountainous.  
Soil, rocky, 4th rate.  
No timber.  
Undergrowth, yucca and greasewood.



North Boundary of Fractional T. 31 N., R. 17 W.

Chains.

Survey executed with Buff solar transit No. 9985, with Smith solar attachment. For description of instrument and certificate of approval, see hereinbefore. I commence at the cor. of Ts. 31 and 32 N., Rs. 16 and 17 W., which is an iron post, hereinbefore described.

- Thence
- West on a true line, bet. secs. 1 and 36.
- Over mountainous land, through scattering undergrowth.
- Desc. 40 ft.
- 4.20 Gulch, course SE. Asc. 90 ft.
- 13.40 Spur, slopes S. Desc. 10 ft.
- 14.30 Gulch, course S. Asc. 235 ft.
- 24.00 Spur, slopes S. Desc. 160 ft.
- 37.20 Gulch, course S. Asc. 545 ft.
- 40.00 Set an iron post, 3 ft. long, 1 in. diam., in a mound of stone, for  $\frac{1}{4}$  sec. cor., marked on brass cap

$\frac{1}{4}$  S36  
 $\frac{1}{4}$  S 1  
 1917

- And raise a mound of stone, 2 ft. base,  $1\frac{1}{2}$  ft. high, N. of cor.
- 59.60 Ridge, brs. N.30° E. and S.30° W. From this point, Mt. Sheep brs. N.40° W., 40 chs. dist. Desc. 425 ft.
- 75.50 Asc.
- 77.50 Spur, slopes N.60° W. Desc. 65 ft.
- 80.00 Gulch, course N.70° W. Impracticable to set permanent cor. at this point.
- Land, mountainous.
- Soil, rocky, 4th rate.
- No timber.
- Undergrowth, greasewood.

- West on a true line, bet. secs. 2 and 35.
- Over mountainous land, through scattering undergrowth.
- Desc. 130 ft.
- 1.00 Set an iron post, 3 ft. long, 2 ins. diam., in a mound of stone, for witness cor. to cor. of secs. 1, 2, 35 and 36, marked on brass cap

T32N R17W  
 S35 | S36 WC  
 $\frac{1}{4}$  S 2 | S 1  
 T31N  
 1917

- And raise amount of stone, 2 ft. base,  $1\frac{1}{2}$  ft. high, W. of cor.
- 9.75 Asc. 10 ft.
- 10.80 Spur, slopes NW. Desc. 120 ft.
- 17.80 Ravine course S.50° W. Asc. 55 ft.
- 22.30 Spur, slopes S. Desc. 310 ft.
- 33.80 Gulch, course S.30° W. Asc. 60 ft.
- 38.40 Spur, slopes SE. Desc. 15 ft.
- 39.60 Gulch, course S.20° E. Asc. 220 ft.
- 40.00 Set an iron post, 3 ft. long, 1 in. diam., in a mound of stone, for  $\frac{1}{4}$  sec. cor., marked on brass cap

$\frac{1}{4}$  S35  
 $\frac{1}{4}$  S 2  
 1917

- And raise a mound of stone, 2 ft. base,  $1\frac{1}{2}$  ft. high, N. of cor.
- 49.30 Spur, slopes S. Desc. 550 ft.
- 70.80 Ravine, course S. Asc. 175 ft.
- 77.10 Point, slopes S. Desc. 145 ft.

Chains.

80.00

Set an iron post, 3 ft. long, 2 ins. diam., in a mound of stone; for cor. of secs. 2, 3, 34 and 35, marked on brass cap

T32N R17W  
S34 | S35  
S 3 | S 2  
T31N  
1917

And raise a mound of stone, 2 ft. base, 1 1/2 ft. high, W. of cor.

Land, mountainous.  
Soil, rocky, 4th rate.  
No timber.  
Undergrowth, greasewood.

West on a true line, bet. secs. 3 and 34.  
Over mountainous land, through scattering undergrowth.  
Desc. 160 ft.

5.00  
8.80  
13.50  
18.60  
34.50  
38.00  
40.00

Gulch, course N.30° W. Asc. 380 ft.  
Rocky point, slopes NW. Continue ascent.  
Spur, slopes S.50° W. Desc. 130 ft.  
Foot of descent, brs. N. and S. Wash, 150 lks. wide, 2 ft. deep, course N. Thence over level land.  
Asc. 55 ft.  
Top of slope, brs. N. and S. Thence over level land.  
Set an iron post, 3 ft. long, 1 in. diam., 26 ins. in the ground, for 1/4 sec. cor., marked on brass cap

1/4 S34  
S 3  
1917

80.00

No stone available. Pits impracticable.  
Set an iron post, 3 ft. long, 2 ins. diam., 24 ins. in the ground, for cor. of secs. 3, 4, 33 and 34, marked on brass cap

T32N R17W  
S33 | S34  
S 4 | S 3  
T31N  
1917

No stone available. Pits impracticable.  
Land, mountainous and level.  
Soil, rocky, 4th rate, and sandy, 3rd rate.  
No timber.  
Undergrowth, greasewood and yucca.

40.00

West on a true line, bet. secs. 4 and 33.  
Over level land, through scattering undergrowth.  
Set an iron post, 3 ft. long, 1 in. diam., 26 ins. in the ground, for 1/4 sec. cor., marked on brass cap

1/4 S33  
S 4  
1917

41.00  
52.10  
57.60  
69.00

No stone available. Pits impracticable.  
Leave level land, brs. N. and S. Desc. 295 ft.  
Gulch, course S.50° W. Asc. 90 ft.  
Spur, slopes S. Desc. 135 ft.  
Set an iron post, 3 ft. long, 2 ins. diam., in a mound of stone, on the left bank of the Colorado River, at mean high water mark, for meander cor. of fract. secs. 4 and 33, marked on brass cap

North Boundary of Fractional T. 31 N., R. 17 W.

Chains.

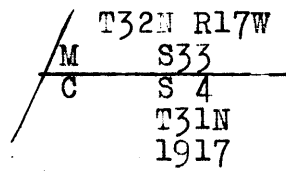

And raise a mound of stone, 2 ft. base, 1½ ft. high, E. of cor.  
Land, level and mountainous;  
Soil, sandy, 2nd rate; and rocky, 4th rate.  
No timber.  
Undergrowth, greasewood.

Boundaries of Fractional T. 31 N., R. 17 W.

Latitudes, departures and closing errors.

Line designated.	True bearing.	Dist. chs.	Latitudes.		Departures.	
			N. chs.	S. chs.	E. chs.	W. chs.
South Boundary.	West.	448.27				448.27
Meanders.			488.92	8.65	214.98	75.96
North Boundary	East	249.00			309.00	
East Boundary	South	480.00		480.00		
Convergency					.40	
<b>Totals</b>			488.92	488.65	524.38	524.23
			488.65		524.23	
<u>Error in latitude.</u>			.27			
<u>Error in departure</u>					.15	

--	--	--	--

Chains.

Survey executed with Buff solar transit No. 9985 and Young and Sons' light mountain transit No. 8489, with Smith solar attachments. For description of instruments and certificate of approval, see page 3 of this book.

40.00

From the cor. of secs. 1, 2, 35 and 36, on the S. bdy. of the Tp., which is an iron post, hereinbefore described, N.0° 1' W., bet. secs. 35 and 36.

Over gently rolling land, through scattering undergrowth. Set an iron post, 3 ft. long, 1 in. diam., 26 ins. in the ground, for 1/4 sec. cor., marked on brass cap

1/4  
S35 | S36  
1917

48.00

No stone available. Pits impracticable.

80.00

Draw, course N.70° E.

Set an iron post, 3 ft. long, 2 ins. diam., 24 ins. in the ground, for cor. of secs. 25, 26, 35 and 36, marked on brass cap

T31N R17W  
S26 | S25  
S35 | S36  
1917

No stone available. Pits impracticable.

Land, gently rolling.

Soil, 2nd and 3rd rate, sandy and gravelly.

No timber.

Undergrowth, greasewood.

40.00

East on a random line, bet. secs. 25 and 36.

80.15

Set temp. 1/4 sec. cor.

Intersect E. bdy. of Tp., 5 lks. N. of the cor. of secs. 25, 30, 31 and 36, which is an iron post, hereinbefore described.

Thence

N.89° 58' W., on a true line, bet. secs. 25 and 36.

Over level land, through scattering undergrowth.

28.60

Old road, brs. N. and S.

40.07 1/2

Set an iron post, 3 ft. long, 1 in. diam., 20 ins. in the ground, in a mound of stone, for 1/4 sec. cor., marked on brass cap

1/4 S25  
S36  
1917

61.15

And raise a mound of stone, 2 ft. base, 2 ft. high, N. of cor.

80.15

Wash, 20 lks. wide, 1 ft. deep, course N.

The cor. of secs. 25, 26, 35 and 36.

Land, level.

Soil, sandy, 2nd rate.

No timber.

Undergrowth, greasewood and yucca.

40.00

N.0° 1' W., bet. secs. 25 and 26.

Over nearly level land, through scattering undergrowth.

Set an iron post, 3 ft. long, 1 in. diam., 20 ins. in the ground, for 1/4 sec. cor., marked on brass cap

Chains.	
80.00	<p style="text-align: center;"> <math>\frac{1}{4}</math>            S26   S25            1917         </p> <p>Dig pits, 18 X 18 X 12 ins., N. and S. of post, 3 ft. dist.</p> <p>Set an iron post, 3 ft. long, 2 ins. diam., 24 ins. in the ground, for cor. of secs. 23, 24, 25 and 26, marked on brass cap</p> <p style="text-align: center;">           T31N R17W            S23   S24            S26   S25            1917         </p> <p>Dig pits, 18 X 18 X 12 ins., in each sec., <math>5\frac{1}{2}</math> ft. dist. Land, nearly level. Soil, sandy, 2nd rate. No timber. Undergrowth, yucca and greasewood.</p>
40.00	<p>S. <math>89^{\circ} 58'</math> E., on a random line, bet. secs. 24 and 25.</p>
80.18	<p>Set temp. <math>\frac{1}{4}</math> sec. cor.          Intersect E. bdy. of Tp., at the cor. of secs. 19, 24, 25 and 30, which is an iron post, hereinbefore described.</p>
40.09	<p>Thence          N. <math>89^{\circ} 58'</math> W., on a true line, bet. secs. 24 and 25.          Over level land, through scattering undergrowth.          Set an iron post, 3 ft. long, 1 in. diam., 26 ins. in the ground, for <math>\frac{1}{4}</math> sec. cor., marked on brass cap</p>
80.18	<p style="text-align: center;"> <math>\frac{1}{4}</math> S24  <math>\frac{1}{4}</math> S25            1917         </p> <p>No stone available. Pits impracticable.          The cor. of secs. 23, 24, 25 and 26.          Land, level.          Soil, sandy, 2nd rate.          No timber.          Undergrowth, greasewood and yucca.</p>
5.00	<p>N. <math>0^{\circ} 1'</math> W., bet. secs. 23 and 24.          Over level land, through scattering undergrowth.</p>
40.00	<p>Wash, 10 lks. wide, 1 ft. deep, course N. <math>40^{\circ}</math> E.          Set an iron post, 3 ft. long, 1 in. diam., 26 ins. in the ground, for <math>\frac{1}{4}</math> sec. cor., marked on brass cap</p>
57.00	<p style="text-align: center;"> <math>\frac{1}{4}</math>            S23   S24            1917         </p>
80.00	<p>No stone available. Pits impracticable.          Wash, 12 lks. wide, 1 ft. deep, course N. Asc. 80 ft.          Set an iron post, 3 ft. long, 2 ins. diam., in a mound of stone, for cor. of secs. 13, 14, 23 and 24, marked on brass cap</p> <p style="text-align: center;">           T31N R17W            S14   S13            S23   S24            1917         </p>

Subdivision of Fractional T. 31 N., R. 17 W. 21

Chains

And raise a mound of stone, 2 ft. base, 1½ ft. high, W. of cor.  
 Land, level and rolling.  
 Soil, sandy, 2nd rate and rocky, 3rd rate.  
 No timber.  
 Undergrowth, yucca and greasewood.

40.00 S.89° 58' E., on a random line, bet. secs. 13 and 24.  
 Set temp. ¼ sec. cor.  
 80.19 Intersect E. bdy. of Tp., 2 lks. S. of the cor. of secs. 13, 18, 19 and 24, which is an iron post, hereinbefore described.  
 Thence  
 N.89° 59' W., on a true line, bet. secs. 13 and 24.  
 Over level land, through scattering undergrowth.  
 40.09½ Set an iron post, 3 ft. long, 1 in. diam., in a mound of stone, for ¼ sec. cor., marked on brass cap

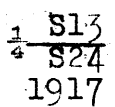

And raise a mound of stone, 2 ft. base, 1½ ft. high, N. of cor.  
 45.20 Wash, course S.70° E. Asc. 25 ft.  
 50.20 Thence over rolling land.  
 70.20 Asc. 50 ft.  
 80.19 The cor. of secs. 13, 14, 23 and 24.  
 Land, level and rolling.  
 Soil, sandy, 2nd rate.  
 No timber.  
 Undergrowth, greasewood and yucca.

N.0° 1' W., bet. secs. 13 and 14.  
 Over rolling land, through scattering undergrowth.  
 Asc. 105 ft.  
 38.40 Rim rock, 80 ft. high, brs. N.40° E. and S.40° W. Desc. 195 ft.  
 40.00 Set an iron post, 3 ft. long, 1 in. diam., in a mound of stone, for ¼ sec. cor., marked on brass cap

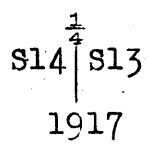

And raise a mound of stone, 2 ft. base, 1½ ft. high, W. of cor.  
 46.70 Gulch, course N.50° W. Asc. 120 ft.  
 53.90 Spur, slopes N.40° W. Desc. 45 ft.  
 57.30 Gulch, course N.40° W. Asc. 45 ft.  
 60.80 Spur, slopes N.60° W. Desc. 100 ft.  
 64.60 Gulch, course N.30° W. Asc. 25 ft.  
 69.50 Spur, slopes N.50° W. Desc. 85 ft.  
 72.30 Gulch, course N.40° W. Asc. 120 ft.  
 74.55 Point of spur, slopes W. Desc. 95 ft.  
 80.00 Set an iron post, 3 ft. long, 2 ins. diam., 8 ins. in the ground, in a mound of stone, for cor. of secs. 11, 12, 13 and 14, marked on brass cap

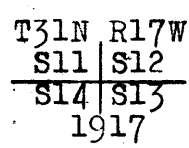

And raise a mound of stone, 2 ft. base, 1½ ft. high, W.

Chains.

of cor.  
Land, rolling.  
Soil, rocky, 4th rate.  
No timber.  
Undergrowth, greasewood.

40.00 S.89° 59' E., on a random line, bet. secs. 12 and 13.  
Set temp. 1/4 sec. cor.  
80.10 Intersect E. bdy. of Tp., 14 lks. S. of the cor. of secs. 7, 12, 13 and 18, which is an iron post, described hereinbefore.  
Thence  
S.89° 55' W., on a true line, bet. secs. 12 and 13  
Over gently rolling land, through scattering undergrowth.  
13.30 Desc. 20 ft.  
15.80 Draw, course S.30° E. Asc. 20 ft.  
18.30 Desc. 20 ft.  
21.50 Draw, course S.20° E. Thence over rolling land.  
28.30 Rim rock, brs. N.20° E. and S.20° W. Desc. 480 ft.  
40.05 Set an iron post, 3 ft. long, 1 in. diam., in a mound of stone, for 1/4 sec. cor., marked on brass cap

1/4 S12  
1/4 S13  
1917

And raise a mound of stone, 2 ft. base, 1 1/2 ft. high, N. of cor.  
49.60 Gulch, course N.30° W. Asc. 225 ft.  
62.50 Spur, slopes N. Desc. 40 ft.  
64.90 Asc. 35 ft.  
69.90 Spur, slopes N. Desc. 195 ft.  
75.90 Gulch, course N.60° W. Asc.  
80.10 The cor. of secs. 11, 12, 13 and 14.  
Land, gently rolling and mountainous.  
Soil, rocky, 4th rate and sandy, 3rd rate.  
No timber.  
Undergrowth, greasewood.

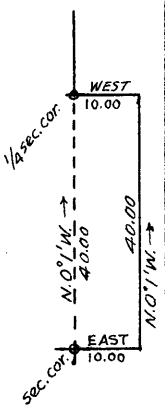

N.0° 1' W., bet. secs. 11 and 12.  
In order to avoid butte on line, I offset East 10.00 chs.;  
thence  
N.0° 1' W., on offset line, in sec. 12.  
Over mountainous land, through scattering undergrowth.  
Desc. 320 ft.  
5.00 Point of spur, slopes N. Desc.  
16.40 Ravine, course W. Asc. 515 ft.  
34.10 Ridge, brs. N.30° E. and W. Desc. 125 ft.  
40.00 Offset West 10.00 chs., and  
Set an iron post, 3 ft. long, 1 in. diam., in a mound of stone, for 1/4 sec. cor., marked on brass cap

1/4 S11 | S12  
1917

And raise a mound of stone, 2 ft. base, 1 1/2 ft. high, W. of cor.  
Desc. 135 ft.  
52.00 Gulch, course W. Asc. 40 ft.  
56.80 Spur, slopes W. Desc. 55 ft.  
59.30 Gulch, course N.70° W. Asc. 30 ft.  
61.80 Spur, slopes N.60° W. Desc. 105 ft.  
68.10 Gulch, course N.40° W. Asc. 35 ft.  
69.10 Spur, slopes N.60° W. Desc. 170 ft.



Subdivision of Fractional T. 31 N., R. 17 W.

Chains.

77.70  
80.00

Gulch, course W. Asc. 55 ft.  
Set an iron post, 3 ft. long, 2 ins. diam., in a mound of stone, for cor. of secs. 1, 2, 11 and 12, marked on brass cap

T31N R17W  
S 2 | S 1  
S11 | S12  
1917

And raise a mound of stone, 2 ft. base, 1½ ft. high, W. of cor.  
Land, mountainous.  
Soil, rocky, 4th rate.  
No timber.  
Undergrowth, greasewood and cactus.

40.00  
80.24

N.89° 55' E., on a random line, bet. secs. 1 and 12.  
Set temp; ¼ sec. cor.  
Intersect E. bdy. of Tp., 19 lks. N. of the cor. of secs. 1, 6, 7 and 12, which is an iron post, hereinbefore described.

Thence  
N.89° 57' W., on a true line, bet. secs. 1 and 12.  
Over mountainous land, through scattering undergrowth.  
Desc. 265 ft.

20.60  
37.20  
40.12

Gulch, course N.20° E. Asc. 220 ft.  
Spur, slopes N. Desc. 75 ft.  
Set an iron post, 3 ft. long, 1 in. diam., in a mound of stone, for ¼ sec. cor., marked on brass cap

1/4 S 1  
S12  
1917

And raise a mound of stone, 2 ft. base, 1½ ft. high, N. of cor.

41.20  
51.00  
65.80  
71.60  
78.70  
80.24

Gulch, course N.40° W. Asc. 40 ft.  
Spur, slopes N.30° W. Desc. 140 ft.  
Gulch, course N.60° W. Asc. 25 ft.  
Spur, slopes N.20° W. Desc. 90 ft.  
Gulch, course S.30° W. Asc. 45 ft.

The cor. of secs. 1, 2, 11 and 12.  
Land, mountainous.  
Soil, rocky, 4th rate.  
No timber.  
Undergrowth, greasewood and yucca.

40.00  
79.96

N.0° 1' W., on a random line, bet. secs. 1 and 2.  
Set temp. ¼ sec. cor.  
Intersect N. bdy. of Tp., 11 lks. E. of the true point for cor. of secs. 1, 2, 35 and 36. the witness cor. to which is an iron post, hereinbefore described.

Thence  
S.0° 6' E., on a true line, bet. secs. 1 and 2.  
Over mountainous land, through scattering undergrowth.  
Asc. 560 ft.

20.15  
39.96

Spur, slopes W. Desc. 1120 ft.  
Set an iron post, 3 ft. long, 1 in. diam., in a mound of stone, for ¼ sec. cor., marked on brass cap

1/4 S 2 | S 1  
1917

And raise a mound of stone, 2 ft. base, 1½ ft. high, W.

Chains.

of cor.  
 55.65 Gulch, course W. Asc. 220 ft.  
 73.25 Spur, slopes N.60° E. Desc. 125 ft.  
 79.96 The cor. of secs. 1, 2, 11 and 12.  
 Land, mountainous.  
 Soil, rocky, 4th rate.  
 No timber.  
 Undergrowth, greasewood and yucca.

From the cor. of secs. 2, 3, 34 and 35, on the S. bdy. of the Tp., which is an iron post, hereinbefore described, N.0° 1' W., bet. secs. 34 and 35.  
 Over mountainous land, through scattering undergrowth.  
 Desc.

1.50 Ravine, course W. Asc. 225 ft.  
 13.38 Spur, slopes W. Desc. 70 ft.  
 22.91 Ravine, course N.60° W. Asc. 50 ft.  
 25.06 Spur, slopes N.60° W. Desc. 105 ft.  
 28.30 Ravine, course N.40° W. Asc. 95 ft.  
 33.72 Spur, slopes W. Desc. 120 ft.  
 39.17 Ravine, course N.50° W. Asc. 65 ft.  
 40.00 Set an iron post, 3 ft. long, 1 in. diam., on bed rock, in a mound of stone, for  $\frac{1}{4}$  sec. cor., marked on brass cap

$\frac{1}{4}$   
 S34 | S35  
 1917

And raise a mound of stone, 2 ft. base,  $1\frac{1}{2}$  ft. high, W. of cor.

41.78 Cliff, 50 ft. high, brs. N.30° E. and S.30° W. Desc. 185 ft.  
 56.66 Spur, slopes W. Desc. 265 ft.  
 80.00 Set an iron post, 3 ft long, 2 ins. diam., on bed rock, in a mound of stone, for cor. of secs. 26, 27, 34 and 35, marked on brass cap

T31N R17W  
 S27 | S26  
 S34 | S35  
 1917

And raise a mound of stone, 3 ft. base, 2 ft. high, W. of cor.

Land, mountainous.  
 Soil, rocky, 4th rate.  
 No timber.  
 Undergrowth, greasewood and cat claw.

40.00 East on a random line, bet. secs. 26 and 35.  
 Set temp.  $\frac{1}{4}$  sec. cor.  
 79.81 Intersect N. and S. line, 1 lk. S. of the cor. of secs. 25, 26, 35 and 36.

Thence  
 West on a true line, bet. secs. 26 and 35.  
 Over rolling land, through scattering undergrowth.  
 39.90 $\frac{1}{2}$  Set an iron post, 3 ft. long, 1 in. diam., 6 ins. in the ground, in a mound of stone, for  $\frac{1}{4}$  sec. cor., marked on brass cap

$\frac{1}{4}$  S26  
 S35  
 1917

And raise a mound of stone, 2 ft. base,  $1\frac{1}{2}$  ft. high, N. of cor.

Subdivision of Fractional T. 31 N., R. 17 W.

Chains.

55.00 Asc. 35 ft.  
 60.00 Desc. 355 ft.  
 76.80 Asc.  
 78.00 Spur, slopes NW. Desc. 50 ft.  
 79.81 The cor. of secs. 26, 27, 34 and 35.  
 Land, rolling, and mountainous.  
 Soil, rocky, 4th rate.  
 No timber.  
 Undergrowth, greasewood.

N.0° 1' W., bet. secs. 26 and 27.  
 Over rolling and mountainous land, through scattering undergrowth.

Asc. 25 ft.  
 0.93 Spur, slopes W. Desc. 160 ft.  
 5.30 Ravine, course N.70° W. Asc. 60 ft.  
 11.39 Spur, slopes W. Desc. 60 ft.  
 14.30 Ravine, course W. Asc. 210 ft.  
 25.90 Spur, slopes W. Desc. 305 ft.  
 40.00 Set an iron post, 3 ft. long, 1 in. diam., 8 ins. in the ground, in a mound of stone, for  $\frac{1}{4}$  sec. cor., marked on brass cap.

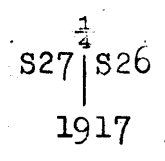

And raise a mound of stone, 3 ft. base, 2 ft. high, W. of cor.

41.62 Ravine, course N.40° W. Asc. 70 ft.  
 45.96 Spur, slopes W. Desc. 90 ft.  
 54.82 Ravine, course W. Asc. 56 ft.  
 58.48 Spur, slopes W. Desc. 105 ft.  
 61.13 Ravine, course W. Asc. 50 ft.  
 66.86 Spur, slopes N.20° W. Desc. 25 ft.  
 71.85 Draw, course W. Asc. 105 ft.  
 79.21 Spur, slopes W. Desc. 25 ft.  
 80.00 Set an iron post, 3 ft. long, 2 ins. diam. 8 ins. in the ground, in a mound of stone, for cor. of secs. 22, 23, 26 and 27. marked on brass cap.

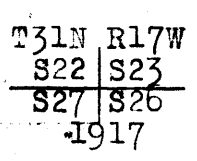

And raise a mound of stone,  $3\frac{1}{2}$  ft. base,  $2\frac{1}{2}$  ft. high, W. of cor.

Land, mountainous.  
 Soil, rocky, 4th rate.  
 No timber.  
 Undergrowth, cat claw and greasewood.

40.00 East on a random line, bet. secs. 23 and 26.  
 79.83 Set temp.  $\frac{1}{4}$  sec. cor.  
 Intersect N. and S. line, 5 lks. N. of the cor. of secs. 23, 24, 25 and 26.

Thence  
 N.89° 58' W., on a true line, bet. secs. 23 and 26.  
 Over nearly level land, through scattering undergrowth.  
 39.91 $\frac{1}{2}$  Set an iron post, 3 ft. long, 1 in. diam., 10 ins. in the ground, in a mound of stone, for  $\frac{1}{4}$  sec. cor., marked on brass cap

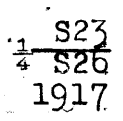

Chains.

And raise a mound of stone, 2 ft. base, 2 ft. high, N. of cor.  
 Asc. 15 ft.  
 42.79 Divide, brs. N.20° E. and S.20° W. Desc. 285 ft.  
 53.18 Ravine, course N.40° W. Asc. 15 ft.  
 60.21 Spur, slopes N.45° W. Desc. 180 ft.  
 66.05 Ravine, course N.40° W. Asc. 35 ft.  
 76.12 Spur, slopes N.20° W. Desc. 80 ft.  
 79.83 The cor. of secs. 22, 23, 26 and 27.  
 Land, level and mountainous.  
 Soil, sandy and rocky, 3rd and 4th rates.  
 No timber.  
 Undergrowth, yucca and greasewood.

N.0° 1' W., bet. secs. 22 and 23.  
 Over mountainous land, through scattering undergrowth.  
 Desc. 15 ft.  
 0.97 Ravine, course N.30° W. Asc. 35 ft.  
 4.39 Spur, slopes N.30° W. Desc. 115 ft.  
 7.94 Ravine, course N.40° W. Asc. 25 ft.  
 16.97 Spur, slopes N.45° W. Desc. 95 ft.  
 21.40 Ravine, course N.50° W. Asc. 165 ft.  
 29.51 Spur, slopes N.60° W. Desc. 140 ft.  
 38.00 Ravine, course N.50° W. Asc. 250 ft.  
 40.00 Set an iron post, 3 ft. long, 1 in. diam., on bed rock, in a mound of stone, for 1/4 sec. cor., marked on brass cap

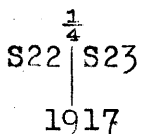

And raise a mound of stone, 3 ft. base, 2 ft. high, W. of cor.  
 48.95 Spur, slopes N.20° W. Desc. 120 ft.  
 63.48 Ravine, course N.40° W. Asc. 40 ft.  
 65.50 Spur, slopes N.45° W. Desc. 105 ft.  
 69.42 Ravine, course N.40° W. Asc.  
 75.20 Desc. 70 ft.  
 80.00 Set an iron post, 3 ft. long, 2 ins. diam., in a mound of stone, for cor. of secs. 14, 15, 22 and 23, marked on brass cap

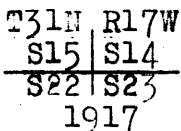

And raise a mound of stone, 3 ft. base, 2 ft. high, W. of cor.  
 Land, mountainous.  
 Soil, rocky, 4th rate.  
 No timber.  
 Undergrowth, greasewood.

40.00 S.89° 58' E., on a random line, bet. secs. 14 and 23.  
 Set temp. 1/4 sec. cor.  
 79.70 Intersect N. and S. line, 11 lks. S. of the cor. of secs. 13, 14, 23 and 24.  
 Thence  
 S.89° 57' W., on a true line, bet. secs. 14 and 23.  
 Over mountainous land, through scattering undergrowth.  
 Asc. 100 ft.  
 10.20 Thence over rolling land.  
 14.20 Rim rock, 80 ft. high, brs. N. and S. Desc. 455 ft.  
 25.70 Gulch, course N.40° W. Asc. 80 ft.  
 30.50 Spur, slopes N. Desc. 60 ft.

Subdivision of Fractional T. 31 N., R. 17 W.

Chains.  
 34.70 Asc. 25 ft.  
 39.70 Spur, slopes N.60° W. Desc. 545 ft.  
 39.85 Set an iron post, 3 ft. long, 1 in. diam., in a mound of stone, for  $\frac{1}{4}$  sec. cor., marked on brass cap

$\frac{1}{4}$  S14  
 $\frac{1}{4}$  S23  
 1917

And raise a mound of stone, 2 ft. base,  $1\frac{1}{2}$  ft. high, N. of cor.

42.20 Spur, slopes S.70° W. Continue descent.  
 54.30 Same spur, slopes N.60° W. Continue descent.  
 63.80 Gulch, course N.50° W. Asc. 20 ft.  
 66.00 Spur, slopes N.60° W. Desc. 160 ft.  
 71.60 Gulch, course N.50° W. Asc. 20 ft.  
 74.70 Spur, slopes N.30° W. Desc. 15 ft.  
 79.70 The cor. of secs. 14, 15, 22 and 23.  
 Land, mountainous.  
 Soil, rocky, 4th rate.  
 No timber.  
 Undergrowth, greasewood and cactus.

N.0° 1' W., bet. secs. 14 and 15.  
 Over nearly level land, through scattering undergrowth.

1.40 Desc. 30 ft.  
 5.88 Ravine, course N.40° W. Asc. 50 ft.  
 7.23 Desc. 30 ft.  
 8.00 Asc. 55 ft.  
 13.47 Spur, slopes N.30° W. Desc. 75 ft.  
 20.27 Ravine, course N.45° W. Asc. 70 ft.  
 40.00 Set an iron post, 3 ft. long, 1 in. diam., on bed rock, in a mound of stone, for  $\frac{1}{4}$  sec. cor., marked on brass cap

$\frac{1}{4}$   
 S15 | S14  
 1917

And raise a mound of stone, 3 ft. base, 2 ft. high, W. of cor.

41.39 Spur, slopes W. Desc.  
 43.00 Ravine, course W. Thence along W. slope.  
 59.70 Desc. 135 ft.  
 77.37 Ravine, course N.70° W. Asc.  
 80.00 Set an iron post, 3 ft. long, 2 ins. diam., on bed rock, in a mound of stone, for cor. of secs. 10, 11, 14 and 15, marked on brass cap

T31N R17W  
 S10 | S11  
 S15 | S14  
 1917

And raise a mound of stone, 3 ft. base, 2 ft. high, W. of cor.  
 Land, rolling and nearly level.  
 Soil, rocky, 4th rate.  
 No timber.  
 Undergrowth, greasewood.

N.89° 57' E., on a random line, bet. secs. 11 and 14.  
 40.00 Set temp.  $\frac{1}{4}$  sec. cor.  
 80.04 Intersect N. and S. line, 23 lks. N. of the cor. of secs. 11, 12, 13 and 14.  
 Thence

Chains.

N.89° 53' W., on a true line, bet. secs. 11 and 14.  
Over mountainous land, through scattering undergrowth.  
Desc. 60 ft.

2.85 Gulch, course N. Asc. 395 ft.

13.47 Ridge, brs. W. and S.40° E. Offset South, 2.00 chs., and run

N.89° 53' W., on offset line, in sec. 14.  
Desc. 860 ft.

40.02 Offset North 2.00 chs., and  
Set an iron post, 3 ft. long, 1 in. diam., in a mound of stone, for 1/4 sec. cor., marked on brass cap

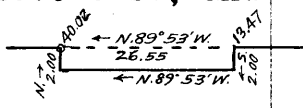

S11  
1/4 S14  
1917

And raise a mound of stone, 2 ft. base, 1 1/2 ft. high, N. of cor.

69.35 Asc. 15 ft.

70.30 Rocky point, slopes S. Desc. 90 ft.

74.10 Gulch, course N.70° W. Asc.

80.04 The cor. of secs. 10, 11, 14 and 15.

Land, mountainous.

Soil, rocky, 4th rate.

No timber.

Undergrowth, greasewood and cactus.

N.0° 1' W., bet. secs. 10 and 11.  
Over mountainous land, through scattering undergrowth.  
Desc. 25 ft.

3.50 Gulch, course N.40° W. Asc. 50 ft.

9.80 Spur, slopes W. Desc. 100 ft.

17.90 Gulch, course W. Asc. 30 ft.

18.80 Spur, slopes W. Desc. 130 ft.

30.10 Gulch, course S.70° W. Asc. 170 ft.

40.00 Set an iron post, 3 ft. long, 1 in. diam., in a mound of stone, for 1/4 sec. cor., marked on brass cap

S10 | S11  
1917

And raise a mound of stone, 2 ft. base, 1 1/2 ft. high, W. of cor.

41.50 Rocky point, slopes W. Desc. 305 ft.

65.80 Gulch, course W. Asc. 55 ft.

71.30 Spur, slopes W. Desc. 25 ft.

79.30 Gulch, course S.40° W. Asc.

80.00 Set an iron post, 3 ft. long, 2 ins. diam., in a mound of stone, for cor. of secs. 2, 3, 10 and 11, marked on brass cap

T31N R17W  
S 3 | S 2  
S10 | S11  
1917

And raise a mound of stone, 2 ft. base, 1 1/2 ft. high, W. of cor.

Land, mountainous.

Soil, rocky, 4th rate.

No timber.

Undergrowth, greasewood and cactus.

S.89° 53' E., on a random line, bet. secs. 2 and 11.

Subdivision of Fractional T. 31 N., R. 17 W.

Chains.  
 25.46 Impossible to chain from this point. I set a flag ahead on line. Thence measure a base, N.0° 7' E., 10 chs., from the N. end of which, flag brs. S.69° 38' E. The distance triangulated is given by 10.00 X tan. 69° 45' = 10.00 X 2.71062 = 27.11 chs., which added to 25.46 makes

52.57 Set temp. witness cor. to 1/4 sec. cor.  
 79.96 Intersect N. and S. line, 5 lks. N. of the cor. of secs. 1, 2, 11 and 12.  
 Thence  
 N.89° 51' W., on a true line, bet. secs. 2 and 11.  
 Over mountainous land, through scattering undergrowth.  
 Asc. 210 ft.

13.10 Spur, slopes S. Desc. 115 ft.  
 17.80 Head of gulch, course S.50° W. Asc. 205 ft.  
 27.40 Clifty point, slopes S.  
 Set an iron post, 3 ft. long, 1 in. diam., in a mound of stone, for witness cor. to 1/4 sec. cor., marked on brass cap

WC  $\frac{1}{4}$   $\frac{S}{SII}$   
 1917

And raise a mound of stone, 2 ft. base, 1 1/2 ft. high, N. of cor.

39.98 The true point for 1/4 sec. cor. falls on side of cliff, where it is inaccessible .  
 54.50 Asc. 90 ft.  
 75.00 Desc. 130 ft.  
 79.96 The cor. of secs. 2, 3, 10 and 11.  
 Land, mountainous.  
 Soil, rocky, 4th rate.  
 No timber.  
 Undergrowth, greasewood and cactus.

---

40.00 N.0° 1' W., on a random line, bet. secs. 2 and 3.  
 79.96 Set temp. 1/4 sec. cor.  
 Intersect N. bdy. of Tp., 14 lks. E. of the cor. of secs. 2, 3, 34 and 35, which is an iron post, hereinbefore described.  
 Thence  
 S.0° 7' E., on a true line, bet. secs. 2 and 3.  
 Over mountainous land, through scattering undergrowth.  
 Asc. 80 ft.

3.35 Spur, slopes N.60° W. Desc. 145 ft.  
 8.95 Wash, course N.60° W. Asc. 290 ft.  
 22.25 Spur, slopes W. Desc. 550 ft.  
 39.96 Set an iron post, 3 ft. long, 1 in. diam., 10 ins. in the ground, in a mound of stone, for 1/4 sec. cor., marked on brass cap

S  $\frac{1}{4}$  S 2  
 1917

And raise a mound of stone, 2 ft. base, 1 1/2 ft. high, W. of cor.

53.70 Wash, course W. Asc. 250 ft.  
 71.70 Spur, slopes W. Desc. 120 ft.  
 79.96 The cor. of secs. 2, 3, 10 and 11.  
 Land, mountainous.  
 Soil, rocky, 4th rate.  
 No timber.  
 Undergrowth, greasewood and cactus.

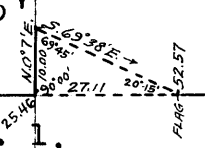

Chains.

From the cor. of secs. 3, 4, 33 and 34, on the S. bdy. of the Tp., which is an iron post, hereinbefore described, N.0° 2' W., bet. secs. 33 and 34.

Over mountainous land, through scattering undergrowth. Desc. 65 ft.

4.07 Ravine, course S.60° W. Asc. 180 ft.

12.56 Spur, slopes E. Desc. 115 ft.

17.26 Draw, course N.60° E. Asc.

21.66 Spur, slopes N.60° E. Desc. 310 ft.

40.00 Set an iron post, 3 ft. long, 1 in. diam., 12 ins. in the ground, in a mound of stone, for 1/4 sec. cor., marked on brass cap

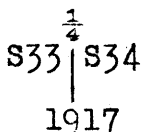

And raise a mound of stone, 2 1/2 ft. base, 2 ft. high, W. of cor.

41.71 Ravine, course N.30° W. Old road, brs. N.30° W. and S.30° E. Thence over rolling land.

59.96 Ravine, 2 chs. wide, course N.40° W.

80.00 Set an iron post, 3 ft. long, 2 ins. diam., 8 ins. in the ground, in a mound of stone, for cor. of secs. 27, 28, 33 and 34, marked on brass cap

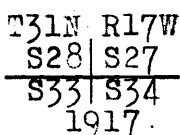

And raise a mound of stone, 3 ft. base, 2 ft. high, W. of cor.

Land, 1st half, mountainous; remainder nearly level.

Soil, sandy and rocky, 3rd and 4th rates.

No timber.

Undergrowth, cat claw and greasewood.

40.00 East on a random line, bet. secs. 27 and 34.

80.19 Set temp. 1/4 sec. cor.

Intersect N. and S. line, 20 lks. N. of the cor. of secs. 26, 27, 34 and 35.

Thence

N.89° 51' W., on a true line, bet. secs. 27 and 34.

Over mountainous land, through scattering undergrowth.

Desc. 530 ft.

22.20 Ravine, course N.20° W. Asc. 75 ft.

23.80 Rocky point, slopes N. Desc. 315 ft.

40.09 1/2 Set an iron post, 3 ft. long, 1 in. diam., in a mound of stone, for 1/4 sec. cor., marked on brass cap

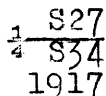

And raise a mound of stone, 2 ft. base, 1 1/2 ft. high, N. of cor.

58.00 Wash, course N. Thence over gently rolling land.

80.19 The cor. of secs. 27, 28, 33 and 34.

Land, mountainous and gently rolling.

Soil, rocky, 4th rate.

No timber.

Undergrowth, greasewood and cat claw.



Subdivision of Fractional T. 31 N., R. 17 W.

Chains.

N.0° 2' W., bet. secs. 27 and 28.  
 Over nearly level land, through scattering undergrowth  
 Ravine, course N.30° W. Asc.  
 32.08  
 35.58 Spur, slopes N.40° W. Desc. 35 ft.  
 40.00 Set an iron post, 3 ft. long, 1 in. diam., 8 ins. in the  
 ground, in a mound of stone, for  $\frac{1}{4}$  sec. cor. marked on  
 brass cap

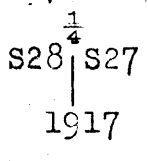

And raise a mound of stone, 2 ft. base, 2 ft. high, W. of cor.

Thence over gently rolling land.  
 55.80 Wash, 2.50 chs. wide, 3 ft. deep, course N.40° W. Asc.  
 25 ft.

61.17 Spur, slopes W. Desc. 25 ft.  
 69.75 Ravine, course N.30° W. Asc. 75 ft.  
 80.00 Set an iron post, 3 ft. long, 2 ins. diam., on bed rock, in  
 a mound of stone, for cor. of secs. 21, 22, 27 and 28,  
 marked on brass cap

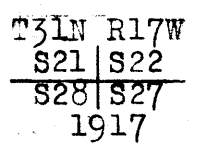

And raise a mound of stone, 3 ft. base,  $3\frac{1}{2}$  ft. high, W. of cor.

Land, rolling and nearly level.  
 Soil, rocky, and sandy, 3rd rate.  
 No timber.  
 Undergrowth, cat claw and greasewood.

40.00 S.89° 51' E., on a random line, bet. secs. 22 and 27.  
 Set temp.  $\frac{1}{4}$  sec. cor.  
 79.98 Intersect N. and S. line, 21 lks. S. of the cor. of secs.  
 22, 23, 26 and 27.

Thence  
 West on a true line, bet. secs. 22 and 27.  
 Over mountainous land, through scattering undergrowth.  
 Asc. 20 ft.  
 3.78 Spur, slopes N.40° W. Desc. 410 ft.  
 31.88 Ravine, course N.30° W. Asc. 65 ft.  
 35.50 Spur, slopes N.30° W. Desc. 95 ft.  
 39.99 Set an iron post, 3 ft. long, 1 in. diam., 10 ins. in the  
 ground, in a mound of stone, for  $\frac{1}{4}$  sec. cor., marked on  
 brass cap

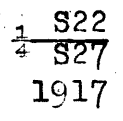

And raise a mound of stone, 2 ft. base, 2 ft. high, N. of cor.

51.14 Ravine, course N.20° W. Asc. 100 ft.  
 58.26 Spur, slopes N.30° W. Desc. 305 ft.  
 79.98 The cor. of secs. 21, 22, 27 and 28.  
 Land, mountainous.  
 Soil, rocky and sandy, 4th rate.  
 No timber.  
 Undergrowth, greasewood.

N.0° 2' W., bet. secs. 21 and 22.  
 Over mountainous land, through scattering undergrowth.

Chains.

- Asc. 200 ft.
- 13.70 Spur, slopes N.70° W. Desc. 235 ft.
- 21.10 Ravine, course N.60° W. Asc. 155 ft.
- 28.30 Spur, slopes W. Desc. 190 ft.
- 37.70 Wash, 1.40 chs. wide, course W. Asc. 280 ft.
- 40.00 Set an iron post, 3 ft. long, 1 in. diam., in a mound of stone, for  $\frac{1}{4}$  sec. cor., marked on brass cap

$\frac{1}{4}$   
 S21 | S22  
 1917

And raise a mound of stone, 2 ft. base,  $1\frac{1}{2}$  ft. high, W. of cor.

- 51.60 Top of slope, brs. N.60° W. and S.60° E. Thence over level mesa.
- 62.20 Leave mesa, brs. N40° E. and S.40° W. Desc. 265 ft.
- 80.00 Set an iron post, 3 ft. long, 2 ins. diam., in a mound of stone, for cor. of secs. 15, 16, 21 and 22, marked on brass cap

T31N R17W  
 S16 | S15  
 S21 | S22  
 1917

And raise a mound of stone, 2 ft. base,  $1\frac{1}{2}$  ft. high, W. of cor.

Land, mountainous.  
 Soil, rocky, 4th rate.  
 No timber.  
 Undergrowth, greasewood and cactus.

- 40.00 East on a random line, bet. secs. 15 and 22.
- 80.08 Set temp.  $\frac{1}{4}$  sec. cor.
- Intersect N. and S. line, 5 lks. N. of the cor. of secs. 14, 15, 22 and 23.
- Thence N.89° 58' W., on a true line, bet. secs. 15 and 22.
- Over mountainous land, through scattering undergrowth.
- Asc. 25 ft.
- 2.57 Spur, slopes N.28° W. Desc. 500 ft.
- 40.04 Set an iron post, 3 ft. long, 1 in. diam., on bed rock, in a mound of stone, for  $\frac{1}{4}$  sec. cor., marked on brass cap

$\frac{1}{4}$  S15  
 $\frac{1}{4}$  S22  
 1917

And raise a mound of stone, 3 ft. base, 2 ft. high, N. of cor.

- 45.00 Rim rock, brs. N. and S.
- 64.44 Ravine, course N.85° W. Continue descent.
- 71.00 Ravine, course N.50° W. Asc. 95 ft.
- 80.08 The cor. of secs. 15, 16, 21 and 22.
- Land, mountainous.
- Soil, sandy and rocky, 4th rate.
- No timber.
- Undergrowth, greasewood and cat claw.

- N.0° 2' W., bet. secs. 15 and 16.
- Over mountainous land, through scattering undergrowth.
- Desc. 140 ft.
- 7.30 Gulch, course N.70° W. Asc. 100 ft.
- 14.60 Thence over rolling land.
- 32.60 Draw, course W. Asc. 105 ft.

Subdivision of Fractional T. 31 N., R. 17 W.

Chains.

40.00 Spur, slopes S.70° W.  
Set an iron post, 3 ft. long, 1 in. diam., in a mound of stone, for  $\frac{1}{4}$  sec. cor., marked on brass cap

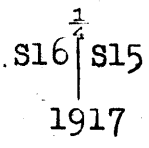

And raise a mound of stone, 2 ft. base,  $1\frac{1}{2}$  ft. high, W. of cor.

51.00 Desc. 105 ft.  
53.70 Gulch, course W. Asc. 65 ft.  
53.70 Spur, slopes W. Desc. 85 ft.  
60.70 Wash, 20 lks. wide, 3 ft. deep, course N.60° W. Thence over rolling land.  
66.60 Wash, 20 lks. wide, 4 ft. deep, course N.50° W.  
80.00 Set an iron post, 3 ft. long, 2 ins. diam., in a mound of stone, for cor. of secs. 9, 10, 15 and 16, marked on brass cap

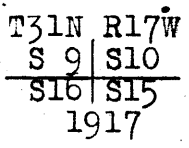

And raise a mound of stone, 2 ft. base,  $1\frac{1}{2}$  ft. high, W. of cor.

Land, mountainous and rolling.  
Soil, rocky, 4th rate.  
No timber.  
Undergrowth, cat claw and greasewood.

40.00 S.89° 58' E., on a random line, bet. secs. 10 and 15.  
80.11 Set temp.  $\frac{1}{4}$  sec. cor.  
Intersect N. and S. line, 19 lks. S. of the cor. of secs. 10, 11, 14 and 15.

Thence S.89° 54' W., on a true line, bet. secs. 10 and 15.  
Over mountainous and rolling land, through scattering undergrowth.

9.43 Desc. 75 ft.  
13.19 Ravine, course N.45° W. Asc. 45 ft.  
40.05 $\frac{1}{2}$  Rim rock, brs. S.70° E. and S.80° W. Desc. 285 ft.  
Set an iron post, 3 ft. long 1 in. diam., 4 ins. in the ground, in a mound of stone, for  $\frac{1}{4}$  sec. cor., marked on brass cap

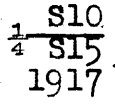

And raise a mound of stone, 3 ft. base, 2 ft. high, N. of cor.

54.04 Ravine, course S.60° W. Asc.  
55.00 Desc. 80 ft.  
71.79 Ravine, course N.40° W. Asc. 50 ft.  
77.45 Spur, slopes N. Desc. 55 ft.  
80.11 The cor. of secs. 9, 10, 15 and 16.  
Land, mountainous and rolling.  
Soil, sandy and rocky, 4th rate.  
No timber.  
Undergrowth, greasewood and cat claw.

N.0° 2' W., bet. secs. 9 and 10.  
Over rolling land, through scattering undergrowth.  
Desc. 40 ft.

Chains.

10.00 Enter wash, course N.40° W.  
 15.00 Leave wash, course N.40° W. Asc. 100 ft.  
 27.40 Low spur, slopes W. Desc. 80 ft.  
 34.80 Ravine, course N.70° W. Asc. 70 ft.  
 38.35 Desc.  
 39.00 Draw, course W. Asc. 60 ft.  
 40.00 Set an iron post, 3 ft. long, 1 in. diam., 6 ins. in the ground, in a mound of stone, for  $\frac{1}{4}$  sec. cor., marked on brass cap

$\frac{1}{4}$   
 S 9 | S 10  
 1917

And raise a mound of stone, 2 ft. base,  $1\frac{1}{2}$  ft. high, W. of cor.

43.30 Spur, slopes W. Desc. 50 ft.  
 47.90 Gulch, course S.60° W. Asc. 75 ft.  
 51.40 Spur, slopes W. Desc. 70 ft.  
 58.99 Gulch, course S.30° W. Asc. 50 ft.  
 61.75 Desc. 180 ft.  
 68.80 Ravine, course N.40° W. Asc. 175 ft.  
 74.70 Spur, slopes W. Desc. 50 ft.  
 80.00 Set an iron post, 3 ft. long, 2 ins. diam., 24 ins. in the ground, for cor. of secs. 3, 4, 9 and 10, marked on brass cap

T31N R17W  
 S 4 | S 3  
 S 9 | S 10  
 1917

And raise a mound of stone, 2 ft. base,  $1\frac{1}{2}$  ft. high, W. of cor.

Land, rolling and mountainous.  
 Soil, rocky, 4th rate.  
 No timber.  
 Undergrowth, greasewood and cat claw.

40.00 N.89° 54' E., on a random line, bet. secs. 3 and 10.  
 Set temp.  $\frac{1}{4}$  sec. cor.  
 80.15 Intersect N. and S. line, 5 lks. S. of the cor. of secs. 2, 3, 10 and 11.

Thence  
 S.89° 52' W., on a true line, bet. secs. 3 and 10.  
 Over mountainous land, through scattering undergrowth.  
 Desc. 120 ft.

9.85 Gulch, course N.30° W. Asc. 20 ft.  
 10.95 Point of spur, slopes N. Desc. 40 ft.  
 13.85 Wash, 110 lks. wide, course N.20° W. Asc. 55 ft.  
 16.15 Desc. 25 ft.  
 18.65 Enter mesa, brs. N.40° W. and S.40° E.  
 23.85 Leave mesa, brs. N.40° W. and S.40° E. Desc. 90 ft.  
 28.05 Gulch, course N.30° W. Asc. 55 ft.  
 30.15 Spur, slopes N. Desc. 25 ft.  
 35.95 Asc. 185 ft.

40.07 $\frac{1}{2}$  Set an iron post, 3 ft. long, 1 in. diam., in a mound of stone, for  $\frac{1}{4}$  sec. cor., marked on brass cap

$\frac{1}{4}$  S 3  
 S 10  
 1917

And raise a mound of stone, 2 ft. base,  $1\frac{1}{2}$  ft. high, N. of cor.

49.15 Ridge, brs. N.50° W. and S.50° E. Desc. 280 ft.  
 60.25 Gulch, course N.30° W. Asc. 45 ft.  
 62.55 Mine shaft, 15 ft. deep, brs. N. 30 lks. dist.  
 69.15 Spur, slopes N.40° W. Desc. 90 ft.  
 76.65 Draw, course NW. Asc. 20 ft.

Subdivision of Fractional T. 31 N., R. 17 W.

Chains.

80.15 The cor. of secs. 3, 4, 9 and 10.  
Land, mountainous.  
Soil, rocky, 4th rate.  
No timber.  
Undergrowth, greasewood and cat claw.

---

40.00 N.0° 2' W., on a random line, bet. secs. 3 and 4.  
Set temp.  $\frac{1}{4}$  sec. cor.

80.04 Intersect N. bdy. of Tp., 21 lks. E. of the cor. of secs. 3, 4, 33 and 34, which is an iron post, hereinbefore described.

Thence  
S.0° 11' E., on a true line, bet. secs. 3 and 4.  
Over level land, through scattering undergrowth.

26.85 Leave level land, brs. N.40° E. and S.40° W. Desc. 165 ft.

34.05 Wash, course S.30° W. Asc.

40.04 Set an iron post, 3 ft. long, 1 in. diam., in a mound of stone, for  $\frac{1}{4}$  sec. cor., marked on brass cap

$\frac{1}{4}$   
S 4 | S 3  
1917

And raise a mound of stone, 2 ft. base,  $1\frac{1}{2}$  ft. high, W. of cor.

45.35 Desc. 80 ft.

52.25 Draw, course S.50° W. Asc. 40 ft.

57.15 Spur, slopes S.40° W. Desc. 130 ft.

62.45 Enter wash, course S.40° W.

65.05 Leave wash, course S.40° W. Asc. 70 ft.

69.00 Spur, slopes W. Desc. 80 ft.

69.95 Ravine course W. Asc. 120 ft.

76.65 Spur, slopes W. Desc. 20 ft.

78.55 Draw, course W. Asc. 20 ft.

80.04 The cor. of secs. 3, 4, 9 and 10.  
Land, level and mountainous.  
Soil, rocky, 4th rate.  
No timber.  
Undergrowth, greasewood and cactus.

From the cor. of secs. 4, 5, 32 and 33, on the S. bdy. of the Tp., which is an iron post, hereinbefore described.

N.0° 3' W., bet. secs. 32 and 33.  
Over rolling land, through scattering undergrowth.

11.80 Desc. 65 ft.

14.93 Ravine, course N.40° W. Asc. 80 ft.

22.49 Spur, slopes W. Desc. 145 ft.

26.77 Ravine, course W. Asc. 180 ft.

36.51 Spur, slopes W. Desc. 75 ft.

38.98 Ravine, course S.50° W. Asc. 65 ft.

40.00 Set an iron post, 3 ft. long, 1 in. diam., on bed rock, in a mound of stone, for  $\frac{1}{4}$  sec. cor., marked on brass cap

$\frac{1}{4}$   
S32 | S33  
1917

And raise a mound of stone, 3 ft. base, 2 ft. high, W. of cor.

44.10 Spur, slopes S.70° W. Thence over gently rolling land.

80.00 Set an iron post, 3 ft. long, 2 ins. diam., 18 ins. in the ground, in a mound of stone, for cor. of secs. 28, 29, 32 and 33, marked on brass cap

Chains.

T31N. R17W  
S29 | S28  
---  
S32 | S33  
1917

And raise a mound of stone, 3 ft. base, 2 ft. high, W. of cor.

Land, rolling and gently rolling.  
Soil, sandy and rocky, 3rd and 4th rates.  
No timber.  
Undergrowth, cat claw, greasewood and mesquite.

40.00 East on a random line, bet. secs. 28 and 33.  
Set temp.  $\frac{1}{4}$  sec. cor.  
80.19 Intersect N. and S. line, at the cor. of secs. 27, 28, 33 and 34.  
Thence  
West on a true line, bet. secs. 28 and 33.  
Over level land, through scattering undergrowth.  
5.00 Desc. 45 ft.  
12.35 Ravine, course S.30° W. Old road, brs. N. and S. Asc. 415 ft.  
30.06 Ridge, brs. N.20° E. and S.20° W. Desc. 470 ft.  
40.09 $\frac{1}{2}$  Set an iron post, 3 ft. long, 1 in. diam., 6 ins. in the ground, in a mound of stone, for  $\frac{1}{4}$  sec. cor., marked on brass cap

S28  
 $\frac{1}{4}$  S33  
1917

And raise a mound of stone, 3 ft. base, 2 ft. high, N. of cor.

45.95 Ravine, course S.30° W. Asc. 50 ft.  
47.68 Spur, slopes S. Desc. 140 ft.  
60.82 Ravine, course N.40° W. Asc. 25 ft.  
62.92 Spur, slopes N.20° W. Desc. 105 ft.  
71.75 Ravine, 1 ch. wide, course N.30° W. Asc. 200 ft.  
80.19 The cor. of secs. 28, 29, 32 and 33.  
Land, mountainous.  
Soil, rocky, 4th rate.  
No timber.  
Undergrowth, greasewood and cactus.

7.40 N.0° 3' W., bet. secs. 28 and 29.  
Over mountainous land, through scattering undergrowth;  
Along E. slope.  
Desc. 285 ft.  
23.69 Ravine, 2 chs. wide, course N.30° W. Asc. 95 ft.  
33.98 Spur, slopes W. Desc. 115 ft.  
40.00 Set an iron post, 3 ft. long, 1 in. diam., on bed rock, in a mound of stone, for  $\frac{1}{4}$  sec. cor., marked on brass cap

$\frac{1}{4}$   
S29 | S28  
1917

And raise a mound of stone, 3 ft. base, 2 ft. high, W. of cor.

44.96 Ravine, course N.70° W. Asc.  
47.60 Desc. 70 ft.  
73.89 Ravine, course N.45° W.  
80.00 Draw, course S.40° W.  
Set an iron post, 3 ft. long, 2 ins. diam., on bed rock, in a mound of stone, for cor. of secs. 20, 21, 28 and 29, marked on brass cap

Subdivision of Fractional T. 31 N., R. 17 W.

Chains.

T31N R17W  
S20 | S21  
S29 | S28  
1917

And raise a mound of stone, 3 ft. base, 2 ft. high, W. of cor.  
Land, mountainous.  
Soil, rocky and sandy, 4th rate.  
No timber.  
Undergrowth, cat claw and greasewood.

40.00  
80.16  
  
9.78  
18.39  
26.47  
33.85  
40.08

East on a random line, bet. secs. 21 and 28.  
Set temp.  $\frac{1}{4}$  sec. cor.  
Intersect N. and S. line, 5 lks. N. of the cor. of secs. 21, 22, 27 and 28.  
Thence  
N.89° 58' W., on a true line, bet. secs. 21 and 28.  
Over mountainous land, through scattering undergrowth.  
Desc. 175 ft.  
Ravine, course N.20° W. Old road in ravine, brs. N.20° W. and S.20° E. Asc. 215 ft.  
Spur, slopes N. Desc. 170 ft.  
Ravine, course N.20° W. Asc. 165 ft.  
Spur, slopes N. Desc. 410 ft.  
Set an iron post, 3 ft. long, 1 in. diam., on bed rock, in a mound of stone, for  $\frac{1}{4}$  sec. cor., marked on brass cap

S21  
 $\frac{1}{4}$  S28  
1917

61.84  
64.65  
69.15  
80.16

And raise a mound of stone, 2 ft. base, 2 ft. high, N. of cor.  
Ravine, course N.20° W. Asc. 20 ft.  
Desc. 40 ft.  
Ravine, course S.40° W. Asc. 45 ft.  
The cor. of secs. 20, 21, 28 and 29.  
Land, mountainous.  
Soil, rocky, 4th rate.  
No timber.  
Undergrowth, greasewood.

2.18  
14.29  
20.45  
40.00

N.0° 3' W., bet. secs. 20 and 21.  
Over nearly level land, through scattering undergrowth.  
Asc. 55 ft.  
Spur, slopes S.70° W. Desc. very gradually.  
Ravine, course W. Asc. 50 ft.  
Thence over gently rolling land.  
Set an iron post, 3 ft. long, 1 in. diam., on bed rock, in a mound of stone, for  $\frac{1}{4}$  sec. cor., marked on brass cap

$\frac{1}{4}$   
S20 | S21  
1917

57.80  
60.89  
75.28  
78.97  
80.00

And raise a mound of stone, 2 ft. base, 2 ft. high, W. of cor.  
Desc. 80 ft.  
Road, brs. N.40° W. and S.40° E.  
Ravine, course N.40° W. Asc. 35 ft.  
Spur, slopes W. Desc.  
Set an iron post, 3 ft. long, 2 ins. diam., 4 ins. in the ground, in a mound of stone, for cor. of secs. 16, 17, 20 and 21, marked on brass cap

Chains.

T31N	R17W
S17	S16
S20	S21
1917	

And raise a mound of stone, 3 ft. base, 2 ft. high, W. of cor.  
 Land, nearly level.  
 Soil, sandy and rocky, 3rd and 4th rates.  
 No timber.  
 Undergrowth, greasewood.

40.00 S.89° 58' E., on a random line, bet. secs. 16 and 21.  
 Set temp.  $\frac{1}{4}$  sec. cor.  
 80.14 Intersect N. and S. line, 5 lks. S. of the cor. of secs. 15, 16, 21 and 22.  
 Thence  
 West on a true line, bet. secs. 16 and 21.  
 Over mountainous land, through scattering undergrowth.  
 Along N. slope.  
 9.00 Desc. 160 ft., on spur, slopes W.  
 24.75 Asc. 30 ft.  
 31.25 Leave spur, slopes N.30° W. Desc. 75 ft.  
 34.56 Draw, course S. Asc. 20 ft.  
 37.00 Desc. 75 ft.  
 40.07 Set an iron post, 3 ft. long, 1 in. diam., in a mound of stone, for  $\frac{1}{4}$  sec. cor., marked on brass cap

$\frac{1}{4}$	S16
$\frac{1}{4}$	S21
1917	

And raise a mound of stone, 2 ft. base,  $1\frac{1}{2}$  ft. high, N. of cor.  
 50.50 Draw, course N.30° W. Asc. 30 ft.  
 52.30 Top of slope, brs. N. and S. Thence over rolling land.  
 65.00 Asc. 25 ft.  
 75.00 Desc. 40 ft.  
 80.14 The cor. of secs. 16, 17, 20 and 21.  
 Land, mountainous.  
 Soil, rocky, 4th rate.  
 No timber.  
 Undergrowth, greasewood and cactus.

N.0° 3' W., bet. secs. 16 and 17.  
 Over rolling land, through scattering undergrowth.  
 Desc. 145 ft.  
 14.84 Ravine, course N.30° W. Asc. 15 ft.  
 20.23 Spur, slopes W. Desc. gradually.  
 40.00 Set an iron post, 3 ft. long, 1 in. diam., 12 ins. in the ground, in a mound of stone, for  $\frac{1}{4}$  sec. cor., marked on brass cap

$\frac{1}{4}$	S17	S16
1917		

And raise a mound of stone, 2 ft. base, 2 ft. high, W. of cor.  
 Asc. gradually.  
 45.69 Spur, slopes N. 50° W. Desc.  
 55.69 Ravine, course W. Road, brs. N.20° E. and S.20° W. Thence over gently rolling land.  
 80.00 Set an iron post, 3 ft. long, 2 ins. diam., 24 ins. in the ground, in a mound of stone, for  $\frac{1}{4}$  sec. cor., marked on brass cap



Subdivision of Fractional T. 31 N., R. 17 W.

Chains.

ground, for cor. of secs. 8, 9, 16 and 17, marked on brass cap

T31N	R17W
S 8	S 9
S17	S16
1917	

And raise a mound of stone; 3 ft. base, 2 ft. high, W. of cor.

Land, rolling and gently rolling.  
Soil, sandy, 3rd rate.  
No timber.  
Undergrowth, cat claw and mesquite.

40.00  
80.18

East on a random line, bet. secs. 9 and 16.  
Set temp.  $\frac{1}{4}$  sec. cor.  
Intersect N. and S. line, 7 lks. N. of the cor. of secs. 9, 10, 15 and 16.

Thence  
N.89° 57' W., on a true line, bet. secs. 9 and 16.  
Over nearly level land, through scattering undergrowth.

17.70  
20.67  
22.70  
23.42  
27.70  
40.09

Desc. 30 ft.  
Ravine, course N.50° W. Asc.  
Desc.  
Ravine, course S.80° W. Asc.  
Desc. 120 ft.  
Set an iron post, 3 ft. long, 1 in. diam., 4 ins. in the ground, in a mound of stone, for  $\frac{1}{4}$  sec. cor., marked on brass cap

$\frac{1}{4}$	S 9
$\frac{1}{4}$	S16
1917	

And raise a mound of stone, 3 ft. base, 2 ft. high, N. of cor.

48.25  
50.60  
60.55  
62.53  
77.26  
80.18

Ravine, course N.45° W. Asc. 25 ft.  
Desc. 50 ft.  
Draw, course NW. Asc. 20 ft.  
Spur, slopes N. Desc. 70 ft.  
Old road, brs. N. and S. Thence over gently rolling land.  
The cor. of secs. 8, 9, 16 and 17.  
Land, rolling and gently rolling.  
Soil, sandy and rocky, 3rd and 4th rates.  
No timber.  
Undergrowth, greasewood and mesquite.

6.80

N.0° 3' W., bet. secs. 8 and 9.  
Over level land, through scattering undergrowth.  
Set an iron post, 3 ft. long, 1 in. diam., 26 ins. in the ground, on the left bank of the Colorado River, at mean high water mark, for meander cor. of fracl. secs. 8 and 9, marked on brass cap

S 8	S 9
T31N	R17W
1917	

Dig a pit, 36 X 36 X 12 ins., 8 ft. S. of cor.  
Land, level.  
Soil, sandy, 3rd rate.  
No timber.  
Undergrowth, greasewood and mesquite.

Chains

From the cor. of secs. 3, 4, 9 and 10,  
 West on a true line, bet. secs. 4 and 9.  
 Over rolling land, through scattering undergrowth.  
 Asc.  
 1.50 Desc. 20 ft.  
 3.70 Draw, course S.40° W. Asc.  
 4.00 Desc. 40 ft.  
 8.60 Rim rock, 100 ft. high, brs. N.40° E. and S.40° W. Desc.  
 165 ft.  
 12.90 Mouth of wash, from NE. Thence over level land.  
 35.00 Set an iron post, 3 ft. long, 1 in. diam., 26 ins. in the  
 ground, on the left bank of the Colorado River, at mean  
 high water mark, for meander cor. of fracl. secs. 4  
 and 9, marked on brass cap

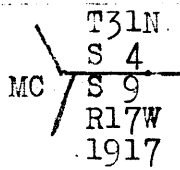

And raise a mound of stone, 2 ft. base, 1½ ft. high, N.  
 of cor.  
 Land, level and rolling.  
 Soil, sandy and rocky, 3rd and 4th rates.  
 No timber  
 Undergrowth, greasewood and mesquite.

From the cor. of secs. 5, 6, 31 and 32, on the S. bdy. of  
 the Tp., which is an iron post, hereinbefore described,  
 N.0° 3' W., bet. secs. 31 and 32.  
 Over mountainous land, through scattering undergrowth.  
 Desc. 165 ft.  
 9.60 Ravine, course N.50° E. Asc. 60 ft.  
 13.13 Spring brs. E. 7 chs. dist.  
 16.60 Sandy spur, slopes E. Desc. 180 ft.  
 24.90 Five wire corral brs. E. 2.50 chs. dist.  
 27.55 Left bank of Hualpai Wash, brs. N.60° W. and S.60° E.  
 Thence across wash, course N.60° W.  
 36.85 Right bank of Hualpai Wash, brs. N.60° W. and S.60° E. Asc.  
 100 ft.  
 39.50 Old road, brs. NW. and SE.  
 40.00 Set an iron post, 3 ft. long, 1 in. diam., on bed rock, in  
 a mound of stone, for ¼ sec. cor., marked on brass cap

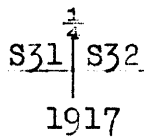

And raise a mound of stone, 3 ft. base, 2 ft. high, W.  
 of cor.  
 44.33 U. S. M. M. No. 2, Lost Basin Mining District, a mound of  
 stone, 5 ft. by 8 ft., with stone on top marked U. S.  
 M. Mt. 2, brs. E. 25 lks. dist.  
 Spur, slopes N.50° W. Desc. 150 ft.  
 53.80 Set an iron post, 3 ft. long, 1 in. diam., 12 ins. in the  
 ground, in a mound of stone, on the left bank of the  
 Colorado River, at mean high water mark, for meander  
 cor. of fracl. secs. 31 and 32, marked on brass cap



Subdivision of Fractional T. 31 N., R. 17 W.

Chains.

And raise a mound of stone, 3 ft. base, 2 ft. high, S. of cor.  
 Land, mountainous and rolling.  
 Soil, sandy and rocky, 3rd and 4th rates.  
 No timber.  
 Undergrowth, cat claw and greasewood.

11.82  
40.00

From the cor. of secs. 28, 29, 32 and 33,  
 West on a true line, bet. secs. 29 and 32.  
 Over mountainous land, through scattering undergrowth.  
 Asc. 170 ft.  
 Ridge, brs. N. and S. Desc. 575 ft.  
 Set an iron post, 3 ft. long, 1 in. diam., on bed rock, in a mound of stone, for  $\frac{1}{4}$  sec. cor., marked on brass cap

$\frac{1}{4}$  S29  
 $\frac{1}{4}$  S32  
 1917

43.13  
45.04  
53.82  
63.10

And raise a mound of stone, 3 ft. base, 2 ft. high, N. of cor.  
 Road, brs. N. to Gregg's Ferry and S. to Gold Basin.  
 Ravine, course N. Asc. 85 ft.  
 Spur, slopes N.20° W. Desc. 195 ft.  
 Set an iron post, 3 ft. long, 1 in. diam., 18 ins. in the ground, on the left bank of the Colorado River, at mean high water mark, for meander cor. of fracl. secs. 29 and 32, marked on brass cap

MC / T31N.  
 S29  
 S32  
 R17W  
 1917

And raise a mound of stone, 3 ft. base, 2  $\frac{1}{2}$  ft. high, E. of cor.  
 Land, mountainous.  
 Soil, rocky, 4th rate.  
 No timber.  
 Undergrowth, cat claw and greasewood.

1.85  
5.10  
12.30  
19.40  
29.14  
31.50  
31.80  
33.79  
36.80  
40.00

From the cor. of secs. 20, 21, 28 and 29,  
 West on a true line, bet. secs. 20 and 29.  
 Over broken land, through scattering undergrowth.  
 Asc. 185 ft.  
 Spur, slopes S.20° W. Desc. 75 ft.  
 Ravine, course N.85° W. Comes from S.50° E. Asc.  
 Thence over gently rolling land.  
 Desc. 185 ft.  
 Ravine, course S.80° W. Asc.  
 Spring brs. N. 40 lks. dist.  
 Desc. 15 ft.  
 Ravine, course N.45° W. Asc. 15 ft.  
 Desc. 30 ft.  
 Set an iron post, 3 ft. long, 1 in. diam., 6 ins. in the ground, in a mound of stone, for  $\frac{1}{4}$  sec. cor., marked on brass cap

S20  
 $\frac{1}{4}$  S29  
 1917

46.20

And raise a mound of stone, 3 ft. base, 2 ft. high, N. of cor;  
 Thence over gently rolling land.  
 Road, brs. N.20° E. to Gregg's Ferry and S.20° W. to Gold

Chains.

70.90

Basin.  
Set an iron post, 3 ft. long, 1 in. diam., 26 ins. in the ground, on the left bank of the Colorado River, at mean high water mark, for meander cor. of fract. secs. 20 and 29, marked on brass cap

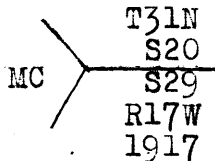

And raise a mound of stone, 2 ft. base, 1½ ft. high, E. of cor.  
Land, broken, rolling and gently rolling.  
Soil, rocky and sandy, 4th rate.  
No timber.  
Undergrowth, cat claw and mesquite.

7.56  
15.56  
17.56  
19.51  
20.83  
22.61  
38.40

From the cor. of secs. 16, 17, 20 and 21,  
West on a true line, bet. secs. 17 and 20.  
Over rolling land, through scattering undergrowth.  
Desc. 85 ft.  
Ravine, course N.30° W. Spring brs, S. 5 chs. dist.  
Irrigation ditch, 1 ft wide, 1 ft. deep, course N.40° W.  
Road, brs. N.40° W. and S.40° E.  
Irrigation ditch, course S.40° W.  
Road, brs. N. to Gregg's Ferry and S. to Gold Basin.  
W. H. Gregg's house brs. S. 4 chs. dist.  
Set an iron post, 3 ft. long, 1 in. diam., 26 ins. in the ground, on the left bank of the Colorado River, at mean high water mark, for meander cor. of fract. secs. 17 and 20, marked on brass cap

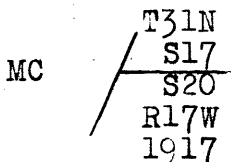

And raise a mound of stone, 2 ft. base, 2 ft. high, E. of cor.  
Land, rolling and nearly level.  
Soil, sandy and rocky, 3rd and 4th rates.  
No timber.  
Undergrowth, cat claw and mesquite.

3.60

From the cor. of secs. 8, 9, 16 and 17,  
West on a true line, bet. secs. 8 and 17.  
Over level land, through scattering undergrowth.  
Set an iron post, 3 ft. long, 1 in. diam., 26 ins. in the ground, on the left bank of the Colorado River, at mean high water mark, for meander cor. of fract. secs. 8 and 17, marked on brass cap

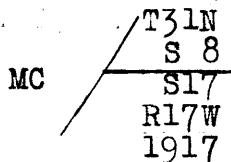

And raise a mound of stone, 3 ft. base, 2 ft. high, E. of cor.  
Land, level.  
Soil, sandy, 3rd rate.

Meanders of fractional Township 31 North, Range 17 West. 43

Chains.

Meanders left bank of the Colorado River, down stream.

From the meander cor. of fracl. secs. 4 and 33, on the N. bdy. of the Tp., which is an iron post, hereinbefore described.

Thence with meanders in fracl. sec. 4.

Over rolling land, thru. scattering undergrowth.

S. 24 1/2° W., 27.70 chs. At 2.20 chs., wash, course NW. At 12.40 chs., enter level land, brs. NW. and SE., and dense undergrowth. At 24.05 chs., enter sandy land, subject to overflow.

S. 17 1/2° E., 17.40 chs.

S. 38° E., 12.50 chs.

S. 52° E., 10.00 chs.

S. 54° E., 24.60 chs.

S. 25° E., 8.64 chs.

East, 1.60 chs. To the meander cor. of fracl. secs. 4 and 9, which is an iron post, hereinbefore described.

Land, level and rolling.

Soil, sandy, 1st rate.

No timber.

Undergrowth, greasewood and mesquite.

Thence in fracl. sec. 9.

Over level land, thru. dense undergrowth.

S. 8° W., 21.50 chs.

S. 57° W., 15.00 chs.

S. 41 1/2° W., 23.60 chs.

S. 29° W., 29.83 chs.

East, 0.47 chs. To the meander cor. of fracl. secs. 8 and 9, which is an iron post, hereinbefore described.

Land, level.

Soil, sandy, 1st rate.

No timber.

Undergrowth, greasewood and mesquite.

Thence, in fracl. sec. 8.

Over level land, thru. dense undergrowth.

Along sand bank, 30 ft. high.

S. 27 1/2° W., 3.60 chs.

S. 28 1/4° W., 4.10 chs.

To the meander cor. of fracl. secs. 8 and 17, which is an iron post, hereinbefore described.

Land, level.

Soil, sandy, 1st rate.

No timber.

Undergrowth, greasewood and mesquite.

Thence in fracl. sec. 17.

Over level land, thru. dense undergrowth.

Along sand bank, 30 ft. high.

S. 36° W., 3.00 chs.

S. 16 1/4° W., 11.40 chs.

S. 3 1/2° W., 5.00 chs.

S. 1 1/2° W., 17.10 chs.

S. 35 1/2° W., 45.50 chs. At 35.50 chs. on this course, ravine from S. 45° E. At 38.00 chs., Gregg's ferry, flat boat but no cable, brs. N. 4.00 chs. dist.

S. 19 1/4° W., 7.94 chs. To the meander cor. of fracl. secs. 17 and 20, which is an iron post,

44. Meanders of Fractional Township 31 North, Range 17 West.

Chains.

hereinbefore described.  
Land, level, Soil, sandy, 1st rate.  
No timber.  
Undergrowth, greasewood and mesquite.

-----  
Thence in fracl. sec. 20.  
Over rolling land, thru. dense undergrowth.  
S. 19° W., 2.11 chs.  
S. 35° W., 13.70 chs.  
S. 44 1/2° W., 40.00 chs.  
S. 27 1/2° W., 14.40 chs.  
S. 11° E., 14.50 chs.  
S. 24 1/2° E., 10.00 chs.  
S. 62° 35' E., 4.40 chs. To the meander cor. of fracl. secs.  
20 and 29, which is an iron  
post, hereinbefore described.  
Land, rolling.  
Soil, sandy, 1st rate.  
No timber.  
Undergrowth, catclaw and mesquite.

-----  
Thence in fracl. sec. 29.  
Over level land, thru. dense undergrowth.  
Along sandy bank, 25 ft. high.  
S. 2 3/4° W., 3.50 chs.  
S. 17 1/2° E., 14.60 chs.  
S. 43 3/4° E., 20.70 chs.  
S. 2 1/2° W., 15.50 chs. Along rocky bank, 40 ft. high. At  
3.00 chs. on this course, wash  
from E.  
S. 20° W., 26.50 chs.  
S. 7 3/4° W., 7.39 chs. To the meander, cor. of fracl. secs.  
29 and 32, which is an iron post  
hereinbefore described.  
Land, level and rolling.  
Soil, sandy, 1st rate and rocky, 4th rate.  
No timber. Undergrowth, greasewood and mesquite.

-----  
Thence in fracl. sec. 32.  
Over rolling land, thru. dense undergrowth.  
S. 29° W., 6.25 chs. At 5.25 chs. on this course, ravine  
from S. 40° E.  
S. 33 3/4° W., 25.00 chs. At 23.70 chs. on this course, ravine  
from S. 30° E. Thence along bank  
10 ft. high to meander cor. of  
fracl. secs. 31 and 32, hereinbe-  
fore described.  
Land, level and rolling.  
Soil, sandy, 1st rate.  
No timber.  
Undergrowth, greasewood, catclaw and mesquite.

-----  
Thence in fracl. sec. 31.  
Over level land, thru. dense undergrowth.  
N. 54 1/2° W., 14.90 chs.  
S. 65 1/2° W., 16.80 chs.  
S. 14° W., 23.20 chs. At 16.00 chs. on this course, Hual-  
pai wash, from S. 60° E.  
S. 3 3/4° W., 15.90 chs.  
S. 36 1/2° W., 20.00 chs.  
S. 64 1/2° W., 2.64 chs. To the meander cor. of fracl. secs.  
6 and 31 on S. bdy. of Tp., which  
is an iron post, hereinbefore  
described.  
Land, level and rolling,  
Soil, sandy and rocky, 1st and 4th rate.  
No timber. Undergrowth, greasewood, catclaw and mesquite.

Chains.

GENERAL DESCRIPTION.

This township lies in the breaks of the Colorado river, and is between the mouth of the Iceberg Canyon and the head of Virgin Canyon. The southeast corner is a rolling, sandy mesa, breaking abruptly to the north west, to the Colorado river breaks. The soil is principally rocks and sand, and of no value except in the vicinity of Gregg's ranch, where the settler has cleared portions of the river bottom, and cultivated them. The northeast corner is broken, light colored cliffs and ledges. In the extreme southwest, the formation is black malpais. In the SW.  $\frac{1}{4}$  of the NW.  $\frac{1}{4}$  of sec. 32 is located U.S.M.M.No.2, Lost Basin Mining District. There are springs in the SW.  $\frac{1}{4}$  of sec.32, and the SE.  $\frac{1}{4}$ , and the NE.  $\frac{1}{4}$  of sec.20. These springs are warm and salty to the taste. W.H.Gregg's house is in the NW.  $\frac{1}{4}$  of the NE.  $\frac{1}{4}$  of sec.20. There are no other settlers. Gregg operates a public ferry across the Colorado river in the SE.  $\frac{1}{4}$  of sec.17.

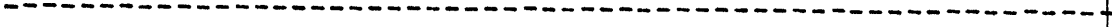





CERTIFICATE OF UNITED STATES SURVEYOR.

TRANSITMAN.

48

I, James C. Hooper, U. S. Surveyor, hereby certify upon honor that, in pursuance of special instructions received from the U. S. Surveyor General, for Group 77, Arizona, bearing date of the 14th day of October, 1916, I have well, faithfully, and truly in my own proper person, and in strict conformity with said instructions, the Manual of Surveying Instructions, and the laws of the United States, surveyed all those parts or portions of the West and North boundaries, and Meanders of the left bank of the Colorado River within TOWNSHIP 30 NORTH, RANGE 17 WEST, and all those parts or portions of the Subdivision lines, and Meanders within TOWNSHIP 31 NORTH, RANGE 17 WEST, of the Gila and Salt River Base and Meridian, in the State of Arizona, which are represented in the foregoing field notes and by diagram on page 2 hereof as having been executed by me, and under my direction; and that all the corners of said survey have been established and perpetuated in strict accordance with the Manual of Surveying Instructions, and the special written instructions of the U. S. Surveyor General, for Group 77, Arizona, and in the specific manner described in the field notes, and that the foregoing are the original field notes of such survey.

James C. Hooper

U. S. Surveyor - Transitman

APPROVAL.

OFFICE OF THE UNITED STATES SURVEYOR GENERAL,

....., 191

The foregoing field notes of the survey of .....

executed by .....

under his special instructions dated ....., 191, having been critically examined, and the necessary corrections and explanations made, the said field notes, and the surveys they describe, are hereby approved.

U. S. Surveyor General.

I certify that the foregoing transcript of the field notes of the above-described surveys in ....., has been correctly copied from the original notes on file in this office.

U. S. Surveyor General.



194

TRANSITMAN.  
~~SURVEYOR.~~

CERTIFICATE OF UNITED STATES

I, S. Frank Walters, <sup>Transitman</sup>~~Surveyor~~, U. S. ~~Surveyor~~, hereby certify upon honor that, in pursuance of special instructions received from the U. S. Surveyor General, for Group 77, Arizona, bearing date of the 14th day of October, 1916, I have well, faithfully, and truly in my own proper person, and in strict conformity with said instructions, the Manual of Surveying Instructions, and the laws of the United States, surveyed all those parts or portions of the East and North boundaries and Subdivision lines, and Meanders of the left bank of the Colorado River within TOWNSHIP 31 NORTH, RANGE 17 WEST, and all those parts of portions of N. and E. bdrs. of TOWNSHIP 30 NORTH, RANGE 17 WEST, of the Gila and Salt River Base & Meridian, in the State of Arizona, which are represented in the foregoing field notes <sup>and by diagram on page 2 hereof</sup> as having been executed by me, and under my direction; and that all the corners of said survey have been established and perpetuated in strict accordance with the Manual of Surveying Instructions, and the special written instructions of the U. S. Surveyor General for Group 77, Arizona, and in the specific manner described in the field notes, and that the foregoing are the original field notes of such survey.

*S. Frank Walters*  
U. S. ~~Surveyor~~  
Transitman.

APPROVAL.

OFFICE OF THE UNITED STATES SURVEYOR GENERAL,

Phoenix, Arizona, February 7, 1920

The foregoing field notes of the survey of part of the West bdy., North boundary, and part of the E. bdy., and Meanders of the left bank of the Colorado river, within TOWNSHIP 30 NORTH, RANGE 17 WEST, and East, and part of the North bdy., Subdivision lines, and Meanders of the left bank of the Colorado River within Tract TOWNSHIP 31 NORTH, RANGE 17 WEST, of the Gila and Salt River Base and Meridian, in the State of Arizona, executed by S. Frank Walters and James C. Hooper, U. S. Transitman, under ~~his~~ special instructions dated October 14, 1916, for Grp. 77, Ariz., having been critically examined, and the necessary corrections and explanations made, the said field notes, and the surveys they describe, are hereby approved.

*James C. Hooper*  
U. S. Surveyor General.

~~I certify that the foregoing transcript of the field notes of the above described surveys in~~ has been correctly copied from the original notes on file in this office.