

FIELD NOTES

OF THE RETRACEMENT OF

3rd. Standard Parallel North, thru part of Range 5 East, and

Portion of the Subdivision lines of Township 13 North, Range 5 East,

and RESURVEY of

Portions of the bdry. of Ft. Verde Garden Reservation,

Portions of the bdry. of Camp Verde Military Reservation,

The 3rd. Standard Parallel N., thru part of Range 5 East,

and

Parts of the East bdy. and Subdivision lines of

TOWNSHIP 13 NORTH, RANGE 5 EAST,

and SURVEY of

Parts of the East, North and West bdrs., and Subdivision lines of

TOWNSHIP 13 NORTH, RANGE 5 EAST, &

Part of the Subdivision lines of TOWNSHIP 13 NORTH, RANGE 4 EAST,

Of the Gila and Salt River Base and Meridian,

In the State of Arizona.

EXECUTED BY

William H. Richards, Jr. U.S.S.

with corrections of survey of part of Subdivision lines of T. 13 N.,

R. 5 E., by Sidney E. Blout, U. S. Cadastral Engineer,

In the capacity of U. S. Surveyor, under Special Instructions dated October 14., 1915,

issued by the United States Surveyor General to govern surveys included in Group

No. 61, Arizona, which were approved by the Commissioner of the General Land

Office, October 28., 1915, and Assignment Instructions dated January 6., 1916

ent,
and Survey commenced February 15., 1916. (Richards)

nt,
and Survey completed April 22., 1916. (Richards)

Corrections, March 7, 1919. (Blout)

3323

3323

SEE SPECIAL INDEX DIAGRAM.



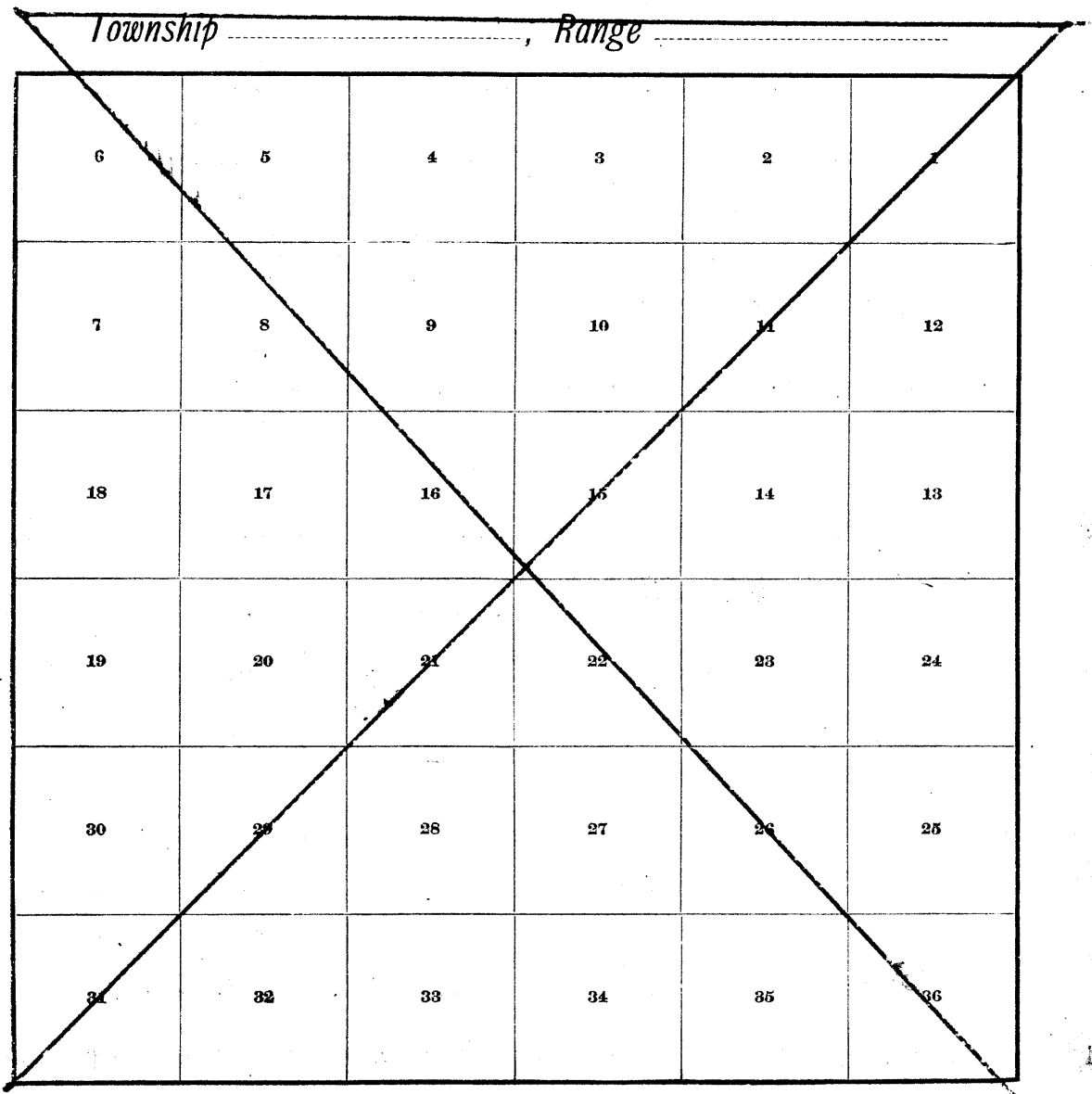



INDEX DIAGRAM.

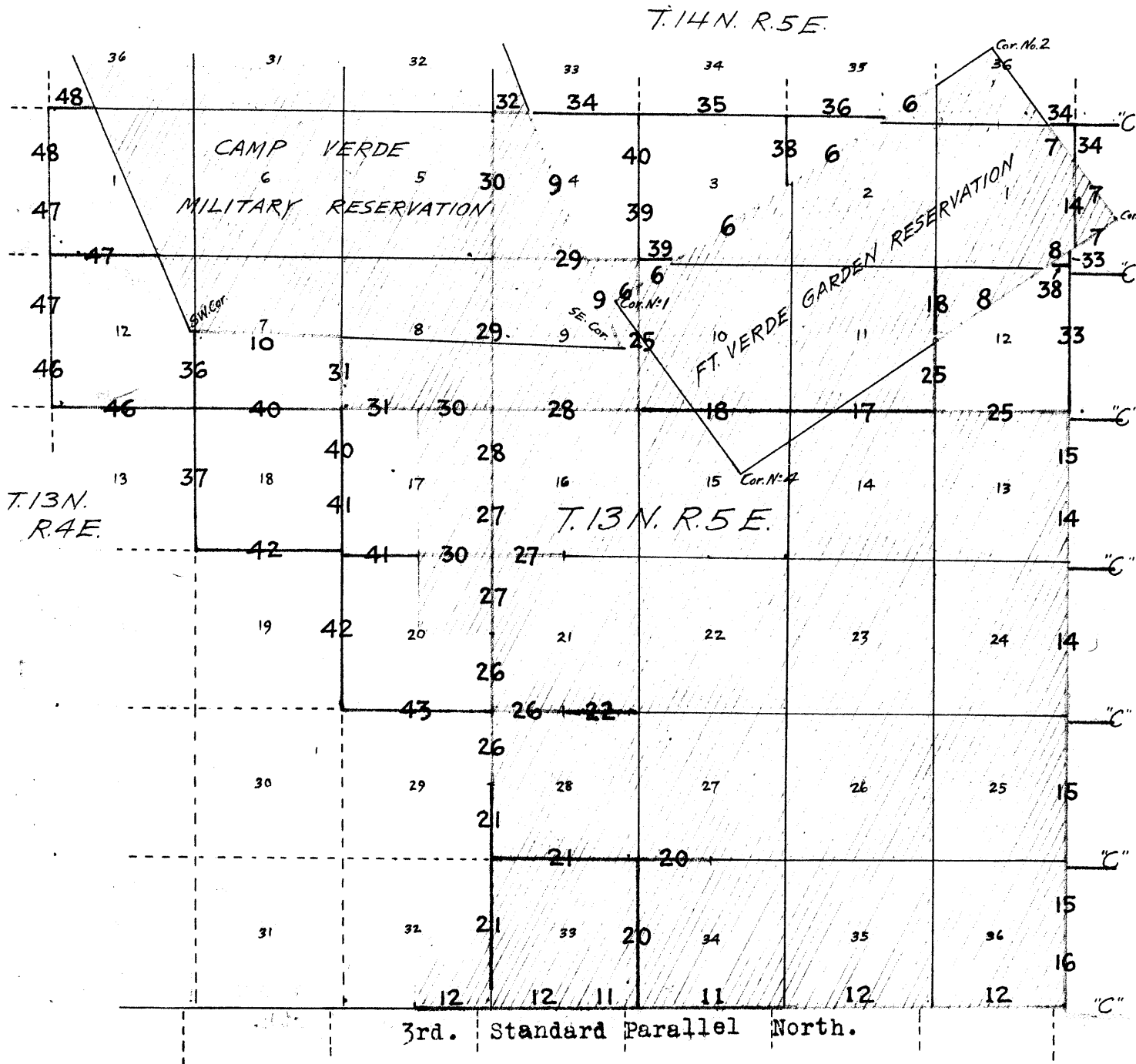

SPECIAL INDEX DIAGRAM

BOOK "B"- GROUP 61-ARIZONA.



-  Surveyed under this group.
-  Retraced under this group.
-  Resurveyed under this group.
-  Accepted surveys.
-  Unsurveyed.
-  Areas surveyed as per accepted plats on file.

"DATE-DIAGRAM"

BOOK "B"-GROUP 61, ARIZ.

BOOK 3323

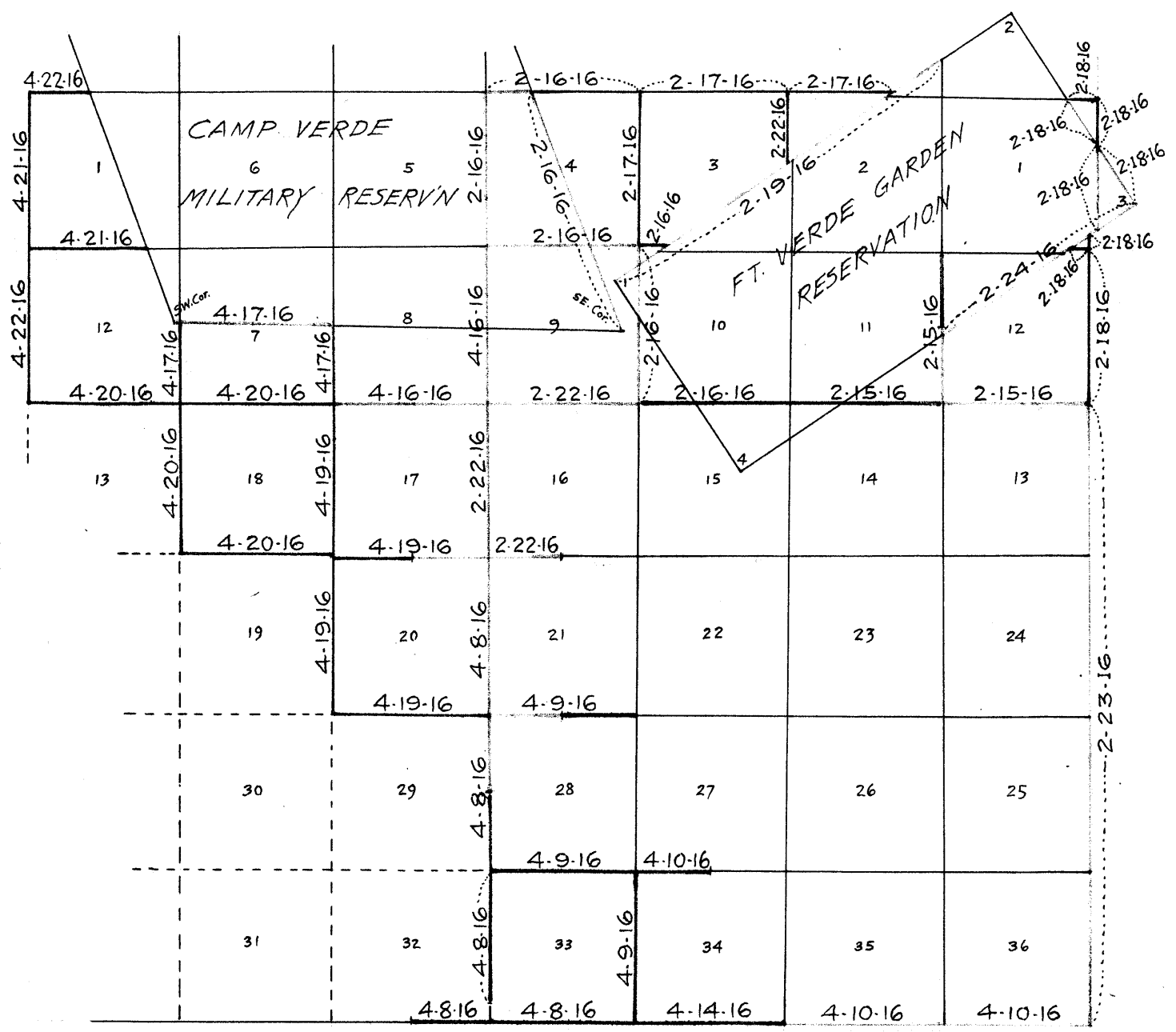

3rd. Standard Parallel North.

- Surveyed)
- Retraced) On dates shown above by Wm.H.Richards, Jr.U.S.S.
- Resurveyed)
- Accepted survey.
- Unsurveyed.

Field correction of $\frac{1}{4}$ sec.cors., on N., S., & W. bdrs. of sec. 20, by Sidney E. Blout, U.S. Cadastral Engineer.

Chains.

Retracements, Resurveys and Surveys hereinafter described, were executed by Wm. H. Richards, Jr., U.S. Surveyor, on dates shown on page 2 hereof, using Buff solar transit No. 9206, with Smith solar attachment. For description of instrument and certificate of approval, see Book "A."

Examine the adjustments of the transit and correct all errors; then, to test the solar apparatus, by comparing its indications resulting from solar observations made during a.m. and p.m. hours, with a meridian determined by observations on Polaris, proceed as follows: February 13, 1916. At camp in the NE. quarter of sec. 15, T. 13 N., R. 5 E., in lat. 34° 32' N.; long. 111° 48' W., at 4h. 0m. p.m., l.m.t., set off 34° 32' N., on the lat. arc; 13° 30' S. on the decl. arc, and determine a meridian with the solar, marking a point thereof by a nail in a stake 10 chs. N. of station.

At 9h. 53.6m. p.m., l.m.t. by watch, which is set to correct local mean time, observe Polaris at western elongation, and mark a point in the line thus determined on a stake set 10 chs. N. of station.

February 13, 1916.

February 14, 1916.

At 8h. a.m., l.m.t., lay off the azimuth of Polaris, 1° 22 1/4' to the east, and mark the meridian thus determined by a nail on the stake set last evening. Referred to this meridian, the bearing of the solar meridian determined last evening is N. 0° 0' 30" E.

At 8h. 10m. a.m., l.m.t., set off 34° 32' N. on the lat. arc; 13° 17' S. on the decl. arc, and determine a meridian with the solar; the line thus determined coincides with the meridian determined by solar last evening, whose bearing is N. 0° 0' 30" E.

The solar apparatus by a.m. and p.m. observations, defines positions for meridians which deviate only 30" from the true meridian; therefore, conclude that the adjustments of the solar are satisfactory.

Certain corrections were found to be required in the location of the 1/4 sec. cors. as set by Wm. H. Richards, U.S. Surveyor, on the N., S. and W. bdrs. of sec. 20, T. 13 N., R. 5 E., and said corrections were made by Sidney E. Blout, U.S. Cadastral Engineer in March, 1919, using a Buff solar transit No. 9984, described with record of test and certificate of approval, in Book "K," of this group. In the following notes such corners as are affected by the corrections made by Sidney E. Blout, U.S. Cadastral Engineer, are preceded by the initials "S.E. B."

RETACEMENT:--Part of Bdy. of FORT VERDE GARDEN RESERVATION.

Retacement for Resurvey.

Begin at the closing cor. of secs. 11 and 12 (reestablished in 1887 on line 4-3 (SE. line) of Fort Verde Garden Reservation bdy., which is a granite stone, 10x6x4 ins. above ground, firmly set, marked "FVGR CC" on NW. face, and witnessed by mound of stone NW. of cor.

Thence, N. 55° 00' E., on random line on line 4-3 (SE. line) of Fort Verde Garden Reservation bdy. SE. of that part of sec. 12, inside the Reservation.

80.01

Fall 23 lks. S. 35° E. of original closing cor. of those parts of secs. 1 and 12, lying inside the Fort Verde Garden Reservation, which is a limestone, 11x8x4 ins. above ground, firmly set, marked "FVGR CC" on NW. face,

Retracement: Part of bdy. of Fort Verde Garden Reservation bdy.
Retracement for resurvey.

Chains.

- and witnessed by a mound of stone NW. of cor..
True course and dist. of that part of line 4-3 (SE. line)
of Fort Verde Garden Reservation bdy. forming SE. bdy.
of that part of sec. 12 inside the Reservation are there-
fore S. 54° 50' W., 80.01 chs.
Thence,
N. 55° 00' E., on a random line, on line 4-3 (SE. line) of
Fort Verde Garden Reservation bdy., SE. of that part of
sec. 1, inside the reservation.
- 13.28 Intersect the original closing cor. of those parts of S.
halves of secs. 1 and 6, T. 13 N., R. 5 and 6 E. lying
inside the reservation, which is a limestone, 26x11x6
ins., set in a mound of stone; marked "FVGR CC" on NW.
face. No accessories visible.
True course and dist. of that part of line 4-3 (SE. line)
of Fort Verde Garden Reservation bdy. forming SE. bdy.
of that part of sec. 1 inside the Reservation are there-
fore S. 55° 00' W., 13.28 chs.
Thence,
N. 55° 00' E., on random line on line 4-3 (SE. line) of Fort
Verde Garden Reservation bdy. SE. of that part of sec.
6, T. 13 N., R. 6 E. inside the Reservation.
- 30.58 Intersect the original cor. No. 3 of the Reservation, which
is a limestone 15x8x6 ins. above ground, firmly set,
marked "FVGR No. 3" on W. face.
No trace of the original mound of stone and bearing tree
can be found.
True course and dist. of that part of line 4-3 (SE. line)
of Fort Verde Garden Reservation bdy., which form the
SE. bdy. of that part of sec. 6, T. 13 N., R. 6 E. inside
the reservation, are therefore S. 55° 00' W., 30.58 chs.
Thence,
N. 35° 00' W., on random line, on that part of line 3-2
(NE. line) of Fort Verde Garden Reservation bdy. within
sec. 6, T. 13 N., R. 6 E.
- 43.01 Fall 6 lks. S. 55° W. of original closing cor. of those
parts of north halves of secs. 1 and 6, T. 13 N., R. 5
and 6 E., lying inside the Reservation, which is a lime-
stone, 16x10x8 ins., loosely set in a mound of stone,
marked "FVGR CC" on SW. face. No accessories visible.
True course and dist. of that part of line 3-2 (NE. line)
of Fort Verde Garden Reservation bdy. within sec. 6, T. 13
N., R. 6 E. are therefore S. 34° 55' E., 43.01 chs.
Thence,
N. 35° 00' W., on random line on that part of line 3-2 (NE.
line) of Fort Verde Garden Reservation bdy. within sec.
1, T. 13 N., R. 5 E.
- 20.14 Fall 12 lks. S. 55° W. of original closing cor. of secs. 1
and 36, T. 13 and 14 N., R. 5 E., which is a limestone,
12x12x9 ins. above ground, firmly set, marked "FVGR CC"
on SW. face. No trace of mound of stone can be found.
No bearing trees.
True course and dist. of that part of line 3-2 (NE. line)
of Fort Verde Garden Reservation bdy. within sec. 1 are
therefore S. 34° 40' E., 20.14 chs.
-
- The original closing cor. of secs. 35 and 36, T. 14 N., R. 5
E. is a limestone, 24x12x8 ins. in a mound of stone,
faintly marked on SE. face, but marks illegible, and
witnessed by a mound of stone SE. of cor. No bearing
trees.
Thence,
S. 55° 00' W., on a random line, on that part of line 2-1
(NW. line) of Fort Verde Garden Reservation bdy. which
forms NW. bdy. of that part of sec. 35, T. 14 N., R. 5 E.,
inside the Reservation.

Retracement: Part of bdy. of Fort Verde Garden Reservation bdy. 5

Chains.		
36.79	<p>Fall 160 lks. S. 35° E. from original closing cor. of those parts of secs. 2 and 35, Ts. 13 and 14 N., R. 5 E. lying inside the Reservation, which is a limestone, 10x8x6 ins. above ground, firmly set, marked "FVGR CC" on SE. face, and witnessed by mound of stone SE. of cor. No bearing trees.</p> <p>True course and dist. of that part of line 2-1 (NW. line) of Fort Verde Garden Reservation bdy. forming NW. bdy. of that part of sec. 35 inside the reservation are N. 57° 29' E., 36.83 chs.</p>	
	<p>Thence, S. 55° 00' W., on random line, on that part of line 2-1 (NW. line) of Fort Verde Garden Reservation bdy., which forms NW. bdy. of that part of sec. 2 inside the Reservation.</p>	
62.05	<p>Fall 43 lks. S. 35° E. of original closing cor. of those parts of secs. 2 and 3 lying inside the Reservation, which is a limestone 24x12x12 ins. above ground, firmly set, marked "FVGR CC" on SE. face, and witnessed by mound of stone, SE. of cor.</p> <p>True course and dist. of that part of line 2-1 (NW. line) of Fort Verde Garden Reservation bdy., forming NW. bdy. of that part of sec. 2 inside the Reservation, are therefore N. 55° 25' E., 62.05 chs.</p>	
	<p>Thence, S. 55° 00' W., on random line, on that part of line 2-1 (NW. line) of Fort Verde Garden Reservation bdy., which forms NW. bdy. of that part of sec. 2 inside the Reservation.</p>	
62.05	<p>Fall 43 lks. S. 35° E. of original closing cor. of those parts of secs. 2 and 3 lying inside the Reservation, which is a limestone 24x12x12 ins. above ground, firmly set, marked "FVGR CC" on SE. face, and witnessed by mound of stone, SE. of cor.</p> <p>True course and dist. of that part of line 2-1 (NW. line) of Fort Verde Garden Reservation bdy., forming NW. bdy. of that part of sec. 2 inside the Reservation, are therefore, N. 55° 25' E., 62.05 chs.</p>	
	<p>Thence, S. 55° 00' W., on random line, on that part of line 2-1 (NW. line) of Fort Verde Garden Reservation bdy., which forms NW. bdy. of that portion of sec. 3 inside the Reservation.</p>	
80.84	<p>Fall 2.68 chs. S. 35° E., of original closing cor. of those parts of secs. 3 and 10 lying inside the Reservation, which is a limestone, 10x10x8 ins. above ground, firmly set, marked "FVGR CC" on SE. face, and witnessed by mound SE. of cor. No bearing trees.</p> <p>True course and dist. of that part of line 2-1 (NW. line) of Fort Verde Garden Reservation bdy. forming NW. bdy. of that part of sec. 3 inside the Reservation are therefore N. 56° 54' E., 80.89 chs.</p>	
	<p>Thence, S. 55° 00' W., on a random line, on that part of line 2-1 (NW. line) of Fort Verde Garden Reservation bdy., which forms NW. bdy. of that part of sec. 10 inside the Reservation.</p>	
20.20	<p>Fall 12 lks. N. 35° W. of closing cor. of secs. 9 and 10, which is a limestone, 10x10x8 ins. above ground, firmly set, marked "FVGR CC" on SE. face, and witnessed by a mound of stone SE. of cor. No bearing trees. (This cor. was reestablished in 1887).</p> <p>True course and dist. of that part of line 2-1 (NW. line) of Fort Verde Garden Reservation bdy. forming NW. bdy. of that part of sec. 10 inside the reservation, are therefore N. 54° 40' E., 20.20 chs.</p>	
	<p>Thence, S. 55° 00' W., on a random line, on line 2-1 (NW. line) of Fort Verde Garden Reservation bdy. in sec. 9.</p>	
10.37	<p>Fall 1 lk. S. 35° E. of original cor. No. 1, or initial mon. of the bdy. of the Fort Verde Garden Reservation, which</p>	

6
 Retracement: Part of Bdy. of Fort Verde Garden Reservation.

Chains.

is a limestone, 15x11x13 ins. above ground, firmly set, marked "IMFVGR No.1" on E. face, and witnessed by a mound of stone E. of cor. No bearing trees. True course and dist of line 2-1 (NW. line) of Fort Verde Garden Reservation bdy. in sec. 9 are therefore N. 55° 03' E., 10.37 chs.

 RESURVEY-Part of Bdy. of Fort Verde Garden Reservation.

- From original cor. No. 1 or Initial Mon. of Fort Verde Garden Reservation bdy. described above, N. 55° 03' E. on a true line, on line 1-2 (NW. line) of Fort Verde Garden Reservation bdy. in sec. 9. Over mountainous land, thru scattering undergrowth. Ascend steeply.
- 10.37 Intersect closing cor. of secs. 9 and 10, hereinbefore described. Reestablish this cor. by moving mound of stone 2 ft. base, 1½ ft. high from SE. to S. of cor., and reset stone in same place with same dimensions above ground, placing marking to the south.
- Thence, N. 54° 40' E., on true line, NW. of sec. 10. Over mountainous land, thru scattering undergrowth. Ascend steeply.
- 20.20 Intersect original closing cor. of those parts of secs. 3 and 10, inside the Reservation, hereinbefore described. Reestablish this cor. by moving mound of stone 2 ft. base, 1½ ft. high from SE. to E. of cor., and reset stone in same place, with same dimensions above ground, placing marking to east.
- Thence, N. 56° 54' E., on true line, NW. of sec. 3. Over mountainous land, thru scattering undergrowth. Ascend steeply.
- 19.04 Top of steep ascent, brs. N. and S. Ascend more gradual slope.
- 34.54 Spur, slopes S. 20° W., 255 ft. above closing cor. of secs. 3 and 10. Descend 30 ft.
- 44.99 Wash, 5 lks. wide, 2 ft. deep, course S. Ascend 65 ft.
- 62.04 Spur, slopes S. Descend 185 ft. to
- 80.89 Intersect original closing cor. of those parts of secs. 2 and 3 inside the Reservation, hereinbefore described. Reestablish this cor. by moving mound of stone, 2 ft. base, 1½ ft. high, from SE. to S. of cor., and reset stone in same place with same dimensions above ground, placing marking to the south.
- Thence, N. 55° 25' E., on true line, NW. of sec. 2. Over mountainous land, thru scattering undergrowth. Descend 30 ft.
- 12.00 Gulch, course S. Ascend 40 ft.
- 18.00 Spur, slopes W. Descend 25 ft.
- 20.00 Gulch, 2 chs. wide, course W. Ascend 45 ft.
- 28.00 End of spur, slopes N. 50° W. Ascend 120 ft. alongside of gulch, which brs. S. 50° W. about 150 lks. NW. of line.
- 62.05 Intersect original closing cor. of these parts of secs. 2 and 35, T. 13 and 14 N., R. 5 E., inside the Reservation, hereinbefore described. Reestablish this cor. by moving mound of stone 2 ft. base, 1½ ft. high, from SE. to E. of cor., and resetting stone to same dimensions above ground, with marking to the east.
- Thence, N. 57° 29' E., on true line, NW. of sec. 35, T. 14 N., R. 5 E. Over mountainous land, thru scattering undergrowth. Ascend along side of gulch, course S. 50° W. about 150 lks. NW. of line.
- 36.83 Intersect original closing cor. of secs. 35 and 36, T. 14 N. R. 5 E., hereinbefore described. Reestablish this cor.

RESURVEY - Part of Bdy. of Fort Verde Garden Reservation.

Chains.

in same place by resetting same stone 24x12x8 ins., 18 ins. in the ground, and raise a mound of stone 2 ft. base, 1 1/2 ft. high, S. of cor. Place the marking on stone to the S. The marking being indistinct, renew the marking to plainly read "FVGR CC".

That portion of line 1-2 (NW. line) of Fort Verde Garden Reservation bdy. resurveyed as hereinbefore described has general description as follows:

Land, mountainous.
Soil, rocky and gravelly, 4th rate.
No timber.
Undergrowth, scattering mesquite, scrub oak and catclaw.
No grass.

Resurvey a part of line 2-3 (NE. line) of Fort Verde Garden Reservation bdy. as follows:

Reestablish the closing cor. of secs. 1 and 36, Ts. 13 and 14 N., R. 5 E., hereinbefore described by resetting stone in same place with same dimensions above ground, placing marking to the west, and raise a mound of stone, 2 ft. base, 1 1/2 ft. high, W. of cor.

Thence,
S. 34° 40' E., on true line, NE. of sec. 1.
Over mountainous land, thru scattering undergrowth. Descend.

20.14 Intersect the closing cor. of those parts of N. halves of secs. 1 and 6, Ts. 13 N., Rs. 5 and 6 E. lying inside the Reservation, hereinbefore described. Reestablish this cor. in same place by resetting the stone 16x10x8 ins., 11 ins. in the ground, with marking to the south, and raise a mound of stone, 2 ft. base, 1 1/2 ft. high, S. of cor.

Thence,
S. 34° 55' E., on true line in sec. 6, T. 13 N., R. 6 E.
Over mountainous land, thru scattering undergrowth. Descend.

43.01 Intersect original cor. No. 3 of Reservation, hereinbefore described.
Reestablish this cor. by raising a mound of stone, 2 ft. base, 1 1/2 ft. high, W. of cor. No bearing trees within limits.

That portion of line 2-3 (NE. line) of Fort Verde Garden Reservation bdy. resurveyed as hereinbefore described has general description as follows:

Land, mountainous.
Soil, rocky, 4th rate.
No timber.
Undergrowth, scattering catclaw, scrub oak and mesquite.
No grass.

Resurvey a part of line 3-4 (SE. line) of Fort Verde Garden Reservation, as follows:

From reestablished cor. No. 3, hereinbefore described, S. 55° 00' W., on true line, SE. of that part of sec. 6, T. 13 N., R. 6 E., inside the Reservation.

Over rolling land, thru scattering undergrowth. Descend SW. slope.

30.43 Road brs. N. 50° W. and S. 50° E.

30.58 Intersect the original closing cor. of those parts of S. halves of secs. 1 and 6 lying inside the Reservation, hereinbefore described.

Reestablish this cor. in same place by resetting the stone 26x11x6 ins., 18 ins. in the ground with marking to the N., and raise a mound of stone, 2 ft. base, 1 1/2 ft. high, N. of cor. No bearing trees within limits.

Thence,

Chains.	
11.78 13.28	S. 55° 00' W., on true line, SE. of sec. 1. Over rolling land, thru scattering undergrowth; descend. Wash, course W. Ascend gradually.
4.00	Intersect original closing cor. of those parts of secs. 1 and 12 inside the Reservation, hereinbefore described. Reestablish this cor. in same place by resetting stone with same dimensions above ground, placing marking to the west, and move mound of stone, 2 ft. base, 1½ ft. high, from NW. to W. of cor. No bearing trees within limits. Thence, S. 54° 50' W., on true line, SE. of that part of sec. 12, inside the Reservation.
80.01	Over rolling land, thru scattering undergrowth. Descend. Enter gulch, course SW. from E. Thence descend alongside of gulch.
	Intersect the closing cor. of secs. 11 and 12, hereinbefore described. Reestablish this cor. in same place, by resetting stone with same dimensions above ground, placing marking to the N., and move mound of stone, 2 ft. base, 1½ ft. high, from NW. to N. of cor. No bearing trees within limits. That portion of line 3-4 (SE. line) of Fort Verde Garden Reservation bdy. resurveyed as hereinbefore described, has general description as follows: Land, mountainous and rolling. Soil, rocky and gravelly, 3rd and 4th rate. No timber. Undergrowth, scattering mesquite and catclaw. No grass.
	----- RETRACEMENT: Part of Bdy. of Camp Verde Military Reservation.
139.30	Retracement for Resurvey: The original closing cor. of secs. 4 and 33, at intersection of N. bdy. of T. 13 N., R. 5 E. with E. line of bdy. of Camp Verde Military Reservation bdy. is a limestone, 16x14x8 ins. above ground, firmly set, marked "CVMR CC" on W. face, with remains of the original mound of earth, W. of cor. No trace of original pits. No bearing trees. Thence, S. 21° 37' E., on a random line, on E. line of Camp Verde Military Reservation bdy. Fall 51 lks. S. 68° 23' W. of original SE. cor. of reservation, which is a post 4x6 ins., 4 ft. above ground in a mound of stone. Post is unmarked, and there are no accessories. True course and dist. of above described part of E. line of Camp Verde Military Reservation are therefore S. 21° 50' E., 139.30 chs.
14.75	----- The initial monument on S. line of Camp Verde Military Reservation bdy., identical with original ¼ sec. cor. of secs. 7 and 8, could not be found after diligent search, but accepted as its previous position, a point identified by Lewis Ball, a settler of long residence in the vicinity as the point of former location of the missing original cor. Thence, N. 86° 30' W., on random line, on S. line of Camp Verde Military Reservation bdy. thru. sec. 7, T. 13 N., R. 5 E. Fall 2 lks. N. 3° 30' E., of original meander cor. of left bank of the Verde River, which is a malpais stone, 16x13x5 ins. above ground, firmly set, marked "MC" on W. face, and witnessed by a pit and mound of earth E. of cor. No bearing trees. True course and dist. of S. line of Camp Verde Military Reservation bdy. from Initial Mon. to this M.C. are therefore N. 86° 35' W., 14.75 chs. Thence, N. 86° 30' W., on random line, continuing measurement.

RETRACEMENT: Part of Bdy. of Camp Verde Military Reservation. 8

Chains

- 67.14 Discontinue chaining at this point, and triangulate measurement across Verde River as follows:
Set flag on line beyond the water on W. side of river,
Lay off a base from 67.14 ch. sta., S. 3° 30' W., 3 chs.
From S. end of base, flag brs. N. 54° 10' W.
Included angles are, 57° 40', 32° 20' and 90° 00', the sum of which is 180° 00'.
Dist. bet. 67.14 chs. sta. and flag is obtained by $\text{tang. } 57^\circ 40' \times \text{base}$, or $1.57981 \times 3.00 = 4.74$ chs., which added to 67.14 chs. =
-
- 71.88 Flag point of above described triangulation. Continue measurement by chaining.
- 76.20 Diligent search in this vicinity fails to reveal any trace of original meander cor. of Right Bank of Verde River.
- 79.84 Fall 50 lks. N. 3° 30' E. of original closing cor. of secs. 7 and 12 at intersection of W. bdy. of T. 13 N., R. 5 E. with S. line of Camp Verde Military Reservation bdy., which is a malpais stone 24x13x11 ins. above ground, firmly set, marked "CC" on N. face. No accessories visible.
- 80.14 Fall 50 lks. N. 3° 30' E. of SW. cor. of Reservation, which is a sawed post, 4x6 ins., 3 ft. above ground in a mound of earth, marked "SW. cor. No. 1, U.S. Mil. Res. 1876," and witnessed by faint traces of pits N. 23° 16' W. and S. 86° 30' E. of post. No bearing trees.
True course and dist. of S. line of Camp Verde Military Reservation bdy. from M.C. on left bank of Verde River to the SW. cor. of Reservation, are therefore, N. 86° 56' W., 65.39 chs.

RESURVEY--Part of bdy. of Camp Verde Mil. Reservation.

- Reestablish the closing cor. of secs. 4 and 33 at intersection of N. bdy. of T. 13 N., R. 5 E. with E. line of Camp Verde Military Reservation, hereinbefore described, by destroying the remains of the mound of earth W. of cor., and in same place raise a mound of stone, 2 ft. base, 1½ ft. high.
- Thence,
S. 21° 50' E., on true line, on E. line of Camp Verde Military Reservation bdy., thru. sec. 4, and part of sec. 9, T. 13 N., R. 5 E.
Over rolling land, thru. scattering undergrowth.
- 19.90 Road brs. S. 50° W. and N. 50° E.
22.10 Dim road brs. E. and W.
22.40 Shack brs. E. 2 chs. dist.
26.90 Wash, 25 lks. wide, 4 ft. deep, course S. 35° W.
69.50 Wash, 25 lks. wide, 3 ft. deep, course S. 60° W.
89.01 Telephone line brs. N. 40° W. and S. 40° E.
90.41 Road brs. N. 45° W. and S. 45° E. Ascend 75 ft.
102.45 Spur, slopes W. Descend.
139.30 Intersect the original SE. cor. of Reservation hereinbefore described. Reestablish this cor. by marking "SE. cor. C.V.M.R." and raise a mound of stone 2 ft. base, 1½ ft. high, NW. of cor.

Reestablish the ¼ sec. cor. of secs. 7 and 8, identical with Initial Mon. of Camp Verde Military Reservation on S. line thereof, at the point hereinbefore described, as follows:

Set a granite stone, 21x8x7 ins., 16 ins. in the ground, marked "1" on W. face, and establish bearing trees to cor. as follows:

On a cottonwood, 23 ins. in diam., bearing S. 89½° E., 145 lks. dist., mark "1S8BT" and

Chains.	
	On a cottonwood, 20 ins. in diam., bearing N. $70\frac{1}{2}^{\circ}$ W., 40 lks. dist., mark "1S 7 B T."
	Thence, N. $86^{\circ} 35'$ W., on true line, on S. line of Camp Verde Military Reservation bdy.
	Over rolling land, thru scattering undergrowth.
14.75	Fence, brs. N. and S. Intersect original meander cor. of Left Bank of Verde River, hereinbefore described.
	Thence, N. $86^{\circ} 56'$ W., on true line, on S. line of Camp Verde Military Reservation bdy., continuing measurement.
15.00	Fence brs. N. 50° W. and S. 50° E. Enter young orchard.
19.20	Leave orchard, brs. N. and S.
39.98	Fence, brs. N. and S.
63.35	Fence, brs. N. and S.
67.14	A point 40 lks. N. of triangulation point hereinbefore described.
69.40	Left, or E. edge of water, brs. N. and S. Thence across running water of Verde River, course S. Measurement obtained by return measurement S. $86^{\circ} 56'$ E., 38 lks. from a point 43 lks. N. of flag point of triangulation, hereinbefore described, to
71.50	Right, or W. edge of water, brs. N. and S. Leave water, thence across river bed.
71.88	A point 43 lks. N. of flag point hereinbefore described. Thence by chain measurement.
72.20	Fence, brs. N. 20° E. and S. 20° W.
72.80	Right bank of Verde river, brs. N. 30° E. and S. 30° W. Road brs. N. 20° E. and S. 20° W.
77.20	Ditch, course S.
77.25	Fence, brs. N. and S.
79.84	Intersect original closing cor. of secs. 7 and 12, on W. bdy. of T. 13 N., R. 5 E., hereinbefore described. Reestablish this cor. by adding marking "C.V.M.R." on N. face, and raising a mound of stone 2 ft. base, $1\frac{1}{2}$ ft. high, N. of cor.
80.14	Continue line and measurement. Intersect the SW. cor. of Camp Verde Military Reservation hereinbefore described. Reestablish this cor. by raising a mound of stone NE. of cor.
	Land, rolling and level river bottom. Soil, sandy and gravelly, 2nd and 3rd rate. No timber except scattering cottonwood along river. Undergrowth, scattering mesquite and catalaw. Fair grass.

Retracement 3rd Standard Parallel North thru Part of R. 5 E.

Chains	From the point of original location of the std.cor.of Rs.13 N.,Rs.5 and 6 E.,identified by remains of an old stake in a mound of stone, West, on random line, S. of sec. 36.
40.00	Diligent search in this vicinity failed to reveal any trace of the original std. $\frac{1}{4}$ sec.cor.
80.00	Diligent search in this vicinity failed to reveal any trace of the original std.cor.of secs.35 and 36. Continue line & measurement S. of sec.35.
120.00	Diligent search in this vicinity failed to reveal any trace of the original std. $\frac{1}{4}$ sec.cor.
161.14	Fall 2.61 chs. S. of the original std.cor.of secs.34 and 35,which is a granite boulder,9x8x8 ins.above ground, marked with 2 notches on E. and 4 notches on W. edge and "SC" on N. face and witnessed by a mound of stone N.of cor. True course and dist.of Parallel,S.of secs.35 and 36,are therefore, N.89°04' W.,161.16 chs.,or for S.bdy.of each of said secs., N'89°04'W.,80.58 chs. See resurvey of this portion of the Parallel hereinafter described.
From original std.cor.of secs.34 and 35,described above	
40.00	West,on random line, S. of sec. 34 Diligent search in this vicinity failed to reveal any trace of the original std. $\frac{1}{4}$ sec.cor.
80.60	Fall 25.79 chs. N. of the original std.cor.of secs.33 and 34,which is a mound of stone,with remains of a cedar post-indistinctly marked,but identified by G.W.Hantz,settler of long residence in this vicinity,as the original std.cor. of secs.33 and 34. This cor.stands beside a National Forest Reserve boundary Post. True course and dist.of Parallel, South of sec.34 are therefore, S.72°15'W.,84.63 chs. Return to std.cor.of secs.34 and 35, thence, S.72°15'W.,on true line,on S.bdy.of sec.34 Over rolling land,thru scattering undergrowth. Descend 90 ft.
6.00	Bottom of gulch,course N.30°E. Ascend 200 ft.over rolling NE.slope to std.cor.of secs.33 and 34.
42.31	Another diligent search in this vicinity failed to reveal any trace of the original std. $\frac{1}{4}$ sec.cor.
60.50	Arizona Power Co's power transmission line,brs.N.35°10'W. and S.35°10'E.
78.75	Bottom of gulch,course N. Ascend.
84.63	Intersect the original std.cor.of secs.33 and 34,hereinbefore described. Land, rolling. Soil,rocky, 4th rate. Timber,scattering cedar. Undergrowth,scattering catclaw,mesquite and scrub oak. Poor grass.
From original std.cor.of secs.33 and 34,hereinbefore described,	
40.00	West, on random line, S. of sec.33 Diligent search in this vicinity failed to reveal any trace of the original std. $\frac{1}{4}$ sec.cor.
80.00	Diligent search in this vicinity failed to reveal any trace of the original std.cor.of secs.32 and 33. Continue line and measurement S. of sec.32
119.49	Fall 36.22 chs. N.of the original std. $\frac{1}{4}$ sec.cor.of sec.32 which is a granite stone, 22x12x6 ins.,in a mound of stone marked " $\frac{1}{4}$ ". Reestablish this cor.in same place by resetting same stone,17 ins.in the ground and by building a mound of stone,2 ft.base,1 $\frac{1}{2}$ ft. high, N. of cor. True course and dist.of Parallel, S. of sec.33 and E. $\frac{1}{2}$ of sec.32, are therefore, S.73°08'W.,124.86 chs.,and for each half of S.bdrs.of said secs., S.73°08'W.,41.62 chs. Return to std.cor.of secs.33 and 34, Thence S.73°08'W.,on true line,on S. bdy.of sec.33 Over rolling land, thru scattering timber and undergrowth. Descend 75 ft.

Retracement, 3rd Std. Parallel N., thru part of R. 5 E.

Chains	
15.50	Bottom of gulch, course N.40°E., water 1 lk. wide, 1 in. deep.
41.62	Another diligent search in this vicinity failed to reveal any trace of the original std. $\frac{1}{4}$ sec. cor. of sec. 33.
45.60	Wash, 5 lks. wide, 2 ft. deep, course N.60°E. Ascend
83.24	point for reestablishment of std. cor. of secs. 32 and 33. Another diligent search in this vicinity failed to reveal any trace of the original std. sec. cor. This point is about 300 ft. above the std. cor. of secs. 33 and 34, on a rolling NE. slope. Land, rolling. Soil, rocky, 4th rate. Timber, scattering cedar. Undergrowth, scattering catclaw, mesquite and scrub oak. Fair grass. From point for reestablishment of std. cor. of secs. 32 and 33, described above S.73°08'W., on true line, on S. bdy. of sec. 32 (E. $\frac{1}{2}$) Over rolling land, thru scattering timber & undergrowth Ascend NE. slope.
19.26	Bottom of gulch, 5 chs. wide, 20 ft. deep, course N.50°E. Asc.
41.62	intersect the reestablished std. $\frac{1}{4}$ sec. cor. of sec. 32, hereinbefore described. This cor. is about 100 ft. above the point for std. cor. of secs. 32 and 33. From this $\frac{1}{4}$ sec. cor., U.S.L.M. No. 1328, Squaw Peak Mining District, brs. S.47°47 $\frac{1}{2}$ 'W., 12.14 chs. dist. Land, rolling. Soil, rocky, 4th rate. Timber, scattering cedar. Fair grass. Undergrowth, scattering catclaw, mesquite and scrub oak.
Resurvey, 3rd Std. Parallel N., thru part of R. 5 E.	
Reestablish the std. cor. of Tns. 13 N., Rs. 5 & 6 E., in its point of original location hereinbefore described, by setting a volcanic stone, 22x15x11 ins., 17 ins. in the ground marked "SC" on N., and 6 grooves on each of N., E. and W. faces and raise a mound of stone, 2 ft. base, 1 $\frac{1}{2}$ ft. high, N. of cor. Thence, N.89°04'W., on true line, on S. bdy. of sec. 36. Over rolling land, thru scattering timber & undergrowth.	
25.00	Descend 105 ft.
40.29	(Proportional dist.) Set a malpais stone, 22x16x8 ins., 14 ins. in the ground, for reestablished std. $\frac{1}{4}$ sec. cor., marked "SC $\frac{1}{4}$ " on N. face; and raise a mound of stone, 2 ft. base, 1 $\frac{1}{2}$ ft. high, N. of cor.
58.45	Top of bluff, brs. N. and S. Descend
61.65	Edge of water in Verde River, brs. N. & S. Thence across water 18 ins. deep, course S.
64.35	Edge of water, brs. N. & S. Leave water. Ascend 40 ft.
70.00	Top of river bank, brs. N. & S. Asc. gradually.
80.58	(Proportional dist.) Set a limestone, 22x14x10 ins., 14 ins. in the ground, for reestablished std. cor. of secs. 35 & 36, marked "SC" on N., and 5 grooves on W. & 1 groove on E. face, and raise a mound of stone, 2 ft. base, 1 $\frac{1}{2}$ ft. high, N. of cor. Land, rolling. Soil, adobe and gravel, 3rd rate Timber, scattering cottonwood and sycamore along the river. Undergrowth, scattering catalaw & mesquite. Fair grass.
N.89°04'W., on true line, on S. bdy. of sec. 35	
17.50	Over rolling land, thru scattering undergrowth. Ascend.
20.60	Top of bluff, 45 ft. high, brs. N.60°E. and S.60°W. Descend.
35.40	Foot of bluff, thence across Verde river bottom. Edge of water, brs. N.60°E. and S.60°W. Thence across water 14 ins. deep, course N.60°E. Verde River.
40.29	(Proportional dist.) True point for reestablishment of std. $\frac{1}{4}$ sec. cor. falls in Verde River
40.70	Edge of water, brs. N.60°E. & S.60°W. Leave water. Ascend.
47.50	Set a limestone, 18x18x6 ins., 12 ins. in the ground, for witness cor. to reestablished std. $\frac{1}{4}$ sec. cor., marked "SCWC" on N. face; and raise mound of stone, 2 ft. base, 1 $\frac{1}{2}$ ft. high, N. of cor.
56.65	Road, brs. N.60°W. and S.60°E.
71.50	Edge of water, brs. N. & S. Thence across water in Verde River, fairly clear, 18 ins. deep, course S.

Resurvey, 3rd Std. Parallel N., thru part of R. 5 E.

Chains
 74.50 Edge of water, brs. N. & S. Leave water. Ascend.
 75.40 Top of bluff, brs. N. and S. Thence ascend gradually.
 80.58 Intersect the original std. cor. of secs. 34 and 35, hereinbefore described. Land, rolling.
 Land, rocky, 4th rate in E. $\frac{1}{2}$, sandy loam, 1st rate in W. $\frac{1}{2}$.
 Timber, scattering cottonwood along the river.
 Undergrowth, scattering catclaw and mesquite. Fair grass.

Retracement- Part of East Bdy. of T. 13 N., R. 5 E.

From reestablished closing cor. of secs. 1 & 6 on line 2-3 (NE. line) of Ft. Verde Garden Reservation Bdy., hereinbefore described,
 South, on random line, bet. secs. 1 & 6, inside F.V.G.R.
 23.22 Fall 20 lks. E. of original $\frac{1}{4}$ sec. cor., a limestone, 12x10x8 ins. above ground, firmly set, marked "1" on W. face, and witnessed by a mound of stone W. of cor.
 True course & dist. of that part of N. $\frac{1}{2}$ of line bet. secs. 1 & 6, inside Reservation, are S. 0°30' W., 23.22 chs.
 Thence,
 South, on random line, on S. $\frac{1}{2}$ bet. secs. 1 & 6, inside F.V.G.R.
 29.56 Fall 24 lks. E. of reestablished closing cor. of secs. 1 & 6, on line 3-4 (SE. line) of F.V.G.R. Bdy., hereinbefore described.
 True course & dist. of that part of S. $\frac{1}{2}$ of line bet. secs. 1 & 6, inside Reservation, are S. 0°28' W., 29.56 chs.

From original cor. of secs. 19, 24, 25 and 30, which is a cedar post, 4 ins. in diam., in a mound of stone, marked "19" on NE., "30" on SE., "25" on SW., and "24" on NW. faces, and 4 notches on N. and 2 notches on S. edges,
 South, on random line, bet. secs. 25 and 30 (N. $\frac{1}{2}$)
 40.70 Fall 97 lks. E. of original $\frac{1}{4}$ sec. cor. of secs. 25 and 30, which is a malpais stone, 18x14x12 ins., in a mound of earth and stone, witnessed by pits N., S., E., & W. No bearing trees.
 True course and dist. of N. $\frac{1}{2}$ of line bet. secs. 25 & 30 are therefore, S. 1°22' W., 40.71 chs.
 Thence
 South, on random line, bet. secs. 25 and 30 (S. $\frac{1}{2}$)
 40.42 Fall 57 lks. E. of original cor. of secs. 25, 30, 31 and 36, which is an oak stake in amount of stone, stake is marked but marks are illegible as the stake is partly decayed. This cor. does not answer in description to the original cor., but as no trace of any other cor. can be found in this vicinity, it is accepted as occupying the same position as the original cor.
 True course and dist. of S. $\frac{1}{2}$ of line bet. secs. 25 and 30 are therefore S. 0°48' W., 40.42 chs.

From above described sec. cor.
 South, on random line, bet. secs. 31 and 36 (N. $\frac{1}{2}$)
 40.43 Fall 55 lks. E. of $\frac{1}{4}$ sec. cor. of secs. 31 and 36, which is a granite stone, 16x10x8 ins. above ground, firmly set, marked "1" on W. face, and witnessed by faint traces of pits N., S., E. and W. No bearing trees. This description differs from that of the original $\frac{1}{4}$ sec. cor., but its position is accepted as being that of the original $\frac{1}{4}$ sec. cor., as there is no trace of any other cor. in this vicinity.
 True course and dist. of N. $\frac{1}{2}$ of line bet. secs. 31 and 36 are therefore, S. 0°47' W., 40.43 chs.
 Thence

South, on random line, bet. secs. 31 and 36, (S. $\frac{1}{2}$)
 40.69 Fall 89 lks. E. of reestablished std. cor. of Ts. 13 N., Rs. 5 and 6 E., on 3rd Std. Par. N., hereinbefore described.
 True course and dist. of S. $\frac{1}{2}$ of line bet. secs. 31 and 36 are therefore, S. 1°15' W., 40.70 chs.

From original cor. of secs. 19, 24, 25 & 30
 North, on random line, searching diligently for original $\frac{1}{4}$ sec. and sec. cors., set temp. $\frac{1}{4}$ sec. and sec. cors. at intervals of 40 chs. and at
 160.00 No trace of original cor. of secs. 7, 12, 13 & 18 can be found after diligent search. Set temp. cor. of said secs. here.

Resurvey- Part of East bdy. of T.13 N., R.5 E.

Chains	
	Retracement and resurvey of E. bdy. of T.13 N., R.5 E. and part of the subdivision therein determines that the $\frac{1}{4}$ sec. and sec. cors. on the E. bdy. will now refer to areas in T.13 N., R.5 E. only, therefore in the following described resurvey the cors. are reestablished accordingly. From reestablished closing cor. of secs. 1 and 6 (N. $\frac{1}{2}$) on line 2-3 (NE. line) of F.V.G.R., hereinbefore described, S. $0^{\circ}30'W.$, on true line, on E. bdy. of sec. 1, (N. $\frac{1}{2}$) inside F.V.G.R. Over mountainous land, thru scattering undergrowth. Descend
23.22	Intersect original $\frac{1}{4}$ sec. cor. of secs. 1 and 6, hereinbefore described. Now refers to sec. 1 only. No change in marking or accessories necessary.
29.56	Thence S. $0^{\circ}28'W.$, on true line, on E. bdy. of sec. 1, (S. $\frac{1}{2}$) inside the F.V.G.R. Over mountainous land, thru scattering undergrowth Descend 70 ft.
10.08	Bottom of gulch, course S. $50^{\circ}W.$ Ascend 15 ft.
13.70	Spur, slopes W. Descend 70 ft.
14.20	Limestone cliff, brs. NW. & SE., facing SW., 55 ft. high. Desc.
29.37	Road, brs. N. $50^{\circ}W.$ & S. $50^{\circ}E.$
29.56	Intersect reestablished closing cor. of secs. 1 and 6 (S. $\frac{1}{2}$) on line 3-4 (SE. line) of F.V.G.R. bdy., hereinbefore described. Land, mountainous. Soil, rocky, 3rd rate. No timber. Undergrowth, scattering catclaw & mesquite.
	----- Destroy all trace of original cor. of secs. 19, 24, 25 and 30, hereinbefore described and in the same place Set a granite stone, 26x16x7 ins., 20 ins. in the ground, for reestablished cor. of secs. 24 and 25, marked with 4 notches on N. and 2 notches on S. edge; and raise a mound of stone, 2 ft. base, 1 $\frac{1}{2}$ ft. high, W. of cor. Thence North, on true line, on E. bdy. of sec. 24. Over rolling land, thru scattering undergrowth. Ascend.
18.00	Ridge, brs. N. $60^{\circ}E.$ and S. $60^{\circ}W.$ Descend.
40.00	Set a malpais stone, 16x12x8 ins., 10 ins. in the ground, for reestablished $\frac{1}{4}$ sec. cor. of sec. 24, marked "1" on W. face; and raise mound of stone, 2 ft. base, 1 $\frac{1}{2}$ ft. high, W. of cor.
55.10	Road, brs. N. $50^{\circ}W.$ and S. $50^{\circ}E.$
59.60	Road, brs. N. $20^{\circ}E.$ and S. $20^{\circ}W.$
80.00	Set a malpais stone, 13x8x5 ins., 8 ins. in the ground, for reestablished cor. of secs. 13 and 24, marked with 3 notches on each of N. and S. edges; and raise a mound of stone, 2 ft. base, 1 $\frac{1}{2}$ ft. high, W. of cor. Land, rolling. Soil, rocky a&obe, 3rd and 4th rates. No timber. Undergrowth, scattering catclaw & scrub cedar.
	----- North, on true line, on E. bdy. of sec. 13. Over rolling and mountainous land, thru scattering undergrowth. Descend.
6.90	Top of S. bank of Clear Creek, brs. E. & W. Desc.
19.30	Edge of water, brs. E. & W. Thence across water, 6 ins. deep, course W.
19.80	Edge of water, brs. E. & W. Leave water. Ascend.
22.10	Top of N. bank of Clear Creek, brs. E. & W.
22.40	Fence, brs. E. & W.
27.00	U.S. Forest Ranger Station, brs. W. 2 chs. dist.
32.35	Fence, brs. E. & W.
40.00	Set an iron post, 3 ft. long, 1 in. in diam., 16 ins. in the ground, supported by a mound of stone, for reestablished $\frac{1}{4}$ sec. cor. of sec. 13, marked on brass cap, S13 1916 and raise mound of stone, 2 ft. base, 1 $\frac{1}{2}$ ft. high, W. of cor. Ascend 30 ft.
43.50	Spur, slopes E. Descend 30 ft.
44.32	Bottom of gulch, course S. $50^{\circ}E.$ Ascend.

Resurvey- Part of the East bdy. of T.13 N., R.5 E.

Chains
72.50
79.35

Spur, slopes N.30°E. Descend.
Set an iron post, 3 ft. long, 3 ins. in diam., 24 ins. in the ground, for witness cor. to reestablished cor. of secs. 12 and 13, marked on brass cap,

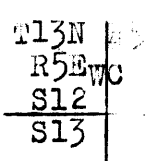

1916

80.00

and raise mound of stone, 2 ft. base, 1½ ft. high, W. of cor. the true point for reestablishment of cor. of secs. 12 and 13, falls in wash, course E., therefore witness cor. is set as described above.
Land, rolling and mountainous.
Soil, rocky, 4th rate.
Timber, scattering cottonwood and sycamore along Clear Creek.
Undergrowth, scattering mesquite, catclaw & mountain cranberry.
No grass.

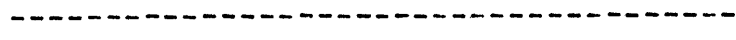

From reestablished cor. of secs. 24 and 25, hereinbefore described,

25.95
31.50
39.97
40.71

S.1°22'W., on true line, on E. bdy. of sec. 25 (N.½)
Over rolling land, thru scattering timber and undergrowth. Gulch, 25 lks. wide, 9 ft. deep, course S.35°W. Ascend 35 ft.
Spur, slopes S.30°W. Descend.
A mound of stone on line.
Intersect original ¼ sec. cor. of secs. 25 and 30, hereinbefore described. Reestablish this cor. to refer to sec. 25 only, by obliterating the pits E. and W., digging out the pits N. and S. to proper dimensions and by raising a mound of stone, 2 ft. base, 1½ ft. high, W. of cor.

Thence

6.70
24.30
34.30
40.42

S.0°48'W., on true line, on E. bdy. of sec. 25 (S.½)
Over rolling land, thru scattering timber and undergrowth Descend.
Wash, 20 lks. wide, 3 ft. deep, course S.59°W. Ascend.
Spur, slopes S.50°W. Descend.
Wash, 10 lks. wide, 8 ft. deep, course S.60°W.
Intersect the cor. of secs. 25, 30, 31 and 36, hereinbefore described. Destroy all trace of this old cor. and in the same place
Set a granite stone, 20x12x6 ins., 15 ins. in the ground, for reestablished cor. of secs. 25 and 36, marked with 5 notches on N. and 1 notch on S. edge; and raise a mound of stone, 2 ft. base, 1½ ft. high, W. of cor.
Land, rolling.
Soil, rocky, 4th rate.
Timber, scattering cedar.
Undergrowth, scattering catclaw and mesquite.
No grass.

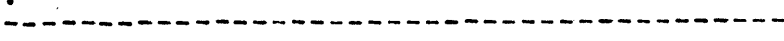

9.40
11.75
20.00
33.10
40.43

S.0°47'W., on true line, on E. bdy. of sec. 36 (N.½)
Over rolling land, thru scattering timber and undergrowth Descend.
Gulch, 1 ch. wide, 8 ft. deep, course S.50°W. Ascend.
A scrub cedar tree, 8 ins. in diam., on line.
Spur, slopes S.80°W. Descend 85 ft.
Cottonwood Creek, 1.20 chs. wide, 9 ft. deep, containing stream of clear running water, 1 lk. wide, 1 in. deep, course W. Ascend 30 ft. thru dense mesquite and scrub oak.
Intersect old ¼ sec. cor. of secs. 31 and 36, hereinbefore described. Remove the stone. Reestablish this cor. to refer to sec. 36 only by obliterating pits E. and W., digging out the pits N. and S. to proper size and by raising a mound of stone, 2 ft. base, 1½ ft. high, W. of cor.

Chains

Thence

S.1°15'W., on true line, on E. bdy. of sec. 36 (S. 1/2)
Over rolling land, thru scattering timber and undergrowth.
Ascend.

31.50
40.70

Spur, slopes S.80°W. Descend.
Intersect the reestablished std. cor. of T.13 N., R.5 and
6 E., hereinbefore described.

Land, rolling.
Soil, gravelly and rocky adobe, 4th rate.
Timber, scattering scrub cedar.
Undergrowth, scattering mesquite and catclaw.
Fair grass.



Retracement- Part of the Subdivision lines- T.13 N.,R.5 E. 17

Chains
4.00
10.00
20.03

The stone reported as marking the cor. of secs. 10, 11, 14 and 15 is missing, but the mound of stone described as accessory to said cor. remains, therefore locate the point of former location of cor. by reference to said mound.

Thence
East, on random line, bet. secs. 11 and 14
Over rolling land, thru scattering timber & undergrowth.
Enter dense mesquite undergrowth, brs. NE. and SW.
Enter cottonwood timber, brs. NE. & SW. in Clear Creek bottom.
N. bank of Clear Creek, brs. SW. from NE. and E. Line E. of this point passes along slope of said bank, making the chaining of measurement on same impracticable, therefore traverse from this point as follows:

N. $24\frac{3}{4}^{\circ}$ E., 9.00 chs. thence,
S. 75° E., 24.00 chs. to a point 1.96 chs. N. of random line projected and at N. of 46.98 ch. station thereon Thence, on offset line in sec. 11
East, 35.22 chs. to a point 1.64 chs. N. of fence cor. in which is a malpais stone, 15x11x8 ins. in a mound of stone, identified by Wm. Wingfield, a settler of long residence in this vicinity, as occupying the same position as the original cor. of secs. 11, 12, 13 & 14, now lost. No trace of the original cor. can be found, therefore accept the above described stone as the sec. cor.
The falling of the random line projected would be 1.96 chs. - 164 chs. = 32 lks. S. of sec. cor., resulting in a true course and dist. for sec. line of N. $89^{\circ}47'E.$, 82.20 chs.

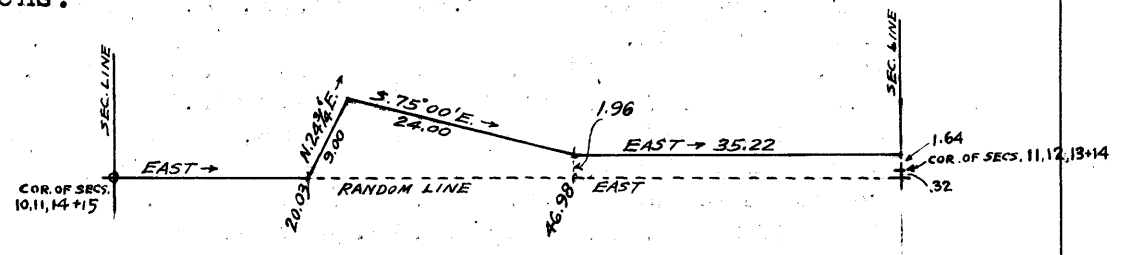

82.20 (Point on random line projected) Fall 32 lks. S. of old sec. cor. described above.
Reestablish this sec. cor. as follows:
Remove the stone from mound, destroy the mound and reset the same stone, 10 ins. in the ground, for reestablished cor. of secs. 11, 12, 13 and 14, marked with 4 notches on S., and 1 notch on E. edge, and on
A cottonwood, 25 ins. in diam., bearing N. $5\frac{3}{4}^{\circ}$ E., 252 lks. dist., mark T13NR5E S12 BT and
An ash, 6 ins. in diam., bearing S. $85\frac{1}{4}^{\circ}$ E., 84 lks. dist., mark T13NR5E S13 BT.
No other trees within prescribed limits.
Raise mound of stone, 2 ft. base, 1 1/2 ft. high, W. of cor. Land, W. 20 chs. rolling, E. 62 chs., broken creek bank. Soil, gravelly clay, 3rd and 4th rate. Timber, mesquite and cottonwood. Undergrowth, mesquite. No grass.

Retracement for Resurvey.

From reestablished cor. of secs. 11, 12, 13 and 14, described above
North, on random line, bet. that part of secs. 11 and 12, lying outside the F.V.G.R.
33.98 Fall 8 lks. E. of original closing cor. of secs. 11 and 12 on line 3-4 (SE. line) of F.V.G.R. bdy., which cor. is hereinbefore described.
True course and dist. of that part of line bet. secs. 11 and 12 lying outside the F.V.G.R. are therefore, N. $0^{\circ}8'W.$, 33.98 chs.
For topographical features on this portion of the sec. line see notes of resurvey of same hereinafter described.
Retracement.
From above described closing cor.
North, on random line, bet. that part of S. 1/2 of secs. 11 and 12 lying inside the F.V.G.R.

180 Retracement- Part of the Subdivision lines- T13 N. R. 5 E.

chains

6.06 (40.04 chs. Northerly from sec. cor.) Fall 2 lks. W. of original $\frac{1}{4}$ sec. cor., which is a limestone, 10x8x2 ins. above ground, firmly set, marked "1" on W. face and witnessed by a mound of stone W. of cor. No bearing trees.
True course and dist. of that part of S. $\frac{1}{2}$ of line bet. secs. 11 and 12 lying inside the F.V.G.R. are therefore, N. 0° 11' E., 6.06 chs.

Thence

RETRACEMENT

10.00 North, on random line, on N. $\frac{1}{2}$ of line bet. secs. 11 and 12.
Over rolling land, thru scattering timber & undergrowth.
Ascend 150 ft. to sec. cor.
39.88 Fall 11 lks. W. of original cor. of secs. 1, 2, 11 and 12, which is a cedar post, 3 ins. square, in a mound of earth, marked "T13NS1" on NE., "R5ES12" on SE., "S11" on SW. and "S2" on NW. faces, with 5 notches on S. and 1 notch on E. edges and witnessed by faint traces of the original pits NE., SE., SW. and NW. of post.
True course and dist. of N. $\frac{1}{2}$ of line bet. secs. 11 and 12 are therefore, N. 0° 9' E., 39.88 chs.
Land, rolling.
Soil, clay and limestone, 2nd and 4th rate.
Timber, scattering cedar.
Undergrowth, scattering mesquite and catclaw.
No grass.

Retracement for Resurvey.

From reestablished cor. of secs. 11, 12, 13 and 14, hereinbefore described,
40.50 East, on random line, on W. $\frac{1}{2}$ bet. secs. 12 and 13
Fall 55 lks. N. of original $\frac{1}{4}$ sec. cor., which is an old weathered post, in a mound of stone, marks obliterated.
No bearing trees.
True course and dist. of W. $\frac{1}{2}$ of line bet. secs. 12 and 13 are therefore, S. 89° 13' E., 40.50 chs.

Thence

37.22 East, on random line, on E. $\frac{1}{2}$ bet. secs. 12 and 13
Fall 1.30 chs. S. of true point for reestablishment of cor. of secs. 12 and 13, hereinbefore described.
True course and dist. of E. $\frac{1}{2}$ of line bet. secs. 12 and 13 are therefore, N. 88° 00' E., 37.24 chs.
For topographical features and reestablishment of the $\frac{1}{4}$ sec. cor. see notes of the resurvey of the line, hereinafter described.

Retracement.

From point of former position of the original cor. of secs. 10, 11, 14 and 15, hereinbefore described
0.10 Road, brs. N. 45° E. and S. 45° W.
11.05 Road, brs. N. and S.
15.54 Telephone line, brs. N. 40° W. and S. 40° E.
16.60 Road, brs. N. 50° E. and S. 50° W.
40.97 Fall 11 lks. N. of original $\frac{1}{4}$ sec. cor., which is a limestone, 16x9x5 ins. above ground, firmly set, marks illegible, and witnessed by a mound of stone N. of cor.
True course and dist. of E. $\frac{1}{2}$ of line bet. secs. 10 and 15 are therefore, S. 89° 51' W., 40.97 chs.

Thence

West, on random line, on that part of the W. $\frac{1}{2}$ of line bet. secs. 10 and 15 lying inside the F.V.G.R.
Over rolling land, thru scattering undergrowth.
4.74 Fall 21 lks. S. of original closing cor. of secs. 10 and 15, on line 1-4 (SW. line) of F.V.G.R. bdy., which is a limestone, 12x10x8 ins. above ground, firmly set, marked "FVGR CC" and witnessed by a mound of stone, NE. of cor.
True course and dist. of that part of W. $\frac{1}{2}$ of line bet. secs. 10 and 15 lying inside the F.V.G.R. are N. 87° 28' W., 4.74 chs.

Thence

West, on random line, on that part of W. $\frac{1}{2}$ of line bet. secs.

Retracement- Part of the Subdivision lines- T.13 N..R.5 E. 19

Chains 10 and 15 lying outside the F.V.G.R.
 Over rolling land, thru scattering undergrowth.
 5.81 Wash, 50 lks.wide, 9 ft.deep, course S.20°W.
 8.01 Road, brs. N.and S.
 9.41 Road, brs. N.and S.
 10.70 Fence, brs.N.and S.
 14.81 Road, brs. S.50°W. and N.50°E.
 32.46 Fence, brs.N.70°E. and SW.
 32.96 Road, brs. N.70°E. and SW.
 35.37 Fall 36 lks. S. of a granite stone, 12x11x8 ins.above ground, firmly set, marked with 4 notches on S. and 3 notches on E. edges. No accessories.
 No cor.of this description is on record, but diligent search in this vicinity fails to reveal any trace of any cor.answering to the reported description of the original cor., therefore accept this cor.as occupying the former position of the original cor.of secs.9,10,15 and 16.
 True course and dist.of that portion of the line bet.secs. 10 and 15 lying outside the F.V.G.R. are therefore, N.89°25'W., 35.37 chs.
 Sec.cor.is 40.11 chs.Westerly from the $\frac{1}{2}$ sec.cor.
 Land, rolling.
 Soil, rocky clay, 3rd rate
 No timber.
 Undergrowth, scattering mesquite.
 No grass,

Retracement for Resurvey.

From the accepted cor.of secs.9,10,15 and 16, described above,
 North, on random line, bet.secs.9 and 10 (S. $\frac{1}{2}$)
 40.30 Fall 53 lks.W.of original $\frac{1}{2}$ sec.cor., which is a wash boulder, 12x12x8 ins.above ground, firmly set, marked "1" on W.face. No traces of the pits and mound originally described as accessories to this cor., could be found.
 True course and dist.of S. $\frac{1}{2}$ of line bet.secs.9 and 10 are therefore, N. 0°45'E., 40.30 chs.
 Thence
 North, on random line, on that part of N. $\frac{1}{2}$ of line bet.secs. 9 and 10 lying outside the F.V.G.R.
 9.93 Fall 44 lks. E.of original closing cor.of secs.9 and 10 on line 1-4 (SW.line) of F.V.G.R.bdy., which is a limestone, 12x10x8 ins.above ground, firmly set, marked "FVGR CC" on NE.face, with mound of stone NE.of cor.No bearing trees.
 True course and dist.of that part of N. $\frac{1}{2}$ of line bet.secs. 9 and 10 lying outside the F.V.G.R. are therefore, N. 2° 32' W., 9.94 chs.
 Thence
 North, on random line, on that part of N. $\frac{1}{2}$ of line bet.secs. 9 and 10 inside the F.V.G.R.
 17.98 Fall 1 lk. W. of reestablished closing cor.of secs.9 and 10 on line 1-2 (NW.line) of F.V.G.R.bdy., hereinbefore described
 True course and dist.of that part of N. $\frac{1}{2}$ of line bet.secs. 9 and 10 inside the F.V.G.R. are therefore, N.0°2'E., 17.98 chs.
 Thence
 North, on random line, on that part of N. $\frac{1}{2}$ of line bet.secs. 9 and 10 lying outside the F.V.G.R.
 12.60 Fall 99 lks. W.of original cor.of secs.3,4,9 and 10, which is a limestone 16x8x11 ins., in a mound of stone, marked with 5 notches on S. and 3 notches on E. edge, and witnessed by a mound of stone, W. of cor.
 True course and dist.of that part of N. $\frac{1}{2}$ of line bet.secs. 9 and 10 outside the F.V.G.R. are therefore, N.4°30'E., 12.64 chs.
 For topographical features on line bet.secs.9 and 10, see resurvey of said line, hereinafter described.

20 Retracement- Part of the Subdivision lines- T.13 N., R.5 E.

Chains
 Make diligent search for the original cor. of secs. 27, 28, 33 and 34, but am unable to find any trace of same, however in a fence cor. find an old cottonwood pole, unmarked, which probably marks the position formerly occupied by the original cor. Accept this as marking the cor.
 Thence
 South, on random line, bet. secs. 33 and 34 (N. $\frac{1}{2}$)
 Over rolling land, thru scattering undergrowth.
 0.20 Fence, brs E. and W.
 14.90 Ditch, course S. 25° W.
 16.03 Fence, brs. E. and W.
 19.85 Fence, brs. S. 45° E. and N. 45° W.
 20.85 Road, brs. N. 45° W. and S. 45° E.
 25.40 End of spur, sloping E. Descend 50 ft.
 27.80 Gulch, course N. 75° E. Ascend 65 ft.
 32.50 Spur, slopes E. Descend 20 ft.
 35.20 Bottom of gulch, course N. 60° E. Ascend 25 ft.
 37.00 Spur, slopes N. 70° E. Descend.
 41.30 Fall 3.72 chs. W. of an unmarked limestone, 13x10x7 ins. in a mound of stone. No trace of pits described as accessory to the original $\frac{1}{4}$ sec. cor. Accept this stone as the $\frac{1}{4}$ sec. cor. of secs. 33 and 34.
 True course and dist. of N. $\frac{1}{2}$ of line bet. secs. 33 and 34 are therefore, N. 5° 9' W., 41.47 chs.
 Thence
 South, on random line, bet. secs. 33 and 34 (S. $\frac{1}{2}$)
 Over rolling land, thru scattering undergrowth. Ascend.
 16.77 A cottonwood post, in a mound of stone, brs. W. 33 lks. dist.
 18.45 Descend 75 ft.
 22.24 Arizona Power Co's power transmission line, brs. N. 35° 10' W. and S. 35° 10' E.
 25.45 Bottom of gulch, course S. 70° E. Ascend 30 ft.
 27.40 Spur, slopes E. Descend 50 ft.
 28.60 Gulch, course E. Ascend 60 ft.
 35.67 Descend 20 ft.
 38.62 Bottom of gulch, course N. 65° E. Ascend 20 ft.
 41.45 Descend 15 ft.
 44.21 Bottom of gulch, course N. 30° E., containing stream of clear running water, 3 lks. wide, 2 ins. deep.
 61.82 Fall 63 lks. W. of original std. cor. of secs. 33 and 34 on the S. bdy. of Tp. (3rd Std. Par. N.) hereinbefore described.
 True course and dist. of S. $\frac{1}{2}$ of line bet. secs. 33 and 34 are therefore, N. 0° 35' W., 61.82 chs.
 Land, rolling.
 Soil, rocky, 4th rate.
 No timber.
 Undergrowth, scattering catclaw and mesquite.
 No grass.

 From the accepted cor. of secs. 27, 28, 33 and 34, hereinbefore described,
 East, on random line, bet. secs. 27 and 34 (W. $\frac{1}{2}$)
 Over rolling land, thru scattering undergrowth.
 4.50 York's house brs. N. 3 chs. dist.
 6.83 Gate in fence bearing N. and S. Road, brs. N. 60° E. & S. 60° W.
 8.80 Top of earth bank of Verde River, brs. NW. and SE.
 Descend 15 ft. to
 9.00 Foot of bank. Thence across Verde River bottom land.
 17.29 Flag point of triangulation hereinafter described.
 18.54 Edge of water in Verde River, brs. NW. and SE., flowing SE.
 As it is impracticable to chain measurement across the river, triangulate as follows:

Leave flag at 17.29 ch. sta.
 Set up instrument on line E. of the river.
 Thence measure a base, South, 2.50 chs.
 From S. end of base, the flag at 17.29 ch. sta. brs. N. 68° 52' W.
 Included angles are 68° 52', 21° 08' and 90° 00' the sum of which is 180° 00'
 Dist. on random line from flag to instrument is therefore obtained by
 tang. 68° 52' x base or 2.58708 x 2.50 = 6.47 chs.
 which, added to 17.29 chs. gives 23.76 ch. sta.
 as location of instrument on E. side of river.

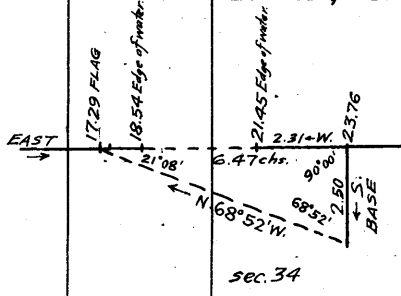

Retracement- Part of the Subdivisions lines of T.13 N., R.5 E. 21

Chains	Thence measure West, 2.31 chs. to
21.45	Edge of water in Verde River, brs. NW. and SE. Thence East, on random line, continuing measurement over Verde River bottom land.
23.76	Instrument point of triangulation hereinbefore described.
40.00	Diligent search in this vicinity failed to reveal any trace of the original $\frac{1}{4}$ sec. cor. Set temp. $\frac{1}{4}$ sec. cor. and discontinue retracement of line bet. secs. 27 and 34. Land, rolling and river bottom. Soil, rocky, 4th rate except in river bottom where it is sandy and gravelly, 2nd and 3rd rate. Timber, scattering cottonwood in river bottom. Undergrowth, scattering catclaw. Fair grass.

	From accepted cor. of secs. 27, 28, 33 and 34, hereinbefore described
	West, on random line, bet. secs. 28 and 33
	Over rolling land, thru scattering undergrowth.
0.15	Ditch, course N. 20° W.
0.60	Fence, brs. N. 20° W. and S. 20° E.
5.50	Road, brs. N. and S.
40.00	Diligent search in this vicinity fails to reveal any trace of the original $\frac{1}{4}$ sec. cor. Set temp. $\frac{1}{4}$ sec. cor.
41.10	Arizona Power Co's power transmission line, brs. N. 35° 10' W. and S. 35° 10' E. Ascend 80 ft.
49.91	Fence, brs. N. 45° E. and S. 45° W.
53.15	Fence, brs. N. and S.
65.74	Wash, 20 lks. wide, 3 ft. deep, course N. 50° E.
80.00	Diligent search in this vicinity fails to reveal any trace of the original cor. of secs. 28, 29, 32 and 33. Set temp. cor. of said secs. at this point. Land, rolling. Soil, rocky, 4th rate. No timber. Undergrowth, scattering catclaw and mesquite. Poor grass.

	From temp. cor. of secs. 28, 29, 32 and 33
	South, on random line, bet. secs. 32 and 33.
	Over rolling land, thru scattering undergrowth. Desc.
14.40	Bottom of wash, 25 lks. wide, 4 ft. deep, course N. 50° E. Ascend 100 ft.
27.26	Spur, slopes N. 45° W. Descend.
40.00	Diligent search in this vicinity fails to reveal any trace of the original $\frac{1}{4}$ sec. cor., but knowing from the retracement of the 3rd Std. Par. N., S. of secs. 32, 33 and 34 as hereinbefore described, that there is a large error in the original survey of these secs., continue random line South, for a search for the missing $\frac{1}{4}$ sec. cor.
44.42	Bottom of gulch, course N. 45° E., containing stream of running water, 1 lk. wide, 2 ins. deep. Ascend 80 ft.
58.83	Wash, 20 lks. wide, 10 ft. deep, course N. 75° E.
71.60	Wash, 15 lks. wide, 8 ft. deep, course N. 80° E. Ascend
77.10	Spur, slopes N. 80° E. Descend.
80.00	Discontinue retracement of line bet. secs. 32 and 33 at this point, as no trace of the original $\frac{1}{4}$ sec. cor. can be found, and knowing from retracement of the 3rd Std. Par. N., that the original std. cor. of secs. 32 and 33 is missing. Land, rolling. Soil, rocky, 4th rate, granite formation. No timber. Undergrowth, scattering mesquite, scrub oak and catclaw. No grass.

	From the temp. cor. of secs. 28, 29, 32 and 33
	North, on random line, bet. secs. 28 and 29 (S. $\frac{1}{2}$)
	Over rolling land, thru scattering undergrowth.
42.81	Fall 12 lks. E. of remains of original $\frac{1}{4}$ sec. cor., which is an old cedar post, 5x3 ins., 18 ins. above ground, in a

Chains

mound of stone. Marks are obliterated. No bearing trees. True course and dist. of S. $\frac{1}{2}$ of line bet. secs. 28 and 29 are therefore, N. $0^{\circ}10'W.$, 42.81 chs.

Land, rolling.

Soil, rocky, 4th rate.

No timber.

Undergrowth, scattering catclaw & mesquite and scattering scrub oak.

Retracement for Resurvey.

From original $\frac{1}{4}$ sec. cor. of secs. 28 and 29, hereinbefore described,

40.39 North, on random line, bet. secs. 28 and 29 (N. $\frac{1}{2}$)
Fall 4.74 chs. W. of original cor. of secs. 20, 21, 28 and 29, which is a cottonwood pole, 5 ins. in diam., 10 ft. high, with decayed remains of the original post alongside in a mound of stone. No bearing trees.

True course and dist. of N. $\frac{1}{2}$ of line bet. secs. 28 and 29 are therefore, N. $6^{\circ}42'E.$, 40.67 chs.

For topographical features on N. $\frac{1}{2}$ of line bet. secs. 28 and 29 and reestablishment of above described sec. cor. see resurvey of same, hereinafter described.

Retracement.

A cedar stake, 2 $\frac{1}{2}$ ins. in diam., loosely set in a fence cor. and marked with 2 notches on one edge, is the only existing evidence of the original location of the cor. of secs. 21, 22, 27 and 28 and as it agrees with the property lines in each direction, accept it as marking the cor.

Thence

West, on random line, bet. secs. 21 and 28, (E. $\frac{1}{2}$)

Over rolling land, thru scattering undergrowth.

20.91 Fence, brs. N. and S. Enter cultivated land.

34.25 Fence, brs. N. and S. Leave cultivated land.

41.03 Ditch. course S.

41.30 Fence, brs. N. and S.

41.49 Fall 66 lks. S. of original $\frac{1}{4}$ sec. cor., which is a stake, 2 ins. in diam., 1 ft. above ground, set in a small mound of stone. Stake is marked "1S" on N. face.

True course and dist. of E. $\frac{1}{2}$ of line bet. secs. 21 and 28 are therefore, N. $89^{\circ}05'W.$, 41.50 chs.

Land, rolling.

Soil, rocky, 4th rate.

No timber.

Undergrowth, scattering catclaw and mesquite.

Fair grass.

Retracement for Resurvey.

From original $\frac{1}{4}$ sec. cor. of secs. 21 and 28, described above,

37.72 West, on random line, bet. secs. 21 and 28, (W. $\frac{1}{2}$)
Fall 69 lks. S. of original cor. of secs. 20, 21, 28 and 29, hereinbefore described.

True course and dist. of W. $\frac{1}{2}$ of line bet. secs. 21 and 28 are therefore, N. $88^{\circ}57'W.$, 37.73 chs.

For topographical features and reestablishment of cor. of secs. 20, 21, 28 and 29, see resurvey of W. $\frac{1}{2}$ of line bet. secs. 21 and 28, hereinafter described.

36.82 North, on random line, bet. secs. 20 and 21, (S. $\frac{1}{2}$)
Fall 1.86 chs. W. of original $\frac{1}{4}$ sec. cor., which is a stake, 2 ins. square, 1 $\frac{1}{2}$ ft. above ground, marked "1S" on W. face, set in a mound of stone.

True course and dist. of S. $\frac{1}{2}$ of line bet. secs. 20 and 21 are therefore, N. $2^{\circ}53'E.$, 36.87 chs.

Thence

40.60 North, on random line, bet. secs. 20 and 21, (N. $\frac{1}{2}$)
Diligent search in this vicinity fails to reveal any trace of the original cor. of secs. 16, 17, 20 and 21. Set temp. cor. Continue line and measurement, bet. secs. 16 and 17 (S. $\frac{1}{2}$)

Retracement- Part of the Subdivision lines-T.13 N..R.5 E.

23

Chains	
80.00	Diligent search in this vicinity fails to reveal any trace of the original $\frac{1}{4}$ sec.cor. Set temp.cor. Continue line and measurement, bet.secs.16 and 17 (N. $\frac{1}{2}$)
120.00	Diligent search in this vicinity fails to reveal any trace of the original cor.of secs.8,9,16 and 17.Set temp.cor. Continue line and measurement, bet.secs.8 and 9, (S. $\frac{1}{2}$)
160.00	Diligent search in this vicinity fails to reveal any trace of the original $\frac{1}{4}$ sec.cor. Set temp.cor. Continue line and measurement, bet.secs.8 and 9, (N. $\frac{1}{2}$)
204.70	Fall 2.91 chs. W. of reestablished cor.of secs.4,5,8 & 9, which is a limestone, 9x8x5 ins.above ground, firmly set, marked with 5 notches on S.and 4 notches on E.edge. The pits and mound described as accessories to this cor. have dissappeared. No bearing trees. This cor.was reestablished in 1892. True lengths of N. $\frac{1}{2}$ of line bet.secs.20 and 21, the N.and S. halves of line bet.secs.16 and 17, and N.and S.halves of line bet.secs.8 and 9, on the random line just run, to maintain the original proportions, are therefore, 40.94 chs. Return on random line, adjusting the position of the temp. cors.set thereon to obtain the proportional measurement noted. Resurvey of N. $\frac{1}{2}$ of line bet.secs.20 and 21, line bet.secs.16 and 17 and line bet.secs.8 and 9, hereinafter described.
	----- Find the original post which marked the $\frac{1}{4}$ sec.cor.of secs.16 and 21, lying alongside mound of earth and stone, No trace of pits. Post is marked "13". Accept the mound as the original position of the cor. Thence
40.00	West, on random line, bet.secs.16 and 21, (W. $\frac{1}{2}$) No trace of original cor.of secs.16, 17, 20 and 21 can be found. Set temp. cor.
43.33	Continue line & measurement, bet.secs.17 and 20, (E. $\frac{1}{2}$) Temp.cor.of secs.16, 17, 20 and 21, set on random N.and S. line as hereinbefore described, brs. S., 5 lks, dist.
87.46	Fall 1.08 chs.S. of original $\frac{1}{4}$ secs cor., which is an ash post, 3 ins.in diam., unmarked, 3 ft.above ground, set in a mound of stone. No bearing trees. Return on random line, adjusting the position of the temp. sec.cor.to the midpoint thereon, or 43.73 chs.from each $\frac{1}{4}$ sec.cor.
	----- From accepted cor.of secs.9,10,15 and 16, hereinbefore described,
39.96	West, on random line, bet.secs.9 and 16 (E. $\frac{1}{2}$) Fall 44 lks. N.of a malpais stone, 11x11x9 ins.above ground, firmly set, marked with a cross (X) on top.No accessories. This is accepted as being in same position as formerly occupied by the original $\frac{1}{4}$ sec.cor., on the testimony of G.W. Hantz, a settler of long residence in the vicinity. True course and dist.of E. $\frac{1}{2}$ of line bet.secs.9 and 16 are therefore, S.89°22'W., 39.96 chs.
	Thence,
40.00	West, random line, bet.secs.9 and 16 (W. $\frac{1}{2}$) No trace of original cor.of secs.8,9,16 and 17 can be found. Set temp. cor.
41.43	Continue line and measurement, bet.secs.8 and 17 (E. $\frac{1}{2}$) Temp.cor.of secs.8,9,16 & 17 of random N.and S.line, hereinbefore described, brs. N., 1.22 chs.dist.
81.70	Fall 3.88 chs. S.of point of former location of the original $\frac{1}{4}$ sec.cor.of secs.8 and 17. Faint traces of the original pits and mound remain. Accept this point on the testimony of L.Young, a settler of long residence in sec. 8 near this cor. Return on random line, adjusting the position the temp.sec. cor.to the midpoint thereon, or 40.85 chs.from each $\frac{1}{4}$ sec. cor.
	----- From above described point of original location of $\frac{1}{4}$ sec.cor.of secs.8 and 17
	West, on random line, bet.secs.8 and 17 (W. $\frac{1}{2}$)

- Chains
40.00 Diligent search in this vicinity fails to reveal any trace of the original $\frac{1}{4}$ sec.cor. Set temp.cor.of secs.7,8,17 and 18.
-
- 39.14 From reestablished $\frac{1}{4}$ sec.cor.of secs.7 and 8, identical with initial monument of the Camp Verde military Reservation Bdy., hereinbefore described, South, on random line, bet.secs.7 and 8, (S. $\frac{1}{2}$) Temp.cor.of secs.7,8,17 and 18 set at 40 chs.W.from $\frac{1}{4}$ sec.cor.of secs.8 and 17as hereinbefore described, bears W. 3.35 chs.dist.
- 40.00 Diligent search in this vicinity fails to reveal any trace of the original cor.of secs.7,8,17 and 18. Set temp. sec. cor. From this temp.sec.cor., the previously set temp. cor.of said secs. brs. N.75°36'W., 3.46 chs.dist., therefore locate point for reestablishment of the missing sec. cor.at the midpoint bet.the temp.sec.cors., at a point 1.67 chs.W.of random line run S. and 43 lks. S.of the random line run W. as hereinbefore described. True course and dist. of S. $\frac{1}{2}$ of line bet.secs.7 and 8, are therefore, N.2°25'E., 39.61 chs. and of W. $\frac{1}{2}$ of line bet. secs.8 and 17, S.89°21'W., 38.32 chs.
-
- 39.77 From original cor.of secs.3,4,9 and 10, hereinbefore described, West, on random line, bet.secs.4 and 9. Diligent search in this vicinity fails to reveal any trace of the $\frac{1}{4}$ sec.cor.which was reestablished in 1892. Set temp. $\frac{1}{4}$ sec.cor.
- 79.50 Fall 1.76 chs. S. of the cor.of secs.4,5,8 and 9 which was reestablished in 1892, and is hereinbefore described. True course and dist.of line bet.secs.4 and 9 are therefore, N.88°44'W., 79.52 chs.
-
- 40.04 From cor.of secs.4,5,8 and 9, hereinbefore described, North, on random line, bet.secs.4 and 5 (S. $\frac{1}{2}$) Intersect the $\frac{1}{4}$ sec.cor.which was reestablished in 1892, which is a limestone, 7x5x6 ins.above ground, firmly set, marked " $\frac{1}{4}$ " on W.face, and witnessed by faint remains of the original mound of earth W.of cor., but no trace of pits. No bearing trees. True course and dist.of S. $\frac{1}{2}$ of line bet.secs.4 and 5 are therefore, North, 40.04 chs. Thence
- 39.95 North, on random line, bet.secs.4 and 5 (N. $\frac{1}{2}$) Intersect cor.of secs.4,5,32 and 33 on N.bdy.of Tp.which was reestablished in 1892, which is a limestone, 17x13x6 ins.above ground, firmly set in a mound of stone, marked with 4 notches on E.edge and 2 notches on W.edge, and witnessed by pits NE., SE., SW., and NW. of cor. The mound of earth has dissappeared. No bearing trees. True course and dist.of N. $\frac{1}{2}$ of line bet.secs.4 and 5 are therefore, North, 39.95 chs.
-
- RETRACEMENT of part of NORTH Bdy.- T. 13 N., R. 5 E.
-
- 24.07 From the cor.of secs.4,5,32 and 33, described above, East, on random line, bet.that part of secs.4 and 33, lying inside the Camp Verde Mil.Res. Fall 8 lks. N.of reestablished closing cor.of secs.4 & 33 on E.line of C.V.M.R. bdy., hereinbefore described. True course and dist.of that part of N.bdy.of T.13 N., R.5 E., bet.secs.4 and 33, lying inside the C.V.M.R. are therefore, S.89°49'E., 24.07 chs.
-

Resurvey- Part of Subdivision lines- T.13 N.. R.5 E.

Chains From reestablished cor. of secs. 11, 12, 13 and 14, hereinbefore described,
 N. 0° 8' W., on true line, bet. that part of line bet. secs. 11 and 12 lying outside the F.V.G.R.
 Over level land, thru dense undergrowth.

5.00 Leave undergrowth, enter cultivated field, brs. E. and W.
 18.06 Leave field, brs. E. and W., enter scattering mesquite.
 19.30 Fence, brs. E. and W.
 21.81 Fence, brs. N. 50° E. and S. 50° W.
 24.33 Bottom of gulch, 130 lks. wide, course S. 30° W.
 26.46 Road, brs. E. and W.
 30.56 Road, brs. N. 60° E. and S. 60° W.
 33.98 Intersect ~~reestablished~~ closing cor. of secs. 11 and 12 on line 3-4 (SE. line) of F.V.G.R. bdy., hereinbefore described. Thence N. 0° 11' E., continuing measurement

40.04 Intersect original 1/4 sec. cor. hereinbefore described.
 Land, level & rolling. Soil, clay & limestone, 2nd & 4th rate. No timber, except a few walnut trees in S. 5.00 chs. Undergrowth, mesquite & catclaw.
 Fair grass.

From reestablished cor. of secs. 11, 12, 13 and 14, hereinbefore described,
 S. 89° 13' E., on true line, bet. secs. 12 and 13 (W. 1/2)
 Over level land, in cultivated field along S. side of fence bearing E. and W.

10.86 Fence, brs. N. and S. Leave field and fence N. of line.
 22.00 Wm. Wingfield's house brs. N. 5.00 chs. dist.
 25.20 H. Wingfield's house brs. S. 10.00 chs. dist.
 25.89 Fence, brs. N. and S.
 26.34 Ditch, course S. Leave level land. Ascend 85 ft.
 40.50 Intersect original 1/4 sec. cor. hereinbefore described.
 Reestablish this cor. in same place as follows:
 Set a granite stone, 20x11x4 ins., 15 ins. in the ground, marked "1" on N. face, for reestablished 1/4 sec. cor. of secs. 12 and 13, and raise a mound of stone, 2 ft. base, 1 1/2 ft. high, N. of cor.
 Thence
 N. 88° 00' E., on true line, bet. secs. 12 and 13 (E. 1/2)
 Over rolling land, thru scattering undergrowth. Descend.

5.68 Wash, course S. 20° E. Ascend 85 ft.
 22.00 Spur, slopes S. 20° W. Descend.
 37.24 Intersect true point for reestablished cor. of secs. 12 and 13, on E. bdy. of Tp., hereinbefore described.
 Land, level and rolling.
 Soil, sandy loam, 1st rate in W 1/2, rocky clay, 4th rate in E 1/2.
 No timber.
 Undergrowth, scattering mesquite and catclaw.
 Fair grass.

From accepted cor. of secs. 9, 10, 15 and 16, hereinbefore described,
 N. 0° 45' E., on true line, on S. 1/2 bet. secs. 9 and 10
 Over rolling land, thru scattering undergrowth. Asc. 80 ft.

7.50 Spur, slopes W. Descend 40 ft.
 15.48 Wash, 10 lks. wide, 2 ft. deep, course S. 50° W. Ascend
 40.30 Intersect the original 1/4 sec. cor. of secs. 9 and 10, hereinbefore described. Reestablish this cor. in same place as follows:
 Reset same stone, 8 ins. in the ground, with marking to the W., and raise a mound of stone, 2 ft. base, 1 1/2 ft. high, W. of cor.
 Thence
 N. 2° 32' W., on true line, on that part of N. 1/2 of line bet. secs. 9 and 10 lying outside the F.V.G.R.
 Over rolling land, thru scattering undergrowth, Asc. 55 ft.

7.70 Spur, slopes W. Descend 50 ft.
 9.94 Intersect original closing cor. of secs. 9 and 10 on line 1-4 (SW. line) of F.V.G.R. bdy., hereinbefore described. Reestablish this cor. by moving mound of stone from NE. to N. 1/2 of cor. Thence, line, on that part of N. 1/2 of line bet. N. 082° E. on true line, on that part of N. 1/2 of line bet. secs. 9 and 10, inside the F.V.G.R. Undergrowth. Descend.
 Over rolling land, thru scattering undergrowth. Descend.

Chains	
9.75	Telephone line, brs. N.45°W. and S.45°E.
15.15	Road, brs. N.45°W. and S.45°E.
17.98	Intersect reestablished closing cor. of secs. 9 and 10 on line 1-2 (NW. line) of F.V.G.R. bdy., hereinbefore described. Thence N.4°30'E., on true line, on that part of N. $\frac{1}{2}$ of line bet. secs. 9 and 10 lying outside the F.V.G.R. Over rolling land, thru scattering undergrowth. Descend.
8.20	Wash, 10 lks. wide, 3 ft. deep, course W.
12.64	Intersect original cor. of secs. 3, 4, 9 and 10, hereinbefore described. Land, rolling. Soil, rocky clay, 4th rate. No timber. Undergrowth, scattering catclaw, mesquite, mountain cranberry and greasewood. No grass.

	From original $\frac{1}{4}$ sec. cor. of secs. 28 and 29, hereinbefore described, N.6°42'E., on true line, bet. secs. 28 and 29 (N. $\frac{1}{2}$) Over rolling land, thru dense undergrowth.
2.65	Road, brs. NE. and SW.
8.83	Arizona Power Co's power transmission line, brs. N.35°10'W. and S.35°10'E.
35.79	Wash, 10 lks. wide, 2 $\frac{1}{2}$ ft. deep, course N.75°E. Ascend 45 ft.
40.67	Intersect original cor. of secs. 20, 21, 28 and 29, hereinbefore described. Destroy all trace of the original cor. and in the same place, reestablish the cor. as follows: Set a granite stone, 23x14x10 ins., 18 ins. in the ground, marked with 4 notches on E. edge and 2 notches on S. edge, for reestablished cor. of secs. 20, 21, 28 and 29, and raise a mound of stone, 2 ft. base, 1 $\frac{1}{2}$ ft. high, W. of cor. Land, rolling. Soil, rocky clay, 4th rate. No timber. Undergrowth, scattering scrub oak and dense catclaw and mesquite. No grass.

	From original $\frac{1}{4}$ sec. cor. of secs. 21 and 28, hereinbefore described, N.88°57'W., on true line, bet. secs. 21 and 28 (W. $\frac{1}{2}$) Over rolling land, thru scattering undergrowth.
2.50	Road, brs. N. and S.
18.00	Gate, in fence bearing N.20°W. and S.20°E.
18.50	Road, brs. N.20°W. and S.20°E.
24.80	Road, brs. N.30°E. and S.30°W. Ascend 140 ft.
37.73	Intersect reestablished cor. of secs. 20, 21, 28 and 29, hereinbefore described. Land, rolling. Soil, rocky clay, 4th rate. No timber. Undergrowth, scattering catclaw and mesquite. No grass.

	N.2°53'E., on true line, bet. secs. 20 and 21 (S. $\frac{1}{2}$) Over rolling and mountainous land, thru scattering undergrowth. Ascend 25 ft.
2.50	Spur, slopes S.45°E. Descend 115 ft.
36.87	Intersect original $\frac{1}{4}$ sec. cor. of secs. 20 and 21, hereinbefore described. Destroy all trace of the old cor. and in the same place reestablish the cor. as follows: Set a granite stone, 22x11x10 ins., 17 ins. in the ground, marked "1" on W. face, for reestablished $\frac{1}{4}$ sec. cor. of secs. 20 and 21, and raise a mound of stone, 2 ft. base, 1 $\frac{1}{2}$ ft. high, W. of cor. Thence N.0°34'W., on true line, bet. secs. 20 and 21 (N. $\frac{1}{2}$) Over rolling land, thru scattering undergrowth & timber.
2.26	Wash, 30 lks. wide, 2 $\frac{1}{2}$ ft. deep, course N.45°E.

Chains	
8.45	Road, brs. N.40°W. and S.40°E.
10.15	Ditch, course S.40°E.
12.15	Ditch, course S.30°W.
14.10	Ditch, course S.30°E.
15.10	Right bank of verde River, brs. NW. and SE. Thence across running water in river, 2 ft. deep, course SE.
19.00	Left bank of Verde River, brs NW. and SE. Leave water. Thence over level bottom land.
40.94	At a point 40 lks. W. of temp. sec. cor. set on random N. and S. line and 5 lks. S. of temp. sec. cor. set on random E. and W. line as hereinbefore described, reestablish the missing sec. cor. as follows: Set a malpais stone, 20x15x7 ins., 15 ins. in the ground, marked with 4 notches on E. edge and 3 notches on S. edge, for reestablished cor. of secs. 16, 17, 20 and 21, and raise a mound of stone, 2 ft. base, 1½ ft. high, W. of cor. Establish one bearing tree to this cor. as follows: On a cottonwood, 23 ins. in diam., bearing S. 65½°W., 135 lks. dist., mark " T13NR5E S20 BT " No other trees within prescribed limits. Land, rolling & mountainous in S. ½, rolling & level in N. ½. Soil, rocky clay, 3rd rate, in S. ½, sandy loam, 1st rate, in N. ½. Timber, scattering cottonwood along the river. Undergrowth, scattering mesquite and catclaw. Fair grass. ----- Destroy all trace of the original ¼ sec. cor. of secs. 16 and 21, hereinbefore described, and reestablish the cor. in same place, as follows: Set a malpais stone, 16x15x4 ins., 11 ins. in the ground, marked " 1 " on N. face, for reestablished ¼ sec. cor. of secs. 16 and 21. Establish bearing trees to this cor. as follows: On a sycamore, 16 ins. in diam., bearing N. 22°W., 191 lks. dist., mark " ¼ S16 BT " and On a willow, 13 ins. in diam., bearing S. 76½°E., 216 lks. dist., mark " ¼ S21 BT " Thence S. 89°56'W., on true line, bet. secs. 16 and 21 (W. ½) Over rolling land, thru scattering timber & undergrowth.
8.43	Road, brs. N. and S.
11.88	Left bank of Clear Creek, brs. N. 20°E. and S. 20°W.
14.68	Edge of water, brs. N. 20°E. & S. 20°W. Thence across muddy running water, 10 ins. deep, course S. 20°W.
16.13	Edge of water and right bank of Clear Creek, brs. N. 20°E. and S. 20°W. Leave water and Clear Creek.
16.18	Fence, brs. N. and S.
20.58	Road, brs. N. 60°E. and S. 60°W.
21.48	Fence, brs. N. and S. Leave scattering timber and enter cultivated land.
26.33	Ditch, course N. 70°E.
26.68	Fence, brs. N. 70°E. and S. 70°W.
30.23	House, brs. S. 5.00 chs. dist.
33.63	Fence, brs. N. and S.
40.63	Fence, brs. N. and S. Leave cultivated field.
40.88	Road, brs. N. and S.
43.73	Intersect the reestablished cor. of secs. 16, 17, 20 and 21, hereinbefore described. Land, rolling. Soil, sandy loam, 1st rate and gravelly clay, 3rd rate. Timber, scattering cottonwood. Undergrowth, scattering catclaw and mesquite. Fair grass. ----- N. 0°41'E., on true line, bet. secs. 16 and 17. Over level land, thru scattering undergrowth.
37.50	Left or East bank of verde River, brs. NE. and SW., and edge of water, same bearing. Thence across running water, 2 ft. deep, course SW.
40.94½	true point for reestablishment of ¼ sec. cor. (9 lks. E. of adjusted temp. cor. set on random N. & S. line as hereinbefore described) falls in water, therefore set witness cor. as

Chains	hereinafter described.
42.00	Right bank and edge of water, brs. NE. and SW. Leave water. Thence over bottom land.
43.72 $\frac{1}{2}$	Set a limestone, 17x11x11 ins., 12 ins. in the ground, marked "1" on W. face and "WC" on S. face, for witness cor. to reestablished $\frac{1}{4}$ sec. cor. of secs. 16 and 17. Establish a bearing tree to this W.C. as follows: On a cottonwood, 27 ins. in diam., bearing N. 63° W., 64 lks. dist., mark "WC $\frac{1}{4}$ S17 BT". No other trees within the prescribed limits.
51.58	Raise a mound of stone, 2 ft. base, 1 $\frac{1}{2}$ ft. high, W. of cor. Enter cultivated field, brs. NE. and SW.
58.70	Ditch, course W.
59.80	Fence, brs. E. and W.
68.70	Ditch, course N. 10° W.
70.40	Fence, brs. N. 10° W. and S. 10° E. Leave cultivated field.
79.20	Fence, brs. N. 65° W. and S. 65° E. Desc. into river bed.
79.49	Set a granite wash boulder, 17x11x5 ins., 12 ins. in the ground, marked with 4 notches on each of E. and S. edges, for witness cor. to reestablished cor. of secs. 8, 9, 16 and 17. Establish a bearing tree to this W.C. as follows: On a cottonwood, 24 ins. in diam., bearing S. 23 $\frac{1}{2}$ ° W., 130 lks. dist., mark "WC T13NR5E S17 BT". No other trees within prescribed limits.
80.00	Raise a mound of stone, 2 ft. base, 1 $\frac{1}{2}$ ft. high, W. of cor. Edge of river bed, brs. NW. and SE. Thence in river bed.
81.89	True point for reestablishment of the cor. of secs. 8, 9, 16 and 17, falls in river bed where it would be impracticable to set post or stone, therefore W.C. to this cor. was set at a point 2.40 chs. S. 0° 41' W. as described above. The true point for cor. is 58 lks. E. of temp. sec. cor. set on random E. and W. line, and 122 lks. N. of temp. sec. cor. set on random E. and W. line as hereinbefore described. Land, rolling and level river bottom and bed. Soil, sandy loam, 1st rate. Timber, scattering cottonwood along river. Undergrowth, scattering mesquite and catclaw. Fair grass.

	From accepted cor. of secs. 9, 10, 15 and 16, hereinbefore described, S. 89° 22' W., on true line, bet. secs. 9 and 16 (E. $\frac{1}{2}$) Over rolling land, thru scattering undergrowth.
15.00	Wash, 10 lks. wide, 2 ft. deep, course S.
25.00	House, brs. S. 10 chs. dist.
37.00	Cemetery, brs. N. 5.00 chs. dist.
39.95	Intersect accepted $\frac{1}{4}$ sec. cor. of secs. 9 and 16, hereinbefore described. Destroy all trace of old cor. and reestablish in same place as follows: Set a malpais stone, 22x11x10 ins., 17 ins. in the ground, marked "1" on N. face, for reestablished $\frac{1}{4}$ sec. cor. of secs. 9 and 16. No trees within prescribed limits. Raise a mound of stone, 2 ft. base, 1 $\frac{1}{2}$ ft. high, N. of cor. Thence N. 88° 17' W., on true line, bet. secs. 9 and 16 (W. $\frac{1}{2}$) Over rolling and level land, thru scattering undergrowth.
11.87	Road, brs. N. 80° W. and S. 80° E. Church, brs. S., 1.70 chs. dist.
13.77	School house, brs. N. 1.50 chs. dist.
14.17	Road, brs. N. and S.
14.42	Fence, brs. N. and S.
16.27	House, brs. S. 12 chs. dist.
17.42	Ditch, course S.
28.17	Fence, brs. N. and S. Leave rolling land. Descend into bed of Verde River.
29.47	Left edge of water, brs. N. and S. Thence across running water, 2 ft. deep, course S.
32.97	Right edge of water, brs. N. and S. Leave water. Thence in river bed.
40.87	Intersect true point for reestablished cor. of secs. 8, 9, 16 and 17, witnessed 2.40 chs., S. 0° 41' W. as hereinbefore described. Land, rolling and level. Soil, adobe and gravel, 3rd rate.

Resurvey- Part of subdivision lines- T.13 N., R.5 E.

Chains No timber except scattering cottonwood along river. Undergrowth, scattering mesquite and catclaw. No grass.

N.1°38'E., on true line, bet. secs. 8 and 9, from cor. point.

3.30 Over river bed, thru scattering undergrowth

6.80 Right edge of water, brs. NW. and SE. Thence across running water, 2 ft. deep, in Verde River, course SE.

10.55 Left edge of water, brs. NW. and SE. Leave water. Thence over river bed

10.70 Left bank of Verde River, brs. NW. and SE. Leave river bed. Thence over level and rolling bottom land, thru scattering undergrowth

11.75 Ditch, course S.60°E.

37.12 Fence, brs. S.30°W. and N.30°E. Fence cor. brs. N.30°E., 75 lks. dist. from which fences extend S.60°E. and N.30°E.

39.30 *Intersect E. bdy. of Camp Verde Military Res. at a point N.86°56'W. 72.25 chs. from the SE Cor.*
Fence, brs. E. and W. Fence cor. brs. E., 20 lks. dist., from which fences extend E. and S.

39.40 Road, brs. E. and W.

40.95 A point 174½ lks. E. of adjusted temp. ¼ sec. cor. set on random N. and S. line as hereinbefore described. At this point, reestablish the missing ¼ sec. cor. as follows:
Set a limestone, 20x12x4 ins., 15 ins. in the ground, marked "¼" on W. face, for reestablished ¼ sec. cor. of secs. 8 and 9, and raise mound of stone, 2 ft. base, 1½ ft. high, W. of cor. No bearing trees within prescribed limits.
Enter dense undergrowth.

81.90 Intersect cor. of secs. 4, 5, 8 and 9, hereinbefore described. Land, level and rolling. Soil, sandy and gravelly, 1st and 3rd rate. No timber except a few cottonwood trees along river. Undergrowth, mesquite and catclaw, scattering in S. ½ and dense in N. ½.
Fair grass.

from original cor. of secs. 3, 4, 9 and 10, hereinbefore described,
N.88°44'W., on true line, bet. secs. 4 and 9.
Over rolling land, thru scattering undergrowth.

22.95 Intersect E. bdy. line of the Camp Verde Military Reservation at a point 51.81 chs. N.21°50'W. from SE. cor. of the Reservation, hereinbefore described.
At point of intersection,
Set an iron post, 3 ft. long, 2 ins. in diam., 24 ins. in the ground, for closing cor. of secs. 4 and 9, marked on brass cap,

T13N
R5E
CVMR ——— S 4
 S 9
 1916

and raise mound of stone, 2 ft. base, 1½ ft. high, E. of cor.

24.10 Telephone line, brs. N.49°W. and S.49°E.

26.15 Road, brs. N.45°W. and S.45°E.

39.76 Set an iron post, 3 ft. long, 1 in. in diam., 26 ins. in the ground, for reestablished ¼ sec. cor. of secs. 4 and 9, marked on brass cap.

S 4
 S 9
 1916

and raise mound of stone, 2 ft. base, 1½ ft. high, N. of cor.

43.80 Wash, 20 lks. wide, 5 ft. deep, course S.20°W.

54.80 Road, brs. N.45°E. and S.45°W.

78.80 Road, brs. N.60°W. and S.60°E.

79.52 Intersect cor. of secs. 4, 5, 8 and 9, hereinbefore described. Land, rolling. Soil, clay, 3rd rate. No timber. Undergrowth, scattering greasewood. Fair grass.

Resurvey- Part of subdivision lines- T.13 N., R.5 E.

Chains.	North, on true line, bet. secs. 4 and 5 (S. $\frac{1}{2}$) Over rolling land, thru scattering undergrowth.
.10	Road, brs. N. 60° W. and S. 60° E.
32.10	Road, brs. N. 30° W. and S. 30° E.
40.04	Intersect the old $\frac{1}{4}$ sec. cor., hereinbefore described. In place of the remains of the mound of earth W. of cor., raise mound of stone, 2 ft. base, $1\frac{1}{2}$ ft. high, W. of cor. Thence North, on true line, bet. secs. 4 and 5 (N. $\frac{1}{2}$) Over rolling land, thru scattering undergrowth.
9.51	Telephone line, brs. N. 49° W. and S. 49° E.
12.26	Dim road, brs. N. 30° W. and S. 30° E.
19.96	Ascend 40 ft.
27.46	Spur, slopes W. Descend.
39.95	Intersect cor. of secs. 4, 5, 32 and 33 on N. bdy. of Tp., hereinbefore described. Raise a mound of stone, 2 ft. base, $1\frac{1}{2}$ ft. high, W. of this cor. Land, rolling. Soil, gravel and clay, 3rd rate. No timber. Undergrowth, scattering mesquite and greasewood. No grass.

	From reestablished cor. of secs. 16, 17, 20 and 21, hereinbefore described, N. $88^{\circ}31'$ W., on true line, bet. secs. 17 and 20 (E. $\frac{1}{2}$) Over river bottom land, thru scattering undergrowth. Descend gradually.
8.00	Left bank and edge of water of Verde River, brs. N. 15° W. and S. 15° E. Thence across clear running water, 17 ins. deep, course S. 15° E.
11.00	Right bank and edge of water of Verde River, brs. N. 15° W. and S. 15° E. Leave river channel. Thence over level bottom land. Ascend gradually.
11.20	Fence, brs. N. and S. Enter cultivated field.
17.95	Leave field, brs. N. and S.
18.15	Vacant house, brs. S. 3 chs. dist.
18.25	Fence, brs. N. and S.
18.40	Ditch, course S.
21.85	Road, brs. N. and S.
39.05	Wash, 10 lks. wide, 3 ft. deep, course N. 70° E.
43.74	Intersect the original $\frac{1}{4}$ sec. cor., hereinbefore described. Remove the old post and all of the mound of stones in which it is set with the exception of a malpais stone, in place, 24x17x18 ins. above ground, on N. face of which, mark "2" for reestablished $\frac{1}{4}$ sec. cor. of secs. 17 and 20 and raise a mound of stone, 2 ft. base, $1\frac{1}{2}$ ft. high, N. of cor. Land, level. Soil, sandy loam, 1st rate. Timber, scattering cottonwood. Undergrowth, scattering catclaw and mesquite. Fair grass.

	From true point for reestablished cor. of secs. 8, 9, 16 and 17, witnessed 2.40 chs. S. $0^{\circ}41'$ W. as hereinbefore described, N. $86^{\circ}16'$ W., on true line, bet. secs. 8 and 17 (E. $\frac{1}{2}$) Over river bed, thru scattering undergrowth.
1.80	Right edge of river bed, brs. NW. and SE. Leave river bed. Thence over level and rolling river bottom land. Ascend gradually.
2.25	Fence, brs. N. 45° W. and S. 45° E. Enter cultivated field.
10.65	Ditch, course S. 30° E.
12.30	Ditch, course S.
23.65	Ditch, course S. Leave field, brs. N. and S.
24.00	Fence, brs. N. and S.
24.10	Ditch, course S. E. Monroe's house, brs. N., 4 chs. dist.
25.50	Granary, brs. S. 30 lks. dist.
25.70	Road, brs. N. and S.
29.60	Leave river bottom. Enter dense mesquite, brs. N. and S. Ascend NE. slope.
40.75	Fence, brs. N. and S.
40.94	Intersect the accepted point of former location of the

Resurvey- Part of subdivision lines- T.13 N., R. 5 E.

Chains original $\frac{1}{4}$ sec. cor., hereinbefore described.
 Reestablish $\frac{1}{4}$ sec. cor. of secs. 8 and 17, at this point as follows:
 Set a malpais stone, 15x13x11 ins., 10 ins. in the ground, marked "1" on N. face, for reestablished $\frac{1}{4}$ sec. cor. of secs. 8 and 17
 and raise mound of stone, 2 ft. base, 1 $\frac{1}{2}$ ft. high, N. of cor.
 From this cor., L. young's house brs. n. 4.50 chs. dist. from $\frac{1}{4}$ sec. cor.
 S. 89° 21' W., on true line, bet. secs. 8 and 17 (W. $\frac{1}{2}$)
 Over rolling land, thru scattering undergrowth. Ascend. Road, brs. N. and S.
 1.00 Fence, brs. N. and S.
 1.65 Top of bluff, 55 ft. high, brs. NE. and SW. Descend from foot of same, over NW. slope.
 32.25 Intersect the point for reestablishment of cor. of secs. 7, 8, 17 and 18, determined as hereinbefore described in subdivisional retracement notes.
 38.32 At this point
 Set an iron post, 3 ft. long, 2 ins. in diam., 30 ins. in the ground, for reestablished cor. of secs. 7, 8, 17 and 18, marked on brass cap,
 T13N R5E
 S7 | S8
 S18 | S17
 1916
 and raise mound of stone, 2 ft. base, 1 $\frac{1}{2}$ ft. high, W. of cor. Land, rolling and level.
 Soil, sandy loam, 1st rate in E. 30 chs.; gravelly clay, 3rd rate in remainder of line.
 No timber except scattering cottonwood at E. end of line. Undergrowth, scattering catclaw and mesquite.
 Fair grass.

N. 2° 25' E., on true line, bet. secs. 7 and 8 (S. $\frac{1}{2}$)
 Over rolling land, thru scattering undergrowth. Descend on NW. slope.
 5.00 Wash, 20 lks. wide, 5 ft. deep, course N. 60° E.
 5.60 Fence, brs. E. and W.
 6.20 Ditch, course S. 60° E. Indian camp, brs. W. 45 lks. dist.
 8.65 Fence, brs. E. and W. Enter cultivated field.
 12.60 Right bank of verde River, brs. E. and W. Indian hut, brs. W., 2.70 chs. dist. Leave field and descend into bed of river.
 14.20 Fence, brs. E. and W.
 19.55 Right edge of water, brs. E. and W. Thence across running water of verde River, 2 ft. deep, course E.
 23.25 Left bank of river and edge of water, brs. E. and W. Leave water. Thence over river bottom land.
 23.80 Fence, brs. E. and W. Enter scattering timber and dense undergrowth, brs. E. and W.
 27.60 Fence, brs. E. and W.
 31.70 Fence, brs. E. and W.
 36.00 Ditch, course S. 80° E.
 39.61 Intersect the reestablished $\frac{1}{4}$ sec. cor. of secs. 7 and 8, which is also initial monument of the bdy. of the Camp verde Military Reservation, hereinbefore described.
 Land, rolling and level.
 Soil, sandy loam, 1st rate.
 Timber, scattering cottonwood.
 Undergrowth, scattering mesquite and cottonwood.
 Fair grass.

Resurvey- Part of North Bdy. of T. 13 N., R. 5 E.

Chains

12.00
24.07

From reestablished cor. of secs. 4, 5, 32 and 33, on N. bdy. of T. 13 N., R. 5 E., hereinbefore described, S. 89° 49' E., on true line, on that part of line bet. secs. 4 and 33, lying inside the Camp Verde military reservation. Over rolling land, thru scattering undergrowth. Ascend. Spur, slopes S. 35° W. Descend. intersect the reestablished closing cor. of secs. 4 and 33, on the East bdy. of the Camp Verde military Reservation, hereinbefore described.

Land, rolling.
Soil, gravel and clay, 3rd rate.
No timber.
Undergrowth, scattering catclaw, mesquite, mountain cranberry and greasewood.
No grass.

Survey- Part of East bdy. of T. 13 N., R. 5 E.

Chains From the true point for reestablished cor. of secs. 12 and 13, on E. bdy. of T. 13 N., R. 5 E., witnessed 65 lks. S. as hereinbefore described; North, on true line, on E. bdy. of sec. 12. Over mountainous and rolling land, thru scattering undergrowth. Ascend 150 ft.

3.15 Road, brs. E. and W.

15.00 Spur, slopes S. 45° W. Descend gradually.

40.00 Set an iron post, 3 ft. long, 1 in. in diam., 26 ins. in the ground, for $\frac{1}{4}$ sec. cor. of sec. 12 only, marked on brass cap.

S12
|
1916

49.40 and raise mound of stone, 2 ft. base, 1 $\frac{1}{2}$ ft. high, W. of cor. Top of bluff, facing NW. Descend 125 ft. from same.

59.10 Bottom of gulch, course S. 80° W. Ascend 70 ft.

64.40 Spur, slopes W. Descend 70 ft.

67.65 Road, brs. E. and W.

80.00 The true point for cor. of secs. 1 and 12 falls in wash, course W., therefore set witness cor. 15 lks. N. as hereinafter described. Land, mountainous and rolling. Soil, rocky, 4th rate. No timber. Undergrowth, scattering catclaw, mesquite, scrub oak, cedar and mountain cranberry. No grass.

From true point for cor. of secs. 1 and 12 North, on true line, on that part of E. bdy. of sec. 1 lying South of the bdy. of the Fort Verde Garden Reservation. Over rolling land, thru scattering undergrowth.

15 Set an iron post, 3 ft. long, 3 ins. in diam., 24 ins. in the ground, for witness cor. to cor. of secs. 1 and 12, marked on brass cap.

T13N
R5E
S 1

S12
WC
1916

7.62 and raise a mound of stone, 2 ft. base, 1 $\frac{1}{2}$ ft. high, W. of cor. intersect line 3-4 (SE. line) of F.V.G.R. bdy., at a point 2.77 chs. S. 55° 00' W. from the reestablished closing cor. thereon of that part of secs. 1 and 6, Ts. 13 N., Rs. 5 and 6 E. lying inside said reservation, hereinbefore described. At point of intersection, Set an iron post, 3 ft. long, 3 ins. in diam., 24 ins. in the ground, for closing cor. of that part of secs. 1 and 6, Ts. 13 N., Rs. 5 and 6 E., lying south of the F.V.G.R., marked on brass cap.

FVGR
S 1 S 6
R5E R6E
C C
T13N
1916

and raise a mound of stone, 2 ft. base, 1 $\frac{1}{2}$ ft. high, S. of cor. Land, rolling. Soil, rocky, 4th rate. No timber. Undergrowth, scattering scrub oak, catclaw and mountain cranberry. No grass.

From reestablished closing cor. of that part of secs. 1 and 6, Ts. 13 N., Rs. 5 and 6 E., lying inside the F.V.G.R., on line 2-3 (NE. line) of F.V.G.R. bdy., hereinbefore described.

36 Survey- Part of East Boundary- T. 13 N., R. 5 E.

Chains North, on true line, on that part of N. $\frac{1}{2}$ of E. bdy. of sec. 1 lying outside the F.V.G.R. bdy.

16.58 Over rolling land, thru scattering undergrowth & timber A point due East of closing cor. on line 2-3 (NE. line) of F.V.G.R. bdy., of that part of secs. 1 and 36, Ts. 13 and 14 N., R. 5 E. lying inside the F.V.G.R., hereinbefore described

At this point Set an iron post, 3 ft. long, 3 ins. in diam., 24 ins. in the ground, for cor. of Ts. 13 and 14 N., Rs. 5 and 6 E., marked on brass cap,

T14N	
R5E	R6E
S36	S31
S 1	S 6
T13N	
1916	

from which
 A cedar, 11 ins. in diam., Brs. N. 15 $\frac{1}{4}$ ° E., 261 lks. dist., marked T14N R6E S31 BT.
 A cedar, 9 ins. in diam., brs. S. 24° E., 100 lks. dist., marked T13N R6E S6 BT.
 No other trees within prescribed limits.
 Raise a mound of stone, 2 ft. base, 1 $\frac{1}{2}$ ft. high, S. of cor.
 Land, rolling.
 Soil, gravelly 3rd rate.
 Timber, scattering cedar.
 Undergrowth, scattering catclaw, scrub oak, and mountain cranberry
 No grass.

Survey- Part of North Bdy. of T. 13 N., R. 5 E.

From closing cor. on line 2-3 (NE. line) of F.V.G.R. bdy., of that part of secs. 1 and 36, Ts. 13 & 14 N., R. 5 E., lying inside the F.V.G.R., hereinbefore described,
 East, on true line, on that part of line bet. secs. 1 and 36, lying outside the F.V.G.R.

11.47 Over rolling land, thru scattering timber & undergrowth. intersect the cor. of Ts. 13 and 14 N., Rs. 5 and 6 E., hereinbefore described.

Land, rolling.
 Soil, gravelly, 3rd rate.
 Timber, scattering cedar.
 Undergrowth, scattering catclaw, scrub oak and mountain cranberry.
 No grass.

from cor. of secs. 3, 4, 9 and 10, T. 13 N., R. 5 E., hereinbefore described,
 north, 80.00 chs. and set temp. cor. of secs. 3, 4, 33 and 34 thence west, 40.00 chs. and set temp. $\frac{1}{4}$ sec. cor. of secs. 4 and 33
 thence west, continuing measurement and at 54.83 chs. intersect the E. bdy. of ~~Samp~~ Verde Mil. Reservation at a point 1.86 chs. S. 21° 50' E. from the reestablished closing cor. of secs. 4 and 33, Ts. 13 & 14 N., R. 5 E., hereinbefore described. From this intersection and from results of resurvey, hereinbefore described, it is evident that a closing cor. will be required on line 1-2 (NW. line) of F.V.G.R. bdy. in executing the survey of N. bdy. of T. 13 N., R. 5 E. between the two reservations, therefore,
 from closing cor. of secs. 4 and 33
 East, on true line, on that part of W. $\frac{1}{2}$ of line bet. secs. 4 and 33 outside the C.V.M.R.
 Over rolling and mountainous land, thru scattering undergrowth.

15.52 (A point 1.73 chs. N. of temp. $\frac{1}{4}$ sec. cor.) Set an iron post, 3 ft. long, 1 in. in diam., 30 ins. in the ground, for $\frac{1}{4}$ sec. cor. of secs. 4 and 33, marked on brass cap.

Survey of a portion of North hdy. of Township 13 North, Range 5 East 35

Chains.

1/4 S 33
S 4
1916

29.50 And raise a mound of stone, 2 ft. base, 1 1/2 ft. high, N. of cor.
Descend.
32.10 Gulch, course S. 50°W. Ascend 255 ft.
55.52 A point on limestone boulder, 1.73 chs. N. of temp. cor. of secs. 3, 4, 9 and 10, hereinbefore described. Impracticable to establish cor. at this point. Therefore, at a point 54 lks. S. of the true point for cor. of secs. 3, 4, 33 and 34, set an iron post, 3 ft. long, 3 ins. diam., 8 ins. in the ground, in mound of stone, for witness cor. to cor. of secs. 3, 4, 33 and 34, marked on brass cap,

T14N R5 E
S 33 S 34
S 4
1/4 S 3
T13N
1916

and raise a mound of stone, 2 ft. base, 1 1/2 ft. high, W. of cor.
And raise a mound of stone; 2ft. base, 1 1/2 ft. high, W. of cor.
Land, rolling and mountainous.
Soil, gravelly and stony, 3rd and 4th rate.
no timber.
Undergrowth, greasewood.
no grass.

from the true point for cor. of secs. 3, 4, 33 and 34, East, on a true line, bet. secs. 3 and 34.
Over rolling and mountainous land, thru scattering undergrowth.

Ascend 50 ft.
5.00 Spur, slopes S. 50°W. Descend.
17.20 head of gulch, course S. 50°W. Ascend.
29.90 Old road, brs. W. and S. on spur, slopes S. Descend 30 ft.
35.51 Wash, 5 lks. wide, 4 ft. deep, course S. 30°E. Ascend.
40.00 Set an iron post, 3 ft. long, 1 in. in diam., 23 ins. in the ground, for a sec. cor., marked on brass cap,

S 34
S 3
1916

and raise a mound of stone 2 ft. base, 1 1/2 ft. high, N. of cor.

43.00 Spur, slopes S. 20°E. Descend 70 ft.
53.04 Wash, 7 lks. wide, 2 ft. deep, course N. 30°E. Ascend 45 ft.

15.25 Spur, slopes N. Descend.
00.00 Set an iron post 3 ft. long, 3 ins. in diam., 13 ins. in the ground in a mound of stone, for cor. of secs. 2, 3, 34 and 35, marked on brass cap,

T14N R5 E
S 34 S 35
S 3 S 2
T13N
1916

and raise a mound of stone, 2 ft. base, 1 1/2 ft. high, W. of cor.
Land, rolling and mountainous.
Soil, limestone formation, 4th rate.
timber, scrub cedar.
undergrowth, mountain cranberry, catclaw, greasewood and scrub cedar.
no grass.

364. Survey of a portion of W. bdy. of Township 13 N., R. 5 E.

Chains.

- East, on a true line, between those parts of secs. 2 and 35, outside the Fort Verde Garden Reservation.
Over rolling and mountainous land, through scattering undergrowth.
Descend 120 ft.
1.17 Bottom of gulch, course S. Ascend 120 ft.
13.00 Spur, slopes N. 60° W. Ascend 140 ft.
32.00 Spur slopes S. 70° W. Descend 45 ft.
35.33 Head of gulch, course S. Ascend 70 ft.
39.50 Spur, slopes S. 60° W. Descend.
40.00 Set an iron post, 3 ft. long, 1 in. in diam., 25 ins. in the ground, for $\frac{1}{4}$ sec. cor. marked on brass cap,

S 35

S 12

N 19 E

- and raise a mound of stone, 2 ft. base, $1\frac{1}{2}$ ft. high, N. of cor.
Ascend 20 ft.
43.00 Descend 135 ft.
56.17 Gulch, course S. 50° W. Ascend.
59.19 Intersect line 1-2 (NW. line) F.V.G. N. bdy., 5.84 cns. N. 57° 29' E. of the reestablished closing cor. of those parts of secs. 2 and 35 inside the Reservation, hereinbefore described.
At the point of intersection,
Set an iron post, 3 ft. long, 3 ins. in diam., 25 ins. in the ground, for closing cor. of those parts of secs. 2 and 35 lying outside the reservation, marked on brass cap,

114 N

N 5 E

S 35

S 2

113 N

CC FVGR

1916

from which,

- A cedar, 11 ins. in diam., brs. N. 15 3/4° E., 261 lks. dist., marked 114 N N 5 E S 35 CC Bl.
A cedar, 9 ins. in diam., brs. S. 24° E., 160 lks. dist., marked 113 N N 5 E S 2 CC Bl.

Land, rolling and mountainous.

Soil, rocky, 4th rate.

Timber, scattering scrub cedar.

Undergrowth, catclaw, scrub oak, and mountain cranberry.

Survey of a portion of W. bdy. of Township 13 N., R. 5 E.

- The original $\frac{1}{4}$ sec. cor. of secs. 7 and 12 on W. bdy. of T. 13 N., R. 5 E. is a limestone, 12 x 14 ins. above ground, firmly set, marked "1/4" on W. face, and witnessed by pits N. and S. and mound of earth W. of cor. no bearing trees.
Thence,
South, bet. secs. 7 and 12 (S. $\frac{1}{2}$).
Over rolling land, through scattering undergrowth.
Descend.
3.72 Wash, 30 lks. wide, 10 ft. deep, course N. 70° E. Ascend 100 ft.
15.35 Ditch, course S. 60° E.
16.50 Fence, brs. S. 50° E. and N. 50° W.
23.87 Arizona Power Company's transmission line, brs. N. 42° W. and S. 42° E.
26.30 Spur, slopes N. 60° E. Descend 20 ft.
26.60 Bottom of gulch, course N. 50° E. containing clear water, 5 lks. wide, 3 ins. deep.

Survey of a portion of W. 1/4 of Township 13 North, Range 5 East. 37

Chains.
39.72

(A point due W. of the reestablished cor. of secs. 7, 8, 17 and 18, hereinbefore described).
Set an iron post 3 ft. long, 3 ins. in diam., 26 ins. in the ground, for cor. of secs. 7, 12, 13 and 18, marked on brass cap,



and raise a mound of stone, 2 ft. base, 1 1/2 ft. high, W. of cor. land, rolling and mountainous. Soil, rocky, 4th rate. No timber. Undergrowth, catclaw, scrub oak and mesquite. Fair grass.

South, bet: secs. 13 and 18.
Over rolling and mountainous land, thru. scattering undergrowth.

- Ascend 60 ft.
- 6.50 Spur, slopes N. 45° E. Descend.
- 9.10 Wash, 10 lks. wide, 3 ft. deep, course N. 45° E. Ascend 240 ft.
- 10.00 Enter scattering timber, brs. N. 45° E. and S. 45° W.
- 19.00 Spur, slopes N. 45° E. Leave timber, brs. N. 45° E. and S. 45° W. Descend 40 ft.
- 22.20 Fence, brs. N. 60° E. and S. 60° W.
- 34.20 Wash, course N. 75° E. Ascend 100 ft.
- 38.50 Enter scattering timber, brs. E. and W.
- 40.00 Set an iron post 3 ft. long, 1 in. in diam., 27 ins. in the ground, for sec. cor., marked on brass cap,

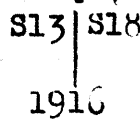

from which,
A pinyon, 6 ins. in diam., brs. S. 9 1/2° E., 100 lks. dist., marked 1/4 S 18 p. r.
A pinyon, 16 ins. in diam., brs. N. 37 1/2° W., 178 lks. dist., marked 1/4 S 13 p. r.

- 45.00 Spur, slopes E. Leave timber, brs. N. 45° E. and S. 45° W. Descend 65 ft.
- 48.00 Gulch, course N. 75° E. Good spring brs. W. 20 lks. dist. Ascend 125 ft.
- 56.50 Spur, slopes N. 70° E. Descend 35 ft.
- 62.50 Gulch, course N. 60° E. Ascend 35 ft.
- 65.50 Thence along E. slope.
- 72.40 Descend 25 ft.
- 73.70 Wash, 20 lks. wide, 2 ft. deep, course E. Ascend.
- 80.00 Set an iron post, 3 ft. long, 3 ins. in diam., 27 ins. in the ground, for cor. of secs. 13, 18, 19 and 24, marked on brass cap,



BOOK 3323

38. Survey of a portion of W. bdy. of township 13 N., R. 5 E.
Chains.

and raise a mound of stone, 2 ft. base, 1 1/2 ft. high, W. of cor.
Land, rolling and mountainous.
Soil, rocky, 4th rate.
Timber, cedar and panyon.
Undergrowth, scrub oak, mesquite, catclaw and palo verde.
Fair grass.

Survey of a portion of the Subdivision of township 13
North, Range 5 East.

From the true point for cor. of secs. 1 and 12, on E. bdy.
of T. 13 N., R. 5 E. witnessed 15 lks. N. as hereinbefore
described,
West, on a true line between those parts of secs. 1 and 12,
outside the Fort Verde Garden Reservation.
Over rolling land, along wash, course west, through scat-
tering undergrowth.
10.86 Intersect line 3-4 (SE. line) of the Fort Verde Garden Res-
ervation, 1.47 chs. N. 55° E. of the reestablished clos-
ing cor. of those parts of secs. 1 and 12, inside the
Reservation, hereinbefore described.
At the point of intersection,
Set an iron post, 3 ft. long, 2 ins. in diam., 26 ins. in
the ground, for closing cor. of those parts of secs. 1
and 12, outside the Reservation, marked on brass cap,

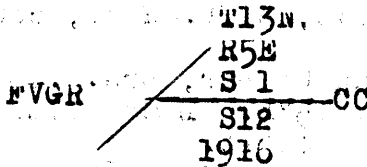

And raise a mound of stone, 2 ft. base, 1 1/2 ft. high, E. of
cor.
Land, rolling.
Soil, rocky, 4th rate.
No timber.
Undergrowth, scrub oak, catclaw, and mountain cranberry.

From the cor. of secs. 2, 3, 34 and 35, on N. bdy. of T. 13
N., R. 5 E., hereinbefore described,
South, on true line, between those parts of secs. 2 and 3,
outside the Reservation.
Over rolling and mountainous land, thru. scattering under-
growth.
Ascend 70 ft.
15.00 Spur, slopes S. 50° E. Descend 30 ft.
16.70 Ascend 20 ft.
32.00 End of spur, slopes E. Descend.
33.00 Ascend.
34.90 Spur, slopes E. Descend 85 ft.
40.00 Set an iron post, 3 ft. long, 1 in. in diam., 25 ins. in
the ground, for sec. cor., marked on brass cap,

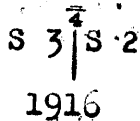

and raise a mound of stone 2 ft. base, 1 1/2 ft. high, W. of cor.
40.45 Intersect line 1-2 (NW. line) of the Fort Verde Garden Res-
ervation bdy. 3.84 chs. S. 56° 54' W. of the reestablished
closing cor. of those parts of secs. 2 and 3, inside the
reservation, hereinbefore described.
At the point of intersection,

Survey of a portion of Subdivision of Township 13 north, Range 5 E. 39

Chains.

Set an iron post, 3 ft. long, 2 ins. in diam., 24 ins. in the ground, for closing cor. of those parts of secs. 2 and 3 outside the Reservation, marked on brass cap,

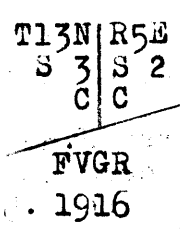

and raise a mound of stone, 2 ft. base, 1 1/2 ft. high, N. of cor.

Land, rolling and mountainous.
Soil, rocky, 4th rate.
No timber.
Undergrowth, catclaw, scrub oak, and mountain cranberry.

From the original cor. of secs. 3, 4, 9 and 10, hereinbefore described, East, on a true line, between those parts of secs. 3 and 10, outside the Fort Verde Garden Reservation.

10.00 Over mountainous land, through scattering undergrowth. Spur, slopes S. Descend.

16.49 Set an iron post, 3 ft. long, 2 ins. in diam., 24 ins. in the ground, for witness cor. to closing cor. of those parts of secs. 3 and 10 outside the Fort Verde Garden Reservation, marked on brass cap

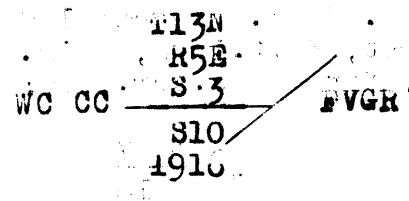

and raise a mound of stone, 2 ft. base, 1 1/2 ft. high, W. of cor.

16.88 intersect line 1-2 (NW. line) of the Fort Verde Garden Reservation ldy., 1.05 chs. N. 50° 54' E. of the reestablished closing cor. of those parts of secs. 3 and 10 inside the Reservation, hereinbefore described. The true point for closing cor. of those parts of secs. 3 and 10 outside the Reservation falls in wash, where it is impracticable to set post or stone.

Land, mountainous.
Soil, rocky, 4th rate.
No timber.
Undergrowth, catclaw, scrub oak and mountain cranberry.

From the original cor. of secs. 3, 4, 9 and 10, hereinbefore described, north, on a true line, bet. secs. 3 and 4.

Over mountainous land, thru. scattering undergrowth. Ascend 30 ft.

3.50 Spur, slopes W. Descend.

5.00 head of wash, course west. Ascend 20 ft.

14.00 Spur, slopes W. Descend 15 ft.

19.71 Wash, 40 lks. wide, 3 ft. deep, course S. 40° W. Ascend 105 ft.

36.98 road hrs. E. and W., on spur, slopes W. Descend 15 ft.

41.73 Set an iron post, 3 ft. long, 1 in. in diam., 20 ins. in the ground, for sec. cor., marked on brass cap,

40 30. Survey of a portion of the Subdivision of T. 13 N., R. 5 E.

Chains.

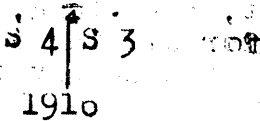

and raise a mound of stone, 2 ft. base, 1½ ft. high, W. or cor.

- 46.05 head of gulch, course S. 50° W. Ascend 75 ft.
- 61.60 Spur, slopes W. Descend 65 ft.
- 69.57 bottom of gulch, course S. 50° W. Ascend 200 ft.
- 79.70 Spur, slopes S. 50° W. Descend.
- 81.18 The witness cor. to cor. of secs. 3, 4, 33 and 34, hereinbefore described.
- 81.73 the true point for cor. of secs. 3, 4, 33 and 34 on N. bdy. of T. 13 N., R. 5 E., witnessed as hereinbefore described.

Land, mountainous.
Soil, limestone formation, stony, 4th rate.
No timber.
Undergrowth, mountain cranberry and greasewood.
No grass.

From the reestablished cor. of secs. 7, 8, 17 and 18, hereinbefore described,

- West, on a true line, bet. secs. 7 and 18.
- Over mountainous land, thru scattering undergrowth.
- Ascend 75 ft.
- 18.00 fence, brs. N. 50° E. and S. 50° W. Descend 55 ft.
- 23.00 Ascend 70 ft.
- 26.00 Descend 20 ft.
- 27.05 Gulch, course N. 30° E. Ascend 100 ft.
- 40.00 Set an iron post, 3 ft. long, 1 in. in diam., 26 ins. in the ground, for ¼ sec. cor., marked on brass cap,

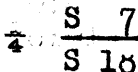

1910

and raise a mound of stone, 2 ft. base, 1½ ft. high, N. of cor.

- 50.00 top of ascent, slopes N. Descend 125 ft.
 - 65.40 Wash, 15 lks. wide, 4 ft. deep, course N. 45° E. Ascend 35 ft.
 - 65.50 Arizona Power Company's transmission line, brs. N. 42° W. and S. 42° E.
 - 78.00 Intersect the cor. of secs. 7, 12, 13 and 18, on W. bdy. of Tp., hereinbefore described.
- Land, mountainous.
Soil, rocky, 4th rate.
No timber.
Undergrowth, catclaw, scrub oak and cranberry.

From the reestablished cor. of secs. 7, 8, 17 and 18, hereinbefore described,

- South, bet. secs. 17 and 18.
- Over rolling land, thru scattering undergrowth.
- Descend.
- 5.85 Wash, 30 lks. wide, 3 ft. deep, course N. 50° E. Ascend steeply, 125 ft.
- 9.95 Ascend gradually.
- 18.45 Pipe line, brs. N. 65° E. and S. 65° W.
- 19.45 Road, brs. N. 65° E. and S. 65° W.
- 32.45 Top of ascent; descend 25 ft.
- 35.55 Wash, course N. 55° E.
- 36.95 Wash, 35 lks. wide, 3 ft. deep, course N. 50° E. Ascend 75 ft.

Survey of a portion of Subdivision of T.13 N., R. 5 E. 41.

Chains.

40.00 Set an iron post, 3 ft. long, 1 in. in diam., 26 ins. in the ground, for $\frac{1}{4}$ sec. cor. ^{sec 18 only} marked on brass cap,



and raise a mound of stone, 2 ft. base, 1 1/2 ft. high, W.

41.48 1/2 of cor. ^{Point for 1/2 sec. cor., Sec 17}

45.45 Fence, brs. E. and W.

48.85 Old road brs. N.45° E. and S.45° W. on spur, slopes N.45° E. Descend.

58.25 Head of gulch, course N.70° E. Ascend 20 ft.

65.45 Top of ascent, brs. N. 45° E. Descend 145 ft.

77.45 Wash, 30 lks. wide, 3 1/2 ft. deep, course E. Ascend 25 ft.

79.00 Arizona Power Company's transmission line, brs. N.42° W. and S.42° E.

80.00 Set an iron post, 3 ft. long, 2 ins. in diam., 26 ins. in the ground, for cor. of secs. 18 and 19, marked on brass cap,



and raise a mound of stone, 2 ft. base, 1 1/2 ft. high, W. of cor.

82.97 (A point due west of the reestablished 1/4 sec. cor. of secs. 17 and 20, hereinbefore described).

Set an iron post, 3 ft. long, 2 ins. in diam., 26 ins. in the ground, for cor. of secs. 17 and 20, marked on brass cap,

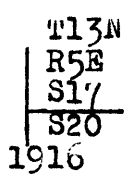

and raise a mound of stone, 2 ft. base, 1 1/2 ft. high, E. of cor.

Land, rolling.
Soil, stony, 4th rate.
no timber.
Undergrowth, catclaw and mesquite.
Some grass.

From the cor. of secs. 17 and 20, hereinbefore described, East, on a true line, bet. secs. 17 and 20 (W. 1/2).
Over rolling land, thru. scattering undergrowth.

2.80 Dim road brs. N.45° E. and S.45° W.

3.10 Arizona Power Company's transmission line, brs. N.42° W., and S.42° E.

21.00 Wash, 30 lks. wide, 3 ft. deep, course N.55° E.

34.49 the reestablished 1/4 sec. cor. of secs. 17 and 20, hereinbefore described.

Land, rolling.
Soil, rocky, 3rd rate.
No timber.
Undergrowth, catclaw, mesquite and greasewood.

From the cor. of secs. 18 and 19, hereinbefore described, West, on a random line, bet. secs. 18 and 19.

40.00 Set temp. 1/4 sec. cor.

42. Survey of portion of Subdivision of T. 13 N. R. 5 E.

Chains.

77.95 Intersect W. bdy. of Tp., 12 lks. S. of the cor. of secs. 13, 18, 19 and 24, hereinbefore described.

Thence, S. 89° 55' E., on a true line, bet. secs. 18 and 19. Over rolling land, thru scattering undergrowth. Descend 100 ft.

14.30 Wash, 20 lks. wide, 4 ft. deep, course N. 50° E.

29.80 Gulch, course N. 60° E. Ascend 25 ft.

37.95 Set an iron post, 3 ft. long, 1 in. in diam., 24 ins. in the ground, for 2 sec. cor., marked on brass cap,

S 18

S 19

1916

from which,

A pinyon, 19 ins. in diam., brs. N. 32 3/4° E., 81 lks. dist., marked 1/4 S 18. B T.

No other trees within limits. Raise a mound of stone, 2 ft. base, 1 1/2 ft. high, N. of cor.

39.00 Descend 295 ft.

66.90 Wash, 10 lks. wide, 3 ft. deep, course N. 40° E. Ascend.

77.95 The cor. of secs. 18 and 19. Land, rolling and mountainous.

Soil, stony, 3rd rate. No timber.

Undergrowth, catclaw, scrub oak and palo verde,

From the cor. of secs. 17 and 20, hereinbefore described, South, on west bdy. of sec. 20.

Over rolling and mountainous land, thru scattering undergrowth.

Ascend 60 ft.

12.40 Dim road, brs. N. 30° E. and SW.

19.80 Top of ascent; descend 30 ft.

28.30 Wash, 25 lks. wide, 3 ft. deep, course N. 55° E., Ascend 255 ft.

(S.E.B.)

40:00 Set an iron post, 3 ft. long, 1 in. in diam., 26 ins. in the ground, for 2 sec. cor. of sec. 20, marked on brass cap,

S 20

1916

and raise a mound of stone, 2 ft. base, 1 1/2 ft. high, E. of cor.

53.45 Spar, slopes N. 45° E. Descend 65 ft.

65.90 Bottom of gulch, course N. 50° E., containing clear water, 5 lks. wide, 1 in. deep. Ascend 165 ft.

78.82 (A point due west of the reestablished cor. of secs. 20; 21, 28 and 29, hereinbefore described).

Set an iron post, 3 ft. long, 2 ins. in diam., 26 ins. in the ground, for cor. of secs. 19, 20; 29 and 30, marked on brass cap,

T13N | R5 E

S19 | S20

S30 | S29

1916

from which,

A cedar, 8 ins. in diam., brs. N. 35° W., 175 lks. dist., marked T13N R5E S19 BT.

No other trees within limits. Raise a mound of stone, 2 ft. base, 1 1/2 ft. high, W. of cor.

Land, rolling and mountainous.

Soil, stony, 4th rate.

Survey of portion of Subdivision of T. 13 N., R. 5 E.

41.45

Chains.

No timber.
undergrowth; mesquite, scrub oak and catclaw.
Fair grass.

From the reestablished cor. of secs. 20, 21, 28 and 29,
hereinbefore described,
West, on a true line, on S. bdy. of sec. 20.
Over rolling land, thru scattering undergrowth.
Descend 80 ft.

10.90 Wash, 15 lks. wide, 2 1/2 ft. deep, course S. 55° E. Ascend
470 ft., over mountainous land.

24.10 Arizona Power Company's transmission line, brs. NW and SE.

31.00 End of spur, slopes N. 80° E. Continue ascent.

(S.E.B.)

40.00 Set an iron post, 3 ft. long, 1 in. in diam., 20 ins. in
the ground, for 1/4 sec. cor. of sec. 20, marked on brass
cap,

S 20

1916

and raise a mound of stone, 2 ft. base, 1 1/2 ft. high, N.
of cor.

52.50 Spur, slopes S. 70° E. from WSW. Descend 65 ft.

63.40 Head of wash, course N. 45° E. Ascend 50 ft.

72.50 Spur, slopes N. 40° E. Descend 30 ft.

74.69 The cor. of secs. 19, 20, 29 and 30.

Land, rolling.

Soil, stony, 4th rate.

No timber.

Undergrowth, scrub oak, mesquite and catclaw.

Fair grass.

142. Survey of portion of Subdivision of T.13 N., R.5 E.

Chains.

Boundaries of that portion of T.13 N., R.5 E.,
Retraced, Resurveyed and Surveyed as described in the
foregoing notes.

Latitudes, departures, and closing errors.

Line designated.	True course.	Dist.	Latitudes.		Departures.	
			N.	S.	E.	W.
South boundary, (3rd. Sta. Par. N.)	N. 89° 04' W. S. 72° 15' W.	161.16 84.63	2.62	25.80		161.14 80.60
Subdivisional boundary,	N. 0° 35' W. N. 5° 9' W. West, N. 0° 10' W. N. 6° 42' E. West, north, N. 89° 55' W.	61.82 41.47 80.00 42.81 40.67 76.69 81.79 77.95	61.82 41.30 42.81 40.39 81.79 .11	4.74	.63 3.72 80.00 .12 76.69 77.95	
West boundary,	north,	239.72	239.72			
North boundary,	East, N. 89° 49' E. East, S. 57° 29' W. East,	159.60 24.07 194.71 5.81 109.12	.08	3.12	159.60 24.07 194.71 109.12	4.90
East boundary,	South, S. 0° 30' W. S. 0° 28' W. S. 55° 00' W. South, S. 1° 22' W. S. 0° 48' W. S. 0° 47' W. S. 1° 15' W.	16.58 23.22 29.56 2.77 247.62 40.71 40.42 40.43 40.70		16.58 23.22 29.56 1.59 247.62 40.70 40.42 40.43 40.69	.20 .24 2.27 .97 .57 .55 .89	
Convergency,					.50	
Totals,			510.04 509.73	509.73	492.74 491.44	491.44
Error in latitude,			0.91			
Error in departure,					1.30	

GENERAL DESCRIPTION.

The survey of that portion of the Subdivision of the township described in the foregoing notes completes the survey of all of the township outside of the Prescott National Forest Reserve. This township is in the Verde River Valley, the surface being rolling and mountainous, with a few scattered level areas. The Verde River, course SE., passes thru. the Tp. from the NW. cor. to the SE. cor., and carries permanent running water. A spring near the W. bdy. of sec. 18 with pipe line from same, furnishes a water supply to settlers in sec. 16. Clear Creek, course W., thru. secs. 13, 14, 15, 16 and 21 also carries permanent running water. The soil, rocky and gravelly, 3rd and 4th rate, except along the Verde River, and Clear Creek, where a sandy loam, 1st rate, is found. There are a number of settlers with cultivated land and some improvements, and some irrigation is being done. The only timber, is a scattering growth of cottonwood, sycamore and cedar along Verde river, and Clear Creek.

(General Description- continued.)

A scattering undergrowth of mesquite, catclaw, scrub cedar, mountain cranberry, greasewood and scrub oak is prevalent in all portions, and also a fair growth of grass. There is no evidence of valuable mineral deposits.

A power transmission line brs. NW. and SE. thru. the western part of the township.

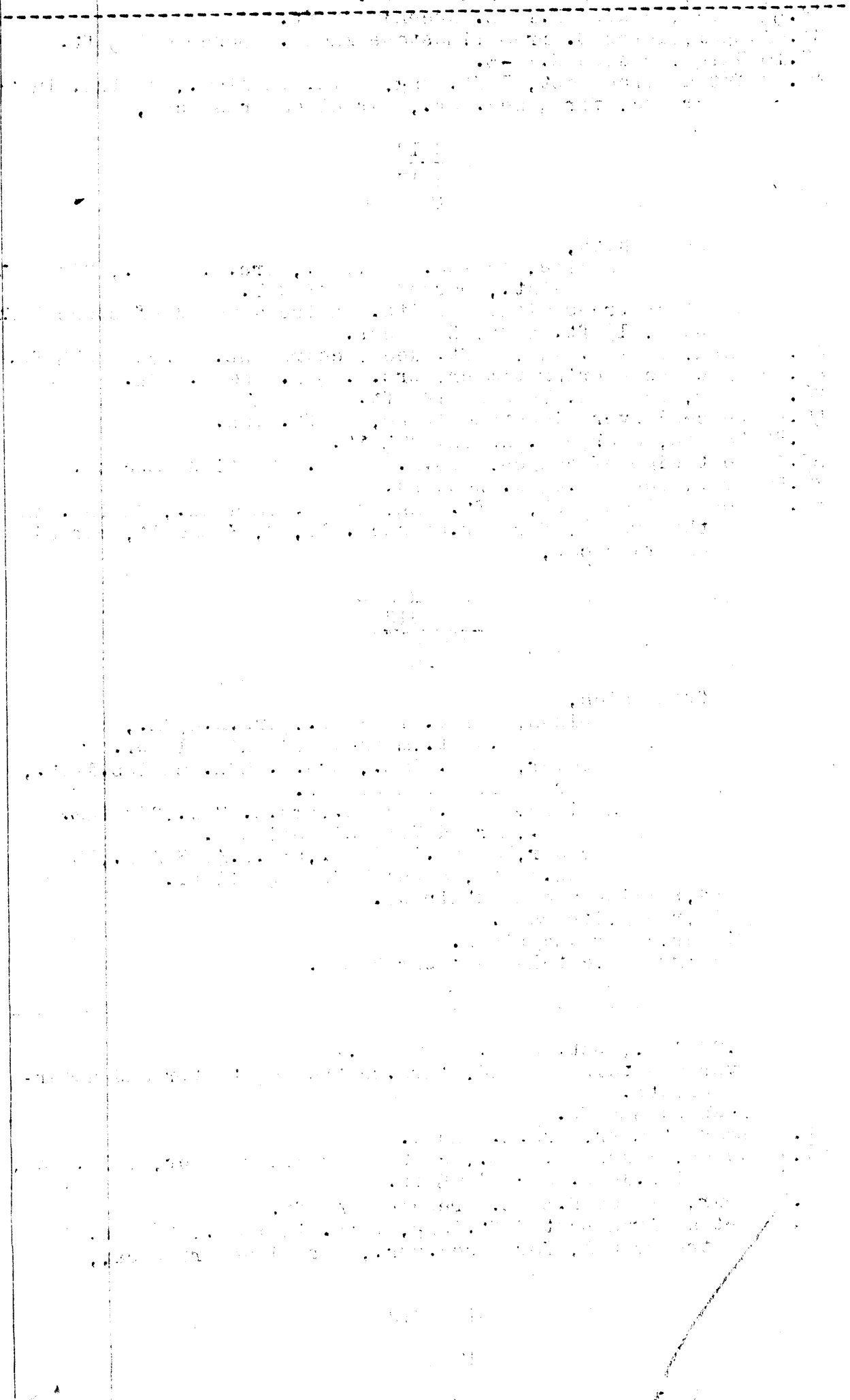

46 Survey of a portion of Subdivision of T. 13 N., R. 4 E.

Chains.

- From the cor. of secs. 7, 12, 13 and 18, on the W. bdy. of T. 13 N., R. 5 E., hereinbefore described, West, on a true line, bet. secs. 12 and 13. Over rolling land, thru scattering undergrowth. Ascend 35 ft.
- 2.12 Spur, slopes N. Descend 30 ft.
- 5.73 Creek, course N. 5° E. Ascend 50 ft.
- 9.83 Low spur, slopes N. 10° E. Descend 60 ft.
- 14.75 Gulch, course N. 15° E. Ascend 50 ft.
- 21.65 Spur, slopes N. Descend 70 ft.
- 28.55 Gulch, course N. 10° E. Ascend 125 ft.
- 34.94 Spur, slopes S. from limestone knoll. Descend 115 ft.
- 38.16 Gulch, course N. 10° E.
- 40.00 Set an iron post, 3 ft. long, 1 in. in diam., 28 ins. in the ground, for $\frac{1}{4}$ sec. cor., marked on brass cap,

$\frac{1}{4}$ S 12
S 13
1916

from which,

- A pine, 12 ins. in diam., brs. S. 37 $\frac{1}{4}$ ° W., 227 lks. dist., marked $\frac{1}{4}$ S 13 B T.
- No other trees within limits. Raise a mound of stone 2 ft. base, 1 $\frac{1}{2}$ ft. high, N. of cor.
- 44.20 Wash, 15 lks. wide, 9 ft. deep, course NE. Ascend 285 ft.
- 45.00 Enter scattering timber, brs. N. 45° W. and S. 45° E.
- 58.00 Spur, slopes N. Descend 120 ft.
- 59.50 Descend over limestone ledge, 40 ft. high.
- 60.85 Canyon, course N. Ascend 295 ft.
- 63.45 West edge of canyon, brs. N. and S. Continue ascent.
- 79.50 Spur, slopes N. 45° W. Descend.
- 80.00 Set an iron post, 3 ft. long, 2 ins. in diam., 26 ins. in the ground, for cor. of secs. 11, 12, 13 and 14, marked on brass cap,

T13N | R 4 E
S11 | S12

S14 | S13
1916

from which,

- A pinon, 7 ins. in diam., brs. N. 6 $\frac{1}{2}$ ° E., 129 lks. dist., marked T13N R4E S12 BT.
- A cedar, 5 ins. diam., brs. S. 16° E., 66 lks. dist., marked T13N R4E S13 BT.
- A pinon, 6 ins. in diam., brs. S. 27° W., 202 lks. dist., marked T13N R4E S14 B T.
- A cedar, 10 ins. in diam., brs. N. 41 $\frac{3}{4}$ ° W., 160 lks. dist., marked T13N R4E S11 BT.
- Land, rolling and mountainous.
- Soil, rocky, 4th rate.
- Timber, cedar and pinon.
- Undergrowth, catclaw and scrub oak.

-
- N. 0° 1' W., bet. secs. 11 and 12.
 - Over mountainous land, thru scattering timber and undergrowth. Descend 365 ft.
 - 5.00 Leave timber, brs. E. and W.
 - 24.70 Gulch, course N. 45° E., containing clear water, 1 lk. wide, 2 ins. deep. Ascend 95 ft.
 - 35.00 Spur, slopes N. 60° E. Descend 140 ft.
 - 40.00 Set an iron post 3 ft. long, 1 in. in diam., 26 ins. in the ground, for $\frac{1}{4}$ sec. cor., marked on brass cap,

S11 | $\frac{1}{4}$ S12
1916

Survey of a portion of Subdivision of T.13 N..R. 4 E. 47

Chains.

from which,
 A pinon, 11 ins. in diam., brs.N.28°E., 118 lks. dist., marked $\frac{1}{4}$ S 12 B T.
 A cedar, 8 ins. in diam., brs. S. 78-3/4° W., 155 lks. dist., marked $\frac{1}{4}$ S 11 B T.
 49.60 Head of wash, course N. 45° E. Ascend 180 ft.
 80.00 Set an iron post, 3 ft. long, 2 ins. in diam., 27 ins. in the ground, for cor. of secs. 1, 2, 11 and 12, marked on brass cap,

T13N R4E
 S 2 S 1
 S11 S12
 1916

and raise a mound of stone, 2 ft. base, 1 1/2 ft. high, W. of cor.
 Land, mountainous.
 Soil, rocky and gravelly, 4th rate; limestone formation, Timber, cedar and pinon.
 Undergrowth, scrub oak, palo verde, catclaw and mesquite.
 Fair grass.

40.00 East, on a random line, bet. secs. 1 and 12.
 Set temp. $\frac{1}{4}$ sec. cor.
 64.36 Fall 38 lks. N. of the closing cor. of those parts of secs. 1 and 12, inside the Camp Verde Military Reservation on the W. bdy. thereof, which is a granite stone, 13x 8x7 ins. above ground, firmly set, marked and witnessed as described by the Surveyor General.
 Thence,
 N. 89° 40' W., on a true line, between those parts of secs. 1 and 12, outside the Reservation.
 Over rolling and mountainous land, thru scattering undergrowth.
 16.35 Arizona Power Company's transmission line, brs. N. 35° W. and S. 35° E.
 24.36 Set an iron post, 3 ft. long, 1 in. in diam., 26 ins. in the ground for $\frac{1}{4}$ sec. cor., marked on brass cap,

$\frac{1}{4}$ S 1
 S 12
 1916

and raise a mound of stone, 2 ft. base, 1 1/2 ft. high, N. of cor.
 25.55 Wash, 20 lks. wide, 8 ft. deep, course N. 50° E.; ascend 265 ft., over mountainous land.
 64.36 The cor. of secs. 1, 2, 11 and 12.
 Land, rolling and mountainous.
 Soil, stony, 3rd and 4th rate.
 No timber.
 Undergrowth, mesquite, catclaw and palo verde.
 Fair grass.

N. 0° 1' W. on true line, bet. secs. 1 and 2.
 Over rolling land, thru scattering undergrowth.
 Descend 165 ft.
 26.40 Road, brs. N. 55° E. to Camp Verde, and S. 55° W. to Dewey.
 27.90 Wash, in Copper Canyon, 35 lks. wide, 4 ft. deep, course NE. Ascend 85 ft.
 40.00 Set an iron post, 3 ft. long, 1 in. in diam., 26 ins. in the ground, for $\frac{1}{4}$ sec. cor., marked on brass cap,

S 2 S 1
 1916

BOOK 3323

49 Survey of portion of Subdivision of T. 13 N., R. 4 E.

Chains.
 and raise a mound of stone, 2 ft. base, 1½ ft. high, W. of cor.
 65.00 Spur, slopes E. Descend 65 ft.
 70.55 Arizona Power Company's transmission line brs. N. 35° W. and S. 35° E.
 78.30 Wash, 40 lks. wide, 20 ft. deep, course N. 60° E. Ascend.
 79.51 (A point due west of the original closing cor. of secs. 1 and 36 on the N. bdy. of Tp. 13 N., R. 4 E., and the West boundary of the Camp Verde Military Reservation).
 Set an iron post, 3 ft. long, 3 ins. in diam., 26 ins. in the ground for cor. of secs. 1, 2, 35 and 36, marked on brass cap,

T14N | R4 E
 S35 | S36
 S 21 | S 1
 T13N
 1916

and raise a mound of stone, 2 ft. base, 1½ ft. high, W. of cor.
 Land, rolling.
 Soil, stony, 4th rate.
 Timber, scattering cedar.
 Undergrowth, mesquite, catclaw, scrub oak and palo verde.
 Some grass.

Survey of portion of North bdy. of T. 13 N., R. 4 E.

From the original closing cor. of secs. 1 and 36, Ts. 13 and 14 N., R. 4 E. on the N. bdy. of T. 13 N., R. 4 E., and the W. bdy. of the Camp Verde Military Reservation, which is a granite stone, 16x13x7 ins. above ground, firmly set, marked and witnessed as described by the Surveyor-General,
 West, on a true line, between those parts of secs. 1 and 36, outside the Camp Verde Military Reservation.
 Over rolling land, thru. scattering undergrowth.
 29.71 Intersect the cor. of secs. 1, 2, 35 and 36, hereinbefore described.
 Land, rolling.
 Soil, stony, 4th rate.
 No timber.
 Undergrowth, catclaw, mesquite, scrub oak and palo verde.
 Some grass.

Boundaries of subdivided portion of T. 13 N., R. 4 E.
 Latitudes, Departures, and Closing Errors.

Line designated.	True course.	Dist.	Latitudes.		Departures.	
			N.	S.	E.	W.
Subdivisional boundary. (S. & W. bars.)	West, N. 0° 1' W.	80.00 159.51	159.51			80.00 .05
North boundary,	East,	79.71			79.71	
East boundary,	South,	159.72		159.72		
Convergency,					.03	
Totals,			159.51	159.72	79.74	80.05
Error in latitude,				159.51		79.74
Error in departure,				0.21		0.31

GENERAL DESCRIPTION.

The portion of this township subdivided as described in the foregoing field notes is that portion of secs. 1 and 12 situated outside the bdy. of the Camp Verde Military Reservation. The surface is rolling and mountainous, draining easterly into the Verde River in the adjoining township on the east. The soil is rocky and gravelly, 3rd and 4th rate. There is a scattering growth of cedar and pinon timber, and a scattering undergrowth of scrub oak, mesquite, catclaw and palo verde. A fair growth of grass is found in some parts. The only permanent running water is near the east bdy. of the Tp. in sec. 13, which is unsurveyed. There are no settlers.

A power transmission line hrs. NW. and SE. thru. the township. There is no indication of valuable mineral deposits. The unsurveyed portion of the township is all within the Prescott National Forest Reserve, and the surface therein is rolling, broken and mountainous, being part of what is known as the "Black Hills."

Report of the Surveyor-General

CERTIFICATE OF UNITED STATES CADASTRAL ENGINEER.

I, Sidney E. Blout, U.S. Cadastral Engineer hereby certify upon honor that, in pursuance of special instructions received from the U. S. Surveyor General, for Group 61, Arizona, bearing date of the 14th day of October, 1915, I have well, faithfully, and truly in my own proper person, and in strict conformity with said instructions, the Manual of Surveying Instructions, and the laws of the United States, ~~surveyed all those parts or portions of~~ corrected all those parts or portions of the survey of the Subdivision lines of Township 13 North, Range 5 East, executed in April, 1916, by William H. Richards, Jr., U.S. Surveyor, under same instructions for Group 61, Arizona, of the Gila and Salt River Base and Meridian, in the State of Arizona, which are represented in the foregoing field notes and by diagram on page 2 hereof, as having been executed by me, and under my direction; and that all the corners of said corrective survey ~~survey~~ have been established and perpetuated in strict accordance with the Manual of Surveying Instructions, and the special written instructions of the U. S. Surveyor General, for Group 61, Arizona, and in the specific manner described in the field notes, and that the foregoing are the original field notes of such corrective survey.

Phoenix - Arizona
Nov. 28, 1919.

Sidney E. Blout
U.S. Cadastral Engineer

APPROVAL

OFFICE OF THE UNITED STATES SURVEYOR GENERAL,

191

The foregoing field notes of the survey of

executed by

under his special instructions dated , 191 , having been critically examined, and the necessary corrections and explanations made, the said field notes, and the surveys they describe, are hereby approved.

U. S. Surveyor General.

I certify that the foregoing transcript of the field notes of the above-described surveys in , has been correctly copied from the original notes on file in this office.

U. S. Surveyor General

BOOK "B"

4-680

FIELD ASSISTANTS.to

William H. Richards, Jr., U.S.S.

NAMES.	CAPACITY.
Marvin J. Lytle,	Chairman,
Charles L. Moore,	Chairman,
Clayton E. Ryckman,	Flagman,
Ben Swanssen,	Moundman,
Walter McDonald,	Moundman.

CERTIFICATE OF UNITED STATES SURVEYOR.

See Book "A" of this Group.

~~U. S. Surveyor, hereby certify upon honor that, in pursuance of instructions received from the U. S. Surveyor General for _____ the _____ day of _____, 191____, I have well, faithfully, and truly surveyed _____ per person, and in strict conformity with said instructions, the Manual of Surveying Instructions and the laws of the United States, surveyed all those parts or portions of _____ of the _____ Meridian, in the State of _____, which are represented in the foregoing field notes as having been executed by me, and under my direction; and that all the corners of the survey have been established and perpetuated in strict accordance with the Manual of Surveying Instructions and the special written instructions of the U. S. Surveyor General for _____ in the specific manner described in the field notes, and that the foregoing are the original field notes of the survey.~~

~~U. S. Surveyor~~

APPROVAL.

OFFICE OF THE UNITED STATES SURVEYOR GENERAL,

Phoenix, Arizona, May 14, 1920

The foregoing field notes of the ~~survey of~~ Retracement of 3rd. Std. Par. N., thru. part of R. 5 E., and part of the Subdivision lines of T. 13 N. R. 5 E. ... survey of a part of the bdry. of Ft. Verde Garden Reservation, a part of the bdry. of Camp Verde Military Reservation, 3rd. Std. Par. N., thru. part of Range 5 E., part of E. bdy. of T. 13 N. R. 5 E. & part of Subdivision lines of Township 13 N., R. 5 E., and SURVEY of parts of the East, North, and West bdrs., and Subdivision lines of TOWNSHIP 13 NORTH, RANGE 5 EAST, and part of the Subdivision lines of TOWNSHIP 15 NORTH, RANGE 4 EAST

of the Gila and Salt River Base and Meridian, in the State of Arizona,

executed by William H. Richards, Jr., U. S. Surveyor, and correction of part of the Subdivision line by Sidney E. Blout, U. S. Cadastral Engineer, under his special instructions dated Oct. 14, 1915, for Group 61, Arizona, ~~191~~, having been fully examined, and the necessary corrections and explanations made, the said field notes, and the ~~refracted~~ ^{resurveys and surveys} describe, are hereby approved.

U. S. Surveyor General.

~~That the foregoing transcript of the field notes of the above-described surveys in _____ has been correctly copied from the original notes on file in this office.~~

U. S. Surveyor General.