

FIELD NOTES

BOOK 3325

OF THE RETRACEMENT of

4th. Standard Parallel North, thru. part of Range 4 East,
Part of West bdrs. of Fractional Tps. 16 N., Ranges 4 and 5 East, and
Part of the Subdivision lines of Fractional Tp. 16 North, Range 4 East.

RESURVEY of the

4th. Standard Parallel North, thru. part of Range 5 East,
Part of the West bdrs. of Fractional Tps. 16 N., Ranges 4 & 5 East,
Part of the South bdy. of Fractional Tp. 16 North, Range 4 East, and
Part of the Subdivision lines of Fractional Tp. 16 North, Range 4 East

and SURVEY of

Part of the Subdivision lines of Fractional Tp. 16 North, Range 4 East.

Of the Gila and Salt River Base and Meridian,

In the State of Arizona.

EXECUTED BY

William H. Richards, Jr.

In the capacity of U. S. Surveyor..., under Special Instructions dated October 14., 1915,
issued by the United States Surveyor General to govern surveys included in Group
No. 61, which were approved by the Commissioner of the General Land
Office, October 28., 1915, and Assignment Instructions dated January 6., 1916

Retracement,
Resurvey and Survey commenced April 25., 1916.
Retracement
Resurvey and Survey completed May 10., 1916.

3325

3325

SEE SPECIAL INDEX DIAGRAM.

~~INDEX DIAGRAM.~~

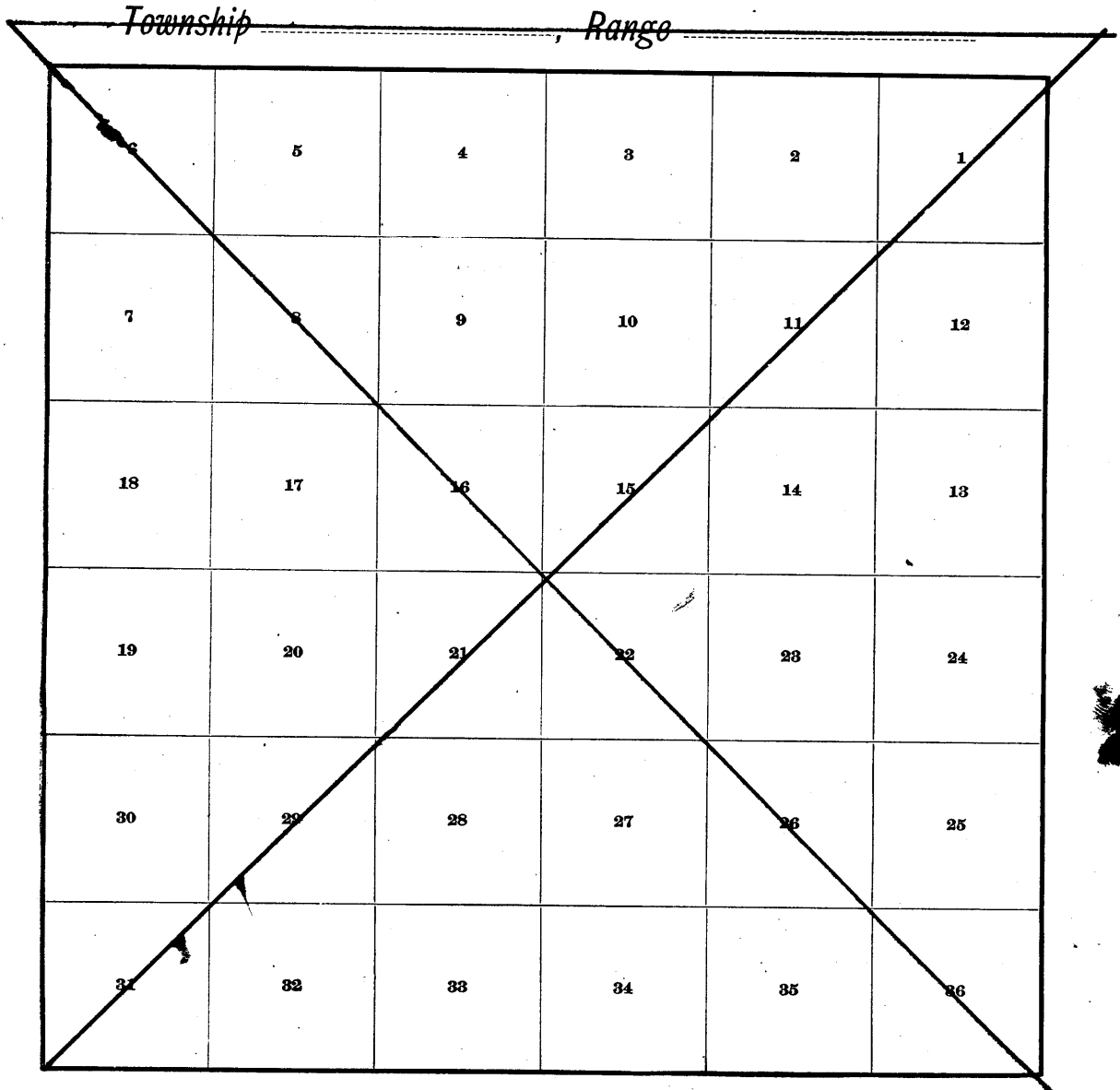

63
AR 16
IA





3325

SPECIAL INDEX DIAGRAM.

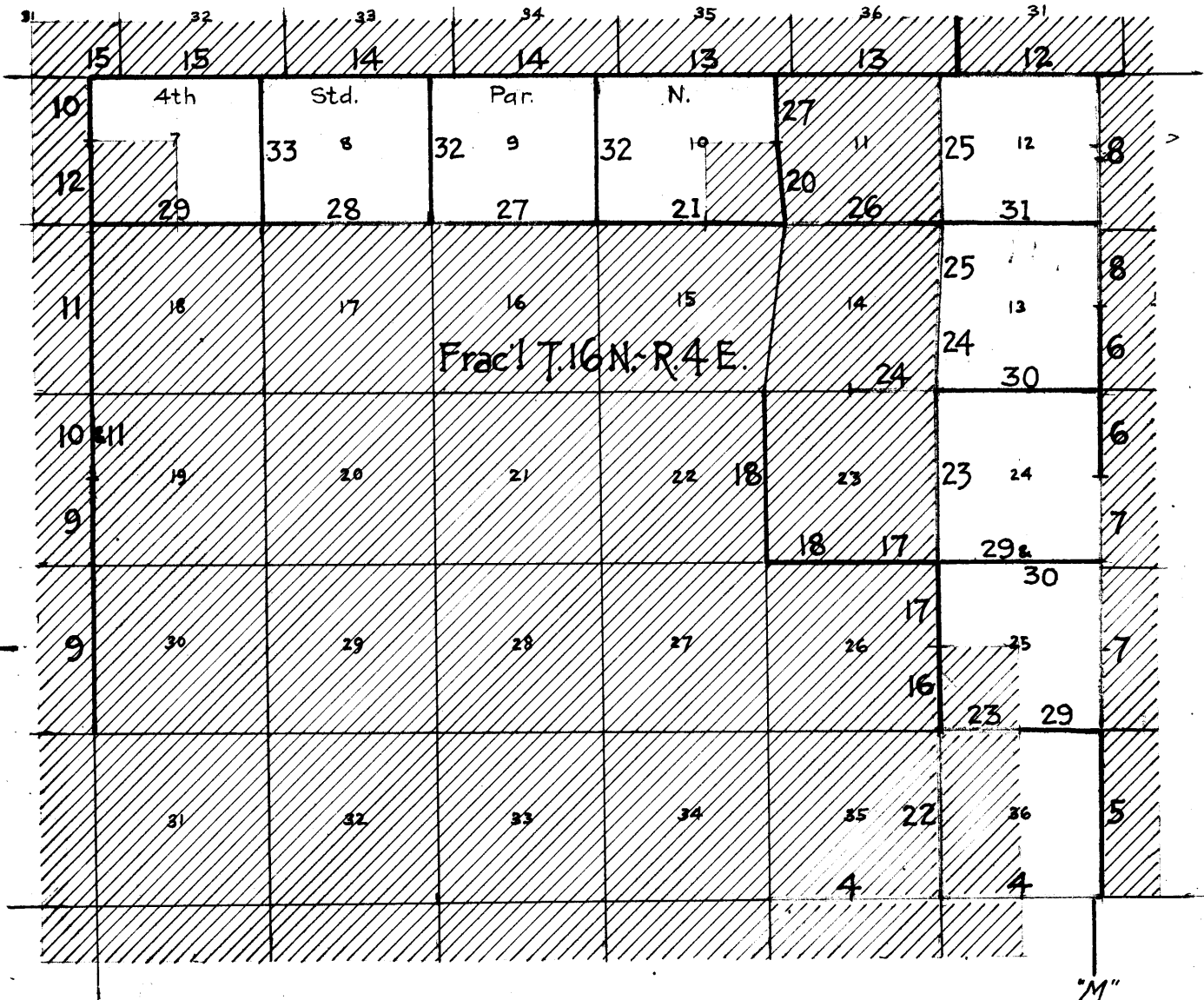
Book "D"- Group 61- Arizona.

BOOK 3325



-  Surveyed under this Group.
-  Retraced under this group.
-  Resurveyed under this group.
-  Accepted surveys.
-  Areas surveyed as per accepted plats on file.

BOOK 3325

~ DATE ~ DIAGRAM ~

Book "D"- Group 61-Arizona.

31	32	33	34	35	36	31
5-5-16	5-5-16	5-5-16	5-5-16	5-4-16	5-4-16	4-25-16
4th. Standard Parallel North						
5-5-16	5-9-16	5-9-16	5-10-16	4-29-16	4-28-16	4-30-16
7	8	9	10	11	12	
5-9-16	5-3-16	5-8-16	5-3-16	5-2-16	5-2-16	
5-8-16	18	17	16	15	14	13
Frac'l T. 16 N. R. 4 E.						
				4-27-16	4-28-16	4-30-16
5-8-16	19	20	21	22	23	24
				4-29-16	4-27-16	4-30-16
5-8-16	30	29	28	27	26	25
					4-25-16	4-30-16
	31	32	33	34	35	36
					4-25-16	4-25-16
					4-26-16	4-26-16
						4-25-16

_____ Surveyed)
 _____ Retraced) --On dates shown on diagram by Wm. H. Richards, Jr., U.S. Surveyor.
 _____ Resurveyed)

Chains.

Retracements, Resurveys and Surveys hereinafter described, executed by William H. Richards, Jr., U.S. Surveyor, on dates shown on page 2 hereof, using Buff solar transit No. 9206, with Smith solar attachment, For description of instrument & certificate of approval, see Book "A." Examine the adjustments of the transit, and correct all errors; then, to test the solar apparatus, by comparing its indications, resulting from solar observation made during a.m. and p.m. hours, with a meridian determined by observations on Polaris, proceed as follows:

April 24, 1916. At camp, in the SE. quarter of sec. 26, fracl. T. 16 N., R. 4 E.; lat. $34^{\circ}45\frac{1}{2}'$ N.; long. $111^{\circ}53\frac{1}{2}'$ W., at 4n. 10m. p.m., l.m.t., set off $34^{\circ}45\frac{1}{2}'$ N. on the lat. arc; $13^{\circ}14'$ N. on the decl. arc, and determine a meridian with the solar, and mark a point thereof by a nail set in a stake, 5 chs. N. of station.

At 5h. 25m. p.m., l.m.t., by watch, which is set to correct local mean time, observe Polaris at western elongation, in accordance with the Manual of Instructions, and mark a point in the line thus determined on a stake 5 chs. N. of station.

April 24, 1916.

April 25, 1916.

At 7h. 2m., a.m., l.m.t., lay off the azimuth of Polaris, $1^{\circ}23\frac{1}{2}'$ to the east, and mark a point in the meridian thus determined by a nail on the stake previously set. Referred to the true meridian thus determined, the solar meridian determined last evening, brs. $0^{\circ}0\frac{1}{2}'$ W.

At 7h. 7m. a.m., l.m.t., set off $34^{\circ}45\frac{1}{2}'$ N. on the lat. arc; $13^{\circ}14'$ N. on the decl. arc, and determine a meridian with the solar. This line referred to the true meridian hereinbefore described, brs. $0^{\circ}0\frac{1}{2}'$ W.

The solar apparatus, by a.m. and p.m. observations, defines positions for meridians which depart less than 1' from the true meridian determined by observations on Polaris at elongation; therefore, conclude that the solar is in satisfactory adjustment.

April 25, 1916.

RETRACEMENT OF PART OF SOUTH BDY. OF FRACL. T. 16 N., R. 4 E.,
Retracement for Resurvey.

Begin at cor. of T. 15 N., R. 4 and 5 E., and fracl. T. 16 N., R. 4 and 5 E., reestablished in 1902, and is a limestone $10 \times 10 \times 7$ ins. above ground, firmly set, marked with 6 notches on each edge, "16N" on NE. face, "5E" on SE. face, "15N" on SW. face, and "4E" on NW. face, and witnessed by mound of earth and stone, S. of cor., and faint remains of pits, N., S.E. and W.

No bearing trees.

Whence, West, on a random line, bet. secs. 1 and 36 (E. $\frac{1}{2}$).

39.99 Intersect the original $\frac{1}{4}$ sec. cor., which is a limestone, $13 \times 8 \times 7$ ins. above ground, firmly set, marked "1" on E. face, and witnessed by mound of stone, W. of cor. No bearing trees.

True course and dist. of E. $\frac{1}{2}$ of line, bet. secs. 1 and 36 are therefore west, 39.99 chs.

Whence, West, on a random line, bet. secs. 1 and 36 (W. $\frac{1}{2}$).

40.00 Diligent search in this vicinity failed to reveal any trace of the original cor. of secs. 1, 2, 35 and 36.

Set temp. cor. of said secs.

Continue line and measurement, bet. secs. 2 and 35.

79.77 A cedar post 6 ins. in diam., squared on four sides, but unmarked, and no accessories, crs. S. 15 kts. dist. Do not accept this as the $\frac{1}{4}$ sec. cor.

80.00 Diligent search in this vicinity fails to reveal any trace of the original $\frac{1}{4}$ sec. cor. of secs. 2 and 35. Set temp. $\frac{1}{4}$ sec. cor. Continue line and measurement.

4. Retracement of part of South bdy. of fract. T. 16 N., R. 4 E.

Chains.
120.21 Fall 25 lks. N. of original cor. of secs. 2, 3, 34 and 35, which is a granite stone, 14x12x10 ins. loosely set, marked with 4 notches on W. face, and 2 notches on E. face. no accessories visible.
True course and dist. of line from original $\frac{1}{4}$ sec. cor. of secs. 1 and 36 to this cor. are therefore S. 89° 53' W., 120.21 chs., giving as a proper interval for the reestablishment of cors. thereon, 40.07 chs.

RESURVEY OF PART OF S. BDY. OF FRACL. T. 16 N., R. 4 E.

Reestablish the cor. of Ts. 15 N., Rs. 4 and 5 E., and fract. Ts. 16 N., Rs. 4 and 5 E., hereinbefore described, by raising a mound of stone, 2 ft. base, 1½ ft. high, S. of cor. in place of the remains of the old mound.

Thence,
West, on a true line, bet. secs. 1 and 36 (E. $\frac{1}{2}$).

39.99 Over rolling land, thru. scattering undergrowth. Descend. Intersect original $\frac{1}{4}$ sec. cor. hereinbefore described. Reestablish this cor. by resetting stone in same place, with marking to north; same dimensions above ground, and move mound of stone, 2 ft. base, 1½ ft. high, from E. to N. of cor.

Thence,
S. 89° 53' W., on true line, bet. secs. 1 and 36 (W. $\frac{1}{2}$).

40.07 Over rolling land, thru. scattering undergrowth. Descend. (Proportional dist.) Set an iron post, 3 ft. long, 3 ins. in diam., 27 ins. in the ground, for reestablished cor. of secs. 1, 2, 35 and 36, marked on brass cap,

T16N R. 4E

S35 | S36
S 2 | S. 1

T15N

1916

and raise a mound of stone, 2 ft. base, 1½ ft. high, W. of cor.

Land, rolling.

Soil, sandy, gravelly and rocky, 3rd rate.

No timber.

undergrowth, scattering mesquite, catclaw and scrub oak.
Fair grass.

S. 89° 53' W., on true line, bet. secs. 2 and 35.

Over rolling land, thru. scattering undergrowth. Descend.

17.23 Road brs. N. to Sedona and S. to Camp Verde.

39.70 Wood post hereinbefore described, brs. N. 3 lks. dist.

40.07 (Proportional dist.) True point for reestablishment of $\frac{1}{4}$ sec. cor. of secs. 2 and 35. No cor. set.

46.30 Road brs. N. 50° E. to Sedona and S. 50° W. to Cornville.

50.00 gulch, course S. 50° W.

72.33 Road brs. N. 5° E. to Sedona and S. 15° E. to Camp Verde.

73.93 Road brs. N. 5° E. and S. 5° W.

75.23 Road brs. N. 10° E. and S. 10° W.

70.63 Lee White's house brs. S. 15 lks. dist.

60.14 Intersect original cor. of secs. 2, 3, 34 and 35, hereinbefore described.

Reestablish this cor. in same place by firmly setting same stone, 10 ins. in the ground, and raising a mound of stone, 2 ft. base, 1½ ft. high, W. of cor. No change made in markings.

Land, rolling.

Soil, sandy, gravelly and rocky, 3rd rate.

No timber.

undergrowth, scattering mesquite, catclaw and scrub oak.
Fair grass.

Doc 6825

Retracement of Part of West bdy. of fract. T.16 N., R. 5 E. 5.

Chains.

From reestablished cor. of Ts. 15 N., Rs. 4 and 5 E., and fract. Ts.16 N., Rs.4 and 5 E., hereinbefore described, North, on random line, bet. secs. 31 and 36 (S. $\frac{1}{2}$).
 Over rolling land, thru scattering undergrowth.

15.30 Wash, 50 lks. wide, 4 $\frac{1}{2}$ ft. deep, course W.
 24.00 Wash, 10 lks. wide, 7 ft. deep, course S. 70° W.
 39.98 Intersect the original $\frac{1}{4}$ sec. cor., which is a limestone, 16x10x6 ins. above ground, firmly set, marked " $\frac{1}{4}$ " on W. face, and witnessed by pits, N. and S. of cor., and mound of earth and stone, W. of cor. No bearing trees. True course and dist. of S. $\frac{1}{2}$ of line bet. secs. 31 and 36 are therefore north, 39.98 chs.

Thence,
 North, on random line, bet. secs. 31 and 36 (N. $\frac{1}{2}$).
 Over rolling land, thru scattering undergrowth.

9.52 Wash, 20 lks. wide, 2 $\frac{1}{2}$ ft. deep, course S. 55° W.
 11.02 Fence, brs. N. 65° W. and S. 65° E.
 17.87 Gulch, course W., containing small stream of clear water.
 21.27 Gulch, course S. 30° E.
 27.02 Malpais ledge 5 to 20 ft. high, brs. N. from SE. Thence along ledge.

30.92 Leave ledge brs. N. 30° E. from S. Descend.
 33.02 Gulch, course S. 25° W. Ascend.
 39.92 Fall 3 lks. E. of original cor. of secs. 25, 30, 31 and 36, which is a malpais stone, 16x13x7 ins. above ground, firmly set, marked with 5 notches on N. edge and 1 notch on S. edge, and witnessed by mound of stone, W. of cor. and bearing trees as follows:
 A cedar, SE. of cor., marked "T16NR5ES31BT."
 A cedar, SW. of cor., marked "T16NR4ES36BT", and
 An oak, NW. of cor., marked "T16NR4ES25 BT."
 True course and dist. of N. $\frac{1}{2}$ of line, bet. secs. 31 and 36, are therefore N. 0° 3' W., 39.92 chs.

Land, rolling.
 Soil, sandy, gravelly and rocky, 3rd and 4th rate.
 No timber.
 Undergrowth, scattering catclaw, mesquite, palo verde and scrub cedar.
 Fair grass.

Retracement for Resurvey.

39.78 North, on random line, on W. bdy. of sec. 30 (S. $\frac{1}{2}$).
 Fall 3 lks. W. of original $\frac{1}{4}$ sec. cor. of secs. 25 and 30, which is a malpais stone, 24x10x7 ins. above ground, firmly set, marked " $\frac{1}{4}$ " on W. face, and witnessed by bearing trees, as follows:
 A cedar, NE. of cor. marked " $\frac{1}{4}$ S30BT", and
 A cedar, SW. of cor., marked " $\frac{1}{4}$ S25BT."
 True course and dist. of S. $\frac{1}{2}$ of W. bdy. of sec. 30, are therefore N. 0° 3' E., 39.78 chs.

39.97 Thence,
 North, on random line, on W. bdy. of sec. 30 (N. $\frac{1}{2}$).
 Fall 2 lks. W. of original cor. of secs. 19, 24, 25 and 30, which is a malpais stone, 28x8x7 ins. firmly set in a mound of stone, marked with 4 notches on E. edge, and 2 notches on S. edge, witnessed by bearing trees as follows:
 A cedar, NE. of cor., marked "T16NR5ES19BT."
 A cedar, SE. of cor., marked "T16NR5ES30BT."
 A cedar, SW. of cor., marked "T16NR4ES25BT", and
 A cedar, NW. of cor., marked "T16NR4ES24BT."
 True course and dist. of N. $\frac{1}{2}$ of W. bdy. of sec. 30 are therefore N. 0° 2' E., 39.97 chs.

40.10 North, on random line, on W. bdy. of sec. 19 (S. $\frac{1}{2}$).
 Fall 5 lks. E. of original $\frac{1}{4}$ sec. cor. of secs. 19 and 24, which is a malpais stone, 10x8x5 ins. above ground, firmly set,

Chains.

marked "1/4" on W. face, and witnessed by bearing trees, as follows:

A cedar, SW. of cor., marked "1/4 S24 BT." and

A cedar, SE. of cor., marked "1/4 S19 BT."

True course and dist. of S. 1/2 of W. bdy. of sec. 19, are therefore N. 0° 4' W., 40.16 chs.

RETRACEMENT.

From 1/4 sec. cor. of secs. 19 and 24,
North, on random line, bet. secs. 19 and 24 (N. 1/2).
Over rolling land, thru scattering undergrowth and timber.
Descend 100 ft.

11.97 Gulch, course W. Ascend 45 ft.

19.64 Top of ascent; descend 155 ft. along W. slope.

35.84 Gulch, course W. Ascend.

39.94 Intersect original cor. of secs. 13, 18, 19 and 24, which is a malpais stone, 8x8x8 ins. above ground, firmly set, marked with 3 notches on each of N. and S. edges, and witnessed by bearing trees as follows:

"A cedar, NE. of cor., marked T16NR5E S18 BT," and

A cedar, SE. of cor., marked "T16NR4ES19 BT."

and a mound of stone, W. of cor.

True course and dist. of N. 1/2 of line bet. secs. 19 and 24, are therefore, north, 39.94 chs.

Land, rolling.

Soil, sandy and gravelly, 3rd rate.

Timber, very scattering cedar.

Undergrowth, scattering mesquite, catclaw, and scrub oak.

Fair grass.

North, on random line, bet. secs. 13 and 18 (S. 1/2).
Over rolling land, thru scattering undergrowth and timber.
Ascend 20 ft.

3.20 Descend 20 ft.

14.45 Gulch, course W. Ascend gradually.

39.95 Fall 6 lks. S. of original 1/4 sec. cor. of secs. 13 and 18, which is a malpais stone, 12x8x8 ins., above ground, firmly set, marked "1/4" on W. face, and witnessed by bearing trees as follows:

A cedar, SE. of cor., marked "1/4 S18 BT," and

A cedar, NW. of cor., marked "1/4 S13 BT."

True course and dist. of S. 1/2 of line, bet. secs. 13 and 18 are therefore N. 0° 5' W., 39.95 chs.

Land, rolling,

Soil, sandy and gravelly, 3rd rate.

Timber, very scattering cedar.

Undergrowth, scattering mesquite, catclaw and scrub oak.

Fair grass.

Retracement for Resurvey.

From original 1/4 sec. cor. of secs. 13 and 18,
North, on random line, on W. bdy. of sec. 18 (N. 1/2).
39.73 Fall 3 lks. W. of original cor. of secs. 7, 12, 13, and 18, which is a malpais stone, 12x8x8 ins. above ground, firmly set, marked with 2 notches on N. edges and 4 notches on S. edge, and witnessed by bearing trees as follows:

A cedar, SE. of cor., marked "T16NR5ES18 BT."

A juniper, SW. of cor., marked "T16NR4ES13 BT." and

A pinyon, NW. of cor., marked "T16NR4ES12 BT."

True course and dist. of N. 1/2 of W. bdy. of sec. 18, are therefore, N. 0° 3' E., 39.73 chs.

From original cor. of secs. 7, 12, 13 and 18,

Retracement of part of W. bdy. of fracl. T. 16 N., R. 5 E. 7

Chains.

39.51 North, on random line, on W. bdy. of sec. 7 (S. 1/2).
 Fall 8 lks. E. of original 1/4 sec. cor. of secs. 7 and 12,
 which is a malpais stone, 12x8x5 ins. above ground, firmly
 set, marked "1/4" on W. face, and witnessed by bearing
 trees as follows:
 A cedar, NW. of cor. marked "1/4S12Dr." and
 A cedar, SE. of cor., marked "1/4S7Dr."
 True course and dist. of S. 1/2 of W. bdy. of sec. 7, are there-
 fore N. 0° 7' W., 39.51 chs.

thence,
 34.97 North, on random line, on W. bdy. of sec. 7 (N. 1/2).
 Fall 3 lks. E. of original closing cor. of secs. 7 and 12,
 and fracl. rs. 10 N., ns. 4 and 5 E., on 4th Std. Par. N., which
 is a red sandstone, 12x8x6 ins. above ground, firmly set,
 marked with 6 grooves on each of E., W. and S. faces, and
 "CC" on S. face, and witnessed by a mound of stone, S. of
 cor., and one bearing tree.
 A cedar, SW. of cor., marked "T16NR4ES12Dr."
 True course and dist. of N. 1/2 of W. bdy. of sec. 7, are there-
 fore N. 0° 3' W., 34.97 chs.

Resurvey of part of W. bdy. of fracl. T. 16 N., R. 5 E.

From original cor. of secs. 25, 30, 31 and 36, hereinbefore
 described,
 N. 0° 3' E., on true line, on W. bdy. of sec. 30 (S. 1/2).
 Over rolling land, thru scattering undergrowth and timber.
 Ascend 275 ft. to spur.
 11.17 Gulch, course S. 10° E.
 20.10 Point of spur, sloping E. Descend 70 ft.
 25.31 Gulch, course S. 20° E. Ascend 40 ft.
 29.70 Descend.
 39.20 Gulch, course S. 15° W. Ascend 10 ft. to
 39.78 Intersect original 1/4 sec. cor. of secs. 25 and 30, hereinbefore
 described.

Reestablish this cor. to refer to sec. 30 only, by obliterate-
 ing marking on SW. bearing tree, and raise a mound of
 stone, 2 ft. base, 1 1/2 ft. high, E. of cor.
 thence,
 N. 0° 2' E., on true line, on W. bdy. of sec. 30 (N. 1/2).
 Over rolling and mountainous land, thru scattering under-
 growth and timber. Ascend 160 ft.
 19.62 Top of ascent. thence along W. slope.
 29.67 Gulch, course S. 40° W. Ascend 140 ft. to
 39.97 Intersect original cor. of secs. 19, 24, 25 and 30, hereinbefore
 described. Reestablish this cor. to refer to secs. 19
 and 30 only by obliterating marking on NW. and SW.
 bearing trees.

Land, rolling and mountainous.
 Soil, sandy, gravelly and rocky, 3rd and 4th rate.
 Timber, very scattering cedar.
 Undergrowth, scattering catclaw, mesquite, palo verde and
 scrub cedar.
 Very little grass.

N. 0° 4' W., on true line, on W. bdy. of sec. 19 (S. 1/2).
 Over rolling land, thru scattering undergrowth and timber. Desc.
 19.38 Head of gulch, course S. 35° W. Ascend 60 ft.
 25.74 Spur, slopes W. Descend 20 ft. to
 40.16 Intersect original 1/4 sec. cor. of secs. 19 and 24, hereinbefore
 described.
 This cor. remains common to two secs.; therefore, make no
 change in same.
 Land, rolling.
 Soil, sandy and gravelly, 3rd rate.
 Timber, very scattering cedar.

8. Resurvey of part of West bdy. of fracl. T. 16 N., R. 5 E.

Chains.

Undergrowth, scattering mesquite, catclaw and scrub oak. Very little grass.

From original 1/4 sec. cor. of secs. 13 and 18, hereinbefore described, which still remains common to two sections, N. 0° 3' E., on true line, on W. bdy. of sec. 18, (N. 1/2). Over mountainous land, thru scattering undergrowth and timber.

Descend 160 ft.

10.81 Gulch, course W. Ascend 55 ft.

19.76 Descend 180 ft.

32.09 Gulch, course N. 45° W. Descend 95 ft. to

39.73 Intersect original cor. of secs. 7, 12, 13 and 18, hereinbefore described.

Reestablish this cor. to refer to secs. 7 and 18, only, by obliterating marking on NW. and SW. bearing trees, and establishing a new bearing tree as follows:

On a cedar, 11 ins. in diam., bearing N. 30 1/4° E., 82 lks. dist., mark "T16NR5E S7BT."

Land, mountainous.

Soil, rocky, 3rd and 4th rate.

Timber, vary scattering cedar.

Undergrowth, scattering mesquite, catclaw and scrub oak.

No grass.

N. 0° 7' W., on a true line, on W. bdy. of sec. 7 (S. 1/2).

Over mountainous land, thru scattering undergrowth and timber.

Descend 90 ft.

4.20 Gulch, course N. 75° W. Ascend 165 ft.

16.98 Spur, slopes W. Descend 110 ft.

24.72 Head of gulch, course W. Thence along W. slope.

39.51 Intersect original 1/4 sec. cor. of secs. 7 and 12, hereinbefore described.

Reestablish this cor. to refer to sec. 7 only, by obliterating marking on NW. bearing tree, and establishing a new bearing tree as follows:

On a cedar, 26 ins. in diam., bearing N. 53 1/2° E., 144 lks. dist., marked "1/4 S7 BT."

Thence,

N. 0° 3' W., on a true line, on W. bdy. of sec. 7 (N. 1/2).

Over mountainous land, thru scattering undergrowth and timber. Descend.

2.89 (40.00 chs. northerly from reestablished cor. of secs. 12 and 13, hereinafter described). Set an iron post, 3 ft. long, 1 in. in diam., 20 ins. in the ground, for reestablished 1/4 sec. cor. of sec. 12, marked on brass cap,

S12

1916

from which,

A cedar, 8 ins. in diam., brs. S. 66 1/2° W., 101 lks. dist. mark "1/4 S12BT."

A cedar, 10 ins. in diam., brs. N. 73 3/4° W., 131 lks. dist., mark "1/4 S12BT."

Descend 235 ft.

12.55 Gulch, course N. 70° W. Thence along W. slope.

27.09 Left bank and edge of water of Oak Creek, brs. N. 50° E. and S. 50° W. Thence across stream of clear running water, course S. 50° W.

27.79 Right bank and edge of water of Oak Creek, brs. N. 50° E. and S. 50° W. Leave water. Ascend.

30.49 House brs. W. 3 chs. dist. P. Charis, owner and occupant.

34.97 Intersect original closing cor. of secs. 7 and 12, and fracl. Ts. 16 N., Rs. 4 and 5 E., on 4th Std. Par. N., hereinbefore described.

Resurvey of part of West bdy. of fracl. T. 16 N., R. 5 E. 9.

Chains.

Land, mountainous.
Soil, sandy, gravelly and rocky, 3rd and 4th rate.
Timber, very scattering cedar.
Undergrowth, scattering mesquite, catclaw and scrub oak.
No grass.

Retracement of part of W. bdy. of fracl. T. 16 N., R. 4 E.

Begin at original cor. of secs. 25, 30, 31 and 36, on W. bdy. of fracl. T. 16 N., R. 4 E., which is a limestone, 10x10x6 ins. above ground, firmly set, marked with 1 notch on S. edge, and 5 notches on N. edge, and witnessed by mound of stone, N. of cor. No bearing trees.

Thence,
North, on random line, bet. secs. 25 and 30 (S. 1/2).
Over rolling land, thru. scattering undergrowth.

- 16.80 Road brs. N. 30° E. and SW.
- 21.00 Low spur, slopes S. 30° W. Descend.
- 26.05 Road brs. N. 20° W. to Clarkdale and S. 20° E. to Cornville. Ascend.

- 33.10 Low spur, slopes W. Descend.
- 40.00 Diligent search in this vicinity failed to reveal any trace of original 1/4 sec. cor.

41.59 Fall 58 lks. E. of property cor., consisting of four mesquite posts, none of which is marked, and no evidence of accessories to the original 1/4 sec. cor. of secs. 25 and 30. However, in the absence of any other evidence of the missing 1/4 sec. cor., accept this point as being the former position of the 1/4 sec. cor.
True course and dist. of S. 1/2 of line bet. secs. 25 and 30, are therefore N. 0° 48' W., 41.59 chs.

Thence,
North, on random line, bet. secs. 25 and 30 (N. 1/2).
Over rolling land, thru. scattering undergrowth. Descend.

- 3.41 Wash, course W.
- 26.41 Road, brs. N. 50° W. to Clarkdale and S. 50° E. to Page's ranch.

- 39.01 Road brs. N. 60° E. to Sedona and S. 60° W. to Verde Valley.

40.00 No trace of original sec. cor. can be found.

40.76 Fall 16 lks. E. of property cor. consisting of a sandstone and four mesquite posts, none of which is marked, and there is no trace of the accessories of the original cor. of secs. 19, 24, 25 and 30. However, since this is the only available evidence of the original cor., accept it as marking the former position of the original cor.
True course and dist. of N. 1/2 of line bet. secs. 25 and 30 are therefore, N. 0° 13' W., 40.76 chs.

Land, rolling.
Soil, sandy and gravelly, 3rd rate.
No timber.
Undergrowth, scattering scrub oak, palo verde and mesquite.
No grass.

From accepted cor. of secs. 19, 24, 25 and 30, described above,

North, on random line, bet. secs. 19 and 24 (S. 1/2).
Over rolling land, thru. scattering undergrowth.

- 40.00 Diligent search fails to reveal any trace of original 1/4 sec. cor.

41.04 Fall 18 lks. W. of old ash post, unmarked. Remains of pits are visible N. and S. of this post; therefore, accept it as marking the former position of the 1/4 sec. cor.
True course and dist. of S. 1/2 of line, bet. secs. 19 and 24 are therefore N. 0° 15' E., 41.04 chs.

Land, rolling.
Soil, sandy and gravelly, 2nd and 3rd rate.

10. Resurvey of part of West bdy. of T.16 N., R. 5 E.

Chains.

No timber.
Undergrowth, scattering scrub cedar, palo verde and mesquite.
No grass.

Retracement for Resurvey.

- From accepted $\frac{1}{4}$ sec. cor. of secs. 19 and 24, described above,
North, on random line, bet. secs. 19 and 24. (N. $\frac{1}{2}$).
40.00 Diligent search in this vicinity fails to reveal any trace of original cor. of secs. 13, 18, 19 and 24. Set temp. sec. cor. Continue line and measurement, bet. secs. 13 and 18.
80.00 Diligent search in this vicinity fails to reveal any trace of original $\frac{1}{4}$ sec. cor. of secs. 13 and 18. Set temp. $\frac{1}{4}$ sec. cor.
120.00 Diligent search in this vicinity fails to reveal any trace of original cor. of secs. 7, 12, 13 and 18. Set temp. sec. cor.
Continue line and measurement, bet. secs. 7 and 12 (S. $\frac{1}{2}$).
159.52 Fall 2.00 chs. E. of the $\frac{1}{4}$ sec. cor. of secs. 7 and 12, which is a limestone, 18x13x11 ins. above ground, firmly set, marked " $\frac{1}{4}$ " on W. face, and witnessed by mound of stone W. of cor. No bearing trees. This cor. was reestablished in 1907.
True course and dist. of line from $\frac{1}{4}$ sec. cor. of secs. 19 and 24 to this $\frac{1}{4}$ sec. cor. are therefore N. $0^{\circ}43'W.$, 159.52 chs., and the proportional interval for cors., 39.88 chs.

Retracement.

- From $\frac{1}{4}$ sec. cor. of secs. 7 and 12, described above,
North, on a random line, bet. secs. 7 and 12 (N. $\frac{1}{2}$).
Over mountainous land, thru scattering undergrowth. Ascend.
30.93 Fall 6 lks. W. of original closing cor. of secs. 7 and 12, and fracl. Ts. 16 N., Rs. 3 and 4 E., which is a limestone 12x6x5 ins. above ground, firmly set, marked with 6 grooves on each of S., E. and W. faces, "CC" on S. face, and witnessed by mound of stone S. of cor., and bearing trees as follows:
A cedar, SE. of cor., marked "T16NR4ES7CCBT.", and
A palo negro, SW. of cor., marked "T16NR3ES12CC BT."
True course and dist. of N. half of line bet. secs. 7 and 12, are therefore N. $0^{\circ}7'E.$, 30.93 chs.
Land, mountainous.
Soil, gravelly and rocky, 3rd and 4th rate.
No timber.
Undergrowth, scattering scrub cedar, pinyon and palo verde.
No grass.

Resurvey of part of W. bdy. of fracl. T. 16 N., R. 4 E.

From the accepted $\frac{1}{4}$ sec. cor. of secs. 19 and 24, hereinbefore described,
Reestablish this cor. in the same place as follows:
Set an iron post, 3 ft. long, 1 in. in diam., 26 ins. in the ground, for reestablished $\frac{1}{4}$ sec. cor., marked on brass cap,

S24 $\frac{1}{4}$ S19

1916

Dig pits, 18x18x12 ins., N. and S. of post, 3 ft. dist., and raise a mound of stone, $3\frac{1}{2}$ ft. base, $1\frac{1}{2}$ ft. high, W. of cor.

Resurvey of part of W. half of frac. Township 16 N, R. 4 E. 11

Chains.

Thence, N.0°43'W., on a true line, bet. secs. 19 and 24 (N. half).
Over rolling mesa, thru scattering undergrowth.

- 28.10 Road brs. N.50°E. and S.50°W.
- 28.95 Leave rolling mesa, brs. N.50°E. and S.50°W. Ascend 100 ft.
- 39.88 Set an iron post 3 ft. long, 3 ins. in diam., 26 ins. in the ground, for reestablished cor. of secs. 13, 18, 19 and 24, marked on brass cap,

T16N
R 3E | R4 E
S13 | S18
S24 | S19
1916

from which,
A cedar, 6 ins. in diam., brs. S.85°E., 113 lks. dist., marked T16N R4E S19 BT.

No other trees within limits. Raise a mound of stone, 2 ft. base, 1½ ft. high, W. of cor.
Land, rolling mesa and mountainous.
Soil, sandy, 2nd rate, and stony, 3rd rate.
No timber.
Undergrowth, cedar and palo verde.

N.0°43'W., on a true line, bet. secs. 13 and 18.
Over rolling land, thru scattering undergrowth.
Descend.

- 8.35 Gulch, course S.45°W.
- 13.35 Same gulch, course S.25°E. Ascend 130 ft.
- 39.88 Set an iron post 3 ft. long, 1 in. in diam., 28 ins. in the ground, for reestablished ¼ sec. cor., marked on brass cap,

S13 | S18
1916

from which,
A cedar, 6 ins. in diam., brs. N.43½°E., 157 lks. dist., marked ¼ S18 BT.

A cedar, 8 ins. in diam., brs. S.80½°W., 75 lks. dist., marked ¼ S13 B T.

Continue ascent 85 ft.

- 52.00 Descend 45 ft.
- 60.40 Gulch, course W. Ascend 45 ft.
- 76.00 Descend 10 ft.
- 77.55 Gulch, course W.
- 79.76 Set an iron post 3 ft. long, 3 ins. in diam., 25 ins. in the ground, for reestablished cor. of secs. 7, 12, 13 and 18, marked on brass cap,

T16N
R3E | R4 E
S12 | S 7
S13 | S18
1916

from which,
A cedar, 8 ins. in diam., brs. S.4½°E., 93 lks. dist., marked T16N R4E S18 BT.

A pinyon, 9 ins. in diam., brs. S.66¼°W., 106 lks. dist., marked T16N R3E S13 BT.

A pinyon, 10 ins. in diam., brs. N.4½°W., 110 lks. dist., marked T16N R3E S12 BT.

No other trees within limits. Raise a mound of stone 2 ft. base, 1½ ft. high, W. of cor.
Land, rolling and mountainous.
Soil, rocky, 4th rate.
No timber.
Undergrowth, scrub cedar and palo verde.

12. Resurvey of part of West bdy. of fractl. T.16 N., R. 4 E.

Chains.

- From the reestablished cor. of secs. 7, 12, 13 and 18, N. $0^{\circ}43'$ W., on a true line, bet. secs. 7 and 12 (S. $\frac{1}{2}$). Over mountainous land, thru scattering undergrowth. Ascend 10 ft.
- 10.00 Descend 35 ft.
- 19.00 Gulch, course S. 50° W. Ascend 245 ft.
- 30.50 Descend 15 ft.
- 39.88 Intersect $\frac{1}{4}$ sec. cor. of secs. 7 and 12, hereinbefore described.
- Land, mountainous.
Soil, rocky, 4th rate.
No timber.
Undergrowth, cedar, pinyon and palo verde.

Retracement of 4th. Standard Par. N., thru. part of Range 5 E.

Retracement for Resurvey.

- Begin at standard cor. of secs. 31 and 32, T.17 N., R. 5 E., on 4th Standard Parallel North, reestablished in 1902, which is a red sandstone 8x6x4 ins. above ground, firmly set, marked "SC" on N. face, 1 notch on W. face, and 5 notches on E. face, and witnessed by mound of stone N. of cor. No bearing trees.
- Thence,
N. $89^{\circ}30'$ W., on random line, on S. bdy. of sec. 31.
- 11.25 A point 15 lks. N. of original closing cor. of secs. 7 and 12, and fractl. Ts. 16 N., Rs. 4 and 5 E., hereinbefore described.
- 40.00 Diligent search in this vicinity fails to reveal any trace of original standard $\frac{1}{4}$ sec. cor. of sec. 31. Set temp. $\frac{1}{4}$ sec. cor.
- 78.42 Fall 104 lks. N. of original standard cor. of Ts. 17 N. Rs. 4 and 5 E., which is a malpais stone, 17x13x7 ins. above ground, firmly set, marked "SC" on N. face, 6 notches on each of N., E. and W. faces, and witnessed by a mound of stone, N. of cor. No bearing trees.
- True course and dist. of S. bdy. of sec. 31, T.17 N., R. 5 E., are therefore S. $89^{\circ}44'$ W., 78.42 chs.

Resurvey of 4th. Std. Par. N., thru. part of Range 5 East.

- From standard cor. of secs. 31 and 32, T.17 N., R. 5 E., hereinbefore described,
S. $89^{\circ}44'$ W., on true line, on S. bdy. of sec. 31.
- Over mountainous land, thru scattering timber and undergrowth. Descend 75 ft.
- 5.00 Oak Creek, clear running water, 60 lks. wide, 6 ins. deep, course S. Ascend 120 ft.
- 11.25 Intersect original closing cor. of secs. 7 and 12, and fractl. Ts. 16 N., Rs. 4 and 5 E., hereinbefore described.
- Continue line and measurement.
- 22.00 Spur, slopes S. Descend 40 ft.
- 25.20 Ascend 25 ft.
- 27.20 Descend over red sandstone ledge, 35 ft. high, bearing N. 55° W. and S. 55° E.
- 39.21 (Proportional dist.) Set an iron post, 3 ft. long, 1 in. in diam., 16 ins. in the ground, supported by a mound of stone, for reestablished standard $\frac{1}{4}$ sec. cor. of sec. 31, marked on brass cap,

S C
S 31

1916

- and raise a mound of stone, 2 ft. base, $1\frac{1}{2}$ ft. high, N. of cor.
- 43.25 Oak Creek, clear running water, 60 lks. wide, 12 ins. deep,

Resurvey of 4th. Stan. Par. North, thru part of Range 5 East. 13.

Chains.

course N.75°W.

- 44.40 House brs.S.5.00 chs.dist. Antonio Chavis,owner and occupant.
- 62.70 Oak Creek,clear running water, 120 lks.wide, 7 ft. deep, course S. Ascend 360 ft.
- 65.20 Bluff, brs.N.and S.
- 70.42 Intersect the original standard cor. of Ts.17 N.,Rs.4 and 5 E., hereinbefore described.
Land, mountainous.
Soil,rocky,4th rate.
Timber,scattering sycamore and ash.
Undergrowth,scattering scrub oak,cactlaw and mesquite.
No grass.

RETRACEMENT- 4th.Standard Par.N.,thru part of Range 4 East.

From original standard cor. of Ts.17 N.,Rs.4 and 5 E.,hereinbefore described,
West,on random line, on S.bdy.of sec.36 (E.1/2).
Over mountainous land, thru.scattering undergrowth. Ascend 85 ft.

- 3.00 Top of ascent; descend 80 ft.
- 20.00 Head of wash, course S.45°E. Ascend 115 ft.
- 32.00 Spur,slopes S.40°W. Descend 30 ft.to
- 40.02 Fall 9 lks.N.of standard 1/4 sec.cor., reestablished in 1904, which is a malpais stone,8x8x6 ins.above ground, firmly set,marked "SC 1/4" on N.face,and witnessed by a mound of stone,N.of cor. and a cedar tree NW.of cor., marked "SC 1/4 S36BT."
True course and dist. of E.1/2 of S.bdy. of sec.36 are therefore S.89°52'W.,40.02 chs.
Thence,
West,on random line,on S.bdy.of sec.36.(W.1/2).
Over rolling and mountainous land,thru.scattering undergrowth. Descend 220 ft.
- 16.88 Gulch,course S.10°E. Ascend 20 ft.
- 26.38 Spur,slopes S.30°W. Descend 155 ft.
- 37.33 Gulch,course S.45°W. Ascend.
- 40.20 Fall 24 lks.S. of standard cor.of secs. 35 and 36, reestablished in 1904, which is a limestone, 14x11x7 ins. above ground, firmly set,marked "SC" on N.face,1 groove on E.face,and 5 grooves on W.face,and witnessed by mound of stone,N.of cor. No bearing trees.
True course and dist. of W.1/2 of S.bdy.of sec.36 are therefore N.89° 39' W., 40.20 chs.
Land, mountainous and rolling.
Soil,gravelly and rocky, 3rd and 4th rate.
No timber.
Undergrowth, scattering scrub cedar,oak and palo verde.
Good grass.

West,on random line,on S.bdy.of sec.35 (E.1/2).
Over mountainous land, thru.scattering undergrowth. Desc. 20 ft.

- 4.70 Gulch, course S.15°E. Ascend 210 ft.
- 17.50 Spur, slopes S. 45°E.
- 30.00 Leave undergrowth, brs.N.45°W. and S.45°E.
- 39.89 Fall 6 lks.S.of standard 1/4 sec.cor.of sec.35, reestablished in 1904, which is a malpais stone,8x6x5 ins. above ground,firmly set,marked "SC 1/4" on N.face,and witnessed by mound of stone,N.of cor.,and a cedar NW.of cor.marked "SC 1/4 S35BT."
True course and dist. of E.half of S.bdy.of sec.35 are therefore, N.89°55'W.,39.89 chs.
Thence,
West,on random line, on S.bdy.of sec.35 (W.1/2).
Over rolling and mountainous land. Ascend.

14. RETRACEMENT-4th. Std. Par. N. thru part of Range 4 East.

Chains.

- 2.91 Ridge, brs. N. and S. Descend 55 ft.
 5.11 Enter scattering undergrowth, brs. N. and S.
 7.36 Road brs. N. to Sedona and S. to Cornville.
 8.11 Head of wash, course S. 10° W. Ascend 125 ft.
 34.11 Spur, slopes N. Descend 105 ft. to
 39.97 Fall 12 lks. N. of standard cor. of secs. 34 and 35, reestablished in 1904, which is a limestone, 12x6x5 ins. above ground, firmly set, marked "SC" on N. face, 2 grooves on E. face, and 4 grooves on W. face, and witnessed by mound of stone, N. of cor., and bearing trees as follows:
 A cedar NE. of cor. mkd. "T17NR4E S35BT.", and
 A cedar, NW. of cor., mkd. "T17NR4ES34BT."
 True course and dist. of W. $\frac{1}{2}$ of S. bdy. of sec. 35 are therefore, S. 89° 50' W., 39.97 chs.
 Land, rolling and mountainous.
 Soil, adobe and gravelly and rocky, 3rd and 4th rate.
 No timber.
 Undergrowth, scattering cedar and palo verde.
 Fair grass.
-
- West, on random line, on S. bdy. of sec. 34 (E. $\frac{1}{2}$).
 Over rolling land, thru scattering undergrowth. Descend 100 ft.
 4.00 Leave undergrowth, brs: N. and S.
 27.20 Wash, 20 lks. wide, 3 ft. deep, course S. 15° W.
 35.00 Enter scattering undergrowth, brs. N. and S.
 40.06 Fall 7 lks. S. of standard $\frac{1}{4}$ sec. cor. of sec. 34, reestablished in 1904, which is a sandstone, 8x8x6 ins. above ground, firmly set, marked "SC $\frac{1}{4}$ " on N. face, and witnessed by pits E. and W., mound of earth, N. of cor., and a cedar NE. of cor., marked "SC $\frac{1}{4}$ S34BT."
 True course and dist. of E. $\frac{1}{2}$ of S. bdy. of sec. 34 are therefore N. 89° 54' W., 40.06 chs.
 Thence,
 West, on random line on S. bdy. of sec. 34 (W. $\frac{1}{2}$).
 Over rolling land, thru scattering undergrowth.
 7.34 Wash, 50 lks. wide, 8 ft. deep, course S. 30° E.; forming head of Spring Creek. Ascend 80 ft.
 40.12 Fall 14 lks. S. of standard cor. of secs. 33 and 34, reestablished in 1904, which is a volcanic stone, 11x8x6 ins. above ground, firmly set, marked "SC" on N. face, 3 grooves on each of E. and W. faces, and witnessed by mound of stone, N. of cor. No bearing trees.
 True course and dist. of W. half of S. bdy. of sec. 34 are therefore, N. 89° 48' W., 40.12 chs.
 Land, rolling.
 Soil, adobe and gravel, 2nd and 3rd rate.
 No timber.
 Undergrowth, scattering scrub cedar, palo verde and mesquite.
 Good grass.
-
- West, on a random line, on S. bdy. of sec. 33 (E. $\frac{1}{2}$).
 Over rolling land, thru scattering undergrowth. Ascend 35 ft.
 5.70 Spur, slopes N. Descend 30 ft.
 12.35 Road brs. N. 50° E. to Sedona and S. 50° W. to Verde Valley.
 12.50 Wash, course N. 50° E. Ascend.
 40.07 Fall 13 lks. S. of standard $\frac{1}{4}$ sec. cor. of sec. 33, reestablished in 1904, which is a malpais stone, 11x8x7 ins., above ground, firmly set, marked "SC $\frac{1}{4}$ " on N. face, and witnessed by mound of stone N. of cor., and a cedar NE. of cor., marked "SC $\frac{1}{4}$ S33 BT."
 True course and dist. of E. $\frac{1}{2}$ of S. bdy. of sec. 33 are therefore N. 89° 49' W., 40.07 chs.
 Thence,
 West, on random line, on S. bdy. of sec. 33 (W. $\frac{1}{2}$).
 Over rolling land, thru scattering undergrowth. Ascend 45 ft.

Retracement-4th.Std.Par. N.,thru.part of Range 4 East. 15.

Chains.

3.00 Enter limestone formation, brs.N.and S.
 6.13 Ridge, brs.N.and S. Descend 75 ft.
 26.93 Leave undergrowth, brs.N.and S.
 27.93 Enter sandy soil.
 40.11 Fall 3 lks.S. of std.cor. of secs. 32 and 33, reestab-
 lished in 1904, which is a limestone, 8x6x5 ins. above
 ground, firmly set, marked "SC" on N.face, 4 grooves
 on E. face, and 2 grooves on W.face, and witnessed by
 pits E.,W. and N. of cor. and mound of earth N.of cor.
 No bearing trees.
 True course and dist. of W. $\frac{1}{2}$ of S. bdy. of sec.33 are
 therefore, N.89° 57' W., 40.11 chs.
 Land, rolling.
 Soil, sandy and gravelly, 2nd and 3rd rate.
 No timber.
 Undergrowth, scattering scrub oak, palo verde and mes-
 quite.
 Fair grass.

West, on random line, on S.bdy.of sec.32 (E. $\frac{1}{2}$).
 Over rolling land, thru.scattering undergrowth.
 3.60 Wash, 5 lks.wide, 2 ft.deep, course S.20° E.
 27.85 Road brs.N.and S.
 32.40 Wash, 30 lks.wide, .7 ft. deep, course S.30° E.
 40.03 Fall 7 lks.S. of standard $\frac{1}{4}$ sec.cor.of sec.32, reestab-
 lished in 1904, which is a sandstone 6x6x6 ins.above
 ground, firmly set, marked "SC $\frac{1}{4}$ " on N.face, and witness-
 ed by pits E.and W., and mound of earth N.of cor. No
 bearing trees.
 True course and dist. of E. $\frac{1}{2}$ of S.bdy. of sec.32 are
 therefore N.89° 54' W., 40.03 chs.

Thence,
 West, on random line, on S.bdy.of sec.32 (W. $\frac{1}{2}$).
 Over rolling land, thru.scattering undergrowth.
 16.00 Enter dense undergrowth, brs.N.15°W. and S.15°E. Ascend 250
 ft.to
 40.05 Fall 9 lks.S. of standard cor. of secs. 31 and 32, reestab-
 lished in 1904, which is a limestone, 8x6x4 ins.above
 ground, firmly set, marked "SC" on N.face, 5 grooves on
 E.face, and 1 groove on W.face, and witnessed by mound
 of stone, N.of cor., and a pinyon tree NE.of cor., marked
 "T17NR4E S32BT."
 True course and dist. of W. $\frac{1}{2}$ of S.bdy. of sec.³²~~31~~ are
 therefore N.89° 52' W., 40.05 chs.
 Land, rolling and mountainous.
 Soil, sandy and gravelly, 3rd rate.
 No timber.
 Undergrowth, scattering and dense scrub cedar, pinyon and
 palo verde.
 Fair grass.

West, on a random line, on part E. $\frac{1}{2}$ of S.bdy.of sec.31.
 Over mountainous land, thru.scattering undergrowth. Ascend
 80 ft.
 9.50 Ridge, brs. N.and S. Descend.
 16.23 Fall 9 lks.S. of original closing cor. of sacs.7 and 12,
 and fract.Ts.16 N.,Rs.3 and 4 E., hereinbefore de-
 scribed.
 True course and dist.of this part of E. $\frac{1}{2}$ of S.bdy.of sec.
 31 are therefore N.89° 41' W., 16.23 chs.
 Land, mountainous.
 Soil, rocky, 4th rate.
 No timber.
 Undergrowth, scattering scrub cedar, palo verde and pin-
 yon.
 No grass.

16. Retracement of part of Subdivision lines of trac. T. 16N., R. 4E.

Chains.	<u>Retracement for Resurvey.</u>
40.17	<p>From reestablished cor. of secs. 1, 2, 35 and 36, on S. bdy. of Tp., hereinbefore described, North, on random line, bet. secs. 35 and 36 (S. $\frac{1}{2}$). Fall 7 lks. W. of original $\frac{1}{4}$ sec. cor., which is a limestone 22x13x8 ins., loosely set in mound of stone, marked "1" on W. face. No bearing trees marked. True course and dist. of S. $\frac{1}{2}$ of line, bet. secs. 35 and 36 are therefore N. 0° 6' E., 40.17 chs. Thence,</p>
39.77	<p>North, on random line, bet. secs. 35 and 36 (N. $\frac{1}{2}$). Fall 6 lks. E. of original cor. of secs. 25, 26, 35 and 36, which is a limestone, 12x10x6 ins. above ground, firmly set, marked with 1 notch on each of S. and E. edges, and witnessed by mound of stone N. of cor., and a cedar SE. of cor., marked "T10NR4E S36BT." True course and dist. of N. $\frac{1}{2}$ of line, bet. secs. 35 and 36, are therefore, N. 0° 5' W., 39.77 chs.</p>
40.00	<p>East, on a random line, bet. secs. 25 and 36 (W. $\frac{1}{2}$). No trace of original $\frac{1}{4}$ sec. cor. can be found. The original survey or line bet. secs. 25 and 36 did not extend E. of the $\frac{1}{4}$ sec. cor. To determine true course of line and position for reestablishment of the $\frac{1}{4}$ sec. cor., continue line and measurement.</p>
80.10	<p>Fall 10 lks. S. of original cor. of secs. 25, 30, 31 and 36, on E. bdy. of Tp., hereinbefore described. The true course and dist. of W. $\frac{1}{2}$ of line, bet. secs. 25 and 36 are therefore S. 89° 56' W., 40.05 chs. Move the temp. $\frac{1}{4}$ sec. cor. E. 5 lks. and N. 5 lks. to the proper point for reestablishment of the $\frac{1}{4}$ sec. cor.</p>

	<u>Retracement.</u>
5.12	<p>From the original cor. of secs. 25, 26, 35 and 36, North on random line, bet. secs. 25 and 26 (S. $\frac{1}{2}$). Over rolling land, thru. scattering undergrowth. Ascend.</p>
6.29	<p>Top of ascent. Descend 150 ft.</p>
12.62	<p>Fence brs. E. and W.</p>
12.72	<p>Foot of descent, brs. E. and W. Enter cottonwood and willow timber. brs. E. and W.</p>
17.37	<p>Ditch, course W.</p>
17.82	<p>Fence brs. N. 40° E. and S. 40° W.</p>
19.07	<p>Ditch, course S. 40° W.</p>
20.62	<p>Telephone line brs. N. 35° E. to Sedona and S. 35° W. to Cornville.</p>
30.12	<p>Road brs. N. 35° E. to Sedona and S. 35° W. to Cornville.</p>
37.92	<p>Oak creek, clear running water, 60 lks. wide, 12 ins. deep, course S. 35° W.</p>
39.07	<p>Oak Creek, clear running water, 60 lks. wide, 12 ins. deep, course SE.</p>
39.22	<p>Ditch, course S. 45° E.</p>
39.27	<p>Telephone line, brs. N. 65° W. to Sedona and S. 65° E. to Cornville.</p>
40.12	<p>Road parallel to telephone line.</p>
40.49	<p>Leave timber, brs. E. and W.</p>
40.49	<p>Fall 11 lks. W. of original $\frac{1}{4}$ sec. cor. in fence, bearing N. 60° W. and S. 60° E. surrounding orchard. The $\frac{1}{4}$ sec. cor. is a granite stone, 8x8x4 ins. above ground, firmly set, marked "1" on W. face. No trace of the original accessories or bearing tree remain.</p>
	<p>True course and dist. of S. $\frac{1}{2}$ of line, bet. secs. 25 and 26 are therefore, N. 0° 9' E., 40.49 chs. Thence,</p>
	<p>North, on random line, bet. secs. 25 and 26 (N. $\frac{1}{2}$). Over rolling land, in orchard, brs. NW. and SE.</p>

Retracement of part of Subdivision lines of Trac. 16 N., R. 4 E. 17

Chains.
 2.58 Leave orchard. Enter field brs. N. 60° W. and S. 60° E.
 3.43 Telephone line, brs. S. 50° W. to Cornville and N. 50° E. to Sedona.
 5.58 House brs. E. 1.50 chs. dist., W. Page, owner and occupant.
 7.38 Ditch, course E. Leave field brs. E. and W.
 9.08 Fence brs. E. and W.
 14.83 Foot of limestone ledge, 10 ft. high, brs. E. and W. From top of ledge, ascend, 215 ft. to
 17.13 Spur, slopes N. 65° W. Descend 130 ft. to wash.
 19.33 Top of limestone ledge, 4 ft. high, brs. E. and W. Descend.
 25.48 Wash, 10 lks. wide, 2 1/2 ft. deep, course N. 70° W. Ascend 115 ft. to
 40.13 Fall 5 lks. W. of original cor. of secs. 23, 24, 25 and 26, which is a volcanic stone, 26x23x10 ins. above ground, firmly set, marked with 1 notch on E. edge, and 2 notches on S. edge, and witnessed by mound of stone, N. of cor. No bearing trees.
 True course and dist. of N. 1/2 of line, bet. secs. 25 and 26 are therefore, N. 0° 4' E., 40.13 chs.
 Land, rolling.
 Soil, sandy loam, 1st rate in Oak Creek bottom, gravelly, 3rd rate elsewhere.
 Timber, scattering willow, asp, cottonwood and sycamore. Undergrowth, scattering mesquite, catclaw, and palo verde. Good grass.

Retracement for Resurvey.

39.73 North, on random line, bet. secs. 23 and 24 (S. 1/2). Fall 39 lks. W. of original 1/4 sec. cor., which is a granite boulder in place, 4x3x3 ft. above ground, marked "1/4" on W. face. No bearing trees.
 True course and dist. of S. 1/2 of line, bet. secs. 23 and 24 are therefore N. 0° 34' E., 39.73 chs.
 Thence,
 40.00 North, on random line, bet. secs. 23 and 24, (N. 1/2). Diligent search in this vicinity fails to reveal any trace of the original cor. of secs. 13, 14, 23 and 24. Set temp. cor. of said secs.
 80.00 Continue line and measurement, bet. secs. 13 and 14. Diligent search in this vicinity fails to reveal any trace of original 1/4 sec. cor. Set temp. 1/4 sec. cor.
 120.00 Diligent search in this vicinity fails to reveal any trace of original cor. of secs. 11, 12, 13 and 14. Set temp. cor. of said secs.
 160.00 Continue line and measurement, bet. secs. 11 and 12. Diligent search in this vicinity fails to reveal any trace of original 1/4 sec. cor. Set temp. 1/4 sec. cor.
 193.14 Intersect 4th. Std. Parallel N., 12.07 chs. S. 89° 52' W. from original standard cor. of Trs. 17 N., Rs. 4 and 5 E., hereinbefore described. Set temp. closing cor.
 200.00 Continue line and measurement in T. 17 N., R. 4 E. Diligent search in this vicinity fails to reveal any trace of original cor. of secs. 1, 2, 11 and 12. Discontinue retracement, as the original survey of the line did not extend N. of cor. of secs. 1, 2, 11 and 12. Temp. 1/4 sec. cor. of secs. 13 & 14, and temp. cor. of secs. 11, 12, 13 & 14, moved as hereinafter described in notes of retracement of E. 1/2 of line, bet. secs. 14 and 23.

RETRACEMENT.

From original cor. of secs. 23, 24, 25 and 26, hereinbefore described,
 West, on random line, bet. secs. 23 and 26 (E. 1/2).
 Over rolling land, thru. scattering undergrowth. Descend 35 ft. on SW. slope to
 3.40 Wash, 10 lks. wide, 3 ft. deep, course S. 40° W. Descend 83 ft. to
 13.55 Telephone line, N. 15° E. to Sedona, and S. 15° W. to Cornville; descend 19 ft. to

18. Retracement of part of Subdivision lines of fruo. 16N. 84E.

Chains.	
14.20	Road brs. N. to Sedona and S. to Cornville. Descend 3 ft. to
14.40	Fence brs. N. and S. Enter scattering timber. Descend 5 ft. to
14.65	Ditch, course S. 5°W. Descend 12 ft. to
15.85	Fence, brs. N. and S. Enter orchard. Descend 14 ft. to
16.60	Ditch, course N. 45°W. House brs. S. 10 chs. dist., James Page, owner and occupant. Descend 15 ft. to
22.00	Fence brs. N. and S. Leave orchard. Descend 13 ft. to
22.45	Left bank and edge of water of Oak creek, brs. N. 20°E. and S. 20°W. Thence across stream of water, 8 ins. deep, course S. 20°W.
23.15	Right bank and edge of water of Oak Creek, brs. N. 20°E. and S. 20°W. Leave water. Thence over level bottom land.
26.95	Fence brs. N. and S.
27.25	Ditch, course S. 15°W. Enter cultivated field.
31.75	Fence brs. N. and S. Leave field and Oak Creek bottom land and scattering timber, brs. N. 40°E. and S. 40°W. Ascend 96 ft. over SE. slope, thru scattering undergrowth, to
40.01	Fall 17 lks. S. of original $\frac{1}{4}$ sec. cor. of secs. 23 and 26, which is a granite stone 18x10x9 ins. set firmly in a mound of stone, marked " $\frac{1}{4}$ " on N. face. No bearing trees. True course and dist. of E. $\frac{1}{2}$ of line bet. secs. 23 and 26 are therefore, N. 89° 45' W., 40.01 chs. Thence, West, on random line, bet. secs. 23 and 26 (W. $\frac{1}{2}$). Over rolling land, thru scattering undergrowth. Ascend 22 ft. on SE. slope, to
18.00	Foot of limestone ledge, 3 ft. high, brs. N. and S. From top of ledge, ascend 124 ft. over limestone formation, to
28.50	Spur, slopes S. Descend 48 ft. to
34.40	Head of gulch, course S. 20°W. Ascend 65 ft. on SE. slope to
39.95	(Record dist.) Diligent search in this vicinity fails to reveal any trace of original cor. of secs. 22, 23, 26 and 27. Set temp. cor. for said secs. Land, rolling and level. Soil, sandy and gravelly, 1st and 2nd rate. Timber, scattering cottonwood, ash, willow and sycamore along creek. Undergrowth, scattering mesquite, greasewood, catclaw and scrub cedar. Fair grass.

	From temp. cor. of secs. 22, 23, 26 and 27, North, on random line, bet. secs. 22 and 23 (S. $\frac{1}{2}$). Over rolling land, thru scattering undergrowth. Ascend 130 ft. on SE. slope, to
6.65	Foot of limestone cliff, 14 ft. high, brs. E. and W.
6.90	Top of cliff, ascend 25 ft. on SE. slope.
22.50	Top of ascent, brs. E. and W. Descend gradual N. slope.
29.05	Top of limestone cliff, 10 ft. high, brs. N. 75°W. and S. 75°E.
	From foot of same, descend 170 ft. to
39.13	Fall 70 lks. E. of original $\frac{1}{4}$ sec. cor. of secs. 22 and 23, which is a limestone, 10x8x6 ins., above ground, firmly set, marked " $\frac{1}{4}$ " on W. face, and witnessed by a mound of stone, W. of cor. Original bearing tree is missing. True course and dist. of S. $\frac{1}{2}$ of line, bet. secs. 22 and 23 are therefore N. 1° 1' W., 39.14 chs. Thence, North, on random line, bet. secs. 22 and 23 (N. $\frac{1}{2}$). Over rolling land, thru scattering undergrowth. Ascend 22 ft.
0.70	Road brs. E. to Page's Ranch and W. to Clarkdale.
7.50	Spur, slopes N. 55°E. Descend 96 ft. to
11.20	Wash, 5 lks. wide, 2 ft. deep, course N. 40°E. Descend 100 ft. on NE. slope.

BOOK 3325

Retracement of part of Subdivision lines of frac. T16N., R. 1 E., 19

Chains.

35.85 Road brs. N.40°W. to Sedona and S.40°E. to Cornville.
 36.75 Fence brs. N.40°W. and S.40°E. Enter dense undergrowth.
 40.00 (Record dist.) Diligent search in this vicinity fails to reveal any trace of original cor. of secs. 14, 15, 22 and 23.
 Set temp. cor. of said secs.
 Land, rolling.
 Soil, rocky, limestone formation, 3rd and 4th rate.
 No timber. Undergrowth, mesquite, greasewood and catclaw, scattering and dense, as noted.
 Fair grass.

Retracement for Resurvey.

From original $\frac{1}{4}$ sec. cor. of secs. 14 and 23, which is a malpais stone with limestone coating, 14x10x6 ins., loosely set in mound of stone, marked " $\frac{1}{4}$ " on N. face. No accessories visible.
 S.89°52'E. (record course), on random line, bet. secs. 14 and 23 (E. $\frac{1}{2}$).
 39.90 (Record dist.) Diligent search in this vicinity failed to reveal any trace of original cor. of secs. 13, 14, 23 and 24. Set temp. cor. of said secs.
 Continue line and measurement.
 40.38 Fall 36 lks. S. of the temp. cor. of said secs. set on 1st meridional sec. line, as hereinbefore described.
 At midpoint on line bet. the temp. sec. cors., or 24 lks. W. of temp. sec. cor. on 1st meridional random sec. line, and 18 lks. N. of temp. cor. on the random line bet. secs. 14 and 23, reestablish the sec. cor. as hereinafter described, giving a true course and dist., for E. half of line bet. secs. 14 and 23 of S.89°52'W., 40.14 chs., and for N. half of line bet. secs. 23 and 24 of N.0°21'W., 39.82 chs.
 Move the temp. $\frac{1}{4}$ sec. cor. of secs. 13 and 14, and the temp. cor. of secs. 11, 12, 13 and 14, W. 24 lks., and S. 18 lks., thereby giving the 1st meridional random sec. line bet. secs. 13 and 14 a bearing of north, from the reestablished cor. of secs. 13, 14, 23 and 24.

From original cor. of secs. 10, 11, 14 and 15, which is a red sandstone, 12x6x5 ins. above ground, firmly set, marked with 2 notches on E. face, and 4 notches on S. face, and witnessed by mound of stone N. of cor. No bearing trees.

12.15 East, on a random line, bet. secs. 11 and 14 (W. $\frac{1}{2}$).
 At this point, discontinue chain measurement, and triangulate across Oak Creek, and over cliffs on E. side of Oak Creek, as follows:

From 12.15 ch. station, measure a base S. 9.45 chs. Set flag on line, on E. side of canyon. From S. end of base flag brs. N. 65°06'E. Included angles are 65°06', 90°00' and 24°54', the sum of which is 180°00'. Dist. triangulated is obtained by tang. 65°06' x base, or 2.15432 x 9.45 = 20.36 chs., which added to 12.15 chs. =

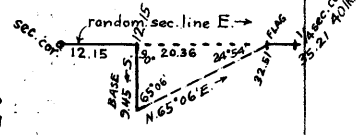

32.51 Flag point. Continue measurement by chaining.

35.21 Fall 40, lks. S. of original $\frac{1}{4}$ sec. cor. of secs. 11 and 14, which is a volcanic stone 20x20x5 ins. above ground, firmly set, marked " $\frac{1}{4}$ " on N. face, and witnessed by mound of stone, N. of cor. No marked tree can be found.
 True course and dist. of W. $\frac{1}{2}$ of line, bet. secs. 11 and 14 are therefore S. 89°21'W., 35.21 chs.

Thence,
 S. 89° 48'E., (record course) on random line, bet. secs. 11 and 14 (E. $\frac{1}{2}$).

32.94 A point 2.52 chs. N. of adjusted temp. cor. of secs. 11, 12, 13 and 14 set on 1st meridional random sec. line (80.00 chs. N. of reestablished cor. of secs. 13, 14, 23 and 24)

- indicated on accompanying diagram by "A."
 40.05 (Record dist.) Set temp.cor.of secs.11,12,13 and 14, indicated on diagram by "B."
 Point for reestablishment of sec.cor.is indicated on diagram by "C" and is located on line A-B at one-third of length of said line.
 from point "B" or 84 lks.S. of E.and W.line, and 2.37 chs.W.of N.and S. line, thru, point "B", and 1.68 chs. N.of E.and W.line, and 4.74 chs.E. of N.and S.line thru, point "A."
 Course of line A-B is S.70°29'W., and its length is 7.54 chs.
 The true position for reestablishment of $\frac{1}{4}$ sec.cor. of sec.14 will be N.70°29'E. from the adjusted temp. $\frac{1}{4}$ sec.cor. a dist. equal to one half of dist. bet. points "A" and "C" or 2.51 chs.
 The true course and dist. of E. $\frac{1}{2}$ of line bet. secs.11 and 14, from point "C" are therefore N.88°31'W., 37.69 chs.
 The true course and dist. of E. vdy. of sec.14, from re-established cor. of secs. 13,14,23 and 24 to point "C" are therefore N.3°19' E., 81.82 chs.
 Sec.cor. and $\frac{1}{4}$ sec.cor. reestablished as hereinafter described in notes of resurvey of line bet. secs.13 and 14.

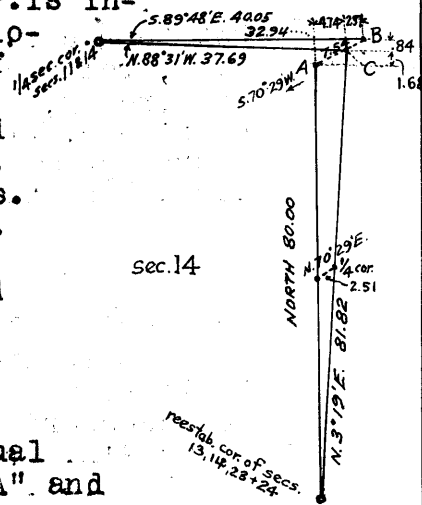

Retracement.

- From original cor. of secs.10,11,14 and 15, hereinbefore described,
 North, on random line, bet. secs.10 and 11 (S. $\frac{1}{2}$).
 Over rolling land, thru scattering undergrowth.
 Descend 126 ft.
 6.00 Foot of descent, brs. E. and W. Enter level bottom land of oak Creek bottom.
 21.85 Road, brs. E. and W.
 22.50 Foot of gradual S. slope, brs. N.55°E. and S.55°W.
 Leave bottom land. Ascend 30 ft. to
 39.65 Fall 4.91 chs. E. of original $\frac{1}{4}$ sec.cor., which is a volcanic stone, 20x14x5 ins., set firmly in a mound of stone, marked "4" on W. face, and witnessed by a cedar SW. of cor., marked "4 S B T."
 True course and dist. of S. $\frac{1}{2}$ of line bet. secs.10 and 11 are therefore N.7°3'W., 39.95 chs.
 Land, rolling and level.
 Soil, sandy, 1st rate in bottom land, gravelly and rocky, 3rd and 4th rate elsewhere.
 No timber.
 Undergrowth, scattering scrub cedar, oak, palo verde and mesquite.
 Good grass in bottom land.

Retracement for Resurvey.

- From original $\frac{1}{4}$ sec.cor. of secs. 10 and 11, described above,
 31.80 North, on random line, bet. secs.10 and 11 (N. $\frac{1}{2}$).
 Intersect 4th. Std. Par. N., 5.15 chs. N.89°55'W. of original standard cor. of secs. 35 and 36, hereinbefore described. Set temp. closing cor.
 40.00 Continue line and measurement into sec.35, T.17 N., R.4 E.
 Diligent search in this vicinity fails to reveal any trace of original cor. of secs. 2,3,10 and 11, and a search in the vicinity of a point 40 chs. E. of this point fails to reveal any trace of original $\frac{1}{4}$ sec.cor. of secs. 2

BOOK 3325

Resurvey of part of Subdivision lines of frac. T. 16 N., R. 4 E., S. 21

Chains.

and 11.

The line bet. secs. 2 and 3 was never previously surveyed.

Retracements.

From original cor. of secs. 10, 11, 14 and 15, hereinbefore described,

West, on random line, bet. secs. 10 and 15 (E. $\frac{1}{2}$).

Over rolling land, thru scattering undergrowth. Ascend 30 ft.

7.80 Spur, slopes N. 45° E. Descend 82 ft.

15.15 Wash, 10 lks. wide, 2 ft. deep, course N. 50° E. Ascend 90 ft.

18.90 Ridge, brs. N. 30° W. and S. 30° E. Descend 85 ft. to $\frac{1}{4}$ sec. cor.

20.10 Rim road, brs. N. 30° W. and S. 30° E.

39.60 Fall 69 lks. S. of original $\frac{1}{4}$ sec. cor., which is a volcanic stone, 16x8x6 ins. above ground, firmly set, marked "1/4" on S. face, and witnessed by mound of stone, N. of cor. no bearing trees.

True course and dist. of E. $\frac{1}{2}$ of line bet. secs. 10 and 15, are therefore N. 89° 00' W., 39.61 chs.

Thence,

West, on random line, bet. secs. 10 and 15 (W. $\frac{1}{2}$).

Over rolling land, thru scattering undergrowth, Descend 16 ft.

8.70 Wash, 10 lks. wide, course S. 25° E. Ascend gradual SE. slope.

11.10 Road brs. N. 20° E. and S. 20° W.

14.80 Road brs. N. 20° W. and S. 20° E.

25.10 Ridge brs. N. 20° W. and S. 20° E. Descend gradual SW. slope.

31.10 Road brs. N. 25° E. and S. 25° W.

33.90 Wash, 15 lks. wide, 3 ft. deep, course S. 45° W. Ascend 33 ft. to

49.92 Fall 2.78 chs. N. of original cor. of secs. 9, 10, 15 and 16, which is a volcanic stone, 14x8x6 ins. above ground, firmly set, marked with 3 notches on E. face, and 4 notches on S. face, and witnessed by mound of stone N. of cor. and 3 bearing trees as follows:

A Cedar NW. of cor. mkd. "T16NR4E S9BT."

A cedar, SE. of cor. mkd. "T16NR4E S15BT." and

A cedar, SW. of cor. mkd. "T16NR4E S16BT."

True course and dist. of W. $\frac{1}{2}$ of line, bet. secs. 10 and 15 are therefore S. 86° 49' W., 50.00 chs.

Land, rolling.

Soil, gravelly and rocky, 3rd and 4th rate.

Timber, very scattering cedar.

Undergrowth, scattering scrub cedar, palo verde and oak. no grass.

Retracement for Resurvey.

From original cor. of secs. 9, 10, 15 and 16, described above,

West, on random line, bet. secs. 9 and 16.

39.90 (Record dist.) Diligent search in this vicinity fails to reveal any trace of original $\frac{1}{4}$ sec. cor. Set temp. $\frac{1}{4}$ sec. cor.

80.38 Fall 68 lks. N. of remains of original cor. of secs. 8, 9, 16 and 17, consisting of mound of stone on S. bank of gulch.

True course and dist. of line, bet. secs. 9 and 16 are therefore S. 89° 31' W., 80.38 chs.

From remains of original cor. of secs. 8, 9, 16 and 17, West, on random line, bet. secs. 8 and 17.

22. Retracement of part of Subdivision lines fracl. T. 16 N. R. 4 E.

Chains.

- 40.00 (Record dist.) Diligent search in this vicinity fails to reveal any trace of original $\frac{1}{4}$ sec. cor. set temp. $\frac{1}{4}$ sec. cor.
- 81.19 Fall 1.27 chs. S. of a limestone, 8x8x5 ins. above ground, unmarked, but as there are remains of the pits NE., SE. SW. and NW. of stone, accept this as the original cor. of secs. 7, 8, 17 and 18.
True course and dist. of line bet. secs. 8 and 17 are therefore N. 89° 06' W., 81.20 chs.

- From accepted cor. of secs. 7, 8, 17 and 18, described above West, on random line, bet. secs. 7 and 18.
- 40.00 (Record dist.) Diligent search in this vicinity fails to reveal any trace of original $\frac{1}{4}$ sec. cor. Set temp. $\frac{1}{4}$ sec. cor.
- 84.68 Fall 2.76 chs. S. of reestablished cor. of secs. 7 and 18, on W. bdy. of Tp., hereinbefore described.
True course and dist. of the line bet. secs. 7 and 18, are therefore, N. 88° 8' W., 84.73 chs.

Resurvey of part of Subdivision lines fracl. T. 16 N., R. 4 E.

- From reestablished cor. of secs. 1, 2, 35 and 36 on S. bdy. of Tp., hereinbefore described,
N. 0° 6' E. on a true line, bet. secs. 35 and 36 (S. $\frac{1}{2}$).
Over rolling land, thru. scattering undergrowth.
- .32 Fence brs. E. and W. Enter cultivated field.
- 14.72 Wash, 20 lks. wide, course W.
- 15.22 Leave filed brs. E. and W.
- 15.42 Wash, 15 lks. wide, 8 ft. deep, course W.
- 29.92 Descend 50 ft. to
- 40.17 Intersect original $\frac{1}{4}$ sec. cor. hereinbefore described.
Reestablish this cor. in same place, by resetting same stone, 17 ins. in the ground, with marking to W. and establish bearing trees as follows:
On a cedar, 12 ins. in diam., bearing N. 64 $\frac{3}{4}$ ° E., 122 lks. dist., mark " $\frac{1}{4}$ S36BT", and
On a cedar, 4 ins. in diam., bearing N. 64° W., 50 lks. dist., mark " $\frac{1}{4}$ S35BT."
and raise a mound of stone, 2 ft. base, 1 $\frac{1}{2}$ ft. high, W. of cor.
- Thence,
N. 0° 5' W., on true line, bet. secs. 35 and 36 (N. $\frac{1}{2}$).
Over rolling and mountainous land, thru. scattering undergrowth. Descend.
- .22 Gulch, course N. 75° W. Ascend 65 ft.
- 3.72 Fence brs. N. 70° W. and S. 70° E.
- 17.57 Edge of limestone ridge, bearing N. and S. at point of rocky spur, sloping W. Descend.
- 21.02 Wash, 10 lks. wide, 2 ft. deep, course N. 60° W. Ascend.
- 26.77 Low spur, sloping W. Descend 50 ft.
- 31.52 Gulch, course S. 65° W. Ascend 105 ft. to
- 39.77 Intersect original cor. of secs. 25, 26, 35 and 36, hereinbefore described.
Land, rolling and mountainous.
Soil, gravelly and rocky, 3rd and 4th rate,
No timber.
Undergrowth, scattering scrub oak, cedar, catclaw and mesquite.
Fair grass.

At the adjusted position of the temp. $\frac{1}{4}$ sec. cor. of secs. 25 and 36, hereinbefore described in notes of retracement of part of subdivision lines, reestablish the

Resurvey of part of Subdivision lines of frac. T.16 N. R.4 E. 23

Chains.

¼ sec.cor.of secs.25 and 36, as follows:
Set an iron post, 3 ft.long, 1 in. in diam., 28 ins.in
the ground, marked on brass cap,

S 25
S 36
1916

and raise a mound of stone, 2 ft. base, 1½ ft. high, N. of
cor.

Thence,
S.89° 56' W. on a true line, bet. secs. 25 and 36 (W.½).
Over rolling land, thru. scattering undergrowth. Descend
60 ft.

- 14.30 Gulch, course S.20°W. Ascend 35 ft.
 - 16.90 Descend 65 ft.
 - 22.50 Gulch, course S.20°W. Ascend 50 ft. to
 - 40.05 Intersect original cor. of secs. 25, 26, 35 and 36, hereinbe-
fore described.
- Land, rolling.
Soil, gravelly and rocky, 3rd and 4th rate.
No timber.
Undergrowth, scattering scrub cedar, catclaw, and mesquite.
No grass.

From original cor. of secs. 23, 24, 25 and 26, hereinbefore
described,

N.0° 34' E., on true line, bet. secs. 23 and 24 (S.½).
Over mountainous land, thru. scattering undergrowth and
timber.

- Ascend 30 ft.
- 5.00 Low spur, slopes W. Descend 60 ft.
- 11.30 Gulch, course S.50°W. Ascend 245 ft.
- 22.50 Spur, slopes S.55° W. Descend 20 ft.
- 24.90 Ascend 45 ft.
- 29.90 Descend 205 ft.
- 39.40 Gulch, course W. Ascend.
- 39.73 Intersect original ¼ sec. cor. of secs. 23 and 24, herein-
before described. Reestablish this cor. by estab-
lishing bearing trees as follows:
On a cedar, 6 ins. diam., bearing N.34°E., 54
lks. dist., mark "S24BT."
On a cedar, 6 ins. in diam., bearing N.28°W., 64
lks. dist., mark "S23BT."

Thence,
N.0°21' W., on true line, bet. secs. 23 and 24 (N.½).
Over mountainous land, thru. scattering undergrowth and
timber. Ascend 210 ft.

- 14.25 Spur, slopes W. Descend 115 ft.
- 21.20 Gulch, course S.70° W. A good spring brs. W. 30 lks. dist.
Ascend 330 ft. to spur.
- 26.25 bluff, 14 ft. high, brs. N.45°W. and S.45°E. facing NE.
- 29.75 Thence over series of bluffs to
- 33.75 Spur, slopes W. Descend 175 ft. to
- 39.82 Intersect point for reestablishment of missing cor. of secs.
13, 14, 23 and 24, determined as hereinbefore described
in notes of retracement of E.½ of line, bet. secs. 14 and
23.

At this point, reestablish the sec. cor. as follows:
Set an iron post 3 ft. long, 2 ins. in diam., 22 ins. in
the ground, supported by a mound of stone, for reestab-
lished cor. of secs. 13, 14, 23 and 24, marked on brass cap,

T16N R4E
S14 S13
S23 S24
1916

and establish bearing trees as follows:
On a cedar, 10 ins. in diam., bearing N.4¼°E., 86
lks. dist., mark "T16NR4E S13BT."

24. Resurvey of part of Subdivision lines fract. 1.6 N. R. 4 E.

Chains.

On a cedar, 8 ins. in diam., bearing S. 41 $\frac{1}{4}$ ° E., 79 lks. dist., mark "T16NR4E S24BT."
 On a cedar, 10 ins. in diam., bearing S. 63 $\frac{3}{4}$ ° W., 89 lks. dist., mark "T16NR4E S23BT.", and
 On a cedar, 14 ins. in diam., bearing N. 73 $\frac{1}{2}$ ° W., 108 lks. dist., mark "T16NR4E S14BT."

Land, mountainous.
 Soil, rocky, 4th rate.
 Timber, scattering cedar.
 Undergrowth, scattering scrub cedar, pinyon and palo verde.
 No grass.

S. 89° 52' W., on true line, bet. secs. 14 and 23 (E. $\frac{1}{2}$).
 Over mountainous land, thru. scattering undergrowth.
 Descend 340 ft.

27.65 Gulch, course S. 10° W. Ascend 70 ft. to
 40.14 Intersect original $\frac{1}{4}$ sec. cor. of secs. 14 and 23, a stone hereinbefore described. Reestablish this cor. in same place by removing mound of stone in which the cor. is set, setting same stone 10 ins. in the ground, with marking to N. and raising a mound of stone, 2 ft. base, 1 $\frac{1}{2}$ ft. high, N. of cor.

No trees within limits.
 Land, mountainous.
 Soil, rocky, 4th rate.
 No timber.
 Undergrowth, scattering scrub palo verde, catclaw and mesquite.
 No grass.

N. 3° 19' E., on true line, bet. secs. 13 and 14.
 Over mountainous land, thru. scattering undergrowth. Desc. 235 ft.

9.60 Gulch, course S. 80° W. Ascend 110 ft.
 15.40 Spur, slopes S. 75° W. Descend 270 ft. to Oak Creek bottom.
 26.00 Ledge, brs. N. 60° E. and S. 60° W.
 26.95 Top of volcanic bluff, 80 ft. high, brs. NE; and SW. facing NW.
 30.20 Foot of descent, brs. N. 55° E. and S. 55° W. Enter Oak Creek bottom, scattering timber and undergrowth.
 31.25 Left bank and edge of water of Oak Creek, brs. N. 55° E. and S. 55° W. Thence across clear running water 130 lks. wide, 6 ins. deep, course S. 55° W.
 32.55 Right bank and edge of water, brs. N. 55° E. and S. 55° W. Leave water; thence across level bottom.
 35.40 Leave bottom and scattering timber, brs. N. 60° E. and S. 60° W. Ascend.
 39.82 (Proportional dist. based on E. bdy. of sec. 13) Set an iron post 3 ft. long, 1 in. in diam., 26 ins. in the ground for reestablished $\frac{1}{4}$ sec. cor. of sec. 13, marked on brass cap.

↑
S13

191b

40.91 and raise a mound of stone, 2 ft. base, 1 $\frac{1}{2}$ ft. high, E. of cor. A point, 2.51 chs. N. 70° 29' E. from adjusted temp. $\frac{1}{4}$ sec. cor. of secs. 13 and 14, being the midpoint on E. bdy. of sec. 14. This point determined as hereinbefore described in notes of retracement of E. $\frac{1}{2}$ of line, bet. secs. 11 and 14.
 Set an iron post, 3 ft. long, 1 in. in diam., 26 ins. in the ground, for reestablished $\frac{1}{4}$ sec. cor. of sec. 14, marked on brass cap.

Resurvey of part of Subdivision lines fracl. T. 16 N., R. 4 E. 25

Chains.

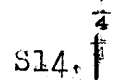

- 1916 and raise a mound of stone, 2 ft. base, 1 1/2 ft. high, W. of cor. Ascend 50 ft. to
- 54.50 Top of bluff, brs. E. and W., facing N. 80 ft. high. At foot of same, enter Oak Creek bottom, brs. E. and W.
- 64.70 Right bank and edge of water of Oak Creek, brs. N. 70° W. and S. 70° E. Thence across clear running water, 100 lks. wide, 90 ins. deep, course S. 70° E.
- 65.70 Left bank and edge of water, brs. N. 70° W. and S. 70° E. Leave water and ascend 675 ft. over limestone cliffs, bearing N. 70° W. and S. 70° E.

81.80 Top of cliffs. Ascend gradually.
 81.82 A point 5.03 chs. N. 70° 29' E., of adjusted temp. sec. cor. This point determined as hereinbefore described in notes of retracement of E. 1/2 of line, bet. secs. 11 and 14. Set an iron post, 3 ft. long, 2 ins. in diam., 12 ins. in the ground, supported by a mound of stone, for reestablished cor. of secs. 11, 12, 13 and 14, marked on brass cap,

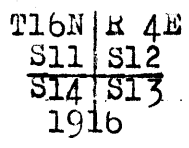

and establish bearing trees as follows:
 On a cedar, 7 ins. in diam., bearing N. 88 1/4° E., 138 lks. dist., marked "T16NR4ES12BT." and
 On a cedar, 10 ins. in diam., bearing N. 29° W., 114 lks. dist., marked "T16NR4ES11BT."

No other trees within prescribed limits.
 Raise a mound of stone, 2 ft. base, 1 1/2 ft. high, W. of cor. Land, mountainous, except in Oak Creek bottom.
 Soil, rocky, 4th rate, except in bottom land where gravelly, 2nd rate soil prevails.
 Timber, scattering sycamore and ash where noted.
 Undergrowth, scattering scrub cedar, oak and palo verde.
 No grass.

 No original cors. having been found in the retracement of line bet. secs. 11 and 12, resurvey said line as follows:
 North, on true line, bet. secs. 11 and 12.
 Over mountainous land, thru scattering undergrowth. Ascend 15 ft.

- 3.00 Spur, slopes W. Descend 525 ft. to
- 23.25 Wash, 30 lks. wide, 10 ft. deep, course N. 55° W. Ascend 40 ft.
- 28.25 Top of ascent. Descend 105 ft. to Oak Creek.
- 40.00 Set an iron post, 3 ft. long, 1 in. in diam., 26 ins. in the ground, for reestablished 1/4 sec. cor. of secs. 11 and 12, marked on brass cap,

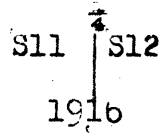

and establish bearing trees as follows:
 On a cedar, 12 ins. in diam., bearing S. 73 1/2° E., 90 lks. dist., mark "1/4 S12BT.", and
 On a sycamore, 9 ins. in diam., bearing S. 20° W., 150 lks. dist., mark "1/4 S11BT."

- 40.20 Left bank and edge of water of Oak Creek, brs. N. 50° E. and S. 50° W. Thence across clear running water, 150 lks. wide, 10 ins. deep, course S. 50° W.
- 41.70 Right bank and edge of water brs. N. 50° E. and S. 50° W. Leave water. Ascend 425 ft. to C.C.
- 45.55 Road brs. N. 55° E. and S. 55° W.
- 71.63 Intersect 4th. Std. Par. N., 7.55 chs. S. 89° 52' W. of the standard cor. of Ts. 17 N., Rs. 4 and 5 E., hereinbefore described.

26. Resurvey of part of Subdivision lines of frac T. 16 N., R. 4 E.

Chains:

at point of intersection,
Set an iron post, 3 ft. long, 2 ins. in diam., 24 ins. in the
ground, for closing cor. of secs. 11 and 12, marked on
brass cap,

T17N R4E

S11 S12

T16N R4E

1910

and establish bearing trees as follows:

On a cedar, 7 ins. in diam., bearing S. $56\frac{1}{2}^{\circ}$ E.,
54 lks. dist., marked "CCT16N R4E S12 Br." and

On a cedar, 8 ins. in diam., bearing S. $14\frac{1}{2}^{\circ}$ W., 47
lks. dist., marked "CC T16N R4E S11 Br."

Land, mountainous.

Soil, rocky, 4th rate.

Timber, scattering sycamore and ash along Oak Creek.

Undergrowth, scattering scrub cedar, oak and palo verde.
No grass.

From reestablished cor. of secs. 11, 12, 13 and 14,
N. $88^{\circ}31'$ W., on true line, bet. secs. 11 and 14 ($E.\frac{1}{2}$).

Over mountainous land, thru, scattering undergrowth.

Descend 315 ft. to $\frac{1}{4}$ sec. cor.

12.39 Bluff, 12 ft. high, brs. N. 75° W. and S. 75° E. facing SW.

18.99 Bluff, 8 ft. high, brs. N. 50° E. and S. 50° W. facing NW.

37.09 Intersect original $\frac{1}{4}$ sec. cor. hereinbefore described.

Reestablish this cor. by establishing a bearing tree as
follows:

On a cedar, 7 ins. in diam., bearing S. 8° W., 188
lks. dist., mark " $\frac{1}{4}$ S14 Br."

Thence,

S. $89^{\circ}21'$ W., on true line, bet. secs. 11 and 14 ($W.\frac{1}{2}$).

Over mountainous land, thru, scattering undergrowth. Desc.

2.70 A point 37 lks. N. of flag point of triangulation herein-
before described.

2.83 Top of bluff, brs. N. 20° W. and S. 20° E., facing SW., 290
ft. above Oak Creek.

Thence by triangulation measurement hereinbefore de-
scribed, across steep cliff on E. side of Oak Creek,
and across Oak Creek, to a point on W. side of creek,
at 23.06 ch. station which is 14 lks. N. of the triangu-
lation point.

Thence

N. $89^{\circ}21'$ E., 11.55 chs. to

11.51 Left bank and edge of water of Oak Creek brs. N. 20° E. and
S. 20° W. at foot of cliff on E. side of creek. Thence

S. $89^{\circ}21'$ W., on true line, bet. secs. 11 and 14 ($W.\frac{1}{2}$) con-
tinuing measurement from $\frac{1}{4}$ sec. cor. by chaining. across
clear running water, 60 lks. wide, 6 ins. deep, course
S. 20° W.

12.11 Right bank and edge of water of Oak Creek, brs. N. 20° E., and
S. 20° W. Leave water, Ascend 150 ft. to sec. cor.

23.06 A point 14 lks. N. of triangulation point of random line.

35.21 Intersect the original cor. of secs. 10, 11, 14 and 15, here-
inbefore described.

Land, mountainous.

Soil, rocky, 4th rate.

Timber, scattering sycamore, oak and cottonwood along Oak
Creek.

Undergrowth, scattering catclaw, scrub cedar and palo
verde.

No grass.

Resurvey of part of Subdivision lines fracl. T.16N. R.4 E. 27

Chains.

No trace of the original cor. of secs. 2, 3, 10 and 11, having been found in the retracement of N. $\frac{1}{2}$ of line bet. secs. 10 and 11, resurvey the line as follows:
 From original $\frac{1}{4}$ sec. cor. of secs. 10 and 11, hereinbefore described,
 North, on true line, bet. secs. 10 and 11 (N. $\frac{1}{2}$).
 Over rolling and mountainous land, thru scattering undergrowth. Ascend 70 ft.
 8.20 Top of ascent; descend 55 ft.
 14.05 Wash, 20 lks. wide, 4 ft. deep, course S. 30° E. Ascend 85 ft.
 20.00 Spur, slopes S. 40° E. Descend 55 ft. to
 31.80 Intersect 4th. Std. Par. N., 5.15 chs. N. 89° 55' W. of the std. cor. of secs. 35 and 36, hereinbefore described.
 At point of intersection,
 Set an iron post, 3 ft. long, 2 ins. in diam., 24 ins. in the ground, for closing cor. of secs. 10 and 11, marked on brass cap,

T17N R4E
 S35
 S10 | S11
 T16N | R 4E
 C | C
 1916

Establish a bearing tree as follows:
 On a cedar, 20 ins. in diam., bearing S. 47 $\frac{3}{4}$ ° E., 182 lks. dist., mark "CC T16N R4E S11 BT."
 No other trees within limits. Raise a mound of stone, 2 ft. base, 1 $\frac{1}{2}$ ft. high, S. of cor.
 Land, rolling and mountainous.
 Soil, rocky, 4th rate.
 No timber.
 Undergrowth, scattering mesquite, cedar, scrub oak and palo verde.
 No grass.

From the original cor. of secs. 9, 10, 15 and 16, hereinbefore described,
 S. 89° 31' W., on a true line, bet. secs. 9 and 16.
 Over mountainous land, thru scattering undergrowth.
 Ascend 50 ft.
 8.40 Spur, slopes S. Descend 125 ft.
 20.80 Spring Creek, dry, 120 lks. wide, 5 ft. deep, course S. 20° E. Ascend 125 ft.
 33.00 Descend 25 ft.
 40.19 Set an iron post, 3 ft. long, 1 in. in diam., 16 ins. in the ground, in a mound of stone, for reestablished $\frac{1}{4}$ sec. cor., marked on brass cap,

$\frac{1}{4}$ S 9
 S 16
 1916

Establish bearing tree as follows:
 On a cedar, 7 ins. in diam., bearing S. 28 $\frac{3}{4}$ ° W. 107 lks. dist., mark "S16 BT."
 No other trees within limits, Raise a mound of stone, 2 ft. base, 1 $\frac{1}{2}$ ft. high, N. of cor.
 42.90 Wash, 20 lks. wide, 5 ft. deep, course S. 40° E. Ascend 155 ft.
 48.45 Malpais bluff, 15 ft. high, ors. N. and S. facing E.
 49.15 Rocky point on spur, slopes S. Descend 185 ft. to wash.
 49.75 Bluff, 17 ft. high, brs. S. 45° W. and N. 45° E.
 62.00 Wash, course S. 60° E.
 64.90 Road brs. N. 45° W. and S. 45° E.
 67.50 Same wash, course N. 60° E.
 68.90 Same wash, course S. 80° E.

28. Resurvey of part of Subdivision of fract. T. 16N. R. 4 E.

Chains.

80.38 Intersect remains of original cor. of secs. 8, 9, 16 and 17, hereinbefore described. At a point 30 lks. S. of this cor.,

Set an iron post, 3 ft. long, 2 ins. in diam., 26 ins. in the ground, for witness cor. to reestablished cor. of secs. 8, 9, 16 and 17, marked on brass cap,

T16N	R 4E
S 8	S 9
W	C
S17	S16
1916.	

On a cedar, 9 ins. in diam., bearing N. 82 3/4° E., 187 lks. dist., mark "WC T16N R4E S9 BT."

On a cedar, 11 ins. in diam., bearing S. 11 1/4° E., 37 lks. dist., mark "WC T16N R4E S16 BT." and

On a cedar, 10 ins. in diam., bearing S. 28° W., 55 lks. dist., mark "WC T16N R4E S17 BT."

No other trees within limits, Raise a mound of stone, 2 ft. base, 1 1/2 ft. high, W. of cor.

Land, mountainous.

Soil, rocky, 4th rate.

No timber.

Undergrowth, cedar, scrub oak and palo verde.

No grass.

From the remains of original cor. of secs. 8, 9, 16 and 17, hereinbefore described,

N. 89° 06' W., on a true line, bet. secs. 8 and 17.

Over rolling land, thru. scattering undergrowth.

Ascend 120 ft.

42.30 Spur, slopes N. 55° E. Descend 50 ft.

23.00 Wash, 5 lks. wide, 3 ft. deep, course N. Ascend 60 ft.

33.59 Ridge, brs. S. 35° E. and N. 35° W. Descend 25 ft.

40.60 Set an iron post, 3 ft. long, 1 in. in diam., 26 ins. in the ground, for reestablished 1/4 sec. cor., marked on brass cap,

1/4	S 8
	S 17
1916	

Dig pits, 18x18x12 ins., E. and W. of post, 3 ft. dist., and raise a mound of earth, 3 1/2 ft. base, 1 1/2 ft. high, N. of cor.

47.05 Road brs. N. 50° E. to Sedona and S. 50° W. to Verde Valley.

52.60 Wash, 7 lks. wide, 3 ft. deep, course S.

81.20 Intersect the accepted cor. of secs. 7, 8, 17 and 18, hereinbefore described. Reestablish this cor. in the same place as follows:

Set an iron post, 3 ft. long, 2 ins. in diam., 24 ins. in the ground, for reestablished cor. of secs. 7, 8, 17 and 18, marked on brass cap,

T16N	R 4 E
S 7	S 8
S18	S17
1916	

Dig pits, 18x18x12 ins. in each sec. 5 1/2 ft. dist., and raise a mound of earth, 4 ft. base, 2 ft. high, W. of cor. Land, rolling.

Soil, gravelly and stony, 3rd rate on E. half; soil, sandy, 2nd rate on W. half.

No timber.

Undergrowth, scattering catclaw, cedar and palo verde.

Fair grass.

Resurvey of part of Subdivision of fracl. T.16 N. R.4 E. 29

Chains.

From the reestablished cor. of secs. 7, 8, 17, and 18, hereinbefore described,
 N. 88° 8' W., on a true line, bet. secs. 7 and 18.
 Over rolling land, thru. scattering undergrowth.
 13.90 Road brs. N. and S.
 43.31 (Proportional measurement), Set an iron post, 3 ft. long, 1 in. in diam., 26 ins. in the ground, for reestablished $\frac{1}{4}$ sec. cor., marked on brass cap,

$\frac{1}{4}$ $\frac{S}{S}$ $\frac{7}{18}$
 1916

and raise a mound of stone, 2 ft. base, 1 $\frac{1}{2}$ ft. high, N. of cor.
 54.05 Wash, 60 lks. wide, 12 ft. deep, course S. 50° E.
 60.70 Ascend 125 ft., over limestone formation.
 73.00 Ridge, brs. N. 15° E. and S. 15° W. Descend 145 ft.
 84.73 Intersect the reestablished cor. of secs. 7, 12, 13 and 18, on W. bdy. of Tp., hereinbefore described.
 Land, rolling and mountainous.
 Soil, rocky, 4th rate.
 No timber.
 Undergrowth, cedar, palo verde and mesquite.
 No grass.

 Survey of completion of Subdivision of fracl. T.16 N. R.4 E.

From original cor. of secs. 25, 30, 31 and 36, hereinbefore described,
 S. 89° 56' W., on a true line, bet. secs. 25 and 36 (E. half).
 Over mountainous land, thru. scattering undergrowth.
 Ascend 125 ft.
 9.00 Spur, slopes S. 20° W. Descend 235 ft.
 24.05 Gulch, course S. Ascend 55 ft.
 30.60 Spur, slopes S. 25° E. Descend 85 ft.
 40.05 Intersect the reestablished $\frac{1}{4}$ sec. cor. of secs. 25 and 36, hereinbefore described.
 Land, mountainous.
 Soil, rocky, 4th rate.
 No timber,
 Undergrowth, scattering cedar, catclaw and palo verde.
 No grass.

 From original cor. of secs. 23, 24, 25 and 26, hereinbefore described,
 East, on random line, bet. secs. 24 and 25.
 40.00 Set temp. $\frac{1}{4}$ sec. cor.
 80.04 Intersect E. bdy. of Tp., 85 lks. N. 0° 4' W., of reestablished cor. of secs. 19 and 30, hereinbefore described, at point of intersection, set an iron post, 3 ft. long, 2 ins. in diam., 20 ins. in the ground, supported by a mound of stone, for closing cor. of secs. 24 and 25, marked on brass cap,

CC $\frac{T16N}{S24}$
 $\frac{S25}{R4E}$
 1916

and establish bearing trees as follows:
 On a cedar, 5 ins. in diam., bearing S. 32° W., 238 lks. dist., mark "CC T16N R4E S25 BT.", and
 On a cedar, 8 ins. in diam., bearing N. 47° W., 75 lks. dist., mark "CC T16N R4E S24 BT."

30 Survey of completion ofnSubdivision of fracl.T.16^N R.4 E.

Chains.

Thence,
West, on true line, bet. secs. 24 and 25.
Over mountainous land, thru scattering undergrowth and
timber. Descend 80 ft. to

12.04 Head of gulch, course S. 55° W. Descend 35 ft. to

18.04 Spur, slopes S. 50° W. Descend 275 ft. to

31.54 Gulch, course S. 65° W. Ascend 15 ft. to

40.02 Set an iron post, 3 ft. long, 1 in. in diam., 12 ins. in
the ground, supported by a mound of stone, for $\frac{1}{4}$ sec. cor.,
of secs. 24 and 25, marked on brass cap,

$\frac{1}{4}$ S 24
S 25
1916

and establish bearing trees as follows:

On a cedar, 8 ins. in diam., bearing N. 5 $\frac{1}{2}$ ° E., 94
lks. dist., mark "S24BT.", and

On a cedar, 16 ins. in diam., bearing S. 69° W., 131
lks. dist., mark "S25BT."

This cor. is on end of spur, sloping S. 45° W.
Descend 335 ft. to gulch.

42.54 Volcanic bluff, 90 ft. high, bearing NE. and SW., facing NW.

50.14 Gulch, course S. 45° W. Ascend 205 ft.

60.04 Spur, slopes S. 55° W. Descend 200 ft.

69.29 Head of wash, course S. 50° W. Ascend 20 ft.

70.52 Spur, slopes S. Descend 145 ft. to

80.04 Intersect original cor. of secs. 23, 24, 25 and 26, here-
inbefore described.

Land mountainous.

Soil rocky, 4th rate.

Timber, very scattering cedar.

Undergrowth, scattering scrub cedar, palo verde, catclaw
and mesquite.

No grass.

From the reestablished cor. of secs. 13, 14, 23 and 24,
hereinbefore described,

EAST, on a random line, bet. secs. 13 and 24.

40.00 Set temp. $\frac{1}{4}$ sec. cor.

79.78 Intersect E. bdy. of Tp., 39 lks. N. of the original cor. of
secs. 13, 18, 19 and 24, hereinbefore described.

Thence,

N. 89° 43' W., on a true line, bet. secs. 13 and 24.

Over mountainous land, thru scattering undergrowth and
timber.

Descend 75 ft.

12.00 Gulch, course N10° W. Ascend 35 ft.

17.50 Descend gradually, 265 ft.

39.89 Set an iron post, 3 ft. long, 1 in. in diam., 12 ins. in
the ground, supported by a mound of stone, for $\frac{1}{4}$ sec.
cor., marked on brass cap,

$\frac{1}{4}$ S 13
S 24
1916

On a cedar, 10 ins. in diam., bearing N. 5 $\frac{1}{2}$ ° W., 141
lks. dist., mark "S13BT."

On a cedar, 12 ins. in diam., bearing S. 44 $\frac{3}{4}$ ° W.,
121 lks. dist., mark "S24BT."

60.55 Descend abruptly.

69.20 Gulch, course N. 40° W. Ascend 125 ft.

71.25 Cliff, 40 ft. high. Continue ascent.

74.85 Spur, slopes N. Descend 40 ft.

79.78 Intersect the reestablished cor. of secs. 13, 14, 23 and 24,
hereinbefore described.

Land, mountainous.

Soil, rocky, 4th rate.

Survey of completion of Subdivision of fractional T. 16 N., R. 4 E. 37

Chains.

Timber, very scattering cedar, undergrowth, scattering cedar, pinon and scrub oak.
No grass.

40.00
74.84

From the reestablished cor. of secs. 11, 12, 13 and 14, herein before described,
East, on a random line, bet. secs. 12 and 13.

Set temp. $\frac{1}{4}$ sec. cor.
Intersect E. bdy. of Tp., 2.40 chs. N. $0^{\circ}7'W.$, of the reestablished cor. of secs. 7 and 18, T. 16 N., R. 5 E., herein before described.

At the point of intersection,
Set an iron post, 3 ft. long, 3 ins. in diam., 24 ins. in the ground, for reestablished cor. of secs. 12 and 13, marked on brass cap,

T16N
S12
S13
R4E
1916

and establish bearing trees as follows:
On a cedar, 26 ins. in diam., bearing S. $11^{\circ}W.$, 35 lks. dist., marked "16N R4E S13 BT." and
On a cedar, 20 ins. in diam., bearing N. $76\frac{1}{2}^{\circ}W.$, 25 lks. dist., mark "16N R4E S12 BT."

9.40
28.90
34.84

Thence,
West, on a true line, bet. secs. 12 and 13.
Over mountainous land, thru scattering undergrowth and timber.
Ascend 70 ft.
Spur, slopes N. $30^{\circ}W.$. Descend 150 ft.
Wash, 5 lks. wide, 2 ft. deep, course N.
(40.00 chs. E. of the reestablished cor. of secs. 11, 12, 13 and 14) Set an iron post, 3 ft. long, 1 in. in diam., 16 ins. in the ground, supported by a mound of stone, for $\frac{1}{4}$ sec. cor. of sec. 12, marked on brass cap,

$\frac{1}{4}$ S 12
1916

40.00

and establish bearing trees as follows:
On a cedar, 21 ins. in diam., bearing N. $24\frac{1}{2}^{\circ}E.$, 132 lks. dist., marked " $\frac{1}{4}$ S12 BT.", and
On a cedar, 12 ins. in diam., bearing N. $10\frac{1}{4}^{\circ}W.$, 102 lks. dist., marked " $\frac{1}{4}$ S12 BT."
Set an iron post, 3 ft. long, 1 in. in diam., 26 ins. in the ground, for $\frac{1}{4}$ sec. cor. of sec. 13, marked on brass cap,

$\frac{1}{4}$ S 13
1916

45.25
55.35
62.30
74.84

and establish bearing trees as follows:
On a cedar, 13 ins. in diam., bearing S. $82\frac{3}{4}^{\circ}E.$, 121 lks. dist., mark $\frac{1}{4}$ S13 BT.
On a pinon, 7 ins. in diam., bearing S. $16\frac{1}{4}^{\circ}W.$, 87 lks. dist., mark $\frac{1}{4}$ S13 BT.
Ridge, brs. S. $55^{\circ}E.$ and N. $55^{\circ}W.$. Descend 100 ft.
Wash, 20 lks. wide, 5 ft. deep, course S. $20^{\circ}E.$. Ascend 235 ft. to cor.
Bluff, 7 ft. high, brs. N. $30^{\circ}E.$ and S. $30^{\circ}W.$ facing SE.
The reestablished cor. of secs. 11, 12, 13 and 14.
Land, mountainous.
Soil, rocky, 4th rate.
Timber, very scattering cedar.
Undergrowth, palo verde, mesquite, cedar and pinon.
No grass.

32. Survey of completion of Subdivision of frac. T. 16 N. R. 4 E.

Chains.

From the original cor. of secs. 9, 10, 15 and 16, hereinbefore described, north, on a true line, bet. secs. 9 and 10. Over rolling land, thru scattering undergrowth.

- Ascend 55 ft.
- 27.95 Descend 35 ft.
- 34.95 Gulch, course N. 55° W.
- 40.00 Set an iron post, 3 ft. long, 1 in. in diam., 26 ins. in the ground, for $\frac{1}{4}$ sec. cor., marked on brass cap,

$\frac{1}{4}$
 S 9 | S 10
 1916

and raise a mound of stone, 2 ft. base, 1 $\frac{1}{2}$ ft. high, W. of cor.

- 73.63 Intersect Fourth Standard Parallel North, 9, 86 chs. N. 89° 54' W. of the standard cor. of secs. 34 and 35, hereinbefore described.

At the point of intersection, Set an iron post 3 ft. long, 2 ins. in diam., 24 ins. in the ground, for closing cor. of secs. 9 and 10, marked on brass cap,

T17N R4E
 S34
 S 9 | S10
 T16N R4 E
 C C
 1916

and raise a mound of stone, 2 ft. base, 1 $\frac{1}{2}$ ft. high, S. of cor.

Land, rolling.
 Soil, rocky, 4th.
 No timber.
 Undergrowth, scattering catclaw, cedar, palo verde and scrub oak.
 Fair grass.

From the remains of the original cor. of secs. 8, 9, 16 and 17, hereinbefore described, north, on a true line, bet. secs. 8 and 9. Over rolling land, thru scattering undergrowth and timber. Descend.

- 1.70 Gulch, course S. 60° E.
- 4.10 Same gulch, course S. 20° W.
- 20.70 Same gulch, course S. 25° E.
- 25.60 Same gulch, course S. 25° W. Ascend 190 ft.
- 40.00 Set an iron post, 3 ft. long, 1 in. in diam., 26 ins. in the ground, for $\frac{1}{4}$ sec. cor., marked on brass cap,

$\frac{1}{4}$
 S 8 | S 9
 1916

and establish bearing trees as follows:

- On a cedar, 8 ins. in diam., bearing S. 75 $\frac{1}{2}$ ° E., 176 lks. dist., mark $\frac{1}{4}$ S9 BT., and
- On a cedar, 11 ins. in diam., bearing S. 41 $\frac{1}{2}$ ° W., 121 lks. dist., mark $\frac{1}{4}$ S8 BT.

- 50.00 Spur, slopes S. 50° E. Descend 20 ft. to
 - 54.00 Spur, slopes N. 50° E. Descend 130 ft. to
 - 74.41 Intersect Fourth Standard Parallel North, 10.09 chs. N. 89° 49' W. of the standard cor. of secs. 33 and 34, hereinbefore described.
- At the point of intersection,

Survey of Completion of Subdivision of frac1.T.16 N. R.4. E. 33

Chains.

Set an iron post, 3 ft. long, 2 ins. in diam., 18 ins. in the ground, supported by a mound of stone, for closing cor. of secs. 8 and 9, marked on brass cap,

T17N R 4E
S33
S 8 | S 9
T16N R4 E
C | C
1916

On a cedar, 10 ins. in diam., bearing S. 31 3/4° E., 286 lks. dist., mark "CC T16N R4E S9BT." and

On a cedar, 8 ins. in diam., bearing S. 22 1/4° W., 249 lks. dist., mark "CC T16N R4E S8BT."

Land, rolling.

Soil, rocky, 3rd rate.

Timber, very scattering cedar, pinon, scrub oak, and palo verde.

Good grass.

From the reestablished cor. of secs. 7, 8, 17 and 18, herein before described,

North, on a true line, bet. secs. 7 and 8.

Over rolling land, thru. scattering undergrowth.

Ascend gradually.

17.00 Low spur, slopes S. 40° E. Descend gradually.

40.00 Set an iron post, 3 ft. long, 1 in. in diam., 26 ins. in the ground, for cor., marked on brass cap,

S7 | S8
1916

and raise a mound of stone, 2 ft. base, 1 1/2 ft. high, W. of cor.

42.12 Wash, 25 lks. wide, 2 ft. deep, course S. 60° E.

73.27 Intersect Fourth Standard Parallel North, 11.15 chs. N. 89° 54' W. of the standard cor. of secs. 32 and 33, herein before described.

At the point of intersection,

Set an iron post, 3 ft. long, 2 ins. in diam., 24 ins. in the ground, for closing cor. of secs. 7 and 8, marked on brass cap.

T17N R 4E
S32
S 7 | S 8
T16N R 4E
C | C
1916

Dig pits, 24x18x12 ins., crosswise on each line E. and W. 3 ft., and S. of post, 7 ft. dist., and raise a mound of earth, 4 ft. base, 2 ft. high, S. of cor.

Land, rolling.

Soil, stony; 3rd rate.

No timber.

Undergrowth, scattering catclaw, cedar, pinon and scrub oak.

Good grass.

34. Boundaries of E. and N. tiers of secs. of fract. T. 16N., R. 4 E.

Latitudes, Departures and Closing Errors.

Line designated.	True bearing.	Dist.	Latitudes.		Departures.	
			N.	S.	E.	W.
South boundary,	West,	39.99				39.99
	S. 89° 53' W.	40.07		.08		40.07
Subdivisional boundary,	N. 0° 6' E.	40.17	40.17		.07	
	N. 0° 5' W.	39.77	39.77			.06
	N. 0° 9' E.	40.49	40.49		.10	
	N. 0° 4' E.	40.13	40.13		.05	
	N. 0° 34' E.	39.73	39.73		.40	
	N. 0° 21' W.	39.82	39.82			.24
	N. 3° 19' E.	81.82	81.68		4.74	
	N. 88° 31' W.	37.69	.98			37.68
	S. 89° 21' W.	35.21		.40		35.21
	N. 89° 00' W.	39.61	.69			39.60
	S. 86° 49' W.	50.00		2.78		49.92
S. 89° 31' W.	80.38		.68		80.38	
N. 89° 6' W.	81.20	1.27			81.19	
N. 88° 8' W.	84.73	2.76			84.59	
West boundary	N. 0° 43' W.	30.88	30.88			.50
	N. 0° 47' E.	30.93	30.93		.06	
North boundary (4th. Std. Par. N.)	S. 89° 41' E.	16.23		.09	16.23	
	S. 89° 52' E.	40.05		.09	40.05	
	S. 89° 54' E.	40.03		.07	40.03	
	S. 89° 57' E.	40.11		.04	40.11	
	S. 89° 49' E.	40.07		.13	40.07	
	S. 89° 48' E.	40.12		.14	40.12	
	S. 89° 54' E.	40.06		.07	40.06	
	N. 89° 50' E.	39.97	.12		39.97	
	S. 89° 55' E.	39.89		.06	39.89	
	S. 89° 39' E.	40.20		.24	40.20	
	N. 89° 52' E.	40.02	.09		40.02	
N. 89° 44' E.	67.17	.30		67.17		
East boundary,	S. 0° 3' E.	34.97		34.97	.04	
	S. 0° 7' E.	39.51		39.51	.08	
	S. 0° 3' W.	39.73		39.73		.03
	S. 0° 5' E.	39.95		39.95	.06	
	South,	39.94		39.94		
	S. 0° 4' E.	40.16		40.16	.05	
	S. 0° 2' W.	39.97		39.97		.02
	S. 0° 3' W.	39.78		39.78		.03
	S. 0° 3' E.	39.92		39.92	.03	
South,	39.98		39.98			
Convergency,				.15		
Totals,			398.81	398.78	489.75	489.61
			398.78		489.61	
	Error in latitude,		.03			
	Error in departure,				.14	

GENERAL DESCRIPTION.

The east tier of secs. in this township lie along the east side of Oak Creek on the west slopes of House Mountain. The general slope and drainage is west and north into Oak Creek. The land is generally mountainous, with the exception of most of sec. 36, the southwest quarter of sec. 25, and about 100 acres in sec. 12, adjacent to the 4th Standard Parallel North, and lying along Oak Creek. These lands are agricultural in character and portions of them are under cultivation.

The north tier of sections is generally rolling, with small patches of prairie, the greater part unfit for cultivation. Oak Creek flows in a narrow canyon, thru. sections 11, 12, 13 and 14,

General Description (continued)

and very little agricultural land is found, probably a total of 300 acres in the sections mentioned.
A heavy growth of cedar and scattering pinyons covered the area surveyed, with the exception of the agricultural lands already described, none of it valuable, except for fire wood.
Good grass is found, and makes this locality good winter pasture.

For **CERTIFICATE OF UNITED STATES SURVEYOR.**
See Book "A," of this Group.

I, _____, U. S. Surveyor, hereby certify upon honor that, in pursuance of special instructions received from the U. S. Surveyor General for _____ bearing date of the _____ day of _____, 191____, I have well, faithfully, and truly in my own proper person, and in strict conformity with said instructions, the Manual of Surveying Instructions, and the laws of the United States, surveyed all those parts or portions of _____ of the _____ Meridian, in the State of _____, which are represented in the foregoing field notes as having been executed by me, and under my direction; and that all the corners of said survey have been established and perpetuated in strict accordance with the Manual of Surveying Instructions, and the special written instructions of the U. S. Surveyor General for _____ and in the specific manner described in the field notes, and that the foregoing are the original field notes of such survey.

U. S. Surveyor

BOOK 3325

APPROVAL.

OFFICE OF THE UNITED STATES SURVEYOR GENERAL,

Phoenix, Arizona, May 14, 1920

The foregoing field notes of the ~~survey of~~ Retracement of 4th. Std. Par. N., thru. part of Range 4 East, part of West bdrs. of Fracl Tps. 16 North, Ranges 4 and 5 East, and part of the Subdivision lines of Fracl Tp. 16 North, Range 4 East; RESURVEY of the 4th. Std. Parallel North, thru. part of Range 5 East, part of the West bdrs. of Fracl Tps. 16 North, Ranges 4 and 5 East, part of the South bdy. of Fracl Tp. 16 North, Range 4 East, and part of the Subdivision lines of Fracl Tp. 16 North, Range 4 East, and SURVEY of part of the Subdivision lines of Fracl Tp. 16 North, Range 4 East,

of the Gila and Salt River Base and Meridian, in the State of Arizona,

executed by William H. Richards, Jr., U.S. Surveyor,

under ~~his~~ special instructions dated Oct. 14, 1915 for Group 61, Arizona, having been critically examined, and the necessary corrections and explanations made, the said field notes, and the ~~surveys~~ retracements, resurveys and surveys they describe, are hereby approved.

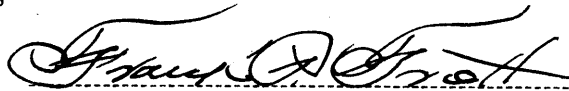
U. S. Surveyor General.

~~I certify that the foregoing transcript of the field notes of the above described surveys in~~

~~_____ has been correctly copied from the original notes on file in this office.~~