

Book "K"
4-679

Original

1913 1920

BOOK 3332

FIELD NOTES

OF THE ^{RE-}SURVEY OF ~~THE~~

3332

Part of the South Boundary of Township 14 North, Range 2 East,
Part of the East Boundary of Township 13 North, Range 1 East,
and the 3rd Standard Parallel North, thru parts of Ranges 1 and 2 East, and
SURVEY OF

Part of the South Boundary of Township 14 North, Range 2 East, and
Part of the East Boundary of Township 13 North, Range 1 East,

3332

Of the Gila and Salt River Base and Meridian,

In the State of Arizona.

EXECUTED BY

Geo. F. Rigby,

In the capacity of U. S. Surveyor, under Special Instructions dated October 14, 1915,
issued by the United States Surveyor General to govern surveys included in Group
No. 61, which were approved by the Commissioner of the General Land
Office, November 10, 1915, and Assignment Instructions dated November 25, 1916.

Resurvey and Survey commenced May 9, 1917.

Resurvey and Survey completed May 17, 1917.





36
11A

3332

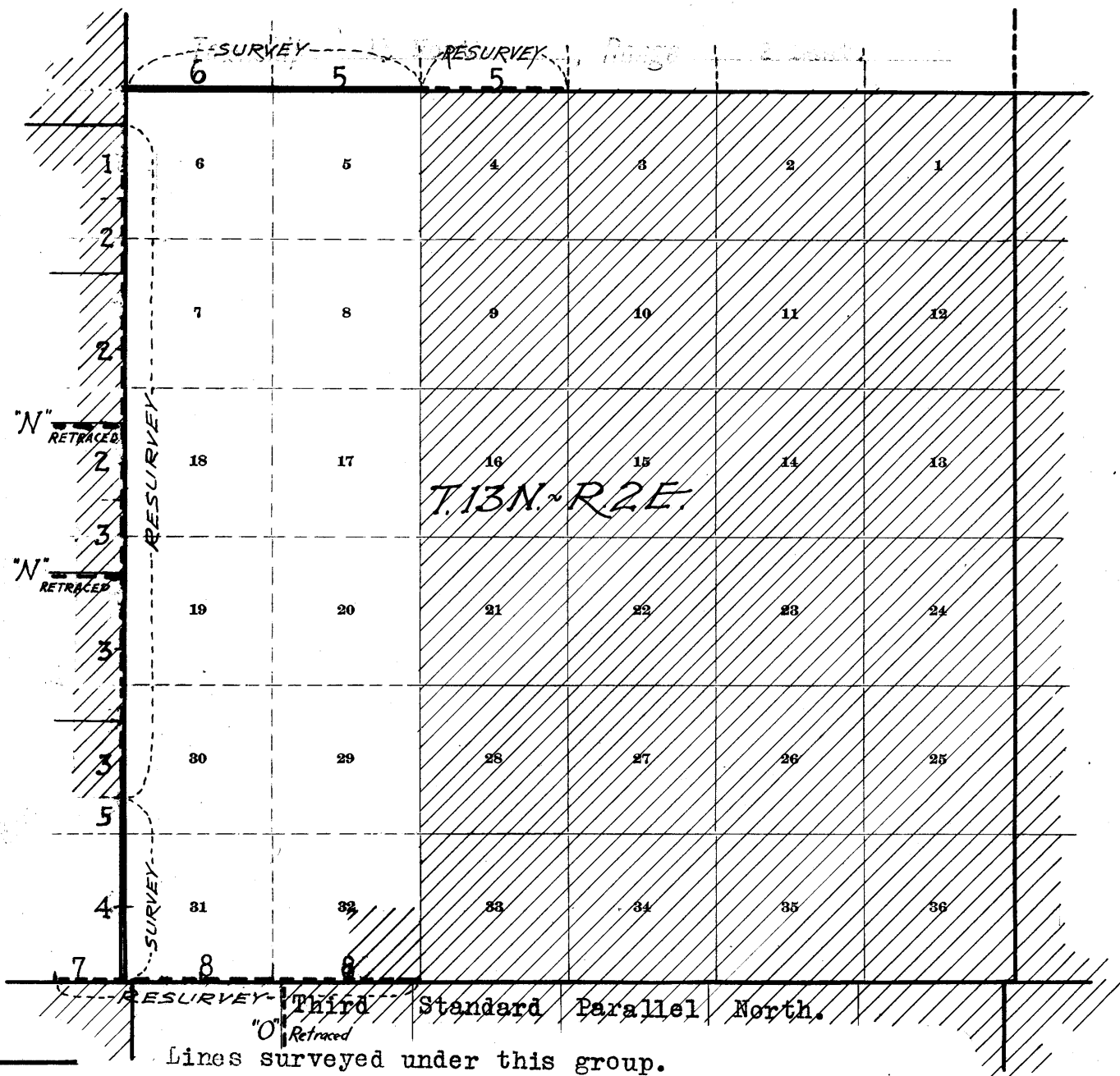
BOOK 3332

INDEX DIAGRAM.

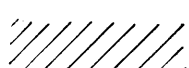

-  Lines surveyed under this group.
-  Lines retraced or resurveyed under this group.
-  Lines of accepted surveys.
-  Unsurveyed.
-  Areas surveyed as per accepted plats on file.

10

chains.

Resurvey and survey by Geo. F. Rigby, U.S. Surveyor, on dates shown on page 10 hereof, using C.L. Berger transit No. 8947, without solar attachment. For description of instrument and certificate of approval, see Book "F." May 5, 1917. At camp in sec. 18, T. 13 N., R. 2 E., in lat. $34^{\circ} 30\frac{1}{2}'$ N., long. $112^{\circ} 12'$ W., at 4h. 42m. a.m., l.m.t., by watch, which is set to correct local mean time, observe Polaris at eastern elongation, in accordance with the Manual of Instructions, and turn an angle of $11^{\circ} 43'$ toward the west, to a hub set in the ground, approximately 10 chs. dist. The azimuth of Polaris at elongation is $1^{\circ} 23'$; the bearing of the reference line is therefore N. $10^{\circ} 20'$ W.

Transfer this meridian by careful transit line and angles to initial cors., and thence throughout the township.

From the original cor. of secs. 10, 11, 14 and 15, T. 13 N., R. 1 E., which is a granite stone, 8x8x10 ins. above ground, properly set, marked and witnessed as described by the surveyor general, retrace east 160.00 chs., and set the temp. cor. of secs. 7, 12, 13 and 18, after making diligent search for the original cors., but without success. From this temp. cor. on east bdy. of T. 13 N., R. 1 E., retrace south for a dist. of $2\frac{1}{2}$ miles, making diligent search for old cors., to the limit of the original survey, but without success. Then, from the same temporary cor., retrace north along E. bdy. of T. 13 N., R. 1 E., but am unable to find any of the original cors. From plat of Mineral Survey No. 2541, find a tie S. $18^{\circ} 53'$ W., 813 ft. from cor. No. 4 of El Paso Mining Claim to original cor. of Ts. 13 and 14 N., Rs. 1 and 2 E., Cor. No. 4 of the El Paso Mining Claim is missing. Therefore, from cor. No. 1 of this claim, run S. $86^{\circ} W.$ 600 ft. to the true position for cor. No. 4, and thence S. $18^{\circ} 53'$ W. 813 ft. to the position for the original cor. of Ts. 13 and 14 N., Rs. 1 and 2 E. Dig at this point, and find the lower part of the old township cor., the top of which is lying close by, but unmarked. Verify this position by running from Mineral Monument No. 2541, the computed course of the line joining this monument with the original township cor., S. $25^{\circ} 19'$ W., 21.41 chs., which arrives at the same point. Reestablish the cor. of Ts. 13 and 14 N., R. 1 E., in the same place as follows:

Set an iron post, 3 ft. long, 3 ins. in diam., 24 ins. in the ground, for reestablished cor. of Ts. 13 and 14 N., R. 1 E., marked on brass cap,

T14N
R1E
S36
S 1
T13N
1917

and raise a mound of stone, 2 ft. base, $1\frac{1}{2}$ ft. high, W. of cor.

Thence, South, on a true line, on E. bdy. of sec. 1, T. 13 N., R. 1 E. Over heavily rolling land, thru dense undergrowth.

7.01
40.00

New road brs. E. to Camp Verde and W. Set an iron post, 3 ft. long, 1 in. in diam., 26 ins. in the ground, for reestablished $\frac{1}{4}$ sec. cor. of sec. 1, marked on brass cap,

S 1
1917

2. Resurvey of the East bdy. of Township 13 North, Range 1 East.

Chains.

and raise a mound of stone, 2 ft. base, 1½ ft. high, W. of cor.
 42.41 Gulch, course W. Ascend 215 ft.
 56.52 Spur, slopes W. Descend 205 ft.
 80.00 Set an iron post, 3 ft. long, 2 ins. in diam., 24 ins. in the ground, for reestablished cor. of secs. 1 and 12, marked on brass cap,

T13N
 S 1
 S12
 R1E
 1917

and raise a mound of stone, 2 ft. base, 1½ ft. high, W. of cor.
 Land, heavily rolling.
 Soil, gravelly clay, 3rd rate.
 No timber.
 Undergrowth, dense scrub oak and manzanita.

South, on a true line, along E. bdy. of sec. 12.
 Over very low hills, thru dense undergrowth.
 30.85 Gulch, course W. Ascend 105 ft.
 40.00 Set an iron post, 3 ft. long, 1 in. in diam., 26 ins. in the ground, for reestablished ¼ sec. cor. of sec. 12, marked on brass cap,

S12
 1917

and raise a mound of stone, 2 ft. base, 1½ ft. high, W. of cor.
 41.65 Spur, slopes W. Descend 200 ft.
 80.00 Set an iron post, 3 ft. long, 2 ins. in diam., 24 ins. in the ground, for reestablished cor. of secs. 12 and 13, marked on brass cap,

T13N
 S12
 S13
 R1E
 1917

and raise a mound of stone, 2 ft. base, 1½ ft. high, W. of cor.
 Land, very low hills and heavily rolling.
 Soil, gravelly clay, 3rd rate.
 No timber.
 Undergrowth, dense scrub oak and manzanita.

South, on a true line, along E. bdy. of sec. 13.
 Over low hills, thru dense undergrowth.
 Ascend 65 ft.
 14.62 Spur, slopes W. Descend 125 ft.
 27.00 Creek, 2 lks. wide, 2 ins. deep, course W. Ascend 75 ft.
 32.00 Spur, slopes W. Thence over broken land.
 40.00 Set an iron post, 3 ft. long, 1 in. in diam., 26 ins. in the ground, for ¼ sec. cor., marked on brass cap,

S13
 1917

and raise a mound of stone, 2 ft. base, 1½ ft. W. of cor.

2000 3332

Resurvey of the
East boundary of Township 13 North, Range 1 East, 3

Chains.

- 52.44 Spur, slopes W. Descend 30 ft.
- 76.00 Gulch, course W. Ascend 75 ft.
- 80.00 Set an iron post, 3 ft. long, 2 ins. in diam., 24 ins. in the ground, for reestablished cor. of secs. 13 and 24, marked on brass cap,

T13N
S13
S24
R1E
1917

and raise a mound of stone, 2 ft. base, 1½ ft. high, W. of cor.
Land, low hills.
Soil, gravelly clay, 3rd rate.
No timber.
Undergrowth, dense scrub oak and manzanita.

- 26.18 Spur, slopes W. Descend 50 ft.
- 36.15 Gulch, course N.20°W. Ascend 320 ft.
- 40.00 Set an iron post, 3 ft. long, 1 in. in diam., 26 ins. in the ground, for reestablished ¼ sec. cor. of sec. 24, marked on brass cap,

S24
↑
1917

and raise a mound of stone, 2 ft. base, 1½ ft. high, W. of cor.
Cor. stands on spur, slopes NW. Continue ascent.

- 54.37 Ridge, hrs. NE. and SW. Ascend.
- 61.34 Spur, slopes E. Descend 345 ft.
- 80.00 Set an iron post, 3 ft. long, 2 ins. in diam., 24 ins. in the ground, for reestablished cor. of secs. 24 and 25, marked on brass cap,

T13N
S24
S25
R1E
1917

and raise a mound of stone, 2 ft. base, 1½ ft. high, W. of cor.
Land, mountainous.
Soil, gravelly, clay 3rd rate.
No timber.
Undergrowth, dense scrub oak and manzanita.

- 20.43 Gulch, course E. Ascend 110 ft.
- 24.65 Spur, slopes E. Thence over rolling land.
- 40.00 Set an iron post, 3 ft. long, 1 in. in diam., 26 ins. in the ground, for reestablished ¼ sec. cor. of sec. 25, marked on brass cap,

4. Resurvey of a portion of E. bdy. of Township 13 N., R. 1 E.

Chains.

S25

1917

and raise a mound of stone, 2 ft. base, 1½ ft. high, W. of cor.
 Original survey of Tp. boundary did not extend any farther south.
 Land, low hills.
 Soil, rocky clay, 3rd rate.
 No timber.
 Undergrowth, dense scrub oak, and manzanita.

SURVEY OF A PORTION OF THE E. BDY. OF T. 13 N., R. 1 E.

108.29

From the reestablished ¼ sec. cor. of secs. 25, hereinbefore described,
 South, on a random line, along E bdy. of T. 13 N., R. 1 E.
 Intersect the Third Standard Parallel North, 16005 chs. W. of Angle Point, originally standard Tp. cor., but change to an angle point as hereinafter described.
 At the point of intersection,
 Set an iron post, 3 ft. long, 3 ins. in diam., 24 ins. in the ground, for reestablished standard cor. of T. 13 N., R. 1 and 2 E., marked on brass cap,

S. C
 T13N
 R1E | R2E
 S36 | S31

1917

and raise a mound of stone, 2 ft. base, 1½ ft. high, N. of cor.
 Thence,
 North, on a true line, along E bdy. of sec. 36.
 Over low hills, thru dense undergrowth.
 Set an iron post, 3 ft. long, 1 in. in diam., 26 ins. in the ground, for ¼ sec. cor., of sec. 36, marked on brass cap,

40.00

S36

1917

48.79

80.00

and raise a mound of stone, 2 ft. base, 1½ ft. high, W. of cor.
 Spur, slope @ SE. Descend 150 ft.
 Set an iron post, 3 ft. long, 2 ins. in diam., 24 ins. in the ground, for cor. of secs. 25 and 36, marked on brass cap,

T13N
 S25
 S36
 R1E
 1917

and raise a mound of stone, 2 ft. base, 1½ ft. high, W. of cor.
 Land, low hills.
 Soil, gravelly clay, 3rd rate.
 No timber.
 Undergrowth, dense scrub oak and manzanita.

Survey of portion of E. bdy. of Township 13 North, Range 1 East, 5

Chains.

North, on a true line, along E. bdy. of sec. 25 (S. $\frac{1}{2}$).
 Over low hills, thru. dense undergrowth.
 Descend 40 ft.
 5.80 Draw, course E. Ascend 150 ft.
 28.29 The reestablished $\frac{1}{4}$ sec. cor. of sec. 25, hereinbefore described,
 Land, low hills.
 Soil, rocky clay, 3rd rate.
 No timber.
 Undergrowth, dense scrub oak and manzanita.

Resurvey of a portion of the South Boundary of Township 14 North, Range 2 East.

From the original cor. of secs. 3, 4, 33 and 34, on SW bdy. of T. 14 N., R. 2 E., which is a granite stone, 12x8x6 ins. above ground, firmly set, marked and witnessed as described by the surveyor general. Retrace west, making diligent search for the original $\frac{1}{4}$ sec. and sec. cor., but without avail. Return to the original cor. of secs. 3, 4, 33 and 34.
 Thence,
 West, on a true line, along S. bdy. of sec. 33.
 Over low hills, thru. dense undergrowth.
 Descend 25 ft.
 10.00 Fence brs. N. and S.
 12.20 Enter alfalfa field, brs. NW. and SE.
 18.90 Leave field, brs. NW and SE.
 19.00 Ash Creek, 15 lks. wide, 8 ins. deep, course SE. Ascend 50 ft.
 21.30 Ranch house, brs. south 1 chain dist.
 31.37 Spur, slopes N. Thence over rolling land.
 40.00 Set an iron post, 3 ft. long, 1 in. in diam., 26 ins. in the ground, for reestablished $\frac{1}{4}$ sec. cor., marked on brass cap,

$\frac{1}{4}$ S 33
 S 4
 1917

and raise a mound of stone, 2 ft. base, 1 $\frac{1}{2}$ ft. high, N. of cor.
 67.40 Spur, slopes S. Descend.
 80.00 Set an iron post, 3 ft. long, 2 ins. in diam., 24 ins. in the ground, for reestablished cor. of secs. 4, 5, 32 and 33, marked on brass cap,

T14N R2E
 S32 | S33
 S 5 | S 4
 T13N
 1917

and raise a mound of stone, 2 ft. base, 1 $\frac{1}{2}$ ft. high, W. of cor.
 Land, low hills.
 Soil, clay loam, 2nd rate.
 No timber.
 Undergrowth, scrub oak and manzanita.

Completion of the Survey of the South bdy. of T. 14 N., R. 2 East.

From the reestablished cor. of secs. 4, 5, 32 and 33, hereinbefore described,
 West, on a true line, along S. bdy. of sec. 32.
 Over rolling land, thru. dense undergrowth.

6. Completion of Survey of S bdy. of Township 14 N., R. 2 E.

Chains.

40.00 Set an iron post, 3 ft. long, 1 in. in diam., 26 ins. in the ground, for $\frac{1}{4}$ sec. cor. of sec. 32, marked on brass cap,

1S 32

1917

and raise a mound of stone, 2 ft. base, 1 $\frac{1}{2}$ ft. high, N. of cor.

53.60 House brs. S. 29° 11' W., 25.00 chs. dist.

78.50 Road brs. N. 10° W. and S. 10° E., in wash, course S.

80.00 Set an iron post, 3 ft. long, 2 ins. in diam., 24 ins. in the ground, for cor. of secs. 31 and 32, marked on brass cap,

T14N | R2E
S31 | S32

1917

and raise a mound of stone, 2 ft. base, 1 $\frac{1}{2}$ ft. high, N. of cor. Land, rolling.

Soil, sandy clay and loam, with large granite boulders, 2nd rate.

No timber,

Undergrowth, scrub oak and manzanita.

No grass.

West, on a true line, along S. bdy. of sec. 31.

Over rolling land, thru dense undergrowth.

40.00 Set an iron post, 3 ft. long, 1 in. in diam., 26 ins. in the ground, for $\frac{1}{4}$ sec. cor. of sec. 31, marked on brass cap,

1S 31

1917

and raise a mound of stone, 2 ft. base, 1 $\frac{1}{2}$ ft. high, N. of cor.

84.90 Road brs. N. 80° E. to Camp Verde and S. 80° W. Ascend 50 ft. Ridge, brs. N. and S. Descend 250 ft.

93.00
151.92 Intersect E. side line (3-4) of Minnehaha Patented Mining Claim, Mineral Survey No. 2541 at a point 8.33 chs. N. 23° 45' E. from cor. No. 4 thereof. Thence across patented mineral land.

172.20 Road brs. N. 15° E. and S. 15° W., in wash, course S. Ascend 100 ft.

179.34 Spur, slopes S. U.S.L.M. No. 2541, Agua Fria Mining District, brs. S. O. 61 chs. dist. Descend 85 ft.

185.68 Intersect W. side line (3-4) of Bonnybel Mining Claim, Mineral Survey No. 2541, at a point, 7.96 chs. N. 4° W. from cor. No. 4 thereof. Leave patented mineral land.

188.58 Intersect E. bdy. of T. 14 N., R. 1 E., 19.86 chs. N. of the reestablished cor. of Ts. 13 and 14 N., R. 1 E., hereinbefore described.

At the point of intersection,

Set an iron post, 3 ft. long, 3 ins. in diam., 24 ins. in the ground, for cor. of Ts. 13 and 14 N., R. 2 E., marked on brass cap,

T14N
R2E
S31
S 6
R13N

1917

and raise mound of stone, 2 ft. base, 1 $\frac{1}{2}$ ft. high, N. of cor. Land rolling. Soil, rocky clay, 3rd rate. No timber. Undergrowth, dense scrub oak and manzanita.

~~The standard sec. cor. of sec. 32, reestablished in~~
~~March, 1913, is a 1 in. iron post, 12 ins. above~~

Retracement for Resurvey of 3rd. Std. Par. N. in parts of Ranges 1 and 2 East. 7.

Chains.

RANGE 1 EAST.

The standard 1/4 sec. cor. of sec. 36, reestablished in March, 1913, is a 1 in. iron post, 12 ins. above ground, firmly set, marked on brass cap,

1/4 S 36

1913

and witnessed by mound of stone, N. of cor. Thence,

40.00 East, on a random line, on S. bdy. of sec. 36, T. 13 N., R. 1 E. Intersect the original standard cor. of Ts. 13 N., Rs. 1 and 2 E., which is a quartzite stone, 6x8x6 ins. above ground, firmly set, marked "SCL3N" on N., "2E" on E., and "1E" on W. face, with 6 grooves on N., E. and W. faces, and witnessed by mound of stone, N. of cor. No bearing trees. True course and dist. of line back to standard 1/4 sec. cor. of sec. 36 are therefore, West, 40.00 chs.

RANGE 2 EAST.

1.35 From original standard cor. of Ts. 13 N., Rs. 1 and 2 E., East, on random line, on S. bdy. of sec. 31 (W. 1/2). Intersect original closing cor. of Ts. 12 N., Rs. 1 and 2 E. which is a quartzite stone, 10x6x5 ins. above ground, firmly set, marked "CC12N" on S., "2E" on E., and "1E" on W. face, with 6 grooves on S., E. and W. faces, and witnessed by mound of stone, S. of cor.

41.96 Continue line and measurement. A point, 185 lks. S. of original standard 1/4 sec. cor. of sec. 31, which is a granite stone, 8x8x7 ins. above ground, firmly set, marked "SC1" on N. face, and witnessed by a mound of stone, N. of cor. No bearing trees. True course and dist. of line from this 1/4 sec. cor. back to Tp. cor. are therefore S. 87° 29' W., 42.00 chs. Continue line and measurement.

79.10 Fall 9 lks. N. of standard cor. of secs. 31 and 32, reestablished in October, 1910, which is a granite stone, 8x8x7 ins. above ground, firmly set, marked "SC" on N. face, with 5 grooves on E. and 1 groove on W. face, and witnessed by mound of stone, N. of cor. No bearing trees. True course and dist. of line, from this standard sec. cor. back to standard 1/4 sec. cor. are therefore N. 87° 2' W., 37.19 chs. True course and dist. of line from this standard sec. cor. back to original standard Tp. cor. are therefore, N. 89° 57' W., 79.10 chs.

.08 From standard cor. of secs. 31 and 32, described above, East, on random line, on S. bdy. of sec. 32. Intersect original closing cor. of secs. 5 and 6, which is a granite stone, 6x4x4 ins. above ground, firmly set, marked "CC" on S. face, with 5 grooves on E. and 1 groove on W. face, and witnessed by mound of stone, S. of cor. Continue line and measurement.

40.00 Diligent search in this vicinity fails to reveal any trace of original standard 1/4 sec. cor.

79.02 A point 7 lks. N. of original closing cor. of secs. 4 and 5, which is a granite stone, 8x6x5 ins. above ground, firmly set, marked "CC" on S. face, with 4 grooves on E. and 2 grooves on W. face, and witnessed by mound of stone, S. of cor. No bearing trees. Continue line and measurement.

80.31 Fall 7 lks. N. of standard cor. of secs. 32 and 33, reestablished in September, 1910, which is a malpais stone, 12x6x5 ins. above ground, firmly set, marked "SC" on N. face, with 4 grooves on E. and 2 grooves on W. face, and witnessed by mound of stone, N. of cor. No bearing trees.

Retracement for Resurvey of
8. Third Std. Par. North, in parts of Ranges, land 2 East.

Chains.

True course and dist. of S. bdy. of sec. 32 are therefore N.
89°57'W., 80.31 chs.

Land, rolling.

Soil, rocky clay, 3rd rate.

No timber.

Undergrowth, dense scrub oak and manzanita.

RESURVEY OF 3RD. STD. PARALLEL NORTH, THRU. PART OF RANGE 2 E.

Dependent Resurvey.

From the standard cor. of secs. 32 and 33, T. 13 N., R. 2 E.,
hereinbefore described,

N. 89°57'W., on a true line, on S. bdy. of sec. 32.

Over heavily rolling land.

Descend 250 ft.

0.39 Intersect the closing cor. of secs. 4 and 5, T. 12 N., R. 2 E.,
hereinbefore described.

40.15 Set an iron post, 3 ft. long, 1 in. in diam., 26 ins. in the
ground, for reestablished standard $\frac{1}{4}$ sec. cor. of sec. 32,
marked on brass cap,

S C
1 S 32'

1917

and raise a mound of stone, 2 ft. base, 1½ ft. high, N. of
corner.

50.30 Creek, water 1 lk. wide, 2 ins. deep, course S. 10°W. Ascend
180 ft.

61.20 Spur, slopes S. Continue ascent.

80.23 Intersect the closing cor. of secs. 5 and 6, T. 12 N., R. 2 E.
hereinbefore described.

80.31 Intersect the standard cor. of secs. 31 and 32, hereinbefore
described.

Land, heavily rolling.

Soil, clay and loam, 2nd rate.

No timber or undergrowth.

A little grass.

Independent Resurvey.

N. 89°57'W., on a true line, on S. bdy. of sec. 31.

Over rough, low mountainous land, thru. very scattering under-
growth.

Descend 70 ft.

11.93 Draw, course S. 15°W. Ascend 305 ft.

14.73 Intersect E. side line (1-2) of "Iowa" patented Mining
Claim, Mineral Survey No. 2959, Agua Fria Mining District
at a point 21.65 chs. S. 12°20'E. from cor. No. 2 thereof.
Thence across patented mineral land.

26.90 Ridge, brs. N. and S. Descend 300 ft.

37.14 The original standard $\frac{1}{4}$ sec. cor. of sec. 31, brs. N. 1.88 chs.
dist. Destroy all trace of this cor.

39.10 Gulch, course S. Ascend 190 ft.

40.00 Set an iron post, 3 ft. long, 1 in. in diam., 26 ins. in the
ground, for reestablished standard $\frac{1}{4}$ sec. cor. of sec. 31,
marked on brass cap,

1 S 31

1917

45.81 and raise a mound of stone, 2 ft. base, 1½ ft. high, N. of cor.
Rock ridge, brs. N. and S. Prehistoric ruins bear N. 1.00 chain
dist. Gallows frame of Copper Queen Mine, brs. S. 1°30'W.

Descend 150 ft.

52.92 Intersect W. side line (1-2) of "Copper Ruin" patented

Resurvey of Third Standard Par N. thru part of Range 2 East. 9

Chains.

Mining Claim, Mineral Survey No. 1694, Agua Fria Mining District, at a point 11.06 chs. S. $13^{\circ} 37'$ E., from cor. No. 1 thereof. Leave patented mineral land.

58.82 Spur, slopes S. Gallows frame on shaft of Copper Queen Mine brs. S. $48^{\circ} 15'$ E. Continue descent.

71.00 Draw, course S. Ascend 100 ft.

76.20 Spur, slopes S. Descend 66 ft.

77.75 Intersect the closing cor. of Ts. 12 N., Rs. 1 and 2 E., hereinbefore described.

79.10 Intersect the original standard cor. of Ts. 13 N., Rs. 1 and 2 E., hereinbefore described. Destroy the original markings on the stone, and mark the letters "AP" for angle point.

Thence,
West, continuing measurement,
on DEPENDENT RESURVEY.

82.10 Gulch, course SW. Ascend 100 ft.

93.50 Spur, slopes SE. Descend.

95.15 A point due south of the reestablished cor. of Ts. 13 and 14 N., R. 1 E., and 16.05 chs. W. of Angle Point. Reestablish the standard cor. of Ts. 13 N., Rs. 1 and 2 E., as hereinbefore described.

Land, rough, low, mountainous.
Soil, very rocky, 4th rate.
No timber.
undergrowth, very scattering catclaw.
No grass.

Dependent Resurvey of 3rd. Std. Parallel N. thru part of R1E.

From reestablished standard cor. of Ts. 13 N., Rs. 1 and 2 E., hereinbefore described.

West, on true line, on S. bdy. of sec. 36 (E. $\frac{1}{2}$).

Over mountainous land, thru scattering undergrowth. Descend.

8.10 Gulch, course S. Ascend.

12.45 Spur, slopes S. Descend.

17.80 Gulch, course S. Ascend.

21.69 Spur, slopes S. Descend.

23.95 Intersect the reestablished standard $\frac{1}{4}$ sec. cor. of sec. 36 hereinbefore described.

Land, mountainous.
Soil, rocky, 4th rate.
No timber.
Undergrowth, very scattering catclaw.
No grass.

Book "K"

Group 61 - - - - Arizona.

DATE DIAGRAM.

T. 13 N., R. 2 E.

	SURVEY		RESURVEY			
	5/17-17	5/17/17	5/12/17			
	6	5	4	3	2	1
	7	8	9	10	11	12
5/16/17	18	17	16	15	14	13
5/16/17	19	20	21	22	23	24
5/16/17	30	29	28	27	26	25
5/16/17	31	32	33	34	35	36
5/9/17	5/9-17	5/9/17				
RESURVEYED	Third	Standard	Parallel	North		

Resurveys and Surveys executed by Geo. F. Rigby, U. S. Surveyor, on dates shown on above diagram.

12 For CERTIFICATE OF UNITED STATES SURVEYOR.
See Book "E" of this Group.

I, _____, U. S. Surveyor, hereby certify upon honor that, in pursuance of special instructions received from the U. S. Surveyor General for _____ bearing date of the _____ day of _____, 191____, I have well, faithfully, and truly in my own proper person, and in strict conformity with said instructions, the Manual of Surveying Instructions, and the laws of the United States, surveyed all those parts or portions of _____ of the _____ Meridian, in the State of _____, which are represented in the foregoing field notes as having been executed by me, and under my direction; and that all the corners of said survey have been established and perpetuated in strict accordance with the Manual of Surveying Instructions, and the special written instructions of the U. S. Surveyor General for _____ and in the specific manner described in the field notes, and that the foregoing are the original field notes of such survey.

U. S. Surveyor.

APPROVAL.

OFFICE OF THE UNITED STATES SURVEYOR GENERAL,

Phoenix, Arizona, May 14, 1920.

The foregoing field notes of the ~~Survey~~ resurvey of Part of the South Boundary of Township 14 North, Range 2 East, Part of the East Boundary of Township 13 North, Range 1 East, and the 3rd Standard Parallel North, thru parts of Rs. 1 and 2 East, and the SURVEY of Part of the South Boundary of Township 14 North, Range 2 East, and Part of the East Boundary of Township 13 North, Range 1 East, of the Gila and Salt River Base and Meridian, in the State of Arizona,

executed by Geo. F. Rigby, U. S. Surveyor

under ~~his~~ special instructions dated October 14, 1915 for Group 61, Arizona, having been critically examined, and the necessary corrections and explanations made, the said field notes, and the ~~resurveys~~ resurveys and surveys they describe, are hereby approved.

U. S. Surveyor General.

I certify that the foregoing transcript of the field notes of the above described surveys in _____, has been correctly copied from the original notes on file in this office.