

3377

Book "A"

4-679

BOOK 3377

12/1
ORIG
Compared

FIELD NOTES

RE-
OF THE SURVEY OF THE

Third Standard Parallel North, thru Range 16 East of 3rd.

East boundary, the EAST and WEST Boundaries

West boundary of TOWNSHIP 13 NORTH, RANGE 16 EAST, and

Part of East bdy. of TOWNSHIP 12 NORTH, RANGE 17 EAST,

and SURVEY of

Part of West of the Subdivision lines of

Subdivision lines of TOWNSHIP 13 NORTH, RANGE 16 EAST, and

Part of the Subdivision lines of

TOWNSHIPS 12 NORTH, RANGES 16 & 17 EAST,

Of the Gila and Salt River Base and Meridian,

In the State of Arizona.

EXECUTED BY

Thomas B. Matthews,

In the capacity of U. S. Surveyor, under Special Instructions dated December 1, 1916 issued by the United States Surveyor General to govern surveys included in Group No. 80, Arizona, which were approved by the Commissioner of the General Land Office, December 19, 1916, and Assignment Instructions dated May 19, 1917

Resurvey & Survey commenced July 11, 1917.

Resurvey & Survey completed August 13, 1917.

3377

3377

1A
122

BOOK 3377

3377

Book "A"

Group 80, Arizona

INDEX DIAGRAM.

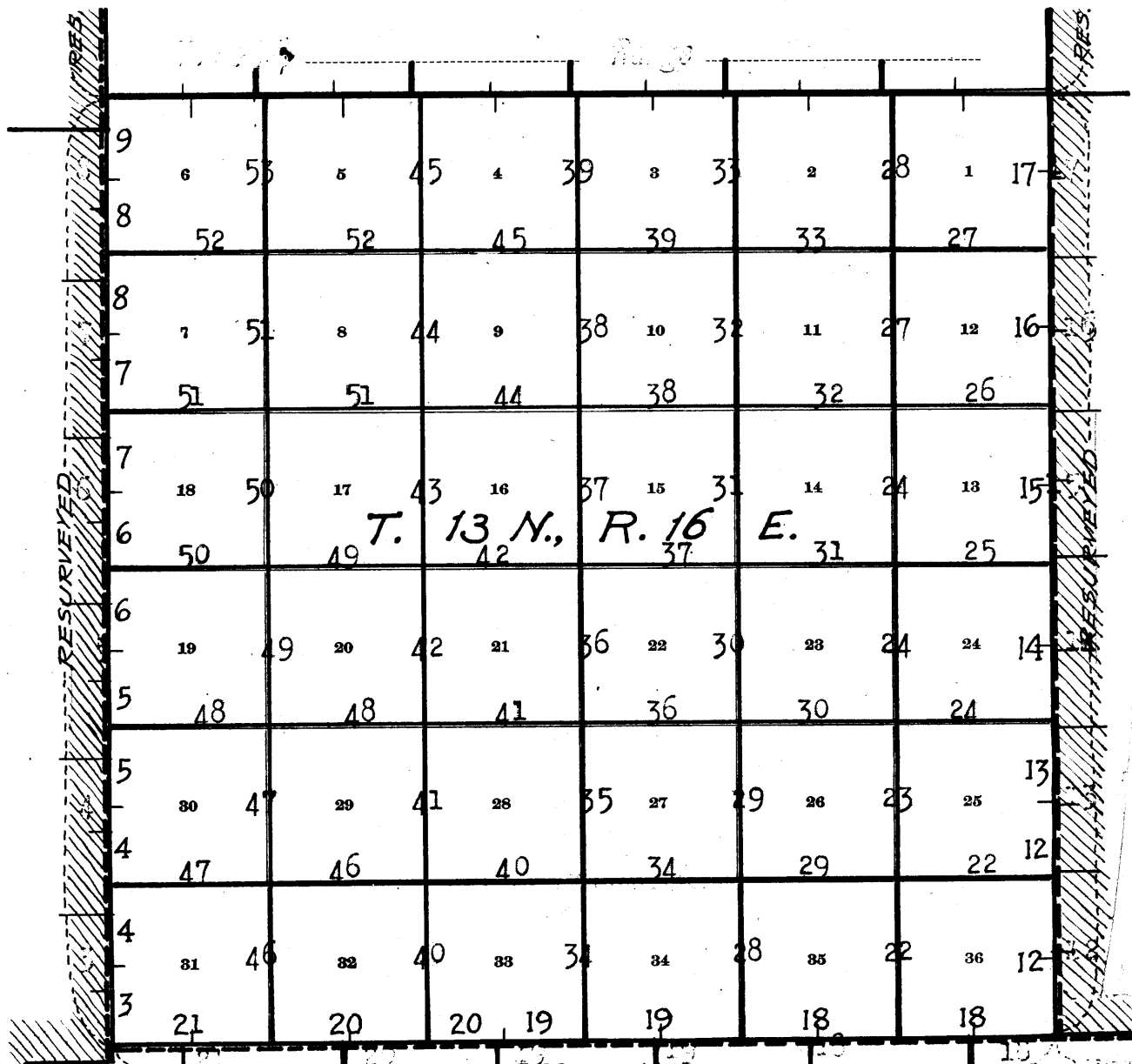

- Lines surveyed under this group (Group 80)
- - - Lines retraced or resurveyed under this group
- Accepted surveys
- - - Unsurveyed lines, theoretical positions of
-  Areas ^{surveyed} as per accepted plats on file.

Chains.

Resurveys and Surveys hereinafter described, executed by Thomas B. Matthews, U.S. Surveyor, on the dates shown on the diagram on page 55 hereof, using Buff and Buff light mountain transit No. 10124, equipped with Smith solar attachment. The horizontal limb is provided with two double verniers, placed opposite to each other, reading to single minutes of arc, which is also the least count of the verniers of the latitude and declination arcs. This instrument was approved May 19, 1917, at Phoenix, Arizona, by Assistant Supervisor of Surveys for District No. 5, subject to satisfactory field test, a record of which is described as follows:

July 10, 1917.

At camp in SW. $\frac{1}{4}$ of sec. 27, T. 13 N., R. 16 E., latitude, $34^{\circ} 29\frac{1}{2}' N.$; longitude, $110^{\circ} 38\frac{1}{2}' W.$, examine the adjustments of the transit, and correct the level and collimation errors.

At 4h. Om. p.m., l.m.t., set off $34^{\circ} 29\frac{1}{2}' N.$ on the latitude arc; $22^{\circ} 14\frac{1}{2}' N.$ on the decl. arc, determine a meridian with the solar, and mark a point thereon, on a stake, 5 chs. N. of instrument.

July 11, 1917.

At 1h. 20m. a.m., l.m.t., observe Polaris at eastern elongation, in accordance with instructions in the Manual of Surveying, and turn off the azimuth of Polaris $1^{\circ} 23'$ to the west. The meridian thus determined coincides with the meridian determined by p.m. solar observations.

At 8h. Om. a.m., l.m.t., set off $34^{\circ} 29\frac{1}{2}' N.$ on the lat. arc; $22^{\circ} 08' N.$ on the decl. arc, and determine a meridian with the solar. This meridian coincides with the meridians determined by p.m. solar and Polaris observations; therefore, conclude that the instrument is in satisfactory adjustment.

In obtaining all measurements recorded in the following notes, and those in Books "B" and "C", 5 chain steel tapes, properly adjusted, were used, slope angles taken by clinometer, and measurements on slopes reduced to horizontal distance.

 DEPENDENT RESURVEY: West bdy. Township 13 N., R. 16 East.

Retracement for Resurvey:

From original cor. of Ts. 13 and 14 N. Rs. 15 and 16 E., which is a sandstone, described in Book "N" of Group 79,
 South, on random line on N. $\frac{1}{2}$ of E. bdy. of sec. 1, T. 13 N., R. 15 E.
 40.03 Fall 6 lks. E. of original $\frac{1}{4}$ sec. cor. of secs. 1 and 6, which is a sandstone, 10x8x5 ins. above ground, firmly set, marked "2" on W. face, and witnessed by 2 bearing trees, properly marked, one each NW. and SE. of cor. True course and dist. of N. $\frac{1}{2}$ of E. bdy. of sec. 1, are therefore N. $0^{\circ} 5' E.$, 40.03 chs.

Thence,
 South, on random line, on S. $\frac{1}{2}$ of E. bdy. of sec. 1.
 40.04 Fall 4 lks. E. of original cor. of secs. 1, 6, 7 and 12, which is a sandstone, 12x6x5 ins. above ground, firmly set, marked with 1 notch, on N. edge, and 5 notches on S. edge, and witnessed by 4 bearing trees, properly marked, one in each sec. True course and dist. of S. $\frac{1}{2}$ of E. bdy. of sec. 1, are therefore, N. $0^{\circ} 3' E.$, 40.04 chs.

 South, on random line, on N. $\frac{1}{2}$ of E. bdy. of sec. 12.
 40.08 Fall 34 lks. W. of original $\frac{1}{4}$ sec. cor. of secs. 7 and 12,

2. Dependent Resurvey: West bdy. of Township 13 North, Range 16 East.

Chains. Retracement for Resurvey (continued)

- which is a sandstone, 12x8x6 ins. above ground, firmly set, marked "1" on W. face, and witnessed by two bearing trees, properly marked, one each NE. and SW. of cor. True course and dist. of N. $\frac{1}{2}$ of E. bdy. of sec. 12, are therefore, N. 0° 29' W., 40.08 chs.
- Thence,
South, on random line, on S. $\frac{1}{2}$ of E. bdy. of sec. 12.
- 40.01 Fall 12 lks. W. of original cor. of secs. 7, 12, 13 and 18, which is a sandstone, 12x8x6 ins. above ground, firmly set, marked with 2 notches on N. edge, and 4 notches on S. edge, and witnessed by 4 bearing trees properly marked, one in each sec. True course and dist. of S. $\frac{1}{2}$ of E. bdy. of sec. 12 are therefore, N. 0° 10' W., 40.01 chs.
-
- South, on random line, on N. $\frac{1}{2}$ of E. bdy. of sec. 13.
- 40.03 Fall 3 lks. E. of original $\frac{1}{4}$ sec. cor. of secs. 13 and 18, which is a sandstone, 10x8x5 ins. above ground, firmly set, marked "1" on W. face, and witnessed by 2 bearing trees, properly marked, one each NW. and SW. of cor. True course and dist. of N. $\frac{1}{2}$ of E. bdy. of sec. 13 are therefore N. 0° 3' E., 40.03 chs.
- Thence,
South, on random line, on S. $\frac{1}{2}$ of E. bdy. of sec. 13.
- 39.78 Fall 26 lks. W. of original cor. of secs. 13, 18, 19 and 24, which is a limestone boulder, 5x3 ft. x 7 ins. above ground, marked with a cross (x) on top, and 3 notches on each of N. and S. edges, and witnessed by 4 bearing trees, properly marked, one in each sec. True course and dist. of S. $\frac{1}{2}$ of E. bdy. of sec. 13 are therefore, N. 0° 22' W., 39.78 chs.
-
- South, on random line, on N. $\frac{1}{2}$ of E. bdy. of sec. 24.
- 39.98 Fall 16 lks. E. of original $\frac{1}{4}$ sec. cor. of secs. 19, and 24, which is a sandstone, 8x6x5 ins. above ground, firmly set, marked "1" on W. face, and witnessed by 2 bearing trees properly marked, one each NE. and SW. of cor. True course and dist. of N. $\frac{1}{2}$ of E. bdy. of sec. 24, are therefore, N. 0° 14' E., 39.98 chs.
- Thence,
South, on random line, on S. $\frac{1}{2}$ of E. bdy. of sec. 24.
- 39.96 Fall 3 lks. W. of original cor. of secs. 19, 24, 25 and 30, which is a sandstone, 12x10x5 ins. above ground, firmly set, marked with 4 notches on N. edge, and 2 notches on S. edge, and witnessed by 4 bearing trees, properly marked, one in each sec. True course and dist. of S. $\frac{1}{2}$ of E. bdy. of sec. 24 are therefore N. 0° 3' W., 39.96 chs.
-
- South, on random line, on N. $\frac{1}{2}$ of E. bdy. of sec. 25.
- 40.00 Fall 5 lks. W. of original $\frac{1}{4}$ sec. cor. of secs. 25 and 30, which is a sandstone 12x8x4 ins., above ground, firmly set, marked "1" on W. face, and witnessed by two bearing tree, properly marked, one each NE. and SW. of cor. True course and dist. of N. $\frac{1}{2}$ of E. bdy. of sec. 25, are therefore N. 0° 4' W., 40.00 chs.
- Thence,
South, on random line, on S. $\frac{1}{2}$ of E. bdy. of sec. 25.
- 40.00 Fall 2 lks. W. of original cor. of secs. 25, 30, 31 and 36, which is a sandstone, 14x10x6 ins. above ground, firmly set, marked with 5 notches on N. edge, and 1 notch on S. edge, and witnessed by 4 bearing trees, properly marked, one in each sec. True course and dist. of S. $\frac{1}{2}$ of E. bdy. of sec. 25, are therefore, N. 0° 2' W., 40.00 chs.
-

Dependent Resurvey of West bdy. of Township 13 North, Range 16 E. 3.

Chains.

Retracement for resurvey (continued)

- 40.13 South, on random line, on N. $\frac{1}{2}$ of E. bdy. of sec. 36. Intersect original $\frac{1}{4}$ sec. cor. of secs. 31 and 36, which is a sandstone, 8x7x5 ins. above ground, firmly set, marked "1" on W. face, and witnessed by 2 bearing trees, properly marked, one each NW. and SE. of cor. True course and dist. of N. $\frac{1}{2}$ of E. bdy. of sec. 36 are therefore, North, 40.13 chs.
- 22.91 Thence, South, on random line, on S. $\frac{1}{2}$ of E. bdy. of sec. 36. Intersect 3rd. Std. Par. N., independently resurveyed due west thru. Range 16 East, as hereinafter described.
- 31.65 Fall 13 lks. W. of original std. cor. of T. 13 N., R. 15 and 16 E., on 3rd. Std. Par. N., which is a decayed pine post, marked with 6 notches on each of N., E. and W. faces set in ground and mound of stone, and witnessed by 4 bearing trees, properly marked, one each NW., NE., SE. and SW. of cor. True course and dist. of S. $\frac{1}{2}$ of E. bdy. of sec. 36, are therefore N. 0° 14' W., 31.65 chs. Reestablish the above described std. Tp. cor. to refer to T. 13 N., R. 15 E., only (SE. cor.) as follows: Remove the old wood post, destroy the mound of stone in which it was set, and in the same place set an iron post, 3 ft. long, 3 ins. in diam., 24 ins. in the ground, for reestablished std. cor. of T. 13 N., R. 15 E. (SE. cor.) marked on brass cap,

SC
T13N
R15E
S36

1917

Change marking on original NE., SE. and SW. bearing tree to read "SLBT."
The original NW. bearing tree is undisturbed.
Raise a mound of stone, 2 ft. base, 1 $\frac{1}{2}$ ft. high, NW. of cor.

RESURVEY:

- 22.91 From reestablished std. cor. of T. 13 N., R. 16 E. (SW. cor.) hereinafter described, N. 0° 14' W., on true line, on W. bdy. of sec. 31, T. 13 N., R. 16 E. (part of S. $\frac{1}{2}$ of E. bdy. of sec. 36, T. 13 N., R. 15 E.) Over gently rolling land, thru. scattering scrub timber, (31.65 chs. N. 0° 14' W., from std. cor. of T. 13 N., R. 15 E.) Intersect original $\frac{1}{4}$ sec. cor. of secs. 31 and 36, hereinafter described. Change this cor. to $\frac{1}{2}$ sec. cor. of sec. 36 only as follows:

Alongside old stone,
Set an iron post, 3 ft. long, 1 in. in diam., 18 ins. in the ground, supported by a mound of stone, for reestablished $\frac{1}{2}$ sec. cor. of sec. 36, marked on brass cap,

S36 $\frac{1}{2}$

1917

- 22.96 Obliterate marking on original SE. bearing tree. Raise a mound of stone, 2 ft. base, 1 $\frac{1}{2}$ ft. high, W. of cor. Thence, North, on true line, continuing measurement of W. bdy. of sec. 31 (beginning of N. $\frac{1}{2}$ of E. bdy. of sec. 36):
- 40.00 Small, draw, course E. (17.09 chs. N. from $\frac{1}{2}$ sec. cor. of sec. 36). Set an iron post, 3 ft. long, 1 in. in diam., 26 ins. in the ground, for reestablished $\frac{1}{2}$ sec. cor., of sec. 31, T. 13 N., R. 16 E., marked on brass cap,

4. Dependent Resurvey of West bdy. of Township 13 North, Range 16 East.

Chains.

$\frac{1}{4}$
 S31
 1917

from which:

A pinyon, 18 ins. in diam., brs. N. $78\frac{3}{4}^{\circ}$ E., 101 lks. dist., marked $\frac{1}{4}$ S 31 BT.

A pinyon, 20 ins. in diam., brs. S. $71\frac{3}{4}^{\circ}$ E., 139 lks. dist., marked $\frac{1}{4}$ S 31 B T.

52.50
63.04

Old Indian Ruins, brs. W. 50 lks. dist. (40.13 chs. N. from $\frac{1}{4}$ sec. cor. of sec. 36) Intersect original cor. of secs. 25, 30, 31 and 36, hereinbefore described. Change this cor. to refer to secs. 25 and 36 only, as follows:

Alongside old stone,
Set an iron post, 3 ft. long, 3 ins. in diam., 24 ins. in the ground, for reestablished cor. of secs. 25 and 36, marked on brass cap,

T13N
 R15E
 S25
 S36
 1917

Obliterate marking on original NE. and SE. bearing trees, leaving original NW. and SW. bearing trees undisturbed.

Thence,
N. $0^{\circ}2'$ W., on true line, continuing measurement of W. bdy. of sec. 31 (beginning of S. $\frac{1}{2}$ of E. bdy. of sec. 25).

71.20
74.20
76.70
80.00

S. rim of draw, brs. NE. and SW. Descend 17 ft.
Bottom of draw, course NE. Ascend.
N. rim of draw, brs. NE* and SW. thence over level land. (16.96 chs. N. $0^{\circ}2'$ W. from cor. of secs. 25 and 36)
Set an iron post, 3 ft. long, 3 ins. in diam., 24 ins. in the ground, for reestablished cor. of secs. 30 and 31, T.13 N., R.16 E., marked on brass cap,

T13N
 R16E
 S30
 S31
 1917

from which,

A pine, 20 ins. in diam., brs. N. $50\frac{1}{2}^{\circ}$ E., 76 lks. dist., marked T13NR16E S30BT.

A pinyon, 12 ins. in diam., brs. S. 73° E., 75 lks. dist., marked T13N R16E S31BT.

Land, rolling and level.
Soil, sandy, 2nd rate.
Timber, scattering scrub cedar and pinyon.
No undergrowth.
Poor grass.

N. $0^{\circ}2'$ W., on true line, on W. bdy. of sec. 30, T.13 N., R. 16 E. (part of S. $\frac{1}{2}$ of E. bdy. of sec. 25, T.13 N., R.15 E.)
Over level land, thru scattering timber.

17.40
23.04

Road brs. E and W. (40.00 chs. N. $0^{\circ}2'$ W., from cor. of secs. 25 and 36) Intersect original $\frac{1}{4}$ sec. cor. of secs. 25 and 30, hereinbefore described. Change this cor. to $\frac{1}{4}$ sec. cor. of sec. 25 only, by obliterating marking on original NE. bearing tree, and raising a mound of stone, 2 ft. base, $1\frac{1}{2}$ ft. high, W. of cor.

Thence,
N. $0^{\circ}4'$ W., on true line, continuing measurement of W. bdy. of sec. 30 (beginning of N. $\frac{1}{2}$ of E. bdy. of sec. 25).
S. rim of draw, brs. E. and W. Leave level land. Descend 40 ft. on N. slope.

25.04

Dependent Resurvey of West bdy. of Township 13 N., R. 16 East 5.

Chains.
31.69
33.79
40.00

Bottom of draw, course NE. Ascend.
North rim of draw, brs. NE. and SW. Thence over level land.
(16.96 chs. N. 0° 4' W., from $\frac{1}{4}$ sec. cor. of sec. 25) S. rim
of draw, brs. E. and W.
Set an iron post, 3 ft. long, 1 in. in diam., 26 ins. in
the ground, for reestablished $\frac{1}{4}$ sec. cor. of sec. 30, T.
13 N., R. 16 E., marked on brass cap.

1
| S30
1917

from which,
A pine, 12 ins. in diam., brs. N. 74 $\frac{1}{2}$ ° E., 33 lks.
dist., marked $\frac{1}{4}$ S 30 B T.
A pine, 18 ins. in diam., brs. S. 28° E., 106 lks.
dist., marked $\frac{1}{4}$ S 30 BT.

40.54
43.54
63.04

Right rim of draw, brs. E. and W. Descend 14 ft. to
Bottom of draw, course E. Ascend.
North rim of draw, brs. E. and W. Thence over level land.
(40.00 chs. N. 0° 4' W. from cor. of secs. 25 and 36) Inter-
sect original cor. of secs. 19, 24, 25 and 30, hereinbe-
fore described. Change this cor. to cor. of secs. 24
and 25 only, by obliterating marking on original NE.
and SE. bearing trees.

80.00

Thence,
N. 0° 3' W., on true line, continuing measurement of W. bdy.
of sec. 30 (beginning of S. $\frac{1}{4}$ of E. bdy. of sec. 24).
(16.96 chs. N. 0° 3' W., from cor. of secs. 24 and 25) Set
an iron post, 3 ft. long, 3 ins. in diam., 24 ins. in
the ground, for reestablished cor. of secs. 19 and 30,
T. 13 N., R. 16 E., marked on brass cap.

T13N
R16E
S19
| S30

1917

from which,
A juniper, 60 ins. diam., brs. N. 80° E., 35 lks.
dist., marked T13N R16E S19BT.
A juniper, 30 ins. in diam., brs. S. 64 $\frac{1}{2}$ ° E., 104 lks.
dist., marked T13N R16E S30BT.

Land, rolling and level.
Soil, sandy, 2nd rate.
Timber, scattering pine, cedar, pinyon and juniper.
No undergrowth.
Poor grass.

23.00

N. 0° 3' W., on true line, on W. bdy. of sec. 19, T. 13 N., R. 16 E.
(part of S. $\frac{1}{4}$ of E. bdy. of sec. 24).
Over level land, thru scattering timber.
(39.96 chs. N. 0° 3' W. from cor. of secs. 24 and 25) Inter-
sect original $\frac{1}{4}$ sec. cor. of secs. 19 and 24, hereinbe-
fore described. Change this cor. to $\frac{1}{4}$ sec. cor. of sec.
24 only, as follows:

Alongside old stone,
Set an iron post, 3 ft. long, 1 in. in diam., 26 ins. in
the ground, for reestablished $\frac{1}{4}$ sec. cor., of sec. 24,
marked on brass cap.

1
| S24
1917

Obliterate marking on original NE. bearing tree, and raise
a mound of stone, 2 ft. base, 1 $\frac{1}{2}$ ft. high, W. of cor.

Thence,
N. 0° 14' E., on true line, continuing measurement of W. bdy.
of sec. 19 (beginning of N. $\frac{1}{4}$ of E. bdy. of sec. 24).

6. Dependent Resurvey of W. bdy. of Township 13 North, Range 16 East.

Chains
 26.00 Rim of draw, brs. NE and SW. Leave level land; descend 40 ft.
 31.26 Bottom of draw, course NE. Ascend.
 33.50 Rim of draw, brs. NE and SW. Thence over level land.
 40.00 (17.00 chs. N. 0° 14' E., from $\frac{1}{4}$ sec. cor. of sec. 24).
 Set an iron post, 3 ft. long, 1 in. in diam., 26 ins. in the ground, for reestablished $\frac{1}{4}$ sec. cor. of sec. 19, T. 13 N., R. 16 E., marked on brass cap,

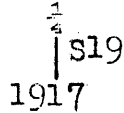

from which,

A juniper, 18 ins. in diam., brs. N. 47 $\frac{1}{2}$ ° E., 157 lks. dist., marked $\frac{1}{4}$ S 19 BT.

A pinyon, 8 ins. in diam., brs. S. 67 $\frac{1}{2}$ ° E., 88 lks. dist., marked $\frac{1}{4}$ S 19 BT.

62.98 (39.98 chs. N. 0° 14' E. from $\frac{1}{4}$ sec. cor. of sec. 24) Intersect original cor. of secs. 13, 18, 19 and 24, hereinbefore described. Change this cor. to refer to secs. 13 and 24 only, by obliterating marking on original NE. and SE. bearing trees.

thence,
 N. 0° 22' W., on true line, continuing measurement of W. bdy. of sec. 19 (beginning of S. $\frac{1}{2}$ of E. bdy. of sec. 13)

80.00 (17.02 chs. N. 0° 22' W. from cor. of secs. 13 and 24)
 Set an iron post, 3 ft. long, 3 ins. in diam., 24 ins. in the ground, for reestablished cor. of secs. 18 and 19, T. 13 N., R. 16 E., marked on brass cap,

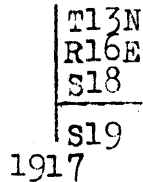

from which,

A pine, 20 ins. in diam., brs. N. 67 $\frac{1}{2}$ ° E., 31 lks. dist., marked T13N R16E S18 BT.

A pinyon, 10 ins. in diam., brs. S. 34° E., 54 lks. dist., marked T13NR16ES19 BT.

Land, level and rolling.
 Soil, thin and rocky, 2nd rate.
 Timber, scattering pine, pinyon and cedar.
 No undergrowth.
 Poor grass.

N. 0° 22' W., on true line on W. bdy. of sec. 18, T. 13 N., R. 16 E. (part of S. $\frac{1}{2}$ of E. bdy. of sec. 13, T. 13 N., R. 15 E.)

22.76 Over level land, thru scattering timber and undergrowth.
 (39.78 chs. N. 0° 22' W. from cor. of secs. 13 and 24) Intersect original $\frac{1}{4}$ sec. cor. of secs. 13 and 18, hereinbefore described. Change this cor. to $\frac{1}{4}$ sec. cor. of sec. 13 only, by obliterating marking on original NE. bearing tree, and raising a mound of stone, 2 ft. base, 1 $\frac{1}{2}$ ft. high, W. of cor.

Thence,
 N. 0° 3' E., on true line, continuing measurement of W. bdy. of sec. 18 (beginning of N. $\frac{1}{2}$ of E. bdy. of sec. 13).

32.55 Road brs. NW. and SE.
 40.00 (17.24 chs. N. 0° 3' E. from $\frac{1}{4}$ sec. cor. of sec. 13)
 Set an iron post, 3 ft. long, 1 in. in diam., 10 ins. in the ground, in a mound of stone, for reestablished $\frac{1}{4}$ sec. cor. of sec. 18, T. 13 N., R. 16 E., marked on brass cap,

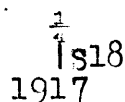

Dependent Resurvey of W. bdy. of Township 13 North, Range 16 East. 7

Chains.

from which,
 A pinyon, 12 ins. in diam., brs. N. 33° E., 85 lks. dist., marked $\frac{1}{4}$ S 18 BT.
 A cedar, 8 ins. in diam., brs. S. 73° E., 25 lks. dist., marked $\frac{1}{4}$ S 18 BT.
 Small wire corral brs. W. 5 chs. dist.
 62.79 (40.03 chs. N. 0° 3' E. from $\frac{1}{4}$ sec. cor. of sec. 13) Intersect original cor. of secs. 7, 12, 13 and 18, hereinbefore described. Change this cor. to refer to secs. 12 and 13 only, by obliterating marking on original NE. and SE. bearing trees.
 Thence,
 N. 0° 10' W., on a true line, continuing measurement of W. bdy. of sec. 18 (beginning of S. $\frac{1}{2}$ of E. bdy. of sec. 12).
 80.00 (17.21 chs. N. 0° 10' W. from cor. of secs. 12 and 13)
 Set an iron post, 3 ft. long, 3 ins. in diam., 24 ins. in the ground, for reestablished cor. of secs. 7 and 18, T. 13 N., R. 16 E., marked on brass cap,

T13N
 R16E
 S 7
 S18
 1917

from which,
 A pinyon, 12 ins. in diam., brs. N. 29 $\frac{1}{4}$ ° E., 159 lks. dist., marked T13NR16ES7BT and
 A pinyon, 12 ins. in diam., brs. S. 27° E., 54 lks. dist., marked T13NR16ES18BT.

Land, level.
 Soil, thin and gravelly, 2nd rate.
 Timber, scattering pinyon, cedar and juniper.
 Undergrowth, scattering algerita and greasewood.

N. 0° 10' W., on true line, on W. bdy. of sec. 7, T. 13 N., R. 16 E. (part of S. $\frac{1}{2}$ of E. bdy. of sec. 12).
 Over level land, thru scattering timber and undergrowth.
 22.80 (40.01 chs. N. 0° 10' W. from cor. of secs. 12 and 13) Intersect original $\frac{1}{4}$ sec. cor. of secs. 7 and 12, hereinbefore described. Change this cor. to $\frac{1}{4}$ sec. cor. of sec. 12 only, by obliterating marking on original NE. bearing tree, and raising a mound of stone, 2 ft. base, 1 $\frac{1}{2}$ ft. high, W. of cor.
 Thence,
 N. 0° 29' W., on true line, continuing measurement of W. bdy. of sec. 7 (beginning of N. $\frac{1}{2}$ of E. bdy. of sec. 12).
 40.00 (17.20 chs. N. 0° 29' W. from $\frac{1}{4}$ sec. cor. of sec. 12)
 Set an iron post, 3 ft. long, 1 in. in diam., 26 ins. in the ground, for reestablished $\frac{1}{4}$ sec. cor. of sec. 7, T. 13 N., R. 16 E., marked on brass cap,

$\frac{1}{4}$
 S 7
 1917

from which,
 A cedar, 12 ins. in diam., brs. N. 57° E., 53 lks. dist., marked $\frac{1}{4}$ S 12 BT.
 A pinyon, 10 ins. in diam., brs. S. 60 $\frac{1}{2}$ ° E., 57 lks. dist., marked $\frac{1}{4}$ S 12 B T.
 62.88 (40.08 chs. N. 0° 29' W. from $\frac{1}{4}$ sec. cor. of sec. 12) Intersect original cor. of secs. 1, 6, 7 and 12, hereinbefore described. Change this cor. to refer to secs. 1 and 12 only, by obliterating marking on original NE. and SE. bearing trees.
 This cor. is on edge of slope, brs. E. and W.
 Thence,
 N. 0° 3' E., on true line, continuing measurement of W. bdy. of sec. 7, (beginning of S. $\frac{1}{2}$ of of E. bdy. of sec. 1).
 Leave level land. Descend 43 ft. on N. slope, to
 69.88 Foot of descent, brs. E. and W. Thence over level land.
 74.47 Top of SE. bank of Potato Wash, brs. NE. and SW. Descend.
 77.95 Bottom of Potato Wash, course NE. Ascend.

8 Dependent Resurvey of W bdy of Township 13 North Range 16 E.

Chains.
80.00

(17.12 chs. N.0°3'E. from cor. of secs. 1 and 12)
Set an iron post, 3 ft. long, 3 ins. in diam., 24 ins. in the ground, for reestablished cor. of sec. 6 and 7, T. 13 N., R. 16 E., marked on brass cap,

T13N
R16E
S 6
S 7

1917

from which,

A pinyon, 12 ins. in diam., brs. N.21°E., 278 lks. dist., marked T13N R16E S6 BT.

A pinyon, 10 ins. in diam., brs. S.12½°E., 300 lks. dist., marked T13N R16E S7 BT.

Land, rolling and level.
Soil, thin and sandy, 2nd rate.
Timber, scattering cedar and pinyon.
No undergrowth.
Poor grass.

3.40

N.0°3'E., on true line, on W. bdy. of sec. 6, T. 13 N., R. 16 E. (part of S. ½ of E. bdy. of sec. 1, T. 13 N., R. 15 E.) Ascend SE. slope of bank of Potato Wash.

Top of NW. bank of Potato Wash, brs. NE. and SW. Leave wash; thence over rolling land, thru scattering timber and undergrowth. Ascend 108 ft. on S. slope, to

22.92

(40.04 chs. N.0°3'E. from cor. of secs. 1 and 12) Intersect original ¼ sec. cor. of secs. 1 and 6, hereinbefore described. Change this cor. to ¼ sec. cor. of sec. 1 only, by obliterating marking on original SE. bearing tree, and raise a mound of stone, 2 ft. base, 1½ ft. high, W. of cor.

Thence,

N.0°5'E., on true line, continuing measurement of W. bdy of sec. 6 (beginning of N. half of E. bdy. of sec. 1).

Over nearly level land, thru scattering timber and undergrowth.

32.42

SE. rim of draw, brs. NE. and SW. Descend into draw.

35.02

Bottom of draw, course NE. Ascend.

36.72

NW. rim of draw, brs. NE. and SW.

40.00

(17.08 chs. N.0°5'E. from ¼ sec. cor. of sec. 1).

Set an iron post, 3 ft. long, 1 in. in diam., 26 ins. in the ground, for reestablished ¼ sec. cor. of sec. 6, T. 13 N., R. 16 E., marked on brass cap,

S6
1917

from which,

A cedar, 14 ins. in diam., brs. N.81°E. 60 lks. dist., marked S 6 B T.

A pinyon, 6 ins. in diam., brs. S.7½°E., 38 lks. dist., marked S 6 B T.

45.65

Road brs. NE. and SW.

62.95

(40.03 chs. N.0°5'E. from ¼ sec. cor. of sec. 1) Intersect original cor. of Ts. 13 and 14 N., Rs. 15 and 16 E., which is a sandstone, 14x10x6 ins. above ground, firmly set, marked with 6 notches on each of N., S., E. and W. edges, and witnessed by 4 bearing trees properly marked, one each NE., SE., SW. and NW. of cor.

Reestablish this cor. to refer to Ts. 13 and 14 N., R. 15 E. only, by obliterating notches on E. edge of stone, and marking on original NE. and SE. bearing trees.

Thence as per result of retracement, described in Book "N" of group No. 79,

North, on true line, continuing measurement of W. bdy. of sec. 6, T. 13 N., R. 16 E. (Beginning of S. ½ of E. bdy. of sec. 36, T. 14 N., R. 15 E.)

Dependent Resurvey of W. bdy. of Township 13 North, Range 16 E. 9.

Chains.

79.73

(16.78 chs. N. from cor. of Ts. 13 and 14 N., R. 15 E.) Intersect reestablished cor. of Ts. 13 and 14 N., R. 16 E., described in Book "N" of group No. 79.

Land, level and rolling.
Soil, thin and sandy, 2nd rate.
Timber, scattering cedar and pinyon.
No undergrowth.
Poor grass.



10. Dependent Resurvey of East bdy. of Township 13 North, Range 16 E.

Chains.

The east bdy. of T.13 N., R.16 E. was originally surveyed in 1883, and designated as "4th Auxiliary Guide Meridian East," but as this line, in connection with the surveys in T.13 N., R.16 E. is not used as a Guide Meridian, the original designation is omitted from the following notes describing the resurvey of the line.

Retracement for Resurvey:

- From reestablished cor. of Ts. 13 and 14 N. Rs. 16 and 17 E. described in Book "N." of Group No. 79, South, on random line, on N. $\frac{1}{2}$ of W. bdy. of sec. 6, T.13 N., R.17 E.
- 39.95 Fall 37 lks. W. of original $\frac{1}{4}$ sec. cor. of secs. 1 and 6, which is a sandstone, 10x8x5 ins. above ground, firmly set, marked " $\frac{1}{4}$ " on W. face, and witnessed by mound of stone, W. of cor., and two bearing trees properly marked, one each SE. and SW. of cor. True course and dist. of N. $\frac{1}{2}$ of W. bdy. of sec. 6, are therefore, N. 0° 32' W., 39.95 chs.
- Thence,
South, on random line, on S. $\frac{1}{2}$ of W. bdy. of sec. 6.
- 39.88 Fall 24 lks. W. of original cor. of secs. 1, 6, 7 and 12, which is a sandstone, 10x8x5 ins. above ground, firmly set, marked with 1 notch on N. edge, and 5 notches on S. edge, and witnessed by mound of stone, W. of cor., and three bearing trees properly marked, one each NE., SW. and NW. of cor. True course and dist. of S. $\frac{1}{2}$ of W. bdy. of sec. 6, are therefore N. 0° 21' W., 39.88 chs.
- South, on random line, on N. $\frac{1}{2}$ of W. bdy. of sec. 7.
- 40.00 Fall 6 lks. W. of original $\frac{1}{4}$ sec. cor. of secs. 7 and 12, which is a sandstone, 10x8x4 ins. above ground, firmly set, marked " $\frac{1}{4}$ " on W. face, and witnessed by mound of stone, W. of cor., and 2 bearing trees, properly marked, one each NE. and SW. of cor. True course and dist. of N. $\frac{1}{2}$ of W. bdy. of sec. 7 are therefore, N. 0° 5' W., 40.00 chs.
- Thence,
South, on random line, on S. $\frac{1}{2}$ of W. bdy. of sec. 7.
- 39.58 Fall 9 lks. E. of original cor. of secs. 7, 12, 13 and 18, which is a sandstone, 10x7x6 ins., above ground, firmly set, marked with 2 notches on N. edge, and 4 notches on S. edge, and witnessed by mound of stone, W. of cor., and 4 bearing trees properly marked, one in each sec. True course and dist. of S. $\frac{1}{2}$ of W. bdy. of sec. 7 are therefore N. 0° 8' E., 39.58 chs.
- South, on random line, on N. $\frac{1}{2}$ of W. bdy. of sec. 18.
- 39.66 Fall 31 lks. W. of original $\frac{1}{4}$ sec. cor. of secs. 13 and 18, which is a sandstone, 12x8x6 ins. above ground, firmly set, marked " $\frac{1}{4}$ " on W. face, and witnessed by mound of stone, W. of cor. and 2 bearing trees properly marked, one each NW. and SE. of cor. True course and dist. of N. $\frac{1}{2}$ of W. bdy. of sec. 18 are therefore, N. 0° 27' W., 39.66 chs.
- Thence,
South, on random line, on S. $\frac{1}{2}$ of W. bdy. of sec. 18.
- 40.11 Fall 36 lks. W. of original cor. of secs. 13, 18, 19 and 24, which is a sandstone, 20x10x4 ins. above ground, firmly set marked with 3 notches on each of N. and S. edges, and witnessed by mound of stone, W. of cor., and 4 bearing trees, properly marked one in each sec. True course and dist. of S. $\frac{1}{2}$ of W. bdy. of sec. 18, are therefore, N. 0° 31' W., 40.11 chs.

Dependent Resurvey of East bdy. of Township 13 North, Range 16 E., 11

Chains. Retracement for Resurvey (continued)

40.29 Thence,
 South, on random line, on N. $\frac{1}{2}$ of W. bdy. of sec. 19.
 Fall 38 lks. W. of original $\frac{1}{2}$ sec. cor. of secs. 19 and 24,
 which is a sandstone, 14x8x4 ins. above ground, firmly
 set, marked "1" on W. face, and witnessed by mound of
 stone, W. of cor., and two bearing trees properly marked,
 one each NE. and SW. of cor.
 True course and dist. of N. $\frac{1}{2}$ of W. bdy. of sec. 19, are
 therefore, N. 0° 33' W., 40.29 chs.

40.18 Thence,
 South, on random line on S. half of W. bdy. of sec. 19.
 Fall 31 lks. W. of original cor. of secs. 19, 24, 25 and 30,
 which is a sandstone, 18x8x6 ins. above ground, firmly
 set, marked with 4 notches on N. edge, and 2 notches on
 S. edge, and witnessed by mound of stone, W. of cor., and
 4 bearing trees properly marked, one in each sec.
 True course and dist. of S. $\frac{1}{2}$ of W. bdy. of sec. 19, are
 therefore, N. 0° 27' W., 40.18 chs.

39.69 South, on random line, on N. $\frac{1}{2}$ of W. bdy. of sec. 30.
 Fall 9 lks. W. of original $\frac{1}{2}$ sec. cor. of secs. 25 and 30,
 which is a sandstone, 14x12x6 ins. above ground, firmly
 set, marked "1" on W. face, and witnessed by mound of
 stone, W. of cor., and two bearing trees properly marked,
 one each NW. and NE. of cor.
 True course and dist. of N. $\frac{1}{2}$ of W. bdy. of sec. 30 are
 therefore, N. 0° 8' W., 39.69 chs.

39.86 Thence,
 South, on random line, on S. $\frac{1}{2}$ of W. bdy. of sec. 30.
 Fall 32 lks. W. of original cor. of secs. 25, 30, 31 and 36,
 which is a sandstone, 12x6x3 ins. above ground, firmly
 set, marked with 5 notches on N. edge, and 1 notch on S.
 edge, and witnessed by mound of stone W. of cor., and
 four bearing trees, properly marked, one in each sec.
 True course and dist. of S. $\frac{1}{2}$ of W. bdy. of sec. 30, are
 therefore, N. 0° 28' W., 39.86 chs.

40.02 South, on random line, on N. $\frac{1}{2}$ of W. bdy. of sec. 31.
 Fall 12 lks. W. of original $\frac{1}{2}$ sec. cor. of secs. 31 and 36,
 which is a sandstone, 15x10x7 ins. above ground, firmly
 set, marked "1" on W. face, and witnessed by mound of
 stone, W. of cor., and 2 bearing trees, properly marked,
 one each SE. and SW. of cor.
 True course and dist. of N. $\frac{1}{2}$ of W. bdy. of sec. 31, are
 therefore N. 0° 10' W., 40.02 chs.

40.10 Thence,
 South, on random line, on S. $\frac{1}{2}$ of W. bdy. of sec. 31.
 Fall 11 lks. W. of original standard cor. of T₁₃ N., R_s.
 16 and 17 E., on 3rd. Std. Parallel N., which is a
 pine post, 4 ins. square, 2 $\frac{1}{2}$ ft. above ground, firmly
 set, marked with 6 notches on each of N., E. and W.
 edges, and witnessed by 4 bearing trees, one each NE.,
 SE., SW. and NW. of cor.
 Reestablish this cor. in same place as follows:
 Remove the old wood post, and set an iron post, 3 ft. long,
 3 ins. in diam., 24 ins. in the ground, for reestab-
 lished std. cor. of T_s. 13 N., R_s. 16 and 17 E., marked
 on brass cap,

S C
 T13 N
 R16E | R17E.
 S36 | S31

1917

Obliterate marking on original SE. and SW. bearing trees,
 leaving the original NE. and NW. trees, which are de-
 scribed as follows:

12. Dependent Resurvey of E. bdy. of Township 13 North, Range 16 East.

Chains,

A pinyon, 12 ins. in diam., N. 27° E., 29 lks. dist., marked "T13NR17ES31BT."
 A pinyon, 12 ins. on diam., N. 11 1/2° W., 50 lks. dist., marked "T13NR16ES36BT."

Resurvey:

From reestablished std. cor. of Ts. 13 N., Rs. 16 and 17 E., hereinbefore described,
 N. 0° 9' W., on true line, on E. bdy. of sec. 36.
 Over gently rolling land, thru scattering timber.
 40.00 Set an iron post, 3 ft. long, 1 in. in diam., 26 ins. in the ground, for reestablished 1/4 sec. cor. of sec. 36, T. 13 N., R. 16 E., marked on brass cap,

S36
 |
 1917

from which,

A pinyon, 10 ins. in diam., brs. S. 60 1/2° W., 75 lks. dist., mark "S36BT." and
 A pinyon, 8 ins. in diam., brs. N. 86 1/4° W., 52 lks. dist., mark "S36BT."
 40.10 Intersect original 1/4 sec. cor. of secs. 31 and 36, hereinbefore described. Change this cor. to 1/4 sec. cor. of sec. 31 only, by obliterating marking on W. face of stone, marking "1" on E. face, destroying mound of stone, W. of cor., obliterating marking on original SW. bearing tree, and raising a mound of stone, 2 ft. base, 1 1/2 ft. high, E. of cor.

Thence,
 N. 0° 10' W., on true line, continuing measurement of E. bdy. of sec. 36 (beginning of N. 1/2 of W. bdy. of sec. 31).

57.60 S. rim of draw, brs. E. and W. Descend 14 ft.
 60.09 Bottom of draw, course W. Ascend.
 62.58 North rim of draw, brs. E* and W.
 66.08 S. rim of draw, brs. E. and W. Descend 16 ft.
 68.07 Bottom of draw, course W. Ascend.
 70.07 North rim of draw, brs. E* and W.
 80.00 Set an iron post, 3 ft. long, 3 ins. in diam., 24 ins. in the ground, for reestablished cor. of secs. 25 and 36, T. 13 N., Rs. 16 E., marked on brass cap,

T13N
 R16E
 S25

 S36
 |
 1917

from which,

A pinyon, 8 ins. in diam., brs. S. 30 1/2° W., 54 lks. dist., mark "T13NR16ES36BT."
 A pinyon, 6 ins. in diam., brs. N. 70 1/4° W., 27 lks. dist., mark "T13NR16E S25BT."

Land, gently rolling.
 Soil, thin and sandy, 2nd rate.
 Timber, scattering cedar and pinyon.
 No undergrowth.
 Poor grass.

N. 0° 10' W., on true line, on E. bdy. of sec. 25, T. 13 N., R. 16 E. (part of N. 1/2 of W. bdy. of sec. 31, T. 13 N., R. 17 E.)
 Over gently rolling land, thru scattering timber.
 0.12 (40.02 chs. N. 0° 10' W. from 1/4 sec. cor. of sec. 31) Intersect original cor. of secs. 25, 30, 31 and 36, hereinbefore described. Change this cor. to cor. of secs. 30 and 31 only, by destroying mound of stone, W. of cor.,

Dependent Resurvey East bdy. of Township 13 North Range 16 East 13

Chains. obliterating marking on original NW. and SW. bearing trees, and raising mound of stone, 2 ft. base, 1½ ft. high, E. of cor.

Thence
 N. 0° 28' W., on true line, continuing measurement of E. bdy. of sec. 25 (beginning of S. ½ of W. bdy. of sec. 30)

2.32 E. edge of ravine, brs. E and W. Descend 25 ft.
 3.88 Bottom of ravine, course W. Ascend 16 ft.
 7.12 North edge of ravine, brs. E and W.
 10.12 Summit of draw, brs. E and W. Descend 40 ft.
 15.06 Bottom of draw, course W. Ascend 46 ft. on rocky bank of draw.
 19.12 N. rim of draw, brs. E. and W.
 20.12 S. edge of ravine, brs. NE. and W. Descend 21 ft.
 22.12 Bottom of ravine, course SW. Ascend.
 23.62 North edge of ravine, brs. NE. and SW. Leave ravine. Thence over level land.
 39.98 (39.86 chs. N. 0° 28' W. from cor. of secs. 30 and 31) Intersect original ¼ sec. cor. of secs. 25 and 30, hereinbefore described. Change this cor. to ¼ sec. cor. of sec. 30 only, by marking "2" on E. face of stone, obliterating old marking on W. face of stone, destroying old mound of stone, W. of cor., obliterating marking on old NW. bearing tree, and raising a mound of stone, 2 ft. base, 1½ ft. high, E. of cor.

Thence,
 N. 0° 8' W., on true line, continuing measurement of E. bdy. of sec. 25 (beginning of N. ½ of W. bdy. of sec. 30).

40.00 On S. edge of ravine, brs. NW. and SE.
 Set an iron post, 3 ft. long, 1 in. in diam., 26 ins. in the ground, for reestablished ¼ sec. cor. of sec. 25, T. 13 N., R. 16 E., marked on brass cap,

S25
 1917

from which,
 A pinyon, 6 ins. in diam., brs. S. 71½° W., 18 lks. dist., mark "1" S 25 BT."
 A pinyon, 8 ins. in diam., brs. N. 15½° W., 52 lks. dist., mark "2" S 25 BT."

Descend into ravine.
 41.18 Bottom of ravine, course NW. Ascend.
 42.24 N. edge of ravine, brs. NW and SE.
 Thence over level land, to
 45.94 S. rim of draw, brs. E. and W. Descend into draw.
 49.84 Bottom of draw, course W. Ascend.
 64.84 Point of spur, sloping W. Descend into another draw.
 69.78 Bottom of draw, course E. from SW. Ascend 41 ft. to
 72.71 N. rim of draw, brs. NE and SW. Ascend 52 ft. on gradual SE. slope, to
 79.67 (39.69 chs. N. 0° 8' W., from ¼ sec. cor. of sec. 30) Top of ascent, brs. NE. and SW.
 Intersect original cor. of secs. 19, 24, 25 and 30, hereinbefore described. Change this cor. to cor. of secs. 19 and 30 only, by destroying original mound of stone, W. of cor., obliterating marking on original NW. and SW. bearing trees, and raising a mound of stone, 2 ft. base, 1½ ft. high, E. of cor.

Thence,
 N. 0° 27' W., on true line, continuing measurement of E. bdy. of sec. 25 (beginning of S. ½ of W. bdy. of sec. 19).

80.00 Set an iron post, 3 ft. long, 3 ins. in diam., 4 ins. in the ground, in a mound of stone, for reestablished cor. of secs. 24 and 25, T. 13 N., R. 16 E., marked on brass cap,

T13N
 R16E
 S24
 S25
 1917

14 Dependent Resurvey of E. bdy. of Township 13 North, Range 16 East.

Chains.

from which,
 A pinyon, 4 ins. in diam., brs. S. 75 $\frac{1}{2}$ ° W., 100 lks. dist., mark "T13N R16E S25BT."
 A pinyon, 6 ins. in diam., brs. N. 78° W., 59 lks. dist., mark "T13N R16ES24BT."
 Land, rolling and level.
 Soil, thin and rocky, 2nd rate.
 Timber, scattering pinyon and cedar.
 No undergrowth.
 Poor grass.

2.67
 8.27
 13.03
 18.67
 21.98
 30.17

N. 0° 27' W., on true line, on E. bdy. of sec. 24, T. 13 N., R. 16 E. (part of S. $\frac{1}{2}$ of W. bdy. of sec. 19, T. 13 N., R. 17 E.)
 Over rolling land, thru scattering timber and undergrowth.
 S. edge of ravine, brs. NE. and SW. Descend 87 ft.
 Bottom of ravine, course NE. Ascend 41 ft.
 N. edge of ravine, brs. NE. and SW. Thence along E. slope.
 S. edge of ravine, brs. NE. and SW. Descend 32 ft.
 Bottom of ravine, course NE. Ascend 40 ft.
 N. edge of ravine brs. NE. and SW. Thence along rocky E. slope.

39.85

(40.18 chs. N. 0° 27' W., from cor. of secs. 19 and 30) Intersect original $\frac{1}{4}$ sec. cor. of secs. 19 and 24, hereinbefore described. Change this cor. to $\frac{1}{2}$ sec. cor. of sec. 19 only, by marking "S" on E. face of stone, obliterating old marking on W. face of stone, destroying old mound of stone, W. of cor., obliterating marking on original SW. bearing tree, and raising a mound of stone; 2 ft. base, 1 $\frac{1}{2}$ ft. high, E. of cor. This cor. is on S. edge of ravine, brs. NE. and SW. Thence, N. 0° 33' W., on true line, continuing measurement of E. bdy. of sec. 24 (beginning of N. $\frac{1}{2}$ of W. bdy. of sec. 19) Descend 32 ft. on NW. slope.

40.00

On S. bank of ravine, Set an iron post 3 ft. long, 1 in. in diam., 26 ins. in the ground, for reestablished $\frac{1}{4}$ sec. cor. of sec. 24, T. 13 N., R. 16 E., marked on brass cap,

S24
 1917

from which,
 A cedar, 8 ins. in diam., brs. S. 64 $\frac{1}{2}$ ° W., 30 lks. dist., mark "S24 BT."
 A pinyon, 8 ins. in diam., brs. N. 57° W., 50 lks. dist., mark "S24 BT."

48.75
 51.85
 56.85
 69.74
 80.00

Descend into ravine.
 Bottom of ravine, course NE. Ascend.
 North edge of ravine, brs. E. and W.
 Foot of S. slope from knoll; brs. E. and W. Ascend 97 ft.
 Top of knoll; descend gradually over N. slope of same.
 Set an iron post, 3 ft. long, 3 ins. in diam., 10 ins. in the ground, in a mound of stone, for reestablished cor. of secs. 13 and 24, T. 13 N., R. 16 E., marked on brass cap,

T13N
 R16E
 S13
 S24
 1917

from which,
 A cedar, 6 ins. in diam., brs. S. 78° W., 83 lks. dist., mark "T13N R16ES24BT."
 A cedar, 8 ins. diam., brs. N. 65° W., 25 lks. dist., mark "T13NR16ES13BT."

Land, rolling and broken.
 Soil, thin and rocky, 2nd and 3rd rate.
 Timber, scattering pinyon and cedar.
 Undergrowth, scattering yucca.
 Poor grass.

Dependent Resurvey of E. bdy. of Township 13 North, Range 16 East.

Chains.

N. 0° 33' W., on true line, on E. bdy. of sec. 13, T. 13 N., R. 16 E. (part of N. ½ of W. bdy. of sec. 19, T. 13 N., R. 17 E.) Over rolling land, thru scattering timber and undergrowth. Descend 87 ft, on N. slope from knoll:

0.14 (40.29 chs. N. 0° 33' W., from ¼ sec. cor. of sec. 19) Intersect original cor. of secs. 13, 18, 19 and 24, hereinbefore described. Change this cor. to cor. of secs. 18 and 19 only, by destroying old mound of stone, W. of cor., obliterating marking on original NW. and SW. bearing trees, and raising a mound of stone, 2 ft. base, 1½ ft. high, E. of cor.

Thence,
N. 0° 31' W., on true line, continuing measurement of E. bdy. of sec. 13 (beginning of S. ½ of W. bdy. of sec. 18). Continue descent on N. slope, from knoll.

10.14 Foot of N. slope from knoll, brs. E. and W.

Thence over nearly level land.

-40.00 Set an iron post, 3 ft. long, 1 in. in diam., 6 ins. in the ground, in a mound of stone, for reestablished ¼ sec. cor. of sec. 13, T. 13 N., R. 16 E., marked on brass cap,

S13
1917

from which,
A cedar, 8 ins. in diam., brs. N. 75½° W., 8 lks. dist., mark "½ S 13 BT."
A pinyon, 6 ins. in diam., brs. S. 30½° W., 4 lks. dist., mark "½ S 13 B T."

40.25 (40.11 chs. N. 0° 31' W., from cor. of secs. 18 and 19) Intersect original ¼ sec. cor. of secs. 13 and 18, hereinbefore described. Change this cor. to ¼ sec. cor. of sec. 18 only, by marking "1" on E. face of stone, obliterating old marking on W. face, destroying old mound of stone, W. of cor., obliterating marking on original NW. bearing tree, and raising a mound of stone, 2 ft. base, 1½ ft. high, E. of cor.

Thence,
N. 0° 27' W., on true line, continuing measurement of E. bdy. of sec. 13 (beginning of N. ½ of W. bdy. of sec. 18).

41.44 Bottom of small draw, course W.

57.23 Top of bank, brs. E. and W. Descend on N. slope into wash.

59.25 Wash, 4 lks. wide, course W.

72.19 Shallow draw, course W.

79.91 (39.66 chs. N. 0° 27' W. from ¼ sec. cor. of sec. 18) Intersect original cor. of secs. 7, 12, 13 and 18, hereinbefore described. Change this cor. to cor. of secs. 7 and 18, only, by destroying old mound of stone, W. of cor., obliterating marking on original NW. and SW. bearing trees, and raising a mound of stone, 2 ft. base, 1½ ft. high, E. of cor.

Thence,
N. 0° 8' E., on true line, continuing measurement of E. bdy. of sec. 13 (beginning of S. ½ of W. bdy. of sec. 7).

80.00 Set an iron post, 3 ft. long, 3 ins. in diam., 5 ins. in the ground, in a mound of stone, for reestablished cor. of secs. 12 and 13, T. 13 N., R. 16 E., marked on brass cap,

T13N
R16E
S12

S13
1917

from which,
A pinyon, 8 ins. in diam., brs. N. 55½° W., 53 lks. dist., mark "T13N R16E S12BT."
A pinyon, 6 ins. in diam., brs. S. 50½° W., 60 lks. dist., mark "T13N R16E S13BT."

Land, rolling and nearly level, and broken.

16 Dependent Resurvey of E. bdy. of Township 13 North Range 16 East

Chains.

Soil, thin and rocky, 2nd and 3rd rate.
 Timber, scattering pinyon and cedar.
 Undergrowth, scattering buck brush.
 Poor grass.

N. 0° 8' E., on true line, on E. bdy. of sec. 12, T. 13 N., R. 16 E. (part of S. 1/2 of W. bdy. of sec. 7, T. 13 N., R. 16 E.)
 Over rolling and broken land, thru scattering timber and undergrowth.

4.12 Descend 55 ft. into ravine.
 6.75 Bottom of ravine, course W. Ascend 45 ft. to
 17.73 N. edge of ravine, brs. E and W.
 S. edge of draw, brs. E and W. Descend 125 ft. to bottom of draw.

39.49 (39.58 chs. N. 0° 8' E., from cor. of secs. 7 and 18) Intersect original 1/4 sec. cor. of secs. 7 and 12, hereinbefore described. Change this cor. to 1/4 sec. cor. of sec. 7 only, by marking "1" on E. face of stone, obliterating old marking on W. face of stone, destroying old mound of stone, W. of cor., obliterating marking on original SW. bearing tree, and raising a mound of stone, 2 ft. base, 1 1/2 ft. high, E. of cor.

40.00 Thence, N. 0° 5' W., on a true line, continuing measurement of E. bdy. of sec. 12 (beginning of N. 1/2 of W. bdy. of sec. 7). Continue descent into draw.
 Set an iron post, 3 ft. long, 1 in. in diam., 26 ins. in the ground, for reestablished 1/4 sec. cor., of sec. 12, T. 13 N., R. 16 E., marked on brass cap,

S12
 1917

and raise a mound of stone, 2 ft. base, 1 1/2 ft. high, W. of cor.

44.49 Continue descent into draw.
 Enter bottom of draw, course N. from SW. Thence down bottom of draw, to

69.49 Leave bottom of draw, course NE. from S. Ascend SE. slope on NW. bank of draw.

79.49 (40.00 chs. N. 0° 5' W. from 1/4 sec. cor. of sec. 7) On NW. edge of draw, brs. NE. and SW.

Intersect original cor. of secs. 1, 6, 7 and 12, hereinbefore described. Change this cor. to cor. of secs. 6 and 7 only, by destroying old mound of stone, W. of cor., obliterating marking on original NW. and SW. bearing trees, and raising a mound of stone, 2 ft. base, 1 1/2 ft. high, E. of cor.

80.00 Thence, N. 0° 21' W., on true line, continuing measurement of E. bdy. of sec. 12 (beginning of S. 1/2 of W. bdy. of sec. 6). Leave bank of draw, and enter slightly rolling land.
 Set an iron post, 3 ft. long, 3 ins. in diam., 12 ins. in the ground, in a mound of stone, for reestablished cor. of secs. 1 and 12, T. 13 N., R. 16 E., marked on brass cap,

T13N
 R16E
 S 1
 S12
 1917

from which,

A pinyon, 6 ins. in diam., brs. S. 86 3/4° W., 60 lks. dist., mark "T13NR16ES12BT."

A cedar, 8 ins. diam., brs. N. 34 1/2° W., 69 lks. dist., mark "T13NR16ES1BT."

Land, rolling and broken.
 Soil, thin and rocky, 3rd rate.

Dependent Resurvey of E. bdy. of Township 13 North Range 16 East. 17

Chains.

Timber, scattering cedar and pinyon.
Undergrowth, scattering greasewood.
Poor grass.

39.37 N. 0°21' W., on true line, on E. bdy. of sec. 1, T. 13 N., R. 16 E. (part of S. 1/2 of W. bdy. of sec. 6, T. 13 N., R. 17 E.)
Over rolling land, thru scattering timber.
(39.88 chs. N. 0°21' W., from cor. of secs. 6 and 7) Intersect original 1/4 sec. cor. of secs. 1 and 6, hereinbefore described. Change this cor. to 1/4 sec. cor. of sec. 6 only, by marking "1" on E. face of stone, obliterating old marking on W. face of stone, destroying old mound of stone, W. of cor., obliterating marking on original SW. bearing tree, and raising mound of stone, 2 ft. base, 1 1/2 ft. high, E. of cor.

40.00 Thence,
N. 0°32' W., on true line, continuing measurement of E. bdy. of sec. 1 (beginning of N. 1/2 of W. bdy. of sec. 6).
Set an iron post, 3 ft. long, 1 in. in diam., 26 ins. in the ground, for reestablished 1/4 sec. cor. of sec. 1, T. 13 N., R. 16 E., marked on brass cap,

S 1 |
1917

from which,
A cedar, 6 ins. in diam., brs. N. 46 1/2° W., 6 lks. dist., mark "1 S 1 BT."
A cedar, 8 ins. diam., brs. S. 23° W., 88 lks. dist., mark "1 S 1 BT."

79.32 (39.95 chs. N. 0°32' W. from 1/4 sec. cor. of sec. 6) Intersect the reestablished cor. of Ts. 13 and 14 N., Rs. 16 and 17 E., described in Book "N," of Group 79.
Land, rolling.
Soil, sandy and rocky, 2nd rate.
Timber, scattering pinyon and cedar.
Undergrowth, none.
Poor grass.

18 Independent Resurvey of 3rd. Std. Par. N. thru. range 16 East.

Chains.

40.00 From the reestablished standard cor. of Ts.13 N., Rs.16 and 17 E., hereinbefore described, West, along S. bdy. of sec.36. Over gently rolling land, thru. scattering timber. Set an iron post, 3 ft. long, 1 in. in diam., 26 ins. in the ground, for reestablished standard $\frac{1}{4}$ sec. cor. of sec.36, marked on brass cap,

S C
 $\frac{1}{4}$
S 36
1917

from which,

- A pinyon; 10 ins. in diam., brs. N. $12\frac{3}{4}^{\circ}$ E., 27 lks. dist., marked S C $\frac{1}{4}$ S 36 BT.
- A pinyon, 18 ins. in diam., brs. N. $65\frac{1}{2}^{\circ}$ W., 89 lks. dist., marked S C $\frac{1}{4}$ S 36 BT.

From this cor., the old standard $\frac{1}{4}$ sec. cor., which is a pine post, 4 ins. in diam., firmly set in a mound of stone, brs. S. 42° W., 122 lks. dist. Destroy this old standard $\frac{1}{4}$ sec. cor.

80.00 Set an iron post 3 ft. long, 3 ins. in diam., 4 ins. in the ground, in a mound of stone, for reestablished standard cor. of secs. 35 and 36, marked on brass cap,

S C
T13N R16E
S35 S36
1917

from which,

- A pinyon, 14 ins. in diam., brs. N. $41\frac{1}{2}^{\circ}$ E., 112 lks. dist., marked T13N R16E S36 BT.
- A pinyon, 10 ins. in diam., brs. N. 44° W., 23 lks. dist., marked T13NR16ES35 BT.

From this cor. the old stand. cor. of secs. 35 and 36, brs. S. 43° W., 223 lks. dist. Destroy all trace of same.

Land, gently rolling.
Soil, sandy, 2nd rate.
Timber, pinyon and cedar.
Undergrowth, buck brush.
Short grass.

West, along S. bdy. of sec. 35.

19.14 Over gently rolling land, thru. scattering timber.
25.12 Edge of draw, brs. NE. and SW. Descend 29 ft. to
40.00 Bottom of draw, course N. Ascend E. slope, 52 ft. to
Set an iron post, 3 ft. long, 1 in. in diam., 26 ins. in the ground, for reestablished standard $\frac{1}{4}$ sec. cor. of sec. 35, marked on brass cap,

S C
 $\frac{1}{4}$
S 35
1917

from which,

- A pinyon, 4 ins. in diam., brs. N. $30\frac{1}{2}^{\circ}$ W., 36 lks. dist., marked S C $\frac{1}{4}$ S 35 BT.
- A pinyon, 6 ins. in diam., brs. N. 25° E., 53 lks. dist., marked S C $\frac{1}{4}$ S 35 B T.

From this cor., the old standard $\frac{1}{4}$ sec. cor., which is a limestone firmly set, brs. S. $36^{\circ}40'$ W., 327 lks. dist. Destroy this old standard $\frac{1}{4}$ sec. cor.

49.27 rocky wash in draw, course S.
80.00 Set an iron post, 3 ft. long, 3 ins. in diam., 24 ins. in the ground, for reestablished standard cor. of secs. 34 and 35, marked on brass cap,

Independent Resurvey of 3rd. Std. Par. N. thru. Range 16 East. 19

Chains.

S C
T13N R16E
S34 S35
1917

from which,

- A cedar, 14 ins. in diam., brs. N. 53° E., 142 lks. dist., marked T13NR16ES35BT.
- A pinyon, 8 ins. in diam., brs. N. 40½° W., 160 lks. dist., marked T13NR16ES34BT.

From this cor. the old standard cor. of secs. 34 and 35, which is a limestone, firmly set, brs. S. 39° 36' W., 406 lks. dist. Destroy this old standard sec. cor.
Land, gently rolling. Soil, sandy, 2nd rate.
Timber, cedar and pinyon.
Undergrowth, buckbrush. Short grass.

19.55
26.63
40.00

West, along S. bdy. of sec. 34.
Over gently rolling land, thru. scattering timber & undergrowth.
Road brs. N. and S.
Indian ruins bear S. 6 chs. dist.
Set an iron post, 3 ft. long, 1 in. in diam., 26 ins. in the ground, for reestablished standard ¼ sec. cor. of sec. 34, marked on brass cap.

S C
S ¼ 34
1917

from which,

- A pinyon, 10 ins. in diam., brs. N. 5½° E., 101 lks. dist., marked S C ¼ S 34 BT.
- A pinyon, 8 ins. in diam., brs. N. 10° W., 43 lks. dist., marked S C ¼ S 34 BT.

From this cor., the old standard ¼ sec. cor., which is a limestone, set in a mound of stone, brs. S. 38° 43' W., 536 lks. dist. Destroy this old standard ¼ sec. cor.

47.76
52.54
62.14
80.00

Bottom of draw, course NW.
Road brs. SE. to Heber and NW. to Sponseller's Ranch. Asc. gradual slope, to
Thence over nearly level land.
Set an iron post 3 ft. long, 3 ins. in diam., 18 ins. in the ground, in a mound of stone, for reestablished standard cor. of secs. 33 and 34, marked on brass cap.

S C
T13N R16E
S33 S34
1917

from which,

- A pine, 18 ins. in diam., brs. N. 6° E., 105 lks. dist., marked T13NR16ES34BT.
- A pinyon, 10 ins. in diam., brs. N. 80½° W., 26 lks. dist., marked T13NR16E S33 BT.

From this cor. the old standard cor. of secs. 33 and 34, which is a limestone set in a mound of stone, brs. S. 39° 45' W., 635 lks. dist., Destroy this old standard cor.
Land, gently rolling. Soil, sandy, 2nd rate.
Timber, pine, pinyon and cedar.
Undergrowth, buck brush.
Fair growth of short grass.

5.00
8.37
16.00
26.00
29.33
33.66

West, along S. bdy. of sec. 33.
Over gently rolling land, thru. scattering timber and undergrowth.
Descend 34 ft. to
Bottom of draw; wash in draw. 40 lks. wide, 3 ft. deep, course N. Ascend gradual slope to
Thence over gently rolling land.
Rocky rim of draw, brs. N. and S. Descend 35 ft. to
Bottom of draw, course NE. Ascend 67 ft. to
Thence over gently rolling land.

20 Independent Resurvey of 3rd. Std. Par. N., thru Range 16 East.

Chains.
40.00 Set an iron post, 3 ft. long, 1 in. in diam., 22 ins. in the ground, in a mound of stone, for reestablished std. $\frac{1}{4}$ sec. cor. of sec. 33, marked on brass cap,
S C
S 33
1917

from which,

A pine, 18 ins. in diam., brs. N. 17° E. 64 lks. dist., marked S C $\frac{1}{4}$ S 33 BT.

A pine, 18 ins. in diam., brs. N. 82 $\frac{1}{2}$ ° W., 120 lks. dist., marked S C $\frac{1}{4}$ S 33 BT.

Diligent search in this vicinity fails to reveal any trace of the old standard $\frac{1}{4}$ sec. cor.

79.15

Wagon road brs. S. to Heber and N. to Mud Tank and Holbrook.

80.00

Set an iron post, 3 ft. long, 3 ins. in diam., 24 ins. in the ground, for reestablished standard cor. of secs. 32 and 33.

S C
T13N | R16E
S32 | S33

1917

from which,

A pinyon, 6 ins. in diam., brs. N. 7 $\frac{1}{2}$ ° E., 207 lks. dist., marked T13N R16E S 33 BT.

A pinyon, 12 ins. in diam., brs. N. 31 $\frac{1}{2}$ ° W., 282 lks. dist., marked T13N R16E S32 BT.

From this cor. the old std. cor. of secs. 32 and 33, which is a mound of stone, with no trace of marked stone, brs. S. 39° 31' W., 812 lks. dist. Destroy this old std. cor.

Land, level and gently rolling. Soil, thin & sandy, 2nd rate. Timber, pine, pinyon and cedar. Undergrowth, sage brush and aldereta. Fair growth of grass.

West, along S. bdy. of sec. 32.

Over gently rolling land, thru scattering timber & undergrowth.

13.60

Line tree, juniper, 24 ins. in diam., on line.

20.00

Enter scattering scrub oak.

28.78

Line tree, pine, 24 ins. in diam.

31.16

Line tree, pine, 18 ins. in diam.

40.00

Set an iron post, 3 ft. long, 1 in. in diam., 10 ins. in the ground, in a mound of stone, for reestablished std. $\frac{1}{4}$ sec. cor. of sec. 32, marked on brass cap,

S C
S 32

1917

from which,

A pine, 18 ins. in diam., brs. N. 40° E. 66 lks. dist., marked S C $\frac{1}{4}$ S 32 BT.

A pine, 18 ins. in diam., brs. N. 20° W., 66 lks. dist., marked S C $\frac{1}{4}$ S32 BT.

From this cor., the old std. $\frac{1}{4}$ sec. cor., position determined from old bearing trees, brs. S. 38° 12' W., 884 lks. dist. Destroy all trace of old std. cor.

80.00

Set an iron post, 3 ft. long, 3 ins. in diam., 6 ins. in the ground, in a mound of stone, for reestablished std. cor. of secs. 31 and 32, marked on brass cap,

S C
T13N | R16E
S31 | S32

1917

from which,

A pine, 18 ins. in diam., brs. N. 36 $\frac{1}{2}$ ° E., 144 lks. dist., marked T13N R16E S32 BT.

A pine, 30 ins. in diam., brs. N. 48° W., 84 lks. dist., marked T13N R16E S31 BT.

From this cor., the old standard cor. of secs. 31 and 32, which is a sandstone, firmly set, brs. S. 39° 21' W., 997 lks. dist.

Destroy this old standard $\frac{1}{4}$ sec. cor.

Independent Resurvey of 3rd Standard Par. N., thru Range 16 E. 21

Chains

Land, level.
Soil, sandy, 2nd rate.
Timber, pine, pinyon, cedar and juniper.
Undergrowth, scrub oak.
Fair growth of grass.

40.00

West, along S bdy. of sec. 31.
Over level land, through timber and undergrowth.
Set an iron post, 3 ft. long, 1 in. in diam., 10 ins. in the ground, in a mound of stone, for reestablished standard $\frac{1}{4}$ sec. cor. of sec. 31, marked on brass cap,

S C
S 31
1917

from which,

- A pine, 18 ins. in diam., brs. N. $28\frac{1}{2}^{\circ}$ E., 44 lks. dist., marked S C $\frac{1}{4}$ S 31 BT.
- A juniper, 18 ins. in diam., brs. N. 74° W., 38 lks. dist., marked S C $\frac{1}{4}$ S 31 BT.

50.00
52.30
60.80
65.00
88.25

From this cor., the old standard $\frac{1}{4}$ sec. cor., which is a decayed pine post, brs. S. $40^{\circ}34'$ W., 11.07 chs. dist.
Destroy this old standard $\frac{1}{4}$ sec. cor.
Descend gradual W. slope.
Descend steep W. slope, 35 ft. to
Bottom of draw, course N. Ascend 23 ft. to
Thence over level land.
Intersect E. bdy. of Tp. 13 N., R. 15 E., 8.74 chs. N. $0^{\circ}14'$ W. of the reestablished standard cor. of T. 13 N., R. 15 E. (SE. cor.), hereinbefore described.
At the point of intersection,
Set an iron post, 3 ft. long, 3 ins. in diam., 24 ins. in the ground, for reestablished standard cor. of T. 13 N., R. 16 E. (SW. cor.) marked on brass cap,

S C
T13N
R16E
S31

1917

from which,

- A juniper, 18 ins. diam., brs. N. 71° E., 54 lks. dist., mark T13N R16E S31 BT.
- No other tree being within prescribed limits, NE. of cor.
- On a pine, 20 ins. in diam., S. 87° W., 95 lks. dist., mark "SCBT."
- and raise a mound of stone, 2 ft. base, 1 $\frac{1}{2}$ ft. high, NE. of cor.

Land, level and gently rolling.
Soil, sandy, 2nd rate.
Timber, pine, juniper and pinyon.
Undergrowth, scrub oak.
Fair growth of grass.

22. survey of subdivision of Township 13 North, Range 16 East.

Chains.

From the reestablished standard cor. of secs. 35 and 36, on S. bdy. of Tp., (3rd. Standard Parallel North) here- inbefore described, North, on Sectional Guide Meridian, bet. secs. 35 and 36. Over gently rolling land, thru pinyon and cedar timber. Bottom of small canyon, course NE.

32.50
40.00

Set an iron post, 3 ft. long, 1 in. in diam., 26 ins. in the ground, for $\frac{1}{4}$ sec. cor., marked on brass cap,

$\frac{1}{4}$
 S35 | S36
 1917

from which,

A pinyon, 10 ins. in diam., brs. S. 18° E., 76 lks. dist., marked $\frac{1}{4}$ S 36 BT.

A cedar, 6 ins. in diam., brs. S. $33\frac{1}{2}^{\circ}$ W., 56 lks. dist. marked $\frac{1}{4}$ S 35 BT.

80.00

Set an iron post, 3 ft. long, 2 ins. in diam., 18 ins. in the ground, in a mound of stone, for cor. of secs. 25, 26, 35 and 36, marked on brass cap,

T13N | R16E
 S26 | S25
 S35 | S36
 1917

from which,

A pine, 14 ins. in diam., brs. N. $55\frac{1}{2}^{\circ}$ E., 160 lks. dist., marked T13N R16E S25 BT.

A pine, 30 ins. in diam., brs. S. $45\frac{1}{2}^{\circ}$ E., 40 lks. dist., marked T13N R16E S36 BT.

A cedar, 12 ins. in diam., brs. S. $51\frac{1}{2}^{\circ}$ W., 236 lks. dist., marked T13N R16E S35 BT.

A pinyon, 12 ins. in diam., brs. N. $61\frac{1}{2}^{\circ}$ W., 84 lks. dist., marked T13N R16E S26 BT.

Land, rolling.

Soil, thin and rocky, 2nd rate.

Timber, pine, pinyon and cedar.

No undergrowth.

40.00
79.78

East, on a random line, bet. secs. 25 and 36.

Set temp. $\frac{1}{4}$ sec. cor.

Fall 6 lks. N. of the reestablished cor. of secs. 25 and 36, on E. bdy. of township, hereinbefore described.

Thence,

N. $89^{\circ} 57'$ W., on a true line, bet. secs. 25 and 36.

Over gently rolling land, thru. scattering timber and undergrowth.

6.92

Descend 41 ft. to

11.88

Draw, course N. Ascend to

21.78

Descend to

25.31

Bottom of draw, course N.

39.78

Set an iron post, 3 ft. long, 1 in. in diam., 26 ins. in the ground, for $\frac{1}{4}$ sec. cor., marked on brass cap,

Subdivision of T. 13 N., R. 16 E.

Chains

S 25
4S 36.
1917

from which,

- A pinyon, 6 ins. diam., brs. N. 24° W.
74 lks. dist.; mkd. 1/4 S 25 B T.
- A pinyon, 12 ins. diam., brs. S. 6 1/2° W.
31 lks. dist.; mkd. 1/4 S 36 B T.

50.00
58.52
67.00
79.78

Desc. 41 ft. to
Bottom of small canyon, course NE. Asc. 56 ft. to
Thence over gently rolling land to
The cor. of secs. 25, 26, 35 and 36.
Land, gently rolling.
Soil, thin, 2nd rate.
Timber, pinyon and cedar.
Undergrowth, buckbrush.
Short grass.

North on sectional guide meridian bet. secs. 25 and 26.
Over rolling land, through timber and undergrowth.

1.00
2.00
15.00
19.96
21.92
40.00

Bottom of small draw, course NE. Asc. to
Edge of draw brs. NE. and SW. Thence over nearly level land.
Desc. 24 ft. to
Bottom of draw, course E. Asc. 25 ft. to
Thence over nearly level land.
Set an iron post, 3 ft. long, 1 in. diam., 26 ins. in the
ground, for 1/4 sec. cor., mkd. on brass cap

S26 | S25
1917

from which,

- A pinyon, 6 ins. diam., brs. N. 72 1/4° E.
55 lks. dist.; mkd. 1/4 S 25 B T.
- A pinyon, 8 ins. diam., brs. S. 67 1/4° W.
16 lks. dist.; mkd. 1/4 S 26 B T.

80.00

Set an iron post, 3 ft. long, 2 ins. diam., 24 ins. in the
ground, for cor. of secs. 23, 24, 25 and 26, mkd. on
brass cap

T13N R16E
S23 | S24
S26 | S25
1917

from which,

- A pinyon, 6 ins. diam., brs. N. 22 1/2° E.
34 lks. dist.; mkd. T 13 N R 16 E S 24 B T.
- A pinyon, 8 ins. diam., brs. S. 29° E.
34 lks. dist.; mkd. T 13 N R 16 E S 25 B T.
- A pinyon, 8 ins. diam., brs. S. 72 1/2° W.
15 lks. dist.; mkd. T 13 N R 16 E S 26 B T.
- A pinyon, 6 ins. diam., brs. N. 9 1/2° W.
45 lks. dist.; mkd. T 13 N R 16 E S 23 B T.

Land, rolling.
Soil, thin, 2nd rate.
Timber, pinyon and cedar.
Undergrowth, buckbrush.
Short grass.

220

Subdivision of T. 13 N., R. 16 E.

Chains

S. 89° 57' E. on a random line bet. secs. 24 and 25.
 40.00 Set temp. $\frac{1}{4}$ sec. cor.
 79.80 Fall 12 lks. N. of the reestablished cor. of secs. 24 and
 25, E. bdy. of Tp., hereinbefore described.
 Thence
 N. 89° 52' W. on a true line bet. secs. 24 and 25.
 Over rolling land, through timber and undergrowth.
 7.00 Desc. 37 ft. to
 17.14 Bottom of draw, course NE. Asc. 53 ft. to
 25.00 Thence along S. slope to
 27.80 Bottom of gulch, course S. Asc. 54 ft. to
 30.00 Thence along S. slope.
 34.80 Asc. gradual slope to
 38.30 Thence over gently rolling land.
 39.80 Set an iron post, 3 ft. long, lin. diam., 26 ins. in the
 ground, for $\frac{1}{4}$ sec. cor., mkd. on brass cap

S 24
 $\frac{1}{4}$ S 25
 1917

from which,

A pinyon, 6 ins. diam., brs. N. 6 $\frac{3}{4}$ ° W.
 64 lks. dist.; mkd. $\frac{1}{4}$ S 24 B T.
 A cedar, 8 ins. diam., brs. S. 25 $\frac{1}{2}$ ° E.
 13 lks. dist.; mkd. $\frac{1}{4}$ S 25 B T.
 Desc. gradual slope to
 41.50 Bottom of gulch, course S. Asc. 34 ft. to
 45.00 Thence over nearly level land.
 79.80 The cor. of secs. 23, 24, 25 and 26.
 Land, rolling.
 Soil, rocky, 3rd rate.
 Timber, cedar and pinyon.
 Undergrowth, sagebrush.
 Sparse grass.

North on sectional guide meridian bet. secs. 23 and 24.
 Over gently rolling land, through scattering timber and
 undergrowth.

19.00 Desc. NW. slope to
 21.00 Bottom of small draw, course NE. Asc. gradual slope.
 40.00 Set an iron post, 3 ft. long, 1 in. diam., 26 ins. in the
 ground, for $\frac{1}{4}$ sec. cor., mkd. on brass cap

$\frac{1}{4}$
 S23 | S24
 1917

from which,

A pinyon, 8 ins. diam., brs. S. 76° E.
 10 lks. dist.; mkd. $\frac{1}{4}$ S 24 B T.
 A pinyon, 6 ins. diam., brs. S. 26 $\frac{3}{4}$ ° W.
 13 lks. dist.; mkd. $\frac{1}{4}$ S 23 B T.
 47.00 Desc. gradual N. slope.
 55.00 Shallow wash, course E.
 63.00 Desc. gradual N. slope.
 65.00 Bottom of shallow ravine course NE. Asc. 23 ft. to
 70.00 Thence over nearly level land.
 80.00 Set an iron post, 3 ft. long, 2 ins. diam., 4 ins. in the
 ground, in a mound of stone, for cor. of secs. 13, 14,
 23 and 24, mkd. on brass cap

T13 N R16 E
 S14 | S13
 S23 | S24
 1917

Chains

from which,

- A pinyon, 6 ins. diam., brs. N. 75 $\frac{1}{2}$ ° E.
22 lks. dist.; mkd. T 13 N R 16 E S 13 B T.
- A pinyon, 10 ins. diam., brs. S. 23 $\frac{3}{4}$ ° E.
16 lks. dist.; mkd. T 13 N R 16 E S 24 B T.
- A pinyon, 8 ins. diam., brs. S. 78° W,
35 lks. dist.; mkd. T 13 N R 16 E S 23 B T.
- A pinyon, 6 ins. diam., brs. N. 71 $\frac{1}{2}$ ° W.
27 lks. dist.; mkd. T 13 N R 16 E S 14 B T.

Land, rolling.
Soil, thin and rocky.
Timber, pinyon and cedar.
Undergrowth, buckbrush.
Short grass.

- 40.00 S. 89° 52' E. on a random line bet. secs. 13 and 24.
- 78.62 Set temp. $\frac{1}{4}$ sec. cor.
- Fall 20 lks. S. of the reestablished cor. of secs. 13 and 24, on E. bdy. of T. P., hereinbefore described.
- Thence
- S. 89° 59' W. on a true line bet. secs. 13 and 24.
- Over rolling land, through scattering undergrowth and cedar and pinyon timber.
- 5.00 Desc. 40 ft. to
- 9.70 Bottom of draw, course N. Asc. 57 ft. to
- 17.15 Thence over gently rolling land.
- 28.15 Sandy wash, 15 lks. wide, 3 ft. deep, course N.
- 38.62 Set an iron post, 3 ft. long, 1 in. diam., 26 ins. in the ground, for $\frac{1}{4}$ sec. cor., mkd. on brass cap

S 13
+ S 24
1917

from which,

- A pinyon, 4 ins. diam., brs. N. 45° E.
48 lks. dist.; mkd. $\frac{1}{4}$ S 13 B T.
- A pinyon, 8 ins. diam., brs. S. 31 $\frac{1}{2}$ ° W.
54 lks. dist.; mkd. $\frac{1}{4}$ S 24 B T.

- 43.85 Desc. 66 ft. to
- Wash, 10 lks. wide, 3 ft. deep, course NW. in draw.
- Asc. 48 ft. to
- 52.15 Thence over gently rolling land to
- 60.00 Desc. 156 ft. to
- 68.80 Bottom of ravine, course N. Asc. 98 ft. to
- 78.62 The cor. of secs. 13, 14, 23 and 24.
- Land, rolling and broken.
- Soil, thin and rocky.
- Timber, pinyon and cedar.
- Undergrowth, yucca.
- Short grass.

- 5.00 North on sectional guide meridian bet. secs. 13 and 14.
- 9.70 Over rolling land, through timber and undergrowth.
- Desc. steep NW. slope 113 ft. to
- Bottom of canyon, course NE. Thence over sandy and grassy canyon bed. (Brookbank Canyon)
- 13.50 Shallow wash in canyon, 10 lks. wide, course NE.
- 29.70 Asc. SE. slope from canyon, 30 ft. to
- 32.05 Point of rocky bluff. Thence over gradual ascent.
- 40.00 Set an iron post, 3 ft. long, 1 in. diam., 26 ins. in the ground, for $\frac{1}{4}$ sec. cor., mkd. on brass cap

S 14 | S 13
1917

148

26

Subdivision of T. 13 N., R. 16 E.

Chains

from which,
 A cedar, 8 ins. diam., brs. N. 56° E.
 99 lks. dist.; mkd. $\frac{1}{4}$ S 13 B T
 A cedar, 18 ins. diam., brs. N. 68 $\frac{1}{2}$ ° W.
 41 lks. dist.; mkd. $\frac{1}{4}$ S 14 B T.

50.00 Asc. 61 ft. to
 57.00 Thence over gently rolling land.
 80.00 Set an iron post, 3 ft. long, 2 ins. diam., 24 ins. in the
 ground, for cor. of secs. 11, 12, 13 and 14, mkd. on
 brass cap

T13N R16E
 S11 | S12
 S14 | S13
 1917

from which,
 A pinyon, 12 ins. diam., brs. N. 46 $\frac{3}{4}$ ° E.
 80 lks. dist.; mkd. T 13 N R 16 E S 12 B T.
 A pinyon, 8 ins. diam., brs. S. 76 $\frac{1}{4}$ ° E.
 44 lks. dist.; mkd. T 13 N R 16 E S 13 B T.
 A cedar, 10 ins. diam., brs. S. 27° W.
 46 lks. dist.; mkd. T 13 N R 16 E S 14 B T.
 A pinyon, 8 ins. diam., brs. N. 34 $\frac{3}{4}$ ° W.
 35 lks. dist.; mkd. T 13 N R 16 E S 11 B T.

Land, rolling.
 Soil, sandy and rocky, 2nd rate.
 Timber, pinyon and cedar.
 Undergrowth, buckbrush.
 Short grass.

40.00 N. 89° 59' E. on a random line bet. secs. 12 and 13.
 78.04 Set temp. $\frac{1}{4}$ sec. cor.
 Fall 25 lks. S. of the reestablished cor. of secs. 12 and
 13, E. bdy. of Tp., hereinbefore described.

Thence
 S. 89° 48' W. on a true line bet. secs. 12 and 13.
 Over gently rolling land, through timber and undergrowth.
 5.00 Desc. 59 ft. to
 8.39 Wash, 3 lks. wide, course N. Asc. 42 ft. to
 12.40 Thence over gently rolling land.
 38.04 Set an iron post, 3 ft. long, 1 in. diam., 26 ins. in the
 ground, for $\frac{1}{4}$ sec. cor., mkd. on brass cap

S 12
 $\frac{1}{4}$ S 13
 1917

from which,
 A pinyon, 18 ins. diam., brs. N. $\frac{3}{4}$ ° E.
 329 lks. dist.; mkd. $\frac{1}{4}$ S 12 B T.
 A pinyon, 12 ins. diam., brs. S. 19 $\frac{1}{4}$ ° W.
 290 lks. dist.; mkd. $\frac{1}{4}$ S 13 B T.

39.40 Bottom of grassy draw, 10 chs. wide; wash, 10 lks. wide,
 course N.
 78.04 The cor. of secs. 11, 12, 13 and 14.
 Soil, sandy and rocky, 2nd rate.
 Timber, cedar and pinyon.
 Land, gently rolling.
 Undergrowth, buckbrush.
 Short grass.

Subdivision of T. 13 N., R. 16 E.

Chains

North on sectional guide meridian bet. secs. 11 and 12.
 Over gently rolling land, through timber and undergrowth.
 25.00 Desc. N. slope 30 ft. to
 26.98 Bottom of draw, course NE. Asc. gradual slope.
 40.00 Set an iron post, 3 ft. long, 1 in. diam., 26 ins. in the
 ground, for $\frac{1}{4}$ sec. cor., mkd. on brass cap

$\frac{1}{4}$
 S11 | S12
 1917

from which,

A pinyon, 6 ins. diam., brs. N. 55° E.
 35 lks. dist.; mkd. $\frac{1}{4}$ S 12 B T.
 A pinyon, 6 ins. diam., brs. N. 81 $\frac{1}{4}$ ° W.
 27 lks. dist.; mkd. $\frac{1}{4}$ S 11 B T.

45.00 Desc. gradual slope, 29 ft. to
 50.00 Bottom of draw; shallow wash, 10 lks. wide, course NE.
 Asc. 64 ft. to
 56.91 Over very gradual ascent.
 64.86 Summit of general slope. Thence over nearly level land.
 80.00 Set an iron post, 3 ft. long, 2 ins. diam., 24 ins. in the
 ground, for cor. of secs. 1, 2, 11 and 12, mkd. on
 brass cap

T13N R16E
 S 2 | S 1
 S11 | S12
 1917

from which,

A pinyon, 8 ins. diam., brs. N. 38° E.
 89 lks. dist.; mkd. T 13 N R 16 E S 1 B T.
 A pinyon, 6 ins. diam., brs. S. 61 $\frac{3}{4}$ ° E.
 53 lks. dist.; mkd. T 13 N R 16 E S 12 B T.
 A cedar, 10 ins. diam., brs. S. 8 $\frac{3}{4}$ ° W.
 28 lks. dist.; mkd. T 13 N R 16 E S 11 B T.
 A pinyon, 8 ins. diam., brs. N. 18 $\frac{1}{2}$ ° W.
 11 lks. dist.; mkd. T 13 N R 16 E S 2 B T.

Land, rolling.
 Soil, loose, sandy and rocky, 2nd rate.
 Timber, pinyon and cedar.
 Undergrowth, yucca.
 Short grass.

40.00 N. 89° 48' E. on a random line bet. secs. 1 and 12.
 Set temp. $\frac{1}{4}$ sec. cor.
 78.32 Fall 18 lks. S. of the reestablished cor. of secs. 1 and
 12, on E. bdy. of Tp., hereinbefore described.
 Thence
 S. 89° 40' W. on a true line bet. secs. 1 and 12.
 Over rolling land, through timber and undergrowth.
 38.32 Set an iron post, 3 ft. long, 1 in. diam., 26 ins. in the
 ground, for $\frac{1}{4}$ sec. cor., mkd. on brass cap

$\frac{1}{4}$ S 1
 $\frac{1}{4}$ S 12
 1917

from which,

A pinyon, 8 ins. diam., brs. N. 70° E.
 261 lks. dist.; mkd. $\frac{1}{4}$ S 1 B T.
 A cedar, 18 ins. diam., brs. S. 29 $\frac{1}{2}$ ° E.
 140 lks. dist.; mkd. $\frac{1}{4}$ S 12 B T.

78.32 These cor. of secs. 1, 2, 11 and 12.
 Land, rolling. Soil thin and rocky.
 Timber, pinyon and cedar.
 Undergrowth, buckbrush.
 Short grass.

28

Subdivision of T. 13 N. R. 16 E.

Chains

North on sectional guide meridian bet. secs. 1 and 2,
 Over rolling land, through timber and undergrowth.
 15.00 Desc. gradual NW. slope.
 40.00 Set an iron post, 3 ft. long, 1 in. diam., 26 ins. in the
 ground, for $\frac{1}{4}$ sec. cor., mkd. on brass cap

$\frac{1}{4}$
 S 2 | S 1
 1917

from which,

A pinyon, 12 ins. diam., brs. S. $63\frac{1}{2}^\circ$ E.
 120 lks. dist.; mkd. $\frac{1}{4}$ S 1 B T.
 A pinyon, 6 ins. diam., brs. N. $15\frac{1}{4}^\circ$ W.
 11 lks. dist.; mkd. $\frac{1}{4}$ S 2 B T.
 45.98 Low rocky point slopes E. Desc. gradual slope to
 47.00 Bottom of shallow draw, course E. Asc. 23 ft. to
 50.00 Desc. gradual slope.
 54.00 Rocky wash, 15 lks. wide, 3 ft. deep, course NE.
 79.50 Intersect N. bdy. of Tp., at which point establish cor. of
 secs. 1 and 2 as described in Book "N" of Group No. 79.
 Land, rolling.
 Soil, sandy and rocky, 2nd rate.
 Timber, pinyon and cedar.
 Undergrowth, yucca.
 Short grass.

From the reestablished standard cor. of secs. 34 and 35,
 on S. bdy. of Tp., (3rd. Std. Par. N.) hereinbefore described,
 N. $0^\circ 1'$ W. bet. secs. 34 and 35.

Over gently rolling land, through timber and undergrowth.
 40.00 Set an iron post, 3 ft. long, 1 in. diam., 26 ins. in the
 ground, for $\frac{1}{4}$ sec. cor., mkd. on brass cap

$\frac{1}{4}$
 S34 | S35
 1917

from which,

A pinyon, 10 ins. diam., brs. N. $83\frac{3}{4}^\circ$ E.
 110 lks. dist.; mkd. $\frac{1}{4}$ S 35 B T.
 A pinyon, 12 ins. diam., brs. N. 86° W.
 75 lks. dist.; mkd. $\frac{1}{4}$ S 34 B T.
 66.39 Bottom of draw, course NW.
 80.00 Set an iron post, 3 ft. long, 2 ins. diam., 1 in. in the
 ground, in a mound of stone, for cor. of secs. 26, 27,
 34 and 35, mkd. on brass cap

T13N R16E
 S27 | S26
 S34 | S35
 1917

from which,

A pinyon, 8 ins. diam., brs. N. 45° E.
 36 lks. dist.; mkd. T 13 N R 16 E S 26 B T.
 A pinyon, 6 ins. diam., brs. S. 13° E.
 39 lks. dist.; mkd. T 13 N R 16 E S 35 B T.
 A pinyon, 6 ins. diam., brs. S. $6\frac{3}{4}^\circ$ W.
 68 lks. dist.; mkd. T 13 N R 16 E S 34 B T.
 A pinyon, 10 ins. diam., brs. N. $47\frac{1}{2}^\circ$ W.
 89 lks. dist.; mkd. T 13 N R 16 E S 27 B T.
 Land, gently rolling.
 Soil, thin and rocky, 2nd rate.
 Timber, pinyon and cedar.
 Undergrowth, buckbrush, aldereta and sagebrush.
 Short grass.

Chains

40.00 East on a random line bet. secs. 26 and 35.
 Set temp. $\frac{1}{4}$ sec. cor.
 80.04 Fall 24 lks. S. of the cor. of secs. 25, 26, 35 and 36.
 Thence
 S. $89^{\circ} 50'$ W. on a true line bet. secs. 26 and 35.
 Over gently rolling land, through scattering timber.
 30.00 Bottom of shallow draw, course NE.
 40.02 Set an iron post, 3 ft. long, 1 in. diam., 26 ins. in the
 ground, for $\frac{1}{4}$ sec. cor., mkd. on brass cap

S 26
 S 35
 1917

from which,

A pinyon, 8 ins. diam., brs. N. $15\frac{3}{4}^{\circ}$ E.

13 lks. dist.; mkd. $\frac{1}{4}$ S 26 B T.

A pinyon, 8 ins. diam., brs. S. 6° W.

68 lks. dist.; mkd. $\frac{1}{4}$ S 35 B T.

78.00 Desc. gradual slope to
 80.04 The cor. of secs. 26, 27, 34 and 35.
 Land rolling.
 Soil, thin, 2nd rate.
 Timber, pine, pinyon and cedar.
 Undergrowth, none.

N. $0^{\circ} 1'$ W. bet. secs. 26 and 27.
 Over rolling land, through timber and undergrowth.
 Desc. 92 ft. to

24.93 Bottom of draw, course W. Asc. 40 ft. to
 29.90 Spur slopes W. Desc. 51 ft. to
 40.00 Set an iron post, 3 ft. long, 1 in. diam., 26 ins. in the
 ground, for $\frac{1}{4}$ sec. cor., mkd. on brass cap

S 27 | S 26
 1917

from which,

A pinyon, 14 ins. diam., brs. N. $79\frac{1}{2}^{\circ}$ E.

177 lks. dist.; mkd. $\frac{1}{4}$ S 26 B T.

A pine, 18 ins. diam., brs. S. $82\frac{1}{2}^{\circ}$ W.

412 lks. dist.; mkd. $\frac{1}{4}$ S 27 B T.

50.00 Bottom of small canyon, course NE. Asc. to
 56.29 Point of spur slopes E. Desc. gradual slope.
 65.98 Bottom of small canyon, course E. Wash, 20 lks. wide,
 in canyon.

72.00 Junction of canyons brs. E. 3 chs. dist.
 80.00 Set an iron post, 3 ft. long, 2 ins. diam., 24 ins. in the
 ground, in a mound of stone, for cor. of secs. 22, 23,
 26 and 27, mkd. on brass cap

T 13 N R 16 E
 S 22 | S 23
 S 27 | S 26
 1917

from which,

A pinyon, 10 ins. diam., brs. N. $5\frac{1}{2}^{\circ}$ E.
52 lks. dist.; mkd. T 13 N R 16 E S 23 B T.

A pinyon, 8 ins. diam., brs. S. $44\frac{1}{2}^{\circ}$ E.
81 lks. dist.; mkd. T 13 N R 16 E S 26 B T.

A pinyon, 12 ins. diam., brs. S. 68° W.
33 lks. dist.; mkd. T 13 N R 16 E S 27 B T.

A pinyon, 6 ins. diam., brs. N. $70\frac{1}{2}^{\circ}$ W.
77 lks. dist.; mkd. T 13 N R 16 E S 22 B T.

Land, rolling.--Soil, thin and rocky, 3rd rate.
 Timber, pinyon and cedar.--Undergrowth, buckbrush.
 Short grass.

30

Subdivision of T. 13 N., R. 16 E.

Chains

N. 89° 50' E. on a random line bet. secs. 23 and 26.
 40.00 Set temp. $\frac{1}{4}$ sec. cor.
 79.97 Fall 10 lks. N. of the cor. of secs. 23, 24, 25 and 26.
 Thence
 S. 89° 54' W. on a true line bet. secs. 23 and 26.
 Over rolling land, through timber and undergrowth.
 11.85 Bottom of small draw, course N. Asc. 44 ft. to
 20.00 Thence over gently rolling land.
 36.55 Desc. 28 ft. to
 39.98 $\frac{1}{2}$ Set an iron post, 3 ft. long, 1 in. diam., 26 ins. in the
 ground, for $\frac{1}{4}$ sec. cor., mkd. on brass cap

S23
 $\frac{1}{4}$ S 26
 1917

from which,

A pinyon, 12 ins. diam., brs. N. 38 $\frac{1}{2}$ ° W.
 117 lks. dist.; mkd. $\frac{1}{4}$ S 23 B T.
 A pinyon, 16 ins. diam., brs. S. 26° W.
 169 lks. dist.; mkd. $\frac{1}{4}$ S 26 B T.
 48.20 Bottom of small draw, course NW. Asc. 30 ft. to
 52.55 Desc. 25 ft. to
 58.40 Bottom of draw; wash, 10h. wide, course NE. Asc. gradual
 E. slope.
 79.97 The cor. of secs. 22, 23, 26 and 27.
 Land, rolling.
 Soil, sandy.
 Timber, pinyon and cedar.
 Undergrowth, buckbrush.
 Short grass.

N. 90° 1' W. bet. secs. 22 and 23.
 Over rolling land, through timber and undergrowth.
 30.00 Desc. gradual N. slope.
 23.00 Change to steep N. slope. Desc. 50 ft. to
 26.41 Bottom of draw, course E. Asc. 57 ft. to
 35.00 Thence over gently rolling land.
 40.00 Set an iron post, 3 ft. long, 1 in. diam., 26 ins. in the
 ground, for $\frac{1}{4}$ sec. cor., mkd. on brass cap

$\frac{1}{4}$
 S22 | S23
 1917

from which,

A pinyon, 10 ins. diam., brs. N. 59 $\frac{1}{2}$ ° E.
 41 lks. dist.; mkd. $\frac{1}{4}$ S 23 B T.
 A pinyon, 6 ins. diam., brs. S. 70 $\frac{1}{2}$ ° W.
 19 lks. dist.; mkd. $\frac{1}{4}$ S 22 B T.
 50.00 Bottom of small draw, course E.
 80.00 Set an iron post, 3 ft. long, 2 ins. diam., 24 ins. in the
 ground, for cor. of secs. 14, 15, 22 and 23, mkd. on
 brass cap

T13N R16E
 S15 | S14
 S22 | S23
 1917

from which,

A cedar, 28 ins. diam., brs. N. 15 $\frac{1}{4}$ ° E.
 187 lks. dist.; mkd. T 13 N R 16 E S 14 B T.
 A cedar, 30 ins. diam., brs. S. 9 $\frac{1}{2}$ ° E.
 155 lks. dist.; mkd. T 13 N R 16 E S 23 B T.
 A cedar, 10 ins. diam., brs. S. 53° W.
 152 lks. dist.; mkd. T 13 N R 16 E S 22 B T.
 A pinyon, 10 ins. diam., brs. N. 52° W.
 108 lks. dist.; mkd. T 13 N R 16 E S 15 B T.

Subdivision of T. 13 N., R. 16 E.

Chains

Land, rolling.
Soil, thin and rocky.
Timber, pinyon and cedar.
Undergrowth, rabbit brush.
Short grass.

40.00 N. 89° 54' E. on a random line bet. secs. 14 and 23.
Set temp. 1/4 sec. cor.
79.93 Fall 30 lks. N. of the cor. of secs. 13, 14, 23 and 24.

Thence
N. 89° 53' W. on a true line bet. secs. 14 and 23.
Over rolling land, through timber and undergrowth.
.60 Desc. 126 ft. to
6.50 Bottom of draw, course NW. Asc. 82 ft. to
16.40 Summit of slope brs. NE. and SW. Desc. 97 ft. to
20.46 Bottom of Brookbank Canyon, 10 lks. wide, course N. Asc. 106
ft. to
35.40 Thence over gently rolling land.
39.96 1/2 Set an iron post, 3 ft. long, 1 in. diam., 26 ins. in the
ground, for 1/4 sec. cor., mkd. on brass cap

S 14
1/4 S 23
1917

from which,
A pinyon, 8 ins. diam., brs. N. 63/4° W.
34 lks. dist.; mkd. 1/4 S 14 B T.
A pinyon, 8 ins. diam., brs. S. 54° E.
63 lks. dist.; mkd. 1/4 S 23 B T.

79.93 The cor. of secs. 14, 15, 22 and 23.
Land, rolling.
Soil, thin and rocky.
Timber, pinyon and cedar.
Undergrowth, buckbrush.
Short grass.

40.00 N. 0° 1' W. bet. secs. 14 and 15.
Over gently rolling land, through timber and undergrowth.
Set an iron post, 3 ft. long, lin. diam., 26 ins. in the
ground, for 1/4 sec. cor., mkd. on brass cap

1/4
S15 | S14
1917

from which,
A pinyon, 8 ins. diam., brs. N. 67 1/2° E.
56 lks. dist.; mkd. 1/4 S 14 B T.
A cedar, 8 ins. diam., brs. S. 42° W.
46 lks. dist.; mkd. 1/4 S-15 B T.

40.02 Line tree, cedar, 20 ins. diam.
57.00 Old indian ruins bear W. 25 lks. dist.
80.00 Set an iron post, 3 ft. long, 2 ins. diam., 24 ins. in the
ground, for cor. of secs. 10, 11, 14 and 15, mkd. on
brass cap.

T13N R16E
S10 | S11
S15 | S14
1917

from which,
A pinyon, 8 ins. diam., brs. N. 50° E.
68 lks. dist.; mkd. T 13 N R 16 E S 11 B T.

32

Subdivision of T. 13 N., R. 16 E.

Chains

Apinyon, 4 ins. diam., brs. S. 51° E.
 43 lks. dist.; mkd. T 13 N R 16 E S 14 B T.
 A juniper, 18 ins. diam., brs. S. 85 $\frac{3}{4}$ ° W.
 17 lks. dist.; mkd. T 13 N R 16 E S 13 B T
 A pinyon, 8 ins. diam., brs. N. 45 $\frac{1}{2}$ ° W.
 61 lks. dist.; mkd. T 13 N R 16 E S 10 B T.

Land, gently rolling.
 Soil, sandy and rocky.
 Timber, pinyon and cedar.
 Undergrowth, scattering yucca.
 Short grass.

40.00 S. 89° 53' E. on a random line bet. secs. 11 and 14.
 Set temp. $\frac{1}{4}$ sec. cor.
 80.12 Fall 23 lks. S. of the cor. of secs. 11, 12, 13 and 14.
 Thence S. 89° 57' W. on a true line bet. secs. 11 and 14.
 Over rolling land, through timber and undergrowth.
 Asc. gradual E. slope to
 5.23 Thence over level land.
 15.23 Desc. gentle W. slope to
 19.58 Bottom of small draw, course N. Asc. gradual SE. slope to
 26.00 Desc. gradual slope to
 34.34 Bottom of small draw, course N. Asc. 29 ft. to
 40.06 Set an iron post, 3 ft. long, 1 in. diam., 26 ins. in the
 ground, for $\frac{1}{4}$ sec. cor., mkd. on brass cap

$\frac{1}{4}$ S 11
 $\frac{1}{4}$ S 14
 1917

from which,
 A juniper, 18 ins. diam., brs. S. 5 $\frac{1}{2}$ ° W.
 128 lks. dist.; mkd. $\frac{1}{4}$ S 14 B T.
 A pinyon, 6 ins. diam., brs. N. 31° W.
 97 lks. dist.; mkd. $\frac{1}{4}$ S 11 B T.

80.12 The cor. of secs. 10, 11, 14 and 15.
 Land, gently rolling.
 Soil, sandy and rocky, 2nd rate.
 Timber, pinyon and cedar and scattering juniper.
 Undergrowth, rabbit brush.
 Short grass.

40.00 N. 0° 1' W. bet. secs. 10 and 11.
 Over gently rolling land, through timber and undergrowth.
 Set an iron post, 3 ft. long, 1 in. diam., 26 ins. in the
 ground, for $\frac{1}{4}$ sec. cor., mkd. on brass cap

$\frac{1}{4}$
 S10 | S11
 1917

from which,
 A cedar, 18 ins. diam., brs. S. 85° E.
 32 lks. dist.; mkd. $\frac{1}{4}$ S 11 B T.
 A pinyon, 18 ins. diam., brs. N. 52° W.
 117 lks. dist.; mkd. $\frac{1}{4}$ S 10 B T.

65.00 Desc. 17 ft. to
 65.97 Wash, 8 lks. wide, in rocky ravine, course NW.
 Thence over rolling land to
 65.97 Bottom of small draw; wash, 5 lks. wide, course NW.
 80.00 Set an iron post, 3 ft. long, 2 ins. diam., 6 ins. in the
 ground, in a mound of stone, for cor. of secs. 2, 3,
 10 and 11, mkd. on brass cap

Subdivision of T. 13 N., R. 16 E.

2933

Chains

T13N R16E.
S 3 | S 2
S10 | S11
1917

from which,
A pinyon, 14 ins. diam., brs. N. 73 $\frac{1}{2}$ ° E.
27 lks. dist.; mkd. T 13 N R 16 E S 2 B T.
A pinyon, 8 ins. diam., brs. S. 34 $\frac{3}{4}$ ° E.
72 lks. dist.; mkd. T 13 N R 16 E S 11 B T.
A pinyon, 14 ins. diam., brs. S. 18 $\frac{1}{4}$ ° W.
57 lks. dist.; mkd. T 13 N R 16 E S 10 B T.
A pinyon, 12 ins. diam., brs. N. 52° W.
61 lks. dist.; mkd. T 13 N R 16 E S 3 B T.

Land, gently rolling.
Soil, sandy and rocky.
Timber, pinyon and cedar.
Undergrowth, buckbrush.
Short grass.

40:00 N. 89° 57' E. on a random line bet. secs. 2 and 11.
Set temp. $\frac{1}{4}$ sec. cor.
80:20 Fall 16 lks. N. of the cor. of secs. 1, 2, 11 and 12.
Thence.
N. 89° 56' W. on a true line bet. secs. 2 and 11.
40:10 Over gently rolling land, through cedar and pinyon timber.
Set an iron post, 3 ft. long, 1 in. diam., 26 ins. in the
ground, for $\frac{1}{4}$ sec. cor., mkd. on brass cap

S 2
S 11
1917

from which,
A pinyon, 10 ins. diam., brs. N. 13 $\frac{1}{4}$ ° E.
58 lks. dist.; mkd. $\frac{1}{4}$ S 2 B T.
A pinyon, 6 ins. diam., brs. S. 33° E.
13 lks. dist.; mkd. $\frac{1}{4}$ S 11 B T.
69:20 Wash, 10 lks. wide, in small draw, course N.
76:70 Shallow wash in small draw, course N.
80:20 The cor. of secs. 2, 3, 10 and 11.
Land, gently rolling.
Soil, thin and rocky.
Timber, pinyon and cedar.
No undergrowth.

40:00 N. 0° 1' W. on a random line bet. secs. 2 and 3.
Set temp. $\frac{1}{4}$ sec. cor.
79:47 Fall 21 lks. W. of the cor. of secs. 2 and 3, on N. bdy of
Tp. described in Book "N" of Group No. 79.
Thence
S. 0° 8' W. on a true line bet. secs. 2 and 3;
Over gently rolling land, through timber and undergrowth.
39:47 Set an iron post, 3 ft. long, 1 in. diam., 26 ins. in the
ground, for $\frac{1}{4}$ sec. cor., mkd. on brass cap

S 3 | S 2
1917

from which,
A pinyon, 14 ins. diam., brs. S. 83° E.
27 lks. dist.; mkd. $\frac{1}{4}$ S 2 B T.
A pinyon, 8 ins. diam., brs. S. 50 $\frac{3}{4}$ ° W.
9 lks. dist.; mkd. $\frac{1}{4}$ S 3 B T.

30

Subdivision of T. 13 N., R. 16 E.

Chains
79.47

The cor. of secs. 2, 3, 10 and 11.
Land, gently rolling.
Soil, thin and rocky.
Timber, pinyon and cedar.
Undergrowth, buckbrush.
Short grass.

From the reestablished standard cor. of secs. 33 and 34,
on S. bdy. of Twp. (3rd. Std. Par. N.) hereinbefore described,
N. 0° 1' W. bet. secs. 33 and 34.

25.00

Over rolling land, through timber and undergrowth.
Desc. 68 ft. to

36.14

Wash, 10 lks. wide, 3 ft. deep, in bottom of draw, course
NE. Asc. 34 ft. to

40.00

Set an iron post, 3 ft. long, 1 in. diam., 26 ins. in the
ground, for $\frac{1}{4}$ sec. cor., mkd. on brass cap

$\frac{1}{4}$
S33|S34
1917

from which,

A pinyon, 12 ins. diam., brs. S. 72° E.
30 lks. dist.; mkd. $\frac{1}{4}$ S 34 B T.

A pine, 16 ins. diam., brs. S. 84° W.
90 lks. dist.; mkd. $\frac{1}{4}$ S 33 B T.

40.75

Smooth wire fence brs. N. 66 $\frac{1}{2}$ ° W. and S. 66 $\frac{1}{2}$ ° E.

52.19

Line tree, pine, 14 ins. diam.

58.58

Desc. 34 ft. to

62.47

Bottom of small draw, course NW. Desc. over rolling land.

75.01

Cor. No. 3, Homestead Entry Survey No. 187 of Sponseller's
homestead brs. E. 3.19 chs. dist.

75.79

Sponseller's house brs. S. 60 $\frac{1}{4}$ ° E, about 22 chs.

80.00

Junction of two small draws, coursing NE and SE.

Set an iron post, 3 ft. long, 2 ins. diam., 24 ins. in the
ground, for cor. of secs. 27, 28, 33 and 34, mkd. on
brass cap

T13N R16E
S28|S27
S33|S34
1917

from which,

A pinyon, 10 ins. diam., brs. N. 33 $\frac{1}{2}$ ° E.
346 lks. dist.; mkd. T 13 N R 16 E S 27 B T.

A pine, 24 ins. diam., brs. S. 64° E.
222 lks. dist.; mkd. T 13 N R 16 E S 34 B T.

A pine, 30 ins. diam., brs. S. 21° W.
219 lks. dist.; mkd. T 13 N R 16 E S 33 B T.

A pine, 20 ins. diam., brs. N. 22 $\frac{1}{4}$ ° W.
48 lks. dist.; mkd. T 13 N R 16 E S 28 B T.

Land, rolling.
Soil, thin and rocky, 2nd rate.
Timber, pine, pinyon and cedar.
Undergrowth, aldereta and buckbrush.
Short grass.

40.00

East on a random line bet. secs. 27 and 34.

79.90

Set temp. $\frac{1}{4}$ sec. cor.
Fall 5 lks. N. of the cor. of secs. 26, 27, 34 and 35.
Thence
N. 89° 58' W. on a true line bet. secs. 27 and 34.
Over rolling land, through timber and undergrowth.

Chains

- 4.00 Bottom of rocky ravine, course NW.
- 14.95 Bottom of small draw, course N.
- 29.30 Road brs. NW. and SE.
- 39.95 Set an iron post, 3 ft. long, 1 in. diam., 26 ins. in the ground, for $\frac{1}{4}$ sec. cor., mkd. on brass cap

$\frac{1}{4}$ S 27
 ~~$\frac{1}{4}$ S 34~~
 1917

from which,

- A pinyon, 8 ins. diam., brs. N. 15° W.
72 lks. dist.; mkd. $\frac{1}{4}$ S 27 B T.
- A pinyon, 8 ins. diam., brs. S. 20° W.
53 lks. dist.; mkd. $\frac{1}{4}$ S 34 B T.
- 40.81 Smooth wire fence brs. NW. and SE.
- 49.00 Desc. rocky W. slope 90 ft. to
- 69.51 Intersects E. bdy. of Sponsellers homestead, 3.34 chs. S.
2° 16' E. of cor. No. 9, Homestead Entry Survey No. 187.
- 69.70 Road brs. N. and S.
- 71.90 Junction of two draw, coursing N. and E., resultant course N.; wash, 10 lks. wide, course N. Thence along draw.
- 74.87 Intersect W. bdy. of Sponseller's homestead, 5.34 chs.
N. 20° 23' E. of cor. No. 3, Homestead Entry Survey No. 187.
- 79.90 The cor. of secs. 27, 28, 33 and 34.
Land, rolling.
Soil, thin and rocky.
Timber, pine, pinyon and cedar.
Undergrowth, buckbrush, aldereta and scrub cedar.
Short grass.

N. 0° 1' W. bet. secs. 27 and 28.
Over rolling land, through timber and undergrowth.
Asc. 91 ft. to

- 10.00 Thence over gently rolling land.
- 24.09 Wire fence brs. E. and W. Desc. 53 ft. to
- 34.64 Bottom of draw, course E. Road brs. E. and W. Asc.
gradual slope.
- 40.00 Set an iron post, 3 ft. long, 1 in. diam., 26 ins. in the ground, for $\frac{1}{4}$ sec. cor., mkd. on brass cap

$\frac{1}{4}$
 S28 | S27
 1917

from which,

- A pinyon, 10 ins. diam., brs. N. 48 $\frac{3}{4}$ ° E.
153 lks. dist.; mkd. $\frac{1}{4}$ S 27 B T.
- A pinyon, 10 ins. diam., brs. S. 44 $\frac{1}{4}$ ° W.
63 lks. dist.; mkd. $\frac{1}{4}$ S 28 B T.
- 60.00 Desc. 23 ft. to
- 67.29 Bottom of draw, course E. Asc. 31 ft. to
- 71.00 Thence over gently rolling land.
- 80.00 Set an iron post, 3 ft. long, 2 ins. diam., 24 ins. in the ground, for cor. of secs. 21, 22, 27 and 28, mkd. on brass cap

T13N R16E
 S21 | S22
 S28 | S27
 1917

from which,

- A pinyon, 8 ins. diam., brs. N. 34 $\frac{1}{2}$ ° E.
58 lks. dist.; mkd. T 13 N R 16 E S 22 B T.
- A pinyon, 8 ins. diam., brs. S. 4° E.
130 lks. dist.; mkd. T 13 N R 16 E S 27 B T.

36

Subdivision of T. 13 N. R. 16 E.

Chains

A pinyon, 6 ins. diam., brs. S. 78° W.
36 lks. dist.; mkd. T 13 N R 16 E S 28 B T.
A pinyon, 8 ins. diam., brs. N. 46½° W.
46 lks. dist.; mkd. T 13 N R 16 E S 21 B T.

Land, rolling.
Soil, thin and rocky, 2nd rate.
Timber, pine, pinyon and cedar.
Undergrowth, buckbrush.
Short grass.

40.00 S. 89° 58' E. on a random line bet. secs. 22 and 27.
Set temp. ¼ sec. cor.
80.03 Fall 23 lks. N. of the cor. of secs. 22, 23, 26 and 27.
Thence
N. 89° 48' W. on a true line bet. secs. 22 and 27.
Over rolling land, through timber and undergrowth.
7.98 Bottom of small draw, course SE. Asc. gradual slope, 21 ft.
11.97 Summit of E. slope from draw. Thence over nearly level land.
40.01½ Set an iron post, 3 ft. long, 1 in. diam., 26 ins. in the
ground, for ¼ sec. cor., mkd. on brass cap

1/4 S 22
4/8 S 27
1917

from which,

A pinyon, 6 ins. diam., brs. N. 35½° E.
33 lks. dist.; mkd. ¼ S 22 B T.
A pinyon, 8 ins. diam., brs. S. 63½° W.
9 lks. dist.; mkd. ¼ S 27 B T.

56.60 Bottom of small draw, course NE.
80.03 The cor. of secs. 21, 22, 27 and 28.
Land, gently rolling.
Soil, thin and rocky.
Timber, pinyon and cedar.
Undergrowth, aldereta.
Short grass.

40.00 N. 0° 1' W. bet. secs. 21 and 22.
Over gently rolling land, through timber and undergrowth.
Set an iron post, 3 ft. long, 1 in. diam., 26 ins. in the
ground, for ¼ sec. cor., mkd. on brass cap

1/4
S21 | S22
1917

from which,

A pinyon, 6 ins. diam., brs. S. 68½° E.
37 lks. dist.; mkd. ¼ S 22 B T.
A pinyon, 6 ins. diam., brs. N. 50½° W.
70 lks. dist.; mkd. ¼ S 21 B T.

75.00 Enter burned over area.
80.00 Set an iron post, 3 ft. long, 2 ins. diam., 8 ins. in the
ground, in a mound of stone, for cor. of secs. 15, 16,
21 and 22, mkd. on brass cap

T13N R16E
S16 | S15
S21 | S22
1917

from which,

A pinyon, 12 ins. diam., brs. N. 83½° E.
345 lks. dist.; mkd. T 13 N R 16 E S 15 B T.

Subdivision of T. 13 N. R. 16 E.

Chains

A pinyon, 12 ins. diam., brs. S. 60³/₄° E.
 215 lks. dist.; mkd. T 13 NR 16 E S 22 B T.
 A pinyon, 8 ins. diam., brs. S. 33° W.
 123 lks. dist.; mkd. T 13 NR 16 E S 21 B T.
 A pinyon, 16 ins. diam., brs. N. 42¹/₂° W.
 329 lks. dist.; mkd. T 13 NR 16 E S 16 B T.

Land, gently rolling.
 Soil, sandy and rocky.
 Timber, pine, pinyon and cedar.
 Undergrowth, buckbrush and rabbit brush.
 Short grass.

40.00 S. 89° 48' E. on a random line bet. secs. 15 and 22.
 Set temp. ¹/₄ sec. cor.
 80.06 Fall 7 lks. N. of the cor. of secs. 14, 15, 22 and 23.
 Thence
 N. 89° 45' W. on a true line bet. secs. 15 and 22.
 40.03 Over level land, through timber and undergrowth.
 Set an iron post, 3 ft. long, 1 in. diam., 26 ins. in the
 ground, for ¹/₄ sec. cor., mkd. on brass cap

1 S 15
1 S 22
 1917

from which,
 A pinyon, 18 ins. diam., brs. N. 58° W.
 87 lks. dist.; mkd. ¹/₄ S 15 B T.
 A pinyon, 6 ins. diam., brs. S. 10° E.
 40 lks. dist.; mkd. ¹/₄ S 22 B T.

75.00 Enter burned over area.
 80.06 The cor. of secs. 15, 16, 21 and 22.
 Land, level.
 Soil, thin and rocky.
 Timber, pinyon and cedar as indicated.
 Undergrowth, buckbrush, rabbit brush.
 Short grass.

12.00 N. 0° 1' W. bet. secs. 15 and 16.
 Over rolling land, through scrub timber and undergrowth,
 mostly burned off.
 Leave burned over area and enter dense timber, brs. NE.
 and SW.
 16.00 Leave dense timber, enter burned over area brs. NE. and SW.
 Thence through dense undergrowth and some second growth
 cedar timber.
 35.00 Enter scattering pine timber.
 39.98 Junction of draws, coursing W. and N., resultant course N.
 Thence along draw.
 40.00 Set an iron post, 3 ft. long, 1 in. diam., 26 ins. in the
 ground, for ¹/₄ sec. cor., mkd. on brass cap

1 S 16 | 1 S 15
 1917

from which,
 A pine, 18 ins. diam., brs. S. 39³/₄° E.
 217 lks. dist.; mkd. ¹/₄ S 15 B T.
 A pine, 36 ins. diam., brs. N. 58¹/₂° W.
 148 lks. dist.; mkd. ¹/₄ S 16 B T.

41.00 Leave old burned over area and enter dense timber.
 42.50 Leave draw, course NW. Rim of draw brs. NW. and SE.
 60.50 Rocky rim brs. NE. and SW. Desc. 24 ft. to
 62.47 Bottom of draw, course NE.

38

Subdivision of T. 13 N., R. 16 E.

Chains

65.00 Rocky rim brs. NE. and SW. Thence along gentle E. slope.
 Enter old burned area; scattering pinyon and cedar timber.
 80.00 Set an iron post, 3 ft. long, 2 ins. diam., 24 ins. in the
 ground, for cor. of secs. 9, 10, 15 and 16, mkd. on
 brass cap

T13N R16E
 S 9 | S10
 S16 | S15
 1917

from which,
 A cedar, 10 ins. diam., brs. N. 18 $\frac{1}{2}$ ° E.
 35 lks. dist.; mkd. T 13 N R 16 E S 10 B T.
 A pinyon, 12 ins. diam., brs. S. 49° E.
 134 lks. dist.; mkd. T 13 N R 16 E S. 15 B T.
 A cedar, 12 ins. diam., brs. S. 50° W.
 44 lks. dist.; mkd. T 13 N R 16 E S 16 B T.
 A pinyon, 10 ins. diam., brs. N. 66° W.
 449 lks. dist.; mkd. T 13 N R 16 E S. 9 B T.
 Land, gently rolling.
 Soil, thin and rocky.
 Timber, pine, pinyon and cedar.
 Undergrowth, aldereta and buckbrush.
 Short grass.

40.00 S. 89° 45' E. on a random line bet. secs. 10 and 15.
 Set temp. $\frac{1}{4}$ sec. cor.
 80.31 Fall 7 lks. S. of the cor. of secs. 19, 11, 14 and 15.
 Thence
 N. 89° 48' W. on a true line bet. secs. 10 and 15.
 Over gently rolling land, through timber and undergrowth.
 30.30 Enter burned over area brs. NE. and SW.
 39.30 Leave burned over area W. edge of which brs. NE. and SW.
 Enter dense timber.
 40.15 $\frac{1}{2}$ Set an iron post, 3 ft. long, 1 in. diam., 26 ins. in the
 ground, for $\frac{1}{4}$ sec. cor., mkd. on brass cap

S 10
 S 15
 1917

from which,
 A pinyon, 8 ins. diam., brs. N. 20 $\frac{3}{4}$ ° E.
 99 lks. dist.; mkd. $\frac{1}{4}$ S 10 B T.
 A pinyon, 10 ins. diam., brs. S. 72° W.
 105 lks. dist.; mkd. $\frac{1}{4}$ S 15 B T.
 42.80 Old Indian ruins (prehistoric).
 75.30 Enter burned over area brs. N. and S. Leave dense timber.
 75.60 Right edge of draw brs. N. and S. Desc. to
 77.30 Bottom of draw, course N. Asc. 65 ft. to
 78.10 Left edge of draw brs. N. and S.
 80.31 The cor. of secs. 9, 10, 15 and 16.
 Land, gently rolling.
 Soil, thin and sandy, 2nd rate.
 Timber, pinyon and cedar.
 Undergrowth, buckbrush and rabbit brush.
 Timber, pinyon and cedar.
 Short grass.

1.49 N. 0° 1' W. bet. secs. 9 and 10.
 10.00 Over gently rolling land, through dense undergrowth.
 Over old burned over area.
 Bottom of small draw, course E.; mouth brs. E. 2 chs. dist.
 Leave burned over area; enter dense timber, brs. E. and W.

Subdivision of Township 13 North, Range 16 East.

Chains.
25.00
33.46
40.00

Descend 57 ft. to
Bottom of draw, course NE. Ascend gradual slope.
Set an iron post, 3 ft. long, 1 in. in diam., 26 ins. in
the ground, for $\frac{1}{4}$ sec. cor., marked on brass cap,

S 9 $\frac{1}{4}$ S 10
1917

from which,

- A pinyon, 6 ins. in diam., brs. S. 70° E. 148 lks. dist.,
marked $\frac{1}{4}$ S 10 BT.
- A cedar, 8 ins. in diam., brs. N. 80 $\frac{1}{2}$ ° W., 234 lks. dist.,
marked $\frac{1}{4}$ S 9 BT.

42.47
80.00

Line tree, pinyon, 20 ins. diam.
Set an iron post, 3 ft. long, 2 ins. in diam., 6 ins. in
the ground, in a mound of stone, for cor. of secs. 3, 4,
9 and 10, marked on brass cap,

T13N R16E
S 4 S 3
S 9 S 10
1917

from which,

- A pinyon, 6 ins. in diam., brs. N. 44° E. 86 lks. dist.,
marked T13N R16E S3 BT.
- A cedar, 8 ins. in diam., brs. S. 12 $\frac{1}{2}$ ° E. 48 lks. dist.,
marked T13NR16E S.10BT.
- A pinyon, 12 ins. in diam., brs. S. 60 $\frac{1}{2}$ ° W., 91 lks.
dist., marked T13N R16E S9 BT.
- A pinyon, 10 ins. in diam., brs. N. 55 $\frac{3}{4}$ ° W., 129 lks.
dist., marked T13N R16E S4 BT.

Land, rolling.
Soil, thin and rocky. Timber, scattering pine, pinyon & cedar.
Undergrowth, buck brush. Short grass.

40.00
80.36
27.90
72.40
38.90
40.18

S. 89° 48' E. on random line, bet. secs. 3 and 10.
Set temp. $\frac{1}{4}$ sec. cor.
Fall 15 lks. S. of cor. of secs. 2, 3, 10 and 11.
Thence, N. 89° 54' W., on true line, bet. secs. 3 and 10.
Over rolling, broken land.

East bank of draw, brs. N. and SE. Desc. 16 ft.
Bottom of draw, course N. Asc. 45 ft.
West bank of draw, brs. N. and S.
Set an iron post, 3 ft. long, 1 in. in diam., 26 ins. in the
ground, for $\frac{1}{4}$ sec. cor., marked on brass cap,

$\frac{1}{4}$ S 3
S 10
1917

from which,

- A pinyon, 6 ins. in diam., brs. N. 52 $\frac{1}{2}$ ° W., 28 lks.
dist., marked $\frac{1}{4}$ S 3 BT.
- A pinyon, 6 ins. in diam., brs. S. 39 $\frac{1}{2}$ ° W., 31 lks.
dist., marked $\frac{1}{4}$ S 10 BT.

Continue over rolling land.
E. bank of draw, brs. NE. and SW. Descend 30 ft.
Bottom of draw, course NE. Ascend 60 ft.
West bank of draw, brs. NE. and SW. Continue ascent on E. slope.
Top of slope, brs. N. and S.
The cor. of secs. 3, 4, 9 and 10.
Land rolling and broken. Soil, thin and rocky, 3rd rate,
Timber, scattering pinyon and cedar.
Undergrowth, scattering buck growth, Fair grass.

40.00
79.44
39.44

N. 0° 1' W., on random line, bet. secs. 3 and 4.
Set temp. $\frac{1}{4}$ sec. cor.
Fall 48 lks. W. of the cor. of secs. 3 and 4, on N. bdy. of Tp.,
described in Book "N," of Group No. 79.
Thence, S. 0° 20' W., on a true line, bet. secs. 3 and 4.
Over rolling land, nearly level, thru timber and undergrowth.
Set an iron post, 3 ft. long, 1 in. in diam., 26 ins. in the
ground, for $\frac{1}{4}$ sec. cor., marked on brass cap,

4036 Subdivision of Township 13 North, Range 16 East.

Chains.

S4 | S3
1917

from which,

A cedar, 8 ins. in diam., brs. N. 50 1/2° E., 93 lks. dist., marked S3 BT.

A pinyon, 8 ins. in diam., brs. S. 73 3/4° W., 64 lks. dist., marked S 4 BT.

79.44

The cor. of secs. 3, 4, 9 and 10.
Land, nearly level. Soil, sandy and rocky.
Timber, cedar and pinyon.
Undergrowth, aldereta and buckbrush. Sparse grass.

From the reestablished std. cor. of secs. 32 and 33, on S. bdy. of Tp. (3rd Std. Par. N.) hereinbefore described, N. 0° 2' W., bet. secs. 32 and 33.

3.80

Over rolling land, thru timber and undergrowth.
Road brs. SE. to Heber, and NW. to Mud Tank and Holbrook.

15.12

Line tree, pine, 24 ins. diam.,

15.28

Pine tree, pine, 28 ins. diam.

18.46

Bottom of small draw, course NE.

19.97

Junction of two draws, coursing SE. and NE., brs. E. 1 ch. dist., resultant course SE.

20.90

Bottom of draw, course SE.

40.00

Set an iron post, 3 ft. long, 1 in. in diam., 26 ins. in the ground, for 1/4 sec. cor., marked on brass cap,

S32 | S33
1917

from which,

A juniper, 14 ins. diam., brs. N. 14° E., 185 lks. dist., marked S33 BT.

A pinyon, 10 ins. in diam., brs. N. 7 1/2° W., 203 lks. dist., marked S 32 BT.

80.00

Set an iron post, 3 ft. long, 2 ins. in diam., 24 ins. in the ground, for cor. of secs. 28, 29, 32 and 33, marked on brass cap.

T13N R16E
S29 | S28
S32 | S33
1917

from which,

A pinyon, 12 ins. in diam., brs. N. 71° E., 180 lks. dist., marked T13NR16ES28BT.

A juniper, 20 ins. in diam., brs. S. 7° E., 290 lks. dist., marked T13N R16E S33 BT.

A juniper, 24 ins. in diam., brs. S. 3 1/2° W., 360 lks. dist., marked T13N R16E S32 BT.

A juniper, 6 ins. in diam., brs. N. 5 1/4° W., 126 lks. dist., marked T13NR16ES29BT.

Land, rolling. Soil, thin and rocky.
Timber, pine, pinyon, juniper and cedar.
Undergrowth, aldereta. Short grass.

East, on a random line, bet. secs. 28 and 33.

40.00

Set temp. 1/4 sec. cor.

80.00

Fall 7 lks. N. of the cor. of secs. 27, 28, 33 and 34. Thence, N. 89° 57' W., on true line, bet. secs. 28 and 33. Over rolling land, thru timber and undergrowth.

16.00

Descend 38 ft. to

18.89

Bottom of small canyon, course SE. Ascend 75 ft. to

25.30

Summit of E. slope from canyon.

26.60

Descend 52 ft. to

30.40

Fence brs. NE. and SW. Bottom of draw, course NE. Ascend gradual slope.

40.00

Set an iron post, 3 ft. long, 1 in. in diam., 26 ins. in the ground, for 1/4 sec. cor., marked on brass cap,

S 28
S 33
1917

Subdivision of T. 13 N., R. 16 E.

Chains

from which,
 A pinyon, 12 ins. diam., brs. N. 62° W.
 97 lks. dist.; mkd. $\frac{1}{4}$ S 28 B T.
 A pinyon, 14 ins. diam., brs. S. 34° E.
 48 lks. dist.; mkd. $\frac{1}{4}$ S 33 B T.

40.20 Desc. 29 ft. to
 45.00 Bottom of small draw, course N. Asc. 18 ft. to
 47.00 Desc. 20 ft. to
 50.45 Bottom of draw, course NE. Asc. gradual slope.
 80.00 The cor. of secs. 28, 29, 32 and 33.
 Land, rolling and broken.
 Soil, thin and rocky.
 Timber, pinyon and pine, juniper and cedar.
 Undergrowth, buckbrush.
 Short grass.

N. 0° 2' W. bet. secs. 28 and 29.
 Over gently rolling land, nearly level, through timber and undergrowth.

31.85 Road brs. E. and W.
 40.00 Set an iron post, 3 ft. long, 1 in. diam., 26 ins. in the ground, for $\frac{1}{4}$ sec. cor., mkd. on brass cap

$\frac{1}{4}$
 S29 | S28
 1917

from which,
 A pinyon, 12 ins. diam., brs. N. 57° E.
 50 lks. dist.; mkd. $\frac{1}{4}$ S 28 B T.
 A pinyon, 8 ins. diam., brs. N. 62° W.
 85 lks. dist.; mkd. $\frac{1}{4}$ S 29 B T.

80.00 Set an iron post, 3 ft. long, 2 ins. diam., 24 ins. in the ground, for cor. of secs. 20, 21, 28 and 29, mkd. on brass cap.

T13N R16E
 S20 | S21
 S29 | S28
 1917

from which,
 A juniper, 12 ins. diam., brs. N. 74 $\frac{1}{2}$ ° E.
 223 lks. dist.; mkd. T 13 N R 16 E S 21 B T.
 A juniper, 8 ins. diam., brs. S. 21 $\frac{3}{4}$ ° E.
 80 lks. dist.; mkd. T 13 N R 16 E S 28 B T.
 A juniper, 8 ins. diam., brs. S. 26° W.
 99 lks. dist.; mkd. T 13 N R 16 E S 29 B T.
 A juniper, 8 ins. diam., brs. N. 49° W.
 86 lks. dist.; mkd. T 13 N R 16 E S 20 B T.

Land, gently rolling.
 Soil, thin and sandy.
 Timber, juniper, pinyon and cedar.
 Undergrowth, aldereta.
 Short grass.

40.00 S. 89° 57' E. on a random line bet. secs. 21 and 28.
 Set temp. $\frac{1}{4}$ sec. cor.
 80.16 Fall 5 lks. N. of the cor. of secs. 21, 22, 27 and 28.
 Thence

N. 89° 55' W. on a true line bet. secs. 21 and 28.
 Over gently rolling land, through timber and undergrowth.
 38.67 Bottom of draw, course SE.
 40.08 Set an iron post, 3 ft. long, 1 in. diam., 26 ins. in the ground, for $\frac{1}{4}$ sec. cor., mkd. on brass cap

42.3

Subdivision of T. 13 N. R. 16 E.

Chains

S 21
1/4 S 28
1917

from which,

A pinyon, 6 ins. diam., brs. N. 22 1/2° E.

40 lks. dist.; mkd. 1/4 S 21 B T.

A pinyon, 10 ins. diam., brs. S. 11 1/2° W.

52 lks. dist.; mkd. 1/4 S 28 B T.

80.16 The cor. of secs. 20, 21, 28 and 29.

Land, gently rolling.
Soil, thin and rocky.
Timber, pinyon and cedar.
Undergrowth, buckbrush.
Short grass.

N. 0° 2' W. bet. secs. 20 and 21.

40.00 Over gently rolling land, through timber and undergrowth.
Set an iron post, 3 ft. long, 1 in. diam., 26 ins. in the
ground, for 1/4 sec. cor., mkd. on brass cap

1/4
S20 | S21
1917

from which,

A pinyon, 8 ins. diam., brs. N. 67 1/2° E.

130 lks. dist.; mkd. 1/4 S 21 B T.

A juniper, 20 ins. diam., brs. S. 56° W.

84 lks. dist.; mkd. 1/4 S 20 B T.

47.00 Enter old burned over area and scattering timber.

70.00 Desc. 37 ft. to

77.48 Bottom of draw, course NE. Scattering pine timber along
edge of draw.

80.00 Set an iron post, 3 ft. long, 2 ins. diam., 6 ins. in the
ground, in a mound of stone, for cor. of secs. 16, 17,
20 and 21, mkd. on brass cap

T13N R16E
S17 | S16
S20 | S21
1917

from which,

A pinyon, 8 ins. diam., brs. N. 34° E.

129 lks. dist.; mkd. T 13 N R 16 E S 16 B T.

A pine, 30 ins. diam., brs. S. 13° E.

307 lks. dist.; mkd. T 13 N R 16 E S 21 B T.

A cedar, 12 ins. diam., brs. S. 16° W.

83 lks. dist.; mkd. T 13 N R 16 E S 20 B T.

No other trees within limits.

Raise a mound of stone, 3 ft. base, 2 ft. high, W. of cor.

Land, gently rolling.

Soil, thin and rocky.

Timber, pinyon, juniper and cedar.

Undergrowth, buckbrush and aldereta.

Short grass.

40.00 S. 89° 55' E. on a random line bet. secs. 16 and 21.

Set temp. 1/4 sec. cor.

79.92 Fall 37 lks. S. of the cor. of secs. 15, 16, 21 and 22.

Thence

S. 89° 49' W. on a true line bet. secs. 16 and 21.

Over gently rolling land, through timber and undergrowth,

5.00 Bottom of shallow draw, course N. over old burn.

39.96 Set an iron post, 3 ft. long, 1 in. diam., 26 ins. in the
for 1/4 sec. cor., mkd. on brass cap (ground

Chains

S16
S21
1917

from which,

A pinyon, 12 ins. diam., brs. N. 58 1/2° E.

339 lks. dist.; mkd. 1/4 S 16 B T.

A cedar, 4 ins. diam., brs. S. 36° W.

100 lks. dist.; mkd. 1/4 S 21 B T.

- 52.56 Bottom of small draw, course N. Pine timber along draw.
 - 78.05 Bottom of small draw, course NE.
 - 79.92 The cor. of secs. 16, 17, 20 and 21.
- Land, gently rolling, burned over area.
Soil, thin and rocky.
Timber, scattering pine, pinyon, cedar and juniper
Undergrowth, buckbrush.
Short grass.

N. 0° 2' W. bet. secs. 16 and 17.

Over old burned area, through scattering timber and undergrowth.

- 17.68 Bottom of small draw, course NE.
- 31.30 Right edge of draw brs. E. and W. Desc. 24 ft. to
- 33.47 Bottom of draw, course E. Asc. gradual slope.
- 36.00 Left edge of draw brs. E. and W.
- 40.00 Set an iron post, 3 ft. long, 1 in. diam., 26 ins. in the ground, for 1/4 sec. cor., mkd. on brass cap,

S17 | S16
1917

from which,

A pinyon, 8 ins. diam., brs. N. 72 3/4° E.

66 lks. dist.; mkd. 1/4 S 16 B T.

A cedar, 10 ins. diam., brs. N. 64 3/4° W.

43 lks. dist.; mkd. 1/4 S 17 B T.

- 80.00 Leave old burn and enter dense timber.
- Set an iron post, 3 ft. long, 2 ins. diam., 24 ins. in the ground, for cor. of secs. 8, 9, 16 and 17, mkd. on brass cap

T13N R16E
S 8 | S 9
S17 | S16
1917

from which,

A pinyon, 8 ins. diam., brs. N. 56 1/2° E.

50 lks. dist.; mkd. T 13 N R 16 E S 9 B T.

A pinyon, 8 ins. diam., brs. S. 70 1/2° E.

42 lks. dist.; mkd. T 13 N R 16 E S 16 B T.

A pinyon, 6 ins. diam., brs. S. 72° W.

8 lks. dist.; mkd. T 13 N R 16 E S 17 B T.

A cedar, 10 ins. diam., brs. N. 22 3/4° W.

40 lks. dist.; mkd. T 13 N R 16 E S 8 B T.

- Land, gently rolling.
- Soil, thin and rocky.
- Timber, pinyon and cedar.
- Undergrowth, buckbrush, and aldereta.
- Short grass.

44

Subdivision of T. 13 N., R. 16 E.

Chains

N. 89° 49' E. on a random line bet. secs. 9 and 16.
 40.00 Set temp. $\frac{1}{4}$ sec. cor.
 79.60 Fall 44 lks. N. of the cor. of secs. 9, 10, 15 and 16.
 Thence
 N. 89° 52' W. on a true line bet. secs. 9 and 16.
 Over burned over area, through scattering timber and under-
 growth.
 Desc. gradual slope to
 1.70 Bottom of small draw, course NE. Asc. 23 ft. to
 10.00 Thence asc. very gradual slope to
 17.00 Thence over nearly level land.
 39.80 Set an iron post, 3 ft. long, 1 in. diam., 26 ins. in the
 ground, for $\frac{1}{4}$ sec. cor., mkd. on brass cap

S 9
 $\frac{1}{4}$ S 16
 1917

from which,

A pinyon, 10 ins. diam., brs. N. 30° E.
 95 lks. dist.; mkd. $\frac{1}{4}$ S 9 B T.
 A pinyon, 6 ins. diam., brs. S. 29 $\frac{3}{4}$ ° W..
 85 lks. dist.; mkd. $\frac{1}{4}$ S 16 B T.
 40.65 Rocky, right rim of draw brs. N. and S. Desc. 34 ft. to
 42.58 Bottom of draw, course N. Asc. to
 45.00 Left rim of draw, brs. N. and S.
 46.00 Leave burned area, thence through dense timber, brs. N. and S.
 79.60 The cor. of secs. 8, 9, 16 and 17.
 Land, E. 45 chs. rolling and broken; remainder gently rolling.
 Soil, thin and rocky.
 Timber, pinyon and cedar; scrub timber on burned area.
 Undergrowth, buckbrush and aldereta.
 Short grass.

N. 0° 2' W. bet. secs. 8 and 9.
 Over gently rolling land, through timber and undergrowth.
 10.00 Desc. 19 ft. to
 16.57 Bottom of small draw, course NE. /Heber.
 Wagon road brs. NE. to Holbrook and SW. to Mud Tank and
 Asc. gradual slope to
 20.00 Thence over nearly level land.
 40.00 Set an iron post, 3 ft. long, 1 in. diam., 26 ins. in the
 ground, for $\frac{1}{4}$ sec. cor., mkd. on brass cap

S 8 | S 9
 1917

from which,

A cedar, 10 ins. diam., brs. N. 28° E.
 36 lks. dist.; mkd. $\frac{1}{4}$ S 9 B T.
 A cedar, 6 ins. diam., brs. S. 32° W.
 59 lks. dist.; mkd. $\frac{1}{4}$ S 8 B T.
 45.00 Desc. gradual slope to
 46.79 Bottom of small draw, course NE. Asc. gradual slope to
 50.00 Thence over nearly level land.
 80.00 Set an iron post, 3 ft. long, 2 ins. diam., 6 ins. in the
 ground, in a mound of stone, for cor. of secs. 4, 5,
 8 and 9, mkd. on brass cap

T13N R16E
 S 5 | S 4
 S 8 | S 9
 1917

Chains

from which;
 A pinyon, 6 ins. diam., brs. N. 58 $\frac{1}{2}$ ° E.
 62 lks. dist.; mkd. T 13 N., R. 16 E. § 4 B T.
 A pinyon, 6 ins. diam., brs. S. 28° E.
 62 lks. dist.; mkd. T 13 N R 16 E S 9 B T.
 A pinyon, 6 ins. diam., brs. S. 19 $\frac{1}{2}$ ° W.
 60 lks. dist.; mkd. T 13 N R 16 E S 8 B T.
 A pinyon, 8 ins. diam., brs. N. 64° W.
 108 lks. dist.; mkd. T 13 N R 16 E S 5 B T.

Land, rolling.
 Soil, sandy and rocky.
 Timber, pinyon and cedar.
 Undergrowth, buckbrush.
 Short grass.

40.00 S. 89° 52' E. on a random line bet. secs. 4 and 9.
 Set temp. $\frac{1}{4}$ sec. cor.
 79.66 Fall 3 lks. N. of the cor. of secs. 3, 4, 9 and 10.
 Thence
 N. 89° 51' W. on a true line bet. secs. 4 and 9.
 Over rolling land, through timber and undergrowth.
 39.83 Set an iron post, 3 ft. long, 1 in. diam., 26 ins. in the
 ground, for $\frac{1}{4}$ sec. cor.; mkd. on brass cap

$\frac{1}{4}$ S. 4
 $\frac{1}{4}$ S. 9
 1917

from which,
 A pinyon, 6 ins. diam., brs. N. 31 $\frac{3}{4}$ ° W.
 170 lks. dist.; mkd. $\frac{1}{4}$ S 4 B T.
 A pinyon, 8 ins. diam., brs. S. 44° W.
 79 lks. dist.; mkd. $\frac{1}{4}$ S 9 B T.

60.00 Desc. 45 ft. to
 66.66 Bottom of draw course N.
 Wagon road in draw brs. N. to Holbrook and S. to Mud Tank.
 Asc. gradual slope.
 68.76 Thence over gently rolling land.
 79.66 The cor. of secs. 4, 5, 8 and 9.
 Land, rolling.
 Soil, thin and rocky.
 Timber, pinyon and cedar.
 Undergrowth, aldereta and buckbrush.
 Short grass.

40.00 N. 0° 2' W. on a random line bet. secs. 4 and 5.
 Set temp. $\frac{1}{4}$ sec. cor.
 79.33 Fall 6 lks. W. of the cor. of secs. 4 and 5 on N. bdy. of
 Tp., described in book "N", of Group No. 79.
 Thence
 S. 0° 1' W. on a true line bet. secs. 4 and 5.
 Over gently rolling land, through timber.
 5.00 Desc. 23 ft. to
 10.00 Bottom of shallow wash, course NE. Asc. gradual slope.
 39.33 Set an iron post, 3 ft. long, 1 in. diam., 26 ins. in the
 ground, for $\frac{1}{4}$ sec. cor., mkd. on brass cap

$\frac{1}{4}$ S 5
 $\frac{1}{4}$ S 4
 1917

from which,
 A pinyon, 8 ins. diam., brs. S. 70° E.
 77 lks. dist.; mkd. $\frac{1}{4}$ S 4 B T.

46

Subdivision of T. 13 N., R. 16 E.

Chains

79.33 A pinyon, 8 ins. diam., brs. N. 80° W.
 19 lks. dist.; mkd. $\frac{1}{4}$ S 5 B T.
 The cor. of secs. 4, 5, 8 and 9.
 Land, gently rolling.
 Soil, thin and rocky.
 Timber, pinyon and cedar.
 No undergrowth.
 Short grass.

40.00 From the reestablished standard cor. of secs. 31 and 32, on
 the S. by of T. 13 N. (3rd. Standard Parallel North) hereinbe-
 fore described,
 N. 0° 2' W. bet. secs. 31 and 32.
 Over gently rolling land, through timber and undergrowth.
 Set an iron post, 3 ft. long, 1 in. diam., 26 ins. in the
 ground, for $\frac{1}{4}$ sec. cor., mkd. on brass cap

$\frac{1}{4}$
 S31 | S32
 1917

80.00 from which,
 A juniper, 10 ins. diam., brs. N. 14° E.
 89 lks. dist.; mkd. $\frac{1}{4}$ S 32 B T.
 A juniper, 14 ins. diam., brs. S. 36° W.
 54 lks. dist.; mkd. $\frac{1}{4}$ S 31 B T.
 Set an iron post, 3 ft. long, 2 ins. diam., 12 ins. in the
 ground, in a mound of stone, for cor. of secs. 29, 30,
 31 and 32, mkd. on brass cap

T13N R16E
 S30 | S29
 S31 | S32
 1917

from which,
 A juniper, 30 ins. diam., brs. N. 40 $\frac{1}{2}$ ° E.
 106 lks. dist.; mkd. T 13 N R 16 E S 29 B T.
 A pine, 36 ins. diam., brs. S. 4 $\frac{1}{2}$ ° E.
 63 lks. dist.; mkd. T 13 N R 16 E S 32 B T.
 A juniper, 36 ins. diam., brs. S. 39 $\frac{1}{2}$ ° W.
 144 lks. dist.; mkd. T 13 N R 16 E S 31 B T.
 A pinyon, 18 ins. diam., brs. N. 45 $\frac{1}{2}$ ° W.
 109 lks. dist.; mkd. T 13 N R 16 E S 30 B T.
 Land, gently rolling.
 Soil, thin and sandy.
 Timber, pine, pinyon, juniper and cedar.
 Undergrowth, aldereta.
 Short grass.

40.00 East on a random line bet. secs. 29 and 32.
 Set temp. $\frac{1}{4}$ sec. cor.
 79.97 Fall 2 lks. S. of the cor. of secs. 28, 29, 32 and 33.
 Thence
 S. 89° 59' W. on a true line bet. secs. 29 and 32.
 Over gently rolling land, nearly level, through timber.
 39.98 $\frac{1}{2}$ Set an iron post, 3 ft. long, 1 in. diam., 26 ins. in the
 ground, for $\frac{1}{4}$ sec. cor., mkd. on brass cap

S 29
 $\frac{1}{4}$ S 32
 1917

from which,
 A juniper, 14 ins. diam., brs. N. 41 $\frac{1}{2}$ ° E.
 38 lks. dist.; mkd. $\frac{1}{4}$ S 29 B T.

Subdivision of T. 13 N., R. 16 E.

Chains

54.00 A juniper, 12 ins. diam., brs. S. 69° W.
 79.97 26 lks. dist.; mkd. $\frac{1}{4}$ S 32 B T.
 Road brs. S. to Heber and N. to Mud Tank and Holbrook.
 The cor. of secs. 29, 30, 31 and 32.
 Land, nearly level.
 Soil, sandy and rocky.
 Timber, pine, pinyon, cedar and juniper.
 Undergrowth, none.
 Fair growth of grass..

40.00 West on a random line bet. secs. 30 and 31.
 88.06 Set temp. $\frac{1}{4}$ sec. cor.
 Fall 2 lks. N. of the reestablished cor. of secs. 30 and
 31, on W. bdy. of Tp., hereinbefore described.
 Thence
 N. 89° 59' E. on a true line bet. secs. 30 and 31.
 Over gently rolling land, through timber and undergrowth.
 Asc. gradual slope to
 8.17 Desc. 49 ft. to
 18.64 Bottom of draw, course NE. Asc. 20 ft. to
 25.00 Desc. 20 ft. to
 30.14 Bottom of draw, course N. Asc. 48 ft. to
 39.00 Thence over gently rolling land.
 48.06 Set an iron post, 3 ft. long, 1 in. diam., 26 ins. in the
 ground, for $\frac{1}{4}$ sec. cor., mkd. on brass cap

S 30
~~48~~ S 31
 1917

from which,
 A juniper, 8 ins. diam., brs. N. 81 $\frac{1}{2}$ ° W.
 99 lks. dist.; mkd. $\frac{1}{4}$ S 30 B T.
 A juniper, 19 ins. diam., brs. S. 15° E.
 130 lks. dist.; mkd. $\frac{1}{4}$ S 31 B T.
 80.07 Bottom of shallow grassy draw, course N. Asc. gradual slope.
 88.06 The cor. of secs. 29, 30, 31 and 32.
 Land, rolling.
 Soil, sandy and rocky.
 Timber, pine, pinyon, cedar and juniper..
 Undergrowth, scrub timber.
 Fair growth of grass.

23.20 N. 0° 2' W. bet. secs. 29 and 30.
 33.40 Over gently rolling land, through timber.
 40.00 Very shallow draw, course NE.
 Wagon road brs. E. and W.
 Set an iron post, 3 ft. long, 1 in. diam., 26 ins. in the
 ground, for $\frac{1}{4}$ sec. cor., mkd. on brass cap

S 30 | S 29
 1917

from which,
 A pine, 30 ins. diam., brs. N. 51° E.
 167 lks. dist.; mkd. $\frac{1}{4}$ S 29 B T.
 A pine, 28 ins. diam., brs. S. 70 $\frac{1}{2}$ ° W.
 47 lks. dist.; mkd. $\frac{1}{4}$ S 30 B T.
 72.80 Road brs. NW. and SE.
 73.00 Bottom of shallow draw, course NW.
 80.00 Set an iron post, 3 ft. long, 2 ins. diam., 6 ins. in the
 ground, in a mound of stone, for cor. of secs. 19, 20,
 29 and 30, mkd. on brass cap

48

Subdivision of T. 13 N. R. 16 E.

Chains

T13 N R16 E
S19 | S20
S30 | S29
1917

from which,

- A pine, 14 ins. diam., brs. N. 44° E.
55 lks. dist.; mkd. T 13 N R 16 E S 20 B T.
- A pine, 30 ins. diam., brs. S. 50½° E.
228 lks. dist.; mkd. T 13 N R 16 E S 29 B T.
- A pine, 24 ins. diam., brs. S. 4° W.
163 lks. dist.; mkd. T 13 N R 16 E S 30 B T.
- A pine, 18 ins. diam., brs. N. 44½° W.
144 lks. dist.; mkd. T 13 N R 16 E S 19 B T.

Land, gently rolling.
Soil, sandy and rocky, 2nd rate.
Timber, pine, pinyon and cedar.
No undergrowth.
Fair growth of grass.

- 40.00 N. 89° 59' E. on a random line bet. secs. 20 and 29.
Set temp. ¼ sec. cor.
- 79.90 Fall 7 lks. N. of the cor. of secs. 20, 21, 28 and 29.
Thence
N. 89° 58' W. on a true line bet. secs. 20 and 29.
Over gently rolling land, through timber.
- 39.10 Bottom of small draw, course N.
- 39.95 Set an iron post, 3 ft. long, 1 in. diam., 26 ins. in the
ground, for ¼ sec. cor., mkd. on brass cap

S 20
S 29
1917

from which,

- A pine, 14 ins. diam., brs. N. 30½° W.
163 lks. dist.; mkd. ¼ S 20 B T.
- A pine, 24 ins. diam., brs. S. 45° E.
107 lks. dist.; mkd. ¼ S 29 B T.
- 79.28 Road brs. NW. to Holbrook, and SE. to Mud Tank. & Heber.
- 79.90 The cor. of secs. 19, 20, 29 and 30.
Land, gently rolling.
Soil, thin and rocky.
Timber, pinyon, pine, juniper and cedar.
No undergrowth.
Fair growth of grass.

- 40.00 S. 89° 59' W. on a random line bet. secs. 19 and 30.
Set temp. ¼ sec. cor.
- 88.17 Fall 21 lks. N. of the reestablished cor. of secs. 19 and
30, on W. bdy. of Tp., hereinbefore described.
Thence
N. 89° 50' E. on a true line bet. secs. 19 and 30.
Over rolling land, through timber.
- 26.70 Bottom of small draw, course NE. Asc. gradual slope to
- 33.00 Thence over nearly level land.
- 48.17 Set an iron post, 3 ft. long, 1 in. diam., 26 ins. in the
ground, for ¼ sec. cor., mkd. on brass cap

S 19
S 30
1917

from which,

subdivision of Township 13 North, Range 16 East. 49.

Chains.

74.70 A pinyon, 14 ins. in diam., brs. N. 38° W., 82 lks. dist., marked $\frac{1}{4}$ S 19 BT.
 A juniper, 6 ins. in diam., brs. S. 66 $\frac{1}{2}$ ° W., 72 lks. dist., marked $\frac{1}{4}$ S 30 BT.
 Bottom of small draw, course NE. Wash, 10 lks. wide, 1 ft. deep, in draw.
 83.02 Road brs. NW. to Holbrook, and SE. to Mud Tank and Heber.
 83.20 Bottom of small draw, course NW.
 88.17 The cor. of secs. 19, 20, 29 and 30.
 Land, rolling.
 Soil, thin and rocky.
 Timber, pine, pinyon, juniper and cedar.
 No undergrowth.
 Fair growth of grass.

 N. 0° 2' W., bet. secs. 19 and 20.
 Over gently rolling land, thru timber and undergrowth.
 6.00 Road brs. NE. to Holbrook, and SW. to Mud Tank and Heber.
 8.53 Line tree, pine, 30 ins. diam.,
 12.14 Line tree, pine, 18 ins. in diam.
 40.00 Set an iron post, 3 ft. long, 1 in. in diam., 26 ins. in the ground, for $\frac{1}{4}$ sec. cor., marked on brass cap,

S 19 | S 20
 1917

from which,
 A juniper, 8 ins. in diam., brs. N. 70° E., 120 lks. dist., marked $\frac{1}{4}$ S 20 BT.
 A pine, 18 ins. in diam., brs. S. 5 $\frac{1}{2}$ ° W., 67 lks. dist., marked $\frac{1}{4}$ S 19 BT.
 63.70 Road brs. NE. to Holbrook, and SW. to Mud Tank and Heber.
 80.00 Set an iron post, 3 ft. long, 2 ins. in diam., 24 ins. in the ground, for cor. of secs. 17, 18, 19 and 20, marked on brass cap,

T 13 N R 16 E
 S 18 | S 17
 S 19 | S 20
 1917

from which,
 A pine, 20 ins. in diam., brs. N. 36° E., 136 lks. dist., marked T 13 N R 16 E S 17 BT.
 A pinyon, 8 ins. in diam., brs. S. 2 $\frac{3}{4}$ ° E., 400 lks. dist., marked T 13 N R 16 E S 20 BT.
 A pinyon, 12 ins. in diam., brs. S. 20 $\frac{1}{2}$ ° W., 297 lks. dist., marked T 13 N R 16 E S 19 BT.
 A pine, 36 lks. dist., brs. N. 59 $\frac{1}{2}$ ° W., 86 lks. dist., marked T 13 N R 16 E S 18 BT.
 Land, gently rolling.
 Soil, sandy and rocky, 2nd rate.
 Timber, pine, pinyon and cedar.
 Undergrowth, none.
 Fair growth of grass.

 S. 89° 58' E., on a random line, bet. secs. 17 and 20.
 40.00 Set temp. $\frac{1}{4}$ sec. cor.
 79.75 Fall 5 lks. S. of the cor. of secs. 16, 17, 20 and 21.
 Thence,
 West, on true line, bet. secs. 17 and 20.
 Over gently rolling land, thru timber and undergrowth on burned over area.
 14.98 Leave burned area, enter open park, extending N. and S. of line, 5 chs. dist.
 24.98 Enter timber, brs. N. and S.
 39.87 $\frac{1}{2}$ Set an iron post, 3 ft. long, 1 in. in diam., 26 ins. in the ground, for $\frac{1}{4}$ sec. cor., marked on brass cap,

$\frac{1}{4}$ S 17
 S 20
 1917

50 Subdivision of Township 13 North, Range 16 East.

chains.

from which,

A pinyon, 10 ins. in diam., brs. S. 21 1/4° E., 37 lks. dist., marked 1/4 S 20 BT.

A pinyon, 14 ins. in diam., brs. N. 21° W., 55 lks. dist., marked 1/4 S 17 BT.

50.00
69.30
79.75

Enter scattering pine timber.
Road brs. NE. to Holbrook, and SW. to Mud Tank, and Heber.
The cor. of secs. 17, 18, 19 and 20.
Land, gently rolling. Soil, sandy and rocky, 3rd rate.
Timber, pine, pinyon, juniper and cedar.
Undergrowth, buck brush and aldereta. Fair growth of grass.

S. 89° 50' W., on a random line, bet. secs. 18 and 19.

40.00
88.14

Set temp. 1/4 sec. cor.
Fall 13 lks. S. of the reestablished cot. of secs. 18 and 19, on W. bdy. of Tp., hereinbefore described.
Thence, N. 89° 55' E., on a true line, bet. secs. 18 and 19.
Descend gradual E. slope; thru. scattering timber and undergrowth.

23.16

Bottom of open grassy, draw, 3 chs. wide, course N. Ascend 29 ft. to

25.00

Thence over nearly level land.

48.14

Set an iron post, 3 ft. long, 1 in. in diam., 26 ins. in the ground, for 1/4 sec. cor., marked on brass cap,

1/4 S 18
S 19
1917.

from which,

A cedar, 8 ins. in diam., brs. N. 29° E., 172 lks. dist., marked 1/4 S 18 BT.

A pine, 36 ins. diam., brs. S. 82° W., 355 lks. dist., marked 1/4 S 19 BT.

88.14

The cor. of secs. 17, 18, 19 and 20.
Land, nearly level. Soil, thin and sandy, 2nd rate.
Timber, pinyon, cedar and juniper, few pine.
Undergrowth, buck brush. Short grass.

N. 0° 2' W., bet. secs. 17 and 18.

10.60
40.00

Over gently rolling land, thru. timber and undergrowth.
Wagon road, brs. E. and W.
Set an iron post, 3 ft. long, 1 in. in diam., 26 ins. in the ground, for 1/4 sec. cor., marked on brass cap,

S 18 S 17
1917

from which,

A pinyon, 8 ins. in diam., brs. S. 37° E., 19 lks. dist., marked 1/4 S 17 BT.

A pinyon, 12 ins. in diam., brs. N. 60 1/2° W., 5 lks. dist., marked 1/4 S 18 BT.

80.00

Set an iron post, 3 ft. long, 2 ins. diam., 24 ins. in the ground, for cor. of secs. 7, 8, 17 and 18, marked on brass cap,

T13N R16E
S 7 S 8
S 18 S 17
1917

from which,

A pinyon, 6 ins. in diam., brs. N. 42 1/2° E., 67 lks. dist., marked T13NR16ES8BT.

A pinyon, 8 ins. in diam., brs. S. 22 1/4° E., 105 lks. dist., marked T13NR16ES17BT.

A pinyon, 6 ins. in diam., brs. S. 75 1/2° W., 74 lks. dist., marked T13NR16ES18BT.

A pinyon, 6 ins. in diam., brs. N. 48° W., 141 lks. dist., marked T13NR16ES7BT.

Land, nearly level. Soil, thin and sandy, 2nd rate.
Timber, pinyon, cedar, and juniper; few pine.
Undergrowth, huck brush.
Short grass.

Subdivision of T. 13 N., R. 16 E.

Chains

40.00 East on a random line bet. secs. 8 and 17.
 Set temp. $\frac{1}{4}$ sec. cor.
 79.82 Fall 29 lks. S. of the cor. of secs. 8, 9, 16 and 17.
 Thence
 S. $89^{\circ} 48'$ W. on a true line bet. secs. 8 and 17.
 Over rolling, nearly level land, through timber and
 undergrowth, along S. edge of old burned area.
 14.81 Leave burned area.
 17.04 Road brs. N. to Holbrook and S. to Mud Tank and Heber.
 39.91 Set an iron post, 3 ft. long, 1 in. diam., 26 ins. in the
 ground, for $\frac{1}{4}$ sec. cor., mkd. on brass cap

$\frac{1}{4}$ S 8
 $\frac{1}{4}$ S 17
 1917

from which,

A pinyon, 6 ins. diam., brs. N. $10\frac{1}{2}^{\circ}$ E.
 33 lks. dist.; mkd. $\frac{1}{4}$ S 8 B T.

A cedar, 8 ins. diam., brs. S. $37\frac{3}{4}^{\circ}$ E.
 96 lks. dist.; mkd. $\frac{1}{4}$ S 17 B T.

79.82 The cor. of secs. 7, 8, 17 and 18.
 Land, W. $\frac{1}{2}$ nearly level, E. $\frac{1}{2}$ mile rolling.
 Soil, thin and rocky, 3rd rate.
 Timber, pinyon and cedar with scattering pine and pinyon.
 Undergrowth, Buckbrush and aldereta.
 Short grass.

40.00 S. $89^{\circ} 55'$ W. on a random line bet. secs. 7 and 18.
 Set temp. $\frac{1}{4}$ sec. cor.
 87.95 Fall 28 lks. N. of the reestablished cor. of secs. 7 and
 18, on W. bdy. of Tp., hereinbefore described.
 Thence
 N. $89^{\circ} 44'$ E. on a true line bet. secs. 7 and 18.
 Over rolling land, through timber and undergrowth.
 28.00 Desc. 53 ft. to
 28.50 Bottom of open grassy draw, 2 chs. wide, course N. Asc.
 gradual slope.
 47.95 Set an iron post, 3 ft. long, 1 in. diam., 26 ins. in the
 ground, for $\frac{1}{4}$ sec. cor., mkd. on brass cap

$\frac{1}{4}$ S 7
 $\frac{1}{4}$ S 18
 1917

from which,

A pinyon, 6 ins. diam., brs. N. $55\frac{1}{4}^{\circ}$ E.
 130 lks. dist.; mkd. $\frac{1}{4}$ S 7 B T.

A pinyon, 6 ins. diam., brs. S. 26° W.
 28 lks. dist.; mkd. $\frac{1}{4}$ S 18 B T.

87.95 The cor. of secs. 7, 8, 17 and 18.
 Land, rolling.
 Soil, thin and rocky, 3rd rate.
 Timber, pinyon and cedar.
 Undergrowth, buckbrush.
 Short grass.

40.00 N. $0^{\circ} 2'$ W. bet. secs. 7 and 8.
 Over level land, through timber and undergrowth.
 Set an iron post, 3 ft. long, 1 in. diam., 26 ins. in the
 ground, for $\frac{1}{4}$ sec. cor., mkd. on brass cap

$\frac{1}{4}$ S 7
 $\frac{1}{4}$ S 8
 1917

174

52

Subdivision of T. 13 N., R. 16 E.

Chains

from which,

A pinyon, 8 ins. diam., brs. N. $57\frac{1}{2}^\circ$ E.
12 lks. dist.; mkd. $\frac{1}{4}$ S 8 B T.

A pinyon, 10 ins. diam., brs. N. $47\frac{1}{2}^\circ$ W.
40 lks. dist.; mkd. $\frac{1}{4}$ S 7 B T.

80.00 Set an iron post, 3 ft. long, 2 ins. diam., 24 ins. in the ground, for cor. of secs. 5, 6, 7 and 8, mkd. on brass cap

T13N R16E
S 6 | S 5
S 7 | S 8
1917

from which,

A pinyon, 6 ins. diam., brs. N. 62° E.
22 lks. dist.; mkd. T 13 N R 16 E S 5 B T.

A pinyon, 10 ins. diam., brs. S. $59\frac{3}{4}^\circ$ E.
30 lks. dist.; mkd. T 13 N R 16 E S 8 B T.

A cedar, 8 ins. diam., brs. S. 26° W.
46 lks. dist.; mkd. T 13 N R 16 E S 7 B T.

A pinyon, 10 ins. diam., brs. N. $21\frac{1}{4}^\circ$ W.
39 lks. dist.; mkd. T 13 N R 16 E S 6 B T.

Land, nearly level.
Soil, sandy and rocky, 2nd rate.
Timber, pinyon and cedar.
Undergrowth, aldereta.
Short grass.

40.00 N. $89^\circ 48'$ E. on a random line bet. secs. 5 and 8.
Set temp. $\frac{1}{4}$ sec. cor.

79.82 Fall 28 lks. N. of the cor. of secs. 4, 5, 8 and 9.
Thence

West on a true line bet. secs. 5 and 8.

Over gently rolling land, through timber.

39.91 Set an iron post, 3 ft. long, 1 in. diam., 26 ins. in the ground, for $\frac{1}{4}$ sec. cor., mkd. on brass cap

$\frac{1}{4}$ S 5
 $\frac{1}{4}$ S 8
1917

from which,

A cedar, 8 ins. diam., brs. N. $21\frac{1}{4}^\circ$ E.
55 lks. dist.; mkd. $\frac{1}{4}$ S 5 B T.

A pinyon, 8 ins. diam., brs. S. $35\frac{1}{4}^\circ$ E.
71 lks. dist.; mkd. $\frac{1}{4}$ S 8 B T.

48.48 Desc. 49 ft. to
Bottom of draw, course N. Asc. gradual slope.
79.82 The cor. of secs. 5, 6, 7 and 8.

Land, gently rolling.
Soil, thin and rocky, 3rd rate.
Timber, pinyon and cedar.
Undergrowth, none.
Short grass.

40.00 S. $89^\circ 44'$ W. on a random line bet. secs. 6 and 7.
Set temp. $\frac{1}{4}$ sec. cor.

87.87 Fall 5 lks. N. of the reestablished cor. of secs. 6 and 7,
on W. bdy. of Tp., which is hereinbefore described.
Thence

N. $89^\circ 42'$ E. on a true line bet. secs. 6 and 7.

Over rolling land, through timber and undergrowth. Desc.

3.00 Bottom of Potato Wash Canyon, course NE. Asc. 23 ft. to

5.00 Right rim of Potato Wash, brs. northeast and southwest.
Summit of NW. slope. Thence over nearly level land.
25.00 Bottom of shallow draw, course N. Asc. gradual slope to
41.80 Left edge of draw brs. N. and S. Desc. 104 ft. to draw.
47.87 Set an iron post, 3 ft. long, 1 in. diam., 26 ins. in the
ground, for $\frac{1}{4}$ sec. cor., mkd. on brass cap

$\frac{1}{4}$ S 6
 $\frac{1}{4}$ S 7
1917

from which,
A pinyon, 10 ins. diam., brs. N. 45° W.
63 lks. dist.; mkd. $\frac{1}{4}$ S 6 B T.
A pinyon, 12 ins. diam., brs. S. 19 $\frac{3}{4}$ ° E.
131 lks. dist.; mkd. $\frac{1}{4}$ S 7 B T.
Desc. E. slope to

57.00 Bottom of draw, course N. Asc. 25 ft. to
59.20 Right edge of draw brs. N. and S.
63.00 Desc. 21 ft. to
65.67 Bottom of draw, course NW. Asc. gradual slope.
87.87 The cor. of secs. 5, 6, 7 and 8.
Land, rolling and broken.
Soil, thin and rocky, 3rd rate.
Timber, pine, pinyon and cedar.
Undergrowth, buckbrush.
Short grass.

40.00 N. 0° 2' W. on a random line bet. secs. 5 and 6.
Set temp. $\frac{1}{4}$ sec. cor.
79.42 Fall 9 lks. E. of the cor. of secs. 5 and 6, on N. bdy. of
Tp., described in book "N", of Group No. 79.
Thence
S. 0° 6' E. on a true line bet. secs. 5 and 6.
Over level land, through timber and undergrowth.
39.42 Set an iron post, 3 ft. long, 1 in. diam., 26 ins. in the
ground, for $\frac{1}{4}$ sec. cor., mkd. on brass cap

$\frac{1}{4}$ S 6
 $\frac{1}{4}$ S 5
1917

from which,
A pinyon, 10 ins. diam., brs. N. 79 $\frac{1}{2}$ ° E.
87 lks. dist.; mkd. $\frac{1}{4}$ S 5 B T.
A pinyon, 5 ins. diam., brs. S. 83 $\frac{1}{4}$ ° W.
65 lks. dist.; mkd. $\frac{1}{4}$ S 6 B T.

79.42 The cor. of secs. 5, 6, 7 and 8.
Land, level.
Soil, thin and rocky, 3rd rate.
Timber, pinyon and cedar.
Undergrowth, yucca.
Short grass.

GENERAL DESCRIPTION

SURFACE: The greater part of the township is gently rolling; the eastern and southeastern parts are broken by Meadowbrook Canyon and a number of draws and small canyons. Potato Wash courses through Sec. 6 in a northeasterly and northerly direction.

DRAINAGE AND WATER SUPPLY: The general drainage of the eastern half of the township is northeasterly, through Brookbank Canyon and other draws. The drainage of the western half of the township is northerly and eventu-

General Description (continued)

ally finds its way into Potato Wash. There is a tank in in Sec. 27.

SOIL: The soil is thin and sandy or rocky, mostly 2nd and 3rd rates.

VEGETATION: This township is covered with a scattering growth of pinyon and cedar. An old forest fire has devastated most of Sec. 16, and parts of Secs. 3, 9, 10, 15 and 21, but this old "burn" is being gradually obliterated by second-growth timber. This township is in the Sitgreaves National Forest. Underbrush is buckbrush, rabbit brush, sagebrush, aldereta and some yucca. Most of the township is covered by a growth of short grass.

MINERAL: No indications of valuable minerals noted on the surface.

IMPROVEMENTS AND SETTLERS: Several unimproved roads cross the township, northerly to Holbrook and southerly to Heber.

One settler, S.A. Sponseller, has a forest home- stead (unpatented as yet at time of survey) in Secs. 27 and 34, with fences in Secs, 28 and 33. He has a fair-sized tank or reservoir under fence near the center of Sec. 27.

There were 4 sites of old Indian ruins noted during this survey, in Secs. 10 and 15, west of Sec. 31, and south of Sec. 34.

Township 13 North, Range 16 East
Table of Latitudes, Departures, and Closing Errors

Line Designated	True Bearing	Dist. chs.	Latitudes		Departures	
			N. chs.	S. chs.	E. chs.	W. chs.
South Bdy. (3rd Std. P. N)	West	488.25				488.25
West Boundary	N.0°14'W.	22.91	22.91			.09
	North	40.13	40.13			.00
	N.0°02'W.	40.00	40.00			.02
	N.0°04'W.	40.00	40.00			.05
	N.0°03'W.	39.96	39.96			.03
	N.0°04'E.	39.98	39.98		.16	.03
	N.0°22'W.	39.78	39.78			.25
	N.0°03'E.	40.03	40.03		.03	
	N.0°10'W.	40.01	40.01			.12
	N.0°29'W.	40.08	40.08			.34
	N.0°03'E.	40.04	40.04		.03	
N.0°05'E.	40.03	40.03		.06		
North Boundary	East	485.19			485.19	
East Boundary	S.0°32'E.	39.95		39.95		
	S.0°21'E.	39.88		39.88	.37	
	S.0°05'E.	40.00		40.00	.24	
	S.0°08'W.	39.58		39.58	.06	
	S.0°27'E.	39.66		39.66		.09
	S.0°31'E.	40.11		40.11	.31	
	S.0°33'E.	40.29		40.29	.36	
	S.0°27'E.	40.18		40.18	.39	
	S.0°08'E.	39.69		39.69	.32	
	S.0°28'E.	39.86		39.86	.09	
	S.0°10'E.	40.02		40.02	.32	
S.0°09'E.	40.10		40.10	.12		
Convergency					.11	
Totals			479.73	479.32	488.66	489.24
Error in Latitude			479.32			488.66
Error in Departure			0.41			.58

D A T E D I A G R A M

BOOK 3877

Book " A "

Group 80 Arizona

Township 13 North Range 16 East

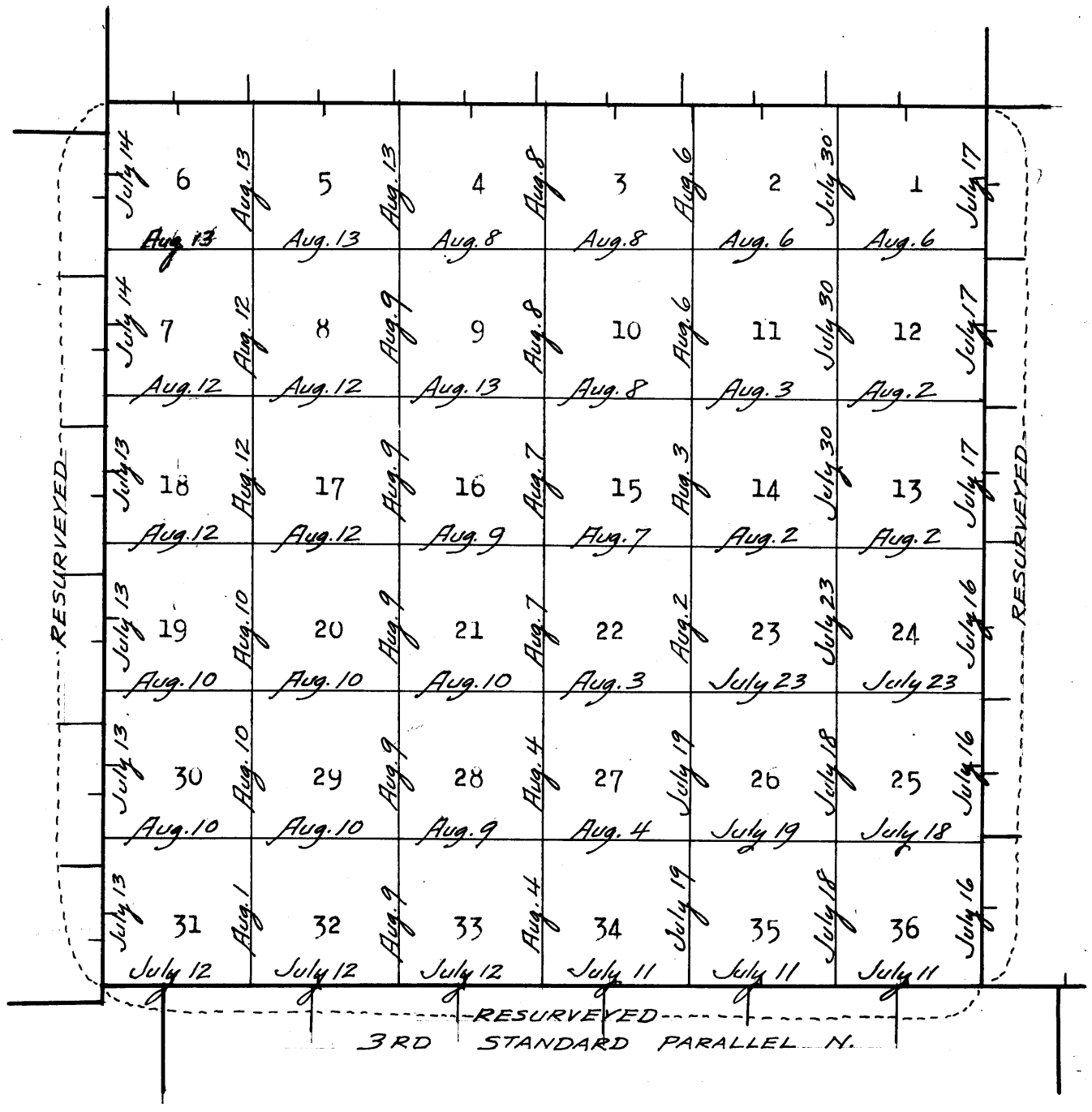

All lines surveyed by Thomas B. Matthews, U.S. Surveyor, in 1917 on dates shown on above diagram.

4-680

BOOK 3377

FIELD ASSISTANTS.

to
Thomas B. Matthews, U.S. Surveyor.

NAMES.	CAPACITY.
M. Alfred Rennie	First Chainman
Stephen Hayes	Second Chainman
Jim Sackarison	Flagman- Axeman
Earnest Lundahl	Cornerman
Bill E. Drye	Axeman

180
BOOK 58
8871

CERTIFICATE OF UNITED STATES SURVEYOR.

Applies to notes in books "A", "B" and "C" of Group No 80.

Thomas B. Matthews

I, *Thomas B. Matthews*, U. S. Surveyor, hereby certify upon honor that, in pursuance of special instructions received from the U. S. Surveyor General, for Group 80, Arizona,

bearing date of the 1st day of December, 1916, I have well, faithfully, and truly

in my own proper person, and in strict conformity with said instructions, the Manual of Surveying Instructions, and the laws of the United States, ~~surveyed~~ ^{RETRACED} all those parts or portions of the Third Standard

Parallel North, in Range 17 East, RESURVEYED all those parts or portions of

the Third Standard Parallel North, in Ranges 16, 17 and 18 East, the East and West bdrs. of Township 13 North, Range 16 East, and East bdy of Township 12 North Range 17 East,

and SURVEYED all those parts or portions of the West boundary and Subdivision lines of Township 12 North, Range 17 East, and

Subdivision lines of Township 13 North, Range 16 East of the Gila and Salt River Base and Meridian, in the State of Arizona, and those in books "B" and "C"

the foregoing field notes ^{as having been executed by me, and under my direction; and that all the corners of said retracement, resurvey and survey} ~~said survey~~ have been established and perpetuated in strict accordance with the Manual of Surveying Instructions, and the special written instructions of the U. S. Surveyor General, for Group 80, Arizona,

and in the specific manner described in the field notes, and that the foregoing ^{and notes in books "B" and "C"} ~~are~~ the original field notes of said retracement, resurvey and survey.

Thomas B. Matthews
U. S. Surveyor.

APPROVAL.

OFFICE OF THE UNITED STATES SURVEYOR GENERAL,

Phoenix, Arizona, June 16, 1920

The foregoing field notes of the ~~survey~~ ^{RESURVEY} of the Third Standard Parallel North, thru

Range 16 East, and of the East and West boundaries of Township 13 North,

Range 16 East, and of the East and West boundaries of Township 12 North,

and of the Survey of the Subdivision lines of Township 12 North,

Township 13 North, Range 16 East

of the Gila and Salt River Base and Meridian, in the State of

Arizona,

executed by Thomas B. Matthews, U. S. Surveyor,

under his special instructions dated Dec. 1, 1916, for Group 80, Arizona, having been critically examined, and the necessary corrections and explanations made, the said field notes, and the ^{and surveys} ~~surveys~~ they describe, are hereby approved.

Frank P. Smith
U. S. Surveyor General.

~~I certify that the foregoing transcript of the field notes of the above-described surveys in~~

~~_____~~, has been correctly copied from the original notes on file in this office.

U. S. Surveyor General.