

3378

Book "B"  
4-678

181  
Original compared (1)

BOOK 3378

# FIELD NOTES

OF THE RETRACEMENT OF

The Third Standard Parallel North, through part of Range 17 East,

and Resurvey of

The Third Standard Parallel North, through parts of Ranges

17 and 18 East, and part of

East Boundary of T. 12 N., R. 17 E.,

and Survey of

Part of West Boundary, and

Part of Subdivision lines of

TOWNSHIP 12 NORTH, RANGE 17 EAST,

Of the Gila and Salt River Base and Meridian,

In the State of Arizona,

EXECUTED BY

Thos. B. Matthews,

In the capacity of U. S. Surveyor, under Special Instructions dated December 1, 1916, issued by the United States Surveyor General to govern surveys included in Group No. 80, Arizona, which were approved by the Commissioner of the General Land Office, December 19, 1916, and Assignment Instructions dated May 19, 1917.

Retracement  
Resurvey and Survey commenced July 24, 1917

Retracement  
Resurvey and Survey completed July 28, 1917

3378

3378

*See Special Index Diagram*

~~INDEX DIAGRAM.~~

Township \_\_\_\_\_, Range \_\_\_\_\_

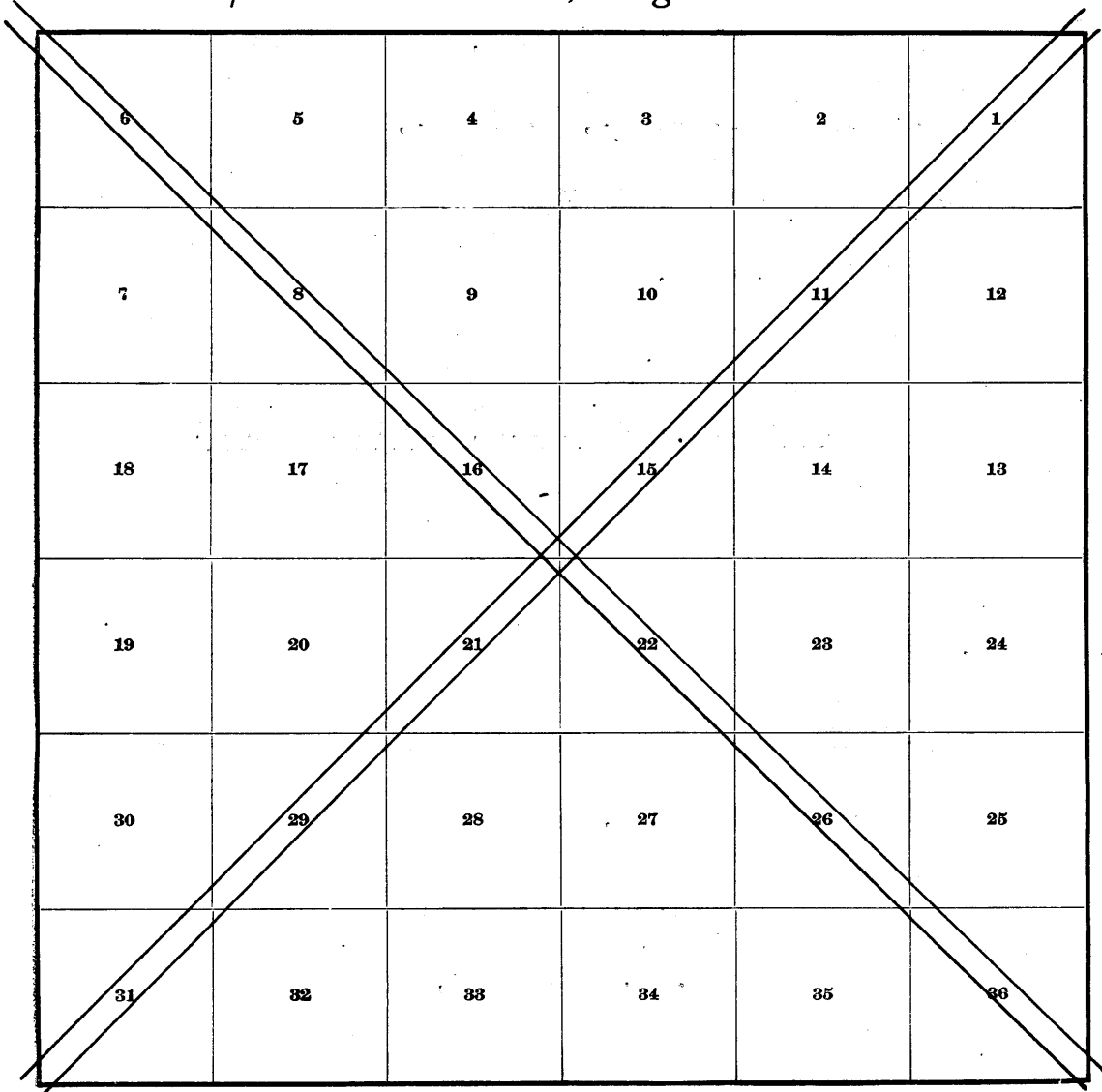

1A

3378 BOOK 3378



INDEX DIAGRAM

Book "B"

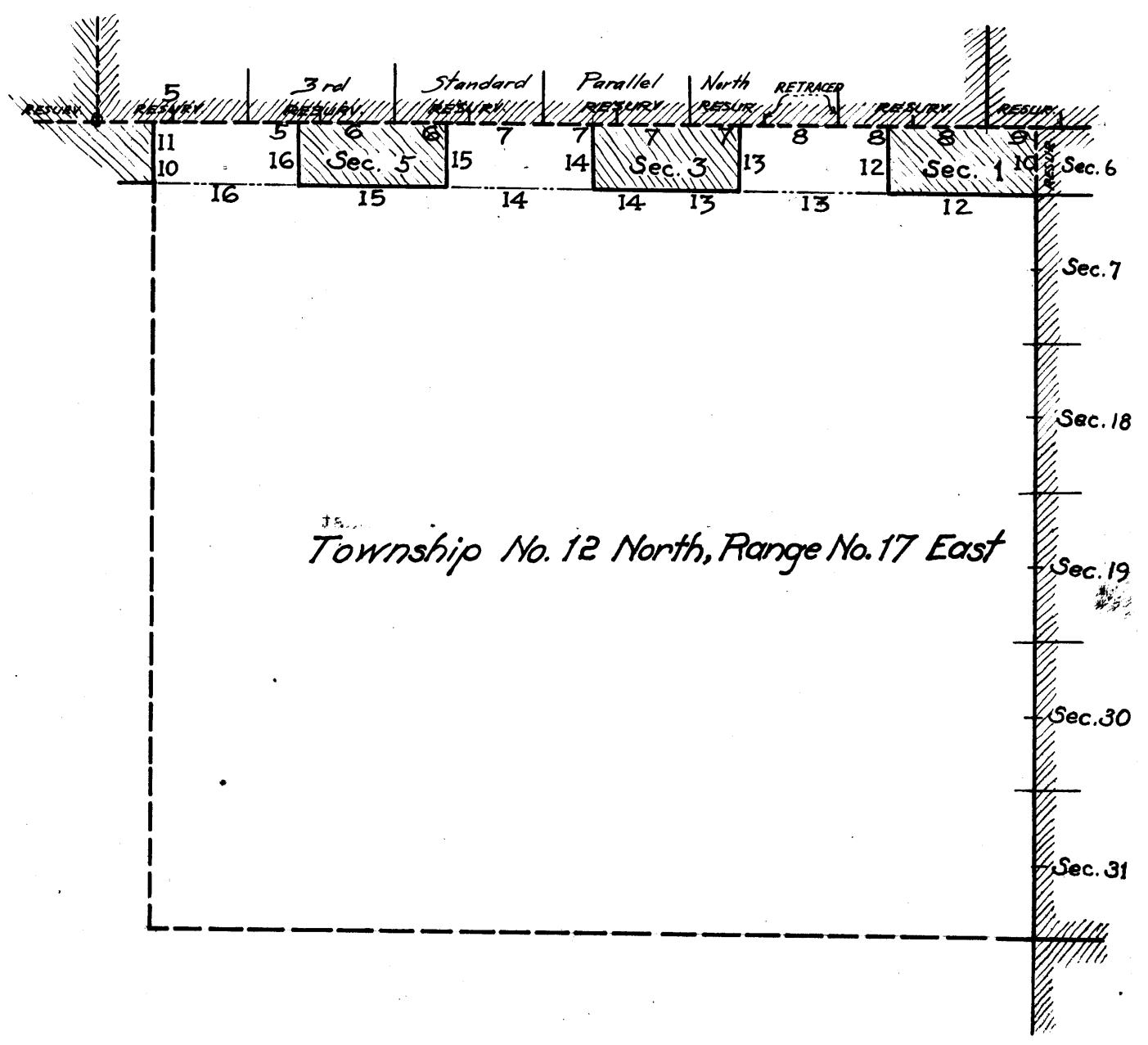
Group 80, Arizona

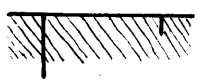

Township No. 12 North, Range No. 17 East

- Lines surveyed under this group ( Group 80 )
- Lines retraced or resurveyed under this group
- ..... Blank lines, this group
- Accepted surveys
- Unsurveyed lines, theoretical positions of
-  Areas surveyed under this group
-  Areas surveyed as per accepted plats on file

BOOK 3378

DATE                      DIAGRAM

Book    "B"

Group    80,            Arizona

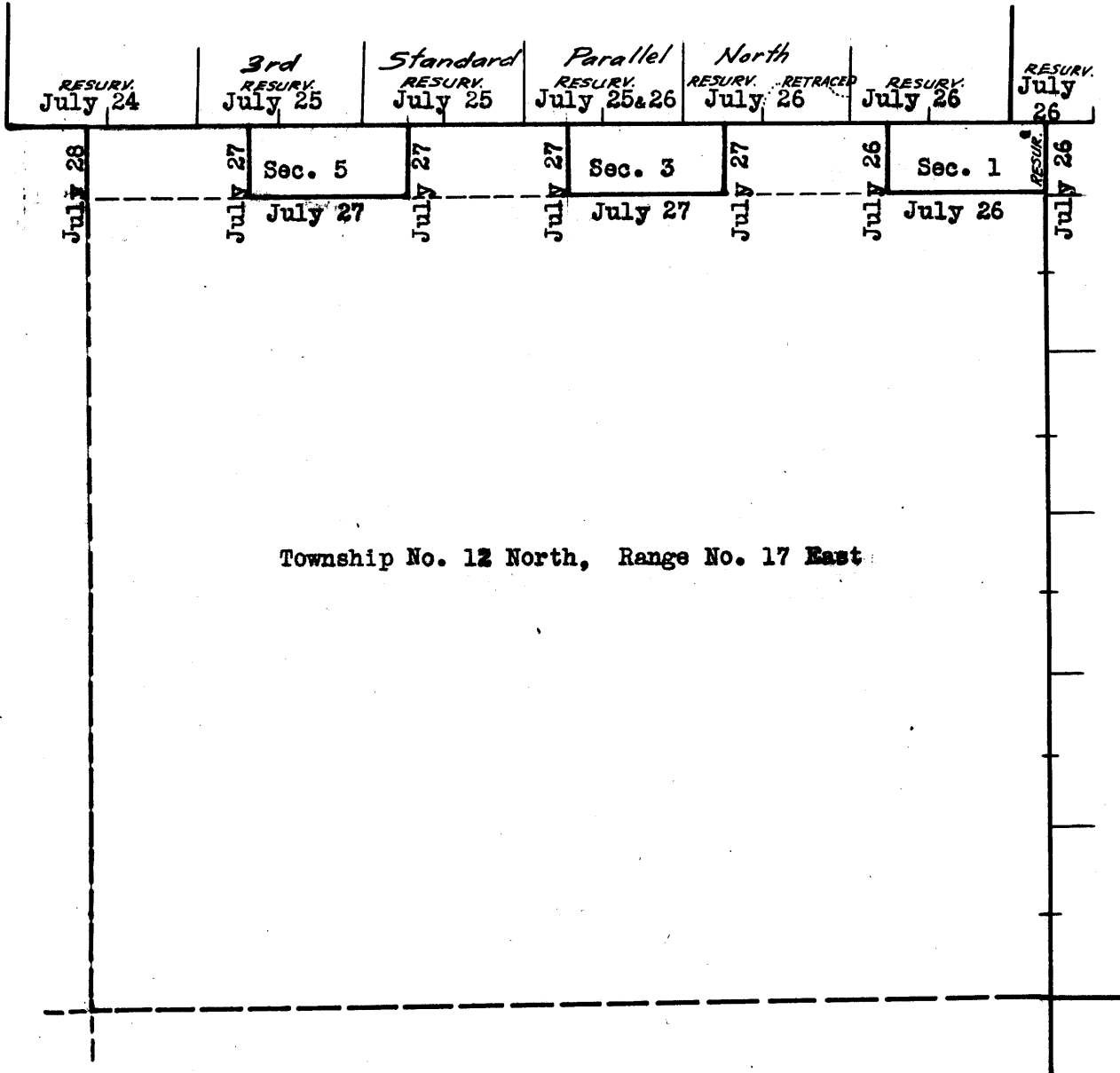

Lines in red surveyed by Thos. B. Matthews, U.S. Surveyor,  
in 1917; dates shown above on diagram.

Chains.

Retracements, Resurveys and Surveys hereinafter described, executed by Thomas B. Matthews, U.S. Surveyor, on dates shown on diagram on page 2 hereof, using Buff and Buff light mountain transit No. 10124 described with record of certificate of approval, and description of field test in Book "A" of this group. The instrument is kept in proper adjustment by daily solar tests.

-----  
Dependent Resurvey of 3rd. Standard Parallel North, thru. part of Ranges 17 and 18 East.

In Range 18 East.

The original standard  $\frac{1}{4}$  sec. cor. of sec. 31, T. 13 N., R. 18 E., is a limestone, 10x6x4 ins. above ground, firmly set, marked " $\frac{1}{4}$ " on N. face, and witnessed by mound of stone, N. of cor. and 2 bearing trees, one each NW. and SW. of cor., each marked "SC $\frac{1}{4}$ S BT."

Thence,

14.11 West, on random line, on W.  $\frac{1}{2}$  of S. bdy. of sec. 31. Original closing cor. of Ts. 12 N., Rs. 17 and 18 E., hereinafter described, brs. S. 41 lks. dist.

Continue line and measurement.

40.37 (Record dist. as per retracement in 1883). Diligent search in this vicinity fails to reveal any trace of original standard cor. of Ts. 13 N., Rs. 17 and 18 E. Set temp. std. Tp. cor.

Thence,

In Range 17 East

West, on random line, on E.  $\frac{1}{2}$  of S. bdy. of sec. 36, T. 13 N., R. 17 E.

Continuing measurement from original  $\frac{1}{4}$  sec. cor. of sec. 31, T. 13 N., R. 18 E.

81.45 Fall 60 lks. N. of original standard  $\frac{1}{4}$  sec. cor. of sec. 36, T. 13 N., R. 17 E., which is a limestone, 10x8x6 ins. above ground, firmly set, marked "SC $\frac{1}{4}$ " on N. face, and witnessed by 2 pits, one each E. and W. of cor., mound of earth, N. of cor., and 2 bearing trees, one each NW. and SW. of cor., each marked "SC $\frac{1}{4}$ SBT."

True course and dist. of line back to std.  $\frac{1}{4}$  sec. cor. of sec. 31, are therefore, N. 89° 35' E., 81.45 chs., which to maintain proportion recorded in retracement made in 1883, gives for length of E.  $\frac{1}{2}$  of S. bdy. of sec. 36, T. 13 N., R. 17 E., 40.74 chs., and for length of W.  $\frac{1}{2}$  of S. bdy. of sec. 36, T. 13 N., R. 18 E., 40.71 chs.

From original standard  $\frac{1}{4}$  sec. cor. of sec. 36, described above,

West, on random line, on W.  $\frac{1}{2}$  of S. bdy. of sec. 36.

41.13 Fall 51 lks. N. of previously reestablished standard cor. of secs. 35 and 36, which is a limestone, 13x8x6 ins. above ground, firmly set, marked "SC" on N. face, and 1 notch on E. edge, and 5 notches on W. edge, and witnessed by pits, E., W. and N. of cor., and mound of earth N. of cor.

No bearing trees.

True course and dist. of W.  $\frac{1}{2}$  of S. bdy. of sec. 36, are therefore N. 89° 17' E. 41.13 chs.

-----  
The original standard  $\frac{1}{4}$  sec. cor. of sec. 35, is a limestone 12x8x6 ins. above ground, firmly set, marked "SC $\frac{1}{4}$ " on N. face, and witnessed by a mound of stone, N. of cor.

No bearing trees.

Thence,

40.35 West, on random line, on W.  $\frac{1}{2}$  of S. bdy. of sec. 35. (Record dist. as per retracement in 1883) Diligent search in this vicinity fails to reveal any trace of original standard cor. of secs. 34 and 35. Set temp.

## 4. Dependent Resurvey of 3rd Std. Par. N. thru parts of Rs 17 &amp; 18 E

Chains.

std. cor. of said secs.

- From temp. std. cor. of secs. 34 and 35.  
West, on random line, on E.  $\frac{1}{2}$  of S. bdy. of sec. 34.  
Continuing measurement from std.  $\frac{1}{4}$  sec. cor. of sec. 35.
- 81.55 Fall 24 lks. N. of point of original location of std.  $\frac{1}{4}$  sec. cor. of sec. 34, which is determined by record distances and bearings from the 2 original bearing trees, one each NW. and SW. of cor. point. No trace of old post, recorded as marking this cor. could be found. True course and dist. of line, back to standard  $\frac{1}{4}$  sec. cor. of sec. 35 are therefore N. 89° 50' E., 81.55 chs., which to maintain proportion recorded in retracement made in 1883, gives a length for E.  $\frac{1}{2}$  of south bdy. of sec. 34 of 40.85 chs., and for W.  $\frac{1}{2}$  of S. bdy. of sec. 34 of 40.70 chs.
- From point of original location of standard  $\frac{1}{4}$  sec. cor. of sec. 34, described above,  
West, on random line, on W.  $\frac{1}{2}$  of S. bdy. of sec. 34.
- 40.61 Fall 64 lks. N. of remains of original std. cor. of secs. 33 and 34, which is the old mound of earth, in which the wood post was originally set. No trace of said post can be found. The 4 original bearing trees, one each NE., SE., SW. and NW. of cor., each marked as per record, still remain. True course and dist. of W.  $\frac{1}{2}$  of S. bdy. of sec. 34, are therefore, N. 89° 6' E., 40.61 chs.
- West, on random line, on E.  $\frac{1}{2}$  of S. bdy. of sec. 33.
- 40.68 Fall 68 lks. N. of original std.  $\frac{1}{4}$  sec. cor. of sec. 33, which is a decayed wood post, in a mound of earth, marked "SC  $\frac{1}{4}$ " on N. face, and witnessed by 2 bearing trees, one each NW. and SE. of cor., each marked "SC  $\frac{1}{4}$  SBT," and 2 pits, one each E. and W. of cor. True course and dist. of E.  $\frac{1}{2}$  of S. bdy. of sec. 33, are therefore, N. 89° 02' E., 40.69 chs.
- Thence,  
West, on random line, on W.  $\frac{1}{2}$  of S. bdy. of sec. 33.
- 41.22 Fall 8 lks. S. of remains of original std. cor. of secs. 32 and 33, which is a mound of earth, with pits N. E. and W. of mound. No bearing trees marked. The old post is lying on ground alongside the mound. True course and dist. of W.  $\frac{1}{2}$  of S. bdy. of sec. 33 are therefore, S. 89° 53' E., 41.22 chs.
- West, on random line, on E.  $\frac{1}{2}$  of S. bdy. of sec. 32.
- 40.44 Fall 267 lks. N. of original std.  $\frac{1}{4}$  sec. cor. of sec. 32, which is a sandstone, 12x9x6 ins. above ground, firmly set, marked "SC  $\frac{1}{4}$ " on N. face, and witnessed by mound of stone, N. of cor., and 2 bearing trees, one each NE. and SW. of cor., each marked "SC  $\frac{1}{4}$  SBT". True course and dist. of E.  $\frac{1}{2}$  of S. bdy. of sec. 32, are therefore, N. 86° 13' E., 40.53 chs.
- Thence,  
West, on random line, on W.  $\frac{1}{2}$  of S. bdy. of sec. 32.
- 40.10 Fall 190 lks. S. of original std. cor. of secs. 31 and 32, which is a limestone, 11x10x6 ins. above ground, firmly set, marked "SC" on N. face, and 1 notch on W. edge, and 5 notches on E. edge, and witnessed by mound of stone, N. of cor., and 4 bearing trees, one each NE., SE., SW. and NW. of cor. True course and dist. of W.  $\frac{1}{2}$  of S. bdy. of sec. 32, are therefore, S. 87° 17' E., 40.15 chs.

## Dependent Resurvey of 3rd. Std. Par. N., thru. part of Rs. 17 and 18 E. 5

Chains.

- 40.57 West, on random line, on E.  $\frac{1}{2}$  of S. bdy. of sec. 31.  
Fall 145 lks. N. of original std.  $\frac{1}{4}$  sec. cor. of sec. 31, which is a sandstone, 8x6x4 ins. above ground, firmly set, marked "SC" on N. face, and witnessed by one bearing tree, marked "SC SBT." NW. of cor.  
True course and dist. of E.  $\frac{1}{2}$  of S. bdy. of sec. 31, are therefore, N. 87° 57' E., 40.59 chs.  
Thence,  
41.39 West, on random line, on W.  $\frac{1}{2}$  of S. bdy. of sec. 31.  
Fall 17 lks. S. of reestablished std. cor. of Ts. 13 N., Rs. 16 and 17 E., described in Book "A."  
True course and dist. of W.  $\frac{1}{2}$  of S. bdy. of sec. 31 are therefore, S. 89° 46' E., 41.39 chs.

RESURVEY.In Range 17 East.

- From reestablished std. cor. of Ts. 13 N., Rs. 16 & 17 E., described in book "A."  
S. 89° 46' E., on true line, on W.  $\frac{1}{2}$  of S. bdy. of sec. 31  
Over rolling land, thru. scattering timber and undergrowth.  
11.30 W. edge of Black Canyon, brs. NW. and SE. Descend 60 ft. to  
18.80 Top of cliff or rim-rock, brs. NW. and SE. Descend 36 ft. to  
20.00 Base of cliff. Descend 38 ft. to  
41.39 Intersect original standard  $\frac{1}{4}$  sec. cor. of sec. 31, hereinbefore described. Change marking on bearing tree NW. of cor. to read "SC  $\frac{1}{4}$  SBT," and raise a mound of stone, 2 ft. base, 1  $\frac{1}{2}$  ft. high, N. of cor.  
Thence,  
N. 87° 57' E., on true line, on E.  $\frac{1}{2}$  of S. bdy. of sec. 31.  
Over rolling and broken land in Black Canyon. Descend 39 ft. to  
6.60 Head of gulch, course SW. Ascend slightly to  
10.00 Top of ascent, brs. NE. and SW. Descend 29 ft. to bottom of Black Canyon.  
20.00 Dry tank brs. south, 1 ch. dist.  
25.00 Sandy and rocky wash, 150 lks. wide, 2 ft. deep, course N. Thence across bottom of Black Canyon.  
30.00 Leave bottom of Black Canyon. Ascend 140 ft. on rocky W. slope.  
35.00 Spur, slopes N. Descend 30 ft. to  
40.59 In bottom of draw, course N. Intersect original std. cor. of secs. 31 and 32, hereinbefore described. Obliterate marking on original SE. and SW. bearing trees.  
Land, rolling and broken.  
Soil, thin and rocky, 3rd rate.  
Timber, scattering pinyon and cedar.  
Undergrowth, scattering buck brush.  
No grass.

- S. 87° 17' E., on true line, on W.  $\frac{1}{2}$  of S. bdy. of sec. 32.  
Over rolling land, in Black Canyon, thru. scattering timber and undergrowth.  
Ascend 108 ft. on rocky W. slope.  
10.00 Top of ascent at E. edge of Black Canyon, brs. N. and S.  
Thence, over nearly level land to  
13.50 Top of bank of draw, brs. N. and S. Descend 69 ft. on E. slope, to  
19.92 Bottom of draw, course NE. Thence across bottom of draw.  
30.00 Leave bottom of draw. Ascend 18 ft. to  
32.50 Top of bank of draw. Descend 28 ft. on E. slope, to  
35.00 Foot of descent in bottom of draw, course N. Ascend 25 ft. to  
37.30 Top of E. bank of draw, brs. N. and S. Thence over nearly level land to  
40.15 Top of W. bank of draw, brs. N. and S. Intersect original

6. dependent Resurvey of 3rd. Std. Par. N., thru. part of R.17 E.

Chains.

(Resurvey, continued)

standard  $\frac{1}{4}$  sec. cor. of sec. 32, hereinbefore described. Obliterate marking on original SW. bearing tree, and change marking on original NE. bearing tree to read "SC $\frac{1}{4}$ S32BT."

Thence,

N. 86°13'E., on true line, on E.  $\frac{1}{2}$  of S. bdy. of sec. 32. Over rolling land, thru. scattering timber and undergrowth. Descend 20 ft. to

- 1.27 Foot of descent in bottom of small draw, course N. Ascend slightly to
- 2.80 Top of ascent brs. N. and S. Descend 14 ft. to
- 5.77 Foot of descent in bottom of small draw, course NE. Ascend 20 ft. to
- 12.00 E. bank of draw, brs. NE. and SW. Thence over slightly rolling land, sloping N.
- 40.53 Intersect the remains of original std. cor. of secs. 32 and 33, hereinbefore described. Reestablish this cor. in same place as follows: Destroy all trace of the old cor., and set an iron post, 3 ft. long, 3 ins. in diam., 24 ins. in the ground, for reestablished std. cor. of secs. 32 and 33, T.13 N., R.17 E., marked on brass cap,

S C  
T13N | R17E  
S32 | S33

1917

and establish bearing trees as follows:

On a pinyon, 12 ins. in diam., N. 82 $\frac{1}{2}$ °E., 263 lks. dist., mark "T13NR17ES33BT."

On a pinyon, 10 ins. in diam., N. 6°W., 350 lks. dist. mark "T13N R17E S32BT."

Land, rolling.

Soil, sandy and rocky, 2nd and 3rd rate.

Timber, scattering pinyon and cedar.

Undergrowth, scattering scrub cedar.

Poor grass.

S. 89°53' E., on true line, on W.  $\frac{1}{2}$  of S. bdy. of sec. 33.

Over rolling land, thru. scattering timber.

- 15.00 Top of W. bank of draw, brs. NE. and SW. Descend 41 ft. to
- 23.70 Bottom of draw, course NE. Ascend on E. bank of draw.
- 41.22 Top of E. bank of draw, brs. NE. and SW. Intersect original standard  $\frac{1}{4}$  sec. cor. of sec. 33, hereinbefore described. Reestablish this cor. in same place as follows:  
Remove old decayed wood post, destroy mound of earth, and set an iron post, 3 ft. long, 1 in. in diam., 26 ins. in the ground, for reestablished standard  $\frac{1}{4}$  sec. cor. of sec. 33, marked on brass cap,

S C  
S 33

1917

Change marking on original NW. bearing tree to read "SC $\frac{1}{4}$ S33BT."

Obliterate marking on original SE. bearing tree.

Dig out pits to 18x18x12 ins.

Thence,

N. 89°02'E., on true line, on E.  $\frac{1}{2}$  of S. bdy. of sec. 33.

Over slightly rolling land, thru. scattering timber.

- 5.00 Top of W. bank of draw, brs. NE. and SW. Descend 41 ft.
- 13.68 Bottom of draw, course NE. Ascend 29 ft. on E. bank of draw.



Dependent Resurvey of 3rd. Std. Par. N., thru. part of Range 17 E. 7.

Chains .  
20.00  
40.69

Top of east bank of draw, brs. N. and S.  
Intersect remains of original std. cor. of secs. 33 and 34, hereinbefore described. Reestablish this cor. in same place as follows: Destroy the old mound of earth, and set an iron post, 3 ft. long, 3 ins. in diam., 20 ins. in the ground, supported by a mound of stone, for reestablished cor. of secs. 33 and 34, T. 13 N., R. 17 E., marked on brass cap,

S C  
T13N | R17E  
S33 | S34  
1917

Obliterate marking on original SE. and SW. bearing trees, leaving the original NE. and NW. bearing trees undisturbed.  
Land, rolling and nearly level.  
Soil, thin and rocky, 3rd rate.  
Timber, scattering pinyon and cedar.  
No undergrowth.  
Poor grass.

7.30  
10.00

N. 89° 06' E., on true line, on W  $\frac{1}{2}$  of S. bdy. of sec. 34.  
Over rolling land, thru. scattering timber.  
Top of bank, brs. N. and S. Descend 28 ft. on E. slope, to foot of bank, brs. N. and S. Thence over nearly level land.

40.61

Intersect point of original location of std.  $\frac{1}{4}$  sec. cor. of sec. 34, hereinbefore described.  
Reestablish the cor. at this point as follows:  
Set an iron post, 3 ft. long, 1 in. in diam., 26 ins. in the ground, for reestablished std.  $\frac{1}{4}$  sec. cor. of sec. 34, marked on brass cap,

S C  
 $\frac{1}{4}$  S 34  
1917

Obliterate marking on original SW. bearing tree.  
Change marking on original NW. bearing tree to read: "SC  $\frac{1}{4}$  S 34 BT," and raise a mound of stone, 2 ft. base, 1  $\frac{1}{2}$  ft. high, N. of cor.

40.85

Thence,  
N. 89° 50' E., on true line, on E.  $\frac{1}{2}$  of S. bdy. of sec. 34.  
Over nearly level land, thru. scattering undergrowth.  
(Proportional dist.), Set an iron post, 3 ft. long, 3 ins. in diam., 24 ins. in the ground, for reestablished std. cor. of secs. 34 and 35, T. 13 N., R. 17 E., marked on brass cap,

S C  
T13N | R17E  
S34 | S35  
1917

and establish bearing trees to this cor. as follows:  
On a cedar, 8 ins. in diam., N. 57° E., 302 lks. dist., mark "T13NR17ES35BT."  
On a pinyon, 20 ins. diam., N. 70° W., 292 lks. dist., mark "T13NR17ES34BT."

Land, rolling and nearly level.  
Soil, thin and rocky, 3rd rate.  
Timber, scattering cedar and pinon.  
No undergrowth.  
Poor grass.

N. 89° 50' E., on true line, on W  $\frac{1}{2}$  of S. bdy. of sec. 35.  
Over slightly rolling land, thru. scattering timber.

8 Dependent Resurvey 3rd. Stand. Par. N., thru. part of Range 17 East.

Chains.

40.70 Intersect original std.  $\frac{1}{4}$  sec. cor. of sec. 35, hereinbefore described.  
Land, slightly rolling N. slope.  
Soil, thin and rocky, 3rd rate.  
Timber, scattering pinyon and cedar.  
No undergrowth.  
Poor grass.

Retracement of 3rd. Standard Parallel North, thru. part of Range 17 East.

40.99 From original standard cor. of secs. 35 and 36, T.13 N., R.17 E., hereinbefore described,  
West, on random line, on E.  $\frac{1}{2}$  of S. bdy. of sec. 35.  
Over slightly rolling N. slope, thru. scattering timber.  
Fall 13 lks. S. of the original std.  $\frac{1}{4}$  sec. cor. of sec. 35, hereinbefore described.  
True course and dist. of E.  $\frac{1}{2}$  of S. bdy. of sec. 35 are therefore S. 89° 49' E., 40.99 chs.  
Land, slightly rolling.  
Soil, thin and rocky, 3rd rate.  
Timber, scattering cedar and pinyon.  
No undergrowth.  
Poor grass.

Dependent Resurvey of 3rd. Standard Parallel North, thru. part of Range 17 East.

30.50 From original std. cor. of secs. 35 and 36, hereinbefore described,  
N. 89° 07' E., on true line, on W.  $\frac{1}{2}$  of S. bdy. of sec. 36, T.13 N., R.17 E.,  
Over rolling land, thru. scattering timber.  
NW. cor. of wire fence, brs. S. 50 lks. dist. Thence N. of fence, bearing E and W. at 50 lks. S. of line.

41.13 Intersect original std.  $\frac{1}{4}$  sec. cor. of sec. 36, T.13 N., R.17 E., hereinbefore described. Reestablish this cor. by obliterating marking on original SW. bearing tree, changing marking on original NW. bearing tree to read "SC-S36BT," and digging out original pits to 18x18x12 ins.

17.70 Thence,  
N. 89° 35' E., on true line, on E.  $\frac{1}{2}$  of S. bdy. of sec. 36, T.13 N., R.17 E.  
Over slightly rolling land, thru. scattering timber, N. of fence, bearing nearly E. and W. at 50 lks. S. of line.

30.00 Wire fence described above crosses line, course N. 85° E. and S. 85° W.

32.15 Top of W. bank of draw, brs. NE. and SW. Descend 46 ft.

39.85 Wire fence brs. N. and S., joins previously described fence at 50 lks. N. of line. Enter cultivated field on W. bank of draw. Thence S. of fence, bearing nearly E. and W. at 50 lks. N. of line.

40.74 Foot of descent in bottom of draw. Wash, 50 lks. wide, course NE. Continue over cultivated field. Ascend 5 ft. over E. bank of draw, to  
(Proportional dist.) Set an iron post, 3 ft. long, 3 ins. in diam., 24 ins. in the ground, for reestablished standard cor. of T.13 N., R.17 and 18 E., marked on brass cap,

S C  
T13N  
R17E | R18E  
S36 | S31  
1917

Dependent Resurvey 3rd. Standard Par. N. thru part of Range 17 E. 9

Chains.

and establish bearing trees to this cor. as follows:  
 On a pine, 18 ins. in diam., N. 15 1/2° E., 610 lks.  
 dist., mark "T13N R18ES31BT."  
 On a pine, 18 ins. in diam., N. 19 1/2° E., 560 lks.  
 dist., mark T13N R17ES36 BT."

Land, slightly rolling.  
 Soil, sandy and gravelly, 2nd and 3rd rate.  
 Timber, scattering pinyon, pine and cedar.  
 No undergrowth.  
 Poor grass.

-----  
 Dependent Resurvey of 3rd. Standard Parallel, North, thru.  
 part of Range 18 East.  
 -----

From reestablished standard cor. of Ts. 13 N., Rs. 17 and 18  
 E., hereinbefore described,  
 N. 89° 35' E., on true line, on W 1/2 of S. bdy. of sec. 31, T.  
 13 N., R. 18 E.

7.70  
 9.96  
 16.54  
 26.60

Over rolling land, across cultivated field on E. bank of  
 draw. Ascend 35 ft. on W. slope.  
 Wire fence brs. N. and S. NE. cor. of fenced field brs. N.  
 60 lks. dist. Leave cultivated field.

Top of E. bank of draw, brs. N. and S. Descend 23 ft. to  
 Draw, course NW. Ascend gradually.

A point 31 lks. N. from original closing cor. of Ts. 12 N.,  
 Rs. 17 and 18 E., which is a wood post in mound of  
 stone, properly marked. Destroy all trace of this  
 old C C, and reestablish the closing cor. on parallel  
 as follows: Set an iron post, 3 ft. long, 3 in. in diam., 20 ins.  
 in the ground, supported by a mound of stone, for reestablished  
 closing cor. of Ts. 12 N., Rs. 17 and 18 E., marked on brass cap,

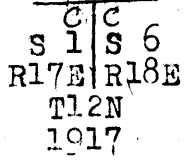

and establish bearing trees to this cor. as follows:  
 On a pinyon, 10 ins. in diam., brs. S. 12 1/2° E., 55  
 lks. dist., mark "T12NR18ES6 CCBT."  
 On a pinyon, 10 ins. in diam., S. 34 1/2° W., 64 lks.  
 dist., mark T12NR17ES1 CCBT."

40.71

Continue line and measurement of W. 1/2 of S. bdy. of sec. 31,  
 T. 13 N., R. 18 E.  
 (Proportional dist.) Intersect the original standard 1/4  
 sec. cor. of sec. 31, T. 13 N., R. 18 E., hereinbefore de-  
 scribed. Reestablish this cor. in same place as fol-  
 lows: Alongside old stone,  
 Set an iron post, 3 ft. long, 1 in. in diam., 26 ins. in  
 the ground, for reestablished std. 1/4 sec. cor. of sec.  
 31, marked on brass cap,

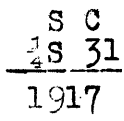

Obliterate marking on original SW. bearing tree. Change  
 marking on original NW. bearing tree to read "SC 1/4 S 31  
 BT."

Leave original mound of stone, 2 ft. base, 1 1/2 ft. high, N. of  
 cor. undisturbed.

Land, rolling.  
 Soil, sandy and gravelly, 2nd and 3rd rate.  
 Timber, scattering pinyon and cedar,  
 No undergrowth.  
 Poor grass.

10. Dependent Resurvey of part of East bdy. of T.12 N., R.17 E.

Chains.

Retracement for Resurvey:

The original cor. of secs. 7 and 12, and fracl. secs. 1 and 6, Ts. 12 N., Rs. 17 and 18 E., is a wood post, 4 ins. square, 3 ft. above ground, much decayed, marks nearly obliterated, set in a mound of earth, and witnessed by 4 pits, one in each sec. No bearing trees.

Thence,

36.38 North, on random line, bet. fracl. secs. 1 and 6. Fall 43 lks. E. of original closing cor. of Ts. 12 N., Rs. 17 and 18 E., hereinbefore described.

This cor. destroyed and reestablished on the 3rd. Std. Par. N., at a point 31 lks. N., or at

36.69 Fall 43 lks. E. of reestablished closing cor. of Ts. 12 N., Rs. 17 and 18 E., on 3rd. Std. Parallel N., 26.60 chs. N. 89° 35' E. from reestablished std. cor. of Ts. 13 N., Rs. 17 and 18 E., both of which cors. are hereinbefore described.

True course and dist. of line, bet. fracl. secs. 1 and 6, are therefore S. 0° 41' E., 36.69 chs.

RESURVEY.

From reestablished closing cor. of Ts. 12 N., Rs. 17 and 18 E., 3rd. Std. Parallel N., hereinbefore described, S. 0° 41' E., on true line, bet. fracl. secs. 1 and 6, Ts. 12 N., Rs. 17 and 18 E.

5.00 Over rolling land, thru. dense timber and undergrowth. Top of N. bank of draw, brs. NW. and SE. Descend 28 ft. on SW. slope.

7.57 Bottom of draw, course NW. Ascend 20 ft. to

10.00 Top of S. bank of draw, brs. NW. and SE. Ascend gradually.

22.39 Road brs. E. to Holbrook and W. to Heber.

29.00 Leave dense timber and undergrowth, brs. E. and W.

Enter scattering timber and undergrowth.

29.80 Old road, brs. E. and W.

36.69 Intersect original cor. of secs. 7 and 12, and fracl. secs. 1 and 6, hereinbefore described. Reestablish this cor. in same place as follows:

Remove the old wood post, destroy the mound of earth, and Set an iron post, 3 ft. long, 2 ins. in diam., 20 ins. in the ground, supported by a mound of stone, for re-established cor. of secs. 7 and 12, and fracl. secs. 1 and 6, marked on brass cap,

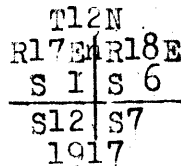

and dig out the original pits 18x18x12 ins., From this cor. NE. cor. of wire fence brs. S. 21 lks. dist. Land, rolling.

Soil, thin and rocky, 3rd rate.

Timber, cedar and pinyon, dense and scattering as noted.

Poor grass.

Survey of part of West bdy. of Township 12 North, Range 17 East.

From cor. of secs. 7 and 12, and fracl. secs. 1 and 6, Ts. 12 N., Rs. 16 and 17 E., hereinafter described,

North, on true line, bet. fracl. secs. 1 and 6.

Over rolling land, thru. scattering timber.

2.90 Enter cultivated land, brs. NW. and SE.

5.00 Leave cultivated land, brs. NE. and SW.

5.30 Wire fence, brs. NE and SW. at foot of S. slope of knoll.

Survey of part of West bdy. of Township 12 North, Range 17 East, 11

Chains

Ascend 105 ft. on S. slope.  
 12.20 Top of round knoll, Descend 96 ft. on N. slope of knoll.  
 20.00 Foot of N. slope of knoll, brs. E. and W.  
 32.20 Intersect the 3rd. Standard Parallel North, 38,74 chs. S.  
 89°46'E., from reestablished standard cor. of Ts. 13 N.,  
 Rs. 16 and 17 E., described in Book "A."  
 At point of intersection,  
 Set an iron post, 3 ft. long, 3 ins. in diam., 24 ins. in  
 the ground, for closing cor. of Ts. 12 N., Rs. 16 and 17  
 E., marked on brass cap,

C | C  
 S 1 | S 6  
 R16E R17E  
 T12N  
 1917

to which establish bearing trees as follows  
 On a pinyon, 12 ins. in diam., S. 14½° E., 136 lks.  
 dist., mark "T12NR17ES6CCBT."  
 On a pine, 18 ins. in diam., S. 71° W., 50 lks. dist.  
 mark "T12NR16ES1CCBT."

Land, rolling and broken.  
 Soil, thin and rocky, 3rd rate.  
 Timber, scattering pine, pinyon and cedar.  
 No undergrowth.  
 Poor grass.

12. Survey of part of Subdivision Lines of T.12 N., R. 17 E.

Chains.

From the reestablished cor. of secs. 7, 12, and fracl. secs. 1 and 6, on E. bdy. of Tp., hereinbefore described, West, on a true line, bet. secs. 12 and fracl. sec. 1. Over rolling land, thru scattering timber. North of fence bearing E. and W., and 20 lks. S. of line.  
 25.60 Miles Ranger station brs. S.  $26\frac{3}{4}^{\circ}$  W.  
 H.W. DeSpain's cabin brs. N.  $36^{\circ}$  W.  
 26.00 Road brs. N. to Holbrook and S. to Taylor and Showlow.  
 34.30 Wash, 30 lks. wide, 3 ft. deep, course N.  
 37.50 Wire fence brs. N. and S., turns W., about 1 ch. N. of line. At about 20 lks. S. this fence is intersected by fence from the E.  
 40.00 Set an iron post, 3 ft. long, 1 in. in diam., 18 ins. in the ground, in a mound of stone, for  $\frac{1}{4}$  sec. cor., marked on brass cap,

$\frac{1}{2}$  S 1  
 S 12  
 1917

from which,

A cedar, 14 ins. in diam., brs. S.  $69\frac{1}{2}^{\circ}$  W., 26 lks. dist., marked  $\frac{1}{2}$  S 12 B T.  
 A pinyon, 12 ins. in diam., brs. N.  $70\frac{3}{4}^{\circ}$  W., 581 lks. dist., marked  $\frac{1}{2}$  S 1 B T.  
 40.60 Miles Ranger Station, brs. S.  $67^{\circ}$  E.  
 H. W. Depain's cabin, brs. N.  $34^{\circ}$  E.  
 79.20 Wire fence brs. N. and S. NW. cor. of fenced field brs. N. 1 chain dist.  
 80.00 Set an iron post, 3 ft. long, 2 ins. in diam., 24 ins. in the ground, for cor. of secs. 11 and 12, and fracl. secs. 1 and 2, marked on brass cap,

T12N | R17E  
 S 2 | S 1  
 S11 | S12  
 1917

from which,

A cedar, 12 ins. in diam., brs. N.  $3\frac{1}{2}^{\circ}$  E., 219 lks. dist., marked T12N R17E S1 BT.  
 A pinyon, 12 ins. in diam., brs. S.  $70^{\circ}$  E., 218 lks. dist., marked T12N R17E S12 BT.  
 A cedar, 6 ins. in diam., brs. S.  $23^{\circ}$  W., 393 lks. dist., marked T12N R17E S11 BT.  
 A pinyon, 6 ins. in diam., brs. N.  $8^{\circ}$  W., 248 lks. dist., marked T12N R17E S2 BT.  
 Land, rolling.  
 Soil, thin and rocky, 3rd rate.  
 Timber, cedar, pinyon and pine.  
 No undergrowth.  
 Short grass.

N.  $0^{\circ} 1' W.$  on true line, bet. fracl. secs. 1 and 2. Over gently rolling land, thru scattering timber, parallel to and 1 ch. W. of wire fence.  
 6.90 Road brs. E. to Holbrook and W. to Heber.  
 36.05 Intersect 3rd. Standard Parallel N., 28.87 chs. N.  $89^{\circ} 17' E.$  of the old standard cor. of secs. 35 and 36, hereinbefore described.  
 At the point of intersection,  
 Set an iron post, 3 ft. long, 2 ins. in diam., 24 ins. in the ground, for closing cor. of fracl. secs. 1 and 2, marked on brass cap,

C | C  
 S 2 | S 1  
 T12N | R17E  
 1917

Subdivision of Township 12 North, Range 17 East

Chains.

from which,  
A pinyon, 14 ins. in diam., brs. S. 30 1/2 ° E., 39 lks. dist., marked T12NR17ES1BT.  
A cedar, 6 ins. in diam., brs. S. 70 ° W., 36 lks. dist., marked T12NR17ES2 BT.

Land, gently rolling.  
Soil, thin, 2nd rate.  
Timber, pinyon and cedar.  
No undergrowth.  
Short grass.

80.00

From the cor. of secs. 11, 12, and frac. secs. 1 and 2, West, on a blank line, bet. sec. 11, and frac. sec. 2. Set an iron post, 3 ft. long, 2 ins. in diam., 24 ins. in the ground, for cor. of secs. 10 and 11, and frac. secs. 2 and 3, marked on brass cap,

T12N R17E  
S 3 | S 2  
-----  
S10 | S11  
1917

from which,  
A cedar, 8 ins. in diam., brs. N. 41 1/2 ° E., 47 lks. dist., marked T12N R17E S2 BT.  
A cedar, 12 ins. in diam., brs. S. 57 1/2 ° E., 132 lks. dist., marked T12NR17ES11 BT.  
A pinyon, 6 ins. in diam., brs. S. 42 ° W., 126 lks. dist., marked T12N R17ES10BT.  
A pinyon, 12 ins. in diam., brs. N. 45 ° W., 73 lks. dist., marked T12N R17E S3BT.

35.92

N. 0 ° 1' W., on true line, bet. frac. secs. 2 and 3. Over gently rolling land, thru. timber and undergrowth. Intersect 3rd. Standard Parallel N., 30.48 chs. N. 89 ° 50' E. from the reestablished standard cor. of secs. 34 and 35, hereinbefore described. At the point of intersection, Set an iron post, 3 ft. long, 2 ins. in diam., 24 ins. in the ground, for closing cor. of frac. secs. 2 and 3, marked on brass cap,

C | C  
S 3 | S 2  
-----  
T12N R17E  
1917

from which,  
A pinyon, 10 ins. in diam., brs. S. 10 ° E., 63 lks. dist., marked T12N R17E S2 BT.  
A pinyon, 14 ins. in diam., brs. S. 49 1/2 ° W., 62 lks. dist., marked T12N R17E S3BT.

Land, gently rolling.  
Soil, sandy, 2nd rate.  
Timber, pinyon and cedar.  
Undergrowth, rabbit brush.  
Short grass.

40.00

From the cor. of secs. 10, 11, and frac. secs. 2 and 3, West, on a true line, bet. sec. 10 and frac. sec. 3. Over gently rolling land, thru. scattering timber. Set an iron post, 3 ft. long, 1 in. in diam., 26 ins. in the ground, for 1/4 sec. cor., marked on brass cap,

14. Subdivision of Township 12 North, Range 17 East.

Chains.

$\frac{1}{2}$  S 3  
S 10  
1917

from which,

A pinyon, 10 ins. in diam., brs. N. 51° E., 112 lks. dist., marked  $\frac{1}{2}$  S 3 B T.

A pinyon, 8 ins. in diam., brs. S. 6 $\frac{1}{2}$ ° W., 31 lks. dist., marked  $\frac{1}{2}$  S 10 B T.

40.35  
80.00

Line tree, pinyon, 14 ins. in diam.,  
Set an iron post, 3 ft. long, 2 ins. in diam., 24 ins. in the ground, for cor. of secs. 9, 10, and frac. secs. 3 and 4, marked on brass cap,

T12N | R17E  
S 4 | S 3  
S 9 | S 10  
1917

from which,

A pinyon, 4 ins. in diam., brs. N. 33° E., 61 lks. dist., marked T12NR17ES3 BT.

A pinyon, 6 ins. in diam., brs. S. 27 $\frac{1}{2}$ ° E., 52 lks. dist., marked T12NR17ES10BT.

A cedar, 4 ins. in diam., brs. S. 44 $\frac{1}{2}$ ° W., 20 lks. dist., marked T12NR17ES9BT.

A pinyon, 10 ins. in diam., brs. N. 58 $\frac{1}{2}$ ° W., 93 lks. dist., marked T12N R17ES4BT.

Land, gently rolling.  
Soil, thin, 2nd rate.  
Timber, pinyon and cedar.  
No undergrowth.  
Short grass.

35.66

N. 0° 2' W., on true line, bet. frac. secs. 3 and 4.  
Over gently rolling land, thru scattering timber and undergrowth.  
Intersect 3rd. Standard Parallel N., 32.20 chs. N. 89° 6' E. from the reestablished standard cor. of secs. 33 and 34, hereinbefore described.  
At the point of intersection,  
Set an iron post, 3 ft. long, 2 ins. in diam., 24 ins. in the ground, for closing cor. of frac. secs. 3 and 4, marked on brass cap,

C | C  
S 4 | S 3  
T12N | R17E  
1917

from which,

A pinyon, 8 ins. in diam., brs. S. 41 $\frac{1}{2}$ ° E., 221 lks. dist., marked T12N R17ES3BT.

A pinyon, 8 ins. in diam., brs. S. 23° W., 349 lks. dist., marked T12NR17ES4BT.

Land, gently rolling.  
Soil, thin and rocky, 3rd rate.  
Timber, pinyon and cedar.  
Undergrowth, sagebrush.

80.00

From the cor. of secs. 9, 10, and frac. secs. 3 and 4. West, on a blank line, bet. sec. 9 and frac. sec. 4.  
Set an iron post, 3 ft. long, 2 ins. in diam., 24 ins. in the ground, for cor. of secs. 8, 9, and frac. secs. 4 and 5, marked on brass cap,



Survey of part of subdivision lines of T.12 N. R.17 E. 15.

Chains.

T12N R17E	
S 5	S 4
S 8	S 9
1917	

from which,

- A pinyon, 6 ins. in diam., brs. N. 58 $\frac{1}{2}$ ° E., 51 lks. dist., marked T12NR17ES4BT.
- A pinyon, 8 ins. in diam., brs. S. 2° E., 33 lks. dist., marked T12NR17ES9BT.
- A pinyon, 8 ins. in diam., brs. S. 74 $\frac{1}{2}$ ° W., 19 lks. dist., marked T12NR17ES8BT.
- A pinyon, 8 ins. in diam., brs. N. 28° W., 19 lks. dist., marked T12NR17ES5BT.

34.42

N. 0° 2' W., on true line, bet. <sup>Fracl.</sup>secs. 4 and 5.  
 Over rolling land, thru scattering timber and undergrowth.  
 Intersect 3rd Standard Parallel North, 34.03 chs. S. 89° 53' E. from the reestablished standard cor. of secs. 32 and 33, hereinbefore described.  
 At the point of intersection,  
 Set an iron post, 3 ft. long, 2 ins. in diam., 24 ins. in the ground, for closing cor. of fracl. secs. 4 and 5, marked on brass cap,

C   C	
S 5	S 4
T12N	R17E
1917	

from which,

- A cedar, 8 ins. in diam., brs. S. 11 $\frac{3}{4}$ ° E., 221 lks. dist., marked T12N R17E S4BT.
- A cedar, 4 ins. in diam., brs. S. 27 $\frac{1}{2}$ ° W., 41 lks. dist., marked T12NR17E S5BT.

Land, rolling.  
 Soil, thin and rocky, 3rd rate.  
 Timber, pinyon and cedar.  
 Undergrowth, buck brush.  
 Short grass.

40.00

From the cor. of secs. 8, 9, and fracl. secs. 4 and 5.  
 West, on a true line, bet. sec. 8, and fracl. sec. 5.  
 Over rolling land, thru timber and undergrowth.  
 Set an iron post, 3 ft. long, 1 in. in diam., 26 ins. in the ground, for  $\frac{1}{4}$  sec. cor., marked on brass cap,

$\frac{1}{4}$ S	5
S	8
1917	

from which,

- A pinyon, 8 ins. in diam., brs. N. 11 $\frac{1}{2}$ ° E., 70 lks. dist., marked  $\frac{1}{4}$  S 5 B T.
- A pinyon, 6 ins. in diam., brs. S. 4° E., 13 lks. dist., marked  $\frac{1}{4}$  S 8 BT.

80.00

Set an iron post, 3 ft. long, 2 ins. in diam., 24 ins. in the ground, for cor. of secs. 7, 8 and fracl. secs. 5 and 6, marked on brass cap,

T12N R17E	
S 6	S 5
S 7	S 8
1917	

from which,

- A cedar, 10 ins. in diam., brs. N. 45 $\frac{1}{2}$ ° E., 45 lks. dist., marked T12NR17ES5BT.
- A pinyon, 8 ins. in diam., brs. S. 39° E., 81 lks. dist., marked T12NR17ES8 BT.

16 Survey of part of Subdivision lines of T 12 N R 17 E

Chains.

A pinyon, 8 ins. in diam., brs. S. 19 $\frac{1}{2}$ ° W., 30 lks.  
 dist., marked T12NR17E S7BT.  
 A pinyon, 8 ins. in diam., brs. N. 39° W., 85 lks.  
 dist., marked T12NR17ES6BT.

Land, rolling.  
 Soil, thin and rocky, 3rd rate.  
 Timber, pinyon and cedar.  
 Undergrowth, buck brush and white sage brush.  
 Short grass.

27.00  
 31.92

N. 0° 3' W. on true line, bet. fracl. secs. 5 and 6.  
 Over rolling land, thru scattering timber and undergrowth.  
 Descend 40 ft. to  
 Intersect 3rd. Standard Parallel N., 35.00 chs. S. 87° 17' E.  
 from the reestablished standard cor. of secs. 31 and 32,  
 hereinbefore described.  
 At the point of intersection,  
 Set an iron post, 3 ft. long, 2 ins. in diam., 24 ins. in  
 the ground, for closing cor. of fracl. secs. 5 and 6,  
 marked on brass cap,

C	C
S 6	S 5
T12N	R17E
1917	

from which,  
 A pinyon, 6 ins. in diam., brs. S. 54 $\frac{3}{4}$ ° E., 57 lks.  
 dist., marked T12NR17ES5BT.  
 A pinyon, 6 ins. in diam., brs. S. 32° W., 23 lks.  
 dist., marked T12NR17ES6BT.

Land, rolling.  
 Soil, thin and rocky, 3rd rate.  
 Timber, pinyon and cedar.  
 Undergrowth, buck brush.  
 Short grass.

78.01

From the cor. of secs. 7, 8 and fracl. secs. 5 and 6,  
 West, on a blank line, bet. sec. 7, and fracl. sec. 6.  
 Making proper allowance for convergency determines inter-  
 section with W. bdy. of Tp., at  
 Set an iron post, 3 ft. long, 3 ins. in diam., 24 ins. in  
 the ground, for cor. of secs. 7, 12 and fracl. secs. 1 and  
 6, marked on brass cap,

T12N	
R16E	R17E
S 1	S 6
S 12	S 7
1917	

from which,  
 A pine, 28 ins. in diam., brs. N. 23 $\frac{1}{2}$ ° E., 204 lks.  
 dist., marked T12N R17E S6BT.  
 A pine, 24 ins. in diam., brs. S. 73 $\frac{1}{2}$ ° E., 16 lks.  
 dist., marked T12NR17ES7 BT.  
 A pine, 20 ins. in diam., brs. S. 80° W., 190 lks.  
 dist., marked T12NR16ES12BT.  
 A pine, 24 ins. in diam., brs. N. 81° W., 345 lks.  
 dist., marked T12NR16E S1BT.

GENERAL DESCRIPTION

of N. tier of secs. of Township 12 North, Range 17 East.

SURFACE: The surveyed portion of this township is rolling and gently rolling, and is broken by a number of gulches and draws, the greatest of which is Black Canyon, coursing northerly in sec. 6, having gradual slopes, and averaging about 155 feet in depth, where it crosses the Standard Parallel.

DRAINAGE AND WATER SUPPLY: The drainage of the surveyed portion of this township is northerly. There is no permanent water. A tank in sec. 6, about 1 chain south of the standard Parallel, was dry at the time of this survey. There is a dam across the sandy wash in the bottom of Black Canyon near the south boundary of sec. 6.

SOIL: The soil of the lands surveyed is thin and sandy, and interspersed with rocks; classed as 2nd and 3rd rate.

TIMBER & VEGETATION: Pinon and cedar cover the surveyed portion of this township in scattering quantities. All lands surveyed are embraced within the Sitgreaves National Forest. The undergrowth is scant to scattering, and consists of rabbit brush, white sagebrush, buck brush and scrub cedar. Short grass in varying quantities covers the area surveyed.

MINERAL: No indications of valuable mineral were observed on the surface.

IMPROVEMENTS & SETTLERS: H. W. Despain has a house and a fenced field under cultivation in sec. 1. The Miles Ranger station is in sec. 12, unsurveyed, a short distance south of sec. 1. H. E. S. No. 551, entered by S. U. Porter, unpatented at time of survey, intersects the west boundary of sec. 6, with various improvements in the vicinity, among which were noted a dam and a tank in Black Canyon and some cultivated ground on the west boundary of sec. 6. A number of unimproved country roads across Sec. 1, being lines of communication between Heber, Holbrook, Taylor and Showlow, and the Miles Ranger station. Heber postoffice is located approximately in the SE. 1/4 of sec. 7, unsurveyed.

INDUSTRY: The surveyed portion of this township is perhaps best suited for grazing, and is more or less practicable for farming. The timber is of little commercial value.

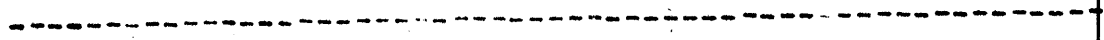

Boundaries of N. tier of secs. of T.12 N., R.17 E.  
 Latitudes, departures and closing errors.

-----

Line designated.	True bearing.	Dist.	Latitudes.		Departures.	
			N	S.	E.	W.
Subdivisional Boundary,	West,	478.01				478.01
West boundary,	North,	32.20	32.20			
North boundary, (3rd. Std. Par. N).	S. 89° 46' E.	2.65		0.01	2.65	
	N. 87° 57' E.	40.59	1.45		40.57	
	S. 87° 17' E.	40.15		1.90	40.11	
	N. 86° 13' E.	40.53	2.67		40.44	
	S. 89° 53' E.	41.22		0.08	41.22	
	N. 80° 02' E.	40.69	0.69		40.68	
	N. 89° 06' E.	40.61	0.64		40.61	
	N. 89° 50' E.	81.55	0.24		81.55	
	S. 89° 49' E.	40.99		0.13	40.99	
	N. 89° 17' E.	41.13	0.51		41.13	
N. 89° 35' E.	67.34	0.49		67.34		
East boundary,	S. 0° 41' E.	36.69		36.69	0.43	
Convergency,					0.04	
Totals,			38.80	38.81	477.76	478.01
			38.81			477.76
	Error in latitude,		.08			
	Error in departure,				0.25	

BOOK 3378

4-680

FIELD ASSISTANTS.to

Thomas B. Matthews, U. S. Surveyor.

NAMES.	CAPACITY.
M. Alfred Rennie	First Chainman
Stephen Hayes	Second Chainman
Jim Sackarison	Flagman, Axeman
Earnest Lundahl	Cornerman
Bill E. Drye	Axeman

For

CERTIFICATE OF UNITED STATES SURVEYOR.

see Book "A", this group.

I, \_\_\_\_\_, U. S. Surveyor, hereby certify upon honor that, in pursuance of special instructions received from the U. S. Surveyor General for \_\_\_\_\_ bearing date of the \_\_\_\_\_ day of \_\_\_\_\_, 191\_\_\_\_, I have well, faithfully, and truly in my own proper person, and in strict conformity with said instructions, the Manual of Surveying Instructions, and the laws of the United States, surveyed all those parts or portions of \_\_\_\_\_ of the \_\_\_\_\_ Meridian, in the State of \_\_\_\_\_, which are represented in the foregoing field notes as having been executed by me, and under my direction; and that all the corners of said survey have been established and perpetuated in strict accordance with the Manual of Surveying Instructions, and the special written instructions of the U. S. Surveyor General for \_\_\_\_\_ and in the specific manner described in the field notes, and that the foregoing are the original field notes of such survey.

U. S. Surveyor.

APPROVAL.

OFFICE OF THE UNITED STATES SURVEYOR GENERAL,

Phoenix Arizona, June 16, 1920.

retracement

The foregoing field notes of the ~~survey~~ of The Third Standard Parallel North, through part of Range 17 East, and Resurvey of the Third Standard Parallel North, through parts of Ranges 17 and 18 East, and part of East Boundary of T. 12 N., R. 17 E., and Survey of part of West Boundary, and part of Subdivision lines of

TOWNSHIP 12 NORTH, RANGE 17 EAST,

of the Gila and Salt River Base and Meridian, State of Arizona,

executed by Thos. B. Matthews, in the capacity of U.S. Surveyor,

under his special instructions dated December 1, 1916, for Group 80, Ariz., having been critically examined, and the necessary corrections and explanations made, the said field notes, and the ~~surveys~~ RETRACEMENTS, RESURVEYS AND SURVEYS they describe, are hereby approved.

*Francis A. Frost*

U. S. Surveyor General.

I certify that the foregoing transcript of the field notes of the above-described surveys in

has been correctly copied from the original notes on file in this office.