

3481

4-679

Book "C"

BOOK 3481

SEP 12 1921

FIELD NOTES

OF THE RESURVEY OF

the Second Standard Parallel South through Range 30 East,

AND OF THE SURVEY OF

the East boundary,

the North boundary,

the West boundary,

and the Subdivision lines of

Township 10 South, Range 30 East,

Of the Gila and Salt River Base and Meridian,

In the State of Arizona

EXECUTED BY

Guy R. Veal, and

Karl L. Siebecker,

U. S. Transitmen,

In the capacity of U. S. Surveyor s, under instructions dated October 6, 1919,

issued by the United States Surveyor General to govern surveys included in

Group No 102, Arizona, which were approved by the Commissioner of the General Land

Office, October 24, 1919 and Assignment Instructions dated Nov 4 & 18, 1919

Resurvey and Survey commenced January 17, 1920

Resurvey and Survey completed February 10, 1920

3481

3481

93

1A

Book "C"

Group 102- - Arizona.

BOOK 3481

INDEX DIAGRAM.

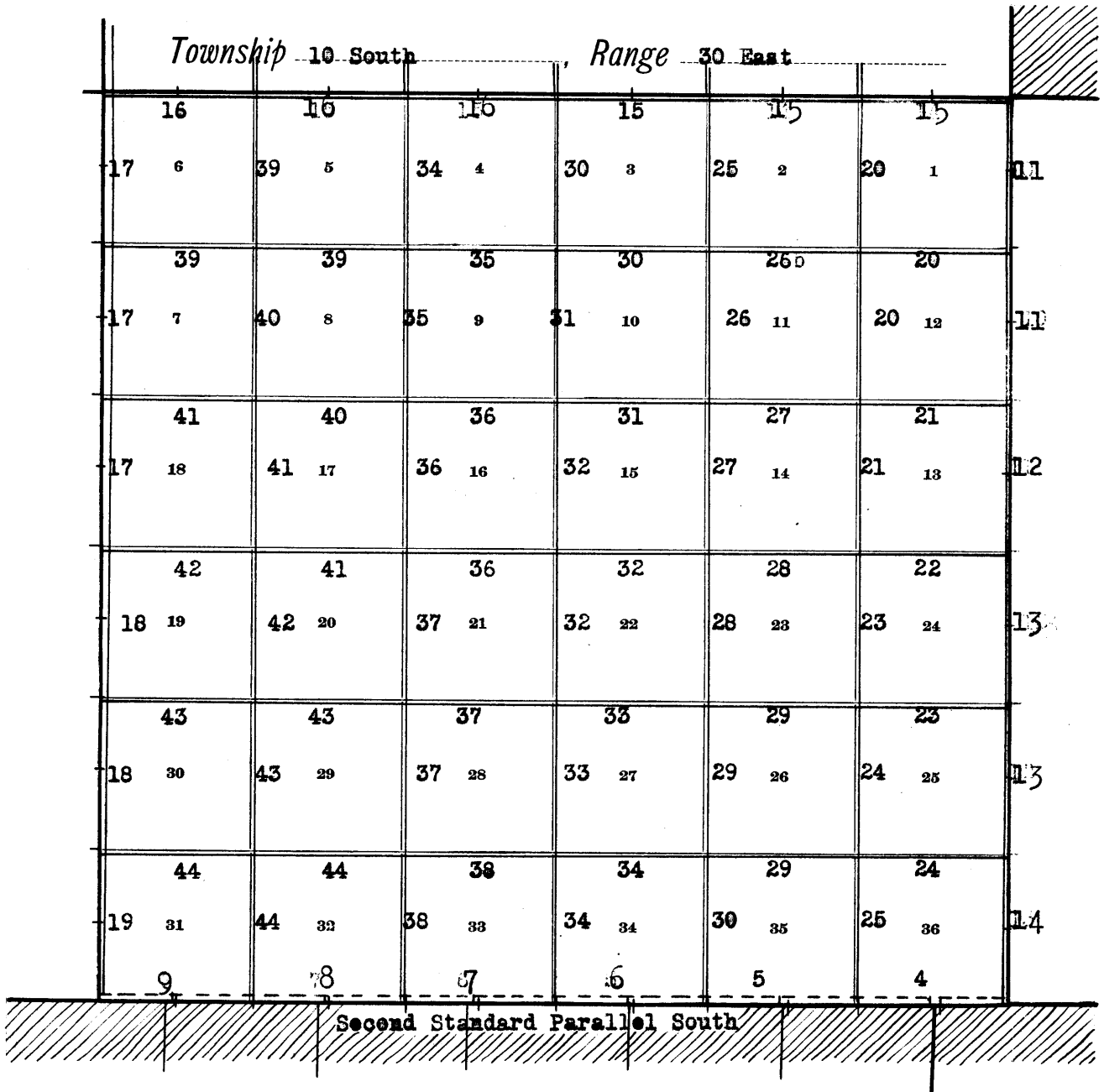

- ==== Lines surveyed under this Group.
- ==== Lines resurveyed under this Group.
- Accepted surveys.
- ▨ Areas surveyed as per accepted plats on file.

3481

Book "C"

BOOK 3461

Date Diagram

Township 10 South, Range 30 East,

				1-24-20		
1-27-20	1-26-20	1-26-20	1-26-20	1-24-20	1-22-20	1-22-20
1-27-20	5	5	4	3	2	1
1-27-20	1-29-20	1-29-20	1-29-20	1-29-20	1-28-20	1-27-20
1-27-20	7	6	9	10	11	12
1-27-20	2-6-20	1-31-20	1-31-20	1-28-20	1-28-20	1-28-20
1-27-20	18	17	16	15	14	13
1-27-20	2-6-20	1-31-20	1-31-20	1-30-20	1-30-20	1-30-20
1-27-20	19	20	21	22	23	24
1-27-20	2-9-20	2-6-20	2-9-20	2-5-20	1-31-20	1-31-20
1-27-20	30	29	28	27	26	25
1-27-20	2-10-20	2-10-20	2-10-20	2-5-20	2-4-20	2-4-20
1-27-20	31	32	33	34	35	36
1-27-20	2-4-20	2-4-20	2-4-20	2-3-20	2-3-20	2-3-20

and Standard Parallel South Resurveyed

Black lines on above diagram indicate surveys executed by Guy R. Veal, U. S. Transitman, on dates shown thereon.

Red lines on above diagram indicate surveys executed by Karl L. Siebecker, U. S. Transitman, on dates shown thereon.

Resurveys and surveys hereinafter described executed by Guy R. Veal and Karl L. Siebecker, U. S. Transitmen, on dates shown on diagram on page 1 hereof, using respectively Buff solar transit No. 9939 and Young and Sons' light mountain transit No. 8522, described with certificate of approval by the Assistant Supervisor of Surveys, in Book "A".

We examine the adjustments of the transits and correct all errors; then, to test the solar apparatus, by comparing their indications, resulting from solar observations made during a.m. and p.m. hours, with a meridian determined by observations on Polaris at elongation, we proceed as follows:

January 24, 1920: At our camp in sec. 17, T. 10 S., R. 30 E., G. and S. R. B. and M., in lat. $32^{\circ}33\frac{1}{2}'$ N., long. $109^{\circ}17'$ W., at 11 hrs. 15.9 m., p.m., l.m.t., we observe Polaris at western elongation, in accordance with the Manual of Instructions, and mark a point in the line thus determined by a tack driven in a hub, 10 chs. N. of our station.

January 25, 1920: We lay off the azimuth of Polaris, $1^{\circ}19\frac{1}{2}'$ to the east, and mark the true meridian thus determined by a tack in a-hub, 10 chs. N. of our station.

At 9 hrs. 0 m., a.m., l.m.t., we set off $32^{\circ}33\frac{1}{2}'$ N. on the lat. arcs; $19^{\circ}7\frac{1}{2}'$ S. on the decl. arcs; and determine a meridian with each solar, which in each case agrees with the true meridian.

At apparent noon, with the lat. arcs unchanged, we observe the sun on the meridian with each solar; the resulting decl. in each case is $19^{\circ}6\frac{1}{2}'$ S., which is the computed decl. of the sun.

At 3 hrs. 0 m., p.m., l.m.t., with the lat. arcs unchanged, we set off $19^{\circ}4'$ S. on the decl. arcs; and determine a meridian with each solar, which in each case agrees with the true meridian.

As all of the solar observations during the usual hours of solar work come within $1'30''$ of the true meridian, we conclude that the adjustments of the instruments are satisfactory.

Unless otherwise specified, all measurements are made with a Lufkin steel tape 5 chs. in length, compared with a Chesterman standard steel tape and found correct. The measurements are made on the slope, the vertical angles determined and the slope measurements properly reduced to true horizontal distances.

Chains

Retracement for Resurvey.

The Second Standard Parallel South, thru Range 30 E., was surveyed in 1882 by Theodore F. White, U. S. D. S., with no subsequent retracements or resurveys, except of the E. $\frac{1}{2}$ of the S. bdy. of sec. 36, which was resurveyed in 1916 by A. B. Rich, U. S. Surveyor, who reestablished in its original position the standard cor. of Ts. 10 S., Rs. 30 and 31 E. The closing cor. of Ts. 11 S., Rs. 30 and 31 E., was established by Lewis Wolfley, U. S. D. S. in 1884, and the subdivisional closing cors. of secs. in T. 11 S., R. 30 E. were established by John C. Smith, U. S. D. S. in 1885, and there is no record of reestablishment or alteration of any of these closing cors.

From the reestablished standard cor. of Ts. 10 S., Rs. 30 and 31 E., hereinafter described,
39.36 West, on retracement on original S. bdy. of sec. 36 (E. $\frac{1}{2}$).
Fall 23 lks. S. of the original standard $\frac{1}{4}$ sec. cor. of sec. 36, hereinafter described.
The true course and dist. of this half mile are therefore N. 89° 40' W., 39.36 chs.

Thence,
0.60 West, on retracement, on original S. bdy. of sec. 36 (W. $\frac{1}{2}$).
Intersect the original closing cor. of Ts. 11 S., Rs. 30 and 31 E., hereinafter described.

Continue line and measurement.
39.94 Fall 15 lks. N. of the original standard cor. of secs. 35 and 36, hereinafter described.
The true course and distance of this half mile are therefore S. 89° 47' W., 39.94 chs.

From the original standard cor. of secs. 35 and 36.
0.44 West, on retracement on original S. bdy. of sec. 35 (E. $\frac{1}{2}$).
Intersect a cor. of unknown origin hereinafter described.
Continue line and measurement.

39.93 Fall 6 lks. S. of the original standard $\frac{1}{4}$ sec. cor. of sec. 35, hereinafter described.
The true course and distance of this half mile are therefore N. 89° 55' W., 39.93 chs.

Thence,
0.48 West, on retracement, on original S. bdy. of sec. 35 (W. $\frac{1}{2}$).
Intersect original closing cor. of secs. 1 and 2, hereinafter described.

Continue line and measurement.
40.26 Fall 12 lks. N. of the original standard cor. of secs. 34 and 35, hereinafter described.
The true course and distance of this half mile are therefore S. 89° 50' W., 40.26 chs.

From the original standard cor. of secs. 34 and 35.
39.97 West, on retracement on original S. bdy. of sec. 34 (E. $\frac{1}{2}$).
Fall 8 lks. N. of the original standard $\frac{1}{4}$ sec. cor. of sec. 34, hereinafter described.
The true course and distance of this half mile are therefore S. 89° 53' W., 39.97 chs.

Thence,
0.44 West, on retracement on original S. bdy. of sec. 34 (W. $\frac{1}{2}$).
Intersect original closing cor. of secs. 2 and 3, hereinafter described.

Continue line and measurement.
40.14 Fall 10 lks. S. of the original standard cor. of secs. 33 and 34, hereinafter described.
The true course and distance of this half mile are therefore N. 89° 51' W., 40.14 chs.

From the original standard cor. of secs. 33 and 34.
40.31 West, on retracement on original S. bdy. of sec. 33 (E. $\frac{1}{2}$).
Fall 4 lks. N. of point of original location of standard $\frac{1}{4}$ sec. cor. of sec. 33, determined as hereinafter described.

- Chains The true course and distance of this half mile are therefore S. 89° 57' W., 40.31 chs.
- Thence,
West, on retracement, on original S. bdy. of sec. 33 (W. $\frac{1}{2}$).
0.44 Intersect original closing cor. of secs. 3 and 4, hereinafter described.
Continue line and measurement.
- 39.46 Fall 38 lks. S. of the original standard cor. of secs. 32 and 33, hereinafter described.
The true course and dist. of this half mile are therefore N. 89° 27' W., 39.46 chs.
- From the original standard cor. of secs. 32 and 33,
West, on retracement, on original S. bdy. of sec. 32 (E. $\frac{1}{2}$).
40.10 Fall 14 lks. N. of the point of original location of standard $\frac{1}{4}$ sec. cor. of sec. 32, determined as hereinafter described.
The true course and dist. of this half mile are therefore S. 89° 48' W., 40.10 chs.
- Thence,
West, on retracement, on original S. bdy. of sec. 32 (W. $\frac{1}{2}$).
0.75 (Record closing dist.) Diligent search in this vicinity fails to reveal any trace of original closing cor. of secs. 4 and 5.
Continue line and measurement.
- 40.21 Fall 14 lks. N. of the original standard cor. of secs. 31 and 32, hereinafter described.
The true course and dist. of this half mile are therefore S. 89° 48' W., 40.21 chs.
- From the original standard cor. of secs. 31 and 32,
West, on retracement, on original S. bdy. of sec. 31 (E. $\frac{1}{2}$).
39.59 Fall 22 lks. S. of the original point of location of the standard $\frac{1}{4}$ sec. cor. of sec. 31, determined as hereinafter described.
The true course and dist. of this half mile are therefore N. 89° 41' W., 39.59 chs.
- Thence,
West, on retracement, on original S. bdy. of sec. 31 (W. $\frac{1}{2}$).
1.08 (Record closing dist.) Diligent search in this vicinity fails to reveal any trace of closing cor. of secs. 5 and 6. Continue line and measurement.
- 40.31 Fall 22 lks. S. of the original standard cor. of Ts. 10 S., Rs. 29 and 30 E., hereinafter described.
The true course and dist. of this half mile are therefore N. 89° 41' W., 40.31 chs.

RESURVEY.

- The reestablished standard cor. of Ts. 10 S., Rs. 30 and 31 E., is an iron post, 3 ins. in diam., projecting 12 ins. above ground, firmly set, properly marked on brass cap, and witnessed by a mound of stone, N. of cor. No bearing trees.
- Thence,
N. 89° 40' W., on a true line, on S. bdy. of sec. 36.
Over mountainous land, thru scattering undergrowth.
Descend.
- 4.10 Wash, course SW. Ascend 340 ft.
24.25 Spur, slopes S. Descend 260 ft.
- 39.36 Intersect the original standard $\frac{1}{4}$ sec. cor. of sec. 36, which is a volcanic stone, 5 x 9 x 6 ins. above ground, firmly set, marked "SC $\frac{1}{4}$ " on N. face, and witnessed by a mound of stone N. of cor. No bearing trees.
Change this cor. to angle point by destroying the existing markings, and chiseling the letters "AP" on stone.
Thence S. 89° 47' W. on a true line, continuing measurement of S. bdy. of sec. 36.
- 39.96 Intersect the original closing cor. of Ts. 11 S., Rs. 30 and 31 E., which is a malpais stone, 14x8x12 ins. above ground, firmly set, marked "CC" on S. face, and 6 notches

Resurvey of Second Standard Parallel South, thru Range 30 East.

Chains:

on each of E., W. and S. edges, and witnessed by a mound of stone, S. of cor. No bearing trees. This description agrees with record.

40.00 Set an iron post 3 ft. long, 1 in. in diam., 18 ins. in the ground, deposit marked (x) stone; and raise a mound of stone around post, for reestablished standard $\frac{1}{4}$ sec. cor. of sec. 36, with brass cap, marked

S C
1/4 S 36
1929.

Continue descent, 150 ft.

59.76 Foot of descent, brs. N. and S. Thence over level land.

79.30 (39.94 chs. S. 89° 47' W., from original std. $\frac{1}{4}$ sec. cor. of sec. 36), Intersect the original standard cor. of secs. 35 and 36, which is a malpais stone, 8x10x14 ins. above ground, firmly set, marked "SC" on N. face, and 1 notch on E. edge, and 5 notches on W. edge, and witnessed by a mound of stone, N. of cor. No bearing trees. Change this cor. to angle point by destroying the existing markings, and chiseling the letters "AP" on stone.

Thence, N. 89° 55' W., on a true line, continuing measurement of S. bdy. of sec. 36.

79.74 Intersect a malpais stone 10x10x16 ins. above ground, marked " $\frac{1}{4}$ CC" on N. face. The origin of this cor. is unknown, but was probably set by private surveyor.

80.00 Set an iron post, 3 ft. long, 2 ins. in diam., 18 ins. in the ground; deposit marked (x) stone, and raise a mound of stone around post, for reestablished std. cor. of secs. 35 and 36, with brass cap, marked

S C
T10S R30E
S35 S36
1920

Land, mountainous and rolling.
Soil, rocky, 3rd rate.
No timber.
Undergrowth, catclaw and cactus:
Fair growth of water grass.

N. 89° 55' W., on a true line, on S. bdy. of sec. 35. Over level land, thru scattering undergrowth.

39.23 (39.93 chs. N. 89° 55' W., from original std. cor. of secs. 35 and 36), Intersect the original standard $\frac{1}{4}$ sec. cor. of sec. 35, which is a malpais stone, 5x8x12 ins. above ground, firmly set, marked "SC $\frac{1}{4}$ " on N. face, and witnessed by a mound of stone, N. of cor. No bearing trees. Change this cor. to angle point by destroying the existing marking, and chiseling the letters "AP" on stone.

Thence S. 89° 50' W., on a true line, continuing measurement of S. bdy. of sec. 35.

39.71 Intersect the original closing cor. of secs. 1 and 2, T. 11 S., R. 30 E., which is a malpais stone, 12x8x10 ins. above ground, firmly set, marked "CC" on S. face, and 1 notch on E. edge, 5 notches on W. edge, and witnessed by mound of stone, S. of cor. No bearing trees.

40.00 Set an iron post, 3 ft. long, 1 in. in diam., 14 ins. in the ground, deposit marked (x) stone, and raise a mound of stone around post, for reestablished std. $\frac{1}{4}$ sec. cor. of sec. 35, with brass cap, marked

S C
1/4 S 35
1920

6 Resurvey of Second Std. Parallel South, thru. Range 30 East.

- Chains.
- 79.49 (40.26 chs. S. 89°50' W. from original standard $\frac{1}{4}$ sec. cor. of sec. 35) Intersect the original standard cor. of secs. 34 and 35, which is a malpais stone, 8x5x8 ins., above ground, firmly set, marked "SC" on N. face and 2 notches on E. edge and 4 notches on W. edge, and witnessed by a mound of stone, N. of cor. No bearing trees. Change this cor. to angle point by destroying the existing markings and chiseling the letters "AP" on stone.
Thence S. 89°53' W., on a true line, continuing measurement of S. bdy. of sec. 35.
- 80.00 Set an iron post, 3 ft. long, 2 ins. in diam., 14 ins. in the ground, deposited marked (x) stone, and raise a mound of stone around post, for reestablished std. cor. of secs. 34 and 35, with brass cap, marked
- | | |
|------|------|
| S | C |
| T10S | R30E |
| S34 | S35 |
- 1920
- Land, level.
Soil, 3rd rate.
No timber.
Undergrowth, yucca, ocotilla and cactus.
-
- 39.46 S. 89°53' W., on a true line, on S. bdy. of sec. 34. Over level land, thru. scattering undergrowth.
(39.97 chs. S. 89°53' W. from original std. cor. of secs. 34 and 35), Intersect the remains of the original standard $\frac{1}{4}$ sec. cor. of sec. 34, which is the mound of stone described in record as having been raised around a wood post. No trace of the post can be found. Slight traces of the original pits E. and W. of cor. are visible.
Change this cor. to angle point as follows: On a malpais stone, 12x6x8 ins., in this mound of stone, chisel the letters "AP".
Thence,
N. 89°51' W., on a true line, continuing measurement of S. bdy. of sec. 34.
- 39.90 Intersect the original closing cor. of secs. 2 and 3, T. 11 S., R. 30 E., which is a malpais stone, 24x10x12 ins. above ground, firmly set, marked "CC" on S. face, 2 notches on E. edge and 4 notches on W. edge, and witnessed by a mound of stone, S. of cor. No bearing trees.
- 40.00 Set an iron post, 3 ft. long, 1 in. in diam., 12 ins. in the ground, deposit marked (x) stone and raise a mound of stone around post, for reestablished std. $\frac{1}{4}$ sec. cor. of sec. 34, with brass cap marked
- | | |
|-----------------|----|
| S | C |
| $\frac{1}{4}$ S | 34 |
- 1920
- 60.00 Ascend E. slope, 170 ft.
74.77 Spur, slopes SE. Descend.
- 79.60 (40.14 chs. N. 89°51' W. from original std. $\frac{1}{4}$ sec. cor. of sec. 34), Intersect the original standard cor. of secs. 33 and 34, which is a malpais stone, 14x8x10 ins. above ground, firmly set, marked "SC" on N. face and 3 notches on each of E. and W. edges, and witnessed by a mound of stone, N. of cor. No bearing trees. Change this cor. to angle point by destroying the existing markings, and chiseling the letters "AP" on stone.
Thence,
S. 89°57' W., on a true line, continuing measurement of S. bdy. of sec. 34.
- 80.00 Set an iron post, 3 ft. long, 2 ins. in diam., 8 ins. in the ground, deposit marked (x) stone, and raise a mound of stone around post, for reestablished std. cor. of secs.

Resurvey of Second Std. Parallel South, thru. Range 30 East.

Chains.

33 and 34, with brass cap, marked

S	C
T10S	R30E
S33	S34

1920

Land, level and mountainous.
Soil, rocky, 3rd rate.
No timber.
Undergrowth, greasewood, yucca and cactus.

S. 89° 57' W., on a true line, on S. bdy. of sec. 33.
Over mountainous land, thru. scattering undergrowth.
Ascend.

2.00
18.00
39.91

Spur, slopes S. Descend 295 ft.
Wash, course SW. Thence over rolling land.
(40.31 chs. S. 89° 57' W., from original std. cor. of secs. 33 and 34), Intersect the point of original location of the std. 1/4 sec. cor. of sec. 33, as determined by reference to faint remains of the original pits E. and W. of cor. point.

Reestablish the cor. at this point for angle point as follows:
Set an iron post, 3 ft. long, 1 in. in diam., 24 ins. in the ground, for angle point, marked on brass cap,

A P

1920

and raise a mound of stone, 2 ft. base, 1 1/2 ft. high, N. of cor.

Thence,
N. 89° 27' W., on a true line, continuing measurement of S. bdy. of sec. 33.

40.00

Set an iron post, 3 ft. long, 1 in. in diam., 26 ins. in the ground, for reestablished standard 1/4 sec. cor. of sec. 33, marked on brass cap,

S	C
1/4 S	33

1920

and raise a mound of stone, 2 ft. base, 1 1/2 ft. high, N. of cor.

40.35

Intersect the original closing cor. of secs. 3 and 4, T. 11 S., R. 30 E., which is a malpais stone, 12x8x5 ins. above ground, firmly set, marked "CC" on S. face, with 3 notches on each of E. and W. edges, and witnessed by a mound of stone, S. of cor. No bearing trees.

43.00

Wash, course SE.

57.00

Wash, course SE.

79.37

(39.46 chs. N. 89° 27' W. from original std. 1/4 sec. cor. of sec. 33), Intersect the original standard cor. of secs. 32 and 33, which is a wooden post, 2 ft. above ground, firmly set in ground and mound of earth, marked "SC" on N. face, "R30E S33" on E. face, illegible markings on W. face, with 4 notches on E. edge, and 2 notches on W. edge, and witnessed by faint traces of old pits N., E. and W. of cor., and one bearing tree, a mesquite, S. 40° E., 96 lks. dist., illegibly marked.

Change this cor. to angle point by destroying marks on old post, and alongside same, set an iron post, 3 ft. long, 2 ins. in diam., 24 ins. in the ground, for angle point, marked on brass cap,

8 Resurvey of Second Std. Parallel South, thru. Range 30 East.

Chains.

A P

1920

Thence,

S. 89°48'W., on a true line, continuing measurement of S. bdy. of sec. 33.

80.00

Set an iron post, 3 ft. long, 2 ins. in diam., 12 ins. in the ground, deposit marked (x) stone, and raise a mound of stone around post, for reestablished standard cor. of secs. 32 and 33, marked on brass cap,

S	C
T10S	R30E
S32	S33

1920

Land, mountainous and rolling.

Soil, sandy and rocky, 4th rate.

No timber.

Undergrowth, yucca, cactus and mesquite.

S. 89°48'W., on a true line, on S. bdy. of sec. 32.

Over rolling land, thru. scattering undergrowth.

34.00

Wash, course SW.

39.47

(40.10 chs. S. 89°48'W. from original std. cor. of secs. 32 and 33), Intersect the point of original location of the standard $\frac{1}{4}$ sec. cor. of sec. 32, determined by reference to the original accessories, consisting of faint traces of the pits E. and W. of cor., and a bearing tree, a mesquite, S. 14 $\frac{1}{2}$ °W., 213 lks. dist., marked "SC $\frac{1}{4}$ SBT."

Reestablish this cor. at this point, as an angle point as follows:

Destroy marks on old bearing tree, and set an iron post, 3 ft. long, 1 in. in diam., 26 ins. in the ground, for angle point, marked on brass cap,

A P

1920

and raise a mound of stone, 2 ft. base, 1 $\frac{1}{2}$ ft. high, N. of cor.

Continue line and measurement.

Diligent search in this vicinity failed to reveal any trace of the original closing cor. of secs. 4 and 5, T.

11 S., R. 30 E.

40.00

Set an iron post, 3 ft. long, 1 in. in diam.; 27 ins. in the ground, for reestablished std. $\frac{1}{4}$ sec. cor. of sec. 32, marked on brass cap,

S	C
$\frac{1}{4}$ S	32

1920

and raise a mound of stone, 2 ft. base, 1 $\frac{1}{2}$ ft. high, N. of cor.

79.68

(40.21 chs. S. 89°48'W., from original std. $\frac{1}{4}$ sec. cor. of sec. 32), Intersect the original standard cor. of secs. 31 and 32, which is a wooden post, 2 ins. square, projecting 2 ft. above ground, firmly set in ground, and mound of earth, marked "SCT10S R30E" on N. face, "S 32" on E. face, "S31" on W. face, 1 notch on W. edge, and 5 notches on E. edge, and witnessed by faint traces of pits N. E. and W. of post. Change this cor. to angle point, by destroying marking on old post, and alongside same, set an iron post, 3 ft. long, 2 ins. in diam., 27 ins. in the ground, for angle point, marked on brass cap,

Resurvey of Second Std. Parallel South, thru. Range 30 East.

Chains.

A P
1920

80.00 Dig pits, 18x18x12 ins., NE. and NW. of post, 3 ft. dist. Thence, N. 89° 41' W., on a true line, continuing measurement of S. bdy. of sec. 31. Set an iron post, 3 ft. long, 2 ins. in diam., 27 ins. in the ground, for reestablished standard cor. of secs. 31 and 32, marked on brass cap,

S C
T10S R30E
S31 S32
1920

from which,
A mesquite, 6 ins. in diam., brs. N. 70° E., 210 lks. dist., mark "SC T10S R30E S32 BT."
A mesquite, 4 ins. in diam., brs. N. 26 1/2° W., 236 lks. dist., mark "SC T10S R30E S31 BT."
Land, rolling.
Soil, sandy, 4th rate.
No timber,
Undergrowth, mesquite, yucca, cactus and catclaw.

39.27 N. 89° 41' W., on a true line, on S. bdy. of sec. 31. Over gently rolling land, thru. scattering undergrowth. (39.59 chs. N. 89° 41' W. from original std. cor. of secs. 31 and 32), Intersect the point of original location of the std. 1/4 sec. cor. of sec. 31, determined by reference to the faint remains of the old pits, E. and W. of cor. There is no trace of the original bearing trees. Reestablish the cor. at this point as an angle point as follows:
Set an iron post, 3 ft. long, 1 in. in diam., 24 ins. in the ground, for angle point, marked on brass cap,

A P
1920

40.00 Dig pits, 18x18x12 ins., E. and W. of post, 3 ft. dist. Continue line and measurement. Diligent search in this vicinity failed to reveal any trace of the original closing cor. of secs. 5 and 6, T. 11 S., R. 30 E. Set an iron post, 3 ft. long, 1 in. in diam., 27 ins. in the ground, for reestablished standard 1/4 sec. cor. of sec. 31, marked on brass cap,

S C
T10S R30E
S31
1920

79.58 Dig pits, 18x18x12, E. and W. of post, 3 ft. dist. (40.31 chs. N. 89° 41' W. from original std. 1/4 sec. cor. of sec. 31), Intersect the original standard cor. of T. 10 S., R. 29 and 30 E., which is a wooden post, 4 ins. square, projecting 3 ft. above ground, firmly set in ground, and mound of earth, with notches and markings "T10S S31" still legible, but all other marks obliterated, and witnessed by a mesquite, S. 50 1/2° W., 228 lks. dist., and a mesquite, N. 84 1/2° W., 154 lks. dist., both properly marked. Destroy mound of earth, reset old post in original position, 24 ins. in the ground, and alongside same, set an iron post, 3 ft. long, 3 ins. in diam., 24 ins. in the ground, for reestablished standard cor. of

10 Resurvey of Second Standard Parallel South, thru. Range 30 East.

Chains.

Ts.10 S., Rs.29 and 30,E., marked on brass cap,

S	C
T10S	
R29E	R30E
S36	S31

1920

In addition to the original bearing trees, establish new bearing trees as follows:

On a mesquite, 4 ins. in diam., N. 59 1/4° E., 8 lks. dist., mark "SCT10S R30E S31BT."

On a catclaw, 6 ins. in diam., N. 25 1/4° W., 34 lks. dist., mark "SC T10S R29E S36 BT."

Land, gently rolling.

Soil, sandy, 3rd rate.

No timber.

Undergrowth, mesquite, catclaw, yucca and cactus.

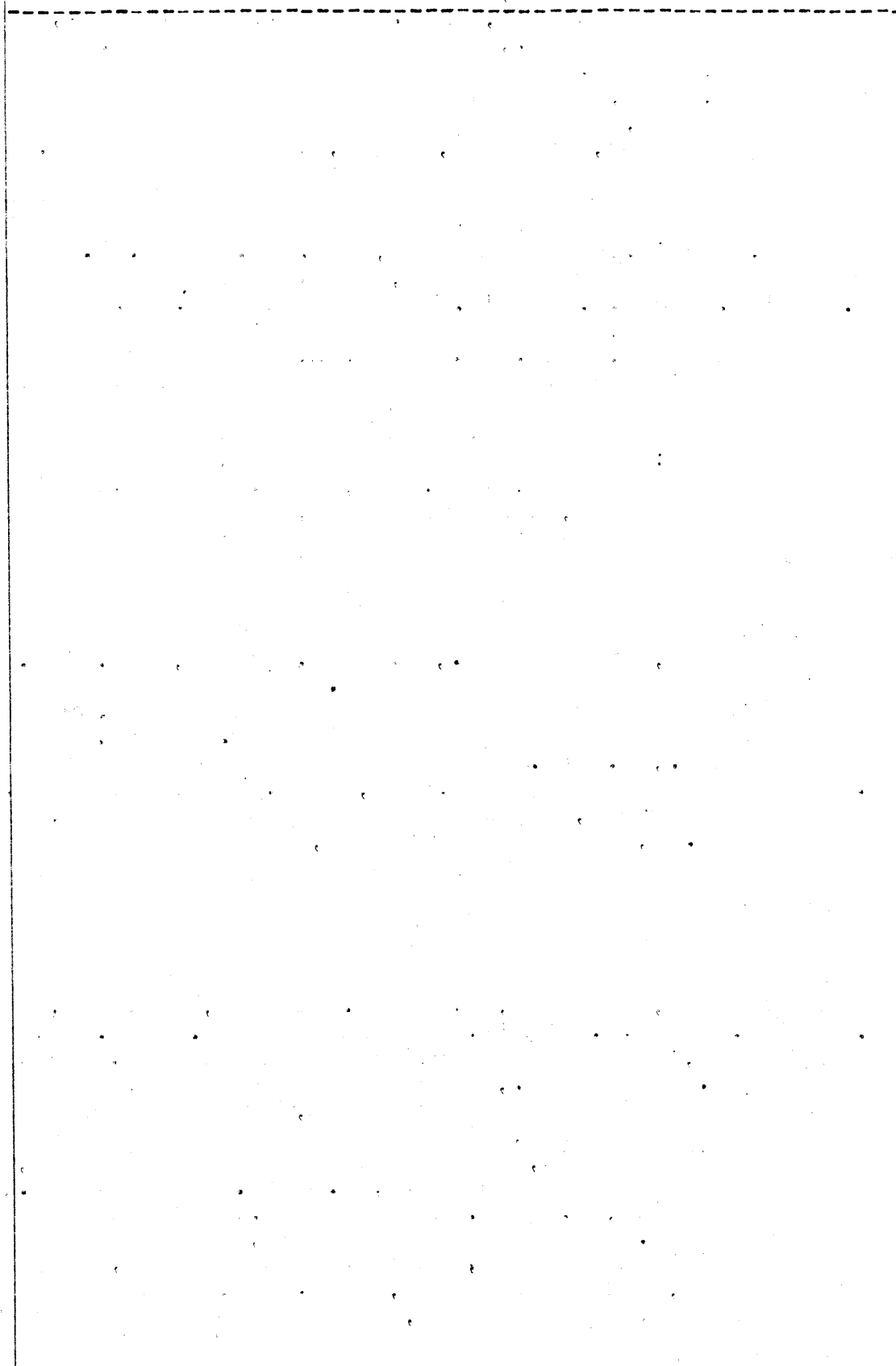

Survey of East bdy. of Township 10 South, Range 30 East.

Chains.

The original cor. of Ts. 9 and 10 S., Rs. 30 and 31 E., established by Hugh F. DuVal, U.S.D.S. in 1910, is a malpais stone, 24x9x6 ins., firmly set in a mound of stone marked "9S" on NE., "31E" on SE., "10S" on SW. and "30E" on NW. face, and 6 notches on each of N., S.E. and W. edges, and witnessed by a mound of stone, S. of cor. No bearing trees.

Thence, South, on a random line, setting temp. 1/4 sec. and sec. cors. at intervals of 40.00 chs.; and at 478.31 chs., fall 50 lks. W. of the reestablished standard cor. of Ts. 10 S., Rs. 30 and 31 E. on 2nd. Standard Parallel South, hereinbefore described. The falling answers to a correction of 0°4', or 9 lks. E. per mile, counting from the NE. cor. of the Tp. Return to the original cor. of Ts. 10 S., Rs. 30 and 31 E.

Thence, S. 0°4'E., on a true line, bet. secs. 1 and 6. Over mountainous land, thru. scattering undergrowth. Descend 415 ft.

- 13.20 Gulch, 10 lks. wide, course SW. Ascend.
- 17.10 Spur, slopes SW. Descend 135 ft.
- 25.10 Gulch, course SW. Ascend 100 ft.
- 29.70 Spur, slopes SW. Descend 90 ft.
- 33.50 Gulch, 15 lks. wide, course SW. Ascend 25 ft.
- 36.25 Spur, slopes SW. Descend 35 ft.
- 40.00 Set an iron post, 3 ft. long, 1 in. in diam., 26 ins. in the ground, for 1/4 sec. cor., marked on brass cap,

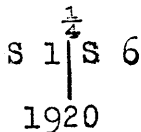

- from which,
- A cedar, 12 ins. in diam., brs. S. 33 1/4° E., 93 lks. dist., mark "1/4 S 6 BT."
- A cedar limb, 4 ins. in diam., brs. S. 82 1/4° W., 113 lks. dist., mark "1/4 S 1 BT."

- Continue descent, 135 ft.
- 63.80 Gulch, 10 lks. wide, course W. Ascend 25 ft.
- 69.90 Descend SW. slope, 40 ft.
- 74.85 Gulch, course W.; ascend.
- 80.00 Set an iron post, 3 ft. long, 2 ins. in diam., 15 ins. in the ground, in a mound of stone, for cor. of secs. 1, 6, 7 and 12, marked on brass cap,

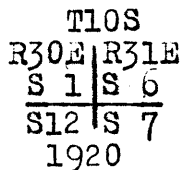

- from which,
- A cedar, 10 ins. in diam., brs. N. 12° E., 307 lks. dist., mark "T10S R31E S6 BT"
- A cedar, 12 ins. in diam., brs. N. 8° W., 400 lks. dist., mark "T10S R30E S1 BT."

No other trees within limits.
Land, mountainous.
Soil, rocky, 4th rate.
No timber.
Undergrowth, cedar, mesquite and soto.

S. 0°4'E., on a true line, bet. secs. 7 and 12. Over rolling and mountainous land, thru. scattering undergrowth. Descend gradually.

12. Survey of East bdy. of Township 10 South Range 30 East.

Chains.	
13.00	Gulch, course NW. Ascend 45 ft.
20.00	Spur, slopes W. Descend 30 ft.
25.00	Gulch, 10 lks. wide, course W. Ascend 95 ft.
31.00	Spur, slopes W. Descend 15 ft.
36.50	Gulch, 10 lks. wide, course NW. Ascend 50 ft.
40.00	Spur, slopes W. Set an iron post, 3 ft. long, 1 in. in diam., 7 ins. in the ground, in a mound of stone, for $\frac{1}{4}$ sec. cor., marked on brass cap,
	$\frac{1}{4}$ S12 S 7 1920
	from which, A cedar, 14 ins. in diam., brs. N. 75° E., 71 lks. dist., mark " $\frac{1}{4}$ S 7 BT."
	A cedar limb, 10 ins. in diam., brs. N. 18 $\frac{1}{2}$ ° W., 133 lks. dist., mark " $\frac{1}{4}$ S12 BT."
	Descend.
43.20	Gulch, course W. Thence along W. slope.
50.80	Gulch, course W. Ascend 100 ft.
56.25	Spur, slopes W. Descend 15 ft.
61.00	Draw, course W. Ascend 50 ft.
66.70	Spur, slopes SW.; descend.
71.10	Head of gulch, course NW. Ascend 110 ft.
80.00	Set an iron post, 3 ft. long, 2 ins. in diam., 24 ins. in the ground, for cor. of secs. 7, 12, 13 and 18, marked on brass cap,
	T10S R30E R31E S12 S 7 S13 S18 1920
	from which, A cedar limb, 10 ins. in diam., brs. N. 39° E., 140 lks. dist., mark "T10S R31E S7 BT."
	A cedar, 10 ins. in diam., brs. S. 76 $\frac{3}{4}$ ° W., 212 lks. dist., mark "T10S R30E S13 BT."
	No other trees within limits. Raise a mound of stone, 2 ft. base, 1 $\frac{1}{2}$ ft. high, W. of cor.
	Land, rolling and mountainous.
	Soil, rocky, 4th rate.
	No timber.
	Undergrowth, cedar, Spanish dagger, cactus and soto.

	S. 0° 4' E., on a true line, bet. secs. 13 and 18. Over mountainous land, thru. scattering undergrowth. Ascend.
0.50	Spur, slopes W. Descend 20 ft.
5.30	Gulch, 10 lks. wide, course NW. Ascend 475 ft., over NW. slope, to
40.00	Set an iron post, 3 ft. long, 1 in. in diam., 20 ins. in the ground, in a mound of stone, for $\frac{1}{4}$ sec. cor., marked on brass cap,
	$\frac{1}{4}$ S13 S18 1920
	Cor. stands on main divide of Peloncillo Mountains, brs. NE. and SW. Descend 45 ft.
45.00	Head of gulch, course SE. Thence along E. slope.
52.00	Main divide of Peloncillo Mts., brs. NW. and SE. Descend 480 ft., over SW. slope, to
79.00	Head of gulch, course W. Ascend 10 ft., over NW. slope, to
80.00	Set an iron post, 3 ft. long, 2 ins. in diam., 20 ins. in the ground, in a mound of stone, for cor. of secs. 13, 18, 19 and 24, marked on brass cap,

Survey of East bdy. of Township 10 South, Range 30 East.

Chains.

T10S	
R30E	R31E
S13	S18
S24	S19

1920

from which,
 A cedar, 24 ins. in diam., brs. S. 65° E., 160 lks.
 dist., mark "T10S R31E S19 BT."
 A cedar, 10 ins. in diam., brs. S. 59½° W., 117 lks.
 dist., mark "T10S R30E S24 BT."

No other trees within limits.
 Land, mountainous.
 Soil, rocky, 4th rate.
 No timber.
 Undergrowth, cedar and cactus.

11.50
 22.30
 29.30
 37.25
 40.00

S. 0° 4' E., on a true line, bet. secs. 19 and 24.
 Over mountainous land, thru. scattering undergrowth.
 Crest of Peloncillo Mts., brs. NE. and SW. Continue ascent.
 Spur, slopes E. Descend.
 Ascend 70 ft.
 Spur, slopes SE. Thence along E. slope.
 Set an iron post, 3 ft. long, 1 in. in diam., 16 ins. in the
 ground, with marked stone, for ¼ sec. cor., and raise a
 mound of stone around post, with brass cap, marked

T10S	
R30E	R31E
S24	S19
1920	

from which,
 A cedar, 12 ins. in diam., brs. S. 86° E., 143 lks.
 dist., mark "T10S R31E S19 BT."
 A forked cedar, 12 ins. in diam., brs. N. 32½° W., 80 lks.
 dist., mark "T10S R30E S24 BT."

50.60
 66.50
 80.00

Descend 245 ft.
 Draw, course SE. Ascend 215 ft.
 Spur, slopes SE. Descend 135 ft. to
 Set an iron post 3 ft. long, 2 ins. in diam., 18 ins. in
 the ground, with marked stone, for cor. of secs. 19, 24,
 25 and 30, and raise a mound of stone, around post, with
 brass cap, marked

T10S	
R30E	R31E
S24	S19
S25	S30
1920	

from which,
 A cedar, 36 ins. in diam., brs. N. 65° E., 204 lks.
 dist., mark "T10S R31E S19 BT."
 A cedar, 12 ins. in diam., brs. N. 55° W., 244 lks.
 dist., mark "T10S R30E S24 BT."

No other trees within limits.
 Land, mountainous.
 Soil, rocky, 4th rate.
 No timber.
 Undergrowth, cedar and cactus.

11.40
 40.00

S. 0° 4' E., on a true line, bet. secs. 25 and 30.
 Over mountainous land, thru. scattering undergrowth.
 Along W. slope.
 Spur, slopes SW. Descend 280 ft.
 Set an iron post, 3 ft. long, 1 in. in diam., 18 ins. in
 the ground, with marked stone, for ¼ sec. cor., and raise

14 Survey of East boundary of Tow ship 10 South, Range 30 East.

Chains.

a mound of stone, around post, with brass cap, marked

S25 | S30
1920

Continue descent, 125 ft.

55.00 Draw, course SE. Ascend 180 ft.

68.00 Spur, slopes SE. Descend 200 ft.

79.00 Draw, course SE, Ascend.

80.00 Set an iron post, 3 ft. long, 2 ins. in diam., 18 ins. in the ground, with marked stone, for cor. of secs. 25, 30, 31 and 36, and raise a mound of stone around post, with brass cap, marked

T10S
R30E | R31E
S25 | S30
S36 | S31
1920

from which,

A cedar, 24 ins. in diam., brs. S. 15 1/4° W., 200 lks. dist., mark "T10S R30E S36 BT."

No other trees within limits.

Land, mountainous.

Soil, rocky, 4th rate.

No timber.

Undergrowth, cedar and cactus.

S. 0° 04' E. on a true line, bet. secs. 31 and 36.

Over mountainous land, thru. scattering undergrowth.

Ascend.

1.00 Peloncillo Mts., bear E. and NW. Descend 700 ft.

30.00 Canyon, course SE. Ascend 45 ft.

36.00 Spur, slopes SE. Descend.

40.00 Set an iron post, 3 ft. long, 1 in. in diam., 15 ins. in the ground, in a mound of stone, for 1/4 sec. cor., marked on brass cap,

S36 | S31
1920

and raise a mound of stone, 2 ft. base, 1 1/2 ft. high, W. of cor.

Continue descent, 385 ft.

53.00 Wash, course SE. Thence over rolling land.

65.00 Draw, course SW.

78.31 The standard cor. of Ts. 10 S., Rs. 30 and 31 E. on 2nd Std. Par. S., hereinbefore described.

Land, mountainous and rolling.

Soil, rocky, 4th rate.

No timber.

Undergrowth, cedar and cactus.

survey of North bdy. of Township 10 South, Range 30 east.

Chains.

From original cor. of T9S and 10 S., R30 and 31 E., here-
inbefore described,

West, on a true line, bet. secs. 1 and 36.

Over mountainous land, thru scattering undergrowth.

Descend 280 ft., over south slope.

9.79 Spur, slopes S. Continue descent.

24.00 Draw, course S. Ascend 35 ft.

29.40 Spur, slopes SW. Descend 90 ft.

40.00 Set an iron post, 3 ft. long, 1 in. in diam., 8 ins. in the
ground, with marked stone, for 1/4 sec. cor., and raise a
mound of stone around post, with brass cap, marked

1/4 S 36
S 1
1920

Continue descent, 85 ft.

40.50 Draw, course SW. Ascend 310 ft.

70.20 Top of Peloncillo Mts., brs. NE. & S. Desc. 340 ft. over SW. slope.

80.00 Set an iron post, 3 ft. long, 2 ins. in diam., 17 ins. in the
ground, with marked stone, for cor. of secs. 1, 2, 35 and 36,
and raise a mound of stone around post, with brass cap,
marked

T9S | R30E
S35 | S36
S 2 | S 1
T10S
1920

and raise a mound of stone, 5 ft. base, 4 ft. high, W. of cor.

Land, mountainous.

Soil, rocky, 4th rate.

No timber.

Undergrowth, greasewood and cactus.

West, on true line, bet. secs. 2 and 35.

Over mountainous land, thru scattering undergrowth.

Descend 905 ft.

22.88 Spur, slopes NW. Continue descent.

40.00 Set an iron post, 3 ft. long, 1 in. in diam., 16 ins. in the
ground, with marked stone, for 1/4 sec. cor., marked on
brass cap,

1/4 S 35
S 2
1920

41.00 Wash, course NW. Continue descent, 325 ft.

72.09 Wash, course NW. Continue descent.

80.00 Set an iron post, 3 ft. long, 2 ins. in diam., 12 ins. in the
ground, with marked stone, for cor. of secs. 2, 3, 34 and
35, and raise a mound of stone around post, with brass
cap, marked

T9S | R30E
S34 | S35
S 3 | S 2
T10S
1920

Land, mountainous.

Soil, rocky, 4th rate.

No timber.

Undergrowth, greasewood, catclaw and cactus.

West, on true line, bet. secs. 3 and 34.

Over rolling land, thru scattering undergrowth. Desc. 35 ft.

10.00 Thence over gently rolling land.

40.00 Set an iron post, 3 ft. long, 1 in. in diam., 12 ins. in the
ground, with marked stone, for 1/4 sec. cor., and raise a
mound of stone around post, with brass cap, marked

1/4 S 34
S 3
1920

80.00 Set an iron post, 3 ft. long, 2 ins. in diam., 27 ins. in the
ground, for cor. of secs. 3, 4, 33 and 34, marked on brass
cap,

16 North boundary of Township 10 South, Range 30 East.

Chains.

T9S	R30E
S33	S34
S 4	S 3
T10S	
1920	

and raise a mound of stone, 2 ft. base, 1 1/2 ft. high, W. of cor. Land, rolling and gently rolling. Soil, rocky and sandy, 4th rate. No timber. Undergrowth, mesquite, greasewood, yucca and cactus.

40.00 West, on a true line, bet. secs. 4 and 33. Over level land, thru. scattering undergrowth. Set an iron post, 3 ft. long, 1 in. in diam., 14 ins. in the ground, with marked stone, for 1/4 sec. cor., and raise a mound of stone around post, with brass cap, marked

1/4	S 33
S 4	
1920	

80.00 Set an iron post, 3 ft. long, 2 ins. in diam., 12 ins. in the ground, with marked stone, for cor. of secs. 4, 5, 32 and 33, and raise a mound of stone, around post, with brass cap, marked

T9S	R30E
S32	S33
S 5	S 4
T10S	
1920	

Land, level. Soil, sandy and rocky, 4th rate. No timber. Undergrowth, mesquite, yucca and cactus.

19.00 West, on a true line, bet. secs. 5 and 32. Over level land, thru. scattering undergrowth. Road brs. NW. to Duncan and SE. to Bowie and San Simon. 40.00 Set an iron post, 3 ft. long, 1 in. in diam., 27 ins. in the ground, for 1/4 sec. cor., marked on brass cap,

1/4	S 32
S 5	
1920	

80.00 dig pits, 18x18x12 ins., E. and W. of post, 3 ft. dist. Set an iron post, 3 ft. long, 2 ins. in diam., 27 ins. in the ground, for cor. of secs. 5, 6, 31 and 32, marked on brass cap,

T9S	R30E
S31	S32
S 6	S 5
T10S	
1920	

Dig pits, 18x18x12 ins., in each sec. 3 ft. dist. Land, level. Soil, sandy, 3rd rate. No timber. Undergrowth, mesquite, yucca and cactus.

40.00 West, on a true line, bet. secs. 6 and 31. Over level land, thru. scattering undergrowth. Set an iron post, 3 ft. long, 1 in. in diam., 27 ins. in the ground, for 1/4 sec. cor., marked on brass cap,

1/4	S 31
S 6	
1920	

60.00 Dig pits, 18x18x12 ins. E. and W. of post, 3 ft. dist. Road brs. N. to Gleason's Ranch and S. to Bowie & San Simon. 79.10 A point due north of the std. cor. of Ts. 10 S., Rs. 29 and 30 E. Set an iron post, 3 ft. long, 3 ins. in diam., 27 ins. in the ground, for cor. of Ts. 9 and 10 S., Rs. 29 and 30 E., marked on brass cap,

T9S	R29E	R30E
S36	S31	
S 1	S 6	
T10S		
1920		

Dig pits, 18x18x12 ins., in each sec. 3 ft. dist. Land, level. Soil, sandy, 3rd rate. No timber. Undergrowth, greasewood, yucca, cactus and mesquite.

Survey of the West Boundary of T. 10 S., R. 30 E. 17

Chains.

From the cor. of Ts. 9 and 10 S., Rs. 29 and 30 E., here-
inbefore described,

South on a true line, bet. secs. 1 and 6.

Over level land, through scattering undergrowth.

24.00 Wash, 5 lks. wide, course E.

39.70 Road, brs. NE. to Gleason's Ranch and SW. to Bowie and
San Simon.

40.00 Set an iron post, 3 ft. long, 1 in. diam., 15 ins. in the
ground, with marked stone, for $\frac{1}{4}$ sec. cor.; and raise
a mound of stone around post, with brass cap marked

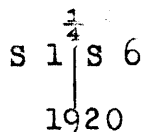

80.00 Set an iron post, 3 ft. long, 2 ins. diam., 24 ins. in the
ground, for cor. of secs. 1, 6, 7 and 12, marked on
brass cap

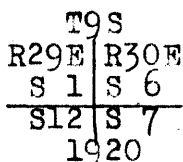

And raise a mound of stone, 2 ft. base, $1\frac{1}{2}$ ft. high,
W. of cor.

Land, level.

Soil, sandy; 4th rate.

No timber.

Undergrowth, greasewood, yucca and soto.

40.00 South on a true line, bet. secs. 7 and 12.
Over level land, through scattering undergrowth.
Set an iron post, 3 ft. long, 1 in. diam., 26 ins. in the
ground, for $\frac{1}{4}$ sec. cor., marked on brass cap

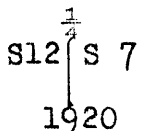

80.00 Dig pits, 18 x 18 x 12 ins., N. and S. of post, 3 ft.
dist.
Set an iron post, 3 ft. long, 2 ins. diam., 24 ins. in the
ground, for cor. of secs. 7, 12, 13 and 18, marked on
brass cap

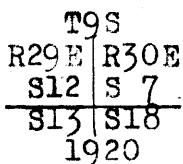

Dig pits, 18 x 18 x 12 ins., in each sec., 3 ft. dist.

Land, level.

Soil, sandy, 4th rate.

No timber.

Undergrowth, cat claw, soto, yucca and cactus.

40.00 South on a true line, bet. secs. 13 and 18.
Over level land, through scattering undergrowth.
Set an iron post, 3 ft. long, 1 in. diam., 26 ins. in the
ground, for $\frac{1}{4}$ sec. cor., marked on brass cap

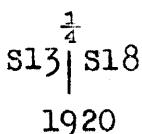

Survey of the West Boundary of T. 10 S., R. 30 E.

Chains.

63.40 Dig pits, 18 X 18 X 12 ins., N. and S. of post, 3 ft. dist.
 65.00 Road, brs. E. to Duncan and W. to Bowie and San Simon.
 65.00 Wash, course W.
 80.00 Set an iron post, 3 ft. long, 2 ins. diam., 24 ins. in the ground, for cor. of secs. 13, 18, 19 and 24, marked on brass cap

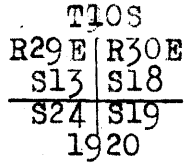

Dig pits, 18 X 18 X 12 ins., in each sec., 3 ft. dist.
 Land, level.
 Soil, sandy, 4th rate.
 No timber.
 Undergrowth, cactus and soto.

40.00 South on a true line, bet. secs. 19 and 24.
 Over level land, through scattering undergrowth.
 Set an iron post, 3 ft. long, 1 in. diam., 26 ins. in the ground, for $\frac{1}{4}$ sec. cor., marked on brass cap

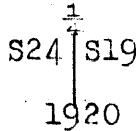

80.00 Dig pits, 18 X 18 X 12 ins., N. and S. of post, 3 ft. dist.
 Set an iron post, 3 ft. long, 2 ins. diam., 24 ins. in the ground, for cor. of secs. 19, 24, 25 and 30, marked on brass cap

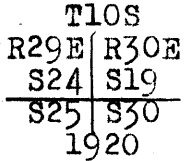

Dig pits, 18 X 18 X 12 ins., in each sec., 3 ft. dist.
 Land, level.
 Soil, sandy, 4th rate.
 No timber.
 Undergrowth, cactus and soto.

40.00 South on a true line, bet. secs. 25 and 30.
 Over level land, through scattering undergrowth.
 Set an iron post, 3 ft. long, 1 in. diam., 26 ins. in the ground, for $\frac{1}{4}$ sec. cor., marked on brass cap

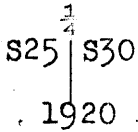

80.00 Dig pits, 18 X 18 X 12 ins., N. and S. of post, 3 ft. dist.
 Set an iron post, 3 ft. long, 2 ins. diam., 24 ins. in the ground, for cor. of secs. 25, 30, 31 and 36, marked on brass cap

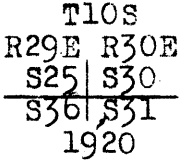

Survey of the West Boundary of T. 10 S., R. 30 E.

Chains.	<p>Dig pits, 18 X 18 X 12 ins., in each sec., 3 ft. dist. Land, level. Soil, sandy, 4th rate. No timber. Undergrowth, soto and cactus.</p>
40.00	<p>South on a true line, bet. secs. 31 and 36. Over level land, through scattering undergrowth. Set an iron post, 3 ft. long, 1 in. diam., 26 ins. in the ground, for $\frac{1}{4}$ sec. cor., marked on brass cap</p> <div style="text-align: center;"> $\begin{array}{c} \frac{1}{4} \\ \\ S36 \quad \quad S31 \\ \\ 1920 \end{array}$ </div> <p>Dig pits, 18 X 18 X 12 ins., N. and S. of post, 3 ft. dist.</p>
77.26	<p>The reestablished standard cor. of Ts. 10 S., Rs. 29 and 30 E., on 2nd. Std. Parallel S., hereinbefore described. Land, level. Soil, sandy, 3rd rate. No timber. Undergrowth, soto and cactus.</p>

Boundaries of T. 10 S., R. 30 E.

Latitudes, departures and closing errors.

Line designated	True bearing	Dist.	Latitudes.		Departures	
			N.	S.	E.	W.
		chs.	chs.	chs.	chs.	chs.
South Boundary (Second Standard Parallel South)	N. 89° 40' W.	39.36	.23			39.36
	S. 89° 47' W.	39.94		.15		39.94
	N. 89° 55' W.	39.93	.06			39.93
	S. 89° 50' W.	40.26		.12		40.26
	S. 89° 53' W.	39.97		.08		39.97
	N. 89° 51' W.	40.14	.10			40.14
	S. 89° 57' W.	40.31		.04		40.31
	N. 89° 27' W.	39.46	.38			39.46
	S. 89° 48' W.	40.10		.14		40.10
	S. 89° 48' W.	40.21		.14		40.21
	N. 89° 41' W.	39.59	.22			39.59
	N. 89° 41' W.	40.31	.22			40.31
West Boundary	North	477.26	477.26			
North Boundary	East	479.10			478.10	
East Boundary	S. 0° 4' E.	478.31		478.31	0.54	
Convergency					.46	
Totals			478.47	478.98	479.10	479.58
				478.47		479.10
Error in latitude				.51		
Error in departure						.48

Chains.

From the cor. of secs. 1, 2, 35 and 36, on the N. bdy. of the Tp., hereinbefore described, S.0°5'E., bet. secs. 1 and 2. Over mountainous land, through scattering undergrowth. Asc. 440 ft.

29.10 Peloncillo Mountain Range, brs. NE. and SW. Thence along E. slope.

38.92 Peloncillo Mountain Range, brs. NW. and SE. Desc.

40.00 Set an iron post, 3 ft. long, 1 in. diam., 14 ins. in the ground, with marked stone, for $\frac{1}{4}$ sec. cor.; and raise a mound of stone around post, with brass cap marked

$\frac{1}{4}$
 S2 | S 1
 1920

Desc. 225 ft.

58.29 Draw, course W. Asc. 175 ft.

67.92 Peloncillo Mountain Range, brs. NE. and SW. Desc. 85 ft.

77.00 Canyon, course SE. Asc.

80.00 Set an iron post, 3 ft. long, 2 ins. diam., 12 ins. in the ground, with marked stone, for cor. of secs. 1, 2, 11 and 12; and raise a mound of stone around post, with brass cap marked

T10S R30E
 S 2 | S 1
 S11 | S12
 1920

Land, mountainous.

Soil, rocky, 4th rate.

No timber.

Undergrowth, cactus, mesquite and cedar.

40.00 East on a random line, bet. secs. 1 and 12.

Set temp. $\frac{1}{4}$ sec. cor.

79.90 Fall 14 lks. N. of the cor. of secs. 1, 6, 7 and 12, on the E. bdy. of Tp., hereinbefore described.

Thence

N.89°54'W., on a true line, bet. secs. 1 and 12.

Over mountainous land, through scattering undergrowth.

Desc.

9.90 Gulch, course SW. Asc. 305 ft.

39.95 Set an iron post, 3 ft. long, 1 in. diam., 12 ins. in the ground, with marked stone, for $\frac{1}{4}$ sec. cor.; and raise a mound of stone around post, with brass cap marked

$\frac{1}{4}$ S 1
 S12
 1920

Continue ascent, 270 ft.

55.10 Spur, slopes SW. Desc. 165 ft.

77.55 Gulch, course SE. Asc. 30 ft.

79.90 The cor. of secs. 1, 2, 11 and 12.

Land, mountainous.

Soil, rocky, 4th rate.

No timber

Undergrowth, mesquite, scrub cedar, cat claw and cactus.

S.0°5'E., bet. secs. 11 and 12.

Over mountainous land, through scattering undergrowth. Asc. 270 ft.

19.41 Spur, slopes SE. Desc. 325 ft.

Subdivision of Township 10 South, Range 30 East.

Chains.

38.27 Draw, course SW. Ascend 30 ft.
 40.00 Set an iron post, 3 ft. long, 1 in. in diam., 14 ins. in the ground, deposit marked (x) stone, and raise a mound of stone around post, for $\frac{1}{4}$ sec. cor., with brass cap, marked

S11 | S12
 1920

53.75 Ascend 210 ft.
 72.00 Descend 535 ft., over SW. slope.
 80.00 Canyon, course SE. Continue descent.
 Set an iron post, 3 ft. long, 2 ins. in diam., 27 ins. in the ground, for cor. of secs. 11, 12, 13 and 14, marked on brass cap,

TLOS | R30E
 S11 | S12
 S14 | S13
 1920

from which,
 A cedar, 8 ins. in diam., brs. S. $28\frac{1}{2}^{\circ}$ W., 72 lks. dist., mark "TLOS R30E S14 PT."

No other trees within limits. Raise a mound of stone, 2 ft. base, $1\frac{1}{2}$ ft. high, W. of cor.
 Land, mountainous. Soil, rocky, 4th rate.
 No timber.
 Undergrowth, cactus, yucca and scrub cedar.

40.00 S. $89^{\circ}54'E.$, on a random line, bet. secs. 12 and 13.
 80.02 Set temp. $\frac{1}{4}$ sec. cor.
 Fall 21 lks. N. of the cor. of secs. 7, 12, 13 and 18, on the E. bdy. of Tp., hereinbefore described.

Thence,
 N. $89^{\circ}45'W.$, on a true line, bet. secs. 12 and 13.
 Over mountainous land, thru. scattering undergrowth.
 Descend 530 ft.

40.01 The true point for $\frac{1}{4}$ sec. cor. falls in bottom of canyon, course SW.; ascend.

41.02 Set an iron post, 3 ft. long, 1 in. in diam., 20 ins. in the ground, deposit marked (x) stone, and raise a mound of stone around post, for witness cor. to $\frac{1}{4}$ sec. cor., with brass cap, marked

WC $\frac{1}{4}$ | S 12
 S 13
 1920

46.15 Continue ascent, 135 ft.
 55.90 Spur, slopes SE. Descend 115 ft.
 60.65 Wash, course SE.; ascend.
 75.00 Spur, slopes SE. Descend 255 ft.
 80.02 Canyon, course SE. Ascend 80 ft.
 The cor. of secs. 11, 12, 13 and 14.
 Land, mountainous.
 Soil, rocky, 4th rate.
 No timber.
 Undergrowth, cactus, catclaw and scrub cedar.

23.10 S. $0^{\circ}5'W.$, bet. secs. 13 and 14.
 Over mountainous land, thru. scattering undergrowth.
 Ascend 395 ft.
 Spur, slopes SE.

Leave flag at this point for triangulation of line bet. secs. 13 and 24, as hereinafter described.
 Descend 305 ft.

34.00 Head of gulch, course SE. Ascend.
 40.00 Set an iron post, 3 ft. long, 1 in. in diam., 18 ins. in the ground, deposit marked (x) stone; and raise a mound of stone around post, for $\frac{1}{4}$ sec. cor., with brass cap, marked

S14 | S13
 1920

22 Subdivision of Township 10 South, Range 30 East.

Chains.

55.00 Ascend gradual slope.
 68.50 Spur, slopes E. Descend 200 ft.
 80.00 Gulch, course E. Ascend 245 ft., over NE. slope, to
 Set an iron post, 3 ft. long, 2 ins. in diam., 10 ins. in
 the ground, deposit marked (x) stone, and raise a mound
 of stone around post, for cor. of secs. 13, 14, 23 and 24,
 with brass cap, marked

T10S | R30E
 S14 | S13
 S23 | S24
 1920

from which,
 A cedar limb, 7 ins. in diam., brs. S. 89¹/₂° E., 505
 lks. dist., mark "T10S R30E S24 BT."
 No other trees within limits.
 Land, mountainous.
 Soil, rocky, 4th rate.
 No timber.
 Undergrowth, cedar, mesquite and ocotilla.

40.00 S. 89° 58' E., on random line, bet. secs. 13 and 24, for distance
 only, flag on cor. of secs. 13, 18, 19 and 24 on E. bdy. of
 Tp. being visible.
 Set temp. ¹/₄ sec. cor. East of this point, the line passes
 over very rough, steep slopes, which render chaining im-
 practicable; therefore, triangulate the measurement of
 the remainder of the mile as follows:

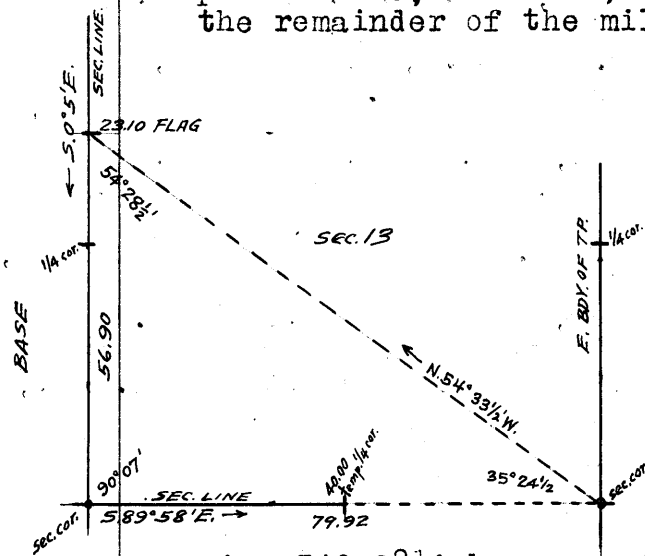

Use the south 56.90 chs. of
 the sec. line, bet. secs. 13 and
 14 as a base for triangula-
 tion, the flag left at 23.10
 ch. station thereon, as herein-
 before described, being at
 the N. end of said base.
 From the cor. of secs. 13, 18, 19
 and 24 on E. bdy. of Tp., the
 flag at N. end of base brs.
 N. 54° 33¹/₂' W.
 Included angles are 35° 24¹/₂',
 90° 07', and 54° 28¹/₂', the sum
 of which is 180° 00'.
 Length of line bet. secs. 13
 and 24 is obtained by

$$\frac{\sin 54^\circ 28\frac{1}{2}' \times \text{base}}{\sin 35^\circ 24\frac{1}{2}'} \text{ or } \frac{81386 \times 56.90}{.57940} = 79.92 \text{ chs.}$$

79.92 Intersect the cor. of secs. 13, 18, 19 and 24 on E. bdy. of Tp.,
 hereinbefore described.

Thence,
 N. 89° 58' W., on true line, bet. secs. 13 and 24.
 Over mountainous land, thru. scattering undergrowth.
 Measurement of 39.92 chs. by triangulation described above.
 Descend over NW. slope.

7.00 (Approximate) Gulch, course NW. Ascend over NE. slope.
 22.00 (Approximate) Spur, slopes N. Descend over NW. slope.
 39.92 Temp. ¹/₄ sec. cor. Continue measurement by chaining.
 39.96 Set an iron post, 3 ft. long, 1 in. in diam., 6 ins. in the
 ground, deposit marked (x) stone, and raise a mound of
 stone around post; for ¹/₄ sec. cor., with brass cap, marked

¹/₄ S 13
 S. 24
 1920

45.42 Descend 100 ft., over W. slope.
 49.90 Gulch, course SW. Ascend 15 ft., over SE. slope.
 61.90 Spur, slopes SW. Descend 110 ft., over W. slope.
 Wash, 30 lks. wide, course S. Ascend 275 ft., over E. slope,
 to
 79.92 The cor. of secs. 13, 14, 23 and 24.

Chains.

Land, mountainous.
Soil, rocky, 3rd rate.
No timber.
Undergrowth, ocotilla and greasewood.

2.85
18.80
21.00
37.00
40.00

S. 0° 5' E., bet. secs. 23 and 24.
Over mountainous land, thru, scattering undergrowth.
Ascend 65 ft.
Spur, slopes E. Descend 380 ft.
Gulch, course SE. Ascend.
Descend 75 ft.
Wash, course SW. Thence over level land.
Set an iron post, 3 ft. long, 1 in. in diam., 20 ins. in the ground, deposit marked (x) stone, and raise a mound of stone around post, for 1/4 sec. cor., with brass cap, marked

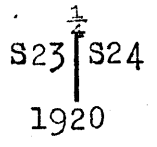

70.00
80.00

Draw, course SW.
Set an iron post, 3 ft. long, 2 ins. in diam., 18 ins. in the ground, deposit marked (x) stone, and raise a mound of stone around post for cor. of secs. 23, 24, 25 and 26, with brass cap, marked

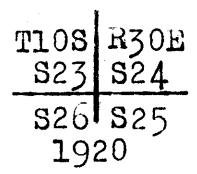

Land, mountainous and level.
Soil, sandy and rocky, 4th rate.
Timber, none.
Undergrowth, cedar, ocotilla and greasewood.

40.00
79.80

S. 89° 58' E., on a random line, bet. secs. 24 and 25.
Set temp. 1/4 sec. cor.
Fall 30 lks. S. of the cor. of secs. 19, 24, 25 and 30, on the E. bdy. of Tp., hereinbefore described.

5.00
19.20
32.30
35.20
39.19

Thence,
S. 89° 49' W., on a true line, bet. secs. 24 and 25.
Over mountainous land, thru, scattering undergrowth.
Descend.
Gulch, 30 lks. wide, course SE. Ascend.
Spur, slopes SE. Descend 210 ft.
Head of gulch, course SE. Ascend.
Ridge, brs. N. and S. Descend 170 ft.
Set an iron post, 3 ft. long, 1 in. in diam., 16 ins. in the ground, deposit marked (x) stone, and raise a mound of stone around post, for witness cor. to 1/4 sec. cor., and with brass cap, marked

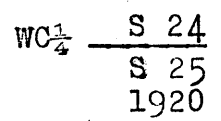

39.90
52.80
53.30
79.80

The true point for 1/4 sec. cor. falls where it is impracticable to establish monument.
Continue descent, 480 ft.
Gulch, 10 lks. wide, course SW. Ascend.
Descend 395 ft.
The cor. of secs. 23, 24, 25 and 26.
Land, mountainous.
Soil, rocky, 3rd rate.

24 Subdivision of Township 10 South, Range 30 East.

Chains.

No timber.
Undergrowth, cedar, ocotilla and greasewood.

32.20

40.00

S.0°5'E., bet. secs. 25 and 26.
Over level land, sloping W., thru. scattering undergrowth.
Draw, course SW.
Set an iron post, 3 ft. long, 1 in. in diam., 18 ins. in the ground, deposit marked (x) stone, and raise a mound of stone around post, for $\frac{1}{4}$ sec. cor., with brass cap, marked

$\frac{1}{4}$
 S26 | S25
 1920

79.95

80.00

Draw, 5 lks. wide, course SW.
The true point for cor. of secs. 25, 26, 35 and 36 falls in draw, course SW., where it would be impracticable to monument the cor.; therefore, at 16 lks. S.0°5'E. therefrom, or at

80.16

Set an iron post, 3 ft. long, 2 ins. in diam., 18 ins. in the ground, deposit marked (x) stone, and raise a mound of stone around post, for witness cor. to cor. of secs. 25, 26, 35 and 36, with brass cap, marked

W	C
T10S	R30E
S26	S25
S35	S36
1920	

Land, level W. slope.
Soil, sandy and rocky, 3rd rate.
No timber.
Undergrowth, scattering cedar, ocotilla and greasewood.

40.00

79.70

From the true point for cor. of secs. 25, 26, 35 and 36, N.89° 49' E., on a random line, bet. secs. 25 and 36. Set temp. $\frac{1}{4}$ sec. cor.
Fall 6 lks. N. of the cor. of secs. 25, 30, 31 and 36, on the E. bdy. of the Tp., hereinbefore described.

33.70

39.85

Thence, S.89° 52' W., on a true line, bet. secs. 25 and 36. Over mountainous land, thru. scattering undergrowth. Ascend 750 ft.
Spur, slopes S.; descend.
Set an iron post, 3 ft. long, 1 in. in diam., 12 ins. in the ground, with mound of stone around post, for $\frac{1}{4}$ sec. cor., marked on brass cap,

$\frac{1}{4}$ S 25
 S 36
 1920

from which,
A cedar, 9 ins. in diam., brs. S.59 $\frac{1}{2}$ ° W., 260 lks. dist., mark " $\frac{1}{4}$ S 36 BT."

79.70

No other trees within limits.
Continue descent, 925 ft.
The true point for cor. of secs. 25, 26, 35 and 36.
Land, mountainous.
Soil, rocky, 4th rate.
No timber.
Undergrowth, scattering scrub cedar and ocotilla.

Chains.

From the true point for cor. of secs. 25, 26, 35 and 36, S. 0° 5' E., on a random line, bet. secs. 35 and 36.
 40.00 Set temp. $\frac{1}{4}$ sec. cor.
 78.00 Fall 30 lks. E. of the reestablished standard cor. of secs. 35 and 36, on the S. bdy. of Tp. (2nd. Std. Par. S.) hereinbefore described.

Thence,
 N. 0° 8' E., on a true line, bet. secs. 35 and 36.
 Over level land, thru scattering undergrowth.
 38.00 Set an iron post, 3 ft. long, 1 in. in diam., 14 ins. in the ground, deposit marked (x) stone; and raise a mound of stone around post, for $\frac{1}{4}$ sec. cor., with brass cap, marked

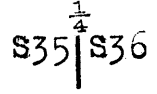

1920
 77.84 The witness cor. to cor. of secs. 25, 26, 35 and 36. (S. 0° 05' E. from cor. point.)

78.00 The true point for cor. of secs. 25, 26, 35 and 36.
 Land, level.
 Soil, sandy and rocky, 3rd rate.
 No timber.
 Undergrowth, greasewood.

From the cor. of secs. 2, 3, 34 and 35, on the N. bdy. of the Tp., hereinbefore described,
 S. 0° 5' E., bet. secs. 2 and 3.
 Over rolling W. slope, thru scattering undergrowth.

11.50 Wash, course W.
 18.40 Gulch, 15 lks. wide, course W. Ascend 75 ft.
 29.90 Spur, slopes NW. Descend along rolling W. slope.
 38.00 Gulch, 15 lks. wide, course NW. Ascend.
 40.00 Set an iron post, 3 ft. long, 1 in. in diam., 8 ins. in the ground, deposit marked (X) stone; and raise a mound of stone around post, for $\frac{1}{4}$ sec. cor., with brass cap, marked

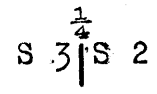

1920

Leave flag at this cor. for triangulation of line, bet. secs. 2 and 11.
 Ascend 30 ft.

43.00 Spur, slopes SW. Thence along level W. slope.
 47.50 Draw, course W.
 50.10 Gulch, 20 lks. wide, course NW. Ascend 50 ft.
 64.92 Spur, slopes W.; descend.
 67.00 Gulch, 20 lks. wide, course NW. Ascend.
 80.00 Set an iron post, 3 ft. long, 2 ins. in diam., 14 ins. in the ground, deposit marked (x) stone, and raise a mound of stone around post, for cor. of secs. 2, 3, 10 and 11.

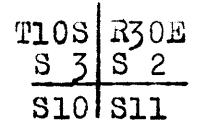

1920

Land, level and rolling W. slope.
 Soil, sandy and gravelly, 4th rate.
 No timber. Undergrowth, greasewood and cactus.

N. 89° 45' E., on a random line, bet. secs. 2 and 11, for dist. only as a flag at a point 2.91 chs. W. of the cor. of secs. 1, 2, 11 and 12 is visible at such bearing.
 40.00 Set temp. $\frac{1}{4}$ sec. cor. The east half mile is impracticable to chain; therefore, triangulate the measurement thereof as follows:

26

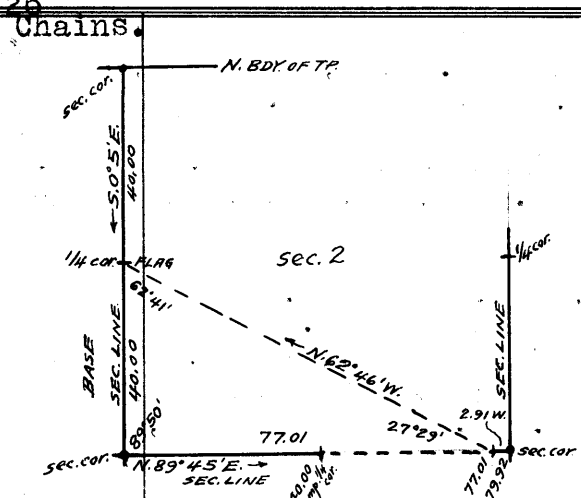

Use $S. \frac{1}{2}$ of line, bet. secs. 2 and 3, as a base $N. 0^{\circ} 5' W.$, 40.00 chs. From point 2.91 chs. W. of cor. of secs. 1, 2, 11 and 12 flag at $\frac{1}{4}$ sec. cor. of secs. 2 and 3, brs. $N. 62^{\circ} 46' W.$ Included angles are $27^{\circ} 29'$, $89^{\circ} 50'$ and $62^{\circ} 41'$, the sum of which is $180^{\circ} 00'$. Triangulated dist. on line bet. secs. 2 and 11 is obtained by $\frac{\text{side } 62^{\circ} 41' \times \text{base}}{\text{side } 27^{\circ} 29'}$ or $\frac{.88848 \times 40}{.46149} = 77.01$ chs.

- 77.01 Triangulation point.
- Continue measurement, $N. 89^{\circ} 45' E.$, by chaining to
- 79.92 The cor. of secs. 1, 2, 11 and 12. Thence, $S. 89^{\circ} 45' W.$, on true line, bet. secs. 2 and 11. Over mountainous land, thru. scattering undergrowth. Ascend 50 ft., over E. slope. Chain measurement to
- 2.91 Triangulation point on top of ridge, brs. N. and S. Descend 965 ft. to $\frac{1}{4}$ sec. cor. over top of spur, sloping W. Measurement by triangulation to
- 39.92 Temp. $\frac{1}{4}$ sec. cor. Thence continue measurement by chaining.
- 39.96 Set an iron post, 3 ft. long, 1 in. in diam., 16 ins. in the ground, deposit marked (x) stone, and raise a mound of stone around post, for $\frac{1}{4}$ sec. cor., with brass cap, marked

$$\frac{1}{4} \frac{S \ 2}{S \ 11} = .1920$$

- from which,
- A cedar, 14 ins. in diam., brs. $S. 7 \frac{1}{2}^{\circ} E.$, 305 lks. dist., mark " $\frac{1}{4}$ S 11 B.T."
- Descend 30 ft., over top of spur, sloping W.
- 45.52 Leave top of spur, which forks at this point, and slopes NW. and SW. Descend 410 ft., over NW. slope, to
- 79.92 The cor. of secs. 2, 3, 10 and 11. Land, mountainous. Soil, rocky, 4th rate. No timber. Undergrowth, ocotilla and scattering cedar.

- $S. 0^{\circ} 5' E.$, bet. secs. 10 and 11. Over rolling land, thru. scattering undergrowth.
- 2.10 Gulch, 10 lks. wide, course NW. Ascend.
- 6.00 Spur, slopes NW. Descend.
- 15.00 Gulch, course NW. Thence over gently rolling land.
- 33.00 Draw, 10 lks. wide, course W.
- 40.00 Set an iron post, 3 ft. long, 1 in. in diam., 18 ins. in the ground, deposit marked (x) stone, and raise a mound of stone around post, for $\frac{1}{4}$ sec. cor., with brass cap, marked

$$\frac{1}{4} \frac{S10 \ S11}{1920}$$

- Leave flag at this cor. for triangulation of line, bet. secs. 11 and 14.
- 60.00 Gulch, course W.
- 80.00 Set an iron post, 3 ft. long, 2 ins. in diam., 14 ins. in the ground, deposit marked (x) stone, and raise a mound of stone around post, for cor. of secs. 10, 11, 14 and 15, with brass cap, marked

$$\frac{T10N \ R30E}{S10 \ S11} = \frac{S15 \ S14}{1920}$$

Chains.

Land, rolling and gently rolling.
Soil, rocky, 4th rate.
No timber.
Undergrowth, ocotilla, catclaw and cactus.

40.00 N. 89° 45' E., on random line, bet. secs. 11 and 14.
Set temp. 1/4 sec. cor. Discontinue chaining, owing to steep, rough slopes E. of this point, and triangulate as follows:

Use S. 1/2 of line bet. secs. 10 and 11 as a base, N. 0° 5' W., 40.00 chs. From a point ahead on random line, flag at N. end of base brs. N. 50° 42' W.

Included angles are 33° 33', 89° 50' and 56° 37', the sum of which is 180° 00'.

Dist. triangulated on random line from sec. cor. to point N. 89° 45' E. from temp. 1/4 sec. cor. is obtained by

$$\frac{\text{sine } 56^{\circ}37' \times \text{base}}{\text{sine } 33^{\circ}33'} \text{ or } \frac{.83501 \times 40}{.55266} = 60.44 \text{ chs.}$$

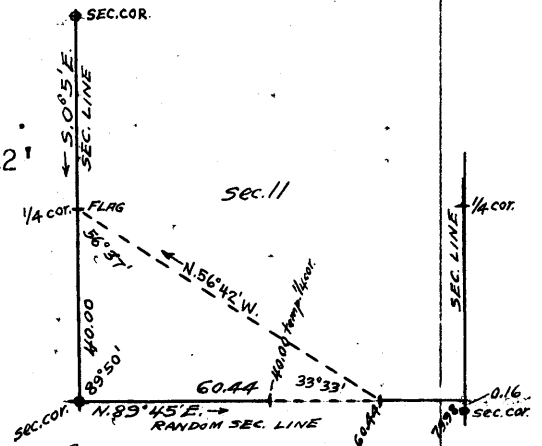

60.44 Triangulation point. Continue measurement by chaining.
79.98 Fall 16 lks. N. of the cor. of secs. 11, 12, 13 and 14.

Thence, S. 89° 52' W., on true line, bet. secs. 11 and 14. Over mountainous land, thru. scattering undergrowth. Ascend 460 ft., over E. slope, measurement by chaining.

19.54 Top of ridge, brs. N. and S. Discontinue chaining. Thence by triangulated measurement. Descend over W. slope.

39.98 A point 8 lks. S. of temp. 1/4 sec. cor. Continue measurement by chaining.

39.99 True point for 1/4 sec. cor. in rocky wash, course SW., where it is impracticable to establish monument.

40.97 Set an iron post, 3 ft. long, 1 in. in diam., 24 ins. in the ground, for witness cor. to 1/4 sec. cor., marked on brass cap,

S 11
WC 1/4
S 14
1920

65.00 and raise a mound of stone, 2 ft. base, 1 1/2 ft. high, N. of cor. Descend 355 ft., over SW. slope, to Gulch, 10 lks. wide, course SW. Descend 170 ft., over SW. slope, to

79.98 The cor. of secs. 10, 11, 14 and 15.

Land, mountainous.
Soil, rocky, 4th rate.
No timber.
Undergrowth, greasewood, ocotilla and cactus.

20.00 S. 0° 5' E., bet. secs. 14 and 15.
Over level land, thru. scattering undergrowth.
Wash, course SW.

40.00 Set an iron post, 3 ft. long, 1 in. in diam., 8 ins. in the ground, deposit marked (x) stone, and raise a mound of stone around post, for 1/4 sec. cor., with brass cap, marked

S 15 | S 14
1920

80.00 Set an iron post, 3 ft. long, 2 ins. in diam., 6 ins. in the ground, deposit marked (x) stone, and raise a mound of stone around post, for cor. of secs. 14, 15, 22 and 23, with brass cap, marked

Chains.

T10S	R30E
S15	S14
S22	S23
1920	

Land, level.
 Soil, rocky, 4th. rate.
 No timber.
 Undergrowth, greasewood, cactus and catclaw.

40.00 N. 89° 52' E., on a random line, bet. secs. 14 and 23.
 79.88 Set temp. $\frac{1}{4}$ sec. cor.
 Intersect N. and S. line, 5 lks. N. of the cor. of secs. 13, 14, 23 and 24, hereinbefore described.
 Thence,
 S. 89° 54' W., on a true line, bet. secs. 14 and 23.
 Over mountainous land, thru. scattering undergrowth.
 Ascend 55 ft.
 14.90 ridge, brs. N. and S. Descend 465 ft.
 39.94 Set an iron post 3 ft. long, 1 in. in diam., 24 ins. in the ground, for $\frac{1}{4}$ sec. cor., marked on brass cap,

$\frac{1}{4}$ S 14
S 23
1920

and raise a mound of stone, 2 ft. base, 1 $\frac{1}{2}$ ft. high, N. of cor.

54.90 Continue descent, 135 ft.
 79.88 Thence over gently rolling land.
 The cor. of secs. 14, 15, 22 and 23.
 Land, mountainous and gently rolling.
 Soil, rocky, 4th rate.
 No timber.
 Undergrowth, mesquite, cactus and yucca.

3.00 S. 0° 5' E., bet. secs. 22 and 23.
 40.00 Over rolling land, thru. scattering undergrowth.
 Draw, course NW.
 Set an iron post, 3 ft. long, 1 in. in diam., 8 ins. in the ground, deposit marked (x) stone, and raise a mound of stone around post, for $\frac{1}{4}$ sec. cor., with brass cap, marked

$\frac{1}{4}$
S22 S23
1920

43.30 Wide draw, course W.
 80.00 Set an iron post, 3 ft. long, 2 ins. in diam., 20 ins. in the ground, deposit marked (x) stone, and raise a mound of stone around post, for cor. of secs. 22, 23, 26 and 27, with brass cap, marked

T10S	R30E
S22	S23
S27	S26
1920	

Land, rolling.
 Soil, rocky, 4th rate.
 No timber.
 Undergrowth, greasewood and ocotilla.

Chains.

N.89°54'E., on a random line, bet. secs. 23 and 26.
 40.00 Set temp. $\frac{1}{4}$ sec. cor.
 80.12 Intersect N. and S. line, 9 lks. S. of the cor. of secs. 23, 24, 25 and 26, hereinbefore described.
 Thence
 S.89°50'W., on a true line, bet. secs. 23 and 26.
 Over rolling land, through scattering undergrowth.
 11.00 Wash, 20 lks. wide, course S.
 40.06 Set an iron post, $\frac{3}{4}$ ft. long, 1 in. diam., 26 ins. in the ground, for $\frac{1}{4}$ sec. cor., marked on brass cap

$\frac{1}{4}$ S23
 $\frac{1}{4}$ S26
 1920

And raise a mound of stone, 2 ft. base, $1\frac{1}{2}$ ft. high, N. of cor.
 80.12 The cor. of secs. 22, 23, 26 and 27.
 Land, rolling.
 Soil, rocky, 3rd rate.
 No timber.
 Undergrowth, few cedar trees, greasewood and cactus.

S.0°5'E., bet. secs. 26 and 27.
 Over level land, through scattering undergrowth.
 19.40 Wash, 15 lks. wide, course W.
 35.60 Wash, 15 lks. wide, course SW.
 40.00 Set an iron post, $\frac{3}{4}$ ft. long, 1 in. diam., 26 ins. in the ground, for $\frac{1}{4}$ sec. cor., marked on brass cap

$\frac{1}{4}$
 S27 | S26
 1920

And raise a mound of stone, 2 ft. base, $1\frac{1}{2}$ ft. high, W. of cor.
 80.00 Set an iron post, $\frac{3}{4}$ ft. long, 2 ins. diam., 16 ins. in the ground, with marked stone, for cor. of secs. 26, 27, 34 and 35; and raise a mound of stone around post, with brass cap marked

T10S R30E
 S27 | S26
 S34 | S35
 1920

Land, level;
 Soil, sandy and rocky; 3rd rate.
 No timber.
 Undergrowth, greasewood and soto.

N.89°50'E., on a random line, bet. secs. 26 and 35.
 40.00 Set temp. $\frac{1}{4}$ sec. cor.
 80.14 Intersect N. and S. line, 10 lks. S. of the true point for cor. of secs. 25, 26, 35 and 36, witnessed at 0.16 chs. S.0°5'E. as hereinbefore described.
 From the true point for cor. of secs. 25, 26, 35 and 36, S.89°46'W., on a true line, bet. secs. 26 and 35.
 Over level land, through scattering undergrowth.
 40.07 Set an iron post, $\frac{3}{4}$ ft. long, 1 in. diam., 24 ins. in the ground, for $\frac{1}{4}$ sec. cor., marked on brass cap

$\frac{1}{4}$ S26
 $\frac{1}{4}$ S35
 1920

Chains.

80.14 And raise a mound of stone, 2 ft. base, 1½ ft. high, N. of cor.
 The cor. of secs. 26, 27, 34 and 35.
 Land, level.
 Soil, sandy, 3rd rate.
 No timber.
 Undergrowth, greasewood and soto brush.

40.00 S.0°8'W., on a random line, bet. secs. 34 and 35.
 Set temp. ¼ sec. cor.
 77.92 Intersect the reestablished standard cor. of secs. 34 and 35, on the S. bdy. of Tp., (2nd. Std. Par. S.), hereinbefore described. Thence,
 N.0°8'E., on a true line, bet. secs. 34 and 35.
 Over level land, through scattering undergrowth.
 37.92 Set an iron post, 3 ft. long, 1 in. diam., 24 ins. in the ground, for ¼ sec. cor., marked on brass cap

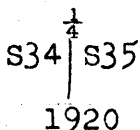

45.90 And raise a mound of stone, 2 ft. base, 1½ ft. high, W. of cor.
 Draw, course W.
 77.92 The cor. of secs. 26, 27, 34 and 35.
 Land, level.
 Soil, sandy and rocky; 3rd rate.
 No timber.
 Undergrowth, greasewood and soto brush.

40.00 From the cor. of secs. 3, 4, 33 and 34, on the N. bdy. of Tp., hereinbefore described,
 S.0°6'E., bet. secs. 3 and 4.
 Over level land, through scattering undergrowth.
 Set an iron post, 3 ft. long, 1 in. diam., 14 ins. in the ground, with marked stone, for ¼ sec. cor.; and raise a mound of stone around post, with brass cap marked

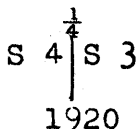

55.00 Draw, course W.
 77.00 Draw, course NW.
 80.00 Set an iron post, 3 ft. long, 2 ins. diam., 18 ins. in the ground, deposit marked (x) stone, and raise a mound of stone around post for cor. of secs. 3, 4, 9 and 10, with brass cap, marked

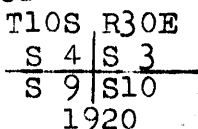

Land, level.
 Soil, sandy, 3rd rate.
 No timber.
 Undergrowth, mesquite and soto brush.

40.00 East on a random line, bet. secs. 3 and 10.
 77.83 Set temp. ¼ sec. cor.
 Intersect N. and S. line, 2 lks. S. of the cor. of secs.

Subdivision of T. 10 S., R. 30 E.

<p>Chains.</p> <p>39.91½</p> <p>57.55</p> <p>79.83</p>	<p>2, 3, 10 and 11, hereinbefore described.</p> <p>Thence S.89°59'W., on a true line, bet. secs. 3 and 10. Over rolling land, through scattering undergrowth. Desc. W. slope, 310 ft.</p> <p>Set an iron post, 3 ft. long, 1 in. diam., 12 ins. in the ground, with marked stone, for ¼ sec. cor.; and raise a mound of stone around post, with brass cap marked</p> $\begin{array}{r} \frac{1}{4} S 3 \\ S 10 \\ 1920 \end{array}$ <p>Continued descent, 180 ft. Draw, course NW. Continue descent. The cor. of secs. 3, 4, 9 and 10. Land, rolling. Soil, rocky, 4th rate. No timber. Undergrowth, mesquite and soto brush.</p>	<p>X2,3</p>
<p>20.00</p> <p>40.00</p> <p>63.70</p> <p>80.00</p>	<p>S.0°6'E., bet. secs. 9 and 10. Over rolling land, through scattering undergrowth. Draw, course SW.</p> <p>Set an iron post, 3 ft. long, 1 in. diam., 16 ins. in the ground, with marked stone, for ¼ sec. cor.; and raise a mound of stone around post, with brass cap marked</p> $\begin{array}{r} \frac{1}{4} \\ S 9 S 10 \\ 1920 \end{array}$ <p>Draw, course W. Set an iron post, 3 ft. long, 2 ins. diam., 14 ins. in the ground, with marked stone, for cor. of secs. 9, 10, 15 and 16; and raise a mound of stone around post, with brass cap marked</p> $\begin{array}{r} T10S R30E \\ \frac{B 9 S 10}{S 16 S 15} \\ 1920 \end{array}$ <p>Land, rolling. Soil, rocky, 3rd rate. No timber. Undergrowth, mesquite, ocotillo and greasewood.</p>	
<p>40.00</p> <p>79.99</p> <p>3.00</p> <p>34.30</p> <p>39.99½</p> <p>79.99</p>	<p>N.89°59'E., on a random line, bet. secs. 10 and 15. Set temp. ¼ sec. cor. Intersect N. and S. line, 2 lks. S. of the cor. of secs. 10, 11, 14 and 15, hereinbefore described.</p> <p>Thence S.89°58'W., on a true line, bet. secs. 10 and 15. Over rolling land, through scattering undergrowth. Desc. gradual slope. Draw, course SW. Continue gradual descent. Draw, course SW.</p> <p>Set an iron post, 3 ft. long, 1 in. diam., 16 ins. in the ground, with marked stone, for ¼ sec. cor.; and raise a mound of stone around post, with brass cap marked</p> $\begin{array}{r} \frac{1}{4} S 10 \\ S 15 \\ 1920 \end{array}$ <p>The cor. of secs. 9, 10, 15 and 16.</p>	

Subdivision of T. 10 S., R. 30 E.

32 Chains.

Land, rolling.
Soil, rocky, 4th rate.
No timber.
Undergrowth, scattering cedar, ocotillo, greasewood and cactus.

S.0°6'E., bet. secs. 15 and 16.
Over rolling land, through scattering undergrowth.
Desc.

- 13.00 Wash, course W. Asc. 65 ft.
- 17.80 Spur, slopes W. Desc. 60 ft.
- 25.00 Draw, course W. Asc. 145 ft.
- 40.00 Set an iron post, 3 ft. long, 1 in. diam., 10 ins. in the ground, with marked stone, for $\frac{1}{4}$ sec. cor.; and raise a mound of stone around post, with brass cap marked

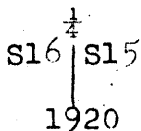

Continue ascent, 25 ft.

- 50.00 Spur, slopes S. Desc. 120 ft.
- 70.00 Foot of descent; thence over level land.
- 80.00 Set an iron post, 3 ft. long, 2 ins. diam., 10 ins. in the ground, with marked stone, for cor. of secs. 15, 16, 21 and 22; and raise a mound of stone around post, with brass cap marked

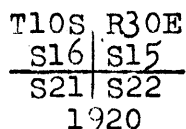

Land, rolling.
Soil, rocky, 4th rate.
No timber.
Undergrowth, greasewood and cactus.

N.89°58'E., on a random line, bet. secs. 15 and 22.

- 40.00 Set temp. $\frac{1}{4}$ sec. cor.
- 80.02 Intersect N. and S. line, 5 lks. S. of the cor. of secs. 14, 15, 22 and 23, hereinbefore described:

Thence
S.89°56'W., on a true line; bet. secs. 15 and 22.

- 40.01 Over gently rolling land, through scattering undergrowth.
Set an iron post, 3 ft. long, 1 in. diam., 14 ins. in the ground, with marked stone, for $\frac{1}{4}$ sec. cor.; and raise a mound of stone around post, with brass cap marked

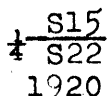

- 60.00 Leave gently rolling land; Asc. 80 ft.
- 70.00 Spur, slopes E. Desc. 25 ft.
- 80.02 The cor. of secs. 15, 16, 21 and 22.
Land, gently rolling and rolling.
Soil, rocky, 4th rate.
No timber.
Undergrowth, greasewood, cat claw and cactus.

S.0°6'E., bet. secs. 21 and 22.
Over level land, through scattering undergrowth.

E000 8481

Subdivision of T. 10 S., R. 30 E.

33

Chains. 40.00	Set an iron post, 3 ft. long, 1 in. diam., 14 ins. in the ground, with marked stone, for $\frac{1}{4}$ sec. cor.; and raise a mound of stone around post, with brass cap marked
	$\begin{array}{c} \frac{1}{4} \\ \text{S21} \text{S22} \\ \hline 1920 \end{array}$
80.00	Asc. gradually. Set an iron post, 3 ft. long, 2 ins. diam., 24 ins. in the ground, for cor. of secs. 21, 22, 27 and 28, marked on brass cap
	$\begin{array}{c} \text{T10S R30E} \\ \text{S21} \text{S22} \\ \hline \text{S28} \text{S27} \\ \hline 1920 \end{array}$
	Land, level and gently rolling. Soil, sandy and rocky; 4th rate. No timber. Undergrowth, greasewood.
40.00	N.89°56'E., on a random line, bet. secs. 22 and 27. Set temp. $\frac{1}{4}$ sec. cor.
80.12	Intersect N. and S. line, 12 lks. S. of the cor. of secs. 22, 23, 26 and 27, hereinbefore described. Thence
40.06	S.89°51'W., on a true line, bet. secs. 22 and 27. Over level land, through scattering undergrowth. Set an iron post, 3 ft. long, 1 in. diam., 18 ins. in the ground, with marked stone, for $\frac{1}{4}$ sec. cor.; and raise a mound of stone around post, with brass cap marked
	$\begin{array}{c} \frac{1}{4} \text{ S22} \\ \hline \frac{1}{4} \text{ S27} \\ \hline 1920 \end{array}$
80.12	The cor. of secs. 21, 22, 27 and 28. Land, level. Soil, sandy, 4th rate. No timber. Undergrowth, greasewood and yucca.
40.00	S.0°6'E., bet. secs. 27 and 28. Over level land, through scattering undergrowth. Set an iron post, 3 ft. long, 1 in. diam., 26 ins. in the ground, for $\frac{1}{4}$ sec. cor., marked on brass cap
	$\begin{array}{c} \frac{1}{4} \\ \text{S28} \text{S27} \\ \hline 1920 \end{array}$
78.00	Dig pits, 18 X 18 X 12 ins., N. and S. of post, 3 ft. dist.
80.00	Draw, course E. Set an iron post, 3 ft. long, 2 ins. diam., 24 ins. in the ground, for cor. of secs. 27, 28, 33 and 34, marked on brass cap
	$\begin{array}{c} \text{T10S R30E} \\ \text{S28} \text{S27} \\ \hline \text{S33} \text{S34} \\ \hline 1920 \end{array}$
	Dig pits, 18 X 18 X 12 ins., in each sec., 3 ft. dist. Land, level. Soil, sandy, 4th rate.

34

Subdivision of T. 10 S., R. 30 E.

Chains.

No timber.
Undergrowth, greasewood and ocotillo.

40.00 N.89°51'E., on a random line, bet. secs. 27 and 34.
Set temp. $\frac{1}{4}$ sec. cor.

80.06 Intersect the cor. of secs. 26, 27, 34 and 35, hereinbefore described.

Thence

40.03 S.89°51'W., on a true line, bet. secs. 27 and 34.
Over level land, through scattering undergrowth.

Set an iron post, 3 ft. long, 1 in. diam., 24 ins. in the ground, for $\frac{1}{4}$ sec. cor., marked on brass cap

$\frac{1}{4}$ S27
 $\frac{1}{4}$ S34
1920

And raise a mound of stone, 2 ft. base, $1\frac{1}{2}$ ft. high, N. of cor.

55.00 Draw, course S. Asc. very gradually.
80.06 The cor. of secs. 27, 28, 33 and 34.

Land, level and rolling.

Soil, sandy, 4th rate.

No timber.

Undergrowth, greasewood and soto brush.

40.00 S.0°8'W., on a random line, bet. secs. 33 and 34.
Set temp. $\frac{1}{4}$ sec. cor.

77.64 Fall 2 lks. E. of the reestablished standard cor. of secs. 33 and 34, on the S. bdy. of Tp., (2nd. Std. Par. S.), hereinbefore described.

Thence

N.0°9'E., on a true line, bet. secs. 33 and 34.

Over mountainous land, through scattering undergrowth.

Asc.

1.40 Spur, slopes E. Desc. 240 ft., over N. slope.

12.75 Desc. NW. slope.

27.65 Foot of descent; thence over level land.

37.64 Set an iron post, 3 ft. long, 1 in. diam., 26 ins. in the ground, for $\frac{1}{4}$ sec. cor., marked on brass cap

S33 $\frac{1}{4}$ S34
1920

And raise a mound of stone, 2 ft. base, $1\frac{1}{2}$ ft. high, W. of cor.

77.64 The cor. of secs. 27, 28, 33 and 34.

Land, level and mountainous.

Soil, rocky, 4th rate.

No timber.

Undergrowth, greasewood, cactus and mesquite.

From the cor. of secs. 4, 5, 32 and 33, on the N. bdy. of Tp., hereinbefore described,

S.0°6'E., bet. secs. 4 and 5.

Over level land, through scattering undergrowth.

40.00 Set an iron post, 3 ft. long, 1 in. diam., 26 ins. in the ground, for $\frac{1}{4}$ sec. cor., marked on brass cap

S 5 $\frac{1}{4}$ S 4
1920

Chains.	Dig pits, 18 X 18 X 12 ins., N. and S. of post, 3 ft. dist.
80.00	Set an iron post, 3 ft. long, 2 ins. diam., 26 ins. in the ground, for cor. of secs. 4, 5, 8 and 9, marked on brass cap
	$\begin{array}{r} T10S \quad R30E \\ \hline S \ 5 \ \ S \ 4 \\ \hline S \ 8 \ \ S \ 9 \\ \hline 1920 \end{array}$
	Dig pits, 18 X 18 X 12 ins., in each sec., 3 ft. dist. Land, level. Soil, sandy, 4th rate. No timber. Undergrowth, mesquite and soto brush.
40.00	East on a random line, bet. secs. 4 and 9.
79.93	Set temp. $\frac{1}{4}$ sec. cor. Intersect N. and S. line, 6 lks. S. of the cor. of secs. 3, 4, 9 and 10, hereinbefore described.
	Thence S.89°57'W., on a true line, bet. secs. 4 and 9. Over rolling land, through scattering undergrowth. Desc. gradual W. slope.
39.96 $\frac{1}{2}$	Set an iron post, 3 ft. long, 1 in. diam., 18 ins. in the ground, with marked stone, for $\frac{1}{4}$ sec. cor.; and raise a mound of stone around post, with brass cap marked
	$\begin{array}{r} \frac{1}{4} \ S \ 4 \\ \hline \frac{1}{4} \ S \ 9 \\ \hline 1920 \end{array}$
72.35	Thence over level land.
79.93	Draw, course SW. The cor. of secs. 4, 5, 8 and 9.
	Land, rolling and level. Soil, sandy, 4th rate. No timber. Undergrowth, mesquite and soto.
40.00	S.0°6'E., bet. secs. 8 and 9. Over level land, through scattering undergrowth.
	Set an iron post, 3 ft. long, 1 in. diam., 27 ins. in the ground, for $\frac{1}{4}$ sec. cor., marked on brass cap
	$\begin{array}{r} \frac{1}{4} \\ \hline S \ 8 \ \ S \ 9 \\ \hline 1920 \end{array}$
80.00	Dig pits, 18 X 18 X 12 ins., N. and S. of post, 3 ft. dist.
	Set an iron post, 3 ft. long, 2 ins. diam., 27 ins. in the ground, for cor. of secs. 8, 9, 16 and 17, marked on brass cap
	$\begin{array}{r} T10S \quad R30E \\ \hline S \ 8 \ \ S \ 9 \\ \hline S17 \ \ S16 \\ \hline 1920 \end{array}$
	Dig pits, 18 X 18 X 12 ins., in each sec., 3 ft. dist. Land, level. Soil, sandy, 3rd rate. No timber. Undergrowth, mesquite, cactus and yucca.

36

Subdivision of T. 10 S., R. 30 E.

Chains.	N.89°57'E., on a random line, bet. secs. 9 and 16. Set temp. $\frac{1}{4}$ sec. cor. 80.00 Intersect N. and S. line, 14 lks. N. of the cor. of secs. 9, 10, 15 and 16, hereinbefore described. Thence N.89°57'W., on a true line, bet. secs. 9 and 16. Over level land, through scattering undergrowth. 40.00 Set an iron post, 3 ft. long, 1 in. diam., 10 ins. in the ground, with marked stone, for $\frac{1}{4}$ sec. cor.; and raise a mound of stone around post, with brass cap marked
	$\begin{array}{r} \frac{1}{4} \text{ S } 9 \\ \hline \frac{1}{4} \text{ S } 16 \\ 1920 \end{array}$
80.00	The cor. of secs. 8, 9, 16 and 17. Land, level. Soil, sandy and rocky; 3rd rate. No timber. Undergrowth, mesquite, cactus and yucca.
40.00	S.0°6'E., bet. secs. 16 and 17. Over level land, through scattering undergrowth. Set an iron post, 3 ft. long, 1 in. diam., 27 ins. in the ground, for $\frac{1}{4}$ sec. cor., marked on brass cap
	$\begin{array}{c} \frac{1}{4} \\ \text{S17} \mid \text{S16} \\ \hline 1920 \end{array}$
80.00	Dig pits, 18 X 18 X 12 ins., N. and S. of post, 3 ft. dist. Set an iron post, 3 ft. long, 2 ins. diam., 27 ins. in the ground, for cor. of secs. 16, 17, 20 and 21, marked on brass cap
	$\begin{array}{r} \text{T10S R30E} \\ \hline \text{S17} \mid \text{S16} \\ \hline \text{S20} \mid \text{S21} \\ 1920 \end{array}$
40.00	S.89°57'E., on a random line, bet. secs. 16 and 21. Set temp. $\frac{1}{4}$ sec. cor. 79.90 Intersect N. and S. line, 3 lks. N. of the cor. of secs. 15, 16, 21 and 22, hereinbefore described. Thence N.89°56'W., on a true line, bet. secs. 16 and 21. Over rolling land, through scattering undergrowth. Desc. 30 ft.
9.90	Draw, course S. Asc. 10 ft.
16.70	Spur, slopes S. Desc. 10 ft.
19.40	Head of draw, course SE. Asc. 20 ft.
24.90	Spur, slopes N. Desc. 270 ft.
39.95	Set an iron post, 3 ft. long, 1 in. diam., 12 ins. in the ground, with marked stone, for $\frac{1}{4}$ sec. cor.; and raise a mound of stone around post, with brass cap marked
	$\begin{array}{r} \frac{1}{4} \text{ S } 16 \\ \hline \frac{1}{4} \text{ S } 21 \\ 1920 \end{array}$

Subdivision of T. 10 S., R. 30 E.

Chains.

52.90 Continue descent, 50 ft.
 79.90 Foot of descent; thence over level bottom land.
 The cor. of secs. 16, 17, 20 and 21.
 Land, rolling, mountainous and level.
 Soil, rocky, 4th rate.
 No timber
 Undergrowth, greasewood and cactus.

40.00 S.0°6'E., bet. secs. 20 and 21.
 Over level land, through scattering undergrowth.
 Set an iron post, 3 ft. long, 1 in. diam., 27 ins. in the
 ground, for 1/4 sec. cor., marked on brass cap

$$\begin{array}{c} \uparrow \\ S20 | S21 \\ \downarrow \\ 1920 \end{array}$$

80.00 Dig pits, 18 X 18 X 12 ins., N. and S. of post, 3 ft.
 dist.
 Set an iron post, 3 ft. long, 2 ins. diam., 24 ins. in
 the ground, for cor. of secs. 20, 21, 28 and 29, marked
 on brass cap

$$\begin{array}{c} T10S R30E \\ \hline S20 | S21 \\ \hline S29 | S28 \\ 1920 \end{array}$$

And raise amount of stone, 2 ft. base, 1 1/2 ft. high,
 W. of cor.
 Land, level.
 Soil, sandy, 3rd rate.
 No timber.
 Undergrowth, greasewood, mesquite and cactus.

40.00 S.89°56'E., on a random line, bet. secs. 21 and 28.
 80.30 Set temp. 1/4 sec. cor.
 Intersect N. and S. line, 5 lks. N. of the cor. of secs.
 21, 22, 27 and 28, hereinbefore described.
 Thence
 N.89°54'W., on a true line, bet. secs. 21 and 28.
 Over rolling and mountainous land, through scattering
 undergrowth.
 Asc. 120 ft.
 40.15 Set an iron post, 3 ft. long, 1 in. diam., 18 ins. in the
 ground, with marked stone, for 1/4 sec. cor.; and raise a
 mound of stone around post, with brass cap marked

$$\begin{array}{c} \frac{1}{4} S21 \\ \frac{1}{4} S28 \\ 1920 \end{array}$$

52.50 Top of ascent; thence over rolling land.
 78.90 Desc. 260 ft.
 80.30 Small wash, course NW.
 The cor. of secs. 20 21, 28 and 29.
 Land, rolling and mountainous.
 Soil, rocky, 4th rate.
 No timber.
 Undergrowth, greasewood and ocotillo.

40.00 S.0°6'E., bet. secs. 28 and 29.
 Over rolling land, through scattering undergrowth.
 Asc. gradual slope, 100 ft.
 Set an iron post, 3 ft. long, 1 in. diam., 20 ins. in the
 ground, with marked stone, for 1/4 sec. cor.; and raise a

Chains.

mound of stone around post, with brass cap marked

S29 | S28
1920

Asc. 150 ft.

64.25
80.00

Head of wash, course NE. Continue ascent.
Set an iron post, 3 ft. long, 2 ins. diam., 20 ins. in the ground, with marked stone, for cor. of secs. 28, 29, 32 and 33; and raise a mound of stone around post, with brass cap marked

T10S R30E
S29 | S28
S32 | S33
1920

Land, rolling.
Soil, rocky, 4th rate.
No timber.
Undergrowth, greasewood and ocotillo.

40.00
80.28

S.89°54'E., on a random line, bet. secs. 28 and 33.
Set temp. 1/4 sec. cor.
Intersect N. and S. line, 26 lks. W. of the cor. of secs. 27, 28, 33 and 34, hereinbefore described.

Thence
N.89°43'W., on a true line, bet. secs. 28 and 33.
Over rolling and mountainous land, through scattering undergrowth.

40.14

Desc. 175 ft.
Set an iron post, 3 ft. long, 1 in. diam., 16 ins. in the ground, with marked stone, for 1/4 sec. cor.; and raise a mound of stone around post, with brass cap marked

1/4 S28
1/4 S33
1920

47.30
62.30
80.28

Cor falls on ridge, brs. N. and S. Desc. 50 ft.
Draw, course NE. Asc. 150 ft.

Ridge, brs. N. and S. Desc. 385 ft.
The cor. of secs. 28, 29, 32 and 33.

Land, rolling and mountainous.
Soil, sandy and rocky; 4th rate.
No timber.
Undergrowth, greasewood, cactus and mesquite.

40.00
77.85

S.0°9'W., on a random line, bet. secs. 32 and 33.
Set temp. 1/4 sec. cor.
Fall 41 lks. W. of the reestablished standard cor. of secs. 32 and 33, on the S. bdy. of Tp. (2nd. Std. Parallel S.), ed. hereinbefore described. Thence,

15.00
37.85

N.0°9'W., on a true line, bet. secs. 32 and 33.
Over gently rolling land, through scattering undergrowth.
Leave gently rolling, enter rolling land; asc. 105 ft.
Set an iron post, 3 ft. long, 1 in. diam., 10 ins. in the ground, with marked stone, for 1/4 sec. cor.; and raise a mound of stone around post, with brass cap marked

S32 | S33
1920

Subdivision of T. 10 S., R. 30 E.

Chains.

42.35
77.85

Continue ascent.
Spur, slopes SW. Desc. 270 ft., over mountainous land.
The cor. of secs. 28, 29, 32 and 33.
Land, gently rolling, rolling and mountainous.
Soil, rocky; 4th rate.
No timber.
Undergrowth, greasewood, cactus and mesquite.

40.00

From the cor. of secs. 5, 6, 31 and 32, on the N. bdy. of Tp., hereinbefore described, S.0° 7'E., bet. secs. 5 and 6.
Over level land, through scattering undergrowth.
Set an iron post, 3 ft. long, 1 in. diam., 27 ins. in the ground, for 1/4 sec. cor., marked on brass cap

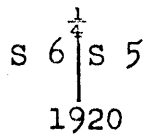

80.00

Dig pits, 18 X 18 X 12 ins., N. and S. of post, 3 ft. dist.
Set an iron post, 3 ft. long, 2 ins. diam., 27 ins. in the ground, for cor. of secs. 5, 6, 7 and 8, marked on brass cap

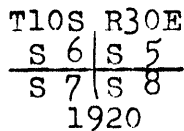

Dig pits, 18 X 18 X 12 ins., in each sec., 3 ft. dist.
Land, level.
Soil, sandy, 3rd rate.
No timber.
Undergrowth, mesquite, yucca and cactus.

40.00
80.04

East on a random line, bet. secs. 5 and 8.
Set temp. 1/4 sec. cor.
Intersect N. and S. line, 6 lks. N. of the cor. of secs. 4, 5, 8 and 9, hereinbefore described.

20.05
40.02

Thence N.89°57'W., on a true line, bet. secs. 5 and 8.
Over level land, through scattering undergrowth.
Road, brs. NW. to Duncan and SE. to Bowie and San Simon.
Set an iron post, 3 ft. long, 1 in. diam., 27 ins. in the ground, for 1/4 sec. cor., marked on brass cap

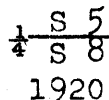

80.04

Dig pits, 18 X 18 X 12 ins., E. and W. of post, 3 ft. dist.
The cor. of secs. 5, 6, 7 and 8.
Land, level.
Soil, sandy, 3rd rate.
No timber.
Undergrowth, mesquite, cactus and yucca.

40.00
79.16

West on a random line, bet. secs. 6 and 7.
Set temp. 1/4 sec. cor.
Fall 24 lks. N. of the cor. of secs. 1, 6, 7 and 12, on the W. bdy. of Tp., hereinbefore described.
Thence N.89°50'E., on a true line, bet. secs. 6 and 7.

40

Subdivision of T. 10 S., R. 30 E.

Chains.

- 39.16 Over level land, through scattering undergrowth.
Set an iron post, 3 ft. long, 1 in. diam., 27 ins. in the ground, for $\frac{1}{4}$ sec. cor., marked on brass cap
- $$\begin{array}{c} \frac{1}{4} \frac{S 6}{S 7} \\ 1920 \end{array}$$
- Dig pits, 18 X 18 X 12 ins., E. and W. of post, 3 ft. dist.
- 79.16 The cor. of secs. 5, 6, 7 and 8.
Land, level.
Soil, sandy, 3rd rate.
No timber.
Undergrowth, mesquite, yucca and cactus.
-
- 40.00 S.0°7'E., bet. secs. 7 and 8.
Over level land, through scattering undergrowth.
Set an iron post, 3 ft. long, 1 in. diam., 27 ins. in the ground, for $\frac{1}{4}$ sec. cor., marked on brass cap
- $$\begin{array}{c} \frac{1}{4} \\ S 7 | S 8 \\ 1920 \end{array}$$
- Dig pits, 18 X 18 X 12 ins., N. and S. of post, 3 ft. dist.
- 80.00 Set an iron post, 3 ft. long, 2 ins. diam., 27 ins. in the ground, for cor. of secs. 7, 8, 17 and 18, marked on brass cap
- $$\begin{array}{c} T10S R30E \\ \frac{S 7 | S 8}{S18 | S17} \\ 1920 \end{array}$$
- Dig pits, 18 X 18 X 12 ins., in each sec., 3 ft. dist.
Land, level.
Soil, sandy, 4th rate.
No timber.
Undergrowth, mesquite, cactus and yucca.
-
- 40.00 S.89°57'E., on a random line, bet. secs. 8 and 17.
Set temp. $\frac{1}{4}$ sec. cor.
- 79.96 Intersect N. and S. line, 2 lks. S. of the cor. of secs. 8, 9, 16 and 17, hereinbefore described.
Thence
N.89°58'W., on a true line, bet. ssecs. 8 and 17.
Over level land, through scattering undergrowth.
- 20.00 Road, brs. NE. to Duncan and SW. to Bowie and San Simon.
- 39.98 Set an iron post, 3 ft. long, 1 in. diam., 27 ins. in the ground, for $\frac{1}{4}$ sec. cor., marked on brass cap
- $$\begin{array}{c} \frac{1}{4} \frac{S 8}{S17} \\ 1920 \end{array}$$
- Dig pits, 18 X 18 X 12 ins., E. and W. of post, 3 ft. dist.
- 79.96 The cor. of secs. 7, 8, 17 and 18.
Land, level.
Soil, sandy, 3rd rate.
No timber.
Undergrowth, mesquite, yucca and cactus.

Subdivision of Township 10 South, Range 30 East.

Chains

40.00 S.89°50'W., on a random line, bet. secs. 7 and 18.
Set temp. ¼ sec. cor.

79.22 Fall 18 lks. S. of the cor. of secs. 7, 12, 13 and 18, on the W. bdy. of Tp., hereinbefore described.
Thence
N.89°58'E., on a true line, bet. secs. 7 and 18.
Over level land, thru. scattering undergrowth.

39.22 Set an iron post, 3 ft. long, 1 in. in diam., 27 ins. in the ground, for ¼ sec. cor., marked on brass cap,

$$\frac{1}{4} \begin{array}{c} S \ 7 \\ S \ 18 \\ 1920 \end{array}$$

79.22 Dig pits, 18x18x12 ins., E. and W. of post, 3 ft. dist.
The cor. of secs. 7, 8, 17 and 18.
Land, level. Soil, sandy, 4th rate.
No timber. Undergrowth, mesquite, cactus and yucca.

40.00 S.0°7'E., bet. secs. 17 and 18.
Over level land, thru. scattering undergrowth.
Set an iron post, 3 ft. long, 1 in. in diam., 27 ins. in the ground, for ¼ sec. cor., marked on brass cap,

$$\frac{1}{4} \begin{array}{c} S18 \ S17 \\ 1920 \end{array}$$

70.00 Dig pits, 18x18x12 ins., N. and S. of post, 3 ft. dist.
Road brs. NE. to Duncan and SW. to Bowie and San Simon.

73.00 Wash, course W. This wash is an outlet to pond in secs. 17 and 20.

80.00 Set an iron post, 3 ft. long, 2 ins. in diam., 14 ins. in the ground, deposit marked (x) stone, and raise a mound of stone, around post, for cor. of secs. 17, 18, 19 and 20, with brass cap, marked

$$\begin{array}{c} T10S \ R30E \\ S18 \ S17 \\ S19 \ S20 \\ 1920 \end{array}$$

Land, level. Soil, sandy, 4th rate.
No timber.
Undergrowth, mesquite, cactus and yucca.

The W½ of line bet. secs. 17 and 20 crosses a large pond; therefore, offset around same as follows:
From cor. of secs. 17, 18, 19 and 20,
N.0°7'W., for 10.00 chs. to offset point.
Thence,
S.89°58'E., for 44.06 chs., to offset point.
Thence,
S.0°7'E., for 10.00 chs. to offset point, on random line at
44.06 (S.89°58'E. from sec. cor.), Set temp. witness cor. to ¼ sec. cor. as the true point for ¼ sec. cor. falls in pond.
Thence,
S.89°58'E., on random line, bet. secs. 17 and 20, continuing measurement from cor. of secs. 17, 18, 19 and 20.

80.00 Intersect N. and S. line, 5 lks. N. of the cor. of secs. 16, 17, 20 and 21.
Thence,
N.89°56'W., on true line, bet. secs. 17 and 20.
Over level land, devoid of timber or undergrowth.

35.94 Set an iron post, 3 ft. long, 1 in. in diam., 27 ins. in the ground, for witness cor., to ¼ sec. cor., marked on brass cap,

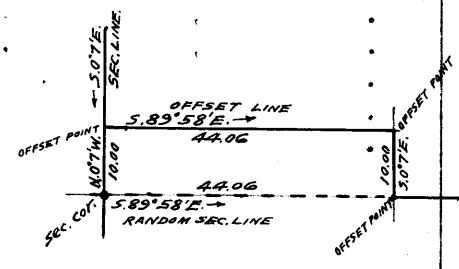

42 Subdivision of Township 10 South, Range 30 East.

Chins.

WC¹/₄ S 17
S 20
1920

Dig pits, 18x18x12 ins., E. and W. of post, 3 ft. dist. From witness cor. offset in sec. 17 to avoid water in pond as follows:

N. 0° 7' W., for 10.00 chs. to offset point.

Thence,

N. 89° 56' W. for 44.00 chs. to offset point.

Thence,

S. 0° 7' E., for 10.00 chs. on sec. line

bet. secs. 17 and 18, to the cor. of secs. 17, 18, 19 and 20.

The approximate positions of the topographical features on true sec. line parallel to the above described offset line are as follows:

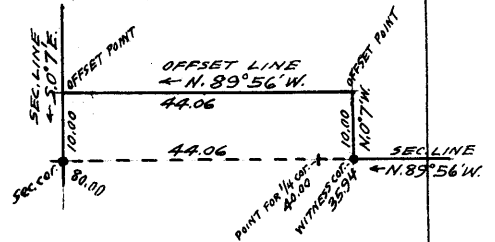

36.05 Edge of water surface of pond, brs. NW. and SE. Thence across water in pond.

40.00 True point for ¹/₄ sec. cor. in pond.

72.00 Edge of water surface of pond, brs. N. and S. Leave water surface of pond. Ascend 20 ft.

75.50 NE. end of spur, sloping NE. Descend 25 ft. to

80.00 The cor. of secs. 17, 18, 19 and 20.

Land, level. Soil, sandy, 3rd rate.

No timber or undergrowth.

S. 89° 58' W., on a random line, bet. secs. 18 and 19.

40.00 Set temp. ¹/₄ sec. cor.

79.30 Fall 20 lks. N. of the cor. of secs. 13, 18, 19 and 24, on the bdy. of Tp., hereinbefore described.

Thence, N. 89° 49' E., on a true line, bet. secs. 18 and 19.

Over level land, thru. scattering undergrowth.

39.30 Set an iron post; 3 ft. long, 1 in. in diam., 27 ins. in the ground, for ¹/₄ sec. cor., marked on brass cap,

¹/₄ S 18
S 19
1920

69.90 Dig pits, 18x18x12 ins., E. and W. of post, 3 ft. dist.

79.30 Road, brs. NE. and SW.

The cor. of secs. 17, 18, 19 and 20.

Land, level. Soil, sandy, 4th rate.

No timber. Undergrowth, mesquite, yucca and cactus.

S. 0° 7' E., bet. secs. 19 and 20.

8.00 Over rolling land, thru. scattering undergrowth. Asc. 65 ft.

20.00 Spur, slopes NE. Descend 35 ft.

30.00 Draw, course E. Thence over level land.

35.00 Ascend 45 ft.

40.00 Thence over level land.

Set an iron post, 3 ft. long, 1 in. in diam., 20 ins. in the ground, deposit marked (x) stone, and raise a mound of stone around post for ¹/₄ sec. cor., with brass cap, marked

S19 | S20
1920

Descend 25 ft.

45:00 Thence over level land.

55:00 Descend 60 ft.

66.00 Draw, course E. Ascend 40 ft.

80.00 Set an iron post, 3 ft. long, 2 ins. in diam., 27 ins. in the the ground, for cor. of secs. 19, 20, 29 and 30, marked on brass cap,

T19S | R30E
S19 | S20
S30 | S29
1920

Dig pits, 18x18x12 ins., in each sec. 3 ft. dist.

Land, level and rolling. Soil, sandy and rocky, 4th rate.

No timber. Undergrowth, greasewood, yucca and mesquite.

Subdivision of T. 10 S., R. 30 E.

Chains.

S.89°56'E., on a random line, bet. secs. 20 and 29.
 40.00 Set temp. $\frac{1}{4}$ sec. cor.
 80.00 Intersect N. and S. line, 20 lks. N. of the cor. of secs. 20, 21, 28 and 29, hereinbefore described.
 Thence
 N.89°47'W., on a true line, bet. secs. 20 and 29.
 Over rolling and level land, through scattering undergrowth.
 25.00 Wash, course N.
 40.00 Set an iron post, 3 ft. long, 1 in. diam., 27 ins. in the ground, for $\frac{1}{4}$ sec. cor., marked on brass cap

$$\begin{array}{r} \frac{1}{4} S20 \\ \frac{1}{4} S29 \\ \hline 1920 \end{array}$$

Dig pits, 18 X 18 X 12 ins., E. and W. of post, 3 ft. dist.
 80.00 The cor. of secs. 19, 20, 29 and 30.
 Land, level and rolling.
 Soil, sandy and rocky, 4th rate.
 No timber.
 Undergrowth, mesquite, yucca and cactus.

S.89°49'W., on a random line, bet. secs. 19 and 30.
 40.00 Set temp. $\frac{1}{4}$ sec. cor.
 79.40 Fall 14 lks. S. of the cor. of secs. 19, 24, 25 and 30, on W. bdy. of Tp., hereinbefore described.
 Thence
 N.89°55'E., on a true line, bet. secs. 19 and 30.
 Over level land, through scattering undergrowth.
 24.40 Asc. 90 ft.
 29.40 Ridge, brs. N. and S. Desc. 75 ft.
 39.40 Set an iron post, 3 ft. long, 1 in. diam., 16 ins. in the ground, with marked stone, for $\frac{1}{4}$ sec. cor.; and raise a mound of stone around post, with brass cap marked

$$\begin{array}{r} \frac{1}{4} S19 \\ \frac{1}{4} S30 \\ \hline 1920 \end{array}$$

Continue descent, 65 ft.
 49.40 Foot of descent, brs. NE. and SW. Thence over level land.
 59.40 Asc. 75 ft.
 69.40 Spur, slopes NE. Desc. 100 ft.
 79.40 The cor. of secs. 19, 20, 29 and 30.
 Land, level and rolling.
 Soil, sandy and rocky, 4th rate.
 No timber.
 Undergrowth, mesquite, yucca, cactus and greasewood.

S.0°7'E., bet. secs. 29 and 30.
 Over level land, through scattering undergrowth.
 25.00 Asc. 70 ft., on spur, slopes N.
 40.00 Set an iron post, 3 ft. long, 1 in. diam., 18 ins. in the ground, with marked stone, for $\frac{1}{4}$ sec. cor.; and raise a mound of stone around post, with brass cap marked

$$\begin{array}{r} \frac{1}{4} \\ S30 | S29 \\ \hline 1920 \end{array}$$

Continue ascent on spur, slopes N., 100 ft.
 55.00 Spur, slopes SE. Desc. 30 ft.
 60.00 Wash, course SE. Asc. 65 ft.
 62.00 Ridge, brs. NW. and SE. Desc. SW. slope, 115 ft.

Subdivision of T. 10 S., R. 30 E.

Chains.

80.00 Set an iron post, 3 ft. long, 2 ins. diam., 27 ins. in the ground, for cor. of secs. 29, 30, 31 and 32, marked on brass cap

$$\begin{array}{r} \text{T10S R30E} \\ \hline \text{S30 | S29} \\ \hline \text{S31 | S32} \\ \hline 1920 \end{array}$$

Dig pits, 18 X 18 X 12 ins., in each sec., 3 ft. dist.
Land, level, rolling and mountainous.
Soil, sandy and rocky, 4th rate.
No timber.
Undergrowth, greasewood, mesquite, yucca and cactus.

40.00

S.89°47'E., on a random line, bet. secs. 29 and 32.

80.14

Set temp. $\frac{1}{4}$ sec. cor.

Intersect N. and S. line, 5 lks. S. of the cor. of secs. 28, 29, 32 and 33, hereinbefore described.

Thence

N.89°49'W., on a true line, bet. secs. 29 and 32.

Over level land, through scattering undergrowth.

25.15

Wash, course NW.

40.07

Set an iron post, 3 ft. long, 1 in. diam., 27 ins. in the ground, for $\frac{1}{4}$ sec. cor., marked on brass cap

$$\begin{array}{r} \frac{1}{4} \text{ S29} \\ \hline \frac{1}{4} \text{ S32} \\ \hline 1920 \end{array}$$

Dig pits, 18 X 18 X 12 ins., E. and W. of post, 3 ft. dist.

Asc. 35 ft.

45.15

Spur, slopes SE. Desc. 30 ft.

50.15

Foot of descent; thence over level land.

80.14

The cor. of secs. 29, 30, 31 and 32.

Land, level and rolling.

Soil, sandy and rocky; 4th rate.

No timber.

Undergrowth, mesquite, yucca and cactus.

40.00

S.89°55'W., on a random line, bet. secs. 30 and 31.

79.54

Set temp. $\frac{1}{4}$ sec. cor.

Fall 7 lks. N. of the cor. of secs. 25, 30, 31 and 36, on the W. bdy. of Tp., hereinbefore described.

Thence

N.89°52'E., on a true line, bet. secs. 30 and 31.

Over level land, through scattering undergrowth.

39.54

Set an iron post, 3 ft. long, 1 in. diam., 27 ins. in the ground, for $\frac{1}{4}$ sec. cor., marked on brass cap

$$\begin{array}{r} \frac{1}{4} \text{ S30} \\ \hline \frac{1}{4} \text{ S31} \\ \hline 1920 \end{array}$$

Dig pits, 18 X 18 X 12 ins., E. and W. of post, 3 ft. dist.

79.54

The cor. of secs. 29, 30, 31 and 32.

Land, level.

Soil, sandy and rocky, 4th rate.

No timber.

Undergrowth, mesquite, yucca, cat claw and greasewood.

40.00

S.0°9'E., on a random line, bet. secs. 31 and 32.

79.54

Set temp. $\frac{1}{4}$ sec. cor.

Chains. 78.00	Fall 30 lks. E. of the reestablished standard cor. of secs. 31 and 32, on the S. bdy. of Tp., (2nd Std. Parallel S.), hereinbefore described. Thence, N.0°4'E., on a true line, bet. secs. 31 and 32. Over level land, through scattering undergrowth.
9.00	Leave level, enter mountainous land, brs. E. and W. Asc. 285 ft.
23.00	Ridge, brs. E. and NW. Desc. 175 ft.
38.00	Set an iron post, 3 ft. long, 1 in. diam., 14 ins. in the ground, with marked stone, for $\frac{1}{4}$ sec. cor.; and raise a mound of stone around post, with brass cap marked
	$\frac{1}{4}$ S31 S32 1920
	Continue descent, 235 ft.
58.00	Foot of descent, brs. NW. and SE. Thence over level land.
78.00	The cor. of secs. 29, 30, 31 and 32. Land, level and mountainous. Soil, sandy and rocky, 4th rate. No timber. Undergrowth, greasewood, cactus and cat claw.

The continued satisfactory adjustment of the solar apparatus during the survey of this township is indicated from field tests as described in Book "D".

GENERAL DESCRIPTION.

The southern part of this township is covered with low malpais hills, and a strip from one to two miles wide along the east bdy. lies in the Peloncillo Mts. Elsewhere, the surface is level or gently rolling. The elevation of the level portion is approximately 4000 ft.- the Peloncillo Mts exceed that by from 1000 to 1500 ft. In the southeastern corner, the drainage is to the S. The remainder drains to the south west.

There is no permanent natural water in the township, but a small shallow lake in secs 17 and 20 catches flood water and holds it for part of the year.

The soil is 4th rate throughout the township. All hilly and mountainous parts are covered with malpais rock and the level parts with sand.

There is a very scattering growth of scrub cedar on the Peloncillo Mts.; elsewhere, a light growth of mesquite brush.

No indication of minerals was found.

There are no settlers.

The township may be classed as poor grazing land, with no evidence of other industrial possibilities.

BOOK 3481

CERTIFICATE OF UNITED STATES TRANSITMAN.

I, Karl L. Siebecker, U. S. Transitman, hereby certify upon honor that, in pursuance of special instructions received from the U. S. Surveyor General, for Group 102, Arizona,

bearing date of the 6th day of October, 1919, I have well, faithfully, and truly

in my own proper person, and in strict conformity with said instructions, the Manual of Surveying Instructions, and the laws of the United States, surveyed all those parts or portions of the Second Standard

Parallel South through Range 30 East, and surveyed all those parts or portions of the North boundary, and Subdivision lines of

Township 10 South, Range 30 East,

of the Gila and Salt River

Base and Meridian, in the State of Arizona, which are represented in and by diagram on page 1 hereof

the foregoing field notes as having been executed by me, and under my direction; and that all the corners of resurvey and said survey have been established and perpetuated in strict accordance with the Manual of Surveying Instruc-

tions, and the special written instructions of the U. S. Surveyor General, for Group 102, Arizona,

and in the specific manner described in the field notes, and that the foregoing are the original field notes of resurvey and such survey.

Place - Augusta - Mont.
Date - Sept. 5th - 1921

Karl L. Siebecker
U. S. Transitman

APPROVAL.

OFFICE OF THE UNITED STATES SURVEYOR GENERAL,

, 191

The foregoing field notes of the survey of

executed by

under his special instructions dated, 191, having been critically examined, and the necessary corrections and explanations made, the said field notes, and the surveys they describe, are hereby approved.

U. S. Surveyor General.

I certify that the foregoing transcript of the field notes of the above-described surveys in

, has been correctly copied from the original notes on file in this office.

U. S. Surveyor General.

CERTIFICATE OF UNITED STATES TRANSITMAN.

I, Guy R. Veal, U. S. Transitman,, hereby certify upon honor that, in pursuance of special instructions received from the U. S. Surveyor General, for Group 102, Arizona, bearing date of the 6th day of October, 1919, I have well, faithfully, and truly in my own proper person, and in strict conformity with said instructions, the Manual of Surveying Instructions, and the laws of the United States, surveyed all those parts or portions of the East and West boundaries, and Subdivision lines of

Township 10 South, Range 30 East,

of the Gila and Salt River

Base and Meridian, in the State of Arizona

and by diagram on page 1 hereof

the foregoing field notes/as having been executed by me, and under my direction; and that all the corners of said survey have been established and perpetuated in strict accordance with the Manual of Surveying Instructions, and the special written instructions of the U. S. Surveyor General, for Group 102, Arizona,

and in the specific manner described in the field notes, and that the foregoing are the original field notes of such survey.

Place Tawas City, Mich.,

Date August 15, 1921.

Guy R. Veal,
U. S. Transitman

APPROVAL.

OFFICE OF THE UNITED STATES SURVEYOR GENERAL,

Phoenix, Arizona SEP 15 1921, 1921

The foregoing field notes of the resurvey of the Second Standard Parallel South through Range 30 East, and of the survey of the East, North, and West boundaries, and the Subdivision lines of

Township 10 South, Range 30 East,

of the Gila and Salt River Base and Meridian,

in the State of Arizona,

executed by Guy R. Veal, and Karl L. Siebecker, U. S. Transitmen,

under special instructions dated October 6, 1919 for Group 102, Arizona, having been critically examined, and the necessary corrections and explanations made, the said field notes, and the resurvey and surveys they describe, are hereby approved.

Frank R. Frost

U. S. Surveyor General.

I certify that the foregoing transcript of the field notes of the above-described surveys in _____, has been correctly copied from the original notes on file in this office.

U. S. Surveyor General.